

Price

PARADISO CONSTRUCTION CO.

GENERAL & PETROLEUM CONTRACTORS

9220 'G' STREET • P.O. BOX 6397 • OAKLAND, CA 94603
(415) 562-5511 Contractor's Lic. #259820

LETTER OF TRANSMITTAL

DATE	3-9-90	JOB NO	571
ATTENTION	Hazardous Materials		
RE:	Line Test - UNOCAL #3135		

TO Alameda County Health Care Services
Division of Environmental Health
Attn: Hazardous Materials
80 Swan Way, Room 200
Oakland, CA 94621

WE ARE SENDING YOU Attached Under separate cover via _____ the following items:

Shop drawings Prints Plans Samples Specifications

Copy of letter Change order _____

COPIES	DATE	NO.	DESCRIPTION
1	3-6-90		Line Test for: UNOCAL #3135
			845-66th Avenue
			Oakland, CA

THESE ARE TRANSMITTED as checked below:

For approval Approved as submitted Resubmit _____ copies for approval

For your use Approved as noted Submit _____ copies for distribution

As requested Returned for corrections Return _____ corrected prints

For review and comment _____

FOR BIDS DUE _____ 19 ____ PRINTS RETURNED AFTER LOAN TO US

REMARKS _____

COPY TO UNOCAL CORPORATION

SIGNED: D. Harding *D. Harding*

If enclosures are not as noted, kindly notify us at once.

DATA CHART For Use With

retro fit
1941-1970

Name
 OWNER: UNOAK
 State
 LOCATION: Calif
 City
 Oakland
 Year
 90
 Mo.
 5
 Day
 DATE OF TEST
 6

1 LOCATION 845 66th Ave Oakland Street No. and/or Corner City State Telephone No.

2 OWNER: UNOAK Name Address Representative Position Telephone No.

3 OPERATOR: _____ Name Dealer, Mgr. or Other Address (if different than Location) Telephone No.

4 REASON FOR TEST UNO System

5 TEST REQUESTED BY: _____ Name Position Order No. Billing Address

6 SPECIAL INSTRUCTIONS: _____

7 CONTRACTOR OR COMPANY MAKING TEST MECHANIC(S) NAME Paradiso Coast Dave Mordick

8 IS A TANK TEST TO BE MADE WITH THIS LINE TEST? YES NO

9 MAKE AND TYPE OF PUMP OR DISPENSER _____

10 WEATHER _____ TEMPERATURE IN TANKS _____ °F _____ °C COVER OVER LINES _____ APPROXIMATE BURIAL DEPTH _____
Concrete, Black Top, etc.

11 IDENTIFY EACH LINE AS TESTED	12 TIME (MILITARY)	13 LOG OF TEST PROCEDURES, AMBIENT TEMPERATURE, WEATHER, ETC.	14 PRESSURE		15 VOLUME		16 TEST RESULTS	
			psi OR lps		READING			NET CHANGE
			BEFORE	AFTER	BEFORE	AFTER		
unload	1030	Begin Test	50		.026			
	1045		50	48	.026	.024	-0.002	
	1100		50	.49	.024	.023	-0.001	
	1115		50	50	.023	.023	±0.000	
	1130		50	50	.023	.023	±0.000	
		Dir unporck	30	0	.038	.058	+0.020	

Line Tight (8) -0.00361PH

pie upon etc ok (8) +0.020

Supor	1145	BEGIN TEST	50		.031		
	1200		50	49	.031	.030	-1.001
	1215		50	49	.030	.029	-1.001
	1230		50	49	.029	.027	-1.002
	1245		50	50	.027	.027	±.000
		Air Vapor ck	30	Q	.040	.064	+1.024

Line Tight @ -1.004 GPH

Air Vapor ck
ck @ +1.024



ROBERT H. LEE & ASSOCIATES, INC.

ARCHITECTURE

PLANNING

ENGINEERING

900 LARKSPUR LANDING CIRCLE, #125, LARKSPUR, CA 94938 • (415) 461-8890

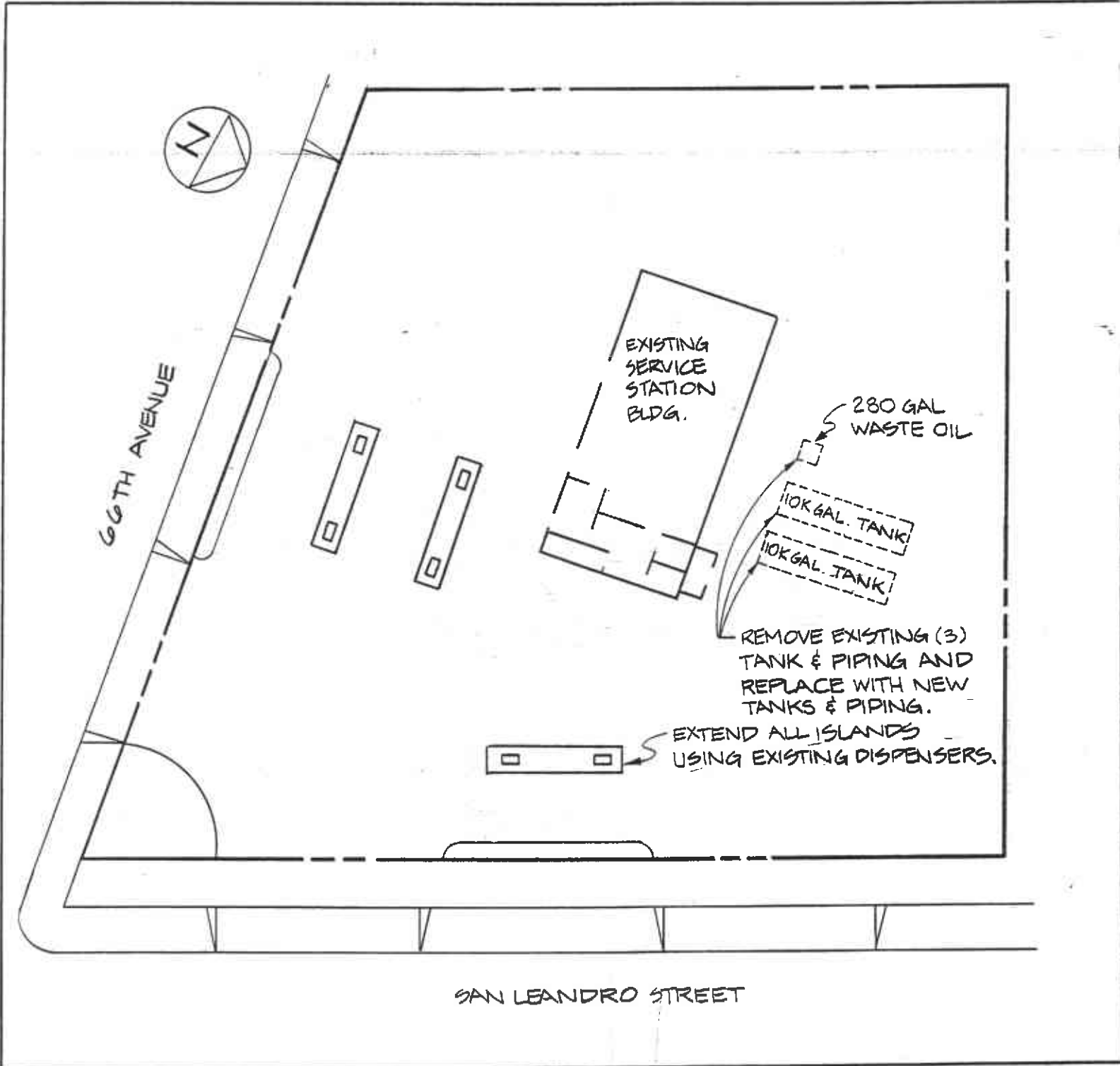

UNOCAL SERVICE STATION # 3135