

ALAMEDA COUNTY
HEALTH CARE SERVICES

AGENCY
DAVID J. KEARS, Agency Director



ENVIRONMENTAL HEALTH SERVICES

ENVIRONMENTAL PROTECTION
1131 Harbor Bay Parkway, Suite 250
Alameda, CA 94502-6577
(510) 567-6700
FAX (510) 337-9335

March 29, 2002

Robert Duggins
Shiloh Christian Fellowship
3250 School St.
Oakland, CA 94602

Subject: Fuel Leak Case No. RO0000406, Shiloh Christian Fellowship,
3250 School St., Oakland, CA 94602

Dear Mr. Duggins:

Alameda County Environmental Health staff has reviewed "Subsurface Investigation Report" dated December 6, 2001, prepared by Cambria Environmental Technology, Inc. We request that you address the following technical comments, perform the proposed work, and send us the technical reports requested below.

TECHNICAL COMMENTS

- 1) Site Characterization - The lateral and vertical extent of groundwater contamination at your site is undefined. A boring, CB-2, was drilled to 28 feet below ground surface (bgs). Water, possibly perched, was encountered in the tank backfill at 12 feet bgs. Groundwater was not encountered deeper. Another boring, CB-1, met with refusal at 1.5 feet bgs. Another site located nearby, 3450-35th Ave., Oakland, had groundwater depths ranging from 28 to 37 feet bgs from 1992 to 1995. Therefore, groundwater depth on site may be greater than 28 feet bgs. It appears that the borings drilled at your site was not completed to sufficient depths to encounter groundwater. Please submit your proposal to complete groundwater characterization in the workplan requested below.

TECHNICAL REPORT REQUEST

Please submit technical reports to the Alameda County Environmental Health (Attention: Don Hwang), according to the following schedule:

June 29, 2002 - Groundwater Sampling Workplan

Mr. Duggins
March 29, 2002
Page 2 of 2

These reports are being requested pursuant to the Regional Water Quality Control Board's (Regional Board) authority under Section 13267 of the California Water Code. If you have any questions, please call me at 510-567-6746.

Sincerely,



Don Hwang
Hazardous Materials Specialist
Local Oversight Program

C: Bob Clark-Riddell, Cambria Environmental Technology, Inc., 1144-65th St.,
Suite B, Oakland, CA 94608

✓ file



State Water Resources Control Board



Winston H. Hickox
Secretary for
Environmental
Protection

Division of Clean Water Programs
2014 T Street • Sacramento, California 95814 • (916) 227-4336
Mailing Address: P.O. Box 944212 • Sacramento, California • 94244-2120
FAX (916) 227-4530 • Internet Address: <http://www.swrcb.ca.gov/cwphome/ustcf>

Gray Davis
Governor

July 26, 2000

Robert C. Duggins
Shiloh Christian Fellowship
3295 School St
Oakland, CA 94602

RO 01/06
~~# 4908~~ DH

**PRE-APPROVAL OF CORRECTIVE ACTION COSTS, CLAIM NO. 012469,
SITE ADDRESS: 3250 SCHOOL ST, OAKLAND, CA 94602**

I have reviewed your request, received on June 26, 2000, for pre-approval of corrective action costs. I have included a copy of the "Cost Pre-Approval Request" form; please use this form in the future for requesting pre-approval of corrective action costs.

With the following provisions, the total cost pre-approved as eligible for reimbursement for completing the August 19, 1998, Subsurface Consultants, Inc. workplan approved by the Alameda County EHD (County) in their October 26, 1998 letter, is \$ 3,780; see the table below for a breakdown of costs.

Be aware that this pre-approval does not constitute a decision on reimbursement **necessary**: (as determined by the fund) corrective action costs for action work **directed and approved by the County** will be eligible for reimbursement at costs consistent with those pre-approved in this letter. However, depending on what happens in the field, some costs may not actually be necessary. If the Fund agrees that they were in fact necessary, the Fund will reimburse at reasonable rates (rates consistent with those pre-approved.)

In an effort to expedite future reimbursement requests associated with the implementation of the corrective action tasks pre-approved in this letter, we ask that the attached pre-approval specific reimbursement request form be completed, updated and submitted with each reimbursement request. All relevant supporting documentation must also be included with each reimbursement request.

In order for future costs for corrective action to be part of the expedited reimbursement process they must be pre-approved in writing by Fund staff. All costs for corrective action must meet the requirements of Article 11, Chapter 16, Underground Storage Tank Regulations in order to be eligible for reimbursement.

00 JUL 31 PM 3:59
CALIFORNIA
ENVIRONMENTAL
PROTECTION

COST PRE-APPROVAL BREAKDOWN

#	Task*	Amount Pre-Approved	Comments
1	Subsurface Investigation	\$2,530	Pre-field Preparation (\$300) - obtain permits Field Activities (\$1700) -2 borings to 25 feet, collect soil samples every 5 feet. Lab Analysis (\$530)- 4 soil and 2 water (TPHg/BTEX/MTBE)
2	Investigation Report	\$1,250	A detailed report-including a summary, data evaluation, boring logs, tables, figures, analytical data, conclusion and recommendations.
TOTAL PRE-APPROVED		\$ 3,780	

* Task descriptions are the same as those identified in Cambria Environmental Technology, Inc.'s January 19, 2000 Cost Estimate

- The lowest bid submitted by Cambria Environmental Technology, Inc.'s January 19, 2000 Cost Estimate was approved, not the requested consultant SCI.
- Only the tasks/costs reflected on the above table are pre-approved at this time. The Fund will review any tasks/cost that go beyond the pre-approved amount to be determined if the additional tasks and costs are necessary and reasonable. However, if costs exceed the above pre-approved amounts the Fund will be unable to expedite your Reimbursement Request.
- The work products must be acceptable to the County and the Regional Water Quality Control Board.
- If a different scope of work becomes necessary, then you must request pre-approval of costs on the new scope of work.
- Although I have referred to the Cambria Environmental Technology, Inc. proposal in my pre-approval above, please be aware that you will be entering into a private contract: the State of California cannot compel you to sign any specific contract. This letter **pre-approves the costs** as presented in the proposal dated January 19, 2000 by Cambria Environmental Technology, Inc. for conducting the work approved by the County for implementing the August 19, 1998, Subsurface Consultants, Inc. workplan.

I also want to remind you that the Fund's regulations require that you obtain at least three bids, or a bid waiver from Fund staff, from qualified firms for all necessary future corrective action work. If you need assistance in procuring contractor and consultant services, don't hesitate to call me.

July 26, 2000

Please remember that it is still necessary to submit the actual costs of the work as explained in the Reimbursement Request Instructions to confirm that the costs are consistent with this pre-approval before you will be reimbursed. ***Please insure that your consultant prepares their invoices to include the required break down of costs on a time and materials basis, that invoiced tasks are consistent with the original proposal, and that reasonable explanations are provided for any changes made in the scope of work or increases in the costs. When the invoices are submitted you must include copies of all:***

- *subcontractor invoices,*
- *technical reports, when available, and*
- *applicable correspondence from the County.*

Please call if you have any questions; I can be reached at (916) 227-4336.

Sincerely,



Sylvia Shorter,
Technical Review Unit
Underground Storage Tank Cleanup Fund

Enclosure

cc: ✓ Mr. Thomas Peacock
Alameda County EHD
1131 Harbor Bay Pkway, 2nd Fl.
Alameda, CA 94502-6577

ALAMEDA COUNTY
HEALTH CARE SERVICES

AGENCY

DAVID J. KEARS, Agency Director



ENVIRONMENTAL HEALTH SERVICES
ENVIRONMENTAL PROTECTION
1131 Harbor Bay Parkway
Alameda, CA 94502-6577
(510) 567-6700
(510) 337-9432

December 22, 1999

Robert Duggins
Shiloh Christian Fellowship
3250 School St.
Oakland, CA 94602

NOTICE OF VIOLATION

Re: Shiloh Christian Fellowship, 3250 School St., Oakland, CA 94602;
StId 4905

Dear Mr. Duggins:

Our office has not received a report of the activities implemented from "Work Plan, Additional Investigation" dated August 19, 1998 by Subsurface Consultants, Inc. You are requested to have the work plan implemented if you have not done so and a report of the activities performed submitted within 30 days.

This letter constitutes a formal request for technical reports pursuant to California Water Code Section 13267(b) and Health and Safety Code Section 25299.37 and 25299.7. Failure to comply with the request will result in referral of this case to the Alameda County District Attorney's Office. You are further advised that failure to comply may subject you to penalties of up to \$5000 per day. If you have any questions, you may call me at (510) 567-6746.

Sincerely,

Don Hwang
Hazardous Materials Specialist

C: Jeriann Alexander, Subsurface Consultants, Inc., 171-12th St. Suite 205, Oakland,
CA 946026

file

6.9.

ALAMEDA COUNTY
HEALTH CARE SERVICES

AGENCY
DAVID J. KEARS, Agency Director



R 406

ENVIRONMENTAL HEALTH SERVICES

1131 Harbor Bay Parkway, Suite 250
Alameda, CA 94502-6577
(510) 567-6700
(510) 337-9335 (FAX)

September 21, 1999

Robert Duggins
Shiloh Christian Fellowship
3250 School St.
Oakland, CA 94602

Re: Shiloh Christian Fellowship, 3250 School St., Oakland, CA 94602;
StId 4905

Dear Mr. Duggins:

"Work Plan, Additional Investigation" dated August 19, 1998 by Subsurface Consultants, Inc., was approved via a letter dated October 26, 1998 from this office. A check with Subsurface Consultants, Inc., indicated that the work plan has not yet been implemented. You are requested to have the work plan implemented and a report of the activities performed submitted within 60 days.

If you have any questions, please call me at (510) 567-6746.

Sincerely,

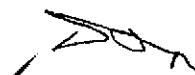
Don Hwang
Hazardous Materials Specialist

C: Jeriann Alexander, Subsurface Consultants, Inc., 171-12th St. Suite 205, Oakland,
CA 946026

file

cc:4580



ALAMEDA COUNTY
HEALTH CARE SERVICES AGENCY
Department Of Environmental Health
Environmental Protection Division
1131 Harbor Bay Parkway, Suite 250
Alameda, CA 94502-6577

Jerriann Alexander
Subsurface Consultants, Inc.
717-12th Street, Suite # 205
Oakland, CA 94602

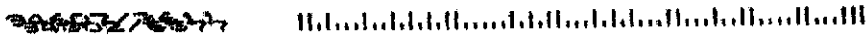
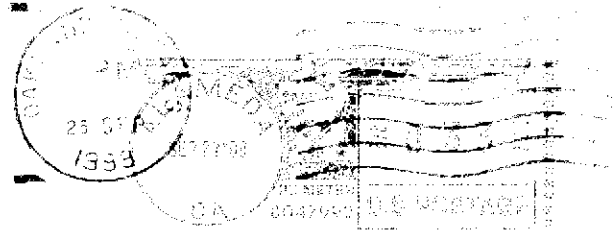

ALAMEDA COUNTY
HEALTH CARE SERVICES

AGENCY
DAVID J. KEARS, Agency Director



June 1, 1999

ENVIRONMENTAL HEALTH SERVICES

1131 Harbor Bay Parkway, Suite 250
Alameda, CA 94502-6577
(510) 567-6700
(510) 337-9335 (FAX)

STID 4905

Robert Duggans
Shiloh Christian Fellowship
3250 School St.
Oakland, CA 94602

RE: 3250 School St., Oakland, CA 94602

LANDOWNER NOTIFICATION AND PARTICIPATION REQUIREMENTS

Dear Mr. Duggans:

This letter is to inform you of new legislative requirements pertaining to cleanup and closure of sites where an unauthorized release of hazardous substance, including petroleum, has occurred from an underground storage tank (UST). Section 25297.15(a) of Ch. 6.7 of the Health & Safety Code requires the primary or active responsible party to notify all current record owners of fee title to the site of: 1) a site cleanup proposal, 2) a site closure proposal, 3) a local agency intention to make a determination that no further action is required, and 4) a local agency intention to issue a closure letter. Section 25297.15(b) requires the local agency to take all reasonable steps to accommodate responsible landowners' participation in the cleanup or site closure process and to consider their input and recommendations.

For purposes of implementing these sections, you have been identified as the primary or active responsible party. Please provide to this agency, within twenty (20) calendar days of receipt of this notice, a complete mailing list of all current record owners of fee title to the site. You may use the enclosed "list of landowners" form (sample letter 2) as a template to comply with this requirement. If the list of current record owners of fee title to the site changes, you must notify the local agency of the change within 20 calendar days from when you are notified of the change.

If you are the sole landowner, please indicate that on the landowner list form. The following notice requirements do not apply to responsible parties who are the sole landowner for the site.

In accordance with Section 25297.15(a) of Ch. 6.7 of the Health & Safety Code, you must certify to the local agency that all current record owners of fee title to the site have been informed of the proposed action before the local agency may do any of the following:

LANDOWNER NOTIFICATION

Re: 3250 School St., Oakland, CA 94602

June 1, 1999

Page 2 of 2

- 1) consider a cleanup proposal (corrective action plan)
- 2) consider a site closure proposal
- 3) make a determination that no further action is required
- 4) issue a closure letter

You may use the enclosed "notice of proposed action" form (sample letter 3) as a template to comply with this requirement. Before approving a cleanup proposal or site closure proposal, determining that no further action is required, or issuing a closure letter, the local agency will take all reasonable steps necessary to accommodate responsible landowner participation in the cleanup and site closure process and will consider all input and recommendations from any responsible landowner.

Please call Amir Gholami at (510) 567-6876 should you have any questions about the content of this letter.

Sincerely,

Thomas Peacock, Manager
Environmental Protection Division

Attachments

c: Chuck Headlee, RWQCB



State Water Resources Control Board



TP

Winston H. Hickox
Secretary for
Environmental
Protection

5710*4905

Division of Clean Water Programs

2014 T Street • Sacramento, California 95814 • (916) 227-4539
Mailing Address: P.O. Box 944212 • Sacramento, California • 94244-2120
FAX (916) 227-4530 • Internet Address: <http://www.swrcb.ca.gov/~cwphome/ustcf>

Gray Davis
Governor

APR 14 1999

Robert C. Duggins
Shiloh Christian Fellowship
3295 School St.
Oakland, CA 94602

UNDERGROUND STORAGE TANK CLEANUP FUND, CLAIM NO. 012469, FOR SITE ADDRESS:
3250 SCHOOL ST, OAKLAND 94602

The State Water Resources Control Board (State Board) is able to issue, pursuant to applicable regulations, the enclosed Letter of Commitment (LOC) in an amount not to exceed \$49,500. This LOC is based upon our review of the corrective action costs you reported to have incurred to date. The LOC may be modified by the State Board.

It is very important that you read the terms and conditions listed in the enclosed LOC. Claims filed with the Underground Storage Tank Cleanup Fund far exceed the funding available and it is very important that you make use of the funding that has been committed to your cleanup in a timely manner.

You are reminded that you must comply with all regulatory agency time schedules and requirements and you must obtain three bids for any required corrective action. Only corrective action costs *required* by the regulatory agency to protect human health, safety and the environment can be claimed for reimbursement. **Unless waived in writing, you are required to obtain preapproval of costs for all future corrective action work (form enclosed).** If you have any questions on obtaining preapproval of your costs or the three bid requirement, please call Mark Owens, our Technical Reviewer assigned to claims in your Region, at (916) 227-7883. Failure to obtain preapproval of your future costs may result in the costs not being reimbursed.

The following documents needed to submit your reimbursement request are enclosed:

- "Reimbursement Request Instructions" package. **Retain this package for future reimbursement requests.** These instructions must be followed when seeking reimbursement for corrective action costs incurred after January 1, 1988. Included in the instruction package are samples of completed reimbursement request forms and spreadsheets.
- "Bid Summary Sheet" to list information on bids received which **must be completed and returned.**
- "Reimbursement Request" forms which you **must use to request reimbursement of costs incurred.**
- "Spreadsheet" forms which you **must use in conjunction with your reimbursement request.**

California Environmental Protection Agency

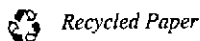

THIS IS IMPORTANT TO YOU. PLEASE NOTE:

You have 90 calendar days from the date of this letter to submit your first reimbursement request for incurred corrective action costs. **NO EXTENSIONS CAN BE GRANTED.** If you fail to do so, your LOC funds will automatically be reduced to zero (deobligated). Once this occurs, any future funds for this site are subject to availability when you submit your first reimbursement request. We continuously review the status of all active claims. You must continue to remain in compliance and submit a reimbursement request every 6 months. Failure to do so will result in the Fund taking steps to withdraw your LOC.

If you have any questions regarding the enclosed documents, please contact Anna Torres at (916) 227-4388.

Sincerely,



Dave Deaner, Manager
UST Cleanup Fund Program

Enclosures

cc: Mr. Thomas Peacock
Alameda County EHD
1131 Harbor Bay Pkway, 2nd Fl.
Alameda, CA 94502-6577

CLAIM NO.: 12469 CLAIMANT NAME: Shiloh Christian Fellowship
 SITE ADDRESS: 3250 School St, Oakland

DATE	COMPLIANCE DOCUMENTATION
5/24/95	Two gas USTs and one waste oil UST were removed.
5/30/95	Reported to local reg. agency
6/27/95	Site placed in LOP
10/24/96	County rec'd UST Removal Report
12/2/96	County requested a workplan to define extent (Significant amounts of petrol. hydrocarbs were identified in the confirmation samples.)
5/18/98	Non-Compliance
5/22/98	CF requested County issue a 90-day ltr. (1/11/98)
8/15/98	Consultant (Salusface) submitted a workplan
10/98	Workplan was approved by the County
3/99	County agreed to sign-off based on work already performed so an LOP can be issued allowing the claimant to move forward.

Post-it® Fax Note 7671 Date 3/29/99 # of pages 1
 To Tom Procock From Cheryl Gordon
 Of Wetmore Health Co. Cleanup Fund
 Phone (916) 367-6782 Phone (916) 227-4539
 Fax (916) 337-9335 Fax (916) 227-4530

Continued on reverse

CONFIRMATION OF CORRECTIVE ACTION COMPLIANCE

- Claimant in corrective action compliance 3/29/99
- Claimant not in corrective action compliance (90 day letter required)
- Claimant not in corrective action compliance - rejection recommended

Tom Procock
 LEAD AGENCY SIGNATURE

3-31-99
 DATE

Cheryl Gordon
 CLAIMS REVIEWER SIGNATURE

3/29/99
 DATE

COM No.	REMOTE STATION	START TIME	DURATION	PAGES	RESULT	USER ID	RS-RTMS
316	916 227 4530	03-31 09:17	01:01	01/01	OK		

743940204E

03/29/99 12:44

CLAIM NO: 12469 CLAIMANT NAME: British Christian Fellowship
 SITE ADDRESS: 3250 School St, Oakland

DATE	COMPLIANCE DOCUMENTATION
5/24/95	Two gas 25Ts and one waste oil UST were removed.
5/30/95	Reported to local reg. agency
6/27/95	Site placed in LOP
10/24/96	County rec'd UST Removal Report
12/2/96	County requested a workplan to remove UST (Suspicious amounts of petrol. hydrocarbons were identified in the confirmation samples.)
5/18/98	Non-Compliance
5/22/98	CF requested County issue a 90-day etc. 11/11/98
8/15/98	Consultant (Subsurface) submitted a workplan
10/98	Workplan was approved by the County
3/99	County agreed to sign-off based on work already performed so an LOP can be issued allowing the claimant to move forward.

Post-it® Fax Note 7671 Date 3/29/99 # of pages 1
 TO Tom Procock From Cheryl Horton
 Co. Alameda Health Co. Cleeford Fund
 Phone (916) 367-6782 Phone (916) 257-4539
 Fax (916) 337-9335 Fax (916) 227-4530

Continued on reverse

ALAMEDA COUNTY
HEALTH CARE SERVICES

AGENCY
DAVID J. KEARS, Agency Director



ENVIRONMENTAL HEALTH SERVICES

1131 Harbor Bay Parkway, Suite 250
Alameda, CA 94502-6577
(510) 567-6700
(510) 337-9335 (FAX)

October 26, 1998

STID 4905

Robert Duggan
Shiloh Christian Fellowship
3250 School St.
Oakland, CA 94602

re: 3250 School St., Oakland, CA 94602

Dear Robert Duggan:

This office has received and reviewed a Workplan for additional investigation, dated August 19, 1998, by Subsurface Consultants, Inc., for the above site. The following are comments concerning this workplan:

This office accepts the workplan as submitted. Please contact us at least 3 working days prior to conducting fieldwork on the site.

Please call me if you have any questions at (510) 567-6782.

Sincerely,

Thomas F. Peacock, Manager
Division of Environmental Protection

c: LeRoy Griffin, City of Oakland Hazardous Materials
Jerian Alexander, Subsurface Consultants, Inc., 3736 Mt.
Diablo Blvd., Suite 200, Lafayette, CA 94549
Pick Pantages, Chief - files- Tom

LOP - RECORD CHANGE REQUEST FORM

printed: *
06/24/98

Mark Out What Needs Changing and Hand to LOP Data Entry
(Name/Address changes go to Annual Programs Data Entry)

Insp: ~~PH~~ *OH*

AGENCY # : 10000 SOURCE OF FUNDS: F SUBSTANCE: 8006619
 StID : 4905 LOC:
 SITE NAME: Shiloh Christian Fellowship DATE REPORTED : 05/30/95
 ADDRESS : 3250 School St DATE CONFIRMED: 05/24/95
 CITY/ZIP : Oakland 94602 MULTIPLE RPs : N

SITE STATUS

CASE TYPE: U CONTRACT STATUS: 4 PRIOR CODE: 2A4 EMERGENCY RESP: 05/30/94
 RP SEARCH: S DATE COMPLETED: 06/26/95
 PRELIMINARY ASMNT: U DATE UNDERWAY: 05/25/95 DATE COMPLETED:
 REM INVESTIGATION: DATE UNDERWAY: DATE COMPLETED:
 REMEDIAL ACTION: DATE UNDERWAY: DATE COMPLETED:
 POST REMED ACT MON: DATE UNDERWAY: DATE COMPLETED:
 ENFORCEMENT ACTION TYPE: 1 DATE ENFORCEMENT ACTION TAKEN: 06/27/95
 LUFT FIELD MANUAL CONSID: 2
 CASE CLOSED: DATE CASE CLOSED:
 DATE EXCAVATION STARTED : 05/24/95 REMEDIAL ACTIONS TAKEN: NT

RESPONSIBLE PARTY INFORMATION

RP#1-CONTACT NAME: Robert Duggans
 COMPANY NAME: Shiloh Christian Fellowship
 ADDRESS: 3250 School Street,
 CITY/STATE: Oakland, Ca - 94602

INSPECTOR VERIFICATION:

NAME _____ SIGNATURE _____ DATE _____

DATA ENTRY INPUT:

Name/Address Changes Only

Case Progress Changes

ANPPGMS _____ LOP _____ DATE _____

LOP _____ DATE _____

ALAMEDA COUNTY
HEALTH CARE SERVICES

AGENCY
DAVID J. KEARS, Agency Director



June 24, 1998
STID 4905

ENVIRONMENTAL HEALTH SERVICES

1131 Harbor Bay Parkway, Suite 250
Alameda, CA 94502-6577
(510) 567-6700
(510) 337-9335 (FAX)

re: 3250 School St., Oakland, CA 94602

Robert Duggan
Shiloh Christian Fellowship
3250 School St.
Oakland, CA 94602

SECOND NOTICE

Dear Robert Duggan:

This office reviewed an underground tank removal report dated October 22, 1966, by Subsurface Consultants, and sent you a letter, dated December 12, 1996, requiring further action. You were requested to submit a workplan for further investigation of the extent of contamination in soil and groundwater at the above site.

To date this office has heard no response from you. Again, we expect a workplan to be submitted within 60 days. Failure to perform investigations, as required will:

1. Disallow site closure.
2. Prevent reimbursement from the UST Cleanup Fund, which you may be eligible for.
3. May result in legal action, as stipulated in the UST law and regulations.

If you have any problems or questions then contact this office immediately. I can be reached at 567-6782.

Sincerely,

Thomas F. Peacock, Manager
Division of Environmental Protection

c: LeRoy Griffin, Oakland Hazardous Materials
Dick Pantages, Chief - **files-Tom**

ALAMEDA COUNTY
HEALTH CARE SERVICES



AGENCY
DAVID J. KEARS, Agency Director

ENVIRONMENTAL HEALTH SERVICES
ENVIRONMENTAL PROTECTION (LOP)
1131 Harbor Bay Parkway, Suite 250
Alameda, CA 94502-6577
(510) 567-6700
FAX (510) 337-9335

December 12, 1995

STID # - 4907 5

Mr. Robert Duggan
Shiloh Christian Fellowship
3250 School Street,
Oakland, CA - 94602

Ref: 3250 School Street, Oakland, CA - 94602

Dear Mr. Duggan:

I am in receipt of the document, "Underground Tank Removal and Supplemental Excavation Report", dated, October 22, 1996, prepared by Subsurface Consultants for the above mentioned site. Two gasoline and one waste oil underground storage tanks were removed on May 24, 1995. Based on the information provided to this Department, significant amounts of petroleum hydrocarbons were detected in the soil samples.

Although adequate source removal (underground storage tanks and contaminated soil) has been conducted, this Department is still concerned with the following issues:

- The extent of soil contamination has not been defined in the areas around AB-3 and AB-5, where benzene was found in concentrations of 9.1 ppb and 43 ppb respectively.
- Since significant amounts of petroleum hydrocarbons were identified in the initial soil samples collected at seven feet from the excavation pit subsequent to tank removal and residual amounts of hydrocarbons were identified in the confirmation soil samples collected at 12 feet, contaminant migration from the vadoze zone to the groundwater is an issue that needs to be explored.

Hence, at least 2 borings should be installed near the previous sample locations, AB-3 and AB-5 and both soil and grab groundwater samples should be collected to define the lateral and vertical extent of contamination. The samples should be analyzed for TPH gasoline, BTEX, MTBE and for PNA's. Please note that the grab groundwater samples will not be necessary, if the depth to groundwater is greater than 25 feet below ground surface. If the laboratory analysis of the sample results indicate significant groundwater contamination, then at least 3 monitoring wells should be installed to define the extent of groundwater contamination.

Please submit a work plan within 30 days from the date of this letter to address the above listed issues. This is a formal request for technical information and any delays should be requested in

writing. If you have any questions, you can contact me at (510) 567-6764

Sincerely,

A handwritten signature in cursive script that reads "Madhulla Logan".

Madhulla Logan
Hazardous Material Specialist

C: Samuel C. Won, Subsurface Consultants, 171, 12th Street, Suite 201, Oakland, CA - 94607

UNDERGROUND STORAGE TANK UNAUTHORIZED RELEASE (LEAK) / CONTAMINATION SITE REPORT

EMERGENCY <input type="checkbox"/> YES <input checked="" type="checkbox"/> NO		HAS STATE OFFICE OF EMERGENCY SERVICES REPORT BEEN FILED? <input type="checkbox"/> YES <input checked="" type="checkbox"/> NO		FOR LOCAL AGENCY USE ONLY I HEREBY CERTIFY THAT I HAVE DISTRIBUTED THIS INFORMATION ACCORDING TO THE DISTRIBUTION SHOWN ON THE INSTRUCTION SHEET ON THE BACK PAGE OF THIS FORM.		
REPORT DATE 05/30/95		CASE #		SIGNED: <i>Madhulu 6/1/95</i> DATE:		
REPORTED BY	NAME OF INDIVIDUAL FILING REPORT VICTOR ORANGE		PHONE (510) 486-4283		SIGNATURE <i>Victor Orange</i>	
	REPRESENTING <input checked="" type="checkbox"/> OWNER/OPERATOR <input type="checkbox"/> REGIONAL BOARD <input type="checkbox"/> LOCAL AGENCY <input type="checkbox"/> OTHER		COMPANY OR AGENCY NAME SHILOH CHRISTIAN FELLOWSHIP			
	ADDRESS 3295 SCHOOL ST. OAKLAND CA 94602					
RESPONSIBLE PARTY	NAME <input checked="" type="checkbox"/> UNKNOWN		CONTACT PERSON ROBERT DIGGANS		PHONE (510) 261-2052	
	ADDRESS					
SITE LOCATION	FACILITY NAME (IF APPLICABLE) SHILOH CHRISTIAN FELLOWSHIP		OPERATOR		PHONE ()	
	ADDRESS 3250 SCHOOL ST. OAKLAND ALAMEDA 94602					
	CROSS STREET MAPLE AVENUE					
IMPLEMENTING AGENCIES	LOCAL AGENCY AGENCY NAME		CONTACT PERSON		PHONE ()	
	REGIONAL BOARD				PHONE ()	
SUBSTANCES INVOLVED	(1) NAME SUPREME LEADED GASOLINE				QUANTITY LOST (GALLONS) <input checked="" type="checkbox"/> UNKNOWN	
	(2) NAME REGULAR LEADED GASOLINE				<input checked="" type="checkbox"/> UNKNOWN	
DISCOVERY/ABATEMENT	DATE DISCOVERED 05/24/95		HOW DISCOVERED <input type="checkbox"/> INVENTORY CONTROL <input type="checkbox"/> SUBSURFACE MONITORING <input type="checkbox"/> NUISANCE CONDITIONS <input type="checkbox"/> TANK TEST <input checked="" type="checkbox"/> TANK REMOVAL <input type="checkbox"/> OTHER			
	DATE DISCHARGE BEGAN <input checked="" type="checkbox"/> UNKNOWN		METHOD USED TO STOP DISCHARGE (CHECK ALL THAT APPLY) <input type="checkbox"/> REMOVE CONTENTS <input checked="" type="checkbox"/> CLOSE TANK & REMOVE <input type="checkbox"/> REPAIR PIPING <input type="checkbox"/> REPAIR TANK <input type="checkbox"/> CLOSE TANK & FILL IN PLACE <input type="checkbox"/> CHANGE PROCEDURE <input type="checkbox"/> REPLACE TANK <input type="checkbox"/> OTHER			
	HAS DISCHARGE BEEN STOPPED? <input checked="" type="checkbox"/> YES <input type="checkbox"/> NO IF YES, DATE 05/24/95					
SOURCE/ CAUSE	SOURCE OF DISCHARGE <input checked="" type="checkbox"/> TANK LEAK <input type="checkbox"/> UNKNOWN <input type="checkbox"/> PIPING LEAK <input type="checkbox"/> OTHER		CAUSE(S) <input type="checkbox"/> OVERFILL <input type="checkbox"/> RUPTURE/FAILURE <input type="checkbox"/> SPILL <input type="checkbox"/> CORROSION <input checked="" type="checkbox"/> UNKNOWN <input type="checkbox"/> OTHER			
	CHECK ONE ONLY <input checked="" type="checkbox"/> UNDETERMINED <input type="checkbox"/> SOIL ONLY <input type="checkbox"/> GROUNDWATER <input type="checkbox"/> DRINKING WATER - (CHECK ONLY IF WATER WELLS HAVE ACTUALLY BEEN AFFECTED)					
CURRENT STATUS	CHECK ONE ONLY <input type="checkbox"/> NO ACTION TAKEN <input type="checkbox"/> PRELIMINARY SITE ASSESSMENT WORKPLAN SUBMITTED <input type="checkbox"/> POLLUTION CHARACTERIZATION <input type="checkbox"/> LEAK BEING CONFIRMED <input type="checkbox"/> PRELIMINARY SITE ASSESSMENT UNDERWAY <input type="checkbox"/> POST CLEANUP MONITORING IN PROGRESS <input type="checkbox"/> REMEDIATION PLAN <input type="checkbox"/> CASE CLOSED (CLEANUP COMPLETED OR UNNECESSARY) <input type="checkbox"/> CLEANUP UNDERWAY					
	CHECK APPROPRIATE ACTION(S) (SEE BACK FOR DETAILS) <input type="checkbox"/> CAP SITE (CD) <input type="checkbox"/> EXCAVATE & DISPOSE (ED) <input type="checkbox"/> REMOVE FREE PRODUCT (FP) <input type="checkbox"/> ENHANCED BIO DEGRADATION (IT) <input type="checkbox"/> CONTAINMENT BARRIER (CB) <input type="checkbox"/> EXCAVATE & TREAT (ET) <input type="checkbox"/> PUMP & TREAT GROUNDWATER (GT) <input type="checkbox"/> REPLACE SUPPLY (RS) <input type="checkbox"/> VACUUM EXTRACT (VE) <input type="checkbox"/> NO ACTION REQUIRED (NA) <input type="checkbox"/> TREATMENT AT HOOKUP (HU) <input type="checkbox"/> VENT SOIL (VS) <input type="checkbox"/> OTHER (OT)					
COMMENTS	COMMENTS					

trns 6/21/95 (na)

#4905

DATE: 6/18/95
TO : Local Oversight Program
FROM: Madhulla Logan
SUBJ: Transfer of Eligible Local Oversight Case

Site name: Shiloh Christian Fellowship
Address: 3250 School Street city Oakland zip 94602

TO BE ELLIGIBLE FOR LOP A CASE MUST MEET 3 QUALIFICATIONS:

1. Number of Tanks: 3 removed? Y N Date of removal 5/24/95
 2. Samples received? Y N Contamination level: looked really bad!
(ppm and type of test) (heard from contractor)
 3. Petroleum Y N Types: Avgas Jet unleaded Diesel
fuel oil waste oil kerosene solvents
- DepRef remaining \$ _____ Closed with Candace/Leslie? Y N
(If no explain why?)

IF YOUR SITE MEETS ALL OF THE ABOVE QUALIFICATIONS YOU SHOULD DO THE FOLLOWING TO TRANSFER THE SITE:

1. YOU MUST CLOSE THE DEPOSIT REFUND CASE AT THIS TIME. YOU MUST ACCOUNT FOR ALL TIME YOU HAVE SPENT ON THE CASE AND TURN IN THE ACCOUNT SHEET TO LESLIE. IF THERE ARE FUNDS STILL REMAINING IT IS STILL BETTER TO TRANSFER THE CASE TO LOP AS THE RATE FOR LOP ALLOWS THE ADDITION OF MANAGEMENT AND CLERICAL TIME. DO NOT ATTEMPT TO CONTINUE TO OVERSEE THE SITE SIMPLY BECAUSE THERE ARE FUNDS REMAINING!
2. COMPLETE THE A AND B PERMIT APPLICATION FORMS AND GIVE TO CONNIE/ELAINE
3. GIVE THE ENTIRE CASE TO THE PROPER LOP STAFF UPSTAIRS FOR THEM TO DO THE REST OF THE TRANSFER AND YOU ARE DONE!

ALAMEDA COUNTY, DEPARTMENT OF
ENVIRONMENTAL HEALTH
Hazardous Materials Inspection Form

II, III

white - env. health
yellow - facility
pink - files

Site ID # _____ Site Name Shiloh Christian Fellowship Today's Date 5/24/95
Site Address 3250 School St
City Oakland Zip 94602 Phone (510)261-2052

MAX AMT stored > 500 lbs, 55 gal., 200 cft.? RP - Bob Duggins

Inspection Categories:

- I. Haz. Mat/Waste GENERATOR/TRANSPORTER
- II. Hazardous Materials Business Plan, Acutely Hazardous Materials
- III. Under ground Storage Tanks Removal

* Calif. Administration Code (CAC) or the Health & Safety Code (HS&C)

Comments:

Crew patched large gash in Tank A w/ plastic sheeting & added LEL 4% O2 6% - Steel tank w/ no holes noted & slight pitting. Groundwater was present under tank. Ground water samples collected for TPHg, BTEX & lead - GA-1. Soil samples collected at soil/water interface @ each end of tank. Samples A1 @ 7' & A2 @ 7'4" - Soil stained green w/ petroleum odor @ A2. A1 = fill end A2 = pump end

Tank B LEL 18% O2 3% more dry ice added LEL 10% O2 2% - Steel tank w/ heavy pitting & hole noted. Soil was stained dark grey @ fill end w/ strong petrol. odor. Sample B1 (fill end) @ 7'2" & sample B2 (pump end) @ 7'3" collected at soil/water interface.

Samples A1 & B1 were collected ~1.5' bgs along pipe trench leading to pump island.

2 stockpiled soil piles on-site - plan to remove from site - 1 composite sample / 50 yds³ required to haul off-site

Overexcavation of gasoline tank pit to occur today & tomorrow. Will call on 5/25 to schedule a time for confirmatory soil samples in overexcavation.

5/25/95 - limits of contamination was not reached. Excavation to approx ~13' at this time. ~~Excavation~~ II, III

Contact Subsurface Consultants
Title Engineering Tech Inspector A Leech
Signature [Signature] Signature [Signature]

Note: RP, Bob Duggins, will discuss future investigations w/ Consultant & contact this office.
 Add sampler NOT to analyze water samples.

Groundwater was not present in pit. Water found yesterday was from tanks or perched. Contact this office for confirmatory soil samples in excavation continues.

white -env.health
yellow -facility
pink -files

ALAMEDA COUNTY, DEPARTMENT OF ENVIRONMENTAL HEALTH

1131 Harbor Bay Pkwy
Alameda CA 94502
510/567-6700

Hazardous Materials Inspection Form

II, III

Site ID # _____ Site Name Shiloh Christian Fellowship Today's Date 5/24/95

Site Address 3250 School St

City Oakland Zip 94602 Phone (510) 261-2052

____ MAX AMT stored > 500 lbs, 55 gal., 200 cft.?

Inspection Categories:

____ I. Haz. Mat/Waste GENERATOR/TRANSPORTER

____ II. Hazardous Materials Business Plan, Acutely Hazardous Materials

III. Under ground Storage Tanks Removal

Tank hauler:
Erickson
man# 93480345
Joan Austin, Inspe. w/OFD

* Calif. Administration Code (CAC) or the Health & Safety Code (HS&C)

2:15 P.M.
Comments: On-site to witness removal of 3 USTs: 2 gasoline in same pit? 1 used oil located behind building.

Used Oil - 250 gallon

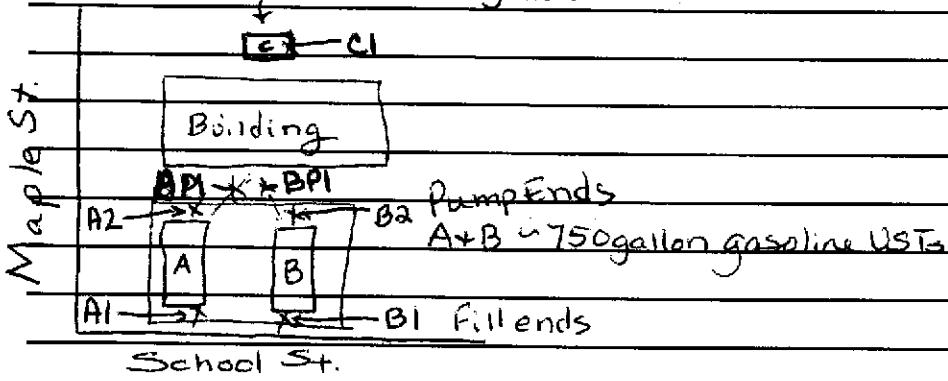

Tank C (250 gallon used oil) reportedly was full of sludge and had to be cut open to remove approx 170 gallons of sludge. Sludge was pumped out by Erickson this morning & hauled off-site. LEL 0% Tank was in bad shape from backhoe but no pitting or holes were noted. No evidence of staining in pit. Sample C1 taken at approx 8'4" beneath fill end of tank. (8' x 4' d)

Tanks A+B (~750 gallon Gasoline) located in front of building in same pit on the corner of School St & Maple. Tank A LEL 5% O2 20% & had large gash in the side from the backhoe.

Contact Subsurface Consultants
Title SL Engineering Tech
Signature X [Signature]

Inspector A. Leech
Signature [Signature]

II, III

Use FP copy of OLR to fill out

RWR

Subsurface Consultants FIELD REPORT

Sheet 1 of 1

REPORT NO. _____

PROJECT: Shiloh Community Fellowship JOB NO: _____

PERSONNEL PRESENT: _____ DATE: 5/23/95

1

HOURS - From: _____ To: _____ From: _____ To: _____ TOTAL HRS: 20
w/ travel

EQUIPMENT IN USE: _____

TYPE OF SERVICES PROVIDED: Exploration Field Density Testing
 Site Meeting Construction Observation _____

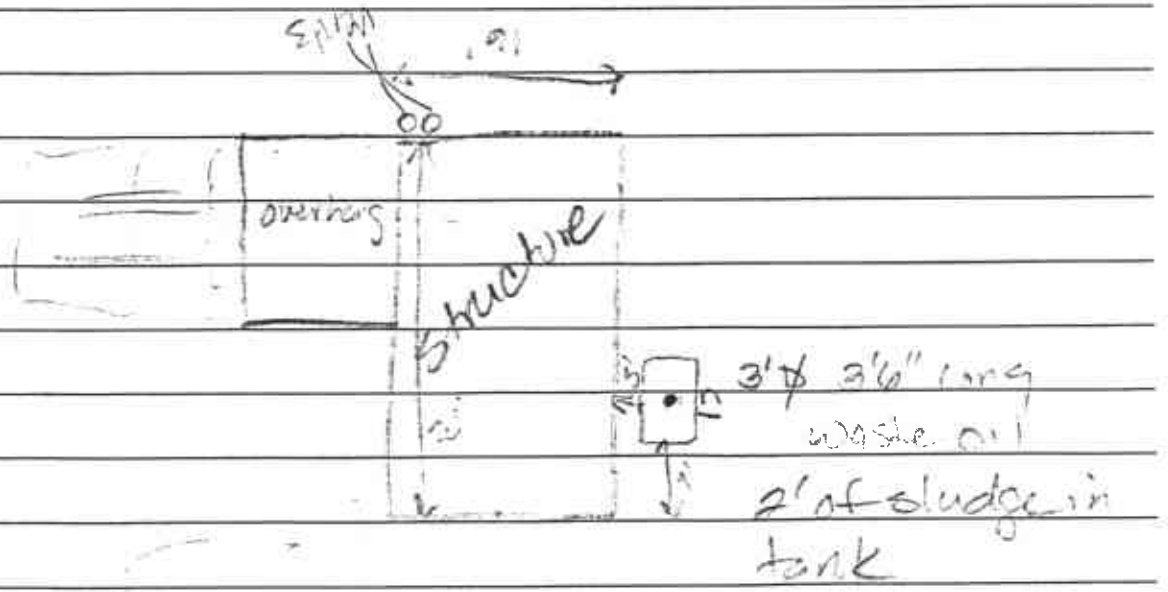
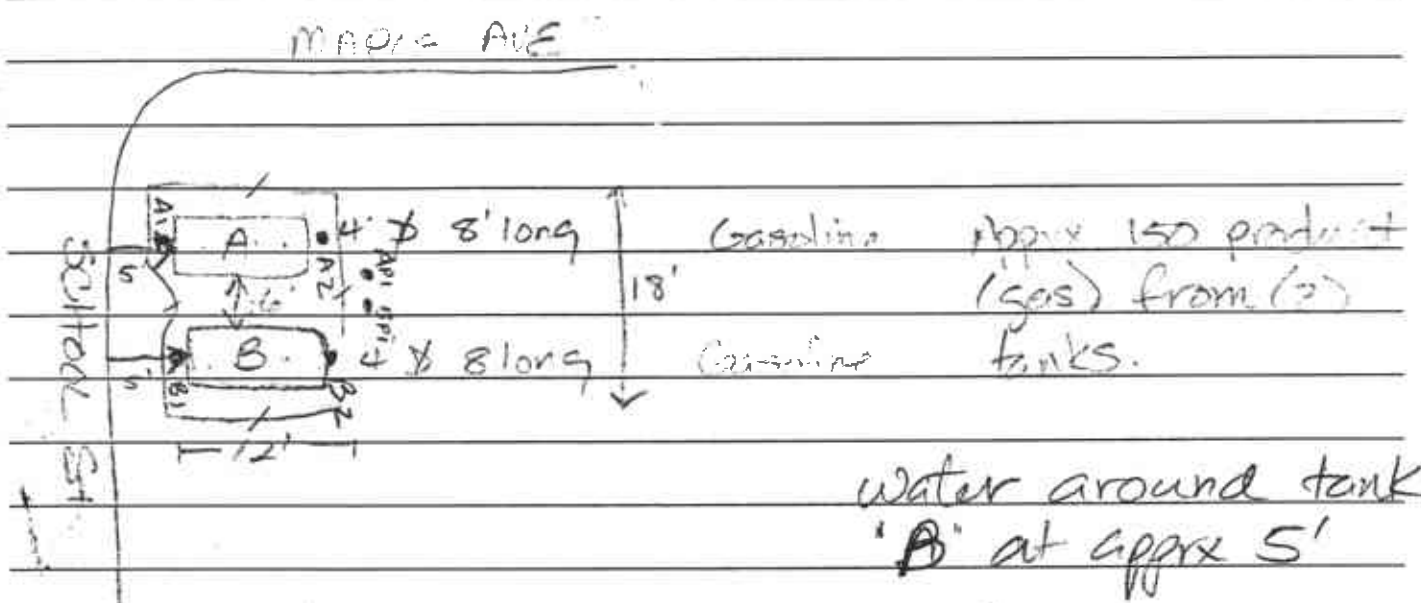

Prepared by: _____ Reviewed by: _____

Subsurface Consultants FIELD REPORT

Sheet 3 of 3

REPORT NO.

PROJECT: Shiloh Christian Fellowship JOB NO: _____

PERSONNEL PRESENT: _____ DATE: 5/25/05

2
3

HOURS - From: _____ To: _____ From: _____ To: _____ TOTAL HRS: _____

EQUIPMENT IN USE: _____

TYPE OF SERVICES PROVIDED: Exploration Field Density Testing
 Site Meeting Construction Observation _____

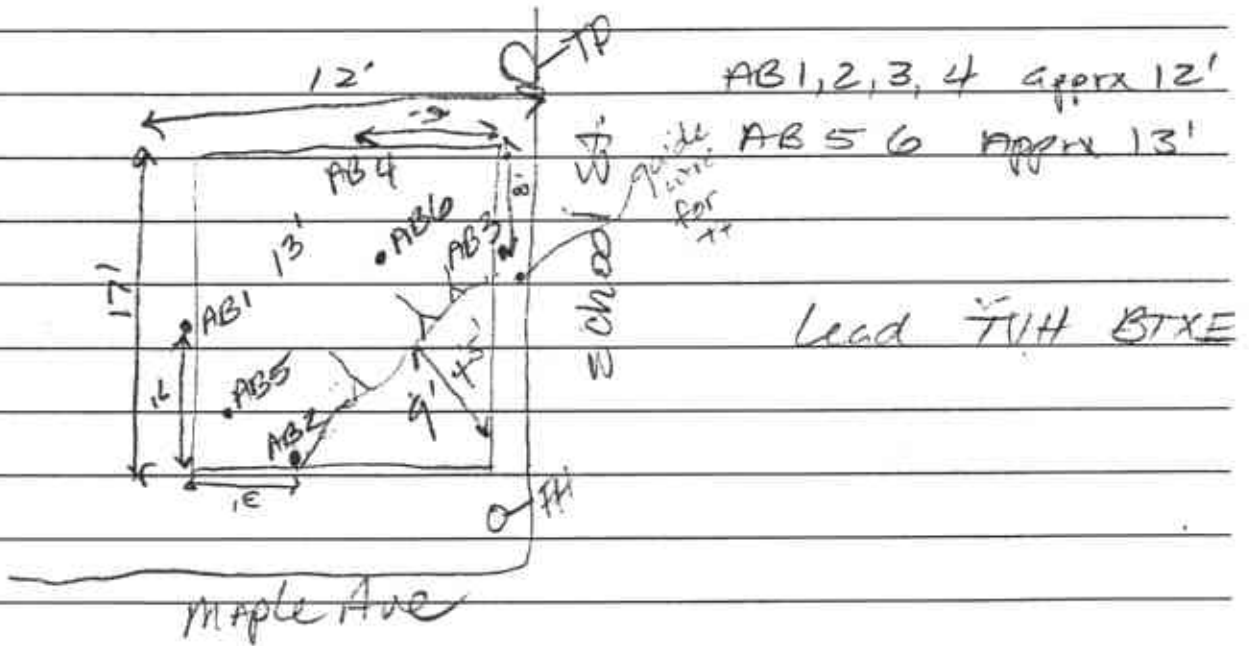

Prepared by: _____ Reviewed by: _____

DEPARTMENT OF ENVIRONMENTAL HEALTH
 HAZARDOUS MATERIALS DIVISION
 80 SWAN WAY, ROOM 200
 OAKLAND, CA 94621
 PHONE NO. 510/271-4320

Extra copy

DEPARTMENT OF ENVIRONMENTAL HEALTH

These plans must be submitted to the Department of Environmental Health for review and approval. The Department will issue a permit to operate a hazardous waste storage tank only if the plans are approved. The Department will also issue a permit to operate a hazardous waste storage tank only if the plans are approved. The Department will also issue a permit to operate a hazardous waste storage tank only if the plans are approved.

ALCO HAZMAT
 91 SEP 21 PM 12:53

AD

THERE IS A FINANCIAL PENALTY FOR OBTAINING THESE INSPECTIONS.

5/17/97

UNDERGROUND TANK CLOSURE PLAN

*** Complete according to attached instructions ***

1. Business Name Shiloh Christian Fellowship
 Business Owner Shiloh Christian Fellowship, Incorporated
2. Site Address 3250 School Street
 City Oakland Zip 94602 Phone N/A
3. Mailing Address 3295 School Street
 City Oakland Zip 94602 Phone (510)261-2052
4. Land Owner Shiloh Christian Fellowship, Inc.
 Address 3295 School Street City, State Oakland, CA zip 94602-3638
5. Generator name under which tank will be manifested Shiloh Christian Fellowship, Inc.
 EPA I.D. No. under which tank will be manifested 6AC 000888552

Notes change from Shiloh

6. Contractor General Environmental Services (GEMS)
Address P.O. Box 8282
City Pittsburg Phone (510)427-4616
License Type* "A" & HAZ ID# 543700

*Effective January 1, 1992, Business and Professional Code Section 7058.7 requires prime contractors to also hold Hazardous Waste Certification issued by the State Contractors License Board. Indicate that the certificate has been received, in addition, to holding the appropriate contractors license type.

7. Consultant Subsurface Consultants, INC.
Address 171 - 12th Street Suite 201
City Oakland Phone (510)268-0461

8. Contact Person for Investigation
Name Pat Echols Title Associate
Phone (510)268-0461

9. Number of tanks being closed under this plan Three(3)
Length of piping being removed under this plan Approx. forty feet
Total number of tanks at facility Three

10. State Registered Hazardous Waste Transporters/Facilities (see instructions).

** Underground tanks are hazardous waste and must be handled **
as hazardous waste

a) Product/Residual Sludge/Rinsate Transporter

Name Erickson, INC. EPA I.D. No. CAD 009466392
Hauler License No. 019 License Exp. Date 7/95
Address 256 Parr Blvd.
City Richmond State CA Zip 94801

b) Product/Residual Sludge/Rinsate Disposal Site

Name Erickson, INC. EPA I.D. No. CAD 009466392
Address 256 Parr Blvd.
City Richmond State CA Zip 94801

c) Tank and Piping Transporter

Name Erickson, INC. EPA I.D. No. CAD 009466392
Hauler License No. 019 License Exp. Date 7/95
Address 256 Parr Blvd.
City Richmond state CA zip 94801

d) Tank and Piping Disposal Site

Name Erickson, INC. EPA I.D. No. CAD 009466392
Address 256 Parr Blvd.
City Richmond State CA Zip 94801

11. Experienced Sample Collector

Name Dennis Alexander
Company Subsurface Consultants, INC.
Address 171 - 12th Street, Suite 201
City Oakland state CA Zip 94607 Phone (510)268-0461

12. Laboratory

Name Curtis & Tompkins, Ltd.
Address 2323 Fifth Street
City Berkeley state CA zip 94710
State Certification No. #159

13. Have tanks or pipes leaked in the past? Yes [] No []

If yes, describe. These tanks have not been in use since the present
owner has taken possession of the property. A thorough document search
has produced nothing about the history of these tanks including the size
and materials which were kept in these tanks.

14. Describe methods to be used for rendering tank inert

1. All product will be removed
2. Residual liquids, solids, and sludge will be removed.
3. All vapors will be purged with a minimum of 25 # of dry ice/ 1000 gallons.

Before tanks are pumped out and inerted, all associated piping must be flushed out into the tanks. All accessible associated piping must then be removed. Inaccessible piping must be plugged.

The Bay Area Air Quality Management District (771-6000), along with local Fire and Building Departments, must also be contacted for tank removal permits. Fire departments typically require the use of explosion proof combustible gas meters to verify tank inertness. It is the contractor's responsibility to bring a working combustible gas meter on site to verify tank inertness.

15. Tank History and Sampling Information

Tank		Material to be sampled (tank contents, soil, ground-water, etc.)	Location and Depth of Samples
Capacity	Use History (see instructions)		
1500 Gals. (Assumed)	Tank installation date unknown. Regular leaded gasoline tag was found at the fill port.	Tank contents, soil and groundwater. (If required)	Beneath the tank a maximum of two feet below the native soil backfill interface, or side wall at the high water mark, if water present.
1500 Gals. (Assumed)	Tank installation date unknown. Premium leaded gasoline to fuel vehicles. Last use of tanks is assumed to have been used to fuel vehicles.	" " "	Minimum of 2 feet end samples at tanks
250 Gals. (Assumed)	Tank installation date unknown. Used to store waste oil from operations. Last use of tank unknown.	" " "	Piping should be sampled every 20 feet. Minimum of one sample should be taken if less than 100 gallons

One soil sample must be collected for every 20 feet of piping that is removed. A ground water sample must be collected should any ground water be present in the excavation.

Excavated/Stockpiled Soil	
Stockpiled Soil Volume (Estimated) 45 Cubic Yards	Sampling Plan <i>Collect 4 samples & composite</i> <i>1/11/88</i> One or more samples will be taken from the stockpiled areas as determined by agency personnel.

Stockpiled soil must be placed on bermed plastic and must be completely covered by plastic sheeting.

16. Chemical methods and associated detection limits to be used for analyzing samples

The Tri-Regional Board recommended minimum verification analyses and practical quantitation reporting limits should be followed. See attached Table 2.

Contaminant Sought	EPA, DHS, or Other Sample Preparation Method Number	EPA, DHS, or Other Analysis Method Number	Method Detection Limit
TPH G	EPA GC FID 5030		
BTX&E	EPA 8020	EPA 624	
Lead	EPA 6010		
TPH D	EPA GC FID 3550	EPA GC FID 3510	
O&G	EPA 5520 D&F		
Semivolatiles Organics Including PCBs	EPA 8270		
5 CAM Metals (Cd, Cr, Pb, Ni, & Zn)	EPA 6010		
CL HC	EPA 8010		

17. Submit Site Health and Safety Plan (See Instructions)

18. Submit Worker's Compensation Certificate copy

Name of Insurer All work will be done utilizing subcontractors who will be required to furnish their own Worker's Compensation Certificate.

19. Submit Plot Plan (See Instructions)

20. Enclose Deposit (See Instructions)-

21. Report any leaks or contamination to this office within 5 days of discovery. The report shall be made on an Underground Storage Tank Unauthorized Leak/Contamination Site Report form. (see Instructions)

22. Submit a closure report to this office within 60 days of the tank removal. This report must contain all the information listed in item 22 of the instructions.

I declare that to the best of my knowledge and belief the statements and information provided above are correct and true.

I understand that information in addition to that provided above may be needed in order to obtain an approval from the Department of Environmental Health and that no work is to begin on this project until this plan is approved.

I understand that any changes in design, materials or equipment will void this plan if prior approval is not obtained.

I understand that all work performed during this project will be done in compliance with all applicable OSHA (Occupational Safety and Health Administration) requirements concerning personnel health and safety. I understand that site and worker safety are solely the responsibility of the property owner or his agent and that this responsibility is not shared nor assumed by the County of Alameda.

Once I have received my stamped, accepted closure plan, I will contact the project Hazardous Materials Specialist at least three working days in advance of site work to schedule the required inspections.

Signature of Contractor

Name (please type) Richard Camacho

Signature 

Date 9/19/94

Signature of Site Owner or Operator

Name (please type) _____

Signature _____

Date _____

ALAMEDA COUNTY HAZARDOUS MATERIALS DIVISION
Acknowledgement of Refund Recipient for Site Account
DEPOSITOR FILLS OUT PER SITE
-- REQUIRED --

The depositor will use this form to acknowledge that the property owner or his or her designee will receive any refund due at the completion of all deposit/refund projects at the site listed below.

SITE NUMBER/ADDRESS:

REFUND RECIPIENT-PROPERTY OWNER

Site Number

Shiloh Christian Fellowship

Shiloh Christian Fellowship

Company Name

Owner's Name

3295 School St.

3295 School St.

Street Address

Owner's Address

Oakland, CA 94602-3638

Oakland, CA 94602-3638

City

Zip Code

Owner's City

State

Zip

I have read the description of the project Deposit/Refund Procedure, and have had an opportunity to ask questions about it. I understand that regardless of who deposits money into the site account, any deposit money remaining at the completion of all projects being conducted at this site will be refunded solely to the property owner or his or her designee.

Signature of Depositor

Date

Depositor Name

Company Name

Street Address

City / Zip

ALAMEDA COUNTY HAZARDOUS MATERIALS DIVISION
Declaration of Site Account Refund Recipient

SITE OWNER FILLS OUT PER SITE

-- OPTIONAL --

The property owner will use this form to designate someone other than him- or her- self to receive any refund due at the completion of all deposit/refund projects at the site listed below. In the absence of this form, the property owner will receive any refund. Only one person at any one time may be designated to receive any refund.

SITE NUMBER/ADDRESS:

PROPERTY OWNER

Site Number

Company Name

Owner's Name

Street Address

Owner's Address

City

Zip Code

Owner's City

State

Zip

I designate the following person to receive any refund due at the completion of all deposit/refund projects:

Name

Street Address

City / Zip

Property Owner Signature

Date

Property Owner Name

RETURN FORM TO: Alameda County, Hazardous Materials Div.
80 Swan Way, Rm 200
Oakland, CA 94621-1439
Phone: (510) 271-4320

CONTRACTORS STATE LICENSE BOARD

No. 543700

Building Quality

ISSUED 10-07-88

This license is the property of the Registrar of Contractors. It is not transferable, and shall be returned to the Registrar upon demand when suspended, revoked, or invalidated for any reason. It becomes void if not renewed.

Contractor's License

Pursuant to the provisions of Chapter 9 of Division 3 of the Business and Professions Code and the Rules and Regulations of the Contractors State License Board, the Registrar of Contractors does hereby issue this license to:

CAMACHO RICHARD EDWARD

to engage in the business or act in the capacity of a contractor in the following classification(s):

A GENERAL ENGINEERING CONTRACTOR

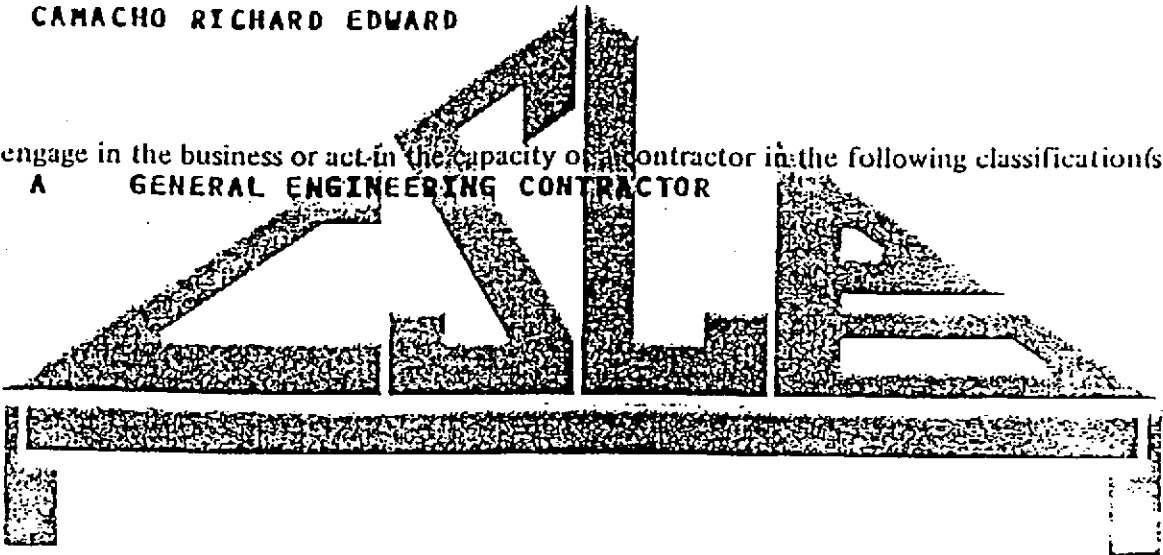

WITNESS my hand and sealed this
24TH day of OCTOBER 1988.



David R Phillips

Registrar of Contractors

[Handwritten Signature]

Signature of Licensee

STATE AND CONSUMER SERVICES AGENCY
DEPARTMENT OF CONSUMER AFFAIRS

Signature of person who qualified
on behalf of the licensee



Building Quality

HAZARDOUS SUBSTANCES REMOVAL AND REMEDIAL ACTIONS CERTIFICATION

Pursuant to the provisions of Section 7058.7 of the Business and Professions Code, the Registrar of Contractors does hereby certify that the following qualifying person has successfully completed the hazardous substances removal and remedial actions examination.



Qualifier: RICHARD EDWARD CAMACHO

License No.: 543700

Namestyle: RICHARD EDWARD CAMACHO

WITNESS my hand and official seal this
23 day of FEBRUARY, 1989

David R. Phillips
Registrar of Contractors

131-36 (7/89)

This certification is the property of the Registrar of Contractors, is not transferable, and shall be returned to the Registrar upon demand when suspended, revoked, or invalidated for any reason.

A3029

**SITE SPECIFIC SAFETY PLAN
FOR THE
SHILOH CHRISTIAN FELLOWSHIP
UNDERGROUND STORAGE TANK
REMOVAL PROJECT**

CONTENTS

	PAGE
1.0 INTRODUCTION	1
2.0 SITE CHARACTERISTICS	3
2.1 Background	3
3.0 WORK DESCRIPTION	4
4.0 KEY PERSONNEL AND RESPONSIBILITIES	5
4.1 Site Safety Personnel	5
4.2 Personnel and Responsibilities	5
4.2.1 Project Manager	5
5.0 HAZARD ANALYSIS	6
5.1 Chemical Hazards	6
5.1.1 Chemical Description of Gasoline	6
5.1.2 Effects of Exposure to Gasoline	6
5.2 Physical Hazards	7
6.0 WORK REQUIREMENTS	7
6.1 Respiratory Protection	7
6.2 Dermal Protection	7
6.2.1 Personal Protective Equipment	7
6.3 Action Levels	8
6.3.1 Action Levels for a Temporary Stop of Work	8
6.3.2 Action Levels for Upgrade to Level C Protection	8
6.4 Protection Against Physical Hazards	8
6.4.1 Excavation Instability	8
6.4.2 Noise	8
6.4.3 Electric Shock	9
6.4.4 Heavy Equipment	9
6.4.5 General Safety	9
6.5 Entry Procedures	9
7.0 WORK ZONE AND DECOTAMINATION PROCEDURES	10
7.1 Control	10
7.2 Field Operations Work Areas	10
7.2.1 Exclusion Zone	11
7.2.2 Contamination Reduction Zone	11
7.2.3 Support Zone	11
7.3 Zone Dimensions	11

7.0	Contd.		
	7.4	Decontamination Procedures	12
	7.4.1	Personal Decontamination During Medical Emergencies	13
8.0	EMERGENCY PROCEDURES		14
	8.1	General Injury	14
	8.2	Specific Treatments	14
	8.3	Emergency Phone Numbers	14
	8.4	Accident Reporting Procedures	15
9.0	DOCUMENTATION		16
10.0	MEDICAL MONITORING		17
11.0	TRAINING PROGRAM		18
12.0	PROPOSITION 65		19
	12.1	Carcinogens and Reproductive Toxicants	19
	12.2	Warnings	19

FIGURE 1: SITE LOCATION

APPENDIX A: CHEMICAL DESCRIPTIONS

OSHA NOTICE

September 19, 1994

**Health and Safety Plan
Tank Removal and Soil Sampling Activities
Shiloh Christian Fellowship, Inc.
3295 School Street
Oakland, CA 94602-3638**

1.0 INTRODUCTION

This Health and Safety Plan ("HSP") addresses the hazards associated with the planned field activities at the Shiloh Christian Fellowship; 3250 School Street; Oakland, CA (See Figure 1 for the Site Location Plan). It presents baseline health and safety requirements for establishing and maintaining a safe working environment during the course of work. The planned field activities at the Site include assisting the assigned Environmental Engineering Firm, Subsurface Consultants, Inc. with soil sample collection and excavation of affected soil under the supervision of The Guterrez Group personnel.

If work plan specifications change during or after the preparation of this HSP, or if site conditions differ as the result of more information, GEMS Health and Safety Director shall be informed immediately and appropriate changes shall be made to this HSP.

At a minimum, all contractor/subcontractor personnel working on site must:

- have read and understood the specifications of this HSP
- have completed all training requirements in Code of Federal Regulations 29 CFR 1910.120
- provide their own health and safety equipment as indicated in this HSP, and with the minimum requirements established by this HSP. If the contractor/subcontractor has prepared his/her own HSP, it must minimally meet requirements contained herein and all applicable Federal, State, and Local health and safety requirements.

This HSP shall be read and approved by GEMS Environmental Health and Safety Director, Project Manager, and Quality Assurance Reviewer.

A copy of this HSP shall be kept on site, easily accessible to all employees and government inspectors, and on file in the GEMS office.

This HSP was prepared using the following documents:

- 29 CFR 1910 Occupational Safety and Health Standards, 1990
- 29 CFR 1926 Safety and Health Regulations for Construction
- 29 CFR 1910.1000 OSHA Air Contaminants Permissible Exposure Limits, 1990
- Title 8, California Code of Regulations, Occupation Health and Safety Standards.
- California Department of Health Services (DHS), Toxic Substances Control Division (TSCD), Technical and Support Unit, Region 3, Los Angeles, California, August 1988. Site Safety Plan Guidance Document.
- National Institute for Occupational Safety and Health (NIOSH); Occupational Safety and Health Administration (OSHA); U.S. Coast Guard (USCGO); U.S. Environmental Protection Agency (EPA), October 1985. Occupational Safety and Health Guidance Manual for Hazardous Waste Site Activities. Washington D.C.: U.S. Government Printing Office.
- NIOSH/OSHA, 1981. Occupational Health Guidelines for Chemical Hazards.
- Sax, N. Irving, 1984, Dangerous Properties of Materials, 6th edition, Van Nostrand Reinhold Company, Inc., New York, New York.
- U.S. EPA, Office of Emergency and Remedial Response, Hazardous Response Support Division, November 1984. Standard Operating Safety Guides.

2.0 SITE CHARACTERISTICS

Site Name: Shiloh Christian Fellowship, Inc.
Site Address: 3250 School Street
Oakland, CA 94602

2.1 Background

The subject property is currently used for miscellaneous storage of excess non-hazardous materials used by the Shiloh Christian Fellowship. The property is currently owned by the Shiloh Christian Fellowship, Inc. The location of the site is shown in Figure 1, Site Location Map. The site is bound to the west by Maple Street, to the south by School Street and to the north and east by private residences.

Prior to the acquisition of the property by the Shiloh Christian Fellowship, Inc, the property was used as a service station dispensing gasoline and general service station type of activities. A thorough document search proved to be fruitless in regards to the size of underground storage tanks situated on the premises. It is the understanding of The Guterrez Group that the tank was probably installed in the 1940's and was last used prior to the acquisition on July 1982. The exact date is unknown. Based upon field investigations, it is believed that the type of hazardous materials that were stored in the underground storage tanks were Regular Leaded Gasoline, Premium Leaded Gasoline and Waste Oil. This premise was based upon a tag found at the filling port of one of the tanks which depicted Regular Leaded Gasoline. The gasoline tanks have been assumed to be approximately 1,500 gallons each and the waste oil tank has been estimated to be approximately 250 gallons. It has been assumed that all the tanks are of steel, single-walled construction.

3.0 WORK DESCRIPTION

Tasks to be performed at the Site include underground tank removal activities.

Work activities are planned in the following order (some activities may be performed concurrently):

- remove and properly dispose of contents of tanks
- break concrete, remove overburden to expose top of tank
- excavate soil to remove tank
- inert tank with a minimum of 25 pounds of dry ice per 1,000 gallons of capacity
- remove tank from excavation, clean, and inspect
- assist environmental soils consultant in obtaining samples
- backfill, compact and restore site including concrete walkways, fencing and other relevant site restoration

4.0 KEY PERSONNEL AND RESPONSIBILITIES

4.1 Site Safety Personnel

<u>NAME</u>	<u>RESPONSIBILITIES</u>
Richard Camacho	Project Manager

4.2 GEMS Personnel and Responsibilities

The responsibilities of the GEMS personnel listed in Section 4.1 are outlined below.

4.2.1 GEMS Project Manager

The Project Manager has the ultimate responsibility for the health and safety of GEMS personnel on site. As part of his duties he shall be responsible for:

- ensuring that onsite GEMS personnel receive the proper training, and are informed of potential hazards anticipated at the Site and procedures and precautions to be implemented on the job
- ensuring that contractors and subcontractors are informed of the expected hazards and appropriate protective measures at the Site (Subcontractors should be given a copy of the GEMS HSP for review)
- ensuring that resources are available to provide a safe and healthy environment for GEMS personnel.

5.0 HAZARD ANALYSIS

Potential chemical, physical and general safety hazards during the excavation / soil sampling program at the Site include the following:

- Chemical hazards
 - respiratory (exposure to volatile organic compounds VOCs)
 - dermal (contact with petroleum products)
- Physical hazards
 - excavation instability
 - noise
 - electric shock
 - heavy equipment
 - auto traffic
 - fire and explosion

Work procedures to protect workers from chemical and physical hazards are discussed in Section 6.0.

5.1 Chemical Hazards

The primary chemical hazard is exposure to chemical compounds from the unleaded gasoline affected soil. Of particular concern is the potential for workers to be exposed to aromatic petroleum compounds in the vicinity of the tank excavation. These hydrocarbons include the primary components of gasoline (the light aliphatic hydrocarbons) and the common minor components of gasoline (benzene, toluene, ethylbenzene, and xylenes).

5.1.1 Chemical Description of Gasoline

Gasoline is produced from the light distillates during petroleum fractionation; its major components include paraffins, olefins, naphthenes, aromatic, and recently ethanol. Gasoline also contains various functional additives as required for different uses, such as antiknock fluids, antioxidants, metal deactivators, corrosion inhibitors, anti icing agents, preignition preventers, upper cylinder lubricants, dyes, and decolorizers.

5.1.2 Effects of Exposure to Gasoline

Mild cases of gasoline ingestion can cause inebriation, vomiting, vertigo, drowsiness, confusion, and fever. Aspiration into the lungs and secondary pneumonia may occur unless prevented. Gasoline can cause hyperemia of the

conjunctiva and other eye disturbances. Inhalation of gasoline during bulk handling operations produced no physiological effects. Gasoline is a skin irritant and a possible allergen. Repeated or chronic dermal contact can result in drying of the skin, lesions, and other dermatologic conditions.

The Permissible Exposure Limit (PEL) for gasoline is 300 ppm and the Short Term Exposure Limit (STEL) is 500 ppm.

Appendix A includes chemical descriptions for other chemicals of concern.

5.2 Physical Hazards

The potential physical hazards at the Site during the planned activities stem from heavy machinery use and the hazardous nature of excavation work. The potential physical hazards are listed under section 5.0.

6.0 WORK REQUIREMENTS

6.1 Respiratory Protection

Field operations will be initiated in Level D. The primary route of potential exposure for chemicals is inhalation. Respirators must be kept available during excavation activities. Respirators will be equipped with NIOSH approved high efficiency particulate / organic vapor combination cartridges (such as North 7600)

6.2 Dermal Protection

Unless adequate precautions are taken, chemicals may contact the skin or clothing. Potential physical contact with chemicals of concern are possible under the following circumstances:

- tank excavation
- soil sampling

6.2.1 Personal Protective Equipment

- hard hats
- steel-toed / steel-shank boots
- disposable PVC gloves
- safety glasses
- tyveks coveralls (if potential for splashing exists)

6.3 ACTION LEVELS

6.3.1 Action Levels for a Temporary Stop Work

The SSO shall impose a temporary stop work and contact the GEMS Health and Safety Director immediately if the following conditions are observed, or if there is a question about site conditions:

- uncontrolled dust generation
- indications of heat stress
- changes in the general health profile of onsite personnel, including symptoms discussed in Appendix A and headaches, dizziness, breathing difficulties, irritation to the eyes, nose, throat, and hands
- vapors detected in excess of 10 percent of the lower explosive limit (LEL) of gasoline depending on the grade of gasoline, the LEL is 1.2 to 1.5 percent, the action level for stop work and site withdrawal will be 1,200 ppm
- detection of benzene in the breathing zone

6.3.2 Action level for upgrade to Level C Protection

The action level to upgrade to level C protection is the detection of ambient air concentration of VOCs in the breathing zone at 25 ppm or greater without the presence of benzene.

6.4 Protection Against Physical Hazards

6.4.1 Excavation Instability

The limits of excavation and method(s) of shoring side walls proposed by the contractor shall be approved by the engineer before the excavation begins. Workers will not enter excavations deeper than 4 feet. All requirements pursuant to 29 CFR 12926.651 and 652, Excavations, Trenching and shoring, shall be observed.

6.4.2 Noise

Results primarily from concrete breaking and excavation equipment, and other machinery. Workers will wear ear plugs when operating heavy machinery to avoid noise that may exceeded the 85 decibel Threshold Limit Value (TLV) established by the American Conference of Governmental Industrial Hygienists.

However, based on previous field experience, expected noise level should not exceed 85 decibels.

6.4.3 Electric Shock

All electrical equipment to be used during field activities will be suitably grounded and insulated.

6.4.4 Heavy Equipment

Hazards related to excavating and soil sampling necessitate securing the work area. All relevant requirements pursuant to 29 CFR 1926.602 and Subpart W, Rollover Protective Structures, Overhead Protection, shall be observed during the course of excavation and soil sampling activities.

All field personnel not directly involved in the excavation work will be kept at safe distances from areas where heavy equipment are in use. Unauthorized visitors will not be permitted near areas where heavy equipment are in use regardless of whether the area has been designated as an exclusion zone.

6.4.5 General Safety

All GEMS and contractor / subcontractor personnel will wear approved head protection while working around heavy equipment in the site area. Fire hydrants, electrical, and underground lines and pipes will be identified before excavation operations begin. Two 10 pound fire extinguishers will be kept on site near the exclusion zone.

6.5 Entry Procedures

At a minimum, all visitors entering the exclusion zone must wear the protective clothing and equipment worn by GEMS and contractor / subcontractor personnel. Permission enter the work area must be obtained from at least one of the personnel named in Section 4.0. Each visitor's name and purpose of visit will be recorded in the field notes.

7.0 WORK ZONE AND DECONTAMINATION PROCEDURES

A site must be controlled to reduce the possibility of exposure to any contaminants present and to limit their transport from the site by personnel or equipment.

7.1 Control

A control system is required to ensure that personnel and equipment working on hazardous waste sites are subjected to appropriate health and safety surveillance and site access control.

The possibility of exposure or translocation of contaminants can be reduced or eliminated in a number of ways of ways, including:

- setting security or physical barriers at control points to regulate access to and or exclude unnecessary personnel from the general area
- minimizing the number of personnel and equipment on site consistent with effective operations
- establishing work zones within the site
- conducting operations in a manner which will reduce the exposure of personnel and equipment
- minimizing the airborne dispersion of contaminants (utilizing dust control procedures)
- implementing appropriate decontamination procedures for both equipment and personnel.

7.2 Field Operations Work Areas

Work areas (zones) will be established based on anticipated contamination. Within these zones, prescribed operations will occur utilizing appropriate personal protective equipment (PPE). Movement between areas will be controlled at checkpoints. The planned zones are:

- Exclusion (contaminated)
- Contamination Reduction
- Support (noncontaminated)

7.2.1 Exclusion Zone

The Exclusion Zone is the innermost area of the three concentric rings and is considered contaminated, dirty, or " hot ". Within this area, the prescribed protection must be worn by any personnel upon entering. An entry checkpoint will be established at the periphery of the exclusion zone to control the flow of personnel and equipment between contiguous zones, and to guarantee that the procedures established to enter and exit the zones are followed.

The Exclusion Zone boundary will be established initially on the presence of the contaminant(s) within the area. Subsequent to initial operations, the boundary may be readjusted based on observations and or measurement. The boundary will be physically secured and posted.

7.2.2 Contamination Reduction Zone

Between the exclusion and the support zone is the contamination reduction zone. The purpose of this zone is to provide an area to prevent or reduce the transfer of contaminants which may have been picked up by personnel or equipment returning from the exclusion zone. All decontamination activities occur in this area. The boundary between the support zone and the contamination reduction zone is the contamination control line. This boundary separates into the contamination reduction zone from the clean area will be through an access control point. Personnel entering at this station will be wearing the prescribed PPE for working in the contamination reduction zone. Exiting the contamination reduction zone to the clean area requires the removal of any suspected or known contaminated PPE, and compliance with the established decontamination procedures.

7.2.3 Support Zone

The Support Zone is the outermost of the three rings and is considered decontaminated, or Clean Area. It contains the Command Post (CP) for field operations and other elements necessary to support site activities. Normal street or Level D work clothes are the appropriate apparel to be worn in this area.

7.3 Zone Dimensions

Considerable judgement is need to ensure safe working distances for each zone, balanced against practical work considerations. Physical and topographical barriers may constrain ideal locations. Field / laboratory measurements combined with meteorological conditions and air dispersion calculations will assist in establishing the control zone distances. When not working in area that require the use of chemical-resistant clothing, work zone procedures may still need to limit the movement of personnel and retain adequate site control.

7.4 Decontamination Procedures

As part of the system to preventer reduce the physical transfer of contaminants by people and or equipment from the site, procedures will be instituted for decontaminating anything leaving the exclusion zone and contamination reduction zone. These procedures include the decontamination of personnel, protective equipment monitoring equipment, clean-up equipment, ect. Unless otherwise demonstrated, everything leaving the exclusion zone should be considered contaminated. In general, decontamination at the site consists of rinsing equipment with detergent water solution. Reusable decontaminated PPE will be stored for air drying.

Decontamination is addressed in two ways: the physical arrangement and control of contamination zones, and the effective use of decontamination procedures.

The decontamination process uses cleaning solutions, followed by rinse solutions. Used solution, brushes, sponges, and containers must be properly disposed of.

Decontamination Solution

<u>Description</u>	<u>usage</u>
3 cupsalconox 1 cup sodium carbonate 5-8 gallons water	light contamination
commercial detergent- full strength or diluted	organic contaminants

As with all alkaline cleaners, continuous or repeated contact with the skin should be avoided. If an employes skin becomes contaminated , he will move to the decontamination area and remove contaminated clothing, and wash with a mild soap detergent and water to remove any contaminant from the skin. He will then see a physician for possible medical treatment.

A rinse solution will be used to remove the contamination solution and neutralize any excess decontamination solution.

All personal will follow these decontamination procedures:

1. When returning from the exclusion zone, remove heavy soil as necessary from boots, gloves, and clothing by using al towel or hose before entering the contamination reduction zone.
2. At the decontamination area, step into decontamination tub(s) and brush boots and gloves clean.

3. Remove disposable suit and discard in proper container
4. Step into rinse tub(s) then remove boots
5. Remove outer gloves and dispose of properly
6. Remove respirator and hard hat
7. Remove inner gloves and dispose of properly

Decontamination procedures may be modified, if necessary, with the approval of the Site Safety Officer.

7.4.1 Personal Decontamination During Medical Emergencies

In the event of personal injury, first-site personnel must decide if the victim/s injuries are potentially ;the type that would be aggravated by movement. If there is any doubt, or if the victim is unconscious and cannot respond, no attempt should be made to move the victim to the decontamination area. Only off-site paramedics may move such victims, If the paramedics approve, the victim/s PPE will be cut of f in the decontamination reduction zone. If the decision is made not to remove the victim's protective clothing, he will be wrapped in a tarp or similar object to protect the ambulance and crew during transportation. If the victims contaminated with materials that threaten to cause additional injury or immediate health hazards, the PPE will be carefully removed and the victim washed appropriately.

8.0 EMERGENCY PROCEDURES

8.1 General Injury

- Step 1: use first aid kit on site, if appropriate
- Step 2: use off-site help and / or assistance if appropriate
- Step 3: notify SSO, Project Manager, and Health and Safety Director

8.2 Specific Treatments

- Eye Exposure: flush eye with eye wash, call ambulance
- Skin Exposure: wash immediately with soap and water
call ambulance if necessary
- Fire (localized): use fire extinguisher and activate alarm
system if necessary
- Fire (uncontrolled): call Fire Department
- Chemical Spill: call Fire Department and National
Response Center for Toxic Chemical and
Oil Spills
- Explosion: call Fire Department if potential for
additional explosions or fire danger exists
- Inhalation: move affected person(s) to fresh air and
cover source of vapors if appropriate
- Ingestion: call ambulance

8.3 Emergency Phone Numbers

- Medical / General Service Numbers

Police Department	911
Fire Department	911
Ambulance	911

- Hospital

Name: Highland Hospital

Address: 1411 E-31st

City, State: Oakland, California

Phone Number: (510)437-4148

8.4 Accident Reporting Procedures

In the event of an emergency, contact the following:

GEMS: (510) 427-4616

Richard Camacho

If an exposure of injury occurs, work shall be temporarily halted until the Site Safety Officer (Project Manager) decides it is safe to continue work.

9.0 DOCUMENTATION

The SSO will record field observations of health and safety procedures by workers conducting the planned activities outlined in Section 3.0, including deviations from the recommended health and safety procedures by having a tailgate safety meeting prior to starting work.

10.0 Medical Monitoring

Appropriate medical monitoring will be required of GEMS personnel to:

- Meet requirements of 29 CFR 1910.120 (f)
- Meet requirements for respirator use
- Meet other legal requirements

A signed physician's statement qualifying the individual for the work to be performed will be required as part of the medical monitoring program.

11.0 Training Program

1. The GEMS SSO shall have fulfilled all appropriate training requirements indicated by 29 CFR 1910.120 (e), including the 40-hour training requirement and required refresher courses.

2. A tailgate session to discuss this HSP will be held before field activities begin. All GEMS personnel and contractor / subcontractor employees shall receive, at a minimum, the following information:

- the names of personnel and alternates responsible for site safety and health
- safety, health, and other hazards at the site
- instruction in the use of personnel protective equipment
- action levels
- employee work practices to minimize risks from on-site hazards
- instruction in the safe use of engineering controls and equipment on site
- control measures
- emergency plans
- Proposition 65 Warnings

12.0 PROPOSITION 65

Under California's Safe Drinking Water and Toxic Enforcement Act of 1986 (Proposition 65), individuals who may be exposed in the work place to chemicals that may cause cancer or birth defects must be warned of such hazards pursuant to California Health and Safety Code (HSC) Section 25249.6. At this Site abnormalities and their respective warnings are listed below.

12.1 Carcinogens and Reproductive Toxicants

Chemicals known to the State of California to cause cancer, as listed in Title 22, California Code of Regulations (CCR) Section 12000(b), which may be present at the Site include benzene. Chemicals known to the State of California as reproductive toxicants, as listed in Title 22 CCR Section 12000(b) which may be present at the Site include lead.

12.2 Warnings

Pursuant to HSC Section 25249.6 and CCR Sections 12601(c) (3) (A) and 12601 (c) (3) (B), the following warnings must be made:

" This area contains chemicals known to the State of California to cause cancer ."

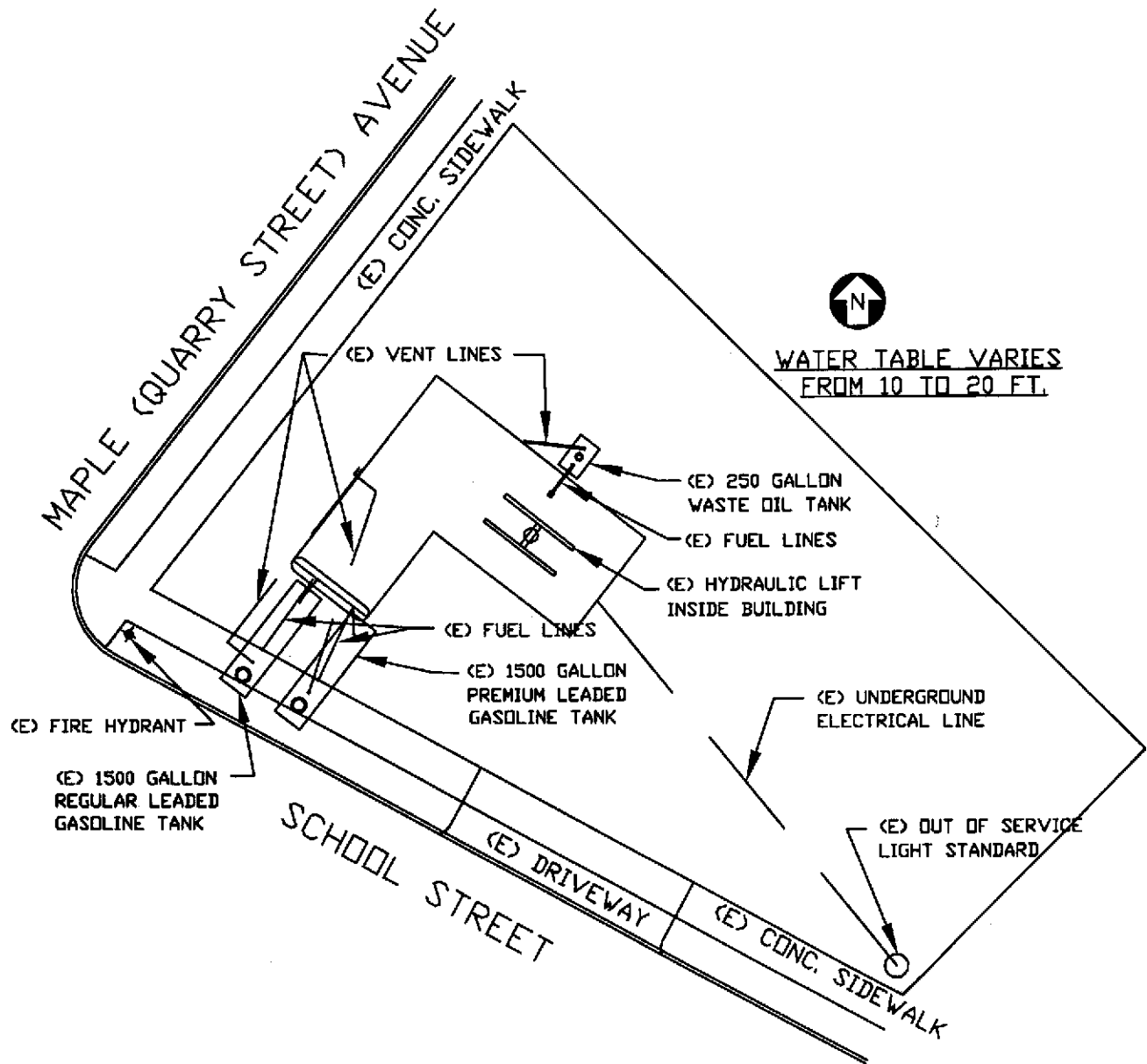

SITE LOCATION PLAN

SCALE: 1" = 20'-0"

LETTER	DRAWN BY	CHECKED BY	APPR'D BY	DATE	REVISIONS
--------	----------	------------	-----------	------	-----------

SHILOH CHRISTIAN FELLOWSHIP
UNDERGROUND TANK REMOVALS
SITE LOCATION PLAN

DRAWN BY	V. ORANGE	DATE	09/19/94
CHECKED BY	V.O.	DATE	09/19/94
APPROVED BY	V. ORANGE	DATE	09/19/94
CAD FILE PATH			

SCALE 1" = 20'-0"

UNIVERSITY OF CALIFORNIA LAWRENCE BERKELEY LABORATORY
FACILITIES DEPARTMENT

DRAWING NO.	SHEET
94-C1	1
PROJECT NO. 000050	1 OF 1

APPENDIX A
CHEMICAL DESCRIPTIONS

Appendix A
Chemical Descriptions

Benzene

Benzene is a clear colorless liquid.

Exposure to high concentrations (3,000) ppm) may result in acute poisoning, characterized by the narcotic action of benzene on the central nervous system. Chronic poisoning occurs most commonly through inhalation and dermal adsorption. Benzene is also a human carcinogen. Unleaded regular gasoline commercially available in the United States typically contains less than about 2 percent benzene.

The PEL for a time-weighted average (TWA) 8-hour periods 1ppm in air (OSHA Standard 29 CFR 1910.1000).

Toluene

Toluene is a colorless liquid with a benzol-like odor.

Inhalation of high vapor concentrations may cause impairment of coordination and reaction time, headaches, nausea, eye irritation, loss of appetite, a bad taste in the mouth, and weariness.

The PEL for a TWA over an 8-hour period is 100 ppm in air (OSHA Standard 29 CFR 1910.1000).

Xylene

Xylene is a clear, colorless liquid.

Exposure to high concentrations of vapor may resulting eye and skin irritation. Eye irritation may occur at concentrations of about 200 ppm.

The PEL for a TWA over an 8-hour period is 100 ppm in air (OSHA Standard 29 CFR 1910.1000).

Ethylbenzene

Ethylbenzene is a clear, colorless liquid.

Exposure to high concentrations of vapor (approximately 1,000 ppm) may result in irritation to the skin and mucous membranes, dizziness, irritation of the nose and throat and a sense of constriction of the chest.

The PEL for a TWA over an 8-hour period is 100 ppm in air (OSHA Standard 29 CFR 1910.1000).

DEPARTMENT OF ENVIRONMENTAL HEALTH
HAZARDOUS MATERIALS DIVISION

1131 HARBOR BAY PARKWAY
ALAMEDA, CA
PHONE NO. (510) 567-6700



BERNABE AN. BRINKER INC.

MBE/WBE
General Engineering Contractor
Hazardous Substances Removal
License No. A610617

ERNESTO F. BERNABE, JR.
President

2240 Wood Street
Oakland, California 94607

TEL: 510 • 451 • 3482
FAX: 510 • 836 • 2635
Pager: 510 • 321 • 7188

*Department of Environmental Health
Hazardous Materials Division
Inspected and approved
5/10/95
Machuga*

UNDERGROUND TANK CLOSURE PLAN

* * * Complete according to attached instructions * * *

1. Business Name Shiloh Christian Fellowship
Business Owner Shiloh Christian Fellowship, Incorporated
2. Site Address 3250 School Street
City Oakland Zip 94602 Phone N/A
3. Mailing Address 3295 School Street
City Oakland Zip 94602 Phone (510)261-2052
4. Land Owner Shiloh Christian Fellowship, Inc.
Address 3295 School Street City, State Oakland, CA Zip 94602-3638
5. Generator name under which tank will be manifested _____
Shiloh Christian Fellowship, Inc.
EPA I.D. No. under which tank will be manifested GAC 000888552

6. Contractor Bernabe & Brinker Inc.
Address 1281 - 30th Street
City Oakland Phone (510)451-3482
License Type* "A", & HAZ
ID# 610617

*Effective January 1, 1992, Business and Professional Code Section 7058.7 requires prime contractors to also hold Hazardous Waste Certification issued by the State Contractors License Board. Indicate that the certificate has been received, in addition, to holding the appropriate contractors license type.

7. Consultant Subsurface Consultants, Inc.
Address 171 - 12th Street, Suite 201
City Oakland Phone (510) 268-0461

8. Contact Person for Investigation
Name Bill Wikander Title Associate
Phone (510) 268-0461

9. Number of tanks being closed under this plan Three (3)
Length of piping being removed under this plan Approximately forty feet
Total number of tanks at facility Three (3)

10. State Registered Hazardous Waste Transporters/Facilities (see instructions).

** Underground tanks are hazardous waste and must be handled **
as hazardous waste

a) Product/Residual Sludge/Rinsate Transporter

Name Erickson, INC. EPA I.D. No. CAD 009466392
Hauler License No. 019 License Exp. Date 7/95
Address 255 Parr Blvd.
City Richmond State CA Zip 94801

b) Product/Residual Sludge/Rinsate Disposal Site

Name Erickson, INC. EPA I.D. No. CAD 009466392
Address 255 Parr Blvd.
City Richmond State CA Zip 94801

c) Tank and Piping Transporter

Name Erickson, INC. EPA I.D. No. CAD 009466392
Hauler License No. 019 License Exp. Date 7/95
Address 255 Parr Blvd.
City Richmond State CA Zip 94810

d) Tank and Piping Disposal Site

Name Erickson, INC. EPA I.D. No. CAD 009466392
Address 255 Parr Blvd.
City Richmond State CA Zip 94810

11. Experienced Sample Collector

Name Dennis Alexander
Company Subsurface Consultants, INC.
Address 171 - 12th Street, Suite 201
City Oakland State CA Zip 94607 Phone (510)268-0461

12. Laboratory

Name Curtis & Tompkins, Ltd.
Address 2323 Fifth Street
City Berkeley State CA Zip 94710
State Certification No. #159

13. Have tanks or pipes leaked in the past? Yes | | No | |

If yes, describe. These tanks have not been used since the present owner has taken possession of the property. A thorough document search has produced nothing about the history of these tanks including the size and materials which were contained in these tanks.

14. Describe methods to be used for rendering tank inert

1. All product will be removed

2. Residual liquids, solids, and sludge will be removed

3. All vapors will be purged with a minimum of 25# of dry ice/1,000 gals.

Before tanks are pumped out and inerted, all associated piping must be flushed out into the tanks. All accessible associated piping must then be removed. Inaccessible piping must be plugged.

The Bay Area Air Quality Management District (771-6000), along with local Fire and Building Departments, must also be contacted for tank removal permits. Fire departments typically require the use of explosion proof combustible gas meters to verify tank inertness. **It is the contractor's responsibility to bring a working combustible gas meter on site to verify tank inertness.**

15. Tank History and Sampling Information

Tank		Material to be sampled (tank contents, soil, ground-water, etc.)	Location and Depth of Samples
Capacity	Use History (see instructions)		
550 Gallons (Assumed) <i>gas</i>	Tank installation date unknown. Regular leaded gas label was found at the fill port.	Tank contents, soil and ground water if water table is encountered.	Beneath the tank a maximum of two feet below, the native soil/backfill interface, or side wall at the high water mark, if water present. <i>min of 1 sample</i>
550 Gallons (Assumed) <i>gas</i>	Tank installation date unknown. Premium leaded gasoline used to fuel motor vehicles. Ascertained by neighbor.	Tank contents, soil and groundwater if water table is encountered.	Beneath the tank a maximum of two feet below, the native soil/backfill interface, or side wall at the high water mark, if water present. <i>min of 1 sample</i>
250 Gallons (Assumed) <i>oil</i>	Tank installation date unknown. Used to store waste oil from operations. Last use of tank unknown.	Tank contents, soil and groundwater if water table encountered.	"Ditto"

One soil sample must be collected for every 20 feet of piping that is removed. A ground water sample must be collected should any ground water be present in the excavation.

Excavated/Stockpiled Soil

Stockpiled Soil Volume (estimated)

45 cubic yards

Sampling Plan

*attached proposal
for review from
subsurface consultants*

Stockpiled soil must be placed on bermed plastic and must be completely covered by plastic sheeting.

Will the excavated soil be returned to the excavation immediately after tank removal? [] yes [] no [] unknown

If yes, explain reasoning _____

If unknown at this point in time, please be aware that excavated soil may not be returned to the excavation without prior approval from Alameda County. This means that the contractor, consultant, or responsible party must communicate with the Specialist IN ADVANCE of backfilling operations.

16. Chemical methods and associated detection limits to be used for analyzing samples:

The Tri-Regional Board recommended minimum verification analyses and practical quantitation reporting limits should be followed. See attached Table 2.

17. Submit Site Health and Safety Plan (See Instructions)

Contaminant Sought	EPA or Other Sample Preparation Method Number	EPA or Other Analysis Method Number	Method Detection Limit
<i>Gasoline</i>		<i>8015</i>	
<i>BTEX</i>		<i>8020</i>	
<i>Diesel</i>		<i>3550</i>	
<i>Oil + Grease</i>		<i>5520</i>	
<i>Volatiles</i>		<i>8010</i>	
<i>organics</i>			
<i>metals</i>		<i>8010</i>	
<i>Cd, Cr, Pb, Zn</i>		<i>8080</i>	
<i>PCB</i>	<i>]- semi volatile</i>	<i>8270</i>	
<i>PNA</i>			

- 18. Submit Worker's Compensation Certificate copy
Name of Insurer STATE FUND
- 19. Submit Plot Plan (See Instructions)
- 20. Enclose Deposit (See Instructions)
- 21. Report any leaks or contamination to this office within 5 days of discovery. The report shall be made on an Underground Storage Tank Unauthorized Leak/Contamination Site Report form. (see Instructions)
- 22. Submit a closure report to this office within 60 days of the tank removal. This report must contain all the information listed in item 22 of the instructions.

I declare that to the best of my knowledge and belief the statements and information provided above are correct and true.

I understand that information in addition to that provided above may be needed in order to obtain an approval from the Department of Environmental Health and that no work is to begin on this project until this plan is approved.

I understand that any changes in design, materials or equipment will void this plan if prior approval is not obtained.

I understand that all work performed during this project will be done in compliance with all applicable OSHA (Occupational Safety and Health Administration) requirements concerning personnel health and safety.

I understand that site and worker safety are solely the responsibility of the property owner or his agent and that this responsibility is not shared nor assumed by the County of Alameda.

Once I have received my stamped, accepted closure plan, I will contact the project Hazardous Materials Specialist at least three working days in advance of site work to schedule the required inspections.

Signature of Contractor

Name (please type) ERNESTO F. BERWASE JR
 Signature *[Handwritten Signature]*
 Date 5-5-95

Signature of Site Owner or Operator

Name (please type) ROBERT E. ALLEN
 Signature *[Handwritten Signature]*
 Date 5-10-95

R. William Rudolph, Jr., PE
Thomas E. Cundey, PE
Jeriann N. Alexander, PE

December 13, 1994
PW 94.154

Shiloh Christian Fellowship
c/o Mr. Victor Orange
Project Manager
1580 Vista Street
Oakland, California 94602

Proposal
Environmental Consultant Services
Underground Tank Closure
3250 School Street
Oakland, California

Dear Mr. Orange:

Subsurface Consultants, Inc. (SCI) is pleased to present this proposal to provide environmental consulting services regarding the closure of two 550 gallon leaded gasoline underground storage tanks and one 250-gallon waste oil tank at the referenced address. The tanks are situated in a parking lot adjacent to a previous gasoline station building.

Proposed Scope of Services

SCI understands you wish to close the tanks in accordance with the City of Oakland, Oakland Fire Prevention Department, Alameda County Health Care Services Agency (ACHCSA), and the Regional Water Quality Control Board (RWQCB) requirements. SCI proposes to provide the consultant services necessary as summarized below.

A. Tank Removal

Task 1 - Observe Tank Removal

SCI will be on-site during tank removal activities to observe the physical condition of the tanks, piping systems and backfill materials. As each tank and accompanying piping system is removed, SCI will obtain samples in accordance with regulatory guidelines. At a minimum, it has been assumed that five samples will be obtained as follows:

■ Subsurface Consultants, Inc.

171 12th Street • Suite 201 • Oakland, California 94607 • Telephone 510-268-0461 • FAX 510-268-0137

Shiloh Christian Fellowship
c/o Mr. Victor Orange
December 13, 1994
PW 94.154
Page 2

- One sample from beneath each 550 gallon leaded fuel tank
- One sample from beneath each fuel supply line
- One sample from beneath the 250 gallon waste oil tank

Additional soil samples may be required by agency personnel. In addition, if groundwater is encountered in the excavations, it is also to be sampled. The additional tests would be performed for the unit costs presented in the fee estimate.

For each soil sample, a backhoe bucket of soil will be brought to the surface. About three inches of soil will be scraped away and a clean brass sample liner will be driven into the exposed soil. The liner ends will be covered with Teflon sheeting and plastic caps, then sealed with duct tape. Water samples will be obtained with a new disposable bailer and retained in appropriate containers. The samples will be placed in an ice filled cooler and will remain iced/refrigerated until delivery to the analytical laboratory.

Selected samples will be submitted to a State of California State of California Department of Health Services analytical laboratory for testing. Sample handling will be recorded using chain-of-custody documents. The testing program will be as specified by the agency and will likely include the following analyses:

1. Benzene, toluene, xylenes and ethylbenzene (BTXE), EPA methods 5030/8020
2. Total volatile hydrocarbons (TVH), EPA methods 5030/8015,
3. Total Oil and Grease (TOG), EPA method 3550, SMWW method 17:5520 E&F
4. Semi-volatile organics, EPA methods 3550/8270,
5. Volatile organics, EPA methods 5030/8240
6. Total Extractable Hydrocarbons (TEH), EPA methods 3550/8015,
7. Total Lead, EPA method 7420,
8. Chromium, cadmium, lead, nickel, and zinc, EPA methods 6010 and 7471, and
9. PCB's, EPA method 8080.

Shiloh Christian Fellowship
c/o Mr. Victor Orange
December 13, 1994
PW 94.154
Page 3

Task 2 - Closure Report

The results of the services provided will be presented in a written report. The report will include a site plan, hazardous waste manifests, analytical test reports and chain-of-custody records.

B. Supplemental Investigations

The scope of services presented above assumes that contaminated soils and water are not encountered during tank removal activities. The RWQCB guidelines indicate that when there has been an unauthorized release (leak) from an underground storage tank, a soil and groundwater investigation should be conducted. The purpose of the investigation is to determine:

1. The lateral and vertical extent of soil contamination, and
2. Whether groundwater has been impacted.

Such an investigation would require numerous test borings, installing groundwater monitoring wells, and analytically testing soil and groundwater samples. Based on the results of the investigations, recommendations regarding remediation would be proposed.

A supplemental investigation is beyond the scope of services proposed herein. In addition, the proposed scope of services does not include analytical testing of soil which you may desire be replaced in the excavation following tank removal. The need for these services cannot be determined until the tanks have been removed and analytical testing is performed.

Fee

SCI proposes to perform the services outlined herein on a time-and-expense basis, in accordance with the attached Service Agreement, Schedule of Charges and Terms and Conditions. On this basis, the fee for services performed during tank removal, assuming contamination is not encountered, will be about \$3500. This fee does not include tank removal contractor costs, permits, or disposal fees. A breakdown of SCI's fee is attached.

As discussed previously, it is very difficult to estimate the scope and as a result the fees associated with performing supplemental investigations when contamination is encountered. SCI will keep you apprised of the findings and provide fee estimates for any additional services when, and if, they are required.

■ Subsurface Consultants, Inc.

Shiloh Christian Fellowship
c/o Mr. Victor Orange
December 13, 1994
PW 94.154

Page 4

SCI appreciates the opportunity to submit this proposal and would be pleased to meet with you and discuss it at your convenience. If you are in agreement with the proposed scope and fee, please sign and return a copy of the attached service agreement as authorization to proceed.

If you have any questions, please call.

Yours very truly,

Subsurface Consultants, Inc.



R. William Rudolph, P.E., G.E.
President

2 copies submitted

JNA:RWR:sld

Attachments: SCI Estimated Fee Estimate

cc. Mr. Robert Duggans
 3295 School Street
 Oakland, CA 94602

SUBSURFACE CONSULTANTS, INC.
ESTIMATED FEE BREAKDOWN
Services During Tank Removal
3250 School Street
Oakland, California
December 1994

Task 1 - Observe Tank Removal Activities

Field Activities

Principal Engineer	1.0 hours	@ \$120/hr	\$ 120
Senior Engineer	2.0 hours	@ \$100/hr	200
Technician	8.0 hours	@ \$ 60/hr	480
Sample Liners	5 liners	@ \$5/liner	<u>25</u>
	Subtotal		\$ 825

Analytical Testing

Two 550 Gallon Leaded Gasoline Tanks and Piping

TVH/BTEX	4 samples	@ \$115/each	\$ 460
Total Lead	4 samples	@ \$25/each	100
Sample Disposal	4 samples	@ \$5/each	<u>20</u>
	Subtotal		\$ 580

250 Gallon Waste Oil Tank

TVH	1 sample	@ \$100/each	\$ 100
TOG	1 sample	@ \$70/each	70
Volatile Organics	1 sample	@ \$260/each	260
TEH	1 sample	@ \$100/each	100
Semi-volatile Organics	1 sample	@ \$405/each	405
PCB's	1 sample	@ \$95/each	95
Metals	1 sample	@ \$230/each	230
Sample Disposal	1 sample	@ 5/each	<u>5</u>
	Subtotal		\$1265

Task 2 - Project Management Closure Report

Principal Engineer	2.0 hours	@ \$120/hr	\$ 240
Senior Engineer	2.0 hours	@ \$100/hr	200
Engineer	4.0 hours	@ \$70/hr	280
Drafting	1.0 hour	@ \$40/hr	40
Clerical	2.0 hours	@ \$35/hr	<u>70</u>
	Subtotal		\$ 830
	Total Estimated Fee		\$3500

SERVICE AGREEMENT

This Agreement is made this 13th day of December 1994, between _____, subsequently referred to as "Client," and Subsurface Consultants, Inc. (SCI) subsequently referred to as "Consultant."

By joining in this Agreement, Client retains Consultant to provide engineering consulting services during tank closure at 3250 School Street in Oakland, California, subsequently referred to as "Project". The Client's relationship to Project is that of _____.

Scope of Services

By this Agreement, the scope of Consultant's services on Project is limited to the Tasks discussed in Consultants proposal dated December 13, 1994.

Fee

Consultant agrees to provide services covered by this Agreement on a time-and-expense basis, in accordance with the attached Schedule of Charges and Terms and Conditions, which are incorporated into and made a part of this Service Agreement. On this basis, Consultant estimates its fee for the services outlined will be \$3500. Consultant will not exceed this fee without Client's authorization.

If Project requirements or subsurface conditions encountered indicate that the Scope of Services covered by this Agreement should be revised, an additional Service Agreement or written addendum to this Agreement shall be entered into to cover the revised scope and fee. Should Client authorize a revision in the scope of services without a revision to this Agreement, Consultant shall be compensated for services actually performed.

If a dispute arises relating to the performance of services covered by this Agreement, and legal or other costs are incurred, it is agreed that the prevailing party shall be entitled to recover all reasonable costs incurred in resolving the claim, including employee-related costs at current billing rates, attorney's fees and other claim-related expenses.

Authorized by:

R. W. [Signature]

Robert E. Allen

Title: President +

V. P.

Date: Dec 13, 1994
Consultant

5-10-95
Client

TERMS AND CONDITIONS

Page 1 of 3

1. SCOPE OF SERVICES

The CLIENT agrees to employ and does hereby employ CONSULTANT to perform the professional services specified in this Agreement, with the term of such employment to commence on the date of execution of this Agreement and to continue until completion of the work provided for herein or termination as described in Article 9. The CONSULTANT agrees to furnish the necessary personnel, incidental services, equipment, and facilities to perform the Scope of Work stated in this Agreement or attached thereto.

Services and work product not expressly included with those specified in this Agreement, as determined by CONSULTANT, are not covered by this Agreement. Additional services or work products resulting in an adjustment of CONSULTANT'S originally estimated fee will be provided at Client's request upon execution by both parties of a written amendment to this Agreement.

2. COMPENSATION

The CLIENT agrees to pay CONSULTANT'S invoices for the services specified in this Agreement in accordance with the attached Schedule of Charges, and such payment shall be considered as full compensation for all personnel, materials, supplies, and equipment used in performing the work.

CLIENT will be invoiced at the end of each billing period. Payment in full of an invoice must be received by CONSULTANT within thirty (30) days of the date of such invoice. Failure of CLIENT to make full payment of an invoice so that it is received by CONSULTANT within said thirty (30) days of invoice date subjects the amount overdue to a delinquent account interest rate of one and one half percent (1 1/2%) per month, compounded monthly, beginning thirty (30) days after invoice date and until full payment is received. Failure of CLIENT to submit full payment of an invoice within thirty (30) days of the date thereof subjects this Agreement and the work herein contemplated to suspension or termination at CONSULTANT'S discretion.

CONSULTANT, without any liability to CLIENT, reserves the right to withhold any services and work products pending payment of CLIENT'S outstanding indebtedness. For services provided on a reimbursable basis, budget may be increased by amendment to complete the Scope of Work, and CONSULTANT is not obligated to provide services in excess of authorized budget.

The work performed by CONSULTANT shall be deemed approved and accepted by CLIENT as and when invoiced unless CLIENT objects within fifteen (15) days of invoice date by written notice specifically stating the details in which CLIENT believes such work is incomplete or defective, and the invoice amount(s) in dispute. CLIENT shall pay undisputed amounts as specified herein.

3. INSURANCE

CONSULTANT, at its own expense, will maintain in force the following policies of insurance during the period of performance of this Agreement:

- (a) Workers Compensation and Employer's Liability Insurance at statutory limits.
- (b) Commercial General Liability Insurance with a combined single limit of \$1,000,000 per occurrence and \$1,000,000 aggregate for bodily injury, including death, and property damage, and
- (c) Automobile Liability Insurance with a combined single limit for bodily injury and property damage of \$1,000,000 per occurrence.

If requested by CLIENT, CONSULTANT will furnish CLIENT with satisfactory evidence of the above insurance with a provision that at least thirty (30) days prior written notice will be given to the CLIENT in the event of cancellation of insurance coverage.

4. EXISTING CONDITIONS (HAZARDOUS MATERIALS AND UNDERGROUND UTILITIES)

CLIENT shall furnish, or cause to be furnished to CONSULTANT, all documents and information known to CLIENT that relate to the identity, location, quantity, nature, or characteristics of any asbestos, PCBs, or any other hazardous materials or waste at, on or under the site. In addition, CLIENT will furnish or cause to be furnished such reports, data, studies, plans, specifications, documents and other information of surface or subsurface site conditions, e.g., underground tanks, pipelines and buried utilities, required by CONSULTANT for proper performance of its services. CONSULTANT shall be entitled to rely upon CLIENT-provided documents and information in performing the services required in this Agreement; however, CONSULTANT assumes no responsibility or liability for their accuracy or completeness nor for any damages to underground improvements not accurately and completely identified prior to the beginning of the work. CLIENT-provided documents will remain the property of the CLIENT.

CLIENT acknowledges that CONSULTANT and its sub-contractors have played no part in the creation of any hazardous waste, pollution sources, nuisance, or chemical or industrial disposal problem, which may exist, and that CONSULTANT has been retained for the sole purpose of assisting the CLIENT in assessing any problem which may exist and in assisting the CLIENT formulating a remedial program, if such is within the Scope of Work which CONSULTANT has assumed. It is recognized and agreed that CONSULTANT has assumed responsibility only for making the investigations, reports and recommendations to the CLIENT included within the Scope of Work. The responsibility for making any disclosures or reports to any third party and for the taking of corrective, remedial, or mitigative action shall be solely that of the CLIENT.

5. STANDARD OF CARE

CONSULTANT agrees that, in connection with its services performed under this Agreement, such services are performed with the care and skill ordinarily exercised by members of the profession practicing under similar conditions at the same time and in the same or a similar locality. CLIENT recognizes that the state of practice, particularly with respect to hazardous waste conditions, is changing and evolving. While CONSULTANT will perform in reasonable accordance with standards in effect at the time its services are performed, it is recognized that such standards may subsequently change because of improvements in the state of practice. When the findings and recommendations of CONSULTANT are based on information supplied by CLIENT and others, CONSULTANT shall have the right to rely on the accuracy and completeness of such information. No warranty or guarantee, express or implied, is made or intended by providing of consulting services or by furnishing oral or written reports of the findings made.

6. LIMITATION ON LIABILITY

CONSULTANT'S liability to CLIENT, CLIENT'S contractors, subcontractors, agents, employees and consultants, and to all other third parties, which may arise from or be due directly or indirectly to the negligent acts, errors and/or omissions of CONSULTANT, its agents, employees or consultants shall not exceed \$50,000 and shall be limited to direct damages. All other damages such as loss of use, profits, anticipated profits, and like losses are consequential damages for which CONSULTANT is not liable. CLIENT shall give written notice to CONSULTANT of any claim of negligent act, error or omission within one (1) year after the completion of the work performed by CONSULTANT. Failure to give notice within the required period shall constitute waiver of said claim by CLIENT.

7. INDEMNITY

CLIENT understands that in seeking the professional services of CONSULTANT, CLIENT may be requesting CONSULTANT to undertake uninsurable obligations for CLIENT'S benefit involving the presence or potential presence of hazardous, toxic or pollutant substances. Therefore, CLIENT agrees to defend, indemnify, and hold harmless CONSULTANT from damages from any cause whatsoever, excepting the willful misconduct or sole negligence of CONSULTANT in the performance of services under this Agreement, as a result of or in connection with the presence (or failure to detect the presence), discharge, release or escape of toxic or hazardous materials or contaminants of any kind, and from any and all claims for damages claimed by other parties to the extent they exceed the limitation contained in Article 6 above.

8. COST ESTIMATES

Any statements of estimated cost furnished by CONSULTANT are predicted costs and are based on professional opinions and judgement. CONSULTANT cannot be held responsible for fluctuations in construction costs due to bidding conditions and other factors which could not be anticipated at the time of preparation of the particular estimate.

TERMS AND CONDITIONS

Page 3 of 3

9. TERMINATION OF AGREEMENT**(a) DUE TO DEFAULT**

This agreement may be terminated by either party upon seven (7) days written notice should the other party fail substantially to perform in accordance with this Agreement through no fault of the party initiating the termination.

(b) WITHOUT CAUSE

This agreement may be terminated by CLIENT upon at least fourteen (14) days written notice to CONSULTANT in the event the project is abandoned.

(c) TERMINATION ADJUSTMENT PAYMENT

If this agreement is terminated through no fault of the CONSULTANT, CONSULTANT shall be paid for services performed and costs incurred to the termination notice date, including Reimbursable Expenses due, plus an additional amount, not to exceed ten percent (10%) of charges incurred to the termination notice date, to cover expenses incurred by CONSULTANT including but not limited to cancellation fees or charges. CONSULTANT will use reasonable efforts to minimize such additional charges.

10. GENERAL PROVISIONS**(a) APPLICABLE LAW**

This Agreement shall be interpreted and enforced according to the laws of the State of California, unless agreed otherwise.

(b) PRECEDENCE OF CONDITIONS

Should any conflict exist between the terms herein and the form of any purchase order or confirmation issued, the terms of Conditions herein shall prevail in the absence of CONSULTANT'S express written agreement.

(c) ASSIGNMENT OR SUBCONTRACTING

Neither CLIENT nor CONSULTANT shall assign its interest in this agreement without the written consent of the other. CONSULTANT may subcontract any portion of the work to be performed hereunder without such consent.

(d) OWNERSHIP OF DOCUMENTS

All plans, specifications, tracings, survey notes, computer programs, and other original documents are instruments of CONSULTANT'S service and shall not be used on other projects without CONSULTANT'S prior written consent; however, if used on other projects, such use shall be at CLIENT'S sole risk. No documents may be altered or modified except by CONSULTANT. The CONSULTANT shall be deemed the author of these documents and shall retain all common law, statutory and other reserved rights, including the copyright. The CLIENT may retain copies, including reproducible copies, of these documents for information and reference in connection with the CLIENT'S use for this project. Submission or distribution of these documents to meet official regulatory requirements or for similar purposes in connection with this project are not to be construed as publication in derogation of the CONSULTANT'S reserved rights.

(e) FORCE MAJEURE

Any delay or default in the performance of any obligation of CONSULTANT under this agreement resulting from any cause(s) beyond CONSULTANT'S reasonable control, shall not be deemed a breach of this Agreement. The occurrence of any such event shall suspend the obligations of CONSULTANT as long as performance is delayed or prevented thereby, and the fees due hereunder shall be equitably adjusted.

(f) ATTORNEY'S FEES

Should either party hereto bring suit in court to enforce any term of this Agreement, it is agreed that the prevailing party shall be entitled to recover its costs, expenses, and reasonable attorney's fees.

(g) MERGER: WAIVER: SURVIVAL

Except for amendments as set forth in Article 1 above, this Agreement constitutes the entire and integrated agreement between the parties hereto and supersedes all prior negotiations, representations, and/or agreements, written or oral. One or more waiver of any term, condition or other provision of this agreement by either party shall not be construed as a waiver of a subsequent breach of the same or any other provision. Any provision hereof which is legally deemed void or unenforceable shall not void this entire Agreement, and all remaining provisions shall survive and be enforceable.

(h) SERVICES BY CLIENT

CLIENT will provide access to site of work, obtain all permits, provide all legal services in connection with the project, and provide environmental reports or any other reports or filings required of the site owner, unless specifically included in the CONSULTANT'S scope of work. CLIENT shall pay the costs of checking and inspection fees, zoning application fees, testing fees, surveying fees, permits, bond premiums, and all other charges not specifically covered by the terms of this Agreement.

SCHEDULE OF CHARGES

**Professional Services for Engineers,
Geologists and Environmental Scientists****Hourly Rates**

Principal	\$110 to 130
Associate	\$90 to 110
Senior	\$70 to 90
Project	\$55 to 75
Expert Witness & Deposition Testimony	\$150

Technical Services

Field Technician	\$45 to 60
Drafting	\$40
Word Processor Operator	\$35
Clerical	\$35

Equipment

Outside Services & Equipment	Cost + 15%
Vehicle	\$5/hour
Geophysical Equipment	Upon request
Nuclear Density Testing Equipment	\$5/test
Photo Copying	\$0.15/page

Travel Time

Travel time will be charged at regular hourly rates, not to exceed 8 hours per day.

Outside Services

Outside services include all services and/or equipment not ordinarily provided by Subsurface Consultants, Inc., such as drilling equipment rental, laborers, special printing, subsistence and lodging, travel by common carrier, etc.

Terms

Billings are payable upon receipt unless other arrangements, confirmed in writing by Subsurface Consultants, Inc., have been made. A finance charge of 1-1/2 percent per month will be payable on accounts not paid within 30 days. Any attorney's fees or other costs incurred collecting any delinquent amount shall be paid by the Client.

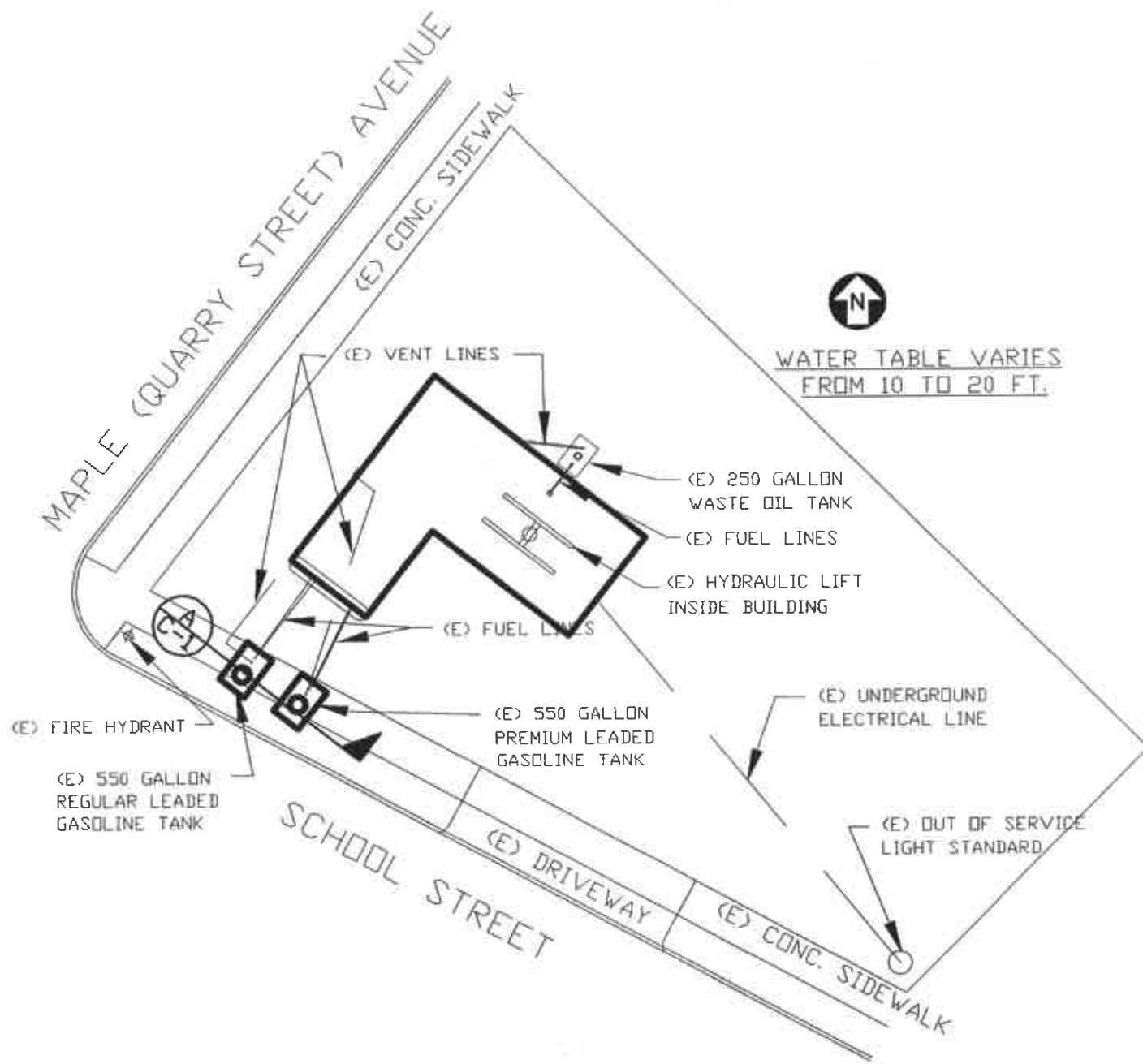

WATER TABLE VARIES FROM 10 TO 20 FT.

SITE PLAN
 SCALE: 1"=20'-0"

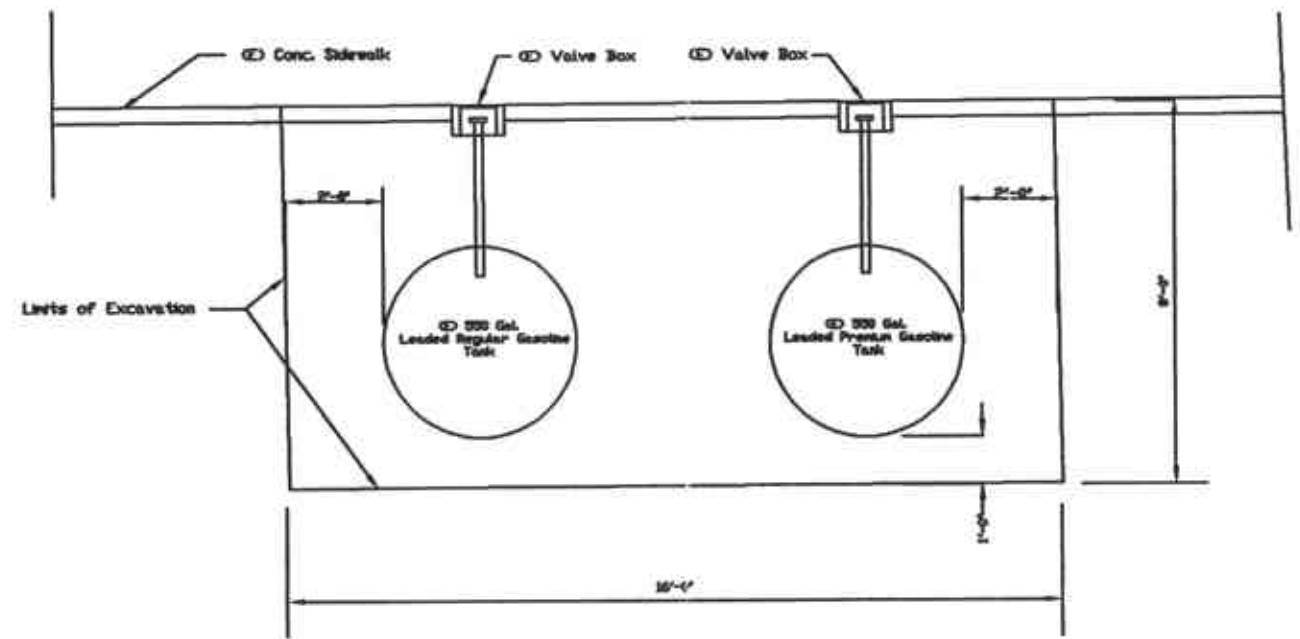

TYPICAL SECTION
 SCALE: 1/4"=1'-0"

A
 C-1



REVISION NUMBER	DRAWN BY	CHECKED BY	APPR'D BY	DATE	REMARKS
1	V.O.			12/07/94	ISSUED FOR BID

SHILOH CHRISTIAN FELLOWSHIP
 UNDERGROUND STORAGE TANK
 REMOVALS
 PLAN AND SECTION

SHILOH CHRISTIAN FELLOWSHIP

DRAWN BY	V. ORANGE	DATE	12/07/94
CHECKED BY			
APPROVED BY			
CAD FILE PATH	C:/S/2CY94001		
SCALE	AS SHOWN		
DRAWING NO.	2CY94001	SHEET	C-1
PROJECT NO.			1 OF 1

Assessor's Map 28.

932

Map of Laurel Grove Park. (BK. 14 Pg. 12)
Scale 1 in = 40 ft



933

950

Suter (Maine) Street.

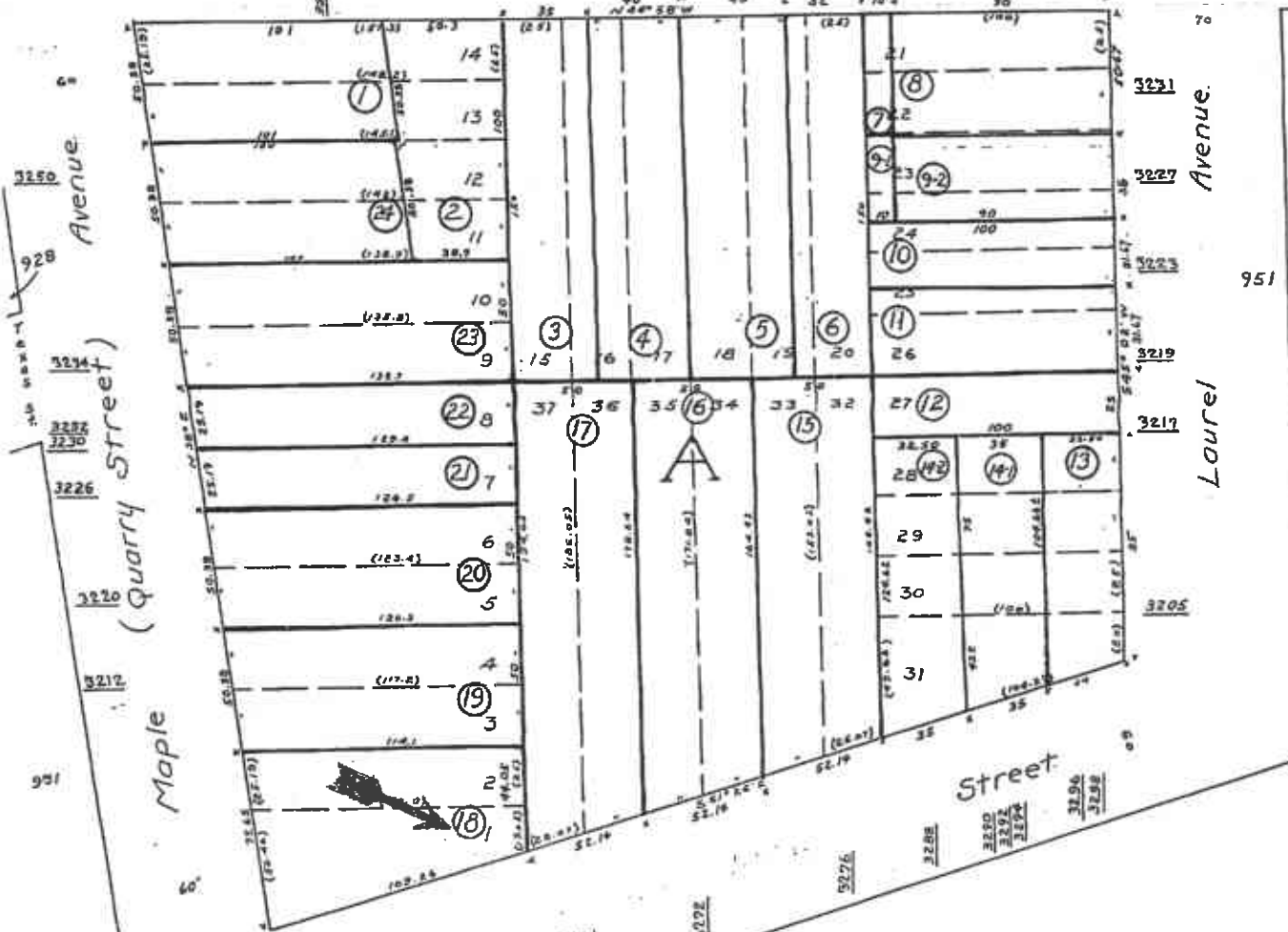

School

Berlin Way

NOTICE

THIS MAP MAY OR MAY NOT BE A SURVEY OF THE LAND DEPICTED HEREON. IT IS NOT TO BE RELIED UPON FOR ANY PURPOSE OTHER THAN ORIENTATING ONE'S SELF AS TO THE GENERAL LOCATION OF THE PARCEL OR PARCELS OF INTEREST. FIRST AMERICAN TITLE COMPANY ASSUMES NO LIABILITY FOR LOSS OR DAMAGE RESULTING FROM RELIANCE THEREON.

STATE OF CALIFORNIA
STATE AND CONSUMER SERVICES AGENCY CONTRACTORS STATE LICENSE BOARD



Building Quality



HAZARDOUS SUBSTANCES REMOVAL AND REMEDIAL ACTIONS CERTIFICATION

Pursuant to the provisions of Section 70587 of the Business and Professions Code, the Registrar of Contractors does hereby certify that the following qualifying person has successfully completed the hazardous substances removal and remedial actions examination.



Qualifier: **ERNESTO FRANCISCO BERNABE JR.**
License No.: **610617**
Namestyle: **BERNABE AND BRINKER, INC.**

WITNESS my hand and official seal this
25TH day of **JANUARY, 1991**

Dennis R. Phillips
Registrar of Contractors

13L-36 (7/88)

This certification is the property of the Registrar of Contractors, is not transferable, and shall be returned to the Registrar upon demand when suspended, revoked, or invalidated for any reason.

A3725

**STATE
COMPENSATION
INSURANCE
FUND**

P.O. BOX 420807, SAN FRANCISCO, CA 94142-0807

CERTIFICATE OF WORKERS' COMPENSATION INSURANCE

FEBRUARY 06, 1995

POLICY NUMBER: 1305773-94
CERTIFICATE EXPIRES: 6-01-95

SHILOH CHRISTIAN FELLOWSHIP
3295 SCHOOL ST.
OAKLAND, CA 94602-3699

This is to certify that we have issued a valid Workers' Compensation insurance policy in a form approved by the California Insurance Commissioner to the employer named below for the policy period indicated.

This policy is not subject to cancellation by the Fund except upon ten days' advance written notice to the employer.

We will also give you TEN days' advance notice should this policy be cancelled prior to its normal expiration.

This certificate of insurance is not an insurance policy and does not amend, extend or alter the coverage afforded by the policies listed herein. Notwithstanding any requirement, term, or condition of any contract or other document with respect to which this certificate of insurance may be issued or may pertain, the insurance afforded by the policies described herein is subject to all the terms, exclusions and conditions of such policies.

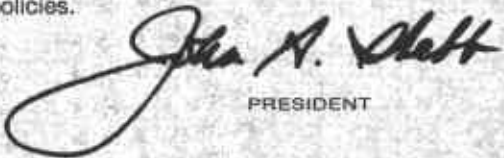
PRESIDENT

EMPLOYER

BERNABE & BRINKER, INC.
1281 30TH ST.
OAKLAND, CA 94608



1
They have renewed it. I called the
Contractors License Board, 1-800-321-
2752 ext # - 610617
— + they license was revert.

B&B SITE SAFETY PLAN

2. JOB HAZARD ANALYSIS:

Hazard Level: High() Moderate() Low(X) Unknown ()

Hazard Type: Liquid() Solid(X) Sludge() Vapor/Gas()

Known or suspected hazardous materials present on site:

TPHG BTXE

Characteristics of hazardous materials included above:

(Complete for each chemical present:)

MATERIAL #1: Corrosive() Ignitable(X) Toxic(X)
Reactive() Volatile(X) Radioactive()
Biological Agent()

Exposure Routes: Inhalation() Ingestion() Contact()

MATERIAL #2: Corrosive() Ignitable(X) Toxic(X)
Reactive() Volatile(X) Radioactive()
Biological Agent()

Exposure Routes: Inhalation() Ingestion() Contact()

MATERIAL #3: Corrosive() Ignitable() Toxic()
Reactive() Volatile() Radioactive()
Biological Agent()

Exposure Routes: Inhalation() Ingestion() Contact()

MATERIAL #4: Corrosive() Ignitable() Toxic()
Reactive() Volatile() Radioactive()
Biological Agent()

Exposure Routes: Inhalation() Ingestion() Contact()

B&B SITE SAFETY PLAN

2.2 JOB-SPECIFIC HAZARDS

For each labor category, specify the possible hazards based information available (i.e., Task-driller, Hazards-trauma from drill rig accidents, etc.) For each hazard, indicate steps to be taken to minimize the hazard.

Jack Hammer and Air Compressor Noise

(Use Earplugs)

The following additional hazards are expected on site (i.e., snake-infested area, extreme heat, etc.):

Measures to minimize the effects of the additional hazards are:

3. MONITORING PLAN

3.1 (a) Air Monitoring Plan

Action levels for implementation of air monitoring. Action levels should be based on published data available on contaminants of concern. Action levels should be set by persons experienced in industrial hygiene.

Level (i.e., .5ppm)	Action Taken (i.e., commence perimeter monitoring)
_____	NA
_____	_____
_____	_____

B&B SITE SAFETY PLAN

(b) Air Monitoring Equipment

Outline the specific equipment to be used, calibration method, frequency of monitoring, locations to be monitored, and analysis of samples (if applicable):

NA

If air monitoring is not to be implemented for this site, explain why:

We are not going into the tank, we are just removing
and disposing the tank.

3.2 Personnel Monitoring

(Include hierarchy of responsibilities in decision-making on the site).

NA

3.3 Sampling Monitoring

(a) Techniques used for sampling NA

B&B SITE SAFETY

(b) Equipments used for sampling _____

(c) Maintenance and calibration of equipments _____

4. **PERSONAL PROTECTIVE EQUIPMENT (PPE)**
Equipment used by employees for the site tasks and operations being conducted. Be specific (i.e., hard hat, impact resistance goggles, other protective glove, etc.).

Rubber gloves, Earplugs, Rubber Boots, Safety Glasses,
Protective Clothing, Hard Hats.

5. **SITE CONTROL AND SECURITY MEASURES**
The following general work zone security guidelines should be implemented:

- Work zone shall be barricaded and caution tape be used.
- Excavations shall be closed when drilling and sampling activities are not actually taking place.
- No excavations shall be left unattended. Visitors will not enter the work zone unless they have attended a project safety briefing.
- Persons will not leave the work zone without first passing through the decontamination zone.

B&B SITE SAFETY PLAN

6. DECONTAMINATION PROCEDURE

List the procedures and specific steps to be taken to decontaminate equipment and PPE.

All equipments has to be wash, soap and rinse.

protective clothing that had been contaminated

has to be dispose of properly.

7. TRAINING REQUIREMENTS

Prior to mobilization at the job site, employees will be attend a safety briefing. The briefing will include the nature of the wastes and the site, donning personal protection clothes and equipment, decontamination procedures and emergency procedures.

8. MEDICAL SURVEILLANCE REQUIREMENTS

If any task requires a very high personnel protection level, personnel shall provide assurances that they have received a physical examination and they are fit to do the task. Also, personnel will be instructed to look for any symptom of heat stress, heat stroke, heat exhaustion, or any other unusual symptom. If there is any report of that, it will be immediately be followed through, and appropriate action will be taken.

9. STANDARD OPERATION PROCEDURES

Bernabe & Brinker, Inc. is responsible for all Bernabe & Brinker, Inc. employees on the site. Each contractor shall provide all the equipment necessary to meet safe operation practices and procedures for their personnel on site, and be responsible for the safety of their workers.

A. "Three Warning" system is utilized to enforce compliance with Health and Safety procedures practices which will be implemented at the site for worker safety:

*Eating, drinking, chewing gum, or tobacco, and smoking will be allowed only in designated areas.

STATE OF CALIFORNIA
STATE AND CONSUMER SERVICES AGENCY CONTRACTORS STATE LICENSE BOARD



Building Quality



HAZARDOUS SUBSTANCES REMOVAL AND REMEDIAL ACTIONS CERTIFICATION

Pursuant to the provisions of Section 70587 of the Business and Professions Code, the Registrar of Contractors does hereby certify that the following qualifying person has successfully completed the hazardous substances removal and remedial actions examination.



Qualifier: **ERNESTO FRANCISCO BERNABE JR.**
License No.: **610617**
Namestyle: **BERNABE AND BRINKER, INC.**

WITNESS my hand and official seal this
25TH day of JANUARY, 1991
Dennis R. Peltzer
Registrar of Contractors

13L-36 (7/88)

This certification is the property of the Registrar of Contractors, is not transferable, and shall be returned to the Registrar upon demand when suspended, revoked, or invalidated for any reason.

A3725

ALAMEDA COUNTY
HEALTH CARE SERVICES



AGENCY
DAVID J. KEARS, Agency Director

RAFAT A. SHAHID, Assistant Agency Director

August 4, 1994

Dept. of Environmental Health
1131 Harbor Bay Pkwy., Rm. 250
Alameda, CA 94502-6577
(510) 567-6700

Mr. Bob Duggins
Shiloh Christian Fellowship
3295 School Street
Oakland, CA 94602

Subject: Former gas station located at 3250 School Street,
Oakland, CA 94602.

Dear Mr. Duggins:

On July 26, 1994, a visual inspection was conducted at the subject property and confirmed the presence of at least one underground storage tank (USTs). Upon review of the Department's records no information was found for the subject property or tank(s) owners.

As discussed during our meeting on August 2, 1994, I am writing you to confirm the inspection that was undertaken and to advise you of the laws regarding USTs, containing, or formerly containing hazardous materials.

In accordance with the California Code of Regulations, Title 23, Chapter 3, Subchapter 16, Underground tank Regulations, you must perform one of the following actions:

- 1) Submit a tank closure plan to this Department as required by Article 7, Section 2670, or
- 2) Apply for a permit as required by Article 10, Section 2710.

The UST laws allow (30) days for either of the above actions to be accomplished. I have enclosed a "checklist" of the requirements needed to permit your tank. In light of the fact that you have never used the tank, this option appears unlikely. However, it is an option available to you as opposed to "Closure" (removal) of the tank. A form letter outlining the process of removing an UST is also enclosed.

If you have any questions regarding this letter or any other questions, please contact this office at (510) 567-6700.

Sincerely,

Roel Meregillano, REHS
Hazardous Materials Specialist

cc: Ariu Levi - files
enclosures