

September 2, 2003

Mr. Don Hwang
 Hazardous Materials Specialist
 Alameda County Health Care Services Agency
 1131 Harbor Bay Parkway, Suite 250
 Alameda, California 94502-9335

Alameda County

SEP 04 2003

Environmental Health

Re: **Additional Subsurface/Baseline Investigation**
 Chevron SS# 9-8341
 3530 MacArthur Boulevard
 Oakland, California
 Cambria Project No: 31D-1650



Dear Mr. Hwang:

On behalf of Chevron Products Company (Chevron), Cambria Environmental Technology Inc. (Cambria) has completed an additional subsurface investigation at the site referenced above. The Alameda County Health Care Services Agency (ACHCSA), in a letter dated December 4, 2002, requested this investigation to further characterize the site by collecting and analyzing additional soil and groundwater data. Presented below are a site description, brief history and investigation results.

SITE DESCRIPTION

The site is an operating Chevron gasoline service station located on the northern corner of the intersection of MacArthur Boulevard and Magee Avenue in Oakland, California. The site is approximately 210 feet above sea level and local topography slopes gently toward the southwest (Figure 1). The site is surrounded by small commercial properties, with residential properties located upslope to the northeast.

INVESTIGATION RESULTS

The objective was to further investigate the occurrence and define the extent of hydrocarbons in soils and groundwater onsite. To meet this objective, Cambria advanced eight soil borings on site. Cambria's investigation results are presented below. The boring logs and laboratory analytical reports are presented in Attachments A and B.

**Cambria
 Environmental
 Technology, Inc.**

5900 Hollis Street
 Suite A
 Emeryville, CA 94608
 Tel (510) 420-0700
 Fax (510) 420-9170

Project Personnel: Staff Geologist Sarah Owen conducted all fieldwork under the supervision of Registered Geologist Robert Foss.

C A M B R I A

Permits: Alameda County Public Works Agency boring permit W03-0630.

Drilling Company: Gregg Drilling & Testing, Inc. of Martinez, California.

Drilling Dates: July 29 and 30, 2003.

Number of Borings: Eight soil boring locations are shown on Figure 2.

Drilling Method: Chevron's safety protocol requires that the first eight feet of each soil boring be cleared prior to drilling. This was accomplished using an air knife. Since the scope of work outlined that the borings be advanced to 10 feet below grade (fbg), the remaining depths of each boring were also cleared with the air knife and samples, at intermediate depths, were collected with a hand auger.

Boring Depths: Soil borings B-1 and B-3 through B-9 were advanced to total depths between 6 and 10.5 fbg.

Site Hydrogeology: The site is predominantly underlain by clayey silts and gravelly silts, with some gravelly sands. Groundwater was encountered from 3 to 10 fbg in all borings. Groundwater beneath the site generally flows south/southwest.

Sampling Technique: The borings were cleared to approximately 10 fbg with an air-knife and/or a hand auger, unless refusal occurred at shallower depths. Soil samples were collected above the water table and at approximately 9-9.5 fbg using a hand sampler. Samples were also collected at areas of suspected hydrocarbon impacts. Grab groundwater samples were collected from each boring, after total depth was reached, using dedicated disposable polyethylene bailers. Groundwater from B-3 was collected the following day in order to allow water to infiltrate into the borehole. All samples were labeled, placed on ice, and transported to Lancaster Laboratories following prescribed Chain of Custody procedures.

Sample Screening: A photo-ionization detector and field observations were used to screen samples from all borings.

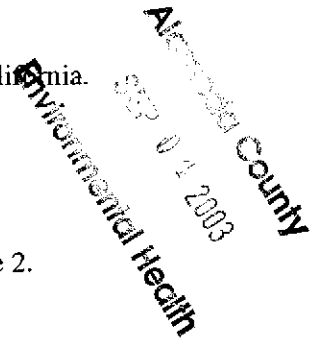

C A M B R I A

Laboratory Analysis: Soil and groundwater samples were analyzed for:

- Total Petroleum Hydrocarbons as gasoline (TPHg), and ethanol by modified EPA Method 8015;
- BTEX, MTBE, DIPE, ETBE, TAME, TBA, 1,2 DCA, and EDB by EPA Method 8260.

Depth to Water: Groundwater was encountered in the borings at depths between 3 and 10 fbg. No groundwater was encountered in boring B-7.



Soil/Water Disposal: Cuttings from the borings were stockpiled and stored onsite. Soil cuttings were characterized by Lancaster Laboratories and transported by Integrated Waste Management of Milipitas, California to Republic Services Vasco Road Landfill in Livermore, California.

HYDROCARBON DISTRIBUTION IN SOIL

Eight soil borings were advanced on site: B-1, and B-3 through B-9 (Figure 2). Boring B-2 was attempted but abandoned due to intersecting tankfield backfill gravels in both the initial boring and the relocated boring attempt. Upon the recommendations of the project manager, no further attempts to relocate B-2 were made and the borings were backfilled with gravel and patched with concrete. Boring B-7 was attempted three times and refusal was met in each boring at 5, 5, and 6 fbg. A soil sample from the third attempted B-7 location was collected at 1.5 fbg. An additional soil boring was advanced on the southern end of the property near MW-3, due to the presence of green-stained soils observed in upgradient borings B-5 and B-6 near the used oil tank.

TPHg was detected in soil samples collected from soil borings B-7 and B-8, at concentrations of 2.5 and 3.3 mg/kg at depths of 1.5 and 2.0 fbg, respectively. MTBE was detected in soil samples collected from all borings, except B-1, at low concentrations. The highest MTBE concentration detected in soil was 0.13 mg/kg collected from B-4 at 9.5 fbg. Low levels of TAME and TBA were detected in borings B-4, B-7 and B-8 at maximum concentrations of 0.002 and 0.044 mg/kg, respectively. Other tested oxygenates, lead scavengers and ethanol were not detect. Table 1 summarizes soil analytic results.

C A M B R I A

HYDROCARBON DISTRIBUTION IN GROUNDWATER

Grab groundwater samples were collected during advancement of soil borings on July 29 and 30, 2003. The highest concentrations of TPHg and MTBE were detected at 5,200 µg/L and 980 µg/L, respectively, in groundwater samples collected from B8. The highest TAME and TBA concentrations were detected in groundwater samples collected from B-8. Other oxygenates, lead scavengers and ethanol were not detected. Table 2 summarizes the grab groundwater analytic results.

CONCLUSIONS AND RECOMMENDATIONS



The objective of this work was to further define the lateral extent of hydrocarbons in soil and groundwater. TPHg concentrations in soil were detected only in B-7 and B-8 at very shallow depths. TPHg concentrations in groundwater were detected only in B-7 and B-8. Low concentrations of MTBE were detected in soil samples from all borings except B-1. MTBE was detected in all grab groundwater samples collected during this investigation, with the highest concentrations being found in B-8, B-7 and B-4. These data suggest that the areas of greatest impact on site are downstream of the used oil tank and groundwater monitoring well MW-2. Cambria recommends the continued monitoring and sampling of onsite wells, with the possible installation of a fourth monitoring well offsite on the south side of Magee Avenue to determine the extent of hydrocarbon impacts to groundwater.

Please contact Sarah Owen at (510) 420-3350 or Robert Foss at (510) 420-3348 with any questions or comments regarding this report.

Sincerely,
Cambria Environmental Technology, Inc.

Sarah Owen
Staff Geologist

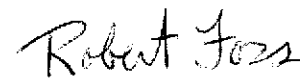
Robert Foss, R.G.
Senior Project Geologist

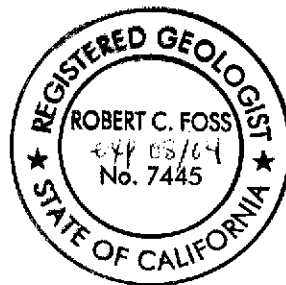

Figures 1 - Site Vicinity Map
 2 - Site Plan with Soil Boring and Well Locations

Mr. Don Hwang
September 2, 2003

C A M B R I A

Tables 1 - Analytic Results for Soil
 2 - Analytic Results for Groundwater

Attachments: A - Boring Logs
 B - Laboratory Soil and Groundwater Analytic Results

cc: Karen Streich, ChevronTexaco, P.O. Box 6012, San Ramon, CA 94583



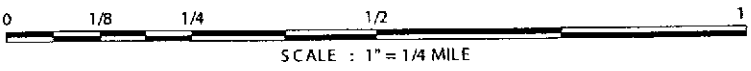
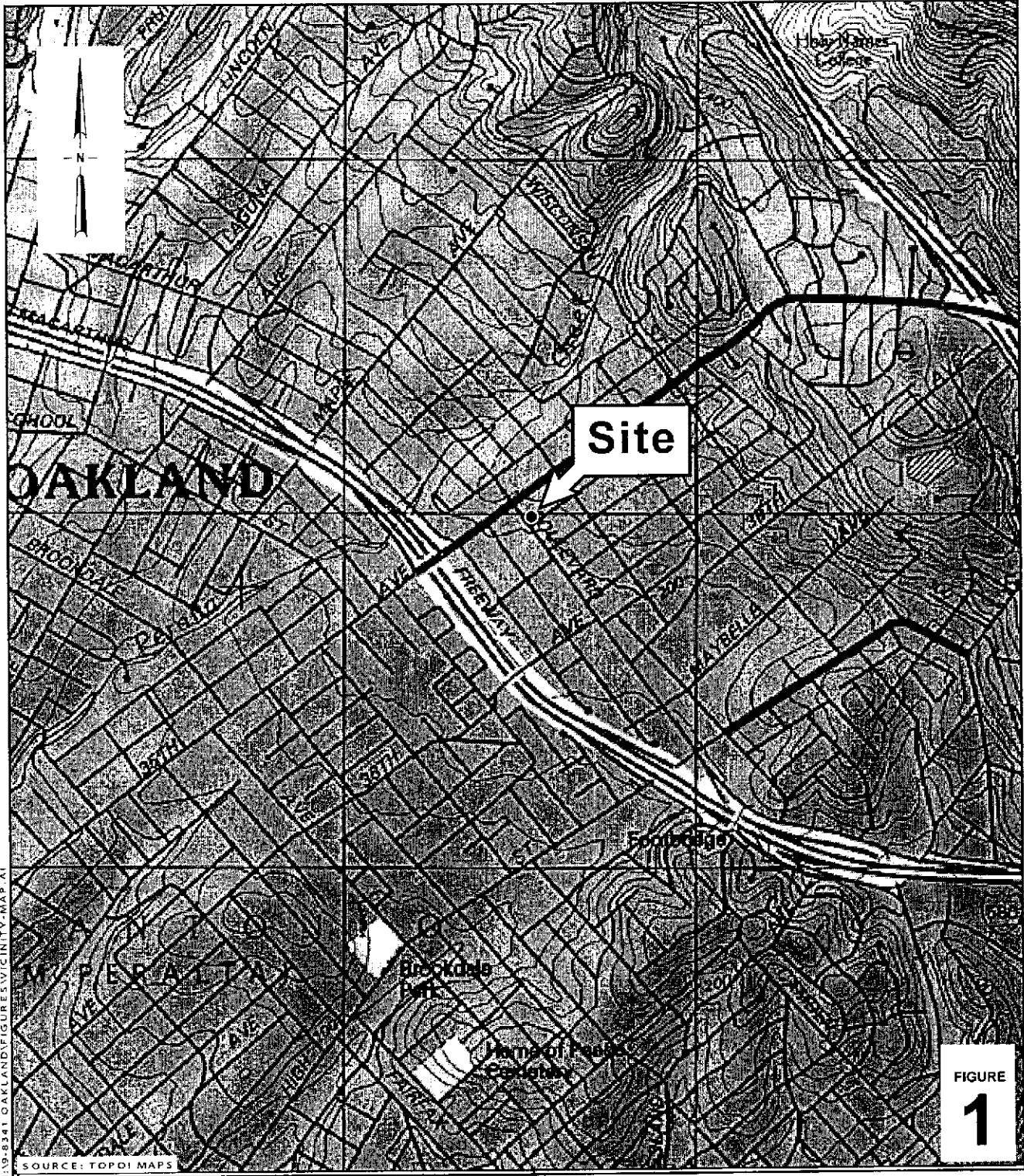

Chevron Service Station 9-8341
 3530 Mac Arthur Boulevard
 Oakland, California



C A M B R I A

Vicinity Map

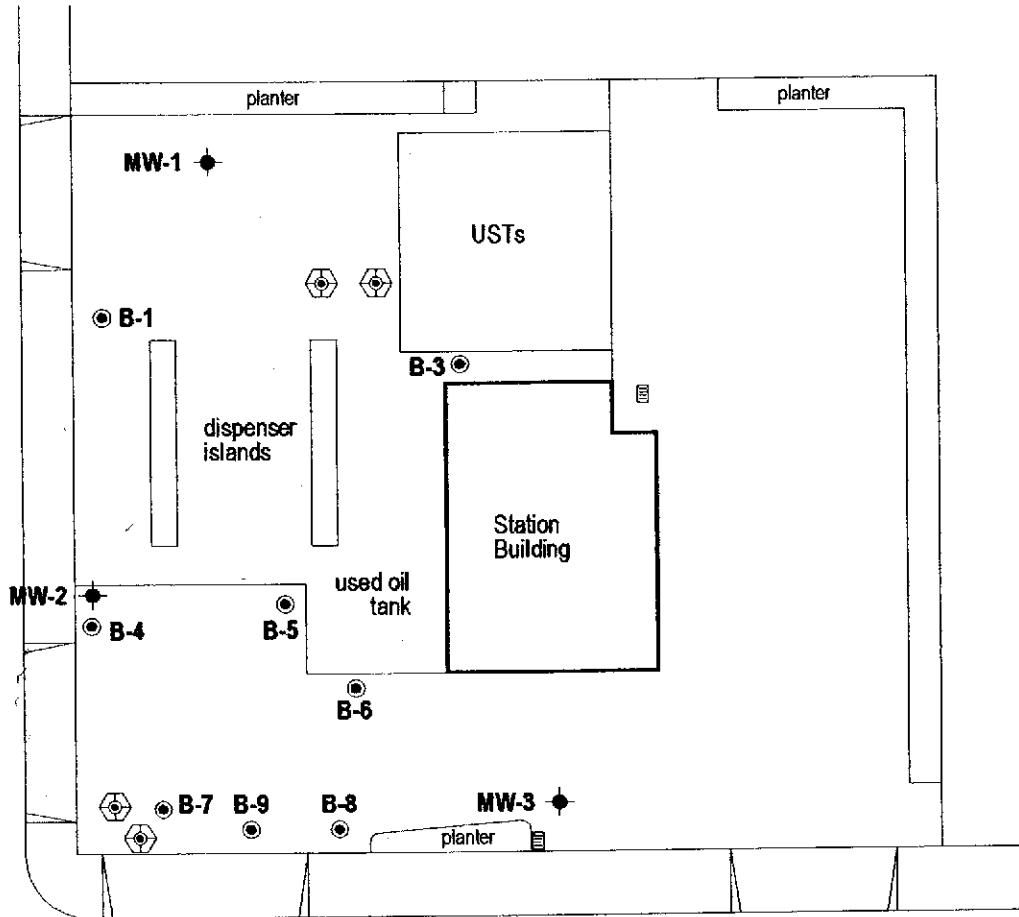

I:\9-8341 OAKLAND\FIGURES\SITEPLAN.DWG

EXPLANATION	
MW-1	Monitoring well location
B-7	Soil boring location
	Attempted soil boring location

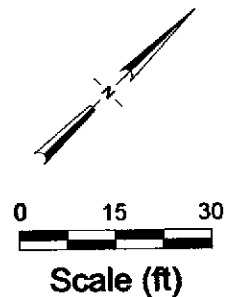

FIGURE
2

Chevron Service Station 9-8341
 3530 MacArthur Boulevard
 Oakland, California



C A M B R I A

Site Plan

Table 1. Analytic Results for Soil - Chevron Station 9-8341, 3530 MacArthur Boulevard, Oakland, California

Sample ID	Sample Date	Sample Depth (fbg)	TPHg	B	T	E	X	MTBE*	TAME*	TBA*
Concentrations reported in milligrams per kilogram - mg/kg										
B-1-A	7/29/03	3.5	<1.0	<0.001	<0.001	<0.001	<0.001	<0.001	<0.001	<0.020
B-3-A	7/29/03	3.5	<1.0	<0.001	<0.001	<0.001	<0.001	<0.001	<0.001	<0.020
B-3-B	7/29/03	10.0	<1.0	<0.001	<0.001	<0.001	<0.001	0.001	<0.001	<0.020
B-4-A	7/30/03	2.5	<1.0	<0.001	<0.001	<0.001	<0.001	0.029	<0.001	<0.020
B-4-B	7/30/03	9.5	<1.0	<0.001	<0.001	<0.001	<0.001	0.13	0.002	<0.020
B-5-A	7/29/03	3.0	<1.0	<0.001	<0.001	<0.001	<0.001	<0.001	<0.001	<0.020
B-5-B	7/29/03	9.5	<1.0	<0.001	<0.001	<0.001	<0.001	0.003	<0.001	<0.020
B-6-A	7/29/03	2.0	<1.0	<0.001	<0.001	<0.001	<0.001	0.003	<0.001	<0.020
B-6-B	7/29/03	9.5	<1.0	<0.001	<0.001	<0.001	<0.001	<0.001	<0.001	<0.020
B-7-A	7/30/03	1.5	2.5	<0.001	<0.001	<0.001	<0.001	0.020	0.001	<0.020
B-8-A	7/30/03	2.0	3.3	<0.001	<0.001	0.001	0.002	0.11	0.002	0.044
B-8-B	7/30/03	9.5	<1.0	<0.001	<0.001	<0.001	0.001	0.034	<0.001	<0.020
B-9-A	7/30/03	3.0	<1.0	<0.001	<0.001	<0.001	<0.001	0.004	<0.001	<0.020
B-9-B	7/30/03	8.0	<1.0	<0.001	<0.001	<0.001	<0.001	0.001	<0.001	<0.020

Abbreviations/Notes:

Total petroleum hydrocarbons as gasoline (TPHg) by EPA Method 8015M

Benzene, toluene, ethylbenzene and xylenes (BTEX) by EPA Method 8260B

Oxygenates and lead scavengers by EPA Method 8260B

<x = Not detected above method detection limit

fbg = Feet below grade

* = No DIPE, ETBE, 1, 2 DCA, or EDB were detected by EPA Method 8260B and no ethanol was detected by EPA Method 8015M

CAMBRIA

Table 2. Analytic Results for Groundwater - Chevron Station 9-8341, 3530 MacArthur Boulevard, Oakland, California

Sample ID	Sample Date	TPHg	B	T	E	X	MTBE*	TAME*	TBA*
Concentrations reported in micrograms per liter - µg/L									
B-1	7/29/03	<50	<0.5	<0.5	<0.5	<0.5	25	0.6	<5.0
B-3	7/30/03	<50	<0.5	<0.5	<0.5	<0.5	10	<0.5	8.0
B-4	7/30/03	<50	<0.5	<0.5	<0.5	<0.5	420	9	28
B-5	7/29/03	<50	<0.5	4	0.6	8	50	11	<5.0
B-6	7/29/03	<50	<0.5	<0.5	<0.5	<0.5	2	<0.5	<5.0
B-7	7/30/03	98	<0.5	<0.5	<0.5	<0.5	460	8	41
B-8	7/30/03	5,200	3	3	160	450	980	15	<5.0
B-9	7/30/03	<50	<0.5	<0.5	<0.5	<0.5	10	0.6	<5.0

Abbreviations/Notes:

Total petroleum hydrocarbons as gasoline (TPHg) by EPA Method 8015M

Benzene, toluene, ethylbenzene and xylenes (BTEX) by EPA Method 8260B

Oxygenates and lead scavengers by EPA Method 8260B

<x = Not detected above method detection limit

fbg = Feet below grade

* = No DIPE, ETBE, 1, 2 DCA, or EDB were detected by EPA Method 8260B and no ethanol was detected by EPA Method 8015M

ATTACHMENT A

Boring Logs



Cambria Environmental Technology, Inc.
 5900 Hollis Street, Ste. A
 Emeryville, CA 94608
 Telephone: (510) 420-0700
 Fax: (510) 420-9170

BORING/WELL LOG

CLIENT NAME	Chevron Products Company	BORING/WELL NAME	B-1
JOB/SITE NAME	Chevron Station #9-8341	DRILLING STARTED	29-Jul-03
LOCATION	3530 Mac Arthur Boulevard, Oakland, CA	DRILLING COMPLETED	29-Jul-03
PROJECT NUMBER	31D-1650	WELL DEVELOPMENT DATE (YIELD)	NA
DRILLER	Gregg Drilling	GROUND SURFACE ELEVATION	Not Surveyed
DRILLING METHOD	Air Vac and Hand Auger	TOP OF CASING ELEVATION	Not Surveyed
BORING DIAMETER	4"	SCREENED INTERVAL	NA
LOGGED BY	Sarah Owen	DEPTH TO WATER (First Encountered)	4.0 ft (29-Jul-03)
REVIEWED BY	B. Foss, RG# 7445	DEPTH TO WATER (Static)	NA
REMARKS	Refusal at 8 fbg.		

TPHg (mg/kg)	BLOW COUNTS	SAMPLE ID	EXTENT	DEPTH (fbg)	U.S.C.S.	GRAPHIC LOG	LITHOLOGIC DESCRIPTION	CONTACT DEPTH (fbg)	WELL DIAGRAM
<1.0		B-1-A		0.5			Concrete.	0.5	
				1.0			Pea gravel.	1.0	
				5	ML		Sandy Gravelly SILT Red-brown; dry; stiff; 45% silt, 20% sand, 20% gravel, 15% clay; moderate plasticity; moderate estimated permeability.	4.0	
				8.0	ML		Clayey SILT Black; damp; stiff; 75% silt, 25% clay; moderate to high plasticity; moderate to low estimated permeability. Vacuum-cleared to 8 fbg.	8.0	Bottom of Boring @ 8 fbg

WELL LOG (TPH-G) I:9-8341 OAKLAND INVESTIGATION 2003\GINT\9-8341.GPJ DEFAULT.GDT 8/25/03



Cambria Environmental Technology, Inc.
 5900 Hollis Street, Ste. A
 Emeryville, CA 94608
 Telephone: (510) 420-0700
 Fax: (510) 420-9170

BORING/WELL LOG

CLIENT NAME	Chevron Products Company	BORING/WELL NAME	B-3
JOB/SITE NAME	Chevron Station #9-8341	DRILLING STARTED	29-Jul-03
LOCATION	3530 Mac Arthur Boulevard, Oakland, CA	DRILLING COMPLETED	29-Jul-03
PROJECT NUMBER	31D-1650	WELL DEVELOPMENT DATE (YIELD)	NA
DRILLER	Gregg Drilling	GROUND SURFACE ELEVATION	Not Surveyed
DRILLING METHOD	Air Vac and Hand Auger	TOP OF CASING ELEVATION	Not Surveyed
BORING DIAMETER	4"	SCREENED INTERVAL	NA
LOGGED BY	Sarah Owen	DEPTH TO WATER (First Encountered)	10.0 ft (29-Jul-03)
REVIEWED BY	B. Foss, RG# 7445	DEPTH TO WATER (Static)	NA

REMARKS

TPHg (mg/kg)	BLOW COUNTS	SAMPLE ID	EXTENT	DEPTH (fbg)	U.S.C.S.	GRAPHIC LOG	LITHOLOGIC DESCRIPTION	CONTACT DEPTH (fbg)	WELL DIAGRAM
<1.0		B-3-A		0.5			Concrete.	0.5	Concrete
				1.0			Pea gravel.	1.0	
				3.5	ML		Gravelly Sandy SILT Light brown; dry; stiff; 55% silt, 25% gravel, 10% sand, 10% clay; moderate plasticity; moderate estimated permeability.	3.5	
				5					
				10	ML		Clayey SILT Red brown; damp; stiff; 75% silt, 20% clay, 5% gravel; moderate plasticity; moderate to low estimated permeability.		Portland Type III
<1.0		B-3-B		10			Vacuum-cleared to 8 fbg.	10.5	Bottom of Boring @ 10.5 fbg

WELL LOG (TPH-G) I:\9-8341 OAKLAND\INVESTIGATION 2003\GINT\9-8341.GPJ DEFAULT.GDT 8/25/03



CLIENT NAME	Chevron Products Company	BORING/WELL NAME	B-4
JOB/SITE NAME	Chevron Station #9-8341	DRILLING STARTED	30-Jul-03
LOCATION	3530 Mac Arthur Boulevard, Oakland, CA	DRILLING COMPLETED	30-Jul-03
PROJECT NUMBER	31D-1650	WELL DEVELOPMENT DATE (YIELD)	NA
DRILLER	Gregg Drilling	GROUND SURFACE ELEVATION	Not Surveyed
DRILLING METHOD	Air Vac and Hand Auger	TOP OF CASING ELEVATION	Not Surveyed
BORING DIAMETER	4"	SCREENED INTERVAL	NA
LOGGED BY	Sarah Owen	DEPTH TO WATER (First Encountered)	3.0 ft (30-Jul-03)
REVIEWED BY	B. Foss, RG# 7445	DEPTH TO WATER (Static)	NA

REMARKS

TPHg (mg/kg)	BLOW COUNTS	SAMPLE ID	EXTENT	DEPTH (fbg)	U.S.C.S.	GRAPHIC LOG	LITHOLOGIC DESCRIPTION	CONTACT DEPTH (fbg)	WELL DIAGRAM
<1.0		B-4-A		0.5	ML		Asphalt. Gravelly SILT Red brown; dry; stiff; 55% silt, 20% gravel, 15% clay, 10% sand; moderate plasticity; moderate estimated permeability.	0.5	Concrete
				4.0	ML		Clayey SILT Black; damp; stiff; 70% silt, 30% clay; moderate to high plasticity; moderate to low estimated permeability.	4.0	
				5.5	ML		Clayey SILT Green; damp; stiff; 70% silt, 30% clay; moderate to high plasticity; moderate to low estimated permeability.	5.5	
				6.5	ML		Clayey Gravelly SILT Red-brown; damp; stiff; 70% silt, 20% clay, 10% gravel; moderate plasticity; moderate to high estimated permeability.	6.5	
<1.0		B-4-B		10.0			Vacuum-cleared to 8 fbg.	10.0	Bottom of Boring @ 10 fbg

WELL LOG (TPH-G) I:\9-8341 OAKLAND\INVESTIGATION 2003\GINT\9-8341.GPJ DEFAULT.GDT 8/25/03



Cambria Environmental Technology, Inc.
 5900 Hollis Street, Ste. A
 Emeryville, CA 94608
 Telephone: (510) 420-0700
 Fax: (510) 420-9170

BORING/WELL LOG

CLIENT NAME	Chevron Products Company	BORING/WELL NAME	B-5
JOB/SITE NAME	Chevron Station #9-8341	DRILLING STARTED	29-Jul-03
LOCATION	3530 Mac Arthur Boulevard, Oakland, CA	DRILLING COMPLETED	29-Jul-03
PROJECT NUMBER	31D-1650	WELL DEVELOPMENT DATE (YIELD)	NA
DRILLER	Gregg Drilling	GROUND SURFACE ELEVATION	Not Surveyed
DRILLING METHOD	Air Vac and Hand Auger	TOP OF CASING ELEVATION	Not Surveyed
BORING DIAMETER	4"	SCREENED INTERVAL	NA
LOGGED BY	Sarah Owen	DEPTH TO WATER (First Encountered)	4.0 ft (29-Jul-03)
REVIEWED BY	B. Foss, RG# 7445	DEPTH TO WATER (Static)	NA

REMARKS

TPHg (mg/kg)	BLOW COUNTS	SAMPLE ID	EXTENT	DEPTH (ftg)	U.S.C.S.	GRAPHIC LOG	LITHOLOGIC DESCRIPTION	CONTACT DEPTH (ftg)	WELL DIAGRAM
<1.0		B-5-A		0.5	ML		Asphalt. Clayey SILT Dark gray to black with intermittent green; dry; soft; 40% clay, 40% silt, 20% gravel; high plasticity; moderate to low estimated permeability.	0.5	
				5.0			Gravelly SAND Red-brown; wet; loose; 65% sand, 15% gravel, 10% silt, 10% clay; moderate to high plasticity; moderate to high estimated permeability.	5.0	
<1.0		B-5-B		10.0	SP		Vacuum-cleared to 8 ftg.	10.0	

WELL LOG (TPH-G) I:\9-8341 OAKLAND\INVESTIGATION 2003\GINTY9-8341.GPJ DEFAULT.GDT 8/25/03



Cambria Environmental Technology, Inc.
 5900 Hollis Street, Ste. A
 Emeryville, CA 94608
 Telephone: (510) 420-0700
 Fax: (510) 420-9170

BORING/WELL LOG

CLIENT NAME	Chevron Products Company	BORING/WELL NAME	B-6
JOB/SITE NAME	Chevron Station #9-8341	DRILLING STARTED	29-Jul-03
LOCATION	3530 Mac Arthur Boulevard, Oakland, CA	DRILLING COMPLETED	29-Jul-03
PROJECT NUMBER	31D-1650	WELL DEVELOPMENT DATE (YIELD)	NA
DRILLER	Gregg Drilling	GROUND SURFACE ELEVATION	Not Surveyed
DRILLING METHOD	Air Vac and Hand Auger	TOP OF CASING ELEVATION	Not Surveyed
BORING DIAMETER	4"	SCREENED INTERVAL	NA
LOGGED BY	Sarah Owen	DEPTH TO WATER (First Encountered)	4.0 ft (29-Jul-03)
REVIEWED BY	B. Foss, RG# 7445	DEPTH TO WATER (Static)	NA

REMARKS

TPHg (mg/kg)	BLOW COUNTS	SAMPLE ID	EXTENT	DEPTH (fbg)	U.S.C.S.	GRAPHIC LOG	LITHOLOGIC DESCRIPTION	CONTACT DEPTH (fbg)	WELL DIAGRAM
<1.0		B-6-A		0.5			Asphalt. Clayey SILT Dark gray to black with intermittent green; dry; soft; 40% clay, 40% silt, 20% gravel; high plasticity; moderate to low estimated permeability.	0.5	
				5	ML				
				6.0			Gravelly SAND Red-brown; wet; loose; 70% sand, 15% gravel, 10% silt, 5% clay; moderate to high plasticity; moderate to high estimated permeability. Vacuum-cleared to 8 fbg.	6.0	
				10	SP			10.0	
<1.0		B-6-B		10				10.0	Bottom of Boring @ 10 fbg

WELL LOG (TPH-G) I:\9-8341 OAKLAND\INVESTIGATION 2003\GINT9-8341.GPJ DEFAULT.GDT 8/25/03



Cambria Environmental Technology, Inc.
 5900 Hollis Street, Ste. A
 Emeryville, CA 94608
 Telephone: (510) 420-0700
 Fax: (510) 420-9170

BORING/WELL LOG

CLIENT NAME	Chevron Products Company	BORING/WELL NAME	B-7
JOB/SITE NAME	Chevron Station #9-8341	DRILLING STARTED	30-Jul-03
LOCATION	3530 Mac Arthur Boulevard, Oakland, CA	DRILLING COMPLETED	30-Jul-03
PROJECT NUMBER	31D-1650	WELL DEVELOPMENT DATE (YIELD)	NA
DRILLER	Gregg Drilling	GROUND SURFACE ELEVATION	Not Surveyed
DRILLING METHOD	Air Vac and Hand Auger	TOP OF CASING ELEVATION	Not Surveyed
BORING DIAMETER	4"	SCREENED INTERVAL	NA
LOGGED BY	Sarah Owen	DEPTH TO WATER (First Encountered)	NA
REVIEWED BY	B. Foss, RG# 7445	DEPTH TO WATER (Static)	NA
REMARKS	Water not encountered. Refusal at 6 fbg.		

TPHg (mg/kg)	BLOW COUNTS	SAMPLE ID	EXTENT	DEPTH (fbg)	U.S.C.S.	GRAPHIC LOG	LITHOLOGIC DESCRIPTION	CONTACT DEPTH (fbg)	WELL DIAGRAM
2.5		B-7-A		0.5	ML		Asphalt. Clayey SILT Black; dry; stiff; 70% silt, 30% clay; moderate plasticity; moderate to low estimated permeability. Upper 1-1.5 foot interval is green.	0.5	
				4.5	ML		Gravelly SILT Red-brown to green; dry; stiff; 60% silt, 20% gravel, 15% sand, 5% clay; low plasticity; moderate to high estimated permeability.	4.5	
				6.0			Vacuum-cleared to 8 fbg.	6.0	Bottom of Boring @ 6 fbg

WELL LOG (TPH-G) 09-8341 OAKLAND INVESTIGATION 2003 GINITY 9-8341.GPJ DEFAULT.GDT 8/25/03



Cambria Environmental Technology, Inc.
 5900 Hollis Street, Ste. A
 Emeryville, CA 94608
 Telephone: (510) 420-0700
 Fax: (510) 420-9170

BORING/WELL LOG

CLIENT NAME	Chevron Products Company	BORING/WELL NAME	B-8
JOB/SITE NAME	Chevron Station #9-8341	DRILLING STARTED	30-Jul-03
LOCATION	3530 Mac Arthur Boulevard, Oakland, CA	DRILLING COMPLETED	30-Jul-03
PROJECT NUMBER	31D-1650	WELL DEVELOPMENT DATE (YIELD)	NA
DRILLER	Gregg Drilling	GROUND SURFACE ELEVATION	Not Surveyed
DRILLING METHOD	Air Vac and Hand Auger	TOP OF CASING ELEVATION	Not Surveyed
BORING DIAMETER	4"	SCREENED INTERVAL	NA
LOGGED BY	Sarah Owen	DEPTH TO WATER (First Encountered)	10.0 ft (30-Jul-03)
REVIEWED BY	B. Foss, RG# 7445	DEPTH TO WATER (Static)	NA

REMARKS

TPHg (mg/kg)	BLOW COUNTS	SAMPLE ID	EXTENT	DEPTH (fbg)	U.S.C.S.	GRAPHIC LOG	LITHOLOGIC DESCRIPTION	CONTACT DEPTH (fbg)	WELL DIAGRAM
3.3		B-8-A		0.5	ML		Asphalt. Clayey SILT Black; dry; stiff; 70% silt, 30% clay; moderate plasticity; moderate to low estimated permeability.	0.5	
				2.0	ML		Clayey SILT Green; dry; stiff; 70% silt, 30% clay; moderate plasticity; moderate to low estimated permeability.	2.0	
				5.5	ML		Clayey SILT Red-brown; dry; stiff; 70% silt, 30% clay; moderate to low plasticity; moderate estimated permeability.	5.5	
<1.0		B-8-B		10.0			Vacuum-cleared to 8 fbg.	10.0	Bottom of Boring @ 10 fbg

WELL LOG (TPHG) I:\9-8341 OAKLAND\INVESTIGATION 2003\GINT\9-8341.GPJ DEFAULT.GDT 8/25/03



Cambria Environmental Technology, Inc.
 5900 Hollis Street, Ste. A
 Emeryville, CA 94608
 Telephone: (510) 420-0700
 Fax: (510) 420-9170

BORING/WELL LOG

CLIENT NAME	Chevron Products Company	BORING/WELL NAME	B-9
JOB/SITE NAME	Chevron Station #9-8341	DRILLING STARTED	30-Jul-03
LOCATION	3530 Mac Arthur Boulevard, Oakland, CA	DRILLING COMPLETED	30-Jul-03
PROJECT NUMBER	31D-1650	WELL DEVELOPMENT DATE (YIELD)	NA
DRILLER	Gregg Drilling	GROUND SURFACE ELEVATION	Not Surveyed
DRILLING METHOD	Air Vac and Hand Auger	TOP OF CASING ELEVATION	Not Surveyed
BORING DIAMETER	4"	SCREENED INTERVAL	NA
LOGGED BY	Sarah Owen	DEPTH TO WATER (First Encountered)	7.0 ft (30-Jul-03)
REVIEWED BY	B. Foss, RG# 7445	DEPTH TO WATER (Static)	NA
REMARKS	Refusal at 8.5 fbg.		

TPHg (mg/kg)	BLOW COUNTS	SAMPLE ID	EXTENT	DEPTH (fbg)	U.S.C.S.	GRAPHIC LOG	LITHOLOGIC DESCRIPTION	CONTACT DEPTH (fbg)	WELL DIAGRAM
<1.0		B-9-A		0.5	ML		Asphalt. Clayey SILT Black; dry; stiff; 75% silt, 25% clay; moderate plasticity; low estimated permeability.	0.5	Concrete
<1.0		B-9-B		3.0	ML		Gravelly SILT Red-brown; dry; stiff; 60% silt, 20% gravel, 10% sand, 10% clay; low plasticity; moderate to high estimated permeability. Upper foot is green.	3.0	Portland Type I/II
<1.0		B-9-B		5.0	ML		Gravelly SILT Red-brown; wet; moderately stiff; 40% silt, 30% gravel, 30% sand; high estimated permeability.	5.0	
				8.5			Vacuum-cleared to 8 fbg.	8.5	Bottom of Boring @ 7 fbg

WELL LOG (TPH-G) I:\9-8341 OAKLAND\INVESTIGATION\2003\GINT\9-8341.GPJ DEFAULT.GDT 8/25/03

ATTACHMENT B

Laboratory Soil and Groundwater Analytic Results



ANALYTICAL RESULTS

Prepared for:

ChevronTexaco
6001 Bollinger Canyon Rd L4310

San Ramon CA 94583
925-842-8582

Prepared by:

Lancaster Laboratories
2425 New Holland Pike
Lancaster, PA 17605-2425

SAMPLE GROUP

The sample group for this submittal is 861569. Samples arrived at the laboratory on Friday, August 01, 2003. The PO# for this group is 99011184 and the release number is STREICH.

<u>Client Description</u>			<u>Lancaster Labs Number</u>
B-1-A-S-3.5-030729	Grab	Soil	4093182
B-3-A-S-3.5-030729	Grab	Soil	4093183
B-3-B-S-10.0-030729	Grab	Soil	4093184
B-4-A-S-2.5-030730	Grab	Soil	4093185
B-4-B-S-9.5-030730	Grab	Soil	4093186
B-5-A-S-3.0-030729	Grab	Soil	4093187
B-5-B-S-9.5-030729	Grab	Soil	4093188
B-6-A-S-2.0-030729	Grab	Soil	4093189
B-6-B-S-9.5-030729	Grab	Soil	4093190
B-7-A-S-1.5-030730	Grab	Soil	4093191
B-8-A-S-2.0-030730	Grab	Soil	4093192
B-8-B-S-9.5-030730	Grab	Soil	4093193
B-9-A-S-3.0-030730	Grab	Soil	4093194
B-9-B-S-8.0-030730	Grab	Soil	4093195

1 COPY TO ChevronTexaco

Attn: Sarah Owen



Lancaster Laboratories, Inc.
2425 New Holland Pike
PO Box 12425
Lancaster, PA 17605-2425
717-656-2300 Fax: 717-656-2681



Questions? Contact your Client Services Representative
Alison M O'Connor at (717) 656-2300.

Respectfully Submitted,

Victoria M Martell
Victoria M. Martell
Chemist



Lancaster Laboratories, Inc.
2425 New Holland Pike
PO Box 12425
Lancaster, PA 17605-2425
717-656-2300 Fax: 717-656-2681



Lancaster Laboratories Sample No. SW 4093182

Collected: 07/29/2003 12:00 by SO

Account Number: 10880

Submitted: 08/01/2003 09:20

ChevronTexaco

Reported: 08/14/2003 at 14:12

6001 Bollinger Canyon Rd L4310

Discard: 09/14/2003

B-1-A-S-3.5-030729

Grab

Soil

San Ramon CA 94583

Facility# 9-8341

CETR

3530 MacArthur Oakland

NA

NA

B-1-A

CAT No.	Analysis Name	CAS Number	As Received Result	As Received		Units	Dilution Factor
				Method	Detection Limit		
01725	TPH-GRO - Soils	n.a.	N.D.		1.0	mg/kg	25
	The analysis for volatiles was performed on a sample which was preserved in methanol. The reporting limits were adjusted appropriately. The reported concentration of TPH-GRO does not include MTBE or other gasoline constituents eluting prior to the C6 (n-hexane) TPH-GRO range start time.						
01428	Methanol and Ethanol						
01429	Ethanol (by Direct Injection)	64-17-5	N.D.		0.20	mg/kg	1
07361	BTEX+5 Oxygenates+EDC+EDB						
02016	Methyl Tertiary Butyl Ether	1634-04-4	N.D.		0.001	mg/kg	1
02017	di-Isopropyl ether	108-20-3	N.D.		0.001	mg/kg	1
02018	Ethyl t-butyl ether	637-92-3	N.D.		0.001	mg/kg	1
02019	t-Amyl methyl ether	994-05-8	N.D.		0.001	mg/kg	1
02020	t-Butyl alcohol	75-65-0	N.D.		0.020	mg/kg	1
05460	Benzene	71-43-2	N.D.		0.001	mg/kg	1
05461	1,2-Dichloroethane	107-06-2	N.D.		0.001	mg/kg	1
05466	Toluene	108-88-3	N.D.		0.001	mg/kg	1
05471	1,2-Dibromoethane	106-93-4	N.D.		0.001	mg/kg	1
05474	Ethylbenzene	100-41-4	N.D.		0.001	mg/kg	1
06301	Xylene (Total)	1330-20-7	N.D.		0.001	mg/kg	1

State of California Lab Certification No. 2116

Laboratory Chronicle

CAT No.	Analysis Name	Method	Trial#	Analysis		Analyst	Dilution Factor
				Date and Time			
01725	TPH-GRO - Soils	N. CA LUFT Gasoline method	1	08/05/2003	04:29	Stephanie A Selis	25
01428	Methanol and Ethanol	SW-846 8015B (modified)	1	08/09/2003	12:13	Lisa A Johnson	1



Lancaster Laboratories, Inc.
 2425 New Holland Pike
 PO Box 12425
 Lancaster, PA 17605-2425
 717-656-2300 Fax: 717-656-2681



Lancaster Laboratories Sample No. SW 4093182

Collected: 07/29/2003 12:00 by SO

Account Number: 10880

Submitted: 08/01/2003 09:20

ChevronTexaco

Reported: 08/14/2003 at 14:12

6001 Bollinger Canyon Rd L4310

Discard: 09/14/2003

B-1-A-S-3.5-030729

Grab

Soil

San Ramon CA 94583

Facility# 9-8341

CETR

3530 MacArthur Oakland

NA

NA

B-1-A

07361	BTEX+5 Oxygenates+EDC+EDB	SW-846 8260B	1	08/04/2003 18:42	Susan McMahon-Luu	1
00374	GC/MS VOA Soil Prep	SW-846 5030A	1	08/04/2003 17:14	Susan McMahon-Luu	n.a.
00380	Direct Injection Solids	SW-846 8015B	1	08/08/2003 15:30	Lisa A Johnson	1
	Ext					
01150	GC VOA Soil Prep	SW-846 5035	1	08/04/2003 15:15	Martha L Seidel	n.a.



Lancaster Laboratories, Inc.
2425 New Holland Pike
PO Box 12425
Lancaster, PA 17605-2425
717-656-2300 Fax: 717-656-2681



Lancaster Laboratories Sample No. SW 4093183

Collected: 07/29/2003 13:20 by SO

Account Number: 10880

Submitted: 08/01/2003 09:20

Reported: 08/14/2003 at 14:12

ChevronTexaco

6001 Bollinger Canyon Rd L4310

Discard: 09/14/2003

B-3-A-S-3.5-030729

Grab

Soil

San Ramon CA 94583

Facility# 9-8341

CETR

3530 MacArthur Oakland

NA

NA

B-3-A

CAT No.	Analysis Name	CAS Number	As Received Result	As Received Method Detection Limit	Units	Dilution Factor
01725	TPH-GRO - Soils The analysis for volatiles was performed on a sample which was preserved in methanol. The reporting limits were adjusted appropriately. The reported concentration of TPH-GRO does not include MTBE or other gasoline constituents eluting prior to the C6 (n-hexane) TPH-GRO range start time.	n.a.	N.D.	1.0	mg/kg	25
01428	Methanol and Ethanol					
01429	Ethanol (by Direct Injection)	64-17-5	N.D.	0.20	mg/kg	1
07361	BTEX+5 Oxygenates+EDC+EDB					
02016	Methyl Tertiary Butyl Ether	1634-04-4	N.D.	0.001	mg/kg	1
02017	di-Isopropyl ether	108-20-3	N.D.	0.001	mg/kg	1
02018	Ethyl t-butyl ether	637-92-3	N.D.	0.001	mg/kg	1
02019	t-Amyl methyl ether	994-05-8	N.D.	0.001	mg/kg	1
02020	t-Butyl alcohol	75-65-0	N.D.	0.020	mg/kg	1
05460	Benzene	71-43-2	N.D.	0.001	mg/kg	1
05461	1,2-Dichloroethane	107-06-2	N.D.	0.001	mg/kg	1
05466	Toluene	108-88-3	N.D.	0.001	mg/kg	1
05471	1,2-Dibromoethane	106-93-4	N.D.	0.001	mg/kg	1
05474	Ethylbenzene	100-41-4	N.D.	0.001	mg/kg	1
06301	Xylene (Total)	1330-20-7	N.D.	0.001	mg/kg	1

State of California Lab Certification No. 2116

Laboratory Chronicle

CAT No.	Analysis Name	Method	Trial#	Analysis Date and Time	Analyst	Dilution Factor
01725	TPH-GRO - Soils	N. CA LUFT Gasoline method	1	08/05/2003 05:07	Stephanie A Selis	25
01428	Methanol and Ethanol	SW-846 8015B (modified)	1	08/09/2003 12:52	Lisa A Johnson	1



Lancaster Laboratories, Inc.
2425 New Holland Pike
PO Box 12425
Lancaster, PA 17605-2425
717-656-2300 Fax: 717-656-2681



Lancaster Laboratories Sample No. SW 4093183

Collected: 07/29/2003 13:20 by SO

Account Number: 10880

Submitted: 08/01/2003 09:20

ChevronTexaco

Reported: 08/14/2003 at 14:12

6001 Bollinger Canyon Rd L4310

Discard: 09/14/2003

B-3-A-S-3.5-030729 Grab Soil

San Ramon CA 94583

Facility# 9-8341

CETR

3530 MacArthur Oakland NA NA

B-3-A

07361	BTEX+5 Oxygenates+EDC+EDB	SW-846 8260B	1	08/07/2003 13:20	Roy R Mellott Jr	1
00374	GC/MS VOA Soil Prep	SW-846 5030A	1	08/05/2003 10:19	Anastasia Papadoplos	n.a.
00380	Direct Injection Solids Ext	SW-846 8015B	1	08/08/2003 15:30	Lisa A Johnson	1
01150	GC VOA Soil Prep	SW-846 5035	1	08/04/2003 15:16	Martha L Seidel	n.a.



Lancaster Laboratories, Inc.
2425 New Holland Pike
PO Box 12425
Lancaster, PA 17605-2425
717-656-2300 Fax: 717-656-2681



Lancaster Laboratories Sample No. SW 4093184

Collected: 07/29/2003 14:15 by SO

Account Number: 10880

Submitted: 08/01/2003 09:20

ChevronTexaco

Reported: 08/14/2003 at 14:12

6001 Bollinger Canyon Rd L4310

Discard: 09/14/2003

B-3-B-S-10.0-030729

Grab

Soil

San Ramon CA 94583

Facility# 9-8341

CETR

3530 MacArthur Oakland

NA

NA

B-3B-

CAT No.	Analysis Name	CAS Number	As Received Result	As Received		Units	Dilution Factor
				Method	Detection Limit		
01725	TPH-GRO - Soils	n.a.	N.D.		1.0	mg/kg	25
	The analysis for volatiles was performed on a sample which was preserved in methanol. The reporting limits were adjusted appropriately. The reported concentration of TPH-GRO does not include MTBE or other gasoline constituents eluting prior to the C6 (n-hexane) TPH-GRO range start time.						
01428	Methanol and Ethanol						
01429	Ethanol (by Direct Injection)	64-17-5	N.D.		0.20	mg/kg	1
07361	BTEX+5 Oxygenates+EDC+EDB						
02016	Methyl Tertiary Butyl Ether	1634-04-4	0.001		0.001	mg/kg	1
02017	di-Isopropyl ether	108-20-3	N.D.		0.001	mg/kg	1
02018	Ethyl t-butyl ether	637-92-3	N.D.		0.001	mg/kg	1
02019	t-Amyl methyl ether	994-05-8	N.D.		0.001	mg/kg	1
02020	t-Butyl alcohol	75-65-0	N.D.		0.020	mg/kg	1
05460	Benzene	71-43-2	N.D.		0.001	mg/kg	1
05461	1,2-Dichloroethane	107-06-2	N.D.		0.001	mg/kg	1
05466	Toluene	108-88-3	N.D.		0.001	mg/kg	1
05471	1,2-Dibromoethane	106-93-4	N.D.		0.001	mg/kg	1
05474	Ethylbenzene	100-41-4	N.D.		0.001	mg/kg	1
06301	Xylene (Total)	1330-20-7	N.D.		0.001	mg/kg	1

State of California Lab Certification No. 2116

Laboratory Chronicle

CAT No.	Analysis Name	Method	Analysis			Dilution Factor
			Trial#	Date and Time	Analyst	
01725	TPH-GRO - Soils	N. CA LUFT Gasoline method	1	08/05/2003 05:45	Stephanie A Selis	25
01428	Methanol and Ethanol	SW-846 8015B (modified)	1	08/09/2003 13:05	Lisa A Johnson	1



Lancaster Laboratories, Inc.
 2425 New Holland Pike
 PO Box 12425
 Lancaster, PA 17605-2425
 717-656-2300 Fax: 717-656-2681



Lancaster Laboratories Sample No. SW 4093184

Collected: 07/29/2003 14:15 by SO

Account Number: 10880

Submitted: 08/01/2003 09:20

ChevronTexaco

Reported: 08/14/2003 at 14:12

6001 Bollinger Canyon Rd L4310

Discard: 09/14/2003

B-3-B-S-10.0-030729

Grab

Soil

San Ramon CA 94583

Facility# 9-8341

CETR

3530 MacArthur Oakland

NA

NA

B-3B-

07361	BTEX+5 Oxygenates+EDC+EDB	SW-846 8260B	1	08/07/2003 13:46	Roy R Mellott Jr	1
00374	GC/MS VOA Soil Prep	SW-846 5030A	1	08/05/2003 10:22	Anastasia Papadoplos	n.a.
00380	Direct Injection Solids Ext	SW-846 8015B	1	08/08/2003 15:30	Lisa A Johnson	1
01150	GC VOA Soil Prep	SW-846 5035	1	08/04/2003 15:17	Martha L Seidel	n.a.



Lancaster Laboratories, Inc.
2425 New Holland Pike
PO Box 12425
Lancaster, PA 17605-2425
717-656-2300 Fax: 717-656-2681



Lancaster Laboratories Sample No. SW 4093185

Collected: 07/30/2003 12:30 by SO

Account Number: 10880

Submitted: 08/01/2003 09:20

ChevronTexaco

Reported: 08/14/2003 at 14:12

6001 Bollinger Canyon Rd L4310

Discard: 09/14/2003

B-4-A-S-2.5-030730

Grab

Soil

San Ramon CA 94583

Facility# 9-8341

CETR

3530 MacArthur Oakland

NA

NA

B-4-A

CAT No.	Analysis Name	CAS Number	As Received Result	As Received		Units	Dilution Factor
				Method	Detection Limit		
01725	TPH-GRO - Soils	n.a.	N.D.		1.0	mg/kg	25
	The analysis for volatiles was performed on a sample which was preserved in methanol. The reporting limits were adjusted appropriately. The reported concentration of TPH-GRO does not include MTBE or other gasoline constituents eluting prior to the C6 (n-hexane) TPH-GRO range start time.						
01428	Methanol and Ethanol						
01429	Ethanol (by Direct Injection)	64-17-5	N.D.		0.20	mg/kg	1
07361	BTEX+5 Oxygenates+EDC+EDB						
02016	Methyl Tertiary Butyl Ether	1634-04-4	0.029		0.001	mg/kg	0.99
02017	di-Isopropyl ether	108-20-3	N.D.		0.001	mg/kg	0.99
02018	Ethyl t-butyl ether	637-92-3	N.D.		0.001	mg/kg	0.99
02019	t-Amyl methyl ether	994-05-8	N.D.		0.001	mg/kg	0.99
02020	t-Butyl alcohol	75-65-0	N.D.		0.020	mg/kg	0.99
05460	Benzene	71-43-2	N.D.		0.001	mg/kg	0.99
05461	1,2-Dichloroethane	107-06-2	N.D.		0.001	mg/kg	0.99
05466	Toluene	108-88-3	N.D.		0.001	mg/kg	0.99
05471	1,2-Dibromoethane	106-93-4	N.D.		0.001	mg/kg	0.99
05474	Ethylbenzene	100-41-4	N.D.		0.001	mg/kg	0.99
06301	Xylene (Total)	1330-20-7	N.D.		0.001	mg/kg	0.99

State of California Lab Certification No. 2116

Laboratory Chronicle

CAT No.	Analysis Name	Method	Analysis		Analyst	Dilution Factor
			Trial#	Date and Time		
01725	TPH-GRO - Soils	N. CA LUFT Gasoline method	1	08/05/2003 06:23	Stephanie A Selis	25
01428	Methanol and Ethanol	SW-846 8015B (modified)	1	08/09/2003 13:18	Lisa A Johnson	1



Lancaster Laboratories, Inc.
 2425 New Holland Pike
 PO Box 12425
 Lancaster, PA 17605-2425
 717-656-2300 Fax: 717-656-2681



Lancaster Laboratories Sample No. SW 4093185

Collected: 07/30/2003 12:30 by SO

Account Number: 10880

Submitted: 08/01/2003 09:20

ChevronTexaco

Reported: 08/14/2003 at 14:12

6001 Bollinger Canyon Rd L4310

Discard: 09/14/2003

B-4-A-S-2.5-030730 Grab Soil

San Ramon CA 94583

Facility# 9-8341

CETR

3530 MacArthur Oakland NA NA

B-4-A

07361	BTEX+5 Oxygenates+EDC+EDB	SW-846 8260B	1	08/07/2003 14:12	Roy R Mellott Jr	0.99
00374	GC/MS VOA Soil Prep	SW-846 5030A	1	08/05/2003 10:25	Anastasia Papadoplos	n.a.
00380	Direct Injection Solids Ext	SW-846 8015B	1	08/08/2003 15:30	Lisa A Johnson	1
01150	GC VOA Soil Prep	SW-846 5035	1	08/04/2003 15:18	Martha L Seidel	n.a.



Lancaster Laboratories, Inc.
2425 New Holland Pike
PO Box 12425
Lancaster, PA 17605-2425
717-656-2300 Fax: 717-656-2681



Lancaster Laboratories Sample No. SW 4093186

Collected: 07/30/2003 12:45 by SO Account Number: 10880

Submitted: 08/01/2003 09:20 ChevronTexaco
 Reported: 08/14/2003 at 14:12 6001 Bollinger Canyon Rd L4310
 Discard: 09/14/2003
 B-4-B-S-9.5-030730 Grab Soil San Ramon CA 94583

Facility# 9-8341 CETR
 3530 MacArthur Oakland NA NA

B-4-B

CAT No.	Analysis Name	CAS Number	As Received Result	As Received Method Detection Limit	Units	Dilution Factor
01725	TPH-GRO - Soils	n.a.	N.D.	1.0	mg/kg	25
The analysis for volatiles was performed on a sample which was preserved in methanol. The reporting limits were adjusted appropriately. The reported concentration of TPH-GRO does not include MTBE or other gasoline constituents eluting prior to the C6 (n-hexane) TPH-GRO range start time.						
01428	Methanol and Ethanol					
01429	Ethanol (by Direct Injection)	64-17-5	N.D.	0.20	mg/kg	1
07361	BTEX+5 Oxygenates+EDC+EDB					
02016	Methyl Tertiary Butyl Ether	1634-04-4	0.13	0.001	mg/kg	1
02017	di-Isopropyl ether	108-20-3	N.D.	0.001	mg/kg	1
02018	Ethyl t-butyl ether	637-92-3	N.D.	0.001	mg/kg	1
02019	t-Amyl methyl ether	994-05-8	0.002	0.001	mg/kg	1
02020	t-Butyl alcohol	75-65-0	N.D.	0.020	mg/kg	1
05460	Benzene	71-43-2	N.D.	0.001	mg/kg	1
05461	1,2-Dichloroethane	107-06-2	N.D.	0.001	mg/kg	1
05466	Toluene	108-88-3	N.D.	0.001	mg/kg	1
05471	1,2-Dibromoethane	106-93-4	N.D.	0.001	mg/kg	1
05474	Ethylbenzene	100-41-4	N.D.	0.001	mg/kg	1
06301	Xylene (Total)	1330-20-7	N.D.	0.001	mg/kg	1

State of California Lab Certification No. 2116

Laboratory Chronicle

CAT No.	Analysis Name	Method	Trial#	Analysis Date and Time	Analyst	Dilution Factor
01725	TPH-GRO - Soils	N. CA LUFT Gasoline method	1	08/05/2003 08:31	Stephanie A Selis	25
01428	Methanol and Ethanol	SW-846 8015B (modified)	1	08/09/2003 13:32	Lisa A Johnson	1



Lancaster Laboratories, Inc.
 2425 New Holland Pike
 PO Box 12425
 Lancaster, PA 17605-2425
 717-656-2300 Fax: 717-656-2681



Lancaster Laboratories Sample No. SW 4093186

Collected: 07/30/2003 12:45 by SO

Account Number: 10880

Submitted: 08/01/2003 09:20

ChevronTexaco

Reported: 08/14/2003 at 14:12

6001 Bollinger Canyon Rd L4310

Discard: 09/14/2003

B-4-B-S-9.5-030730

Grab

Soil

San Ramon CA 94583

Facility# 9-8341

CETR

3530 MacArthur Oakland

NA

NA

B-4-B

07361	BTEX+5 Oxygenates+EDC+EDB	SW-846 8260B	1	08/07/2003 14:38	Roy R Mellott Jr	1
00374	GC/MS VOA Soil Prep	SW-846 5030A	1	08/05/2003 10:58	Anastasia Papadoplos	n.a.
00380	Direct Injection Solids Ext	SW-846 8015B	1	08/08/2003 15:30	Lisa A Johnson	1
01150	GC VOA Soil Prep	SW-846 5035	1	08/04/2003 15:19	Martha L Seidel	n.a.



Lancaster Laboratories, Inc.
2425 New Holland Pike
PO Box 12425
Lancaster, PA 17605-2425
717-656-2300 Fax: 717-656-2681



Lancaster Laboratories Sample No. SW 4093187

Collected: 07/29/2003 09:30 by SO

Account Number: 10880

Submitted: 08/01/2003 09:20
 Reported: 08/14/2003 at 14:12
 Discard: 09/14/2003

ChevronTexaco
 6001 Bollinger Canyon Rd L4310

B-5-A-S-3.0-030729 Grab Soil

San Ramon CA 94583

Facility# 9-8341
 3530 MacArthur Oakland NA CETR

B-5-A

CAT No.	Analysis Name	CAS Number	As Received Result	As Received Method Detection Limit	Units	Dilution Factor
01725	TPH-GRO - Soils	n.a.	N.D.	1.0	mg/kg	25
The analysis for volatiles was performed on a sample which was preserved in methanol. The reporting limits were adjusted appropriately. The reported concentration of TPH-GRO does not include MTBE or other gasoline constituents eluting prior to the C6 (n-hexane) TPH-GRO range start time.						
01428	Methanol and Ethanol					
01429	Ethanol (by Direct Injection)	64-17-5	N.D.	0.20	mg/kg	1
07361	BTEX+5 Oxygenates+EDC+EDB					
02016	Methyl Tertiary Butyl Ether	1634-04-4	N.D.	0.001	mg/kg	0.99
02017	di-Isopropyl ether	108-20-3	N.D.	0.001	mg/kg	0.99
02018	Ethyl t-butyl ether	637-92-3	N.D.	0.001	mg/kg	0.99
02019	t-Amyl methyl ether	994-05-8	N.D.	0.001	mg/kg	0.99
02020	t-Butyl alcohol	75-65-0	N.D.	0.020	mg/kg	0.99
05460	Benzene	71-43-2	N.D.	0.001	mg/kg	0.99
05461	1,2-Dichloroethane	107-06-2	N.D.	0.001	mg/kg	0.99
05466	Toluene	108-88-3	N.D.	0.001	mg/kg	0.99
05471	1,2-Dibromoethane	106-93-4	N.D.	0.001	mg/kg	0.99
05474	Ethylbenzene	100-41-4	N.D.	0.001	mg/kg	0.99
06301	Xylene (Total)	1330-20-7	N.D.	0.001	mg/kg	0.99

State of California Lab Certification No. 2116

Laboratory Chronicle

CAT No.	Analysis Name	Method	Trial#	Analysis Date and Time	Analyst	Dilution Factor
01725	TPH-GRO - Soils	N. CA LUFT Gasoline method	1	08/05/2003 09:09	Stephanie A Selis	25
01428	Methanol and Ethanol	SW-846 8015B (modified)	1	08/09/2003 13:45	Lisa A Johnson	1



Lancaster Laboratories, Inc.
 2425 New Holland Pike
 PO Box 12425
 Lancaster, PA 17605-2425
 717-656-2300 Fax: 717-656-2681



Lancaster Laboratories Sample No. SW 4093187

Collected: 07/29/2003 09:30 by SO

Account Number: 10880

Submitted: 08/01/2003 09:20

ChevronTexaco

Reported: 08/14/2003 at 14:12

6001 Bollinger Canyon Rd L4310

Discard: 09/14/2003

B-5-A-S-3.0-030729

Grab

Soil

San Ramon CA 94583

Facility# 9-8341

CETR

3530 MacArthur Oakland

NA

NA

B-5-A

07361	BTEX+5 Oxygenates+EDC+EDB	SW-846 8260B	1	08/07/2003 15:04	Roy R Mellott Jr	0.99
00374	GC/MS VOA Soil Prep	SW-846 5030A	1	08/05/2003 10:59	Anastasia Papadopoulos	n.a.
00380	Direct Injection Solids Ext	SW-846 8015B	1	08/08/2003 15:30	Lisa A Johnson	1
01150	GC VOA Soil Prep	SW-846 5035	1	08/04/2003 15:20	Martha L Seidel	n.a.



Lancaster Laboratories, Inc.
2425 New Holland Pike
PO Box 12425
Lancaster, PA 17605-2425
717-656-2300 Fax: 717-656-2681



Lancaster Laboratories Sample No. SW 4093188

Collected: 07/29/2003 10:10 by SO Account Number: 10880

Submitted: 08/01/2003 09:20
 Reported: 08/14/2003 at 14:12
 Discard: 09/14/2003
 B-5-B-S-9.5-030729 Grab Soil San Ramon CA 94583
 ChevronTexaco
 6001 Bollinger Canyon Rd L4310

Facility# 9-8341 CETR
 3530 MacArthur Oakland NA NA

B-5-B

CAT No.	Analysis Name	CAS Number	As Received Result	As Received Method Detection Limit	Units	Dilution Factor
01725	TPH-GRO - Soils	n.a.	N.D.	1.0	mg/kg	25
The analysis for volatiles was performed on a sample which was preserved in methanol. The reporting limits were adjusted appropriately. The reported concentration of TPH-GRO does not include MTBE or other gasoline constituents eluting prior to the C6 (n-hexane) TPH-GRO range start time.						
01428	Methanol and Ethanol					
01429	Ethanol (by Direct Injection)	64-17-5	N.D.	0.20	mg/kg	1
07361	BTEX+5 Oxygenates+EDC+EDB					
02016	Methyl Tertiary Butyl Ether	1634-04-4	0.003	0.001	mg/kg	0.99
02017	di-Isopropyl ether	108-20-3	N.D.	0.001	mg/kg	0.99
02018	Ethyl t-butyl ether	637-92-3	N.D.	0.001	mg/kg	0.99
02019	t-Amyl methyl ether	994-05-8	N.D.	0.001	mg/kg	0.99
02020	t-Butyl alcohol	75-65-0	N.D.	0.020	mg/kg	0.99
05460	Benzene	71-43-2	N.D.	0.001	mg/kg	0.99
05461	1,2-Dichloroethane	107-06-2	N.D.	0.001	mg/kg	0.99
05466	Toluene	108-88-3	N.D.	0.001	mg/kg	0.99
05471	1,2-Dibromoethane	106-93-4	N.D.	0.001	mg/kg	0.99
05474	Ethylbenzene	100-41-4	N.D.	0.001	mg/kg	0.99
06301	Xylene (Total)	1330-20-7	N.D.	0.001	mg/kg	0.99

State of California Lab Certification No. 2116

Laboratory Chronicle

CAT No.	Analysis Name	Method	Trial#	Analysis Date and Time	Analyst	Dilution Factor
01725	TPH-GRO - Soils	N. CA LUFT Gasoline method	1	08/05/2003 09:47	Stephanie A Selis	25
01428	Methanol and Ethanol	SW-846 8015B (modified)	1	08/09/2003 13:58	Lisa A Johnson	1



Lancaster Laboratories, Inc.
 2425 New Holland Pike
 PO Box 12425
 Lancaster, PA 17605-2425
 717-656-2300 Fax: 717-656-2681



Lancaster Laboratories Sample No. SW 4093188

Collected: 07/29/2003 10:10 by SO

Account Number: 10880

Submitted: 08/01/2003 09:20

ChevronTexaco

Reported: 08/14/2003 at 14:12

6001 Bollinger Canyon Rd L4310

Discard: 09/14/2003

B-5-B-S-9.5-030729

Grab

Soil

San Ramon CA 94583

Facility# 9-8341

CETR

3530 MacArthur Oakland

NA

NA

B-5-B

07361	BTEX+5 Oxygenates+EDC+EDB	SW-846 8260B	1	08/07/2003 15:30	Roy R Mellott Jr	0.99
00374	GC/MS VOA Soil Prep	SW-846 5030A	1	08/05/2003 11:01	Anastasia Papadoplos	n.a.
00380	Direct Injection Solids Ext	SW-846 8015B	1	08/08/2003 15:30	Lisa A Johnson	1
01150	GC VOA Soil Prep	SW-846 5035	1	08/04/2003 15:21	Martha L Seidel	n.a.



Lancaster Laboratories, Inc.
2425 New Holland Pike
PO Box 12425
Lancaster, PA 17605-2425
717-656-2300 Fax: 717-656-2681



Lancaster Laboratories Sample No. SW 4093189

Collected: 07/29/2003 11:15 by SO Account Number: 10880

Submitted: 08/01/2003 09:20 ChevronTexaco
 Reported: 08/14/2003 at 14:12 6001 Bollinger Canyon Rd L4310
 Discard: 09/14/2003
 B-6-A-S-2.0-030729 Grab Soil San Ramon CA 94583

Facility# 9-8341 CETR
 3530 MacArthur Oakland NA NA

B-6-A

CAT No.	Analysis Name	CAS Number	As Received Result	As Received Method Detection Limit	Units	Dilution Factor
01725	TPH-GRO - Soils	n.a.	N.D.	1.0	mg/kg	25
The analysis for volatiles was performed on a sample which was preserved in methanol. The reporting limits were adjusted appropriately. The reported concentration of TPH-GRO does not include MTBE or other gasoline constituents eluting prior to the C6 (n-hexane) TPH-GRO range start time.						
01428	Methanol and Ethanol					
01429	Ethanol (by Direct Injection)	64-17-5	N.D.	0.20	mg/kg	1
07361	BTEX+5 Oxygenates+EDC+EDB					
02016	Methyl Tertiary Butyl Ether	1634-04-4	0.003	0.001	mg/kg	1.01
02017	di-Isopropyl ether	108-20-3	N.D.	0.001	mg/kg	1.01
02018	Ethyl t-butyl ether	637-92-3	N.D.	0.001	mg/kg	1.01
02019	t-Amyl methyl ether	994-05-8	N.D.	0.001	mg/kg	1.01
02020	t-Butyl alcohol	75-65-0	N.D.	0.020	mg/kg	1.01
05460	Benzene	71-43-2	N.D.	0.001	mg/kg	1.01
05461	1,2-Dichloroethane	107-06-2	N.D.	0.001	mg/kg	1.01
05466	Toluene	108-88-3	N.D.	0.001	mg/kg	1.01
05471	1,2-Dibromoethane	106-93-4	N.D.	0.001	mg/kg	1.01
05474	Ethylbenzene	100-41-4	N.D.	0.001	mg/kg	1.01
06301	Xylene (Total)	1330-20-7	N.D.	0.001	mg/kg	1.01

State of California Lab Certification No. 2116

Laboratory Chronicle

CAT No.	Analysis Name	Method	Trial#	Analysis Date and Time	Analyst	Dilution Factor
01725	TPH-GRO - Soils	N. CA LUFT Gasoline method	1	08/05/2003 10:25	Stephanie A Selis	25
01428	Methanol and Ethanol	SW-846 8015B (modified)	1	08/09/2003 14:11	Lisa A Johnson	1



Lancaster Laboratories, Inc.
 2425 New Holland Pike
 PO Box 12425
 Lancaster, PA 17605-2425
 717-656-2300 Fax: 717-656-2681



Lancaster Laboratories Sample No. SW 4093189

Collected: 07/29/2003 11:15 by SO

Account Number: 10880

Submitted: 08/01/2003 09:20

ChevronTexaco

Reported: 08/14/2003 at 14:12

6001 Bollinger Canyon Rd L4310

Discard: 09/14/2003

B-6-A-S-2.0-030729 Grab Soil

San Ramon CA 94583

Facility# 9-8341

CETR

3530 MacArthur Oakland NA NA

B-6-A

07361	BTEX+5 Oxygenates+EDC+EDB	SW-846 8260B	1	08/07/2003 15:56	Roy R Mellott Jr	1.01
00374	GC/MS VOA Soil Prep	SW-846 5030A	1	08/05/2003 11:03	Anastasia Papadoplos	n.a.
00380	Direct Injection Solids Ext	SW-846 8015B	1	08/08/2003 15:30	Lisa A Johnson	1
01150	GC VOA Soil Prep	SW-846 5035	1	08/04/2003 15:22	Martha L Seidel	n.a.



Lancaster Laboratories, Inc.
2425 New Holland Pike
PO Box 12425
Lancaster, PA 17605-2425
717-656-2300 Fax: 717-656-2681



Lancaster Laboratories Sample No. SW 4093190

Collected: 07/29/2003 11:30 by SO Account Number: 10880

Submitted: 08/01/2003 09:20 ChevronTexaco
 Reported: 08/14/2003 at 14:13 6001 Bollinger Canyon Rd L4310

Discard: 09/14/2003
 B-6-B-S-9.5-030729 Grab Soil San Ramon CA 94583

Facility# 9-8341 CETR
 3530 MacArthur Oakland NA NA

B-6-B

CAT No.	Analysis Name	CAS Number	As Received Result	As Received Method Detection Limit	Units	Dilution Factor
01725	TPH-GRO - Soils	n.a.	N.D.	1.0	mg/kg	25
The analysis for volatiles was performed on a sample which was preserved in methanol. The reporting limits were adjusted appropriately. The reported concentration of TPH-GRO does not include MTBE or other gasoline constituents eluting prior to the C6 (n-hexane) TPH-GRO range start time.						
01428	Methanol and Ethanol					
01429	Ethanol (by Direct Injection)	64-17-5	N.D.	200.	ug/kg	1
07361	BTEX+5 Oxygenates+EDC+EDB					
02016	Methyl Tertiary Butyl Ether	1634-04-4	N.D.	0.001	mg/kg	1
02017	di-Isopropyl ether	108-20-3	N.D.	0.001	mg/kg	1
02018	Ethyl t-butyl ether	637-92-3	N.D.	0.001	mg/kg	1
02019	t-Amyl methyl ether	994-05-8	N.D.	0.001	mg/kg	1
02020	t-Butyl alcohol	75-65-0	N.D.	0.020	mg/kg	1
05460	Benzene	71-43-2	N.D.	0.001	mg/kg	1
05461	1,2-Dichloroethane	107-06-2	N.D.	0.001	mg/kg	1
05466	Toluene	108-88-3	N.D.	0.001	mg/kg	1
05471	1,2-Dibromoethane	106-93-4	N.D.	0.001	mg/kg	1
05474	Ethylbenzene	100-41-4	N.D.	0.001	mg/kg	1
06301	Xylene (Total)	1330-20-7	N.D.	0.001	mg/kg	1

State of California Lab Certification No. 2116

Laboratory Chronicle

CAT No.	Analysis Name	Method	Trial#	Analysis Date and Time	Analyst	Dilution Factor
01725	TPH-GRO - Soils	N. CA LUFT Gasoline method	1	08/05/2003 11:03	Stephanie A Selis	25
01428	Methanol and Ethanol	SW-846 8015B (modified)	1	08/09/2003 14:37	Lisa A Johnson	1



Lancaster Laboratories, Inc.
 2425 New Holland Pike
 PO Box 12425
 Lancaster, PA 17605-2425
 717-656-2300 Fax: 717-656-2681



Lancaster Laboratories Sample No. SW 4093190

Collected: 07/29/2003 11:30 by SO

Account Number: 10880

Submitted: 08/01/2003 09:20

ChevronTexaco

Reported: 08/14/2003 at 14:13

6001 Bollinger Canyon Rd L4310

Discard: 09/14/2003

B-6-B-S-9.5-030729 Grab Soil

San Ramon CA 94583

Facility# 9-8341

CETR

3530 MacArthur Oakland NA NA

B-6-B

07361	BTEX+5 Oxygenates+EDC+EDB	SW-846 8260B	1	08/07/2003 16:22	Roy R Mellott Jr	1
00374	GC/MS VOA Soil Prep	SW-846 5030A	1	08/05/2003 12:01	Anastasia Papadoplos	n.a.
00380	Direct Injection Solids Ext	SW-846 8015B	1	08/08/2003 15:30	Lisa A Johnson	1
01150	GC VOA Soil Prep	SW-846 5035	1	08/04/2003 15:23	Martha L Seidel	n.a.



Lancaster Laboratories, Inc.
2425 New Holland Pike
PO Box 12425
Lancaster, PA 17605-2425
717-656-2300 Fax: 717-656-2681



Lancaster Laboratories Sample No. SW 4093191

Collected: 07/30/2003 08:50 by SO Account Number: 10880

Submitted: 08/01/2003 09:20 ChevronTexaco
 Reported: 08/14/2003 at 14:13 6001 Bollinger Canyon Rd L4310
 Discard: 09/14/2003
 B-7-A-S-1.5-030730 Grab Soil San Ramon CA 94583

Facility# 9-8341 CETR
 3530 MacArthur Oakland NA NA

B-7-A

CAT No.	Analysis Name	CAS Number	As Received Result	As Received Method Detection Limit	Units	Dilution Factor
01725	TPH-GRO - Soils The analysis for volatiles was performed on a sample which was preserved in methanol. The reporting limits were adjusted appropriately. The reported concentration of TPH-GRO does not include MTBE or other gasoline constituents eluting prior to the C6 (n-hexane) TPH-GRO range start time.	n.a.	2.5	1.0	mg/kg	25
01428	Methanol and Ethanol					
01429	Ethanol (by Direct Injection)	64-17-5	N.D.	0.20	mg/kg	1
07361	BTEX+5 Oxygenates+EDC+EDB					
02016	Methyl Tertiary Butyl Ether	1634-04-4	0.020	0.001	mg/kg	1
02017	di-Isopropyl ether	108-20-3	N.D.	0.001	mg/kg	1
02018	Ethyl t-butyl ether	637-92-3	N.D.	0.001	mg/kg	1
02019	t-Amyl methyl ether	994-05-8	0.001	0.001	mg/kg	1
02020	t-Butyl alcohol	75-65-0	N.D.	0.020	mg/kg	1
05460	Benzene	71-43-2	N.D.	0.001	mg/kg	1
05461	1,2-Dichloroethane	107-06-2	N.D.	0.001	mg/kg	1
05466	Toluene	108-88-3	N.D.	0.001	mg/kg	1
05471	1,2-Dibromoethane	106-93-4	N.D.	0.001	mg/kg	1
05474	Ethylbenzene	100-41-4	N.D.	0.001	mg/kg	1
06301	Xylene (Total)	1330-20-7	N.D.	0.001	mg/kg	1

Matrix QC was performed on this sample for the GCMS volatile analysis. Please see the attached QC summary report for compounds showing a matrix bias.

State of California Lab Certification No. 2116

Laboratory Chronicle

CAT No.	Analysis Name	Method	Trial#	Analysis Date and Time	Analyst	Dilution Factor
---------	---------------	--------	--------	------------------------	---------	-----------------



Lancaster Laboratories Sample No. SW 4093191

Collected: 07/30/2003 08:50 by SO

Account Number: 10880

Submitted: 08/01/2003 09:20

ChevronTexaco

Reported: 08/14/2003 at 14:13

6001 Bollinger Canyon Rd L4310

Discard: 09/14/2003

B-7-A-S-1.5-030730

Grab

Soil

San Ramon CA 94583

Facility# 9-8341

CETR

3530 MacArthur Oakland

NA

NA

B-7-A

01725	TPH-GRO - Soils	N. CA LUFT Gasoline method	1	08/05/2003 11:41	Stephanie A Selis	25
01428	Methanol and Ethanol	SW-846 8015B (modified)	1	08/09/2003 14:50	Lisa A Johnson	1
07361	BTEX+5 Oxygenates+EDC+EDB	SW-846 8260B	1	08/07/2003 16:48	Roy R Mellott Jr	1
00374	GC/MS VOA Soil Prep	SW-846 5030A	1	08/07/2003 11:46	Roy R Mellott Jr	n.a.
00380	Direct Injection Solids Ext	SW-846 8015B	1	08/08/2003 15:30	Lisa A Johnson	1
01150	GC VOA Soil Prep	SW-846 5035	1	08/04/2003 15:24	Martha L Seidel	n.a.



Lancaster Laboratories, Inc.
2425 New Holland Pike
PO Box 12425
Lancaster, PA 17605-2425
717-656-2300 Fax: 717-656-2681



Lancaster Laboratories Sample No. SW 4093192

Collected: 07/30/2003 10:30 by SO Account Number: 10880

Submitted: 08/01/2003 09:20 ChevronTexaco
 Reported: 08/14/2003 at 14:13 6001 Bollinger Canyon Rd L4310

Discard: 09/14/2003
 B-8-A-S-2.0-030730 Grab Soil San Ramon CA 94583

Facility# 9-8341 CETR

3530 MacArthur Oakland NA NA

B-8-A

CAT No.	Analysis Name	CAS Number	As Received Result	As Received Method Detection Limit	Units	Dilution Factor
01725	TPH-GRO - Soils	n.a.	3.3	1.0	mg/kg	25
The analysis for volatiles was performed on a sample which was preserved in methanol. The reporting limits were adjusted appropriately. The reported concentration of TPH-GRO does not include MTBE or other gasoline constituents eluting prior to the C6 (n-hexane) TPH-GRO range start time.						
01428	Methanol and Ethanol					
01429	Ethanol (by Direct Injection)	64-17-5	N.D.	0.20	mg/kg	1
07361	BTEX+5 Oxygenates+EDC+EDB					
02016	Methyl Tertiary Butyl Ether	1634-04-4	0.11	0.001	mg/kg	1
02017	di-Isopropyl ether	108-20-3	N.D.	0.001	mg/kg	1
02018	Ethyl t-butyl ether	637-92-3	N.D.	0.001	mg/kg	1
02019	t-Amyl methyl ether	994-05-8	0.002	0.001	mg/kg	1
02020	t-Butyl alcohol	75-65-0	0.044	0.020	mg/kg	1
05460	Benzene	71-43-2	N.D.	0.001	mg/kg	1
05461	1,2-Dichloroethane	107-06-2	N.D.	0.001	mg/kg	1
05466	Toluene	108-88-3	N.D.	0.001	mg/kg	1
05471	1,2-Dibromoethane	106-93-4	N.D.	0.001	mg/kg	1
05474	Ethylbenzene	100-41-4	0.001	0.001	mg/kg	1
06301	Xylene (Total)	1330-20-7	0.002	0.001	mg/kg	1

State of California Lab Certification No. 2116

Laboratory Chronicle

CAT No.	Analysis Name	Method	Trial#	Analysis Date and Time	Analyst	Dilution Factor
01725	TPH-GRO - Soils	N. CA LUFT Gasoline method	1	08/06/2003 07:51	Deborah S Garrison	25
01428	Methanol and Ethanol	SW-846 8015B (modified)	1	08/09/2003 15:03	Lisa A Johnson	1
07361	BTEX+5 Oxygenates+EDC+EDB	SW-846 8260B	1	08/07/2003 18:06	Roy R Mellott Jr	1
00374	GC/MS VOA Soil Prep	SW-846 5030A	1	08/07/2003 12:12	Roy R Mellott Jr	n.a.



Lancaster Laboratories, Inc.
 2425 New Holland Pike
 PO Box 12425
 Lancaster, PA 17605-2425
 717-656-2300 Fax: 717-656-2681



Lancaster Laboratories Sample No. SW 4093192

Collected: 07/30/2003 10:30 by SO

Account Number: 10880

Submitted: 08/01/2003 09:20

ChevronTexaco

Reported: 08/14/2003 at 14:13

6001 Bollinger Canyon Rd L4310

Discard: 09/14/2003

B-8-A-S-2.0-030730

Grab

Soil

San Ramon CA 94583

Facility# 9-8341

CETR

3530 MacArthur Oakland

NA

NA

B-8-A

00380	Direct Injection Solids	SW-846 8015B	1	08/08/2003 15:30	Lisa A Johnson	1
	Ext					
01150	GC VOA Soil Prep	SW-846 5035	1	08/04/2003 15:25	Martha L Seidel	n.a.



Lancaster Laboratories, Inc.
2425 New Holland Pike
PO Box 12425
Lancaster, PA 17605-2425
717-656-2300 Fax: 717-656-2681



Lancaster Laboratories Sample No. SW 4093193

Collected: 07/30/2003 10:45 by SO

Account Number: 10880

Submitted: 08/01/2003 09:20

ChevronTexaco

Reported: 08/14/2003 at 14:13

6001 Bollinger Canyon Rd L4310

Discard: 09/14/2003

B-8-B-S-9.5-030730

Grab

Soil

San Ramon CA 94583

Facility# 9-8341

CETR

3530 MacArthur Oakland

NA

NA

B-8-B

CAT No.	Analysis Name	CAS Number	As Received Result	As Received		Units	Dilution Factor
				Method	Detection Limit		
01725	TPH-GRO - Soils	n.a.	N.D.		1.0	mg/kg	25
	The analysis for volatiles was performed on a sample which was preserved in methanol. The reporting limits were adjusted appropriately. The reported concentration of TPH-GRO does not include MTBE or other gasoline constituents eluting prior to the C6 (n-hexane) TPH-GRO range start time.						
01428	Methanol and Ethanol						
01429	Ethanol (by Direct Injection)	64-17-5	N.D.		0.20	mg/kg	1
07361	BTEX+5 Oxygenates+EDC+EDB						
02016	Methyl Tertiary Butyl Ether	1634-04-4	0.034		0.001	mg/kg	1
02017	di-Isopropyl ether	108-20-3	N.D.		0.001	mg/kg	1
02018	Ethyl t-butyl ether	637-92-3	N.D.		0.001	mg/kg	1
02019	t-Amyl methyl ether	994-05-8	N.D.		0.001	mg/kg	1
02020	t-Butyl alcohol	75-65-0	N.D.		0.020	mg/kg	1
05460	Benzene	71-43-2	N.D.		0.001	mg/kg	1
05461	1,2-Dichloroethane	107-06-2	N.D.		0.001	mg/kg	1
05466	Toluene	108-88-3	N.D.		0.001	mg/kg	1
05471	1,2-Dibromoethane	106-93-4	N.D.		0.001	mg/kg	1
05474	Ethylbenzene	100-41-4	N.D.		0.001	mg/kg	1
06301	Xylene (Total)	1330-20-7	0.001		0.001	mg/kg	1

State of California Lab Certification No. 2116

Laboratory Chronicle

CAT No.	Analysis Name	Method	Trial#	Analysis		Analyst	Dilution Factor
				Date and Time			
01725	TPH-GRO - Soils	N. CA LUFT Gasoline method	1	08/06/2003	08:27	Deborah S Garrison	25
01428	Methanol and Ethanol	SW-846 8015B (modified)	1	08/09/2003	15:16	Lisa A Johnson	1



Lancaster Laboratories, Inc.
 2425 New Holland Pike
 PO Box 12425
 Lancaster, PA 17605-2425
 717-656-2300 Fax: 717-656-2681



Lancaster Laboratories Sample No. SW 4093193

Collected: 07/30/2003 10:45 by SO

Account Number: 10880

Submitted: 08/01/2003 09:20

ChevronTexaco

Reported: 08/14/2003 at 14:13

6001 Bollinger Canyon Rd L4310

Discard: 09/14/2003

B-8-B-S-9.5-030730

Grab

Soil

San Ramon CA 94583

Facility# 9-8341

CETR

3530 MacArthur Oakland

NA

NA

B-8-B

07361	BTEX+5 Oxygenates+EDC+EDB	SW-846 8260B	1	08/07/2003 18:32	Roy R Mellott Jr	1
00374	GC/MS VOA Soil Prep	SW-846 5030A	1	08/07/2003 12:14	Roy R Mellott Jr	n.a.
00380	Direct Injection Solids Ext	SW-846 8015B	1	08/08/2003 15:30	Lisa A Johnson	1
01150	GC VOA Soil Prep	SW-846 5035	1	08/04/2003 15:26	Martha L Seidel	n.a.



Lancaster Laboratories, Inc.
2425 New Holland Pike
PO Box 12425
Lancaster, PA 17605-2425
717-656-2300 Fax: 717-656-2681



Lancaster Laboratories Sample No. SW 4093194

Collected: 07/30/2003 09:50 by SO Account Number: 10880

Submitted: 08/01/2003 09:20 ChevronTexaco
 Reported: 08/14/2003 at 14:13 6001 Bollinger Canyon Rd L4310

Discard: 09/14/2003
 B-9-A-S-3.0-030730 Grab Soil San Ramon CA 94583

Facility# 9-8341 CETR
 3530 MacArthur Oakland NA NA

B-9-A

CAT No.	Analysis Name	CAS Number	As Received Result	As Received Method Detection Limit	Units	Dilution Factor
01725	TPH-GRO - Soils The analysis for volatiles was performed on a sample which was preserved in methanol. The reporting limits were adjusted appropriately. The reported concentration of TPH-GRO does not include MTBE or other gasoline constituents eluting prior to the C6 (n-hexane) TPH-GRO range start time.	n.a.	N.D.	1.0	mg/kg	25
01428	Methanol and Ethanol					
01429	Ethanol (by Direct Injection)	64-17-5	N.D.	0.20	mg/kg	1
07361	BTEX+5 Oxygenates+EDC+EDB					
02016	Methyl Tertiary Butyl Ether	1634-04-4	0.004	0.001	mg/kg	1
02017	di-Isopropyl ether	108-20-3	N.D.	0.001	mg/kg	1
02018	Ethyl t-butyl ether	637-92-3	N.D.	0.001	mg/kg	1
02019	t-Amyl methyl ether	994-05-8	N.D.	0.001	mg/kg	1
02020	t-Butyl alcohol	75-65-0	N.D.	0.020	mg/kg	1
05460	Benzene	71-43-2	N.D.	0.001	mg/kg	1
05461	1,2-Dichloroethane	107-06-2	N.D.	0.001	mg/kg	1
05466	Toluene	108-88-3	N.D.	0.001	mg/kg	1
05471	1,2-Dibromoethane	106-93-4	N.D.	0.001	mg/kg	1
05474	Ethylbenzene	100-41-4	N.D.	0.001	mg/kg	1
06301	Xylene (Total)	1330-20-7	N.D.	0.001	mg/kg	1

State of California Lab Certification No. 2116

Laboratory Chronicle

CAT No.	Analysis Name	Method	Trial#	Analysis Date and Time	Analyst	Dilution Factor
01725	TPH-GRO - Soils	N. CA LUFT Gasoline method	1	08/06/2003 09:03	Deborah S Garrison	25
01428	Methanol and Ethanol	SW-846 8015B (modified)	1	08/09/2003 15:29	Lisa A Johnson	1



Lancaster Laboratories, Inc.
 2425 New Holland Pike
 PO Box 12425
 Lancaster, PA 17605-2425
 717-656-2300 Fax: 717-656-2681



Lancaster Laboratories Sample No. SW 4093194

Collected: 07/30/2003 09:50 by SO

Account Number: 10880

Submitted: 08/01/2003 09:20

ChevronTexaco

Reported: 08/14/2003 at 14:13

6001 Bollinger Canyon Rd L4310

Discard: 09/14/2003

B-9-A-S-3.0-030730 Grab Soil

San Ramon CA 94583

Facility# 9-8341

CETR

3530 MacArthur Oakland NA NA

B-9-A

07361	BTEX+5 Oxygenates+EDC+EDB	SW-846 8260B	1	08/07/2003 18:58	Roy R Mellott Jr	1
00374	GC/MS VOA Soil Prep	SW-846 5030A	1	08/07/2003 12:17	Roy R Mellott Jr	n.a.
00380	Direct Injection Solids Ext	SW-846 8015B	1	08/08/2003 15:30	Lisa A Johnson	1
01150	GC VOA Soil Prep	SW-846 5035	1	08/04/2003 15:27	Martha L Seidel	n.a.



Lancaster Laboratories, Inc.
2425 New Holland Pike
PO Box 12425
Lancaster, PA 17605-2425
717-656-2300 Fax: 717-656-2681



Lancaster Laboratories Sample No. SW 4093195

Collected: 07/30/2003 10:15 by SO

Account Number: 10880

Submitted: 08/01/2003 09:20

ChevronTexaco

Reported: 08/14/2003 at 14:13

6001 Bollinger Canyon Rd L4310

Discard: 09/14/2003

B-9-B-S-8.0-030730

Grab

Soil

San Ramon CA 94583

Facility# 9-8341

CETR

3530 MacArthur Oakland

NA

NA

B-9-B

CAT No.	Analysis Name	CAS Number	As Received Result	As Received Method Detection Limit	Units	Dilution Factor
01725	TPH-GRO - Soils	n.a.	N.D.	1.0	mg/kg	25
The analysis for volatiles was performed on a sample which was preserved in methanol. The reporting limits were adjusted appropriately. The reported concentration of TPH-GRO does not include MTBE or other gasoline constituents eluting prior to the C6 (n-hexane) TPH-GRO range start time.						
01428	Methanol and Ethanol					
01429	Ethanol (by Direct Injection)	64-17-5	N.D.	0.20	mg/kg	1
07361	BTEX+5 Oxygenates+EDC+EDB					
02016	Methyl Tertiary Butyl Ether	1634-04-4	0.001	0.001	mg/kg	1
02017	di-Isopropyl ether	108-20-3	N.D.	0.001	mg/kg	1
02018	Ethyl t-butyl ether	637-92-3	N.D.	0.001	mg/kg	1
02019	t-Amyl methyl ether	994-05-8	N.D.	0.001	mg/kg	1
02020	t-Butyl alcohol	75-65-0	N.D.	0.020	mg/kg	1
05460	Benzene	71-43-2	N.D.	0.001	mg/kg	1
05461	1,2-Dichloroethane	107-06-2	N.D.	0.001	mg/kg	1
05466	Toluene	108-88-3	N.D.	0.001	mg/kg	1
05471	1,2-Dibromoethane	106-93-4	N.D.	0.001	mg/kg	1
05474	Ethylbenzene	100-41-4	N.D.	0.001	mg/kg	1
06301	Xylene (Total)	1330-20-7	N.D.	0.001	mg/kg	1

State of California Lab Certification No. 2116

Laboratory Chronicle

CAT No.	Analysis Name	Method	Trial#	Analysis Date and Time	Analyst	Dilution Factor
01725	TPH-GRO - Soils	N. CA LUFT Gasoline method	1	08/06/2003 09:40	Deborah S Garrison	25
01428	Methanol and Ethanol	SW-846 8015B (modified)	1	08/09/2003 15:42	Lisa A Johnson	1



Lancaster Laboratories, Inc.
2425 New Holland Pike
PO Box 12425
Lancaster, PA 17605-2425
717-656-2300 Fax: 717-656-2681



Lancaster Laboratories Sample No. SW 4093195

Collected: 07/30/2003 10:15 by SO

Account Number: 10880

Submitted: 08/01/2003 09:20

ChevronTexaco

Reported: 08/14/2003 at 14:13

6001 Bollinger Canyon Rd L4310

Discard: 09/14/2003

B-9-B-S-8.0-030730

Grab

Soil

San Ramon CA 94583

Facility# 9-8341

CETR

3530 MacArthur Oakland

NA

NA

B-9-B

07361	BTEX+5 Oxygenates+EDC+EDB	SW-846 8260B	1	08/07/2003 19:24	Roy R Mellott Jr	1
00374	GC/MS VOA Soil Prep	SW-846 5030A	1	08/07/2003 12:37	Roy R Mellott Jr	n.a.
00380	Direct Injection Solids	SW-846 8015B	1	08/08/2003 15:30	Lisa A Johnson	1
	Ext					
01150	GC VOA Soil Prep	SW-846 5035	1	08/04/2003 15:28	Martha L Seidel	n.a.



Lancaster Laboratories, Inc.
2425 New Holland Pike
PO Box 12425
Lancaster, PA 17605-2425
717-656-2300 Fax: 717-656-2681



Quality Control Summary

Client Name: ChevronTexaco
 Reported: 08/14/03 at 02:13 PM

Group Number: 861569

Laboratory Compliance Quality Control

<u>Analysis Name</u>	<u>Blank Result</u>	<u>Blank MDL</u>	<u>Report Units</u>	<u>LCS %REC</u>	<u>LCS D %REC</u>	<u>LCS/LCSD Limits</u>	<u>RPD</u>	<u>RPD Max</u>
Batch number: 03215A34A TPH-GRO - Soils	Sample number(s): 4093182-4093185 N.D.	1.0	mg/kg	103		70-130		
Batch number: 03215A34B TPH-GRO - Soils	Sample number(s): 4093186-4093191 N.D.	1.0	mg/kg	103		70-130		
Batch number: 03217A31A TPH-GRO - Soils	Sample number(s): 4093192-4093195 N.D.	1.0	mg/kg	93		70-130		
Batch number: 032200019A Ethanol (by Direct Injection)	Sample number(s): 4093182-4093195 N.D.	200.	ug/kg	102		85-121		
Batch number: D032101AD Methyl Tertiary Butyl Ether	Sample number(s): 4093182 N.D.	1.	ug/kg	106		75-125		
di-Isopropyl ether	N.D.	1.	ug/kg	122		70-129		
Ethyl t-butyl ether	N.D.	1.	ug/kg	113		71-124		
t-Amyl methyl ether	N.D.	1.	ug/kg	109		70-122		
t-Butyl alcohol	N.D.	20.	ug/kg	79		46-158		
Benzene	N.D.	1.	ug/kg	113		83-118		
1,2-Dichloroethane	N.D.	1.	ug/kg	114		76-126		
Toluene	N.D.	1.	ug/kg	101		81-116		
1,2-Dibromoethane	N.D.	1.	ug/kg	94		77-114		
Ethylbenzene	N.D.	1.	ug/kg	105		82-115		
Xylene (Total)	N.D.	1.	ug/kg	103		82-117		
Batch number: X032191AA Methyl Tertiary Butyl Ether	Sample number(s): 4093183-4093195 N.D.	1.	ug/kg	100		75-125		
di-Isopropyl ether	N.D.	1.	ug/kg	96		70-129		
Ethyl t-butyl ether	N.D.	1.	ug/kg	96		71-124		
t-Amyl methyl ether	N.D.	1.	ug/kg	99		70-122		
t-Butyl alcohol	N.D.	20.	ug/kg	101		46-158		
Benzene	N.D.	1.	ug/kg	95		83-118		
1,2-Dichloroethane	N.D.	1.	ug/kg	97		76-126		
Toluene	N.D.	1.	ug/kg	93		81-116		
1,2-Dibromoethane	N.D.	1.	ug/kg	95		77-114		
Ethylbenzene	N.D.	1.	ug/kg	91		82-115		
Xylene (Total)	N.D.	1.	ug/kg	91		82-117		

Sample Matrix Quality Control

<u>Analysis Name</u>	<u>MS %REC</u>	<u>MSD %REC</u>	<u>MS/MSD Limits</u>	<u>RPD</u>	<u>BKG MAX</u>	<u>Conc</u>	<u>DUP Conc</u>	<u>DUP RPD</u>	<u>Dup RPD Max</u>
Batch number: 03215A34A									

*- Outside of specification

- (1) The result for one or both determinations was less than five times the LOQ.
- (2) The background result was more than four times the spike added.



Lancaster Laboratories, Inc.
 2425 New Holland Pike
 PO Box 12425
 Lancaster, PA 17605-2425
 717-656-2300 Fax: 717-656-2681



Quality Control Summary

Client Name: ChevronTexaco
 Reported: 08/14/03 at 02:13 PM

Group Number: 861569

Sample Matrix Quality Control

<u>Analysis Name</u>	<u>MS</u>	<u>MSD</u>	<u>MS/MSD</u>	<u>RPD</u>	<u>BKG</u>	<u>DUP</u>	<u>DUP</u>	<u>Dup</u>	
	<u>%REC</u>	<u>%REC</u>	<u>Limits</u>	<u>RPD</u>	<u>MAX</u>	<u>Conc</u>	<u>Conc</u>	<u>RPD</u>	
								<u>Max</u>	
TPH-GRO - Soils	81	83	70-130	3	30				
Batch number: 03215A34B Sample number(s): 4093186-4093191									
TPH-GRO - Soils	81	83	70-130	3	30				
Batch number: 03217A31A Sample number(s): 4093192-4093195									
TPH-GRO - Soils	81	79	70-130	3	30				
Batch number: 032200019A Sample number(s): 4093182-4093195									
Ethanol (by Direct Injection)	98	91	73-109	8	20				
Batch number: D032101AD Sample number(s): 4093182									
Methyl Tertiary Butyl Ether	90	97	57-136	8	30				
di-Isopropyl ether	105	108	55-132	3	30				
Ethyl t-butyl ether	96	101	58-127	6	30				
t-Amyl methyl ether	90	93	58-126	3	30				
t-Butyl alcohol	69	71	14-185	3	30				
Benzene	103	106	52-141	3	30				
1,2-Dichloroethane	98	99	57-137	2	30				
Toluene	99	100	53-137	1	30				
1,2-Dibromoethane	83	85	61-125	3	30				
Ethylbenzene	100	99	50-136	1	30				
Xylene (Total)	96	95	47-139	1	30				
Batch number: X032191AA Sample number(s): 4093183-4093195									
Methyl Tertiary Butyl Ether	67	42*	57-136	17	30				
di-Isopropyl ether	89	91	55-132	2	30				
Ethyl t-butyl ether	89	89	58-127	0	30				
t-Amyl methyl ether	85	83	58-126	3	30				
t-Butyl alcohol	96	100	14-185	3	30				
Benzene	77	78	52-141	2	30				
1,2-Dichloroethane	85	86	57-137	1	30				
Toluene	74	74	53-137	0	30				
1,2-Dibromoethane	75	77	61-125	1	30				
Ethylbenzene	69	71	50-136	2	30				
Xylene (Total)	65	66	47-139	1	30				

Surrogate Quality Control

Analysis Name: TPH-GRO - Soils
 Batch number: 03215A34A
 Trifluorotoluene-F

4093182 98

*- Outside of specification

- (1) The result for one or both determinations was less than five times the LOQ.
- (2) The background result was more than four times the spike added.



Lancaster Laboratories, Inc.
 2425 New Holland Pike
 PO Box 12425
 Lancaster, PA 17605-2425
 717-656-2300 Fax: 717-656-2681



Quality Control Summary

Client Name: ChevronTexaco
 Reported: 08/14/03 at 02:13 PM

Group Number: 861569

Surrogate Quality Control

4093183	100
4093184	97
4093185	96
Blank	107
LCS	112
MS	95
MSD	96

Limits: 66-117

Analysis Name: TPH-GRO - Soils
 Batch number: 03215A34B
 Trifluorotoluene-F

4093186	99
4093187	97
4093188	87
4093189	100
4093190	94
4093191	92
Blank	115
LCS	112
MS	95
MSD	96

Limits: 66-117

Analysis Name: TPH-GRO - Soils
 Batch number: 03217A31A
 Trifluorotoluene-F

4093192	101
4093193	95
4093194	92
4093195	90
Blank	99
LCS	108
MS	98
MSD	94

Limits: 66-117

Analysis Name: Methanol and Ethanol
 Batch number: 032200019A
 Acetone

4093182	84
4093183	116
4093184	87
4093185	116
4093186	109

***- Outside of specification**

- (1) The result for one or both determinations was less than five times the LOQ.
- (2) The background result was more than four times the spike added.





Quality Control Summary

Client Name: ChevronTexaco
 Reported: 08/14/03 at 02:13 PM

Group Number: 861569

Surrogate Quality Control

4093187 100
 4093188 103
 4093189 107
 4093190 99
 4093191 107
 4093192 108
 4093193 100
 4093194 100
 4093195 95
 Blank 103
 LCS 103
 MS 109
 MSD 91

Limits: 55-127

Analysis Name: BTEX+5 Oxygenates+EDC+EDB
 Batch number: D032101AD

	Dibromofluoromethane	1,2-Dichloroethane-d4	Toluene-d8	4-Bromofluorobenzene
4093182	88	84	97	85
Blank	87	86	97	85
LCS	84	89	97	92
MS	84	82	102	86
MSD	86	83	100	86

Limits: 70-129 70-121 70-130 70-128

Analysis Name: BTEX+5 Oxygenates+EDC+EDB
 Batch number: X032191AA

	Dibromofluoromethane	1,2-Dichloroethane-d4	Toluene-d8	4-Bromofluorobenzene
4093183	89	88	93	91
4093184	91	85	91	90
4093185	92	89	92	92
4093186	89	85	93	90
4093187	94	88	102	77
4093188	93	88	94	87
4093189	89	86	93	90
4093190	89	84	92	90
4093191	93	90	97	88
4093192	92	87	93	93
4093193	91	86	92	90
4093194	92	86	92	92
4093195	91	86	92	92
Blank	90	89	91	92
LCS	91	92	91	93
MS	91	87	97	87
MSD	92	88	99	86

Limits: 70-129 70-121 70-130 70-128

*- Outside of specification

- (1) The result for one or both determinations was less than five times the LOQ.
- (2) The background result was more than four times the spike added.



Lancaster Laboratories, Inc.
 2425 New Holland Pike
 PO Box 12425
 Lancaster, PA 17605-2425
 717-656-2300 Fax: 717-656-2681



Quality Control Summary

Client Name: ChevronTexaco
Reported: 08/14/03 at 02:13 PM

Group Number: 861569

Surrogate Quality Control

*- Outside of specification

- (1) The result for one or both determinations was less than five times the LOQ.
- (2) The background result was more than four times the spike added.



Lancaster Laboratories, Inc.
2425 New Holland Pike
PO Box 12425
Lancaster, PA 17605-2425
717-656-2300 Fax: 717-656-2681

Chevron California Region Analysis Request/Chain of Custody



073003-018

Acct. #: 10880 Sample #: 4093482-95 For Lancaster Laboratories use only
 SCR#: 861569

Facility #: 9-8341
 Site Address: 3530 Mac Arthur Blvd Oakland
 Chevron PM: Streich Lead Consultant:
 Consultant/Office: Cambridge
 Consultant Prj. Mgr.: Fox
 Consultant Phone #: 510 420 3350 Fax #: 510 420 9170
 Sampler: Sarah Owen
 Service Order #: Non SAR:

Analyses Requested

Preservation Codes

BTEX + MTBE	8260	8021																	
<input type="checkbox"/>	<input checked="" type="checkbox"/>	<input type="checkbox"/>																	
TPH 8015 MOD	GRO																		
<input type="checkbox"/>	<input type="checkbox"/>																		
TPH 8015 MOD DRO																			
<input type="checkbox"/>																			
8260 full scan																			
<input type="checkbox"/>																			
Oxygenates																			
<input checked="" type="checkbox"/>																			
Lead 7420																			
<input type="checkbox"/>																			
7421																			
<input type="checkbox"/>																			

Preservative Codes
 H = HCl T = Thiosulfate
 N = HNO₃ B = NaOH
 S = H₂SO₄ O = Other

J value reporting needed
 Must meet lowest detection limits possible for 8260 compounds

8021 MTBE Confirmation
 Confirm highest hit by 8260
 Confirm all hits by 8260
 Run ___ oxy's on highest hit
 Run ___ oxy's on all hits

Field Point Name	Matrix	Repeat Sample	Top Depth	Year Month Day	Time Collected	New Field Pt.	Grab	Composite	Total Number of Containers	BTEX + MTBE 8260	8021	TPH 8015 MOD GRO	TPH 8015 MOD DRO	Silica Gel Cleanup	8260 full scan	Oxygenates	Lead 7420	7421
B-1-A	S		3.5'	7/29/03	12:00		X			X	X					X		
B-3-A			3.5'	7/29/03	12:20													
B-3-B			10.0'	7/29/03	2:15													
B-4-A			2.5'	7/30/03	12:30													
B-4-B			9.5'	7/30/03	12:45													
B-5-A			3.0'	7/29/03	9:30													
B-5-B			9.5'	7/29/03	10:10													
B-6-A			2.0'	7/29/03	11:15													
B-6-B			9.5'	7/29/03	11:30													
B-7-A			1.5'	7/30/03	8:50													
B-8-A			2.0'	7/30/03	10:30													
B-8-B			9.5'	7/30/03	10:45													
B-9-A			3.0'	7/30/03	9:50													
B-9-B			8.0'	7/30/03	10:15													

Comments / Remarks

8 oxy's =
 MTBE
 TAME
 DIPE
 ETBE
 TBA
 EOB
 1,2 DCA
 Ethanol

Turnaround Time Requested (TAT) (please circle)

STD. TAT	72 hour	48 hour
24 hour	4 day	5 day

Relinquished by: Sarah Cody Owen Date: 7/30/03 Time: 4:15

Relinquished by: Bernardo Araya Date: 7/30/03 Time: 6:45

Relinquished by: _____ Date: _____ Time: _____

Received by: Bernardo Araya Date: 7/30/03 Time: 16:15

Received by: Airborne Date: 7/31/03 Time: _____

Received by: _____ Date: _____ Time: _____

Data Package Options (please circle if required)

QC Summary Type I - Full
 Type VI (Raw Data) Coelt Deliverable not needed
 WIP (RWQCB)
 Disk

Relinquished by Commercial Carrier:

UPS FedEx Other Airborne

Temperature Upon Receipt 3.0 C°

Received by: [Signature] Date: 8/1/03 Time: 09:20

Custody Seals Intact? Yes No



ANALYTICAL RESULTS

Prepared for:

ChevronTexaco
6001 Bollinger Canyon Rd L4310

San Ramon CA 94583
925-842-8582

Prepared by:

Lancaster Laboratories
2425 New Holland Pike
Lancaster, PA 17605-2425

SAMPLE GROUP

The sample group for this submittal is 861306. Samples arrived at the laboratory on Thursday, July 31, 2003. The PO# for this group is 99011184 and the release number is STREICH.

<u>Client Description</u>		<u>Lancaster Labs Number</u>
B-1-W-030729	Grab Water	4091656
B-3-W-030730	Grab Water	4091657
B-4-W-030730	Grab Water	4091658
B-5-W-030729	Grab Water	4091659
B-6-W-030729	Grab Water	4091660
B-7-W-030730	Grab Water	4091661
B-8-W-030730	Grab Water	4091662
B-9-W-030730	Grab Water	4091663

1 COPY TO

Cambria Environmental

Attn: Bob Foss

Questions? Contact your Client Services Representative
Alison M O'Connor at (717) 656-2300.

Respectfully Submitted,

A handwritten signature in black ink that reads "Robert E. Mellinger".

Robert E. Mellinger
Sr Chemist/Coordinator



Lancaster Laboratories, Inc.
2425 New Holland Pike
PO Box 12425
Lancaster, PA 17605-2425
717-656-2300 Fax: 717-656-2681



Lancaster Laboratories Sample No. **WW 4091656**

Collected: 07/29/2003 00:00 by **SO** Account Number: 10880

Submitted: 07/31/2003 09:10
 Reported: 08/14/2003 at 12:19
 Discard: 09/14/2003
 B-1-W-030729 Grab Water San Ramon CA 94583
 ChevronTexaco
 6001 Bollinger Canyon Rd L4310

Facility# 98341 CETR
 3530 MacArthur Blvd T0600101790 B-1

729B1

CAT No.	Analysis Name	CAS Number	As Received Result	As Received	Units	Dilution Factor
				Method		
01728	TPH-GRO - Waters	n.a.	N.D.	50. Detection Limit	ug/l	1
The reported concentration of TPH-GRO does not include MTBE or other gasoline constituents eluting prior to the C6 (n-hexane) TPH-GRO range start time. A site-specific MSD sample was not submitted for the project. A LCS/LCSD was performed to demonstrate precision and accuracy at a batch level.						
01594	BTEX+5 Oxygenates+EDC+EDB+ETOH					
01587	Ethanol	64-17-5	N.D.	50.	ug/l	1
02010	Methyl Tertiary Butyl Ether	1634-04-4	25.	0.5	ug/l	1
02011	di-Isopropyl ether	108-20-3	N.D.	0.5	ug/l	1
02013	Ethyl t-butyl ether	637-92-3	N.D.	0.5	ug/l	1
02014	t-Amyl methyl ether	994-05-8	0.6	0.5	ug/l	1
02015	t-Butyl alcohol	75-65-0	N.D.	5.	ug/l	1
05401	Benzene	71-43-2	N.D.	0.5	ug/l	1
05402	1,2-Dichloroethane	107-06-2	N.D.	0.5	ug/l	1
05407	Toluene	108-88-3	N.D.	0.5	ug/l	1
05412	1,2-Dibromoethane	106-93-4	N.D.	0.5	ug/l	1
05415	Ethylbenzene	100-41-4	N.D.	0.5	ug/l	1
06310	Xylene (Total)	1330-20-7	N.D.	0.5	ug/l	1

State of California Lab Certification No. 2116
 Trip blank vials were not received by the laboratory for this sample group.

Laboratory Chronicle

CAT No.	Analysis Name	Method	Trial#	Analysis	Analyst	Dilution Factor
				Date and Time		
01728	TPH-GRO - Waters	N. CA LUFT Gasoline	1	08/04/2003 05:44	K. Robert Caulfeild-James	1
01594	BTEX+5 Oxygenates+EDC+EDB+ETOH	SW-846 8260B	1	08/12/2003 10:49	Trent S Sprenkle	1
01146	GC VOA Water Prep	SW-846 5030B	1	08/04/2003 05:44	K. Robert Caulfeild-James	n.a.



Lancaster Laboratories, Inc.
 2425 New Holland Pike
 PO Box 12425
 Lancaster, PA 17605-2425
 717-656-2300 Fax: 717-656-2681



Lancaster Laboratories Sample No. WW 4091656

Collected: 07/29/2003 00:00 by SO

Account Number: 10880

Submitted: 07/31/2003 09:10

ChevronTexaco

Reported: 08/14/2003 at 12:19

6001 Bollinger Canyon Rd L4310

Discard: 09/14/2003

B-1-W-030729

Grab Water

San Ramon CA 94583

Facility# 98341

CETR

3530 MacArthur Blvd

T0600101790 B-1

729B1

01163 GC/MS VOA Water Prep

SW-846 5030B

1 08/12/2003 10:49 Trent S Sprenkle n.a.





Lancaster Laboratories Sample No. **WW 4091657**

Collected: 07/30/2003 13:00 by SO Account Number: 10880

Submitted: 07/31/2003 09:10 ChevronTexaco
 Reported: 08/14/2003 at 12:19 6001 Bollinger Canyon Rd L4310

Discard: 09/14/2003
 B-3-W-030730 Grab Water San Ramon CA 94583

Facility# 98341 CETR
 3530 MacArthur Blvd T0600101790 B-3

730B3

CAT No.	Analysis Name	CAS Number	As Received Result	As Received Method Detection Limit	Units	Dilution Factor
01728	TPH-GRO - Waters	n.a.	N.D.	50.	ug/l	1
The reported concentration of TPH-GRO does not include MTBE or other gasoline constituents eluting prior to the C6 (n-hexane) TPH-GRO range start time. A site-specific MSD sample was not submitted for the project. A LCS/LCSD was performed to demonstrate precision and accuracy at a batch level.						
01594	BTEX+5 Oxygenates+EDC+EDB+ETOH					
01587	Ethanol	64-17-5	N.D.	50.	ug/l	1
02010	Methyl Tertiary Butyl Ether	1634-04-4	10.	0.5	ug/l	1
02011	di-Isopropyl ether	108-20-3	N.D.	0.5	ug/l	1
02013	Ethyl t-butyl ether	637-92-3	N.D.	0.5	ug/l	1
02014	t-Amyl methyl ether	994-05-8	N.D.	0.5	ug/l	1
02015	t-Butyl alcohol	75-65-0	8.	5.	ug/l	1
05401	Benzene	71-43-2	N.D.	0.5	ug/l	1
05402	1,2-Dichloroethane	107-06-2	N.D.	0.5	ug/l	1
05407	Toluene	108-88-3	N.D.	0.5	ug/l	1
05412	1,2-Dibromoethane	106-93-4	N.D.	0.5	ug/l	1
05415	Ethylbenzene	100-41-4	N.D.	0.5	ug/l	1
06310	Xylene (Total)	1330-20-7	N.D.	0.5	ug/l	1

State of California Lab Certification No. 2116
 Trip blank vials were not received by the laboratory for this sample group.

Laboratory Chronicle

CAT No.	Analysis Name	Method	Trial#	Analysis Date and Time	Analyst	Dilution Factor
01728	TPH-GRO - Waters	N. CA LUFT Gasoline Method	1	08/04/2003 06:14	K. Robert Caulfeild-James	1
01594	BTEX+5 Oxygenates+EDC+EDB+ETOH	SW-846 8260B	1	08/12/2003 15:40	Trent S Sprenkle	1
01146	GC VOA Water Prep	SW-846 5030B	1	08/04/2003 06:14	K. Robert Caulfeild-James	n.a.
01163	GC/MS VOA Water Prep	SW-846 5030B	1	08/12/2003 15:40	Trent S Sprenkle	n.a.



Lancaster Laboratories, Inc.
 2425 New Holland Pike
 PO Box 12425
 Lancaster, PA 17605-2425
 717-656-2300 Fax: 717-656-2681



Lancaster Laboratories Sample No. WW 4091657

Collected: 07/30/2003 13:00 by SO

Account Number: 10880

Submitted: 07/31/2003 09:10

ChevronTexaco

Reported: 08/14/2003 at 12:19

6001 Bollinger Canyon Rd L4310

Discard: 09/14/2003

B-3-W-030730

Grab Water

San Ramon CA 94583

Facility# 98341

CETR

3530 MacArthur Blvd

T0600101790 B-3

730B3





Lancaster Laboratories Sample No. **WW 4091658**

Collected: 07/30/2003 13:15 by SO Account Number: 10880

Submitted: 07/31/2003 09:10 ChevronTexaco
 Reported: 08/14/2003 at 12:19 6001 Bollinger Canyon Rd L4310

Discard: 09/14/2003
 B-4-W-030730 Grab Water San Ramon CA 94583

Facility# 98341 CETR
 3530 MacArthur Blvd T0600101790 B-4

730B4

CAT No.	Analysis Name	CAS Number	As Received Result	As Received Method Detection Limit	Units	Dilution Factor
01728	TPH-GRO - Waters	n.a.	N.D.	50.	ug/l	1
The reported concentration of TPH-GRO does not include MTBE or other gasoline constituents eluting prior to the C6 (n-hexane) TPH-GRO range start time. A site-specific MSD sample was not submitted for the project. A LCS/LCSD was performed to demonstrate precision and accuracy at a batch level.						
01594	BTEX+5 Oxygenates+EDC+EDB+ETOH					
01587	Ethanol	64-17-5	N.D.	50.	ug/l	1
02010	Methyl Tertiary Butyl Ether	1634-04-4	420.	2.	ug/l	4
02011	di-Isopropyl ether	108-20-3	N.D.	0.5	ug/l	1
02013	Ethyl t-butyl ether	637-92-3	N.D.	0.5	ug/l	1
02014	t-Amyl methyl ether	994-05-8	9.	0.5	ug/l	1
02015	t-Butyl alcohol	75-65-0	28.	5.	ug/l	1
05401	Benzene	71-43-2	N.D.	0.5	ug/l	1
05402	1,2-Dichloroethane	107-06-2	N.D.	0.5	ug/l	1
05407	Toluene	108-88-3	N.D.	0.5	ug/l	1
05412	1,2-Dibromoethane	106-93-4	N.D.	0.5	ug/l	1
05415	Ethylbenzene	100-41-4	N.D.	0.5	ug/l	1
06310	Xylene (Total)	1330-20-7	N.D.	0.5	ug/l	1

State of California Lab Certification No. 2116
 Trip blank vials were not received by the laboratory for this sample group.

Laboratory Chronicle

CAT No.	Analysis Name	Method	Trial#	Analysis Date and Time	Analyst	Dilution Factor
01728	TPH-GRO - Waters	N. CA LUFT Gasoline Method	1	08/04/2003 06:45	K. Robert Caulfeild-James	1
01594	BTEX+5 Oxygenates+EDC+EDB+ETOH	SW-846 8260B	1	08/12/2003 16:11	Trent S Sprenkle	1
01594	BTEX+5 Oxygenates+EDC+EDB+ETOH	SW-846 8260B	1	08/12/2003 20:16	Trent S Sprenkle	4
01146	GC VOA Water Prep	SW-846 5030B	1	08/04/2003 06:45	K. Robert Caulfeild-James	n.a.



Lancaster Laboratories, Inc.
 2425 New Holland Pike
 PO Box 12425
 Lancaster, PA 17605-2425
 717-656-2300 Fax: 717-656-2681



Lancaster Laboratories Sample No. WW 4091658

Collected: 07/30/2003 13:15 by SO

Account Number: 10880

Submitted: 07/31/2003 09:10

ChevronTexaco

Reported: 08/14/2003 at 12:19

6001 Bollinger Canyon Rd L4310

Discard: 09/14/2003

B-4-W-030730

Grab Water

San Ramon CA 94583

Facility# 98341

CETR

3530 MacArthur Blvd

T0600101790 B-4

730B4

01163 GC/MS VOA Water Prep

SW-846 5030B

1 08/12/2003 16:11 Trent S Sprenkle

n.a.



Lancaster Laboratories, Inc.
2425 New Holland Pike
PO Box 12425
Lancaster, PA 17605-2425
717-656-2300 Fax: 717-656-2681



Lancaster Laboratories Sample No. **WW 4091659**

Collected: 07/29/2003 00:00 by **SO** Account Number: 10880

Submitted: 07/31/2003 09:10 ChevronTexaco
 Reported: 08/14/2003 at 12:19 6001 Bollinger Canyon Rd L4310

Discard: 09/14/2003
 B-5-W-030729 Grab Water San Ramon CA 94583

Facility# 98341 CETR
 3530 MacArthur Blvd T0600101790 B-5

729B5

CAT No.	Analysis Name	CAS Number	As Received Result	As Received		Units	Dilution Factor
				Method	Detection Limit		
01728	TPH-GRO - Waters	n.a.	N.D.		50.	ug/l	1
The reported concentration of TPH-GRO does not include MTBE or other gasoline constituents eluting prior to the C6 (n-hexane) TPH-GRO range start time. A site-specific MSD sample was not submitted for the project. A LCS/LCSD was performed to demonstrate precision and accuracy at a batch level.							
01594	BTEX+5 Oxygenates+EDC+EDB+ETOH						
01587	Ethanol	64-17-5	N.D.		50.	ug/l	1
02010	Methyl Tertiary Butyl Ether	1634-04-4	50.		0.5	ug/l	1
02011	di-Isopropyl ether	108-20-3	N.D.		0.5	ug/l	1
02013	Ethyl t-butyl ether	637-92-3	N.D.		0.5	ug/l	1
02014	t-Amyl methyl ether	994-05-8	11.		0.5	ug/l	1
02015	t-Butyl alcohol	75-65-0	N.D.		5.	ug/l	1
05401	Benzene	71-43-2	N.D.		0.5	ug/l	1
05402	1,2-Dichloroethane	107-06-2	N.D.		0.5	ug/l	1
05407	Toluene	108-88-3	4.		0.5	ug/l	1
05412	1,2-Dibromoethane	106-93-4	N.D.		0.5	ug/l	1
05415	Ethylbenzene	100-41-4	0.6		0.5	ug/l	1
06310	Xylene (Total)	1330-20-7	8.		0.5	ug/l	1

State of California Lab Certification No. 2116
 Trip blank vials were not received by the laboratory for this sample group.

Laboratory Chronicle

CAT No.	Analysis Name	Method	Trial#	Analysis		Analyst	Dilution Factor
				Date and Time			
01728	TPH-GRO - Waters	N. CA LUFT Gasoline Method	1	08/04/2003	07:17	K. Robert Caulfeild-James	1
01594	BTEX+5 Oxygenates+EDC+EDB+ETOH	SW-846 8260B	1	08/12/2003	13:38	Trent S Sprenkle	1
01146	GC VOA Water Prep	SW-846 5030B	1	08/04/2003	07:17	K. Robert Caulfeild-James	n.a.
01163	GC/MS VOA Water Prep	SW-846 5030B	1	08/12/2003	13:38	Trent S Sprenkle	n.a.



Lancaster Laboratories, Inc.
 2425 New Holland Pike
 PO Box 12425
 Lancaster, PA 17605-2425
 717-656-2300 Fax: 717-656-2681



Lancaster Laboratories Sample No. WW 4091659

Collected: 07/29/2003 00:00 by SO

Account Number: 10880

Submitted: 07/31/2003 09:10

ChevronTexaco

Reported: 08/14/2003 at 12:19

6001 Bollinger Canyon Rd L4310

Discard: 09/14/2003

B-5-W-030729

Grab Water

San Ramon CA 94583

Facility# 98341

CETR

3530 MacArthur Blvd

T0600101790 B-5

729B5



Lancaster Laboratories, Inc.
2425 New Holland Pike
PO Box 12425
Lancaster, PA 17605-2425
717-656-2300 Fax: 717-656-2681



Lancaster Laboratories Sample No. **WW 4091660**

Collected: 07/29/2003 00:00 by SO Account Number: 10880

Submitted: 07/31/2003 09:10 ChevronTexaco
 Reported: 08/14/2003 at 12:19 6001 Bollinger Canyon Rd L4310

Discard: 09/14/2003
 B-6-W-030729 Grab Water San Ramon CA 94583

Facility# 98341 CETR
 3530 MacArthur Blvd T0600101790 B-6

729B6

CAT No.	Analysis Name	CAS Number	As Received Result	As Received Method Detection Limit	Units	Dilution Factor
01728	TPH-GRO - Waters	n.a.	N.D.	50.	ug/l	1
The reported concentration of TPH-GRO does not include MTBE or other gasoline constituents eluting prior to the C6 (n-hexane) TPH-GRO range start time. A site-specific MSD sample was not submitted for the project. A LCS/LCSD was performed to demonstrate precision and accuracy at a batch level.						
01594	BTEX+5 Oxygenates+EDC+EDB+ETOH					
01587	Ethanol	64-17-5	N.D.	50.	ug/l	1
02010	Methyl Tertiary Butyl Ether	1634-04-4	2.	0.5	ug/l	1
02011	di-Isopropyl ether	108-20-3	N.D.	0.5	ug/l	1
02013	Ethyl t-butyl ether	637-92-3	N.D.	0.5	ug/l	1
02014	t-Amyl methyl ether	994-05-8	N.D.	0.5	ug/l	1
02015	t-Butyl alcohol	75-65-0	N.D.	5.	ug/l	1
05401	Benzene	71-43-2	N.D.	0.5	ug/l	1
05402	1,2-Dichloroethane	107-06-2	N.D.	0.5	ug/l	1
05407	Toluene	108-88-3	N.D.	0.5	ug/l	1
05412	1,2-Dibromoethane	106-93-4	N.D.	0.5	ug/l	1
05415	Ethylbenzene	100-41-4	N.D.	0.5	ug/l	1
06310	Xylene (Total)	1330-20-7	N.D.	0.5	ug/l	1

State of California Lab Certification No. 2116
 Trip blank vials were not received by the laboratory for this sample group.

Laboratory Chronicle

CAT No.	Analysis Name	Method	Analysis		Analyst	Dilution Factor
			Trial#	Date and Time		
01728	TPH-GRO - Waters	N. CA LUFT Gasoline Method	1	08/04/2003 07:48	K. Robert Caulfeild-James	1
01594	BTEX+5 Oxygenates+EDC+EDB+ETOH	SW-846 8260B	1	08/12/2003 14:08	Trent S Sprenkle	1
01146	GC VOA Water Prep	SW-846 5030B	1	08/04/2003 07:48	K. Robert Caulfeild-James	n.a.
01163	GC/MS VOA Water Prep	SW-846 5030B	1	08/12/2003 14:08	Trent S Sprenkle	n.a.



Lancaster Laboratories, Inc.
 2425 New Holland Pike
 PO Box 12425
 Lancaster, PA 17605-2425
 717-656-2300 Fax: 717-656-2681



Lancaster Laboratories Sample No. WW 4091660

Collected: 07/29/2003 00:00 by SO

Account Number: 10880

Submitted: 07/31/2003 09:10

ChevronTexaco

Reported: 08/14/2003 at 12:19

6001 Bollinger Canyon Rd L4310

Discard: 09/14/2003

B-6-W-030729

Grab Water

San Ramon CA 94583

Facility# 98341

CETR

3530 MacArthur Blvd

T0600101790 B-6

729B6



Lancaster Laboratories, Inc.
2425 New Holland Pike
PO Box 12425
Lancaster, PA 17605-2425
717-656-2300 Fax: 717-656-2681



Lancaster Laboratories Sample No. **WW 4091661**

Collected: 07/30/2003 13:45 by **SO**

Account Number: 10880

Submitted: 07/31/2003 09:10

ChevronTexaco

Reported: 08/14/2003 at 12:19

6001 Bollinger Canyon Rd L4310

Discard: 09/14/2003

B-7-W-030730

Grab Water

San Ramon CA 94583

Facility# 98341

CETR

3530 MacArthur Blvd

T0600101790 B-7

730B7

CAT No.	Analysis Name	CAS Number	As Received Result	As Received		Units	Dilution Factor
				Method	Detection Limit		
01728	TPH-GRO - Waters	n.a.	98.		50.	ug/l	1
	The reported concentration of TPH-GRO does not include MTBE or other gasoline constituents eluting prior to the C6 (n-hexane) TPH-GRO range start time.						
	A site-specific MSD sample was not submitted for the project. A LCS/LCSD was performed to demonstrate precision and accuracy at a batch level.						
01594	BTEX+5 Oxygenates+EDC+EDB+ETOH						
01587	Ethanol	64-17-5	N.D.		50.	ug/l	1
02010	Methyl Tertiary Butyl Ether	1634-04-4	460.		3.	ug/l	5
02011	di-Isopropyl ether	108-20-3	N.D.		0.5	ug/l	1
02013	Ethyl t-butyl ether	637-92-3	N.D.		0.5	ug/l	1
02014	t-Amyl methyl ether	994-05-8	8.		0.5	ug/l	1
02015	t-Butyl alcohol	75-65-0	41.		5.	ug/l	1
05401	Benzene	71-43-2	N.D.		0.5	ug/l	1
05402	1,2-Dichloroethane	107-06-2	N.D.		0.5	ug/l	1
05407	Toluene	108-88-3	N.D.		0.5	ug/l	1
05412	1,2-Dibromoethane	106-93-4	N.D.		0.5	ug/l	1
05415	Ethylbenzene	100-41-4	N.D.		0.5	ug/l	1
06310	Xylene (Total)	1330-20-7	N.D.		0.5	ug/l	1

State of California Lab Certification No. 2116

Trip blank vials were not received by the laboratory for this sample group.

Laboratory Chronicle

CAT No.	Analysis Name	Method	Analysis		Analyst	Dilution Factor
			Trial#	Date and Time		
01728	TPH-GRO - Waters	N. CA LUFT Gasoline Method	1	08/04/2003 08:18	K. Robert Caulfeild-James	1
01594	BTEX+5 Oxygenates+EDC+EDB+ETOH	SW-846 8260B	1	08/12/2003 16:41	Trent S Sprenkle	1
01594	BTEX+5 Oxygenates+EDC+EDB+ETOH	SW-846 8260B	1	08/12/2003 20:46	Trent S Sprenkle	5
01146	GC VOA Water Prep	SW-846 5030B	1	08/04/2003 08:18	K. Robert Caulfeild-James	n.a.



Lancaster Laboratories, Inc.
 2425 New Holland Pike
 PO Box 12425
 Lancaster, PA 17605-2425
 717-656-2300 Fax: 717-656-2681



Lancaster Laboratories Sample No. WW 4091661

Collected: 07/30/2003 13:45 by SO

Account Number: 10880

Submitted: 07/31/2003 09:10

ChevronTexaco

Reported: 08/14/2003 at 12:19

6001 Bollinger Canyon Rd L4310

Discard: 09/14/2003

B-7-W-030730

Grab Water

San Ramon CA 94583

Facility# 98341

CETR

3530 MacArthur Blvd

T0600101790 B-7

730B7

01163 GC/MS VOA Water Prep

SW-846 5030B

1

08/12/2003 16:41

Trent S Sprenkle

n.a.





Lancaster Laboratories Sample No. **WW 4091662**

Collected: 07/30/2003 14:00 by SO Account Number: 10880

Submitted: 07/31/2003 09:10 ChevronTexaco
 Reported: 08/14/2003 at 12:20 6001 Bollinger Canyon Rd L4310

Discard: 09/14/2003
 B-8-W-030730 Grab Water San Ramon CA 94583

Facility# 98341 CETR
 3530 MacArthur Blvd T0600101790 B-8

730B8

CAT No.	Analysis Name	CAS Number	As Received Result	As Received		Units	Dilution Factor
				Method	Detection Limit		
01728	TPH-GRO - Waters The reported concentration of TPH-GRO does not include MTBE or other gasoline constituents eluting prior to the C6 (n-hexane) TPH-GRO range start time. A site-specific MSD sample was not submitted for the project. A LCS/LCSD was performed to demonstrate precision and accuracy at a batch level.	n.a.	5,200.		50.	ug/l	1
01594	BTEX+5 Oxygenates+EDC+EDB+ETOH						
01587	Ethanol	64-17-5	N.D.		50.	ug/l	1
02010	Methyl Tertiary Butyl Ether	1634-04-4	980.		5.	ug/l	10
02011	di-Isopropyl ether	108-20-3	N.D.		0.5	ug/l	1
02013	Ethyl t-butyl ether	637-92-3	N.D.		0.5	ug/l	1
02014	t-Amyl methyl ether	994-05-8	15.		0.5	ug/l	1
02015	t-Butyl alcohol	75-65-0	N.D.		5.	ug/l	1
05401	Benzene	71-43-2	3.		0.5	ug/l	1
05402	1,2-Dichloroethane	107-06-2	N.D.		0.5	ug/l	1
05407	Toluene	108-88-3	3.		0.5	ug/l	1
05412	1,2-Dibromoethane	106-93-4	N.D.		0.5	ug/l	1
05415	Ethylbenzene	100-41-4	160.		5.	ug/l	10
06310	Xylene (Total)	1330-20-7	450.		5.	ug/l	10

State of California Lab Certification No. 2116
 Trip blank vials were not received by the laboratory for this sample group.

Laboratory Chronicle

CAT No.	Analysis Name	Method	Analysis		Analyst	Dilution Factor
			Trial#	Date and Time		
01728	TPH-GRO - Waters	N. CA LUFT Gasoline Method	1	08/06/2003 11:12	Linda C Pape	1
01594	BTEX+5 Oxygenates+EDC+EDB+ETOH	SW-846 8260B	1	08/12/2003 17:12	Trent S Sprenkle	1
01594	BTEX+5 Oxygenates+EDC+EDB+ETOH	SW-846 8260B	1	08/12/2003 21:17	Trent S Sprenkle	10
01146	GC VOA Water Prep	SW-846 5030B	1	08/06/2003 11:12	Linda C Pape	n.a.
01163	GC/MS VOA Water Prep	SW-846 5030B	1	08/12/2003 17:12	Trent S Sprenkle	n.a.



Lancaster Laboratories, Inc.
 2425 New Holland Pike
 PO Box 12425
 Lancaster, PA 17605-2425
 717-656-2300 Fax: 717-656-2681



Lancaster Laboratories Sample No. WW 4091662

Collected: 07/30/2003 14:00 by SO

Account Number: 10880

Submitted: 07/31/2003 09:10

ChevronTexaco

Reported: 08/14/2003 at 12:20

6001 Bollinger Canyon Rd L4310

Discard: 09/14/2003

B-8-W-030730

Grab Water

San Ramon CA 94583

Facility# 98341

CETR

3530 MacArthur Blvd

T0600101790 B-8

730B8





Lancaster Laboratories Sample No. **WW 4091663**

Collected: 07/30/2003 13:30 by SO

Account Number: 10880

Submitted: 07/31/2003 09:10

ChevronTexaco

Reported: 08/14/2003 at 12:20

6001 Bollinger Canyon Rd L4310

Discard: 09/14/2003

B-9-W-030730

Grab Water

San Ramon CA 94583

Facility# 98341

CETR

3530 MacArthur Blvd

T0600101790 B-9

730B9

CAT No.	Analysis Name	CAS Number	As Received Result	As Received		Dilution Factor
				Method	Units	
01728	TPH-GRO - Waters	n.a.	N.D.	Detection Limit	50.	ug/l 1
The reported concentration of TPH-GRO does not include MTBE or other gasoline constituents eluting prior to the C6 (n-hexane) TPH-GRO range start time. A site-specific MSD sample was not submitted for the project. A LCS/LCSD was performed to demonstrate precision and accuracy at a batch level.						
01594	BTEX+5 Oxygenates+EDC+EDB+ETOH					
01587	Ethanol	64-17-5	N.D.		50.	ug/l 1
02010	Methyl Tertiary Butyl Ether	1634-04-4	10.		0.5	ug/l 1
02011	di-Isopropyl ether	108-20-3	N.D.		0.5	ug/l 1
02013	Ethyl t-butyl ether	637-92-3	N.D.		0.5	ug/l 1
02014	t-Amyl methyl ether	994-05-8	0.6		0.5	ug/l 1
02015	t-Butyl alcohol	75-65-0	N.D.		5.	ug/l 1
05401	Benzene	71-43-2	N.D.		0.5	ug/l 1
05402	1,2-Dichloroethane	107-06-2	N.D.		0.5	ug/l 1
05407	Toluene	108-88-3	N.D.		0.5	ug/l 1
05412	1,2-Dibromoethane	106-93-4	N.D.		0.5	ug/l 1
05415	Ethylbenzene	100-41-4	N.D.		0.5	ug/l 1
06310	Xylene (Total)	1330-20-7	N.D.		0.5	ug/l 1

State of California Lab Certification No. 2116

Trip blank vials were not received by the laboratory for this sample group.

Laboratory Chronicle

CAT No.	Analysis Name	Method	Trial#	Analysis		Analyst	Dilution Factor
				Date	Time		
01728	TPH-GRO - Waters	N. CA LUFT Gasoline Method	1	08/06/2003	11:43	Linda C Pape	1
01594	BTEX+5 Oxygenates+EDC+EDB+ETOH	SW-846 8260B	1	08/13/2003	10:30	Trent S Sprenkle	1
01146	GC VOA Water Prep	SW-846 5030B	1	08/06/2003	11:43	Linda C Pape	n.a.
01163	GC/MS VOA Water Prep	SW-846 5030B	1	08/13/2003	10:30	Trent S Sprenkle	n.a.



Lancaster Laboratories, Inc.
 2425 New Holland Pike
 PO Box 12425
 Lancaster, PA 17605-2425
 717-656-2300 Fax: 717-656-2681



Lancaster Laboratories Sample No. WW 4091663

Collected: 07/30/2003 13:30 by SO

Account Number: 10880

Submitted: 07/31/2003 09:10

ChevronTexaco

Reported: 08/14/2003 at 12:20

6001 Bollinger Canyon Rd L4310

Discard: 09/14/2003

B-9-W-030730

Grab Water

San Ramon CA 94583

Facility# 98341

CETR

3530 MacArthur Blvd

T0600101790 B-9

730B9



Lancaster Laboratories, Inc.
2425 New Holland Pike
PO Box 12425
Lancaster, PA 17605-2425
717-656-2300 Fax: 717-656-2681



Quality Control Summary

Client Name: ChevronTexaco
 Reported: 08/14/03 at 12:20 PM

Group Number: 861306

Laboratory Compliance Quality Control

<u>Analysis Name</u>	<u>Blank Result</u>	<u>Blank MDL</u>	<u>Report Units</u>	<u>LCS %REC</u>	<u>LCS/LCSD %REC</u>	<u>LCS/LCSD Limits</u>	<u>RPD</u>	<u>RPD Max</u>		
Batch number: 03213A16B TPH-GRO - Waters	Sample number(s): 4091656-4091661		N.D.	50.	ug/l	105	107	70-130	2	30
Batch number: 03218A16A TPH-GRO - Waters	Sample number(s): 4091662-4091663		N.D.	50.	ug/l	102	102	70-130	0	30
Batch number: P032231AB	Sample number(s): 4091656,4091659-4091660		N.D.	50.	ug/l	97		43-159		
Ethanol	N.D.	50.	ug/l	97		43-159				
Methyl Tertiary Butyl Ether	N.D.	0.5	ug/l	104		77-127				
di-Isopropyl ether	N.D.	0.5	ug/l	99		74-125				
Ethyl t-butyl ether	N.D.	0.5	ug/l	102		74-120				
t-Amyl methyl ether	N.D.	0.5	ug/l	105		79-113				
t-Butyl alcohol	N.D.	5.	ug/l	139		53-147				
Benzene	N.D.	0.5	ug/l	101		85-117				
1,2-Dichloroethane	N.D.	0.5	ug/l	109		77-132				
Toluene	N.D.	0.5	ug/l	102		85-115				
1,2-Dibromoethane	N.D.	0.5	ug/l	99		81-114				
Ethylbenzene	N.D.	0.5	ug/l	105		82-119				
Xylene (Total)	N.D.	0.5	ug/l	105		84-120				
Batch number: P032241AA	Sample number(s): 4091657-4091658,4091661-4091662		N.D.	50.	ug/l	93		43-159		
Ethanol	N.D.	50.	ug/l	93		43-159				
Methyl Tertiary Butyl Ether	N.D.	0.5	ug/l	98		77-127				
di-Isopropyl ether	N.D.	0.5	ug/l	98		74-125				
Ethyl t-butyl ether	N.D.	0.5	ug/l	100		74-120				
t-Amyl methyl ether	N.D.	0.5	ug/l	103		79-113				
t-Butyl alcohol	N.D.	5.	ug/l	139		53-147				
Benzene	N.D.	0.5	ug/l	100		85-117				
1,2-Dichloroethane	N.D.	0.5	ug/l	113		77-132				
Toluene	N.D.	0.5	ug/l	102		85-115				
1,2-Dibromoethane	N.D.	0.5	ug/l	100		81-114				
Ethylbenzene	N.D.	0.5	ug/l	103		82-119				
Xylene (Total)	N.D.	0.5	ug/l	106		84-120				
Batch number: P032241AB	Sample number(s): 4091663		N.D.	50.	ug/l	93		43-159		
Ethanol	N.D.	50.	ug/l	93		43-159				
Methyl Tertiary Butyl Ether	N.D.	0.5	ug/l	98		77-127				
di-Isopropyl ether	N.D.	0.5	ug/l	98		74-125				
Ethyl t-butyl ether	N.D.	0.5	ug/l	100		74-120				
t-Amyl methyl ether	N.D.	0.5	ug/l	103		79-113				
t-Butyl alcohol	N.D.	5.	ug/l	139		53-147				
Benzene	N.D.	0.5	ug/l	100		85-117				
1,2-Dichloroethane	N.D.	0.5	ug/l	113		77-132				
Toluene	N.D.	0.5	ug/l	102		85-115				
1,2-Dibromoethane	N.D.	0.5	ug/l	100		81-114				
Ethylbenzene	N.D.	0.5	ug/l	103		82-119				
Xylene (Total)	N.D.	0.5	ug/l	106		84-120				

*- Outside of specification

- (1) The result for one or both determinations was less than five times the LOQ.
- (2) The background result was more than four times the spike added.



Lancaster Laboratories, Inc.
 2425 New Holland Pike
 PO Box 12425
 Lancaster, PA 17605-2425
 717-656-2300 Fax: 717-656-2681



Quality Control Summary

Client Name: ChevronTexaco
 Reported: 08/14/03 at 12:20 PM

Group Number: 861306

Laboratory Compliance Quality Control

<u>Analysis Name</u>	<u>Blank Result</u>	<u>Blank MDL</u>	<u>Report Units</u>	<u>LCS %REC</u>	<u>LCSD %REC</u>	<u>LCS/LCSD Limits</u>	<u>RPD</u>	<u>RPD Max</u>
----------------------	---------------------	------------------	---------------------	-----------------	------------------	------------------------	------------	----------------

Sample Matrix Quality Control

<u>Analysis Name</u>	<u>MS %REC</u>	<u>MSD %REC</u>	<u>MS/MSD Limits</u>	<u>RPD</u>	<u>MAX</u>	<u>BKG Conc</u>	<u>DUP Conc</u>	<u>DUP RPD</u>	<u>Dup RPD Max</u>
Batch number: 03213A16B Sample number(s): 4091656-4091661									
TPH-GRO - Waters	110		70-130						
Batch number: 03218A16A Sample number(s): 4091662-4091663									
TPH-GRO - Waters	118		70-130						
Batch number: P032231AB Sample number(s): 4091656,4091659-4091660									
Ethanol	95	100	34-163	6	30				
Methyl Tertiary Butyl Ether	102	110	69-134	7	30				
di-Isopropyl ether	101	102	75-130	1	30				
Ethyl t-butyl ether	105	103	73-123	2	30				
t-Amyl methyl ether	115	109	77-117	5	30				
t-Butyl alcohol	139	144	39-155	3	30				
Benzene	106	105	83-128	1	30				
1,2-Dichloroethane	113	111	73-136	2	30				
Toluene	107	108	83-127	1	30				
1,2-Dibromoethane	101	101	78-120	1	30				
Ethylbenzene	109	112	82-134	3	30				
Xylene (Total)	111	113	82-130	2	30				
Batch number: P032241AA Sample number(s): 4091657-4091658,4091661-4091662									
Ethanol	97	103	34-163	6	30				
Methyl Tertiary Butyl Ether	99	99	69-134	0	30				
di-Isopropyl ether	100	102	75-130	2	30				
Ethyl t-butyl ether	103	103	73-123	0	30				
t-Amyl methyl ether	111	109	77-117	2	30				
t-Butyl alcohol	155	157*	39-155	1	30				
Benzene	104	105	83-128	1	30				
1,2-Dichloroethane	115	112	73-136	3	30				
Toluene	103	104	83-127	1	30				
1,2-Dibromoethane	100	100	78-120	0	30				
Ethylbenzene	107	106	82-134	1	30				
Xylene (Total)	108	109	82-130	1	30				
Batch number: P032241AB Sample number(s): 4091663									
Ethanol	97	103	34-163	6	30				
Methyl Tertiary Butyl Ether	99	99	69-134	0	30				
di-Isopropyl ether	100	102	75-130	2	30				
Ethyl t-butyl ether	103	103	73-123	0	30				

*- Outside of specification

- (1) The result for one or both determinations was less than five times the LOQ.
- (2) The background result was more than four times the spike added.



Lancaster Laboratories, Inc.
 2425 New Holland Pike
 PO Box 12425
 Lancaster, PA 17605-2425
 717-656-2300 Fax: 717-656-2681



Quality Control Summary

Client Name: ChevronTexaco
 Reported: 08/14/03 at 12:20 PM

Group Number: 861306

Sample Matrix Quality Control

Analysis Name	MS	MSD	MS/MSD	RPD	BKG	DUP	DUP	Dup
	%REC	%REC	Limits	RPD	MAX	Conc	RPD	RPD
t-Amyl methyl ether	111	109	77-117	2	30			Max
t-Butyl alcohol	155	157*	39-155	1	30			
Benzene	104	105	83-128	1	30			
1,2-Dichloroethane	115	112	73-136	3	30			
Toluene	103	104	83-127	1	30			
1,2-Dibromoethane	100	100	78-120	0	30			
Ethylbenzene	107	106	82-134	1	30			
Xylene (Total)	108	109	82-130	1	30			

Surrogate Quality Control

Analysis Name: TPH-GRO - Waters
 Batch number: 03213A16B
 Trifluorotoluene-F

4091656	112
4091657	113
4091658	112
4091659	112
4091660	112
4091661	119
Blank	112
LCS	113
LCSD	116
MS	114

Limits: 57-146

Analysis Name: TPH-GRO - Waters
 Batch number: 03218A16A
 Trifluorotoluene-F

4091662	119
4091663	112
Blank	112
LCS	115
LCSD	115
MS	116

Limits: 57-146

Analysis Name: BTEX+5 Oxygenates+EDC+EDB+ETOH
 Batch number: P032231AB
 Dibromofluoromethane 1,2-Dichloroethane-d4 Toluene-d8 4-Bromofluorobenzene

***- Outside of specification**

- (1) The result for one or both determinations was less than five times the LOQ.
- (2) The background result was more than four times the spike added.



Lancaster Laboratories, Inc.
 2425 New Holland Pike
 PO Box 12425
 Lancaster, PA 17605-2425
 717-656-2300 Fax: 717-656-2681



Quality Control Summary

Client Name: ChevronTexaco
 Reported: 08/14/03 at 12:20 PM

Group Number: 861306

Surrogate Quality Control

4091656	95	93	101	97
4091659	98	96	101	98
4091660	97	95	100	98
Blank	95	91	99	97
LCS	95	94	102	99
MS	95	96	99	97
MSD	94	99	100	99

Limits: 81-120 82-112 85-112 83-113

Analysis Name: BTEX+5 Oxygenates+EDC+EDB+ETOH
 Batch number: P032241AA

	Dibromofluoromethane	1,2-Dichloroethane-d4	Toluene-d8	4-Bromofluorobenzene
4091657	97	93	100	94
4091658	97	93	100	98
4091661	95	93	100	98
4091662	96	96	99	100
Blank	95	91	99	97
LCS	95	100	100	100
MS	96	96	98	98
MSD	95	96	98	98

Limits: 81-120 82-112 85-112 83-113

Analysis Name: BTEX+5 Oxygenates+EDC+EDB+ETOH
 Batch number: P032241AB

	Dibromofluoromethane	1,2-Dichloroethane-d4	Toluene-d8	4-Bromofluorobenzene
4091663	96	98	100	99
Blank	97	97	101	98
LCS	95	100	100	100
MS	96	96	98	98
MSD	95	96	98	98

Limits: 81-120 82-112 85-112 83-113

*- Outside of specification

- (1) The result for one or both determinations was less than five times the LOQ.
- (2) The background result was more than four times the spike added.



Lancaster Laboratories, Inc.
 2425 New Holland Pike
 PO Box 12425
 Lancaster, PA 17605-2425
 717-656-2300 Fax: 717-656-2681

Explanation of Symbols and Abbreviations

The following defines common symbols and abbreviations used in reporting technical data:

N.D.	none detected	BMQL	Below Minimum Quantitation Level
TNTC	Too Numerous To Count	MPN	Most Probable Number
IU	International Units	CF Units	cobalt-chloroplatinate units
umhos/cm	micromhos/cm	NTU	nephelometric turbidity units
C	degrees Celsius	F	degrees Fahrenheit
meq	milliequivalents	lb.	pound(s)
g	gram(s)	kg	kilogram(s)
ug	microgram(s)	mg	milligram(s)
ml	milliliter(s)	l	liter(s)
m3	cubic meter(s)	ul	microliter(s)
<	less than - The number following the sign is the <u>limit of quantitation</u> , the smallest amount of analyte which can be reliably determined using this specific test.		
>	greater than		
J	estimated value - The result falls within the Method Detection Limit (MDL) and Limit of Quantitation (LOQ).		
ppm	parts per million - One ppm is equivalent to one milligram per kilogram (mg/kg), or one gram per million grams. For aqueous liquids, ppm is usually taken to be equivalent to milligrams per liter (mg/l), because one liter of water has a weight very close to a kilogram. For gases or vapors, one ppm is equivalent to one microliter of gas per liter of gas.		
ppb	parts per billion		
Dry weight basis	Results printed under this heading have been adjusted for moisture content. This increases the analyte weight concentration to approximate the value present in a similar sample without moisture. All other results are reported on an as-received basis		

U.S. EPA CLP Data Qualifiers:

Organic Qualifiers		Inorganic Qualifiers	
A	TIC is a possible aldol-condensation product	B	Value is <ORDL, but ≥IDL
B	Analyte was also detected in the blank	E	Estimated due to interference
C	Pesticide result confirmed by GC/MS	M	Duplicate injection precision not met
D	Compound quantitated on a diluted sample	N	Spike sample not within control limits
E	Concentration exceeds the calibration range of the instrument	S	Method of standard additions (MSA) used for calculation
N	Presumptive evidence of a compound (TICs only)	U	Compound was not detected
P	Concentration difference between primary and confirmation columns >25%	W	Post digestion spike out of control limits
U	Compound was not detected	*	Duplicate analysis not within control limits
X,Y,Z	Defined in case narrative	+	Correlation coefficient for MSA <0.995

Analytical test results for methods listed on the laboratories' accreditation scope meet all requirements of NELAC unless otherwise noted under the individual analysis.

Measurement uncertainty values, as applicable, are available upon request.

Tests results relate only to the sample tested. Clients should be aware that a critical step in a chemical or microbiological analysis is the collection of the sample. Unless the sample analyzed is truly representative of the bulk of material involved, the test results will be meaningless. If you have questions regarding the proper techniques of collecting samples, please contact us. We cannot be held responsible for sample integrity, however, unless sampling has been performed by a member of our staff. This report shall not be reproduced except in full, without the written approval of the laboratory.

WARRANTY AND LIMITS OF LIABILITY - In accepting analytical work, we warrant the accuracy of test results for the sample as submitted. THE FOREGOING EXPRESS WARRANTY IS EXCLUSIVE AND IS GIVEN IN LIEU OF ALL OTHER WARRANTIES, EXPRESSED OR IMPLIED. WE DISCLAIM ANY OTHER WARRANTIES, EXPRESSED OR IMPLIED, INCLUDING A WARRANTY OF FITNESS FOR PARTICULAR PURPOSE AND WARRANTY OF MERCHANTABILITY. IN NO EVENT SHALL LANCASTER LABORATORIES BE LIABLE FOR INDIRECT, SPECIAL, CONSEQUENTIAL, OR INCIDENTAL DAMAGES INCLUDING, BUT NOT LIMITED TO, DAMAGES FOR LOSS OF PROFIT OR GOODWILL REGARDLESS OF (A) THE NEGLIGENCE (EITHER SOLE OR CONCURRENT) OF LANCASTER LABORATORIES AND (B) WHETHER LANCASTER LABORATORIES HAS BEEN INFORMED OF THE POSSIBILITY OF SUCH DAMAGES. We accept no legal responsibility for the purposes for which the client uses the test results. No purchase order or other order for work shall be accepted by Lancaster Laboratories which includes any conditions that vary from the Standard Terms and Conditions of Lancaster Laboratories and we hereby object to any conflicting terms contained in any acceptance or order submitted by client.

Chevron California Region Analysis Request/Chain of Custody



073003-016

For Lancaster Laboratories use only
 Acct. #: 10880 Sample #: 4091656-63 SR# 861306

Facility #: Chevron 9-8341
 Site Address: 3530 Mac Arthur Oakland
 Chevron PM: Stretch Lead Consultant: _____
 Consultant/Office: Cambria
 Consultant Prj. Mgr.: FOSS
 Consultant Phone #: 510 420 3350 Fax #: 510 420 9170
 Sampler: Sarah Owen
 Service Order #: _____ Non SAR:

Analyses Requested

Preservation Codes									
A	H		H						
<input checked="" type="checkbox"/>	<input checked="" type="checkbox"/>	<input type="checkbox"/>	<input type="checkbox"/>	<input type="checkbox"/>	<input type="checkbox"/>	<input type="checkbox"/>	<input type="checkbox"/>	<input type="checkbox"/>	<input type="checkbox"/>
BTEX + MTBE 8260 <input checked="" type="checkbox"/> 8021	TPH 8015 MOD GRO	TPH 8015 MOD DRO <input type="checkbox"/> Silica Gel Cleanup	8260 full scan	<input checked="" type="checkbox"/> Oxygenates	Lead 7420 <input type="checkbox"/> 7421	ethanol by 8260PT			

Preservative Codes
 H = HCl T = Thiosulfate
 N = HNO₃ B = NaOH
 S = H₂SO₄ O = Other

- J value reporting needed
- Must meet lowest detection limits possible for 8260 compounds
- 8021 MTBE Confirmation
 - Confirm highest hit by 8260
 - Confirm all hits by 8260
 - Run ___ oxy's on highest hit
 - Run ___ oxy's on all hits

Field Point Name	Matrix	Repeat Sample	Top Depth	Year Month Day	Time Collected	New Field Pt.	Grab	Composite	Total Number of Containers
B-1	W			7/29/03			X	F	X X
B-2				7/30/03	1:50		↓	↓	↓ ↓
B-4				7/30/03	1:15		↓	↓	↓ ↓
B-5				7/29/03			↓	↓	↓ ↓
B-6				7/29/03			↓	↓	↓ ↓
B-7				7/30/03	1:45		↓	↓	↓ ↓
B-8				7/30/03	2:00		↓	↓	↓ ↓
B-9				7/30/03	1:30		↓	↓	↓ ↓

Comments / Remarks
 7 oxy's =
 MTBE
 TAME
 DIPE
 ETBE
 TBA
 EDB
 1,2 DCA

Turnaround Time Requested (TAT) (please circle)
 STD. TAT 72 hour 48 hour
 24 hour 4 day 5 day

Data Package Options (please circle if required)
 QC Summary Type I - Full
 Type V! (Raw Data) Coelt Deliverable not needed
 WIP (RWQCB)
 Disk

Relinquished by: <u>Sarah Owen</u>	Date: <u>7/30/03</u>	Time: <u>3:55</u>	Received by: <u>Bernard Arroyo</u>	Date: <u>7/30/03</u>	Time: <u>1:00</u>
Relinquished by: <u>Bernard Arroyo</u>	Date: <u>7/30/03</u>	Time: <u>1:45</u>	Received by: <u>Airborne</u>	Date: <u>7/30/03</u>	Time: _____
Relinquished by: _____	Date: _____	Time: _____	Received by: _____	Date: _____	Time: _____
Relinquished by Commercial Carrier: _____	Date: _____ Time: _____		Received by: <u>Kevin [Signature]</u>	Date: <u>7/31/03</u>	Time: <u>0910</u>
UPS FedEx <input checked="" type="radio"/> Other <u>Airborne</u>	Temperature Upon Receipt: <u>3.0</u> °C		Custody Seals Intact? <input checked="" type="radio"/> Yes <input type="radio"/> No		