



Atlantic Richfield Company
(a BP affiliated company)

P.O. Box 1257
San Ramon, CA 94583
Phone: (925) 275-3801
Fax: (925) 275-3815

18 July 2008

Re: Second Quarter 2008 Status Report
Former BP Service Station # 11133
2220 98th Avenue
Oakland, California
ACEH Case #RO0000403

“I declare, that to the best of my knowledge at the present time, that the information and/or recommendations contained in the attached document are true and correct.”

Submitted by:

Paul Supple
Environmental Business Manger

RECEIVED

2:28 pm, Jul 29, 2008

Alameda County
Environmental Health



18 July 2008

Project No. 06-08-656

Atlantic Richfield Company
P.O. Box 1257
San Ramon, California 94583
Submitted via ENFOS

Attn.: Mr. Paul Supple

Re: Second Quarter 2008 Status Report, Former BP Service Station #11133, 2220 98th
Avenue, Oakland, Alameda County, California; ACEH Case #RO0000403.

Dear Mr. Supple:

Provided herein is the *Second Quarter 2008 Status Report* for Former BP Service Station #11133 (herein referred to as Station #11133) located at 2220 98th Avenue, Oakland, California (Property). This report presents a summary of current developments at the Site through the Second Quarter of 2008.

Should you have questions regarding the work performed or results obtained, please do not hesitate to contact us at (530) 566-1400.

Sincerely,

BROADBENT & ASSOCIATES, INC.

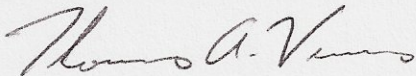

Thomas A. Venus, P.E.
Senior Engineer

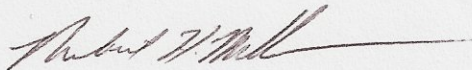

Robert H. Miller, P.G., C.HG.
Principal Hydrogeologist

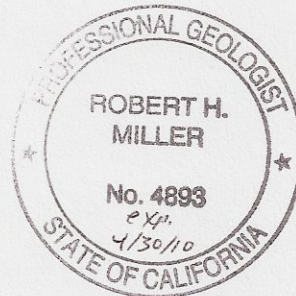

Enclosure

cc: Mr. Paresh Khatri, Alameda County Environmental Health (Submitted via ACEH ftp Site)
Ms. Shelby Lathrop, ConocoPhillips, 76 Broadway, Sacramento, California 95818
Electronic copy uploaded to GeoTracker

STATION #11133 QUARTERLY STATUS REPORT

Facility: #11133	Address: 2220 98 th Avenue, Oakland
Environmental Business Manager:	Mr. Paul Supple
Consulting Co./Contact Persons:	Broadbent & Associates, Inc.(BAI)/Rob Miller & Tom Venus (530) 566-1400
Primary Agency/Regulatory ID No.:	Alameda County Environmental Health (ACEH) ACEH Case #RO0000403
Consultant Project No.:	06-08-644
Facility Permits/Permitting Agency:	NA

WORK PERFORMED THIS QUARTER (Second Quarter 2008):

1. Prepared and submitted First Quarter 2008 Semi-Annual Groundwater Monitoring Report.
2. Source for liquid salts (Nitrate and Sulfate) was located. Concentrations being calculated for pilot study injection.

WORK PROPOSED FOR NEXT QUARTER (Third Quarter 2008):

1. Prepared and submitted this Second Quarter 2008 Status Report (contained herein).
2. Commence Nitrate/Sulfate Injection Feasibility Pilot Study.
3. Conduct semi-annual ground-water monitoring/sampling for Third Quarter 2008, including indicator parameters for intrinsic bioremediation.

QUARTERLY RESULTS SUMMARY:

Current phase of project:	ground-water monitoring/sampling/treatment pilot study
Frequency of ground-water monitoring:	Semi-Annually (1Q & 3Q): Wells MW-1, MW-2, MW-3, AW-1 through AW-9, RW-1
Frequency of ground-water sampling:	Semi-Annually (1Q & 3Q): Wells MW-1, MW-3, AW-1, AW-4, AW-5, AW-6, and RW-1 Semi-Annual Free Product (FP) gauging: Well RW-1 Annually (1Q): Well AW-2 Not Sampled: Wells MW-2, AW-3, AW-7, AW-8, AW-9
Is free product (FP) present on-site:	No
FP recovered this quarter:	NA
Current remediation techniques:	Nitrate/Sulfate Injection Feasibility Pilot Study
Depth to ground water (below TOC):	NA
General ground-water flow direction:	NA
Approximate hydraulic gradient:	NA

DISCUSSION:

BP submitted a Nitrate/Sulfate Feasibility Study Work Plan, dated 8 July 2005 to ACEH. On 20 December 2007, BP received approval with comments to the work plan. No environmental activities took place at the Site during this quarter while pilot study salts were located and injection concentrations calculated. The most recent quarterly data can be referenced in the First Quarter 2008 Semi-Annual Ground-Water Monitoring Report for the Site. A Ground-Water Elevation Contour and Analytical Summary Map from First Quarter 2008 is provided as Drawing 1.

ATTACHMENTS:

Drawing 1. Ground-Water Elevation Contour and Analytical Summary Map, 5 February 2008, Former BP Service Station #11133, 2220 98th Avenue, Oakland, California

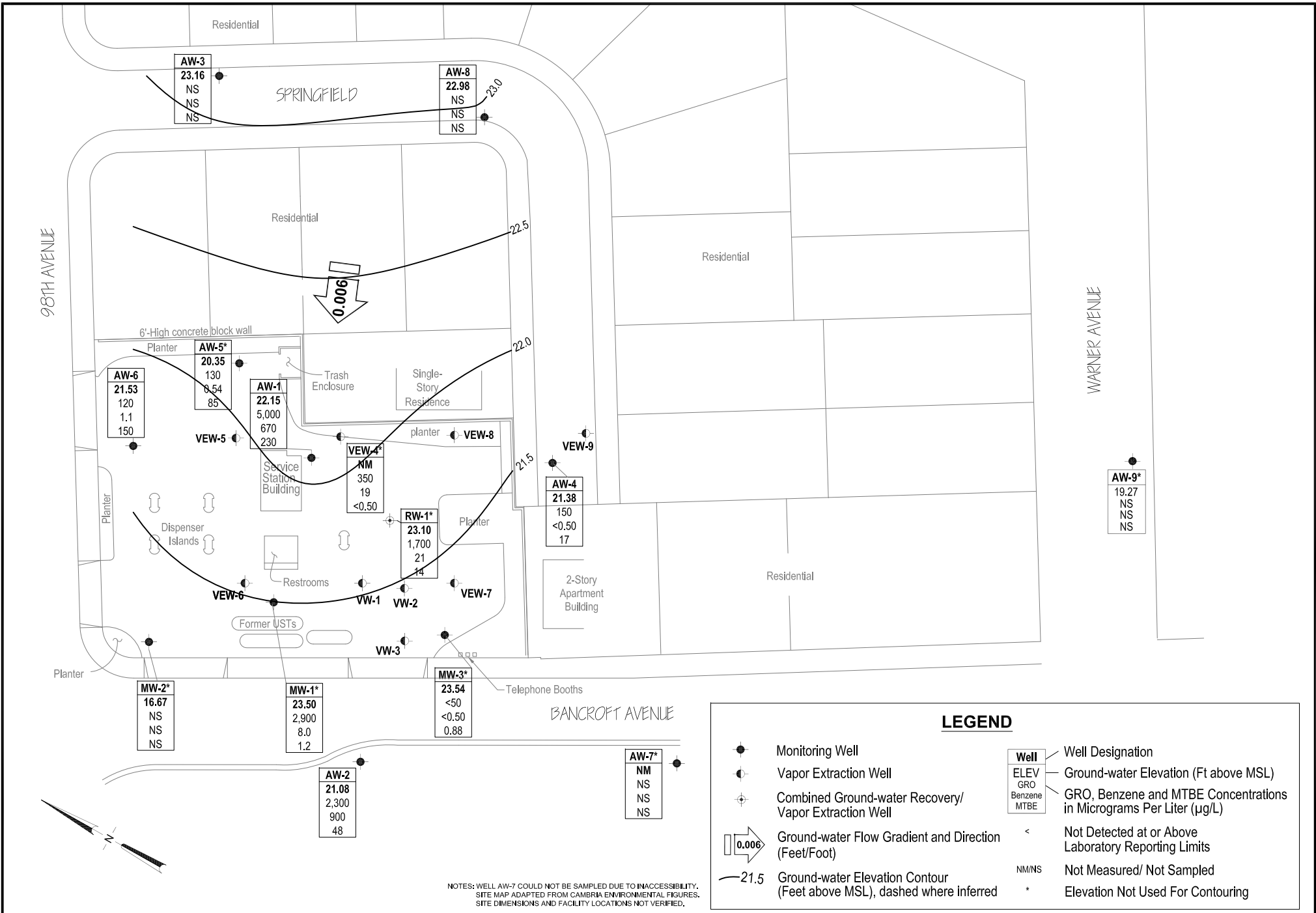

NOTES: WELL AW-7 COULD NOT BE SAMPLED DUE TO INACCESSIBILITY. SITE MAP ADAPTED FROM CAMBRIA ENVIRONMENTAL FIGURES. SITE DIMENSIONS AND FACILITY LOCATIONS NOT VERIFIED.

LEGEND

- Monitoring Well
- Vapor Extraction Well
- Combined Ground-water Recovery/Vapor Extraction Well
- Ground-water Flow Gradient and Direction (Feet/Foot)
- Ground-water Elevation Contour (Feet above MSL), dashed where inferred

Well Designation

Well	Well Designation
ELEV	Ground-water Elevation (Ft above MSL)
GRO	GRO, Benzene and MTBE Concentrations in Micrograms Per Liter (µg/L)
Benzene	
MTBE	

- < Not Detected at or Above Laboratory Reporting Limits
- NM/NS Not Measured/ Not Sampled
- * Elevation Not Used For Contouring

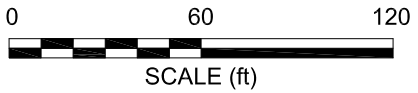

BROADBENT & ASSOCIATES, INC.
 ENGINEERING, WATER RESOURCES & ENVIRONMENTAL
 1324 Mangrove Ave. Suite 212, Chico, California 95926
 Project No.: 06-08-656 Date: 2/22/08

Former BP Service Station #11133
 2220 98th Avenue
 Oakland, California

Ground-Water Elevation Contour
 and Analytical Summary Map
 5 February 2008