



Atlantic Richfield Company
(a BP affiliated company)

P.O. Box 1257
San Ramon, CA 94583
Phone: (925) 275-3801
Fax: (925) 275-3815

18 January 2008

Re: Fourth Quarter 2007 Status Report
Former BP Service Station # 11133
2220 98th Avenue
Oakland, California
ACEH Case #RO0000403

“I declare, that to the best of my knowledge at the present time, that the information and/or recommendations contained in the attached document are true and correct.”

Submitted by:

Paul Supple
Environmental Business Manger

RECEIVED

2:06 pm, Jan 28, 2008

Alameda County
Environmental Health



Broadbent & Associates, Inc.
1324 Mangrove Ave., Suite 212
Chico, CA 95926
Voice (530) 566-1400
Fax (530) 566-1401



18 January 2008

Project No. 06-08-656

Atlantic Richfield Company
P.O. Box 1257
San Ramon, California 94583
Submitted via ENFOS

Attn.: Mr. Paul Supple

Re: Fourth Quarter 2007 Status Report, Former BP Service Station #11133, 2220 98th Avenue, Oakland, Alameda County, California; ACEH Case #RO0000403.

Dear Mr. Supple:

Provided herein is the *Fourth Quarter 2007 Status Report* for Former BP Service Station #11133 (herein referred to as Station #11133) located at 2220 98th Avenue, Oakland, California (Property). This report presents a summary of current developments at the Site through Fourth Quarter 2007.

Should you have questions regarding the work performed or results obtained, please do not hesitate to contact us at (530) 566-1400.

Sincerely,

BROADBENT & ASSOCIATES, INC.

A handwritten signature in blue ink that reads 'Thomas A. Venus'.

Thomas A. Venus, P.E.
Senior Engineer

A handwritten signature in blue ink that reads 'Robert H. Miller'.

Robert H. Miller, P.G., C.HG.
Principal Hydrogeologist

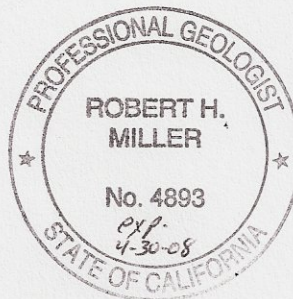

Enclosure

cc: Mr. Steven Plunkett, Alameda County Environmental Health (Submitted via ACEH ftp Site)
Ms. Shelby Lathrop, ConocoPhillips, 76 Broadway, Sacramento, California 95818
Electronic copy uploaded to GeoTracker

STATION #11133 QUARTERLY STATUS REPORT

Facility: #11133	Address: 2220 98 th Avenue, Oakland
Environmental Business Manager:	Mr. Paul Supple
Consulting Co./Contact Persons:	Broadbent & Associates, Inc.(BAI)/Rob Miller & Tom Venus (530) 566-1400
Primary Agency/Regulatory ID No.:	Alameda County Environmental Health (ACEH) ACEH Case #RO0000403
Consultant Project No.:	06-08-644
Facility Permits/Permitting Agency:	NA

WORK PERFORMED THIS QUARTER (Fourth Quarter 2007):

1. Prepared and submitted Third Quarter 2007 Semi-Annual Groundwater Monitoring Report.
2. No environmental work was conducted at the Site during the Fourth Quarter of 2007.

WORK PROPOSED FOR NEXT QUARTER (First Quarter 2008):

1. Prepared and submitted this Fourth Quarter 2007 Status Report (contained herein).
2. Conduct semi-annual ground-water monitoring/sampling for First Quarter 2008, including baseline round of indicator parameters for intrinsic bioremediation.
3. Commence Nitrate/Sulfate Injection Feasibility Pilot Study.

QUARTERLY RESULTS SUMMARY:

Current phase of project:	Ground-Water Monitoring/Sampling
Frequency of ground-water monitoring:	Semi-Annually (1Q & 3Q): Wells MW-1, MW-2, MW-3, AW-1, AW-2, AW-3, AW-4, AW-5, AW-6, AW-7, AW-8, RW-1
Frequency of ground-water sampling:	Semi-Annually (1Q & 3Q): Wells MW-1, MW-3, AW-1, AW-4, AW-5, AW-6, and RW-1 Semi-Annual Free Product (FP) gauging: Well RW-1 Annually (1Q): Well AW-2 Not Sampled: Wells MW-2, AW-3, AW-7, AW-8, AW-9
Is free product (FP) present on-site:	No
FP recovered this quarter:	NA
Current remediation techniques:	NA
Depth to ground water (below TOC):	NA
General ground-water flow direction:	NA
Approximate hydraulic gradient:	NA

DISCUSSION:

BP submitted a Nitrate/Sulfate Feasibility Study Work Plan, dated 8 July 2005 to ACEH. On 20 December 2007, BP received approval with comments to the work plan. No environmental activities took place at the Site during this quarter. The most recent quarterly data can be referenced in the Third Quarter 2007 Semi-Annual Ground-Water Monitoring Report for the Site. A Ground-Water Elevation Contour and Analytical Summary Map from Third Quarter 2007 is provided as Drawing 1.

ATTACHMENTS:

Drawing 1. Ground-Water Elevation Contour and Analytical Summary Map, 10 July 2007, Former BP Service Station #11133, 2220 98th Avenue, Oakland, California

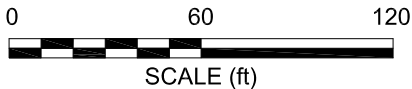
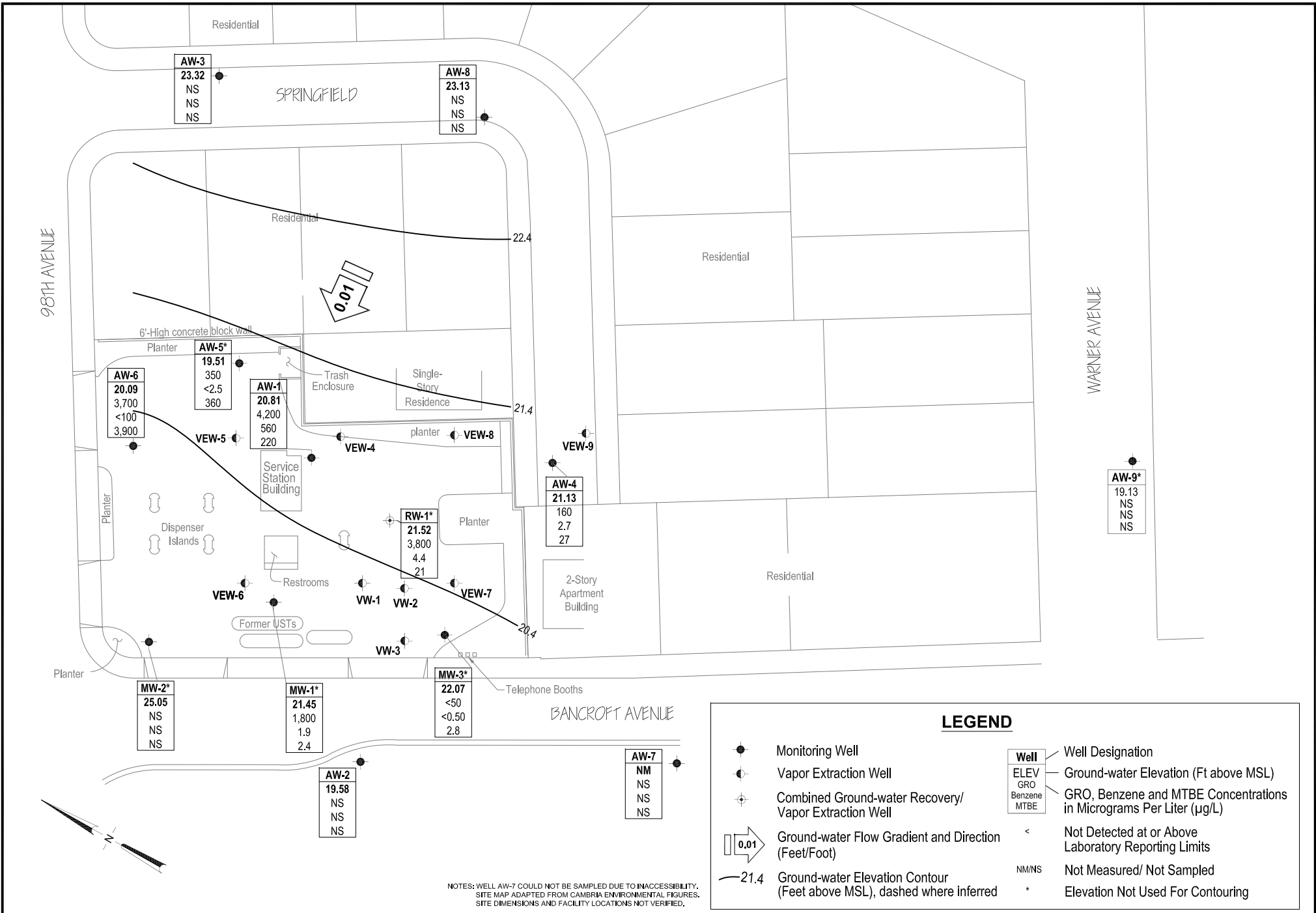

BROADBENT & ASSOCIATES, INC.
ENGINEERING, WATER RESOURCES & ENVIRONMENTAL
1324 Mangrove Ave. Suite 212, Chico, California 95926
Project No.: 06-08-656 Date: 08/08/07

Former BP Service Station #11133
2220 98th Avenue
Oakland, California

Ground-Water Elevation Contour
and Analytical Summary Map
10 July 2007