



Atlantic Richfield Company
(a BP affiliated company)

P.O. Box 1257
San Ramon, CA 94583
Phone: (925) 275-3801
Fax: (925) 275-3815

6 July 2007

Re: Second Quarter 2007 Status Report
Former BP Service Station # 11133
2220 98th Avenue
Oakland, California
ACEH Case #RO0000403

RECEIVED

1:50 pm, Jul 27, 2007

Alameda County
Environmental Health



"I declare, that to the best of my knowledge at the present time, that the information and/or recommendations contained in the attached document are true and correct."

Submitted by:

Paul Supple
Environmental Business Manger



A BP affiliated company

6 July 2007

Project No. 06-08-656

Atlantic Richfield Company
P.O. Box 1257
San Ramon, California 94583
Submitted via ENFOS

Attn.: Mr. Paul Supple

Re: Second Quarter 2007 Status Report, Former BP Service Station #11133, 2220 98th
Avenue, Oakland, Alameda County, California; ACEH Case #RO0000403.

Dear Mr. Supple:

Provided herein is the *Second Quarter 2007 Status Report* for Former BP Service Station #11133 (herein referred to as Station #11133) located at 2220 98th Avenue, Oakland, California (Property).

Should you have questions regarding the work performed or results obtained, please do not hesitate to contact us at (530) 566-1400.

Sincerely,

BROADBENT & ASSOCIATES, INC.



Thomas A. Venus, P.E.
Senior Engineer

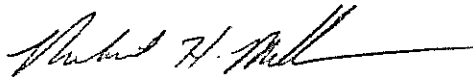

Robert H. Miller, P.G., C.HG.
Principal Hydrogeologist

Enclosure

cc: Mr. Steven Plunkett, Alameda County Environmental Health (Submitted via ACEH ftp Site)
Ms. Shelby Lathrop, ConocoPhillips (Submitted via WebXtender)
Electronic copy uploaded to GeoTracker

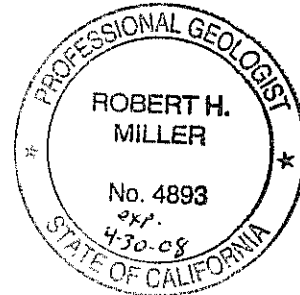

STATION #11133 QUARTERLY STATUS REPORT

Facility: #11133	Address: 2220 98 th Avenue, Oakland
Environmental Business Manager:	Mr. Paul Supple
Consulting Co./Contact Persons:	Broadbent & Associates, Inc.(BAI)/Rob Miller & Tom Venus (530) 566-1400
Primary Agency/Regulatory ID No.:	Alameda County Environmental Health (ACEH) ACEH Case #RO0000403
Consultant Project No.:	06-08-644
Facility Permits/Permitting Agency:	NA

WORK PERFORMED THIS QUARTER (Second Quarter 2007):

1. Prepared and submitted First Quarter 2007 Semi-Annual Groundwater Monitoring Report.
2. No environmental work was conducted in Second Quarter 2007.

WORK PROPOSED FOR NEXT QUARTER (Third Quarter 2007):

1. Prepared and submitted this Second Quarter 2007 Status Report (contained herein).
2. Conduct semi-annual ground-water monitoring/sampling for Third Quarter 2007.

QUARTERLY RESULTS SUMMARY:

Current phase of project:	Ground-Water Monitoring/Sampling
Frequency of ground-water monitoring:	Semi-Annually (1Q & 3Q): Wells MW-1, MW-2, MW-3, AW-1, AW-2, AW-3, AW-4, AW-5, AW-6, AW-7, AW-8, RW-1
Frequency of ground-water sampling:	Semi-Annually (1Q & 3Q): Wells MW-1, MW-3, AW-1, AW-4, AW-5, AW-6, and RW-1 Semi-Annual Free Product (FP) gauging: Well RW-1 Annually (1Q): Well AW-2 Not Sampled: Wells MW-2, AW-3, AW-7, AW-8, AW-9
Is free product (FP) present on-site:	No
FP recovered this quarter:	NA
Current remediation techniques:	NA
Depth to ground water (below TOC):	NA
General ground-water flow direction:	NA
Approximate hydraulic gradient:	NA

DISCUSSION:

BP submitted a Nitrate/Sulfate Feasibility Study Work Plan, dated 8 July 2005 to ACEH. BP is currently awaiting a response from ACEH to this work plan. No environmental activities took place at the Site during this quarter. The most recent quarterly data can be referenced in the First Quarter 2007 Semi-Annual Ground-Water Monitoring Report for the Site. A Ground-Water Elevation Contour and Analytical Summary Map from First Quarter 2007 is provided as Drawing 1.

ATTACHMENTS:

Drawing 1. Ground-Water Elevation Contour and Analytical Summary Map, 8 January 2007, Former BP Service Station #11133, 2220 98th Avenue, Oakland, California

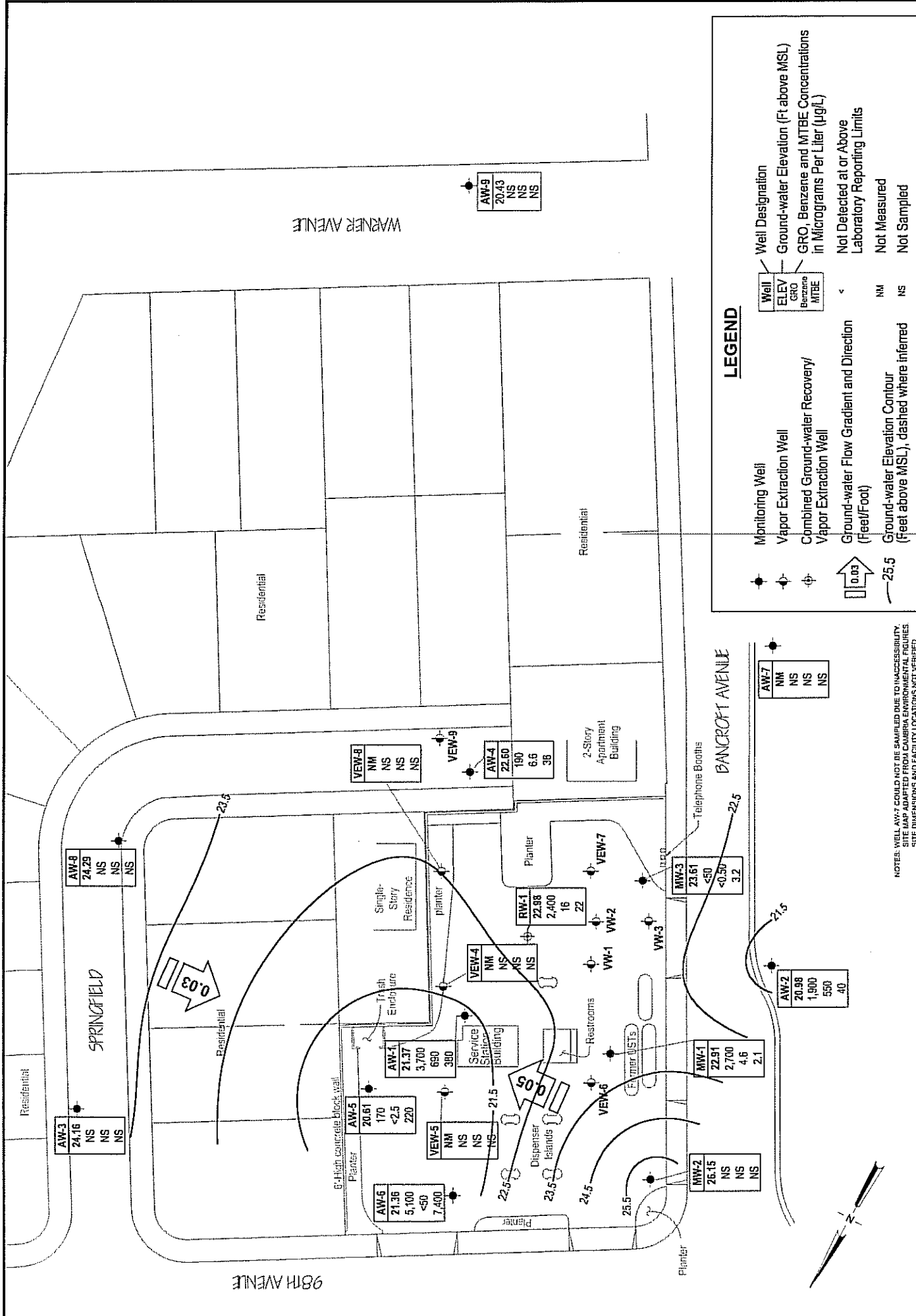

LEGEND

Monitoring Well	Well	Well Designation
Vapor Extraction Well	ELEV	Ground-water Elevation (Ft above MSL)
Combined Ground-water Recovery/Vapor Extraction Well	GRO	GRO, Benzene and MTBE Concentrations in Micrograms Per Liter (µg/L)
Ground-water Flow Gradient and Direction (Feet/Foot)	Benzene	Not Detected at or Above Laboratory Reporting Limits
Ground-water Elevation Contour (Feet above MSL), dashed where inferred	MTBE	Not Measured
		Not Sampled

NOTES: WELL AW-7 COULD NOT BE SAMPLED DUE TO INACCESSIBILITY. THE DIMENSIONS AND FACILITY LOCATIONS NOT VERIFIED.

BROADBENT & ASSOCIATES, INC.
 ENGINEERING, WATER RESOURCES & ENVIRONMENTAL
 1324 Mangrove Ave. Suite 212, Chico, California 95926
 Project No.: 06-08-656 Date: 02/08/07

0 60 120
 SCALE (ft)

Former BP Service Station #1133
 2220 98th Avenue
 Oakland, California

Ground-Water Elevation Contour and Analytical Summary Map
 8 January 2007

Drawing
1