



Atlantic Richfield Company
(a BP affiliated company)

P.O. Box 1257
San Ramon, California 94583
Phone: (925) 275-3801
Fax: (925) 275-3815



RECEIVED

By dehloptoxic at 3:24 pm, Oct 31, 2006

30 October 2006

Re: Third Quarter 2006 Semi-Annual Ground-Water Monitoring Report
Former BP Service Station # 11133
2220 98th Avenue
Oakland, California
ACEH Case # RO0000403

"I declare, that to the best of my knowledge at the present time, that the information and/or recommendations contained in the attached document are true and correct."

Submitted by:

Paul Supple
Environmental Business Manager

**Third Quarter 2006 Semi-Annual
Ground-Water Monitoring Report**
Former BP Service Station #11133
2220 98th Avenue
Oakland, California

Prepared for

Mr. Paul Supple
Environmental Business Manager
Atlantic Richfield Company
P.O. Box 1257
San Ramon, California 94583

Prepared by



1324 Mangrove Avenue, Suite 212
Chico, California 95926
(530) 566-1400
www.broadbentinc.com

30 October 2006

Project No. 06-08-656

Broadbent & Associates, Inc.
1324 Mangrove Ave., Suite 212
Chico, CA 95926
Voice (530) 566-1400
Fax (530) 566-1401



30 October 2006

Project No. 06-08-656

Atlantic Richfield Company
P.O. Box 1257
San Ramon, California 94583
Submitted via ENFOS

Attn.: Mr. Paul Supple

Re: Third Quarter 2006 Semi-Annual Ground-Water Monitoring Report, Former BP Service Station #11133, 2220 98th Avenue, Oakland, Alameda County, California
ACEH Case #RO0000403

Dear Mr. Supple:

Provided herein is the *Third Quarter 2006 Semi-Annual Ground-Water Monitoring Report* for Former BP Service Station #11133 (herein referred to as Station #11133) located at 2220 98th Avenue, Oakland, California (Property). This report presents the results of ground-water monitoring conducted at Station #11133 during the Third Quarter of 2006.

Should you have questions regarding the work performed or results obtained, please do not hesitate to contact us at (530) 566-1400.

Sincerely,

BROADBENT & ASSOCIATES, INC.

Thomas A. Venus, P.E.
Senior Engineer

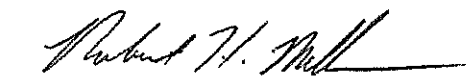
Robert H. Miller, P.G., C.HG.
Principal Hydrogeologist

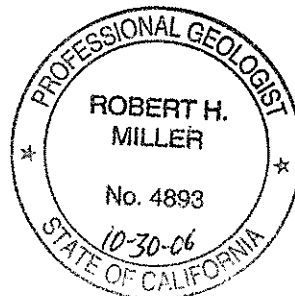

Enclosure

cc: Mr. Steven Plunkett, Alameda County Environmental Health (Submitted via ACEH ftp site)
Ms. Shelby Lathrop, ConocoPhillips (Submitted via WebXtender)

STATION #11133 SEMI-ANNUAL GROUNDWATER MONITORING REPORT

Facility: #11133	Address: 2220 98 th Avenue, Oakland
Environmental Business Manager:	Mr. Paul Supple
Consulting Co./Contact Persons:	Broadbent & Associates, Inc.(BAI)/Rob Miller & Tom Venus (530) 566-1400
Primary Agency/Regulatory ID No.:	Alameda County Environmental Health (ACEH) ACEH Case #RO0000403
Consultant Project No.:	06-08-656
Facility Permits/Permitting Agency:	NA

WORK PERFORMED THIS QUARTER (Third Quarter 2006):

1. Prepared and submitted Second Quarter 2006 Status Report.
2. Conducted semi-annual ground-water monitoring/sampling for Third Quarter 2006. Work performed by Blain Tech Services for URS on 6 July 2006.

WORK PROPOSED FOR NEXT QUARTER (Fourth Quarter 2006):

1. Prepared and submitted this Third Quarter 2006 Semi-Annual Groundwater Monitoring Report (contained herein).
2. No environmental work is scheduled to be conducted in Fourth Quarter 2006.

QUARTERLY RESULTS SUMMARY:

Current phase of project:	Ground-water monitoring/sampling
Frequency of ground-water sampling:	Semi-Annually (1Q & 3Q): Wells MW-1, MW-3, AW-1, AW-4, AW-5, AW-6, and RW-1 Semi-Annual Free Product (FP) gauging: Well RW-1 Annually (1Q): Well AW-2 Not Sampled: Wells MW-2, AW-3, AW-7, AW-8, AW-9
Frequency of ground-water monitoring:	Semi-Annually: All wells
Is free product (FP) present on-site:	No
FP recovered this quarter:	None
Current remediation techniques:	NA
Depth to ground water (below TOC):	8.33 ft (MW-2) to 17.44 ft (AW-1)
General ground-water flow direction:	Variable: East to West toward center of site
Approximate hydraulic gradient:	0.04 to 0.05 ft/ft

DISCUSSION:

Third quarter 2006 semi-annual ground-water monitoring and sampling was conducted at Station #11133 on 6 July 2006 by Blaine Tech Services personnel for URS. Water levels were gauged in 11 wells at the Site. Well A-9 could not be located, and well A-7 is believed to be paved over. Otherwise no other irregularities were noted during water level gauging. Depth to water measurements ranged from 8.33 ft at well MW-2 to 17.44 ft at well AW-1. Resulting ground-water surface elevations ranged from 27.81 ft above mean sea level in well AW-8 to 20.67 ft at well AW-1. Water level elevations were between historic minimum and maximum ranges for each well, as summarized in Table 1. Water level elevations yielded variable potentiometric ground-water flow directions and gradient towards the center of the site at approximately 0.04 to 0.05 ft/ft. Ground-water monitoring field data sheets are provided

within Appendix A. Measured depths to ground-water and respective ground-water elevations are summarized in Table 1. Potentiometric ground-water elevation contours are presented in Drawing 1.

Consistent with the current ground-water sampling schedule, water samples were collected from seven wells: AW-1, AW-4, AW-5, AW-6, MW-1, and RW-1. No irregularities were reported during sampling with the exception that well RW-1 dewatered during purging. Samples were submitted under chain of custody protocol to Test America Analytical Testing Corporation (Morgan Hill, California), for analysis of Gasoline Range Organics (GRO, C4-12) by the LUFT GCMS Method; for Benzene, Toluene, Ethylbenzene, and Total Xylenes (BTEX) by EPA Method 8260B; and tert-Amyl methyl ether (TAME), tert-Butyl alcohol (TBA), Di-isopropyl ether (DIPE), 1,2-Dibromomethane (EDB), 1,2-Dichloroethane (1,2-DCA), Ethanol, Ethyl tert-butyl ether (ETBE), and Methyl tert-butyl ether (MTBE) by EPA Method 8260B. No significant irregularities were encountered during laboratory analysis of the samples. Ground-water sampling field data sheets and the laboratory analytical report, including chain of custody documentation, are provided in Appendix A.

Gasoline range organics (GRO) were detected above the laboratory reporting limits in six of the seven wells sampled at concentrations up to 16,000 micrograms per liter ($\mu\text{g/L}$) in well RW-1. Benzene was detected above the laboratory reporting limit in three of the seven wells sampled at concentrations up to 1,300 $\mu\text{g/L}$ in well AW-1. Toluene was detected above the laboratory reporting limit in three of the seven wells sampled at concentrations up to 70 $\mu\text{g/L}$ in well AW-1. Ethylbenzene was detected above the laboratory reporting limit in four of the seven wells sampled at concentrations up to 570 $\mu\text{g/L}$ in well AW-1. Total Xylenes were detected above the laboratory reporting limit in four of the seven wells sampled at concentrations up to 680 $\mu\text{g/L}$ in well AW-4. TAME was detected above the laboratory reporting limit in three of the seven wells sampled at concentrations up to 780 $\mu\text{g/L}$ in well AW-6. TBA was detected above the laboratory reporting limit only in well AW-5 at a concentration of 240 $\mu\text{g/L}$. MTBE was detected above the laboratory reporting limit in six of the seven wells sampled at concentrations up to 2,800 $\mu\text{g/L}$ in well AW-6. The remaining fuel additives and oxygenates were not detected above their laboratory reporting limits in the seven wells sampled this quarter. Detected analyte concentrations were within the historic minimum and maximum ranges recorded for each well, with the following exceptions: concentrations of GRO, Ethylbenzene, and Total Xylenes reported in well MW-1 were the lowest recorded for this well. Historic laboratory analytical results are summarized in Table 1 and Table 2. A copy of the Laboratory Analytical Report, including chain of custody documentation is provided in Appendix A.

CLOSURE:

The findings presented in this report are based upon: observations of URS and Blaine Tech Services field personnel (see Appendix A), the points investigated, and results of laboratory tests performed by Test America (Morgan Hill, California). Our services were performed in accordance with the generally accepted standard of practice at the time this report was written. No other warranty, expressed or implied was made. This report has been prepared for the exclusive use of Atlantic Richfield Company. It is possible that variations in soil or ground-water conditions could exist beyond points explored in this investigation. Also, changes in site conditions could occur in the future due to variations in rainfall, temperature, regional water usage, or other factors.

ATTACHMENTS:

Drawing 1. Ground-Water Elevation Contour and Analytical Summary Map, 6 July 2006, Former BP Service Station #11133, 2220 98th Avenue, Oakland, California

- Table 1. Summary of Ground-Water Monitoring Data: Relative Water Elevations and Laboratory Analyses, Station #11133, 2220 98th Avenue, Oakland, CA
- Table 2. Summary of Fuel Additives Analytical Data, Station #11133, 2220 98th Avenue, Oakland, CA
- Appendix A. URS Ground-Water Sampling Data Package (Includes Laboratory Report and Chain of Custody Documentation, Field and Laboratory Procedures, and Field Data Sheets)
- Appendix B. GeoTracker Upload Confirmation

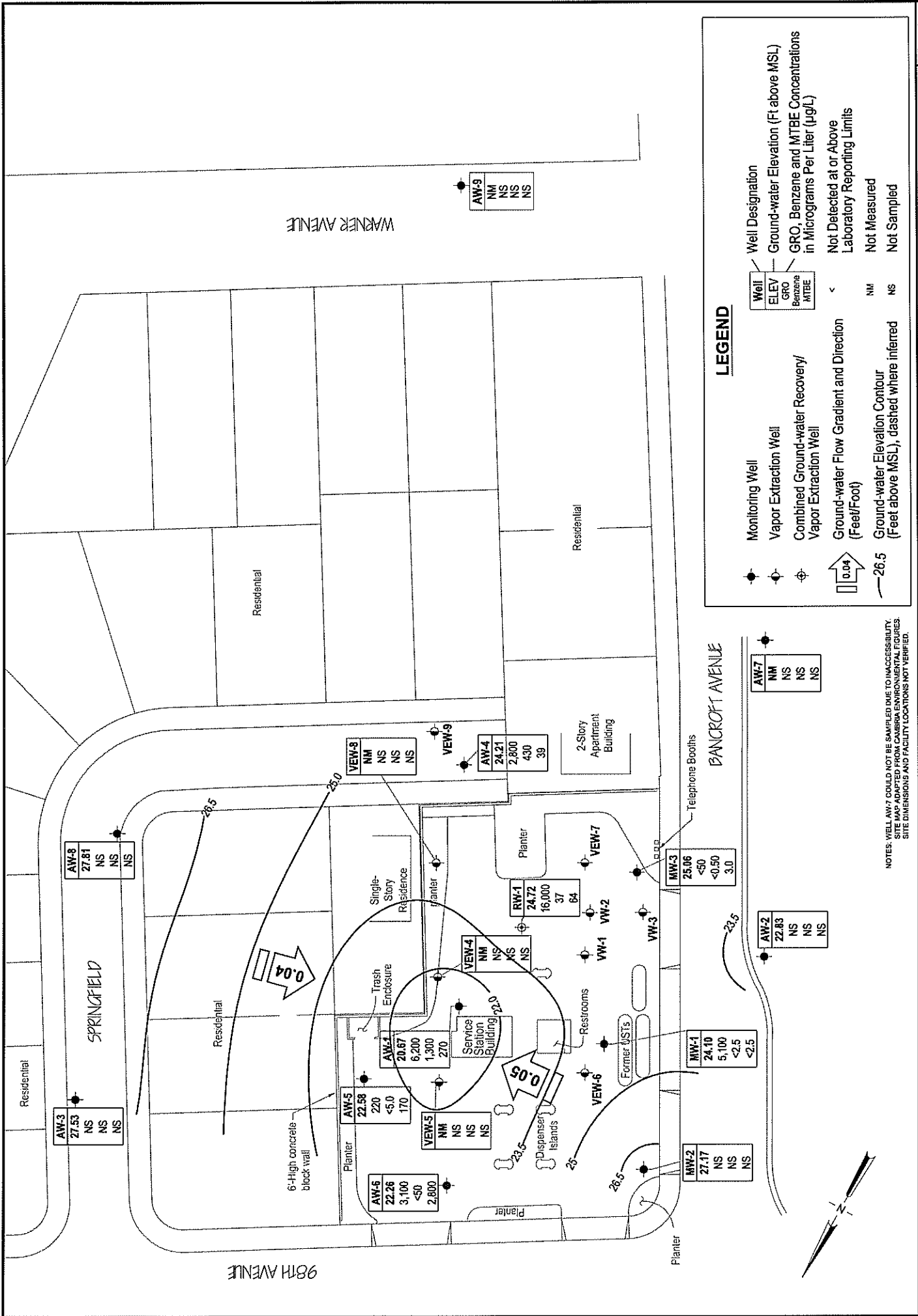

NOTES: WELL AW-7 COULD NOT BE SAMPLED DUE TO INACCESSIBILITY. SITE MAP ADAPTED FROM CAMBRIA ENVIRONMENTAL FIGURES. SITE DIMENSIONS AND FACILITY LOCATIONS NOT VERIFIED.

Drawing **1**

Ground-Water Elevation Contour and Analytical Summary Map
6 July 2006

Former BP Service Station #11133
2220 98th Avenue
Oakland, California

BROADBENT & ASSOCIATES, INC.
ENGINEERING, WATER RESOURCES & ENVIRONMENTAL
1324 Mangrove Ave., Suite 212, Chico, California 95926
Project No.: 06-08-656 Date: 10/26/06

0 60 120
SCALE (ft)

Table 1. Summary of Ground-Water Monitoring Data: Relative Water Elevations and Laboratory Analyses

Station #11133, 2220 98th Ave., Oakland, CA

Well and Sample Date	P/NP	TOC Elevation (feet msl)	Depth to Water (feet bgs)	Product Thickness (feet)	Water Level Elevation (feet msl)	Concentrations in (µg/L)						(mg/L) DO	Lab	pH	Comments
						GRO/TPHg	Benzene	Toluene	Ethyl-Benzene	Total Xylenes	MTBE				
AW-1															
4/5/1991	--	38.11	25.44	--	12.67	4,100	1,500	69	100	83	--	--	SUP	--	
4/1/1992	--	38.11	23.22	--	14.89	--	--	--	--	--	--	--	--	--	
4/2/1992	--	38.11	--	--	--	11,000	1,800	210	210	490	--	--	APP	--	
7/6/1992	--	38.11	24.89	--	13.22	6,500	4,000	40	290	530	--	--	ANA	--	
10/7/1992	--	38.11	26.55	--	11.56	4,700	1,500	41	47	300	--	--	ANA	--	
10/7/1992	--	38.11	--	--	--	2,900	1,200	25	37	210	--	--	ANA	--	e
1/14/1993	--	38.11	23.73	--	14.38	2,800	830	31	140	240	--	--	PACE	--	m
1/14/1993	--	38.11	--	--	--	4,100	1,700	28	130	230	--	--	PACE	--	m, e
4/22/1993	--	38.11	--	--	--	39,000	14,000	530	1,800	6,100	987	--	PACE	--	c, m
7/15/1993	--	38.11	22.5	--	15.61	6,200	2,200	28	210	540	838	--	PACE	--	c, m
10/21/1993	--	38.11	24.32	--	13.79	2,400	820	13	55	120	832	--	PACE	--	c, m
1/27/1994	--	38.11	23.72	--	14.39	3,500	1,400	26	130	220	650	--	PACE	--	c, n
4/21/1994	--	38.11	22.48	--	15.63	40,000	12,000	1,900	1,600	5,000	1,119	1.4	PACE	--	m
9/9/1994	--	38.11	23.04	--	15.07	3,500	1,600	5	200	250	--	2.1	PACE	--	m
9/9/1994	--	38.11	--	--	--	3,900	1,900	5.5	190	240	--	--	PACE	--	e
12/21/1994	--	38.11	21.7	--	16.41	7,600	3,100	36	370	320	855	1.6	PACE	--	m
1/30/1995	--	38.11	17.71	--	20.4	35,000	23,000	650	3,200	4,100	--	1.7	ATI	--	
4/10/1995	--	38.11	--	--	--	56,000	17,000	2,000	3,900	10,000	--	--	ATI	--	e
4/10/1995	--	38.11	20.04	--	18.07	60,000	18,000	2,000	4,300	11,000	--	7.9	ATI	--	
6/29/1995	--	38.11	20.6	--	17.51	72,000	10,000	7,300	4,200	15,000	--	6.2	ATI	--	
6/29/1995	--	38.11	--	--	--	86,000	12,000	8,400	4,800	18,000	--	--	ATI	--	e
9/18/1995	--	38.11	21.87	--	16.24	--	--	--	--	--	--	--	--	--	
9/19/1995	--	38.11	--	--	--	65,000	12,000	3,100	4,400	14,000	1,000	8.5	ATI	--	
12/7/1995	--	38.11	22.06	--	16.05	25,000	8,700	<50	2,500	1,300	1,100	2.9	ATI	--	
3/28/1996	--	38.11	16.91	--	21.2	24,000	11,000	<100	3,200	3,390	<1000	6.6	SPL	--	
6/20/1996	--	38.11	20.82	--	17.29	38,000	6,900	1,100	3,200	7,300	<100	6.4	SPL	--	
10/11/1996	--	38.11	23.2	--	14.91	33,000	8,500	69	3,300	4,230	580	6.3	SPL	--	
1/2/1997	--	38.11	20.41	--	17.7	32,000	8,000	<50	3,100	2,300	700	6.7	SPL	--	
4/14/1997	--	38.11	21.61	--	16.5	--	--	--	--	--	--	--	--	--	
4/15/1997	--	38.11	--	--	--	31,000	5,000	160	2,400	4,540	340	5.4	SPL	--	
7/2/1997	--	38.11	21.17	--	16.94	26,000	5,800	<100	2,600	2,200	<1000	6.2	SPL	--	

Table 1. Summary of Ground-Water Monitoring Data: Relative Water Elevations and Laboratory Analyses
Station #11133, 2220 98th Ave., Oakland, CA

Well and Sample Date	P/NP	TOC Elevation (feet msl)	Depth to Water (feet bgs)	Product Thickness (feet)	Water Level Elevation (feet msl)	Concentrations in (µg/L)						(mg/L) DO	Lab	pH	Comments
						GRO/TPHg	Benzene	Toluene	Ethyl-Benzene	Total Xylenes	MTBE				
AW-1 Cont.															
9/30/1997	--	38.11	21.48	--	16.63	29,000	9,200	17	1,400	130	560	6.9	SPL	--	
1/21/1998	--	38.11	20.02	--	18.09	50,000	6,900	450	3,200	4,450	720	5.8	SPL	--	
4/9/1998	--	38.11	13.37	--	24.74	--	--	--	--	--	--	--	--	--	
4/10/1998	--	38.11	--	--	--	46,000	5,800	1,900	3,000	7,400	1,000	4.3	SPL	--	
6/19/1998	--	38.11	--	--	--	43,000	6,800	260	3,100	3,490	620	--	SPL	--	e
6/19/1998	--	38.11	19.12	--	18.99	42,000	6,600	200	3,000	3,350	660	4.9	SPL	--	
11/30/1998	--	38.11	21.13	--	16.98	23,000	6,700	<25	3,100	130	710/820	--	SPL	--	g
1/21/1999	--	38.11	20.77	--	17.34	25,000	4,800	54	2,800	780	1,000	--	SPL	--	
4/30/1999	--	38.11	20.8	--	17.31	21,000	5,300	67	2,800	750	1,500	--	SPL	--	
7/9/1999	--	38.11	20.41	--	17.7	11,000	3,000	<10	760	180	1,300	--	SPL	--	
11/3/1999	--	38.11	20.82	--	17.29	--	--	--	--	--	--	--	--	--	
1/12/2000	--	38.11	19.99	--	18.12	330,000	5,300	10	2,900	560	2,200	--	PACE	--	
4/13/2000	--	38.11	20.14	--	17.97	--	--	--	--	--	--	--	--	--	
5/24/2000	--	38.11	20.17	--	17.94	--	--	--	--	--	--	--	--	--	
6/1/2000	--	38.11	23.05	--	15.06	--	--	--	--	--	--	--	--	--	
6/8/2000	--	38.11	17.08	--	21.03	--	--	--	--	--	--	--	--	--	
6/15/2000	--	38.11	16.93	--	21.18	--	--	--	--	--	--	--	--	--	
7/26/2000	--	38.11	20.07	--	18.04	15,000	290	98	77	220	37,000	--	PACE	--	
10/24/2000	--	38.11	20.1	--	18.01	--	--	--	--	--	--	--	--	--	
1/19/2001	--	38.11	19.82	--	18.29	7,600	2,220	10.9	415	58.4	1,630	--	PACE	--	
7/24/2001	--	38.11	19.86	--	18.25	9,600	2,140	6.34	281	43	1,440	--	PACE	--	
1/18/2002	--	38.11	15.6	--	22.51	20,000	2,170	75.2	1,800	2,080	1,250	--	PACE	--	
8/1/2002	--	38.11	19.55	--	18.56	14,000	2,150	<12.5	197	42.4	1,120	--	PACE	--	
1/16/2003	--	38.11	16.32	--	21.79	15,000	2,300	75	1,600	1,800	1,100	--	SEQ	--	p
7/7/2003	--	38.11	19.8	--	18.31	9,700	1,600	<25	540	110	1,100	--	SEQ	--	q, u
02/05/2004	--	38.11	18.75	--	19.36	12,000	2,000	<50	820	590	930	--	SEQM	6.7	
07/01/2004	P	38.11	19.72	--	18.39	9,900	2,600	<25	300	<25	1,100	--	SEQM	6.5	
03/16/2005	P	38.11	18.78	--	19.33	10,000	1,100	30	630	560	720	0.8	SEQM	6.7	
07/22/2005	P	38.11	15.53	--	22.58	8,000	770	5.4	520	50	510	--	SEQM	6.5	
01/25/2006	P	38.11	18.10	--	20.01	6,400	1,200	10	490	290	490	--	SEQM	7.0	
7/6/2006	P	38.11	17.44	--	20.67	6,200	1,300	70	570	180	270	--	TAMC	6.8	

Table 1. Summary of Ground-Water Monitoring Data: Relative Water Elevations and Laboratory Analyses

Station #11133, 2220 98th Ave., Oakland, CA

Well and Sample Date	P/NP	TOC Elevation (feet msl)	Depth to Water (feet bgs)	Product Thickness (feet)	Water Level Elevation (feet msl)	Concentrations in (µg/L)						(mg/L) DO	Lab	pH	Comments
						GRO/TPHg	Benzene	Toluene	Ethyl-Benzene	Total Xylenes	MTBE				
AW-1															
AW-2															
4/5/1991	--	36.83	22.36	--	14.47	<50	<0.3	<0.3	<0.3	<0.3	--	--	SUP	--	
4/1/1992	--	36.83	20.81	--	16.02	--	--	--	--	--	--	--	--	--	
4/2/1992	--	36.83	--	--	--	130	25	2.3	0.7	2.1	--	--	APP	--	
7/6/1992	--	36.83	23.57	--	13.26	<50	<0.5	<0.5	<0.5	<0.5	--	--	ANA	--	
10/7/1992	--	36.83	25.24	--	11.59	<50	<0.5	<0.5	<0.5	<0.5	--	--	ANA	--	
1/14/1993	--	36.83	20.82	--	16.01	<50	<0.5	<0.5	<0.5	<0.5	--	--	PACE	--	m
4/22/1993	--	36.83	19.37	--	17.46	<50	<0.5	<0.5	<0.5	<0.5	--	--	PACE	--	m
7/15/1993	--	36.83	21.29	--	15.54	<50	<0.5	<0.5	<0.5	<0.5	<5.0	--	PACE	--	m
10/21/1993	--	36.83	23.14	--	13.69	<50	1.3	1.1	0.9	2.1	<5.0	--	PACE	--	m
1/27/1994	--	36.83	22.34	--	14.49	<50	<0.5	<0.5	<0.5	<0.5	--	--	PACE	--	m
4/21/1994	--	36.83	21.15	--	15.68	<50	<0.5	<0.5	<0.5	<0.5	<5.0	2.0	PACE	--	m
9/9/1994	--	36.83	22.09	--	14.74	<50	<0.5	<0.5	<0.5	<0.5	--	4.1	PACE	--	m
12/21/1994	--	36.83	20.12	--	16.71	<50	<0.5	<0.5	<0.5	<0.5	<5.0	2.0	PACE	--	m
1/30/1995	--	36.83	16.65	--	20.18	<50	<0.50	<0.50	<0.50	<1.0	--	2.5	ATI	--	
4/10/1995	--	36.83	16.22	--	20.61	<50	<0.50	<0.50	<0.50	<1.0	--	4.4	ATI	--	
6/29/1995	--	36.83	17.55	--	19.28	<50	<0.50	<0.50	<0.50	<1.0	--	7.8	ATI	--	
9/18/1995	--	36.83	19.87	--	16.96	--	--	--	--	--	--	--	--	--	
9/19/1995	--	36.83	--	--	--	<50	<0.50	<0.50	<0.50	<1.0	<5.0	--	ATI	--	e
9/19/1995	--	36.83	--	--	--	<50	<0.50	<0.50	<0.50	<1.0	<5.0	4.5	ATI	--	
12/7/1995	--	36.83	21.31	--	15.52	<50	<0.50	<0.50	<0.50	<1.0	<5.0	4.9	ATI	--	
3/28/1996	--	36.83	15.61	--	21.22	<50	<0.5	<1	<1	<1	<10	4.1	SPL	--	
6/20/1996	--	36.83	16.3	--	20.53	<50	<0.5	<1	<1	<1	<10	5.2	SPL	--	
10/11/1996	--	36.83	19.6	--	17.23	<50	<0.5	<1.0	<1.0	<1.0	<10	6.0	SPL	--	
1/2/1997	--	36.83	15.97	--	20.86	<50	<0.5	<1.0	<1.0	<1.0	<10	6.1	SPL	--	
4/14/1997	--	36.83	17.19	--	19.64	<50	<0.5	<1.0	<1.0	<1.0	<10	5.3	SPL	--	
7/2/1997	--	36.83	18.11	--	18.72	<50	<0.5	<1.0	<1.0	<1.0	<10	5.7	SPL	--	
9/30/1997	--	36.83	18.52	--	18.31	<50	<0.5	<1.0	<1.0	<1.0	860	5.4	SPL	--	
1/21/1998	--	36.83	14.46	--	22.37	160	13	<1.0	<1.0	<1.0	110	4.9	SPL	--	
4/9/1998	--	36.83	12.85	--	23.98	--	--	--	--	--	--	--	--	--	

Table 1. Summary of Ground-Water Monitoring Data: Relative Water Elevations and Laboratory Analyses
Station #11133, 2220 98th Ave., Oakland, CA

Well and Sample Date	P/NP	TOC Elevation (feet msl)	Depth to Water (feet bgs)	Product Thickness (feet)	Water Level Elevation (feet msl)	Concentrations in (µg/L)						(mg/L) DO	Lab	pH	Comments
						GRO/TPHg	Benzene	Toluene	Ethyl-Benzene	Total Xylenes	MTBE				
AW-2 Cont.															
4/10/1998	--	36.83	--	--	--	<50	<0.5	<1.0	<1.0	<1.0	<10	3.9	SPL	--	
6/19/1998	--	36.83	14.37	--	22.46	60	<0.5	<1.0	<1.0	<1.0	<10	3.6	SPL	--	
11/30/1998	--	36.83	16.9	--	19.93	--	--	--	--	--	--	--	--	--	
1/21/1999	--	36.83	16.87	--	19.96	<50	<1.0	<1.0	<1.0	<1.0	<1.0	--	SPL	--	
4/30/1999	--	36.83	17.01	--	19.82	--	--	--	--	--	--	--	--	--	
7/9/1999	--	36.83	17.83	--	19	--	--	--	--	--	--	--	--	--	
11/3/1999	--	36.83	19.74	--	17.09	--	--	--	--	--	--	--	--	--	
1/12/2000	--	36.83	19.9	--	16.93	<50	<0.5	<0.5	<0.5	<0.5	<0.5	--	PACE	--	
4/13/2000	--	36.83	19.75	--	17.08	--	--	--	--	--	--	--	--	--	
7/26/2000	--	36.83	19.86	--	16.97	--	--	--	--	--	--	--	--	--	
10/24/2000	--	36.83	18.77	--	18.06	--	--	--	--	--	--	--	--	--	
1/19/2001	--	36.83	--	--	--	--	--	--	--	--	--	--	--	--	f
7/24/2001	--	36.83	--	--	--	--	--	--	--	--	--	--	--	--	f
1/18/2002	--	36.83	15.17	--	21.66	<50	<0.5	<0.5	<0.5	<1.0	<0.5	--	PACE	--	
8/1/2002	--	36.83	17.17	--	19.66	--	--	--	--	--	--	--	--	--	
1/16/2003	--	36.83	14.81	--	22.02	<50	<0.50	<0.50	<0.50	<0.50	<2.5	--	SEQ	--	p
7/7/2003	--	36.83	16.65	--	20.18	--	--	--	--	--	--	--	--	--	
02/05/2004	--	36.83	15.37	--	21.46	<50	3.0	<0.50	<0.50	<0.50	5.1	--	SEQM	6.6	
07/01/2004	--	36.83	17.55	--	19.28	--	--	--	--	--	--	--	--	--	
03/16/2005	P	36.83	14.58	--	22.25	<50	0.75	<0.50	1.1	1.1	<0.50	1.7	SEQM	6.7	
07/22/2005	--	36.83	15.41	--	21.42	--	--	--	--	--	--	--	--	--	
01/25/2006	P	36.83	14.17	--	22.66	280	110	<1.0	3.9	8.7	12	--	SEQM	7.1	
7/6/2006	--	36.83	14.00	--	22.83	--	--	--	--	--	--	--	--	--	
AW-3															
4/5/1991	--	39.13	23.9	--	15.23	5,200	980	450	95	310	--	--	SUP	--	
4/1/1992	--	39.13	22.5	--	16.63	4,700	890	47	43	110	--	--	APP	--	
7/6/1992	--	39.13	23.26	--	15.87	3,900	3,100	30	80	99	--	--	ANA	--	
10/7/1992	--	39.13	24.75	--	14.38	5,000	2,600	<0.5	<0.5	59	--	--	ANA	--	
1/14/1993	--	39.13	23.59	--	15.54	350	250	<0.5	<0.5	<0.5	--	--	PACE	--	m
4/22/1993	--	39.13	19.42	--	19.71	240	71	2.4	0.6	4	--	--	PACE	--	m

Table 1. Summary of Ground-Water Monitoring Data: Relative Water Elevations and Laboratory Analyses
Station #11133, 2220 98th Ave., Oakland, CA

Well and Sample Date	P/NP	TOC Elevation (feet msl)	Depth to Water (feet bgs)	Product Thickness (feet)	Water Level Elevation (feet msl)	Concentrations in (µg/L)						(mg/L) DO	Lab	pH	Comments
						GRO/TPHg	Benzene	Toluene	Ethyl-Benzene	Total Xylenes	MTBE				
AW-3 Cont.															
7/15/1993	--	39.13	20.09	--	19.04	650	71	2.8	1.5	1.1	37.3	--	PACE	--	c, m
10/21/1993	--	39.13	--	--	--	170	6.1	2	1.7	4.4	--	--	PACE	--	e
10/21/1993	--	39.13	21.88	--	17.25	160	4.8	1.7	1.6	3.6	8.95	--	PACE	--	m
1/27/1994	--	39.13	--	--	--	90	2.9	0.5	<0.5	<0.5	--	--	PACE	--	e
1/27/1994	--	39.13	22.33	--	16.8	92	2.1	<0.5	<0.5	<0.5	7.37	--	PACE	--	m
4/21/1994	--	39.13	20.96	--	18.17	150	3.6	0.8	0.9	2.5	9.36	1.3	PACE	--	m
9/9/1994	--	39.13	21.6	--	17.53	53	<0.5	<0.5	<0.5	<0.5	--	1.9	PACE	--	m
12/21/1994	--	39.13	--	--	--	--	--	--	--	--	--	--	--	--	f
1/30/1995	--	39.13	--	--	--	--	--	--	--	--	--	--	--	--	f
4/10/1995	--	39.13	--	--	--	--	--	--	--	--	--	--	--	--	f
6/29/1995	--	39.13	15.41	--	23.72	<50	<0.50	<0.50	<0.50	<1.0	--	8.0	ATI	--	
9/18/1995	--	39.13	17.83	--	21.3	--	--	--	--	--	--	--	--	--	
9/19/1995	--	39.13	--	--	--	61,000	11,000	2,900	4,100	13,000	790	7.4	ATI	--	
12/7/1995	--	39.13	--	--	--	<50	<0.50	<0.50	<0.50	<1.0	<5.0	--	ATI	--	e
12/7/1995	--	39.13	19.27	--	19.86	<50	<0.50	<0.50	<0.50	<1.0	<5.0	3.4	ATI	--	
3/28/1996	--	39.13	--	--	--	<50	<0.5	<1	<1	<1	<10	--	SPL	--	e
3/28/1996	--	39.13	13.85	--	25.28	<50	<0.5	<1	<1	<1	<10	4.1	SPL	--	
6/20/1996	--	39.13	14.47	--	24.66	<50	<0.5	<1	<1	<1	<10	4.2	SPL	--	
6/20/1996	--	39.13	--	--	--	<50	<0.5	<1	<1	<1	<10	--	SPL	--	e
10/11/1996	--	39.13	17.97	--	21.16	<50	<0.5	<1.0	<1.0	<1.0	<10	4.7	SPL	--	
10/11/1996	--	39.13	--	--	--	<50	<0.5	<1.0	<1.0	<1.0	<10	--	SPL	--	e
1/2/1997	--	39.13	13	--	26.13	<50	<0.5	<1.0	<1.0	<1.0	<10	5.6	SPL	--	
4/14/1997	--	39.13	14.36	--	24.77	<50	<0.5	<1.0	<1.0	<1.0	<10	5.0	SPL	--	
4/15/1997	--	39.13	--	--	--	<50	<0.5	<1.0	<1.0	<1.0	<10	--	SPL	--	e
7/2/1997	--	39.13	15.87	--	23.26	<50	<0.5	<1.0	<1.0	<1.0	<10	5.4	SPL	--	
9/30/1997	--	39.13	17.5	--	21.63	<250	<2.5	<5.0	<5.0	<5.0	810	5.7	SPL	--	
1/21/1998	--	39.13	11.98	--	27.15	140	<0.5	<1.0	<1.0	<1.0	99	4.6	SPL	--	
1/21/1998	--	39.13	--	--	--	150	<0.5	<1.0	<1.0	1.2	110	--	SPL	--	e
4/9/1998	--	39.13	9.45	--	29.68	--	--	--	--	--	--	--	--	--	
4/10/1998	--	39.13	--	--	--	<50	<0.5	<1.0	<1.0	1.6	<10	4.5	SPL	--	
4/10/1998	--	39.13	--	--	--	<50	<0.5	<1.0	1.4	1.7	<10	--	SPL	--	e

Table 1. Summary of Ground-Water Monitoring Data: Relative Water Elevations and Laboratory Analyses

Station #11133, 2220 98th Ave., Oakland, CA

Well and Sample Date	P/NP	TOC Elevation (feet msl)	Depth to Water (feet bgs)	Product Thickness (feet)	Water Level Elevation (feet msl)	Concentrations in (µg/L)						(mg/L) DO	Lab	pH	Comments
						GRO/TPHg	Benzene	Toluene	Ethyl-Benzene	Total Xylenes	MTBE				
AW-3 Cont.															
6/19/1998	--	39.13	12.13	--	27	<50	<0.5	<1.0	<1.0	<1.0	<10	4.4	SPL	--	
11/30/1998	--	39.13	15.91	--	23.22	--	--	--	--	--	--	--	--	--	
1/21/1999	--	39.13	15.93	--	23.2	<50	<1.0	<1.0	<1.0	<1.0	<1.0	--	SPL	--	
4/30/1999	--	39.13	15.98	--	23.15	--	--	--	--	--	--	--	--	--	
7/9/1999	--	39.13	14.58	--	24.55	--	--	--	--	--	--	--	--	--	
11/3/1999	--	39.13	17.43	--	21.7	--	--	--	--	--	--	--	--	--	
1/12/2000	--	39.13	18.3	--	20.83	<50	<0.5	<0.5	<0.5	<0.5	<0.5	--	PACE	--	
4/13/2000	--	39.13	18.89	--	20.24	--	--	--	--	--	--	--	--	--	
7/26/2000	--	39.13	18.67	--	20.46	--	--	--	--	--	--	--	--	--	
10/24/2000	--	39.13	18.98	--	20.15	--	--	--	--	--	--	--	--	--	
1/19/2001	--	39.13	16.74	--	22.39	--	--	--	--	--	--	--	--	--	
7/24/2001	--	39.13	18.55	--	20.58	--	--	--	--	--	--	--	--	--	
1/18/2002	--	39.13	14.49	--	24.64	--	--	--	--	--	--	--	--	--	
8/1/2002	--	39.13	14.27	--	24.86	--	--	--	--	--	--	--	--	--	
1/16/2003	--	39.13	14.25	--	24.88	--	--	--	--	--	--	--	--	--	
7/7/2003	--	39.13	14.7	--	24.43	--	--	--	--	--	--	--	--	--	
02/05/2004	--	39.13	14.61	--	24.52	--	--	--	--	--	--	--	--	--	
07/01/2004	--	39.13	15.62	--	23.51	--	--	--	--	--	--	--	--	--	
03/16/2005	P	39.13	12.70	--	26.43	<50	<0.50	<0.50	<0.50	<0.50	<0.50	1.1	SEQM	7.3	
07/22/2005	--	39.13	13.44	--	25.69	--	--	--	--	--	--	--	--	--	
01/25/2006	--	39.13	13.56	--	25.57	--	--	--	--	--	--	--	--	--	
7/6/2006	--	39.13	11.60	--	27.53	--	--	--	--	--	--	--	--	--	
AW-4															
4/5/1991	--	39.08	25.12	--	13.96	110,000	40,000	13,000	2,000	5,500	--	--	SUP	--	
4/1/1992	--	39.08	--	--	--	210,000	55,000	23,000	2,900	7,000	--	--	APP	--	e
4/1/1992	--	39.08	23.56	--	15.52	230,000	57,000	31,000	2,900	7,600	--	--	APP	--	
7/6/1992	--	39.08	25.87	--	13.21	38,000	16,000	5,400	2,000	6,100	--	--	ANA	--	
10/7/1992	--	39.08	27.53	--	11.55	120,000	41,000	26,000	4,700	13,000	--	--	ANA	--	
1/14/1993	--	39.08	24.12	--	14.96	62,000	18,000	14,000	2,700	7,700	1,400	--	PACE	--	c, m
4/22/1993	--	39.08	21.47	--	17.61	18,000	1,100	2,100	320	3,500	--	--	PACE	--	m

Table 1. Summary of Ground-Water Monitoring Data: Relative Water Elevations and Laboratory Analyses
Station #11133, 2220 98th Ave., Oakland, CA

Well and Sample Date	P/NP	TOC Elevation (feet msl)	Depth to Water (feet bgs)	Product Thickness (feet)	Water Level Elevation (feet msl)	Concentrations in (µg/L)						(mg/L) DO	Lab	pH	Comments
						GRO/TPHg	Benzene	Toluene	Ethyl-Benzene	Total Xylenes	MTBE				
AW-4 Cont.															
7/15/1993	--	39.08	23.3	--	15.78	21,000	820	2,300	590	3,800	1,978	--	PACE	--	c, m
10/21/1993	--	39.08	25.08	--	14	11,000	570	83	630	2,300	4,600	--	PACE	--	c, m
1/27/1994	--	39.08	24.61	--	14.47	12,000	420	460	600	2,200	6,400	--	PACE	--	c, m
4/21/1994	--	39.08	22.96	--	16.12	12,000	110	250	150	1,900	16,010	1.5	PACE	--	c, m
4/21/1994	--	39.08	--	--	--	14,000	71	160	29	1,200	13,000	--	PACE	--	c, e
9/9/1994	--	39.08	23.85	--	15.23	9,700	75	64	280	2,000	--	2.1	PACE	--	m
12/21/1994	--	39.08	--	--	--	--	--	--	--	--	--	--	--	--	f
1/30/1995	--	39.08	--	--	--	--	--	--	--	--	--	--	--	--	f
4/10/1995	--	39.08	18.07	--	21.01	3,700	69	8.7	44	130	--	8.5	ATI	--	
6/29/1995	--	39.08	19.25	--	19.83	8,000	62	190	190	1,100	--	7.5	ATI	--	
9/18/1995	--	39.08	20.73	--	18.35	--	--	--	--	--	--	--	--	--	
9/19/1995	--	39.08	--	--	--	12,000	660	1,600	200	1,900	7,100	8.3	ATI	--	
12/7/1995	--	39.08	22.49	--	16.59	41,000	8,400	7,200	710	6,300	5,200	3.6	ATI	--	
3/28/1996	--	39.08	16.49	--	22.59	--	--	--	--	--	--	--	--	--	f
6/20/1996	--	39.08	16	--	23.08	<50	<0.5	<1	<1	<1	12	--	SPL	--	
10/11/1996	--	39.08	19.52	--	19.56	36,000	12,000	5,500	<25	3,800	880/1000	6.2	SPL	--	g
1/2/1997	--	39.08	15.8	--	23.28	<50	<0.5	<1.0	<1.0	<1.0	22	6.4	SPL	--	
1/2/1997	--	39.08	--	--	--	<50	61	3.8	3.5	8.1	110	--	SPL	--	e
4/14/1997	--	39.08	17.01	--	22.07	--	--	--	--	--	--	--	--	--	
4/15/1997	--	39.08	--	--	--	<50	<0.5	<1.0	<1.0	<1.0	<10	5.4	SPL	--	
7/2/1997	--	39.08	19.68	--	19.4	<50	21	<1.0	<1.0	<1.0	41	4.1	SPL	--	
9/30/1997	--	39.08	22.71	--	16.37	--	--	--	--	--	--	--	--	--	f
1/21/1998	--	39.08	15.89	--	23.19	13,000	2,900	<10	230	314	3,100	3.9	SPL	--	
4/9/1998	--	39.08	13.5	--	25.58	--	--	--	--	--	--	--	--	--	
4/10/1998	--	39.08	--	--	--	890	<0.5	<1	<1	<1	730	4.9	SPL	--	
6/19/1998	--	39.08	14.75	--	24.33	60	<0.5	<1.0	<1.0	<1.0	34	4.3	SPL	--	
11/30/1998	--	39.08	19.25	--	19.83	--	--	--	--	--	--	--	--	--	
1/21/1999	--	39.08	18.94	--	20.14	3,700	830	93	200	360	30	--	--	--	
4/30/1999	--	39.08	19.1	--	19.98	--	--	--	--	--	--	--	--	--	
7/9/1999	--	39.08	18.93	--	20.15	76,000	12,000	6,600	2,000	8,700	320	--	SPL	--	
11/3/1999	--	39.08	20.65	--	18.43	--	--	--	--	--	--	--	--	--	

Table 1. Summary of Ground-Water Monitoring Data: Relative Water Elevations and Laboratory Analyses

Station #11133, 2220 98th Ave., Oakland, CA

Well and Sample Date	P/NP	TOC Elevation (feet msl)	Depth to Water (feet bgs)	Product Thickness (feet)	Water Level Elevation (feet msl)	Concentrations in (µg/L)						(mg/L) DO	Lab	pH	Comments
						GRO/TPHg	Benzene	Toluene	Ethyl-Benzene	Total Xylenes	MTBE				
AW-4 Cont.															
1/12/2000	--	39.08	21.21	--	17.87	67,000	12,000	3,500	2,900	15,000	280	--	PACE	--	
4/13/2000	--	39.08	21.33	--	17.75	--	--	--	--	--	--	--	--	--	
5/24/2000	--	39.08	19.84	--	19.24	--	--	--	--	--	--	--	--	--	
6/1/2000	--	39.08	19.04	--	20.04	--	--	--	--	--	--	--	--	--	
6/8/2000	--	39.08	18.32	--	20.76	--	--	--	--	--	--	--	--	--	
6/15/2000	--	39.08	16.7	--	22.38	--	--	--	--	--	--	--	--	--	
7/26/2000	--	39.08	21.5	--	17.58	910	<0.5	<0.5	<0.5	<0.5	3,500	--	PACE	--	
10/24/2000	--	39.08	22	--	17.08	--	--	--	--	--	--	--	--	--	
1/19/2001	--	39.08	18.97	--	20.11	6,600	2,460	24	497	534	267	--	PACE	--	
7/24/2001	--	39.08	18.55	--	20.53	5,100	1,080	143	409	827	115	--	PACE	--	
1/18/2002	--	39.08	17.22	--	21.86	3,900	442	241	157	681	85.3	--	PACE	--	
8/1/2002	--	39.08	--	--	--	--	--	--	--	--	--	--	--	--	f
1/16/2003	--	39.08	16.85	--	22.23	2,900	260	160	120	590	<120	--	SEQ	--	p
7/7/2003	--	39.08	17.94	--	21.14	600	90	7.9	18	36	56	--	SEQ	--	q
02/05/2004	--	39.08	16.94	--	22.14	420	40	3.1	15	27	40	--	SEQM	6.8	
07/01/2004	P	39.08	18.24	--	20.84	6,000	970	200	310	1,500	64	--	SEQM	6.7	
03/16/2005	P	39.08	16.16	--	22.92	3,600	71	31	200	870	23	0.6	SEQM	6.5	
07/22/2005	P	39.08	15.89	--	23.19	4,800	750	48	300	840	59	--	SEQM	6.7	
01/25/2006	P	39.08	15.48	--	23.60	<500	13	<5.0	14	62	12	--	SEQM	7.0	
7/6/2006	P	39.08	14.87	--	24.21	2,800	430	21	230	680	39	--	TAMC	6.7	
AW-5															
4/5/1991	--	38.51	25.48	--	13.03	420	31	7.5	20	68	--	--	SUP	--	
4/1/1992	--	38.51	23.95	--	14.56	--	--	--	--	--	--	--	--	--	
4/2/1992	--	38.51	--	--	--	4,000	270	63	190	290	--	--	APP	--	
7/6/1992	--	38.51	26.48	--	12.03	1,400	160	<2.5	250	58	--	--	ANA	--	
10/7/1992	--	38.51	28.18	--	10.33	360	12	0.6	8.7	5	--	--	ANA	--	
1/14/1993	--	38.51	24.15	--	14.36	1,700	270	7.5	130	62	--	--	PACE	--	m
4/22/1993	--	38.51	22.43	--	16.08	2,700	780	30	220	180	--	--	PACE	--	m
4/22/1993	--	38.51	--	--	--	3,500	780	29	240	210	--	--	PACE	--	m, c
7/15/1993	--	38.51	--	--	--	1,300	68	8.3	64	99	<50	--	PACE	--	m, c

Table 1. Summary of Ground-Water Monitoring Data: Relative Water Elevations and Laboratory Analyses

Station #11133, 2220 98th Ave., Oakland, CA

Well and Sample Date	P/NP	TOC Elevation (feet msl)	Depth to Water (feet bgs)	Product Thickness (feet)	Water Level Elevation (feet msl)	Concentrations in (µg/L)						(mg/L) DO	Lab	pH	Comments
						GRO/TPHg	Benzene	Toluene	Ethyl-Benzene	Total Xylenes	MTBE				
AW-5 Cont.															
7/15/1993	--	38.51	24.31	--	14.2	1,300	69	16	67	120	<50	--	PACE	--	m
10/21/1993	--	38.51	26.05	--	12.46	510	9.6	1.5	17	45	75	--	PACE	--	c, m
1/27/1994	--	38.51	26.42	--	12.09	420	3.3	<0.5	1	0.9	48.9	--	PACE	--	m
4/21/1994	--	38.51	24.36	--	14.15	1,000	110	25	56	27	75	1.3	PACE	--	c, m
9/9/1994	--	38.51	24.55	--	13.96	210	<0.5	<0.5	0.5	0.9	--	2.7	PACE	--	m
12/21/1994	--	38.51	22.3	--	16.21	410	<0.5	20	4.3	1.4	114	1.1	PACE	--	m
12/21/1994	--	38.51	--	--	--	340	<0.5	15	3.3	1.4	104	--	PACE	--	m, e
1/30/1995	--	38.51	18.88	--	19.63	210	0.6	11	8.8	2	--	1.5	ATI	--	
4/10/1995	--	38.51	18.44	--	20.07	500	1.4	0.59	6.5	4.3	--	8.3	ATI	--	
6/29/1995	--	38.51	19.92	--	18.59	490	1.2	0.58	7.3	2.2	--	6.9	ATI	--	d
9/18/1995	--	38.51	22.15	--	16.36	--	--	--	--	--	--	--	--	--	
9/19/1995	--	38.51	--	--	--	260	0.62	<0.50	3.1	1.1	110	8.2	ATI	--	
12/7/1995	--	38.51	23.75	--	14.76	60	<0.50	<0.50	<0.50	<1.0	210	4.3	ATI	--	
3/28/1996	--	38.51	17.76	--	20.75	<50	<0.5	<1	<1	<1	63	3.0	SPL	--	
6/20/1996	--	38.51	18.46	--	20.05	<50	<0.5	<1	<1	<1	<10	3.6	SPL	--	
10/11/1996	--	38.51	21.84	--	16.67	<50	<0.5	<1.0	<1.0	<1.0	<10	4.5	SPL	--	
1/2/1997	--	38.51	18.01	--	20.5	<50	<0.5	<1.0	<1.0	<1.0	<10	4.6	SPL	--	
4/14/1997	--	38.51	19.35	--	19.16	<50	<0.5	<1.0	<1.0	<1.0	<10	5.1	SPL	--	
7/2/1997	--	38.51	20.29	--	18.22	<50	<0.5	<1.0	<1.0	<1.0	<10	4.0	SPL	--	
9/30/1997	--	38.51	23.15	--	15.36	<250	<2.5	<5.0	<5.0	<5.0	1,300	6.3	SPL	--	
1/21/1998	--	38.51	17.33	--	21.18	6,100	<0.5	2.1	<1.0	<1.0	3,700	4.5	SPL	--	
4/9/1998	--	38.51	15.25	--	23.26	--	--	--	--	--	--	--	--	--	
4/10/1998	--	38.51	--	--	--	3,500	<0.5	<1.0	<1.0	<1.0	3,000	5.4	SPL	--	
6/19/1998	--	38.51	17.39	--	21.12	3,300	<0.5	<1.0	<1.0	<1.0	2,500	5.2	SPL	--	
11/30/1998	--	38.51	--	--	--	--	--	--	--	--	--	--	--	--	f
1/21/1999	--	38.51	21.22	--	17.29	2,800	<1.0	<1.0	<1.0	<1.0	1,800	--	SPL	--	
4/30/1999	--	38.51	21.5	--	17.01	--	--	--	--	--	--	--	--	--	
7/9/1999	--	38.51	20.15	--	18.36	4,000	<1.0	<1.0	<1.0	<1.0	3400/3500	--	SPL	--	g
11/3/1999	--	38.51	22.04	--	16.47	--	--	--	--	--	--	--	--	--	
1/12/2000	--	38.51	22.59	--	15.92	1,000	7.3	30	6.7	40	4,600	--	PACE	--	j (TPH-g/GRO)
4/13/2000	--	38.51	23.11	--	15.4	--	--	--	--	--	--	--	--	--	

Table 1. Summary of Ground-Water Monitoring Data: Relative Water Elevations and Laboratory Analyses
Station #11133, 2220 98th Ave., Oakland, CA

Well and Sample Date	P/NP	TOC Elevation (feet msl)	Depth to Water (feet bgs)	Product Thickness (feet)	Water Level Elevation (feet msl)	Concentrations in (µg/L)						(mg/L) DO	Lab	pH	Comments
						GRO/TPHg	Benzene	Toluene	Ethyl-Benzene	Total Xylenes	MTBE				
AW-5 Cont.															
7/26/2000	--	38.51	22.72	--	15.79	1,800	94	35	5.9	27	16,000	--	PACE	--	
10/24/2000	--	38.51	20.15	--	18.36	--	--	--	--	--	--	--	--	--	
1/19/2001	--	38.51	19.79	--	18.72	2,600	<0.5	<0.5	<0.5	<0.5	4,580	--	PACE	--	
7/24/2001	--	38.51	20.17	--	18.34	5,400	18.4	17.2	<12.5	40.8	5,170	--	PACE	--	
1/18/2002	--	38.51	17.34	--	21.17	3,800	343	0.738	<0.5	<1.0	3,750	--	PACE	--	
8/1/2002	--	38.51	19.49	--	19.02	5,300	<12.5	<12.5	<12.5	<25	3,470	--	PACE	--	
1/16/2003	--	38.51	17.3	--	21.21	1,400	140	<10	<10	<10	1,600	--	SEQ	--	p
7/7/2003	--	38.51	18.43	--	20.08	1,400	<10	<10	<10	<10	980	--	SEQ	--	q
02/05/2004	--	38.51	17.24	--	21.27	1,800	<10	<10	<10	<10	810	--	SEQM	6.7	
07/01/2004	P	38.51	19.43	--	19.08	1,100	<5.0	<5.0	<5.0	<5.0	550	--	SEQM	6.6	
03/16/2005	P	38.51	15.30	--	23.21	<5,000	<50	<50	<50	130	890	2.1	SEQM	6.7	
07/22/2005	P	38.51	17.22	--	21.29	<500	5.2	<5.0	<5.0	6.9	390	--	SEQM	6.6	
01/25/2006	P	38.51	15.28	--	23.23	<500	<5.0	<5.0	<5.0	<5.0	26	--	SEQM	7.0	
7/6/2006	P	38.51	15.93	--	22.58	220	<5.0	<5.0	<5.0	<5.0	170	--	TAMC	6.5	
AW-6															
4/5/1991	--	37.08	22.48	--	14.6	1,100	80	19	1.4	230	--	--	SUP	--	
4/1/1992	--	37.08	22.5	--	14.58	--	--	--	--	--	--	--	--	--	
4/2/1992	--	37.08	--	--	--	<50	<0.5	<0.5	<0.5	<0.5	--	--	APP	--	
7/6/1992	--	37.08	22.74	--	14.34	<50	<0.5	<0.5	<0.5	<0.5	--	--	ANA	--	
10/7/1992	--	37.08	24.64	--	12.44	<50	<0.5	<0.5	<0.5	<0.5	--	--	ANA	--	
1/14/1993	--	37.08	22.36	--	14.72	<50	<0.5	<0.5	<0.5	<0.5	--	--	PACE	--	m
4/22/1993	--	37.08	22.82	--	14.26	<50	<0.5	<0.5	<0.5	<0.5	--	--	PACE	--	m
7/15/1993	--	37.08	20.49	--	16.59	<50	<0.5	<0.5	<0.5	0.8	<5.0	--	PACE	--	m
10/21/1993	--	37.08	22.84	--	14.24	<50	0.5	0.6	<0.5	0.7	<5.0	--	PACE	--	m
1/27/1994	--	37.08	22.33	--	14.75	<50	<0.5	0.9	3.1	12	<5.0	--	PACE	--	m
4/21/1994	--	37.08	20.66	--	16.42	<50	<0.5	<0.5	<0.5	<0.5	<5.0	1.7	PACE	--	m
9/9/1994	--	37.08	21.57	--	15.51	<50	0.9	<0.5	<0.5	0.5	--	2.9	PACE	--	m
12/21/1994	--	37.08	19.4	--	17.68	<50	1.8	0.8	0.8	3.2	5.19	1.1	PACE	--	m
1/30/1995	--	37.08	16.74	--	20.34	<50	<0.50	<0.50	<0.50	<1.0	--	2.2	ATI	--	
1/30/1995	--	37.08	--	--	--	<50	<0.50	<0.50	<0.50	<1.0	--	--	ATI	--	e

Table 1. Summary of Ground-Water Monitoring Data: Relative Water Elevations and Laboratory Analyses
Station #11133, 2220 98th Ave., Oakland, CA

Well and Sample Date	P/NP	TOC Elevation (feet msl)	Depth to Water (feet bgs)	Product Thickness (feet)	Water Level Elevation (feet msl)	Concentrations in (µg/L)						(mg/L) DO	Lab	pH	Comments
						GRO/TPHg	Benzene	Toluene	Ethyl-Benzene	Total Xylenes	MTBE				
AW-6 Cont.															
4/10/1995	--	37.08	16.01	--	21.07	<50	<0.50	<0.50	<0.50	<1.0	--	8.6	ATI	--	
6/29/1995	--	37.08	17.54	--	19.54	<50	<0.50	<0.50	<0.50	<1.0	--	6.3	ATI	--	
9/18/1995	--	37.08	19.65	--	17.43	--	--	--	--	--	--	--	--	--	
9/19/1995	--	37.08	--	--	--	<50	<0.50	<0.50	<0.50	<1.0	25	8.3	ATI	--	
12/7/1995	--	37.08	20.35	--	16.73	<50	<0.50	<0.50	<0.50	<1.0	16	4.7	ATI	--	
3/28/1996	--	37.08	14.99	--	22.09	<50	<0.5	<1	<1	<1	<10	4.0	SPL	--	
6/20/1996	--	37.08	15.59	--	21.49	<50	<0.5	<1	<1	<1	<10	4.6	SPL	--	
10/11/1996	--	37.08	19.09	--	17.99	<50	<0.5	<1.0	<1.0	<1.0	<10	5.3	SPL	--	
1/2/1997	--	37.08	15.11	--	21.97	<50	<0.5	<1.0	<1.0	<1.0	<10	5.5	SPL	--	
4/14/1997	--	37.08	16.25	--	20.83	<50	<0.5	<1.0	<1.0	<1.0	<10	3.9	SPL	--	
7/2/1997	--	37.08	17.99	--	19.09	<50	<0.5	<1.0	<1.0	<1.0	<10	5.2	SPL	--	
9/30/1997	--	37.08	20.5	--	16.58	<50	<0.5	<1.0	<1.0	<1.0	<10	6.0	SPL	--	
1/21/1998	--	37.08	15.72	--	21.36	160	<0.5	<1.0	<1.0	<1.0	110	5.0	SPL	--	
4/9/1998	--	37.08	13.31	--	23.77	--	--	--	--	--	--	--	--	--	
4/10/1998	--	37.08	--	--	--	370	<0.5	<1.0	<1.0	<1.0	300	4.3	SPL	--	
6/19/1998	--	37.08	15.18	--	21.9	830	2	<1.0	<1.0	<1.0	690	4.0	SPL	--	
11/30/1998	--	37.08	--	--	--	--	--	--	--	--	--	--	--	--	f
1/21/1999	--	37.08	15.78	--	21.3	2,300	<1.0	<1.0	<1.0	<1.0	1,900	--	SPL	--	
4/30/1999	--	37.08	16.01	--	21.07	--	--	--	--	--	--	--	--	--	
7/9/1999	--	37.08	17.63	--	19.45	--	--	--	--	--	--	--	--	--	
11/3/1999	--	37.08	18.42	--	18.66	--	--	--	--	--	--	--	--	--	
1/12/2000	--	37.08	19.92	--	17.16	<50	<0.5	<0.5	<0.5	<0.5	2,700	--	PACE	--	
4/13/2000	--	37.08	19.87	--	17.21	--	--	--	--	--	--	--	--	--	
7/26/2000	--	37.08	19.99	--	17.09	--	--	--	--	--	--	--	--	--	
10/24/2000	--	37.08	18.12	--	18.96	--	--	--	--	--	--	--	--	--	
1/19/2001	--	37.08	17.04	--	20.04	2,700	<0.5	<0.5	<0.5	<0.5	4,850	--	PACE	--	
7/24/2001	--	37.08	17.83	--	19.25	--	--	--	--	--	--	--	--	--	
1/18/2002	--	37.08	15.54	--	21.54	5,500	614	<0.5	<0.5	<1.0	5,390	--	PACE	--	
8/1/2002	--	37.08	16.98	--	20.1	--	--	--	--	--	--	--	--	--	
1/16/2003	--	37.08	15.05	--	22.03	2,900	<20	<20	<20	63	2,500	--	SEQ	--	p
7/7/2003	--	37.08	16.58	--	20.5	--	--	--	--	--	--	--	--	--	

Table 1. Summary of Ground-Water Monitoring Data: Relative Water Elevations and Laboratory Analyses

Station #11133, 2220 98th Ave., Oakland, CA

Well and Sample Date	P/NP	TOC Elevation (feet msl)	Depth to Water (feet bgs)	Product Thickness (feet)	Water Level Elevation (feet msl)	Concentrations in (µg/L)						(mg/L) DO	Lab	pH	Comments
						GRO/TPHg	Benzene	Toluene	Ethyl-Benzene	Total Xylenes	MTBE				
AW-6 Cont.															
02/05/2004	--	37.08	15.84	--	21.24	7,000	<50	<50	<50	<50	5,400	--	SEQM	6.7	
07/01/2004	P	37.08	17.91	--	19.17	9,600	<50	<50	<50	<50	4,600	--	SEQM	6.5	
03/16/2005	P	37.08	16.04	--	21.04	6,700	<25	<25	<25	<25	4,400	3.0	SEQM	6.8	
07/22/2005	P	37.08	14.20	--	22.88	<5,000	<50	<50	<50	<50	5,500	--	SEQM	6.7	
01/25/2006	P	37.08	14.17	--	22.91	<5,000	<50	<50	<50	<50	3,000	--	SEQM	7.0	
7/6/2006	P	37.08	14.82	--	22.26	3,100	<50	<50	<50	<50	2,800	--	TAMC	6.5	
AW-7															
4/5/1991	--	37.60	23.38	--	14.22	<50	0.4	0.7	<0.3	<0.3	--	--	SUP	--	
4/1/1992	--	37.60	21.92	--	15.68	--	--	--	--	--	--	--	--	--	
4/2/1992	--	37.60	--	--	--	<50	<0.5	3.2	1	5.4	--	--	APP	--	
7/6/1992	--	37.60	24.5	--	13.1	<50	<0.5	<0.5	<0.5	<0.5	--	--	ANA	--	
10/7/1992	--	37.60	26.18	--	11.42	<50	<0.5	<0.5	<0.5	<0.5	--	--	ANA	--	
1/14/1993	--	37.60	22.03	--	15.57	<50	<0.5	<0.5	<0.5	<0.5	--	--	PACE	--	m
4/22/1993	--	37.60	21.18	--	16.42	<50	<0.5	<0.5	<0.5	<0.5	--	--	PACE	--	m
7/15/1993	--	37.60	22.09	--	15.51	<50	<0.5	<0.5	<0.5	<0.5	<5.0	--	PACE	--	m
10/21/1993	--	37.60	24.05	--	13.55	51	5	4.2	3.5	8.2	<5.0	--	PACE	--	m
1/27/1994	--	37.60	23.4	--	14.2	<50	<0.5	<0.5	<0.5	<0.5	<5.0	--	PACE	--	m
4/21/1994	--	37.60	22.24	--	15.36	<50	<0.5	<0.5	<0.5	<0.5	<5.0	2.5	PACE	--	m
9/9/1994	--	37.60	22.94	--	14.66	<50	<0.5	<0.5	<0.5	0.5	--	4.3	PACE	--	m
12/21/1994	--	37.60	20.86	--	16.74	<50	<0.5	<0.5	<0.5	<0.5	<5.0	2.2	PACE	--	m
1/30/1995	--	37.60	17.51	--	20.09	<50	<0.50	<0.50	<0.50	<1.0	--	2.7	ATI	--	
4/10/1995	--	37.60	16.69	--	20.91	<50	<0.50	<0.50	<0.50	<1.0	--	4.8	ATI	--	
6/29/1995	--	37.60	18.33	--	19.27	<50	<0.50	<0.50	<0.50	<1.0	--	7.6	ATI	--	
9/18/1995	--	37.60	20.68	--	16.92	--	--	--	--	--	--	--	--	--	
9/19/1995	--	37.60	--	--	--	<50	<0.50	<0.50	<0.50	<1.0	<5.0	5.1	ATI	--	
12/7/1995	--	37.60	22.15	--	15.45	<50	<0.50	<0.50	<0.50	<1.0	<5.0	5.2	ATI	--	
3/28/1996	--	37.60	16.38	--	21.22	<50	<0.5	<1	<1	<1	<10	3.9	SPL	--	
6/20/1996	--	37.60	17.02	--	20.58	<50	<0.5	<1	<1	<1	<10	5.0	SPL	--	
10/11/1996	--	37.60	20.47	--	17.13	<50	<0.5	<1.0	<1.0	<1.0	<10	6.3	SPL	--	
1/2/1997	--	37.60	16.7	--	20.9	<50	<0.5	<1.0	<1.0	<1.0	<10	6.2	SPL	--	

Table 1. Summary of Ground-Water Monitoring Data: Relative Water Elevations and Laboratory Analyses
Station #11133, 2220 98th Ave., Oakland, CA

Well and Sample Date	P/NP	TOC Elevation (feet msl)	Depth to Water (feet bgs)	Product Thickness (feet)	Water Level Elevation (feet msl)	Concentrations in (µg/L)						(mg/L) DO	Lab	pH	Comments
						GRO/TPHg	Benzene	Toluene	Ethyl-Benzene	Total Xylenes	MTBE				
AW-7 Cont.															
4/14/1997	--	37.60	17.96	--	19.64	<50	<0.5	<1.0	<1.0	<1.0	<10	5.0	SPL	--	
7/2/1997	--	37.60	19.11	--	18.49	<50	<0.5	<1.0	<1.0	<1.0	<10	5.4	SPL	--	
9/30/1997	--	37.60	22.97	--	14.63	<250	<2.5	<5.0	<5.0	<5.0	1,100	6.5	SPL	--	
1/21/1998	--	37.60	16.5	--	21.1	<50	<0.5	<1.0	<1.0	<1.0	<10	4.9	SPL	--	
4/9/1998	--	37.60	13.56	--	24.04	<50	<0.5	<1.0	<1.0	<1.0	<10	4.9	SPL	--	
6/19/1998	--	37.60	15.41	--	22.19	<50	<0.5	<1.0	<1.0	<1.0	<10	4.4	SPL	--	
11/30/1998	--	37.60	18.9	--	18.7	--	--	--	--	--	--	--	--	--	
1/21/1999	--	37.60	18.39	--	19.21	--	--	--	--	--	--	--	--	--	
4/30/1999	--	37.60	18.54	--	19.06	--	--	--	--	--	--	--	--	--	
7/9/1999	--	37.60	17.98	--	19.62	--	--	--	--	--	--	--	--	--	
11/3/1999	--	37.60	20.22	--	17.38	--	--	--	--	--	--	--	--	--	
1/12/2000	--	37.60	19.46	--	18.14	--	--	--	--	--	--	--	--	--	
4/13/2000	--	37.60	19.59	--	18.01	--	--	--	--	--	--	--	--	--	
7/26/2000	--	37.60	19.69	--	17.91	--	--	--	--	--	--	--	--	--	
10/24/2000	--	37.60	18.78	--	18.82	--	--	--	--	--	--	--	--	--	
1/19/2001	--	37.60	--	--	--	--	--	--	--	--	--	--	--	--	f
7/25/2001	--	37.60	--	--	--	--	--	--	--	--	--	--	--	--	f
1/18/2002	--	37.60	--	--	--	--	--	--	--	--	--	--	--	--	o
8/1/2002	--	37.60	--	--	--	--	--	--	--	--	--	--	--	--	o
1/16/2003	--	37.60	--	--	--	--	--	--	--	--	--	--	--	--	o
7/7/2003	--	37.60	--	--	--	--	--	--	--	--	--	--	--	--	o
02/05/2004	--	37.60	--	--	--	--	--	--	--	--	--	--	--	--	o
07/01/2004	--	37.60	--	--	--	--	--	--	--	--	--	--	--	--	o
03/16/2005	--	37.60	--	--	--	--	--	--	--	--	--	--	--	--	o
07/22/2005	--	37.60	--	--	--	--	--	--	--	--	--	--	--	--	o
01/25/2006	--	37.60	--	--	--	--	--	--	--	--	--	--	--	--	o
AW-8															
4/5/1991	--	40.86	26.68	--	14.18	80	1.9	2.2	0.5	1.3	--	--	SUP	--	
4/1/1992	--	40.86	25.11	--	15.75	73	<0.5	0.7	<0.5	0.6	--	--	APP	--	
7/6/1992	--	40.86	26.43	--	14.43	<50	<0.5	<0.5	<0.5	<0.5	--	--	ANA	--	

Table 1. Summary of Ground-Water Monitoring Data: Relative Water Elevations and Laboratory Analyses
Station #11133, 2220 98th Ave., Oakland, CA

Well and Sample Date	P/NP	TOC Elevation (feet msl)	Depth to Water (feet bgs)	Product Thickness (feet)	Water Level Elevation (feet msl)	Concentrations in (µg/L)						(mg/L) DO	Lab	pH	Comments
						GRO/TPHg	Benzene	Toluene	Ethyl-Benzene	Total Xylenes	MTBE				
AW-8 Cont.															
10/7/1992	--	40.86	28.59	--	12.27	<50	<0.5	<0.5	<0.5	<0.5	--	--	ANA	--	
1/14/1993	--	40.86	25.55	--	15.31	<50	<0.5	<0.5	<0.5	<0.5	--	--	PACE	--	m
4/22/1993	--	40.86	22.29	--	18.57	<50	<0.5	<0.5	<0.5	<0.5	--	--	PACE	--	m
7/15/1993	--	40.86	23.42	--	17.44	<50	<0.5	<0.5	<0.5	<0.5	<5.0	--	PACE	--	m
10/21/1993	--	40.86	25.15	--	15.71	<50	1.9	1.8	1.3	3.3	<5.0	--	PACE	--	m
1/27/1994	--	40.86	25.42	--	15.44	<50	<0.5	0.5	0.6	8.5	<5.0	--	PACE	--	m
4/21/1994	--	40.86	24.14	--	16.72	<50	<0.5	<0.5	<0.5	<0.5	<5.0	1.5	PACE	--	m
9/9/1994	--	40.86	24.55	--	16.31	<50	<0.5	<0.5	<0.5	<0.5	--	2.4	PACE	--	m
12/21/1994	--	40.86	22.72	--	18.14	<50	<0.5	<0.5	<0.5	<0.5	<5.0	1.1	PACE	--	m
1/30/1995	--	40.86	19.75	--	21.11	<50	<0.50	1	<0.50	1	--	0.8	ATI	--	
4/10/1995	--	40.86	17.78	--	23.08	<50	<0.50	<0.50	<0.50	<1.0	--	8.3	ATI	--	
6/29/1995	--	40.86	18.18	--	22.68	<50	<0.50	<0.50	<0.50	<1.0	--	8.3	ATI	--	
9/18/1995	--	40.86	20.2	--	20.66	--	--	--	--	--	--	--	--	--	
9/19/1995	--	40.86	--	--	--	<50	<0.50	<0.50	<0.50	<1.0	<5.0	7.7	ATI	--	
12/7/1995	--	40.86	21.54	--	19.32	<50	<0.50	<0.50	<0.50	<1.0	<5.0	4.4	ATI	--	
3/28/1996	--	40.86	15.77	--	25.09	<50	<0.5	<1	<1	<1	<10	3.8	SPL	--	
6/20/1996	--	40.86	16.41	--	24.45	<50	<0.5	<1	<1	<1	<10	3.6	SPL	--	
10/11/1996	--	40.86	19.9	--	20.96	<50	<0.5	<1.0	<1.0	<1.0	<10	6.4	SPL	--	
1/2/1997	--	40.86	15.89	--	24.97	<50	<0.5	<1.0	<1.0	<1.0	<10	5.9	SPL	--	
4/14/1997	--	40.86	17.07	--	23.79	<50	<0.5	<1.0	<1.0	<1.0	<10	4.6	SPL	--	
7/2/1997	--	40.86	18.67	--	22.19	<50	<0.5	<1.0	<1.0	<1.0	<10	5.6	SPL	--	
9/30/1997	--	40.86	22.52	--	18.34	<50	<5	<10	<10	<10	820	6.7	SPL	--	
1/21/1998	--	40.86	16.01	--	24.85	<50	<0.5	<1.0	<1.0	<1.0	<10	5.2	SPL	--	
4/9/1998	--	40.86	11.18	--	29.68	<50	<0.5	<1.0	<1.0	<1.0	<10	4.4	SPL	--	
6/19/1998	--	40.86	13.01	--	27.85	<50	<0.5	<1.0	<1.0	<1.0	<10	4.1	SPL	--	
11/30/1998	--	40.86	17.46	--	23.4	--	--	--	--	--	--	--	--	--	
1/21/1999	--	40.86	17.47	--	23.39	--	--	--	--	--	--	--	--	--	
4/30/1999	--	40.86	17.6	--	23.26	--	--	--	--	--	--	--	--	--	
7/9/1999	--	40.86	16.5	--	24.36	--	--	--	--	--	--	--	--	--	
11/3/1999	--	40.86	19.29	--	21.57	--	--	--	--	--	--	--	--	--	
1/12/2000	--	40.86	21.49	--	19.37	--	--	--	--	--	--	--	--	--	

Table 1. Summary of Ground-Water Monitoring Data: Relative Water Elevations and Laboratory Analyses

Station #11133, 2220 98th Ave., Oakland, CA

Well and Sample Date	P/NP	TOC Elevation (feet msl)	Depth to Water (feet bgs)	Product Thickness (feet)	Water Level Elevation (feet msl)	Concentrations in (µg/L)						(mg/L) DO	Lab	pH	Comments
						GRO/TPHg	Benzene	Toluene	Ethyl-Benzene	Total Xylenes	MTBE				
AW-8 Cont.															
4/13/2000	--	40.86	21.6	--	19.26	--	--	--	--	--	--	--	--	--	
7/26/2000	--	40.86	21.53	--	19.33	--	--	--	--	--	--	--	--	--	
10/24/2000	--	40.86	19.37	--	21.49	--	--	--	--	--	--	--	--	--	
1/19/2001	--	40.86	18.6	--	22.26	--	--	--	--	--	--	--	--	--	
7/24/2001	--	40.86	18.22	--	22.64	--	--	--	--	--	--	--	--	--	
1/18/2002	--	40.86	16.29	--	24.57	--	--	--	--	--	--	--	--	--	
8/1/2002	--	40.86	17.25	--	23.61	--	--	--	--	--	--	--	--	--	
1/16/2003	--	40.86	15.82	--	25.04	--	--	--	--	--	--	--	--	--	
7/7/2003	--	40.86	18.55	--	22.31	--	--	--	--	--	--	--	--	--	
02/05/2004	--	40.86	--	--	--	--	--	--	--	--	--	--	--	--	t
07/01/2004	--	40.86	18.25	--	22.61	--	--	--	--	--	--	--	--	--	t
03/16/2005	P	40.86	15.20	--	25.66	<50	<0.50	<0.50	<0.50	<0.50	<0.50	1.5	SEQM	7.3	
07/22/2005	--	40.86	--	--	--	--	--	--	--	--	--	--	--	--	f
01/25/2006	--	40.86	--	--	--	--	--	--	--	--	--	--	--	--	f
7/6/2006	--	40.86	13.05	--	27.81	--	--	--	--	--	--	--	--	--	
AW-9															
1/2/1997	--	37.78	10	--	27.78	<50	<0.5	<1.0	<1.0	<1.0	<10	6.7	SPL	--	
4/14/1997	--	37.78	--	--	--	--	--	--	--	--	--	--	--	--	f
7/2/1997	--	37.78	12.71	--	25.07	<50	<0.5	<1.0	<1.0	<1.0	<10	6.0	SPL	--	
9/30/1997	--	37.78	21.22	--	16.56	<50	<0.5	<1.0	<1.0	<1.0	<10	6.8	SPL	--	
1/21/1998	--	37.78	10.26	--	27.52	<50	<0.5	<1.0	<1.0	<1.0	<10	5.3	SPL	--	
4/9/1998	--	37.78	6.77	--	31.01	<50	<0.5	<1.0	<1.0	<1.0	<10	5.6	SPL	--	
6/19/1998	--	37.78	8.96	--	28.82	<50	<0.5	<1.0	<1.0	<1.0	<10	4.8	SPL	--	
MW-1															
4/5/1991	--	34.46	--	--	--	--	--	--	--	--	--	--	--	--	
4/1/1992	--	34.46	11.25	--	23.2	--	--	--	--	--	--	--	--	--	
7/6/1992	--	34.46	13.61	--	20.83	--	--	--	--	--	--	--	--	--	
10/7/1992	--	34.46	15.15	--	19.22	--	--	--	--	--	--	--	--	--	
1/14/1993	--	34.46	10.73	--	23.72	--	--	--	--	--	--	--	--	--	

Table 1. Summary of Ground-Water Monitoring Data: Relative Water Elevations and Laboratory Analyses
Station #11133, 2220 98th Ave., Oakland, CA

Well and Sample Date	P/NP	TOC Elevation (feet msl)	Depth to Water (feet bgs)	Product Thickness (feet)	Water Level Elevation (feet msl)	Concentrations in (µg/L)						(mg/L) DO	Lab	pH	Comments
						GRO/TPHg	Benzene	Toluene	Ethyl-Benzene	Total Xylenes	MTBE				
MW-1 Cont.															
4/22/1993	--	34.46	11.64	--	22.66	--	--	--	--	--	--	--	--	--	
7/15/1993	--	34.46	13.5	--	19.85	--	--	--	--	--	--	--	--	--	
10/21/1993	--	34.46	15.21	--	18.25	--	--	--	--	--	--	--	--	--	
1/27/1994	--	34.46	17.48	--	16.17	--	--	--	--	--	--	--	--	--	
4/21/1994	--	34.46	10.94	--	23.52	110,000	1,400	9,100	3,400	30,000	11,000	1.6	PACE	--	c
9/9/1994	--	34.46	13.8	--	20.66	--	--	--	--	--	--	--	--	--	
12/21/1994	--	34.46	12.6	--	21.84	--	--	--	--	--	--	--	--	--	
1/30/1995	--	34.46	--	--	--	--	--	--	--	--	--	--	--	--	
4/10/1995	--	34.46	10.62	--	23.84	--	--	--	--	--	--	--	--	--	
6/29/1995	--	34.46	18.72	--	15.74	--	--	--	--	--	--	--	--	--	
9/18/1995	--	34.46	12.92	--	21.54	--	--	--	--	--	--	--	--	--	
12/7/1995	--	34.46	13.82	--	20.64	--	--	--	--	--	--	--	--	--	
3/28/1996	--	34.46	10.03	--	24.42	--	--	--	--	--	--	--	--	--	
6/20/1996	--	34.46	11.29	--	23.15	--	--	--	--	--	--	--	--	--	
10/11/1996	--	34.46	14.86	--	19.59	--	--	--	--	--	--	--	--	--	
1/2/1997	--	34.46	11.03	--	23.42	--	--	--	--	--	--	--	--	--	
4/14/1997	--	34.46	12.25	--	22.2	--	--	--	--	--	--	--	--	--	
4/15/1997	--	34.46	--	--	--	35,000	130	650	1,700	8,200	4,800	--	SPL	--	
7/2/1997	--	34.46	14.11	--	20.35	42,000	<250	<500	2,000	9,600	<5000	5.5	SPL	--	
9/30/1997	--	34.46	14.4	--	20.06	61,000	130	1,100	2,700	14,600	2,000	6.7	SPL	--	
1/21/1998	--	34.46	7.99	--	26.46	14,000	11	60	310	1,790	1,300	4.5	SPL	--	
4/9/1998	--	34.46	7.89	--	26.57	--	--	--	--	--	--	--	--	--	
4/10/1998	--	34.46	--	--	--	45,000	380	520	2,100	6,800	9,300	5.3	SPL	--	
6/19/1998	--	34.46	10.31	--	24.15	35,000	170	100	1,100	3,590	5,000	4.9	SPL	--	
11/30/1998	--	34.46	11.16	--	23.3	10,000	100	24	350	1,040	1800/2800	--	SPL	--	g
1/21/1999	--	34.46	10.76	--	23.7	18,000	120	37	590	1,800	2,700	--	SPL	--	
4/30/1999	--	34.46	10.78	--	23.68	17,000	240	89	1,100	1,900	1,600	--	SPL	--	
7/9/1999	--	34.46	12.62	--	21.84	58,000	140	100	1,800	6,900	1,200	--	SPL	--	
11/3/1999	--	34.46	14	--	20.46	20,000	62	42	620	2,100	630	--	PACE	--	
1/12/2000	--	34.46	15.25	--	19.21	72,000	110	120	2,400	8,200	630	--	PACE	--	
4/13/2000	--	34.46	15.57	--	18.89	37,000	300	32	1,000	1,700	810	--	PACE	--	

Table 1. Summary of Ground-Water Monitoring Data: Relative Water Elevations and Laboratory Analyses

Station #11133, 2220 98th Ave., Oakland, CA

Well and Sample Date	P/NP	TOC Elevation (feet msl)	Depth to Water (feet bgs)	Product Thickness (feet)	Water Level Elevation (feet msl)	Concentrations in (µg/L)						(mg/L) DO	Lab	pH	Comments
						GRO/TPHg	Benzene	Toluene	Ethyl-Benzene	Total Xylenes	MTBE				
MW-1 Cont.															
5/24/2000	--	34.46	11.75	--	22.71	--	--	--	--	--	--	--	--	--	--
6/1/2000	--	34.46	11.41	--	23.05	--	--	--	--	--	--	--	--	--	--
6/8/2000	--	34.46	11.68	--	22.78	--	--	--	--	--	--	--	--	--	--
6/15/2000	--	34.46	11.85	--	22.61	--	--	--	--	--	--	--	--	--	--
7/26/2000	--	34.46	16.19	--	18.27	10,000	480	210	470	710	1,100	--	PACE	--	--
10/24/2000	--	34.46	13.89	--	20.57	9,900	31	7.2	550	1,200	4,400	--	PACE	--	--
1/19/2001	--	34.46	12.9	--	21.56	57,000	199	7.66	1,170	3,260	514	--	PACE	--	--
7/24/2001	--	34.46	13.55	--	20.91	27,000	96.7	<5.0	548	1,460	285	--	PACE	--	--
1/18/2002	--	34.46	10.91	--	23.55	25,000	150	31.5	597	1,040	138	--	PACE	--	--
8/1/2002	--	34.46	12.97	--	21.49	25,000	80.2	17.7	714	1,280	489	--	PACE	--	--
1/16/2003	--	34.46	10.45	--	24.01	22,000	170	110	630	670	<500	--	SEQ	--	p
7/7/2003	--	34.46	12.4	--	22.06	9,900	42	<5.0	160	150	24	--	SEQ	--	q, u
02/05/2004	--	34.46	10.26	--	24.20	6,200	56	11	250	210	9.2	--	SEQM	6.9	--
07/01/2004	--	34.46	13.20	--	21.26	18,000	<50	<50	210	300	<50	--	SEQM	--	u
03/16/2005	P	34.46	9.62	--	24.84	7,600	33	5.4	200	130	<5.0	0.9	SEQM	6.9	--
07/22/2005	P	34.46	11.23	--	23.23	15,000	<10	<10	110	130	<10	--	SEQM	6.8	u
01/25/2006	P	34.46	8.75	--	25.71	8,300	8.4	4.8	130	120	<2.5	--	SEQM	7.3	u
7/6/2006	P	34.46	10.36	--	24.10	5,100	<2.5	<2.5	16	12	<2.5	--	TAMC	6.9	--
MW-2															
4/5/1991	--	35.50	16.62	--	18.88	<50	0.6	0.9	<0.3	<0.3	--	--	SUP	--	--
4/1/1992	--	35.50	11.25	--	24.25	--	--	--	--	--	--	--	--	--	--
4/2/1992	--	35.50	--	--	--	<50	<0.5	<0.5	<0.5	<0.5	--	--	APP	--	--
7/6/1992	--	35.50	12.72	--	22.78	<50	<0.5	<0.5	<0.5	<0.5	--	--	ANA	--	--
10/7/1992	--	35.50	15.08	--	20.42	<50	<0.5	1.8	<0.5	2.3	--	--	ANA	--	--
1/14/1993	--	35.50	9.69	--	25.81	<50	<0.5	<0.5	<0.5	<0.5	--	--	PACE	--	m
4/22/1993	--	35.50	10.46	--	25.04	<50	<0.5	<0.5	<0.5	<0.5	30	--	PACE	--	c
7/15/1993	--	35.50	12.02	--	23.48	<50	<0.5	<0.5	<0.5	<0.5	21.7	--	PACE	--	c, m
10/21/1993	--	35.50	13.12	--	22.38	<50	0.7	0.9	<0.5	0.9	14.9	--	PACE	--	m
1/27/1994	--	35.50	12.01	--	23.49	<50	0.6	<0.5	<0.5	<0.5	11.5	--	PACE	--	m
4/21/1994	--	35.50	10.6	--	24.9	<50	<0.5	<0.5	<0.5	<0.5	11.4	1.1	PACE	--	m

Table 1. Summary of Ground-Water Monitoring Data: Relative Water Elevations and Laboratory Analyses

Station #11133, 2220 98th Ave., Oakland, CA

Well and Sample Date	P/NP	TOC Elevation (feet msl)	Depth to Water (feet bgs)	Product Thickness (feet)	Water Level Elevation (feet msl)	Concentrations in (µg/L)						(mg/L) DO	Lab	pH	Comments
						GRO/TPHg	Benzene	Toluene	Ethyl-Benzene	Total Xylenes	MTBE				
MW-2 Cont.															
9/9/1994	--	35.50	12.42	--	23.08	<50	<0.5	<0.5	<0.5	0.6	--	2.2	PACE	--	m
12/21/1994	--	35.50	10.85	--	24.65	<50	<0.5	<0.5	<0.5	<0.5	<5.0	1.2	PACE	--	m
1/30/1995	--	35.50	8.38	--	27.12	<50	<0.50	<0.50	<0.50	<1.0	--	1.7	ATI	--	
4/10/1995	--	35.50	9	--	26.5	<50	<0.50	<0.50	<0.50	<1.0	--	7.8	ATI	--	
6/29/1995	--	35.50	9.91	--	25.59	<50	<0.50	<0.50	<0.50	<1.0	--	9.1	ATI	--	
9/18/1995	--	35.50	10.98	--	24.52	--	--	--	--	--	--	--	--	--	
9/19/1995	--	35.50	--	--	--	<50	<0.50	<0.50	<0.50	<1.0	<5.0	7.2	ATI	--	
12/7/1995	--	35.50	12.3	--	23.2	<50	<0.50	<0.50	<0.50	<1.0	<5.0	2.4	ATI	--	
3/28/1996	--	35.50	8.57	--	26.93	<50	<0.5	<1	<1	<1	<10	3.2	SPL	--	
6/20/1996	--	35.50	9.77	--	25.73	<50	<0.5	<1	<1	<1	<10	4.2	SPL	--	
10/11/1996	--	35.50	13.32	--	22.18	<50	<0.5	<1.0	<1.0	<1.0	<10	6.3	SPL	--	
1/2/1997	--	35.50	9.6	--	25.9	<50	<0.5	<1.0	<1.0	<1.0	<10	6.7	SPL	--	
4/14/1997	--	35.50	10.93	--	24.57	<50	<0.5	<1.0	<1.0	<1.0	<10	5.7	SPL	--	
7/2/1997	--	35.50	12.57	--	22.93	<50	<0.5	<1.0	<1.0	<1.0	<10	5.9	SPL	--	
9/30/1997	--	35.50	12.91	--	22.59	<50	<0.5	<1.0	<1.0	<1.0	<10	6.3	SPL	--	
1/21/1998	--	35.50	10.12	--	25.38	160	<0.5	<1.0	<1.0	<1.0	100	5.4	SPL	--	
4/9/1998	--	35.50	6.82	--	28.68	--	--	--	--	--	--	--	--	--	
4/10/1998	--	35.50	--	--	--	<50	1	<1.0	<1.0	<1.0	23	5.0	SPL	--	
6/19/1998	--	35.50	9	--	26.5	<50	<0.5	<1.0	<1.0	<1.0	<10	4.9	SPL	--	
11/30/1998	--	35.50	9.44	--	26.06	--	--	--	--	--	--	--	--	--	
1/21/1999	--	35.50	8.96	--	26.54	<50	<1.0	<1.0	<1.0	<1.0	1.9	--	SPL	--	
4/30/1999	--	35.50	9.15	--	26.35	--	--	--	--	--	--	--	--	--	
7/9/1999	--	35.50	10.82	--	24.68	--	--	--	--	--	--	--	--	--	
11/3/1999	--	35.50	11.86	--	23.64	--	--	--	--	--	--	--	--	--	
1/12/2000	--	35.50	12.35	--	23.15	<50	<0.5	<0.5	<0.5	<0.5	<0.5	--	PACE	--	
4/13/2000	--	35.50	13.01	--	22.49	--	--	--	--	--	--	--	--	--	
7/26/2000	--	35.50	13.01	--	22.49	--	--	--	--	--	--	--	--	--	
10/24/2000	--	35.50	11.57	--	23.93	--	--	--	--	--	--	--	--	--	
1/19/2001	--	35.50	10.52	--	24.98	--	--	--	--	--	--	--	--	--	
7/24/2001	--	35.50	11.13	--	24.37	--	--	--	--	--	--	--	--	--	
1/18/2002	--	35.50	8.85	--	26.65	--	--	--	--	--	--	--	--	--	

Table 1. Summary of Ground-Water Monitoring Data: Relative Water Elevations and Laboratory Analyses
Station #11133, 2220 98th Ave., Oakland, CA

Well and Sample Date	P/NP	TOC Elevation (feet msl)	Depth to Water (feet bgs)	Product Thickness (feet)	Water Level Elevation (feet msl)	Concentrations in (µg/L)						(mg/L) DO	Lab	pH	Comments
						GRO/TPHg	Benzene	Toluene	Ethyl-Benzene	Total Xylenes	MTBE				
MW-2 Cont.															
8/1/2002	--	35.50	10.47	--	25.03	--	--	--	--	--	--	--	--	--	--
1/14/2003	--	35.50	8.49	--	27.01	--	--	--	--	--	--	--	--	--	--
7/7/2003	--	35.50	9.63	--	25.87	--	--	--	--	--	--	--	--	--	--
02/05/2004	--	35.50	8.40	--	27.10	--	--	--	--	--	--	--	--	--	--
07/01/2004	NP	35.50	9.94	--	25.56	--	--	--	--	--	--	--	--	--	--
03/16/2005	P	35.50	8.39	--	27.11	<50	<0.50	<0.50	<0.50	<0.50	<0.50	1.3	SEQM	7.1	
07/22/2005	--	35.50	8.80	--	26.70	--	--	--	--	--	--	--	--	--	--
01/25/2006	--	35.50	7.85	--	27.65	--	--	--	--	--	--	--	--	--	--
7/6/2006	--	35.50	8.33	--	27.17	--	--	--	--	--	--	--	--	--	--
MW-3															
4/5/1991	--	36.53	17.84	--	18.69	<50	<0.3	<0.3	<0.3	<0.3	--	--	SUP	--	--
4/1/1992	--	36.53	15.64	--	20.89	--	--	--	--	--	--	--	--	--	--
4/2/1992	--	36.53	--	--	--	<50	1.4	<0.5	<0.5	<0.5	--	--	APP	--	--
7/6/1992	--	36.53	19.03	--	17.5	<50	<0.5	<0.5	<0.5	<0.5	--	--	ANA	--	--
10/7/1992	--	36.53	21.83	--	14.7	<50	<0.5	<0.5	<0.5	<0.5	--	--	ANA	--	--
1/14/1993	--	36.53	15.96	--	20.57	350	<0.5	<0.5	<0.5	<0.5	714	--	PACE	--	c, m
4/22/1993	--	36.53	16.2	--	20.33	2,800	<0.5	<0.5	<0.5	<0.5	3,600	--	PACE	--	c, m
7/15/1993	--	36.53	16.82	--	19.71	1,400	1.2	<0.5	2	3.5	2,204	--	PACE	--	c, m
10/21/1993	--	36.53	18.84	--	17.69	370	2.1	2.3	2.3	6	847	--	PACE	--	c, m
1/27/1994	--	36.53	18	--	18.53	1,300	6.3	<0.5	<0.5	<0.5	3,892	--	PACE	--	c, m
4/21/1994	--	36.53	16.62	--	19.91	2,000	<0.5	<0.5	<0.5	<0.5	3,864	1.4	PACE	--	c, m
9/9/1994	--	36.53	18.38	--	18.15	1,300	<0.5	<0.5	0.5	1.2	--	3.0	PACE	--	m
12/21/1994	--	36.53	15.28	--	21.25	420	16	0.7	3.5	5.9	800	1.9	PACE	--	m
1/30/1995	--	36.53	12.62	--	23.91	<50	<0.50	<0.50	<0.50	<1.0	--	2.5	ATI	--	
4/10/1995	--	36.53	12.41	--	24.12	150	<0.50	<0.50	<0.50	<1.0	--	6.9	ATI	--	
6/29/1995	--	36.53	14.95	--	21.58	100	<0.50	<0.50	<0.50	<1.0	--	6.4	ATI	--	d (TPH-g)
9/18/1995	--	36.53	15.82	--	20.71	--	--	--	--	--	--	--	--	--	--
9/19/1995	--	36.53	--	--	--	82	<0.50	<0.50	<0.50	<1.0	260	7.0	ATI	--	
12/7/1995	--	36.53	17.09	--	19.44	<50	<0.50	<0.50	<0.50	<1.0	91	4.5	ATI	--	
3/28/1996	--	36.53	11.9	--	24.63	<50	<0.5	<1	<1	<1	230	4.2	SPL	--	

Table 1. Summary of Ground-Water Monitoring Data: Relative Water Elevations and Laboratory Analyses
Station #11133, 2220 98th Ave., Oakland, CA

Well and Sample Date	P/NP	TOC Elevation (feet msl)	Depth to Water (feet bgs)	Product Thickness (feet)	Water Level Elevation (feet msl)	Concentrations in (µg/L)						(mg/L) DO	Lab	pH	Comments
						GRO/TPHg	Benzene	Toluene	Ethyl-Benzene	Total Xylenes	MTBE				
MW-3 Cont.															
6/20/1996	--	36.53	12.66	--	23.87	260	<0.5	<1	<1	<1	370	4.4	SPL	--	
10/11/1996	--	36.53	16.23	--	20.3	330	<0.5	<1.0	<1.0	<1.0	440	5.8	SPL	--	
1/2/1997	--	36.53	12.17	--	24.36	<50	<0.5	<1.0	<1.0	<1.0	140	6.0	SPL	--	
4/14/1997	--	36.53	13.45	--	23.08	--	--	--	--	--	--	--	--	--	
4/15/1997	--	36.53	--	--	--	1,500	<0.5	<1.0	<1.0	<1.0	1,800	5.6	SPL	--	
7/2/1997	--	36.53	15.6	--	20.93	880	<0.5	<1.0	<1.0	<1.0	940	5.3	SPL	--	
9/30/1997	--	36.53	17.16	--	19.37	40,000	13,000	2,400	870	3,100	510	6.6	SPL	--	
1/21/1998	--	36.53	11.77	--	24.76	120	<0.5	<1.0	<1.0	<1.0	98	4.7	SPL	--	
4/9/1998	--	36.53	9.42	--	27.11	950	<0.5	<1.0	<1.0	<1.0	890	5.7	SPL	--	
6/19/1998	--	36.53	12.09	--	24.44	1,800	<0.5	<1.0	<1.0	<1.0	1,900	4.7	SPL	--	
6/19/1998	--	36.53	15.28	--	21.25	1,800	<0.5	<1.0	<1.0	<1.0	1,900	4.7	SPL	--	
1/21/1999	--	36.53	14.67	--	21.86	1,100	<1.0	<1.0	<1.0	<1.0	1,200	--	SPL	--	
4/30/1999	--	36.53	16	--	20.53	--	--	--	--	--	--	--	--	--	
7/9/1999	--	36.53	14.64	--	21.89	470	<1.0	<1.0	<1.0	<1.0	460/470	--	SPL	--	eg
11/3/1999	--	36.53	16.39	--	20.14	--	--	--	--	--	--	--	--	--	
1/12/2000	--	36.53	16.8	--	19.73	<50	<0.5	<0.5	<0.5	<0.5	34	--	PACE	--	
4/13/2000	--	36.53	16.43	--	20.1	--	--	--	--	--	--	--	--	--	
7/26/2000	--	36.53	16.93	--	19.6	<50	<0.5	<0.5	<0.5	<0.5	<0.5	--	PACE	--	
10/24/2000	--	36.53	15.69	--	20.84	--	--	--	--	--	--	--	--	--	
1/19/2001	--	36.53	14.84	--	21.69	<50	<0.5	<0.5	<0.5	1	25.9	--	PACE	--	
7/23/2001	--	36.53	15.11	--	21.42	62	<0.5	<0.5	<0.5	<1.5	28.7	--	PACE	--	
1/18/2002	--	36.53	12.37	--	24.16	<50	<0.5	<0.5	<0.5	<1.0	17.8	--	PACE	--	
8/1/2002	--	36.53	14.44	--	22.09	66	<0.5	<0.5	<0.5	<1.0	<0.5	--	PACE	--	
1/16/2003	--	36.53	12.07	--	24.46	<50	<0.50	<0.50	<0.50	<0.50	20	--	SEQ	--	p
7/7/2003	--	36.53	13.9	--	22.63	<50	<0.50	<0.50	<0.50	<0.50	8.8	--	SEQ	--	q
02/05/2004	--	36.53	12.60	--	23.93	<50	<0.50	<0.50	<0.50	<0.50	4.6	--	SEQM	7.0	
07/01/2004	--	36.53	14.57	--	21.96	<50	<0.50	<0.50	<0.50	<0.50	3.3	--	SEQM	--	
03/16/2005	P	36.53	11.03	--	25.50	<50	<0.50	<0.50	<0.50	<0.50	4.4	1.5	SEQM	6.8	
07/22/2005	P	36.53	12.68	--	23.85	<50	<0.50	<0.50	<0.50	<0.50	4.1	--	SEQM	6.8	
01/25/2006	P	36.53	11.35	--	25.18	81	<0.50	<0.50	<0.50	<0.50	3.0	--	SEQM	6.9	
7/6/2006	P	36.53	11.47	--	25.06	<50	<0.50	<0.50	<0.50	<0.50	3.0	--	TAMC	6.9	

Table 1. Summary of Ground-Water Monitoring Data: Relative Water Elevations and Laboratory Analyses

Station #11133, 2220 98th Ave., Oakland, CA

Well and Sample Date	P/NP	TOC Elevation (feet msl)	Depth to Water (feet bgs)	Product Thickness (feet)	Water Level Elevation (feet msl)	Concentrations in (µg/L)						(mg/L) DO	Lab	pH	Comments
						GRO/TPHg	Benzene	Toluene	Ethyl-Benzene	Total Xylenes	MTBE				
MW-3															
QC-2															
10/7/1992	--	37.73	--	--	--	<50	<0.5	<0.5	<0.5	<0.5	--	--	ANA	--	i
1/14/1993	--	37.73	--	--	--	<50	<0.5	<0.5	<0.5	<0.5	--	--	PACE	--	i, m
4/22/1993	--	37.73	--	--	--	<50	<0.5	<0.5	<0.5	<0.5	--	--	PACE	--	i, m
7/15/1993	--	37.73	--	--	--	<50	<0.5	<0.5	<0.5	<0.5	<5.0	--	PACE	--	i, m
10/21/1993	--	37.73	--	--	--	<50	<0.5	<0.5	<0.5	<0.5	--	--	PACE	--	i
1/27/1994	--	37.73	--	--	--	<50	<0.5	<0.5	<0.5	<0.5	--	--	PACE	--	i
4/21/1994	--	37.73	--	--	--	<50	<0.5	<0.5	<0.5	<0.5	--	--	PACE	--	i
9/9/1994	--	37.73	--	--	--	<50	<0.5	<0.5	<0.5	<0.5	--	--	PACE	--	i
12/21/1994	--	37.73	--	--	--	<50	<0.5	<0.5	<0.5	<0.5	--	--	PACE	--	i
1/30/1995	--	37.73	--	--	--	<50	<0.50	<0.50	<0.50	<1.0	--	--	ATI	--	i
4/10/1995	--	37.73	--	--	--	<50	<0.50	<0.50	<0.50	<1.0	--	--	ATI	--	i
6/27/1995	--	37.73	--	--	--	<50	<0.50	<0.50	<0.50	<1.0	--	--	ATI	--	i
9/19/1995	--	37.73	--	--	--	<50	<0.50	<0.50	<0.50	<1.0	<5.0	--	ATI	--	i
12/7/1995	--	37.73	--	--	--	<50	<0.50	<0.50	<0.50	<1.0	<5.0	--	ATI	--	i
3/28/1996	--	37.73	--	--	--	<50	<0.5	<1	<1	<1	<10	--	SPL	--	i
6/20/1996	--	37.73	--	--	--	<50	<0.5	<1	<1	<1	<10	--	SPL	--	i
RW-1															
4/5/1991	--	37.73	--	--	--	--	--	--	--	--	--	--	--	--	--
4/1/1992	--	37.73	22.81	--	14.62	--	--	--	--	--	--	--	--	--	--
7/6/1992	--	37.73	26.92	--	10.4	--	--	--	--	--	--	--	--	--	--
10/7/1992	--	37.73	28.51	--	7.96	--	--	--	--	--	--	--	--	--	--
1/14/1993	--	37.73	23.75	--	13.73	--	--	--	--	--	--	--	--	--	--
4/22/1993	--	37.73	22.7	--	13.65	--	--	--	--	--	--	--	--	--	--
7/15/1993	--	37.73	26.1	--	10.82	--	--	--	--	--	--	--	--	--	--
10/21/1993	--	37.73	25.4	--	11.84	--	--	--	--	--	--	--	--	--	--
1/27/1994	--	37.73	28.02	--	9.34	--	--	--	--	--	--	--	--	--	--
4/21/1994	--	37.73	23.1	--	13.72	--	--	--	--	--	--	--	--	--	--
9/9/1994	--	37.73	24.39	--	12.3	--	--	--	--	--	--	--	--	--	--

Table 1. Summary of Ground-Water Monitoring Data: Relative Water Elevations and Laboratory Analyses
Station #11133, 2220 98th Ave., Oakland, CA

Well and Sample Date	P/NP	TOC Elevation (feet msl)	Depth to Water (feet bgs)	Product Thickness (feet)	Water Level Elevation (feet msl)	Concentrations in (µg/L)						(mg/L) DO	Lab	pH	Comments
						GRO/TPHg	Benzene	Toluene	Ethyl-Benzene	Total Xylenes	MTBE				
RW-1 Cont.															
12/21/1994	--	37.73	--	--	--	--	--	--	--	--	--	--	--	--	h
12/7/1995	--	37.73	25.71	--	10.98	150,000	34,000	35,000	4,300	21,000	2,700	--	ATI	--	
3/28/1996	--	37.73	16.75	--	20.8	--	--	--	--	--	--	--	--	--	
6/20/1996	--	37.73	25.1	--	12.61	--	--	--	--	--	--	--	--	--	h
10/11/1996	--	37.73	25.51	--	12.22	130,000	20,000	32,000	2,800	20,700	1400/1200	7.4	SPL	--	g
1/2/1997	--	37.73	24.49	--	13.23	--	--	--	--	--	--	--	--	--	
4/14/1997	--	37.73	23.99	--	13.7	--	--	--	--	--	--	--	--	--	
4/15/1997	--	37.73	--	--	--	1,800,000	38,000	190,000	48,000	281,000	<25000	--	SPL	--	
7/2/1997	--	37.73	--	--	--	130,000	19,000	54,000	4,700	33,400	<10000	--	SPL	--	e
7/2/1997	--	37.73	16.4	--	21.13	140,000	19,000	55,000	4,400	32,400	<10000	5.7	SPL	--	
9/30/1997	--	37.73	--	--	--	140,000	17,000	29,000	2,500	15,900	1,200	--	SPL	--	e
9/30/1997	--	37.73	27.97	--	9.74	110,000	13,000	22,000	2,000	12,500	1,100	7.0	SPL	--	
1/21/1998	--	37.73	14.14	--	23.15	270,000	21,000	48,000	3,500	25,000	1,100	4.8	SPL	--	
4/9/1998	--	37.73	25.01	--	12.67	--	--	--	--	--	--	--	--	--	
4/10/1998	--	37.73	--	--	--	220,000	26,000	46,000	4,400	24,500	<2500	5.1	SPL	--	
6/19/1998	--	37.73	11.43	--	26.3	180,000	19,000	32,000	3,000	17,400	<2500	4.6	SPL	--	
11/30/1998	--	37.73	7.87	--	29.86	--	--	--	--	--	--	--	--	--	
1/21/1999	--	37.73	18.9	--	18.8	260,000	24,000	46,000	5,100	30,000	1,700	--	SPL	--	
7/9/1999	--	37.73	18.58	--	18.89	--	--	--	--	--	--	--	--	--	
11/3/1999	--	37.73	20.85	--	16.28	160,000	19,000	37,000	3,800	25,000	1,500	--	PACE	--	
1/12/2000	--	37.73	21.2	--	16.3	240,000	18,000	46,000	5,800	26,000	2,100	--	PACE	--	
4/13/2000	--	37.73	21.71	--	15.91	120,000	2,100	33,000	2,800	28,000	1,500	--	PACE	--	
5/24/2000	--	37.73	21.89	--	15.6	--	--	--	--	--	--	--	--	--	
6/1/2000	--	37.73	16.3	--	21.42	--	--	--	--	--	--	--	--	--	
6/8/2000	--	37.73	17.88	--	19.65	--	--	--	--	--	--	--	--	--	
6/15/2000	--	37.73	16.72	--	20.97	--	--	--	--	--	--	--	--	--	
6/20/2000	--	37.73	21.04	--	16.49	--	--	--	--	--	--	--	--	--	
7/7/2000	--	37.73	17.21	--	20.51	--	--	--	--	--	--	--	--	--	
7/20/2000	--	37.73	21.87	--	15.68	--	--	--	--	--	--	--	--	--	
7/26/2000	--	37.73	21.45	--	16.15	67,000	160	5,300	2,100	18,000	1,100	--	PACE	--	
7/31/2000	--	37.73	22.11	--	15.62	--	--	--	--	--	--	--	--	--	

Table 1. Summary of Ground-Water Monitoring Data: Relative Water Elevations and Laboratory Analyses

Station #11133, 2220 98th Ave., Oakland, CA

Well and Sample Date	P/NP	TOC Elevation (feet msl)	Depth to Water (feet bgs)	Product Thickness (feet)	Water Level Elevation (feet msl)	Concentrations in (µg/L)						(mg/L) DO	Lab	pH	Comments
						GRO/TPHg	Benzene	Toluene	Ethyl-Benzene	Total Xylenes	MTBE				
RW-1 Cont.															
8/8/2000	--	37.73	17.8	--	19.92	--	--	--	--	--	--	--	--	--	--
8/16/2000	--	37.73	17.92	--	19.81	--	--	--	--	--	--	--	--	--	--
8/23/2000	--	37.73	18.11	--	19.6	--	--	--	--	--	--	--	--	--	--
10/24/2000	--	37.73	18.93	--	18.8	--	--	--	--	--	--	--	--	--	--
10/25/2000	--	37.73	19.04	--	18.69	360,000	18,000	78,000	34,000	180,000	2,100	--	PACE	--	k
1/19/2001	--	37.73	18.19	--	19.49	110,000	9,450	19,600	3,510	21,100	1,270	--	PACE	--	--
7/24/2001	--	37.73	17.93	--	19.8	--	--	--	--	--	--	--	--	--	l
1/18/2002	--	37.73	14.87	--	22.86	63,000	2,060	4,370	1,770	13,900	491	--	PACE	--	--
8/1/2002	--	37.73	16.84	--	20.89	60,000	1,210	2,200	1,520	10,600	390	--	PACE	--	--
1/16/2003	--	37.73	14.42	--	23.31	34,000	2,500	2,700	780	5,300	680	--	SEQ	--	p
7/7/2003	--	37.73	16.11	--	21.62	50,000	640	280	1,600	10,000	<250	--	SEQ	--	q, u
07/01/2004	P	37.73	16.75	--	20.98	47,000	320	87	1,900	7,500	72	--	SEQM	6.7	--
03/16/2005	P	37.73	12.48	--	25.25	17,000	28	23	350	590	53	1.0	SEQM	6.8	--
07/22/2005	P	37.73	14.40	--	23.34	5,900	50	35	120	220	51	--	SEQM	6.7	u
01/25/2006	P	37.73	12.00	--	25.73	7,000	22	5.9	190	--	34	--	SEQM	7.1	--
7/6/2006	P	37.73	13.01	--	24.72	16,000	37	14	470	230	64	--	TAMC	6.8	--
VEW-4															
07/22/2005	P	--	14.04	--	--	680	41	24	20	67	<0.50	--	SEQM	6.8	--
VEW-5															
07/22/2005	--	--	--	--	--	--	--	--	--	--	--	--	--	--	v
VEW-8															
07/22/2005	P	--	14.24	--	--	<50	<0.50	<0.50	<0.50	<0.50	<0.50	--	SEQM	6.8	--

ABBREVIATIONS & SYMBOLS:

-- = Not analyzed/applicable/measured/available
< = Not detected at or above specified laboratory reporting limit
DO = Dissolved oxygen
DTW = Depth to water in ft bgs
ft bgs = Feet below ground surface
ft MSL = Feet above mean sea level
GRO = Gasoline range organics
GWE = Groundwater elevation in ft MSL
mg/L = Milligrams per liter
MTBE = Methyl tert-butyl ether
NP = Well not purged prior to sampling
P = Well purged prior to sampling
TOC = Top of casing in ft MSL
TPH-g = Total petroleum hydrocarbons as gasoline
µg/L = Micrograms per liter
ANA = Anamatrix, Inc.
PACE = Pace, Inc.
ATI = Analytical Technologies, Inc.
CEI = Ceimic Corporation
SPL = Southern Petroleum Laboratories
SEQ/SEQM= Sequoia Analytical/Sequoia Analytical Morgan Hill Laboratories

FOOTNOTES:

c = A copy of the documentation for this data is included in Appendix C of Alistoreport 10-025-13-003.
d = MTBE peak. See documentation in Appendix C of Alisto report 10-025-13-003.
e = Blind duplicate.
f = Well inaccessible.
g = EPA Methods 8020/8260 used.
h = Well not monitored and/or sampled due to vapor extraction system.
i = Travel blank.
j = This gasoline does not include MTBE.
k = Well was sampled on a different date from the other wells due to lack of proper equipment.
l = Unable to sample due to nature of product.
m = A copy of the documentation for this data is included in Blaine Tech Services, Inc., Report 010724-B-2. The data for sampling events January 14, 1993 and April 22, 1993 has been destroyed. No chromatograms could be located for samples AW-2 on January 27, 1994, and for samples AW-1, AW-2, AW-3, AW-4, AW-5, AW-6, AW-7, AW-8, MW-2 and MW-3 on September 9, 1994.
n = On June 1, 2001, after reviewing chromatograms, Sequoia reported the value as <5.0.
o = Unable to locate well.
p = TPH-g data analyzed by EPA Method 8015B modified; BTEX and MTBE by EPA Method 8021B
q = TPH-g, BTEX, and MTBE analyzed by EPA method 8260B beginning on the third quarter 2003 sampling event 07/07/03.
r = Discrete peak at C5.
t = Well was not gauged during the quarter due to an oversight by the technician.
u = Sheen in well.
v = Well was dry.

NOTES:

Beginning in the fourth quarter 2003, the laboratory modified the reported analyte list. TPH-g was changed to GRO. The resulting data may be impacted by the potential of non-TPH-g analytes within the requested fuel range resulting in a higher concentration being reported.

Beginning in the second quarter 2004, the carbon range for GRO was changed from C6-C10 to C4-C12.

Values for DO and pH were obtained through field measurements.

GWEs adjusted assuming a specific gravity of 0.75 for free product

Note: The data within this table collected prior to April 2006 was provided to Broadbent & Associates, Inc. by Atlantic Richfield Company and their previous consultants. Broadbent & Associates, Inc. has not verified the accuracy of this information.

Table 2. Summary of Fuel Additives Analytical Data
Station #11133, 2220 98th Ave., Oakland, CA

Well and Sample Date	Concentrations in (µg/L)								Comments
	Ethanol	TBA	MTBE	DIPE	ETBE	TAME	1,2-DCA	EDB	
AW-1									
7/7/2003	<5,000	<1,000	1,100	<25	<25	190	--	--	
02/05/2004	<10,000	<2,000	930	<50	<50	160	<50	<50	
07/01/2004	<5,000	<1,000	1,100	<25	<25	170	<25	<25	
03/16/2005	<5,000	<1,000	720	<25	<25	130	<25	<25	
07/22/2005	<1,000	<200	510	<5.0	<5.0	93	31	<5.0	
01/25/2006	<6,000	<400	490	<10	<10	94	21	<10	
7/6/2006	<6,000	<400	270	<10	<10	49	<10	<10	
AW-2									
02/05/2004	<100	<20	5.1	<0.50	<0.50	<0.50	<0.50	<0.50	
03/16/2005	<100	<20	<0.50	<0.50	<0.50	<0.50	<0.50	<0.50	
01/25/2006	<600	<40	12	<1.0	<1.0	1.0	<1.0	<1.0	
AW-3									
03/16/2005	<100	<20	<0.50	<0.50	<0.50	<0.50	<0.50	<0.50	
AW-4									
7/7/2003	<1,000	<200	56	<5.0	<5.0	<5.0	--	--	
02/05/2004	<200	<40	40	<1.0	<1.0	3.7	<1.0	<1.0	
07/01/2004	<1,000	<200	64	<5.0	<5.0	9.6	<5.0	<5.0	
03/16/2005	<500	<100	23	<2.5	<2.5	<2.5	<2.5	<2.5	
07/22/2005	<2,000	<400	59	<10	<10	<10	<10	<10	
01/25/2006	<3,000	<200	12	<5.0	<5.0	<5.0	<5.0	<5.0	
7/6/2006	<3,000	<5.0	39	<5.0	<5.0	<5.0	<5.0	<5.0	
AW-5									
7/7/2003	<2,000	1,200	980	<10	<10	210	--	--	
02/05/2004	<2,000	1,200	810	<10	<10	160	<10	<10	
07/01/2004	<1,000	1,600	550	<5.0	<5.0	94	<5.0	<5.0	
03/16/2005	<10,000	2,100	890	<50	<50	190	<50	<50	
07/22/2005	<1,000	370	390	<5.0	<5.0	78	<5.0	<5.0	
01/25/2006	<3,000	580	26	<5.0	<5.0	5.2	<5.0	<5.0	
7/6/2006	<3,000	240	170	<5.0	<5.0	37	<5.0	<5.0	

Table 2. Summary of Fuel Additives Analytical Data
Station #11133, 2220 98th Ave., Oakland, CA

Well and Sample Date	Concentrations in (µg/L)								Comments
	Ethanol	TBA	MTBE	DIPE	ETBE	TAME	1,2-DCA	EDB	
AW-6									
02/05/2004	<10,000	<2,000	5,400	<50	<50	1,800	<50	<50	
07/01/2004	<10,000	<2,000	4,600	<50	<50	1,600	<50	<50	
03/16/2005	<5,000	<1,000	4,400	<25	<25	1,400	<25	<25	
07/22/2005	<10,000	<2,000	5,500	<50	<50	1,400	<50	<50	
01/25/2006	<30,000	<2,000	3,000	<50	<50	940	<50	<50	
7/6/2006	<30,000	<2,000	2,800	<50	<50	780	<50	<50	
AW-7									
AW-8									
03/16/2005	<100	<20	<0.50	<0.50	<0.50	<0.50	<0.50	<0.50	a
MW-1									
7/7/2003	<1,000	<200	24	<5.0	<5.0	<5.0	--	--	
02/05/2004	<1,000	<200	9.2	<5.0	<5.0	<5.0	<5.0	<5.0	
07/01/2004	<10,000	<2,000	<50	<50	<50	<50	<50	<50	
03/16/2005	<1,000	<200	<5.0	<5.0	<5.0	<5.0	<5.0	<5.0	
07/22/2005	<2,000	<400	<10	<10	<10	<10	<10	<10	
01/25/2006	<1,500	<100	<2.5	<2.5	<2.5	<2.5	<2.5	<2.5	
7/6/2006	<1,500	<100	<2.5	<2.5	<2.5	<2.5	<2.5	<2.5	
MW-2									
03/16/2005	<100	<20	<0.50	<0.50	<0.50	<0.50	<0.50	<0.50	
MW-3									
7/7/2003	<100	<20	8.8	<0.50	<0.50	0.65	--	--	
02/05/2004	<100	<20	4.6	<0.50	<0.50	<0.50	<0.50	<0.50	
07/01/2004	<100	<20	3.3	<0.50	<0.50	<0.50	<0.50	<0.50	
03/16/2005	<100	<20	4.4	<0.50	<0.50	<0.50	<0.50	<0.50	
07/22/2005	<100	<20	4.1	<0.50	<0.50	<0.50	<0.50	<0.50	
01/25/2006	<300	<20	3.0	<0.50	<0.50	<0.50	<0.50	<0.50	
7/6/2006	<300	<50	3.0	<0.50	<0.50	<0.50	<0.50	<0.50	
RW-1									

Table 2. Summary of Fuel Additives Analytical Data
Station #11133, 2220 98th Ave., Oakland, CA

Well and Sample Date	Concentrations in (µg/L)								Comments
	Ethanol	TBA	MTBE	DIPE	ETBE	TAME	1,2-DCA	EDB	
RW-1 Cont.									
7/7/2003	<50,000	<10,000	<250	<250	<250	<250	--	--	
07/01/2004	<10,000	<2,000	72	<50	<50	<50	<50	<50	
03/16/2005	<2,000	<400	53	<10	<10	<10	<10	<10	
07/22/2005	<500	<100	51	<2.5	<2.5	5.6	<2.5	<2.5	
01/25/2006	<3,000	<200	34	<5.0	<5.0	<5.0	<5.0	<5.0	
7/6/2006	<6,000	<400	64	<10	<10	<10	<10	<10	
VEW-4									
07/22/2005	<100	<20	<0.50	<0.50	<0.50	<0.50	<0.50	<0.50	
VEW-5									
VEW-8									
07/22/2005	<100	<20	<0.50	<0.50	<0.50	<0.50	<0.50	<0.50	

ABBREVIATIONS & SYMBOLS:

-- = Not analyzed/applicable/measured/available

< = Not detected at or above specified laboratory reporting limit

1,2-DCA = 1,2-Dichloroethane

DIPE = Di-isopropyl ether

EDB = 1,2-Dibromoethane

ETBE = Ethyl tert-butyl ether

MTBE = Methyl tert-butyl ether

TAME = tert-Amyl methyl ether

TBA = tert-Butyl alcohol

µg/L = Micrograms per Liter

FOOTNOTES:

a = Calibration verification for ethanol is within method limits but outside contractual limits.

NOTES:

All volatile organic compounds analyzed using EPA Method 8260B.

Note: The data within this table collected prior to April 2006 was provided to Broadbent & Associates, Inc. by Atlantic Richfield Company and their previous consultants. Broadbent & Associates, Inc. has not verified the accuracy of this information.

APPENDIX A

URS GROUND-WATER SAMPLING DATA PACKAGE (INCLUDES LABORATORY
REPORT AND CHAIN OF CUSTODY DOCUMENTATION, FIELD AND
LABORATORY PROCEDURES, AND FIELD DATA SHEETS)



July 31, 2006

Mr. Rob Miller
Broadbent & Associates, Inc.
2000 Kirman Avenue
Reno, NV 89502

Groundwater Sampling Data Package
Former BP Service Station #11133
2220 98th Avenue
Oakland, CA
Field Work Performed: 07/06/06

General Information

Data Submittal Prepared/Reviewed by: Alok Kolekar

Phone Number: 510-874-3152

On-Site Supplier Representative: Blaine Tech

Scope of Work Performed: Groundwater Monitoring in accordance with 3rd Quarter 2006 protocols as identified in the Quarterly Monitoring Program Table in the Field and Laboratory Procedures Attachment.

Variations from Work Scope: Well AW-7 could not be located. Therefore, it was not gauged or sampled.

This submittal presents the tabulation of data collected in association with routine groundwater monitoring. The attachments include, at a minimum, sampling procedures, field data collected, laboratory results, chain of custody documentation, and waste management activities. The information is being provided to BP-ARCO's Scoping Supplier for use in preparing a report for regulatory submittal. This submittal is limited to presentation of collected data and does not include data interpretation or conclusions or recommendations. Any questions concerning this submittal should be addressed to the Preparer/Reviewer identified above.

Alok D. Kolekar, P.E.
Project Manager

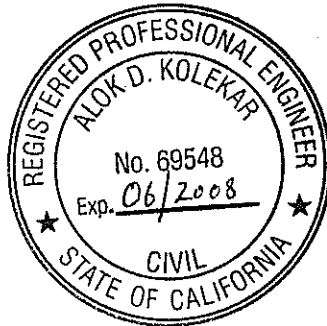

cc: Paul Supple, Atlantic Richfield Company (RM), electronic copy uploaded to ENFOS

URS Corporation
1333 Broadway, Suite 800
Oakland, CA 94612-1924
Tel: 510.893.3600
Fax: 510.874.3268



Attachments

Field and Laboratory Procedures

Laboratory Report

Chain of Custody Documentation

Field Data Sheets

Well Gauging Data

Well Monitoring Data Sheets

FIELD & LABORATORY PROCEDURES

Sampling Procedures

The sampling procedure for each well consists first of measuring the water level and depth to bottom, and checking for the presence of free phase petroleum product (free product), using either an electronic indicator and a clear Teflon™ bailer or an oil-water interface probe. Wells not containing free product are purged approximately three casing volumes of water (or until dewatered) using a centrifugal pump, gas displacement pump, or bailer. Equipment and purging method used for the current sampling event is noted on the attached field data sheets. During purging, temperature, pH, and electrical conductivity are monitored to document that these parameters are stable prior to collecting samples. After purging, water levels are allowed to partially (approximately 80%) recover. Groundwater samples (both purge and no purge) are collected using a Teflon bailer, placed into appropriate Environmental Protection Agency- (EPA) approved containers, labeled, logged onto chain-of-custody records, and transported on ice to a California State-certified laboratory. Wells with free product are not sampled and free product is removed according to California Code of Regulation, Title 23, Div. 3, Chap. 16, Section 2655, UST Regulations.

Laboratory Procedures

The groundwater samples were analyzed for the presence of the chemicals mentioned in the chain of custody using standard EPA methods. The methods of analysis for the groundwater samples are documented in the certified analytical report. The certified analytical reports and chain-of-custody record are presented in this attachment. The analytical data provided by the laboratory approved by RM have been reviewed and verified by that laboratory.

21 July, 2006

Alok Kolekar
URS Corporation [Arco]
1333 Broadway, Suite 800
Oakland, CA 94612

RE: BP Heritage #11133, Oakland, CA
Work Order: MPG0146

Enclosed are the results of analyses for samples received by the laboratory on 07/07/06 18:30. If you have any questions concerning this report, please feel free to contact me.

Sincerely,



Lisa Race
Senior Project Manager

CA ELAP Certificate # 1210

The results in this laboratory report pertain only to the samples tested in the laboratory. The analyses contained in this report were performed in accordance with the BPGCLN Technical Specifications, applicable Federal, State, local regulations and certification requirements as well as the methodologies as described in laboratory SOPs reviewed by the BPGCLN. This entire report was reviewed and approved for release.

URS Corporation [Arco] 1333 Broadway, Suite 800 Oakland CA, 94612	Project: BP Heritage #11133, Oakland, CA Project Number: G07TT-0034 Project Manager: Alok Kolekar	MPG0146 Reported: 07/21/06 15:24
---	---	--

ANALYTICAL REPORT FOR SAMPLES

Sample ID	Laboratory ID	Matrix	Date Sampled	Date Received
MW-1	MPG0146-01	Water	07/06/06 13:30	07/07/06 18:30
MW-3	MPG0146-02	Water	07/06/06 12:35	07/07/06 18:30
AW-1	MPG0146-03	Water	07/06/06 14:45	07/07/06 18:30
AW-4	MPG0146-04	Water	07/06/06 11:25	07/07/06 18:30
AW-5	MPG0146-05	Water	07/06/06 13:00	07/07/06 18:30
AW-6	MPG0146-06	Water	07/06/06 13:45	07/07/06 18:30
RW-1	MPG0146-07	Water	07/06/06 15:00	07/07/06 18:30
TB-11133-07062006	MPG0146-08	Water	07/06/06 00:00	07/07/06 18:30

The carbon range for the TPH-GRO has been changed from C6-C10 to C4-C12. The carbon range for TPH-DRO has been changed from C10-C28 to C10-C36. EPA 8015B has been modified to better meet the requirements of California regulatory agencies.

These samples were received with no custody seals.

URS Corporation [Arco] 1333 Broadway, Suite 800 Oakland CA, 94612	Project: BP Heritage #11133, Oakland, CA Project Number: G07TT-0034 Project Manager: Alok Kolekar	MPG0146 Reported: 07/21/06 15:24
---	---	--

Total Purgeable Hydrocarbons by GC/MS (CA LUFT)
TestAmerica - Morgan Hill, CA

Analyte	Result	Reporting Limit	Units	Dilution	Batch	Prepared	Analyzed	Method	Notes
MW-1 (MPG0146-01) Water Sampled: 07/06/06 13:30 Received: 07/07/06 18:30									
Gasoline Range Organics (C4-C12)	5100	250	ug/l	5	6G13006	07/13/06	07/13/06	LUFT GCMS	
Surrogate: 1,2-Dichloroethane-d4		106 %	60-145		"	"	"	"	
MW-3 (MPG0146-02) Water Sampled: 07/06/06 12:35 Received: 07/07/06 18:30									
Gasoline Range Organics (C4-C12)	ND	50	ug/l	1	6G13006	07/13/06	07/13/06	LUFT GCMS	
Surrogate: 1,2-Dichloroethane-d4		99 %	60-145		"	"	"	"	
AW-1 (MPG0146-03) Water Sampled: 07/06/06 14:45 Received: 07/07/06 18:30									
Gasoline Range Organics (C4-C12)	6200	1000	ug/l	20	6G13006	07/13/06	07/13/06	LUFT GCMS	
Surrogate: 1,2-Dichloroethane-d4		101 %	60-145		"	"	"	"	
AW-4 (MPG0146-04) Water Sampled: 07/06/06 11:25 Received: 07/07/06 18:30									
Gasoline Range Organics (C4-C12)	2800	500	ug/l	10	6G13006	07/13/06	07/13/06	LUFT GCMS	
Surrogate: 1,2-Dichloroethane-d4		93 %	60-145		"	"	"	"	
AW-5 (MPG0146-05) Water Sampled: 07/06/06 13:00 Received: 07/07/06 18:30									
Gasoline Range Organics (C4-C12)	220	50	ug/l	1	6G14007	07/14/06	07/14/06	LUFT GCMS	
Surrogate: 1,2-Dichloroethane-d4		110 %	60-145		"	"	"	"	
AW-6 (MPG0146-06) Water Sampled: 07/06/06 13:45 Received: 07/07/06 18:30									
Gasoline Range Organics (C4-C12)	3100	500	ug/l	10	6G14007	07/14/06	07/14/06	LUFT GCMS	
Surrogate: 1,2-Dichloroethane-d4		117 %	60-145		"	"	"	"	
RW-1 (MPG0146-07) Water Sampled: 07/06/06 15:00 Received: 07/07/06 18:30									
Gasoline Range Organics (C4-C12)	16000	1000	ug/l	20	6G13006	07/13/06	07/13/06	LUFT GCMS	
Surrogate: 1,2-Dichloroethane-d4		106 %	60-145		"	"	"	"	

URS Corporation [Arco]
1333 Broadway, Suite 800
Oakland CA, 94612

Project: BP Heritage #11133, Oakland, CA
Project Number: G07TT-0034
Project Manager: Alok Kolekar

MPG0146
Reported:
07/21/06 15:24

Volatile Organic Compounds by EPA Method 8260B

TestAmerica - Morgan Hill, CA

Analyte	Result	Reporting Limit	Units	Dilution	Batch	Prepared	Analyzed	Method	Notes
MW-1 (MPG0146-01) Water Sampled: 07/06/06 13:30 Received: 07/07/06 18:30									
tert-Amyl methyl ether	ND	2.5	ug/l	5	6G13006	07/13/06	07/13/06	EPA 8260B	
Benzene	ND	2.5	"	"	"	"	"	"	
tert-Butyl alcohol	ND	100	"	"	"	"	"	"	
Di-isopropyl ether	ND	2.5	"	"	"	"	"	"	
1,2-Dibromoethane (EDB)	ND	2.5	"	"	"	"	"	"	
1,2-Dichloroethane	ND	2.5	"	"	"	"	"	"	
Ethanol	ND	1500	"	"	"	"	"	"	
Ethyl tert-butyl ether	ND	2.5	"	"	"	"	"	"	
Ethylbenzene	16	2.5	"	"	"	"	"	"	
Methyl tert-butyl ether	ND	2.5	"	"	"	"	"	"	
Toluene	ND	2.5	"	"	"	"	"	"	
Xylenes (total)	12	2.5	"	"	"	"	"	"	
<i>Surrogate: 1,2-Dichloroethane-d4</i>		106 %	60-145	"	"	"	"	"	
<i>Surrogate: 4-Bromofluorobenzene</i>		101 %	60-115	"	"	"	"	"	
<i>Surrogate: Dibromofluoromethane</i>		96 %	75-130	"	"	"	"	"	
<i>Surrogate: Toluene-d8</i>		99 %	70-130	"	"	"	"	"	
MW-3 (MPG0146-02) Water Sampled: 07/06/06 12:35 Received: 07/07/06 18:30									
tert-Amyl methyl ether	ND	0.50	ug/l	1	6G13006	07/13/06	07/13/06	EPA 8260B	
Benzene	ND	0.50	"	"	"	"	"	"	
tert-Butyl alcohol	ND	5.0	"	"	"	"	"	"	
Di-isopropyl ether	ND	0.50	"	"	"	"	"	"	
1,2-Dibromoethane (EDB)	ND	0.50	"	"	"	"	"	"	
1,2-Dichloroethane	ND	0.50	"	"	"	"	"	"	
Ethanol	ND	300	"	"	"	"	"	"	
Ethyl tert-butyl ether	ND	0.50	"	"	"	"	"	"	
Ethylbenzene	ND	0.50	"	"	"	"	"	"	
Methyl tert-butyl ether	3.0	0.50	"	"	"	"	"	"	
Toluene	ND	0.50	"	"	"	"	"	"	
Xylenes (total)	ND	0.50	"	"	"	"	"	"	
<i>Surrogate: 1,2-Dichloroethane-d4</i>		99 %	60-145	"	"	"	"	"	
<i>Surrogate: 4-Bromofluorobenzene</i>		93 %	60-115	"	"	"	"	"	
<i>Surrogate: Dibromofluoromethane</i>		98 %	75-130	"	"	"	"	"	
<i>Surrogate: Toluene-d8</i>		95 %	70-130	"	"	"	"	"	

TestAmerica - Morgan Hill, CA

The results in this report apply to the samples analyzed in accordance with the chain of custody document. Unless otherwise stated, results are reported on a wet weight basis. This analytical report must be reproduced in its entirety.

URS Corporation [Arco]
1333 Broadway, Suite 800
Oakland CA, 94612

Project: BP Heritage #11133, Oakland, CA
Project Number: G07TT-0034
Project Manager: Alok Kolekar

MPG0146
Reported:
07/21/06 15:24

Volatile Organic Compounds by EPA Method 8260B
TestAmerica - Morgan Hill, CA

Analyte	Result	Reporting Limit	Units	Dilution	Batch	Prepared	Analyzed	Method	Notes
AW-1 (MPG0146-03) Water Sampled: 07/06/06 14:45 Received: 07/07/06 18:30									
tert-Amyl methyl ether	49	10	ug/l	20	6G13006	07/13/06	07/13/06	EPA 8260B	
Benzene	1300	10	"	"	"	"	"	"	
tert-Butyl alcohol	ND	400	"	"	"	"	"	"	
Di-isopropyl ether	ND	10	"	"	"	"	"	"	
1,2-Dibromoethane (EDB)	ND	10	"	"	"	"	"	"	
1,2-Dichloroethane	ND	10	"	"	"	"	"	"	
Ethanol	ND	6000	"	"	"	"	"	"	
Ethyl tert-butyl ether	ND	10	"	"	"	"	"	"	
Ethylbenzene	570	10	"	"	"	"	"	"	
Methyl tert-butyl ether	270	10	"	"	"	"	"	"	
Toluene	70	10	"	"	"	"	"	"	
Xylenes (total)	180	10	"	"	"	"	"	"	
Surrogate: 1,2-Dichloroethane-d4		101 %		60-145	"	"	"	"	
Surrogate: 4-Bromofluorobenzene		96 %		60-115	"	"	"	"	
Surrogate: Dibromofluoromethane		94 %		75-130	"	"	"	"	
Surrogate: Toluene-d8		97 %		70-130	"	"	"	"	
AW-4 (MPG0146-04) Water Sampled: 07/06/06 11:25 Received: 07/07/06 18:30									
tert-Amyl methyl ether	ND	5.0	ug/l	10	6G13006	07/13/06	07/13/06	EPA 8260B	
Benzene	430	5.0	"	"	"	"	"	"	
tert-Butyl alcohol	ND	200	"	"	"	"	"	"	
Di-isopropyl ether	ND	5.0	"	"	"	"	"	"	
1,2-Dibromoethane (EDB)	ND	5.0	"	"	"	"	"	"	
1,2-Dichloroethane	ND	5.0	"	"	"	"	"	"	
Ethanol	ND	3000	"	"	"	"	"	"	
Ethyl tert-butyl ether	ND	5.0	"	"	"	"	"	"	
Ethylbenzene	230	5.0	"	"	"	"	"	"	
Methyl tert-butyl ether	39	5.0	"	"	"	"	"	"	
Toluene	21	5.0	"	"	"	"	"	"	
Xylenes (total)	680	5.0	"	"	"	"	"	"	
Surrogate: 1,2-Dichloroethane-d4		93 %		60-145	"	"	"	"	
Surrogate: 4-Bromofluorobenzene		89 %		60-115	"	"	"	"	
Surrogate: Dibromofluoromethane		92 %		75-130	"	"	"	"	
Surrogate: Toluene-d8		93 %		70-130	"	"	"	"	

TestAmerica - Morgan Hill, CA

The results in this report apply to the samples analyzed in accordance with the chain of custody document. Unless otherwise stated, results are reported on a wet weight basis. This analytical report must be reproduced in its entirety.

URS Corporation [Arco]
1333 Broadway, Suite 800
Oakland CA, 94612

Project: BP Heritage #11133, Oakland, CA
Project Number: G07TT-0034
Project Manager: Alok Kolekar

MPG0146
Reported:
07/21/06 15:24

Volatile Organic Compounds by EPA Method 8260B
TestAmerica - Morgan Hill, CA

Analyte	Result	Reporting Limit	Units	Dilution	Batch	Prepared	Analyzed	Method	Notes
AW-5 (MPG0146-05) Water Sampled: 07/06/06 13:00 Received: 07/07/06 18:30									
tert-Amyl methyl ether	37	5.0	ug/l	10	6G13006	07/13/06	07/13/06	EPA 8260B	
Benzene	ND	5.0	"	"	"	"	"	"	
tert-Butyl alcohol	240	200	"	"	"	"	"	"	
Di-isopropyl ether	ND	5.0	"	"	"	"	"	"	
1,2-Dibromoethane (EDB)	ND	5.0	"	"	"	"	"	"	
1,2-Dichloroethane	ND	5.0	"	"	"	"	"	"	
Ethanol	ND	3000	"	"	"	"	"	"	
Ethyl tert-butyl ether	ND	5.0	"	"	"	"	"	"	
Ethylbenzene	ND	5.0	"	"	"	"	"	"	
Methyl tert-butyl ether	170	5.0	"	"	"	"	"	"	
Toluene	ND	5.0	"	"	"	"	"	"	
Xylenes (total)	ND	5.0	"	"	"	"	"	"	
<i>Surrogate: 1,2-Dichloroethane-d4</i>		94 %	60-145		"	"	"	"	
<i>Surrogate: 4-Bromofluorobenzene</i>		90 %	60-115		"	"	"	"	
<i>Surrogate: Dibromofluoromethane</i>		95 %	75-130		"	"	"	"	
<i>Surrogate: Toluene-d8</i>		94 %	70-130		"	"	"	"	
AW-6 (MPG0146-06) Water Sampled: 07/06/06 13:45 Received: 07/07/06 18:30									
tert-Amyl methyl ether	780	50	ug/l	100	6G13006	07/13/06	07/13/06	EPA 8260B	
Benzene	ND	50	"	"	"	"	"	"	
tert-Butyl alcohol	ND	2000	"	"	"	"	"	"	
Di-isopropyl ether	ND	50	"	"	"	"	"	"	
1,2-Dibromoethane (EDB)	ND	50	"	"	"	"	"	"	
1,2-Dichloroethane	ND	50	"	"	"	"	"	"	
Ethanol	ND	30000	"	"	"	"	"	"	
Ethyl tert-butyl ether	ND	50	"	"	"	"	"	"	
Ethylbenzene	ND	50	"	"	"	"	"	"	
Methyl tert-butyl ether	2800	50	"	"	"	"	"	"	
Toluene	ND	50	"	"	"	"	"	"	
Xylenes (total)	ND	50	"	"	"	"	"	"	
<i>Surrogate: 1,2-Dichloroethane-d4</i>		109 %	60-145		"	"	"	"	
<i>Surrogate: 4-Bromofluorobenzene</i>		97 %	60-115		"	"	"	"	
<i>Surrogate: Dibromofluoromethane</i>		97 %	75-130		"	"	"	"	
<i>Surrogate: Toluene-d8</i>		96 %	70-130		"	"	"	"	

TestAmerica - Morgan Hill, CA

The results in this report apply to the samples analyzed in accordance with the chain of custody document. Unless otherwise stated, results are reported on a wet weight basis. This analytical report must be reproduced in its entirety.

URS Corporation [Arco]
1333 Broadway, Suite 800
Oakland CA, 94612

Project: BP Heritage #11133, Oakland, CA
Project Number: G07TT-0034
Project Manager: Alok Kolekar

MPG0146
Reported:
07/21/06 15:24

Volatile Organic Compounds by EPA Method 8260B
TestAmerica - Morgan Hill, CA

Analyte	Result	Reporting Limit	Units	Dilution	Batch	Prepared	Analyzed	Method	Notes
RW-1 (MPG0146-07) Water Sampled: 07/06/06 15:00 Received: 07/07/06 18:30									
tert-Amyl methyl ether	ND	10	ug/l	20	6G13006	07/13/06	07/13/06	EPA 8260B	
Benzene	37	10	"	"	"	"	"	"	
tert-Butyl alcohol	ND	400	"	"	"	"	"	"	
Di-isopropyl ether	ND	10	"	"	"	"	"	"	
1,2-Dibromoethane (EDB)	ND	10	"	"	"	"	"	"	
1,2-Dichloroethane	ND	10	"	"	"	"	"	"	
Ethanol	ND	6000	"	"	"	"	"	"	
Ethyl tert-butyl ether	ND	10	"	"	"	"	"	"	
Ethylbenzene	470	10	"	"	"	"	"	"	
Methyl tert-butyl ether	64	10	"	"	"	"	"	"	
Toluene	14	10	"	"	"	"	"	"	
Xylenes (total)	230	10	"	"	"	"	"	"	
<i>Surrogate: 1,2-Dichloroethane-d4</i>		106 %		60-145	"	"	"	"	
<i>Surrogate: 4-Bromofluorobenzene</i>		96 %		60-115	"	"	"	"	
<i>Surrogate: Dibromofluoromethane</i>		96 %		75-130	"	"	"	"	
<i>Surrogate: Toluene-d8</i>		97 %		70-130	"	"	"	"	

URS Corporation [Arco] 1333 Broadway, Suite 800 Oakland CA, 94612	Project: BP Heritage #11133, Oakland, CA Project Number: G07TT-0034 Project Manager: Alok Kolekar	MPG0146 Reported: 07/21/06 15:24
---	---	--

Total Purgeable Hydrocarbons by GC/MS (CA LUFT) - Quality Control
TestAmerica - Morgan Hill, CA

Analyte	Result	Reporting Limit	Units	Spike Level	Source Result	%REC	%REC Limits	RPD	RPD Limit	Notes
---------	--------	-----------------	-------	-------------	---------------	------	-------------	-----	-----------	-------

Batch 6G13006 - EPA 5030B P/T / LUFT GCMS

Blank (6G13006-BLK1)		Prepared & Analyzed: 07/13/06								
Gasoline Range Organics (C4-C12)	ND	50	ug/l							
Surrogate: 1,2-Dichloroethane-d4	2.43		"	2.50		97	60-145			
Laboratory Control Sample (6G13006-BS2)		Prepared & Analyzed: 07/13/06								
Gasoline Range Organics (C4-C12)	247	50	ug/l	220		112	75-140			
Surrogate: 1,2-Dichloroethane-d4	2.53		"	2.50		101	60-145			
Matrix Spike (6G13006-MS1)		Source: MPG0146-02		Prepared & Analyzed: 07/13/06						
Gasoline Range Organics (C4-C12)	321	50	ug/l	400	16	76	75-140			
Surrogate: 1,2-Dichloroethane-d4	2.51		"	2.50		100	60-145			
Matrix Spike Dup (6G13006-MSD1)		Source: MPG0146-02		Prepared & Analyzed: 07/13/06						
Gasoline Range Organics (C4-C12)	290	50	ug/l	400	16	68	75-140	10	20	LN
Surrogate: 1,2-Dichloroethane-d4	2.37		"	2.50		95	60-145			

Batch 6G14007 - EPA 5030B P/T / LUFT GCMS

Blank (6G14007-BLK1)		Prepared & Analyzed: 07/14/06								
Gasoline Range Organics (C4-C12)	ND	50	ug/l							
Surrogate: 1,2-Dichloroethane-d4	5.22		"	5.00		104	60-145			
Laboratory Control Sample (6G14007-BS1)		Prepared & Analyzed: 07/14/06								
Gasoline Range Organics (C4-C12)	439	50	ug/l	440		100	75-140			
Surrogate: 1,2-Dichloroethane-d4	5.36		"	5.00		107	60-145			
Matrix Spike (6G14007-MS1)		Source: MPG0005-05		Prepared & Analyzed: 07/14/06						
Gasoline Range Organics (C4-C12)	7290	500	ug/l	4400	2900	100	75-140			
Surrogate: 1,2-Dichloroethane-d4	4.95		"	5.00		99	60-145			

URS Corporation [Arco] 1333 Broadway, Suite 800 Oakland CA, 94612	Project: BP Heritage #11133, Oakland, CA Project Number: G07TT-0034 Project Manager: Alok Kolekar	MPG0146 Reported: 07/21/06 15:24
---	---	--

Total Purgeable Hydrocarbons by GC/MS (CA LUFT) - Quality Control
TestAmerica - Morgan Hill, CA

Analyte	Result	Reporting Limit	Units	Spike Level	Source Result	%REC	%REC Limits	RPD	RPD Limit	Notes
---------	--------	-----------------	-------	-------------	---------------	------	-------------	-----	-----------	-------

Batch 6G14007 - EPA 5030B P/T / LUFT GCMS

Matrix Spike Dup (6G14007-MSD1)	Source: MPG0005-05			Prepared & Analyzed: 07/14/06						
Gasoline Range Organics (C4-C12)	7420	500	ug/l	4400	2900	103	75-140	2	20	
Surrogate: 1,2-Dichloroethane-d4	5.44		"	5.00		109	60-145			

URS Corporation [Arco]
1333 Broadway, Suite 800
Oakland CA, 94612

Project: BP Heritage #11133, Oakland, CA
Project Number: G07TT-0034
Project Manager: Alok Kolekar

MPG0146
Reported:
07/21/06 15:24

Volatile Organic Compounds by EPA Method 8260B - Quality Control
TestAmerica - Morgan Hill, CA

Analyte	Result	Reporting Limit	Units	Spike Level	Source Result	%REC	%REC Limits	RPD	RPD Limit	Notes
---------	--------	-----------------	-------	-------------	---------------	------	-------------	-----	-----------	-------

Batch 6G13006 - EPA 5030B P/T / EPA 8260B

Blank (6G13006-BLK1)

Prepared & Analyzed: 07/13/06

tert-Amyl methyl ether	ND	0.50	ug/l							
Benzene	ND	0.50	"							
tert-Butyl alcohol	ND	5.0	"							
Di-isopropyl ether	ND	0.50	"							
1,2-Dibromoethane (EDB)	ND	0.50	"							
1,2-Dichloroethane	ND	0.50	"							
Ethanol	ND	300	"							
Ethyl tert-butyl ether	ND	0.50	"							
Ethylbenzene	ND	0.50	"							
Methyl tert-butyl ether	ND	0.50	"							
Toluene	ND	0.50	"							
Xylenes (total)	ND	0.50	"							
<i>Surrogate: 1,2-Dichloroethane-d4</i>	2.43		"	2.50		97	60-145			
<i>Surrogate: 4-Bromofluorobenzene</i>	2.31		"	2.50		92	60-115			
<i>Surrogate: Dibromofluoromethane</i>	2.42		"	2.50		97	75-130			
<i>Surrogate: Toluene-d8</i>	2.39		"	2.50		96	70-130			

Laboratory Control Sample (6G13006-BS1)

Prepared & Analyzed: 07/13/06

tert-Amyl methyl ether	9.58	0.50	ug/l	10.0		96	65-135			
Benzene	9.36	0.50	"	10.0		94	70-125			
tert-Butyl alcohol	197	5.0	"	200		98	60-135			
Di-isopropyl ether	9.10	0.50	"	10.0		91	70-130			
1,2-Dibromoethane (EDB)	10.9	0.50	"	10.0		109	85-125			
1,2-Dichloroethane	9.78	0.50	"	10.0		98	75-125			
Ethanol	200	300	"	200		100	15-150			
Ethyl tert-butyl ether	9.26	0.50	"	10.0		93	65-130			
Ethylbenzene	9.52	0.50	"	10.0		95	80-130			
Methyl tert-butyl ether	10.0	0.50	"	10.0		100	50-140			
Toluene	9.44	0.50	"	10.0		94	70-120			
Xylenes (total)	28.9	0.50	"	30.0		96	85-125			
<i>Surrogate: 1,2-Dichloroethane-d4</i>	2.46		"	2.50		98	60-145			
<i>Surrogate: 4-Bromofluorobenzene</i>	2.43		"	2.50		97	60-115			
<i>Surrogate: Dibromofluoromethane</i>	2.53		"	2.50		101	75-130			
<i>Surrogate: Toluene-d8</i>	2.45		"	2.50		98	70-130			

TestAmerica - Morgan Hill, CA

The results in this report apply to the samples analyzed in accordance with the chain of custody document. Unless otherwise stated, results are reported on a wet weight basis. This analytical report must be reproduced in its entirety.

URS Corporation [Arco] 1333 Broadway, Suite 800 Oakland CA, 94612	Project: BP Heritage #11133, Oakland, CA Project Number: G07TT-0034 Project Manager: Alok Kolekar	MPG0146 Reported: 07/21/06 15:24
---	---	--

Volatile Organic Compounds by EPA Method 8260B - Quality Control
TestAmerica - Morgan Hill, CA

Analyte	Result	Reporting Limit	Units	Spike Level	Source Result	%REC	%REC Limits	RPD	RPD Limit	Notes
---------	--------	-----------------	-------	-------------	---------------	------	-------------	-----	-----------	-------

Batch 6G13006 - EPA 5030B P/T / EPA 8260B

Laboratory Control Sample (6G13006-BS2)

Prepared & Analyzed: 07/13/06

tert-Amyl methyl ether	8.13	0.50	ug/l	7.52		108	65-135			
Benzene	2.69	0.50	"	2.58		104	70-125			
tert-Butyl alcohol	86.7	5.0	"	71.6		121	60-135			
Di-isopropyl ether	8.07	0.50	"	7.56		107	70-130			
1,2-Dibromoethane (EDB)	8.75	0.50	"	7.44		118	85-125			
1,2-Dichloroethane	8.72	0.50	"	7.36		118	75-125			
Ethanol	95.5	300	"	70.8		135	15-150			
Ethyl tert-butyl ether	8.02	0.50	"	7.52		107	65-130			
Ethylbenzene	3.81	0.50	"	3.77		101	80-130			
Methyl tert-butyl ether	4.00	0.50	"	3.51		114	50-140			
Toluene	17.9	0.50	"	18.6		96	70-120			
Xylenes (total)	20.8	0.50	"	20.6		101	85-125			
<i>Surrogate: 1,2-Dichloroethane-d4</i>	<i>2.53</i>		<i>"</i>	<i>2.50</i>		<i>101</i>	<i>60-145</i>			
<i>Surrogate: 4-Bromofluorobenzene</i>	<i>2.42</i>		<i>"</i>	<i>2.50</i>		<i>97</i>	<i>60-115</i>			
<i>Surrogate: Dibromofluoromethane</i>	<i>2.42</i>		<i>"</i>	<i>2.50</i>		<i>97</i>	<i>75-130</i>			
<i>Surrogate: Toluene-d8</i>	<i>2.45</i>		<i>"</i>	<i>2.50</i>		<i>98</i>	<i>70-130</i>			

Matrix Spike (6G13006-MS1)

Source: MPG0146-02

Prepared & Analyzed: 07/13/06

tert-Amyl methyl ether	5.22	0.50	ug/l	5.00	ND	104	65-135			
Benzene	4.75	0.50	"	5.00	ND	95	70-125			
tert-Butyl alcohol	102	5.0	"	100	ND	102	60-135			
Di-isopropyl ether	4.85	0.50	"	5.00	ND	97	70-130			
1,2-Dibromoethane (EDB)	5.59	0.50	"	5.00	ND	112	85-125			
1,2-Dichloroethane	5.12	0.50	"	5.00	ND	102	75-125			
Ethanol	109	300	"	100	ND	109	15-150			
Ethyl tert-butyl ether	4.88	0.50	"	5.00	ND	98	65-130			
Ethylbenzene	4.74	0.50	"	5.00	ND	95	80-130			
Methyl tert-butyl ether	8.23	0.50	"	5.00	3.0	105	50-140			
Toluene	4.82	0.50	"	5.00	ND	96	70-120			
Xylenes (total)	14.5	0.50	"	15.0	ND	97	85-125			
<i>Surrogate: 1,2-Dichloroethane-d4</i>	<i>2.51</i>		<i>"</i>	<i>2.50</i>		<i>100</i>	<i>60-145</i>			
<i>Surrogate: 4-Bromofluorobenzene</i>	<i>2.37</i>		<i>"</i>	<i>2.50</i>		<i>95</i>	<i>60-115</i>			
<i>Surrogate: Dibromofluoromethane</i>	<i>2.57</i>		<i>"</i>	<i>2.50</i>		<i>103</i>	<i>75-130</i>			
<i>Surrogate: Toluene-d8</i>	<i>2.43</i>		<i>"</i>	<i>2.50</i>		<i>97</i>	<i>70-130</i>			

TestAmerica - Morgan Hill, CA

The results in this report apply to the samples analyzed in accordance with the chain of custody document. Unless otherwise stated, results are reported on a wet weight basis. This analytical report must be reproduced in its entirety.

URS Corporation [Arco]
1333 Broadway, Suite 800
Oakland CA, 94612

Project: BP Heritage #11133, Oakland, CA
Project Number: G07TT-0034
Project Manager: Alok Kolekar

MPG0146
Reported:
07/21/06 15:24

Volatile Organic Compounds by EPA Method 8260B - Quality Control
TestAmerica - Morgan Hill, CA

Analyte	Result	Reporting Limit	Units	Spike Level	Source Result	%REC	%REC Limits	RPD	RPD Limit	Notes
---------	--------	-----------------	-------	-------------	---------------	------	-------------	-----	-----------	-------

Batch 6G13006 - EPA 5030B P/T / EPA 8260B

Matrix Spike Dup (6G13006-MSD1)	Source: MPG0146-02	Prepared & Analyzed: 07/13/06								
tert-Amyl methyl ether	4.55	0.50	ug/l	5.00	ND	91	65-135	14	25	
Benzene	4.39	0.50	"	5.00	ND	88	70-125	8	15	
tert-Butyl alcohol	92.8	5.0	"	100	ND	93	60-135	9	35	
Di-isopropyl ether	4.22	0.50	"	5.00	ND	84	70-130	14	35	
1,2-Dibromoethane (EDB)	4.79	0.50	"	5.00	ND	96	85-125	15	15	
1,2-Dichloroethane	4.43	0.50	"	5.00	ND	89	75-125	14	10	RB
Ethanol	105	300	"	100	ND	105	15-150	4	35	
Ethyl tert-butyl ether	4.23	0.50	"	5.00	ND	85	65-130	14	35	
Ethylbenzene	4.45	0.50	"	5.00	ND	89	80-130	6	15	
Methyl tert-butyl ether	6.76	0.50	"	5.00	3.0	75	50-140	20	25	
Toluene	4.41	0.50	"	5.00	ND	88	70-120	9	15	
Xylenes (total)	13.6	0.50	"	15.0	ND	91	85-125	6	15	
Surrogate: 1,2-Dichloroethane-d4	2.37		"	2.50		95	60-145			
Surrogate: 4-Bromofluorobenzene	2.40		"	2.50		96	60-115			
Surrogate: Dibromofluoromethane	2.51		"	2.50		100	75-130			
Surrogate: Toluene-d8	2.44		"	2.50		98	70-130			

URS Corporation [Arco]
1333 Broadway, Suite 800
Oakland CA, 94612

Project: BP Heritage #11133, Oakland, CA
Project Number: G07TT-0034
Project Manager: Alok Kolekar

MPG0146
Reported:
07/21/06 15:24

Notes and Definitions

RB RPD exceeded method control limit; % recoveries within limits.
LN MS and/or MSD below acceptance limits. See Blank Spike(LCS).
DET Analyte DETECTED
ND Analyte NOT DETECTED at or above the reporting limit or MDL, if MDL is specified
NR Not Reported
dry Sample results reported on a dry weight basis
RPD Relative Percent Difference



BTS #

066706-5c1

Chain of Custody Record

Project Name: Analytical for QMR sampling
 BP BU/AR Region/Enfos Segment: BP > Americas > West Coast > Retail > WCBU > CA > Central > 11133 > Historical/BL
 State or Lead Regulatory Agency: California Regional Water Quality Control Board - San Francisco
 Requested Due Date (mm/dd/yy): 10 Day TAT

On-site Time: 0640	Temp: 85°
Off-site Time: 1520	Temp: 85°
Sky Conditions: Clear	
Meteorological Events:	
Wind Speed:	Direction:

Lab Name: Sequoia	BP/AR Facility No.: 11133	Consultant/Contractor: URS
Address: 885 Jarvis Drive Morgan Hill, CA 95037	BP/AR Facility Address: 2220 98th Ave., Oakland, CA 94603	Address: 1333 Broadway, Suite 800 Oakland, CA 94612
Lab PM: Lisa Race/ Katt Min	Site Lat/Long: 37.748269 / -122.161	Consultant/Contractor Project No.: 38487139
Tele/Fax: 408.782.8156 / 408.782.6308	California Global ID No.: T0600100210	Consultant/Contractor PM: Alok Kolekar
BP/AR PM Contact: Paul Supple	Enfos Project No.: G07TT-0034	Tele/Fax: 510.874.3152 / 510.874.3268
Address: P.O. Box 6549 Moraga, CA 94570	Provision or RCOP: Provision	Report Type & QC Level: Level 1 with EDF
Tele/Fax: 925-299-8891	Phase/WBS: 04 - Mon/Remed by Natural Attenuation	E-mail BDD To: jane.field@urscorp.com
Lab Bottle Order No: 11133	Sub Phase/Task: 03 - Analytical	Invoice to: Atlantic Richfield Company
	Cost Element: 05 - Subcontracted Costs	

Item No.	Sample Description	Time	Date	Matrix			Laboratory No.	No. of Containers	Preservative					Requested Analysis					Comments
				Soil/Solid	Water/Liquid	Air			Unpreserved	H ₂ SO ₄	HNO ₃	HCl	Methanol	GRO / BTEX (\$260)	MTBE, TAME, ETBE (\$260)	DPE, TBA (\$260)	EDB, 1,2-DCA (\$260)	Ethanol (\$260)	
1	MW-1	1330	8/2/06		X		01	3						X	X	X	X		
2	MW-3	1235			X		02	3						X	X	X	X		
3	AW-1	1445			X		03	3						X	X	X	X		
4	AW-4	1125			X		04	3						X	X	X	X		
5	AW-5	1300			X		05	3						X	X	X	X		
6	AW-6	1345			X		04	3						X	X	X	X		
7	RW-1	1500			X		07	3						X	X	X	X		
8	TB-11133-07082006				X		08	2						X	X	X	X		
9																			ON HOLD
10																			

Sampler's Name: S. Carmack	Relinquished By / Affiliation: [Signature] BTS	Date: 07/04/06	Time: 1855	Accepted By / Affiliation: [Signature] BTS	Date: 07/04/06	Time: 1700
Sampler's Company: Blain Tech Services		07/06/06	1830		07/06/06	1830
Shipment Date:		7-7-06	1830	[Signature]	7-7	1830
Shipment Method:						
Shipment Tracking No:						
Special Instructions: CC to bpedf@broadbentinc.com						

Is In Place Yes No Temp Blank Yes No Cooler Temperature on Receipt 3.8 F(C) Trip Blank Yes No
 White Copy - Laboratory / Yellow Copy - BP/Atlantic Richfield Co. / Pink Copy - Consultant/Contractor
 BP COC Rev. 4 10/17/04

SEQUOIA ANALYTICAL SAMPLE RECEIPT LOG

CLIENT NAME: BO
 REC. BY (PRINT): EA
 WORKORDER: MPG 0142

DATE REC'D AT LAB: 7/7/06
 TIME REC'D AT LAB: 1830
 DATE LOGGED IN: 7-10-06

For Regulatory Purposes?
 DRINKING WATER YES/NO NO
 WASTE WATER YES/NO NO

CIRCLE THE APPROPRIATE RESPONSE	LAB SAMPLE #	DASH #	CLIENT ID	CONTAINER DESCRIPTION	PRESERVATIVE	PH	SAMPLE MATRIX	DATE SAMPLED	REMARKS: CONDITION (ETC.)
1. Custody Seal(s) Present / <u>Absent</u> Intact / Broken*	01	A-C	MW-1	3 VOAS	HEL	-	L	7/6	
2. Chain-of-Custody <u>Present</u> / Absent*	02		-3						
3. Traffic Reports or Packing List: Present / <u>Absent</u>	03		AW-1						
4. Airbill: Airbill / Sticker Present / <u>Absent</u>	04		-4						
5. Airbill #:	05		-5						
6. Sample Labels: <u>Present</u> / Absent	06		-6						
7. Sample IDs: <u>Listed</u> / Not Listed on Chain-of-Custody	07		RW-1						
8. Sample Condition: <u>Intact</u> / Broken* / Leaking*	08	A,B	TB-11133	VOAS 2					
9. Does information on chain-of-custody, traffic reports and sample labels agree? <u>Yes</u> / No*									
10. Sample received within hold time? <u>Yes</u> / No*									
11. Adequate sample volume received? <u>Yes</u> / No*									
12. Proper preservatives used? <u>Yes</u> / No*									
13. Trip Blank / Temp Blank Received? (circle which, if yes). <u>Yes</u> / No*									
14. Read Temp: <u>3.8°C</u> Corrected Temp: <u>3.8°C</u> Is corrected temp 4 +/- 2°C? <u>Yes</u> / No**									

*IF CIRCLED, CONTACT PROJECT MANAGER AND ATTACH RECORD OF RESOLUTION.

WELL GAUGING DATA

Project # 060706-SC1 Date 07/06/06 Client BP 11133

Site 2220 98th Ave Oakland, CA

Well ID	Well Size (in.)	Sheen / Odor	Depth to Immiscible Liquid (ft.)	Thickness of Immiscible Liquid (ft.)	Volume of Immiscibles Removed (ml)	Depth to water (ft.)	Depth to well bottom (ft.)	Survey Point: TOB or TOC	
MW-1	2					10.36	28.35		
MW-2	2					8.33	31.15		6.0 ✓
MW-3	2					11.47	33.99		
AW-1	2					17.44	38.27		
AW-2	2					14.00	31.37		6.0 Tr ✓
AW-3	2					11.60	34.14		6.0 Tr ✓
AW-4	2					14.87	32.77		Tr
AW-5	4					15.93	42.82		
AW-6	4					14.82	33.94		
AW-7	*Unable to locate					—	—		6.0 Tr ✓
AW-8	*Monument Lid w/ built-in center; could not remove.					13.05	36.64		6.0 Tr ✓
RW-1	6	No Sch detected				13.01	37.70	✓	Sph ✓

ARCO / BP WELL MONITORING DATA SHEET

BTS #: 060706-jcl	Station # BP 11173
Sampler: S. Carmack	Date: 07/06/06
Well I.D.: ^{CP} MW-1	Well Diameter: (2) 3 4 6 8
Total Well Depth: 28.35	Depth to Water: 10.36
Depth to Free Product:	Thickness of Free Product (feet):
Referenced to: PVC Grade	D.O. Meter (if req'd): YSI HACH

Well Diameter	Multiplier	Well Diameter	Multiplier
1"	0.04	4"	0.65
2"	0.16	6"	1.47
3"	0.37	Other	radius ² * 0.163

Purge Method: <input type="checkbox"/> Bailer <input checked="" type="checkbox"/> Disposable Bailer <input type="checkbox"/> Positive Air Displacement <input type="checkbox"/> Electric Submersible <input type="checkbox"/> Extraction Pump Other: _____	Sampling Method: <input type="checkbox"/> Bailer <input checked="" type="checkbox"/> Disposable Bailer <input type="checkbox"/> Extraction Port Other: _____
---	---

Top of Screen: _____ If well is listed as a no-purge, confirm that water level is below the top of screen. Otherwise, the well must be purged.

2.9	x	3	=	8.7	Gals.
1 Case Volume (Gals.)		Specified Volumes		Calculated Volume	

Time	Temp (°F)	pH	Conductivity (mS or μS)	Gals. Removed	Observations
1313	67.6	6.9	552	2.9	Clear; mod. odor
1317	67.4	6.9	569	5.8	" " "
1321	67.4	6.9	583	8.7	" " "

Did well dewater? Yes <input type="checkbox"/> No <input checked="" type="checkbox"/>	Gallons actually evacuated: 8.7
Sampling Time: 1330	Sampling Date: 07/06/06
Sample I.D.: MW-1	Laboratory: Pace <u>Sequoia</u> Other _____

Analyzed for: GRO BTEX MTBE DRO Oxy's 1,2-DCA EDB Ethanol	Other: Fe ₂ COC	
D.O. (if req'd):	Pre-purge: _____ mg/L	Post-purge: _____ mg/L
O.R.P. (if req'd):	Pre-purge: _____ mV	Post-purge: _____ mV

ARCO / BP WELL MONITORING DATA SHEET

BTS #: 060706-5C1	Station # BF 11133
Sampler: J. Carmack	Date: 07/06/06
Well I.D.: MW-3	Well Diameter: (2) 3 4 6 8
Total Well Depth: 33.99	Depth to Water: 11.47
Depth to Free Product:	Thickness of Free Product (feet):
Referenced to: (PVC) Grade	D.O. Meter (if req'd): YSI HACH

Well Diameter	Multiplier	Well Diameter	Multiplier
1"	0.04	4"	0.65
2"	0.16	6"	1.47
3"	0.37	Other	radius ² * 0.163

Purge Method: <input type="checkbox"/> Bailer <input checked="" type="checkbox"/> Disposable Bailer <input type="checkbox"/> Positive Air Displacement <input type="checkbox"/> Electric Submersible <input type="checkbox"/> Extraction Pump Other: _____	Sampling Method: <input type="checkbox"/> Bailer <input checked="" type="checkbox"/> Disposable Bailer <input type="checkbox"/> Extraction Port Other: _____
---	---

Top of Screen: _____ If well is listed as a no-purge, confirm that water level is below the top of screen. Otherwise, the well must be purged.

3.6	x	3	=	10.8	Gals.
1 Case Volume (Gals.)		Specified Volumes		Calculated Volume	

Time	Temp (°F)	pH	Conductivity (mS or μ S)	Gals. Removed	Observations
1215	65.7	7.6	521	3.6	cldy; brownish; No odor
1220	65.7	7.2	506	7.2	lc cc
1226	65.5	6.9	494	10.8	lc cc lc cc

Did well dewater? Yes No Gallons actually evacuated: 10.8

Sampling Time: 1235 Sampling Date: 07/06/06

Sample I.D.: MW-3 Laboratory: Pace (Sequoia) Other _____

Analyzed for: GRO BTEX MTBE DRO Oxy's 1,2-DCA EDB Ethanol Other: See COC

D.O. (if req'd):	Pre-purge:	mg/L	Post-purge:	mg/L
O.R.P. (if req'd):	Pre-purge:	mV	Post-purge:	mV

ARCO / BP WELL MONITORING DATA SHEET

BTS #: 060706-SC1	Station # BP 11133
Sampler: S. Carnuck	Date: 07/06/06
Well I.D.: AW-1	Well Diameter: (2) 3 4 6 8 _____
Total Well Depth: 38.27	Depth to Water: 17.44
Depth to Free Product:	Thickness of Free Product (feet):
Referenced to: PVC Grade	D.O. Meter (if req'd): YSI HACH

Well Diameter	Multiplier	Well Diameter	Multiplier
1"	0.04	4"	0.65
2"	0.16	6"	1.47
3"	0.37	Other	radius ² * 0.163

Purge Method: <input type="checkbox"/> Bailer <input checked="" type="checkbox"/> Disposable Bailer <input type="checkbox"/> Positive Air Displacement <input type="checkbox"/> Electric Submersible <input type="checkbox"/> Extraction Pump Other: _____	Sampling Method: <input type="checkbox"/> Bailer <input checked="" type="checkbox"/> Disposable Bailer <input type="checkbox"/> Extraction Port Other: _____
---	---

Top of Screen: _____ If well is listed as a no-purge, confirm that water level is below the top of screen. Otherwise, the well must be purged.

3.4	x	3	=	10.2	Gals.
1 Case Volume (Gals.)		Specified Volumes		Calculated Volume	

Time	Temp (°F)	pH	Conductivity (mS or <u>µS</u>)	Gals. Removed	Observations
1431	66.1	6.6	931	3.4	cldy; mod odor
1436	66.2	6.7	948	6.8	cldy grey; 11.11
1441	66.4	6.8	958	10.2	cldy grey;

Did well dewater? Yes No Gallons actually evacuated: 10.2

Sampling Time: 1445 Sampling Date: 07/06/06

Sample I.D.: AW-1 Laboratory: Pace Sequoia Other _____

Analyzed for: GRO BTEX MTBE DRO Oxy's 1,2-DCA EDB Ethanol Other: SO₂ COC

D.O. (if req'd):	Pre-purge:	mg/L	Post-purge:	mg/L
O.R.P. (if req'd):	Pre-purge:	mV	Post-purge:	mV

ARCO / BP WELL MONITORING DATA SHEET

BTS #: 060706-5C1	Station # BP 11133
Sampler: S. Carmack	Date: 07/06/06
Well I.D.: AW-4	Well Diameter: (2) 3 4 6 8
Total Well Depth: 32.77	Depth to Water: 14.87
Depth to Free Product:	Thickness of Free Product (feet):
Referenced to: (PVC) Grade	D.O. Meter (if req'd): YSI HACH

Well Diameter	Multiplier	Well Diameter	Multiplier
1"	0.04	4"	0.65
2"	0.16	6"	1.47
3"	0.37	Other	radius ² * 0.163

Purge Method: <input type="checkbox"/> Bailer <input checked="" type="checkbox"/> Disposable Bailer <input type="checkbox"/> Positive Air Displacement <input type="checkbox"/> Electric Submersible <input type="checkbox"/> Extraction Pump Other: _____	Sampling Method: <input type="checkbox"/> Bailer <input checked="" type="checkbox"/> Disposable Bailer <input type="checkbox"/> Extraction Port Other: _____
---	---

Top of Screen: _____ If well is listed as a no-purge, confirm that water level is below the top of screen. Otherwise, the well must be purged.

2.9	x	3	=	8.7	Gals.
1 Case Volume (Gals.)		Specified Volumes		Calculated Volume	

Time	Temp (°F)	pH	Conductivity (mS or μ S)	Gals. Removed	Observations
1102	66.3	6.5	1242	2.9	turbid; brownish
1108	66.5	6.6	1287	5.8	more turbid; brownish mild odor
1113	66.6	6.7	1335	8.7	" " " "

Did well dewater? Yes No Gallons actually evacuated: 8.7

Sampling Time: 1125 Sampling Date: 07/06/06

Sample I.D.: AW-4 Laboratory: Pace (Sequoia) Other: _____

Analyzed for: GRO BTX MTBE DRO Oxy's 1,2-DCA EDB Ethanol Other: See COC

D.O. (if req'd):	Pre-purge:	mg/L	Post-purge:	mg/L
O.R.P. (if req'd):	Pre-purge:	mV	Post-purge:	mV

ARCO / BP WELL MONITORING DATA SHEET

BTS #: 060706-SCI	Station # BP1133
Sampler: S. Carmack	Date: 07/06/06
Well I.D.: AW-5	Well Diameter: 2 3 <u>4</u> 6 8
Total Well Depth: 42.82	Depth to Water: 15.93
Depth to Free Product:	Thickness of Free Product (feet):
Referenced to: <u>PVC</u> Grade	D.O. Meter (if req'd): YSI HACH

Well Diameter	Multiplier	Well Diameter	Multiplier
1"	0.04	4"	0.65
2"	0.16	6"	1.47
3"	0.37	Other	radius ² * 0.163

Purge Method: <input type="checkbox"/> Bailer <input type="checkbox"/> Disposable Bailer <input type="checkbox"/> Positive Air Displacement <input checked="" type="checkbox"/> Electric Submersible <input type="checkbox"/> Extraction Pump Other: _____	Sampling Method: <input type="checkbox"/> Bailer <input checked="" type="checkbox"/> Disposable Bailer <input type="checkbox"/> Extraction Port Other: _____
---	---

Top of Screen: _____ If well is listed as a no-purge, confirm that water level is below the top of screen. Otherwise, the well must be purged.

17.5	x	3	=	52.5	Gals.
1 Case Volume (Gals.)		Specified Volumes		Calculated Volume	

Time	Temp (°F)	pH	Conductivity (mS or <u>µS</u>)	Gals. Removed	Observations
1244	66.9	6.6	557	17.5	clear; slight odor
1248	67.1	6.5	540	35.0	" ; " "
1251	67.2	6.5	562	52.5	" ; " "

Did well dewater? Yes <input type="checkbox"/> <u>No</u>	Gallons actually evacuated: 52.5
Sampling Time: 1300	Sampling Date: 07/06/06
Sample I.D.: AW-5	Laboratory: Pace <u>Sequoia</u> Other _____
Analyzed for: GRO BTEX MTBE DRO Oxy's 1,2-DCA EDB Ethanol	Other: See CoC
D.O. (if req'd):	Pre-purge: _____ mg/L Post-purge: _____ mg/L
O.R.P. (if req'd):	Pre-purge: _____ mV Post-purge: _____ mV

ARCO / BP WELL MONITORING DATA SHEET

BTS #: 060706-SC1	Station # BP11133
Sampler: S. Carmack	Date: 07/06/06
Well I.D.: AW-6	Well Diameter: 2 3 4 6 8
Total Well Depth: 33.94	Depth to Water: 14.92
Depth to Free Product:	Thickness of Free Product (feet):
Referenced to: PVC Grade	D.O. Meter (if req'd): YSI HACH

Well Diameter	Multiplier	Well Diameter	Multiplier
1"	0.04	4"	0.65
2"	0.16	6"	1.47
3"	0.37	Other	radius ² * 0.163

Purge Method: <input type="checkbox"/> Bailer <input type="checkbox"/> Disposable Bailer <input type="checkbox"/> Positive Air Displacement <input checked="" type="checkbox"/> Electric Submersible Extraction Pump Other: _____	Sampling Method: <input type="checkbox"/> Bailer <input checked="" type="checkbox"/> Disposable Bailer Extraction Port Other: _____
--	--

Top of Screen: _____ If well is listed as a no-purge, confirm that water level is below the top of screen. Otherwise, the well must be purged.

12.5	x	3	=	37.5	Gals.
1 Case Volume (Gals.)		Specified Volumes		Calculated Volume	

Time	Temp (°F)	pH	Conductivity (mS or μS)	Gals. Removed	Observations
1332	68.6	7.0	451	12.5	clear
1335	68.4	6.6	438	25.0	"
1337	68.6	6.5	461	37.5	"

Did well dewater? Yes <input type="checkbox"/> No <input checked="" type="checkbox"/>	Gallons actually evacuated: 37.5
Sampling Time: 1345	Sampling Date: 07/06/06
Sample I.D.: AW-6	Laboratory: Pace Sequoia Other _____

Analyzed for: GRO BTEX MTBE DRO Oxy's 1,2-DCA EDB Ethanol	Other: See COC	
D.O. (if req'd):	Pre-purge: _____ mg/L	Post-purge: _____ mg/L
O.R.P. (if req'd):	Pre-purge: _____ mV	Post-purge: _____ mV

ARCO / BP WELL MONITORING DATA SHEET

BTS #: 060706-5C1	Station # BP 11133
Sampler: S-Carmack	Date: 07/06/06
Well I.D.: RW-1	Well Diameter: 2 3 4 (6) 8
Total Well Depth: 37.70	Depth to Water: 13.01
Depth to Free Product:	Thickness of Free Product (feet):
Referenced to: (PVC) Grade	D.O. Meter (if req'd): YSI HACH

Well Diameter	Multiplier	Well Diameter	Multiplier
1"	0.04	4"	0.65
2"	0.16	6"	1.47
3"	0.37	Other	radius ² * 0.163

80% → 18.00

Purge Method: <input type="checkbox"/> Bailer <input type="checkbox"/> Disposable Bailer <input type="checkbox"/> Positive Air Displacement <input checked="" type="checkbox"/> Electric Submersible <input type="checkbox"/> Extraction Pump Other: _____	Sampling Method: <input type="checkbox"/> Bailer <input checked="" type="checkbox"/> Disposable Bailer <input type="checkbox"/> Extraction Port Other: _____
---	---

Top of Screen: _____ If well is listed as a no-purge, confirm that water level is below the top of screen. Otherwise, the well must be purged.

<u>36.3</u>	x	<u>3</u>	=	<u>108.9</u>	Gals.
1 Case Volume (Gals.)		Specified Volumes		Calculated Volume	

Time	Temp (°F)	pH	Conductivity (mS or (µS))	Gals. Removed	Observations
¹⁴ 1405 1408	69.6	6.8	652	36.3	clear; no odor
1412	69.7	6.7	663	72.6	slightly turbid; " "
1414	* Well dewatered @			80.0	—
1455	67.4	6.8	770	—	turbid; odor

Did well dewater? **(Yes)** No Gallons actually evacuated: 80.0

Sampling Time: 1500 Sampling Date: 07/06/06

Sample I.D.: RW-1 Laboratory: Pace **(Sequoia)** Other _____

Analyzed for: GRO BTEX MTBE DRO Oxy's 1,2-DCA EDB Ethanol Other: See COC

D.O. (if req'd):	Pre-purge:	mg/L	Post-purge:	mg/L
O.R.P. (if req'd):	Pre-purge:	mV	Post-purge:	mV

BP GEM OIL COMPANY TYPE A BILL OF LADING

SOURCE RECORD **BILL OF LADING** FOR NON-HAZARDOUS PURGEWATER RECOVERED FROM GROUNDWATER WELLS AT BP GEM OIL COMPANY FACILITIES IN THE STATE OF CALIFORNIA. THE NON-HAZARDOUS PURGE- WATER WHICH HAS BEEN RECOVERED FROM GROUND- WATER WELLS IS COLLECTED BY THE CONTRACTOR, MADE UP INTO LOADS OF APPROPRIATE SIZE AND HAULED BY DILLARD ENVIRONMENTAL TO THE ALTAMONT LANDFILL AND RESOURCE RECOVERY FACILITY IN LIVERMORE, CALIFORNIA.

The contractor performing this work is PLAINE TECH SERVICES, INC. (BTS), 1680 Rogers Avenue, San Jose, CA 95112 (phone [408] 573-0555). Blaine Tech Services, Inc. is authorized by BP GEM OIL COMPANY to recover, collect, apportion into loads the Non-Hazardous Well Purgewater that is drawn from wells at the BP GEM Oil Company facility indicated below and deliver that purgewater to BTS. Transport routing of the Non-Hazardous Well Purgewater may be direct from one BP GEM facility to the designated destination point; from one BP GEM facility to the designated destination point via another BP GEM facility; from a BP GEM facility to the designated destination point via the contractor's facility, or any combination thereof. The Non-Hazardous Well Purgewater is and remains the property of BP GEM Oil Company.

This Source Record **BILL OF LADING** was initiated to cover the recovery of Non-Hazardous Well Purgewater from wells at the BP GEM Oil Company facility described below:

BP 11133

Station #

2220 98th Ave. Oakland, CA

Station Address

Total Gallons Collected From Groundwater Monitoring Wells:

208

added equip. rinse water

5 Gal

any other adjustments

TOTAL GALS. RECOVERED

213

loaded onto BTS vehicle #

22

BTS event #

060766-501

time

1510

date

02/06/88

signature

[Handwritten Signature]

REC'D AT

time

date

unloaded by signature

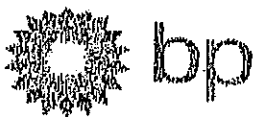

WELLHEAD INSPECTION CHECKLIST
BP / GEM

Date 07/06/06

Site Address 2720 98th Ave. Oakland, CA

Job Number 060706-SC1

Technician S. Carmack

Well ID	Well Inspected - No Corrective Action Required	Water Bailed From Wellbox	Wellbox Components Cleaned	Cap Replaced	Debris Removed From Wellbox	Lock Replaced	Other Action Taken (explain below)	Well Not Inspected (explain below)
MW-1							X	
MW-2							X	
MW-3							X	
AW-1							X	
AW-2	X							
AW-3							X	
AW-4		X					X	
AW-5							X	
AW-6							X	
AW-7	Could Not	Locate						
AW-8	*Monument Lid w/ bolt; could not remove							
RW-1							X	

NOTES: MW-2 → Christy box; MW-3 → Christy box; MW-1 → Christy box
 AW-5 → 1/3 bolts missing & 1/3 bolts stripped - MW-6 → 1/2 bolts stripped
 RW-1 → 3/3 bolts missing; AW-1 → 1/3 bolts missing
 AW-4 → Monument Lid; AW-3 → Monument lid no bolt
 No bolt

APPENDIX B

GEOTRACKER UPLOAD CONFIRMATION

Electronic Submittal Information

Main Menu | View/Add Facilities | Upload EDD | Check EDD

Your EDF file has been successfully uploaded!

Confirmation Number: 8142904996
Date/Time of Submittal: 10/25/2006 12:35:18 PM
Facility Global ID: T0600100210
Facility Name: BP #11133
Submittal Title: 3Q 06 GW Monitoring
Submittal Type: GW Monitoring Report

[Click here to view the detections report for this upload.](#)

BP #11133 2220 98TH OAKLAND, CA 94603	Regional Board - Case #: 01-0224 SAN FRANCISCO BAY RWQCB (REGION 2) Local Agency (lead agency) - Case #: RO0000403 ALAMEDA COUNTY LOP - (SP)
--	---

CONF #	TITLE	QUARTER
8142904996	3Q 06 GW Monitoring	Q3 2006
SUBMITTED BY	SUBMIT DATE	STATUS
Broadbent & Associates, Inc.	10/25/2006	PENDING REVIEW

SAMPLE DETECTIONS REPORT

# FIELD POINTS SAMPLED	7
# FIELD POINTS WITH DETECTIONS	7
# FIELD POINTS WITH WATER SAMPLE DETECTIONS ABOVE MCL	6
SAMPLE MATRIX TYPES	WATER

METHOD QA/QC REPORT

METHODS USED	8260FA,8260TPH
TESTED FOR REQUIRED ANALYTES?	Y
LAB NOTE DATA QUALIFIERS	Y

QA/QC FOR 8021/8260 SERIES SAMPLES

TECHNICAL HOLDING TIME VIOLATIONS	0
METHOD HOLDING TIME VIOLATIONS	0
LAB BLANK DETECTIONS ABOVE REPORTING DETECTION LIMIT	0
LAB BLANK DETECTIONS	0
DO ALL BATCHES WITH THE 8021/8260 SERIES INCLUDE THE FOLLOWING?	
- LAB METHOD BLANK	Y
- MATRIX SPIKE	Y
- MATRIX SPIKE DUPLICATE	Y
- BLANK SPIKE	Y
- SURROGATE SPIKE	Y

WATER SAMPLES FOR 8021/8260 SERIES

MATRIX SPIKE / MATRIX SPIKE DUPLICATE(S) % RECOVERY BETWEEN 65-135%	Y
MATRIX SPIKE / MATRIX SPIKE DUPLICATE(S) RPD LESS THAN 30%	Y
SURROGATE SPIKES % RECOVERY BETWEEN 85-115%	N
BLANK SPIKE / BLANK SPIKE DUPLICATES % RECOVERY BETWEEN 70-130%	Y

SOIL SAMPLES FOR 8021/8260 SERIES

MATRIX SPIKE / MATRIX SPIKE DUPLICATE(S) % RECOVERY BETWEEN 65-135% n/a
 MATRIX SPIKE / MATRIX SPIKE DUPLICATE(S) RPD LESS THAN 30% n/a
 SURROGATE SPIKES % RECOVERY BETWEEN 70-125% n/a
 BLANK SPIKE / BLANK SPIKE DUPLICATES % RECOVERY BETWEEN 70-130% n/a

FIELD QC SAMPLES

<u>SAMPLE</u>	<u>COLLECTED</u>	<u>DETECTIONS > REPDL</u>
QCTB SAMPLES	N	0
QCEB SAMPLES	N	0
QCAB SAMPLES	N	0

Logged in as BROADBENT-C (CONTRACTOR)

CONTACT SITE ADMINISTRATOR.

#11133

Electronic Submittal Information
Main Menu | View/Add Facilities | Upload EDD | Check EDD

UPLOADING A GEO_WELL FILE

**Processing is complete. No errors were found!
Your file has been successfully submitted!**

Submittal Title: 3Q 06 GEO_WELL
Submittal Date/Time: 10/23/2006 5:59:17 PM
Confirmation Number: 1455172479

[Back to Main Menu](#)

Logged in as BROADBENT-C
(CONTRACTOR)

[CONTACT SITE ADMINISTRATOR.](#)