

Broadbent & Associates, Inc.
1324 Mangrove Ave., Suite 212
Chico, CA 95926
Voice (530) 566-1400
Fax (530) 566-1401

RECEIVED

10:48 am, Nov 02, 2009

Alameda County
Environmental Health



October 26, 2009

Project No. 06-82-637

Atlantic Richfield Company
P.O. Box 1257
San Ramon, CA 94583
Submitted via ENFOS

Attn.: Mr. Chuck Carmel

Re: Third Quarter, 2009 Status Report, Atlantic Richfield Company (a BP affiliated company) Station #6113, 785 East Stanley Boulevard, Livermore, CA. Case No. RO0000393.

Dear Mr. Carmel:

Attached is the *Third Quarter, 2009 Status Report* for Atlantic Richfield Company Station #6113 (herein referred to as Station #6113) located at 785 East Stanley Boulevard, Livermore, CA (Property).

Should you have questions please do not hesitate to contact us at (530) 566-1400.

Sincerely,

BROADBENT & ASSOCIATES, INC.

A handwritten signature in black ink, appearing to read 'J. Emme', with the initials '(EOR)' written below it.

Jason R. Emme
Senior Staff Scientist

A handwritten signature in black ink, appearing to read 'M. Herrick', with the initials 'lh' written below it.

Matthew G. Herrick, P.G., C.H.G.
Senior Hydrogeologist

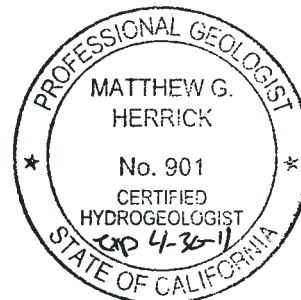

Enclosures

cc: Mr. Paresh Khatri, Alameda County Environmental Health (submitted via ACEH ftp site)
Mr. Paul M. Smith/Ms. Danielle Stefani, Livermore-Pleasanton Fire Department (submitted via GeoTracker)
Mr. Bejan Farahbakhsh, Property Owner, 4501 Main Street, Oakley, CA 94561
GeoTracker

STATION #6113 QUARTERLY STATUS REPORT

Facility: 6113	Address: 785 East Stanley Boulevard, Livermore, CA
Station 6113 Environmental Business Manager:	Mr. Chuck Carmel
Consulting Co./Contact Persons:	Broadbent & Associates, Inc. (BAI) / Rob Miller & Matt Herrick
Primary Agency/Regulatory ID No.:	Alameda County Environmental Health (ACEH) / Case No. RO0000393
Consultant Project No.:	06-82-637
Facility Permits/Permitting Agency.:	NA

WORK PERFORMED THIS QUARTER (Third Quarter, 2009):

1. Submitted Second Quarter, 2009 Semi-Annual Ground-Water Monitoring Report. Report completed by BAI.
2. Submitted the September 4, 2009 Replacement Well Work Plan. Report completed by BAI and approved by ACEH in their October 22, 2009 letter.
3. No ground-water monitoring/sampling work activities were completed on the Property during the Second Quarter, 2009.

WORK PROPOSED FOR NEXT QUARTER (Fourth Quarter, 2009):

1. Submit Third Quarter, 2009 Status Report (contained herein).
2. Conduct ground-water monitoring/sampling for Fourth Quarter, 2009.
3. Complete installation of replacement well and submit well installation report by December 31, 2009.

QUARTERLY RESULTS SUMMARY:

Current phase of project:	Groundwater monitoring/sampling
Frequency of ground-water sampling:	Wells MW-4, MW-7, MW-11, MW-12, and VW-1: Semi Annually (2Q and 4Q) Well MW-9: Annually (4Q)
Frequency of ground-water monitoring:	Semi-Annually (2Q and 4Q)
Is free product (FP) present on-site:	No
FP recovered this quarter:	NA
Bulk Soil Removed to Date:	288 cubic yards TPH impacted soil
Current remediation techniques:	Air Diffusion (discontinued in September 2008 as a result of station raze and rebuild activities)
Depth to ground water (below TOC):	NA
General ground-water flow direction:	NA
Approximate hydraulic gradient:	NA

DISCUSSION:

No groundwater monitoring/sampling activities took place at Station #6113 during the Third Quarter, 2009. The attached Drawing 1 shows a site location map. The attached Drawing 2 depicts the site and monitor well locations. The most recent quarterly data is provided in the Second Quarter, 2009 Semi-Annual Ground-Water Monitoring Report.

ATTACHMENTS:

- Drawing 1. Site Location Map, Station #6113, Livermore, CA
Drawing 2. Site Map, Station #6113, Livermore, California

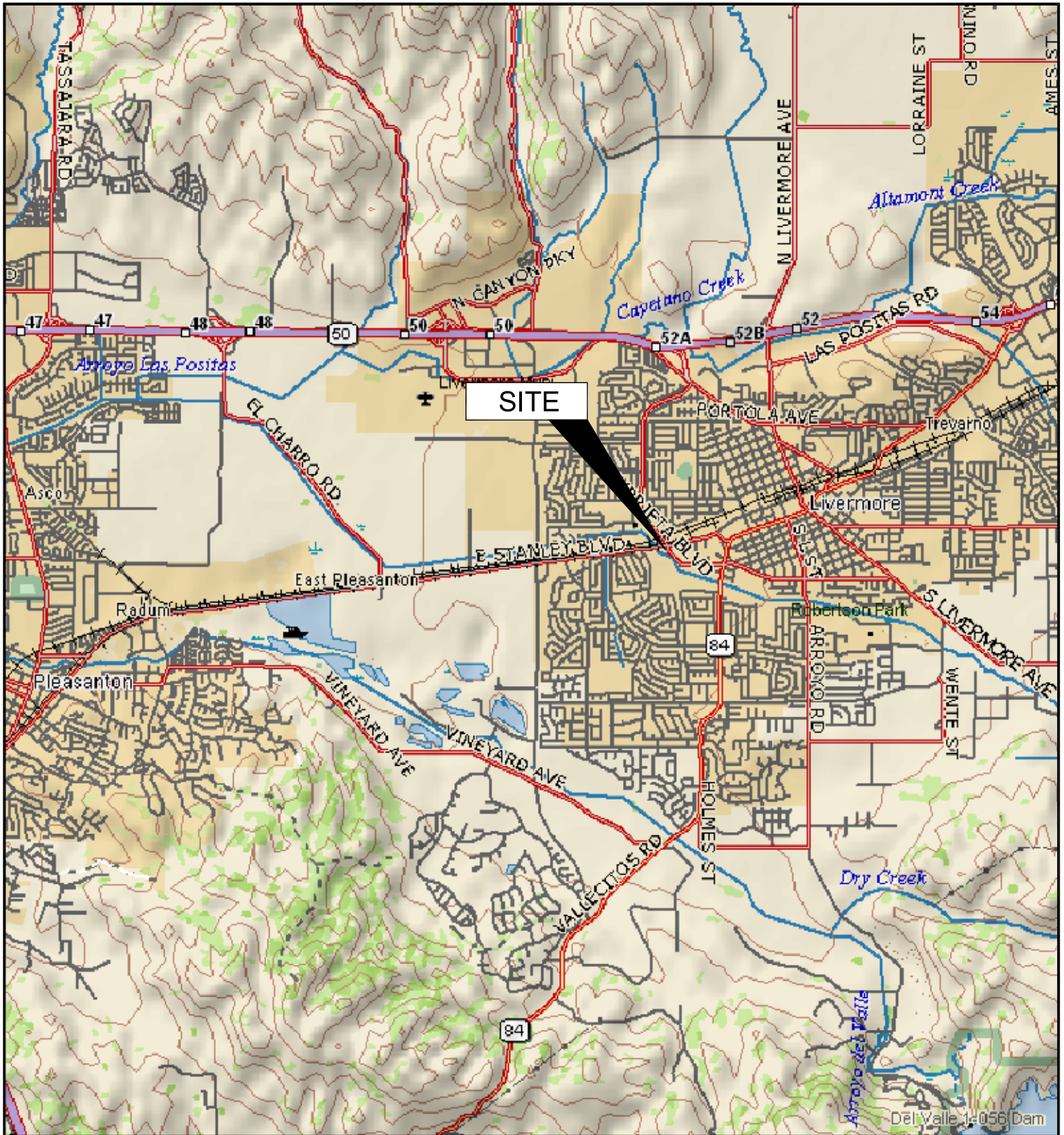

APPROXIMATE SCALE (mi)

IMAGE SOURCE: DELORME

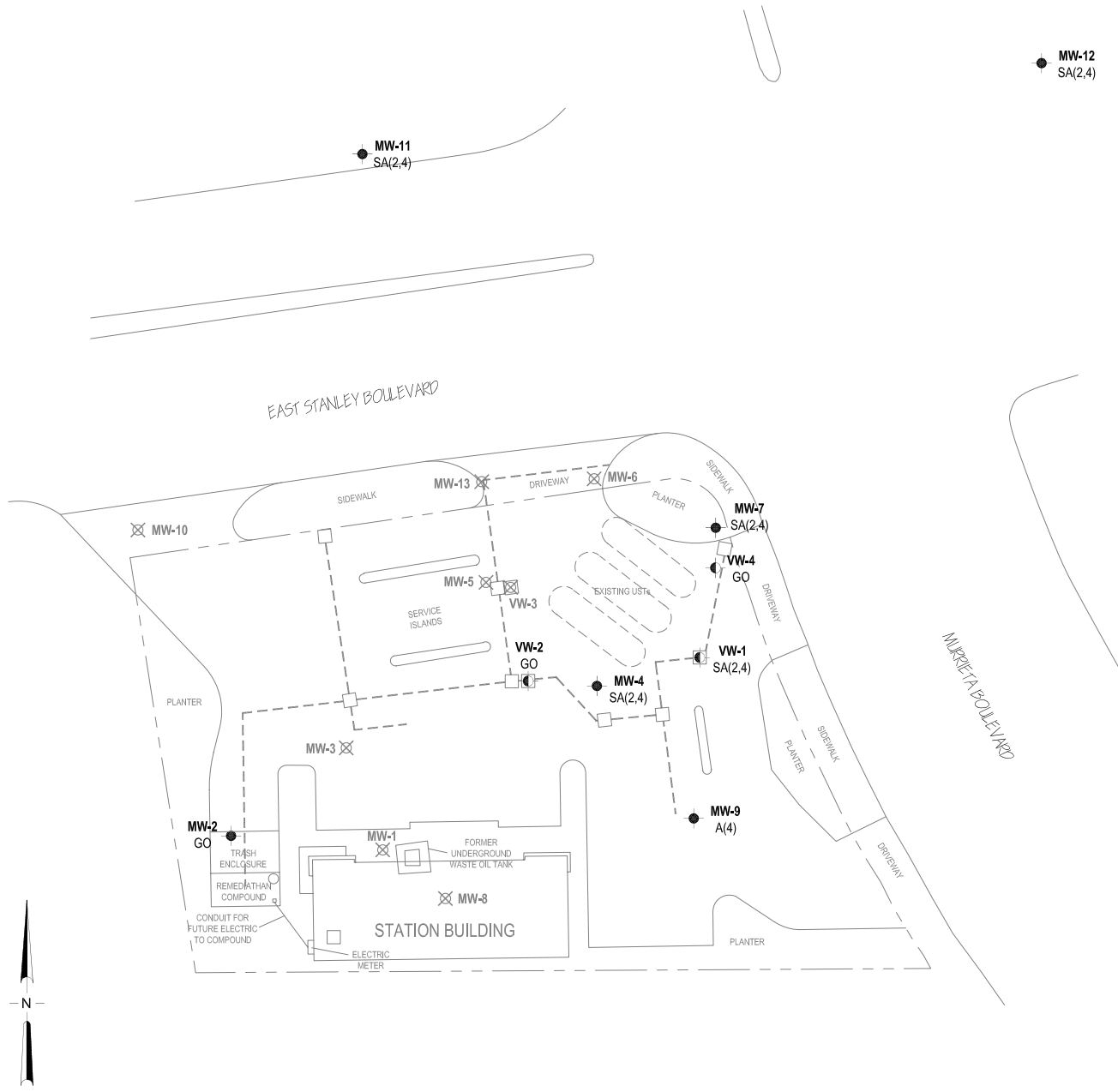

LEGEND

- Monitoring well
- ◐ Vapor extraction well
- ⊗ Abandoned well
- Well / Sampling Frequency
- A(4) Sampled annually, 4th quarter
- SA(2,4) Semi-annual sampling, 2nd and 4th quarters
- GO Gauge Only
- Vault box
- - - Piping trench

NOTE: SITE MAP ADAPTED FROM CAMBRIA ENVIRONMENTAL FIGURES. SITE DIMENSIONS AND FACILITY LOCATIONS NOT VERIFIED. STATION BUILDING LOCATION REVISED IN 2009 BASED ON WD PARTNERS DESIGN DRAWINGS FOR RAZE AND REBUILD.

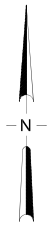

BROADBENT & ASSOCIATES, INC.
 ENGINEERING, WATER RESOURCES & ENVIRONMENTAL
 1324 Mangrove Ave, Suite 212, Chico, California 95926
 Project No.: 06-82-637 Date: 4/15/2009

Station #6113
 785 East Stanley Boulevard
 Livermore, California

Site Map