

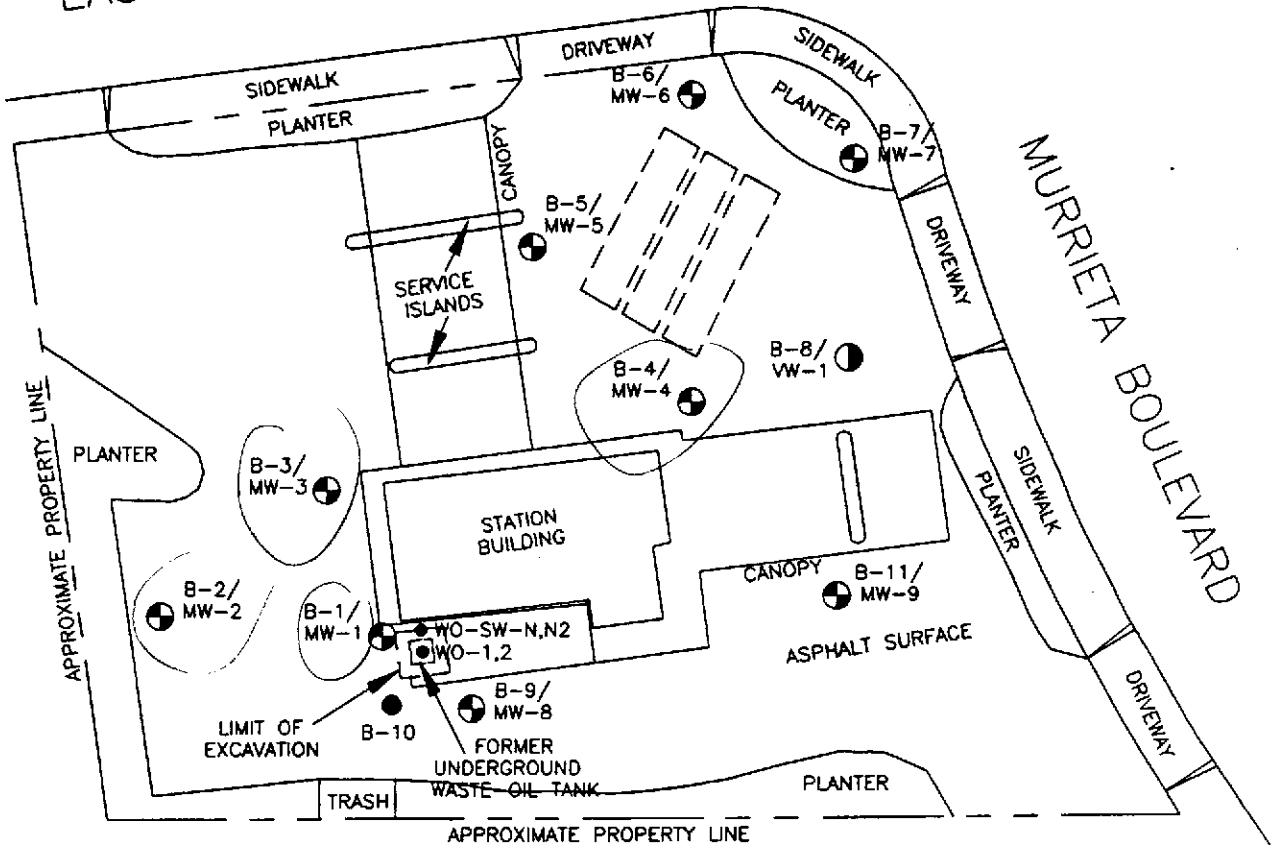



EAST STANLEY BOULEVARD



EXPLANATION

- B-11/MW-9  = Boring/monitoring well (RESNA, 09/89, 02/91, and 06/92)
- B-8/VW-1  = Boring/vapor extraction well (RESNA, 06/92)
- B-10  = Boring (RESNA, 06/92)
- WO-SW-N,N2  = Soil sample collected by Pacific (1989)
-  = Underground gasoline storage tanks

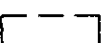
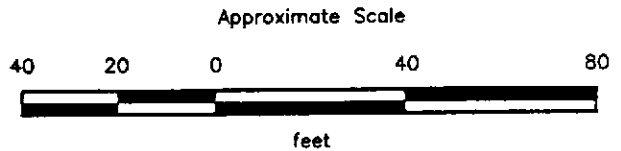

Source: Modified from plan supplied by Ron Archer, Civil Engineer Inc., Feb 1991 and John Koch, Land Surveyor, June 1992.

RESNA
Working to Restore Nature

PROJECT: 69028.08

GENERALIZED SITE PLAN

ARCO Station 6113
785 East Stanley Boulevard
Livermore, California

PLATE

2

TABLE 2
 CUMULATIVE RESULTS OF GROUNDWATER LABORATORY ANALYSES – TPHg and BTEX
 ARCO Station 6113
 785 East Stanley Boulevard
 Livermore, California
 (Page 1 of 2)

<u>Well</u> <u>Date</u>	TPHg	Benzene	Toluene	Ethyl- benzene	Total Xylenes
<u>MW-1</u>					
09/20/89	80	3.0	1.0	0.7	1
06/21/90	<20	<0.50	0.66	<0.50	<0.50
09/20/90	<50	<0.5	1.0	<0.5	1.8
12/18/90	<50	<0.5	1.8	<0.5	1.7
02/21/91	<50	1.2	2.3	<0.5	2.2
05/20/91	<30	<0.30	<0.30	<0.30	<0.30
08/13/91		Not sampled--dry			
11/13/91		Not sampled--dry			
03/19/92	400	<3.5*	<1.2*	<0.8*	<1.0*
06/29/92		Not sampled--residual water only			
09/11/92		Not sampled--dry			
<u>MW-2</u>					
09/20/89	<50	<0.5	<0.5	<0.5	<1
06/21/90	<20	<0.50	<0.50	<0.50	<0.50
09/20/90	<50	<0.5	0.7	<0.5	1.4
12/18/90	<50	0.6	1.5	<0.5	1.9
02/21/91	<50	<0.5	<0.5	<0.5	<0.5
05/20/91	<30	<0.30	<0.30	<0.30	<0.30
08/13/91		Not sampled--dry			
11/13/91		Not sampled--dry			
03/19/92	<50	<0.5	<0.5	<0.5	<0.5
06/29/92	<50	<0.5	<0.5	<0.5	<0.5
09/11/92		Not sampled--residual water only			
<u>MW-3</u>					
09/20/89	170	8.9	0.6	1.1	<1
06/21/90	<20	<0.50	1.0	<0.50	<0.50
09/20/90	<50	<0.5	1.0	<0.5	1.9
12/18/90	<50	<0.5	1.7	<0.5	2.0
02/21/91	<50	<0.5	<0.5	<0.5	<0.5
05/20/91	97	1.3	1.1	6.2	8.4
08/13/91		Not sampled--dry			
11/13/91		Not sampled--dry			
03/19/92	220	<1.1*	<1.9	<0.6*	<0.8*
06/29/92		Not sampled --residual water only			
09/11/92		Not sampled --residual water only			
<u>MW-4</u>					
02/21/91	3,500	410	7.6	30	47
05/20/91	1,400	150	6.0	4.4	3.1
08/13/91		Not sampled--dry			

TABLE 2
 CUMULATIVE RESULTS OF GROUNDWATER LABORATORY ANALYSES -- TPHg and BTEX
 ARCO Station 6113
 785 East Stanley Boulevard
 Livermore, California
 (Page 2 of 2)

Well Date	TPHg	Benzene	Toluene	Ethyl- benzene	Total Xylenes
<u>MW-4cont.</u>					
11/13/91		Not sampled--dry			
03/19/92		Not sampled--dry			
06/29/92		Not sampled--dry			
09/11/92		Not sampled--dry			
<u>MW-5</u>					
06/29/92	8,900	1,700	640	310	1,100
09/11/92	13,000	2,200	1,500	130	930
<u>MW-6</u>					
06/29/92	8,600	1,800	460	52	450
09/11/92		Not sampled--floating product ✓			
<u>MW-7</u>					
06/29/92	270	38	3.7	1.1	4.4
09/11/92	420	20	0.7	<0.5	<0.5
<u>MW-8</u>					
06/29/92	<50	<0.5	<0.5	<0.5	<0.5
09/11/92	<50	<0.5	<0.5	<0.5	<0.5
<u>MW-9</u>					
06/29/92	<50	<0.5	<0.5	<0.5	<0.5
09/11/92	<50	<0.5	<0.5	<0.5	<0.5
<u>October 1990</u>					
MCLs	None	1.0	None	680	1,750
DWAL	None	None	100	None	None

Results in parts per billion (ppb).

TPHg = Total petroleum hydrocarbons as gasoline

< = Less than the detection limits shown.

MCLs = Adopted Maximum Contaminant Levels in Drinking Water, DHS (October 1990)

DWAL = Recommended Drinking Water Action Level, DHS (October 1990)

* = Laboratory reportedly raised detection limit due to matrix interference.

TABLE 3
 CUMULATIVE RESULTS OF GROUNDWATER LABORATORY ANALYSES – VOC, TPHd, TOG, and Metals
 ARCO Station 6113
 785 East Stanley Boulevard
 Livermore, California
 (Page 1 of 2)

Well Date	VOC	TPHd	TOG	Cd	Cr	Pb	Zn	Ni
<u>MW-1</u>								
09/20/89	NA	<50	<5,000	NA	NA	NA	NA	NA
06/21/90	NA	<100	13,000	NA	NA	NA	NA	NA
09/20/90	NA	<50	<5,000	NA	NA	NA	NA	NA
12/18/90	NA	NA	<5,000	NA	NA	NA	NA	NA
02/21/91	NA	NA	<5,000	NA	NA	NA	NA	NA
05/20/91	NA	NA	<75,000	NA	NA	NA	NA	NA
08/13/91	NS	NS	NS	NS	NS	NS	NS	NS
11/13/91	NS	NS	NS	NS	NS	NS	NS	NS
03/19/92	NA	NA	NA	NA	NA	NA	NA	NA
06/29/92	NS	NS	NS	NS	NS	NS	NS	NS
09/11/92	NS	NS	NS	NS	NS	NS	NS	NS
<u>MW-2</u>								
09/20/89	NA	<50	<5,000	NA	NA	NA	NA	NA
06/21/90	NA	<100	<5,000	NA	NA	NA	NA	NA
09/20/90	NA	<50	<5,000	NA	NA	NA	NA	NA
12/18/90	NA	NA	<5,000	NA	NA	NA	NA	NA
02/21/91	NA	NA	<5,000	NA	NA	NA	NA	NA
05/20/91	NA	NA	<75,000	NA	NA	NA	NA	NA
08/13/91	NS	NS	NS	NS	NS	NS	NS	NS
11/13/91	NS	NS	NS	NS	NS	NS	NS	NS
03/19/92	NA	NA	NA	NA	NA	NA	NA	NA
06/29/92	NA	NA	NA	NA	NA	NA	NA	NA
09/11/92	NS	NS	NS	NS	NS	NS	NS	NS
<u>MW-3</u>								
09/20/89	NA	<50	<5,000	NA	NA	NA	NA	NA
06/21/90	NA	<100	10,000	NA	NA	NA	NA	NA
09/20/90	NA	<50	<5,000	NA	NA	NA	NA	NA
12/18/90	NA	NA	<5,000	NA	NA	NA	NA	NA
02/21/91	NA	NA	<5,000	NA	NA	NA	NA	NA
05/20/91	NA	NA	<75,000	NA	NA	NA	NA	NA
08/13/91	NS	NS	NS	NS	NS	NS	NS	NS
11/13/91	NS	NS	NS	NS	NS	NS	NS	NS
03/19/92	NA	<50	<5,000	NA	NA	NA	NA	NA
06/29/92	NS	NS	NS	NS	NS	NS	NS	NS
09/11/92	NS	NS	NS	NS	NS	NS	NS	NS

See notes on Page 2 of 2.

TABLE 3
 CUMULATIVE RESULTS OF GROUNDWATER LABORATORY ANALYSES – VOC, TPHd, TOG, and Metals
 ARCO Station 6113
 785 East Stanley Boulevard
 Livermore, California
 (Page 2 of 2)

Well Date	VOC	TPHd	TOG	Cd	Cr	Pb	Zn	Ni
<u>MW-4</u>								
02/21/91	NA	NA	<5,000	NA	NA	NA	NA	NA
05/20/91	NA	NA	<75,000	NA	NA	NA	NA	NA
08/13/91	NS	NS	NS	NS	NS	NS	NS	NS
11/13/91	NS	NS	NS	NS	NS	NS	NS	NS
03/19/92	NS	NS	NS	NS	NS	NS	NS	NS
06/29/92	NS	NS	NS	NS	NS	NS	NS	NS
09/29/92	NS	NS	NS	NS	NS	NS	NS	NS
<u>MW-8</u>								
06/29/92	ND*	<50	<500	<3	1,780	143	1,310	5,100
09/11/92	NA	<50	<500	13	3,580	308	2,620	10,300
MCL:	Varies	--	--	10	50	50	5,000	--

Results in micrograms per liter (ug/L) = parts per billion (ppb).

VOC: Halogenated Volatile Organic Compounds by EPA Method 5030/601.

TPHd: Total petroleum hydrocarbons as diesel by EPA Methods 3510/California DHS LUFT Method.

TOG: Total oil and grease measured by EPA Method 5520C&F.

NA: Not analyzed.

<: Results reported as less than the detection limit.

NS: Well not sampled.

ND: Not detected.

*: 31 compounds tested were nondetectable.

MCL: Adopted Maximum Contaminant Levels in Drinking Water (October 1990)

TABLE 3
 CUMULATIVE RESULTS OF LABORATORY ANALYSES OF SOIL SAMPLES
 ARCO Station 6113
 785 East Stanley Boulevard
 Livermore, California
 Page 1 of 3

Sample	B	T	E	X	TPHg	TPHd	TOG
<u>September 1989</u>							
S-14½-B1	<0.005	<0.005	<0.005	<0.005	<1.0	<10	<30
S-34½-B1	<0.005	<0.005	<0.005	<0.005	<1.0	<10	<30
S-44½-B1	<0.005	<0.005	<0.005	<0.005	<1.0	<10	<30
S-19-B2	<0.005	<0.005	<0.005	<0.005	<1.0	<10	<50
S-34-B2	<0.005	<0.005	<0.005	<0.005	<1.0	<10	<50
S-41-B2	<0.005	<0.005	<0.005	<0.005	<1.0	<10	<50
S-14-B3	<0.005	<0.005	<0.005	<0.005	<1.0	<10	<50
S-34-B3	<0.005	<0.005	<0.005	<0.005	<1.0	<10	<50
S-37½-B3	<0.005	<0.005	<0.005	<0.005	<1.0	<10	<50
<u>February 1991</u>							
S-14½-B4	<0.005	<0.005	<0.005	<0.005	<1.0	<10	<50
S-19½-B4	<0.005	<0.005	<0.005	<0.005	<1.0	<10	<50
S-29-B4	0.008	<0.005	<0.005	<0.005	<1.0	<10	<50
S-0221-SP(A-D)	<0.005	<0.005	<0.005	<0.005	<1.0	<10	NA
<u>June 1992</u>							
S-10½-B5	<0.005	<0.005	<0.005	<0.005	<1.0	NA	NA
S-20½-B5	1.4	2.0	13	67	1,200	NA	NA
S-30½-B5	1.1	0.30	1.1	6.0	150	NA	NA
S-40½-B5	17	32	14	150	230	NA	NA
S-50½-B5	0.012	<0.005	<0.005	<0.005	<1.0	NA	NA
S-10½-B6	<0.005	<0.005	<0.005	<0.005	<1.0	NA	NA
S-20½-B6	<0.005	<0.005	<0.005	<0.005	<1.0	NA	NA
S-30½-B6	0.45	0.079	0.035	0.15	23	NA	NA
S-45½-B6	0.70	0.021	<0.005	<0.005	1.9	NA	NA
S-50½-B6	0.056	<0.005	<0.005	0.006	<1.0	NA	NA
S-10½-B7	<0.005	<0.005	<0.005	<0.005	<1.0	NA	NA
S-20½-B7	0.43	1.3	0.35	2.5	21	NA	NA
S-30½-B7	0.094	0.20	<0.005	0.023	1.6	NA	NA
S-40½-B7	0.009	<0.005	<0.005	<0.005	<1.0	NA	NA
S-50½-B7	<0.005	<0.005	<0.005	<0.005	<1.0	NA	NA
S-10½-B8	<0.005	<0.005	<0.005	<0.005	<1.0	NA	NA
S-20½-B8	<0.005	0.22	0.42	2.1	68	NA	NA
S-30½-B8	0.043	<0.005	<0.005	<0.005	<1.0	NA	NA
S-45½-B8	0.022	<0.005	<0.005	<0.005	1.1	NA	NA

See notes on Page 3 of 3.

TABLE 3
 CUMULATIVE RESULTS OF LABORATORY ANALYSES OF SOIL SAMPLES
 ARCO Station 6113
 785 East Stanley Boulevard
 Livermore, California
 Page 2 of 3

Sample	B	T	E	X	TPHg	TPHd	TOG
S-8½-B9	<0.005	<0.005	<0.005	<0.005	<1.0	<1.0	30
S-20½-B9	<0.005	<0.005	<0.005	<0.005	<1.0	<1.0	74
S-30½-B9	<0.005	<0.005	<0.005	<0.005	<1.0	<1.0	<30
S-40½-B9	<0.005	<0.005	<0.005	<0.005	<1.0	<1.0	<30
S-50½-B9	<0.005	<0.005	<0.005	<0.005	<1.0	<1.0	<30
S-10-B10	<0.005	<0.005	<0.005	<0.005	<1.0	<1.0	<30
S-20-B10	<0.005	<0.005	<0.005	<0.005	<1.0	<1.0	<30
S-30-B10	<0.005	<0.005	<0.005	<0.005	<1.0	<1.0	<30
S-45-B10	<0.005	<0.005	<0.005	<0.005	<1.0	<1.0	30
S-55-B10	<0.005	<0.005	<0.005	<0.005	<1.0	<1.0	77
S-10½-B11	<0.005	<0.005	<0.005	<0.005	<1.0	NA	NA
S-20½-B11	<0.005	<0.005	<0.005	<0.005	<1.0	NA	NA
S-30½-B11	<0.005	<0.005	<0.005	<0.005	5.7	NA	NA
S-40½-B11	<0.005	<0.005	<0.005	<0.005	<1.0	NA	NA
S-50½-B11	<0.005	<0.005	<0.005	<0.005	<1.0	NA	NA
S-55½-B11	<0.005	<0.005	<0.005	<0.005	<1.0	NA	NA
S-0615-SP1(A-D)	<0.005	<0.005	<0.005	<0.005	<1.0	NA	NA
S-0615-SP2(A-D)	0.014	0.037	0.054	0.45	24	NA	NA
<u>August 1992</u>							
S-10-B12	<0.005	<0.005	<0.005	<0.005	<1.0	NA	NA
S-20-B12	<0.005	<0.005	<0.005	<0.005	<1.0	NA	NA
S-30-B12	<0.005	<0.005	<0.005	<0.005	<1.0	NA	NA
S-40-B12	0.59	0.60	1.3	2.0	110	NA	NA
S-50-B12	<0.005	<0.005	<0.005	<0.005	<1.0	NA	NA
S-0804-SP(A-D)	<0.005	0.011	0.030	0.066	2.6	NA	NA

See notes on Page 3 of 3.

TABLE 3
 CUMULATIVE RESULTS OF LABORATORY ANALYSES OF SOIL SAMPLES
 ARCO Station 6113
 785 East Stanley Boulevard
 Livermore, California
 Page 3 of 3

Sample	Cadmium	Chromium	Lead	Nickel	Zinc	VOC
<u>June 1992</u>						
S-8½-B9	<0.010	<0.010	<0.0050	0.051	0.47	ND*
S-50½-B9	<0.010	<0.010	<0.0050	0.098	0.57	ND*
S-10-B10	<0.010	<0.010	<0.0050	0.13	0.44	ND*
S-55-B10	<0.010	<0.010	<0.0050	0.063	0.75	ND*
Background average concentrations in soil (ppm) ^{1,2}						
	0.06	100	11.5	74	50	-

Results in parts per million (ppm).

<: Results reported as less than the detection limit.

NA: Not Analyzed

TPHg: Total petroleum hydrocarbons as gasoline by EPA method 5030/8015/8020.

TPHd: Total petroleum hydrocarbons as diesel by EPA method 3550/8015.

B: Benzene, T: Toluene, E: Ethylbenzene, T: Total Xylene isomers

BTEX: Analyzed by EPA method 5030/8015/8020.

TOG: Total Oil and Grease by Standard Method 5520 E&F.

VOCs = Halogenated volatile organics.

NA = Compound not analyzed for.

ND = Compound not detected.

* = 37 compounds were tested

¹Lindsay, W.L. 1979. Chemical Equilibria in Soil. John Wiley & Sons.

²Scot, L.M. December 1991. Background Metal Concentrations in Soils in Northern Santa Clara County, California. M.S. Thesis, University of San Francisco.

Composite soil sample S-0615-SP2(A-D) consists of four soil samples taken from stockpiled soil.

Sample designation:

S-55-B11



Boring number

Sample depth in feet below ground surface

Soil sample

TABLE 6
 LABORATORY ANALYSES OF AIR SAMPLES
 ARCO Station 6113
 Livermore, California

Sample ID	Sample Location	Elapsed Time of Sample	TPHg	B	T	E	X
AS-VW1-35	VW-1	35	45,000	900	89	27	68
AS-VW2-30	VW-2	30	52,000	510	58	15	35
AS-VW2-EFF	VW-2	35	630	33	5	2	6
AS-VW2-120	VW-2	120	37,000	350	34	10	21
AS-MW5-90	MW-5	90	130,000	530	120	17	39

Concentrations reported in milligrams per cubic meter (mg/m³).
 Effluent sample collected from stack of internal combustion engine.

TPHg: Total petroleum hydrocarbons as gasoline (analyzed by EPA Methods 8015 and 8020).
 B: Benzene
 T: Toluene
 E: Ethylbenzene
 X: Total Xylene Isomers
 BTEX: Analyzed by EPA Methods 8015 and 8020

TABLE 2
 CUMULATIVE RESULTS OF GROUNDWATER LABORATORY ANALYSES - TPHg and BTEX
 ARCO Station 6113
 785 East Stanley Boulevard
 Livermore, California
 (Page 1 of 2)

Well Date	TPHg	Benzene	Toluene	Ethyl- benzene	Total Xylenes
<u>MW-1</u>					
09/20/89	80	3.0	1.0	0.7	1
06/21/90	<20	<0.50	0.66	<0.50	<0.50
09/20/90	<50	<0.5	1.0	<0.5	1.8
12/18/90	<50	<0.5	1.8	<0.5	1.7
02/21/91	<50	1.2	2.3	<0.5	2.2
05/20/91	<30	<0.30	<0.30	<0.30	<0.30
08/13/91		Not sampled--dry			
11/13/91		Not sampled--dry			
03/19/92	400	<3.5*	<1.2*	<0.8*	<1.0*
06/29/92		Not sampled--residual water only			
09/11/92		Not sampled--dry			
<u>MW-2</u>					
09/20/89	<50	<0.5	<0.5	<0.5	<1
06/21/90	<20	<0.50	<0.50	<0.50	<0.50
09/20/90	<50	<0.5	0.7	<0.5	1.4
12/18/90	<50	0.6	1.5	<0.5	1.9
02/21/91	<50	<0.5	<0.5	<0.5	<0.5
05/20/91	<30	<0.30	<0.30	<0.30	<0.30
08/13/91		Not sampled--dry			
11/13/91		Not sampled--dry			
03/19/92	<50	<0.5	<0.5	<0.5	<0.5
06/29/92	<50	<0.5	<0.5	<0.5	<0.5
09/11/92		Not sampled--residual water only			
<u>MW-3</u>					
09/20/89	170	8.9	0.6	1.1	<1
06/21/90	<20	<0.50	1.0	<0.50	<0.50
09/20/90	<50	<0.5	1.0	<0.5	1.9
12/18/90	<50	<0.5	1.7	<0.5	2.0
02/21/91	<50	<0.5	<0.5	<0.5	<0.5
05/20/91	97	1.3	1.1	6.2	8.4
08/13/91		Not sampled--dry			
11/13/91		Not sampled--dry			
03/19/92	220	<1.1*	<1.9	<0.6*	<0.8*
06/29/92		Not sampled --residual water only			
09/11/92		Not sampled --residual water only			
<u>MW-4</u>					
02/21/91	3,500	410	7.6	30	47
05/20/91	1,400	150	6.0	4.4	3.1
08/13/91		Not sampled--dry			

TABLE 2
 CUMULATIVE RESULTS OF GROUNDWATER LABORATORY ANALYSES - TPHg and BTEX
 ARCO Station 6113
 785 East Stanley Boulevard
 Livermore, California
 (Page 2 of 2)

Well Date	TPHg	Benzene	Toluene	Ethyl- benzene	Total Xylenes
<u>MW-4cont.</u>					
11/13/91		Not sampled—dry			
03/19/92		Not sampled—dry			
06/29/92		Not sampled—dry			
09/11/92		Not sampled—dry			
<u>MW-5</u>					
06/29/92	8,900	1,700	640	310	1,100
09/11/92	13,000	2,200	1,500	130	930
<u>MW-6</u>					
06/29/92	8,600	1,800	460	52	450
09/11/92		Not sampled—floating product			
<u>MW-7</u>					
06/29/92	270	38	3.7	1.1	4.4
09/11/92	420	20	0.7	<0.5	<0.5
<u>MW-8</u>					
06/29/92	<50	<0.5	<0.5	<0.5	<0.5
09/11/92	<50	<0.5	<0.5	<0.5	<0.5
<u>MW-9</u>					
06/29/92	<50	<0.5	<0.5	<0.5	<0.5
09/11/92	<50	<0.5	<0.5	<0.5	<0.5
<u>October 1990</u>					
MCLs	None	1.0	None	680	1,750
DWAL	None	None	100	None	None

Results in parts per billion (ppb).

TPHg = Total petroleum hydrocarbons as gasoline

< = Less than the detection limits shown.

MCLs = Adopted Maximum Contaminant Levels in Drinking Water, DHS (October 1990)

DWAL = Recommended Drinking Water Action Level, DHS (October 1990)

* = Laboratory reportedly raised detection limit due to matrix interference.

TABLE 3
 CUMULATIVE RESULTS OF GROUNDWATER LABORATORY ANALYSES -- VOC, TPHd, TOG, and Metals
 ARCO Station 6113
 785 East Stanley Boulevard
 Livermore, California
 (Page 1 of 2)

Well Date	VOC	TPHd	TOG	Cd	Cr	Pb	Zn	Ni
<u>MW-1</u>								
09/20/89	NA	<50	<5,000	NA	NA	NA	NA	NA
06/21/90	NA	<100	13,000	NA	NA	NA	NA	NA
09/20/90	NA	<50	<5,000	NA	NA	NA	NA	NA
12/18/90	NA	NA	<5,000	NA	NA	NA	NA	NA
02/21/91	NA	NA	<5,000	NA	NA	NA	NA	NA
05/20/91	NA	NA	<75,000	NA	NA	NA	NA	NA
08/13/91	NS	NS	NS	NS	NS	NS	NS	NS
11/13/91	NS	NS	NS	NS	NS	NS	NS	NS
03/19/92	NA	NA	NA	NA	NA	NA	NA	NA
06/29/92	NS	NS	NS	NS	NS	NS	NS	NS
09/11/92	NS	NS	NS	NS	NS	NS	NS	NS
<u>MW-2</u>								
09/20/89	NA	<50	<5,000	NA	NA	NA	NA	NA
06/21/90	NA	<100	<5,000	NA	NA	NA	NA	NA
09/20/90	NA	<50	<5,000	NA	NA	NA	NA	NA
12/18/90	NA	NA	<5,000	NA	NA	NA	NA	NA
02/21/91	NA	NA	<5,000	NA	NA	NA	NA	NA
05/20/91	NA	NA	<75,000	NA	NA	NA	NA	NA
08/13/91	NS	NS	NS	NS	NS	NS	NS	NS
11/13/91	NS	NS	NS	NS	NS	NS	NS	NS
03/19/92	NA	NA	NA	NA	NA	NA	NA	NA
06/29/92	NA	NA	NA	NA	NA	NA	NA	NA
09/11/92	NS	NS	NS	NS	NS	NS	NS	NS
<u>MW-3</u>								
09/20/89	NA	<50	<5,000	NA	NA	NA	NA	NA
06/21/90	NA	<100	10,000	NA	NA	NA	NA	NA
09/20/90	NA	<50	<5,000	NA	NA	NA	NA	NA
12/18/90	NA	NA	<5,000	NA	NA	NA	NA	NA
02/21/91	NA	NA	<5,000	NA	NA	NA	NA	NA
05/20/91	NA	NA	<75,000	NA	NA	NA	NA	NA
08/13/91	NS	NS	NS	NS	NS	NS	NS	NS
11/13/91	NS	NS	NS	NS	NS	NS	NS	NS
03/19/92	NA	<50	<5,000	NA	NA	NA	NA	NA
06/29/92	NS	NS	NS	NS	NS	NS	NS	NS
09/11/92	NS	NS	NS	NS	NS	NS	NS	NS

See notes on Page 2 of 2.

TABLE 3
 CUMULATIVE RESULTS OF GROUNDWATER LABORATORY ANALYSES – VOC, TPHd, TOG, and Metals
 ARCO Station 6113
 785 East Stanley Boulevard
 Livermore, California
 (Page 2 of 2)

Well Date	VOC	TPHd	TOG	Cd	Cr	Pb	Zn	Ni
<u>MW-4</u>								
02/21/91	NA	NA	<5,000	NA	NA	NA	NA	NA
05/20/91	NA	NA	<75,000	NA	NA	NA	NA	NA
08/13/91	NS	NS	NS	NS	NS	NS	NS	NS
11/13/91	NS	NS	NS	NS	NS	NS	NS	NS
03/19/92	NS	NS	NS	NS	NS	NS	NS	NS
06/29/92	NS	NS	NS	NS	NS	NS	NS	NS
09/29/92	NS	NS	NS	NS	NS	NS	NS	NS
<u>MW-8</u>								
06/29/92	ND*	<50	<500	<3	1,780	143	1,310	5,100
09/11/92	NA	<50	<500	13	3,580	308	2,620	10,300
MCL:	Varies	--	--	10	50	50	5,000	--

Results in micrograms per liter (ug/L) = parts per billion (ppb).

VOC: Halogenated Volatile Organic Compounds by EPA Method 5030/601.

TPHd: Total petroleum hydrocarbons as diesel by EPA Methods 3510/California DHS LUFT Method.

TOG: Total oil and grease measured by EPA Method 5520C&F.

NA: Not analyzed.

<: Results reported as less than the detection limit.

NS: Well not sampled.

ND: Not detected.

*: 31 compounds tested were nondetectable.

MCL: Adopted Maximum Contaminant Levels in Drinking Water (October 1990)