

RECEIVED

By Alameda County Environmental Health at 4:42 pm, Oct 29, 2013

Atlantic Richfield Company

Chuck Carmel
Project Manager

PO Box 1257
San Ramon, CA 94583
Phone: (925) 275-3803
Fax: (925) 275-3815
E-Mail: charles.carmel@bp.com

October 25, 2013

Re: Third Quarter 2013 Status Report
Atlantic Richfield Company Station #6113
785 East Stanley Boulevard, Livermore, California
ACEH Case #RO0000393

"I declare, that to the best of my knowledge at the present time, that the information and/or recommendations contained in the attached document are true and correct.

Submitted by,



Chuck Carmel
Project Manager

Attachment

THIRD QUARTER 2013 STATUS REPORT
Atlantic Richfield Company Station #6113
785 East Stanley Blvd., Livermore, California
ACEH Case # RO0000393

Prepared for

Mr. Chuck Carmel
Project Manager
Atlantic Richfield Company
P.O. Box 1257
San Ramon, California 94583

Prepared by



1370 Ridgewood Drive, Suite 5
Chico, California 95973
(530) 566-1400
www.broadbentinc.com

October 25, 2013

Project No. 06-82-637



BROADBENT

1370 Ridgewood Drive, Suite 5, Chico, CA 95973

[T] 530-566-1400 [F] 530-566-1401

broadbentinc.com

CREATING SOLUTIONS. BUILDING TRUST.

October 25, 2013

Project No. 06-82-637

Atlantic Richfield Company
P.O. Box 1257
San Ramon, California 94583
Submitted via ENFOS

Attn.: Mr. Chuck Carmel

Re: Third Quarter 2013 Status Report, Atlantic Richfield Company Station #6113
785 East Stanley Blvd, Livermore, California; ACEH Case #RO0000393

Dear Mr. Carmel:

Provided herein is the *Third Quarter 2013 Status Report* for Atlantic Richfield Company (a BP affiliated company) Station #6113 located at 785 East Stanley Blvd., Livermore, Alameda County, California (Site). This report presents a summary of current developments regarding the Site through the Third Quarter 2013.

Should you have questions regarding this submission, please do not hesitate to contact us at (530) 566-1400.

Sincerely,

BROADBENT & ASSOCIATES, INC.

Jason Duda
Project Scientist

Robert H. Miller, P.G., C.H.G.
Principal Hydrogeologist

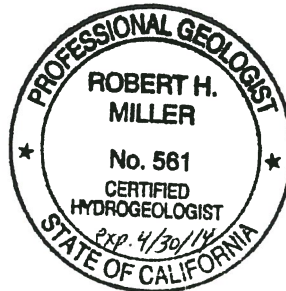

Enclosures

cc: Mr. Jerry Wickham, ACEH (Submitted via ACEH ftp Site)
Mr. Paul M. Smith/Ms. Danielle Stefani, Livermore-Pleasanton Fire Department
(submitted via GeoTracker)
Electronic copy uploaded to GeoTracker

**THIRD QUARTER 2013
STATUS REPORT
STATION #6113, LIVERMORE, CA**

Broadbent & Associates, Inc. (Broadbent) is pleased to present this *Third Quarter 2013 Status Report* on behalf of Atlantic Richfield Company (a BP affiliated company) for Station #6113 located in Livermore, Alameda County, California. Quarterly reporting is being submitted to the Alameda County Environmental Health Services Agency (ACEH) consistent with their requirements under the legal authority of the California Regional Water Quality Control Board as codified by California Code of Regulations Title 23, Section 2652(d). A summary description of current developments regarding the site is provided below.

Facility Name / Address:	Station #6113 / 785 East Stanley Boulevard, Livermore, CA
Client Project Manager / Title:	Mr. Chuck Carmel / Project Manager
Broadbent Contact:	Jason Duda, (530) 566-1400
Broadbent Project No.:	06-82-637
Primary Regulatory Agency / ID No.:	ACEH, Case #RO0000393
Current phase of project:	Closure
List of Acronyms / Abbreviations:	See end of report text for list of acronyms/abbreviations used in report.

WORK PERFORMED THIS QUARTER (Third Quarter 2013):

1. Prepared and submitted the *Second Quarter 2013 Semi-Annual Groundwater Monitoring Report* (Broadbent, 7/26/2013).
2. Prepared and submitted the *Conceptual Site Model and Case Closure Request* (Broadbent, 8/30/2013).

WORK PROPOSED FOR NEXT QUARTER (Fourth Quarter 2013):

1. Prepared and submitted this *Third Quarter 2013 Status Report* (contained herein).
2. Prepare for well abandonment activities.

GROUNDWATER MONITORING PLAN SUMMARY:

Groundwater level gauging:	Suspended due to closure
Groundwater sample collection:	Suspended due to closure
Biodegradation indicator parameter monitoring:	NA

DISCUSSION:

For reference, a Site Location Map is provided as Drawing 1. Provided as Drawing 2 is the Groundwater Elevation Contour and Analytical Summary Map from the *Second Quarter 2013 Semi-Annual Groundwater Monitoring Report* (Broadbent, 7/26/2013) for groundwater monitoring/sampling conducted on April 9-10, 2013.

A letter from ACEH was received on October 23, 2013 stating that the case is pending closure following public notification and a comment period. As such, groundwater monitoring and sampling has been suspended. Well abandonment activities are anticipated to be completed during First Quarter 2014.

ATTACHMENTS:

- Drawing 1 Site Location Map, Station #6113, 785 East Stanley Boulevard, Livermore, California
- Drawing 2. Groundwater Elevation Contour and Analytical Summary Map, April 9-10, 2013,
Station #6113, 785 East Stanley Boulevard, Livermore, California

LIST OF COMMONLY USED ACCRONYMS/ABBREVIATIONS:

ACEH:	Alameda County Environmental Health	gal:	Gallons
BTEX:	Benzene, Toluene, Ethylbenzene, Total Xylenes	GRO:	Gasoline-Range Organics
1,2-DCA:	1,2-Dichloroethane	LNAPL:	Light Non-Aqueous Phase Liquid
DIPE:	Di-Isopropyl Ether	MTBE:	Methyl Tertiary Butyl Ether
DO:	Dissolved Oxygen	NO ₃ :	Nitrate as Nitrogen
DRO:	Diesel-Range Organics	ppb:	parts per billion
EDB:	1,2-Dibromomethane	SO ₄ :	Sulfate
Eh:	Oxidation Reduction Potential	TAME:	Tert-Amyl Methyl Ether
EPA:	Environmental Protection Agency	TBA:	Tertiary Butyl Ether
ETBE:	Ethyl Tertiary Butyl Ether	TOC:	Top of Casing
Fe ²⁺ :	Ferrous Iron	µg/L:	micrograms per liter
ft/ft:	feet per foot		

DRAWINGS

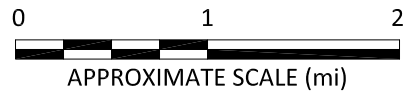
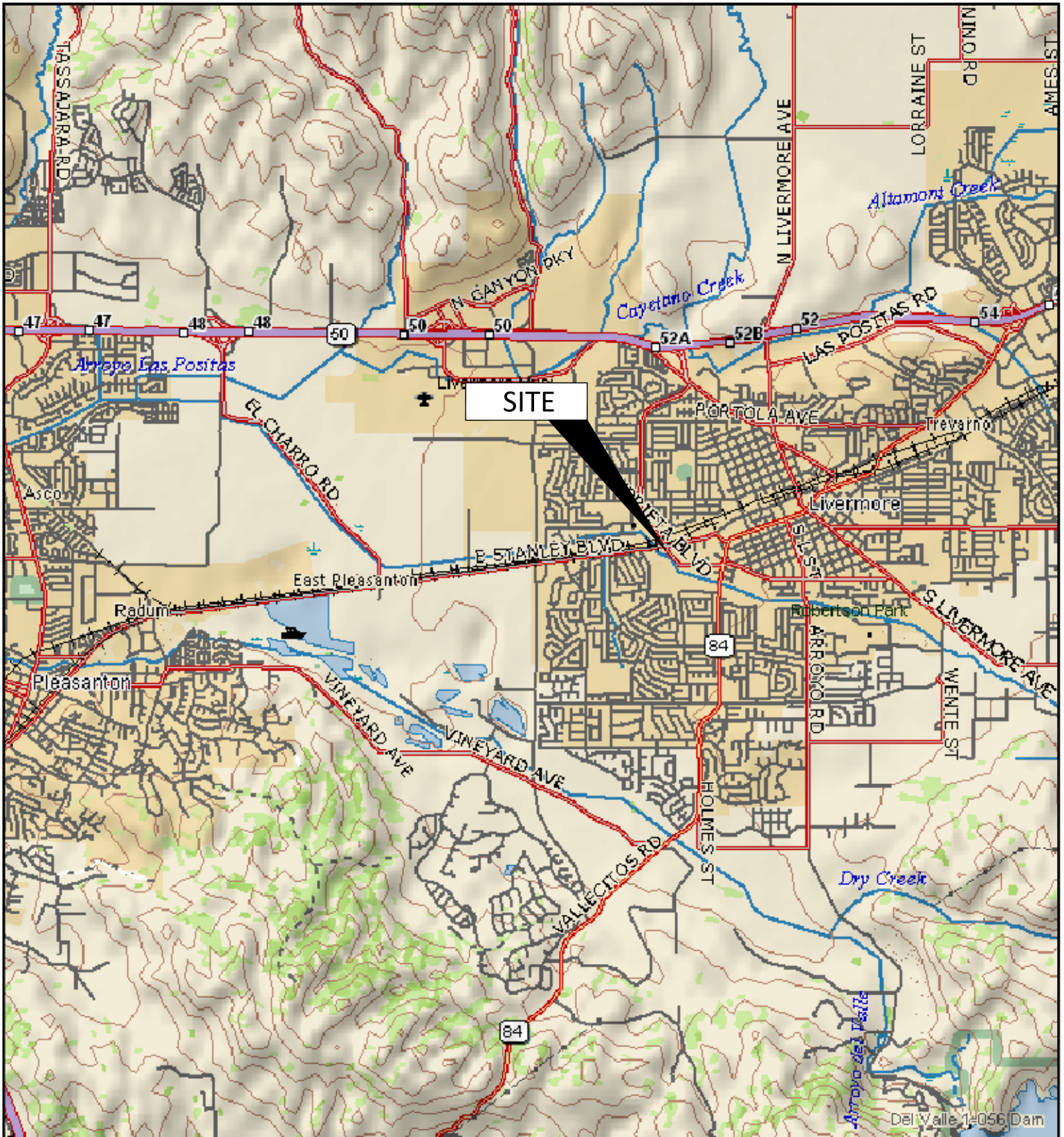
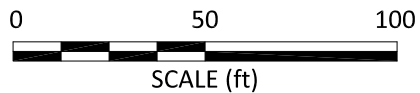
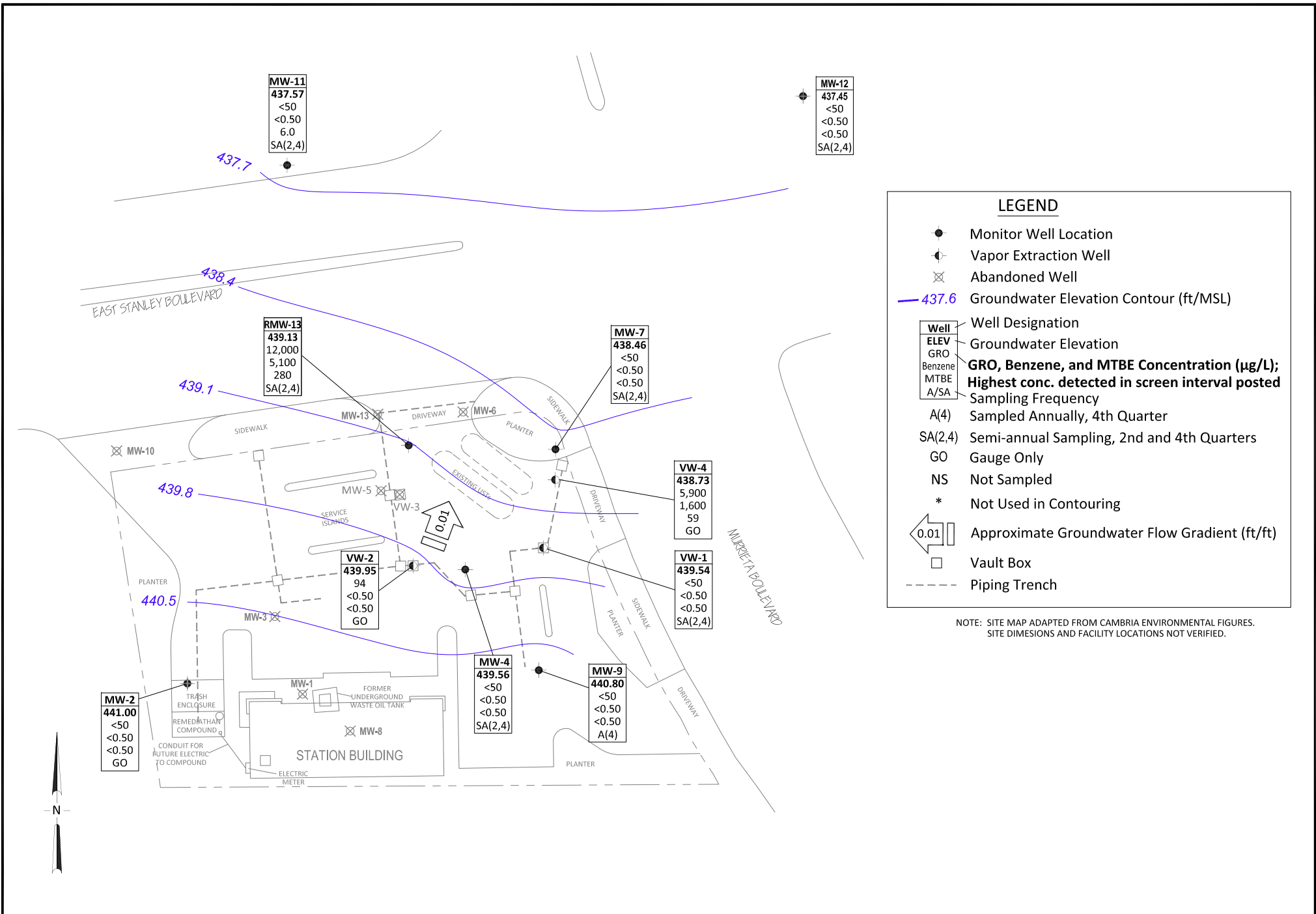

IMAGE SOURCE: DELORME



BROADBENT
 1370 Ridgewood Dr., Suite 5
 Chico, California 95973
 Project No.: 06-82-637 Date: 7/19/2013

Station #6113
 785 East Stanley Boulevard
 Livermore, California

Groundwater Elevation Contour
 and Analytical Summary Map
 April 9-10, 2013

Drawing
2