

Wickham, Jerry, Env. Health

From: Wickham, Jerry, Env. Health
Sent: Tuesday, May 14, 2013 3:20 PM
To: 'Jason Duda'
Cc: Shannon Couch; Rob Miller
Subject: RO393 BP Station #6113 - 785 E. Stanley Blvd., Livermore

Hi Jason,

Based on your request, the schedule for submittal of the report referenced below is extended to August 30, 2013.

Regards,
Jerry Wickham
Alameda County Environmental Health
1131 Harbor Bay Parkway
Alameda, CA 94502-6577
phone: 510-567-6791
jerry.wickham@acgov.org

From: Jason Duda [<mailto:jduda@broadbentinc.com>]
Sent: Tuesday, May 14, 2013 2:36 PM
To: Wickham, Jerry, Env. Health
Cc: Shannon Couch; Rob Miller
Subject: BP Station #6113 - 785 E. Stanley Blvd., Livermore

Hi Jerry,

Per our phone conversation, we would like to request an extension of the current deadline (May 31, 2013) for submittal of a Remedial Well Installation, Geochemical Sampling, and Dual-Phase Extraction Event Report to **August 30, 2013**. As you are aware, we encountered up to approx. 8' of pea gravel within the first location chosen for well installation activities. We are currently evaluating the possibility of installing the proposed remedial well (RW-1) beneath the canopy and further west of the existing UST basin (see attached Drawing). We plan to schedule a Site visit with Gregg Drilling within the next week or so to further assess the safety and height clearance issues associated with well installation between the pump islands and under the canopy. Completion of the DPE event has been postponed as use of the proposed remedial well during this event would be preferred. Please feel free to contact me directly with any comments, questions or concerns. Thank you. Talk with you soon.

Jason Duda
Project Scientist

1370 Ridgewood Dr., Suite 5, Chico, CA 95973
[T] 530-566-1400 • [C] 530-592-6822 • [F] 530-566-1401
jduda@broadbentinc.com



CONFIDENTIALITY: This communication, including attachments, is for the exclusive use of the addressee(s) and may contain proprietary, confidential or privileged information. If you are not the intended recipient, any use, copying, disclosure, or distribution or the taking of any action in reliance upon this information is strictly prohibited. If you are not the intended recipient, please notify the sender immediately and delete this communication and destroy all copies.

MW-12

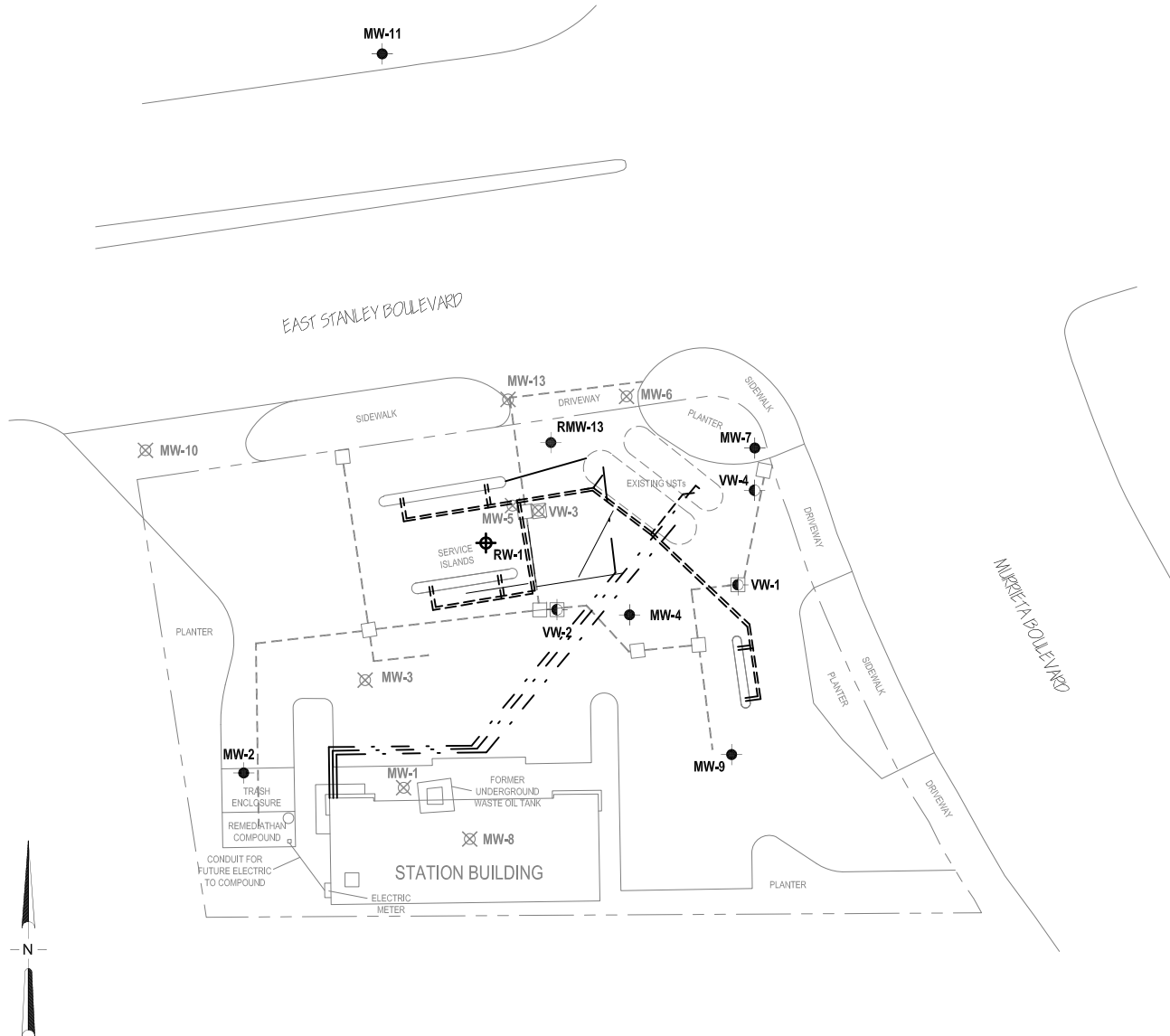

LEGEND

- Monitoring well
- | Vapor extraction well
- ⊗ Abandoned well
- ◆ Proposed remedial well location
- Vault box
- - - Piping trench
- - - Approximate product lines
- Presumed utility line
- · - Approximate vent lines
- Undifferentiated utility lines

NOTE: SITE MAP ADAPTED FROM CAMBRIA ENVIRONMENTAL FIGURES. SITE DIMENSIONS AND FACILITY LOCATIONS NOT VERIFIED.

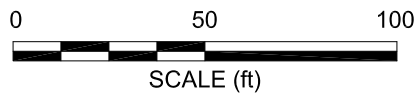

BROADBENT
1370 Ridgewood Dr., Suite 5
Chico, California 95973

Project No.: 06-82-637 Date: 03/06/2013

Station #6113
785 East Stanley Boulevard
Livermore, California

Site Map with Proposed
Remedial Well Location

Drawing

1