

Atlantic Richfield Company

Chuck Carmel
Environmental Business Manager

RECEIVED

10:25 am, Jul 07, 2010

Alameda County
Environmental Health

PO Box 1257
San Ramon, CA 94583
Phone: (925) 275-3803
Fax: (925) 275-3815
E-Mail: charles.carmel@bp.com

6 July 2010

Re: Second Quarter 2010 Status Report
Atlantic Richfield Company Station #2185
9800 International Boulevard, Oakland, California
ACEH Case #RO0000392

"I declare, that to the best of my knowledge at the present time, that the information and/or recommendations contained in the attached document are true and correct.

Submitted by,



Chuck Carmel
Environmental Business Manager

Attachment

6 July 2010

Project No. 06-88-622

Atlantic Richfield Company
P.O. Box 1257
San Ramon, California 94583
Submitted via ENFOS

Attn.: Mr. Chuck Carmel

Re: Second Quarter 2010 Status Report, Atlantic Richfield Company Service Station #2185
9800 International Boulevard, Oakland, California; ACEH Case #RO0000392

Dear Mr. Carmel:

Provided herein is the *Second Quarter 2010 Status Report* for Atlantic Richfield Company (a BP affiliated company) Station #2185, located at 9800 International Boulevard (formerly known as East 14th Street), Oakland, California (Site). This report presents a summary of current developments at the Site through the Second Quarter of 2010.

Should you have questions regarding this submittal, please do not hesitate to contact me at (530) 566-1400.

Sincerely,

BROADBENT & ASSOCIATES, INC.



Thomas A. Venus, P.E.
Senior Engineer



Enclosures

cc: Mr. Paresh Khatri, Alameda County Environmental Health (Submitted via ACEH ftp site)
Electronic copy uploaded to GeoTracker

STATION #2185 QUARTERLY STATUS REPORT

Facility: #2185	Address: 9800 International Boulevard, Oakland, California
Environmental Business Manager:	Mr. Chuck Carmel
Consulting Company/Contact Person:	Broadbent & Associates, Inc.(BAI)/Mr. Tom Venus, PE (530) 566-1400
Consultant Project No.:	06-08-622
Primary Agency/Regulatory ID No.:	Alameda County Environmental Health (ACEH) ACEH Case #RO0000392

WORK PERFORMED THIS QUARTER (Second Quarter 2010):

1. Prepared and submitted the *First Quarter 2010 Status Report* (BAI, 4/5/2010).
2. Prepared and submitted List of Landowners Form on 15 January 2010, as requested in the ACEH directive letter dated 7 January 2010.

WORK PROPOSED FOR NEXT QUARTER (Third Quarter 2010):

1. Prepared and submitted this *Second Quarter 2010 Status Report* (contained herein).
2. No environmental field work is schedule at the Site during the Third Quarter of 2010.

DISCUSSION:

In a letter dated 17 September 2008 from the Alameda County Environmental Health (ACEH), Mr. Paresh Khatri stated that as concentrations of contaminants in ground water appeared low and concentrations of contaminants in the confirmation soil samples were not detected above the laboratory detection limits, the Site appeared to qualify for case closure evaluation. As stated in a letter dated 7 January 2010, the ACEH and California Regional Water Quality Control Board have reviewed the fuel leak case and case closure summary for the Site and concur that no further action related to the underground storage tank fuel release is required at this time. However, prior to issuance of a remedial action completion certificate, the monitoring wells at the Site must be properly decommissioned and a List of Landowners Form must be completed. On 15 January 2010, the completed List of Landowners Form was submitted to ACEH and GeoTracker listing the following individuals as owners of the property: Nooshin Salkhi, Ali Salkhi, Arash Salkhi, Banassheh Salkhi, Amin Salkhi, Souri Salkhi, and Ajang Salkhi, in care of Amin Salkhi at 605 Contra Costa Boulevard in Concord, California 94523.

On April 13-15 2010, BAI observed Cascade Drilling (a C-57 licensed drilling contractor) decommission the former monitoring wells associated with the Site. On 28 May 2010, BAI submitted the requested *Monitoring Well Decommissioning Report* to the ACEH. On June 28-29 2010, BAI observed Cornerstone Environmental (a Class A General Contractor) replace the three damaged sidewalk panels at former well locations MW-7, MW-9, and MW-10, as required by the City of Oakland. BAI has completed the work requested by ACEH as necessary to obtain the remedial action completion certificate stating that no further action is required. BAI and BP are eagerly awaiting the receipt from ACEH of the 'no further action'/remedial action completion certificate. As a reminder, a Site Location Map is provided as Drawing 1. A former Site Layout Plan is presented as Drawing 2.

ATTACHMENTS:

- Drawing 1. Site Location Map, Station #2185, 9800 International Blvd., Oakland, California
- Drawing 2. Site Layout Plan, Station #2185, 9800 International Blvd., Oakland, California

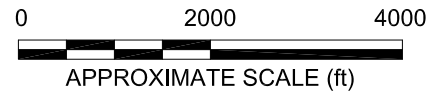
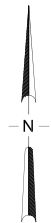
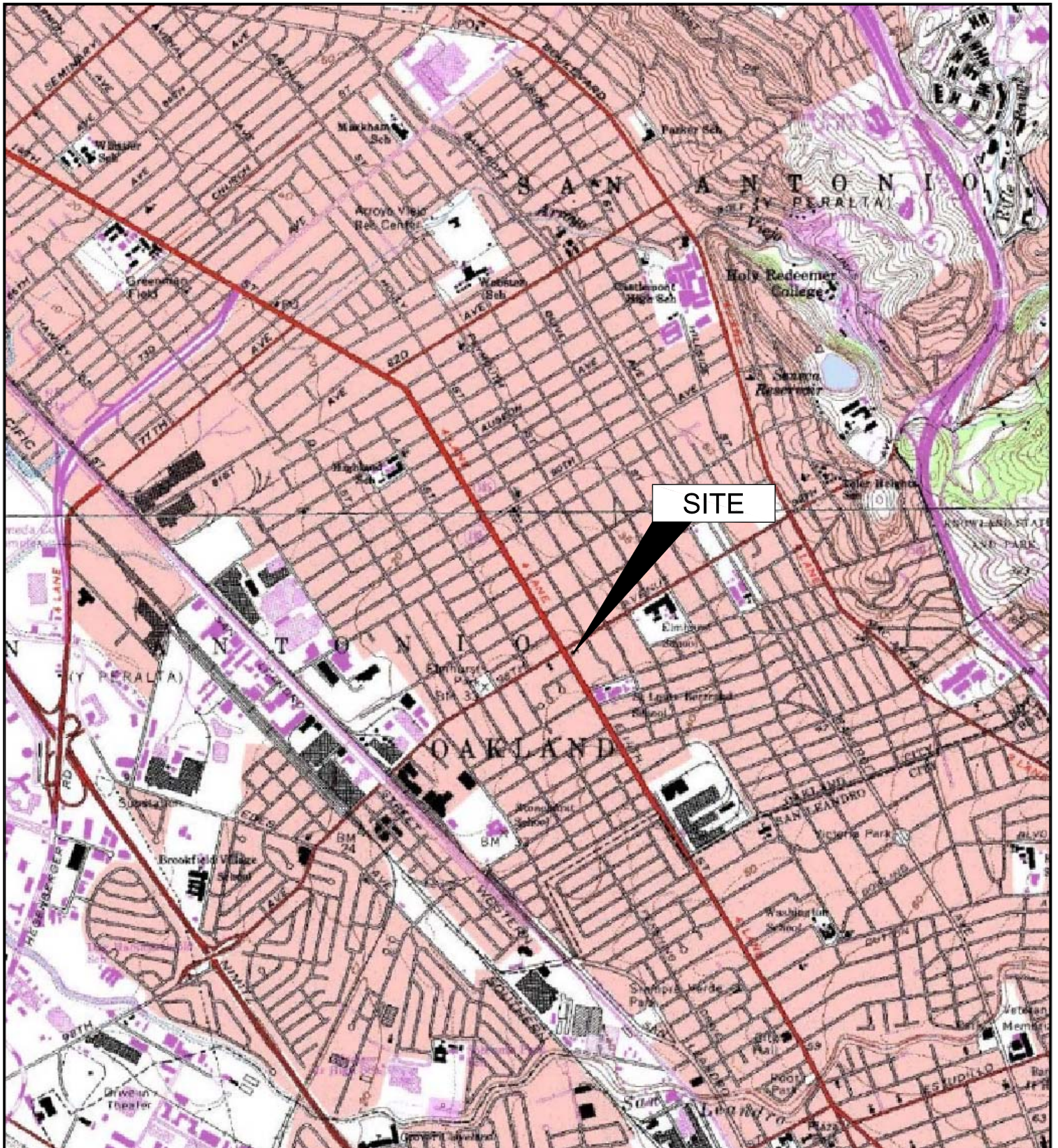
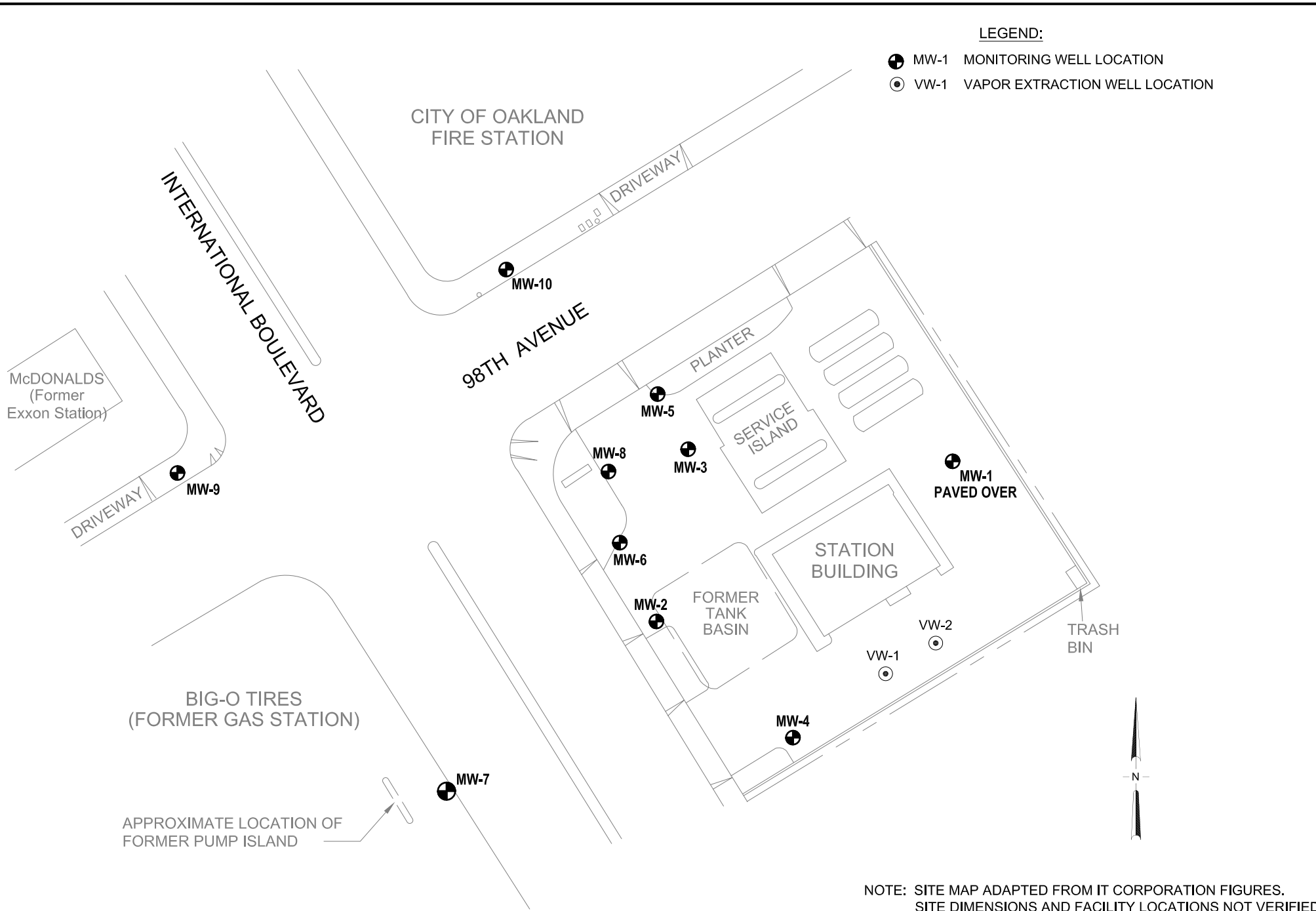

IMAGE SOURCE: USGS

LEGEND:

- ⊕ MW-1 MONITORING WELL LOCATION
- ⊙ VW-1 VAPOR EXTRACTION WELL LOCATION



NOTE: SITE MAP ADAPTED FROM IT CORPORATION FIGURES.
SITE DIMENSIONS AND FACILITY LOCATIONS NOT VERIFIED

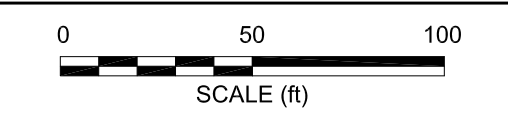

BROADBENT & ASSOCIATES, INC.
ENGINEERING, WATER RESOURCES & ENVIRONMENTAL
1324 Mangrove Ave. Suite 212, Chico, California
Project No.: 06-08-622 Date: 1/20/10

Station #2185
9800 International Blvd.
Oakland, California

Site Layout Plan

Drawing
2