



Atlantic Richfield Company
(a BP affiliated company)

P.O. Box 1257
San Ramon, California 94583
Phone: (925) 275-3801
Fax: (925) 275-3815

6 July 2007

Re: Second Quarter 2007 Status Report
Atlantic Richfield Company Service Station #2185
9800 International Boulevard
Oakland, California
ACEH Case #RO0000392

RECEIVED

1:41 pm, Jul 27, 2007

Alameda County
Environmental Health



bp

"I declare, that to the best of my knowledge at the present time, that the information and/or recommendations contained in the attached document are true and correct."

Submitted by:

Paul Supple
Environmental Business Manager

6 July 2007

Project No. 06-08-622

Atlantic Richfield Company
P.O. Box 1257
San Ramon, California 94583
Submitted via ENFOS

Attn.: Mr. Paul Supple

Re: Second Quarter 2007 Status Report, Atlantic Richfield Company (a BP affiliated company) Service Station #2185, 9800 International Boulevard, Oakland, California; ACEH Case #RO0000392

Dear Mr. Supple:

Provided herein is the *Second Quarter 2007 Status Report* for Atlantic Richfield Company Station #2185 (herein after referred to as Station #2185), located at 9800 International Boulevard (formerly known as East 14th Street), Oakland, Alameda County, California (Site).

Case closure was requested by BP from Alameda County Environmental Health (ACEH) on 9 September 2003. BP is currently awaiting a response from ACEH.

Should you have questions regarding this submission, please do not hesitate to contact us at (530) 566-1400.

Sincerely,

BROADBENT & ASSOCIATES, INC.



Thomas A. Venus, P.E.
Senior Engineer

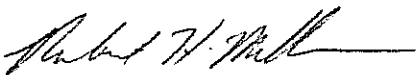

Robert H. Miller, P.G., C.HG.
Principal Hydrogeologist

Enclosures

cc: Mr. Stephen Plunkett, ACEH (Submitted via ACEH ftp site)
Electronic copy uploaded to GeoTracker

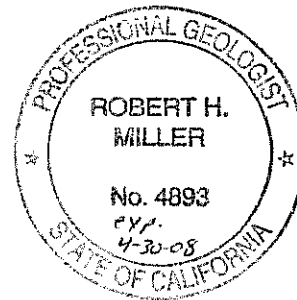

STATION #2185 QUARTERLY STATUS REPORT

Facility: #2185	Address: 9800 International Boulevard, Oakland, California
Environmental Business Manager:	Mr. Paul Supple
Consulting Company/Contact Person:	Broadbent & Associates, Inc.(BAI)/Rob Miller & Tom Venus (530)566-1400
Consultant Project No.:	06-08-622
Primary Agency/Regulatory ID No.:	Alameda County Environmental Health (ACEH) ACEH Case #RO0000392

WORK PERFORMED THIS QUARTER (Second Quarter 2007):

1. Prepared and submitted the First Quarter 2007 Status Report.
2. No environmental work was conducted at the site during Second Quarter of 2007.

WORK PROPOSED FOR NEXT QUARTER (Third Quarter 2007):

1. Prepared and submitted the Second Quarter 2007 Status Report (contained herein).
2. No environmental work is proposed for the site during the Third Quarter 2007.

DISCUSSION:

Case closure was requested by BP on 9 September 2003 from ACEH. BP is currently awaiting a response from the ACEH. A Site Map is provided as Drawing 1.

ATTACHMENTS:

Drawing 1. Site Map, Station #2185, 9800 International Blvd., Oakland, California

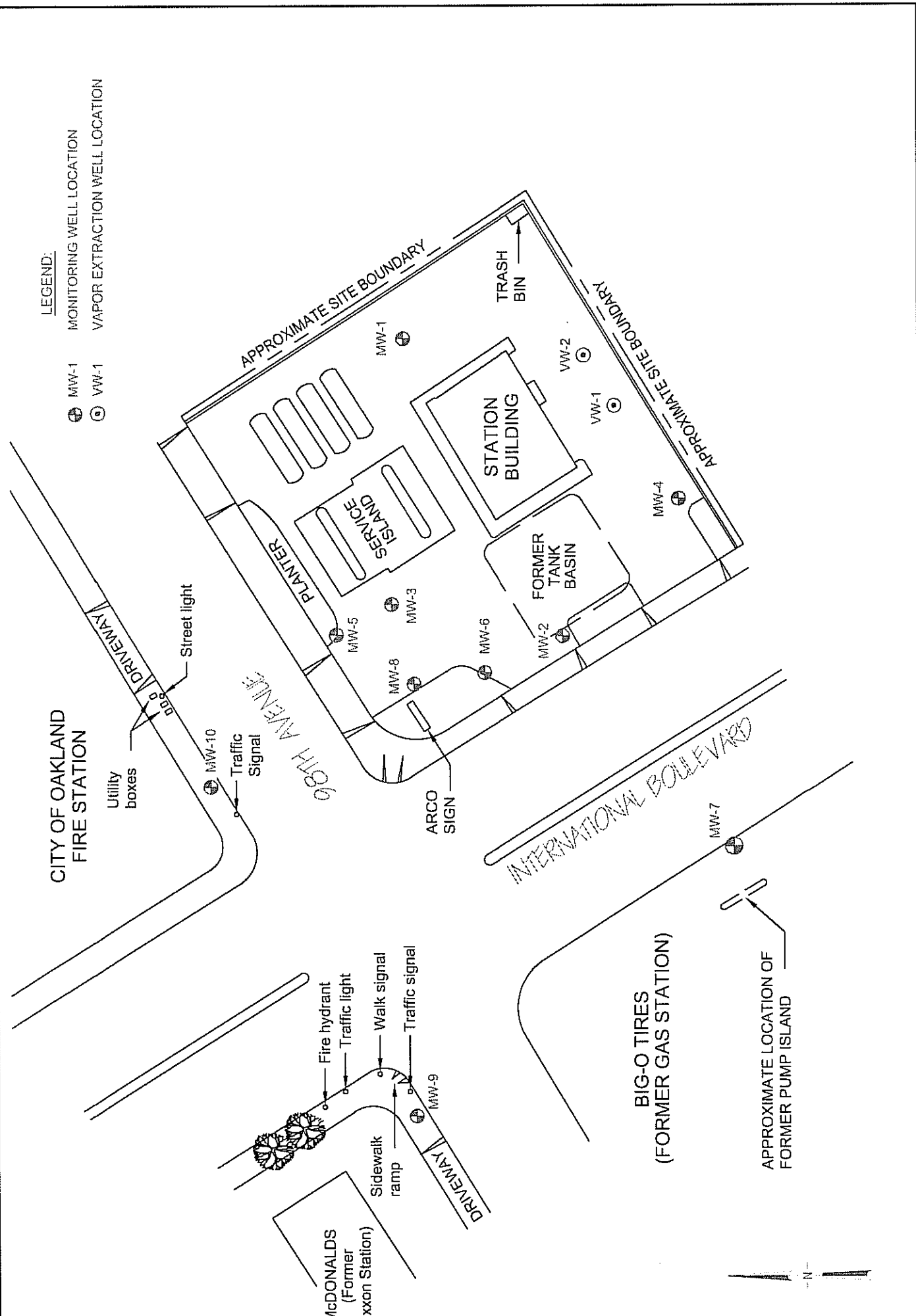

<p>0 50 100 SCALE (ft)</p>	<p>BROADBENT & ASSOCIATES, INC. ENGINEERING, WATER RESOURCES & ENVIRONMENTAL 1324 Mangrove Ave. Suite 212, Chico, California</p> <p>Project No.: 06-08-622 Date: 10/03/06</p>	<p>Station #2185 9800 International Blvd. Oakland, California</p>	<p>Site Map</p> <p>Drawing 1</p>
--------------------------------	--	---	---