



**RECEIVED**

*By dehloptoxic at 11:01 am, Feb 01, 2007*



Atlantic Richfield Company  
(a BP affiliated company)

P.O. Box 1257  
San Ramon, California 94583  
Phone: (925) 275-3801  
Fax: (925) 275-3815

26 January 2007

Re: Fourth Quarter 2006 Status Report  
Atlantic Richfield Company Service Station #2185  
9800 International Boulevard  
Oakland, California  
ACEH Case #RO0000392

"I declare, that to the best of my knowledge at the present time, that the information and/or recommendations contained in the attached document are true and correct."

Submitted by:

Paul Supple  
Environmental Business Manager

Broadbent & Associates, Inc.  
1324 Mangrove Ave., Suite 212  
Chico, CA 95926  
Voice (530) 566-1400  
Fax (530) 566-1401



26 January 2007

Project No. 06-08-622

Atlantic Richfield Company  
P.O. Box 1257  
San Ramon, California 94583  
Submitted via ENFOS

Attn.: Mr. Paul Supple

Re: Fourth Quarter 2006 Status Report, Atlantic Richfield Company (a BP affiliated company) Service Station #2185, 9800 International Boulevard, Oakland, California  
ACEH Case #RO0000392

Dear Mr. Supple:

Provided herein is the *Fourth Quarter 2006 Status Report* for Atlantic Richfield Company Station #2185 (herein after referred to as Station #2185), located at 9800 International Boulevard (formerly known as East 14<sup>th</sup> Street), Oakland, Alameda County, California (Site).

Case closure was requested by BP from Alameda County Environmental Health (ACEH) on 9 September 2003. BP is currently awaiting a response from ACEH.

Should you have questions regarding this submission, please do not hesitate to contact us at (530) 566-1400.

Sincerely,

BROADBENT & ASSOCIATES, INC.

A handwritten signature in black ink, appearing to read 'Thomas A. Venus'.

Thomas A. Venus, P.E.  
Senior Engineer

A handwritten signature in black ink, appearing to read 'Robert H. Miller'.

Robert H. Miller, P.G., C.HG.  
Principal Hydrogeologist

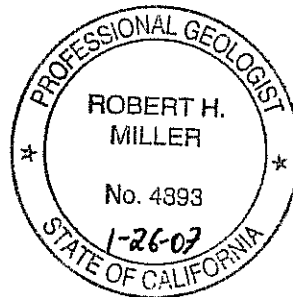

Enclosures

cc: Mr. Stephen Plunkett, ACEH (Submitted via ACEH ftp site)  
Electronic copy uploaded to GeoTracker

## STATION #2185 QUARTERLY STATUS REPORT

Facility: #2185	Address: 9800 International Boulevard, Oakland, California
Environmental Business Manager:	Mr. Paul Supple
Consulting Company/Contact Person:	Broadbent & Associates, Inc.(BAI)/Rob Miller & Tom Venus (530)566-1400
Consultant Project No.:	06-08-622
Primary Agency/Regulatory ID No.:	Alameda County Environmental Health (ACEH) ACEH Case #RO0000392

### WORK PERFORMED THIS QUARTER (Fourth Quarter 2006):

1. Prepared and submitted the Third Quarter 2006 Status Report.
2. No environmental work was conducted at the site during Fourth Quarter 2006.

### WORK PROPOSED FOR NEXT QUARTER (First Quarter 2007):

1. Prepared and submitted the Fourth Quarter 2006 Status Report (contained herein).
2. No environmental work is proposed for the site during the First Quarter 2007.

### DISCUSSION:

Case closure was requested by BP on 9 September 2003 from ACEH. BP is currently awaiting a response from the ACEH. A Site Map is provided as Drawing 1.

### ATTACHMENTS:

Drawing 1. Site Map, Station #2185, 9800 International Blvd., Oakland, California

CITY OF OAKLAND  
FIRE STATION

LEGEND:

- ⊕ MW-1 MONITORING WELL LOCATION
- ⊙ VW-1 VAPOR EXTRACTION WELL LOCATION

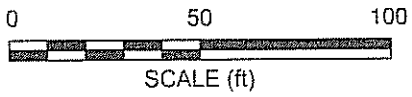
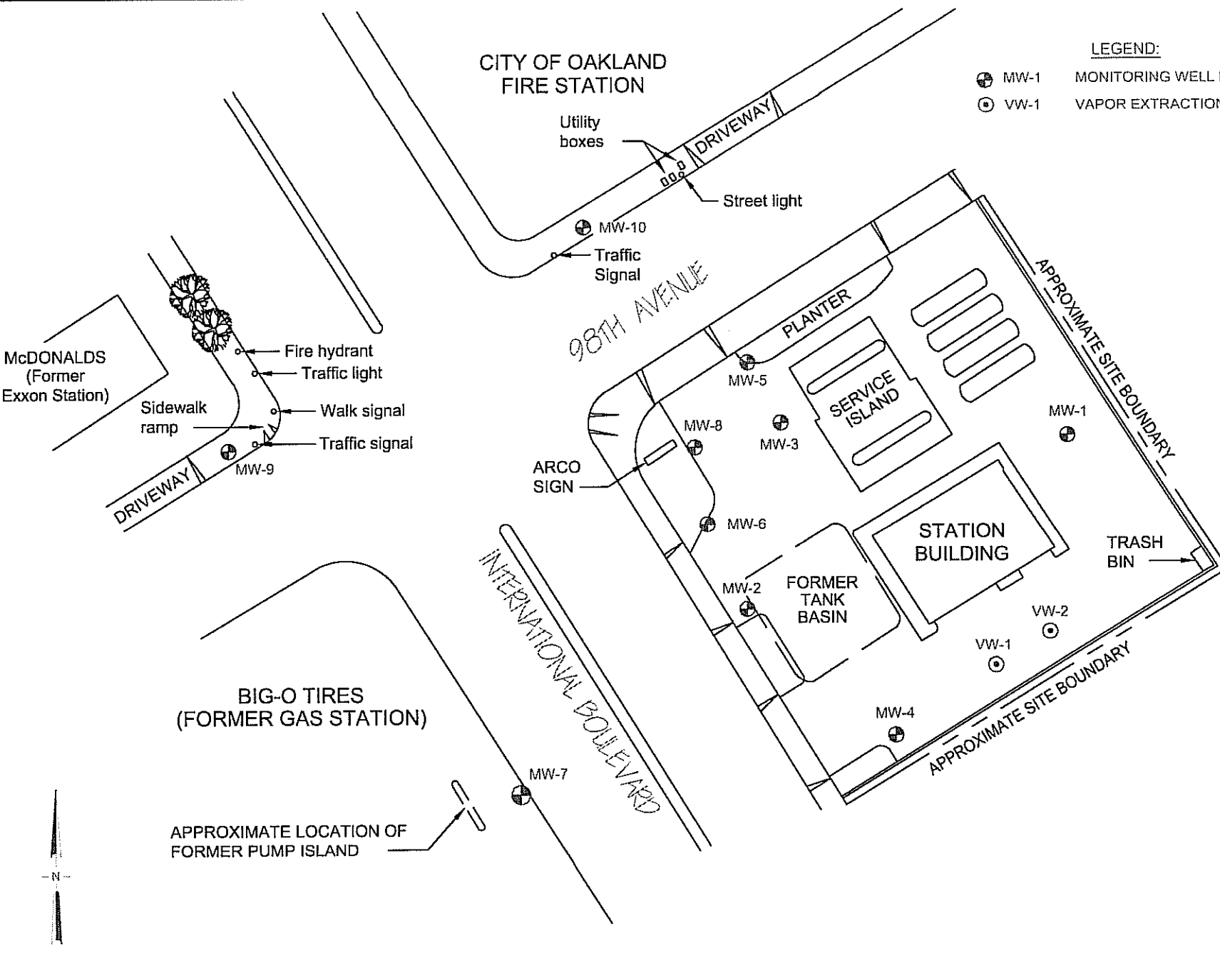

**BROADBENT & ASSOCIATES, INC.**  
ENGINEERING, WATER RESOURCES & ENVIRONMENTAL  
1324 Mangrove Ave. Suite 212, Chico, California  
Project No.: 06-08-622 Date: 10/03/06

Station #2185  
9800 International Blvd.  
Oakland, California

Site Map  
1

Drawing  
1

Broadbent & Associates, Inc.  
1324 Mangrove Ave., Suite 212  
Chico, CA 95926  
Voice (530) 566-1400  
Fax (530) 566-1401

**RECEIVED**

*By dehloptoxic at 10:25 am, Aug 01, 2006*



19 July 2006

Project No. 06-08-622

Atlantic Richfield Company  
P.O. Box 1257  
San Ramon, California 94583  
Submitted via ENFOS

Attn.: Mr. Paul Supple

Re: Second Quarter 2006 Report, Atlantic Richfield Company (a BP affiliated company)  
Station #2185, 9800 East 14<sup>th</sup> Street, Oakland, Alameda County, California;  
ACEH Case No.3876/RO392.

Dear Mr. Supple:

Provided herein is the *Second Quarter 2006 Status Report* for Atlantic Richfield Company Station #2185 located at 9800 East 14<sup>th</sup> Street, Oakland, Alameda County, California. Case closure was requested from Alameda County Environmental Health (ACEH) on 10 November 2004. BP is currently awaiting a response from ACEH.

Should you have questions regarding this submission, please do not hesitate to contact us at (530) 566-1400.

Sincerely,

BROADBENT & ASSOCIATES, INC.

A handwritten signature in cursive script that reads 'Thomas A. Venus'.

Thomas A. Venus, P.E.  
Senior Engineer

A handwritten signature in cursive script that reads 'Robert H. Miller'.

Robert H. Miller, P.G., C.HG.  
Principal Hydrogeologist

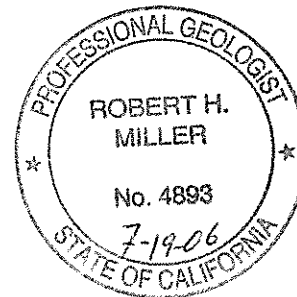

Enclosures

cc: Mr. Stephen Plunkett, ACEH (Submitted via ACEH ftp Site)  
Electronic copy uploaded to GeoTracker

## STATION #2185 QUARTERLY GROUND-WATER STATUS REPORT

Facility: #2185	Address: 9800 East 14 <sup>th</sup> Street, Oakland, California
Environmental Business Manager:	Mr. Paul Supple
Primary Agency/Regulatory ID No.:	Alameda County Environmental Health (ACEH) ACEH Case No. 3876 / RO0000392
Consulting Company/Contact Person:	Broadbent & Associates/Rob Miller & Thomas A. Venus, (530)566-1400
Consultant Project No.:	06-08-622

### WORK PERFORMED THIS QUARTER (Second Quarter, 2006):

1. URS prepared and submitted the First Quarter 2006 report.
2. No environmental work was conducted at the site during the Second Quarter 2006.

### WORK PROPOSED FOR NEXT QUARTER (Third Quarter, 2006):

1. Prepared and submitted this Second Quarter 2006 Status Report.
2. No environmental work is proposed for the site during the Third Quarter 2006.
3. Prepare and submit the Third Quarter 2006 Status Report.

### DISCUSSION:

Case closure was requested on 10 November 2004 from ACEH. BP is currently awaiting a response from the ACEH.



Atlantic Richfield Company  
(a BP affiliated company)

P.O. Box 6549  
Moraga, California 94570  
Phone: (925) 299-8891  
Fax: (925) 299-8872



**RECEIVED**

*By loprojectop at 9:48 am, Apr 17, 2006*

April 5, 2006

Re: ARCO Service Station # 2185  
9800 East 14<sup>th</sup> Street  
Oakland, California  
First Quarter 2006 Status Report  
ACEH Case # 3876

"I declare, that to the best of my knowledge at the present time, that the information and/or recommendations contained in the attached document are true and correct.

Submitted by:

Paul Supple  
Environmental Business Manager



**RECEIVED**

By lopprojectop at 9:48 am, Apr 17, 2006

April 5, 2006

Mr. Don Hwang  
Alameda County Environmental Health (ACEH)  
1131 Harbor Bay Parkway, Suite 250  
Alameda, CA 94502

**Re: First Quarter 2006 Status Report  
ARCO Service Station #2185  
9800 East 14<sup>th</sup> Street  
Oakland, California  
ACEH Case No. 3876**

Dear Mr. Hwang:

On behalf of Atlantic Richfield Company, a BP affiliated Company, URS Corporation (URS) is submitting the *First Quarter 2006 Status Report* for the ARCO Service Station #2185, located at 9800 East 14<sup>th</sup> Street, Oakland, California.

Case closure was requested on November 10, 2004 from ACEH. BP is currently awaiting the agency's response.

If you have any questions regarding this submission, please call at (510) 874-3296.

Sincerely,

**URS CORPORATION**

Barbara J. Jakub, P.G.  
Project Manager

Enclosure: First Quarter 2006 Status Report

cc: Mr. Paul Supple, RM, electronic copy uploaded to ENFOS  
Mr. Rob Miller, Broadbent & Associates, Inc., electronic copy uploaded to ENFOS and to  
rhmillier@broadbentinc.com

URS Corporation  
1333 Broadway, Suite 800  
Oakland, CA 94612-1924  
Tel: 510.893.3600  
Fax: 510.874.3268



Date: April 5, 2006  
Quarter: 1Q 06

**FIRST QUARTER 2006 STATUS REPORT**

Facility No.: 2185 Address: 9800 East 14<sup>th</sup> Street, Oakland, California  
RM Environmental Business Manager: Paul Supple  
Consulting Co./Contact Person: URS Corporation / Barbara Jakub  
Primary Agency: Alameda County Environmental Health (ACEH)  
ACEH Case No.: 3876

**WORK PERFORMED THIS QUARTER (First – 2006):**

1. Prepared and submitted the Fourth Quarter 2005 Status Report.
2. No environmental work was conducted at the site during the first quarter 2006.

**WORK PROPOSED FOR NEXT QUARTER (Second – 2006):**

1. Prepared and submitted this First Quarter 2006 Status Report.
2. No environmental work is expected for the site during the second quarter 2006.
3. Prepare and submit the Second Quarter 2006 Status Report.

**DISCUSSION:**

Case closure was requested on November 10, 2004 from ACEH. BP is currently awaiting the agency's response.