

ALCO  
HAZMAT

**RESNA**  
Working To Restore Nature

94 MAR 14 PM 2:55

3315 Almaden Expressway, Suite 34  
San Jose, CA 95118  
Phone: (408) 264-7723  
FAX: (408) 264-2435

**TRANSMITTAL**

3876

**TO: Mr. Barney Chan**  
Alameda County Health  
Care Services Agency  
80 Swan Way, Room 200  
Oakland, California 94621

**DATE: March 10, 1994**  
**PROJECT NUMBER: 62026.05**  
**SUBJECT: ARCO Station 2185**

**FROM: Erin D. Krueger**

**WE ARE SENDING YOU:**

COPIES DATED	DESCRIPTION
1 03/10/94	Response to letter dated February 10, 1994 at ARCO Station 2185, 9800 East 14th Street, Oakland, California.

**THESE ARE TRANSMITTED as checked below:**

- For review and comment     Approved as submitted     Resubmit \_\_\_ copies for approval
- As requested     Approved as noted     Submit \_\_\_ copies for distribution
- For approval     Return for corrections     Return \_\_\_ corrected prints
- For your files     Regular Mail     Certified Mail

**REMARKS:**

Copies: 1 to RESNA project file no. 62026.05

  
Erin D. Krueger, Staff Geologist

cc: Mr. Michael Whelan, ARCO  
Mr. Richard Hiatt, RWQCB

3315 Almaden Expressway, Suite 34  
San Jose, CA 95118  
Phone: (408) 264-7723  
FAX: (408) 264-2435

March 10, 1994

Mr. Barney Chan  
Alameda County Health Care Services Agency  
Department of Environmental Health  
80 Swan Way, Room 200  
Oakland, California 94621

Subject: Response to letter dated February 10, 1994  
ARCO Station 2185  
9800 East 14th Street, Oakland, California.

Dear Mr. Chan:

At the request of ARCO Products Company (ARCO), RESNA Industries Inc. (RESNA), has prepared this letter as a written response to your letter of February 10, 1994, and to confirm a schedule of work at the above referenced site (Plate 1). As agreed upon in the February 28, 1994, meeting with Mr. Michael Whelan of ARCO, Mr. John C. Young of RESNA, and yourself, RESNA will install one compliance well (MW-10) in the northwestern portion of the site (Plate 2), and two compliance wells (MW-8 and MW-9) offsite as previously proposed in RESNA's January 20, 1994, Work Plan. Compliance well MW-10 is located as close to the location discussed in the meeting as is possible due to the location of on street utilities, and a concrete filled planter onsite.

As agreed upon in the above mentioned meeting, RESNA will provide a schedule for the installation of onsite compliance well MW-10 (Plate 3), and will begin work immediately. RESNA anticipates a letter report of results will be submitted 12 weeks from the date of this document (Plate 3). RESNA will also immediately initiate permitting (and possible offsite access negotiations) for previously proposed compliance wells MW-8 and MW-9 (RESNA, January 1994), and anticipates completion of work in approximately 22 weeks (Plate 4).

Additionally, as agreed upon in the meeting, RESNA will perform quarterly groundwater monitoring for two quarters following well installation to accumulate data and evaluate hydrocarbon impact to groundwater. Based on these results, RESNA will evaluate whether this site still warrants review for alternative points of compliance.

If you have any questions or comments, please contact us at (408) 264-7723.

Sincerely,  
RESNA Industries Inc.



Erin D. Krueger  
Staff Geologist

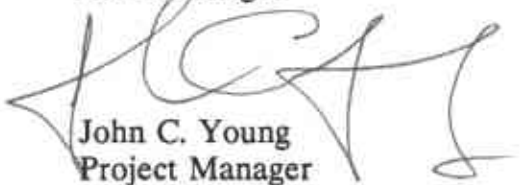

John C. Young  
Project Manager

cc: Michael Whelan, ARCO  
Richard Heitt, RWQCB

Attachments: Plate 1, Site Vicinity  
Plate 2, Locations of Proposed Wells  
Plate 3, Preliminary Time Schedule  
Plate 4, Preliminary Time Schedule

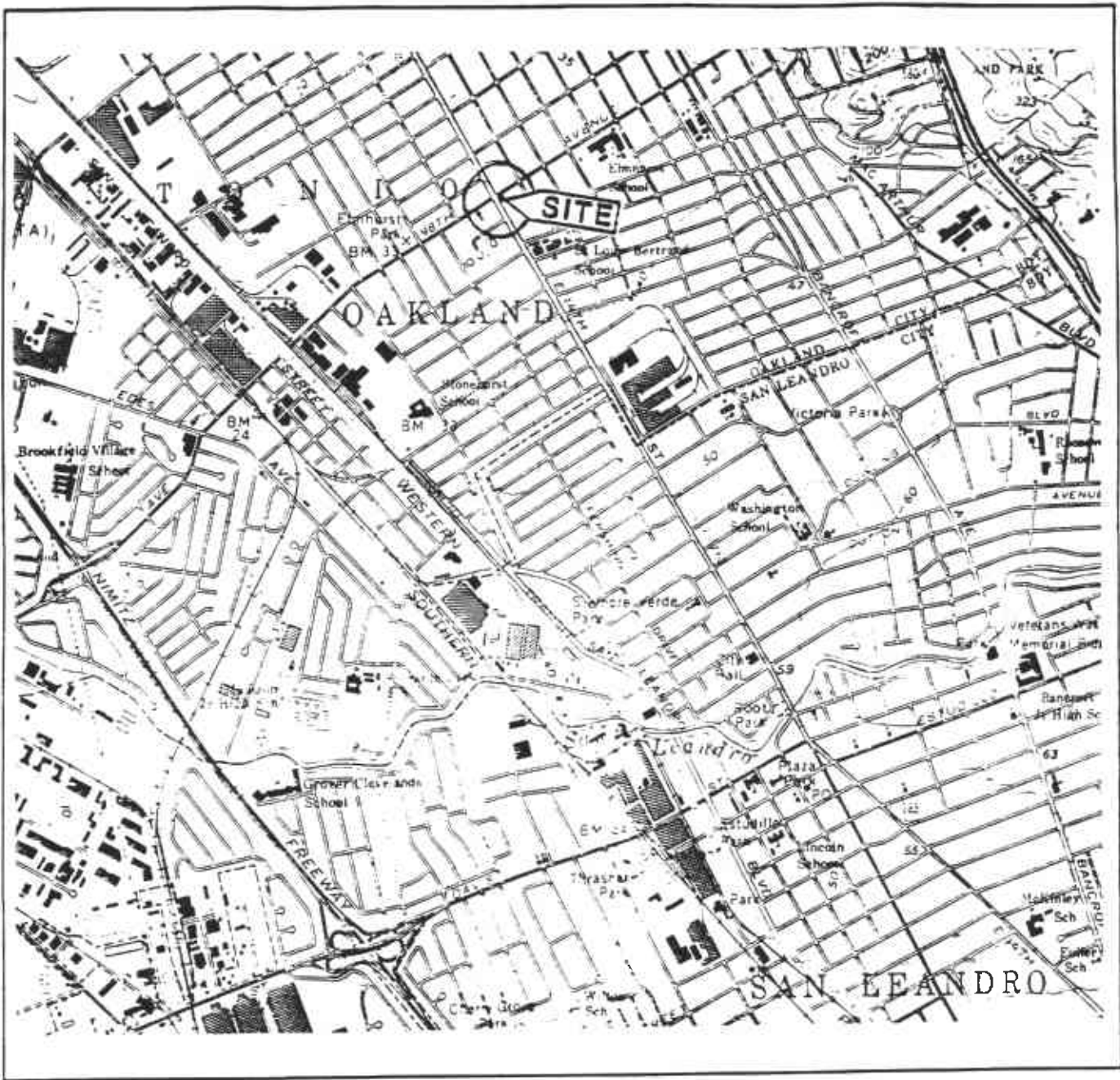

Source: U.S. Geological Survey  
 7.5-Minute Quadrangle  
 San Leandro, California  
 Photorevised 1980

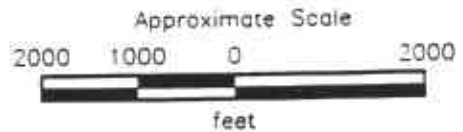

**RESNA**  
 Working to Restore Nature

SITE VICINITY MAP  
 ARCO Station 2185  
 9800 East 14th Street  
 San Leandro, California

PLATE  
 1

PROJECT

62026.05

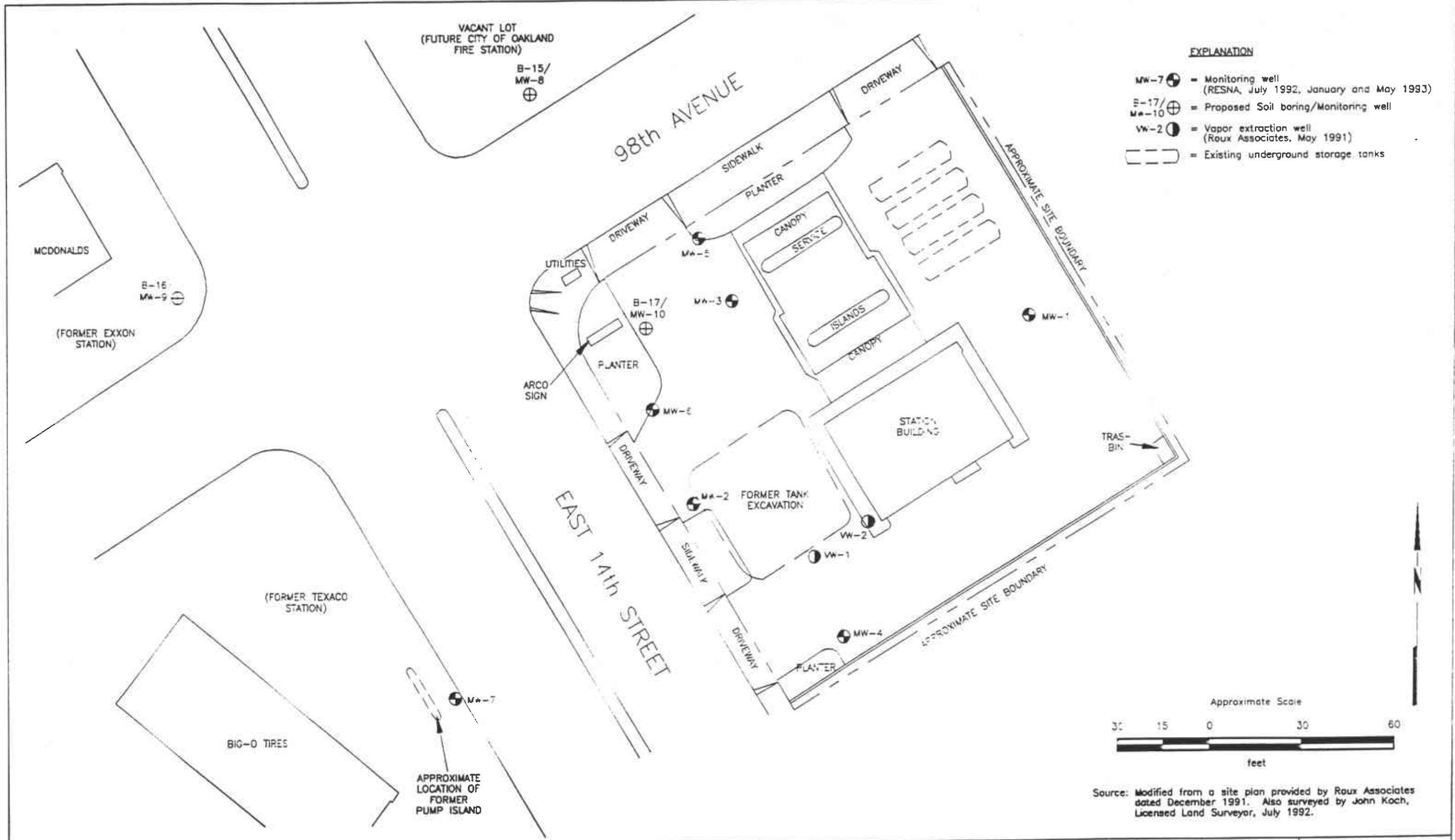

PROJECT 62026.05 62026-SP

**PROPOSED WELL LOCATIONS**  
 ARCO Station 2185  
 9800 East 14th Street  
 Oakland, California

**PLATE**  
 2

**STEP 1:**

Obtain a well construction permit from zone 7.

**STEP 2:**

Drill one soil boring (B-17) and install one monitoring well (MW-10). Submit selected soil samples and receive results.

**STEP 3:**

Develop and sample monitoring well MW-10. Submit water samples and receive results.

**STEP 4:**

Prepare and submit a letter report of results to ACHCSA and CRWQCB.

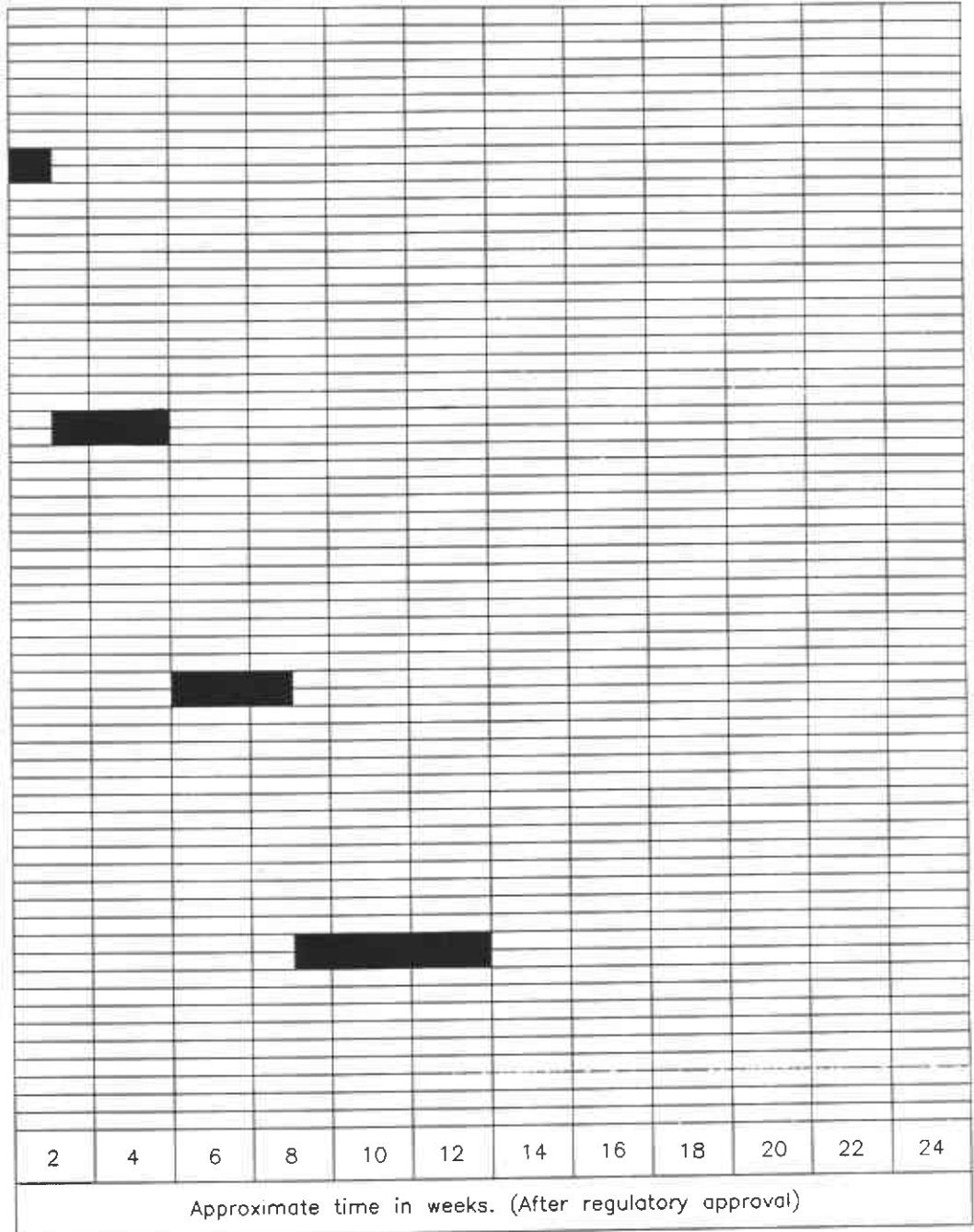

PROJECT 62026.05

PRELIMINARY TIME SCHEDULE  
ARCO Station 2185  
9800 East 14th Street  
Oakland, California

PLATE  
3

**STEP 1:**

Conduct a records search.

**STEP 2:**

Obtain encroachment, excavation, and well construction permits from CalTrans, City of Oakland, and Zone 7.

**STEP 3:**

Drill two soil borings (B-15 and B-16) and install two monitoring wells (MW-8 and MW-9). Submit selected soil samples and receive results.

**STEP 4:**

Develop monitoring wells MW-8 and MW-9.

**STEP 4:**

Sample monitoring wells MW-8 and MW-9. Submit water samples and receive results.

**STEP 4:**

Survey wellhead elevations.

**STEP 4:**

Prepare a report for submittal to ACHCSA and CRWQCB.

