



Epigene International
CONSULTING GEOLOGISTS

Recd 2/3/97

August 15, 1996

Mr. J. W. Silveira
J. W. Silveira Company
499 Embarcadero
Oakland, CA 94606

Subject: Tank Closure Report for Property Located at 744 East 12th Street, Oakland
(former Harley Davidson Dealership, StID # 2947)

Dear Mr. Silveira,

The site is located at 744 East 12th Street at the intersection with 8th Avenue in Oakland. A site location map is shown on Figure 1. The tank was located below the sidewalk area on the north side of 8th Avenue approximately 70 feet northeast of the curb line of 12th Street. A site plan that shows the former tank location and area of excavation is presented on Figure 2.

The tank was approximately 500 gallons in size and reportedly used for gasoline. Because of the age of the tank, it is assumed that the gasoline was leaded. A tank removal application was submitted to the City of Oakland and Alameda County and approved prior to the work. Copies of misc. Permits and receipts are included in Appendix D. The Tank Closure Plan is presented in Appendix C.

The excavation and removal was carried out by Bernabe and Brinker, Inc. of Oakland. The top of the tank was exposed on April 2, 1996. Water was encountered in the excavation and had to be removed by vacuum truck service. The water appears to have come from the tank as groundwater is

Tank Closure Report
744 East 12th Street, Oakland
August 15, 1996
Page 2

significantly below the depth of the tank.

The tank was removed on April 3, 1996. Dry ice was placed in the tank to displace hydrocarbon fumes and render the tank inert. Mr. Leroy Griffin of the Oakland Fire Department and Mr. Barney Chan of The Alameda County Department of Environmental Health Department were on site during the removal.

The tank was single-wall steel construction. It was rusted and had several doles on the top. One seam had corrosion holes along it. There was also a half inch hole in the bottom of the tank at the fill end (east side). Figure 3 shows a detail of the tank in the excavation. A portion of the piping between the tank and the outside edge of the building was broken off and removed during the tank removal. A short section of the piping adjacent to the building was left in place. *(What about piping w/holes?)*

The tank was removed from the site and disposed of by Erickson. A copy of the manifest is included in Appendix B.

Soil below the tank was discolored and had a gasoline odor, especially at the fill end. Over-excavation of the contaminated soil extended to a depth of approximately 10 feet. Five soil samples were collected from the excavation. The locations and depths are shown on Figure 3. The samples were collected by driving a brass tube into soil brought to the surface by the backhoe bucket. The samples were labeled, sealed and placed in a cooled ice chest.

The samples were transported to a State-certified laboratory under chain-of-custody control. Each sample was analyzed for THP as gasoline, BTEX and total lead. The results of the analysis are summarized in Table 1. The certified laboratory report and copies of the chain-of-custody documentation are presented in Appendix A.

Tank Closure Report
744 East 12th Street, Oakland
August 15, 1996
Page 3

The spoil from the over-excavation was stored inside the building. A soil profile was prepared for disposal of the soil at the BFI facility on Vasco Road in Livermore. In addition to the existing data, BFI requested a four to one composite from the spoil pile for TCLP Benzene. These samples were collected on June 3, 1996. The results of this analysis are also included in Appendix A.

BFI accepted the soil and it was taken to the Vasco Road facility on June 14, 1996. A copy of the manifest for the disposal of the soil is presented in Appendix B.

Based on the results of the analysis of the soil samples from the excavation, it is recommended that two hydro punches be installed that extend to groundwater. Groundwater samples will be collected to assess whether or not the groundwater has been impacted. At least two soil samples will be collected from each hydro punch probe. Samples will be analyzed for TPH as gasoline, BTEX and total lead.

Electrical lines are present directly above the former tank location, therefore it is not possible to put a hydro punch there. It is recommended that one hydro punch be located inside the building and the second in the street as close to the tank location as possible.

Groundwater was not encountered in the excavation and the depth to groundwater is not presently known. It is estimated to be approximately 15 to 20 feet based on the hydrogeologic setting. The screened portion of the hydro punch will extend 5 feet into the saturated zone. The hydro punch holes will be grouted to the surface after collection of the samples.

After receiving the results of the groundwater analysis a risk assessment will be carried out. Based on the results of the risk assessment, recommendations will be provided regarding whether or not any additional site characterization and/or remediation is required.

Tank Closure Report
744 East 12th Street, Oakland
August 15, 1996
Page 4

It was a pleasure to be of service to you on this project. Should you have any questions please contact the undersigned. I will meet with Mr. Barney Chan of Alameda County Department of Environmental Health to discuss the proposed investigation of the site. Based on that, a cost estimate will be prepared as a separate document. We are prepared to initiate the hydro punch investigation upon receiving your authorization to proceed.

Sincerely,

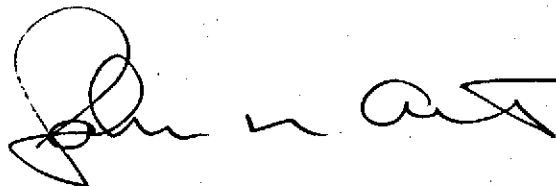

John N. Alt

Certified Engineering Geologist No. 1136

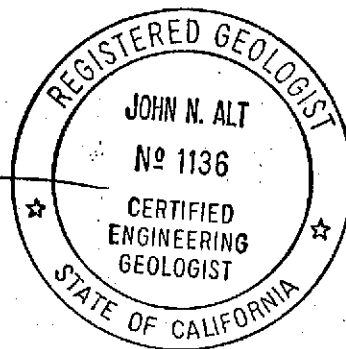

Attachments

CC: Mr. James Brinker, Bernabe and Brinker
Mr. Robert Shapiro, Esq.
Mr. Barney Chan, Alameda County

Table 1-Results of Soil Sample Analysis in PPM, 744 East 12th Street, Oakland

Sample No.	Depth	Location	TPHG	Benzene	Toluene	Ethylbenzene	Xylenes	Lead
S-1	7'	East Wall	18	1.2	0.54	0.49	12	5.6
S-2	10'	Center	580	4.6	30	13	61	6.8
S-3	8'	East Wall	9.2	0.70	0.61	0.31	1.1	12
S-4	9'	South Wall	900	16	6.1	17	48	3.4
S-5	10'	West Wall	1300	12	60	28	120	6.4

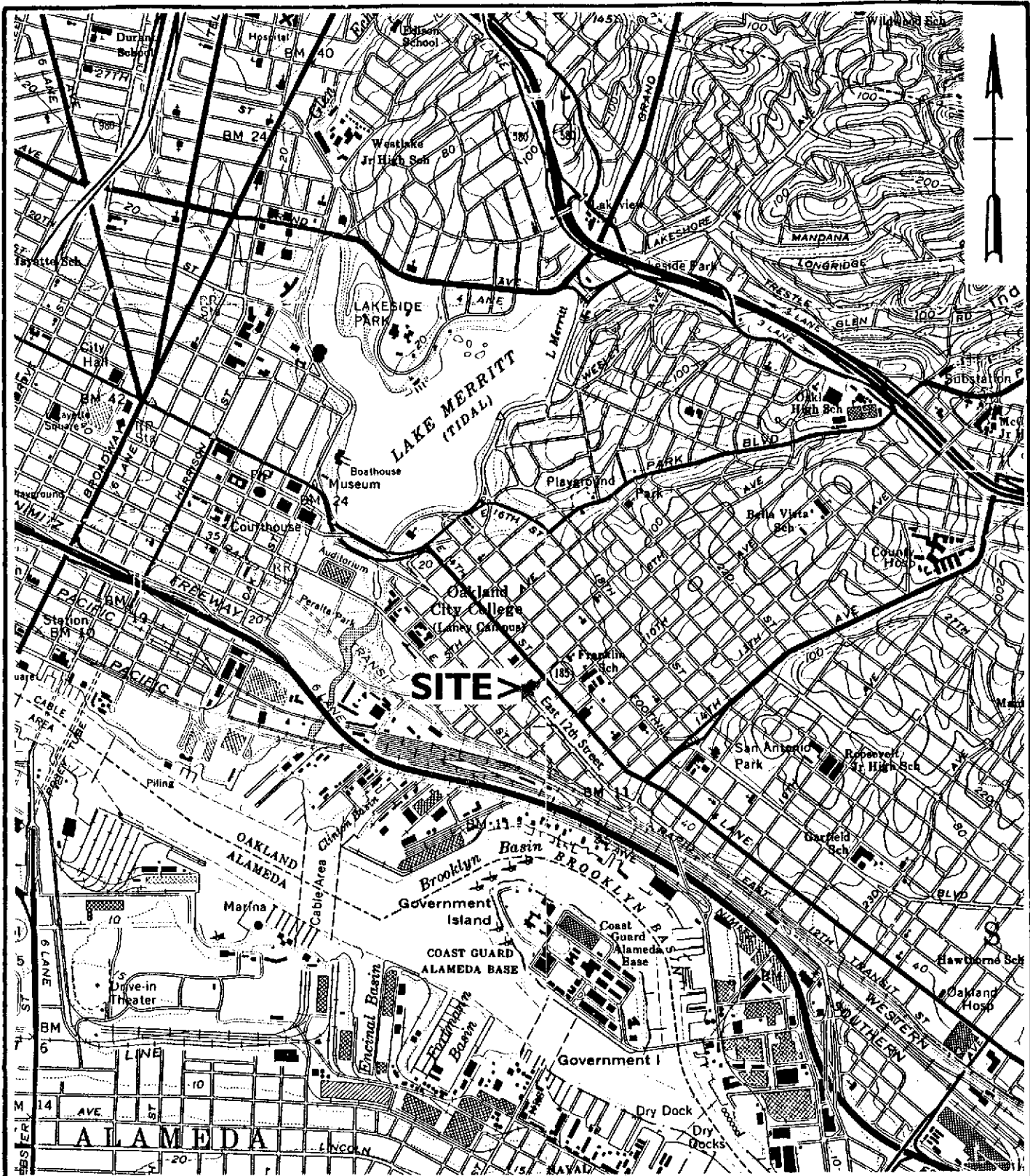

Base map from USGS 7 1/2 minute series
 Oakland East and Oakland West quadrangles, 1980.

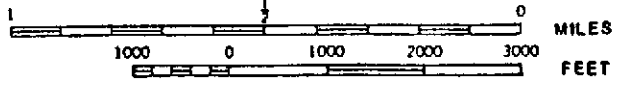

EPIGENE INTERNATIONAL Project # 96 - 149
 744 EAST 12TH STREET,
 Oakland, California.
 Fig. 1
SITE LOCATION MAP

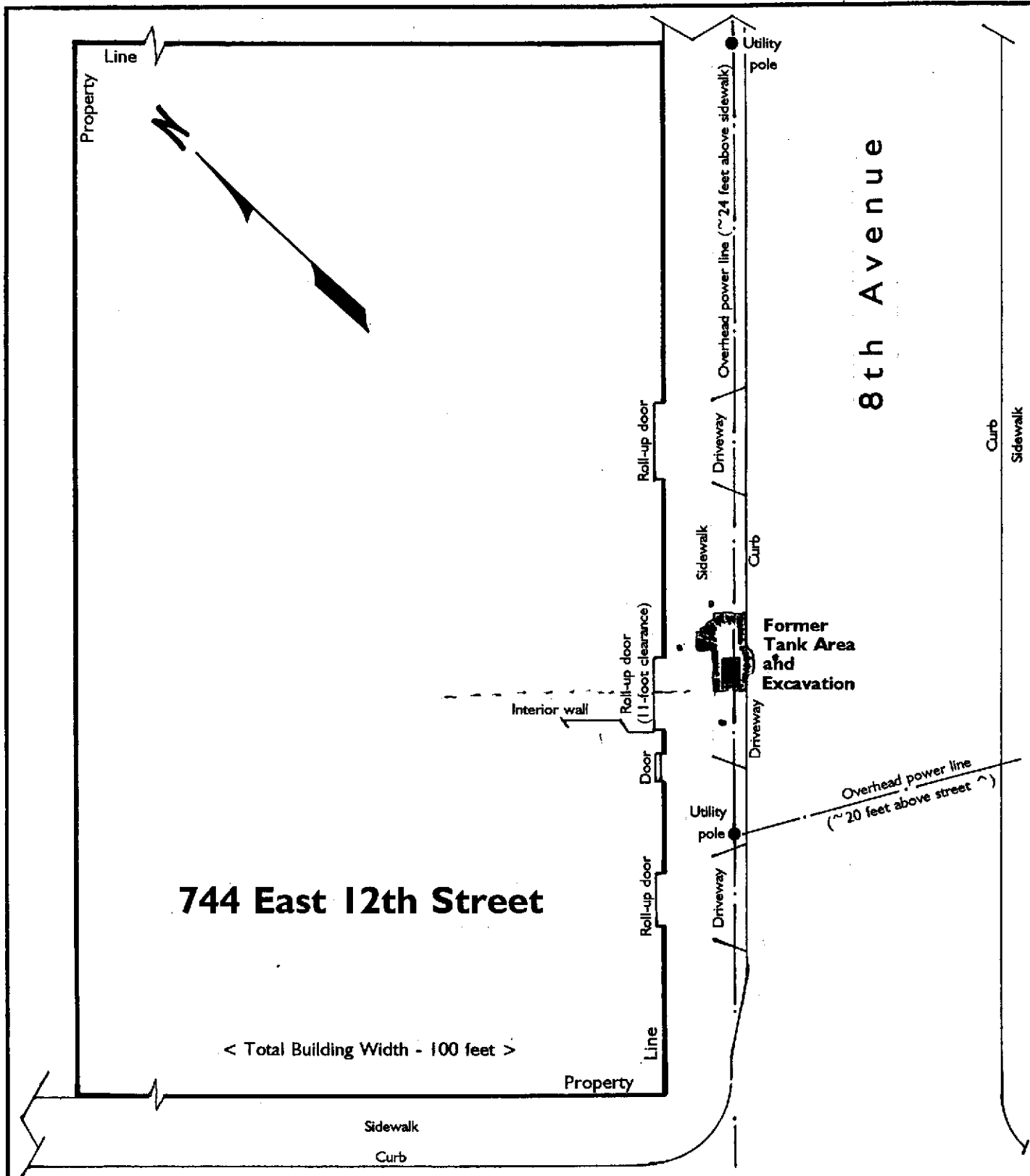

744 East 12th Street

< Total Building Width - 100 feet >



< to Downtown Oakland East 12th Street

<p>EPIGENE INTERNATIONAL</p>	<p>Project # 96 - 149 744 EAST 12TH STREET, Oakland, California.</p>
<p>Fig. 2 SITE PLAN</p>	

Plan based on field measurements by Epigene International, Fremont, California, April 3, 1996.

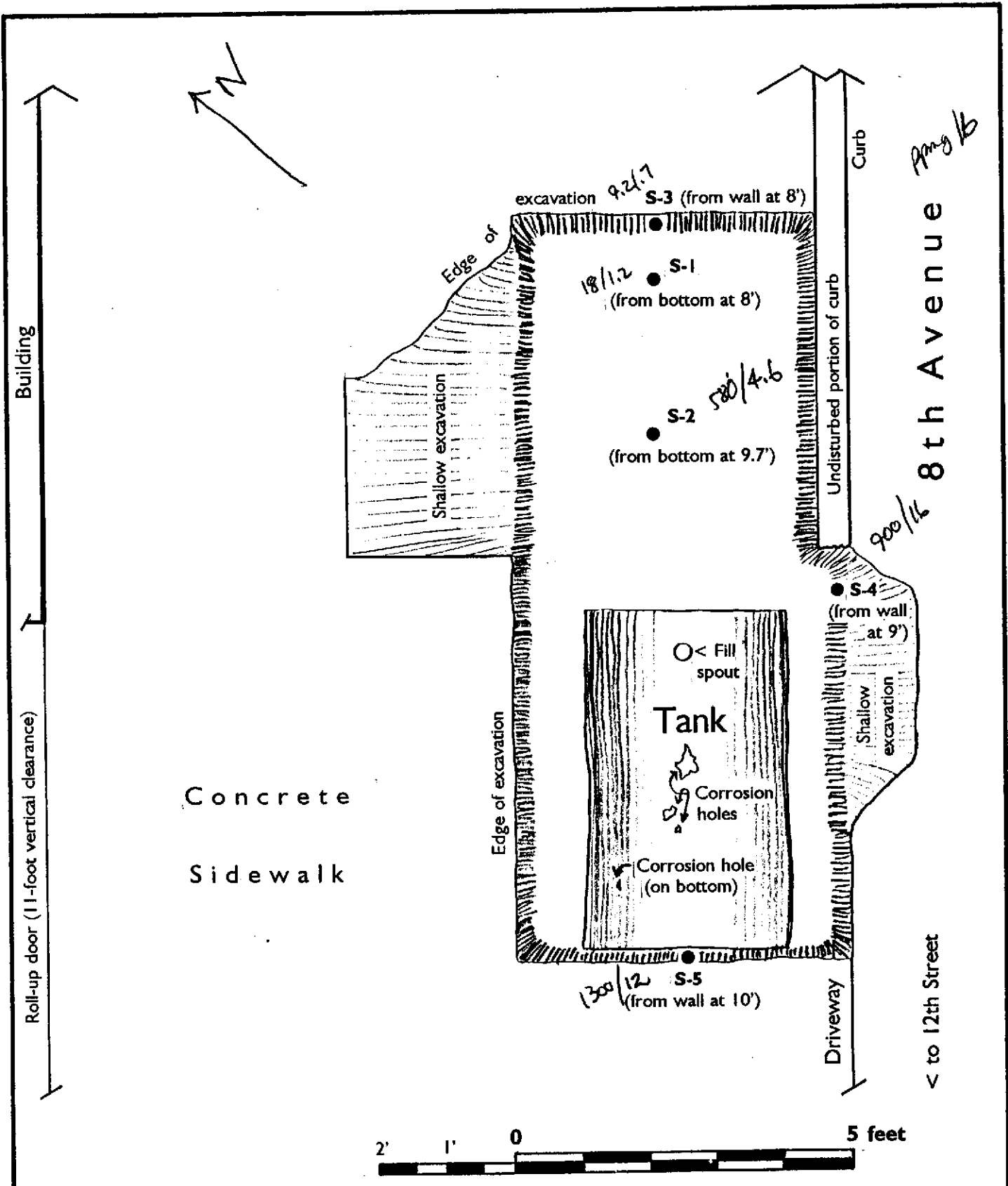

● Soil sample location.
 Soil samples taken April 3, 1996.

Drawing derived from field measurements taken by
 Epigene International, Fremont, California, April 3, 1996.

EPIGENE INTERNATIONAL	Project # 96 - 149 744 EAST 12TH STREET, Oakland, California.
----------------------------------	---

Fig. 3
TANK AREA DETAIL

APPENDIX A

CERTIFIED LABORATORY REPORT

McCAMPBELL ANALYTICAL INC.

110 2nd Avenue South, #D7, Pacheco, CA 94553
Tele: 510-798-1620 Fax: 510-798-1622

04/12/96

Dear John:

Enclosed are:

- 1). the results of 5 samples from your # 96-149; 744 East 12th St., Oakland project,
- 2). a QC report for the above samples
- 3). a copy of the chain of custody, and
- 4). a bill for analytical services.

If you have any questions please contact me. McCampbell Analytical Laboratories strives for excellence in quality, service and cost. Thank you for your business and I look forward to working with you again.

Yours truly,



Edward Hamilton

Epigene International 38750 Paseo Padre Pkwy, # A11 Fremont, CA 94536	Client Project ID: # 96-149; 744 East 12th St., Oakland	Date Sampled: 04/03/96
	Client Contact: John Alt	Date Received: 04/05/96
	Client P.O.:	Date Extracted: 04/05/96
		Date Analyzed: 04/05-04/06/96

Gasoline Range (C6-C12) Volatile Hydrocarbons as Gasoline*, with BTEX*

EPA methods 5030, modified 8015, and 8020 or 602; California RWQCB (SF Bay Region) method GCFID(5030)

Lab ID	Client ID	Matrix	TPH(g) ⁺	Benzene	Toluene	Ethylbenzene	Xylenes	% Rec. Surrogate
62984	S-1	S	18,a	1.2	0.54	0.49	1.2	102
62985	S-2	S	580,a	4.6	30	13	61	102
62986	S-3	S	9.2,a	0.70	0.61	0.31	1.1	103
62987	S-4	S	900,a	16	6.1	17	48	102
62988	S-5	S	1300,a	12	60	28	120	103
Reporting Limit unless otherwise stated; ND means not detected above the reporting limit	W	50 ug/L	0.5	0.5	0.5	0.5	0.5	
	S	1.0 mg/kg	0.005	0.005	0.005	0.005	0.005	

* water and vapor samples are reported in ug/L, soil samples in mg/kg, and all TCLP extracts in mg/L
 # cluttered chromatogram; sample peak coelutes with surrogate peak
 + The following descriptions of the TPH chromatogram are cursory in nature and McCampbell Analytical is not responsible for their interpretation: a) unmodified or weakly modified gasoline is significant; b) heavier gasoline range compounds are significant(aged gasoline?); c) lighter gasoline range compounds (the most mobile fraction) are significant; d) gasoline range compounds having broad chromatographic peaks are significant; biologically altered gasoline?; e) TPH pattern that does not appear to be derived from gasoline (?); f) one to a few isolated peaks present; g) strongly aged gasoline or diesel range compounds are significant; h) lighter than water immiscible sheen is present; i) liquid sample that contains greater than ~ 5 vol. % sediment; j) no recognizable pattern.

Epigene International 38750 Paseo Padre Pkwy, # A11 Fremont, CA 94536	Client Project ID: # 96-149; 744 East 12th St., Oakland	Date Sampled: 04/03/96
	Client Contact: John Alt	Date Received: 04/05/96
	Client P.O:	Date Extracted: 04/05/96
		Date Analyzed: 04/05/96

Lead*

EPA analytical methods 6010/200.7, 239.2⁺

Lab ID	Client ID	Matrix	Extraction ^o	Lead*	% Recovery Surrogate
62984	S-1	S	TTLC	5.6	90
62985	S-2	S	TTLC	6.8	93
62986	S-3	S	TTLC	12	91
62987	S-4	S	TTLC	3.4	90
62988	S-5	S	TTLC	6.4	91
Reporting Limit unless otherwise stated; ND means not detected above the reporting limit	S	TTLC	3.0 mg/kg		
	W	TTLC	0.005 mg/L		
	---	STLC,TCLP	0.2 mg/L		

* soil samples are reported in mg/kg, and water samples and all STLC & TCLP extracts in mg/L
 + Lead is analysed using EPA method 6010 (ICP) for soils, STLC & TCLP extracts and method 239.2 (AA Furnace) for water samples
 o EPA extraction methods 1311(TCLP), 3010/3020(water,TTLC), 3040(organic matrices,TTLC), 3050(solids,TTLC); STLC from CA Title 22
 # surrogate diluted out of range; N/A means surrogate not applicable to this analysis
 i) liquid sample that contains greater than ~ 2 vol. % sediment; this sediment is extracted with the liquid, in accordance with EPA methodologies and can significantly effect reported metal concentrations.

QC REPORT FOR AA METALS

Date: 04/05/96

Matrix: Soil

Analyte	Concentration (mg/kg, mg/L)			Amount Spiked	% Recovery		RPD
	Sample	MS	MSD		MS	MSD	
Total Lead	0.0	4.5	4.6	5.0	89	91	2.0
Total Cadmium	N/A	N/A	N/A	N/A	N/A	N/A	N/A
Total Chromium	N/A	N/A	N/A	N/A	N/A	N/A	N/A
Total Nickel	N/A	N/A	N/A	N/A	N/A	N/A	N/A
Total Zinc	N/A	N/A	N/A	N/A	N/A	N/A	N/A
TCLP Lead	0.00	5.15	5.20	5.0	103	104	1.1
Organic Lead	N/A	N/A	N/A	N/A	N/A	N/A	N/A

$$\% \text{ Rec.} = (\text{MS} - \text{Sample}) / \text{amount spiked} \times 100$$

$$\text{RPD} = (\text{MS} - \text{MSD}) / (\text{MS} + \text{MSD}) \times 2 \times 100$$

ADT 0709
4-4-96

6157AEIX79

CHAIN OF CUSTODY



Epigene International

CONSULTING GEOLOGISTS

38750 Paseo Padre Parkway, Suite A-11
Fremont, California, 94536

Business: (510) 791-1986 FAX: (510) 791-3306

JO

Laboratory: McCampbell Analytical	
110 2nd Avenue South, D-7	
Pacheco, California 94553.	
telephone: (510) 798-1620	FAX: (510) 798-1622
Contact: Ed Hamilton	

Contact: John Alt	Sampler: JNA/MJ
Project Name: 744 East 12 St., Oakland	
Project no. 96-149	Date: 4/4/96

Analyses Requested

Sample I.D.	Date/Time Sampled	Matrix Desc.	Container No. of	Type	Comments	Analyses Requested							Lab. #	
						TPH/Gasoline	BTEX	TPH/Diesel	801/8010	802/8020	Total Oil & Grease	Total Lead		
1. S-1	4/3/96 PM	Soil	1	brass tube		X	X					X		62984
2. S-2	"	"	"	"		X	X					X		62985
3. S-3	"	"	"	"		X	X					X		62986
4. S-4	"	"	"	"		X	X					X		62987
5. S-5	"	"	"	"		X	X					X		62988
6.														
7.														
8.		ICE/T			VAS ORG METALS PCB									
9.		GOOD CONDITION			PRESERVATIVE APPROPRIATE									
10.		HEAD SPACE ABSENT			CONTAINERS									

Relinquished by: <i>[Signature]</i>	Date: 4/4/96	Time: 1:35 PM	Received by: <i>[Signature]</i>	Date: 4-4-96	Time: 1:37
Relinquished by: <i>[Signature]</i>	Date: 4-4-96	Time: 8:55	Received by: <i>[Signature]</i>	Date: 4/5/96	Time: 8:55
Relinquished by:	Date:	Time:	Received by:	Date:	Time:

Turnaround Time: *Standard*

Additional Comments: _____

Page 1 of 1

McCAMPBELL ANALYTICAL INC.

110 2nd Avenue South, #D7, Pacheco, CA 94553
Tele: 510-798-1620 Fax: 510-798-1622

06/10/96

Dear John:

Enclosed are:

- 1). the results of 1 samples from your 744 East 12th Street project,
- 2). a QC report for the above samples
- 3). a copy of the chain of custody, and
- 4). a bill for analytical services.

If you have any questions please contact me. McCampbell Analytical Laboratories strives for excellence in quality, service and cost. Thank you for your business and I look forward to working with you again.

Yours truly,



Edward Hamilton

Epigene International 38750 Paseo Padre Pkwy, # A11 Fremont, CA 94536	Client Project ID: 744 East 12th Street	Date Sampled: 06/03/96
		Date Received: 06/03/96
	Client Contact: John Alt	Date Extracted: 06/03-06/04/96
	Client P.O:	Date Analyzed: 06/04/96

Gasoline Range (C6-C12) Volatile Hydrocarbons as Gasoline*, with BTEX*

EPA methods 5030, modified 8015, and 8020 or 602; California RWQCB (SF Bay Region) method GCFID(5030)

Lab ID	Client ID	Matrix	TPH(g) ⁺	Benzene	Toluene	Ethylbenzene	Xylenes	% Rec. Surrogate
65603	S-1,2,3,4	ZHETCLP	---	ND	---	---	---	101
Reporting Limit unless otherwise stated; ND means not detected above the reporting limit	TCLP		0.1mg/L	0.001	0.001	0.001	0.001	
	S		1.0 mg/kg	0.005	0.005	0.005	0.005	

* water and vapor samples are reported in ug/L, soil samples in mg/kg, and all TCLP extracts in mg/L

cluttered chromatogram; sample peak coelutes with surrogate peak

+ The following descriptions of the TPH chromatogram are cursory in nature and McCampbell Analytical is not responsible for their interpretation: a) unmodified or weakly modified gasoline is significant; b) heavier gasoline range compounds are significant(aged gasoline?); c) lighter gasoline range compounds (the most mobile fraction) are significant; d) gasoline range compounds having broad chromatographic peaks are significant; biologically altered gasoline?; e) TPH pattern that does not appear to be derived from gasoline (?); f) one to a few isolated peaks present; g) strongly aged gasoline or diesel range compounds are significant; h) lighter than water immiscible sheen is present; i) liquid sample that contains greater than ~ 5 vol. % sediment; j) no recognizable pattern.

QC REPORT FOR HYDROCARBON ANALYSES

Date: 06/04/96

Matrix: TCLP

Analyte	Concentration (ug/L)			Amount Spiked	% Recovery		RPD
	Sample	MS	MSD		MS	MSD	
TPH (gas)	0.0	112.4	115.0	100.0	112.4	115.0	2.3
Benzene	0.0	10.7	10.9	10.0	107.0	109.0	1.9
Toluene	0.0	10.2	10.5	10.0	102.0	105.0	2.9
Ethyl Benzene	0.0	10.1	10.4	10.0	101.0	104.0	2.9
Xylenes	0.0	30.8	31.5	30.0	102.7	105.0	2.2
TPH (diesel)	N/A	N/A	N/A	N/A	N/A	N/A	N/A
TRPH (oil & grease)	N/A	N/A	N/A	N/A	N/A	N/A	N/A

$$\% \text{ Rec.} = (\text{MS} - \text{Sample}) / \text{amount spiked} \times 100$$

$$\text{RPD} = (\text{MS} - \text{MSD}) / (\text{MS} + \text{MSD}) \times 2 \times 100$$

CHAIN OF CUSTODY



Epigene International

CONSULTING GEOLOGISTS

38750 Paseo Padre Parkway, Suite A-11
Fremont, California, 94538

Business: (510) 791-1988 FAX: (510) 791-3306

6502 AEIX82

Laboratory: McCampbell Analytical

Contact:

Contact: John D. Act Sampler: John D. Act

Project Name: 744 East 12th Street

Project no. _____ Date: June 3, 1996

Sample I.D.	Date/Time Sampled	Matrix Desc.	Container No. of	Type	Comments	Analyses Requested							Lab. #	
						TPH/Gasoline	BTEX	TPH/Diesel	601/8010	602/8020	Total Oil & Grease	TCLP Benzene		
1. S-1	6/96 ^{11:45 am} am	Soil	1	Brass	Composite 4 to 1									65603
2. S-2	6/96 am	↓	1	Brass										
3. S-3	6/96 am	↓	1	↓										
4. S-4	6/96 am	↓	1	↓										
5.														
6.														
7.														
8.														
9.														
10.														

Relinquished by: <u>[Signature]</u>	Date: <u>6/9/96</u>	Time: <u>3:04 pm</u>	Received by: <u>[Signature]</u>	Date: <u>6-3-96</u>	Time: <u>3:04</u>
Relinquished by:	Date:	Time:	Received by:	Date:	Time:
Relinquished by:	Date:	Time:	Received by:	Date:	Time:

Turnaround Time: RUSH

Additional Comments: TCLP Benzene Composite 4 to 1

Page 1 of 1

ICEIT[®] PRESERVATIVE
 GOOD CONDITION APPROPRIATE
 HEAD SPACE ABSENT CONTAINERS

WAS LOG METALS OVER

APPENDIX B

MANIFESTS FOR DISPOSAL OF TANK AND SOIL

IN CASE OF EMERGENCY OR SPILL, CALL THE NATIONAL RESPONSE CENTER 1-800-424-8802; WITHIN CALIFORNIA, CALL 1-800-852-7550

GENERATOR FACILITY

UNIFORM HAZARDOUS WASTE MANIFEST		1. Generator's US EPA ID No.		Manifest Document No.		2. Page 1 of 1		Information in the shaded areas is not required by Federal law.	
		CA1C10011211084091811517							
3. Generator's Name and Mailing Address		J.W. Silvera Properties Inc. 499 Embarcadero OAKLAND, CA. 94607		A. State Manifest Document Number		95898159			
4. Generator's Phone		(510) 834-9810		B. State Generator's ID					
5. Transporter 1 Company Name		ERICKSON		C. State Transporter's ID					
6. US EPA ID Number		CA1D10019416163942		D. Transporter's Phone		(510) 835-1393			
7. Transporter 2 Company Name				E. State Transporter's ID					
8. US EPA ID Number				F. Transporter's Phone					
9. Designated Facility Name and Site Address		Erickson, Inc. 255 Fair Blvd. Richmond, CA. 94801		10. US EPA ID Number		CA1D10019416163942		G. State Facility's ID	
								H. Facility's Phone	
								(510) 285-1393	
11. US DOT Description (including Proper Shipping Name, Hazard Class, and ID Number)		12. Containers		13. Total Quantity		14. Unit Wt/Vol		I. Waste Number	
		No. Type		Quantity		Wt/Vol		State EPA/Other	
a. UN1993 Hazardous Waste Solid Waste Empty Storage Tank.		001 T E		010500 E				State 12 EPA NONE	
b.								State EPA/Other	
c.								State EPA/Other	
d.								State EPA/Other	
15. Special Handling Instructions and Additional Information		Keep away from sources of ignition. Always wear hardhats when working around U.G.S.T.'s 24 Hr. Contact Name J.W. Silvera & Phone 510-834-9810		K. Handling Codes for Wastes Listed Above					
16. GENERATOR'S CERTIFICATION: I hereby declare that the contents of this consignment are fully and accurately described above by proper shipping name and are classified, packed, marked, and labeled, and are in all respects in proper condition for transport by highway according to applicable international and national government regulations.		If I am a large quantity generator, I certify that I have a program in place to reduce the volume and toxicity of waste generated to the degree I have determined to be economically practicable and that I have selected the practicable method of treatment, storage, or disposal currently available to me which minimizes the present and future threat to human health and the environment; OR, if I am a small quantity generator, I have made a good faith effort to minimize my waste generation and select the best waste management method that is available to me and that I can afford.							
17. Transporter 1 Acknowledgement of Receipt of Materials		Printed/Typed Name: J.E. BRINKER-FOR, J.W. SILVERA		Signature: J.E. Brinker, J.W. Silvera		Month Day Year: 01/10/13/96			
18. Transporter 2 Acknowledgement of Receipt of Materials		Printed/Typed Name: Stanley D. Wiles		Signature: Stanley D. Wiles		Month Day Year: 01/10/13/96			
19. Discrepancy Indication Space									
20. Facility Owner or Operator Certification of receipt of hazardous materials covered by this manifest except as noted in Item 19.		Printed/Typed Name		Signature		Month Day Year			

DO NOT WRITE BELOW THIS LINE.

40: John Alt, Epigene International
 Fax: 791-3306
 Fr. Alvin Brinker
 Ph. 836-2635

JUL-22-96 MON 14:08 BFI FAX NO. 5104470499 P. 02



NON-HAZARDOUS SPECIAL WASTE & ASBESTOS MANIFEST

If waste is asbestos waste, complete Sections I, II, III and IV.
 If waste is NOT asbestos waste, complete only Sections I, II and III. No. 004877

a. Generator Name: **J.W. Silveira Company**
 Address: **499 Embarcadero Oakland, CA. 94606**
 Phone No.: **510-834-9810**
 b. Generating Location: **Former Harley Davidson**
 d. Address: **744-East 12th Street Oakland, CA. 94606**
 f. Phone No.: _____
 g. Owner's Name: _____
 h. Owner's Phone No.: _____

RFI WASTE CODE: **CA 405060695 14272**
 Description of Waste: **Non hazardous soil**
 k. Quantity: **20** Units: **Y** No.: **1** TYPE: **T**

- CONTAINERS
- DM - METAL DRUM
 - DP - PLASTIC DRUM
 - B - BAG
 - BA - 6 MIL. PLASTIC BAG or WFLAP
 - T - TRUCK
 - O - OTHER
- UNITS
- P - POUNDS
 - Y - YARDS
 - M - CUBIC METERS
 - V - CUBIC YARDS
 - O - OTHER

GENERATOR'S CERTIFICATION: I hereby certify that the above named material is not a hazardous waste as defined by 49 CFR Part 261 or any applicable state law, has been properly described, classified and packaged, and is in proper condition for transportation according to applicable regulations. AND, if the waste is a residual residue of a previously regulated hazardous waste subject to the Land Disposal Restrictions, I certify and warrant that the waste has been treated in accordance with the requirements of 49 CFR Part 268 and is no longer a hazardous waste as defined by 49 CFR Part 261.

James E. Brinker
 Signature: *J. E. Brinker* Date: **06/14/96**
 Generator Authorized Agent Name Signature Date

TRANSPORTER I
 Name: **De Lafosse Trucking**
 Address: **P.O. Box 1622 Union City, CA 94587**
 Driver Name/Title: _____
 Phone No.: **510-783-5390**
 e. Truck No.: _____
 Vehicle License No./State: _____
 Acknowledgement of Receipt of Materials: _____
 Date: **06/14/96**

TRANSPORTER II
 h. Name: _____
 i. Address: _____
 Driver Name/Title: _____
 k. Phone No.: _____
 l. Truck No.: _____
 m. Vehicle License No./State: _____
 Acknowledgement of Receipt of Materials: _____
 n. _____
 Driver Signature: _____ Date: _____

Site Name: **B.F.I.**
 Physical Address: **4001 N. Vasco Road Livermore, CA. 94550**
 a. Phone No.: **510-447-0491**
 d. Mailing Address: **4001 N. Vasco Road Livermore, CA. 94550**

I hereby certify that the above named material has been accepted and to the best of my knowledge the foregoing is true and accurate.

Signature: *[Signature]* Date: _____
 Receipt Date

Operator's Name: _____
 b. Operator's Phone No.: _____

Special Handling Instructions and additional information:

APPENDIX C

TANK CLOSURE PLAN

ALAMEDA COUNTY HEALTH CARE SERVICES AGENCY
DEPARTMENT OF ENVIRONMENTAL HEALTH
HAZARDOUS MATERIALS DIVISION
80 SWAN WAY, ROOM 200
OAKLAND, CA 94621
PHONE NO. 415/271-4320

Project Specialist (print) BARNEY CHAN

Need: plot plan } Rec'd
A+B forms } 7/20/94
Reviewed again
ok. Behan ok. 3/1/96

ACCEPTED

Underground Storage Tank Closure Permit Application
Alameda County Division of Hazardous Materials
80 Swan Way, Suite 200,
Oakland, CA 94621
Telephone: (510) 271-4320

These closure/removal plans have been received and found to be acceptable and essentially meet the requirements of State and Local Health Laws. Changes to your closure plans indicated by this Department are to assure compliance with State and local laws. The project proposed herein is now released for issuance of any required building permits for construction/destruction. One copy of the accepted plans must be on the job and available to all contractors and craftsmen involved with the removal. Any changes or alterations of these plans and specifications must be submitted to this Department and to the Fire and Building Inspections Department to determine if such changes meet the requirements of State and local laws.

Notify this Department at least 72 hours prior to the following required inspections:
____ Removal of Tank(s) and Piping
____ Sampling
____ Final Inspection

Issuance of a) permit to operate, b) permanent site closure is dependent on compliance with accepted plans and all applicable laws and regulations.

THERE IS A FINANCIAL PENALTY FOR NOT OBTAINING THESE INSPECTIONS

Contact Specialist:

UNDERGROUND TANK CLOSURE PLAN

*** Complete according to attached instructions ***

- Business Name FORMER HARLEY DAVIDSON
Business Owner NA
 - Site Address 744 East 12th Street
City Oakland Zip CA. 94606 Phone _____
 - Mailing Address 499 Embarcadero Way
City Oakland Zip 94606 Phone 510-834-9810
 - Land Owner J.W.Silveira Company
Address 499 Embarcadero, Oakland City, State CA Zip 94606
 - Generator name under which tank will be manifested _____
J.W.Silveira Company
- EPA I.D. No. under which tank will be manifested _____

6. Contractor BERNABE AND BRINKER, INC.
 Address ~~1281 30th Street~~ 2240 WOOD ST.
 City Oakland, CA. ~~94608~~ 94607. Phone 510-451-3482
 License Type A-HAZ ID# 610617

*Effective January 1, 1992, Business and Professional Code Section 7058.7 requires prime contractors to also hold Hazardous Waste Certification issued by the State Contractors License Board. Indicate that the certificate has been received, in addition, to holding the appropriate contractors license type.

7. Consultant JAMES BRINKER
 Address ~~1281 30th Street~~ 2240 WOOD ST.
 City Oakland CA. ~~94608~~ 94607 Phone 510-451-3482

8. Contact Person for Investigation
 Name JAMES BRINKER Title Consultant
 Phone 510-451-3482

9. Number of tanks being closed under this plan 1 (one)
 Length of piping being removed under this plan 10 feet
 Total number of tanks at facility 1 (one)

10. State Registered Hazardous Waste Transporters/Facilities (see instructions).

** Underground tanks are hazardous waste and must be handled **
 as hazardous waste

a) Product/Residual Sludge/Rinsate Transporter

Name Waste Oil Recovery Systems EPA I.D. No. CAD000626515
 Hauler License No. 843 License Exp. Date July 31, 1994
 Address 6401 Leona Street
 City Oakland, State CA Zip 94605

b) Product/Residual Sludge/Rinsate Disposal Site

Name Demunno-Kerdoon EPA I.D. No. CAT080013352
 Address 2000 North Alameda
 City Compton State CA Zip 90222

c) Tank and Piping Transporter

Name Erickson INC. EPA I.D. No. CAD009466392
Hauler License No. 0019 License Exp. Date 5-31-95
Address 55 Parr Blvd
City Richmond State CA Zip 94801

d) Tank and Piping Disposal Site

Name Erickson INC. EPA I.D. No. CAT009466392
Address 55 Parr Blvd.
City Richmond State CA. Zip 94801

11. Experienced Sample Collector

Name John Alt
Company Epigene International
Address 38750 Paseo Padre Parkway
City Fremont State CA Zip 94536 Phone 510-791-1986

12. Laboratory

Name McC Campbell Analytical
Address 110-2nd Avenue South # D7
City Pacheco State CA Zip 94533
State Certification No. 1644

13. Have tanks or pipes leaked in the past? Yes [] No [x]

If yes, describe. _____

14. Describe methods to be used for rendering tank inert

CO2, Dry Ice

Before tanks are pumped out and inerted, all associated piping must be flushed out into the tanks. All accessible associated piping must then be removed. Inaccessible piping must be plugged.

The Bay Area Air Quality Management District (771-6000), along with local Fire and Building Departments, must also be contacted for tank removal permits. Fire departments typically require the use of explosion proof combustible gas meters to verify tank inertness. It is the contractor's responsibility to bring a working combustible gas meter on site to verify tank inertness.

15. Tank History and Sampling Information

Tank		Material to be sampled (tank contents, soil, groundwater, etc.)	Location and Depth of Samples
Capacity	Use History (see instructions)		
250 gallon	Leaded gasoline Empty for ten years	soil groundwater	2 feet below the bottom of the tank if possible

One soil sample must be collected for every 20 feet of piping that is removed. A ground water sample must be collected should any ground water be present in the excavation.

Excavated/Stockpiled Soil	
Stockpiled Soil Volume (Estimated) 20 yards	Sampling Plan Composite three soil samples

Stockpiled soil must be placed on bermed plastic and must be completely covered by plastic sheeting.

16. Chemical methods and associated detection limits to be used for analyzing samples

The Tri-Regional Board recommended minimum verification analyses and practical quantitation reporting limits should be followed. See attached Table 2.

Contaminant Sought	EPA, DHS, or Other Sample Preparation Method Number	EPA, DHS, or Other Analysis Method Number	Method Detection Limit
<i>Rev</i> TPH Gasoline BTX&E Total Lead TPH AND BTX&E <i>W. M. Hill</i>	GCFID (5030) 8020 or 8240 AA 8260 <i>BA/AB/CSA</i>		<i>1ppm Gas</i> <i>5ppb BTX&E</i>

17. Submit Site Health and Safety Plan (See Instructions)

18. Submit Worker's Compensation Certificate copy

Name of Insurer STATE WORKMENS COMPENSATION

19. Submit Plot Plan (See Instructions)

20. Enclose Deposit (See Instructions)

21. Report any leaks or contamination to this office within 5 days of discovery. The report shall be made on an Underground Storage Tank Unauthorized Leak/Contamination Site Report form. (see Instructions)

22. Submit a closure report to this office within 60 days of the tank removal. This report must contain all the information listed in item 22 of the instructions.

I declare that to the best of my knowledge and belief the statements and information provided above are correct and true.

I understand that information in addition to that provided above may be needed in order to obtain an approval from the Department of Environmental Health and that no work is to begin on this project until this plan is approved.

I understand that any changes in design, materials or equipment will void this plan if prior approval is not obtained.

I understand that all work performed during this project will be done in compliance with all applicable OSHA (Occupational Safety and Health Administration) requirements concerning personnel health and safety. I understand that site and worker safety are solely the responsibility of the property owner or his agent and that this responsibility is not shared nor assumed by the County of Alameda.

Once I have received my stamped, accepted closure plan, I will contact the project Hazardous Materials Specialist at least three working days in advance of site work to schedule the required inspections.

Signature of Contractor

Name (please type) ERNESTO F. BERNABE JR

Signature 

Date JUNE 10, 1994

X Signature of Site Owner or Operator

Name (please type) J.W. Silveira

Signature 

Date May 31, 1994

ALAMEDA COUNTY HAZARDOUS MATERIALS DIVISION
Acknowledgement of Refund Recipient for Site Account
 DEPOSITOR FILLS OUT PER SITE
 -- REQUIRED --

The depositor will use this form to acknowledge that the property owner or his or her designee will receive any refund due at the completion of all deposit/refund projects at the site listed below.

SITE NUMBER/ADDRESS:

REFUND RECIPIENT-PROPERTY OWNER

 Site Number
 Former Harley Davidson

 Company Name

 744 East 12th Street

 Street Address

 Oakland, CA. 94606

 City Zip Code

X J.W. : Barbara Silveira

 Owner's Name

 X 6839 Cotton Blvd.

 Owner's Address

 X Oakland, Ca 94611

 Owner's City State Zip

I have read the description of the project Deposit/Refund Procedure, and have had an opportunity to ask questions about it. I understand that regardless of who deposits money into the site account, any deposit money remaining at the completion of all projects being conducted at this site will be refunded solely to the property owner or his or her designee.

X _____
 Signature of Depositor Date 5/31/94

X J.W. : Barbara Silveira

 Depositor Name

X d.w. Silveira Company

 Company Name

X 499 Embarcadero

 Street Address

X Oakland, Ca 94606

 City / Zip

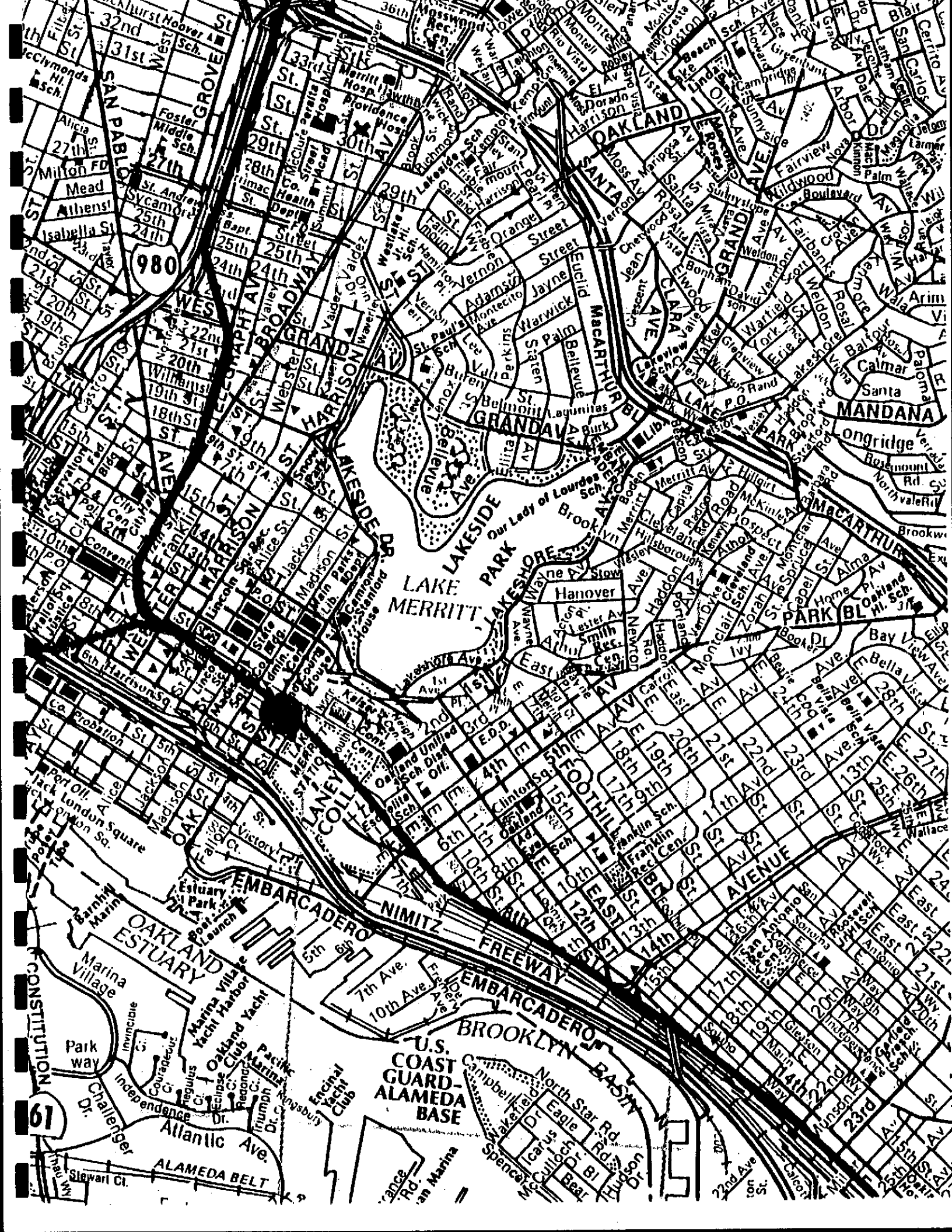

APPENDIX D

COPIES OF MISC. PERMITS AND RECEIPTS

EXCAVATION PERMIT

TO EXCAVATE IN STREETS OR OTHER SPECIFIED WORK

CIVIL
ENGINEERING

PAGE 2 of 2

PERMIT NUMBER X9600272		SITE ADDRESS/LOCATION 744 - E 12th ST	
APPROX. START DATE 4/2/96	APPROX. END DATE 4/5/96	24-HOUR EMERGENCY PHONE NUMBER (Permit not valid without 24-Hour number) 415-3482	
CONTRACTOR'S LICENSE # AND CLASS 016017 610617		CITY BUSINESS TAX #	

ATTENTION:

- 1) State law requires that the contractor/owner call *Underground Service Alert (USA)* two working days before excavating. This permit is not valid unless applicant has secured an inquiry identification number issued by USA. The USA telephone number is 1 (800) 642-2444. UNDERGROUND SERVICE ALERT (USA) #: _____
- 2) **48 hours prior to starting work, YOU MUST CALL (510) 238-3651 TO SCHEDULE AN INSPECTION.**

OWNER/BUILDER

I hereby affirm that I am exempt from the Contractor's License Law for the following reason (Sec. 7031.5 Business and Professions Code: Any city or county which requires a permit to construct, alter, improve, demolish, or repair any structure, prior to its issuance, also requires the applicant for such permit to file a signed statement that he is licensed pursuant to the provisions of the Contractor's License law Chapter 9 (commencing with Sec. 7000) of Division 3 of the Business and Professions Code, or that he is exempt therefrom and the basis for the alleged exemption. Any violation of Section 7031.5 by any applicant for a permit subjects the applicant to a civil penalty of not more than \$500):

- I, as an owner of the property, or my employees with wages as their sole compensation, will do the work, and the structure is not intended or offered for sale (Sec. 7044, Business Professions Code: The Contractor's License Law does not apply to an owner of property who builds or improves thereon, and who does such work himself or through his own employees, provided that such improvements are not intended or offered for sale. If however, the building or improvement is sold within one year of completion, the owner-builder will have the burden of proving that he did not build or improve for the purpose of sale).
- I, as owner of the property, am exempt from the sale requirements of the above due to: (1) I am improving my principal place of residence or appurtenances thereto, (2) the work will be performed prior to sale, (3) I have resided in the residence for the 12 months prior to completion of the work, and (4) I have not claimed exemption on this subdivision on more than two structures more than once during any three-year period. (Sec. 7044 Business and Professions Code).
- I, as owner of the property, am exclusively contracting with licensed contractors to construct the project, (Sec. 7044, Business and Professions Code: The Contractor's License Law does not apply to an owner of property who builds or improves thereon, and who contracts for such projects with a contractor(s) licensed pursuant to the Contractor's License law).
- I am exempt under Sec. _____, B&PC for this reason _____

WORKER'S COMPENSATION

- I hereby affirm that I have a certificate of consent to self-insure, or a certificate of Worker's Compensation Insurance, or a certified copy thereof (Sec. 3700, Labor Code).
- Policy # _____ Company Name _____
- I certify that in the performance of the work for which this permit is issued, I shall not employ any person in any manner so as to become subject to the Worker's Compensation Laws of California (not required for work valued at one hundred dollars (\$100) or less).

NOTICE TO APPLICANT: If, after making this Certificate of Exemption, you should become subject to the Worker's Compensation provisions of the Labor Code, you must forthwith comply with such provisions or this permit shall be deemed revoked. This permit is issued pursuant to all provisions of Chapter 6, Article 2 of the Oakland Municipal Code. It is granted upon the express condition that the permittee shall be responsible for all claims and liabilities arising out of work performed under the permit or arising out of permittee's failure to perform the obligations with respect to street maintenance. The permittee shall, and by acceptance of the permit agrees to defend, indemnify, save and hold harmless the City, its officers and employees, from and against any and all suits, claims, or actions brought by any person for or on account of any bodily injuries, disease or illness or damage to persons and/or property sustained or arising in the construction of the work performed under the permit or in consequence of permittee's failure to perform the obligations with respect to street maintenance. This permit is void 90 days from the date of issuance unless an extension is granted by the Director of the Office of Planning and Building.

I hereby affirm that I am licensed under provisions of Chapter 9 of Division 3 of the Business and Professions Code and my license is in full force and effect (if contractor), that I have read this permit and agree to its requirements, and that the above information is true and correct under penalty of law.

James E. Brinkes _____ **4-1-96**
Signature of Permittee Agent for Contractor Owner Date

DATE STREET LAST RESURFACED	SPECIAL PAVING DETAIL REQUIRED? <input checked="" type="checkbox"/> YES <input checked="" type="checkbox"/> NO	HOLIDAY RESTRICTION? (NOV 1 - JAN 1) <input type="checkbox"/> YES <input checked="" type="checkbox"/> NO	LIMITED OPERATION AREA? (7AM-9AM & 4PM-6PM) <input type="checkbox"/> YES <input type="checkbox"/> NO
ISSUED BY: <i>James E. Brinkes</i>		DATE ISSUED: 4-1-96	

RECEIPT NO.

142601

PAYMENT RECEIPT - CITY OF OAKLAND

<input checked="" type="checkbox"/> BUSINESS TAX <input type="checkbox"/> MANDATORY GARBAGE	<input type="checkbox"/> OTHER	RT. #	ACCOUNT / INVOICE NO. 546100	
BUSINESS NAME & LOCATION / SERVICE ADDRESS B + B Associated Serv. Blunah & Brunke, Inc.				
TAX YEAR / SVC. PER. 1996	1. <input type="checkbox"/> TAX <input type="checkbox"/> SVC. CHARGE <input type="checkbox"/> REG. FEE	\$	DOLLARS 313	CENTS 45
DATE PAID 3-28-96	2. PENALTY (10% - 25%) ADMIN. CHARGE	\$	31	35
CHECK NO. 2689	3. PRIOR AMOUNT DUE	\$		
	4. INTEREST (1% PER MONTH)	\$	3	44
	ENTER TOTAL LINES 1-4	\$	348	24

PLEASE RETAIN FOR YOUR RECORDS.

Received By: 



City of Oakland
CASH RECEIPT

Cash Receipt No 735963

Cash Receipt Voucher # CR: _____

Cash
Check

Side

Payment Received from: Bernabe and Brinker, INC

DIRECT CASH CREDITS

Item	Remarks	Fund/SF	Organization	Account	Proj/Grant/ Cost Ctr/WO	Yr	Loc	Task	Dept Specific	Fixed Asset No	Trans ID	Revenue Source	Amount
1	Tank Rental	10100	20310	42412		6							150.-
2													.
3													.
4													.
5													.
SUBTOTAL												150.-	

Auxiliary Receipt Reference # 744 E. 12th St

Explanation: _____

ACCOUNTS RECEIVABLES

Item	Description	Customer Number	Invoice Number	Amount
1				150.-
2				.
3				.
4				.
5				.
SUBTOTAL				.
TOTAL				150.-

<u>Fire Prevention Bureau</u> Department Collecting the Cash <u>S. Smith</u> Received by	Received by: _____ Entered by: _____ Treasury Section RRCC or Grant Fiscal Affairs
	<u>311894</u>

REF./
A/C NO. Remove

COUNTY OF ALAMEDA
OFFICE OF THE AUDITOR-CONTROLLER

DATE: 06/13/94

NO: 725634 AG

MISCELLANEOUS RECEIPT

\$483
DOLLARS

RECEIVED FROM:	<u>Bernabe & Brinker, Inc 1281-30th St, Oakland, CA 94608</u>	
FOR:	<u>Former Harley Davidson</u>	
	<u>744 E 12th St, Oakland, CA 94606</u>	
RECEIVED BY:	<u>Shirley M. Simr.</u>	DEPT. NO.: <u>430-453</u>

CASH PERSONAL/CASHIER'S CHECK/M. O. # 1551 OTHER: _____

110-1 (Rev 10/85) [0134E (08)] 3-Part Distribution: White - Payor Yellow & Pink - Depart.

CITY OF OAKLAND
FIRE MARSHAL'S OFFICE
ROOM 201. CITY HALL
OAKLAND, CALIFORNIA 94612
273-3851

Permit No.	_____
Copies to	_____
Date Issued	_____

APPLICATION for PERMIT to INSTALL, REMOVE or REPAIR TANKS

IN THE CITY OF OAKLAND

Date 03/18/1996

Application is hereby made for permit to remove gasoline tank and excavate, commencing four feet inside the curb line install fuel oil tank and excavate, commencing inside the property line repair

on the 80th side of 8 Ave St. 65 feet S of 12 St.

House No. and Street 744 E 12 Proposed Street Avenue Present storage 0

Owner JW-STIVERA INC Address 499 Embarcadero Phone 510 834-9810

Applicant BERNABE BRITNER Address 2240 Wood St Phone 510 451-3482
Oakland 94607

Remarks 500 GALN TANK

Sidewalk surface to be disturbed 6' x 8' Number of Tanks 1 Capacity 300 Gallons each

Signature _____

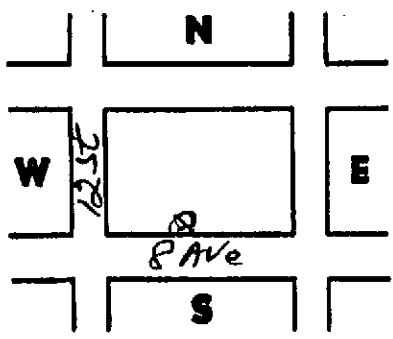
PERMIT
EXCAVATION

Parcel# 020 -0122-007-00

Appl# X9600272

Work from sidewalk

Permit Issued 04/01/96

CITY OF OAKLAND
Office of Planning and Building
1338 Broadway, 2nd Fl, Oakland CA, 94612
Phone: (510)238-4774 FAX: (510)238-2263

PAYMENT RECEIPT

Application#:	X9600272	Payment#:	801
APPLICATION FEE			\$40.00
EXCAVATION PERMIT			\$195.00
Subtotal:			\$235.00
Sales Tax:			\$0.00
***** TOTAL PAID:			\$235.00
Check Payment:			\$235.00

Payee: BERNABE AND BRINKER INC
Date: 04/01/96 Time: 10:16:33
By: TT Register R02 Receipt# 003595

***** ORIGINAL RECEIPT REQUIRED FOR REFUND *****

Util Co. Job #	Acctg#:		
UTIL Fund #:			
Applicant	Phone#	Lic#	License Classes--
A O TRS	X	(415)451-3482	610617 A
CA, 94608			

\$235.00 TOTAL FEES PAID AT ISSUANCE	
\$40.00 Applic	\$195.00 Permit
\$0.00 Process	\$0.00 Rec Mgmt
\$0.00 Gen Plan	\$0.00 Invstg
\$0.00 Other	

CITY OF OAKLAND



BAY AREA AIR QUALITY MANAGEMENT DISTRICT

117 ELLIS STREET
SAN FRANCISCO, CALIFORNIA 94109
415-771-6000

FAX 415-928-0338

REGULATION 8, RULE 40
Aeration of Contaminated Soil and
Removal of Underground Storage Tanks

NOTIFICATION FORM

- Removal or Replacement of Tanks
- Excavation of Contaminated Soil

SITE INFORMATION

SITE ADDRESS 744 East 12th Street

CITY, STATE, ZIP Oakland, CA

OWNER NAME J.W. Silveira

SPECIFIC LOCATION OF PROJECT 744 East 12th Street, Oakland, CA

TANK REMOVAL

CONTAMINATED SOIL EXCAVATION

SCHEDULED STARTUP DATE 07-25-94

SCHEDULED STARTUP DATE _____

VAPORS REMOVED BY:

STOCKPILES WILL BE COVERED? YES NO

WATER WASH

ALTERNATIVE METHOD OF AERATION (DESCRIBE BELOW):

VAPOR FREEING (CO²)

VENTILATION

(MAY REQUIRE PERMIT)

CONTRACTOR INFORMATION

NAME Bernabe and Brinker Inc. CONTACT Ernesto F. Bernabe Jr.

ADDRESS 1281-30th St. PHONE (510) 451-3482

CITY, STATE, ZIP Oakland, CA 94608

CONSULTANT INFORMATION

(IF APPLICABLE)

NAME Epigene International CONTACT John Alt

ADDRESS 38750 Paseo Padre Parkway PHONE (510) 791-1986

CITY, STATE, ZIP Fremont, CA 94536

DR OFFICE USE ONLY

DATE RECEIVED _____ BY _____ (INIT.)

CC: INSPECTOR NO. _____ DATE _____ BY _____ (INIT.)

TELEPHONE UPDATE: CALLER _____ CHANGE MADE _____

BAAQMD # _____