

BERNABE AND BRINKER INC.

General Engineering Contractor • Hazardous Substances Removal • License #610617

1281 - 30th Street
Oakland, California 94608

TEL: 510 • 451 • 3482
FAX: 510 • 836 • 2635

November 01, 1993

J.W. Silveira Properties
499 Embarcadero
Oakland, CA 94606

Attn: J.W. Silveira

This is regarding weekly bailing of water from monitoring wells on properties located at 923-925 - 87th Ave., and 2301 E-12th St, in Oakland, California.

Enclosed please find the following:

- 1) Invoice
- 2) Agreement
- 3) Site location map
- 4) Site Gradient map
- 5) Site map
- 6) Bailing totals from wells
- 7) E.P.A. Hazardous Waste Hauler Manifest
- 8) Uniform Hazardous Waste Manifest
- 9) Summary of ground water analyses results in parts per million.
- 10) Summary of ground water elevation measurement.

It is recommended that the weekly bailing should continue until a more permanent remediation system is installed.

It is a pleasure to continue to work with you on this project. Should you have any questions please contact the undersigned.

Sincerely,

James E. Brinker

c.c. Mr. Barney Chan, Alameda County, Department of
Environmental Health
Mr. Robert Shapiro, ESQ.
Mr. John N. Alt. CEG #1136

ALCO
HAZMAT
93 DEC -6 PM 1:59

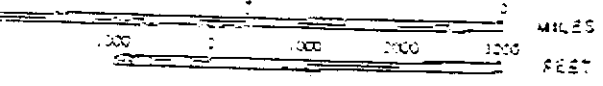
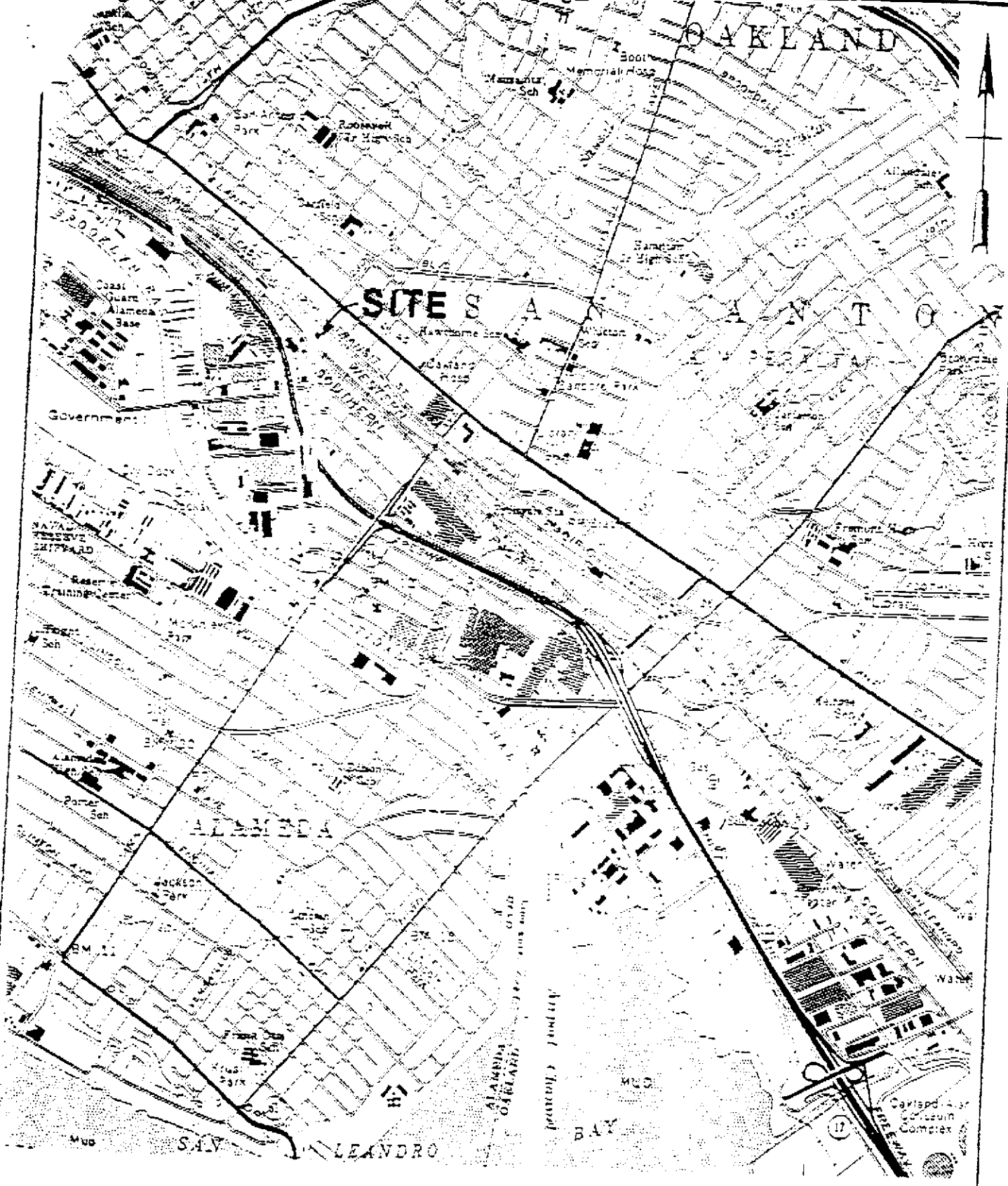

From U.S.G.S. 7 1/2" Quadrangle OAKLAND EAST

PLATE	No.
SITE LOCATION MAP	

Gradient: 0.011 ft./ft.

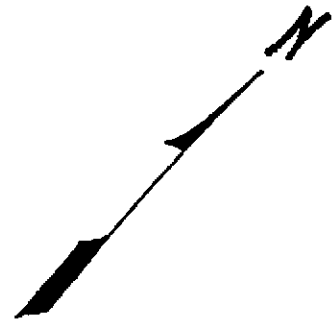

Cul-de-sac

23RD AVENUE

MW-2

MW-3

Approximate

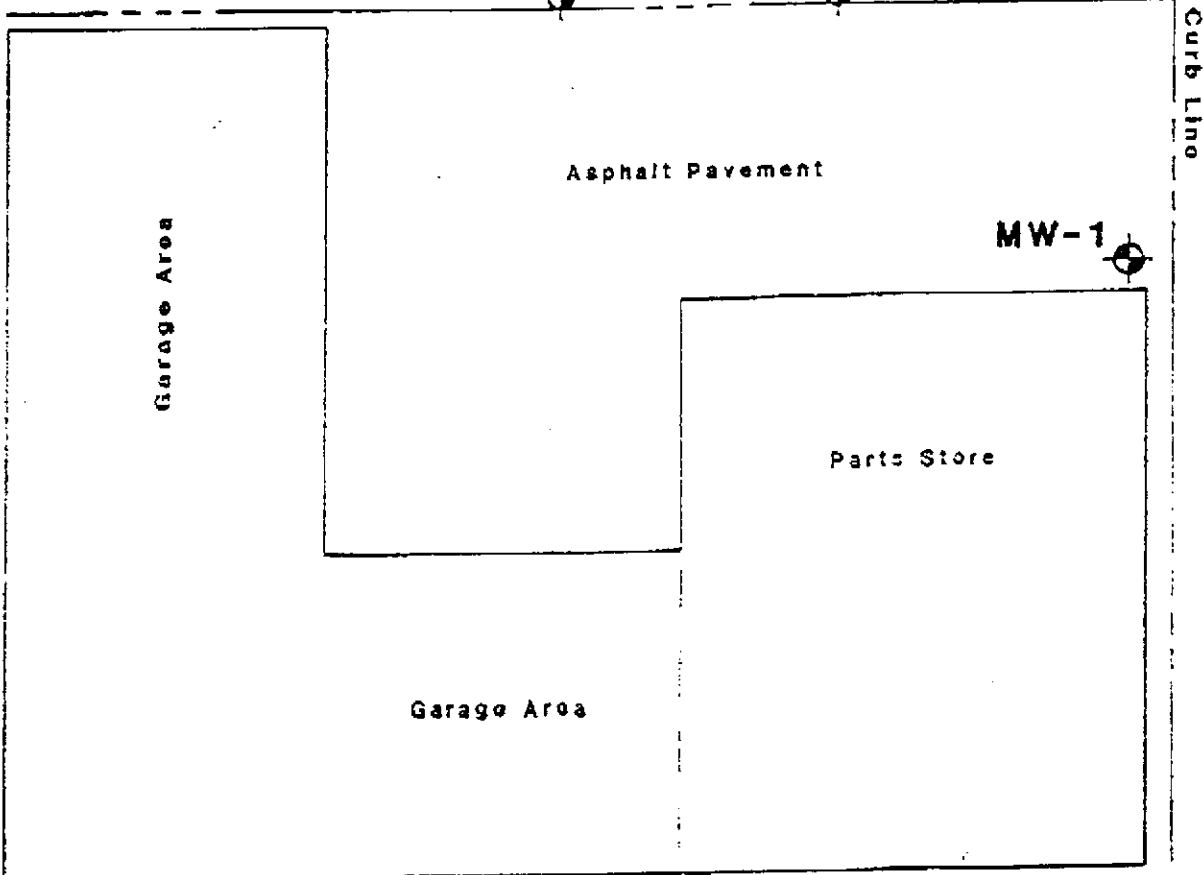

12TH STREET

Map derived from
Artesian Environmental Consultants,
Mill Valley, California
July, 1992

Approximate Scale: 1 Inch equals 20 Feet

Gradient based on
data from 8/27/93

PLATE 3

GROUNDWATER GRADIENT

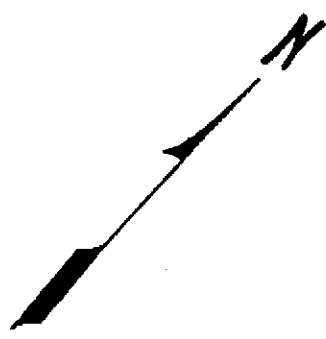

Cul-de-sac

23RD AVENUE

MW-2

MW-3

Approximate

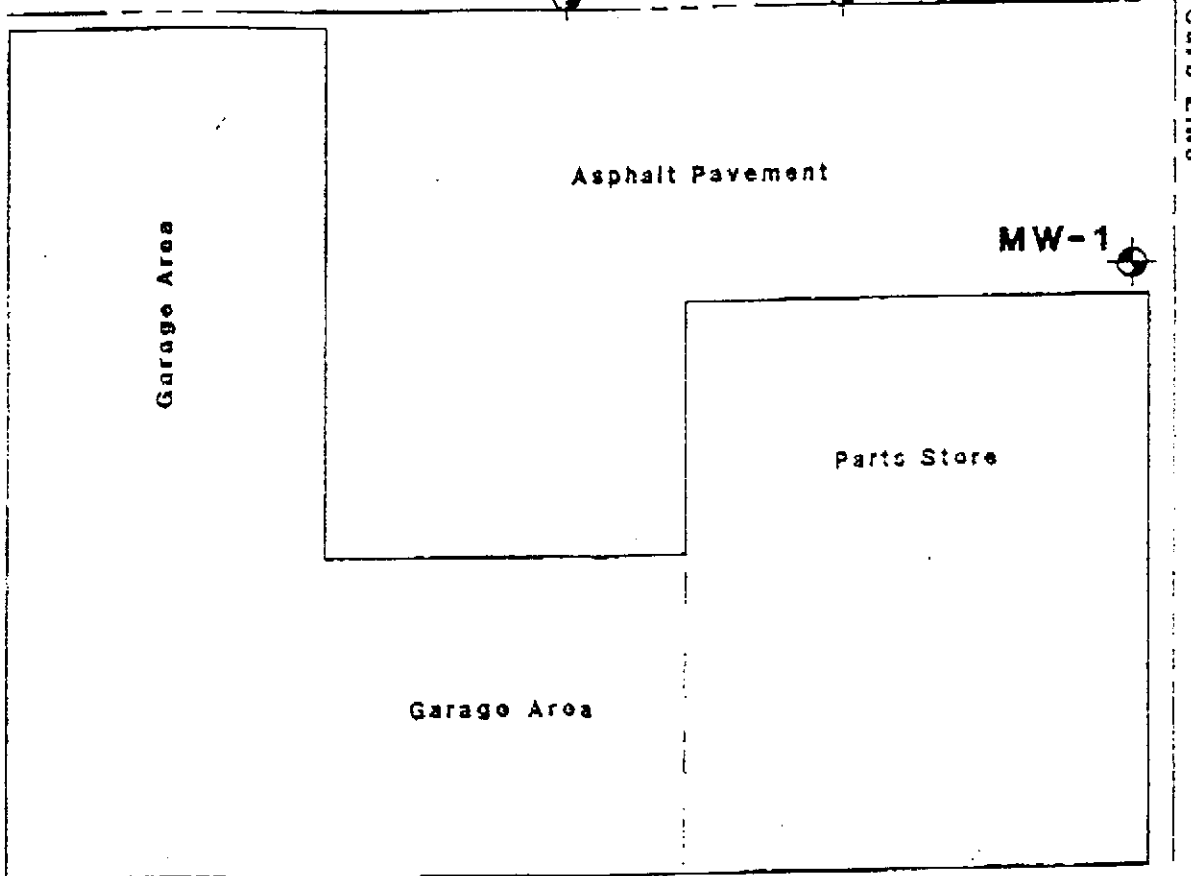

Curb Line

12TH STREET

Map derived from
Artesian Environmental Consultants,
Mill Valley, California
July, 1992

Approximate Scale: 1 Inch equals 20 Feet

PLATE 2

SITE MAP

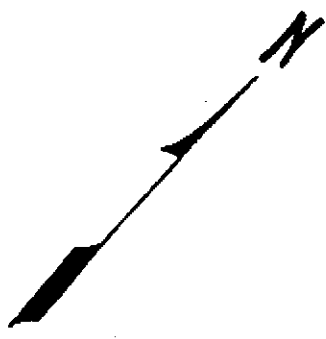

Cul-de-sac

23RD AVENUE

MW-2

MW-3

Approximate

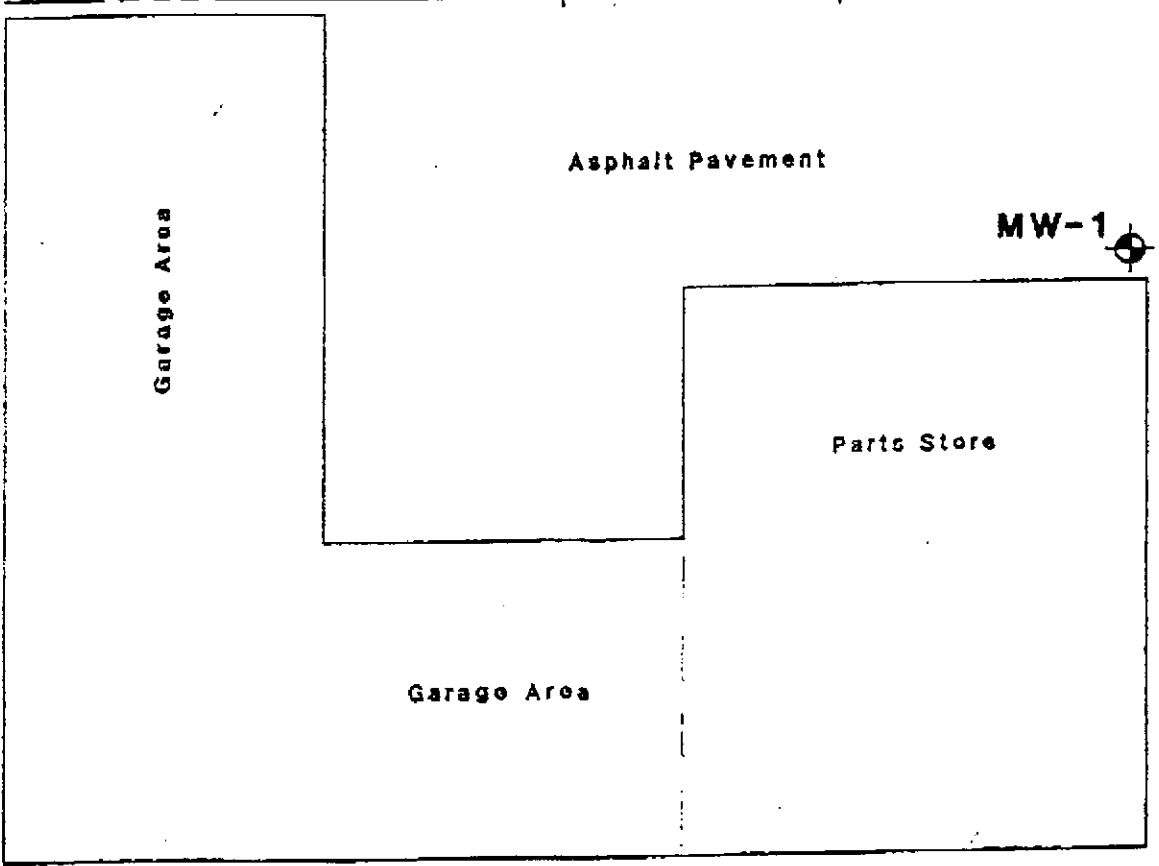

Curb Line

12TH STREET

Map derived from
Artesian Environmental Consultants,
Mill Valley, California
July, 1992

Approximate Scale: 1 Inch equals 20 Feet

PLATE 2	
SITE MAP	

BERNABE AND BRINKER INC.
1281-30TH STREET
OAKLAND, CA 94608

TEL: (510) 451-3482
FAX: (510) 836-2635

FIELD DATA SHEET / MONITORING WELL / PURGING

Date: 10-12-93 Well No.: 1
Project Name: ALECO AUTO PARTS
Project Location: 2301-E-12th St. Oakland
Possible Contaminants: gasoline
Well Diameter: 2 1/4" Well Depth: 30'
Depth to Groundwater: 7' Approximate Casing Volume: _____
Purge Method: FAILER
Evidence of Floating Product: Yes No _____; If yes, Thickness _____
Sheen Yes No _____; Odor: Yes No _____

Time Purge Volume Cumulative Purge

Time	Purge Volume	Cumulative Purge			
9:00	5	5			
9:20	5	10			
9:40	5	15			
10:00	5	20			

Comments: There is an odor but NOT gas.

Signature: James P. Brinker

BERNABE AND BRINKER INC.
1281-30TH STREET
OAKLAND, CA 94608

TEL: (510) 451-3482
FAX: (510) 836-2635

FIELD DATA SHEET / MONITORING WELL / PURGING

Date: 10-12-93 Well No.: 2

Project Name: ALEJO AUTO PARTS

Project Location: 2301 E. 12TH. STREET

Possible Contaminants: GASOLINE

Well Diameter: 2" Well Depth: 20'

Depth to Groundwater: _____ Approximate Casing Volume: _____

Purge Method: BAILER

Evidence of Floating Product: Yes No _____; If yes, Thickness _____

Sheen Yes No _____; Odor: Yes No _____

Time Purge Volume Cumulative Purge

Time	Purge Volume	Cumulative Purge
10:00	2.5	2.5
10:20	2.5	5
10:40	2.5	7.5
10:55	2.5	10

Sheen on top of water
Comments: Odor of gas very strong
Signature: J. Brinker

BERNABE AND BRINKER INC.
1281-30TH STREET
OAKLAND, CA 94608

TEL: (510) 451-3482
FAX: (510) 836-2635

FIELD DATA SHEET / MONITORING WELL / PURGING

Date: 10-12-93- Well No.: 3

Project Name: ALEJO AUTO PARTS

Project Location: 2301 E. 12TH. STREET

Possible Contaminants: GASOLINE

Well Diameter: 2" Well Depth: 20'

Depth to Groundwater: _____ Approximate Casing Volume: _____

Purge Method: BAILER

Evidence of Floating Product: Yes No. _____; If yes, Thickness _____

Sheen Yes No. _____; Odor: Yes No. _____

Time Purge Volume Cumulative Purge

Time	Purge Volume	Cumulative Purge			
11:20	5	5			
11:45	5	10			
12:15	5	15			
1:00	5	20			

Comments: Odor of gasoline strong

Signature: [Signature]

BERNABE AND BRINKER INC.
1281-30TH STREET
OAKLAND, CA 94608

TEL: (510) 451-3482
FAX: (510) 836-2635

FIELD DATA SHEET / MONITORING WELL / PURGING

Date: 10-15-93 Well No.: 1

Project Name: ALEJO AUTO PARTS

Project Location: 2301 E. 12TH. STREET

Possible Contaminants: GASOLINE

Well Diameter: 2" Well Depth: 30'

Depth to Groundwater: _____ Approximate Casing Volume: _____

Purge Method: BAILER

Evidence of Floating Product: Yes No _____; If yes, Thickness _____

Sheen Yes No _____; Odor: Yes No _____

Time Purge Volume Cumulative Purge

Time	Purge Volume	Cumulative Purge			
9:30	5	5			
9:55	5	10			
10:25	5	15			
10:45	5	20			

Comments: _____

Signature: J Brinker

BERNABE AND BRINKER INC.
1281-30TH STREET
OAKLAND, CA 94608

TEL: (510) 451-3482
FAX: (510) 836-2635

FIELD DATA SHEET / MONITORING WELL / PURGING

Date: 10-13-93 Well No.: 2

Project Name: ALEJO AUTO PARTS

Project Location: 2301 E. 12TH. STREET

Possible Contaminants: GASOLINE

Well Diameter: 2" Well Depth: 20'

Depth to Groundwater: _____ Approximate Casing Volume: _____

Purge Method: BAILER

Evidence of Floating Product: Yes No. _____; If yes, Thickness _____

Sheen Yes No. _____; Odor: Yes No. _____

Time Purge Volume Cumulative Purge

Time	Purge Volume	Cumulative Purge			
11:00	2.5	2.5			
11:30	2.5	5			
11:50	2.5	7.5			
12:25	2.5	10			

Comments: strong odor of gas.

Signature: J Brinker

BERNABE AND BRINKER INC.
1281-30TH STREET
OAKLAND, CA 94608

TEL: (510) 451-3482
FAX: (510) 836-2635

FIELD DATA SHEET / MONITORING WELL / PURGING

Date: 10-15 Well No.: 3

Project Name: ALEJO AUTO PARTS

Project Location: 2301 East 12Th Street

Possible Contaminants: GASOLINE

Well Diameter: 2" Well Depth: 20'

Depth to Groundwater: _____ Approximate Casing Volume: _____

Purge Method: PLASTIC BAILER

Evidence of Floating Product: Yes No _____; If yes, Thickness _____

Sheen Yes No _____; Odor: Yes No _____

Time Purge Volume Cumulative Purge

Time	Purge Volume	Cumulative Purge			
1:00	5	5			
1:30	5	10			
1:50	5	15			
2:20	5	20			

Comments: Product floating on water

Signature: J. Brinker

BERNABE AND BRINKER INC.
1281-30TH STREET
OAKLAND, CA 94608

TEL: (510) 451-3482
FAX: (510) 836-2635

FIELD DATA SHEET / MONITORING WELL / PURGING

Date: 10-22-93 Well No.: 1

Project Name: ALEJO AUTO PARTS

Project Location: 2301 East 12Th Street

Possible Contaminants: GASOLINE

Well Diameter: 2" Well Depth: 30'

Depth to Groundwater: _____ Approximate Casing Volume: _____

PLASTIC BAITER

Purge Method: _____

Evidence of Floating Product: Yes _____ No. ; If yes, Thickness _____

Sheen Yes _____ No. ; Odor: Yes _____ No.

Time Purge Volume Cumulative Purge

Time	Purge Volume	Cumulative Purge		
9:10	5	5		
9:30	5	10		
9:55	5	15		
10:20	5	20		

Comments: _____

Signature: J. Brinker

BERNABE AND BRINKER INC.
1281-30TH STREET
OAKLAND, CA 94608

TEL: (510) 451-3482
FAX: (510) 836-2635

FIELD DATA SHEET / MONITORING WELL / PURGING

Date: 10-22-93 Well No.: 2

Project Name: ALEJO AUTO PARTS

Project Location: 2301 East 12Th Street

Possible Contaminants: GASOLINE

Well Diameter: 2" Well Depth: 20'

Depth to Groundwater: _____ Approximate Casing Volume: _____

Purge Method: PLASTIC BAILER

Evidence of Floating Product: Yes No ; If yes, Thickness _____

Sheen Yes No ; Odor: Yes No

Time Purge Volume Cumulative Purge

Time	Purge Volume	Cumulative Purge			
10:30	5	5			
12:45	2	7			

Comments: sheens on water

Signature: J. Brinker

BERNABE AND BRINKER INC.
1281-30TH STREET
OAKLAND, CA 94608

TEL: (510) 451-3482
FAX: (510) 836-2635

FIELD DATA SHEET / MONITORING WELL / PURGING

Date: 10-22-93 Well No.: 3

Project Name: ALEJO AUTO PARTS

Project Location: 2301 East 12Th Street

Possible Contaminants: GASOLINE

Well Diameter: 2" Well Depth: 20'

Depth to Groundwater: _____ Approximate Casing Volume: _____

Purge Method: PLASTIC BAITER

Evidence of Floating Product: Yes _____ No. ; If yes, Thickness _____

Sheen Yes No _____; Odor: Yes No. _____

Time Purge Volume Cumulative Purge

Time	Purge Volume	Cumulative Purge			
1:00	5	5			
1:30	5	10			
2:00	5	15			
2:45	5	20			

Comments: _____

Signature: J. Branks

BERNABE AND BRINKER INC.
1281-30TH STREET
OAKLAND, CA 94608

TEL: (510) 451-3482
FAX: (510) 836-2635

FIELD DATA SHEET / MONITORING WELL / PURGING

Date: 10-29-93- Well No.: 1

Project Name: ALEJO AUTO PARTS

Project Location: 2301 East 12Th Street

Possible Contaminants: GASOLINE

Well Diameter: 2" Well Depth: 30'

Depth to Groundwater: _____ Approximate Casing Volume: _____

Purge Method: PLASTIC BAILER

Evidence of Floating Product: Yes _____ No. ; If yes, Thickness _____

Sheen Yes _____ No. ; Odor: Yes _____ No.

Time Purge Volume Cumulative Purge

Time	Purge Volume	Cumulative Purge			
8:20	5	5			
8:45	5	10			
9:15	5	15			
10:00	5	20			

Comments: _____

Signature: J Brinker

BERNABE AND BRINKER INC.
1281-30TH STREET
OAKLAND, CA 94608

TEL: (510) 451-3482
FAX: (510) 836-2635

FIELD DATA SHEET / MONITORING WELL / PURGING

Date: 10-29-93 Well No.: 2

Project Name: ALEJO AUTO PARTS

Project Location: 2301 East 12Th Street

Possible Contaminants: GASOLINE

Well Diameter: 2" Well Depth: 20'

Depth to Groundwater: _____ Approximate Casing Volume: _____

PLASTIC BAILER

Purge Method: _____

Evidence of Floating Product: Yes No _____; If yes, Thickness _____

Sheen Yes No _____; Odor: Yes No _____

Time Purge Volume Cumulative Purge

Time	Purge Volume	Cumulative Purge		
10:30	5	5		
11:30	2	7		

Comments: _____

Signature: J. Brinker

BERNABE AND BRINKER INC.
1281-30TH STREET
OAKLAND, CA 94608

TEL: (510) 451-3482
FAX: (510) 836-2635

FIELD DATA SHEET / MONITORING WELL / PURGING

Date: 10-29-93 Well No.: 3

Project Name: ALEJO AUTO PARTS

Project Location: 2301 East 12Th Street

Possible Contaminants: GASOLINE

Well Diameter: 2" Well Depth: 20'

Depth to Groundwater: _____ Approximate Casing Volume: _____

Purge Method: PLASTIC BAILER

Evidence of Floating Product: Yes No _____; If yes, Thickness _____

Sheen Yes No _____; Odor: Yes No _____

Time Purge Volume Cumulative Purge

Time	Purge Volume	Cumulative Purge			
12:20	5	5			
12:45	5	10			
1:30	5	15			
2:10	5	20			

Comments: _____

Signature: J. Brinker



PRC PATTERSON, INC.

DBA Refineries Service

13331 N. Hwy 33 / P.O.Box 1167
Patterson, CA 95363
(209) 892-6742 / (800) 874-4444

92694669
STATE MANIFEST #
USED OIL HAULER # 86-050
EPA # CAD083166728
HAZARDOUS WASTE
HAULER REG # 2591

INV. # 32220

11-2-93
DATE

CUSTOMER	NAME Pacific Petrochem		DRIVER Marc 115	
	ADDRESS 938 Adams St		TRUCK #	
	CITY STATE ZIP Benicia CA		TERMS CASH	
	PHONE		NET 10 DAY	
CITY STATE ZIP Dogg Scott		PO #		

• PLEASE PAY FROM THIS INVOICE •

PRODUCT	GALLONS	HOURS	RATE	AMOUNT
HAZARDOUS WASTE OIL	695			
TEST FEE				
HAZARDOUS WASTE				
HOURLY CHARGES				

I certify amount shown above to be correct.

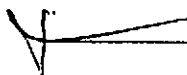
(Customer Signature)

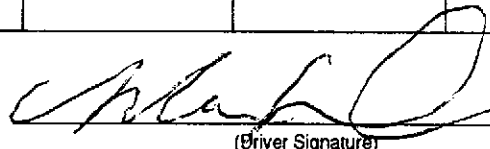
(Driver Signature)

PAYMENT DUE UPON RECEIPT OF INVOICE. A service charge of 1 1/2% per month shall be charged on all past due accounts. In the event this account becomes delinquent and it is necessary to institute legal proceedings, purchaser agrees to pay reasonable attorney's fee and court costs.

TOTAL

RSINVMP91

WHITE: Customer CANARY: Alphabetical PINK: Numeric GOLDENROD: File

IN CASE OF EMERGENCY OR SPILL, CALL THE NATIONAL RESPONSE CENTER 1-800-424-8802; WITHIN CALIFORNIA, CALL 1-800-852-7550
 GENERATOR FACILITY

UNIFORM HAZARDOUS WASTE MANIFEST		1. Generator's US EPA ID No. CA T 0 8 0 0 1 1 0 5 9	Manifest Document No.	2. Page 1 of _____	Information in the shaded areas is not required by Federal law.	
3. Generator's Name and Mailing Address BAY AREA ROUTE		PRC PATTERSON, INC. P.O. BOX 1167 PATTERSON, CA. 95363				
4. Generator's Phone (800 874-4444)	6. US EPA ID Number					
5. Transporter 1 Company Name PRC PATTERSON, INC.	8. US EPA ID Number CA T 0 8 0 0 1 1 0 5 9					
7. Transporter 2 Company Name	10. US EPA ID Number					
9. Designated Facility Name and Site Address PRC PATTERSON, INC. 13331 N. HWY. 33 PATTERSON, CA. 95363		10. US EPA ID Number				
11. US DOT Description (including Proper Shipping Name, Hazard Class, and ID Number)		12. Containers		13. Total Quantity	14. Unit Wt/Vol	
a. WASTE PETROLEUM OIL, COMBUSTIBLE LIQUID, NA 1270		0 0 1 T T		2840	21620 G	
b.						
c.						
d.						
15. Special Handling Instructions and Additional Information 24 HR. EMERGENCY CONTACT: PRC # 1-(800)-874-4444 24 HR. EMERGENCY RESPONSE: CHEM TEL INC. # 1-(800)-255-3924 APPROPRIATE PROTECTIVE CLOTHING AND RESPIRATOR.						
16. GENERATOR'S CERTIFICATION: I hereby declare that the contents of the consignment are fully and accurately described above by proper shipping name and are classified, packed, marked, and labeled, and are in all respects in proper condition for transport by highway according to applicable federal, state and international laws. If I am a large quantity generator, I certify that I have a program in place to reduce the volume and toxicity of waste generated to the degree I have determined to be economically practicable and that I have selected the practicable method of treatment, storage, or disposal currently available to me which minimizes the present and future threat to human health and the environment; OR, if I am a small quantity generator, I have made a good faith effort to minimize my waste generation and select the best waste management method that is available to me and that I can afford.						
Printed/Typed Name Marc Arcus		Signature <i>Marc Arcus</i>		Month 11	Day 21	
17. Transporter 1 Acknowledgement of Receipt of Materials		Signature <i>Marc Arcus</i>		Month 11	Day 21	
Printed/Typed Name Marc Arcus		Signature		Month	Day	
18. Transporter 2 Acknowledgement of Receipt of Materials		Signature		Month	Day	
Printed/Typed Name		Signature		Month	Day	
19. Discrepancy Indication Space						
20. Facility Owner or Operator Certification of receipt of hazardous materials covered by this manifest except as noted in Item 19.						
Printed/Typed Name		Signature		Month	Day	
				Month	Day	

DO NOT WRITE BELOW THIS LINE.

Table 2 - Summary of groundwater elevation measurements
2301 East 12th Street, Oakland

DATE	MEASUREMENT	MW-1	MW-2	MW-3
5/26/93	ELEVATION TOP OF CASING*	10.00 ft.	8.23 ft.	8.72 ft.
11/06/92	DEPTH TO GROUNDWATER	9.15 ft.	7.30 ft.	7.59 ft.
11/06/92	GROUNDWATER ELEVATIONS	0.85 ft.	0.93 ft.	1.13 ft.
3/02/93	DEPTH TO GROUNDWATER	7.45 ft.	5.71 ft.	6.07 ft.
3/02/93	GROUNDWATER ELEVATIONS	2.55 ft.	2.52 ft.	2.65 ft.
5/26/93	DEPTH TO GROUNDWATER	8.05 ft.	6.28 ft.	7.22 ft.
5/26/93	GROUNDWATER ELEVATIONS	1.95 ft.	1.95 ft.	1.50 ft.
8/27/93	DEPTH TO GROUNDWATER	9.06 ft.	7.98 ft.	8.21 ft.
8/27/93	GROUNDWATER ELEVATIONS	0.94 ft.	0.25 ft.	0.51 ft.

* Based on an assumed elevation of 10.00 ft. for MW-1