

# BERNABE AND BRINKER INC.

General Engineering Contractor • Hazardous Substances Removal • License #610617

1281 - 30th Street  
Oakland, California 94608

TEL: 510 • 451 • 3482  
FAX: 510 • 836 • 2635

December 1, 1993

J.W. Silveira Properties  
499 Embarcadero  
Oakland, CA 94606

Attn: J.W. Silveira

Site address: Alejo Auto Parts  
2301-E-12th St., Oakland, California

This is regarding weekly bailing of water from monitoring wells on properties located at 2301 - E12th Street in Oakland, California.

Enclosed please find the following:

- 1) Site location map.
- 2) Site Gradient map
- 3) Site map
- 4) Bailing totals from wells
- 5) E.P.A. Hazardous Waste Hauler Manifest
- 6) Uniform Hazardous Waste Manifest
- 7) Summary of ground water analyses results in parts per million.
- 8) Summary of last ground water elevation measurement.

It is recommended that the weekly bailing should continue until a more permanent remediation system is installed.

It is a pleasure to continue to work with you on this project. Should you have any questions please contact the undersigned.

Sincerely,

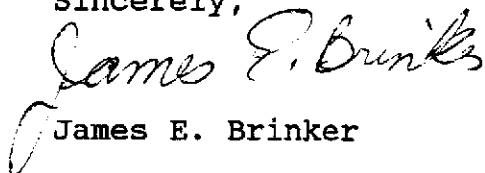
  
James E. Brinker

ALCO  
HAZMAT  
93 DEC -6 PM 1:59

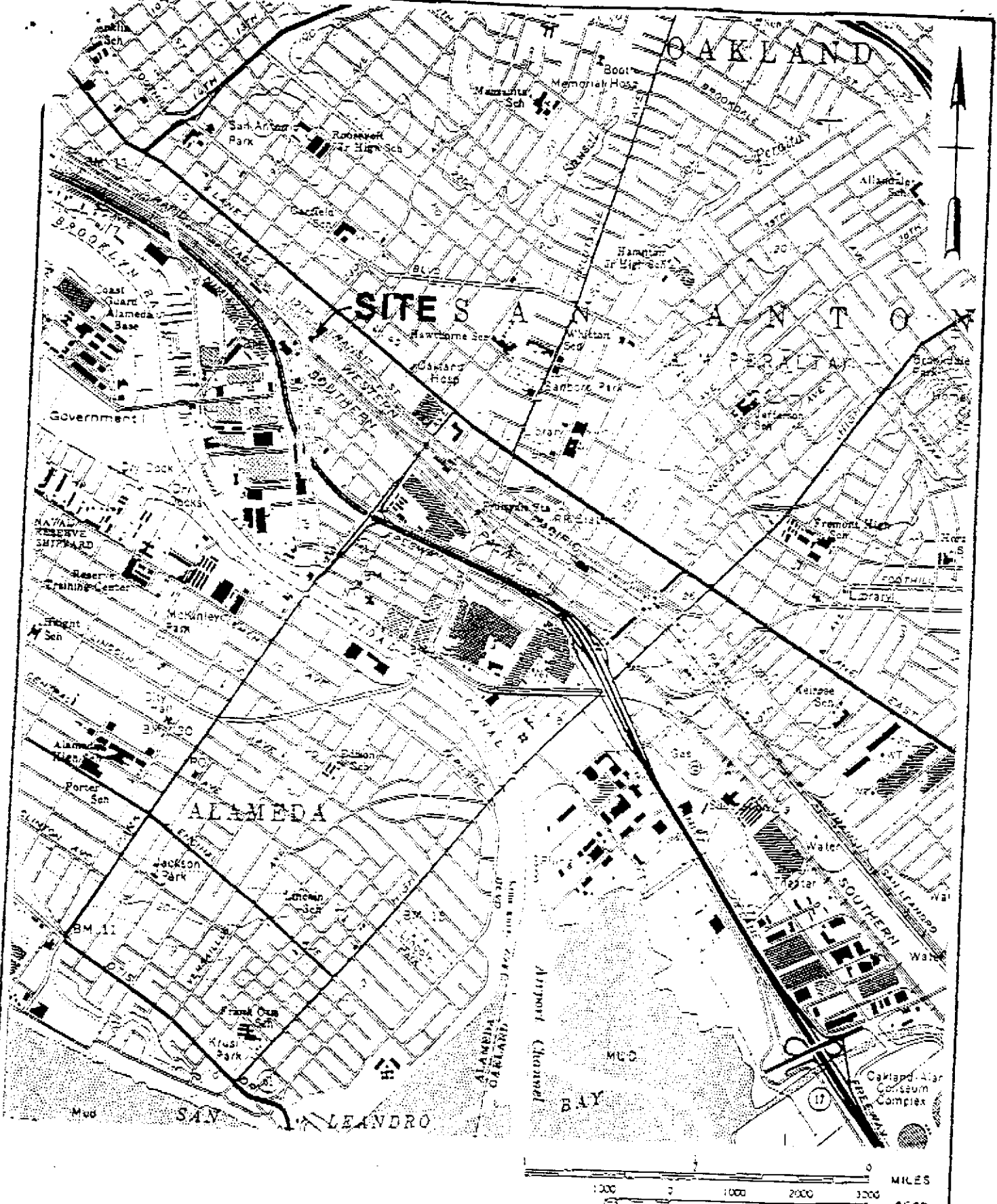

From U.S.G.S. 7 1/2" Quadrangle OAKLAND EAST

PLATE	No.
<b>SITE LOCATION MAP</b>	

**Gradient: 0.011 ft./ft.**

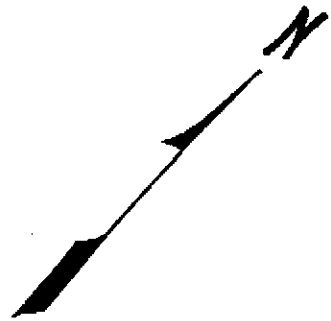

Cul-de-sac

**23RD AVENUE**

**MW-2**

**MW-3**

Approximate

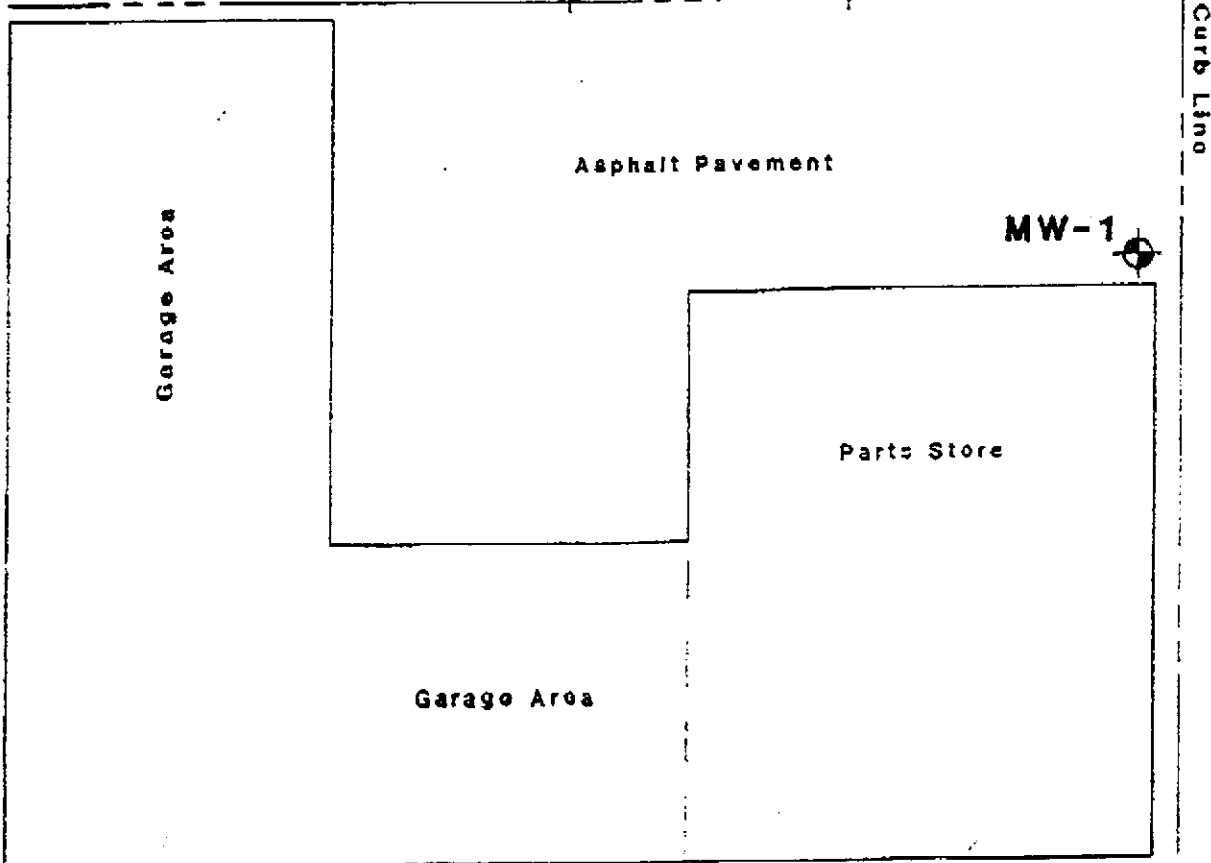

**12TH STREET**

Map derived from  
Artesian Environmental Consultants,  
Mill Valley, California  
July, 1992

Approximate Scale: 1 inch equals 20 Feet

Gradient based on  
data from 8/27/93

**PLATE 3**

**GROUNDWATER GRADIENT**

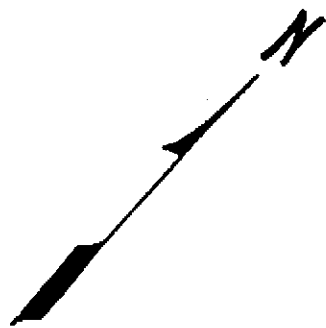

Cul-de-sac

23RD AVENUE

MW-2

MW-3

Approximate

Curb Line

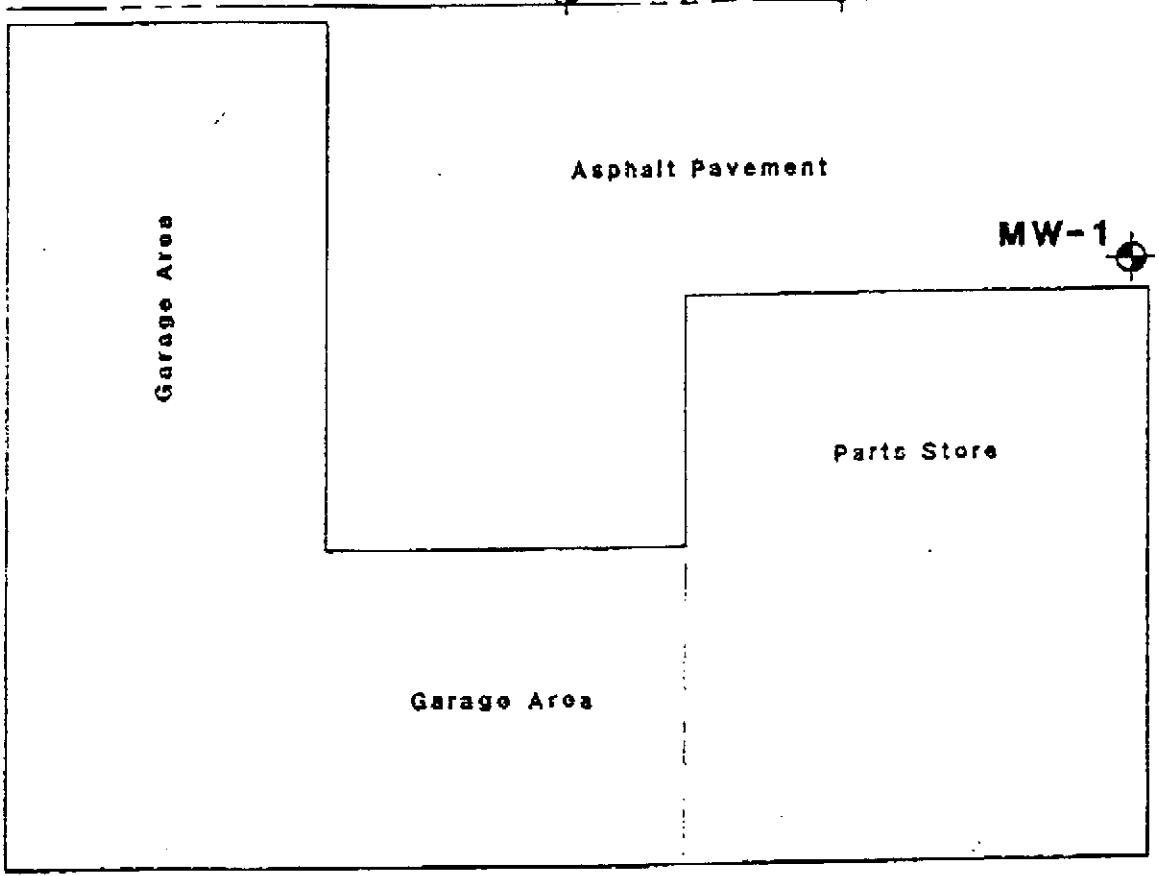

12TH STREET

Map derived from  
Artesian Environmental Consultants,  
Mill Valley, California  
July, 1982

Approximate Scale: 1 Inch equals 20 Feet

PLATE 2	
<b>SITE MAP</b>	