

#229

CAMBRIA



Fax

To: Barney Chan

Company: ACHCSA

Fax: (510) 337-9335

Phone: (510) 567-6765

From: Troy Buggle

Phone: 510-420-3333

Pages: 7

Date: 3/1/00

Re: 2101 Park Blvd, Oakland, CA

Hard Copy to Follow? Yes No

Barney,

I am enclosing a copy of the Tank closure/sampling report for the second generation waste oil tank for the above referenced site. Also, I have enclosed a map showing the waste oil tank locations in reference to the Shell building and the Good Year building.

Additionally, I spoke with Diane Lundquist in our office who knew some of the site history. She indicated that the first generation waste oil tank (previously one of the first generation USTs) would have been removed when the second generation USTs were removed. At that time, the USTs were apparently removed and replaced with the third generation USTs and the second generation waste oil tank. Nonetheless, we have no record of this (most likely due to the lack of record keeping of this type, historically), though it does make sense.

Please go ahead and send a copy of the third generation waste oil tank removal report.

Please let me know if there are any other questions or comments.

Thank you again, Barney!

Troy A. Buggle
 Troy A. Buggle
 Project Scientist

This fax transmittal is intended solely for use by the person or entity identified above. Any copying or distribution of this document by anyone other than the intended recipient is strictly prohibited. If you are not the intended recipient, please telephone us immediately and return the original transmittal to us at the address listed below.

Cambria Environmental Technology, Inc., 1144 - 65th Street, Suite C, Oakland, CA 94608 Tel (510) 420-0700 Fax (510) 420-9170

MAR-01-2000 12:26
CAMBRIA
510 420 9170 P.02/07

EXPLANATION

⊕ GROUNDWATER MONITORING WELL

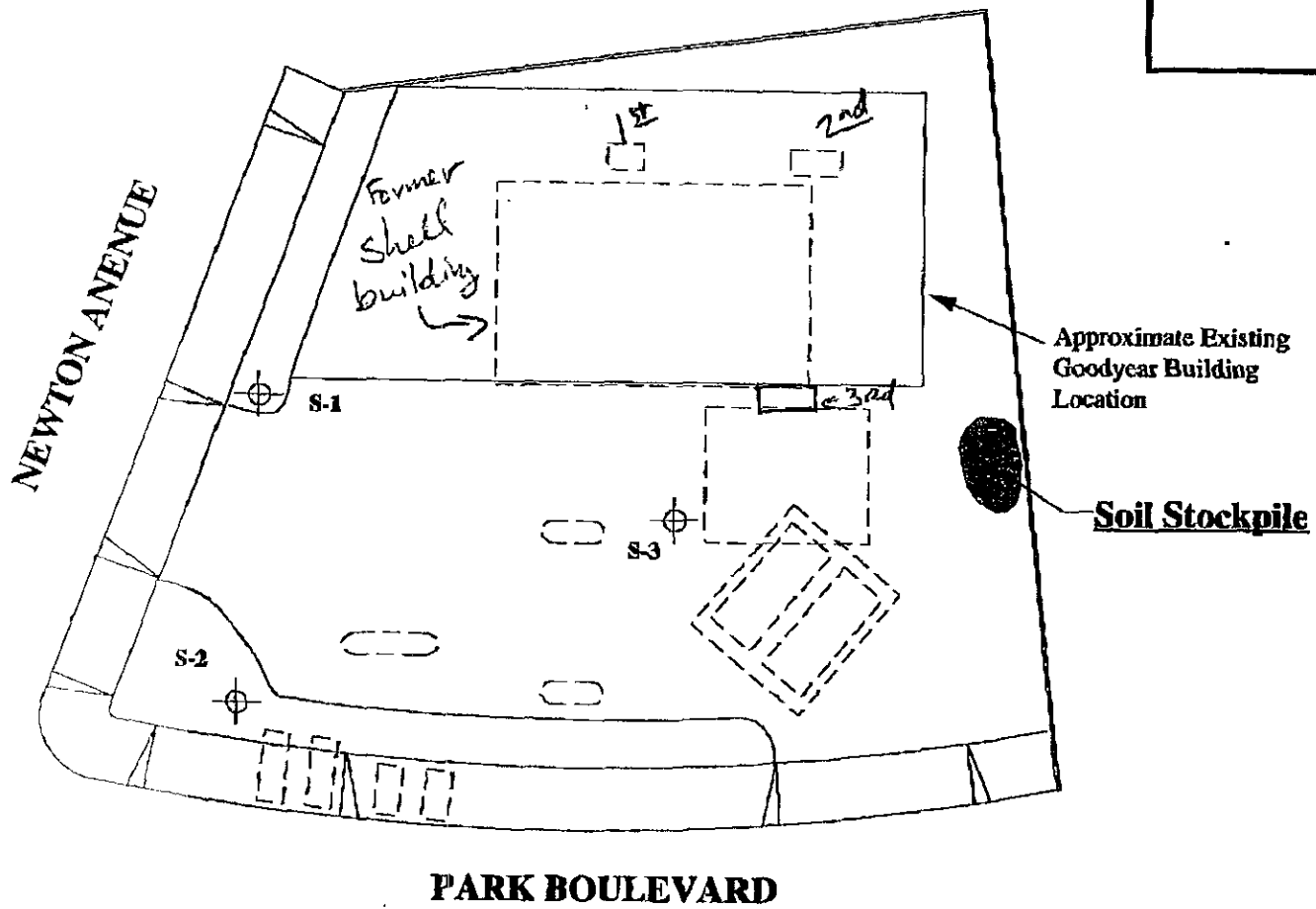

PLATE

SITE PLAN
Former Shell Service Station
2101 Park Boulevard
Oakland, California

enviros
95267

Drawn By: JWN

Date: 6-21-95

Approved By: _____ Date: _____

BLAINE TECH SERVICES

P.O. BOX 5745
SAN JOSE, CA 95150
(408) 723-3974

November 21, 1986

Shell Oil Company
P.O. Box 7004
Lafayette, CA 94549

Attention: Stan Roller

Re: Field sampling at

Project No.	95267				
RPT	PF	X	EF		
1	2	3	4	5	6
				X	

2101 Park Avenue
Oakland, CA
on
November 12, 1986

SAMPLING REPORT

Field sampling was undertaken in accordance with State and local enforcement agency standards and requirements for objective analytical information on the levels of residual contaminants found outside the primary containment structure. This project concerned the following:

Underground storage tank removal

Reason for removal -- discontinuation of on site storage

Type -- one approximately 550 gallon waste oil

Age -- unspecified

Sampling was performed in accordance with approved methodology at the location shown on the accompanying site diagram. Additional information is presented on the diagram including our field sampling designation and the lab identification number which references the analytical results which will be found in the separate laboratory report. Sample material was collected in a special container appropriate to the type of analysis intended. The sample container was sealed, chilled, and transported to the laboratory with standard chain of custody records maintained at each transmittal. This sampling report, the chain of custody, and the analytical report comprise the formal documentation of the sampling conducted during this phase of work at the site.

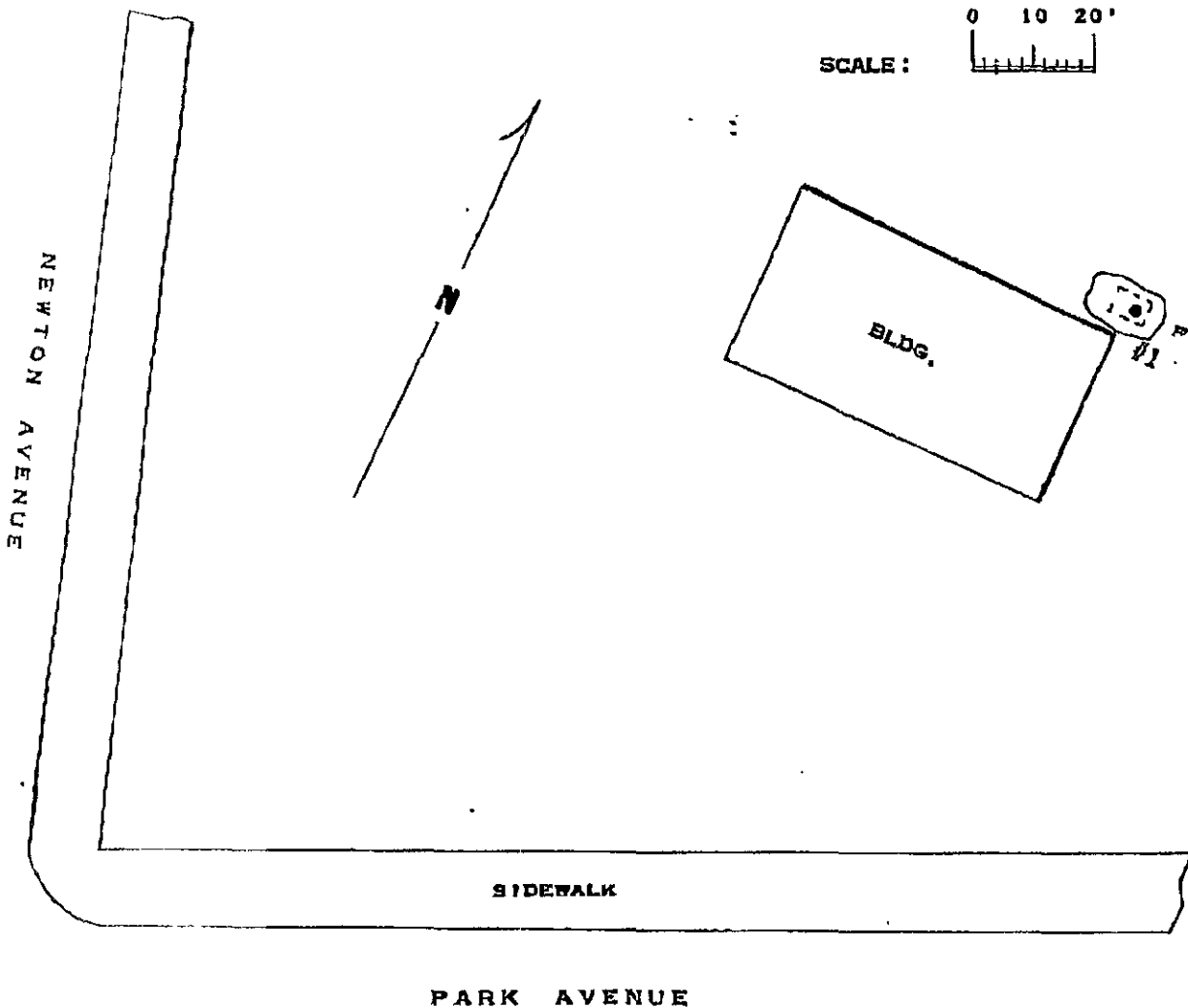

MAP REF: THOMAS BROS.
ALAMEDA COUNTY
P. 9 D-5

LEGEND: F = FILL END

#1 SOIL FROM 12.5'
ANALYSIS FOR WASTE OIL
AT SOIL AND WATER LABORATORY
S & W LAB NO. 316B6-12

SAMPLING PERFORMED BY
FRANK A. CLINE

DIAGRAM PREPARED BY
TAMMIE STALLINGS

Tammie Stallings

Figure 1.

Reportage

Submission to the Regional Water Quality Control Board and the local regulatory/enforcement agency should include copies of the sampling report, the chain of custody, and the laboratory report. The property owner should attach a cover letter and submit all documents together in a package.

The following addresses have been listed here for your convenience:

Water Quality Control Board
San Francisco Bay Region
1111 Jackson Street
Room 6040
Oakland, CA 94607
ATTN: Peter Johnson

City of Oakland Fire Prevention Bureau
One City Hall Plaza
Oakland, CA 94612
ATTN: Robert Dawson

If I can be of any further assistance, please call.

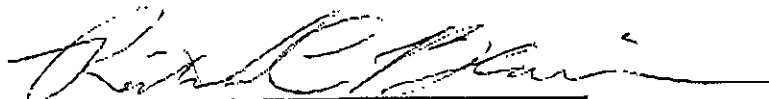

Richard C. Blaine

RCB/tls

BLAINE TECH SERVICES

P.O. BOX 5745
SAN JOSE, CA 95150
(408) 723-3974

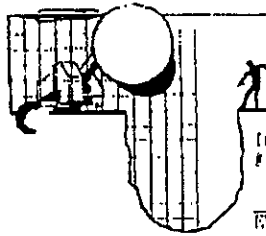

Include ALL of the following designation in lab reports and invoices

86316 M1

SHELL
2101 Park
Oakland

EVERYTHING written above this line is the project designation

Field sampling completed 10:20 hrs. 11-12-86 performed by Henry M. Shukronsky

RELEASED BY	ACCEPTED BY
<u>15:44 hrs. 11-12-86 Henry M. Shukronsky</u>	<u>to Blaine Tech Services 11:44 hrs. 11-12-86 Alan Foster</u>
: hrs. - '86	: hrs. - '86
: hrs. - '86	: hrs. - '86
: hrs. - '86	: hrs. - '86

I.D.	TYPE	ANALYSIS	LAB #	PRELIMS	FINAL
<u>#1</u>	<u>Soil</u>	<u>Wash Oil</u>			

TURN ARCHIVE immediately

REPORT TO: Blaine Tech Services

BILLING INVOICE TO: BLAINE TECH SERVICES

Attn _____
Phone _____

Attn _____
Verbal/Ref. Bl. From:

cc BLAINE TECH SERVICES (always)
cc OTHER:

SPECIAL INSTRUCTIONS

1) Phone results to RFS
2) Phone results to client direct

Laboratory Report

S&W
SOIL AND WATER
LABORATORY
 Soil Fertility—Plant Tissue
 Pollution and Residue Control
 Drinking Water

14072 W. Park Avenue
 Boulder Creek, CA 95006
 (408) 338-3053

831

Client	Report Date
Blaine Tech Services P. O. Box 5745 San Jose, CA. 95150	11/17/86

Sample Site	Date Received
Shell Oil 2101 Park Oakland, CA. 86316M1 #1	11/12/86

Analysis Requested	Procedure	Date Analyzed
Soil/Waste Oil	EPA 3550 (Sorption/Extraction)	11/12/86

S&W Ref. #	Client Ref. #	Matrix/Analysis	Concentration (ppm)	Detection Limit (ppm)
316B6-12	#1	Soil/Waste Oil	2464	20 ppm

Analyst Signature

R. H. Remoy