



# Health Care Services

## Alameda County Environmental Health Meeting Sign-In Sheet

Sheaffs Garage  
5930 College Avenue, Oakland, CA  
RO0000377

Friday, June 13, 2014  
1:30 PM

NAME	COMPANY	MAILING ADDRESS	PHONE	Signature	E-MAIL
Dilan Roe	Alameda County	1131 Harbor Bay Pkwy, Suite 250 Alameda, CA 94502	(510) 567-6767	<i>Dilan Roe</i>	<a href="mailto:dilan.roe@acgov.org">dilan.roe@acgov.org</a>
Mark Detterman	Alameda County	1131 Harbor Bay Pkwy, Suite 250 Alameda, CA 94502	(510) 567-6876	<i>Mark Detterman</i>	<a href="mailto:mark.detterman@acgov.org">mark.detterman@acgov.org</a>
<i>Mark Youngkin</i>	<i>GGE</i>		<i>415.730.6189</i>	<i>Mark Youngkin</i>	<i>mark.youngkin@gmail.com</i>
<i>BREST WASSER</i>	<i>GGE</i>	<i>1455 ROSEMATE AVE., S.F., CA 94124</i>	<i>415-512-1335</i>	<i>Brest Wasser</i>	<i>B.WASSER@CGTA.COM</i>
<i>John Accacia</i>	<i>Sheaffs Garage</i>	<i>711 El Verano Dr W/C CA 94598</i>	<i>925- 595-5573</i>	<i>John Accacia</i>	<i>John.Accacia@Yahoo.com</i>
<i>Dorian Sheaffs</i>	<i>TRUSTEE for property</i>	<i>1945 PRANSIDE DR CONCORD, CA</i>	<i>925 689-3450</i>	<i>Dorian Sheaffs</i>	<i>DORIAN.SHEAFFS@ACGOV.ORG</i>

PW-1

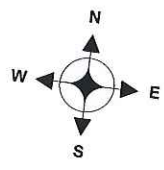

DTW - 6 to 8 ft

Res 63 mg/L

Commer  
ESL  
VI to IDH  
640 mg/L

PCE  
< ND

0.16 ppm @ 2 ft  
up @ 4 ft

120 mg/L

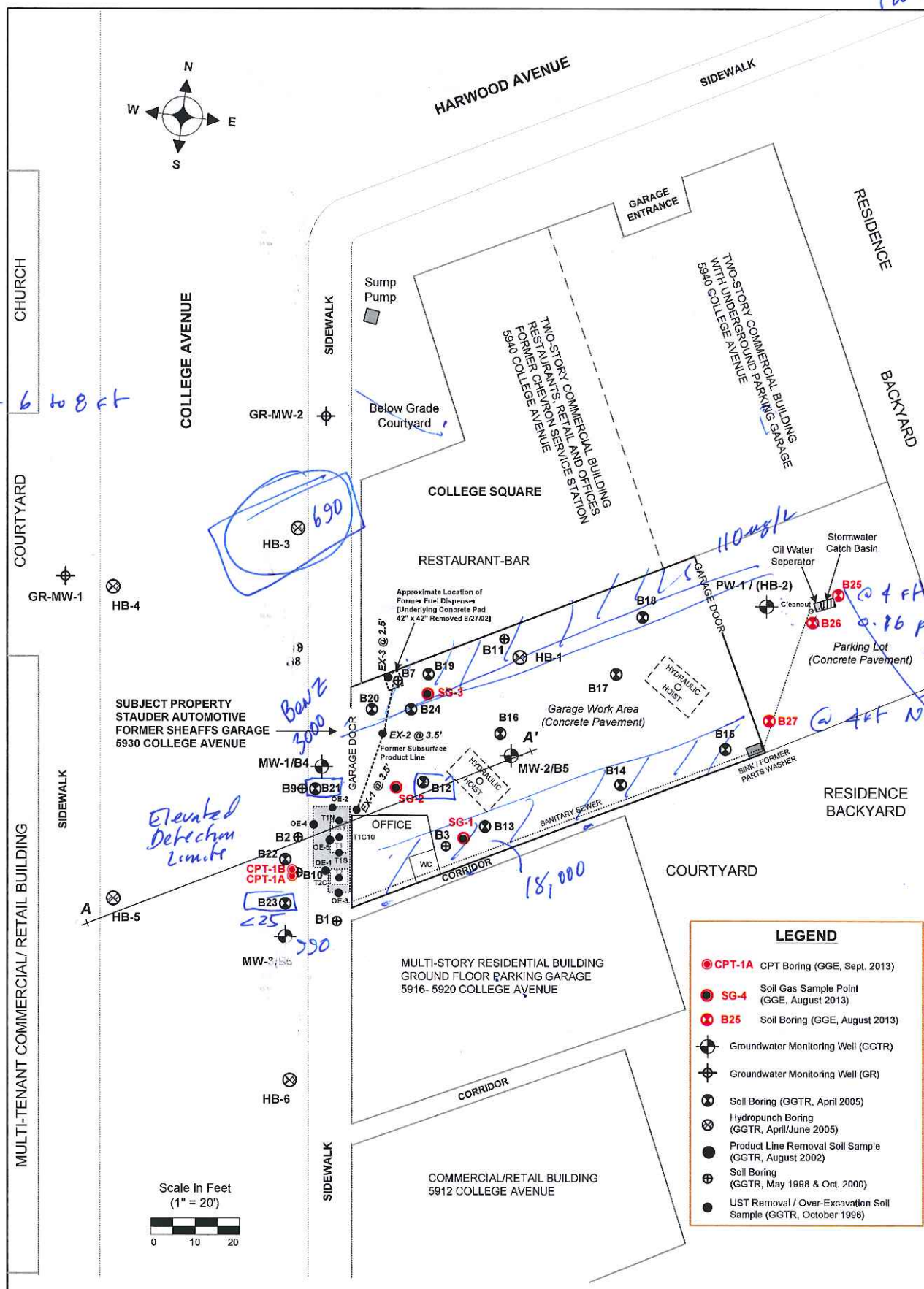

LEGEND	
	CPT-1A CPT Boring (GGE, Sept. 2013)
	SG-4 Soil Gas Sample Point (GGE, August 2013)
	B25 Soil Boring (GGE, August 2013)
	Groundwater Monitoring Well (GGTR)
	Groundwater Monitoring Well (GR)
	Soil Boring (GGTR, April 2005)
	Hydropunch Boring (GGTR, April/June 2005)
	Product Line Removal Soil Sample (GGTR, August 2002)
	Soil Boring (GGTR, May 1998 & Oct. 2000)
	UST Removal / Over-Excavation Soil Sample (GGTR, October 1998)

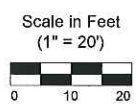

**GOLDEN GATE ENVIRONMENTAL, INC.**  
 1455 Yosemite Avenue, San Francisco, CA 94124  
 Phone (415) 970-9088 Fax (415) 970-9089

**SITE PLAN**  
 Former Sheaff's Service Garage  
 5930 College Avenue, Oakland, CA 94618

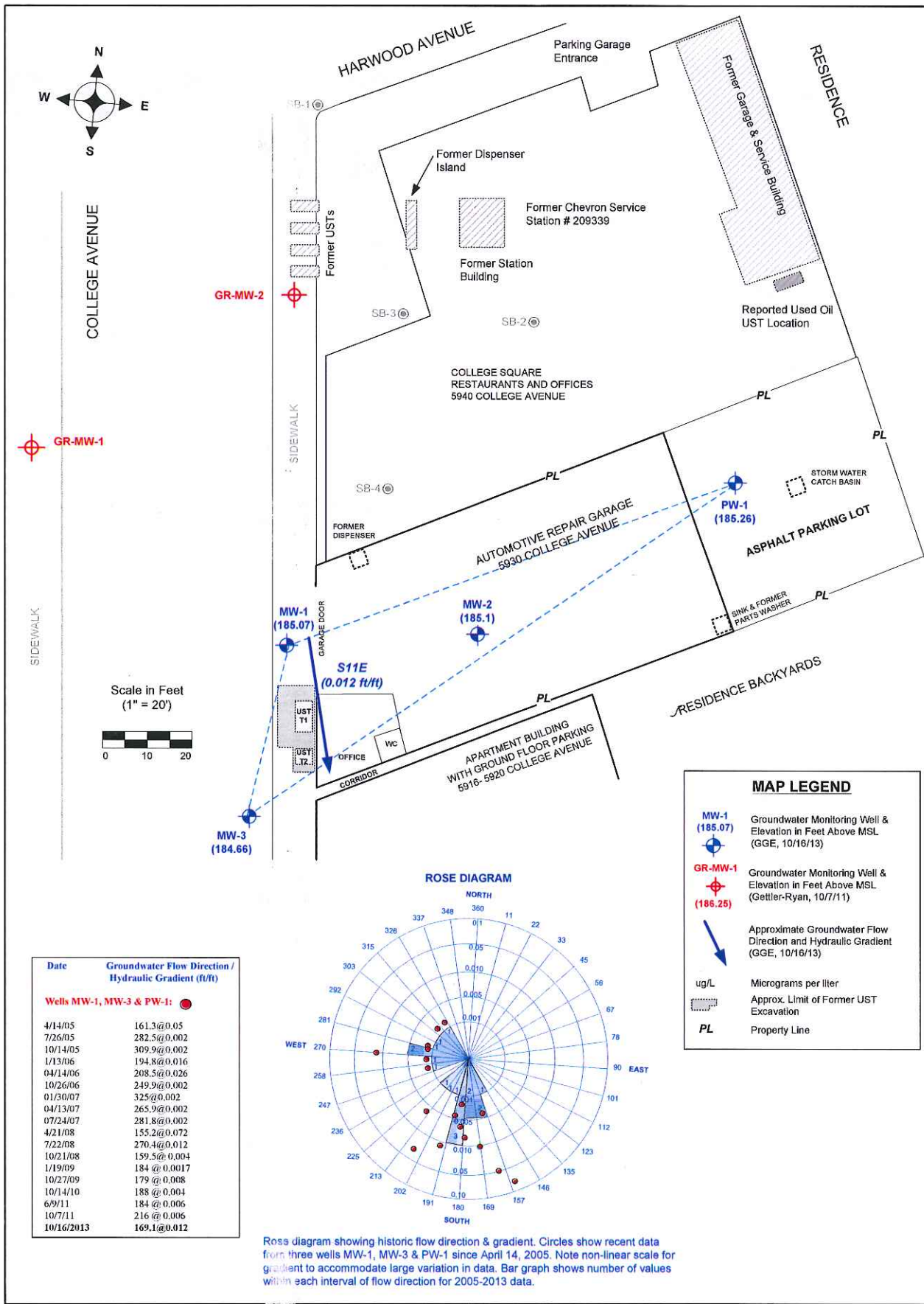

Date	Groundwater Flow Direction / Hydraulic Gradient (ft/ft)
<b>Wells MW-1, MW-3 &amp; PW-1:</b>	
4/14/05	161.3 @ 0.05
7/26/05	282.5 @ 0.002
10/14/05	309.9 @ 0.002
1/13/06	194.8 @ 0.016
04/14/06	208.5 @ 0.026
10/26/06	249.9 @ 0.002
01/30/07	325 @ 0.002
04/13/07	265.9 @ 0.002
07/24/07	281.8 @ 0.002
4/21/08	155.2 @ 0.072
7/22/08	270.4 @ 0.012
10/21/08	159.5 @ 0.004
1/19/09	184 @ 0.0017
10/27/09	179 @ 0.008
10/14/10	188 @ 0.004
6/9/11	184 @ 0.006
10/7/11	216 @ 0.006
10/16/2013	169.1 @ 0.012

Rose diagram showing historic flow direction & gradient. Circles show recent data from three wells MW-1, MW-3 & PW-1 since April 14, 2005. Note non-linear scale for gradient to accommodate large variation in data. Bar graph shows number of values within each interval of flow direction for 2005-2013 data.

**GOLDEN GATE ENVIRONMENTAL, INC.**  
 3730 Mission Street, San Francisco, CA 94110  
 Phone (415) 970-9088 Fax (415) 970-9089

**GROUNDWATER DATA DIAGRAM**  
 October 2013  
 Sheaffs Service Garage  
 5930 College Avenue, Oakland, CA 94618

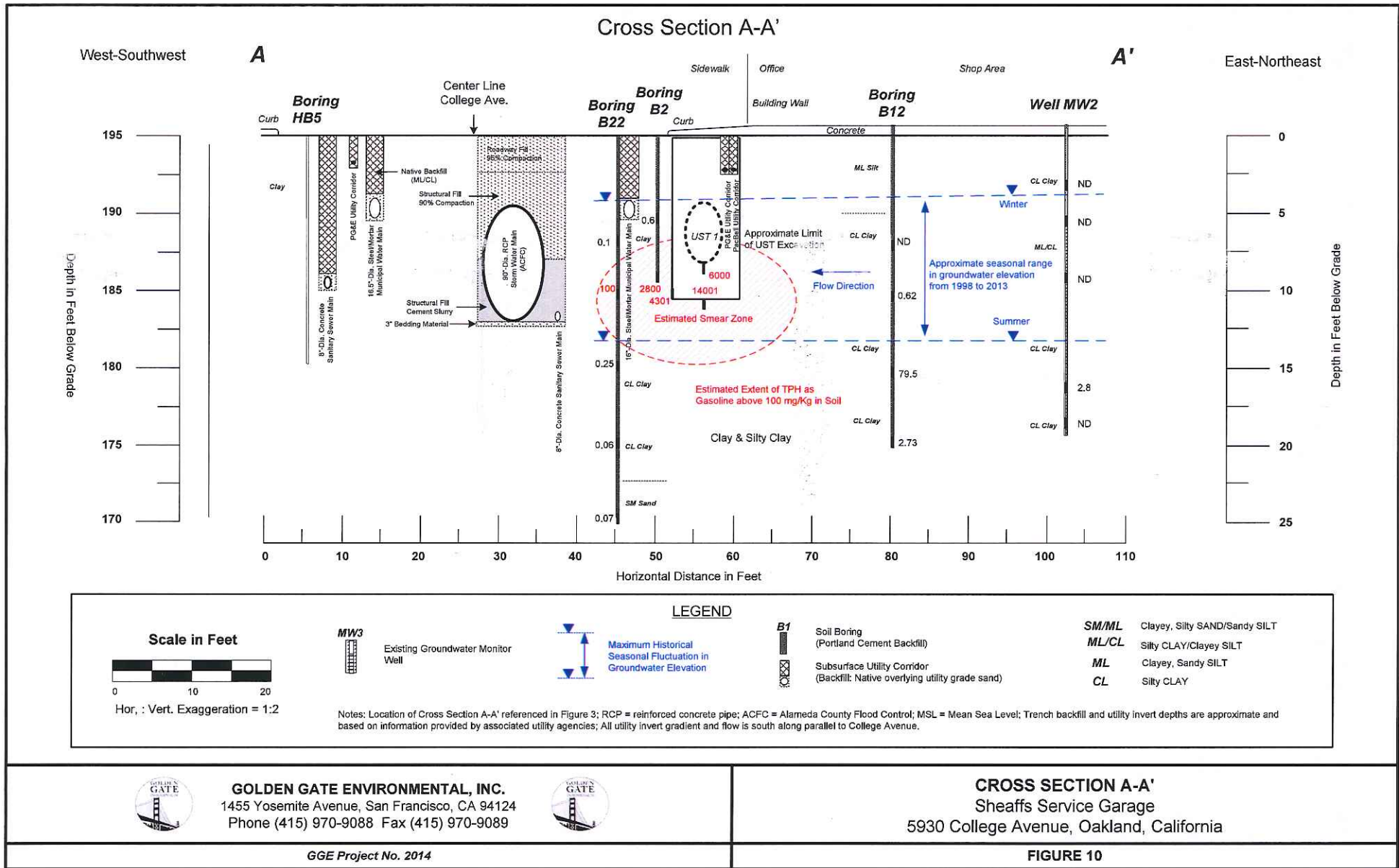

DILAN

**TABLE 1A**  
**Results of Soil Sample Analysis for Petroleum Hydrocarbon Constituents**  
**5930 College Avenue, Oakland, CA**

Sample Location	Sample ID	Sample Depth (ftg)	Sample Date	TPH-G (mg/Kg)	TRPH (mg/Kg)	TPH-D (mg/Kg)	TEPH (mg/kg)	MTBE (mg/Kg)	B/T/B/X (mg/Kg)	
<b>UST Removal Activities - 1996</b>										
UST 1 Excavation, North End	7189-T1-N	8	8/6/1996	6000.00	--	--	--	--	19/240/76/470	
UST 1 Excavation, South End	7189-T1-S	8		8100.00	--	--	--	--	16/240/72/530	
UST 1 Excavation, Center	7189-T1-C-10	10		1200.00	--	--	--	--	9.1/68/10/79	
UST 2 Excavation, Center	7189-T2-C	8		560.00	16000.00	ND	--	--	2.7/16/3.3/33	
UST 1 Overburden Soil Stockpile	7189-SP1	--		ND	--	ND	--	--	ND/ND/ND/ND	
UST 2 Overburden Soil Stockpile	7189-SP2	--		1.30	14000.00	ND	--	--	ND/ND/ND/0.020	
UST 1 & UST 2 Over-Ex Stockpile	7189-OE-1	10.5	10/2/1996	14001.00	1700.00	ND	--	--	9.8/81/14/110 <sup>1</sup>	
UST 1 & UST 2 Over-Ex Stockpile	7189-OE-2	10.5		8401.00	320.00	ND	--	--	3.3/51/12/91 <sup>1</sup>	
UST 1 & UST 2 Over-Ex Stockpile	7189-OE-3	10.5		ND	21.00	ND	--	--	ND/0.01/ND/0.027	
UST 1 & UST 2 Over-Ex Stockpile	7189-OE-4	10.5		4301.00	240.00	ND	--	--	0.93/18/4.6/41 <sup>1</sup>	
UST 1 & UST 2 Over-Ex Stockpile	7189-OE-5	10.5		14001.00	1100.00	ND	--	--	2.2/40/14/120 <sup>1</sup>	
<b>Preliminary Site Assessment - May 1998 &amp; October 1999</b>										
B1	7335-B1-5	5	5/6/1998	ND	--	--	ND	ND<0.005	ND/ND/ND/ND	
	7335-B1-9	9		75.00	--	--	53.00	0.06	0.07/0.04/0.53/1	
B2	7335-B2-5	5		0.60	--	--	60.00	0.03	ND/ND/ND/ND	
	7335-B2-9	9		2800.00	--	--	ND	ND<0.005	13/78/38/160	
B3	7335-B3-6	6		ND	--	--	ND	ND<0.005	ND/ND/ND/ND	
	7335-B3-10	10		48.00	--	--	ND	ND<0.005	0.5/0.6/0.5/2	
B4 (MW1)	7335-B4-5	5		ND	--	--	ND	ND<0.005	ND/ND/ND/0.02	
	7335-B4-9	9		280.00	--	--	ND	1.00	4/8/6/27	
B5 (MW2)	7335-B5-3.0	3		10/1/99	ND	--	--	ND	ND<0.005	ND/ND/ND/ND
	7335-B5-5.0	5			ND	--	--	ND	ND<0.005	ND/ND/ND/ND
	7335-B5-9.0	9	ND		--	--	ND	ND<0.005	ND/ND/ND/ND	
	7335-B5-15.5	15.5	2.80		--	--	ND	ND<0.005	0.69/0.092/0.066/0.22	
B6 (MW3)	7335-B5-20.0	20	ND		--	--	ND	ND<0.005	0.028/0.021/0.007/0.029	
	7335-B6-5.0	5	ND		--	--	200.00	ND<0.005	ND/ND/ND/ND	
	7335-B6-10.0	10	1.50		--	--	ND	ND<0.005	ND/ND/0.005/0.013	
	7335-B6-15.0	15	ND		--	--	ND	0.03	ND/ND/ND/ND	
	7335-B6-19.0	19	ND		--	--	ND	0.04	ND/ND/ND/ND	
<b>Soil &amp; Groundwater Investigation - October 2002</b>										
B7	7335-B7-8	8	10/30/2002	1.71	--	--	--	ND<0.005	0.005/ND<0.005/ND<0.005/ND<0.01	
	7335-B7-13	13		20.10	--	--	--	ND<0.005	0.720/0.162/0.803/2.5	
	7335-B7-16	16		61.80	--	--	--	ND<0.02	0.762/2.37/1.4/6.34	
	7335-B7-20	20		1.97	--	--	--	ND<0.005	0.020/0.034/0.032/0.140	
B8	7335-B8-12	12		0.61	--	--	--	ND<0.005	ND<0.005/ND<0.005/ND<0.005/ND<0.005	
	7335-B8-16	16		14.00	--	--	--	ND<0.005	0.184/0.019/0.495/0.628	
	7335-B8-20	20		5.66	--	--	--	ND<0.005	0.037/0.136/0.105/0.461	
B9	7335-B9-12	12		27.40	--	--	--	ND<0.005	0.097/0.027/0.171/0.161	
	7335-B9-15	15		47.50	--	--	--	ND<0.005	1.12/1.96/2.09/9.46	
	7335-B9-20	20		0.86	--	--	--	ND<0.005	ND<0.005/0.007/0.010/0.049	
B10	7335-B10-11 <sup>2,3</sup>	11		81.80	--	--	ND	0.18	0.444/2.26/1.65/8.84	
	7335-B10-15	15	479.00	--	--	ND	ND<0.250	4.16/15.9/9.21		
	7335-B10-17	17	7.44	--	--	ND	ND<0.005	0.036/0.075/0.079/0.442		
B11	7335-B11-8	8	ND	--	--	--	ND<0.005	ND<0.005/ND<0.005/ND<0.005/0.014		
	7335-B11-13	13	ND	--	--	--	ND<0.005	ND<0.005/ND<0.005/ND<0.005/ND<0.01		
CRWQCB February 2013 ESL - Residential Land Use				100	NC	100	NC	8.4	0.54/9.3/2.9/11	
CRWQCB February 2013 ESL - Commercial Land Use				420	NC	500	NC	8.4	1.2/9.3/4.7/11	

Table & Notes Following

**TABLE 1A (Cont'd)**  
**Results of Soil Sample Analysis for Petroleum Hydrocarbon Constituents**  
**5930 College Avenue, Oakland, CA**

Sample Location	Sample ID	Sample Depth (ft)	Sample Date	TPH-G (mg/Kg)	TRPH (mg/Kg)	TPH-D (mg/Kg)	TEPH (mg/Kg)	MTBE (mg/Kg)	B/T/E/X (mg/Kg)
<b>Site Characterization - April &amp; June 2005</b>									
B12	B12-7	7	4/30/2005	ND<0.5	--	--	--	ND<0.005	<0.005/0.006/<0.005/0.021
	B12-10	10		0.62	ND<10	--	ND<50	ND<0.005	<0.005/<0.005/<0.005/0.011
	B12-15	15		79.50	ND<10	--	ND<50	0.03	0.537/0.394/0.826/2.740
	B12-20	20		2.73	--	--	--	0.12	0.016/0.035/0.045/0.280
B16	B16-7.5	7.5		1.90	--	--	--	ND<0.005	<0.005/0.013/0.027/0.113
	B16-9.5	9.5		ND<0.5	--	--	--	ND<0.005	<0.005/<0.005/0.009/0.037
	B16-15	15		5.27	--	--	--	ND<0.005	0.061/0.014/0.061/0.190
	B16-25	25		ND<0.5	--	--	--	0.06	<0.005/0.007/0.010/0.042
B19	B19-7	7		ND<0.5	--	--	--	ND<0.005	<0.005/<0.005/<0.005/<0.010
	B19-10	10		0.99	--	--	--	0.02	<0.005/<0.005/<0.005/<0.010
	B19-15	15		139.00	--	--	--	ND<0.020	0.841/0.995/4.290/12.00
	B19-20	20		10.00	--	--	--	ND<0.005	0.039/0.163/0.091/0.341
B20	B20-7	7		8.15	--	--	--	ND<0.005	0.094/0.163/0.091/0.341
	B20-15	15		0.52	--	--	--	ND<0.005	0.022/<0.005/0.014/0.023
	B20-20	20		63.60	--	--	--	ND<0.020	0.395/0.491/0.961/2.750
	B20-25	25		3.97	--	--	--	0.09	0.013/0.019/0.069/0.271
B21	B21-6.5	6.5	6/22/2005	ND<0.05	--	--	--	ND<0.005	<0.005/<0.005/<0.005/<0.010
	B21-8.5	9.5		14.00	--	ND<25	--	ND<0.250	<0.250/<0.250/<0.250/<0.500
	B21-11.5	11.5		170.00	--	--	--	ND<5	<5/<5/<5/13
	B21-14.5	14.5		970.00	--	--	--	ND<25	<25/28/<25/100
	B21-19.5	19.5		6.90	--	--	--	ND<0.250	<0.250/<0.250/<0.250/<0.500
	B21-24.5	24.5		73.00	--	--	--	ND<0.250	0.280/1.30/1.30/7.0
B22	B22-6.5	6.5		0.10	--	--	--	ND<0.005	<0.005/0.052/<0.005/0.011
	B22-10	10		100.00	--	ND<25	--	ND<0.50	<0.5/<0.680/<0.5/3.0
	B22-14.5	14.5		0.25	--	--	--	ND<0.005	<0.005/<0.005/<0.005/<0.010
	B22-19.5	19.5		0.06	--	--	--	0.07	<0.005/<0.005/<0.005/<0.010
B23	B23-6.5	6.5		0.07	--	--	--	0.09	<0.005/<0.005/<0.005/<0.010
	B23-10	10		ND<0.05	--	--	--	ND<0.005	<0.005/<0.005/<0.005/<0.010
	B23-11.5	11.5		300.00	--	230.00	--	ND<2.50	<2.5/<2.5/1.29
	B23-15	15		420.00	--	--	--	ND<5	<5.0/16.0/9.2/53
	B23-17	17		870.00	--	--	--	ND<2.50	<2.5/<2.5/19/76
	B23-19.5	19.5		910.00	--	--	--	ND<5	<5.0/28/20/110
B24	B24-7	7	4/30/2005	0.06	--	--	--	ND<0.005	<0.005/<0.005/<0.005/<0.010
	B24-10	10		1.29	--	--	--	0.07	0.006/0.009/0.048/0.203
	B24-15	15		31.10	--	--	--	ND<0.020	0.341/0.112/0.490/0.789
	B24-22	22		27.30	--	--	--	0.08	0.260/0.272/0.747/2.140
PW-1	PW1-4.5	4.5	4/5/2005	ND<0.5	--	--	--	ND<0.005	<0.005/<0.005/<0.005/<0.010
	PW1-6	6		ND<0.5	--	--	--	ND<0.005	<0.005/<0.005/<0.005/<0.010
	PW1-9	9		ND<0.5	--	--	--	ND<0.005	<0.005/<0.005/<0.005/<0.010
	PW1-11.5	11.5		ND<0.5	--	--	--	ND<0.005	<0.005/<0.005/<0.005/<0.010
	PW1-20	20		0.80	--	--	--	ND<0.005	<0.005/<0.005/<0.005/<0.010
<b>Soil &amp; Groundwater Investigation - August/October 2013</b>									
SG-1	SG-1-4 <sup>5</sup>	4	8/8/2013	ND<0.1	--	--	--	--	--
SG-2	SG-2-5	5		ND<0.1	--	--	--	--	--
SG-3	SG-3-5 <sup>5</sup>	5		ND<0.1	--	--	--	--	--
CRWQCB February 2013 ESL - Residential Land Use				100	NC	100	NC	8.4	0.54/9.3/2.9/11
CRWQCB February 2013 ESL - Commercial Land Use				420	NC	500	NC	8.4	1.2/9.3/4.7/11

**TABLE NOTES:**

TPH-G = total petroleum hydrocarbons (TPH) as gasoline (EPA Method 8015M)

TEPH = total extractable petroleum hydrocarbons [SM 5520 E&F + EPA 1664 (Silica Gel Treated Hexane; B10 only)]

B/T/E/X = benzene, toluene, ethylbenzene, total xylenes (EPA Method 8020)

MTBE = methyl tertiary-butyl ether (EPA Method 8020)

Total Lead by EPA Method 7420/AA Spectroscopy

ftg = feet below grade

mg/kg = milligrams per kilogram (parts per million)

-- = not analyzed for this constituent; ND = concentration below associated laboratory reporting limit

1 = confirmed by EPA Method 8260

2 = sample also analyzed (EPA 6010B ICAP) for cadmium (ND<2.0 mg/kg), chromium (38.2 mg/kg), nickel (51.5 mg/kg), and zinc (47.7 mg/kg);

3 = sample also analyzed for VOCs (EPA 8260) in mg/kg: MTBE (0.599), benzene (0.397), toluene (1.81), ethylbenzene (1.05), total xylenes (5.37), isopropylbenzene (0.100), n-propylbenzene (0.453), 1,3,5-trimethylbenzene (2.63), 1,2,4-trimethylbenzene (0.832), n-butylbenzene (0.313),

4 = sample also analyzed for HVOs (EPA 8010): All concentrations ND

5 = sample also analyzed by Cooper Testing Labs for Grain Size Analysis, % Moisture & % Organic Matter (See CTL Lab Report Dated 8/15/13)

CRWQCB/ESL = California Regional Water Quality Control Board's Interim Final - February 2013, Tier 1 Environmental Screening Level for hallow soil (vadose zone) at a residential or commercial use permitted site with groundwater that Is Not a potential source of drinking water

**TABLE 1B**  
**Results of Soil Sample Analysis for Volatile Organic Compounds**  
**5930 College Avenue, Oakland, CA**

Sample Location	Sample ID	Sample Depth (fbg)	Sample Date	IPB (mg/Kg)	n-PB (mg/Kg)	1,3,5-TMB (mg/Kg)	1,2,4-TMB (mg/Kg)	Sec-BB (mg/Kg)	n-BB (mg/Kg)	Napthalene (mg/Kg)	MIBK (mg/Kg)	TCE (mg/Kg)	MC (mg/Kg)	cis-1,2-DCE (mg/Kg)	PCE (mg/Kg)	
<i>UST Removal Activities - 1996</i>																
UST 2 Excavation	7189-T2-C	8	10/2/1996	0.14	1.1	2.8	7.5	0.2	--	ND<0.005	0.36	ND<0.005	ND<0.005	ND<0.005	0.024	
UST 2 Overburden Soil	7189-SP2	NA		ND<5	0.017	0.92	0.037	ND<5	--	ND<0.005	0.042	ND<0.005	ND<0.005	ND<0.005	0.031	
<i>Preliminary Site Assessment - May 1998 &amp; October 1999</i>																
B10	7335-B10-11 <sup>2,3</sup>	11	10/30/2002	0.1	0.453	2.63	0.832	ND<0.020	0.313	715	ND<0.20	ND<0.020	ND<1.0	ND<0.020	ND<0.020	
<i>Soil &amp; Groundwater Investigation - October 2002</i>																
B12	B12-10	10	4/30/2005	ND<5	ND<5	ND<5	ND<5	ND<5	ND<5	ND<10	ND<50	ND<5	ND<50	ND<5	ND<5	
	B12-15	15		134	416	788	617	78	331	819	ND<50	ND<5	ND<50	ND<5	ND<5	
<i>Site Characterization - April &amp; June 2005</i>																
B21	B21-8.5	9.5	6/22/2005	ND<250	ND<250	1100	870	ND<250	ND<250	ND<250	ND<2000	ND<250	ND<1200	ND<250	ND<250	
B22	B22-10	10		ND<500	830	5100	4000	ND<500	720	640	ND<4000	ND<500	ND<4000	ND<500	ND<500	
<i>Soil &amp; Groundwater Investigation - August/October 2013</i>																
B25	B25-4	4	8/8/2013	ND<0.010	ND<0.010	ND<0.010	ND<0.010	ND<0.010	ND<0.010	ND<0.010	ND<0.010	ND<0.010	ND<0.050	ND<0.010	ND<0.010	
B26	B26-2	2		ND<0.010	ND<0.010	ND<0.010	ND<0.010	ND<0.010	ND<0.010	ND<0.010	ND<0.010	ND<0.010	ND<0.010	ND<0.050	ND<0.010	0.016
	B26-4	4		ND<0.010	ND<0.010	ND<0.010	ND<0.010	ND<0.010	ND<0.010	ND<0.010	ND<0.010	ND<0.010	ND<0.010	ND<0.050	ND<0.010	ND<0.010
B27	B27-4	4		ND<0.010	ND<0.010	ND<0.010	ND<0.010	ND<0.010	ND<0.010	ND<0.010	ND<0.010	ND<0.010	ND<0.010	ND<0.050	ND<0.010	ND<0.010
CRWQCB February 2013 ESL - Residential Land Use				NC	NC	NC	NC	NC	NC	1.7	3.9	1.1	8.8	18	0.43	
CRWQCB February 2013 ESL - Commercial Land Use				NC	NC	NC	NC	NC	NC	4.8	3.9	5.9	34	18	3.4	

**TABLE NOTES:**

- mg/kg = milligrams per kilogram
- NC - no criteria established for this chemical constituent
- not analyzed for this constituent
- fbg - feet below grade surface
- IPB - Isopropylbenzene
- n-PB - n-Propylbenzene
- 1,3,5-TMB - 135 Trimethylbenzene
- 1,2,4-TMB - 1,2,4 Trimethylbenzene
- Sec-BB - Sec-Butylbenzene
- n-BB - n-Butylbenzene
- TCE - Trichloroethene
- MC - Methylene Chloride
- cis-1,2-DCE - cis-1,2-Dichloroethene
- Tri-CFM - Trichlorofluoromethane
- PCE - Tetrachloroethene
- CRWQCB/ESL = California Regional Water Quality Control Board's Interim Final - February 2013, Tier 1 Environmental Screening Level for hallow soil (vadose zone) at a residential or commercial use permitted site with groundwater that Is Not a potential source of drinking water

**TABLE 1C**  
**Results of Soil Sample Analysis for LUFT 5 Metals**  
**5930 College Avenue, Oakland, CA**

Sample Location	Sample ID	Sample Depth (fbg)	Sample Date	Cd (mg/kg)	Cr (mg/kg)	Pb (mg/kg)	Ni (mg/kg)	Zn (mg/kg)
<i>UST Removal Activities - 1996</i>								
center of T2 excavation	7189-T2-C	8		ND<2.0	49	48	68	210
T2 Soil Stockpile	7189-SP2	NA		ND<2.0	34	79	32	130
<i>Soil &amp; Groundwater Investigaion - October 2002</i>								
B10	7335-B10-15	15	10/30/2002	ND<2.0	38.2	19.6	51.5	47.7
<i>Site Characterization - April &amp; June 2005</i>								
B21	B21-8.5	8.5	6/22/2005	ND<1.0	74	4.6	78	36
B22	B22-10	10		ND<1.0	43	5.3	53	41
B23	B23-10	10		ND<1.0	47	7.2	63	50
CRWQCB February 2013 ESL - Shallow Soil				12	NC	80	150	600
CRWQCB February 2013 ESL - Deep Soil				12	NC	320	150	600

**TABLE NOTES:**

- Cd - Cadmium
- Cr - Chromium (Total)
- Pb - Lead
- Ni - Nickel
- Zn - Zinc
- mg/Kg - milligrams per Kilogram; parts per million (ppm)
- NC - no criteria established for this chemical constituent
- fbg - feet below grade

CRWQCB/ESL = California Regional Water Quality Control Board's Interim Final - February 2013, Tier 1 Environmental Screening Level for hallow soil (vadose zone) at a residential or commercial use permitted site with groundwater that Is Not a potential source of drinking water



**TABLE 2A**

**Historical Results of Grab Groundwater Sample Hydrocarbon Analysis**

**5930 College Avenue, Oakland, CA**

Sample Location	Sample ID	Sample Depth (fbg)	Sample Date	TPH-G (ug/L)	TEPH (ug/L)	TPH-D (ug/L)	O&G (ug/L)	MTBE (ug/L)	B/T/E/X (ug/L)
<i>Preliminary Site Assessment - May 1998 &amp; October 1999</i>									
B1	B1-GW	8.5	5/6/1998	31000	6000	--	--	ND<5	2600 / 390 / 1600 / 4200
B2	B2-GW	6.5		200000	ND<5000	--	--	2500	30000 / 49000 / 45000 / 21000
B3	B3-GW	6.5		1x10 <sup>6</sup>	7000	--	--	18000	17000 / 24000 / 20000 / 80000
<i>Soil &amp; Groundwater Investigation - October/November 2002</i>									
B7	B7-W	16.4	10/30/2002	296000	--	--	--	1360	18400 / 21900 / 8310 / 33800
B8	B8-W	11.5		1480	--	--	--	35	386 / 9 / 74 / 81
B9	B9-W	16.95	11/1/2002	16100	--	--	--	879	1250 / 1380 / 820 / 3480
B10	B10-W	13.85		49400	--	--	ND<5000	2040	6600 / 9940 / 1610 / 7600
<i>Site Characterization - April-July 2005</i>									
B12	B12-W	NM	5/2/2005	934000	--	--	92000*	ND<5000	13900 / 22300 / 20800 / 86800
B14	B14-W	NM	5/19/2005	ND<50	--	--	--	2.2	ND<0.5 / 1.2 / 0.6 / 3.5
B15	B15-W	NM		53	--	--	--	ND<0.5	8.4 / ND<0.5 / ND<0.5 / ND<1.0
B16	B16-W	NM	5/2/2005	154000	--	--	--	ND<500	2510 / 3020 / 4300 / 20400
B17	B17-W		5/19/2005	ND<50	--	--	--	--	ND<0.5 / ND<0.5 / ND<0.5 / ND<1.0
B18	B18-W	6.4	4/14/2005	51	--	--	--	ND<0.5	ND<0.5 / ND<0.5 / ND<0.5 / 1.8
B19	B19-W	NM	5/2/2005	4600000	--	--	--	ND<250	31100 / 70500 / 75600 / 228000
B20	B20-W		5/19/2005	60700	--	--	--	--	6800 / 2600 / 1550 / 6520
B21	B21-W	15	6/22/2005	130000	--	--	5800000	--	21000 / 24000 / 4500 / 23000
B23	B23-W	6.9	7/11/2005	21000	1800	--	9200	880	2200 / 2600 / 450 / 3000
B24	B24-W	NM	5/2/2005	3830000	--	--	--	ND<50	33200 / 46300 / 65500 / 175000
HB-1	HB-1-W	7.52	4/14/2005	173	--	--	--	0.9	0.8 / ND<0.5 / 0.9 / 3.9
HB-3	HB-3-W	8.05	7/11/2005	13000	--	--	--	ND<20	690 / 21 / 1200 / 190
HB-4	HB-4-W	8.43		14000	--	--	--	ND<20	13 / ND<10 / 10 / ND<10
HB-6	HB-6-W	6.45		45	--	--	--	ND<1	ND<0.5
<i>Soil &amp; Groundwater Investigation - August/October 2013</i>									
CPT-1	CPT-1B-GW	6.5	9/27/2013	16000	NM	NM	NM	ND<4.2	360 / 910 / 550 / 2810
				500	NC	640	NC	1800	27 / 130 / 43 / 100
				CRWQCB February 2013 ESL					

*Table Notes Following*

**TABLE 2A (Cont'd)**  
**Historical Results of Grab Groundwater Sample Hydrocarbon Analysis**  
**5930 College Avenue, Oakland, CA**

---

---

**TABLE NOTES:**

TPH-G = total petroleum hydrocarbons (TPH) as gasoline (EPA Method 8015M or 8260B)

TEPH = total extractable petroleum hydrocarbons [SM 5520 E&F + EPA 1664 (Silica Gel Treated Hexane; B10 only)]

B/T/E/X = benzene, toluene, ethylbenzene, total xylenes (EPA Method 8020 or 8260B)

MTBE = methyl tertiary-butyl ether (EPA Method 8020 or 8260B)

fbg = feet below grade

ug/L = micrograms per liter (parts per billion)

NM = not measured

-- = not analyzed for this constituent; ND = concentration below associated laboratory reporting limit

CRWQCB/ESL = California Regional Water Quality Control Board's Interim Final - February 2013, Environmental Screening Level at a residential or commercial use permitted site with groundwater that Is Not a potential source of drinking water.

**TABLE 2B**

**Historical Results of Grab Groundwater Volatile Organic Compound Analysis**

**5930 College Avenue, Oakland, CA**

Sample Location	Sample ID	Sample Depth (fbg)	Sample Date	IPB (ug/L)	n-PB (ug/L)	1,3,5-TMB (ug/L)	1,2,4-TMB (ug/L)	Sec-BB (ug/L)	n-BB (ug/L)	Napthalene (ug/L)	MIBK (ug/L)	TCE (ug/L)	MC (ug/L)	cis-1,2-DCE (ug/L)	PCE (ug/L)
<i>Soil &amp; Groundwater Investigation - October 2002</i>															
B10	B10-W	13.85	11/1/2002	74	230	1610	441	ND<50	ND<50	765	ND<500	ND<100	ND<5000	ND<50	ND<50
<i>Site Characterization - April-July 2005</i>															
B12	B12-W	NM	5/2/2005	61200	236000	430000	1270000	28600	ND<10000	305000	ND<10000	ND<5000	ND<250000	ND<10000	ND<5000
B21	B21-W	15	6/22/2005	ND<1000	ND<5000	ND<5000	ND<5000	ND<5000	ND<5000	ND<5000	ND<20000	ND<500	ND<5000	ND<500	ND<500
B23	B23-W	6.9	7/11/2005	ND<50	ND<250	ND<250	320	ND<250	ND<250	ND<250	ND<1000	ND<25	ND<250	ND<25	ND<25
<i>Soil &amp; Groundwater Investigation - August/October 2013</i>															
CPT-1	CPT-1B-GW*	6.5	9/27/2013	--	--	--	--	--	--	810	--	--	--	--	--
CRWQCB February 2013: ESL				NC	NC	NC	NC	NC	NC	24	170	130	2,200	590	63

**TABLE NOTES:**

ug/L = micrograms per liter

NC - no criteria established for this chemical constituent

-- - not analyzed for this constituent

fbg - feet below grade surface

NM = not measured

IPB- Isopropylbenzene

n-PB - n-Propylbenzene

1,3,5-TMB - 135 Trimethylbenzene

1,2,4-TMB - 1,2,4- Trimethylbenzene

Sec-BB - Sec-Butylbenzene

n-BB - n-Butylbenzene

MIBK - Methyl Isobutal Ketone

TCE - Trichloroethene

MC - Methylene Chloride

cis-1,2-DCE - cis-1,2-Dichloroethene

PCE - Tetrachloroethene

\* Sample additionally analyzed for Tert-Butanol (ND<42), 1,2-Dichloroethane (ND<4.2), 1,2-Dibromothane (ND<4.2); See Table 2A for BTEX & MTBE Results

CRWQCB/ESL = California Regional Water Quality Control Board's Interim Final - February 2013, Environmental Screening Level at a residential or commercial use permitted site with groundwater that is Not a potential source of drinking water.

**TABLE 2C**  
**Results of Grab Groundwater Sample Analysis for LUFT 5 Metals**  
**5930 College Avenue, Oakland, CA**

Sample Location	Sample ID	Sample Depth (fbg)	Sample Date	Cd (ug/L)	Cr (ug/L)	Pb (ug/L)	Ni (ug/L)	Zn (ug/L)
<i>Soil &amp; Groundwater Investigaion - October 2002</i>								
B10	B10-W	13.85	11/1/2002	ND<0.5	0.28	0.26	0.33	0.41
<i>Site Characterization - April-July 2005</i>								
B12	B12-W	NM	5/2/2005	17.4	9.51	106	30.7	100
B21	B21-W	15	6/22/2005	38	1400	75	1500	1900
B23	B23-W	6.9	7/11/2005	ND<2	ND<5	10	13	32
B23**	B23-W	6.9	7/11/2005	ND<2	ND<5	ND<5	11	30
CRWQCB February 2013 ESL				12	NC	320	150	600

**TABLE NOTES:**

- Cd - Cadmium
- Cr - Chromium
- Pb - Lead
- Ni - Nickel
- Zn - Zinc
- ug/L - micrograms per liter
- fbg - feet below grade
- NM = not measured
- \*\* Results from filtered field sample

CRWQCB/ESL = California Regional Water Quality Control Board's Interim Final - February 2013, Environmental Screening Level at a residential or commercial use permitted site with groundwater that Is Not a potential source of drinking water.

**TABLE 3A**  
**Historical Groundwater Levels & Hydrocarbon Analytical Results**  
**5930 College Avenue, Oakland, CA**

Well ID	Sample Date	Casing Elevation (ft, MSL)	Depth to GW (ft, TOC)	Water Elevation (ft, MSL)	Product Odor/ Sheen	TPH-G (ug/L)	MTBE (ug/L)	BTEX (ug/L)
MW-1	6/1/98	50.00 *	4.81	45.19	slight sheen	160000	1900	28000 / 21000 / 3800 / 21000
	9/10/98	50.00 *	7.5	42.5	Odor	290000	440	<50 / 25000 / 7100 / 32000
	10/7/99	50.00 *	10.04	39.96	Odor	85000	1100	20000 / 13000 / 3800 / 17000
	1/26/00	50.00 *	8.26	41.74	slight sheen	130000	470	25000 / 18000 / 4500 / 22000
	10/25/00	50.00 *	10.1	39.9	Odor	130000	1300	23000 / 12000 / 3900 / 18000
	2/2/01	50.00 *	9.61	40.39	Odor	128000	780	19000 / 11000 / 3800 / 18000
	4/25/01	195.9	7.39	188.51	Odor	120000	900	21000 / 13000 / 390 / 18000
	7/10/01		9.72	186.18	Odor	79000	660	15000 / 7800 / 3000 / 15000
	10/8/01		10.88	185.02	Odor/sheen	112000	374	25300 / 11800 / 4280 / 20600
	1/7/02		4.34	191.56	Odor	96100	596	21100 / 13500 / 4160 / 21900
	4/8/02		6.84	189.06	slight odor	111000	679	21200 / 13400 / 4230 / 21000
	7/9/02		9.4	186.5	slight odor	110000	570	20300 / 13300 / 4060 / 19800
	10/23/02		11.04	184.86	None	54100	1010 (1080)**	10800 / 3870 / 2320 / 9440
	10/15/03		10.8	185.1	None	90700	724	17800 / 4740 / 3150 / 13900
	2/2/04		7.35	188.55	None	108000	194	14200 / 7420 / 3450 / 19800
	4/23/04		6.83	189.07	slight odor	49200	114	7910 / 1480 / 1810 / 10100
	7/19/04		8.95	186.95	Odor	63900	303	7260 / 2270 / 2510 / 10100
	10/22/04		10.15	185.75	None	80700	493 (296)**	13900 / 1670 / 3550 / 15200
	1/21/05		5.45	190.45	Odor	278000	271 (174)**	14700 / 25300 / 10800 / 73500
	4/14/05		5.3	190.6	Odor /sheen	116000	366 (410)**	15100 / 7080 / 4220 / 20700
	7/26/05		7.6	188.3	Odor	82000	ND<250	12000 / 4500 / 3300 / 14000
	10/14/05		9.58	186.32	Odor/sheen	64000	ND<250	13000 / 5700 / 3400 / 16000
	1/13/06		4.6	191.3	Odor/sheen	49000	ND<250	12000 / 5300 / 3500 / 17000
	4/14/06		3.08	192.82	Odor	51000	270	14000 / 5300 / 3500 / 17000
	10/26/06		9.22	186.68	Odor	34000	ND<250	12000 / 1600 / 3100 / 8600
	1/30/07		9.6	186.3	Odor	39000	ND<200	10000 / 2200 / 2900 / 10000
	4/13/07		9.24	186.66	NM	52000	150	9100 / 2600 / 3100 / 11000
	7/24/07		10.67	185.23	None	46000	240	10000 / 1200 / 3500 / 6200
	4/21/08		7.24	188.66	None	50000	ND<100	7800 / 1500 / 3000 / 12000
	7/22/08		9.71	186.19	Odor	60000	470 <sup>1</sup>	8100 / 1500 / 2700 / 9800
	10/21/08		11.63	184.27	Odor	15000	110	4900 / 430 / 1900 / 2260
	1/19/09		10.91	184.99	Odor/Sheen	33000	143	8830/837/2160/3880
	4/27/09		7.7	188.2	Odor	75000	53	8500/2100/2300/11000
10/27/09	9.34		186.56	Odor	61000	75	8300/1500/2600/7900	
10/14/10	10.3		185.6	Clear/Odor	24000 <sup>2</sup>	220	8100/820/2200/4400	
6/9/11	6.38		189.5	Clear/Odor	53000	NA	14000/3000/3800/16900	
10/7/11	9.08		186.82	None	50000 <sup>2</sup>	89	9200/1500/4200/13500	
10/16/13	10.83		185.07	Clear	12000 <sup>2</sup>	ND<21	2400/330/1500/2780	
CRWQCB February 2013 ESL						500	1800	27 / 130 / 43 / 100

Table & Notes Following

**TABLE 3A (Cont.)**  
**Historical Groundwater Levels & Hydrocarbon Analytical Results**  
**5930 College Avenue, Oakland, CA**

Well ID	Sample Date	Casing Elevation (ft. MSL)	Depth to GW (ft. TOC)	Water Elevation (ft. MSL)	Product Odor/ Sheen	TPH-G (ug/L)	MTBE (ug/L)	BTEX (ug/L)
MW-2	10/7/99	51.42*	11.49	39.93	slight/odor	18000	490	3000 / 1700 / 1000 / 3900
	1/26/00	51.42*	7.85	43.57	None	42000	560	9300 / 2200 / 2300 / 7700
	10/25/00	51.42*	11.57	39.85	slight/odor	31000	500	5500 / 370 / 1700 / 2600
	2/2/01	51.42*	10.77	40.65	Odor	36000	400	4300 / 530 / 1800 / 4500
	4/25/01	197.28	8.52	188.76	Odor	56000	460	6700 / 1700 / 2600 / 8200
	7/10/01		11.05	186.23	Odor	39000	180	6200 / 730 / 2300 / 6100
	10/8/01		12.79	184.49	Odor/sheen	40700	6460	6310 / 399 / 2100 / 5320
	1/7/02		4.92	192.36	Odor	59600	366**	10300 / 3250 / 4180 / 14400
	4/8/02		8.4	188.88	slight odor	66700	583**	10200 / 2670 / 3840 / 13200
	7/9/02		10.55	186.73	slight odor	37100	303 (298)**	5340 / 890 / 2110 / 6920
	10/23/02		13.85	183.43	None	13300	322 (360)**	2420 / 216 / 922 / 1470
	10/15/03		12.38	184.9	None	11300	264 (322)**	2660 / 51 / 1180 / 1220
	2/2/04		8.8	188.48	None	21700	168 (200)**	2130 / 51 / 1030 / 2060
	4/23/04		8.4	188.88	Slight odor	30400	112 (203)**	3570 / 322 / 1620 / 4140
	7/19/04		10.3	186.98	Odor	28300	283 (373)**	2540 / 239 / 1320 / 2300
	10/22/04		10.25	187.03	Mod odor	13500	273 (229)**	1790 / 54 / 892 / 915
	1/21/05		6.65	190.63	Mod odor	278000	161 (163)**	5980 / 1030 / 2890 / 9070
	4/14/05		8.7	188.58	None	46100	155 (150)**	5170 / 787 / 2530 / 6010
	7/26/05		8.95	188.33	Mod odor	41000	ND (ND)**	5600 / 550 / 2600 / 4600
	10/14/05		10.92	186.36	Odor/sheen	13000	130	2900 / 100 / 1300 / 1200
	1/13/06		5.48	191.8	Odor	20000	ND<100	4900 / 490 / 2400 / 4200
	4/14/06		3.61	193.67	Odor	21000	ND<100	4000 / 740 / 2300 / 5100
	10/26/06		10.58	186.7	Odor	8200	68	1400 / 51 / 840 / 500
	1/30/07		10.98	186.3	Odor	17000	62	3200 / 150 / 2200 / 1800
	4/13/07		10.54	186.74	NM	19000	57	2000 / 85 / 1300 / 1100
	7/24/07		12.04	185.24	None	10000	84	1300 / 41 / 710 / 270
	4/21/08		8.01	189.27	None	17000	48	1800 / 100 / 1400 / 1300
	7/22/08		11.12	186.16	None	16000	100 <sup>1</sup>	1900 / 98 / 1600 / 741
	10/21/08		13.11	184.17	Odor/sheen	4900	65	700 / 20 / 370 / 52
	1/19/09		12.31	184.97	Odor	2500	90	167/8.49/114/50.3
4/27/09	9.01		188.27	Odor/sheen	21000	ND<0.5	1700/130/1100/1800	
10/27/09	10.52		186.76	Odor	7000	ND<0.5***	510/19/330/160	
10/14/2010	11.56		185.72	None	3200 <sup>2</sup>	35	460/16/230/110	
6/9/2011	7.67		189.61	Clear/Odor	9900	NA	1900/75/1100/1013	
10/7/2011	10.42	186.86	Clear/Odor	9200 <sup>4</sup>	ND<22	810/34/610/100		
10/16/2013	12.18	185.1	Clear/Odor	4400 <sup>2,5</sup>	ND<4.2	780/33/200/39.8		
CRWQCB February 2013 ESL						500	1800	27 / 130 / 43 / 100

Table & Notes Following

**TABLE 3A (Cont.)**  
**Historical Groundwater Levels & Hydrocarbon Analytical Results**  
**5930 College Avenue, Oakland, CA**

Well ID	Sample Date	Casing Elevation (ft. MSL)	Depth to GW (ft. TOC)	Water Elevation (ft. MSL)	Product Odor/Sheen	TPH-G (ug/L)	MTBE (ug/L)	BTEX (ug/L)
MW-3	10/7/99	49.39*	9.67	39.72	None	6600	390	310 / 110 / 430 / 1000
	1/26/00	49.39*	5.4	43.99	None	3300	40	110 / 8 / 100 / 32
	10/25/00	49.39*	9.24	40.15	Slight odor	4500	ND	100 / 2 / 120 / 130
	2/2/01	49.39*	8.73	40.66	Slight odor	2900	35	35 / 3 / 160 / 298
	4/25/01	195.22	6.61	188.61	Slight odor	8400	56	260 / 33 / 290 / 510
	7/10/01		8.85	186.37	Slight odor	12000	35	39 / 10 / 690 / 1600
	10/8/01		9.75	185.47	Odor/sheen	4913	52	108 / 4 / 99 / 133
	1/7/02		4.25	190.97	Odor/sheen	7260	81.7**	723 / 138 / 492 / 887
	4/8/02		6.33	188.89	Odor	11700	ND**	540 / 108 / 706 / 1710
	7/9/02		8.56	186.66	Odor	2320	28.3 (20)**	37.1 / 4.7 / 98.5 / 187
	10/23/02		10.02	185.2	Odor/sheen	2830	ND (ND)**	46.8 / 4.7 / 43.6 / 65.5
	10/15/03		9.8	185.42	Odor/sheen	3040	ND (ND)**	91.3 / 8.4 / 69.9 / 148
	2/2/04		6.85	188.37	Odor/sheen	5140	ND (ND)**	126 / 8.7 / 134 / 238
	4/23/04		6.17	189.05	None	7210	ND (ND)**	227 / 39.5 / 448 / 879
	7/19/04		8.25	186.97	Slight odor	9860	ND (ND)**	20.4 / 3.2 / 30.6 / 117
	10/22/04		9.25	185.97	None	7420	96 (21)**	152 / 12.8 / 267 / 480
	1/21/05		5.22	190	Slight odor	2420	ND (ND)**	111 / 11.4 / 139 / 265
	4/14/05		6.64	188.58	Odor/sheen	5130	54 (41.4)**	357 / 19.4 / 287 / 510
	7/26/05		6.9	188.32	None	9800	ND (21)**	200 / 23 / 220 / 360
	10/14/05		8.83	186.39	Odor/sheen	6100	ND	76 / 19 / 170 / 350
	1/13/06		4.61	190.61	Odor	3900	24	380 / 17 / 230 / 300
	4/14/06		3.41	191.81	Odor	5000	69	760 / 44 / 230 / 190
	10/26/06		8.57	186.65	Odor	3100	17	120 / 9.8 / 55 / 54
	1/30/07		8.83	186.39	Odor	4500	ND<10	90 / 7.6 / 75 / 44
	4/13/07		8.57	186.65	NM	2800	ND<5	55 / 4.9 / 19 / 6.1
	7/24/07		9.98	185.24	None	4800	ND<5	140 / 8.3 / 66 / 22
	4/21/08		9.3	185.92	None	4300	ND<5	200 / 11 / 30 / 14
	7/22/08		9.05	186.17	None	2400	53 <sup>1</sup>	140 / 13 / 26 / 18.5
	10/21/08		11.12	184.1	Slight Odor	2900	2.2	170 / 9.2 / 99 / 25.8
	1/19/09		10.29	184.93	Odor	3600	ND<0.5	148/6.73/24.5/22.1
	4/27/09		7.15	188.07	Odor/sheen	5800	8.8	370/12/82/84
	10/27/09		8.96	186.26	Odor	4900 <sup>2</sup>	ND<0.5***	130/8.5/89/130
10/14/2010	9.76		185.46	None	2700 <sup>2</sup>	ND<4.4	270/11/290/399.2	
6/9/2011	5.92		189.3	Clear/Odor	3200 <sup>2</sup>	NA	220/ND<4.4/37/20	
10/7/2011	8.6		186.62	None	5400 <sup>2</sup>	ND<4.4	140/7.0/160/67	
10/16/2013	10.56		184.66	Lt. Gray/Odor	3400 <sup>2</sup>	ND<4.2	990/58/75/71	
CRWQCB February 2013 ESL						500	1800	27 / 130 / 43 / 100

Table & Notes Following

**TABLE 3A (Cont.)**  
**Historical Groundwater Levels & Hydrocarbon Analytical Results**  
**5930 College Avenue, Oakland, CA**

Well ID	Sample Date	Casing Elevation (ft. MSL)	Depth to GW (ft. TOC)	Water Elevation (ft. MSL)	Product Odor/ Sheen	TPH-G (ug/L)	MTBE (ug/L)	BTEX (ug/L)
PW-1	4/14/05	197.17	6.4	190.77	None	3360	ND (ND**)	62.8 / 6.7 / 79.5 / 317
	7/26/05		8.63	188.54	None	1300	ND (ND**)	22 / ND / 48 / 110
	10/14/05		10.71	186.46	None	4300	ND	93 / 1.2 / 100 / 140
	1/13/06		4.87	192.3	None	450	ND<2.0	10 / ND / 37 / 72
	4/14/06		2.27	194.9	Odor	120	ND<2.0	2.3 / ND<1.0 / 3.5 / 9.3
	10/26/06		10.3	186.87	Odor	2800	ND<1.0	61 / ND<5.0 / 130 / 34
	1/30/07		10.8	186.37	Odor	1200	ND<2	22 / ND<1.0 / 100 / 200
	4/13/07		10.31	186.86	NM	510	ND<1	6 / ND<0.5 / 30 / 56
	7/24/07		11.81	185.36	None	3400	ND<5	63 / ND<2.5 / 180 / 5.6
	4/21/08		9.08	188.09	None	300	ND<1	3 / ND<0.5 / 16 / 26
	7/22/08		9.83	187.34	None	710	3.1 <sup>1</sup>	9.3 / 1.2 <sup>1</sup> / 49 / 67.86
	10/21/08		12.9	184.27	None	1500 <sup>2</sup>	1	20 / ND<0.5 / 57 / 20
	1/19/09		12.11	185.06	Odor/sheen	1100 <sup>2</sup>	ND<0.5	12.3/ND<0.5/30.8/9.20
	4/27/2009		8.69	188.48	None	360 <sup>3</sup>	ND<0.5	2.7/ND<0.5/12/18
	10/27/2009		10.32	186.85	None	1100 <sup>2</sup>	ND<0.5	12/ND<0.5/36/34
	10/14/2010		11.38	185.79	None	860 <sup>3</sup>	ND<0.5	8.8/.55/44/44
	6/9/2011		7.43	189.74	None	96 <sup>3</sup>	ND<0.5	ND<0.5/ND<0.5/3.1/2.5
	10/7/2011		9.79	187.38	None	260 <sup>5</sup>	ND<0.5	ND<0.5/ND<0.5/5.9/4.5
10/16/2013	11.91	185.26	Clear	150 <sup>2,5</sup>	ND<0.5	0.87/ND<0.5/ND<0.5/ND≤1.0		
CRWQCB February 2013 ESL						500	1800	27 / 130 / 43 / 100

**NOTES:**

ft. MSL = feet Above Mean Sea Level

TOC = Top of Well Casing

GW = Depth to Groundwater in feet Below TOC

TPH-G = Total Petroleum Hydrocarbons as Gasoline

MTBE = Methyl Tertiary Butyl Ether

BTEX = Benzene / Toluene / Ethylbenzene / Total Xylenes

ug/L = micrograms per liter

ND = Not detected above laboratory reporting limit

<sup>1</sup> = Presence confirmed, but Relative Percentage Difference (RPD) between columns exceeds 40%

<sup>2</sup> = Sample exhibit chromatographic pattern that does not resemble standard; See laboratory report for additional information

<sup>3</sup> = Although TPH-gas compounds are present, value is elevated due to discrete peak (PCE) within C5-C12 range quantified as gasoline

<sup>4</sup> = Result is elevated due to contribution from heavy end hydrocarbons within C5-C12 range quantified as gasoline

<sup>5</sup> = Result is elevated due to contribution from heavy end hydrocarbons and discrete peak of non-fuel compound within C5-C12 range quantified as gasoline

\* = Arbitrary datum point with assumed elevation of 50 ft used prior to MSL survey on 4/25/01

\*\* = Concentration confirmed by EPA Method 8260

\*\* = Sample also analyzed for other Fuel oxygenates (EPA Method 8260); All results ND (See Lab Report)

CRWQCB/ESL = California Regional Water Quality Control Board's Interim Final - February 2013, Environmental Screening Level at a residential or commercial use permitted site with groundwater that Is Not a potential source of drinking water.



**TABLE 3B**  
**Historical Groundwater VOC Analytical Results in PW-1**  
**5930 College Avenue, Oakland, CA**

Well ID	Sample Date	IPB (ug/L)	n-PB (ug/L)	1,3,5-TMB (ug/L)	1,2,4-TMB (ug/L)	Sec-BB (ug/L)	n-BB (ug/L)	Naphthalene (ug/L)	TCE (ug/L)	MC (ug/L)	cis-1,2-DCE (ug/L)	Vinyl Chloride (ug/L)	PCE (ug/L)
PW-1	4/14/05	11	22	110	100	ND,10	ND<10	43	3.3	ND<25	12	ND<0.5	84.9
	7/26/05	7.3	17	37	100	ND<10	ND<10	43	ND<1	ND<10	7	ND<1	48
	10/14//05	28	72	67	120	12	17	43	4.1	ND<40	29	ND<1	25
	1/13/06	ND<20	ND<10	ND<10	37	ND<10	ND<10	ND<10	1.4	ND<40	5	ND<1	95
	4/14/06	ND<2	ND<10	ND<10	ND<10	ND<10	ND<10	ND<10	1.1	ND<40	2.8	ND<1	68
	10/26/06	ND<10	ND<50	ND<50	ND<50	ND<50	ND<50	ND<50	6.2	ND<200	32	ND<5.0	26
	1/30/07	ND<2	23	31	120	ND<10	ND<10	18	ND<1	ND<40	11	ND<1	29
	4/13/07	2.4	6.1	7	30	ND<5	ND<5	6.8	ND<1	ND<20	4.7	ND<0.5	64
	7/24/07	ND<5.0	60	ND<25	ND<25	ND<25	ND<25	ND<25	ND<2.5	ND<100	58	ND<2.5	50
	4/21/08	1.1	ND<5	ND<5	15	ND<5	ND<5	ND<5	0.88	ND<20	3.7	ND<0.5	91
	7/22/08	NA	NA	NA	NA	NA	NA	NA	NA	NA	NA	NA	NA
	10/21/08	17	14	5	15	9.4	14	5.1	6.2	ND<10	56	0.6	44
	4/27/09	1.2	3.3	3.4	16	ND<0.5	ND<0.5	ND<1.0	1.4	ND<5.0	4	ND<0.5	120
	10/27/09	6	4.8	ND<0.5	15	ND<0.5	ND<0.5	ND<1.0	ND<0.5	ND<5.0	35	ND<0.5	78
	10/14/10	9.8	15	12	44	4.4	ND<0.5	4	5	ND<5.0	61	ND<0.5	35
6/9/11	0.55	1.7	0.98	3.7	ND<0.5	ND<0.5	ND<1.0	0.85	ND<5.0	1.4	ND<0.5	86	
10/7/11	0.79	1.8	0.99	3.8	ND<0.5	0.68	1.2	0.63	ND<5.0	2	ND<0.5	76	
10/16/13	ND<0.5	ND<0.5	ND<0.5	ND<0.5	ND<0.5	ND<0.5	ND<1.0	2.7	ND<5.0	12	ND<0.5	45	
CRWQCB ESL	NC	NC	NC	NC	NC	NC	NC	24	130	2200	590	1.8	63

**NOTES:**

- VOC = Volatile Organic Compounds
- IPB = Isopropylbenzene
- n-PB = n-Propylbenzene
- 1,3,5-TMB = 1,3,5-Trimethylbenzene
- 1,2,4-TMB = 1,2,4-Trimethylbenzene
- sec-BB = sec-Butylbenzene
- n-BB = n-Butylbenzene
- TCE = Trichloroethene
- MC = Methylene Chloride
- cis-1,2-DCE = cis-1,2-Dichloroethene
- PCE = Tetrachloroethene
- ug/l = micrograms per liter
- ND = Not detected above laboratory reporting limit
- NC = No Criteria Listed
- NA = Not Analyzed

CRWQCB/ESL = California Regional Water Quality Control Board's Interim Final - February 2013, Environmental Screening Level at a residential or commercial use permitted site with groundwater that is Not a potential source of drinking water.

3100  
 Res 1.8  
 Com 18  
 GW →