

TYPICAL SECTION - COLLEGE AVENUE - VIEW 1
MISCELLANEOUS DETAILS
 C.L. STA. 207+55 - STA. 214+00±
 NO SCALE

TYPICAL SECTION
P.C.I.

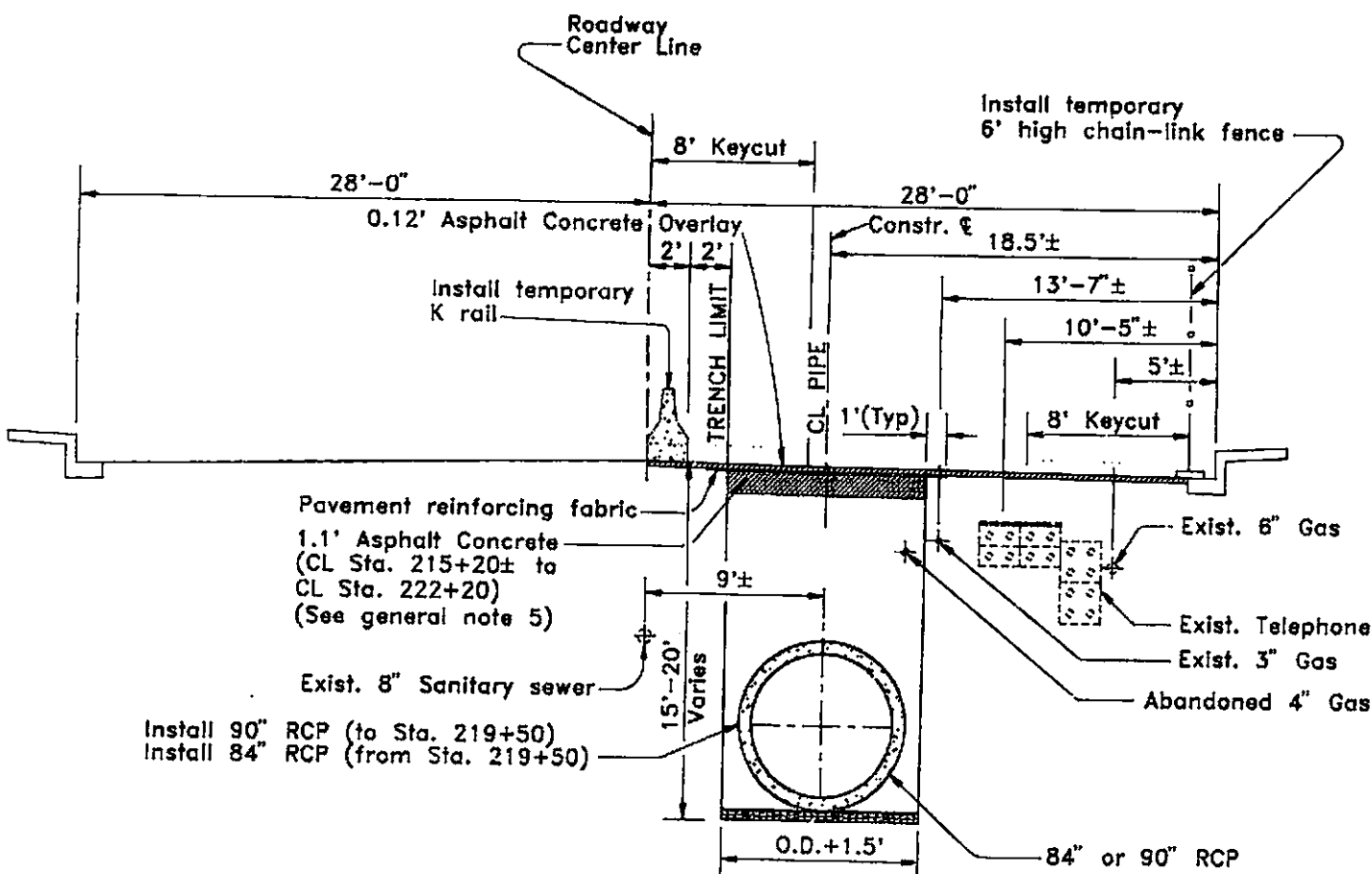

TYPICAL SECTION - CLAREMONT AVENUE
 NO SCALE

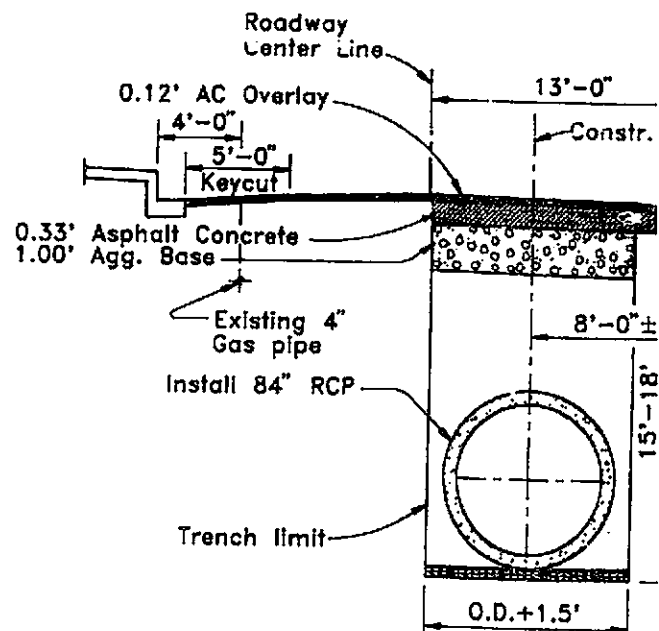

TYPICAL SECTION - MYSTIC S.
 C.L. STA. 222+20 - STA. 227+20±
 NO SCALE

R350

FOR REDUCED ENGLISH PLANS 0
 ORIGINAL SCALE IS IN INCHES
 FOR REDUCED METRIC PLANS 0

GENERAL NOTES

1. The information regarding utilities is not guaranteed. See General Condition No. 5.17 of the Specifications. The Contractor shall prospect for existing utilities within the proposed construction area in accordance with Section 4 of the Special Provisions. The Contractor shall contact Underground Services Alert (U.S.A.) at 800-642-2444 at least 72 hours prior to the start of work to have utilities marked. The Contractor shall adequately support and protect all existing utilities alongside of or crossing the excavation, to the satisfaction of the Owner-Agency.
2. Any landscaping, fences or other improvements which are disturbed during construction shall be restored to their original condition and location unless otherwise stated on the plans or directed otherwise in writing by the Engineer. If damaged, said item shall be replaced in kind with the new material as directed by the Engineer.
3. Construction shall be performed in stages. See Specifications section 13.8.
4. All work within the street right of way shall be done to the satisfaction of the City of Oakland. The trench is to be closed, enclosed within fencing or plated at the end of each working day.
5. The Contractor shall coordinate his work with adjacent residences and shall notify them prior to the start of work. See section 13.8 of the Specifications.
6. All existing storm drains and laterals intercepted during the progress of the job shall be connected to the new construction as directed by the Engineer, unless noted otherwise on the plans. Unless otherwise noted, making these connections shall be considered as included in the lump sum price bid for "Miscellaneous Work".
7. The Contractor shall provide and maintain temporary drainage for all excavation, drains, sewers, ditches, trenches and structures. The Contractor shall keep the excavation dry throughout the construction operations. Wherever necessary in order to provide proper drainage, the Contractor shall at his own expense, furnish and operate all necessary pumping equipment, drainage sumps, wellpoint systems and other drainage facilities.
8. Before excavation, the pavement section shall be sawcut as follows:
Asphalt Concrete- 6" deep minimum
Concrete Pavement- full depth
9. Results of borings for the shown existing roadway structural sections are in the specifications. The Contractor shall replace concrete pavement found on College and Claremont Avenues, with 1.00' aggregate base, 0.50' concrete pavement and 0.25' asphalt concrete in addition to 0.12' AC overlay. If no concrete pavement is found then replace with 1.10' asphalt concrete, in addition to 0.12' AC overlay.
10. Asphalt Concrete above existing concrete slab shall be removed 6" beyond edge of trench on both sides and replaced with asphalt concrete and concrete pavement as shown on the typical section. This work shall be included in the bid price for 90", 84" and 12" RCP, 8" PVC pipe and structures.
11. Existing and new sewer and storm drain manhole frames and covers shall conform to finished grade.
12. During construction, EBMUD will be replacing a 16" water line on College Avenue from Chabot Road to approximately Harwood Avenue. See specifications section 13.9.
13. References to SD numbers are references to Design Guidelines in the Specifications.

Wadi I. Saad
June 12, 1995

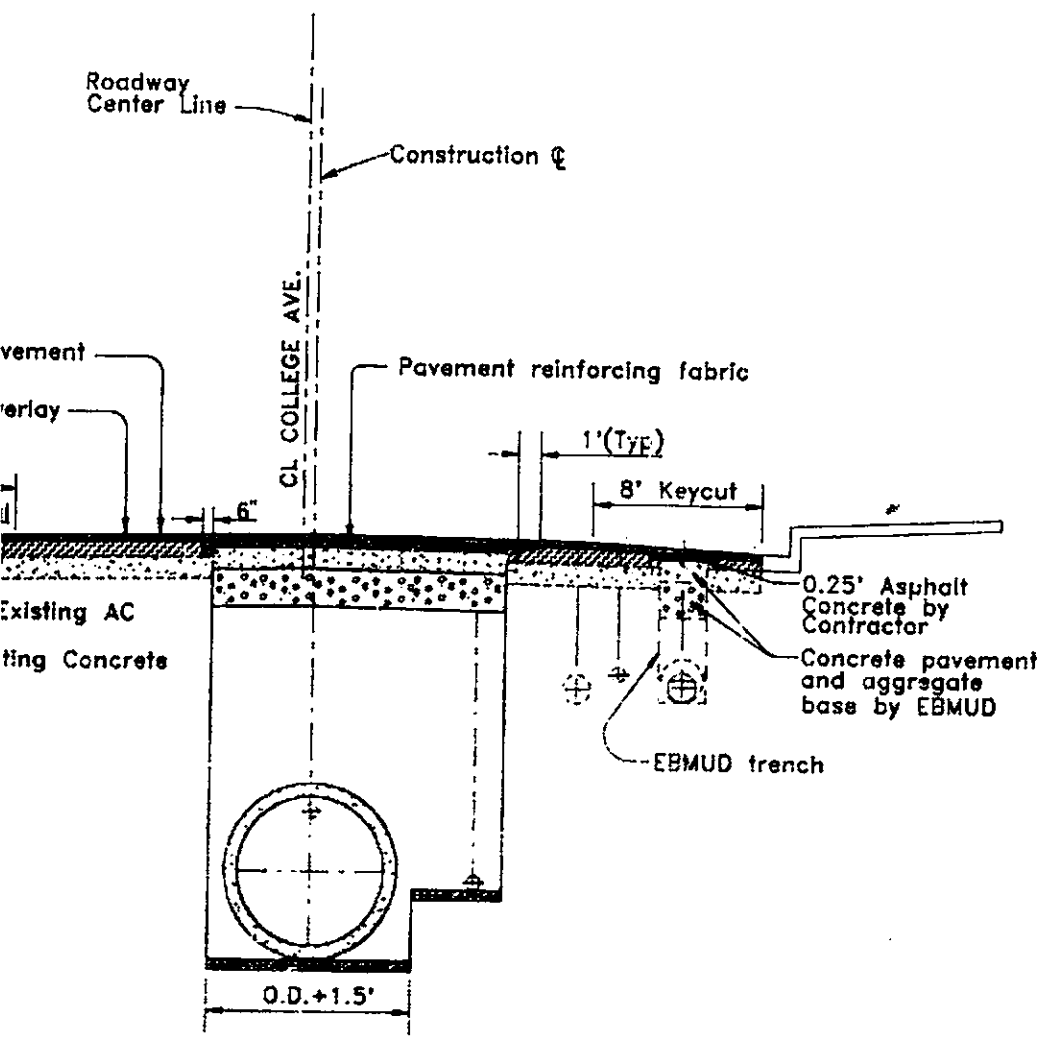

SECTION - COLLEGE AVENUE - VIEW 2
PAVEMENT REQUIREMENTS
 C.L. STA. 207+55 - STA. 214+00±
 NO SCALE

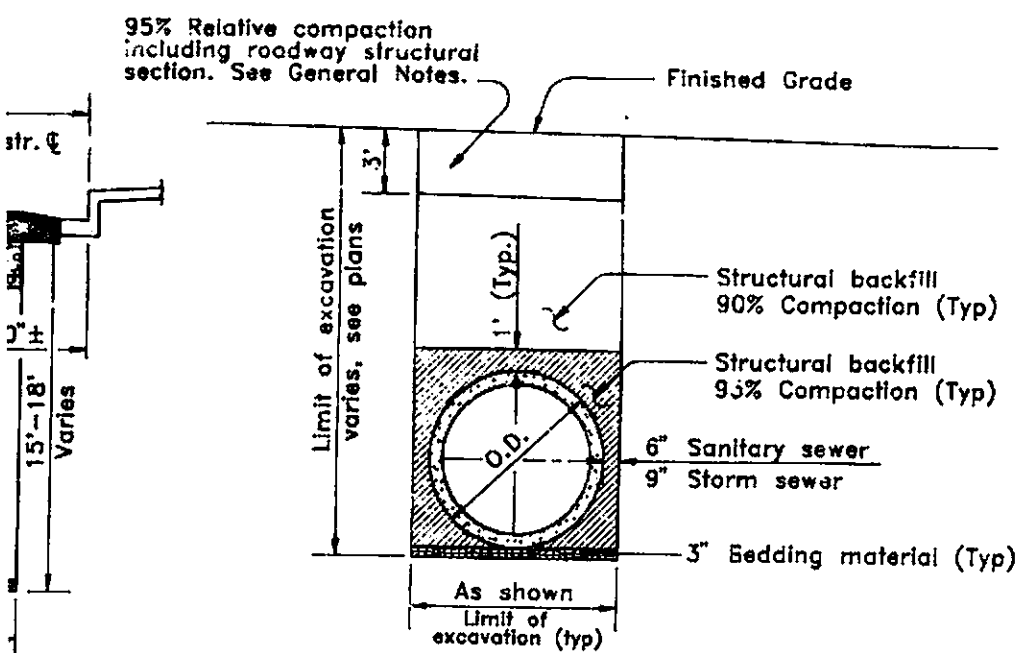

TYPICAL EXCAVATION AND BACKFILL DETAIL
 (FOR SEWER AND STORM DRAIN CULVERTS)
 NO SCALE

REVISIONS	NO.	DESCRIPTION	BY	DATE	APVD
5					
4					
3					
2					
1		RECORD DRAWING	EA	4-11-95	

SPECIFICATION NO. FC 12-1

COUNTY OF ALAMEDA ★ PUBLIC WORKS AGENCY

DRAWN K.T. DESIGNED M.T./R.P. CHECKED R.P.	APPROVAL RECOMMENDED <i>Wadi I. Saad</i> APPROVED <i>[Signature]</i>	ZONE NO. 12 PROJECT LINE A-1 TYPICAL SECTIONS
DATE JUNE 1992	SCALE AS SHOWN	FILE NO. CB-724
		SHEET NO. 2 OF 14

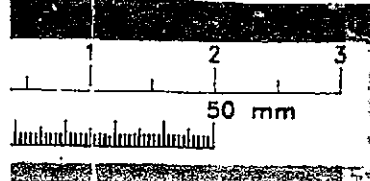

236

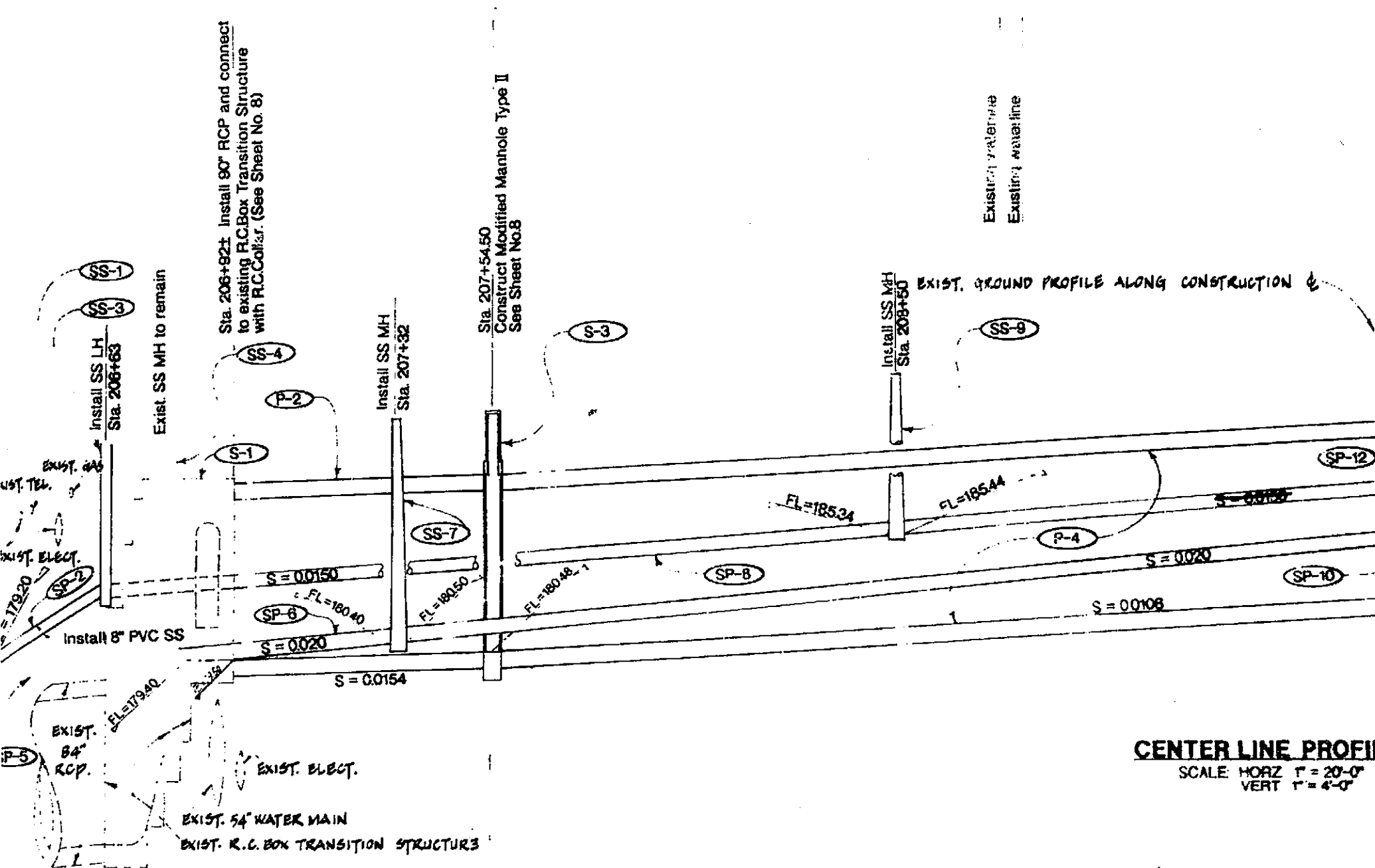

CENTER LINE PROFILE
 SCALE: HORIZ 1" = 20'-0"
 VERT 1" = 4'-0"

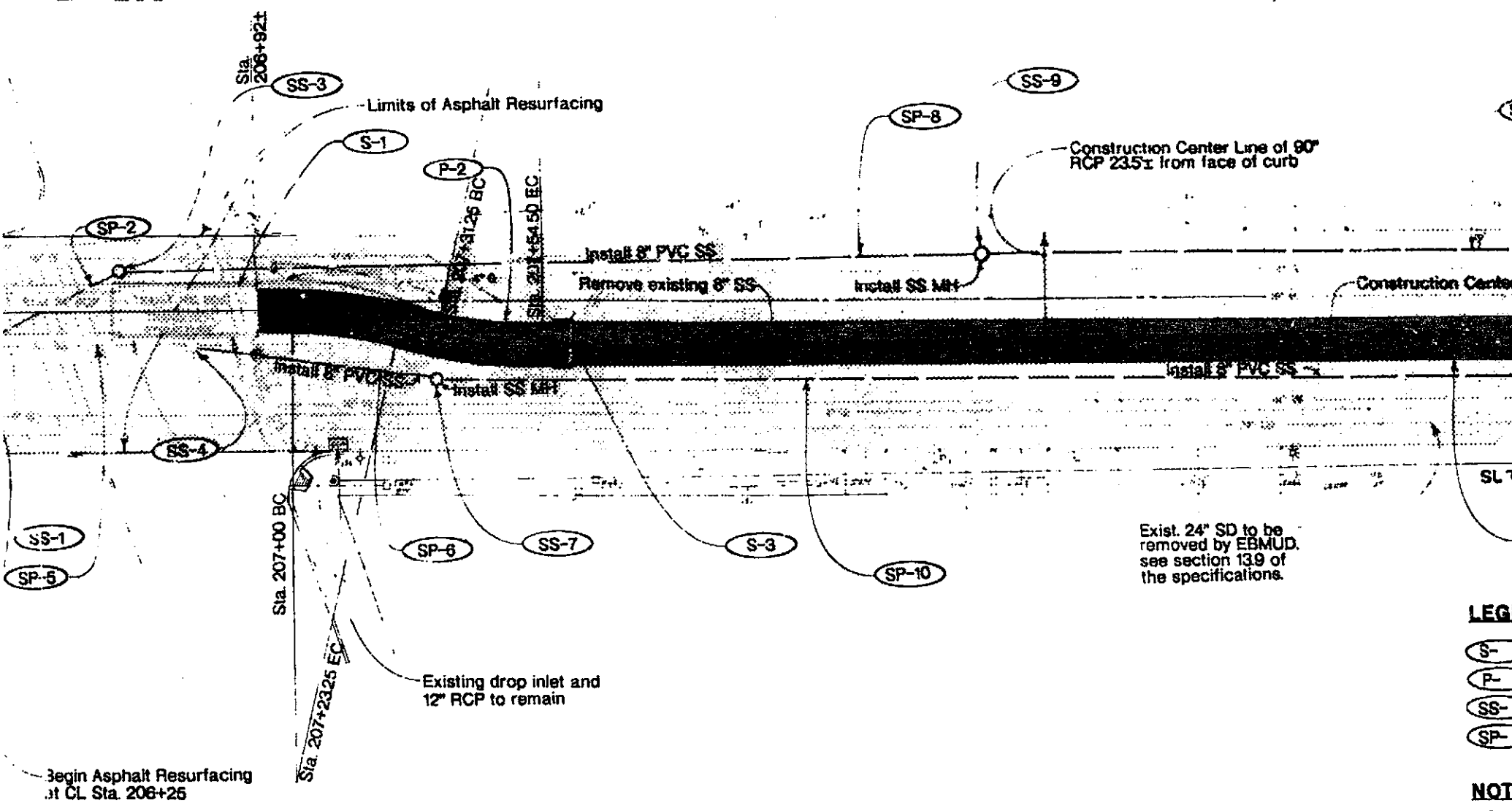

Exist. 24" SD to be removed by EBMUD, see section 13.9 of the specifications.

- LEGEND**
- (S) -
 - (P) -
 - (SS) -
 - (SP) -

NOTE
 1. See S Sanit

PLAN
 SCALE: 1" = 20'-0"

R350

FOR REDUCED ENGLISH PLANS ORIGINAL SCALE IS IN INCHES
 FOR REDUCED METRIC PLANS ORIGINAL SCALE IS IN METERS

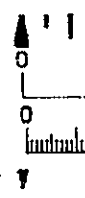

4" Underground Electric

Remove exist. SS MH
Install SS MH
Sta. 210+33

Existing Storm Drain M.H.

Existing drop inlet

Existing drop inlet

Install SS MH
Sta. 211+00

Install 8" PVC SS
S = 0.0150

Remove exist. 8" SS
S = 0.0205

Install 8" PVC SS

S = 0.0106

FL=188.10

FL=188.20

FL=188.20

FL=189.30

MATCH CENTER LINE STA. 212+60

NGVD



SS-13

SP-15

Install SS MH

Install 8" PVC SS

Remove existing 8" SS and Manholes

Remove exist. 8" SS

MATCH LINE STA. 212+57

Install SS MH

Install 8" PVC SS

SS-11

P-13

P-14

S-20

S-22

SP-14

Remove existing drop inlet and replace with City of Oakland Type "B" inlet

Plug existing storm drain

REVISIONS	NO.	DESCRIPTION	BY	DATE	APVD
5					
4					
3					
2					
1		PELDRD SEAMING	EA	7-11-95	

SPECIFICATION NO. FC 12 - 147

COUNTY OF ALAMEDA * PUBLIC WORKS AGENCY

DRAWN JT/MT DESIGNED MT CHECKED RP

APPROVAL RECOMMENDED Wadi I. Saad

APPROVED [Signature]

DATE SCALE HOR. 1" = 20' VER. 1" = 4'

ZONE NO. 12 PROJECT
LINE A - 1
PLAN AND PROFILE
COLLEGE AVENUE

FILE NO. CB-724 SHEET NO. 3 OF 14

Image Structure
m Drain Pipe
itary Sewer Structure
itary Sewer Pipe

* for Drainage and
wer Construction Notes.

[Signatures]
June 14, 1995
6/12/95



237

B

C

D