



**CONESTOGA-ROVERS
& ASSOCIATES**

RECEIVED

2:06 pm, Feb 20, 2008

Alameda County
Environmental Health

5900 Hollis Street, Suite A, Emeryville, California 94608
Telephone: 510-420-0700 Facsimile: 510-420-9170
www.CRAworld.com

February 19, 2008

Mr. Steven Plunkett
Alameda County Health Care Services Agency
1131 Harbor Bay Parkway, Suite 250
Alameda, California 94502

Re: **Site Assessment and Preferential Pathway Study
Extension Request**

Former Olympic Service Station
1436 Grant Avenue
San Lorenzo, California
Fuel Leak Case No. RO00000373
CRA Project No. 629100

Dear Mr. Plunkett:

On behalf of Mr. George Jaber, Conestoga-Rovers & Associates, Inc. (CRA) is requesting a deadline extension for the Soil and Groundwater Investigation and Preferential Pathway Study that Alameda County Environmental Health (ACEH) requested in its January 22, 2008 letter. Currently, we have scheduled the field work for February 25 and 26, 2008. We have received our boring permit from Alameda County Public Works (ACPW) and they have approved our traffic control plan. However, we have not been issued an encroachment permit. CRA has had the utilities at the site marked by Underground Service Alert and a private utility locating service. We have received the Well Driller Reports from the Department of Water Resources; however, we are waiting to receive the signed release form from ACEH to receive the well information from ACPW. Therefore, based on these issues we will not be able to meet the March 1 and 15, 2008 deadlines requested in your January 22, 2008 letter. Therefore, CRA proposes extending the submittal deadlines to April 30, 2008. Please contact us as soon as possible to verify this deadline extension is acceptable.

Attached is a revised figure showing the proposed boring locations and the utilities currently identified. These locations are clear of utilities and other physical obstacles. Some of the previously proposed boring locations are not accessible. CRA would like to clarify the proposed boring locations since we have submitted proposed boring figures in our March 2, 2007 workplan and May 31, 2007 workplan addendum, and we received a figure requesting new boring locations from ACEH in their January 22, 2008 letter. Please contact me if you have any questions or concerns related to the proposed boring locations.

If you have any questions or comments regarding this extension request, please contact Brandon Wilken at (510) 420-3355.

Equal
Employment
Opportunity Employer



**CONESTOGA-ROVERS
& ASSOCIATES**

Site Assessment and Preferential Pathway Study
Extension Request
1436 Grant Avenue, San Lorenzo, CA
February 19, 2008

Sincerely,
Conestoga-Rovers & Associates, Inc.

Brandon S. Wilken, P.G.
Senior Project Geologist



Figures: 1 – Revised Proposed Boring Locations

Cc: Mr. George Jaber, Encinal Properties, 2801 Encinal Avenue, Alameda, CA 94501-4726

I:\IR\Encinal Property-San Lorenzo\Correspondence\2008-February SI Extension Letter.doc

EXPLANATION

- MW-1 Monitoring well location
- BH-A Soil boring location
- 411-39-1 Assessor's Parcel Number
- Electrical line
- Overhead electrical line
- Water line
- Gas line

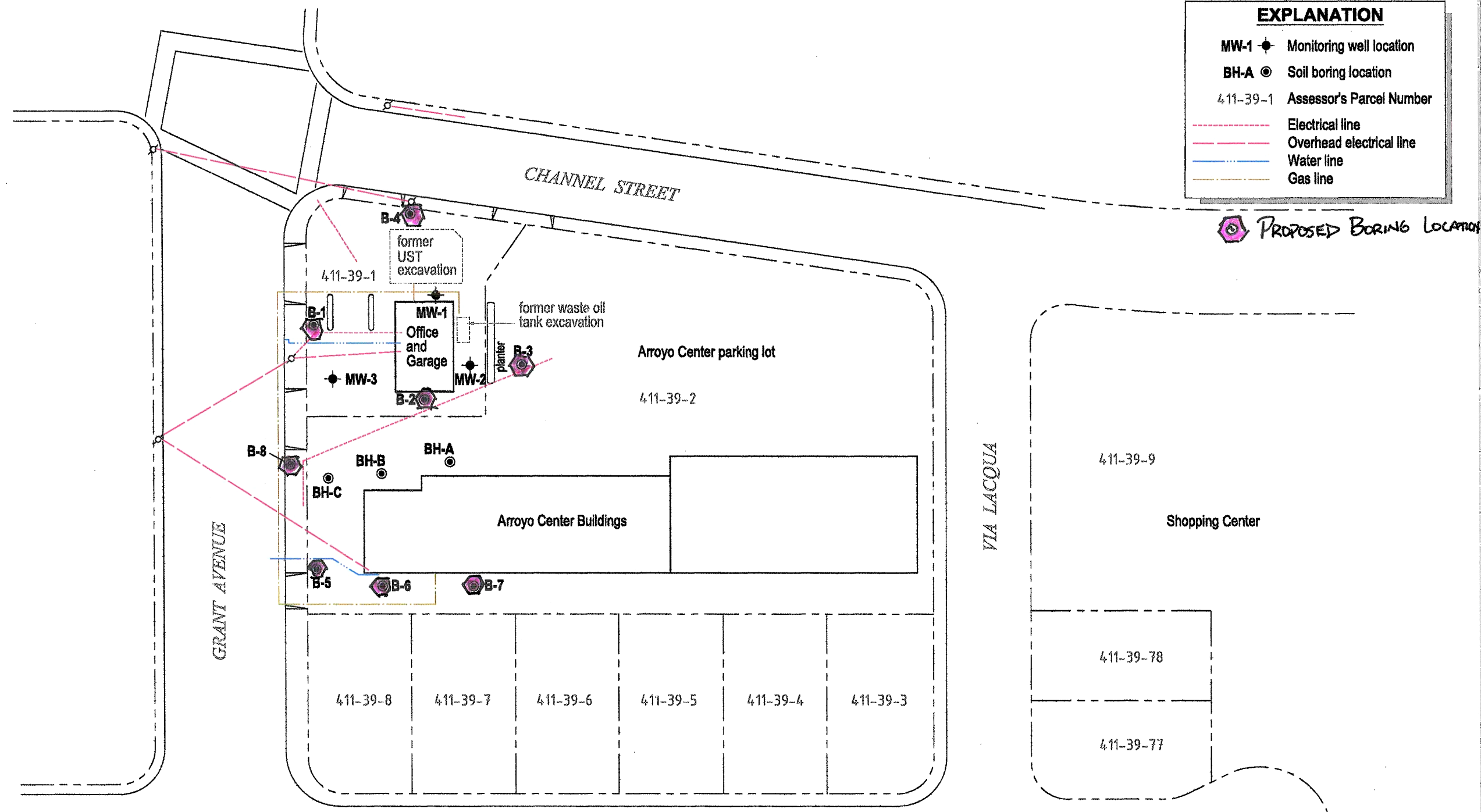

PROPOSED BORING LOCATION

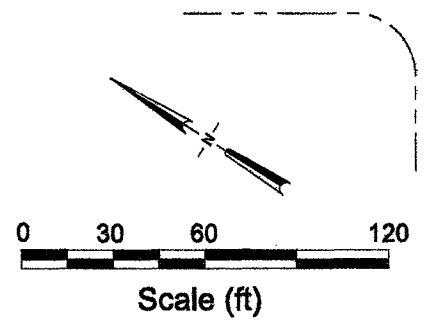

Revised Boring Locations



CONESTOGA-ROVERS & ASSOCIATES

FIGURE 1

Olympic Service Station
1436 Grant Avenue
San Lorenzo, California

RECREATIONAL PROPERTY-SAN LORENZO/FIGURE/SUBS/INCINAL-AREA.DWG