

Ro-371



GETTLER-RYAN INC.

TRANSMITTAL

December 9, 2002

G-R #180106

TO: Mr. David B. De Witt
Phillips 66 Company
2000 Crow Canyon Place, Suite 400
San Ramon, California 94583

CC: Mr. David Vossler
Gettler-Ryan Inc.
Petaluma, California

DEC 27 2002

FROM: Deanna L. Harding
Project Coordinator
Gettler-Ryan Inc.
6747 Sierra Court, Suite J
Dublin, California 94568

RE: Former Tosco (Unocal)
Service Station #7004
15599 Hesperian Blvd.
San Leandro, California

WE HAVE ENCLOSED THE FOLLOWING:

COPIES	DATED	DESCRIPTION
1	December 2, 2002	Groundwater Monitoring and Sampling Report Fourth Quarter - Events of August 29, September 14, and October 25, 2002

COMMENTS:

This report is being sent to you for your review/comment, prior to being distributed on your behalf. If no comments are received by **December 23, 2002**, this report will be distributed to the following:

cc: Mr. Scott Seary, Alameda County Health Care Services, 1131 Harbor Bay Parkway, Alameda, CA 94502
Mr. Michael Bakaldin, City of San Leandro Fire Department, 835 East 14th Street, San Leandro, CA 94577

Enclosure

trans/7004-DBD



GETTLER-RYAN INC.

Ro-371

December 2, 2002
G-R Job #180106

Mr. David B. De Witt
Phillips 66 Company
2000 Crow Canyon Place, Suite 400
San Ramon, CA 94583

RE: Monthly Event of August 29, 2002
Monthly Event of September 14, 2002
Fourth Quarter Event of October 25, 2002
Groundwater Monitoring & Sampling Report
Former Tosco (Unocal) Service Station #7004
15599 Hesperian Boulevard
San Leandro, California

DEC 27 2002

Dear Mr. De Witt:

This report documents the monthly site visits and the most recent groundwater monitoring and sampling event performed by Gettler-Ryan Inc. (G-R) at the referenced site. All field work was conducted in accordance with G-R Standard Operating Procedure - Groundwater Sampling (attached).

Static groundwater levels were measured and all wells were checked for the presence of separate-phase hydrocarbons. Separate-phase hydrocarbons were not present in the wells. Static water level data and groundwater elevations are summarized in Table 1. Dissolved Oxygen Concentrations are summarized in Table 3. Potentiometric Maps are included as Figures 1, 3 and 5.

Groundwater samples were collected from the monitoring wells and submitted to a state certified laboratory for analyses. The field data sheets for this event are attached. Analytical results are presented in the table(s) listed below. Concentration Maps are included as Figures 2, 4 and 6. The chain of custody document and laboratory analytical reports are also attached.

Sincerely,

Deanna L. Harding
Deanna L. Harding
Project Coordinator

Robert C. Mallory
Robert C. Mallory
Registered Geologist, No. 7285

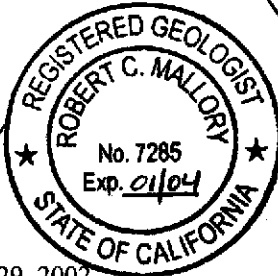

- Figure 1: Potentiometric Map - August 29, 2002
- Figure 2: Concentration Map - August 29, 2002
- Figure 3: Potentiometric Map - September 14, 2002
- Figure 4: Concentration Map - September 14, 2002
- Figure 5: Potentiometric Map - October 25, 2002
- Figure 6: Concentration Map - October 25, 2002
- Table 1: Groundwater Monitoring Data and Analytical Results
- Table 2: Groundwater Analytical Results - Oxygenated Compounds
- Table 3: Dissolved Oxygen Concentrations
- Attachments: Standard Operating Procedure - Groundwater Sampling
Field Data Sheets
Chain of Custody Document and Laboratory Analytical Reports

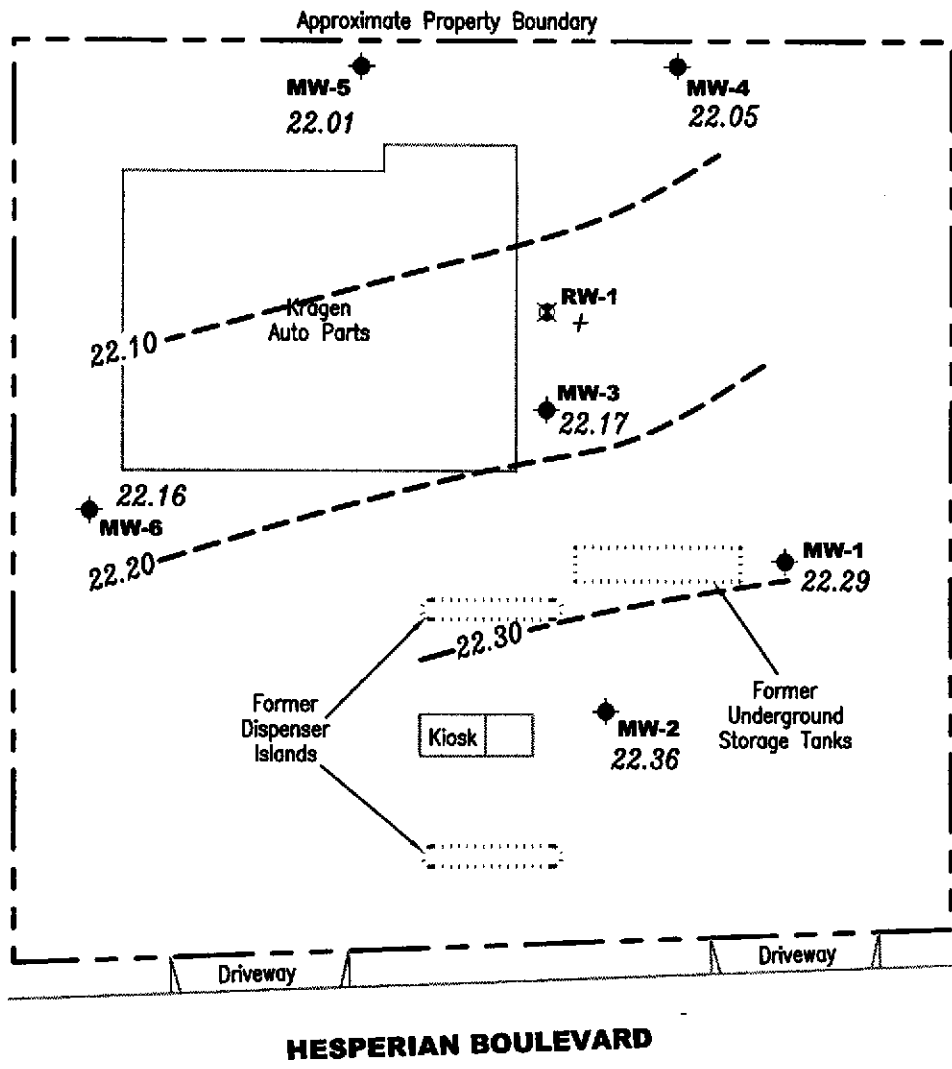

EXPLANATION

- ◆ Groundwater monitoring well
- ⊠ Aquifer testing well
- 99.99 Groundwater elevation in feet referenced to Mean Sea Level
- - - 99.99 - - - Groundwater elevation contour, dashed where inferred
- + TOC not available



Approximate groundwater flow direction at a gradient of 0.002 to 0.003 Ft./Ft.

DEC 27 2002



Scale in Feet

Source: Figure modified from drawing provided by MPDS Services Inc..

GETTLER - RYAN INC.
 6747 Sierra Ct., Suite J
 Dublin, CA 94568 (925) 551-7555

POTENTIOMETRIC MAP
 Former Tosco (Unocal) Service Station #7004
 15599 Hesperian Boulevard
 San Leandro, California

FIGURE
1

PROJECT NUMBER 180106	REVIEWED BY	DATE August 29, 2002	REVISED DATE
--------------------------	-------------	-------------------------	--------------

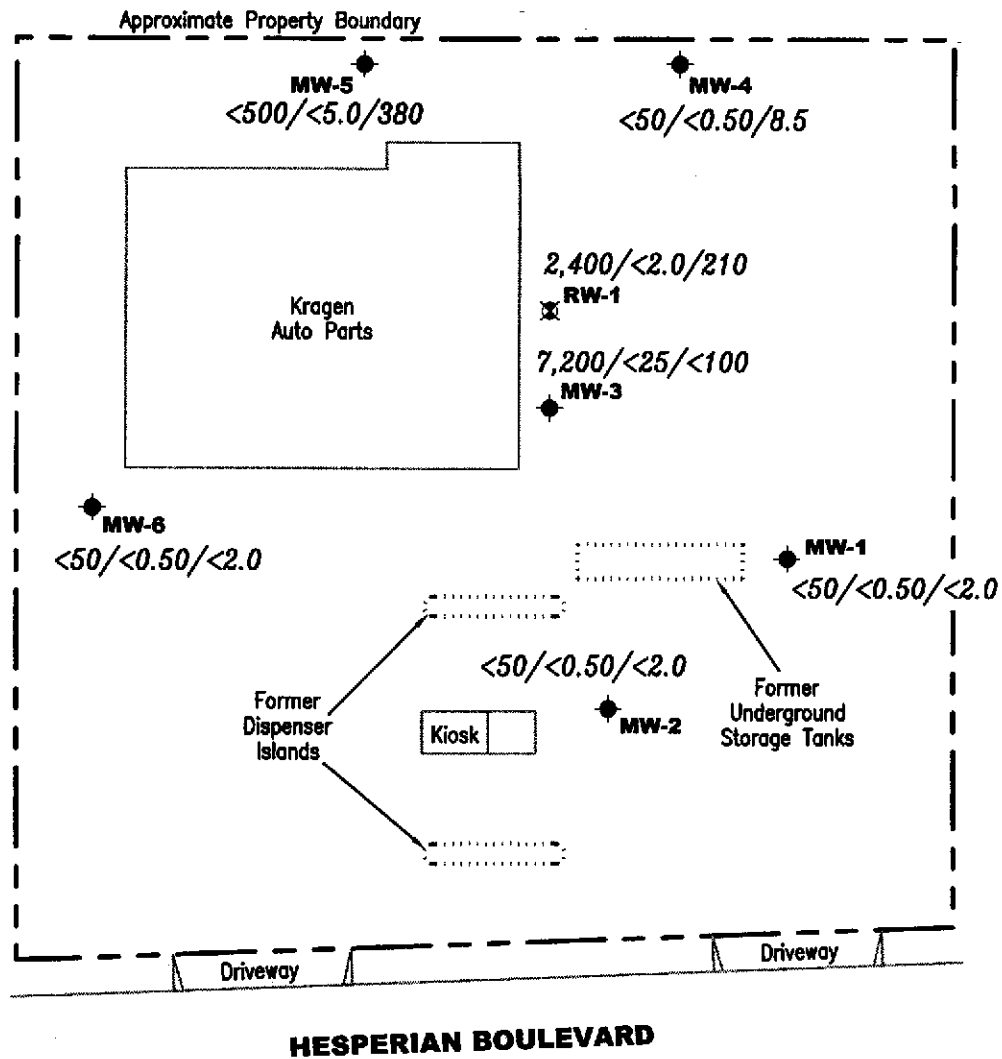

EXPLANATION

- ◆ Groundwater monitoring well
- ⊠ Aquifer testing well
- A/B/C Total Petroleum Hydrocarbons (TPH) as Gasoline/Benzene/MTBE concentrations in ppb
- Note: Analyses by EPA Method 8260

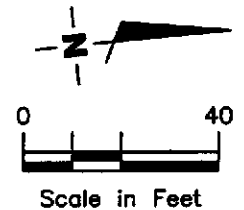

Source: Figure modified from drawing provided by MPDS Services Inc..

GETTLER - RYAN INC.
6747 Sierra Ct., Suite J
Dublin, CA 94568 (925) 551-7555

CONCENTRATION MAP
Former Tosco (Unocal) Service Station #7004
15599 Hesperian Boulevard
San Leandro, California

FIGURE

2

PROJECT NUMBER
180106

REVIEWED BY

DATE
August 29, 2002

REVISED DATE

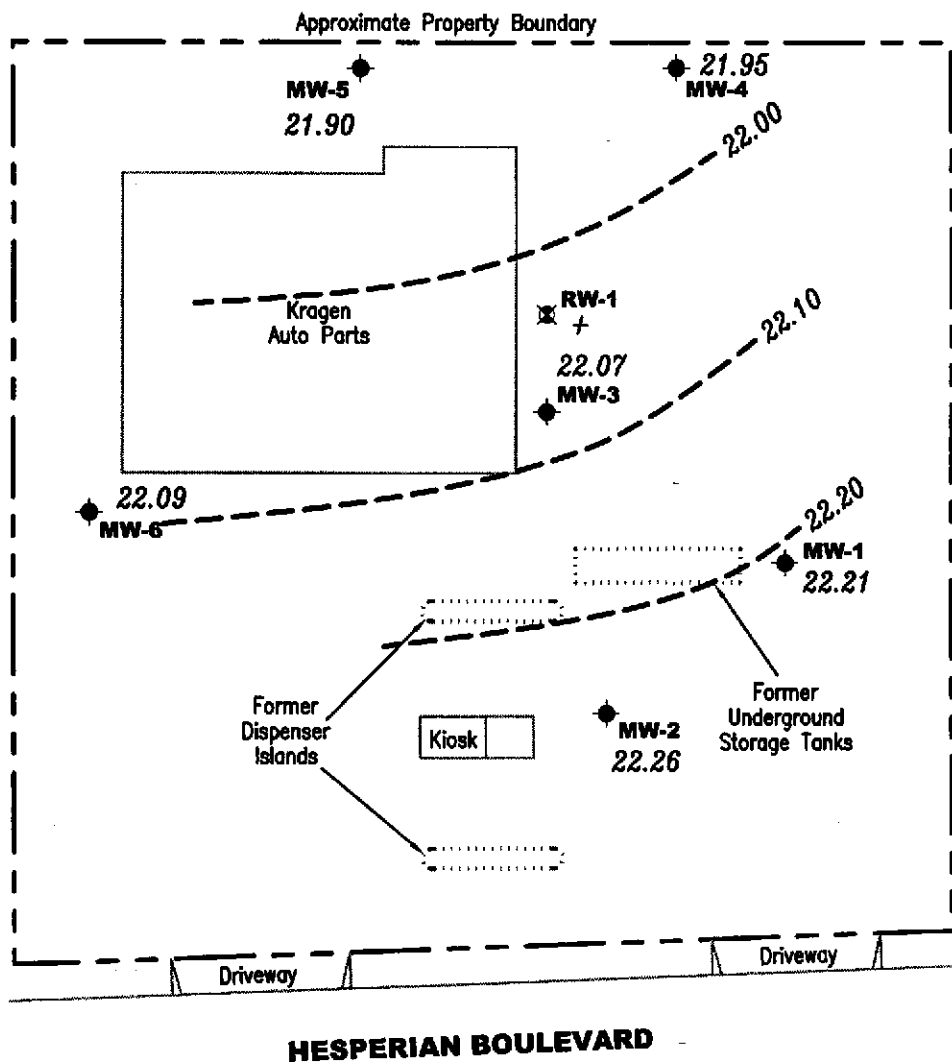

EXPLANATION

- ◆ Groundwater monitoring well
- ⊠ Aquifer testing well
- 99.99 Groundwater elevation in feet referenced to Mean Sea Level
- - - 99.99 - - - Groundwater elevation contour, dashed where inferred
- + TOC not available



Approximate groundwater flow direction at a gradient of 0.002 to 0.003 Ft./Ft.

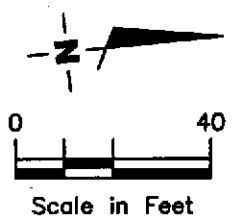

Source: Figure modified from drawing provided by MPDS Services Inc..

GETTLER - RYAN INC.
 6747 Sierra Ct., Suite J
 Dublin, CA 94568 (925) 551-7555

POTENTIOMETRIC MAP
 Former Tosco (Unocal) Service Station #7004
 15599 Hesperian Boulevard
 San Leandro, California

FIGURE
3

PROJECT NUMBER	REVIEWED BY	DATE	REVISED DATE
180106		September 14, 2002	

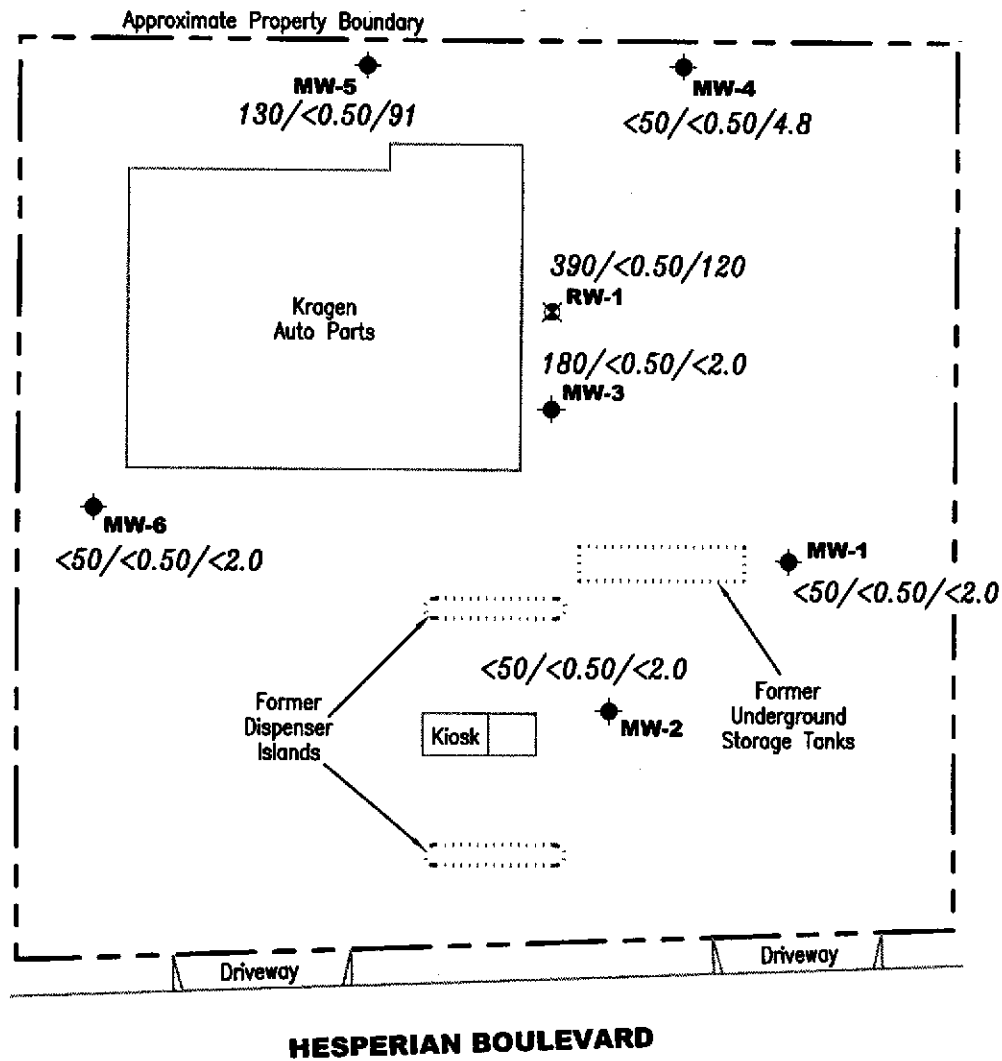

EXPLANATION

- ◆ Groundwater monitoring well
- ⊠ Aquifer testing well
- A/B/C Total Petroleum Hydrocarbons (TPH) as Gasoline/Benzene/MTBE concentrations in ppb
- Note: Analyses by EPA Method 8260

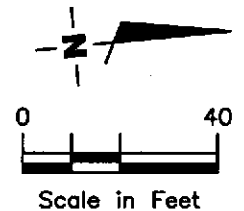

Source: Figure modified from drawing provided by MPDS Services Inc.

GETTLER - RYAN INC.
6747 Sierra Ct., Suite J
Dublin, CA 94568 (925) 551-7555

CONCENTRATION MAP
Former Tosco (Unocal) Service Station #7004
15599 Hesperian Boulevard
San Leandro, California

FIGURE
4

PROJECT NUMBER
180106

REVIEWED BY

DATE
September 14, 2002

REVISED DATE

FILE NAME: P:\ENVIRO\TOSCO\7004\Q02-7004.DWG | Layout Tab: ConJ-Sep

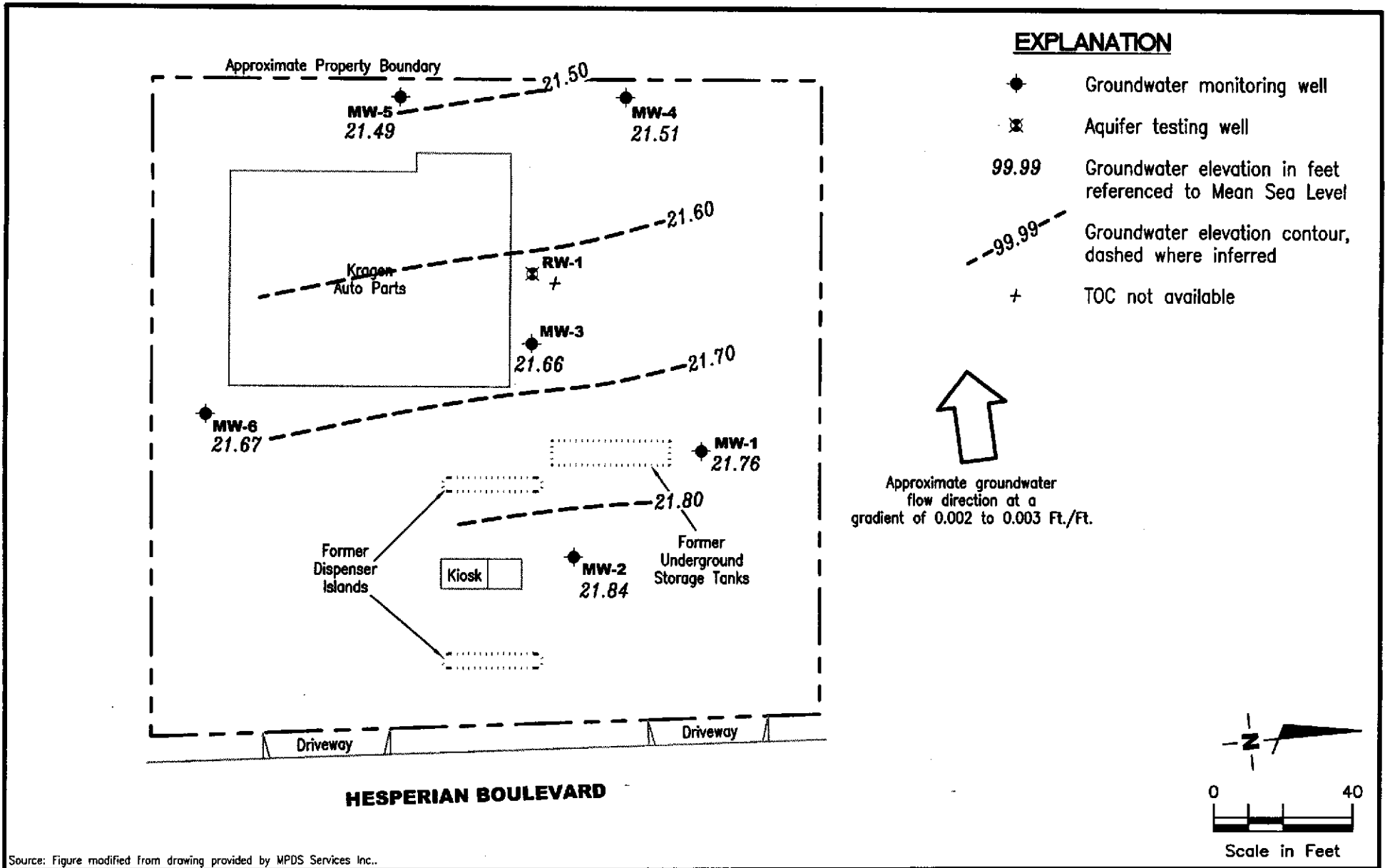

Source: Figure modified from drawing provided by MPDS Services Inc..

GETTLER - RYAN INC.
 6747 Sierra Ct., Suite J
 Dublin, CA 94568 (925) 551-7555

POTENTIOMETRIC MAP
 Former Tosco (Unocal) Service Station #7004
 15599 Hesperian Boulevard
 San Leandro, California

FIGURE
5

PROJECT NUMBER
 180106

REVIEWED BY

DATE
 October 25, 2002

REVISED DATE

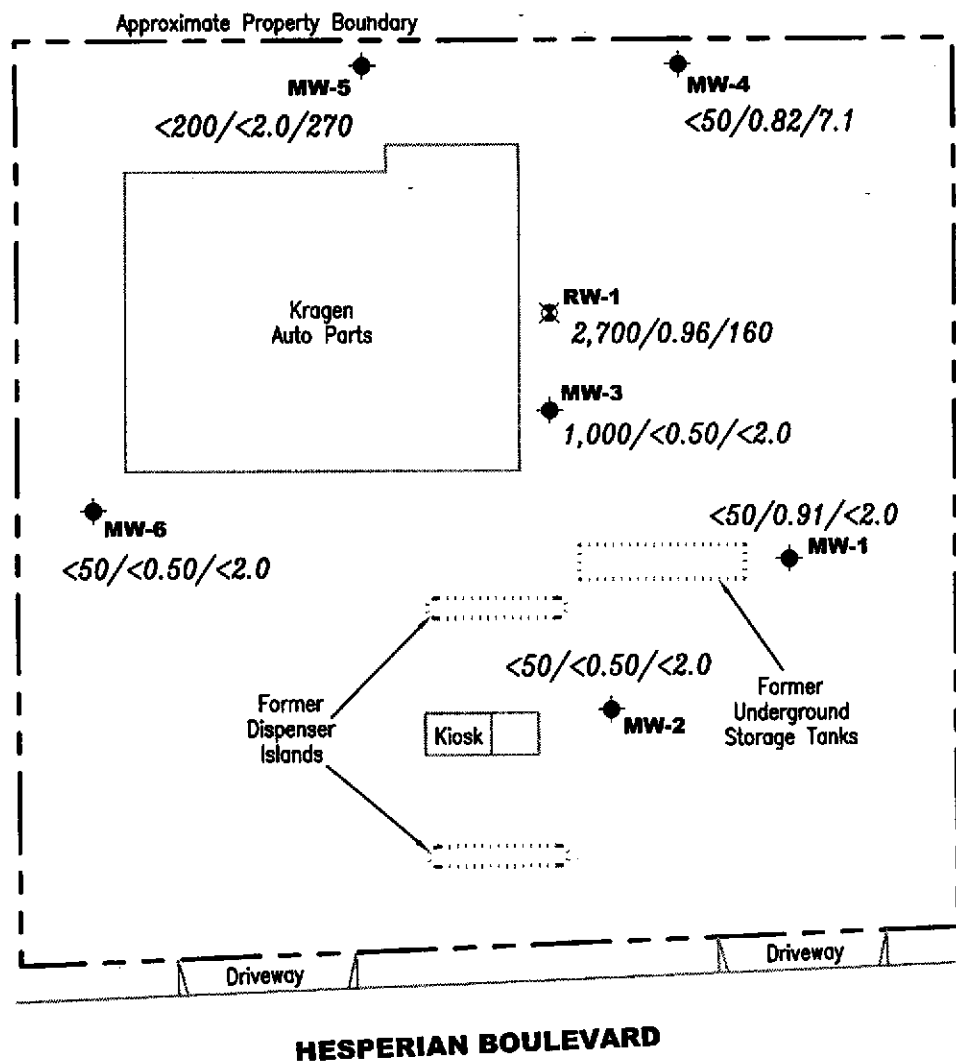

EXPLANATION

- ◆ Groundwater monitoring well
- ⊗ Aquifer testing well
- A/B/C Total Petroleum Hydrocarbons (TPH) as Gasoline/Benzene/MTBE concentrations in ppb
- Note: Analyses by EPA Method 8260

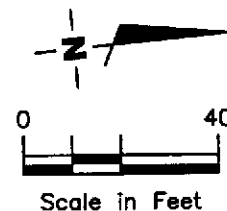

Source: Figure modified from drawing provided by MPDS Services Inc..

GETTLER - RYAN INC.
6747 Sierra Ct., Suite J
Dublin, CA 94568 (925) 551-7555

CONCENTRATION MAP
Former Tosco (Unocal) Service Station #7004
15599 Hesperian Boulevard
San Leandro, California

FIGURE

6

PROJECT NUMBER
180106

REVIEWED BY

DATE
October 25, 2002

REVISED DATE

Table 1
Groundwater Monitoring Data and Analytical Results
Former Tosco (Unocal) Service Station #7004
15599 Hesperian Boulevard
San Leandro, California

WELL ID/ TOC*(ft.)	DATE	DTW (ft.)	S.I. (ft. bgs)	GWE (msl)	TPH-G (ppb)	B (ppb)	T (ppb)	E (ppb)	X (ppb)	MTBE (ppb)
MW-1	05/04/91	--	10.0-25.0	--	ND	ND	ND	ND	ND	--
	07/23/91	--		--	ND	ND	ND	ND	ND	--
	10/14/91	--		--	ND	ND	ND	ND	ND	--
	01/14/92	--		--	ND	ND	ND	ND	ND	--
	04/14/92	--		--	76 ¹	ND	ND	ND	ND	--
	07/09/92	--		--	70 ¹	ND	ND	ND	ND	130
	10/28/92	--		--	SAMPLED SEMI-ANNUALLY		--	--	--	--
	01/21/93	--		--	ND	ND	ND	ND	ND	42
36.89	04/20/93	14.89		22.00	--	--	--	--	--	56
	07/22/93	14.34		22.55	ND	ND	ND	ND	ND	77
36.39	10/06/93	14.87		21.52	--	--	--	--	--	--
	01/11/94	15.14		21.25	ND	ND	ND	ND	ND	--
	04/06/94	14.19		22.20	--	--	--	--	--	--
	07/08/94	14.66		21.73	ND	ND	ND	ND	ND	--
	10/06/94	16.71		19.68	--	--	--	--	--	--
	01/05/95	14.68		21.71	ND	ND	ND	ND	ND	--
	04/05/95	11.76		24.63	--	--	--	--	--	--
	07/14/95	12.93		23.46	ND	0.65	2.2	ND	2.3	--
	10/12/95	14.29		22.10	--	--	--	--	--	--
	01/08/96	14.18		22.21	ND	ND	ND	ND	ND	--
	07/08/96	12.74		23.65	ND	ND	ND	ND	ND	ND
	01/03/97	12.89		23.50	87 ¹	ND	ND	ND	ND	ND
	07/02/97	13.66		22.73	ND	ND	ND	ND	ND	ND
	01/15/98	13.08		23.31	ND	ND	ND	ND	ND	ND
	07/08/98	11.25		25.14	ND	ND	ND	ND	ND	ND
	01/11/99	13.68		22.71	51 ⁹	ND	ND	ND	ND	4.8
	07/07/99	12.15		24.24	ND	ND	ND	ND	ND	ND
	01/04/00	13.95		22.44	ND	ND	ND	ND	ND	ND
	07/15/00	13.46		22.93	ND	ND	0.86	ND	ND	ND
	01/19/01	12.96		23.43	ND	ND	ND	ND	ND	ND
	07/31/01	14.36		22.03	ND	ND	ND	ND	ND	ND
	01/28/02	12.89		23.50	<50	<0.50	<0.50	<0.50	<0.50	<2.5

Table 1
Groundwater Monitoring Data and Analytical Results
Former Tosco (Unocal) Service Station #7004
15599 Hesperian Boulevard
San Leandro, California

WELL ID/ TOC*(ft.)	DATE	DTW (ft.)	S.I. (ft. bgs)	GWE (msl)	TPH-G (ppb)	B (ppb)	T (ppb)	E (ppb)	X (ppb)	MTBE (ppb)
MW-1	04/22/02	12.86	10.0-25.0	23.53	<50	<0.50	<0.50	<0.50	<0.50	<2.5
(cont)	05/24/02 ¹⁶	13.16		23.23	<50	<0.50	<0.50	<0.50	<1.0	<0.50
	06/21/02 ¹⁶	13.52		22.87	76 ¹⁵	<0.50	<0.50	<0.50	<1.0	0.59
	07/29/02 ¹⁶	13.76		22.63	54 ¹⁵	<0.50	<0.50	<0.50	<1.0	<2.0
	08/29/02 ¹⁶	14.10		22.29	<50	<0.50	<0.50	<0.50	<1.0	<2.0
	09/14/02 ¹⁶	14.18		22.21	<50	<0.50	<0.50	<0.50	<1.0	<2.0
	10/25/02 ¹⁶	14.63		21.76	<50	0.91	<0.50	<0.50	<1.0	<2.0
MW-2	05/04/91	--	10.0-25.0	--	ND	ND	ND	ND	ND	--
	07/23/91	--		--	ND	ND	ND	ND	ND	--
	10/14/91	--		--	ND	ND	ND	ND	ND	--
	01/14/92	--		--	ND	ND	ND	ND	ND	--
	04/14/92	--		--	45 ¹	ND	ND	ND	ND	--
	07/09/92	--		--	ND	ND	ND	ND	ND	49
	10/28/92	--		--	SAMPLED SEMI-ANNUALLY		--	--	--	--
	01/21/93	--		--	ND	ND	ND	ND	ND	17
37.35	04/20/93	15.20		22.15	--	--	--	--	--	80
	07/22/93	14.75		22.60	62 ¹	ND	ND	ND	ND	42
37.07	10/06/93	15.49		21.58	--	--	--	--	--	--
	01/11/94	15.77		21.30	120 ¹	ND	ND	ND	ND	--
	04/06/94	14.83		22.24	--	--	--	--	--	--
	07/08/94	15.28		21.79	140 ¹	ND	ND	ND	ND	--
	10/06/94	16.32		20.75	--	--	--	--	--	--
	01/05/95	15.30		21.77	310 ¹	ND	ND	ND	ND	--
	04/05/95	12.12		24.95	--	--	--	--	--	--
	07/14/95	13.55		23.52	86 ¹	ND	ND	ND	ND	--
	10/12/95	14.88		22.19	--	--	--	--	--	--
	01/08/96	14.81		22.26	91 ¹	ND	ND	ND	ND	--
	07/08/96	13.37		23.70	100 ¹	ND	ND	ND	ND	ND
	01/03/97	13.14		23.93	160 ¹	ND	ND	ND	ND	ND
	07/02/97	14.26		22.81	91 ¹	ND	ND	ND	ND	ND

Table 1
Groundwater Monitoring Data and Analytical Results
Former Tosco (Unocal) Service Station #7004
15599 Hesperian Boulevard
San Leandro, California

WELL ID/ TOC*(ft.)	DATE	DTW (ft.)	S.I. (ft. bgs)	GWE (msl)	TPH-G (ppb)	B (ppb)	T (ppb)	E (ppb)	X (ppb)	MTBE (ppb)
MW-2	01/15/98	13.31	10.0-25.0	23.76	ND	ND	ND	ND	ND	ND
(cont)	07/08/98	11.57		25.50	ND	ND	ND	ND	ND	ND
	01/11/99	14.26		22.81	ND	ND	ND	ND	ND	9.8
	07/07/99	12.24		24.83	ND	ND	ND	ND	ND	9.4
	01/04/00	14.14		22.93	ND	ND	0.518	ND	ND	9.07
	07/15/00	13.75		23.32	ND	ND	0.51	ND	ND	6.0
	01/19/01	13.37		23.70	ND	ND	ND	ND	ND	6.84
	07/31/01	14.96		22.11	ND	ND	ND	ND	ND	ND
	01/28/02	13.51		23.56	<50	<0.50	<0.50	<0.50	<0.50	<2.5
	04/22/02	13.48		23.59	<50	<0.50	<0.50	<0.50	<0.50	<2.5
	05/24/02 ¹⁶	13.78		23.29	<50	<0.50	<0.50	<0.50	<1.0	<0.50
	06/21/02 ¹⁶	14.11		22.96	100 ¹⁵	<0.50	<0.50	<0.50	<1.0	<0.50
	07/29/02 ¹⁶	14.36		22.71	60 ¹⁵	<0.50	<0.50	<0.50	<1.0	<2.0
	08/29/02 ¹⁶	14.71		22.36	<50	<0.50	<0.50	<0.50	<1.0	<2.0
	09/14/02 ¹⁶	14.81		22.26	<50	<0.50	<0.50	<0.50	<1.0	<2.0
	10/25/02 ¹⁶	15.23		21.84	<50	<0.50	<0.50	<0.50	<1.0	<2.0
MW-3	05/04/91	--	10.0-25.0	--	34,000	6,100	32	1,200	6,100	--
	07/23/91	--		--	17,000	5,500	26	1,800	2,800	--
	10/14/91	--		--	25,000	6,300	78	2,000	1,400	--
	01/14/92	--		--	13,000	6,600	19	2,600	1,800	--
	04/14/92	--		--	16,000	3,400	19	1,400	1,300	--
	07/09/92	--		--	13,000	3,200	12	1,900	1,100	--
	10/28/92	--		--	15,000	4,400	15	2,400	800	--
	01/21/93	--		--	12,000	2,800	11	1,600	590	--
37.22	04/20/93	15.13		22.09	18,000	3,700	11	2,300	1,300	410
	07/22/93	13.52		23.70	16,000	4,500	17	3,600	1,900	440
36.79	10/06/93	15.41		21.38	24,000	4,100	ND	3,600	2,000	ND
	01/11/94	15.66		21.13	19,000	3,300	31	3,300	890	--
	04/06/94	14.72		22.07	24,000	3,100	ND	3,300	820	--
	07/08/94	15.20		21.59	18,000	2,200	25	2,500	860	--

Table 1
Groundwater Monitoring Data and Analytical Results
Former Tosco (Unocal) Service Station #7004
15599 Hesperian Boulevard
San Leandro, California

WELL ID/ TOC*(ft.)	DATE	DTW (ft.)	S.I. (ft. bgs)	GWE (msl)	TPH-G (ppb)	B (ppb)	T (ppb)	E (ppb)	X (ppb)	MTBE (ppb)
MW-3	10/06/94	16.23	10.0-25.0	20.56	20,000	2,100	26	3,000	900	--
(cont)	01/05/95	15.12		21.67	20,000	2,100	ND	3,200	3,800	--
	04/05/95	12.03		24.76	18,000	2,100	ND	3,700	690	--
	07/14/95	13.46		23.33	21,000	1,600	ND	3,900	1,500	--
	10/12/95	14.81		21.98	17,000	1,000	ND	3,600	1,000	-- ³
	01/08/96	14.70		22.09	14,000	760	ND	3,100	380	-- ⁴
	07/08/96	13.29		23.50	16,000	470	45	4,400	1,000	340
	01/03/97	13.09		23.70	14,000	160	ND	2,100	120	620
	07/02/97	13.96		22.83	23,000	110	ND	3,600	1,600	1,200
	01/15/98	13.26		23.53	12,000	33	ND ⁵	2,800	120	1,100
	07/08/98	11.64		25.15	20,000	76	ND ⁵	4,100	1,400	750
	01/11/99	14.17		22.62	23,000 ¹⁰	ND ⁵	ND ⁵	4,100	460	920
	07/07/99	13.18		23.61	15,000 ¹¹	35	ND ⁵	3,400	470	1,700
	01/04/00	14.27		22.52	15,500	ND ⁵	ND ⁵	3,330	191	827
	07/15/00	13.91		22.88	15,000 ¹²	ND ⁵	ND ⁵	3,400	420	3,300
	08/25/00	14.24		22.55	--	--	--	--	--	1,920 ¹³
	01/19/01	13.42		23.37	11,100 ¹⁴	38.4	ND ⁵	1,760	38.8	ND ⁵
	07/31/01	14.90		21.89	13,000 ¹⁴	ND ⁵	ND ⁵	1,600	63	ND ⁵
	01/28/02	13.41		23.38	82	<0.50	<0.50	10	<0.50	<2.5
	04/22/02	13.41		23.38	7,300	39	<25	970	<25	<120
	05/24/02 ¹⁶	13.69		23.10	8,500 ¹⁵	<5.0	<5.0	1,200	<10	12
	06/21/02 ¹⁶	14.04		22.75	11,000	<5.0	<5.0	690	<10	17
	07/29/02 ¹⁶	14.28		22.51	6,800	<5.0	<5.0	1,100	<10	<20
	08/29/02 ¹⁶	14.62		22.17	7,200 ¹⁵	<25	<25	1,200	<50	<100
	09/14/02 ¹⁶	14.72		22.07	180	<0.50	<0.50	20	<1.0	<2.0
	10/25/02 ¹⁶	15.13		21.66	1,000	<0.50	<0.50	110	<1.0	<2.0
MW-4	07/23/91	--	10.0-26.0	--	ND	ND	ND	ND	ND	--
	10/14/91	--		--	ND	ND	ND	ND	ND	--
	01/14/92	--		--	ND	ND	ND	ND	ND	--
	04/14/92	--		--	ND	ND	ND	ND	ND	--

Table 1
Groundwater Monitoring Data and Analytical Results
Former Tosco (Unocal) Service Station #7004
15599 Hesperian Boulevard
San Leandro, California

WELL ID/ TOC*(ft.)	DATE	DTW (ft.)	S.I. (ft. bgs)	GWE (msl)	TPH-G (ppb)	B (ppb)	T (ppb)	E (ppb)	X (ppb)	MTBE (ppb)
MW-4	07/09/92	--	10.0-26.0	--	ND	ND	ND	ND	ND	--
(cont)	10/28/92	--		--	SAMPLED SEMI-ANNUALLY			--	--	--
	01/21/93	--		--	ND	ND	ND	ND	ND	--
35.81	04/20/93	13.84		21.97	--	--	--	--	--	65
	07/22/93	13.52		22.29	ND	ND	ND	ND	ND	54
35.44	10/06/93	14.17		21.27	--	--	--	--	--	--
	01/11/94	14.42		21.02	ND	ND	ND	ND	ND	--
	04/06/94	13.44		22.00	--	--	--	--	--	--
	07/08/94	13.96		21.48	ND	ND	ND	ND	ND	--
	10/06/94	15.00		20.44	--	--	--	--	--	--
	01/05/95	13.83		21.61	ND	ND	ND	ND	ND	--
	04/05/95	11.05		24.39	--	--	--	--	--	--
	07/14/95	12.23		23.21	ND	ND	ND	ND	ND	--
	10/12/95	13.59		21.85	--	--	--	--	--	--
	01/08/96	13.43		22.01	ND	ND	ND	ND	ND	-- ⁴
	07/08/96	12.04		23.40	ND	ND	ND	ND	ND	ND
	01/03/97	12.38		23.06	80 ¹	ND	ND	ND	ND	ND
	07/02/97	13.00		22.44	ND	ND	ND	ND	ND	25
	01/15/98	12.50		22.94	ND	ND	ND	ND	ND	ND
	07/08/98	10.53		24.91	ND	ND	ND	ND	ND	25
	01/11/99	12.95		22.49	ND	ND	ND	ND	ND	23
	07/07/99	11.76		23.68	ND	ND	ND	ND	ND	15
	01/04/00	13.17		22.27	ND	ND	ND	ND	ND	13.2
	07/15/00	13.04		22.40	ND	ND	ND	ND	ND	11
	01/19/01	12.65		22.79	ND	ND	ND	ND	ND	9.97
	07/31/01	13.69		21.75	ND	ND	ND	ND	ND	6.0
	01/28/02	12.17		23.27	<50	<0.50	<0.50	<0.50	<0.50	13
	04/22/02	12.18		23.26	<50	<0.50	<0.50	<0.50	<0.50	5.7
	05/24/02 ¹⁶	12.45		22.99	<50	<0.50	<0.50	<0.50	<1.0	2.9
	06/21/02 ¹⁶	12.48		22.96	54 ¹⁵	<0.50	<0.50	<0.50	<1.0	3.6
	07/29/02 ¹⁶	13.08		22.36	<50	<0.50	<0.50	<0.50	<1.0	5.7

Table 1
Groundwater Monitoring Data and Analytical Results
Former Tosco (Unocal) Service Station #7004
15599 Hesperian Boulevard
San Leandro, California

WELL ID/ TOC*(ft.)	DATE	DTW (ft.)	S.I. (ft. bgs)	GWE (msl)	TPH-G (ppb)	B (ppb)	T (ppb)	E (ppb)	X (ppb)	MTBE (ppb)
MW-4	08/29/02 ¹⁶	13.39	10.0-26.0	22.05	<50	<0.50	<0.50	<0.50	<1.0	8.5
(cont)	09/14/02 ¹⁶	13.49		21.95	<50	<0.50	<0.50	<0.50	<1.0	4.8
	10/25/02 ¹⁶	13.93		21.51	<50	0.82	<0.50	<0.50	<1.0	7.1
MW-5	07/23/91	--	10.0-26.0	--	260	1.2	0.39	10	0.71	--
	10/14/91	--		--	140	0.72	ND	1.3	0.89	--
	01/14/92	--		--	60 ¹	ND	ND	ND	ND	--
	04/14/92	--		--	86 ¹	ND	ND	ND	ND	--
	07/09/92	--		--	ND	ND	ND	ND	ND	71
	10/28/92	--		--	ND	ND	ND	ND	ND	45
	01/21/93	--		--	100 ¹	ND	ND	ND	ND	160
37.01	04/20/93	14.87		22.14	99 ¹	ND	ND	ND	ND	120
	07/22/93	14.82		22.19	59 ²	ND	ND	2.6	ND	42
36.81	10/06/93	15.61		21.20	150	1.1	ND	3.1	0.85	57
	01/11/94	15.84		20.97	160	ND	0.79	0.54	ND	--
	04/06/94	14.90		21.91	260	1.4	ND	0.88	ND	--
	07/08/94	15.38		21.43	200	ND	ND	ND	ND	--
	10/06/94	16.42		20.39	350	1.3	ND	ND	ND	--
	01/05/95	15.20		21.61	85	ND	ND	ND	ND	--
	04/05/95	11.72		25.09	ND	ND	ND	ND	ND	--
	07/14/95	13.69		23.12	180	1.3	ND	7.9	ND	--
	10/12/95	15.02		21.79	310	ND	ND	31	1.2	-- ³
	01/08/96	14.85		21.96	ND	0.55	ND	ND	0.58	-- ⁴
	07/08/96	13.52		23.29	140	2.1	1.4	5.6	0.51	110
◆	07/12/96	14.50		22.31	--	--	--	--	--	--
	01/03/97	12.85		23.96	12,000	150	ND	2,100	120	660
	07/02/97	13.79		23.02	ND	ND	ND	ND	ND	72
	01/15/98	13.03		23.78	69 ⁶	ND	ND	ND	ND	-- ⁷
	07/08/98	12.05		24.76	ND	0.74	ND	ND	ND	95
◆◆	01/11/99	14.41		22.40	ND	1.0	ND	ND	ND	170
	07/07/99	12.38		24.43	130	0.64	ND	ND	ND	330

Table 1
Groundwater Monitoring Data and Analytical Results
Former Tosco (Unocal) Service Station #7004
15599 Hesperian Boulevard
San Leandro, California

WELL ID/ TOC*(ft.)	DATE	DTW (ft.)	S.I. (ft. bgs)	GWE (msl)	TPH-G (ppb)	B (ppb)	T (ppb)	E (ppb)	X (ppb)	MTBE (ppb)
MW-5	01/04/00	14.33	10.0-26.0	22.48	ND	ND	ND	ND	ND	183
(cont)	07/15/00	13.88		22.93	ND	0.68	ND	ND	ND	350
	01/19/01	13.41		23.40	ND	ND	ND	ND	ND	195
	07/31/01	15.12		21.69	ND	ND	ND	ND	ND	190
	01/28/02	13.59		23.22	<50	<0.50	<0.50	<0.50	<0.50	97
	04/22/02	13.61		23.20	<50	<0.50	<0.50	<0.50	<0.50	160
	05/24/02 ¹⁶	13.89		22.92	89	<0.50	<0.50	<0.50	<1.0	180
	06/21/02 ¹⁶	14.22		22.59	190 ¹⁵	<0.50	<0.50	<0.50	<1.0	85
	07/29/02 ¹⁶	14.48		22.33	120 ¹⁵	<0.50	<0.50	<0.50	<1.0	76
	08/29/02 ¹⁶	14.80		22.01	<500	<5.0	<5.0	<5.0	<10	380
	09/14/02 ¹⁶	14.91		21.90	130 ¹⁵	<0.50	<0.50	<0.50	<1.0	91
	10/25/02 ¹⁶	15.32		21.49	<200	<2.0	<2.0	<2.0	<4.0	270
MW-6	07/23/91	--	10.0-26.0	--	ND	ND	ND	ND	ND	--
	10/14/91	--		--	ND	ND	ND	ND	ND	--
	01/14/92	--		--	ND	ND	ND	ND	ND	--
	04/14/92	--		--	ND	ND	ND	ND	ND	--
	07/09/92	--		--	ND	ND	ND	ND	ND	--
	10/28/92	--		--	SAMPLED SEMI-ANNUALLY		--	--	--	--
	01/21/93	--		--	ND	ND	ND	ND	ND	--
37.55	04/20/93	15.27		22.28	--	--	--	--	--	ND
	07/22/93	15.20		22.35	ND	ND	ND	ND	ND	ND
37.13	10/06/93	15.75		21.38	--	--	--	--	--	--
	01/11/94	16.02		21.11	ND	ND	ND	ND	ND	--
	04/06/94	15.07		22.06	--	--	--	--	--	--
	07/08/94	15.55		21.58	ND	ND	ND	ND	ND	--
	10/06/94	16.58		20.55	--	--	--	--	--	--
	01/05/95	15.42		21.71	ND	ND	ND	ND	ND	--
	04/05/95	12.14		24.99	--	--	--	--	--	--
	07/14/95	13.87		23.26	ND	ND	ND	ND	ND	--
	10/12/95	15.17		21.96	--	--	--	--	--	--

Table 1
Groundwater Monitoring Data and Analytical Results
Former Tosco (Unocal) Service Station #7004
15599 Hesperian Boulevard
San Leandro, California

WELL ID/ TOC*(ft.)	DATE	DTW (ft.)	S.L. (ft. bgs)	GWE (msl)	TPH-G (ppb)	B (ppb)	T (ppb)	E (ppb)	X (ppb)	MTBE (ppb)
MW-6 (cont)	01/08/96	15.05	10.0-26.0	22.08	ND	ND	ND	ND	ND	--
	07/08/96	13.71		23.42	ND	ND	ND	ND	ND	ND
	01/03/97	13.12		24.01	97 ⁱ	ND	ND	ND	ND	ND
	07/02/97	14.57		22.56	ND	ND	ND	ND	ND	ND
	01/15/98	13.30		23.83	ND	ND	ND	ND	ND	ND
	07/08/98	12.33		24.80	ND	ND	ND	ND	ND	ND
	01/11/99	14.60		22.53	ND	ND	ND	ND	ND	ND
	07/07/99	13.23		23.90	ND	ND	ND	ND	ND	ND
	01/04/00	14.41		22.72	ND	ND	ND	ND	ND	ND
	07/15/00	14.05		23.08	ND	ND	ND	ND	ND	ND
	01/19/01	13.58		23.55	ND	ND	ND	ND	ND	ND
	07/31/01	15.24		21.89	ND	ND	ND	ND	ND	ND
	01/28/02	13.80		23.33	<50	<0.50	<0.50	<0.50	<0.50	<2.5
	04/22/02	13.22		23.91	<50	<0.50	<0.50	<0.50	<0.50	<2.5
	05/24/02 ¹⁶	14.07		23.06	<50	<0.50	<0.50	<0.50	<1.0	<0.50
	06/21/02 ¹⁶	14.38		22.75	<50	<0.50	<0.50	<0.50	<1.0	<0.50
	07/29/02 ¹⁶	14.64		22.49	<50	<0.50	<0.50	<0.50	<1.0	<2.0
	08/29/02 ¹⁶	14.97		22.16	<50	<0.50	<0.50	<0.50	<1.0	<2.0
	09/14/02 ¹⁶	15.04		22.09	<50	<0.50	<0.50	<0.50	<1.0	<2.0
	10/25/02 ¹⁶	15.46		21.67	<50	<0.50	<0.50	<0.50	<1.0	<2.0
RW-1	07/08/98	11.72	12.5-27.5	--	80 ⁸	1.7	ND	ND	ND	1,300
	01/11/99	14.05		--	ND ⁵	3.0	ND ⁵	ND ⁵	ND ⁵	1,200
	07/07/99	13.05		--	ND	ND	ND	ND	ND	590
	01/04/00	14.26		--	ND	ND	ND	ND	ND	270
	07/15/00	13.77		--	ND	0.55	ND	ND	ND	460
	01/19/01	13.29		--	ND	ND	ND	ND	ND	338
	07/31/01	14.72		--	ND ⁵	ND ⁵	ND ⁵	ND ⁵	ND ⁵	1,900
	01/28/02	13.21		--	72 ¹⁵	0.98	<0.50	<0.50	<0.50	460
	04/22/02	13.22		--	<50	<0.50	<0.50	<0.50	<0.50	290
	05/24/02 ¹⁶	13.51		--	1,200 ¹⁵	<1.0	<1.0	30	<2.0	300

Table 1
Groundwater Monitoring Data and Analytical Results
Former Tosco (Unocal) Service Station #7004
15599 Hesperian Boulevard
San Leandro, California

WELL ID/ TOC*(ft.)	DATE	DTW (ft.)	S.I. (ft. bgs)	GWE (msl)	TPH-G (ppb)	B (ppb)	T (ppb)	E (ppb)	X (ppb)	MTBE (ppb)
RW-1	06/21/02 ¹⁶	13.85	12.5-27.5	--	400	<0.50	<0.50	<0.50	<1.0	130
(cont)	07/29/02 ¹⁶	14.11		--	130	<0.50	<0.50	<0.50	<1.0	91
	08/29/02 ¹⁶	14.43		--	2,400	<2.0	<2.0	47	<4.0	210
	09/14/02 ¹⁶	14.54		--	390	<0.50	<0.50	<0.50	<1.0	120
	10/25/02 ¹⁶	14.95		--	2,700	0.96	1.1	51	<1.0	160
Trip Blank										
TB-LB	01/15/98	--	--	--	ND	ND	ND	ND	ND	ND
	07/08/98	--		--	ND	ND	ND	ND	ND	ND
	01/11/99	--		--	ND	ND	ND	ND	ND	ND
	07/07/99	--		--	ND	ND	ND	ND	ND	ND
	01/04/00	--		--	ND	ND	ND	ND	ND	ND
	07/15/00	--		--	ND	ND	ND	ND	ND	ND
	01/19/01	--		--	ND	ND	ND	ND	ND	ND
	07/31/01	--		--	ND	ND	ND	ND	ND	ND
	01/28/02	--		--	<50	<0.50	<0.50	<0.50	<0.50	<2.5
	04/22/02	--		--	<50	<0.50	<0.50	<0.50	<0.50	<2.5
QA	05/24/02 ¹⁶	--		--	<50	<0.50	<0.50	<0.50	<1.0	<0.50
	06/21/02 ¹⁶	--		--	<50	<0.50	<0.50	<0.50	<1.0	<0.50
	07/29/02 ¹⁶	--		--	<50	<0.50	<0.50	<0.50	<1.0	<2.0
	08/29/02 ¹⁶	--		--	<50	<0.50	<0.50	<0.50	<1.0	<2.0
	09/14/02 ¹⁶	--		--	<50	<0.50	<0.50	<0.50	<1.0	<2.0
	10/25/02 ¹⁶	--		--	<50	<0.50	<0.50	<0.50	<1.0	<2.0

Table 1
Groundwater Monitoring Data and Analytical Results
Former Tosco (Unocal) Service Station #7004
15599 Hesperian Boulevard
San Leandro, California

EXPLANATIONS:

Groundwater monitoring data and laboratory analytical results prior to January 15, 1998, were compiled from reports prepared by MPDS Services, Inc.

TOC = Top of Casing	TPH-G = Total Petroleum Hydrocarbons as Gasoline	(ppb) = Parts per billion
DTW = Depth to Water	B = Benzene	ND = Not Detected
(ft.) = Feet	T = Toluene	-- = Not Measured/Not Analyzed/Not Available
S.I. = Screen Interval	E = Ethylbenzene	QA = Quality Assurance
(ft. bgs) = Feet Below Ground Surface	X = Xylenes	
GWE = Groundwater Elevation	MTBE = Methyl tertiary butyl ether	
(msl) = Mean sea level		

* TOC elevations are relative to mean sea level (msl), based on the City of San Leandro Benchmark (Elevation = 36.04 feet msl). Prior to October 6, 1993, the DTW measurements were taken from the top of well covers.

◆ ORC installed.

◆◆ ORC removed from well.

- 1 Laboratory report indicates the hydrocarbons detected did not appear to be gasoline.
- 2 Laboratory report indicates the hydrocarbons detected appeared to be a gasoline and non-gasoline mixture.
- 3 Laboratory has potentially identified the presence of MTBE at reportable levels in the groundwater sample collected from this well.
- 4 Laboratory has identified the presence of MTBE at a level above or equal to the taste and odor threshold of 40 ppb in the sample collected from this well.
- 5 Detection limit raised. Refer to analytical reports.
- 6 Laboratory report indicates unidentified hydrocarbons C6-C8.
- 7 Laboratory narrative: MTBE was not reported due to the presence of a chlorinated hydrocarbon pattern.
- 8 Laboratory report indicates discrete peaks and unidentified hydrocarbons <C7.
- 9 Laboratory report indicates discrete peaks.
- 10 Laboratory report indicates gasoline and unidentified hydrocarbons C6-C12.
- 11 Laboratory report indicates gasoline and unidentified hydrocarbons <C6.
- 12 Laboratory report indicates gasoline C6-C12.
- 13 MTBE by EPA Method 8260.
- 14 Laboratory report indicates weathered gasoline C6-C12.
- 15 Laboratory report indicates hydrocarbon pattern is present in the requested fuel quantitation range but does not resemble the pattern of the requested fuel.
- 16 TPH-G, BTEX and MTBE by EPA Method 8260.

Table 2
Groundwater Analytical Results - Oxygenate Compounds
Former Tosco (Unocal) Service Station #7004
15599 Hesperian Boulevard
San Leandro, California

WELL ID	DATE	ETHANOL (ppb)	TBA (ppb)	MTBE (ppb)	DIPE (ppb)	ETBE (ppb)	TAME (ppb)	1,2-DCA (ppb)	EDB (ppb)
MW-1	05/24/02	--	--	<0.50	--	--	--	--	--
	06/21/02	--	--	0.59	--	--	--	--	--
	07/29/02	--	--	<2.0	--	--	--	--	--
	08/29/02	--	--	<2.0	--	--	--	--	--
	09/14/02	--	--	<2.0	--	--	--	--	--
	10/25/02	--	--	<2.0	--	--	--	--	--
MW-2	05/24/02	--	--	<0.50	--	--	--	--	--
	06/21/02	--	--	<0.50	--	--	--	--	--
	07/29/02	--	--	<2.0	--	--	--	--	--
	08/29/02	--	--	<2.0	--	--	--	--	--
	09/14/02	--	--	<2.0	--	--	--	--	--
	10/25/02	--	--	<2.0	--	--	--	--	--
MW-3	08/25/00	--	ND ¹	1,920	ND ¹	ND ¹	ND ¹	ND ¹	ND ¹
	05/24/02	--	--	12	--	--	--	--	--
	06/21/02	--	--	17	--	--	--	--	--
	07/29/02	--	--	<20	--	--	--	--	--
	08/29/02	--	--	<100	--	--	--	--	--
	09/14/02	--	--	<2.0	--	--	--	--	--
	10/25/02	--	--	<2.0	--	--	--	--	--
MW-4	05/24/02	--	--	2.9	--	--	--	--	--
	06/21/02	--	--	3.6	--	--	--	--	--
	07/29/02	--	--	5.7	--	--	--	--	--
	08/29/02	--	--	8.5	--	--	--	--	--
	09/14/02	--	--	4.8	--	--	--	--	--
	10/25/02	--	--	7.1	--	--	--	--	--

Table 2
Groundwater Analytical Results - Oxygenate Compounds
Former Tosco (Unocal) Service Station #7004
15599 Hesperian Boulevard
San Leandro, California

WELL ID	DATE	ETHANOL (ppb)	TBA (ppb)	MTBE (ppb)	DIPE (ppb)	ETBE (ppb)	TAME (ppb)	1,2-DCA (ppb)	EDB (ppb)
MW-5	05/24/02	--	--	180	--	--	--	--	--
	06/21/02	--	--	85	--	--	--	--	--
	07/29/02	--	--	76	--	--	--	--	--
	08/29/02	--	--	380	--	--	--	--	--
	09/14/02	--	--	91	--	--	--	--	--
	10/25/02	--	--	270	--	--	--	--	--
MW-6	05/24/02	--	--	<0.50	--	--	--	--	--
	06/21/02	--	--	<0.50	--	--	--	--	--
	07/29/02	--	--	<2.0	--	--	--	--	--
	08/29/02	--	--	<2.0	--	--	--	--	--
	09/14/02	--	--	<2.0	--	--	--	--	--
	10/25/02	--	--	<2.0	--	--	--	--	--
RW-1	05/24/02	<50	<10	300	<2.0	<1.0	<1.0	<0.5	<0.5
	06/21/02	--	--	130	--	--	--	--	--
	07/29/02	--	--	91	--	--	--	--	--
	08/29/02	--	--	210	--	--	--	--	--
	09/14/02	--	--	120	--	--	--	--	--
	10/25/02	--	--	160	--	--	--	--	--
QA	05/24/02	--	--	<0.50	--	--	--	--	--
	06/21/02	--	--	<0.50	--	--	--	--	--
	07/29/02	--	--	<2.0	--	--	--	--	--
	08/29/02	--	--	<2.0	--	--	--	--	--
	09/14/02	--	--	<2.0	--	--	--	--	--
	10/25/02	--	--	<2.0	--	--	--	--	--

Table 2
Groundwater Analytical Results - Oxygenate Compounds
Former Tosco (Unocal) Service Station #7004
15599 Hesperian Boulevard
San Leandro, California

EXPLANATIONS:

TBA = Tertiary butyl alcohol
MTBE = Methyl tertiary butyl ether
DIPE = Di-isopropyl ether
ETBE = Ethyl tertiary butyl ether
TAME = Tertiary amyl methyl ether
1,2-DCA = 1,2-Dichloroethane
EDB = 1,2-Dibromoethane
(ppb) = Parts per billion
QA = Quality Assurance
ND = Not Detected
-- = Not Analyzed

¹ Dectection limit raised. Refer to analytical reports.

ANALYTICAL METHOD:

EPA Method 8260 for Oxygenate Compounds

Table 3
Dissolved Oxygen Concentrations
Former Tosco (Unocal) Service Station #7004
15599 Hesperian Boulevard
San Leandro, California

WELL ID	DATE	Before Purging (mg/L)	After Purging (mg/L)
MW-5	07/02/97	3.82	3.97
	01/03/97	4.35	4.27
	07/12/96	3.44	3.67
	01/15/98	4.19	4.38
	07/08/98	4.67	4.60

EXPLANATIONS:

Dissolved oxygen concentrations prior to January 15, 1998, were compiled from reports prepared by MPDS Services, Inc.

(mg/L) = milligrams per liter

STANDARD OPERATING PROCEDURE - GROUNDWATER SAMPLING

Gettler-Ryan Inc. field personnel adhere to the following procedures for the collection and handling of groundwater samples prior to analysis by the analytical laboratory. Prior to sample collection, the type of analysis to be performed is determined. Loss prevention of volatile compounds is controlled and sample preservation for subsequent analysis is maintained.

Prior to sampling, the presence or absence of free-phase hydrocarbons is determined using an interface probe. Product thickness, if present, is measured to the nearest 0.01 foot and is noted in the field notes. In addition, all depth to water level measurements are collected with a static water level indicator and are also recorded in the field notes, prior to purging and sampling any wells.

After water levels are collected and prior to sampling, temperature, pH and electrical conductivity are measured. If purging is to occur, each well is purged a minimum of three well casing volumes of water using pre-cleaned pumps (stack, suction, Grundfos), or disposable bailers. The measurements are taken a minimum of three times during the purging. Purging continues until these parameters stabilize.

Groundwater samples are collected using disposable bailers. The water samples are transferred from the bailer into appropriate containers. Pre-preserved containers, supplied by analytical laboratories, are used when possible. When pre-preserved containers are not available, the laboratory is instructed to preserve the sample as appropriate. Duplicate samples are collected for the laboratory to use in maintaining quality assurance/quality control standards. The samples are labeled to include the job number, sample identification, collection date and time, analysis, preservation (if any), and the sample collector's initials. The water samples are placed in a cooler, maintained at 4°C for transport to the laboratory. Once collected in the field, all samples are maintained under chain of custody until delivered to the laboratory.

The chain of custody document includes the job number, type of preservation, if any, analysis requested, sample identification, date and time collected, and the sample collector's name. The chain of custody is signed and dated (including time of transfer) by each person who receives or surrenders the samples, beginning with the field personnel and ending with the laboratory personnel.

A laboratory supplied trip blank accompanies each sampling set and is labeled as QA. For sampling sets greater than 20 samples, 5% trip blanks are included. The trip blank is analyzed for some or all of the same compounds as the groundwater samples.

As requested by Phillips 66 Company, the purge water and decontamination water generated during sampling activities is transported to Phillips 66 - San Francisco Refinery, located in Rodeo, California.

***TOSCO (UNOCAL) SERVICE STATION#7004
SAN LEANDRO, CA***

***MONITORING AND SAMPLING
EVENT OF August 29, 2002***



GETTLER-RYAN INC.

WELL MONITORING/SAMPLING FIELD DATA SHEET

Client/Facility #: Tosco #7004 Job Number: 180106
 Site Address: 15599 Hesperian Blvd. Event Date: 8/29/02
 City: San Leandro Sampler: VT

Well ID: MW-1 Well Condition: OK
 Well Diameter: 2 in. Hydrocarbon Amount Bailed
 Total Depth: 23.87 ft. Thickness: 0.00 ft. (product/water): 0 gal.
 Depth to Water: 14.10 ft.

Volume	3/4"= 0.02	1"= 0.04	2"= 0.17	3"= 0.38
Factor (VF)	4"= 0.66	5"= 1.02	6"= 1.50	12"= 5.80

9.77 xVF 0.17 = 1.66 x3 (case volume) = Estimated Purge Volume: 5 gal.

Purge Equipment: Disposable Bailer _____ Sampling Equipment: Disposable Bailer
 Stainless Steel Bailer _____ Pressure Bailer _____
 Stack Pump _____ Discrete Bailer _____
 Suction Pump Other: _____
 Grundfos _____
 Other: _____

Start Time (purge): 0950 Weather Conditions: ptly cloudy
 Sample Time/Date: 1005/8/29/02 Water Color: brn. Odor: no
 Purging Flow Rate: 1 gpm. Sediment Description: silt (little)
 Did well de-water? no If yes, Time: _____ Volume: _____ gal.

Time (2400 hr.)	Volume (gal.)	pH	Conductivity (umhos/cm)	Temperature (C/E)	D.O. (mg/L)	ORP (mV)
<u>0952</u>	<u>1.5</u>	<u>7.53</u>	<u>529</u>	<u>72.7</u>	_____	_____
<u>0954</u>	<u>3</u>	<u>7.47</u>	<u>536</u>	<u>72.6</u>	_____	_____
<u>0956</u>	<u>5</u>	<u>7.45</u>	<u>536</u>	<u>72.4</u>	_____	_____
_____	_____	_____	_____	_____	_____	_____

LABORATORY INFORMATION

SAMPLE ID	(#) CONTAINER	REFRIG.	PRESERV. TYPE	LABORATORY	ANALYSES
<u>MW-1</u>	<u>3 x vial</u>	<u>YES</u>	<u>HCL</u>	<u>STL Pleasanton</u>	<u>TPH-G,BTEX,MTBE by 8260</u>
_____	_____	_____	_____	_____	_____
_____	_____	_____	_____	_____	_____

COMMENTS: _____

Add/Replaced Lock: _____ Add/Replaced Plug: _____ Size: _____



GETTLER - RYAN INC.

WELL MONITORING/SAMPLING FIELD DATA SHEET

Client/Facility #: Tosco #7004 Job Number: 180106
 Site Address: 15599 Hesperian Blvd. Event Date: 8/29/02
 City: San Leandro Sampler: JS

Well ID: MW-2 Well Condition: DR
 Well Diameter: 2 in. Hydrocarbon Amount Bailed
 Total Depth: 24.06 ft. Thickness: 0.00 ft. (product/water): 0 gal.
 Depth to Water: 14.71 ft.

Volume	3/4" = 0.02	1" = 0.04	2" = 0.17	3" = 0.38
Factor (VF)	4" = 0.66	5" = 1.02	6" = 1.50	12" = 5.80

9.35 x VF 0.17 = 1.58 x3 (case volume) = Estimated Purge Volume: 5 gal.

Purge Equipment: Disposable Bailer _____ Sampling Equipment: Disposable Bailer
 Stainless Steel Bailer _____ Pressure Bailer _____
 Stack Pump _____ Discrete Bailer _____
 Suction Pump _____ Other: _____
 Grundfos _____
 Other: _____

Start Time (purge): 0918 Weather Conditions: ptly cldy
 Sample Time/Date: 0935 8/29/02 Water Color: brn. Odor: no
 Purging Flow Rate: 1 gpm. Sediment Description: silt (light)
 Did well de-water? no If yes, Time: _____ Volume: _____ gal.

Time (2400 hr.)	Volume (gal.)	pH	Conductivity (umhos/cm)	Temperature (C)	D.O. (mg/L)	ORP (mV)
<u>0920</u>	<u>1.0</u>	<u>7.60</u>	<u>523</u>	<u>72.6</u>		
<u>0922</u>	<u>3</u>	<u>7.44</u>	<u>535</u>	<u>72.7</u>		
<u>0924</u>	<u>5</u>	<u>7.45</u>	<u>535</u>	<u>72.7</u>		

LABORATORY INFORMATION

SAMPLE ID	(#) CONTAINER	REFRIG.	PRESERV. TYPE	LABORATORY	ANALYSES
MW-2	3 x voa vial	YES	HCL	STL Pleasanton	TPH-G,BTEX,MTBE by 8260

COMMENTS: _____

Add/Replaced Lock: _____ Add/Replaced Plug: _____ Size: _____



GETTLER-RYAN INC.

WELL MONITORING/SAMPLING FIELD DATA SHEET

Client/Facility #: Tosco #7004 Job Number: 180106
 Site Address: 15599 Hesperian Blvd. Event Date: 8/29/02
 City: San Leandro Sampler: VT

Well ID: MW-3 Well Condition: OK
 Well Diameter: 2 in. Hydrocarbon Amount Bailed
 Total Depth: 24.38 ft. Thickness: 0.00 ft. (product/water): 0 gal.
 Depth to Water: 14.62 ft.

Volume	3/4" = 0.02	1" = 0.04	2" = 0.17	3" = 0.38
Factor (VF)	4" = 0.66	5" = 1.02	6" = 1.50	12" = 5.80

9.76 xVF 0.17 = 1.65 x3 (case volume) = Estimated Purge Volume: 5 gal.

Purge Equipment: Disposable Bailer _____ Sampling Equipment: Disposable Bailer
 Stainless Steel Bailer _____ Pressure Bailer _____
 Stack Pump _____ Discrete Bailer _____
 Suction Pump Other: _____
 Grundfos _____
 Other: _____

Start Time (purge): 1135 Weather Conditions: clear
 Sample Time/Date: 1150 18/29/02 Water Color: clear Odor: 7
 Purging Flow Rate: _____ gpm. Sediment Description: _____
 Did well de-water? _____ If yes, Time: _____ Volume: _____ gal.

Time (2400 hr.)	Volume (gal.)	pH	Conductivity (umhos/cm)	Temperature (°C)	D.O. (mg/L)	ORP (mV)
<u>1137</u>	<u>1.5</u>	<u>7.28</u>	<u>584</u>	<u>72.4</u>		
<u>1139</u>	<u>3</u>	<u>7.11</u>	<u>593</u>	<u>72.4</u>		
<u>1141</u>	<u>5</u>	<u>7.04</u>	<u>591</u>	<u>72.3</u>		

LABORATORY INFORMATION

SAMPLE ID	(#) CONTAINER	REFRIG.	PRESERV. TYPE	LABORATORY	ANALYSES
<u>MW-3</u>	<u>3</u> x voa vial	<u>YES</u>	<u>HCL</u>	<u>STL Pleasanton</u>	<u>TPH-G,BTEX,MTBE by 8260</u>

COMMENTS: _____

Add/Replaced Lock: _____

Add/Replaced Plug: _____ Size: _____



GETTLER-RYAN INC.

WELL MONITORING/SAMPLING FIELD DATA SHEET

Client/Facility #: Tosco #7004 Job Number: 180106
 Site Address: 15599 Hesperian Blvd. Event Date: 8/29/02
 City: San Leandro Sampler: JT

Well ID: MW-4 Well Condition: oa
 Well Diameter: 2 in. Hydrocarbon Amount Bailed
 Total Depth: 25.34 ft. Thickness: 0.00 ft. (product/water): 0 gal.
 Depth to Water: 13.39 ft.

Volume	3/4" = 0.02	1" = 0.04	2" = 0.17	3" = 0.38
Factor (VF)	4" = 0.66	5" = 1.02	6" = 1.50	12" = 5.80

11.95 xVF 0.17 = 2.03 x3 (case volume) = Estimated Purge Volume: 6 gal.

Purge Equipment: Disposable Bailer _____
 Stainless Steel Bailer _____
 Stack Pump _____
 Suction Pump ✓
 Grundfos _____
 Other: _____

Sampling Equipment: Disposable Bailer ✓
 Pressure Bailer _____
 Discrete Bailer _____
 Other: _____

Start Time (purge): 0845 Weather Conditions: cldy
 Sample Time/Date: 0900 8/29/02 Water Color: clear Odor: no
 Purging Flow Rate: 1 gpm. Sediment Description: _____
 Did well de-water? no If yes, Time: _____ Volume: _____ gal.

Time (2400 hr.)	Volume (gal.)	pH	Conductivity (umhos/cm)	Temperature (C/F)	D.O. (mg/L)	ORP (mV)
<u>0847</u>	<u>2</u>	<u>7.56</u>	<u>526</u>	<u>71.2</u>		
<u>0849</u>	<u>4</u>	<u>7.43</u>	<u>540</u>	<u>71.6</u>		
<u>0851</u>	<u>6</u>	<u>7.40</u>	<u>540</u>	<u>71.6</u>		

LABORATORY INFORMATION

SAMPLE ID	(#) CONTAINER	REFRIG.	PRESERV. TYPE	LABORATORY	ANALYSES
<u>MW-4</u>	<u>3</u> x voa vial	<u>YES</u>	<u>HCL</u>	<u>STL Pleasanton</u>	<u>TPH-G,BTEX,MTBE by 8260</u>

COMMENTS: _____

Add/Replaced Lock: _____ Add/Replaced Plug: _____ Size: _____



GETTLER-RYAN INC.

WELL MONITORING/SAMPLING FIELD DATA SHEET

Client/Facility #: Tosco #7004 Job Number: 180106
 Site Address: 15599 Hesperian Blvd. Event Date: 8/29/02
 City: San Leandro Sampler: ST

Well ID: MW-5 Well Condition: OK
 Well Diameter: 2 in. Hydrocarbon Amount Bailed
 Total Depth: 25.80 ft. Thickness: 0.00 ft. (product/water): 0 gal.
 Depth to Water: 14.80 ft.

Volume	3/4"= 0.02	1"= 0.04	2"= 0.17	3"= 0.38
Factor (VF)	4"= 0.66	5"= 1.02	6"= 1.50	12"= 5.80

11.00 xVF 0.17 = 1.87 x3 (case volume) = Estimated Purge Volume: 6 gal.

Purge Equipment: Disposable Bailer _____
 Stainless Steel Bailer _____
 Stack Pump _____
 Suction Pump / _____
 Grundfos _____
 Other: _____

Sampling Equipment: Disposable Bailer ✓ _____
 Pressure Bailer _____
 Discrete Bailer _____
 Other: _____

Start Time (purge): 1020 Weather Conditions: clear
 Sample Time/Date: 1035 8/29/02 Water Color: brn. Odor: no
 Purging Flow Rate: 1 gpm. Sediment Description: Silt (little)
 Did well de-water? no If yes, Time: _____ Volume: _____ gal.

Time (2400 hr.)	Volume (gal.)	pH	Conductivity (umhos/cm)	Temperature (°F)	D.O. (mg/L)	ORP (mV)
<u>1022</u>	<u>2</u>	<u>7.54</u>	<u>528</u>	<u>71.5</u>		
<u>1024</u>	<u>4</u>	<u>7.42</u>	<u>543</u>	<u>71.1</u>		
<u>1026</u>	<u>6</u>	<u>7.48</u>	<u>546</u>	<u>70.9</u>		

LABORATORY INFORMATION

SAMPLE ID	(#) CONTAINER	REFRIG.	PRESERV. TYPE	LABORATORY	ANALYSES
<u>MW-5</u>	<u>3</u> x vov vial	<u>YES</u>	<u>HCL</u>	<u>STL Pleasanton</u>	<u>TPH-G,BTEX,MTBE by 8260</u>

COMMENTS: _____

Add/Replaced Lock: _____ Add/Replaced Plug: _____ Size: _____



GETTLER-RYAN INC.

WELL MONITORING/SAMPLING FIELD DATA SHEET

Client/Facility #: Tosco #7004 Job Number: 180106
 Site Address: 15599 Hesperian Blvd. Event Date: 8/29/02
 City: San Leandro Sampler: VT

Well ID: MW-6 Well Condition: OK
 Well Diameter: 2 in. Hydrocarbon Thickness: 0.00 ft. Amount Bailed (product/water): 0 gal.
 Total Depth: 25.31 ft.
 Depth to Water: 14.97 ft.

Volume Factor (VF)	3/4"= 0.02	1"= 0.04	2"= 0.17	3"= 0.38
	4"= 0.66	5"= 1.02	6"= 1.50	12"= 5.80

10.34 xVF 0.17 = 1.75 x3 (case volume) = Estimated Purge Volume: 5.5 gal.

Purge Equipment: Disposable Bailer _____
 Stainless Steel Bailer _____
 Stack Pump _____
 Suction Pump _____
 Grundfos _____
 Other: _____

Sampling Equipment: Disposable Bailer _____
 Pressure Bailer _____
 Discrete Bailer _____
 Other: _____

Start Time (purge): 0815 Weather Conditions: overcast
 Sample Time/Date: 0830/8/29/02 Water Color: clear Odor: no
 Purging Flow Rate: 1 gpm. Sediment Description: _____
 Did well de-water? _____ If yes, Time: _____ Volume: _____ gal.

Time (2400 hr.)	Volume (gal.)	pH	Conductivity (umhos/cm)	Temperature (C/E)	D.O. (mg/L)	ORP (mV)
<u>0817</u>	<u>2</u>	<u>7.67</u>	<u>604</u>	<u>70.8</u>	_____	_____
<u>0819</u>	<u>4</u>	<u>7.53</u>	<u>604</u>	<u>71.3</u>	_____	_____
<u>0821</u>	<u>5.5</u>	<u>7.49</u>	<u>601</u>	<u>71.7</u>	_____	_____
_____	_____	_____	_____	_____	_____	_____

LABORATORY INFORMATION

SAMPLE ID	(#) CONTAINER	REFRIG.	PRESERV. TYPE	LABORATORY	ANALYSES
<u>MW-6</u>	<u>3 x voa vial</u>	<u>YES</u>	<u>HCL</u>	<u>STL Pleasanton</u>	<u>TPH-G,BTEX,MTBE by 8260</u>
_____	_____	_____	_____	_____	_____
_____	_____	_____	_____	_____	_____

COMMENTS: _____

Add/Replaced Lock: _____ Add/Replaced Plug: _____ Size: _____



GETTLER-RYAN INC.

WELL MONITORING/SAMPLING FIELD DATA SHEET

Client/Facility #: Tosco #7004 Job Number: 180106
 Site Address: 15599 Hesperian Blvd. Event Date: 8/29/02
 City: San Leandro Sampler: VF

Well ID: RW-1 Well Condition: OK
 Well Diameter: 6 in. Hydrocarbon: _____ Amount Bailed: _____
 Total Depth: 26.41 ft. Thickness: 0.00 ft. (product/water): 0 gal.
 Depth to Water: 14.43 ft.

Volume	3/4"= 0.02	1"= 0.04	2"= 0.17	3"= 0.38
Factor (VF)	4"= 0.66	5"= 1.02	6"= 1.50	12"= 5.80

11.98 xVF ^{1.50} ~~0.77~~ = 17.97 x3 (case volume) = Estimated Purge Volume: 54 gal.

Purge Equipment: Disposable Bailer _____
 Stainless Steel Bailer _____
 Stack Pump _____
 Suction Pump ✓ _____
 Grundfos _____
 Other: _____

Sampling Equipment: Disposable Bailer ✓ _____
 Pressure Bailer _____
 Discrete Bailer _____
 Other: _____

Start Time (purge): 1050 Weather Conditions: clear
 Sample Time/Date: 1125 8/29/02 Water Color: clear Odor: y (mild)
 Purging Flow Rate: 2.5-2 gpm. Sediment Description: _____
 Did well de-water? _____ If yes, Time: _____ Volume: _____ gal.

Time (2400 hr.)	Volume (gal.)	pH	Conductivity (umhos/cm)	Temperature (CE)	D.O. (mg/L)	ORP (mV)
<u>1058</u>	<u>18</u>	<u>7.50</u>	<u>521</u>	<u>71.7</u>	_____	_____
<u>1107</u>	<u>36</u>	<u>7.37</u>	<u>527</u>	<u>71.8</u>	_____	_____
<u>1116</u>	<u>54</u>	<u>7.31</u>	<u>533</u>	<u>72.0</u>	_____	_____
_____	_____	_____	_____	_____	_____	_____
_____	_____	_____	_____	_____	_____	_____

LABORATORY INFORMATION

SAMPLE ID	(#) CONTAINER	REFRIG.	PRESERV. TYPE	LABORATORY	ANALYSES
RW-1	<u>3</u> x vva vial	YES	HCL	STL Pleasanton	TPH-G,BTEX,MTBE by 8260

COMMENTS: _____

Add/Replaced Lock: _____ Add/Replaced Plug: _____ Size: _____

68510-09-0010

68510 Gettler-Ryan Inc., Chain-of-Custody

Sep 17 02 10:13P

st10nsite

9256003002

P.3

Toeco Corp./
Phillips 66 Co.
2000 Crow Canyon Place
Suite 400
San Ramon, CA 94583

Facility Number 77004
Facility Address 15999 HESPERIAN BLVD., SAN LEANDRO, CA
Global ID T0800101451 Project 180106.80
Client Contact MR. DAVID B. DEWITT
Phone (925) 277-2384

Laboratory Name STL - PLEASANTON, CA
Consultant GETTLER-RYAN, INC. DEANNA L. HARDING
Address 6747 SIERRA CT., SUITE J, DUBLIN CA 94568
Phone (925) 551-7555 Fax (925) 551-7899
Samples Collected by Vanthas Tashjian

SAMPLE ID	Number of Containers Matrix	S = Soil A = Air W = Water C = Charcoal		Sample Preservation	Date/Time (2400 Hrs)	TPH-GAS/BTEX/MTBE EPA 8015/8021B	TPH-DIESEL EPA 8015	TPH-DIESEL w/Silica gel EPA 8015	TPH-GAS EPA 8015	TPH-GAS/BTEX/MTBE EPA 8260	OXYGENATES EPA 8260	METHANOL EPA 8015	TOTAL OIL & GREASE EPA 5820	METALS Cd, Cr, Pb, Zn, Ni	NITRATE/SULFATE/ALKALINITY EPA 300 SERIES	HMOC'S (8010) EPA 8021B	VOC'S (8240) EPA 8260	SVOC'S EPA 8270					Remarks	
QA	1	W	HC		8/29/02					X														
MW-1	3	W	HC		1005					X														
MW-2	3	W	HC		0935					X														
MW-3	3	W	HC		1150					X														
MW-4	3	W	HC		0900					X														
MW-5	3	W	HC		1035					X														
MW-6	3	W	HC		0830					X														
PW-1	3	W	HC		1125					X														

- OXYGENATES 8260
- 1 - MTBE
 - 2 - TBA
 - 3 - TAME
 - 4 - DIPE
 - 5 - ETBE
 - 6 - 1,2-DCA
 - 7 - EDB
 - 8 - ETHANOL

Quished By (Signature)
[Signature]

Quished By (Signature)
[Signature]

Quished By (Signature)
[Signature]

Organization
GR

Organization
GR

Organization
GR

Date/Time 1105
8/29/02

Date/Time

Date/Time

Received By (Signature)

Received By (Signature)

Received For Laboratory By (Signature)
[Signature]

Organization

Organization

Organization

Date/Time

Date/Time

Date/Time
09-3-02

Iced Y/N

Iced Y/N

Iced Y/N
1225

Turn Around Time (Circle Choice)

- 24 Hrs.
- 48 Hrs.
- 72 Hrs.
- 5 Days
- 10 Days
- As Contracted

Submission#: 2002-09-0013

September 17, 2002

SEVERN

TRENT

LABORATORY

Gettler Ryan

6747 Sierra Court Suite J
Dublin, CA 94568

Attn.: Deanna Harding

Project#: 180106.80

Project: Tosco # 7004

Site: 15599 Hesperian Blvd.
San Leandro, CA

STL San Francisco
1220 Quarry Ln
Pleasanton CA 94566

Tel.: (925) 484-1919
Fax: (925) 484-1096
www.stl-inc.com
www.chromalab.com

CA DHS ELAP#:2496

RECEIVED

7

GETTLER-RYAN
GENERAL CONTRACTORS

Dear Ms. Harding,

Attached is our report for your samples received on 09/03/2002 12:25

This report has been reviewed and approved for release. Reproduction of this report is permitted only in its entirety.

Please note that any unused portion of the samples will be discarded after 10/18/2002 unless you have requested otherwise.

We appreciate the opportunity to be of service to you. If you have any questions, please call me at (925) 484-1919.

You can also contact me via email. My email address is: tgranicher@chromalab.com

Sincerely,

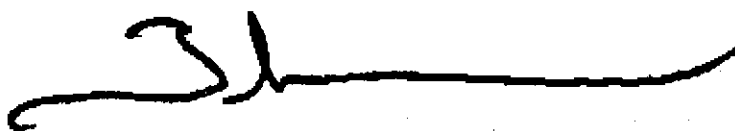

Tod Granicher
Project Manager

Submission #: 2002-09-0013

Gas/BTEX Fuel Oxygenates by 8260B

Gettler Ryan

Attn.: Deanna Harding
6747 Sierra Court Suite J
Dublin, CA 94568
Phone: (925) 551-7444 Fax: (925) 551-7899

Project: 180106.80
Tosco # 7004

Received: 09/03/2002 12:25

Site: 15599 Hesperian Blvd.
San Leandro, CA

SEVERN
TRENT
LABORATORY

STL San Francisco
1220 Quarry Lane
Pleasanton, CA 94566

Tel: (925) 484-1919
Fax: (925) 484-1096
www.stl-inc.com
www.chromalab.com

CA DHS ELAP# 2496

Samples Reported

Sample Name	Date Sampled	Matrix	Lab #
QA	08/29/2002	Water	1
MW-1	08/29/2002 10:05	Water	2
MW-2	08/29/2002 09:35	Water	3
MW-3	08/29/2002 11:50	Water	4
MW-4	08/29/2002 09:00	Water	5
MW-5	08/29/2002 10:35	Water	6
MW-6	08/29/2002 08:30	Water	7
RW-1	08/29/2002 11:25	Water	8

Submission #: 2002-09-0013

Gas/BTEX Fuel Oxygenates by 8260B

Gettler Ryan

Attn.: Deanna Harding
6747 Sierra Court Suite J
Dublin, CA 94568

Phone: (925) 551-7444 Fax: (925) 551-7899

Project: 180106.80
Tosco # 7004

Received: 09/03/2002 12:25

Site: 15599 Hesperian Blvd.
San Leandro, CA

SEVERN
TRENT
LABORATORY

STL San Francisco
1220 Quarry Lane
Pleasanton, CA 94566

Tel: (925) 484-1919
Fax: (925) 484-1096
www.stl-inc.com
www.chromalab.com

CA DHS ELAP# 2496

Prep(s):	5030B	Test(s):	8260FAB
Sample ID:	QA	Lab ID:	2002-09-0013 - 1
Sampled:	08/29/2002	Extracted:	9/12/2002 13:01
Matrix:	Water	QC Batch#:	2002/09/12-01.27

Compound	Conc.	RL	Unit	Dilution	Analyzed	Flag
Gasoline	ND	50	ug/L	1.00	09/12/2002 13:01	
Benzene	ND	0.50	ug/L	1.00	09/12/2002 13:01	
Toluene	ND	0.50	ug/L	1.00	09/12/2002 13:01	
Ethylbenzene	ND	0.50	ug/L	1.00	09/12/2002 13:01	
Total xylenes	ND	1.0	ug/L	1.00	09/12/2002 13:01	
Methyl tert-butyl ether (MTBE)	ND	2.0	ug/L	1.00	09/12/2002 13:01	
Surrogates(s)						
1,2-Dichloroethane-d4	108.6	76-114	%	1.00	09/12/2002 13:01	
Toluene-d8	98.3	88-110	%	1.00	09/12/2002 13:01	

Submission #: 2002-09-0013

Gas/BTEX Fuel Oxygenates by 8260B

Gettler Ryan

Attn.: Deanna Harding
6747 Sierra Court Suite J
Dublin, CA 94568
Phone: (925) 551-7444 Fax: (925) 551-7899

Project: 180106.80
Tosco # 7004

Received: 09/03/2002 12:25

Site: 15599 Hesperian Blvd.
San Leandro, CA

SEVERN

TRENT

LABORATORY

STL San Francisco
1220 Quarry Lane
Pleasanton, CA 94566

Tel: (925) 484-1919
Fax: (925) 484-1096
www.stl-inc.com
www.chromalab.com

CA DHS ELAP# 2496

Prep(s): 5030B Test(s): 8260FAB
Sample ID: MW-1 Lab ID: 2002-09-0013-2
Sampled: 08/29/2002 10:05 Extracted: 9/12/2002 13:23
Matrix: Water QC Batch#: 2002/09/12-01.27

Compound	Conc.	RL	Unit	Dilution	Analyzed	Flag
Gasoline	ND	50	ug/L	1.00	09/12/2002 13:23	
Benzene	ND	0.50	ug/L	1.00	09/12/2002 13:23	
Toluene	ND	0.50	ug/L	1.00	09/12/2002 13:23	
Ethylbenzene	ND	0.50	ug/L	1.00	09/12/2002 13:23	
Total xylenes	ND	1.0	ug/L	1.00	09/12/2002 13:23	
Methyl tert-butyl ether (MTBE)	ND	2.0	ug/L	1.00	09/12/2002 13:23	
Surrogates(s)						
1,2-Dichloroethane-d4	107.4	76-114	%	1.00	09/12/2002 13:23	
Toluene-d8	95.6	88-110	%	1.00	09/12/2002 13:23	

Submission #: 2002-09-0013

Gas/BTEX Fuel Oxygenates by 8260B

Gettler Ryan

Attn.: Deanna Harding
6747 Sierra Court Suite J
Dublin, CA 94568
Phone: (925) 551-7444 Fax: (925) 551-7899

Project: 180106.80
Tosco # 7004

Received: 09/03/2002 12:25

Site: 15599 Hesperian Blvd.
San Leandro, CA

SEVERN
TRENT
LABORATORY

STL San Francisco
1220 Quarry Lane
Pleasanton, CA 94566

Tel: (925) 484-1919
Fax: (925) 484-1096
www.stl-inc.com
www.chromalab.com

CA DHS ELAP# 2496

Prep(s):	5030B	Test(s):	8260FAB
Sample ID:	MW-2	Lab ID:	2002-09-0013 - 3
Sampled:	08/29/2002 09:35	Extracted:	9/12/2002 13:46
Matrix:	Water	QC Batch#:	2002/09/12-01.27

Compound	Conc.	RL	Unit	Dilution	Analyzed	Flag
Gasoline	ND	50	ug/L	1.00	09/12/2002 13:46	
Benzene	ND	0.50	ug/L	1.00	09/12/2002 13:46	
Toluene	ND	0.50	ug/L	1.00	09/12/2002 13:46	
Ethylbenzene	ND	0.50	ug/L	1.00	09/12/2002 13:46	
Total xylenes	ND	1.0	ug/L	1.00	09/12/2002 13:46	
Methyl tert-butyl ether (MTBE)	ND	2.0	ug/L	1.00	09/12/2002 13:46	
Surrogates(s)						
1,2-Dichloroethane-d4	111.7	76-114	%	1.00	09/12/2002 13:46	
Toluene-d8	97.0	88-110	%	1.00	09/12/2002 13:46	

Submission #: 2002-09-0013

Gas/BTEX Fuel Oxygenates by 8260B

Gettler Ryan

Attn.: Deanna Harding
6747 Sierra Court Suite J
Dublin, CA 94568
Phone: (925) 551-7444 Fax: (925) 551-7899

Project: 180106.80
Tosco # 7004

Received: 09/03/2002 12:25

Site: 15599 Hesperian Blvd.
San Leandro, CA

SEVERN

TRENT

LABORATORY

STL San Francisco
1220 Quarry Lane
Pleasanton, CA 94566

Tel: (925) 484-1919
Fax: (925) 484-1096
www.stl-inc.com
www.chromalab.com

CA DHS ELAP# 2496

Prep(s): 5030B Test(s): 8260FAB
Sample ID: MW-3 Lab ID: 2002-09-0013 - 4
Sampled: 08/29/2002 11:50 Extracted: 9/11/2002 01:30
Matrix: Water QC Batch#: 2002/09/10-02.27
Analysis Flag: o (See Legend and Note Section)

Compound	Conc.	RL	Unit	Dilution	Analyzed	Flag
Gasoline	7200	2500	ug/L	50.00	09/11/2002 01:30	g
Benzene	ND	25	ug/L	50.00	09/11/2002 01:30	
Toluene	ND	25	ug/L	50.00	09/11/2002 01:30	
Ethylbenzene	1200	25	ug/L	50.00	09/11/2002 01:30	
Total xylenes	ND	50	ug/L	50.00	09/11/2002 01:30	
Methyl tert-butyl ether (MTBE)	ND	100	ug/L	50.00	09/11/2002 01:30	
Surrogates(s)						
1,2-Dichloroethane-d4	112.2	76-114	%	50.00	09/11/2002 01:30	
Toluene-d8	96.6	88-110	%	50.00	09/11/2002 01:30	

Submission #: 2002-09-0013

Gas/BTEX Fuel Oxygenates by 8260B

Gettler Ryan

Attn.: Deanna Harding
6747 Sierra Court Suite J
Dublin, CA 94568
Phone: (925) 551-7444 Fax: (925) 551-7899

Project: 180106.80
Tosco # 7004

Received: 09/03/2002 12:25

Site: 15599 Hesperian Blvd.
San Leandro, CA

SEVERN
TRENT
LABORATORY

STL San Francisco
1220 Quarry Lane
Pleasanton, CA 94566

Tel: (925) 484-1919
Fax: (925) 484-1096
www.stl-inc.com
www.chromalab.com

CA DHS ELAP# 2496

Prep(s):	5030B	Test(s):	8260FAB
Sample ID:	MW-4	Lab ID:	2002-09-0013 - 5
Sampled:	08/29/2002 09:00	Extracted:	9/12/2002 14:08
Matrix:	Water	QC Batch#:	2002/09/12-01 27

Compound	Conc.	RL	Unit	Dilution	Analyzed	Flag
Gasoline	ND	50	ug/L	1.00	09/12/2002 14:08	
Benzene	ND	0.50	ug/L	1.00	09/12/2002 14:08	
Toluene	ND	0.50	ug/L	1.00	09/12/2002 14:08	
Ethylbenzene	ND	0.50	ug/L	1.00	09/12/2002 14:08	
Total xylenes	ND	1.0	ug/L	1.00	09/12/2002 14:08	
Methyl tert-butyl ether (MTBE)	8.5	2.0	ug/L	1.00	09/12/2002 14:08	
Surrogates(s)						
1,2-Dichloroethane-d4	106.3	76-114	%	1.00	09/12/2002 14:08	
Toluene-d8	92.7	88-110	%	1.00	09/12/2002 14:08	

Submission #: 2002-09-0013

Gas/BTEX Fuel Oxygenates by 8260B

Gettler Ryan

Attn.: Deanna Harding
6747 Sierra Court Suite J
Dublin, CA 94568
Phone: (925) 551-7444 Fax: (925) 551-7899

Project: 180106.80
Tosco # 7004

Received: 09/03/2002 12:25

Site: 15599 Hesperian Blvd.
San Leandro, CA

SEVERN
TRENT
LABORATORY

STL San Francisco
1220 Quarry Lane
Pleasanton, CA 94566

Tel: (925) 484-1919
Fax: (925) 484-1096
www.stl-inc.com
www.chromalab.com

CA DHS ELAP# 2496

Prep(s): 5030B	Test(s): 8260FAB
Sample ID: MW-6	Lab ID: 2002-09-0013 - 7
Sampled: 08/29/2002 08:30	Extracted: 9/12/2002 14:53
Matrix: Water	QC Batch#: 2002/09/12-01.27

Compound	Conc.	RL	Unit	Dilution	Analyzed	Flag
Gasoline	ND	50	ug/L	1.00	09/12/2002 14:53	
Benzene	ND	0.50	ug/L	1.00	09/12/2002 14:53	
Toluene	ND	0.50	ug/L	1.00	09/12/2002 14:53	
Ethylbenzene	ND	0.50	ug/L	1.00	09/12/2002 14:53	
Total xylenes	ND	1.0	ug/L	1.00	09/12/2002 14:53	
Methyl tert-butyl ether (MTBE)	ND	2.0	ug/L	1.00	09/12/2002 14:53	
Surrogates(s)						
1,2-Dichloroethane-d4	105.4	76-114	%	1.00	09/12/2002 14:53	
Toluene-d8	97.3	88-110	%	1.00	09/12/2002 14:53	

Submission #: 2002-09-0013

Gas/BTEX Fuel Oxygenates by 8260B

Gettler Ryan

Attn.: Deanna Harding
6747 Sierra Court Suite J
Dublin, CA 94568

Phone: (925) 551-7444 Fax: (925) 551-7899

Project: 180106.80
Tosco # 7004

Received: 09/03/2002 12:25

Site: 15599 Hesperian Blvd.
San Leandro, CA

SEVERN
TRENT
LABORATORY

STL San Francisco
1220 Quarry Lane
Pleasanton, CA 94566

Tel: (925) 484-1919
Fax: (925) 484-1096
www.stl-inc.com
www.chromalab.com

CA DHS ELAP# 2496

Prep(s): 5030B	Test(s): 8260FAB
Sample ID: RW-1	Lab ID: 2002-09-0013 - 8
Sampled: 08/29/2002 11:25	Extracted: 9/12/2002 15:43
Matrix: Water	QC Batch#: 2002/09/12-02.62

Analysis Flag: o (See Legend and Note Section)

Compound	Conc.	RL	Unit	Dilution	Analyzed	Flag
Gasoline	2400	200	ug/L	4.00	09/12/2002 15:43	
Benzene	ND	2.0	ug/L	4.00	09/12/2002 15:43	
Toluene	ND	2.0	ug/L	4.00	09/12/2002 15:43	
Ethylbenzene	47	2.0	ug/L	4.00	09/12/2002 15:43	
Total xylenes	ND	4.0	ug/L	4.00	09/12/2002 15:43	
Methyl tert-butyl ether (MTBE)	210	8.0	ug/L	4.00	09/12/2002 15:43	
Surrogates(s)						
1,2-Dichloroethane-d4	79.6	76-114	%	4.00	09/12/2002 15:43	
Toluene-d8	96.5	88-110	%	4.00	09/12/2002 15:43	

Submission #: 2002-09-0013

Gas/BTEX Fuel Oxygenates by 8260B

Gettler Ryan

Attn.: Deanna Harding
6747 Sierra Court Suite J
Dublin, CA 94568
Phone: (925) 551-7444 Fax: (925) 551-7899

Project: 180106.80
Tosco # 7004

Received: 09/03/2002 12:25

Site: 15599 Hesperian Blvd.
San Leandro, CA

SEVERN
TRENT
LABORATORY

STL San Francisco
1220 Quarry Lane
Pleasanton, CA 94566

Tel: (925) 484-1919
Fax: (925) 484-1096
www.sti-inc.com
www.chromalab.com

CA DHS ELAP# 2496

Batch QC Report

Prep(s): 5030B

Method Blank

MB: 2002/09/10-02.27-017

Water

Test(s): 8260FAB

QC Batch # 2002/09/10-02.27

Date Extracted: 09/10/2002 17:56

Compound	Conc.	RL	Unit	Analyzed	Flag
Gasoline	ND	50	ug/L	09/10/2002 17:56	
Benzene	ND	0.5	ug/L	09/10/2002 17:56	
Toluene	ND	0.5	ug/L	09/10/2002 17:56	
Ethylbenzene	ND	0.5	ug/L	09/10/2002 17:56	
Total xylenes	ND	1.0	ug/L	09/10/2002 17:56	
Methyl tert-butyl ether (MTBE)	ND	2.0	ug/L	09/10/2002 17:56	
Surrogates(s)					
1,2-Dichloroethane-d4	112.2	76-114	%	09/10/2002 17:56	
Toluene-d8	95.0	88-110	%	09/10/2002 17:56	

Submission #: 2002-09-0013

Gas/BTEX Fuel Oxygenates by 8260B

Gettler Ryan

Attn.: Deanna Harding
6747 Sierra Court Suite J
Dublin, CA 94568
Phone: (925) 551-7444 Fax: (925) 551-7899

Project: 180106.80
Tosco # 7004

Received: 09/03/2002 12:25

Site: 15599 Hesperian Blvd.
San Leandro, CA

SEVERN
TRENT
LABORATORY

STL San Francisco
1220 Quarry Lane
Pleasanton, CA 94566

Tel: (925) 484-1919
Fax: (925) 484-1096
www.stl-inc.com
www.chromalab.com

CA DHS ELAP# 2496

Batch QC Report

Prep(s): 5030B

Method Blank

MB: 2002/09/12-01.27-007

Water

Test(s): 8260FAB

QC Batch # 2002/09/12-01.27

Date Extracted: 09/12/2002 12:11

Compound	Conc.	RL	Unit	Analyzed	Flag
Gasoline	ND	50	ug/L	09/12/2002 12:11	
Benzene	ND	0.5	ug/L	09/12/2002 12:11	
Toluene	ND	0.5	ug/L	09/12/2002 12:11	
Ethylbenzene	ND	0.5	ug/L	09/12/2002 12:11	
Total xylenes	ND	1.0	ug/L	09/12/2002 12:11	
Methyl tert-butyl ether (MTBE)	ND	2.0	ug/L	09/12/2002 12:11	
Surrogates(s)					
1,2-Dichloroethane-d4	108.0	76-114	%	09/12/2002 12:11	
Toluene-d8	98.8	88-110	%	09/12/2002 12:11	

Submission #: 2002-09-0013

Gas/BTEX Fuel Oxygenates by 8260B

Gettler Ryan

Attn.: Deanna Harding
6747 Sierra Court Suite J
Dublin, CA 94568

Phone: (925) 551-7444 Fax: (925) 551-7899

Project: 180106.80
Tosco # 7004

Received: 09/03/2002 12:25

Site: 15599 Hesperian Blvd.
San Leandro, CA

SEVERN
TRENT
LABORATORY

STL San Francisco
1220 Quarry Lane
Pleasanton, CA 94566

Tel: (925) 484-1919
Fax: (925) 484-1096
www.stl-inc.com
www.chromalab.com

CA DHS ELAP# 2496

Batch QC Report

Prep(s): 5030B

Method Blank

MB: 2002/09/12-02.62-049

Water

Test(s): 8260FAB

QC Batch # 2002/09/12-02.62

Date Extracted: 09/12/2002 13:10

Compound	Conc.	RL	Unit	Analyzed	Flag
Gasoline	ND	50	ug/L	09/12/2002 13:10	
Benzene	ND	0.5	ug/L	09/12/2002 13:10	
Toluene	ND	0.5	ug/L	09/12/2002 13:10	
Ethylbenzene	ND	0.5	ug/L	09/12/2002 13:10	
Total xylenes	ND	1.0	ug/L	09/12/2002 13:10	
Methyl tert-butyl ether (MTBE)	ND	2.0	ug/L	09/12/2002 13:10	
Surrogates(s)					
1,2-Dichloroethane-d4	79.8	76-114	%	09/12/2002 13:10	
Toluene-d8	96.8	88-110	%	09/12/2002 13:10	

Submission #: 2002-09-0013

Gas/BTEX Fuel Oxygenates by 8260B

Gettler Ryan

Attn.: Deanna Harding
6747 Sierra Court Suite J
Dublin, CA 94568
Phone: (925) 551-7444 Fax: (925) 551-7899

Project: 180106.80
Tosco # 7004

Received: 09/03/2002 12:25

Site: 15599 Hesperian Blvd.
San Leandro, CA

SEVERN
TRENT
LABORATORY

STL San Francisco
1220 Quarry Lane
Pleasanton, CA 94566

Tel: (925) 484-1919
Fax: (925) 484-1096
www.stl-inc.com
www.chromalab.com

CA DHS ELAP# 2496

Batch QC Report

Prep(s): 5030B

Test(s): 8260B

Laboratory Control Spike

Water

QC Batch # 2002/09/10-02.27

LCS 2002/09/10-02.27-014

Extracted: 09/10/2002

Analyzed: 09/10/2002 16:58

LCSD 2002/09/10-02.27-015

Extracted: 09/10/2002

Analyzed: 09/10/2002 17:21

Compound	Conc. ug/L		Exp. Conc.	Recovery		RPD %	Ctrl. Limits %		Flags	
	LCS	LCSD		LCS	LCSD		Rec.	RPD	LCS	LCSD
Methyl tert-butyl ether (MTBE)	27.5	29.0	25.0	110.0	116.0	5.3	65-165	20		
Benzene	23.6	20.2	25.0	94.4	80.8	15.5	69-129	20		
Toluene	25.3	21.9	25.0	101.2	87.6	14.4	70-130	20		
Surrogates(s)										
1,2-Dichloroethane-d4	539	555	500	107.8	111.0		76-114			
Toluene-d8	474	470	500	94.8	94.0		88-110			

Gas/BTEX Fuel Oxygenates by 8260B

Gettler Ryan

Attn.: Deanna Harding
 6747 Sierra Court Suite J
 Dublin, CA 94568
 Phone: (925) 551-7444 Fax: (925) 551-7899

Project: 180106.80
 Tosco # 7004

Received: 09/03/2002 12:25

Site: 15599 Hesperian Blvd.
 San Leandro, CA

SEVERN
TRENT
LABORATORY

STL San Francisco
 1220 Quarry Lane
 Pleasanton, CA 94566

Tel: (925) 484-1919
 Fax: (925) 484-1096
 www.stl-inc.com
 www.chromalab.com

CA DHS ELAP# 2496

Batch QC Report

Prep(s): 5030B

Test(s): 8260FAB

Laboratory Control Spike

Water

QC Batch # 2002/09/12-01.27

LCS 2002/09/12-01.27-003

Extracted: 09/12/2002

Analyzed: 09/12/2002 11:18

LCSD 2002/09/12-01.27-004

Extracted: 09/12/2002

Analyzed: 09/12/2002 11:49

Compound	Conc. ug/L		Exp.Conc.	Recovery		RPD	Ctrl.Limits %		Flags	
	LCS	LCSD		LCS	LCSD		%	Rec.	RPD	LCS
Benzene	25.3	24.8	25.0	101.2	99.2	2.0	69-129	20		
Toluene	28.1	27.7	25.0	112.4	110.8	1.4	70-130	20		
Methyl tert-butyl ether (MTBE)	30.5	29.7	25.0	122.0	118.8	2.7	65-165	20		
Surrogates(s)										
1,2-Dichloroethane-d4	553	549	500	110.6	109.8		76-114			
Toluene-d8	488	498	500	97.6	99.6		88-110			

Submission #: 2002-09-0013

Gas/BTEX Fuel Oxygenates by 8260B

Gettler Ryan

Attn.: Deanna Harding
6747 Sierra Court Suite J
Dublin, CA 94568
Phone: (925) 551-7444 Fax: (925) 551-7899

Project: 180106.80
Tosco # 7004

Received: 09/03/2002 12:25

Site: 15599 Hesperian Blvd.
San Leandro, CA

SEVERN
TRENT
LABORATORY

STL San Francisco
1220 Quarry Lane
Pleasanton, CA 94566

Tel: (925) 484-1919
Fax: (925) 484-1096
www.stl-inc.com
www.chromalab.com

CA DHS ELAP# 2496

Batch QC Report

Prep(s): 5030B

Test(s): 8260B

Laboratory Control Spike

Water

QC Batch # 2002/09/12-02.62

LCS 2002/09/12-02.62-026

Extracted: 09/12/2002

Analyzed: 09/12/2002 12:26

LCSD 2002/09/12-02.62-048

Extracted: 09/12/2002

Analyzed: 09/12/2002 12:48

Compound	Conc. ug/L		Exp.Conc.	Recovery		RPD	Ctrl.Limits %		Flags	
	LCS	LCSD		LCS	LCSD		%	Rec.	RPD	LCS
Methyl tert-butyl ether (MTBE)	22.6	22.4	25.0	90.4	89.6	0.9	65-165	20		
Benzene	23.2	23.3	25.0	92.8	93.2	0.4	69-129	20		
Toluene	25.6	25.3	25.0	102.4	101.2	1.2	70-130	20		
Surrogates(s)										
1,2-Dichloroethane-d4	436	459	500	87.2	91.8		76-114			
Toluene-d8	494	498	500	98.8	99.6		88-110			

Submission #: 2002-09-0013

Gas/BTEX Fuel Oxygenates by 8260B

Gettler Ryan

Attn.: Deanna Harding

6747 Sierra Court Suite J

Dublin, CA 94568

Phone: (925) 551-7444 Fax: (925) 551-7899

Project: 180106.80

Tosco # 7004

Received: 09/03/2002 12:25

Site: 15599 Hesperian Blvd.
San Leandro, CA

SEVERN

TRENT

LABORATORY

STL San Francisco
1220 Quarry Lane
Pleasanton, CA 94566

Tel: (925) 484-1919
Fax: (925) 484-1096
www.stl-inc.com
www.chromalab.com

CA DHS ELAP# 2496

Legend and Notes

Analysis Flag

o

Reporting limits were raised due to high level of analyte present in the sample.

Result Flag

g

Hydrocarbon reported in the gasoline range does not match our gasoline standard.

***TOSCO (UNOCAL) SERVICE STATION#7004
SAN LEANDRO, CA***

***MONITORING AND SAMPLING
EVENT OF September 14, 2002***



GETTLER-RYAN INC.

WELL MONITORING/SAMPLING FIELD DATA SHEET

Client/Facility #: Tosco #7004 Job Number: 180106
 Site Address: 15599 Hesperian Blvd. Event Date: 9/14/02
 City: San Leandro, CA Sampler: G. Peasanton

Well ID: MW-1 Well Condition: OK
 Well Diameter: 2 in.
 Total Depth: 23.87 ft.
 Depth to Water: 14.18 ft.
 Volume Factor (VF) table:

3/4" = 0.02	1" = 0.04	2" = 0.17	3" = 0.38
4" = 0.66	5" = 1.02	6" = 1.50	12" = 5.80

 xVF 0.17 = 1.65 x3 (case volume) = Estimated Purge Volume: 5 gal.

Purge Equipment:
 Disposable Bailer
 Stainless Steel Bailer _____
 Stack Pump _____
 Suction Pump _____
 Grundfos _____
 Other: _____

Sampling Equipment:
 Disposable Bailer
 Pressure Bailer _____
 Discrete Bailer _____
 Other: _____

Time Started: _____ (2400 hrs)
 Time Bailed: _____ (2400 hrs)
 Depth to Product: _____ ft.
 Depth to Water: _____ ft.
 Hydrocarbon Thickness: _____ ft.
 Visual Confirmation/Description: _____
 Skimmer / Absorbant Sock (circle one)
 Amt Removed from Skimmer: _____ gal
 Amt Removed from Well: _____ gal
 Product Transferred to: _____

Start Time (purge): 0745 Weather Conditions: Overcast
 Sample Time/Date: 0820 / 9/14/02 Water Color: Clear Odor: NO
 Purging Flow Rate: _____ gpm. Sediment Description: _____
 Did well de-water? No If yes, Time: _____ Volume: _____ gal.

Time (2400 hr.)	Volume (gal.)	pH	Conductivity (umhos/cm)	Temperature (C/F)	D.O. (mg/L)	ORP (mV)
<u>0755</u>	<u>2</u>	<u>7.19</u>	<u>639</u>	<u>29.8</u>	_____	_____
<u>0800</u>	<u>4</u>	<u>7.14</u>	<u>635</u>	<u>29.7</u>	_____	_____
<u>0805</u>	<u>5</u>	<u>7.13</u>	<u>633</u>	<u>29.7</u>	_____	_____
_____	_____	_____	_____	_____	_____	_____

LABORATORY INFORMATION

SAMPLE ID	(#) CONTAINER	REFRIG.	PRESERV. TYPE	LABORATORY	ANALYSES
<u>MW-1</u>	<u>3</u> x voa vial	<u>YES</u>	<u>HCL</u>	<u>STL Peasanton</u>	<u>TPH-G, BTEX, MTBE (8260)</u>
_____	_____	_____	_____	_____	_____
_____	_____	_____	_____	_____	_____

COMMENTS: _____

Add/Replaced Lock: _____ Add/Replaced Plug: _____ Size: _____



GETTLER-RYAN INC.

WELL MONITORING/SAMPLING FIELD DATA SHEET

Client/Facility #: Tosco #7004 Job Number: 180106
 Site Address: 15599 Hesperian Blvd. Event Date: 9/14/0
 City: San Leandro, CA Sampler: G. Ryan

Well ID: MW-2 Well Condition: OK
 Well Diameter: 2 in.
 Total Depth: 24.06 ft.
 Depth to Water: 14.81 ft.
 Volume Factor (VF) table:

3/4" = 0.02	1" = 0.04	2" = 0.17	3" = 0.38
4" = 0.66	5" = 1.02	6" = 1.50	12" = 5.80

 xVF 0.17 = 1.57 x3 (case volume) = Estimated Purge Volume: 5 gal.

Purge Equipment: Disposable Bailer
 Stainless Steel Bailer
 Stack Pump
 Suction Pump
 Grundfos
 Other: _____

Sampling Equipment: Disposable Bailer
 Pressure Bailer
 Discrete Bailer
 Other: _____

Time Started: _____ (2400 hrs)
 Time Bailed: _____ (2400 hrs)
 Depth to Product: _____ ft
 Depth to Water: _____ ft
 Hydrocarbon Thickness: _____ ft
 Visual Confirmation/Description: _____
 Skimmer / Absorbant Sock (circle one)
 Amt Removed from Skimmer: _____ gal
 Amt Removed from Well: _____ gal
 Product Transferred to: _____

Start Time (purge): 0830 Weather Conditions: Overcast
 Sample Time/Date: 0905 / 9/14/0 Water Color: Clear Odor: No
 Purging Flow Rate: _____ gpm. Sediment Description: _____
 Did well de-water? No If yes, Time: _____ Volume: _____ gal.

Time (2400 hr.)	Volume (gal.)	pH	Conductivity (umhos/cm)	Temperature (C/F)	D.O. (mg/L)	ORP (mV)
<u>0840</u>	<u>2</u>	<u>7.22</u>	<u>630</u>	<u>29.8</u>		
<u>0845</u>	<u>4</u>	<u>7.17</u>	<u>626</u>	<u>29.7</u>		
<u>0850</u>	<u>5</u>	<u>7.11</u>	<u>624</u>	<u>29.7</u>		

LABORATORY INFORMATION

SAMPLE ID	(#) CONTAINER	REFRIG.	PRESERV. TYPE	LABORATORY	ANALYSES
<u>MW-2</u>	<u>3 x vva vial</u>	<u>YES</u>	<u>HCL</u>	<u>STL Peasanton</u>	<u>TPH-G, BTEX, MTBE (8260)</u>

COMMENTS: _____

Add/Replaced Lock: _____ Add/Replaced Plug: _____ Size: _____



GETTLER-RYAN INC.

WELL MONITORING/SAMPLING FIELD DATA SHEET

Client/Facility #: Tosco #7004 Job Number: 180106
 Site Address: 15599 Hesperian Blvd. Event Date: 9/14/02
 City: San Leandro, CA Sampler: G.R.

Well ID: MW-3 Well Condition: OK
 Well Diameter: 2 in.
 Total Depth: 24.38 ft.
 Depth to Water: 14.72 ft.
 $9.66 \times VF \ 0.17 = 1.64 \times 3 \text{ (case volume)} = \text{Estimated Purge Volume: } \underline{5} \text{ gal.}$

Volume	3/4" = 0.02	1" = 0.04	2" = 0.17	3" = 0.38
Factor (VF)	4" = 0.66	5" = 1.02	6" = 1.50	12" = 5.80

Purge Equipment:
 Disposable Bailer
 Stainless Steel Bailer _____
 Stack Pump _____
 Suction Pump _____
 Grundfos _____
 Other: _____

Sampling Equipment:
 Disposable Bailer
 Pressure Bailer _____
 Discrete Bailer _____
 Other: _____

Time Started: _____ (2400 hrs)
 Time Bailed: _____ (2400 hrs)
 Depth to Product: _____ ft
 Depth to Water: _____ ft
 Hydrocarbon Thickness: _____ ft
 Visual Confirmation/Description: _____
 Skimmer / Absorbant Sock (circle one)
 Amt Removed from Skimmer: _____ gal
 Amt Removed from Well: _____ gal
 Product Transferred to: _____

Start Time (purge): 1110 Weather Conditions: Overcast
 Sample Time/Date: 1135 9/14/02 Water Color: Clear-grey Odor: Yes
 Purging Flow Rate: — gpm. Sediment Description: _____
 Did well de-water? NO If yes, Time: _____ Volume: _____ gal.

Time (2400 hr.)	Volume (gal.)	pH	Conductivity (umhos/cm)	Temperature (C/F)	D.O. (mg/L)	ORP (mV)
<u>1120</u>	<u>2</u>	<u>7.11</u>	<u>697</u>	<u>28.7</u>	_____	_____
<u>1125</u>	<u>4</u>	<u>6.99</u>	<u>691</u>	<u>28.6</u>	_____	_____
<u>1130</u>	<u>5</u>	<u>6.96</u>	<u>688</u>	<u>28.6</u>	_____	_____
_____	_____	_____	_____	_____	_____	_____

LABORATORY INFORMATION

SAMPLE ID	(#) CONTAINER	REFRIG.	PRESERV. TYPE	LABORATORY	ANALYSES
<u>MW-3</u>	<u>3 x vov vial</u>	<u>YES</u>	<u>HCL</u>	<u>STL Peasanton</u>	<u>TPH-G, BTEX, MTBE (8260)</u>
_____	_____	_____	_____	_____	_____
_____	_____	_____	_____	_____	_____

COMMENTS: _____

Add/Replaced Lock: _____ Add/Replaced Plug: _____ Size: _____



GETTLER-RYAN INC.

WELL MONITORING/SAMPLING FIELD DATA SHEET

Client/Facility #: Tosco #7004 Job Number: 180106
 Site Address: 15599 Hesperian Blvd. Event Date: 9/14/02
 City: San Leandro, CA Sampler: G.R.

Well ID: MW-4 Well Condition: OK
 Well Diameter: 2 in.
 Total Depth: 25.34 ft.
 Depth to Water: 13.49 ft.
 $11.85 \times VF \ 0.17 = 2.01 \times 3 \text{ (case volume)} = \text{Estimated Purge Volume: } \underline{6} \text{ gal.}$

Volume	3/4" = 0.02	1" = 0.04	2" = 0.17	3" = 0.38
Factor (VF)	4" = 0.66	5" = 1.02	6" = 1.50	12" = 5.80

Purge Equipment:
 Disposable Bailer
 Stainless Steel Bailer _____
 Stack Pump _____
 Suction Pump _____
 Grundfos _____
 Other: _____

Sampling Equipment:
 Disposable Bailer
 Pressure Bailer _____
 Discrete Bailer _____
 Other: _____

Time Started: _____ (2400 hrs)
 Time Bailed: _____ (2400 hrs)
 Depth to Product: _____ ft
 Depth to Water: _____ ft
 Hydrocarbon Thickness: _____ ft
 Visual Confirmation/Description:
 Skimmer / Absorbant Sock (circle one)
 Amt Removed from Skimmer: _____ gal
 Amt Removed from Well: _____ gal
 Product Transferred to: _____

Start Time (purge): 0700 Weather Conditions: overcast
 Sample Time/Date: 0735 / 9/14/02 Water Color: clear Odor: NO
 Purging Flow Rate: _____ gpm. Sediment Description: _____
 Did well de-water? NO If yes, Time: _____ Volume: _____ gal.

Time (2400 hr.)	Volume (gal.)	pH	Conductivity (umhos/cm)	Temperature (C/F)	D.O. (mg/L)	ORP (mV)
<u>0710</u>	<u>2</u>		<u>639</u>	<u>30.4</u>		
<u>0715</u>	<u>4</u>		<u>641</u>	<u>30.3</u>		
<u>0720</u>	<u>6</u>		<u>634</u>	<u>30.3</u>		

LABORATORY INFORMATION

SAMPLE ID	(#) CONTAINER	REFRIG.	PRESERV. TYPE	LABORATORY	ANALYSES
<u>MW-4</u>	<u>3</u> x vva vial	<u>YES</u>	<u>HCL</u>	<u>STL Peasanton</u>	<u>TPH-G, BTEX, MTBE (8260)</u>

COMMENTS: _____

Add/Replaced Lock: _____ Add/Replaced Plug: _____ Size: _____



GETTLER-RYAN INC.

WELL MONITORING/SAMPLING FIELD DATA SHEET

Client/Facility #: Tosco #7004 Job Number: 180106
 Site Address: 15599 Hesperian Blvd. Event Date: 9/14/07
 City: San Leandro, CA Sampler: G.R.

Well ID: MW-5 Well Condition: OK
 Well Diameter: 2 in.
 Total Depth: 25.80 ft.
 Depth to Water: 14.91 ft.
10.89 xVF 0.17 = 1.85 x3 (case volume) = Estimated Purge Volume: 5.5 gal.

Volume	3/4"= 0.02	1"= 0.04	2"= 0.17	3"= 0.38
Factor (VF)	4"= 0.66	5"= 1.02	6"= 1.50	12"= 5.80

Purge Equipment:
 Disposable Bailer
 Stainless Steel Bailer _____
 Stack Pump _____
 Suction Pump _____
 Grundfos _____
 Other: _____

Sampling Equipment:
 Disposable Bailer
 Pressure Bailer _____
 Discrete Bailer _____
 Other: _____

Time Started: _____ (2400 hrs)
 Time Bailed: _____ (2400 hrs)
 Depth to Product: _____ ft
 Depth to Water: _____ ft
 Hydrocarbon Thickness: _____ ft
 Visual Confirmation/Description:
 Skimmer / Absorbant Sock (circle one)
 Amt Removed from Skimmer: _____ gal
 Amt Removed from Well: _____ gal
 Product Transferred to: _____

Start Time (purge): 0915 Weather Conditions: Overcast
 Sample Time/Date: 0950 9/14/07 Water Color: Clear Odor: No
 Purging Flow Rate: _____ gpm. Sediment Description: _____
 Did well de-water? No If yes, Time: _____ Volume: _____ gal.

Time (2400 hr.)	Volume (gal.)	pH	Conductivity (umhos/cm)	Temperature (°F)	D.O. (mg/L)	ORP (mV)
<u>0925</u>	<u>2</u>	<u>7.33</u>	<u>644</u>	<u>28.6</u>		
<u>0930</u>	<u>4</u>	<u>7.24</u>	<u>641</u>	<u>28.5</u>		
<u>0936</u>	<u>5.5</u>	<u>7.21</u>	<u>639</u>	<u>28.5</u>		

LABORATORY INFORMATION

SAMPLE ID	(#) CONTAINER	REFRIG.	PRESERV. TYPE	LABORATORY	ANALYSES
<u>MW-5</u>	<u>3</u> x voa vial	<u>YES</u>	<u>HCL</u>	<u>STL Peasanton</u>	<u>TPH-G, BTEX, MTBE (8260)</u>

COMMENTS: _____

Add/Replaced Lock: _____ Add/Replaced Plug: _____ Size: _____



GETTLER - RYAN INC.

WELL MONITORING/SAMPLING FIELD DATA SHEET

Client/Facility #: Tosco #7004 Job Number: 180106
 Site Address: 15599 Hesperian Blvd. Event Date: 9/14/02
 City: San Leandro, CA Sampler: G.B.

Well ID: MW-6 Well Condition: OK
 Well Diameter: 2 in.
 Total Depth: 25.31 ft.
 Depth to Water: 15.04 ft.
 $10.27 \times VF \ 0.17 = 1.75 \times 3 \text{ (case volume)} = \text{Estimated Purge Volume: } 5.5 \text{ gal.}$

Volume	3/4" = 0.02	1" = 0.04	2" = 0.17	3" = 0.38
Factor (VF)	4" = 0.66	5" = 1.02	6" = 1.50	12" = 5.80

Purge Equipment:
 Disposable Bailer
 Stainless Steel Bailer _____
 Stack Pump _____
 Suction Pump _____
 Grundfos _____
 Other: _____

Sampling Equipment:
 Disposable Bailer
 Pressure Bailer _____
 Discrete Bailer _____
 Other: _____

Time Started: _____ (2400 hrs)
 Time Bailed: _____ (2400 hrs)
 Depth to Product: _____ ft
 Depth to Water: _____ ft
 Hydrocarbon Thickness: _____ ft
 Visual Confirmation/Description: _____
 Skimmer / Absorbant Sock (circle one)
 Amt Removed from Skimmer: _____ gal
 Amt Removed from Well: _____ gal
 Product Transferred to: _____

Start Time (purge): 0615 Weather Conditions: Overcast
 Sample Time/Date: 0650 9/14/02 Water Color: Clear Odor: No
 Purging Flow Rate: _____ gpm. Sediment Description: _____
 Did well de-water? No If yes, Time: _____ Volume: _____ gal.

Time (2400 hr.)	Volume (gal.)	pH	Conductivity (umhos/cm)	Temperature (C/F)	D.O. (mg/L)	ORP (mV)
<u>0625</u>	<u>2</u>	<u>7.07</u>	<u>712</u>	<u>29.9</u>		
<u>0630</u>	<u>4</u>	<u>7.02</u>	<u>719</u>	<u>29.8</u>		
<u>0635</u>	<u>5.5</u>	<u>7.00</u>	<u>714</u>	<u>29.8</u>		

LABORATORY INFORMATION

SAMPLE ID	(#) CONTAINER	REFRIG.	PRESERV. TYPE	LABORATORY	ANALYSES
<u>MW-6</u>	<u>3 x voa vial</u>	<u>YES</u>	<u>HCL</u>	<u>STL Peasanton</u>	<u>TPH-G, BTEX, MTBE (8260)</u>

COMMENTS: _____

Add/Replaced Lock: _____

Add/Replaced Plug: _____ Size: _____



GETTLER-RYAN INC.

WELL MONITORING/SAMPLING FIELD DATA SHEET

Client/Facility #: Tosco #7004 Job Number: 180106
 Site Address: 15599 Hesperian Blvd. Event Date: 9/14/07
 City: San Leandro, CA Sampler: G.R.

Well ID: RW-1 Well Condition: OK
 Well Diameter: 6 in.
 Total Depth: 26.41 ft.
 Depth to Water: 14.54 ft.
11.87 xVF 1.50 = 17.8 x3 (case volume) = Estimated Purge Volume: 54 gal.

Volume	3/4"= 0.02	1"= 0.04	2"= 0.17	3"= 0.38
Factor (VF)	4"= 0.66	5"= 1.02	6"= 1.50	12"= 5.80

Purge Equipment:
 Disposable Bailer _____
 Stainless Steel Bailer _____
 Stack Pump _____
 Suction Pump _____
 Grundfos _____
 Other: _____

Sampling Equipment:
 Disposable Bailer
 Pressure Bailer _____
 Discrete Bailer _____
 Other: _____

Time Started: _____ (2400 hrs)
 Time Bailed: _____ (2400 hrs)
 Depth to Product: _____ ft
 Depth to Water: _____ ft
 Hydrocarbon Thickness: _____ ft
 Visual Confirmation/Description: _____
 Skimmer / Absorbant Sock (circle one)
 Amt Removed from Skimmer: _____ gal
 Amt Removed from Well: _____ gal
 Product Transferred to: _____

Start Time (purge): 1000 Weather Conditions: Overcast
 Sample Time/Date: 1100 9/14/07 Water Color: Clear Odor: NO
 Purging Flow Rate: 22 gpm. Sediment Description: _____
 Did well de-water? NO If yes, Time: _____ Volume: _____ gal.

Time (2400 hr.)	Volume (gal.)	pH	Conductivity (umhos/cm)	Temperature (C/F)	D.O. (mg/L)	ORP (mV)
<u>1020</u>	<u>18</u>	<u>7.27</u>	<u>651</u>	<u>29.8</u>		
<u>1030</u>	<u>36</u>	<u>7.22</u>	<u>642</u>	<u>29.9</u>		
<u>1040</u>	<u>54</u>	<u>7.19</u>	<u>639</u>	<u>30.2</u>		

LABORATORY INFORMATION

SAMPLE ID	(#) CONTAINER	REFRIG.	PRESERV. TYPE	LABORATORY	ANALYSES
<u>RW-1</u>	<u>3</u> x voa vial	<u>YES</u>	<u>HCL</u>	<u>STL Peasanton</u>	<u>TPH-G, BTEX, MTBE (8260)</u>

COMMENTS: _____

Add/Replaced Lock: _____ Add/Replaced Plug: _____ Size: _____

2002-09-0373

Gettler-Ryan Inc., Chain-of-Custody

68858

Tosco Corp./
Phillips 66 Co.
2000 Crow Canyon Place
Suite 400
San Ramon, CA 94583

Facility Number 87004
Facility Address 15599 HESPERIAN BLVD., SAN LEANDRO, CA
Global ID T0600101451 Project 180106.80
Client Contact MR. DAVID B. DEWITT
Phone (925) 277-2384

Laboratory Name STL - PLEASANTON, CA
Consultant GETTLER-RYAN, INC. DEANNA L. HARDING
Address 6747 SIERRA CT., SUITE J, DUBLIN CA 94568
Phone (925) 551-7555 Fax (925) 551-7699
Samples Collected by G. Rogert

SAMPLE ID	Number of Containers Matrix	S = Soil A = Air W = Water C = Charcoal	Sample Preservation	Date/Time (2400 Hrs)	TPH-GAS/BTEX/MTBE EPA 8015/8021B	TPH-DIESEL EPA 8015	TPH-DIESEL w/SIBCA 904 EPA 8015	TPH-GAS EPA 8015	TPH-GAS/BTEX/MTBE EPA 8260	OXYGENATES EPA 8260	METHANOL EPA 8015	TOTAL OIL & GREASE EPA 5520	METALS Cd, Cr, Pb, Zn, Ni	NITRATE/SULFATE/ALKALINITY EPA 300 SERIES	HYDROCARBONS (B010) EPA 8021B	VOC'S (8240) EPA 8260	SVOC'S EPA 8270	Remarks
QA	1	W	HCL	9/14/02					✓									
MW-1	3	W	HCL	0830					✓									
MW-2	3	W	HCL	0905					✓									
MW-3	3	W	HCL	1135					✓									
MW-4	3	W	HCL	0735					✓									
MW-5	3	W	HCL	0950					✓									
MW-6	3	W	HCL	0650					✓									
DW-1	3	W	HCL	1100					✓									

- OXYGENATES 8260
- 1 - MTBE
 - 2 - TBA
 - 3 - TAME
 - 4 - DIPE
 - 5 - ETBE
 - 6 - 1,2-DCA
 - 7 - EDG
 - 8 - ETHANOL

Shipped By (Signature) <i>[Signature]</i>	Organization <i>[Signature]</i>	Date/Time 0600 9/14/02	Received By (Signature)	Organization	Date/Time	Iced Y/N	Turn Around Time (Circle Choice) 24 Hrs. 48 Hrs. 72 Hrs. 5 Days 10 Days As Contracted 5.0
Shipped By (Signature)	Organization	Date/Time	Received By (Signature)	Organization	Date/Time	Iced Y/N	
Shipped By (Signature)	Organization	Date/Time	Received For Laboratory By (Signature) <i>[Signature]</i>	Organization	Date/Time 9-17-02	Iced Y/N 1450	

Sep 27 02 04:12p

st10n site

9256003002

P.2

Submission#: 2002-09-0373

September 27, 2002

SEVERN

TRENT

LABORATORY

Gettler Ryan

6747 Sierra Court Suite J
Dublin, CA 94568

Attn.: Deanna Harding

Project#: 180106.80

Project: Tosco #7004

Site: 15599 Hesperian Blvd.
San Leandro, CA

STL San Francisco
1220 Quarry Ln
Pleasanton CA 94566

Tel.: (925) 484-1919
Fax: (925) 484-1096
www.stl-inc.com
www.chromalab.com

CA DHS ELAP#:2496

RECEIVED

SEP 27 2002

GETTLER-RYAN INC.
GENERAL CONTRACTOR

Dear Ms. Harding,

Attached is our report for your samples received on 09/17/2002 14:30

This report has been reviewed and approved for release. Reproduction of this report is permitted only in its entirety.

Please note that any unused portion of the samples will be discarded after 11/01/2002 unless you have requested otherwise.

We appreciate the opportunity to be of service to you. If you have any questions, please call me at (925) 484-1919.

You can also contact me via email. My email address is: tgranicher@chromalab.com

Sincerely,



Tod Granicher
Project Manager

Submission #: 2002-09-0373

Gas/BTEX Fuel Oxygenates by 8260B

Gettler Ryan

Attn.: Deanna Harding

6747 Sierra Court Suite J

Dublin, CA 94568

Phone: (925) 551-7444 Fax: (925) 551-7899

Project: 180106.80

Tosco #7004

Received: 09/17/2002 14:30

Site: 15599 Hesperian Blvd.
San Leandro, CA

SEVERN
TRENT
LABORATORY

STL San Francisco
1220 Quarry Lane
Pleasanton, CA 94566

Tel: (925) 484-1919
Fax: (925) 484-1096
www.stl-inc.com
www.chromalab.com

CA DHS ELAP# 2496

Samples Reported

Sample Name	Date Sampled	Matrix	Lab #
QA	09/14/2002	Water	1
MW-1	09/14/2002 08:20	Water	2
MW-2	09/14/2002 09:05	Water	3
MW-3	09/14/2002 11:35	Water	4
MW-4	09/14/2002 07:35	Water	5
MW-5	09/14/2002 09:50	Water	6
MW-6	09/14/2002 06:50	Water	7
RW-1	09/14/2002 11:00	Water	8

Submission #: 2002-09-0373

Gas/BTEX Fuel Oxygenates by 8260B

Gettler Ryan

Attn.: Deanna Harding
6747 Sierra Court Suite J
Dublin, CA 94568

Phone: (925) 551-7444 Fax: (925) 551-7899

Project: 180106.80
Tosco #7004

Received: 09/17/2002 14:30

Site: 15599 Hesperian Blvd.
San Leandro, CA

SEVERN

TRENT

LABORATORY

STL San Francisco
1220 Quarry Lane
Pleasanton, CA 94566

Tel: (925) 484-1919
Fax: (925) 484-1096
www.stl-inc.com
www.chromalab.com

CA DHS ELAP# 2496

Prep(s):	5030B	Test(s):	8260FAB
Sample ID:	QA	Lab ID:	2002-09-0373 - 1
Sampled:	09/14/2002	Extracted:	9/25/2002 17:13
Matrix:	Water	QC Batch#:	2002/09/25-01.62

Compound	Conc.	RL	Unit	Dilution	Analyzed	Flag
Gasoline	ND	50	ug/L	1.00	09/25/2002 17:13	
Benzene	ND	0.50	ug/L	1.00	09/25/2002 17:13	
Toluene	ND	0.50	ug/L	1.00	09/25/2002 17:13	
Ethylbenzene	ND	0.50	ug/L	1.00	09/25/2002 17:13	
Total xylenes	ND	1.0	ug/L	1.00	09/25/2002 17:13	
Methyl tert-butyl ether (MTBE)	ND	2.0	ug/L	1.00	09/25/2002 17:13	
Surrogates(s)						
1,2-Dichloroethane-d4	92.0	76-114	%	1.00	09/25/2002 17:13	
Toluene-d8	101.9	88-110	%	1.00	09/25/2002 17:13	

Submission #: 2002-09-0373

Gas/BTEX Fuel Oxygenates by 8260B

Gettler Ryan

Attn.: Deanna Harding
6747 Sierra Court Suite J
Dublin, CA 94568
Phone: (925) 551-7444 Fax: (925) 551-7899

Project: 180106.80
Tosco #7004

Received: 09/17/2002 14:30

Site: 15599 Hesperian Blvd.
San Leandro, CA

SEVERN
TRENT
LABORATORY

STL San Francisco
1220 Quarry Lane
Pleasanton, CA 94566

Tel: (925) 484-1919
Fax: (925) 484-1096
www.stl-inc.com
www.chromalab.com

CA DHS ELAP# 2496

Prep(s):	5030B	Test(s):	8260FAB
Sample ID:	MW-1	Lab ID:	2002-09-0373 - 2
Sampled:	09/14/2002 08:20	Extracted:	9/25/2002 17:35
Matrix:	Water	QC Batch#:	2002/09/25-01.62

Compound	Conc.	RL	Unit	Dilution	Analyzed	Flag
Gasoline	ND	50	ug/L	1.00	09/25/2002 17:35	
Benzene	ND	0.50	ug/L	1.00	09/25/2002 17:35	
Toluene	ND	0.50	ug/L	1.00	09/25/2002 17:35	
Ethylbenzene	ND	0.50	ug/L	1.00	09/25/2002 17:35	
Total xylenes	ND	1.0	ug/L	1.00	09/25/2002 17:35	
Methyl tert-butyl ether (MTBE)	ND	2.0	ug/L	1.00	09/25/2002 17:35	
Surrogates(s)						
1,2-Dichloroethane-d4	93.7	76-114	%	1.00	09/25/2002 17:35	
Toluene-d8	96.3	88-110	%	1.00	09/25/2002 17:35	

Submission #: 2002-09-0373

Gas/BTEX Fuel Oxygenates by 8260B

Gettler Ryan

Attn.: Deanna Harding
6747 Sierra Court Suite J
Dublin, CA 94568
Phone: (925) 551-7444 Fax: (925) 551-7899

Project: 180106.80
Tosco #7004

Received: 09/17/2002 14:30

Site: 15599 Hesperian Blvd.
San Leandro, CA

SEVERN
TRENT
LABORATORY

STL San Francisco
1220 Quarry Lane
Pleasanton, CA 94566

Tel: (925) 484-1919
Fax: (925) 484-1096
www.stl-inc.com
www.chromalab.com

CA DHS ELAP# 2496

Prep(s):	5030B	Test(s):	8260FAB
Sample ID:	MW-2	Lab ID:	2002-09-0373 - 3
Sampled:	09/14/2002 09:05	Extracted:	9/25/2002 17:57
Matrix:	Water	QC Batch#:	2002/09/25-01.62

Compound	Conc.	RL	Unit	Dilution	Analyzed	Flag
Gasoline	ND	50	ug/L	1.00	09/25/2002 17:57	
Benzene	ND	0.50	ug/L	1.00	09/25/2002 17:57	
Toluene	ND	0.50	ug/L	1.00	09/25/2002 17:57	
Ethylbenzene	ND	0.50	ug/L	1.00	09/25/2002 17:57	
Total xylenes	ND	1.0	ug/L	1.00	09/25/2002 17:57	
Methyl tert-butyl ether (MTBE)	ND	2.0	ug/L	1.00	09/25/2002 17:57	
Surrogates(s)						
1,2-Dichloroethane-d4	91.8	76-114	%	1.00	09/25/2002 17:57	
Toluene-d8	94.6	88-110	%	1.00	09/25/2002 17:57	

Submission #: 2002-09-0373

Gas/BTEX Fuel Oxygenates by 8260B

Gettler Ryan

Attn.: Deanna Harding
6747 Sierra Court Suite J
Dublin, CA 94568
Phone: (925) 551-7444 Fax: (925) 551-7899

Project: 180106.80
Tosco #7004

Received: 09/17/2002 14:30

Site: 15599 Hesperian Blvd.
San Leandro, CA

SEVERN
TRENT
LABORATORY

STL San Francisco
1220 Quarry Lane
Pleasanton, CA 94566

Tel: (925) 484-1919
Fax: (925) 484-1096
www.stl-inc.com
www.chromalab.com

CA DHS ELAP# 2496

Prep(s):	5030B	Test(s):	8260FAB
Sample ID:	MW-3	Lab ID:	2002-09-0373 - 4
Sampled:	09/14/2002 11:35	Extracted:	9/25/2002 18:19
Matrix:	Water	QC Batch#:	2002/09/25-01 62

Compound	Conc.	RL	Unit	Dilution	Analyzed	Flag
Gasoline	180	50	ug/L	1.00	09/25/2002 18:19	
Benzene	ND	0.50	ug/L	1.00	09/25/2002 18:19	
Toluene	ND	0.50	ug/L	1.00	09/25/2002 18:19	
Ethylbenzene	20	0.50	ug/L	1.00	09/25/2002 18:19	
Total xylenes	ND	1.0	ug/L	1.00	09/25/2002 18:19	
Methyl tert-butyl ether (MTBE)	ND	2.0	ug/L	1.00	09/25/2002 18:19	
Surrogates(s)						
1,2-Dichloroethane-d4	97.6	76-114	%	1.00	09/25/2002 18:19	
Toluene-d8	104.0	88-110	%	1.00	09/25/2002 18:19	

Gas/BTEX Fuel Oxygenates by 8260B

Gettler Ryan

Attn.: Deanna Harding
6747 Sierra Court Suite J
Dublin, CA 94568
Phone: (925) 551-7444 Fax: (925) 551-7899

Project: 180106.80
Tosco #7004

Received: 09/17/2002 14:30

Site: 15599 Hesperian Blvd.
San Leandro, CA

STL San Francisco
1220 Quarry Lane
Pleasanton, CA 94566

Tel: (925) 484-1919
Fax: (925) 484-1096
www.stl-inc.com
www.chromalab.com

CA DHS ELAP# 2496

Prep(s):	5030B	Test(s):	8260FAB
Sample ID:	MW-4	Lab ID:	2002-09-0373 - 5
Sampled:	09/14/2002 07:35	Extracted:	9/25/2002 18:42
Matrix:	Water	QC Batch#:	2002/09/25-01.62

Compound	Conc.	RL	Unit	Dilution	Analyzed	Flag
Gasoline	ND	50	ug/L	1.00	09/25/2002 18:42	
Benzene	ND	0.50	ug/L	1.00	09/25/2002 18:42	
Toluene	ND	0.50	ug/L	1.00	09/25/2002 18:42	
Ethylbenzene	ND	0.50	ug/L	1.00	09/25/2002 18:42	
Total xylenes	ND	1.0	ug/L	1.00	09/25/2002 18:42	
Methyl tert-butyl ether (MTBE)	4.8	2.0	ug/L	1.00	09/25/2002 18:42	
Surrogates(s)						
1,2-Dichloroethane-d4	92.2	76-114	%	1.00	09/25/2002 18:42	
Toluene-d8	96.9	88-110	%	1.00	09/25/2002 18:42	

Submission #: 2002-09-0373

Gas/BTEX Fuel Oxygenates by 8260B

Gettler Ryan

Attn.: Deanna Harding
6747 Sierra Court Suite J
Dublin, CA 94568
Phone: (925) 551-7444 Fax: (925) 551-7899

Project: 180106.80
Tosco #7004

Received: 09/17/2002 14:30

Site: 15599 Hesperian Blvd.
San Leandro, CA

SEVERN
TRENT
LABORATORY

STL San Francisco
1220 Quarry Lane
Pleasanton, CA 94566

Tel: (925) 484-1919
Fax: (925) 484-1096
www.stl-inc.com
www.chromalab.com

CA DHS ELAP# 2496

Prep(s):	5030B	Test(s):	8260FAB
Sample ID:	MW-5	Lab ID:	2002-09-0373 - 6
Sampled:	09/14/2002 09:50	Extracted:	9/25/2002 19:04
Matrix:	Water	QC Batch#:	2002/09/25-01.62

Compound	Conc.	RL	Unit	Dilution	Analyzed	Flag
Gasoline	130	50	ug/L	1.00	09/25/2002 19:04	g
Benzene	ND	0.50	ug/L	1.00	09/25/2002 19:04	
Toluene	ND	0.50	ug/L	1.00	09/25/2002 19:04	
Ethylbenzene	ND	0.50	ug/L	1.00	09/25/2002 19:04	
Total xylenes	ND	1.0	ug/L	1.00	09/25/2002 19:04	
Methyl tert-butyl ether (MTBE)	91	2.0	ug/L	1.00	09/25/2002 19:04	
Surrogates(s)						
1,2-Dichloroethane-d4	94.0	76-114	%	1.00	09/25/2002 19:04	
Toluene-d8	98.7	88-110	%	1.00	09/25/2002 19:04	

Submission #: 2002-09-0373

Gas/BTEX Fuel Oxygenates by 8260B

Gettler Ryan

Attn.: Deanna Harding
6747 Sierra Court Suite J
Dublin, CA 94568
Phone: (925) 551-7444 Fax: (925) 551-7899

Project: 180106.80
Tosco #7004

Received: 09/17/2002 14:30

Site: 15599 Hesperian Blvd.
San Leandro, CA

SEVERN
TRENT
LABORATORY

STL San Francisco
1220 Quarry Lane
Pleasanton, CA 94566

Tel: (925) 484-1919
Fax: (925) 484-1096
www.stl-inc.com
www.chromalab.com

CA DHS ELAP# 2496

Prep(s):	5030B	Test(s):	8260FAB
Sample ID:	MW-6	Lab ID:	2002-09-0373 - 7
Sampled:	09/14/2002 06:50	Extracted:	9/25/2002 19:26
Matrix:	Water	QC Batch#:	2002/09/25-01.62

Compound	Conc.	RL	Unit	Dilution	Analyzed	Flag
Gasoline	ND	50	ug/L	1.00	09/25/2002 19:26	
Benzene	ND	0.50	ug/L	1.00	09/25/2002 19:26	
Toluene	ND	0.50	ug/L	1.00	09/25/2002 19:26	
Ethylbenzene	ND	0.50	ug/L	1.00	09/25/2002 19:26	
Total xylenes	ND	1.0	ug/L	1.00	09/25/2002 19:26	
Methyl tert-butyl ether (MTBE)	ND	2.0	ug/L	1.00	09/25/2002 19:26	
Surrogates(s)						
1,2-Dichloroethane-d4	89.4	76-114	%	1.00	09/25/2002 19:26	
Toluene-d8	103.0	88-110	%	1.00	09/25/2002 19:26	

Submission #: 2002-09-0373

Gas/BTEX Fuel Oxygenates by 8260B

Gettler Ryan

Attn.: Deanna Harding
6747 Sierra Court Suite J
Dublin, CA 94568

Phone: (925) 551-7444 Fax: (925) 551-7899

Project: 180106.80
Tosco #7004

Received: 09/17/2002 14:30

Site: 15599 Hesperian Blvd.
San Leandro, CA

SEVERN
TRENT
LABORATORY

STL San Francisco
1220 Quarry Lane
Pleasanton, CA 94566

Tel: (925) 484-1919
Fax: (925) 484-1096
www.stl-inc.com
www.chromalab.com

CA DHS ELAP# 2496

Prep(s):	5030B	Test(s):	8260FAB
Sample ID:	RW-1	Lab ID:	2002-09-0373 - 8
Sampled:	09/14/2002 11:00	Extracted:	9/25/2002 19:48
Matrix:	Water	QC Batch#:	2002/09/25-01.62

Compound	Conc.	RL	Unit	Dilution	Analyzed	Flag
Gasoline	390	50	ug/L	1.00	09/25/2002 19:48	
Benzene	ND	0.50	ug/L	1.00	09/25/2002 19:48	
Toluene	ND	0.50	ug/L	1.00	09/25/2002 19:48	
Ethylbenzene	ND	0.50	ug/L	1.00	09/25/2002 19:48	
Total xylenes	ND	1.0	ug/L	1.00	09/25/2002 19:48	
Methyl tert-butyl ether (MTBE)	120	2.0	ug/L	1.00	09/25/2002 19:48	
Surrogates(s)						
1,2-Dichloroethane-d4	94.0	76-114	%	1.00	09/25/2002 19:48	
Toluene-d8	97.3	88-110	%	1.00	09/25/2002 19:48	

Submission #: 2002-09-0373

Gas/BTEX Fuel Oxygenates by 8260B

Gettler Ryan

Attn.: Deanna Harding
6747 Sierra Court Suite J
Dublin, CA 94568
Phone: (925) 551-7444 Fax: (925) 551-7899

Project: 180106.80
Tosco #7004

Received: 09/17/2002 14:30

Site: 15599 Hesperian Blvd.
San Leandro, CA

SEVERN
TRENT
LABORATORY

STL San Francisco
1220 Quarry Lane
Pleasanton, CA 94566

Tel: (925) 484-1919
Fax: (925) 484-1096
www.stl-inc.com
www.chromalab.com

CA DHS ELAP# 2496

Batch QC Report			
Prep(s): 5030B			Test(s): 8260FAB
Method Blank	Water		QC Batch # 2002/09/25-01.62
MB: 2002/09/25-01.62-054			Date Extracted: 09/25/2002 11:15

Compound	Conc.	RL	Unit	Analyzed	Flag
Gasoline	ND	50	ug/L	09/25/2002 11:15	
Benzene	ND	0.5	ug/L	09/25/2002 11:15	
Toluene	ND	0.5	ug/L	09/25/2002 11:15	
Ethylbenzene	ND	0.5	ug/L	09/25/2002 11:15	
Total xylenes	ND	1.0	ug/L	09/25/2002 11:15	
Methyl tert-butyl ether (MTBE)	ND	2.0	ug/L	09/25/2002 11:15	
Surrogates(s)					
1,2-Dichloroethane-d4	94.8	76-114	%	09/25/2002 11:15	
Toluene-d8	96.4	88-110	%	09/25/2002 11:15	

Submission #: 2002-09-0373

Gas/BTEX Fuel Oxygenates by 8260B

Gettler Ryan

Attn.: Deanna Harding
6747 Sierra Court Suite J
Dublin, CA 94568

Phone: (925) 551-7444 Fax: (925) 551-7899

Project: 180106.80
Tosco #7004

Received: 09/17/2002 14:30

Site: 15599 Hesperian Blvd.
San Leandro, CA

SEVERN

TRENT

LABORATORY

STL San Francisco
1220 Quarry Lane
Pleasanton, CA 94566

Tel: (925) 484-1919
Fax: (925) 484-1096
www.stl-inc.com
www.chromalab.com

CA DHS ELAP# 2496

Batch QC Report

Prep(s): 5030B

Test(s): 8260B

Laboratory Control Spike

Water

QC Batch # 2002/09/25-01.62

LCS 2002/09/25-01.62-032

Extracted: 09/25/2002

Analyzed: 09/25/2002 10:32

LCSD 2002/09/25-01.62-053

Extracted: 09/25/2002

Analyzed: 09/25/2002 10:53

Compound	Conc. ug/L		Exp.Conc.	Recovery		RPD	Ctrl.Limits %		Flags	
	LCS	LCSD		LCS	LCSD		%	Rec.	RPD	LCS
Methyl tert-butyl ether (MTBE)	23.4	20.3	25.0	93.6	81.2	14.2	65-165	20		
Benzene	23.5	21.0	25.0	94.0	84.0	11.2	69-129	20		
Toluene	26.1	22.9	25.0	104.4	91.6	13.1	70-130	20		
Surrogates(s)										
1,2-Dichloroethane-d4	489	474	500	97.8	94.8		76-114			
Toluene-d8	504	497	500	100.8	99.4		88-110			

Submission #: 2002-09-0373

Gas/BTEX Fuel Oxygenates by 8260B

Gettler Ryan

Attn.: Deanna Harding
6747 Sierra Court Suite J
Dublin, CA 94568

Phone: (925) 551-7444 Fax: (925) 551-7899

Project: 180106.80
Tosco #7004

Received: 09/17/2002 14:30

Site: 15599 Hesperian Blvd.
San Leandro, CA

SEVERN

TRENT

LABORATORY

STL San Francisco
1220 Quarry Lane
Pleasanton, CA 94566

Tel: (925) 484-1919
Fax: (925) 484-1096
www.stl-inc.com
www.chromalab.com

CA DHS ELAP# 2496

Legend and Notes

Result Flag

g

Hydrocarbon reported in the gasoline range does not match our gasoline standard.

***TOSCO (UNOCAL) SERVICE STATION#7004
SAN LEANDRO, CA***

***QUARTERLY MONITORING AND SAMPLING
EVENT OF October 25, 2002***



GETTLER - RYAN INC.

WELL MONITORING/SAMPLING FIELD DATA SHEET

Client/Facility #: Tosco #7004 Job Number: 180106
 Site Address: 15599 Hesperian Blvd. Event Date: 10-25-02 (inclusive)
 City: San Leandro, CA Sampler: K-Kelly

Well ID: MW-1 Well Condition: OK
 Well Diameter: 2 in.
 Total Depth: 23.87 ft.
 Depth to Water: 14.63 ft.
9.24 xVF 0.17 = 1.57 x3 (case volume) = Estimated Purge Volume: 4.71 gal.

Volume	3/4"= 0.02	1"= 0.04	2"= 0.17	3"= 0.38
Factor (VF)	4"= 0.66	5"= 1.02	6"= 1.50	12"= 5.80

Purge Equipment:
 Disposable Bailer _____
 Stainless Steel Bailer
 Stack Pump _____
 Suction Pump _____
 Grundfos _____
 Other: _____

Sampling Equipment:
 Disposable Bailer
 Pressure Bailer _____
 Discrete Bailer _____
 Other: _____

Time Started: _____ (2400 hrs)
 Time Bailed: _____ (2400 hrs)
 Depth to Product: _____ ft
 Depth to Water: _____ ft
 Hydrocarbon Thickness: _____ ft
 Visual Confirmation/Description: _____
 Skimmer / Absorbant Sock (circle one)
 Amt Removed from Skimmer: _____ gal
 Amt Removed from Well: _____ gal
 Product Transferred to: _____

Start Time (purge): 119 Weather Conditions: Clear
 Sample Time/Date: 1324 / 10-25-02 Water Color: Clear Odor: No
 Purging Flow Rate: 1.5 gpm. Sediment Description: -
 Did well de-water? No If yes, Time: _____ Volume: _____ gal.

Time (2400 hr.)	Volume (gal.)	pH	Conductivity (umhos/cm)	Temperature (°F)	D.O. (mg/L)	ORP (mV)
<u>121</u>	<u>1.5</u>	<u>7.03</u>	<u>703</u>	<u>21.8</u>		
<u>122</u>	<u>3.0</u>	<u>6.00</u>	<u>618</u>	<u>21.7</u>		
<u>123</u>	<u>4.5</u>	<u>6.99</u>	<u>701</u>	<u>22.0</u>		

LABORATORY INFORMATION

SAMPLE ID	(#) CONTAINER	REFRIG.	PRESERV. TYPE	LABORATORY	ANALYSES
<u>MW-1</u>	<u>3</u> x vva vial	<u>YES</u>	<u>HCL</u>	<u>STL Pleasanton</u>	<u>TPH-G/BTEX/MTBE(8260)</u>

COMMENTS: Needs 1 Bolt.

Add/Replaced Lock: _____ Add/Replaced Plug: _____ Size: _____



GETTLER-RYAN INC.

WELL MONITORING/SAMPLING FIELD DATA SHEET

Client/Facility #: Tosco #7004 Job Number: 180106
 Site Address: 15599 Hesperian Blvd. Event Date: 10-25-02 (inclusive)
 City: San Leandro, CA Sampler: _____

Well ID: MW-2 Well Condition: OK
 Well Diameter: 2 in.
 Total Depth: 24.06 ft.
 Depth to Water: 15.23 ft.
8.83 xVF 0.17 = 1.50 x3 (case volume) = Estimated Purge Volume: 4.50 gal.

Volume	3/4" = 0.02	1" = 0.04	2" = 0.17	3" = 0.38
Factor (VF)	4" = 0.66	5" = 1.02	6" = 1.50	12" = 5.80

Purge Equipment:
 Disposable Bailer _____
 Stainless Steel Bailer _____
 Stack Pump
 Suction Pump _____
 Grundfos _____
 Other: _____

Sampling Equipment:
 Disposable Bailer
 Pressure Bailer _____
 Discrete Bailer _____
 Other: _____

Time Started: _____ (2400 hrs)
 Time Bailed: _____ (2400 hrs)
 Depth to Product: _____ ft
 Depth to Water: _____ ft
 Hydrocarbon Thickness: _____ ft
 Visual Confirmation/Description: _____
 Skimmer / Absorbant Sock (circle one)
 Amt Removed from Skimmer: _____ gal
 Amt Removed from Well: _____ gal
 Product Transferred to: _____

Start Time (purge): 1337 Weather Conditions: Clear
 Sample Time/Date: 1354 10-25-02 Water Color: Clear Odor: No
 Purging Flow Rate: _____ gpm. Sediment Description: _____
 Did well de-water? No If yes, Time: _____ Volume: _____ gal.

Time (2400 hr.)	Volume (gal.)	pH	Conductivity (umhos/cm)	Temperature (°F)	D.O. (mg/L)	ORP (mV)
<u>1339</u>	<u>1.5</u>	<u>7.02</u>	<u>651</u>	<u>21.4</u>		
<u>1341</u>	<u>3.0</u>	<u>7.14</u>	<u>683</u>	<u>20.9</u>		
<u>1342</u>	<u>4.5</u>	<u>7.20</u>	<u>592</u>	<u>21.1</u>		

LABORATORY INFORMATION

SAMPLE ID	(#) CONTAINER	REFRIG.	PRESERV. TYPE	LABORATORY	ANALYSES
<u>MW-2</u>	<u>3</u> x vva vial	<u>YES</u>	<u>HCL</u>	<u>STL Pleasanton</u>	<u>TPH-G/BTEX/MTBE(8260)</u>

COMMENTS: Installed a Ball

Add/Replaced Lock: Add/Replaced Plug: Size: 2in.



GETTLER - RYAN INC.

WELL MONITORING/SAMPLING FIELD DATA SHEET

Client/Facility #: Tosco #7004 Job Number: 180106
 Site Address: 15599 Hesperian Blvd. Event Date: 10-25-02 (inclusive)
 City: San Leandro, CA Sampler: K. Kelly

Well ID: MW-3 Well Condition: OK
 Well Diameter: 2 in.
 Total Depth: 24.38 ft.
 Depth to Water: 15.13 ft.
 Volume Factor (VF) table:

Volume	3/4" = 0.02	1" = 0.04	2" = 0.17	3" = 0.36
Factor (VF)	4" = 0.66	5" = 1.02	6" = 1.50	12" = 5.80

 $9.25 \times VF_{1.57} = 1.57 \times 3 = 4.71$ gal. Estimated Purge Volume: 4.71 gal.

Purge Equipment: Disposable Bailer Stainless Steel Bailer _____ Stack Pump _____ Suction Pump _____ Grundfos _____ Other: _____
 Sampling Equipment: Disposable Bailer Pressure Bailer _____ Discrete Bailer _____ Other: _____

Time Started: _____ (2400 hrs)
 Time Bailed: _____ (2400 hrs)
 Depth to Product: _____ ft
 Depth to Water: _____ ft
 Hydrocarbon Thickness: _____ ft
 Visual Confirmation/Description: _____
 Skimmer / Absorbant Sock (circle one)
 Amt Removed from Skimmer: _____ gal
 Amt Removed from Well: _____ gal
 Product Transferred to: _____

Start Time (purge): 16:37 Weather Conditions: clear
 Sample Time/Date: 16:49 10-25-02 Water Color: clear / blue Odor: gas
 Purging Flow Rate: _____ gpm. Sediment Description: _____
 Did well de-water? No If yes, Time: _____ Volume: _____ gal.

Time (2400 hr.)	Volume (gal.)	pH	Conductivity (umhos/cm)	Temperature (°F)	D.O. (mg/L)	ORP (mV)
1640	1.50	7.77	734	20.9		
1643	3.0	7.16	736	21.3		
1646	4.5	7.02	742	21.2		

LABORATORY INFORMATION

SAMPLE ID	(#) CONTAINER	REFRIG.	PRESERV. TYPE	LABORATORY	ANALYSES
MW-3	3 x vov vial	YES	HCL	STL Pleasanton	TPH-G/BTEX/MTBE(8260)

COMMENTS: Installed as Bolt

Add/Replaced Lock: _____ Add/Replaced Plug: _____ Size: _____



GETTLER-RYAN INC.

WELL MONITORING/SAMPLING FIELD DATA SHEET

Client/Facility #: Tosco #7004 Job Number: 180106
 Site Address: 15599 Hesperian Blvd. Event Date: 10-25-02 (inclusive)
 City: San Leandro, CA Sampler: K. Kelly

Well ID: MW-4
 Well Diameter: 2 in.
 Total Depth: 85.34 ft.
 Depth to Water: 13.93 ft.

Well Condition: OK

Volume	3/4" = 0.02	1" = 0.04	2" = 0.17	3" = 0.38
Factor (VF)	4" = 0.66	5" = 1.02	6" = 1.50	12" = 5.80

11.41 xVF 0.14 = 1.93 x3 (case volume) = Estimated Purge Volume: 5.81 gal.

Purge Equipment:

Disposable Bailer _____
 Stainless Steel Bailer _____
 Stack Pump _____
 Suction Pump _____
 Grundfos _____
 Other: _____

Sampling Equipment:

Disposable Bailer _____
 Pressure Bailer _____
 Discrete Bailer _____
 Other: _____

Time Started: _____ (2400 hrs)
 Time Bailed: _____ (2400 hrs)
 Depth to Product: _____ ft
 Depth to Water: _____ ft
 Hydrocarbon Thickness: _____ ft
 Visual Confirmation/Description: _____
 Skimmer / Absorbent Sock (circle one)
 Amt Removed from Skimmer: _____ gal
 Amt Removed from Well: _____ gal
 Product Transferred to: _____

Start Time (purge): 1243 Weather Conditions: Clear
 Sample Time/Date: 1258 / 10-25-02 Water Color: Cloudy Odor: No
 Purging Flow Rate: _____ gpm. Sediment Description: _____
 Did well de-water? No If yes, Time: _____ Volume: _____ gal.

Time (2400 hr.)	Volume (gal.)	pH	Conductivity (umhos/cm)	Temperature (C/F)	D.O. (mg/L)	ORP (mV)
<u>1247</u>	<u>2.0</u>	<u>7.52</u>	<u>723</u>	<u>20.4</u>	_____	_____
<u>1249</u>	<u>4.0</u>	<u>7.37</u>	<u>725</u>	<u>21.1</u>	_____	_____
<u>1251</u>	<u>6.0</u>	<u>7.31</u>	<u>679</u>	<u>21.1</u>	_____	_____
_____	_____	_____	_____	_____	_____	_____

LABORATORY INFORMATION

SAMPLE ID	(#) CONTAINER	REFRIG.	PRESERV. TYPE	LABORATORY	ANALYSES
<u>MW-4</u>	<u>3</u> x voa vial	<u>YES</u>	<u>HCL</u>	<u>STL Pleasanton</u>	<u>TPH-G/BTEX/MTBE(8260)</u>
_____	_____	_____	_____	_____	_____
_____	_____	_____	_____	_____	_____

COMMENTS: Installed a Bolt

Add/Replaced Lock: _____ Add/Replaced Plug: _____ Size: _____



GETTLER-RYAN INC.

WELL MONITORING/SAMPLING FIELD DATA SHEET

Client/Facility #: Tosco #7004 Job Number: 180106
 Site Address: 15599 Hesperian Blvd. Event Date: 10.25.02 (inclusive)
 City: San Leandro, CA Sampler: K Kelly

Well ID: MW-5 Well Condition: OK
 Well Diameter: 2 in.
 Total Depth: 25.80 ft.
 Depth to Water: 15.32 ft.
10.48 x VF 0.17 = 1.78 x3 (case volume) = Estimated Purge Volume: 5.34 gal.

Volume	3/4"= 0.02	1"= 0.04	2"= 0.17	3"= 0.38
Factor (VF)	4"= 0.66	5"= 1.02	6"= 1.50	12"= 5.80

Purge Equipment:
 Disposable Bailer
 Stainless Steel Bailer _____
 Stack Pump _____
 Suction Pump _____
 Grundfos _____
 Other: _____

Sampling Equipment:
 Disposable Bailer
 Pressure Bailer _____
 Discrete Bailer _____
 Other: _____

Time Started: _____ (2400 hrs)
 Time Bailed: _____ (2400 hrs)
 Depth to Product: _____ ft.
 Depth to Water: _____ ft.
 Hydrocarbon Thickness: _____ ft.
 Visual Confirmation/Description: _____
 Skimmer / Absorbant Sock (circle one)
 Amt Removed from Skimmer: _____ gal
 Amt Removed from Well: _____ gal
 Product Transferred to: _____

Start Time (purge): 1416 Weather Conditions: clear
 Sample Time/Date: 1433 10-25-02 Water Color: tan Odor: No
 Purging Flow Rate: _____ gpm. Sediment Description: _____
 Did well de-water? No If yes, Time: _____ Volume: _____ gal.

Time (2400 hr.)	Volume (gal.)	pH	Conductivity (umhos/cm)	Temperature (°F)	D.O. (mg/L)	ORP (mV)
<u>1420</u>	<u>1.75</u>	<u>6.13</u>	<u>3.53</u>	<u>20.3</u>		
<u>1424</u>	<u>3.5</u>	<u>7.58</u>	<u>526</u>	<u>21.1</u>		
<u>1428</u>	<u>5.0</u>	<u>7.34</u>	<u>711</u>	<u>21.4</u>		

LABORATORY INFORMATION

SAMPLE ID	(#) CONTAINER	REFRIG.	PRESERV. TYPE	LABORATORY	ANALYSES
<u>MW-5</u>	<u>3 x vov vial</u>	<u>YES</u>	<u>HCL</u>	<u>STL Pleasanton</u>	<u>TPH-G/BTEX/MTBE(8260)</u>

COMMENTS: _____

Add/Replaced Lock: _____ Add/Replaced Plug: _____ Size: _____



GETTLER-RYAN INC.

WELL MONITORING/SAMPLING FIELD DATA SHEET

Client/Facility #: Tosco #7004 Job Number: 180106
 Site Address: 15599 Hesperian Blvd. Event Date: 10-25-02 (inclusive)
 City: San Leandro, CA Sampler: K. Kelly

Well ID: MW-6 Well Condition: LIO cracked
 Well Diameter: 2 in.
 Total Depth: 25.31 ft.
 Depth to Water: 15.46 ft.
 Volume Factor (VF) table:

Volume	3/4" = 0.02	1" = 0.04	2" = 0.17	3" = 0.38
Factor (VF)	4" = 0.66	5" = 1.02	6" = 1.50	12" = 5.80

 xVF 0.17 = 1.67 x3 (case volume) = Estimated Purge Volume: 5.02 gal.

Purge Equipment:
 Disposable Bailer
 Stainless Steel Bailer _____
 Stack Pump _____
 Suction Pump _____
 Grundfos _____
 Other: _____

Sampling Equipment:
 Disposable Bailer
 Pressure Bailer _____
 Discrete Bailer _____
 Other: _____

Time Started: _____ (2400 hrs)
 Time Bailed: _____ (2400 hrs)
 Depth to Product: _____ ft
 Depth to Water: _____ ft
 Hydrocarbon Thickness: _____ ft
 Visual Confirmation/Description: _____
 Skimmer / Absorbant Sock (circle one)
 Amt Removed from Skimmer: _____ gal
 Amt Removed from Well: _____ gal
 Product Transferred to: _____

Start Time (purge): 1142 Weather Conditions: clear
 Sample Time/Date: 1157 / 10-25-02 Water Color: cloudy Odor: no
 Purging Flow Rate: _____ gpm. Sediment Description: _____
 Did well de-water? No If yes, Time: _____ Volume: _____ gal.

Time (2400 hr.)	Volume (gal.)	pH	Conductivity (umhos/cm)	Temperature (OF)	D.O. (mg/L)	ORP (mV)
<u>1146</u>	<u>1.5</u>	<u>6.95</u>	<u>789</u>	<u>20.7</u>		
<u>1150</u>	<u>3.0</u>	<u>6.77</u>	<u>805</u>	<u>21.6</u>		
<u>1153</u>	<u>5.0</u>	<u>6.87</u>	<u>781</u>	<u>21.2</u>		

LABORATORY INFORMATION

SAMPLE ID	(#) CONTAINER	REFRIG.	PRESERV. TYPE	LABORATORY	ANALYSES
<u>MW-6</u>	<u>3 x voa vial</u>	<u>YES</u>	<u>HCL</u>	<u>STL Pleasanton</u>	<u>TPH-G/BTEX/MTBE(8260)</u>

COMMENTS: _____

Add/Replaced Lock: _____ Add/Replaced Plug: _____ Size: _____



GETTLER - RYAN INC.

WELL MONITORING/SAMPLING FIELD DATA SHEET

Client/Facility #: Tosco #7004 Job Number: 180106
 Site Address: 15599 Hesperian Blvd. Event Date: 10-25-02 (inclusive)
 City: San Leandro, CA Sampler: K. Kelly

Well ID: RW-1
 Well Diameter: 6 in.
 Total Depth: 26.41 ft.
 Depth to Water: 14.95 ft.

Well Condition: See notes

Volume	3/4" = 0.02	1" = 0.04	2" = 0.17	3" = 0.38
Factor (VF)	4" = 0.66	5" = 1.02	6" = 1.50	12" = 5.80

11.46 x VF 1.50 = 17.19 x3 (case volume) = Estimated Purge Volume: 51.57 gal.

Purge Equipment:
 Disposable Bailer _____
 Stainless Steel Bailer _____
 Stack Pump ✓
 Suction Pump _____
 Grundfos _____
 Other: _____

Sampling Equipment:
 Disposable Bailer ✓
 Pressure Bailer _____
 Discrete Bailer _____
 Other: _____

Time Started: _____ (2400 hrs)
 Time Bailed: _____ (2400 hrs)
 Depth to Product: _____ ft
 Depth to Water: _____ ft
 Hydrocarbon Thickness: _____ ft
 Visual Confirmation/Description: _____
 Skimmer / Absorbant Sock (circle one)
 Amt Removed from Skimmer: _____ gal
 Amt Removed from Well: _____ gal
 Product Transferred to: _____

Start Time (purge): 1520 Weather Conditions: Clear
 Sample Time/Date: 10/10/10 25/02 Water Color: Clear Odor: None
 Purging Flow Rate: 3.0 gpm. Sediment Description: _____
 Did well de-water? No If yes, Time: _____ Volume: _____ gal.

Time (2400 hr.)	Volume (gal.)	pH	Conductivity (umhos/cm)	Temperature (C/F)	D.O. (mg/L)	ORP (mV)
<u>1528</u>	<u>14.0</u>	<u>4.54</u>	<u>608</u>	<u>21.1</u>		
<u>1538</u>	<u>34.0</u>	<u>7.40</u>	<u>812</u>	<u>19.6</u>		
<u>1600</u>	<u>51.0</u>	<u>7.35</u>	<u>667</u>	<u>19.4</u>		

LABORATORY INFORMATION

SAMPLE ID	(#) CONTAINER	REFRIG.	PRESERV. TYPE	LABORATORY	ANALYSES
<u>RW-1</u>	<u>3 x vva vial</u>	<u>YES</u>	<u>HCL</u>	<u>STL Pleasanton</u>	<u>TPH-G/BTEX/MTBE(8260)</u>

COMMENTS: Started Purge @ 1445 No water / Picked and Reset with Generator/Boiler
Well box Needs tapped for bolts.

Add/Replaced Lock: ✓ Add/Replaced Plug: _____ Size: _____

2002-10-0592

Gettler-Ryan Inc., Chain-of-Custod

69792

Tosco Corp./ Phillips 66 Co. 2000 Crow Canyon Place Suite 400 San Ramon, CA 94583	Facility Number	#7004	Laboratory Name	STL - PLEASANTON, CA
	Facility Address	15599 HESPERIAN BLVD., SAN LEANDRO, CA	Consultant	GETTLER-RYAN, INC. DEANNA L. HARDING
	Global ID	TD600101451	Project	180106.80
	Client Contact	MR. DAVID B. DEWITT	Address	6747 SIERRA CT., SUITE J, DUBLIN CA 94568
	Phone	(925) 277-2384	Phone	(925) 551-7555
			Fax	(925) 551-7899
			Samples Collected by	Kristina Kelly

SAMPLE ID	Number of Containers Matrix	S = Soil W = Water A = Air C = Chiroood	Sample Preservation	Date/Time (2400 Hrs)	TPH-GAS/BTEX/MTBE EPA 8015/8021B	TPH-DIESEL EPA 8015	TPH-DIESEL w/Silica gel EPA 8015	TPH-GAS EPA 8015	TPH-GAS/BTEX/MTBE EPA 8260	OXYGENATES EPA 8260	METHANOL EPA 8015	TOTAL OIL & GREASE EPA 5620	METALS Cd, Cr, Pb, Zn, Ni	NITRATE/SULFATE/ALKALINITY EPA 300 SERIES	MVOC'S (9010) EPA 8021B	VOC'S (9240) EPA 8260	SVOC'S EPA 8270	Remarks
QA 1	1	W		10.25.02					X									
MW-1	3	H		1327					X									
MW-2	3	H		1354					X									
MW-3	3	H		11049					X									
MW-4	3	H		1258					X									
MW-5	3	H		1433					X									
MW-6	3	H		1157					X									
RW-1	3	H		1610					X									

- OXYGENATES 8260
- 1 - MTBE
 - 2 - TBA
 - 3 - TAME
 - 4 - DIPE
 - 5 - ETBE
 - 6 - 1,2-DCA
 - 7 - EDB
 - 8 - ETHANOL

Relinquished By (Signature)	Organization	Date/Time	Received By (Signature)	Organization	Date/Time	Iced Y/N	Turn Around Time (Circle Choice)
<i>Kristina Kelly</i>	Gettler Ryan	10/25/02					
Relinquished By (Signature)	Organization	Date/Time	Received By (Signature)	Organization	Date/Time	Iced Y/N	
Relinquished By (Signature)	Organization	Date/Time	Received For Laboratory By (Signature)		Date/Time	Iced Y/N	
			<i>3</i>		10-28-02	1430	

- 24 Hrs.
- 48 Hrs.
- 72 Hrs.
- 5 Days
- 10 Days
- As Contracted

Submission#: 2002-10-0592

November 12, 2002

SEVERN

TRENT

LABORATORY

Gettler Ryan

6747 Sierra Court Suite J
Dublin, CA 94568

Attn.: Deanna Harding

Project#: 180106.80

Project: Tosco # 7004

Site: 15599 Hesperian Blvd.
San Leandro, CA

RECEIVED

NOV 14 2002

GETTLER RYAN INC.
GENERAL CONTRACTORS

STL San Francisco
1220 Quarry Ln
Pleasanton CA 94566

Tel.: (925) 484-1919
Fax: (925) 484-1096
www.stl-inc.com
www.chromalab.com

CA DHS ELAP#:2496

Dear Ms. Harding,

Attached is our report for your samples received on 10/28/2002 14:30

This report has been reviewed and approved for release. Reproduction of this report is permitted only in its entirety.

Please note that any unused portion of the samples will be discarded after 12/12/2002 unless you have requested otherwise.

We appreciate the opportunity to be of service to you. If you have any questions, please call me at (925) 484-1919.

You can also contact me via email. My email address is: tgranicher@chromalab.com

Sincerely,

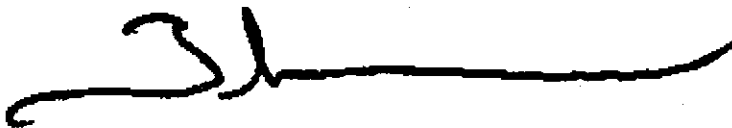

Tod Granicher
Project Manager

Submission #: 2002-10-0592

Gas/BTEX Fuel Oxygenates by 8260B

Gettler Ryan

Attn.: Deanna Harding
6747 Sierra Court Suite J
Dublin, CA 94568

Phone: (925) 551-7444 Fax: (925) 551-7899

Project: 180106.80
Tosco # 7004

Received: 10/28/2002 14:30

Site: 15599 Hesperian Blvd.
San Leandro, CA

SEVERN

TRENT

LABORATORY

STL San Francisco
1220 Quarry Lane
Pleasanton, CA 94566

Tel: (925) 484-1919
Fax: (925) 484-1096
www.stl-inc.com
www.chromalab.com

CA DHS ELAP# 2496

Samples Reported

Sample Name	Date Sampled	Matrix	Lab #
QA	10/25/2002	Water	1
MW-1	10/25/2002 13:27	Water	2
MW-2	10/25/2002 13:54	Water	3
MW-3	10/25/2002 16:49	Water	4
MW-4	10/25/2002 12:58	Water	5
MW-5	10/25/2002 14:33	Water	6
MW-6	10/25/2002 11:57	Water	7
RW-1	10/25/2002 16:10	Water	8

Submission #: 2002-10-0592

Gas/BTEX Fuel Oxygenates by 8260B

Gettler Ryan

Attn.: Deanna Harding
6747 Sierra Court Suite J
Dublin, CA 94568
Phone: (925) 551-7444 Fax: (925) 551-7899

Project: 180106.80
Tosco # 7004

Received: 10/28/2002 14:30

Site: 15599 Hesperian Blvd.
San Leandro, CA

SEVERN
TRENT
LABORATORY

STL San Francisco
1220 Quarry Lane
Pleasanton, CA 94566

Tel: (925) 484-1919
Fax: (925) 484-1096
www.stl-inc.com
www.chromalab.com

CA DHS ELAP# 2496

Prep(s):	5030B	Test(s):	8260FAB
Sample ID:	QA	Lab ID:	2002-10-0592 - 1
Sampled:	10/25/2002	Extracted:	11/7/2002 21:12
Matrix:	Water	QC Batch#:	2002/11/07-01.27

Compound	Conc.	RL	Unit	Dilution	Analyzed	Flag
Gasoline	ND	50	ug/L	1.00	11/07/2002 21:12	
Benzene	ND	0.50	ug/L	1.00	11/07/2002 21:12	
Toluene	ND	0.50	ug/L	1.00	11/07/2002 21:12	
Ethylbenzene	ND	0.50	ug/L	1.00	11/07/2002 21:12	
Total xylenes	ND	1.0	ug/L	1.00	11/07/2002 21:12	
Methyl tert-butyl ether (MTBE)	ND	2.0	ug/L	1.00	11/07/2002 21:12	
Surrogates(s)						
1,2-Dichloroethane-d4	105.7	76-114	%	1.00	11/07/2002 21:12	
Toluene-d8	101.2	88-110	%	1.00	11/07/2002 21:12	

Submission #: 2002-10-0592

SEVERN

Gas/BTEX Fuel Oxygenates by 8260B

TRENT

LABORATORY

Gettler Ryan

Attn.: Deanna Harding
6747 Sierra Court Suite J
Dublin, CA 94568

Phone: (925) 551-7444 Fax: (925) 551-7899

Project: 180106.80
Tosco # 7004

Received: 10/28/2002 14:30

Site: 15599 Hesperian Blvd.
San Leandro, CA

STL San Francisco
1220 Quarry Lane
Pleasanton, CA 94566

Tel: (925) 484-1919
Fax: (925) 484-1096
www.stl-inc.com
www.chromalab.com

CA DHS ELAP# 2496

Prep(s):	5030B	Test(s):	8260FAB
Sample ID:	MW-1	Lab ID:	2002-10-0592 - 2
Sampled:	10/25/2002 13:27	Extracted:	11/7/2002 22:39
Matrix:	Water	QC Batch#:	2002/11/07-01.27

Compound	Conc.	RL	Unit	Dilution	Analyzed	Flag
Gasoline	ND	50	ug/L	1.00	11/07/2002 22:39	
Benzene	0.91	0.50	ug/L	1.00	11/07/2002 22:39	
Toluene	ND	0.50	ug/L	1.00	11/07/2002 22:39	
Ethylbenzene	ND	0.50	ug/L	1.00	11/07/2002 22:39	
Total xylenes	ND	1.0	ug/L	1.00	11/07/2002 22:39	
Methyl tert-butyl ether (MTBE)	ND	2.0	ug/L	1.00	11/07/2002 22:39	
Surrogates(s)						
1,2-Dichloroethane-d4	101.8	76-114	%	1.00	11/07/2002 22:39	
Toluene-d8	101.8	88-110	%	1.00	11/07/2002 22:39	

Gas/BTEX Fuel Oxygenates by 8260B

Gettler Ryan

Attn.: Deanna Harding
6747 Sierra Court Suite J
Dublin, CA 94568
Phone: (925) 551-7444 Fax: (925) 551-7899

Project: 180106.80
Tosco # 7004

Received: 10/28/2002 14:30

Site: 15599 Hesperian Blvd.
San Leandro, CA

STL San Francisco
1220 Quarry Lane
Pleasanton, CA 94566

Tel: (925) 484-1919
Fax: (925) 484-1096
www.stl-inc.com
www.chromalab.com

CA DHS ELAP# 2496

Prep(s):	5030B	Test(s):	8260FAB
Sample ID:	MW-2	Lab ID:	2002-10-0592 - 3
Sampled:	10/25/2002 13:54	Extracted:	11/7/2002 23:00
Matrix:	Water	QC Batch#:	2002/11/07-01.27

Compound	Conc.	RL	Unit	Dilution	Analyzed	Flag
Gasoline	ND	50	ug/L	1.00	11/07/2002 23:00	
Benzene	ND	0.50	ug/L	1.00	11/07/2002 23:00	
Toluene	ND	0.50	ug/L	1.00	11/07/2002 23:00	
Ethylbenzene	ND	0.50	ug/L	1.00	11/07/2002 23:00	
Total xylenes	ND	1.0	ug/L	1.00	11/07/2002 23:00	
Methyl tert-butyl ether (MTBE)	ND	2.0	ug/L	1.00	11/07/2002 23:00	
Surrogates(s)						
1,2-Dichloroethane-d4	100.9	76-114	%	1.00	11/07/2002 23:00	
Toluene-d8	102.9	88-110	%	1.00	11/07/2002 23:00	

Submission #: 2002-10-0592

Gas/BTEX Fuel Oxygenates by 8260B

Gettler Ryan

Attn.: Deanna Harding
6747 Sierra Court Suite J
Dublin, CA 94568
Phone: (925) 551-7444 Fax: (925) 551-7899

Project: 180106.80
Tosco # 7004

Received: 10/28/2002 14:30

Site: 15599 Hesperian Blvd.
San Leandro, CA

SEVERN

TRENT

LABORATORY

STL San Francisco
1220 Quarry Lane
Pleasanton, CA 94566

Tel: (925) 484-1919
Fax: (925) 484-1096
www.stl-inc.com
www.chromalab.com

CA DHS ELAP# 2496

Prep(s):	5030B	Test(s):	8260FAB
Sample ID:	MW-3	Lab ID:	2002-10-0592 - 4
Sampled:	10/25/2002 16:49	Extracted:	11/7/2002 23:22
Matrix:	Water	QC Batch#:	2002/11/07-01.27

Compound	Conc.	RL	Unit	Dilution	Analyzed	Flag
Gasoline	1000	50	ug/L	1.00	11/07/2002 23:22	
Benzene	ND	0.50	ug/L	1.00	11/07/2002 23:22	
Toluene	ND	0.50	ug/L	1.00	11/07/2002 23:22	
Ethylbenzene	110	0.50	ug/L	1.00	11/07/2002 23:22	
Total xylenes	ND	1.0	ug/L	1.00	11/07/2002 23:22	
Methyl tert-butyl ether (MTBE)	ND	2.0	ug/L	1.00	11/07/2002 23:22	
Surrogates(s)						
1,2-Dichloroethane-d4	101.0	76-114	%	1.00	11/07/2002 23:22	
Toluene-d8	104.3	88-110	%	1.00	11/07/2002 23:22	

Submission #: 2002-10-0592

Gas/BTEX Fuel Oxygenates by 8260B

Gettler Ryan

Attn.: Deanna Harding
6747 Sierra Court Suite J
Dublin, CA 94568
Phone: (925) 551-7444 Fax: (925) 551-7899

Project: 180106.80
Tosco # 7004

Received: 10/28/2002 14:30

Site: 15599 Hesperian Blvd.
San Leandro, CA

SEVERN
TRENT
LABORATORY

STL San Francisco
1220 Quarry Lane
Pleasanton, CA 94566

Tel: (925) 484-1919
Fax: (925) 484-1096
www.stl-inc.com
www.chromalab.com

CA DHS ELAP# 2496

Prep(s):	5030B	Test(s):	8260FAB
Sample ID:	MW-4	Lab ID:	2002-10-0592 - 5
Sampled:	10/25/2002 12:58	Extracted:	11/7/2002 23:44
Matrix:	Water	QC Batch#:	2002/11/07-01.27

Compound	Conc.	RL	Unit	Dilution	Analyzed	Flag
Gasoline	ND	50	ug/L	1.00	11/07/2002 23:44	
Benzene	0.82	0.50	ug/L	1.00	11/07/2002 23:44	
Toluene	ND	0.50	ug/L	1.00	11/07/2002 23:44	
Ethylbenzene	ND	0.50	ug/L	1.00	11/07/2002 23:44	
Total xylenes	ND	1.0	ug/L	1.00	11/07/2002 23:44	
Methyl tert-butyl ether (MTBE)	7.1	2.0	ug/L	1.00	11/07/2002 23:44	
Surrogates(s)						
1,2-Dichloroethane-d4	100.7	76-114	%	1.00	11/07/2002 23:44	
Toluene-d8	96.4	88-110	%	1.00	11/07/2002 23:44	

Submission #: 2002-10-0592

Gas/BTEX Fuel Oxygenates by 8260B

Gettler Ryan

Attn.: Deanna Harding
6747 Sierra Court Suite J
Dublin, CA 94568
Phone: (925) 551-7444 Fax: (925) 551-7899

Project: 180106.80
Tosco # 7004

Received: 10/28/2002 14:30

Site: 15599 Hesperian Blvd.
San Leandro, CA

SEVERN
TRENT
LABORATORY

STL San Francisco
1220 Quarry Lane
Pleasanton, CA 94566

Tel: (925) 484-1919
Fax: (925) 484-1096
www.stl-inc.com
www.chromalab.com

CA DHS ELAP# 2496

Prep(s):	5030B	Test(s):	8260FAB
Sample ID:	MW-5	Lab ID:	2002-10-0592 - 6
Sampled:	10/25/2002 14:33	Extracted:	11/8/2002 00:05
Matrix:	Water	QC Batch#:	2002/11/07-01 27

Compound	Conc.	RL	Unit	Dilution	Analyzed	Flag
Gasoline	ND	200	ug/L	4.00	11/08/2002 00:05	
Benzene	ND	2.0	ug/L	4.00	11/08/2002 00:05	
Toluene	ND	2.0	ug/L	4.00	11/08/2002 00:05	
Ethylbenzene	ND	2.0	ug/L	4.00	11/08/2002 00:05	
Total xylenes	ND	4.0	ug/L	4.00	11/08/2002 00:05	
Methyl tert-butyl ether (MTBE)	270	8.0	ug/L	4.00	11/08/2002 00:05	
Surrogates(s)						
1,2-Dichloroethane-d4	109.9	76-114	%	4.00	11/08/2002 00:05	
Toluene-d8	100.5	88-110	%	4.00	11/08/2002 00:05	

Gas/BTEX Fuel Oxygenates by 8260B

Gettler Ryan

Attn.: Deanna Harding
6747 Sierra Court Suite J
Dublin, CA 94568
Phone: (925) 551-7444 Fax: (925) 551-7899

Project: 180106.80
Tosco # 7004

Received: 10/28/2002 14:30

Site: 15599 Hesperian Blvd.
San Leandro, CA

STL San Francisco
1220 Quarry Lane
Pleasanton, CA 94566

Tel: (925) 484-1919
Fax: (925) 484-1096
www.stl-inc.com
www.chromalab.com

CA DHS ELAP# 2496

Prep(s):	5030B	Test(s):	8260FAB
Sample ID:	MW-6	Lab ID:	2002-10-0592 - 7
Sampled:	10/25/2002 11:57	Extracted:	11/8/2002 00:27
Matrix:	Water	QC Batch#:	2002/11/07-01.27

Compound	Conc.	RL	Unit	Dilution	Analyzed	Flag
Gasoline	ND	50	ug/L	1.00	11/08/2002 00:27	
Benzene	ND	0.50	ug/L	1.00	11/08/2002 00:27	
Toluene	ND	0.50	ug/L	1.00	11/08/2002 00:27	
Ethylbenzene	ND	0.50	ug/L	1.00	11/08/2002 00:27	
Total xylenes	ND	1.0	ug/L	1.00	11/08/2002 00:27	
Methyl tert-butyl ether (MTBE)	ND	2.0	ug/L	1.00	11/08/2002 00:27	
Surrogates(s)						
1,2-Dichloroethane-d4	100.4	76-114	%	1.00	11/08/2002 00:27	
Toluene-d8	98.8	88-110	%	1.00	11/08/2002 00:27	

Submission #: 2002-10-0592

Gas/BTEX Fuel Oxygenates by 8260B

Gettler Ryan

Attn.: Deanna Harding
6747 Sierra Court Suite J
Dublin, CA 94568
Phone: (925) 551-7444 Fax: (925) 551-7899

Project: 180106.80
Tosco # 7004

Received: 10/28/2002 14:30

Site: 15599 Hesperian Blvd.
San Leandro, CA

SEVERN

TRENT

LABORATORY

STL San Francisco
1220 Quarry Lane
Pleasanton, CA 94566

Tel: (925) 484-1919
Fax: (925) 484-1096
www.stl-inc.com
www.chromalab.com

CA DHS ELAP# 2496

Prep(s):	5030B	Test(s):	8260FAB
Sample ID:	RW-1	Lab ID:	2002-10-0592 - 8
Sampled:	10/25/2002 16:10	Extracted:	11/8/2002 00:49
Matrix:	Water	QC Batch#:	2002/11/07-01.27

Compound	Conc.	RL	Unit	Dilution	Analyzed	Flag
Gasoline	2700	50	ug/L	1.00	11/08/2002 00:49	
Benzene	0.96	0.50	ug/L	1.00	11/08/2002 00:49	
Toluene	1.1	0.50	ug/L	1.00	11/08/2002 00:49	
Ethylbenzene	51	0.50	ug/L	1.00	11/08/2002 00:49	
Total xylenes	ND	1.0	ug/L	1.00	11/08/2002 00:49	
Methyl tert-butyl ether (MTBE)	160	2.0	ug/L	1.00	11/08/2002 00:49	
Surrogates(s)						
1,2-Dichloroethane-d4	108.2	76-114	%	1.00	11/08/2002 00:49	
Toluene-d8	99.0	88-110	%	1.00	11/08/2002 00:49	

Submission #: 2002-10-0592

Gas/BTEX Fuel Oxygenates by 8260B

Gettler Ryan

Attn.: Deanna Harding
6747 Sierra Court Suite J
Dublin, CA 94568

Phone: (925) 551-7444 Fax: (925) 551-7899

Project: 180106.80
Tosco # 7004

Received: 10/28/2002 14:30

Site: 15599 Hesperian Blvd.
San Leandro, CA

SEVERN

TRENT

LABORATORY

STL San Francisco
1220 Quarry Lane
Pleasanton, CA 94566

Tel: (925) 484-1919
Fax: (925) 484-1096
www.stl-inc.com
www.chromalab.com

CA DHS ELAP# 2496

Batch QC Report

Prep(s): 5030B

Method Blank

MB: 2002/11/07-01.27-012

Water

Test(s): 8260FAB

QC Batch # 2002/11/07-01.27

Date Extracted: 11/07/2002 14:50

Compound	Conc.	RL	Unit	Analyzed	Flag
Gasoline	ND	50	ug/L	11/07/2002 14:50	
Benzene	ND	0.5	ug/L	11/07/2002 14:50	
Toluene	ND	0.5	ug/L	11/07/2002 14:50	
Ethylbenzene	ND	0.5	ug/L	11/07/2002 14:50	
Total xylenes	ND	1.0	ug/L	11/07/2002 14:50	
Methyl tert-butyl ether (MTBE)	ND	2.0	ug/L	11/07/2002 14:50	
Surrogates(s)					
1,2-Dichloroethane-d4	95.2	76-114	%	11/07/2002 14:50	
Toluene-d8	98.6	88-110	%	11/07/2002 14:50	

Submission #: 2002-10-0592

Gas/BTEX Fuel Oxygenates by 8260B

Gettler Ryan

Attn.: Deanna Harding
6747 Sierra Court Suite J
Dublin, CA 94568
Phone: (925) 551-7444 Fax: (925) 551-7899

Project: 180106.80
Tosco # 7004

Received: 10/28/2002 14:30

Site: 15599 Hesperian Blvd.
San Leandro, CA

SEVERN
TRENT
LABORATORY

STL San Francisco
1220 Quarry Lane
Pleasanton, CA 94566

Tel: (925) 484-1919
Fax: (925) 484-1096
www.stl-inc.com
www.chromalab.com

CA DHS ELAP# 2496

Batch QC Report

Prep(s): 5030B

Test(s): 8260FAB

Laboratory Control Spike

Water

QC Batch # 2002/11/07-01.27

LCS 2002/11/07-01.27-010

Extracted: 11/07/2002

Analyzed: 11/07/2002 14:03

LCSD 2002/11/07-01.27-011

Extracted: 11/07/2002

Analyzed: 11/07/2002 14:29

Compound	Conc. ug/L		Exp.Conc.	Recovery		RPD %	Ctrl.Limits %		Flags	
	LCS	LCSD		LCS	LCSD		Rec.	RPD	LCS	LCSD
Benzene	23.9	23.0	25.0	95.6	92.0	3.8	69-129	20		
Toluene	24.8	24.3	25.0	99.2	97.2	2.0	70-130	20		
Methyl tert-butyl ether (MTBE)	25.1	27.5	25.0	100.4	110.0	9.1	65-165	20		
Surrogates(s)										
1,2-Dichloroethane-d4	486	484	500	97.2	96.8		76-114			
Toluene-d8	501	502	500	100.2	100.4		88-110			