

RECEIVED

By dehloptoxic at 8:04 am, Mar 06, 2007

February 14, 2007

Mr. Steven Plunkett
Alameda County Department of Environmental Health
1131 Harbor Bay Parkway, Suite 250
Alameda, CA 94502

SUBJECT: QUARTERLY GROUNDWATER MONITORING AND SAMPLING REPORT
(June 14-15, 2006 SAMPLING EVENT) CERTIFICATION
Former Haber Oil Station
1401 Grand Ave.
San Leandro, California

Dear Mr. Plunkett:

You will find enclosed one copy of the following report prepared by P&D Environmental, Inc.

- Quarterly Groundwater Monitoring and Sampling Report dated July 31, 2006 (document 0055.R27) for monitoring and sampling on June 14-15, 2006

I declare, under penalty of perjury, that the information and/or recommendations contained in the above-mentioned report for the subject site is true and correct to the best of my knowledge.

Should you have any questions, please do not hesitate to contact me at (510) 785-0565.

Sincerely,

Manmohan Chopra

Enclosure

0055.L71

P&D ENVIRONMENTAL, INC.

55 Santa Clara Avenue, Suite 240

Oakland, CA 94610

(510) 658-6916

July 5, 2006

Report 0055.R27

Mr. Manmohan Chopra
29211 Marshbrook Drive
Hayward, CA 94545

SUBJECT: QUARTERLY GROUNDWATER MONITORING AND SAMPLING REPORT
(JUNE 14-15, 2006 SAMPLING EVENT)
Former Haber Oil Station
1401 Grand Avenue
San Leandro, California

Dear Mr. Chopra:

P&D Environmental, Inc. (P&D) is pleased to present this report documenting the results of the most recent quarterly monitoring and sampling of the eight groundwater monitoring wells at or near the subject site. This work was performed in accordance with P&D's proposal 022698.P1 dated February 26, 1998. All of the wells were monitored and sampled on June 14 and 15, 2006. A Site Location Map (Figure 1) and Site Vicinity Map (Figure 2) are attached with this report.

BACKGROUND

The site is presently used as an active gasoline station. It is P&D's understanding that on April 24, 1991 Aegis Environmental, Inc. (Aegis) personnel drilled four soil borings, designated as B-1 through B-4, to a vertical depth of approximately 40 feet at the site. The locations of the borings are shown on Figure 2. A total of nine soil samples collected from the boreholes were analyzed for total petroleum hydrocarbons as gasoline (TPH-G); Benzene, Toluene, Ethylbenzene, and total Xylenes (BTEX) by EPA Method 8260; and for total lead by EPA Method 7420. TPH-G concentrations ranged from below detection limit to 66 milligram per kilogram (mg/kg). Benzene concentrations ranged from not detected to 0.94 mg/kg. Total lead concentrations ranged from not detected to 3 mg/kg. Documentation of the subsurface investigation and results are presented in a report prepared by Aegis titled, "Soil Boring Results Report," dated June 10, 1991.

It is P&D's understanding that on April 14, 1992 Aegis personnel returned to the site to drill three slant borings, designated as B5 through B7, to a total vertical depth of approximately 49 feet at the site. The borings were drilled at an angle of approximately 26 to 28 degrees to collect samples from beneath the underground storage tanks. The locations of the borings are shown on Figure 2. A total of twenty-two soil samples were analyzed for TPH-G using EPA Method 5030, and for BTEX using EPA Method 8240. In addition, one of the samples was analyzed for total lead using EPA Method 7420, and several of the soil samples were analyzed for soluble lead using the California Waste Extraction Test. TPH-G concentrations ranged from not detected to 4,000 mg/kg. Benzene, concentrations ranged from not detected to 11 mg/kg. Total lead was not detected, and soluble lead concentrations ranged from not detected to 0.061 mg/kg.

Documentation of the subsurface investigation and results are presented in a report prepared by Aegis titled, "Initial Subsurface Investigation Results Report," dated June 22, 1992.

It is P&D's understanding that between September 15 and 18, 1992 Aegis personnel returned to the site to install five groundwater monitoring wells, designated as MW1 through MW5. The wells were drilled to total depths of between 50 and 55 feet, and were constructed using four-inch diameter PVC pipe. Wells MW1 and MW2 were constructed with perforated casing between the depths of approximately 15 and 55 feet. Wells MW3, MW4 and MW5 were constructed with perforated casing between the depths of approximately 35 and 55 feet. Groundwater was reported as first encountered at a depth of 42 feet. The well locations are shown in Figure 2.

A total of thirty-one soil samples were analyzed for TPH-G using EPA Method 5030/8015; and for BTEX using EPA Method 8020. In addition, three soil samples containing TPH-G were analyzed for total metals concentrations of cadmium, chromium, lead, and zinc using EPA Method 6010 and 7421. One soil sample was collected from each borehole from below the air-water interface and analyzed for petrophysical properties, including saturated permeability and grain size distribution.

TPH-G concentrations ranged from not detected to 39 mg/kg. Benzene concentrations ranged from not detected to 0.27 mg/kg. The total metals concentrations were all less than 10 times their respective STLC values. The subsurface materials encountered in the borings indicate that soil types vary across the site, but generally consist of silty clay, silt, clayey silt and sandy silt from the surface to a depth of between 30 and 35 feet. Below the depth of 30 to 35 feet, layers of sand and sandy silt were reported to have been encountered.

It is P&D's understanding that on September 29, 1992 Aegis personnel collected groundwater samples from wells MW1, MW2, MW4 and MW5 at the site. A sample was not collected from well MW3 due to the reported presence of 0.02 feet of floating hydrocarbons. The measured depth to water ranged from approximately 41.5 to 44.5 feet. The samples were analyzed for TPH-G using EPA Method 5030/8015; and for BTEX using EPA Method 8020. TPH-G concentrations ranged from 0.06 to 20 mg/L, and benzene concentrations ranged from 0.16 to 10 mg/L. Based upon the water level measurements in the wells, the groundwater flow direction was reported to be to the northwest. The water level measurements are summarized in Table 1. The analytical results are summarized in Table 2.

It is P&D's understanding that on October 7, 1992 Aegis personnel performed rising head slug tests wells MW1, MW2, and MW4 to estimate the saturated hydraulic conductivity at the site. In addition, two short-term soil vapor extraction tests were performed on wells MW1 and MW2. Wells MW3, MW4, and MW5 were used as vacuum influence monitoring points. Documentation of the monitoring well groundwater sample collection, slug test and vapor extraction tests are presented in a report prepared by Aegis titled, "Problem Assessment Report," dated December 16, 1992.

On February 18, 1994 P&D personnel monitored the five groundwater monitoring wells at the site for depth to water and the presence of free product or sheen. The depth to water was measured using an electric water level indicator, and the presence of free product and sheen was evaluated using a transparent bailer. The measured depth to water in the wells ranged from approximately 39.8 to 42.9 feet. No evidence of free product or sheen was detected in any of the wells. Based on

the measured depth to water in the wells, the groundwater flow direction was calculated to be to the north with a gradient of 0.054. In a letter dated October 19, 1995 Mr. Scott Seery of the Alameda County Department of Environmental Health (ACDEH) requested that all of the onsite and offsite wells be monitored and sampled for the quarterly monitoring and sampling program. The measured depth to water in the wells is presented in Table 1.

On June 15 and 16, 1995 P&D installed three offsite monitoring wells, designated as MW6 through MW8. The locations of the wells are shown on Figure 2. Documentation of the well installation and sample results is presented in P&D's report 0055.R5 dated August 23, 1995.

The underground storage tanks at the subject site were replaced in the first half of 1997. Following removal of the tanks, excavation of soil was performed in the area surrounding well MW1. As a result of the excavation activities, the elevation at the top of well MW1 was altered. The present elevation for the top of well MW1 is unknown.

In January 2003 Ms. Eva Chu of the ACDEH requested that the wells be analyzed for fuel oxygenates using EPA Method 8260. In a letter dated June 20, 2003 Ms. Chu requested that the analysis be continued.

FIELD ACTIVITIES

On June 14 and 15, 2006 all eight of the wells in the groundwater monitoring network for the site were monitored, purged, and sampled by P&D personnel. The wells were monitored for depth to water and the presence of free product or sheen. Depth to water was measured to the nearest 0.01 foot using an electric water level indicator. The presence of sheen was evaluated using a transparent bailer. No free product or sheen was observed in any of the wells. Depth to water level measurements and monitoring well groundwater surface elevations are presented in Table 1.

Prior to sampling, the wells were purged of a minimum of three casing volumes of water. Petroleum hydrocarbon odors were detected in purge water from wells MW1, MW2 and MW3. During purging operations, the field parameters of electrical conductivity, temperature and pH were monitored. Once the field parameters were observed to stabilize, and a minimum of approximately three casing volumes had been purged, water samples were collected using a clean Teflon bailer. The water samples were transferred to 40-milliliter glass Volatile Organic Analysis (VOA) vials, which were sealed with Teflon-lined screw caps. The VOA vials were overturned and tapped to ensure that no air bubbles were present.

The VOA vials were then transferred to a cooler with ice, and later were transported to McCampbell Analytical, Inc. in Pittsburg, California. McCampbell Analytical, Inc. is a State-certified hazardous waste testing laboratory. Chain of custody documentation accompanied the samples to the laboratory. Records of the field parameters measured during well purging are attached with this report.

GEOLOGY AND HYDROGEOLOGY

The subsurface materials encountered in the borings drilled by Aegis indicate that soil types vary across the site, but generally consist of silty clay, silt, clayey silt, and sandy silt from the surface to a

depth of between 30 and 35 feet. Below the depth of 30 to 35 feet, layers of sand and sandy silt were reported to have been encountered. Groundwater has historically been encountered at the site at depths ranging from approximately 40 to 45 feet below grade.

Based upon the regional groundwater flow direction identified by Woodward-Clyde Consultants in a report titled, "Hydrogeology of Central San Leandro and Remedial Investigation of Regional Groundwater Contamination - San Leandro Plume - San Leandro, California - Volume I," prepared for the California Environmental Protection Agency and dated December 29, 1993 the regional groundwater flow direction to the west of the site appears to be to the southwest. However, based upon the measured depth to water in the five wells at the site on September 29, 1992 Aegis identified a northwesterly groundwater flow direction. Based upon water level measurements collected by P&D from the five wells at the site on February 18, July 5, and October 12, 1994, February 1, and May 4, 1995 the groundwater flow direction at the site was calculated to be to the north, towards San Leandro Creek. Based upon water level measurements collected in wells MW1 through MW8 by P&D personnel on June 23 and December 19, 1995, March 28 and June 21, 1996 the groundwater flow direction was calculated to be to the northwest.

Since the previous quarterly monitoring on February 15, 2006, groundwater elevations have increased in all of the wells by amounts ranging from 0.27 to 0.91 feet, with the exception of MW1 where the water level has decreased by 0.51 feet. Based on the measured water levels in the wells, the groundwater flow direction on June 14, 2006 was to the northwest with a gradient of 0.056.

The northwesterly groundwater flow direction has remained relatively unchanged and the gradient has increased from 0.050 since the previous water level measurements on February 15, 2006. The groundwater monitoring data are presented in Table 1. The groundwater flow direction at the site on June 14, 2006 is shown on Figure 2.

LABORATORY RESULTS

All of the groundwater samples collected from the monitoring wells were analyzed for TPH-G using Modified EPA Method 8015C and for Volatile Organic Compounds (VOCs), including fuel oxygenates and lead scavengers using EPA Method 8260B in accordance with a request from Ms. Eva Chu of the ACDEH.

The laboratory analytical results for the groundwater samples from wells MW2, MW3 and MW4 show that TPH-G was detected at concentrations of 12, 2.7 and 0.075 mg/L, respectively. TPH-G was not detected in any of the other wells. MTBE was detected in wells MW1, MW2, MW3, MW4 and MW6 at concentrations of 0.28, 0.26, 4.3, 0.55 and 0.072 mg/L, respectively. MTBE was not detected in wells MW5, MW7, or MW8.

BTEX compounds were not detected in any of the wells with the exception of well MW2 where concentrations ranged from 2 to 6.6 mg/L, and well MW3 where concentrations ranged from 0.12 to 0.61 mg/L. No fuel oxygenates or lead scavengers other than MTBE were detected in any of the groundwater samples.

In well MW2, 1,2,4-trimethylbenzene, naphthalene, n-Propyl benzene and 1,3,5-trimethylbenzene were detected at concentrations of 0.56, 0.10, 0.064 and 0.12 mg/L, respectively. None of these compounds were detected in any of the other wells, except for well MW3 where 1,2,4-

trimethylbenzene was detected at a concentration of 0.34 mg/L. Chloroform was detected in well MW8 at a concentration of 0.00062 mg/L and was not detected in any of the other wells. Tetrachloroethene (PCE) was detected in well MW7 at a concentration of 0.0028 mg/L, respectively, and was not detected in any other wells.

Since the previous sampling event on February 15, 2006, all analyte concentrations have increased in well MW3 and have decreased in all of the other wells with the exception of MTBE in wells MW1 and MW6 and n-Propyl benzene which have increased.

The laboratory analytical results are summarized in Table 2. Copies of the laboratory analytical report and chain of custody documentation are attached with this report.

DISCUSSION AND RECOMMENDATIONS

Based on the depth to water measurements on June 14, 2006 for monitoring wells MW4, MW6, MW7, and MW8, the groundwater flow direction at the subject site has remained northwesterly and the gradient has increased since the previous monitoring and sampling event on February 15, 2006.

Since the previous sampling event on February 15, 2006, all analyte concentrations have increased in well MW3 and have decreased in all of the other wells with the exception of MTBE in wells MW1 and MW6 and n-Propyl benzene which have increased. No fuel oxygenates or lead scavengers other than MTBE were detected in any of the groundwater samples.

The near-detection limit concentrations of halogenated volatile organic compounds (HVOCs) detected in the wells were not detected during this sampling event with the exception of chloroform in well MW8. The detected HVOCs have been interpreted to be associated with sources not related to the subject site.

Based on the TPH-G results, the extent of TPH-G appears to be limited to the vicinity of wells MW2 and MW3. Similarly, the highest concentration of MTBE is encountered in well MW3. However, the presence of MTBE in well MW6 suggests that it is unclear if the downgradient extent of petroleum hydrocarbons to the northwest (between wells MW6 and MW7) has been defined. P&D recommends that the delineation of the downgradient extent of petroleum hydrocarbons be confirmed by drilling exploratory boreholes on the north side of Joaquin Avenue between wells MW6 and MW7 for the collection of groundwater grab samples. In addition, P&D recommends that petroleum hydrocarbon concentrations at wells MW2 and MW3 be reduced to below Regional Water Quality Control Board Environmental Screening Levels to obtain case closure. Based on the sample results P&D recommends that the quarterly groundwater monitoring and sampling program be continued.

DISTRIBUTION

A copy of this report will be uploaded to the ACDEH and State Water Resources Control Board GeoTracker databases.

LIMITATIONS

This report was prepared solely for the use of Mr. Manmohan Chopra. The content and conclusions provided by P&D in this assessment are based on information collected during our investigation, which may include, but not be limited to, visual site inspections; interviews with the site owner, regulatory agencies and other pertinent individuals; review of available public documents; subsurface exploration and our professional judgment based on said information at the time of preparation of this document. Any subsurface sample results and observations presented herein are considered to be representative of the area of investigation; however, geological conditions may vary between borings and pits and may not necessarily apply to the general site as a whole. If future subsurface or other conditions are revealed which vary from these findings, the newly revealed conditions must be evaluated and may invalidate the findings of this report.

This report is issued with the understanding that it is the responsibility of the owner, or his representative, to ensure that the information contained herein is brought to the attention of the appropriate regulatory agencies, where required by law. Additionally, it is the sole responsibility of the owner to properly dispose of any hazardous materials or hazardous wastes left onsite, in accordance with existing laws and regulations.

This report has been prepared in accordance with generally accepted practices using standards of care and diligence normally practiced by recognized consulting firms performing services of a similar nature. P&D is not responsible for the accuracy or completeness of information provided by other individuals or entities, which is used in this report. This report presents our professional judgment based upon data and findings identified in this report and interpretation of such data based upon our experience and background, and no warranty, either express or implied, is made. The conclusions presented are based upon the current regulatory climate and may require revision if future regulatory changes occur.

July 5, 2006
Report 0055.R27

Should you have any questions, please do not hesitate to contact us at (510) 658-6916.

Sincerely,

P&D Environmental, Inc.



Paul H. King
President
Professional Geologist #5901
Expires: 12/31/07

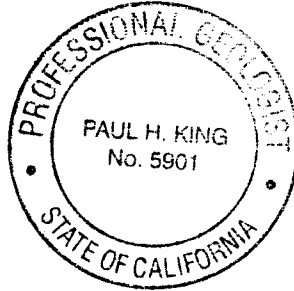

Attachments: Tables 1 & 2
Site Location Map (Figure 1)
Site Vicinity Map (Figure 2)
Groundwater Monitoring/Well Purging Data Sheets
Laboratory Analytical Reports
Chain of Custody Documentation

PHK/efo
0055.R27

TABLES

TABLE 1
 WELL MONITORING DATA

Well No.	Date Monitored	Top of Casing Elevation (ft.)	Depth to Water (ft.)	Water Table Elevation (ft.)
MWI	6/14/06	Not Available	36.37	Not Available
	2/15/06	Not Available	36.88	Not Available
	11/14/05	Not Available	39.77	Not Available
	8/31/05	Not Available	39.27	Not Available
	6/22/05	Not Available	37.91	Not Available
	2/09/05	Not Available	38.02	Not Available
	8/31/04	Not Available	40.35	Not Available
	6/03/04	Not Available	39.59	Not Available
	2/20/04	Not Available	38.45	Not Available
	11/25/03	Not Available	40.00	Not Available
	7/15/03	Not Available	39.60	Not Available
	4/16/03	Not Available	38.91	Not Available
	1/20/03	Not Available	38.21	Not Available
	2/16/99	Not Available	34.58	Not Available
	1/25/98	Not Available	33.70	Not Available
	7/14/97	Not Available	39.45	Not Available
	3/11/97	87.98+	36.90	51.08
	6/21/96		38.56	49.42
	3/28/96		37.10	50.88
	12/19/95		40.16	47.82
	6/23/95		38.54	49.44
	5/04/95	87.96++	37.65	50.33
	2/01/95		38.46	49.52
	10/12/94		42.01	45.97
	7/05/94		41.36	46.62
	2/18/94		41.02	46.96
	9/29/92		42.77	45.21

NOTES:

Elevations are in feet above Mean Sea Level.

ft. = Feet.

+ = Indicates survey data provided by Kier & Wright dated June 26, 1995.

++ = Indicates survey data provided by Aegis Environmental

TABLE 1 (Continued)
 WELL MONITORING DATA

Well No.	Date Monitored	Top of Casing Elevation (ft.)	Depth to Water (ft.)	Water Table Elevation (ft.)
MW2	6/14/06	86.61+	35.22	51.39
	2/15/06		35.78	50.83
	11/14/05		38.50	48.11
	8/31/05		38.00	48.61
	6/22/05		36.76	49.85
	2/10/05		37.15	49.46
	8/31/04		39.07	47.54
	6/03/04		38.32	48.29
	2/20/04		37.27	49.34
	11/25/03	38.68		47.93
	7/15/03		38.15	48.46
	4/16/03		37.50	49.11
	1/20/03		37.04	49.57
	2/16/99		33.51	53.10
	1/25/98		32.80	53.81
	7/14/97		38.46	48.15
	3/11/97		35.71	50.90
	6/21/96		37.30	49.31
	3/28/96		35.97	50.64
	12/19/95		38.80	47.81
	6/23/95		37.40	49.21
	5/04/95	86.60++	36.54	50.07
	2/01/95		37.27	49.34
	10/12/94		40.77	45.84
	7/05/94		40.13	46.48
	2/18/94		39.81	46.80
	9/29/92		41.55	45.06

NOTES:

Elevations are in feet above Mean Sea Level.

ft. = Feet.

+ = Indicates survey data provided by Kier & Wright dated June 26, 1995.

++ = Indicates survey data provided by Aegis Environmental

TABLE 1 (Continued)
 WELL MONITORING DATA

Well No.	Date Monitored	Top of Casing Elevation (ft.)	Depth to Water (ft.)	Water Table Elevation (ft.)
MW3	6/14/06	87.48+	38.12	49.36
	2/15/06		38.56	48.92
	11/14/05		41.51	45.97
	8/31/05		41.12	46.36
	6/22/05		39.78	47.70
	2/10/05		40.11	47.37
	8/31/04		42.03	45.45
	6/03/04		41.34	46.14
	2/20/04		40.23	47.25
	11/25/03		41.70	45.78
	7/15/03		41.34	46.14
	4/16/03		40.60	46.88
	1/20/03		39.81	47.67
	2/16/99		34.91	52.57
	1/25/98		33.91	53.57
	7/14/97		40.61	46.87
	3/11/97		38.71	48.77
	6/21/96		40.61	46.87
	3/28/96		38.75	48.73
	12/19/95		42.20	45.28
	6/23/95		40.65	46.83
	5/04/95	87.50++	39.61	47.87
	2/01/95		40.13	47.35
10/12/94		43.92	43.56	
7/05/94		43.32	44.16	
2/18/94		43.09	44.39	
9/29/92			44.60	42.88*

NOTES:

Elevations are in feet above Mean Sea Level.

ft. = Feet.

+ = Indicates survey data provided by Kier & Wright dated June 26, 1995.

++ = Indicates survey data provided by Aegis Environmental, Inc.

** = Indicates depth to water measurements prior to groundwater monitoring well development.

TABLE 1 (Continued)
 WELL MONITORING DATA

Well No.	Date Monitored	Top of Casing Elevation (ft.)	Depth to Water (ft.)	Water Table Elevation (ft.)
MW4	6/14/06	86.21+	35.17	51.04
	2/15/06		35.57	50.64
	11/14/05		38.26	47.95
	8/31/05		37.81	48.40
	6/22/05		36.54	49.67
	2/10/05		36.99	49.22
	8/31/04		38.68	47.53
	6/03/04		38.01	48.20
	2/20/04		36.91	49.30
	11/25/03		38.43	47.78
	7/15/03		38.04	48.17
	4/16/03		37.32	48.89
	1/20/03		36.70	49.51
	2/16/99		33.43	52.78
	1/25/98		32.96	53.25
	7/14/97		38.10	48.11
	3/11/97		33.24	52.97
	6/21/96		37.12	49.09
	3/28/96		35.00	51.21
	12/19/95	38.45	47.76	
	6/23/95	37.40	48.81	
	5/04/95	86.20++	36.33	49.88
	2/01/95		36.96	49.25
10/12/94	40.48		45.73	
7/05/94	39.69		46.52	
	2/18/94		39.36	46.85
	9/29/92		44.29	41.92

NOTES:

Elevations are in feet above Mean Sea Level.

ft. = Feet.

+ = Indicates survey data provided by Kier & Wright dated June 26, 1995.

++ = Indicates survey data provided by Aegis Environmental, Inc.

TABLE 1 (Continued)
 WELL MONITORING DATA

Well No.	Date Monitored	Top of Casing Elevation (ft.)	Depth to Water (ft.)	Water Table Elevation (ft.)
MW5	6/14/06	89.10+	37.46	51.64
	2/15/06		38.08	51.02
	11/14/05		41.11	47.99
	8/31/05		40.68	48.42
	6/22/05		39.28	49.82
	2/09/05		39.49	49.61
	8/31/04		41.75	47.35
	6/03/04		40.95	48.15
	2/20/04		39.69	49.41
	11/25/03		41.41	47.69
	7/15/03		41.06	48.04
	4/16/03		39.92	49.18
	1/20/03		39.50	49.60
	2/16/99		35.08	54.02
	1/25/98		34.08	55.02
	7/14/97		41.20	47.90
	3/11/97		38.02	51.08
	6/21/96		40.03	49.07
	3/28/96		38.30	50.80
	12/19/95		41.79	47.31
	6/23/95		39.87	49.23
	5/04/95	89.06++	38.94	50.16
	2/01/95		39.94	49.16
10/12/94		43.81	45.29	
7/05/94		43.08	46.02	
2/18/94		42.88	46.22	
9/29/92		44.53	44.57	

NOTES:

Elevations are in feet above Mean Sea Level.

ft. = Feet.

+ = Indicates survey data provided by Kier & Wright dated June 26, 1995.

++ = Indicates survey data provided by Aegis Environmental, Inc.

TABLE 1 (Continued)
 WELL MONITORING DATA

Well No.	Date Monitored	Top of Casing Elevation (ft.)	Depth to Water (ft.)	Water Table Elevation (ft.)
MW6	6/14/06	84.02+	35.86	48.16
	2/15/06		36.13	47.89
	11/14/05		38.83	45.19
	8/31/05		38.51	45.51
	6/22/05		37.30	46.72
	2/09/05		37.51	46.51
	8/31/04		39.27	44.75
	6/03/04		38.64	45.38
	2/20/04		37.61	46.41
	11/25/03		38.97	45.05
	7/15/03		38.61	45.41
	4/16/03		38.00	46.02
	1/20/03		37.21	46.81
	2/16/99		32.82	51.20
	1/25/98		31.64	52.38
	7/14/97		39.04	44.98
	3/11/97		36.32	47.70
	6/21/96		38.00	46.02
	3/28/96		36.18	47.84
	12/19/95		39.25	44.77
6/23/95	38.17	45.85		
6/21/95**	38.11	45.91		

NOTES:

Elevations are in feet above Mean Sea Level.

ft. = Feet.

+ = Indicates survey data provided by Kier & Wright dated June 26, 1995.

++ = Indicates survey data provided by Aegis Environmental, Inc.

** = Indicates depth to water measurements prior to groundwater monitoring well development.

TABLE 1 (Continued)
 WELL MONITORING DATA

Well No.	Date Monitored	Top of Casing Elevation (ft.)	Depth to Water (ft.)	Water Table Elevation (ft.)
MW7	6/14/06	87.11+	38.59	48.52
	2/15/06		38.59	48.52
	11/14/05		41.48	45.93
	8/31/05		41.16	45.95
	6/22/05		39.85	47.26
	2/09/05		40.03	47.08
	8/31/04		41.94	45.17
	6/03/04		41.33	45.78
	2/20/04		40.21	46.90
	11/25/03		41.68	45.43
	7/15/03		41.30	45.81
	4/16/03		40.63	46.48
	1/20/03		39.77	47.34
	2/16/99		34.59	52.52
	1/25/98		33.47	53.64
	7/14/97		41.97	45.14
	3/11/97		38.96	48.15
	6/21/96		40.80	46.31
3/28/96	38.94	48.17		
12/19/95	42.26	44.85		
6/23/95	41.00	46.11		
6/21/95**	40.30	46.81		

NOTES:

Elevations are in feet above Mean Sea Level.

ft. = Feet.

+ = Indicates survey data provided by Kier & Wright dated June 26, 1995.

** = Indicates depth to water measurements prior to groundwater monitoring well development

TABLE 1 (Continued)
 WELL MONITORING DATA

Well No.	Date Monitored	Top of Casing Elevation (ft.)	Depth to Water (ft.)	Water Table Elevation (ft.)
MW8	6/14/06	89.70+	36.53	53.17
	2/15/06		37.44	52.26
	11/14/05		40.40	49.30
	8/31/05		39.95	49.75
	6/22/05		38.43	51.27
	2/09/05		38.93	50.77
	8/31/04		41.19	48.51
	6/03/04		40.36	49.34
	2/20/04		39.15	50.55
	11/25/03		40.92	48.78
	7/15/03		40.50	49.20
	4/16/03		39.52	50.18
	1/20/03		38.94	50.76
	2/16/99		33.92	55.78
	1/25/98		32.73	56.97
	7/14/97		39.98	49.72
	3/11/97		36.74	52.96
	6/21/96		38.69	51.01
	3/28/96		36.98	52.72
	12/19/95		40.35	49.35
6/23/95	38.36	51.34		
6/21/95**	38.20	51.50		

NOTES:

Elevations are in feet above Mean Sea Level.

Ft. = Feet.

+ = Indicates survey data provided by Kier & Wright dated June 26, 1995.

** = Indicates depth to water measurements prior to groundwater monitoring well development.

TABLE 2
 GROUNDWATER
 LABORATORY ANALYTICAL RESULTS
 (MW1)

Date	TPH-G	MTBE	Benzene	Toluene	Ethyl- benzene	Total Xylenes	Other VOCs by EPA 8260
06/15/06	ND<0.05	0.28	ND<0.005	ND<0.005	ND<0.005	ND<0.005	ND
02/15/06	0.095,a	0.18	ND<0.005	ND<0.005	ND<0.005	ND<0.005	ND, except Tetrachloroethene = 0.016
11/14/05	ND<0.05	0.049	ND<0.0005	ND<0.0005	ND<0.0005	ND<0.0005	ND<0.0005
08/31/05	ND<0.05	0.14	ND<0.0025	ND<0.0025	ND<0.0025	ND<0.0025	ND
06/22/05	ND<0.05	0.32	ND<0.005	ND<0.005	ND<0.005	ND<0.005	ND

NOTES:

TPH-G = Total Petroleum Hydrocarbons as Gasoline.

MTBE = Methyl Tert Butyl Ether.

VOCs = Volatile Organic Compounds

ND = Not Detected.

a = No recognizable pattern.

Results are reported in milligrams per liter (mg/L), unless otherwise specified.

TABLE 2 (Continued)
 GROUNDWATER
 LABORATORY ANALYTICAL RESULTS
 (MW1 Continued)

Date	TPH-G	MTBE	Benzene	Toluene	Ethyl- benzene	Total Xylenes	Other VOCs by EPA 8260
02/09/05	0.13	0.79	ND<0.01	ND<0.01	ND<0.01	ND<0.01	ND
08/31/04	ND<0.05	0.031	ND<0.0005	ND<0.0005	ND<0.0005	ND<0.0005	ND
06/03/04	0.059	0.13	ND<0.0025	ND<0.0025	ND<0.0025	ND< 0.0025	ND
02/20/04	0.22	0.18	0.0085	ND<0.005	ND<0.005	0.0098	ND
11/25/03	0.140	0.032	0.0025	ND<0.001	ND<0.001	ND<0.001	ND
07/15/03	0.060	0.053	ND<0.001	ND<0.001	ND<0.001	ND<0.001	ND, except t-Butyl Alcohol (TBA) = 0.012
04/17/03	0.052	0.056	0.0011	ND<0.001	ND<0.001	ND<0.001	ND, except t-Butyl Alcohol (TBA) = 0.013
01/20/03	0.17	0.085	ND<0.005	ND<0.005	ND<0.005	ND<0.005	ND
02/17/99	0.97	0.29	0.067	0.12	0.0093	0.058	--
01/25/98	0.30	ND<0.014	0.021	0.00073	0.0076	0.0010	--
07/14/97	0.20	0.035	0.020	0.0055	0.0012	0.0023	--
03/11/97	0.60	0.014	0.053	0.00095	0.003	0.0015	--
06/21/96	1.4	0.019	0.30	0.0087	0.033	0.0098	--
03/28/96	1.3	0.022	0.32	0.0023	0.034	0.0046	--
12/19/95	0.50	0.0081	0.087	0.0015	0.011	0.0035	--
06/23/95	Not	Sampled					
05/4/95	2.4	--	0.67	0.0028	0.076	0.0060	--
02/01/95	4.6	--	1.8	0.0099	0.23	0.030	--
10/12/94	2.5	--	0.82	0.0039	0.10	0.020	--
07/05/94	3.0	--	1.3	0.0038	0.035	0.0025	--
09/29/92	3.1	--	0.16	ND	ND	0.0060	--

NOTES:

TPH-G = Total Petroleum Hydrocarbons as Gasoline.

MTBE = Methyl Tert Butyl Ether.

VOCs = Volatile Organic Compounds

ND = Not Detected.

-- = Sample not analyzed for this compound during this sampling event.

Results are reported in milligrams per liter (mg/L), unless otherwise specified.

TABLE 2 (Continued)
 GROUNDWATER
 LABORATORY ANALYTICAL RESULTS
 (MW2)

Date	TPH-G	MTBE	Benzene	Toluene	Ethyl- benzene	Total Xylenes	Other VOCs by EPA 8260
06/15/06	12	0.26	1.1	1.1	0.74	2.6	ND, except 1,2,4-Trimethylbenzene = 0.56 Naphthalene = 0.10 n-Propyl benzene = 0.064 1,3,5-Trimethylbenzene = 0.12
02/15/06	38	2	3.7	2.7	2	6.6	ND, except 1,2,4-Trimethylbenzene = 1.8 Naphthalene = 0.24 Tetrachloroethene = 0.24 1,3,5-Trimethylbenzene = 0.36
11/14/05	42	2	4.5	2.1	1.5	6.3	ND, except Isopropylbenzene = 0.051 1,2,4-Trimethylbenzene = 1.1 Naphthalene = 0.29 n-Propyl benzene = 0.13 1,3,5-Trimethylbenzene = 0.22
08/31/05	43	3.6	5.8	2.3	2.3	8.3	ND, except 1,2,4-Trimethylbenzene = 1.9 Naphthalene = 0.65 n-Propyl benzene = 0.26 1,3,5-Trimethylbenzene = 0.43
06/22/05	37	3.9	5.5	1.4	2.5	8.6	ND, except 1,2,4-Trimethylbenzene = 1.5 Naphthalene = 0.33 n-Propyl benzene = 0.22 1,3,5-Trimethylbenzene = 0.32
02/10/05	46	5.6	5.8	3.6	1.8	7.9	ND, except 1,2,4-Trimethylbenzene = 1.3 Naphthalene = 0.30 n-Propyl benzene = 0.13 1,3,5-Trimethylbenzene = 0.29

NOTES:

TPH-G = Total Petroleum Hydrocarbons as Gasoline.

MTBE = Methyl Tert Butyl Ether.

VOCs = Volatile Organic Compounds

ND = Not Detected.

Results are reported in milligrams per liter (mg/L), unless otherwise specified.

TABLE 2 (Continued)
 GROUNDWATER
 LABORATORY ANALYTICAL RESULTS
 (MW2 Continued)

Date	TPH-G	MTBE	Benzene	Toluene	Ethyl- benzene	Total Xylenes	Other VOCs by EPA 8260
08/31/04	43	2.7	4.4	2.3	2.3	8.2	ND, except Isopropylbenzene = 0.061 1,2,4-Trimethylbenzene = 1.9 Naphthalene = 0.57 n-Propyl benzene = 0.20 1,3,5-Trimethylbenzene = 0.4
06/03/04	50	3.9	5.4	4.2	2.2	8.8	ND, except Naphthalene = 0.36 n-Propyl benzene = 0.14 1,2,4-Trimethylbenzene = 1.3 1,3,5-Trimethylbenzene = 0.3
02/20/04	61	2.7	5.9	3.5	2.4	10	ND, except tert-Butyl benzene = 0.15 Naphthalene = 0.23 n-Propyl benzene = 0.15 1,2,4-Trimethylbenzene = 1.3 1,3,5-Trimethylbenzene = 0.33
11/25/03	65	2.7	6.8	8.8	2.9	16	ND, except Naphthalene = 0.54 1,2,4-Trimethylbenzene = 1.8 1,3,5-Trimethylbenzene = 0.42
07/15/03	78	4.1	3.3	4.4	1.8	9.3	ND, except Naphthalene = 0.29 1,2,4-Trimethylbenzene = 1.3 1,3,5-Trimethylbenzene = 0.32 n-Propyl benzene = 0.15
04/17/03	57	5.6	3.4	5.1	2.8	10	ND, except Naphthalene = 0.43 1,2,4-Trimethylbenzene = 2.2 n-Propyl benzene = 0.26 1,3,5-Trimethylbenzene = 0.55

NOTES:

TPH-G = Total Petroleum Hydrocarbons as Gasoline.

MTBE = Methyl Tert Butyl Ether.

VOCs = Volatile Organic Compounds

ND = Not Detected.

Results are reported in milligrams per liter (mg/L), unless otherwise specified.

TABLE 2 (Continued)
 GROUNDWATER
 LABORATORY ANALYTICAL RESULTS
 (MW2 Continued)

Date	TPH-G	MTBE	Benzene	Toluene	Ethyl- benzene	Total Xylenes	Other VOCs by EPA 8260
01/20/03	48	3.8	2.9	3.0	2.0	11	ND, except Naphthalene = 0.35 1,2,4-Trimethylbenzene = 1.4 1,3,5-Trimethylbenzene = 0.32 Isopropylbenzene = 0.069 n-Propyl benzene = 0.16
02/17/99	7.3	0.29	0.067	0.12	0.0093	0.058	--
01/25/98	24	2.7	2.7	4.9	0.70	4.0	--
07/14/97	43	1.6	6.2	8.9	1.5	7.4	--
03/11/97	28	0.71	4.0	4.5	0.99	4.3	--
06/21/96	49	0.53	6.6	6.3	1.4	6.2	--
03/28/96	38	0.45	5.8	4.7	1.1	5.1	--
12/19/95	25	0.45	5.2	3.8	0.86	3.8	--
06/23/95	Not Sampled						
05/4/95	63	--	10	11	1.6	8.8	--
02/01/95	45	--	7.0	5.1	1.2	6.1	--
10/12/94	24	--	4.4	2.8	0.73	3.5	--
07/05/94	46	--	9.1	7.0	1.4	7.3	--
09/29/92	20	--	4.6	3.8	0.26	3.3	--

NOTES:

TPH-G = Total Petroleum Hydrocarbons as Gasoline.

MTBE = Methyl Tert Butyl Ether.

VOCs = Volatile Organic Compounds

ND = Not Detected.

-- = Sample not analyzed for this compound during this sampling event.

Results are reported in milligrams per liter (mg/L), unless otherwise specified.

TABLE 2 (Continued)
 GROUNDWATER
 LABORATORY ANALYTICAL RESULTS
 (MW3)

Date	TPH-G	MTBE	Benzene	Toluene	Ethyl- benzene	Total Xylenes	Other VOCs by EPA 8260
06/15/06	2.7	4.3	ND<0.10	ND<0.10	0.12	0.61	ND, except 1,2,4- Trimethylbenzene = 0.34
02/15/06	0.56,a,b	2.6	ND<0.05	ND<0.05	ND<0.05	ND<0.05	ND, except Tetrachloroethene = 0.1
11/14/05	0.21,a	1.5	ND<0.025	ND<0.025	ND<0.025	ND<0.025	ND
08/31/05	0.49,a,b	2.5	ND<0.050	ND<0.050	ND<0.050	ND<0.050	ND
06/22/05	3.9	5.6	ND<0.10	ND<0.10	ND<0.10	0.69	ND, except 1,2,4- Trimethylbenzene = 0.36

NOTES:

TPH-G = Total Petroleum Hydrocarbons as Gasoline.

MTBE = Methyl Tert Butyl Ether.

VOCs = Volatile Organic Compounds

ND = Not Detected.

a = No recognizable pattern.

b = Heavier gasoline range compounds are significant (aged gasoline?)

Results are reported in milligrams per liter (mg/L), unless otherwise specified.

TABLE 2 (Continued)
GROUNDWATER
LABORATORY ANALYTICAL RESULTS
(MW3 Continued)

Date	TPH-G	MTBE	Benzene	Toluene	Ethyl- benzene	Total Xylenes	Other VOCs by EPA 8260
02/10/05	1.0	2.7	ND<0.050	ND<0.050	ND<0.050	0.27	ND, except t-butyl alcohol = 0.83
08/31/04	0.11	0.86	ND<0.0005	ND<0.0005	ND<0.0005	ND<0.0005	ND
06/03/04	0.11,a	1.4	ND<0.050	ND<0.050	ND<0.050	ND<0.050	ND
02/20/04	0.090	0.73	ND<0.005	ND<0.005	ND<0.005	ND<0.005	ND
11/25/03	0.11	0.33	ND<0.005	ND<0.005	ND<0.005	ND<0.005	ND
07/15/03	0.16	0.66	ND<0.0012	ND<0.0012	ND<0.0012	ND<0.0012	ND
04/17/03	0.18	0.34	ND<0.0005	ND<0.0005	ND<0.0005	ND<0.0005	ND
01/20/03	0.12	0.25	ND<0.005	ND<0.005	ND<0.005	0.0052	ND
02/17/99	ND	0.29	0.067	0.12	0.0093	0.058	--
01/25/98	0.49	0.71	0.0079	0.0061	0.0053	0.029	--
07/14/97	0.40	0.11	0.00093	0.010	0.0013	0.00068	--
03/11/97	1.1	0.68	0.053	0.013	0.063	0.017	--
06/21/96	1.3	0.3	0.094	0.0021	0.039	0.002	--
03/28/96	4.6	1.1	1.4	0.012	0.17	0.020	--
12/19/95	0.95	0.12	0.16	0.0023	0.015	0.0016	--
06/23/95	Not Sampled						
05/4/95	7.2	--	3.1	0.038	0.20	0.062	--
02/01/95	11	--	4.2	0.031	0.33	0.29	--
10/12/94	1.7	--	0.39	0.00090	0.018	0.0057	--
07/05/94	3.6	--	1.6	0.0083	0.076	0.047	--
09/29/92	Not Sampled						

NOTES:

TPH-G = Total Petroleum Hydrocarbons as Gasoline.

MTBE = Methyl Tert Butyl Ether.

VOCs = Volatile Organic Compounds

ND = Not Detected.

-- = Sample not analyzed for this compound during this sampling event.

b = heavier gasoline range compounds are significant (aged gasoline?)

c = lighter gasoline range compounds (the most notable fraction) are significant

Results are reported in milligrams per liter (mg/L), unless otherwise specified.

TABLE 2 (Continued)
GROUNDWATER
LABORATORY ANALYTICAL RESULTS
(MW4)

Date	TPH-G	MTBE	Benzene	Toluene	Ethyl- benzene	Total Xylenes	Other VOCs by EPA 8260
06/15/06	0.075	0.55	ND<0.025	ND<0.025	ND<0.025	ND<0.025	ND
02/15/06	0.22	1.1	ND<0.017	ND<0.017	ND<0.017	ND<0.017	ND, except Tetrachloroethene = 0.024
11/14/05	0.13	1.7	ND<0.05	ND<0.05	ND<0.05	ND<0.05	ND
08/31/05	0.064	1.5	ND<0.025	ND<0.025	ND<0.025	ND<0.025	ND
06/22/05	0.059	1.0	ND<0.025	ND<0.025	ND<0.025	ND<0.025	ND
02/10/05	0.39	6.6	ND<0.1	ND<0.1	ND<0.1	ND<0.1	ND
08/31/04	ND<0.250	3.9	ND<0.0005	ND<0.0005	ND<0.0005	ND<0.0005	ND
06/03/04	0.32	6.2	ND<0.1	ND<0.1	ND<0.1	ND<0.1	ND
02/20/04	ND<0.25,a	6.6	ND<0.1	ND<0.1	ND<0.1	ND<0.1	ND
11/25/03	ND<1.0,a	8.8	ND<0.25	ND<0.25	ND<0.25	ND<0.25	ND
07/15/03	0.44	6.8	ND<0.12	ND<0.12	ND<0.12	ND<0.12	ND
04/17/03	0.38	5.4	ND<0.12	ND<0.12	ND<0.12	ND<0.12	ND
01/20/03	0.21	3.0	ND<0.05	ND<0.05	ND<0.05	ND<0.05	ND
02/17/99	0.23	0.20	0.065	0.0022	0.0096	0.033	--
01/25/98	0.91	0.23	0.15	0.019	0.31	0.14	--
07/14/97	0.98	0.40	0.21	0.0017	0.090	0.046	--
03/11/97	3.8	1.1	1.1	0.053	0.24	0.26	--
06/21/96	11	1.2	2.4	0.083	0.53	0.91	--
03/28/96	5.6	0.64	1.4	0.038	0.31	0.30	--
12/19/95	2.0	0.21	0.70	0.029	0.089	0.15	--
06/23/95	Not	Sampled					
05/4/95	3.3	--	0.89	0.068	0.15	0.30	--
02/01/95	1.4	--	0.39	0.055	0.049	0.18	--
10/12/94	0.68	--	0.14	0.0087	0.014	0.052	--
07/05/94	2.6	--	0.47	0.045	0.084	0.25	--
09/29/92	0.63	--	0.17	0.06	0.0073	0.65	--

NOTES:

TPH-G = Total Petroleum Hydrocarbons as Gasoline.

MTBE = Methyl Tert Butyl Ether.

VOCs = Volatile Organic Compounds

ND = Not Detected.

-- = Sample not analyzed for this compound during this sampling event.

a = Laboratory Report Note: reporting limit raised due to high MTBE content

Results are reported in milligrams per liter (mg/L), unless otherwise specified.

TABLE 2 (Continued)
 GROUNDWATER
 LABORATORY ANALYTICAL RESULTS
 (MW5)

Date	TPH-G	MTBE	Benzene	Toluene	Ethyl- benzene	Total Xylenes	Other VOCs by EPA 8260
06/14/06	ND<0.05	ND<0.0005	ND<0.0005	ND<0.0005	ND<0.0005	ND<0.0005	ND
02/15/06	ND<0.05	ND<0.0005	ND<0.0005	ND<0.0005	ND<0.0005	ND<0.0005	ND, except Tetrachloroethene = 0.0012
11/14/05	ND<0.05	0.00051	ND<0.0005	ND<0.0005	ND<0.0005	ND<0.0005	ND, except Chloroform = 0.00063
08/31/05	ND<0.05	0.0027	ND<0.0005	ND<0.0005	ND<0.0005	ND<0.0005	ND, except Chloroform = 0.00063
06/22/05	ND<0.05	0.0022	ND<0.0005	ND<0.0005	ND<0.0005	ND<0.0005	ND, except Chloroform = 0.00052
02/09/05	ND<0.05	ND<0.0005	ND<0.0005	ND<0.0005	ND<0.0005	ND<0.0005	ND
08/31/04	ND<0.05	0.0025	ND<0.0005	ND<0.0005	ND<0.0005	ND<0.0005	ND
06/03/04	ND<0.05	0.0072	ND<0.001	ND<0.001	ND<0.001	ND<0.001	ND<0.001
02/20/04	ND<0.05	ND<0.005	ND<0.005	ND<0.005	ND<0.005	ND<0.005	ND
11/25/03	ND<0.05	0.00084	ND<0.001	ND<0.001	ND<0.001	ND<0.001	ND
07/15/03	ND<0.05	0.0014	ND<0.0005	ND<0.0005	ND<0.0005	ND<0.0005	ND
04/17/03	ND<0.05	ND<0.0005	ND<0.0005	ND<0.0005	ND<0.0005	ND<0.0005	ND
01/20/03	ND<0.05	ND<0.0005	ND<0.0005	ND<0.0005	ND<0.0005	ND<0.0005	ND
02/17/99	0.17	ND	ND	0.00074	ND	ND	--
01/25/98	ND	ND	ND	ND	ND	ND	--
07/14/97	ND	ND	ND	ND	ND	ND	--
03/11/97	ND	ND	ND	ND	ND	0.00077	--
06/21/96	ND	ND	ND	ND	ND	ND	--
03/28/96	ND	ND	ND	ND	ND	ND --	--
12/19/95	ND	ND	ND	ND	ND	ND	--
06/23/95	Not	Sampled					
05/4/95	ND	--	ND	ND	ND	ND	--
02/01/95	ND	--	ND	ND	ND	ND	--
10/12/94	ND	--	ND	ND	ND	ND	--
07/05/94	ND	--	ND	ND	ND	0.0010	--
09/29/92	0.06	--	10	0.0071	ND	0.0069	--

NOTES:

TPH-G = Total Petroleum Hydrocarbons as Gasoline.

MTBE = Methyl Tert Butyl Ether.

VOCs = Volatile Organic Compounds

ND = Not Detected.

-- = Sample not analyzed for this compound during this sampling event.

Results are reported in milligrams per liter (mg/L), unless otherwise specified.

TABLE 2 (Continued)
 GROUNDWATER
 LABORATORY ANALYTICAL RESULTS
 (MW6)

Date	TPH-G	MTBE	Benzene	Toluene	Ethyl- benzene	Total Xylenes	Other VOCs by EPA 8260
06/14/06	ND<0.05	0.072	ND<0.0005	ND<0.0005	ND<0.0005	ND<0.0005	ND
02/15/06	ND<0.05	0.0025	ND<0.0005	ND<0.0005	ND<0.0005	ND<0.0005	ND, except Tetrachloroethene = 0.00075
11/14/05	ND<0.05	0.00073	ND<0.0005	ND<0.0005	ND<0.0005	ND<0.0005	ND, except Chloroform = 0.00067, Tetrachloroethene = 0.0005
08/31/05	ND<0.05	0.0014	ND<0.0005	ND<0.0005	ND<0.0005	ND<0.0005	ND, except Chloroform = 0.00062

NOTES:

TPH-G = Total Petroleum Hydrocarbons as Gasoline.

MTBE = Methyl Tert Butyl Ether.

VOCs = Volatile Organic Compounds

ND = Not Detected.

Results are reported in milligrams per liter (mg/L), unless otherwise specified.

TABLE 2 (Continued)
GROUNDWATER
LABORATORY ANALYTICAL RESULTS
(MW6 Continued)

Date	TPH-G	MTBE	Benzene	Toluene	Ethyl- benzene	Total Xylenes	Other VOCs by EPA 8260
06/22/05	ND<0.05	0.00080	ND<0.0005	ND<0.0005	ND<0.0005	ND<0.0005	ND, except Tetrachloroethene = 0.00053
02/09/05	ND<0.05	0.002	ND<0.0005	ND<0.0005	ND<0.0005	ND<0.0005	ND, except Chloroform = 0.00059
08/31/04	ND<0.05	0.00051	ND<0.0005	ND<0.0005	ND<0.0005	ND<0.0005	ND, except Chloroform = 0.00084 Tetrachloroethene=0.00051
06/03/04	ND<0.05	ND<0.001	ND<0.001	ND<0.001	ND<0.001	ND<0.001	ND<0.001
02/20/04	ND<0.05	0.0011	ND<0.005	ND<0.005	ND<0.005	ND<0.005	ND
11/25/03	ND<0.05	0.00084	ND<0.001	ND<0.001	ND<0.001	ND<0.001	ND, except Chloroform = 0.00089
07/15/03	ND<0.05	ND<0.0005	ND<0.0005	ND<0.0005	ND<0.0005	ND<0.0005	ND, except Chloroform = 0.00084 1,2-Dibromo- 3-chloropropane = 0.00066 Tetrachloroethene = 0.00067
04/17/03	ND<0.05	ND<0.0005	ND<0.0005	ND<0.0005	ND<0.0005	ND<0.0005	ND, except Chloroform = 0.0012
01/20/03	ND<0.05	0.0012	ND<0.0005	ND<0.0005	ND<0.0005	ND<0.0005	ND, except Chloroform = 0.0011
02/17/99	ND	ND	ND	ND	ND	ND	--
01/25/98	ND	ND	ND	ND	ND	ND	--
07/14/97	ND	0.019	ND	ND	ND	ND	--
03/11/97	ND	ND	ND	ND	ND	ND	--
06/21/96	ND	ND	ND	ND	ND	ND	--
03/28/96	ND	ND	ND	ND	ND	ND	--
12/19/95	ND	0.01	ND	ND	ND	ND	--
06/23/95	ND	0.003	ND	ND	ND	ND	--

NOTES:

TPH-G = Total Petroleum Hydrocarbons as Gasoline.

MTBE = Methyl Tert Butyl Ether.

VOCs = Volatile Organic Compounds

ND = Not Detected.

-- = Sample not analyzed for this compound during this sampling event.

Results are reported in milligrams per liter (mg/L), unless otherwise specified.

TABLE 2 (Continued)
 GROUNDWATER
 LABORATORY ANALYTICAL RESULTS
 (MW7)

Date	TPH-G	MTBE	Benzene	Toluene	Ethyl- benzene	Total Xylenes	Other VOCs by EPA 8260
06/14/06	ND<0.05	ND<0.0005	ND<0.0005	ND<0.0005	ND<0.0005	ND<0.0005	ND, except Tetrachloroethene = 0.0028
02/15/06	ND<0.05	ND<0.0005	ND<0.0005	ND<0.0005	ND<0.0005	ND<0.0005	ND, except Tetrachloroethene = 0.0043
11/14/05	ND<0.05	ND<0.0005	ND<0.0005	ND<0.0005	ND<0.0005	ND<0.0005	ND, except Chloroform = 0.00082 Tetrachloroethene = 0.0068
08/31/05	ND<0.05	ND<0.0005	ND<0.0005	ND<0.0005	ND<0.0005	ND<0.0005	ND, except Chloroform = 0.0011
06/22/05	ND<0.05	ND<0.0005	ND<0.0005	ND<0.0005	ND<0.0005	ND<0.0005	ND, except Tetrachloroethene = 0.0016
02/09/05	ND<0.05	ND<0.0005	ND<0.0005	ND<0.0005	ND<0.0005	ND<0.0005	ND, except Chloroform = 0.00064 Tetrachloroethene = 0.0025

NOTES:

TPH-G = Total Petroleum Hydrocarbons as Gasoline.

MTBE = Methyl Tert Butyl Ether.

VOCs = Volatile Organic Compounds

ND = Not Detected.

Results are reported in milligrams per liter (mg/L), unless otherwise specified.

TABLE 2 (Continued)
GROUNDWATER
LABORATORY ANALYTICAL RESULTS
(MW7 Continued)

Date	TPH-G	MTBE	Benzene	Toluene	Ethyl- benzene	Total Xylenes	Other VOCs by EPA 8260
08/31/04	ND<0.05	ND<0.0005	ND<0.0005	ND<0.0005	ND<0.0005	ND<0.0005	ND, except Tetrachloroethene = 0.00073
06/03/04	ND<0.05	ND<0.001	ND<0.001	ND<0.001	ND<0.001	ND<0.001	ND, except Tetrachloroethene = 0.00098
02/20/04	ND<0.05	ND<0.005	ND<0.005	ND<0.005	ND<0.005	ND<0.005	ND, except Tetrachloroethene = 0.0013
11/25/03	ND<0.05	ND<0.001	ND<0.001	ND<0.001	ND<0.001	ND<0.001	ND, except Chloroform = 0.00076 Tetrachloroethene = 0.00078
07/15/03	ND<0.05	ND<0.0005	ND<0.0005	ND<0.0005	ND<0.0005	ND<0.0005	ND, except Chloroform = 0.00061 1,2-Dibromo- 3-chloropropane = 0.00064 Tetrachloroethene = 0.0012
04/17/03	ND<0.05	ND<0.0005	ND<0.0005	ND<0.0005	ND<0.0005	ND<0.0005	ND, except Chloroform = 0.00075 Tetrachloroethene = 0.0012
01/20/03	ND<0.05	ND<0.0005	ND<0.0005	ND<0.0005	ND<0.0005	ND<0.0005	ND, except Chloroform = 0.00056
02/17/99	ND	ND	ND	ND	ND	ND	--
01/25/98	ND	ND	ND	ND	ND	ND	--
07/14/97	ND	ND	ND	ND	ND	ND	--
03/11/97	ND	ND	ND	ND	ND	ND	--
06/21/96	ND	ND	ND	ND	ND	ND	--
03/28/96	ND	ND	ND	ND	ND	ND	--
12/19/95	ND	ND	ND	ND	ND	ND	--
06/23/95	ND	ND	ND	ND	ND	ND	--

NOTES:

TPH-G = Total Petroleum Hydrocarbons as Gasoline.

MTBE = Methyl Tert Butyl Ether.

VOCs = Volatile Organic Compounds

ND = Not Detected.

-- = Sample not analyzed for this compound during this sampling event.

Results are reported in milligrams per liter (mg/L), unless otherwise specified.

TABLE 2 (Continued)
 GROUNDWATER
 LABORATORY ANALYTICAL RESULTS
 (MW8)

Date	TPH-G	MTBE	Benzene	Toluene	Ethyl- benzene	Total Xylenes	Other VOCs by EPA 8260
06/14/06	ND<0.05	ND<0.0005	ND<0.0005	ND<0.0005	ND<0.0005	ND<0.0005	ND, except Chloroform = 0.00062
02/15/06	ND<0.05	ND<0.0005	ND<0.0005	ND<0.0005	ND<0.0005	ND<0.0005	ND, except Chloroform = 0.00098
11/14/05	ND<0.05	ND<0.0005	ND<0.0005	ND<0.0005	ND<0.0005	ND<0.0005	ND, except Chloroform = 0.00094
08/31/05	ND<0.05	ND<0.0005	ND<0.0005	ND<0.0005	ND<0.0005	ND<0.0005	ND, except Chloroform = 0.00067 Tetrachloroethene = 0.002

NOTES:

TPH-G = Total Petroleum Hydrocarbons as Gasoline.

MTBE = Methyl Tert Butyl Ether.

VOCs = Volatile Organic Compounds

ND = Not Detected.

Results are reported in milligrams per liter (mg/L), unless otherwise specified.

TABLE 2 (Continued)
GROUNDWATER
LABORATORY ANALYTICAL RESULTS
(MW8 Continued)

Date	TPH-G	MTBE	Benzene	Toluene	Ethyl- benzene	Total Xylenes	Other VOCs by EPA 8260
06/22/05	ND<0.05	ND<0.0005	ND<0.0005	ND<0.0005	ND<0.0005	ND<0.0005	ND, except Chloroform = 0.00093
02/09/05	ND<0.05	ND<0.0005	ND<0.0005	ND<0.0005	ND<0.0005	ND<0.0005	ND, except Chloroform = 0.0011
08/31/04	ND<0.05	ND<0.0005	ND<0.0005	ND<0.0005	ND<0.0005	ND<0.0005	ND, except Chloroform = 0.0013
06/03/04	ND<0.05	ND<0.001	ND<0.001	ND<0.001	ND<0.001	ND<0.001	ND, except Chloroform = 0.001
02/20/04	ND<0.05	ND<0.005	ND<0.005	ND<0.005	ND<0.005	ND<0.005	ND, except Chloroform = 0.00078
11/25/03	ND<0.05	ND<0.001	ND<0.001	ND<0.001	ND<0.001	ND<0.001	ND, except Chloroform = 0.0014
07/15/03	ND<0.05	ND<0.0005	ND<0.0005	ND<0.0005	ND<0.0005	0.00066	ND, except Chloroform = 0.0014 1,2-Dibromo- 3-chloropropane = 0.00052
04/17/03	ND<0.05	ND<0.0005	ND<0.0005	ND<0.0005	ND<0.0005	ND<0.0005	ND, except Chloroform = 0.0018
01/20/03	ND<0.05	ND<0.0005	ND<0.0005	ND<0.0005	ND<0.0005	ND<0.0005	ND, except Chloroform = 0.0013
02/17/99	ND	ND	ND	ND	ND	ND	--
01/25/98	ND	ND	ND	ND	ND	ND	--
07/14/97	ND	ND	ND	ND	ND	ND	--
03/11/97	ND	ND	ND	ND	ND	ND	--
06/21/96	ND	ND	ND	ND	ND	ND	--
03/28/96	ND	ND	ND	ND	ND	ND	--
12/19/95	ND	ND	ND	ND	ND	ND	--
06/23/95	ND	ND	ND	ND	ND	ND	--

NOTES:

TPH-G = Total Petroleum Hydrocarbons as Gasoline.

MTBE = Methyl Tert Butyl Ether.

VOCs = Volatile Organic Compounds

ND = Not Detected.

-- = Sample not analyzed for this compound during this sampling event.

Results are reported in milligrams per liter (mg/L), unless otherwise specified.

FIGURES

P & D ENVIRONMENTAL, INC.

55 Santa Clara Ave, Suite 240

Oakland, CA 94610

(510) 658-6916



Base Map From:
U.S. Geological Survey
San Leandro, Calif.
7.5 Minute Quadrangle
Photorevised 1980

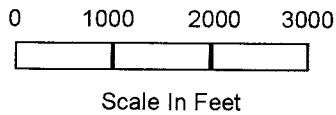

North



Figure 1
SITE LOCATION MAP
Former Haber Oil Station
1401 Grand Avenue
San Leandro, California

P & D ENVIRONMENTAL, INC.

55 Santa Clara Ave, Suite 240
Oakland, CA 94610
(510) 658-6916

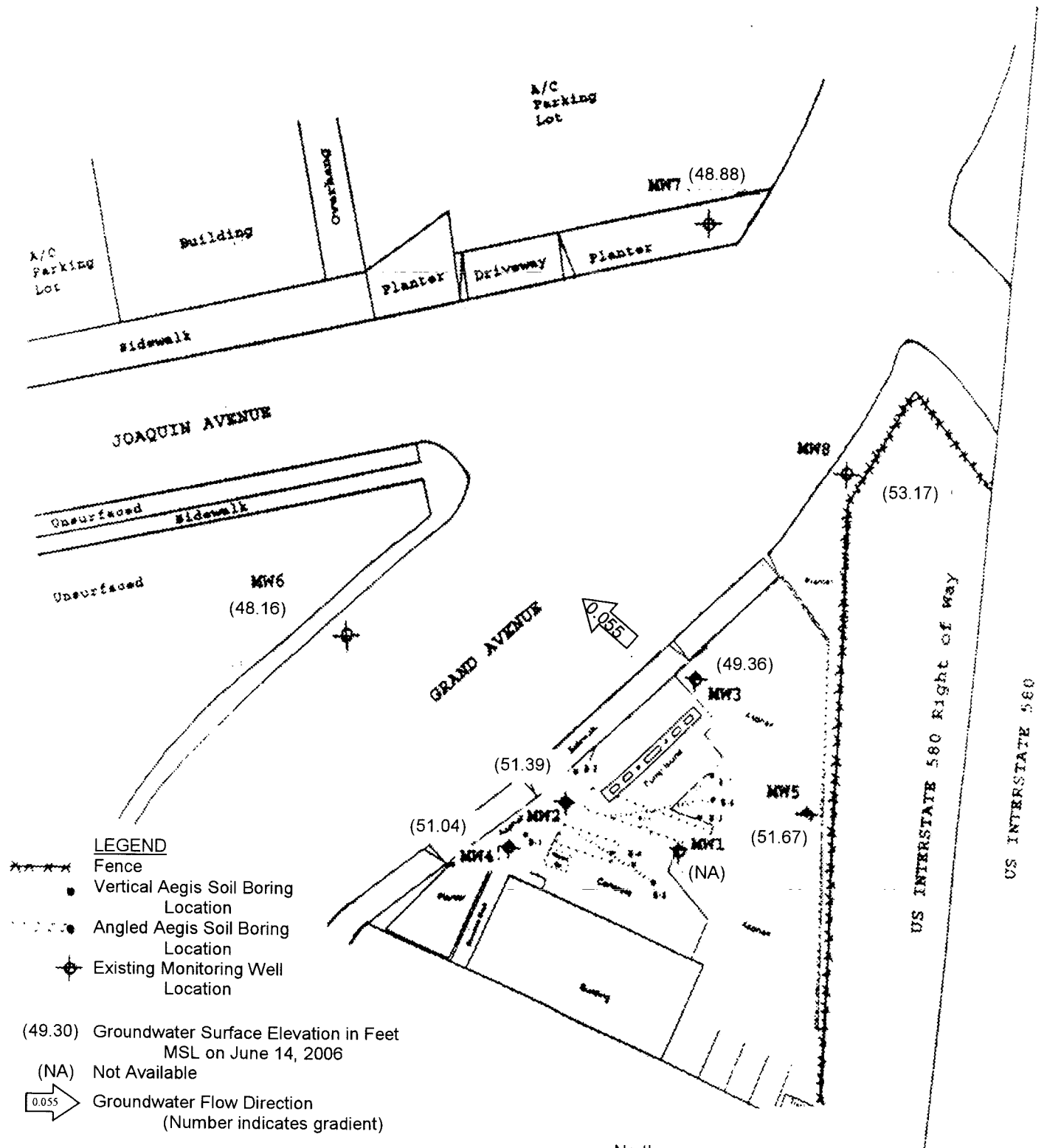

Vicinity Base Map From:
P&D Environmental
February, 1995
Site base Map From:
Aegis Environmental, Inc.
Problem Assessment Report
dated December 16, 1992

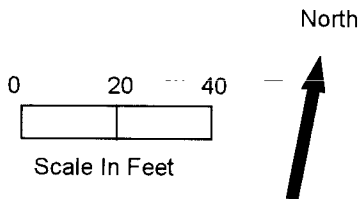

Figure 2
SITE VICINITY MAP
Former Haber Oil Station
1401 Grand Avenue
San Leandro, California

**GROUNDWATER
MONITORING/WELL PURGING
DATA SHEETS**

P&D ENVIRONMENTAL
GROUNDWATER MONITORING/WELL PURGING
DATA SHEET

Site Name Former Haber oil
 Job No. 0055
 TOC to Water (ft.) ~~36.53~~ 36.37
 Well Depth (ft.) 55
 Well Diameter 4 in (.646 gal/ft)
 Gal./Casing Vol. ~~36.53~~ 12

Well No. MW 1
 Date 6/15/6
 Sheen NO
 Free Product Thickness NO
 Sample Collection Method teflon bailer

TIME	GAL. PURGED	DH	TEMPERATURE	ELECTRICAL CONDUCTIVITY
<u>1:32</u>	<u>5</u>	<u>5.46</u>	<u>73.5</u>	<u>.73</u>
<u>1:35</u>	<u>10</u>	<u>5.43</u>	<u>69.4</u>	<u>.69</u>
<u>1:39</u>	<u>15</u>	<u>5.39</u>	<u>68.1</u>	<u>.66</u>
<u>1:44</u>	<u>20</u>	<u>5.35</u>	<u>67.2</u>	<u>.64</u>
<u>1:50</u>	<u>33 28</u>	<u>5.31</u>	<u>67.9</u>	<u>.67</u>
<u>1:55</u>	<u>36</u>	<u>5.29</u>	<u>67.8</u>	<u>.67</u>
<u>2:15</u>	<u>Sampling complete</u>			

NOTES: some odor & no sheen on purge water

P&D ENVIRONMENTAL
GROUNDWATER MONITORING/WELL PURGING
DATA SHEET

Site Name Former Haber oil
 Job No. 0055
 TOC to Water (ft.) 38.12
 Well Depth (ft.) 55
 Well Diameter 4 in (1.646 in / 4)
 Gal./Casing Vol. ~~11~~ 11
 $E = SA 33$

Well No. MW3
 Date 6/15/6
 Sheen no
 Free Product Thickness no
 Sample Collection Method bottom bailer

TIME	GAL. PURGED	pH	TEMPERATURE	ELECTRICAL CONDUCTIVITY
4:27	2 5	5.37	70.4	.77
4:33	6 10	5.37	68.2	.74
4:40	10 15	5.35	68.9	.75
4:48	20 18 20	5.42	68.2	.75
4:57	26.5 40 26.5	5.29	69.1	.72
5:05	SA 33	5.23	69.4	.77

5:00 sampling complete

NOTES: Odor no sheen

P&D ENVIRONMENTAL
GROUNDWATER MONITORING/WELL PURGING
DATA SHEET

Site Name Former Haber Oil

Well No. MW4

Job No. 0055

Date 6/15/6

TOC to Water (ft.) 35.17

Sheen no

Well Depth (ft.) 55

Free Product Thickness no

Well Diameter 4 in (.646 gal/ft)

Sample Collection Method tetlon bailer

Gal./Casing Vol. ~~12.8~~ 12.8

start 2:45

~~12.8~~ 12.8

TIME	GAL. PURGED	pH	TEMPERATURE	ELECTRICAL CONDUCTIVITY
2:50	8.5	5.37	70.2	.77
2:57	10	5.36	69.1	.79
3:02	12.15	5.38	69.3	.79
3:10	20	5.37	69.8	.78
3:16	40 30.28	5.36	68.8	.78
3:26	38 38	5.34	68.5	.78

3:45 sampling complete

NOTES: no sheen or odor on purge water
very clear

P&D ENVIRONMENTAL
GROUNDWATER MONITORING/WELL PURGING
DATA SHEET

Site Name Former Haber Oil

Well No. MW5

Job No. 0055

Date ~~6/14/06~~ 6/15/06

TOC to Water (ft.) 37.46] 17.54 ft

Sheen No

Well Depth (ft.) 55

Free Product Thickness No

Well Diameter 4 in (0.6464 ft)

Sample Collection Method _____

Gal./Casing Vol. 11.33

Teplon Barler

~~3~~ 3 = 33.99

ELECTRICAL CONDUCTIVITY ^{ms/cm}

TIME	GAL. PURGED	pH	TEMPERATURE	ELECTRICAL CONDUCTIVITY
12:13 pm	5	6.2	67.5	85
12:17	10	5.6	65.1	80
12:22	15	5.49	64.6	78
12:26	20	5.42	65.2	73
1:31	25 27	5.32	65.9	76
	30			
12:35	35 34	5.36	67.0	76

Sampling complete 12:57

NOTES: sheen? color no
then clear

- first gallon black

P&D ENVIRONMENTAL
GROUNDWATER MONITORING/WELL PURGING
DATA SHEET

Site Name Farmer Hooker Oil

Well No. MW 7

Job No. 0055

Date 6-14-06

TOC to Water (ft.) 38.23

Sheen NO

Well Depth (ft.) 55

Free Product Thickness NO

Well Diameter 2 in (0.163 gal/ft)

Sample Collection Method _____

Gal./Casing Vol. 2.7

Peplan Beiler

$\Sigma = 8$

TIME	GAL. PURGED	pH	TEMPERATURE °F	ELECTRICAL CONDUCTIVITY $\mu\text{S}/\text{cm}$
1:53	1	5.63	76.6	59
1:54	2	5.92	68.2	56
1:55	4	5.41	71.0	59
1:56	5	5.41	66.7	59
1:57	6	5.41	66.2	55
1:58	8	5.36	66.2	57

sampling complete 2:18

NOTES: no sheen or odor on purge water

P&D ENVIRONMENTAL
GROUNDWATER MONITORING/WELL PURGING
DATA SHEET

Site Name Former Habes-Or 1 Well No. MW 8
 Job No. 0055 Date 6-14-06
 TOC to Water (ft.) 36.53 Sheen None
 Well Depth (ft.) 50 Free Product Thickness Ø
 Well Diameter 2 in Sample Collection Method Teflon Barker
 Gal./Casing Vol. 2.2

$Z = 6.6$

TIME	GAL. PURGED	pH	TEMPERATURE ^F	ELECTRICAL CONDUCTIVITY ^{µs/cm}
<u>12:56</u>	<u>1</u>	<u>5.74</u>	<u>80.2</u>	<u>0.92</u>
<u>12:57</u>	<u>2</u>	<u>5.73</u>	<u>72.9</u>	<u>0.85</u>
<u>12:57</u>	<u>3</u>	<u>5.55</u>	<u>70.4</u>	<u>0.77</u>
<u>12:58</u>	<u>4</u>	<u>5.57</u>	<u>69.0</u>	<u>0.75</u>
<u>12:58</u>	<u>5</u>	<u>5.52</u>	<u>68.2</u>	<u>0.79</u>
<u>12:59</u>	<u>7</u>	<u>5.53</u>	<u>66.3</u>	<u>0.79</u>
<u>13:05</u>	<u>Sample Time</u>			

NOTES: No pH Sheen or odor on purge water

**LABORATORY REPORTS
AND CHAIN OF CUSTODY
DOCUMENTATION**



McC Campbell Analytical, Inc.

110 2nd Avenue South, #D7, Pacheco, CA 94553-5560
 Telephone : 925-798-1620 Fax : 925-798-1622
 Website: www.mcccampbell.com E-mail: main@mcccampbell.com

P & D Environmental 55 Santa Clara, Ste.240 Oakland, CA 94610	Client Project ID: #0055; Former Haber Oil	Date Sampled: 06/14/06-06/15/06
	Client Contact: Nick Mitchell	Date Received: 06/16/06
	Client P.O.:	Date Extracted: 06/19/06-06/21/06
		Date Analyzed: 06/19/06-06/21/06

Gasoline Range (C6-C12) Volatile Hydrocarbons as Gasoline*

Extraction method: SW5030B

Analytical methods: SW8015Cm

Work Order: 0606386

Lab ID	Client ID	Matrix	TPH(g)	DF	% SS
001A	MW-1	W	ND	1	108
002A	MW-2	W	12,000,a	20	103
003A	MW-3	W	2700,a	2.5	106
004A	MW-4	W	75,a	1	104
005A	MW-5	W	ND	1	105
006A	MW-6	W	ND	1	105
007A	MW-7	W	ND	1	102
008A	MW-8	W	ND	1	102

Reporting Limit for DF =1; ND means not detected at or above the reporting limit	W	50	µg/L
	S	NA	NA

* water and vapor samples and all TCLP & SPLP extracts are reported in µg/L, soil/sludge/solid samples in mg/kg, wipe samples in µg/wipe, product/oil/non-aqueous liquid samples in mg/L.

cluttered chromatogram; sample peak coelutes with surrogate peak.

+The following descriptions of the TPH chromatogram are cursory in nature and McC Campbell Analytical is not responsible for their interpretation: a) unmodified or weakly modified gasoline is significant; b) heavier gasoline range compounds are significant(aged gasoline?); c) lighter gasoline range compounds (the most mobile fraction) are significant; d) gasoline range compounds having broad chromatographic peaks are significant; biologically altered gasoline?; e) TPH pattern that does not appear to be derived from gasoline (stoddard solvent / mineral spirit?); f) one to a few isolated non-target peaks present; g) strongly aged gasoline or diesel range compounds are significant; h) lighter than water immiscible sheen/product is present; i) liquid sample that contains greater than ~1 vol. % sediment; j) reporting limit raised due to high MTBE content; k) TPH pattern that does not appear to be derived from gasoline (aviation gas). m) no recognizable pattern; n) TPH(g) range non-target isolated peaks subtracted out of the TPH(g) concentration at the client's request; p) see attached narrative.

P & D Environmental 55 Santa Clara, Ste.240 Oakland, CA 94610	Client Project ID: #0055; Former Haber Oil	Date Sampled: 06/15/06
	Client Contact: Nick Mitchell	Date Received: 06/16/06
	Client P.O.:	Date Extracted: 06/19/06
		Date Analyzed: 06/19/06

Volatile Organics by P&T and GC/MS (Basic Target List)*

Extraction Method: SW5030B Analytical Method: SW8260B Work Order: 0606386

Lab ID	0606386-001B
Client ID	MW-1
Matrix	Water

Compound	Concentration *	DF	Reporting Limit	Compound	Concentration *	DF	Reporting Limit
Acetone	ND<5.0	10	5.0	Acrolein (Propenal)	ND<5.0	10	5.0
Acrylonitrile	ND<2.0	10	2.0	tert-Amyl methyl ether (TAME)	ND<5.0	10	0.5
Benzene	ND<5.0	10	0.5	Bromobenzene	ND<5.0	10	0.5
Bromochloromethane	ND<5.0	10	0.5	Bromodichloromethane	ND<5.0	10	0.5
Bromoform	ND<5.0	10	0.5	Bromomethane	ND<5.0	10	0.5
2-Butanone (MEK)	ND<2.0	10	2.0	t-Butyl alcohol (TBA)	ND<5.0	10	5.0
n-Butyl benzene	ND<5.0	10	0.5	sec-Butyl benzene	ND<5.0	10	0.5
tert-Butyl benzene	ND<5.0	10	0.5	Carbon Disulfide	ND<5.0	10	0.5
Carbon Tetrachloride	ND<5.0	10	0.5	Chlorobenzene	ND<5.0	10	0.5
Chloroethane	ND<5.0	10	0.5	2-Chloroethyl Vinyl Ether	ND<10	10	1.0
Chloroform	ND<5.0	10	0.5	Chloromethane	ND<5.0	10	0.5
2-Chlorotoluene	ND<5.0	10	0.5	4-Chlorotoluene	ND<5.0	10	0.5
Dibromochloromethane	ND<5.0	10	0.5	1,2-Dibromo-3-chloropropane	ND<5.0	10	0.5
1,2-Dibromoethane (EDB)	ND<5.0	10	0.5	Dibromomethane	ND<5.0	10	0.5
1,2-Dichlorobenzene	ND<5.0	10	0.5	1,3-Dichlorobenzene	ND<5.0	10	0.5
1,4-Dichlorobenzene	ND<5.0	10	0.5	Dichlorodifluoromethane	ND<5.0	10	0.5
1,1-Dichloroethane	ND<5.0	10	0.5	1,2-Dichloroethane (1,2-DCA)	ND<5.0	10	0.5
1,1-Dichloroethene	ND<5.0	10	0.5	cis-1,2-Dichloroethene	ND<5.0	10	0.5
trans-1,2-Dichloroethene	ND<5.0	10	0.5	1,2-Dichloropropane	ND<5.0	10	0.5
1,3-Dichloropropane	ND<5.0	10	0.5	2,2-Dichloropropane	ND<5.0	10	0.5
1,1-Dichloropropene	ND<5.0	10	0.5	cis-1,3-Dichloropropene	ND<5.0	10	0.5
trans-1,3-Dichloropropene	ND<5.0	10	0.5	Diisopropyl ether (DIPE)	ND<5.0	10	0.5
Ethylbenzene	ND<5.0	10	0.5	Ethyl tert-butyl ether (ETBE)	ND<5.0	10	0.5
Freon 113	ND<100	10	10	Hexachlorobutadiene	ND<5.0	10	0.5
Hexachloroethane	ND<5.0	10	0.5	2-Hexanone	ND<5.0	10	0.5
Isopropylbenzene	ND<5.0	10	0.5	4-Isopropyl toluene	ND<5.0	10	0.5
Methyl-t-butyl ether (MTBE)	280	10	0.5	Methylene chloride	ND<5.0	10	0.5
4-Methyl-2-pentanone (MIBK)	ND<5.0	10	0.5	Naphthalene	ND<5.0	10	0.5
Nitrobenzene	ND<100	10	10	n-Propyl benzene	ND<5.0	10	0.5
Styrene	ND<5.0	10	0.5	1,1,1,2-Tetrachloroethane	ND<5.0	10	0.5
1,1,2,2-Tetrachloroethane	ND<5.0	10	0.5	Tetrachloroethene	ND<5.0	10	0.5
Toluene	ND<5.0	10	0.5	1,2,3-Trichlorobenzene	ND<5.0	10	0.5
1,2,4-Trichlorobenzene	ND<5.0	10	0.5	1,1,1-Trichloroethane	ND<5.0	10	0.5
1,1,2-Trichloroethane	ND<5.0	10	0.5	Trichloroethene	ND<5.0	10	0.5
Trichlorofluoromethane	ND<5.0	10	0.5	1,2,3-Trichloropropane	ND<5.0	10	0.5
1,2,4-Trimethylbenzene	ND<5.0	10	0.5	1,3,5-Trimethylbenzene	ND<5.0	10	0.5
Vinyl Chloride	ND<5.0	10	0.5	Xylenes	ND<5.0	10	0.5

Surrogate Recoveries (%)

%SS1:	113	%SS2:	97
%SS3:	105		

Comments:

* water and vapor samples are reported in µg/L, soil/sludge/solid samples in mg/kg, product/oil/non-aqueous liquid samples and all TCLP & SPLP extracts are reported in mg/L, wipe samples in µg/wipe.

ND means not detected above the reporting limit; N/A means analyte not applicable to this analysis.

surrogate diluted out of range or coelutes with another peak; &) low surrogate due to matrix interference.

h) lighter than water immiscible sheen/product is present; i) liquid sample that contains greater than ~1 vol. % sediment; j) sample diluted due to high organic content/matrix interference; k) reporting limit near, but not identical to our standard reporting limit due to variable Encore sample weight; m) reporting limit raised due to insufficient sample amount; n) results are reported on a dry weight basis; p) see attached narrative.



P & D Environmental 55 Santa Clara, Ste.240 Oakland, CA 94610	Client Project ID: #0055; Former Haber Oil	Date Sampled: 06/15/06
	Client Contact: Nick Mitchell	Date Received: 06/16/06
	Client P.O.:	Date Extracted: 06/19/06
		Date Analyzed: 06/19/06

Volatile Organics by P&T and GC/MS (Basic Target List)*

Extraction Method: SW5030B

Analytical Method: SW8260B

Work Order: 0606386

Lab ID	0606386-002B
Client ID	MW-2
Matrix	Water

Compound	Concentration *	DF	Reporting Limit	Compound	Concentration *	DF	Reporting Limit
Acetone	ND<500	100	5.0	Acrolein (Propenal)	ND<500	100	5.0
Acrylonitrile	ND<200	100	2.0	tert-Amyl methyl ether (TAME)	ND<50	100	0.5
Benzene	1100	100	0.5	Bromobenzene	ND<50	100	0.5
Bromochloromethane	ND<50	100	0.5	Bromodichloromethane	ND<50	100	0.5
Bromoform	ND<50	100	0.5	Bromomethane	ND<50	100	0.5
2-Butanone (MEK)	ND<200	100	2.0	t-Butyl alcohol (TBA)	ND<500	100	5.0
n-Butyl benzene	ND<50	100	0.5	sec-Butyl benzene	ND<50	100	0.5
tert-Butyl benzene	ND<50	100	0.5	Carbon Disulfide	ND<50	100	0.5
Carbon Tetrachloride	ND<50	100	0.5	Chlorobenzene	ND<50	100	0.5
Chloroethane	ND<50	100	0.5	2-Chloroethyl Vinyl Ether	ND<100	100	1.0
Chloroform	ND<50	100	0.5	Chloromethane	ND<50	100	0.5
2-Chlorotoluene	ND<50	100	0.5	4-Chlorotoluene	ND<50	100	0.5
Dibromochloromethane	ND<50	100	0.5	1,2-Dibromo-3-chloropropane	ND<50	100	0.5
1,2-Dibromoethane (EDB)	ND<50	100	0.5	Dibromomethane	ND<50	100	0.5
1,2-Dichlorobenzene	ND<50	100	0.5	1,3-Dichlorobenzene	ND<50	100	0.5
1,4-Dichlorobenzene	ND<50	100	0.5	Dichlorodifluoromethane	ND<50	100	0.5
1,1-Dichloroethane	ND<50	100	0.5	1,2-Dichloroethane (1,2-DCA)	ND<50	100	0.5
1,1-Dichloroethene	ND<50	100	0.5	cis-1,2-Dichloroethene	ND<50	100	0.5
trans-1,2-Dichloroethene	ND<50	100	0.5	1,2-Dichloropropane	ND<50	100	0.5
1,3-Dichloropropane	ND<50	100	0.5	2,2-Dichloropropane	ND<50	100	0.5
1,1-Dichloropropene	ND<50	100	0.5	cis-1,3-Dichloropropene	ND<50	100	0.5
trans-1,3-Dichloropropene	ND<50	100	0.5	Diisopropyl ether (DIPE)	ND<50	100	0.5
Ethylbenzene	740	100	0.5	Ethyl tert-butyl ether (ETBE)	ND<50	100	0.5
Freon 113	ND<1000	100	10	Hexachlorobutadiene	ND<50	100	0.5
Hexachloroethane	ND<50	100	0.5	2-Hexanone	ND<50	100	0.5
Isopropylbenzene	ND<50	100	0.5	4-Isopropyl toluene	ND<50	100	0.5
Methyl-t-butyl ether (MTBE)	260	100	0.5	Methylene chloride	ND<50	100	0.5
4-Methyl-2-pentanone (MIBK)	ND<50	100	0.5	Naphthalene	100	100	0.5
Nitrobenzene	ND<1000	100	10	n-Propyl benzene	64	100	0.5
Styrene	ND<50	100	0.5	1,1,1,2-Tetrachloroethane	ND<50	100	0.5
1,1,2,2-Tetrachloroethane	ND<50	100	0.5	Tetrachloroethene	ND<50	100	0.5
Toluene	1100	100	0.5	1,2,3-Trichlorobenzene	ND<50	100	0.5
1,2,4-Trichlorobenzene	ND<50	100	0.5	1,1,1-Trichloroethane	ND<50	100	0.5
1,1,2-Trichloroethane	ND<50	100	0.5	Trichloroethene	ND<50	100	0.5
Trichlorofluoromethane	ND<50	100	0.5	1,2,3-Trichloropropane	ND<50	100	0.5
1,2,4-Trimethylbenzene	560	100	0.5	1,3,5-Trimethylbenzene	120	100	0.5
Vinyl Chloride	ND<50	100	0.5	Xylenes	2600	100	0.5

Surrogate Recoveries (%)

%SS1:	113	%SS2:	95
%SS3:	102		

Comments:

* water and vapor samples are reported in µg/L, soil/sludge/solid samples in mg/kg, product/oil/non-aqueous liquid samples and all TCLP & SPLP extracts are reported in mg/L, wipe samples in µg/wipe.

ND means not detected above the reporting limit; N/A means analyte not applicable to this analysis.

surrogate diluted out of range or coelutes with another peak; &) low surrogate due to matrix interference.

h) lighter than water immiscible sheen/product is present; i) liquid sample that contains greater than ~1 vol. % sediment; j) sample diluted due to high organic content/matrix interference; k) reporting limit near, but not identical to our standard reporting limit due to variable Encore sample weight; m) reporting limit raised due to insufficient sample amount; n) results are reported on a dry weight basis; p) see attached narrative.

P & D Environmental 55 Santa Clara, Ste.240 Oakland, CA 94610	Client Project ID: #0055; Former Haber Oil	Date Sampled: 06/15/06
	Client Contact: Nick Mitchell	Date Received: 06/16/06
	Client P.O.:	Date Extracted: 06/26/06
		Date Analyzed: 06/26/06

Volatile Organics by P&T and GC/MS (Basic Target List)*

Extraction Method: SW5030B Analytical Method: SW8260B Work Order: 0606386

Lab ID	0606386-003B
Client ID	MW-3
Matrix	Water

Compound	Concentration *	DF	Reporting Limit	Compound	Concentration *	DF	Reporting Limit
Acetone	ND<1000	200	5.0	Acrolein (Propenal)	ND<1000	200	5.0
Acrylonitrile	ND<400	200	2.0	tert-Amyl methyl ether (TAME)	ND<100	200	0.5
Benzene	ND<100	200	0.5	Bromobenzene	ND<100	200	0.5
Bromochloromethane	ND<100	200	0.5	Bromodichloromethane	ND<100	200	0.5
Bromoform	ND<100	200	0.5	Bromomethane	ND<100	200	0.5
2-Butanone (MEK)	ND<400	200	2.0	t-Butyl alcohol (TBA)	ND<1000	200	5.0
n-Butyl benzene	ND<100	200	0.5	sec-Butyl benzene	ND<100	200	0.5
tert-Butyl benzene	ND<100	200	0.5	Carbon Disulfide	ND<100	200	0.5
Carbon Tetrachloride	ND<100	200	0.5	Chlorobenzene	ND<100	200	0.5
Chloroethane	ND<100	200	0.5	2-Chloroethyl Vinyl Ether	ND<200	200	1.0
Chloroform	ND<100	200	0.5	Chloromethane	ND<100	200	0.5
2-Chlorotoluene	ND<100	200	0.5	4-Chlorotoluene	ND<100	200	0.5
Dibromochloromethane	ND<100	200	0.5	1,2-Dibromo-3-chloropropane	ND<100	200	0.5
1,2-Dibromoethane (EDB)	ND<100	200	0.5	Dibromomethane	ND<100	200	0.5
1,2-Dichlorobenzene	ND<100	200	0.5	1,3-Dichlorobenzene	ND<100	200	0.5
1,4-Dichlorobenzene	ND<100	200	0.5	Dichlorodifluoromethane	ND<100	200	0.5
1,1-Dichloroethane	ND<100	200	0.5	1,2-Dichloroethane (1,2-DCA)	ND<100	200	0.5
1,1-Dichloroethene	ND<100	200	0.5	cis-1,2-Dichloroethene	ND<100	200	0.5
trans-1,2-Dichloroethene	ND<100	200	0.5	1,2-Dichloropropane	ND<100	200	0.5
1,3-Dichloropropane	ND<100	200	0.5	2,2-Dichloropropane	ND<100	200	0.5
1,1-Dichloropropene	ND<100	200	0.5	cis-1,3-Dichloropropene	ND<100	200	0.5
trans-1,3-Dichloropropene	ND<100	200	0.5	Diisopropyl ether (DIPE)	ND<100	200	0.5
Ethylbenzene	120	200	0.5	Ethyl tert-butyl ether (ETBE)	ND<100	200	0.5
Freon 113	ND<2000	200	10	Hexachlorobutadiene	ND<100	200	0.5
Hexachloroethane	ND<100	200	0.5	2-Hexanone	ND<100	200	0.5
Isopropylbenzene	ND<100	200	0.5	4-Isopropyl toluene	ND<100	200	0.5
Methyl-t-butyl ether (MTBE)	4300	200	0.5	Methylene chloride	ND<100	200	0.5
4-Methyl-2-pentanone (MIBK)	ND<100	200	0.5	Naphthalene	ND<100	200	0.5
Nitrobenzene	ND<2000	200	10	n-Propyl benzene	ND<100	200	0.5
Styrene	ND<100	200	0.5	1,1,1,2-Tetrachloroethane	ND<100	200	0.5
1,1,2,2-Tetrachloroethane	ND<100	200	0.5	Tetrachloroethene	ND<100	200	0.5
Toluene	ND<100	200	0.5	1,2,3-Trichlorobenzene	ND<100	200	0.5
1,2,4-Trichlorobenzene	ND<100	200	0.5	1,1,1-Trichloroethane	ND<100	200	0.5
1,1,2-Trichloroethane	ND<100	200	0.5	Trichloroethene	ND<100	200	0.5
Trichlorofluoromethane	ND<100	200	0.5	1,2,3-Trichloropropane	ND<100	200	0.5
1,2,4-Trimethylbenzene	340	200	0.5	1,3,5-Trimethylbenzene	ND<100	200	0.5
Vinyl Chloride	ND<100	200	0.5	Xylenes	610	200	0.5

Surrogate Recoveries (%)			
%SS1:	108	%SS2:	97
%SS3:	104		

Comments:

* water and vapor samples are reported in µg/L, soil/sludge/solid samples in mg/kg, product/oil/non-aqueous liquid samples and all TCLP & SPLP extracts are reported in mg/L, wipe samples in µg/wipe.

ND means not detected above the reporting limit; N/A means analyte not applicable to this analysis.

surrogate diluted out of range or coelutes with another peak; &) low surrogate due to matrix interference.

h) lighter than water immiscible sheen/product is present; i) liquid sample that contains greater than ~1 vol. % sediment; j) sample diluted due to high organic content/matrix interference; k) reporting limit near, but not identical to our standard reporting limit due to variable Encore sample weight; m) reporting limit raised due to insufficient sample amount; n) results are reported on a dry weight basis; p) see attached narrative.



P & D Environmental 55 Santa Clara, Ste.240 Oakland, CA 94610	Client Project ID: #0055; Former Haber Oil	Date Sampled: 06/15/06
	Client Contact: Nick Mitchell	Date Received: 06/16/06
	Client P.O.:	Date Extracted: 06/21/06
		Date Analyzed: 06/21/06

Volatile Organics by P&T and GC/MS (Basic Target List)*

Extraction Method: SW5030B

Analytical Method: SW8260B

Work Order: 0606386

Lab ID	0606386-004B
Client ID	MW-4
Matrix	Water

Compound	Concentration *	DF	Reporting Limit	Compound	Concentration *	DF	Reporting Limit
Acetone	ND<250	50	5.0	Acrolein (Propenal)	ND<250	50	5.0
Acrylonitrile	ND<100	50	2.0	tert-Amyl methyl ether (TAME)	ND<25	50	0.5
Benzene	ND<25	50	0.5	Bromobenzene	ND<25	50	0.5
Bromochloromethane	ND<25	50	0.5	Bromodichloromethane	ND<25	50	0.5
Bromoform	ND<25	50	0.5	Bromomethane	ND<25	50	0.5
2-Butanone (MEK)	ND<100	50	2.0	t-Butyl alcohol (TBA)	ND<250	50	5.0
n-Butyl benzene	ND<25	50	0.5	sec-Butyl benzene	ND<25	50	0.5
tert-Butyl benzene	ND<25	50	0.5	Carbon Disulfide	ND<25	50	0.5
Carbon Tetrachloride	ND<25	50	0.5	Chlorobenzene	ND<25	50	0.5
Chloroethane	ND<25	50	0.5	2-Chloroethyl Vinyl Ether	ND<50	50	1.0
Chloroform	ND<25	50	0.5	Chloromethane	ND<25	50	0.5
2-Chlorotoluene	ND<25	50	0.5	4-Chlorotoluene	ND<25	50	0.5
Dibromochloromethane	ND<25	50	0.5	1,2-Dibromo-3-chloropropane	ND<25	50	0.5
1,2-Dibromoethane (EDB)	ND<25	50	0.5	Dibromomethane	ND<25	50	0.5
1,2-Dichlorobenzene	ND<25	50	0.5	1,3-Dichlorobenzene	ND<25	50	0.5
1,4-Dichlorobenzene	ND<25	50	0.5	Dichlorodifluoromethane	ND<25	50	0.5
1,1-Dichloroethane	ND<25	50	0.5	1,2-Dichloroethane (1,2-DCA)	ND<25	50	0.5
1,1-Dichloroethene	ND<25	50	0.5	cis-1,2-Dichloroethene	ND<25	50	0.5
trans-1,2-Dichloroethene	ND<25	50	0.5	1,2-Dichloropropane	ND<25	50	0.5
1,3-Dichloropropane	ND<25	50	0.5	2,2-Dichloropropane	ND<25	50	0.5
1,1-Dichloropropene	ND<25	50	0.5	cis-1,3-Dichloropropene	ND<25	50	0.5
trans-1,3-Dichloropropene	ND<25	50	0.5	Diisopropyl ether (DIPE)	ND<25	50	0.5
Ethylbenzene	ND<25	50	0.5	Ethyl tert-butyl ether (ETBE)	ND<25	50	0.5
Freon 113	ND<500	50	10	Hexachlorobutadiene	ND<25	50	0.5
Hexachloroethane	ND<25	50	0.5	2-Hexanone	ND<25	50	0.5
Isopropylbenzene	ND<25	50	0.5	4-Isopropyl toluene	ND<25	50	0.5
Methyl-t-butyl ether (MTBE)	550	50	0.5	Methylene chloride	ND<25	50	0.5
4-Methyl-2-pentanone (MIBK)	ND<25	50	0.5	Naphthalene	ND<25	50	0.5
Nitrobenzene	ND<500	50	10	n-Propyl benzene	ND<25	50	0.5
Styrene	ND<25	50	0.5	1,1,1,2-Tetrachloroethane	ND<25	50	0.5
1,1,2,2-Tetrachloroethane	ND<25	50	0.5	Tetrachloroethene	ND<25	50	0.5
Toluene	ND<25	50	0.5	1,2,3-Trichlorobenzene	ND<25	50	0.5
1,2,4-Trichlorobenzene	ND<25	50	0.5	1,1,1-Trichloroethane	ND<25	50	0.5
1,1,2-Trichloroethane	ND<25	50	0.5	Trichloroethene	ND<25	50	0.5
Trichlorofluoromethane	ND<25	50	0.5	1,2,3-Trichloropropane	ND<25	50	0.5
1,2,4-Trimethylbenzene	ND<25	50	0.5	1,3,5-Trimethylbenzene	ND<25	50	0.5
Vinyl Chloride	ND<25	50	0.5	Xylenes	ND<25	50	0.5

Surrogate Recoveries (%)

%SS1:	110	%SS2:	98
%SS3:	100		

Comments:

* water and vapor samples are reported in µg/L, soil/sludge/solid samples in mg/kg, product/oil/non-aqueous liquid samples and all TCLP & SPLP extracts are reported in mg/L, wipe samples in µg/wipe.

ND means not detected above the reporting limit; N/A means analyte not applicable to this analysis.

surrogate diluted out of range or coelutes with another peak; &) low surrogate due to matrix interference.

h) lighter than water immiscible sheen/product is present; i) liquid sample that contains greater than ~1 vol. % sediment; j) sample diluted due to high organic content/matrix interference; k) reporting limit near, but not identical to our standard reporting limit due to variable Encore sample weight; m) reporting limit raised due to insufficient sample amount; n) results are reported on a dry weight basis; p) see attached narrative.



P & D Environmental 55 Santa Clara, Ste.240 Oakland, CA 94610	Client Project ID: #0055; Former Haber Oil	Date Sampled: 06/15/06
	Client Contact: Nick Mitchell	Date Received: 06/16/06
	Client P.O.:	Date Extracted: 06/20/06
		Date Analyzed: 06/20/06

Volatile Organics by P&T and GC/MS (Basic Target List)*

Extraction Method: SW5030B

Analytical Method: SW8260B

Work Order: 0606386

Lab ID	0606386-005B
Client ID	MW-5
Matrix	Water

Compound	Concentration *	DF	Reporting Limit	Compound	Concentration *	DF	Reporting Limit
Acetone	ND	1.0	5.0	Acrolein (Propenal)	ND	1.0	5.0
Acrylonitrile	ND	1.0	2.0	tert-Amyl methyl ether (TAME)	ND	1.0	0.5
Benzene	ND	1.0	0.5	Bromobenzene	ND	1.0	0.5
Bromochloromethane	ND	1.0	0.5	Bromodichloromethane	ND	1.0	0.5
Bromoform	ND	1.0	0.5	Bromomethane	ND	1.0	0.5
2-Butanone (MEK)	ND	1.0	2.0	t-Butyl alcohol (TBA)	ND	1.0	5.0
n-Butyl benzene	ND	1.0	0.5	sec-Butyl benzene	ND	1.0	0.5
tert-Butyl benzene	ND	1.0	0.5	Carbon Disulfide	ND	1.0	0.5
Carbon Tetrachloride	ND	1.0	0.5	Chlorobenzene	ND	1.0	0.5
Chloroethane	ND	1.0	0.5	2-Chloroethyl Vinyl Ether	ND	1.0	1.0
Chloroform	ND	1.0	0.5	Chloromethane	ND	1.0	0.5
2-Chlorotoluene	ND	1.0	0.5	4-Chlorotoluene	ND	1.0	0.5
Dibromochloromethane	ND	1.0	0.5	1,2-Dibromo-3-chloropropane	ND	1.0	0.5
1,2-Dibromoethane (EDB)	ND	1.0	0.5	Dibromomethane	ND	1.0	0.5
1,2-Dichlorobenzene	ND	1.0	0.5	1,3-Dichlorobenzene	ND	1.0	0.5
1,4-Dichlorobenzene	ND	1.0	0.5	Dichlorodifluoromethane	ND	1.0	0.5
1,1-Dichloroethane	ND	1.0	0.5	1,2-Dichloroethane (1,2-DCA)	ND	1.0	0.5
1,1-Dichloroethene	ND	1.0	0.5	cis-1,2-Dichloroethene	ND	1.0	0.5
trans-1,2-Dichloroethene	ND	1.0	0.5	1,2-Dichloropropane	ND	1.0	0.5
1,3-Dichloropropane	ND	1.0	0.5	2,2-Dichloropropane	ND	1.0	0.5
1,1-Dichloropropene	ND	1.0	0.5	cis-1,3-Dichloropropene	ND	1.0	0.5
trans-1,3-Dichloropropene	ND	1.0	0.5	Diisopropyl ether (DIPE)	ND	1.0	0.5
Ethylbenzene	ND	1.0	0.5	Ethyl tert-butyl ether (ETBE)	ND	1.0	0.5
Freon 113	ND	1.0	10	Hexachlorobutadiene	ND	1.0	0.5
Hexachloroethane	ND	1.0	0.5	2-Hexanone	ND	1.0	0.5
Isopropylbenzene	ND	1.0	0.5	4-Isopropyl toluene	ND	1.0	0.5
Methyl-t-butyl ether (MTBE)	ND	1.0	0.5	Methylene chloride	ND	1.0	0.5
4-Methyl-2-pentanone (MIBK)	ND	1.0	0.5	Naphthalene	ND	1.0	0.5
Nitrobenzene	ND	1.0	10	n-Propyl benzene	ND	1.0	0.5
Styrene	ND	1.0	0.5	1,1,1,2-Tetrachloroethane	ND	1.0	0.5
1,1,2,2-Tetrachloroethane	ND	1.0	0.5	Tetrachloroethene	ND	1.0	0.5
Toluene	ND	1.0	0.5	1,2,3-Trichlorobenzene	ND	1.0	0.5
1,2,4-Trichlorobenzene	ND	1.0	0.5	1,1,1-Trichloroethane	ND	1.0	0.5
1,1,2-Trichloroethane	ND	1.0	0.5	Trichloroethene	ND	1.0	0.5
Trichlorofluoromethane	ND	1.0	0.5	1,2,3-Trichloropropane	ND	1.0	0.5
1,2,4-Trimethylbenzene	ND	1.0	0.5	1,3,5-Trimethylbenzene	ND	1.0	0.5
Vinyl Chloride	ND	1.0	0.5	Xylenes	ND	1.0	0.5

Surrogate Recoveries (%)

%SS1:	114	%SS2:	87
%SS3:	96		

Comments:

* water and vapor samples are reported in µg/L, soil/sludge/solid samples in mg/kg, product/oil/non-aqueous liquid samples and all TCLP & SPLP extracts are reported in mg/L, wipe samples in µg/wipe.

ND means not detected above the reporting limit; N/A means analyte not applicable to this analysis.

surrogate diluted out of range or coelutes with another peak; &) low surrogate due to matrix interference.

h) lighter than water immiscible sheen/product is present; i) liquid sample that contains greater than ~1 vol. % sediment; j) sample diluted due to high organic content/matrix interference; k) reporting limit near, but not identical to our standard reporting limit due to variable Encore sample weight; m) reporting limit raised due to insufficient sample amount; n) results are reported on a dry weight basis; p) see attached narrative.



P & D Environmental 55 Santa Clara, Ste.240 Oakland, CA 94610	Client Project ID: #0055; Former Haber Oil	Date Sampled: 06/14/06
	Client Contact: Nick Mitchell	Date Received: 06/16/06
	Client P.O.:	Date Extracted: 06/20/06
		Date Analyzed: 06/20/06

Volatile Organics by P&T and GC/MS (Basic Target List)*

Extraction Method: SW5030B

Analytical Method: SW8260B

Work Order: 0606386

Lab ID	0606386-006B
Client ID	MW-6
Matrix	Water

Compound	Concentration *	DF	Reporting Limit	Compound	Concentration *	DF	Reporting Limit
Acetone	ND<1.0	2.0	5.0	Acrolein (Propenal)	ND<1.0	2.0	5.0
Acrylonitrile	ND<4.0	2.0	2.0	tert-Amyl methyl ether (TAME)	ND<1.0	2.0	0.5
Benzene	ND<1.0	2.0	0.5	Bromobenzene	ND<1.0	2.0	0.5
Bromochloromethane	ND<1.0	2.0	0.5	Bromodichloromethane	ND<1.0	2.0	0.5
Bromoform	ND<1.0	2.0	0.5	Bromomethane	ND<1.0	2.0	0.5
2-Butanone (MEK)	ND<4.0	2.0	2.0	t-Butyl alcohol (TBA)	ND<10	2.0	5.0
n-Butyl benzene	ND<1.0	2.0	0.5	sec-Butyl benzene	ND<1.0	2.0	0.5
tert-Butyl benzene	ND<1.0	2.0	0.5	Carbon Disulfide	ND<1.0	2.0	0.5
Carbon Tetrachloride	ND<1.0	2.0	0.5	Chlorobenzene	ND<1.0	2.0	0.5
Chloroethane	ND<1.0	2.0	0.5	2-Chloroethyl Vinyl Ether	ND<2.0	2.0	1.0
Chloroform	ND<1.0	2.0	0.5	Chloromethane	ND<1.0	2.0	0.5
2-Chlorotoluene	ND<1.0	2.0	0.5	4-Chlorotoluene	ND<1.0	2.0	0.5
Dibromochloromethane	ND<1.0	2.0	0.5	1,2-Dibromo-3-chloropropane	ND<1.0	2.0	0.5
1,2-Dibromoethane (EDB)	ND<1.0	2.0	0.5	Dibromomethane	ND<1.0	2.0	0.5
1,2-Dichlorobenzene	ND<1.0	2.0	0.5	1,3-Dichlorobenzene	ND<1.0	2.0	0.5
1,4-Dichlorobenzene	ND<1.0	2.0	0.5	Dichlorodifluoromethane	ND<1.0	2.0	0.5
1,1-Dichloroethane	ND<1.0	2.0	0.5	1,2-Dichloroethane (1,2-DCA)	ND<1.0	2.0	0.5
1,1-Dichloroethene	ND<1.0	2.0	0.5	cis-1,2-Dichloroethene	ND<1.0	2.0	0.5
trans-1,2-Dichloroethene	ND<1.0	2.0	0.5	1,2-Dichloropropane	ND<1.0	2.0	0.5
1,3-Dichloropropane	ND<1.0	2.0	0.5	2,2-Dichloropropane	ND<1.0	2.0	0.5
1,1-Dichloropropene	ND<1.0	2.0	0.5	cis-1,3-Dichloropropene	ND<1.0	2.0	0.5
trans-1,3-Dichloropropene	ND<1.0	2.0	0.5	Diisopropyl ether (DIPE)	ND<1.0	2.0	0.5
Ethylbenzene	ND<1.0	2.0	0.5	Ethyl tert-butyl ether (ETBE)	ND<1.0	2.0	0.5
Freon 113	ND<20	2.0	10	Hexachlorobutadiene	ND<1.0	2.0	0.5
Hexachloroethane	ND<1.0	2.0	0.5	2-Hexanone	ND<1.0	2.0	0.5
Isopropylbenzene	ND<1.0	2.0	0.5	4-Isopropyl toluene	ND<1.0	2.0	0.5
Methyl-t-butyl ether (MTBE)	72	2.0	0.5	Methylene chloride	ND<1.0	2.0	0.5
4-Methyl-2-pentanone (MIBK)	ND<1.0	2.0	0.5	Naphthalene	ND<1.0	2.0	0.5
Nitrobenzene	ND<20	2.0	10	n-Propyl benzene	ND<1.0	2.0	0.5
Styrene	ND<1.0	2.0	0.5	1,1,1,2-Tetrachloroethane	ND<1.0	2.0	0.5
1,1,2,2-Tetrachloroethane	ND<1.0	2.0	0.5	Tetrachloroethene	ND<1.0	2.0	0.5
Toluene	ND<1.0	2.0	0.5	1,2,3-Trichlorobenzene	ND<1.0	2.0	0.5
1,2,4-Trichlorobenzene	ND<1.0	2.0	0.5	1,1,1-Trichloroethane	ND<1.0	2.0	0.5
1,1,2-Trichloroethane	ND<1.0	2.0	0.5	Trichloroethene	ND<1.0	2.0	0.5
Trichlorofluoromethane	ND<1.0	2.0	0.5	1,2,3-Trichloropropane	ND<1.0	2.0	0.5
1,2,4-Trimethylbenzene	ND<1.0	2.0	0.5	1,3,5-Trimethylbenzene	ND<1.0	2.0	0.5
Vinyl Chloride	ND<1.0	2.0	0.5	Xylenes	ND<1.0	2.0	0.5

Surrogate Recoveries (%)

%SS1:	116	%SS2:	88
%SS3:	97		

Comments:

* water and vapor samples are reported in µg/L, soil/sludge/solid samples in mg/kg, product/oil/non-aqueous liquid samples and all TCLP & SPLP extracts are reported in mg/L, wipe samples in µg/wipe.

ND means not detected above the reporting limit; N/A means analyte not applicable to this analysis.

surrogate diluted out of range or coelutes with another peak; &) low surrogate due to matrix interference.

h) lighter than water immiscible sheen/product is present; i) liquid sample that contains greater than ~1 vol. % sediment; j) sample diluted due to high organic content/matrix interference; k) reporting limit near, but not identical to our standard reporting limit due to variable Encore sample weight; m) reporting limit raised due to insufficient sample amount; n) results are reported on a dry weight basis; p) see attached narrative.



P & D Environmental 55 Santa Clara, Ste.240 Oakland, CA 94610	Client Project ID: #0055; Former Haber Oil	Date Sampled: 06/14/06
	Client Contact: Nick Mitchell	Date Received: 06/16/06
	Client P.O.:	Date Extracted: 06/19/06
		Date Analyzed: 06/19/06

Volatile Organics by P&T and GC/MS (Basic Target List)*

Extraction Method: SW5030B

Analytical Method: SW8260B

Work Order: 0606386

Lab ID	0606386-007B
Client ID	MW-7
Matrix	Water

Compound	Concentration *	DF	Reporting Limit	Compound	Concentration *	DF	Reporting Limit
Acetone	ND	1.0	5.0	Acrolein (Propenal)	ND	1.0	5.0
Acrylonitrile	ND	1.0	2.0	tert-Amyl methyl ether (TAME)	ND	1.0	0.5
Benzene	ND	1.0	0.5	Bromobenzene	ND	1.0	0.5
Bromochloromethane	ND	1.0	0.5	Bromodichloromethane	ND	1.0	0.5
Bromoform	ND	1.0	0.5	Bromomethane	ND	1.0	0.5
2-Butanone (MEK)	ND	1.0	2.0	t-Butyl alcohol (TBA)	ND	1.0	5.0
n-Butyl benzene	ND	1.0	0.5	sec-Butyl benzene	ND	1.0	0.5
tert-Butyl benzene	ND	1.0	0.5	Carbon Disulfide	ND	1.0	0.5
Carbon Tetrachloride	ND	1.0	0.5	Chlorobenzene	ND	1.0	0.5
Chloroethane	ND	1.0	0.5	2-Chloroethyl Vinyl Ether	ND	1.0	1.0
Chloroform	ND	1.0	0.5	Chloromethane	ND	1.0	0.5
2-Chlorotoluene	ND	1.0	0.5	4-Chlorotoluene	ND	1.0	0.5
Dibromochloromethane	ND	1.0	0.5	1,2-Dibromo-3-chloropropane	ND	1.0	0.5
1,2-Dibromoethane (EDB)	ND	1.0	0.5	Dibromomethane	ND	1.0	0.5
1,2-Dichlorobenzene	ND	1.0	0.5	1,3-Dichlorobenzene	ND	1.0	0.5
1,4-Dichlorobenzene	ND	1.0	0.5	Dichlorodifluoromethane	ND	1.0	0.5
1,1-Dichloroethane	ND	1.0	0.5	1,2-Dichloroethane (1,2-DCA)	ND	1.0	0.5
1,1-Dichloroethene	ND	1.0	0.5	cis-1,2-Dichloroethene	ND	1.0	0.5
trans-1,2-Dichloroethene	ND	1.0	0.5	1,2-Dichloropropane	ND	1.0	0.5
1,3-Dichloropropane	ND	1.0	0.5	2,2-Dichloropropane	ND	1.0	0.5
1,1-Dichloropropene	ND	1.0	0.5	cis-1,3-Dichloropropene	ND	1.0	0.5
trans-1,3-Dichloropropene	ND	1.0	0.5	Diisopropyl ether (DIPE)	ND	1.0	0.5
Ethylbenzene	ND	1.0	0.5	Ethyl tert-butyl ether (ETBE)	ND	1.0	0.5
Freon 113	ND	1.0	10	Hexachlorobutadiene	ND	1.0	0.5
Hexachloroethane	ND	1.0	0.5	2-Hexanone	ND	1.0	0.5
Isopropylbenzene	ND	1.0	0.5	4-Isopropyl toluene	ND	1.0	0.5
Methyl-t-butyl ether (MTBE)	ND	1.0	0.5	Methylene chloride	ND	1.0	0.5
4-Methyl-2-pentanone (MIBK)	ND	1.0	0.5	Naphthalene	ND	1.0	0.5
Nitrobenzene	ND	1.0	10	n-Propyl benzene	ND	1.0	0.5
Styrene	ND	1.0	0.5	1,1,1,2-Tetrachloroethane	ND	1.0	0.5
1,1,2,2-Tetrachloroethane	ND	1.0	0.5	Tetrachloroethene	2.8	1.0	0.5
Toluene	ND	1.0	0.5	1,2,3-Trichlorobenzene	ND	1.0	0.5
1,2,4-Trichlorobenzene	ND	1.0	0.5	1,1,1-Trichloroethane	ND	1.0	0.5
1,1,2-Trichloroethane	ND	1.0	0.5	Trichloroethene	ND	1.0	0.5
Trichlorofluoromethane	ND	1.0	0.5	1,2,3-Trichloropropane	ND	1.0	0.5
1,2,4-Trimethylbenzene	ND	1.0	0.5	1,3,5-Trimethylbenzene	ND	1.0	0.5
Vinyl Chloride	ND	1.0	0.5	Xylenes	ND	1.0	0.5

Surrogate Recoveries (%)

%SS1:	113	%SS2:	94
%SS3:	103		

Comments:

* water and vapor samples are reported in µg/L, soil/sludge/solid samples in mg/kg, product/oil/non-aqueous liquid samples and all TCLP & SPLP extracts are reported in mg/L, wipe samples in µg/wipe.

ND means not detected above the reporting limit; N/A means analyte not applicable to this analysis.

surrogate diluted out of range or coelutes with another peak; &) low surrogate due to matrix interference.

h) lighter than water immiscible sheen/product is present; i) liquid sample that contains greater than ~1 vol. % sediment; j) sample diluted due to high organic content/matrix interference; k) reporting limit near, but not identical to our standard reporting limit due to variable Encore sample weight; m) reporting limit raised due to insufficient sample amount; n) results are reported on a dry weight basis; p) see attached narrative.



P & D Environmental 55 Santa Clara, Ste.240 Oakland, CA 94610	Client Project ID: #0055; Former Haberm Oil	Date Sampled: 06/14/06
	Client Contact: Nick Mitchell	Date Received: 06/16/06
	Client P.O.:	Date Extracted: 06/19/06
		Date Analyzed: 06/19/06

Volatile Organics by P&T and GC/MS (Basic Target List)*

Extraction Method: SW5030B

Analytical Method: SW8260B

Work Order: 0606386

Lab ID	0606386-008B
Client ID	MW-8
Matrix	Water

Compound	Concentration *	DF	Reporting Limit	Compound	Concentration *	DF	Reporting Limit
Acetone	ND	1.0	5.0	Acrolein (Propenal)	ND	1.0	5.0
Acrylonitrile	ND	1.0	2.0	tert-Amyl methyl ether (TAME)	ND	1.0	0.5
Benzene	ND	1.0	0.5	Bromobenzene	ND	1.0	0.5
Bromochloromethane	ND	1.0	0.5	Bromodichloromethane	ND	1.0	0.5
Bromoform	ND	1.0	0.5	Bromomethane	ND	1.0	0.5
2-Butanone (MEK)	ND	1.0	2.0	t-Butyl alcohol (TBA)	ND	1.0	5.0
n-Butyl benzene	ND	1.0	0.5	sec-Butyl benzene	ND	1.0	0.5
tert-Butyl benzene	ND	1.0	0.5	Carbon Disulfide	ND	1.0	0.5
Carbon Tetrachloride	ND	1.0	0.5	Chlorobenzene	ND	1.0	0.5
Chloroethane	ND	1.0	0.5	2-Chloroethyl Vinyl Ether	ND	1.0	1.0
Chloroform	0.62	1.0	0.5	Chloromethane	ND	1.0	0.5
2-Chlorotoluene	ND	1.0	0.5	4-Chlorotoluene	ND	1.0	0.5
Dibromochloromethane	ND	1.0	0.5	1,2-Dibromo-3-chloropropane	ND	1.0	0.5
1,2-Dibromoethane (EDB)	ND	1.0	0.5	Dibromomethane	ND	1.0	0.5
1,2-Dichlorobenzene	ND	1.0	0.5	1,3-Dichlorobenzene	ND	1.0	0.5
1,4-Dichlorobenzene	ND	1.0	0.5	Dichlorodifluoromethane	ND	1.0	0.5
1,1-Dichloroethane	ND	1.0	0.5	1,2-Dichloroethane (1,2-DCA)	ND	1.0	0.5
1,1-Dichloroethene	ND	1.0	0.5	cis-1,2-Dichloroethene	ND	1.0	0.5
trans-1,2-Dichloroethene	ND	1.0	0.5	1,2-Dichloropropane	ND	1.0	0.5
1,3-Dichloropropane	ND	1.0	0.5	2,2-Dichloropropane	ND	1.0	0.5
1,1-Dichloropropene	ND	1.0	0.5	cis-1,3-Dichloropropene	ND	1.0	0.5
trans-1,3-Dichloropropene	ND	1.0	0.5	Diisopropyl ether (DIPE)	ND	1.0	0.5
Ethylbenzene	ND	1.0	0.5	Ethyl tert-butyl ether (ETBE)	ND	1.0	0.5
Freon 113	ND	1.0	10	Hexachlorobutadiene	ND	1.0	0.5
Hexachloroethane	ND	1.0	0.5	2-Hexanone	ND	1.0	0.5
Isopropylbenzene	ND	1.0	0.5	4-Isopropyl toluene	ND	1.0	0.5
Methyl-t-butyl ether (MTBE)	ND	1.0	0.5	Methylene chloride	ND	1.0	0.5
4-Methyl-2-pentanone (MIBK)	ND	1.0	0.5	Naphthalene	ND	1.0	0.5
Nitrobenzene	ND	1.0	10	n-Propyl benzene	ND	1.0	0.5
Styrene	ND	1.0	0.5	1,1,1,2-Tetrachloroethane	ND	1.0	0.5
1,1,2,2-Tetrachloroethane	ND	1.0	0.5	Tetrachloroethene	ND	1.0	0.5
Toluene	ND	1.0	0.5	1,2,3-Trichlorobenzene	ND	1.0	0.5
1,2,4-Trichlorobenzene	ND	1.0	0.5	1,1,1-Trichloroethane	ND	1.0	0.5
1,1,2-Trichloroethane	ND	1.0	0.5	Trichloroethene	ND	1.0	0.5
Trichlorofluoromethane	ND	1.0	0.5	1,2,3-Trichloropropane	ND	1.0	0.5
1,2,4-Trimethylbenzene	ND	1.0	0.5	1,3,5-Trimethylbenzene	ND	1.0	0.5
Vinyl Chloride	ND	1.0	0.5	Xylenes	ND	1.0	0.5

Surrogate Recoveries (%)

%SS1:	114	%SS2:	94
%SS3:	104		

Comments:

* water and vapor samples are reported in µg/L, soil/sludge/solid samples in mg/kg, product/oil/non-aqueous liquid samples and all TCLP & SPLP extracts are reported in mg/L, wipe samples in µg/wipe.

ND means not detected above the reporting limit; N/A means analyte not applicable to this analysis.

surrogate diluted out of range or coelutes with another peak; &) low surrogate due to matrix interference.

h) lighter than water immiscible sheen/product is present; i) liquid sample that contains greater than ~1 vol. % sediment; j) sample diluted due to high organic content/matrix interference; k) reporting limit near, but not identical to our standard reporting limit due to variable Encore sample weight; m) reporting limit raised due to insufficient sample amount; n) results are reported on a dry weight basis; p) see attached narrative.



QC SUMMARY REPORT FOR SW8021B/8015Cm

W.O. Sample Matrix: Water

QC Matrix: Water

WorkOrder: 0606386

EPA Method: SW8021B/8015Cm		Extraction: SW5030B				BatchID: 22234			Spiked Sample ID: 0606386-008A	
Analyte	Sample	Spiked	MS	MSD	MS-MSD	LCS	LCSD	LCS-LCSD	Acceptance Criteria (%)	
	µg/L	µg/L	% Rec.	% Rec.	% RPD	% Rec.	% Rec.	% RPD	MS / MSD	LCS / LCSD
TPH(btex)£	ND	60	104	106	2.32	99.9	110	9.66	70 - 130	70 - 130
MTBE	ND	10	125	112	11.0	120	114	5.16	70 - 130	70 - 130
Benzene	ND	10	105	104	0.447	102	104	1.93	70 - 130	70 - 130
Toluene	ND	10	97.8	95.2	2.77	93.6	95.6	2.09	70 - 130	70 - 130
Ethylbenzene	ND	10	105	93.8	10.8	102	95.5	6.65	70 - 130	70 - 130
Xylenes	ND	30	95.7	94.7	1.05	91.3	91.7	0.364	70 - 130	70 - 130
%SS:	102	10	100	101	1.06	101	101	0	70 - 130	70 - 130

All target compounds in the Method Blank of this extraction batch were ND less than the method RL with the following exceptions:
NONE

BATCH 22234 SUMMARY

Sample ID	Date Sampled	Date Extracted	Date Analyzed	Sample ID	Date Sampled	Date Extracted	Date Analyzed
0606386-001A	6/15/06	6/21/06	6/21/06 1:21 PM	0606386-002A	6/15/06	6/21/06	6/21/06 7:33 AM
0606386-003A	6/15/06	6/20/06	6/20/06 7:58 AM	0606386-003A	6/15/06	6/21/06	6/21/06 6:26 AM
0606386-004A	6/15/06	6/20/06	6/20/06 6:11 AM	0606386-004A	6/15/06	6/21/06	6/21/06 4:53 AM
0606386-005A	6/15/06	6/20/06	6/20/06 3:02 AM	0606386-006A	6/14/06	6/21/06	6/21/06 2:55 AM
0606386-007A	6/14/06	6/20/06	6/20/06 7:10 AM	0606386-008A	6/14/06	6/19/06	6/19/06 5:14 PM

MS = Matrix Spike; MSD = Matrix Spike Duplicate; LCS = Laboratory Control Sample; LCSD = Laboratory Control Sample Duplicate; RPD = Relative Percent Deviation.
 % Recovery = 100 * (MS-Sample) / (Amount Spiked); RPD = 100 * (MS - MSD) / ((MS + MSD) / 2).
 MS / MSD spike recoveries and / or %RPD may fall outside of laboratory acceptance criteria due to one or more of the following reasons: a) the sample is inhomogenous AND contains significant concentrations of analyte relative to the amount spiked, or b) the spiked sample's matrix interferes with the spike recovery.
 £ TPH(btex) = sum of BTEX areas from the FID.
 # cluttered chromatogram; sample peak coelutes with surrogate peak.
 N/A = not applicable or not enough sample to perform matrix spike and matrix spike duplicate.
 NR = analyte concentration in sample exceeds spike amount for soil matrix or exceeds 2x spike amount for water matrix or sample diluted due to high matrix or analyte content.



QC SUMMARY REPORT FOR SW8260B

W.O. Sample Matrix: Water

QC Matrix: Water

WorkOrder: 0606386

EPA Method: SW8260B		Extraction: SW5030B			BatchID: 22254			Spiked Sample ID: 0606384-003A		
Analyte	Sample	Spiked	MS	MSD	MS-MSD	LCS	LCSD	LCS-LCSD	Acceptance Criteria (%)	
	µg/L	µg/L	% Rec.	% Rec.	% RPD	% Rec.	% Rec.	% RPD	MS / MSD	LCS / LCSD
tert-Amyl methyl ether (TAME)	ND	10	95.3	102	6.50	97.2	98.4	1.28	70 - 130	70 - 130
Benzene	ND	10	117	120	2.43	118	117	0.203	70 - 130	70 - 130
t-Butyl alcohol (TBA)	ND	50	97.3	94.1	3.34	98.5	95.1	3.53	70 - 130	70 - 130
Chlorobenzene	ND	10	86.3	88	1.97	90.3	89.2	1.26	70 - 130	70 - 130
1,2-Dibromoethane (EDB)	ND	10	104	106	2.03	109	108	0.824	70 - 130	70 - 130
1,2-Dichloroethane (1,2-DCA)	ND	10	98.5	105	6.52	99.7	101	1.61	70 - 130	70 - 130
1,1-Dichloroethene	ND	10	119	90	28.1	119	119	0	70 - 130	70 - 130
Diisopropyl ether (DIPE)	ND	10	103	109	6.13	103	105	1.60	70 - 130	70 - 130
Ethyl tert-butyl ether (ETBE)	ND	10	90.3	95.5	5.65	91.7	92	0.295	70 - 130	70 - 130
Methyl-t-butyl ether (MTBE)	ND	10	93.5	99.7	6.41	94.4	95.1	0.735	70 - 130	70 - 130
Toluene	ND	10	102	103	1.29	104	102	2.31	70 - 130	70 - 130
Trichloroethene	ND	10	80.8	87.4	7.85	84.5	83.1	1.63	70 - 130	70 - 130
%SS1:	113	10	104	110	5.17	105	102	3.13	70 - 130	70 - 130
%SS2:	95	10	94	94	0	96	95	0.895	70 - 130	70 - 130
%SS3:	120	10	105	105	0	105	105	0	70 - 130	70 - 130

All target compounds in the Method Blank of this extraction batch were ND less than the method RL with the following exceptions:

NONE

BATCH 22254 SUMMARY

Sample ID	Date Sampled	Date Extracted	Date Analyzed	Sample ID	Date Sampled	Date Extracted	Date Analyzed
0606386-001B	6/15/06	6/19/06	6/19/06 3:28 PM	0606386-002B	6/15/06	6/19/06	6/19/06 4:16 PM
0606386-003B	6/15/06	6/21/06	6/21/06 1:16 AM	0606386-004B	6/15/06	6/21/06	6/21/06 3:32 PM
0606386-005B	6/15/06	6/20/06	6/20/06 7:51 PM	0606386-006B	6/14/06	6/20/06	6/20/06 5:18 PM
0606386-007B	6/14/06	6/19/06	6/19/06 9:46 PM	0606386-008B	6/14/06	6/19/06	6/19/06 10:31 PM

MS = Matrix Spike; MSD = Matrix Spike Duplicate; LCS = Laboratory Control Sample; LCSD = Laboratory Control Sample Duplicate; RPD = Relative Percent Deviation.

% Recovery = 100 * (MS-Sample) / (Amount Spiked); RPD = 100 * (MS - MSD) / ((MS + MSD) / 2).

MS / MSD spike recoveries and / or %RPD may fall outside of laboratory acceptance criteria due to one or more of the following reasons: a) the sample is inhomogenous AND contains significant concentrations of analyte relative to the amount spiked, or b) the spiked sample's matrix interferes with the spike recovery.

N/A = not enough sample to perform matrix spike and matrix spike duplicate.

NR = analyte concentration in sample exceeds spike amount for soil matrix or exceeds 2x spike amount for water matrix or sample diluted due to high matrix or analyte content.

Laboratory extraction solvents such as methylene chloride and acetone may occasionally appear in the method blank at low levels.

McC Campbell Analytical, Inc.

110 Second Avenue South, #D7
 Pacheco, CA 94553-5560
 (925) 798-1620

CHAIN-OF-CUSTODY RECORD

WorkOrder: 0606386

ClientID: PDEO

EDF: NO

Report to:

Nick Mitchell
 P & D Environmental
 55 Santa Clara, Ste.240
 Oakland, CA 94610

TEL: (510) 658-6916
 FAX: 510-834-0152
 ProjectNo: #0055; Former Haber Oil
 PO:

Bill to:

Accounts Payable
 P & D Environmental
 55 Santa Clara, Ste.240
 Oakland, CA 94610

Requested TAT: 5 days

Date Received: 06/16/2006

Date Printed: 06/16/2006

Sample ID	ClientSampID	Matrix	Collection Date	Hold	Requested Tests (See legend below)														
					1	2	3	4	5	6	7	8	9	10	11	12			
0606386-001	MW-1	Water	6/15/06	<input type="checkbox"/>	B	A													
0606386-002	MW-2	Water	6/15/06	<input type="checkbox"/>	B	A													
0606386-003	MW-3	Water	6/15/06	<input type="checkbox"/>	B	A													
0606386-004	MW-4	Water	6/15/06	<input type="checkbox"/>	B	A													
0606386-005	MW-5	Water	6/15/06	<input type="checkbox"/>	B	A													
0606386-006	MW-6	Water	6/14/06	<input type="checkbox"/>	B	A													
0606386-007	MW-7	Water	6/14/06	<input type="checkbox"/>	B	A													
0606386-008	MW-8	Water	6/14/06	<input type="checkbox"/>	B	A													

Test Legend:

1	8260B_W	2	G-MBTX_W	3		4		5	
6		7		8		9		10	
11		12							

Prepared by: Melissa Valles

Comments:

NOTE: Samples are discarded 60 days after results are reported unless other arrangements are made. Hazardous samples will be returned to client or disposed of at client expense.

CHAIN OF CUSTODY RECORD

*TPH & Lead
Scavengers*

PROJECT NUMBER: <u>0055</u>		PROJECT NAME: <u>Former Haber Oil</u>			NUMBER OF CONTAINERS	ANALYSIS(ES): <u>TPH-6</u> <u>BZ&C + Fuel Oil</u>	PRESERVATIVE	REMARKS
SAMPLED BY: (PRINTED AND SIGNATURE) <u>Nick Mitchell</u>								
SAMPLE NUMBER	DATE	TIME	TYPE	SAMPLE LOCATION				
+ MW1	6/15/6		Water		7	X	ICE Normal Turnaround	
+ MW2	6/15/6				7	X		
+ MW3	6/15/6				7	X		
+ MW4	6/15/6				7	X		
+ MW5	6/15/6				7	X		
+ MW6	6/14/6				7	X		
+ MW7	6/14/6				7	X		
+ MW8	6/14/6				7	X		
ICE <input checked="" type="checkbox"/> GOOD CONDITION <input checked="" type="checkbox"/> HEAD SPACE ABSENT <input checked="" type="checkbox"/> APPROPRIATE CONTAINERS <input checked="" type="checkbox"/> DECHLORINATED IN LAB <input checked="" type="checkbox"/> PRESERVED IN LAB <input checked="" type="checkbox"/> PRESERVATION: VOAS <input checked="" type="checkbox"/> O&G <input checked="" type="checkbox"/> METALS <input checked="" type="checkbox"/> OTHER <input checked="" type="checkbox"/>								
RELINQUISHED BY: (SIGNATURE) <i>[Signature]</i>		DATE <u>6/16/6</u>	TIME <u>3:5</u>	RECEIVED BY: (SIGNATURE) <i>[Signature]</i>		TOTAL NO. OF SAMPLES (THIS SHIPMENT) <u>5</u>	LABORATORY: <u>McCampbell Analytical</u>	
RELINQUISHED BY: (SIGNATURE) <i>[Signature]</i>		DATE <u>6/16/6</u>	TIME <u>6:15</u>	RECEIVED BY: (SIGNATURE) <u>me Vall</u>		TOTAL NO. OF CONTAINERS (THIS SHIPMENT) <u>56</u>	LABORATORY CONTACT: <u>Ange Rydelius</u>	
RELINQUISHED BY: (SIGNATURE)		DATE	TIME	RECEIVED FOR LABORATORY BY: (SIGNATURE)		LABORATORY PHONE NUMBER: <u>(925) 798 1620</u>		
						SAMPLE ANALYSIS REQUEST SHEET ATTACHED: () YES (X) NO		
REMARKS: <u>Voas preserved w HCl</u>								