

ENVIRONMENTAL
PROTECTION

00 JAN -6 PM 4:07



Chevron

Chevron U.S.A. Products Company
6001 Bollinger Canyon Rd. Bldg. L
P. O. Box 6004
San Ramon, CA 94583-0804

Site Assessment and
Remediation Group
Phone (510) 842-9500
Fax (510) 842-8370

Date: December 27, 1999
To: Distribution
Re: Groundwater Monitoring Report, 9-8139

The enclosed groundwater monitoring report has been properly reviewed by a Chevron authorized representative. Agency guidelines have been followed. Blaine Tech Services is authorized to distribute the report directly to interested parties.

If you have any questions, please call me at (510) 842-8695.

Sincerely,

A handwritten signature in cursive script that reads "Brett L. Hunter".

Brett Hunter
Site Assessment and Remediation
Project Manager

BLAINE
TECH SERVICES INC.



1680 ROGERS AVENUE
SAN JOSE, CALIFORNIA 95112-1105
(408) 573-7771 FAX
(408) 573-0555 PHONE

December 27, 1999

Brett Hunter
Chevron U.S.A. Products Company
P.O. Box 6004
San Ramon, CA 94583-0904

4th Quarter 1999 Monitoring at 9-8139

Fourth Quarter 1999 Groundwater Monitoring at
Chevron Service Station Number 9-8139
16304 Foothill Blvd.
San Leandro, CA

Monitoring Performed on October 26, 1999

Groundwater Sampling Report 991026-A-2

This report covers the routine monitoring of groundwater wells at this Chevron facility. Blaine Tech Services, Inc.'s work at the site includes inspection, gauging, evacuation, purgewater containment, sample collection and sample handling in accordance with standard procedures that conform to Regional Water Quality Control Board requirements.

Routine field data collection includes depth to water, total well depth, thickness of any separate immiscible layer, water column volume, calculated volume of a three-case volume purge, elapsed evacuation time, total volume of water removed, and standard water parameter instrument readings. Sample material is collected, contained, stored, and transported to the laboratory in conformance with EPA standards. Purgewater is, likewise, collected and transported to McKittrick Waste Treatment Site for disposal.

Basic field information is presented alongside analytical values excerpted from the laboratory report in the cumulative table of **WELL DATA AND ANALYTICAL RESULTS**. The full analytical report for the most recent samples is located in the **Analytical Appendix**. The table also contains new groundwater elevation calculations taken from the computer plotted gradient map which is located in the **Professional Engineering Appendix**.

At a minimum, Blaine Tech Services, Inc. field personnel are certified upon completion of a forty-hour Hazardous Materials and Emergency Response training course per 29 CFR 1910.120. Field personnel are also enrolled in annual eight hour refresher courses.

Blaine Tech Services, Inc. conducts sampling and documentation assignments of this type as an independent third party. In order to avoid compromising the objectivity necessary for the proper and disinterested performance of this work, Blaine Tech Services, Inc. concentrates on objective data collection and does not participate in the interpretation of analytical results, the definition of geological or hydrological conditions, the formulation of recommendations, or the marketing of remedial systems.

Please call if you have any questions.

Yours truly,

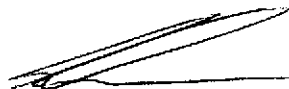

Scott Boor
Project Coordinator

SDB/jbt

attachments: Professional Engineering Appendix
Cumulative Table of Well Data and Analytical Results
Analytical Appendix
Field Data Sheets

cc: Scott Seery, Alameda County Health Care Services, Dept of
Environmental Health
Chuck Headlee, RWQCB-San Francisco Bay Region
Harv Dhaliwal, P.E., G & S Associates, Inc.
Greg Gurss, Gettler-Ryan, Inc.
Bette Owen, Chevron Products Company (w/o enclosure)

Professional Engineering Appendix

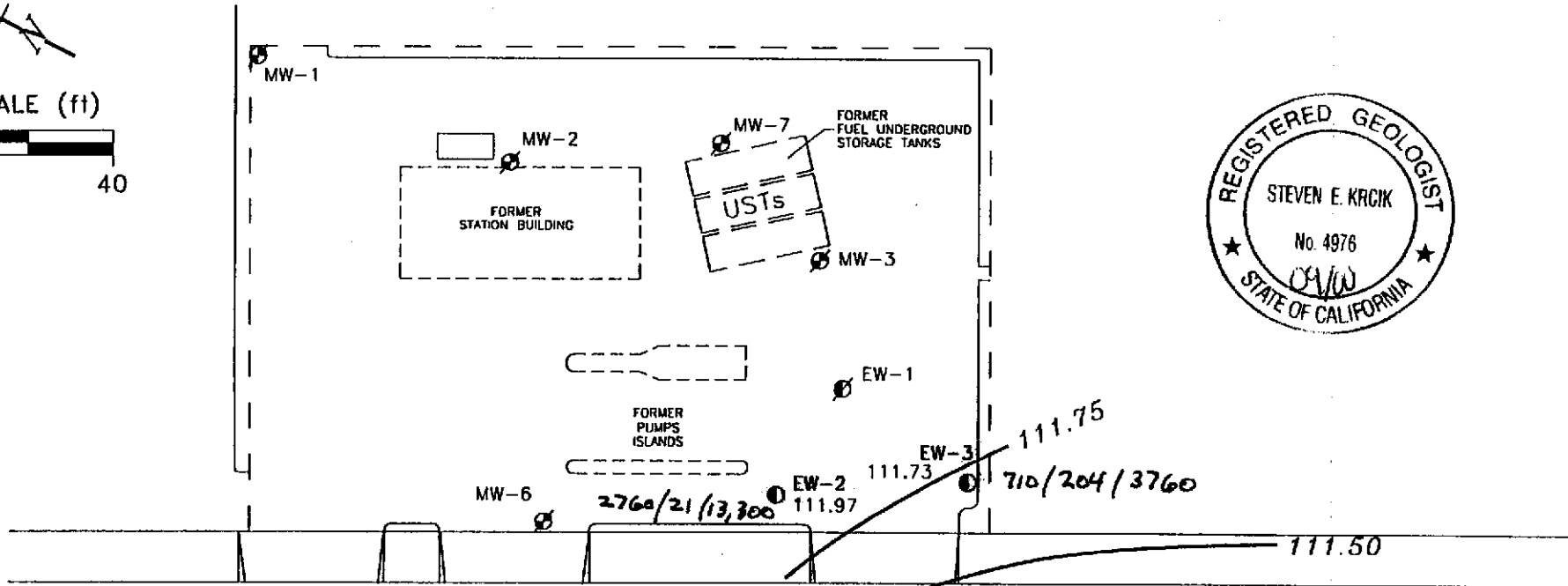
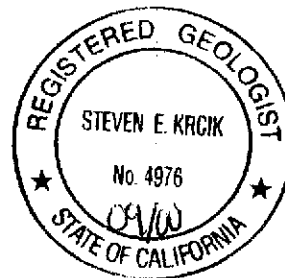
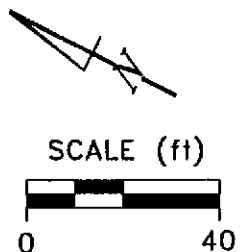

FOOTHILL BOULEVARD

- EXPLANATION**
- ⊕ MONITORING WELL
 - ⊙ EXTRACTION WELL
 - ⊗ ABANDONED WELL
 - 111.73 GROUNDWATER ELEVATION (FT. MSL)
 - GROUNDWATER ELEVATION CONTOUR (FT. MSL)
 - ↓ APPROXIMATE GROUNDWATER FLOW DIRECTION; APPROXIMATE GRADIENT = 0.01

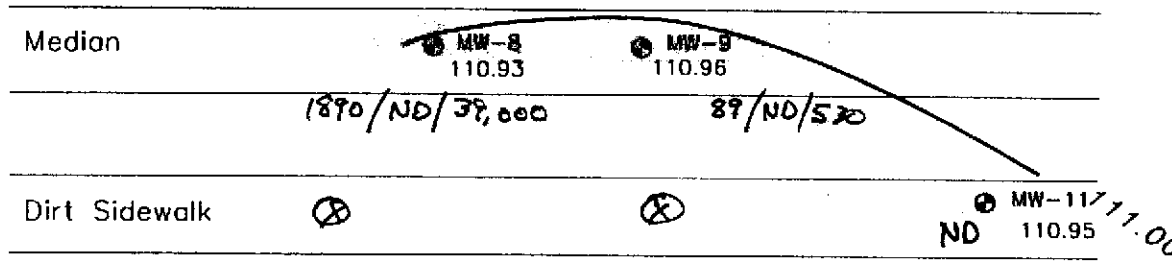

TPH-G / benzene / MEBE

Basemap from Cambria Environmental Technology, Inc.

PREPARED BY



Chevron Station 9-8139
 16304 Foothill Boulevard
 San Leandro, California

GROUNDWATER ELEVATION CONTOUR MAP,
 OCTOBER 26, 1999

FIGURE:
1
PROJECT:
 DAC04

Table of Well Data and Analytical Results

Cumulative Table of Well Data and Analytical Results

Vertical Measurements are in feet.

Analytical results are in parts per billion (ppb)

DATE	Well Head Elev.	Ground Water Elev.	Depth To Water	Notes	TPH-Gasoline	Benzene	Toluene	Ethyl-Benzene	Xylene	MTBE	EDB
MW-1											
12/05/89	127.09	--	--	*	<500	<0.5	<0.5	<0.5	<0.5	<0.5	<0.5
03/23/90	127.09	114.17	12.92	--	--	--	--	--	--	--	--
05/24/90	127.09	--	--	--	<50	<0.5	<0.5	<0.5	<0.5	--	--
09/06/90	127.09	112.41	14.68	--	<50	<0.5	0.8	<0.5	<0.5	<0.5	<0.5
09/25/90	127.09	112.08	15.01	--	--	--	--	--	--	--	--
11/29/90	127.09	112.27	14.82	--	<50	0.7	0.9	<0.5	1.0	--	--
02/20/91	127.09	112.80	14.29	--	<50	<0.5	<0.5	<0.5	<0.5	--	--
04/19/91	127.09	114.93	12.16	--	--	--	--	--	--	--	--
05/22/91	127.09	113.40	13.69	--	<50	<0.5	<0.5	<0.5	<0.5	--	--
08/22/91	127.09	111.71	15.38	--	<50	<0.5	<0.5	<0.5	<0.5	--	--
11/13/91	127.09	111.29	15.80	--	<50	<0.5	<0.5	<0.5	<0.5	--	--
01/30/92	127.09	112.38	14.71	--	<50	0.5	<0.5	<0.5	0.5	--	--
04/23/92	127.09	114.87	12.22	--	<50	<0.5	<0.5	<0.5	<0.5	--	--
07/27/92	127.09	112.79	14.30	--	<50	<0.5	<0.5	<0.5	<0.5	--	--
10/26/92	127.09	111.19	15.90	--	<50	0.6	<0.5	<0.5	<0.5	--	--
01/29/93	127.09	116.58	10.51	--	<50	3.0	3.0	0.7	3.0	--	--
04/30/93	127.09	117.19	9.90	--	<50	<0.5	0.7	<0.5	1.0	--	--
07/14/93	127.09	114.81	12.28	--	<50	0.7	1.0	<0.5	3.0	--	--
10/27/93	127.09	111.56	15.53	--	<50	0.9	2.0	<0.5	2.0	--	--
01/13/94	127.09	114.85	12.24	--	<50	<0.5	0.9	<0.5	<0.5	--	--
04/22/94	127.09	114.18	12.91	--	<50	1.1	2.6	1.0	5.5	--	--
07/29/94	127.09	114.34	12.75	--	<50	<0.5	0.9	<0.5	<0.5	--	--
10/25/94	127.09	113.46	13.63	--	100	0.6	1.6	<0.5	4.1	--	--
01/19/95	127.09	117.16	9.93	Well Abandoned	<50	<0.5	<0.5	<0.5	<0.5	--	--

NO LONGER MONITORED OR SAMPLED

*TPH-Diesel not detected at detection limit of 1000 ppb. Oil and Grease not detected at detection limit of 5000 ppb.

Cumulative Table of Well Data and Analytical Results

Vertical Measurements are in feet.

Analytical results are in parts per billion (ppb)

DATE	Well Head Elev.	Ground Water Elev.	Depth To Water	Notes	TPH-Gasoline	Benzene	Toluene	Ethyl-Benzene	Xylene	MTBE	EDB
MW-2											
12/05/89	125.98	--	--	*	<500	<0.5	<0.5	<0.5	0.9	<0.5	<0.5
03/23/90	125.98	113.58	12.40	--	--	--	--	--	--	--	--
05/24/90	125.98	--	--	--	<50	<0.5	<0.5	<0.5	<0.5	--	--
09/06/90	125.98	111.13	14.85	--	<50	<0.5	<0.5	<0.5	<0.5	<0.5	<0.5
09/25/90	125.98	111.18	14.80	--	--	--	--	--	--	--	--
11/29/90	125.98	111.58	14.40	--	<50	<0.5	<0.5	<0.5	<0.5	--	--
02/20/91	125.98	111.89	14.09	--	<50	<0.5	<0.5	<0.5	<0.5	--	--
04/19/91	125.98	113.36	12.62	--	--	--	--	--	--	--	--
05/22/91	125.98	113.00	12.98	--	<50	<0.5	<0.5	<0.5	<0.5	--	--
08/22/91	125.98	111.05	14.93	--	<50	<0.5	<0.5	<0.5	<0.5	--	--
11/13/91	125.98	110.56	15.42	--	58	<0.5	0.5	0.7	2.3	--	--
01/30/92	125.98	111.28	14.70	--	<50	<0.5	<0.5	<0.5	<0.5	--	--
04/23/92	125.98	112.15	13.83	--	<50	<0.5	<0.5	<0.5	<0.5	--	--
07/27/92	125.98	110.68	15.30	--	<50	<0.5	<0.5	<0.5	1.1	--	--
10/26/92	125.98	110.36	15.62	--	<50	<0.5	<0.5	<0.5	<0.5	--	--
01/29/93	125.98	116.72	9.26	--	<50	3.0	8.0	1.0	5.0	--	--
04/30/93	125.98	116.32	9.66	--	<1300	<13	<13	<13	<13	--	--
07/14/93	125.98	114.08	11.90	--	<50	0.8	2.0	0.8	4.0	--	--
10/27/93	125.98	112.49	13.49	--	<50	1.0	2.0	1.0	2.0	--	--
01/13/94	125.98	113.99	11.99	--	<50	<0.5	0.6	<0.5	<0.5	--	--
04/22/94	125.98	113.25	12.73	--	<50	0.6	<0.5	<0.5	1.7	--	--
07/29/94	125.98	113.68	12.30	--	<50	<0.5	0.9	<0.5	<0.5	--	--
10/25/94	125.98	112.59	13.39	--	<50	<0.5	0.8	<0.5	2.1	--	--
01/19/95	125.98	117.27	8.71	Well Abandoned	<50	<0.5	2.3	<0.5	<0.5	--	--

NO LONGER MONITORED OR SAMPLED

*TPH-Diesel not detected at detection limit of 1000 ppb. Oil and Grease not detected at detection limit of 5000 ppb.

Cumulative Table of Well Data and Analytical Results

Vertical Measurements are in feet.

Analytical results are in parts per billion (ppb)

DATE	Well Head Elev.	Ground Water Elev.	Depth To Water	Notes	TPH-Gasoline	Benzene	Toluene	Ethyl-Benzene	Xylene	MTBE	EDB
MW-3											
12/05/89	127.84	--	--	*	24,000	2400	1800	360	2600	<0.5	<0.5
12/05/89	127.84	--	--	Duplicate	24,000	2500	1900	390	2600	<0.5	<0.5
03/23/90	127.84	110.34	17.50	--	--	--	--	--	--	--	--
05/24/90	127.84	--	--	--	9000	2600	1700	250	1500	--	--
05/24/90	127.84	--	--	Duplicate	10,000	2600	1800	260	1600	--	--
09/06/90	126.77	108.05	18.72	--	3500	900	550	110	460	<0.5	<0.5
09/25/90	126.77	108.37	18.40	--	--	--	--	--	--	--	--
11/29/90	126.77	107.80	18.97	--	9200	1100	1100	210	1100	--	--
02/20/91	126.77	107.57	19.20	--	8800	960	780	200	920	--	--
04/19/91	126.77	108.96	17.81	--	--	--	--	--	--	--	--
05/22/91	126.77	108.89	17.88	--	28,000	5800	1200	460	2300	--	--
08/01/91	126.77	107.54	19.23	--	--	--	--	--	--	--	--
08/22/91	126.77	106.60	20.17	--	21,000	3100	2000	480	2000	--	--
08/22/91	126.77	--	--	Duplicate	19,000	2700	1800	420	1700	--	--
11/13/91	126.77	106.82	19.95	--	18,000	2400	1200	450	2200	--	--
01/30/92	126.77	107.63	19.14	--	18,000	3800	920	700	2600	--	--
04/23/92	126.77	109.02	17.75	--	46,000	5000	1900	1000	3500	--	--
07/27/92	126.77	107.77	19.00	--	26,000	4900	1100	1200	3600	--	--
10/26/92	126.77	107.15	19.62	--	6600	1100	41	220	570	--	--
01/29/93	126.77	110.82	15.95	--	32,000	5900	2900	1300	5000	--	--
04/30/93	126.77	111.10	15.67	--	14,000	6100	98	870	2400	--	--
07/14/93	126.77	109.94	16.83	--	12,000	3100	1100	720	2900	--	--
10/27/93	126.77	109.07	17.70	--	19,000	7800	400	1500	3400	--	--
01/13/94	126.77	110.23	16.54	--	51,000	3700	140	720	1800	--	--
04/22/94	126.77	109.75	17.02	--	22,000	9300	89	1200	2400	--	--
07/29/94	126.77	109.82	16.95	--	13,000	4700	44	580	420	--	--
10/25/94	126.77	109.11	17.66	--	24,000	8700	52	1500	1400	--	--
01/19/95	126.77	112.90	13.87	--	17,000	9300	36	1600	740	--	--
10/12/95	126.77	112.54	14.23	--	37,000	12,000	180	1800	1500	13,000	--
04/11/96	126.77	115.73	11.04	--	19,000	2400	81	1400	1500	6800	--
10/03/96	126.77	112.15	14.62	Well Abandoned	--	--	--	--	--	--	--

NO LONGER MONITORED OR SAMPLED

*Oil and Grease not detected at detection limit of 5000 ppb.

Cumulative Table of Well Data and Analytical Results

Vertical Measurements are in feet.

Analytical results are in parts per billion (ppb)

DATE	Well Head Elev.	Ground Water Elev.	Depth To Water	Notes	TPH-Gasoline	Benzene	Toluene	Ethyl-Benzene	Xylene	MTBE	EDB
MW-4											
12/05/89	125.22	--	--	--	19,000	390	1300	460	1800	<0.5	<0.5
03/23/90	125.22	109.20	16.02	--	--	--	--	--	--	--	--
05/24/90	125.22	--	--	--	4500	210	440	140	480	--	--
09/06/90	125.22	107.87	17.35	--	6000	680	520	170	580	<0.5	<0.5
09/25/90	125.22	107.74	17.48	--	--	--	--	--	--	--	--
11/29/90	125.22	107.61	17.61	--	15,000	800	1000	430	1700	--	--
02/20/91	125.22	107.41	17.81	--	15,000	640	390	420	1600	--	--
02/20/91	125.22	--	--	Duplicate	15,000	680	410	430	1600	--	--
04/19/91	125.22	109.42	15.80	--	--	--	--	--	--	--	--
05/22/91	125.22	108.54	16.68	--	9800	580	140	310	740	--	--
05/22/91	125.22	--	--	Duplicate	7200	520	130	270	670	--	--
REDESIGNATED EW-3											
EW-3											
08/01/91	125.22	107.73	17.49	--	--	--	--	--	--	--	--
10/27/93	125.22	--	--	--	<50	<0.5	<0.5	<0.5	<0.5	--	--
01/13/94	125.22	--	--	--	<50	<0.5	<0.5	<0.5	<0.5	--	--
04/22/94	125.22	--	--	--	<50	<0.5	<0.5	<0.5	<0.5	--	--
07/29/94	125.22	--	--	--	<50	1.3	1.3	0.6	5.3	--	--
10/25/94	125.22	109.02	16.20	--	--	--	--	--	--	--	--
01/19/95	125.22	112.51	12.71	--	240	45	0.8	22	48	--	--
04/03/97	125.22	112.89	12.33	--	450	140	<1.2	4.3	3.9	17	--
10/07/97	125.22	110.64	14.58	--	1900	510	<5.0	26	8.7	12	--
04/14/98	125.22	--	--	Inaccessible	--	--	--	--	--	--	--
10/13/98	125.22	112.74	12.48	--	1500	130	<2.5	9.0	4.7	3600	--
04/16/99	125.22	113.67	11.55	--	3800	280	37	270	300	2800	--
07/29/99	125.22	--	--	Inaccessible	--	--	--	--	--	--	--
10/26/99	125.22	111.73	13.49	--	710	204	2.87	7.31	11.8	3760	--

Cumulative Table of Well Data and Analytical Results

Vertical Measurements are in feet.

Analytical results are in parts per billion (ppb)

DATE	Well Head Elev.	Ground Water Elev.	Depth To Water	Notes	TPH-Gasoline	Benzene	Toluene	Ethyl-Benzene	Xylene	MTBE	EDB
MW-5											
03/23/90	125.85	108.96	16.89	--	--	--	--	--	--	--	--
05/25/90	125.85	--	--	--	28,000	920	1100	460	1300	2.4	2.4
09/07/90	125.85	107.42	18.46	Free Product (0.04')	--	--	--	--	--	--	--
09/25/90	125.85	107.54	18.87	Free Product (1.30')	--	--	--	--	--	--	--
11/29/90	125.85	107.31	18.91	Free Product (0.71')	--	--	--	--	--	--	--
02/20/91	125.85	109.24	16.99	Free Product (0.47')	--	--	--	--	--	--	--
04/19/91	125.85	107.58	19.30	Free Product (0.48')	--	--	--	--	--	--	--
05/22/91	125.85	108.42	17.69	Free Product (0.33')	--	--	--	--	--	--	--
REDESIGNATED EW-2											
EW-2											
08/01/91	125.79	107.72	18.07	--	--	--	--	--	--	--	--
04/22/94	125.79	--	--	--	<50	<0.5	<0.5	<0.5	<0.5	--	--
10/25/94	125.79	109.10	16.69	--	--	--	--	--	--	--	--
01/19/95	125.79	113.59	12.20	--	1700	540	69	56	400	--	--
05/01/95	125.79	113.63	12.16	--	<50	13	<0.5	<0.5	2.1	--	--
04/16/99	125.79	115.75	10.04	--	3500	350	160	130	550	3800	--
07/29/99	125.79	--	--	Inaccessible	--	--	--	--	--	--	--
10/26/99	125.79	111.97	13.82	--	2760	20.6	17.8	40.2	196	13,300	--

Cumulative Table of Well Data and Analytical Results

Vertical Measurements are in feet.

Analytical results are in parts per billion (ppb)

DATE	Well Head Elev.	Ground Water Elev.	Depth To Water	Notes	TPH-Gasoline	Benzene	Toluene	Ethyl-Benzene	Xylene	MTBE	EDB
MW-6											
03/23/90	124.18	105.67	18.51	--	--	--	--	--	--	--	--
05/25/90	124.18	--	--	--	<50	<2.0	<3.0	<3.0	<3.0	<0.02	<0.02
09/07/90	124.18	108.00	16.18	--	<50	<2.0	<3.0	<3.0	<3.0	<0.05	<0.05
09/25/90	124.18	107.76	16.42	--	--	--	--	--	--	--	--
11/29/90	124.18	108.07	16.11	--	<50	<0.5	<0.5	<0.5	<0.5	<0.05	<0.05
02/20/91	124.18	108.09	16.09	--	<50	<0.5	<0.5	<0.5	<0.5	--	--
04/19/91	124.18	109.03	15.15	--	--	--	--	--	--	--	--
05/22/91	124.18	108.77	15.41	--	<50	0.5	0.7	<0.5	1.1	--	--
08/23/91	124.18	106.38	17.80	--	<50	<0.5	<0.5	<0.5	<0.5	--	--
11/14/91	124.18	107.66	16.52	--	<50	<0.5	<0.5	<0.5	<0.5	<0.02	<0.02
11/14/91	124.18	--	--	Duplicate	<50	<0.5	0.6	<0.5	1.1	<0.05	<0.05
01/31/92	124.18	107.70	16.48	--	<50	<0.5	<0.5	<0.5	<0.5	--	--
01/31/92	124.18	--	--	Duplicate	<50	<0.5	<0.5	<0.5	<0.5	--	--
04/23/92	124.18	107.98	16.20	--	<50	<0.5	<0.5	<0.5	<0.5	--	--
04/23/92	124.18	--	--	Duplicate	--	--	--	--	--	--	--
07/27/92	124.18	107.66	16.52	--	<50	1.2	0.6	<0.5	1.9	--	--
10/26/92	124.18	107.06	17.12	--	<50	<0.5	<0.5	<0.5	<0.5	--	--
01/29/93	124.18	111.05	13.13	--	<50	<0.5	<0.5	<0.5	<0.5	--	--
04/30/93	124.18	109.32	14.86	--	<50	<0.5	<0.5	<0.5	0.6	--	--
07/14/93	124.18	109.57	14.61	--	<50	<0.5	<0.5	<0.5	<0.5	--	--
10/27/93	124.18	108.80	15.38	--	<50	0.9	1.0	0.6	1.0	--	--
01/13/94	124.18	108.84	15.34	--	<50	<0.5	<0.5	<0.5	<0.5	--	--
04/22/94	124.18	109.11	15.07	--	<50	<0.5	<0.5	<0.5	2.5	--	--
07/29/94	124.18	108.88	15.30	--	<50	7.5	1.2	1.0	1.1	--	--
10/25/94	124.18	108.49	15.69	--	<50	<0.5	<0.5	<0.5	1.2	--	--
01/19/95	124.18	112.69	11.49	--	<50	<0.5	3.1	<0.5	0.6	--	--
10/11/95	124.18	110.02	14.16	--	--	--	--	--	--	--	--
11/07/95	124.18	109.88	14.30	--	<50	<0.5	<0.5	<0.5	<0.5	<2.5	--
04/11/96	124.18	113.55	10.63	--	<50	<0.5	<0.5	<0.5	<0.5	<2.5	--
10/03/96	124.18	110.84	13.34	Well Abandoned	--	--	--	--	--	--	--

NO LONGER MONITORED OR SAMPLED

Cumulative Table of Well Data and Analytical Results

Vertical Measurements are in feet.

Analytical results are in parts per billion (ppb)

DATE	Well Head Elev.	Ground Water Elev.	Depth To Water	Notes	TPH-Gasoline	Benzene	Toluene	Ethyl-Benzene	Xylene	MTBE	EDB
MW-7											
03/23/90	126.86	105.46	21.40	--	--	--	--	--	--	--	--
05/25/90	126.86	--	--	--	<50	<2.0	<3.0	<3.0	<3.0	<0.02	<0.02
09/07/90	126.86	108.48	18.38	--	--	--	--	--	--	--	--
09/25/90	126.86	107.61	19.25	--	--	--	--	--	--	--	--
09/27/90	126.86	--	--	--	<50	<2.0	<3.0	<3.0	<3.0	<0.05	<0.05
09/27/90	126.86	--	--	Duplicate	<50	<2.0	<3.0	<3.0	<3.0	<0.05	<0.05
11/29/90	126.86	108.31	18.55	--	<50	<0.5	<0.5	<0.5	<0.5	--	--
02/20/91	126.86	108.31	18.55	--	<50	<0.5	<0.5	<0.5	<0.5	--	--
04/19/91	126.86	109.53	17.33	--	--	--	--	--	--	--	--
05/22/91	126.86	109.44	17.42	--	<50	<0.5	<0.5	<0.5	<0.5	--	--
08/22/91	126.86	107.81	19.05	--	<50	<0.5	<0.5	<0.5	<0.5	--	--
11/13/91	126.86	105.02	21.84	--	<50	<0.5	<0.5	<0.5	<0.5	--	--
01/30/92	126.86	104.44	22.42	--	<50	<0.5	<0.5	<0.5	<0.5	--	--
04/23/92	126.86	104.82	22.04	--	<50	<0.5	<0.5	<0.5	<0.5	--	--
07/27/92	126.86	104.62	22.24	--	<50	<0.5	<0.5	<0.5	<0.5	--	--
10/26/92	126.86	104.75	22.11	--	<50	<0.5	<0.5	<0.5	<0.5	--	--
01/29/93	126.86	109.79	17.07	--	<50	4.0	13	2.0	8.0	--	--
04/30/93	126.86	112.00	14.86	--	<50	<0.5	<0.5	<0.5	0.6	--	--
07/14/93	126.86	110.76	16.10	--	<50	<0.5	1.0	<0.5	2.0	--	--
10/27/93	126.86	108.15	18.71	--	<50	<0.5	<0.5	<0.5	<0.5	--	--
01/13/94	126.86	108.97	17.89	--	<50	<0.5	0.9	<0.5	1.0	--	--
04/22/94	126.86	109.92	16.94	--	<50	<0.5	<0.5	<0.5	1.3	--	--
07/29/94	126.86	110.16	16.70	--	74	19	8.2	7.8	11	--	--
10/25/94	126.86	109.44	17.42	--	<50	<0.5	0.6	<0.5	1.6	--	--
01/19/95	126.86	113.20	13.66	Well Abandoned	<50	<0.5	1.4	<0.5	<0.5	--	--

NO LONGER MONITORED OR SAMPLED

Cumulative Table of Well Data and Analytical Results

Vertical Measurements are in feet.

Analytical results are in parts per billion (ppb)

DATE	Well Head Elev.	Ground Water Elev.	Depth To Water	Notes	TPH-Gasoline	Benzene	Toluene	Ethyl-Benzene	Xylene	MTBE	EDB
MW-8											
09/07/90	123.61	107.54	16.07	--	<50	<0.5	<0.5	<0.5	<0.5	<0.05	<0.05
09/25/90	123.61	107.41	16.20	--	--	--	--	--	--	--	--
11/29/90	123.61	107.31	16.30	--	<50	<0.5	<0.5	<0.5	<0.5	--	--
11/29/90	123.61	--	--	Duplicate	<50	<0.5	<0.5	<0.5	<0.5	--	--
02/20/91	123.61	107.29	16.32	--	<50	<0.5	<0.5	<0.5	<0.5	--	--
04/19/91	123.61	108.90	14.71	--	--	--	--	--	--	--	--
05/22/91	123.61	108.19	15.42	--	<50	0.6	<0.5	<0.5	1.0	--	--
08/22/91	123.61	106.46	17.15	--	<50	<0.5	<0.5	<0.5	<0.5	--	--
11/14/91	123.61	106.62	16.99	--	<50	<0.5	<0.5	<0.5	<0.5	--	--
01/30/92	123.61	107.31	16.30	--	<50	1.0	0.7	<0.5	1.1	--	--
04/23/92	123.61	108.56	15.05	--	<50	<0.5	<0.5	<0.5	<0.5	--	--
07/27/92	123.61	107.53	16.08	--	<50	<0.5	<0.5	<0.5	<0.5	--	--
10/26/92	123.61	106.89	16.72	--	<50	<0.5	<0.5	<0.5	<0.5	--	--
01/29/93	123.61	110.79	12.82	--	1400	470	470	37	160	--	--
04/30/93	123.61	110.07	13.54	--	1600	<13	15	18	29	--	--
07/14/93	123.61	108.96	14.65	--	<50	<0.5	0.7	<0.5	2.0	--	--
10/27/93	123.61	108.57	15.04	--	<50	3.0	4.0	2.0	4.0	--	--
01/13/94	123.61	108.47	15.14	--	<50	<0.5	4.0	<0.5	<0.5	--	--
04/22/94	123.61	108.60	15.01	--	<50	<0.5	<0.5	<0.5	<0.5	--	--
07/28/94	123.61	108.91	14.70	--	69	7.3	18	3.3	12	--	--
10/25/94	123.61	108.41	15.20	--	<50	<0.5	0.8	<0.5	1.6	--	--
01/19/95	123.61	111.61	12.00	--	<50	<0.5	3.1	<0.5	0.7	--	--
05/01/95	123.61	112.21	11.40	--	<50	<0.5	<0.5	<0.5	<0.5	--	--
04/03/97	123.61	111.89	11.72	--	<200	<2.0	<2.0	<2.0	<2.0	610	--
10/07/97	123.61	110.01	13.60	--	<50	<0.5	<0.5	<0.5	<0.5	500	--
04/14/98	123.61	114.86	8.75	--	<50	<0.5	<0.5	<0.5	<0.5	120	--
10/13/98	123.61	110.89	12.72	--	270	<0.5	<0.5	<0.5	<0.5	2600	--
04/16/99	123.61	112.06	11.55	--	480	<2.0	<2.0	<2.0	<2.0	5000	--
07/29/99	123.61	111.26	12.35	ORC Socks installed	--	--	--	--	--	--	--
10/26/99	123.61	110.93	12.68	--	1890	<5.0	12.1	<5.0	<5.0	39,000	--

Cumulative Table of Well Data and Analytical Results

Vertical Measurements are in feet.

Analytical results are in parts per billion (ppb)

DATE	Well Head Elev.	Ground Water Elev.	Depth To Water	Notes	TPH-Gasoline	Benzene	Toluene	Ethyl-Benzene	Xylene	MTBE	EDB
MW-9											
08/22/91	124.20	106.60	17.60	--	9600	46	170	98	1200	<0.05	<0.05
11/14/91	124.20	106.72	17.48	--	11,000	130	58	86	1500	<0.05	<0.05
01/30/92	124.20	107.49	16.71	--	11,000	210	29	110	1900	--	--
04/23/92	124.20	108.97	15.23	--	17,000	180	25	100	1900	--	--
07/27/92	124.20	107.48	16.72	--	2800	59	1.6	18	280	--	--
10/26/92	124.20	106.98	17.22	--	3200	38	<0.5	19	200	--	--
01/29/93	124.20	110.81	13.39	--	1300	23	6.0	8.0	100	--	--
04/30/93	124.20	110.20	14.00	--	<1300	<13	<13	<13	58	--	--
07/14/93	124.20	109.12	15.08	--	1300	25	4.0	15	120	--	--
10/27/93	124.20	108.58	15.62	--	1100	21	10	19	73	--	--
01/13/94	124.20	108.61	15.59	--	80	0.7	3.0	0.6	3.0	--	--
04/22/94	124.20	108.77	15.43	--	<50	<0.5	<0.5	<0.5	<0.5	--	--
07/29/94	124.20	109.00	15.20	--	1400	19	11	11	69	--	--
10/25/94	124.20	108.50	15.70	--	1200	11	2.0	7.6	28	--	--
01/19/95	124.20	111.62	12.58	--	380	1.6	4.3	1.5	11	--	--
05/01/95	124.20	112.24	11.96	--	350	1.1	<0.5	1.8	2.3	--	--
10/12/95	124.20	110.35	13.85	--	1700	3.8	<2.5	5.3	7.8	18	--
04/11/96	124.20	112.33	11.87	--	140	<0.5	<0.5	<0.5	<0.5	2.8	--
10/03/96	124.20	110.13	14.07	--	53	<0.5	<0.5	<0.5	<0.5	<2.5	--
04/03/97	124.20	111.82	12.38	--	<50	<0.5	<0.5	<0.5	<0.5	<2.5	--
10/07/97	124.20	110.06	14.14	--	66	1.3	<0.5	<0.5	<0.5	<2.5	--
04/14/98	124.20	114.65	9.55	--	<50	<0.5	<0.5	<0.5	<0.5	<2.5	--
10/13/98	124.20	111.59	12.61	--	190	<0.5	<0.5	<0.5	<0.5	1900	--
04/16/99	124.20	113.19	11.01	--	3800	<12	<12	<12	<12	4400	--
07/29/99	124.20	111.35	12.85	ORC Socks installed	--	--	--	--	--	--	--
10/26/99	124.20	110.96	13.24	--	88.6	<0.5	<0.5	<0.5	<0.5	530	--

Cumulative Table of Well Data and Analytical Results

Vertical Measurements are in feet.

Analytical results are in parts per billion (ppb)

DATE	Well Head Elev.	Ground Water Elev.	Depth To Water	Notes	TPH-Gasoline	Benzene	Toluene	Ethyl-Benzene	Xylene	MTBE	EDB
MW-10											
07/27/92	125.03	107.51	17.52	--	<50	<0.5	<0.5	<0.5	<0.5	--	--
10/27/92	125.03	106.97	18.06	--	<50	<0.5	<0.5	<0.5	<0.5	--	--
01/29/93	125.03	110.88	14.15	--	<50	<0.5	<0.5	<0.5	0.7	--	--
04/30/93	125.03	110.35	14.68	--	<50	<0.5	<0.5	<0.5	<0.5	--	--
07/14/93	125.03	109.23	15.80	--	<50	<0.5	<0.5	<0.5	<0.5	--	--
10/27/93	125.03	108.70	16.33	--	<50	<0.5	<0.5	<0.5	<0.5	--	--
01/13/94	125.03	108.74	16.29	--	<50	<0.5	0.5	<0.5	<0.5	--	--
04/22/94	125.03	108.88	16.15	--	<50	<0.5	<0.5	<0.5	1.1	--	--
07/29/94	125.03	109.18	15.85	--	<50	0.8	2.1	0.5	1.3	--	--
10/25/94	125.03	108.62	16.41	--	<50	<0.5	<0.5	<0.5	<0.5	--	--
01/19/95	125.03	111.74	13.29	--	<50	<0.5	<0.5	<0.5	<0.5	--	--
05/01/95	125.03	112.43	12.60	--	<50	<0.5	<0.5	<0.5	<0.5	--	--
10/11/95	125.03	110.49	14.54	--	<50	<0.5	<0.5	<0.5	<0.5	<2.5	--
04/11/96	125.03	112.56	12.47	--	<50	<0.5	<0.5	<0.5	<0.5	<2.5	--
10/03/96	125.03	110.29	14.74	--	<50	<0.5	<0.5	<0.5	<0.5	<2.5	--
04/03/97	125.03	112.04	12.99	--	<50	<0.5	<0.5	<0.5	<0.5	<2.5	--
10/07/97	125.03	110.17	14.86	--	<50	<0.5	<0.5	<0.5	<0.5	<2.5	--
04/14/98	125.03	114.79	10.24	--	<50	<0.5	<0.5	<0.5	<0.5	<2.5	--
10/13/98	124.69*	111.63	13.06	--	<50	<0.5	<0.5	<0.5	<0.5	<2.5	--
04/16/99	124.69	112.89	11.80	--	<50	<0.5	<0.5	<0.5	<0.5	<2.5	--
10/26/99	124.69	111.26	13.43	--	<50	<0.5	<0.5	<0.5	<0.5	<2.5	--

* Wellhead elevation altered due to wellhead maintenance.

Cumulative Table of Well Data and Analytical Results

Vertical Measurements are in feet.

Analytical results are in parts per billion (ppb)

DATE	Well Head Elev.	Ground Water Elev.	Depth To Water	Notes	TPH-Gasoline	Benzene	Toluene	Ethyl-Benzene	Xylene	MTBE	EDB
MW-11											
07/27/92	122.92	107.54	15.38	--	<50	<0.5	<0.5	<0.5	<0.5	--	--
10/26/92	122.92	106.95	15.97	--	<50	<0.5	<0.5	<0.5	<0.5	--	--
01/29/93	122.92	110.68	12.24	--	<50	8.0	16	2.0	10	--	--
04/30/93	122.92	110.15	12.77	--	<50	<0.5	<0.5	<0.5	<0.5	--	--
07/14/93	122.92	109.08	13.84	--	<50	<0.5	0.7	<0.5	1.0	--	--
10/27/93	122.92	108.69	14.23	--	<50	<0.5	<0.5	<0.5	<0.5	--	--
01/13/94	122.92	108.68	14.24	--	<50	<0.5	1.0	<0.5	<0.5	--	--
04/22/94	122.92	108.84	14.08	--	<50	<0.5	0.5	<0.5	1.4	--	--
07/29/94	122.92	109.02	13.90	--	<50	<0.5	<0.5	<0.5	<0.5	--	--
10/25/94	122.92	108.54	14.38	--	<50	<0.5	<0.5	<0.5	<0.5	--	--
01/19/95	122.92	111.47	11.45	--	<50	<0.5	1.8	<0.5	<0.5	--	--
05/01/95	122.92	111.82	11.10	--	<50	<0.5	<0.5	<0.5	<0.5	--	--
10/11/95	122.92	110.35	12.57	--	<50	<0.5	<0.5	<0.5	<0.5	<2.5	--
04/11/96	122.92	111.87	11.05	--	<50	<0.5	<0.5	<0.5	<0.5	<2.5	--
10/03/96	122.92	110.00	12.92	--	<50	<0.5	<0.5	<0.5	<0.5	<2.5	--
04/03/97	122.92	111.70	11.22	--	<50	<0.5	<0.5	<0.5	<0.5	<2.5	--
10/07/97	122.92	109.87	13.05	--	<50	<0.5	<0.5	<0.5	<0.5	<2.5	--
04/14/98	122.92	113.87	9.05	--	<50	<0.5	<0.5	<0.5	<0.5	<2.5	--
10/13/98	122.92	110.58	12.34	--	<50	<0.5	<0.5	<0.5	<0.5	<2.5	--
04/16/99	122.92	112.19	10.73	--	<50	<0.5	<0.5	<0.5	<0.5	<2.5	--
10/26/99	122.92	110.95	11.97	--	<50	<0.5	<0.5	<0.5	<0.5	<2.5	--

Cumulative Table of Well Data and Analytical Results

Vertical Measurements are in feet.

Analytical results are in parts per billion (ppb)

DATE	Well Head Elev.	Ground Water Elev.	Depth To Water	Notes	TPH-Gasoline	Benzene	Toluene	Ethyl-Benzene	Xylene	MTBE	EDB
EW-1											
05/25/90	124.95	--	--	--	3900	260	430	64	340	0.03	0.03
08/01/91	124.95	107.41	17.54	--	--	--	--	--	--	--	--
10/27/93	124.95	--	--	--	350	<0.5	<0.5	<0.5	<0.5	--	--
01/13/94	124.95	--	--	--	<50	<0.5	<0.5	<0.5	<0.5	--	--
04/22/94	124.95	--	--	--	<50	<0.5	<0.5	<0.5	<0.5	--	--
07/29/94	124.95	--	--	--	97	0.6	0.5	0.6	5.1	--	--
01/19/95	124.95	112.32	12.63	Well Abandoned	3000	1600	100	350	760	--	--

NO LONGER MONITORED OR SAMPLED

Cumulative Table of Well Data and Analytical Results

Vertical Measurements are in feet.

Analytical results are in parts per billion (ppb)

DATE	Well Head Elev.	Ground Water Elev.	Depth To Water	Notes	TPH-Gasoline	Benzene	Toluene	Ethyl-Benzene	Xylene	MTBE	EDB
TRIP BLANK											
02/20/91	--	--	--	--	<50	<0.5	<0.5	<0.5	<0.5	--	--
05/22/91	--	--	--	--	<50	<0.5	<0.5	<0.5	<0.5	--	--
05/22/91	--	--	--	--	<50	<0.5	<0.5	<0.5	<0.5	--	--
11/13/91	--	--	--	--	<50	<0.5	<0.5	<0.5	<0.5	--	--
01/30/92	--	--	--	--	<50	<0.5	<0.5	<0.5	<0.5	--	--
04/23/92	--	--	--	--	<50	<0.5	<0.5	<0.5	<0.5	--	--
07/27/92	--	--	--	--	<0.5	<0.5	<0.5	<0.5	<0.5	--	--
10/26/92	--	--	--	--	<0.5	<0.5	<0.5	<0.5	<0.5	--	--
01/29/93	--	--	--	--	<50	<0.5	<0.5	<0.5	<0.5	--	--
04/30/93	--	--	--	--	<50	<0.5	<0.5	<0.5	<0.5	--	--
07/14/93	--	--	--	--	<50	<0.5	<0.5	<0.5	<0.5	--	--
10/27/93	--	--	--	--	<50	<0.5	<0.5	<0.5	<0.5	--	--
01/13/94	--	--	--	--	<50	<0.5	<0.5	<0.5	<0.5	--	--
04/22/94	--	--	--	--	<50	<0.5	<0.5	<0.5	<0.5	--	--
07/29/94	--	--	--	--	<50	<0.5	<0.5	<0.5	<0.5	--	--
10/25/94	--	--	--	--	<50	<0.5	<0.5	<0.5	<0.5	--	--
01/19/95	--	--	--	--	<50	<0.5	<0.5	<0.5	<0.5	--	--
05/01/95	--	--	--	--	<50	<0.5	<0.5	<0.5	<0.5	--	--
10/12/95	--	--	--	--	<50	<0.5	<0.5	<0.5	<0.5	--	--
04/11/96	--	--	--	--	<50	<0.5	<0.5	<0.5	<0.5	<2.5	--
10/03/96	--	--	--	--	<50	<0.5	<0.5	<0.5	<0.5	<2.5	--
04/03/97	--	--	--	--	<50	<0.5	<0.5	<0.5	<0.5	<2.5	--
10/07/97	--	--	--	--	<50	<0.5	<0.5	<0.5	<0.5	<2.5	--
04/14/98	--	--	--	--	<50	<0.5	<0.5	<0.5	<0.5	<2.5	--
10/13/98	--	--	--	--	<50	<0.5	<0.5	<0.5	<0.5	<2.5	--
04/16/99	--	--	--	--	<50	<0.5	<0.5	<0.5	<0.5	<2.5	--

Note: Blaine Tech Services, Inc. began routine monitoring of the groundwater wells at this site on May 1, 1995.
Earlier field data and analytical results provided by Sierra Environmental.

ABBREVIATIONS:

TPH = Total Petroleum Hydrocarbons
 MTBE = Methyl t-Butyl Ether
 EDB = Ethylene Dibromide

Analytical Appendix



November 11, 1999

Scott Boor
Blaine Tech Services (Chev)
1680 Rogers Avenue
San Jose, CA 95112

RE: Chevron 9-8139 16304 Foothill Blvd. Blvd., San Leandro/M910AAM

Dear Scott Boor

Enclosed are the results of analyses for sample(s) received by the laboratory on October 28, 1999. If you have any questions concerning this report, please feel free to contact me.

Sincerely,

Wendy Bohmes
Project Manager

CA ELAP Certificate Number 1210





Blaine Tech Services (Chev) 1680 Rogers Avenue San Jose, CA 95112	Project: Chevron 9-8139 Project Number: 16304 Foothill Blvd., San Leandro Project Manager: Scott Boor	Sampled: 10/26/99 to 10/27/99 Received: 10/28/99 Reported: 11/11/99
---	---	---

ANALYTICAL REPORT FOR M910AAM

Sample Description	Laboratory Sample Number	Sample Matrix	Date Sampled
MW-8	M910AAM-01	Water	10/26/99
MW-9	M910AAM-02	Water	10/26/99
MW-10	M910AAM-03	Water	10/26/99
MW-11	M910AAM-04	Water	10/26/99
EW-2	M910AAM-05	Water	10/27/99
EW-3	M910AAM-06	Water	10/27/99





Blaine Tech Services (Chev) 1680 Rogers Avenue San Jose, CA 95112	Project: Chevron 9-8139 Project Number: 16304 Foothill Blvd., San Leandro Project Manager: Scott Boor	Sampled: 10/26/99 to 10/27/99 Received: 10/28/99 Reported: 11/11/99
---	---	---

**Total Purgeable Hydrocarbons (C6-C12), BTEX and MTBE by DHS LUFT
Sequoia Analytical - Morgan Hill**

Analyte	Batch Number	Date Prepared	Date Analyzed	Surrogate Limits	Reporting Limit	Result	Units	Notes*
MW-8				M910AAM-01			Water	
Purgeable Hydrocarbons	9110117	11/3/99	11/3/99		500	1890	ug/l	1,D
Benzene	"	"	"		5.00	ND	"	D
Toluene	"	"	"		5.00	12.1	"	D
Ethylbenzene	"	"	"		5.00	ND	"	D
Xylenes (total)	"	"	"		5.00	ND	"	D
Methyl tert-butyl ether	"	"	11/5/99		2500	39000	"	D
<i>Surrogate: a,a,a-Trifluorotoluene</i>	"	"	11/3/99	70.0-130		95.1	%	
MW-9				M910AAM-02			Water	
Purgeable Hydrocarbons	9110117	11/3/99	11/3/99		50.0	88.6	ug/l	1
Benzene	"	"	"		0.500	ND	"	
Toluene	"	"	"		0.500	ND	"	
Ethylbenzene	"	"	"		0.500	ND	"	
Xylenes (total)	"	"	"		0.500	ND	"	
Methyl tert-butyl ether	"	"	11/5/99		25.0	530	"	D
<i>Surrogate: o,a,a-Trifluorotoluene</i>	"	"	11/3/99	70.0-130		90.1	%	
MW-10				M910AAM-03			Water	
Purgeable Hydrocarbons	9110117	11/3/99	11/3/99		50.0	ND	ug/l	
Benzene	"	"	"		0.500	ND	"	
Toluene	"	"	"		0.500	ND	"	
Ethylbenzene	"	"	"		0.500	ND	"	
Xylenes (total)	"	"	"		0.500	ND	"	
Methyl tert-butyl ether	"	"	"		2.50	ND	"	
<i>Surrogate: a,a,a-Trifluorotoluene</i>	"	"	"	70.0-130		98.9	%	
MW-11				M910AAM-04			Water	
Purgeable Hydrocarbons	9110117	11/3/99	11/3/99		50.0	ND	ug/l	
Benzene	"	"	"		0.500	ND	"	
Toluene	"	"	"		0.500	ND	"	
Ethylbenzene	"	"	"		0.500	ND	"	
Xylenes (total)	"	"	"		0.500	ND	"	
Methyl tert-butyl ether	"	"	"		2.50	ND	"	
<i>Surrogate: a,a,a-Trifluorotoluene</i>	"	"	"	70.0-130		94.1	%	
EW-2				M910AAM-05			Water	
Purgeable Hydrocarbons	9110117	11/3/99	11/3/99		500	2760	ug/l	2,D
Benzene	"	"	"		5.00	20.6	"	D
Toluene	"	"	"		5.00	17.8	"	D
Ethylbenzene	"	"	"		5.00	40.2	"	D
Xylenes (total)	"	"	"		5.00	196	"	D





Blaine Tech Services (Chev) 1680 Rogers Avenue San Jose, CA 95112	Project: Chevron 9-8139 Project Number: 16304 Foothill Blvd., San Leandro Project Manager: Scott Boor	Sampled: 10/26/99 to 10/27/99 Received: 10/28/99 Reported: 11/11/99
---	---	---

**Total Purgeable Hydrocarbons (C6-C12), BTEX and MTBE by DHS LUFT
Sequoia Analytical - Morgan Hill**

Analyte	Batch Number	Date Prepared	Date Analyzed	Surrogate Limits	Reporting Limit	Result	Units	Notes*
<u>EW-2 (continued)</u>				<u>M910AAM-05</u>			<u>Water</u>	
Methyl tert-butyl ether	9110117	11/3/99	11/5/99		500	13300	ug/l	D
Surrogate: a,a,a-Trifluorotoluene	"	"	11/3/99	70.0-130		94.7	%	
<u>EW-3</u>				<u>M910AAM-06</u>			<u>Water</u>	
Purgeable Hydrocarbons	9110333	11/10/99	11/10/99		200	710	ug/l	2,D
Benzene	"	"	"		2.00	204	"	D
Toluene	"	"	"		2.00	2.87	"	D
Ethylbenzene	"	"	"		2.00	7.31	"	D
Xylenes (total)	"	"	"		2.00	11.8	"	D
Methyl tert-butyl ether	"	"	"		50.0	3760	"	3,D
Surrogate: a,a,a-Trifluorotoluene	"	"	"	70.0-130		73.3	%	





Blaine Tech Services (Chev) 1680 Rogers Avenue San Jose, CA 95112	Project: Chevron 9-8139 Project Number: 16304 Foothill Blvd., San Leandro Project Manager: Scott Boor	Sampled: 10/26/99 to 10/27/99 Received: 10/28/99 Reported: 11/11/99
---	---	---

Total Purgeable Hydrocarbons (C6-C12), BTEX and MTBE by DHS LUFT/Quality Control
Sequoia Analytical - Morgan Hill

Analyte	Date Analyzed	Spike Level	Sample Result	QC Result	Units	Reporting Limit Recov. Limits	Recov. %	RPD Limit	RPD %	Notes*
Batch: 9110117			Date Prepared: 11/3/99			Extraction Method: EPA 5030B [P/T]				
Blank			9110117-BLK1							
Purgeable Hydrocarbons	11/3/99			ND	ug/l	50.0				
Benzene	"			ND	"	0.500				
Toluene	"			ND	"	0.500				
Ethylbenzene	"			ND	"	0.500				
Xylenes (total)	"			ND	"	0.500				
Methyl tert-butyl ether	"			ND	"	2.50				
Surrogate: <i>a,a,a</i> -Trifluorotoluene	"	10.0		11.5	"	70.0-130	115			
LCS			9110117-BS1							
Purgeable Hydrocarbons	11/3/99	250		235	ug/l	70.0-130	94.0			
Surrogate: <i>a,a,a</i> -Trifluorotoluene	"	10.0		8.68	"	70.0-130	86.8			
Matrix Spike			9110117-MS1 M910886-01							
Purgeable Hydrocarbons	11/3/99	250	ND	226	ug/l	60.0-140	90.4			
Surrogate: <i>a,a,a</i> -Trifluorotoluene	"	10.0		8.66	"	70.0-130	86.6			
Matrix Spike Dup			9110117-MSD1 M910886-01							
Purgeable Hydrocarbons	11/3/99	250	ND	225	ug/l	60.0-140	90.0	25.0	0.443	
Surrogate: <i>a,a,a</i> -Trifluorotoluene	"	10.0		8.26	"	70.0-130	82.6			
Batch: 9110333			Date Prepared: 11/10/99			Extraction Method: EPA 5030B [P/T]				
Blank			9110333-BLK1							
Purgeable Hydrocarbons	11/10/99			ND	ug/l	50.0				
Benzene	"			ND	"	0.500				
Toluene	"			ND	"	0.500				
Ethylbenzene	"			ND	"	0.500				
Xylenes (total)	"			ND	"	0.500				
Methyl tert-butyl ether	"			ND	"	2.50				
Surrogate: <i>a,a,a</i> -Trifluorotoluene	"	10.0		10.3	"	70.0-130	103			
LCS			9110333-BS1							
Purgeable Hydrocarbons	11/10/99	250		215	ug/l	70.0-130	86.0			
Surrogate: <i>a,a,a</i> -Trifluorotoluene	"	10.0		9.30	"	70.0-130	93.0			
LCS Dup			9110333-BSD1							
Purgeable Hydrocarbons	11/10/99	250		226	ug/l	70.0-130	90.4	25.0	4.99	
Surrogate: <i>a,a,a</i> -Trifluorotoluene	"	10.0		9.32	"	70.0-130	93.2			





Blaine Tech Services (Chev) 1680 Rogers Avenue San Jose, CA 95112	Project: Chevron 9-8139 Project Number: 16304 Foothill Blvd., San Leandro Project Manager: Scott Boor	Sampled: 10/26/99 to 10/27/99 Received: 10/28/99 Reported: 11/11/99
---	---	---

Notes and Definitions

#	Note
---	------

- D Data reported from a dilution.
- 1 Chromatogram Pattern: Unidentified Hydrocarbons C6-C12
- 2 Chromatogram Pattern: Gasoline C6-C12
- 3 Sample was analyzed at a second dilution per clients request.
- DET Analyte DETECTED
- ND Analyte NOT DETECTED at or above the reporting limit
- NR Not Reported
- dry Sample results reported on a dry weight basis
- Recov Recovery
- RPD Relative Percent Difference





Report Exceptions List
(for internal use only)

<u>Exception</u>	<u>Analysis or Specific Method</u>	<u>Lab Number</u>	<u>Analyte or General Method</u>
D (D)	TPH-G/B/M2	M910AAM-01	Benzene
D (D)	TPH-G/B/M2	M910AAM-01	Ethylbenzene
D (D)	TPH-G/B/M2	M910AAM-01	Methyl tert-butyl ether
D (D)	TPH-G/B/M2	M910AAM-01	Purgeable Hydrocarbons
P-03 (1)	TPH-G/B/M2	M910AAM-01	Purgeable Hydrocarbons
D (D)	TPH-G/B/M2	M910AAM-01	Toluene
D (D)	TPH-G/B/M2	M910AAM-01	Xylenes (total)
D (D)	TPH-G/B/M2	M910AAM-02	Methyl tert-butyl ether
P-03 (1)	TPH-G/B/M2	M910AAM-02	Purgeable Hydrocarbons
D (D)	TPH-G/B/M2	M910AAM-05	Benzene
D (D)	TPH-G/B/M2	M910AAM-05	Ethylbenzene
D (D)	TPH-G/B/M2	M910AAM-05	Methyl tert-butyl ether
D (D)	TPH-G/B/M2	M910AAM-05	Purgeable Hydrocarbons
P-01 (2)	TPH-G/B/M2	M910AAM-05	Purgeable Hydrocarbons
D (D)	TPH-G/B/M2	M910AAM-05	Toluene
D (D)	TPH-G/B/M2	M910AAM-05	Xylenes (total)
D (D)	TPH-G/B/M2	M910AAM-06	Benzene
D (D)	TPH-G/B/M2	M910AAM-06	Ethylbenzene
D (D)	TPH-G/B/M2	M910AAM-06	Methyl tert-butyl ether
M-03 (3)	TPH-G/B/M2	M910AAM-06	Methyl tert-butyl ether
D (D)	TPH-G/B/M2	M910AAM-06	Purgeable Hydrocarbons
P-01 (2)	TPH-G/B/M2	M910AAM-06	Purgeable Hydrocarbons
D (D)	TPH-G/B/M2	M910AAM-06	Toluene
D (D)	TPH-G/B/M2	M910AAM-06	Xylenes (total)

Report calculations are based on the MRL



Field Data Sheets

CHEVRON WELL MONITORING DATA SHEET

Project #: 991026-A2	Station #: 9-8139
Sampler: OSCAR	Date: 10-26-99
Well I.D.: MW8	Well Diameter: Ø 3 4 6 8 _____
Total Well Depth: 30.74	Depth to Water: 12.68
Depth to Free Product:	Thickness of Free Product (feet):
Referenced to: <u>PVC</u> Grade	D.O. Meter (if req'd): YSI HACH

Well Diameter	Multiplier	Well Diameter	Multiplier
2"	0.16	5"	1.02
3"	0.37	6"	1.47
4"	0.65	Other	radius ² * 0.163

Purge Method: Bailer Disposable Bailer <input checked="" type="checkbox"/> Middleburg Electric Submersible Extraction Pump Other: _____	Sampling Method: Bailer Disposable Bailer <input checked="" type="checkbox"/> Extraction Port Other: _____
--	---

2.8	x	3	=	8.4	Gals.
1 Case Volume (Gals.)		Specified Volumes		Calculated Volume	

Time	Temp (°F)	pH	Cond.	Gals. Removed	Observations
1418 1518	69.1	7.9	897	2.8 3	
1425 1525	68.7	7.8	891	5.6 6	
1424 1529	68.7	7.8	883	9	

Did well dewater? Yes <input type="checkbox"/> No <input checked="" type="checkbox"/>	Gallons actually evacuated: 9
Sampling Time: 1533 1433	Sampling Date: 10-26-99
Sample I.D.: MW8	Laboratory: <u>Sequoia</u> GTEL N. Creek Assoc. Labs
Analyzed for: <u>TPH-G</u> BTEX MTBE TPH-D Other:	
Duplicate I.D.:	Analyzed for: TPH-G BTEX MTBE TPH-D Other:
D.O. (if req'd):	Pre-purge: _____ mg/L Post-purge: _____ mg/L
O.R.P. (if req'd):	Pre-purge: _____ mV Post-purge: _____ mV

CHEVRON WELL MONITORING DATA SHEET

Project #: 991026-A2	Station #: 7-8139
Sampler: OSCAR	Date: 10-26-99
Well I.D.: MW9	Well Diameter: <u>2</u> 3 4 6 8
Total Well Depth: 26.38	Depth to Water: 13.24
Depth to Free Product:	Thickness of Free Product (feet):
Referenced to: <u>PVE</u> Grade	D.O. Meter (if req'd): YSI HACH

Well Diameter	Multiplier	Well Diameter	Multiplier
<u>2"</u>	0.16	5"	1.02
3"	0.37	6"	1.47
4"	0.65	Other	radius ² * 0.163

Purge Method: Bailer Disposabale Bailer Middleburg Electric Submersible Extraction Pump Other: _____	Sampling Method: Bailer Disposabale Bailer Extraction Port Other: _____
---	--

<u>2.1</u>	x	<u>3</u>	=	<u>6.3</u>	Gals.
1 Case Volume (Gals.)		Specified Volumes		Calculated Volume	

Time	Temp (°F)	pH	Cond.	Gals. Removed	Observations
1447 1447	68.6 68.6	7.9	891 763	3	
1450 1450	68.4	7.9	763	5	
1453 1453	68.7	7.9	767	7	

Did well dewater? Yes <input type="checkbox"/> No <input checked="" type="checkbox"/>	Gallons actually evacuated: <u>7</u>
Sampling Time: 1455 1455	Sampling Date: 10-26-99
Sample I.D.: MW9	Laboratory: <u>Sequoia</u> CORE N. Creek Assoc. Labs.
Analyzed for: TPH-G BTEX MTBE TPH-D Other:	
Duplicate I.D.:	Analyzed for: TPH-G BTEX MTBE TPH-D Other:
D.O. (if req'd):	Pre-purge: mg/L Post-purge: mg/L
O.R.P. (if req'd):	Pre-purge: mV Post-purge: mV

CHEVRON WELL MONITORING DATA SHEET

Project #: 991026-A2 991026-A2	Station #: 9-8139
Sampler: OSCAR	Date: 10-26-99
Well I.D.: MW10	Well Diameter: 2 3 4 6 8
Total Well Depth: 99.18	Depth to Water: 13.43
Depth to Free Product:	Thickness of Free Product (feet):
Referenced to: PVC Grade	D.O. Meter (if req'd): YSI HACH

Well Diameter	Multiplier	Well Diameter	Multiplier
2"	0.16	5"	1.02
3"	0.37	6"	1.47
4"	0.65	Other	radius ² * 0.163

Purge Method: Bailer Disposable Bailer <input checked="" type="checkbox"/> Middleburg Electric Submersible Extraction Pump Other: _____	Sampling Method: Bailer Disposable Bailer <input checked="" type="checkbox"/> Extraction Port Other: _____
---	--

<u>2.5</u>	x	<u>3</u>	=	<u>7.5</u>	Gals.
1 Case Volume (Gals.)		Specified Volumes		Calculated Volume	

Time	Temp (°F)	pH	Cond.	Gals. Removed	Observations
1330	68.4	7.5	854	2.5	
1335	69.0	7.6	855	3.55	
1340	69.1	7.6	857	0	

Did well dewater? Yes <input type="checkbox"/> No <input checked="" type="checkbox"/>	Gallons actually evacuated: 8	
Sampling Time: 1342	Sampling Date: 10-26-99	
Sample I.D.: MW10	Laboratory: Sequoia GTEL N. Creek Assoc. Labs	
Analyzed for: TPH-G BTEX MTBE TPH-D Other:		
Duplicate I.D.:	Analyzed for: TPH-G BTEX MTBE TPH-D Other:	
D.O. (if req'd):	Pre-purge: <input type="text"/> mg/L	Post-purge: <input type="text"/> mg/L
O.R.P. (if req'd):	Pre-purge: <input type="text"/> mV	Post-purge: <input type="text"/> mV

CHEVRON WELL MONITORING DATA SHEET

Project #: 991026- A 2	Station #: 9-8139
Sampler: DSCAR	Date: 10-26-99
Well I.D.: MW 11	Well Diameter: <u>2</u> 3 4 6 8
Total Well Depth: 29.44	Depth to Water: 11.97
Depth to Free Product:	Thickness of Free Product (feet):
Referenced to: <u>PVC</u> Grade	D.O. Meter (if req'd): YSI HACH

Well Diameter	Multiplier	Well Diameter	Multiplier
2"	0.16	5"	1.02
3"	0.37	6"	1.47
4"	0.65	Other	radius ² * 0.163

Purge Method: Bailer Disposable Bailer <input checked="" type="checkbox"/> Middleburg Electric Submersible Extraction Pump Other: _____	Sampling Method: Bailer Disposable Bailer <input checked="" type="checkbox"/> Extraction Port Other: _____
--	---

<u>2.8</u>	x	<u>3</u>	=	<u>8.4</u>	Gals.
1 Case Volume (Gals.)		Specified Volumes		Calculated Volume	

Time	Temp (°F)	pH	Cond.	Gals. Removed	Observations
1620 ¹⁵²⁰	68.2	7.4	775	3	
1627 ¹⁵²⁷	68.1	7.4	781	6	
1630 ¹⁵³⁰	68.2	7.4	782	9	

Did well dewater? Yes <input type="checkbox"/> No <input checked="" type="checkbox"/>	Gallons actually evacuated: 9
Sampling Time: 1635 1535	Sampling Date: 10-26-99
Sample I.D.: MW 11	Laboratory: <u>Sequoia</u> CORE N. Creek Assoc. Labs
Analyzed for: <u>TPH-G</u> <u>BTEX</u> <u>MTBE</u> TPH-D Other:	
Duplicate I.D.:	Analyzed for: TPH-G BTEX MTBE TPH-D Other:
D.O. (if req'd):	Pre-purge: mg/L Post-purge: mg/L
O.R.P. (if req'd):	Pre-purge: mV Post-purge: mV

CHEVRON WELL MONITORING DATA SHEET

Project #: 991026-A2	Station #: 9-8139
Sampler: OSHA Josh	Date: 10-26-99 10-27-99
Well I.D.: EW 2	Well Diameter: 2 3 <u>4</u> 6 8
Total Well Depth: 30.00	Depth to Water: 13.82
Depth to Free Product:	Thickness of Free Product (feet):
Referenced to: <u>PTC</u> Grade	D.O. Meter (if req'd): YSI HACH

Well Diameter	Multiplier	Well Diameter	Multiplier
2"	0.16	5"	1.02
3"	0.37	6"	1.47
<u>4"</u>	0.65	Other	radius ² * 0.163

Purge Method: Bailer Sampling Method: Bailer
 Disposable Bailer ~~X~~ Disposable Bailer ~~X~~
 Middleburg Extraction Port
~~Electric Submersible~~ Other: _____
 Extraction Pump

Other: _____

<u>10.5</u>	X	<u>3</u>	=	<u>31.5</u>	Gals.
1 Case Volume (Gals.)		Specified Volumes		Calculated Volume	

Time	Temp (°F)	pH	Cond.	Gals. Removed	Observations
1537	70.0	7.7	780	11	
1538	69.8	7.3	962	21	
1539	70.0	7.3	981	32	

Did well dewater? Yes No Gallons actually evacuated: 32

Sampling Time: 1545 Sampling Date: 10-27-99

Sample I.D.: EW-2 Laboratory: Sequoia CORE N. Creek Assoc. Labs

Analyzed for: TPH-G BTEX MIBE TPH-D Other:

Duplicate I.D.: Analyzed for: TPH-G BTEX MIBE TPH-D Other:

D.O. (if req'd):	Pre-purge:	mg/L	Post-purge:	mg/L
O.R.P. (if req'd):	Pre-purge:	mV	Post-purge:	mV

CHEVRON WELL MONITORING DATA SHEET

Project #: <u>991026-A2</u>	Station #: <u>9-8139</u>
Sampler: <u>OSCAR Josh</u>	Date: 10-26-99 <u>10-27-99</u>
Well I.D.: <u>EW03</u>	Well Diameter: 2 3 <u>4</u> 6 8
Total Well Depth: <u>29.98</u>	Depth to Water: <u>13.49</u>
Depth to Free Product:	Thickness of Free Product (feet):
Referenced to: <u>PVC</u> Grade	D.O. Meter (if req'd): YSI HACH

Well Diameter	Multiplier	Well Diameter	Multiplier
2"	0.16	5"	1.02
3"	0.37	6"	1.47
<u>4"</u>	0.65	Other	radius ² * 0.163

Purge Method: Bailer Sampling Method: Bailer
 Disposable Bailer Disposable Bailer
 Middleburg Extraction Port
 Electric Submersible Other: _____
 Extraction Pump
 Other: _____

<u>10.7</u>	X	_____	=	<u>32.1</u>	Gals.
1 Case Volume (Gals.)		Specified Volumes		Calculated Volume	

Time	Temp (°F)	pH	Cond.	Gals. Removed	Observations
1513	70.6	7.6	1368	11	
1514	69.7	7.5	763	22	
1517	69.5	7.5	760	33	

Did well dewater? Yes No Gallons actually evacuated: 33

Sampling Time: Sampling Date: 10-27-99

Sample I.D.: EW-3 Laboratory: sequoia CORE N. Creek Assoc. Labs

Analyzed for: TPH-G BTEX MTBE TPH-D Other:

Duplicate I.D.: Analyzed for: TPH-G BTEX MTBE TPH-D Other:

D.O. (if req'd):	Pre-purge:	mg/L	Post-purge:	mg/L
O.R.P. (if req'd):	Pre-purge:	mV	Post-purge:	mV