

90 JUL -6 AM 9:10

June 30, 1998

Chevron Products Company
6001 Bollinger Canyon Road
Building L
San Ramon, CA 94583
P.O. Box 6004
San Ramon, CA 94583-0904

Marketing - Sales West
Phone 510 842-9500

Mr. Scott Seery
Alameda County Health Care Services
Department of Environmental Health
1131 Harbor Bay Parkway, Suite 250
Alameda, CA 94502-6577

**Re: Chevron Service Station #9-8139
16304 Foothill Blvd.
San Leandro, California**

Dear Mr. Seery:

Enclosed is the Second Quarter Groundwater Monitoring Report for 1998 that was prepared by our consultant Blaine Tech Services Inc., for the above noted site. The groundwater samples were analyzed for the presence of TPH-g, BTEX and MtBE constituents. Monitoring wells EW-3, MW-8, MW-9, MW-10, and MW-11 are currently being sampled semi-annually, in the 2nd and 4th quarters.

Monitoring wells MW-9, MW-10 and MW-11 were below method detection limits for all the constituents, while well MW-8 was below method detection limits for the TPH-g and BTEX constituents. Monitoring well EW-3 was inaccessible due to a vehicle parked over the well location.

Depth to groundwater varied from 8.75 feet to 10.24 feet below grade with the direction of flow southwesterly.

Chevron will continue to monitor the site as outlined above. If you have any questions call me at (510) 842-9136.

Sincerely,
CHEVRON PRODUCTS COMPANY

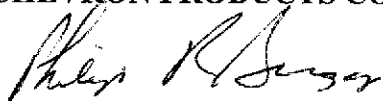

Philip R. Briggs
Site Assessment and Remediation Project Manager

June 30, 1998
Mr. Scott Seery
Chevron Service Station #9-8431
Page 2

Enclosure

Cc. Mr. Chuck Headlee
RWQCB-San Francisco Bay Region
2101 Webster St., Suite 500
Oakland, CA 94612

Mr. Bill Scudder, Chevron

BLAINE
TECH SERVICES, INC.



1680 ROGERS AVENUE
SAN JOSE, CALIFORNIA 95112
(408) 573-7771 FAX
(408) 573-0555 PHONE

June 17, 1998

Phil Briggs
Chevron U.S.A. Products Company
P.O. Box 6004
San Ramon, CA 94583-0904

2nd Quarter 1998 Monitoring at 9-8139

Second Quarter 1998 Groundwater Monitoring at
Chevron Service Station Number 9-8139
16304 Foothill Blvd.
San Leandro, CA

Monitoring Performed on April 14, 1998

Groundwater Sampling Report 980414-D-2

This report covers the routine monitoring of groundwater wells at this Chevron facility. Blaine Tech Services, Inc.'s work at the site includes inspection, gauging, evacuation, purgewater containment, sample collection and sample handling in accordance with standard procedures that conform to Regional Water Quality Control Board requirements.

Routine field data collection includes depth to water, total well depth, thickness of any separate immiscible layer, water column volume, calculated volume of a three-case volume purge, elapsed evacuation time, total volume of water removed, and standard water parameter instrument readings. Sample material is collected, contained, stored, and transported to the laboratory in conformance with EPA standards. Purgewater is, likewise, collected and transported to McKittrick Waste Treatment Site for disposal.

Basic field information is presented alongside analytical values excerpted from the laboratory report in the cumulative table of **WELL DATA AND ANALYTICAL RESULTS**. The full analytical report for the most recent samples is located in the **Analytical Appendix**. The table also contains new groundwater elevation calculations taken from the computer plotted gradient map which is located in the **Professional Engineering Appendix**.

At a minimum, Blaine Tech Services, Inc. field personnel are certified upon completion of a forty-hour Hazardous Materials and Emergency Response training course per 29 CFR 1910.120. Field personnel are also enrolled in annual eight hour refresher courses.

Blaine Tech Services, Inc. conducts sampling and documentation assignments of this type as an independent third party. In order to avoid compromising the objectivity necessary for the proper and disinterested performance of this work, Blaine Tech Services, Inc. concentrates on objective data collection and does not participate in the interpretation of analytical results, the definition of geological or hydrological conditions, the formulation of recommendations, or the marketing of remedial systems.

Please call if you have any questions.

Yours truly,

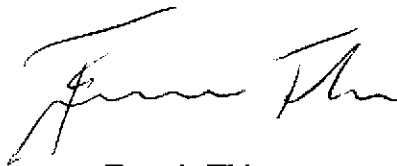
A handwritten signature in black ink, appearing to read "Francis Thie". The signature is fluid and cursive, with the first name being more prominent.

Francis Thie
Vice President

FPT/aa

attachments: Professional Engineering Appendix
Cumulative Table of Well Data and Analytical Results
Analytical Appendix
Field Data Sheets

Professional Engineering Appendix

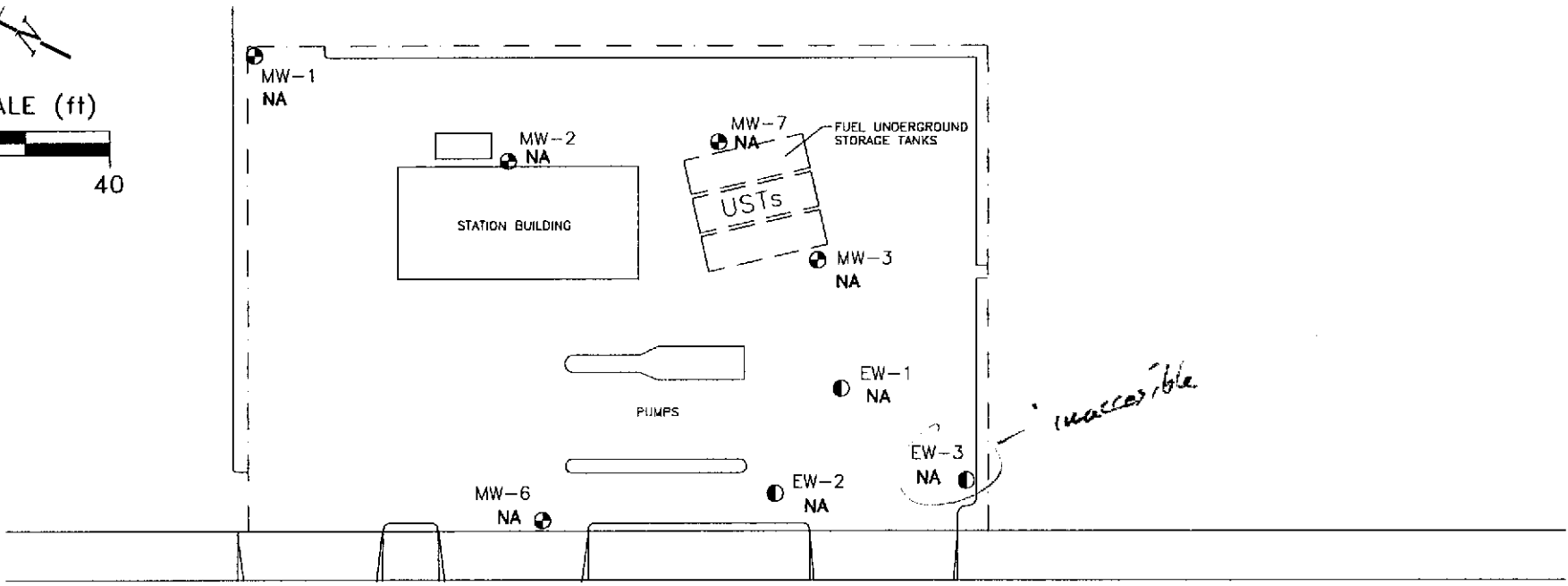
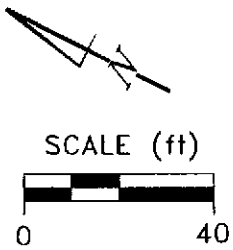

FOOTHILL BOULEVARD

- EXPLANATION**
- MONITORING WELL
 - ⊙ EXTRACTION WELL
 - 113.87 GROUNDWATER ELEVATION (FT, MSL)
 - GROUNDWATER ELEVATION CONTOUR (FT, MSL)
 - NA DATA NOT AVAILABLE
 - ↘ APPROXIMATE GROUNDWATER FLOW DIRECTION;
APPROXIMATE GRADIENT = 0

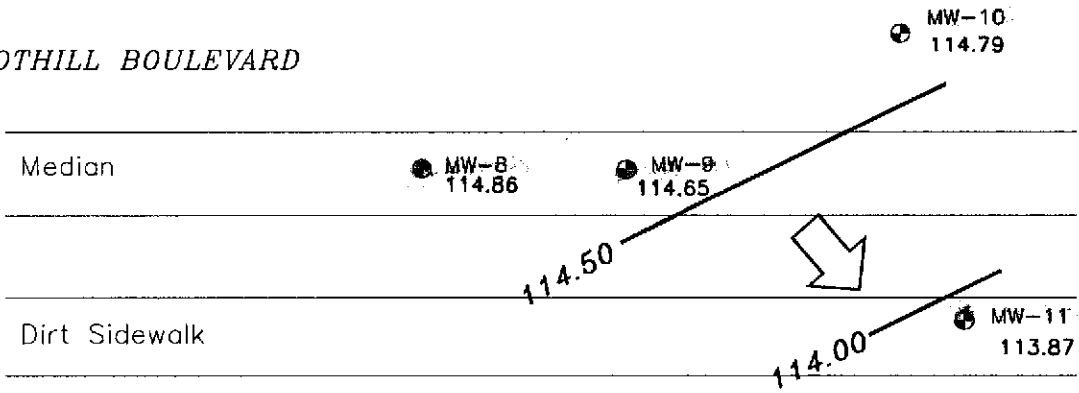

Basemap from Cambria Environmental Technology, Inc.

PREPARED BY

Chevron Station 9-8139
16304 Foothill Boulevard
San Leandro, California

GROUNDWATER ELEVATION CONTOUR MAP,
APRIL 14, 1998

FIGURE:
1
PROJECT:
DAC04

Table of Well Data and Analytical Results

Cumulative Table of Well Data and Analytical Results

Vertical Measurements are in feet.

Analytical results are in parts per billion (ppb)

DATE	Well Head Elev.	Ground Water Elev.	Depth To Water	Notes	TPH-Gasoline	Benzene	Toluene	Ethyl-Benzene	Xylene	MTBE	EDB
MW-1											
12/05/89	127.09	--	--	*	<500	<0.5	<0.5	<0.5	<0.5	<0.5	<0.5
03/23/90	127.09	114.17	12.92	--	--	--	--	--	--	--	--
05/24/90	127.09	--	--	--	<50	<0.5	<0.5	<0.5	<0.5	--	--
09/06/90	127.09	112.41	14.68	--	<50	<0.5	0.8	<0.5	<0.5	<0.5	<0.5
09/25/90	127.09	112.08	15.01	--	--	--	--	--	--	--	--
11/29/90	127.09	112.27	14.82	--	<50	0.7	0.9	<0.5	1.0	--	--
02/20/91	127.09	112.80	14.29	--	<50	<0.5	<0.5	<0.5	<0.5	--	--
04/19/91	127.09	114.93	12.16	--	--	--	--	--	--	--	--
05/22/91	127.09	113.40	13.69	--	<50	<0.5	<0.5	<0.5	<0.5	--	--
08/22/91	127.09	111.71	15.38	--	<50	<0.5	<0.5	<0.5	<0.5	--	--
11/13/91	127.09	111.29	15.80	--	<50	<0.5	<0.5	<0.5	<0.5	--	--
01/30/92	127.09	112.38	14.71	--	<50	0.5	<0.5	<0.5	0.5	--	--
04/23/92	127.09	114.87	12.22	--	<50	<0.5	<0.5	<0.5	<0.5	--	--
07/27/92	127.09	112.79	14.30	--	<50	<0.5	<0.5	<0.5	<0.5	--	--
10/26/92	127.09	111.19	15.90	--	<50	0.6	<0.5	<0.5	<0.5	--	--
01/29/93	127.09	116.58	10.51	--	<50	3.0	3.0	0.7	3.0	--	--
04/30/93	127.09	117.19	9.90	--	<50	<0.5	0.7	<0.5	1.0	--	--
07/14/93	127.09	114.81	12.28	--	<50	0.7	1.0	<0.5	3.0	--	--
10/27/93	127.09	111.56	15.53	--	<50	0.9	2.0	<0.5	2.0	--	--
01/13/94	127.09	114.85	12.24	--	<50	<0.5	0.9	<0.5	<0.5	--	--
04/22/94	127.09	114.18	12.91	--	<50	1.1	2.6	1.0	5.5	--	--
07/29/94	127.09	114.34	12.75	--	<50	<0.5	0.9	<0.5	<0.5	--	--
10/25/94	127.09	113.46	13.63	--	100	0.6	1.6	<0.5	4.1	--	--
01/19/95	127.09	117.16	9.93	--	<50	<0.5	<0.5	<0.5	<0.5	--	--

NO LONGER MONITORED OR SAMPLED

*TPH-Diesel not detected at detection limit of 1000 ppb. Oil and Grease not detected at detection limit of 5000 ppb.

Cumulative Table of Well Data and Analytical Results

Vertical Measurements are in feet.

Analytical results are in parts per billion (ppb)

DATE	Well Head Elev.	Ground Water Elev.	Depth To Water	Notes	TPH-Gasoline	Benzene	Toluene	Ethyl-Benzene	Xylene	MTBE	EDB
MW-2											
12/05/89	125.98	--	--	*	<500	<0.5	<0.5	<0.5	0.9	<0.5	<0.5
03/23/90	125.98	113.58	12.40	--	--	--	--	--	--	--	--
05/24/90	125.98	--	--	--	<50	<0.5	<0.5	<0.5	<0.5	--	--
09/06/90	125.98	111.13	14.85	--	<50	<0.5	<0.5	<0.5	<0.5	<0.5	<0.5
09/25/90	125.98	111.18	14.80	--	--	--	--	--	--	--	--
11/29/90	125.98	111.58	14.40	--	<50	<0.5	<0.5	<0.5	<0.5	--	--
02/20/91	125.98	111.89	14.09	--	<50	<0.5	<0.5	<0.5	<0.5	--	--
04/19/91	125.98	113.36	12.62	--	--	--	--	--	--	--	--
05/22/91	125.98	113.00	12.98	--	<50	<0.5	<0.5	<0.5	<0.5	--	--
08/22/91	125.98	111.05	14.93	--	<50	<0.5	<0.5	<0.5	<0.5	--	--
11/13/91	125.98	110.56	15.42	--	58	<0.5	0.5	0.7	2.3	--	--
01/30/92	125.98	111.28	14.70	--	<50	<0.5	<0.5	<0.5	<0.5	--	--
04/23/92	125.98	112.15	13.83	--	<50	<0.5	<0.5	<0.5	<0.5	--	--
07/27/92	125.98	110.68	15.30	--	<50	<0.5	<0.5	<0.5	1.1	--	--
10/26/92	125.98	110.36	15.62	--	<50	<0.5	<0.5	<0.5	<0.5	--	--
01/29/93	125.98	116.72	9.26	--	<50	3.0	8.0	1.0	5.0	--	--
04/30/93	125.98	116.32	9.66	--	<1300	<13	<13	<13	<13	--	--
07/14/93	125.98	114.08	11.90	--	<50	0.8	2.0	0.8	4.0	--	--
10/27/93	125.98	112.49	13.49	--	<50	1.0	2.0	1.0	2.0	--	--
01/13/94	125.98	113.99	11.99	--	<50	<0.5	0.6	<0.5	<0.5	--	--
04/22/94	125.98	113.25	12.73	--	<50	0.6	<0.5	<0.5	1.7	--	--
07/29/94	125.98	113.68	12.30	--	<50	<0.5	0.9	<0.5	<0.5	--	--
10/25/94	125.98	112.59	13.39	--	<50	<0.5	0.8	<0.5	2.1	--	--
01/19/95	125.98	117.27	8.71	--	<50	<0.5	2.3	<0.5	<0.5	--	--

NO LONGER MONITORED OR SAMPLED

*TPH-Diesel not detected at detection limit of 1000 ppb. Oil and Grease not detected at detection limit of 5000 ppb.

Cumulative Table of Well Data and Analytical Results

Vertical Measurements are in feet.

Analytical results are in parts per billion (ppb)

DATE	Well Head Elev.	Ground Water Elev.	Depth To Water	Notes	TPH-Gasoline	Benzene	Toluene	Ethyl-Benzene	Xylene	MTBE	EDB
MW-3											
12/05/89	127.84	--	--	*	24,000	2400	1800	360	2600	<0.5	<0.5
12/05/89	127.84	--	--	Duplicate	24,000	2500	1900	390	2600	<0.5	<0.5
03/23/90	127.84	110.34	17.50	--	--	--	--	--	--	--	--
05/24/90	127.84	--	--	--	9000	2600	1700	250	1500	--	--
05/24/90	127.84	--	--	Duplicate	10,000	2600	1800	260	1600	--	--
09/06/90	126.77	108.05	18.72	--	3500	900	550	110	460	<0.5	<0.5
09/25/90	126.77	108.37	18.40	--	--	--	--	--	--	--	--
11/29/90	126.77	107.80	18.97	--	9200	1100	1100	210	1100	--	--
02/20/91	126.77	107.57	19.20	--	8800	960	780	200	920	--	--
04/19/91	126.77	108.96	17.81	--	--	--	--	--	--	--	--
05/22/91	126.77	108.89	17.88	--	28,000	5800	1200	460	2300	--	--
08/01/91	126.77	107.54	19.23	--	--	--	--	--	--	--	--
08/22/91	126.77	106.60	20.17	--	21,000	3100	2000	480	2000	--	--
08/22/91	126.77	--	--	Duplicate	19,000	2700	1800	420	1700	--	--
11/13/91	126.77	106.82	19.95	--	18,000	2400	1200	450	2200	--	--
01/30/92	126.77	107.63	19.14	--	18,000	3800	920	700	2600	--	--
04/23/92	126.77	109.02	17.75	--	46,000	5000	1900	1000	3500	--	--
07/27/92	126.77	107.77	19.00	--	26,000	4900	1100	1200	3600	--	--
10/26/92	126.77	107.15	19.62	--	6600	1100	41	220	570	--	--
01/29/93	126.77	110.82	15.95	--	32,000	5900	2900	1300	5000	--	--
04/30/93	126.77	111.10	15.67	--	14,000	6100	98	870	2400	--	--
07/14/93	126.77	109.94	16.83	--	12,000	3100	1100	720	2900	--	--
10/27/93	126.77	109.07	17.70	--	19,000	7800	400	1500	3400	--	--
01/13/94	126.77	110.23	16.54	--	51,000	3700	140	720	1800	--	--
04/22/94	126.77	109.75	17.02	--	22,000	9300	89	1200	2400	--	--
07/29/94	126.77	109.82	16.95	--	13,000	4700	44	580	420	--	--
10/25/94	126.77	109.11	17.66	--	24,000	8700	52	1500	1400	--	--
01/19/95	126.77	112.90	13.87	--	17,000	9300	36	1600	740	--	--
10/12/95	126.77	112.54	14.23	--	37,000	12,000	180	1800	1500	13,000	--
04/11/96	126.77	115.73	11.04	--	19,000	2400	81	1400	1500	6800	--
10/03/96	126.77	112.15	14.62	--	--	--	--	--	--	--	--

NO LONGER MONITORED OR SAMPLED

*Oil and Grease not detected at detection limit of 5000 ppb.

Cumulative Table of Well Data and Analytical Results

Vertical Measurements are in feet.

Analytical results are in parts per billion (ppb)

DATE	Well Head Elev.	Ground Water Elev.	Depth To Water	Notes	TPH-Gasoline	Benzene	Toluene	Ethyl-Benzene	Xylene	MTBE	EDB
MW-4											
12/05/89	125.22	--	--	--	19,000	390	1300	460	1800	<0.5	<0.5
03/23/90	125.22	109.20	16.02	--	--	--	--	--	--	--	--
05/24/90	125.22	--	--	--	4500	210	440	140	480	--	--
09/06/90	125.22	107.87	17.35	--	6000	680	520	170	580	<0.5	<0.5
09/25/90	125.22	107.74	17.48	--	--	--	--	--	--	--	--
11/29/90	125.22	107.61	17.61	--	15,000	800	1000	430	1700	--	--
02/20/91	125.22	107.41	17.81	--	15,000	640	390	420	1600	--	--
02/20/91	125.22	--	--	Duplicate	15,000	680	410	430	1600	--	--
04/19/91	125.22	109.42	15.80	--	--	--	--	--	--	--	--
05/22/91	125.22	108.54	16.68	--	9800	580	140	310	740	--	--
05/22/91	125.22	--	--	Duplicate	7200	520	130	270	670	--	--
06/10/91	--	--	--	Redesignated EW-3	--	--	--	--	--	--	--
EW-3											
08/01/91	125.22	107.73	17.49	--	--	--	--	--	--	--	--
10/27/93	125.22	--	--	--	<50	<0.5	<0.5	<0.5	<0.5	--	--
01/13/94	125.22	--	--	--	<50	<0.5	<0.5	<0.5	<0.5	--	--
04/22/94	125.22	--	--	--	<50	<0.5	<0.5	<0.5	<0.5	--	--
07/29/94	125.22	--	--	--	<50	1.3	1.3	0.6	5.3	--	--
10/25/94	125.22	109.02	16.20	--	--	--	--	--	--	--	--
01/19/95	125.22	112.51	12.71	--	240	45	0.8	22	48	--	--
04/03/97	125.22	112.89	12.33	--	450	140	<1.2	4.3	3.9	17	--
10/07/97	125.22	110.64	14.58	--	1900	510	<5.0	26	8.7	12	--
04/14/98	125.22	--	--	Inaccessible	--	--	--	--	--	--	--

Cumulative Table of Well Data and Analytical Results

Vertical Measurements are in feet.

Analytical results are in parts per billion (ppb)

DATE	Well Head Elev.	Ground Water Elev.	Depth To Water	Notes	TPH-Gasoline	Benzene	Toluene	Ethyl-Benzene	Xylene	MTBE	EDB
MW-5											
03/23/90	125.85	108.96	16.89	--	--	--	--	--	--	--	--
05/25/90	125.85	--	--	--	28,000	920	1100	460	1300	2.4	2.4
09/07/90	125.85	107.42	18.46	Free Product (0.04')	--	--	--	--	--	--	--
09/25/90	125.85	107.54	18.87	Free Product (1.30')	--	--	--	--	--	--	--
11/29/90	125.85	107.31	18.91	Free Product (0.71')	--	--	--	--	--	--	--
02/20/91	125.85	109.24	16.99	Free Product (0.47')	--	--	--	--	--	--	--
04/19/91	125.85	107.58	19.30	Free Product (0.48')	--	--	--	--	--	--	--
05/22/91	125.85	108.42	17.69	Free Product (0.33')	--	--	--	--	--	--	--
06/10/91	--	--	--	Redesignated EW-2	--	--	--	--	--	--	--
EW-2											
08/01/91	125.79	107.72	18.07	--	--	--	--	--	--	--	--
04/22/94	125.79	--	--	--	<50	<0.5	<0.5	<0.5	<0.5	--	--
10/25/94	125.79	109.10	16.69	--	--	--	--	--	--	--	--
01/19/95	125.79	113.59	12.20	--	1700	540	69	56	400	--	--
05/01/95	125.79	113.63	12.16	--	<50	13	<0.5	<0.5	2.1	--	--

NO LONGER MONITORED OR SAMPLED

Cumulative Table of Well Data and Analytical Results

Vertical Measurements are in feet.

Analytical results are in parts per billion (ppb)

DATE	Well Head Elev.	Ground Water Elev.	Depth To Water	Notes	TPH-Gasoline	Benzene	Toluene	Ethyl-Benzene	Xylene	MTBE	EDB
MW-6											
03/23/90	124.18	105.67	18.51	--	--	--	--	--	--	--	--
05/25/90	124.18	--	--	--	<50	<2.0	<3.0	<3.0	<3.0	<0.02	<0.02
09/07/90	124.18	108.00	16.18	--	<50	<2.0	<3.0	<3.0	<3.0	<0.05	<0.05
09/25/90	124.18	107.76	16.42	--	--	--	--	--	--	--	--
11/29/90	124.18	108.07	16.11	--	<50	<0.5	<0.5	<0.5	<0.5	<0.05	<0.05
02/20/91	124.18	108.09	16.09	--	<50	<0.5	<0.5	<0.5	<0.5	--	--
04/19/91	124.18	109.03	15.15	--	--	--	--	--	--	--	--
05/22/91	124.18	108.77	15.41	--	<50	0.5	0.7	<0.5	1.1	--	--
08/23/91	124.18	106.38	17.80	--	<50	<0.5	<0.5	<0.5	<0.5	--	--
11/14/91	124.18	107.66	16.52	--	<50	<0.5	<0.5	<0.5	<0.5	<0.02	<0.02
11/14/91	124.18	--	--	Duplicate	<50	<0.5	0.6	<0.5	1.1	<0.05	<0.05
01/31/92	124.18	107.70	16.48	--	<50	<0.5	<0.5	<0.5	<0.5	--	--
01/31/92	124.18	--	--	Duplicate	<50	<0.5	<0.5	<0.5	<0.5	--	--
04/23/92	124.18	107.98	16.20	--	<50	<0.5	<0.5	<0.5	<0.5	--	--
04/23/92	124.18	--	--	Duplicate	--	--	--	--	--	--	--
07/27/92	124.18	107.66	16.52	--	<50	1.2	0.6	<0.5	1.9	--	--
10/26/92	124.18	107.06	17.12	--	<50	<0.5	<0.5	<0.5	<0.5	--	--
01/29/93	124.18	111.05	13.13	--	<50	<0.5	<0.5	<0.5	<0.5	--	--
04/30/93	124.18	109.32	14.86	--	<50	<0.5	<0.5	<0.5	0.6	--	--
07/14/93	124.18	109.57	14.61	--	<50	<0.5	<0.5	<0.5	<0.5	--	--
10/27/93	124.18	108.80	15.38	--	<50	0.9	1.0	0.6	1.0	--	--
01/13/94	124.18	108.84	15.34	--	<50	<0.5	<0.5	<0.5	<0.5	--	--
04/22/94	124.18	109.11	15.07	--	<50	<0.5	<0.5	<0.5	2.5	--	--
07/29/94	124.18	108.88	15.30	--	<50	7.5	1.2	1.0	1.1	--	--
10/25/94	124.18	108.49	15.69	--	<50	<0.5	<0.5	<0.5	1.2	--	--
01/19/95	124.18	112.69	11.49	--	<50	<0.5	3.1	<0.5	0.6	--	--
10/11/95	124.18	110.02	14.16	--	--	--	--	--	--	--	--
11/07/95	124.18	109.88	14.30	--	<50	<0.5	<0.5	<0.5	<0.5	<2.5	--
04/11/96	124.18	113.55	10.63	--	<50	<0.5	<0.5	<0.5	<0.5	<2.5	--
10/03/96	124.18	110.84	13.34	--	--	--	--	--	--	--	--

NO LONGER MONITORED OR SAMPLED

Cumulative Table of Well Data and Analytical Results

Vertical Measurements are in feet.

Analytical results are in parts per billion (ppb)

DATE	Well Head Elev.	Ground Water Elev.	Depth To Water	Notes	TPH-Gasoline	Benzene	Toluene	Ethyl-Benzene	Xylene	MTBE	EDB
MW-7											
03/23/90	126.86	105.46	21.40	--	--	--	--	--	--	--	--
05/25/90	126.86	--	--	--	<50	<2.0	<3.0	<3.0	<3.0	<0.02	<0.02
09/07/90	126.86	108.48	18.38	--	--	--	--	--	--	--	--
09/25/90	126.86	107.61	19.25	--	--	--	--	--	--	--	--
09/27/90	126.86	--	--	--	<50	<2.0	<3.0	<3.0	<3.0	<0.05	<0.05
09/27/90	126.86	--	--	Duplicate	<50	<2.0	<3.0	<3.0	<3.0	<0.05	<0.05
11/29/90	126.86	108.31	18.55	--	<50	<0.5	<0.5	<0.5	<0.5	--	--
02/20/91	126.86	108.31	18.55	--	<50	<0.5	<0.5	<0.5	<0.5	--	--
04/19/91	126.86	109.53	17.33	--	--	--	--	--	--	--	--
05/22/91	126.86	109.44	17.42	--	<50	<0.5	<0.5	<0.5	<0.5	--	--
08/22/91	126.86	107.81	19.05	--	<50	<0.5	<0.5	<0.5	<0.5	--	--
11/13/91	126.86	105.02	21.84	--	<50	<0.5	<0.5	<0.5	<0.5	--	--
01/30/92	126.86	104.44	22.42	--	<50	<0.5	<0.5	<0.5	<0.5	--	--
04/23/92	126.86	104.82	22.04	--	<50	<0.5	<0.5	<0.5	<0.5	--	--
07/27/92	126.86	104.62	22.24	--	<50	<0.5	<0.5	<0.5	<0.5	--	--
10/26/92	126.86	104.75	22.11	--	<50	<0.5	<0.5	<0.5	<0.5	--	--
01/29/93	126.86	109.79	17.07	--	<50	4.0	13	2.0	8.0	--	--
04/30/93	126.86	112.00	14.86	--	<50	<0.5	<0.5	<0.5	0.6	--	--
07/14/93	126.86	110.76	16.10	--	<50	<0.5	1.0	<0.5	2.0	--	--
10/27/93	126.86	108.15	18.71	--	<50	<0.5	<0.5	<0.5	<0.5	--	--
01/13/94	126.86	108.97	17.89	--	<50	<0.5	0.9	<0.5	1.0	--	--
04/22/94	126.86	109.92	16.94	--	<50	<0.5	<0.5	<0.5	1.3	--	--
07/29/94	126.86	110.16	16.70	--	74	19	8.2	7.8	11	--	--
10/25/94	126.86	109.44	17.42	--	<50	<0.5	0.6	<0.5	1.6	--	--
01/19/95	126.86	113.20	13.66	--	<50	<0.5	1.4	<0.5	<0.5	--	--

NO LONGER MONITORED OR SAMPLED

Cumulative Table of Well Data and Analytical Results

Vertical Measurements are in feet.

Analytical results are in parts per billion (ppb)

DATE	Well Head Elev.	Ground Water Elev.	Depth To Water	Notes	TPH-Gasoline	Benzene	Toluene	Ethyl-Benzene	Xylene	MTBE	EDB
MW-8											
09/07/90	123.61	107.54	16.07	--	<50	<0.5	<0.5	<0.5	<0.5	<0.05	<0.05
09/25/90	123.61	107.41	16.20	--	--	--	--	--	--	--	--
11/29/90	123.61	107.31	16.30	--	<50	<0.5	<0.5	<0.5	<0.5	--	--
11/29/90	123.61	--	--	Duplicate	<50	<0.5	<0.5	<0.5	<0.5	--	--
02/20/91	123.61	107.29	16.32	--	<50	<0.5	<0.5	<0.5	<0.5	--	--
04/19/91	123.61	108.90	14.71	--	--	--	--	--	--	--	--
05/22/91	123.61	108.19	15.42	--	<50	0.6	<0.5	<0.5	1.0	--	--
08/22/91	123.61	106.46	17.15	--	<50	<0.5	<0.5	<0.5	<0.5	--	--
11/14/91	123.61	106.62	16.99	--	<50	<0.5	<0.5	<0.5	<0.5	--	--
01/30/92	123.61	107.31	16.30	--	<50	1.0	0.7	<0.5	1.1	--	--
04/23/92	123.61	108.56	15.05	--	<50	<0.5	<0.5	<0.5	<0.5	--	--
07/27/92	123.61	107.53	16.08	--	<50	<0.5	<0.5	<0.5	<0.5	--	--
10/26/92	123.61	106.89	16.72	--	<50	<0.5	<0.5	<0.5	<0.5	--	--
01/29/93	123.61	110.79	12.82	--	1400	470	470	37	160	--	--
04/30/93	123.61	110.07	13.54	--	1600	<13	15	18	29	--	--
07/14/93	123.61	108.96	14.65	--	<50	<0.5	0.7	<0.5	2.0	--	--
10/27/93	123.61	108.57	15.04	--	<50	3.0	4.0	2.0	4.0	--	--
01/13/94	123.61	108.47	15.14	--	<50	<0.5	4.0	<0.5	<0.5	--	--
04/22/94	123.61	108.60	15.01	--	<50	<0.5	<0.5	<0.5	<0.5	--	--
07/28/94	123.61	108.91	14.70	--	69	7.3	18	3.3	12	--	--
10/25/94	123.61	108.41	15.20	--	<50	<0.5	0.8	<0.5	1.6	--	--
01/19/95	123.61	111.61	12.00	--	<50	<0.5	3.1	<0.5	0.7	--	--
05/01/95	123.61	112.21	11.40	--	<50	<0.5	<0.5	<0.5	<0.5	--	--
04/03/97	123.61	111.89	11.72	--	<200	<2.0	<2.0	<2.0	<2.0	610	--
10/07/97	123.61	110.01	13.60	--	<50	<0.5	<0.5	<0.5	<0.5	500	--
04/14/98	123.61	114.86	8.75	--	<50	<0.5	<0.5	<0.5	<0.5	120	--

Cumulative Table of Well Data and Analytical Results

Vertical Measurements are in feet.

Analytical results are in parts per billion (ppb)

DATE	Well Head Elev.	Ground Water Elev.	Depth To Water	Notes	TPH-Gasoline	Benzene	Toluene	Ethyl-Benzene	Xylene	MTBE	EDB
MW-9											
08/22/91	124.20	106.60	17.60	--	9600	46	170	98	1200	<0.05	<0.05
11/14/91	124.20	106.72	17.48	--	11,000	130	58	86	1500	<0.05	<0.05
01/30/92	124.20	107.49	16.71	--	11,000	210	29	110	1900	--	--
04/23/92	124.20	108.97	15.23	--	17,000	180	25	100	1900	--	--
07/27/92	124.20	107.48	16.72	--	2800	59	1.6	18	280	--	--
10/26/92	124.20	106.98	17.22	--	3200	38	<0.5	19	200	--	--
01/29/93	124.20	110.81	13.39	--	1300	23	6.0	8.0	100	--	--
04/30/93	124.20	110.20	14.00	--	<1300	<13	<13	<13	58	--	--
07/14/93	124.20	109.12	15.08	--	1300	25	4.0	15	120	--	--
10/27/93	124.20	108.58	15.62	--	1100	21	10	19	73	--	--
01/13/94	124.20	108.61	15.59	--	80	0.7	3.0	0.6	3.0	--	--
04/22/94	124.20	108.77	15.43	--	<50	<0.5	<0.5	<0.5	<0.5	--	--
07/29/94	124.20	109.00	15.20	--	1400	19	11	11	69	--	--
10/25/94	124.20	108.50	15.70	--	1200	11	2.0	7.6	28	--	--
01/19/95	124.20	111.62	12.58	--	380	1.6	4.3	1.5	11	--	--
05/01/95	124.20	112.24	11.96	--	350	1.1	<0.5	1.8	2.3	--	--
10/12/95	124.20	110.35	13.85	--	1700	3.8	<2.5	5.3	7.8	18	--
04/11/96	124.20	112.33	11.87	--	140	<0.5	<0.5	<0.5	<0.5	2.8	--
10/03/96	124.20	110.13	14.07	--	53	<0.5	<0.5	<0.5	<0.5	<2.5	--
04/03/97	124.20	111.82	12.38	--	<50	<0.5	<0.5	<0.5	<0.5	<2.5	--
10/07/97	124.20	110.06	14.14	--	66	1.3	<0.5	<0.5	<0.5	<2.5	--
04/14/98	124.20	114.65	9.55	--	<50	<0.5	<0.5	<0.5	<0.5	<2.5	--

Cumulative Table of Well Data and Analytical Results

Vertical Measurements are in feet.

Analytical results are in parts per billion (ppb)

DATE	Well Head Elev.	Ground Water Elev.	Depth To Water	Notes	TPH-Gasoline	Benzene	Toluene	Ethyl-Benzene	Xylene	MTBE	EDB
MW-10											
07/27/92	125.03	107.51	17.52	--	<50	<0.5	<0.5	<0.5	<0.5	--	--
10/27/92	125.03	106.97	18.06	--	<50	<0.5	<0.5	<0.5	<0.5	--	--
01/29/93	125.03	110.88	14.15	--	<50	<0.5	<0.5	<0.5	0.7	--	--
04/30/93	125.03	110.35	14.68	--	<50	<0.5	<0.5	<0.5	<0.5	--	--
07/14/93	125.03	109.23	15.80	--	<50	<0.5	<0.5	<0.5	<0.5	--	--
10/27/93	125.03	108.70	16.33	--	<50	<0.5	<0.5	<0.5	<0.5	--	--
01/13/94	125.03	108.74	16.29	--	<50	<0.5	0.5	<0.5	<0.5	--	--
04/22/94	125.03	108.88	16.15	--	<50	<0.5	<0.5	<0.5	1.1	--	--
07/29/94	125.03	109.18	15.85	--	<50	0.8	2.1	0.5	1.3	--	--
10/25/94	125.03	108.62	16.41	--	<50	<0.5	<0.5	<0.5	<0.5	--	--
01/19/95	125.03	111.74	13.29	--	<50	<0.5	<0.5	<0.5	<0.5	--	--
05/01/95	125.03	112.43	12.60	--	<50	<0.5	<0.5	<0.5	<0.5	--	--
10/11/95	125.03	110.49	14.54	--	<50	<0.5	<0.5	<0.5	<0.5	<2.5	--
04/11/96	125.03	112.56	12.47	--	<50	<0.5	<0.5	<0.5	<0.5	<2.5	--
10/03/96	125.03	110.29	14.74	--	<50	<0.5	<0.5	<0.5	<0.5	<2.5	--
04/03/97	125.03	112.04	12.99	--	<50	<0.5	<0.5	<0.5	<0.5	<2.5	--
10/07/97	125.03	110.17	14.86	--	<50	<0.5	<0.5	<0.5	<0.5	<2.5	--
04/14/98	125.03	114.79	10.24	--	<50	<0.5	<0.5	<0.5	<0.5	<2.5	--

Cumulative Table of Well Data and Analytical Results

Vertical Measurements are in feet.

Analytical results are in parts per billion (ppb)

DATE	Well Head Elev.	Ground Water Elev.	Depth To Water	Notes	TPH-Gasoline	Benzene	Toluene	Ethyl-Benzene	Xylene	MTBE	EDB
MW-11											
07/27/92	122.92	107.54	15.38	--	<50	<0.5	<0.5	<0.5	<0.5	--	--
10/26/92	122.92	106.95	15.97	--	<50	<0.5	<0.5	<0.5	<0.5	--	--
01/29/93	122.92	110.68	12.24	--	<50	8.0	16	2.0	10	--	--
04/30/93	122.92	110.15	12.77	--	<50	<0.5	<0.5	<0.5	<0.5	--	--
07/14/93	122.92	109.08	13.84	--	<50	<0.5	0.7	<0.5	1.0	--	--
10/27/93	122.92	108.69	14.23	--	<50	<0.5	<0.5	<0.5	<0.5	--	--
01/13/94	122.92	108.68	14.24	--	<50	<0.5	1.0	<0.5	<0.5	--	--
04/22/94	122.92	108.84	14.08	--	<50	<0.5	0.5	<0.5	1.4	--	--
07/29/94	122.92	109.02	13.90	--	<50	<0.5	<0.5	<0.5	<0.5	--	--
10/25/94	122.92	108.54	14.38	--	<50	<0.5	<0.5	<0.5	<0.5	--	--
01/19/95	122.92	111.47	11.45	--	<50	<0.5	1.8	<0.5	<0.5	--	--
05/01/95	122.92	111.82	11.10	--	<50	<0.5	<0.5	<0.5	<0.5	--	--
10/11/95	122.92	110.35	12.57	--	<50	<0.5	<0.5	<0.5	<0.5	<2.5	--
04/11/96	122.92	111.87	11.05	--	<50	<0.5	<0.5	<0.5	<0.5	<2.5	--
10/03/96	122.92	110.00	12.92	--	<50	<0.5	<0.5	<0.5	<0.5	<2.5	--
04/03/97	122.92	111.70	11.22	--	<50	<0.5	<0.5	<0.5	<0.5	<2.5	--
10/07/97	122.92	109.87	13.05	--	<50	<0.5	<0.5	<0.5	<0.5	<2.5	--
04/14/98	122.92	113.87	9.05	--	<50	<0.5	<0.5	<0.5	<0.5	<2.5	--
EW-1											
05/25/90	124.95	--	--	--	3900	260	430	64	340	0.03	0.03
08/01/91	124.95	107.41	17.54	--	--	--	--	--	--	--	--
10/27/93	124.95	--	--	--	350	<0.5	<0.5	<0.5	<0.5	--	--
01/13/94	124.95	--	--	--	<50	<0.5	<0.5	<0.5	<0.5	--	--
04/22/94	124.95	--	--	--	<50	<0.5	<0.5	<0.5	<0.5	--	--
07/29/94	124.95	--	--	--	97	0.6	0.5	0.6	5.1	--	--
01/19/95	124.95	112.32	12.63	--	3000	1600	100	350	760	--	--

NO LONGER MONITORED OR SAMPLED

Cumulative Table of Well Data and Analytical Results

Vertical Measurements are in feet.

Analytical results are in parts per billion (ppb)

DATE	Well Head Elev.	Ground Water Elev.	Depth To Water	Notes	TPH-Gasoline	Benzene	Toluene	Ethyl-Benzene	Xylene	MTBE	EDB
TRIP BLANK											
02/20/91	--	--	--	--	<50	<0.5	<0.5	<0.5	<0.5	--	--
05/22/91	--	--	--	--	<50	<0.5	<0.5	<0.5	<0.5	--	--
05/22/91	--	--	--	--	<50	<0.5	<0.5	<0.5	<0.5	--	--
11/13/91	--	--	--	--	<50	<0.5	<0.5	<0.5	<0.5	--	--
01/30/92	--	--	--	--	<50	<0.5	<0.5	<0.5	<0.5	--	--
04/23/92	--	--	--	--	<50	<0.5	<0.5	<0.5	<0.5	--	--
07/27/92	--	--	--	--	<0.5	<0.5	<0.5	<0.5	<0.5	--	--
10/26/92	--	--	--	--	<0.5	<0.5	<0.5	<0.5	<0.5	--	--
01/29/93	--	--	--	--	<50	<0.5	<0.5	<0.5	<0.5	--	--
04/30/93	--	--	--	--	<50	<0.5	<0.5	<0.5	<0.5	--	--
07/14/93	--	--	--	--	<50	<0.5	<0.5	<0.5	<0.5	--	--
10/27/93	--	--	--	--	<50	<0.5	<0.5	<0.5	<0.5	--	--
01/13/94	--	--	--	--	<50	<0.5	<0.5	<0.5	<0.5	--	--
04/22/94	--	--	--	--	<50	<0.5	<0.5	<0.5	<0.5	--	--
07/29/94	--	--	--	--	<50	<0.5	<0.5	<0.5	<0.5	--	--
10/25/94	--	--	--	--	<50	<0.5	<0.5	<0.5	<0.5	--	--
01/19/95	--	--	--	--	<50	<0.5	<0.5	<0.5	<0.5	--	--
05/01/95	--	--	--	--	<50	<0.5	<0.5	<0.5	<0.5	--	--
10/12/95	--	--	--	--	<50	<0.5	<0.5	<0.5	<0.5	<2.5	--
04/11/96	--	--	--	--	<50	<0.5	<0.5	<0.5	<0.5	<2.5	--
10/03/96	--	--	--	--	<50	<0.5	<0.5	<0.5	<0.5	--	--
04/03/97	--	--	--	--	<50	<0.5	<0.5	<0.5	<0.5	<2.5	--
10/07/97	--	--	--	--	<50	<0.5	<0.5	<0.5	<0.5	<2.5	--
04/14/98	--	--	--	--	<50	<0.5	<0.5	<0.5	<0.5	<2.5	--

Note: Blaine Tech Services, Inc. began routine monitoring of the groundwater wells at this site on May 1, 1995.
Earlier field data and analytical results provided by Sierra Environmental.

ABBREVIATIONS:

TPH = Total Petroleum Hydrocarbons
 MTBE = Methyl t-Butyl Ether
 EDB = Ethylene Dibromide

Analytical Appendix



Sequoia Analytical

680 Chesapeake Drive
 404 N. Wiget Lane
 819 Striker Avenue, Suite 8
 1455 McDowell Blvd. North, Ste. D

Redwood City, CA 94063
 Walnut Creek, CA 94598
 Sacramento, CA 95834
 Petaluma, CA 94954

(650) 364-9600
 (510) 988-9600
 (916) 921-9600
 (707) 792-1865

FAX (650) 364-9233
 FAX (510) 988-9673
 FAX (916) 921-0100
 FAX (707) 792-0342

Blaine Tech Services 1680 Rogers Avenue San Jose, CA 95112	Client Proj. ID: Chevron 9-8139/980414-D2 Sample Descript: MW-8 Matrix: LIQUID Analysis Method: 8015Mod/8020 Lab Number: 9804980-01	Sampled: 04/14/98 Received: 04/15/98 Analyzed: 04/21/98 Reported: 04/24/98
--	---	---

QC Batch Number: GC042198BTEX04A
 Instrument ID: GCHP4

Analyte	Detection Limit ug/L	Sample Results ug/L
TPPH as Gas	50	N.D.
Methyl t-Butyl Ether	2.5	120
Benzene	0.50	N.D.
Toluene	0.50	N.D.
Ethyl Benzene	0.50	N.D.
Xylenes (Total)	0.50	N.D.
Chromatogram Pattern:		
Surrogates	Control Limits %	% Recovery
Trifluorotoluene	70 130	82

Analytes reported as N.D. were not present above the stated limit of detection.

SEQUOIA ANALYTICAL - ELAP #1210

 Peggy Penner
 Project Manager





Sequoia Analytical

680 Chesapeake Drive
404 N. Wiget Lane
819 Striker Avenue, Suite 8
1455 McDowell Blvd. North, Ste. D

Redwood City, CA 94063
Walnut Creek, CA 94598
Sacramento, CA 95834
Petaluma, CA 94954

(650) 364-9600
(510) 988-9600
(916) 921-9600
(707) 792-1865

FAX (650) 364-9233
FAX (510) 988-9673
FAX (916) 921-0100
FAX (707) 792-0342

Blaine Tech Services 1680 Rogers Avenue San Jose, CA 95112	Client Proj. ID: Chevron 9-8139/980414-D2 Sample Descript: MW-9 Matrix: LIQUID Analysis Method: 8015Mod/8020 Lab Number: 9804980-02	Sampled: 04/14/98 Received: 04/15/98 Analyzed: 04/20/98 Reported: 04/24/98
Attention: Fran Thie		

QC Batch Number: GC042098BTEX04A
Instrument ID: GCHP4

Analyte	Detection Limit ug/L	Sample Results ug/L
TPPH as Gas	50	N.D.
Methyl t-Butyl Ether	2.5	N.D.
Benzene	0.50	N.D.
Toluene	0.50	N.D.
Ethyl Benzene	0.50	N.D.
Xylenes (Total)	0.50	N.D.
Chromatogram Pattern:		
Surrogates	Control Limits %	% Recovery
Trifluorotoluene	70 130	84

Analytes reported as N.D. were not present above the stated limit of detection.

SEQUOIA ANALYTICAL - ELAP #1210

Peggy Penner
Project Manager





Sequoia Analytical

680 Chesapeake Drive
404 N. Wiger Lane
819 Striker Avenue, Suite 8
1455 McDowell Blvd. North, Ste. D

Redwood City, CA 94063
Walnut Creek, CA 94598
Sacramento, CA 95834
Petaluma, CA 94954

(650) 364-9600
(510) 988-9600
(916) 921-9600
(707) 792-1865

FAX (650) 364-9233
FAX (510) 988-9673
FAX (916) 921-0100
FAX (707) 792-0342

Blaine Tech Services 1680 Rogers Avenue San Jose, CA 95112 Attention: Fran Thie	Client Proj. ID: Chevron 9-8139/980414-D2 Sample Descript: MW-10 Matrix: LIQUID Analysis Method: 8015Mod/8020 Lab Number: 9804980-03	Sampled: 04/14/98 Received: 04/15/98 Analyzed: 04/21/98 Reported: 04/24/98
--	--	---

QC Batch Number: GC042198BTEX04A
Instrument ID: GCHP4

Analyte	Detection Limit ug/L	Sample Results ug/L
TPPH as Gas	50	N.D.
Methyl t-Butyl Ether	2.5	N.D.
Benzene	0.50	N.D.
Toluene	0.50	N.D.
Ethyl Benzene	0.50	N.D.
Xylenes (Total)	0.50	N.D.
Chromatogram Pattern:		
Surrogates	Control Limits %	% Recovery
Trifluorotoluene	70 130	74

Analytes reported as N.D. were not present above the stated limit of detection.

SEQUOIA ANALYTICAL - ELAP #1210

Peggy Penner
Project Manager





Sequoia Analytical

680 Chesapeake Drive
404 N. Wiget Lane
819 Striker Avenue, Suite 8
1455 McDowell Blvd. North, Ste. D

Redwood City, CA 94063
Walnut Creek, CA 94598
Sacramento, CA 95834
Petaluma, CA 94954

(650) 364-9600 FAX (650) 364-9233
(510) 988-9600 FAX (510) 988-9673
(916) 921-9600 FAX (916) 921-0100
(707) 792-1865 FAX (707) 792-0342

Blaine Tech Services 1680 Rogers Avenue San Jose, CA 95112 Attention: Fran Thie	Client Proj. ID: Chevron 9-8139/980414-D2 Sample Descript: MW-11 Matrix: LIQUID Analysis Method: 8015Mod/8020 Lab Number: 9804980-04	Sampled: 04/14/98 Received: 04/15/98 Analyzed: 04/21/98 Reported: 04/24/98
--	--	---

QC Batch Number: GC042198BTEX04A
Instrument ID: GCHP4

Analyte	Detection Limit ug/L	Sample Results ug/L
TPPH as Gas	50	N.D.
Methyl t-Butyl Ether	2.5	N.D.
Benzene	0.50	N.D.
Toluene	0.50	N.D.
Ethyl Benzene	0.50	N.D.
Xylenes (Total)	0.50	N.D.
Chromatogram Pattern:		
Surrogates	Control Limits %	% Recovery
Trifluorotoluene	70 130	72

Analytes reported as N.D. were not present above the stated limit of detection.

SEQUOIA ANALYTICAL - ELAP #1210

Peggy Penner
Project Manager





Sequoia Analytical

680 Chesapeake Drive
404 N. Wiget Lane
819 Striker Avenue, Suite 8
1455 McDowell Blvd, North, Ste. D

Redwood City, CA 94063
Walnut Creek, CA 94598
Sacramento, CA 95834
Petaluma, CA 94954

(650) 364-9600
(510) 988-9600
(916) 921-9600
(707) 792-1865

FAX (650) 364-9233
FAX (510) 988-9673
FAX (916) 921-0100
FAX (707) 792-0342

Blaine Tech Services 1680 Rogers Avenue San Jose, CA 95112	Client Proj. ID: Chevron 9-8139/980414-D2 Sample Descript: TB Matrix: LIQUID Analysis Method: 8015Mod/8020 Lab Number: 9804980-05	Sampled: 04/14/98 Received: 04/15/98 Analyzed: 04/22/98 Reported: 04/24/98
Attention: Fran Thie		

QC Batch Number: GC042298BTEX04A
Instrument ID: GCHP4

Analyte	Detection Limit ug/L	Sample Results ug/L
TPPH as Gas	50	N.D.
Methyl t-Butyl Ether	2.5	N.D.
Benzene	0.50	N.D.
Toluene	0.50	N.D.
Ethyl Benzene	0.50	N.D.
Xylenes (Total)	0.50	N.D.
Chromatogram Pattern:		
Surrogates	Control Limits %	% Recovery
Trifluorotoluene	70 130	80

Analytes reported as N.D. were not present above the stated limit of detection.

SEQUOIA ANALYTICAL - ELAP #1210

Peggy Penner
Project Manager





Sequoia Analytical

680 Chesapeake Drive
404 N. Wiget Lane
819 Striker Avenue, Suite 8
1455 McDowell Blvd. North, Ste. D

Redwood City, CA 94063
Walnut Creek, CA 94598
Sacramento, CA 95834
Petaluma, CA 94954

(650) 364-9600
(510) 988-9600
(916) 921-9600
(707) 792-1865

FAX (650) 364-9233
FAX (510) 988-9673
FAX (916) 921-0100
FAX (707) 792-0342

Blaine Tech Services, Inc.
1680 Rogers Ave.
San Jose, CA 95112
Attention: Fran Thie

Client Project ID: **Chevron 9-8139/ 980414-D2**
Matrix: **Liquid**

Work Order #: **9804980 -01, 03-04**

Reported: **May 6, 1998**

QUALITY CONTROL DATA REPORT

Analyte:	Benzene	Toluene	Ethyl Benzene	Xylenes	Gas
QC Batch#:	GC042198802004A	GC042198802004A	GC042198802004A	GC042198802004A	GC042198802004A
Analy. Method:	EPA 8020	EPA 8020	EPA 8020	EPA 8020	EPA 8015M
Prep. Method:	EPA 5030	EPA 5030	EPA 5030	EPA 5030	EPA 5030

Analyst:	S.L.	S.L.	S.L.	S.L.	S.L.
MS/MSD #:	98040458	98040458	98040458	98040458	-
Sample Conc.:	11	N.D.	N.D.	N.D.	-
Prepared Date:	4/21/98	4/21/98	4/21/98	4/21/98	-
Analyzed Date:	4/21/98	4/21/98	4/21/98	4/21/98	-
Instrument I.D.#:	GC4	GC4	GC4	GC4	-
Conc. Spiked:	20 µg/L	20 µg/L	20 µg/L	60 µg/L	-
Result:	28.1	19.5	19.6	59.4	-
MS % Recovery:	86	98	98	99	-
Dup. Result:	27.2	18.6	19	57.3	-
MSD % Recov.:	81	93	95	96	-
RPD:	3.3	4.7	3.1	3.6	-
RPD Limit:	0-25	0-25	0-25	0-25	-

LCS #:	LCS042198	LCS042198	LCS042198	LCS042198	LCS042198
Prepared Date:	4/21/98	4/21/98	4/21/98	4/21/98	4/21/98
Analyzed Date:	4/21/98	4/21/98	4/21/98	4/21/98	4/21/98
Instrument I.D.#:	GC4	GC4	GC4	GC4	GC4
Conc. Spiked:	20 µg/L	20 µg/L	20 µg/L	60 µg/L	500 µg/L
LCS Result:	18	18.9	19.8	60.4	485
LCS % Recov.:	90	95	99	101	97

MS/MSD	60-140	60-140	60-140	60-140	60-140
LCS	70-130	70-130	70-130	70-130	70-130
Control Limits					

SEQUOIA ANALYTICAL
Elap #2142

Peggy Penner

Peggy Penner
Project Manager

Please Note:

The LCS is a control sample of known, interferent-free matrix that is analyzed using the same reagents, preparation, and analytical methods employed for the samples. The matrix spike is an aliquot of sample fortified with known quantities of specific compounds and subjected to the entire analytical procedure. If the recovery of analytes from the matrix spike does not fall within specified control limits due to matrix interference, the LCS recovery is to be used to validate the batch.

** MS=Matrix Spike, MSD=MS Duplicate, RPD=Relative % Difference

9804980.BLA <1>





Sequoia Analytical

680 Chesapeake Drive
404 N. Wiget Lane
819 Striker Avenue, Suite 8
1455 McDowell Blvd. North, Ste. D

Redwood City, CA 94063
Wainur Creek, CA 94598
Sacramento, CA 95834
Petaluma, CA 94954

(650) 364-9600
(510) 988-9600
(916) 921-9600
(707) 792-1865

FAX (650) 364-9233
FAX (510) 988-9673
FAX (916) 921-0100
FAX (707) 792-0342

Blaine Tech Services, Inc.
1680 Rogers Ave.
San Jose, CA 95112
Attention: Fran Thie

Client Project ID: Chevron 9-8139/ 980414-D2
Matrix: Liquid

Work Order #: 9804980-02

Reported: May 6, 1998

QUALITY CONTROL DATA REPORT

Analyte:	Benzene	Toluene	Ethyl Benzene	Xylenes	Gas
QC Batch#:	GC042298802004A	GC042298802004A	GC042298802004A	GC042298802004A	GC042298802004A
Analy. Method:	EPA 8020	EPA 8020	EPA 8020	EPA 8020	EPA 8015M
Prep. Method:	EPA 5030	EPA 5030	EPA 5030	EPA 5030	EPA 5030

Analyst:	S.L.	S.L.	S.L.	S.L.	S.L.
MS/MSD #:	98040458	98040458	98040458	98040458	-
Sample Conc.:	11	N.D.	N.D.	N.D.	-
Prepared Date:	4/21/98	4/21/98	4/21/98	4/21/98	-
Analyzed Date:	4/21/98	4/21/98	4/21/98	4/21/98	-
Instrument I.D.#:	GC4	GC4	GC4	GC4	-
Conc. Spiked:	20 µg/L	20 µg/L	20 µg/L	60 µg/L	-
Result:	28.1	19.5	19.6	59.4	-
MS % Recovery:	86	98	98	99	-
Dup. Result:	27.2	18.6	19	57.3	-
MSD % Recov.:	81	93	95	96	-
RPD:	3.3	4.7	3.1	3.6	-
RPD Limit:	0-25	0-25	0-25	0-25	-

LCS #:	LCS042298	LCS042298	LCS042298	LCS042298	LCS042298
Prepared Date:	4/22/98	4/22/98	4/22/98	4/22/98	4/22/98
Analyzed Date:	4/22/98	4/22/98	4/22/98	4/22/98	4/22/98
Instrument I.D.#:	GC4	GC4	GC4	GC4	GC4
Conc. Spiked:	20 µg/L	20 µg/L	20 µg/L	60 µg/L	500 µg/L
LCS Result:	17.3	18.2	19.1	58	510
LCS % Recov.:	87	91	96	97	102

MS/MSD	60-140	60-140	60-140	60-140	60-140
LCS	70-130	70-130	70-130	70-130	70-130
Control Limits					

SEQUOIA ANALYTICAL
Elap #2142

Peggy Penner For

Peggy Penner
Project Manager

Please Note:

The LCS is a control sample of known, interferent-free matrix that is analyzed using the same reagents, preparation, and analytical methods employed for the samples. The matrix spike is an aliquot of sample fortified with known quantities of specific compounds and subjected to the entire analytical procedure. If the recovery of analytes from the matrix spike does not fall within specified control limits due to matrix interference, the LCS recovery is to be used to validate the batch.

** MS=Matrix Spike, MSD=MS Duplicate, RPD=Relative % Difference

9804980.BLA <2>





Sequoia Analytical

680 Chesapeake Drive
404 N. Wiget Lane
819 Striker Avenue, Suite B
1455 McDowell Blvd. North, Ste. D

Redwood City, CA 94063
Walnut Creek, CA 94598
Sacramento, CA 95834
Petaluma, CA 94954

(650) 364-9600
(510) 988-9600
(916) 921-9600
(707) 792-1865

FAX (650) 364-9233
FAX (510) 988-9673
FAX (916) 921-0100
FAX (707) 792-0342

Blaine Tech Services, Inc.
1680 Rogers Ave.
San Jose, CA 95112
Attention: Fran Thie

Client Project ID: Chevron 9-8139/ 980414-D2
Matrix: Liquid

Work Order #: 9804980-02

Reported: May 6, 1998

QUALITY CONTROL DATA REPORT

Analyte:	Benzene	Toluene	Ethyl Benzene	Xylenes	Gas
QC Batch#:	GC042098802004A	GC042098802004A	GC042098802004A	GC042098802004A	GC042098802004A
Analy. Method:	EPA 8020	EPA 8020	EPA 8020	EPA 8020	EPA 8015M
Prep. Method:	EPA 5030	EPA 5030	EPA 5030	EPA 5030	EPA 5030

Analyst:	S.L.	S.L.	S.L.	S.L.	S.L.
MS/MSD #:	98040464	98040464	98040464	98040464	-
Sample Conc.:	11	N.D.	N.D.	N.D.	-
Prepared Date:	4/20/98	4/20/98	4/20/98	4/20/98	-
Analyzed Date:	4/20/98	4/20/98	4/20/98	4/20/98	-
Instrument I.D.#:	GC4	GC4	GC4	GC4	-
Conc. Spiked:	20 µg/L	20 µg/L	20 µg/L	60 µg/L	-
Result:	16	17.2	17.9	54.2	-
MS % Recovery:	80	86	90	90	-
Dup. Result:	16.1	17.1	17.8	53.4	-
MSD % Recov.:	81	86	89	89	-
RPD:	0.62	0.58	0.56	1.5	-
RPD Limit:	0-25	0-25	0-25	0-25	-

LCS #:	LCS042098	LCS042098	LCS042098	LCS042098	LCS042098
Prepared Date:	4/20/98	4/20/98	4/20/98	4/20/98	4/20/98
Analyzed Date:	4/20/98	4/20/98	4/20/98	4/20/98	4/20/98
Instrument I.D.#:	GC4	GC4	GC4	GC4	GC4
Conc. Spiked:	20 µg/L	20 µg/L	20 µg/L	60 µg/L	500 µg/L
LCS Result:	17.2	18	18.9	57.1	519
LCS % Recov.:	86	90	95	95	104

MS/MSD	60-140	60-140	60-140	60-140	60-140
LCS	70-130	70-130	70-130	70-130	70-130
Control Limits					

SEQUOIA ANALYTICAL
Elap #2142

For

Peggy Penner
Project Manager

Please Note:

The LCS is a control sample of known, interferent-free matrix that is analyzed using the same reagents, preparation, and analytical methods employed for the samples. The matrix spike is an aliquot of sample fortified with known quantities of specific compounds and subjected to the entire analytical procedure. If the recovery of analytes from the matrix spike does not fall within specified control limits due to matrix interference, the LCS recovery is to be used to validate the batch.

** MS=Matrix Spike, MSD=MS Duplicate, RPD=Relative % Difference

9804980.BLA <3>





**Sequoia
Analytical**

680 Chesapeake Drive
404 N. Wiget Lane
819 Striker Avenue, Suite 8
1455 McDowell Blvd. North, Ste. D

Redwood City, CA 94063
Walnut Creek, CA 94598
Sacramento, CA 95834
Petaluma, CA 94954

(650) 364-9600 FAX (650) 364-9233
(510) 988-9600 FAX (510) 988-9673
(916) 921-9600 FAX (916) 921-0100
(707) 792-1865 FAX (707) 792-0342

Blaine Tech Services 1680 Rogers Avenue San Jose, CA 95112 Attention: Fran Thie	Client Proj. ID: Chevron 9-8139/980414-D2 Lab Proj. ID: 9804980	Received: 04/15/98 Reported: 04/24/98
--	--	--

LABORATORY NARRATIVE

In order to properly interpret this report, it must be reproduced in its entirety. This report contains a total of 8 pages including the laboratory narrative, sample results, quality control, and related documents as required (cover page, COC, raw data, etc.).

SEQUOIA ANALYTICAL

Peggy Penner
Project Manager



Fax copy of Lab Report and COC to Chevron Contact: Yes No

Chain-of-Custody-Record

Chevron U.S.A. Inc.
P.O. BOX 5004
San Ramon, CA 94583
FAX (415)842-9591

Chevron Facility Number 9-8139
Facility Address 16304 Foothill Blvd., San Leandro, CA
Consultant Project Number 980414-PZ
Consultant Name Blaine Tech Services, Inc.
Address 1680 Rogers Ave., San Jose, CA 95112
Project Contact (Name) Fran Thie
(Phone) (408) 573-0555 (Fax Number) (408) 573-7771

Chevron Contact (Name) Tammy Hodge
(Phone) (510) 842-9449
Laboratory Name Sequoia
Laboratory Release Number 9029546
Samples Collected by (Name) Pat Venor
Collection Date 4/14/98
Signature [Signature]

Sample Number	Lab Sample Number	Number of Containers	Matrix S = Soil W = Water A = Air C = Charcoal	Type G = Grab C = Composite D = Discrete	Time	Sample Preservation	Iced (Yes or No)	Analytes To Be Performed <u>7504980</u>										DO NOT BILL FOR TB-LB. AP 15/1/98 Remarks	
								BTX + TPH GAS (8020 + 8015) + ANY D.E.	TPH Diesel (8015)	Oil and Grease (5520)	Purgeable Halocarbons (8010)	Purgeable Aromatics (8020)	Purgeable Organics (8240)	Extractable Organics (8270)	Metals Cd, Cr, Pb, Zn, Ni (ICAP or AA)				
MW-8	1	3	W		12:34	HCL	Y	X											
MW-9	2	1			11:55			X											
MW-10	3	1			10:52			X											
MW-11	4	1			11:26			X											
TIS	5	2	W		-			X											

Relinquished By (Signature) <u>[Signature]</u>	Organization <u>BTS</u>	Date/Time <u>4/15/98 10:00</u>	Received By (Signature) <u>[Signature]</u>	Organization <u>SEQUOIA</u>	Date/Time <u>4/15/98 10:00</u>	Turn Around Time (Circle Choice) 24 Hrs. 48 Hrs. 5 Days 10 Days As Contracted
Relinquished By (Signature) <u>[Signature]</u>	Organization <u>SEQUOIA</u>	Date/Time <u>4/15/98</u>	Received By (Signature) <u>[Signature]</u>	Organization	Date/Time	
Relinquished By (Signature) <u>[Signature]</u>	Organization	Date/Time	Received For Laboratory By (Signature) <u>Juni Dawn</u>	Date/Time <u>4/15/98 1131</u>		

3/03 91/MCH

2/1/98

Field Data Sheets

CHEVRON WELL MONITORING DATA SHEET

Project #: 980414-DZ	Station #: 9-8139
Sampler: DV	Date: 4/14
Well I.D.: MW-8	Well Diameter: (2) 3 4 6 8 ____
Total Well Depth: 30.81	Depth to Water: 8.75
Depth to Free Product:	Thickness of Free Product (feet):
Referenced to: (PVC) Grade	D.O. Meter (if req'd): YSI HACH

Well Diameter	Multiplier	Well Diameter	Multiplier
2"	0.16	5"	1.02
3"	0.37	6"	1.47
4"	0.65	Other	radius ² * 0.163

Purge Method: Bailer Disposable Bailer <input checked="" type="checkbox"/> Middleburg Electric Submersible Extraction Pump Other: _____	Sampling Method: Bailer Disposable Bailer <input checked="" type="checkbox"/> Extraction Port Other: _____
--	---

3.8	x	3	=	11.4	Gals.
1 Case Volume (Gals.)		Specified Volumes		Calculated Volume	

Time	Temp (°F)	pH	Cond.	Gals. Removed	Observations
12:20	67.7	7.4	800	4	
12:25	66.6	7.3	770	8	
12:30	65.8	7.3	690	11.5	

Did well dewater? Yes <input type="checkbox"/> No <input checked="" type="checkbox"/>	Gallons actually evacuated: 11.5
Sampling Time: 12:34	Sampling Date: 4/14
Sample I.D.: MW-8	Laboratory: Sequoia GTEL N. Creek Assoc. Labs
Analyzed for: (TPH-G) (BTEX) (MTBE) TPH-D Other:	
Duplicate I.D.:	Analyzed for: TPH-G BTEX MTBE TPH-D Other:
D.O. (if req'd):	Pre-purge: mg/L
O.R.P. (if req'd):	Pre-purge: mV

CHEVRON WELL MONITORING DATA SHEET

Project #: 980414-DZ	Station #: 9-8139
Sampler: DV	Date: 4/14
Well I.D.: MW-9	Well Diameter: (2) 3 4 6 8
Total Well Depth: 26.65	Depth to Water: 9.55
Depth to Free Product:	Thickness of Free Product (feet):
Referenced to: (PVC) Grade	D.O. Meter (if req'd): YSI HACH

Well Diameter	Multiplier	Well Diameter	Multiplier
2"	0.16	5"	1.02
3"	0.37	6"	1.47
4"	0.65	Other	radius ² * 0.163

Purge Method: Bailer Disposable Bailer <input checked="" type="checkbox"/> Middleburg Electric Submersible Extraction Pump Other: _____	Sampling Method: Bailer Disposable Bailer <input checked="" type="checkbox"/> Extraction Port Other: _____
--	---

2.9	x	3	=	8.7	Gals.
1 Case Volume (Gals.)		Specified Volumes		Calculated Volume	

Time	Temp (°F)	pH	Cond.	Gals. Removed	Observations
11:42	68.4	7.5	780	3	
11:46	67.7	7.3	660	6	
11:50	67.2	7.2	620	8.75	

Did well dewater? Yes <input type="checkbox"/> No <input checked="" type="checkbox"/>	Gallons actually evacuated: 8.75
Sampling Time: 11:55	Sampling Date: 4/14
Sample I.D.: MW-9	Laboratory: Sequoia GTEL N. Creek Assoc. Labs
Analyzed for: TPH-G <input checked="" type="checkbox"/> BTEX <input checked="" type="checkbox"/> MTBE <input checked="" type="checkbox"/> TPH-D Other:	
Duplicate I.D.:	Analyzed for: TPH-G BTEX MTBE TPH-D Other:
D.O. (if req'd):	Pre-purge: <input type="text"/> mg/L Post-purge: <input type="text"/> mg/L
O.R.P. (if req'd):	Pre-purge: <input type="text"/> mV Post-purge: <input type="text"/> mV

CHEVRON WELL MONITORING DATA SHEET

Project #: 980414-DL	Station #: 9-8139
Sampler: PV	Date: 2/14
Well I.D.: MW-10	Well Diameter: <u>2</u> 3 4 6 8
Total Well Depth: 29.42	Depth to Water: 10.24
Depth to Free Product:	Thickness of Free Product (feet):
Referenced to: <u>PVC</u> Grade	D.O. Meter (if req'd): YSI HACH

Well Diameter	Multiplier	Well Diameter	Multiplier
2"	0.16	5"	1.02
3"	0.37	6"	1.47
4"	0.65	Other	radius ² * 0.163

Purge Method: Bailer Disposable Bailer <input checked="" type="checkbox"/> Middleburg Electric Submersible Extraction Pump Other: _____	Sampling Method: Bailer Disposable Bailer <input checked="" type="checkbox"/> Extraction Port Other: _____
--	---

<u>3.3</u>	x	<u>3</u>	=	<u>9.9</u>	Gals.
1 Case Volume (Gals.)		Specified Volumes		Calculated Volume	

Time	Temp (°F)	pH	Cond.	Gals. Removed	Observations
10:42	61.6	8.0	920	3.5	
10:47	63.0	7.7	900	7.0	
10:52	65.6	7.6	880	10.0	

Did well dewater? Yes <input type="checkbox"/> No <input checked="" type="checkbox"/>	Gallons actually evacuated: 10
Sampling Time: 10:59	Sampling Date: 2/14
Sample I.D.: MW-10	Laboratory: <u>Sequoia</u> GTEL N. Creek Assoc. Labs
Analyzed for: <u>TPH-G</u> <u>BTEX</u> <u>MTBE</u> TPH-D Other:	
Duplicate I.D.:	Analyzed for: TPH-G BTEX MTBE TPH-D Other:
D.O. (if req'd):	Pre-purge: mg/L
	Post-purge: mg/L
O.R.P. (if req'd):	Pre-purge: mV
	Post-purge: mV

CHEVRON WELL MONITORING DATA SHEET

Project #: 980414-D2	Station #: 9-8139
Sampler: PV	Date: 4/14
Well I.D.: MW-11	Well Diameter: (2) 3 4 6 8
Total Well Depth: 29.37	Depth to Water: 9.05
Depth to Free Product:	Thickness of Free Product (feet):
Referenced to: (FVC) Grade	D.O. Meter (if req'd): YSI HACH

Well Diameter	Multiplier	Well Diameter	Multiplier
2"	0.16	5"	1.02
3"	0.37	6"	1.47
4"	0.65	Other	radius ² * 0.163

Purge Method: Bailer Disposable Bailer <input checked="" type="checkbox"/> Middleburg Electric Submersible Extraction Pump Other: _____	Sampling Method: Bailer Disposable Bailer <input checked="" type="checkbox"/> Extraction Port Other: _____
--	---

3.4	x	3	=	10.2	Gals.
1 Case Volume (Gals.)		Specified Volumes		Calculated Volume	

Time	Temp (°F)	pH	Cond.	Gals. Removed	Observations
11:12	68.8	7.6	1140	3.5	
11:17	69.3	7.4	1150	7	
11:22	69.5	7.3	1160	10.25	

Did well dewater? Yes <input type="checkbox"/> No <input checked="" type="checkbox"/>	Gallons actually evacuated: 10.25
Sampling Time: 11:26	Sampling Date: 4/14
Sample I.D.: MW-11	Laboratory: Sequoia GTEL N. Creek Assoc. Labs
Analyzed for: TPH-G <input checked="" type="checkbox"/> BTEX <input checked="" type="checkbox"/> MTBE <input checked="" type="checkbox"/> TPH-D Other:	
Duplicate I.D.:	Analyzed for: TPH-G BTEX MTBE TPH-D Other:
D.O. (if req'd):	Pre-purge: <input type="text"/> mg/L Post-purge: <input type="text"/> mg/L
O.R.P. (if req'd):	Pre-purge: <input type="text"/> mV Post-purge: <input type="text"/> mV

CHEVRON WELL MONITORING DATA SHEET

Project #: 980414-DZ	Station #: 9-8139
Sampler: DV	Date: 4/14
Well I.D.: EW-3	Well Diameter: 2 3 4 6 8 ____
Total Well Depth:	Depth to Water:
Depth to Free Product:	Thickness of Free Product (feet):
Referenced to: PVC Grade	D.O. Meter (if req'd): YSI HACH

Well Diameter	Multiplier	Well Diameter	Multiplier
2"	0.16	5"	1.02
3"	0.37	6"	1.47
4"	0.65	Other	radius ² * 0.163

Purge Method: Bailer Disposable Bailer Middleburg Electric Submersible Extraction Pump Other: _____	Sampling Method: Bailer Disposable Bailer Extraction Port Other: _____
--	---

_____	X	_____	=	_____ Gals.
1 Case Volume (Gals.)		Specified Volumes		Calculated Volume

Time	Temp (°F)	pH	Cond.	Gals. Removed	Observations
		Well	inaccessable		
		Car	Parked	over well	@ 10:30 → 12:30

Did well dewater? Yes No	Gallons actually evacuated:
Sampling Time:	Sampling Date:
Sample I.D.:	Laboratory: Sequoia GTEL N. Creek Assoc. Labs
Analyzed for: TPH-G BTEX MTBE TPH-D Other:	
Duplicate I.D.:	Analyzed for: TPH-G BTEX MTBE TPH-D Other:
D.O. (if req'd):	Pre-purge: _____ mg/L Post-purge: _____ mg/L
O.R.P. (if req'd):	Pre-purge: _____ mV Post-purge: _____ mV