

C A M B R I A

June 2, 2003

eva chu
Alameda County Health Care Services Agency
1131 Harbor Bay Parkway, Suite 250
Alameda, California 94502-6577

Re: **First Quarter 2003 Monitoring Report**
Shell-branded Service Station
1784 150th Avenue
San Leandro, California
Incident #98996068
Cambria Project #245-0612-002

Alameda County
JUN 04 2003
Environmental Health



Dear Ms. chu:

On behalf of Equilon Enterprises LLC dba Shell Oil Products US, Cambria Environmental Technology, Inc. (Cambria) is submitting this groundwater monitoring report in accordance with the reporting requirements of 23 CCR 2652d.

FIRST QUARTER 2003 ACTIVITIES

Groundwater Monitoring: Blaine Tech Services, Inc. (Blaine) of San Jose gauged all site wells, sampled selected wells, calculated groundwater elevations, and compiled the analytical data. Cambria prepared a vicinity map which includes previously submitted well survey information (Figure 1) and a groundwater elevation contour map (Figure 2). Blaine's report, presenting the laboratory report and supporting field documents, is included as Attachment A.

Additional Oxygenate Analysis: As requested in a letter dated October 22, 2002 from Alameda County Health Care Services Agency (ACHCSA), groundwater samples were analyzed for the presence of methyl tert-butyl ether (MTBE), tert-butyl alcohol (TBA), ethyl tert-butyl ether (ETBE), tert-amyl methyl ether (TAME), di-isopropyl ether (DIPE), 1,2-dichloroethane (1,2-DCA) and 1,2-dibromoethane (or ethylene dibromide) (EDB) using EPA Method 8260. No analytes were detected in any of the groundwater samples from off-site wells. Analytical results showed MTBE concentrations of 230 parts per billion (ppb) and 21,000 ppb, and TBA concentrations of 290 ppb and 10,000 ppb in on-site wells MW-1 and MW-2, respectively. In addition, 13 ppb of 1,2-DCA were detected in MW-1. Analytical results are presented in Table 1.

**Cambria
Environmental
Technology, Inc.**

5900 Hollis Street
Suite A
Emeryville, CA 94608
Tel (510) 420-0700
Fax (510) 420-9170

Mobile Groundwater Extraction (GWE): In July 2002, Onyx Industrial Services (Onyx) of Benicia, California began conducting semi-monthly GWE using monitoring well MW-2 for three events and continuing on a monthly basis thereafter. Through the end of March 2003, approximately 2.8 pounds of total petroleum hydrocarbons as gasoline and approximately 1.8 pounds of MTBE were removed from the subsurface (Table 2). The effect of GWE on the MTBE concentrations in well MW-2 is depicted graphically in Figure 3.

ANTICIPATED SECOND QUARTER 2003 ACTIVITIES



Groundwater Monitoring: Blaine will gauge all wells, sample selected wells, and tabulate the data. Cambria will prepare a monitoring report.

Volatile Organic Compounds (VOC) Analysis Reduction Proposal: Groundwater from wells MW-1, MW-2 and MW-3 has been analyzed annually for VOCs by EPA Method 8260B since 1995. Given that concentrations are typically below or very near the method detection limits for all wells except MW-3, Cambria proposed in the *Third Quarter 2002 Monitoring Report* to reduce annual analysis for VOCs to include well MW-3 only. Cambria will implement this proposal in the second quarter 2003.

Additional Oxygenate and Lead Scavenger Analysis: Groundwater from on-site wells MW-1, MW-2 and MW-3 will continue to be analyzed quarterly for MTBE, TAME, TBA and 1,2-DCA.

GWE: Onyx will continue conducting monthly GWE using monitoring well MW-2.

Soil and Groundwater Investigation: In a letter dated May 5, 2003, ACHCSA conditionally approved Cambria's March 10, 2003 *Soil and Water Investigation Work Plan and Well Screen Interval Evaluation*. In a May 15, 2003 telephone conversation between eva chu of ACHCSA and Melody Munz of Cambria, the scope of work was revised to include a total of seven off-site and one on-site soil borings (as shown in Figure 2). Cambria will collect soil samples at approximately 5-foot intervals and/or based on field observations (including changes in color, odor, stratigraphy) to approximately 15 feet below the current groundwater level and one grab-groundwater sample from each boring. Permitting is in progress and the work is scheduled to begin on June 24, 2003 pending receipt of all appropriate permits.

CLOSING

We appreciate the opportunity to work with you on this project. Please call Melody Munz at (510) 420-3324 if you have any questions or comments.

Sincerely,
Cambria Environmental Technology, Inc

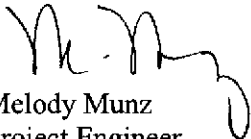

Melody Munz
Project Engineer

Matthew W. Derby, P.E.
Senior Project Engineer

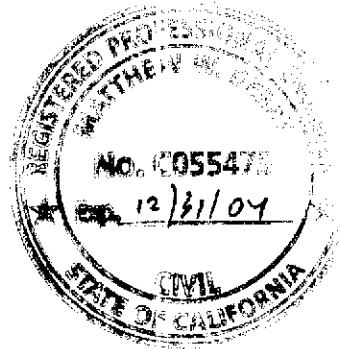

Figures: 1 - Vicinity/Area Well Survey Map
2 - Groundwater Elevation Contour Map
3 - GWE VacOps Effect on MTBE Concentration (MW-2)

Tables: 1 - Groundwater Analytical Data - Oxygenates
2 - Groundwater Extraction - Mass Removal Data

Attachment: A - Blaine Groundwater Monitoring Report and Field Notes

cc: Karen Petryna, Shell Oil Products US, P.O. Box 7869, Burbank, CA 91510-7869

G:\San Leandro 1784 150th\QM\1q03\1q03.doc

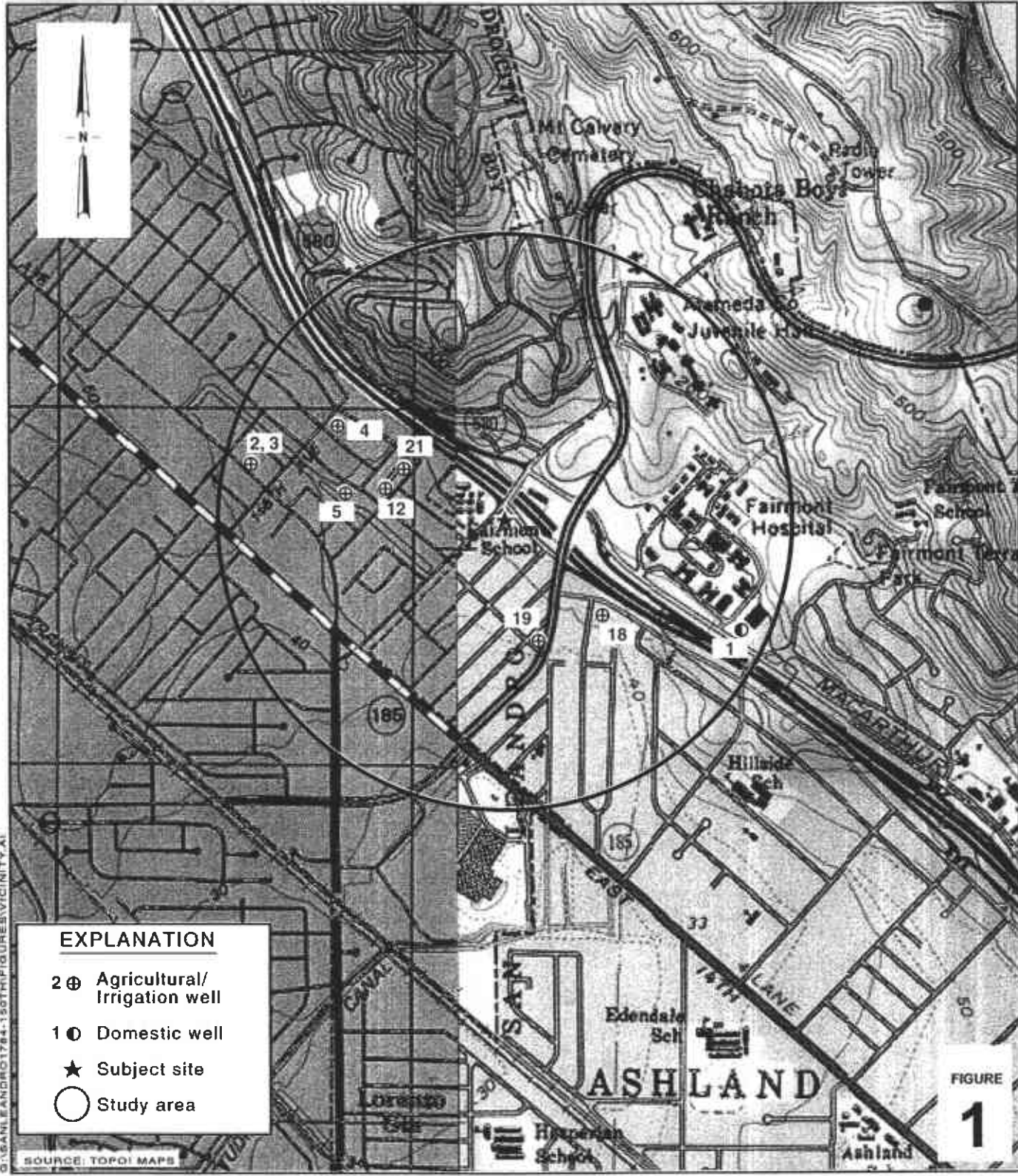

G:\SANLEANDRO\1784-150TH\FIGURE\VICINITY.A1

Shell-branded Service Station
 1784 150th Avenue
 San Leandro, California
 Incident #98996068



C A M B R I A

**Vicinity/Area Well
 Survey Map**
 1/2-Mile Radius

FIGURE
1

G:\SANLEANDRO-1784-150TH\FIGURES\10MD03.MPA1

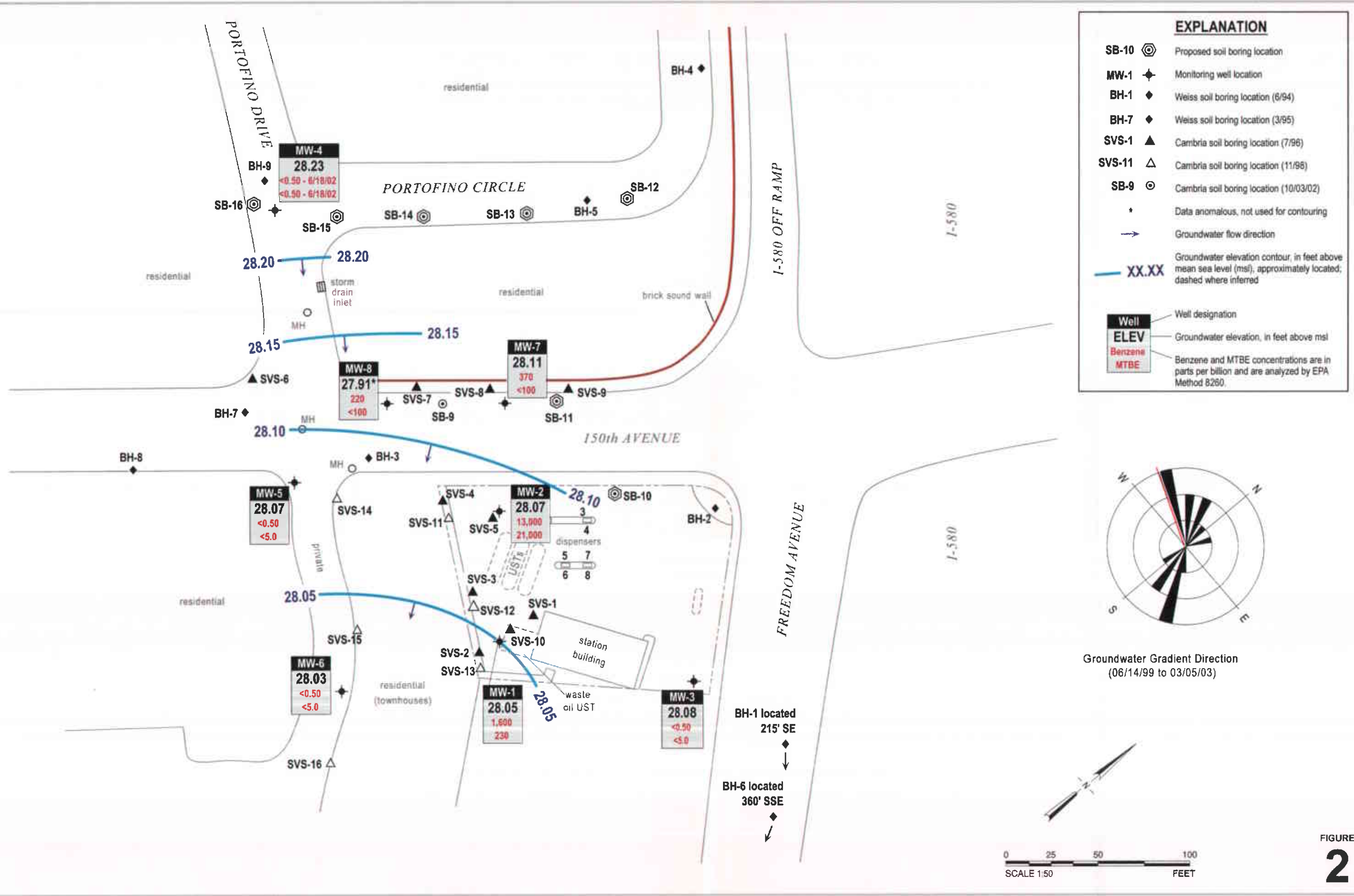

Groundwater Elevation Contour Map

March 5, 2003



CAMBRIA

Shell-branded Service Station

1784 150th Avenue
San Leandro, California
Incident #98996068

FIGURE 2

TFE VacOps Effect on MTBE Concentration
1784 150th Street, San Leandro, MW-2

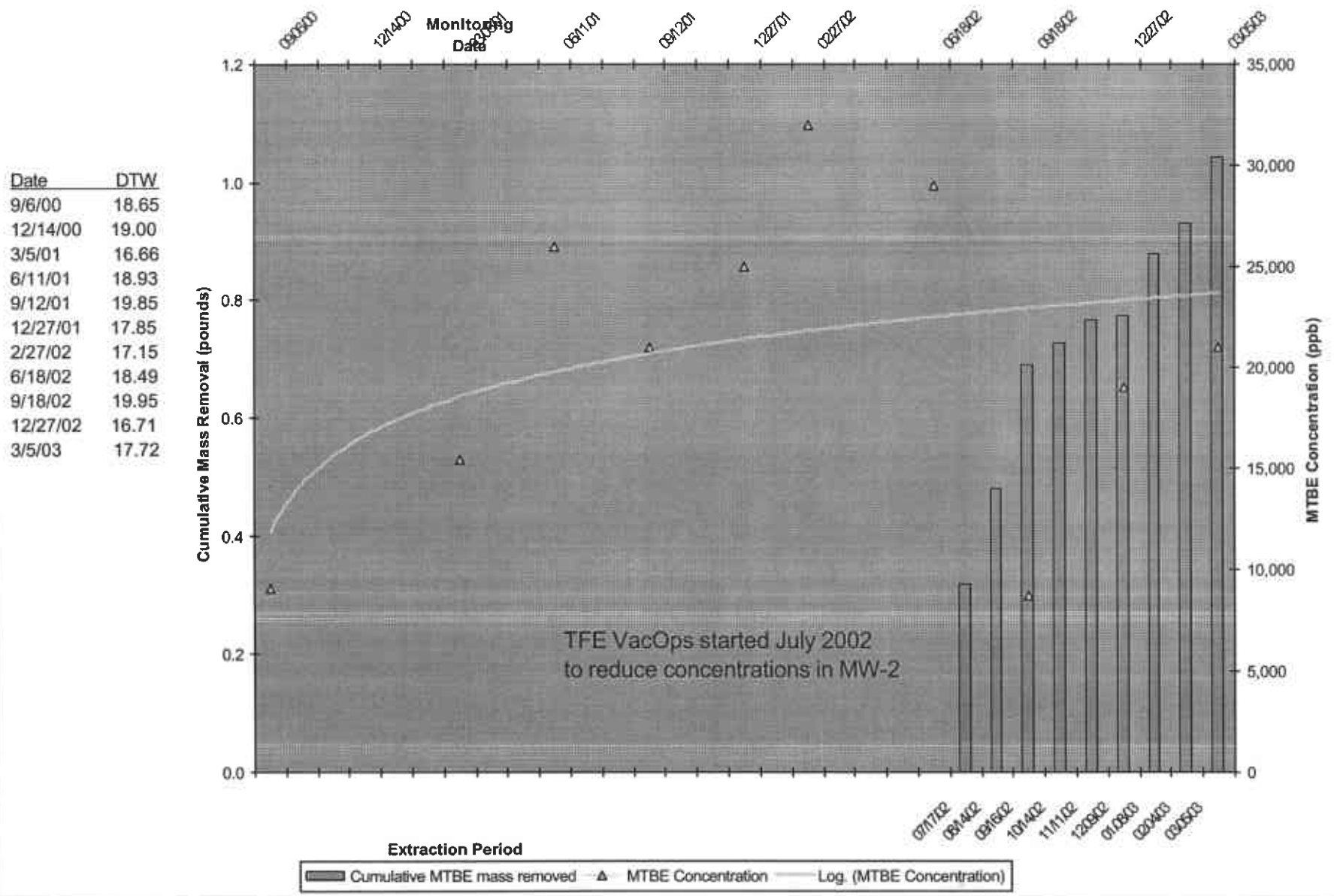

Figure 3

Table 1. Groundwater Analytical Data - Oxygenates - Shell-branded Service Station, Incident #98996068, 1784 150th Avenue, San Leandro, California

Sample ID	Date Sampled	MTBE	DIPE	ETBE	TAME	TBA	1,2-DCA	EDB
		(Concentrations in ppb)						
MW-1	12/27/02	230	<5.0	<5.0	<5.0	310	31	<5.0
	03/05/03	230	---	---	<10	290	<10	---
MW-2	12/27/02	19,000	<50	<50	55	10,000	<50	<50
	03/05/03	21,000	---	---	<50	10,000	<50	---
MW-3	03/05/03	<5.0	---	---	<2.0	<50	13	---
MW-5	12/27/02	<0.50	<2.0	<2.0	<2.0	<50	<2.0	<2.0
MW-6	12/27/02	<0.50	<2.0	<2.0	<2.0	<50	<2.0	<2.0
MW-7	12/27/02	<10	<10	<10	<10	<100	<10	<10
MW-8	12/27/02	<10	<10	<10	<10	<100	<10	<10

Abbreviations:

MTBE = Methyl tert-butyl ether, analyzed by EPA Method 8260
 DIPE = Di-isopropyl ether, analyzed by EPA Method 8260
 ETBE = Ethyl tert-butyl ether, analyzed by EPA Method 8260
 TAME = Tert-amyl methyl ether, analyzed by EPA Method 8260
 TBA = Tert-butyl alcohol, analyzed by EPA Method 8260
 1,2-DCA = 1,2-dichloroethane, analyzed by EPA Method 8260
 EDB = 1,2-dibromomethane or ethylene dibromide, analyzed by EPA Method 8260
 ppb = Parts per billion
 --- = Not analyzed

Table 2: Groundwater Extraction - Mass Removal Data - Shell-branded Service Station, Incident #98996068, 1784 150th Avenue, San Leandro, California

Date Purged	Well ID	Volume Pumped (gal)	Cumulative Volume Pumped (gal)	Date Sampled	TPPH			Benzene			MTBE		
					TPPH Concentration (ppb)	TPPH Removed (pounds)	TPPH Removed To Date (pounds)	Benzene Concentration (ppb)	Benzene Removed (pounds)	Benzene Removed To Date (pounds)	MTBE Concentration (ppb)	MTBE Removed (pounds)	MTBE Removed To Date (pounds)
07/03/02	MW-2	482	482	06/18/02	72,000	0.28958	0.28958	9,500	0.03821	0.03821	29,000	0.11664	0.11664
07/17/02	MW-2	834	1,316	06/18/02	72,000	0.50106	0.79064	9,500	0.06611	0.10432	29,000	0.20182	0.31845
07/31/02	MW-2	213	1,529	06/18/02	72,000	0.12797	0.91861	9,500	0.01688	0.12121	29,000	0.05154	0.37000
08/14/02	MW-2	664	2,193	06/18/02	72,000	0.39893	1.31754	9,500	0.05264	0.17384	29,000	0.16068	0.53068
09/16/02	MW-2	662	2,855	06/18/02	72,000	0.39773	1.71527	9,500	0.05248	0.22632	29,000	0.16019	0.69087
10/14/02	MW-2	501	3,356	09/18/02	48,000	0.20067	1.91593	7,600	0.03177	0.25809	8,700	0.03637	0.72724
11/11/02	MW-2	547	3,903	09/18/02	48,000	0.21909	2.13502	7,600	0.03469	0.29278	8,700	0.03971	0.76695
12/09/02	MW-2	106	4,009	09/18/02	48,000	0.04246	2.17748	7,600	0.00672	0.29950	8,700	0.00770	0.77465
01/08/03	MW-2	652	4,661	12/27/02	40,000	0.21762	2.39510	5,900	0.03210	0.33160	19,000	0.10337	0.87802
02/04/03	MW-2	326	4,987	12/27/02	40,000	0.10881	2.50391	5,900	0.01605	0.34765	19,000	0.05168	0.92970
03/05/03	MW-2	647	5,634	03/05/03	62,000	0.33473	2.83863	13,000	0.07018	0.41784	21,000	0.11337	1.04308
Total Gallons Extracted:							2.83863			0.41784			1.04308
					Total Pounds Removed:		0.46535			0.05724			0.16824
					Total Gallons Removed:								

Abbreviations & Notes:

TPPH = Total purgeable hydrocarbons as gasoline

MTBE = Methyl tert-butyl ether

ppb = Parts per billion

gal = Gallon

Mass removed based on the formula: volume extracted (gal) x Concentration (µg/L) x (g/10⁶µg) x (pound/453.6g) x (3.785 L/gal)

Volume removal data based on the formula: density (in gms/cc) x 9.339 (ccxlbs/gmsxgals)

TPPH, benzene, and MTBE analyzed by EPA Method 8260

If concentration is less than the laboratory detection limit, one half of the detection limit concentration is used in the mass removal calculation.

Groundwater extracted by vacuum trucks provided by Onyx. Water disposed of at a Martinez Refinery.

ATTACHMENT A
Blaine Groundwater Monitoring Report
and Field Notes

BLAINE
TECH SERVICES, INC.

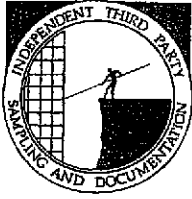

1680 ROGERS AVENUE
SAN JOSE, CA 95112-1105
(408) 573-7771 FAX
(408) 573-0555 PHONE
CONTRACTOR'S LICENSE #746684
www.blainetech.com

April 15, 2003

Karen Petryna
Shell Oil Products US
P.O. Box 7869
Burbank, CA 91510-7869

First Quarter 2003 Groundwater Monitoring at
Shell-branded Service Station
1784 150th Avenue
San Leandro, CA

Monitoring performed on March 5, 2003

Groundwater Monitoring Report **030305-RH-1**

This report covers the routine monitoring of groundwater wells at this Shell-branded facility. In accordance with standard procedures that conform to Regional Water Quality Control Board requirements, routine field data collection includes depth to water, total well depth, thickness of any separate immiscible layer, water column volume, calculated purge volume (if applicable), elapsed evacuation time (if applicable), total volume of water removed (if applicable), and standard water parameter instrument readings. Sample material is collected, contained, stored, and transported to the laboratory in conformance with EPA standards. Purgewater (if applicable) is, likewise, collected and transported to the Shell Martinez Manufacturing Complex.

Basic field information is presented alongside analytical values excerpted from the laboratory report in the cumulative table of **WELL CONCENTRATIONS**. The full analytical report for the most recent samples and the field data sheets are attached to this report.

At a minimum, Blaine Tech Services, Inc. field personnel are certified on completion of a forty-hour Hazardous Materials and Emergency Response training course per 29 CFR 1910.120. Field personnel are also enrolled in annual eight-hour refresher courses.

Blaine Tech Services, Inc. conducts sampling and documentation assignments of this type as an independent third party. Our activities at this site consisted of objective data and sample collection only. No interpretation of analytical results, defining of hydrological conditions or formulation of recommendations was performed.

Please call if you have any questions.

Yours truly,

Leon Gearhart
Project Coordinator

LG/jt

attachments: Cumulative Table of WELL CONCENTRATIONS
Certified Analytical Report
Field Data Sheet

cc: Anni Kreml
Cambria Environmental Technology, Inc.
5900 Hollis Street, Suite A
Oakland, CA 94608

WELL CONCENTRATIONS
Shell-branded Service Station
1784 150th Avenue
San Leandro, CA

Well ID	Date	TPPH (ug/L)	TEPH (ug/L)	B (ug/L)	T (ug/L)	E (ug/L)	X (ug/L)	MTBE 8020 (ug/L)	MTBE 8260 (ug/L)	TOC (MSL)	Depth to Water (ft)	GW Elevation (MSL)	SPH Thickness (ft)	DO Reading (ppm)
MW-1	03/08/1990	510	120	1.5	0.8	<0.5	5.4	NA	NA	49.13	25.29	23.84	NA	NA
MW-1	06/12/1990	390	100	86	1.3	0.7	6.2	NA	NA	49.13	25.85	23.28	NA	NA
MW-1	09/13/1990	100	130	56	0.75	2.4	2.8	NA	NA	49.13	27.49	21.64	NA	NA
MW-1	12/18/1990	480	<50	54	1.7	3.3	3.7	NA	NA	49.13	27.41	21.72	NA	NA
MW-1	03/07/1991	80	<50	266	<0.5	1.2	<1.5	NA	NA	49.13	25.79	23.34	NA	NA
MW-1	06/07/1991	510	<50	130	3.8	6.1	11	NA	NA	49.13	25.64	23.49	NA	NA
MW-1	09/17/1991	330	120a	67	<0.5	3.0	2.2	NA	NA	49.13	27.54	21.59	NA	NA
MW-1	12/09/1991	140a	80	<0.5	<0.5	1.7	4.7	NA	NA	49.13	27.81	21.32	NA	NA
MW-1	02/13/1992	NA	NA	NA	NA	NA	NA	NA	NA	49.13	25.57	23.56	NA	NA
MW-1	02/24/1992	NA	NA	NA	NA	NA	NA	NA	NA	49.13	22.83	26.30	NA	NA
MW-1	02/27/1992	NA	NA	NA	NA	NA	NA	NA	NA	49.13	23.09	26.04	NA	NA
MW-1	03/01/1992	<50	<50	<0.5	<0.5	<0.5	<0.5	NA	NA	49.13	23.26	25.87	NA	NA
MW-1	06/03/1992	1,500	NA	520	180	72	230	NA	NA	49.13	24.64	24.49	NA	NA
MW-1	09/01/1992	130	NA	16	1.4	1.8	3.4	NA	NA	49.13	26.74	22.39	NA	NA
MW-1	10/06/1992	NA	NA	NA	NA	NA	NA	NA	NA	49.13	27.18	21.95	NA	NA
MW-1	11/11/1992	NA	NA	NA	NA	NA	NA	NA	NA	49.13	27.99	21.14	NA	NA
MW-1	12/04/1992	150	NA	360	0.7	1.8	2.1	NA	NA	49.13	27.14	21.99	NA	NA
MW-1	01/22/1993	NA	NA	NA	NA	NA	NA	NA	NA	49.13	20.09	29.04	NA	NA
MW-1	02/10/1993	NA	NA	NA	NA	NA	NA	NA	NA	49.13	24.26	24.87	NA	NA
MW-1	03/03/1993	<50	NA	1.5	<0.5	<0.5	<0.5	NA	NA	49.13	20.50	28.63	NA	NA
MW-1	05/11/1993	NA	NA	NA	NA	NA	NA	NA	NA	49.13	21.70	27.43	NA	NA
MW-1	06/17/1993	1,600	NA	340	120	120	440	NA	NA	49.13	22.42	26.71	NA	NA
MW-1	09/10/1993	2,600	NA	670	340	310	730	NA	NA	49.13	24.11	25.02	NA	NA
MW-1	12/13/1993	11,000	NA	470	320	380	2,300	NA	NA	49.13	23.73	25.40	NA	NA
MW-1	03/03/1994	16,000	NA	700	690	480	3,200	NA	NA	49.13	22.08	27.05	NA	NA
MW-1	06/06/1994	7,500	NA	420	280	200	1,000	NA	NA	49.13	23.10	26.03	NA	NA
MW-1	09/12/1994	1,200	NA	110	21	3.3	420	NA	NA	49.13	25.19	23.94	NA	NA

WELL CONCENTRATIONS
Shell-branded Service Station
1784 150th Avenue
San Leandro, CA

Well ID	Date	TPPH (ug/L)	TEPH (ug/L)	B (ug/L)	T (ug/L)	E (ug/L)	X (ug/L)	MTBE 8020 (ug/L)	MTBE 8260 (ug/L)	TOC (MSL)	Depth to Water (ft)	GW Elevation (MSL)	SPH Thickness (ft)	DO Reading (ppm)
MW-1	12/19/1994	4,600	NA	470	330	230	1,300	NA	NA	49.13	23.06	26.07	NA	NA
MW-1	02/28/1995	500	NA	59	32	6.8	68	NA	NA	49.13	20.90	28.23	NA	NA
MW-1	03/24/1995	NA	NA	NA	NA	NA	NA	NA	NA	49.13	18.28	30.85	NA	NA
MW-1	06/26/1995	5,500	NA	740	420	300	1,800	NA	NA	49.13	20.40	28.73	NA	NA
MW-1	09/13/1995	84,000	NA	1,900	2,600	3,000	14,000	NA	NA	49.13	22.62	26.51	NA	NA
MW-1	12/19/1995	80,000	NA	660	350	170	18,000	NA	NA	49.13	22.10	27.03	NA	NA
MW-1	03/07/1996	NA	NA	NA	NA	NA	NA	NA	NA	49.13	18.83	30.34	0.05	NA
MW-1	06/28/1996	270,000	NA	2,800	820	1,000	16,000	<0.5	NA	49.13	21.46	27.67	NA	NA
MW-1 (D)	06/28/1996	790,000	NA	2,200	780	1,000	13,000	15,000	NA	49.13	21.46	27.67	NA	NA
MW-1	09/26/1996	29,000	NA	1,100	260	270	1,900	<1,000	NA	49.13	23.57	25.57	0.01	NA
MW-1	09/26/1996	25,000	NA	1,200	320	240	1,900	<1,000	NA	49.13	NA	NA	NA	NA
MW-1	12/10/1996	13,000	NA	510	240	230	1,200	100	NA	49.13	21.43	27.70	NA	1.0
MW-1 (D)	12/10/1996	8,400	NA	420	130	140	680	81	NA	49.13	21.43	27.70	NA	1.0
MW-1	03/10/1997	4,200	NA	13	8.8	16	74	<12	NA	49.13	20.08	29.05	NA	2.0
MW-1 (D)	03/10/1997	5,100	NA	12	8.9	17	79	<25	NA	49.13	20.08	29.05	NA	2.0
MW-1	06/30/1997	5,700	NA	320	120	140	700	47	NA	49.13	21.68	27.45	NA	1.6
MW-1 (D)	06/30/1997	5,300	NA	300	95	120	580	45	NA	49.13	21.68	27.45	NA	1.6
MW-1	09/12/1997	6,300	NA	120	26	82	260	30	NA	49.13	21.78	27.35	NA	2.1
MW-1 b	12/18/1997	NA	NA	NA	NA	NA	NA	NA	NA	49.13	20.78	28.35	NA	1.3
MW-1	02/02/1998	84	NA	5.1	<0.50	<0.50	2.1	2.5	NA	49.13	19.65	29.48	NA	2.0
MW-1	06/24/1998	13,000	NA	3,000	260	410	1,400	<250	NA	49.13	19.65	29.48	NA	2.5
MW-1 (D)	06/24/1998	12,000	NA	3,800	250	47	1,400	710	NA	49.13	19.65	29.48	NA	2.5
MW-1	08/26/1998	3,100	NA	1,200	27	170	50	88	NA	49.13	20.49	28.64	NA	2.1
MW-1	12/23/1998	45,000	NA	5,300	220	1,000	3,600	970	NA	49.13	21.22	27.91	NA	3.8
MW-1	03/01/1999	22,300	NA	2,540	436	753	3,370	<400	NA	49.13	19.27	29.86	NA	1.8
MW-1	06/14/1999	18,800	NA	6,820	210	436	958	1,360	NA	49.13	20.80	28.33	NA	2.2
MW-1	09/28/1999	21,500	NA	7,470	281	467	927	1,800	NA	49.13	22.55	26.58	NA	2.0

WELL CONCENTRATIONS
Shell-branded Service Station
1784 150th Avenue
San Leandro, CA

Well ID	Date	TPPH (ug/L)	TEPH (ug/L)	B (ug/L)	T (ug/L)	E (ug/L)	X (ug/L)	MTBE 8020 (ug/L)	MTBE 8260 (ug/L)	TOC (MSL)	Depth to Water (ft)	GW Elevation (MSL)	SPH Thickness (ft)	DO Reading (ppm)
---------	------	----------------	----------------	-------------	-------------	-------------	-------------	------------------------	------------------------	--------------	---------------------------	--------------------------	--------------------------	------------------------

MW-1	12/08/1999	22,300	NA	6,140	135	256	367	232	NA	49.13	23.12	26.01	NA	2.1
MW-1	03/14/2000	6,690	NA	1,880	63.5	134	307	460	NA	49.13	18.87	30.26	NA	2.3
MW-1	06/28/2000	8,080	NA	2,690	85.1	149	514	701	NA	49.13	21.12	28.01	NA	2.4
MW-1	09/06/2000	17,800	NA	7,390	212	329	1,270	<1,000	NA	49.13	21.90	27.23	NA	3.0
MW-1	12/14/2000	8,900	NA	4,870	79.2	106	370	1,840	673*	49.13	22.60	26.53	NA	2.0
MW-1	03/05/2001	7,520	NA	2,120	66.0	107	129	668	NA	49.13	20.06	29.07	NA	0.4
MW-1	06/11/2001	30,000	NA	7,400	390	600	2,300	NA	170	49.13	22.39	26.74	NA	1.6
MW-1	09/12/2001	23,000	NA	7,500	120	280	910	NA	320	49.13	23.37	25.76	NA	2.2
MW-1	12/27/2001	16,000	NA	2,400	190	330	1,500	NA	350	49.13	20.97	28.16	NA	1.3
MW-1	02/27/2002	26,000	NA	6,100	330	510	2,000	NA	210	49.10	20.47	28.63	NA	1.3
MW-1	06/18/2002	29,000	NA	8,100	280	510	1,800	NA	140	49.10	21.99	27.11	NA	2.2
MW-1	09/18/2002	34,000	NA	5,900	350	700	3,000	NA	<250	49.10	23.21	25.89	NA	0.8
MW-1	12/27/2002	7,500	NA	1,200	30	120	410	NA	230	49.10	20.10	29.00	NA	0.6
MW-1	03/05/2003	17,000	NA	1,600	88	400	1,400	NA	230	49.10	21.05	28.05	NA	1.7

MW-2	02/13/1992	NA	NA	NA	NA	NA	NA	NA	NA	45.83	22.22	23.61	NA	NA
MW-2	02/24/1992	17,000	2,700a	6,200	1,600	550	1,900	NA	NA	45.83	19.61	26.22	NA	NA
MW-2	02/27/1992	NA	NA	NA	NA	NA	NA	NA	NA	45.83	19.92	25.91	NA	NA
MW-2	03/01/1992	86,000	1,000a	30,000	34,000	2,300	16,000	NA	NA	45.83	21.11	24.72	NA	NA
MW-2	06/03/1992	87,000	NA	28,000	18,000	2,000	10,000	NA	NA	45.83	21.58	24.25	NA	NA
MW-2	09/01/1992	110,000	NA	21,000	13,000	1,900	7,800	NA	NA	45.83	23.46	22.37	NA	NA
MW-2	10/06/1992	NA	NA	NA	NA	NA	NA	NA	NA	45.83	23.99	21.84	NA	NA
MW-2	11/11/1992	NA	NA	NA	NA	NA	NA	NA	NA	45.83	24.25	21.58	NA	NA
MW-2	12/04/1992	42,000	NA	15,000	2,400	960	2,900	NA	NA	45.83	23.89	21.94	NA	NA
MW-2	01/22/1993	NA	NA	NA	NA	NA	NA	NA	NA	45.83	17.03	28.80	NA	NA
MW-2	02/10/1993	NA	NA	NA	NA	NA	NA	NA	NA	45.83	18.08	27.75	NA	NA
MW-2	03/03/1993	160,000	NA	36,000	3,800	32,000	21,000	NA	NA	45.83	17.28	28.55	NA	NA

WELL CONCENTRATIONS
Shell-branded Service Station
1784 150th Avenue
San Leandro, CA

Well ID	Date	TPPH (ug/L)	TEPH (ug/L)	B (ug/L)	T (ug/L)	E (ug/L)	X (ug/L)	MTBE 8020 (ug/L)	MTBE 8260 (ug/L)	TOC (MSL)	Depth to Water (ft.)	GW Elevation (MSL)	SPH Thickness (ft)	DO Reading (ppm)
MW-2 (D)	03/03/1993	150,000	NA	31,000	3,100	20,000	14,000	NA	NA	45.83	17.28	28.55	NA	NA
MW-2	05/11/1993	NA	NA	NA	NA	NA	NA	NA	NA	45.83	18.41	27.42	NA	NA
MW-2	06/17/1993	65,000	NA	34,000	15,000	3,200	11,000	NA	NA	45.83	19.06	26.77	NA	NA
MW-2 (D)	06/17/1993	62,000	NA	28,000	14,000	2,700	10,000	NA	NA	45.83	19.06	26.77	NA	NA
MW-2	09/10/1993	72,000	NA	24,000	16,000	2,300	11,000	NA	NA	45.83	20.88	24.95	NA	NA
MW-2 (D)	09/10/1993	71,000	NA	23,000	15,000	2,300	10,000	NA	NA	45.83	20.88	24.95	NA	NA
MW-2	12/13/1993	19,000	NA	5,400	4,900	680	3,100	NA	NA	45.83	20.42	25.41	NA	NA
MW-2 (D)	12/13/1993	17,000	NA	6,200	5,500	720	3,500	NA	NA	45.83	20.42	25.41	NA	NA
MW-2	03/03/1994	110,000	NA	21,000	24,000	2,000	13,000	NA	NA	45.83	18.48	27.35	NA	NA
MW-2 (D)	03/03/1994	93,000	NA	19,000	22,000	1,800	12,000	NA	NA	45.83	18.48	27.35	NA	NA
MW-2	06/06/1994	10,000	NA	1,900	3,300	2,500	13,000	NA	NA	45.83	20.26	25.57	NA	NA
MW-2 (D)	06/06/1994	99,000	NA	9,900	12,000	2,400	12,000	NA	NA	45.83	20.26	25.57	NA	NA
MW-2	09/12/1994	160,000	NA	22,000	33,000	3,400	23,000	NA	NA	45.83	21.80	24.03	NA	NA
MW-2 (D)	09/12/1994	150,000	NA	23,000	34,000	3,500	23,000	NA	NA	45.83	21.80	24.03	NA	NA
MW-2	12/19/1994	80,000	NA	17,000	16,000	2,300	14,000	NA	NA	45.83	19.66	26.17	NA	NA
MW-2 (D)	12/19/1994	100,000	NA	28,000	26,000	3,400	20,000	NA	NA	45.83	19.66	26.17	NA	NA
MW-2	02/28/1995	100,000	NA	24,000	18,000	2,300	17,000	NA	NA	45.83	17.51	28.32	NA	NA
MW-2 (D)	02/28/1995	100,000	NA	31,000	21,000	3,200	18,000	NA	NA	45.83	17.51	28.32	NA	NA
MW-2	03/24/1995	NA	NA	NA	NA	NA	NA	NA	NA	45.83	14.88	30.95	NA	NA
MW-2	06/26/1995	45,000	NA	14,000	12,000	1,500	7,500	NA	NA	45.83	17.58	28.25	NA	NA
MW-2 (D)	06/26/1995	68,000	NA	13,000	11,000	1,800	7,700	NA	NA	45.83	17.58	28.25	NA	NA
MW-2	09/13/1995	110,000	NA	19,000	19,000	2,800	15,000	NA	NA	45.83	19.28	26.55	NA	NA
MW-2 (D)	09/13/1995	120,000	NA	20,000	20,000	2,900	15,000	NA	NA	45.83	19.28	26.55	NA	NA
MW-2	12/19/1995	180,000	NA	18,000	29,000	4,100	24,000	NA	NA	45.83	18.61	27.22	NA	NA
MW-2 (D)	12/19/1995	160,000	NA	18,000	28,000	3,800	24,000	NA	NA	45.83	18.61	27.22	NA	NA
MW-2	03/06/1996	120,000	NA	28,000	15,000	3,900	17,000	NA	NA	45.83	15.41	30.42	NA	NA
MW-2	06/28/1996	96,000	NA	20,000	20,000	4,100	22,000	2,400	NA	45.83	17.84	27.99	NA	NA

WELL CONCENTRATIONS
Shell-branded Service Station
1784 150th Avenue
San Leandro, CA

Well ID	Date	TPPH (ug/L)	TEPH (ug/L)	B (ug/L)	T (ug/L)	E (ug/L)	X (ug/L)	MTBE 8020 (ug/L)	MTBE 8260 (ug/L)	TOC (MSL)	Depth to Water (ft)	GW Elevation (MSL)	SPH Thickness (ft)	DO Reading (ppm)
MW-2	09/26/1996	87,000	NA	7,600	11,000	2,500	15,000	990	840	45.83	19.60	26.23	NA	NA
MW-2	12/10/1996	NA	NA	NA	NA	NA	NA	NA	NA	45.83	18.15	27.88	0.25	NA
MW-2	03/10/1997	NA	NA	NA	NA	NA	NA	NA	NA	45.83	17.02	28.97	0.20	NA
MW-2	06/30/1997	57,000	NA	3,600	4,600	1,300	9,700	2,300	NA	45.83	19.42	26.41	NA	2.4
MW-2	09/12/1997	88,000	NA	7,800	8,800	2,600	16,000	3,200	NA	45.83	19.40	26.43	NA	1.7
MW-2 (D)	09/12/1997	90,000	NA	8,300	9,400	2,700	17,000	3,400	NA	45.83	19.40	26.43	NA	1.7
MW-2 b	12/18/1997	NA	NA	NA	NA	NA	NA	NA	NA	45.83	17.56	28.27	NA	1.3
MW-2	02/02/1998	<50	NA	0.6	1.9	0.93	6.0	9.3	NA	45.83	18.14	27.69	NA	2
MW-2 (D)	02/02/1998	56	NA	1.0	2.8	1.4	9.3	13	NA	45.83	18.14	27.69	NA	2
MW-2	06/24/1998	20,000	NA	<200	620	560	4,500	<1,000	NA	45.83	16.08	29.75	NA	2.4
MW-2	08/26/1998	22,000	NA	380	1,100	560	4,400	330	NA	45.83	19.25	26.58	NA	NA
MW-2 (D)	08/26/1998	11,000	NA	180	130	290	500	1,400	NA	45.83	19.25	26.58	NA	NA
MW-2	12/23/1998	100,000	NA	4,100	6,500	2,400	16,000	<500	NA	45.83	18.29	27.54	NA	3.8
MW-2	03/01/1999	50,800	NA	3,910	7,480	1,890	13,100	9,620	NA	45.83	22.81	23.02	NA	2.0
MW-2	06/14/1999	4,930	NA	128	270	139	1,040	2,200	2,540*	45.83	18.86	26.97	NA	1.6
MW-2	09/28/1999	16,200	NA	647	1,070	542	4,130	5,320	4,790	45.83	21.41	24.42	NA	1.8
MW-2	12/08/1999	25,700	NA	1,670	2,110	977	6,600	6,190	5,970	45.83	21.89	23.94	NA	1.8
MW-2	03/14/2000	45,100	NA	2,070	4,710	1,920	12,800	16,700	18,300*	45.83	15.57	30.26	NA	2.0
MW-2	06/28/2000	52,100	NA	5,150	4,200	1,880	13,300	15,500	13,500*	45.83	17.79	28.04	NA	1.9
MW-2	09/06/2000	39,500	NA	4,490	3,290	2,100	14,000	18,500	9,060*	45.83	18.65	27.18	NA	3.5
MW-2	12/14/2000	209	NA	3.51	1.11	1.00	64.4	79.4	NA	45.83	19.00	26.83	NA	1.5
MW-2	03/05/2001	38,200	NA	2,010	927	1,250	8,300	13,100	15,400	45.83	16.66	29.17	NA	1.0
MW-2	06/11/2001	50,000	NA	4,400	2,200	1,800	11,000	NA	26,000	45.83	18.93	26.90	NA	1.7
MW-2	09/12/2001	59,000	NA	6,100	2,800	2,300	14,000	NA	21,000	45.83	19.85	25.98	NA	1.6
MW-2	12/27/2001	74,000	NA	8,600	2,500	2,500	17,000	NA	25,000	45.83	17.85	27.98	NA	2.6
MW-2	02/27/2002	70,000	NA	8,100	2,600	2,100	13,000	NA	32,000	45.79	17.15	28.64	NA	2.0
MW-2	06/18/2002	72,000	NA	9,500	3,000	2,200	13,000	NA	29,000	45.79	18.49	27.30	NA	0.6

WELL CONCENTRATIONS
Shell-branded Service Station
1784 150th Avenue
San Leandro, CA

Well ID	Date	TPPH (ug/L)	TEPH (ug/L)	B (ug/L)	T (ug/L)	E (ug/L)	X (ug/L)	MTBE 8020 (ug/L)	MTBE 8260 (ug/L)	TOC (MSL)	Depth to Water (ft)	GW Elevation (MSL)	SPH Thickness (ft)	DO Reading (ppm)
MW-2	09/18/2002	48,000	NA	7,600	850	1,300	6,300	NA	8,700	45.79	19.95	25.84	NA	1.0
MW-2	12/27/2002	40,000	NA	5,900	1,200	1,400	7,800	NA	19,000	45.79	16.71	29.08	NA	1.0
MW-2	03/05/2003	62,000	NA	13,000	1,400	2,000	7,900	NA	21,000	45.79	17.72	28.07	NA	1.4
MW-3	02/13/1992	NA	NA	NA	NA	NA	NA	NA	NA	51.97	27.97	24.00	NA	NA
MW-3	02/24/1992	4,500	1,300a	97	<5	78	18	NA	NA	51.97	25.60	26.37	NA	NA
MW-3	02/27/1992	NA	NA	NA	NA	NA	NA	NA	NA	51.97	25.88	26.09	NA	NA
MW-3	03/01/1992	2,200	440	69	<0.5	<0.5	<0.5	NA	NA	51.97	26.00	25.97	NA	NA
MW-3	06/03/1992	4,100	NA	13	72	44	65	NA	NA	51.97	27.70	24.27	NA	NA
MW-3	09/01/1992	1,900	NA	20	6.8	5.5	<5	NA	NA	51.97	29.46	22.51	NA	NA
MW-3 (D)	09/01/1992	1,900	NA	21	6.6	3.4	<5	NA	NA	51.97	29.46	22.51	NA	NA
MW-3	10/06/1992	NA	NA	NA	NA	NA	NA	NA	NA	51.97	30.01	21.96	NA	NA
MW-3	11/11/1992	NA	NA	NA	NA	NA	NA	NA	NA	51.97	30.26	21.71	NA	NA
MW-3	12/04/1992	2,400	NA	8.2	<5	<5	<5	NA	NA	51.97	29.93	22.04	NA	NA
MW-3 (D)	12/04/1992	2,100	NA	11	<0.5	5.7	<0.5	NA	NA	51.97	29.93	22.04	NA	NA
MW-3	01/22/1993	NA	NA	NA	NA	NA	NA	NA	NA	51.97	22.76	29.21	NA	NA
MW-3	02/10/1993	NA	NA	NA	NA	NA	NA	NA	NA	51.97	21.40	30.57	NA	NA
MW-3	03/03/1993	5,100	NA	63	61	75	150	NA	NA	51.97	23.08	28.89	NA	NA
MW-3	05/11/1993	NA	NA	NA	NA	NA	NA	NA	NA	51.97	24.51	27.46	NA	NA
MW-3	06/17/1993	4,000	NA	94	140	82	150	NA	NA	51.97	25.21	26.76	NA	NA
MW-3	09/10/1993	3,200	NA	140	12.5	12.5	12.5	NA	NA	51.97	26.95	25.02	NA	NA
MW-3	12/13/1993	6,200	NA	<12.5	<12.5	<12.5	<12.5	NA	NA	51.97	26.52	25.45	NA	NA
MW-3	03/03/1994	4,500	NA	73	<5	<5	<5	NA	NA	51.97	24.50	27.47	NA	NA
MW-3	06/06/1994	3,200	NA	<0.5	<0.5	3.1	<0.5	NA	NA	51.97	26.33	25.64	NA	NA
MW-3	09/12/1994	3,900	NA	<0.5	<0.5	9.6	4.1	NA	NA	51.97	27.98	23.99	NA	NA
MW-3	12/19/1994	2,400	NA	21	22	4.2	2.6	NA	NA	51.97	25.63	26.34	NA	NA
MW-3	02/28/1995	4,000	NA	58	<0.5	7.1	3.5	NA	NA	51.97	23.45	28.52	NA	NA

WELL CONCENTRATIONS
Shell-branded Service Station
1784 150th Avenue
San Leandro, CA

Well ID	Date	TPPH (ug/L)	TEPH (ug/L)	B (ug/L)	T (ug/L)	E (ug/L)	X (ug/L)	MTBE 8020 (ug/L)	MTBE 8260 (ug/L)	TOC (MSL)	Depth to Water (ft)	GW Elevation (MSL)	SPH Thickness (ft)	DO Reading (ppm)
MW-3	03/24/1995	NA	NA	NA	NA	NA	NA	NA	NA	51.97	21.07	30.90	NA	NA
MW-3	06/26/1995	3,900	NA	8.1	<0.5	12	2.4	NA	NA	51.97	23.64	28.33	NA	NA
MW-3	09/13/1995	4,100	NA	58	5.5	5.5	<0.5	NA	NA	51.97	25.40	26.57	NA	NA
MW-3	12/19/1995	3,600	NA	<0.5	4.3	2.1	1.1	NA	NA	51.97	24.53	27.44	NA	NA
MW-3	03/07/1996	NA	NA	NA	NA	NA	NA	NA	NA	51.97	21.59	30.41	0.04	NA
MW-3	06/28/1996	2,400	NA	55	<0.5	<0.5	11	120	NA	51.97	23.95	28.02	NA	NA
MW-3	09/26/1996	2,500	NA	<5.0	<5.0	<5.0	<5.0	160	NA	51.97	25.89	26.08	NA	NA
MW-3	12/10/1996	1,600	NA	28	4.2	<2.0	3.9	110	NA	51.97	24.22	27.75	NA	0.8
MW-3	03/10/1997	130	NA	<0.50	<0.50	<0.50	1.4	4.2	NA	51.97	23.05	28.92	NA	2.8
MW-3	06/30/1997	1,200	NA	21	2.3	<2.0	<2.0	69	NA	51.97	24.34	27.63	NA	2.3
MW-3	09/12/1997	440	NA	8.3	0.82	<0.50	1.9	3.4	NA	51.97	24.47	27.50	NA	1.9
MW-3 b	12/18/1997	NA	NA	NA	NA	NA	NA	NA	NA	51.97	23.54	28.43	NA	0.8
MW-3	02/02/1998	400	NA	9.3	0.68	<0.50	<0.50	9	NA	51.97	21.92	30.05	NA	1.5
MW-3	06/24/1998	<50	NA	<0.50	<0.50	<0.50	<0.50	<2.5	NA	51.97	22.35	29.62	NA	1.9
MW-3	08/26/1998	140	NA	7.4	<0.50	<0.50	2.5	13	NA	51.97	23.45	28.52	NA	1.3
MW-3	12/23/1998	1,200	NA	50	<2.0	<2.0	<2.0	69	NA	51.97	24.01	27.96	NA	4.2
MW-3	03/01/1999	2,550	NA	<0.500	<0.500	<0.500	0.658	32.4	NA	51.97	22.08	29.89	NA	2.0
MW-3	06/14/1999	514	NA	18.1	0.728	<0.500	<0.500	15.9	NA	51.97	23.15	28.82	NA	1.7
MW-3	09/28/1999	1,180	NA	<1.00	<1.00	<1.00	<1.00	<10.0	NA	51.97	25.36	26.61	NA	1.2
MW-3	12/08/1999	1,740	NA	71.5	23.0	24.2	61.3	103	NA	51.97	25.75	26.22	NA	2.0
MW-3	03/14/2000	1,410	NA	5.63	35.6	<5.00	8.41	38.7	NA	51.97	21.64	30.33	NA	2.1
MW-3	06/28/2000	2,460	NA	<5.00	9.48	<5.00	28.4	64.0	NA	51.97	23.84	28.13	NA	2.87
MW-3	09/06/2000	887	NA	<1.00	<1.00	<1.00	<1.00	<10.0	NA	51.97	24.73	27.24	NA	2.0
MW-3	12/14/2000	955	NA	25.4	1.96	<0.500	1.13	10.2	NA	51.97	25.45	26.52	NA	2.1
MW-3	03/05/2001	2,100	NA	4.90	56.5	<2.00	3.62	261	NA	51.97	22.83	29.14	NA	0.8
MW-3	06/11/2001	2,000	NA	1.0	<0.50	<0.50	<0.50	NA	<0.50	51.97	25.20	26.77	NA	0.7
MW-3	09/12/2001	1,500	NA	0.50	0.54	<0.50	1.8	NA	<5.0	51.97	26.15	25.82	NA	1.5

WELL CONCENTRATIONS
Shell-branded Service Station
1784 150th Avenue
San Leandro, CA

Well ID	Date	TPPH (ug/L)	TEPH (ug/L)	B (ug/L)	T (ug/L)	E (ug/L)	X (ug/L)	MTBE 8020 (ug/L)	MTBE 8260 (ug/L)	TOC (MSL)	Depth to Water (ft)	GW Elevation (MSL)	SPH Thickness (ft)	DO Reading (ppm)
MW-3	12/27/2001	2,100	NA	<0.50	<0.50	<0.50	<0.50	NA	<5.0	51.97	23.67	28.30	NA	1.9
MW-3	02/27/2002	2,300	NA	<0.50	<0.50	<0.50	<0.50	NA	<5.0	51.92	23.23	28.69	NA	1.5
MW-3	06/18/2002	2,000	NA	<0.50	<0.50	<0.50	<0.50	NA	<0.50	51.92	24.74	27.18	NA	2.0
MW-3	09/18/2002	2,600	NA	<0.50	<0.50	<0.50	<0.50	NA	<5.0	51.92	26.05	25.87	NA	1.4
MW-3	12/27/2002	Well inaccessible		NA	NA	NA	NA	NA	NA	51.92	NA	NA	NA	NA
MW-3	03/05/2003	2,300	NA	<0.50	<0.50	<0.50	<0.50	NA	<5.0	51.92	23.84	28.08	NA	1.3
MW-4	03/24/1995	<50	NA	<0.5	<0.5	<0.5	<0.5	NA	NA	40.51	9.16	31.35	NA	NA
MW-4	06/26/1995	<50	NA	<0.5	<0.5	<0.5	<0.5	NA	NA	40.51	12.06	28.45	NA	NA
MW-4	09/13/1995	<50	NA	<0.5	<0.5	<0.5	<0.5	NA	NA	40.51	13.90	26.61	NA	NA
MW-4	12/19/1995	<50	NA	<0.5	<0.5	<0.5	<0.5	NA	NA	40.51	12.90	27.61	NA	NA
MW-4	03/06/1996	<50	NA	<0.5	<0.5	<0.5	<0.5	NA	NA	40.51	9.63	30.88	NA	NA
MW-4	06/28/1996	40	NA	<0.5	0.59	0.97	3.8	26	NA	40.51	12.30	28.21	NA	NA
MW-4	09/26/1996	<50	NA	<0.5	<0.5	<0.5	<0.5	<2.5	NA	40.51	14.12	26.39	NA	NA
MW-4	12/10/1996	<50	NA	<0.5	<0.5	<0.5	<0.5	<2.5	NA	40.51	12.31	28.20	NA	1.2
MW-4	03/10/1997	<50	NA	<0.50	<0.50	<0.50	<0.50	<2.5	NA	40.51	11.34	29.17	NA	NA
MW-4	06/30/1997	<50	NA	<0.50	<0.50	<0.50	<0.50	<2.5	NA	40.51	13.80	26.71	NA	1.9
MW-4	09/12/1997	<50	NA	<0.50	<0.50	<0.50	<0.50	<2.5	NA	40.51	13.99	26.52	NA	1.7
MW-4 b	12/18/1997	NA	NA	NA	NA	NA	NA	NA	NA	40.51	12.02	28.49	NA	1.8
MW-4	02/02/1998	<50	NA	<0.50	<0.50	<0.50	<0.50	<2.5	NA	40.51	11.23	29.28	NA	1
MW-4	06/24/1998	<50	NA	<0.50	<0.50	<0.50	<0.50	<2.5	NA	40.51	10.58	29.93	NA	1.9
MW-4	08/26/1998	<50	NA	<0.50	<0.50	<0.50	<0.50	<2.5	NA	40.51	11.75	28.76	NA	1.2
MW-4	12/23/1998	<50	NA	0.60	<0.50	<0.50	<0.50	<2.5	NA	40.51	12.41	28.10	NA	4.2
MW-4	03/01/1999	<50.0	NA	<0.500	<0.500	<0.500	<0.500	<2.00	NA	40.51	10.38	30.13	NA	2.1
MW-4	06/14/1999	<50.0	NA	<0.500	<0.500	<0.500	<0.500	<2.50	NA	40.51	11.91	28.60	NA	2.4
MW-4	09/28/1999	<50.0	NA	<0.500	<0.500	<0.500	<0.500	<5.00	NA	40.51	10.19	30.32	NA	2.2
MW-4	12/08/1999	<50.0	NA	<0.500	<0.500	<0.500	<0.500	<2.50	NA	40.51	10.67	29.84	NA	1.8

WELL CONCENTRATIONS
Shell-branded Service Station
1784 150th Avenue
San Leandro, CA

Well ID	Date	TPPH (ug/L)	TEPH (ug/L)	B (ug/L)	T (ug/L)	E (ug/L)	X (ug/L)	MTBE 8020 (ug/L)	MTBE 8260 (ug/L)	TOC (MSL)	Depth to Water (ft)	GW Elevation (MSL)	SPH Thickness (ft)	DO Reading (ppm)
MW-4	03/14/2000	<50.0	NA	<0.500	<0.500	<0.500	<0.500	<2.50	NA	40.51	9.95	30.56	NA	2.5
MW-4	06/28/2000	<50.0	NA	<0.500	<0.500	<0.500	<0.500	<2.50	NA	40.51	12.22	28.29	NA	0.9
MW-4	09/06/2000	NA	NA	NA	NA	NA	NA	NA	NA	40.51	13.17	27.34	NA	3.0
MW-4	12/14/2000	NA	NA	NA	NA	NA	NA	NA	NA	40.51	8.65	31.86	NA	NA
MW-4	03/05/2001	NA	NA	NA	NA	NA	NA	NA	NA	40.51	11.07	29.44	NA	NA
MW-4	06/11/2001	<50	NA	<0.50	<0.50	<0.50	<0.50	NA	<0.50	40.51	13.62	26.89	NA	1.3
MW-4	09/12/2001	NA	NA	NA	NA	NA	NA	NA	NA	40.51	14.61	25.90	NA	NA
MW-4	12/27/2001	NA	NA	NA	NA	NA	NA	NA	NA	40.51	12.19	28.32	NA	NA
MW-4	02/27/2002	NA	NA	NA	NA	NA	NA	NA	NA	40.45	11.64	28.81	NA	NA
MW-4	06/18/2002	<50	NA	<0.50	<0.50	<0.50	<0.50	NA	<0.50	40.45	13.22	27.23	NA	0.6
MW-4	09/18/2002	NA	NA	NA	NA	NA	NA	NA	NA	40.45	14.46	25.99	NA	NA
MW-4	12/27/2002	NA	NA	NA	NA	NA	NA	NA	NA	40.45	11.23	29.22	NA	NA
MW-4	03/05/2003	NA	NA	NA	NA	NA	NA	NA	NA	40.45	12.22	28.23	NA	NA
MW-5	01/29/2002	NA	NA	NA	NA	NA	NA	NA	NA	41.46	12.82	28.64	NA	NA
MW-5	02/27/2002	190	NA	<0.50	<0.50	0.85	1.5	NA	<5.0	41.46	12.85	28.61	NA	1.9
MW-5	06/18/2002	650	NA	1.4	3.0	52	28	NA	<0.50	41.46	13.65	27.81	NA	0.8
MW-5	09/18/2002	390	NA	0.72	0.51	<0.50	<0.50	NA	<5.0	41.46	15.57	25.89	NA	1.1
MW-5	12/27/2002	380	NA	<0.50	<0.50	0.56	<0.50	NA	<0.50	41.46	12.51	28.95	NA	1.9
MW-5	03/05/2003	290	NA	<0.50	1.7	9.4	22	NA	<5.0	41.46	13.39	28.07	NA	2.6
MW-6	01/29/2002	NA	NA	NA	NA	NA	NA	NA	NA	41.50	3.88	37.62	NA	NA
MW-6	01/31/2002	NA	NA	NA	NA	NA	NA	NA	NA	41.50	12.43	29.07	NA	NA
MW-6	02/27/2002	<50	NA	<0.50	<0.50	<0.50	<0.50	NA	<5.0	41.50	12.82	28.68	NA	4.1
MW-6	06/18/2002	<50	NA	<0.50	<0.50	<0.50	<0.50	NA	<0.50	41.50	4.26	37.24	NA	3.9
MW-6	09/18/2002	<50	NA	<0.50	<0.50	<0.50	<0.50	NA	<5.0	41.50	5.26	36.24	NA	4.2
MW-6	12/27/2002	<50	NA	<0.50	<0.50	<0.50	<0.50	NA	<0.50	41.50	12.11	29.39	NA	3.0

WELL CONCENTRATIONS
Shell-branded Service Station
1784 150th Avenue
San Leandro, CA

Well ID	Date	TPPH (ug/L)	TEPH (ug/L)	B (ug/L)	T (ug/L)	E (ug/L)	X (ug/L)	MTBE 8020 (ug/L)	MTBE 8260 (ug/L)	TOC (MSL)	Depth to Water (ft)	GW Elevation (MSL)	SPH Thickness (ft)	DO Reading (ppm)
MW-6	03/05/2003	<50	NA	<0.50	<0.50	<0.50	<0.50	NA	<5.0	41.50	13.47	28.03	NA	4.9
MW-7	10/21/2002	NA	NA	NA	NA	NA	NA	NA	NA	44.45	18.90	25.55	NA	NA
MW-7	12/27/2002	49,000	NA	830	980	2,000	5,200	NA	<10	44.45	15.43	29.02	NA	2.1
MW-7	03/05/2003	32,000	NA	370	490	1,600	2,900	NA	<100	44.45	16.34	28.11	NA	2.6
MW-8	10/21/2002	NA	NA	NA	NA	NA	NA	NA	NA	43.27	17.70	25.57	NA	NA
MW-8	12/27/2002	30,000	NA	280	220	2,000	5,300	NA	<10	43.27	14.25	29.02	NA	1.2
MW-8	03/05/2003	30,000	NA	220	150	2,100	4,200	NA	<100	43.27	15.36	27.91	NA	1.3

Abbreviations:

TPPH = Total petroleum hydrocarbons as gasoline by EPA Method 8260B; prior to June 11, 2001, analyzed by EPA Method 8015.

TEPH = Total petroleum hydrocarbons as diesel by modified EPA Method 8015.

BTEX = Benzene, toluene, ethylbenzene, xylenes by EPA Method 8260B; prior to June 11, 2001, analyzed by EPA Method 8020.

MTBE = Methyl-tertiary-butyl ether

TOC = Top of Casing Elevation

SPH = Separate-Phase Hydrocarbons

GW = Groundwater

DO = Dissolved Oxygen

ug/L = Parts per billion

ppm = Parts per million

MSL = Mean sea level

ft = Feet

<n = Below detection limit

D = Duplicate sample

NA = Not applicable

WELL CONCENTRATIONS
Shell-branded Service Station
1784 150th Avenue
San Leandro, CA

Well ID	Date	TPPH (ug/L)	TEPH (ug/L)	B (ug/L)	T (ug/L)	E (ug/L)	X (ug/L)	MTBE 8020 (ug/L)	MTBE 8260 (ug/L)	TOC (MSL)	Depth to Water (ft)	GW Elevation (MSL)	SPH Thickness (ft)	DO Reading (ppm)
---------	------	----------------	----------------	-------------	-------------	-------------	-------------	------------------------	------------------------	--------------	---------------------------	--------------------------	--------------------------	------------------------

Notes:

a = Chromatogram pattern indicates an unidentified hydrocarbon.

b = Samples not analyzed due to laboratory oversight.

* = Sample analyzed out of EPA recommended hold time.

Site surveyed January 23, 2002, by Virgil Chavez Land Surveying of Vallejo, California.

Survey data for wells MW-7 and MW-8 provided by Cambria Environmental Technology.



Report Number : 31953

Date : 03/26/2003

Leon Gearhart
Blaine Tech Services
1680 Rogers Avenue
San Jose, CA 95112-1105

Subject : 7 Water Samples
Project Name : 1784 150th Ave., San Leandro
Project Number : 030305-RH1
P.O. Number : 98996068

Dear Mr. Gearhart,

Chemical analysis of the samples referenced above has been completed. Summaries of the data are contained on the following pages. Sample(s) were received under documented chain-of-custody. US EPA protocols for sample storage and preservation were followed.

Kiff Analytical is certified by the State of California (# 2236). If you have any questions regarding procedures or results, please call me at 530-297-4800.

Sincerely,

A handwritten signature in black ink that reads "Joel Kiff". The signature is written in a cursive style with a large initial "J".

Joel Kiff



Report Number : 31953

Date : 03/26/2003

Subject : 7 Water Samples
Project Name : 1784 150th Ave., San Leandro
Project Number : 030305-RH1
P.O. Number : 98996068

Case Narrative

Matrix Spike/Matrix Spike Duplicate Results associated with sample MW-3 for the analyte Tert-Butanol were affected by the analyte concentrations already present in the un-spiked sample.

Approved By:  _____
Joel Kiff

2795 2nd St, Suite 300 Davis, CA 95616 530-297-4800



Report Number : 31953

Date : 03/26/2003

Project Name : 1784 150th Ave., San Leandro

Project Number : 030305-RH1

Sample : MW-1

Matrix : Water

Lab Number : 31953-01

Sample Date :03/05/2003

Parameter	Measured Value	Method Reporting Limit	Units	Analysis Method	Date Analyzed
Benzene	1600	10	ug/L	EPA 8260B	03/11/2003
Toluene	88	10	ug/L	EPA 8260B	03/11/2003
Ethylbenzene	400	10	ug/L	EPA 8260B	03/11/2003
Total Xylenes	1400	10	ug/L	EPA 8260B	03/11/2003
Methyl-t-butyl ether (MTBE)	230	100	ug/L	EPA 8260B	03/11/2003
Tert-amyl methyl ether (TAME)	< 10	10	ug/L	EPA 8260B	03/11/2003
Tert-Butanol	290	100	ug/L	EPA 8260B	03/11/2003
TPH as Gasoline	17000	1000	ug/L	EPA 8260B	03/11/2003
1,2-Dichloroethane	< 10	10	ug/L	EPA 8260B	03/11/2003
Toluene - d8 (Surr)	102		% Recovery	EPA 8260B	03/11/2003
4-Bromofluorobenzene (Surr)	97.3		% Recovery	EPA 8260B	03/11/2003
Dibromofluoromethane (Surr)	100		% Recovery	EPA 8260B	03/11/2003
1,2-Dichloroethane-d4 (Surr)	98.4		% Recovery	EPA 8260B	03/11/2003

Approved By:  Joel Kiff

2795 2nd St., Suite 300 Davis, CA 95616 530-297-4800



Report Number : 31953

Date : 03/26/2003

Project Name : 1784 150th Ave., San Leandro

Project Number : 030305-RH1

Sample : MW-2

Matrix : Water

Lab Number : 31953-02

Sample Date :03/05/2003

Parameter	Measured Value	Method Reporting Limit	Units	Analysis Method	Date Analyzed
Benzene	13000	50	ug/L	EPA 8260B	03/11/2003
Toluene	1400	50	ug/L	EPA 8260B	03/11/2003
Ethylbenzene	2000	50	ug/L	EPA 8260B	03/11/2003
Total Xylenes	7900	50	ug/L	EPA 8260B	03/11/2003
Methyl-t-butyl ether (MTBE)	21000	500	ug/L	EPA 8260B	03/11/2003
Tert-amyl methyl ether (TAME)	< 50	50	ug/L	EPA 8260B	03/11/2003
Tert-Butanol	10000	500	ug/L	EPA 8260B	03/11/2003
TPH as Gasoline	62000	5000	ug/L	EPA 8260B	03/11/2003
1,2-Dichloroethane	< 50	50	ug/L	EPA 8260B	03/11/2003
Toluene - d8 (Surr)	99.9		% Recovery	EPA 8260B	03/11/2003
4-Bromofluorobenzene (Surr)	104		% Recovery	EPA 8260B	03/11/2003
Dibromofluoromethane (Surr)	97.0		% Recovery	EPA 8260B	03/11/2003
1,2-Dichloroethane-d4 (Surr)	101		% Recovery	EPA 8260B	03/11/2003

Approved By:  Joel Kiff

2795 2nd St., Suite 300 Davis, CA 95616 530-297-4800



Report Number : 31953

Date : 03/26/2003

Project Name : 1784 150th Ave., San Leandro

Project Number : 030305-RH1

Sample : MW-3

Matrix : Water

Lab Number : 31953-03

Sample Date :03/05/2003

Parameter	Measured Value	Method Reporting Limit	Units	Analysis Method	Date Analyzed
Benzene	< 0.50	0.50	ug/L	EPA 8260B	03/08/2003
Toluene	< 0.50	0.50	ug/L	EPA 8260B	03/08/2003
Ethylbenzene	< 0.50	0.50	ug/L	EPA 8260B	03/08/2003
Total Xylenes	< 0.50	0.50	ug/L	EPA 8260B	03/08/2003
Methyl-t-butyl ether (MTBE)	< 5.0	5.0	ug/L	EPA 8260B	03/08/2003
Tert-amyl methyl ether (TAME)	< 2.0	2.0	ug/L	EPA 8260B	03/08/2003
Tert-Butanol	< 50	50	ug/L	EPA 8260B	03/08/2003
TPH as Gasoline	2300	50	ug/L	EPA 8260B	03/08/2003
1,2-Dichloroethane	13	2.0	ug/L	EPA 8260B	03/08/2003
Toluene - d8 (Surr)	93.3		% Recovery	EPA 8260B	03/08/2003
4-Bromofluorobenzene (Surr)	103		% Recovery	EPA 8260B	03/08/2003
Dibromofluoromethane (Surr)	116		% Recovery	EPA 8260B	03/08/2003
1,2-Dichloroethane-d4 (Surr)	104		% Recovery	EPA 8260B	03/08/2003

Approved By:  Joel Kiff



Report Number : 31953

Date : 03/26/2003

Project Name : 1784 150th Ave., San Leandro

Project Number : 030305-RH1

Sample : MW-5

Matrix : Water

Lab Number : 31953-04

Sample Date :03/05/2003

Parameter	Measured Value	Method Reporting Limit	Units	Analysis Method	Date Analyzed
Benzene	< 0.50	0.50	ug/L	EPA 8260B	03/08/2003
Toluene	1.7	0.50	ug/L	EPA 8260B	03/08/2003
Ethylbenzene	9.4	0.50	ug/L	EPA 8260B	03/08/2003
Total Xylenes	22	0.50	ug/L	EPA 8260B	03/08/2003
Methyl-t-butyl ether (MTBE)	< 5.0	5.0	ug/L	EPA 8260B	03/08/2003
TPH as Gasoline	290	50	ug/L	EPA 8260B	03/08/2003
Toluene - d8 (Surr)	94.6		% Recovery	EPA 8260B	03/08/2003
4-Bromofluorobenzene (Surr)	104		% Recovery	EPA 8260B	03/08/2003

Approved By:  Joel Kiff

2795 2nd St., Suite 300 Davis, CA 95616 530-297-4800



Report Number : 31953

Date : 03/26/2003

Project Name : 1784 150th Ave., San Leandro

Project Number : 030305-RH1

Sample : MW-6

Matrix : Water

Lab Number : 31953-05

Sample Date :03/05/2003

Parameter	Measured Value	Method Reporting Limit	Units	Analysis Method	Date Analyzed
Benzene	< 0.50	0.50	ug/L	EPA 8260B	03/08/2003
Toluene	< 0.50	0.50	ug/L	EPA 8260B	03/08/2003
Ethylbenzene	< 0.50	0.50	ug/L	EPA 8260B	03/08/2003
Total Xylenes	< 0.50	0.50	ug/L	EPA 8260B	03/08/2003
Methyl-t-butyl ether (MTBE)	< 5.0	5.0	ug/L	EPA 8260B	03/08/2003
TPH as Gasoline	< 50	50	ug/L	EPA 8260B	03/08/2003
Toluene - d8 (Surr)	95.9		% Recovery	EPA 8260B	03/08/2003
4-Bromofluorobenzene (Surr)	102		% Recovery	EPA 8260B	03/08/2003

Approved By:  Joel Kiff

2795 2nd St., Suite 300 Davis, CA 95616 530-297-4800



Report Number : 31953

Date : 03/26/2003

Project Name : 1784 150th Ave., San Leandro

Project Number : 030305-RH1

Sample : MW-7

Matrix : Water

Lab Number : 31953-06

Sample Date :03/05/2003

Parameter	Measured Value	Method Reporting Limit	Units	Analysis Method	Date Analyzed
Benzene	370	10	ug/L	EPA 8260B	03/11/2003
Toluene	490	10	ug/L	EPA 8260B	03/11/2003
Ethylbenzene	1600	10	ug/L	EPA 8260B	03/11/2003
Total Xylenes	2900	10	ug/L	EPA 8260B	03/11/2003
Methyl-t-butyl ether (MTBE)	< 100	100	ug/L	EPA 8260B	03/11/2003
TPH as Gasoline	32000	1000	ug/L	EPA 8260B	03/11/2003
Toluene - d8 (Surr)	99.2		% Recovery	EPA 8260B	03/11/2003
4-Bromofluorobenzene (Surr)	97.2		% Recovery	EPA 8260B	03/11/2003

Approved By:  Joel Kiff

2795 2nd St., Suite 300 Davis, CA 95616 530-297-4800



Report Number : 31953

Date : 03/26/2003

Project Name : 1784 150th Ave., San Leandro

Project Number : 030305-RH1

Sample : MW-8

Matrix : Water

Lab Number : 31953-07

Sample Date :03/05/2003

Parameter	Measured Value	Method Reporting Limit	Units	Analysis Method	Date Analyzed
Benzene	220	10	ug/L	EPA 8260B	03/11/2003
Toluene	150	10	ug/L	EPA 8260B	03/11/2003
Ethylbenzene	2100	10	ug/L	EPA 8260B	03/11/2003
Total Xylenes	4200	10	ug/L	EPA 8260B	03/11/2003
Methyl-t-butyl ether (MTBE)	< 100	100	ug/L	EPA 8260B	03/11/2003
TPH as Gasoline	30000	1000	ug/L	EPA 8260B	03/11/2003
Toluene - d8 (Surr)	99.3		% Recovery	EPA 8260B	03/11/2003
4-Bromofluorobenzene (Surr)	104		% Recovery	EPA 8260B	03/11/2003

Approved By:  Joel Kiff

2795 2nd St., Suite 300 Davis, CA 95616 530-297-4800

Report Number : 31953

Date : 03/26/2003

QC Report : Method Blank Data

Project Name : 1784 150th Ave., San Leandro

Project Number : 030305-RH1

Parameter	Measured Value	Method Reporting Limit	Units	Analysis Method	Date Analyzed
Benzene	< 0.50	0.50	ug/L	EPA 8260B	03/10/2003
Toluene	< 0.50	0.50	ug/L	EPA 8260B	03/10/2003
Ethylbenzene	< 0.50	0.50	ug/L	EPA 8260B	03/10/2003
Total Xylenes	< 0.50	0.50	ug/L	EPA 8260B	03/10/2003
Methyl-t-butyl ether (MTBE)	< 5.0	5.0	ug/L	EPA 8260B	03/10/2003
Tert-amyl methyl ether (TAME)	< 2.0	2.0	ug/L	EPA 8260B	03/10/2003
Tert-Butanol	< 50	50	ug/L	EPA 8260B	03/10/2003
TPH as Gasoline	< 50	50	ug/L	EPA 8260B	03/10/2003
1,2-Dichloroethane	< 2.0	2.0	ug/L	EPA 8260B	03/10/2003
Toluene - d8 (Surr)	95.1		%	EPA 8260B	03/10/2003
4-Bromofluorobenzene (Surr)	88.7		%	EPA 8260B	03/10/2003
Dibromofluoromethane (Surr)	90.9		%	EPA 8260B	03/10/2003
1,2-Dichloroethane-d4 (Surr)	96.4		%	EPA 8260B	03/10/2003
Benzene	< 0.50	0.50	ug/L	EPA 8260B	03/07/2003
Toluene	< 0.50	0.50	ug/L	EPA 8260B	03/07/2003
Ethylbenzene	< 0.50	0.50	ug/L	EPA 8260B	03/07/2003
Total Xylenes	< 0.50	0.50	ug/L	EPA 8260B	03/07/2003
Methyl-t-butyl ether (MTBE)	< 5.0	5.0	ug/L	EPA 8260B	03/07/2003
Tert-amyl methyl ether (TAME)	< 2.0	2.0	ug/L	EPA 8260B	03/07/2003
Tert-Butanol	< 50	50	ug/L	EPA 8260B	03/07/2003
TPH as Gasoline	< 50	50	ug/L	EPA 8260B	03/07/2003
1,2-Dichloroethane	< 2.0	2.0	ug/L	EPA 8260B	03/07/2003
Toluene - d8 (Surr)	94.9		%	EPA 8260B	03/07/2003
4-Bromofluorobenzene (Surr)	102		%	EPA 8260B	03/07/2003
Dibromofluoromethane (Surr)	115		%	EPA 8260B	03/07/2003
1,2-Dichloroethane-d4 (Surr)	108		%	EPA 8260B	03/07/2003

Parameter	Measured Value	Method Reporting Limit	Units	Analysis Method	Date Analyzed
-----------	----------------	------------------------	-------	-----------------	---------------

Approved By:  _____
 Joel Kiff

Report Number : 31953

Date : 03/26/2003

QC Report : Matrix Spike/ Matrix Spike Duplicate

Project Name : **1784 150th Ave., San**

Project Number : **030305-RH1**

Parameter	Spiked Sample	Sample Value	Spike Level	Spike Dup. Level	Spiked Sample Value	Duplicate Spiked Sample Value	Units	Analysis Method	Date Analyzed	Spiked Sample Percent Recov.	Duplicate Spiked Sample Percent Recov.	Relative Percent Diff.	Spiked Sample Recov. Limit	Relative Percent Diff. Limit
Benzene	31938-04	<0.50	38.5	38.4	38.2	36.5	ug/L	EPA 8260B	3/10/03	99.1	95.2	4.02	70-130	25
Toluene	31938-04	0.55	38.5	38.4	34.7	34.4	ug/L	EPA 8260B	3/10/03	88.5	88.3	0.261	70-130	25
Methyl-t-Butyl Ether	31938-04	<0.50	38.5	38.4	33.6	36.2	ug/L	EPA 8260B	3/10/03	87.3	94.4	7.84	70-130	25
Benzene	31879-04	<0.50	40.0	40.0	43.0	43.3	ug/L	EPA 8260B	3/7/03	108	108	0.626	70-130	25
Toluene	31879-04	<0.50	40.0	40.0	43.2	40.6	ug/L	EPA 8260B	3/7/03	108	102	6.27	70-130	25
Methyl-t-Butyl Ether	31879-04	<0.50	40.0	40.0	43.8	44.3	ug/L	EPA 8260B	3/7/03	110	111	1.14	70-130	25
Tert-Butanol	31938-04	74	193	192	252	257	ug/L	EPA 8260B	3/10/03	92.4	95.1	2.92	70-130	25
Tert-Butanol	31879-04	510	200	200	995	973	ug/L	EPA 8260B	3/7/03	242	231	4.54	70-130	25

Approved By:  _____
 Joel Kiff

Report Number : 31953

Date : 03/26/2003

QC Report : Laboratory Control Sample (LCS)

Project Name : **1784 150th Ave., San**

Project Number : **030305-RH1**

Parameter	Spike Level	Units	Analysis Method	Date Analyzed	LCS Percent Recov.	LCS Percent Recov. Limit
Benzene	40.0	ug/L	EPA 8260B	3/10/03	104	70-130
Toluene	40.0	ug/L	EPA 8260B	3/10/03	90.6	70-130
Methyl-t-Butyl Ether	40.0	ug/L	EPA 8260B	3/10/03	88.7	70-130
Benzene	40.0	ug/L	EPA 8260B	3/7/03	106	70-130
Toluene	40.0	ug/L	EPA 8260B	3/7/03	103	70-130
Methyl-t-Butyl Ether	40.0	ug/L	EPA 8260B	3/7/03	106	70-130
Tert-Butanol	200	ug/L	EPA 8260B	3/10/03	90.1	70-130
Tert-Butanol	200	ug/L	EPA 8260B	3/7/03	109	70-130

KIFF ANALYTICAL, LLC

2795 2nd St, Suite 300 Davis, CA 95616 530-297-4800

Approved By:

Joel Kiff

LAB: KEFF

SHELL Chain Of Custody Record

Lab Identification (if necessary):

Address:

City, State, Zip:

Shell Project Manager to be Invoiced:

SCIENCE & ENGINEERING
 TECHNICAL SERVICES
 GRANT HOUSTON

Karen Petryna

31953

INCIDENT NUMBER (S&E ONLY)

9 8 9 9 6 0 6 8

SAP or CRMT NUMBER (ITS/CRMT)

DATE: 3/5/03

PAGE: 1 of 1

SAMPLING COMPANY: **Blaine Tech Services** LOG CODE: **BTSS** SITE ADDRESS (Street and City): **1784 150th Ave., San Leandro** GLOBAL ID NO.: **T0600101230**

ADDRESS: **1680 Rogers Avenue, San Jose, CA 95112** EDF DELIVERABLE TO (Responsible Party or Designee): **Anni Kreml** PHONE NO.: **(510) 420-3335** E-MAIL: **ShellOaklandEDF@cambria-env.com** CONSULTANT PROJECT NO.: **BTS #030305-P#1**

PROJECT CONTACT (Hardcopy or PDF Report to): **Leon Gearhart** SAMPLER NAME(S) (PIN): **Ryan Hamstett** LAB USE ONLY

TELEPHONE: **408-573-0555** FAX: **408-573-7771** E-MAIL: **lgearhart@blainetech.com**

TURNAROUND TIME (BUSINESS DAYS):
 10 DAYS 5 DAYS 72 HOURS 48 HOURS 24 HOURS LESS THAN 24 HOURS

LA - RWQCB REPORT FORMAT UST AGENCY: _____

GC/MS MTBE CONFIRMATION: HIGHEST _____ HIGHEST per BORING _____ ALL _____

SPECIAL INSTRUCTIONS OR NOTES: CHECK BOX IF EDD IS NOT NEEDED

REQUESTED ANALYSIS

LAB USE ONLY	Field Sample Identification	SAMPLING		MATRIX	NO. OF CONT.	TPH - Gas, Purgeable	BTEX	MTBE (8021B - 5ppb RL)	MTBE (8260B - 0.5ppb RL)	Oxygenates (5) by (8260B)	Ethanol (8260B)	Methanol	EDB & 1,2-DCA (8260B)	TPH - Diesel, Extractable (8015m)	MTBE (8260B) Confirmation, See Note	FIELD NOTES: Containers/Preservative or PID Readings or Laboratory Notes	TEMPERATURE ON RECEIPT C°	
		DATE	TIME															
	mw-1	3/5/03	1039	GW	3	X	X	X										-01
	mw-2		803			X	X	X										-02
	mw-3		1018			X	X	X										-03
	mw-5		953			X	X	X										-04
	mw-6		932			X	X	X										-05
	mw-7		907			X	X	X										-06
	mw-8		847			X	X	X										-07

Relinquished by (Signature): <u>[Signature]</u>	Received by (Signature): _____	Date: _____	Time: _____
Relinquished by (Signature): _____	Received by (Signature): _____	Date: _____	Time: _____
Relinquished by (Signature): _____	Received by (Signature): <u>B. A. Brown Kiff Analytical</u>	Date: <u>030603</u>	Time: <u>1255</u>

O&G Graphic (714) 898-9702

WELL GAUGING DATA

Project # 030305-EH1 Date 3/5/03 Client Shell

Site 1784 150th Ave, San Leandro

Well ID	Well Size (in.)	Sheen / Odor	Depth to Immiscible Liquid (ft.)	Thickness of Immiscible Liquid (ft.)	Volume of Immiscibles Removed (ml)	Depth to water (ft.)	Depth to well bottom (ft.)	Survey Point: TOB or TOC	
mw-1	4					21.05	44.40		
mw-2	4	gauged w/ stinger in well				17.72	44.68		
mw-3	4					23.84	41.30		
mw-4	2					12.22	24.90 41.30		✓
mw-5	2					13.39	24.80		
mw-6	2					13.47	19.80		
mw-7	2					16.34	26.95		
mw-8	2					15.36	24.19		↓
* All logs removed 15 min prior to gauging									
Note: mw-2 purged before mw-4, mw-7, mw-8 gauged due to other work being done on site by Dynex Industrial Services									

SHIELD WELL MONITORING DATA SHEET

BTS #: 030305-R11	Site: 1784 150th Ave, San Leandro
Sampler: Ryan H	Date: 3/5/03
Well I.D.: mw-2	Well Diameter: <u>2</u> 3 4 6 8
Total Well Depth (TD): 44.65	Depth to Water (DTW): 17.72
Depth to Free Product:	Thickness of Free Product (feet):
Referenced to: <u>PVC</u> Grnd	D.O. Meter (if req'd): <u>YSI</u> HACH
DTW with 80% Recharge [(Height of Water Column x 0.20) + DTW]: 23.11	

Bailer Disposable Bailer Middleburg <u>Electric Submersible</u>	Water Peristaltic Extraction Pump Other _____	Sampling Method: <u>Bailer</u> Disposable Bailer Extraction Port Dedicated Tubing Other: _____
--	--	--

$17.5 \text{ (Gals.)} \times 3 = 52.5 \text{ Onls.}$
 Case Volume Specified Volumes Calculated Volume

Well Diameter	Multiplier	Well Diameter	Multiplier
1"	0.04	4"	0.65
2"	0.16	6"	1.47
3"	0.37	Other	radius ² * 0.163

Time	Temp (°F)	pH	Cond. (mS or <u>µS</u>)	Turbidity (NTUs)	Gals. Removed	Observations
751	64.2	5.8	796	76.5	17.5	foetid, strong H ₂ S odor
754	66.6	5.9	1004	49.4	35.0	clear, " " "
758	67.4	6.0	1380	11.9	52.5	" " " "

Did well dewater? Yes No Gallons actually evacuated: 52.5

Sampling Date: 3/5/03 Sampling Time: 903 Depth to Water: 23.00

Sample I.D.: mw-2 Laboratory: KIT SPL Other _____

Analyzed for: TPH-G BTEX MTBE TPH-D Other: _____

B.I.D. (if applicable): @ Time Duplicate I.D. (if applicable): _____

Analyzed for: TPH-G BTEX MTBE TPH-D Other: _____

D.O. (if req'd):	Pre-purge:	mg/L	Post-purge:	1.4	mg/L
.R.P. (if req'd):	Pre-purge:	mV	Post-purge:		mV

SHELL WELL MONITORING DATA SHEET

WTS #: 030305-R111	Site: 1784 150 th Ave, San Leandro
Sampler: Ryan H	Date: 3/5/03
Well I.D.: mw-3	Well Diameter: 2 3 <u>4</u> 6 8
Total Well Depth (TD): 4130	Depth to Water (DTW): 23.94
Depth to Free Product:	Thickness of Free Product (feet):
Referenced to: <u>PVC</u> Gmde	D.O. Meter (if req'd): <u>YSI</u> HACH
DTW with 80% Recharge [(Height of Water Column x 0.20) + DTW]: 27.33	

purge Method: <u>Bailer</u> Disposable Bailer Middleburg Electric Submersible	Water: _____ Peristaltic Extraction Pump Other: _____	Sampling Method: <u>Bailer</u> Disposable Bailer Extraction Port Dedicated Tubing Other: _____
---	--	--

$\frac{11.4 \text{ (Gals.)} \times 3}{\text{Specified Volumes}} = \frac{34.2 \text{ Gals.}}{\text{Calculated Volume}}$	<table border="1" style="width: 100%; border-collapse: collapse;"> <thead> <tr> <th>Well Diameter</th> <th>Multiplier</th> <th>Well Diameter</th> <th>Multiplier</th> </tr> </thead> <tbody> <tr> <td>1"</td> <td>0.04</td> <td>4"</td> <td>0.65</td> </tr> <tr> <td>2"</td> <td>0.16</td> <td>6"</td> <td>1.47</td> </tr> <tr> <td>3"</td> <td>0.37</td> <td>Other</td> <td>radius² * 0.163</td> </tr> </tbody> </table>	Well Diameter	Multiplier	Well Diameter	Multiplier	1"	0.04	4"	0.65	2"	0.16	6"	1.47	3"	0.37	Other	radius ² * 0.163
Well Diameter	Multiplier	Well Diameter	Multiplier														
1"	0.04	4"	0.65														
2"	0.16	6"	1.47														
3"	0.37	Other	radius ² * 0.163														

Time	Temp (°F)	pH	Cond. (mS or <u>µS</u>)	Turbidity (NTUs)	Gals. Removed	Observations
1008	65.7	6.9	1394	>200	11.4	cloudy
1010	67.0	6.7	1397	15.5	22.8	clear
1013	66.9	6.7	1430	7.3	34.2	"

Is well dewater? Yes No Gallons actually evacuated: 34.2

Sampling Date: 3/5/03 Sampling Time: 1018 Depth to Water: 23.90

Sample I.D.: mw-3 Laboratory: KIT SPL Other: _____

Analyzed for: TPH-G BTEX MTBE TPH-D Other: _____

3 I.D. (if applicable): _____ @ _____ Time Duplicate I.D. (if applicable): _____

Analyzed for: TPH-G BTEX MTBE TPH-D Other: _____

D.O. (if req'd):	Pre-purge:	mg/L	Post-purge:	1.3	mg/L
R.P. (if req'd):	Pre-purge:	mV	Post-purge:		mV

SHELL WELL MONITORING DATA SHEET

BTS #: 030305-2H1	Site: 1784 150th Ave, San Leandro
Sampler: Ryan H	Date: 3/5/03
Well I.D.: mw-5	Well Diameter: (2) 3 4 6 8
Total Well Depth (TD): 21.80	Depth to Water (DTW): 13.37
Depth to Free Product:	Thickness of Free Product (feet):
Referenced to: PVC Grade	D.O. Meter (if req'd): YSI HACH
DTW with 80% Recharge [(Height of Water Column x 0.20) + DTW]: 15.67	

Bailer Method: <u>Bailer</u> Disposable Bailer Middleburg Electric Submersible	Water: Peristaltic Extraction Pump Other:	Sampling Method: <u>Bailer</u> Disposable Bailer Extraction Port Dedicated Tubing Other:
---	---	--

1.75 (Gals.) X 3 = 5.25 Gals. Case Volume Specified Volumes Calculated Volume	<table border="1" style="width: 100%; border-collapse: collapse;"> <thead> <tr> <th>Well Diameter</th> <th>Multiflier</th> <th>Well Diameter</th> <th>Multiflier</th> </tr> </thead> <tbody> <tr> <td>1"</td> <td>0.04</td> <td>4"</td> <td>0.65</td> </tr> <tr> <td>2"</td> <td>0.16</td> <td>6"</td> <td>1.47</td> </tr> <tr> <td>3"</td> <td>0.37</td> <td>Other</td> <td>radius² * 0.163</td> </tr> </tbody> </table>	Well Diameter	Multiflier	Well Diameter	Multiflier	1"	0.04	4"	0.65	2"	0.16	6"	1.47	3"	0.37	Other	radius ² * 0.163
Well Diameter	Multiflier	Well Diameter	Multiflier														
1"	0.04	4"	0.65														
2"	0.16	6"	1.47														
3"	0.37	Other	radius ² * 0.163														

Time	Temp (°F)	pH	Cond. (mS or μ S)	Turbidity (NTUs)	Gals. Removed	Observations
944	65.4	7.3	1901	>200	1.75	light brown, cloudy
946	66.0	7.4	1912	>200	3.5	" " "
948	66.6	7.4	1822	>200	5.25	" " "

Is well dewatered? Yes No Gallons actually evacuated: 9.25

Sampling Date: 3/5/03 Sampling Time: 953 Depth to Water: 14.70

Sample I.D.: mw-5 Laboratory: Kiff SPL Other: _____

Analyzed for: TPH-G BTEX MTBE TPH-D Other: _____

B I.D. (if applicable): @ Time Duplicate I.D. (if applicable): _____

Analyzed for: TPH-G BTEX MTBE TPH-D Other: _____

D.O. (if req'd):	Pre-purge:	mg/L	<u>Post-purge:</u>	2.6	mg/L
R.P. (if req'd):	Pre-purge:	mV	Post-purge:		mV

SHELL WELL MONITORING DATA SHEET

WTS #: 030305-2H1	Site: 1784 150th Ave, San Leandro
Sampler: Ryan H	Date: 3/5/03
Well I.D.: mw-6	Well Diameter: <u>2</u> 3 4 6 8
Total Well Depth (TD): 19.50	Depth to Water (DTW): 13.47
Depth to Free Product:	Thickness of Free Product (feet):
Referenced to: <u>PVC</u> Grade	D.O. Meter (if req'd): <u>YSI</u> HACH
DTW with 80% Recharge [(Height of Water Column x 0.20) + DTW]: 14.74	

Bailer Method: <u>Bailer</u> Disposable Bailer Middleburg Electric Submersible	Water: Peristaltic Extraction Pump Other: _____	Sampling Method: <u>Bailer</u> Disposable Bailer Extraction Port Dedicated Tubing Other: _____
---	---	--

$$\frac{1.0 \text{ (Gals.)} \times 3}{\text{Specified Volumes}} = \frac{3.0}{\text{Calculated Volume}} \text{ Gals.}$$

Well Diameter	Multiplier	Well Diameter	Multiplier
1"	0.04	4"	0.65
2"	0.16	6"	1.47
3"	0.37	Other	radius ² * 0.163

Time	Temp (°F)	pH	Cond. (mS or <u>µS</u>)	Turbidity (NTUs)	Gals. Removed	Observations
925	60.2	7.9	651	>200	1.0	brown, cloudy
926	60.6	7.6	532	>200	2.0	" "
927	60.6	7.5	532	>200	3.0	" "

Did well dewater? Yes No Gallons actually evacuated: 3.0

Sampling Date: 3/5/03 Sampling Time: 932 Depth to Water: 14.35

Sample I.D.: mw-6 Laboratory: KIF SPL Other: _____

Analyzed for: TPH-G BTEX MTBE TPH-D Other: _____

B I.D. (if applicable): _____ @ _____ Time Duplicate I.D. (if applicable): _____

Analyzed for: TPH-G BTEX MTBE TPH-D Other: _____

D.O. (if req'd):	Pre-purge:	mg/L	Post-purge:	4.9 mg/L
R.P. (if req'd):	Pre-purge:	mV	Post-purge:	mV

SHELL WELL MONITORING DATA SHEET

3TS #: 030305-2H1	Site: 1734 150th Ave, San Leandro
Sampler: Ryan H	Date: 3/5/03
Well I.D.: mw-7	Well Diameter: (2) 3 4 6 8
Total Well Depth (TD): 26.95	Depth to Water (DTW): 16.39
Depth to Free Product:	Thickness of Free Product (feet):
Referenced to: PVC Grade	D.O. Meter (if req'd): YSP HACH
DTW with 80% Recharge [(Height of Water Column x 0.20) + DTW]: 18.46	

Purge Method: <u>Bailer</u> Disposable Bailer Middleburg Electric Submersible	Water Peristaltic Extraction Pump Other _____	Sampling Method: <u>Bailer</u> Disposable Bailer Extraction Port Dedicated Tubing Other: _____
--	--	--

$\frac{1.75 \text{ (Gals.)} \times 3 \text{ Specified Volumes}}{\text{Case Volume}} = 5.25 \text{ Gals. Calculated Volume}$	<table border="1" style="width: 100%; border-collapse: collapse;"> <thead> <tr> <th>Well Diameter</th> <th>Multiplier</th> <th>Well Diameter</th> <th>Multiplier</th> </tr> </thead> <tbody> <tr> <td>1"</td> <td>0.04</td> <td>4"</td> <td>0.65</td> </tr> <tr> <td>2"</td> <td>0.16</td> <td>6"</td> <td>1.47</td> </tr> <tr> <td>3"</td> <td>0.37</td> <td>Other</td> <td>radius² * 0.163</td> </tr> </tbody> </table>	Well Diameter	Multiplier	Well Diameter	Multiplier	1"	0.04	4"	0.65	2"	0.16	6"	1.47	3"	0.37	Other	radius ² * 0.163
Well Diameter	Multiplier	Well Diameter	Multiplier														
1"	0.04	4"	0.65														
2"	0.16	6"	1.47														
3"	0.37	Other	radius ² * 0.163														

Time	Temp (°F)	pH	Cond. (mS or μ S)	Turbidity (NTUs)	Gals. Removed	Observations
858	67.1	6.8	3359	>200	1.75	cloudy, color
900	67.7	6.6	3341	>200	3.5	" "
902	68.0	6.6	3405	>200	5.25	" "

Did well dewater? Yes No Gallons actually evacuated: 5.25

Sampling Date: 3/5/03 Sampling Time: 8: 907 Depth to Water: 18.78 due to traffic

Sample I.D.: mw-7 Laboratory: Kiff SPL Other _____

Analyzed for: TPH-G BTEX MTBE TPH-D Other: _____

B.I.D. (if applicable): @ Time Duplicate I.D. (if applicable): _____

Analyzed for: TPH-G BTEX MTBE TPH-D Other: _____

D.O. (if req'd):	Pre-purge:	mg/L	Post-purge: 2.6	mg/L
.R.P. (if req'd):	Pre-purge:	mV	Post-purge:	mV

SHELL WELL MONITORING DATA SHEET

3TS #: 030305-R11	Site: 1784 150th Ave, San Leandro
Sampler: Ryan H	Date: 3/5/03
Well I.D.: mw-4	Well Diameter: (2) 3 4 6 8
Total Well Depth (TD): 24.19	Depth to Water (DTW): 15.36
Depth to Free Product:	Thickness of Free Product (feet):
Referenced to: PVC Grade	D.O. Meter (if req'd): YSI HACH
DTW with 80% Recharge [(Height of Water Column x 0.20) + DTW]: 17.12	

Urge Method: <u>Boiler</u> Disposable Bailor Middleburg Electric Submersible	Waterra Peristaltic Extraction Pump Other _____	Sampling Method: <u>Boiler</u> Disposable Bailor Extraction Port Dedicated Tubing Other: _____
---	--	--

1.5 (Gals.) X 3 = 4.5 Gals.
 Case Volume Specified Volume Calculated Volume

Well Diameter	Multiplier	Well Diameter	Multiplier
1"	0.04	4"	0.65
2"	0.16	6"	1.47
3"	0.37	Other	radius ² * 0.163

Time	Temp (°F)	pH	Cond. (mS or μ S)	Turbidity (NTUs)	Gals. Removed	Observations
839	65.5	6.9	1630	>200	1.5	cloudy, color
841	66.1	6.8	1589	>200	3.0	" "
842	67.0	6.7	1585	1585 >200	4.5	" "

Did well dewater? Yes No Gallons actually evacuated: 4.5
 Sampling Date: 3/5/03 Sampling Time: 847 Depth to Water: 15.45 ^{due to traffic}

Sample I.D.: mw-4 Laboratory: Kiff SPL Other _____

Analyzed for: TPH-G BTEX MTBE TPH-D Other: _____

B I.D. (if applicable): _____ @ _____ Time Duplicate I.D. (if applicable): _____

Analyzed for: TPH-G BTEX MTBE TPH-D Other: _____

D.O. (if req'd):	Pre-purge:	μ g/L	Post-purge:	1.3	μ g/L
.R.P. (if req'd):	Pre-purge:	mV	Post-purge:		mV