



ENVIRONMENTAL  
PROTECTION

97 AUG 22 PM 2:47

3164 Gold Camp Drive  
Suite 200  
Rancho Cordova, CA 95670  
916/638-2085  
FAX: 916/638-8385

August 20, 1997

Mr. Scott Seery  
Alameda County Health Care Services  
1131 Harbor Bay Parkway  
Alameda, California 94502-5577

Subject: *Addendum to Problem Assessment Report/Remedial Action Plan*  
Exxon Service Station No. 7-3399  
2991 Hopyard Road  
Pleasanton, California  
Delta Project No. D094-836

Dear Mr. Seery:

Delta Environmental Consultants, Inc. (Delta), has been authorized by Exxon Company, U.S.A. (Exxon), to conduct environmental assessment work and perform remedial activities at the above-referenced site (Figures 1 and 2). **This letter is an addendum to Delta's *Problem Assessment Report/Remedial Action Plan (PAR/RAP)* dated May 30, 1996.**

In the remedial action portion of the PAR/RAP, it was proposed that the existing soil vapor extraction system be restarted utilizing soil vapor extraction well VR-4, and that an air sparging and bio-venting system be installed to air sparge into monitoring well MW-9, and to bio-vent soil using vapor extraction well VR-3. During recent station modifications, a well box was installed for a possible future soil vapor extraction well intended to address petroleum hydrocarbon impacted soil in the vicinity of soil boring B-17. The soil vapor extraction well may be installed if the soil vapor extraction radius of influence from VR-4 is insufficient to influence that area. Previous soil vapor extraction activities consisted of inducing a vacuum on VR-1 through VR-4 simultaneously which may have reduced the radius of influence from VR-4 had the system utilized only this well. The location of the soil boring B-17, and the well box for a possible soil vapor extraction well are illustrated on Figure 2.

Although it has not been decided whether the nearby supply well will be relocated or rehabilitated, it is Exxon's intention to proceed with the proposed remedial actions. Even if the well is currently not at risk, and in the event that the well is destroyed and a new well is installed, Exxon requests approval to proceed with the proposed remedial actions since there is a drinking well located directly across Valley Avenue.

Mr. Scott Seery  
Alameda County Health Care Services  
August 20, 1997  
Page 2

If you have any questions concerning this project, please contact Keoni Almeida at (916) 638-2085.

Sincerely,

**DELTA ENVIRONMENTAL CONSULTANTS, INC.**

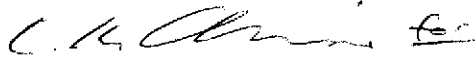

William L. Brattain  
Project Engineer



Charles Keoni Almeida  
Project Manager



Eric J. Holm, R.G.  
California Registered Geologist No. 5880

WLB (CL006.836)  
Enclosure

cc: Ms. Marla D. Guensler, Exxon Company, U.S.A.

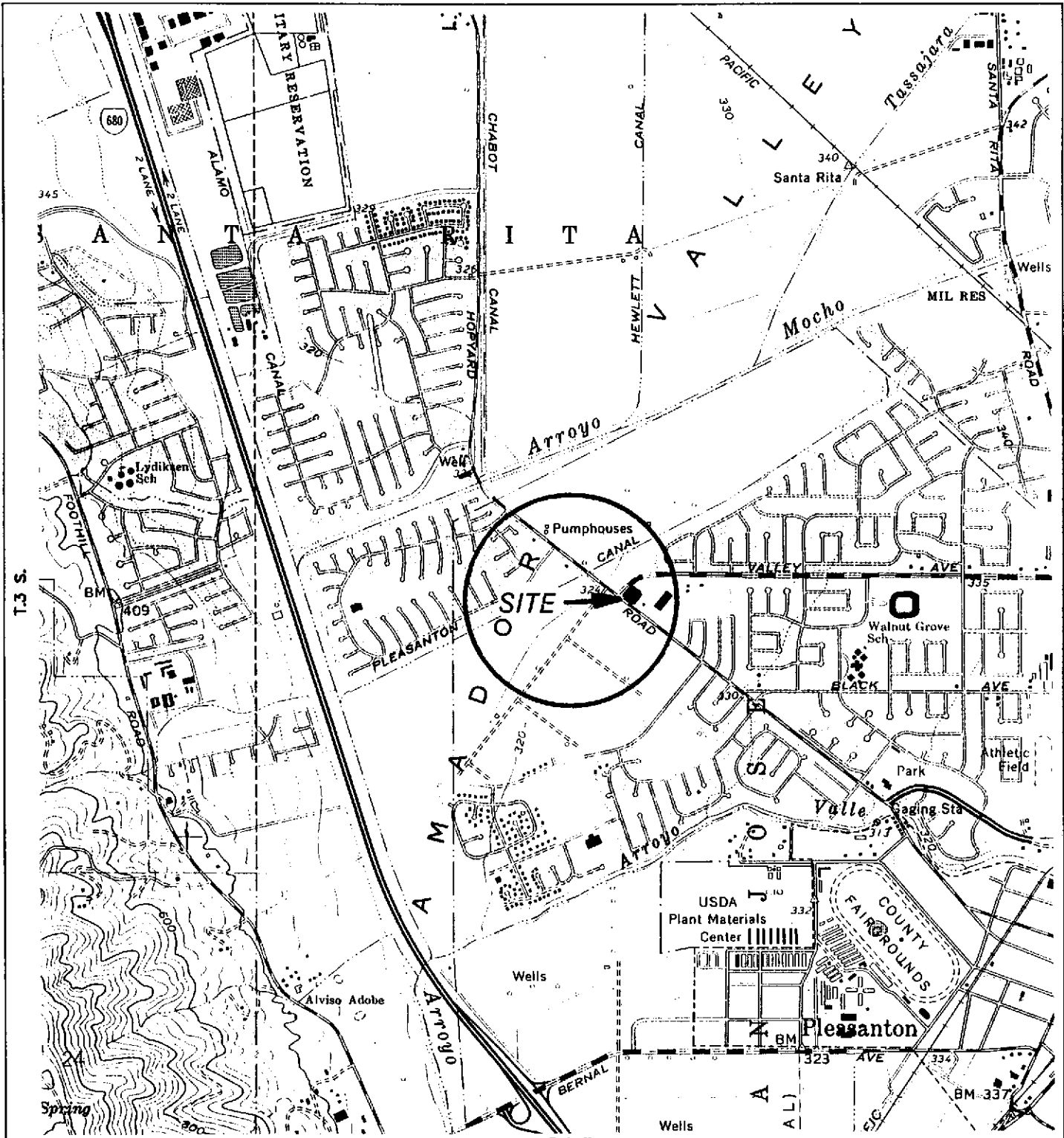

GENERAL NOTES:  
 BASE MAP FROM U.S.G.S.  
 DUBLIN, CA.  
 7.5 MINUTE TOPOGRAPHIC  
 PHOTOREVISED 1980

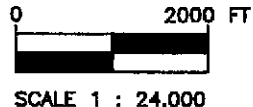
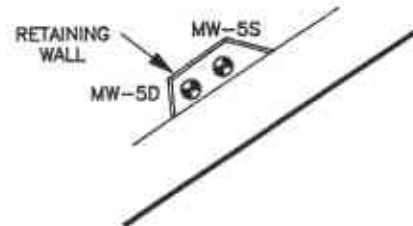

FIGURE 1  
 SITE LOCATION MAP  
 EXXON STATION NO 7-3399  
 2991 HOPYARD ROAD  
 PLEASANTON, CA.

PROJECT NO. D094-836	DRAWN BY I.H. 9/22/84
FILE NO.	PREPARED BY TMG
REVISION NO. 1	REVIEWED BY





LEGEND:

- ⊕ MW-1 MONITORING WELL LOCATION
- ⊙ VR-1 VAPOR EXTRACTION WELL LOCATION
- MW-2 DESTROYED MONITORING WELL
- B-12 SOIL BORING LOCATION
- ⊙ 36" WELL BOX/POSSIBLE VAPOR EXTRACTION WELL LOCATION

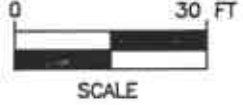
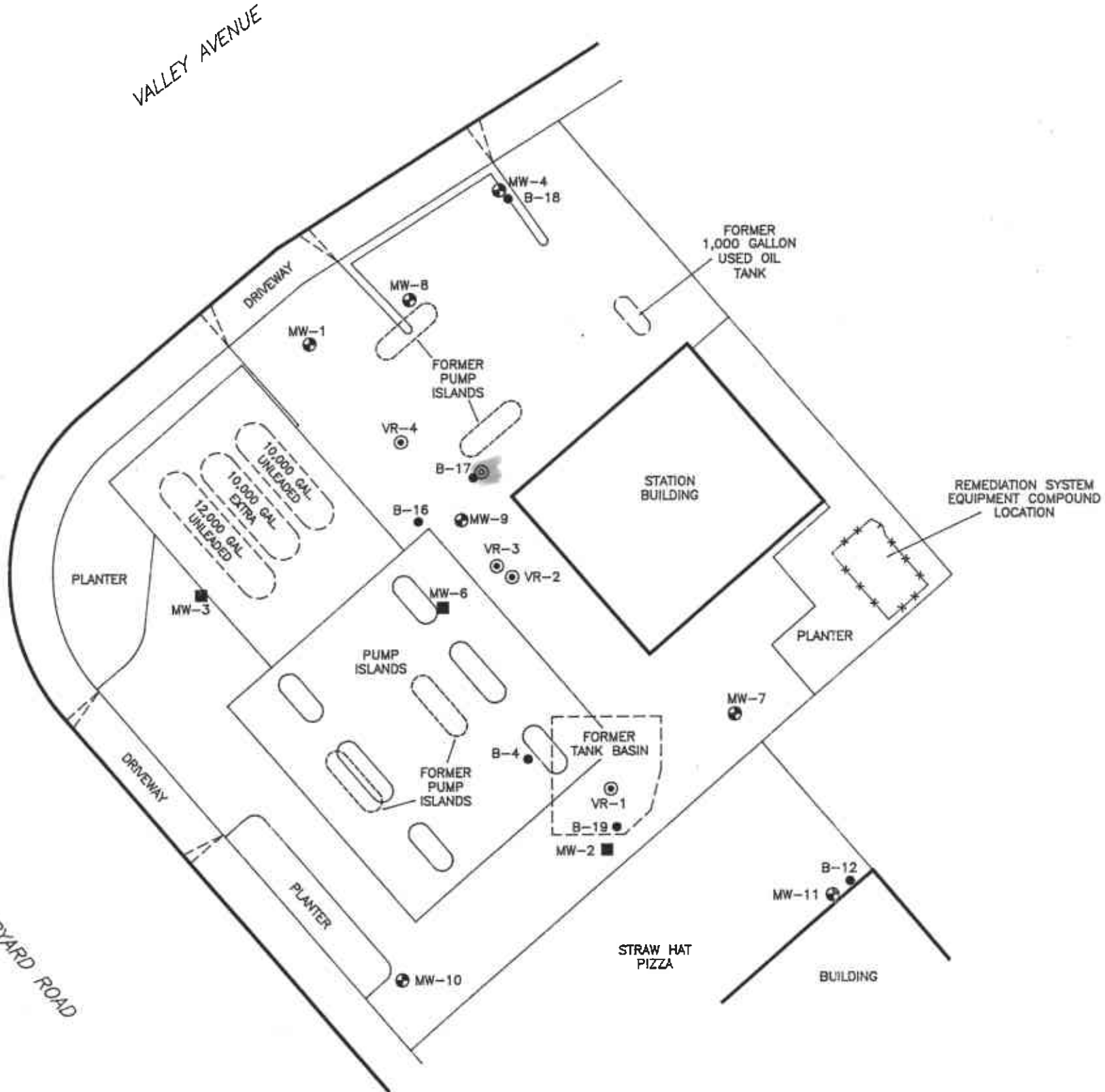

NOTE:  
 BASE MAP ADAPTED FROM RESNA FIGURE.SITE  
 DIMENSIONS AND FACILITY LOCATIONS NOT VERIFIED.

FIGURE 2  
 SITE MAP  
 EXXON STATION NO 7-3399  
 2991 HOPYARD ROAD  
 PLEASANTON, CA.

PROJECT NO. D094-836	DRAWN BY M.L. 7/8/97
FILE NO. 94-836-1	PREPARED BY CKA
REVISION NO. 8	REVIEWED BY <i>CKA</i>

**Delta**  
 Environmental  
 Consultants, Inc.