



3164 Gold Camp Drive
Suite 200
Rancho Cordova, CA 95670-6021
U.S.A.
916/638-2085
FAX: 916/638-8385

November 12, 1998

Ms. Marla D. Guensler
Exxon Company, U.S.A.
2300 Clayton Road, Suite 1250
Concord, California 94520

Subject: *Quarterly Ground Water Monitoring and
Remediation System Status Report, Third Quarter 1998*
Exxon Service Station No. 7-3399
2991 Hopyard Road
Pleasanton, California
Solano County File No. 30081
Delta Project No. D094-836

Dear Ms. Guensler:

Delta Environmental Consultants, Inc. (Delta), has been authorized by Exxon Company, U.S.A. (Exxon), to conduct quarterly ground water monitoring at Exxon Service Station No. 7-3399, located at 2991 Hopyard Road, Pleasanton, California. This report presents the results of quarterly ground water monitoring and sampling conducted for the third quarter 1998. The location of the site is shown in Figure 1 and site features are illustrated in Figure 2. Work conducted at the site by Delta was performed in accordance with the field methods and procedures described in Enclosure A.

Ground Water Elevation Measurements, Flow Direction, and Hydraulic Gradient

On September 11, 1998, ground water elevations were measured in on-site monitoring wells MW-1, MW-4, MW-7 through MW-10 and off-site monitoring wells MW-5D, MW-5S, and MW-11. Depth to ground water in the monitoring wells ranged from 28.72 (MW-9) to 31.79 (MW-10) feet below the top of the well casings. Ground water table elevations decreased an average of 5.29 feet in the monitoring wells since the June 15, 1998, monitoring event. Cumulative ground water elevation measurements recorded are presented in Enclosure B.

A ground water elevation contour map was constructed from the ground water elevations recorded on September 11, 1998, and is included as Figure 3. The ground water elevation measurements from monitoring wells MW-5D and MW-8 were not included in the ground water elevation contour map, because these wells are screened in a lower zone; additionally, the measurement obtained from monitoring well MW-9 was not used due to air sparging within this well. The ground water elevation contours, illustrated in Figure 3, indicate that ground water in the upper water-bearing zone generally flowed toward the southwest. Based on the ground water elevation contour map, the hydraulic gradient is approximately 0.14.

Subjective Analysis

No liquid-phase petroleum hydrocarbons or hydrocarbon sheens were present in the wells during the September 11, 1998, sampling visit.

Ground Water Analytical Results

Ground water samples were collected from monitoring wells MW-1, MW-4, MW-5S, MW-5D, MW 7, MW-8 and MW-9 on September 11, 1998. All ground water samples were submitted to Sequoia Analytical (a California-certified laboratory) for analysis of benzene, toluene, ethylbenzene, and total xylenes (BTEX), and methyl tertiary butyl ether (MTBE) using EPA Method 8020, and total purgeable petroleum hydrocarbons (TPPH) as gasoline using EPA Method 8015 Modified. On October 28, 1998, a ground water sample was collected from monitoring well MW-5D and submitted to the laboratory for analysis of BTEX, MTBE, and TPPH. Monitoring wells MW-10 and MW-11 will continue to be excluded from quarterly sampling because hydrocarbon concentrations in ground water samples collected from these wells have historically been less than laboratory reporting limits. confirmation?

The analytical results indicated that all analytes were below the laboratory's reporting limits, with the exception of the samples obtained from monitoring wells MW-5D and MW-9. The concentration of benzene was reported in the ground water sample collected from monitoring well MW-9 at 1.5 micrograms per liter ($\mu\text{g/L}$). A benzene concentration map based on the September 11, 1998, analytical results is included in Figure 4. Concentrations of MTBE in the samples collected from MW-5D and MW-9 were 33 $\mu\text{g/L}$ and 7.1 $\mu\text{g/L}$, respectively; a duplicate sample collected from MW-5D contained 35 $\mu\text{g/L}$ of MTBE. On October 28, 1998, monitoring well MW-5D was resampled and the chemical analysis indicated that MTBE was less than the laboratory reporting limit. Laboratory chemical analyses results for the last four monitoring events are presented Table 1. Cumulative ground water analytical results are presented in Enclosure B, and a copy of the laboratory analytical report for the September 11, 1998, sampling event is included in Enclosure C.

Remediation System Status

A soil vapor extraction (SVE), air sparging, and bio-venting system has been installed to remediate petroleum hydrocarbon constituents in soil and ground water underlying the site. The SVE system was shut down on April 20, 1998, due to high ground water in vapor recovery well VR-4. Since the SVE system was turned off, the depth to ground water in VR-4 has ranged from 6.90 feet on April 20, 1998, to 11.75 feet on September 11, 1998. Vapor well VR-4 is screened from 12 feet to 32 feet below surface grade. data sheet

The SVE system consists of vapor recovery well VR-4, a vacuum blower, and two 200-pound vapor phase granular activated carbon columns in series. Air is injected into VR-3 and MW-9. Vapor recovery wells VR-1 and VR-2 are not presently in use. The locations of the wells and equipment compound are illustrated in Figure 2, and a process flow diagram of the SVE system is included as Figure 5.

Ms. Marla Guensler
Exxon Company, U.S.A.
November 12, 1998
Page 3

Delta collects influent, mid-carbon, and effluent soil vapor samples on a monthly basis during the months the system is operational. The samples are submitted to Sequoia Analytical for analysis of BTEX and TPPH as gasoline. Results of the SVE system sampling are summarized in Table 2, and a copy of the laboratory analytical reports are submitted to the Bay Area Air Quality Management District in compliance with the permit to operate.

Discussion

The concentration of MTBE in the sample collected on September 11, 1998, from monitoring well MW-5D, which is screened below the water table, was 33 µg/L. The well was resampled on October 28, 1998, and the MTBE concentration was less than the laboratory reporting limit of 2 µg/L. Monitoring well MW-5D is located between the site and a City of Pleasanton municipal water supply well which is northeast of the site. Delta is evaluating options for addressing the reported concentration of MTBE in ground water beneath the site.

Concentrations of hydrocarbons in the sample collected from monitoring well MW-8, which is screened within a lower water-bearing zone, was below the laboratory's reporting limits for all analytes. Monitoring of residual dissolved hydrocarbons in the deep monitoring well will continue, due to the proximity of the City of Pleasanton municipal wells northeast of the site.

Future Work

The next quarterly monitoring event for this site is scheduled for December 1998.

Remarks/Signatures

The interpretations contained in this report represent our professional opinions, and are based in part, on information supplied by the client. These opinions are based on currently available information and are arrived at in accordance with currently accepted hydrogeologic and engineering practices at this time and location. Other than this, no warranty is implied or intended.

Delta recommends that copies of this report be forwarded to:

Mr. Scott Seery
Alameda County Health Care Services
1131 Harbor Bay Parkway
Alameda, California 94502-5577

Mr. Steve Cusenza
City of Pleasanton Public Works Dept.
Post Office Box 520
Pleasanton, California 94566

Mr. Chuck Headlee
California Regional Water Quality Control Board,
San Francisco Bay Region
2101 Street, Suite 500
Oakland, California 94612

Mr. David Lum
Alameda County Flood Control and
Water Conservation District (Zone 7)
5997 Parkside Drive
Pleasanton, California 94566

Ms. Marla Guensler
Exxon Company, U.S.A.
November 12, 1998
Page 4

If you have any questions or comments, please contact Jim Brownell at (916) 638-2765.

Sincerely,

DELTA ENVIRONMENTAL CONSULTANTS, INC.

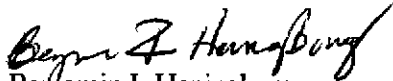
Benjamin I. Heningburg
Staff Geologist

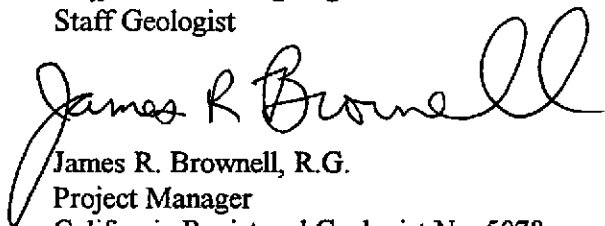
James R. Brownell, R.G.
Project Manager
California Registered Geologist No. 5078

BIH (LRP021.836)
Enclosures

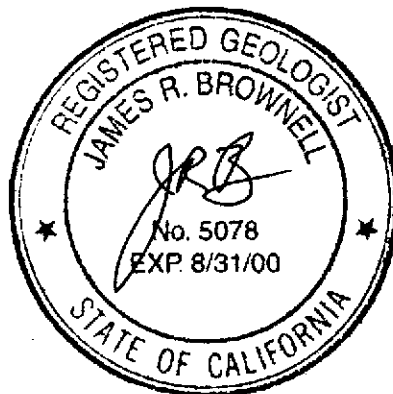

TABLE 1

RECENT GROUND WATER MONITORING DATA

Exxon Service Station No. 7-3399
2991 Hopyard Road
Pleasanton, California

Monitoring Well	Date	Reference Elevation (ft)	Depth to Water (ft)	Ground Water Elevation (ft)	Benzene (µg/L)	Toluene (µg/L)	Ethyl-benzene (µg/L)	Total Xylenes (µg/L)	TPPH as gasoline (µg/L)	MTBE (µg/L)	Oxygenate Compounds (µg/L)	Industrial Solvents (mg/L)	Comments
MW-1	12/30/97	321.44	36.74	284.70	<0.5	<0.5	<0.5	<0.5	<50	NA	ND	<1.0	No LPH
	03/24/98		31.65	289.79	1.4	2.5	<0.5	1.4	<50	16	NA	NA	No LPH
	06/15/98		29.28	292.16	<0.5	<0.5	<0.5	<0.5	<50	22	NA	NA	No LPH
	09/11/98		34.94	286.50	<0.5	<0.5	<0.5	<0.5	<50	<2.5	NA	NA	No LPH
MW-2	07/12/88	NM	Well destroyed										
MW-3	08/29/88	NM	Well destroyed										
MW-4	12/30/97	321.56	37.78	283.78	NS	NS	NS	NS	NS	NS	NS	NS	No LPH
	03/24/98		NM	NC	NS	NS	NS	NS	NS	NS	NS	NS	Not measured
	06/15/98		30.32	291.24	NS	NS	NS	NS	NS	NS	NS	NS	No LPH
	09/11/98		35.97	285.59	<0.5	<0.5	<0.5	<0.5	<50	<2.5	NA	NA	No LPH
MW-5S	12/30/97	321.64	37.83	283.81	<0.5	<0.5	<0.5	<0.5	<50	NA	ND	<1.0	No LPH
	03/24/98		32.76	288.88	<0.5	<0.5	<0.5	<0.5	<50	<2.5	NA	NA	No LPH
	06/15/98		30.46	291.18	<0.5	<0.5	<0.5	<0.5	<50	<2.5	NA	NA	No LPH
	09/11/98		36.04	285.60	<0.5	<0.5	<0.5	<0.5	<50	<2.5	NA	NA	No LPH
MW-5D	12/30/97	321.79	38.30	283.49	<0.5	<0.5	<0.5	<0.5	<50	NA	ND	<1.0	No LPH
Duplicate	12/30/97		NM	NC	<0.5	<0.5	<0.5	<0.5	<50	NA	ND	<1.0	Not measured
Rinseate	12/30/97		NM	NC	<0.5	<0.5	<0.5	<0.5	<50	NA	ND	<1.0	Not measured
	03/24/98		32.77	289.02	<0.5	<0.5	<0.5	<0.5	<50	<2.5	NA	NA	No LPH
Duplicate	06/15/98	30.69	291.10	<0.5	<0.5	<0.5	<0.5	<50	<2.5	NA	NA	No LPH	
	06/15/98	NM	NC	<0.5	<0.5	<0.5	<0.5	<50	<2.5	NA	NA	No LPH	
	09/11/98	36.68	285.11	<0.5	<0.5	<0.5	<0.5	<50	33	NA	NA	No LPH	
Duplicate	09/11/98	NM	NC	<0.5	<0.5	<0.5	<0.5	<50	35	NA	NA	No LPH	
	10/28/98	NM	NC	<0.5	<0.5	<0.5	<0.5	<50	<2.0 ^f	NA	NA	No LPH	

TABLE 1

RECENT GROUND WATER MONITORING DATA

Exxon Service Station No. 7-3399

2991 Hopyard Road

Pleasanton, California

Monitoring Well	Date	Reference Elevation (ft)	Depth to Water (ft)	Ground Water Elevation (ft)	Benzene (µg/L)	Toluene (µg/L)	Ethyl-benzene (µg/L)	Total Xylenes (µg/L)	TPPH as gasoline (µg/L)	MTBE (µg/L)	Oxygenate Compounds (µg/L)	Industrial Solvents (mg/L)	Comments	
MW-6	10/24/88	NM	Well destroyed											
MW-7	12/30/97	321.27	37.45	283.82	NS	NS	NS	NS	NS	NS	NS	NS	No LPH	
	03/24/98		NM	NC	NS	NS	NS	NS	NS	NS	NS	NS	NS	Not measured
	06/15/98		30.05	291.22	NS	NS	NS	NS	NS	NS	NS	NS	NS	No LPH
	09/11/98		35.63	285.64	<0.5	<0.5	<0.5	<0.5	<50	<2.5	NS	NS	NS	No LPH
MW-8	12/30/97	321.86	39.81	282.05	<0.5	<0.5	<0.5	<0.5	<50	NA	ND	<1.0	No LPH	
	Duplicate 12/30/97		NM	NC	<0.5	<0.5	<0.5	<0.5	<50	NA	ND	<1.0	Not measured	
	Rinseate 12/30/97		NM	NC	<0.5	0.52	<0.5	<0.5	<50	NA	3.2 ^f	<1.0	Not measured	
	03/24/98		31.46	290.40	<0.5	<0.5	<0.5	<0.5	<50	<2.5	NA	NA	NA	No LPH
Duplicate	06/15/98	31.43	290.43	<0.5	<0.5	<0.5	<0.5	<50	NA	NA	NA	NA	No LPH	
	06/15/98	NM	NC	<0.5	<0.5	<0.5	<0.5	<50	NA	NA	NA	NA	No LPH	
Duplicate	09/11/98	38.73	283.13	<0.5	<0.5	<0.5	<0.5	<50	<2.5	NA	NA	NA	No LPH	
	09/11/98	NM	NC	<0.5	<0.5	<0.5	<0.5	<50	<2.5	NA	NA	NA	No LPH	
MW-9	12/30/97	320.68	38.83	281.85	840	750	80	310	4,600	NA	1,100 ^f	<1.0	No LPH	
	03/24/98		31.32	289.36	11,000	16,000	1,200	6,200	62,000	7,000	NA	NA	NA	No LPH
	06/15/98		28.72	291.96	1.8	2.7	<0.5	3.8	<50	8.1	NA	NA	NA	No LPH
	09/11/98		31.52	289.16	1.5	0.97	<0.5	1.1	<50	7.1	NA	NA	NA	No LPH
MW-10	12/30/97	322.99	38.20	284.79	NS	NS	NS	NS	NS	NS	NS	NS	No LPH	
	03/24/98		34.12	288.87	NS	NS	NS	NS	NS	NS	NS	NS	NS	Not measured
	06/15/98		31.79	291.20	NS	NS	NS	NS	NS	NS	NS	NS	NS	No LPH
	09/11/98		35.40	287.59	NS	NS	NS	NS	NS	NS	NS	NS	NS	Not measured
MW-11	12/30/97	321.77	37.94	283.83	NS	NS	NS	NS	NS	NS	NS	NS	No LPH	
	03/24/98		32.86	289.65	NS	NS	NS	NS	NS	NS	NS	NS	NS	Not measured
	06/15/98		30.49	291.28	NS	NS	NS	NS	NS	NS	NS	NS	NS	No LPH
	09/11/98		35.96	285.81	NS	NS	NS	NS	NS	NS	NS	NS	NS	Not measured

TABLE 1

RECENT GROUND WATER MONITORING DATA

Exxon Service Station No. 7-3399
 2991 Hopyard Road
 Pleasanton, California

Monitoring Well	Date	Reference Elevation (ft)	Depth to Water (ft)	Ground Water Elevation (ft)	Benzene (µg/L)	Toluene (µg/L)	Ethyl-benzene (µg/L)	Total Xylenes (µg/L)	TPPH as gasoline (µg/L)	MTBE (µg/L)	Oxygenate Compounds (µg/L)	Industrial Solvents (mg/L)	Comments
VR-1	03/24/92		NM	NC	1.7	<0.5	<0.5	<0.5	<50	NA	NA	NA	Not measured

- ^a Water level recorded during pumping of MW-7.
- ^b Anomalous water level possibly due to recharge from a perched water zone.
- ^c Casing head cut to lower elevation.
- ^d Casing head damaged by construction.
- ^e Results obtained past the technical holding time.
- ^f Methyl tertiary butyl ether by EPA Method 8260.

Reference elevation = Elevation relative to mean sea level.
 Depth to ground water = Measured from notch/mark on north edge of well casing.
 µg/L = Micrograms per liter.
 TPPH = Total purgeable petroleum hydrocarbons.
 MTBE = Methyl tertiary butyl ether by EPA Method 8020.
 Oxygenate compounds = Ethanol, tertiary butanol, methyl tertiary butyl ether, diisopropyl ether, ethyl tertiary butyl ether, tertiary amyl methyl ether.
 Concentrations confirmed by EPA Method 8260.
 LPH = Liquid-phase petroleum hydrocarbons.
 NA = Not analyzed.
 ND = Not detected at or above the laboratory's reporting limit.
 NS = Not sampled.
 NM = Not measured.
 NC = Not calculated.

NOTE: Elevation detection limit quantified by multiplying laboratory limits by report limit multiplication factor.

TABLE 2

SVE SYSTEM LABORATORY ANALYTICAL RESULTS

Exxon Service Station No. 7-3399
2991 Hopyard Road
Pleasanton, California

Sample ID	Date Collected	Benzene (ppmv)	Toluene (ppmv)	Ethyl-benzene (ppmv)	Total Xylenes (ppmv)	TPPH as gasoline (ppmv)
Influent	08/14/97	<0.031	<0.027	<0.023	<0.023	<2.4
Mid-Carbon	08/14/97	<0.031	<0.027	<0.023	<0.023	<2.4
Effluent	08/14/97	<0.031	<0.027	<0.023	<0.023	<2.4
Influent	09/04/97	<0.031	<0.027	<0.023	<0.023	<2.4
Mid-Carbon	09/04/97	<0.031	<0.027	<0.023	<0.023	<2.4
Effluent	09/04/97	<0.031	<0.027	<0.023	<0.023	<2.4
Influent	10/09/97	<0.031	<0.027	<0.023	<0.023	<2.4
Mid-Carbon	10/09/97	<0.031	<0.027	<0.023	<0.023	<2.4
Effluent	10/09/97	<0.031	<0.027	<0.023	<0.023	<2.4
Influent	11/06/97	<0.031	<0.027	<0.023	<0.023	<2.4
Mid-Carbon	11/06/97	<0.031	<0.027	<0.023	<0.023	<2.4
Effluent	11/06/97	<0.031	<0.027	<0.023	<0.023	<2.4
Influent	12/08/97	<0.031	<0.027	<0.023	<0.023	<2.4
Mid-Carbon	12/08/97	<0.031	<0.027	<0.023	<0.023	<2.4
Effluent	12/08/97	<0.031	<0.027	<0.023	<0.023	<2.4
Influent	01/12/98	<0.031	<0.027	<0.023	<0.023	<2.4
Mid-Carbon	01/12/98	<0.031	<0.027	<0.023	<0.023	<2.4
Effluent	01/12/98	<0.031	<0.027	<0.023	<0.023	<2.4
Influent	02/12/98	<0.031	<0.027	<0.023	<0.023	<2.4
Mid-Carbon	02/12/98	<0.031	<0.027	<0.023	<0.023	<2.4
Effluent	02/12/98	<0.031	<0.027	<0.023	<0.023	<2.4
Influent	03/09/98	<0.031	<0.027	<0.023	<0.023	<2.4
Mid-Carbon	03/09/98	<0.031	<0.027	<0.023	<0.023	<2.4
Effluent	03/09/98	<0.031	<0.027	<0.023	<0.023	<2.4
Influent	04/06/98	<0.031	<0.027	<0.023	<0.023	<2.4
Mid-Carbon	04/06/98	<0.031	<0.027	<0.023	<0.023	<2.4
Effluent	04/06/98	<0.031	<0.027	<0.023	<0.023	<2.4

TPPH = Total purgeable petroleum hydrocarbons.
ppmv = Parts per million by volume.

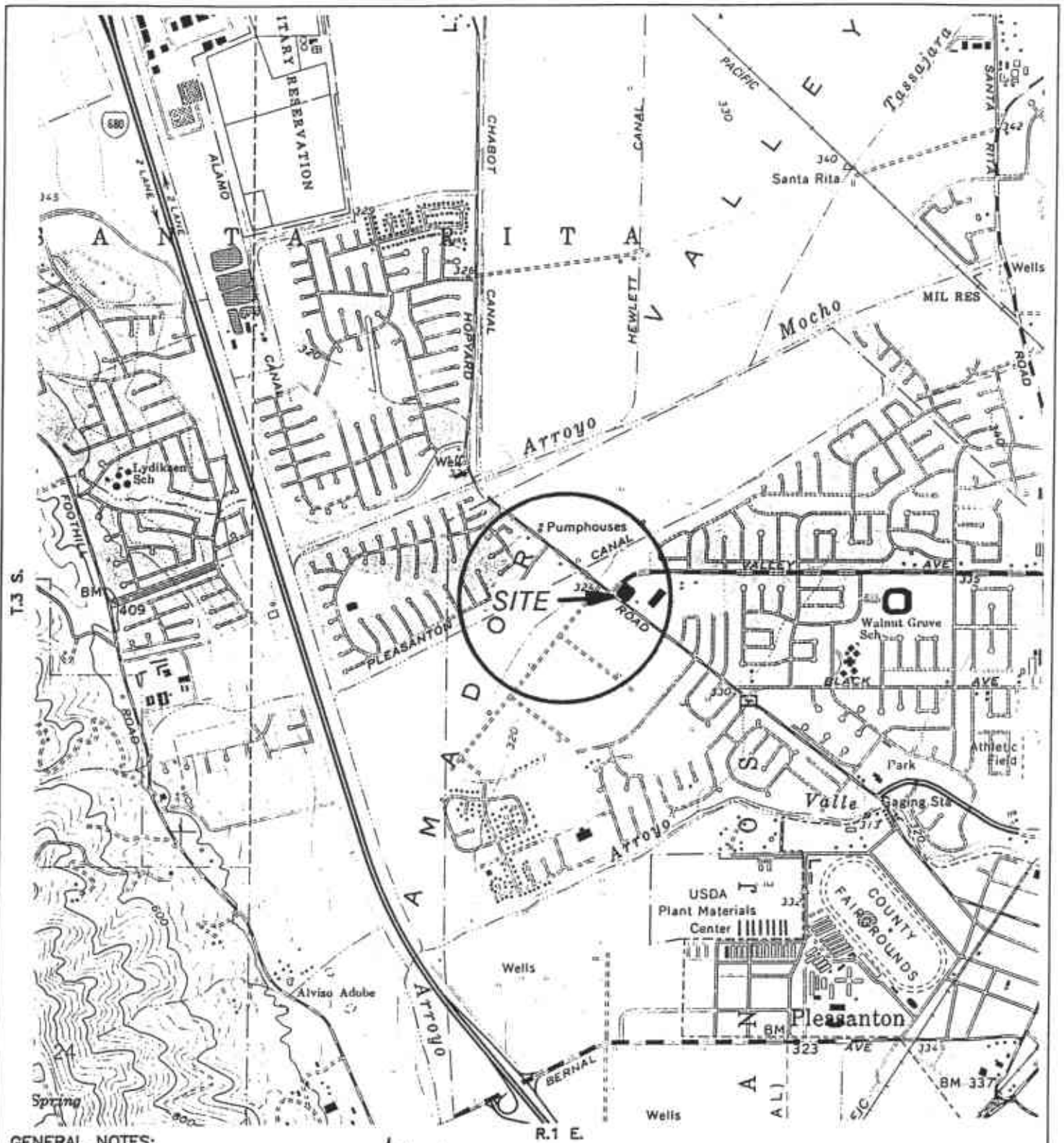

GENERAL NOTES:
 BASE MAP FROM U.S.G.S.
 DUBLIN, CA.
 7.5 MINUTE TOPOGRAPHIC
 PHOTOREVISED 1980

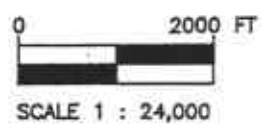
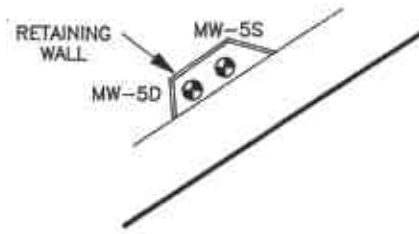

FIGURE 1
 SITE LOCATION MAP
 EXXON STATION NO 7-3399
 2991 HOPYARD ROAD
 PLEASANTON, CA.

PROJECT NO. D094-836	DRAWN BY L.H. 9/22/94
FILE NO. ---	PREPARED BY TMG
REVISION NO. 1	REVIEWED BY [Signature]





LEGEND:

- ⊕ MW-1 MONITORING WELL LOCATION
- ⊙ VR-1 VAPOR EXTRACTION WELL LOCATION
- MW-2 DESTROYED MONITORING WELL
- B-12 SOIL BORING LOCATION
- ⊙ 36" WELL BOX/POSSIBLE VAPOR EXTRACTION WELL LOCATION

VALLEY AVENUE

HOPYARD ROAD

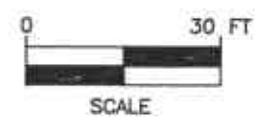
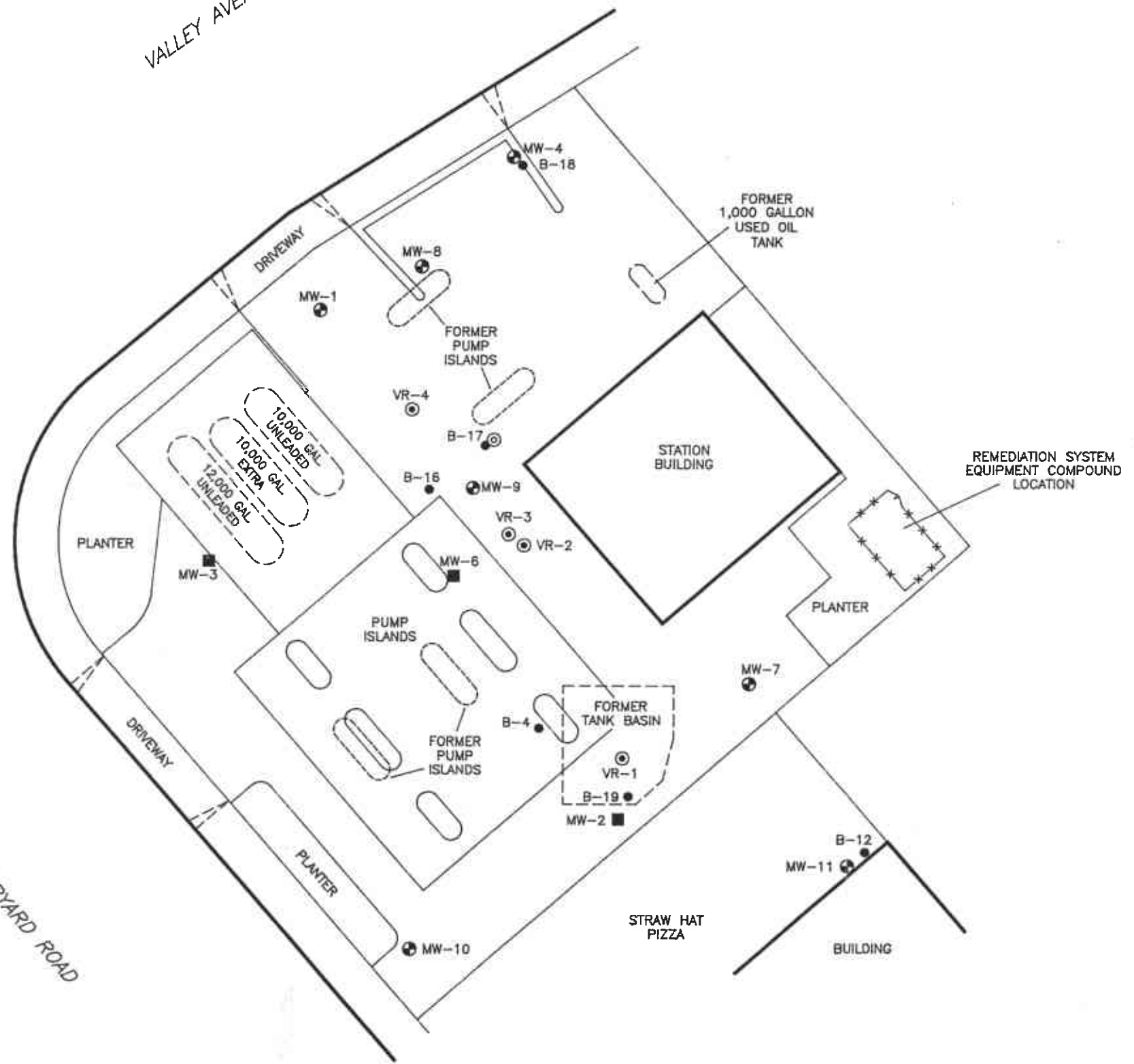

NOTE:
BASE MAP ADAPTED FROM RESNA FIGURE. SITE DIMENSIONS AND FACILITY LOCATIONS NOT VERIFIED.

FIGURE 2
SITE MAP
EXXON STATION NO 7-3399
2991 HOPYARD ROAD
PLEASANTON, CA.

PROJECT NO. 0094-836	DRAWN BY M.L. 7/8/97
FILE NO. 94-836-1	PREPARED BY CKA
REVISION NO. 8	REVIEWED BY <i>CKA</i>

Delta
Environmental
Consultants, Inc.

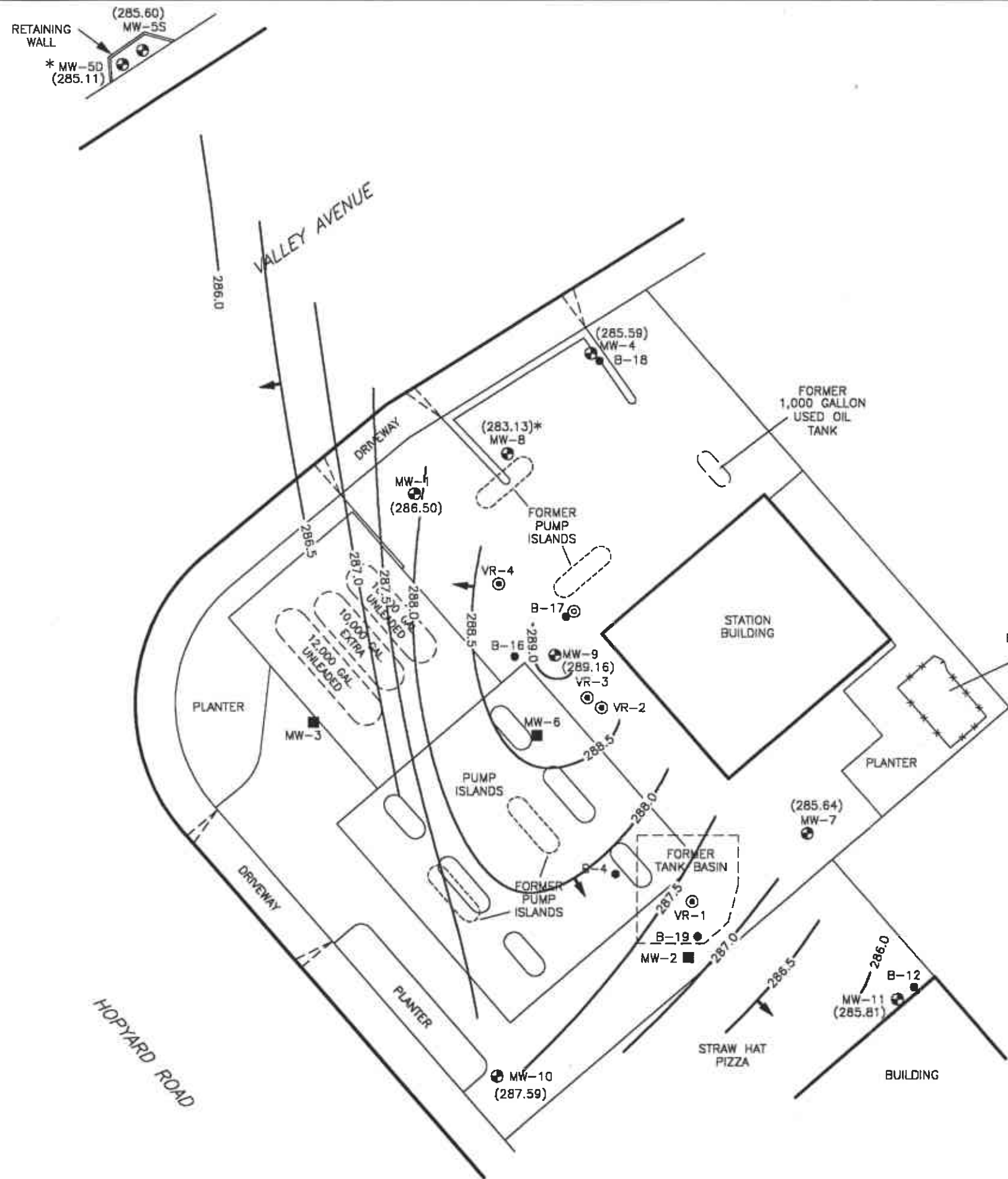

LEGEND:

- ⊕ MW-1 MONITORING WELL LOCATION
- ⊙ VR-1 VAPOR EXTRACTION WELL LOCATION
- MW-2 DESTROYED MONITORING WELL
- B-12 SOIL BORING LOCATION
- ⊙ 36" WELL BOX/POSSIBLE VAPOR EXTRACTION WELL LOCATION
- (283.13) GROUND WATER ELEVATION IN FEET ABOVE MEAN SEA LEVEL
- 288.5 — WATER ELEVATION CONTOUR IN FEET ABOVE MEAN SEA LEVEL
- ➔ GROUND WATER FLOW DIRECTION
- NM NOT MEASURED

NOTE:

* MONITORING WELLS MW-5D AND MW-8 WERE NOT USED IN THE CALCULATION OF THE WATER TABLE CONTOURS BECAUSE THEY ARE SCREENED IN LOWER WATER BEARING ZONES.

NOTE:

BASE MAP ADAPTED FROM RESNA FIGURE. SITE DIMENSIONS AND FACILITY LOCATIONS NOT VERIFIED.

FIGURE 3
GROUND WATER ELEVATION CONTOUR MAP
9/11/98
EXXON STATION NO 7-3399
2991 HOPYARD ROAD
PLEASANTON, CA.

PROJECT NO. D094-836	DRAWN BY M.L. 10/12/98
FILE NO. 94-836-1	PREPARED BY BHH
REVISION NO. 1	REVIEWED BY RB 1/23/99



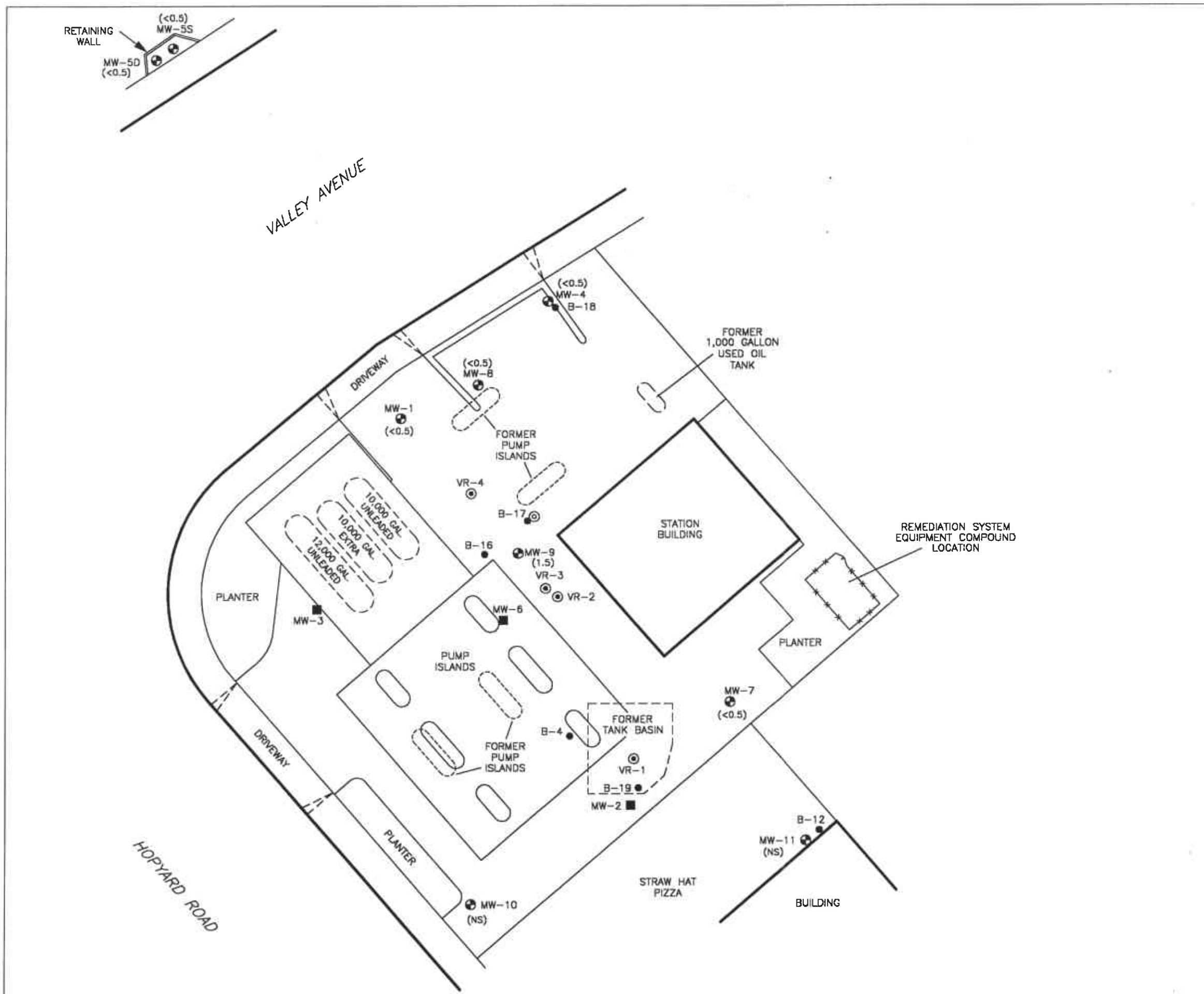

- LEGEND:
- MW-1 MONITORING WELL LOCATION
 - ⊙ VR-1 VAPOR EXTRACTION WELL LOCATION
 - MW-2 DESTROYED MONITORING WELL
 - B-12 SOIL BORING LOCATION
 - ⊙ 36" WELL BOX/POSSIBLE VAPOR EXTRACTION WELL LOCATION
 - (<math><0.5</math>) DISSOLVED BENZENE CONCENTRATION IN GROUND WATER IN MICROGRAMS PER LITER
 - (NS) NOT SAMPLED

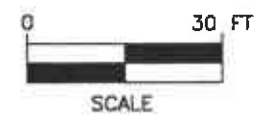

NOTE:
 BASE MAP ADAPTED FROM RESNA FIGURE. SITE DIMENSIONS AND FACILITY LOCATIONS NOT VERIFIED.

FIGURE 4
 DISSOLVED BENZENE CONCENTRATION MAP
 9/11/98
 EXXON STATION NO 7-3399
 2991 HOPYARD ROAD
 PLEASANTON, CA.

PROJECT NO. 0094-836	DRAWN BY M.L 10/12/98	
FILE NO. 94-836-1	PREPARED BY BHH	
REVISION NO. 1	REVIEWED BY JTB n/12/98	

ENCLOSURE A

Field Methods and Procedures

FIELD METHODS AND PROCEDURES

1.0 GROUND WATER AND LIQUID-PHASE PETROLEUM HYDROCARBON

DEPTH ASSESSMENT

A water/petroleum interface probe was used to assess the liquid-phase petroleum hydrocarbons (LPH) thickness if present, and a water level indicator was used to assess ground water depth in monitoring wells that do not contain LPH. Depth to ground water was measured from the top of each monitoring well casing. The tip of the water level indicator was subjectively analyzed for hydrocarbon sheen. All measurements and physical observations were recorded in the field.

2.0 SUBJECTIVE ANALYSIS OF GROUND WATER

Prior to purging, a water sample was collected from the monitoring well for subjective assessment. The sample was retrieved by gently lowering a clean, disposable bailer to approximately one-half the bailer length past the air/liquid interface. The bailer was then retrieved and the sample contained within the bailer was examined for floating LPH and the appearance of an LPH sheen.

3.0 MONITORING WELL PURGING AND SAMPLING

Monitoring wells were purged using a centrifugal pump until pH, temperature, and conductivity of the purge water had stabilized and a minimum of three well volumes of water had been removed. Ground water removed from the wells was stored in 55-gallon barrels at the site. The barrels were labeled with corresponding monitoring well numbers and the date of purging. After purging, ground water levels were allowed to stabilize. A ground water sample was then removed from each of the wells using a disposable bailer. If the well was purged dry, it was allowed to sufficiently recharge and a sample was collected. Samples were collected in air-tight vials, appropriately labeled, and stored on ice from the time of collection through the time of delivery to the laboratory. A chain-of-custody form was completed to document possession of the samples. Ground water samples were transported to the laboratory and analyzed within the EPA-specified holding times for the requested analyses. Purge water will be collected from the storage barrels in a vacuum truck and transported to an appropriate facility for treatment and/or disposal.

ENCLOSURE B

Cumulative Ground Water Monitoring Data

TABLE 1

CUMULATIVE GROUND WATER MONITORING DATA

Exxon Service Station No. 7-3399
2991 Hopyard Road
Pleasanton, California

Monitoring Well	Date	Reference Elevation (ft)	Depth to Water (ft)	Ground Water Elevation (ft)	Benzene (µg/L)	Toluene (µg/L)	Ethyl-benzene (µg/L)	Total Xylenes (µg/L)	TPPH as gasoline (µg/L)	MTBE (µg/L)	Oxygenate Compounds (µg/L)	Industrial Solvents (mg/L)	Comments
MW-1	04/02/88	321.44	NM	NC	<0.5	1.7	<0.5	<0.5	<20	NA	NA	NA	Not measured
	04/06/88		36.34	285.10	NS	NS	NS	NS	NS	NS	NS	NS	No LPH
	04/08/88		36.29	285.15	NS	NS	NS	NS	NS	NS	NS	NS	No LPH
	04/19/88		36.36	285.08	NS	NS	NS	NS	NS	NS	NS	NS	No LPH
	06/06/88		38.16	283.28	NS	NS	NS	NS	NS	NS	NS	NS	No LPH
	06/23/88		38.71	282.73	NS	NS	NS	NS	NS	NS	NS	NS	No LPH
	06/28/88		39.16	282.28	NS	NS	NS	NS	NS	NS	NS	NS	No LPH
	07/06/88		39.73	281.71	<0.5	<0.5	<0.5	<0.5	<20	NA	NA	NA	No LPH
	07/13/88		40.22	281.22	<0.5	<0.5	<0.5	<0.5	<20	NA	NA	NA	No LPH
	08/12/88		NM	NC	NS	NS	NS	NS	NS	NS	NS	NS	Not measured
	08/26/88		41.90	279.54	NS	NS	NS	NS	NS	NS	NS	NS	No LPH
	09/07/88		42.27	279.17	<0.5	<0.5	<0.5	<0.5	<20	NA	NA	NA	No LPH
	12/07/88		43.94	277.50	NS	NS	NS	NS	NS	NS	NS	NS	No LPH
	12/19/88		43.70	277.74	NS	NS	NS	NS	NS	NS	NS	NS	No LPH
	02/09/89		42.53	278.91	NS	NS	NS	NS	NS	NS	NS	NS	No LPH
	03/03/89		NM	NC	1.6	<0.5	<0.5	<0.5	<20	NA	NA	NA	Not measured
	03/08/89		41.96	279.48	NS	NS	NS	NS	NS	NS	NS	NS	No LPH
	04/03/89		41.59	279.85	NS	NS	NS	NS	NS	NS	NS	NS	No LPH
	04/26/89		41.67	279.77	NS	NS	NS	NS	NS	NS	NS	NS	No LPH
	06/30/89		43.79	277.65	<0.5	<0.5	<0.5	<0.5	<20	NA	NA	NA	No LPH
	07/17/89		44.74	276.70	<0.5	<0.5	<0.5	<0.5	23	NA	NA	NA	No LPH
	07/18/89		44.76	276.68	NS	NS	NS	NS	NS	NS	NS	NS	No LPH
	07/19/89		44.82	276.62	NS	NS	NS	NS	NS	NS	NS	NS	No LPH
	07/20/89		44.85	276.59	<0.5	<0.5	<0.5	<0.5	<20	NA	NA	NA	No LPH
	07/21/89		44.95	276.49	NS	NS	NS	NS	NS	NS	NS	NS	No LPH
	07/26/89		45.42	276.02	<0.5	<0.5	<0.5	<0.5	<20	NA	NA	NA	No LPH
	08/02/89		NM	NC	<0.5	<0.5	<0.5	<0.5	<20	NA	NA	NA	Not measured
	08/03/89		46.18	275.26	NS	NS	NS	NS	NS	NS	NS	NS	No LPH
	08/17/89		47.12	274.32	NS	NS	NS	NS	NS	NS	NS	NS	No LPH
	09/13/89		49.08	272.36	39	0.6	<0.5	5.1	220	NA	NA	NA	No LPH
	11/28/89		50.21	271.23	NS	NS	NS	NS	NS	NS	NS	NS	No LPH
	12/20/89		NM	NC	56	0.72	<0.5	0.71	220	NA	NA	NA	Not measured

TABLE 1

CUMULATIVE GROUND WATER MONITORING DATA

Exxon Service Station No. 7-3399

2991 Hopyard Road

Pleasanton, California

Monitoring Well	Date	Reference Elevation (ft)	Depth to Water (ft)	Ground Water Elevation (ft)	Benzene (µg/L)	Toluene (µg/L)	Ethyl-benzene (µg/L)	Total Xylenes (µg/L)	TPPH as gasoline (µg/L)	MTBE (µg/L)	Oxygenate Compounds (µg/L)	Industrial Solvents (mg/L)	Comments
MW-1	01/09/90	321.44	49.31	272.13	NS	NS	NS	NS	NS	NS	NS	NS	No LPH
(Cont.)	01/25/90		NM	NC	18	1.6	<0.5	1.8	57	NA	NA	NA	Not measured
	01/26/90		49.29	272.15	NS	NS	NS	NS	NS	NS	NS	NS	No LPH
	02/23/90		49.02 ^a	272.42	NS	NS	NS	NS	NS	NS	NS	NS	No LPH
	02/23/90		49.02	272.42	NS	NS	NS	NS	NS	NS	NS	NS	No LPH
	02/27/90		NM	NC	3.2	2.3	<0.5	3.2	55	NA	NA	NA	Not measured
	03/26/90		48.71 ^a	272.73	<0.5	<0.5	<0.5	<0.5	<20	NA	NA	NA	No LPH
	03/26/90		48.70	272.74	NS	NS	NS	NS	NS	NS	NS	NS	No LPH
	04/18/90		48.79	272.65	1.1	1.6	<0.5	3.1	25	NA	NA	NA	No LPH
	05/17/90		49.40	272.04	<0.5	<0.5	<0.5	<0.5	<20	NA	NA	NA	No LPH
	06/11/90		50.83	270.61	<0.5	<0.5	<0.5	<0.5	<20	NA	NA	NA	No LPH
	07/30/90		52.17	269.27	<0.5	<0.5	<0.5	<0.5	<20	NA	NA	NA	No LPH
	08/27/90		53.44	268.00	<0.5	<0.5	<0.5	<0.5	<20	NA	NA	NA	No LPH
	09/28/90		53.40	268.04	<0.5	<0.5	<0.5	<0.5	<50	NA	NA	NA	No LPH
	12/27/90		NM	NC	NS	NS	NS	NS	NS	NS	NS	NS	Not measured
	03/20/91		53.35	268.09	NS	NS	NS	NS	NS	NS	NS	NS	No LPH
	06/20/91		53.55	267.89	NS	NS	NS	NS	NS	NS	NS	NS	No LPH
	09/12/91		NM	NC	NS	NS	NS	NS	NS	NS	NS	NS	Not measured
	12/30/91		NM	NC	NS	NS	NS	NS	NS	NS	NS	NS	Not measured
	12/10/92		NM	NC	NS	NS	NS	NS	NS	NS	NS	NS	Not measured
	01/30/92		NM	NC	NS	NS	NS	NS	NS	NS	NS	NS	Not measured
	02/16/93		NM	NC	NS	NS	NS	NS	NS	NS	NS	NS	Not measured
	03/02/92		NM	NC	NS	NS	NS	NS	NS	NS	NS	NS	Not measured
	03/24/92		NM	NC	NS	NS	NS	NS	NS	NS	NS	NS	Not measured
	04/14/92		NM	NC	NS	NS	NS	NS	NS	NS	NS	NS	Not measured
	05/21/92		NM	NC	NS	NS	NS	NS	NS	NS	NS	NS	Not measured
	06/08/92		NM	NC	NS	NS	NS	NS	NS	NS	NS	NS	Not measured
	07/14/92		NM	NC	NS	NS	NS	NS	NS	NS	NS	NS	Not measured
	08/10/92		NM	NC	NS	NS	NS	NS	NS	NS	NS	NS	Not measured
	09/16/92		NM	NC	NS	NS	NS	NS	NS	NS	NS	NS	Not measured
	10/07/92		NM	NC	NS	NS	NS	NS	NS	NS	NS	NS	Not measured
	11/09/92		NM	NC	NS	NS	NS	NS	NS	NS	NS	NS	Not measured
	12/10/92		NM	NC	NS	NS	NS	NS	NS	NS	NS	NS	Dry
													Not measured

TABLE 1

CUMULATIVE GROUND WATER MONITORING DATA

Exxon Service Station No. 7-3399

2991 Hopyard Road

Pleasanton, California

Monitoring Well	Date	Reference Elevation (ft)	Depth to Water (ft)	Ground Water Elevation (ft)	Benzene (µg/L)	Toluene (µg/L)	Ethyl-benzene (µg/L)	Total Xylenes (µg/L)	TPPH as gasoline (µg/L)	MTBE (µg/L)	Oxygenate Compounds (µg/L)	Industrial Solvents (mg/L)	Comments
MW-1	01/26/93	321.44	NM	NC	NS	NS	NS	NS	NS	NS	NS	NS	Not measured
(Cont.)	02/16/93		NM	NC	NS	NS	NS	NS	NS	NS	NS	NS	Not measured
	03/11/93		53.09	268.35	NS	NS	NS	NS	NS	NS	NS	NS	No LPH
	04/12/93		53.32	268.12	NS	NS	NS	NS	NS	NS	NS	NS	No LPH
	06/01/93		53.40	268.04	NS	NS	NS	NS	NS	NS	NS	NS	No LPH
	07/15/93		59.80	261.64	NS	NS	NS	NS	NS	NS	NS	NS	No LPH
	08/15/93		53.45	267.99	NS	NS	NS	NS	NS	NS	NS	NS	No LPH
	09/29/93		53.43	268.01	NS	NS	NS	NS	NS	NS	NS	NS	No LPH
	09/30/93		NM	NC	<0.5	<0.5	<0.5	<0.5	<50	NA	NA	NA	Not measured
	10/28/93		53.38	268.06	NS	NS	NS	NS	NS	NS	NS	NS	No LPH
	11/23/93		53.46	267.98	NS	NS	NS	NS	NS	NS	NS	NS	No LPH
	11/24/93		NM	NC	<0.5	<0.5	<0.5	<0.5	<50	NA	NA	NA	Not measured
	03/10-11/94		53.46	267.98	<0.5	<0.5	<0.5	<0.5	<50	NA	NA	NA	No LPH
	05/04-05/94		53.34	268.10	<0.5	<0.5	<0.5	<0.5	<50	NA	NA	NA	No LPH
	09/01/94 ^e		NM	NC	<0.5	<0.5	<0.5	<0.5	<50	NA	NA	NA	No LPH
	11/16/94		52.09	269.35	<0.5	<0.5	<0.5	<0.5	<50	NA	NA	NA	No LPH
	02/15/95		49.41	272.03	<0.5	<0.5	<0.5	<0.5	<50	NA	NA	NA	No LPH
	05/09/95		39.97	281.47	<0.5	<0.5	<0.5	<0.5	<50	NA	NA	NA	No LPH
	08/21/95		40.68	280.76	<0.5	0.83	<0.5	<0.5	<50	<2.5	NA	NA	No LPH
	11/30/95		38.99	282.45	<0.5	<0.5	<0.5	<0.5	<50	<5.0	NA	NA	No LPH
	03/28/96		35.70	285.74	<0.5	<0.5	<0.5	<0.5	<50	<5.0	NA	NA	No LPH
	05/31/96		34.17	287.27	<0.5	<0.5	<0.5	<0.5	52	<5.0	NA	NA	No LPH
	08/28/96		38.37	283.07	<0.5	<0.5	<0.5	<0.5	<50	<5.0	NA	NA	No LPH
	11/18/96		38.40	283.04	<0.5	<0.5	<0.5	<0.5	<50	<5.0	NA	NA	No LPH
	02/28/97		33.29	288.15	<0.5	<0.5	<0.5	<0.5	<50	<2.5	NA	NA	No LPH
	05/23/97		33.63	287.91	<0.5	<0.5	<0.5	<0.5	<50	<2.5	NA	NA	No LPH
	09/23/97		38.05	283.39	<0.5	<0.5	<0.5	<0.5	<50	29	NA	NA	No LPH
	12/30/97		36.74	284.70	<0.5	<0.5	<0.5	<0.5	<50	NA	ND	<1.0	No LPH
	03/24/98		31.65	289.79	1.4	2.5	<0.5	1.4	<50	16	NA	NA	No LPH
	06/15/98		29.28	292.16	<0.5	<0.5	<0.5	<0.5	<50	22	NA	NA	No LPH
	09/11/98		34.94	286.50	<0.5	<0.5	<0.5	<0.5	<50	<2.5	NA	NA	No LPH

TABLE 1

CUMULATIVE GROUND WATER MONITORING DATA

Exxon Service Station No. 7-3399
2991 Hopyard Road
Pleasanton, California

Monitoring Well	Date	Reference Elevation (ft)	Depth to Water (ft)	Ground Water Elevation (ft)	Benzene (µg/L)	Toluene (µg/L)	Ethyl-benzene (µg/L)	Total Xylenes (µg/L)	TPPH as gasoline (µg/L)	MTBE (µg/L)	Oxygenate Compounds (µg/L)	Industrial Solvents (mg/L)	Comments	
MW-2	04/02/88	NM	NM	NC	NS	NS	NS	NS	NS	NS	NS	NS	0.25	
	04/04/88		NM	NC	NS	NS	NS	NS	NS	NS	NS	NS	1.5	
	04/05/88		NM	NC	NS	NS	NS	NS	NS	NS	NS	NS	1.5	
	04/06/88		39.31	NC	NS	NS	NS	NS	NS	NS	NS	NS	3.2	
	04/08/88		NM	NC	NS	NS	NS	NS	NS	NS	NS	NS	Not measured	
	04/19/88		38.90	NC	NS	NS	NS	NS	NS	NS	NS	NS	2.48	
	06/06/88		38.78	NC	NS	NS	NS	NS	NS	NS	NS	NS	0.26	
	06/23/88		39.23	NC	NS	NS	NS	NS	NS	NS	NS	NS	0.13	
	06/28/88		39.72	NC	NS	NS	NS	NS	NS	NS	NS	NS	Not measured	
	07/06/88		40.31	NC	25,700	18,500	2,900	21,400	62,000	NA	NA	NA	NA	Slight sheen
	07/12/88		Well destroyed											
MW-3	04/06/88	NM	37.19	NC	<0.5	<0.5	<0.5	<0.5	20	NA	NA	NA	No LPH	
	04/08/88		37.14	NC	NS	NS	NS	NS	NS	NS	NS	NS	No LPH	
	04/19/88		37.22	NC	NS	NS	NS	NS	NS	NS	NS	NS	No LPH	
	06/06/88		39.02	NC	NS	NS	NS	NS	NS	NS	NS	NS	No LPH	
	06/23/88		39.58	NC	NS	NS	NS	NS	NS	NS	NS	NS	No LPH	
	06/28/88		40.04	NC	NS	NS	NS	NS	NS	NS	NS	NS	No LPH	
	07/06/88		40.60	NC	<0.5	<0.5	<0.5	<0.5	<20	NA	NA	NA	NA	No LPH
	07/13/88		41.09	NC	<0.5	<0.5	<0.5	<0.5	<20	NA	NA	NA	NA	No LPH
	08/12/88		NM	NC	NS	NS	NS	NS	NS	NS	NS	NS	NS	No LPH
	08/26/88		42.77	NC	<0.5	<0.5	<0.5	<0.5	<20	NA	NA	NA	NA	Not measured
	08/29/88		Well destroyed											

TABLE 1

CUMULATIVE GROUND WATER MONITORING DATA

Exxon Service Station No. 7-3399

2991 Hopyard Road

Pleasanton, California

Monitoring Well	Date	Reference Elevation (ft)	Depth to Water (ft)	Ground Water Elevation (ft)	Benzene (µg/L)	Toluene (µg/L)	Ethyl-benzene (µg/L)	Total Xylenes (µg/L)	TPPH as gasoline (µg/L)	MTBE (µg/L)	Oxygenate Compounds (µg/L)	Industrial Solvents (mg/L)	Comments
MW-4	04/08/88	321.56	36.41	285.15	NS	NS	NS	NS	NS	NS	NS	NS	No LPH
	04/11/88		NM	NC	1.8	16.3	0.6	7.1	80	NA	NA	NA	Not measured
	04/19/88		36.51	285.05	NS	NS	NS	NS	NS	NS	NS	NS	No LPH
	06/06/88		38.26	283.30	NS	NS	NS	NS	NS	NS	NS	NS	No LPH
	06/23/88		38.83	282.73	NS	NS	NS	NS	NS	NS	NS	NS	No LPH
	06/28/88		39.28	282.28	NS	NS	NS	NS	NS	NS	NS	NS	No LPH
	07/06/88		39.85	281.71	<0.5	<0.5	<0.5	<0.5	<20	NA	NA	NA	No LPH
	07/13/88		40.31	281.25	<0.5	0.9	<0.5	<0.5	<20	NA	NA	NA	No LPH
	08/12/88		NM	NC	NS	NS	NS	NS	NS	NS	NS	NS	Not measured
	08/26/88		42.01	279.55	NS	NS	NS	NS	NS	NS	NS	NS	No LPH
	09/07/88		NM	NC	NS	NS	NS	NS	NS	NS	NS	NS	Not measured
	12/07/88		NM	NC	NS	NS	NS	NS	NS	NS	NS	NS	Not measured
	12/19/88		43.83	277.73	NS	NS	NS	NS	NS	NS	NS	NS	No LPH
	02/09/89		42.67	278.89	NS	NS	NS	NS	NS	NS	NS	NS	No LPH
	03/08/89		42.11	279.45	3.8	1.0	<0.5	<0.5	440	NA	NA	NA	No LPH
	04/03/89		41.73	279.83	NS	NS	NS	NS	NS	NS	NS	NS	No LPH
	04/26/89		41.79	279.77	NS	NS	NS	NS	NS	NS	NS	NS	No LPH
	06/30/89		43.88	277.68	<0.5	<0.5	<0.5	<0.5	100	NA	NA	NA	No LPH
	07/17/89		44.85	276.71	<0.5	<0.5	<0.5	<0.5	390	NA	NA	NA	No LPH
	07/18/89		44.88	276.68	NS	NS	NS	NS	NS	NS	NS	NS	No LPH
	07/19/89		44.92	276.64	NS	NS	NS	NS	NS	NS	NS	NS	No LPH
	07/20/89		44.98	276.58	<0.5	<0.5	<0.5	<0.5	200	NA	NA	NA	No LPH
	07/21/89		45.04	276.52	NS	NS	NS	NS	NS	NS	NS	NS	No LPH
	07/26/89		45.50	276.06	<0.5	<0.5	<0.5	<0.5	66	NA	NA	NA	No LPH
	08/02/89		NM	NC	NS	NS	NS	NS	NS	NS	NS	NS	Not measured
	08/03/89		46.28	275.28	NS	NS	NS	NS	NS	NS	NS	NS	No LPH
	08/17/89		47.22	274.34	NS	NS	NS	NS	NS	NS	NS	NS	No LPH
	09/13/89		49.19	272.37	<0.5	<0.5	<0.5	<0.5	<20	NA	NA	NA	No LPH
	11/28/89		50.34	271.22	NS	NS	NS	NS	NS	NS	NS	NS	No LPH
	12/20/89		NM	NC	<0.5	<0.5	<0.5	<0.5	<20	NA	NA	NA	Not measured
	01/09/90		49.47	272.09	NS	NS	NS	NS	NS	NS	NS	NS	No LPH
	01/26/90		49.36	272.20	NS	NS	NS	NS	NS	NS	NS	NS	No LPH
	02/23/90		49.18 ^a	272.38	NS	NS	NS	NS	NS	NS	NS	NS	No LPH

TABLE 1

CUMULATIVE GROUND WATER MONITORING DATA

Exxon Service Station No. 7-3399

2991 Hopyard Road

Pleasanton, California

Monitoring Well	Date	Reference Elevation (ft)	Depth to Water (ft)	Ground Water Elevation (ft)	Benzene (µg/L)	Toluene (µg/L)	Ethyl-benzene (µg/L)	Total Xylenes (µg/L)	TPPH as gasoline (µg/L)	MTBE (µg/L)	Oxygenate Compounds (µg/L)	Industrial Solvents (mg/L)	Comments
MW-4	02/23/90	321.56	49.15	272.41	NS	NS	NS	NS	NS	NS	NS	NS	No LPH
(Cont.)	03/26/90		48.84*	272.72	<0.5	<0.5	<0.5	<0.5	<20	NA	NA	NA	No LPH
	03/26/90		48.83	272.73	NS	NS	NS	NS	NS	NS	NS	NS	No LPH
	04/18/90		48.90	272.66	NS	NS	NS	NS	NS	NS	NS	NS	No LPH
	05/17/90		50.03	271.53	NS	NS	NS	NS	NS	NS	NS	NS	No LPH
	06/11/90		50.98	270.58	NS	NS	NS	NS	NS	NS	NS	NS	No LPH
	07/30/90		53.57	267.99	NS	NS	NS	NS	NS	NS	NS	NS	No LPH
	08/01/90		NM	NC	<0.5	<0.5	<0.5	<0.5	<20	NA	NA	NA	Not measured
	08/27/90		53.61	267.95	NS	NS	NS	NS	NS	NS	NS	NS	No LPH
	09/28/90		53.57	267.99	NS	NS	NS	NS	NS	NS	NS	NS	No LPH
	12/27/90		53.68	267.88	<0.5	<0.5	<0.5	<0.5	<50	NA	NA	NA	No LPH
	03/20/91		53.56	268.00	<0.5	<0.5	<0.5	<0.5	<50	NA	NA	NA	No LPH
	06/20/91		53.75	267.81	NS	NS	NS	NS	NS	NS	NS	NS	No LPH
	09/12/91		53.70	267.86	NS	NS	NS	NS	NS	NS	NS	NS	No LPH
	12/30/91		NM	NC	NS	NS	NS	NS	NS	NS	NS	NS	Dry
	01/30/92		NM	NC	NS	NS	NS	NS	NS	NS	NS	NS	Dry
	03/02/92		53.83	267.73	NS	NS	NS	NS	NS	NS	NS	NS	No LPH
	03/24/92		53.73	267.83	<0.5	<0.5	<0.5	<0.5	<50	NA	NA	NA	No LPH
	12/10/92		NM	NC	NS	NS	NS	NS	NS	NS	NS	NS	Not measured
	04/14/92		53.76	267.80	NS	NS	NS	NS	NS	NS	NS	NS	No LPH
	05/21/92		54.73	266.83	NS	NS	NS	NS	NS	NS	NS	NS	No LPH
	06/08/92		53.80	267.76	NS	NS	NS	NS	NS	NS	NS	NS	No LPH
	07/14/92		53.60	267.96	NS	NS	NS	NS	NS	NS	NS	NS	No LPH
	08/10/92		53.71	267.85	NS	NS	NS	NS	NS	NS	NS	NS	No LPH
	09/16/92		53.89	267.67	NS	NS	NS	NS	NS	NS	NS	NS	No LPH
	10/07/92		NM	NC	NS	NS	NS	NS	NS	NS	NS	NS	Dry
	11/09/92		NM	NC	NS	NS	NS	NS	NS	NS	NS	NS	Dry
	12/10/92		53.83	267.73	57	34	11	200	600	NA	NA	NA	No LPH
	01/26/93		NM	NC	NS	NS	NS	NS	NS	NS	NS	NS	Dry
	02/16/93		53.64	267.92	NS	NS	NS	NS	NS	NS	NS	NS	No LPH
	03/11/93		53.54	268.02	NS	NS	NS	NS	NS	NS	NS	NS	No LPH
	04/12/93		53.62	267.94	20	10	22	80	360	NA	NA	NA	No LPH
	06/01/93		53.52	268.04	NS	NS	NS	NS	NS	NS	NS	NS	No LPH

TABLE 1

CUMULATIVE GROUND WATER MONITORING DATA

Exxon Service Station No. 7-3399

2991 Hopyard Road

Pleasanton, California

Monitoring Well	Date	Reference Elevation (ft)	Depth to Water (ft)	Ground Water Elevation (ft)	Benzene (µg/L)	Toluene (µg/L)	Ethyl-benzene (µg/L)	Total Xylenes (µg/L)	TPPH as gasoline (µg/L)	MTBE (µg/L)	Oxygenate Compounds (µg/L)	Industrial Solvents (mg/L)	Comments
MW-4	07/15/93	321.56	53.80	267.76	NS	NS	NS	NS	NS	NS	NS	NS	No LPH
(Cont.)	08/15/93		53.65	267.91	NS	NS	NS	NS	NS	NS	NS	NS	No LPH
	09/29/93		54.23	267.33	NS	NS	NS	NS	NS	NS	NS	NS	No LPH
	09/30/93		NM	NC	<0.5	<0.5	<0.5	<0.5	<50	NA	NA	NA	Not measured
	10/28/93		53.54	268.25	NS	NS	NS	NS	NS	NS	NS	NS	No LPH
	11/23/93		53.57	267.99	NS	NS	NS	NS	NS	NS	NS	NS	No LPH
	11/24/93		NM	NC	<0.5	<0.5	<0.5	<0.5	<50	NA	NA	NA	Not measured
	03/10-11/94		53.64	267.92	<0.5	<0.5	<0.5	<0.5	<50	NA	NA	NA	No LPH
	05/04-05/94		53.54	268.02	<0.5	<0.5	<0.5	<0.5	<50	NA	NA	NA	No LPH
	09/01/94°		NM	NM	<0.5	<0.5	<0.5	<0.5	<50	NA	NA	NA	No LPH
	11/16/94		52.96	268.60	<0.5	<0.5	<0.5	<0.5	<50	NA	NA	NA	No LPH
	02/15/95		50.37	271.19	<0.5	<0.5	<0.5	<0.5	<50	NA	NA	NA	No LPH
	05/09/95		44.86	276.70	<0.5	<0.5	<0.5	<0.5	<50	NA	NA	NA	No LPH
	08/21/95		41.71	279.85	<0.5	<0.5	<0.5	<0.5	<50	2.6	NA	NA	No LPH
	11/30/95		39.95	281.61	<0.5	<0.5	<0.5	<0.5	<50	<5.0	NA	NA	No LPH
	03/28/96		36.76	284.80	<0.5	<0.5	<0.5	<0.5	<50	<5.0	NA	NA	No LPH
	05/31/96		35.19	286.37	<0.5	<0.5	<0.5	<0.5	<50	<5.0	NA	NA	No LPH
	08/28/96		39.39	282.17	NS	NS	NS	NS	NS	NS	NA	NA	No LPH
	11/18/96		39.42	282.14	NS	NS	NS	NS	NS	NS	NS	NS	No LPH
	02/28/97		34.38	287.18	NS	NS	NS	NS	NS	NS	NS	NS	No LPH
	05/23/97		34.66	286.90	NS	NS	NS	NS	NS	NS	NS	NS	No LPH
	09/23/97		39.05	282.51	<0.5	<0.5	<0.5	<0.5	<50	<2.5	NA	NA	No LPH
	12/30/97		37.78	283.78	NS	NS	NS	NS	NS	NS	NS	NS	No LPH
	03/24/98		NM	NC	NS	NS	NS	NS	NS	NS	NS	NS	Not measured
	06/15/98		30.32	291.24	NS	NS	NS	NS	NS	NS	NS	NS	No LPH
	09/11/98		35.97	285.59	<0.5	<0.5	<0.5	<0.5	<50	<2.5	NA	NA	No LPH

TABLE 1

CUMULATIVE GROUND WATER MONITORING DATA

Exxon Service Station No. 7-3399

2991 Hopyard Road

Pleasanton, California

Monitoring Well	Date	Reference Elevation (ft)	Depth to Water (ft)	Ground Water Elevation (ft)	Benzene (µg/L)	Toluene (µg/L)	Ethyl-benzene (µg/L)	Total Xylenes (µg/L)	TPPH as gasoline (µg/L)	MTBE (µg/L)	Oxygenate Compounds (µg/L)	Industrial Solvents (mg/L)	Comments
MW-5S	05/25/88	321.64	38.46	283.18	<0.5	0.9	<0.5	<0.5	<20	NA	NA	NA	No LPH
	06/06/88		38.86	282.78	NS	NS	NS	NS	NS	NS	NS	NS	No LPH
	06/23/88		39.52	282.12	NS	NS	NS	NS	NS	NS	NS	NS	No LPH
	06/28/88		39.84	281.80	NS	NS	NS	NS	NS	NS	NS	NS	No LPH
	07/06/88		40.45	281.19	<0.5	<0.5	<0.5	<0.5	<20	NA	NA	NA	No LPH
	07/13/88		40.90	280.74	<0.5	<0.5	<0.5	<0.5	<20	NA	NA	NA	No LPH
	07/22/88		41.30	280.34	0.9	4.1	1.3	8.7	50	NA	NA	NA	No LPH
	08/05/88		23.84 ^b	297.80	<0.5	<0.5	<0.5	<0.5	<20	NA	NA	NA	No LPH
	08/12/88		42.21	279.43	NS	NS	NS	NS	NS	NS	NS	NS	No LPH
	08/26/88		42.55	279.09	NS	NS	NS	NS	NS	NS	NS	NS	No LPH
	09/07/88		42.94	278.70	<0.5	<0.5	<0.5	<0.5	<20	NA	NA	NA	No LPH
	12/07/88		44.67	276.97	NS	NS	NS	NS	NS	NS	NS	NS	No LPH
	02/09/89		43.19	278.45	NS	NS	NS	NS	NS	NS	NS	NS	No LPH
	03/08/89		42.11	279.53	<0.5	<0.5	<0.5	<1.0	<20	NA	NA	NA	No LPH
	04/26/89		41.84	279.80	NS	NS	NS	NS	NS	NS	NS	NS	No LPH
	06/30/89		43.95	277.69	<0.5	<0.5	<0.5	<0.5	<20	NA	NA	NA	No LPH
	07/17/89		44.91	276.73	<0.5	<0.5	<0.5	<0.5	<20	NA	NA	NA	No LPH
	07/18/89		44.93	276.71	NS	NS	NS	NS	NS	NS	NS	NS	No LPH
	07/19/89		44.98	276.66	NS	NS	NS	NS	NS	NS	NS	NS	No LPH
	07/20/89		45.02	276.62	<0.5	<0.5	<0.5	<0.5	<20	NA	NA	NA	No LPH
	07/21/89		45.10	276.54	NS	NS	NS	NS	NS	NS	NS	NS	No LPH
	07/26/89		45.57	276.07	<0.5	<0.5	<0.5	<0.5	<20	NA	NA	NA	No LPH
	08/02/89		NM	NC	<0.5	<0.5	<0.5	<0.5	<20	NA	NA	NA	No LPH
	08/03/89		46.31	275.33	NS	NS	NS	NS	NS	NS	NS	NS	Not measured
	08/17/89		47.25	274.39	NS	NS	NS	NS	NS	NS	NS	NS	No LPH
	09/13/89		49.22	272.42	<0.5	<0.5	<0.5	<0.5	<20	NA	NA	NA	No LPH
	11/28/89		50.39	271.25	NS	NS	NS	NS	NS	NS	NS	NS	No LPH
	12/20/89		NM	NC	<0.5	<0.5	<0.5	<0.5	<20	NA	NA	NA	No LPH
	01/09/90		49.51	272.13	NS	NS	NS	NS	NS	NS	NS	NS	Not measured
	01/26/90		49.40	272.24	NS	NS	NS	NS	NS	NS	NS	NS	No LPH
	02/23/90		49.20 ^a	272.44	NS	NS	NS	NS	NS	NS	NS	NS	No LPH
	02/23/90		49.20	272.44	NS	NS	NS	NS	NS	NS	NS	NS	No LPH
	03/26/90		48.89 ^a	272.75	<0.5	<0.5	<0.5	<0.5	<20	NA	NA	NA	No LPH

TABLE 1

CUMULATIVE GROUND WATER MONITORING DATA

Exxon Service Station No. 7-3399

2991 Hopyard Road

Pleasanton, California

Monitoring Well	Date	Reference Elevation (ft)	Depth to Water (ft)	Ground Water Elevation (ft)	Benzene (µg/L)	Toluene (µg/L)	Ethyl-benzene (µg/L)	Total Xylenes (µg/L)	TPPH as gasoline (µg/L)	MTBE (µg/L)	Oxygenate Compounds (µg/L)	Industrial Solvents (mg/L)	Comments
MW-5S	03/26/90	321.64	48.88	272.76	NS	NS	NS	NS	NS	NS	NS	NS	No LPH
(Cont.)	04/18/90		48.95	272.69	NS	NS	NS	NS	NS	NS	NS	NS	No LPH
	05/17/90		50.06	271.58	NS	NS	NS	NS	NS	NS	NS	NS	No LPH
	06/11/90		50.98	270.66	NS	NS	NS	NS	NS	NS	NS	NS	No LPH
	07/30/90		53.40	268.24	NS	NS	NS	NS	NS	NS	NS	NS	No LPH
	08/01/90		NM	NC	<0.5	<0.5	<0.5	<0.5	<50	NA	NA	NA	Not measured
	08/27/90		53.60	268.04	NS	NS	NS	NS	NS	NS	NS	NS	No LPH
	09/28/90		53.55	268.09	NS	NS	NS	NS	NS	NS	NS	NS	No LPH
	12/27/90		53.61	268.03	<0.5	<0.5	<0.5	<0.5	<50	NA	NA	NA	No LPH
	03/20/91		53.56	268.08	NS	NS	NS	NS	NS	NS	NS	NS	No LPH
	06/20/91		53.73	267.91	NS	NS	NS	NS	NS	NS	NS	NS	No LPH
	09/12/91		53.78	267.86	NS	NS	NS	NS	NS	NS	NS	NS	No LPH
	12/30/91		53.80	267.84	NS	NS	NS	NS	NS	NS	NS	NS	No LPH
	01/30/92		53.82	267.82	NS	NS	NS	NS	NS	NS	NS	NS	No LPH
	03/02/92		53.82	267.82	NS	NS	NS	NS	NS	NS	NS	NS	No LPH
	04/14/92		53.74	267.90	NS	NS	NS	NS	NS	NS	NS	NS	No LPH
	05/21/92		53.77	267.87	NS	NS	NS	NS	NS	NS	NS	NS	No LPH
	06/08/92		53.81	267.83	NS	NS	NS	NS	NS	NS	NS	NS	No LPH
	07/14/92		53.74	267.90	NS	NS	NS	NS	NS	NS	NS	NS	No LPH
	08/10/92		53.78	267.86	NS	NS	NS	NS	NS	NS	NS	NS	No LPH
	09/16/92		53.90	267.74	NS	NS	NS	NS	NS	NS	NS	NS	No LPH
	10/07/92		NM	NC	NS	NS	NS	NS	NS	NS	NS	NS	Dry
	11/09/92		53.87	267.77	NS	NS	NS	NS	NS	NS	NS	NS	No LPH
	12/10/92		53.78	267.86	NS	NS	NS	NS	NS	NS	NS	NS	No LPH
	01/26/93		53.38	268.26	NS	NS	NS	NS	NS	NS	NS	NS	No LPH
	02/16/93		53.44	268.20	NS	NS	NS	NS	NS	NS	NS	NS	No LPH
	03/11/93		53.28	268.36	NS	NS	NS	NS	NS	NS	NS	NS	No LPH
	04/12/93		53.42	268.22	11	5.9	13	48	220	NA	NA	NA	No LPH
	06/01/93		53.56	268.08	NS	NS	NS	NS	NS	NS	NS	NS	No LPH
	07/15/93		53.00	268.64	NS	NS	NS	NS	NS	NS	NS	NS	No LPH
	08/15/93		53.60	268.04	NS	NS	NS	NS	NS	NS	NS	NS	No LPH
	09/29/93		53.62	268.02	NS	NS	NS	NS	NS	NS	NS	NS	No LPH
	09/30/93		NM	NC	<0.5	<0.5	<0.5	<0.5	<50	NA	NA	NA	Not measured

TABLE 1

CUMULATIVE GROUND WATER MONITORING DATA

Exxon Service Station No. 7-3399
2991 Hopyard Road
Pleasanton, California

Monitoring Well	Date	Reference Elevation (ft)	Depth to Water (ft)	Ground Water Elevation (ft)	Benzene (µg/L)	Toluene (µg/L)	Ethyl-benzene (µg/L)	Total Xylenes (µg/L)	TPPH as gasoline (µg/L)	MTBE (µg/L)	Oxygenate Compounds (µg/L)	Industrial Solvents (mg/L)	Comments
MW-5S	10/28/93	321.64	54.62	267.02	NS	NS	NS	NS	NS	NS	NS	NS	No LPH
(Cont.)	11/23/93		53.62	268.02	NS	NS	NS	NS	NS	NS	NS	NS	No LPH
	03/10-11/94		53.61	268.03	<0.5	<0.5	<0.5	<0.5	<50	NA	NA	NA	No LPH
	05/04-05/94		53.52	268.12	<0.5	<0.5	<0.5	<0.5	<50	NA	NA	NA	No LPH
	09/01/94 ^e		NM	NC	<0.5	<0.5	<0.5	<0.5	<50	NA	NA	NA	No LPH
	11/16/94		53.05	268.59	<0.5	<0.5	<0.5	<0.5	<50	NA	NA	NA	No LPH
	09/01/94		NM	NC	<0.5	<0.5	<0.5	<0.5	<50	NA	NA	NA	Not measured
	11/16/94		NM	NC	<0.5	<0.5	<0.5	<0.5	<50	NA	NA	NA	Not measured
	02/15/95		50.55	271.09	<0.5	<0.5	<0.5	<0.5	<50	NA	NA	NA	No LPH
	05/09/95		44.96	276.68	<0.5	<0.5	<0.5	<0.5	<50	NA	NA	NA	No LPH
	08/21/95		41.77	279.87	<0.5	<0.5	<0.5	<0.5	<50	<2.5	NA	NA	No LPH
	11/30/95		39.95	281.69	<0.5	<0.5	<0.5	<0.5	<50	<5.0	NA	NA	No LPH
	03/28/96		36.80	284.84	<0.5	<0.5	<0.5	<0.5	<50	<5.0	NA	NA	No LPH
	05/31/96		35.28	286.36	<0.5	<0.5	<0.5	<0.5	<50	<5.0	NA	NA	No LPH
	08/28/96		39.46	282.18	<0.5	<0.5	<0.5	<0.5	<50	<5.0	NA	NA	No LPH
	11/18/96		39.47	282.17	<0.5	<0.5	<0.5	<0.5	<50	<5.0	NA	NA	No LPH
	02/28/97		34.44	287.20	<0.5	<0.5	<0.5	<0.5	<50	<2.5	NA	NA	No LPH
	05/23/97		34.72	286.92	<0.5	<0.5	<0.5	<0.5	<50	<2.5	NA	NA	No LPH
	09/23/97		39.09	282.55	<0.5	<0.5	<0.5	<0.5	<50	<2.5	NA	NA	No LPH
	12/30/97		37.83	283.81	<0.5	<0.5	<0.5	<0.5	<50	NA	ND	<1.0	No LPH
	03/24/98		32.76	288.88	<0.5	<0.5	<0.5	<0.5	<50	<2.5	NA	NA	No LPH
	06/15/98		30.46	291.18	<0.5	<0.5	<0.5	<0.5	<50	<2.5	NA	NA	No LPH
	09/11/98		36.04	285.60	<0.5	<0.5	<0.5	<0.5	<50	<2.5	NA	NA	No LPH

TABLE 1

CUMULATIVE GROUND WATER MONITORING DATA

Exxon Service Station No. 7-3399
2991 Hopyard Road
Pleasanton, California

Monitoring Well	Date	Reference Elevation (ft)	Depth to Water (ft)	Ground Water Elevation (ft)	Benzene (µg/L)	Toluene (µg/L)	Ethyl-benzene (µg/L)	Total Xylenes (µg/L)	TPPH as gasoline (µg/L)	MTBE (µg/L)	Oxygenate Compounds (µg/L)	Industrial Solvents (mg/L)	Comments
MW-5D	05/25/88	321.79	38.55	283.24	<0.5	3.1	<0.5	<0.5	<20	NA	NA	NA	No LPH
	06/06/88		38.90	282.89	NS	NS	NS	NS	NS	NS	NS	NS	No LPH
	06/23/88		39.56	282.23	NS	NS	NS	NS	NS	NS	NS	NS	No LPH
	06/28/88		40.23	281.56	NS	NS	NS	NS	NS	NS	NS	NS	No LPH
	07/06/88		40.69	281.10	<0.5	<0.5	<0.5	<0.5	<20	NA	NA	NA	No LPH
	07/13/88		41.22	280.57	<0.5	<0.5	<0.5	<0.5	40	NA	NA	NA	No LPH
	08/12/88		42.34	279.45	NS	NS	NS	NS	NS	NS	NS	NS	No LPH
	08/26/88		42.60	279.19	NS	NS	NS	NS	NS	NS	NS	NS	No LPH
	09/07/88		42.99	278.80	NS	NS	NS	NS	NS	NS	NS	NS	No LPH
	12/07/88		44.58	277.21	NS	NS	NS	NS	NS	NS	NS	NS	No LPH
	02/09/89 ^c		NM	NC	NS	NS	NS	NS	NS	NS	NS	NS	Not measured
	03/08/89 ^d		NM	NC	<0.5	<0.5	<0.5	<0.5	<20	NA	NA	NA	Not measured
	03/08/89		42.49	279.30	NS	NS	NS	NS	NS	NS	NS	NS	No LPH
	04/03/89		42.21	279.58	NS	NS	NS	NS	NS	NS	NS	NS	No LPH
	04/26/89		42.36	279.43	NS	NS	NS	NS	NS	NS	NS	NS	No LPH
	06/30/89		44.79	277.00	<0.5	<0.5	<0.5	<0.5	<20	NA	NA	NA	No LPH
	07/17/89		45.73	276.06	<0.5	<0.5	<0.5	<0.5	<20	NA	NA	NA	No LPH
	07/18/89		45.75	276.04	NS	NS	NS	NS	NS	NS	NS	NS	No LPH
	07/19/89		44.89	276.90	NS	NS	NS	NS	NS	NS	NS	NS	No LPH
	07/20/89		46.02	275.77	<0.5	<0.5	<0.5	<0.5	<20	NA	NA	NA	No LPH
	07/21/89		46.18	275.61	NS	NS	NS	NS	NS	NS	NS	NS	No LPH
	07/26/89		46.83	274.96	<0.5	<0.5	<0.5	<0.5	<20	NA	NA	NA	No LPH
	08/02/89		NM	NC	<0.5	<0.5	<0.5	<0.5	<20	NA	NA	NA	Not measured
	08/03/89		47.67	274.12	NS	NS	NS	NS	NS	NS	NS	NS	No LPH
	08/17/89		48.27	273.52	NS	NS	NS	NS	NS	NS	NS	NS	No LPH
	09/13/89		50.60	271.19	<0.5	<0.5	<0.5	<0.5	<20	NA	NA	NA	No LPH
	11/28/89		51.16	270.63	NS	NS	NS	NS	NS	NS	NS	NS	No LPH
	12/20/89		NM	NC	<0.5	<0.5	<0.5	<0.5	<20	NA	NA	NA	Not measured
	01/09/90		50.42	271.37	NS	NS	NS	NS	NS	NS	NS	NS	No LPH
	01/26/90		50.10	271.69	NS	NS	NS	NS	NS	NS	NS	NS	No LPH
	02/23/90		50.08	271.71	NS	NS	NS	NS	NS	NS	NS	NS	No LPH
	03/26/90		49.80 ^f	271.99	NS	NS	NS	NS	NS	NS	NS	NS	No LPH
	03/26/90		49.77	272.02	<0.5	<0.5	<0.5	<0.5	<20	NA	NA	NA	No LPH

TABLE 1

CUMULATIVE GROUND WATER MONITORING DATA

Exxon Service Station No. 7-3399

2991 Hopyard Road

Pleasanton, California

Monitoring Well	Date	Reference Elevation (ft)	Depth to Water (ft)	Ground Water Elevation (ft)	Benzene (µg/L)	Toluene (µg/L)	Ethyl-benzene (µg/L)	Total Xylenes (µg/L)	TPPH as gasoline (µg/L)	MTBE (µg/L)	Oxygenate Compounds (µg/L)	Industrial Solvents (mg/L)	Comments
MW-5D	04/18/90	321.79	49.80	271.99	NS	NS	NS	NS	NS	NS	NS	NS	No LPH
(Cont.)	05/17/90		51.32	270.47	NS	NS	NS	NS	NS	NS	NS	NS	No LPH
	06/11/90		52.10	269.69	NS	NS	NS	NS	NS	NS	NS	NS	No LPH
	07/30/90		53.47	268.32	NS	NS	NS	NS	NS	NS	NS	NS	No LPH
	08/01/90		NM	NM	<0.5	<0.5	<0.5	<0.5	<20	NA	NA	NA	Not measured
	08/27/90		58.24	263.55	NS	NS	NS	NS	NS	NS	NS	NS	No LPH
	09/29/90		60.70	261.09	NS	NS	NS	NS	NS	NS	NS	NS	No LPH
	12/27/90		62.52	259.27	<0.5	<0.5	<0.5	<0.5	<50	NA	NA	NA	No LPH
	03/20/91		59.18	262.61	<0.5	<0.5	<0.5	<0.5	<50	NA	NA	NA	No LPH
	06/20/91		65.02	256.77	<0.5	<0.5	<0.5	<0.5	<50	NA	NA	NA	No LPH
	09/12/91		DRY	DRY	NS	NS	NS	NS	NS	NS	NS	NS	Not measured
	12/30/91		DRY	DRY	NS	NS	NS	NS	NS	NS	NS	NS	Not measured
	01/30/92		DRY	DRY	NS	NS	NS	NS	NS	NS	NS	NS	Not measured
	03/02/92		DRY	DRY	NS	NS	NS	NS	NS	NS	NS	NS	Not measured
	03/24/92		74.98	246.81	NS	NS	NS	NS	NS	NS	NS	NS	No LPH
	04/14/92		74.42	247.37	NS	NS	NS	NS	NS	NS	NS	NS	No LPH
	05/21/92		75.67	246.12	NS	NS	NS	NS	NS	NS	NS	NS	No LPH
	06/08/92		NM	NC	NS	NS	NS	NS	NS	NS	NS	NS	Dry
	07/14/92		NM	NC	NS	NS	NS	NS	NS	NS	NS	NS	Dry
	08/10/92		NM	NC	NS	NS	NS	NS	NS	NS	NS	NS	Dry
	09/16/92		NM	NC	NS	NS	NS	NS	NS	NS	NS	NS	Dry
	10/07/92		NM	NC	NS	NS	NS	NS	NS	NS	NS	NS	Dry
	11/09/92		NM	NC	NS	NS	NS	NS	NS	NS	NS	NS	Dry
	12/10/92		NM	NC	NS	NS	NS	NS	NS	NS	NS	NS	Dry
	01/26/93		NM	NC	NS	NS	NS	NS	NS	NS	NS	NS	Dry
	02/16/93		76.47	245.32	NS	NS	NS	NS	NS	NS	NS	NS	Dry
	03/11/93		74.03	247.76	NS	NS	NS	NS	NS	NS	NS	NS	No LPH
	04/12/93		70.96	250.83	1.0	1.0	2.5	7.4	<50	NA	NA	NA	No LPH
	06/01/93		67.64	254.15	NS	NS	NS	NS	NS	NS	NS	NS	No LPH
	07/15/93		54.40	267.39	<0.5	<0.5	<0.5	<0.5	<50	NA	NA	NA	No LPH
	08/15/93		67.85	253.94	<0.5	<0.5	<0.5	<0.5	<50	NA	NA	NA	No LPH
	09/29/93		67.62	254.17	NS	NS	NS	NS	NS	NS	NS	NS	No LPH
	09/30/93		NM	NC	<0.5	<0.5	<0.5	<0.5	<50	NA	NA	NA	Not measured

TABLE 1

CUMULATIVE GROUND WATER MONITORING DATA

Exxon Service Station No. 7-3399
2991 Hopyard Road
Pleasanton, California

Monitoring Well	Date	Reference Elevation (ft)	Depth to Water (ft)	Ground Water Elevation (ft)	Benzene (µg/L)	Toluene (µg/L)	Ethyl-benzene (µg/L)	Total Xylenes (µg/L)	TPPH as gasoline (µg/L)	MTBE (µg/L)	Oxygenate Compounds (µg/L)	Industrial Solvents (mg/L)	Comments
MW-5D	10/28/93	321.79	66.15	255.49	NS	NS	NS	NS	NS	NS	NS	NS	No LPH
(Cont.)	11/23/93		64.80	256.84	<0.5	<0.5	<0.5	<0.5	<50	NA	NA	NA	No LPH
	03/10-11/94		59.10	262.69	<0.5	<0.5	<0.5	<0.5	<50	NA	NA	NA	No LPH
	05/04-05/94		55.66	265.13	<0.5	<0.5	<0.5	<0.5	<50	NA	NA	NA	No LPH
	09/01/94°		NM	NC	<0.5	<0.5	<0.5	<0.5	<50	NA	NA	NA	No LPH
	11/16/94		54.36	268.74	<0.5	<0.5	<0.5	<0.5	<50	NA	NA	NA	No LPH
	02/15/95		51.20	270.59	NS	NS	NS	NS	NS	NS	NS	NS	No LPH
	05/09/95		45.49	276.30	NS	NS	NS	NS	NS	NS	NS	NS	No LPH
	05/12/95		NM	NC	<0.5	<0.5	<0.5	<0.5	<50	NA	NA	NA	Not measured
	08/21/95		42.35	279.44	<0.5	<0.5	<0.5	<0.5	<50	<2.5	NA	NA	No LPH
	11/30/95		43.60	278.19	5.4	10	1.4	12	77	<5.0	NA	NA	No LPH
	03/28/96		37.12	284.67	<0.5	<0.5	<0.5	<0.5	<50	<5.0	NA	NA	No LPH
	05/31/96		35.67	286.12	<0.5	<0.5	<0.5	<0.5	<50	<5.0	NA	NA	No LPH
	08/28/96		40.22	281.57	<0.5	<0.5	<0.5	<0.5	<50	<5.0	NA	NA	No LPH
	11/18/96		39.89	281.90	<0.5	<0.5	<0.5	<0.5	<50	<5.0	NA	NA	No LPH
	02/28/97		34.75	287.04	<0.5	<0.5	<0.5	<0.5	<50	<2.5	NA	NA	No LPH
Duplicate	02/28/97		NM	NC	<0.5	<0.5	<0.5	<0.5	<50	<2.5	NA	NA	Not measured
Rinseate	02/28/97		NM	NC	<0.5	<0.5	<0.5	<0.5	<50	<2.5	NA	NA	Not measured
	05/23/97		35.21	286.58	<0.5	<0.5	<0.5	<0.5	<50	<2.5	NA	NA	No LPH
Duplicate	05/23/97		NM	NC	<0.5	<0.5	<0.5	<0.5	<50	<2.5	NA	NA	Not measured
Rinseate	05/23/97		NM	NC	<0.5	<0.5	<0.5	<0.5	<50	<2.5	NA	NA	Not measured
	09/23/97		39.58	282.21	<0.5	<0.5	<0.5	<0.5	<50	<2.5	NA	NA	No LPH
Duplicate	09/23/97		NM	NC	<0.5	<0.5	<0.5	<0.5	<50	<2.5	NA	NA	Not measured
Rinseate	09/23/97		NM	NC	<0.5	1.5	<0.5	<0.5	<50	3.0	NA	NA	Not measured
	12/30/97		38.30	283.49	<0.5	<0.5	<0.5	<0.5	<50	NA	ND	<1.0	No LPH
Duplicate	12/30/97		NM	NC	<0.5	<0.5	<0.5	<0.5	<50	NA	ND	<1.0	Not measured
Rinseate	12/30/97		NM	NC	<0.5	<0.5	<0.5	<0.5	<50	NA	ND	<1.0	Not measured
	03/24/98		32.77	289.02	<0.5	<0.5	<0.5	<0.5	<50	<2.5	NA	NA	No LPH
	06/15/98		30.69	291.10	<0.5	<0.5	<0.5	<0.5	<50	<2.5	NA	NA	No LPH
Duplicate	06/15/98		NM	NC	<0.5	<0.5	<0.5	<0.5	<50	<2.5	NA	NA	No LPH
	09/11/98		36.68	285.11	<0.5	<0.5	<0.5	<0.5	<50	33	NA	NA	No LPH
Duplicate	09/11/98		NM	NC	<0.5	<0.5	<0.5	<0.5	<50	35	NA	NA	No LPH
	10/28/98		NM	NC	<0.5	<0.5	<0.5	<0.5	<50	<2.0 ^f	NA	NA	No LPH

TABLE 1

CUMULATIVE GROUND WATER MONITORING DATA

Exxon Service Station No. 7-3399

2991 Hopyard Road

Pleasanton, California

Monitoring Well	Date	Reference Elevation (ft)	Depth to Water (ft)	Ground Water Elevation (ft)	Benzene (µg/L)	Toluene (µg/L)	Ethyl-benzene (µg/L)	Total Xylenes (µg/L)	TPPH as gasoline (µg/L)	MTBE (µg/L)	Oxygenate Compounds (µg/L)	Industrial Solvents (mg/L)	Comments
MW-6	05/11/88	NM	37.31	NC	NS	NS	NS	NS	NS	NS	NS	NS	No LPH
	05/17/88		NM	NM	<0.5	<0.5	<0.5	<0.5	<20	NA	NA	NA	Not measured
	06/06/88		38.70	NC	NS	NS	NS	NS	NS	NS	NS	NS	No LPH
	06/23/88		39.23	NC	NS	NS	NS	NS	NS	NS	NS	NS	No LPH
	06/28/88		39.74	NC	31.8	7.5	5.4	6.7	440	NA	NA	NA	No LPH
	07/13/88		40.78	NC	162.3	7.7	22.5	14.1	290	NA	NA	NA	No LPH
	08/05/88		41.72	NC	245	5.2	47.1	23.7	1,180	NA	NA	NA	No LPH
	08/12/88		42.14	NC	NS	NS	NS	NS	NS	NS	NS	NS	No LPH
	08/17/88		NM	NC	NS	NS	NS	NS	NS	NS	NS	NS	Not measured
	08/26/88		42.51	NC	NS	NS	NS	NS	NS	NS	NS	NS	No LPH
	09/07/88		42.85	NC	474	16	262	136	2,920	NA	NA	NA	No LPH
	10/24/88		Well destroyed										

TABLE 1

CUMULATIVE GROUND WATER MONITORING DATA

Exxon Service Station No. 7-3399
2991 Hopyard Road
Pleasanton, California

Monitoring Well	Date	Reference Elevation (ft)	Depth to Water (ft)	Ground Water Elevation (ft)	Benzene (µg/L)	Toluene (µg/L)	Ethyl-benzene (µg/L)	Total Xylenes (µg/L)	TPPH as gasoline (µg/L)	MTBE (µg/L)	Oxygenate Compounds (µg/L)	Industrial Solvents (mg/L)	Comments
MW-7	07/13/88	321.27	40.50	280.77	860	1,910	710	4,420	16,700	NA	NA	NA	No LPH
	07/22/88		41.85 ^a	279.42	136	85	5	58	460	NA	NA	NA	No LPH
	08/05/88		41.45 ^a	279.82	73.3	52.8	2.3	28.1	270	NA	NA	NA	No LPH
	08/12/88		42.69	278.58	NS	NS	NS	NS	NS	NS	NS	NS	Not measured
	09/07/88		42.60	278.67	NS	NS	NS	NS	NS	NS	NS	NS	Not measured
	12/07/88		NM	NC	NS	NS	NS	NS	NS	NS	NS	NS	Not measured
	01/17/89		43.20	278.07	NS	NS	NS	NS	NS	NS	NS	NS	Not measured
	02/09/89		NM	NC	600	688	10	448	6,700	NA	NA	NA	Not measured
	06/30/89		NM	NC	180	50	13	40	1,100	NA	NA	NA	Not measured
	08/02/89		NM	NC	1.6	<0.5	<0.5	0.6	31	NA	NA	NA	Not measured
	09/13/89		NM	NC	<0.5	2.6	<0.5	12	87	NA	NA	NA	Not measured
	10/12/89		49.93	271.34	NS	NS	NS	NS	NS	NS	NS	NS	No LPH
	11/28/89		57.61 ^a	263.66	NS	NS	NS	NS	NS	NS	NS	NS	No LPH
	12/20/89		NM	NC	<0.5	<0.5	<0.5	<0.5	<20	NA	NA	NA	Not measured
	01/09/90		57.57 ^a	263.70	NS	NS	NS	NS	NS	NS	NS	NS	No LPH
	01/26/90		57.54 ^a	263.73	NS	NS	NS	NS	NS	NS	NS	NS	No LPH
	01/26/90		49.08	272.19	NS	NS	NS	NS	NS	NS	NS	NS	No LPH
	02/23/90		55.26 ^a	266.01	NS	NS	NS	NS	NS	NS	NS	NS	No LPH
	02/23/90		48.93	272.34	NS	NS	NS	NS	NS	NS	NS	NS	No LPH
	03/26/90		57.52 ^a	263.75	NS	NS	NS	NS	NS	NS	NS	NS	No LPH
	03/26/90		48.60	272.67	NS	NS	NS	NS	NS	NS	NS	NS	No LPH
	04/18/90		57.55 ^a	263.72	NS	NS	NS	NS	NS	NS	NS	NS	No LPH
	05/17/90		57.40 ^a	263.87	NS	NS	NS	NS	NS	NS	NS	NS	No LPH
	06/11/90		50.68	270.59	NS	NS	NS	NS	NS	NS	NS	NS	No LPH
	07/30/90		NM	NC	NS	NS	NS	NS	NS	NS	NS	NS	Not measured
	08/27/90		53.05	268.22	NS	NS	NS	NS	NS	NS	NS	NS	No LPH
	09/28/90		NM	NC	NS	NS	NS	NS	NS	NS	NS	NS	Not measured
	12/27/90		NM	NC	NS	NS	NS	NS	NS	NS	NS	NS	Not measured
	03/20/91		54.11	267.16	NS	NS	NS	NS	NS	NS	NS	NS	No LPH
	06/20/91		55.14	266.13	<0.5	1.8	0.6	4.1	74	NA	NA	NA	No LPH
	09/12/91		55.84	265.43	3.5	<0.5	1.7	6.8	<50	NA	NA	NA	No LPH
	12/30/91		55.21	266.06	<0.5	<0.5	<0.5	<0.5	<50	NA	NA	NA	No LPH
	01/30/92		54.88	266.39	NS	NS	NS	NS	NS	NS	NS	NS	No LPH

TABLE 1

CUMULATIVE GROUND WATER MONITORING DATA

Exxon Service Station No. 7-3399

2991 Hopyard Road

Pleasanton, California

Monitoring Well	Date	Reference Elevation (ft)	Depth to Water (ft)	Ground Water Elevation (ft)	Benzene (µg/L)	Toluene (µg/L)	Ethyl-benzene (µg/L)	Total Xylenes (µg/L)	TPPH as gasoline (µg/L)	MTBE (µg/L)	Oxygenate Compounds (µg/L)	Industrial Solvents (mg/L)	Comments
MW-7	03/02/92	321.27	NM	NC	NS	NS	NS	NS	NS	NS	NS	NS	Not measured
(Cont.)	03/24/92		NM	NC	NS	NS	NS	NS	NS	NS	NS	NS	Not measured
	04/14/92		NM	NC	NS	NS	NS	NS	NS	NS	NS	NS	Not measured
	05/21/92		53.36	267.91	NS	NS	NS	NS	NS	NS	NS	NS	No LPH
	06/08/92		54.20	267.07	<0.5	<0.5	<0.5	<0.5	<50	NA	NA	NA	No LPH
	07/14/92		53.31	267.96	NS	NS	NS	NS	NS	NS	NS	NS	No LPH
	08/10/92		54.01	267.26	NS	NS	NS	NS	NS	NS	NS	NS	No LPH
	09/16/92		55.97	265.30	NS	NS	NS	NS	NS	NS	NS	NS	No LPH
	10/07/92		56.09	265.18	NS	NS	NS	NS	NS	NS	NS	NS	No LPH
	11/09/92		54.16	267.11	NS	NS	NS	NS	NS	NS	NS	NS	No LPH
	12/10/92		56.02	265.25	NS	NS	NS	NS	NS	NS	NS	NS	No LPH
	01/26/93		56.15	265.12	NS	NS	NS	NS	NS	NS	NS	NS	No LPH
	02/16/93		56.23	265.04	28	30	17	200	600	NA	NA	NA	No LPH
	03/11/93		55.82	265.45	NS	NS	NS	NS	NS	NS	NS	NS	No LPH
	04/12/93		55.45	265.82	NS	NS	NS	NS	NS	NS	NS	NS	No LPH
	06/01/93		54.90	266.37	NS	NS	NS	NS	NS	NS	NS	NS	No LPH
	07/15/93		54.50	266.77	NS	NS	NS	NS	NS	NS	NS	NS	No LPH
	08/15/93		54.25	267.02	NS	NS	NS	NS	NS	NS	NS	NS	No LPH
	09/29/93		54.55	266.72	NS	NS	NS	NS	NS	NS	NS	NS	No LPH
	09/30/93		NM	NC	NS	NS	NS	NS	NS	NS	NS	NS	Not measured
	10/28/93		54.94	266.92	NS	NS	NS	NS	NS	NS	NS	NS	No LPH
	11/23/93		54.73	266.54	NS	NS	NS	NS	NS	NS	NS	NS	No LPH
	11/24/93		NM	NC	<0.5	<0.5	<0.5	<0.5	<50	NA	NA	NA	Not measured
	03/10-11-94		52.83	268.44	<0.5	<0.5	<0.5	<0.5	<50	NA	NA	NA	No LPH
	05/04-05/94		52.77	268.50	<0.5	<0.5	<0.5	<0.5	<50	NA	NA	NA	No LPH
	09/01/94*		NM	NC	<0.5	<0.5	<0.5	<0.5	<50	NA	NA	NA	No LPH
	11/16/94		52.74	268.53	<0.5	<0.5	<0.5	<0.5	<50	NA	NA	NA	No LPH
	02/15/95		50.05	271.22	<0.5	<0.5	<0.5	<0.5	<50	NA	NA	NA	No LPH
	05/09/95		44.61	276.66	<0.5	<0.5	<0.5	<0.5	<50	NA	NA	NA	No LPH
	08/21/95		41.40	279.87	<0.5	<0.5	<0.5	<0.5	<50	4.1	NA	NA	No LPH
	11/30/95		39.64	281.63	<0.5	<0.5	<0.5	<0.5	<50	<5.0	NA	NA	No LPH
	03/28/96		36.42	284.85	<0.5	<0.5	<0.5	<0.5	<50	<5.0	NA	NA	No LPH
	05/31/96		34.87	286.40	<0.5	<0.5	<0.5	<0.5	<50	<5.0	NA	NA	No LPH

TABLE 1

CUMULATIVE GROUND WATER MONITORING DATA

Exxon Service Station No. 7-3399
2991 Hopyard Road
Pleasanton, California

Monitoring Well	Date	Reference Elevation (ft)	Depth to Water (ft)	Ground Water Elevation (ft)	Benzene (µg/L)	Toluene (µg/L)	Ethyl-benzene (µg/L)	Total Xylenes (µg/L)	TPPH as gasoline (µg/L)	MTBE (µg/L)	Oxygenate Compounds (µg/L)	Industrial Solvents (mg/L)	Comments
MW-7	08/28/96	321.27	39.11	282.16	NS	NS	NS	NS	NS	NS	NS	NS	No LPH
(Cont.)	11/18/96		39.10	282.17	NS	NS	NS	NS	NS	NS	NS	NS	No LPH
	02/28/97		34.03	287.24	NS	NS	NS	NS	NS	NS	NS	NS	No LPH
	05/23/97		34.36	286.91	NS	NS	NS	NS	NS	NS	NS	NS	No LPH
	09/23/97		38.66	282.61	<0.5	<0.5	<0.5	<0.5	<50	4.4	NA	NA	No LPH
	12/30/97		37.45	283.82	NS	NS	NS	NS	NS	NS	NS	NS	No LPH
	03/24/98		NM	NC	NS	NS	NS	NS	NS	NS	NS	NS	Not measured
	06/15/98		30.05	291.22	NS	NS	NS	NS	NS	NS	NS	NS	No LPH
	09/11/98		35.63	285.64	<0.5	<0.5	<0.5	<0.5	<50	<2.5	NS	NS	No LPH

TABLE 1

CUMULATIVE GROUND WATER MONITORING DATA

Exxon Service Station No. 7-3399
2991 Hopyard Road
Pleasanton, California

Monitoring Well	Date	Reference Elevation (ft)	Depth to Water (ft)	Ground Water Elevation (ft)	Benzene (µg/L)	Toluene (µg/L)	Ethyl-benzene (µg/L)	Total Xylenes (µg/L)	TPPH as gasoline (µg/L)	MTBE (µg/L)	Oxygenate Compounds (µg/L)	Industrial Solvents (mg/L)	Comments
MW-8	10/01/89	321.86	53.88	267.98	NS	NS	NS	NS	NS	NS	NS	NS	No LPH
	10/03/89		NM	NC	<0.5	<0.5	<0.5	<0.5	<20	NA	NA	NA	Not measured
	11/28/89		53.74	268.12	NS	NS	NS	NS	NS	NS	NS	NS	No LPH
	12/20/89		NM	NC	<0.5	<0.5	<0.5	0.61	<20	NA	NA	NA	Not measured
	01/09/90		57.90	263.96	NS	NS	NS	NS	NS	NS	NS	NS	No LPH
	01/26/90		53.57	268.29	NS	NS	NS	NS	NS	NS	NS	NS	No LPH
	01/31/90		NM	NC	<0.5	<0.5	<0.5	0.87	<20	NA	NA	NA	Not measured
	02/09/90		NM	NC	<0.5	<0.5	<0.5	1.1	<20	NA	NA	NA	Not measured
	(Blank)		NM	NC	<0.5	<0.5	<0.5	<0.5	<20	NA	NA	NA	Not measured
	02/23/90		52.16	269.70	NS	NS	NS	NS	NS	NS	NS	NS	No LPH
	03/26/90		52.80 ^a	269.06	<0.5	<0.5	<0.5	<0.5	<20	NA	NA	NA	No LPH
	(Blank)		NM	NC	<0.5	<0.5	<0.5	<0.5	<20	NA	NA	NA	Not measured
	04/18/90		51.60	270.26	<0.5	0.58	<0.5	1.1	<20	NA	NA	NA	No LPH
	05/17/90		58.21	263.65	<0.5	<0.5	<0.5	<0.5	<20	NA	NA	NA	No LPH
	06/11/90		58.65	263.21	<0.5	<0.5	<0.5	<0.5	<20	NA	NA	NA	No LPH
	07/30/90		64.33	257.53	NS	NS	NS	NS	NS	NS	NS	NS	No LPH
	08/01/90		NM	NC	<0.5	<0.5	<0.5	<0.5	<20	NA	NA	NA	Not measured
	08/27/90		70.41	251.45	<0.5	<0.5	<0.5	0.5	<20	NA	NA	NA	No LPH
	09/28/90		71.93	249.93	<0.5	<0.5	<0.5	0.5	<50	NA	NA	NA	No LPH
	12/27/90		66.60	255.26	<0.5	<0.5	<0.5	0.6	<50	NA	NA	NA	No LPH
	03/20/91		60.75	261.11	<0.5	<0.5	<0.5	<0.5	<50	NA	NA	NA	No LPH
	06/20/91		88.77	233.09	<0.5	<0.5	<0.5	0.6	<50	NA	NA	NA	No LPH
	09/12/91		103.17	218.69	NS	NS	NS	NS	NS	NS	NS	NS	No LPH
	10/14/91		NM	NC	<0.5	<0.5	<0.5	<0.5	<50	NA	NA	NA	Not measured
	12/30/91		81.15	240.71	<0.5	<0.5	<0.5	<0.5	<50	NA	NA	NA	No LPH
	01/30/92		81.69	240.17	NS	NS	NS	NS	NS	NS	NS	NS	No LPH
	03/02/92		78.45	243.41	NS	NS	NS	NS	NS	NS	NS	NS	No LPH
	03/24/92		76.55	245.31	<0.5	<0.5	<0.5	<0.5	<50	NA	NA	NA	No LPH
	04/14/92		75.56	246.30	NS	NS	NS	NS	NS	NS	NS	NS	No LPH
	05/21/92		86.99	234.87	NS	NS	NS	NS	NS	NS	NS	NS	No LPH
	06/08/92		91.69	230.17	<0.5	<0.5	<0.5	<0.5	<50	NA	NA	NA	No LPH
	07/14/92		94.65	227.21	NS	NS	NS	NS	NS	NS	NS	NS	No LPH
	08/10/92		95.02	226.84	NS	NS	NS	NS	NS	NS	NS	NS	No LPH

TABLE 1

CUMULATIVE GROUND WATER MONITORING DATA

Exxon Service Station No. 7-3399

2991 Hopyard Road

Pleasanton, California

Monitoring Well	Date	Reference Elevation (ft)	Depth to Water (ft)	Ground Water Elevation (ft)	Benzene (µg/L)	Toluene (µg/L)	Ethyl-benzene (µg/L)	Total Xylenes (µg/L)	TPPH as gasoline (µg/L)	MTBE (µg/L)	Oxygenate Compounds (µg/L)	Industrial Solvents (mg/L)	Comments
MW-8 (Cont.)	09/16/92	321.86	91.90	229.96	<0.5	0.9	<0.5	<0.5	<50	NA	NA	NA	No LPH
	10/07/92		NM	NC	NS	NS	NS	NS	NS	NS	NS	NS	Dry
	11/09/92		84.35	237.51	NS	NS	NS	NS	NS	NS	NS	NS	No LPH
	12/10/92		82.20	239.66	<0.5	0.6	<0.5	<0.5	<50	NA	NA	NA	No LPH
	01/26/93		78.63	243.23	NS	NS	NS	NS	NS	NS	NS	NS	No LPH
	02/16/93		76.90	244.96	0.7	0.6	<0.5	2.3	<50	NA	NA	NA	No LPH
	03/11/93		74.39	247.47	NS	NS	NS	NS	NS	NS	NS	NS	No LPH
	04/12/93		71.20	250.66	26	7.3	11	38	230	NA	NA	NA	No LPH
	06/01/93		68.04	253.82	NS	NS	NS	NS	NS	NS	NS	NS	No LPH
	07/15/93		78.05	243.81	NS	NS	NS	NS	NS	NS	NS	NS	No LPH
	08/15/93		78.45	243.41	NS	NS	NS	NS	NS	NS	NS	NS	No LPH
	09/29/93		73.64	248.22	NS	NS	NS	NS	NS	NS	NS	NS	No LPH
	09/30/93		NM	NC	<0.5	<0.5	<0.5	<0.5	<50	NA	NA	NA	Not measured
	10/28/93		67.53	253.91	NS	NS	NS	NS	NS	NS	NS	NS	No LPH
	11/23/93		64.68	256.76	NS	NS	NS	NS	NS	NS	NS	NS	No LPH
	11/24/93		NM	NC	<0.5	<0.5	<0.5	<0.5	<50	NA	NA	NA	Not measured
	03/10-11/94		59.26	262.60	<0.5	<0.5	<0.5	<0.5	<50	NA	NA	NA	No LPH
	05/04-05/94		56.84	265.02	<0.5	<0.5	<0.5	<0.5	<50	NA	NA	NA	No LPH
	09/01/94 ^e		NM	NC	<0.5	<0.5	<0.5	<0.5	<50	NA	NA	NA	No LPH
	11/16/94		55.47	266.39	<0.5	<0.5	<0.5	<0.5	<50	NA	NA	NA	No LPH
	02/15/95		52.00	269.86	NS	NS	NS	NS	NS	NS	NS	NS	No LPH
	05/09/95		46.60	275.26	NS	NS	NS	NS	NS	NS	NS	NS	No LPH
	05/12/95		NM	NC	2.3	1.2	2.0	7.4	<50	NA	NA	NA	No LPH
	08/21/95		43.86	278.00	<0.5	<0.5	<0.5	<0.5	<50	<2.5	NA	NA	No LPH
	11/30/95		41.25	280.61	<0.5	<0.5	0.69	2.7	<50	<5.0	NA	NA	No LPH
	03/28/96		37.71	284.15	<0.5	<0.5	<0.5	<0.5	<50	<5.0	NA	NA	No LPH
	05/31/96		36.71	285.15	<0.5	<0.5	<0.5	<0.5	<50	<5.0	NA	NA	No LPH
	08/28/96		42.80	279.06	<0.5	<0.5	<0.5	<0.5	<50	<5.0	NA	NA	No LPH

TABLE 1

CUMULATIVE GROUND WATER MONITORING DATA

Exxon Service Station No. 7-3399
2991 Hopyard Road
Pleasanton, California

Monitoring Well	Date	Reference Elevation (ft)	Depth to Water (ft)	Ground Water Elevation (ft)	Benzene (µg/L)	Toluene (µg/L)	Ethyl-benzene (µg/L)	Total Xylenes (µg/L)	TPPH as gasoline (µg/L)	MTBE (µg/L)	Oxygenate Compounds (µg/L)	Industrial Solvents (mg/L)	Comments
MW-8	11/18/96	321.86	40.78	281.08	<0.5	<0.5	<0.5	<0.5	<50	<5.0	NA	NA	No LPH
(Cont.)	02/28/97		35.14	286.72	<0.5	<0.5	<0.5	<0.5	<50	<2.5	NA	NA	No LPH
Duplicate	02/28/97		NM	NC	<0.5	<0.5	<0.5	<0.5	<50	<2.5	NA	NA	Not measured
Rinseate	02/28/97		NM	NC	<0.5	<0.5	<0.5	<0.5	<50	<2.5	NA	NA	Not measured
	05/23/97		36.41	285.45	<0.5	<0.5	<0.5	<0.5	<50	<2.5	NA	NA	No LPH
Duplicate	05/23/97		NM	NC	<0.5	<0.5	<0.5	<0.5	<50	<2.5	NA	NA	Not measured
Rinseate	05/23/97		NM	NC	<0.5	<0.5	<0.5	<0.5	<50	<2.5	NA	NA	Not measured
	09/23/97		41.22	280.64	<0.5	<0.5	<0.5	<0.5	<50	<2.5	NA	NA	No LPH
Duplicate	09/23/97		NM	NC	<0.5	<0.5	<0.5	<0.5	<50	<2.5	NA	NA	Not measured
Rinseate	09/23/09		NM	NC	<0.5	<0.5	<0.5	<0.5	<50	<2.5	NA	NA	Not measured
	12/30/97		39.81	282.05	<0.5	<0.5	<0.5	<0.5	<50	NA	ND	<1.0	No LPH
Duplicate	12/30/97		NM	NC	<0.5	<0.5	<0.5	<0.5	<50	NA	ND	<1.0	Not measured
Rinseate	12/30/97		NM	NC	<0.5	0.52	<0.5	<0.5	<50	NA	3.2 ^f	<1.0	Not measured
	03/24/98		31.46	290.40	<0.5	<0.5	<0.5	<0.5	<50	<2.5	NA	NA	No LPH
	06/15/98		31.43	290.43	<0.5	<0.5	<0.5	<0.5	<50	NA	NA	NA	No LPH
Duplicate	06/15/98		NM	NC	<0.5	<0.5	<0.5	<0.5	<50	NA	NA	NA	No LPH
	09/11/98		38.73	283.13	<0.5	<0.5	<0.5	<0.5	<50	<2.5	NA	NA	No LPH
Duplicate	09/11/98		NM	NC	<0.5	<0.5	<0.5	<0.5	<50	<2.5	NA	NA	No LPH

TABLE 1

CUMULATIVE GROUND WATER MONITORING DATA

Exxon Service Station No. 7-3399
2991 Hopyard Road
Pleasanton, California

Monitoring Well	Date	Reference Elevation (ft)	Depth to Water (ft)	Ground Water Elevation (ft)	Benzene (µg/L)	Toluene (µg/L)	Ethyl-benzene (µg/L)	Total Xylenes (µg/L)	TPPH as gasoline (µg/L)	MTBE (µg/L)	Oxygenate Compounds (µg/L)	Industrial Solvents (mg/L)	Comments
MW-9	10/03/89	321.44	NM	NC	1,000	9,200	3,000	13,000	89,000	NA	NA	NA	No LPH
	10/12/89		50.24	271.20	NS	NS	NS	NS	NS	NS	NS	NS	No LPH
	11/28/89		50.59	270.85	NS	NS	NS	NS	NS	NS	NS	NS	0.10
	12/01/89		50.32	271.12	NS	NS	NS	NS	NS	NS	NS	NS	0.02
	12/07/89		50.13	271.31	NS	NS	NS	NS	NS	NS	NS	NS	0.16
	12/13/89		49.91	271.53	NS	NS	NS	NS	NS	NS	NS	NS	Slight Sheen
	12/20/89		49.78	271.66	6,300	31,000	9,500	55,000	190,000	NA	NA	NA	Slight Sheen
	01/02/90		NM	NC	NS	NS	NS	NS	NS	NS	NS	NS	Not measured
	01/09/90		49.39	272.05	NS	NS	NS	NS	NS	NS	NS	NS	Slight Sheen
	01/25/90		NM	NC	2,400	9,400	2,700	15,000	77,000	NA	NA	NA	Not measured
	01/26/90		49.30	272.14	NS	NS	NS	NS	NS	NS	NS	NS	No LPH
	02/23/90		49.06 ^a	272.38	1,200	7,100	2,300	14,000	97,000	NA	NA	NA	No LPH
	02/23/90		49.05	272.39	NS	NS	NS	NS	NS	NS	NS	NS	No LPH
	03/26/90		48.75 ^a	272.69	1,800	7,700	2,000	11,000	89,000	NA	NA	NA	No LPH
	03/26/90		48.73	272.71	NS	NS	NS	NS	NS	NS	NS	NS	Slight sheen
	04/18/90		48.81	272.63	2,000	7,500	2,500	16,000	110,000	NA	NA	NA	No LPH
	05/17/90		49.96	271.48	1,500	5,700	2,300	14,000	81,000	NA	NA	NA	No LPH
	06/11/90		51.58	269.86	NS	NS	NS	NS	NS	NS	NS	NS	No LPH
	06/20/90		NM	NC	<0.5	<0.5	<0.5	<0.5	430	NA	NA	NA	No LPH
	07/30/90		NM	NC	NS	NS	NS	NS	NS	NS	NS	NS	Dry
	08/27/90		NM	NC	NS	NS	NS	NS	NS	NS	NS	NS	Dry
	09/28/90		NM	NC	NS	NS	NS	NS	NS	NS	NS	NS	Dry
	12/27/90		NM	NC	NS	NS	NS	NS	NS	NS	NS	NS	Dry
	03/20/91		NM	NC	NS	NS	NS	NS	NS	NS	NS	NS	Not measured
	06/20/91		49.63	271.81	NS	NS	NS	NS	NS	NS	NS	NS	Dry
	09/12/91		NM	NC	NS	NS	NS	NS	NS	NS	NS	NS	Not measured
	12/30/91		NM	NC	NS	NS	NS	NS	NS	NS	NS	NS	No LPH
	12/10/92		NM	NC	NS	NS	NS	NS	NS	NS	NS	NS	Not measured
	01/30/92		NM	NC	NS	NS	NS	NS	NS	NS	NS	NS	Not measured
	03/02/92		NM	NC	NS	NS	NS	NS	NS	NS	NS	NS	Not measured
	03/24/92		NM	NC	NS	NS	NS	NS	NS	NS	NS	NS	Not measured
	04/14/92		NM	NC	NS	NS	NS	NS	NS	NS	NS	NS	Not measured
	05/21/92		NM	NC	NS	NS	NS	NS	NS	NS	NS	NS	Not measured

TABLE 1

CUMULATIVE GROUND WATER MONITORING DATA

Exxon Service Station No. 7-3399

2991 Hopyard Road

Pleasanton, California

Monitoring Well	Date	Reference Elevation (ft)	Depth to Water (ft)	Ground Water Elevation (ft)	Benzene (µg/L)	Toluene (µg/L)	Ethyl-benzene (µg/L)	Total Xylenes (µg/L)	TPPH as gasoline (µg/L)	MTBE (µg/L)	Oxygenate Compounds (µg/L)	Industrial Solvents (mg/L)	Comments
MW-9 (Cont.)	06/08/92	321.44	NM	NC	NS	NS	NS	NS	NS	NS	NS	NS	Not measured
	07/14/92		NM	NC	NS	NS	NS	NS	NS	NS	NS	NS	Not measured
08/10/92	NM		NC	NS	NS	NS	NS	NS	NS	NS	NS	NS	Not measured
09/16/92	NM		NC	NS	NS	NS	NS	NS	NS	NS	NS	NS	Not measured
10/07/92	NM		NC	NS	NS	NS	NS	NS	NS	NS	NS	NS	Dry
11/09/92	NM		NC	NS	NS	NS	NS	NS	NS	NS	NS	NS	Dry
12/10/92	NM		NC	NS	NS	NS	NS	NS	NS	NS	NS	NS	Not measured
01/26/93	NM		NC	NS	NS	NS	NS	NS	NS	NS	NS	NS	Dry
02/16/93	NM		NC	NS	NS	NS	NS	NS	NS	NS	NS	NS	Dry
03/11/93	NM		NC	NS	NS	NS	NS	NS	NS	NS	NS	NS	Dry
04/12/93	NM		NC	NS	NS	NS	NS	NS	NS	NS	NS	NS	Dry
06/01/93	NM		NC	NS	NS	NS	NS	NS	NS	NS	NS	NS	Dry
07/15/93	NM		NC	NS	NS	NS	NS	NS	NS	NS	NS	NS	Dry
08/15/93	NM		NC	NS	NS	NS	NS	NS	NS	NS	NS	NS	Dry
09/29/93	NM		NC	NS	NS	NS	NS	NS	NS	NS	NS	NS	Dry
10/28/93	NM		NC	NS	NS	NS	NS	NS	NS	NS	NS	NS	Dry
11/23/93	NM		NC	NS	NS	NS	NS	NS	NS	NS	NS	NS	Dry
03/10-11/94	NM	NC	NS	NS	NS	NS	NS	NS	NS	NS	NS	Dry	
05/04-05/94	NM	NC	NS	NS	NS	NS	NS	NS	NS	NS	NS	Dry	
11/16/94			52.62	268.82	NS	NS	NS	NS	NS	NS	NS	NS	No LPH
02/15/95			49.76	271.68	<0.5	<0.5	<0.5	<0.5	<50	NA	NA	NA	No LPH
05/09/95			44.30	277.14	<0.5	<0.5	<0.5	<0.5	<50	NA	NA	NA	No LPH
08/21/95			41.11	280.33	270	51	5.2	140	1,100	<25	NA	NA	No LPH
11/30/95			39.40	282.04	920	680	120	870	6,600	<100	NA	NA	No LPH
03/28/96			36.13	285.31	72	28	1.8	49	360	<10	NA	NA	No LPH
05/31/96			34.56	286.88	2,800	510	<50	400	8,200	<5.0	NA	NA	No LPH
08/28/96			38.80	282.64	1.6	<0.5	<0.5	9.6	160	28	NA	NA	No LPH
11/18/96			38.74	282.70	2,000	610	130	790	7,100	<200	NA	NA	No LPH
02/28/97			33.74	287.70	2,900	2,600	280	2,400	22,000	4,200	NA	NA	No LPH
05/23/97			33.77	287.67	5,300	5,200	800	3,900	32,000	1,600	NA	NA	No LPH
09/23/97		320.68	38.17	282.51	<0.5	<0.5	<0.5	<0.5	<50	20	NA	NA	No LPH
12/30/97			38.83	281.85	840	750	80	310	4,600	NA	1,100 ^f	<1.0	No LPH

TABLE 1

CUMULATIVE GROUND WATER MONITORING DATA

Exxon Service Station No. 7-3399
2991 Hopyard Road
Pleasanton, California

Monitoring Well	Date	Reference Elevation (ft)	Depth to Water (ft)	Ground Water Elevation (ft)	Benzene (µg/L)	Toluene (µg/L)	Ethyl-benzene (µg/L)	Total Xylenes (µg/L)	TPPH as gasoline (µg/L)	MTBE (µg/L)	Oxygenate Compounds (µg/L)	Industrial Solvents (mg/L)	Comments
MW-9	03/24/98	320.68	31.32	289.36	11,000	16,000	1,200	6,200	62,000	7,000	NA	NA	No LPH
(Cont.)	06/15/98		28.72	291.96	1.8	2.7	<0.5	3.8	<50	8.1	NA	NA	No LPH
	09/11/98		31.52	289.16	1.5	0.97	<0.5	1.1	<50	7.1	NA	NA	No LPH

TABLE 1

CUMULATIVE GROUND WATER MONITORING DATA

Exxon Service Station No. 7-3399

2991 Hopyard Road

Pleasanton, California

Monitoring Well	Date	Reference Elevation (ft)	Depth to Water (ft)	Ground Water Elevation (ft)	Benzene (µg/L)	Toluene (µg/L)	Ethyl-benzene (µg/L)	Total Xylenes (µg/L)	TPPH as gasoline (µg/L)	MTBE (µg/L)	Oxygenate Compounds (µg/L)	Industrial Solvents (mg/L)	Comments
MW-10	10/12/89	322.99	51.93	271.06	<0.5	<0.5	<0.5	<0.5	20	NA	NA	NA	No LPH
	11/28/89		51.88	271.11	NS	NS	NS	NS	NS	NS	NS	NS	No LPH
	12/20/89		51.47	271.52	<0.5	<0.5	<0.5	<0.5	<20	NA	NA	NA	No LPH
	01/09/90		50.98	272.01	NS	NS	NS	NS	NS	NS	NS	NS	No LPH
	01/26/90		50.87	272.12	NS	NS	NS	NS	NS	NS	NS	NS	No LPH
	02/23/90		50.67 ^a	272.32	NS	NS	NS	NS	NS	NS	NS	NS	No LPH
	02/23/90		50.65	272.34	NS	NS	NS	NS	NS	NS	NS	NS	No LPH
	03/26/90		50.36 ^a	272.63	<0.5	<0.5	<0.5	<0.5	<20	NA	NA	NA	No LPH
	03/26/90		50.35	272.64	NS	NS	NS	NS	NS	NS	NS	NS	No LPH
	04/18/90		50.45	272.54	NS	NS	NS	NS	NS	NS	NS	NS	No LPH
	06/11/90		51.16	271.83	NS	NS	NS	NS	NS	NS	NS	NS	No LPH
	07/30/90		55.72	267.27	NS	NS	NS	NS	NS	NS	NS	NS	No LPH
	08/27/90		57.75	265.24	<0.5	<0.5	<0.5	<0.5	<20	NA	NA	NA	No LPH
	09/28/90		NM	NC	NS	NS	NS	NS	NS	NS	NS	NS	Not measured
	12/27/90		58.08	264.91	NS	NS	NS	NS	NS	NS	NS	NS	No LPH
	03/20/91		57.80	265.19	NS	NS	NS	NS	NS	NS	NS	NS	No LPH
	06/20/91		58.00	264.99	NS	NS	NS	NS	NS	NS	NS	NS	No LPH
	09/12/91		NM	NC	NS	NS	NS	NS	NS	NS	NS	NS	Dry
	12/30/91		NM	NC	NS	NS	NS	NS	NS	NS	NS	NS	Not measured
	01/30/92		NM	NC	NS	NS	NS	NS	NS	NS	NS	NS	Dry
	03/02/92		NM	NC	NS	NS	NS	NS	NS	NS	NS	NS	Dry
	03/24/92		58.53	264.46	NS	NS	NS	NS	NS	NS	NS	NS	No LPH
	04/14/92		NM	NC	NS	NS	NS	NS	NS	NS	NS	NS	Dry
	05/21/92		NM	NC	NS	NS	NS	NS	NS	NS	NS	NS	Dry
	06/08/92		NM	NC	NS	NS	NS	NS	NS	NS	NS	NS	Dry
	07/14/92		NM	NC	NS	NS	NS	NS	NS	NS	NS	NS	Dry
	08/10/92		NM	NC	NS	NS	NS	NS	NS	NS	NS	NS	Dry
	09/16/92		NM	NC	NS	NS	NS	NS	NS	NS	NS	NS	Dry
	10/07/92		NM	NC	NS	NS	NS	NS	NS	NS	NS	NS	Dry
	11/09/92		NM	NC	NS	NS	NS	NS	NS	NS	NS	NS	Dry
	12/10/92		NM	NC	NS	NS	NS	NS	NS	NS	NS	NS	Dry
	01/26/93		NM	NC	NS	NS	NS	NS	NS	NS	NS	NS	Dry
	02/16/93		58.23	264.76	NS	NS	NS	NS	NS	NS	NS	NS	No LPH

TABLE 1

CUMULATIVE GROUND WATER MONITORING DATA

Exxon Service Station No. 7-3399
2991 Hopyard Road
Pleasanton, California

Monitoring Well	Date	Reference Elevation (ft)	Depth to Water (ft)	Ground Water Elevation (ft)	Benzene (µg/L)	Toluene (µg/L)	Ethyl-benzene (µg/L)	Total Xylenes (µg/L)	TPPH as gasoline (µg/L)	MTBE (µg/L)	Oxygenate Compounds (µg/L)	Industrial Solvents (mg/L)	Comments
MW-10	03/11/93	322.99	57.81	265.18	NS	NS	NS	NS	NS	NS	NS	NS	No LPH
(Cont.)	04/12/93		57.84	265.15	21	11	21	75	350	NA	NA	NA	No LPH
	06/01/93		57.88	265.11	NS	NS	NS	NS	NS	NS	NS	NS	Not measured
	07/15/93		NM	NC	NS	NS	NS	NS	NS	NS	NS	NS	Dry
	08/15/93		NM	NC	NS	NS	NS	NS	NS	NS	NS	NS	Dry
	09/29/93		NM	NC	NS	NS	NS	NS	NS	NS	NS	NS	Dry
	10/28/93		NM	NC	NS	NS	NS	NS	NS	NS	NS	NS	Dry
	11/23/93		NM	NC	NS	NS	NS	NS	NS	NS	NS	NS	Dry
	03/10-11/94		NM	NC	NS	NS	NS	NS	NS	NS	NS	NS	Dry
	05/04-05/94		57.21	265.78	NS	NS	NS	NS	NS	NS	NS	NS	Dry
	09/01/94°		NM	NC	<0.5	<0.5	<0.5	<0.5	<50	NA	NA	NA	No LPH
	11/16/94		54.82	268.17	<0.5	<0.5	<0.5	<0.5	<50	NA	NA	NA	No LPH
	02/15/95		51.90	271.09	<0.5	<0.5	<0.5	<0.5	<50	NA	NA	NA	No LPH
	05/09/95		46.32	276.67	<0.5	<0.5	<0.5	<0.5	<50	NA	NA	NA	No LPH
	08/21/95		43.06	279.93	<0.5	<0.5	<0.5	<0.5	<50	<2.5	NA	NA	No LPH
	11/30/95		41.34	281.65	<0.5	<0.5	<0.5	<0.5	<50	<5.0	NA	NA	No LPH
	03/28/96		38.15	284.84	<0.5	<0.5	<0.5	<0.5	<50	<5.0	NA	NA	No LPH
	05/31/96		36.61	286.38	<0.5	<0.5	<0.5	<0.5	<50	<5.0	NA	NA	No LPH
	08/28/96		40.86	282.13	NS	NS	NS	NS	NS	NS	NS	NS	No LPH
	11/18/96		40.90	282.09	NS	NS	NS	NS	NS	NS	NS	NS	No LPH
	02/28/97		35.75	287.24	NS	NS	NS	NS	NS	NS	NS	NS	No LPH
	05/23/97		36.07	286.92	NS	NS	NS	NS	NS	NS	NS	NS	No LPH
	09/23/97		40.41	282.58	NS	NS	NS	NS	NS	NS	NS	NS	No LPH
	12/30/97		38.20	284.79	NS	NS	NS	NS	NS	NS	NS	NS	No LPH
	03/24/98		34.12	288.87	NS	NS	NS	NS	NS	NS	NS	NS	Not measured
	06/15/98		31.79	291.20	NS	NS	NS	NS	NS	NS	NS	NS	No LPH
	09/11/98		35.40	287.59	NS	NS	NS	NS	NS	NS	NS	NS	Not measured

TABLE 1

CUMULATIVE GROUND WATER MONITORING DATA

Exxon Service Station No. 7-3399
2991 Hopyard Road
Pleasanton, California

Monitoring Well	Date	Reference Elevation (ft)	Depth to Water (ft)	Ground Water Elevation (ft)	Benzene (µg/L)	Toluene (µg/L)	Ethyl-benzene (µg/L)	Total Xylenes (µg/L)	TPPH as gasoline (µg/L)	MTBE (µg/L)	Oxygenate Compounds (µg/L)	Industrial Solvents (mg/L)	Comments
MW-11	11/10/89	321.77	50.64	272.13	NS	NS	NS	NS	NS	NS	NS	NS	No LPH
	11/16/89		NM	NC	4.1	9.4	0.74	20	150	NA	NA	NA	Not measured
	11/28/89		50.51	272.26	NS	NS	NS	NS	NS	NS	NS	NS	No LPH
	12/20/89		51.47	271.30	7.2	7.5	2.9	13	150	NA	NA	NA	No LPH
	01/09/90		49.68	273.09	NS	NS	NS	NS	NS	NS	NS	NS	No LPH
	01/26/90		49.55	273.22	NS	NS	NS	NS	NS	NS	NS	NS	No LPH
	02/23/90		49.37 ^a	273.40	NS	NS	NS	NS	NS	NS	NS	NS	No LPH
	02/23/90		49.35	273.42	NS	NS	NS	NS	NS	NS	NS	NS	No LPH
	03/26/90		49.03 ^a	273.74	<0.5	<0.5	<0.5	2.7	32	NA	NA	NA	No LPH
	04/18/90		49.12	273.65	NS	NS	NS	NS	NS	NS	NS	NS	No LPH
	05/17/90		50.30	272.47	NS	NS	NS	NS	NS	NS	NS	NS	No LPH
	06/11/90		51.16	271.61	NS	NS	NS	NS	NS	NS	NS	NS	No LPH
	07/30/90		53.50	269.27	<0.5	<0.5	<0.5	3.8	26	NA	NA	NA	No LPH
	08/27/90		53.65	269.12	NS	NS	NS	NS	NS	NS	NS	NS	No LPH
	09/28/90		53.62	269.15	NS	NS	NS	NS	NS	NS	NS	NS	No LPH
	12/27/90		53.63	269.14	NS	NS	NS	NS	NS	NS	NS	NS	No LPH
	03/20/91		53.26	269.51	NS	NS	NS	NS	NS	NS	NS	NS	No LPH
	06/20/91		53.60	269.17	NS	NS	NS	NS	NS	NS	NS	NS	No LPH
	09/12/91		53.60	269.17	NS	NS	NS	NS	NS	NS	NS	NS	No LPH
	12/30/91		53.95	268.82	NS	NS	NS	NS	NS	NS	NS	NS	No LPH
	01/30/92		53.65	269.12	NS	NS	NS	NS	NS	NS	NS	NS	No LPH
	03/02/92		53.68	269.09	NS	NS	NS	NS	NS	NS	NS	NS	No LPH
	03/24/92		53.70	269.07	NS	NS	NS	NS	NS	NS	NS	NS	No LPH
	04/14/92		53.66	269.11	NS	NS	NS	NS	NS	NS	NS	NS	No LPH
	05/21/92		53.62	269.15	NS	NS	NS	NS	NS	NS	NS	NS	No LPH
	06/08/92		53.61	269.16	NS	NS	NS	NS	NS	NS	NS	NS	No LPH
	07/14/92		53.53	269.24	NS	NS	NS	NS	NS	NS	NS	NS	No LPH
	08/10/92		53.58	269.19	NS	NS	NS	NS	NS	NS	NS	NS	No LPH
	09/16/92		53.60	269.17	NS	NS	NS	NS	NS	NS	NS	NS	No LPH
	10/07/92		DRY	DRY	NS	NS	NS	NS	NS	NS	NS	NS	Not measured
	11/09/92		DRY	DRY	NS	NS	NS	NS	NS	NS	NS	NS	Not measured
	12/10/92		53.59	269.18	NS	NS	NS	NS	NS	NS	NS	NS	No LPH
	01/26/93		53.67	269.10	NS	NS	NS	NS	NS	NS	NS	NS	No LPH

TABLE 1

CUMULATIVE GROUND WATER MONITORING DATA

Exxon Service Station No. 7-3399
2991 Hopyard Road
Pleasanton, California

Monitoring Well	Date	Reference Elevation (ft)	Depth to Water (ft)	Ground Water Elevation (ft)	Benzene (µg/L)	Toluene (µg/L)	Ethyl-benzene (µg/L)	Total Xylenes (µg/L)	TPPH as gasoline (µg/L)	MTBE (µg/L)	Oxygenate Compounds (µg/L)	Industrial Solvents (mg/L)	Comments
MW-11	02/16/93	321.77	53.60	269.17	NS	NS	NS	NS	NS	NS	NS	NS	No LPH
(Cont.)	03/11/93		53.58	269.19	NS	NS	NS	NS	NS	NS	NS	NS	No LPH
	04/12/93		53.54	269.23	<0.5	<0.5	<0.5	<0.5	<50	NA	NA	NA	No LPH
	06/01/93		53.52	269.25	NS	NS	NS	NS	NS	NS	NS	NS	No LPH
	07/15/93		53.60	269.17	NS	NS	NS	NS	NS	NS	NS	NS	No LPH
	08/15/93		53.55	269.22	NS	NS	NS	NS	NS	NS	NS	NS	No LPH
	09/29/93		53.62	269.15	NS	NS	NS	NS	NS	NS	NS	NS	No LPH
	09/30/93		NM	NC	NS	NS	NS	NS	NS	NS	NS	NS	Not measured
	10/28/93		53.63	269.14	NS	NS	NS	NS	NS	NS	NS	NS	No LPH
	11/23/93		53.58	268.19	NS	NS	NS	NS	NS	NS	NS	NS	No LPH
	11/24/93		NM	NC	<0.5	<0.5	<0.5	<0.5	<50	NA	NA	NA	Not measured
	03/10-11/94		53.61	268.16	NS	NS	NS	NS	NS	NS	NS	NS	No LPH
	05/04-05/94		53.51	268.26	NS	NS	NS	NS	NS	NS	NS	NS	No LPH
	11/16/94		53.46	268.31	NS	NS	NS	NS	NS	NS	NS	NS	No LPH
	02/15/95		50.57	271.20	<0.5	<0.5	<0.5	<0.5	<50	NA	NA	NA	No LPH
	05/09/95		45.05	276.72	<0.5	<0.5	<0.5	<0.5	<50	NA	NA	NA	No LPH
	08/21/95		41.88	279.89	<0.5	<0.5	<0.5	<0.5	<50	2.8	NA	NA	No LPH
	11/30/95		40.04	281.73	<0.5	<0.5	<0.5	<0.5	<50	<5.0	NA	NA	No LPH
	03/28/96		36.90	284.87	<0.5	<0.5	<0.5	<0.5	<50	<5.0	NA	NA	No LPH
	05/31/96		35.34	286.43	<0.5	<0.5	<0.5	<0.5	<50	<5.0	NA	NA	No LPH
	08/28/96		39.56	282.21	NS	NS	NS	NS	NS	NS	NS	NS	No LPH
	11/18/96		39.56	282.21	NS	NS	NS	NS	NS	NS	NS	NS	No LPH
	02/28/97		34.50	287.27	NS	NS	NS	NS	NS	NS	NS	NS	No LPH
	05/23/97		34.80	286.97	NS	NS	NS	NS	NS	NS	NS	NS	No LPH
	09/23/97		39.18	282.59	NS	NS	NS	NS	NS	NS	NS	NS	No LPH
	12/30/97		37.94	283.83	NS	NS	NS	NS	NS	NS	NS	NS	No LPH
	03/24/98		32.86	289.65	NS	NS	NS	NS	NS	NS	NS	NS	Not measured
	06/15/98		30.49	291.28	NS	NS	NS	NS	NS	NS	NS	NS	No LPH
	09/11/98		35.96	285.81	NS	NS	NS	NS	NS	NS	NS	NS	Not measured

TABLE 1

CUMULATIVE GROUND WATER MONITORING DATA

Exxon Service Station No. 7-3399
 2991 Hopyard Road
 Pleasanton, California

Monitoring Well	Date	Reference Elevation (ft)	Depth to Water (ft)	Ground Water Elevation (ft)	Benzene (µg/L)	Toluene (µg/L)	Ethyl-benzene (µg/L)	Total Xylenes (µg/L)	TPPH as gasoline (µg/L)	MTBE (µg/L)	Oxygenate Compounds (µg/L)	Industrial Solvents (mg/L)	Comments
VR-1	03/24/92		NM	NC	1.7	<0.5	<0.5	<0.5	<50	NA	NA	NA	Not measured

^a Water level recorded during pumping of MW-7.

^b Anomalous water level possibly due to recharge from a perched water zone.

^c Casing head cut to lower elevation.

^d Casing head damaged by construction.

^e Results obtained past the technical holding time.

^f Methyl tertiary butyl ether by EPA Method 8250.

Reference elevation = Elevation relative to mean sea level.

Depth to ground water = Measured from notch/mark on north edge of well casing.

µg/L = Micrograms per liter.

TPPH = Total purgeable petroleum hydrocarbons.

MTBE = Methyl tertiary butyl ether by EPA Method 8020.

Oxygenate compounds = Ethanol, tertiary butanol, methyl tertiary butyl ether, diisopropyl ether, ethyl tertiary butyl ether, tertiary amyl methyl ether.
 Concentrations confirmed by EPA Method 8260.

LPH = Liquid-phase petroleum hydrocarbons.

NA = Not analyzed.

ND = Not detected at or above the laboratory's reporting limits.

NS = Not sampled.

NM = Not measured.

NC = Not calculated.

NOTE: Elevation detection limit quantified by multiplying laboratory limits by report limit multiplication factor.

ENCLOSURE C

Laboratory Analytical Reports



Sequoia Analytical

680 Chesapeake Drive
404 N. Wiget Lane
819 Striker Avenue, Suite 8
1455 McDowell Blvd. North, Ste. D

Redwood City, CA 94063
Walnut Creek, CA 94598
Sacramento, CA 95834
Petaluma, CA 94954

(650) 364-9600
(925) 988-9600
(916) 921-9600
(707) 792-1865

FAX (650) 364-9233
FAX (925) 988-9673
FAX (916) 921-0100
FAX (707) 792-0342

Delta Environmental 3164 Gold Camp Drive, #200 Rancho Cordova, CA 95670 Attention: Jim Brownell	Client Proj. ID: Exxon 7-3399, D094-836 Sample Descript: MW1 Matrix: LIQUID Analysis Method: 8015Mod/8020 Lab Number: 9809917-01	Sampled: 09/11/98 Received: 09/14/98 Analyzed: 09/22/98 Reported: 09/29/98
--	--	---

QC Batch Number: GC092298BTEX30A
Instrument ID: GCHP30

Total Purgeable Petroleum Hydrocarbons (TPPH) with BTEX and MTBE

Analyte	Detection Limit ug/L	Sample Results ug/L
TPPH as Gas	50	N.D.
Methyl t-Butyl Ether	2.5	N.D.
Benzene	0.50	N.D.
Toluene	0.50	N.D.
Ethyl Benzene	0.50	N.D.
Xylenes (Total)	0.50	N.D.
Chromatogram Pattern:		

Surrogates	Control Limits %	% Recovery
Trifluorotoluene	70 130	90

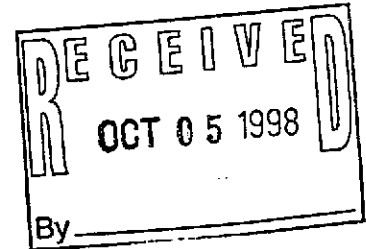

Analytes reported as N.D. were not present above the stated limit of detection.

SEQUOIA ANALYTICAL - ELAP #1210

Mei Mei Shin
Project Manager



**Sequoia
Analytical**

680 Chesapeake Drive
404 N. Wiget Lane
819 Striker Avenue, Suite 8
1455 McDowell Blvd. North, Ste. D

Redwood City, CA 94063
Walnut Creek, CA 94598
Sacramento, CA 95834
Petaluma, CA 94954

(650) 364-9600
(925) 988-9600
(916) 921-9600
(707) 792-1865

FAX (650) 364-9233
FAX (925) 988-9673
FAX (916) 921-0100
FAX (707) 792-0342

Delta Environmental 3164 Gold Camp Drive, #200 Rancho Cordova, CA 95670	Client Proj. ID: Exxon 7-3399, D094-836 Sample Descript: MW4 Matrix: LIQUID Analysis Method: 8015Mod/8020 Lab Number: 9809917-02	Sampled: 09/11/98 Received: 09/14/98 Analyzed: 09/22/98 Reported: 09/29/98
---	--	---

QC Batch Number: GC092298BTEX30A
Instrument ID: GCHP30

Total Purgeable Petroleum Hydrocarbons (TPPH) with BTEX and MTBE

Analyte	Detection Limit ug/L	Sample Results ug/L
TPPH as Gas	50	N.D.
Methyl t-Butyl Ether	2.5	N.D.
Benzene	0.50	N.D.
Toluene	0.50	N.D.
Ethyl Benzene	0.50	N.D.
Xylenes (Total)	0.50	N.D.
Chromatogram Pattern:		
Surrogates	Control Limits %	% Recovery
Trifluorotoluene	70 130	86

Analytes reported as N.D. were not present above the stated limit of detection.

SEQUOIA ANALYTICAL - ELAP #1210

Mei Mei Shin
Project Manager



Delta Environmental 3164 Gold Camp Drive, #200 Rancho Cordova, CA 95670	Client Proj. ID: Exxon 7-3399, D094-836 Sample Descript: MW5S Matrix: LIQUID Analysis Method: 8015Mod/8020 Lab Number: 9809917-03	Sampled: 09/11/98 Received: 09/14/98 Analyzed: 09/22/98 Reported: 09/29/98
---	---	---

QC Batch Number: GC092298BTEX30A
Instrument ID: GCHP30

Total Purgeable Petroleum Hydrocarbons (TPPH) with BTEX and MTBE

Analyte	Detection Limit ug/L	Sample Results ug/L
TPPH as Gas	50	N.D.
Methyl t-Butyl Ether	2.5	N.D.
Benzene	0.50	N.D.
Toluene	0.50	N.D.
Ethyl Benzene	0.50	N.D.
Xylenes (Total)	0.50	N.D.
Chromatogram Pattern:		
Surrogates	Control Limits %	% Recovery
Trifluorotoluene	70 130	84

Analytes reported as N.D. were not present above the stated limit of detection.

SEQUOIA ANALYTICAL - ELAP #1210

Mei Mei Shin
Project Manager



Sequoia Analytical

680 Chesapeake Drive
404 N. Wiget Lane
819 Striker Avenue, Suite 8
1455 McDowell Blvd. North, Ste. D

Redwood City, CA 94063
Walnut Creek, CA 94598
Sacramento, CA 95834
Petaluma, CA 94954

(650) 364-9600
(925) 988-9600
(916) 921-9600
(707) 792-1865

FAX (650) 364-9233
FAX (925) 988-9673
FAX (916) 921-0100
FAX (707) 792-0342

Delta Environmental 3164 Gold Camp Drive, #200 Rancho Cordova, CA 95670	Client Proj. ID: Exxon 7-3399, D094-836 Sample Descript: MW5D Matrix: LIQUID Analysis Method: 8015Mod/8020 Lab Number: 9809917-04	Sampled: 09/11/98 Received: 09/14/98 Analyzed: 09/23/98 Reported: 09/29/98
---	---	---

QC Batch Number: GC092398BTEX03A
Instrument ID: GCHP03

Total Purgeable Petroleum Hydrocarbons (TPPH) with BTEX and MTBE

Analyte	Detection Limit ug/L	Sample Results ug/L
TPPH as Gas	50	N.D.
Methyl t-Butyl Ether	2.5	33
Benzene	0.50	N.D.
Toluene	0.50	N.D.
Ethyl Benzene	0.50	N.D.
Xylenes (Total)	0.50	N.D.
Chromatogram Pattern:		
Surrogates	Control Limits %	% Recovery
Trifluorotoluene	70 130	94

Analytes reported as N.D. were not present above the stated limit of detection.

SEQUOIA ANALYTICAL - ELAP #1210

Mei Mei Shin
Project Manager



Sequoia Analytical

680 Chesapeake Drive
404 N. Wiget Lane
819 Striker Avenue, Suite 8
1455 McDowell Blvd. North, Ste. D

Redwood City, CA 94063
Walnut Creek, CA 94598
Sacramento, CA 95834
Petaluma, CA 94954

(650) 364-9600 FAX (650) 364-9233
(925) 988-9600 FAX (925) 988-9673
(916) 921-9600 FAX (916) 921-0100
(707) 792-1865 FAX (707) 792-0342

Delta Environmental 3164 Gold Camp Drive, #200 Rancho Cordova, CA 95670 Attention: Jim Brownell	Client Proj. ID: Exxon 7-3399, D094-836 Sample Descript: MW7 Matrix: LIQUID Analysis Method: 8015Mod/8020 Lab Number: 9809917-05	Sampled: 09/11/98 Received: 09/14/98 Analyzed: 09/22/98 Reported: 09/29/98
--	--	---

QC Batch Number: GC092298BTEX30A
Instrument ID: GCHP30

Total Purgeable Petroleum Hydrocarbons (TPPH) with BTEX and MTBE

Analyte	Detection Limit ug/L	Sample Results ug/L
TPPH as Gas	50	N.D.
Methyl t-Butyl Ether	2.5	N.D.
Benzene	0.50	N.D.
Toluene	0.50	N.D.
Ethyl Benzene	0.50	N.D.
Xylenes (Total)	0.50	N.D.
Chromatogram Pattern:		
Surrogates	Control Limits %	% Recovery
Trifluorotoluene	70 130	78

Analytes reported as N.D. were not present above the stated limit of detection.

SEQUOIA ANALYTICAL - ELAP #1210

Mei Mei Shin
Project Manager



**Sequoia
Analytical**

680 Chesapeake Drive
404 N. Wiget Lane
819 Striker Avenue, Suite 8
1455 McDowell Blvd. North, Ste. D

Redwood City, CA 94063
Walnut Creek, CA 94598
Sacramento, CA 95834
Petaluma, CA 94954

(650) 364-9600 FAX (650) 364-9233
(925) 988-9600 FAX (925) 988-9673
(916) 921-9600 FAX (916) 921-0100
(707) 792-1865 FAX (707) 792-0342

Delta Environmental 3164 Gold Camp Drive, #200 Rancho Cordova, CA 95670	Client Proj. ID: Exxon 7-3399, D094-836 Sample Descript: MW8 Matrix: LIQUID Analysis Method: 8015Mod/8020 Lab Number: 9809917-06	Sampled: 09/11/98 Received: 09/14/98 Analyzed: 09/24/98 Reported: 09/29/98
Attention: Jim Brownell		

QC Batch Number: GC092498BTEX02A
Instrument ID: GCHP02

Total Purgeable Petroleum Hydrocarbons (TPPH) with BTEX and MTBE

Analyte	Detection Limit ug/L	Sample Results ug/L
TPPH as Gas	50	N.D.
Methyl t-Butyl Ether	2.5	N.D.
Benzene	0.50	N.D.
Toluene	0.50	N.D.
Ethyl Benzene	0.50	N.D.
Xylenes (Total)	0.50	N.D.
Chromatogram Pattern:		
Surrogates	Control Limits %	% Recovery
Trifluorotoluene	70 130	94

Analytes reported as N.D. were not present above the stated limit of detection.

SEQUOIA ANALYTICAL - ELAP #1210

Mei Mei Shin
Project Manager



Sequoia Analytical

680 Chesapeake Drive
404 N. Wiget Lane
819 Striker Avenue, Suite 8
1455 McDowell Blvd. North, Ste. D

Redwood City, CA 94063
Walnut Creek, CA 94598
Sacramento, CA 95834
Petaluma, CA 94954

(650) 364-9600
(925) 988-9600
(916) 921-9600
(707) 792-1865

FAX (650) 364-9233
FAX (925) 988-9673
FAX (916) 921-0100
FAX (707) 792-0342

Delta Environmental 3164 Gold Camp Drive, #200 Rancho Cordova, CA 95670	Client Proj. ID: Exxon 7-3399, D094-836 Sample Descript: MW9 Matrix: LIQUID Analysis Method: 8015Mod/8020 Lab Number: 9809917-07	Sampled: 09/11/98 Received: 09/14/98 Analyzed: 09/22/98 Reported: 09/29/98
Attention: Jim Brownell		

QC Batch Number: GC092298BTEX30A
Instrument ID: GCHP30

Total Purgeable Petroleum Hydrocarbons (TPPH) with BTEX and MTBE

Analyte	Detection Limit ug/L	Sample Results ug/L
TPPH as Gas	50	N.D.
Methyl t-Butyl Ether	2.5	7.1
Benzene	0.50	1.5
Toluene	0.50	0.97
Ethyl Benzene	0.50	N.D.
Xylenes (Total)	0.50	1.1
Chromatogram Pattern:		
Surrogates	Control Limits %	% Recovery
Trifluorotoluene	70 130	88

Analytes reported as N.D. were not present above the stated limit of detection.

SEQUOIA ANALYTICAL - ELAP #1210

Mei Mei Shin
Project Manager



**Sequoia
Analytical**

680 Chesapeake Drive
404 N. Wiger Lane
819 Striker Avenue, Suite B
1455 McDowell Blvd. North, Ste. D

Redwood City, CA 94063
Walnut Creek, CA 94598
Sacramento, CA 95834
Petaluma, CA 94954

(650) 364-9600
(925) 988-9600
(916) 921-9600
(707) 792-1865

FAX (650) 364-9233
FAX (925) 988-9673
FAX (916) 921-0100
FAX (707) 792-0342

Delta Environmental 3164 Gold Camp Drive, #200 Rancho Cordova, CA 95670	Client Proj. ID: Exxon 7-3399, D094-836 Sample Descript: MW5DD Matrix: LIQUID Analysis Method: 8015Mod/8020 Lab Number: 9809917-08	Sampled: 09/11/98 Received: 09/14/98 Analyzed: 09/23/98 Reported: 09/29/98
Attention: Jim Brownell		

QC Batch Number: GC092398BTEX03A
Instrument ID: GCHP03

Total Purgeable Petroleum Hydrocarbons (TPPH) with BTEX and MTBE

Analyte	Detection Limit ug/L	Sample Results ug/L
TPPH as Gas	50	N.D.
Methyl t-Butyl Ether	2.5	35
Benzene	0.50	N.D.
Toluene	0.50	N.D.
Ethyl Benzene	0.50	N.D.
Xylenes (Total)	0.50	N.D.
Chromatogram Pattern:		
Surrogates	Control Limits %	% Recovery
Trifluorotoluene	70 130	75

Analytes reported as N.D. were not present above the stated limit of detection.

SEQUOIA ANALYTICAL - ELAP #1210

Mei Mei Shin
Project Manager



**Sequoia
Analytical**

680 Chesapeake Drive
404 N. Wiget Lane
819 Striker Avenue, Suite 8
1455 McDowell Blvd, North, Ste. D

Redwood City, CA 94063
Walnut Creek, CA 94598
Sacramento, CA 95834
Petaluma, CA 94954

(650) 364-9600
(925) 988-9600
(916) 921-9600
(707) 792-1865

FAX (650) 364-9233
FAX (925) 988-9673
FAX (916) 921-0100
FAX (707) 792-0342

Delta Environmental 3164 Gold Camp Drive, #200 Rancho Cordova, CA 95670	Client Proj. ID: Exxon 7-3399, D094-836 Sample Descript: MW8D Matrix: LIQUID Analysis Method: 8015Mod/8020 Lab Number: 9809917-09	Sampled: 09/11/98 Received: 09/14/98 Analyzed: 09/25/98 Reported: 09/29/98
Attention: Jim Brownell		

QC Batch Number: GC092598BTEX03A
Instrument ID: GCHP03

Total Purgeable Petroleum Hydrocarbons (TPPH) with BTEX and MTBE

Analyte	Detection Limit ug/L	Sample Results ug/L
TPPH as Gas	50	N.D.
Methyl t-Butyl Ether	2.5	N.D.
Benzene	0.50	N.D.
Toluene	0.50	N.D.
Ethyl Benzene	0.50	N.D.
Xylenes (Total)	0.50	N.D.
Chromatogram Pattern:		
Surrogates	Control Limits %	% Recovery
Trifluorotoluene	70 130	77

Analytes reported as N.D. were not present above the stated limit of detection.

SEQUOIA ANALYTICAL - ELAP #1210

Mei Mei Shin
Project Manager



Sequoia Analytical

680 Chesapeake Drive
404 N. Wiget Lane
819 Striker Avenue, Suite 8
1455 McDowell Blvd. North, Ste. D

Redwood City, CA 94063
Walnut Creek, CA 94598
Sacramento, CA 95834
Petaluma, CA 94954

(650) 364-9600
(925) 988-9600
(916) 921-9600
(707) 792-1865

FAX (650) 364-9233
FAX (925) 988-9673
FAX (916) 921-0100
FAX (707) 792-0342

DELTA ENVIRONMENTAL
3164 Gold Camp Drive # 200
Rancho Cordova, CA 95670
Attention: Jim Brownell

Client Project ID: EXXON 7-3399, D094-836

QC Sample Group: 9809917

Reported: Oct 1, 1998

QUALITY CONTROL DATA REPORT

Matrix: Liquid
Method: EPA 8015
Analyst: GR/MM

ANALYTE Gasoline

QC Batch #: GC092598BTEX03A

Sample No.: GW9809641-11

Date Prepared: 9/25/98
Date Analyzed: 9/25/98
Instrument I.D.#: GCHP03

Sample Conc., ug/L: N.D.
Conc. Spiked, ug/L: 250

Matrix Spike, ug/L: 260
% Recovery: 103

Matrix
Spike Duplicate, ug/L: 250
% Recovery: 99

Relative % Difference: 4.0

RPD Control Limits: 0-25

LCS Batch#: GWLCS092598A

Date Prepared: 9/25/98
Date Analyzed: 9/25/98
Instrument I.D.#: GCHP03

Conc. Spiked, ug/L: 250

LCS Recovery, ug/L: 240
LCS % Recovery: 97

Percent Recovery Control Limits:

MS/MSD 60-140
LCS 70-130

Quality Assurance Statement: All standard operating procedures and quality control requirements have been met.

SEQUOIA ANALYTICAL

Mei Mei Shin
Project Manager

Please Note:

The LCS is a control sample of known, interferent free matrix that is analyzed using the same reagents, preparation, and analytical methods employed for the samples. The matrix spike is an aliquot of sample fortified with known quantities of specific compounds and subjected to the entire analytical procedure. If the recovery of analytes from the matrix spike does not fall within specified control limits due to matrix interference, the LCS recovery is to be used to validate the batch.



Sequoia Analytical

680 Chesapeake Drive
404 N. Wiget Lane
819 Striker Avenue, Suite 8
1455 McDowell Blvd, North, Ste. D

Redwood City, CA 94063
Walnut Creek, CA 94598
Sacramento, CA 95834
Petaluma, CA 94954

(650) 364-9600
(925) 988-9600
(916) 921-9600
(707) 792-1865

FAX (650) 364-9233
FAX (925) 988-9673
FAX (916) 921-0100
FAX (707) 792-0342

DELTA ENVIRONMENTAL
3164 Gold Camp Drive # 200
Rancho Cordova, CA 95670
Attention: Jim Brownell

Client Project ID: EXXON 7-3399, D094-836

QC Sample Group: 9809917

Reported: Oct 1, 1998

QUALITY CONTROL DATA REPORT

Matrix: Liquid
Method: EPA 8015
Analyst: GR/DB

ANALYTE Gasoline

QC Batch #: GC092498BTEX02A

Sample No.: GW9809917-2

Date Prepared: 9/24/98

Date Analyzed: 9/24/98

Instrument I.D.#: GCHP02

Sample Conc., ug/L: N.D.

Conc. Spiked, ug/L: 250

Matrix Spike, ug/L: 280

% Recovery: 112

Matrix

Spike Duplicate, ug/L: 270

% Recovery: 106

Relative % Difference: 5.5

RPD Control Limits: 0-25

LCS Batch#: GWLCS092498A

Date Prepared: 9/24/98

Date Analyzed: 9/24/98

Instrument I.D.#: GCHP02

Conc. Spiked, ug/L: 250

LCS Recovery, ug/L: 260

LCS % Recovery: 105

Percent Recovery Control Limits:

MS/MSD 60-140

LCS 70-130

Quality Assurance Statement: All standard operating procedures and quality control requirements have been met.

SEQUOIA ANALYTICAL

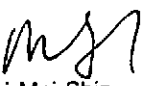
Mei Mei Shin
Project Manager

Please Note:

The LCS is a control sample of known, interferent free matrix that is analyzed using the same reagents, preparation, and analytical methods employed for the samples. The matrix spike is an aliquot of sample fortified with known quantities of specific compounds and subjected to the entire analytical procedure. If the recovery of analytes from the matrix spike does not fall within specified control limits due to matrix interference, the LCS recovery is to be used to validate the batch.



Sequoia Analytical

680 Chesapeake Drive
404 N. Wiget Lane
819 Striker Avenue, Suite 8
1455 McDowell Blvd. North, Ste. D

Redwood City, CA 94063
Walnut Creek, CA 94598
Sacramento, CA 95834
Petaluma, CA 94954

(650) 364-9600
(925) 988-9600
(916) 921-9600
(707) 792-1865

FAX (650) 364-9233
FAX (925) 988-9673
FAX (916) 921-0100
FAX (707) 792-0342

DELTA ENVIRONMENTAL
3164 Gold Camp Drive # 200
Rancho Cordova, CA 95670
Attention: Jim Brownell

Client Project ID: EXXON 7-3399, D094-836

QC Sample Group: 9809917

Reported: Oct 1, 1998

QUALITY CONTROL DATA REPORT

Matrix: Liquid
Method: EPA 8015
Analyst: GR/DB

ANALYTE Gasoline

QC Batch #: GC092298BTEX30A

Sample No.: GW9809733-4

Date Prepared: 9/22/98

Date Analyzed: 9/22/98

Instrument I.D.#: GCHP30

Sample Conc., ug/L: N.D.

Conc. Spiked, ug/L: 250

Matrix Spike, ug/L: 320

% Recovery: 129

Matrix

Spike Duplicate, ug/L: 300

% Recovery: 120

Relative % Difference: 7.2

RPD Control Limits: 0-25

LCS Batch#: GWLCS092298A

Date Prepared: 9/22/98

Date Analyzed: 9/22/98

Instrument I.D.#: GCHP30

Conc. Spiked, ug/L: 250

LCS Recovery, ug/L: 310

LCS % Recovery: 124

Percent Recovery Control Limits:

MS/MSD 60-140

LCS 70-130

Quality Assurance Statement: All standard operating procedures and quality control requirements have been met.

Please Note:

The LCS is a control sample of known, interferent free matrix that is analyzed using the same reagents, preparation, and analytical methods employed for the samples. The matrix spike is an aliquot of sample fortified with known quantities of specific compounds and subjected to the entire analytical procedure. If the recovery of analytes from the matrix spike does not fall within specified control limits due to matrix interference, the LCS recovery is to be used to validate the batch.

SEQUOIA ANALYTICAL

Mei Mei Shin
Project Manager



Sequoia Analytical

680 Chesapeake Drive
404 N. Wiger Lane
819 Striker Avenue, Suite 8
1455 McDowell Blvd. North, Ste. D

Redwood City, CA 94063
Walnut Creek, CA 94598
Sacramento, CA 95834
Petaluma, CA 94954

(650) 364-9600
(925) 988-9600
(916) 921-9600
(707) 792-1865

FAX (650) 364-9233
FAX (925) 988-9673
FAX (916) 921-0100
FAX (707) 792-0342

DELTA ENVIRONMENTAL
3164 Gold Camp Drive # 200
Rancho Cordova, CA 95670
Attention: Jim Brownell

Client Project ID: EXXON 7-3399, D094-836

QC Sample Group: 9809917

Reported: Oct 1, 1998

QUALITY CONTROL DATA REPORT

Matrix: Liquid
Method: EPA 8015
Analyst: NC

ANALYTE Gasoline

QC Batch #: GC092398BTEX03A

Sample No.: GW9809750-3

Date Prepared: 9/23/98

Date Analyzed: 9/23/98

Instrument I.D.#: GCHP03

Sample Conc., ug/L: N.D.

Conc. Spiked, ug/L: 250

Matrix Spike, ug/L: 280

% Recovery: 112

Matrix

Spike Duplicate, ug/L: 280

% Recovery: 112

Relative % Difference: 0.0

RPD Control Limits: 0-25

LCS Batch#: GWLCS092398A

Date Prepared: 9/23/98

Date Analyzed: 9/23/98

Instrument I.D.#: GCHP03

Conc. Spiked, ug/L: 250

LCS Recovery, ug/L: 270

LCS % Recovery: 108

Percent Recovery Control Limits:

MS/MSD 60-140

LCS 70-130

Quality Assurance Statement: All standard operating procedures and quality control requirements have been met.

Please Note:

The LCS is a control sample of known, interferent free matrix that is analyzed using the same reagents, preparation, and analytical methods employed for the samples. The matrix spike is an aliquot of sample fortified with known quantities of specific compounds and subjected to the entire analytical procedure. If the recovery of analytes from the matrix spike does not fall within specified control limits due to matrix interference, the LCS recovery is to be used to validate the batch.

SEQUOIA ANALYTICAL

Mei Mei Shin
Project Manager



Sequoia
Analytical

680 Chesapeake Drive
404 N. Wiger Lane
819 Striker Avenue, Suite B
1455 McDowell Blvd. North. Ste. D

Redwood City, CA 94063
Walnut Creek, CA 94598
Sacramento, CA 95834
Petaluma, CA 94954

(650) 364-9600
(925) 988-9600
(916) 921-9600
(707) 792-1865

FAX (650) 364-9233
FAX (925) 988-9673
FAX (916) 921-0100
FAX (707) 792-0342

Delta Environmental 3164 Gold Camp Drive, #200 Rancho Cordova, CA 95670 Attention: Jim Brownell	Client Proj. ID: Exxon 7-3399, D094-836 Lab Proj. ID: 9809917	Received: 09/14/98 Reported: 09/29/98
--	--	--

LABORATORY NARRATIVE

In order to properly interpret this report, it must be reproduced in its entirety. This report contains a total of 15 pages including the laboratory narrative, sample results, quality control, and related documents as required (cover page, COC, raw data, etc.).

SEQUOIA ANALYTICAL

Mei Mei Shin
Project Manager



Sequoia Analytical
680 Chesapeake Dr.
Redwood City, CA 94063
(415) 364-9600 • FAX (415) 364-9233

EXXON COMPANY, U.S.A.

P.O. Box 2180, Houston, TX 77002-7426

CHAIN OF CUSTODY

980991+

Consultant's Name: Delta Environmental Page 1 of 1

Address: <u>3164 Gold Camp DR Rancho Conejo</u>		Site Location: <u>Placentia</u>
Project #:	Consultant Project #: <u>D094-836</u>	Consultant Work Release #: <u>19432526</u>
Project Contact: <u>Jim Brannell</u>	Phone #: <u>916-638-2085</u>	Laboratory Work Release #:
EXXON Contact: <u>Munka</u>	Phone #:	EXXON RAS #: <u>7-3399</u>
Sampled by (print): <u>Chris Hill / Monty Meyer</u>	Sampler's Signature:	
Shipment Method:	Air Bill #:	

TAT: 24 hr 48 hr 72 hr 96 hr Standard (10 day)

Sample Description	Collection Date	Collection Time	Matrix Soil/Water/Air	Prsv	# of Cont.	Sequoia's Sample #	ANALYSIS REQUIRED				Temperature: _____
							TPH/Gas BTEX/8015/8020	TPH/Diesel EPA 8015	TRPH S.M. 5520	8020 MTBE	
1 mw 1	9-11-98	1104	Water	Hcl	6		X			X	
2 mw 4	}	1139	}	}	6		X			X	
3 mw 5S		0821			6		X			X	
4 mw 5D		0859			6		X			X	
5 mw 7		0947			6		X			X	
6 mw 8		1231			6		X			X	
7 mw 9		1027			6		X			X	
8 mw 5DD					0900			6		X	
9 mw 8D	9-11-98	1232			6		X			X	

RELINQUISHED BY / AFFILIATION	Date	Time	ACCEPTED / AFFILIATION	Date	Time	Additional Comments
	9/14/98	1150	John Yuwell / Sequoia	9/14/98	1150	
John Yuwell / Sequoia	9/14/98	1220	Endi Hensel / Sequoia	9/14/98	1220	
Endi Hensel / Sequoia						

Pink - Client
Yellow - Sequoia
White - Sequoia



**Sequoia
Analytical**

680 Chesapeake Drive
404 N. Wiget Lane
819 Striker Avenue, Suite 8
1455 McDowell Blvd. North, Ste. D

Redwood City, CA 94063
Walnut Creek, CA 94598
Sacramento, CA 95834
Petaluma, CA 94954

(650) 364-9600
(925) 988-9600
(916) 921-9600
(707) 792-1865

FAX (650) 364-9233
FAX (925) 988-9673
FAX (916) 921-0100
FAX (707) 792-0342

Delta Environmental
3164 Gold Camp Drive, #200
Rancho Cordova, CA 95670

Client Proj. ID: Exxon 7-3399, DO94-836
Sample Descript: MW5D
Matrix: LIQUID
Analysis Method: EPA 8260
Lab Number: 9810J07-01

Sampled: 10/28/98
Received: 10/28/98
Analyzed: 10/28/98
Reported: 10/30/98

QC Batch Number: MS102898MTBEH6A
Instrument ID: H6

Methyl t-Butyl Ether (MTBE)

Analyte	Detection Limit ug/L	Sample Results ug/L
Methyl t-Butyl Ether	2.0	N.D.
Surrogates	Control Limits %	% Recovery
1,2-Dichloroethane-d4	76 114	97

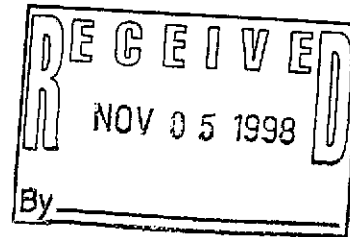

Analytes reported as N.D. were not present above the stated limit of detection.

SEQUOIA ANALYTICAL - ELAP #1210

Mei Mei Shin
Project Manager





Delta Environmental 3164 Gold Camp Drive, #200 Rancho Cordova, CA 95670	Client Proj. ID: Exxon 7-3399, DO94-836 Sample Descript: MW5D Matrix: LIQUID Analysis Method: 8015Mod/8020 Lab Number: 9810J07-01	Sampled: 10/28/98 Received: 10/28/98 Analyzed: 10/28/98 Reported: 10/30/98
Attention: Jim Brownell		

QC Batch Number: GC102898BTEX03A
Instrument ID: GCHP03

Total Purgeable Petroleum Hydrocarbons (TPPH) with BTEX

Analyte	Detection Limit ug/L	Sample Results ug/L
TPPH as Gas	50	N.D.
Benzene	0.50	N.D.
Toluene	0.50	N.D.
Ethyl Benzene	0.50	N.D.
Xylenes (Total)	0.50	N.D.
Chromatogram Pattern:		
Surrogates	Control Limits %	% Recovery
Trifluorotoluene	70 130	94

Analytes reported as N.D. were not present above the stated limit of detection.

SEQUOIA ANALYTICAL - ELAP #1210

Mei Mei Shin
Project Manager





Sequoia Analytical

680 Chesapeake Drive
404 N. Wiger Lane
819 Striker Avenue, Suite 8
1455 McDowell Blvd. North, Ste. D

Redwood City, CA 94063
Walnut Creek, CA 94598
Sacramento, CA 95834
Petaluma, CA 94954

(650) 364-9600 FAX (650) 364-9233
(925) 988-9600 FAX (925) 988-9673
(916) 921-9600 FAX (916) 921-0100
(707) 792-1865 FAX (707) 792-0342

DELTA ENVIRONMENTAL
3164 Gold Camp Dr. #200
Rancho Cordova, CA 95670
Attention: Jim Brownell

Client Project ID: EXXON 7-3399, D094-836

QC Sample Group: 9810J07

Reported: Oct 30, 1998

QUALITY CONTROL DATA REPORT

Matrix: Liquid
Method: EPA 8015
Analyst: P.ALCALA

ANALYTE Gasoline

QC Batch #: GC102898BTEX03A

Sample No.: 9810C21-3
Date Prepared: 10/28/98
Date Analyzed: 10/28/98
Instrument I.D.#: GCHP03

Sample Conc., ug/L: N.D.
Conc. Spiked, ug/L: 250

Matrix Spike, ug/L: 260
% Recovery: 103

Matrix
Spike Duplicate, ug/L: 220
% Recovery: 88

Relative % Difference: 16

RPD Control Limits: 0-25

LCS Batch#: GC102898BTEX03A

Date Prepared: 10/28/98
Date Analyzed: 10/28/98
Instrument I.D.#: GCHP03

Conc. Spiked, ug/L: 250

LCS Recovery, ug/L: 260
LCS % Recovery: 102

Percent Recovery Control Limits:

MS/MSD 60-140
LCS 70-130

Quality Assurance Statement: All standard operating procedures and quality control requirements have been met.

SEQUOIA ANALYTICAL

Mei Mei Shin
Project Manager

Please Note:

The LCS is a control sample of known, interferent free matrix that is analyzed using the same reagents, preparation, and analytical methods employed for the samples. The matrix spike is an aliquot of sample fortified with known quantities of specific compounds and subjected to the entire analytical procedure. If the recovery of analytes from the matrix spike does not fall within specified control limits due to matrix interference, the LCS recovery is to be used to validate the batch.





Sequoia
Analytical

680 Chesapeake Drive
404 N. Wiget Lane
819 Striker Avenue, Suite B
1455 McDowell Blvd. North, Ste. D

Redwood City, CA 94063
Walnut Creek, CA 94598
Sacramento, CA 95834
Petaluma, CA 94954

(650) 364-9600
(925) 988-9600
(916) 921-9600
(707) 792-1865

FAX (650) 364-9233
FAX (925) 988-9673
FAX (916) 921-0100
FAX (707) 792-0342

Delta Environmental
3164 Gold Camp Drive, #200
Rancho Cordova, CA 95670
Attention: Jim Brownell

Client Proj. ID: Exxon 7-3399, DO94-836

Received: 10/28/98

Lab Proj. ID: 9810J07

Reported: 10/30/98

LABORATORY NARRATIVE

In order to properly interpret this report, it must be reproduced in its entirety. This report contains a total of 5 pages including the laboratory narrative, sample results, quality control, and related documents as required (cover page, COC, raw data, etc.).

SEQUOIA ANALYTICAL

Mei Mei Shin
Project Manager





Sequoia Analytical
 680 Chesapeake Dr.
 Redwood City, CA 94063
 (415) 364-9600 • FAX (415) 364-9233

EXXON COMPANY, U.S.A.

P.O. Box 2180, Houston, TX 77002-7426

CHAIN OF CUSTODY

Consultant's Name: Delta Environmental		Page <u>1</u> of <u>1</u>
Address: 3164 Gold Camp Dr. Rancho Cordova		Site Location: Pleasanton
Project #:	Consultant Project #: D094-83L	Consultant Work Release #: 19432526
Project Contact: Jim Brownell	Phone #: 916-638-2085	Laboratory Work Release #:
EXXON Contact: Mark	Phone #:	EXXON RAS #: 7-3399
Sampled by (print): Chris Hill / Marty Nguyen	Sampler's Signature: <i>[Signature]</i>	
Shipment Method:	Air Bill #:	

TAT: 24 hr 48 hr 72 hr 96 hr Standard (10 day)

							ANALYSIS REQUIRED						
Sample Description	Collection Date	Collection Time	Matrix Soil/Water/Air	Prsv	# of Cont.	Sequoia's Sample #	TPH/Gas BTEX/ 8015/ 8020	TPH/ Diesel EPA 8015	TRPH S.M. 5520	MSL 826	Temperature: _____	Inbound Seal: Yes No	Outbound Seal: Yes No
98-10-507													
MW5D	10-25-98	16:14	Water	16.1	6		X			X			

RELINQUISHED BY / AFFILIATION	Date	Time	ACCEPTED / AFFILIATION	Date	Time	Additional Comments
<i>[Signature]</i> Delta	10-25-98	15:10	<i>[Signature]</i> / SEQUOIA	10/26/98	15:10	

Pink - Client

Yellow - Sequoia

White - Sequoia