

ATTORNEYS AT LAW

Alameda County

DEC 21 2007

Environmental Health

1111 Broadway, 24th Floor
Oakland, CA 94607-4036

Post Office Box 2047
Oakland, CA 94604-2047

Telephone: (510) 834-6600
Fax: (510) 834-1928
lhausrath@wendel.com

20361

December 20, 2007

Mr. Jerry Wickham
Hazardous Materials Specialist
Alameda County Health Agency
1131 Harbor Bay parkway, Suite 250
Alameda, CA 94502

Re: Pleasanton Transportation Corridor

Dear Mr. Wickham:

Thank you again for taking the time to meet with Rory MacNeil and me last week to discuss the environmental issues relating to the Transportation Corridor in Pleasanton owned by the County of Alameda.

With respect to the Unocal 76 station site, we have been in contact with Conoco Phillips and have provided them a right of entry form which would allow the borings to take place in the very near future. We hope that the form will be acceptable to Conoco and will facilitate the borings. We indicated to Conoco that we could address the longer term license agreement issues after the borings are conducted.

We were also advised yesterday by the City of Pleasanton that the borings undertaken by the City's consultant (BSK) revealed jet fuel, which possibly could originate from the Kinder Morgan petroleum pipeline. A copy of what we received from the City is enclosed. When we contacted Kinder Morgan, they indicated that such data is frequently misinterpreted, and that the pipeline would not contain commercial jet fuel. So perhaps the boring samples have been misinterpreted. Kinder Morgan requested from us, and we in turn requested from the City of Pleasanton, the lab analysis which would help determine the nature of the materials found in the boring. So at this point we are not sure if there is a pipeline leak, although it is a possibility. We wanted to bring this to your Agency's attention, and we will provide the additional information once we receive it from the City. We will also provide a copy of the Phase 2 report, once we receive that. The enclosed data is apparently from a draft version of the report.

As indicated, we will keep you apprised of all developments. If you have any questions, please do not hesitate to contact me. As I will be out of the office for the holidays commencing

Mr. Jerry Wickham
December 20, 2007
Page 2

WENDEL, ROSEN, BLACK & DEAN LLP

December 20, if something of an urgent nature arises, please contact either my partner, Catherine Johnson, or my assistant, Maria Jones, who can get in touch with me.

Very truly yours,

WENDEL, ROSEN, BLACK & DEAN LLP

Les Hausrath/mmj

Les A. Hausrath

LAH:mmj
Enclosures

cc: Richard Winnie, Esq.
Catherine Johnson, Esq.
Regional Water Quality Control Board

DRAFT

TABLE 2
SOIL SAMPLE ANALYTICAL RESULTS - PID/FID RESULTS
 Alameda County Transportation Corridor
 Pleasanton, California

Sample Location	Sample Depth	Date	PID Reading (ppm)	FID Reading (ppm)	TPH-d (mg/kg)	TPH-g Aviation Fuel (mg/kg)	TPH-g Jet Fuel (mg/kg)	Benzene (mg/kg)	Ethylbenzene (mg/kg)	Toluene (mg/kg)	Total Xylenes (mg/kg)	Hydrocarbon Oil & Grease	Tert-Butyl Alcohol (mg/kg)	MTBE (mg/kg)
SB-1	10	11/6/2007	19.5	0	<4.0	<1.0	<1.0	<4.0	<0.0050	<0.0050	<0.0050	<20	<50	<5.0
	30	11/6/2007	21.5	0	<2.0	<1.0	<1.0	<2.0	<0.0050	<0.0050	<0.0050	<20	<50	<5.0
	60	11/6/2007	23.5	0	<4.0	<1.0	<1.0	<4.0	<0.0050	<0.0050	<0.0050	<20	<50	<5.0
SB-2	10	11/6/2007	24	0	<4.0	<1.0	<1.0	<4.0	<0.0050	<0.0050	<0.0050	<20	<50	<5.0
	30	11/6/2007	19.5	0	<2.0	<1.0	<1.0	<2.0	<0.0050	<0.0050	<0.0050	<20	<50	6.1
	40	11/6/2007	19	0	<2.0	<1.0	<1.0	<2.0	<0.0050	<0.0050	<0.0050	<20	<50	<5.0
	50	11/6/2007	24	16	<4.0	<1.0	<1.0	<4.0	<0.0050	<0.0050	<0.0050	<20	<50	<5.0
SB-3	10	11/6/2007	7	0	<4.0	<1.0	<1.0	<4.0	<0.0050	<0.0050	<0.0050	<20	<50	<5.0
	30	11/6/2007	7	6	<2.0	<1.0	<1.0	<2.0	<0.0050	<0.0050	<0.0050	<20	<50	<5.0
	50	11/6/2007	20	2	<2.0	<1.0	<1.0	<2.0	<0.0050	<0.0050	<0.0050	<20	<50	<5.0
SB-4	10	11/6/2007	7	0	<2.0	<1.0	<1.0	2.7	<0.0050	<0.0050	<0.0050	93	<50	<5.0
	30	11/6/2007	16	2	<2.0	<1.0	<1.0	<2.0	<0.0050	<0.0050	<0.0050	<20	<50	<5.0
	40	11/6/2007	17	1	<2.0	<1.0	<1.0	<2.0	<0.0050	<0.0050	<0.0050	<20	<50	<5.0
	50	11/6/2007	17	1	<4.0	<1.0	<1.0	<4.0	<0.0050	<0.0050	<0.0050	<20	<50	<5.0
SB-5	10	11/7/2007	2	0	<4.0	<1.0	<1.0	<4.0	<0.0050	<0.0050	<0.0050	<20	<50	<5.0
	20	11/7/2007	67	360	140	1.5	8.5	150	0.39	0.028	0.059	290	69	21
	30	11/7/2007	500	41,700	8,100	860	170	9600	37	0.38	1.2	11,000	<310	260
	40	11/7/2007	400	5200	1300	8.9	28	1400	0.69	0.5	0.11	2400	69	52
	50	11/7/2007	300	3,500	1,700	9	52	1800	2.4	1.2	0.55	3400	130	81
	60	11/7/2007	95	360	<2.0	<1.0	<1.0	<2.0	<0.0050	<0.0050	<0.0050	<20	120	7.1
SB-6	10	11/7/2007	200	350	<2.0	<1.0	<1.0	2.1	<0.0050	<0.0050	<0.0050	<20	<50	<5.0
	20	11/7/2007	35	20	<2.0	<1.0	<1.0	<2.0	<0.0050	<0.0050	<0.0050	<20	<50	6.6
	30	11/7/2007	1,500	22,000	1,100	67	380	1400	1.4	4.8	1.2	2400	<2500	<250

J:\01\Projects\07\0707_048.DWG Alameda Corridor Phase II Phase 2 - Soil Sampling\Site.dwg
 User:mlh001 Date Plotted: 11/28/07 4:17pm
 Plot Scale: 1" = 40' (APPROXIMATELY)

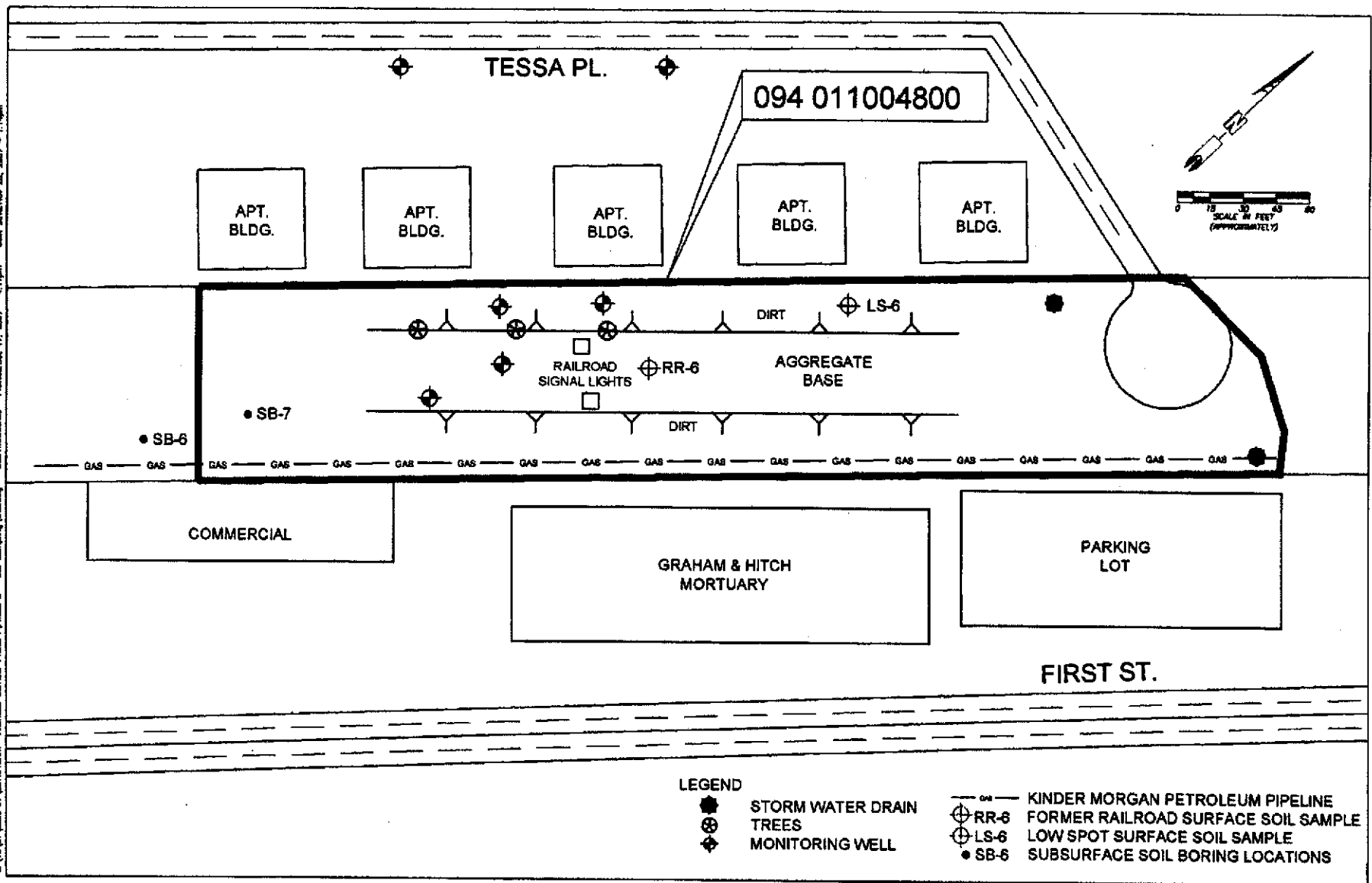

SITE PLAN
 Alameda County Transportation Corridor Phase II
 Alameda County Assessor's Parcel No. 094 011004800
 Pleasanton, California

J:\40107\ahn_07\07_048.dwg Alameda Corridor Phase II\Phase 2 - Soil Sampling\Site.dwg User: mthorpe Published: Dec 17, 2007 - 4:18pm Lot: Section 28, 2007 - 1:16pm

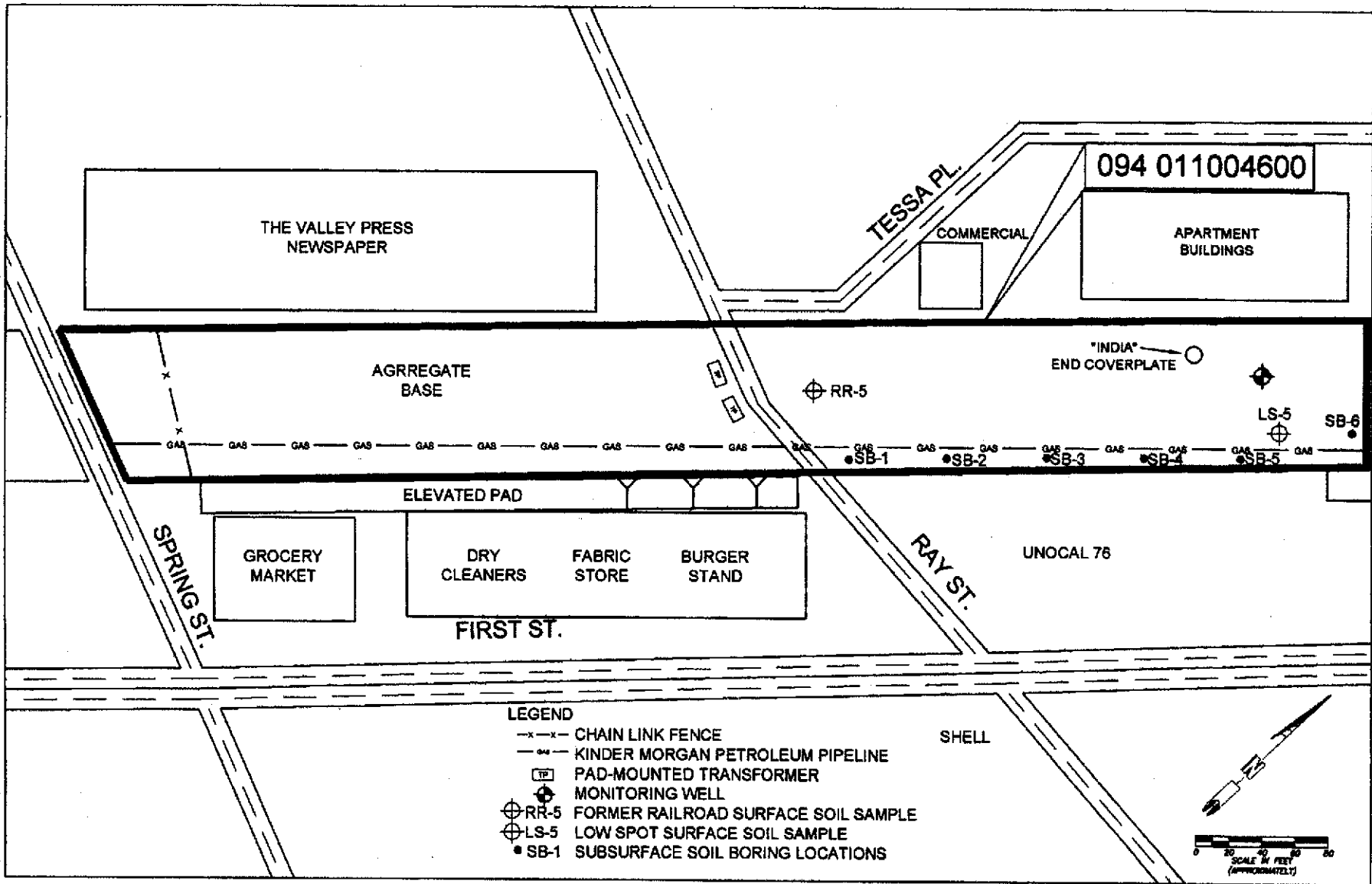

BSK

SITE PLAN
 Alameda County Transportation Corridor Phase II
 Alameda County Assessor's Parcel No. 094 011004600
 Pleasanton, California

DRAFT

TABLE 2
SOIL SAMPLE ANALYTICAL RESULTS - PID/FID RESULTS
 Alameda County Transportation Corridor
 Pleasanton, California

Sample Location	Sample Depth	Date	PID Reading (ppm)	FID Reading (ppm)	TPH-d (mg/kg)	TPH-g Aviation Fuel		TPH-j Jet Fuel		Benzene (mg/kg)	Ethylbenzene (mg/kg)	Toluene (mg/kg)	Total Xylenes (mg/kg)	Hydrocarbon Oil & Grease	Tert-Butyl Alcohol (mg/kg)	MTBE (mg/kg)
						(mg/kg)	(mg/kg)	(mg/kg)	(mg/kg)							
SB-7	10	11/7/2007	22	0	82	<1.0	<1.0	73	<0.0050	<0.0050	<0.0050	<0.0050	<20	<50	<5.0	
	20	11/7/2007	23	8	<2.0	<1.0	<1.0	2.1	<0.0050	<0.0050	<0.0050	<0.0050	<20	<50	<5.0	
	30	11/7/2007	25	60	<2.0	<1.0	<1.0	<2.0	<0.0050	<0.0050	<0.0050	<0.0050	<20	<50	<5.0	
	40	11/7/2007	300	2,300	58	3	4.7	66	0.21	0.015	0.057	<0.0050	250	<50	<5.0	
	50	11/7/2007	11	20	<2.0	<1.0	<1.0	<2.0	<0.0050	<0.0050	<0.0050	<0.0050	<20	120	170	

ppm - parts per million

mg/kg - milligrams per kilogram

PID - Photo Ionization Detector

FID - Flame Ionization Detector

TPHd - Total Petroleum Hydrocarbons as diesel

TPHg - Total Petroleum Hydrocarbons - Aviation Fuel

TPHj - Total Petroleum Hydrocarbons as gasoline

TPHj - Total Petroleum Hydrocarbons - Jet Fuel

MTBE - Methyl tert-butyl ether

ND - None Detected