

**ExxonMobil**  
**Refining & Supply Company**  
Global Remediation

**Gene N. Ortega**  
Territory Manager  
Global Remediation – US Retail

2300 Clayton Road, Suite 1250  
Concord, CA 94520  
(925) 246-8747 Telephone  
(925) 246-8798 Facsimile  
gene.n.ortega@exxonmobil.com

**ExxonMobil**  
*Refining & Supply*

**Alameda County**  
**OCT 11 2002**  
**Environmental Health**

October 8, 2002

Mr. Don Hwang  
Alameda County Health Care Services  
Department of Environmental Health  
1131 Harbor Bay Parkway, Suite 250  
Alameda, California 94502-6577

**RE: Former Exxon RAS #7-0235/2225 Telegraph Avenue, Oakland, California.**

Dear Mr. Hwang:

Attached for your review and comment is a letter report entitled *Quarterly Groundwater Monitoring Report, Third Quarter 2002*, dated October 8, 2002, for the above-referenced site. The report was prepared by Environmental Resolutions, Inc. (ERI) of Novato, California, and presents the details of monitoring and sampling activities at the subject site.

If you have any questions or comments, please contact me at (925) 246-8747.

Sincerely,

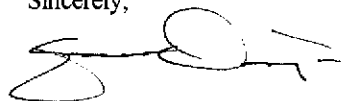

Gene N. Ortega  
Territory Manager

Attachment: ERI's Quarterly Groundwater Monitoring Report, Third Quarter 2002, dated October 8, 2002.

cc: w/ attachment  
Mr. Chuck Headlee, California Regional Water Quality Control Board, San Francisco Bay Region  
Mr. Joseph A. Aldridge, Valero Energy Corporation

w/o attachment  
Ms. Paula Sime, Environmental Resolutions, Inc.

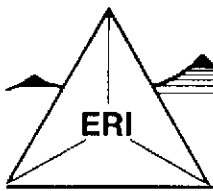

**Alameda County**

October 8, 2002

ERI 222913.R19

**OCT 11 2002**

**Environmental Health**

Mr. Gene N. Ortega  
ExxonMobil Oil Corporation  
2300 Clayton Road, Suite 1250  
Concord, California 94520

Subject: Quarterly Groundwater Monitoring Report, Third Quarter 2002, Former Exxon Service Station 7-0235, 2225 Telegraph Avenue, Oakland, California.

Mr. Ortega:

At the request of ExxonMobil Oil Corporation (ExxonMobil), Environmental Resolutions, Inc. (ERI) performed the third quarter 2002 groundwater monitoring and sampling event at the subject site. The purpose of quarterly monitoring is to evaluate concentrations of dissolved hydrocarbons in groundwater and groundwater flow direction and hydraulic gradient. The location of the site is shown on the Site Vicinity Map (Plate 1). The locations of groundwater monitoring wells and other select site features are shown on the Generalized Site Plan (Plate 2).

#### **GROUNDWATER MONITORING AND SAMPLING**

On July 1, 2002, ERI measured depth to water (DTW) and collected groundwater samples from select wells for laboratory analyses. Work was performed in accordance with ERI's groundwater sampling protocol (Attachment A).

The calculated groundwater flow direction and hydraulic gradient are shown on Plate 2. Historical and recent monitoring data are summarized in Table 1.

#### **Laboratory Analyses and Results**

ERI submitted groundwater samples to Test America Incorporated (Test America), a California state-certified laboratory, under Chain-of-Custody protocol. The samples were analyzed for benzene, toluene, ethylbenzene, and total xylenes (BTEX); methyl tertiary butyl ether (MTBE); and total petroleum hydrocarbons as gasoline (TPHg) using the methods listed in the notes in Table 1. The laboratory analysis report and Chain-of-Custody record are provided in Attachment B. Cumulative analytical laboratory results of groundwater samples are summarized in Table 1. Analytical results of groundwater samples collected during the recent sampling event are shown on Plate 2.

**DOCUMENT DISTRIBUTION**

ERI recommends forwarding copies of this report to:

Mr. Don Hwang  
Alameda County Health Care Services Agency  
Department of Environmental Health  
1131 Harbor Bay Parkway, Suite 250  
Alameda, California 94502-6577

Mr. Chuck Headlee  
California Regional Water Quality Control Board  
San Francisco Bay Region  
1515 Clay Street, Suite 1400  
Oakland, California 94612

Mr. Joseph A. Aldridge  
Valero Energy Corporation  
685 West Third Street  
Hanford, California 93230

**LIMITATIONS**

This report was prepared in accordance with generally accepted standards of environmental practice in California at the time this investigation was performed. This report has been prepared for ExxonMobil, and any reliance on this report by third parties shall be at such party's sole risk.

Please call Ms. Paula Sime, ERI's senior staff geologist for this site, at (415) 382-4324 with any questions regarding this report.

Sincerely,  
Environmental Resolutions, Inc.



Paula Sime  
Senior Staff Geologist

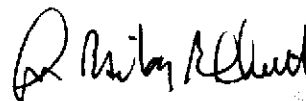

John B. Bobbitt  
R.G. 4313

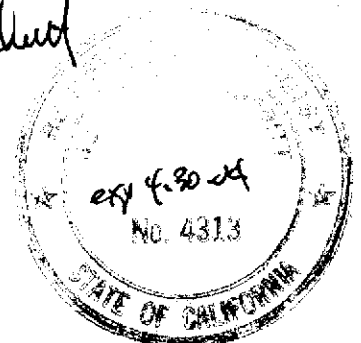

Attachments: Table 1: Cumulative Groundwater Monitoring and Sampling Data

Plate 1: Site Vicinity Map

Plate 2: Generalized Site Plan

Attachment A: Groundwater Sampling Protocol

Attachment B: Laboratory Analysis Report and Chain-of-Custody Record

TABLE 1  
 CUMULATIVE GROUNDWATER MONITORING AND SAMPLING DATA  
 Former Exxon Service Station 7-0235  
 2225 Telegraph Avenue  
 Oakland, California  
 (Page 1 of 7)

Well ID # (TOC)	Sampling Date	SUBJ <.....>	DTW feet.....>	Elev.	TPHg <.....>	MTBE	B g/L.....>	T	E	X	TPHmo
MW6B	11/26/96	NLPH	12.26	5.22	<50	<30	<0.5	<0.5	<0.5	<0.5	---
(17.48)	02/27/97	NLPH	11.73	5.75	<50	<30	<0.5	<0.5	<0.5	0.80	---
	05/21/97	NLPH	12.70	4.78	<50	<30	<0.5	<0.5	<0.5	<0.5	---
	08/18/97	NLPH	12.89	4.59	380	<30	4.3	<0.5	1.2	1.5	---
	03/13/98	NLPH	11.15	6.33	360	<6.2	93	4.9	4.1	12	---
	04/20/98	NLPH	11.49	5.99	110	5.5	19	1.3	1.5	3.9	---
(21.37)	07/21/98	NLPH	12.18	9.19	<50	8.7	0.84	0.59	<0.5	<0.5	---
	10/06/98	NLPH	12.70	8.67	190	6.0	2.4	0.56	0.51	1.2	---
	01/11/99	NLPH	12.48	8.89	50	3.9	1.2	<0.5	<0.5	0.95	---
	04/08/99	NLPH	11.52	9.85	85	14.0	4.4	<0.5	<0.5	<0.5	---
	07/19/99	NLPH	11.39	9.98	<50	<2.50	<0.5	<0.5	<0.5	<0.5	---
	07/27/99	NLPH	12.71	8.66	---	---	---	---	---	---	---
	10/25/99	NLPH	12.49	8.88	260	<2	2.3	<0.5	<0.5	<0.5	---
	01/27/00	NLPH	11.80	9.57	770	13	210	4.8	4.9	13	---
	04/03/00	NLPH	11.61	9.76	670	3.4	110	6.6	3.8	9.45	---
	07/05/00	NLPH	12.27	9.10	<50	2.1	0.89	<0.5	<0.5	<0.5	---
	10/04/00	NLPH	12.67	8.70	<50	54	<0.5	<0.5	<0.5	2	---
	10/05/00	---	---	---	---	---	---	---	---	---	<1,000
	01/04/01	NLPH	12.47	8.90	<50	35	<0.5	<0.5	<0.5	<0.5	---
	04/03/01	NLPH	11.81	9.56	<50	7.8	<0.5	<0.5	<0.5	<0.5	---
	07/05/01	NLPH	12.44	8.93	<50	3	<0.5	<0.5	<0.5	<0.5	---
	10/03/01	NLPH	12.52	8.85	310	10	2.1	<0.5	6.5	11.6	---
(21.09)	Nov-01	Well surveyed in compliance with AB 2886 requirements.									
	01/02/02	NLPH	11.25	9.84	710	21.8	99.5	4.40	3.30	7.40	---
	04/02/02	NLPH	11.72	9.37	<50.0	12.2	0.60	<0.50	<0.50	<0.50	<100
	07/01/02	NLPH	12.34	8.75	<50	10.7	<0.5	<0.5	<0.5	<0.5	<100b
MW6E	11/26/96	NLPH	12.94	4.69	<50	<30	1.1	<0.5	<0.5	<0.5	---
(17.63)	02/27/97	NLPH	12.28	5.35	<50	<30	<0.5	<0.5	<0.5	<0.5	---
	05/21/97	NLPH	13.60	4.03	160	<5	10	1.4	5.5	4.8	---
	08/18/97	NLPH	13.75	3.88	66	<30	<0.5	<0.5	<0.5	<0.5	---
	03/13/98	NLPH	11.36	6.27	<50	<2.5	<0.5	<0.5	<0.5	<0.5	---
	04/20/98	NLPH	11.88	5.75	<50	<2.5	<0.5	<0.5	<0.5	<0.5	---
(21.58)	07/21/98	NLPH	13.10	8.48	1,200	<10	81	3.1	28	77	---
	10/06/98	NLPH	13.55	8.03	<50	6.6	1.4	0.51	<0.5	0.97	---
	01/11/99	NLPH	13.40	8.18	<50	5.1	<0.5	<0.5	<0.5	<0.5	---
	04/08/99	NLPH	12.04	9.54	<50	4.7	<0.5	<0.5	<0.5	<0.5	---

TABLE 1  
 CUMULATIVE GROUNDWATER MONITORING AND SAMPLING DATA  
 Former Exxon Service Station 7-0235  
 2225 Telegraph Avenue  
 Oakland, California  
 (Page 2 of 7)

Well ID # (TOC)	Sampling Date	SUBJ <.....>	DTW feet.....>	Elev.	TPHg <.....>	MTBE	B g/L.....>	T	E	X	TPHmo	
MW6E (cont.) (21.58)	07/19/99	NLPH	11.59	9.99	---	---	---	---	---	---	---	
	07/27/99	NLPH	13.65	7.93	---	---	---	---	---	---	---	
	10/25/99	NLPH	13.52	8.06	<50	2.5	<0.5	<0.5	<0.5	<0.5	---	
	01/27/00	NLPH	11.71	9.87	<50	2.3	<0.5	<0.5	<0.5	<0.5	---	
	04/03/00	NLPH	12.11	9.47	<50	<2	0.51	<0.5	<0.5	<0.5	---	
	07/05/00	NLPH	12.91	8.67	<50	<2	3.7	<0.5	<0.5	<0.5	---	
	10/04/00	NLPH	13.35	8.23	<50	<2	4.1	<0.5	<0.5	<0.5	---	
	10/05/00	---	---	---	---	---	---	---	---	---	<1,000	
	01/04/01	NLPH	13.09	8.49	61	<2	11	<0.5	<0.5	<0.5	---	
	04/03/01	NLPH	12.39	9.19	<50	<2	<0.5	<0.5	<0.5	<0.5	---	
	07/05/01	NLPH	13.21	8.37	210	<2	80	<0.5	0.94	2.3	---	
	10/03/01	NLPH	13.30	8.28	<50	<2	2.8	<0.5	<0.5	<0.5	---	
	(21.24)	Nov-01	Well surveyed in compliance with AB 2886 requirements.									
		01/02/02	NLPH	10.11	11.13	<100	<0.5	<0.50	<0.50	<0.50	<0.50	---
	04/02/02	NLPH	12.11	9.13	<50.0	0.70	<0.50	<0.50	<0.50	<0.50	<100	
	07/01/02	NLPH	12.46	8.78	56.0	<0.5	19.9	<0.5	<0.5	<0.5	<100b	
MW6F (18.58)	11/26/96	NLPH	13.29	5.29	<50	<30	<0.5	<0.5	<0.5	<0.5	---	
	02/27/97	---	---	---	---	---	---	---	---	---	---	
	05/21/97	NLPH	14.18	4.40	---	---	---	---	---	---	---	
	08/18/97	NLPH	14.69	3.89	---	---	---	---	---	---	---	
	03/13/98	NLPH	10.93	7.65	<50	<2.5	<0.5	<0.5	<0.5	<0.5	---	
	04/20/98	NLPH	11.77	6.81	---	---	---	---	---	---	---	
	(22.51)	07/21/98	NLPH	13.62	8.89	---	---	---	---	---	---	---
		10/06/98	NLPH	13.52	8.99	---	---	---	---	---	---	---
		01/11/99	NLPH	14.06	8.45	---	---	---	---	---	---	---
		04/08/99	NLPH	11.86	10.65	---	---	---	---	---	---	---
		07/19/99	---	---	---	---	---	---	---	---	---	---
		07/27/99	Well Inaccessible									
		10/25/99	NLPH	12.63	9.88	---	---	---	---	---	---	---
		01/27/00	NLPH	12.23	10.28	---	---	---	---	---	---	---
		04/03/00	NLPH	12.11	10.40	---	---	---	---	---	---	---
		07/05/00	NLPH	13.38	9.13	<50	<2	<0.5	<0.5	<0.5	<0.5	---
		10/04/00	NLPH	14.02	8.49	<50	<2	<0.5	<0.5	<0.5	0.7	---
		10/05/00	---	---	---	---	---	---	---	---	---	<1,000
		01/04/01	NLPH	13.69	8.82	<50	<2	<0.5	<0.5	<0.5	<0.5	---
		04/03/01	NLPH	12.55	9.96	<50	<2	<0.5	<0.5	<0.5	<0.5	---

**TABLE 1**  
**CUMULATIVE GROUNDWATER MONITORING AND SAMPLING DATA**  
Former Exxon Service Station 7-0235  
2225 Telegraph Avenue  
Oakland, California  
(Page 3 of 7)

Well ID # (TOC)	Sampling Date	SUBJ <.....>	DTW feet	Elev. >.....<	TPHg <.....>	MTBE <.....>	B g/L	T <.....>	E <.....>	X <.....>	TPHmo >.....<
MW6F (cont.) (22.17)	07/05/01	NLPH	13.74	8.77	<50	<2	<0.5	<0.5	<0.5	<0.5	---
	10/03/01	NLPH	13.82	8.69	<50	<2	<0.5	<0.5	<0.5	<0.5	---
	Nov-01	Well surveyed in compliance with AB 2886 requirements.									
	01/02/02	NLPH	9.16	13.01	<100	<0.5	<0.50	<0.50	<0.50	<0.50	---
	04/02/02	NLPH	12.14	10.03	<50.0	<0.50	<0.50	<0.50	<0.50	<0.50	<100
	07/01/02	NLPH	13.46	8.71	<50	<0.5	<0.5	<0.5	<0.5	<0.5	<100b
MW6G (16.82)  (20.72)	11/26/96	NLPH	11.12	5.70	<50	<30	<0.5	<0.5	<0.5	<0.5	---
	02/27/97	---	---	---	---	---	---	---	---	---	---
	05/21/97	NLPH	11.76	5.06	---	---	---	---	---	---	---
	08/18/97	NLPH	12.23	4.59	---	---	---	---	---	---	---
	03/13/98	NLPH	9.13	7.69	<50	4.4	<0.5	<0.5	<0.5	<0.5	---
	04/20/98	NLPH	9.73	7.09	---	---	---	---	---	---	---
	07/21/98	NLPH	11.15	9.57	---	---	---	---	---	---	---
	10/06/98	NLPH	11.91	8.81	---	---	---	---	---	---	---
	01/11/99	NLPH	12.00	8.72	---	---	---	---	---	---	---
	04/08/99	NLPH	10.04	10.68	---	---	---	---	---	---	---
	07/19/99	---	---	---	---	---	---	---	---	---	---
	07/27/99	NLPH	11.75	8.97	---	---	---	---	---	---	---
	10/25/99	NLPH	11.76	8.96	---	---	---	---	---	---	---
	01/27/00	NLPH	11.46	9.26	---	---	---	---	---	---	---
	04/03/00	NLPH	10.00	10.72	---	---	---	---	---	---	---
	07/05/00	NLPH	11.24	9.48	<50	<2	<0.5	<0.5	<0.5	<0.5	---
	10/04/00	NLPH	11.88	8.84	<50	<2	<0.5	<0.5	<0.5	<0.5	---
	10/05/00	---	---	---	---	---	---	---	---	---	<1,000
	01/04/01	NLPH	11.56	9.16	<50	<2	<0.5	<0.5	<0.5	<0.5	---
	04/03/01	NLPH	10.45	10.27	<50	<2	<0.5	<0.5	<0.5	<0.5	---
07/05/01	NLPH	11.51	9.21	<50	<2	0.75	<0.5	<0.5	<0.5	---	
10/03/01	NLPH	11.63	9.09	<50	<2	<0.5	<0.5	<0.5	<0.5	---	
(20.46)	Nov-01	Well surveyed in compliance with AB 2886 requirements.									
	01/02/02	NLPH	9.15	11.31	<100	1.8	<0.50	<0.50	<0.50	<0.50	---
	04/02/02	NLPH	10.19	10.27	<50.0	1.10	<0.50	<0.50	<0.50	<0.50	<100
	07/01/02	NLPH	11.35	9.11	<50	1.3	<0.5	<0.5	<0.5	<0.5	<100b
MW6H (16.58)	11/26/96	NLPH	11.87	4.71	1,200	<30	320	110	22	85	---
	02/27/97	NLPH	11.58	5.00	1,800	<200	760	31	8.4	44	---
	05/21/97	NLPH	12.23	4.35	1,100	81	640	18	5.4	45	---





TABLE 1  
 CUMULATIVE GROUNDWATER MONITORING AND SAMPLING DATA  
 Former Exxon Service Station 7-0235  
 2225 Telegraph Avenue  
 Oakland, California  
 (Page 5 of 7)

Well ID # (TOC)	Sampling Date	SUBJ <.....>	DTW feet.....>	Elev.	TPHg <.....>	MTBE <.....>	B g/L.....>	T g/L.....>	E g/L.....>	X g/L.....>	TPHmo
MW6I (cont.) (20.24)	01/27/00	NLPH	12.06	8.18	<50	<2	<0.5	<0.5	<0.5	<0.5	---
	04/03/00	NLPH	12.24	8.00	---	---	---	---	---	---	---
	07/05/00	NLPH	12.48	7.76	<50	<2	<0.5	<0.5	<0.5	<0.5	---
	10/04/00	---	---	---	---	---	---	---	---	---	---
	10/05/00	---	---	---	---	---	---	---	---	---	<1,000
	01/04/01	NLPH	12.54	7.70	<50	<2	<0.5	<0.5	<0.5	<0.5	---
	04/03/01	NLPH	12.32	7.92	<50	<2	<0.5	<0.5	<0.5	<0.5	---
	07/05/01	NLPH	12.55	7.69	<50	<2	<0.5	<0.5	<0.5	<0.5	---
	10/03/01	NLPH	12.67	7.57	<50	<2	<0.5	<0.5	<0.5	<0.5	---
	(19.87) Nov-01	Well surveyed in compliance with AB 2886 requirements.									
	01/02/02	NLPH	10.98	8.89	<100	<0.5	<0.50	<0.50	<0.50	<0.50	---
	04/02/02	NLPH	12.24	7.63	---	---	---	---	---	---	---
	07/01/02	NLPH	12.51	7.36	<50	<0.5	<0.5	<0.5	<0.5	<0.5	<100b
MW6J (20.72) (20.75)	07/05/01	NLPH	13.47	7.25	<50	<2	<0.5	<0.5	<0.5	<0.5	---
	10/03/01	NLPH	13.57	7.15	<50	<2	<0.5	<0.5	<0.5	<0.5	---
	Nov-01	Well surveyed in compliance with AB 2886 requirements.									
	01/02/02	NLPH	13.19	7.56	<100	<0.5	<0.50	<0.50	<0.50	<0.50	---
	04/02/02	NLPH	13.74	7.01	<50.0	1.00	0.80	<0.50	<0.50	0.80	<100
07/01/02	NLPH	13.58	7.17	<50	<0.5	<0.5	<0.5	<0.5	<0.5	<100b	
RW1 (20.24)	Not Monitored 6/16/92 through 10/6/98.										
01/11/99	NLPH	12.37	7.87	---	---	---	---	---	---	---	---
04/08/99	NLPH	10.41	9.83	---	---	---	---	---	---	---	---
07/19/99	---	---	---	---	---	---	---	---	---	---	---
07/27/99	NLPH	12.76	7.48	---	---	---	---	---	---	---	---
10/25/99	NLPH	12.50	7.74	---	---	---	---	---	---	---	---
01/27/00	NLPH	12.11	8.13	---	---	---	---	---	---	---	---
04/03/00	NLPH	12.07	8.17	---	---	---	---	---	---	---	---
07/05/00	---	---	---	---	---	---	---	---	---	---	---
10/04/00	---	---	---	---	---	---	---	---	---	---	---
10/05/00	---	---	---	---	---	---	---	---	---	---	---
01/04/01	NLPH	13.90	6.34	8,000	2,500	1,200	65	250	258	---	
04/03/01	NLPH	11.92	8.32	4,100	610	62	<2.5	18	61	---	
07/05/01	Not sampled: inaccessible										
10/03/01	NLPH	12.32	7.92	11,000	4,100	1,900	780	150	700	---	
(20.43) Nov-01	Well surveyed in compliance with AB 2886 requirements.										

**TABLE 1**  
**CUMULATIVE GROUNDWATER MONITORING AND SAMPLING DATA**  
Former Exxon Service Station 7-0235  
2225 Telegraph Avenue  
Oakland, California  
(Page 6 of 7)

Well ID # (TOC)	Sampling Date	SUBJ <.....>	DTW feet.....>	Elev.	TPHg <.....>	MTBE	B	T	E	X	TPHmo >
RW1 (cont.) (20.43)	01/02/02	NLPH	10.85	9.58	32,000	7,760	358	2,270	894	4,820	---
	04/02/02	NLPH	11.72	8.71	4,220	922	172	22.5	106	340	<500
	07/01/02	NLPH	12.17	8.26	2,500	986	176	8.0	71.0	75.0	<100b
RW2 (20.44)	Not Monitored 6/16/92 through 4/20/98.										
	07/21/98	NLPH	12.65	7.79	3,500	170	240	100	41	96	---
	10/06/98	NLPH	13.06	7.38	3,200	200	120	48	56	120	---
	01/11/99	NLPH	12.88	7.56	3,300	350	150	17	35	40	---
	04/08/99	sheen	11.76	8.68	---	---	---	---	---	---	---
	07/19/99	NLPH	11.61	8.83	1,980	160/499a	44	4.16	22.3	11.6	---
	07/27/99	NLPH	13.26	7.18	---	---	---	---	---	---	---
	10/25/99	NLPH	12.96	7.48	1,800	440	51	<0.5	4.7	9.5	---
	01/27/00	NLPH	12.70	7.74	1,900	750	38	<2.5	4.8	10.4	---
	04/03/00	NLPH	11.97	8.47	2,100	300	28	2.4	1.4	0.73	---
	07/05/00	NLPH	12.50	7.94	2,300	230	20	<2.5	5.3	8	---
	10/04/00	NLPH	12.97	7.47	1,300	570	42	<2.5	15	17.7	---
	10/05/00	---	---	---	---	---	---	---	---	---	<1,000
	01/04/01	NLPH	13.71	6.73	1,000	380	33	<2.5	13	17.7	---
	04/03/01	NLPH	12.10	8.34	1,300	99	18	2.1	16	19.4	---
	07/05/01	Not sampled: inaccessible			---	---	---	---	---	---	---
	10/03/01	NLPH	12.8	7.64	1,900	240	35	4.4	34	105	---
(20.64)	Nov-01	Well surveyed in compliance with AB 2886 requirements.									
	01/02/02	NLPH	10.22	10.42	2,440	76.0	24.4	6.20	26.2	83.0	---
	04/02/02	NLPH	12.02	8.62	1,460	47.5	8.60	3.30	5.30	29.1	260
	07/01/02	NLPH	12.51	8.13	1,380	39.9	11.0	1.8	17.9	45.0	<100b
RW3A (21.75)	Not Monitored 6/16/92 through 4/20/98.										
	07/21/98	NLPH	13.08	8.67	280	16	97	<1.2	<1.2	<1.2	---
	10/06/98	NLPH	13.72	8.03	78	26	26	0.89	<0.5	<0.5	---
	01/11/99	NLPH	12.00	9.75	1,000	230	490	5.0	<5.0	7.4	---
	04/08/99	NLPH	11.90	9.85	130	11	70	<1.0	<1.0	<1.0	---
	07/19/99	NLPH	11.75	10.00	989	16.4	393	6.40	5.70	15.0	---
	07/27/99	NLPH	13.68	8.07	---	---	---	---	---	---	---
	10/25/99	NLPH	13.61	8.14	150	19	53	<0.5	<0.5	<0.5	---
	01/27/00	NLPH	12.22	9.53	500	12	210	0.59	1.40	2.29	---
	04/03/00	NLPH	12.00	9.75	1,100	16	420	1.6	1.8	1.4	---
	07/05/00	NLPH	13.01	8.74	1,200	16	440	1.4	2.5	1.9	---

**TABLE 1**  
**CUMULATIVE GROUNDWATER MONITORING AND SAMPLING DATA**  
Former Exxon Service Station 7-0235  
2225 Telegraph Avenue  
Oakland, California  
(Page 7 of 7)

Well ID #	Sampling	SUBJ	DTW	Elev.	TPHg	MTBE	B	T	E	X	TPHmo
(TOC)	Date	<.....feet.....>	<.....feet.....>	<.....feet.....>	<.....g/L.....>						
RW3A (cont.)	10/04/00	NLPH	13.60	8.15	390	8.3	160	1.1	1.5	2.6	---
(21.75)	10/05/00	---	---	---	---	---	---	---	---	---	<1,000
	01/04/01	NLPH	13.65	8.10	500	12	230	0.97	1.1	1.4	---
	04/03/01	NLPH	12.30	9.45	710	7.5	290	<0.5	<0.5	<0.5	---
	07/05/01	NLPH	13.28	8.47	640	9	280	1.4	1.6	2.7	---
	10/03/01	NLPH	13.58	8.17	<50	12	21	<0.5	<0.5	<0.5	---
(21.89)	Nov-01	Well surveyed in compliance with AB 2886 requirements.									
	01/02/02	NLPH	10.80	11.09	<100	11.2	<0.50	<0.50	<0.50	<0.50	---
	04/02/02	NLPH	12.03	9.86	55.7	11.0	1.30	<0.50	<0.50	<0.50	<100
	07/01/02	NLPH	13.13	8.76	275	21.7	60.4	<0.5	2.4	4.2	<100b

Notes:

- SUBJ = Results of subjective evaluation.
- NLPH = No liquid-phase hydrocarbons present in well.
- sheen = Liquid-phase hydrocarbon present as sheen.
- TOC = Elevation of top of well casing; relative to mean sea level.
- DTW = Depth to water.
- Elev. = Elevation of groundwater surface; relative to mean sea level.
- TPHg = Total petroleum hydrocarbons as gasoline analyzed using EPA Method 5030/8015 (modified).
- TPHmo = Total petroleum hydrocarbons as motor oil using EPA Method 8015B.
- MTBE = Methyl tertiary butyl ether analyzed using EPA Method 8021B.
- BTEX = Benzene, toluene, ethylbenzene, and total xylenes analyzed using EPA Method 8021B.
- < = Less than the indicated reporting limit shown by the laboratory.
- = Not measured/Not sampled.
- g/L = Micrograms per liter.
- a = Analyzed using EPA Method 8260B.
- b = TPHmo analyses performed outside of hold time.

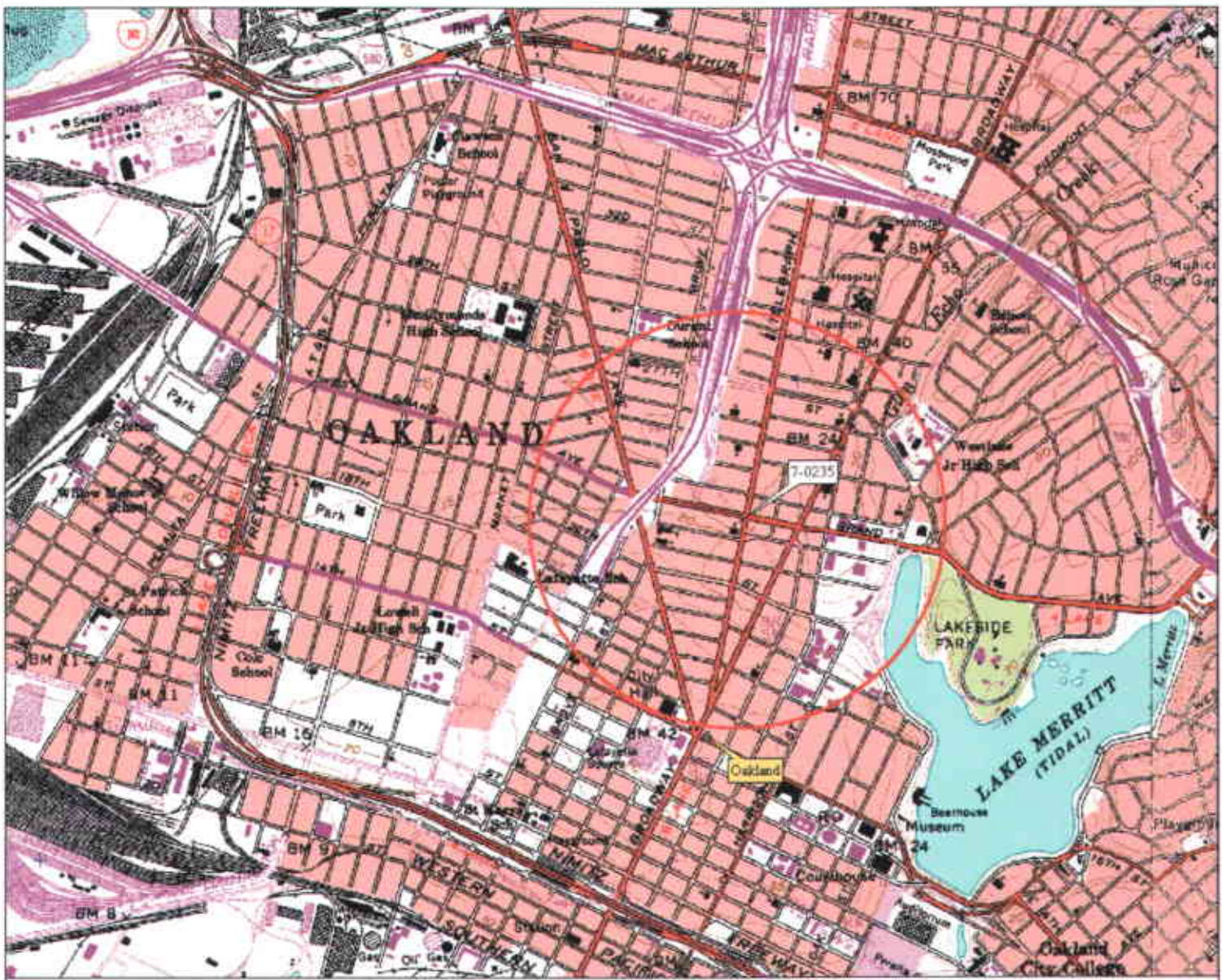

3-D TopoQuads Copyright © 1999 DeLorme Topograph, ME 04094 Source Data: USGS 500 ft Scale 1:10,000 Detail 1:4,000 Datum: WGS84

FN 2229Topo

**EXPLANATION**

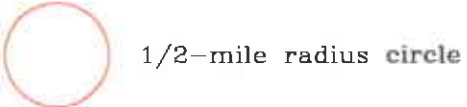

**APPROXIMATE SCALE**

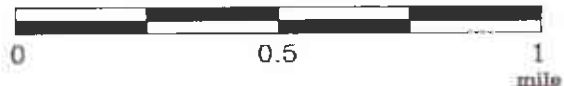

SOURCE:  
Modified from a map  
provided by  
DeLorme 3-D TopoQuads



**SITE VICINITY MAP**

FORMER EXXON SERVICE STATION 7-0235  
2225 Telegraph Avenue  
Oakland, California

**PROJECT NO.**

2229

**PLATE**

1

Analyte Concentrations in ug/L  
 Sampled July 1, 2002

- 5,370 Total Petroleum Hydrocarbons as gasoline
- 1,910 Methyl Tertiary Butyl Ether
- 1,170 Benzene
- 200 Toluene
- 44.0 Ethylbenzene
- 158 Total Xylenes
- <100b Total Petroleum Hydrocarbons as motor oil (TPHmo)

< Less Than the Stated Laboratory Reporting Limit

ug/L Micrograms per Liter

NS Not Sampled

b TPHmo analyses performed outside of hold time.

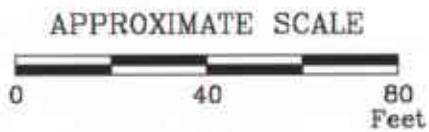
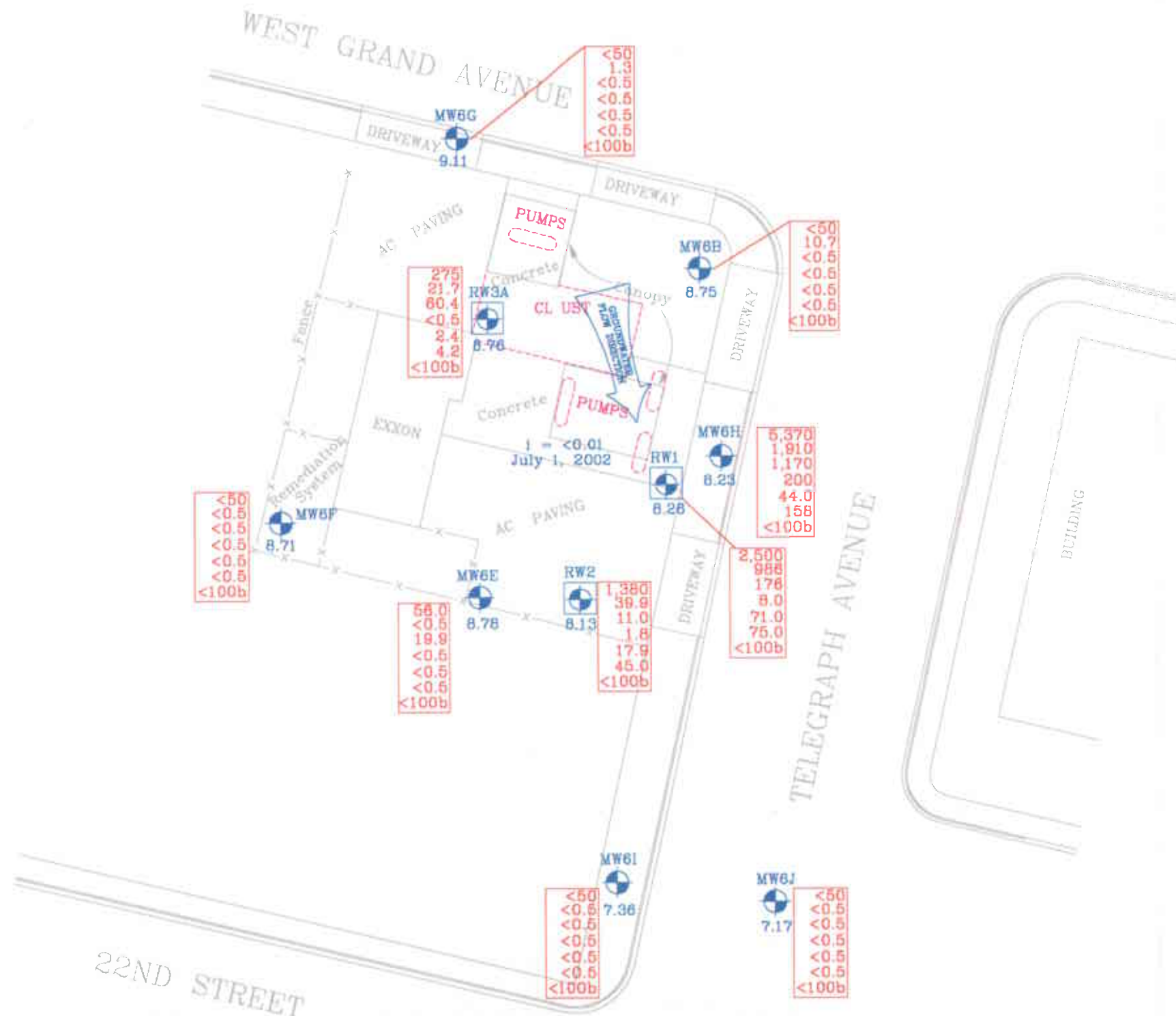

FN 2229004a

i = Interpreted Hydraulic Gradient



**GENERALIZED SITE PLAN**  
 FORMER  
 EXXON SERVICE STATION 7-0235  
 2225 Telegraph Avenue  
 Oakland, California

**EXPLANATION**

- MW6J
- Groundwater Monitoring Well
- 7.17 Groundwater elevation in feet; datum is mean sea level
- RW3A
- Recovery Groundwater Monitoring Well

**PROJECT NO.**  
2229

**PLATE**  
2

**ATTACHMENT A**  
**GROUNDWATER SAMPLING PROTOCOL**

## GROUNDWATER SAMPLING PROTOCOL

The static water level and separate-phase product level, if present, in each well that contains water and/or separate-phase product are measured with an ORS Interface Probe, which is accurate to the nearest 0.01 foot. To calculate groundwater elevations and evaluate groundwater gradient, depth to water (DTW) levels are subtracted from top of casing elevations.

Groundwater samples collected for subjective evaluation are collected by gently lowering approximately half the length of a clean Teflon® or polypropylene bailer past the air-water interface (if possible) and collecting a sample from near the surface of the water in the well. The samples are checked for measurable free-phase hydrocarbons or sheen. If appropriate, free-phase hydrocarbons are removed from the well.

Before water samples are collected from the groundwater monitoring wells, the wells are purged until a minimum of three well casing volumes is purged and stabilization of the temperature, pH, and conductivity is obtained. Water samples from the wells that do not obtain stability of the temperature, pH, and conductivity are considered to be "grab samples". The quantity of water purged from each well is calculated as follows:

1 well casing volume =  $\pi r^2 h(7.48)$  where:

r	=	radius of the well casing in feet.
h	=	column of water in the well in feet (depth to bottom - depth to water)
7.48	=	conversion constant from cubic feet to gallons
$\pi$	=	ratio of the circumference of a circle to its diameter

Gallons of water purged/gallons in 1 well casing volume = well casing volumes removed.

After purging, each well is allowed to recharge to at least 80% of the initial water level. Water samples from wells that do not recover at least 80% (due to slow recharging of the well) between purging and sampling are considered to be "grab samples". Water samples are collected with a new, disposable Teflon® or polypropylene bailer. The groundwater is carefully poured into selected sample containers (40-milliliter (ml) glass vials, 1,000 ml glass amber bottles, etc.), which are filled so as to produce a positive meniscus.

Depending on the required analysis, each sample container is preserved with hydrochloric acid, nitric acid, etc., or it is preservative free. The type of preservative used for each sample is specified on the chain of custody form.

Each vial and glass amber bottle is sealed with a cap containing a Teflon® septum, and subsequently examined for air bubbles to avoid headspace, which would allow volatilization to occur. The samples are promptly transported in iced storage in a thermally-insulated ice chest, accompanied by a Chain of Custody Record, to a California-certified laboratory.

**ATTACHMENT B**

**LABORATORY ANALYSIS REPORT  
AND CHAIN-OF-CUSTODY RECORD**



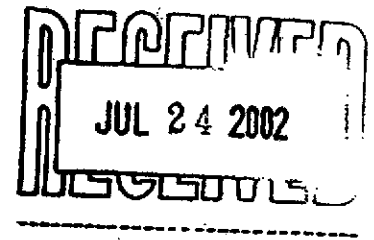

7/23/02

ERI - NORTHERN CA 3876  
PAULA SIME  
73 DIGITAL DRIVE, SUITE 100  
NOVATO, CA 94949

This report includes the analytical certificates of analysis for all samples listed below. These samples relate to your project 222913X EXXONMOBIL 7-0235. The Laboratory Project number is 292111. An executed copy of the chain of custody, the project quality control data, and the sample receipt form are also included as an addendum to this report.

Page 1

Sample Identification	Lab Number	Collection Date
TB	02-A111953	
MW6B	02-A111954	7/ 1/02
MW6E	02-A111955	7/ 1/02
MW6F	02-A111956	7/ 1/02
MW6G	02-A111957	7/ 1/02
MW6H	02-A111958	7/ 1/02
MW6I	02-A111959	7/ 1/02
MW6J	02-A111960	7/ 1/02
RW1	02-A111961	7/ 1/02
RW2	02-A111962	7/ 1/02
RW3A	02-A111963	7/ 1/02

# TestAmerica

INCORPORATED

Page 2

Sample Identification

Lab Number

Collection Date

These results relate only to the items tested.  
This report shall not be reproduced except in full and with  
permission of the laboratory.

Report Approved By: Michael H. Dunn

Report Date: 7/16/02

Paul E. Lane, Jr., Lab Director  
Michael H. Dunn, M.S., Technical Director  
Johnny A. Mitchell, Dir. Technical Serv.  
Eric S. Smith, Assistant Technical Director  
Roxanne L. Connor, Technical Services

Gail A. Lage, Technical Serv.  
Glenn L. Norton, Technical Serv.  
Kelly S. Comstock, Technical Serv.  
Pamela A. Langford, Technical Serv.

Laboratory Certification Number: 01168CA

## ANALYTICAL REPORT

ERI - NORTHERN CA 3876  
 PAULA SIME  
 73 DIGITAL DRIVE, SUITE 100  
 NOVATO, CA 94949

Lab Number: 02-A111953  
 Sample ID: TB  
 Sample Type: Water  
 Site ID: 7-0235

Project: 222913X  
 Project Name: EXXONMOBIL 7-0235  
 Sampler: STEVE BURKE

Date Collected:  
 Time Collected:  
 Date Received: 7/ 9/02  
 Time Received: 9:00  
 Page: 1

Analyte	Result	Units	Report Limit	Dil Factor	Analysis Date	Analysis Time	Analyst	Method	Batch
*ORGANIC PARAMETERS*									
Benzene	ND	ug/L	0.5	1.0	7/15/02	14:30	D.Yeager	8021B	2036
Ethylbenzene	ND	ug/L	0.5	1.0	7/15/02	14:30	D.Yeager	8021B	2036
Toluene	ND	ug/L	0.5	1.0	7/15/02	14:30	D.Yeager	8021B	2036
Xylenes (Total)	ND	ug/L	0.5	1.0	7/15/02	14:30	D.Yeager	8021B	2036
Methyl-t-butylether	ND	ug/L	0.5	1.0	7/15/02	14:30	D.Yeager	8021B	2036
TPH (Gasoline Range)	ND	ug/L	50.0	1.0	7/15/02	14:30	D.Yeager	8015B	2036

Surrogate	% Recovery	Target Range
BTEX/GRO Surr., a,a,a-TFT	101.	69. - 132.

**LABORATORY COMMENTS:**

ND - Not detected at the report limit.  
 B - Analyte was detected in the method blank.  
 J - Estimated Value below Report Limit.  
 E - Estimated Value above the calibration limit of the instrument.  
 # - Recovery outside Laboratory historical or method prescribed limits.  
 DRO/ORO were received out of holding time, client notified.

End of Sample Report.

## ANALYTICAL REPORT

ERI - NORTHERN CA 3876  
 PAULA SIME  
 73 DIGITAL DRIVE, SUITE 100  
 NOVATO, CA 94949

Lab Number: 02-A11954  
 Sample ID: MW6B  
 Sample Type: Water  
 Site ID: 7-0235

Project: 222913X  
 Project Name: EXXONMOBIL 7-0235  
 Sampler: STEVE BURKE

Date Collected: 7/ 1/02  
 Time Collected: 16:50  
 Date Received: 7/ 9/02  
 Time Received: 9:00  
 Page: 1

Analyte	Result	Units	Report	Dil	Analysis	Analysis	Analyst	Method	Batch
			Limit	Factor	Date	Time			
*ORGANIC PARAMETERS*									
TRPH ORO (C24-C40)	ND	ug/L	100.	1.0	7/11/02	19:07	K.Phelps	8015B/3510	3810
Benzene	ND	ug/L	0.5	1.0	7/15/02	15:01	D.Yeager	8021B	2036
Ethylbenzene	ND	ug/L	0.5	1.0	7/15/02	15:01	D.Yeager	8021B	2036
Toluene	ND	ug/L	0.5	1.0	7/15/02	15:01	D.Yeager	8021B	2036
Xylenes (Total)	ND	ug/L	0.5	1.0	7/15/02	15:01	D.Yeager	8021B	2036
Methyl-t-butylether	10.7	ug/L	0.5	1.0	7/15/02	15:01	D.Yeager	8021B	2036
TPH (Gasoline Range)	ND	ug/L	50.0	1.0	7/15/02	15:01	D.Yeager	8015B	2036

Sample Extraction Data

Parameter	Wt/Vol		Date	Time	Analyst	Method
	Extracted	Extract Vol				
EPH	1000 ml	1.00 ml	7/ 9/02		M. Ricke	3510

Surrogate	% Recovery	Target Range
surr-o-Terphenyl	61.	50. - 150.
BTEX/GRO Surr., a,a,a-TPT	101.	69. - 132.

Sample report continued . . .

## ANALYTICAL REPORT

Laboratory Number: 02-A111954

Sample ID: MW6B

Project: 222913X

Page 2

### LABORATORY COMMENTS:

ND - Not detected at the report limit.

B - Analyte was detected in the method blank.

J - Estimated Value below Report Limit.

E - Estimated Value above the calibration limit of the instrument.

# - Recovery outside Laboratory historical or method prescribed limits.

DRO/ORO were received out of holding time, client notified.

End of Sample Report.

## ANALYTICAL REPORT

ERI - NORTHERN CA 3876  
 PAULA SIME  
 73 DIGITAL DRIVE, SUITE 100  
 NOVATO, CA 94949

Lab Number: 02-A111955  
 Sample ID: MW6E  
 Sample Type: Water  
 Site ID: 7-0235

Project: 222913X  
 Project Name: EXXONMOBIL 7-0235  
 Sampler: STEVE BURKE

Date Collected: 7/ 1/02  
 Time Collected: 16:05  
 Date Received: 7/ 9/02  
 Time Received: 9:00  
 Page: 1

Analyte	Result	Units	Report Limit	Dil Factor	Analysis Date	Analysis Time	Analyst	Method	Batch
*ORGANIC PARAMETERS*									
TRPH ORO (C24-C40)	ND	ug/L	100.	1.0	7/10/02	20:54	D.Haywood	8015B/3510	9775
Benzene	19.9	ug/L	0.5	1.0	7/15/02	15:32	D.Yeager	8021B	2036
Ethylbenzene	ND	ug/L	0.5	1.0	7/15/02	15:32	D.Yeager	8021B	2036
Toluene	ND	ug/L	0.5	1.0	7/15/02	15:32	D.Yeager	8021B	2036
Xylenes (Total)	ND	ug/L	0.5	1.0	7/15/02	15:32	D.Yeager	8021B	2036
Methyl-t-butylether	ND	ug/L	0.5	1.0	7/15/02	15:32	D.Yeager	8021B	2036
TPH (Gasoline Range)	56.0	ug/L	50.0	1.0	7/15/02	15:32	D.Yeager	8015B	2036

Sample Extraction Data

Parameter	Wt/Vol		Date	Time	Analyst	Method
	Extracted	Extract Vol				
EPH	1000 ml	1.00 ml	7/10/02		M. Ricke	3510

Surrogate	% Recovery	Target Range
surr-o-Terphenyl	80.	50. - 150.
BTEX/GRO Surr., a,a,a-TFT	100.	69. - 132.

Sample report continued . . .

## ANALYTICAL REPORT

Laboratory Number: 02-A111955  
Sample ID: MW6E  
Project: 222913X  
Page 2

### LABORATORY COMMENTS:

- ND - Not detected at the report limit.
  - B - Analyte was detected in the method blank.
  - J - Estimated Value below Report Limit.
  - E - Estimated Value above the calibration limit of the instrument.
  - # - Recovery outside Laboratory historical or method prescribed limits.
- DRO/ORO were received out of holding time, client notified.

End of Sample Report.

## ANALYTICAL REPORT

ERI - NORTHERN CA 3876  
 PAULA SIME  
 73 DIGITAL DRIVE, SUITE 100  
 NOVATO, CA 94949

Lab Number: 02-A111956  
 Sample ID: MW6F  
 Sample Type: Water  
 Site ID: 7-0235

Project: 222913X  
 Project Name: EXXONMOBIL 7-0235  
 Sampler: STEVE BURKE

Date Collected: 7/ 1/02  
 Time Collected: 15:35  
 Date Received: 7/ 9/02  
 Time Received: 9:00  
 Page: 1

Analyte	Result	Units	Report Limit	Dil Factor	Analysis Date	Analysis Time	Analyst	Method	Batch
<b>*ORGANIC PARAMETERS*</b>									
TRPH ORO (C24-C40)	ND	ug/L	100.	1.0	7/10/02	21:14	D.Haywood	8015B/3510	9775
Benzene	ND	ug/L	0.5	1.0	7/15/02	16:03	D.Yeager	8021B	2036
Ethylbenzene	ND	ug/L	0.5	1.0	7/15/02	16:03	D.Yeager	8021B	2036
Toluene	ND	ug/L	0.5	1.0	7/15/02	16:03	D.Yeager	8021B	2036
Xylenes (Total)	ND	ug/L	0.5	1.0	7/15/02	16:03	D.Yeager	8021B	2036
Methyl-t-butylether	ND	ug/L	0.5	1.0	7/15/02	16:03	D.Yeager	8021B	2036
TPH (Gasoline Range)	ND	ug/L	50.0	1.0	7/15/02	16:03	D.Yeager	8015B	2036

Sample Extraction Data

Parameter	Wt/Vol		Date	Time	Analyst	Method
	Extracted	Extract Vol				
EPH	1000 ml	1.00 ml	7/10/02		M. Ricke	3510

Surrogate	% Recovery	Target Range
surr-o-Terphenyl	72.	50. - 150.
BTEX/GRO Surr., a,a,a-TFT	102.	69. - 132.

Sample report continued . . .



## ANALYTICAL REPORT

Laboratory Number: 02-A111956  
Sample ID: MW6F  
Project: 222913X  
Page 2

### LABORATORY COMMENTS:

- ND - Not detected at the report limit.
  - B - Analyte was detected in the method blank.
  - J - Estimated Value below Report Limit.
  - E - Estimated Value above the calibration limit of the instrument.
  - # - Recovery outside Laboratory historical or method prescribed limits.
- DRO/ORO were received out of holding time, client notified.

End of Sample Report.

## ANALYTICAL REPORT

ERI - NORTHERN CA 3876  
 PAULA SIME  
 73 DIGITAL DRIVE, SUITE 100  
 NOVATO, CA 94949

Lab Number: 02-A111957  
 Sample ID: MW6G  
 Sample Type: Water  
 Site ID: 7-0235

Project: 222913X  
 Project Name: EXXONMOBIL 7-0235  
 Sampler: STEVE BURKE

Date Collected: 7/ 1/02  
 Time Collected: 16:25  
 Date Received: 7/ 9/02  
 Time Received: 9:00  
 Page: 1

Analyte	Result	Units	Report Limit	Dil Factor	Analysis Date	Analysis Time	Analyst	Method	Batch
*ORGANIC PARAMETERS*									
TRPH ORO (C24-C40)	ND	ug/L	100.	1.0	7/10/02	21:34	D.Baywood	8015B/3510	9775
Benzene	ND	ug/L	0.5	1.0	7/15/02	16:33	D.Yeager	8021B	2036
Ethylbenzene	ND	ug/L	0.5	1.0	7/15/02	16:33	D.Yeager	8021B	2036
Toluene	ND	ug/L	0.5	1.0	7/15/02	16:33	D.Yeager	8021B	2036
Xylenes (Total)	ND	ug/L	0.5	1.0	7/15/02	16:33	D.Yeager	8021B	2036
Methyl-t-butylether	1.3	ug/L	0.5	1.0	7/15/02	16:33	D.Yeager	8021B	2036
TPH (Gasoline Range)	ND	ug/L	50.0	1.0	7/15/02	16:33	D.Yeager	8015B	2036

Sample Extraction Data

Parameter	Wt/Vol		Date	Time	Analyst	Method
	Extracted	Extract Vol				
EPH	1000 ml	1.00 ml	7/10/02		M. Ricke	3510

Surrogate	% Recovery	Target Range
surr-o-Terphenyl	73.	50. - 150.
BTEX/GRO Surr., a,a,a-TFT	102.	69. - 132.

Sample report continued . . .

## ANALYTICAL REPORT

Laboratory Number: 02-A111957  
Sample ID: MW6G  
Project: 222913X  
Page 2

### LABORATORY COMMENTS:

- ND - Not detected at the report limit.
  - B - Analyte was detected in the method blank.
  - J - Estimated Value below Report Limit.
  - E - Estimated Value above the calibration limit of the instrument.
  - # - Recovery outside Laboratory historical or method prescribed limits.
- DRO/ORO were received out of holding time, client notified.

End of Sample Report.

## ANALYTICAL REPORT

ERI - NORTHERN CA 3876  
 PAULA SIME  
 73 DIGITAL DRIVE, SUITE 100  
 NOVATO, CA 94949

Lab Number: 02-A111958  
 Sample ID: MW6H  
 Sample Type: Water  
 Site ID: 7-0235

Project: 222913X  
 Project Name: EXXONMOBIL 7-0235  
 Sampler: STEVE BURKE

Date Collected: 7/ 1/02  
 Time Collected: 17:25  
 Date Received: 7/ 9/02  
 Time Received: 9:00  
 Page: 1

Analyte	Result	Units	Report Limit	Dil Factor	Analysis Date	Analysis Time	Analyst	Method	Batch
<b>*ORGANIC PARAMETERS*</b>									
TRPH ORO (C24-C40)	ND	ug/L	100.	1.0	7/10/02	22:13	D.Haywood	8015B/3510	9775
Benzene	1170	ug/L	10.0	20.0	7/15/02	20:09	D.Yeager	8021B	2036
Ethylbenzene	44.0	ug/L	10.0	20.0	7/15/02	20:09	D.Yeager	8021B	2036
Toluene	200.	ug/L	10.0	20.0	7/15/02	20:09	D.Yeager	8021B	2036
Xylenes (Total)	158.	ug/L	10.0	20.0	7/15/02	20:09	D.Yeager	8021B	2036
Methyl-t-butylether	1910	ug/L	10.0	20.0	7/15/02	20:09	D.Yeager	8021B	2036
TPH (Gasoline Range)	5370	ug/L	1000	20.0	7/15/02	20:09	D.Yeager	8015B	2036

Sample Extraction Data

Parameter	Wt/Vol		Date	Time	Analyst	Method
	Extracted	Extract Vol				
EPH	1000 ml	1.00 ml	7/10/02		M. Ricke	3510

Surrogate	% Recovery	Target Range
surr-o-Terphenyl	74.	50. - 150.
BTEX/GRO Surr., a,a,a-TFT	97.	69. - 132.

Sample report continued . . .

## ANALYTICAL REPORT

Laboratory Number: 02-A111958  
Sample ID: MW6H  
Project: 222913X  
Page 2

### LABORATORY COMMENTS:

- ND - Not detected at the report limit.
  - B - Analyte was detected in the method blank.
  - J - Estimated Value below Report Limit.
  - E - Estimated Value above the calibration limit of the instrument.
  - # - Recovery outside Laboratory historical or method prescribed limits.
- DRO/ORO were received out of holding time, client notified.

End of Sample Report.

## ANALYTICAL REPORT

ERI - NORTHERN CA 3876  
 PAULA SIME  
 73 DIGITAL DRIVE, SUITE 100  
 NOVATO, CA 94949

Lab Number: 02-A111959  
 Sample ID: MW6I  
 Sample Type: Water  
 Site ID: 7-0235

Project: 222913X  
 Project Name: EXXONMOBIL 7-0235  
 Sampler: STEVE BURKE

Date Collected: 7/ 1/02  
 Time Collected: 15:50  
 Date Received: 7/ 9/02  
 Time Received: 9:00  
 Page: 1

Analyte	Result	Units	Report Limit	Dil Factor	Analysis Date	Analysis Time	Analyst	Method	Batch
*ORGANIC PARAMETERS*									
TRPH GRO (C24-C40)	ND	ug/L	100.	1.0	7/10/02	22:33	D.Haywood	8015B/3510	9775
Benzene	ND	ug/L	0.5	1.0	7/15/02	17:36	D.Yeager	8021B	2036
Ethylbenzene	ND	ug/L	0.5	1.0	7/15/02	17:36	D.Yeager	8021B	2036
Toluene	ND	ug/L	0.5	1.0	7/15/02	17:36	D.Yeager	8021B	2036
Xylenes (Total)	ND	ug/L	0.5	1.0	7/15/02	17:36	D.Yeager	8021B	2036
Methyl-t-butylether	ND	ug/L	0.5	1.0	7/15/02	17:36	D.Yeager	8021B	2036
TPH. (Gasoline Range)	ND	ug/L	50.0	1.0	7/15/02	17:36	D.Yeager	8015B	2036

Sample Extraction Data

Parameter	Wt/Vol		Date	Time	Analyst	Method
	Extracted	Extract Vol				
EPH	1000 ml	1.00 ml	7/10/02		M. Ricke	3510

Surrogate	% Recovery	Target Range
surr-o-Terphenyl	91.	50. - 150.
BTEX/GRO Surr., a,a,a-TFT	99.	69. - 132.

Sample report continued . . .

## ANALYTICAL REPORT

Laboratory Number: 02-A111959  
Sample ID: MW6I  
Project: 222913X  
Page 2

### LABORATORY COMMENTS:

- ND - Not detected at the report limit.
  - B - Analyte was detected in the method blank.
  - J - Estimated Value below Report Limit.
  - E - Estimated Value above the calibration limit of the instrument.
  - # - Recovery outside Laboratory historical or method prescribed limits.
- DRO/ORO were received out of holding time, client notified.

End of Sample Report.

## ANALYTICAL REPORT

ERI - NORTHERN CA 3876  
 PAULA SIME  
 73 DIGITAL DRIVE, SUITE 100  
 NOVATO, CA 94949

Lab Number: 02-A111960  
 Sample ID: MW6J  
 Sample Type: Water  
 Site ID: 7-0235

Project: 222913X  
 Project Name: EXXONMOBIL 7-0235  
 Sampler: STEVE BURKE

Date Collected: 7/ 1/02  
 Time Collected: 12:35  
 Date Received: 7/ 9/02  
 Time Received: 9:00  
 Page: 1

Analyte	Result	Units	Report Limit	Dil Factor	Analysis Date	Analysis Time	Analyst	Method	Batch
*ORGANIC PARAMETERS*									
TRPH ORO (C24-C40)	ND	ug/L	100.	1.0	7/10/02	22:52	D.Haywood	8015B/3510	9775
Benzene	ND	ug/L	0.5	1.0	7/15/02	18:07	D.Yeager	8021B	2036
Ethylbenzene	ND	ug/L	0.5	1.0	7/15/02	18:07	D.Yeager	8021B	2036
Toluene	ND	ug/L	0.5	1.0	7/15/02	18:07	D.Yeager	8021B	2036
Xylenes (Total)	ND	ug/L	0.5	1.0	7/15/02	18:07	D.Yeager	8021B	2036
Methyl-t-butylether	ND	ug/L	0.5	1.0	7/15/02	18:07	D.Yeager	8021B	2036
TPH (Gasoline Range)	ND	ug/L	50.0	1.0	7/15/02	18:07	D.Yeager	8015B	2036

Sample Extraction Data

Parameter	Wt/Vol		Date	Time	Analyst	Method
	Extracted	Extract Vol				
EPH	1000 ml	1.00 ml	7/10/02		M. Ricke	3510

Surrogate	% Recovery	Target Range
surr-o-Terphenyl	78.	50. - 150.
BTEX/GRO Surr., a,a,a-TFT	102.	69. - 132.

Sample report continued . . .



## ANALYTICAL REPORT

Laboratory Number: 02-A111960  
Sample ID: MW6J  
Project: 222913X  
Page 2

### LABORATORY COMMENTS:

- ND - Not detected at the report limit.
  - B - Analyte was detected in the method blank.
  - J - Estimated Value below Report Limit.
  - E - Estimated Value above the calibration limit of the instrument.
  - # - Recovery outside Laboratory historical or method prescribed limits.
- DRO/ORO were received out of holding time, client notified.

End of Sample Report.

## ANALYTICAL REPORT

ERI - NORTHERN CA 3876  
 PAULA SIME  
 73 DIGITAL DRIVE, SUITE 100  
 NOVATO, CA 94949

Lab Number: 02-A111961  
 Sample ID: RW1  
 Sample Type: Water  
 Site ID: 7-0235

Project: 222913X  
 Project Name: EXXONMOBIL 7-0235  
 Sampler: STEVE BURKE

Date Collected: 7/ 1/02  
 Time Collected: 17:15  
 Date Received: 7/ 9/02  
 Time Received: 9:00  
 Page: 1

Analyte	Result	Units	Report	Dil	Analysis	Analysis	Analyst	Method	Batch
			Limit	Factor	Date	Time			
*ORGANIC PARAMETERS*									
TRPH ORO (C24-C40)	ND	ug/L	100.	1.0	7/11/02	10:31	D.Haywood	8015B/3510	9775
Benzene	176.	ug/L	5.0	10.0	7/15/02	22:42	D.Yeager	8021B	2036
Ethylbenzene	71.0	ug/L	5.0	10.0	7/15/02	22:42	D.Yeager	8021B	2036
Toluene	8.0	ug/L	5.0	10.0	7/15/02	22:42	D.Yeager	8021B	2036
Xylenes (Total)	75.0	ug/L	5.0	10.0	7/15/02	22:42	D.Yeager	8021B	2036
Methyl-t-butylether	986.	ug/L	5.0	10.0	7/15/02	22:42	D.Yeager	8021B	2036
TPH (Gasoline Range)	2500	ug/L	500.	10.0	7/15/02	22:42	D.Yeager	8015B	2036

Sample Extraction Data

Parameter	Wt/Vol		Date	Time	Analyst	Method
	Extracted	Extract Vol				
EPH	1000 ml	1.00 ml	7/10/02		M. Ricke	3510

Surrogate	% Recovery	Target Range
surr-o-Terphenyl	7. #	50. - 150.
BTEX/GRO Surr., a,a,a-TFT	97.	69. - 132.

Sample report continued . . .

## ANALYTICAL REPORT

Laboratory Number: 02-A111961  
Sample ID: RW1  
Project: 222913X  
Page 2

### LABORATORY COMMENTS:

ND - Not detected at the report limit.  
B - Analyte was detected in the method blank.  
J - Estimated Value below Report Limit.  
E - Estimated Value above the calibration limit of the instrument.  
# - Recovery outside Laboratory historical or method prescribed limits.  
DRO/ORO were received out of holding time, client notified.  
trph-d surrogate was low. not enough for reprep, also  
out of hold.

End of Sample Report.

## ANALYTICAL REPORT

ERI - NORTHERN CA 3876  
 PAULA SIME  
 73 DIGITAL DRIVE, SUITE 100  
 NOVATO, CA 94949

Lab Number: 02-A111962  
 Sample ID: RW2  
 Sample Type: Water  
 Site ID: 7-0235

Project: 222913X  
 Project Name: EXXONMOBIL 7-0235  
 Sampler: STEVE BURKE

Date Collected: 7/ 1/02  
 Time Collected: 17:05  
 Date Received: 7/ 9/02  
 Time Received: 9:00  
 Page: 1

Analyte	Result	Units	Report Limit	Dil Factor	Analysis Date	Analysis Time	Analyst	Method	Batch
*ORGANIC PARAMETERS*									
TRPH ORO (C24-C40)	ND	ug/L	100.	1.0	7/10/02	23:32	D.Haywood	8015B/3510	9775
Benzene	11.0	ug/L	0.5	1.0	7/15/02	19:08	D.Yeager	8021B	2036
Ethylbenzene	17.9	ug/L	0.5	1.0	7/15/02	19:08	D.Yeager	8021B	2036
Toluene	1.8	ug/L	0.5	1.0	7/15/02	19:08	D.Yeager	8021B	2036
Xylenes (Total)	45.0	ug/L	0.5	1.0	7/15/02	19:08	D.Yeager	8021B	2036
Methyl-t-butylether	39.9	ug/L	0.5	1.0	7/15/02	19:08	D.Yeager	8021B	2036
TPH (Gasoline Range)	1380	ug/L	50.0	1.0	7/15/02	19:08	D.Yeager	8015B	2036

Sample Extraction Data

Parameter	Wt/Vol		Date	Time	Analyst	Method
	Extracted	Extract Vol				
EPH	1000 ml	1.00 ml	7/10/02		M. Ricke	3510

Surrogate	% Recovery	Target Range
surr-o-Terphenyl	71.	50. - 150.
BTEX/GRO Surr., a,a,a-TFT	74.	69. - 132.

Sample report continued . . .

## ANALYTICAL REPORT

Laboratory Number: 02-A111962  
Sample ID: RW2  
Project: 222913X  
Page 2

### LABORATORY COMMENTS:

- ND - Not detected at the report limit.
  - B - Analyte was detected in the method blank.
  - J - Estimated Value below Report Limit.
  - E - Estimated Value above the calibration limit of the instrument.
  - # - Recovery outside Laboratory historical or method prescribed limits.
- DRO/ORO were received out of holding time, client notified.

End of Sample Report.

## ANALYTICAL REPORT

ERI - NORTHERN CA 3876  
 PAULA SIME  
 73 DIGITAL DRIVE, SUITE 100  
 NOVATO, CA 94949

Lab Number: 02-A111963  
 Sample ID: RW3A  
 Sample Type: Water  
 Site ID: 7-0235

Project: 222913X  
 Project Name: EXXONMOBIL 7-0235  
 Sampler: STEVE BURKE

Date Collected: 7/ 1/02  
 Time Collected: 16:35  
 Date Received: 7/ 9/02  
 Time Received: 9:00  
 Page: 1

Analyte	Result	Units	Report Limit	Dil Factor	Analysis Date	Analysis Time	Analyst	Method	Batch
*ORGANIC PARAMETERS*									
TRPH ORO (C24-C40)	ND	ug/L	100.	1.0	7/10/02	23:51	D.Haywood	8015B/3510	9775
Benzene	60.4	ug/L	0.5	1.0	7/15/02	19:39	D.Yeager	8021B	2036
Ethylbenzene	2.4	ug/L	0.5	1.0	7/15/02	19:39	D.Yeager	8021B	2036
Toluene	ND	ug/L	0.5	1.0	7/15/02	19:39	D.Yeager	8021B	2036
Xylenes (Total)	4.2	ug/L	0.5	1.0	7/15/02	19:39	D.Yeager	8021B	2036
Methyl-t-butylether	21.7	ug/L	0.5	1.0	7/15/02	19:39	D.Yeager	8021B	2036
TPH (Gasoline Range)	275.	ug/L	50.0	1.0	7/15/02	19:39	D.Yeager	8015B	2036

Sample Extraction Data

Parameter	Wt/Vol		Date	Time	Analyst	Method
	Extracted	Extract Vol				
EPH	1000 ml	1.00 ml	7/10/02		M. Ricke	3510

Surrogate	% Recovery	Target Range
surr-o-Terphenyl	67.	50. - 150.
BTEX/GRO Surr., a,a,a-TFT	97.	69. - 132.

Sample report continued . . .

## ANALYTICAL REPORT

Laboratory Number: 02-A111963  
Sample ID: RW3A  
Project: 222913X  
Page 2

### LABORATORY COMMENTS:

- ND - Not detected at the report limit.
  - E - Analyte was detected in the method blank.
  - J - Estimated Value below Report Limit.
  - E - Estimated Value above the calibration limit of the instrument.
  - # - Recovery outside Laboratory historical or method prescribed limits.
- DRO/ORO were received out of holding time, client notified.

End of Sample Report.

**PROJECT QUALITY CONTROL DATA**

Project Number: 222913X

Page: 1

Matrix Spike Recovery

Analyte	units	Orig. Val.	MS Val	Spike Conc	Recovery	Target Range	Q.C. Batch	Spike Sample
<b>**UST ANALYSIS**</b>								
Benzene	mg/l	< 0.0005	0.0540	0.0500	108	74. - 129.	2036	blank
Toluene	mg/l	< 0.0005	0.0529	0.0500	106	74. - 128.	2036	blank
Ethylbenzene	mg/l	< 0.0005	0.0529	0.0500	106	75. - 128.	2036	blank
Xylenes (Total)	mg/l	< 0.0005	0.104	0.100	104	72. - 126.	2036	blank
Methyl-t-butylether	mg/l	< 0.0005	0.0533	0.0500	107	64. - 133.	2036	blank
TPH (Gasoline Range)	mg/l	< 0.050	0.955	1.00	96	59. - 128.	2036	blank
TPH (Diesel Range)	mg/l	< 0.100	1.06	1.00	106	23. - 120.	9775	blank
TPH (Diesel Range)	mg/l	< 0.050	0.995	1.00	100	23. - 120.	9815	BLANK
BTEX/GRO Surr., a,a,a-TFT	% Recovery				98	69. - 132.	2036	

Matrix Spike Duplicate

Analyte	units	Orig. Val.	Duplicate	RPD	Limit	Q.C. Batch
<b>**UST PARAMETERS**</b>						
Benzene	mg/l	0.0540	0.0540	0.00	15.	2036
Toluene	mg/l	0.0529	0.0531	0.38	15.	2036
Ethylbenzene	mg/l	0.0529	0.0529	0.00	15.	2036
Xylenes (Total)	mg/l	0.104	0.104	0.00	19.	2036
Methyl-t-butylether	mg/l	0.0533	0.0528	0.94	23.	2036
TPH (Gasoline Range)	mg/l	0.955	0.914	4.39	22.	2036
TPH (Diesel Range)	mg/l	1.06	1.03	2.87	49.	9775
TPH (Diesel Range)	mg/l	0.995	1.26	23.50	49.	9815
BTEX/GRO Surr., a,a,a-TFT	% Recovery		98.			2036

Project QC continued . . .



**PROJECT QUALITY CONTROL DATA**  
**Project Number: 222913X**  
**Page: 2**

Laboratory Control Data

Analyte	units	Known Val.	Analyzed Val	% Recovery	Target Range	Q.C. Batch
---------	-------	------------	--------------	------------	--------------	------------

Laboratory Control Data

Analyte	units	Known Val.	Analyzed Val	% Recovery	Target Range	Q.C. Batch
---------	-------	------------	--------------	------------	--------------	------------

**\*\*UST PARAMETERS\*\***

Benzene	mg/l	0.100	0.106	106	74 - 124	2036
Toluene	mg/l	0.100	0.104	104	74 - 121	2036
Ethylbenzene	mg/l	0.100	0.103	103	75 - 123	2036
Xylenes (Total)	mg/l	0.200	0.203	102	72 - 120	2036
Methyl-t-butylether	mg/l	0.100	0.104	104	64 - 128	2036
TPH (Gasoline Range)	mg/l	1.00	0.955	96	61 - 139	2036
TPH (Diesel Range)	mg/l	1.00	0.939	94	28 - 115	9775
TPH (Diesel Range)	mg/l	1.00	1.04	104	28 - 115	9815
BTEX/GRO Surr., a,a,a-TFT	% Recovery			97	69 - 132	2036

Blank Data

Analyte	Blank Value	Units	Q.C. Batch	Date Analyzed	Time Analyzed
---------	-------------	-------	------------	---------------	---------------

**\*\*UST PARAMETERS\*\***

TRPH ORO (C24-C40)	< 0.100	mg/l	9775	7/10/02	18:36
Benzene	< 0.0005	mg/l	2036	7/15/02	13:59
Toluene	< 0.0005	mg/l	2036	7/15/02	13:59
Ethylbenzene	< 0.0005	mg/l	2036	7/15/02	13:59
Xylenes (Total)	< 0.0005	mg/l	2036	7/15/02	13:59
Methyl-t-butylether	< 0.0005	mg/l	2036	7/15/02	13:59
TPH (Gasoline Range)	< 0.050	mg/l	2036	7/15/02	13:59
TPH (Diesel Range)	< 0.100	mg/l	9775	7/10/02	18:36
TPH (Diesel Range)	< 0.050	mg/l	9815	7/11/02	10:50

Project QC continued . . .

PROJECT QUALITY CONTROL DATA

Project Number: 222913X

Page: 3

Blank Data

Analyte	Blank Value	Units	Q.C. Batch	Date Analyzed	Time Analyzed
---------	-------------	-------	------------	---------------	---------------

\*\*UST PARAMETERS\*\*

surr-o-Terphenyl	72.	% Recovery	9775	7/10/02	18:36
BTEX/GRO Surr., a,a,a-TFT	101.	% Recovery	2036	7/15/02	13:59

# - Value outside Laboratory historical or method prescribed QC limits.

End of Report for Project 292111

# SAMPLE NONCONFORMANCE/COC REVISION FORM

**TestAmerica**  
CORPORATE

Nashville Division

292111

ACCT NO. 3876

DATE RECEIVED 7/9/02

COMPANY ERT

Relinquished by:	Date/Time:	Received by:	Date/Time:
<u>MB</u>	<u>7/9/02 15:10</u>	<u>LK/CG 7/9 15:09</u>	
Relinquished by:	Date/Time:	Received by:	Date/Time:
<u>MB</u>	<u>7:10/0800</u>	<u>MB</u>	
Relinquished by:	Date/Time:	Received by:	Date/Time:

**PROBLEM(S):**

- |                          |                                       |
|--------------------------|---------------------------------------|
| FOC/TOC?                 | METALS LIST? <u>EM 7-0235</u>         |
| TPH METHOD?              | TCLP WHAT?                            |
| EDB METHOD?              | HERB LIST- LONG OR SHORT?             |
| NEED LIST OF COMPOUNDS:  | 8260 INSTEAD OF 8021?                 |
| TEMPERATURE UPON RECEIPT | SATURDAY DELIVERY MARKED?             |
| ICE -- OR-- NO ICE??     | FIELD TEST-- OUT OF HOLD              |
| NO COC - PLEASE FAX      | NO ANALYSIS REQUESTED                 |
| DOCUMENTATION LEVEL?     | <u>OUT OF HOLDING TIME-- TEST DRO</u> |

OTHER: Analyze ?

RESOLUTION: Asa Per Paula - Analyze for Motor Oil, 47.9@ 1701

CONTACTED	DATE/TIME	EMAIL	LEFT MESSAGE
<u>Paula Sime</u>	<u>7-9/1355</u>		<u>✓</u>

# TESTAMERICA, INC.

## COOLER RECEIPT FORM

Client: ERI BC# 20211

Cooler Received On: 7/9/02 And Opened On: 7/9/02 By: Mark Beasley

M. Beasley  
(Signature)

1. Temperature of Cooler when opened 2.0 DEGREES CELSIUS
2. Were custody seals on outside of cooler and intact?..... YES  NO
  - a. If yes, what kind and where: TAPE | Front
  - b. Were the signature and date correct?..... YES  NO
3. Were custody seals on containers intact?..... YES  NO
4. Were custody papers inside cooler?..... YES  NO
5. Were custody papers properly filled out (ink, signed, etc)?..... YES  NO
6. Did you sign the custody papers in the appropriate place?..... YES  NO
7. What kind of packing material was used?  Bubblewrap  Peanuts  Other  None
8. Was sufficient ice used (if appropriate)?..... YES  NO
9. Did all bottles arrive in good condition (unbroken)?..... YES  NO
10. Were all bottle labels complete (#, date, signed, pres, etc)?..... YES  NO
11. Did all bottle labels and tags agree with custody papers?..... YES  NO
12. Were correct bottles used for the analysis requested?..... YES  NO
13. If present, was any observable VOA headspace present?..... YES  NO
14. If present, were VOA vials checked for absence of air bubbles and noted if found?..... YES  NO
15. Was sufficient amount of sample sent in each bottle?..... YES  NO
16. Were correct preservatives used?..... YES  NO
17. Was residual chlorine present (if appropriate)?..... YES  NO
18. Corrective action taken, if necessary:
  - a. Name of person contacted: SEE ATTACHED FOR RESOLUTION IF NEEDED
  - b. Date: \_\_\_\_\_

**TestAmerica**  
INCORPORATED

(615) 726-0177

Nashville Division

2960 Foster Creighton

Nashville, TN 37204

**ExxonMobil**

Consultant Name: Environmental Resolutions, Inc.

Address: 73 Digital Drive, Suite 100

City/State/Zip: Novato, California 94949

Project Manager: Paula Sime

Telephone Number: (415) 382-4324

ERI Job Number: 222913X

Sampler Name: (Print) Steve Berke

Sampler Signature: [Signature]

ExxonMobil Engineer Gene Ortega

Telephone Number (925) 246-8747

Account #: 3876

PO #: 4501667111

Facility ID # 70235

Global ID# T0600101354

Site Address 2225 Telegraph Avenue

City, State Zip Oakland, California

Shipping Method:  Lab Courier  Hand Deliver  Commercial Express  Other

TAT  
 24 hour  72 hour  
 48 hour  96 hour  
 8 day

PROVIDE:  
 EDF Report  
 FAX Results

Special Instructions:  
 \*\*Please hold analyses on sample "TB".

Matrix			Analyze For:							
Water	Soil	Vapor	TPHd 8015B	TPHg 8015B	BTEX 8021B	MTBE 8021B	Confirm MTBE 8260B	Oxygenates 8260B	VOCs 8260B	TPH motor oil 8015B
X				H	O	L	D			
X				X	X	X				X
X				X	X	X				X
X				X	X	X				X
X				X	X	X				X
X				X	X	X				X
X				X	X	X				X
X				X	X	X				X
X				X	X	X				X

Sample ID / Description	DATE	TIME	COMP	GRAB	PRESERV	NUMBER
TB	11/9/02	6/6/02			HCL	2 UO4
2 MW6B	54	7/1/02			HCL	4 VOAs/ 2 AMBs
MW6E	55				HCL	4 VOAs/ 2 AMBs
4 MW6F	56				HCL	4 VOAs/ 2 AMBs
MW6G	57				HCL	4 VOAs/ 2 AMBs
6 MW6H	58				HCL	4 VOAs/ 2 AMBs
MW6I	59				HCL	4 VOAs/ 2 AMBs
4 MW6J	60				HCL	4 VOAs/ 2 AMBs
RW1	61				HCL	4 VOAs/ 2 AMBs
10 RW2	62				HCL	4 VOAs/ 2 AMBs
RW3A	11/9/02	1635			HCL	4 VOAs/ 2 AMBs

Relinquished by: Steve Berke Date 7/8/02 Time 0930 Received by: \_\_\_\_\_ Time \_\_\_\_\_  
 Relinquished by: \_\_\_\_\_ Date \_\_\_\_\_ Time \_\_\_\_\_ Received by TestAmerica: [Signature] Time 7/9/02 9:00

Laboratory Comments:  
 Temperature Upon Receipt: 20  
 Sample Containers Intact?  
 VOAs Free of Headspace?