

El Dorado Environmental, Inc

ENVIRONMENTAL
PROTECTION

2221 Goldorado Trail, El Dorado, California 95626

80 MAR 22 PM 4: 42

(916) 626-3898
Fax (916) 626-3899

March 6, 2000

Mr. Scott Seery
Alameda County Health Agency, Division of Hazardous Materials
Department of Environmental Health
80 Swan Way, Room 350
Oakland, California 94621

Subject: **Fourth Quarter 1999 Ground Water Monitoring Report
Former Beacon Station #574**
22315 Redwood Road, Castro Valley, California

Dear Mr. Seery:

El Dorado Environmental, Inc. (EDE) has prepared this report to document the results of quarterly ground water monitoring **conducted on December 13, 1999**, at the subject site (Figure 1). The monitoring, conducted by Doulos Environmental (Doulos), included measurements of depth to ground water, subjective analysis for the presence or absence of free product, ground water purging and collection of ground water samples. Doulos reports that all field activities were conducted in accordance with the Ultramar Field Procedures described in Attachment A.

GROUND WATER ELEVATIONS

Prior to purging, Doulos collected depth to ground water measurements. Copies of Doulos' field data sheets are contained in Attachment B. Ground water elevation data collected since March 1992 are summarized in Table 1. Historical ground water elevation data are contained in Attachment C. On the basis of the current measurements, ground water flows toward the southwest (Figure 2) at a gradient of approximately 0.01 foot per foot. Ground water elevations in monitoring wells MW-1 through MW-5 decreased an average of 0.06 feet and increased in monitoring well MW-6 0.01 feet compared to the last monitoring event.

GROUND WATER SAMPLING AND ANALYSES

Ground water samples were collected from two monitoring wells (by agreement with Alameda County, ground water samples were collected from monitoring wells MW-5 and MW-6 this quarter). All samples were analyzed for concentrations of:

- TPH, as gasoline, by modified EPA Method 8015.
- BTEX by EPA Method 602.
- MTBE by EPA Method 602.

Analytical results collected since March 1992 are summarized in Table 2. Historical analytical data are contained in Attachment D. Figure 3 illustrates the inferred distribution of dissolved benzene in ground water based on the current data. The laboratory report and chain-of-custody form for the current sampling event are included in Attachment E. Benzene was not detected in ground water samples collected from monitoring wells MW-5 and MW-6.

The interpretations and/or conclusions that may be contained within this report represent our professional opinions. These opinions are based on currently available information. Other than this, no warranty is implied or intended. This report has been prepared solely for the use of Ultramar Inc. Any reliance on this report by third parties will be at such parties' sole risk.

If you have any questions or comments, please contact us at (530) 626-3898.

Regards,

EL DORADO ENVIRONMENTAL, INC.

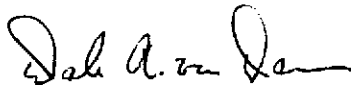

Dale A. van Dam, R.G.
Hydrogeologist

DAvD/davd

Attachments

cc: Mr. Joe Aldridge, Senior Project Manager, Ultramar Inc., 525 West Third Street, Hanford, California 93230
Mr. Rich Hiatt, California Regional Water Quality Control Board, San Francisco Bay Region,
2101 Webster Street, Suite 500, Oakland, California 94612

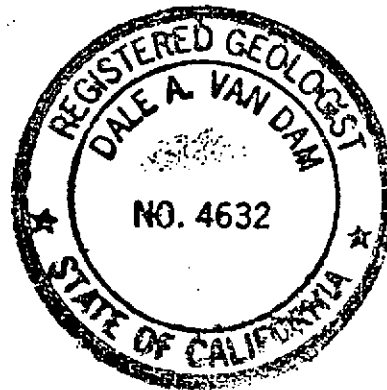

FIGURES:

FIGURE 1 SITE LOCATION MAP

FIGURE 2 GROUND WATER CONTOUR MAP
DECEMBER 13, 1999

FIGURE 3 DISSOLVED BENZENE DISTRIBUTION MAP
DECEMBER 13, 1999

TABLES:

TABLE 1 GROUND WATER ELEVATION DATA

TABLE 2 GROUND WATER ANALYTICAL RESULTS

ATTACHMENTS:

A ULTRAMAR FIELD PROCEDURES

B DOULOS ENVIRONMENTAL
FIELD DATA SHEETS

C HISTORICAL GROUND WATER ELEVATION DATA

D HISTORICAL GROUND WATER ANALYTICAL DATA

E LABORATORY REPORT AND
CHAIN-OF-CUSTODY FORM

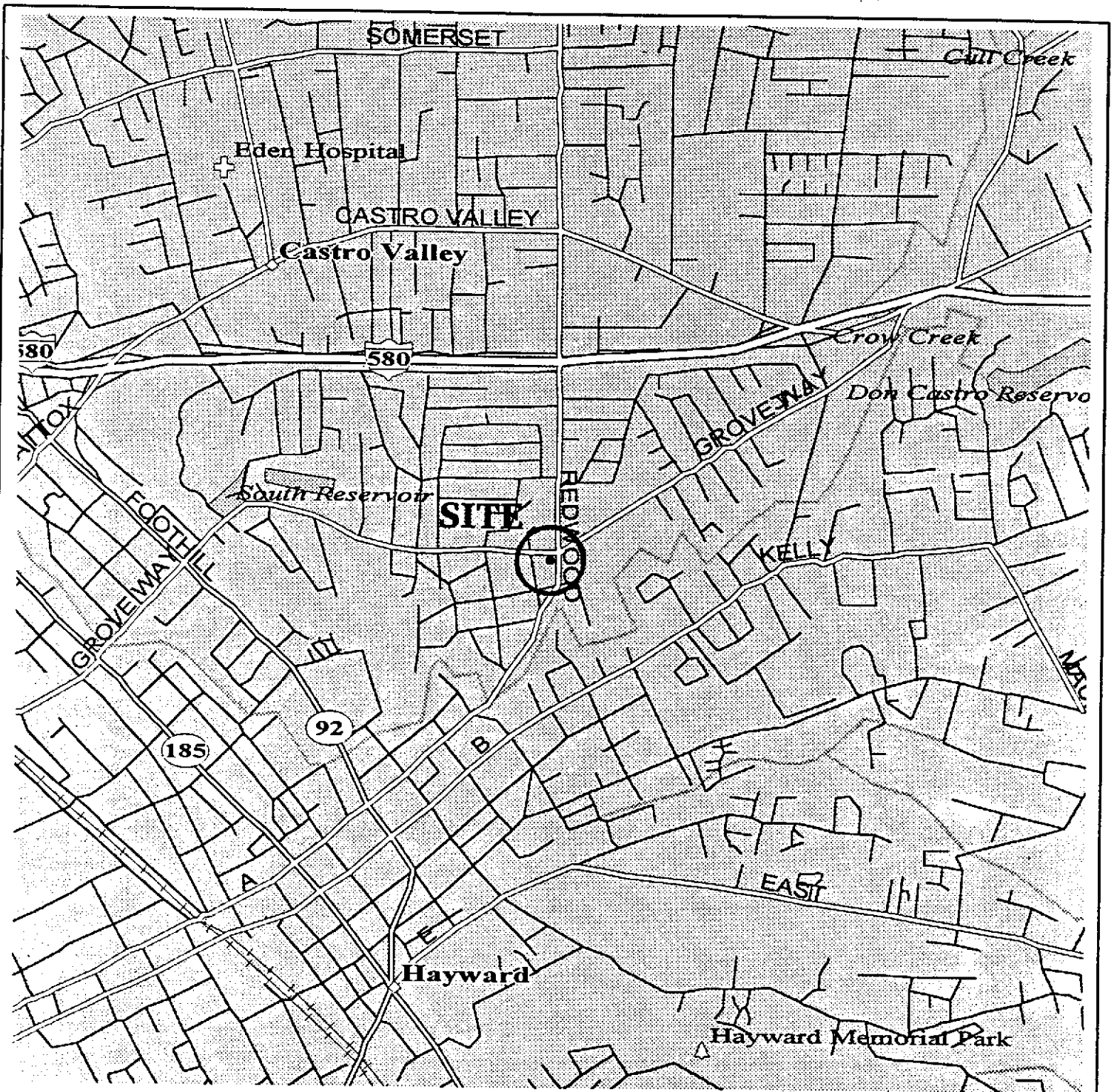

SITE LOCATION MAP		FIGURE 1
BEACON STATION #574 22315 REDWOOD ROAD CASTRO VALLEY, CALIFORNIA		PROJECT NUMBER U065.01
EL DORADO ENVIRONMENTAL, INC.		DRAWN BY: D.A.V.D.
		CHECKED BY: D.V.D.

SOURCE: STREET ATLAS U.S.A., DELORME MAPPING, 1994

GROVE WAY

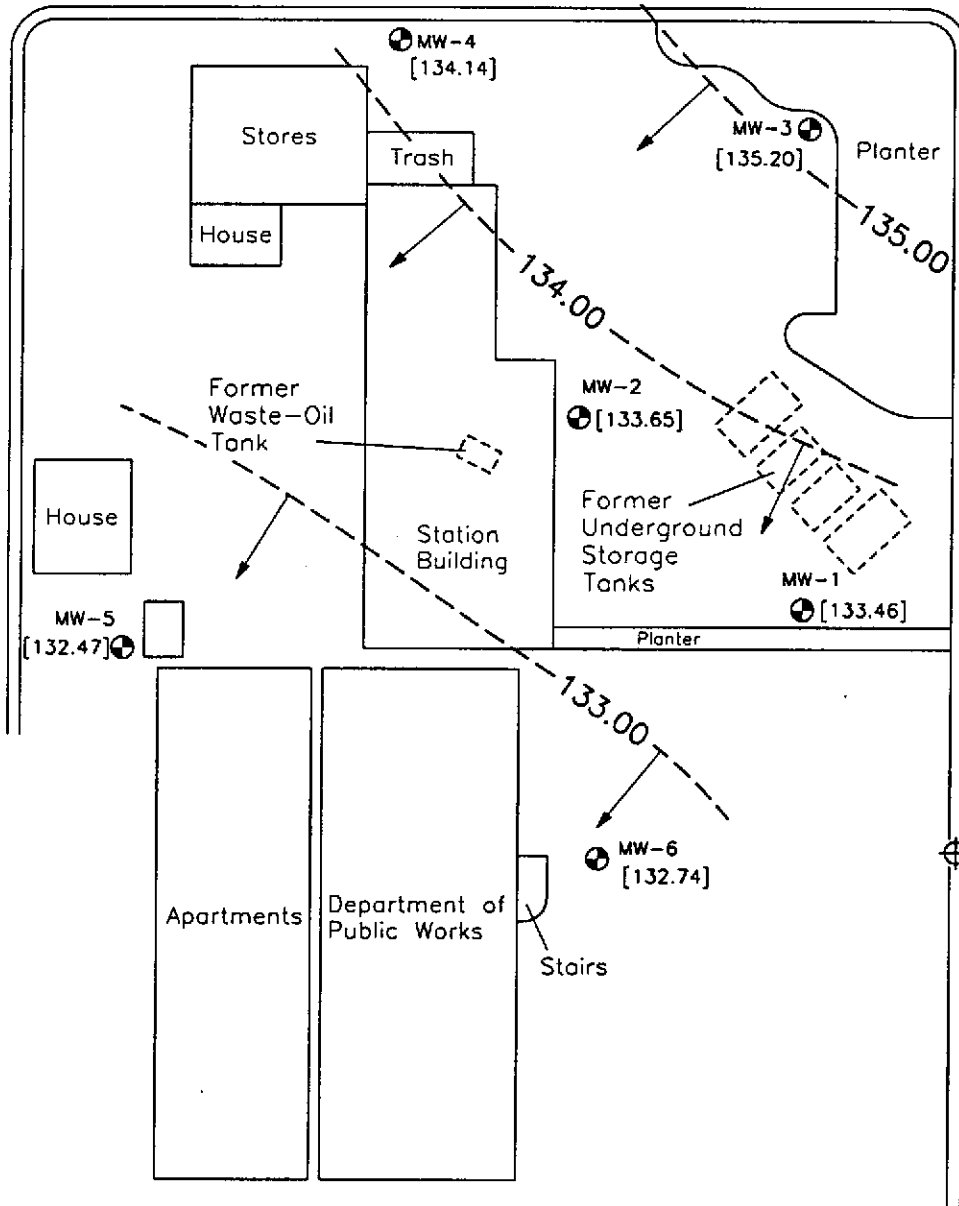

REDWOOD ROAD

EXPLANATION

- MW-1 ⊕ Monitoring Well Location
- MW-7 ⊕ Abandoned Monitoring Well
- [133.46] Elevation of Ground Water Measured in Feet; Datum is Mean Sea Level
- [NM] Well Not Measured
- 135.00 --- Line of Equal Elevation of Ground Water Measured in Feet; Datum is Mean Sea Level
- ↘ Inferred Direction of Ground Water Flow



SOURCE: FIGURE MODIFIED FROM DRAWING PROVIDED BY FUGRO WEST, INC.

GROUND WATER CONTOUR MAP, DECEMBER 13, 1999		FIGURE 2
BEACON STATION #574 22315 REDWOOD ROAD CASTRO VALLEY, CALIFORNIA		PROJECT NUMBER: U065.01
EL DORADO ENVIRONMENTAL, INC.		DRAWN BY: D.A.
		CHECKED BY: Dvd

GROVE WAY

MW-8



Island

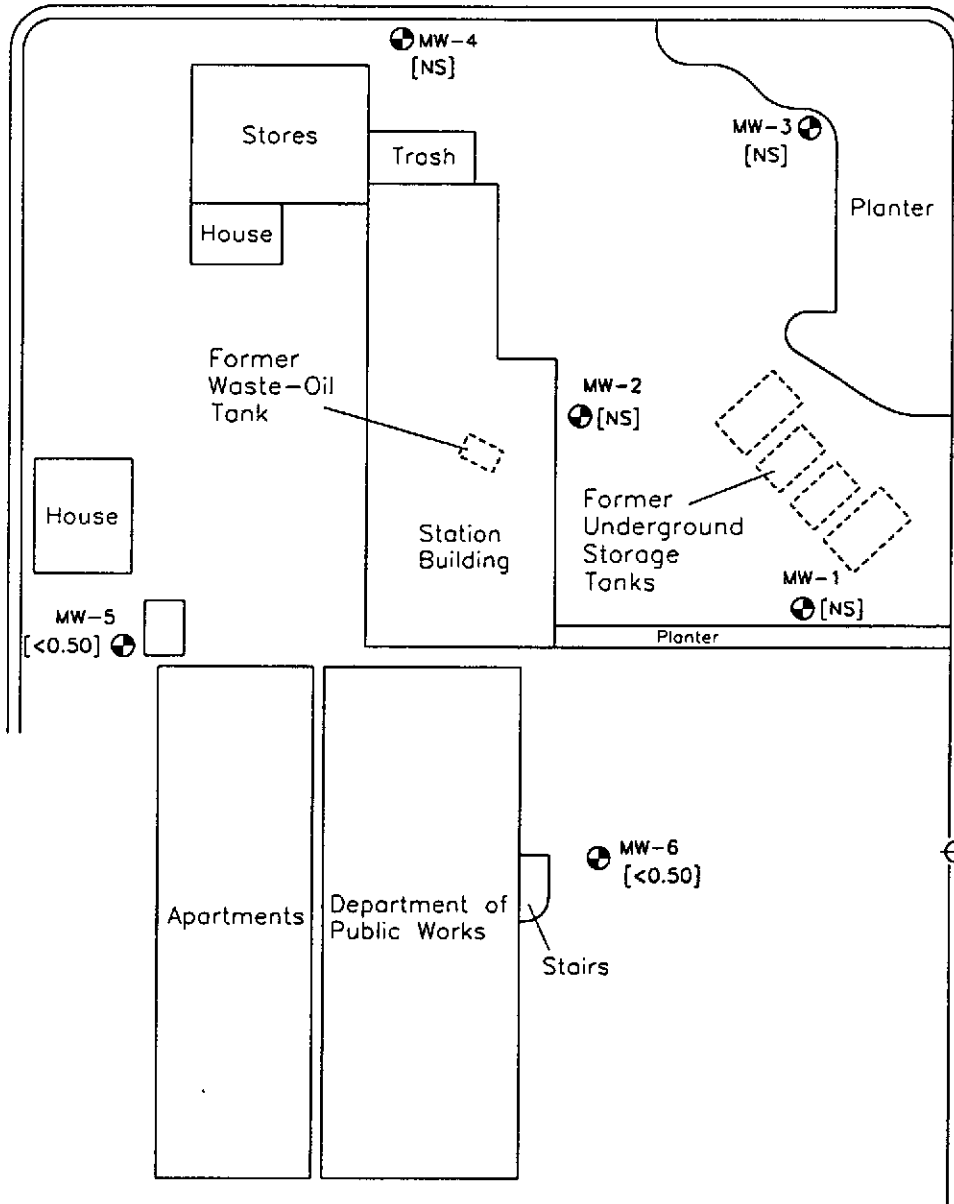

REDWOOD ROAD

EXPLANATION

- MW-2 Monitoring Well Location
- MW-7 Abandoned Monitoring Well

[14000] Concentration of Benzene in Ground Water; Concentration in Micrograms per Liter

[NS] Well Not Sampled

Line of Equal Concentration of Benzene in Ground Water; Concentration in Micrograms per Liter



NORTH



DISSOLVED BENZENE DISTRIBUTION MAP, DECEMBER 13, 1999

FIGURE 3

BEACON STATION #574
22315 REDWOOD ROAD
CASTRO VALLEY, CALIFORNIA

PROJECT NUMBER:
U065.01

DRAWN BY:
D.A.

SOURCE: FIGURE MODIFIED FROM DRAWING PROVIDED BY FUGRO WEST, INC.

EL DORADO ENVIRONMENTAL, INC.

CHECKED BY:
D.A.

TABLE 1
GROUND WATER ELEVATION DATA
BEACON STATION #574
22315 REDWOOD ROAD, CASTRO VALLEY, CALIFORNIA
(Measurements in feet)

Monitoring Well	Date	Reference Elevation (top of casing) ¹	Depth to Ground Water ¹	Ground Water Elevation ²	Well Depth	Comments
MW-1	03/27/92	156.55	22.43	134.12	---	
	06/04/92		23.40	133.15	---	
	09/23/92		24.07	132.48	---	
	11/12/92		24.16	132.39	29.33	
	02/02/93		21.87	134.68	29.80	
	05/07/93		22.58	133.97	29.84	
	05/18/93		22.66	133.89	---	
	08/11/93		23.41	133.14	29.81	
	11/05/93		24.09	132.46	29.81	
	03/01/94		22.76	133.79	29.85	
	06/02/94		23.24	133.31	29.85	
	09/09/94		23.93	132.62	29.86	
	12/20/94		22.94	133.61	29.85	
	03/08/95		22.20	134.35	29.71	
	06/14/95		22.65	133.90	29.70	
	09/26/95		23.44	133.11	29.71	
	12/27/95		23.04	133.51	29.72	
	03/26/96		21.39	135.16	29.71	
	06/05/96		22.43	134.12	29.73	
	09/16/96		24.42	132.13	29.74	
	12/02/96		23.14	133.41	29.75	
	03/10/97		22.30	134.25	29.76	
	06/12/97		22.97	133.58	29.76	
	09/29/97		23.35	133.20	29.78	
	12/01/97		22.73	133.82	29.79	
	03/19/98		20.56	135.99	29.78	
05/28/98	21.78	134.77	29.76			
08/31/98	22.64	133.91	29.78			
12/08/98	22.87	133.68	29.76			
02/17/99	21.53	135.02	29.75			
06/10/99	22.74	133.81	29.74			
09/07/99	23.06	133.49	29.73			
12/13/99	23.09	133.46	29.74			

NOTES: 1 = Measurement and reference elevation taken from notch/mark on top north side of well casing.
2 = Elevation referenced to mean sea level.
Well Depth = Measurement from top of casing to bottom of well.
3 = Well abandoned.

TABLE 1
GROUND WATER ELEVATION DATA
BEACON STATION #574
22315 REDWOOD ROAD, CASTRO VALLEY, CALIFORNIA
(Measurements in feet)

Monitoring Well	Date	Reference Elevation (top of casing) ¹	Depth to Ground Water ¹	Ground Water Elevation ²	Well Depth	Comments
MW-2	03/27/92	155.17	20.82	134.35	---	
	06/04/92		21.81	133.36	---	
	09/23/92		22.45	132.72	---	
	11/12/92		22.60	132.57	29.71	
	02/02/93		20.28	134.89	29.73	
	05/07/93		20.97	134.20	29.73	
	05/18/93		21.06	134.11	---	
	08/11/93		21.85	133.32	29.70	
	11/05/93		22.32	132.85	29.70	
	03/01/94		21.19	133.98	29.68	
	06/02/94		21.59	133.58	29.69	
	09/09/94		22.33	132.84	29.66	
	12/20/94		21.37	133.80	29.65	
	03/08/95		20.60	134.57	29.52	
	06/14/95		21.04	134.13	29.54	
	09/26/95		21.84	133.33	29.53	
	12/27/95		21.44	133.73	29.56	
	03/26/96		19.81	135.36	29.56	
	06/05/96		20.83	134.34	29.59	
	09/16/96		21.93	133.24	29.58	
	12/02/96		21.54	133.63	29.58	
	03/10/97		20.71	134.46	29.58	
	06/12/97		21.41	133.76	29.52	
	09/29/97		21.26	133.91	29.51	
	12/01/97		20.97	134.20	29.50	
	03/19/98		18.98	136.19	29.51	
05/28/98	20.22	134.95	29.50			
08/31/98	21.09	134.08	29.51			
12/08/98	21.31	133.86	29.50			
02/17/99	20.02	135.15	29.51			
06/10/99	21.30	133.87	29.50			
09/07/99	21.49	133.68	29.50			
12/13/99	21.52	133.65	29.50			

NOTES: 1 = Measurement and reference elevation taken from notch/mark on top north side of well casing.
2 = Elevation referenced to mean sea level.
Well Depth = Measurement from top of casing to bottom of well.
3 = Well abandoned.

TABLE 1
GROUND WATER ELEVATION DATA
BEACON STATION #574
22315 REDWOOD ROAD, CASTRO VALLEY, CALIFORNIA
(Measurements in feet)

Monitoring Well	Date	Reference Elevation (top of casing) ¹	Depth to Ground Water ¹	Ground Water Elevation ²	Well Depth	Comments
MW-3	03/27/92	157.13	21.46	135.67	---	
	06/04/92		22.34	134.79	---	
	09/23/92		22.84	134.29	---	
	11/12/92		23.04	134.09	29.55	
	02/02/93		21.03	136.10	29.45	
	05/07/93		21.59	135.54	29.53	
	05/18/93		21.73	135.40	---	
	08/11/93		22.31	134.82	29.41	
	11/05/93		22.85	134.28	29.41	
	03/01/94		21.97	135.16	29.55	
	06/02/94		22.29	134.84	29.56	
	09/09/94		22.91	134.22	29.56	
	12/20/94		22.11	135.02	29.54	
	03/08/95		21.40	135.73	29.38	
	06/14/95		21.80	135.33	29.36	
	09/26/95		22.38	134.75	29.37	
	12/27/95		22.07	135.06	29.37	
	03/26/96		20.73	136.40	29.38	
	06/05/96		21.54	135.59	29.40	
	09/16/96		22.37	134.76	29.43	
	12/02/96		22.35	134.78	29.45	
	03/10/97		21.44	135.69	29.47	
	06/12/97		21.97	135.16	29.45	
	09/29/97		22.30	134.83	29.45	
	12/01/97		21.78	135.35	29.46	
	03/19/98		19.88	137.25	29.46	
	05/28/98		20.91	136.22	29.47	
	08/31/98		21.61	135.52	29.47	
	12/08/98		21.83	135.30	29.47	
	02/17/99		20.81	136.32	29.45	
06/10/99	21.61	135.52	29.45			
09/07/99	21.91	135.22	29.45			
12/13/99	21.93	135.20	29.44			

NOTES: 1 = Measurement and reference elevation taken from notch/mark on top north side of well casing.
2 = Elevation referenced to mean sea level.
Well Depth = Measurement from top of casing to bottom of well.
3 = Well abandoned.

TABLE 1
GROUND WATER ELEVATION DATA
BEACON STATION #574
22315 REDWOOD ROAD, CASTRO VALLEY, CALIFORNIA
(Measurements in feet)

Monitoring Well	Date	Reference Elevation (top of casing) ¹	Depth to Ground Water ¹	Ground Water Elevation ²	Well Depth	Comments
MW-4	05/18/93	151.96	17.55	134.41	---	
	08/11/93		17.50	134.46	28.43	
	11/05/93		15.84	136.12	28.43	
	03/01/94		17.35	134.61	28.11	
	06/02/94		17.68	134.28	28.12	
	09/09/94		18.19	133.77	28.13	
	12/20/94		17.52	134.44	28.10	
	03/08/95		16.82	135.14	27.97	
	06/14/95		17.22	134.74	27.97	
	09/26/95		17.79	134.17	27.91	
	12/27/95		17.47	134.49	27.89	
	03/26/96		16.32	135.64	27.89	
	06/05/96		17.10	134.86	27.88	
	09/16/96		17.85	134.11	27.89	
	12/02/96		17.59	134.37	27.88	
	03/10/97		16.79	135.17	27.89	
	06/12/97		17.49	134.47	27.90	
	09/29/97		18.33	133.63	27.91	
	12/01/97		17.36	134.60	27.90	
	03/19/98		15.90	136.06	27.91	
	05/28/98		16.34	135.62	27.90	
	08/31/98		16.83	135.13	27.90	
	12/08/98		17.37	134.59	27.91	
02/17/99	16.49	135.47	27.98			
06/10/99	17.63	134.33	24.76			
09/07/99	17.80	134.16	24.75			
12/13/99	17.82	134.14	24.73			
MW-5	05/18/93	148.68	15.72	132.96	---	
	08/11/93		16.42	132.26	25.43	
	11/05/93		16.92	131.76	25.43	
	03/01/94		15.54	133.14	25.00	
	06/02/94		16.19	132.49	25.00	
	09/09/94		16.87	131.81	25.00	
	12/20/94		15.84	132.84	25.01	
	03/08/95		15.11	133.57	24.85	
	06/14/95		15.69	132.99	24.86	
	09/26/95		16.46	132.22	24.81	
	12/27/95		15.91	132.77	24.80	
	03/26/96		14.31	134.37	24.81	
	06/05/96		15.43	133.25	24.75	
	09/16/96		16.52	132.16	24.74	
	12/02/96		16.05	132.63	24.76	
	03/10/97		14.80	133.88	24.74	
	06/12/97		15.95	132.78	24.75	
	09/29/97		16.33	132.35	24.76	
	12/01/97		15.48	133.20	24.78	
	03/19/98		13.16	135.52	24.77	
	05/28/98		14.04	134.64	24.78	
	08/31/98		14.81	133.87	24.79	
	12/08/98		15.75	132.93	24.76	
02/17/99	14.80	133.88	24.78			
06/10/99	15.54	133.14	29.62			
09/07/99	16.01	132.67	29.61			
12/13/99	16.21	132.47	29.61			

NOTES. 1 = Measurement and reference elevation taken from notch/mark on top north side of well casing.
2 = Elevation referenced to mean sea level.
Well Depth = Measurement from top of casing to bottom of well.
3 = Well abandoned.

TABLE 1
GROUND WATER ELEVATION DATA
BEACON STATION #574
22315 REDWOOD ROAD, CASTRO VALLEY, CALIFORNIA
(Measurements in feet)

Monitoring Well	Date	Reference Elevation (top of casing) ¹	Depth to Ground Water ¹	Ground Water Elevation ²	Well Depth	Comments
MW-6	05/18/93	153.96	20.80	133.16	---	
	08/11/93		21.64	132.32	31.15	
	11/05/93		22.11	131.85	31.15	
	03/01/94		20.80	133.16	29.96	
	06/02/94		21.37	132.59	29.98	
	09/09/94		22.05	131.91	29.96	
	12/20/94		21.06	132.90	29.89	
	03/08/95		20.29	133.67	29.67	
	06/14/95		20.81	133.15	29.65	
	09/26/95		21.62	132.34	29.66	
	12/27/95		21.12	132.84	29.63	
	03/26/96		19.50	134.46	29.60	
	06/05/96		20.56	133.40	29.63	
	09/16/96		21.70	132.26	29.65	
	12/02/96		21.25	132.71	29.66	
	03/10/97		20.16	133.80	29.64	
	06/12/97		21.16	132.80	29.62	
	09/29/97		21.51	132.45	29.62	
	12/01/97		20.89	133.07	29.61	
	03/19/98		18.71	135.25	29.60	
	05/28/98		19.99	133.97	29.62	
08/31/98	20.81	133.15	29.63			
12/08/98	21.00	132.96	29.64			
02/17/99	19.54	134.42	29.63			
06/10/99	20.74	133.22	27.98			
09/07/99	21.23	132.73	27.98			
12/13/99	21.22	132.74	27.98			
MW-7	05/18/93	156.09	22.64	133.45	---	
	08/11/93		23.25	132.84	30.75	
	11/05/93		23.93	132.16	30.75	
	03/01/94		22.72	133.37	30.11	
	06/02/94		23.22	132.87	30.12	
	09/09/94		23.90	132.19	30.12	
	12/20/94		22.98	133.11	30.10	
	03/08/95		22.14	133.95	29.91	
	06/14/95		22.61	133.48	29.91	
	09/26/95		23.43	132.66	29.90	
	12/27/95		23.01	133.08	29.90	
	03/26/96		21.32	134.77	29.87	
	06/05/96		22.37	133.72	29.91	
	09/16/96		23.51	132.58	29.90	
	12/02/96		23.08	133.01	29.91	
	03/10/97		21.94	134.15	29.90	
	06/12/97		22.96	133.13	29.88	
	09/29/97		23.35	132.74	29.87	
	12/01/97		22.68	133.41	29.88	
	03/19/98		20.52	135.57	29.88	
	05/28/98		21.76	134.33	29.88	
08/31/98	22.66	133.43	29.86			
12/08/98 ³						

NOTES: 1 = Measurement and reference elevation taken from notch/mark on top north side of well casing.
2 = Elevation referenced to mean sea level.
Well Depth 3 = Measurement from top of casing to bottom of well.
3 = Well abandoned.

TABLE 1
GROUND WATER ELEVATION DATA
BEACON STATION #574
22315 REDWOOD ROAD, CASTRO VALLEY, CALIFORNIA
(Measurements in feet)

Monitoring Well	Date	Reference Elevation (top of casing) ¹	Depth to Ground Water ¹	Ground Water Elevation ²	Well Depth	Comments
MW-8	05/18/93	158.04	21.55	136.49	---	
	08/11/93		22.43	135.61	34.82	
	11/05/93		23.00	135.04	34.82	
	03/01/94		22.05	135.99	34.04	
	06/02/94		22.29	135.75	34.04	
	09/09/94		22.99	135.05	34.04	
	12/20/94		22.14	135.90	33.98	
	03/08/95		21.25	136.79	34.48	
	06/14/95		21.70	136.34	34.49	
	09/26/95		22.29	135.75	34.40	
	12/27/95		21.96	136.08	34.43	
	03/26/96		20.48	137.56	34.42	
	06/05/96		21.50	136.54	34.41	
	09/16/96		22.38	135.66	34.43	
	12/02/96		22.39	135.65	34.42	
	03/10/97		20.89	137.16	34.43	
	06/12/97		21.80	136.24	34.42	
	09/29/97		22.81	135.23	34.40	
	12/01/97		21.70	136.34	34.41	
	03/19/98		19.35	138.69	34.42	
05/28/98	20.52	137.52	34.41			
08/31/98	21.40	136.64	34.40			
12/08/98 ³						

NOTES: 1 = Measurement and reference elevation taken from notch/mark on top north side of well casing.
2 = Elevation referenced to mean sea level.
Well Depth = Measurement from top of casing to bottom of well.
3 = Well abandoned.

TABLE 2
GROUND WATER ANALYTICAL RESULTS
BEACON STATION #574
22315 REDWOOD ROAD, CASTRO VALLEY, CALIFORNIA
(All results in micrograms per Liter)

Monitoring Well	Date Collected	Total Petroleum Hydrocarbons			Aromatic Volatile Organics				
		Gasoline	Diesel	Motor Oil	MTBE ¹	Benzene	Toluene	Ethyl-benzene	Total Xylenes
MW-1	03/27/92	5,600	<50	<50		760	900	250	1,100
	06/04/92	2,600	<800	NA		270	57	250	440
	09/23/92	3,400	NA	NA		480	430	110	550
	11/12/92	2,700	NA	NA		58	<5.0	140	340
	02/02/93	8,500	NA	NA		760	770	250	1,200
	05/07/93	7,700	NA	NA		970	630	280	1,500
	08/11/93	11,000	NA	NA		1,400	1,000	260	1,600
	11/05/93	36,000	NA	NA		6,200	4,700	1,400	7,100
	03/01/94	3,800	NA	NA		580	490	110	620
	06/02/94	8,900	NA	NA		1,900	1,200	420	2,100
	09/09/94	4,300	NA	NA		740	290	200	630
	12/20/94	3,900	NA	NA		550	260	150	510
	03/08/95	8,100	NA	NA		1,100	540	250	1,100
	06/14/95	NS	NS	NS		NS	NS	NS	NS
	09/26/95	8,600	NA	NA		2,100	550	420	1,300
	12/27/95	NS	NS	NS		NS	NS	NS	NS
	03/26/96	21,000	NA	NA		7,000	2,700	590	7,000
	06/05/96	NS	NS	NS		NS	NS	NS	NS
	09/16/96	13,000	NA	NA	1,400	3,200	770	470	2,900
	12/02/96	NS	NS	NS	NS	NS	NS	NS	NS
	03/10/97	30,000	NA	NA	1,100	7,300	1,900	850	7,100
	06/12/97	NS	NS	NS	NS	NS	NS	NS	NS
	09/29/97	25,000	NA	NA	840	5,500	920	920	4,000
	12/01/97	NS	NS	NS	NS	NS	NS	NS	NS
	03/19/98	90,000	NA	NA	<1,500	15,000	7,000	3,300	20,000
	05/28/98	NS	NS	NS	NS	NS	NS	NS	NS
	08/31/98	50,000	NA	NA	890	9,900	1,500	2,100	9,400
	12/08/98	NS	NS	NS	NS	NS	NS	NS	NS
	02/17/99	30,000	NA	NA	720	8,000	1,100	2,200	10,000
	06/10/99	NS	NS	NS	NS	NS	NS	NS	NS
	09/07/99	37,000	NA	NA	570	13,000	410	2,000	10,000
	12/13/99	NS	NS	NS	NS	NS	NS	NS	NS

NOTES: < = Below indicated detection limit.
NS = Not sampled.
NA = Not analyzed.
1 = Product is not typical gasoline.
2 = Well abandoned.

TABLE 2
GROUND WATER ANALYTICAL RESULTS
BEACON STATION #574
22315 REDWOOD ROAD, CASTRO VALLEY, CALIFORNIA
(All results in micrograms per Liter)

Monitoring Well	Date Collected	Total Petroleum Hydrocarbons			Aromatic Volatile Organics				
		Gasoline	Diesel	Motor Oil	MTBE ¹	Benzene	Toluene	Ethyl-benzene	Total Xylenes
MW-2	03/27/92	18,000	<50	<50		2,400	2,300	870	3,300
	06/04/92	14,000	<5,000	NA		1,900	1,700	580	2,300
	09/23/92	22,000	NA	NA		2,100	1,500	760	2,900
	11/12/92	29,000	NA	NA		2,400	860	540	3,500
	02/02/93	24,000	NA	NA		2,700	1,900	590	2,600
	05/07/93	19,000	NA	NA		1,800	1,300	460	2,600
	08/11/93	23,000	NA	NA		2,300	1,500	550	2,300
	11/05/93	30,000	NA	NA		3,100	2,900	860	3,700
	03/01/94	13,000	NA	NA		1,500	490	350	1,000
	06/02/94	12,000	NA	NA		2,000	790	460	1,300
	09/09/94	13,000	NA	NA		1,800	660	440	1,000
	12/20/94	16,000	NA	NA		2,300	1,000	650	1,900
	03/08/95	16,000	NA	NA		2,200	1,000	550	2,100
	06/14/95	NS	NS	NS		NS	NS	NS	NS
	09/26/95	18,000	NA	NA		2,500	1,000	770	2,700
	12/27/95	NS	NS	NS		NS	NS	NS	NS
	03/26/96	33,000	NA	NA		4,200	2,600	1,100	5,000
	06/05/96	NS	NS	NS		NS	NS	NS	NS
	09/16/96	19,000	NA	NA	940	2,600	490	560	2,000
	12/02/96	NS	NS	NS	NS	NS	NS	NS	NS
	03/10/97	23,000	NA	NA	1,400	3,700	870	650	3,000
	06/12/97	NS	NS	NS	NS	NS	NS	NS	NS
	09/29/97	30,000	NA	NA	1,400	4,900	880	990	3,800
	12/01/97	NS	NS	NS	NS	NS	NS	NS	NS
	03/19/98	72,000	NA	NA	<1,500	14,000	9,500	2,500	11,000
	05/28/98	NS	NS	NS	NS	NS	NS	NS	NS
	08/31/98	29,000	NA	NA	890	4,900	1,600	960	3,900
	12/08/98	NS	NS	NS	NS	NS	NS	NS	NS
	02/17/99	26,000	NA	NA	640	5,200	930	1,200	4,400
	06/10/99	NS	NS	NS	NS	NS	NS	NS	NS
	09/07/99	32,000	NA	NA	1,100	5,700	600	1,200	3,500
	12/13/99	NS	NS	NS	NS	NS	NS	NS	NS

NOTES: < = Below indicated detection limit.
NS = Not sampled.
NA = Not analyzed.
1 = Product is not typical gasoline.
2 = Well abandoned.

TABLE 2
GROUND WATER ANALYTICAL RESULTS
BEACON STATION #574
22315 REDWOOD ROAD, CASTRO VALLEY, CALIFORNIA
(All results in micrograms per Liter)

Monitoring Well	Date Collected	Total Petroleum Hydrocarbons			Aromatic Volatile Organics				
		Gasoline	Diesel	Motor Oil	MTBE ¹	Benzene	Toluene	Ethylbenzene	Total Xylenes
MW-3	03/27/92	160	<50	<50		9.2	4.8	10	23
	06/04/92	120	<50	NA		7.5	2.7	0.5	15
	09/23/92	220	NA	NA		8.3	4.3	6.2	19
	11/12/92	230	NA	NA		12	5.5	7.7	19
	02/02/93	86	NA	NA		2.4	0.71	2.7	6.2
	05/07/93	140	NA	NA		2.6	1.2	3.9	8.4
	08/11/93	490	NA	NA		15	8.1	14	37
	11/05/93	820	NA	NA		45	24	34	93
	03/01/94	410	NA	NA		7.4	2.7	5.6	10
	06/02/94	440	NA	NA		13	4.9	14	31
	09/09/94	620	NA	NA		12	4.8	9.7	20
	12/20/94	770	NA	NA		24	11	16	36
	03/08/95	300	NA	NA		6.1	0.97	4.8	7.5
	06/14/95	NS	NS	NS		NS	NS	NS	NS
	09/26/95	130	NA	NA		4.8	1.6	4.8	9.4
	12/27/95	NS	NS	NS		NS	NS	NS	NS
	03/26/96	<50	NA	NA		<0.50	<0.50	<0.50	<0.50
	06/05/96	NS	NS	NS		NS	NS	NS	NS
	09/16/96	170	NA	NA	<5.0	10	2.9	4.4	15
	12/02/96	NS	NS	NS	NS	NS	NS	NS	NS
	03/10/97	84	NA	NA	<5.0	2.3	<0.50	1.4	2.6
	06/12/97	NS	NS	NS	NS	NS	NS	NS	NS
	09/29/97	740	NA	NA	<5.0	61	9.8	12	61
	12/01/97	NS	NS	NS	NS	NS	NS	NS	NS
	03/19/98	<50	NA	NA	<5.0	<0.50	<0.50	<0.50	<0.50
	05/28/98	NS	NS	NS	NS	NS	NS	NS	NS
	08/31/98	320	NA	NA	3.4	6.7	1.0	10	9.3
	12/08/98	NS	NS	NS	NS	NS	NS	NS	NS
	02/17/99	310	NA	NA	<5.0	8.6	1.8	13	14
	06/10/99	NS	NS	NS	NS	NS	NS	NS	NS
	09/07/99	99	NA	NA	<5.0	4.2	0.51	4.0	3.0
	12/13/99	NS	NS	NS	NS	NS	NS	NS	NS

NOTES: < = Below indicated detection limit.
NS = Not sampled.
NA = Not analyzed.
1 = Product is not typical gasoline.
2 = Well abandoned.

TABLE 2
GROUND WATER ANALYTICAL RESULTS
BEACON STATION #574
22315 REDWOOD ROAD, CASTRO VALLEY, CALIFORNIA
(All results in micrograms per Liter)

Monitoring Well	Date Collected	Total Petroleum Hydrocarbons			Aromatic Volatile Organics				
		Gasoline	Diesel	Motor Oil	MTBE ¹	Benzene	Toluene	Ethylbenzene	Total Xylenes
MW-4	05/18/93	<50	NA	NA		<0.5	<0.5	<0.5	<0.5
	08/11/93	<50	NA	NA		<0.5	<0.5	<0.5	<0.5
	11/05/93	<50	NA	NA		<0.5	<0.5	<0.5	<0.5
	03/01/94	<50	NA	NA		<0.5	<0.5	<0.5	<0.5
	06/02/94	<50	NA	NA		<0.5	<0.5	<0.5	<0.5
	09/09/94	<50	NA	NA		<0.5	<0.5	<0.5	<0.5
	12/20/94	<50	NA	NA		<0.5	<0.5	<0.5	<0.5
	03/08/95	NS	NS	NS		NS	NS	NS	NS
	06/14/95	NS	NS	NS		NS	NS	NS	NS
	09/26/95	NS	NS	NS		NS	NS	NS	NS
	12/27/95	NS	NS	NS		NS	NS	NS	NS
	03/26/96	NS	NS	NS		NS	NS	NS	NS
	06/05/96	NS	NS	NS		NS	NS	NS	NS
	09/16/96	<50	NA	NA	<5.0	<0.50	<0.50	<0.50	<0.50
	12/02/96	NS	NS	NS	NS	NS	NS	NS	NS
	03/10/97	NS	NS	NS	NS	NS	NS	NS	NS
	06/12/97	NS	NS	NS	NS	NS	NS	NS	NS
	09/29/97	NS	NS	NS	NS	NS	NS	NS	NS
	12/01/97	NS	NS	NS	NS	NS	NS	NS	NS
	03/19/98	NS	NS	NS	NS	NS	NS	NS	NS
05/28/98	NS	NS	NS	NS	NS	NS	NS	NS	
08/31/98	NS	NS	NS	NS	NS	NS	NS	NS	
12/08/98	NS	NS	NS	NS	NS	NS	NS	NS	
02/17/99	NS	NS	NS	NS	NS	NS	NS	NS	
06/10/99	NS	NS	NS	NS	NS	NS	NS	NS	
09/07/99	NS	NS	NS	NS	NS	NS	NS	NS	
12/13/99	NS	NS	NS	NS	NS	NS	NS	NS	
MW-5	05/18/93	<50	NA	NA		<0.5	<0.5	<0.5	<0.5
	08/11/93	<50	NA	NA		<0.5	<0.5	<0.5	<0.5
	11/05/93	<50	NA	NA		<0.5	<0.5	<0.5	<0.5
	03/01/94	<50	NA	NA		<0.5	<0.5	<0.5	<0.5
	06/02/94	<50	NA	NA		<0.5	<0.5	<0.5	<0.5
	09/09/94	<50	NA	NA		<0.5	<0.5	<0.5	<0.5
	12/20/94	<50	NA	NA		<0.5	<0.5	<0.5	<0.5
	03/08/95	<50	NA	NA		<0.5	<0.5	<0.5	<0.5
	06/14/95	<50	NA	NA		<0.5	<0.5	<0.5	<0.5
	09/26/95	<50	NA	NA		<0.50	<0.50	<0.50	<0.50
	12/27/95	<50	NA	NA		<0.50	<0.50	<0.50	<0.50
	03/26/96	<50	NA	NA		<0.50	<0.50	<0.50	<0.50
	06/05/96	<50	NA	NA	15	<0.50	<0.50	<0.50	<0.50
	09/16/96	<50	NA	NA	20	<0.50	<0.50	<0.50	<0.50
	12/02/96	<50	NA	NA	12	<0.50	<0.50	<0.50	<0.50
	03/10/97	<50	NA	NA	7.0	<0.50	<0.50	<0.50	<0.50
	06/12/97	<50	NA	NA	7.2	<0.50	<0.50	<0.50	<0.50
	09/29/97	<50	NA	NA	<5.0	<0.50	<0.50	<0.50	<0.50
	12/01/97	<50	NA	NA	<5.0	<0.50	<0.50	<0.50	<0.50
	03/19/98	<50	NA	NA	<5.0	<0.50	<0.50	<0.50	<0.50
05/28/98	<50	NA	NA	<5.0	<0.50	<0.50	<0.50	<0.50	
08/31/98	<50	NA	NA	<0.50	<0.50	<0.50	<0.50	<0.50	
12/08/98	<50	NA	NA	<5.0	<0.50	<0.50	<0.50	<0.50	
02/17/99	<50	NA	NA	<5.0	<0.50	<0.50	<0.50	<0.50	
06/10/99	<50	NA	NA	<5.0	<0.50	<0.50	<0.50	<0.50	
09/07/99	<50	NA	NA	<5.0	<0.50	<0.50	<0.50	<0.50	
12/13/99	<50	NA	NA	<5.0	<0.50	<0.50	<0.50	<0.50	

NOTES: < = Below indicated detection limit.
NS = Not sampled.
NA = Not analyzed.
1 = Product is not typical gasoline.
2 = Well abandoned.

TABLE 2
GROUND WATER ANALYTICAL RESULTS
BEACON STATION #574
22315 REDWOOD ROAD, CASTRO VALLEY, CALIFORNIA
(All results in micrograms per Liter)

Monitoring Well	Date Collected	Total Petroleum Hydrocarbons			Aromatic Volatile Organics				
		Gasoline	Diesel	Motor Oil	MTBE ¹	Benzene	Toluene	Ethyl-benzene	Total Xylenes
MW-6	05/18/93	170	NA	NA		<0.5	<0.5	<0.5	<0.5
	08/11/93	78	NA	NA		<0.5	<0.5	<0.5	<0.5
	11/05/93	170	NA	NA		<0.5	<0.5	<0.5	0.65
	03/01/94	210	NA	NA		<0.5	<0.5	<0.5	<0.5
	06/02/94	190	NA	NA		<0.5	<0.5	<0.5	<0.5
	09/09/94	140	NA	NA		<0.5	<0.5	<0.5	<0.5
	12/20/94	210	NA	NA		<0.5	<0.5	<0.5	<0.5
	03/08/95	180 ¹	NA	NA		<0.5	<0.5	<0.5	<0.5
	06/14/95	220 ¹	NA	NA		<0.5	<0.5	<0.5	<0.5
	09/26/95	110 ¹	NA	NA		<0.50	<0.50	<0.50	<0.50
	12/27/95	130 ¹	NA	NA		<0.50	<0.50	<0.50	<0.50
	03/26/96	100 ¹	NA	NA		<0.50	<0.50	<0.50	<0.50
	06/05/96	100 ¹	NA	NA	430	<0.50	<0.50	<0.50	<0.50
	09/16/96	170	NA	NA	430	<0.50	<0.50	<0.50	<0.50
	12/02/96	160	NA	NA	160	<0.50	<0.50	<0.50	<0.50
	03/10/97	140	NA	NA	390	<0.50	<0.50	<0.50	<0.50
	06/12/97	<50	NA	NA	330	<0.50	<0.50	<0.50	<0.50
	09/29/97	<50	NA	NA	130	<0.50	<0.50	<0.50	<0.50
	12/01/97	<50	NA	NA	200	<0.50	<0.50	<0.50	<0.50
	03/19/98	<50	NA	NA	240	<0.50	<0.50	<0.50	<0.50
05/28/98	<50	NA	NA	290	<0.50	<0.50	<0.50	<0.50	
08/31/98	<50	NA	NA	290	<0.50	<0.50	<0.50	<0.50	
12/08/98	<50	NA	NA	230	<0.50	<0.50	<0.50	<0.50	
02/17/99	<50	NA	NA	200	<0.50	<0.50	<0.50	<0.50	
06/10/99	<50	NA	NA	290	<0.50	<0.50	<0.50	<0.50	
09/07/99	<50	NA	NA	230	<0.50	<0.50	<0.50	<0.50	
12/13/99	<50	NA	NA	180	<0.50	<0.50	<0.50	<0.50	
MW-7	05/18/93	<50	NA	NA		<0.5	<0.5	<0.5	<0.5
	08/11/93	<50	NA	NA		<0.5	<0.5	<0.5	<0.5
	11/05/93	<50	NA	NA		<0.5	<0.5	<0.5	<0.5
	03/01/94	60	NA	NA		<0.5	<0.5	<0.5	<0.5
	06/02/94	<50	NA	NA		<0.5	<0.5	<0.5	<0.5
	09/09/94	<50	NA	NA		<0.5	<0.5	<0.5	<0.5
	12/20/94	<50	NA	NA		<0.5	<0.5	<0.5	<0.5
	03/08/95	<50	NA	NA		<0.5	<0.5	<0.5	<0.5
	06/14/95	<50	NA	NA		<0.5	<0.5	<0.5	<0.5
	09/26/95	<50	NA	NA		<0.50	<0.50	<0.50	<0.50
	12/27/95	<50	NA	NA		<0.50	<0.50	<0.50	<0.50
	03/26/96	<50	NA	NA		<0.50	<0.50	<0.50	<0.50
	06/05/96	<50	NA	NA	20	<0.50	<0.50	<0.50	<0.50
	09/16/96	<50	NA	NA	26	<0.50	<0.50	<0.50	<0.50
	12/02/96	140	NA	NA	140	<0.50	<0.50	<0.50	<0.50
	03/10/97	<50	NA	NA	29	<0.50	<0.50	<0.50	<0.50
	06/12/97	<50	NA	NA	28	<0.50	<0.50	<0.50	<0.50
	09/29/97	<50	NA	NA	27	<0.50	<0.50	<0.50	<0.50
	12/01/97	<50	NA	NA	29	<0.50	<0.50	<0.50	<0.50
	03/19/98	<50	NA	NA	6.0	<0.50	<0.50	<0.50	<0.50
05/28/98	<50	NA	NA	25	<0.50	<0.50	<0.50	<0.50	
08/31/98	<50	NA	NA	20	<0.50	<0.50	<0.50	<0.50	
12/08/98 ²									

NOTES: < = Below indicated detection limit.
NS = Not sampled
NA = Not analyzed.
1 = Product is not typical gasoline.
2 = Well abandoned.

TABLE 2
GROUND WATER ANALYTICAL RESULTS
BEACON STATION #574
22315 REDWOOD ROAD, CASTRO VALLEY, CALIFORNIA
(All results in micrograms per Liter)

Monitoring Well	Date Collected	Total Petroleum Hydrocarbons			Aromatic Volatile Organics				
		Gasoline	Diesel	Motor Oil	MTBE ¹	Benzene	Toluene	Ethyl-benzene	Total Xylenes
MW-8	05/18/93	<50	NA	NA		<0.5	<0.5	<0.5	<0.5
	08/11/93	<50	NA	NA		<0.5	<0.5	<0.5	<0.5
	11/05/93	<50	NA	NA		<0.5	<0.5	<0.5	<0.5
	03/01/94	<50	NA	NA		<0.5	<0.5	<0.5	<0.5
	06/02/94	<50	NA	NA		<0.5	<0.5	<0.5	<0.5
	09/09/94	<50	NA	NA		<0.5	<0.5	<0.5	<0.5
	12/20/94	<50	NA	NA		<0.5	<0.5	<0.5	<0.5
	03/08/95	NS	NS	NS		NS	NS	NS	NS
	06/14/95	NS	NS	NS		NS	NS	NS	NS
	09/26/95	NS	NS	NS		NS	NS	NS	NS
	12/27/95	NS	NS	NS		NS	NS	NS	NS
	03/26/96	NS	NS	NS		NS	NS	NS	NS
	06/05/96	NS	NS	NS		NS	NS	NS	NS
	09/16/96	<50	NA	NA	<5.0	<0.50	<0.50	<0.50	<0.50
	12/02/96	NS	NS	NS	NS	NS	NS	NS	NS
	03/10/97	NS	NS	NS	NS	NS	NS	NS	NS
	06/12/97	NS	NS	NS	NS	NS	NS	NS	NS
	09/29/97	NS	NS	NS	NS	NS	NS	NS	NS
	12/01/97	NS	NS	NS	NS	NS	NS	NS	NS
	03/19/98	NS	NS	NS	NS	NS	NS	NS	NS
05/28/98	NS	NS	NS	NS	NS	NS	NS	NS	
08/31/98	NS	NS	NS	NS	NS	NS	NS	NS	
12/08/98 ²									

NOTES: < = Below indicated detection limit.
NS = Not sampled.
NA = Not analyzed.
1 = Product is not typical gasoline.
2 = Well abandoned.

ATTACHMENT A
ULTRAMAR FIELD PROCEDURES

ATTACHMENT A - ULTRAMAR FIELD PROCEDURES

The following section describes procedures used by field personnel in the performance of ground water sampling at Ultramar Inc. sites.

Ground Water Level and Total Depth Determination

A water level indicator is lowered down the well and a measurement of the depth to water from an established reference point on the casing is taken. The indicator probe is used to sound the bottom of the well and a measurement of the total depth of the well is taken. Both the water level and total depth measurements are taken to the nearest 0.01-foot.

Visual Analysis of Ground Water

Prior to purging and sampling ground water monitoring wells, a water sample is collected from each well for subjective analysis. The visual analysis involves gently lowering a clean, disposable, polyethylene bailer to approximately one-half the bailer length past the water table interface. The bailer is then retrieved, and the sample contained within the bailer is examined for floating product or the appearance of a petroleum product sheen. If measurable free product is noted in the bailer, a water/product interface probe is used to determine the thickness of the free product to the nearest 0.01-foot. The thickness of free product is determined by subtracting the depth to product from the depth to water.

Monitoring Well Purging and Sampling

Monitoring wells are purged by removing approximately four casing volumes of water from the well using a clean disposable bailer or electrical submersible purge pump. Purge volumes are calculated prior to purging. During purging, the temperature, pH, and electric conductivity of the purge water are monitored. The well is considered to be sufficiently purged when: The four casing volumes have been removed; the temperature, pH, and conductivity values have stabilized to within 10% of the initial readings; and the ground water being removed is relatively free of suspended solids. After purging, ground water levels are allowed to stabilize to within 80% of the initial water level reading. A water sample is then collected from each well with a clean, disposable polyethylene bailer. If the well is bailed or pumped dry prior to removing the minimum volume of water, the ground water is allowed to recharge. If the well has recharged to within 80% of the initial depth to water reading within two hours, the well will continue to be purged until the minimum volume of water has been removed. If the well has not recharged to at least 80% of the initial depth to water reading within two hours, the well is considered to contain formational water and a ground water sample is collected. Ground water removed from the well is stored in 55-gallon drums at the site and labeled pending disposal.

In wells where free product is detected, the wells will be bailed to remove the free product. An estimate of the volume of product and water well be recorded. If the free product thickness is reduced to the point where a measurable thickness is no longer present in the well, a ground water sample will be collected. If free product persists throughout the purging process, a final free product thickness measurement will be taken and a ground water sample will not be collected.

Ground water samples are stored in 40-milliliter vials so that air passage through the sample is minimized (to prevent volatilization of the sample). The vial is tilted and filled slowly until an upward convex meniscus forms over the mouth of the vial. The Teflon™ side of the septum (in cap) is then placed against the meniscus, and the cap is screwed on tightly. The sample is then inverted and the bottle is tapped lightly to check for air bubbles. If an air bubble is present in the vial, the cap is removed and more sample is transferred from the bailer. The vial is then resealed and rechecked for air bubbles. The sample is then appropriately labeled and stored on ice from the time of collection through the time of delivery to the laboratory. The Chain-of-Custody form is completed to ensure sample integrity. Ground water samples are transported to a state-certified laboratory and analyzed within the U.S. Environmental Protection Agency-specified hold times for the specified analytes.

ATTACHMENT B
DOULOS ENVIRONMENTAL FIELD DATA SHEETS

DOULOS ENVIRONMENTAL COMPANY
 GROUNDWATER/LIQUID LEVEL DATA
 (measurements in feet)

Project Address:

Beacon 574, 22315 Redwood Rd

Date: 12-13-99

Castro Valley Ca

Project No.: 94-574-01

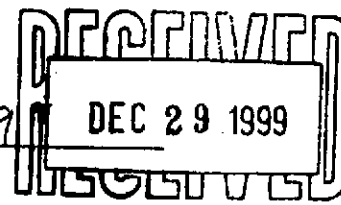

Recorded by: _____

Well No	Time	Well Elev. TOC	Depth to Gr. Water	Measured Total Depth	Gr. Water Elevation	Depth to Product	Product Thickness	Comments
MW-1	10:23		23.09	29.74				
MW-2	10:21		21.59	29.50				
MW-3	10:18		21.93	29.44				
MW-4	10:10		17.82	24.73				
MW-5	10:07		16.21	29.61				
MW-6	10:14		21.22	27.98				

Notes:

Client: Ultramar

Sampling Date: 12-13-99

Site: Beacon #574

Project No.: 94-574-01

22315 Redwood Road

Well Designation: MW-5

Castro Valley, CA

Is setup of traffic control devices required? NO YES time: _____ hours
 Is there standing water in well box? YES Above TOC Below TOC
 Is top of casing cut level? NO YES If no, see remarks
 Is well cap sealed and locked? NO YES If no, see remarks
 Height of well casing riser (in inches): 3
 Well cover type: 8" UV 12" UV _____ 12" EMCO _____ 8" BK _____
 12" BK _____ 12" DWP _____ 12" CNI _____ 36" CNI _____ Other _____
 General condition of wellhead assembly: Excellent Good Fair Poor

Purging Equipment: _____ 2" disposable bailer _____ Submersible pump
 _____ 2" PVC bailer _____ Dedicated bailer
 _____ 4" PVC bailer Centrifugal pump

Sampled with: Disposal bailer: Teflon bailer: _____

Well Diameter: 2" 4" _____ 6" _____ 8" _____

Purge Vol. Multiplier: 0.16 0.65 1.47 2.61 gal/ft.

Initial Measurement

Recharge Measurement

Time: 10:07

Time: 10:45

Calculated purge: 8.6 gal

Depth of well: 29.61

Depth to water: 17.10

Actual purge: 8.6 gal

Depth to water: 16.21

Start purge: 10:30

Sampling time: 10:46

Time	Temp.	E.C.	pH	Turbidity	Volume
10:31	59.1	1470	7.30	—	1
10:32	60.3	1410	7.26	—	2
10:33	60.7	1400	7.22	—	3
10:35	61.7	1398	7.20	—	4

Sample appearance: Clear Lock: Dolphin

Equipment replaced: (Check all that apply) Note condition of replaced item
 2" Locking Cap: _____ Lock #3753: _____ 7/32 Allenhead: _____
 4" Locking Cap: _____ Lock-Dolphin: _____ 9/16 Bolt: _____
 6" Locking Cap: _____ Pinned Allenhead (DWP): _____

Remarks: _____

Signature: _____

Client: Ultramar
 Site: Beacon #574
22315 Redwood Road
Castro Valley, CA

Sampling Date: 12-13-99
 Project No.: 94-574-01
 Well Designation: MW- 6

Is setup of traffic control devices required? NO YES time: _____ hours
 Is there standing water in well box? NO YES Above TOC Below TOC
 Is top of casing cut level? NO YES If no, see remarks
 Is well cap sealed and locked? NO YES If no, see remarks
 Height of well casing riser (in inches): 10
 Well cover type: 8" UV 12" UV _____ 12" EMCO _____ 8" BK _____
 12" BK _____ 12" DWP _____ 12" CNI _____ 36" CNI _____ Other _____
 General condition of wellhead assembly: Excellent Good Fair Poor

Purging Equipment: _____ 2" disposable bailer _____ Submersible pump
 _____ 2" PVC bailer _____ Dedicated bailer
 _____ 4" PVC bailer Centrifugal pump

Sampled with: Disposal bailer: Teflon bailer: _____

Well Diameter: 2" 4" _____ 6" _____ 8" _____

Purge Vol. Multiplier: 0.16 0.65 1.47 2.61 gal/ft.

Initial Measurement Recharge Measurement
 Time: 10:14 Time: 11:10 Calculated purge: 4.3 gal
 Depth of well: 27.98 Depth to water: 21.90 Actual purge: 4.3 gal
 Depth to water: 21.22

Start purge: 10:55 Sampling time: 11:11

Time	Temp.	E.C.	pH	Turbidity	Volume
10:56	60.4	1640	7.33	—	1
10:57	59.8	1610	7.30	—	2
10:58	59.9	1579	7.28	—	3
10:59	59.9	1591	7.26	—	4

Sample appearance: Clear Lock: Dolphin

Equipment replaced: (Check all that apply) Note condition of replaced item
 2" Locking Cap: _____ Lock #3753: _____ 7/32 Allenhead: _____
 4" Locking Cap: _____ Lock-Dolphin: _____ 9/16 Bolt: _____
 6" Locking Cap: _____ Pinned Allenhead (DWP): _____

Remarks: _____

Signature: _____

ATTACHMENT C
HISTORICAL GROUND WATER ELEVATION DATA

TABLE 2
WATER LEVEL DATA
(measurements in feet)

Monitoring Well	Date	Reference Elevation (top of casing)	Depth to Ground Water	Ground Water Elevation
MW-1	04-01-91	156.55	22.37	134.18
	03-27-92		22.43	134.12
	06-04-92		23.40	133.15
	09-23-92		24.07	132.48
	11-12-92		24.16	132.39
	02-02-93		21.87	134.68
	05-18-93		22.66	133.89
MW-2	04-01-91	155.17	20.82	134.25
	03-27-92		20.82	134.35
	06-04-92		21.81	133.36
	09-23-92		22.45	132.72
	11-12-92		22.60	132.57
	02-02-93		20.28	134.89
	05-18-93		21.06	134.11
MW-3	04-01-91	157.13	21.55	135.58
	03-27-92		21.46	135.67
	06-04-92		22.34	134.79
	09-23-92		22.84	134.29
	11-12-92		23.03	134.09
	02-02-93		21.03	136.10
	05-18-93		21.73	135.40
MW-4	05-18-93	151.96	17.55	134.41
MW-5	05-18-93	148.68	15.72	132.96
MW-6	05-18-93	153.96	20.80	133.16
MW-7	05-18-93	156.09	22.64	133.45
MW-8	05-18-93	158.04	21.55	136.49

ATTACHMENT D
HISTORICAL GROUND WATER ANALYTICAL DATA

TABLE 3
GROUND WATER ANALYTICAL RESULTS
 (concentrations in parts per billion)

Monitoring Well	Date Collected	Total Petroleum Hydrocarbons			Aromatic Volatile Organics			
		Gasoline	Diesel	Motor Oil	Benzene	Toluene	Ethylbenzene	Total Xylenes
MW-1	04-01-91	4,100	<100	-	140	570	76	460
	03-27-92	5,600	<50	<50	760	900	230	1,100
	06-04-92	2,600	<300	-	270	57	230	440
	09-23-92	3,400	-	-	480	430	110	550
	11-12-92	2,700	-	-	5.8	<5.0	140	140
	02-02-93	8,500	-	-	760	770	250	1,200
	05-07-93	7,700	-	-	970	630	280	1,500
MW-2	04-01-91	10,000	<100	-	650	640	150	960
	03-27-92	18,000	<50	<50	2,400	2,300	870	3,300
	06-04-92	14,000	<5,000	-	1,900	1,700	580	2,300
	09-23-92	22,000	-	-	2,100	1,500	760	2,900
	11-12-92	29,000	-	-	2,400	860	540	3,500
	02-02-93	24,000	-	-	2,700	1,900	590	2,600
	05-07-93	19,000	-	-	1,800	1,300	460	2,600
MW-3	04-01-91	3,100	<100	-	41	91	37	420
	03-27-92	160	<50	<50	9.2	4.8	10	23
	06-04-92	120	<50	-	7.5	2.7	0.5	15
	09-23-92	220	-	-	8.3	4.3	6.2	19
	11-12-92	230	-	-	12	5.5	7.7	19
	02-02-93	86	-	-	2.4	0.71	2.7	6.2
	05-07-93	140	-	-	2.6	1.2	3.9	8.4
MW-4	05-18-93	<50	-	-	<0.50	<0.50	<0.50	<0.50
MW-5	05-18-93	<50	-	-	<0.50	<0.50	<0.50	<0.50
MW-6	05-18-93	170	-	-	<0.50	<0.50	<0.50	<0.50
MW-7	05-18-93	<50	-	-	<0.50	<0.50	<0.50	<0.50
MW-8	05-18-93	<50	-	-	<0.50	<0.50	<0.50	<0.50

Note: Dash (-) indicates that the sample was not analyzed for this constituent.

ATTACHMENT E

**LABORATORY REPORT AND
CHAIN-OF-CUSTODY FORM**



Report Number : 15643

Date : 12/28/99

Dale van Dam
El Dorado Environmental
2221 Goldorado Trail
El Dorado, CA 95623

Subject : 2 Water Samples
Project Name : Beacon 574
Project Number : 94-574-01

Dear Mr. van Dam,

Chemical analysis of the samples referenced above has been completed. Summaries of the data are contained on the following pages. Sample(s) were received under documented chain-of-custody. US EPA protocols for sample storage and preservation were followed.

Kiff Analytical is certified by the State of California (# 2236). If you have any questions regarding procedures or results, please call me at 530-297-4800.

Sincerely,

Joel Kiff



Report Number : 15643

Date : 12/28/99

Project Name : Beacon 574

Project Number : 94-574-01

Sample : MW-5

Matrix : Water

Sample Date :12/13/99

Parameter	Measured Value	Method Reporting Limit	Units	Analysis Method	Date Analyzed
Benzene	< 0.50	0.50	ug/L	EPA 8020	12/21/99
Toluene	< 0.50	0.50	ug/L	EPA 8020	12/21/99
Ethylbenzene	< 0.50	0.50	ug/L	EPA 8020	12/21/99
Total Xylenes	< 0.50	0.50	ug/L	EPA 8020	12/21/99
Methyl-t-butyl ether	< 5.0	5.0	ug/L	EPA 8020	12/21/99
TPH as Gasoline	< 50	50	ug/L	M EPA 8015	12/21/99
aaa-Trifluorotoluene (8020 Surrogate)	104		% Recovery	EPA 8020	12/21/99
aaa-Trifluorotoluene (Gasoline Surrogate)	95.4		% Recovery	M EPA 8015	12/21/99

Sample : MW-6

Matrix : Water

Sample Date :12/13/99

Parameter	Measured Value	Method Reporting Limit	Units	Analysis Method	Date Analyzed
Benzene	< 0.50	0.50	ug/L	EPA 8020	12/21/99
Toluene	< 0.50	0.50	ug/L	EPA 8020	12/21/99
Ethylbenzene	< 0.50	0.50	ug/L	EPA 8020	12/21/99
Total Xylenes	< 0.50	0.50	ug/L	EPA 8020	12/21/99
Methyl-t-butyl ether	180	5.0	ug/L	EPA 8020	12/21/99
TPH as Gasoline	< 50	50	ug/L	M EPA 8015	12/21/99
aaa-Trifluorotoluene (8020 Surrogate)	102		% Recovery	EPA 8020	12/21/99
aaa-Trifluorotoluene (Gasoline Surrogate)	96.3		% Recovery	M EPA 8015	12/21/99

Approved By:  Joel Kiff



Ultramar Inc.
CHAIN OF CUSTODY REPORT

BEACON

15643

Beacon Station No. 574		Sampler (Print Name) Edgar Abuelata			ANALYSES				Date 12-13-99	Form No. 1 of 1
Project No. 94-574-01		Sampler (Signature) 							STANDARD TAT	
Project Location CASTRO VALLEY		Affiliation DOULOS								
Sample No./Identification	Date	Time	Lab No.	BTEX	TPH (gasoline)	TPH (diesel)			No. of Containers	REMARKS
MU-5	12-13-99	10:46	-01	XX					3	
MU-6	V	11:11	-02	XX					3	
Relinquished by: (Signature/Affiliation) DOULOS		Date	Time	Received by: (Signature/Affiliation)				Date	Time	
Relinquished by: (Signature/Affiliation)		Date	Time	Received by: (Signature/Affiliation)				Date	Time	
Relinquished by: (Signature/Affiliation)		Date	Time	Received by: (Signature/Affiliation) KISS				Date 12/14/99	Time 11:00	
Report To: LAN DAM				Bill to: ULTRAMAR INC. 525 West Third Street Hanford, CA 93230 Attention: JOE ALDRIDGE						

WHITE: Return to Client with Report

YELLOW: Laboratory Copy

PINK: Originator Copy