



3164 Gold Camp Drive  
Suite 200  
Rancho Cordova, CA 95670-6021  
U.S.A.  
916/638 2085  
FAX: 916/638-8385

August 31, 2001

Mr. Scott Seery  
Alameda County Health Care Services  
Department of Environmental Health  
1130 Harbor Bay Parkway, Suite 250  
Alameda, CA 94502-6577

SEP 05 2001

Subject: *Well Destruction Report*  
Former Chevron Station No. 9-5607  
5269 Crow Canyon Road  
Castro Valley, California  
Delta Project No. DG95-607

Dear Mr. Seery:

Delta Environmental Consultants, Inc. (Delta), has been authorized by Chevron Products Company, (Chevron), to destroy off-site groundwater monitoring wells C10a and C10b at Former Chevron Service Station No. 9-5607, located at 5269 Crow Canyon Road, Castro Valley, Alameda County, California. The destruction of the wells was conducted in accordance with the Alameda County Health Care Service's (ACHCS) letter dated June 25, 2001. A copy of ACHCS's letter is included in Enclosure A. The location of the site is shown in Figure 1, and a site map illustrating the locations of site features is shown in Figure 2.

**Scope of Work**

On July 18, 2001, a Delta representative observed Cascade Drilling Inc. of Rancho Cordova, California destroy two groundwater monitoring wells. ~~The wells were destroyed by pressure grouting.~~ The bottom 25 feet of well C-10a was filled with neat cement grout. The bottom 35 feet of well C-10b was filled with neat cement grout. The grout was emplaced from the bottom up via a tremie pipe to within 18-inches of surface grade. Approximately 30 pounds per square inch of pressure was used to force the slurry into the surrounding formation. Existing well boxes were removed and the upper most five feet of each well casing was overdrilled and backfilled with concrete. The surface was completed with clean fill to match the surrounding area. Copies of approved well destruction permits are included in Enclosure B. Copies of the California Department of Water Resources well drillers reports outlining destruction activities is included as Enclosure C.

Mr. Scott Seery  
Alameda County Health Care Services  
August 31, 2001  
Page 2

SEP 05 2001

**Remarks/Signatures**

The interpretations contained in this report represent our professional opinions, and are based in part on information supplied by the client. These opinions are based on currently available information and are arrived at in accordance with currently accepted hydrogeologic and engineering practices at this time and location. Other than this, no warranty is implied or intended.

If you have any questions concerning this project, please contact Ben Heningburg at (916) 536-2623.

Sincerely,

**DELTA ENVIRONMENTAL CONSULTANTS, INC.**

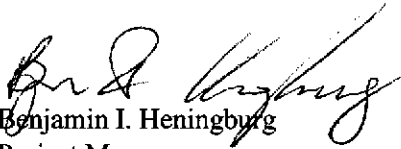
  
Benjamin I. Heningburg  
Project Manager

  
Steven W. Meeks, P.E.  
Project Manager  
California Registered Civil Engineer No. C057461



BIH (Lrp001-9-5607)  
Enclosures

- cc: Mr. Tom Bauhs – Chevron Products Company
- Ms. Amy Naamani – Deputy County Counsel
- Mr. James Yoo – Water Resources Section
- Mr. John Fenstermacher – County of Alameda Public Works Agency

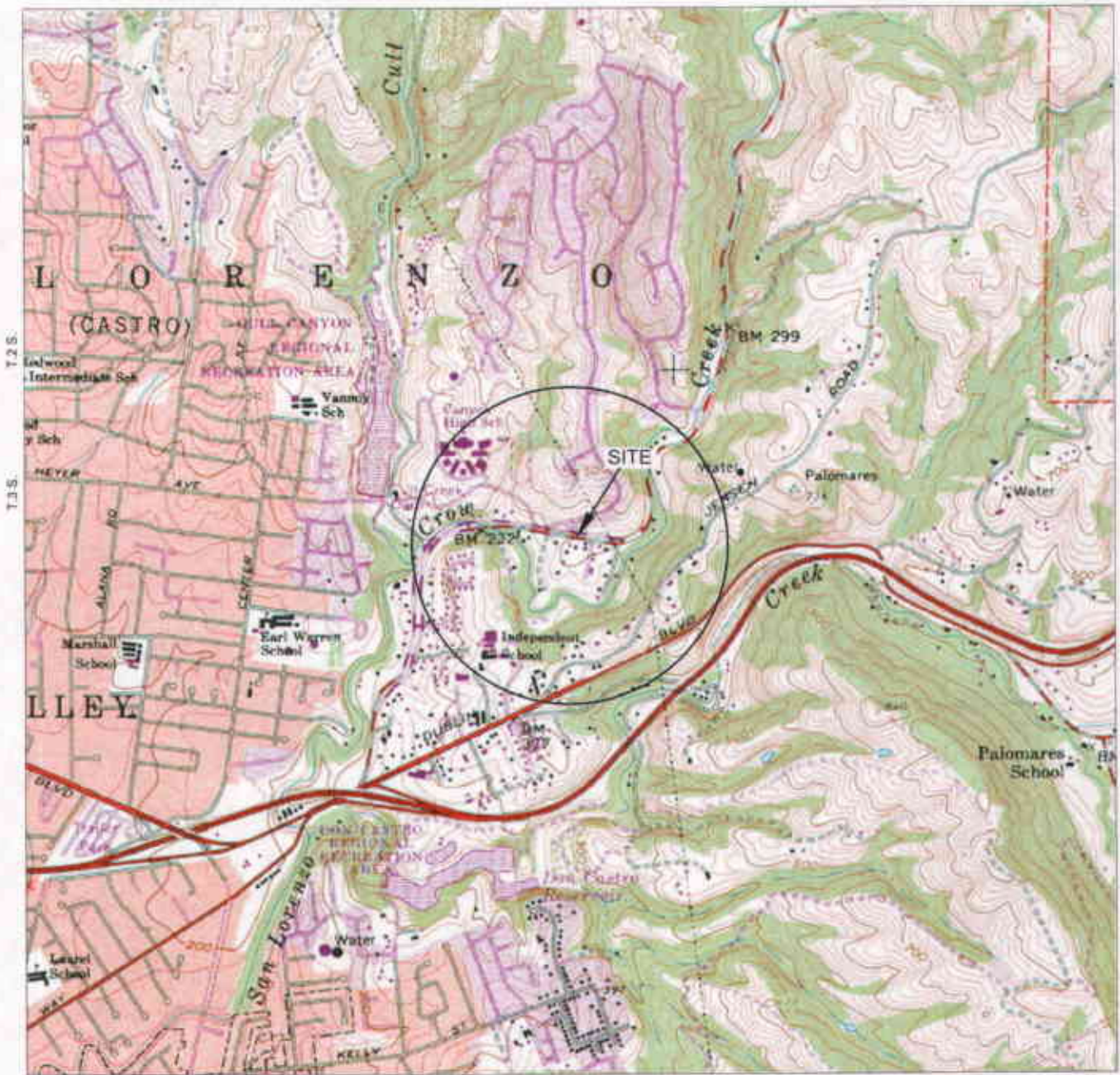

R.2W. R.1W.

**GENERAL NOTES:**  
 BASE MAP FROM U.S.G.S.  
 HAYWARD, CALIFORNIA  
 7.5 MINUTE TOPOGRAPHIC  
 PHOTOREVISED 1980



QUADRANGLE LOCATION



SCALE 1:24,000



**FIGURE 1**  
**SITE LOCATION MAP**  
**CHEVRON SERVICE STATION NO. 9-5607**  
**5269 CROW CANYON ROAD**  
**CASTRO VALLEY, CALIFORNIA**

PROJECT NO. DG95-607	DRAWN BY TLA 7/12/01
FILE NO. 9-5607-1A	PREPARED BY TLA
REVISION NO. 2	REVIEWED BY

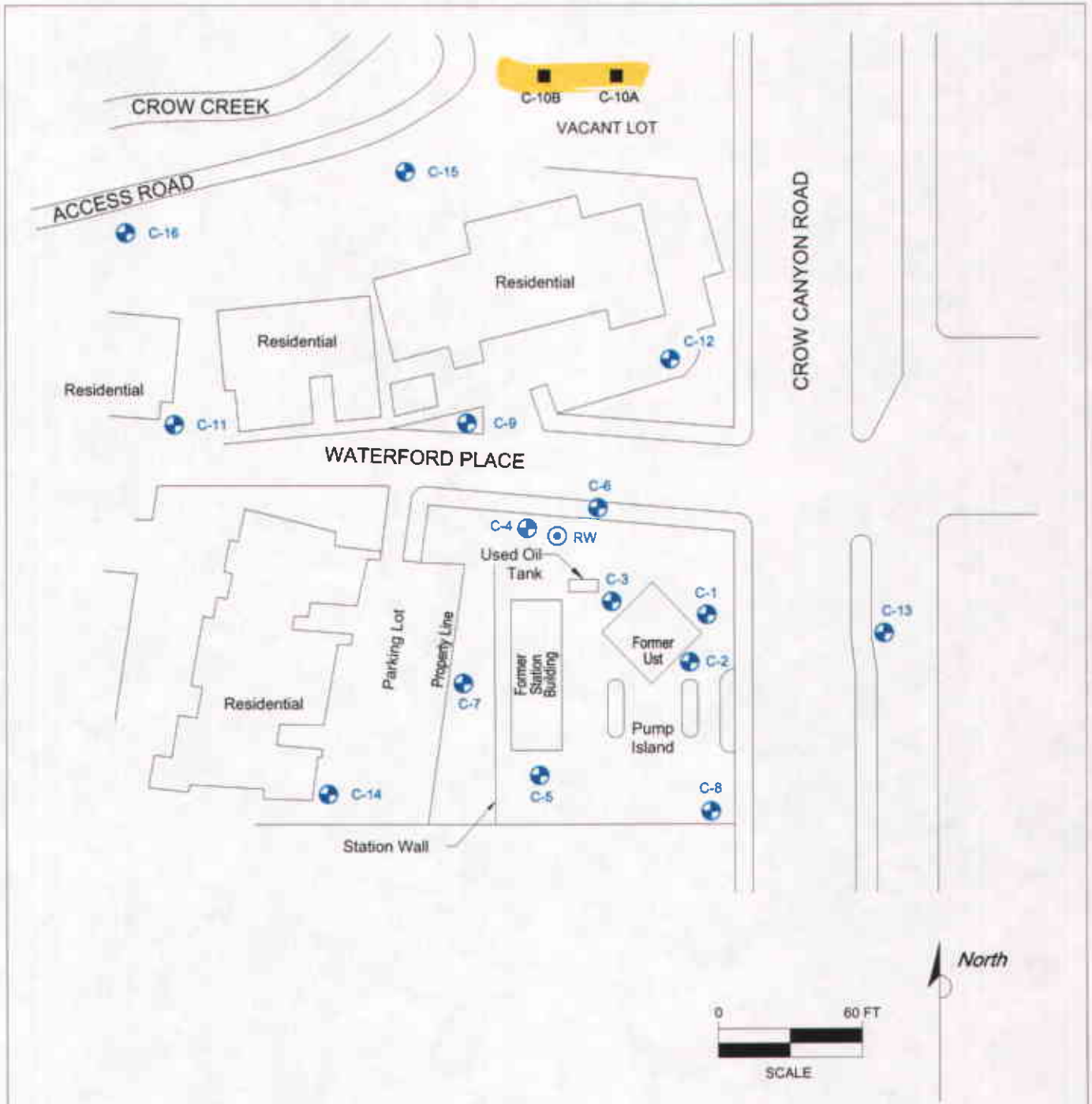



**LEGEND:**

-  C-1 MONITORING WELL LOCATION
-  RW RECOVERY WELL LOCATION
-  C-10A DESTROYED WELL LOCATION

NOTE: SITE MAP ADAPTED FROM HISTORICAL SITE FIGURES.  
SITE DIMENSIONS AND FACILITY LOCATIONS NOT VERIFIED.

**FIGURE 2**  
**SITE VICINITY MAP**

**CHEVRON SERVICE STATION NO. 9-5607**  
**5269 CROW CANYON ROAD**  
**CASTRO VALLEY, CALIFORNIA**

PROJECT NO. DG95-607	DRAWN BY TLA 8/1901
FILE NO. 9-5607-A	PREPARED BY TLA
REVISION NO. 2	REVIEWED BY



**ENCLOSURE A**

Alameda County's Letter dated June 25, 2001

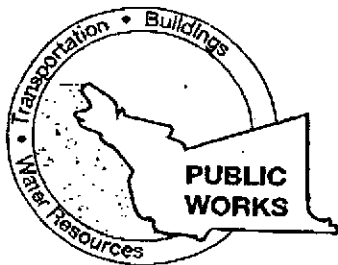

**COUNTY OF ALAMEDA  
PUBLIC WORKS AGENCY**

399 Elmhurst Street • Hayward, CA 94544-1395  
(510) 670-5480

May 31, 2001

Tom Bauhs  
Remediation Project Manager  
Chevron Products Co.  
P.O. Box 6004  
San Ramon, CA 94583-0904

Dear Mr. Bauhs:

Re: CROW CANYON ROAD R/W - No. 35873  
Assessor's Parcel No. 85-5300-13-1 (Por.)

The County is processing the public sale of an excess parcel of County-owned real property located on the south side of Crow Canyon Road approximately 200+ feet east of Crow Creek Place (private) and a like distance west from Waterford Place (private). There are two monitoring wells located on the property. There are markings 10A and 10B on the wells. I have been advised by the Public Works Agency's engineer in charge of monitoring wells that these two wells were installed by Chevron for the former Chevron station #9-5607 for the Henkley Auto Repair property located at 5269 Crow Canyon Road.

Although the paperwork which allowed for these two wells to be placed on the County's property could not be found, it is assumed that there would be provisions in the permit whereby the County could request Chevron to remove the wells.

Because the wells impede the County's ability to sell the property, you are hereby requested to remove the wells as expeditiously as possible within the next sixty days. If the County of Alameda Environmental Health require that these wells remain in the area, I will be more than willing to work with you to accommodate their relocation onto remaining County-owned property.

Your expeditious addressing the removal of these wells will be appreciated and should a question arise, feel free to give me a call at (510) 670-5585.

Yours truly,

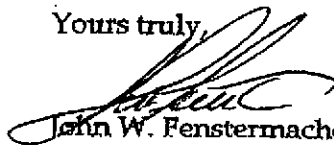
  
John W. Fenstermacher  
Chief, Real Estate Division

/mbc

cc: Amy Naamani, Deputy County Counsel  
James Yoo - Water Resources Section

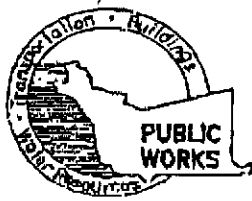

# ALAMEDA COUNTY PUBLIC WORKS AGENCY

## WATER RESOURCES SECTION

399 Alhambra St., BAYWARD, CA 94544  
PHONE (510) 670-5554 FAX (510) 782-1939

### DRILLING PERMIT APPLICATION

#### FOR APPLICANT TO COMPLETE

LOCATION OF PROJECT Formal Chevron Service Station # 9-5607  
5267 Erwin Canyon Road  
Castro Valley, California

California Coordinates Source \_\_\_\_\_ ft. Accuracy ± \_\_\_\_\_ ft.  
CCN \_\_\_\_\_ ft. CCE \_\_\_\_\_ ft.  
APN \_\_\_\_\_

CLIENT  
Name Chevron U.S.A. Inc.  
Address 600 Bollinger Canyon Rd Phone 925-942-8998  
City San Ramon, CA Zip \_\_\_\_\_

APPLICANT  
Name Delta Environmental Consultants, Inc.  
Address 3167 Gold Camp Drive Phone 916/638-2164  
City Rancho Cordova Zip 95670

TYPE OF PROJECT  
Well Construction  Geotechnical Investigation   
Cathodic Protection  General   
Water Supply  Contamination   
Monitoring  Well Destruction

PROPOSED WATER SUPPLY WELL USE  
New Domestic  Replacement Domestic   
Municipal  Irrigation   
Industrial  Other NA

DRILLING METHOD:  
Mud Rotary  Air Rotary  Auger   
Cable  Other  Hollow Stem

DRILLER'S LICENSE NO. 257-71750

WELL PROJECTS 1.05 (Cascade Drilling # 1-31-02)  
Drill Hole Diameter \_\_\_\_\_ in. Maximum \_\_\_\_\_  
Casing Diameter 3 in. Depth 35 ft.  
Surface Seal Depth 6 ft. Number 10B

GEOTECHNICAL PROJECTS  
Number of Borings NA Maximum \_\_\_\_\_  
Hole Diameter NA in. Depth NA ft.

ESTIMATED STARTING DATE 7/19/01  
ESTIMATED COMPLETION DATE 7/19/01

I hereby agree to comply with all requirements of this permit and Alameda County Ordinance No. 73-58.

APPLICANT'S SIGNATURE Brett Berdinsky DATE \_\_\_\_\_  
Delta Environmental

#### FOR OFFICE USE

PERMIT NUMBER W11-558  
WELL NUMBER \_\_\_\_\_  
APN \_\_\_\_\_

#### PERMIT CONDITIONS

Circled Permit Requirements Apply

##### A. GENERAL

1. A permit application should be submitted so as to arrive at the ACPWA office five days prior to proposed starting date.
2. Submit to ACPWA within 60 days after completion of permitted work the original Department of Water Resources Water Well Drillers Report or equivalent for well projects, or drilling logs and location sketch for geotechnical projects.
3. Permit is void if project not begun within 90 days of approval date.

##### B. WATER SUPPLY WELLS

1. Minimum surface seal thickness is two inches of cement grout placed by tremie.
2. Minimum seal depth is 50 feet for municipal and industrial wells or 20 feet for domestic and irrigation wells unless a lesser depth is specially approved.

##### C. GROUNDWATER MONITORING WELLS INCLUDING PIEZOMETERS

1. Minimum surface seal thickness is two inches of cement grout placed by tremie.
2. Minimum seal depth for monitoring wells is the maximum depth practicable or 20 feet.

##### D. GEOTECHNICAL

Backfill bore hole with compacted cuttings or heavy bentonite and upper two feet with compacted material. In areas of known or suspected contamination, tremie cement grout shall be used in place of compacted cuttings.

##### E. CATHODIC

Fill hole above anode zone with concrete placed by tremie.

##### F. WELL DESTRUCTION

See attached.

##### G. SPECIAL CONDITIONS

Attached. Pressure Start

APPROVED [Signature] DATE 7-11-01  
[Signature]

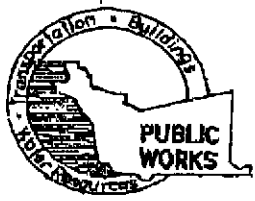

# ALAMEDA COUNTY PUBLIC WORKS AGENCY

## WATER RESOURCES SECTION

399 Elmhurst St., BAYARD, CA 94544  
PHONE (510) 670-5554 FAX (510) 782-1939

### DRILLING PERMIT APPLICATION

#### FOR APPLICANT TO COMPLETE

#### FOR OFFICE USE

LOCATION OF PROJECT Former Chevron Service Station # 9-5607  
4269 Crow Canyon Road  
Castro Valley, California

PERMIT NUMBER W11-557  
WELL NUMBER \_\_\_\_\_  
APN \_\_\_\_\_

California Coordinates Source \_\_\_\_\_ ft. Accuracy ± \_\_\_\_\_ ft.  
CCN \_\_\_\_\_ R CCB \_\_\_\_\_ ft.  
APN \_\_\_\_\_

#### PERMIT CONDITIONS

Circled Permit Requirements Apply

CLIENT  
Name Chevron U.S.A. Inc.  
Address 6001 Bollinger Canyon Rd Phone 925-992-8998  
City Sacramento, CA Zip \_\_\_\_\_

#### A. GENERAL

1. A permit application should be submitted so as to arrive at the ACPWA office five days prior to proposed starting date.
2. Submit to ACPWA within 60 days after completion of permitted work the original Department of Water Resources Water Well Drillers Report or equivalent for well projects, or drilling logs and location sketch for geotechnical projects.
3. Permit is void if project not begun within 90 days of approval date.

APPLICANT  
Name DELTA Environmental Consultants, Inc.  
Address 3144 Gold Camp Drive Phone 916/438-2164  
City Bancho Cordova Zip 95670

#### B. WATER SUPPLY WELLS

1. Minimum surface seal thickness is two inches of cement grout placed by tremie.
2. Minimum seal depth is 50 feet for municipal and industrial wells or 20 feet for domestic and irrigation wells unless a lesser depth is specially approved.

TYPE OF PROJECT

Well Construction	<input type="checkbox"/>	Geotechnical Investigation	<input type="checkbox"/>
Cathodic Protection	<input type="checkbox"/>	General	<input type="checkbox"/>
Water Supply	<input type="checkbox"/>	Contamination	<input type="checkbox"/>
Monitoring	<input checked="" type="checkbox"/>	Well Destruction	<input checked="" type="checkbox"/>

#### C. GROUNDWATER MONITORING WELLS INCLUDING PIEZOMETERS

1. Minimum surface seal thickness is two inches of cement grout placed by tremie.
2. Minimum seal depth for monitoring wells is the maximum depth practicable or 20 feet.

PROPOSED WATER SUPPLY WELL USE

New Domestic	<input type="checkbox"/>	Replacement Domestic	<input type="checkbox"/>
Municipal	<input checked="" type="checkbox"/>	Irrigation	<input type="checkbox"/>
Industrial	<input type="checkbox"/>	Other <u>NA</u>	<input type="checkbox"/>

#### D. GEOTECHNICAL

Backfill bore hole with compacted cuttings or heavy bentonite and upper two feet with compacted material. In areas of known or suspected contamination, tremie cement grout shall be used in place of compacted cuttings.

DRILLING METHOD:

Mud Rotary	<input type="checkbox"/>	Air Rotary	<input type="checkbox"/>	Auger	<input checked="" type="checkbox"/>
Cable	<input type="checkbox"/>	Other	<input type="checkbox"/>	Hollow Stem	<input type="checkbox"/>

#### E. CATHODIC

Fill hole above anode zone with concrete placed by tremie.

DRILLER'S LICENSE NO. C 57-71750  
Cascade Drilling # 1-3102

#### F. WELL DESTRUCTION

See attached.

WELL PROJECTS

Drill Hole Diameter <u>2.25</u> in.	Maximum Depth <u>25</u> ft.
Casing Diameter <u>3</u> in.	Number <u>10A</u> <u>10A</u>
Surface Seal Depth <u>6</u> ft.	

#### G. SPECIAL CONDITIONS

Attached - pressure grout

GEOTECHNICAL PROJECTS

Number of Borings <u>NA</u>	Maximum Depth <u>NA</u> ft.
Hole Diameter <u>NA</u> in.	

APPROVED [Signature] DATE 7-11-01  
James Yoo

ESTIMATED STARTING DATE 7/17/01  
ESTIMATED COMPLETION DATE 7/17/01

I hereby agree to comply with all requirements of this permit and Alameda County Ordinance No. 73-68.

APPLICANT'S SIGNATURE Brett Bardsley DATE \_\_\_\_\_  
Delta Environmental



**ENCLOSURE C**

California Department of Water Resources  
Well Drillers Report

**CONFIDENTIAL**

STATE OF CALIFORNIA DWR  
WELL COMPLETION REPORT  
(WELL LOGS)

**REMOVED**

**CONFIDENTIAL**

STATE OF CALIFORNIA DWR  
WELL COMPLETION REPORT  
(WELL LOGS)

**REMOVED**