



# GETTLER-RYAN INC.

## TRANSMITTAL

December 4, 2001

G-R #386539

TO: Mr. James Brownell  
Delta Environmental Consultants, Inc.  
3164 Gold Camp Drive, Suite 200  
Rancho Cordova, California 95670

CC: Mr. Thomas Bauhs  
Chevron Products Company  
P.O. Box 6004  
San Ramon, California 94583

FROM: Deanna L. Harding  
Project Coordinator  
Gettler-Ryan Inc.  
6747 Sierra Court, Suite J  
Dublin, California 94568

RE: **Chevron Service Station**  
**#9-5607**  
**5269 Crow Canyon Road**  
**Castro Valley, California**

WE HAVE ENCLOSED THE FOLLOWING:

COPIES	DATED	DESCRIPTION
1	November 30, 2001	Groundwater Monitoring and Sampling Report Fourth Quarter - Event of October 10, 2001

### COMMENTS:

Please provide any comments/changes and propose any groundwater monitoring modifications for the next event prior to **December 18, 2001**, at which time the final report will be distributed to the following:

cc: Mr. Scott Seery, Alameda County Health Care Services, Dept. of Environmental Health, 1131 Harbor Bay Parkway, Suite 250, Alameda, CA 94502-6577  
Mr. Greg Gurss, Gettler-Ryan Inc., 3140 Gold Camp Drive, Suite 170, Rancho Cordova, CA 95670  
Mr. Chuck Headlee, RWQCB - San Francisco Bay Region, 1515 Clay Street, Suite 1400, Oakland, CA 94612  
Mr. Kevin Hinckley, 5269 Crow Canyon Road, Castro Valley, CA 94546  
Ms. Diane Riggs, Forest Creek Townhomes Assoc., c/o Walsh Property Management, P.O. Box 2657, Castro Valley, CA, 94541  
Mr. Tim Utterback, Weiss Associates, 5801 Christy Avenue, Suite 600, Emeryville, CA 94608

Enclosures

trans/9-5607-TB



# GETTLER-RYAN INC.

November 30, 2001  
G-R Job #386539

Mr. Thomas Bauhs  
Chevron Products Company  
P.O. Box 6004  
San Ramon, CA 94583

**RE: Fourth Quarter Event of October 10, 2001**  
Groundwater Monitoring & Sampling Report  
Chevron Service Station #9-5607  
5269 Crow Canyon Road  
Castro Valley, California

Dear Mr. Bauhs:

This report documents the most recent groundwater monitoring and sampling event performed by Gettler-Ryan Inc. (G-R) at the referenced site. All field work was conducted in accordance with G-R Standard Operating Procedure - Groundwater Sampling (attached).

Static groundwater levels were measured and the wells were checked for the presence of separate-phase hydrocarbons. Static water level data, groundwater elevations, and separate-phase hydrocarbon thickness (if any) are presented in the attached Table 1. A Potentiometric Map is included as Figure 1.

Groundwater samples were collected from the monitoring wells and submitted to a state certified laboratory for analyses. The field data sheets for this event are attached. Analytical results are presented in the table(s) listed below. Isoconcentration Maps are included as Figures 2 and 3. The chain of custody document and laboratory analytical report are also attached.

Please call if you have any questions or comments regarding this report. Thank you.

Sincerely,

- For -

Deanna L. Harding  
Project Coordinator

Douglas J. Lee  
Senior Geologist, R.G. No. 6882

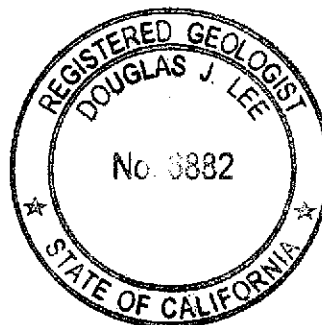
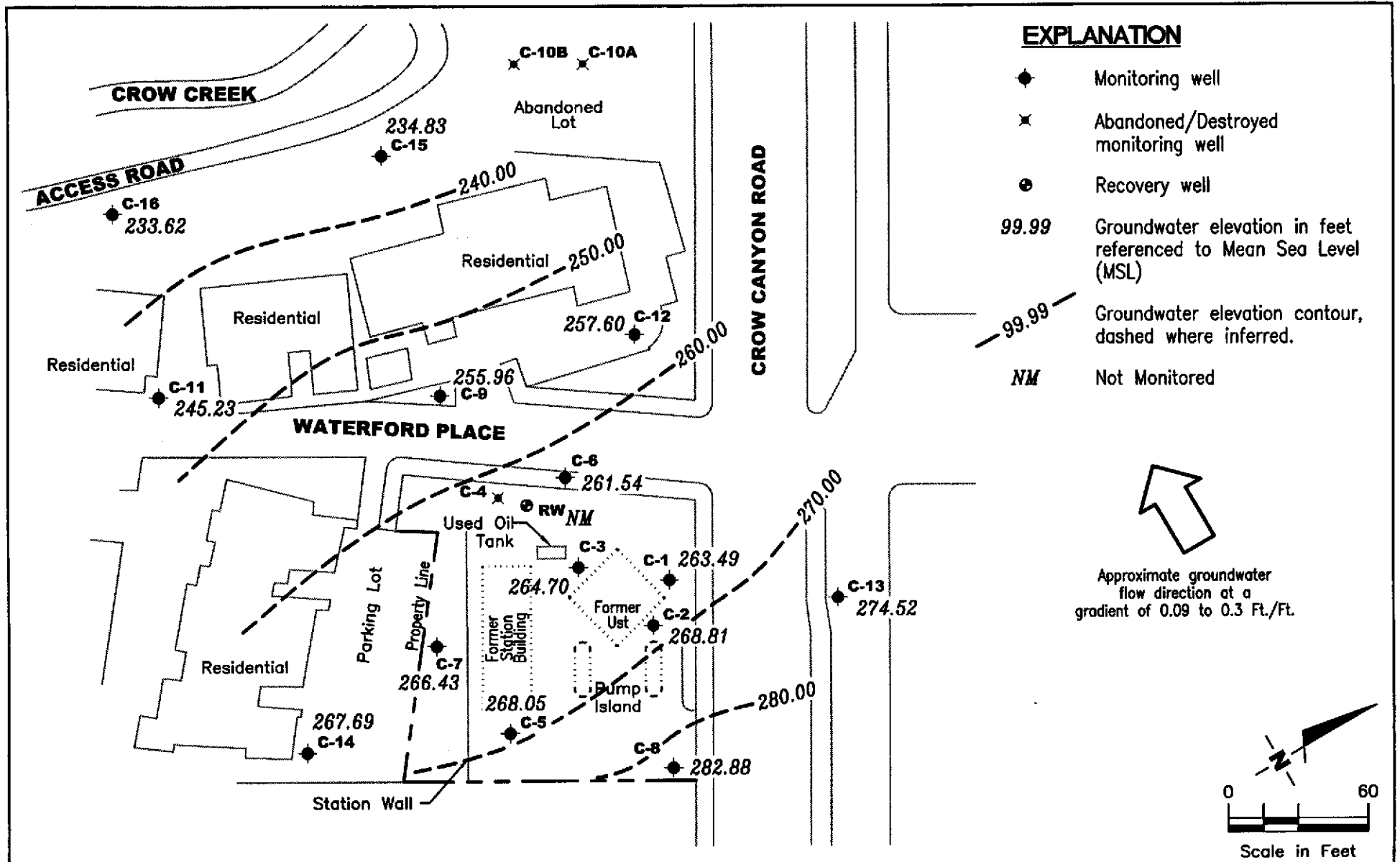

Figure 1: Potentiometric Map  
Figure 2: TPH-G Isoconcentration Map  
Figure 3: Benzene Isoconcentration Map  
Table 1: Groundwater Monitoring Data and Analytical Results  
Table 2: Groundwater Analytical Results - Oxygenate Compounds  
Attachments: Standard Operating Procedure - Groundwater Sampling  
Field Data Sheets  
Chain of Custody Document and Laboratory Analytical Reports



Source: Figure modified from drawing provided by RRM engineering contracting firm.

**GETTLER - RYAN INC.**  
 6747 Sierra Ct., Suite J  
 Dublin, CA 94568 (925) 551-7555

**POTENTIOMETRIC MAP**  
 Chevron Service Station #9-5607  
 5269 Crow Canyon Road  
 Castro Valley, California

FIGURE

1

PROJECT NUMBER  
 386539

REVIEWED BY

DATE  
 October 10, 2001

REVISED DATE

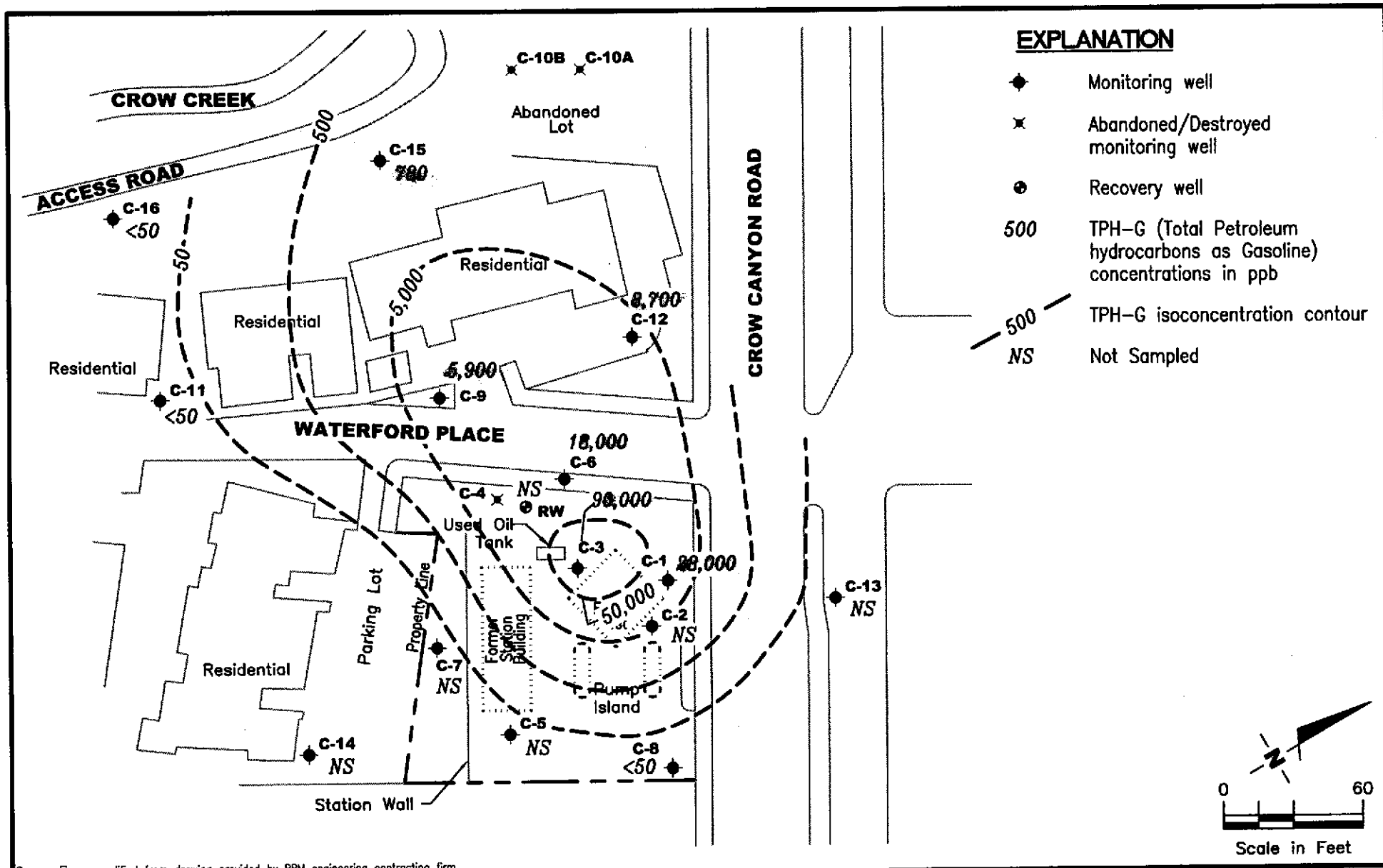

**EXPLANATION**

- ◆ Monitoring well
- ✕ Abandoned/Destroyed monitoring well
- ⊙ Recovery well
- 500 TPH-G (Total Petroleum hydrocarbons as Gasoline) concentrations in ppb
- 500 TPH-G isoconcentration contour
- NS Not Sampled

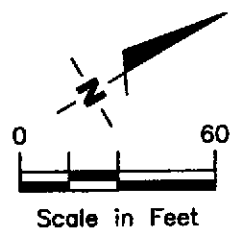

Source: Figure modified from drawing provided by RRM engineering contracting firm.

**GETTLER - RYAN INC.**  
 6747 Sierra Ct., Suite J  
 Dublin, CA 94568 (925) 551-7555

**TPH-G ISOCONCENTRATION MAP**  
 Chevron Service Station #9-5607  
 5269 Crow Canyon Road  
 Castro Valley, California

FIGURE  
**2**

PROJECT NUMBER <b>386539</b>	REVIEWED BY	DATE <b>October 10, 2001</b>	REVISED DATE
---------------------------------	-------------	---------------------------------	--------------

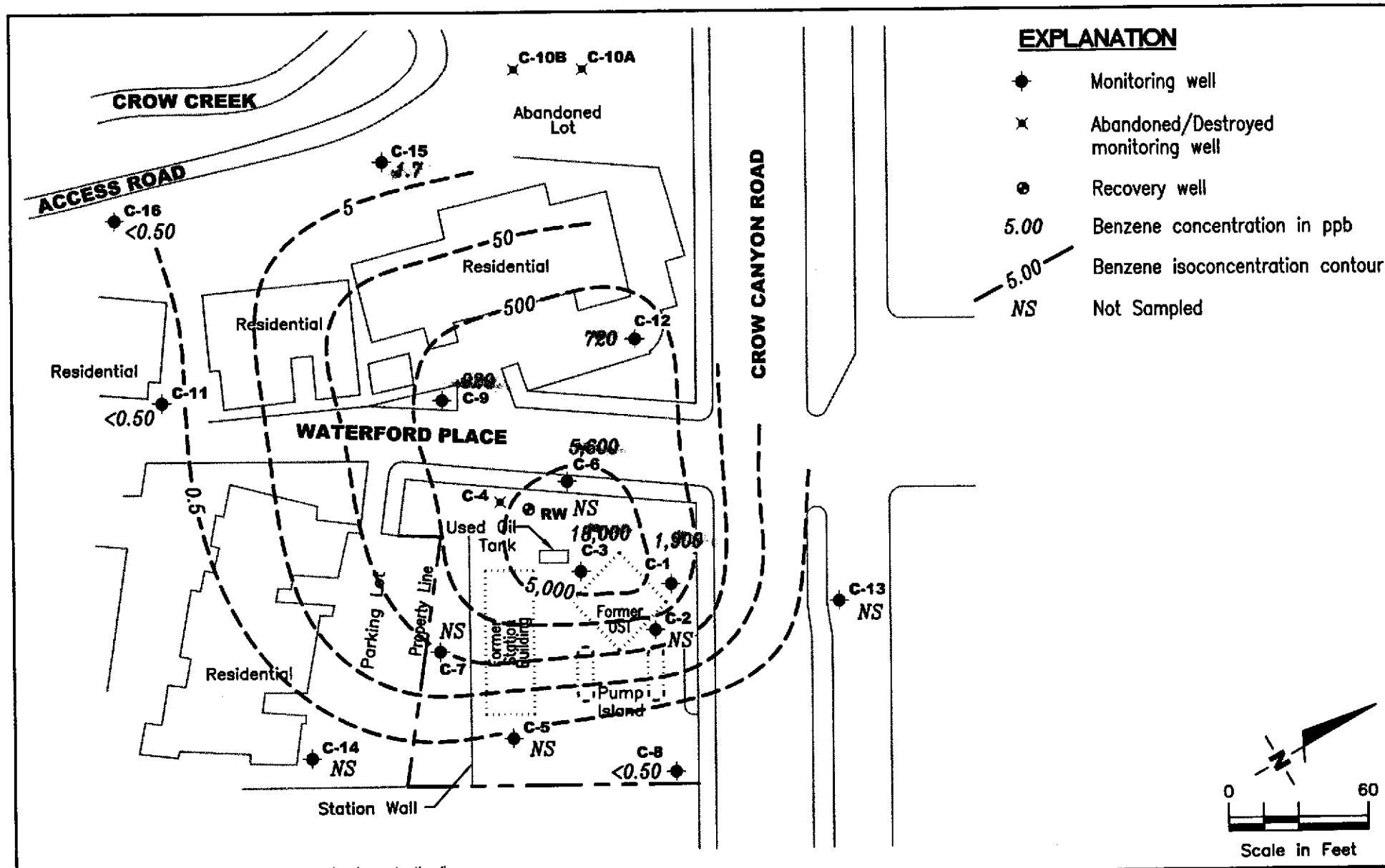

Source: Figure modified from drawing provided by RRM engineering contracting firm.

**GETTLER - RYAN INC.**  
 6747 Sierra Ct., Suite J  
 Dublin, CA 94568 (925) 551-7555

**BENZENE ISOCONCENTRATION**  
 Chevron Service Station #9-5607  
 5269 Crow Canyon Road  
 Castro Valley, California

FIGURE

3

PROJECT NUMBER  
 386539

REVIEWED BY

DATE  
 October 10, 2001

REVISED DATE

**Table 1**  
**Groundwater Monitoring Data and Analytical Results**  
Chevron Service Station #9-5607  
5269 Crow Canyon Road  
Castro Valley, California

WELL ID/ DATE	TOC (ft.)	GWE (msl)	DTW (ft.)	SPHT (ft.)	TPH-G (ppb)	B (ppb)	T (ppb)	E (ppb)	X (ppb)	MTBE (ppb)
C-1										
03/26/85	283.46	260.63	22.83	--	--	--	--	--	--	--
07/03/86	283.46	259.88	23.58	--	--	--	--	--	--	--
03/26/87	283.46	262.96	20.50	--	--	--	--	--	--	--
03/28/88	283.46	257.46	26.00	--	--	--	--	--	--	--
03/10/89	283.46	267.60	15.86	--	--	--	--	--	--	--
04/03/89	283.46	266.61	16.85	--	--	--	--	--	--	--
05/08/89	283.46	260.78	22.68	--	--	--	--	--	--	--
06/05/89	283.46	258.80	24.66	--	--	--	--	--	--	--
07/12/90	283.46	257.90	25.56	--	--	--	--	--	--	--
08/10/90	283.46	257.57	25.89	--	--	--	--	--	--	--
09/13/89	283.46	256.91	26.55	--	22,000	3,600	1,100	1,000	3,500	--
10/04/89	283.46	258.22	25.24	--	--	--	--	--	--	--
11/03/89	283.46	258.43	25.03	--	--	--	--	--	--	--
12/04/89	283.46	257.09	26.37	--	13,000	2,000	550	610	1,600	--
03/07/90	283.46	260.98	22.48	--	--	--	--	--	--	--
03/09/90	283.46	--	--	--	--	--	--	--	--	--
06/12/90	283.46	259.11	24.35	--	21,000	3,500	1,400	840	4,000	--
09/20/90	283.46	257.19	26.27	--	23,000	2,100	1,200	860	5,000	--
12/20/90	283.46	260.87	22.59	--	8,200	760	410	260	1,100	--
03/27/91	283.46	264.38	19.08	--	--	--	--	--	--	--
06/18/91	283.46	256.35	27.11	--	--	--	--	--	--	--
09/12/91	283.46	255.24	28.22	--	--	--	--	--	--	--
01/23/92	283.46	256.81	26.65	--	--	--	--	--	--	--
04/13/92	283.46	261.30	22.16	--	38,000	3,100	1,300	850	3,100	--
08/03/92	283.46	257.31	26.15	--	13,000	3,100	1,300	850	3,100	--
10/22/92	283.46	256.67	26.79	--	24,000	3,500	1,400	1,500	4,300	--
01/18/93	283.46	264.86	18.60	--	370,000	6,900	8,900	3,100	23,000	--

**Table 1**  
**Groundwater Monitoring Data and Analytical Results**  
 Chevron Service Station #9-5607  
 5269 Crow Canyon Road  
 Castro Valley, California

WELL ID/ DATE	TOC (ft.)	GWE (msl)	DTW (ft.)	SPHT (ft.)	TPH-G (ppb)	B (ppb)	T (ppb)	E (ppb)	X (ppb)	MTBE (ppb)
C-1 (cont)										
04/19/93	283.46	262.34	21.12	--	51,000	8,000	7,000	1,400	10,000	--
07/21-22/93	283.46	260.18	23.28	--	22,000	3,400	1,000	990	3,100	--
10/25/93	283.46	258.80	24.66	--	14,000	2,000	550	790	2,300	--
01/21/94	283.46	262.99	20.47	--	1,100	350	6.0	3.0	15	--
04/18/94	283.46	260.36	23.10	--	24,000	3,200	1,000	1,000	3,100	--
07/06-07/94	283.46	260.56	22.90	--	65,000	6,500	4,200	1,600	9,300	--
10/07/94	283.46	258.75	24.71	--	27,000	5,100	1,200	1,400	4,300	--
01/11/95	283.46	265.16	18.30	--	29,000	1,300	1,200	930	4,000	--
04/24/95	283.46	266.52	16.94	--	75,000	8,900	5,000	1,700	8,400	--
07/31/95	283.46	262.90	20.56	--	56,000	11,000	2,600	2,500	11,000	--
10/02/95	283.46	272.88	10.58	--	44,000	7,900	1,100	2,100	6,500	--
01/16/96	283.46	261.71	21.75	--	29,000	5,300	460	1,000	2,800	<500
04/18/96	283.46	264.51	18.95	--	59,000	7,100	3,000	2,000	7,600	<250
07/22/96	283.46	262.46	21.00	--	26,000	6,100	610	1,800	4,700	<250
10/10/96	283.46	261.46	22.00	--	24,000	7,100	600	1,700	3,200	<250
01/09/97	283.46	268.05	15.41	--	32,000	4,600	820	1,500	4,000	670
04/15/97	283.46	264.12	19.34	--	100,000	11,000	4,500	3,200	13,000	1,700/<200 <sup>1</sup>
07/08/97	283.46	263.68	19.78	--	42,000	5,500	880	2,000	4,800	920
10/22/97	283.46	265.13	18.33	--	29,000	5,200	970	1,800	4,200	740
01/12/98	283.46	271.81	11.65	--	31,000	2,700	960	2,100	5,700	<1000
04/21/98	283.46	271.17	12.29	--	60,000	3,300	2,100	3,100	10,000	1,400
07/08/98	283.46	264.89	18.57	--	33,000	4,400	1,500	2,800	8,200	<250
10/13/98	283.46	262.11	21.35	--	27,000	3,900	580	2,000	4,200	210
01/27/99	283.46	262.91	20.55	--	1,220	126	21.9	1.6	163	10.3
04/27/99	283.46	265.81	17.65	--	21,300	1,720	226	1,230	2,060	<500
07/23/99	283.46	264.00	19.46	--	17,200	1,440	257	1,070	1,960	<500
11/01/99	283.46	264.53	18.93	--	45,700	4,020	1,280	2,690	8,140	1,250

**Table 1**  
**Groundwater Monitoring Data and Analytical Results**  
Chevron Service Station #9-5607  
5269 Crow Canyon Road  
Castro Valley, California

WELL ID/ DATE	TOC (ft.)	GWE (mst)	DTW (ft.)	SPHT (ft.)	TPH-G (ppb)	B (ppb)	T (ppb)	E (ppb)	X (ppb)	MTBE (ppb)
<b>C-1 (cont)</b>										
01/20/00	283.46	262.62	20.84	--	18,000	2,110	354	1,340	2,330	<500
04/28-29/00	283.46	265.61	17.85	0.00	8,300 <sup>3</sup>	1,300	470	370	1,300	<130
07/21/00	283.46	264.57	18.89	0.00	18,000 <sup>3</sup>	3,100	1,200	1,600	5,700	1,100
10/09-10/00	283.46	263.38	20.08	0.00	31,800 <sup>5</sup>	3,280	<50.0	2,230	6,800	<250
01/08-09/01	283.46	262.95	20.51	0.00	43,700 <sup>5</sup>	3,160	1,250	2,580	7,140	1,100
04/30/01	283.46	265.37	18.09	0.00	41,600 <sup>3</sup>	3,060	791	2,380	6,260	<1,000
07/09-10/01	283.46	263.78	19.68	0.00	27,000 <sup>3</sup>	2,500	480	1,900	5,100	1,900
10/10/01	283.46	263.49	19.97	0.00	28,000	1,900	320	1,500	4,000	170
<b>C-2</b>										
03/26/85	284.37	--	--	--	--	--	--	--	--	--
07/03/86	284.37	264.68	19.69	--	--	--	--	--	--	--
03/26/87	284.37	268.92	15.45	--	--	--	--	--	--	--
03/28/88	284.37	263.45	20.92	--	--	--	--	--	--	--
03/10/89	284.37	271.57	12.80	--	--	--	--	--	--	--
04/03/89	284.37	270.11	14.26	--	--	--	--	--	--	--
05/08/89	284.37	265.95	18.42	--	--	--	--	--	--	--
06/05/89	284.37	264.28	20.09	--	--	--	--	--	--	--
07/12/90	284.37	263.58	20.79	--	--	--	--	--	--	--
08/10/90	284.37	262.97	21.40	--	--	--	--	--	--	--
09/13/89	284.37	262.51	21.86	--	320	62	4.0	10	14	--
10/04/89	284.37	264.48	19.89	--	--	--	--	--	--	--
11/03/89	284.37	263.61	20.76	--	--	--	--	--	--	--
12/04/89	284.37	263.55	20.82	--	1,000	240	37	66	130	--
03/07/90	284.37	266.54	17.83	--	--	--	--	--	--	--
03/09/90	284.37	266.54	17.83	--	390	280	35	27	50	--



**Table 1**  
**Groundwater Monitoring Data and Analytical Results**  
Chevron Service Station #9-5607  
5269 Crow Canyon Road  
Castro Valley, California

WELL ID/ DATE	TOC (ft.)	GWE (msl)	DTW (ft.)	SPHT (ft.)	TPH-G (ppb)	B (ppb)	T (ppb)	E (ppb)	X (ppb)	MTBE (ppb)
C-2 (cont)										
06/12/90	284.37	264.48	19.89	--	700	260	34	28	55	--
09/20/90	284.37	262.40	21.97	--	--	--	--	--	--	--
12/20/90	284.37	266.64	17.73	--	--	--	--	--	--	--
03/27/91	284.37	269.27	15.10	--	--	--	--	--	--	--
06/18/91	284.37	261.69	22.68	--	--	--	--	--	--	--
09/12/91	284.37	260.45	23.92	--	--	--	--	--	--	--
01/23/92	284.37	263.13	21.24	--	--	--	--	--	--	--
04/13/92	284.37	266.83	17.54	--	1,100	120	76	17	72	--
08/03/92	284.37	262.32	22.05	--	--	--	--	--	--	--
10/22/92	284.37	261.34	23.03	--	--	--	--	--	--	--
01/18/93	284.37	269.51	14.86	--	70	6.4	ND	ND	ND	--
04/19/93	284.37	267.57	16.80	--	--	--	--	--	--	--
07/21-22/93	284.37	265.12	19.25	--	--	--	--	--	--	--
10/25/93	284.37	264.72	19.65	--	--	--	--	--	--	--
07/06-07/94	284.37	265.61	18.76	--	--	--	--	--	--	--
10/07/94	284.37	264.20	20.17	--	--	--	--	--	--	--
01/11/95	284.37	270.33	14.04	--	780	290	9.1	19	58	--
04/24/95	284.37	272.03	12.34	--	SAMPLED ANNUALLY		--	--	--	--
07/31/95	287.37	266.82	17.55	--	--	--	--	--	--	--
10/02/95	284.37	265.39	18.98	--	--	--	--	--	--	--
01/16/96	284.37	268.37	16.00	--	260	29	2.9	5.7	21	6.1
04/18/96	284.37	270.47	13.90	--	--	--	--	--	--	--
07/22/96	284.37	266.63	17.74	--	--	--	--	--	--	--
10/10/96	284.37	265.46	18.91	--	--	--	--	--	--	--
01/09/97	284.37	271.62	12.75	--	460	25	15	72	24	6.3
04/15/97	284.37	268.32	16.05	--	--	--	--	--	--	--
07/08/97	284.37	267.95	16.42	--	--	--	--	--	--	--

**Table 1**  
**Groundwater Monitoring Data and Analytical Results**  
Chevron Service Station #9-5607  
5269 Crow Canyon Road  
Castro Valley, California

WELL ID/ DATE	TOC (ft.)	GWE (msl)	DTW (ft.)	SPHT (ft.)	TPH-G (ppb)	B (ppb)	T (ppb)	E (ppb)	X (ppb)	MTBE (ppb)
<b>C-2 (cont)</b>										
10/22/97	284.37	268.95	15.42	--	--	--	--	--	--	--
01/12/98	284.37	272.85	11.52	--	280	22	1.4	5.3	1.2	13
04/21/98	284.37	274.22	10.15	--	--	--	--	--	--	--
07/08/98	284.37	268.29	16.08	--	--	--	--	--	--	--
10/13/98	284.37	265.40	18.97	--	--	--	--	--	--	--
01/27/99	284.37	268.52	15.85	--	153	4.83	0.628	<0.5	<0.5	4.73
04/27/99	284.37	270.11	14.26	--	--	--	--	--	--	--
07/23/99	284.37	268.99	15.38	--	--	--	--	--	--	--
11/01/99	284.37	266.74	17.63	--	--	--	--	--	--	--
01/20/00	284.37	266.92	17.45	--	201	9.68	<0.5	7.32	4.78	<5.0
04/28-29/00	284.37	269.86	14.51	0.00	SAMPLED ANNUALLY		--	--	--	--
07/21/00	284.37	269.30	15.07	0.00	--	--	--	--	--	--
10/09-10/00	284.37	266.54	17.83	0.00	--	--	--	--	--	--
01/08-09/01	284.37	INACCESSIBLE	--	--	--	--	--	--	--	--
04/30/01	284.37	269.86	14.51	0.00	--	--	--	--	--	--
07/09-10/01	284.37	268.82	15.55	0.00	--	--	--	--	--	--
10/10/01	284.37	268.81	15.56	0.00	SAMPLED ANNUALLY		--	--	--	--
<b>C-3</b>										
03/26/85	285.98	--	--	--	--	--	--	--	--	--
07/03/86	285.98	259.94	26.04	--	--	--	--	--	--	--
03/26/87	285.98	260.34	25.64	--	--	--	--	--	--	--
03/28/88	285.98	257.16	28.82	--	--	--	--	--	--	--
03/10/89	285.98	263.20	22.78	--	--	--	--	--	--	--
04/03/89	285.98	263.27	22.71	--	--	--	--	--	--	--
05/08/89	285.98	260.03	25.95	--	--	--	--	--	--	--

**Table 1**  
**Groundwater Monitoring Data and Analytical Results**  
Chevron Service Station #9-5607  
5269 Crow Canyon Road  
Castro Valley, California

WELL ID/ DATE	TOC (ft.)	GWE (msl)	DTW (ft.)	SPHT (ft.)	TPH-G (ppb)	B (ppb)	T (ppb)	E (ppb)	X (ppb)	MTBE (ppb)
C-3 (cont)										
06/05/89	285.98	258.36	27.62	--	--	--	--	--	--	--
07/12/90	285.98	257.69	28.29	--	--	--	--	--	--	--
08/10/90	285.98	257.52	28.46	--	--	--	--	--	--	--
09/13/89	285.98	256.65	29.33	--	60,000	1,400	6,800	2,300	10,000	--
10/04/89	285.98	257.01	28.97	--	--	--	--	--	--	--
11/03/89	285.98	257.26	28.72	--	--	--	--	--	--	--
12/04/89	285.98	256.97	29.01	--	56,000	1,300	3,300	1,400	2,700	--
03/07/90	285.98	258.29	27.69	--	--	--	--	--	--	--
03/09/90	285.98	258.29	27.69	--	42,000	1,100	5,700	1,600	7,900	--
06/12/90	285.98	257.89	28.09	--	160,000	1,400	7,100	3,400	16,000	--
09/24/90	285.98	256.80	29.18	--	53,000	850	7,700	2,000	10,000	--
12/20/90	285.98	257.71	28.27	--	520	1,200	5,400	5,400	33,000	--
03/27/91	285.98	261.18	24.80	--	92,000	1,300	3,100	1,200	11,000	--
06/18/91	285.98	255.14	30.84	--	--	--	--	--	--	--
09/12/91	285.98	254.34	31.64	0.03	--	--	--	--	--	--
01/23/92	285.98	255.46	30.52	Sheen	--	--	--	--	--	--
04/13/92	285.98	259.04	26.94	0.01	--	--	--	--	--	--
08/03/92	285.98	255.98	30.00	--	220,000	1,300	2,800	3,100	17,000	--
10/22/92	285.98	255.38	30.62	0.03	--	--	--	--	--	--
01/18/93	285.98	262.07	23.91	--	1,000,000	2,400	5,300	10,000	61,000	--
04/19/93	285.98	260.98	25.00	--	94,000	33,000	22,000	1,600	9,200	--
07/21-22/93	285.98	259.43	26.55	--	44,000	2,600	5,500	1,300	6,900	--
10/25/93	285.98	257.26	28.72	--	35,000	3,900	2,400	1,100	6,600	--
01/21/94	285.98	256.32	29.66	--	120,000	4,200	2,200	2,000	11,000	--
04/18/94	285.98	259.24	26.74	--	29,000	1,200	310	520	2,000	--
07/06-07/94	285.98	259.62	26.36	--	84,000	2,700	1,400	1,400	9,700	--
10/07/94	285.98	257.49	28.49	--	40,000	1,600	390	1,200	6,100	--

**Table 1**  
**Groundwater Monitoring Data and Analytical Results**  
Chevron Service Station #9-5607  
5269 Crow Canyon Road  
Castro Valley, California

WELL ID/ DATE	TOC (ft.)	GWE (msl)	DTW (ft.)	SPHT (ft.)	TPH-G (ppb)	B (ppb)	T (ppb)	E (ppb)	X (ppb)	MTBE (ppb)
C-3 (cont)										
01/11/95	285.98	262.84	23.14	--	34,000	4,200	910	720	3,800	--
04/24/95	285.98	266.10	19.88	--	210,000	43,000	28,000	2,400	13,000	--
07/31/95	285.98	261.30	24.68	--	110,000	33,000	17,000	2,300	12,000	--
10/02/95	285.98	258.84	27.14	--	69,000	6,700	4,000	2,000	11,000	--
01/16/96	285.98	261.60	24.38	--	40,000	2,400	440	1,200	5,500	<500
04/18/96	285.98	265.28	20.70	--	66,000	26,000	17,000	2,200	12,000	1,250
07/22/96	285.98	261.32	24.66	--	69,000	21,000	8,800	1,800	9,900	<1000
10/10/96	285.98	260.75	25.23	--	53,000	12,000	2,600	1,900	9,300	<500
01/09/97	285.98	267.74	18.24	--	73,000	17,000	6,000	1,700	7,800	<1250
04/15/97	285.98	263.96	22.02	--	160,000	28,000	17,000	2,600	12,000	<2500
07/08/97	285.98	263.04	22.96	0.03	--	--	--	--	--	--
10/22/97	285.98	264.08	21.90	--	59,000	13,000	5,200	2,100	11,000	1,500
01/12/98	285.98	277.93	8.05	--	62,000	10,000	4,100	1,700	8,000	1,000
04/21/98	285.98	270.70	15.28	--	70,000	13,000	5,800	1,600	7,100	<1000
07/08/98	285.98	264.83	21.15	--	22,000	7,300	2,100	560	2,900	<25
10/13/98	285.98	268.38	17.60	--	390	32	4.8	26	42	2.9
01/27/99	285.98	262.31	23.67	--	57,100	18,400	2,440	1,660	8,690	<200
04/27/99	285.98	265.98	20.00	--	121,000	22,500	11,500	2,970	14,500	<2000
07/23/99	285.98	255.45	31.09	0.70	--	--	--	--	--	--
11/01/99	285.98	255.45	21.03	--	138,000	23,900	14,700	3,970	18,400	1,180
01/20/00	285.98	262.72	23.26	--	135,000	20,700	9,870	2,840	13,600	<5000
04/28-29/00	285.98	265.63	20.35	0.00	120,000 <sup>3</sup>	24,000	11,000	2,700	14,000	2,100
07/21/00	285.98	265.34	20.64	0.00	93,000 <sup>3</sup>	24,000	11,000	3,100	15,000	2,000
10/09-10/00	285.98	264.35	21.63	0.00	83,400 <sup>5</sup>	21,400	7,130	2,160	12,000	<2,500
01/08-09/01	285.98	INACCESSIBLE	--	--	--	--	--	--	--	--

**Table 1**  
**Groundwater Monitoring Data and Analytical Results**  
Chevron Service Station #9-5607  
5269 Crow Canyon Road  
Castro Valley, California

WELL ID/ DATE	TOC (ft.)	GWE (msl)	DTW (ft.)	SPHT (ft.)	TPH-G (ppb)	B (ppb)	T (ppb)	E (ppb)	X (ppb)	MTBE (ppb)
<b>C-3 (cont)</b>										
04/30/01	285.98	265.65	20.33	0.00	104,000 <sup>3</sup>	20,800	6,170	2,370	12,800	<2,500
07/09-10/01	285.98	264.53	21.45	0.00	81,000 <sup>3</sup>	19,000	6,200	2,800	14,000	2,600
10/10/01	285.98	264.70	21.28	0.00	90,000	18,000	4,200	1,900	13,000	<50
<b>C-4</b>										
03/26/85	273.01	257.87	15.14	--	--	--	--	--	--	--
07/03/86	273.01	257.64	15.37	--	--	--	--	--	--	--
03/26/87	273.01	--	--	--	--	--	--	--	--	--
03/28/88	273.01	254.97	18.04	--	--	--	--	--	--	--
03/10/89	273.01	--	--	--	--	--	--	--	--	--
04/03/89	273.01	259.67	13.34	--	--	--	--	--	--	--
05/08/89	273.01	257.41	15.60	--	--	--	--	--	--	--
06/05/89	273.01	256.50	16.51	--	--	--	--	--	--	--
09/13/89	273.01	254.85	18.16	--	57,000	21,000	3,100	3,200	11,000	--
10/04/89	273.01	254.77	18.24	--	--	--	--	--	--	--
11/03/89	273.01	254.84	18.17	--	--	--	--	--	--	--
12/04/89	273.01	254.56	18.45	--	48,000	17,000	2,200	2,800	9,800	--
03/07/90	273.01	255.81	17.20	--	--	--	--	--	--	--
03/09/90	273.01	255.81	17.20	--	43,000	20,000	2,300	2,800	11,000	--
06/12/90	273.01	256.35	16.66	--	82,000	21,000	2,400	4,000	16,000	--
07/12/90	273.01	256.02	16.99	--	--	--	--	--	--	--
08/10/90	273.01	255.74	17.27	--	--	--	--	--	--	--
09/24/90	273.01	254.90	18.11	--	--	--	--	--	--	--

ABANDONED

**Table 1**  
**Groundwater Monitoring Data and Analytical Results**  
 Chevron Service Station #9-5607  
 5269 Crow Canyon Road  
 Castro Valley, California

WELL ID/ DATE	TOC (ft.)	GWE (msl)	DTW (ft.)	SPHT (ft.)	TPH-G (ppb)	B (ppb)	T (ppb)	E (ppb)	X (ppb)	MTBE (ppb)
C-5										
03/26/85	287.95	262.62	25.33	--	--	--	--	--	--	--
07/03/86	287.95	261.54	26.41	--	--	--	--	--	--	--
03/26/87	287.95	262.99	24.96	--	--	--	--	--	--	--
03/28/88	287.95	258.15	29.80	--	--	--	--	--	--	--
03/10/89	287.95	262.06	25.89	--	--	--	--	--	--	--
04/03/89	287.95	263.57	24.38	--	--	--	--	--	--	--
05/08/89	287.95	260.15	27.80	--	--	--	--	--	--	--
06/05/89	287.95	258.53	29.42	--	--	--	--	--	--	--
07/12/90	287.95	258.09	29.86	--	--	--	--	--	--	--
08/10/90	287.95	258.18	29.77	--	--	--	--	--	--	--
09/13/89	287.95	257.00	30.95	--	310	ND	ND	ND	ND	--
10/04/89	287.95	256.47	31.48	--	--	--	--	--	--	--
11/03/89	287.95	256.63	31.32	--	--	--	--	--	--	--
12/04/89	287.95	256.25	31.70	--	ND	ND	ND	ND	ND	--
03/07/90	287.95	257.67	30.28	--	--	--	--	--	--	--
03/09/90	287.95	257.67	30.28	--	ND	ND	ND	ND	ND	--
06/12/90	287.95	257.47	30.48	--	90	ND	ND	ND	ND	--
09/24/90	287.95	256.17	31.78	--	ND	ND	ND	ND	ND	--
12/20/90	287.95	254.66	33.29	--	170	ND	ND	1.0	0.7	--
03/27/91	287.95	259.97	27.98	--	--	--	--	--	--	--
06/18/91	287.95	255.43	32.52	--	--	--	--	--	--	--
09/12/91	287.95	254.58	33.37	--	--	--	--	--	--	--
01/23/92	287.95	255.28	32.67	--	--	--	--	--	--	--
04/13/92	287.95	259.47	28.48	--	140	ND	ND	0.7	ND	--
08/03/92	287.95	255.45	32.50	--	ND	ND	ND	ND	ND	--
10/22/92	287.95	253.97	33.98	--	--	--	--	--	--	--
01/18/93	287.95	260.93	27.02	--	230	6.6	2.2	3.4	2.2	--

**Table 1**  
**Groundwater Monitoring Data and Analytical Results**  
Chevron Service Station #9-5607  
5269 Crow Canyon Road  
Castro Valley, California

WELL ID/ DATE	TOC (ft.)	GWE (msl)	DTW (ft.)	SPHT (ft.)	TPH-G (ppb)	B (ppb)	T (ppb)	E (ppb)	X (ppb)	MTBE (ppb)
C-5 (cont)										
04/19/93	287.95	263.14	24.81	--	--	--	--	--	--	--
07/21-22/93	287.95	258.89	29.06	--	130	ND	0.6	ND	ND	--
10/25/93	287.95	257.00	30.95	--	--	--	--	--	--	--
01/21/94	287.95	256.04	31.91	--	ND	ND	ND	ND	ND	--
04/18/94	287.95	257.80	30.15	--	--	--	--	--	--	--
07/06-07/94	287.95	258.91	29.04	--	ND	ND	ND	ND	ND	--
10/07/94	287.95	256.11	31.84	--	--	--	--	--	--	--
01/11/95	287.95	262.97	24.98	--	700	1.1	6.0	1.5	2.1	--
04/24/95	287.95	266.17	21.78	--	SAMPLED SEMI-ANNUALLY			--	--	--
07/31/95	287.95	INACCESSIBLE	--	--	--	--	--	--	--	--
10/02/95	287.95	257.77	30.18	--	--	--	--	--	--	--
01/16/96	287.95	261.23	26.72	--	200	<0.5	<0.5	<0.5	1.3	<2.5
04/18/96	287.95	266.15	21.80	--	--	--	--	--	--	--
07/22/96	287.95	INACCESSIBLE	--	--	--	--	--	--	--	--
10/10/96	287.95	261.17	26.78	--	--	--	--	--	--	--
01/09/97	287.95	268.93	19.02	--	190	0.630	<0.5	<0.5	<0.5	<2.5
04/15/97	287.95	264.64	23.31	--	--	--	--	--	--	--
07/08/97	287.95	INACCESSIBLE	--	--	--	--	--	--	--	--
10/22/97	287.95	INACCESSIBLE	--	--	--	--	--	--	--	--
01/12/98	287.95	269.37	18.58	--	200	1.10	0.570	1.30	2.5	<2.5
04/21/98	287.95	272.75	15.20	--	--	--	--	--	--	--
07/08/98	287.95	264.76	23.19	--	52 <sup>2</sup>	<0.5	<0.5	<0.5	<0.5	<2.5
10/13/98	287.95	261.95	26.00	--	--	--	--	--	--	--
01/27/99	287.95	263.97	23.98	--	<50	<0.5	<0.5	<0.5	<0.5	<2.0
04/27/99	287.95	267.29	20.66	--	--	--	--	--	--	--
07/23/99	287.95	266.73	21.22	--	80.7	<0.5	<0.5	<0.5	<0.5	<5.0
11/01/99	287.95	268.22	19.73	--	--	--	--	--	--	--

**Table 1**  
**Groundwater Monitoring Data and Analytical Results**  
Chevron Service Station #9-5607  
5269 Crow Canyon Road  
Castro Valley, California

WELL ID/ DATE	TOC (ft.)	GWE (msl)	DTW (ft.)	SPHT (ft.)	TPH-G (ppb)	B (ppb)	T (ppb)	E (ppb)	X (ppb)	MTBE (ppb)
<b>C-5 (cont)</b>										
01/20/00	287.95	263.93	24.02	--	82.5	<0.5	<0.5	<0.5	<0.5	<5.0
04/28-29/00	287.95	267.84	20.11	0.00	SAMPLED SEMI-ANNUALLY		--	--	--	--
07/21/00	287.95	267.95	20.00	0.00	--	--	--	--	--	--
07/26/00	287.95	267.86	20.09	0.00	66 <sup>3</sup>	<0.50	<0.50	<0.50	<0.50	3.1
10/09-10/00	287.95	266.19	21.76	0.00	--	--	--	--	--	--
01/08-09/01	287.95	INACCESSIBLE	--	--	--	--	--	--	--	--
04/30/01	287.95	267.79	20.16	0.00	--	--	--	--	--	--
07/09-10/01	287.95	267.13	20.82	0.00	<50	<0.50	<0.50	<0.50	<0.50	<2.5
10/10/01	287.95	268.05	19.90	0.00	SAMPLED SEMI-ANNUALLY		--	--	--	--
<b>C-6</b>										
03/26/85	--	--	16.74	--	--	--	--	--	--	--
07/03/86	275.28	257.82	17.46	--	--	--	--	--	--	--
03/26/87	275.28	256.91	18.37	--	--	--	--	--	--	--
03/28/88	275.28	245.44	29.84	--	--	--	--	--	--	--
03/10/89	275.28	260.84	14.44	--	--	--	--	--	--	--
04/03/89	275.28	260.84	14.44	--	--	--	--	--	--	--
05/08/89	275.28	258.12	17.16	--	--	--	--	--	--	--
06/05/89	275.28	256.77	18.51	--	--	--	--	--	--	--
07/12/90	275.28	256.57	18.71	--	--	--	--	--	--	--
08/10/90	275.28	255.96	19.32	--	--	--	--	--	--	--
09/13/89	275.28	255.33	19.95	--	47	5,600	3,000	2,400	10,000	--
10/04/89	275.28	255.41	19.87	--	--	--	--	--	--	--
11/03/89	275.28	255.93	19.35	--	--	--	--	--	--	--
12/04/89	275.28	255.69	19.59	--	40,000	8,100	1,800	1,700	7,500	--
03/07/90	275.28	256.89	18.39	--	--	--	--	--	--	--



**Table 1**  
**Groundwater Monitoring Data and Analytical Results**  
Chevron Service Station #9-5607  
5269 Crow Canyon Road  
Castro Valley, California

WELL ID/ DATE	TOC (ft.)	GWE (msl)	DTW (ft.)	SPHT (ft.)	TPH-G (ppb)	B (ppb)	T (ppb)	E (ppb)	X (ppb)	MTBE (ppb)
C-6 (cont)										
03/09/90	275.28	256.89	18.39	--	73,000	23,000	5,900	3,400	17,000	--
06/12/90	275.28	256.41	18.87	--	85,000	19,000	6,500	3,400	16,000	--
09/24/90	275.28	255.29	19.99	--	72,000	15,000	3,200	2,600	11,000	--
12/20/90	275.28	253.71	21.57	--	100,000	11,000	4,200	3,400	16,000	--
03/27/91	275.28	258.96	16.32	--	100,000	11,000	4,400	2,300	11,000	--
06/18/91	275.28	251.95	23.33	--	--	--	--	--	--	--
09/12/91	275.28	251.32	23.96	--	--	--	--	--	--	--
01/23/92	275.28	263.20	12.08	--	--	--	--	--	--	--
04/13/92	275.28	255.43	19.85	Sheen	--	--	--	--	--	--
08/03/92	275.28	260.56	14.72	--	120,000	16,000	1,100	2,300	15,000	--
10/22/92	275.28	260.37	14.91	--	63,000	7,400	920	1,800	14,000	--
01/18/93	275.28	259.84	15.44	--	77,000	13,000	1,600	2,700	12,000	--
04/19/93	275.28	266.03	9.25	--	56,000	14,000	1,100	2,400	9,100	--
07/21-22/93	275.28	257.93	17.35	--	38,000	6,600	610	1,500	5,800	--
10/25/93	275.28	254.25	21.03	--	42,000	11,000	800	2,200	8,200	--
01/21/94	275.28	253.71	21.57	--	57,000	11,000	940	2,300	9,800	--
04/18/94	275.28	257.17	18.11	--	48,000	9,800	830	1,900	7,500	--
07/06-07/94	275.28	258.28	17.00	--	46,000	6,800	610	900	6,200	--
10/07/94	275.28	256.09	19.19	--	35,000	5,900	410	1,400	3,800	--
01/11/95	275.28	256.64	18.64	--	54,000	1,200	1,100	2,100	9,500	--
04/24/95	275.28	262.72	12.56	--	81,000	12,000	1,500	2,400	9,900	--
07/31/95	275.28	259.54	15.74	--	75,000	12,000	1,200	2,800	11,000	--
10/02/95	275.28	257.56	17.72	--	59,000	13,000	990	2,800	10,000	--
01/16/96	275.28	259.81	15.47	--	63,000	10,000	650	2,200	7,500	<500
04/18/96	275.28	259.33	15.95	--	56,000	9,800	590	1,500	5,800	660
07/22/96	275.28	INACCESSIBLE	--	--	--	--	--	--	--	--
10/10/96	275.28	INACCESSIBLE	--	--	--	--	--	--	--	--

**Table 1**  
**Groundwater Monitoring Data and Analytical Results**  
Chevron Service Station #9-5607  
5269 Crow Canyon Road  
Castro Valley, California

WELL ID/ DATE	TOC (ft.)	GWE (msl)	DTW (ft.)	SPHT (ft.)	TPH-G (ppb)	B (ppb)	T (ppb)	E (ppb)	X (ppb)	MTBE (ppb)
<b>C-6 (cont)</b>										
01/09/97	275.28	INACCESSIBLE	--	--	--	--	--	--	--	--
04/15/97	275.28	INACCESSIBLE	--	--	--	--	--	--	--	--
07/08/97	275.28	INACCESSIBLE	--	--	--	--	--	--	--	--
07/15/97	275.28	260.95	14.33	--	64,000	12,000	400	1,500	4,400	<1000
10/22/97	275.28	261.80	13.48	--	49,000	15,000	570	1,900	5,600	1,500
01/12/98	275.28	265.14	10.14	--	60,000	16,000	540	1,800	5,400	<1000
04/21/98	275.28	267.73	7.55	--	51,000	16,000	310	1,400	3,400	<1000
07/08/98	275.28	262.80	12.48	--	19,000	8,200	150	720	1,100	<250
10/13/98	275.28	259.82	15.46	--	46,000	12,000	490	1600	3,600	<250
01/27/99	275.28	263.32	11.96	--	16,000	4,440	132	688	1,290	190
04/27/99	275.28	263.15	12.13	--	38,800	13,100	403	1,540	3,430	<1250
07/23/99	275.28	261.82	13.46	--	33,400	9,460	182	1,030	2,040	<1000
11/01/99	275.28	262.01	13.27	--	23,700	7,250	335	775	882	161
01/20/00	275.28	260.64	14.64	--	32,300	8,970	181	1,020	1,450	<1000
04/28-29/00	275.28	263.21	12.07	0.00	1,900 <sup>3</sup>	3,100	40	51	130	120
07/21/00	275.28	262.88	12.40	0.00	5,000 <sup>3</sup>	4,400	43	50	88	130
10/09-10/00	275.28	261.89	13.39	0.00	4,810 <sup>5</sup>	2,570	<25.0	<25.0	<25.0	<125
01/08-09/01	275.28	261.51	13.77	0.00	110 <sup>5</sup>	16.8	0.827	<0.500	1.88	<2.50
04/30/01	275.28	265.16	10.12	0.00	19,400 <sup>3</sup>	5,290	74.0	171	648	<500
07/09-10/01	275.28	261.77	13.51	0.00	7,000 <sup>3</sup>	5,300	65	200	360	680
10/10/01	275.28	261.54	13.74	0.00	18,000	5,600	51	140	340	<50

**Table 1**  
**Groundwater Monitoring Data and Analytical Results**  
Chevron Service Station #9-5607  
5269 Crow Canyon Road  
Castro Valley, California

WELL ID/ DATE	TOC (ft.)	GWE (msl)	DTW (ft.)	SPHT (ft.)	TPH-G (ppb)	B (ppb)	T (ppb)	E (ppb)	X (ppb)	MTBE (ppb)
C-7										
03/26/85	--	--	9.61	--	--	--	--	--	--	--
07/03/86	270.70	259.96	10.74	--	--	--	--	--	--	--
03/26/87	270.70	260.62	10.08	--	--	--	--	--	--	--
03/28/88	270.70	256.91	13.79	--	--	--	--	--	--	--
03/10/89	270.70	260.28	10.42	--	--	--	--	--	--	--
04/03/89	270.70	261.56	9.14	--	--	--	--	--	--	--
05/08/89	270.70	258.79	11.91	--	--	--	--	--	--	--
06/05/89	270.70	259.16	11.54	--	--	--	--	--	--	--
07/12/90	270.70	257.25	13.45	--	--	--	--	--	--	--
08/10/90	270.70	257.33	13.37	--	--	--	--	--	--	--
09/13/89	270.70	256.10	14.60	--	410	1.3	ND	10	ND	--
10/04/89	270.70	255.53	15.17	--	--	--	--	--	--	--
11/03/89	270.70	255.42	15.28	--	--	--	--	--	--	--
12/04/89	270.70	255.00	15.70	--	1,000	1.0	ND	5.0	ND	--
03/07/90	270.70	256.48	14.22	--	--	--	--	--	--	--
03/09/90	270.70	256.48	14.22	--	590	2.8	2.4	3.5	2.0	--
06/12/90	270.70	256.52	14.18	--	1,200	ND	5.0	8.2	3.2	--
09/24/90	270.70	255.26	15.44	Sheen	400	1.4	1.9	1.4	2.2	--
09/24/90 (D)	270.70	255.26	15.44	--	580	ND	2.4	1.4	1.5	--
12/20/90	270.70	253.62	17.08	--	2,300	ND	6.5	4.7	9.3	--
03/27/91	270.70	258.05	12.65	--	980	ND	2.4	9.1	3.0	--
06/18/91	270.70	254.26	16.44	--	--	--	--	--	--	--
09/12/91	270.70	253.65	17.05	--	1,200	ND	3.1	6.5	2.7	--
01/23/92	270.70	253.78	16.92	--	--	--	--	--	--	--
04/13/92	270.70	257.70	13.00	--	830	ND	1.0	7.8	1.2	--
08/03/92	270.70	--	--	--	--	--	--	--	--	--
10/22/92	270.70	UNABLE TO LOCATE	--	--	--	--	--	--	--	--

**Table 1**  
**Groundwater Monitoring Data and Analytical Results**  
Chevron Service Station #9-5607  
5269 Crow Canyon Road  
Castro Valley, California

WELL ID/ DATE	TOC (ft.)	GWE (msl)	DTW (ft.)	SPHT (ft.)	TPH-G (ppb)	B (ppb)	T (ppb)	E (ppb)	X (ppb)	MTBE (ppb)
C-7 (cont)										
01/18/93	270.70	UNABLE TO LOCATE		--	--	--	--	--	--	--
04/19/93	270.70	UNABLE TO LOCATE		--	--	--	--	--	--	--
07/21-22/93	270.70	257.76	12.94	--	890	0.9	3.0	4.0	4.0	--
10/25/93	270.70	255.87	14.83	--	--	--	--	--	--	--
01/21/94	270.70	254.76	15.94	--	660	ND	6.0	1.0	3.0	--
04/18/94	270.70	255.72	14.98	--	--	--	--	--	--	--
07/06-07/94	270.70	257.76	12.94	--	960	ND	5.8	4.2	8.2	--
10/07/94	270.70	254.87	15.83	--	--	--	--	--	--	--
01/11/95	270.70	261.45	9.25	--	900	<0.5	<0.5	2.3	1.3	--
04/24/95	270.70	264.00	6.70	--	SAMPLED SEMI-ANNUALLY		--	--	--	--
07/31/95	270.70	259.46	11.24	--	690	<1.2	<1.2	<1.2	<1.2	--
10/02/95	270.70	256.68	14.02	--	--	--	--	--	--	--
01/16/96	270.70	259.48	11.22	--	<50	<0.5	<0.5	<0.5	<0.5	<2.5
04/18/96	270.70	264.05	6.65	--	--	--	--	--	--	--
07/22/96	270.70	259.60	11.10	--	360	4.4	2.0	<0.5	<0.5	17
10/10/96	270.70	259.35	11.35	--	--	--	--	--	--	--
01/09/97	270.70	266.82	3.88	--	69	<0.5	<0.5	<0.5	<0.5	<2.5
04/15/97	270.70	262.82	7.88	--	--	--	--	--	--	--
07/08/97	270.70	261.70	9.00	--	710	8.0	1.20	<0.5	<0.5	22
10/22/97	270.70	262.09	8.61	--	--	--	--	--	--	--
01/12/98	270.70	267.03	3.67	--	400	7.20	<1.0	1.60	1.30	16
04/21/98	270.70	270.19	0.51	--	--	--	--	--	--	--
07/08/98	270.70	263.72	6.98	--	<50	<0.5	<0.5	<0.5	<0.5	<2.5
10/13/98	270.70	261.58	9.12	--	--	--	--	--	--	--
01/27/99	270.70	262.15	8.55	--	<50	<0.5	<0.5	<0.5	<0.5	<2.0
04/27/99	270.70	265.75	4.95	--	--	--	--	--	--	--
07/23/99	270.70	265.60	5.10	--	500	7.84	0.983	1.71	0.658	<5.0

**Table 1**  
**Groundwater Monitoring Data and Analytical Results**  
Chevron Service Station #9-5607  
5269 Crow Canyon Road  
Castro Valley, California

WELL ID/ DATE	TOC (ft.)	GWE (msl)	DTW (ft.)	SPHT (ft.)	TPH-G (ppb)	B (ppb)	T (ppb)	E (ppb)	X (ppb)	MTBE (ppb)
<b>C-7 (cont)</b>										
11/01/99	270.70	263.41	7.29	--	--	--	--	--	--	--
01/20/00	270.70	262.94	7.76	--	503	6.82	0.56	<0.5	1.35	<5.0
04/28-29/00	270.70	266.33	4.37	0.00	SAMPLED SEMI-ANNUALLY		--	--	--	--
07/21/00	270.70	266.51	4.19	0.00	--	--	--	--	--	--
07/26/00	270.70	266.41	4.29	0.00	110 <sup>4</sup>	1.8	1.1	<0.50	<0.50	<2.5
10/09-10/00	270.70	265.47	5.23	0.00	--	--	--	--	--	--
01/08-09/01	270.70	264.00	6.70	0.00	<50.0	<0.500	<0.500	<0.500	<0.500	<2.50
04/30/01	270.70	266.39	4.31	0.00	--	--	--	--	--	--
07/09-10/01	270.70	265.87	4.83	0.00	150 <sup>3</sup>	1.9	0.83	<0.50	0.95	4.8
10/10/01	270.70	266.43	4.27	0.00	SAMPLED SEMI-ANNUALLY		--	--	--	--
<b>C-8</b>										
03/26/85	--	--	8.68	--	--	--	--	--	--	--
07/03/86	288.40	274.51	13.89	--	--	--	--	--	--	--
03/26/87	288.40	282.39	6.01	--	--	--	--	--	--	--
03/28/88	288.40	277.74	10.66	--	--	--	--	--	--	--
03/10/89	288.40	281.79	6.61	--	--	--	--	--	--	--
04/03/89	288.40	281.94	6.46	--	--	--	--	--	--	--
05/08/89	288.40	279.43	8.97	--	--	--	--	--	--	--
06/05/89	288.40	277.52	10.88	--	--	--	--	--	--	--
07/12/90	288.40	276.25	12.15	--	--	--	--	--	--	--
08/10/90	288.40	275.94	12.46	--	--	--	--	--	--	--
09/13/89	288.40	275.62	12.78	--	ND	ND	ND	ND	ND	--
10/04/89	288.40	275.89	12.51	--	--	--	--	--	--	--

**Table 1**  
**Groundwater Monitoring Data and Analytical Results**  
 Chevron Service Station #9-5607  
 5269 Crow Canyon Road  
 Castro Valley, California

WELL ID/ DATE	TOC (ft.)	GWE (msl)	DTW (ft.)	SPHT (ft.)	TPH-G (ppb)	B (ppb)	T (ppb)	E (ppb)	X (ppb)	MTBE (ppb)
<b>C-8 (cont)</b>										
11/03/89	288.40	273.77	14.63	--	--	--	--	--	--	--
12/04/89	288.40	278.81	9.59	--	64	0.6	0.6	ND	1.0	--
03/07/90	288.40	279.60	8.80	--	--	--	--	--	--	--
03/09/90	288.40	279.60	8.80	--	ND	ND	ND	ND	ND	--
06/12/90	288.40	279.46	8.94	--	120	2.5	1.2	1.0	1.4	--
09/24/90	288.40	274.86	13.54	--	--	--	--	--	--	--
12/20/90	288.40	279.07	9.33	--	--	--	--	--	--	--
03/27/91	288.40	282.30	6.10	--	54	0.7	ND	0.7	1.9	--
06/18/91	288.40	276.44	11.96	--	--	--	--	--	--	--
09/12/91	288.40	274.80	13.60	--	ND	ND	ND	ND	ND	--
09/12/91 (D)	288.40	274.80	13.60	--	ND	ND	ND	ND	ND	--
01/23/92	288.40	264.20	24.20	--	--	--	--	--	--	--
04/13/92	288.40	280.05	8.35	--	ND	ND	ND	ND	ND	--
08/03/92	288.40	275.82	12.58	--	ND	ND	ND	ND	ND	--
10/22/92	288.40	275.30	13.10	--	ND	ND	ND	ND	ND	--
01/18/93	288.40	282.28	6.12	--	ND	ND	ND	ND	ND	--
04/19/93	288.40	281.35	7.05	--	ND	ND	ND	ND	ND	--
07/21-22/93	288.40	277.05	11.35	--	ND	ND	ND	ND	ND	--
10/25/93	288.40	275.55	12.85	--	ND	ND	ND	ND	ND	--
01/21/94	288.40	277.85	10.55	--	ND	ND	ND	ND	ND	--
04/18/94	288.40	278.89	9.51	--	ND	1.2	0.9	ND	1.6	--
07/06-07/94	288.40	277.02	11.38	--	ND	ND	ND	ND	ND	--
10/07/94	288.40	275.48	12.92	--	ND	ND	ND	ND	ND	--
01/11/95	288.40	283.04	5.36	--	<50	<0.5	<0.5	<0.5	<0.5	--
04/24/95	288.40	281.82	6.58	--	<50	<0.5	0.61	<0.5	0.51	--
07/31/95	288.40	278.94	9.46	--	<50	<0.5	<0.5	<0.5	<0.5	--
10/02/95	288.40	276.56	11.84	--	<50	<0.5	<0.5	<0.5	<0.5	--

**Table 1**  
**Groundwater Monitoring Data and Analytical Results**  
Chevron Service Station #9-5607  
5269 Crow Canyon Road  
Castro Valley, California

WELL ID/ DATE	TOC (ft.)	GWE (msl)	DTW (ft.)	SPHT (ft.)	TPH-G (ppb)	B (ppb)	T (ppb)	E (ppb)	X (ppb)	MTBE (ppb)
<b>C-8 (cont)</b>										
01/16/96	288.40	281.40	7.00	--	<50	<0.5	<0.5	<0.5	<0.5	5.4
04/18/96	288.40	281.77	6.63	--	<50	<0.5	<0.5	<0.5	<0.5	<2.5
07/22/96	288.40	280.49	7.91	--	<50	<0.5	<0.5	<0.5	<0.5	<2.5
10/10/96	288.40	279.71	8.69	--	<50	<0.5	<0.5	<0.5	<0.5	<2.5
01/09/97	288.40	283.11	5.29	--	<50	<0.5	<0.5	<0.5	<0.5	<2.5
04/15/97	288.40	281.90	6.50	--	<50	<0.5	<0.5	<0.5	<0.5	<2.5
07/08/97	288.40	281.90	6.50	--	<50	<0.5	<0.5	<0.5	<0.5	<2.5
10/22/97	288.40	283.00	5.40	--	<50	<0.5	<0.5	<0.5	<0.5	<2.5
01/12/98	288.40	284.27	4.13	--	<50	<0.5	<0.5	<0.5	<0.5	<2.5
04/21/98	288.40	283.84	4.56	--	<50	<0.5	<0.5	<0.5	<0.5	<2.5
07/08/98	288.40	277.81	10.59	--	<50	<0.5	0.57	<0.5	<0.5	<2.5
10/13/98	288.40	276.32	12.08	--	<50	<0.5	<0.5	<0.5	<0.5	<2.5
01/27/99	288.40	276.89	11.51	--	<50	<0.5	<0.5	<0.5	<0.5	<2.0
04/27/99	288.40	282.40	6.00	--	<50	<0.5	<0.5	<0.5	<0.5	<5.0
07/23/99	288.40	282.13	6.27	--	<50	<0.5	<0.5	<0.5	<0.5	<5.0
11/01/99	288.40	282.30	6.10	--	<50	<0.5	<0.5	<0.5	<0.5	<2.5
01/20/00	288.40	281.92	6.48	--	<50	<0.5	<0.5	<0.5	<0.5	<5.0
04/28-29/00	288.40	282.82	5.58	0.00	<50	<0.50	<0.50	<0.50	<0.50	<2.5
07/21/00	288.40	282.45	5.95	0.00	<50	<0.50	<0.50	<0.50	<0.50	<2.5
10/09-10/00	288.40	281.82	6.58	0.00	<50.0	<0.500	<0.500	<0.500	<0.500	<2.50
01/08-09/01	288.40	INACCESSIBLE	--	--	--	--	--	--	--	--
04/30/01	288.40	282.44	5.96	0.00	<50.0	<0.500	<0.500	<0.500	<0.500	<5.00
07/09-10/01	288.40	282.81	5.59	0.00	<50	<0.50	<0.50	<0.50	<0.50	<2.5
10/10/01	288.40	282.88	5.52	0.00	<50	<0.50	<0.50	<0.50	<1.5	<2.5

**Table 1**  
**Groundwater Monitoring Data and Analytical Results**  
Chevron Service Station #9-5607  
5269 Crow Canyon Road  
Castro Valley, California

WELL ID/ DATE	TOC (ft.)	GWE (msl)	DTW (ft.)	SPHT (ft.)	TPH-G (ppb)	B (ppb)	T (ppb)	E (ppb)	X (ppb)	MTBE (ppb)
<b>C-9</b>										
07/03/86	268.46	254.57	13.89	--	--	--	--	--	--	--
03/26/87	268.46	254.72	13.74	--	--	--	--	--	--	--
03/28/88	268.46	253.47	14.99	--	--	--	--	--	--	--
03/10/89	268.46	255.07	13.39	--	--	--	--	--	--	--
04/03/89	268.46	255.62	12.84	--	--	--	--	--	--	--
05/08/89	268.46	254.08	14.38	--	--	--	--	--	--	--
06/05/89	268.46	253.10	15.36	--	--	--	--	--	--	--
07/12/90	268.46	252.81	15.65	--	--	--	--	--	--	--
08/10/90	268.46	252.66	15.80	--	--	--	--	--	--	--
09/13/89	268.46	251.93	16.53	--	42,000	14,000	1,100	2,800	4,200	--
10/04/89	268.46	251.94	16.52	--	--	--	--	--	--	--
11/03/89	268.46	251.95	16.51	--	--	--	--	--	--	--
12/04/89	268.46	251.67	16.79	--	36,000	11,000	670	2,500	3,800	--
03/07/90	268.46	252.24	16.22	--	--	--	--	--	--	--
03/09/90	268.46	252.24	16.22	--	28,000	12,000	940	3,000	4,700	--
06/12/90	268.46	253.58	14.88	--	39,000	11,000	1,600	2,300	4,800	--
09/24/90	268.46	252.16	16.30	--	120,000	13,000	1,600	3,700	6,800	--
12/20/90	268.46	251.23	17.23	--	51,000	9,300	560	2,800	3,300	--
12/20/90	(D) 268.46	251.23	17.23	--	44,000	12,000	580	2,800	3,500	--
03/27/91	268.46	254.68	13.78	--	56,000	3,400	5,000	1,600	5,600	--
06/18/91	268.46	249.82	18.64	--	--	--	--	--	--	--
09/12/91	268.46	INACCESSIBLE	--	--	--	--	--	--	--	--
10/24/95	268.46	250.39	18.07	--	30,000	7,200	440	2,500	1,600	--
01/16/96	268.46	252.18	16.28	--	36,000	8,200	700	2,500	2,100	<500
01/16/96	268.46	252.18	16.28	--	36,000	8,200	700	2,500	2,100	<500
07/08/98	268.46	256.46	12.00	--	20,000	4,900	880	1,100	2,500	<250
10/13/98	268.46	254.19	14.27	--	28,000	7,100	1,100	1,300	2,700	<125



**Table 1**  
**Groundwater Monitoring Data and Analytical Results**  
Chevron Service Station #9-5607  
5269 Crow Canyon Road  
Castro Valley, California

WELL ID/ DATE	TOC (ft.)	GWE (msl)	DTW (ft.)	SPHT (ft.)	TPH-G (ppb)	B (ppb)	T (ppb)	E (ppb)	X (ppb)	MTBE (ppb)
<b>C-9 (cont)</b>										
01/27/99	268.46	256.92	11.54	--	12,100	3,490	249	654	1,260	131
04/27/99	268.46	257.46	11.00	--	42,400	12,500	732	3,060	2,760	1000
07/23/99	268.46	257.16	11.30	--	28,800	7,420	418	1,900	1,720	<1000
11/01/99	268.46	257.02	11.44	--	10,100	2,050	227	628	830	933
01/20/00	268.46	255.38	13.08	--	33,100	7,990	239	1,990	1,030	<1000
04/28-29/00	268.46	257.61	10.85	0.00	7,400 <sup>3</sup>	1,100	<50	440	280	<250
07/21/00	268.46	256.93	11.53	0.00	3,900 <sup>3</sup>	770	33	270	200	210
10/09-10/00	268.46	254.76	13.70	0.00	4,190 <sup>5</sup>	732	32.3	340	200	<50.0
01/08-09/01	268.46	254.68	13.78	0.00	7,430 <sup>5</sup>	1,740	<50.0	554	317	297
04/30/01 <sup>9</sup>	268.46	255.07	13.39	0.00	5,040 <sup>3</sup>	509	12.2	248	119	<100
07/09-10/01 <sup>9</sup>	268.46	255.46	13.00	0.00	2,800 <sup>3</sup>	430	<25	200	91	200
10/10/01 <sup>9</sup>	268.46	255.96	12.50	0.00	5,900	920	33	300	240	<20
<b>C-10A</b>										
03/07/90	264.84	244.63	20.21	--	--	--	--	--	--	--
03/09/90	264.84	--	--	--	ND	1.6	0.7	0.8	3.5	--
06/12/90	264.84	245.14	19.70	--	ND	ND	ND	ND	ND	--
09/24/90	264.84	245.30	19.54	--	ND	ND	ND	ND	ND	--
12/20/90	264.84	245.00	19.84	--	ND	ND	ND	ND	ND	--
03/27/91	264.84	246.83	18.01	--	--	--	--	--	--	--
06/18/91	264.84	244.68	20.16	--	ND	ND	ND	ND	ND	--
09/12/91	264.84	244.27	20.57	--	ND	ND	ND	ND	ND	--
01/23/92	264.84	244.17	20.67	--	ND	ND	ND	ND	ND	--
04/13/92	264.84	245.44	19.40	--	53	0.9	1.3	ND	1.0	--
08/03/92	264.84	245.03	19.81	--	ND	ND	ND	ND	ND	--
10/22/92	264.84	245.01	19.83	--	ND	ND	ND	ND	0.5	--

**Table 1**  
**Groundwater Monitoring Data and Analytical Results**  
Chevron Service Station #9-5607  
5269 Crow Canyon Road  
Castro Valley, California

WELL ID/ DATE	TOC (ft.)	GWE (msl)	DTW (ft.)	SPHT (ft.)	TPH-G (ppb)	B (ppb)	T (ppb)	E (ppb)	X (ppb)	MTBE (ppb)
C-10A (cont)										
01/18/93	264.84	247.80	17.04	--	ND	ND	ND	ND	ND	--
04/19/93	264.84	247.07	17.77	--	ND	ND	ND	ND	ND	--
04/19/93	264.84	247.28	17.56	--	ND	ND	ND	ND	ND	--
10/25/93	264.84	247.07	17.77	--	ND	ND	ND	ND	ND	--
01/21/94	264.84	246.93	17.91	--	ND	ND	ND	ND	ND	--
04/18/94	264.84	247.81	17.03	--	ND	3.0	3.0	1.4	5.5	--
07/06-07/94	264.84	248.06	16.78	--	ND	ND	ND	ND	ND	--
10/07/94	264.84	247.63	17.21	--	ND	ND	ND	ND	ND	--
01/11/95	264.84	248.78	16.06	--	<50	<0.5	<0.5	<0.5	<0.5	--
04/24/95	264.84	248.32	16.52	--	<50	<0.5	<0.5	<0.5	<0.5	--
07/31/95	264.84	245.82	19.02	--	<50	<0.5	<0.5	<0.5	<0.5	--
10/02/95	264.84	245.14	19.70	--	<50	<0.5	<0.5	<0.5	<0.5	--
01/16/96	264.84	246.21	18.63	--	<50	<0.5	<0.5	<0.5	<0.5	<2.5
04/18/96	264.84	247.19	17.65	--	<50	<0.5	<0.5	<0.5	<0.5	<2.5
07/22/96	264.84	245.99	18.85	--	<50	<0.5	<0.5	<0.5	<0.5	<2.5
10/10/96	264.84	245.40	19.44	--	<50	<0.5	<0.5	<0.5	<0.5	<2.5
01/09/97	264.84	248.00	16.84	--	<50	<0.5	<0.5	<0.5	<0.5	<2.5
04/15/97	264.84	246.47	18.37	--	<50	<0.5	<0.5	<0.5	<0.5	<2.5
07/08/97	264.84	246.33	18.51	--	<50	<0.5	<0.5	<0.5	<0.5	<2.5
10/22/97	264.84	246.64	18.20	--	<50	<0.5	<0.5	<0.5	<0.5	<2.5
01/12/98	264.84	248.00	16.84	--	<50	<0.5	<0.5	<0.5	<0.5	<2.5
04/21/98	264.84	248.04	16.80	--	<50	<0.5	<0.5	<0.5	<0.5	<2.5
07/08/98	264.84	246.89	17.95	--	<50	<0.5	0.57	<0.5	<0.5	<2.5
10/13/98	264.84	246.16	18.68	--	<50	1.3	<0.5	0.67	1.5	<2.5
01/27/99	264.84	246.96	17.88	--	79.2	<0.5	<0.5	<0.5	<0.5	<2.0
04/27/99	264.84	247.53	17.31	--	<50	<0.5	<0.5	<0.5	<0.5	<5.0
07/23/99	264.84	246.27	18.57	--	<50	<0.5	<0.5	<0.5	<0.5	<5.0

**Table 1**  
**Groundwater Monitoring Data and Analytical Results**  
Chevron Service Station #9-5607  
5269 Crow Canyon Road  
Castro Valley, California

WELL ID/ DATE	TOC (ft.)	GWE (msl)	DTW (ft.)	SPHT (ft.)	TPH-G (ppb)	B (ppb)	T (ppb)	E (ppb)	X (ppb)	MTBE (ppb)
<b>C-10A (cont)</b>										
11/01/99	264.84	246.75	18.09	--	<50	<0.5	<0.5	<0.5	<0.5	<2.5
01/20/00	264.84	246.85	17.99	--	<50	<0.5	<0.5	<0.5	<0.5	<5.0
04/28-29/00	264.84	247.53	17.31	0.00	<50	<0.50	<0.50	<0.50	<0.50	<2.5
07/21/00	264.84	247.26	17.58	0.00	<50	<0.50	<0.50	<0.50	<0.50	<2.5
10/09-10/00	264.84	246.80	18.04	0.00	<50.0	<0.500	<0.500	<0.500	<0.500	<2.50
01/08-09/01	264.84	246.94	17.90	0.00	<50.0	<0.500	<0.500	<0.500	<0.500	<2.50
04/30/01	264.84	247.53	17.31	0.00	<50.0	<0.500	<0.500	<0.500	<0.500	<5.00
07/09-10/01	264.84	247.02	17.82	0.00	<50	<0.50	<0.50	<0.50	<0.50	<2.5
<b>DESTROYED</b>										
<b>C-10B</b>										
03/07/90	264.85	243.41	21.44	--	--	--	--	--	--	--
06/12/90	264.85	244.91	19.94	--	ND	ND	ND	ND	ND	--
09/24/90	264.85	245.08	19.77	--	ND	ND	ND	ND	ND	--
12/20/90	264.85	244.85	20.00	--	ND	ND	ND	ND	ND	--
03/27/91	264.85	246.62	18.23	--	--	--	--	--	--	--
06/18/91	264.85	244.41	20.44	--	--	--	--	--	--	--
09/12/91	264.85	244.03	20.82	--	ND	ND	ND	ND	ND	--
01/23/92	264.85	243.93	20.92	--	ND	ND	ND	ND	ND	--
04/13/92	264.85	245.17	19.68	--	ND	ND	ND	ND	ND	--
08/03/92	264.85	244.78	20.07	--	ND	ND	ND	ND	ND	--
10/22/92	264.85	244.73	20.12	--	ND	ND	ND	ND	ND	--
01/18/93	264.85	247.49	17.36	--	60	3.3	11	2.1	8.9	--
04/19/93	264.85	246.95	17.90	--	ND	ND	ND	ND	ND	--
07/21-22/93	264.85	246.99	17.86	--	ND	ND	ND	ND	ND	--
10/25/93	264.85	246.75	18.10	--	ND	ND	ND	ND	ND	--

**Table 1**  
**Groundwater Monitoring Data and Analytical Results**  
Chevron Service Station #9-5607  
5269 Crow Canyon Road  
Castro Valley, California

WELL ID/ DATE	TOC (ft.)	GWE (msl)	DTW (ft.)	SPHT (ft.)	TPH-G (ppb)	B (ppb)	T (ppb)	E (ppb)	X (ppb)	MTBE (ppb)
<b>C-10B (cont)</b>										
01/21/94	264.85	246.62	18.23	--	ND	ND	ND	ND	ND	--
04/18/94	264.85	247.49	17.36	--	ND	ND	ND	ND	0.5	--
07/06-07/94	264.85	247.80	17.05	--	ND	ND	ND	ND	ND	--
10/07/94	264.85	247.31	17.54	--	ND	ND	ND	ND	ND	--
01/11/95	264.85	248.61	16.24	--	<50	<0.5	<0.5	<0.5	<0.5	--
04/24/95	264.85	247.95	16.90	--	<50	<0.5	<0.5	<0.5	<0.5	--
07/31/95	264.85	245.57	19.28	--	<50	<0.5	<0.5	<0.5	<0.5	--
10/02/95	264.85	244.91	19.94	--	<50	<0.5	<0.5	<0.5	<0.5	--
01/16/96	264.85	246.25	18.60	--	<50	<0.5	<0.5	<0.5	<0.5	<2.5
04/18/96	264.85	246.87	17.98	--	<50	<0.5	<0.5	<0.5	<0.5	<2.5
07/22/96	264.85	245.75	19.10	--	<50	<0.5	<0.5	<0.5	<0.5	<2.5
10/10/96	264.85	245.14	19.71	--	<50	<0.5	<0.5	<0.5	<0.5	<2.5
01/09/97	264.85	247.65	17.20	--	<50	<0.5	<0.5	<0.5	<0.5	<2.5
04/15/97	264.85	246.11	18.74	--	<50	<0.5	<0.5	<0.5	<0.5	<2.5
07/08/97	264.85	246.10	18.75	--	<50	<0.5	<0.5	<0.5	<0.5	<2.5
10/22/97	264.85	246.35	18.50	--	<50	<0.5	<0.5	<0.5	<0.5	<2.5
01/12/98	264.85	247.71	17.14	--	<50	<0.5	<0.5	<0.5	<0.5	<2.5
04/21/98	264.85	247.69	17.16	--	<50	<0.5	<0.5	<0.5	<0.5	<2.5
07/08/98	264.85	246.61	18.24	--	<50	<0.5	0.62	<0.5	<0.5	<2.5
10/13/98	264.85	245.93	18.92	--	<50	<0.5	<0.5	<0.5	<0.5	<2.5
01/27/99	264.85	246.74	18.11	--	<50	<0.5	<0.5	<0.5	<0.5	<2.0
04/27/99	264.85	247.26	17.59	--	<50	<0.5	<0.5	<0.5	<0.5	<5.0
07/23/99	264.85	246.70	18.15	--	<50	<0.5	<0.5	<0.5	<0.5	<5.0
11/01/99	264.85	247.16	17.69	--	<50	<0.5	<0.5	<0.5	<0.5	<2.5
01/20/00	264.85	246.62	18.23	--	<50	<0.5	<0.5	<0.5	<0.5	<5.0
04/28-29/00	264.85	247.34	17.51	0.00	<50	<0.50	<0.50	<0.50	<0.50	<2.5
07/21/00	264.85	247.03	17.82	0.00	<50	<0.50	<0.50	<0.50	<0.50	<2.5

**Table 1**  
**Groundwater Monitoring Data and Analytical Results**  
Chevron Service Station #9-5607  
5269 Crow Canyon Road  
Castro Valley, California

WELL ID/ DATE	TOC (ft.)	GWE (mst)	DTW (ft.)	SPHT (ft.)	TPH-G (ppb)	B (ppb)	T (ppb)	E (ppb)	X (ppb)	MTBE (ppb)
<b>C-10B (cont)</b>										
10/09-10/00	264.85	246.62	18.23	0.00	<50.0	<0.500	<0.500	<0.500	<0.500	<2.50
01/08-09/01	264.85	246.72	18.13	0.00	<50.0	<0.500	<0.500	<0.500	<0.500	<2.50
04/30/01	264.85	247.31	17.54	0.00	<50.0	<0.500	<0.500	<0.500	<0.500	<5.00
07/09-10/01	264.85	246.80	18.05	0.00	<50	<0.50	<0.50	<0.50	<0.50	<2.5
<b>DESTROYED</b>										
<b>C-11</b>										
03/07/90	265.30	242.56	22.74	--	--	--	--	--	--	--
03/09/90	265.30	--	--	--	ND	1.2	0.7	ND	1.4	--
06/12/90	265.30	243.32	21.98	--	ND	ND	ND	ND	ND	--
09/24/90	265.30	243.42	21.88	--	ND	ND	ND	ND	ND	--
12/20/90	265.30	242.12	23.18	--	ND	ND	ND	ND	ND	--
03/27/91	265.30	243.78	21.52	--	ND	ND	ND	ND	1.5	--
06/18/91	265.30	243.40	21.90	--	--	--	--	--	--	--
09/12/91	265.30	242.60	22.70	--	ND	ND	ND	ND	ND	--
01/23/92	265.30	241.84	23.46	--	ND	ND	ND	ND	ND	--
04/13/92	265.30	243.73	21.57	--	ND	ND	ND	ND	ND	--
08/03/92	265.30	242.63	22.67	--	ND	ND	ND	ND	ND	--
10/22/92	265.30	242.01	23.29	--	ND	ND	ND	ND	ND	--
01/18/93	265.30	243.94	21.36	--	ND	ND	1.2	ND	2.2	--
04/19/93	265.30	245.33	19.97	--	ND	ND	ND	ND	ND	--
07/21-22/93	265.30	244.65	20.65	--	ND	ND	ND	ND	ND	--
10/25/93	265.30	244.55	20.75	--	ND	ND	ND	ND	ND	--
01/21/94	265.30	243.69	21.61	--	ND	ND	ND	ND	ND	--
04/18/94	265.30	244.52	20.78	--	ND	ND	ND	ND	ND	--
07/06-07/94	265.30	244.88	20.42	--	ND	ND	ND	ND	ND	--

**Table 1**  
**Groundwater Monitoring Data and Analytical Results**  
Chevron Service Station #9-5607  
5269 Crow Canyon Road  
Castro Valley, California

WELL ID/ DATE	TOC (ft.)	GWE (msl)	DTW (ft.)	SPHT (ft.)	TPH-G (ppb)	B (ppb)	T (ppb)	E (ppb)	X (ppb)	MTBE (ppb)
C-11 (cont)										
10/07/94	265.30	243.70	21.60	--	ND	ND	ND	ND	ND	--
01/11/95	265.30	245.28	20.02	--	<50	<0.5	<0.5	<0.5	<0.5	--
04/24/95	265.30	247.58	17.72	--	<50	<0.5	<0.5	<0.5	<0.5	--
07/31/95	265.30	246.12	19.18	--	<50	<0.5	<0.5	<0.5	<0.5	--
10/02/95	265.30	244.88	20.42	--	<50	<0.5	<0.5	<0.5	<0.5	--
01/16/96	265.30	245.48	19.82	--	<50	<0.5	<0.5	<0.5	<0.5	<2.5
04/18/96	265.30	248.30	17.00	--	260	7.9	6.9	5.3	23	11
07/22/96	265.30	248.40	16.90	--	<50	<0.5	<0.5	<0.5	<0.5	<2.5
10/10/96	265.30	245.74	19.56	--	130	32	2.70	4.30	14	3.40
01/09/97	265.30	249.28	16.02	--	75	5.30	6.40	2.0	9.0	<2.5
04/15/97	265.30	247.35	17.95	--	<50	<0.5	<0.5	<0.5	<0.5	<2.5
07/08/97	265.30	245.55	19.75	--	<50	<0.5	<0.5	<0.5	<0.5	<2.5
10/22/97	265.30	245.74	19.56	--	<50	<0.5	<0.5	<0.5	<0.5	<2.5
01/12/98	265.30	246.97	18.33	--	<50	<0.5	<0.5	<0.5	<0.5	<2.5
04/21/98	265.30	248.62	16.68	--	<50	<0.5	<0.5	<0.5	<0.5	<2.5
07/08/98	265.30	246.76	18.54	--	<50	<0.5	0.58	<0.5	<0.5	<2.5
10/13/98	265.30	245.02	20.28	--	<50	<0.5	<0.5	<0.5	<0.5	<2.5
01/27/99	265.30	245.85	19.45	--	<50	<0.5	<0.5	<0.5	<0.5	<2.0
04/27/99	265.30	246.90	18.40	--	<50	<0.5	<0.5	<0.5	<0.5	<5.0
07/23/99	265.30	246.05	19.25	--	<50	<0.5	<0.5	<0.5	<0.5	<5.0
11/01/99	265.30	247.47	17.83	--	<50	<0.5	<0.5	<0.5	<0.5	<2.5
01/20/00	265.30	245.06	20.24	--	<50	<0.5	<0.5	<0.5	<0.5	<5.0
04/28-29/00	265.30	246.35	18.95	0.00	<50	<0.50	<0.50	<0.50	<0.50	<2.5
07/21/00	265.30	246.07	19.23	0.00	<50	<0.50	<0.50	<0.50	<0.50	<2.5
10/09-10/00	265.30	245.57	19.73	0.00	<50.0	<0.500	<0.500	<0.500	<0.500	<2.50
01/08-09/01	265.30	244.99	20.31	0.00	<50.0	<0.500	<0.500	<0.500	<0.500	<2.50

**Table 1**  
**Groundwater Monitoring Data and Analytical Results**  
Chevron Service Station #9-5607  
5269 Crow Canyon Road  
Castro Valley, California

WELL ID/ DATE	TOC (ft.)	GWE (msl)	DTW (ft.)	SPHT (ft.)	TPH-G (ppb)	B (ppb)	T (ppb)	E (ppb)	X (ppb)	MTBE (ppb)
<b>C-11 (cont)</b>										
04/30/01	265.30	246.01	19.29	0.00	<50.0	<0.500	<0.500	<0.500	<0.500	<5.00
07/09-10/01	265.30	245.51	19.79	0.00	<50	<0.50	<0.50	<0.50	<0.50	<2.5
10/10/01	265.30	245.23	20.07	0.00	<50	<0.50	<0.50	<0.50	<1.5	<2.5
<b>C-12</b>										
03/07/90	269.66	254.74	14.92	--	--	--	--	--	--	--
03/09/90	269.66	--	--	--	1,400	230	140	33	180	--
06/12/90	269.66	254.87	14.79	--	720	190	71	18	73	--
09/24/90	269.66	253.94	15.72	--	ND	1.1	ND	ND	0.6	--
12/20/90	269.66	254.40	15.26	--	810	210	26	8.2	23	--
03/27/91	269.66	257.55	12.11	--	2,900	350	220	52	210	--
06/18/91	269.66	253.28	16.38	--	--	--	--	--	--	--
09/12/91	269.66	252.11	17.55	--	350	59	12	4.5	8.5	--
01/23/92	269.66	252.55	17.11	--	450	110	31	7.9	22	--
04/13/92	269.66	255.26	14.40	--	5,000	1,100	76	100	200	--
08/03/92	269.66	253.83	15.83	--	520	200	21	13	25	--
10/22/92	269.66	253.52	16.14	--	1,300	310	66	35	56	--
01/18/93	269.66	257.96	11.70	--	5,600	1,200	430	220	610	--
04/19/93	269.66	256.61	13.05	--	2,000	600	99	96	170	--
07/21-22/93	269.66	256.82	12.84	--	540	95	36	18	56	--
10/25/93	269.66	255.63	14.03	--	350	90	29	20	50	--
01/21/94	269.66	255.51	14.15	--	450	73	18	14	37	--
04/18/94	269.66	256.71	12.95	--	370	70	21	12	39	--
07/06-07/94	269.66	257.35	12.31	--	840	200	35	28	66	--
10/07/94	269.66	256.31	13.35	--	830	85	29	17	63	--
01/11/95	269.66	258.43	11.23	--	2,100	570	190	98	390	--

**Table 1**  
**Groundwater Monitoring Data and Analytical Results**  
Chevron Service Station #9-5607  
5269 Crow Canyon Road  
Castro Valley, California

WELL ID/ DATE	TOC (ft.)	GWE (msl)	DTW (ft.)	SPHT (ft.)	TPH-G (ppb)	B (ppb)	T (ppb)	E (ppb)	X (ppb)	MTBE (ppb)
C-12 (cont)										
04/24/95	269.66	259.34	10.32	--	820	120	28	23	61	--
07/31/95	269.66	256.92	12.74	--	520	79	13	16	42	--
10/02/95	269.66	255.26	14.40	--	400	50	5.3	11	29	--
01/16/96	269.66	256.94	12.72	--	1,900	490	32	60	120	<25
04/18/96	269.66	258.91	10.75	--	2,900	640	54	100	190	68
07/22/96	269.66	256.46	13.20	--	730	150	13	26	75	10
10/10/96	269.66	255.95	13.71	--	270	58	4.40	7.70	31	<2.5
01/09/97	269.66	260.60	9.06	--	2,900	550	67	94	300	63
04/15/97	269.66	258.13	11.53	--	2,500	350	29	92	200	43
07/08/97	269.66	257.92	11.74	--	1,400	190	17	54	120	21
10/22/97	269.66	258.78	10.88	--	2,300	490	45	110	340	42
01/12/98	269.66	260.76	8.90	--	5,000	840	89	220	610	<50
04/21/98	269.66	262.41	7.25	--	2,400	410	39	79	270	130
07/08/98	269.66	258.95	10.71	--	<50	7.6	<0.5	2.0	2.9	<2.5
10/13/98	269.66	257.01	12.65	--	2,600	460	34	120	240	11
01/27/99	269.66	257.41	12.25	--	96.9	6.88	<0.5	<0.5	<0.5	<2.0
04/27/99	269.66	259.46	10.20	--	2,720	614	32	128	300	<50
07/23/99	269.66	258.27	11.39	--	1,230	220	10	45	93.6	<20
11/01/99	269.66	257.13	12.53	--	70.7	10.7	1.02	<0.5	1.61	5.55
01/20/00	269.66	257.85	11.81	--	1,390	301	10.7	29.9	90.8	<50
04/28-29/00	269.66	259.37	10.29	0.00	310 <sup>3</sup>	57	<0.50	11	6.8	15
07/21/00	269.66	258.67	10.99	0.00	260 <sup>1</sup>	74	1.5	<0.50	12	5.55
10/09-10/00	269.66	257.63	12.03	0.00	3,510 <sup>5</sup>	903	24.0	53.9	200	<100
01/08-09/01	269.66	257.70	11.96	0.00	1,600 <sup>7</sup>	319	<5.00	60.7	55.1	84.8



**Table 1**  
**Groundwater Monitoring Data and Analytical Results**  
Chevron Service Station #9-5607  
5269 Crow Canyon Road  
Castro Valley, California

WELL ID/ DATE	TOC ( <i>fl.</i> )	GWE ( <i>msl</i> )	DTW ( <i>fl.</i> )	SPHT ( <i>fl.</i> )	TPH-G ( <i>ppb</i> )	B ( <i>ppb</i> )	T ( <i>ppb</i> )	E ( <i>ppb</i> )	X ( <i>ppb</i> )	MTBE ( <i>ppb</i> )
<b>C-12 (cont)</b>										
04/30/01	269.66	259.08	10.58	0.00	985 <sup>3</sup>	114	<2.50	26.4	14.6	<25.0
07/09-10/01	269.66	258.04	11.62	0.00	<50	6.5	<0.50	<0.50	<0.50	<2.5
<b>10/10/01</b>	<b>269.66</b>	<b>257.60</b>	<b>12.06</b>	<b>0.00</b>	<b>8,700</b>	<b>720</b>	<b>15</b>	<b>430</b>	<b>250</b>	<b>&lt;50</b>
<b>C-13</b>										
03/07/90	284.32	273.14	11.18	--	--	--	--	--	--	--
03/09/90	284.32	--	--	--	ND	15	3.7	1.0	6.2	--
06/12/90	284.32	273.62	10.70	--	ND	2.6	ND	ND	ND	--
09/24/90	284.32	272.72	11.60	--	ND	2.4	ND	ND	ND	--
12/20/90	284.32	274.16	10.16	--	ND	1.6	ND	ND	ND	--
03/27/91	284.32	276.68	7.64	--	--	--	--	--	--	--
06/18/91	284.32	273.00	11.32	--	--	--	--	--	--	--
09/12/91	284.32	272.48	11.84	--	ND	ND	ND	ND	ND	--
01/23/92	284.32	273.77	10.55	--	--	--	--	--	--	--
04/13/92	284.32	273.36	10.96	--	ND	1.0	ND	ND	ND	--
08/03/92	284.32	273.42	10.90	--	ND	ND	ND	ND	ND	--
10/22/92	284.32	273.14	11.18	--	--	--	--	--	--	--
01/18/93	284.32	276.92	7.40	--	290	54	10	5.4	12	--
04/19/93	284.32	275.39	8.93	--	--	--	--	--	--	--
07/21-22/93	284.32	273.57	10.75	--	ND	ND	ND	ND	ND	--
10/25/93	284.32	273.47	10.85	--	--	--	--	--	--	--
01/21/94	284.32	273.27	11.05	--	ND	ND	ND	ND	ND	--
04/18/94	284.32	273.61	10.71	--	--	--	--	--	--	--
07/06-07/94	284.32	273.67	10.65	--	ND	0.5	ND	ND	ND	--
10/07/94	284.32	273.24	11.08	--	--	--	--	--	--	--
01/11/95	284.32	278.94	5.38	--	120	15	<0.5	3.1	2.7	--

**Table 1**  
**Groundwater Monitoring Data and Analytical Results**  
Chevron Service Station #9-5607  
5269 Crow Canyon Road  
Castro Valley, California

WELL ID/ DATE	TOC (ft.)	GWE (mst)	DTW (ft.)	SPHT (ft.)	TPH-G (ppb)	B (ppb)	T (ppb)	E (ppb)	X (ppb)	MTBE (ppb)
C-13 (cont)										
04/24/95	284.32	276.54	7.78	--	SAMPLED SEMI-ANNUALLY	--	--	--	--	--
07/31/95	284.32	274.38	9.94	--	<50	<0.5	<0.5	<0.5	<0.5	--
10/02/95	284.32	273.74	10.58	--	--	--	--	--	--	--
01/16/96	284.32	274.52	9.80	--	<50	<0.5	<0.5	<0.5	<0.5	<2.5
04/18/96	284.32	276.57	7.75	--	--	--	--	--	--	--
07/22/96	284.32	274.82	9.50	--	59	18	<0.5	1.0	<0.5	<2.5
10/10/96	284.32	273.63	10.69	--	--	--	--	--	--	--
01/09/97	284.32	276.95	7.37	--	<50	0.60	<0.5	<0.5	<0.5	<2.5
04/15/97	284.32	275.63	8.69	--	--	--	--	--	--	--
07/08/97	284.32	276.12	8.20	--	SAMPLES LOST	--	--	--	--	--
07/15/97	284.32	276.02	8.30	--	<50	2.6	<0.5	<0.5	1.6	<2.5
10/22/97	284.32	276.79	7.53	--	--	--	--	--	--	--
01/12/98	284.32	278.38	5.94	--	<50	<0.5	<0.5	<0.5	<0.5	<2.5
04/21/98	284.32	277.35	6.97	--	--	--	--	--	--	--
07/08/98	284.32	274.45	9.87	--	<50	<0.5	<0.5	<0.5	<0.5	<2.5
10/13/98	284.32	273.51	10.81	--	--	--	--	--	--	--
01/27/99	284.32	273.06	11.26	--	<50	<0.5	<0.5	<0.5	<0.5	<2.0
04/27/99	284.32	275.42	8.90	--	--	--	--	--	--	--
07/23/99	284.32	275.00	9.32	--	158	14.9	<0.5	0.69	0.928	<5.0
11/01/99	284.32	272.83	11.49	--	--	--	--	--	--	--
01/20/00	284.32	274.23	10.09	--	<50	<0.5	<0.5	<0.5	<0.5	<5.0
04/28-29/00	284.32	275.43	8.89	0.00	SAMPLED SEMI-ANNUALLY	--	--	--	--	--
07/21/00	284.32	274.87	9.45	0.00	--	--	--	--	--	--
07/26/00	284.32	INACCESSIBLE	--	--	--	--	--	--	--	--
10/09-10/00	284.32	274.07	10.25	0.00	--	--	--	--	--	--

**Table 1**  
**Groundwater Monitoring Data and Analytical Results**  
Chevron Service Station #9-5607  
5269 Crow Canyon Road  
Castro Valley, California

WELL ID/ DATE	TOC (ft.)	GWE (msl)	DTW (ft.)	SPHT (ft.)	TPH-G (ppb)	B (ppb)	T (ppb)	E (ppb)	X (ppb)	MTBE (ppb)
<b>C-13 (cont)</b>										
01/08-09/01	284.32	INACCESSIBLE	--	--	--	--	--	--	--	--
04/30/01	284.32	275.17	9.15	0.00	<50.0	0.925	<0.500	<0.500	<0.500	<5.00
07/09-10/01	284.32	274.72	9.60	0.00	<50	0.66	<0.50	<0.50	<0.50	<2.5
10/10/01	284.32	274.52	9.80	0.00	SAMPLED SEMI-ANNUALLY		--	--	--	--
<b>C-14</b>										
03/07/90	270.74	255.56	15.18	--	--	--	--	--	--	--
03/09/90	270.74	--	--	--	ND	ND	ND	ND	ND	--
06/12/90	270.74	257.32	13.42	--	ND	ND	ND	ND	ND	--
09/24/90	270.74	257.90	12.84	--	ND	ND	ND	ND	ND	--
12/20/90	270.74	254.02	16.72	--	ND	1.7	0.7	ND	0.7	--
03/27/91	270.74	262.74	8.00	--	ND	ND	ND	ND	1.3	--
06/18/91	270.74	255.53	15.21	--	--	--	--	--	--	--
09/12/91	270.74	255.13	15.61	--	ND	ND	ND	ND	ND	--
01/23/92	270.74	246.10	24.64	--	--	--	--	--	--	--
04/13/92	270.74	258.53	12.21	--	ND	ND	ND	ND	ND	--
08/03/92	270.74	256.10	14.64	--	ND	ND	ND	ND	ND	--
10/22/92	270.74	253.80	16.94	--	--	--	--	--	--	--
01/18/93	270.74	265.64	5.10	--	ND	ND	ND	ND	ND	--
04/19/93	270.74	263.86	6.88	--	--	--	--	--	--	--
07/21-22/93	270.74	259.58	11.16	--	ND	ND	ND	ND	ND	--
10/25/93	270.74	256.87	13.87	--	--	--	--	--	--	--
01/21/94	270.74	255.42	15.32	--	ND	ND	ND	ND	ND	--
04/18/94	270.74	254.85	15.89	--	--	--	--	--	--	--
07/06-07/94	270.74	258.66	12.08	--	ND	ND	ND	ND	ND	--
10/07/94	270.74	255.45	15.29	--	--	--	--	--	--	--

**Table 1**  
**Groundwater Monitoring Data and Analytical Results**  
Chevron Service Station #9-5607  
5269 Crow Canyon Road  
Castro Valley, California

WELL ID/ DATE	TOC (ft.)	GWE (msl)	DTW (ft.)	SPHT (ft.)	TPH-G (ppb)	B (ppb)	T (ppb)	E (ppb)	X (ppb)	MTBE (ppb)
<b>C-14 (cont)</b>										
01/11/95	270.74	266.94	3.80	--	<50	<0.5	<0.5	<0.5	<0.5	--
04/24/95	270.74	265.68	5.06	--	SAMPLED SEMI-ANNUALLY		--	--	--	--
07/31/95	270.74	260.34	10.40	--	<50	<0.5	<0.5	<0.5	<0.5	--
10/02/95	270.74	257.20	13.54	--	--	--	--	--	--	--
01/16/96	270.74	259.62	11.12	--	<50	<0.5	<0.5	<0.5	<0.5	<2.5
04/18/96	270.74	265.78	4.96	--	--	--	--	--	--	--
07/22/96	270.74	259.89	10.85	--	<50	<0.5	<0.5	<0.5	<0.5	<2.5
10/10/96	270.74	261.44	9.30	--	--	--	--	--	--	--
01/09/97	270.74	269.80	0.94	--	56	3.80	4.20	1.10	5.0	<2.5
04/15/97	270.74	263.59	7.15	--	--	--	--	--	--	--
07/08/97	270.74	261.44	9.30	--	<50	<0.5	<0.5	<0.5	<0.5	<2.5
10/22/97	270.74	261.17	9.57	--	--	--	--	--	--	--
01/12/98	270.74	268.45	2.29	--	<50	<0.5	<0.5	<0.5	<0.5	<2.5
04/21/98	270.74	270.70	0.04	--	--	--	--	--	--	--
07/08/98	270.74	264.85	5.89	--	<50	<0.5	<0.5	<0.5	<0.5	<2.5
10/13/98	270.74	260.38	10.36	--	--	--	--	--	--	--
01/27/99	270.74	263.42	7.32	--	<50	<0.5	<0.5	<0.5	<0.5	<2.0
04/27/99	270.74	267.98	2.76	--	--	--	--	--	--	--
07/23/99	270.74	269.59	1.15	--	<50	<0.5	<0.5	<0.5	<0.5	<5.0
11/01/99	270.74	267.11	3.63	--	--	--	--	--	--	--
01/20/00	270.74	266.77	3.97	--	<50	<0.5	<0.5	<0.5	<0.5	<5.0
04/28-29/00	270.74	269.13	1.61	0.00	SAMPLED SEMI-ANNUALLY		--	--	--	--
07/21/00	270.74	268.72	2.02	0.00	--	--	--	--	--	--
07/26/00	270.74	268.45	2.29	0.00	<50	<0.50	<0.50	<0.50	<0.50	<2.5
10/09-10/00	270.74	267.39	3.35	0.00	--	--	--	--	--	--
01/08-09/01	270.74	266.72	4.02	0.00	<50.0	<0.500	<0.500	<0.500	<0.500	<2.50

**Table 1**  
**Groundwater Monitoring Data and Analytical Results**  
Chevron Service Station #9-5607  
5269 Crow Canyon Road  
Castro Valley, California

WELL ID/ DATE	TOC (ft.)	GWE (msl)	DTW (ft.)	SPHT (ft.)	TPH-G (ppb)	B (ppb)	T (ppb)	E (ppb)	X (ppb)	MTBE (ppb)
<b>C-14 (cont)</b>										
04/30/01	270.74	268.19	2.55	0.00	--	--	--	--	--	--
07/09-10/01	270.74	267.56	3.18	0.00	<50	<0.50	<0.50	<0.50	<0.50	<2.5
10/10/01	270.74	267.69	3.05	0.00	SAMPLED SEMI-ANNUALLY			--	--	--
<b>C-15</b>										
03/07/90	246.15	235.05	11.10	--	--	--	--	--	--	--
03/09/90	246.15	--	--	--	410	ND	1.4	0.5	0.6	--
06/12/90	246.15	235.37	10.78	--	420	11	ND	ND	ND	--
09/24/90	246.15	235.22	10.93	--	430	ND	1.5	ND	ND	--
12/20/90	246.15	235.07	11.08	--	300	1.3	1.1	0.6	1.5	--
03/27/91	246.15	237.65	8.50	--	520	4.6	1.1	ND	1.0	--
06/18/91	246.15	235.32	10.83	--	290	ND	1.1	ND	ND	--
06/18/91 (D)	246.15	235.32	10.83	--	320	ND	1.3	ND	ND	--
09/12/91	246.15	235.10	11.05	--	330	ND	0.9	ND	ND	--
01/23/92	246.15	235.35	10.80	--	210	ND	0.6	ND	ND	--
01/23/92 (D)	246.15	235.35	10.80	--	190	1.2	0.8	ND	ND	--
04/13/92	246.15	236.57	9.58	--	430	1.8	ND	ND	ND	--
08/03/92	246.15	234.94	11.21	--	640	ND	2.1	0.7	1.3	--
10/22/92	246.15	234.50	11.65	--	420	ND	ND	ND	0.8	--
01/18/93	246.15	239.03	7.12	--	640	7.0	3.0	2.9	6.7	--
04/19/93	246.15	237.22	8.93	--	260	6.0	2.0	0.7	ND	--
07/21-22/93	246.15	236.37	9.78	--	580	ND	8.0	ND	0.6	--
10/25/93	246.15	236.41	9.74	--	240	ND	12	ND	0.6	--
01/21/94	246.15	235.78	10.37	--	420	0.6	ND	0.6	ND	--
04/18/94	246.15	236.19	9.96	--	550	1.0	4.6	0.6	ND	--
07/06-07/94	246.15	235.92	10.23	--	660	0.7	ND	ND	0.7	--

**Table 1**  
**Groundwater Monitoring Data and Analytical Results**  
Chevron Service Station #9-5607  
5269 Crow Canyon Road  
Castro Valley, California

WELL ID/ DATE	TOC (ft.)	GWE (msl)	DTW (ft.)	SPHT (ft.)	TPH-G (ppb)	B (ppb)	T (ppb)	E (ppb)	X (ppb)	MTBE (ppb)
C-15 (cont)										
10/07/94	246.15	235.47	10.68	--	440	13	0.8	ND	1.2	--
01/11/95	246.15	238.84	7.31	--	750	2.5	<0.5	<0.5	0.6	--
04/24/95	246.15	237.41	8.74	--	850	<0.5	<0.5	<0.5	<0.5	--
07/31/95	246.15	235.41	10.74	--	640	<0.5	1.6	<0.5	<0.5	--
10/02/95	246.15	234.83	11.32	--	560	<0.5	<0.5	<0.5	<0.5	--
01/16/96	246.15	235.58	10.57	--	740	<0.5	<0.5	<0.5	<0.5	<2.5
04/18/96	246.15	237.55	8.60	--	760	<0.5	<0.5	<0.5	<0.5	<2.5
07/22/96	246.15	235.57	10.58	--	690	<0.5	1.60	<0.5	<0.5	7.90
10/10/96	246.15	234.97	11.18	--	870	7.0	2.10	<0.5	<0.5	11
01/09/97	246.15	238.83	7.32	--	370	2.60	1.10	<0.5	<0.5	4.60
04/15/97	246.15	235.76	10.39	--	510	22	<0.5	<0.5	<0.5	<2.5
07/08/97	246.15	235.68	10.47	--	490	71	6.80	22	48	7.0
10/22/97	246.15	235.01	11.14	--	790	2.30	1.80	<0.5	<0.5	5.10
01/12/98	246.15	238.17	7.98	--	400	13	<1.0	<1.0	<1.0	<5.0
04/21/98	246.15	238.05	8.10	--	770	<0.5	0.6	0.82	0.51	<2.5
07/08/98	246.15	235.65	10.50	--	540	13	<0.5	<0.5	<0.5	<2.5
10/13/98	246.15	234.95	11.20	--	<50	<0.5	<0.5	<0.5	0.54	<2.5
01/27/99	246.15	235.53	10.62	--	769	<0.5	1.88	0.675	<0.5	4.35
04/27/99	246.15	236.91	9.24	--	612	2.57	1.79	<0.5	<0.5	<5.0
07/23/99	246.15	235.11	11.04	--	626	13.6	<0.5	<0.5	<0.5	<5.0
11/01/99	246.15	235.25	10.90	--	739	21.9	4.54	1.45	1.28	17.3
01/20/00 <sup>6</sup>	246.15	235.06	11.09	--	465	1.43	0.815	<0.5	<0.5	<5.0
04/28-29/00	246.15	235.85	10.30	0.00	470 <sup>3</sup>	2.9	3.2	<0.50	<0.50	8.0
07/21/00	246.15	235.19	10.96	0.00	610 <sup>3</sup>	2.1	3.5	<0.50	1.7	7.9
10/09-10/00	246.15	235.01	11.14	0.00	527 <sup>5</sup>	<0.500	<0.500	<0.500	<0.500	10.3

**Table 1**  
**Groundwater Monitoring Data and Analytical Results**  
Chevron Service Station #9-5607  
5269 Crow Canyon Road  
Castro Valley, California

WELL ID/ DATE	TOC (ft.)	GWE (msl)	DTW (ft.)	SPHT (ft.)	TPH-G (ppb)	B (ppb)	T (ppb)	E (ppb)	X (ppb)	MTBE (ppb)
<b>C-15 (cont)</b>										
01/08-09/01	246.15	235.07	11.08	0.00	677 <sup>7</sup>	3.86	0.862	<0.500	<0.500	12.1
04/30/01	246.15	235.38	10.77	0.00	690 <sup>8</sup>	<1.00	<1.00	<1.00	<1.00	11.0
07/09-10/01	246.15	234.93	11.22	0.00	510 <sup>3</sup>	30	1.6	<0.50	1.2	11
10/10/01	246.15	234.83	11.32	0.00	780	1.7	<1.0	<0.50	<1.5	7.0
<b>C-16</b>										
03/07/90	246.69	228.19	18.50	--	--	--	--	--	--	--
03/09/90	246.69	--	--	--	ND	ND	ND	ND	ND	--
06/12/90	246.69	235.27	11.42	--	ND	ND	ND	ND	ND	--
09/24/90	246.69	235.30	11.39	--	ND	ND	ND	ND	ND	--
12/20/90	246.69	235.12	11.57	--	ND	ND	ND	ND	0.7	--
03/27/91	246.69	237.93	8.76	--	ND	ND	ND	ND	1.3	--
03/27/91 (D)	246.69	237.93	8.76	--	ND	ND	ND	ND	1.2	--
06/18/91	246.69	235.51	11.18	--	ND	ND	ND	ND	ND	--
09/12/91	246.69	234.74	11.95	--	ND	ND	ND	ND	ND	--
01/23/92	246.69	234.28	12.41	--	ND	ND	ND	ND	ND	--
04/13/92	246.69	236.00	10.69	--	ND	ND	ND	ND	ND	--
08/03/92	246.69	234.49	12.20	--	ND	ND	ND	ND	ND	--
10/22/92	246.69	234.09	12.60	--	ND	ND	ND	ND	ND	--
01/18/93	246.69	237.69	9.00	--	ND	ND	ND	ND	ND	--
04/19/93	246.69	236.80	9.89	--	ND	ND	ND	ND	ND	--
07/21-22/93	246.69	236.44	10.25	--	ND	ND	ND	ND	ND	--
10/25/93	246.69	235.73	10.96	--	ND	ND	ND	ND	ND	--
01/21/94	246.69	234.93	11.76	--	ND	ND	0.7	ND	1.0	--
04/18/94	246.69	235.47	11.22	--	ND	ND	ND	ND	ND	--
07/06-07/94	246.69	235.32	11.37	--	ND	ND	ND	ND	ND	--

**Table 1**  
**Groundwater Monitoring Data and Analytical Results**  
Chevron Service Station #9-5607  
5269 Crow Canyon Road  
Castro Valley, California

WELL ID/ DATE	TOC (ft.)	GWE (msl)	DTW (ft.)	SPHT (ft.)	TPH-G (ppb)	B (ppb)	T (ppb)	E (ppb)	X (ppb)	MTBE (ppb)
C-16 (cont)										
10/07/94	246.69	234.30	12.39	--	ND	ND	ND	ND	ND	--
01/11/95	246.69	237.73	8.96	--	<50	<0.5	<0.5	<0.5	<0.5	--
04/24/95	246.69	236.31	10.38	--	<50	<0.5	<0.5	<0.5	<0.5	--
07/31/95	246.69	235.37	11.32	--	<50	<0.5	<0.5	<0.5	<0.5	--
10/02/95	246.69	234.29	12.40	--	<50	<0.5	<0.5	<0.5	<0.5	--
01/16/96	246.69	235.15	11.54	--	<50	<0.5	<0.5	<0.5	<0.5	<2.5
04/18/96	246.69	236.09	10.60	--	<50	<0.5	<0.5	<0.5	<0.5	<2.5
07/22/96	246.69	235.12	11.57	--	<50	<0.5	<0.5	<0.5	<0.5	<2.5
10/10/96	246.69	234.25	12.44	--	<50	<0.5	<0.5	<0.5	<0.5	<2.5
01/09/97	246.69	237.16	9.53	--	<50	<0.5	<0.5	<0.5	<0.5	<2.5
04/15/97	246.69	234.66	12.03	--	<50	<0.5	<0.5	<0.5	<0.5	<2.5
07/08/97	246.69	234.51	12.18	--	<50	<0.5	<0.5	<0.5	<0.5	<2.5
10/22/97	246.69	233.94	12.75	--	<50	<0.5	<0.5	<0.5	<0.5	<2.5
01/12/98	246.69	236.34	10.35	--	<50	<0.5	<0.5	<0.5	<0.5	<2.5
04/21/98	246.69	236.06	10.63	--	<50	<0.5	<0.5	<0.5	<0.5	<2.5
07/08/98	246.69	234.62	12.07	--	<50	<0.5	0.51	<0.5	<0.5	<2.5
10/13/98	246.69	233.94	12.75	--	<50	<0.5	<0.5	<0.5	<0.5	<2.0
01/27/99	246.69	234.58	12.11	--	<50	<0.5	<0.5	<0.5	<0.5	<5.0
04/27/99	246.69	235.56	11.13	--	<50	<0.5	<0.5	<0.5	<0.5	<5.0
07/23/99	246.69	234.35	12.34	--	<50	<0.5	<0.5	<0.5	<0.5	<2.5
11/01/99	246.69	233.57	13.12	--	<50	<0.5	<0.5	<0.5	<0.5	<5.0
01/20/00	246.69	233.84	12.85	--	<50	<0.5	<0.5	<0.5	<0.5	<5.0
04/28-29/00	246.69	234.49	12.20	0.00	<50	<0.50	<0.50	<0.50	<0.50	<2.5
07/21/00	246.69	234.03	12.66	0.00	<50	<0.50	<0.50	<0.50	<0.50	<2.5
10/09-10/00	246.69	233.80	12.89	0.00	<50.0	<0.500	<0.500	<0.500	<0.500	<2.50



**Table 1**  
**Groundwater Monitoring Data and Analytical Results**  
Chevron Service Station #9-5607  
5269 Crow Canyon Road  
Castro Valley, California

WELL ID/ DATE	TOC (ft.)	GWE (msl)	DTW (ft.)	SPHT (ft.)	TPH-G (ppb)	B (ppb)	T (ppb)	E (ppb)	X (ppb)	MTBE (ppb)
<b>C-16 (cont)</b>										
01/08-09/01	246.69	233.73	12.96	0.00	<50.0	<0.500	<0.500	<0.500	<0.500	<2.50
04/30/01	246.69	235.95	10.74	0.00	724 <sup>R</sup>	<1.00	<1.00	<1.00	<1.00	<10.0
07/09-10/01	246.69	233.90	12.79	0.00	<50	<0.50	<0.50	<0.50	<0.50	<2.5
10/10/01	246.69	233.62	13.07	0.00	<50	<0.50	<0.50	<0.50	<1.5	<2.5
<b>RW</b>										
12/04/89	--	--	--	--	62,000	29,000	1,700	1,800	8,800	--
03/07/90	274.52	256.02	18.50	--	--	--	--	--	--	--
06/12/90	274.52	256.03	18.49	--	31,000	15,000	2,000	560	3,100	--
09/24/90	274.52	--	--	--	--	--	--	--	--	--
12/20/90	274.52	--	--	--	ND	0.5	ND	ND	1.2	--
03/27/91	274.52	--	--	--	--	--	--	--	--	--
06/18/91	274.52	--	--	--	--	--	--	--	--	--
09/12/91	274.52	INSUFFICIENT WATER	--	--	--	--	--	--	--	--
01/23/92	274.52	INSUFFICIENT WATER	--	--	--	--	--	--	--	--
04/13/92	274.52	INSUFFICIENT WATER	--	--	--	--	--	--	--	--
08/03/92	274.52	INSUFFICIENT WATER	--	--	--	--	--	--	--	--
10/22/92	274.52	INSUFFICIENT WATER	--	--	--	--	--	--	--	--
01/18/93	274.52	INSUFFICIENT WATER	--	--	--	--	--	--	--	--
04/19/93	274.52	INSUFFICIENT WATER	--	--	--	--	--	--	--	--
07/21-22/93	274.52	INSUFFICIENT WATER	--	--	--	--	--	--	--	--
10/25/93	274.52	--	--	--	--	--	--	--	--	--
01/21/94	274.52	--	--	--	--	--	--	--	--	--
04/18/94	274.52	--	--	--	--	--	--	--	--	--
07/06-07/94	274.52	--	--	--	--	--	--	--	--	--

**Table 1**  
**Groundwater Monitoring Data and Analytical Results**  
Chevron Service Station #9-5607  
5269 Crow Canyon Road  
Castro Valley, California

WELL ID/ DATE	TOC ( <i>ft.</i> )	GWE ( <i>mst</i> )	DTW ( <i>ft.</i> )	SPHT ( <i>ft.</i> )	TPH-G ( <i>ppb</i> )	B ( <i>ppb</i> )	T ( <i>ppb</i> )	E ( <i>ppb</i> )	X ( <i>ppb</i> )	MTBE ( <i>ppb</i> )
<b>RW (cont)</b>										
10/07/94	274.52	--	--	--	--	--	--	--	--	--
10/24/95	274.52	256.63	17.89	--	37,000	11,000	380	1,100	3,000	--
01/16/96	274.52	259.09	15.43	--	59,000	17,000	660	1,600	5,400	<1000
<b>NOT MONITORED/SAMPLED</b>										
<b>TRIP BLANK</b>										
01/11/95	--	--	--	--	<50	<0.5	<0.5	<0.5	<0.5	--
04/24/95	--	--	--	--	<50	<0.5	<0.5	<0.5	<0.5	--
07/31/95	--	--	--	--	<50	<0.5	<0.5	<0.5	<0.5	--
10/02/95	--	--	--	--	<50	<0.5	<0.5	<0.5	<0.5	--
01/16/96	--	--	--	--	<50	<0.5	<0.5	<0.5	<0.5	--
04/18/96	--	--	--	--	<50	<0.5	<0.5	<0.5	<0.5	--
07/22/96	--	--	--	--	<50	<0.5	<0.5	<0.5	<0.5	--
10/10/96	--	--	--	--	<50	<0.5	<0.5	<0.5	<0.5	--
01/09/97	--	--	--	--	<50	<0.5	<0.5	<0.5	<0.5	<2.5
04/15/97	--	--	--	--	<50	<0.5	<0.5	<0.5	<0.5	<2.5
07/08/97	--	--	--	--	<50	<0.5	<0.5	<0.5	<0.5	<2.5
07/15/97	--	--	--	--	<50	<0.5	<0.5	<0.5	<0.5	<2.5
10/22/97	--	--	--	--	<50	<0.5	<0.5	<0.5	<0.5	<2.5
01/12/98	--	--	--	--	<50	<0.5	<0.5	<0.5	<0.5	<2.5
04/21/98	--	--	--	--	<50	<0.5	<0.5	<0.5	<0.5	<2.5
07/08/98	--	--	--	--	<50	<0.5	<0.5	<0.5	<0.5	<2.5
10/13/98	--	--	--	--	<50	<0.5	<0.5	<0.5	<0.5	<2.5
01/27/99	--	--	--	--	<50	<0.5	<0.5	<0.5	<0.5	<2.0
04/27/99	--	--	--	--	<50	<0.5	<0.5	<0.5	<0.5	<5.0
07/23/99	--	--	--	--	<50	<0.5	<0.5	<0.5	<0.5	<5.0

**Table 1**  
**Groundwater Monitoring Data and Analytical Results**  
Chevron Service Station #9-5607  
5269 Crow Canyon Road  
Castro Valley, California

WELL ID/ DATE	TOC (ft.)	GWE (msl)	DTW (ft.)	SPHT (ft.)	TPH-G (ppb)	B (ppb)	T (ppb)	E (ppb)	X (ppb)	MTBE (ppb)
<b>TRIP BLANK (cont)</b>										
11/01/99	--	--	--	--	<50	<0.5	<0.5	<0.5	<0.5	<2.5
01/20/00	--	--	--	--	<50	<0.5	<0.5	<0.5	<0.5	<5.0
04/28-29/00	--	--	--	--	<50	<0.50	<0.50	<0.50	<0.50	<2.5
07/21/00	--	--	--	--	<50	<0.50	<0.50	<0.50	<0.50	<2.5
07/26/00	--	--	--	--	<50	<0.50	<0.50	<0.50	<0.50	<2.5
10/09-10/00	--	--	--	--	<50.0	<0.500	<0.500	<0.500	<0.500	<2.50
01/08-09/01	--	--	--	--	<50.0	<0.500	<0.500	<0.500	<0.500	<2.50
04/30/01	--	--	--	--	<50.0	<0.500	<0.500	<0.500	<0.500	<5.00
07/09-10/01	--	--	--	--	<50	<0.50	<0.50	<0.50	<0.50	<2.5
<b>QA</b>										
10/10/01	--	--	--	--	<50	<0.50	<0.50	<0.50	<1.5	<2.5

**Table 1**  
**Groundwater Monitoring Data and Analytical Results**  
 Chevron Service Station #9-5607  
 5269 Crow Canyon Road  
 Castro Valley, California

**EXPLANATIONS:**

Groundwater monitoring data and laboratory analytical results prior to April 28, 2000, were compiled from reports prepared by Blaine Tech Services, Inc.

TOC = Top of Casing

(ft.) = Feet

GWE = Groundwater Elevation

(msl) = Mean sea level

DTW = Depth to Water

SPHT = Separate Phase Hydrocarbon Thickness

TPH-G = Total Petroleum Hydrocarbons as Gasoline

B = Benzene

T = Toluene

E = Ethylbenzene

X = Xylenes

MTBE = Methyl tertiary butyl ether

(ppb) = Parts per billion

(D) = Duplicate

-- = Not Measured/Not Analyzed

ND = Not Detected

QA = Quality Assurance

<sup>1</sup> Confirmation run.

<sup>2</sup> Chromatogram pattern indicates an unidentified hydrocarbon.

<sup>3</sup> Laboratory report indicates gasoline C6-C12.

<sup>4</sup> Laboratory report indicates gasoline C6-C12 + unidentified hydrocarbons C6-C12.

<sup>5</sup> Laboratory report indicates weathered gasoline C6-C12.

<sup>6</sup> Insufficient Preservative to reduce sample pH to less than 2. Sample was analyzed within 14 days, but beyond the seventh day recommended for Benzene, Toluene, Xylene and Ethylbenzene.

<sup>7</sup> Laboratory report indicates weathered gasoline C6-C12 + unidentified hydrocarbons C6-C12.

<sup>8</sup> Laboratory report indicates unidentified hydrocarbons C6-C12.

<sup>9</sup> Pump in well.

**Table 2**  
**Groundwater Analytical Results - Oxygenate Compounds**  
 Chevron Service Station #9-5607  
 5269 Crow Canyon Road  
 Castro Valley, California

WELL ID/ DATE	ETHANOL (ppb)	TBA (ppb)	MTBE (ppb)	DIPE (ppb)	ETBE (ppb)	TAME (ppb)
C-1 10/13/98	<10,000	<2,000	<40	<40	<40	<40

**EXPLANATIONS:**

Groundwater laboratory analytical results were compiled from reports prepared by Blaine Tech Services, Inc.

TBA = Tertiary butyl alcohol

MTBE = Methyl tertiary butyl ether

DIPE = Di-isopropyl ether

ETBE = Ethyl tertiary butyl ether

TAME = Tertiary amyl methyl ether

(ppb) = Parts per billion

**ANALYTICAL METHOD:**

EPA Method 8260 for Oxygenate Compounds

## STANDARD OPERATING PROCEDURE - GROUNDWATER SAMPLING

Gettler-Ryan Inc. field personnel adhere to the following procedures for the collection and handling of groundwater samples prior to analysis by the analytical laboratory. Prior to sample collection, the type of analysis to be performed is determined. Loss prevention of volatile compounds is controlled and sample preservation for subsequent analysis is maintained.

Prior to sampling, the presence or absence of free-phase hydrocarbons is determined using an interface probe. Product thickness, if present, is measured to the nearest 0.01 foot and is noted in the field notes. In addition, static water level measurements are collected with the interface probe and are also recorded in the field notes.

After water levels are collected and prior to sampling, each well is purged a minimum of three well casing volumes of water using pre-cleaned pumps (stack, suction, Grundfos), or polyvinyl chloride bailers. Temperature, pH and electrical conductivity are measured a minimum of three times during the purging. Purging continues until these parameters stabilize.

Groundwater samples are collected using Chevron-designated disposable bailers. The water samples are transferred from the bailer into appropriate containers. Pre-preserved containers, supplied by analytical laboratories, are used when possible. When pre-preserved containers are not available, the laboratory is instructed to preserve the sample as appropriate. Duplicate samples are collected for the laboratory to use in maintaining quality assurance/quality control standards. The samples are labeled to include the job number, sample identification, collection date and time, analysis, preservation (if any), and the sample collector's initials. The water samples are placed in a cooler, maintained at 4°C for transport to the laboratory. Once collected in the field, all samples are maintained under chain of custody until delivered to the laboratory.

The chain of custody document includes the job number, type of preservation, if any, analysis requested, sample identification, date and time collected, and the sample collector's name. The chain of custody is signed and dated (including time of transfer) by each person who receives or surrenders the samples, beginning with the field personnel and ending with the laboratory personnel.

A laboratory supplied trip blank accompanies each sampling set. For sampling sets greater than 20 samples, 5% trip blanks are included. The trip blank is analyzed for some or all of the same compounds as the groundwater samples.

As requested by Chevron Products Company, the purge water and decontamination water generated during sampling activities is transported by IWM to McKittrick Waste Management located in McKittrick, California.

## WELL MONITORING/SAMPLING FIELD DATA SHEET

Client/Facility # Chevron # 9-5607 Job#: 386539  
 Address: 5269 Crow Canyon Rd. Date: 10-10-01  
 City: Castro Valley, CA Sampler: FB

Well ID: C-1  
 Well Diameter: 21.31 in.  
 Total Depth: 43.20 ft.  
 Depth to Water: 19.97 ft.

Well Condition: OK  
 Hydrocarbon Thickness: ∅ in. Amount Bailed (product/water): ∅ (gal.)  
 Volume Factor (VF) 2" = 0.17 3" = 0.38 4" = 0.66  
 6" = 1.50 12" = 5.80

23.23 x VF 1.50 = 34.845 (case volume) = Estimated Purge Volume: 46 (gal.)

Purge Equipment: Disposable Bailer  
 Bailer Stack  
 Suction  
 Grundfos  
 Other: \_\_\_\_\_

Sampling Equipment:  Disposable Bailer  
 Bailer  
 Pressure Bailer  
 Grab Sample  
 Other: \_\_\_\_\_

Starting Time: 1257  
 Sampling Time: 1328  
 Purging Flow Rate: 2 gpm.  
 Did well de-water? NO

Weather Conditions: clear  
 Water Color: clear Odor: YES  
 Sediment Description: \_\_\_\_\_  
 If yes; Time: \_\_\_\_\_ Volume: \_\_\_\_\_ (gal.)

Time	Volume (gal.)	pH	Conductivity (µmhos/cm)	Temperature (°C)	D.O. (mg/L)	ORP (mV)	Alkalinity (ppm)
<u>1304</u>	<u>15.5</u>	<u>6.15</u>	<u>838</u>	<u>72.0</u>			
<u>1311</u>	<u>31.0</u>	<u>5.90</u>	<u>822</u>	<u>76.6</u>			
<u>1318</u>	<u>46.0</u>	<u>5.81</u>	<u>810</u>	<u>71.0</u>			

### LABORATORY INFORMATION

SAMPLE ID	(#) - CONTAINER	REFRIG.	PRESERV. TYPE	LABORATORY	ANALYSES
<u>C-1</u>	<u>X VDA VIAL</u>	<u>Y</u>	<u>HCL</u>	<u>Lancaster</u>	<u>TPH/G/BTEX/MTOE</u>

COMMENTS: \_\_\_\_\_  
 \_\_\_\_\_  
 \_\_\_\_\_

## WELL MONITORING/SAMPLING FIELD DATA SHEET

Client/Facility # Chevron # 9-5607 Job#: 386539  
 Address: 5269 Crow Canyon Rd. Date: 10-10-01  
 City: Castro Valley, CA Sampler: FB

Well ID: C-2 Well Condition: OK  
 Well Diameter: 21.31(4) Hydrocarbon Thickness: ∅ in. Amount Bailed (product/water): ∅ (gal.)  
 Total Depth: 44.55 ft  
 Depth to Water: 15.56 ft

Volume Factor (VF)	2" = 0.17	6" = 1.50	3" = 0.38	12" = 5.80	4" = 0.66
--------------------	-----------	-----------	-----------	------------	-----------

       X VF ~~∅~~ X 3 (case volume) = Estimated Purge Volume:        (gal.)

Purge Equipment: Disposable Bailer, Bailer, Stack, Suction, Grundfos, Other: \_\_\_\_\_  
 Sampling Equipment: Disposable Bailer, Bailer, Pressure Bailer, Grab Sample, Other: \_\_\_\_\_

Starting Time: \_\_\_\_\_ Weather Conditions: Clear  
 Sampling Time: \_\_\_\_\_ Water Color: \_\_\_\_\_ Odor: \_\_\_\_\_  
 Purging Flow Rate: \_\_\_\_\_ gpm. Sediment Description: \_\_\_\_\_  
 Did well de-water? \_\_\_\_\_ If yes; Time: \_\_\_\_\_ Volume: \_\_\_\_\_ (gal.)

Time	Volume (gal.)	pH	Conductivity (µmhos/cm)	Temperature (°C)	D.O. (mg/L)	ORP (mV)	Alkalinity (ppm)

### LABORATORY INFORMATION

SAMPLE ID	(#) - CONTAINER	REFRIG.	PRESERV. TYPE	LABORATORY	ANALYSES
<u>C-2</u>	<u>X VDA VIAL</u>	<u>Y</u>	<u>HCL</u>	<u>Lancaster</u>	<u>TPH, BTEX, MTBE</u>

COMMENTS: Monitor only



## WELL MONITORING/SAMPLING FIELD DATA SHEET

Client/Facility # Chevron #9-5607 Job#: 386539  
 Address: 5269 Crow Canyon Rd. Date: 10-10-01  
 City: Castro Valley, CA Sampler: EB

Well ID: C-3  
 Well Diameter: 21.3 (4)  
 Total Depth: 31.86 ft.  
 Depth to Water: 21.28 ft.

Well Condition: OK  
 Hydrocarbon Thickness: ∅ in. Amount Bailed (product/water): ∅ (gal.)  
 Volume Factor (VF) 2" = 0.17 3" = 0.38 4" = 0.66  
 6" = 1.50 12" = 5.80

10.58 x VF 1.66 = 17.56 (case volume) = Estimated Purge Volume: 21 (gal.)

Purge Equipment: Stack  
 Disposable Bailer  
 Bailer  
 Suction  
 Grundfos  
 Other: \_\_\_\_\_

Sampling Equipment: Disposable Bailer  
 Bailer  
 Pressure Bailer  
 Grab Sample  
 Other: \_\_\_\_\_

Starting Time: 1340  
 Sampling Time: 1400  
 Purging Flow Rate: 1.5 gpm  
 Did well de-water? NO

Weather Conditions: Clear  
 Water Color: Clear ~~over YES~~  
 Sediment Description: \_\_\_\_\_  
 If yes; Time: \_\_\_\_\_ Volume: \_\_\_\_\_ (gal.)

Time	Volume (gal.)	pH	Conductivity $\mu$ mhos/cm	Temperature $^{\circ}$ C	D.O. (mg/L)	ORP (mV)	Alkalinity (ppm)
<u>1344</u>	<u>7.8</u>	<u>6.18</u>	<u>993</u>	<u>77.0</u>			
<u>1348</u>	<u>14.6</u>	<u>5.48</u>	<u>970</u>	<u>76.1</u>			
<u>1352</u>	<u>21.2</u>	<u>5.40</u>	<u>947</u>	<u>75.2</u>			

### LABORATORY INFORMATION

SAMPLE ID	(#) - CONTAINER	REFRIG.	PRESERV. TYPE	LABORATORY	ANALYSES
<u>C-3</u>	<u>X VDA VIAL</u>	<u>Y</u>	<u>HCL</u>	<u>Lancaster</u>	<u>TPHG/BTEX/MTOE</u>

COMMENTS: \_\_\_\_\_  
 \_\_\_\_\_  
 \_\_\_\_\_

## WELL MONITORING/SAMPLING FIELD DATA SHEET

Client/Facility # Chevron # 9-5607 Job#: 386539  
 Address: 5269 Crow Canyon Rd. Date: 10-10-05  
 City: Castro Valley, CA Sampler: FB

Well ID: C-5  
 Well Diameter: 21.314 in.  
 Total Depth: 40.18 ft.  
 Depth to Water: 19.90 ft.

Well Condition: OK  
 Hydrocarbon Thickness: ∅ in. Amount Bailed (product/water): ∅ (gal.)  
 Volume Factor (VF) 2" = 0.17 3" = 0.38 4" = 0.66  
 6" = 1.50 12" = 5.80

∅ X VF ∅ = ∅ X 3 (case volume) = Estimated Purge Volume: ∅ (gal.)

Purge Equipment: Disposable Bailer  
 Bailer  
 Stack  
 Suction  
 Grundfos  
 Other: \_\_\_\_\_

Sampling Equipment: Disposable Bailer  
 Bailer  
 Pressure Bailer  
 Grab Sample  
 Other: \_\_\_\_\_

Starting Time: \_\_\_\_\_ Weather Conditions: Clear  
 Sampling Time: \_\_\_\_\_ Water Color: \_\_\_\_\_ Odor: \_\_\_\_\_  
 Purging Flow Rate: \_\_\_\_\_ gpm Sediment Description: \_\_\_\_\_  
 Did well de-water? \_\_\_\_\_ If yes: Time: \_\_\_\_\_ Volume: \_\_\_\_\_ (gal.)

Time	Volume (gal.)	pH	Conductivity (µmhos/cm)	Temperature (°C)	D.O. (mg/L)	ORP (mV)	Alkalinity (ppm)

### LABORATORY INFORMATION

SAMPLE ID	(#) - CONTAINER	REFRIG.	PRESERV. TYPE	LABORATORY	ANALYSES
<u>C-5</u>	<u>X VDA VIAL</u>	<u>Y</u>	<u>HLL</u>	<u>Lancaster</u>	<u>TPHG/BTEX/MTOE</u>

COMMENTS: Monitor only

## WELL MONITORING/SAMPLING FIELD DATA SHEET

Client/Facility # Chevron #9-5607 Job#: 386539  
 Address: 5269 Crow Canyon Rd. Date: 10-10-05  
 City: Castro Valley, CA Sampler: FB

Well ID: C-6 Well Condition: OK \*  
 Well Diameter: 21.3 (4) in. Hydrocarbon Thickness: ∅ in. Amount Bailed (product/water): ∅ gal.  
 Total Depth: 29.95 ft. Volume Factor (VF) table:  
 Depth to Water: 13.74 ft.

	2" = 0.17	3" = 0.38	4" = 0.66
6" = 1.50	12" = 5.80		

16.21 x VF 1.46 = 10.69 x 3 (case volume) = Estimated Purge Volume: 32 gal.

Purge Equipment:  Disposable Bailer  
 Bailer  
 Stack  
 Suction  
 Grundfos  
 Other: \_\_\_\_\_  
 Sampling Equipment:  Disposable Bailer  
 Bailer  
 Pressure Bailer  
 Grab Sample  
 Other: \_\_\_\_\_

Starting Time: 1210 Weather Conditions: clear  
 Sampling Time: 1240 Water Color: clear Odor: YES  
 Purging Flow Rate: \_\_\_\_\_ gpm Sediment Description: \_\_\_\_\_  
 Did well de-water? NO If yes; Time: \_\_\_\_\_ Volume: \_\_\_\_\_ gal.

Time	Volume (gal.)	pH	Conductivity $\mu\text{mhos/cm}$	Temperature $^{\circ}\text{C}$	D.O. (mg/L)	ORP (mV)	Alkalinity (ppm)
<u>1217</u>	<u>10.5</u>	<u>558</u>	<u>896</u>	<u>70.3</u>			
<u>1224</u>	<u>21.0</u>	<u>546</u>	<u>924</u>	<u>69.0</u>			
<u>1231</u>	<u>32.0</u>	<u>541</u>	<u>930</u>	<u>68.4</u>			

### LABORATORY INFORMATION

SAMPLE ID	(#) - CONTAINER	REFRIG.	PRESERV. TYPE	LABORATORY	ANALYSES
<u>C-6</u>	<u>X VDA VIAL</u>	<u>Y</u>	<u>HCL</u>	<u>Lancaster</u>	<u>TPHG/BTEX/MTOE</u>

COMMENTS: \* WELL IS IN 12" ROUND GREEN IRRIGATION BOX

## WELL MONITORING/SAMPLING FIELD DATA SHEET

Client/Facility # Chevron #9-5607 Job#: 386539  
 Address: 5269 Crow Canyon Rd. Date: 10-10-01  
 City: Castro Valley, CA Sampler: FB

Well ID: C-7  
 Well Diameter: 2 3/4 in.  
 Total Depth: 26.67 ft  
 Depth to Water: 4.27 ft

Well Condition: OK  
 Hydrocarbon Thickness: Ø in. Amount Bailed (product/water): Ø (gal.)  
 Volume Factor (VF) 2" = 0.17 3" = 0.38 4" = 0.66  
6" = 1.50 12" = 5.80

\_\_\_\_\_ X VF \_\_\_\_\_ = \_\_\_\_\_ X 3 (case volume) = Estimated Purge Volume: \_\_\_\_\_ (gal.)

Purge Equipment: Disposable Bailer  
 Bailer  
 Stack  
 Suction  
 Grundfos  
 Other: \_\_\_\_\_

Sampling Equipment: Disposable Bailer  
 Bailer  
 Pressure Bailer  
 Grab Sample  
 Other: \_\_\_\_\_

Starting Time: \_\_\_\_\_ Weather Conditions: clear  
 Sampling Time: \_\_\_\_\_ Water Color: \_\_\_\_\_ Odor: \_\_\_\_\_  
 Purging Flow Rate: \_\_\_\_\_ gpm Sediment Description: \_\_\_\_\_  
 Did well de-water? \_\_\_\_\_ If yes; Time: \_\_\_\_\_ Volume: \_\_\_\_\_ (gal.)

Time	Volume (gal.)	pH	Conductivity (µmhos/cm)	Temperature (°C)	D.O. (mg/L)	ORP (mV)	Alkalinity (ppm)

### LABORATORY INFORMATION

SAMPLE ID	(#) - CONTAINER	REFRIG.	PRESERV. TYPE	LABORATORY	ANALYSES
	<u>X VOA VIAL</u>	<u>Y</u>	<u>HCL</u>	<u>Lancaster</u>	<u>TPH, G, BTEX, MTOE</u>

COMMENTS: monitor only

# WELL MONITORING/SAMPLING FIELD DATA SHEET

Client/Facility # Chevron # 9-5607  
 Address: 5269 Crow Canyon Rd.  
 City: Castro Valley, CA

Job #: 386539  
 Date: 10-10-01  
 Sampler: FB

Well ID: C-8  
 Well Diameter: 21.314 in.  
 Total Depth: 25.06 ft.  
 Depth to Water: 5.52 ft.

Well Condition: OK  
 Hydrocarbon Thickness: ∅ in. Amount Bailed (product/water): ∅ (gal.)  
 Volume Factor (VF) 2" = 0.17 3" = 0.38 4" = 0.66  
 6" = 1.50 12" = 5.80

19.54 x VF 1.7 = 3.32 x 3 (case volume) = Estimated Purge Volume: 10 (gal.)

Purge Equipment: Disposable Bailer  
 Bailer  
 Stack  
 Suction  
 Grundfos  
 Other: \_\_\_\_\_

Sampling Equipment: Disposable Bailer  
 Bailer  
 Pressure Bailer  
 Grab Sample  
 Other: \_\_\_\_\_

Starting Time: 10:51  
 Sampling Time: 11:15  
 Purging Flow Rate: \_\_\_\_\_ gpm.  
 Did well de-water? NO

Weather Conditions: CLEAR  
 Water Color: CLEAR Odor: NO  
 Sediment Description: \_\_\_\_\_  
 If yes; Time: \_\_\_\_\_ Volume: \_\_\_\_\_ (gal.)

Time	Volume (gal.)	pH	Conductivity $\mu\text{mhos/cm}$	Temperature $^{\circ}\text{C}$	D.O. (mg/L)	ORP (mV)	Alkalinity (ppm)
<u>10:57</u>	<u>3.5</u>	<u>6.13</u>	<u>473</u>	<u>69.7</u>	_____	_____	_____
<u>11:03</u>	<u>7.0</u>	<u>6.05</u>	<u>486</u>	<u>71.5</u>	_____	_____	_____
<u>11:08</u>	<u>10.2</u>	<u>6.00</u>	<u>490</u>	<u>71.0</u>	_____	_____	_____

### LABORATORY INFORMATION

SAMPLE ID	(#) - CONTAINER	REFRIG.	PRESERV. TYPE	LABORATORY	ANALYSES
<u>C-8</u>	<u>X VDA VIAL</u>	<u>Y</u>	<u>HCL</u>	<u>Lancaster</u>	<u>TPHG/BTEX/MTOE</u>

COMMENTS: \_\_\_\_\_

## WELL MONITORING/SAMPLING FIELD DATA SHEET

Client/ Facility # Chesron # 9-5607 Job#: 386539  
 Address: 5269 Crow Canyon Rd. Date: 10-10-07  
 City: Castro Valley, CA Sampler: FB

Well ID: C-9 Well Condition: OK \* See Below  
 Well Diameter: 21.34 in Hydrocarbon Thickness: Ø Amount Bailed (product/water): Ø (gal.)  
 Total Depth: 28.05 ft  
 Depth to Water: 12.50 ft

Volume Factor (VF)	2" = 0.17	3" = 0.38	4" = 0.66
	6" = 1.50	12" = 5.80	

15.95 x VF .66 = 10.26 x 3 (case volume) = Estimated Purge Volume: 30 (gal.)

Purge Equipment: Disposable Bailer Bailer Stack Suction Grundfos Other: \_\_\_\_\_  
 Sampling Equipment: Disposable Bailer Bailer Pressure Bailer Grab Sample Other: \_\_\_\_\_

Starting Time: 1129 Weather Conditions: Clear  
 Sampling Time: 1152 Water Color: Gray odor: V/S  
 Purging Flow Rate: 2 gpm Sediment Description: \_\_\_\_\_  
 Did well de-water? NO If yes; Time: \_\_\_\_\_ Volume: \_\_\_\_\_ (gal.)

Time	Volume (gal.)	pH	Conductivity (µmhos/cm)	Temperature (°C)	D.O. (mg/L)	ORP (mV)	Alkalinity (ppm)
<u>1134</u>	<u>10</u>	<u>6.60</u>	<u>816</u>	<u>70.4</u>			
<u>1139</u>	<u>20</u>	<u>6.42</u>	<u>897</u>	<u>74.8</u>			
<u>1144</u>	<u>30</u>	<u>6.30</u>	<u>924</u>	<u>74.0</u>			

### LABORATORY INFORMATION

SAMPLE ID	(#) - CONTAINER	REFRIG.	PRESERV. TYPE	LABORATORY	ANALYSES
<u>C-9</u>	<u>X VDA VIAL</u>	<u>Y</u>	<u>HCL</u>	<u>Lancaster</u>	<u>TPH/G/BTEX/MTOE</u>

COMMENTS: Has Pump in Well

## WELL MONITORING/SAMPLING FIELD DATA SHEET

Client/Facility # Chevron #9-5607 Job#: 386539  
 Address: 5269 Crow Canyon Rd. Date: 10-10-01  
 City: Castro Valley, CA Sampler: FB

Well ID: C-11  
 Well Diameter: 21(3)4 in.  
 Total Depth: 33.59 ft.  
 Depth to Water: 20.07 ft.

Well Condition: OK  
 Hydrocarbon Thickness: ∅ in. Amount Bailed (product/water): ∅ (gal.)  
 Volume Factor (VF) 2" = 0.17 3" = 0.38 4" = 0.66  
 6" = 1.50 12" = 5.80

13.52 x VF 1.38 = 5.13 x 3 (case volume) = Estimated Purge Volume: 15.5 (gal.)

Purge Equipment: Disposable Bailer Bailer  
 Stack  
 Suction  
 Grundfos  
 Other: \_\_\_\_\_

Sampling Equipment: Disposable Bailer  
 Bailer  
 Pressure Bailer  
 Grab Sample  
 Other: \_\_\_\_\_

Starting Time: 7:54  
 Sampling Time: 8:17  
 Purging Flow Rate: 1.5 gpm  
 Did well de-water? \_\_\_\_\_

Weather Conditions: clear  
 Water Color: clear Odor: no  
 Sediment Description: \_\_\_\_\_  
 If yes: Time: \_\_\_\_\_ Volume: \_\_\_\_\_ (gal.)

Time	Volume (gal.)	pH	Conductivity $\mu$ mhos/cm	Temperature $^{\circ}$ C	D.O. (mg/L)	ORP (mV)	Alkalinity (ppm)
<u>7:58</u>	<u>5</u>	<u>7.15</u>	<u>775</u>	<u>63.5</u>			
<u>8:02</u>	<u>10</u>	<u>7.15</u>	<u>802</u>	<u>64.9</u>			
<u>8:06</u>	<u>15.5</u>	<u>7.13</u>	<u>810</u>	<u>65.0</u>			

### LABORATORY INFORMATION

SAMPLE ID	CONTAINER	REFRIG.	PRESERV. TYPE	LABORATORY	ANALYSES	
<u>C-11</u>	<u>X VDA VIAL</u>	<u>Y</u>	<u>HCL</u>	<u>Lancaster</u>	<u>TPHG/BTEX/MTOE</u>	

COMMENTS: \_\_\_\_\_

**WELL MONITORING/SAMPLING  
FIELD DATA SHEET**

Client/Facility # Chevron # 9-5607 Job#: 386539  
 Address: 5269 Crow Canyon Rd. Date: 10-10-01  
 City: Castro Valley, CA Sampler: FB

Well ID: C-12 Well Condition: OK  
 Well Diameter: 2 (3) 4 in. Hydrocarbon Thickness: ∅ in. Amount Bailed (product/water): ∅ gal.  
 Total Depth: 29.41 ft.  
 Depth to Water: 12.06 ft.

Volume Factor (VF)	2" = 0.17	3" = 0.38	4" = 0.66
	6" = 1.50	12" = 5.80	

17.35 x VF 0.38 = 6.59 x 3 (case volume) = Estimated Purge Volume: 20 gal.

Purge Equipment: Stack Disposable Bailer Bailer  
 Sampling Equipment: Disposable Bailer Bailer  
 Pressure Bailer  
 Grab Sample  
 Other: \_\_\_\_\_

Starting Time: 8:35 Weather Conditions: clear  
 Sampling Time: 8:57 Water Color: CLEAR Odor: YES  
 Purging Flow Rate: 1.5 gpm Sediment Description: \_\_\_\_\_  
 Did well de-water? \_\_\_\_\_ If yes; Time: \_\_\_\_\_ Volume: \_\_\_\_\_ gal.

Time	Volume (gal.)	pH	Conductivity $\mu$ mhos/cm $\times 10^6$	Temperature $^{\circ}$ C	D.O. (mg/L)	ORP (mV)	Alkalinity (ppm)
8:39	6.5	7.14	699	64.6			
8:43	13.0	7.10	628	65.7			
8:47	20.0	7.11	600	65.7			

**LABORATORY INFORMATION**

SAMPLE ID	(#) - CONTAINER	REFRIG.	PRESERV. TYPE	LABORATORY	ANALYSES
<u>C-12</u>	<u>X VDA VIAL</u>	<u>Y</u>	<u>HCL</u>	<u>Lancaster</u>	<u>TPHG/BTEX/MTOE</u>

COMMENTS: WELL IS IN 12" ROUND GREEN IRRIGATION BOX



## WELL MONITORING/SAMPLING FIELD DATA SHEET

Client/Facility # Chertron # 9-5607 Job#: 386539  
 Address: 5269 Crow Canyon Rd. Date: 10-10-01  
 City: Castro Valley, CA Sampler: FB

Well ID: C-13  
 Well Diameter: 2 (3) 4 in.  
 Total Depth: 28.23 ft.  
 Depth to Water: 9.80 ft.

Well Condition: OK  
 Hydrocarbon Thickness: ∅ in. Amount Bailed (product/water): ∅ (gal.)  
 Volume Factor (VF) 2" = 0.17 3" = 0.38 4" = 0.66  
 6" = 1.50 12" = 5.80

Purge Equipment: Disposable Bailer Sampling Equipment: Disposable Bailer  
Bailer Stack Pressure Bailer  
Suction Grab Sample  
Grundfos Other: \_\_\_\_\_  
Other: \_\_\_\_\_

\_\_\_\_\_ X VF 2.38 = \_\_\_\_\_ X 3 (case volume) = Estimated Purge Volume: \_\_\_\_\_ (gal.)

Starting Time: \_\_\_\_\_ Weather Conditions: clear  
 Sampling Time: \_\_\_\_\_ Water Color: \_\_\_\_\_ Odor: \_\_\_\_\_  
 Purging Flow Rate: \_\_\_\_\_ gpm. Sediment Description: \_\_\_\_\_  
 Did well de-water? \_\_\_\_\_ If yes; Time: \_\_\_\_\_ Volume: \_\_\_\_\_ (gal.)

Time	Volume (gal.)	pH	Conductivity (µmhos/cm)	Temperature	D.O. (mg/L)	ORP (mV)	Alkalinity (ppm)

### LABORATORY INFORMATION

SAMPLE ID	(#) - CONTAINER	REFRIG.	PRESERV. TYPE	LABORATORY	ANALYSES
<u>C-13</u>	<u>X VOA VIAL</u>	<u>Y</u>	<u>HCL</u>	<u>Lancaster</u>	<u>TPHG/BTEX/MTDE</u>

COMMENTS: monitor only

## WELL MONITORING/SAMPLING FIELD DATA SHEET

Client/Facility # Chevron # 9-5607 Job#: 386539  
 Address: 5269 Crow Canyon Rd. Date: 10-10-01  
 City: Castro Valley, CA Sampler: FD

Well ID: C-14  
 Well Diameter: 21(3)4 in.  
 Total Depth: 27.66 ft.  
 Depth to Water: 3.05 ft.

Well Condition: OK  
 Hydrocarbon Thickness: 0 in. Amount Bailed (product/water): 0 (gal.)  

Volume Factor (VF)	2" = 0.17	3" = 0.38	4" = 0.66
	6" = 1.50	12" = 5.80	

\_\_\_\_\_ X VF \_\_\_\_\_ X 3 (case volume) = Estimated Purge Volume: \_\_\_\_\_ (gal.)

Purge Equipment: Disposable Bailer  
 Bailer  
 Stack  
 Suction  
 Grundfos  
 Other: \_\_\_\_\_

Sampling Equipment: Disposable Bailer  
 Bailer  
 Pressure Bailer  
 Grab Sample  
 Other: \_\_\_\_\_

Starting Time: \_\_\_\_\_  
 Sampling Time: \_\_\_\_\_  
 Purging Flow Rate: \_\_\_\_\_ gpm.  
 Did well de-water? \_\_\_\_\_

Weather Conditions: clear  
 Water Color: \_\_\_\_\_ Odor: \_\_\_\_\_  
 Sediment Description: \_\_\_\_\_  
 If yes; Time: \_\_\_\_\_ Volume: \_\_\_\_\_ (gal.)

Time	Volume (gal.)	pH	Conductivity (µmhos/cm)	Temperature (°C)	D.O. (mg/L)	ORP (mV)	Alkalinity (ppm)

### LABORATORY INFORMATION

SAMPLE ID	(?) - CONTAINER	REFRIG.	PRESERV. TYPE	LABORATORY	ANALYSES
	X VOA VIAL	Y	HEL	Lancaster	TPHG/BTEX/MTOE

COMMENTS: monitor only



## WELL MONITORING/SAMPLING FIELD DATA SHEET

Client/ Facility # Chevron # 9-5607 Job#: 386539  
 Address: 5269 Crow Canyon Rd. Date: 10-10-09  
 City: Castro Valley, CA Sampler: FB

Well ID: C-16 Well Condition: OK  
 Well Diameter: 21.314 in. Hydrocarbon Thickness: ∅ in. Amount Bailed (product/water): ∅ (gal.)  
 Total Depth: 30.76 ft  
 Depth to Water: 13.07 ft

Volume Factor (VF)	2" = 0.17	6" = 1.50	3" = 0.38	12" = 5.80	4" = 0.66
--------------------	-----------	-----------	-----------	------------	-----------

Purge Equipment: Disposable Bailer x VF 38 6.72 x 3 (case volume) = Estimated Purge Volume: 20 (gal.)

Purge Equipment: Disposable Bailer  
 Bailer  
 Stack  
 Suction  
 Grundfos  
 Other: \_\_\_\_\_  
 Sampling Equipment: Disposable Bailer  
 Bailer  
 Pressure Bailer  
 Grab Sample  
 Other: \_\_\_\_\_

Starting Time: 9:21 Weather Conditions: clear  
 Sampling Time: 9:59 Water Color: clear Odor: NO  
 Purging Flow Rate: \_\_\_\_\_ ppm Sediment Description: \_\_\_\_\_  
 Did well de-water? NO If yes; Time: \_\_\_\_\_ Volume: \_\_\_\_\_ (gal.)

Time	Volume (gal.)	pH	Conductivity (µmhos/cm)	Temperature (°C)	D.O. (mg/L)	ORP (mV)	Alkalinity (ppm)
9:31	6.5	6.01	714	63.3			
9:41	13.0	5.81	710	64.3			
9:51	20.0	5.77	710	64.5			

### LABORATORY INFORMATION

SAMPLE ID	(#) CONTAINER	REFRIG.	PRESERV. TYPE	LABORATORY	ANALYSES
C-16	3 x VDA VIAL	Y	HCL	Lancaster	TPH6/BTEX/MTOE

COMMENTS: \_\_\_\_\_

## STANDARD OPERATING PROCEDURE - GROUNDWATER SAMPLING

Gettler-Ryan Inc. field personnel adhere to the following procedures for the collection and handling of groundwater samples prior to analysis by the analytical laboratory. Prior to sample collection, the type of analysis to be performed is determined. Loss prevention of volatile compounds is controlled and sample preservation for subsequent analysis is maintained.

Prior to sampling, the presence or absence of free-phase hydrocarbons is determined using an interface probe. Product thickness, if present, is measured to the nearest 0.01 foot and is noted in the field notes. In addition, static water level measurements are collected with the interface probe and are also recorded in the field notes.

After water levels are collected and prior to sampling, each well is purged a minimum of three well casing volumes of water using pre-cleaned pumps (stack, suction, Grundfos), or polyvinyl chloride bailers. Temperature, pH and electrical conductivity are measured a minimum of three times during the purging. Purging continues until these parameters stabilize.

Groundwater samples are collected using Chevron-designated disposable bailers. The water samples are transferred from the bailer into appropriate containers. Pre-preserved containers, supplied by analytical laboratories, are used when possible. When pre-preserved containers are not available, the laboratory is instructed to preserve the sample as appropriate. Duplicate samples are collected for the laboratory to use in maintaining quality assurance/quality control standards. The samples are labeled to include the job number, sample identification, collection date and time, analysis, preservation (if any), and the sample collector's initials. The water samples are placed in a cooler, maintained at 4°C for transport to the laboratory. Once collected in the field, all samples are maintained under chain of custody until delivered to the laboratory.

The chain of custody document includes the job number, type of preservation, if any, analysis requested, sample identification, date and time collected, and the sample collector's name. The chain of custody is signed and dated (including time of transfer) by each person who receives or surrenders the samples, beginning with the field personnel and ending with the laboratory personnel.

A laboratory supplied trip blank accompanies each sampling set. For sampling sets greater than 20 samples, 5% trip blanks are included. The trip blank is analyzed for some or all of the same compounds as the groundwater samples.

As requested by Chevron Products Company, the purge water and decontamination water generated during sampling activities is transported by IWM to McKittrick Waste Management located in McKittrick, California.

# Chevron California Region Analysis Request/Chain of Custody



111001-003

For Lancaster Laboratories use only  
 Acct. #: 10405 Sample #: 3705654-163 SCR#: \_\_\_\_\_

Facility #: <u>9-5607</u> JOB # <u>386539</u>			<b>Matrix</b>  Potable <input type="checkbox"/> NPDES <input type="checkbox"/> Water <input type="checkbox"/> Oil <input type="checkbox"/> Air <input type="checkbox"/> Total Number of Containers _____		<b>Analyses Requested</b>										<b>Preservative Codes</b>																																																																																																																																																																																																													
Site Address: <u>5269 Crow Canyon Rd., Castro Valley, CA</u>					<b>Preservation Codes</b>										H = HCl      T = Thiosulfate N = HNO <sub>3</sub> B = NaOH S = H <sub>2</sub> SO <sub>4</sub> O = Other																																																																																																																																																																																																													
Chevron PM: <u>Thomas Bauhs</u> Lead Consultant: <u>Delta/G-R</u>					H    H <input type="checkbox"/> BTEX + MTBE 8260 <input type="checkbox"/> 8021 <input checked="" type="checkbox"/> <input type="checkbox"/> TPH 8015 MOD GRO <input type="checkbox"/> Silica Gel Cleanup <input type="checkbox"/> TPH 8015 MOD DRO <input type="checkbox"/> 8260 full scan _____ Oxygenates Lead 7420 <input type="checkbox"/> 7421 <input type="checkbox"/>										<input type="checkbox"/> J value reporting needed <input type="checkbox"/> Must meet lowest detection limits possible for 8260 compounds 8021 MTBE Confirmation <input type="checkbox"/> Confirm highest hit by 8260 <input type="checkbox"/> Confirm all hits by 8260 <input type="checkbox"/> Run ___ oxy s on highest hit <input type="checkbox"/> Run ___ oxy s on all hits																																																																																																																																																																																																													
Consultant/Office: <u>G-R Inc, 6747 Sierra Ct, Dublin, CA 94568</u>					Soil <input type="checkbox"/> Water <input type="checkbox"/> Oil <input type="checkbox"/> Air <input type="checkbox"/>										<b>Comments / Remarks</b>																																																																																																																																																																																																													
Consultant Prj. Mgr.: <u>Deanna L. Harding</u> <u>Deanna@grinc.com</u>					Grab <input type="checkbox"/> Composite <input type="checkbox"/>																																																																																																																																																																																																																							
Consultant Phone #: <u>925-551-7555</u> Fax #: <u>925-551-7899</u>			Service Order #: _____ <input type="checkbox"/> Non SAR: _____																																																																																																																																																																																																																									
Sampler: <u>Frank Bohnet</u>			Sample Identification																																																																																																																																																																																																																									
Date Collected: _____ Time Collected: _____			<table border="1" style="width: 100%; border-collapse: collapse;"> <thead> <tr> <th style="width: 20%;">Sample Identification</th> <th style="width: 10%;">Date Collected</th> <th style="width: 10%;">Time Collected</th> <th style="width: 5%;">Grab</th> <th style="width: 5%;">Composite</th> <th style="width: 5%;">Soil</th> <th style="width: 5%;">Water</th> <th style="width: 5%;">Oil</th> <th style="width: 5%;">Air</th> <th style="width: 5%;">Total Number of Containers</th> <th style="width: 5%;">BTEX + MTBE 8260</th> <th style="width: 5%;">8021</th> <th style="width: 5%;">TPH 8015 MOD GRO</th> <th style="width: 5%;">TPH 8015 MOD DRO</th> <th style="width: 5%;">8260 full scan</th> <th style="width: 5%;">Oxygenates</th> <th style="width: 5%;">Lead 7420</th> <th style="width: 5%;">7421</th> </tr> </thead> <tbody> <tr> <td><u>FIELD QA</u></td> <td><u>10-10-d</u></td> <td>—</td> <td><input checked="" type="checkbox"/></td> <td></td> <td><input checked="" type="checkbox"/></td> <td></td> <td></td> <td></td> <td><u>2</u></td> <td><input checked="" type="checkbox"/></td> <td><input checked="" type="checkbox"/></td> <td></td> <td></td> <td></td> <td></td> <td></td> <td></td> <td></td> </tr> <tr> <td><u>RAW C-1</u></td> <td></td> <td><u>1328</u></td> <td><input checked="" type="checkbox"/></td> <td></td> <td><input checked="" type="checkbox"/></td> <td></td> <td></td> <td></td> <td><u>3</u></td> <td><input checked="" type="checkbox"/></td> <td><input checked="" type="checkbox"/></td> <td></td> <td></td> <td></td> <td></td> <td></td> <td></td> <td></td> </tr> <tr> <td><u>C-3</u></td> <td></td> <td><u>1400</u></td> <td><input checked="" type="checkbox"/></td> <td></td> <td><input checked="" type="checkbox"/></td> <td></td> <td></td> <td></td> <td><u>3</u></td> <td><input checked="" type="checkbox"/></td> <td><input checked="" type="checkbox"/></td> <td></td> <td></td> <td></td> <td></td> <td></td> <td></td> <td></td> </tr> <tr> <td><u>C-6</u></td> <td></td> <td><u>1240</u></td> <td><input checked="" type="checkbox"/></td> <td></td> <td><input checked="" type="checkbox"/></td> <td></td> <td></td> <td></td> <td><u>3</u></td> <td><input checked="" type="checkbox"/></td> <td><input checked="" type="checkbox"/></td> <td></td> <td></td> <td></td> <td></td> <td></td> <td></td> <td></td> </tr> <tr> <td><u>C-8</u></td> <td></td> <td><u>1115</u></td> <td><input checked="" type="checkbox"/></td> <td></td> <td><input checked="" type="checkbox"/></td> <td></td> <td></td> <td></td> <td><u>3</u></td> <td><input checked="" type="checkbox"/></td> <td><input checked="" type="checkbox"/></td> <td></td> <td></td> <td></td> <td></td> <td></td> <td></td> <td></td> </tr> <tr> <td><u>C-9</u></td> <td></td> <td><u>1152</u></td> <td><input checked="" type="checkbox"/></td> <td></td> <td><input checked="" type="checkbox"/></td> <td></td> <td></td> <td></td> <td><u>3</u></td> <td><input checked="" type="checkbox"/></td> <td><input checked="" type="checkbox"/></td> <td></td> <td></td> <td></td> <td></td> <td></td> <td></td> <td></td> </tr> <tr> <td><u>C-11</u></td> <td></td> <td><u>817</u></td> <td><input checked="" type="checkbox"/></td> <td></td> <td><input checked="" type="checkbox"/></td> <td></td> <td></td> <td></td> <td><u>3</u></td> <td><input checked="" type="checkbox"/></td> <td><input checked="" type="checkbox"/></td> <td></td> <td></td> <td></td> <td></td> <td></td> <td></td> <td></td> </tr> <tr> <td><u>C-12</u></td> <td></td> <td><u>857</u></td> <td><input checked="" type="checkbox"/></td> <td></td> <td><input checked="" type="checkbox"/></td> <td></td> <td></td> <td></td> <td><u>3</u></td> <td><input checked="" type="checkbox"/></td> <td><input checked="" type="checkbox"/></td> <td></td> <td></td> <td></td> <td></td> <td></td> <td></td> <td></td> </tr> <tr> <td><u>C-15</u></td> <td></td> <td><u>1036</u></td> <td><input checked="" type="checkbox"/></td> <td></td> <td><input checked="" type="checkbox"/></td> <td></td> <td></td> <td></td> <td><u>3</u></td> <td><input checked="" type="checkbox"/></td> <td><input checked="" type="checkbox"/></td> <td></td> <td></td> <td></td> <td></td> <td></td> <td></td> <td></td> </tr> <tr> <td><u>C-16</u></td> <td></td> <td><u>959</u></td> <td><input checked="" type="checkbox"/></td> <td></td> <td><input checked="" type="checkbox"/></td> <td></td> <td></td> <td></td> <td><u>3</u></td> <td><input checked="" type="checkbox"/></td> <td><input checked="" type="checkbox"/></td> <td></td> <td></td> <td></td> <td></td> <td></td> <td></td> <td></td> </tr> </tbody> </table>										Sample Identification	Date Collected			Time Collected	Grab	Composite	Soil	Water	Oil	Air	Total Number of Containers	BTEX + MTBE 8260	8021	TPH 8015 MOD GRO	TPH 8015 MOD DRO	8260 full scan	Oxygenates	Lead 7420	7421	<u>FIELD QA</u>	<u>10-10-d</u>	—	<input checked="" type="checkbox"/>		<input checked="" type="checkbox"/>				<u>2</u>	<input checked="" type="checkbox"/>	<input checked="" type="checkbox"/>								<u>RAW C-1</u>		<u>1328</u>	<input checked="" type="checkbox"/>		<input checked="" type="checkbox"/>				<u>3</u>	<input checked="" type="checkbox"/>	<input checked="" type="checkbox"/>								<u>C-3</u>		<u>1400</u>	<input checked="" type="checkbox"/>		<input checked="" type="checkbox"/>				<u>3</u>	<input checked="" type="checkbox"/>	<input checked="" type="checkbox"/>								<u>C-6</u>		<u>1240</u>	<input checked="" type="checkbox"/>		<input checked="" type="checkbox"/>				<u>3</u>	<input checked="" type="checkbox"/>	<input checked="" type="checkbox"/>								<u>C-8</u>		<u>1115</u>	<input checked="" type="checkbox"/>		<input checked="" type="checkbox"/>				<u>3</u>	<input checked="" type="checkbox"/>	<input checked="" type="checkbox"/>								<u>C-9</u>		<u>1152</u>	<input checked="" type="checkbox"/>		<input checked="" type="checkbox"/>				<u>3</u>	<input checked="" type="checkbox"/>	<input checked="" type="checkbox"/>								<u>C-11</u>		<u>817</u>	<input checked="" type="checkbox"/>		<input checked="" type="checkbox"/>				<u>3</u>	<input checked="" type="checkbox"/>	<input checked="" type="checkbox"/>								<u>C-12</u>		<u>857</u>	<input checked="" type="checkbox"/>		<input checked="" type="checkbox"/>				<u>3</u>	<input checked="" type="checkbox"/>	<input checked="" type="checkbox"/>								<u>C-15</u>		<u>1036</u>	<input checked="" type="checkbox"/>		<input checked="" type="checkbox"/>				<u>3</u>	<input checked="" type="checkbox"/>	<input checked="" type="checkbox"/>								<u>C-16</u>		<u>959</u>	<input checked="" type="checkbox"/>		<input checked="" type="checkbox"/>				<u>3</u>	<input checked="" type="checkbox"/>	<input checked="" type="checkbox"/>					
Sample Identification	Date Collected	Time Collected	Grab	Composite	Soil	Water	Oil	Air	Total Number of Containers	BTEX + MTBE 8260	8021	TPH 8015 MOD GRO	TPH 8015 MOD DRO	8260 full scan	Oxygenates	Lead 7420	7421																																																																																																																																																																																																											
<u>FIELD QA</u>	<u>10-10-d</u>	—	<input checked="" type="checkbox"/>		<input checked="" type="checkbox"/>				<u>2</u>	<input checked="" type="checkbox"/>	<input checked="" type="checkbox"/>																																																																																																																																																																																																																	
<u>RAW C-1</u>		<u>1328</u>	<input checked="" type="checkbox"/>		<input checked="" type="checkbox"/>				<u>3</u>	<input checked="" type="checkbox"/>	<input checked="" type="checkbox"/>																																																																																																																																																																																																																	
<u>C-3</u>		<u>1400</u>	<input checked="" type="checkbox"/>		<input checked="" type="checkbox"/>				<u>3</u>	<input checked="" type="checkbox"/>	<input checked="" type="checkbox"/>																																																																																																																																																																																																																	
<u>C-6</u>		<u>1240</u>	<input checked="" type="checkbox"/>		<input checked="" type="checkbox"/>				<u>3</u>	<input checked="" type="checkbox"/>	<input checked="" type="checkbox"/>																																																																																																																																																																																																																	
<u>C-8</u>		<u>1115</u>	<input checked="" type="checkbox"/>		<input checked="" type="checkbox"/>				<u>3</u>	<input checked="" type="checkbox"/>	<input checked="" type="checkbox"/>																																																																																																																																																																																																																	
<u>C-9</u>		<u>1152</u>	<input checked="" type="checkbox"/>		<input checked="" type="checkbox"/>				<u>3</u>	<input checked="" type="checkbox"/>	<input checked="" type="checkbox"/>																																																																																																																																																																																																																	
<u>C-11</u>		<u>817</u>	<input checked="" type="checkbox"/>		<input checked="" type="checkbox"/>				<u>3</u>	<input checked="" type="checkbox"/>	<input checked="" type="checkbox"/>																																																																																																																																																																																																																	
<u>C-12</u>		<u>857</u>	<input checked="" type="checkbox"/>		<input checked="" type="checkbox"/>				<u>3</u>	<input checked="" type="checkbox"/>	<input checked="" type="checkbox"/>																																																																																																																																																																																																																	
<u>C-15</u>		<u>1036</u>	<input checked="" type="checkbox"/>		<input checked="" type="checkbox"/>				<u>3</u>	<input checked="" type="checkbox"/>	<input checked="" type="checkbox"/>																																																																																																																																																																																																																	
<u>C-16</u>		<u>959</u>	<input checked="" type="checkbox"/>		<input checked="" type="checkbox"/>				<u>3</u>	<input checked="" type="checkbox"/>	<input checked="" type="checkbox"/>																																																																																																																																																																																																																	

**Turnaround Time Requested (TAT) (please circle)**

STD. TAT      72 hour      48 hour  
 24 hour      4 day      5 day

**Data Package Options (please circle if required)**

QC Summary      Type I — Full  
 Type VI (Raw Data)       Coelt Deliverable not needed  
 WIP (RWQCB)  
 Disk

Relinquished by:	Date	Time	Received by:	Date	Time
<u>Frank H Bohnet</u>	<u>10/10/01</u>	<u>1435</u>	<u>Denise Vance</u>	<u>10/11/01</u>	<u>1345</u>
Relinquished by:	Date	Time	Received by:	Date	Time
<u>Denise Vance</u>	<u>10/11/01</u>	<u>1345</u>	<u>Andres Amaya</u>	<u>10-11-01</u>	<u>1350</u>
Relinquished by:	Date	Time	Received by:	Date	Time
<u>Andres Amaya</u>	<u>10-11-01</u>	<u>13:50</u>	<u>Fed Ex</u>	<u>10-11-01</u>	
Relinquished by Commercial Carrier:			Received by:	Date	Time
UPS <input checked="" type="checkbox"/> FedEx <input type="checkbox"/> Other _____			<u>[Signature]</u>	<u>10/11/01</u>	<u>13:50</u>
Temperature Upon Receipt <u>2.5</u> °C			Custody Seals Intact?	Yes <input checked="" type="checkbox"/> No <input type="checkbox"/>	



## Lancaster Laboratories

Where quality is a science.

### ANALYTICAL RESULTS

Prepared for:

Chevron Products Company  
6001 Bollinger Canyon Road  
Building L PO Box 6004  
San Ramon CA 94583-0904  
925-842-8582

Prepared by:

Lancaster Laboratories  
2425 New Holland Pike  
Lancaster, PA 17605-2425

RECEIVED

001 11 2001

GETTLER-RYAN, INC.  
GENERAL CONTRACTOR

### SAMPLE GROUP

The sample group for this submittal is 782003. Samples arrived at the laboratory on Friday, October 12, 2001. The PO# for this group is 99011184 and the release number is BAUHS.

<u>Client Description</u>		<u>Lancaster Labs Number</u>
QA-W-011010	NA Water	3705654
C-1-W-011010	Grab Water	3705655
C-3-W-011010	Grab Water	3705656
C-6-W-011010	Grab Water	3705657
C-8-W-011010	Grab Water	3705658
C-9-W-011010	Grab Water	3705659
C-11-W-011010	Grab Water	3705660
C-12-W-011010	Grab Water	3705661
C-15-W-011010	Grab Water	3705662
C-16-W-011010	Grab Water	3705663

### METHODOLOGY

The specific methodologies used in obtaining the enclosed analytical results are indicated on the laboratory chronicles.

1 COPY TO

Delta C/O Gettler-Ryan

Attn: Deanna L. Harding



Lancaster Laboratories, Inc.  
2425 New Holland Pike  
PO Box 12425  
Lancaster, PA 17605-2425  
717-656-2300 Fax: 717-656-2681



Questions? Contact your Client Services Representative  
Teresa M. Lis at (717) 656-2300.

Respectfully Submitted,



Victoria M. Martelli  
Chemist





Lancaster Laboratories Sample No. **WW 3705654**

Collected: 10/10/2001 00:00

Account Number: 10905

Submitted: 10/12/2001 10:05

Chevron Products Company

Reported: 10/22/2001 at 12:19

6001 Bollinger Canyon Road

Discard: 11/22/2001

Building L PO Box 6004

QA-W-011010

NA

Water

San Ramon CA 94583-0904

Facility# 9-5607

Job# 386539

GRD

5269 Crow Canyon Castro V T0600100344 QA

CAT No.	Analysis Name	CAS Number	As Received Result	As Received		Units	Dilution Factor
				Method	Detection Limit		
01729	TPH-GRO N. California (waters)						
01730	TPH-GRO N. California (waters)	n.a.	N.D.		50.	ug/l	1
	The reported concentration of TPH-GRO does not include MTBE or other gasoline constituents eluting prior to the C6 (n-hexane) TPH-GRO range start time.						
08214	BTEX, MTBE (8021)						
00776	Benzene	71-43-2	N.D.		0.50	ug/l	1
00777	Toluene	108-88-3	N.D.		0.50	ug/l	1
00778	Ethylbenzene	100-41-4	N.D.		0.50	ug/l	1
00779	Total Xylenes	1330-20-7	N.D.		1.5	ug/l	1
00780	Methyl tert-Butyl Ether	1634-04-4	N.D.		2.5	ug/l	1
	A site-specific MSD sample was not submitted for the project. A LCS/LCSD was performed to demonstrate precision and accuracy at a batch level.						

State of California Lab Certification No. 2116

### Laboratory Chronicle

CAT No.	Analysis Name	Method	Analysis		Analyst	Dilution Factor
			Trial#	Date and Time		
01729	TPH-GRO N. California (waters)	N. CALIF. LUFT Gasoline Method	1	10/17/2001 09:49	Melissa Mann	1
08214	BTEX, MTBE (8021)	SW-846 8021B	1	10/17/2001 09:49	Melissa Mann	1
01146	GC VOA Water Prep	SW-846 5030B	1	10/17/2001 09:49	Melissa Mann	n.a.



Lancaster Laboratories, Inc.  
 2425 New Holland Pike  
 PO Box 12425  
 Lancaster, PA 17605-2425  
 717-656-2300 Fax: 717-656-2681



Lancaster Laboratories Sample No. WW 3705655

Collected: 10/10/2001 13:28 by FB

Account Number: 10905

Submitted: 10/12/2001 10:05  
 Reported: 10/22/2001 at 12:19  
 Discard: 11/22/2001

Chevron Products Company  
 6001 Bollinger Canyon Road  
 Building L PO Box 6004  
 San Ramon CA 94583-0904

C-1-W-011010 Grab Water

Facility# 9-5607 Job# 386539 GRD  
 5269 Crow Canyon Castro V T0600100344 C-1

CAT No.	Analysis Name	CAS Number	As Received Result	As Received Method Detection Limit	Units	Dilution Factor
01729	TPH-GRO N. California (waters)					
01730	TPH-GRO N. California (waters)	n.a.	28,000.	500.	ug/l	10
	The reported concentration of TPH-GRO does not include MTBE or other gasoline constituents eluting prior to the C6 (n-hexane) TPH-GRO range start time.					
08214	BTEX, MTBE (8021)					
00776	Benzene	71-43-2	1,900.	2.0	ug/l	10
00777	Toluene	108-88-3	320.	2.0	ug/l	10
00778	Ethylbenzene	100-41-4	1,500.	2.0	ug/l	10
00779	Total Xylenes	1330-20-7	4,000.	6.0	ug/l	10
00780	Methyl tert-Butyl Ether	1634-04-4	170.	3.0	ug/l	10
	A site-specific MSD sample was not submitted for the project. A LCS/LCSD was performed to demonstrate precision and accuracy at a batch level.					

State of California Lab Certification No. 2116

### Laboratory Chronicle

CAT No.	Analysis Name	Method	Analysis		Analyst	Dilution Factor
			Trial#	Date and Time		
01729	TPH-GRO N. California (waters)	N. CALIF. LUFT Gasoline Method	1	10/17/2001 03:40	Linda C. Pape	10
08214	BTEX, MTBE (8021)	SW-846 8021B	1	10/17/2001 03:40	Linda C. Pape	10
01146	GC VOA Water Prep	SW-846 5030B	1	10/17/2001 03:40	Linda C. Pape	n.a.



Lancaster Laboratories, Inc.  
 2425 New Holland Pike  
 PO Box 12425  
 Lancaster, PA 17605-2425  
 717-656-2300 Fax: 717-656-2681



Lancaster Laboratories Sample No. **WW 3705656**

Collected: 10/10/2001 14:00 by FB

Account Number: 10905

Submitted: 10/12/2001 10:05

Chevron Products Company

Reported: 10/22/2001 at 12:19

6001 Bollinger Canyon Road

Discard: 11/22/2001

Building L PO Box 6004

C-3-W-011010

Grab Water

San Ramon CA 94583-0904

Facility# 9-5607 Job# 386539 GRD

5269 Crow Canyon Castro V T0600100344 C-3

CAT No.	Analysis Name	CAS Number	As Received Result	As Received Method Detection Limit	Units	Dilution Factor
01729	TPH-GRO N. California (waters)					
01730	TPH-GRO N. California (waters)	n.a.	90,000.	1,000.	ug/l	20
	The reported concentration of TPH-GRO does not include MTBE or other gasoline constituents eluting prior to the C6 (n-hexane) TPH-GRO range start time.					
08214	BTEX, MTBE (8021)					
00776	Benzene	71-43-2	18,000.	20.	ug/l	100
00777	Toluene	108-88-3	4,200.	4.0	ug/l	20
00778	Ethylbenzene	100-41-4	1,900.	4.0	ug/l	20
00779	Total Xylenes	1330-20-7	13,000.	12.	ug/l	20
00780	Methyl tert-Butyl Ether	1634-04-4	N.D. #	50.	ug/l	20

A site-specific MSD sample was not submitted for the project. A LCS/LCSD was performed to demonstrate precision and accuracy at a batch level.

Due to the presence of an interferent near its retention time, the normal reporting limit was not attained for MTBE. The presence or concentration of this compound cannot be determined due to the presence of this interferent.

State of California Lab Certification No. 2116

### Laboratory Chronicle

CAT No.	Analysis Name	Method	Trial#	Analysis Date and Time	Analyst	Dilution Factor
01729	TPH-GRO N. California (waters)	N. CALIF. LUFT Gasoline Method	1	10/17/2001 20:03	Melissa Mann	20
08214	BTEX, MTBE (8021)	SW-846 8021B	1	10/17/2001 04:15	Linda C. Pape	100
08214	BTEX, MTBE (8021)	SW-846 8021B	1	10/17/2001 20:03	Melissa Mann	20
01146	GC VOA Water Prep	SW-846 5030B	1	10/17/2001 04:15	Melissa Mann	n.a.



Lancaster Laboratories, Inc.  
 2425 New Holland Pike  
 PO Box 12425  
 Lancaster, PA 17605-2425  
 717-656-2300 Fax: 717-656-2681



Lancaster Laboratories Sample No. WW 3705656

Collected: 10/10/2001 14:00 by FB

Account Number: 10905

Submitted: 10/12/2001 10:05

Reported: 10/22/2001 at 12:19

Discard: 11/22/2001

C-3-W-011010

Grab

Water

Chevron Products Company  
6001 Bollinger Canyon Road  
Building L PO Box 6004  
San Ramon CA 94583-0904

Facility# 9-5607 Job# 386539  
5269 Crow Canyon Castro V T0600100344 C-3

GRD



Lancaster Laboratories, Inc.  
2425 New Holland Pike  
PO Box 12425  
Lancaster, PA 17605-2425  
717-656-2300 Fax: 717-656-2681



Lancaster Laboratories Sample No. **WW 3705657**

Collected: 10/10/2001 12:40 by **FB**

Account Number: 10905

Submitted: 10/12/2001 10:05

Chevron Products Company

Reported: 10/22/2001 at 12:19

6001 Bollinger Canyon Road

Discard: 11/22/2001

Building L PO Box 6004

C-6-W-011010

Grab

Water

San Ramon CA 94583-0904

Facility# 9-5607

Job# 386539

GRD

5269 Crow Canyon Castro V T0600100344 C-6

CAT No.	Analysis Name	CAS Number	As Received Result	As Received Method Detection Limit	Units	Dilution Factor
01729	TPH-GRO N. California (waters)					
01730	TPH-GRO N. California (waters)	n.a.	18,000.	1,000.	ug/l	20
	The reported concentration of TPH-GRO does not include MTBE or other gasoline constituents eluting prior to the C6 (n-hexane) TPH-GRO range start time.					
08214	BTEX, MTBE (8021)					
00776	Benzene	71-43-2	5,600.	4.0	ug/l	20
00777	Toluene	108-88-3	51.	4.0	ug/l	20
00778	Ethylbenzene	100-41-4	140.	4.0	ug/l	20
00779	Total Xylenes	1330-20-7	340.	12.	ug/l	20
00780	Methyl tert-Butyl Ether	1634-04-4	N.D. #	50.	ug/l	20

A site-specific MSD sample was not submitted for the project. A LCS/LCSD was performed to demonstrate precision and accuracy at a batch level.

Due to the presence of an interferent near its retention time, the normal reporting limit was not attained for MTBE. The presence or concentration of this compound cannot be determined due to the presence of this interferent.

State of California Lab Certification No. 2116

### Laboratory Chronicle

CAT No.	Analysis Name	Method	Trial#	Analysis Date and Time	Analyst	Dilution Factor
01729	TPH-GRO N. California (waters)	N. CALIF. LUFT Gasoline Method	1	10/17/2001 04:50	Linda C. Pape	20
08214	BTEX, MTBE (8021)	SW-846 8021B	1	10/17/2001 04:50	Linda C. Pape	20
01146	GC VOA Water Prep	SW-846 5030B	1	10/17/2001 04:50	Linda C. Pape	n.a.



Lancaster Laboratories, Inc.  
 2425 New Holland Pike  
 PO Box 12425  
 Lancaster, PA 17605-2425  
 717-656-2300 Fax: 717-656-2681



Lancaster Laboratories Sample No. WW 3705658

Collected: 10/10/2001 11:15 by FB

Account Number: 10905

Submitted: 10/12/2001 10:05  
 Reported: 10/22/2001 at 12:19  
 Discard: 11/22/2001

Chevron Products Company  
 6001 Bollinger Canyon Road  
 Building L PO Box 6004  
 San Ramon CA 94583-0904

C-8-W-011010 Grab Water

Facility# 9-5607 Job# 386539 GRD  
 5269 Crow Canyon Castro V T0600100344 C-8

CAT No.	Analysis Name	CAS Number	As Received Result	As Received Method Detection Limit	Units	Dilution Factor
01729	TPH-GRO N. California (waters)					
01730	TPH-GRO N. California (waters)	n.a.	N.D.	50.	ug/l	1
	The reported concentration of TPH-GRO does not include MTBE or other gasoline constituents eluting prior to the C6 (n-hexane) TPH-GRO range start time.					
08214	BTEX, MTBE (8021)					
00776	Benzene	71-43-2	N.D.	0.50	ug/l	1
00777	Toluene	108-88-3	N.D.	0.50	ug/l	1
00778	Ethylbenzene	100-41-4	N.D.	0.50	ug/l	1
00779	Total Xylenes	1330-20-7	N.D.	1.5	ug/l	1
00780	Methyl tert-Butyl Ether	1634-04-4	N.D.	2.5	ug/l	1
	A site-specific MSD sample was not submitted for the project. A LCS/LCSD was performed to demonstrate precision and accuracy at a batch level.					

State of California Lab Certification No. 2116

### Laboratory Chronicle

CAT No.	Analysis Name	Method	Trial#	Analysis Date and Time	Analyst	Dilution Factor
01729	TPH-GRO N. California (waters)	N. CALIF. LUFT Gasoline Method	1	10/17/2001 11:35	Melissa Mann	1
08214	BTEX, MTBE (8021)	SW-846 8021B	1	10/17/2001 11:35	Melissa Mann	1
01146	GC VOA Water Prep	SW-846 5030B	1	10/17/2001 11:35	Melissa Mann	n.a.



Lancaster Laboratories Sample No. WW 3705657

Collected: 10/10/2001 12:40 by FB

Account Number: 10905

Submitted: 10/12/2001 10:05

Reported: 10/22/2001 at 12:19

Discard: 11/22/2001

C-6-W-011010

Grab

Water

Chevron Products Company

6001 Bollinger Canyon Road

Building L PO Box 6004

San Ramon CA 94583-0904

Facility# 9-5607

Job# 386539

GRD

5269 Crow Canyon Castro V T0600100344 C-6



Lancaster Laboratories, Inc.  
2425 New Holland Pike  
PO Box 12425  
Lancaster, PA 17605-2425  
717-656-2300 Fax: 717-656-2681



Lancaster Laboratories Sample No. WW 3705659

Collected: 10/10/2001 11:52 by FB

Account Number: 10905

Submitted: 10/12/2001 10:05

Chevron Products Company

Reported: 10/22/2001 at 12:19

6001 Bollinger Canyon Road

Discard: 11/22/2001

Building L PO Box 6004

C-9-W-011010

Grab

Water

San Ramon CA 94583-0904

Facility# 9-5607 Job# 386539 GRD

5269 Crow Canyon Castro V T0600100344 C-9

CAT No.	Analysis Name	CAS Number	As Received Result	As Received Method Detection Limit	Units	Dilution Factor
01729	TPH-GRO N. California (waters)					
01730	TPH-GRO N. California (waters)	n.a.	5,900.	250.	ug/l	5
	The reported concentration of TPH-GRO does not include MTBE or other gasoline constituents eluting prior to the C6 (n-hexane) TPH-GRO range start time.					
08214	BTEX, MTBE (8021)					
00776	Benzene	71-43-2	920.	1.0	ug/l	5
00777	Toluene	108-88-3	33.	1.0	ug/l	5
00778	Ethylbenzene	100-41-4	300.	1.0	ug/l	5
00779	Total Xylenes	1330-20-7	240.	3.0	ug/l	5
00780	Methyl tert-Butyl Ether	1634-04-4	N.D. #	20.	ug/l	5

A site-specific MSD sample was not submitted for the project. A LCS/LCSD was performed to demonstrate precision and accuracy at a batch level.

Due to the presence of an interferent near its retention time, the normal reporting limit was not attained for the compound listed below. The presence or concentration of this compound cannot be determined due to the presence of this interferent.

Methyl t-butyl ether

State of California Lab Certification No. 2116

### Laboratory Chronicle

CAT No.	Analysis Name	Method	Trial#	Analysis Date and Time	Analyst	Dilution Factor
01729	TPH-GRO N. California (waters)	N. CALIF. LUFT Gasoline Method	1	10/17/2001 12:10	Melissa Mann	5
08214	BTEX, MTBE (8021)	SW-846 8021B	1	10/17/2001 12:10	Melissa Mann	5



Lancaster Laboratories, Inc.  
 2425 New Holland Pike  
 PO Box 12425  
 Lancaster, PA 17605-2425  
 717-656-2300 Fax: 717-656-2681





Lancaster Laboratories Sample No. WW 3705659

Collected: 10/10/2001 11:52 by FB

Account Number: 10905

Submitted: 10/12/2001 10:05

Reported: 10/22/2001 at 12:19

Discard: 11/22/2001

C-9-W-011010

Grab

Water

Chevron Products Company

6001 Bollinger Canyon Road

Building L PO Box 6004

San Ramon CA 94583-0904

Facility# 9-5607 Job# 386539 GRD  
5269 Crow Canyon Castro V T0600100344 C-9

01146 GC VOA Water Prep SW-846 5030B 1 10/17/2001 12:10 Melissa Mann n.a.





Lancaster Laboratories Sample No. **WW 3705660**

Collected: 10/10/2001 08:17 by **FB**

Account Number: 10905

Submitted: 10/12/2001 10:05  
 Reported: 10/22/2001 at 12:19  
 Discard: 11/22/2001  
 C-11-W-011010                      Grab              Water

Chevron Products Company  
 6001 Bollinger Canyon Road  
 Building L PO Box 6004  
 San Ramon CA 94583-0904

Facility# 9-5607      Job# 386539                      GRD  
 5269 Crow Canyon Castro V T0600100344 C-11

CAT No.	Analysis Name	CAS Number	As Received Result	As Received Method Detection Limit	Units	Dilution Factor
01729	TPH-GRO N. California (waters)					
01730	TPH-GRO N. California (waters)	n.a.	N.D.	50.	ug/l	1
	The reported concentration of TPH-GRO does not include MTBE or other gasoline constituents eluting prior to the C6 (n-hexane) TPH-GRO range start time.					
08214	BTEX, MTBE (8021)					
00776	Benzene	71-43-2	N.D.	0.50	ug/l	1
00777	Toluene	108-88-3	N.D.	0.50	ug/l	1
00778	Ethylbenzene	100-41-4	N.D.	0.50	ug/l	1
00779	Total Xylenes	1330-20-7	N.D.	1.5	ug/l	1
00780	Methyl tert-Butyl Ether	1634-04-4	N.D.	2.5	ug/l	1
	A site-specific MSD sample was not submitted for the project. A LCS/LCSD was performed to demonstrate precision and accuracy at a batch level.					

State of California Lab Certification No. 2116

### Laboratory Chronicle

CAT No.	Analysis Name	Method	Analysis		Analyst	Dilution Factor
			Trial#	Date and Time		
01729	TPH-GRO N. California (waters)	N. CALIF. LUFT Gasoline Method	1	10/16/2001 23:35	Melissa Mann	1
08214	BTEX, MTBE (8021)	SW-846 8021B	1	10/16/2001 23:35	Melissa Mann	1
01146	GC VOA Water Prep	SW-846 5030B	1	10/16/2001 23:35	Melissa Mann	n.a.



Lancaster Laboratories, Inc.  
 2425 New Holland Pike  
 PO Box 12425  
 Lancaster, PA 17605-2425  
 717-656-2300 Fax: 717-656-2681



Lancaster Laboratories Sample No. WW 3705661

Collected: 10/10/2001 08:57 by FB

Account Number: 10905

Submitted: 10/12/2001 10:05  
Reported: 10/22/2001 at 12:19  
Discard: 11/22/2001  
C-12-W-011010 Grab Water

Chevron Products Company  
6001 Bollinger Canyon Road  
Building L PO Box 6004  
San Ramon CA 94583-0904

Facility# 9-5607 Job# 386539 GRD  
5269 Crow Canyon Castro V T0600100344 C-12

CAT No.	Analysis Name	CAS Number	As Received Result	As Received Method Detection Limit	Units	Dilution Factor
01729	TPH-GRO N. California (waters)					
01730	TPH-GRO N. California (waters)	n.a.	8,700.	250.	ug/l	5
The reported concentration of TPH-GRO does not include MTBE or other gasoline constituents eluting prior to the C6 (n-hexane) TPH-GRO range start time.						
08214	BTEX, MTBE (8021)					
00776	Benzene	71-43-2	720.	1.0	ug/l	5
00777	Toluene	108-88-3	15.	1.0	ug/l	5
00778	Ethylbenzene	100-41-4	430.	1.0	ug/l	5
00779	Total Xylenes	1330-20-7	250.	3.0	ug/l	5
00780	Methyl tert-Butyl Ether	1634-04-4	N.D. #	50.	ug/l	5
A site-specific MSD sample was not submitted for the project. A LCS/LCSD was performed to demonstrate precision and accuracy at a batch level.						

Due to the presence of an interferent near its retention time, the normal reporting limit was not attained for the compound listed below. The presence or concentration of this compound cannot be determined due to the presence of this interferent.  
Methyl t-butyl ether

State of California Lab Certification No. 2116

### Laboratory Chronicle

CAT No.	Analysis Name	Method	Trial#	Analysis Date and Time	Analyst	Dilution Factor
01729	TPH-GRO N. California (waters)	N. CALIF. LUFT Gasoline Method	1	10/17/2001 12:45	Melissa Mann	5
08214	BTEX, MTBE (8021)	SW-846 8021B	1	10/17/2001 12:45	Melissa Mann	5



Lancaster Laboratories, Inc.  
2425 New Holland Pike  
PO Box 12425  
Lancaster, PA 17605-2425  
717-656-2300 Fax: 717-656-2681



## Lancaster Laboratories

*Where quality is a science.*

Page 2 of 2

Lancaster Laboratories Sample No. WW 3705661

Collected: 10/10/2001 08:57 by FB

Account Number: 10905

Submitted: 10/12/2001 10:05

Chevron Products Company

Reported: 10/22/2001 at 12:19

6001 Bollinger Canyon Road

Discard: 11/22/2001

Building L PO Box 6004

C-12-W-011010

Grab

Water

San Ramon CA 94583-0904

Facility# 9-5607 Job# 386539 GRD

5269 Crow Canyon Castro V T0600100344 C-12

01146 GC VOA Water Prep SW-846 5030B 1 10/17/2001 12:45 Melissa Mann n.a.



Lancaster Laboratories, Inc.  
2425 New Holland Pike  
PO Box 12425  
Lancaster, PA 17605-2425  
717-656-2300 Fax: 717-656-2681



Lancaster Laboratories Sample No. **WW 3705662**

Collected: 10/10/2001 10:36 by **FB**

Account Number: 10905

Submitted: 10/12/2001 10:05

Chevron Products Company

Reported: 10/22/2001 at 12:19

6001 Bollinger Canyon Road

Discard: 11/22/2001

Building L PO Box 6004

C-15-W-011010

Grab Water

San Ramon CA 94583-0904

Facility# 9-5607 Job# 386539 GRD

5269 Crow Canyon Castro V T0600100344 C-15

CAT No.	Analysis Name	CAS Number	As Received Result	As Received Method Detection Limit	Units	Dilution Factor
01729	TPH-GRO N. California (waters)					
01730	TPH-GRO N. California (waters)	n.a.	780.	50.	ug/l	1
The reported concentration of TPH-GRO does not include MTBE or other gasoline constituents eluting prior to the C6 (n-hexane) TPH-GRO range start time.						
Site-specific MS/MSD samples were not submitted for the project. A LCS/LCSD was performed to demonstrate precision and accuracy at a batch level.						
08214	BTEX, MTBE (8021)					
00776	Benzene	71-43-2	1.7	0.50	ug/l	1
00777	Toluene	108-88-3	N.D. #	1.0	ug/l	1
00778	Ethylbenzene	100-41-4	N.D.	0.50	ug/l	1
00779	Total Xylenes	1330-20-7	N.D.	1.5	ug/l	1
00780	Methyl tert-Butyl Ether	1634-04-4	7.0	2.5	ug/l	1
Site-specific MS/MSD samples were not submitted for the project. A LCS/LCSD was performed to demonstrate precision and accuracy at a batch level.						

Due to the presence of an interferent near its retention time, the normal reporting limit was not attained for toluene. The presence or concentration of this compound cannot be determined due to the presence of this interferent.

State of California Lab Certification No. 2116

### Laboratory Chronicle

CAT No.	Analysis Name	Method	Trial#	Analysis Date and Time	Analyst	Dilution Factor
01729	TPH-GRO N. California (waters)	N. CALIF. LUFT Gasoline Method	1	10/18/2001 06:54	Linda C. Pape	1



Lancaster Laboratories, Inc.  
 2425 New Holland Pike  
 PO Box 12425  
 Lancaster, PA 17605-2425  
 717-656-2300 Fax: 717-656-2681



Lancaster Laboratories Sample No. WW 3705662

Collected: 10/10/2001 10:36 by FB

Account Number: 10905

Submitted: 10/12/2001 10:05  
Reported: 10/22/2001 at 12:19  
Discard: 11/22/2001  
C-15-W-011010

Chevron Products Company  
6001 Bollinger Canyon Road  
Building L PO Box 6004  
San Ramon CA 94583-0904

Grab Water

Facility# 9-5607 Job# 386539 GRD  
5269 Crow Canyon Castro V T0600100344 C-15

08214	BTEX, MTBE (8021)	SW-846 8021B	1	10/18/2001 06:54	Linda C. Pape	1
01146	GC VOA Water Prep	SW-846 5030B	1	10/18/2001 06:54	Linda C. Pape	n.a.



Lancaster Laboratories, Inc.  
2425 New Holland Pike  
PO Box 12425  
Lancaster, PA 17605-2425  
717-656-2300 Fax: 717-656-2681



Lancaster Laboratories Sample No. **WW 3705663**

Collected: 10/10/2001 09:59 by **FB**

Account Number: 10905

Submitted: 10/12/2001 10:05  
 Reported: 10/22/2001 at 12:19  
 Discard: 11/22/2001  
 C-16-W-011010                      Grab              Water

Chevron Products Company  
 6001 Bollinger Canyon Road  
 Building L PO Box 6004  
 San Ramon CA 94583-0904

Facility# 9-5607      Job# 386539                      GRD  
 5269 Crow Canyon Castro V T0600100344 C-16

CAT No.	Analysis Name	CAS Number	As Received Result	As Received Method Detection Limit	Units	Dilution Factor
01729	TPH-GRO N. California (waters)					
01730	TPH-GRO N. California (waters)	n.a.	N.D.	50.	ug/l	1
The reported concentration of TPH-GRO does not include MTBE or other gasoline constituents eluting prior to the C6 (n-hexane) TPH-GRO range start time.						
A site-specific MSD sample was not submitted for the project. A LCS/LCSD was performed to demonstrate precision and accuracy at a batch level.						
08214	BTEX, MTBE (8021)					
00776	Benzene	71-43-2	N.D.	0.50	ug/l	1
00777	Toluene	108-88-3	N.D.	0.50	ug/l	1
00778	Ethylbenzene	100-41-4	N.D.	0.50	ug/l	1
00779	Total Xylenes	1330-20-7	N.D.	1.5	ug/l	1
00780	Methyl tert-Butyl Ether	1634-04-4	N.D.	2.5	ug/l	1
A site-specific MSD sample was not submitted for the project. A LCS/LCSD was performed to demonstrate precision and accuracy at a batch level.						

State of California Lab Certification No. 2116

### Laboratory Chronicle

CAT No.	Analysis Name	Method	Trial#	Analysis Date and Time	Analyst	Dilution Factor
01729	TPH-GRO N. California (waters)	N. CALIF. LUFT Gasoline Method	1	10/17/2001 02:36	Linda C. Pape	1
08214	BTEX, MTBE (8021)	SW-846 8021B	1	10/17/2001 02:36	Linda C. Pape	1
01146	GC VOA Water Prep	SW-846 5030B	1	10/17/2001 02:36	Linda C. Pape	n.a.



Lancaster Laboratories, Inc.  
 2425 New Holland Pike  
 PO Box 12425  
 Lancaster, PA 17605-2425  
 717-656-2300 Fax: 717-656-2681



### Quality Control Summary

Client Name: Chevron Products Company  
 Reported: 10/22/01 at 12:19 PM

Group Number: 782003

#### Laboratory Compliance Quality Control

<u>Analysis Name</u>	<u>Blank Result</u>	<u>Blank MDL</u>	<u>Report Units</u>	<u>LCS %REC</u>	<u>LCSD %REC</u>	<u>LCS/LCSD Limits</u>	<u>RPD</u>	<u>RPD Max</u>
Batch number: 01289A55      Sample number(s): 3705654-3705661								
Benzene	N.D.	0.5	ug/l	98	99	80-118	2	30
Toluene	N.D.	0.5	ug/l	106	109	82-119	3	30
Ethylbenzene	N.D.	0.5	ug/l	105	107	81-119	2	30
Total Xylenes	N.D.	1.5	ug/l	103	105	82-120	2	30
Methyl tert-Butyl Ether	N.D.	2.5	ug/l	86	88	79-127	2	30
TPH-GRO N. California (waters)	N.D.	50.	ug/l	117	112	76-119	4	20
Batch number: 01289A56      Sample number(s): 3705663								
Benzene	N.D.	0.5	ug/l	107	101	80-118	5	30
Toluene	N.D.	0.5	ug/l	106	99	82-119	7	30
Ethylbenzene	N.D.	0.5	ug/l	109	101	81-119	8	30
Total Xylenes	N.D.	1.5	ug/l	109	101	82-120	7	30
Methyl tert-Butyl Ether	N.D.	2.5	ug/l	114	114	79-127	0	30
TPH-GRO N. California (waters)	N.D.	50.	ug/l	108	108	76-119	0	20
Batch number: 01290A53      Sample number(s): 3705662								
Benzene	N.D.	0.5	ug/l	111	112	80-118	1	30
Toluene	N.D.	0.5	ug/l	109	109	82-119	0	30
Ethylbenzene	N.D.	0.5	ug/l	110	110	81-119	0	30
Total Xylenes	N.D.	1.5	ug/l	110	108	82-120	1	30
Methyl tert-Butyl Ether	N.D.	2.5	ug/l	112	116	79-127	4	30
TPH-GRO N. California (waters)	N.D.	50.	ug/l	104	103	76-119	1	20

#### Sample Matrix Quality Control

<u>Analysis Name</u>	<u>MS %REC</u>	<u>MSD %REC</u>	<u>MS/MSD Limits</u>	<u>RPD</u>	<u>MAX</u>	<u>BKG Conc</u>	<u>DUP Conc</u>	<u>DUP RPD</u>	<u>Dup RPD Max</u>
Batch number: 01289A55      Sample number(s): 3705654-3705661									
Benzene	95		66-140						
Toluene	101		72-138						
Ethylbenzene	103		71-138						
Total Xylenes	100		69-140						
Methyl tert-Butyl Ether	85		60-145						
TPH-GRO N. California (waters)	103	119	74-132	7	20				
Batch number: 01289A56      Sample number(s): 3705663									
Benzene	116		66-140						
Toluene	118		72-138						
Ethylbenzene	119		71-138						
Total Xylenes	118		69-140						
Methyl tert-Butyl Ether	120		60-145						
TPH-GRO N. California (waters)	110		74-132						

\*- Outside of specification

- (1) The result for one or both determinations was less than five times the LOQ.
- (2) The background result was more than four times the spike added.







## Lancaster Laboratories

Where quality is a science

### Quality Control Summary

Client Name: Chevron Products Company  
Reported: 10/22/01 at 12:19 PM

Group Number: 782003

### Surrogate Quality Control

Analysis Name: TPH-GRO N. California (waters)  
Batch number: 01289A55

	Trifluorotoluene-F	Trifluorotoluene-P
3705654	80	98
3705655	91	116
3705656	89	111
3705657	84	98
3705658	77	96
3705659	84	105
3705660	82	98
3705661	102	123
Blank	90	97
LCS	96	97
LCSD	89	97
MS	93	101
MSD	99	

Limits: 65-137 72-134

Analysis Name: TPH-GRO N. California (waters)  
Batch number: 01289A56

	Trifluorotoluene-F	Trifluorotoluene-P
3705663	105	95
Blank	103	96
LCS	116	97
LCSD	115	98
MS	122	96

Limits: 65-137 72-134

Analysis Name: TPH-GRO N. California (waters)  
Batch number: 01290A53

	Trifluorotoluene-F	Trifluorotoluene-P
3705662	109	88
Blank	98	98
LCS	109	93
LCSD	105	93

Limits: 65-137 72-134

DEC 21 2001

\*- Outside of specification

- (1) The result for one or both determinations was less than five times the LOQ.
- (2) The background result was more than four times the spike added.



Lancaster Laboratories, Inc.  
2425 New Holland Pike  
PO Box 12425  
Lancaster, PA 17605-2425  
717-656-2300 Fax: 717-656-2681