

BLAINE
TECH SERVICES INC.

1680 ROGERS AVENUE
SAN JOSE, CA 95112-1105
(408) 573-7771 FAX
(408) 573-0555 PHONE



December 21, 1998

Brett Hunter
Chevron U.S.A. Products Company
P.O. Box 6004
San Ramon, CA 94583-0904

4th Quarter 1998 Monitoring at 9-5607

Fourth Quarter 1998 Groundwater Monitoring at
Chevron Service Station Number 9-5607
5269 Crow Canyon Road
Castro Valley, CA

Monitoring Performed on October 13, 1998

Groundwater Sampling Report 981013-T-2

This report covers the routine monitoring of groundwater wells at this Chevron facility. Blaine Tech Services, Inc.'s work at the site includes inspection, gauging, evacuation, purgewater containment, sample collection and sample handling in accordance with standard procedures that conform to Regional Water Quality Control Board requirements.

Routine field data collection includes depth to water, total well depth, thickness of any separate immiscible layer, water column volume, calculated volume of a three-case volume purge, elapsed evacuation time, total volume of water removed, and standard water parameter instrument readings. Sample material is collected, contained, stored, and transported to the laboratory in conformance with EPA standards. Purgewater is, likewise, collected and transported to McKittrick Waste Treatment Site for disposal.

Basic field information is presented alongside analytical values excerpted from the laboratory report in the cumulative table of **WELL DATA AND ANALYTICAL RESULTS**. The full analytical report for the most recent samples is located in the **Analytical Appendix**. The table also contains new groundwater elevation calculations taken from the computer plotted gradient

map which is located in the **Professional Engineering Appendix**.

At a minimum, Blaine Tech Services, Inc. field personnel are certified upon completion of a forty-hour Hazardous Materials and Emergency Response training course per 29 CFR 1910.120. Field personnel are also enrolled in annual eight hour refresher courses.

Blaine Tech Services, Inc. conducts sampling and documentation assignments of this type as an independent third party. In order to avoid compromising the objectivity necessary for the proper and disinterested performance of this work, Blaine Tech Services, Inc. concentrates on objective data collection and does not participate in the interpretation of analytical results, the definition of geological or hydrological conditions, the formulation of recommendations, or the marketing of remedial systems.

Please call if you have any questions.

Yours truly,

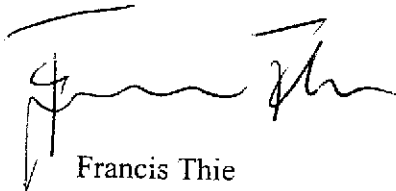

Francis Thie
Vice President

FPT/ap

attachments: Professional Engineering Appendix
Cumulative Table of Well Data and Analytical Results
Analytical Appendix
Field Data Sheets

cc: Scott Seery, Alameda County Environmental Health
Kevin Hinckley
Diane Riggs, Forest Creek Townhomes Assoc.
Tim Utterback, Weiss Associates
Bette Owen, Chevron (w/o enclosure)

Professional Engineering Appendix

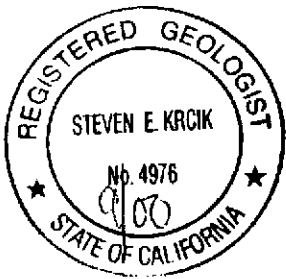
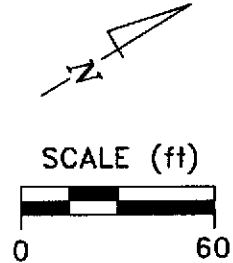

- EXPLANATION**
- ◆ MONITORING WELL
 - ∅ ABANDONED MONITORING WELL
 - ▲ RECOVERY WELL
 - 260.38 GROUNDWATER ELEVATION (FT, MSL)
 - 268.00 GROUNDWATER ELEVATION CONTOUR (FT, MSL)
 - NA DATA NOT AVAILABLE
 - APPROXIMATE GROUNDWATER FLOW DIRECTION;
APPROXIMATE GRADIENT = 0.1

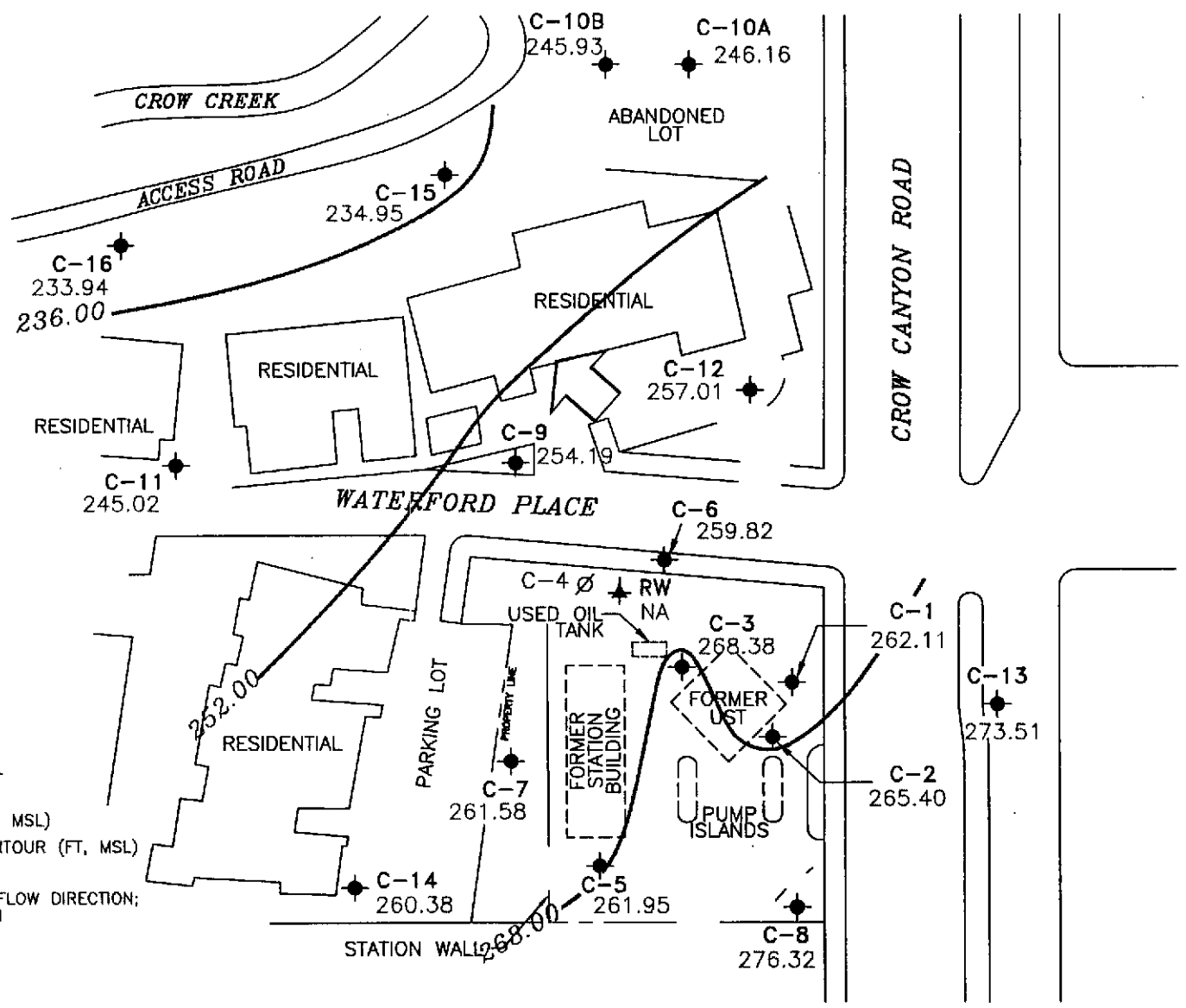

Basemap from Cambria Environmental Technology, Inc.

PREPARED BY

Chevron Station 9-5607
 5269 Crow Canyon Road
 Castro Valley, California

GROUNDWATER ELEVATION CONTOUR MAP,
 OCTOBER 13, 1998

FIGURE:
 1
PROJECT:
 DAC04



SCALE (ft)

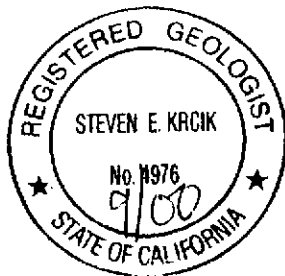

EXPLANATION

- MONITORING WELL
- ABANDONED MONITORING WELL
- RECOVERY WELL
- <0.5 BENZENE CONCENTRATIONS (ppb)
- BENZENE CONCENTRATION CONTOUR (ppb)
- NA DATA NOT AVAILABLE

NOTE: CONTOURS BASED ON CURRENT AND HISTORIC DATA.

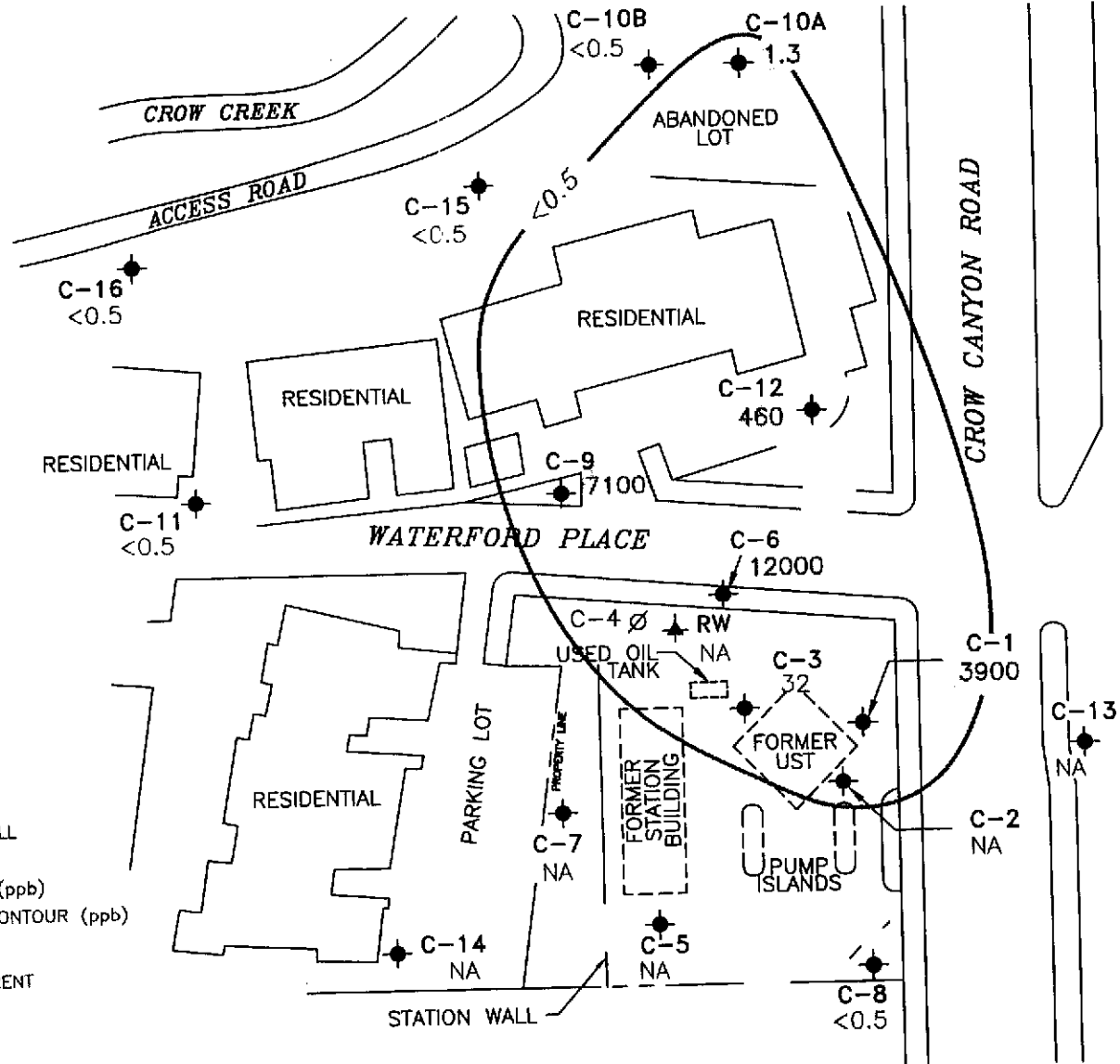

Basemap from Cambria Environmental Technology, Inc.

PREPARED BY

RRM
engineering contracting firm

Chevron Station 9-5607
5269 Crow Canyon Road
Castro Valley, California

BENZENE CONCENTRATION IN
GROUNDWATER, OCTOBER 13, 1998

FIGURE:
2
PROJECT:
DAC04

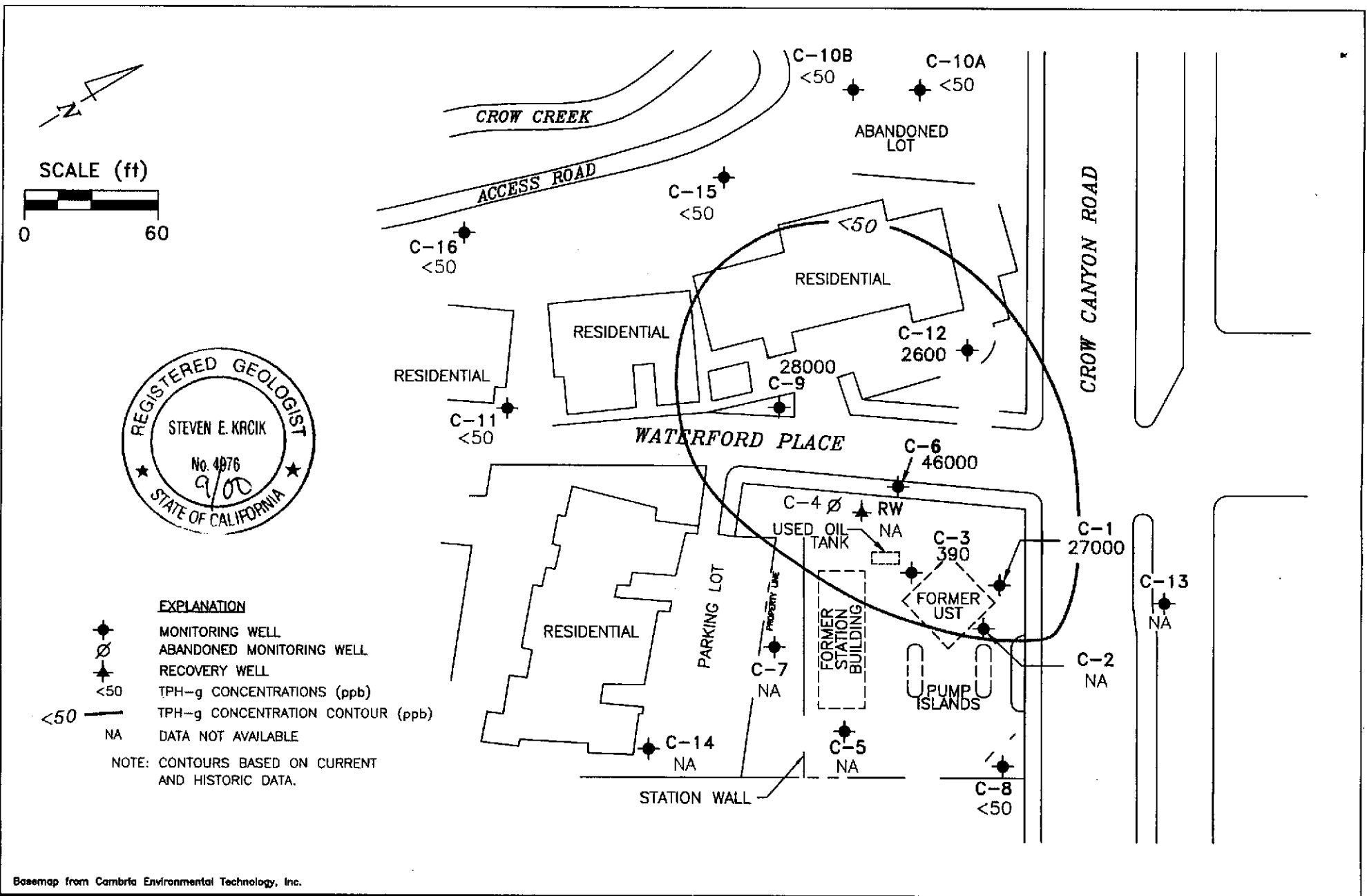

PREPARED BY

RRM
engineering contracting firm

Chevron Station 9-5607
5269 Crow Canyon Road
Castro Valley, California

TPH-GASOLINE CONCENTRATION IN GROUNDWATER, OCTOBER 13, 1998

FIGURE:
3
PROJECT:
DAC04

Table of Well Data and Analytical Results

Cumulative Table of Well Data and Analytical Results

Vertical Measurements are in feet.

Volumetric Measurements are in gallons.

Analytical results are in parts per billion (ppb)

DATE	Well	Ground	Depth	Total			Notes	Analytical results are in parts per billion (ppb)						
	Head Elev.	Water Elev.	To Water	SPH Thickness	SPH Removed	SPH Removed		TPH-Gasoline	Benzene	Toluene	Ethyl-Benzene	Xylene	MTBE	Organic Lead
C-1														
03/26/85	283.46	260.63	22.83	--	--	--	--	--	--	--	--	--	--	--
07/03/86	283.46	259.88	23.58	--	--	--	--	--	--	--	--	--	--	--
03/26/87	283.46	262.96	20.50	--	--	--	--	--	--	--	--	--	--	--
03/28/88	283.46	257.46	26.00	--	--	--	--	--	--	--	--	--	--	--
03/10/89	283.46	267.60	15.86	--	--	--	--	--	--	--	--	--	--	--
04/03/89	283.46	266.61	16.85	--	--	--	--	--	--	--	--	--	--	--
05/08/89	283.46	260.78	22.68	--	--	--	--	--	--	--	--	--	--	--
06/05/89	283.46	258.80	24.66	--	--	--	--	--	--	--	--	--	--	--
07/12/90	283.46	257.90	25.56	--	--	--	--	--	--	--	--	--	--	--
08/10/90	283.46	257.57	25.89	--	--	--	--	--	--	--	--	--	--	--
09/13/89	283.46	256.91	26.55	--	--	--	--	22,000	3600	1100	1000	3500	--	--
10/04/89	283.46	258.22	25.24	--	--	--	--	--	--	--	--	--	--	--
11/03/89	283.46	258.43	25.03	--	--	--	--	--	--	--	--	--	--	--
12/04/89	283.46	257.09	26.37	--	--	--	--	13,000	2000	550	610	1600	--	--
03/07/90	283.46	260.98	22.48	--	--	--	--	--	--	--	--	--	--	--
03/09/90	283.46	--	--	--	--	--	--	--	--	--	--	--	--	--
06/12/90	283.46	259.11	24.35	--	--	--	--	21,000	3500	1400	840	4000	--	--
09/20/90	283.46	257.19	26.27	--	--	--	--	23,000	2100	1200	860	5000	--	--
12/20/90	283.46	260.87	22.59	--	--	--	--	8200	760	410	260	1100	--	--
03/27/91	283.46	264.38	19.08	--	--	--	--	--	--	--	--	--	--	--
06/18/91	283.46	256.35	27.11	--	--	--	--	--	--	--	--	--	--	--
09/12/91	283.46	255.24	28.22	--	--	--	--	--	--	--	--	--	--	--
01/23/92	283.46	256.81	26.65	--	--	--	--	--	--	--	--	--	--	--
04/13/92	283.46	261.30	22.16	--	--	--	--	38,000	3100	1300	850	3100	--	--
08/03/92	283.46	257.31	26.15	--	--	--	--	13,000	1300	470	550	1600	--	ND
10/22/92	283.46	256.67	26.79	--	--	--	--	24,000	3500	1400	1500	4300	--	--
01/18/93	283.46	264.86	18.60	--	--	--	--	370,000	6900	8900	3100	23,000	--	--
04/19/93	283.46	262.34	21.12	--	--	--	--	51,000	8000	7000	1400	10,000	--	--
07/21-22/93	283.46	260.18	23.28	--	--	--	--	22,000	3400	1000	990	3100	--	--
10/25/93	283.46	258.80	24.66	--	--	--	--	14,000	2000	550	790	2300	--	--
01/21/94	283.46	262.99	20.47	--	--	--	--	1100	350	6.0	3.0	15	--	--
04/18/94	283.46	260.36	23.10	--	--	--	--	24,000	3200	1000	1000	3100	--	--
07/06-07/94	283.46	260.56	22.90	--	--	--	--	65,000	6500	4200	1600	9300	--	--
10/07/94	283.46	258.75	24.71	--	--	--	--	27,000	5100	1200	1400	4300	--	--

CONTINUED ON NEXT PAGE

Cumulative Table of Well Data and Analytical Results

Vertical Measurements are in feet.

Analytical results are in parts per billion (ppb)

DATE	Well Head Elev.	Ground Water Elev.	Depth To Water	SPH Thickness	SPH Removed	Total SPH Removed	Notes	TPH-Gasoline	Benzene	Toluene	Ethyl-Benzene	Xylene	MTBE	Organic Lead	
C-2 (CONT'D)															
01/11/95	284.37	270.33	14.04	--	--	--	Sampled annually	780	290	9.1	19	58	--	--	
04/24/95	284.37	272.03	12.34	--	--	--	--	--	--	--	--	--	--	--	
07/31/95	284.37	266.82	17.55	--	--	--	--	--	--	--	--	--	--	--	
10/02/95	284.37	265.39	18.98	--	--	--	--	--	--	--	--	--	--	--	
01/16/96	284.37	268.37	16.00	--	--	--	--	260	29	2.9	5.7	21	6.1	--	
04/18/96	284.37	270.47	13.90	--	--	--	--	--	--	--	--	--	--	--	
07/22/96	284.37	266.63	17.74	--	--	--	--	--	--	--	--	--	--	--	
10/10/96	284.37	265.46	18.91	--	--	--	--	--	--	--	--	--	--	--	
01/09/97	284.37	271.62	12.75	--	--	--	--	460	25	15	72	24	6.3	--	
04/15/97	284.37	268.32	16.05	--	--	--	--	--	--	--	--	--	--	--	
07/08/97	284.37	267.95	16.42	--	--	--	--	--	--	--	--	--	--	--	
10/22/97	284.37	268.95	15.42	--	--	--	--	--	--	--	--	--	--	--	
01/12/98	284.37	272.85	11.52	--	--	--	--	280	22	1.4	5.3	1.2	13	--	
04/21/98	284.37	274.22	10.15	--	--	--	--	--	--	--	--	--	--	--	
07/08/98	284.37	268.29	16.08	--	--	--	--	--	--	--	--	--	--	--	
10/13/98	284.37	265.40	18.97	--	--	--	--	--	--	--	--	--	--	--	

Cumulative Table of Well Data and Analytical Results

Vertical Measurements are in feet.

Analytical results are in parts per billion (ppb)

DATE	Well Head Elev.	Ground Water Elev.	Depth To Water	SPH Thickness	SPH Removed	Total SPH Removed	Notes	Analytical results are in parts per billion (ppb)								
								TPH-Gasoline	Benzene	Toluene	Ethyl-Benzene	Xylene	MTBE	Organic Lead		
C-3																
03/26/85	285.98	--	--	--	--	--	--	--	--	--	--	--	--	--	--	--
07/03/86	285.98	259.94	26.04	--	--	--	--	--	--	--	--	--	--	--	--	--
03/26/87	285.98	260.34	25.64	--	--	--	--	--	--	--	--	--	--	--	--	--
03/28/88	285.98	257.16	28.82	--	--	--	--	--	--	--	--	--	--	--	--	--
03/10/89	285.98	263.20	22.78	--	--	--	--	--	--	--	--	--	--	--	--	--
04/03/89	285.98	263.27	22.71	--	--	--	--	--	--	--	--	--	--	--	--	--
05/08/89	285.98	260.03	25.95	--	--	--	--	--	--	--	--	--	--	--	--	--
06/05/89	285.98	258.36	27.62	--	--	--	--	--	--	--	--	--	--	--	--	--
07/12/90	285.98	257.69	28.29	--	--	--	--	--	--	--	--	--	--	--	--	--
08/10/90	285.98	257.52	28.46	--	--	--	--	--	--	--	--	--	--	--	--	--
09/13/89	285.98	256.65	29.33	--	--	--	--	60,000	1400	6800	2300	10,000	--	--	--	--
10/04/89	285.98	257.01	28.97	--	--	--	--	--	--	--	--	--	--	--	--	--
11/03/89	285.98	257.26	28.72	--	--	--	--	--	--	--	--	--	--	--	--	--
12/04/89	285.98	256.97	29.01	--	--	--	--	56,000	1300	3300	1400	2700	--	--	--	--
03/07/90	285.98	258.29	27.69	--	--	--	--	--	--	--	--	--	--	--	--	--
03/09/90	285.98	258.29	27.69	--	--	--	--	42,000	1100	5700	1600	7900	--	--	--	--
06/12/90	285.98	257.89	28.09	--	--	--	--	160,000	1400	7100	3400	16,000	--	--	--	--
09/24/90	285.98	256.80	29.18	--	--	--	--	53,000	850	7700	2000	10,000	--	--	--	--
12/20/90	285.98	257.71	28.27	--	--	--	--	520	1200	5400	5400	33,000	--	--	--	--
03/27/91	285.98	261.18	24.80	--	--	--	--	92,000	1300	3100	1200	11,000	--	--	--	--
06/18/91	285.98	255.14	30.84	--	--	--	--	--	--	--	--	--	--	--	--	--
09/12/91	285.98	254.34	31.64	0.03	--	--	--	--	--	--	--	--	--	--	--	--
01/23/92	285.98	255.46	30.52	--	--	--	Sheen	--	--	--	--	--	--	--	--	--
04/13/92	285.98	259.04	26.94	0.01	--	--	--	--	--	--	--	--	--	--	--	--
08/03/92	285.98	255.98	30.00	--	--	--	--	220,000	1300	2800	3100	17,000	--	--	ND	--
10/22/92	285.98	255.38	30.62	0.03	--	--	--	--	--	--	--	--	--	--	--	--
01/18/93	285.98	262.07	23.91	--	--	--	--	1,000,000	2400	5300	10,000	61,000	--	--	--	--
04/19/93	285.98	260.98	25.00	--	--	--	--	94,000	33,000	22,000	1800	9200	--	--	--	--
07/21-22/93	285.98	259.43	26.55	--	--	--	--	44,000	2600	5500	1300	6900	--	--	--	--
10/25/93	285.98	257.26	28.72	--	--	--	--	35,000	3900	2400	1100	6600	--	--	--	--
01/21/94	285.98	256.32	29.66	--	--	--	--	120,000	4200	2200	2000	11,000	--	--	--	--
04/18/94	285.98	259.24	26.74	--	--	--	--	29,000	1200	310	520	2000	--	--	--	--
07/06-07/94	285.98	259.62	26.36	--	--	--	--	84,000	2700	1400	1400	9700	--	--	--	--
10/07/94	285.98	257.49	28.49	--	--	--	--	40,000	1600	390	1200	6100	--	--	--	--

CONTINUED ON NEXT PAGE

Cumulative Table of Well Data and Analytical Results

Vertical Measurements are in feet.

Analytical results are in parts per billion (ppb)

DATE	Well	Ground	Depth	Total			Notes	TPH- Gasoline	Benzene	Toluene	Ethyl- Benzene	Xylene	MTBE	Organic Lead
	Head Elev.	Water Elev.	To Water	SPH Thickness	SPH Removed	SPH Removed								
C-3 (CONT'D)														
01/11/95	285.98	262.84	23.14	--	--	--	--	34,000	4200	910	720	3800	--	--
04/24/95	285.98	266.10	19.88	--	--	--	--	210,000	43,000	28,000	2400	13,000	--	--
07/31/95	285.98	261.30	24.68	--	--	--	--	110,000	33,000	17,000	2300	12,000	--	--
10/02/95	285.98	258.84	27.14	--	--	--	--	69,000	6700	4000	2000	11,000	--	--
01/16/96	285.98	261.60	24.38	--	--	--	--	40,000	2400	440	1200	5500	<500	--
04/18/96	285.98	265.31	20.67	--	--	--	--	66,000	26,000	17,000	2200	12,000	<1250	--
07/22/96	285.98	261.32	24.66	--	--	--	--	69,000	21,000	8800	1800	9900	<1000	--
10/10/96	285.98	260.75	25.23	--	--	--	--	53,000	12,000	2600	1900	9300	<500	--
01/09/97	285.98	267.74	18.24	--	--	--	--	73,000	17,000	6000	1700	7800	<1250	--
04/15/97	285.98	263.96	22.02	--	--	--	--	160,000	28,000	17,000	2600	12,000	<2500	--
07/08/97	285.98	263.02	22.96	0.03	--	--	--	--	--	--	--	--	--	--
10/22/97	285.98	264.08	21.90	--	--	--	--	59,000	13,000	5200	2100	11,000	1500	--
01/12/98	285.98	277.93	8.05	--	--	--	--	62,000	10,000	4100	1700	8000	1000	--
04/21/98	285.98	270.70	15.28	--	--	--	--	70,000	13,000	5800	1600	7100	<1000	--
07/08/98	285.98	264.83	21.15	--	--	--	--	22,000	7300	2100	560	2900	<25	--
10/13/98	285.98	268.38	17.60	--	--	--	--	390	32	4.8	26	42	2.9	--

Cumulative Table of Well Data and Analytical Results

Vertical Measurements are in feet.

Analytical results are in parts per billion (ppb)

DATE	Well Head Elev.	Ground Water Elev.	Depth To Water	SPH Thickness	SPH Removed	Total SPH Removed	Notes	TPH-Gasoline	Benzene	Toluene	Ethyl-Benzene	Xylene	MTBE	Organic Lead
C-4														
03/26/85	273.01	257.87	15.14	--	--	--	--	--	--	--	--	--	--	--
07/03/86	273.01	257.64	15.37	--	--	--	--	--	--	--	--	--	--	--
03/26/87	273.01	--	--	--	--	--	--	--	--	--	--	--	--	--
03/28/88	273.01	254.97	18.04	--	--	--	--	--	--	--	--	--	--	--
03/10/89	273.01	--	--	--	--	--	--	--	--	--	--	--	--	--
04/03/89	273.01	259.67	13.34	--	--	--	--	--	--	--	--	--	--	--
05/08/89	273.01	257.41	15.60	--	--	--	--	--	--	--	--	--	--	--
06/05/89	273.01	256.50	16.51	--	--	--	--	--	--	--	--	--	--	--
07/12/90	273.01	256.02	16.99	--	--	--	--	--	--	--	--	--	--	--
08/10/90	273.01	255.74	17.27	--	--	--	--	--	--	--	--	--	--	--
09/13/89	273.01	254.85	18.16	--	--	--	--	57,000	21,000	3100	3200	11,000	--	--
10/04/89	273.01	254.77	18.24	--	--	--	--	--	--	--	--	--	--	--
11/03/89	273.01	254.84	18.17	--	--	--	--	--	--	--	--	--	--	--
12/04/89	273.01	254.56	18.45	--	--	--	--	48,000	17,000	2200	2800	9800	--	--
03/07/90	273.01	255.81	17.20	--	--	--	--	--	--	--	--	--	--	--
03/09/90	273.01	255.81	17.20	--	--	--	--	43,000	20,000	2300	2800	11,000	--	--
06/12/90	273.01	256.35	16.66	--	--	--	--	82,000	21,000	2400	4000	16,000	--	--
09/24/90	273.01	254.90	18.11	--	--	--	--	--	--	--	--	--	--	--
12/20/90	273.01	--	--	--	--	--	Abandoned	--	--	--	--	--	--	--

Cumulative Table of Well Data and Analytical Results

Vertical Measurements are in feet.

Analytical results are in parts per billion (ppb)

DATE	Well Head Elev.	Ground Water Elev.	Depth To Water	SPH Thickness	SPH Removed	Total SPH Removed	Notes	TPH-Gasoline	Benzene	Toluene	Ethyl-Benzene	Xylene	MTBE	Organic Lead
C-5														
03/26/85	287.95	262.62	25.33	--	--	--	--	--	--	--	--	--	--	--
07/03/86	287.95	261.54	26.41	--	--	--	--	--	--	--	--	--	--	--
03/26/87	287.95	262.99	24.96	--	--	--	--	--	--	--	--	--	--	--
03/28/88	287.95	258.15	29.80	--	--	--	--	--	--	--	--	--	--	--
03/10/89	287.95	262.06	25.89	--	--	--	--	--	--	--	--	--	--	--
04/03/89	287.95	263.57	24.38	--	--	--	--	--	--	--	--	--	--	--
05/08/89	287.95	260.15	27.80	--	--	--	--	--	--	--	--	--	--	--
06/05/89	287.95	258.53	29.42	--	--	--	--	--	--	--	--	--	--	--
07/12/90	287.95	258.09	29.86	--	--	--	--	--	--	--	--	--	--	--
08/10/90	287.95	258.18	29.77	--	--	--	--	--	--	--	--	--	--	--
09/13/89	287.95	257.00	30.95	--	--	--	--	310	ND	ND	ND	ND	--	--
10/04/89	287.95	256.47	31.48	--	--	--	--	--	--	--	--	--	--	--
11/03/89	287.95	256.63	31.32	--	--	--	--	--	--	--	--	--	--	--
12/04/89	287.95	256.25	31.70	--	--	--	--	ND	ND	ND	ND	ND	--	--
03/07/90	287.95	257.67	30.28	--	--	--	--	--	--	--	--	--	--	--
03/09/90	287.95	257.67	30.28	--	--	--	--	ND	ND	ND	ND	ND	--	--
06/12/90	287.95	257.47	30.48	--	--	--	--	90	ND	ND	ND	ND	--	--
09/24/90	287.95	256.17	31.78	--	--	--	--	ND	ND	ND	ND	ND	--	--
12/20/90	287.95	254.66	33.29	--	--	--	--	170	ND	ND	1.0	0.7	--	--
03/27/91	287.95	259.97	27.98	--	--	--	--	--	--	--	--	--	--	--
06/18/91	287.95	255.43	32.52	--	--	--	--	--	--	--	--	--	--	--
09/12/91	287.95	254.58	33.37	--	--	--	--	--	--	--	--	--	--	--
01/23/92	287.95	255.28	32.67	--	--	--	--	--	--	--	--	--	--	--
04/13/92	287.95	259.47	28.48	--	--	--	--	140	ND	ND	0.7	ND	--	--
08/03/92	287.95	255.45	32.50	--	--	--	--	ND	ND	ND	ND	ND	--	ND
10/22/92	287.95	253.97	33.98	--	--	--	--	--	--	--	--	--	--	--
01/18/93	287.95	260.93	27.02	--	--	--	--	230	6.6	2.2	3.4	2.2	--	--
04/19/93	287.95	263.14	24.81	--	--	--	--	--	--	--	--	--	--	--
07/21-22/93	287.95	258.89	29.06	--	--	--	--	130	ND	0.6	ND	ND	--	--
10/25/93	287.95	257.00	30.95	--	--	--	--	--	--	--	--	--	--	--
01/21/94	287.95	256.04	31.91	--	--	--	--	ND	ND	ND	ND	ND	--	--
04/18/94	287.95	257.80	30.15	--	--	--	--	--	--	--	--	--	--	--
07/06-07/94	287.95	258.91	29.04	--	--	--	--	ND	ND	ND	ND	ND	--	--
10/07/94	287.95	256.11	31.84	--	--	--	--	--	--	--	--	--	--	--

CONTINUED ON NEXT PAGE

Cumulative Table of Well Data and Analytical Results

Vertical Measurements are in feet.

Analytical results are in parts per billion (ppb)

DATE	Well Head Elev.	Ground Water Elev.	Depth To Water	SPH Thickness	Total SPH		Notes	TPH-Gasoline	Benzene	Toluene	Ethyl-Benzene	Xylene	MTBE	Organic Lead
					Removed	Removed								
C-5 (CONT'D)														
01/11/95	287.95	262.97	24.98	--	--	--	Sampled biannually	700	1.1	6.0	1.5	2.1	--	--
04/24/95	287.95	266.17	21.78	--	--	--	--	--	--	--	--	--	--	--
07/31/95	287.95	--	--	--	--	--	Inaccessible	--	--	--	--	--	--	--
10/02/95	287.95	257.77	30.18	--	--	--	--	--	--	--	--	--	--	--
01/16/96	287.95	261.23	26.72	--	--	--	--	200	<0.5	<0.5	<0.5	1.3	<2.5	--
04/18/96	287.95	266.15	21.80	--	--	--	--	--	--	--	--	--	--	--
07/22/96	287.95	--	--	--	--	--	Inaccessible	--	--	--	--	--	--	--
10/10/96	287.95	261.17	26.78	--	--	--	--	--	--	--	--	--	--	--
01/09/97	287.95	268.93	19.02	--	--	--	--	190	0.63	<0.5	<0.5	<0.5	<2.5	--
04/15/97	287.95	264.64	23.31	--	--	--	--	--	--	--	--	--	--	--
07/08/97	287.95	--	--	--	--	--	Inaccessible	--	--	--	--	--	--	--
10/22/97	287.95	--	--	--	--	--	Inaccessible	--	--	--	--	--	--	--
01/12/98	287.95	269.37	18.58	--	--	--	--	200	1.1	0.57	1.3	2.5	<2.5	--
04/21/98	287.95	272.75	15.20	--	--	--	--	--	--	--	--	--	--	--
07/08/98	287.95	264.76	23.19	--	--	--	--	52*	<0.5	<0.5	<0.5	<0.5	<2.5	--
10/13/98	287.95	261.95	26.00	--	--	--	--	--	--	--	--	--	--	--

* Chromatogram pattern indicates an unidentified hydrocarbon.

Cumulative Table of Well Data and Analytical Results

Vertical Measurements are in feet.

Analytical results are in parts per billion (ppb)

DATE	Well Head Elev.	Ground Water Elev.	Depth To Water	SPH Thickness	Total SPH		Notes	TPH- Gasoline	Benzene	Toluene	Ethyl- Benzene	Xylene	MTBE	Organic Lead
					SPH Removed	SPH Removed								
C-6														
03/26/85	--	--	16.74	--	--	--	--	--	--	--	--	--	--	--
07/03/86	275.28	257.82	17.46	--	--	--	--	--	--	--	--	--	--	--
03/26/87	275.28	256.91	18.37	--	--	--	--	--	--	--	--	--	--	--
03/28/88	275.28	245.44	29.84	--	--	--	--	--	--	--	--	--	--	--
03/10/89	275.28	260.84	14.44	--	--	--	--	--	--	--	--	--	--	--
04/03/89	275.28	260.84	14.44	--	--	--	--	--	--	--	--	--	--	--
05/08/89	275.28	258.12	17.16	--	--	--	--	--	--	--	--	--	--	--
06/05/89	275.28	256.77	18.51	--	--	--	--	--	--	--	--	--	--	--
07/12/90	275.28	256.57	18.71	--	--	--	--	--	--	--	--	--	--	--
08/10/90	275.28	255.96	19.32	--	--	--	--	--	--	--	--	--	--	--
09/13/89	275.28	255.33	19.95	--	--	--	--	47	5600	3000	2400	10,000	--	--
10/04/89	275.28	255.41	19.87	--	--	--	--	--	--	--	--	--	--	--
11/03/89	275.28	255.93	19.35	--	--	--	--	--	--	--	--	--	--	--
12/04/89	275.28	255.69	19.59	--	--	--	--	40,000	8100	1800	1700	7500	--	--
03/07/90	275.28	256.89	18.39	--	--	--	--	--	--	--	--	--	--	--
03/09/90	275.28	256.89	18.39	--	--	--	--	73,000	23,000	5900	3400	17,000	--	--
06/12/90	275.28	256.41	18.87	--	--	--	--	85,000	19,000	6500	3400	16,000	--	--
09/24/90	275.28	255.29	19.99	--	--	--	--	72,000	15,000	3200	2600	11,000	--	--
12/20/90	275.28	253.71	21.57	--	--	--	--	100,000	11,000	4200	3400	16,000	--	--
03/27/91	275.28	258.96	16.32	--	--	--	--	100,000	11,000	4400	2300	11,000	--	--
06/18/91	275.28	251.95	23.33	--	--	--	--	--	--	--	--	--	--	--
09/12/91	275.28	251.32	23.96	--	--	--	--	--	--	--	--	--	--	--
01/23/92	275.28	263.20	12.08	--	--	--	--	--	--	--	--	--	--	--
04/13/92	275.28	255.43	19.85	--	--	--	--	--	--	--	--	--	--	--
08/03/92	275.28	260.56	14.72	--	--	--	--	120,000	16,000	1100	2300	15,000	--	ND
10/22/92	275.28	260.37	14.91	--	--	--	--	63,000	7400	920	1800	14,000	--	--
01/18/93	275.28	259.84	15.44	--	--	--	--	77,000	13,000	1600	2700	12,000	--	--
04/19/93	275.28	266.03	9.25	--	--	--	--	56,000	14,000	1100	2400	9100	--	--
07/21-22/93	275.28	257.93	17.35	--	--	--	--	38,000	6600	610	1500	5800	--	--
10/25/93	275.28	254.25	21.03	--	--	--	--	42,000	11,000	800	2200	8200	--	--
01/21/94	275.28	253.71	21.57	--	--	--	--	57,000	11,000	940	2300	9800	--	--
04/18/94	275.28	257.17	18.11	--	--	--	--	48,000	9800	830	1900	7500	--	--
07/06-07/94	275.28	258.28	17.00	--	--	--	--	46,000	6800	610	900	6200	--	--
10/07/94	275.28	256.09	19.19	--	--	--	--	35,000	5900	410	1400	3800	--	--

CONTINUED ON NEXT PAGE

Cumulative Table of Well Data and Analytical Results

Vertical Measurements are in feet.

Analytical results are in parts per billion (ppb)

DATE	Well	Ground	Depth	Total			Notes	TPH- Gasoline	Benzene	Toluene	Ethyl- Benzene	Xylene	MTBE	Organic Lead
	Head Elev.	Water Elev.	To Water	SPH Thickness	SPH Removed	SPH Removed								
C-6 (CONT'D)														
01/11/95	275.28	256.64	18.64	--	--	--	--	54,000	1200	1100	2100	9500	--	--
04/24/95	275.28	262.72	12.56	--	--	--	--	81,000	12,000	1500	2400	9900	--	--
07/31/95	275.28	259.54	15.74	--	--	--	--	75,000	12,000	1200	2800	11,000	--	--
10/02/95	275.28	257.56	17.72	--	--	--	--	59,000	13,000	990	2800	10,000	--	--
01/16/96	275.28	259.81	15.47	--	--	--	--	63,000	10,000	650	2200	7500	<500	--
04/18/96	275.28	259.33	15.95	--	--	--	--	56,000	9800	590	1500	5800	660	--
07/22/96	275.28	--	--	--	--	--	Inaccessible	--	--	--	--	--	--	--
10/10/96	275.28	--	--	--	--	--	Inaccessible	--	--	--	--	--	--	--
01/09/97	275.28	--	--	--	--	--	Inaccessible	--	--	--	--	--	--	--
04/15/97	275.28	--	--	--	--	--	Inaccessible	--	--	--	--	--	--	--
07/08/97	275.28	--	--	--	--	--	Inaccessible	--	--	--	--	--	--	--
07/15/97	275.28	260.95	14.33	--	--	--	--	64,000	12,000	400	1500	4400	<1000	--
10/22/97	275.28	261.80	13.48	--	--	--	--	49,000	15,000	570	1900	5600	1500	--
01/12/98	275.28	265.14	10.14	--	--	--	--	60,000	16,000	540	1800	5400	<1000	--
04/21/98	275.28	267.73	7.55	--	--	--	--	51,000	16,000	310	1400	3400	<1000	--
07/08/98	275.28	262.80	12.48	--	--	--	--	19,000	8200	150	720	1100	<250	--
10/13/98	275.28	259.82	15.46	--	--	--	--	46,000	12,000	490	1600	3600	<250	--

Cumulative Table of Well Data and Analytical Results

Vertical Measurements are in feet.

Analytical results are in parts per billion (ppb)

DATE	Well Head Elev.	Ground Water Elev.	Depth To Water	SPH Thickness	Total SPH		Notes	TPH-Gasoline	Benzene	Toluene	Ethyl-Benzene	Xylene	MTBE	Organic Lead
					Removed	Removed								
C-7														
03/26/85	--	--	9.61	--	--	--	--	--	--	--	--	--	--	--
07/03/86	270.70	259.96	10.74	--	--	--	--	--	--	--	--	--	--	--
03/26/87	270.70	260.62	10.08	--	--	--	--	--	--	--	--	--	--	--
03/28/88	270.70	256.91	13.79	--	--	--	--	--	--	--	--	--	--	--
03/10/89	270.70	260.28	10.42	--	--	--	--	--	--	--	--	--	--	--
04/03/89	270.70	261.56	9.14	--	--	--	--	--	--	--	--	--	--	--
05/08/89	270.70	258.79	11.91	--	--	--	--	--	--	--	--	--	--	--
06/05/89	270.70	259.16	11.54	--	--	--	--	--	--	--	--	--	--	--
07/12/90	270.70	257.25	13.45	--	--	--	--	--	--	--	--	--	--	--
08/10/90	270.70	257.33	13.37	--	--	--	--	--	--	--	--	--	--	--
09/13/89	270.70	256.10	14.60	--	--	--	--	410	1.3	ND	10	ND	--	--
10/04/89	270.70	255.53	15.17	--	--	--	--	--	--	--	--	--	--	--
11/03/89	270.70	255.42	15.28	--	--	--	--	--	--	--	--	--	--	--
12/04/89	270.70	255.00	15.70	--	--	--	--	1000	1.0	ND	5.0	ND	--	--
03/07/90	270.70	256.48	14.22	--	--	--	--	--	--	--	--	--	--	--
03/09/90	270.70	256.48	14.22	--	--	--	--	590	2.8	2.4	3.5	2.0	--	--
06/12/90	270.70	256.52	14.18	--	--	--	--	1200	ND	5	8.2	3.2	--	--
09/24/90	270.70	255.26	15.44	--	--	--	Sheen	400	1.4	1.9	1.4	2.2	--	--
09/24/90	270.70	255.26	15.44	--	--	--	Duplicate	580	ND	2.4	1.4	1.5	--	--
12/20/90	270.70	253.62	17.08	--	--	--	--	2300	ND	6.5	4.7	9.3	--	--
03/27/91	270.70	258.05	12.65	--	--	--	--	980	ND	2.4	9.1	3.0	--	--
06/18/91	270.70	254.26	16.44	--	--	--	--	--	--	--	--	--	--	--
09/12/91	270.70	253.65	17.05	--	--	--	--	1200	ND	3.1	6.5	2.7	--	--
01/23/92	270.70	253.78	16.92	--	--	--	--	--	--	--	--	--	--	--
04/13/92	270.70	257.70	13.00	--	--	--	--	830	ND	1.0	7.8	1.2	--	--
08/03/92	270.70	--	--	--	--	--	--	--	--	--	--	--	--	--
10/22/92	270.70	--	--	--	--	--	Could not locate	--	--	--	--	--	--	--
01/18/93	270.70	--	--	--	--	--	Could not locate	--	--	--	--	--	--	--
04/19/93	270.70	--	--	--	--	--	Could not locate	--	--	--	--	--	--	--
07/21-22/93	270.70	257.76	12.94	--	--	--	--	890	0.9	3.0	4.0	4.0	--	--
10/25/93	270.70	255.87	14.83	--	--	--	--	--	--	--	--	--	--	--
01/21/94	270.70	254.76	15.94	--	--	--	--	660	ND	6.0	1.0	3.0	--	--
04/18/94	270.70	255.72	14.98	--	--	--	--	--	--	--	--	--	--	--
07/06-07/94	270.70	257.76	12.94	--	--	--	--	960	ND	5.8	4.2	8.2	--	--
10/07/94	270.70	254.87	15.83	--	--	--	--	--	--	--	--	--	--	--

CONTINUED ON NEXT PAGE

Cumulative Table of Well Data and Analytical Results

Vertical Measurements are in feet.

Analytical results are in parts per billion (ppb)

DATE	Well Head Elev.	Ground Water Elev.	Depth To Water	SPH Thickness	SPH Removed	Total SPH Removed	Notes	TPH-Gasoline	Benzene	Toluene	Ethyl-Benzene	Xylene	MTBE	Organic Lead	
C-7 (CONT'D)															
01/11/95	270.70	261.45	9.25	--	--	--	Sampled biannually	900	<0.5	<0.5	2.3	1.3	--	--	
04/24/95	270.70	264.00	6.70	--	--	--	--	--	--	--	--	--	--	--	
07/31/95	270.70	259.46	11.24	--	--	--	--	690	<1.2	<1.2	<1.2	<1.2	--	--	
10/02/95	270.70	256.68	14.02	--	--	--	--	--	--	--	--	--	--	--	
01/16/96	270.70	259.48	11.22	--	--	--	--	<50	<0.5	<0.5	<0.5	<0.5	<2.5	--	
04/18/96	270.70	264.05	6.65	--	--	--	--	--	--	--	--	--	--	--	
07/22/96	270.70	259.60	11.10	--	--	--	--	360	4.4	2.0	<0.5	<0.5	17	--	
10/10/96	270.70	259.35	11.35	--	--	--	--	--	--	--	--	--	--	--	
01/09/97	270.70	266.82	3.88	--	--	--	--	69	<0.5	<0.5	<0.5	<0.5	<2.5	--	
04/15/97	270.70	262.82	7.88	--	--	--	--	--	--	--	--	--	--	--	
07/08/97	270.70	261.70	9.00	--	--	--	--	710	8.0	1.2	<0.5	<0.5	22	--	
10/22/97	270.70	262.09	8.61	--	--	--	--	--	--	--	--	--	--	--	
01/12/98	270.70	267.03	3.67	--	--	--	--	400	7.2	<1.0	1.6	1.3	16	--	
04/21/98	270.70	270.19	0.51	--	--	--	--	--	--	--	--	--	--	--	
07/08/98	270.70	263.72	6.98	--	--	--	--	<50	<0.5	<0.5	<0.5	<0.5	<2.5	--	
10/13/98	270.70	261.58	9.12	--	--	--	--	--	--	--	--	--	--	--	

Cumulative Table of Well Data and Analytical Results

Vertical Measurements are in feet.

Analytical results are in parts per billion (ppb)

DATE	Well	Ground	Depth	Total			Notes	TPH- Gasoline	Benzene	Toluene	Ethyl- Benzene	Xylene	MTBE	Organic Lead
	Head Elev.	Water Elev.	To Water	SPH	SPH	SPH								
C-8														
03/26/85	--	--	8.68	--	--	--	--	--	--	--	--	--	--	--
07/03/86	288.40	274.51	13.89	--	--	--	--	--	--	--	--	--	--	--
03/26/87	288.40	282.39	6.01	--	--	--	--	--	--	--	--	--	--	--
03/28/88	288.40	277.74	10.66	--	--	--	--	--	--	--	--	--	--	--
03/10/89	288.40	281.79	6.61	--	--	--	--	--	--	--	--	--	--	--
04/03/89	288.40	281.94	6.46	--	--	--	--	--	--	--	--	--	--	--
05/08/89	288.40	279.43	8.97	--	--	--	--	--	--	--	--	--	--	--
06/05/89	288.40	277.52	10.88	--	--	--	--	--	--	--	--	--	--	--
07/12/90	288.40	276.25	12.15	--	--	--	--	--	--	--	--	--	--	--
08/10/90	288.40	275.94	12.46	--	--	--	--	--	--	--	--	--	--	--
09/13/89	288.40	275.62	12.78	--	--	--	--	ND	ND	ND	ND	ND	--	--
10/04/89	288.40	275.89	12.51	--	--	--	--	--	--	--	--	--	--	--
11/03/89	288.40	273.77	14.63	--	--	--	--	--	--	--	--	--	--	--
12/04/89	288.40	278.81	9.59	--	--	--	--	64	0.6	0.6	ND	1.0	--	--
03/07/90	288.40	279.60	8.80	--	--	--	--	--	--	--	--	--	--	--
03/09/90	288.40	279.60	8.80	--	--	--	--	ND	ND	ND	ND	ND	--	--
06/12/90	288.40	279.46	8.94	--	--	--	--	120	2.5	1.2	1.0	1.4	--	--
09/24/90	288.40	274.86	13.54	--	--	--	--	--	--	--	--	--	--	--
12/20/90	288.40	279.07	9.33	--	--	--	--	--	--	--	--	--	--	--
03/27/91	288.40	282.30	6.10	--	--	--	--	54	0.7	ND	0.7	1.9	--	--
06/18/91	288.40	276.44	11.96	--	--	--	--	--	--	--	--	--	--	--
09/12/91	288.40	274.80	13.60	--	--	--	--	ND	ND	ND	ND	ND	--	--
09/12/91	288.40	274.80	13.60	--	--	--	Duplicate	ND	ND	ND	ND	ND	--	--
01/23/92	288.40	264.20	24.20	--	--	--	--	--	--	--	--	--	--	--
04/13/92	288.40	280.05	8.35	--	--	--	--	ND	ND	ND	ND	ND	--	--
08/03/92	288.40	275.82	12.58	--	--	--	--	ND	ND	ND	ND	ND	--	ND
10/22/92	288.40	275.30	13.10	--	--	--	--	ND	ND	ND	ND	ND	--	--
01/18/93	288.40	282.28	6.12	--	--	--	--	ND	ND	ND	ND	ND	--	--
04/19/93	288.40	281.35	7.05	--	--	--	--	ND	ND	ND	ND	ND	--	--
07/21-22/93	288.40	277.05	11.35	--	--	--	--	ND	ND	ND	ND	ND	--	--
10/25/93	288.40	275.55	12.85	--	--	--	--	ND	ND	ND	ND	ND	--	--
01/21/94	288.40	277.85	10.55	--	--	--	--	ND	ND	ND	ND	ND	--	--
04/18/94	288.40	278.89	9.51	--	--	--	--	ND	1.2	0.9	ND	1.6	--	--
07/06-07/94	288.40	277.02	11.38	--	--	--	--	ND	ND	ND	ND	ND	--	--
10/07/94	288.40	275.48	12.92	--	--	--	--	ND	ND	ND	ND	ND	--	--

CONTINUED ON NEXT PAGE

Cumulative Table of Well Data and Analytical Results

Vertical Measurements are in feet.

Analytical results are in parts per billion (ppb)

DATE	Well	Ground	Depth	Total			Notes	TPH- Gasoline	Benzene	Toluene	Ethyl- Benzene	Xylene	MTBE	Organic Lead
	Head Elev.	Water Elev.	To Water	SPH Thickness	SPH Removed	SPH Removed								
C-8 (CONT'D)														
01/11/95	288.40	283.04	5.36	--	--	--	--	<50	<0.5	<0.5	<0.5	<0.5	--	--
04/24/95	288.40	281.82	6.58	--	--	--	--	<50	<0.5	0.61	<0.5	0.51	--	--
07/31/95	288.40	278.94	9.46	--	--	--	--	<50	<0.5	<0.5	<0.5	<0.5	--	--
10/02/95	288.40	276.56	11.84	--	--	--	--	<50	<0.5	<0.5	<0.5	<0.5	--	--
01/16/96	288.40	281.40	7.00	--	--	--	--	<50	<0.5	<0.5	<0.5	<0.5	5.4	--
04/18/96	288.40	281.77	6.63	--	--	--	--	<50	<0.5	<0.5	<0.5	<0.5	<2.5	--
07/22/96	288.40	280.49	7.91	--	--	--	--	<50	<0.5	<0.5	<0.5	<0.5	<2.5	--
10/10/96	288.40	279.71	8.69	--	--	--	--	<50	<0.5	<0.5	<0.5	<0.5	<2.5	--
01/09/97	288.40	283.11	5.29	--	--	--	--	<50	<0.5	<0.5	<0.5	<0.5	<2.5	--
04/15/97	288.40	281.90	6.50	--	--	--	--	<50	<0.5	<0.5	<0.5	<0.5	<2.5	--
07/08/97	288.40	281.90	6.50	--	--	--	--	<50	<0.5	<0.5	<0.5	<0.5	<2.5	--
10/22/97	288.40	283.00	5.40	--	--	--	--	<50	<0.5	<0.5	<0.5	<0.5	<2.5	--
01/12/98	288.40	284.27	4.13	--	--	--	--	<50	<0.5	<0.5	<0.5	<0.5	<2.5	--
04/21/98	288.40	283.84	4.56	--	--	--	--	<50	<0.5	<0.5	<0.5	<0.5	<2.5	--
07/08/98	288.40	277.81	10.59	--	--	--	--	<50	<0.5	0.57	<0.5	<0.5	<2.5	--
10/13/98	288.40	276.32	12.08	--	--	--	--	<50	<0.5	<0.50	<0.5	<0.5	<2.5	--

Cumulative Table of Well Data and Analytical Results

Vertical Measurements are in feet.

Analytical results are in parts per billion (ppb)

DATE	Well Head Elev.	Ground Water Elev.	Depth To Water	SPH Thickness	Total SPH		Notes	TPH-Gasoline	Benzene	Toluene	Ethyl-Benzene	Xylene	MTBE	Organic Lead
					Removed	Removed								
C-9														
07/03/86	268.46	254.57	13.89	--	--	--	--	--	--	--	--	--	--	--
03/26/87	268.46	254.72	13.74	--	--	--	--	--	--	--	--	--	--	--
03/28/88	268.46	253.47	14.99	--	--	--	--	--	--	--	--	--	--	--
03/10/89	268.46	255.07	13.39	--	--	--	--	--	--	--	--	--	--	--
04/03/89	268.46	255.62	12.84	--	--	--	--	--	--	--	--	--	--	--
05/08/89	268.46	254.08	14.38	--	--	--	--	--	--	--	--	--	--	--
06/05/89	268.46	253.10	15.36	--	--	--	--	--	--	--	--	--	--	--
07/12/90	268.46	252.81	15.65	--	--	--	--	--	--	--	--	--	--	--
08/10/90	268.46	252.66	15.80	--	--	--	--	--	--	--	--	--	--	--
09/13/89	268.46	251.93	16.53	--	--	--	--	42,000	14,000	1100	2800	4200	--	--
10/04/89	268.46	251.94	16.52	--	--	--	--	--	--	--	--	--	--	--
11/03/89	268.46	251.95	16.51	--	--	--	--	--	--	--	--	--	--	--
12/04/89	268.46	251.67	16.79	--	--	--	--	36,000	11,000	670	2500	3800	--	--
03/07/90	268.46	252.24	16.22	--	--	--	--	--	--	--	--	--	--	--
03/09/90	268.46	252.24	16.22	--	--	--	--	28,000	12,000	940	3000	4700	--	--
06/12/90	268.46	253.58	14.88	--	--	--	--	39,000	11,000	1600	2300	4800	--	--
09/24/90	268.46	252.16	16.30	--	--	--	--	120,000	13,000	1600	3700	6800	--	--
12/20/90	268.46	251.23	17.23	--	--	--	--	51,000	9300	560	2800	3300	--	--
12/20/90	268.46	251.23	17.23	--	--	--	Duplicate	44,000	12,000	580	2800	3500	--	--
03/27/91	268.46	254.68	13.78	--	--	--	--	56,000	3400	5000	1600	5600	--	--
06/18/91	268.46	249.82	18.64	--	--	--	--	--	--	--	--	--	--	--
09/12/91	268.46	--	--	--	--	--	Inaccessible	--	--	--	--	--	--	--
10/24/95	268.46	250.39	18.07	--	--	--	--	30,000	7200	440	2500	1600	--	--
01/16/96	268.46	252.18	16.28	--	--	--	--	36,000	8200	700	2500	2100	<500	--
07/08/98	268.46	256.46	12.00	--	--	--	--	20,000	4900	880	1100	2500	<250	--
10/13/98	268.46	254.19	14.27	--	--	--	--	28,000	7100	1100	1300	2700	<125	--

Cumulative Table of Well Data and Analytical Results

Vertical Measurements are in feet.

Analytical results are in parts per billion (ppb)

DATE	Well Head Elev.	Ground Water Elev.	Depth To Water	SPH Thickness	Total SPH			Notes	TPH-Gasoline	Benzene	Toluene	Ethyl-Benzene	Xylene	MTBE	Organic Lead
					SPH	SPH	SPH								
C-10A															
03/07/90	264.84	244.63	20.21	--	--	--	--	--	--	--	--	--	--	--	--
03/09/90	264.84	--	--	--	--	--	--	ND	1.6	0.7	0.8	3.5	--	--	--
06/12/90	264.84	245.14	19.70	--	--	--	--	ND	ND	ND	ND	ND	--	--	--
09/24/90	264.84	245.30	19.54	--	--	--	--	ND	ND	ND	ND	ND	--	--	--
12/20/90	264.84	245.00	19.84	--	--	--	--	ND	ND	ND	ND	ND	--	--	--
03/27/91	264.84	246.83	18.01	--	--	--	--	--	--	--	--	--	--	--	--
06/18/91	264.84	244.68	20.16	--	--	--	--	ND	ND	ND	ND	ND	--	--	--
09/12/91	264.84	244.27	20.57	--	--	--	--	ND	ND	ND	ND	ND	--	--	--
01/23/92	264.84	244.17	20.67	--	--	--	--	ND	ND	ND	ND	ND	--	--	--
04/13/92	264.84	245.44	19.40	--	--	--	--	53	0.9	1.3	ND	1.0	--	--	--
08/03/92	264.84	245.03	19.81	--	--	--	--	ND	ND	ND	ND	ND	--	ND	--
10/22/92	264.84	245.01	19.83	--	--	--	--	ND	ND	ND	ND	0.5	--	--	--
01/18/93	264.84	247.80	17.04	--	--	--	--	ND	ND	ND	ND	ND	--	--	--
04/19/93	264.84	247.07	17.77	--	--	--	--	ND	ND	ND	ND	ND	--	--	--
04/19/93	264.84	247.28	17.56	--	--	--	--	ND	ND	ND	ND	ND	--	--	--
10/25/93	264.84	247.07	17.77	--	--	--	--	ND	ND	ND	ND	ND	--	--	--
01/21/94	264.84	246.93	17.91	--	--	--	--	ND	ND	ND	ND	ND	--	--	--
04/18/94	264.84	247.81	17.03	--	--	--	--	ND	3.0	3.0	1.4	5.5	--	--	--
07/06-07/94	264.84	248.06	16.78	--	--	--	--	ND	ND	ND	ND	ND	--	--	--
10/07/94	264.84	247.63	17.21	--	--	--	--	ND	ND	ND	ND	ND	--	--	--
01/11/95	264.84	248.78	16.06	--	--	--	--	<50	<0.5	<0.5	<0.5	<0.5	--	--	--
04/24/95	264.84	248.32	16.52	--	--	--	--	<50	<0.5	<0.5	<0.5	<0.5	--	--	--
07/31/95	264.84	245.82	19.02	--	--	--	--	<50	<0.5	<0.5	<0.5	<0.5	--	--	--
10/02/95	264.84	245.14	19.70	--	--	--	--	<50	<0.5	<0.5	<0.5	<0.5	--	--	--
01/16/96	264.84	246.21	18.63	--	--	--	--	<50	<0.5	<0.5	<0.5	<0.5	<2.5	--	--
04/18/96	264.84	247.19	17.65	--	--	--	--	<50	<0.5	<0.5	<0.5	<0.5	<2.5	--	--
07/22/96	264.84	245.99	18.85	--	--	--	--	<50	<0.5	<0.5	<0.5	<0.5	<2.5	--	--
10/10/96	264.84	245.40	19.44	--	--	--	--	<50	<0.5	<0.5	<0.5	<0.5	<2.5	--	--
01/09/97	264.84	248.00	16.84	--	--	--	--	<50	<0.5	<0.5	<0.5	<0.5	<2.5	--	--
04/15/97	264.84	246.47	18.37	--	--	--	--	<50	<0.5	<0.5	<0.5	<0.5	<2.5	--	--
07/08/97	264.84	246.33	18.51	--	--	--	--	<50	<0.5	<0.5	<0.5	<0.5	<2.5	--	--
10/22/97	264.84	246.64	18.20	--	--	--	--	<50	<0.5	<0.5	<0.5	<0.5	<2.5	--	--

CONTINUED ON NEXT PAGE

Cumulative Table of Well Data and Analytical Results

Vertical Measurements are in feet.

Analytical results are in parts per billion (ppb)

DATE	Well	Ground	Depth	Total			Notes	TPH- Gasoline	Benzene	Toluene	Ethyl- Benzene	Xylene	MTBE	Organic Lead
	Head Elev.	Water Elev.	To Water	SPH Thickness	SPH Removed	SPH Removed								
C-10A (CONT'D)														
01/12/98	264.84	248.00	16.84	--	--	--	--	<50	<0.5	<0.5	<0.5	<0.5	<2.5	--
04/21/98	264.84	248.04	16.80	--	--	--	--	<50	<0.5	<0.5	<0.5	<0.5	<2.5	--
07/08/98	264.84	246.89	17.95	--	--	--	--	<50	<0.5	0.57	<0.5	<0.5	<2.5	--
10/13/98	264.84	246.16	18.68	--	--	--	--	<50	1.3	<0.5	0.67	1.5	<2.5	--

Cumulative Table of Well Data and Analytical Results

Vertical Measurements are in feet.

Analytical results are in parts per billion (ppb)

DATE	Well Head Elev.	Ground Water Elev.	Depth To Water	SPH Thickness	SPH Removed	Total SPH Removed	Notes	TPH-Gasoline	Benzene	Toluene	Ethyl-Benzene	Xylene	MTBE	Organic Lead
C-10B														
03/07/90	264.85	243.41	21.44	--	--	--	--	--	--	--	--	--	--	--
06/12/90	264.85	244.91	19.94	--	--	--	--	ND	ND	ND	ND	ND	--	--
09/24/90	264.85	245.08	19.77	--	--	--	--	ND	ND	ND	ND	ND	--	--
12/20/90	264.85	244.85	20.00	--	--	--	--	ND	ND	ND	ND	ND	--	--
03/27/91	264.85	246.62	18.23	--	--	--	--	--	--	--	--	--	--	--
06/18/91	264.85	244.41	20.44	--	--	--	--	--	--	--	--	--	--	--
09/12/91	264.85	244.03	20.82	--	--	--	--	ND	ND	ND	ND	ND	--	--
01/23/92	264.85	243.93	20.92	--	--	--	--	ND	ND	ND	ND	ND	--	--
04/13/92	264.85	245.17	19.68	--	--	--	--	ND	ND	ND	ND	ND	--	--
08/03/92	264.85	244.78	20.07	--	--	--	--	ND	ND	ND	ND	ND	--	ND
10/22/92	264.85	244.73	20.12	--	--	--	--	ND	ND	ND	ND	ND	--	--
01/18/93	264.85	247.49	17.36	--	--	--	--	60	3.3	11	2.1	8.9	--	--
04/19/93	264.85	246.95	17.90	--	--	--	--	ND	ND	ND	ND	ND	--	--
07/21-22/93	264.85	246.99	17.86	--	--	--	--	ND	ND	ND	ND	ND	--	--
10/25/93	264.85	246.75	18.10	--	--	--	--	ND	ND	ND	ND	ND	--	--
01/21/94	264.85	246.62	18.23	--	--	--	--	ND	ND	ND	ND	ND	--	--
04/18/94	264.85	247.49	17.36	--	--	--	--	ND	ND	ND	ND	0.5	--	--
07/06-07/94	264.85	247.80	17.05	--	--	--	--	ND	ND	ND	ND	ND	--	--
10/07/94	264.85	247.31	17.54	--	--	--	--	ND	ND	ND	ND	ND	--	--
01/11/95	264.85	248.61	16.24	--	--	--	--	<50	<0.5	<0.5	<0.5	<0.5	--	--
04/24/95	264.85	247.95	16.90	--	--	--	--	<50	<0.5	<0.5	<0.5	<0.5	--	--
07/31/95	264.85	245.57	19.28	--	--	--	--	<50	<0.5	<0.5	<0.5	<0.5	--	--
10/02/95	264.85	244.91	19.94	--	--	--	--	<50	<0.5	<0.5	<0.5	<0.5	--	--
01/16/96	264.85	246.25	18.60	--	--	--	--	<50	<0.5	<0.5	<0.5	<0.5	<2.5	--
04/18/96	264.85	246.87	17.98	--	--	--	--	<50	<0.5	<0.5	<0.5	<0.5	<2.5	--
07/22/96	264.85	245.75	19.10	--	--	--	--	<50	<0.5	<0.5	<0.5	<0.5	<2.5	--
10/10/96	264.85	245.14	19.71	--	--	--	--	<50	<0.5	<0.5	<0.5	<0.5	<2.5	--
01/09/97	264.85	247.65	17.20	--	--	--	--	<50	<0.5	<0.5	<0.5	<0.5	<2.5	--
04/15/97	264.85	246.11	18.74	--	--	--	--	<50	<0.5	<0.5	<0.5	<0.5	<2.5	--
07/08/97	264.85	246.10	18.75	--	--	--	--	<50	<0.5	<0.5	<0.5	<0.5	<2.5	--
10/22/97	264.85	246.35	18.50	--	--	--	--	<50	<0.5	<0.5	<0.5	<0.5	<2.5	--
01/12/98	264.85	247.71	17.14	--	--	--	--	<50	<0.5	<0.5	<0.5	<0.5	<2.5	--
04/21/98	264.85	247.69	17.16	--	--	--	--	<50	<0.5	<0.5	<0.5	<0.5	<2.5	--
07/08/98	264.85	246.61	18.24	--	--	--	--	<50	<0.5	0.62	<0.5	<0.5	<2.5	--
10/13/98	264.85	245.93	18.92	--	--	--	--	<50	<0.5	<0.5	<0.5	<0.5	<2.5	--

Cumulative Table of Well Data and Analytical Results

Vertical Measurements are in feet.

Analytical results are in parts per billion (ppb)

DATE	Well	Ground	Depth	Total			Notes	TPH- Gasoline	Benzene	Toluene	Ethyl- Benzene	Xylene	MTBE	Organic Lead
	Head Elev.	Water Elev.	To Water	SPH Thickness	SPH Removed	SPH Removed								
C-11														
03/07/90	265.30	242.56	22.74	--	--	--	--	--	--	--	--	--	--	--
03/09/90	265.30	--	--	--	--	--	--	ND	1.2	0.7	ND	1.4	--	--
06/12/90	265.30	243.32	21.98	--	--	--	--	ND	ND	ND	ND	ND	--	--
09/24/90	265.30	243.42	21.88	--	--	--	--	ND	ND	ND	ND	ND	--	--
12/20/90	265.30	242.12	23.18	--	--	--	--	ND	ND	ND	ND	ND	--	--
03/27/91	265.30	243.78	21.52	--	--	--	--	ND	ND	ND	ND	1.5	--	--
06/18/91	265.30	243.40	21.90	--	--	--	--	--	--	--	--	--	--	--
09/12/91	265.30	242.60	22.70	--	--	--	--	ND	ND	ND	ND	ND	--	--
01/23/92	265.30	241.84	23.46	--	--	--	--	ND	ND	ND	ND	ND	--	--
04/13/92	265.30	243.73	21.57	--	--	--	--	ND	ND	ND	ND	ND	--	--
08/03/92	265.30	242.63	22.67	--	--	--	--	ND	ND	ND	ND	ND	--	ND
10/22/92	265.30	242.01	23.29	--	--	--	--	ND	ND	ND	ND	ND	--	--
01/18/93	265.30	243.94	21.36	--	--	--	--	ND	ND	1.2	ND	2.2	--	--
04/19/93	265.30	245.33	19.97	--	--	--	--	ND	ND	ND	ND	ND	--	--
07/21-22/93	265.30	244.65	20.65	--	--	--	--	ND	ND	ND	ND	ND	--	--
10/25/93	265.30	244.55	20.75	--	--	--	--	ND	ND	ND	ND	ND	--	--
01/21/94	265.30	243.69	21.61	--	--	--	--	ND	ND	ND	ND	ND	--	--
04/18/94	265.30	244.52	20.78	--	--	--	--	ND	ND	ND	ND	ND	--	--
07/06-07/94	265.30	244.88	20.42	--	--	--	--	ND	ND	ND	ND	ND	--	--
10/07/94	265.30	243.70	21.60	--	--	--	--	ND	ND	ND	ND	ND	--	--
01/11/95	265.30	245.28	20.02	--	--	--	--	<50	<0.5	<0.5	<0.5	<0.5	--	--
04/24/95	265.30	247.58	17.72	--	--	--	--	<50	<0.5	<0.5	<0.5	<0.5	--	--
07/31/95	265.30	246.12	19.18	--	--	--	--	<50	<0.5	<0.5	<0.5	<0.5	--	--
10/02/95	265.30	244.88	20.42	--	--	--	--	<50	<0.5	<0.5	<0.5	<0.5	--	--
01/16/96	265.30	245.48	19.82	--	--	--	--	<50	<0.5	<0.5	<0.5	<0.5	<2.5	--
04/18/96	265.30	248.30	17.00	--	--	--	--	260	7.9	6.9	5.3	23	11	--
07/22/96	265.30	248.40	16.90	--	--	--	--	<50	<0.5	<0.5	<0.5	<0.5	<2.5	--
10/10/96	265.30	245.74	19.56	--	--	--	--	130	32	2.7	4.3	14	3.4	--
01/09/97	265.30	249.28	16.02	--	--	--	--	75	5.3	6.4	2.0	9.0	<2.5	--
04/15/97	265.30	247.35	17.95	--	--	--	--	<50	<0.5	<0.5	<0.5	<0.5	<2.5	--
07/08/97	265.30	245.55	19.75	--	--	--	--	<50	<0.5	<0.5	<0.5	<0.5	<2.5	--
10/22/97	265.30	245.74	19.56	--	--	--	--	<50	<0.5	<0.5	<0.5	<0.5	<2.5	--

CONTINUED ON NEXT PAGE

Cumulative Table of Well Data and Analytical Results

Vertical Measurements are in feet.

Analytical results are in parts per billion (ppb)

DATE	Well Head Elev.	Ground Water Elev.	Depth To Water	SPH Thickness	SPH Removed	Total SPH Removed	Notes	TPH- Gasoline	Benzene	Toluene	Ethyl- Benzene	Xylene	MTBE	Organic Lead
C-11(CONT'D)														
01/12/98	265.30	246.97	18.33	--	--	--	--	<50	<0.5	<0.5	<0.5	<0.5	<2.5	--
04/21/98	265.30	248.62	16.68	--	--	--	--	<50	<0.5	<0.5	<0.5	<0.5	<2.5	--
07/08/98	265.30	246.76	18.54	--	--	--	--	<50	<0.5	0.58	<0.5	<0.5	<2.5	--
10/13/98	265.30	245.02	20.28	--	--	--	--	<50	<0.5	<0.5	<0.5	<0.5	<2.5	--

Cumulative Table of Well Data and Analytical Results

Vertical Measurements are in feet.

Analytical results are in parts per billion (ppb)

DATE	Well Head Elev.	Ground Water Elev.	Depth To Water	SPH Thickness	SPH Removed	Total SPH Removed	Notes	TPH-Gasoline	Benzene	Toluene	Ethyl-Benzene	Xylene	MTBE	Organic Lead
C-12														
03/07/90	269.66	254.74	14.92	--	--	--	--	--	--	--	--	--	--	--
03/09/90	269.66	--	--	--	--	--	--	1400	230	140	33	180	--	--
06/12/90	269.66	254.87	14.79	--	--	--	--	720	190	71	18	73	--	--
09/24/90	269.66	253.94	15.72	--	--	--	--	ND	1.1	ND	ND	0.6	--	--
12/20/90	269.66	254.40	15.26	--	--	--	--	810	210	26	8.2	23	--	--
03/27/91	269.66	257.55	12.11	--	--	--	--	2900	350	220	52	210	--	--
06/18/91	269.66	253.28	16.38	--	--	--	--	--	--	--	--	--	--	--
09/12/91	269.66	252.11	17.55	--	--	--	--	350	59	12	4.5	8.5	--	--
01/23/92	269.66	252.55	17.11	--	--	--	--	450	110	31	7.9	22	--	--
04/13/92	269.66	255.26	14.40	--	--	--	--	5000	1100	76	100	200	--	--
08/03/92	269.66	253.83	15.83	--	--	--	--	520	200	21	13	25	--	ND
10/22/92	269.66	253.52	16.14	--	--	--	--	1300	310	66	35	56	--	--
01/18/93	269.66	257.96	11.70	--	--	--	--	5600	1200	430	220	610	--	--
04/19/93	269.66	256.61	13.05	--	--	--	--	2000	600	99	96	170	--	--
07/21-22/93	269.66	256.82	12.84	--	--	--	--	540	95	36	18	56	--	--
10/25/93	269.66	255.63	14.03	--	--	--	--	350	90	29	20	50	--	--
01/21/94	269.66	255.51	14.15	--	--	--	--	450	73	18	14	37	--	--
04/18/94	269.66	256.71	12.95	--	--	--	--	370	70	21	12	39	--	--
07/06-07/94	269.66	257.35	12.31	--	--	--	--	840	200	35	28	66	--	--
10/07/94	269.66	256.31	13.35	--	--	--	--	830	85	29	17	63	--	--
01/11/95	269.66	258.43	11.23	--	--	--	--	2100	570	190	98	390	--	--
04/24/95	269.66	259.34	10.32	--	--	--	--	820	120	28	23	61	--	--
07/31/95	269.66	256.92	12.74	--	--	--	--	520	79	13	16	42	--	--
10/02/95	269.66	255.26	14.40	--	--	--	--	400	50	5.3	11	29	--	--
01/16/96	269.66	256.94	12.72	--	--	--	--	1900	490	32	60	120	<25	--
04/18/96	269.66	258.91	10.75	--	--	--	--	2900	640	54	100	190	68	--
07/22/96	269.66	256.46	13.20	--	--	--	--	730	150	13	26	75	9.5	--
10/10/96	269.66	255.95	13.71	--	--	--	--	270	58	4.4	7.7	31	<2.5	--
01/09/97	269.66	260.60	9.06	--	--	--	--	2900	550	67	94	300	63	--
04/15/97	269.66	258.13	11.53	--	--	--	--	2500	350	29	92	200	43	--
07/08/97	269.66	257.92	11.74	--	--	--	--	1400	190	17	54	120	21	--
10/22/97	269.66	258.78	10.88	--	--	--	--	2300	490	45	110	340	42	--

CONTINUED ON NEXT PAGE

Cumulative Table of Well Data and Analytical Results

Vertical Measurements are in feet.

Analytical results are in parts per billion (ppb)

DATE	Well	Ground	Depth	Total			Notes	TPH- Gasoline	Benzene	Toluene	Ethyl- Benzene	Xylene	MTBE	Organic Lead
	Head Elev.	Water Elev.	To Water	SPH Thickness	SPH Removed	SPH Removed								
C-12 (CONT'D)														
01/12/98	269.66	260.76	8.90	--	--	--	--	5000	840	89	220	610	<50	--
04/21/98	269.66	262.41	7.25	--	--	--	--	2400	410	39	79	270	130	--
07/08/98	269.66	258.95	10.71	--	--	--	--	<50	7.6	<0.5	2.0	2.9	<2.5	--
10/13/98	269.66	257.01	12.65	--	--	--	--	2600	460	34	120	240	11	--

Cumulative Table of Well Data and Analytical Results

Vertical Measurements are in feet.

Analytical results are in parts per billion (ppb)

DATE	Well Head Elev.	Ground Water Elev.	Depth To Water	SPH Thickness	SPH Removed	Total SPH Removed	Notes	TPH-Gasoline	Benzene	Toluene	Ethyl-Benzene	Xylene	MTBE	Organic Lead
C-13														
03/07/90	284.32	273.14	11.18	--	--	--	--	--	--	--	--	--	--	--
03/09/90	284.32	--	--	--	--	--	--	ND	15	3.7	1.0	6.2	--	--
06/12/90	284.32	273.62	10.70	--	--	--	--	ND	2.6	ND	ND	ND	--	--
09/24/90	284.32	272.72	11.60	--	--	--	--	ND	2.4	ND	ND	ND	--	--
12/20/90	284.32	274.16	10.16	--	--	--	--	ND	1.6	ND	ND	ND	--	--
03/27/91	284.32	276.68	7.64	--	--	--	--	--	--	--	--	--	--	--
06/18/91	284.32	273.00	11.32	--	--	--	--	--	--	--	--	--	--	--
09/12/91	284.32	272.48	11.84	--	--	--	--	ND	ND	ND	ND	ND	--	--
01/23/92	284.32	273.77	10.55	--	--	--	--	--	--	--	--	--	--	--
04/13/92	284.32	273.36	10.96	--	--	--	--	ND	1.0	ND	ND	ND	--	--
08/03/92	284.32	273.42	10.90	--	--	--	--	ND	ND	ND	ND	ND	--	ND
10/22/92	284.32	273.14	11.18	--	--	--	--	--	--	--	--	--	--	--
01/18/93	284.32	276.92	7.40	--	--	--	--	290	54	10	5.4	12	--	--
04/19/93	284.32	275.39	8.93	--	--	--	--	--	--	--	--	--	--	--
07/21-22/93	284.32	273.57	10.75	--	--	--	--	ND	ND	ND	ND	ND	--	--
10/25/93	284.32	273.47	10.85	--	--	--	--	--	--	--	--	--	--	--
01/21/94	284.32	273.27	11.05	--	--	--	--	ND	ND	ND	ND	ND	--	--
04/18/94	284.32	273.61	10.71	--	--	--	--	--	--	--	--	--	--	--
07/06-07/94	284.32	273.67	10.65	--	--	--	--	ND	0.5	ND	ND	ND	--	--
10/07/94	284.32	273.24	11.08	--	--	--	--	--	--	--	--	--	--	--
01/11/95	284.32	278.94	5.38	--	--	--	Sampled bi-annually	120	15	<0.5	3.1	2.7	--	--
04/24/95	284.32	276.54	7.78	--	--	--	--	--	--	--	--	--	--	--
07/31/95	284.32	274.38	9.94	--	--	--	--	<50	<0.5	<0.5	<0.5	<0.5	--	--
10/02/95	284.32	273.74	10.58	--	--	--	--	--	--	--	--	--	--	--
01/16/96	284.32	274.52	9.80	--	--	--	--	<50	<0.5	<0.5	<0.5	<0.5	<2.5	--
04/18/96	284.32	276.57	7.75	--	--	--	--	--	--	--	--	--	--	--
07/22/96	284.32	274.82	9.50	--	--	--	--	59	18	<0.5	1.0	<0.5	<2.5	--
10/10/96	284.32	273.63	10.69	--	--	--	--	--	--	--	--	--	--	--
01/09/97	284.32	276.95	7.37	--	--	--	--	<50	0.60	<0.5	<0.5	<0.5	<2.5	--
04/15/97	284.32	275.63	8.69	--	--	--	--	--	--	--	--	--	--	--
07/08/97	284.32	276.12	8.20	--	--	--	Samples lost	--	--	--	--	--	--	--
07/15/97	284.32	276.02	8.30	--	--	--	--	<50	2.6	<0.5	<0.5	1.6	<2.5	--
10/22/97	284.32	276.79	7.53	--	--	--	--	--	--	--	--	--	--	--

CONTINUED ON NEXT PAGE

Cumulative Table of Well Data and Analytical Results

Vertical Measurements are in feet.

Analytical results are in parts per billion (ppb)

DATE	Well	Ground	Depth	Total			Notes	TPH- Gasoline	Benzene	Toluene	Ethyl- Benzene	Xylene	MTBE	Organic Lead
	Head Elev.	Water Elev.	To Water	SPH Thickness	SPH Removed	SPH Removed								
C-13														
01/12/98	284.32	278.38	5.94	--	--	--	--	<50	<0.5	<0.5	<0.5	<0.5	<2.5	--
04/21/98	284.32	277.35	6.97	--	--	--	--	--	--	--	--	--	--	--
07/08/98	284.32	274.45	9.87	--	--	--	--	<50	<0.5	<0.5	<0.5	<0.5	<2.5	--
10/13/98	284.32	273.51	10.81	--	--	--	--	--	--	--	--	--	--	--

Cumulative Table of Well Data and Analytical Results

Vertical Measurements are in feet.

Analytical results are in parts per billion (ppb)

DATE	Well	Ground	Depth	Total			Notes	TPH- Gasoline	Benzene	Toluene	Ethyl- Benzene	Xylene	MTBE	Organic Lead
	Head Elev.	Water Elev.	To Water	SPH Thickness	SPH Removed	SPH Removed								
C-14														
03/07/90	270.74	255.56	15.18	--	--	--	--	--	--	--	--	--	--	--
03/09/90	270.74	--	--	--	--	--	--	ND	ND	ND	ND	ND	--	--
06/12/90	270.74	257.32	13.42	--	--	--	--	ND	ND	ND	ND	ND	--	--
09/24/90	270.74	257.90	12.84	--	--	--	--	ND	ND	ND	ND	ND	--	--
12/20/90	270.74	254.02	16.72	--	--	--	--	ND	1.7	0.7	ND	0.7	--	--
03/27/91	270.74	262.74	8.00	--	--	--	--	ND	ND	ND	ND	1.3	--	--
06/18/91	270.74	255.53	15.21	--	--	--	--	--	--	--	--	--	--	--
09/12/91	270.74	255.13	15.61	--	--	--	--	ND	ND	ND	ND	ND	--	--
01/23/92	270.74	246.10	24.64	--	--	--	--	--	--	--	--	--	--	--
04/13/92	270.74	258.53	12.21	--	--	--	--	ND	ND	ND	ND	ND	--	--
08/03/92	270.74	256.10	14.64	--	--	--	--	ND	ND	ND	ND	ND	--	ND
10/22/92	270.74	253.80	16.94	--	--	--	--	--	--	--	--	--	--	--
01/18/93	270.74	265.64	5.10	--	--	--	--	ND	ND	ND	ND	ND	--	--
04/19/93	270.74	263.86	6.88	--	--	--	--	--	--	--	--	--	--	--
07/21-22/93	270.74	259.58	11.16	--	--	--	--	ND	ND	ND	ND	ND	--	--
10/25/93	270.74	256.87	13.87	--	--	--	--	--	--	--	--	--	--	--
01/21/94	270.74	255.42	15.32	--	--	--	--	ND	ND	ND	ND	ND	--	--
04/18/94	270.74	254.85	15.89	--	--	--	--	--	--	--	--	--	--	--
07/06-07/94	270.74	258.66	12.08	--	--	--	--	ND	ND	ND	ND	ND	--	--
10/07/94	270.74	255.45	15.29	--	--	--	--	--	--	--	--	--	--	--
01/11/95	270.74	266.94	3.80	--	--	--	Sampled bi-annually	<50	<0.5	<0.5	<0.5	<0.5	--	--
04/24/95	270.74	265.68	5.06	--	--	--	--	--	--	--	--	--	--	--
07/31/95	270.74	260.34	10.40	--	--	--	--	<50	<0.5	<0.5	<0.5	<0.5	--	--
10/02/95	270.74	257.20	13.54	--	--	--	--	--	--	--	--	--	--	--
01/16/96	270.74	259.62	11.12	--	--	--	--	<50	<0.5	<0.5	<0.5	<0.5	<2.5	--
04/18/96	270.74	265.78	4.96	--	--	--	--	--	--	--	--	--	--	--
07/22/96	270.74	259.89	10.85	--	--	--	--	<50	<0.5	<0.5	<0.5	<0.5	<2.5	--
10/10/96	270.74	261.44	9.30	--	--	--	--	--	--	--	--	--	--	--
01/09/97	270.74	269.80	0.94	--	--	--	--	56	3.8	4.2	1.1	5.0	<2.5	--
04/15/97	270.74	263.59	7.15	--	--	--	--	--	--	--	--	--	--	--
07/08/97	270.74	261.44	9.30	--	--	--	--	<50	<0.5	<0.5	<0.5	<0.5	<2.5	--
10/22/97	270.74	261.17	9.57	--	--	--	--	--	--	--	--	--	--	--

Cumulative Table of Well Data and Analytical Results

Vertical Measurements are in feet.

Analytical results are in parts per billion (ppb)

DATE	Well	Ground	Depth	Total			Notes	TPH- Gasoline	Benzene	Toluene	Ethy- Benzene	Xylene	MTBE	Organic Lead
	Head Elev.	Water Elev.	To Water	SPH Thickness	SPH Removed	SPH Removed								
C-14 (CONT'D)														
01/12/98	270.74	268.45	2.29	--	--	--	--	<50	<0.5	<0.5	<0.5	<0.5	<2.5	--
04/21/98	270.74	270.70	0.04	--	--	--	--	--	--	--	--	--	--	--
07/08/98	270.74	264.85	5.89	--	--	--	--	<50	<0.5	<0.5	<0.5	<0.5	<2.5	--
10/13/98	270.74	260.38	10.36	--	--	--	--	--	--	--	--	--	--	--

Cumulative Table of Well Data and Analytical Results

Vertical Measurements are in feet.

Analytical results are in parts per billion (ppb)

DATE	Well Head Elev.	Ground Water Elev.	Depth To Water	SPH Thickness	SPH Removed	Total SPH Removed	Notes	TPH-Gasoline	Benzene	Toluene	Ethyl-Benzene	Xylene	MTBE	Organic Lead
C-15														
03/07/90	246.15	235.05	11.10	--	--	--	--	--	--	--	--	--	--	--
03/09/90	246.15	--	--	--	--	--	--	410	ND	1.4	0.5	0.6	--	--
06/12/90	246.15	235.37	10.78	--	--	--	--	420	11	ND	ND	ND	--	--
09/24/90	246.15	235.22	10.93	--	--	--	--	430	ND	1.5	ND	ND	--	--
12/20/90	246.15	235.07	11.08	--	--	--	--	300	1.3	1.1	0.6	1.5	--	--
03/27/91	246.15	237.65	8.50	--	--	--	--	520	4.6	1.1	ND	1.0	--	--
06/18/91	246.15	235.32	10.83	--	--	--	--	290	ND	1.1	ND	ND	--	--
06/18/91	246.15	235.32	10.83	--	--	--	Duplicate	320	ND	1.3	ND	ND	--	--
09/12/91	246.15	235.10	11.05	--	--	--	--	330	ND	0.9	ND	ND	--	--
01/23/92	246.15	235.35	10.80	--	--	--	--	210	ND	0.6	ND	ND	--	--
01/23/92	246.15	235.35	10.80	--	--	--	Duplicate	190	1.2	0.8	ND	ND	--	--
04/13/92	246.15	236.57	9.58	--	--	--	--	430	1.8	ND	ND	ND	--	--
08/03/92	246.15	234.94	11.21	--	--	--	--	640	ND	2.1	0.7	1.3	--	ND
10/22/92	246.15	234.50	11.65	--	--	--	--	420	ND	ND	ND	0.8	--	--
01/18/93	246.15	239.03	7.12	--	--	--	--	640	7.0	3.0	2.9	6.7	--	--
04/19/93	246.15	237.22	8.93	--	--	--	--	260	6.0	2.0	0.7	ND	--	--
07/21-22/93	246.15	236.37	9.78	--	--	--	--	580	ND	8.0	ND	0.6	--	--
10/25/93	246.15	236.41	9.74	--	--	--	--	240	ND	12	ND	0.6	--	--
01/21/94	246.15	235.78	10.37	--	--	--	--	420	0.6	ND	0.6	ND	--	--
04/18/94	246.15	236.19	9.96	--	--	--	--	550	1.0	4.6	0.6	ND	--	--
07/06-07/94	246.15	235.92	10.23	--	--	--	--	660	0.7	ND	ND	0.7	--	--
10/07/94	246.15	235.47	10.68	--	--	--	--	440	13	0.8	ND	1.2	--	--
01/11/95	246.15	238.84	7.31	--	--	--	--	750	2.5	<0.5	<0.5	0.6	--	--
04/24/95	246.15	237.41	8.74	--	--	--	--	850	<0.5	<0.5	<0.5	<0.5	--	--
07/31/95	246.15	235.41	10.74	--	--	--	--	640	<0.5	1.6	<0.5	<0.5	--	--
10/02/95	246.15	234.83	11.32	--	--	--	--	560	<0.5	<0.5	<0.5	<0.5	--	--
01/16/96	246.15	235.58	10.57	--	--	--	--	740	<0.5	<0.5	<0.5	<0.5	<2.5	--
04/18/96	246.15	237.55	8.60	--	--	--	--	760	<0.5	<0.5	<0.5	<0.5	<2.5	--
07/22/96	246.15	235.57	10.58	--	--	--	--	690	<0.5	1.6	<0.5	<0.5	7.9	--
10/10/96	246.15	234.97	11.18	--	--	--	--	870	7.0	2.1	<0.5	<0.5	11	--
01/09/97	246.15	238.83	7.32	--	--	--	--	370	2.6	1.1	<0.5	<0.5	4.6	--
04/15/97	246.15	235.76	10.39	--	--	--	--	510	22	<0.5	<0.5	<0.5	<2.5	--
07/08/97	246.15	235.68	10.47	--	--	--	--	490	71	6.8	22	48	7.0	--
10/22/97	246.15	235.01	11.14	--	--	--	--	790	2.3	1.8	<0.5	<0.5	5.1	--

CONTINUED ON NEXT PAGE

Cumulative Table of Well Data and Analytical Results

Vertical Measurements are in feet.

Analytical results are in parts per billion (ppb)

DATE	Well	Ground	Depth	Total			Notes	Analytical results are in parts per billion (ppb)						
	Head Elev.	Water Elev.	To Water	SPH Thickness	SPH Removed	SPH Removed		TPH-Gasoline	Benzene	Toluene	Ethyl-Benzene	Xylene	MTBE	Organic Lead
C-15 (CONT'D)														
01/12/98	246.15	238.17	7.98	--	--	--	--	400	13	<1.0	<1.0	<1.0	<5.0	--
04/21/98	246.15	238.05	8.10	--	--	--	--	770	<0.5	0.60	0.82	0.51	<2.5	--
07/08/98	246.15	235.65	10.50	--	--	--	--	540	13	<0.5	<0.5	<0.5	<2.5	--
10/13/98	246.15	234.95	11.20	--	--	--	--	<50	<0.5	<0.5	<0.5	0.54	<2.5	--

Cumulative Table of Well Data and Analytical Results

Vertical Measurements are in feet.

Analytical results are in parts per billion (ppb)

DATE	Well Head Elev.	Ground Water Elev.	Depth To Water	SPH Thickness	SPH Removed	Total SPH Removed	Notes	TPH-Gasoline	Benzene	Toluene	Ethyl-Benzene	Xylene	MTBE	Organic Lead
C-16														
03/07/90	246.69	228.19	18.50	--	--	--	--	--	--	--	--	--	--	--
03/09/90	246.69	--	--	--	--	--	--	ND	ND	ND	ND	ND	--	--
06/12/90	246.69	235.27	11.42	--	--	--	--	ND	ND	ND	ND	ND	--	--
09/24/90	246.69	235.30	11.39	--	--	--	--	ND	ND	ND	ND	ND	--	--
12/20/90	246.69	235.12	11.57	--	--	--	--	ND	ND	ND	ND	0.7	--	--
03/27/91	246.69	237.93	8.76	--	--	--	--	ND	ND	ND	ND	1.3	--	--
03/27/91	246.69	237.93	8.76	--	--	--	Duplicate	ND	ND	ND	ND	1.2	--	--
06/18/91	246.69	235.51	11.18	--	--	--	--	ND	ND	ND	ND	ND	--	--
09/12/91	246.69	234.74	11.95	--	--	--	--	ND	ND	ND	ND	ND	--	--
01/23/92	246.69	234.28	12.41	--	--	--	--	ND	ND	ND	ND	ND	--	--
04/13/92	246.69	236.00	10.69	--	--	--	--	ND	ND	ND	ND	ND	--	--
08/03/92	246.69	234.49	12.20	--	--	--	--	ND	ND	ND	ND	ND	--	ND
10/22/92	246.69	234.09	12.60	--	--	--	--	ND	ND	ND	ND	ND	--	--
01/18/93	246.69	237.69	9.00	--	--	--	--	ND	ND	ND	ND	ND	--	--
04/19/93	246.69	236.80	9.89	--	--	--	--	ND	ND	ND	ND	ND	--	--
07/21-22/93	246.69	236.44	10.25	--	--	--	--	ND	ND	ND	ND	ND	--	--
10/25/93	246.69	235.73	10.96	--	--	--	--	ND	ND	ND	ND	ND	--	--
01/21/94	246.69	234.93	11.76	--	--	--	--	ND	ND	0.7	ND	1.0	--	--
04/18/94	246.69	235.47	11.22	--	--	--	--	ND	ND	ND	ND	ND	--	--
07/06-07/94	246.69	235.32	11.37	--	--	--	--	ND	ND	ND	ND	ND	--	--
10/07/94	246.69	234.30	12.39	--	--	--	--	ND	ND	ND	ND	ND	--	--
01/11/95	246.69	237.73	8.96	--	--	--	--	<50	<0.5	<0.5	<0.5	<0.5	--	--
04/24/95	246.69	236.31	10.38	--	--	--	--	<50	<0.5	<0.5	<0.5	<0.5	--	--
07/31/95	246.69	235.37	11.32	--	--	--	--	<50	<0.5	<0.5	<0.5	<0.5	--	--
10/02/95	246.69	234.29	12.40	--	--	--	--	<50	<0.5	<0.5	<0.5	<0.5	--	--
01/16/96	246.69	235.15	11.54	--	--	--	--	<50	<0.5	<0.5	<0.5	<0.5	<2.5	--
04/18/96	246.69	236.09	10.60	--	--	--	--	<50	<0.5	<0.5	<0.5	<0.5	<2.5	--
07/22/96	246.69	235.12	11.57	--	--	--	--	<50	<0.5	<0.5	<0.5	<0.5	<2.5	--
10/10/96	246.69	234.25	12.44	--	--	--	--	<50	<0.5	<0.5	<0.5	<0.5	<2.5	--
01/09/97	246.69	237.16	9.53	--	--	--	--	<50	<0.5	<0.5	<0.5	<0.5	<2.5	--
04/15/97	246.69	234.66	12.03	--	--	--	--	<50	<0.5	<0.5	<0.5	<0.5	<2.5	--
07/08/97	246.69	234.51	12.18	--	--	--	--	<50	<0.5	<0.5	<0.5	<0.5	<2.5	--
10/22/97	246.69	233.94	12.75	--	--	--	--	<50	<0.5	<0.5	<0.5	<0.5	<2.5	--

CONTINUED ON NEXT PAGE

Cumulative Table of Well Data and Analytical Results

Vertical Measurements are in feet.

Analytical results are in parts per billion (ppb)

DATE	Well Head Elev.	Ground Water Elev.	Depth To Water	SPH Thickness	SPH Removed	Total SPH Removed	Notes	TPH-Gasoline	Benzene	Toluene	Ethyl-Benzene	Xylene	MTBE	Organic Lead
C-16 (CONT'D)														
01/12/98	246.69	236.34	10.35	--	--	--	--	<50	<0.5	<0.5	<0.5	<0.5	<2.5	--
04/21/98	246.69	236.06	10.63	--	--	--	--	<50	<0.5	<0.5	<0.5	<0.5	<2.5	--
07/08/98	246.69	234.62	12.07	--	--	--	--	<50	<0.5	0.51	<0.5	<0.5	<2.5	--
10/13/98	246.69	233.94	12.75	--	--	--	--	<50	<0.5	<0.5	<0.5	<0.5	<2.5	--

Cumulative Table of Well Data and Analytical Results

Vertical Measurements are in feet.

Analytical results are in parts per billion (ppb)

DATE	Well Head Elev.	Ground Water Elev.	Depth To Water	SPH Thickness	SPH Removed	Total SPH Removed	Notes	TPH-Gasoline	Benzene	Toluene	Ethyl-Benzene	Xylene	MTBE	Organic Lead
RW														
12/04/89	--	--	--	--	--	--	--	62,000	29,000	1700	1800	8800	--	--
03/07/90	274.52	256.02	18.50	--	--	--	--	--	--	--	--	--	--	--
06/12/90	274.52	256.03	18.49	--	--	--	--	31,000	15,000	2000	560	3100	--	--
09/24/90	274.52	--	--	--	--	--	--	--	--	--	--	--	--	--
12/20/90	274.52	--	--	--	--	--	--	ND	0.5	ND	ND	1.2	--	--
03/27/91	274.52	--	--	--	--	--	--	--	--	--	--	--	--	--
06/18/91	274.52	--	--	--	--	--	--	--	--	--	--	--	--	--
09/12/91	274.52	--	--	--	--	--	Insufficient water	--	--	--	--	--	--	--
01/23/92	274.52	--	--	--	--	--	Insufficient water	--	--	--	--	--	--	--
04/13/92	274.52	--	--	--	--	--	Insufficient water	--	--	--	--	--	--	--
08/03/92	274.52	--	--	--	--	--	Insufficient water	--	--	--	--	--	--	--
10/22/92	274.52	--	--	--	--	--	Insufficient water	--	--	--	--	--	--	--
01/18/93	274.52	--	--	--	--	--	Insufficient water	--	--	--	--	--	--	--
04/19/93	274.52	--	--	--	--	--	Insufficient water	--	--	--	--	--	--	--
07/21-22/93	274.52	--	--	--	--	--	Insufficient water	--	--	--	--	--	--	--
10/25/93	274.52	--	--	--	--	--	--	--	--	--	--	--	--	--
01/21/94	274.52	--	--	--	--	--	--	--	--	--	--	--	--	--
04/18/94	274.52	--	--	--	--	--	--	--	--	--	--	--	--	--
07/06-07/94	274.52	--	--	--	--	--	--	--	--	--	--	--	--	--
10/07/94	274.52	--	--	--	--	--	--	--	--	--	--	--	--	--
10/24/95	274.52	256.63	17.89	--	--	--	--	37,000	11,000	380	1100	3000	--	--
01/16/96	274.52	259.09	15.43	--	--	--	--	59,000	17,000	660	1600	5400	<1000	--

NO LONGER MONITORED OR SAMPLED

Cumulative Table of Well Data and Analytical Results

Vertical Measurements are in feet.

Analytical results are in parts per billion (ppb)

DATE	Well	Ground	Depth	Total			Notes	TPH- Gasoline	Benzene	Toluene	Ethyl- Benzene	Xylene	MTBE	Organic Lead
	Head Elev.	Water Elev.	To Water	SPH Thickness	SPH Removed	SPH Removed								
TRIP BLANK														
01/11/95	--	--	--	--	--	--	--	<50	<0.5	<0.5	<0.5	<0.5	--	--
04/24/95	--	--	--	--	--	--	--	<50	<0.5	<0.5	<0.5	<0.5	--	--
07/31/95	--	--	--	--	--	--	--	<50	<0.5	<0.5	<0.5	<0.5	--	--
10/02/95	--	--	--	--	--	--	--	<50	<0.5	<0.5	<0.5	<0.5	--	--
01/16/96	--	--	--	--	--	--	--	<50	<0.5	<0.5	<0.5	<0.5	--	--
04/18/96	--	--	--	--	--	--	--	<50	<0.5	<0.5	<0.5	<0.5	--	--
07/22/96	--	--	--	--	--	--	--	<50	<0.5	<0.5	<0.5	<0.5	--	--
10/10/96	--	--	--	--	--	--	--	<50	<0.5	<0.5	<0.5	<0.5	--	--
01/09/97	--	--	--	--	--	--	--	<50	<0.5	<0.5	<0.5	<0.5	<2.5	--
04/15/97	--	--	--	--	--	--	--	<50	<0.5	<0.5	<0.5	<0.5	<2.5	--
07/08/97	--	--	--	--	--	--	--	<50	<0.5	<0.5	<0.5	<0.5	<2.5	--
07/15/97	--	--	--	--	--	--	--	<50	<0.5	<0.5	<0.5	<0.5	<2.5	--
10/22/97	--	--	--	--	--	--	--	<50	<0.5	<0.5	<0.5	<0.5	<2.5	--
01/12/98	--	--	--	--	--	--	--	<50	<0.5	<0.5	<0.5	<0.5	<2.5	--
04/21/98	--	--	--	--	--	--	--	<50	<0.5	<0.5	<0.5	<0.5	<2.5	--
07/08/98	--	--	--	--	--	--	--	<50	<0.5	<0.5	<0.5	<0.5	<2.5	--
10/13/98	--	--	--	--	--	--	--	<50	<0.5	<0.5	<0.5	<0.5	<2.5	--

* See Table of Additional Analyses.

Cumulative Table of Well Data and Analytical Results

ADDITIONAL ANALYSES

Analytical values are in parts per billion (ppb)

DATE	Notes	Ethanol	t-Butanol	MTBE	DIPE	ETBE	TAME
C-1							
10/13/98	--	<10,000	<2000	<40	<40	<40	<40

Note: Blaine Tech Services, Inc. began routine monitoring of the groundwater wells at this site on November 1, 1994.
 Earlier field data and analytical results are drawn from the November 4, 1994 Groundwater Technology, Inc. report.

ABBREVIATIONS:

TPH = Total Petroleum Hydrocarbons

ND = Not detected at or above the minimum quantitation limit. See laboratory reports for minimum quantitation limits.

MTBE = Methyl t-butyl ether

DIPE = Di-Isopropyl Ether

ETBE = Ethyl t-Butyl Ether

TAME = t-Amyl Methyl Ether

Analytical Appendix



Blaine Tech Services 1680 Rogers Avenue San Jose, CA 95112	Client Proj. ID: Chevron 9-5607, 981013-T2 Sample Descript: C-1 Matrix: LIQUID Analysis Method: 8015Mod/8020 Lab Number: 9810A02-01	Sampled: 10/13/98 Received: 10/13/98 Analyzed: 10/21/98 Reported: 11/04/98
Attention: Fran Thie		

Total Purgeable Petroleum Hydrocarbons (TPPH) with BTEX and MTBE

Analyte	Detection Limit ug/L	Sample Results ug/L
TPPH as Gas	1000	27000
Methyl t-Butyl Ether	50	210
Benzene	10	3900
Toluene	10	580
Ethyl Benzene	10	2000
Xylenes (Total)	10	4200
Chromatogram Pattern:		GAS

Surrogates	Control Limits %	% Recovery
Trifluorotoluene	70 130	108

Analytes reported as N.D. were not present above the stated limit of detection.

SEQUOIA ANALYTICAL - ELAP #1210

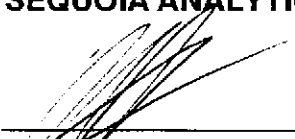

Mike Gregory
Project Manager



**Sequoia
Analytical**

680 Chesapeake Drive
404 N. Wiger Lane
819 Striker Avenue, Suite 8
1455 McDowell Blvd. North. Ste. D

Redwood City, CA 94063
Walnut Creek, CA 94598
Sacramento, CA 95834
Petaluma, CA 94954

(650) 364-9600 FAX (650) 364-9233
(925) 988-9600 FAX (925) 988-9673
(916) 921-9600 FAX (916) 921-0100
(707) 792-1865 FAX (707) 792-0342

Blaine Tech Services 1680 Rogers Avenue San Jose, CA 95112	Client Proj. ID: Chevron 9-5607, 981013-T2 Sample Descript: C-1 Matrix: LIQUID Analysis Method: EPA 8260 Lab Number: 9810A02-01	Sampled: 10/13/98 Received: 10/13/98 Analyzed: 10/23/98 Reported: 11/04/98
Attention: Fran Thie		

QC Batch Number: MS102298MTBEH6B
Instrument ID: H6

Oxygenate Compounds (EPA 8260)

Analyte	Detection Limit ug/L	Sample Results ug/L
Ethanol	10000	N.D.
t-Butanol	2000	N.D.
Methyl t-Butyl Ether (MTBE)	40	N.D.
Di-Isopropyl Ether (DIPE)	40	N.D.
Ethyl t-Butyl Ether (ETBE)	40	N.D.
t-Amyl Methyl Ether (TAME)	40	N.D.
Surrogates	Control Limits %	% Recovery
1,2-Dichloroethane-d4	76 114	103

Analytes reported as N.D. were not present above the stated limit of detection.

SEQUOIA ANALYTICAL - ELAP #1210

Mike Gregory
Project Manager



Blaine Tech Services 1680 Rogers Avenue San Jose, CA 95112	Client Proj. ID: Chevron 9-5607, 981013-T2 Sample Descript: C-3 Matrix: LIQUID Analysis Method: 8015Mod/8020 Lab Number: 9810A02-02	Sampled: 10/13/98 Received: 10/13/98 Analyzed: 10/21/98 Reported: 11/04/98
Attention: Fran Thie		

Total Purgeable Petroleum Hydrocarbons (TPPH) with BTEX and MTBE

Analyte	Detection Limit ug/L	Sample Results ug/L
TPPH as Gas	50	390
Methyl t-Butyl Ether	2.5	2.9
Benzene	0.50	32
Toluene	0.50	4.8
Ethyl Benzene	0.50	26
Xylenes (Total)	0.50	42
Chromatogram Pattern:		GAS
Surrogates	Control Limits %	% Recovery
Trifluorotoluene	70 130	117

Analytes reported as N.D. were not present above the stated limit of detection.

SEQUOIA ANALYTICAL - ELAP #1210

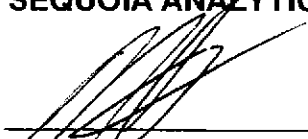

Mike Gregory
Project Manager



Blaine Tech Services 1680 Rogers Avenue San Jose, CA 95112	Client Proj. ID: Chevron 9-5607, 981013-T2 Sample Descript: C-6 Matrix: LIQUID Analysis Method: 8015Mod/8020 Lab Number: 9810A02-03	Sampled: 10/13/98 Received: 10/13/98 Analyzed: 10/22/98 Reported: 11/04/98
Attention: Fran Thie		

Total Purgeable Petroleum Hydrocarbons (TPPH) with BTEX and MTBE

Analyte	Detection Limit ug/L	Sample Results ug/L
TPPH as Gas	5000	46000
Methyl t-Butyl Ether	250	N.D.
Benzene	50	12000
Toluene	50	490
Ethyl Benzene	50	1600
Xylenes (Total)	50	3600
Chromatogram Pattern:		GAS
Surrogates	Control Limits %	% Recovery
Trifluorotoluene	70 130	107

Analytes reported as N.D. were not present above the stated limit of detection.

SEQUOIA ANALYTICAL - ELAP #1210

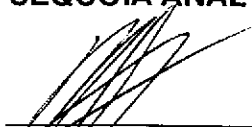
Mike Gregory
Project Manager



Blaine Tech Services 1680 Rogers Avenue San Jose, CA 95112	Client Proj. ID: Chevron 9-5607, 981013-T2 Sample Descript: C-8 Matrix: LIQUID Analysis Method: 8015Mod/8020 Lab Number: 9810A02-04	Sampled: 10/13/98 Received: 10/13/98 Analyzed: 10/22/98 Reported: 11/04/98
Attention: Fran Thie		

Total Purgeable Petroleum Hydrocarbons (TPPH) with BTEX and MTBE

Analyte	Detection Limit ug/L	Sample Results ug/L
TPPH as Gas	50	N.D.
Methyl t-Butyl Ether	2.5	N.D.
Benzene	0.50	N.D.
Toluene	0.50	N.D.
Ethyl Benzene	0.50	N.D.
Xylenes (Total)	0.50	N.D.
Chromatogram Pattern:		
Surrogates	Control Limits %	% Recovery
Trifluorotoluene	70 130	105

Analytes reported as N.D. were not present above the stated limit of detection.

SEQUOIA ANALYTICAL - ELAP #1210

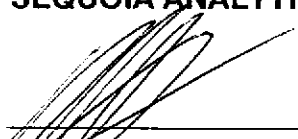

Mike Gregory
Project Manager



Blaine Tech Services 1680 Rogers Avenue San Jose, CA 95112 Attention: Fran Thie	Client Proj. ID: Chevron 9-5607, 981013-T2 Sample Descript: C-9 Matrix: LIQUID Analysis Method: 8015Mod/8020 Lab Number: 9810A02-05	Sampled: 10/13/98 Received: 10/13/98 Analyzed: 10/22/98 Reported: 11/04/98
--	---	---

Total Purgeable Petroleum Hydrocarbons (TPPH) with BTEX and MTBE

Analyte	Detection Limit ug/L	Sample Results ug/L
TPPH as Gas	2500	28000
Methyl t-Butyl Ether	125	N.D.
Benzene	25	7100
Toluene	25	1100
Ethyl Benzene	25	1300
Xylenes (Total)	25	2700
Chromatogram Pattern:		GAS
Surrogates	Control Limits %	% Recovery
Trifluorotoluene	70 130	107

Analytes reported as N.D. were not present above the stated limit of detection.

SEQUOIA ANALYTICAL - ELAP #1210

Mike Gregory
Project Manager



Blaine Tech Services 1680 Rogers Avenue San Jose, CA 95112	Client Proj. ID: Chevron 9-5607, 981013-T2 Sample Descript: C-10A Matrix: LIQUID Analysis Method: 8015Mod/8020 Lab Number: 9810A02-06	Sampled: 10/13/98 Received: 10/13/98 Analyzed: 10/22/98 Reported: 11/04/98
Attention: Fran Thie		

Total Purgeable Petroleum Hydrocarbons (TPPH) with BTEX and MTBE

Analyte	Detection Limit ug/L	Sample Results ug/L
TPPH as Gas	50	N.D.
Methyl t-Butyl Ether	2.5	N.D.
Benzene	0.50	1.3
Toluene	0.50	N.D.
Ethyl Benzene	0.50	0.67
Xylenes (Total)	0.50	1.5
Chromatogram Pattern:		
Surrogates	Control Limits %	% Recovery
Trifluorotoluene	70 130	106

Analytes reported as N.D. were not present above the stated limit of detection.

SEQUOIA ANALYTICAL - ELAP #1210

Mike Gregory
Project Manager



**Sequoia
Analytical**

680 Chesapeake Drive
404 N. Wiger Lane
819 Striker Avenue, Suite 8
1455 McDowell Blvd. North, Ste. D

Redwood City, CA 94063
Walnut Creek, CA 94598
Sacramento, CA 95834
Petaluma, CA 94954

(650) 364-9600
(925) 988-9600
(916) 921-9600
(707) 792-1865

FAX (650) 364-9233
FAX (925) 988-9673
FAX (916) 921-0100
FAX (707) 792-0342

Blaine Tech Services
1680 Rogers Avenue
San Jose, CA 95112

Client Proj. ID: Chevron 9-5607, 981013-T2
Sample Descript: C-10B
Matrix: LIQUID
Analysis Method: 8015Mod/8020
Lab Number: 9810A02-07

Sampled: 10/13/98
Received: 10/13/98
Analyzed: 10/21/98
Reported: 11/04/98

Attention: Fran Thie

Total Purgeable Petroleum Hydrocarbons (TPPH) with BTEX and MTBE

Analyte	Detection Limit ug/L	Sample Results ug/L
TPPH as Gas	50	N.D.
Methyl t-Butyl Ether	2.5	N.D.
Benzene	0.50	N.D.
Toluene	0.50	N.D.
Ethyl Benzene	0.50	N.D.
Xylenes (Total)	0.50	N.D.
Chromatogram Pattern:		
Surrogates	Control Limits %	% Recovery
Trifluorotoluene	70 130	102

Analytes reported as N.D. were not present above the stated limit of detection.

SEQUOIA ANALYTICAL - ELAP #1210



Mike Gregory
Project Manager



**Sequoia
Analytical**

680 Chesapeake Drive
404 N. Wiget Lane
819 Striker Avenue, Suite 8
1455 McDowell Blvd. North, Ste. D

Redwood City, CA 94063
Walnut Creek, CA 94598
Sacramento, CA 95834
Petaluma, CA 94954

(650) 364-9600
(925) 988-9600
(916) 921-9600
(707) 792-1865

FAX (650) 364-9233
FAX (925) 988-9673
FAX (916) 921-0100
FAX (707) 792-0342

Blaine Tech Services
1680 Rogers Avenue
San Jose, CA 95112

Client Proj. ID: Chevron 9-5607, 981013-T2
Sample Descript: C-11
Matrix: LIQUID
Analysis Method: 8015Mod/8020
Lab Number: 9810A02-08

Sampled: 10/13/98
Received: 10/13/98
Analyzed: 10/21/98
Reported: 11/04/98

Attention: Fran Thie

Total Purgeable Petroleum Hydrocarbons (TPPH) with BTEX and MTBE

Analyte	Detection Limit ug/L	Sample Results ug/L
TPPH as Gas	50	N.D.
Methyl t-Butyl Ether	2.5	N.D.
Benzene	0.50	N.D.
Toluene	0.50	N.D.
Ethyl Benzene	0.50	N.D.
Xylenes (Total)	0.50	N.D.
Chromatogram Pattern:		
Surrogates	Control Limits %	% Recovery
Trifluorotoluene	70 130	104

Analytes reported as N.D. were not present above the stated limit of detection.

SEQUOIA ANALYTICAL - ELAP #1210

Mike Gregory
Project Manager



Blaine Tech Services 1680 Rogers Avenue San Jose, CA 95112	Client Proj. ID: Chevron 9-5607, 981013-T2 Sample Descript: C-12 Matrix: LIQUID Analysis Method: 8015Mod/8020 Lab Number: 9810A02-09	Sampled: 10/13/98 Received: 10/13/98 Analyzed: 10/22/98 Reported: 11/04/98
Attention: Fran Thie		

Total Purgeable Petroleum Hydrocarbons (TPPH) with BTEX and MTBE

Analyte	Detection Limit ug/L	Sample Results ug/L
TPPH as Gas	100	2600
Methyl t-Butyl Ether	5.0	11
Benzene	1.0	460
Toluene	1.0	34
Ethyl Benzene	1.0	120
Xylenes (Total)	1.0	240
Chromatogram Pattern:		GAS
Surrogates	Control Limits %	% Recovery
Trifluorotoluene	70 130	94

Analytes reported as N.D. were not present above the stated limit of detection.

SEQUOIA ANALYTICAL - ELAP #1210



Mike Gregory
Project Manager



Blaine Tech Services 1680 Rogers Avenue San Jose, CA 95112	Client Proj. ID: Chevron 9-5607, 981013-T2 Sample Descript: C-15 Matrix: LIQUID Analysis Method: 8015Mod/8020 Lab Number: 9810A02-10	Sampled: 10/13/98 Received: 10/13/98 Analyzed: 10/22/98 Reported: 11/04/98
Attention: Fran Thie		

Total Purgeable Petroleum Hydrocarbons (TPPH) with BTEX and MTBE

Analyte	Detection Limit ug/L	Sample Results ug/L
TPPH as Gas	50	N.D.
Methyl t-Butyl Ether	2.5	N.D.
Benzene	0.50	N.D.
Toluene	0.50	N.D.
Ethyl Benzene	0.50	N.D.
Xylenes (Total)	0.50	0.54
Chromatogram Pattern:		
Surrogates	Control Limits %	% Recovery
Trifluorotoluene	70 130	105

Analytes reported as N.D. were not present above the stated limit of detection.

SEQUOIA ANALYTICAL - ELAP #1210



Mike Gregory
Project Manager



Blaine Tech Services 1680 Rogers Avenue San Jose, CA 95112	Client Proj. ID: Chevron 9-5607, 981013-T2 Sample Descript: C-16 Matrix: LIQUID Analysis Method: 8015Mod/8020 Lab Number: 9810A02-11	Sampled: 10/13/98 Received: 10/13/98 Analyzed: 10/22/98 Reported: 11/04/98
Attention: Fran Thie		

Total Purgeable Petroleum Hydrocarbons (TPPH) with BTEX and MTBE

Analyte	Detection Limit ug/L	Sample Results ug/L
TPPH as Gas	50	N.D.
Methyl t-Butyl Ether	2.5	N.D.
Benzene	0.50	N.D.
Toluene	0.50	N.D.
Ethyl Benzene	0.50	N.D.
Xylenes (Total)	0.50	N.D.
Chromatogram Pattern:		
Surrogates	Control Limits %	% Recovery
Trifluorotoluene	70 130	108

Analytes reported as N.D. were not present above the stated limit of detection.

SEQUOIA ANALYTICAL - ELAP #1210



Mike Gregory
Project Manager



Blaine Tech Services 1680 Rogers Avenue San Jose, CA 95112	Client Proj. ID: Chevron 9-5607, 981013-T2 Sample Descript: TB Matrix: LIQUID Analysis Method: 8015Mod/8020 Lab Number: 9810A02-12	Sampled: 10/13/98 Received: 10/13/98 Analyzed: 10/22/98 Reported: 11/04/98
Attention: Fran Thie		

Total Purgeable Petroleum Hydrocarbons (TPPH) with BTEX and MTBE

Analyte	Detection Limit ug/L	Sample Results ug/L
TPPH as Gas	50	N.D.
Methyl t-Butyl Ether	2.5	N.D.
Benzene	0.50	N.D.
Toluene	0.50	N.D.
Ethyl Benzene	0.50	N.D.
Xylenes (Total)	0.50	N.D.
Chromatogram Pattern:		
Surrogates	Control Limits %	% Recovery
Trifluorotoluene	70 130	115

Analytes reported as N.D. were not present above the stated limit of detection.

SEQUOIA ANALYTICAL - ELAP #1210



Mike Gregory
Project Manager



**Sequoia
Analytical**

680 Chesapeake Drive
404 N. Wiger Lane
819 Striker Avenue, Suite 8
1455 McDowell Blvd. North, Ste. D

Redwood City, CA 94063
Wainut Creek, CA 94598
Sacramento, CA 95834
Petaluma, CA 94954

(650) 364-9600
(925) 988-9600
(916) 921-9600
(707) 792-1865

FAX (650) 364-9233
FAX (925) 988-9673
FAX (916) 921-0100
FAX (707) 792-0342

Blaine Tech Services
1680 Rogers Avenue
San Jose, CA 95112
Attention: Fran Thie

Client Proj. ID: Chevron 9-5607, 981013-T2

Received: 10/13/98

Lab Proj. ID: 9810A02

Reported: 11/04/98

LABORATORY NARRATIVE

In order to properly interpret this report, it must be reproduced in its entirety. This report contains a total of 18 pages including the laboratory narrative, sample results, quality control, and related documents as required (cover page, COC, raw data, etc.).

OXY Note:

Sample 9810A02-01 was diluted 20 times due to high hydrocarbons.

TPH-GAS/BTEX:

Sample 9810A02-01 was diluted 20-fold.
Sample 9810A02-03 was diluted 100-fold.
Sample 9810A02-05 was diluted 50-fold.
Sample 9810A02-09 was diluted 2-fold.

SEQUOIA ANALYTICAL

Mike Gregory
Project Manager



Blaine Tech Services, Inc.
1680 Rogers Ave.
San Jose, CA 95112
Attention: Fran Thie

Client Project ID: Chevron 9-5607, 981013-T2
Matrix: Liquid

Work Order #: 9810A02 -01-08

Reported: Nov 10, 1998

QUALITY CONTROL DATA REPORT

Analyte:	Benzene	Toluene	Ethyl Benzene	Xylenes
QC Batch#:	8100385	8100385	8100385	8100385
Analy. Method:	EPA 8020	EPA 8020	EPA 8020	EPA 8020
Prep. Method:	EPA 8015M	EPA 8015M	EPA 8015M	EPA 8015M

Analyst:	-	-	-	-
MS/MSD #:	P810266-01	P810266-01	P810266-01	P810266-01
Sample Conc.:	N.D.	N.D.	N.D.	N.D.
Prepared Date:	10/21/98	10/21/98	10/21/98	10/21/98
Analyzed Date:	10/21/98	10/21/98	10/21/98	10/21/98
Instrument I.D.#:	-	-	-	-
Conc. Spiked:	100 µg/L	100 µg/L	100 µg/L	300 µg/L
Result:	99.7	99.5	98.7	302
MS % Recovery:	99.7	99.5	98.7	100
Dup. Result:	101	101	101	309
MSD % Recov.:	101	101	101	103
RPD:	1.3	1.5	2.3	2.29
RPD Limit:	0-5	0-6	0-4	0-5

LCS #:	LCS102198	LCS102198	LCS102198	LCS102198
Prepared Date:	10/21/98	10/21/98	10/21/98	10/21/98
Analyzed Date:	10/21/98	10/21/98	10/21/98	10/21/98
Instrument I.D.#:	-	-	-	-
Conc. Spiked:	100 µg/L	100 µg/L	100 µg/L	300 µg/L
LCS Result:	92.7	93	92.9	284
LCS % Recov.:	92.7	93	92.9	94.7

MS/MSD	82-119	80-117	66-125	73-119
LCS	84-116	81-117	79-115	80-114
Control Limits				

SEQUOIA ANALYTICAL
Elap #2245

Mike Gregory
Project Manager

Please Note:

The LCS is a control sample of known, interferent-free matrix that is analyzed using the same reagents, preparation, and analytical methods employed for the samples. The matrix spike is an aliquot of sample fortified with known quantities of specific compounds and subjected to the entire analytical procedure. If the recovery of analytes from the matrix spike does not fall within specified control limits due to matrix interference, the LCS recovery is to be used to validate the batch.

** MS = Matrix Spike, MSD = MS Duplicate, RPD = Relative % Difference

9810A02.BLA <1>





Sequoia Analytical

680 Chesapeake Drive
404 N. Wiget Lane
819 Striker Avenue, Suite 8
1455 McDowell Blvd. North, Ste. D

Redwood City, CA 94063
Walnut Creek, CA 94598
Sacramento, CA 95834
Petaluma, CA 94954

(650) 364-9600
(925) 988-9600
(916) 921-9600
(707) 792-1865

FAX (650) 364-9233
FAX (925) 988-9673
FAX (916) 921-0100
FAX (707) 792-0342

Blaine Tech Services, Inc.
1680 Rogers Ave.
San Jose, CA 95112
Attention: Fran Thie

Client Project ID: Chevron 9-5607, 981013-T2
Matrix: Liquid

Work Order #: 9810A02-09-12

Reported: Nov 10, 1998

QUALITY CONTROL DATA REPORT

Analyte:	Benzene	Toluene	Ethyl Benzene	Xylenes
QC Batch#:	8100407	8100407	8100407	8100407
Analy. Method:	EPA 8020	EPA 8020	EPA 8020	EPA 8020
Prep. Method:	EPA 8015M	EPA 8015M	EPA 8015M	EPA 8015M

Analyst:	-	-	-	-
MS/MSD #:	P810281-01	P810281-01	P810281-01	P810281-01
Sample Conc.:	N.D.	N.D.	N.D.	N.D.
Prepared Date:	10/22/98	10/22/98	10/22/98	10/22/98
Analyzed Date:	10/22/98	10/22/98	10/22/98	10/22/98
Instrument I.D.#:	-	-	-	-
Conc. Spiked:	100 µg/L	100 µg/L	100 µg/L	300 µg/L
Result:	96.1	93.6	92.9	279
MS % Recovery:	96.1	93.6	92.9	92.8
Dup. Result:	98.7	96.1	95.2	286
MSD % Recov.:	98.7	96.1	95.2	95.2
RPD:	2.67	2.64	2.45	2.48
RPD Limit:	0-5	0-6	0-4	0-5

LCS #:	LCS102298	LCS102298	LCS102298	LCS102298
Prepared Date:	10/22/98	10/22/98	10/22/98	10/22/98
Analyzed Date:	10/22/98	10/22/98	10/22/98	10/22/98
Instrument I.D.#:	-	-	-	-
Conc. Spiked:	100 µg/L	100 µg/L	100 µg/L	300 µg/L
LCS Result:	97.4	92.8	91.3	281
LCS % Recov.:	97.4	92.8	91.3	93.7

MS/MSD	82-119	80-117	66-125	73-119
LCS	84-116	81-117	79-115	80-114
Control Limits				

SEQUOIA ANALYTICAL
Elap #2245

Mike Gregory
Project Manager

Please Note:

The LCS is a control sample of known, interferent-free matrix that is analyzed using the same reagents, preparation, and analytical methods employed for the samples. The matrix spike is an aliquot of sample fortified with known quantities of specific compounds and subjected to the entire analytical procedure. If the recovery of analytes from the matrix spike does not fall within specified control limits due to matrix interference, the LCS recovery is to be used to validate the batch.

** MS=Matrix Spike, MSD=MS Duplicate, RPD=Relative % Difference

9810A02.BLA <2>





**Sequoia
Analytical**

680 Chesapeake Drive
404 N. Wiget Lane
819 Striker Avenue, Suite 8
1455 McDowell Blvd. North, Ste. D

Redwood City, CA 94063
Walnut Creek, CA 94598
Sacramento, CA 95834
Petaluma, CA 94954

(650) 364-9600
(925) 988-9600
(916) 921-9600
(707) 792-1865

FAX (650) 364-9233
FAX (925) 988-9673
FAX (916) 921-0100
FAX (707) 792-0342

Blaine Tech Services, Inc.
1680 Rogers Ave.
San Jose, CA 95112
Attention: Fran Thie

Client Project ID: Chevron 9-5607, 981013-T2
Matrix: Liquid

Work Order #: 9810A02-01

Reported: Nov 10, 1998

QUALITY CONTROL DATA REPORT

Analyte: MTBE

QC Batch#: MS102298MTBEH6B

Analy. Method: EPA 8260

Prep. Method: N.A.

Analyst: T. Costello

MS/MSD #: 980911504

Sample Conc.: 31

Prepared Date: 10/22/98

Analyzed Date: 10/22/98

Instrument I.D.#: H6

Conc. Spiked: 50 µg/L

Result: 74

MS % Recovery: 86

Dup. Result: 76

MSD % Recov.: 90

RPD: 2.7

RPD Limit: 0-25

LCS #: LCS102298

Prepared Date: 10/22/98

Analyzed Date: 10/22/98

Instrument I.D.#: H6

Conc. Spiked: 50 µg/L

LCS Result: 45

LCS % Recov.: 90

MS/MSD 60-140

LCS 70-130

Control Limits

SEQUOIA ANALYTICAL

Mike Gregory
Project Manager

Please Note:

The LCS is a control sample of known, interferent-free matrix that is analyzed using the same reagents, preparation, and analytical methods employed for the samples. The matrix spike is an aliquot of sample fortified with known quantities of specific compounds and subjected to the entire analytical procedure. If the recovery of analytes from the matrix spike does not fall within specified control limits due to matrix interference, the LCS recovery is to be used to validate the batch.

** MS= Matrix Spike, MSD= MS Duplicate, RPD= Relative % Difference

9810A02.BLA <3>



Field Data Sheets

WELL GAUGING DATA

Project # 98D13-T2

Date 10/13/78

Client 9-5607

Site 5769 Crow Canyon Rd., Castro Valley, CA

Well ID	Well Size (in)	Sheen / Odor	Depth to Immiscible Liquid (ft)	Thickness of Immiscible Liquid (ft)	Volume of Immiscibles Removed (ml)	Depth to water (ft)	Depth to well bottom (ft)	Survey Point TOB or TOC
C-1	4	odor			✓	21.35	43.06	TOC
C-2	4				✓	18.97	44.68	}
C-3	4	odor			✓	17.60	31.81	
✓✓ C-5	4				✓	26.50	32.10	
C-6	4	odor			✓	15.46	30.06	
✓✓ C-7	2				✓	9.12	26.34	
C-8	2				✓	12.08	25.15	
C-9	4				✓	14.27	—	
C-10A	3				✓	18.68	22.71	
C-10B	3				✓	18.92	34.19	
C-11	3				✓	20.29	33.45	
C-12	3				✓	21.05	29.16	
C-13	3				✓	10.81	28.33	
C-14	3				✓	10.36	24.39	
C-15	3				✓	11.20	19.70	
C-16	3					12.15	30.04	

✓✓ = Possible check

CHEVRON WELL MONITORING DATA SHEET

Project #: 981013-T2	Station #: 9-5607
Sampler: MT	Date: 10/13
Well I.D.: C-1	Well Diameter: 2 3 4 6 8 <u> </u>
Total Well Depth: 43.00	Depth to Water: 21.35
Depth to Free Product:	Thickness of Free Product (feet):
Referenced to: PVC Grade	D.O. Meter (if req'd): YSI HACH

Well Diameter	Multiplier	Well Diameter	Multiplier
2"	0.16	5"	1.02
3"	0.37	6"	1.47
4"	0.65	Other	radius ² * 0.163

Purge Method:	Sampling Method:
<input type="checkbox"/> Bailer <input type="checkbox"/> Disposable Bailer <input type="checkbox"/> Middleburg <input checked="" type="checkbox"/> Electric Submersible <input type="checkbox"/> Extraction Pump Other: _____	<input type="checkbox"/> Bailer <input type="checkbox"/> Disposable Bailer & <input type="checkbox"/> Extraction Port Other: _____

<u>14.2</u>	x	<u>3</u>	=	<u>42.6</u>	Gals.
1 Case Volume (Gals.)		Specified Volumes		Calculated Volume	

Time	Temp (°F)	pH	Cond.	Gals. Removed	Observations
1239	69.3	6.7	1670	15	Strong odor, Slown
1242	69.4	6.5	1656	30	" " "
1245	69.9	6.5	1643	43	

Did well dewater? Yes <input checked="" type="checkbox"/> No <input type="checkbox"/>	Gallons actually evacuated: 43
Sampling Time: 1250	Sampling Date: 10/13
Sample I.D.: C-1	Laboratory: Sequoia GTEL N. Creek Assoc. Labs
Analyzed for: TPH-G BTEX MTBE TPH-D Other: 82100 (Oxygenates)	
Duplicate I.D.:	Analyzed for: TPH-G BTEX MTBE TPH-D Other:
D.O. (if req'd):	Pre-purge: <u> </u> mg/L Post-purge: <u> </u> mg/L
O.R.P. (if req'd):	Pre-purge: <u> </u> mV Post-purge: <u> </u> mV

CHEVRON WELL MONITORING DATA SHEET

Project #: 981013-T2	Station #: 9-5607
Sampler: MT	Date: 10/13
Well I.D.: C-3	Well Diameter: 2 3 4 6 8
Total Well Depth: 31.81	Depth to Water: 17.60
Depth to Free Product:	Thickness of Free Product (feet):
Referenced to: PVC Grade	D.O. Meter (if req'd): YSI HACH

Well Diameter	Multiplier	Well Diameter	Multiplier
2"	0.16	5"	1.02
3"	0.37	6"	1.47
4"	0.65	Other	radius ² * 0.163

Purge Method: Bailer Sampling Method: Bailer
 Disposable Bailer Disposable Bailer
 Middleburg Extraction Port
 Electric Submersible
 Extraction Pump Other: _____
 Other: _____

93	x	3	=	27.9	Gals.
1 Case Volume (Gals.)		Specified Volumes		Calculated Volume	

Time	Temp (°F)	pH	Cond.	Gals. Removed	Observations
1302	70.6	6.8	1636	10	Order
1304	70.4	6.7	1640	20	"
1305	70.2	6.7	1650	28	"

Did well dewater? Yes No Gallons actually evacuated: 28

Sampling Time: 1310 Sampling Date: 10/13

Sample I.D.: C-3 Laboratory: Sequoia GTEL N. Creek Assoc. Labs

Analyzed for: TPH-G BTEX MTBE TPH-D Other: _____

Duplicate I.D.: _____ Analyzed for: TPH-G BTEX MTBE TPH-D Other: _____

D.O. (if req'd):	Pre-purge:	mg/L	Post-purge:	mg/L
O.R.P. (if req'd):	Pre-purge:	mV	Post-purge:	mV

CHEVRON WELL MONITORING DATA SHEET

Project #: 981013-T2	Station #: 9-5607
Sampler: MT	Date: 10/13
Well I.D.: C-6	Well Diameter: 2 3 <input checked="" type="radio"/> 6 8 _____
Total Well Depth: 30.06	Depth to Water: 15.46
Depth to Free Product:	Thickness of Free Product (feet):
Referenced to: PVC Grade	D.O. Meter (if req'd): YSI HACH

Well Diameter	Multplier	Well Diameter	Multplier
2"	0.16	5"	1.02
3"	0.37	6"	1.47
4"	0.65	Other	radius ² * 0.163

Purge Method: <input type="checkbox"/> Bailer <input type="checkbox"/> Disposable Bailer <input type="checkbox"/> Middleburg <input checked="" type="checkbox"/> Electric Submersible <input type="checkbox"/> Extraction Pump Other: _____	Sampling Method: <input checked="" type="checkbox"/> Bailer <input checked="" type="checkbox"/> Disposable Bailer <input type="checkbox"/> Extraction Port Other: _____
--	--

<u>9.5</u>	\times	<u>3</u>	$=$	<u>28.5</u>	Gals.
1 Case Volume (Gals.)		Specified Volumes		Calculated Volume	

Time	Temp (°F)	pH	Cond.	Gals. Removed	Observations
1230	68.8	6.8	1660	10	
				12	
					Dewatered @
					DW = 19.27

Did well dewater?	<input checked="" type="checkbox"/> Yes	<input type="checkbox"/> No	Gallons actually evacuated: 12
Sampling Time: 1314	Sampling Date: 10/13		
Sample I.D.: C-6	Laboratory: Sequoia GTEL N. Creek Assoc. Labs		
Analyzed for: TPH-G BTEX MTBE TPH-D Other:			
Duplicate I.D.:	Analyzed for: TPH-G BTEX MTBE TPH-D Other:		
D.O. (if req'd):	Pre-purge:	mg/L	Post-purge: mg/L
O.R.P. (if req'd):	Pre-purge:	mV	Post-purge: mV

CHEVRON WELL MONITORING DATA SHEET

Project #: 981013-T2	Station #: 9-5L007
Sampler: MT	Date: 10/13
Well I.D.: C-8	Well Diameter: <u>2</u> 3 4 6 8 _____
Total Well Depth: 25.15	Depth to Water: 12.00
Depth to Free Product:	Thickness of Free Product (feet):
Referenced to: <u>PVC</u> Grade	D.O. Meter (if req'd): YSI HACH

Well Diameter	Multiplier	Well Diameter	Multiplier
2"	0.16	5"	1.02
3"	0.37	6"	1.47
4"	0.65	Other	radius ² * 0.163

Purge Method: Bailer Disposable Bailer <input checked="" type="checkbox"/> Middleburg Electric Submersible Extraction Pump Other: _____	Sampling Method: Bailer Disposable Bailer <input checked="" type="checkbox"/> Extraction Port Other: _____
--	---

21	x	3	=	6.3	Gals.
1 Case Volume (Gals.)		Specified Volumes		Calculated Volume	

Time	Temp (°F)	pH	Cond.	Gals. Removed	Observations
1059	66.9	7.6	920	2.25	
1103	66.5	7.6	896	4.5	
1107	66.3	7.6	871	6.5	

Did well dewater? Yes <input type="checkbox"/> No <input checked="" type="checkbox"/>	Gallons actually evacuated: 6.5
Sampling Time: 1111	Sampling Date: 10/13
Sample I.D.: C-8	Laboratory: <u>Sequoia</u> GTEL N. Creek Assoc. Labs
Analyzed for: <u>TPH-G BTEX MTBE</u> TPH-D Other:	
Duplicate I.D.:	Analyzed for: TPH-G BTEX MTBE TPH-D Other:
D.O. (if req'd):	Pre-purge: _____ mg/L Post-purge: _____ mg/L
O.R.P. (if req'd):	Pre-purge: _____ mV Post-purge: _____ mV

CHEVRON WELL MONITORING DATA SHEET

Project #: 981013-T2	Station #: 9-5L007
Sampler: MT	Date: 10/13
Well I.D.: C-9	Well Diameter: 2 3 4 6 8
Total Well Depth: —	Depth to Water: 14.27
Depth to Free Product:	Thickness of Free Product (feet):
Referenced to: <u>PVC</u> Grade	D.O. Meter (if req'd): YSI HACH

Well Diameter	Multiplier	Well Diameter	Multiplier
2"	0.16	5"	1.02
3"	0.37	6"	1.47
4"	0.65	Other	radius ² * 0.163

Purge Method: Bailer Disposable Bailer Middleburg Electric Submersible Extraction Pump Other: _____	Sampling Method: Bailer Disposable Bailer Extraction Port Other: _____
--	---

_____	X	_____	=	_____	Gals.
1 Case Volume (Gals.)		Specified Volumes		Calculated Volume	

Time	Temp (°F)	pH	Cond.	Gals. Removed	Observations
					- Extraction Pump in well. System is off, Unable to Remove Pump
					- Grab sample.
1215	16.1	7.4	1100		

Did well dewater?	Yes	No	Gallons actually evacuated: -
Sampling Time: 1215	Sampling Date: 10/13		
Sample I.D.: C-9	Laboratory: <u>Sequoia</u> GTEL N. Creek Assoc. Labs		
Analyzed for: <u>TPH-G BTEX MTBE</u> TPH-D	Other: _____		
Duplicate I.D.:	Analyzed for: TPH-G BTEX MTBE TPH-D Other: _____		
D.O. (if req'd):	Pre-purge:	mg/L	Post-purge: mg/L
O.R.P. (if req'd):	Pre-purge:	mV	Post-purge: mV

CHEVRON WELL MONITORING DATA SHEET

Project #: 981013-T2	Station #: 9-5607
Sampler: MT	Date: 10/13
Well I.D.: C-10A	Well Diameter: 2 ③ 4 6 8
Total Well Depth: 22.71	Depth to Water: 18.68
Depth to Free Product:	Thickness of Free Product (feet):
Referenced to: PVC Grade	D.O. Meter (if req'd): YSI HACH

Well Diameter	Multiplier	Well Diameter	Multiplier
2"	0.16	5"	1.02
3"	0.37	6"	1.47
4"	0.65	Other	radius ² * 0.163

Purge Method: Bailer Disposable Bailer <input checked="" type="checkbox"/> Middleburg Electric Submersible Extraction Pump Other: _____	Sampling Method: Bailer Disposable Bailer <input checked="" type="checkbox"/> Extraction Port Other: _____
--	---

1.5	x	3	=	4.5	Gals.
I Case Volume (Gals.)		Specified Volumes		Calculated Volume	

Time	Temp (°F)	pH	Cond.	Gals. Removed	Observations
1123	64.8	7.0	1081	1.5	
		Dewatered @	2.5	3	
				4.5	
		DTW = 20.17			

Did well dewater? Yes No Gallons actually evacuated: 2.5

Sampling Time: 1315 Sampling Date: 10/13

Sample I.D.: C-10A Laboratory: Sequoia GTEL N. Creek Assoc. Labs

Analyzed for: TPH-G BTEX MTBE TPH-D Other:

Duplicate I.D.: Analyzed for: TPH-G BTEX MTBE TPH-D Other:

D.O. (if req'd):	Pre-purge:	mg/L	Post-purge:	mg/L
O.R.P. (if req'd):	Pre-purge:	mV	Post-purge:	mV

CHEVRON WELL MONITORING DATA SHEET

Project #: <u>981013-T2</u>	Station #: <u>9-56007</u>
Sampler: <u>MT</u>	Date: <u>10/13</u>
Well I.D.: <u>C-10B</u>	Well Diameter: 2 <input checked="" type="radio"/> 4 <input type="radio"/> 6 <input type="radio"/> 8 <input type="radio"/> _____
Total Well Depth: <u>34.19</u>	Depth to Water: <u>18.92</u>
Depth to Free Product:	Thickness of Free Product (feet):
Referenced to: <u>PVC</u> Grade	D.O. Meter (if req'd): YSI HACH

Well Diameter	Multplier	Well Diameter	Multplier
2"	0.16	5"	1.02
3"	0.37	6"	1.47
4"	0.65	Other	radius ² * 0.163

Purge Method:	Sampling Method:
Bailer Disposable Bailer Middleburg Electric Submersible <input checked="" type="checkbox"/> Extraction Pump Other: _____	Bailer Disposable Bailer <input checked="" type="checkbox"/> Extraction Port Other: _____

<u>5.7</u>	x	<u>3</u>	=	<u>17.1</u> Gals.
1 Case Volume (Gals.)		Specified Volumes		Calculated Volume

Time	Temp (°F)	pH	Cond.	Gals. Removed	Observations
1144	<u>14.7</u>	<u>7.1</u>	<u>1037</u>	<u>6</u>	
				<u>10</u>	<u>Dewatered @</u>
					<u>DTW = 21.97</u>

Did well dewater? Yes No Gallons actually evacuated: 10

Sampling Time: 1313 Sampling Date: 10/13

Sample I.D.: C-10B Laboratory: Sequoia GTEL N. Creek Assoc. Labs

Analyzed for: TPH-G BTEX MTBE TPH-D Other:

Duplicate I.D.: Analyzed for: TPH-G BTEX MTBE TPH-D Other:

D.O. (if req'd):	Pre-purge:	mg/L	Post-purge:	mg/L
O.R.P. (if req'd):	Pre-purge:	mV	Post-purge:	mV

CHEVRON WELL MONITORING DATA SHEET

Project #: 981013-T2	Station #: 9-5607
Sampler: MT	Date: 10/13
Well I.D.: C-11	Well Diameter: 2 ③ 4 6 8 _____
Total Well Depth: 33.65	Depth to Water: 20.28
Depth to Free Product:	Thickness of Free Product (feet):
Referenced to: PVC Grade	D.O. Meter (if req'd): YSI HACH

Well Diameter	Multiplier	Well Diameter	Multiplier
2"	0.16	5"	1.02
3"	0.37	6"	1.47
4"	0.65	Other	radius ² * 0.163

Purge Method: Bailer Disposable Bailer Middleburg Electric Submersible <input checked="" type="checkbox"/> Extraction Pump Other: _____	Sampling Method: Bailer Disposable Bailer <input checked="" type="checkbox"/> Extraction Port Other: _____
--	---

5.0	x	3	=	15	Gals.
1 Case Volume (Gals.)		Specified Volumes		Calculated Volume	

Time	Temp (°F)	pH	Cond.	Gals. Removed	Observations
1134	60.1	6.5	1596	5	
				8	Dewatered @
					DTW = 23.96

Did well dewater? <input checked="" type="checkbox"/> Yes	No	Gallons actually evacuated: 8
Sampling Time: 1331	Sampling Date: 10/13	
Sample I.D.: C-11	Laboratory: Sequoia	GTEL N. Creek Assoc. Labs
Analyzed for: <input checked="" type="checkbox"/> TPH-G <input checked="" type="checkbox"/> BTEX <input checked="" type="checkbox"/> MTBE <input type="checkbox"/> TPH-D	Other:	
Duplicate I.D.:	Analyzed for: TPH-G BTEX MTBE TPH-D Other:	
D.O. (if req'd):	Pre-purge: _____ mg/L	Post-purge: _____ mg/L
O.R.P. (if req'd):	Pre-purge: _____ mV	Post-purge: _____ mV

CHEVRON WELL MONITORING DATA SHEET

Project #: 981013-T2	Station #: 9-5607
Sampler: MT	Date: 10/13
Well I.D.: C-12	Well Diameter: 2 @ 4 6 8 _____
Total Well Depth: 29.68	Depth to Water: 12.65
Depth to Free Product:	Thickness of Free Product (feet):
Referenced to: PVC Grade	D.O. Meter (if req'd): YSI HACH

Well Diameter	Multiplier	Well Diameter	Multiplier
2"	0.16	5"	1.02
3"	0.37	6"	1.47
4"	0.65	Other	radius ² * 0.163

Purge Method:	Sampling Method:
Bailer Disposable Bailer Middleburg Electric Submersible <input checked="" type="checkbox"/> Extraction Pump Other: _____	Bailer Disposable Bailer Extraction Port Other: _____

<u>6.3</u>	\times	<u>3</u>	$=$	<u>18.9</u>	Gals.
1 Case Volume (Gals.)		Specified Volumes		Calculated Volume	

Time	Temp (°F)	pH	Cond.	Gals. Removed	Observations
1208	66.0	7.0	1122	7	Strong Odor
		Dewatered @		9	
		DTW = 16.99			

Did well dewater? Yes No	Gallons actually evacuated: 9
Sampling Time: 1338	Sampling Date: 10/13
Sample I.D.: C-12	Laboratory: Sequoia GTEL N. Creek Assoc. Labs
Analyzed for: TPH-G BTEX MTBE TPH-D Other:	
Duplicate I.D.:	Analyzed for: TPH-G BTEX MTBE TPH-D Other:
D.O. (if req'd):	Pre-purge: _____ mg/L Post-purge: _____ mg/L
O.R.P. (if req'd):	Pre-purge: _____ mV Post-purge: _____ mV

CHEVRON WELL MONITORING DATA SHEET

Project #: 981013-T2	Station #: 9-5607
Sampler: MT	Date: 10/13
Well I.D.: C15	Well Diameter: 2 3 4 6 8
Total Well Depth: 19.70	Depth to Water: 11.20
Depth to Free Product:	Thickness of Free Product (feet):
Referenced to: <u>PVC</u> Grade	D.O. Meter (if req'd): YSI HACH

Well Diameter	Multiplier	Well Diameter	Multiplier
2"	0.16	5"	1.02
3"	0.37	6"	1.47
4"	0.65	Other	radius ² * 0.163

Purge Method: Bailer Disposable Bailer <input checked="" type="checkbox"/> Middleburg Electric Submersible Extraction Pump Other: _____	Sampling Method: Bailer Disposable Bailer <input checked="" type="checkbox"/> Extraction Port Other: _____
--	---

3.2	X	3	=	9.6	Gals.
1 Case Volume (Gals.)		Specified Volumes		Calculated Volume	

Time	Temp (°F)	pH	Cond.	Gals. Removed	Observations
1159	66.9	7.1	1296	3.25	
		Dewatered		6.0	
	DTW = 14.68				

Did well dewater? Yes No Gallons actually evacuated: 6.0

Sampling Time: 1324 Sampling Date: 10/13

Sample I.D.: C15 Laboratory: Sequoia GTEL N. Creek Assoc. Labs

Analyzed for: TPH-G BTEX MTBE TPH-D Other:

Duplicate I.D.: Analyzed for: TPH-G BTEX MTBE TPH-D Other:

D.O. (if req'd):	Pre-purge:	mg/L	Post-purge:	mg/L
------------------	------------	------	-------------	------

O.R.P. (if req'd):	Pre-purge:	mV	Post-purge:	mV
--------------------	------------	----	-------------	----

CHEVRON WELL MONITORING DATA SHEET

Project #: 991013-T2	Station #: 9-56007
Sampler: MT	Date: 10/13
Well I.D.: C-16	Well Diameter: 2 <input checked="" type="radio"/> 4 <input type="radio"/> 6 <input type="radio"/> 8 <input type="checkbox"/>
Total Well Depth: 30.64	Depth to Water: 12.75
Depth to Free Product:	Thickness of Free Product (feet):
Referenced to: PVC Grade	D.O. Meter (if req'd): YSI <input type="checkbox"/> HACH <input type="checkbox"/>

Well Diameter	Multiplier	Well Diameter	Multiplier
2"	0.16	5"	1.02
3"	0.37	6"	1.47
4"	0.65	Other	radius ² * 0.163

Purge Method: <input type="checkbox"/> Bailer <input type="checkbox"/> Disposable Bailer <input type="checkbox"/> Middleburg <input type="checkbox"/> Electric Submersible <input type="checkbox"/> Extraction Pump Other: <input checked="" type="checkbox"/>	Sampling Method: <input type="checkbox"/> Bailer <input type="checkbox"/> Disposable Bailer <input type="checkbox"/> Extraction Port Other: _____
---	--

<u>6.7</u>	x	<u>3</u>	=	<u>20.1</u>	Gals.
1 Case Volume (Gals.)		Specified Volumes		Calculated Volume	

Time	Temp (°F)	pH	Cond.	Gals. Removed	Observations
1026	68.6	7.3	1220	6.75	
1035	69.0	7.3	1200	13.5	
1043	70.3	7.3	1198	20.25	

Did well dewater? Yes <input checked="" type="checkbox"/>	Gallons actually evacuated: 20.25	
Sampling Time: 1050	Sampling Date: 10/13	
Sample I.D.: C-16	Laboratory: Sequoia GTEL N. Creek Assoc. Labs	
Analyzed for: TPH-G BTEX MTBE TPH-D Other:		
Duplicate I.D.: Analyzed for: TPH-G BTEX MTBE TPH-D Other:		
D.O. (if req'd):	Pre-purge: <input type="checkbox"/> mg/L	Post-purge: <input type="checkbox"/> mg/L
O.R.P. (if req'd):	Pre-purge: <input type="checkbox"/> mV	Post-purge: <input type="checkbox"/> mV



AIR TOXICS LTD.

AN ENVIRONMENTAL ANALYTICAL LABORATORY

180 BLUE RAVINE ROAD, SUITE B
FOLSOM, CA 95630-4719
(916) 985-1000 FAX: (916) 985-1020

CHAIN-OF-CUSTODY RECORD

No. 016028

Page 1 of 1

Contact Person Tim Utterback
 Company Weiss Associates
 Address 5500 Shellmound St City Emeryville State Ca Zip 94608
 Phone 510 450-6193 FAX 510 547-5043
 Collected By: Signature William L. McConibe

Project info:
 P.O. # 4-1129-73
 Project # 4-1129-73
 Project Name Chevron CVI

Turn Around Time:
 Normal
 Rush _____
 Specify _____

Lab I.D.	Field Sample I.D.	Date & Time	Analyses Requested	Canister Pressure / Vacuum		
				Initial	Final	Receipt
01N	SV-9 @ 3'	7/30/98 10:40	Benzene, Toluene, Ethylbenzene, Xylene by EPA Method TO-14	< 30" Hg	0" Hg	0.275
02N	SV-10 @ 3'	7/30/98 10:21				0.475
03N	SV-11 @ 3'	7/30/98 12:34				0.275
04N	SV-12 @ 6'	7/30/98 11:10				0.475
05N	SV-13 @ 6.5'	7/30/98 11:41				0.775
06N	SV-14 @ 6'	7/30/98 12:16				0.775
07N	SV-15 @ 6'	7/30/98 12:58				0.775
08N	SV-16 @ 6'	7/30/98 13:25				0.275
						0.275

Relinquished By: (Signature) William L. McConibe Date/Time 8/17/98 16:49 Print Name William L. McConibe
 Relinquished By: (Signature) _____ Date/Time _____ Received By: (Signature) [Signature] Date/Time 8/19/98 9:57
 Relinquished By: (Signature) _____ Date/Time _____ Received By: (Signature) _____ Date/Time _____

Notes:

Lab Use Only

Shipper Name Fed Ex Air Bill # 4324759773 Opened By: [Signature] Date/Time 8/19/98 Temp. (°C) Ambient Condition Good Custody Seals Intact? Yes Work Order # 9808015