



Chevron

Chevron U.S.A. Products Company
6001 Bollinger Canyon Rd. Bldg. L
P. O. Box 6004
San Ramon, CA 94583-0804

**Site Assessment and
Remediation Group**
Phone (510) 842-9500
Fax (510) 842-8370

Date: August 12, 1998
To: Distribution
Re: **Groundwater Monitoring Report**

The enclosed groundwater monitoring report has been properly reviewed by a Chevron authorized representative. Agency guidelines have been followed. Blaine Tech Services is authorized to distribute the report directly to interested parties.

If you have any questions, please call me at (510) 842-8695.

Sincerely,

Brett Hunter
Site Assessment and Remediation
Project Manager

ENVIRONMENTAL
PROTECTION

98 AUG 13 PM 2:41

BLAINE
TECH SERVICES INC.



1680 ROGERS AVENUE
SAN JOSE, CALIFORNIA 95112
(408) 573-7771 FAX
(408) 573-0555 PHONE

August 12, 1998

Brett Hunter
Chevron U.S.A. Products Company
P.O. Box 6004
San Ramon, CA 94583-0904

3rd Quarter 1998 Monitoring at 9-5607

Third Quarter 1998 Groundwater Monitoring at
Chevron Service Station Number 9-5607
5269 Crow Canyon Road
Castro Valley, CA

Monitoring Performed on July 8, 1998

Groundwater Sampling Report 980708-C-1

This report covers the routine monitoring of groundwater wells at this Chevron facility. Blaine Tech Services, Inc.'s work at the site includes inspection, gauging, evacuation, purgewater containment, sample collection and sample handling in accordance with standard procedures that conform to Regional Water Quality Control Board requirements.

Routine field data collection includes depth to water, total well depth, thickness of any separate immiscible layer, water column volume, calculated volume of a three-case volume purge, elapsed evacuation time, total volume of water removed, and standard water parameter instrument readings. Sample material is collected, contained, stored, and transported to the laboratory in conformance with EPA standards. Purgewater is, likewise, collected and transported to McKittrick Waste Treatment Site for disposal.

Basic field information is presented alongside analytical values excerpted from the laboratory report in the cumulative table of **WELL DATA AND ANALYTICAL RESULTS**. The full analytical report for the most recent samples is located in the **Analytical Appendix**. The table also contains new groundwater elevation calculations taken from the computer plotted gradient map which is located in the **Professional Engineering Appendix**.

At a minimum, Blaine Tech Services, Inc. field personnel are certified upon completion of a forty-hour Hazardous Materials and Emergency Response training course per 29 CFR 1910.120. Field personnel are also enrolled in annual eight hour refresher courses.

Blaine Tech Services, Inc. conducts sampling and documentation assignments of this type as an independent third party. In order to avoid compromising the objectivity necessary for the proper and disinterested performance of this work, Blaine Tech Services, Inc. concentrates on objective data collection and does not participate in the interpretation of analytical results, the definition of geological or hydrological conditions, the formulation of recommendations, or the marketing of remedial systems.

Please call if you have any questions.

Yours truly,

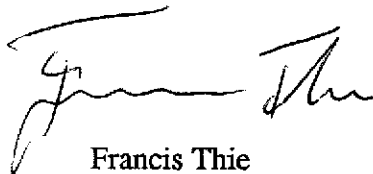
A handwritten signature in black ink, appearing to read "Francis Thie". The signature is fluid and cursive, with a large initial "F" and a long horizontal stroke.

Francis Thie
Vice President

FPT/ap

attachments: Professional Engineering Appendix
Cumulative Table of Well Data and Analytical Results
Analytical Appendix
Field Data Sheets

cc: Scott Seery, Alameda County Environmental Health
Kevin Hinckley
Diane Riggs, Forest Creek Townhomes Assoc.
Tim Utterback, Weiss Associates
Bette Owen, Chevron (w/o enclosure)



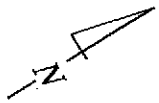

Professional Engineering Appendix

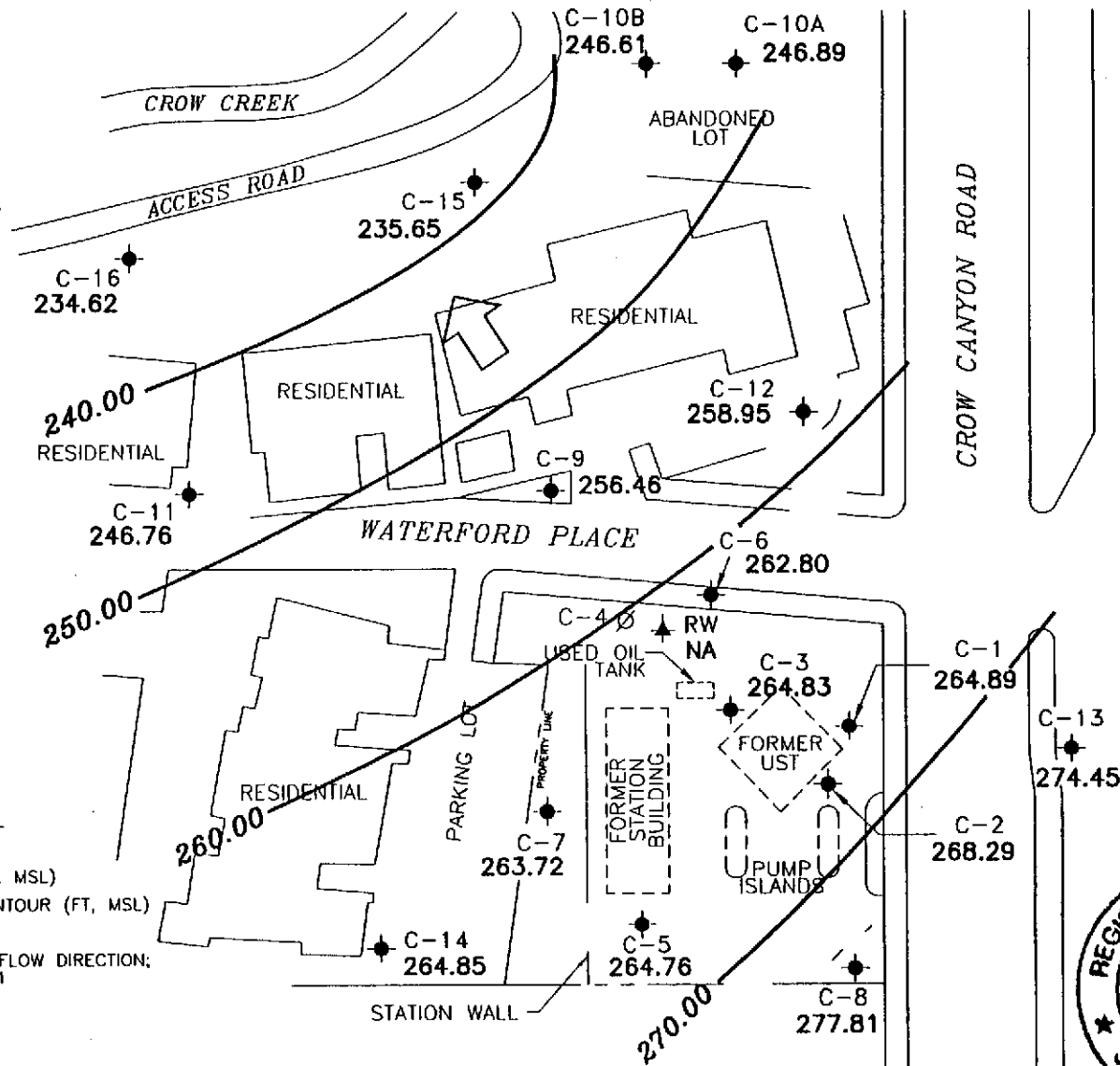
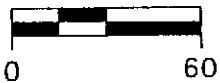

SCALE (ft)

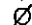

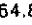
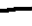
EXPLANATION

-  MONITORING WELL
-  ABANDONED MONITORING WELL
-  RECOVERY WELL
-  GROUNDWATER ELEVATION (FT, MSL)
-  GROUNDWATER ELEVATION CONTOUR (FT, MSL)
-  NA
-  APPROXIMATE GROUNDWATER FLOW DIRECTION;
APPROXIMATE GRADIENT = 0.1

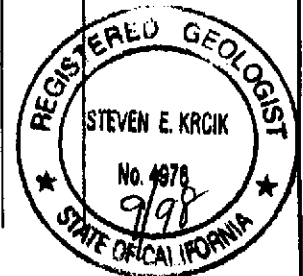

Basemap from Cambria Environmental Technology, Inc.

PREPARED BY



Chevron Station 9-5607
5269 Crow Canyon Road
Castro Valley, California

GROUNDWATER ELEVATION
CONTOUR MAP, JULY 8, 1998

FIGURE:
1
PROJECT:
DAC04

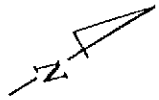

SCALE (ft)

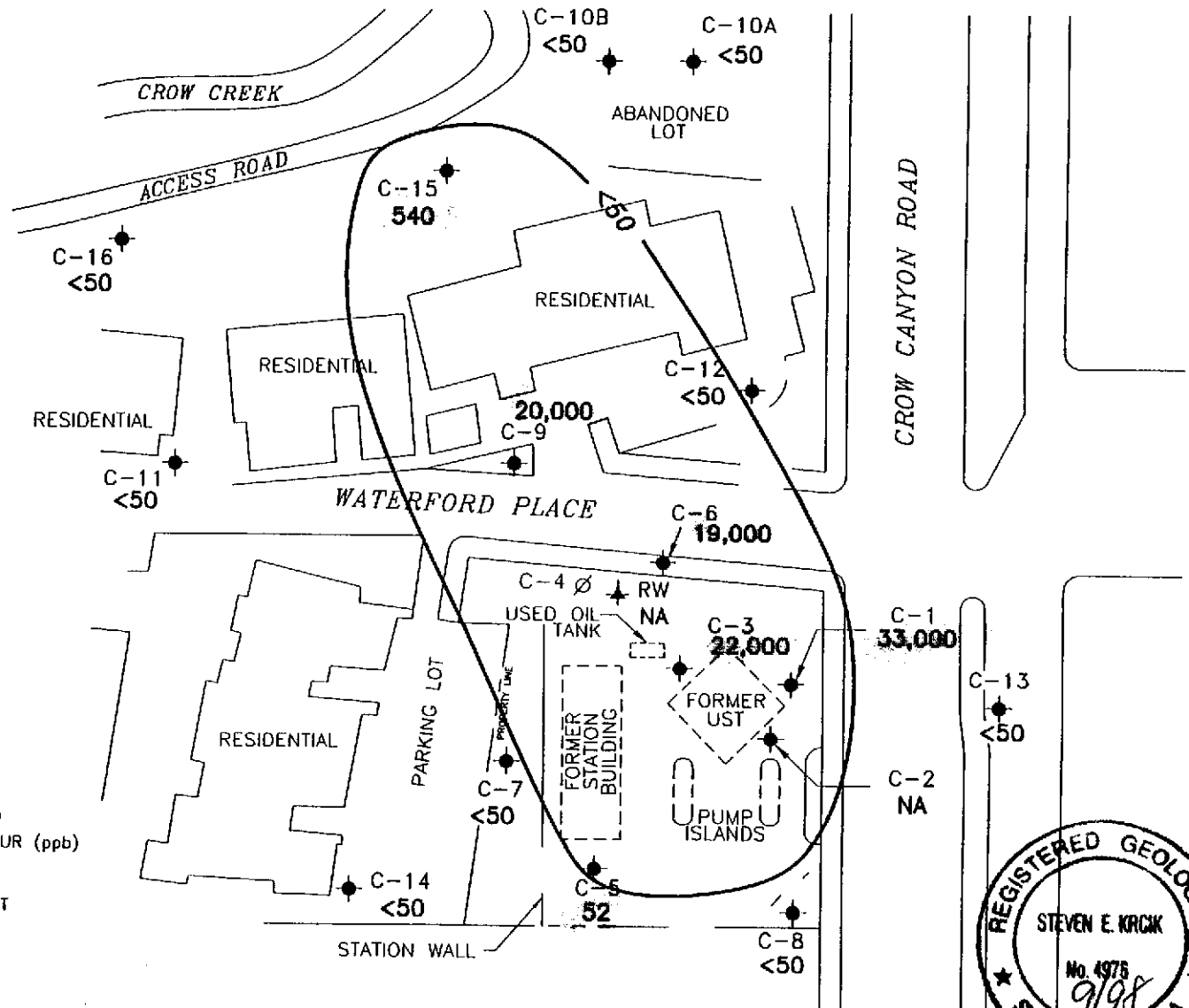
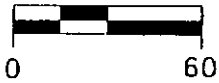

EXPLANATION

- MONITORING WELL
- ABANDONED MONITORING WELL
- RECOVERY WELL
- <50 TPH-g CONCENTRATIONS (ppb)
- <50 ——— TPH-g CONCENTRATION CONTOUR (ppb)
- NA DATA NOT AVAILABLE

NOTE: CONTOURS BASED ON CURRENT AND HISTORIC DATA.

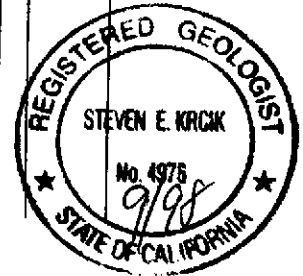

Basemap from Cambrio Environmental Technology, Inc.

PREPARED BY



Chevron Station 9-5607
5269 Crow Canyon Road
Castro Valley, California

TPH-GASOLINE CONCENTRATION IN
GROUNDWATER, JULY 8, 1998

FIGURE:
2
PROJECT:
DAC04

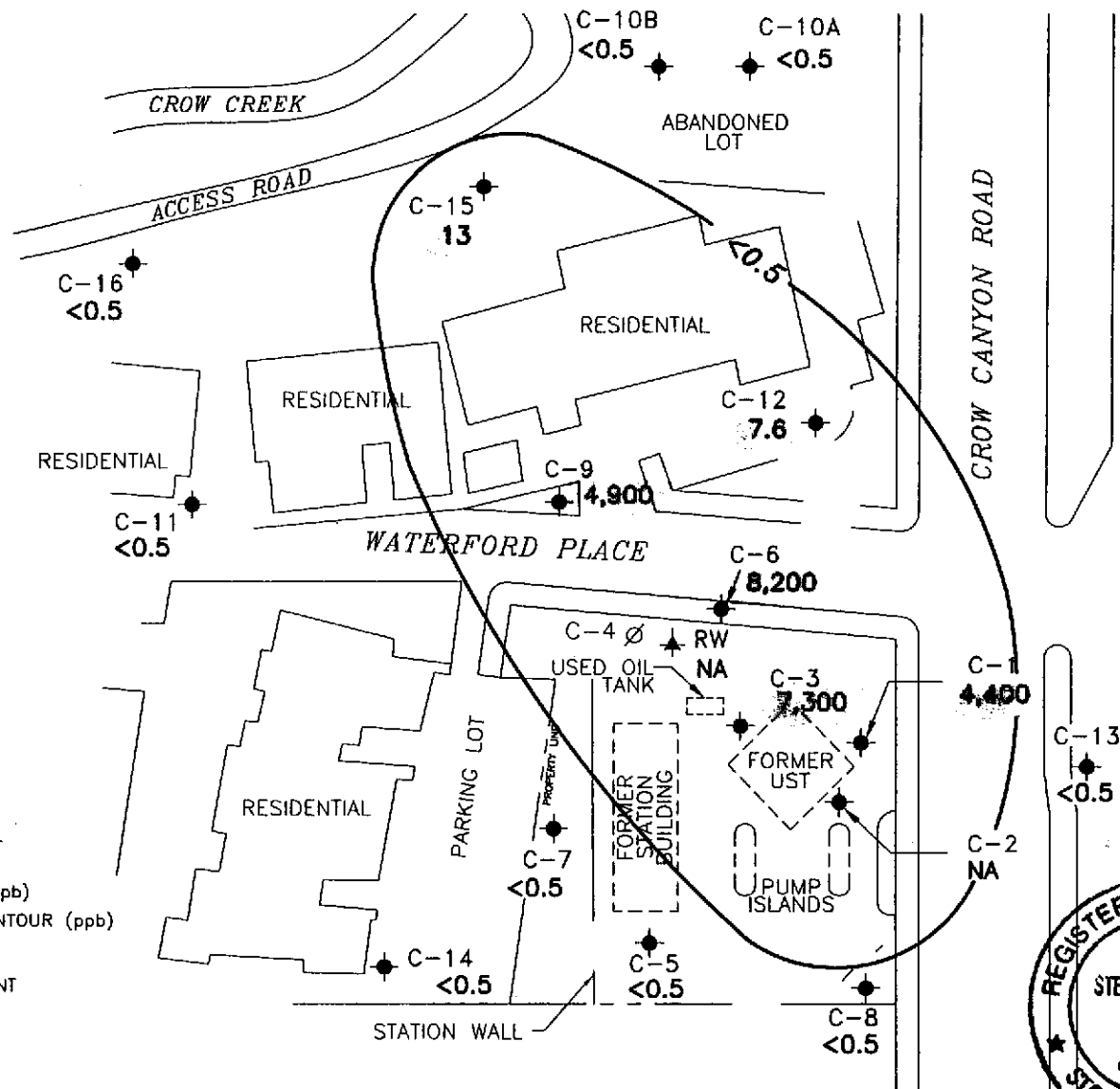
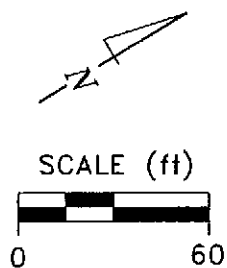

- EXPLANATION**
- ◆ MONITORING WELL
 - ∅ ABANDONED MONITORING WELL
 - ★ RECOVERY WELL
 - <0.5 BENZENE CONCENTRATIONS (ppb)
 - BENZENE CONCENTRATION CONTOUR (ppb)
 - NA DATA NOT AVAILABLE
- NOTE: CONTOURS BASED ON CURRENT AND HISTORIC DATA.

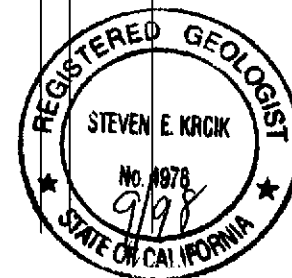

Basemap from Cambria Environmental Technology, Inc.

PREPARED BY

RRM
engineering contracting firm

Chevron Station 9-5607
5269 Crow Canyon Road
Castro Valley, California

BENZENE CONCENTRATION IN
GROUNDWATER, JULY 8, 1998

FIGURE:
3
PROJECT:
DAC04

Table of Well Data and Analytical Results

Cumulative Table of Well Data and Analytical Results

Vertical Measurements are in feet.

Volumetric Measurements are in gallons.

Analytical results are in parts per billion (ppb)

DATE	Well Head Elev.	Ground Water Elev.	Depth To Water	SPH Thickness	SPH Removed	Total SPH Removed	Notes	TPH-Gasoline	Benzene	Toluene	Ethyl-Benzene	Xylene	MTBE	Organic Lead
C-1														
03/26/85	283.46	260.63	22.83	--	--	--	--	--	--	--	--	--	--	--
07/03/86	283.46	259.88	23.58	--	--	--	--	--	--	--	--	--	--	--
03/26/87	283.46	262.96	20.50	--	--	--	--	--	--	--	--	--	--	--
03/28/88	283.46	257.46	26.00	--	--	--	--	--	--	--	--	--	--	--
03/10/89	283.46	267.60	15.86	--	--	--	--	--	--	--	--	--	--	--
04/03/89	283.46	266.61	16.85	--	--	--	--	--	--	--	--	--	--	--
05/08/89	283.46	260.78	22.68	--	--	--	--	--	--	--	--	--	--	--
06/05/89	283.46	258.80	24.66	--	--	--	--	--	--	--	--	--	--	--
07/12/90	283.46	257.90	25.56	--	--	--	--	--	--	--	--	--	--	--
08/10/90	283.46	257.57	25.89	--	--	--	--	--	--	--	--	--	--	--
09/13/89	283.46	256.91	26.55	--	--	--	--	22,000	3600	1100	1000	3500	--	--
10/04/89	283.46	258.22	25.24	--	--	--	--	--	--	--	--	--	--	--
11/03/89	283.46	258.43	25.03	--	--	--	--	--	--	--	--	--	--	--
12/04/89	283.46	257.09	26.37	--	--	--	--	13,000	2000	550	610	1600	--	--
03/07/90	283.46	260.98	22.48	--	--	--	--	--	--	--	--	--	--	--
03/09/90	283.46	--	--	--	--	--	--	--	--	--	--	--	--	--
06/12/90	283.46	259.11	24.35	--	--	--	--	21,000	3500	1400	840	4000	--	--
09/20/90	283.46	257.19	26.27	--	--	--	--	23,000	2100	1200	860	5000	--	--
12/20/90	283.46	260.87	22.59	--	--	--	--	8200	760	410	260	1100	--	--
03/27/91	283.46	264.38	19.08	--	--	--	--	--	--	--	--	--	--	--
06/18/91	283.46	256.35	27.11	--	--	--	--	--	--	--	--	--	--	--
09/12/91	283.46	255.24	28.22	--	--	--	--	--	--	--	--	--	--	--
01/23/92	283.46	256.81	26.65	--	--	--	--	--	--	--	--	--	--	--
04/13/92	283.46	261.30	22.16	--	--	--	--	--	--	--	--	--	--	--
08/03/92	283.46	257.31	26.15	--	--	--	--	38,000	3100	1300	850	3100	--	--
10/22/92	283.46	256.67	26.79	--	--	--	--	13,000	1300	470	550	1600	--	ND
01/18/93	283.46	264.86	18.60	--	--	--	--	24,000	3500	1400	1500	4300	--	--
04/19/93	283.46	262.34	21.12	--	--	--	--	370,000	6900	8900	3100	23,000	--	--
07/21,22/93	283.46	260.18	23.28	--	--	--	--	51,000	8000	7000	1400	10,000	--	--
10/25/93	283.46	258.80	24.66	--	--	--	--	22,000	3400	1000	990	3100	--	--
01/21/94	283.46	262.99	20.47	--	--	--	--	14,000	2000	550	790	2300	--	--
04/18/94	283.46	260.36	23.10	--	--	--	--	1100	350	6.0	3.0	15	--	--
07/06-07/94	283.46	260.56	22.90	--	--	--	--	24,000	3200	1000	1000	3100	--	--
10/07/94	283.46	258.75	24.71	--	--	--	--	65,000	6500	4200	1600	9300	--	--
01/11/95	283.46	265.16	18.30	--	--	--	--	27,000	5100	1200	1400	4300	--	--
04/24/95	283.46	266.52	16.94	--	--	--	--	29,000	1300	1200	930	4000	--	--
07/31/95	283.46	262.90	20.56	--	--	--	--	75,000	8900	5000	1700	8400	--	--
10/02/95	283.46	272.88	10.58	--	--	--	--	56,000	11,000	2600	2500	11,000	--	--
								44,000	7900	1100	2100	6500	--	--

CONTINUED ON NEXT PAGE

Cumulative Table of Well Data and Analytical Results

Vertical Measurements are in feet.

Analytical results are in parts per billion (ppb)

DATE	Well Head Elev.	Ground Water Elev.	Depth To Water	SPH Thickness	SPH Removed	Total SPH Removed	Notes	TPH-Gasoline	Benzene	Toluene	Ethyl-Benzene	Xylene	MTBE	Organic Lead
C-1 (CONT'D)														
01/16/96	283.46	261.71	21.75	--	--	--	--	29,000	5300	460	1000	2800	<500	--
04/18/96	283.46	264.51	18.95	--	--	--	--	59,000	7100	3000	2000	7600	<250	--
07/22/96	283.46	262.46	21.00	--	--	--	--	26,000	6100	610	1800	4700	<250	--
10/10/96	283.46	261.46	22.00	--	--	--	--	24,000	7100	600	1700	3200	<250	--
01/09/97	283.46	268.05	15.41	--	--	--	--	32,000	4600	820	1500	4000	670	--
04/15/97	283.46	264.12	19.34	--	--	--	--	100,000	11,000	4500	3200	13,000	1700	--
04/15/97	283.46	264.12	19.34	--	--	--	Confirmation run	--	--	--	--	--	<200	--
07/08/97	283.46	263.68	19.78	--	--	--	--	42,000	5500	880	2000	4800	920	--
10/22/97	283.46	265.13	18.33	--	--	--	--	29,000	5200	970	1800	4200	740	--
01/12/98	283.46	271.81	11.65	--	--	--	--	31,000	2700	960	2100	5700	<1000	--
04/21/98	283.46	271.17	12.29	--	--	--	--	60,000	3300	2100	3100	10,000	1400	--
07/08/98	283.46	264.89	18.57	--	--	--	--	33,000	4400	1500	2800	8200	<250	--

Cumulative Table of Well Data and Analytical Results

Vertical Measurements are in feet.

Analytical results are in parts per billion (ppb)

DATE	Well Head Elev.	Ground Water Elev.	Depth To Water	SPH Thickness	SPH Removed	Total SPH Removed	Notes	TPH-Gasoline	Benzene	Toluene	Ethyl-Benzene	Xylene	MTBE	Organic Lead
C-2														
03/26/85	284.37	--	--	--	--	--	--	--	--	--	--	--	--	--
07/03/86	284.37	264.68	19.69	--	--	--	--	--	--	--	--	--	--	--
03/26/87	284.37	268.92	15.45	--	--	--	--	--	--	--	--	--	--	--
03/28/88	284.37	263.45	20.92	--	--	--	--	--	--	--	--	--	--	--
03/10/89	284.37	271.57	12.80	--	--	--	--	--	--	--	--	--	--	--
04/03/89	284.37	270.11	14.26	--	--	--	--	--	--	--	--	--	--	--
05/08/89	284.37	265.95	18.42	--	--	--	--	--	--	--	--	--	--	--
06/05/89	284.37	264.28	20.09	--	--	--	--	--	--	--	--	--	--	--
07/12/90	284.37	263.58	20.79	--	--	--	--	--	--	--	--	--	--	--
08/10/90	284.37	262.97	21.40	--	--	--	--	--	--	--	--	--	--	--
09/13/89	284.37	262.51	21.86	--	--	--	--	320	62	4.0	10	14	--	--
10/04/89	284.37	264.48	19.89	--	--	--	--	--	--	--	--	--	--	--
11/03/89	284.37	263.61	20.76	--	--	--	--	--	--	--	--	--	--	--
12/04/89	284.37	263.55	20.82	--	--	--	--	1000	240	37	66	130	--	--
03/07/90	284.37	266.54	17.83	--	--	--	--	--	--	--	--	--	--	--
03/09/90	284.37	266.54	17.83	--	--	--	--	390	280	35	27	50	--	--
06/12/90	284.37	264.48	19.89	--	--	--	--	700	260	34	28	55	--	--
09/20/90	284.37	262.40	21.97	--	--	--	--	--	--	--	--	--	--	--
12/20/90	284.37	266.64	17.73	--	--	--	--	--	--	--	--	--	--	--
03/27/91	284.37	269.27	15.10	--	--	--	--	--	--	--	--	--	--	--
06/18/91	284.37	261.69	22.68	--	--	--	--	--	--	--	--	--	--	--
09/12/91	284.37	260.45	23.92	--	--	--	--	--	--	--	--	--	--	--
01/23/92	284.37	263.13	21.24	--	--	--	--	--	--	--	--	--	--	--
04/13/92	284.37	266.83	17.54	--	--	--	--	1100	120	76	17	72	--	--
08/03/92	284.37	262.32	22.05	--	--	--	--	--	--	--	--	--	--	--
10/22/92	284.37	261.34	23.03	--	--	--	--	--	--	--	--	--	--	--
01/18/93	284.37	269.51	14.86	--	--	--	--	70	6.4	ND	ND	ND	--	--
04/19/93	284.37	267.57	16.80	--	--	--	--	--	--	--	--	--	--	--
07/21, 22/93	284.37	265.12	19.25	--	--	--	--	--	--	--	--	--	--	--
10/25/93	284.37	264.72	19.65	--	--	--	--	--	--	--	--	--	--	--
01/21/94	284.37	258.80	25.57	--	--	--	--	43,000	5100	1800	2000	6800	--	--
04/18/94	284.37	274.61	9.76	--	--	--	--	--	--	--	--	--	--	--
07/06-07/94	284.37	265.61	18.76	--	--	--	--	--	--	--	--	--	--	--
10/07/94	284.37	264.20	20.17	--	--	--	--	--	--	--	--	--	--	--
01/11/95	284.37	270.33	14.04	--	--	--	Sampled annually	780	290	9.1	19	58	--	--
04/24/95	284.37	272.03	12.34	--	--	--	--	--	--	--	--	--	--	--
07/31/95	284.37	266.82	17.55	--	--	--	--	--	--	--	--	--	--	--
10/02/95	284.37	265.39	18.98	--	--	--	--	--	--	--	--	--	--	--

CONTINUED ON NEXT PAGE

Cumulative Table of Well Data and Analytical Results

Vertical Measurements are in feet.

Analytical results are in parts per billion (ppb)

DATE	Well Head Elev.	Ground Water Elev.	Depth To Water	SPH Thickness	SPH Removed	Total SPH Removed	Notes	TPH-Gasoline	Benzene	Toluene	Ethyl-Benzene	Xylene	MTBE	Organic Lead
C-2 (CONT'D)														
01/16/96	284.37	268.37	16.00	--	--	--	--	260	29	2.9	5.7	21	6.1	--
04/18/96	284.37	270.47	13.90	--	--	--	--	--	--	--	--	--	--	--
07/22/96	284.37	266.63	17.74	--	--	--	--	--	--	--	--	--	--	--
10/10/96	284.37	265.46	18.91	--	--	--	--	--	--	--	--	--	--	--
01/09/97	284.37	271.62	12.75	--	--	--	--	460	25	15	72	24	6.3	--
04/15/97	284.37	268.32	16.05	--	--	--	--	--	--	--	--	--	--	--
07/08/97	284.37	267.95	16.42	--	--	--	--	--	--	--	--	--	--	--
10/22/97	284.37	268.95	15.42	--	--	--	--	--	--	--	--	--	--	--
01/12/98	284.37	272.85	11.52	--	--	--	--	280	22	1.4	5.3	1.2	13	--
04/21/98	284.37	274.22	10.15	--	--	--	--	--	--	--	--	--	--	--
07/08/98	284.37	268.29	16.08	--	--	--	--	--	--	--	--	--	--	--

Cumulative Table of Well Data and Analytical Results

Vertical Measurements are in feet.

Analytical results are in parts per billion (ppb)

DATE	Well Head Elev.	Ground Water Elev.	Depth To Water	SPH Thickness	SPH Removed	Total SPH Removed	Notes	TPH-Gasoline	Benzene	Toluene	Ethyl-Benzene	Xylene	MTBE	Organic Lead
C-3														
03/26/85	285.98	--	--	--	--	--	--	--	--	--	--	--	--	--
07/03/86	285.98	259.94	26.04	--	--	--	--	--	--	--	--	--	--	--
03/26/87	285.98	260.34	25.64	--	--	--	--	--	--	--	--	--	--	--
03/28/88	285.98	257.16	28.82	--	--	--	--	--	--	--	--	--	--	--
03/10/89	285.98	263.20	22.78	--	--	--	--	--	--	--	--	--	--	--
04/03/89	285.98	263.27	22.71	--	--	--	--	--	--	--	--	--	--	--
05/08/89	285.98	260.03	25.95	--	--	--	--	--	--	--	--	--	--	--
06/05/89	285.98	258.36	27.62	--	--	--	--	--	--	--	--	--	--	--
07/12/90	285.98	257.69	28.29	--	--	--	--	--	--	--	--	--	--	--
08/10/90	285.98	257.52	28.46	--	--	--	--	--	--	--	--	--	--	--
09/13/89	285.98	256.65	29.33	--	--	--	--	60,000	1400	6800	2300	10,000	--	--
10/04/89	285.98	257.01	28.97	--	--	--	--	--	--	--	--	--	--	--
11/03/89	285.98	257.26	28.72	--	--	--	--	--	--	--	--	--	--	--
12/04/89	285.98	256.97	29.01	--	--	--	--	56,000	1300	3300	1400	2700	--	--
03/07/90	285.98	258.29	27.69	--	--	--	--	--	--	--	--	--	--	--
03/09/90	285.98	258.29	27.69	--	--	--	--	42,000	1100	5700	1600	7900	--	--
06/12/90	285.98	257.89	28.09	--	--	--	--	160,000	1400	7100	3400	16,000	--	--
09/24/90	285.98	256.80	29.18	--	--	--	--	53,000	850	7700	2000	10,000	--	--
12/20/90	285.98	257.71	28.27	--	--	--	--	520	1200	5400	5400	33,000	--	--
03/27/91	285.98	261.18	24.80	--	--	--	--	92,000	1300	3100	1200	11,000	--	--
06/18/91	285.98	255.14	30.84	--	--	--	--	--	--	--	--	--	--	--
09/12/91	285.98	254.34	31.64	0.03	--	--	--	--	--	--	--	--	--	--
01/23/92	285.98	255.46	30.52	--	--	--	Sheen	--	--	--	--	--	--	--
04/13/92	285.98	259.04	26.94	0.01	--	--	--	--	--	--	--	--	--	--
08/03/92	285.98	255.98	30.00	--	--	--	--	220,000	1300	2800	3100	17,000	--	ND
10/22/92	285.98	255.38	30.62	0.03	--	--	--	--	--	--	--	--	--	--
01/18/93	285.98	262.07	23.91	--	--	--	--	1,000,000	2400	5300	10,000	61,000	--	--
04/19/93	285.98	260.98	25.00	--	--	--	--	94,000	33,000	22,000	1600	9200	--	--
07/21,22/93	285.98	259.43	26.55	--	--	--	--	44,000	2600	5500	1300	6900	--	--
10/25/93	285.98	257.26	28.72	--	--	--	--	35,000	3900	2400	1100	6600	--	--
01/21/94	285.98	256.32	29.66	--	--	--	--	120,000	4200	2200	2000	11,000	--	--
04/18/94	285.98	259.24	26.74	--	--	--	--	29,000	1200	310	520	2000	--	--
07/06-07/94	285.98	259.62	26.36	--	--	--	--	84,000	2700	1400	1400	9700	--	--
10/07/94	285.98	257.49	28.49	--	--	--	--	40,000	1600	390	1200	6100	--	--
01/11/95	285.98	262.84	23.14	--	--	--	--	34,000	4200	910	720	3800	--	--
04/24/95	285.98	266.10	19.88	--	--	--	--	210,000	43,000	28,000	2400	13,000	--	--
07/31/95	285.98	261.30	24.68	--	--	--	--	110,000	33,000	17,000	2300	12,000	--	--
10/02/95	285.98	258.84	27.14	--	--	--	--	69,000	6700	4000	2000	11,000	--	--

CONTINUED ON NEXT PAGE

Cumulative Table of Well Data and Analytical Results

Vertical Measurements are in feet.

Analytical results are in parts per billion (ppb)

DATE	Well Head Elev.	Ground Water Elev.	Depth To Water	SPH Thickness	SPH Removed	Total SPH Removed	Notes	TPH-Gasoline	Benzene	Toluene	Ethyl-Benzene	Xylene	MTBE	Organic Lead
C-3 (CONT'D)														
01/16/96	285.98	261.60	24.38	--	--	--	--	40,000	2400	440	1200	5500	<500	--
04/18/96	285.98	265.31	20.67	--	--	--	--	66,000	26,000	17,000	2200	12,000	<1250	--
07/22/96	285.98	261.32	24.66	--	--	--	--	69,000	21,000	8800	1800	9900	<1000	--
10/10/96	285.98	260.75	25.23	--	--	--	--	53,000	12,000	2600	1900	9300	<500	--
01/09/97	285.98	267.74	18.24	--	--	--	--	73,000	17,000	6000	1700	7800	<1250	--
04/15/97	285.98	263.96	22.02	--	--	--	--	160,000	28,000	17,000	2600	12,000	<2500	--
07/08/97	285.98	263.02	22.96	0.03	--	--	--	--	--	--	--	--	--	--
10/22/97	285.98	264.08	21.90	--	--	--	--	59,000	13,000	5200	2100	11,000	1500	--
01/12/98	285.98	277.93	8.05	--	--	--	--	62,000	10,000	4100	1700	8000	1000	--
04/21/98	285.98	270.70	15.28	--	--	--	--	70,000	13,000	5800	1600	7100	<1000	--
07/08/98	285.98	264.83	21.15	--	--	--	--	22,000	7300	2100	560	2900	<25	--

Cumulative Table of Well Data and Analytical Results

Vertical Measurements are in feet.

Analytical results are in parts per billion (ppb)

DATE	Well Head Elev.	Ground Water Elev.	Depth To Water	SPH Thickness	SPH Removed	Total SPH Removed	Notes	TPH-Gasoline	Benzene	Toluene	Ethyl-Benzene	Xylene	MTBE	Organic Lead
C-4														
03/26/85	273.01	257.87	15.14	--	--	--	--	--	--	--	--	--	--	--
07/03/86	273.01	257.64	15.37	--	--	--	--	--	--	--	--	--	--	--
03/26/87	273.01	--	--	--	--	--	--	--	--	--	--	--	--	--
03/28/88	273.01	254.97	18.04	--	--	--	--	--	--	--	--	--	--	--
03/10/89	273.01	--	--	--	--	--	--	--	--	--	--	--	--	--
04/03/89	273.01	259.67	13.34	--	--	--	--	--	--	--	--	--	--	--
05/08/89	273.01	257.41	15.60	--	--	--	--	--	--	--	--	--	--	--
06/05/89	273.01	256.50	16.51	--	--	--	--	--	--	--	--	--	--	--
07/12/90	273.01	256.02	16.99	--	--	--	--	--	--	--	--	--	--	--
08/10/90	273.01	255.74	17.27	--	--	--	--	--	--	--	--	--	--	--
09/13/89	273.01	254.85	18.16	--	--	--	--	57,000	21,000	3100	3200	11,000	--	--
10/04/89	273.01	254.77	18.24	--	--	--	--	--	--	--	--	--	--	--
11/03/89	273.01	254.84	18.17	--	--	--	--	--	--	--	--	--	--	--
12/04/89	273.01	254.56	18.45	--	--	--	--	48,000	17,000	2200	2800	9800	--	--
03/07/90	273.01	255.81	17.20	--	--	--	--	--	--	--	--	--	--	--
03/09/90	273.01	255.81	17.20	--	--	--	--	43,000	20,000	2300	2800	11,000	--	--
06/12/90	273.01	256.35	16.66	--	--	--	--	82,000	21,000	2400	4000	16,000	--	--
09/24/90	273.01	254.90	18.11	--	--	--	--	--	--	--	--	--	--	--
12/20/90	273.01	--	--	--	--	--	Abandoned	--	--	--	--	--	--	--

Cumulative Table of Well Data and Analytical Results

Vertical Measurements are in feet.

Analytical results are in parts per billion (ppb)

DATE	Well Head Elev.	Ground Water Elev.	Depth To Water	SPH Thickness	SPH Removed	Total SPH Removed	Notes	TPH-Gasoline	Benzene	Toluene	Ethyl-Benzene	Xylene	MTBE	Organic Lead
C-5														
03/26/85	287.95	262.62	25.33	--	--	--	--	--	--	--	--	--	--	--
07/03/86	287.95	261.54	26.41	--	--	--	--	--	--	--	--	--	--	--
03/26/87	287.95	262.99	24.96	--	--	--	--	--	--	--	--	--	--	--
03/28/88	287.95	258.15	29.80	--	--	--	--	--	--	--	--	--	--	--
03/10/89	287.95	262.06	25.89	--	--	--	--	--	--	--	--	--	--	--
04/03/89	287.95	263.57	24.38	--	--	--	--	--	--	--	--	--	--	--
05/08/89	287.95	260.15	27.80	--	--	--	--	--	--	--	--	--	--	--
06/05/89	287.95	258.53	29.42	--	--	--	--	--	--	--	--	--	--	--
07/12/90	287.95	258.09	29.86	--	--	--	--	--	--	--	--	--	--	--
08/10/90	287.95	258.18	29.77	--	--	--	--	--	--	--	--	--	--	--
09/13/89	287.95	257.00	30.95	--	--	--	--	310	ND	ND	ND	ND	--	--
10/04/89	287.95	256.47	31.48	--	--	--	--	--	--	--	--	--	--	--
11/03/89	287.95	256.63	31.32	--	--	--	--	--	--	--	--	--	--	--
12/04/89	287.95	256.25	31.70	--	--	--	--	ND	ND	ND	ND	ND	--	--
03/07/90	287.95	257.67	30.28	--	--	--	--	--	--	--	--	--	--	--
03/09/90	287.95	257.67	30.28	--	--	--	--	ND	ND	ND	ND	ND	--	--
06/12/90	287.95	257.47	30.48	--	--	--	--	90	ND	ND	ND	ND	--	--
09/24/90	287.95	256.17	31.78	--	--	--	--	ND	ND	ND	ND	ND	--	--
12/20/90	287.95	254.66	33.29	--	--	--	--	170	ND	ND	1.0	0.7	--	--
03/27/91	287.95	259.97	27.98	--	--	--	--	--	--	--	--	--	--	--
06/18/91	287.95	255.43	32.52	--	--	--	--	--	--	--	--	--	--	--
09/12/91	287.95	254.58	33.37	--	--	--	--	--	--	--	--	--	--	--
01/23/92	287.95	255.28	32.67	--	--	--	--	--	--	--	--	--	--	--
04/13/92	287.95	259.47	28.48	--	--	--	--	140	ND	ND	0.7	ND	--	--
08/03/92	287.95	255.45	32.50	--	--	--	--	ND	ND	ND	ND	ND	--	ND
10/22/92	287.95	253.97	33.98	--	--	--	--	--	--	--	--	--	--	--
01/18/93	287.95	260.93	27.02	--	--	--	--	230	6.6	2.2	3.4	2.2	--	--
04/19/93	287.95	263.14	24.81	--	--	--	--	--	--	--	--	--	--	--
07/21,22/93	287.95	258.89	29.06	--	--	--	--	130	ND	0.6	ND	ND	--	--
10/25/93	287.95	257.00	30.95	--	--	--	--	--	--	--	--	--	--	--
01/21/94	287.95	256.04	31.91	--	--	--	--	ND	ND	ND	ND	ND	--	--
04/18/94	287.95	257.80	30.15	--	--	--	--	--	--	--	--	--	--	--
07/06-07/94	287.95	258.91	29.04	--	--	--	--	ND	ND	ND	ND	ND	--	--
10/07/94	287.95	256.11	31.84	--	--	--	--	--	--	--	--	--	--	--
01/11/95	287.95	262.97	24.98	--	--	--	Sampled biannually	700	1.1	6.0	1.5	2.1	--	--
04/24/95	287.95	266.17	21.78	--	--	--	--	--	--	--	--	--	--	--
07/31/95	287.95	--	--	--	--	--	Inaccessible	--	--	--	--	--	--	--
10/02/95	287.95	257.77	30.18	--	--	--	--	--	--	--	--	--	--	--

CONTINUED ON NEXT PAGE

Cumulative Table of Well Data and Analytical Results

Vertical Measurements are in feet.

Analytical results are in parts per billion (ppb)

DATE	Well Head Elev.	Ground Water Elev.	Depth To Water	SPH Thickness	SPH Removed	Total SPH Removed	Notes	TPH-Gasoline	Benzene	Toluene	Ethyl-Benzene	Xylene	MTBE	Organic Lead
C-5 (CONT'D)														
01/16/96	287.95	261.23	26.72	--	--	--	--	200	<0.5	<0.5	<0.5	1.3	<2.5	--
04/18/96	287.95	266.15	21.80	--	--	--	--	--	--	--	--	--	--	--
07/22/96	287.95	--	--	--	--	--	Inaccessible	--	--	--	--	--	--	--
10/10/96	287.95	261.17	26.78	--	--	--	--	--	--	--	--	--	--	--
01/09/97	287.95	268.93	19.02	--	--	--	--	190	0.63	<0.5	<0.5	<0.5	<2.5	--
04/15/97	287.95	264.64	23.31	--	--	--	--	--	--	--	--	--	--	--
07/08/97	287.95	--	--	--	--	--	Inaccessible	--	--	--	--	--	--	--
10/22/97	287.95	--	--	--	--	--	Inaccessible	--	--	--	--	--	--	--
01/12/98	287.95	269.37	18.58	--	--	--	--	200	1.1	0.57	1.3	2.5	<2.5	--
04/21/98	287.95	272.75	15.20	--	--	--	--	--	--	--	--	--	--	--
07/08/98	287.95	264.76	23.19	--	--	--	--	52*	<0.5	<0.5	<0.5	<0.5	<2.5	--

* Chromatogram pattern indicates an unidentified hydrocarbon.

Cumulative Table of Well Data and Analytical Results

Vertical Measurements are in feet.

Analytical results are in parts per billion (ppb)

DATE	Well Head Elev.	Ground Water Elev.	Depth To Water	SPH Thickness	SPH Removed	Total SPH Removed	Notes	TPH-Gasoline	Benzene	Toluene	Ethyl-Benzene	Xylene	MTBE	Organic Lead
C-6														
03/26/85	--	--	16.74	--	--	--	--	--	--	--	--	--	--	--
07/03/86	275.28	257.82	17.46	--	--	--	--	--	--	--	--	--	--	--
03/26/87	275.28	256.91	18.37	--	--	--	--	--	--	--	--	--	--	--
03/28/88	275.28	245.44	29.84	--	--	--	--	--	--	--	--	--	--	--
03/10/89	275.28	260.84	14.44	--	--	--	--	--	--	--	--	--	--	--
04/03/89	275.28	260.84	14.44	--	--	--	--	--	--	--	--	--	--	--
05/08/89	275.28	258.12	17.16	--	--	--	--	--	--	--	--	--	--	--
06/05/89	275.28	256.77	18.51	--	--	--	--	--	--	--	--	--	--	--
07/12/90	275.28	256.57	18.71	--	--	--	--	--	--	--	--	--	--	--
08/10/90	275.28	255.96	19.32	--	--	--	--	--	--	--	--	--	--	--
09/13/89	275.28	255.33	19.95	--	--	--	--	47	5600	3000	2400	10,000	--	--
10/04/89	275.28	255.41	19.87	--	--	--	--	--	--	--	--	--	--	--
11/03/89	275.28	255.93	19.35	--	--	--	--	--	--	--	--	--	--	--
12/04/89	275.28	255.69	19.59	--	--	--	--	40,000	8100	1800	1700	7500	--	--
03/07/90	275.28	256.89	18.39	--	--	--	--	--	--	--	--	--	--	--
03/09/90	275.28	256.89	18.39	--	--	--	--	73,000	23,000	5900	3400	17,000	--	--
06/12/90	275.28	256.41	18.87	--	--	--	--	85,000	19,000	6500	3400	16,000	--	--
09/24/90	275.28	255.29	19.99	--	--	--	--	72,000	15,000	3200	2600	11,000	--	--
12/20/90	275.28	253.71	21.57	--	--	--	--	100,000	11,000	4200	3400	16,000	--	--
03/27/91	275.28	258.96	16.32	--	--	--	--	100,000	11,000	4400	2300	11,000	--	--
06/18/91	275.28	251.95	23.33	--	--	--	--	--	--	--	--	--	--	--
09/12/91	275.28	251.32	23.96	--	--	--	--	--	--	--	--	--	--	--
01/23/92	275.28	263.20	12.08	--	--	--	--	--	--	--	--	--	--	--
04/13/92	275.28	255.43	19.85	--	--	--	Sheen	--	--	--	--	--	--	--
08/03/92	275.28	260.56	14.72	--	--	--	--	120,000	16,000	1100	2300	15,000	--	ND
10/22/92	275.28	260.37	14.91	--	--	--	--	63,000	7400	920	1800	14,000	--	--
01/18/93	275.28	259.84	15.44	--	--	--	--	77,000	13,000	1600	2700	12,000	--	--
04/19/93	275.28	266.03	9.25	--	--	--	--	56,000	14,000	1100	2400	9100	--	--
07/21,22/93	275.28	257.93	17.35	--	--	--	--	38,000	6600	610	1500	5800	--	--
10/25/93	275.28	254.25	21.03	--	--	--	--	42,000	11,000	800	2200	8200	--	--
01/21/94	275.28	253.71	21.57	--	--	--	--	57,000	11,000	940	2300	9800	--	--
04/18/94	275.28	257.17	18.11	--	--	--	--	48,000	9800	830	1900	7500	--	--
07/06-07/94	275.28	258.28	17.00	--	--	--	--	46,000	6800	610	900	6200	--	--
10/07/94	275.28	256.09	19.19	--	--	--	--	35,000	5900	410	1400	3800	--	--
01/11/95	275.28	256.64	18.64	--	--	--	--	54,000	1200	1100	2100	9500	--	--
04/24/95	275.28	262.72	12.56	--	--	--	--	81,000	12,000	1500	2400	9900	--	--
07/31/95	275.28	259.54	15.74	--	--	--	--	75,000	12,000	1200	2800	11,000	--	--
10/02/95	275.28	257.56	17.72	--	--	--	--	59,000	13,000	990	2800	10,000	--	--

CONTINUED ON NEXT PAGE

Cumulative Table of Well Data and Analytical Results

Vertical Measurements are in feet.

Analytical results are in parts per billion (ppb)

DATE	Well Head Elev.	Ground Water Elev.	Depth To Water	SPH Thickness	SPH Removed	Total SPH Removed	Notes	TPH-Gasoline	Benzene	Toluene	Ethyl-Benzene	Xylene	MTBE	Organic Lead
C-6 (CONT'D)														
01/16/96	275.28	259.81	15.47	--	--	--	--	63,000	10,000	650	2200	7500	<500	--
04/18/96	275.28	259.33	15.95	--	--	--	--	56,000	9800	590	1500	5800	660	--
07/22/96	275.28	--	--	--	--	--	Inaccessible	--	--	--	--	--	--	--
10/10/96	275.28	--	--	--	--	--	Inaccessible	--	--	--	--	--	--	--
01/09/97	275.28	--	--	--	--	--	Inaccessible	--	--	--	--	--	--	--
04/15/97	275.28	--	--	--	--	--	Inaccessible	--	--	--	--	--	--	--
07/08/97	275.28	--	--	--	--	--	Inaccessible	--	--	--	--	--	--	--
07/15/97	275.28	260.95	14.33	--	--	--	--	64,000	12,000	400	1500	4400	<1000	--
10/22/97	275.28	261.80	13.48	--	--	--	--	49,000	15,000	570	1900	5600	1500	--
01/12/98	275.28	265.14	10.14	--	--	--	--	60,000	16,000	540	1800	5400	<1000	--
04/21/98	275.28	267.73	7.55	--	--	--	--	51,000	16,000	310	1400	3400	<1000	--
07/08/98	275.28	262.80	12.48	--	--	--	--	19,000	8200	150	720	1100	<250	--

Cumulative Table of Well Data and Analytical Results

Vertical Measurements are in feet.

Analytical results are in parts per billion (ppb)

DATE	Well Head Elev.	Ground Water Elev.	Depth To Water	SPH Thickness	SPH Removed	Total SPH Removed	Notes	TPH-Gasoline	Benzene	Toluene	Ethyl-Benzene	Xylene	MTBE	Organic Lead
C-7														
03/26/85	--	--	9.61	--	--	--	--	--	--	--	--	--	--	--
07/03/86	270.70	259.96	10.74	--	--	--	--	--	--	--	--	--	--	--
03/26/87	270.70	260.62	10.08	--	--	--	--	--	--	--	--	--	--	--
03/28/88	270.70	256.91	13.79	--	--	--	--	--	--	--	--	--	--	--
03/10/89	270.70	260.28	10.42	--	--	--	--	--	--	--	--	--	--	--
04/03/89	270.70	261.56	9.14	--	--	--	--	--	--	--	--	--	--	--
05/08/89	270.70	258.79	11.91	--	--	--	--	--	--	--	--	--	--	--
06/05/89	270.70	259.16	11.54	--	--	--	--	--	--	--	--	--	--	--
07/12/90	270.70	257.25	13.45	--	--	--	--	--	--	--	--	--	--	--
08/10/90	270.70	257.33	13.37	--	--	--	--	--	--	--	--	--	--	--
09/13/89	270.70	256.10	14.60	--	--	--	--	410	1.3	ND	10	ND	--	--
10/04/89	270.70	255.53	15.17	--	--	--	--	--	--	--	--	--	--	--
11/03/89	270.70	255.42	15.28	--	--	--	--	--	--	--	--	--	--	--
12/04/89	270.70	255.00	15.70	--	--	--	--	1000	1.0	ND	5.0	ND	--	--
03/07/90	270.70	256.48	14.22	--	--	--	--	--	--	--	--	--	--	--
03/09/90	270.70	256.48	14.22	--	--	--	--	590	2.8	2.4	3.5	2.0	--	--
06/12/90	270.70	256.52	14.18	--	--	--	--	1200	ND	5	8.2	3.2	--	--
09/24/90	270.70	255.26	15.44	--	--	--	Sheen Duplicate	400	1.4	1.9	1.4	2.2	--	--
09/24/90	270.70	255.26	15.44	--	--	--		580	ND	2.4	1.4	1.5	--	--
12/20/90	270.70	253.62	17.08	--	--	--	--	2300	ND	6.5	4.7	9.3	--	--
03/27/91	270.70	258.05	12.65	--	--	--	--	980	ND	2.4	9.1	3.0	--	--
06/18/91	270.70	254.26	16.44	--	--	--	--	--	--	--	--	--	--	--
09/12/91	270.70	253.65	17.05	--	--	--	--	1200	ND	3.1	6.5	2.7	--	--
01/23/92	270.70	253.78	16.92	--	--	--	--	--	--	--	--	--	--	--
04/13/92	270.70	257.70	13.00	--	--	--	--	830	ND	1.0	7.8	1.2	--	--
08/03/92	270.70	--	--	--	--	--	--	--	--	--	--	--	--	--
10/22/92	270.70	--	--	--	--	--	Could not locate	--	--	--	--	--	--	--
01/18/93	270.70	--	--	--	--	--	Could not locate	--	--	--	--	--	--	--
04/19/93	270.70	--	--	--	--	--	Could not locate	--	--	--	--	--	--	--
07/21,22/93	270.70	257.76	12.94	--	--	--	--	890	0.9	3.0	4.0	4.0	--	--
10/25/93	270.70	255.87	14.83	--	--	--	--	--	--	--	--	--	--	--
01/21/94	270.70	254.76	15.94	--	--	--	--	660	ND	6.0	1.0	3.0	--	--
04/18/94	270.70	255.72	14.98	--	--	--	--	--	--	--	--	--	--	--
07/06-07/94	270.70	257.76	12.94	--	--	--	--	960	ND	5.8	4.2	8.2	--	--
10/07/94	270.70	254.87	15.83	--	--	--	--	--	--	--	--	--	--	--
01/11/95	270.70	261.45	9.25	--	--	--	Sampled biannually	900	<0.5	<0.5	2.3	1.3	--	--
04/24/95	270.70	264.00	6.70	--	--	--	--	--	--	--	--	--	--	--

CONTINUED ON NEXT PAGE

Cumulative Table of Well Data and Analytical Results

Vertical Measurements are in feet.

Analytical results are in parts per billion (ppb)

DATE	Well Head Elev.	Ground Water Elev.	Depth To Water	SPH Thickness	SPH Removed	Total SPH Removed	Notes	TPH-Gasoline	Benzene	Toluene	Ethyl-Benzene	Xylene	MTBE	Organic Lead	
C-7 (CONT'D)															
07/31/95	270.70	259.46	11.24	--	--	--	--	690	<1.2	<1.2	<1.2	<1.2	--	--	
10/02/95	270.70	256.68	14.02	--	--	--	--	--	--	--	--	--	--	--	
01/16/96	270.70	259.48	11.22	--	--	--	--	<50	<0.5	<0.5	<0.5	<0.5	<2.5	--	
04/18/96	270.70	264.05	6.65	--	--	--	--	--	--	--	--	--	--	--	
07/22/96	270.70	259.60	11.10	--	--	--	--	360	4.4	2.0	<0.5	<0.5	17	--	
10/10/96	270.70	259.35	11.35	--	--	--	--	--	--	--	--	--	--	--	
01/09/97	270.70	266.82	3.88	--	--	--	--	69	<0.5	<0.5	<0.5	<0.5	<2.5	--	
04/15/97	270.70	262.82	7.88	--	--	--	--	--	--	--	--	--	--	--	
07/08/97	270.70	261.70	9.00	--	--	--	--	710	8.0	1.2	<0.5	<0.5	22	--	
10/22/97	270.70	262.09	8.61	--	--	--	--	--	--	--	--	--	--	--	
01/12/98	270.70	267.03	3.67	--	--	--	--	400	7.2	<1.0	1.6	1.3	16	--	
04/21/98	270.70	270.19	0.51	--	--	--	--	--	--	--	--	--	--	--	
07/08/98	270.70	263.72	6.98	--	--	--	--	<50	<0.5	<0.5	<0.5	<0.5	<2.5	--	

Cumulative Table of Well Data and Analytical Results

Vertical Measurements are in feet.

Analytical results are in parts per billion (ppb)

DATE	Well Head Elev.	Ground Water Elev.	Depth To Water	SPH Thickness	SPH Removed	Total SPH Removed	Notes	TPH-Gasoline	Benzene	Toluene	Ethyl-Benzene	Xylene	MTBE	Organic Lead
C-8														
03/26/85	--	--	8.68	--	--	--	--	--	--	--	--	--	--	--
07/03/86	288.40	274.51	13.89	--	--	--	--	--	--	--	--	--	--	--
03/26/87	288.40	282.39	6.01	--	--	--	--	--	--	--	--	--	--	--
03/28/88	288.40	277.74	10.66	--	--	--	--	--	--	--	--	--	--	--
03/10/89	288.40	281.79	6.61	--	--	--	--	--	--	--	--	--	--	--
04/03/89	288.40	281.94	6.46	--	--	--	--	--	--	--	--	--	--	--
05/08/89	288.40	279.43	8.97	--	--	--	--	--	--	--	--	--	--	--
06/05/89	288.40	277.52	10.88	--	--	--	--	--	--	--	--	--	--	--
07/12/90	288.40	276.25	12.15	--	--	--	--	--	--	--	--	--	--	--
08/10/90	288.40	275.94	12.46	--	--	--	--	--	--	--	--	--	--	--
09/13/89	288.40	275.62	12.78	--	--	--	--	ND	ND	ND	ND	ND	--	--
10/04/89	288.40	275.89	12.51	--	--	--	--	--	--	--	--	--	--	--
11/03/89	288.40	273.77	14.63	--	--	--	--	--	--	--	--	--	--	--
12/04/89	288.40	278.81	9.59	--	--	--	--	64	0.6	0.6	ND	1.0	--	--
03/07/90	288.40	279.60	8.80	--	--	--	--	--	--	--	--	--	--	--
03/09/90	288.40	279.60	8.80	--	--	--	--	ND	ND	ND	ND	ND	--	--
06/12/90	288.40	279.46	8.94	--	--	--	--	120	2.5	1.2	1.0	1.4	--	--
09/24/90	288.40	274.86	13.54	--	--	--	--	--	--	--	--	--	--	--
12/20/90	288.40	279.07	9.33	--	--	--	--	--	--	--	--	--	--	--
03/27/91	288.40	282.30	6.10	--	--	--	--	54	0.7	ND	0.7	1.9	--	--
06/18/91	288.40	276.44	11.96	--	--	--	--	--	--	--	--	--	--	--
09/12/91	288.40	274.80	13.60	--	--	--	--	ND	ND	ND	ND	ND	--	--
09/12/91	288.40	274.80	13.60	--	--	--	Duplicate	ND	ND	ND	ND	ND	--	--
01/23/92	288.40	264.20	24.20	--	--	--	--	--	--	--	--	--	--	--
04/13/92	288.40	280.05	8.35	--	--	--	--	ND	ND	ND	ND	ND	--	--
08/03/92	288.40	275.82	12.58	--	--	--	--	ND	ND	ND	ND	ND	--	ND
10/22/92	288.40	275.30	13.10	--	--	--	--	ND	ND	ND	ND	ND	--	--
01/18/93	288.40	282.28	6.12	--	--	--	--	ND	ND	ND	ND	ND	--	--
04/19/93	288.40	281.35	7.05	--	--	--	--	ND	ND	ND	ND	ND	--	--
07/21,22/93	288.40	277.05	11.35	--	--	--	--	ND	ND	ND	ND	ND	--	--
10/25/93	288.40	275.55	12.85	--	--	--	--	ND	ND	ND	ND	ND	--	--
01/21/94	288.40	277.85	10.55	--	--	--	--	ND	ND	ND	ND	ND	--	--
04/18/94	288.40	278.89	9.51	--	--	--	--	ND	1.2	0.9	ND	1.6	--	--
07/06-07/94	288.40	277.02	11.38	--	--	--	--	ND	ND	ND	ND	ND	--	--
10/07/94	288.40	275.48	12.92	--	--	--	--	ND	ND	ND	ND	ND	--	--
01/11/95	288.40	283.04	5.36	--	--	--	--	<50	<0.5	<0.5	<0.5	<0.5	--	--
04/24/95	288.40	281.82	6.58	--	--	--	--	<50	<0.5	0.61	<0.5	0.51	--	--

CONTINUED ON NEXT PAGE

Cumulative Table of Well Data and Analytical Results

Vertical Measurements are in feet.

Analytical results are in parts per billion (ppb)

DATE	Well Head Elev.	Ground Water Elev.	Depth To Water	SPH Thickness	SPH Removed	Total SPH Removed	Notes	TPH-Gasoline	Benzene	Toluene	Ethyl-Benzene	Xylene	MTBE	Organic Lead	
C-8 (CONT'D)															
07/31/95	288.40	278.94	9.46	--	--	--	--	<50	<0.5	<0.5	<0.5	<0.5	--	--	
10/02/95	288.40	276.56	11.84	--	--	--	--	<50	<0.5	<0.5	<0.5	<0.5	--	--	
01/16/96	288.40	281.40	7.00	--	--	--	--	<50	<0.5	<0.5	<0.5	<0.5	5.4	--	
04/18/96	288.40	281.77	6.63	--	--	--	--	<50	<0.5	<0.5	<0.5	<0.5	<2.5	--	
07/22/96	288.40	280.49	7.91	--	--	--	--	<50	<0.5	<0.5	<0.5	<0.5	<2.5	--	
10/10/96	288.40	279.71	8.69	--	--	--	--	<50	<0.5	<0.5	<0.5	<0.5	<2.5	--	
01/09/97	288.40	283.11	5.29	--	--	--	--	<50	<0.5	<0.5	<0.5	<0.5	<2.5	--	
04/15/97	288.40	281.90	6.50	--	--	--	--	<50	<0.5	<0.5	<0.5	<0.5	<2.5	--	
07/08/97	288.40	281.90	6.50	--	--	--	--	<50	<0.5	<0.5	<0.5	<0.5	<2.5	--	
10/22/97	288.40	283.00	5.40	--	--	--	--	<50	<0.5	<0.5	<0.5	<0.5	<2.5	--	
01/12/98	288.40	284.27	4.13	--	--	--	--	<50	<0.5	<0.5	<0.5	<0.5	<2.5	--	
04/21/98	288.40	283.84	4.56	--	--	--	--	<50	<0.5	<0.5	<0.5	<0.5	<2.5	--	
07/08/98	288.40	277.81	10.59	--	--	--	--	<50	<0.5	0.57	<0.5	<0.5	<2.5	--	

Cumulative Table of Well Data and Analytical Results

Vertical Measurements are in feet.

Analytical results are in parts per billion (ppb)

DATE	Well Head Elev.	Ground Water Elev.	Depth To Water	SPH Thickness	SPH Removed	Total SPH Removed	Notes	TPH-Gasoline	Benzene	Toluene	Ethyl-Benzene	Xylene	MTBE	Organic Lead
C-9														
07/03/86	268.46	254.57	13.89	--	--	--	--	--	--	--	--	--	--	--
03/26/87	268.46	254.72	13.74	--	--	--	--	--	--	--	--	--	--	--
03/28/88	268.46	253.47	14.99	--	--	--	--	--	--	--	--	--	--	--
03/10/89	268.46	255.07	13.39	--	--	--	--	--	--	--	--	--	--	--
04/03/89	268.46	255.62	12.84	--	--	--	--	--	--	--	--	--	--	--
05/08/89	268.46	254.08	14.38	--	--	--	--	--	--	--	--	--	--	--
06/05/89	268.46	253.10	15.36	--	--	--	--	--	--	--	--	--	--	--
07/12/90	268.46	252.81	15.65	--	--	--	--	--	--	--	--	--	--	--
08/10/90	268.46	252.66	15.80	--	--	--	--	--	--	--	--	--	--	--
09/13/89	268.46	251.93	16.53	--	--	--	--	42,000	14,000	1100	2800	4200	--	--
10/04/89	268.46	251.94	16.52	--	--	--	--	--	--	--	--	--	--	--
11/03/89	268.46	251.95	16.51	--	--	--	--	--	--	--	--	--	--	--
12/04/89	268.46	251.67	16.79	--	--	--	--	36,000	11,000	670	2500	3800	--	--
03/07/90	268.46	252.24	16.22	--	--	--	--	--	--	--	--	--	--	--
03/09/90	268.46	252.24	16.22	--	--	--	--	28,000	12,000	940	3000	4700	--	--
06/12/90	268.46	253.58	14.88	--	--	--	--	39,000	11,000	1600	2300	4800	--	--
09/24/90	268.46	252.16	16.30	--	--	--	--	120,000	13,000	1600	3700	6800	--	--
12/20/90	268.46	251.23	17.23	--	--	--	--	51,000	9300	560	2800	3300	--	--
12/20/90	268.46	251.23	17.23	--	--	--	Duplicate	44,000	12,000	580	2800	3500	--	--
03/27/91	268.46	254.68	13.78	--	--	--	--	56,000	3400	5000	1600	5600	--	--
06/18/91	268.46	249.82	18.64	--	--	--	--	--	--	--	--	--	--	--
09/12/91	268.46	--	--	--	--	--	Inaccessible	--	--	--	--	--	--	--
10/24/95	268.46	250.39	18.07	--	--	--	--	30,000	7200	440	2500	1600	--	--
01/16/96	268.46	252.18	16.28	--	--	--	--	36,000	8200	700	2500	2100	<500	--
07/08/98	268.46	256.46	12.00	--	--	--	--	20,000	4900	880	1100	2500	<250	--

Cumulative Table of Well Data and Analytical Results

Vertical Measurements are in feet.

Analytical results are in parts per billion (ppb)

DATE	Well Head Elev.	Ground Water Elev.	Depth To Water	SPH Thickness	SPH Removed	Total SPH Removed	Notes	TPH-Gasoline	Benzene	Toluene	Ethyl-Benzene	Xylene	MTBE	Organic Lead
C-10A														
03/07/90	264.84	244.63	20.21	--	--	--	--	--	--	--	--	--	--	--
03/09/90	264.84	--	--	--	--	--	--	ND	1.6	0.7	0.8	3.5	--	--
06/12/90	264.84	245.14	19.70	--	--	--	--	ND	ND	ND	ND	ND	--	--
09/24/90	264.84	245.30	19.54	--	--	--	--	ND	ND	ND	ND	ND	--	--
12/20/90	264.84	245.00	19.84	--	--	--	--	ND	ND	ND	ND	ND	--	--
03/27/91	264.84	246.83	18.01	--	--	--	--	--	--	--	--	--	--	--
06/18/91	264.84	244.68	20.16	--	--	--	--	ND	ND	ND	ND	ND	--	--
09/12/91	264.84	244.27	20.57	--	--	--	--	ND	ND	ND	ND	ND	--	--
01/23/92	264.84	244.17	20.67	--	--	--	--	ND	ND	ND	ND	ND	--	--
04/13/92	264.84	245.44	19.40	--	--	--	--	53	0.9	1.3	ND	1.0	--	--
08/03/92	264.84	245.03	19.81	--	--	--	--	ND	ND	ND	ND	ND	--	ND
10/22/92	264.84	245.01	19.83	--	--	--	--	ND	ND	ND	ND	0.5	--	--
01/18/93	264.84	247.80	17.04	--	--	--	--	ND	ND	ND	ND	ND	--	--
04/19/93	264.84	247.07	17.77	--	--	--	--	ND	ND	ND	ND	ND	--	--
04/19/93	264.84	247.28	17.56	--	--	--	--	ND	ND	ND	ND	ND	--	--
10/25/93	264.84	247.07	17.77	--	--	--	--	ND	ND	ND	ND	ND	--	--
01/21/94	264.84	246.93	17.91	--	--	--	--	ND	ND	ND	ND	ND	--	--
04/18/94	264.84	247.81	17.03	--	--	--	--	ND	3.0	3.0	1.4	5.5	--	--
07/06-07/94	264.84	248.06	16.78	--	--	--	--	ND	ND	ND	ND	ND	--	--
10/07/94	264.84	247.63	17.21	--	--	--	--	ND	ND	ND	ND	ND	--	--
01/11/95	264.84	248.78	16.06	--	--	--	--	<50	<0.5	<0.5	<0.5	<0.5	--	--
04/24/95	264.84	248.32	16.52	--	--	--	--	<50	<0.5	<0.5	<0.5	<0.5	--	--
07/31/95	264.84	245.82	19.02	--	--	--	--	<50	<0.5	<0.5	<0.5	<0.5	--	--
10/02/95	264.84	245.14	19.70	--	--	--	--	<50	<0.5	<0.5	<0.5	<0.5	--	--
01/16/96	264.84	246.21	18.63	--	--	--	--	<50	<0.5	<0.5	<0.5	<0.5	<2.5	--
04/18/96	264.84	247.19	17.65	--	--	--	--	<50	<0.5	<0.5	<0.5	<0.5	<2.5	--
07/22/96	264.84	245.99	18.85	--	--	--	--	<50	<0.5	<0.5	<0.5	<0.5	<2.5	--
10/10/96	264.84	245.40	19.44	--	--	--	--	<50	<0.5	<0.5	<0.5	<0.5	<2.5	--
01/09/97	264.84	248.00	16.84	--	--	--	--	<50	<0.5	<0.5	<0.5	<0.5	<2.5	--
04/15/97	264.84	246.47	18.37	--	--	--	--	<50	<0.5	<0.5	<0.5	<0.5	<2.5	--
07/08/97	264.84	246.33	18.51	--	--	--	--	<50	<0.5	<0.5	<0.5	<0.5	<2.5	--
10/22/97	264.84	246.64	18.20	--	--	--	--	<50	<0.5	<0.5	<0.5	<0.5	<2.5	--
01/12/98	264.84	248.00	16.84	--	--	--	--	<50	<0.5	<0.5	<0.5	<0.5	<2.5	--
04/21/98	264.84	248.04	16.80	--	--	--	--	<50	<0.5	<0.5	<0.5	<0.5	<2.5	--
07/08/98	264.84	246.89	17.95	--	--	--	--	<50	<0.5	0.57	<0.5	<0.5	<2.5	--

Cumulative Table of Well Data and Analytical Results

Vertical Measurements are in feet.

Analytical results are in parts per billion (ppb)

DATE	Well Head Elev.	Ground Water Elev.	Depth To Water	SPH Thickness	SPH Removed	Total SPH Removed	Notes	TPH-Gasoline	Benzene	Toluene	Ethyl-Benzene	Xylene	MTBE	Organic Lead
C-10B														
03/07/90	264.85	243.41	21.44	--	--	--	--	--	--	--	--	--	--	--
06/12/90	264.85	244.91	19.94	--	--	--	--	ND	ND	ND	ND	ND	--	--
09/24/90	264.85	245.08	19.77	--	--	--	--	ND	ND	ND	ND	ND	--	--
12/20/90	264.85	244.85	20.00	--	--	--	--	ND	ND	ND	ND	ND	--	--
03/27/91	264.85	246.62	18.23	--	--	--	--	--	--	--	--	--	--	--
06/18/91	264.85	244.41	20.44	--	--	--	--	--	--	--	--	--	--	--
09/12/91	264.85	244.03	20.82	--	--	--	--	ND	ND	ND	ND	ND	--	--
01/23/92	264.85	243.93	20.92	--	--	--	--	ND	ND	ND	ND	ND	--	--
04/13/92	264.85	245.17	19.68	--	--	--	--	ND	ND	ND	ND	ND	--	--
08/03/92	264.85	244.78	20.07	--	--	--	--	ND	ND	ND	ND	ND	--	ND
10/22/92	264.85	244.73	20.12	--	--	--	--	ND	ND	ND	ND	ND	--	--
01/18/93	264.85	247.49	17.36	--	--	--	--	60	3.3	11	2.1	8.9	--	--
04/19/93	264.85	246.95	17.90	--	--	--	--	ND	ND	ND	ND	ND	--	--
07/21,22/93	264.85	246.99	17.86	--	--	--	--	ND	ND	ND	ND	ND	--	--
10/25/93	264.85	246.75	18.10	--	--	--	--	ND	ND	ND	ND	ND	--	--
01/21/94	264.85	246.62	18.23	--	--	--	--	ND	ND	ND	ND	ND	--	--
04/18/94	264.85	247.49	17.36	--	--	--	--	ND	ND	ND	ND	0.5	--	--
07/06-07/94	264.85	247.80	17.05	--	--	--	--	ND	ND	ND	ND	ND	--	--
10/07/94	264.85	247.31	17.54	--	--	--	--	ND	ND	ND	ND	ND	--	--
01/11/95	264.85	248.81	16.24	--	--	--	--	<50	<0.5	<0.5	<0.5	<0.5	--	--
04/24/95	264.85	247.95	16.90	--	--	--	--	<50	<0.5	<0.5	<0.5	<0.5	--	--
07/31/95	264.85	245.57	19.28	--	--	--	--	<50	<0.5	<0.5	<0.5	<0.5	--	--
10/02/95	264.85	244.91	19.94	--	--	--	--	<50	<0.5	<0.5	<0.5	<0.5	--	--
01/16/96	264.85	246.25	18.60	--	--	--	--	<50	<0.5	<0.5	<0.5	<0.5	<2.5	--
04/18/96	264.85	246.87	17.98	--	--	--	--	<50	<0.5	<0.5	<0.5	<0.5	<2.5	--
07/22/96	264.85	245.75	19.10	--	--	--	--	<50	<0.5	<0.5	<0.5	<0.5	<2.5	--
10/10/96	264.85	245.14	19.71	--	--	--	--	<50	<0.5	<0.5	<0.5	<0.5	<2.5	--
01/09/97	264.85	247.65	17.20	--	--	--	--	<50	<0.5	<0.5	<0.5	<0.5	<2.5	--
04/15/97	264.85	246.11	18.74	--	--	--	--	<50	<0.5	<0.5	<0.5	<0.5	<2.5	--
07/08/97	264.85	246.10	18.75	--	--	--	--	<50	<0.5	<0.5	<0.5	<0.5	<2.5	--
10/22/97	264.85	246.35	18.50	--	--	--	--	<50	<0.5	<0.5	<0.5	<0.5	<2.5	--
01/12/98	264.85	247.71	17.14	--	--	--	--	<50	<0.5	<0.5	<0.5	<0.5	<2.5	--
04/21/98	264.85	247.69	17.16	--	--	--	--	<50	<0.5	<0.5	<0.5	<0.5	<2.5	--
07/08/98	264.85	246.61	18.24	--	--	--	--	<50	<0.5	0.62	<0.5	<0.5	<2.5	--

Cumulative Table of Well Data and Analytical Results

Vertical Measurements are in feet.

Analytical results are in parts per billion (ppb)

DATE	Well Head Elev.	Ground Water Elev.	Depth To Water	SPH Thickness	SPH Removed	Total SPH Removed	Notes	TPH-Gasoline	Benzene	Toluene	Ethyl-Benzene	Xylene	MTBE	Organic Lead
C-11														
03/07/90	265.30	242.56	22.74	--	--	--	--	--	--	--	--	--	--	--
03/09/90	265.30	--	--	--	--	--	--	ND	1.2	0.7	ND	1.4	--	--
06/12/90	265.30	243.32	21.98	--	--	--	--	ND	ND	ND	ND	ND	--	--
09/24/90	265.30	243.42	21.88	--	--	--	--	ND	ND	ND	ND	ND	--	--
12/20/90	265.30	242.12	23.18	--	--	--	--	ND	ND	ND	ND	ND	--	--
03/27/91	265.30	243.78	21.52	--	--	--	--	ND	ND	ND	ND	1.5	--	--
06/18/91	265.30	243.40	21.90	--	--	--	--	--	--	--	--	--	--	--
09/12/91	265.30	242.60	22.70	--	--	--	--	ND	ND	ND	ND	ND	--	--
01/23/92	265.30	241.84	23.46	--	--	--	--	ND	ND	ND	ND	ND	--	--
04/13/92	265.30	243.73	21.57	--	--	--	--	ND	ND	ND	ND	ND	--	--
08/03/92	265.30	242.63	22.67	--	--	--	--	ND	ND	ND	ND	ND	--	ND
10/22/92	265.30	242.01	23.29	--	--	--	--	ND	ND	ND	ND	ND	--	--
01/18/93	265.30	243.94	21.36	--	--	--	--	ND	ND	1.2	ND	2.2	--	--
04/19/93	265.30	245.33	19.97	--	--	--	--	ND	ND	ND	ND	ND	--	--
07/21,22/93	265.30	244.65	20.65	--	--	--	--	ND	ND	ND	ND	ND	--	--
10/25/93	265.30	244.55	20.75	--	--	--	--	ND	ND	ND	ND	ND	--	--
01/21/94	265.30	243.69	21.61	--	--	--	--	ND	ND	ND	ND	ND	--	--
04/18/94	265.30	244.52	20.78	--	--	--	--	ND	ND	ND	ND	ND	--	--
07/06-07/94	265.30	244.88	20.42	--	--	--	--	ND	ND	ND	ND	ND	--	--
10/07/94	265.30	243.70	21.60	--	--	--	--	ND	ND	ND	ND	ND	--	--
01/11/95	265.30	245.28	20.02	--	--	--	--	<50	<0.5	<0.5	<0.5	<0.5	--	--
04/24/95	265.30	247.58	17.72	--	--	--	--	<50	<0.5	<0.5	<0.5	<0.5	--	--
07/31/95	265.30	246.12	19.18	--	--	--	--	<50	<0.5	<0.5	<0.5	<0.5	--	--
10/02/95	265.30	244.88	20.42	--	--	--	--	<50	<0.5	<0.5	<0.5	<0.5	--	--
01/16/96	265.30	245.48	19.82	--	--	--	--	<50	<0.5	<0.5	<0.5	<0.5	<2.5	--
04/18/96	265.30	248.30	17.00	--	--	--	--	260	7.9	6.9	5.3	23	11	--
07/22/96	265.30	248.40	16.90	--	--	--	--	<50	<0.5	<0.5	<0.5	<0.5	<2.5	--
10/10/96	265.30	245.74	19.56	--	--	--	--	130	32	2.7	4.3	14	3.4	--
01/09/97	265.30	249.28	16.02	--	--	--	--	75	5.3	6.4	2.0	9.0	<2.5	--
04/15/97	265.30	247.35	17.95	--	--	--	--	<50	<0.5	<0.5	<0.5	<0.5	<2.5	--
07/08/97	265.30	245.55	19.75	--	--	--	--	<50	<0.5	<0.5	<0.5	<0.5	<2.5	--
10/22/97	265.30	245.74	19.56	--	--	--	--	<50	<0.5	<0.5	<0.5	<0.5	<2.5	--
01/12/98	265.30	246.97	18.33	--	--	--	--	<50	<0.5	<0.5	<0.5	<0.5	<2.5	--
04/21/98	265.30	248.62	16.68	--	--	--	--	<50	<0.5	<0.5	<0.5	<0.5	<2.5	--
07/08/98	265.30	246.76	18.54	--	--	--	--	<50	<0.5	0.58	<0.5	<0.5	<2.5	--

Cumulative Table of Well Data and Analytical Results

Vertical Measurements are in feet.

Analytical results are in parts per billion (ppb)

DATE	Well Head Elev.	Ground Water Elev.	Depth To Water	SPH Thickness	SPH Removed	Total SPH Removed	Notes	TPH-Gasoline	Benzene	Toluene	Ethyl-Benzene	Xylene	MTBE	Organic Lead
C-12														
03/07/90	269.66	254.74	14.92	--	--	--	--	--	--	--	--	--	--	--
03/09/90	269.66	--	--	--	--	--	--	1400	230	140	33	180	--	--
06/12/90	269.66	254.87	14.79	--	--	--	--	720	190	71	18	73	--	--
09/24/90	269.66	253.94	15.72	--	--	--	--	ND	1.1	ND	ND	0.6	--	--
12/20/90	269.66	254.40	15.26	--	--	--	--	810	210	26	8.2	23	--	--
03/27/91	269.66	257.55	12.11	--	--	--	--	2900	350	220	52	210	--	--
06/18/91	269.66	253.28	16.38	--	--	--	--	--	--	--	--	--	--	--
09/12/91	269.66	252.11	17.55	--	--	--	--	350	59	12	4.5	8.5	--	--
01/23/92	269.66	252.55	17.11	--	--	--	--	450	110	31	7.9	22	--	--
04/13/92	269.66	255.26	14.40	--	--	--	--	5000	1100	76	100	200	--	--
08/03/92	269.66	253.83	15.83	--	--	--	--	520	200	21	13	25	--	ND
10/22/92	269.66	253.52	16.14	--	--	--	--	1300	310	66	35	56	--	--
01/18/93	269.66	257.96	11.70	--	--	--	--	5600	1200	430	220	610	--	--
04/19/93	269.66	256.61	13.05	--	--	--	--	2000	600	99	96	170	--	--
07/21,22/93	269.66	256.82	12.84	--	--	--	--	540	95	36	18	56	--	--
10/25/93	269.66	255.63	14.03	--	--	--	--	350	90	29	20	50	--	--
01/21/94	269.66	255.51	14.15	--	--	--	--	450	73	18	14	37	--	--
04/18/94	269.66	256.71	12.95	--	--	--	--	370	70	21	12	39	--	--
07/06-07/94	269.66	257.35	12.31	--	--	--	--	840	200	35	28	66	--	--
10/07/94	269.66	256.31	13.35	--	--	--	--	830	85	29	17	63	--	--
01/11/95	269.66	258.43	11.23	--	--	--	--	2100	570	190	98	390	--	--
04/24/95	269.66	259.34	10.32	--	--	--	--	820	120	28	23	61	--	--
07/31/95	269.66	256.92	12.74	--	--	--	--	520	79	13	16	42	--	--
10/02/95	269.66	255.26	14.40	--	--	--	--	400	50	5.3	11	29	--	--
01/16/96	269.66	256.94	12.72	--	--	--	--	1900	490	32	60	120	<25	--
04/18/96	269.66	258.91	10.75	--	--	--	--	2900	640	54	100	190	68	--
07/22/96	269.66	256.46	13.20	--	--	--	--	730	150	13	26	75	9.5	--
10/10/96	269.66	255.95	13.71	--	--	--	--	270	58	4.4	7.7	31	<2.5	--
01/09/97	269.66	260.60	9.06	--	--	--	--	2900	550	67	94	300	63	--
04/15/97	269.66	258.13	11.53	--	--	--	--	2500	350	29	92	200	43	--
07/08/97	269.66	257.92	11.74	--	--	--	--	1400	190	17	54	120	21	--
10/22/97	269.66	258.78	10.88	--	--	--	--	2300	490	45	110	340	42	--
01/12/98	269.66	260.76	8.90	--	--	--	--	5000	840	89	220	610	<50	--
04/21/98	269.66	262.41	7.25	--	--	--	--	2400	410	39	79	270	130	--
07/08/98	269.66	258.95	10.71	--	--	--	--	<50	7.6	<0.5	2.0	2.9	<2.5	--

Cumulative Table of Well Data and Analytical Results

Vertical Measurements are in feet.

Analytical results are in parts per billion (ppb)

DATE	Well Head Elev.	Ground Water Elev.	Depth To Water	SPH Thickness	SPH Removed	Total SPH Removed	Notes	TPH-Gasoline	Benzene	Toluene	Ethyl-Benzene	Xylene	MTBE	Organic Lead
C-13														
03/07/90	284.32	273.14	11.18	--	--	--	--	--	--	--	--	--	--	--
03/09/90	284.32	--	--	--	--	--	--	ND	15	3.7	1.0	6.2	--	--
06/12/90	284.32	273.62	10.70	--	--	--	--	ND	2.6	ND	ND	ND	--	--
09/24/90	284.32	272.72	11.60	--	--	--	--	ND	2.4	ND	ND	ND	--	--
12/20/90	284.32	274.16	10.16	--	--	--	--	ND	1.6	ND	ND	ND	--	--
03/27/91	284.32	276.68	7.64	--	--	--	--	--	--	--	--	--	--	--
06/18/91	284.32	273.00	11.32	--	--	--	--	--	--	--	--	--	--	--
09/12/91	284.32	272.48	11.84	--	--	--	--	ND	ND	ND	ND	ND	--	--
01/23/92	284.32	273.77	10.55	--	--	--	--	--	--	--	--	--	--	--
04/13/92	284.32	273.36	10.96	--	--	--	--	ND	1.0	ND	ND	ND	--	--
08/03/92	284.32	273.42	10.90	--	--	--	--	ND	ND	ND	ND	ND	--	ND
10/22/92	284.32	273.14	11.18	--	--	--	--	--	--	--	--	--	--	--
01/18/93	284.32	276.92	7.40	--	--	--	--	290	54	10	5.4	12	--	--
04/19/93	284.32	275.39	8.93	--	--	--	--	--	--	--	--	--	--	--
07/21,22/93	284.32	273.57	10.75	--	--	--	--	ND	ND	ND	ND	ND	--	--
10/25/93	284.32	273.47	10.85	--	--	--	--	--	--	--	--	--	--	--
01/21/94	284.32	273.27	11.05	--	--	--	--	ND	ND	ND	ND	ND	--	--
04/18/94	284.32	273.61	10.71	--	--	--	--	--	--	--	--	--	--	--
07/06-07/94	284.32	273.67	10.65	--	--	--	--	ND	0.5	ND	ND	ND	--	--
10/07/94	284.32	273.24	11.08	--	--	--	--	--	--	--	--	--	--	--
01/11/95	284.32	278.94	5.38	--	--	--	Sampled bi-annually	120	15	<0.5	3.1	2.7	--	--
04/24/95	284.32	276.54	7.78	--	--	--	--	--	--	--	--	--	--	--
07/31/95	284.32	274.38	9.94	--	--	--	--	<50	<0.5	<0.5	<0.5	<0.5	--	--
10/02/95	284.32	273.74	10.58	--	--	--	--	--	--	--	--	--	--	--
01/16/96	284.32	274.52	9.80	--	--	--	--	<50	<0.5	<0.5	<0.5	<0.5	<2.5	--
04/18/96	284.32	276.57	7.75	--	--	--	--	--	--	--	--	--	--	--
07/22/96	284.32	274.82	9.50	--	--	--	--	59	18	<0.5	1.0	<0.5	<2.5	--
10/10/96	284.32	273.63	10.69	--	--	--	--	--	--	--	--	--	--	--
01/09/97	284.32	276.95	7.37	--	--	--	--	<50	0.60	<0.5	<0.5	<0.5	<2.5	--
04/15/97	284.32	275.63	8.69	--	--	--	--	--	--	--	--	--	--	--
07/08/97	284.32	276.12	8.20	--	--	--	Samples lost	--	--	--	--	--	--	--
07/15/97	284.32	276.02	8.30	--	--	--	--	<50	2.6	<0.5	<0.5	1.6	<2.5	--
10/22/97	284.32	276.79	7.53	--	--	--	--	--	--	--	--	--	--	--
01/12/98	284.32	278.38	5.94	--	--	--	--	<50	<0.5	<0.5	<0.5	<0.5	<2.5	--
04/21/98	284.32	277.35	6.97	--	--	--	--	--	--	--	--	--	--	--
07/08/98	284.32	274.45	9.87	--	--	--	--	<50	<0.5	<0.5	<0.5	<0.5	<2.5	--

Cumulative Table of Well Data and Analytical Results

Vertical Measurements are in feet.

Analytical results are in parts per billion (ppb)

DATE	Well Head Elev.	Ground Water Elev.	Depth To Water	SPH Thickness	SPH Removed	Total SPH Removed	Notes	TPH-Gasoline	Benzene	Toluene	Ethyl-Benzene	Xylene	MTBE	Organic Lead
C-14														
03/07/90	270.74	255.56	15.18	--	--	--	--	--	--	--	--	--	--	--
03/09/90	270.74	--	--	--	--	--	--	ND	ND	ND	ND	ND	--	--
06/12/90	270.74	257.32	13.42	--	--	--	--	ND	ND	ND	ND	ND	--	--
09/24/90	270.74	257.90	12.84	--	--	--	--	ND	ND	ND	ND	ND	--	--
12/20/90	270.74	254.02	16.72	--	--	--	--	ND	1.7	0.7	ND	0.7	--	--
03/27/91	270.74	262.74	8.00	--	--	--	--	ND	ND	ND	ND	1.3	--	--
06/18/91	270.74	255.53	15.21	--	--	--	--	--	--	--	--	--	--	--
09/12/91	270.74	255.13	15.61	--	--	--	--	ND	ND	ND	ND	ND	--	--
01/23/92	270.74	246.10	24.64	--	--	--	--	--	--	--	--	--	--	--
04/13/92	270.74	258.53	12.21	--	--	--	--	ND	ND	ND	ND	ND	--	--
08/03/92	270.74	258.10	14.64	--	--	--	--	ND	ND	ND	ND	ND	--	ND
10/22/92	270.74	253.80	16.94	--	--	--	--	--	--	--	--	--	--	--
01/18/93	270.74	265.64	5.10	--	--	--	--	ND	ND	ND	ND	ND	--	--
04/19/93	270.74	263.86	6.88	--	--	--	--	--	--	--	--	--	--	--
07/21,22/93	270.74	259.58	11.16	--	--	--	--	ND	ND	ND	ND	ND	--	--
10/25/93	270.74	256.87	13.87	--	--	--	--	--	--	--	--	--	--	--
01/21/94	270.74	255.42	15.32	--	--	--	--	ND	ND	ND	ND	ND	--	--
04/18/94	270.74	254.85	15.89	--	--	--	--	--	--	--	--	--	--	--
07/06-07/94	270.74	258.66	12.08	--	--	--	--	ND	ND	ND	ND	ND	--	--
10/07/94	270.74	255.45	15.29	--	--	--	--	--	--	--	--	--	--	--
01/11/95	270.74	266.94	3.80	--	--	--	Sampled bi-annually	<50	<0.5	<0.5	<0.5	<0.5	--	--
04/24/95	270.74	265.68	5.06	--	--	--	--	--	--	--	--	--	--	--
07/31/95	270.74	260.34	10.40	--	--	--	--	<50	<0.5	<0.5	<0.5	<0.5	--	--
10/02/95	270.74	257.20	13.54	--	--	--	--	--	--	--	--	--	--	--
01/16/96	270.74	259.62	11.12	--	--	--	--	<50	<0.5	<0.5	<0.5	<0.5	<2.5	--
04/18/96	270.74	265.78	4.96	--	--	--	--	--	--	--	--	--	--	--
07/22/96	270.74	259.89	10.85	--	--	--	--	<50	<0.5	<0.5	<0.5	<0.5	<2.5	--
10/10/96	270.74	261.44	9.30	--	--	--	--	--	--	--	--	--	--	--
01/09/97	270.74	269.80	0.94	--	--	--	--	56	3.8	4.2	1.1	5.0	<2.5	--
04/15/97	270.74	263.59	7.15	--	--	--	--	--	--	--	--	--	--	--
07/08/97	270.74	261.44	9.30	--	--	--	--	<50	<0.5	<0.5	<0.5	<0.5	<2.5	--
10/22/97	270.74	261.17	9.57	--	--	--	--	--	--	--	--	--	--	--
01/12/98	270.74	268.45	2.29	--	--	--	--	<50	<0.5	<0.5	<0.5	<0.5	<2.5	--
04/21/98	270.74	270.70	0.04	--	--	--	--	--	--	--	--	--	--	--
07/08/98	270.74	264.85	5.89	--	--	--	--	<50	<0.5	<0.5	<0.5	<0.5	<2.5	--

Cumulative Table of Well Data and Analytical Results

Vertical Measurements are in feet.

Analytical results are in parts per billion (ppb)

DATE	Well Head Elev.	Ground Water Elev.	Depth To Water	SPH Thickness	SPH Removed	Total SPH Removed	Notes	TPH-Gasoline	Benzene	Toluene	Ethyl-Benzene	Xylene	MTBE	Organic Lead
C-15														
03/07/90	246.15	235.05	11.10	--	--	--	--	--	--	--	--	--	--	--
03/09/90	246.15	--	--	--	--	--	--	410	ND	1.4	0.5	0.6	--	--
06/12/90	246.15	235.37	10.78	--	--	--	--	420	11	ND	ND	ND	--	--
09/24/90	246.15	235.22	10.93	--	--	--	--	430	ND	1.5	ND	ND	--	--
12/20/90	246.15	235.07	11.08	--	--	--	--	300	1.3	1.1	0.6	1.5	--	--
03/27/91	246.15	237.65	8.50	--	--	--	--	520	4.6	1.1	ND	1.0	--	--
06/18/91	246.15	235.32	10.83	--	--	--	--	290	ND	1.1	ND	ND	--	--
06/18/91	246.15	235.32	10.83	--	--	--	Duplicate	320	ND	1.3	ND	ND	--	--
09/12/91	246.15	235.10	11.05	--	--	--	--	330	ND	0.9	ND	ND	--	--
01/23/92	246.15	235.35	10.80	--	--	--	--	210	ND	0.6	ND	ND	--	--
01/23/92	246.15	235.35	10.80	--	--	--	Duplicate	190	1.2	0.8	ND	ND	--	--
04/13/92	246.15	236.57	9.58	--	--	--	--	430	1.8	ND	ND	ND	--	--
08/03/92	246.15	234.94	11.21	--	--	--	--	640	ND	2.1	0.7	1.3	--	ND
10/22/92	246.15	234.50	11.65	--	--	--	--	420	ND	ND	ND	0.8	--	--
01/18/93	246.15	239.03	7.12	--	--	--	--	640	7.0	3.0	2.9	6.7	--	--
04/19/93	246.15	237.22	8.93	--	--	--	--	260	6.0	2.0	0.7	ND	--	--
07/21,22/93	246.15	236.37	9.78	--	--	--	--	580	ND	8.0	ND	0.6	--	--
10/25/93	246.15	236.41	9.74	--	--	--	--	240	ND	12	ND	0.6	--	--
01/21/94	246.15	235.78	10.37	--	--	--	--	420	0.6	ND	0.6	ND	--	--
04/18/94	246.15	236.19	9.96	--	--	--	--	550	1.0	4.6	0.6	ND	--	--
07/06-07/94	246.15	235.92	10.23	--	--	--	--	660	0.7	ND	ND	0.7	--	--
10/07/94	246.15	235.47	10.68	--	--	--	--	440	13	0.8	ND	1.2	--	--
01/11/95	246.15	238.84	7.31	--	--	--	--	750	2.5	<0.5	<0.5	0.6	--	--
04/24/95	246.15	237.41	8.74	--	--	--	--	850	<0.5	<0.5	<0.5	<0.5	--	--
07/31/95	246.15	235.41	10.74	--	--	--	--	640	<0.5	1.6	<0.5	<0.5	--	--
10/02/95	246.15	234.83	11.32	--	--	--	--	560	<0.5	<0.5	<0.5	<0.5	--	--
01/16/96	246.15	235.58	10.57	--	--	--	--	740	<0.5	<0.5	<0.5	<0.5	<2.5	--
04/18/96	246.15	237.55	8.60	--	--	--	--	760	<0.5	<0.5	<0.5	<0.5	<2.5	--
07/22/96	246.15	235.57	10.58	--	--	--	--	690	<0.5	1.6	<0.5	<0.5	7.9	--
10/10/96	246.15	234.97	11.18	--	--	--	--	870	7.0	2.1	<0.5	<0.5	11	--
01/09/97	246.15	238.83	7.32	--	--	--	--	370	2.6	1.1	<0.5	<0.5	4.6	--
04/15/97	246.15	235.76	10.39	--	--	--	--	510	22	<0.5	<0.5	<0.5	<2.5	--
07/08/97	246.15	235.68	10.47	--	--	--	--	490	71	6.8	22	48	7.0	--
10/22/97	246.15	235.01	11.14	--	--	--	--	790	2.3	1.8	<0.5	<0.5	5.1	--
01/12/98	246.15	238.17	7.98	--	--	--	--	400	13	<1.0	<1.0	<1.0	<5.0	--
04/21/98	246.15	238.05	8.10	--	--	--	--	770	<0.5	0.60	0.82	0.51	<2.5	--
07/08/98	246.15	235.65	10.50	--	--	--	--	540	13	<0.5	<0.5	<0.5	<2.5	--

Cumulative Table of Well Data and Analytical Results

Vertical Measurements are in feet.

Analytical results are in parts per billion (ppb)

DATE	Well Head Elev.	Ground Water Elev.	Depth To Water	SPH Thickness	SPH Removed	Total SPH Removed	Notes	TPH-Gasoline	Benzene	Toluene	Ethyl-Benzene	Xylene	MTBE	Organic Lead
C-16														
03/07/90	246.69	228.19	18.50	--	--	--	--	--	--	--	--	--	--	--
03/09/90	246.69	--	--	--	--	--	--	ND	ND	ND	ND	ND	--	--
06/12/90	246.69	235.27	11.42	--	--	--	--	ND	ND	ND	ND	ND	--	--
09/24/90	246.69	235.30	11.39	--	--	--	--	ND	ND	ND	ND	ND	--	--
12/20/90	246.69	235.12	11.57	--	--	--	--	ND	ND	ND	ND	0.7	--	--
03/27/91	246.69	237.93	8.76	--	--	--	--	ND	ND	ND	ND	1.3	--	--
03/27/91	246.69	237.93	8.76	--	--	--	Duplicate	ND	ND	ND	ND	1.2	--	--
06/18/91	246.69	235.51	11.18	--	--	--	--	ND	ND	ND	ND	ND	--	--
09/12/91	246.69	234.74	11.95	--	--	--	--	ND	ND	ND	ND	ND	--	--
01/23/92	246.69	234.28	12.41	--	--	--	--	ND	ND	ND	ND	ND	--	--
04/13/92	246.69	236.00	10.69	--	--	--	--	ND	ND	ND	ND	ND	--	--
08/03/92	246.69	234.49	12.20	--	--	--	--	ND	ND	ND	ND	ND	--	ND
10/22/92	246.69	234.09	12.60	--	--	--	--	ND	ND	ND	ND	ND	--	--
01/18/93	246.69	237.69	9.00	--	--	--	--	ND	ND	ND	ND	ND	--	--
04/19/93	246.69	236.80	9.89	--	--	--	--	ND	ND	ND	ND	ND	--	--
07/21,22/93	246.69	236.44	10.25	--	--	--	--	ND	ND	ND	ND	ND	--	--
10/25/93	246.69	235.73	10.96	--	--	--	--	ND	ND	ND	ND	ND	--	--
01/21/94	246.69	234.93	11.76	--	--	--	--	ND	ND	0.7	ND	1.0	--	--
04/18/94	246.69	235.47	11.22	--	--	--	--	ND	ND	ND	ND	ND	--	--
07/06-07/94	246.69	235.32	11.37	--	--	--	--	ND	ND	ND	ND	ND	--	--
10/07/94	246.69	234.30	12.39	--	--	--	--	ND	ND	ND	ND	ND	--	--
01/11/95	246.69	237.73	8.96	--	--	--	--	<50	<0.5	<0.5	<0.5	<0.5	--	--
04/24/95	246.69	236.31	10.38	--	--	--	--	<50	<0.5	<0.5	<0.5	<0.5	--	--
07/31/95	246.69	235.37	11.32	--	--	--	--	<50	<0.5	<0.5	<0.5	<0.5	--	--
10/02/95	246.69	234.29	12.40	--	--	--	--	<50	<0.5	<0.5	<0.5	<0.5	--	--
01/16/96	246.69	235.15	11.54	--	--	--	--	<50	<0.5	<0.5	<0.5	<0.5	<2.5	--
04/18/96	246.69	236.09	10.60	--	--	--	--	<50	<0.5	<0.5	<0.5	<0.5	<2.5	--
07/22/96	246.69	235.12	11.57	--	--	--	--	<50	<0.5	<0.5	<0.5	<0.5	<2.5	--
10/10/96	246.69	234.25	12.44	--	--	--	--	<50	<0.5	<0.5	<0.5	<0.5	<2.5	--
01/09/97	246.69	237.16	9.53	--	--	--	--	<50	<0.5	<0.5	<0.5	<0.5	<2.5	--
04/15/97	246.69	234.66	12.03	--	--	--	--	<50	<0.5	<0.5	<0.5	<0.5	<2.5	--
07/08/97	246.69	234.51	12.18	--	--	--	--	<50	<0.5	<0.5	<0.5	<0.5	<2.5	--
10/22/97	246.69	233.94	12.75	--	--	--	--	<50	<0.5	<0.5	<0.5	<0.5	<2.5	--
01/12/98	246.69	236.34	10.35	--	--	--	--	<50	<0.5	<0.5	<0.5	<0.5	<2.5	--
04/21/98	246.69	236.06	10.63	--	--	--	--	<50	<0.5	<0.5	<0.5	<0.5	<2.5	--
07/08/98	246.69	234.62	12.07	--	--	--	--	<50	<0.5	0.51	<0.5	<0.5	<2.5	--

Cumulative Table of Well Data and Analytical Results

Vertical Measurements are in feet.

Analytical results are in parts per billion (ppb)

DATE	Well Head Elev.	Ground Water Elev.	Depth To Water	SPH Thickness	SPH Removed	Total SPH Removed	Notes	TPH-Gasoline	Benzene	Toluene	Ethyl-Benzene	Xylene	MTBE	Organic Lead
RW														
12/04/89	--	--	--	--	--	--	--	62,000	29,000	1700	1800	8800	--	--
03/07/90	274.52	256.02	18.50	--	--	--	--	--	--	--	--	--	--	--
06/12/90	274.52	256.03	18.49	--	--	--	--	31,000	15,000	2000	560	3100	--	--
09/24/90	274.52	--	--	--	--	--	--	--	--	--	--	--	--	--
12/20/90	274.52	--	--	--	--	--	--	ND	0.5	ND	ND	1.2	--	--
03/27/91	274.52	--	--	--	--	--	--	--	--	--	--	--	--	--
06/18/91	274.52	--	--	--	--	--	--	--	--	--	--	--	--	--
09/12/91	274.52	--	--	--	--	--	Insufficient water	--	--	--	--	--	--	--
01/23/92	274.52	--	--	--	--	--	Insufficient water	--	--	--	--	--	--	--
04/13/92	274.52	--	--	--	--	--	Insufficient water	--	--	--	--	--	--	--
08/03/92	274.52	--	--	--	--	--	Insufficient water	--	--	--	--	--	--	--
10/22/92	274.52	--	--	--	--	--	Insufficient water	--	--	--	--	--	--	--
01/18/93	274.52	--	--	--	--	--	Insufficient water	--	--	--	--	--	--	--
04/19/93	274.52	--	--	--	--	--	Insufficient water	--	--	--	--	--	--	--
07/21, 22/93	274.52	--	--	--	--	--	Insufficient water	--	--	--	--	--	--	--
10/25/93	274.52	--	--	--	--	--	--	--	--	--	--	--	--	--
01/21/94	274.52	--	--	--	--	--	--	--	--	--	--	--	--	--
04/18/94	274.52	--	--	--	--	--	--	--	--	--	--	--	--	--
07/06-07/94	274.52	--	--	--	--	--	--	--	--	--	--	--	--	--
10/07/94	274.52	--	--	--	--	--	--	--	--	--	--	--	--	--
10/24/95	274.52	256.63	17.89	--	--	--	--	37,000	11,000	380	1100	3000	--	--
01/16/96	274.52	259.09	15.43	--	--	--	--	59,000	17,000	660	1600	5400	<1000	--

NO LONGER MONITORED OR SAMPLED

Cumulative Table of Well Data and Analytical Results

Vertical Measurements are in feet.

Analytical results are in parts per billion (ppb)

DATE	Well Head Elev.	Ground Water Elev.	Depth To Water	SPH Thickness	SPH Removed	Total SPH Removed	Notes	TPH-Gasoline	Benzene	Toluene	Ethyl-Benzene	Xylene	MTBE	Organic Lead
TRIP BLANK														
01/11/95	--	--	--	--	--	--	--	<50	<0.5	<0.5	<0.5	<0.5	--	--
04/24/95	--	--	--	--	--	--	--	<50	<0.5	<0.5	<0.5	<0.5	--	--
07/31/95	--	--	--	--	--	--	--	<50	<0.5	<0.5	<0.5	<0.5	--	--
10/02/95	--	--	--	--	--	--	--	<50	<0.5	<0.5	<0.5	<0.5	--	--
01/16/96	--	--	--	--	--	--	--	<50	<0.5	<0.5	<0.5	<0.5	--	--
04/18/96	--	--	--	--	--	--	--	<50	<0.5	<0.5	<0.5	<0.5	--	--
07/22/96	--	--	--	--	--	--	--	<50	<0.5	<0.5	<0.5	<0.5	--	--
10/10/96	--	--	--	--	--	--	--	<50	<0.5	<0.5	<0.5	<0.5	--	--
01/09/97	--	--	--	--	--	--	--	<50	<0.5	<0.5	<0.5	<0.5	<2.5	--
04/15/97	--	--	--	--	--	--	--	<50	<0.5	<0.5	<0.5	<0.5	<2.5	--
07/08/97	--	--	--	--	--	--	--	<50	<0.5	<0.5	<0.5	<0.5	<2.5	--
07/15/97	--	--	--	--	--	--	--	<50	<0.5	<0.5	<0.5	<0.5	<2.5	--
10/22/97	--	--	--	--	--	--	--	<50	<0.5	<0.5	<0.5	<0.5	<2.5	--
01/12/98	--	--	--	--	--	--	--	<50	<0.5	<0.5	<0.5	<0.5	<2.5	--
04/21/98	--	--	--	--	--	--	--	<50	<0.5	<0.5	<0.5	<0.5	<2.5	--
07/08/98	--	--	--	--	--	--	--	<50	<0.5	<0.5	<0.5	<0.5	<2.5	--

Note: Blaine Tech Services, Inc. began routine monitoring of the groundwater wells at this site on November 1, 1994.
 Earlier field data and analytical results are drawn from the November 4, 1994 Groundwater Technology, Inc. report.

ABBREVIATIONS:

TPH = Total Petroleum Hydrocarbons

ND = Not detected at or above the minimum quantitation limit. See laboratory reports for minimum quantitation limits.

MTBE = Methyl t-butyl ether

Analytical Appendix



Sequoia Analytical

680 Chesapeake Drive
404 N. Wiget Lane
819 Striker Avenue, Suite 8
1455 McDowell Blvd. North, Ste. D

Redwood City, CA 94063
Walnut Creek, CA 94598
Sacramento, CA 95834
Petaluma, CA 94954

(650) 364-9600
(925) 988-9600
(916) 921-9600
(707) 792-1865

FAX (650) 364-9233
FAX (925) 988-9673
FAX (916) 921-0100
FAX (707) 792-0342

Blaine Tech Services 1680 Rogers Avenue San Jose, CA 95112	Client Proj. ID: Chevron 9-5607, Castro Valley Sample Descript: C-1 Matrix: LIQUID Analysis Method: 8015Mod/8020 Lab Number: 9807444-01	Sampled: 07/08/98 Received: 07/09/98 Extracted: 07/14/98 Analyzed: 07/14/98 Reported: 07/17/98
--	---	--

QC Batch Number: GC071498802007A
Instrument ID: GC-4

Analyte	Detection Limit ug/L	Sample Results ug/L
TPPH as Gas	5000	33000
Methyl t-Butyl Ether	250	N.D.
Benzene	50	4400
Toluene	50	1500
Ethyl Benzene	50	2800
Xylenes (Total)	50	8200
Chromatogram Pattern:		GAS
Surrogates	Control Limits %	% Recovery
Trifluorotoluene	70 130	106

Analytes reported as N.D. were not present above the stated limit of detection.

SEQUOIA ANALYTICAL - ELAP #1210

Mike Gregory
Project Manager





Sequoia Analytical

680 Chesapeake Drive
404 N. Wiget Lane
819 Striker Avenue, Suite 8
1455 McDowell Blvd. North, Ste. D

Redwood City, CA 94063
Walnut Creek, CA 94598
Sacramento, CA 95834
Petaluma, CA 94954

(650) 364-9600
(925) 988-9600
(916) 921-9600
(707) 792-1865

FAX (650) 364-9233
FAX (925) 988-9673
FAX (916) 921-0100
FAX (707) 792-0342

Blaine Tech Services 1680 Rogers Avenue San Jose, CA 95112	Client Proj. ID: Chevron 9-5607, Castro Valley Sample Descript: C-3 Matrix: LIQUID Analysis Method: 8015Mod/8020 Lab Number: 9807444-02	Sampled: 07/08/98 Received: 07/09/98 Extracted: 07/14/98 Analyzed: 07/14/98 Reported: 07/17/98
Attention: Fran Thie		

QC Batch Number: GC071498802007A
Instrument ID: GC-4

Analyte	Detection Limit ug/L	Sample Results ug/L
TPPH as Gas	500	22000
Methyl t-Butyl Ether	25	N.D.
Benzene	5.0	7300
Toluene	5.0	2100
Ethyl Benzene	5.0	560
Xylenes (Total)	5.0	2900
Chromatogram Pattern:		GAS
Surrogates	Control Limits %	% Recovery
Trifluorotoluene	70	130

Analytes reported as N.D. were not present above the stated limit of detection.

SEQUOIA ANALYTICAL - ELAP #1210

Mike Gregory
Project Manager





Sequoia Analytical

680 Chesapeake Drive
404 N. Wiger Lane
819 Striker Avenue, Suite 8
1455 McDowell Blvd. North, Ste. D

Redwood City, CA 94063
Walnut Creek, CA 94598
Sacramento, CA 95834
Petaluma, CA 94954

(650) 364-9600
(925) 988-9600
(916) 921-9600
(707) 792-1865

FAX (650) 364-9233
FAX (925) 988-9673
FAX (916) 921-0100
FAX (707) 792-0342

Blaine Tech Services 1680 Rogers Avenue San Jose, CA 95112	Client Proj. ID: Chevron 9-5607, Castro Valley Sample Descript: C-5 Matrix: LIQUID Analysis Method: 8015Mod/8020 Lab Number: 9807444-03	Sampled: 07/08/98 Received: 07/09/98 Extracted: 07/14/98 Analyzed: 07/14/98 Reported: 07/17/98
--	---	--

QC Batch Number: GC071498802007A
Instrument ID: GC-4

Analyte	Detection Limit ug/L	Sample Results ug/L
TPPH as Gas	50	52
Methyl t-Butyl Ether	2.5	N.D.
Benzene	0.50	N.D.
Toluene	0.50	N.D.
Ethyl Benzene	0.50	N.D.
Xylenes (Total)	0.50	N.D.
Chromatogram Pattern: Unidentified HC		C6-C12
Surrogates	Control Limits %	% Recovery
Trifluorotoluene	70 130	103

Analytes reported as N.D. were not present above the stated limit of detection.

SEQUOIA ANALYTICAL - ELAP #1210

Mike Gregory
Project Manager





Sequoia Analytical

680 Chesapeake Drive
404 N. Wiger Lane
819 Striker Avenue, Suite 8
1455 McDowell Blvd. North, Ste. D

Redwood City, CA 94063
Walnut Creek, CA 94598
Sacramento, CA 95834
Petaluma, CA 94954

(650) 364-9600
(925) 988-9600
(916) 921-9600
(707) 792-1865

FAX (650) 364-9233
FAX (925) 988-9673
FAX (916) 921-0100
FAX (707) 792-0342

Blaine Tech Services 1680 Rogers Avenue San Jose, CA 95112	Client Proj. ID: Chevron 9-5607, Castro Valley Sample Descript: C-6 Matrix: LIQUID Analysis Method: 8015Mod/8020 Lab Number: 9807444-04	Sampled: 07/08/98 Received: 07/09/98 Extracted: 07/14/98 Analyzed: 07/14/98 Reported: 07/17/98
Attention: Fran Thie		

QC Batch Number: GC071498802007A
Instrument ID: GC-4

Analyte	Detection Limit ug/L	Sample Results ug/L
TPPH as Gas	5000	19000
Methyl t-Butyl Ether	250	N.D.
Benzene	50	8200
Toluene	50	150
Ethyl Benzene	50	720
Xylenes (Total)	50	1100
Chromatogram Pattern:		GAS
Surrogates	Control Limits %	% Recovery
Trifluorotoluene	70 130	109

Analytes reported as N.D. were not present above the stated limit of detection.

SEQUOIA ANALYTICAL - ELAP #1210

Mike Gregory
Project Manager





Sequoia Analytical

680 Chesapeake Drive
404 N. Wiget Lane
819 Striker Avenue, Suite 8
1455 McDowell Blvd. North, Ste. D

Redwood City, CA 94063
Walnut Creek, CA 94598
Sacramento, CA 95834
Petaluma, CA 94954

(650) 364-9600 FAX (650) 364-9233
(925) 988-9600 FAX (925) 988-9673
(916) 921-9600 FAX (916) 921-0100
(707) 792-1865 FAX (707) 792-0342

Blaine Tech Services 1680 Rogers Avenue San Jose, CA 95112	Client Proj. ID: Chevron 9-5607, Castro Valley Sample Descript: C-7 Matrix: LIQUID Analysis Method: 8015Mod/8020 Lab Number: 9807444-05	Sampled: 07/08/98 Received: 07/09/98 Extracted: 07/14/98 Analyzed: 07/14/98 Reported: 07/17/98
Attention: Fran Thie		

QC Batch Number: GC071498802007A
Instrument ID: GC-4

Analyte	Detection Limit ug/L	Sample Results ug/L
TPPH as Gas	50	N.D.
Methyl t-Butyl Ether	2.5	N.D.
Benzene	0.50	N.D.
Toluene	0.50	N.D.
Ethyl Benzene	0.50	N.D.
Xylenes (Total)	0.50	N.D.
Chromatogram Pattern:		
Surrogates	Control Limits %	% Recovery
Trifluorotoluene	70 130	100

Analytes reported as N.D. were not present above the stated limit of detection.

SEQUOIA ANALYTICAL - ELAP #1210

Mike Gregory
Project Manager





Sequoia Analytical

680 Chesapeake Drive
404 N. Wiger Lane
819 Striker Avenue, Suite 8
1455 McDowell Blvd. North, Ste. D

Redwood City, CA 94063
Walnut Creek, CA 94598
Sacramento, CA 95834
Petaluma, CA 94954

(650) 364-9600
(925) 988-9600
(916) 921-9600
(707) 792-1865

FAX (650) 364-9233
FAX (925) 988-9673
FAX (916) 921-0100
FAX (707) 792-0342

Blaine Tech Services 1680 Rogers Avenue San Jose, CA 95112 Attention: Fran Thie	Client Proj. ID: Chevron 9-5607, Castro Valley Sample Descript: C-8 Matrix: LIQUID Analysis Method: 8015Mod/8020 Lab Number: 9807444-06	Sampled: 07/08/98 Received: 07/09/98 Extracted: 07/14/98 Analyzed: 07/14/98 Reported: 07/17/98
--	---	--

QC Batch Number: GC071498802007A
Instrument ID: GC-4

Analyte	Detection Limit ug/L	Sample Results ug/L
TPPH as Gas	50	N.D.
Methyl t-Butyl Ether	2.5	N.D.
Benzene	0.50	N.D.
Toluene	0.50	0.57
Ethyl Benzene	0.50	N.D.
Xylenes (Total)	0.50	N.D.
Chromatogram Pattern:		
Surrogates	Control Limits %	% Recovery
Trifluorotoluene	70 130	99

Analytes reported as N.D. were not present above the stated limit of detection.

SEQUOIA ANALYTICAL - ELAP #1210

Mike Gregory
Project Manager





Sequoia Analytical

680 Chesapeake Drive
404 N. Wiget Lane
819 Striker Avenue, Suite 8
1455 McDowell Blvd. North, Ste. D

Redwood City, CA 94063
Walnut Creek, CA 94598
Sacramento, CA 95834
Petaluma, CA 94954

(650) 364-9600 FAX (650) 364-9233
(925) 988-9600 FAX (925) 988-9673
(916) 921-9600 FAX (916) 921-0100
(707) 792-1865 FAX (707) 792-0342

Blaine Tech Services 1680 Rogers Avenue San Jose, CA 95112	Client Proj. ID: Chevron 9-5607, Castro Valley Sample Descript: C-9 Matrix: LIQUID Analysis Method: 8015Mod/8020 Lab Number: 9807444-07	Sampled: 07/08/98 Received: 07/09/98 Extracted: 07/14/98 Analyzed: 07/14/98 Reported: 07/17/98
--	---	--

QC Batch Number: GC071498802007A
Instrument ID: GC-4

Analyte	Detection Limit ug/L	Sample Results ug/L
TPPH as Gas	5000	20000
Methyl t-Butyl Ether	250	N.D.
Benzene	50	4900
Toluene	50	880
Ethyl Benzene	50	1100
Xylenes (Total)	50	2500
Chromatogram Pattern:		GAS
Surrogates	Control Limits %	% Recovery
Trifluorotoluene	70	130
		120

Analytes reported as N.D. were not present above the stated limit of detection.

SEQUOIA ANALYTICAL - ELAP #1210

Mike Gregory
Project Manager





Sequoia Analytical

680 Chesapeake Drive
404 N. Wiger Lane
819 Striker Avenue, Suite B
1455 McDowell Blvd. North, Ste. D

Redwood City, CA 94063
Walnut Creek, CA 94598
Sacramento, CA 95834
Petaluma, CA 94954

(650) 364-9600
(925) 988-9600
(916) 921-9600
(707) 792-1865

FAX (650) 364-9233
FAX (925) 988-9673
FAX (916) 921-0100
FAX (707) 792-0342

Blaine Tech Services 1680 Rogers Avenue San Jose, CA 95112	Client Proj. ID: Chevron 9-5607, Castro Valley Sample Descript: C-10A Matrix: LIQUID Analysis Method: 8015Mod/8020 Lab Number: 9807444-08	Sampled: 07/08/98 Received: 07/09/98 Extracted: 07/13/98 Analyzed: 07/13/98 Reported: 07/17/98
--	---	--

QC Batch Number: GC071398802007A
Instrument ID: GC-4

Analyte	Detection Limit ug/L	Sample Results ug/L
TPPH as Gas	50	N.D.
Methyl t-Butyl Ether	2.5	N.D.
Benzene	0.50	N.D.
Toluene	0.50	0.57
Ethyl Benzene	0.50	N.D.
Xylenes (Total)	0.50	N.D.
Chromatogram Pattern:		
Surrogates	Control Limits %	% Recovery
Trifluorotoluene	70 130	96

Analytes reported as N.D. were not present above the stated limit of detection.

SEQUOIA ANALYTICAL - ELAP #1210

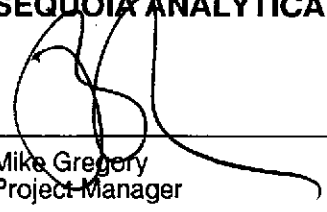

Mike Gregory
Project Manager





Sequoia Analytical

680 Chesapeake Drive
404 N. Wiger Lane
819 Striker Avenue, Suite 8
1455 McDowell Blvd. North, Ste. D

Redwood City, CA 94063
Walnut Creek, CA 94598
Sacramento, CA 95834
Petaluma, CA 94954

(650) 364-9600
(925) 988-9600
(916) 921-9600
(707) 792-1865

FAX (650) 364-9233
FAX (925) 988-9673
FAX (916) 921-0100
FAX (707) 792-0342

Blaine Tech Services 1680 Rogers Avenue San Jose, CA 95112	Client Proj. ID: Chevron 9-5607, Castro Valley Sample Descript: C-10B Matrix: LIQUID Analysis Method: 8015Mod/8020 Lab Number: 9807444-09	Sampled: 07/08/98 Received: 07/09/98 Extracted: 07/13/98 Analyzed: 07/13/98 Reported: 07/17/98
--	---	--

QC Batch Number: GC071398802007A
Instrument ID: GC-4

Analyte	Detection Limit ug/L	Sample Results ug/L
TPPH as Gas	50	N.D.
Methyl t-Butyl Ether	2.5	N.D.
Benzene	0.50	N.D.
Toluene	0.50	0.62
Ethyl Benzene	0.50	N.D.
Xylenes (Total)	0.50	N.D.
Chromatogram Pattern:		
Surrogates	Control Limits %	% Recovery
Trifluorotoluene	70 130	94

Analytes reported as N.D. were not present above the stated limit of detection.

SEQUOIA ANALYTICAL - ELAP #1210

Mike Gregory
Project Manager





Sequoia Analytical

680 Chesapeake Drive
404 N. Wiget Lane
819 Striker Avenue, Suite 8
1455 McDowell Blvd. North, Ste. D

Redwood City, CA 94063
Walnut Creek, CA 94598
Sacramento, CA 95834
Petaluma, CA 94954

(650) 364-9600
(925) 988-9600
(916) 921-9600
(707) 792-1865

FAX (650) 364-9233
FAX (925) 988-9673
FAX (916) 921-0100
FAX (707) 792-0342

Blaine Tech Services 1680 Rogers Avenue San Jose, CA 95112	Client Proj. ID: Chevron 9-5607, Castro Valley Sample Descript: C-11 Matrix: LIQUID Analysis Method: 8015Mod/8020 Lab Number: 9807444-10	Sampled: 07/08/98 Received: 07/09/98 Extracted: 07/13/98 Analyzed: 07/13/98 Reported: 07/17/98
--	--	--

QC Batch Number: GC071398802007A
Instrument ID: GC-4

Analyte	Detection Limit ug/L	Sample Results ug/L
TPPH as Gas	50	N.D.
Methyl t-Butyl Ether	2.5	N.D.
Benzene	0.50	N.D.
Toluene	0.50	0.58
Ethyl Benzene	0.50	N.D.
Xylenes (Total)	0.50	N.D.
Chromatogram Pattern:		
Surrogates	Control Limits %	% Recovery
Trifluorotoluene	70 130	95

Analytes reported as N.D. were not present above the stated limit of detection.

SEQUOIA ANALYTICAL - ELAP #1210

Mike Gregory
Project Manager





Sequoia Analytical

680 Chesapeake Drive
404 N. Wiget Lane
819 Striker Avenue, Suite 8
1455 McDowell Blvd. North, Ste. D

Redwood City, CA 94063
Walnut Creek, CA 94598
Sacramento, CA 95834
Petaluma, CA 94954

(650) 364-9600
(925) 988-9600
(916) 921-9600
(707) 792-1865

FAX (650) 364-9233
FAX (925) 988-9673
FAX (916) 921-0100
FAX (707) 792-0342

Blaine Tech Services 1680 Rogers Avenue San Jose, CA 95112	Client Proj. ID: Chevron 9-5607, Castro Valley Sample Descript: C-12 Matrix: LIQUID Analysis Method: 8015Mod/8020 Lab Number: 9807444-11	Sampled: 07/08/98 Received: 07/09/98 Extracted: 07/14/98 Analyzed: 07/14/98 Reported: 07/17/98
--	--	--

QC Batch Number: GC071498802007A
Instrument ID: GC-4

Analyte	Detection Limit ug/L	Sample Results ug/L
TPPH as Gas	50	N.D.
Methyl t-Butyl Ether	2.5	N.D.
Benzene	0.50	7.6
Toluene	0.50	N.D.
Ethyl Benzene	0.50	2.0
Xylenes (Total)	0.50	2.9
Chromatogram Pattern:		
Surrogates	Control Limits %	% Recovery
Trifluorotoluene	70 130	89

Analytes reported as N.D. were not present above the stated limit of detection.

SEQUOIA ANALYTICAL - ELAP #1210

Mike Gregory
Project Manager





Sequoia Analytical

680 Chesapeake Drive
404 N. Wiget Lane
819 Striker Avenue, Suite 8
1455 McDowell Blvd. North, Ste. D

Redwood City, CA 94063
Walnut Creek, CA 94598
Sacramento, CA 95834
Petaluma, CA 94954

(650) 364-9600 FAX (650) 364-9233
(925) 988-9600 FAX (925) 988-9673
(916) 921-9600 FAX (916) 921-0100
(707) 792-1865 FAX (707) 792-0342

Blaine Tech Services 1680 Rogers Avenue San Jose, CA 95112	Client Proj. ID: Chevron 9-5607, Castro Valley Sample Descript: C-13 Matrix: LIQUID Analysis Method: 8015Mod/8020 Lab Number: 9807444-12	Sampled: 07/08/98 Received: 07/09/98 Extracted: 07/14/98 Analyzed: 07/14/98 Reported: 07/17/98
--	--	--

QC Batch Number: GC071498802007A
Instrument ID: GC-4

Analyte	Detection Limit ug/L	Sample Results ug/L
TPPH as Gas	50	N.D.
Methyl t-Butyl Ether	2.5	N.D.
Benzene	0.50	N.D.
Toluene	0.50	N.D.
Ethyl Benzene	0.50	N.D.
Xylenes (Total)	0.50	N.D.
Chromatogram Pattern:		
Surrogates	Control Limits %	% Recovery
Trifluorotoluene	70 130	78

Analytes reported as N.D. were not present above the stated limit of detection.

SEQUOIA ANALYTICAL - ELAP #1210

Mike Gregory
Project Manager





Sequoia Analytical

680 Chesapeake Drive
404 N. Wiget Lane
819 Striker Avenue, Suite B
1455 McDowell Blvd. North, Ste. D

Redwood City, CA 94063
Walnut Creek, CA 94598
Sacramento, CA 95834
Petaluma, CA 94954

(650) 364-9600 FAX (650) 364-9233
(925) 988-9600 FAX (925) 988-9673
(916) 921-9600 FAX (916) 921-0100
(707) 792-1865 FAX (707) 792-0342

Blaine Tech Services 1680 Rogers Avenue San Jose, CA 95112	Client Proj. ID: Chevron 9-5607, Castro Valley Sample Descript: C-14 Matrix: LIQUID Analysis Method: 8015Mod/8020 Lab Number: 9807444-13	Sampled: 07/08/98 Received: 07/09/98 Extracted: 07/14/98 Analyzed: 07/14/98 Reported: 07/17/98
Attention: Fran Thie		

QC Batch Number: GC071498802007A
Instrument ID: GC-4

Analyte	Detection Limit ug/L	Sample Results ug/L
TPPH as Gas	50	N.D.
Methyl t-Butyl Ether	2.5	N.D.
Benzene	0.50	N.D.
Toluene	0.50	N.D.
Ethyl Benzene	0.50	N.D.
Xylenes (Total)	0.50	N.D.
Chromatogram Pattern:		
Surrogates	Control Limits %	% Recovery
Trifluorotoluene	70 130	97

Analytes reported as N.D. were not present above the stated limit of detection.

SEQUOIA ANALYTICAL - ELAP #1210

Mike Gregory
Project Manager





Sequoia Analytical

680 Chesapeake Drive
404 N. Wiger Lane
819 Striker Avenue, Suite 8
1455 McDowell Blvd. North, Ste. D

Redwood City, CA 94063
Walnut Creek, CA 94598
Sacramento, CA 95834
Petaluma, CA 94954

(650) 364-9600 FAX (650) 364-9233
(925) 988-9600 FAX (925) 988-9673
(916) 921-9600 FAX (916) 921-0100
(707) 792-1865 FAX (707) 792-0342

Blaine Tech Services
1680 Rogers Avenue
San Jose, CA 95112

Client Proj. ID: Chevron 9-5607, Castro Valley
Sample Descript: C-15
Matrix: LIQUID
Analysis Method: 8015Mod/8020
Lab Number: 9807444-14

Sampled: 07/08/98
Received: 07/09/98
Extracted: 07/13/98
Analyzed: 07/13/98
Reported: 07/17/98

QC Batch Number: GC071398802007A
Instrument ID: GC-4

Analyte	Detection Limit ug/L	Sample Results ug/L
TPPH as Gas	50	540
Methyl t-Butyl Ether	2.5	N.D.
Benzene	0.50	13
Toluene	0.50	N.D.
Ethyl Benzene	0.50	N.D.
Xylenes (Total)	0.50	N.D.
Chromatogram Pattern: Unidentified HC		C6-C12
Surrogates	Control Limits %	% Recovery
Trifluorotoluene	70 130	189 Q

Analytes reported as N.D. were not present above the stated limit of detection.

SEQUOIA ANALYTICAL - ELAP #1210

Mike Gregory
Project Manager





Sequoia Analytical

680 Chesapeake Drive
404 N. Wiger Lane
819 Striker Avenue, Suite 8
1455 McDowell Blvd. North, Ste. D

Redwood City, CA 94063
Walnut Creek, CA 94598
Sacramento, CA 95834
Petaluma, CA 94954

(650) 364-9600 FAX (650) 364-9233
(925) 988-9600 FAX (925) 988-9673
(916) 921-9600 FAX (916) 921-0100
(707) 792-1865 FAX (707) 792-0342

Blaine Tech Services 1680 Rogers Avenue San Jose, CA 95112	Client Proj. ID: Chevron 9-5607, Castro Valley Sample Descript: C-16 Matrix: LIQUID Analysis Method: 8015Mod/8020 Lab Number: 9807444-15	Sampled: 07/08/98 Received: 07/09/98 Extracted: 07/14/98 Analyzed: 07/14/98 Reported: 07/17/98
--	--	--

QC Batch Number: GC071498802007A
Instrument ID: GC-4

Analyte	Detection Limit ug/L	Sample Results ug/L
TPPH as Gas	50	N.D.
Methyl t-Butyl Ether	2.5	N.D.
Benzene	0.50	N.D.
Toluene	0.50	0.51
Ethyl Benzene	0.50	N.D.
Xylenes (Total)	0.50	N.D.
Chromatogram Pattern:		
Surrogates	Control Limits %	% Recovery
Trifluorotoluene	70 130	99

Analytes reported as N.D. were not present above the stated limit of detection.

SEQUOIA ANALYTICAL - ELAP #1210

Mike Gregory
Project Manager





Sequoia Analytical

680 Chesapeake Drive
404 N. Wiget Lane
819 Striker Avenue, Suite 8
1455 McDowell Blvd. North. Ste. D

Redwood City, CA 94063
Wainur Creek, CA 94598
Sacramento, CA 95834
Petaluma, CA 94954

(650) 364-9600
(925) 988-9600
(916) 921-9600
(707) 792-1865

FAX (650) 364-9233
FAX (925) 988-9673
FAX (916) 921-0100
FAX (707) 792-0342

Blaine Tech Services 1680 Rogers Avenue San Jose, CA 95112	Client Proj. ID: Chevron 9-5607, Castro Valley Sample Descript: TB Matrix: LIQUID Analysis Method: 8015Mod/8020 Lab Number: 9807444-16	Sampled: 07/08/98 Received: 07/09/98 Extracted: 07/13/98 Analyzed: 07/13/98 Reported: 07/17/98
--	--	--

QC Batch Number: GC071398802007A
Instrument ID: GC-4

Analyte	Detection Limit ug/L	Sample Results ug/L
TPPH as Gas	50	N.D.
Methyl t-Butyl Ether	2.5	N.D.
Benzene	0.50	N.D.
Toluene	0.50	N.D.
Ethyl Benzene	0.50	N.D.
Xylenes (Total)	0.50	N.D.
Chromatogram Pattern:		
Surrogates	Control Limits %	% Recovery
Trifluorotoluene	70 130	96

Analytes reported as N.D. were not present above the stated limit of detection.

SEQUOIA ANALYTICAL - ELAP #1210

Mike Gregory
Project Manager





Blaine Tech Services, Inc.
1680 Rogers Ave.
San Jose, CA 95112
Attention: Fran Thie

Client Project ID: Chevron 9-5607, Castro Valley
Matrix: Liquid

Work Order #: 9807444 -01-07, 11-13, 15 Reported: Jul 17, 1998

QUALITY CONTROL DATA REPORT

Analyte:	Benzene	Toluene	Ethyl Benzene	Xylenes	Gas
QC Batch#:	GC071498802004A	GC071498802004A	GC071498802004A	GC071498802004A	GC071498802004A
Analy. Method:	EPA 8020	EPA 8020	EPA 8020	EPA 8020	EPA 8015M
Prep. Method:	EPA 5030	EPA 5030	EPA 5030	EPA 5030	EPA 5030

Analyst:	S.L.	S.L.	S.L.	S.L.	S.L.
MS/MSD #:	98070242	98070242	98070242	98070242	-
Sample Conc.:	N.D.	N.D.	N.D.	N.D.	-
Prepared Date:	7/14/98	7/14/98	7/14/98	7/14/98	-
Analyzed Date:	7/14/98	7/14/98	7/14/98	7/14/98	-
Instrument I.D.#:	GC4	GC4	GC4	GC4	-
Conc. Spiked:	20 µg/L	20 µg/L	20 µg/L	60 µg/L	-
Result:	19	20	21	62	-
MS % Recovery:	93	101	107	103	-
Dup. Result:	20	22	23	67	-
MSD % Recov.:	101	110	116	112	-
RPD:	5.1	9.5	9.1	7.8	-
RPD Limit:	0-25	0-25	0-25	0-25	-

LCS #:	LCS071498	LCS071498	LCS071498	LCS071498	LCS071498
Prepared Date:	7/14/98	7/14/98	7/14/98	7/14/98	7/14/98
Analyzed Date:	7/14/98	7/14/98	7/14/98	7/14/98	7/14/98
Instrument I.D.#:	GC4	GC4	GC4	GC4	GC4
Conc. Spiked:	20 µg/L	20 µg/L	20 µg/L	60 µg/L	500 µg/L
LCS Result:	18	20	21	61	477
LCS % Recov.:	92	98	106	102	95

MS/MSD	60-140	60-140	60-140	60-140	
LCS	70-130	70-130	70-130	70-130	60-140
Control Limits					

SEQUOIA ANALYTICAL
EPA #2142

Mike Gregory
Project Manager

Please Note:

The LCS is a control sample of known, interferent-free matrix that is analyzed using the same reagents, preparation, and analytical methods employed for the samples. The matrix spike is an aliquot of sample fortified with known quantities of specific compounds and subjected to the entire analytical procedure. If the recovery of analytes from the matrix spike does not fall within specified control limits due to matrix interference, the LCS recovery is to be used to validate the batch.

** MS=Matrix Spike, MSD=MS Duplicate, RPD=Relative % Difference

9807444.BLA <1>



Blaine Tech Services, Inc.
1680 Rogers Ave.
San Jose, CA 95112
Attention: Fran Thie

Client Project ID: Chevron 9-5607, Castro Valley
Matrix: Liquid

Work Order #: 9807444-08-10, 14, 16

Reported: Jul 17, 1998

QUALITY CONTROL DATA REPORT

Analyte:	Benzene	Toluene	Ethyl Benzene	Xylenes	Gas
QC Batch#:	GC071398802004A	GC071398802004A	GC071398802004A	GC071398802004A	GC071398802004A
Analy. Method:	EPA 8020	EPA 8020	EPA 8020	EPA 8020	EPA 8015M
Prep. Method:	EPA 5030	EPA 5030	EPA 5030	EPA 5030	EPA 5030

Analyst:	S.L.	S.L.	S.L.	S.L.	S.L.
MS/MSD #:	98070238	98070238	98070238	98070238	-
Sample Conc.:	N.D.	N.D.	N.D.	N.D.	-
Prepared Date:	7/13/98	7/13/98	7/13/98	7/13/98	-
Analyzed Date:	7/13/98	7/13/98	7/13/98	7/13/98	-
Instrument I.D.#:	GC4	GC4	GC4	GC4	-
Conc. Spiked:	20 µg/L	20 µg/L	20 µg/L	60 µg/L	-
Result:	18	19	20	60	-
MS % Recovery:	90	97	102	99	-
Dup. Result:	20	22	23	67	-
MSD % Recov.:	101	109	116	112	-
RPD:	10.5	14.6	14	11	-
RPD Limit:	0-25	0-25	0-25	0-25	-

LCS #:	LCS071398	LCS071398	LCS071398	LCS071398	LCS071398
Prepared Date:	7/13/98	7/13/98	7/13/98	7/13/98	7/13/98
Analyzed Date:	7/13/98	7/13/98	7/13/98	7/13/98	7/13/98
Instrument I.D.#:	GC4	GC4	GC4	GC4	GC4
Conc. Spiked:	20 µg/L	20 µg/L	20 µg/L	60 µg/L	500 µg/L
LCS Result:	19	20	22	62	397
LCS % Recov.:	95	101	108	103	79

MS/MSD	60-140	60-140	60-140	60-140	
LCS	70-130	70-130	70-130	70-130	60-140
Control Limits					

SEQUOIA ANALYTICAL
Elap #2142

Mike Gregory
Project Manager

Please Note:

The LCS is a control sample of known, interferent-free matrix that is analyzed using the same reagents, preparation, and analytical methods employed for the samples. The matrix spike is an aliquot of sample fortified with known quantities of specific compounds and subjected to the entire analytical procedure. If the recovery of analytes from the matrix spike does not fall within specified control limits due to matrix interference, the LCS recovery is to be used to validate the batch.

** MS=Matrix Spike, MSD=MS Duplicate, RPD=Relative % Difference

9807444.BLA <2>





Blaine Tech Services
1680 Rogers Avenue
San Jose, CA 95112
Attention: Fran Thie

Client Proj. ID: Chevron 9-5607, Castro Valley

Received: 07/09/98

Lab Proj. ID: 9807444

Reported: 07/17/98

LABORATORY NARRATIVE

In order to properly interpret this report, it must be reproduced in its entirety. This report contains a total of 19 pages including the laboratory narrative, sample results, quality control, and related documents as required (cover page, COC, raw data, etc.).

TPH-GAS/BTEX:

Sample 9807444-01 was diluted 100-fold.
Sample 9807444-02 was diluted 10-fold.
Sample 9807444-04 was diluted 100-fold.
Sample 9807444-07 was diluted 100-fold.

SEQUOIA ANALYTICAL

Mike Gregory
Project Manager



Fax copy of Lab Report and COC to Chevron Contact: No

Chain-of-Custody-Record

Chevron U.S.A. Inc.
P.O. BOX 5004
San Ramon, CA 94583
FAX (415)842-9591

Chevron Facility Number 9-5607
Facility Address 5269 Crow Canyon Rd., Castro Valley, CA
Consultant Project Number _____
Consultant Name Blaine Tech Services, Inc.
Address 1680 Rogers Ave., San Jose, CA 95112
Project Contact (Name) Fran Thie
(Phone) 408-573-0555 (Fax Number) 408-573-7771

Chevron Contact (Name) Brett Hunter
(Phone) (510) 842-8695
Laboratory Name Sequoia
Laboratory Release Number 9033495
Sample Collected by (Name) Cassidy
Collection Date 7-8-98
Signature [Signature]

Sample Number	Lab Sample Number	Number of Containers	Matrix S = Soil W = Water A = Air C = Charcoal	Type G = Grab C = Composite D = Discrete	Time	Sample Preservation	Lead (Yes or No)	Analyses To Be Performed											Remarks			
								TEX + TPH GAS (8020 + 8015)	TPH Diesel (8015)	Oil and Grease (5520)	Purgeable Hydrocarbons (8010)	Purgeable Aromatics (8020)	Purgeable Organics (8240)	Extractable Organics (8270)	Metals Cd, Cr, Pb, Zn, Ni (ICAP or AA)							
C-1	1	3	W		1423	HCL	Y	X														
C-3	2				1435			X														
C-5	3				1245			X														
C-6	4				1410			X														
C-7	5				1225			X														
C-8	6				1155			X														
C-9	7				1355			X														
C-10A	8				1000			X														
C-10B	9				1020			X														
C-11	10				1100			X														
C-12	11				1340			X														
C-13	12				940			X														
C-14	13				1125			X														
C-15	14				1515			X														

9807444

DO NOT BILL FOR TB-LB

7 9 12 04

03/98

Relinquished By (Signature) <u>[Signature]</u>	Organization <u>BTS</u>	Date/Time <u>7-9-98 10:45</u>	Received By (Signature) <u>[Signature]</u>	Organization <u>SEQUOIA</u>	Date/Time <u>7-9-98 10:45</u>	Turn Around Time (Circle Choice) 24 Hrs. 48 Hrs. 5 Days 10 Days As Contracted
Relinquished By (Signature) <u>[Signature]</u>	Organization <u>SEQUOIA</u>	Date/Time <u>7-9-98</u>	Received By (Signature) _____	Organization _____	Date/Time _____	
Relinquished By (Signature) _____	Organization _____	Date/Time _____	Received For Laboratory By (Signature) <u>[Signature]</u>	Organization _____	Date/Time <u>7-9-12-04</u>	

Chevron U.S.A. Inc.
P.O. BOX 5004
San Ramon, CA 94583
FAX (415)842-9591

Chevron Facility Number 9-5607
Facility Address 5269 Crow Canyon Rd., Castro Valley, CA
Consultant Project Number _____
Consultant Name Blaine Tech Services, Inc.
Address 1680 Rogers Ave., San Jose, CA 95112
Project Contact (Name) Fran Thie
(Phone) 408-573-0555 (Fax Number) 408-573-7771

Chevron Contact (Name) Brett Hunter
(Phone) (510) 842-8695
Laboratory Name Sequoia
Laboratory Release Number 9033495
Samples Collected by (Name) Cassidy
Collection Date 7-9-98
Signature _____

Sample Number	Lab Sample Number	Number of Containers	Matrix S = Soil W = Water C = Charcoal	Type G = Grab C = Composite D = Discrete	Time	Sample Preservation	Iced (Yes or No)	Analyses To Be Performed											Remarks							
								BTX + TPH GAS (8020 + 8015)	TPH Diesel (8015)	Oil and Grease (5520)	Purgeable Hydrocarbons (8010)	Purgeable Aromatics (8020)	Purgeable Organics (8240)	Extractable Organics (8270)	Metals Cd, Cr, Pb, Zn, Ni (ICAP or AA)											
C-16	15	3	W		10:00	HCL	Y	X																		
TB	16	2	W		-	↓	↓	X																		

9807444

DO NOT BILL FOR TB-LB

JL 9 12 98

03 81/HCH

Relinquished By (Signature)	Organization <u>BT5</u>	Date/Time <u>7.9.98 10:45</u>	Received By (Signature)	Organization <u>SEQUOIA</u>	Date/Time <u>7.9.98 10:45</u>	Turn Around Time (Circle Choice) 24 Hrs. 48 Hrs. 5 Days 10 Days As Contracted
Relinquished By (Signature)	Organization <u>SEQUOIA</u>	Date/Time <u>7.9.98</u>	Received By (Signature)	Organization	Date/Time	
Relinquished By (Signature)	Organization	Date/Time	Received For Laboratory By (Signature)		Date/Time	

Field Data Sheets

WELL GAUGING DATA

Project # 980708-C1 Date 7-8-98 Client Cherren

Site 5269 Coon Canyon rd Castro Valley

Well ID	Well Size (in.)	Sheen / Odor	Depth to Immiscible Liquid (ft.)	Thickness of Immiscible Liquid (ft.)	Volume of Immiscibles Removed (ml)	Depth to water (ft.)	Depth to well bottom (ft.)	Survey Point: TOB or TOC
C1	4	odor				18.57	43.00	TOC
C2	4					16.08	44.65	
C3	4	odor				21.15	31.83	
C5	4					23.19	32.07	
C6	4					12.48	30.00	
C7	2					6.98	26.30	
C8	2					10.59	25.12	
C9	4	odor				12.00	—	Extraction system
C10A	3					17.95	22.64	
C10B	3					18.24	34.14	
C11	3					18.54	33.60	
C12	3					10.71	29.60	
C13	3					9.87	28.30	
C14	3	odor				5.89	24.39	
C15	3					10.50	19.67	
C16	3					12.07	30.59	

CHEVRON WELL MONITORING DATA SHEET

Project #: 980708-c1	Station #: 9-5607
Sampler: CM	Date: 7-8-98
Well I.D.: C-1	Well Diameter: 2 3 <u>4</u> 6 8
Total Well Depth: 43.00	Depth to Water: 18.57
Depth to Free Product:	Thickness of Free Product (feet):
Referenced to: <u>PVC</u> Grade	D.O. Meter (if req'd): YSI HACH

Well Diameter	Multiplier	Well Diameter	Multiplier
2"	0.16	5"	1.02
3"	0.37	6"	1.47
4"	0.65	Other	radius ² * 0.163

Purge Method:	Sampling Method:
<input type="checkbox"/> Bailer <input type="checkbox"/> Disposable Bailer <input type="checkbox"/> Middleburg <input checked="" type="checkbox"/> Electric Submersible <input type="checkbox"/> Extraction Pump Other: _____	<input type="checkbox"/> Bailer <input checked="" type="checkbox"/> Disposable Bailer <input type="checkbox"/> Extraction Port Other: _____

<u>15.9</u>	x	<u>3</u>	=	<u>47.7</u>	Gals.
1 Case Volume (Gals.)		Specified Volumes		Calculated Volume	

Time	Temp (°F)	pH	Cond.	Gals. Removed	Observations
1415	79.8	7.3	2000	16	
1417	80.1	7.1	1600	32	
1419	78.7	7.1	1600	48	

Did well dewater? Yes <input type="checkbox"/> No <input checked="" type="checkbox"/>	Gallons actually evacuated: <u>48</u>
Sampling Time: <u>14:23</u>	Sampling Date: <u>7-8-98</u>
Sample I.D.: <u>C-1</u>	Laboratory: <u>Sequoia</u> GTEL N. Creek Assoc. Labs
Analyzed for: <u>TPH-G</u> <u>BTEX</u> <u>MTBE</u> TPH-D Other:	
Duplicate I.D.: Analyzed for: TPH-G BTEX MTBE TPH-D Other:	
D.O. (if req'd):	Pre-purge: <input type="text"/> mg/L Post-purge: <input type="text"/> mg/L
O.R.P. (if req'd):	Pre-purge: <input type="text"/> mV Post-purge: <input type="text"/> mV

CHEVRON WELL MONITORING DATA SHEET

Project #: 980708-c1	Station #: 9-5607
Sampler: CM	Date: 7-8-98
Well I.D.: C-3	Well Diameter: 2 3 <u>4</u> 6 8
Total Well Depth: 31.83	Depth to Water: 21.15
Depth to Free Product:	Thickness of Free Product (feet):
Referenced to: <u>PVC</u> Grade	D.O. Meter (if req'd): YSI HACH

Well Diameter	Multiplier	Well Diameter	Multiplier
2"	0.16	5"	1.02
3"	0.37	6"	1.47
4"	0.65	Other	radius ² * 0.163

Purge Method: Bailer Sampling Method: Bailer

Disposable Bailer Disposable Bailer X

Middleburg Extraction Port

Electric Submersible Other: _____

Extraction Pump

Other: _____

7.0	x	3	=	21	Gals.
1 Case Volume (Gals.)		Specified Volumes		Calculated Volume	

Time	Temp (°F)	pH	Cond.	Gals. Removed	Observations
1430	83.0	7.0	1200	7	
1431	82.1	7.0	1200	14	
1432	82.0	7.0	1200	21	

Did well dewater? Yes No Gallons actually evacuated: 21

Sampling Time: 14:35 Sampling Date: 7-8-98

Sample I.D.: C-3 Laboratory: Sequoia GTEL N. Creek Assoc. Labs

Analyzed for: TPH-G BTEX MTBE TPH-D Other:

Duplicate I.D.: Analyzed for: TPH-G BTEX MTBE TPH-D Other:

D.O. (if req'd):	Pre-purge:	mg/L	Post-purge:	mg/L
O.R.P. (if req'd):	Pre-purge:	mV	Post-purge:	mV

CHEVRON WELL MONITORING DATA SHEET

Project #: 980708-c1	Station #: 9-5607
Sampler: CM	Date: 7-8-98
Well I.D.: C-5	Well Diameter: 2 3 4 6 8
Total Well Depth: 32.07	Depth to Water: 23.19
Depth to Free Product:	Thickness of Free Product (feet):
Referenced to: PVC Grade	D.O. Meter (if req'd): YSI HACH

Well Diameter	Multiplier	Well Diameter	Multiplier
2"	0.16	5"	1.02
3"	0.37	6"	1.47
4"	0.65	Other	radius ² * 0.163

Purge Method:	Sampling Method:
Bailer	Bailer
Disposable Bailer	Disposable Bailer X
Middleburg	Extraction Port
Electric Submersible X	Other: _____
Extraction Pump	
Other: _____	

5.6	x	3	=	16.8	Gals.
1 Case Volume (Gals.)		Specified Volumes		Calculated Volume	

Time	Temp (°F)	pH	Cond.	Gals. Removed	Observations
12 37	65.6	7.4	1000	6	
12 38	66.4	7.3	900	12	
12 39	66.2	7.3	880	17	

Did well dewater? Yes **No** Gallons actually evacuated: 17

Sampling Time: 12 45 Sampling Date: 7-8-98

Sample I.D.: C-5 Laboratory: **Sequoia** GTEL N. Creek Assoc. Labs

Analyzed for: **TPH-G** **BTEX** **MTBE** TPH-D Other:

Duplicate I.D.: Analyzed for: TPH-G BTEX MTBE TPH-D Other:

D.O. (if req'd):	Pre-purge:	mg/L	Post-purge:	mg/L
------------------	------------	------	-------------	------

O.R.P. (if req'd):	Pre-purge:	mV	Post-purge:	mV
--------------------	------------	----	-------------	----

CHEVRON WELL MONITORING DATA SHEET

Project #: 980708-C1	Station #: 9-5607
Sampler: CM	Date: 7-8-98
Well I.D.: C-6	Well Diameter: 2 3 <u>4</u> 6 8
Total Well Depth: 30.06	Depth to Water: 12.48
Depth to Free Product:	Thickness of Free Product (feet):
Referenced to: <u>PVC</u> Grade	D.O. Meter (if req'd): YSI HACH

Well Diameter	Multiplier	Well Diameter	Multiplier
2"	0.16	5"	1.02
3"	0.37	6"	1.47
4"	0.65	Other	radius ² * 0.163

Purge Method: Bailer	Sampling Method: Bailer
Disposable Bailer	Disposable Bailer <input checked="" type="checkbox"/>
Middleburg	Extraction Port
Electric Submersible <input checked="" type="checkbox"/>	Other: _____
Extraction Pump	
Other: _____	

11.4	x	3	=	34.2	Gals.
1 Case Volume (Gals.)		Specified Volumes		Calculated Volume	

Time	Temp (°F)	pH	Cond.	Gals. Removed	Observations
1400	80.1	7.0	2400	11.5	
1401	81.2	7.0	2200	23.0	
1402	81.0	7.0	2240	34.5	

Did well dewater? Yes <input type="checkbox"/> No <input checked="" type="checkbox"/>	Gallons actually evacuated: 34.5
Sampling Time: 14:10	Sampling Date: 7-8-98
Sample I.D.: C-6	Laboratory: <u>Sequoia</u> GTEL N. Creek Assoc. Labs
Analyzed for: <u>TPH-G</u> <u>BTEX</u> <u>MTBE</u> TPH-D Other:	
Duplicate I.D.:	Analyzed for: TPH-G BTEX MTBE TPH-D Other:
D.O. (if req'd):	Pre-purge: _____ mg/L Post-purge: _____ mg/L
O.R.P. (if req'd):	Pre-purge: _____ mV Post-purge: _____ mV

CHEVRON WELL MONITORING DATA SHEET

Project #: 980708-C1	Station #: 9-5607
Sampler: CM	Date: 7-8-98
Well I.D.: C-7	Well Diameter: (2) 3 4 6 8
Total Well Depth: 2630	Depth to Water: 6.98
Depth to Free Product: -	Thickness of Free Product (feet): -
Referenced to: PVC Grade	D.O. Meter (if req'd): YSI HACH

Well Diameter	Multiplier	Well Diameter	Multiplier
2"	0.16	5"	1.02
3"	0.37	6"	1.47
4"	0.65	Other	radius ² * 0.163

Purge Method:	Sampling Method:
Bailer	Bailer
Disposable Bailer	Disposable Bailer <input checked="" type="checkbox"/>
Middleburg	Extraction Port
Electric Submersible	Other: _____
Extraction Pump	
Other: _____	

3.1	x	3	=	9.3	Gals.
1 Case Volume (Gals.)		Specified Volumes		Calculated Volume	

Time	Temp (°F)	pH	Cond.	Gals. Removed	Observations
1210	66.7	7.3	800	3.5	
1215	66.8	7.4	760	7.0	
1220	68.9	7.4	740	9.5	

Did well dewater? Yes <input type="checkbox"/> No <input checked="" type="checkbox"/>	Gallons actually evacuated: 9.5
Sampling Time: 12:25	Sampling Date: 7-8-98
Sample I.D.: C-7	Laboratory: Sequoia GTEL N. Creek Assoc. Labs
Analyzed for: TPH-G BTEX MTBE TPH-D Other:	
Duplicate I.D.:	Analyzed for: TPH-G BTEX MTBE TPH-D Other:
D.O. (if req'd):	Pre-purge: mg/L Post-purge: mg/L
O.R.P. (if req'd):	Pre-purge: mV Post-purge: mV

CHEVRON WELL MONITORING DATA SHEET

Project #: 980708-C1	Station #: 9-5607
Sampler: CM	Date: 7-8-98
Well I.D.: C-8	Well Diameter: (2) 3 4 6 8 ____
Total Well Depth: 25.12	Depth to Water: 10.59
Depth to Free Product:	Thickness of Free Product (feet):
Referenced to: PVC - Grade	D.O. Meter (if req'd): YSI HACH

Well Diameter	Multiplier	Well Diameter	Multiplier
2"	0.16	5"	1.02
3"	0.37	6"	1.47
4"	0.65	Other	radius ² * 0.163

Purge Method:	Bailer	Sampling Method:	Bailer
	Disposable Bailer <input checked="" type="checkbox"/>		Disposable Bailer <input checked="" type="checkbox"/>
	Middleburg		Extraction Port
	Electric Submersible		Other: _____
	Extraction Pump		
	Other: _____		

<u>2.3</u>	\times	<u>3</u>	$=$	<u>6.9</u>	Gals.
1 Case Volume (Gals.)		Specified Volumes		Calculated Volume	

Time	Temp (°F)	pH	Cond.	Gals. Removed	Observations
11:40	70.7	7.4	680	2.5	
11:44	70.2	7.4	640	5.0	
11:48	70.6	7.4	620	7.5	

Did well dewater? Yes <input type="checkbox"/> No <input checked="" type="checkbox"/>	Gallons actually evacuated: 7.5
Sampling Time: 11:55	Sampling Date: 7-8-98
Sample I.D.: C-8	Laboratory: Sequoia GTEL N. Creek Assoc. Labs
Analyzed for: <input checked="" type="checkbox"/> TPH-G <input checked="" type="checkbox"/> BTEX <input checked="" type="checkbox"/> MTBE <input type="checkbox"/> TPH-D Other:	
Duplicate I.D.:	Analyzed for: TPH-G BTEX MTBE TPH-D Other:
D.O. (if req'd):	Pre-purge: _____ mg/L Post-purge: _____ mg/L
O.R.P. (if req'd):	Pre-purge: _____ mV Post-purge: _____ mV

CHEVRON WELL MONITORING DATA SHEET

Project #: 980708-C1	Station #: 9-5607
Sampler: CM	Date: 7-8-98
Well I.D.: C-9	Well Diameter: 2 3 (4) 6 8
Total Well Depth: —	Depth to Water: 1200
Depth to Free Product:	Thickness of Free Product (feet):
Referenced to: (PVC) Grade	D.O. Meter (if req'd): YSI HACH

Well Diameter	Multiplier	Well Diameter	Multiplier
2"	0.16	5"	1.00
3"	0.37	6"	1.47
4"	0.65	Other	radius ² * 0.163

Purge Method: ~~Bailer~~
~~Disposable Bailer~~
~~Middleburg~~
~~Electric Submersible Extraction Pump~~
 Other: _____

Sampling Method: Bailer
 Disposable Bailer
 Extraction Port
 Other: _____

_____	X	_____	=	_____ Gals.
1 Case Volume (Gals.)		Specified Volumes		Calculated Volume

Time	Temp (°F)	pH	Cond.	Gals. Removed	Observations
					- Unable to Pull Pump to get total depth
					- I was able to get a disposable down for a grab sample, (treatment facility not operating NO, Power)
1350	76.8	7.8	2000	—	—

Did well dewater? Yes No Gallons actually evacuated: —

Sampling Time: 1355 Sampling Date: 7-8-98

Sample I.D.: C-4 Laboratory: (Sequoia) GTEL N. Creek Assoc. Labs

Analyzed for: (TPH-G) (BTEX) (MTBE) (TPH-D) Other:

Duplicate I.D.: Analyzed for: TPH-G BTEX MTBE TPH-D Other:

D.O. (if req'd):	Pre-purge:	mg/L	Post-purge:	mg/L
------------------	------------	------	-------------	------

O.R.P. (if req'd):	Pre-purge:	mV	Post-purge:	mV
--------------------	------------	----	-------------	----

CHEVRON WELL MONITORING DATA SHEET

Project #: 980708-C1	Station #: 9-5607
Sampler: CM	Date: 7-8-98
Well I.D.: C-10A	Well Diameter: 2 (3) 4 6 8 _____
Total Well Depth: 22.64	Depth to Water: 17.95
Depth to Free Product:	Thickness of Free Product (feet):
Referenced to: PVC Grade	D.O. Meter (if req'd): YSI HACH

Well Diameter	Multiplier	Well Diameter	Multiplier
2"	0.16	5"	1.02
3"	0.37	6"	1.47
4"	0.65	Other	radius ² * 0.163

Purge Method: Bailer	Sampling Method: Bailer
Disposable Bailer <input checked="" type="checkbox"/>	Disposable Bailer <input checked="" type="checkbox"/>
Middleburg	Extraction Port
Electric Submersible	Other: _____
Extraction Pump	
Other: _____	

1.7	x	3	=	5.1	Gals.
1 Case Volume (Gals.)		Specified Volumes		Calculated Volume	

Time	Temp (°F)	pH	Cond.	Gals. Removed	Observations
950	63.3	7.2	1300	2	
952	64.0	7.2	1200	4	
954	63.8	7.1	1200	6	

Did well dewater? Yes <input type="checkbox"/> No <input checked="" type="checkbox"/>	Gallons actually evacuated: 6
Sampling Time: 10:00	Sampling Date: 7-8-98
Sample I.D.: C-10A	Laboratory: Sequoia GTEL N. Creek Assoc. Labs
Analyzed for: TPH-G BTEX MTBE TPH-D Other:	
Duplicate I.D.:	Analyzed for: TPH-G BTEX MTBE TPH-D Other:
D.O. (if req'd):	Pre-purge: _____ mg/L Post-purge: _____ mg/L
O.R.P. (if req'd):	Pre-purge: _____ mV Post-purge: _____ mV

CHEVRON WELL MONITORING DATA SHEET

Project #: 980708-C1	Station #: 9-5607
Sampler: CM	Date: 7-8-98
Well I.D.: C-10B	Well Diameter: 2 (3) 4 6 8 ____
Total Well Depth: 34.14	Depth to Water: 18.24
Depth to Free Product:	Thickness of Free Product (feet):
Referenced to: PVC - Grade	D.O. Meter (if req'd): YSI HACH

Well Diameter	Multiplier	Well Diameter	Multiplier
2"	0.16	5"	1.02
3"	0.37	6"	1.47
4"	0.65	Other	radius ² * 0.163

Purge Method:	Sampling Method:
Bailer	Bailer
Disposable Bailer	Disposable Bailer <input checked="" type="checkbox"/>
Middleburg	Extraction Port
Electric Submersible	Other: _____
Extraction Pump	
Other: _____	

<u>5.9</u>	\times	<u>3</u>	$=$	<u>17.7</u> Gals.
1 Case Volume (Gals.)		Specified Volumes		Calculated Volume

Time	Temp (°F)	pH	Cond.	Gals. Removed	Observations
10:10	64.3	7.4	900	6	
10:11	63.8	7.1	860	12	
10:12	62.1	7.1	800	18	

Did well dewater? Yes <input type="checkbox"/> No <input checked="" type="checkbox"/>	Gallons actually evacuated: 18
Sampling Time: 10:20	Sampling Date: 7-8-98
Sample I.D.: C-10 B	Laboratory: Sequoia GTEL N. Creek Assoc. Labs
Analyzed for: TPH-G BTEX MTBE TPH-D Other:	
Duplicate I.D.:	Analyzed for: TPH-G BTEX MTBE TPH-D Other:
D.O. (if req'd):	Pre-purge: <input type="text"/> mg/L Post-purge: <input type="text"/> mg/L
O.R.P. (if req'd):	Pre-purge: <input type="text"/> mV Post-purge: <input type="text"/> mV

CHEVRON WELL MONITORING DATA SHEET

Project #: 980708-C1	Station #: 9-5607
Sampler: CM	Date: 7-8-98
Well I.D.: C11	Well Diameter: 2 <u>3</u> 4 6 8
Total Well Depth: 33 60	Depth to Water: 18.54
Depth to Free Product:	Thickness of Free Product (feet):
Referenced to: <u>PVC</u> Grade	D.O. Meter (if req'd): YSI HACH

Well Diameter	Multiplier	Well Diameter	Multiplier
2"	0.16	5"	1.02
3"	0.37	6"	1.47
4"	0.65	Other	radius ² * 0.163

Purge Method:	Sampling Method:
Bailer Disposable Bailer Middleburg Electric Submersible <input checked="" type="checkbox"/> Extraction Pump	Bailer Disposable Bailer <input checked="" type="checkbox"/> Extraction Port Other: _____
Other: _____	

5.6	x	3	=	16.8	Gals.
1 Case Volume (Gals.)		Specified Volumes		Calculated Volume	

Time	Temp (°F)	pH	Cond.	Gals. Removed	Observations
10:50	75.6	7.4	2200	6	
10:51	74.3	7.2	2000	12	
10:52	74.0	7.2	1800	18	

Did well dewater? Yes <input type="checkbox"/> No <input checked="" type="checkbox"/>	Gallons actually evacuated: 18
Sampling Time: 11 00	Sampling Date: 7-8-98
Sample I.D.: C-11	Laboratory: <u>Sequoia</u> GTEL N. Creek Assoc. Labs
Analyzed for: <u>TPH-G</u> <u>BTEX</u> <u>MTBE</u> TPH-D Other:	
Duplicate I.D.:	Analyzed for: TPH-G BTEX MTBE TPH-D Other:
D.O. (if req'd):	Pre-purge: <input type="text"/> mg/L Post-purge: <input type="text"/> mg/L
O.R.P. (if req'd):	Pre-purge: <input type="text"/> mV Post-purge: <input type="text"/> mV

CHEVRON WELL MONITORING DATA SHEET

Project #: 980708-C1	Station #: 9-5607
Sampler: CM	Date: 7-8-98
Well I.D.: C-12	Well Diameter: 2 (3) 4 6 8
Total Well Depth: 29.60	Depth to Water: 10.71
Depth to Free Product:	Thickness of Free Product (feet):
Referenced to: PVC Grade	D.O. Meter (if req'd): YSI HACH

Well Diameter	Multiplier	Well Diameter	Multiplier
2"	0.16	5"	1.02
3"	0.37	6"	1.47
4"	0.65	Other	radius ² * 0.163

Purge Method: Bailer Sampling Method: Bailer

Disposable Bailer Disposable Bailer

Middleburg Extraction Port

Electric Submersible Other: _____

Extraction Pump

Other: _____

7.0	x	3	=	21	Gals.
I Case Volume (Gals.)		Specified Volumes		Calculated Volume	

Time	Temp (°F)	pH	Cond.	Gals. Removed	Observations
13:30	80.1	7.6	1100	7	
13:31	80.3	7.7	1200	14	
13:32	79.4	7.7	1100	21	

Did well dewater? Yes No Gallons actually evacuated: 21

Sampling Time: 1340 Sampling Date: 7-8-98

Sample I.D.: C-12 Laboratory: Sequoia GTEL N. Creek Assoc. Labs

Analyzed for: TPH-G BTEX MTBE TPH-D Other:

Duplicate I.D.: Analyzed for: TPH-G BTEX MTBE TPH-D Other:

D.O. (if req'd):	Pre-purge:	mg/L	Post-purge:	mg/L
O.R.P. (if req'd):	Pre-purge:	mV	Post-purge:	mV

CHEVRON WELL MONITORING DATA SHEET

Project #: 980708-C1	Station #: 9-5607
Sampler: CM	Date: 7-8-98
Well I.D.: C-13	Well Diameter: 2 (3) 4 6 8
Total Well Depth: 28.30	Depth to Water: 987
Depth to Free Product:	Thickness of Free Product (feet):
Referenced to: PVC Grade	D.O. Meter (if req'd): YSI HACH

Well Diameter	Multiplier	Well Diameter	Multiplier
2"	0.16	5"	1.02
3"	0.37	6"	1.47
4"	0.65	Other	radius ² * 0.163

Purge Method: Bailer Disposable Bailer Middleburg Electric Submersible Extraction Pump

Other: _____

Sampling Method: Bailer Disposable Bailer Extraction Port

Other: _____

6.8	x	3	=	20.4	Gals.
1 Case Volume (Gals.)		Specified Volumes		Calculated Volume	

Time	Temp (°F)	pH	Cond.	Gals. Removed	Observations
9:30	65.4	7.3	900	7	
9:31	64.8	7.5	840	14	
9:32	64.2	7.5	780	21	

Did well dewater? Yes No Gallons actually evacuated: 21

Sampling Time: 940 Sampling Date: 7-8-98

Sample I.D.: C-13 Laboratory: Sequoia GTEL N. Creek Assoc. Labs

Analyzed for: TPH-G BTEX MTBE TPH-D Other:

Duplicate I.D.: Analyzed for: TPH-G BTEX MTBE TPH-D Other:

D.O. (if req'd):	Pre-purge:	mg/L	Post-purge:	mg/L
O.R.P. (if req'd):	Pre-purge:	mV	Post-purge:	mV

CHEVRON WELL MONITORING DATA SHEET

Project #: 980708-C1	Station #: 9-5607
Sampler: CM	Date: 7-8-98
Well I.D.: C-14	Well Diameter: 2 (3) 4 6 8
Total Well Depth: 24.39	Depth to Water: 5.89
Depth to Free Product: —	Thickness of Free Product (feet): —
Referenced to: PVC Grade	D.O. Meter (if req'd): YSI HACH

Well Diameter	Multiplier	Well Diameter	Multiplier
2"	0.16	5"	1.02
3"	0.37	6"	1.47
4"	0.65	Other	radius ² * 0.163

Purge Method:	Sampling Method:
Bailer	Bailer
Disposable Bailer	Disposable Bailer X
Middleburg	Extraction Port
Electric Submersible X	Other: _____
Extraction Pump	
Other: _____	

<u>6.8</u>	x	<u>3</u>	=	<u>20.4</u>	Gals.
1 Case Volume (Gals.)		Specified Volumes		Calculated Volume	

Time	Temp (°F)	pH	Cond.	Gals. Removed	Observations
11:15	63.9	7.7	600	7	
11:16	64.8	7.5	580	14	
11:17	64.6	7.4	540	21	

Did well dewater? Yes <input type="radio"/> No <input checked="" type="radio"/>	Gallons actually evacuated: 21
Sampling Time: 11:25	Sampling Date: 7-8-98
Sample I.D.: C-14	Laboratory: Sequoia GTEL N. Creek Assoc. Labs
Analyzed for: TPH-G BTEX MTBE TPH-D Other:	
Duplicate I.D.:	Analyzed for: TPH-G BTEX MTBE TPH-D Other:
D.O. (if req'd):	Pre-purge: <input type="text"/> mg/L Post-purge: <input type="text"/> mg/L
O.R.P. (if req'd):	Pre-purge: <input type="text"/> mV Post-purge: <input type="text"/> mV

CHEVRON WELL MONITORING DATA SHEET

Project #: 980708-C1	Station #: 9-5607
Sampler: CM	Date: 7-8-98
Well I.D.: C-15	Well Diameter: 2 (3) 4 6 8
Total Well Depth: 19.67	Depth to Water: 10.50
Depth to Free Product:	Thickness of Free Product (feet):
Referenced to: PVC Grade	D.O. Meter (if req'd): YSI HACH

Well Diameter	Multiplier	Well Diameter	Multiplier
2"	0.16	5"	1.02
3"	0.37	6"	1.47
4"	0.65	Other	radius ² * 0.163

Purge Method: Bailer Sampling Method: Bailer
 Disposable Bailer X Disposable Bailer X
 Middleburg Extraction Port
 Electric Submersible Other: _____
 Extraction Pump
 Other: _____

3.4	x	3	=	13.2	Gals.
1 Case Volume (Gals.)		Specified Volumes		Calculated Volume	

Time	Temp (°F)	pH	Cond.	Gals. Removed	Observations
1300	64.8	7.3	1300	3.5	
1305	65.1	7.3	1300	7.0	
1310	64.8	7.3	1280	13.5	

Did well dewater? Yes No Gallons actually evacuated: 13.5

Sampling Time: 13:15 Sampling Date: 7-8-98

Sample I.D.: C-15 Laboratory: Sequoia GTEL N. Creek Assoc. Labs

Analyzed for: TPH-G BTEX MTBE TPH-D Other: _____

Duplicate I.D.: _____ Analyzed for: TPH-G BTEX MTBE TPH-D Other: _____

D.O. (if req'd):	Pre-purge:	mg/L	Post-purge:	mg/L
O.R.P. (if req'd):	Pre-purge:	mV	Post-purge:	mV

CHEVRON WELL MONITORING DATA SHEET

Project #: 980708-C1	Station #: 9-5607
Sampler: CM	Date: 7-8-98
Well I.D.: C-16	Well Diameter: 2 (3) 4 6 8
Total Well Depth: 30 59	Depth to Water: 1207
Depth to Free Product:	Thickness of Free Product (feet):
Referenced to: PVC Grade	D.O. Meter (if req'd): YSI HACH

Well Diameter	Multiplier	Well Diameter	Multiplier
2"	0.16	5"	1.02
3"	0.37	6"	1.47
4"	0.65	Other	radius ² * 0.163

Purge Method:	Sampling Method:
Bailer Disposable Bailer <input checked="" type="checkbox"/> Middleburg Electric Submersible <input checked="" type="checkbox"/> Extraction Pump Other: _____	Bailer Disposable Bailer <input checked="" type="checkbox"/> Extraction Port Other: _____

<u>6.9</u>	\times	<u>3</u>	$=$	<u>20.7</u> Gals.
1 Case Volume (Gals.)		Specified Volumes		Calculated Volume

Time	Temp (°F)	pH	Cond.	Gals. Removed	Observations
10:30	64.3	7.6	1200	7	
10:31	63.1	7.4	1100	14	
10:32	63.4	7.4	1100	21	

Did well dewater? Yes No Gallons actually evacuated: 21

Sampling Time: 10:40 Sampling Date: 7-8-98

Sample I.D.: C-16 Laboratory: Sequoia GTEL N. Creek Assoc. Labs

Analyzed for: TPH-G BTEX MTBE TPH-D Other:

Duplicate I.D.: Analyzed for: TPH-G BTEX MTBE TPH-D Other:

D.O. (if req'd): Pre-purge: mg/L Post-purge: mg/L

O.R.P. (if req'd): Pre-purge: mV Post-purge: mV