



Chevron

Chevron U.S.A. Products Company
6001 Bollinger Canyon Rd. Bldg. L
P. O. Box 6004
San Ramon, CA 94583-0804

**Site Assessment and
Remediation Group**
Phone (510) 842-9500
Fax (510) 842-8370

Date: June 12, 1998
To: Distribution
Re: **Groundwater Monitoring Report**

The enclosed groundwater monitoring report has been properly reviewed by a Chevron authorized representative. Agency guidelines have been followed. Blaine Tech Services is authorized to distribute the report directly to interested parties.

If you have any questions, please call me at (510) 842-8695.

Sincerely,

A handwritten signature in cursive script that reads "Brett L. Hunter".

Brett Hunter
Site Assessment and Remediation
Project Manager

RECEIVED
JUN 16 1998

ENVIRONMENTAL HEALTH SERVICES
NORTH COUNTY

BLAINE
TECH SERVICES INC.

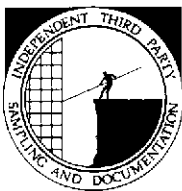

1680 ROGERS AVENUE
SAN JOSE, CALIFORNIA 95112
(408) 573-7771 FAX
(408) 573-0555 PHONE

RECEIVED
JUN 16 1998

ENVIRONMENTAL HEALTH SERVICES
NORTH COUNTY

June 4, 1998

Brett Hunter
Chevron U.S.A. Products Company
P.O. Box 6004
San Ramon, CA 94583-0904

2nd Quarter 1998 Monitoring at 9-5607

Second Quarter 1998 Groundwater Monitoring at
Chevron Service Station Number 9-5607
5269 Crow Canyon Road
Castro Valley, CA

Monitoring Performed on April 21, 1998

Groundwater Sampling Report 980421-S-1

This report covers the routine monitoring of groundwater wells at this Chevron facility. Blaine Tech Services, Inc.'s work at the site includes inspection, gauging, evacuation, purgewater containment, sample collection and sample handling in accordance with standard procedures that conform to Regional Water Quality Control Board requirements.

Routine field data collection includes depth to water, total well depth, thickness of any separate immiscible layer, water column volume, calculated volume of a three-case volume purge, elapsed evacuation time, total volume of water removed, and standard water parameter instrument readings. Sample material is collected, contained, stored, and transported to the laboratory in conformance with EPA standards. Purgewater is, likewise, collected and transported to McKittrick Waste Treatment Site for disposal.

Basic field information is presented alongside analytical values excerpted from the laboratory report in the cumulative table of **WELL DATA AND ANALYTICAL RESULTS**. The full analytical report for the most recent samples is located in the **Analytical Appendix**. The table also contains new groundwater elevation calculations taken from the computer plotted gradient map which is located in the **Professional Engineering Appendix**.

At a minimum, Blaine Tech Services, Inc. field personnel are certified upon completion of a forty-hour Hazardous Materials and Emergency Response training course per 29 CFR 1910.120. Field personnel are also enrolled in annual eight hour refresher courses.

Blaine Tech Services, Inc. conducts sampling and documentation assignments of this type as an independent third party. In order to avoid compromising the objectivity necessary for the proper and disinterested performance of this work, Blaine Tech Services, Inc. concentrates on objective data collection and does not participate in the interpretation of analytical results, the definition of geological or hydrological conditions, the formulation of recommendations, or the marketing of remedial systems.

Please call if you have any questions.

Yours truly,

A handwritten signature in black ink, appearing to read "Francis Thie", followed by a small "Es." or similar mark.

Francis Thie
Vice President

FPT/aa

attachments: Professional Engineering Appendix
Cumulative Table of Well Data and Analytical Results
Analytical Appendix
Field Data Sheets

cc: Scott Seery, Alameda County Environmental Health
Kevin Hinckley
Diane Riggs, Forest Creek Townhomes Assoc.
Tim Utterback, Weiss Associates
Bette Owen, Chevron (w/o enclosure)

Professional Engineering Appendix

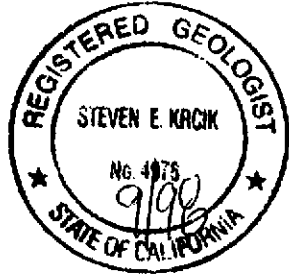
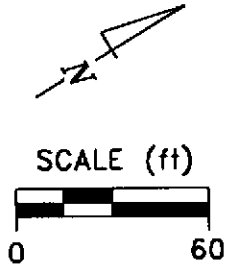

- EXPLANATION**
- MONITORING WELL
 - ABANDONED MONITORING WELL
 - ★ RECOVERY WELL
 - 272.75 GROUNDWATER ELEVATION (FT, MSL)
 - 270.00 GROUNDWATER ELEVATION CONTOUR (FT, MSL)
 - NA DATA NOT AVAILABLE
 - APPROXIMATE GROUNDWATER FLOW DIRECTION;
APPROXIMATE GRADIENT = 0.10

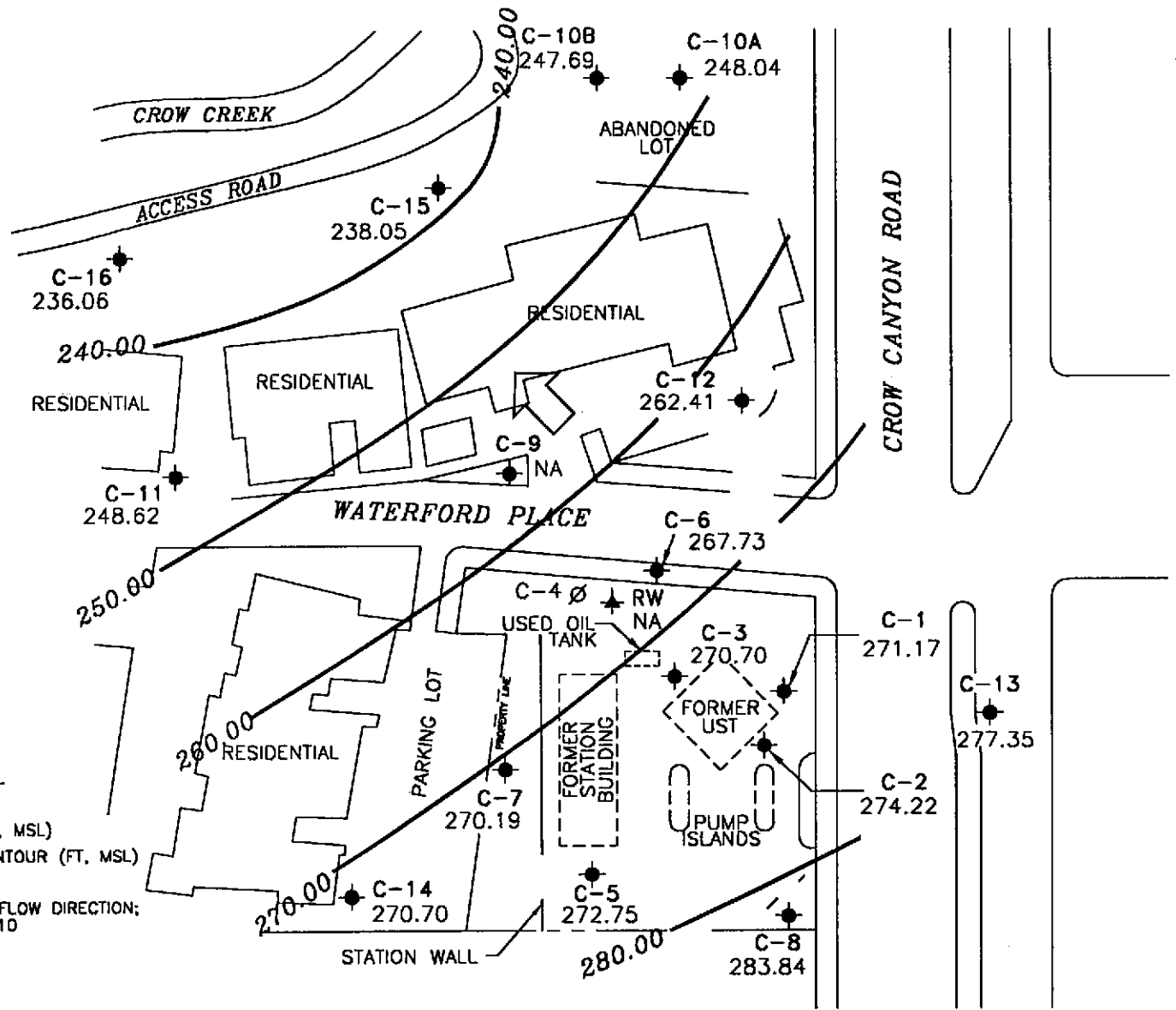

Basemap from Cambria Environmental Technology, Inc.

PREPARED BY

RRM
engineering contracting firm

Chevron Station 9-5607
5269 Crow Canyon Road
Castro Valley, California

**GROUNDWATER ELEVATION
CONTOUR MAP, APRIL 21, 1998**

**FIGURE:
1
PROJECT:
DAC04**

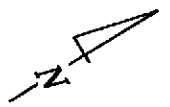

SCALE (ft)

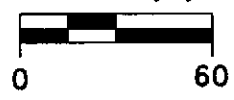

EXPLANATION

- MONITORING WELL
- ABANDONED MONITORING WELL
- RECOVERY WELL
- <50 TPH-g CONCENTRATIONS (ppb)
- <50 TPH-g CONCENTRATION CONTOUR (ppb)
- DATA NOT AVAILABLE

NOTE: CONTOURS BASED ON CURRENT AND HISTORIC DATA.

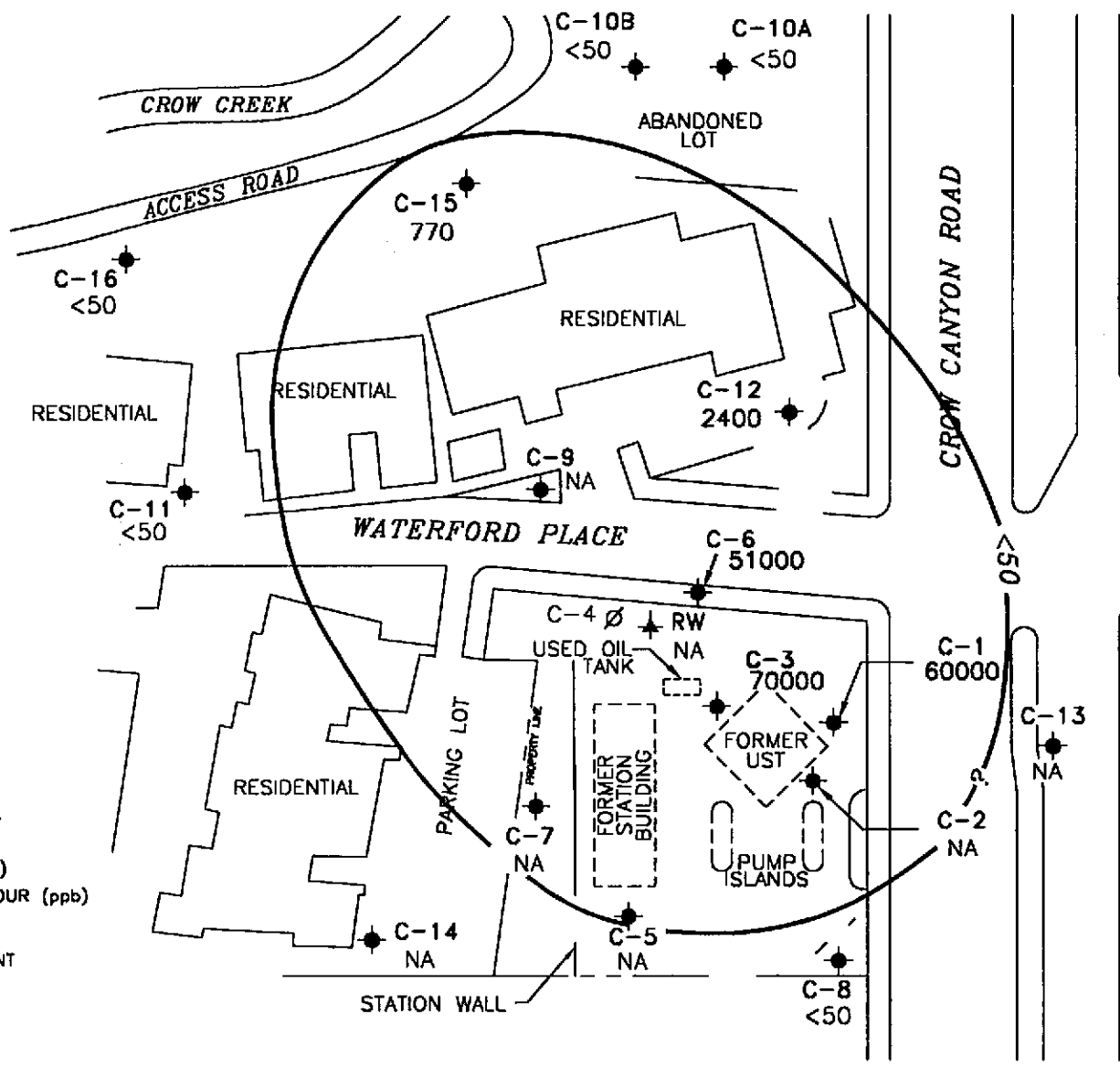

Basemap from Cambria Environmental Technology, Inc.

PREPARED BY

Chevron Station 9-5607
 5269 Crow Canyon Road
 Castro Valley, California

TPH-GASOLINE CONCENTRATION IN GROUNDWATER, APRIL 21, 1998

FIGURE:
 2
 PROJECT:
 DAC04

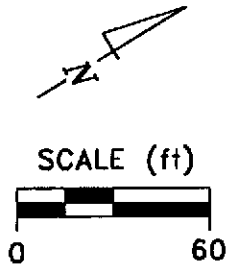

- EXPLANATION**
- ◆ MONITORING WELL
 - ∅ ABANDONED MONITORING WELL
 - ★ RECOVERY WELL
 - <0.5 BENZENE CONCENTRATIONS (ppb)
 - BENZENE CONCENTRATION CONTOUR (ppb)
 - NA DATA NOT AVAILABLE
- NOTE: CONTOURS BASED ON CURRENT AND HISTORIC DATA.

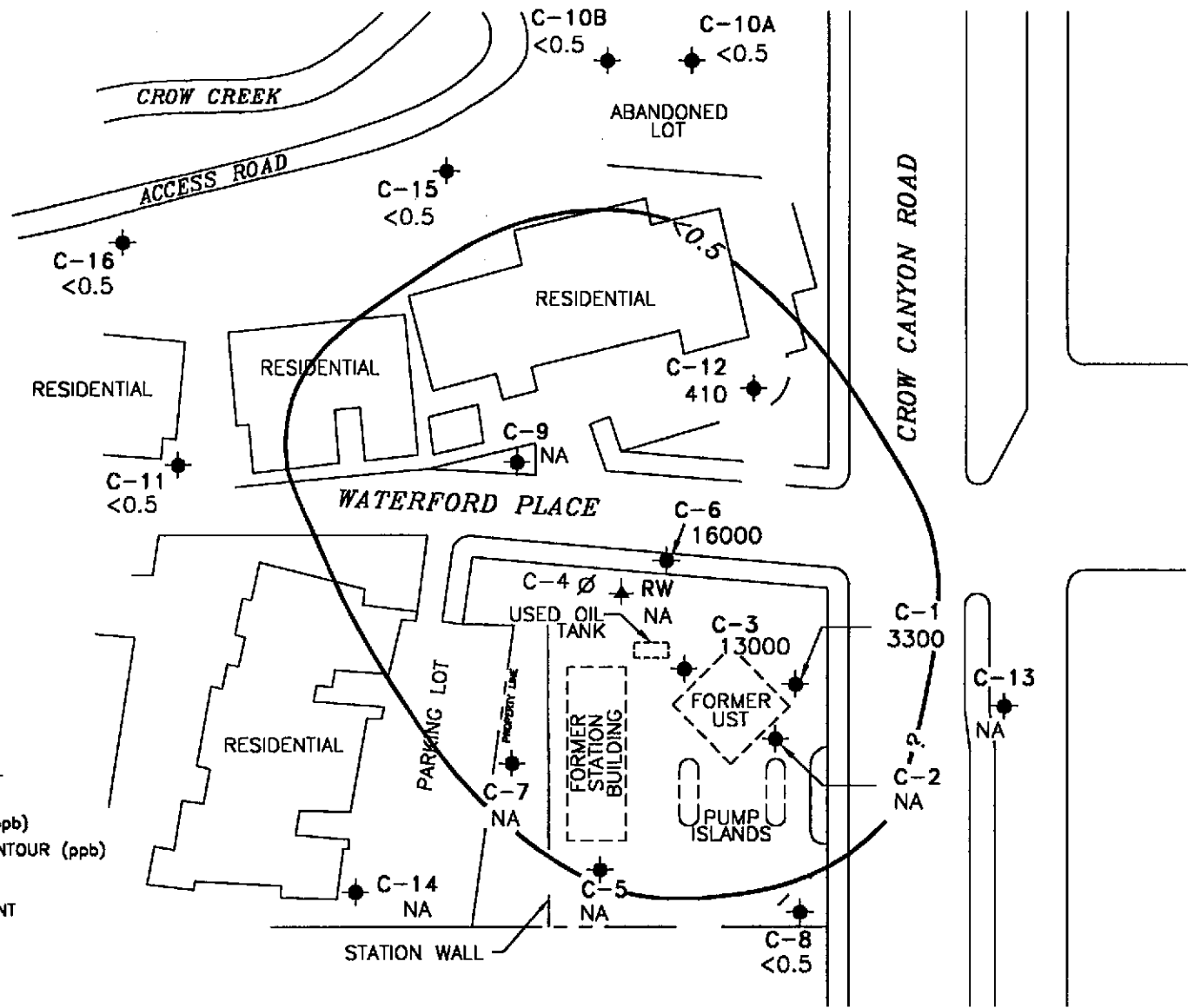

Basemap from Cambria Environmental Technology, Inc.

PREPARED BY

Chevron Station 9-5607
 5269 Crow Canyon Road
 Castro Valley, California

BENZENE CONCENTRATION IN GROUNDWATER, APRIL 21, 1998

FIGURE: 3
PROJECT: DAC04

Cumulative Table of Well Data and Analytical Results

Vertical Measurements are in feet.

Volumetric Measurements are in gallons.

Analytical results are in parts per billion (ppb)

DATE	Well Head Elev.	Ground Water Elev.	Depth To Water	SPH Thickness	SPH Removed	Total SPH Removed	Notes	TPH-Gasoline	Benzene	Toluene	Ethyl-Benzene	Xylene	MTBE	Organic Lead
C-1														
03/26/85	283.46	260.63	22.83	--	--	--	--	--	--	--	--	--	--	--
07/03/86	283.46	259.88	23.58	--	--	--	--	--	--	--	--	--	--	--
03/26/87	283.46	262.96	20.50	--	--	--	--	--	--	--	--	--	--	--
03/28/88	283.46	257.46	26.00	--	--	--	--	--	--	--	--	--	--	--
03/10/89	283.46	267.60	15.86	--	--	--	--	--	--	--	--	--	--	--
04/03/89	283.46	266.61	16.85	--	--	--	--	--	--	--	--	--	--	--
05/08/89	283.46	260.78	22.68	--	--	--	--	--	--	--	--	--	--	--
06/05/89	283.46	258.80	24.66	--	--	--	--	--	--	--	--	--	--	--
07/12/90	283.46	257.90	25.56	--	--	--	--	--	--	--	--	--	--	--
08/10/90	283.46	257.57	25.89	--	--	--	--	--	--	--	--	--	--	--
09/13/89	283.46	256.91	26.55	--	--	--	--	22,000	3600	1100	1000	3500	--	--
10/04/89	283.46	258.22	25.24	--	--	--	--	--	--	--	--	--	--	--
11/03/89	283.46	258.43	25.03	--	--	--	--	--	--	--	--	--	--	--
12/04/89	283.46	257.09	26.37	--	--	--	--	13,000	2000	550	610	1600	--	--
03/07/90	283.46	260.98	22.48	--	--	--	--	--	--	--	--	--	--	--
03/09/90	283.46	--	--	--	--	--	--	--	--	--	--	--	--	--
06/12/90	283.46	259.11	24.35	--	--	--	--	21,000	3500	1400	840	4000	--	--
09/20/90	283.46	257.19	26.27	--	--	--	--	23,000	2100	1200	860	5000	--	--
12/20/90	283.46	260.87	22.59	--	--	--	--	8200	760	410	260	1100	--	--
03/27/91	283.46	264.38	19.08	--	--	--	--	--	--	--	--	--	--	--
06/18/91	283.46	256.35	27.11	--	--	--	--	--	--	--	--	--	--	--
09/12/91	283.46	255.24	28.22	--	--	--	--	--	--	--	--	--	--	--
01/23/92	283.46	256.81	26.65	--	--	--	--	--	--	--	--	--	--	--
04/13/92	283.46	261.30	22.16	--	--	--	--	38,000	3100	1300	850	3100	--	--
08/03/92	283.46	257.31	26.15	--	--	--	--	13,000	1300	470	550	1600	--	ND
10/22/92	283.46	256.67	26.79	--	--	--	--	24,000	3500	1400	1500	4300	--	--
01/18/93	283.46	264.86	18.60	--	--	--	--	370,000	6900	8900	3100	23,000	--	--
04/19/93	283.46	262.34	21.12	--	--	--	--	51,000	8000	7000	1400	10,000	--	--
07/21,22/93	283.46	260.18	23.28	--	--	--	--	22,000	3400	1000	990	3100	--	--
10/25/93	283.46	258.80	24.66	--	--	--	--	14,000	2000	550	790	2300	--	--
01/21/94	283.46	262.99	20.47	--	--	--	--	1100	350	6.0	3.0	15	--	--
04/18/94	283.46	260.36	23.10	--	--	--	--	24,000	3200	1000	1000	3100	--	--
07/06-07/94	283.46	260.56	22.90	--	--	--	--	65,000	6500	4200	1600	9300	--	--
10/07/94	283.46	258.75	24.71	--	--	--	--	27,000	5100	1200	1400	4300	--	--
01/11/95	283.46	265.16	18.30	--	--	--	--	29,000	1300	1200	930	4000	--	--
04/24/95	283.46	266.52	16.94	--	--	--	--	75,000	8900	5000	1700	8400	--	--
07/31/95	283.46	262.90	20.56	--	--	--	--	56,000	11,000	2600	2500	11,000	--	--
10/02/95	283.46	272.88	10.58	--	--	--	--	44,000	7900	1100	2100	6500	--	--

CONTINUED ON NEXT PAGE

Cumulative Table of Well Data and Analytical Results

Vertical Measurements are in feet.

Analytical results are in parts per billion (ppb)

DATE	Well Head Elev.	Ground Water Elev.	Depth To Water	SPH Thickness	SPH Removed	Total SPH Removed	Notes	TPH-Gasoline	Benzene	Toluene	Ethyl-Benzene	Xylene	MTBE	Organic Lead
C-1 (CONT'D)														
01/16/96	283.46	261.71	21.75	--	--	--	--	29,000	5300	460	1000	2800	<500	--
04/18/96	283.46	264.51	18.95	--	--	--	--	59,000	7100	3000	2000	7600	<250	--
07/22/96	283.46	262.46	21.00	--	--	--	--	26,000	6100	610	1800	4700	<250	--
10/10/96	283.46	261.46	22.00	--	--	--	--	24,000	7100	600	1700	3200	<250	--
01/09/97	283.46	268.05	15.41	--	--	--	--	32,000	4600	820	1500	4000	670	--
04/15/97	283.46	264.12	19.34	--	--	--	--	100,000	11,000	4500	3200	13,000	1700	--
04/15/97	283.46	264.12	19.34	--	--	--	Confirmation run	--	--	--	--	--	<200	--
07/08/97	283.46	263.68	19.78	--	--	--	--	42,000	5500	880	2000	4800	920	--
10/22/97	283.46	265.13	18.33	--	--	--	--	29,000	5200	970	1800	4200	740	--
01/12/98	283.46	271.81	11.65	--	--	--	--	31,000	2700	960	2100	5700	<1000	--
04/21/98	283.46	271.17	12.29	--	--	--	--	60,000	3300	2100	3100	10,000	1400	--

Cumulative Table of Well Data and Analytical Results

Vertical Measurements are in feet.

Analytical results are in parts per billion (ppb)

DATE	Well Head Elev.	Ground Water Elev.	Depth To Water	SPH Thickness	SPH Removed	Total SPH Removed	Notes	TPH-Gasoline	Benzene	Toluene	Ethyl-Benzene	Xylene	MTBE	Organic Lead
C-2														
03/26/85	284.37	--	--	--	--	--	--	--	--	--	--	--	--	--
07/03/86	284.37	264.68	19.69	--	--	--	--	--	--	--	--	--	--	--
03/26/87	284.37	268.92	15.45	--	--	--	--	--	--	--	--	--	--	--
03/28/88	284.37	263.45	20.92	--	--	--	--	--	--	--	--	--	--	--
03/10/89	284.37	271.57	12.80	--	--	--	--	--	--	--	--	--	--	--
04/03/89	284.37	270.11	14.26	--	--	--	--	--	--	--	--	--	--	--
05/08/89	284.37	265.95	18.42	--	--	--	--	--	--	--	--	--	--	--
06/05/89	284.37	264.28	20.09	--	--	--	--	--	--	--	--	--	--	--
07/12/90	284.37	263.58	20.79	--	--	--	--	--	--	--	--	--	--	--
08/10/90	284.37	262.97	21.40	--	--	--	--	--	--	--	--	--	--	--
09/13/89	284.37	262.51	21.86	--	--	--	--	320	62	4.0	10	14	--	--
10/04/89	284.37	264.48	19.89	--	--	--	--	--	--	--	--	--	--	--
11/03/89	284.37	263.61	20.76	--	--	--	--	--	--	--	--	--	--	--
12/04/89	284.37	263.55	20.82	--	--	--	--	1000	240	37	66	130	--	--
03/07/90	284.37	266.54	17.83	--	--	--	--	--	--	--	--	--	--	--
03/09/90	284.37	266.54	17.83	--	--	--	--	390	280	35	27	50	--	--
06/12/90	284.37	264.48	19.89	--	--	--	--	700	260	34	28	55	--	--
09/20/90	284.37	262.40	21.97	--	--	--	--	--	--	--	--	--	--	--
12/20/90	284.37	266.64	17.73	--	--	--	--	--	--	--	--	--	--	--
03/27/91	284.37	269.27	15.10	--	--	--	--	--	--	--	--	--	--	--
06/18/91	284.37	261.69	22.68	--	--	--	--	--	--	--	--	--	--	--
09/12/91	284.37	260.45	23.92	--	--	--	--	--	--	--	--	--	--	--
01/23/92	284.37	263.13	21.24	--	--	--	--	--	--	--	--	--	--	--
04/13/92	284.37	266.83	17.54	--	--	--	--	1100	120	76	17	72	--	--
08/03/92	284.37	262.32	22.05	--	--	--	--	--	--	--	--	--	--	--
10/22/92	284.37	261.34	23.03	--	--	--	--	--	--	--	--	--	--	--
01/18/93	284.37	269.51	14.86	--	--	--	--	70	6.4	ND	ND	ND	--	--
04/19/93	284.37	267.57	16.80	--	--	--	--	--	--	--	--	--	--	--
07/21,22/93	284.37	265.12	19.25	--	--	--	--	--	--	--	--	--	--	--
10/25/93	284.37	264.72	19.65	--	--	--	--	--	--	--	--	--	--	--
01/21/94	284.37	258.80	25.57	--	--	--	--	43,000	5100	1800	2000	6800	--	--
04/18/94	284.37	274.61	9.76	--	--	--	--	--	--	--	--	--	--	--
07/06-07/94	284.37	265.61	18.76	--	--	--	--	--	--	--	--	--	--	--
10/07/94	284.37	264.20	20.17	--	--	--	--	--	--	--	--	--	--	--
01/11/95	284.37	270.33	14.04	--	--	--	Sampled annually	780	290	9.1	19	58	--	--
04/24/95	284.37	272.03	12.34	--	--	--	--	--	--	--	--	--	--	--
07/31/95	284.37	266.82	17.55	--	--	--	--	--	--	--	--	--	--	--
10/02/95	284.37	265.39	18.98	--	--	--	--	--	--	--	--	--	--	--

CONTINUED ON NEXT PAGE

Cumulative Table of Well Data and Analytical Results

Vertical Measurements are in feet.

Analytical results are in parts per billion (ppb)

DATE	Well Head Elev.	Ground Water Elev.	Depth To Water	SPH Thickness	SPH Removed	Total SPH Removed	Notes	TPH-Gasoline	Benzene	Toluene	Ethyl-Benzene	Xylene	MTBE	Organic Lead	
C-2 (CONT'D)															
01/16/96	284.37	268.37	16.00	--	--	--	--	260	29	2.9	5.7	21	6.1	--	
04/18/96	284.37	270.47	13.90	--	--	--	--	--	--	--	--	--	--	--	
07/22/96	284.37	266.63	17.74	--	--	--	--	--	--	--	--	--	--	--	
10/10/96	284.37	265.46	18.91	--	--	--	--	--	--	--	--	--	--	--	
01/09/97	284.37	271.62	12.75	--	--	--	--	460	25	15	72	24	6.3	--	
04/15/97	284.37	268.32	16.05	--	--	--	--	--	--	--	--	--	--	--	
07/08/97	284.37	267.95	16.42	--	--	--	--	--	--	--	--	--	--	--	
10/22/97	284.37	268.95	15.42	--	--	--	--	--	--	--	--	--	--	--	
01/12/98	284.37	272.85	11.52	--	--	--	--	280	22	1.4	5.3	1.2	13	--	
04/21/98	284.37	274.22	10.15	--	--	--	--	--	--	--	--	--	--	--	

Cumulative Table of Well Data and Analytical Results

Vertical Measurements are in feet.

Analytical results are in parts per billion (ppb)

DATE	Well Head Elev.	Ground Water Elev.	Depth To Water	SPH Thickness	SPH Removed	Total SPH Removed	Notes	TPH-Gasoline	Benzene	Toluene	Ethyl-Benzene	Xylene	MTBE	Organic Lead
C-3														
03/26/85	285.98	--	--	--	--	--	--	--	--	--	--	--	--	--
07/03/86	285.98	259.94	26.04	--	--	--	--	--	--	--	--	--	--	--
03/26/87	285.98	260.34	25.64	--	--	--	--	--	--	--	--	--	--	--
03/28/88	285.98	257.16	28.82	--	--	--	--	--	--	--	--	--	--	--
03/10/89	285.98	263.20	22.78	--	--	--	--	--	--	--	--	--	--	--
04/03/89	285.98	263.27	22.71	--	--	--	--	--	--	--	--	--	--	--
05/08/89	285.98	260.03	25.95	--	--	--	--	--	--	--	--	--	--	--
06/05/89	285.98	258.36	27.62	--	--	--	--	--	--	--	--	--	--	--
07/12/90	285.98	257.69	28.29	--	--	--	--	--	--	--	--	--	--	--
08/10/90	285.98	257.52	28.46	--	--	--	--	--	--	--	--	--	--	--
09/13/89	285.98	256.65	29.33	--	--	--	--	60,000	1400	6800	2300	10,000	--	--
10/04/89	285.98	257.01	28.97	--	--	--	--	--	--	--	--	--	--	--
11/03/89	285.98	257.26	28.72	--	--	--	--	--	--	--	--	--	--	--
12/04/89	285.98	256.97	29.01	--	--	--	--	56,000	1300	3300	1400	2700	--	--
03/07/90	285.98	258.29	27.69	--	--	--	--	--	--	--	--	--	--	--
03/09/90	285.98	258.29	27.69	--	--	--	--	42,000	1100	5700	1600	7900	--	--
06/12/90	285.98	257.89	28.09	--	--	--	--	160,000	1400	7100	3400	16,000	--	--
09/24/90	285.98	256.80	29.18	--	--	--	--	53,000	850	7700	2000	10,000	--	--
12/20/90	285.98	257.71	28.27	--	--	--	--	520	1200	5400	5400	33,000	--	--
03/27/91	285.98	261.18	24.80	--	--	--	--	92,000	1300	3100	1200	11,000	--	--
06/18/91	285.98	255.14	30.84	--	--	--	--	--	--	--	--	--	--	--
09/12/91	285.98	254.34	31.64	0.03	--	--	--	--	--	--	--	--	--	--
01/23/92	285.98	255.46	30.52	--	--	--	Sheen	--	--	--	--	--	--	--
04/13/92	285.98	259.04	26.94	0.01	--	--	--	--	--	--	--	--	--	--
08/03/92	285.98	255.98	30.00	--	--	--	--	220,000	1300	2800	3100	17,000	--	ND
10/22/92	285.98	255.38	30.62	0.03	--	--	--	--	--	--	--	--	--	--
01/18/93	285.98	262.07	23.91	--	--	--	--	1,000,000	2400	5300	10,000	61,000	--	--
04/19/93	285.98	260.98	25.00	--	--	--	--	94,000	33,000	22,000	1600	9200	--	--
07/21,22/93	285.98	259.43	26.55	--	--	--	--	44,000	2600	5500	1300	6900	--	--
10/25/93	285.98	257.26	28.72	--	--	--	--	35,000	3900	2400	1100	6600	--	--
01/21/94	285.98	256.32	29.66	--	--	--	--	120,000	4200	2200	2000	11,000	--	--
04/18/94	285.98	259.24	26.74	--	--	--	--	29,000	1200	310	520	2000	--	--
07/06-07/94	285.98	259.62	26.36	--	--	--	--	84,000	2700	1400	1400	9700	--	--
10/07/94	285.98	257.49	28.49	--	--	--	--	40,000	1600	390	1200	6100	--	--
01/11/95	285.98	262.84	23.14	--	--	--	--	34,000	4200	910	720	3800	--	--
04/24/95	285.98	266.10	19.88	--	--	--	--	210,000	43,000	28,000	2400	13,000	--	--
07/31/95	285.98	261.30	24.68	--	--	--	--	110,000	33,000	17,000	2300	12,000	--	--
10/02/95	285.98	258.84	27.14	--	--	--	--	69,000	6700	4000	2000	11,000	--	--

CONTINUED ON NEXT PAGE

Cumulative Table of Well Data and Analytical Results

Vertical Measurements are in feet.

Analytical results are in parts per billion (ppb)

DATE	Well Head Elev.	Ground Water Elev.	Depth To Water	SPH Thickness	SPH Removed	Total SPH Removed	Notes	TPH-Gasoline	Benzene	Toluene	Ethyl-Benzene	Xylene	MTBE	Organic Lead
C-3 (CONT'D)														
01/16/96	285.98	261.60	24.38	--	--	--	--	40,000	2400	440	1200	5500	<500	--
04/18/96	285.98	265.31	20.67	--	--	--	--	66,000	26,000	17,000	2200	12,000	<1250	--
07/22/96	285.98	261.32	24.66	--	--	--	--	69,000	21,000	8800	1800	9900	<1000	--
10/10/96	285.98	260.75	25.23	--	--	--	--	53,000	12,000	2600	1900	9300	<500	--
01/09/97	285.98	267.74	18.24	--	--	--	--	73,000	17,000	6000	1700	7800	<1250	--
04/15/97	285.98	263.96	22.02	--	--	--	--	160,000	28,000	17,000	2600	12,000	<2500	--
07/08/97	285.98	263.02	22.96	0.03	--	--	--	--	--	--	--	--	--	--
10/22/97	285.98	264.08	21.90	--	--	--	--	59,000	13,000	5200	2100	11,000	1500	--
01/12/98	285.98	277.93	8.05	--	--	--	--	62,000	10,000	4100	1700	8000	1000	--
04/21/98	285.98	270.70	15.28	--	--	--	--	70,000	13,000	5800	1600	7100	<1000	--

Cumulative Table of Well Data and Analytical Results

Vertical Measurements are in feet.

Analytical results are in parts per billion (ppb)

DATE	Well Head Elev.	Ground Water Elev.	Depth To Water	SPH Thickness	SPH Removed	Total SPH Removed	Notes	TPH-Gasoline	Benzene	Toluene	Ethyl-Benzene	Xylene	MTBE	Organic Lead
C-4														
03/26/85	273.01	257.87	15.14	--	--	--	--	--	--	--	--	--	--	--
07/03/86	273.01	257.64	15.37	--	--	--	--	--	--	--	--	--	--	--
03/26/87	273.01	--	--	--	--	--	--	--	--	--	--	--	--	--
03/28/88	273.01	254.97	18.04	--	--	--	--	--	--	--	--	--	--	--
03/10/89	273.01	--	--	--	--	--	--	--	--	--	--	--	--	--
04/03/89	273.01	259.67	13.34	--	--	--	--	--	--	--	--	--	--	--
05/08/89	273.01	257.41	15.60	--	--	--	--	--	--	--	--	--	--	--
06/05/89	273.01	256.50	16.51	--	--	--	--	--	--	--	--	--	--	--
07/12/90	273.01	256.02	16.99	--	--	--	--	--	--	--	--	--	--	--
08/10/90	273.01	255.74	17.27	--	--	--	--	--	--	--	--	--	--	--
09/13/89	273.01	254.85	18.16	--	--	--	--	57,000	21,000	3100	3200	11,000	--	--
10/04/89	273.01	254.77	18.24	--	--	--	--	--	--	--	--	--	--	--
11/03/89	273.01	254.84	18.17	--	--	--	--	--	--	--	--	--	--	--
12/04/89	273.01	254.56	18.45	--	--	--	--	48,000	17,000	2200	2800	9800	--	--
03/07/90	273.01	255.81	17.20	--	--	--	--	--	--	--	--	--	--	--
03/09/90	273.01	255.81	17.20	--	--	--	--	43,000	20,000	2300	2800	11,000	--	--
06/12/90	273.01	256.35	16.66	--	--	--	--	82,000	21,000	2400	4000	16,000	--	--
09/24/90	273.01	254.90	18.11	--	--	--	--	--	--	--	--	--	--	--
12/20/90	273.01	--	--	--	--	--	Abandoned	--	--	--	--	--	--	--

Cumulative Table of Well Data and Analytical Results

Vertical Measurements are in feet.

Analytical results are in parts per billion (ppb)

DATE	Well Head Elev.	Ground Water Elev.	Depth To Water	SPH Thickness	SPH Removed	Total SPH Removed	Notes	TPH-Gasoline	Benzene	Toluene	Ethyl-Benzene	Xylene	MTBE	Organic Lead
C-5														
03/26/85	287.95	262.62	25.33	--	--	--	--	--	--	--	--	--	--	--
07/03/86	287.95	261.54	26.41	--	--	--	--	--	--	--	--	--	--	--
03/26/87	287.95	262.99	24.96	--	--	--	--	--	--	--	--	--	--	--
03/28/88	287.95	258.15	29.80	--	--	--	--	--	--	--	--	--	--	--
03/10/89	287.95	262.06	25.89	--	--	--	--	--	--	--	--	--	--	--
04/03/89	287.95	263.57	24.38	--	--	--	--	--	--	--	--	--	--	--
05/08/89	287.95	260.15	27.80	--	--	--	--	--	--	--	--	--	--	--
06/05/89	287.95	258.53	29.42	--	--	--	--	--	--	--	--	--	--	--
07/12/90	287.95	258.09	29.86	--	--	--	--	--	--	--	--	--	--	--
08/10/90	287.95	258.18	29.77	--	--	--	--	--	--	--	--	--	--	--
09/13/89	287.95	257.00	30.95	--	--	--	--	310	ND	ND	ND	ND	--	--
10/04/89	287.95	256.47	31.48	--	--	--	--	--	--	--	--	--	--	--
11/03/89	287.95	256.63	31.32	--	--	--	--	--	--	--	--	--	--	--
12/04/89	287.95	256.25	31.70	--	--	--	--	ND	ND	ND	ND	ND	--	--
03/07/90	287.95	257.67	30.28	--	--	--	--	--	--	--	--	--	--	--
03/09/90	287.95	257.67	30.28	--	--	--	--	ND	ND	ND	ND	ND	--	--
06/12/90	287.95	257.47	30.48	--	--	--	--	90	ND	ND	ND	ND	--	--
09/24/90	287.95	256.17	31.78	--	--	--	--	ND	ND	ND	ND	ND	--	--
12/20/90	287.95	254.66	33.29	--	--	--	--	170	ND	ND	1.0	0.7	--	--
03/27/91	287.95	259.97	27.98	--	--	--	--	--	--	--	--	--	--	--
06/18/91	287.95	255.43	32.52	--	--	--	--	--	--	--	--	--	--	--
09/12/91	287.95	254.58	33.37	--	--	--	--	--	--	--	--	--	--	--
01/23/92	287.95	255.28	32.67	--	--	--	--	--	--	--	--	--	--	--
04/13/92	287.95	259.47	28.48	--	--	--	--	--	--	--	--	--	--	--
08/03/92	287.95	255.45	32.50	--	--	--	--	140	ND	ND	0.7	ND	--	--
10/22/92	287.95	253.97	33.98	--	--	--	--	ND	ND	ND	ND	ND	--	ND
01/18/93	287.95	260.93	27.02	--	--	--	--	--	--	--	--	--	--	--
04/19/93	287.95	263.14	24.81	--	--	--	--	230	6.6	2.2	3.4	2.2	--	--
07/21,22/93	287.95	258.89	29.06	--	--	--	--	--	--	--	--	--	--	--
10/25/93	287.95	257.00	30.95	--	--	--	--	130	ND	0.6	ND	ND	--	--
01/21/94	287.95	256.04	31.91	--	--	--	--	--	--	--	--	--	--	--
04/18/94	287.95	257.80	30.15	--	--	--	--	ND	ND	ND	ND	ND	--	--
07/06-07/94	287.95	258.91	29.04	--	--	--	--	ND	ND	ND	ND	ND	--	--
10/07/94	287.95	256.11	31.84	--	--	--	--	--	--	--	--	--	--	--
01/11/95	287.95	262.97	24.98	--	--	--	Sampled biannually	700	1.1	6.0	1.5	2.1	--	--
04/24/95	287.95	266.17	21.78	--	--	--	--	--	--	--	--	--	--	--
07/31/95	287.95	--	--	--	--	--	Inaccessible	--	--	--	--	--	--	--
10/02/95	287.95	257.77	30.18	--	--	--	--	--	--	--	--	--	--	--

CONTINUED ON NEXT PAGE

Cumulative Table of Well Data and Analytical Results

Vertical Measurements are in feet.

Analytical results are in parts per billion (ppb)

DATE	Well Head Elev.	Ground Water Elev.	Depth To Water	SPH Thickness	SPH Removed	Total SPH Removed	Notes	TPH-Gasoline	Benzene	Toluene	Ethyl-Benzene	Xylene	MTBE	Organic Lead	
C-5 (CONT'D)															
01/16/96	287.95	261.23	26.72	--	--	--	--	200	<0.5	<0.5	<0.5	1.3	<2.5	--	
04/18/96	287.95	266.15	21.80	--	--	--	--	--	--	--	--	--	--	--	
07/22/96	287.95	--	--	--	--	--	Inaccessible	--	--	--	--	--	--	--	
10/10/96	287.95	261.17	26.78	--	--	--	--	--	--	--	--	--	--	--	
01/09/97	287.95	268.93	19.02	--	--	--	--	190	0.63	<0.5	<0.5	<0.5	<2.5	--	
04/15/97	287.95	264.64	23.31	--	--	--	--	--	--	--	--	--	--	--	
07/08/97	287.95	--	--	--	--	--	Inaccessible	--	--	--	--	--	--	--	
10/22/97	287.95	--	--	--	--	--	Inaccessible	--	--	--	--	--	--	--	
01/12/98	287.95	269.37	18.58	--	--	--	--	200	1.1	0.57	1.3	2.5	<2.5	--	
04/21/98	287.95	272.75	15.20	--	--	--	--	--	--	--	--	--	--	--	

Cumulative Table of Well Data and Analytical Results

Vertical Measurements are in feet.

Analytical results are in parts per billion (ppb)

DATE	Well Head Elev.	Ground Water Elev.	Depth To Water	SPH Thickness	SPH Removed	Total SPH Removed	Notes	TPH-Gasoline	Benzene	Toluene	Ethyl-Benzene	Xylene	MTBE	Organic Lead	
C-6															
03/26/85	--	--	16.74	--	--	--	--	--	--	--	--	--	--	--	--
07/03/86	275.28	257.82	17.46	--	--	--	--	--	--	--	--	--	--	--	--
03/26/87	275.28	256.91	18.37	--	--	--	--	--	--	--	--	--	--	--	--
03/28/88	275.28	245.44	29.84	--	--	--	--	--	--	--	--	--	--	--	--
03/10/89	275.28	260.84	14.44	--	--	--	--	--	--	--	--	--	--	--	--
04/03/89	275.28	260.84	14.44	--	--	--	--	--	--	--	--	--	--	--	--
05/08/89	275.28	258.12	17.16	--	--	--	--	--	--	--	--	--	--	--	--
06/05/89	275.28	256.77	18.51	--	--	--	--	--	--	--	--	--	--	--	--
07/12/90	275.28	256.57	18.71	--	--	--	--	--	--	--	--	--	--	--	--
08/10/90	275.28	255.96	19.32	--	--	--	--	--	--	--	--	--	--	--	--
09/13/89	275.28	255.33	19.95	--	--	--	--	47	5600	3000	2400	10,000	--	--	--
10/04/89	275.28	255.41	19.87	--	--	--	--	--	--	--	--	--	--	--	--
11/03/89	275.28	255.93	19.35	--	--	--	--	--	--	--	--	--	--	--	--
12/04/89	275.28	255.69	19.59	--	--	--	--	40,000	8100	1800	1700	7500	--	--	--
03/07/90	275.28	256.89	18.39	--	--	--	--	--	--	--	--	--	--	--	--
03/09/90	275.28	256.89	18.39	--	--	--	--	73,000	23,000	5900	3400	17,000	--	--	--
06/12/90	275.28	256.41	18.87	--	--	--	--	85,000	19,000	6500	3400	16,000	--	--	--
09/24/90	275.28	255.29	19.99	--	--	--	--	72,000	15,000	3200	2600	11,000	--	--	--
12/20/90	275.28	253.71	21.57	--	--	--	--	100,000	11,000	4200	3400	16,000	--	--	--
03/27/91	275.28	258.96	16.32	--	--	--	--	100,000	11,000	4400	2300	11,000	--	--	--
06/18/91	275.28	251.95	23.33	--	--	--	--	--	--	--	--	--	--	--	--
09/12/91	275.28	251.32	23.96	--	--	--	--	--	--	--	--	--	--	--	--
01/23/92	275.28	263.20	12.08	--	--	--	--	--	--	--	--	--	--	--	--
04/13/92	275.28	255.43	19.85	--	--	--	Sheen	--	--	--	--	--	--	--	--
08/03/92	275.28	260.56	14.72	--	--	--	--	120,000	16,000	1100	2300	15,000	--	ND	--
10/22/92	275.28	260.37	14.91	--	--	--	--	63,000	7400	920	1800	14,000	--	--	--
01/18/93	275.28	259.84	15.44	--	--	--	--	77,000	13,000	1600	2700	12,000	--	--	--
04/19/93	275.28	266.03	9.25	--	--	--	--	56,000	14,000	1100	2400	9100	--	--	--
07/21, 22/93	275.28	257.93	17.35	--	--	--	--	38,000	6600	610	1500	5800	--	--	--
10/25/93	275.28	254.25	21.03	--	--	--	--	42,000	11,000	800	2200	8200	--	--	--
01/21/94	275.28	253.71	21.57	--	--	--	--	57,000	11,000	940	2300	9800	--	--	--
04/18/94	275.28	257.17	18.11	--	--	--	--	48,000	9800	830	1900	7500	--	--	--
07/06-07/94	275.28	258.28	17.00	--	--	--	--	46,000	6800	610	900	6200	--	--	--
10/07/94	275.28	256.09	19.19	--	--	--	--	35,000	5900	410	1400	3800	--	--	--
01/11/95	275.28	256.64	18.64	--	--	--	--	54,000	1200	1100	2100	9500	--	--	--
04/24/95	275.28	262.72	12.56	--	--	--	--	81,000	12,000	1500	2400	9900	--	--	--
07/31/95	275.28	259.54	15.74	--	--	--	--	75,000	12,000	1200	2800	11,000	--	--	--
10/02/95	275.28	257.56	17.72	--	--	--	--	59,000	13,000	990	2800	10,000	--	--	--

CONTINUED ON NEXT PAGE

Cumulative Table of Well Data and Analytical Results

Vertical Measurements are in feet.

Analytical results are in parts per billion (ppb)

DATE	Well Head Elev.	Ground Water Elev.	Depth To Water	SPH Thickness	SPH Removed	Total SPH Removed	Notes	TPH-Gasoline	Benzene	Toluene	Ethyl-Benzene	Xylene	MTBE	Organic Lead
C-6 (CONT'D)														
01/16/96	275.28	259.81	15.47	--	--	--	--	63,000	10,000	650	2200	7500	<500	--
04/18/96	275.28	259.33	15.95	--	--	--	--	56,000	9800	590	1500	5800	660	--
07/22/96	275.28	--	--	--	--	--	Inaccessible	--	--	--	--	--	--	--
10/10/96	275.28	--	--	--	--	--	Inaccessible	--	--	--	--	--	--	--
01/09/97	275.28	--	--	--	--	--	Inaccessible	--	--	--	--	--	--	--
04/15/97	275.28	--	--	--	--	--	Inaccessible	--	--	--	--	--	--	--
07/08/97	275.28	--	--	--	--	--	Inaccessible	--	--	--	--	--	--	--
07/15/97	275.28	260.95	14.33	--	--	--	--	64,000	12,000	400	1500	4400	<1000	--
10/22/97	275.28	261.80	13.48	--	--	--	--	49,000	15,000	570	1900	5600	1500	--
01/12/98	275.28	265.14	10.14	--	--	--	--	60,000	16,000	540	1800	5400	<1000	--
04/21/98	275.28	267.73	7.55	--	--	--	--	51,000	16,000	310	1400	3400	<1000	--

Cumulative Table of Well Data and Analytical Results

Vertical Measurements are in feet.

Analytical results are in parts per billion (ppb)

DATE	Well Head Elev.	Ground Water Elev.	Depth To Water	SPH Thickness	SPH Removed	Total SPH Removed	Notes	TPH-Gasoline	Benzene	Toluene	Ethyl-Benzene	Xylene	MTBE	Organic Lead
C-7														
03/26/85	--	--	9.61	--	--	--	--	--	--	--	--	--	--	--
07/03/86	270.70	259.96	10.74	--	--	--	--	--	--	--	--	--	--	--
03/26/87	270.70	260.62	10.08	--	--	--	--	--	--	--	--	--	--	--
03/28/88	270.70	256.91	13.79	--	--	--	--	--	--	--	--	--	--	--
03/10/89	270.70	260.28	10.42	--	--	--	--	--	--	--	--	--	--	--
04/03/89	270.70	261.56	9.14	--	--	--	--	--	--	--	--	--	--	--
05/08/89	270.70	258.79	11.91	--	--	--	--	--	--	--	--	--	--	--
06/05/89	270.70	259.16	11.54	--	--	--	--	--	--	--	--	--	--	--
07/12/90	270.70	257.25	13.45	--	--	--	--	--	--	--	--	--	--	--
08/10/90	270.70	257.33	13.37	--	--	--	--	--	--	--	--	--	--	--
09/13/89	270.70	256.10	14.60	--	--	--	--	410	1.3	ND	10	ND	--	--
10/04/89	270.70	255.53	15.17	--	--	--	--	--	--	--	--	--	--	--
11/03/89	270.70	255.42	15.28	--	--	--	--	--	--	--	--	--	--	--
12/04/89	270.70	255.00	15.70	--	--	--	--	1000	1.0	ND	5.0	ND	--	--
03/07/90	270.70	256.48	14.22	--	--	--	--	--	--	--	--	--	--	--
03/09/90	270.70	256.48	14.22	--	--	--	--	590	2.8	2.4	3.5	2.0	--	--
06/12/90	270.70	256.52	14.18	--	--	--	--	1200	ND	5	8.2	3.2	--	--
09/24/90	270.70	255.26	15.44	--	--	--	Sheen Duplicate	400	1.4	1.9	1.4	2.2	--	--
09/24/90	270.70	255.26	15.44	--	--	--	Duplicate	580	ND	2.4	1.4	1.5	--	--
12/20/90	270.70	253.62	17.08	--	--	--	--	2300	ND	6.5	4.7	9.3	--	--
03/27/91	270.70	258.05	12.65	--	--	--	--	980	ND	2.4	9.1	3.0	--	--
06/18/91	270.70	254.26	16.44	--	--	--	--	--	--	--	--	--	--	--
09/12/91	270.70	253.65	17.05	--	--	--	--	1200	ND	3.1	6.5	2.7	--	--
01/23/92	270.70	253.78	16.92	--	--	--	--	--	--	--	--	--	--	--
04/13/92	270.70	257.70	13.00	--	--	--	--	830	ND	1.0	7.8	1.2	--	--
08/03/92	270.70	--	--	--	--	--	--	--	--	--	--	--	--	--
10/22/92	270.70	--	--	--	--	--	Could not locate	--	--	--	--	--	--	--
01/18/93	270.70	--	--	--	--	--	Could not locate	--	--	--	--	--	--	--
04/19/93	270.70	--	--	--	--	--	Could not locate	--	--	--	--	--	--	--
07/21,22/93	270.70	257.76	12.94	--	--	--	--	890	0.9	3.0	4.0	4.0	--	--
10/25/93	270.70	255.87	14.83	--	--	--	--	--	--	--	--	--	--	--
01/21/94	270.70	254.76	15.94	--	--	--	--	660	ND	6.0	1.0	3.0	--	--
04/18/94	270.70	255.72	14.98	--	--	--	--	--	--	--	--	--	--	--
07/06-07/94	270.70	257.76	12.94	--	--	--	--	960	ND	5.8	4.2	8.2	--	--
10/07/94	270.70	254.87	15.83	--	--	--	--	--	--	--	--	--	--	--
01/11/95	270.70	261.45	9.25	--	--	--	Sampled biannually	900	<0.5	<0.5	2.3	1.3	--	--
04/24/95	270.70	264.00	6.70	--	--	--	--	--	--	--	--	--	--	--

CONTINUED ON NEXT PAGE

Cumulative Table of Well Data and Analytical Results

Vertical Measurements are in feet.

Analytical results are in parts per billion (ppb)

DATE	Well Head Elev.	Ground Water Elev.	Depth To Water	SPH Thickness	SPH Removed	Total SPH Removed	Notes	TPH-Gasoline	Benzene	Toluene	Ethyl-Benzene	Xylene	MTBE	Organic Lead	
C-7 (CONT'D)															
07/31/95	270.70	259.46	11.24	--	--	--	--	690	<1.2	<1.2	<1.2	<1.2	--	--	
10/02/95	270.70	256.88	14.02	--	--	--	--	--	--	--	--	--	--	--	
01/16/96	270.70	259.48	11.22	--	--	--	--	<50	<0.5	<0.5	<0.5	<0.5	<2.5	--	
04/18/96	270.70	264.05	6.65	--	--	--	--	--	--	--	--	--	--	--	
07/22/96	270.70	259.60	11.10	--	--	--	--	360	4.4	2.0	<0.5	<0.5	17	--	
10/10/96	270.70	259.35	11.35	--	--	--	--	--	--	--	--	--	--	--	
01/09/97	270.70	266.82	3.88	--	--	--	--	69	<0.5	<0.5	<0.5	<0.5	<2.5	--	
04/15/97	270.70	262.82	7.88	--	--	--	--	--	--	--	--	--	--	--	
07/08/97	270.70	261.70	9.00	--	--	--	--	710	8.0	1.2	<0.5	<0.5	22	--	
10/22/97	270.70	262.09	8.61	--	--	--	--	--	--	--	--	--	--	--	
01/12/98	270.70	267.03	3.67	--	--	--	--	400	7.2	<1.0	1.6	1.3	16	--	
04/21/98	270.70	270.19	0.51	--	--	--	--	--	--	--	--	--	--	--	

Cumulative Table of Well Data and Analytical Results

Vertical Measurements are in feet.

Analytical results are in parts per billion (ppb)

DATE	Well Head Elev.	Ground Water Elev.	Depth To Water	SPH Thickness	SPH Removed	Total SPH Removed	Notes	TPH-Gasoline	Benzene	Toluene	Ethyl-Benzene	Xylene	MTBE	Organic Lead
C-8														
03/26/85	--	--	8.68	--	--	--	--	--	--	--	--	--	--	--
07/03/86	288.40	274.51	13.89	--	--	--	--	--	--	--	--	--	--	--
03/26/87	288.40	282.39	6.01	--	--	--	--	--	--	--	--	--	--	--
03/28/88	288.40	277.74	10.66	--	--	--	--	--	--	--	--	--	--	--
03/10/89	288.40	281.79	6.61	--	--	--	--	--	--	--	--	--	--	--
04/03/89	288.40	281.94	6.46	--	--	--	--	--	--	--	--	--	--	--
05/08/89	288.40	279.43	8.97	--	--	--	--	--	--	--	--	--	--	--
06/05/89	288.40	277.52	10.88	--	--	--	--	--	--	--	--	--	--	--
07/12/90	288.40	276.25	12.15	--	--	--	--	--	--	--	--	--	--	--
08/10/90	288.40	275.94	12.46	--	--	--	--	--	--	--	--	--	--	--
09/13/89	288.40	275.62	12.78	--	--	--	--	ND	ND	ND	ND	ND	--	--
10/04/89	288.40	275.89	12.51	--	--	--	--	--	--	--	--	--	--	--
11/03/89	288.40	273.77	14.63	--	--	--	--	--	--	--	--	--	--	--
12/04/89	288.40	278.81	9.59	--	--	--	--	64	0.6	0.6	ND	1.0	--	--
03/07/90	288.40	279.60	8.80	--	--	--	--	--	--	--	--	--	--	--
03/09/90	288.40	279.60	8.80	--	--	--	--	ND	ND	ND	ND	ND	--	--
06/12/90	288.40	279.46	8.94	--	--	--	--	120	2.5	1.2	1.0	1.4	--	--
09/24/90	288.40	274.86	13.54	--	--	--	--	--	--	--	--	--	--	--
12/20/90	288.40	279.07	9.33	--	--	--	--	--	--	--	--	--	--	--
03/27/91	288.40	282.30	6.10	--	--	--	--	54	0.7	ND	0.7	1.9	--	--
06/18/91	288.40	276.44	11.96	--	--	--	--	--	--	--	--	--	--	--
09/12/91	288.40	274.80	13.60	--	--	--	--	ND	ND	ND	ND	ND	--	--
09/12/91	288.40	274.80	13.60	--	--	--	Duplicate	ND	ND	ND	ND	ND	--	--
01/23/92	288.40	264.20	24.20	--	--	--	--	--	--	--	--	--	--	--
04/13/92	288.40	280.05	8.35	--	--	--	--	ND	ND	ND	ND	ND	--	--
08/03/92	288.40	275.82	12.58	--	--	--	--	ND	ND	ND	ND	ND	--	ND
10/22/92	288.40	275.30	13.10	--	--	--	--	ND	ND	ND	ND	ND	--	--
01/18/93	288.40	282.28	6.12	--	--	--	--	ND	ND	ND	ND	ND	--	--
04/19/93	288.40	281.35	7.05	--	--	--	--	ND	ND	ND	ND	ND	--	--
07/21,22/93	288.40	277.05	11.35	--	--	--	--	ND	ND	ND	ND	ND	--	--
10/25/93	288.40	275.55	12.85	--	--	--	--	ND	ND	ND	ND	ND	--	--
01/21/94	288.40	277.85	10.55	--	--	--	--	ND	ND	ND	ND	ND	--	--
04/18/94	288.40	278.89	9.51	--	--	--	--	ND	1.2	0.9	ND	1.6	--	--
07/06-07/94	288.40	277.02	11.38	--	--	--	--	ND	ND	ND	ND	ND	--	--
10/07/94	288.40	275.48	12.92	--	--	--	--	ND	ND	ND	ND	ND	--	--
01/11/95	288.40	283.04	5.36	--	--	--	--	<50	<0.5	<0.5	<0.5	<0.5	--	--
04/24/95	288.40	281.82	6.58	--	--	--	--	<50	<0.5	0.61	<0.5	0.51	--	--

CONTINUED ON NEXT PAGE

Cumulative Table of Well Data and Analytical Results

Vertical Measurements are in feet.

Analytical results are in parts per billion (ppb)

DATE	Well Head Elev.	Ground Water Elev.	Depth To Water	SPH Thickness	SPH Removed	Total SPH Removed	Notes	TPH-Gasoline	Benzene	Toluene	Ethyl-Benzene	Xylene	MTBE	Organic Lead	
C-8 (CONT'D)															
07/31/95	288.40	278.94	9.46	--	--	--	--	<50	<0.5	<0.5	<0.5	<0.5	--	--	
10/02/95	288.40	276.56	11.84	--	--	--	--	<50	<0.5	<0.5	<0.5	<0.5	--	--	
01/16/96	288.40	281.40	7.00	--	--	--	--	<50	<0.5	<0.5	<0.5	<0.5	5.4	--	
04/18/96	288.40	281.77	6.63	--	--	--	--	<50	<0.5	<0.5	<0.5	<0.5	<2.5	--	
07/22/96	288.40	280.49	7.91	--	--	--	--	<50	<0.5	<0.5	<0.5	<0.5	<2.5	--	
10/10/96	288.40	279.71	8.69	--	--	--	--	<50	<0.5	<0.5	<0.5	<0.5	<2.5	--	
01/09/97	288.40	283.11	5.29	--	--	--	--	<50	<0.5	<0.5	<0.5	<0.5	<2.5	--	
04/15/97	288.40	281.90	6.50	--	--	--	--	<50	<0.5	<0.5	<0.5	<0.5	<2.5	--	
07/08/97	288.40	281.90	6.50	--	--	--	--	<50	<0.5	<0.5	<0.5	<0.5	<2.5	--	
10/22/97	288.40	283.00	5.40	--	--	--	--	<50	<0.5	<0.5	<0.5	<0.5	<2.5	--	
01/12/98	288.40	284.27	4.13	--	--	--	--	<50	<0.5	<0.5	<0.5	<0.5	<2.5	--	
04/21/98	288.40	283.84	4.56	--	--	--	--	<50	<0.5	<0.5	<0.5	<0.5	<2.5	--	

Cumulative Table of Well Data and Analytical Results

Vertical Measurements are in feet.

Analytical results are in parts per billion (ppb)

DATE	Well Head Elev.	Ground Water Elev.	Depth To Water	SPH Thickness	SPH Removed	Total SPH Removed	Notes	TPH-Gasoline	Benzene	Toluene	Ethyl-Benzene	Xylene	MTBE	Organic Lead
C-9														
07/03/86	268.46	254.57	13.89	--	--	--	--	--	--	--	--	--	--	--
03/26/87	268.46	254.72	13.74	--	--	--	--	--	--	--	--	--	--	--
03/28/88	268.46	253.47	14.99	--	--	--	--	--	--	--	--	--	--	--
03/10/89	268.46	255.07	13.39	--	--	--	--	--	--	--	--	--	--	--
04/03/89	268.46	255.62	12.84	--	--	--	--	--	--	--	--	--	--	--
05/08/89	268.46	254.08	14.38	--	--	--	--	--	--	--	--	--	--	--
06/05/89	268.46	253.10	15.36	--	--	--	--	--	--	--	--	--	--	--
07/12/90	268.46	252.81	15.65	--	--	--	--	--	--	--	--	--	--	--
08/10/90	268.46	252.66	15.80	--	--	--	--	--	--	--	--	--	--	--
09/13/89	268.46	251.93	16.53	--	--	--	--	42,000	14,000	1100	2800	4200	--	--
10/04/89	268.46	251.94	16.52	--	--	--	--	--	--	--	--	--	--	--
11/03/89	268.46	251.95	16.51	--	--	--	--	--	--	--	--	--	--	--
12/04/89	268.46	251.67	16.79	--	--	--	--	36,000	11,000	670	2500	3800	--	--
03/07/90	268.46	252.24	16.22	--	--	--	--	--	--	--	--	--	--	--
03/09/90	268.46	252.24	16.22	--	--	--	--	28,000	12,000	940	3000	4700	--	--
06/12/90	268.46	253.58	14.88	--	--	--	--	39,000	11,000	1600	2300	4800	--	--
09/24/90	268.46	252.16	16.30	--	--	--	--	120,000	13,000	1600	3700	6800	--	--
12/20/90	268.46	251.23	17.23	--	--	--	--	51,000	9300	560	2800	3300	--	--
12/20/90	268.46	251.23	17.23	--	--	--	Duplicate	44,000	12,000	580	2800	3500	--	--
03/27/91	268.46	254.68	13.78	--	--	--	--	56,000	3400	5000	1600	5600	--	--
06/18/91	268.46	249.82	18.64	--	--	--	--	--	--	--	--	--	--	--
09/12/91	268.46	--	--	--	--	--	Inaccessible	--	--	--	--	--	--	--
10/24/95	268.46	250.39	18.07	--	--	--	--	30,000	7200	440	2500	1600	--	--
01/16/96	268.46	252.18	16.28	--	--	--	--	36,000	8200	700	2500	2100	<500	--

NO LONGER MONITORED OR SAMPLED

Cumulative Table of Well Data and Analytical Results

Vertical Measurements are in feet.

Analytical results are in parts per billion (ppb)

DATE	Well Head Elev.	Ground Water Elev.	Depth To Water	SPH Thickness	SPH Removed	Total SPH Removed	Notes	TPH-Gasoline	Benzene	Toluene	Ethyl-Benzene	Xylene	MTBE	Organic Lead
C-10A														
03/07/90	264.84	244.63	20.21	--	--	--	--	--	--	--	--	--	--	--
03/09/90	264.84	--	--	--	--	--	--	ND	1.6	0.7	0.8	3.5	--	--
06/12/90	264.84	245.14	19.70	--	--	--	--	ND	ND	ND	ND	ND	--	--
09/24/90	264.84	245.30	19.54	--	--	--	--	ND	ND	ND	ND	ND	--	--
12/20/90	264.84	245.00	19.84	--	--	--	--	ND	ND	ND	ND	ND	--	--
03/27/91	264.84	246.83	18.01	--	--	--	--	--	--	--	--	--	--	--
06/18/91	264.84	244.68	20.16	--	--	--	--	ND	ND	ND	ND	ND	--	--
09/12/91	264.84	244.27	20.57	--	--	--	--	ND	ND	ND	ND	ND	--	--
01/23/92	264.84	244.17	20.67	--	--	--	--	ND	ND	ND	ND	ND	--	--
04/13/92	264.84	245.44	19.40	--	--	--	--	53	0.9	1.3	ND	1.0	--	--
08/03/92	264.84	245.03	19.81	--	--	--	--	ND	ND	ND	ND	ND	--	ND
10/22/92	264.84	245.01	19.83	--	--	--	--	ND	ND	ND	ND	0.5	--	--
01/18/93	264.84	247.80	17.04	--	--	--	--	ND	ND	ND	ND	ND	--	--
04/19/93	264.84	247.07	17.77	--	--	--	--	ND	ND	ND	ND	ND	--	--
04/19/93	264.84	247.28	17.56	--	--	--	--	ND	ND	ND	ND	ND	--	--
10/25/93	264.84	247.07	17.77	--	--	--	--	ND	ND	ND	ND	ND	--	--
01/21/94	264.84	246.93	17.91	--	--	--	--	ND	ND	ND	ND	ND	--	--
04/18/94	264.84	247.81	17.03	--	--	--	--	ND	3.0	3.0	1.4	5.5	--	--
07/06-07/94	264.84	248.06	16.78	--	--	--	--	ND	ND	ND	ND	ND	--	--
10/07/94	264.84	247.63	17.21	--	--	--	--	ND	ND	ND	ND	ND	--	--
01/11/95	264.84	248.78	16.06	--	--	--	--	<50	<0.5	<0.5	<0.5	<0.5	--	--
04/24/95	264.84	248.32	16.52	--	--	--	--	<50	<0.5	<0.5	<0.5	<0.5	--	--
07/31/95	264.84	245.82	19.02	--	--	--	--	<50	<0.5	<0.5	<0.5	<0.5	--	--
10/02/95	264.84	245.14	19.70	--	--	--	--	<50	<0.5	<0.5	<0.5	<0.5	--	--
01/16/96	264.84	246.21	18.63	--	--	--	--	<50	<0.5	<0.5	<0.5	<0.5	<2.5	--
04/18/96	264.84	247.19	17.65	--	--	--	--	<50	<0.5	<0.5	<0.5	<0.5	<2.5	--
07/22/96	264.84	245.99	18.85	--	--	--	--	<50	<0.5	<0.5	<0.5	<0.5	<2.5	--
10/10/96	264.84	245.40	19.44	--	--	--	--	<50	<0.5	<0.5	<0.5	<0.5	<2.5	--
01/09/97	264.84	248.00	16.84	--	--	--	--	<50	<0.5	<0.5	<0.5	<0.5	<2.5	--
04/15/97	264.84	246.47	18.37	--	--	--	--	<50	<0.5	<0.5	<0.5	<0.5	<2.5	--
07/08/97	264.84	246.33	18.51	--	--	--	--	<50	<0.5	<0.5	<0.5	<0.5	<2.5	--
10/22/97	264.84	246.64	18.20	--	--	--	--	<50	<0.5	<0.5	<0.5	<0.5	<2.5	--
01/12/98	264.84	248.00	16.84	--	--	--	--	<50	<0.5	<0.5	<0.5	<0.5	<2.5	--
04/21/98	264.84	248.04	16.80	--	--	--	--	<50	<0.5	<0.5	<0.5	<0.5	<2.5	--

Cumulative Table of Well Data and Analytical Results

Vertical Measurements are in feet.

Analytical results are in parts per billion (ppb)

DATE	Well Head Elev.	Ground Water Elev.	Depth To Water	SPH Thickness	SPH Removed	Total SPH Removed	Notes	TPH-Gasoline	Benzene	Toluene	Ethyl-Benzene	Xylene	MTBE	Organic Lead
C-10B														
03/07/90	264.85	243.41	21.44	--	--	--	--	--	--	--	--	--	--	--
06/12/90	264.85	244.91	19.94	--	--	--	--	ND	ND	ND	ND	ND	--	--
09/24/90	264.85	245.08	19.77	--	--	--	--	ND	ND	ND	ND	ND	--	--
12/20/90	264.85	244.85	20.00	--	--	--	--	ND	ND	ND	ND	ND	--	--
03/27/91	264.85	246.62	18.23	--	--	--	--	--	--	--	--	--	--	--
06/18/91	264.85	244.41	20.44	--	--	--	--	--	--	--	--	--	--	--
09/12/91	264.85	244.03	20.82	--	--	--	--	ND	ND	ND	ND	ND	--	--
01/23/92	264.85	243.93	20.92	--	--	--	--	ND	ND	ND	ND	ND	--	--
04/13/92	264.85	245.17	19.68	--	--	--	--	ND	ND	ND	ND	ND	--	--
08/03/92	264.85	244.78	20.07	--	--	--	--	ND	ND	ND	ND	ND	--	ND
10/22/92	264.85	244.73	20.12	--	--	--	--	ND	ND	ND	ND	ND	--	--
01/18/93	264.85	247.49	17.36	--	--	--	--	60	3.3	11	2.1	8.9	--	--
04/19/93	264.85	246.95	17.90	--	--	--	--	ND	ND	ND	ND	ND	--	--
07/21,22/93	264.85	246.99	17.86	--	--	--	--	ND	ND	ND	ND	ND	--	--
10/25/93	264.85	246.75	18.10	--	--	--	--	ND	ND	ND	ND	ND	--	--
01/21/94	264.85	246.62	18.23	--	--	--	--	ND	ND	ND	ND	ND	--	--
04/18/94	264.85	247.49	17.36	--	--	--	--	ND	ND	ND	ND	0.5	--	--
07/06-07/94	264.85	247.80	17.05	--	--	--	--	ND	ND	ND	ND	ND	--	--
10/07/94	264.85	247.31	17.54	--	--	--	--	ND	ND	ND	ND	ND	--	--
01/11/95	264.85	248.61	16.24	--	--	--	--	<50	<0.5	<0.5	<0.5	<0.5	--	--
04/24/95	264.85	247.95	16.90	--	--	--	--	<50	<0.5	<0.5	<0.5	<0.5	--	--
07/31/95	264.85	245.57	19.28	--	--	--	--	<50	<0.5	<0.5	<0.5	<0.5	--	--
10/02/95	264.85	244.91	19.94	--	--	--	--	<50	<0.5	<0.5	<0.5	<0.5	--	--
01/16/96	264.85	246.25	18.60	--	--	--	--	<50	<0.5	<0.5	<0.5	<0.5	<2.5	--
04/18/96	264.85	246.87	17.98	--	--	--	--	<50	<0.5	<0.5	<0.5	<0.5	<2.5	--
07/22/96	264.85	245.75	19.10	--	--	--	--	<50	<0.5	<0.5	<0.5	<0.5	<2.5	--
10/10/96	264.85	245.14	19.71	--	--	--	--	<50	<0.5	<0.5	<0.5	<0.5	<2.5	--
01/09/97	264.85	247.65	17.20	--	--	--	--	<50	<0.5	<0.5	<0.5	<0.5	<2.5	--
04/15/97	264.85	246.11	18.74	--	--	--	--	<50	<0.5	<0.5	<0.5	<0.5	<2.5	--
07/08/97	264.85	246.10	18.75	--	--	--	--	<50	<0.5	<0.5	<0.5	<0.5	<2.5	--
10/22/97	264.85	246.35	18.50	--	--	--	--	<50	<0.5	<0.5	<0.5	<0.5	<2.5	--
01/12/98	264.85	247.71	17.14	--	--	--	--	<50	<0.5	<0.5	<0.5	<0.5	<2.5	--
04/21/98	264.85	247.69	17.16	--	--	--	--	<50	<0.5	<0.5	<0.5	<0.5	<2.5	--

Cumulative Table of Well Data and Analytical Results

Vertical Measurements are in feet.

Analytical results are in parts per billion (ppb)

DATE	Well Head Elev.	Ground Water Elev.	Depth To Water	SPH Thickness	SPH Removed	Total SPH Removed	Notes	TPH-Gasoline	Benzene	Toluene	Ethyl-Benzene	Xylene	MTBE	Organic Lead
C-11														
03/07/90	265.30	242.56	22.74	--	--	--	--	--	--	--	--	--	--	--
03/09/90	265.30	--	--	--	--	--	--	ND	1.2	0.7	ND	1.4	--	--
06/12/90	265.30	243.32	21.98	--	--	--	--	ND	ND	ND	ND	ND	--	--
09/24/90	265.30	243.42	21.88	--	--	--	--	ND	ND	ND	ND	ND	--	--
12/20/90	265.30	242.12	23.18	--	--	--	--	ND	ND	ND	ND	ND	--	--
03/27/91	265.30	243.78	21.52	--	--	--	--	ND	ND	ND	ND	1.5	--	--
06/18/91	265.30	243.40	21.90	--	--	--	--	--	--	--	--	--	--	--
09/12/91	265.30	242.60	22.70	--	--	--	--	ND	ND	ND	ND	ND	--	--
01/23/92	265.30	241.84	23.46	--	--	--	--	ND	ND	ND	ND	ND	--	--
04/13/92	265.30	243.73	21.57	--	--	--	--	ND	ND	ND	ND	ND	--	--
08/03/92	265.30	242.63	22.67	--	--	--	--	ND	ND	ND	ND	ND	--	ND
10/22/92	265.30	242.01	23.29	--	--	--	--	ND	ND	ND	ND	ND	--	--
01/18/93	265.30	243.94	21.36	--	--	--	--	ND	ND	1.2	ND	2.2	--	--
04/19/93	265.30	245.33	19.97	--	--	--	--	ND	ND	ND	ND	ND	--	--
07/21,22/93	265.30	244.65	20.65	--	--	--	--	ND	ND	ND	ND	ND	--	--
10/25/93	265.30	244.55	20.75	--	--	--	--	ND	ND	ND	ND	ND	--	--
01/21/94	265.30	243.69	21.61	--	--	--	--	ND	ND	ND	ND	ND	--	--
04/18/94	265.30	244.52	20.78	--	--	--	--	ND	ND	ND	ND	ND	--	--
07/06-07/94	265.30	244.88	20.42	--	--	--	--	ND	ND	ND	ND	ND	--	--
10/07/94	265.30	243.70	21.60	--	--	--	--	ND	ND	ND	ND	ND	--	--
01/11/95	265.30	245.28	20.02	--	--	--	--	<50	<0.5	<0.5	<0.5	<0.5	--	--
04/24/95	265.30	247.58	17.72	--	--	--	--	<50	<0.5	<0.5	<0.5	<0.5	--	--
07/31/95	265.30	246.12	19.18	--	--	--	--	<50	<0.5	<0.5	<0.5	<0.5	--	--
10/02/95	265.30	244.88	20.42	--	--	--	--	<50	<0.5	<0.5	<0.5	<0.5	--	--
01/16/96	265.30	245.48	19.82	--	--	--	--	<50	<0.5	<0.5	<0.5	<0.5	<2.5	--
04/18/96	265.30	248.30	17.00	--	--	--	--	260	7.9	6.9	5.3	23	11	--
07/22/96	265.30	248.40	16.90	--	--	--	--	<50	<0.5	<0.5	<0.5	<0.5	<2.5	--
10/10/96	265.30	245.74	19.56	--	--	--	--	130	32	2.7	4.3	14	3.4	--
01/09/97	265.30	249.28	16.02	--	--	--	--	75	5.3	6.4	2.0	9.0	<2.5	--
04/15/97	265.30	247.35	17.95	--	--	--	--	<50	<0.5	<0.5	<0.5	<0.5	<2.5	--
07/08/97	265.30	245.55	19.75	--	--	--	--	<50	<0.5	<0.5	<0.5	<0.5	<2.5	--
10/22/97	265.30	245.74	19.56	--	--	--	--	<50	<0.5	<0.5	<0.5	<0.5	<2.5	--
01/12/98	265.30	246.97	18.33	--	--	--	--	<50	<0.5	<0.5	<0.5	<0.5	<2.5	--
04/21/98	265.30	248.62	16.68	--	--	--	--	<50	<0.5	<0.5	<0.5	<0.5	<2.5	--

Cumulative Table of Well Data and Analytical Results

Vertical Measurements are in feet.

Analytical results are in parts per billion (ppb)

DATE	Well Head Elev.	Ground Water Elev.	Depth To Water	SPH Thickness	SPH Removed	Total SPH Removed	Notes	TPH-Gasoline	Benzene	Toluene	Ethyl-Benzene	Xylene	MTBE	Organic Lead
C-12														
03/07/90	269.66	254.74	14.92	--	--	--	--	--	--	--	--	--	--	--
03/09/90	269.66	--	--	--	--	--	--	1400	230	140	33	180	--	--
06/12/90	269.66	254.87	14.79	--	--	--	--	720	190	71	18	73	--	--
09/24/90	269.66	253.94	15.72	--	--	--	--	ND	1.1	ND	ND	0.6	--	--
12/20/90	269.66	254.40	15.26	--	--	--	--	810	210	26	8.2	23	--	--
03/27/91	269.66	257.55	12.11	--	--	--	--	2900	350	220	52	210	--	--
06/18/91	269.66	253.28	16.38	--	--	--	--	--	--	--	--	--	--	--
09/12/91	269.66	252.11	17.55	--	--	--	--	350	59	12	4.5	8.5	--	--
01/23/92	269.66	252.55	17.11	--	--	--	--	450	110	31	7.9	22	--	--
04/13/92	269.66	255.26	14.40	--	--	--	--	5000	1100	76	100	200	--	--
08/03/92	269.66	253.83	15.83	--	--	--	--	520	200	21	13	25	--	ND
10/22/92	269.66	253.52	16.14	--	--	--	--	1300	310	66	35	56	--	--
01/18/93	269.66	257.96	11.70	--	--	--	--	5600	1200	430	220	610	--	--
04/19/93	269.66	256.61	13.05	--	--	--	--	2000	600	99	96	170	--	--
07/21,22/93	269.66	256.82	12.84	--	--	--	--	540	95	36	18	56	--	--
10/25/93	269.66	255.63	14.03	--	--	--	--	350	90	29	20	50	--	--
01/21/94	269.66	255.51	14.15	--	--	--	--	450	73	18	14	37	--	--
04/18/94	269.66	256.71	12.95	--	--	--	--	370	70	21	12	39	--	--
07/06-07/94	269.66	257.35	12.31	--	--	--	--	840	200	35	28	66	--	--
10/07/94	269.66	256.31	13.35	--	--	--	--	830	85	29	17	63	--	--
01/11/95	269.66	258.43	11.23	--	--	--	--	2100	570	190	98	390	--	--
04/24/95	269.66	259.34	10.32	--	--	--	--	820	120	28	23	61	--	--
07/31/95	269.66	256.92	12.74	--	--	--	--	520	79	13	16	42	--	--
10/02/95	269.66	255.26	14.40	--	--	--	--	400	50	5.3	11	29	--	--
01/16/96	269.66	256.94	12.72	--	--	--	--	1900	490	32	60	120	<25	--
04/18/96	269.66	258.91	10.75	--	--	--	--	2900	640	54	100	190	68	--
07/22/96	269.66	256.46	13.20	--	--	--	--	730	150	13	26	75	9.5	--
10/10/96	269.66	255.95	13.71	--	--	--	--	270	58	4.4	7.7	31	<2.5	--
01/09/97	269.66	260.60	9.06	--	--	--	--	2900	550	67	94	300	63	--
04/15/97	269.66	258.13	11.53	--	--	--	--	2500	350	29	92	200	43	--
07/08/97	269.66	257.92	11.74	--	--	--	--	1400	190	17	54	120	21	--
10/22/97	269.66	258.78	10.88	--	--	--	--	2300	490	45	110	340	42	--
01/12/98	269.66	260.76	8.90	--	--	--	--	5000	840	89	220	610	<50	--
04/21/98	269.66	262.41	7.25	--	--	--	--	2400	410	39	79	270	130	--

Cumulative Table of Well Data and Analytical Results

Vertical Measurements are in feet.

Analytical results are in parts per billion (ppb)

DATE	Well Head Elev.	Ground Water Elev.	Depth To Water	SPH Thickness	SPH Removed	Total SPH Removed	Notes	TPH-Gasoline	Benzene	Toluene	Ethyl-Benzene	Xylene	MTBE	Organic Lead
C-13														
03/07/90	284.32	273.14	11.18	--	--	--	--	--	--	--	--	--	--	--
03/09/90	284.32	--	--	--	--	--	--	ND	15	3.7	1.0	6.2	--	--
06/12/90	284.32	273.62	10.70	--	--	--	--	ND	2.6	ND	ND	ND	--	--
09/24/90	284.32	272.72	11.60	--	--	--	--	ND	2.4	ND	ND	ND	--	--
12/20/90	284.32	274.16	10.16	--	--	--	--	ND	1.6	ND	ND	ND	--	--
03/27/91	284.32	276.68	7.64	--	--	--	--	--	--	--	--	--	--	--
06/18/91	284.32	273.00	11.32	--	--	--	--	--	--	--	--	--	--	--
09/12/91	284.32	272.48	11.84	--	--	--	--	ND	ND	ND	ND	ND	--	--
01/23/92	284.32	273.77	10.55	--	--	--	--	--	--	--	--	--	--	--
04/13/92	284.32	273.36	10.96	--	--	--	--	ND	1.0	ND	ND	ND	--	--
08/03/92	284.32	273.42	10.90	--	--	--	--	ND	ND	ND	ND	ND	--	ND
10/22/92	284.32	273.14	11.18	--	--	--	--	--	--	--	--	--	--	--
01/18/93	284.32	276.92	7.40	--	--	--	--	290	54	10	5.4	12	--	--
04/19/93	284.32	275.39	8.93	--	--	--	--	--	--	--	--	--	--	--
07/21,22/93	284.32	273.57	10.75	--	--	--	--	ND	ND	ND	ND	ND	--	--
10/25/93	284.32	273.47	10.85	--	--	--	--	--	--	--	--	--	--	--
01/21/94	284.32	273.27	11.05	--	--	--	--	ND	ND	ND	ND	ND	--	--
04/18/94	284.32	273.61	10.71	--	--	--	--	--	--	--	--	--	--	--
07/06-07/94	284.32	273.67	10.65	--	--	--	--	ND	0.5	ND	ND	ND	--	--
10/07/94	284.32	273.24	11.08	--	--	--	--	--	--	--	--	--	--	--
01/11/95	284.32	278.94	5.38	--	--	--	Sampled bi-annually	120	15	<0.5	3.1	2.7	--	--
04/24/95	284.32	276.54	7.78	--	--	--	--	--	--	--	--	--	--	--
07/31/95	284.32	274.38	9.94	--	--	--	--	<50	<0.5	<0.5	<0.5	<0.5	--	--
10/02/95	284.32	273.74	10.58	--	--	--	--	--	--	--	--	--	--	--
01/16/96	284.32	274.52	9.80	--	--	--	--	<50	<0.5	<0.5	<0.5	<0.5	<2.5	--
04/18/96	284.32	276.57	7.75	--	--	--	--	--	--	--	--	--	--	--
07/22/96	284.32	274.82	9.50	--	--	--	--	59	18	<0.5	1.0	<0.5	<2.5	--
10/10/96	284.32	273.63	10.69	--	--	--	--	--	--	--	--	--	--	--
01/09/97	284.32	276.95	7.37	--	--	--	--	<50	0.60	<0.5	<0.5	<0.5	<2.5	--
04/15/97	284.32	275.63	8.69	--	--	--	--	--	--	--	--	--	--	--
07/08/97	284.32	276.12	8.20	--	--	--	Samples lost	--	--	--	--	--	--	--
07/15/97	284.32	276.02	8.30	--	--	--	--	<50	2.6	<0.5	<0.5	1.6	<2.5	--
10/22/97	284.32	276.79	7.53	--	--	--	--	--	--	--	--	--	--	--
01/12/98	284.32	278.38	5.94	--	--	--	--	<50	<0.5	<0.5	<0.5	<0.5	<2.5	--
04/21/98	284.32	277.35	6.97	--	--	--	--	--	--	--	--	--	--	--

Cumulative Table of Well Data and Analytical Results

Vertical Measurements are in feet.

Analytical results are in parts per billion (ppb)

DATE	Well Head Elev.	Ground Water Elev.	Depth To Water	SPH Thickness	SPH Removed	Total SPH Removed	Notes	TPH-Gasoline	Benzene	Toluene	Ethyl-Benzene	Xylene	MTBE	Organic Lead	
C-14															
03/07/90	270.74	255.56	15.18	--	--	--	--	--	--	--	--	--	--	--	
03/09/90	270.74	--	--	--	--	--	--	ND	ND	ND	ND	ND	--	--	
06/12/90	270.74	257.32	13.42	--	--	--	--	ND	ND	ND	ND	ND	--	--	
09/24/90	270.74	257.90	12.84	--	--	--	--	ND	ND	ND	ND	ND	--	--	
12/20/90	270.74	254.02	16.72	--	--	--	--	ND	1.7	0.7	ND	0.7	--	--	
03/27/91	270.74	262.74	8.00	--	--	--	--	ND	ND	ND	ND	1.3	--	--	
06/18/91	270.74	255.53	15.21	--	--	--	--	--	--	--	--	--	--	--	
09/12/91	270.74	255.13	15.61	--	--	--	--	ND	ND	ND	ND	ND	--	--	
01/23/92	270.74	246.10	24.64	--	--	--	--	--	--	--	--	--	--	--	
04/13/92	270.74	258.53	12.21	--	--	--	--	ND	ND	ND	ND	ND	--	--	
08/03/92	270.74	256.10	14.64	--	--	--	--	ND	ND	ND	ND	ND	--	ND	
10/22/92	270.74	253.80	16.94	--	--	--	--	--	--	--	--	--	--	--	
01/18/93	270.74	265.64	5.10	--	--	--	--	ND	ND	ND	ND	ND	--	--	
04/19/93	270.74	263.86	6.88	--	--	--	--	--	--	--	--	--	--	--	
07/21,22/93	270.74	259.58	11.16	--	--	--	--	ND	ND	ND	ND	ND	--	--	
10/25/93	270.74	256.87	13.87	--	--	--	--	--	--	--	--	--	--	--	
01/21/94	270.74	255.42	15.32	--	--	--	--	ND	ND	ND	ND	ND	--	--	
04/18/94	270.74	254.85	15.89	--	--	--	--	--	--	--	--	--	--	--	
07/06-07/94	270.74	258.66	12.08	--	--	--	--	ND	ND	ND	ND	ND	--	--	
10/07/94	270.74	255.45	15.29	--	--	--	--	--	--	--	--	--	--	--	
01/11/95	270.74	266.94	3.80	--	--	--	Sampled bi-annually	<50	<0.5	<0.5	<0.5	<0.5	--	--	
04/24/95	270.74	265.68	5.06	--	--	--	--	--	--	--	--	--	--	--	
07/31/95	270.74	260.34	10.40	--	--	--	--	<50	<0.5	<0.5	<0.5	<0.5	--	--	
10/02/95	270.74	257.20	13.54	--	--	--	--	--	--	--	--	--	--	--	
01/16/96	270.74	259.62	11.12	--	--	--	--	<50	<0.5	<0.5	<0.5	<0.5	<2.5	--	
04/18/96	270.74	265.78	4.96	--	--	--	--	--	--	--	--	--	--	--	
07/22/96	270.74	259.89	10.85	--	--	--	--	<50	<0.5	<0.5	<0.5	<0.5	<2.5	--	
10/10/96	270.74	261.44	9.30	--	--	--	--	--	--	--	--	--	--	--	
01/09/97	270.74	269.80	0.94	--	--	--	--	56	3.8	4.2	1.1	5.0	<2.5	--	
04/15/97	270.74	263.59	7.15	--	--	--	--	--	--	--	--	--	--	--	
07/08/97	270.74	261.44	9.30	--	--	--	--	<50	<0.5	<0.5	<0.5	<0.5	<2.5	--	
10/22/97	270.74	261.17	9.57	--	--	--	--	--	--	--	--	--	--	--	
01/12/98	270.74	268.45	2.29	--	--	--	--	<50	<0.5	<0.5	<0.5	<0.5	<2.5	--	
04/21/98	270.74	270.70	0.04	--	--	--	--	--	--	--	--	--	--	--	

Cumulative Table of Well Data and Analytical Results

Vertical Measurements are in feet.

Analytical results are in parts per billion (ppb)

DATE	Well Head Elev.	Ground Water Elev.	Depth To Water	SPH Thickness	SPH Removed	Total SPH Removed	Notes	TPH-Gasoline	Benzene	Toluene	Ethyl-Benzene	Xylene	MTBE	Organic Lead
C-15														
03/07/90	246.15	235.05	11.10	--	--	--	--	--	--	--	--	--	--	--
03/09/90	246.15	--	--	--	--	--	--	410	ND	1.4	0.5	0.6	--	--
06/12/90	246.15	235.37	10.78	--	--	--	--	420	11	ND	ND	ND	--	--
09/24/90	246.15	235.22	10.93	--	--	--	--	430	ND	1.5	ND	ND	--	--
12/20/90	246.15	235.07	11.08	--	--	--	--	300	1.3	1.1	0.6	1.5	--	--
03/27/91	246.15	237.65	8.50	--	--	--	--	520	4.6	1.1	ND	1.0	--	--
06/18/91	246.15	235.32	10.83	--	--	--	--	290	ND	1.1	ND	ND	--	--
06/18/91	246.15	235.32	10.83	--	--	--	Duplicate	320	ND	1.3	ND	ND	--	--
09/12/91	246.15	235.10	11.05	--	--	--	--	330	ND	0.9	ND	ND	--	--
01/23/92	246.15	235.35	10.80	--	--	--	--	210	ND	0.6	ND	ND	--	--
01/23/92	246.15	235.35	10.80	--	--	--	Duplicate	190	1.2	0.8	ND	ND	--	--
04/13/92	246.15	236.57	9.58	--	--	--	--	430	1.8	ND	ND	ND	--	--
08/03/92	246.15	234.94	11.21	--	--	--	--	640	ND	2.1	0.7	1.3	--	ND
10/22/92	246.15	234.50	11.65	--	--	--	--	420	ND	ND	ND	0.8	--	--
01/18/93	246.15	239.03	7.12	--	--	--	--	640	7.0	3.0	2.9	6.7	--	--
04/19/93	246.15	237.22	8.93	--	--	--	--	260	6.0	2.0	0.7	ND	--	--
07/21,22/93	246.15	236.37	9.78	--	--	--	--	580	ND	8.0	ND	0.6	--	--
10/25/93	246.15	236.41	9.74	--	--	--	--	240	ND	12	ND	0.6	--	--
01/21/94	246.15	235.78	10.37	--	--	--	--	420	0.6	ND	0.6	ND	--	--
04/18/94	246.15	236.19	9.96	--	--	--	--	550	1.0	4.6	0.6	ND	--	--
07/06-07/94	246.15	235.92	10.23	--	--	--	--	660	0.7	ND	ND	0.7	--	--
10/07/94	246.15	235.47	10.68	--	--	--	--	440	13	0.8	ND	1.2	--	--
01/11/95	246.15	238.84	7.31	--	--	--	--	750	2.5	<0.5	<0.5	0.6	--	--
04/24/95	246.15	237.41	8.74	--	--	--	--	850	<0.5	<0.5	<0.5	<0.5	--	--
07/31/95	246.15	235.41	10.74	--	--	--	--	640	<0.5	1.6	<0.5	<0.5	--	--
10/02/95	246.15	234.83	11.32	--	--	--	--	560	<0.5	<0.5	<0.5	<0.5	--	--
01/16/96	246.15	235.58	10.57	--	--	--	--	740	<0.5	<0.5	<0.5	<0.5	<2.5	--
04/18/96	246.15	237.55	8.60	--	--	--	--	760	<0.5	<0.5	<0.5	<0.5	<2.5	--
07/22/96	246.15	235.57	10.58	--	--	--	--	690	<0.5	1.6	<0.5	<0.5	7.9	--
10/10/96	246.15	234.97	11.18	--	--	--	--	870	7.0	2.1	<0.5	<0.5	11	--
01/09/97	246.15	238.83	7.32	--	--	--	--	370	2.6	1.1	<0.5	<0.5	4.6	--
04/15/97	246.15	235.76	10.39	--	--	--	--	510	22	<0.5	<0.5	<0.5	<2.5	--
07/08/97	246.15	235.68	10.47	--	--	--	--	490	71	6.8	22	48	7.0	--
10/22/97	246.15	235.01	11.14	--	--	--	--	790	2.3	1.8	<0.5	<0.5	5.1	--
01/12/98	246.15	238.17	7.98	--	--	--	--	400	13	<1.0	<1.0	<1.0	<5.0	--
04/21/98	246.15	238.05	8.10	--	--	--	--	770	<0.5	0.60	0.82	0.51	<2.5	--

Cumulative Table of Well Data and Analytical Results

Vertical Measurements are in feet.

Analytical results are in parts per billion (ppb)

DATE	Well Head Elev.	Ground Water Elev.	Depth To Water	SPH Thickness	SPH Removed	Total SPH Removed	Notes	TPH-Gasoline	Benzene	Toluene	Ethyl-Benzene	Xylene	MTBE	Organic Lead
C-16														
03/07/90	246.69	228.19	18.50	--	--	--	--	--	--	--	--	--	--	--
03/09/90	246.69	--	--	--	--	--	--	ND	ND	ND	ND	ND	--	--
06/12/90	246.69	235.27	11.42	--	--	--	--	ND	ND	ND	ND	ND	--	--
09/24/90	246.69	235.30	11.39	--	--	--	--	ND	ND	ND	ND	ND	--	--
12/20/90	246.69	235.12	11.57	--	--	--	--	ND	ND	ND	ND	0.7	--	--
03/27/91	246.69	237.93	8.76	--	--	--	--	ND	ND	ND	ND	1.3	--	--
03/27/91	246.69	237.93	8.76	--	--	--	Duplicate	ND	ND	ND	ND	1.2	--	--
06/18/91	246.69	235.51	11.18	--	--	--	--	ND	ND	ND	ND	ND	--	--
09/12/91	246.69	234.74	11.95	--	--	--	--	ND	ND	ND	ND	ND	--	--
01/23/92	246.69	234.28	12.41	--	--	--	--	ND	ND	ND	ND	ND	--	--
04/13/92	246.69	236.00	10.69	--	--	--	--	ND	ND	ND	ND	ND	--	--
08/03/92	246.69	234.49	12.20	--	--	--	--	ND	ND	ND	ND	ND	--	ND
10/22/92	246.69	234.09	12.60	--	--	--	--	ND	ND	ND	ND	ND	--	--
01/18/93	246.69	237.69	9.00	--	--	--	--	ND	ND	ND	ND	ND	--	--
04/19/93	246.69	236.80	9.89	--	--	--	--	ND	ND	ND	ND	ND	--	--
07/21,22/93	246.69	236.44	10.25	--	--	--	--	ND	ND	ND	ND	ND	--	--
10/25/93	246.69	235.73	10.96	--	--	--	--	ND	ND	ND	ND	ND	--	--
01/21/94	246.69	234.93	11.76	--	--	--	--	ND	ND	0.7	ND	1.0	--	--
04/18/94	246.69	235.47	11.22	--	--	--	--	ND	ND	ND	ND	ND	--	--
07/06-07/94	246.69	235.32	11.37	--	--	--	--	ND	ND	ND	ND	ND	--	--
10/07/94	246.69	234.30	12.39	--	--	--	--	ND	ND	ND	ND	ND	--	--
01/11/95	246.69	237.73	8.96	--	--	--	--	<50	<0.5	<0.5	<0.5	<0.5	--	--
04/24/95	246.69	236.31	10.38	--	--	--	--	<50	<0.5	<0.5	<0.5	<0.5	--	--
07/31/95	246.69	235.37	11.32	--	--	--	--	<50	<0.5	<0.5	<0.5	<0.5	--	--
10/02/95	246.69	234.29	12.40	--	--	--	--	<50	<0.5	<0.5	<0.5	<0.5	--	--
01/16/96	246.69	235.15	11.54	--	--	--	--	<50	<0.5	<0.5	<0.5	<0.5	<2.5	--
04/18/96	246.69	236.09	10.60	--	--	--	--	<50	<0.5	<0.5	<0.5	<0.5	<2.5	--
07/22/96	246.69	235.12	11.57	--	--	--	--	<50	<0.5	<0.5	<0.5	<0.5	<2.5	--
10/10/96	246.69	234.25	12.44	--	--	--	--	<50	<0.5	<0.5	<0.5	<0.5	<2.5	--
01/09/97	246.69	237.16	9.53	--	--	--	--	<50	<0.5	<0.5	<0.5	<0.5	<2.5	--
04/15/97	246.69	234.66	12.03	--	--	--	--	<50	<0.5	<0.5	<0.5	<0.5	<2.5	--
07/08/97	246.69	234.51	12.18	--	--	--	--	<50	<0.5	<0.5	<0.5	<0.5	<2.5	--
10/22/97	246.69	233.94	12.75	--	--	--	--	<50	<0.5	<0.5	<0.5	<0.5	<2.5	--
01/12/98	246.69	236.34	10.35	--	--	--	--	<50	<0.5	<0.5	<0.5	<0.5	<2.5	--
04/21/98	246.69	236.06	10.63	--	--	--	--	<50	<0.5	<0.5	<0.5	<0.5	<2.5	--

Cumulative Table of Well Data and Analytical Results

Vertical Measurements are in feet.

Analytical results are in parts per billion (ppb)

DATE	Well Head Elev.	Ground Water Elev.	Depth To Water	SPH Thickness	SPH Removed	Total SPH Removed	Notes	TPH-Gasoline	Benzene	Toluene	Ethyl-Benzene	Xylene	MTBE	Organic Lead	
RW															
12/04/89	--	--	--	--	--	--	--	62,000	29,000	1700	1800	8800	--	--	
03/07/90	274.52	256.02	18.50	--	--	--	--	--	--	--	--	--	--	--	
06/12/90	274.52	256.03	18.49	--	--	--	--	31,000	15,000	2000	560	3100	--	--	
09/24/90	274.52	--	--	--	--	--	--	--	--	--	--	--	--	--	
12/20/90	274.52	--	--	--	--	--	--	ND	0.5	ND	ND	1.2	--	--	
03/27/91	274.52	--	--	--	--	--	--	--	--	--	--	--	--	--	
06/18/91	274.52	--	--	--	--	--	--	--	--	--	--	--	--	--	
09/12/91	274.52	--	--	--	--	--	Insufficient water	--	--	--	--	--	--	--	
01/23/92	274.52	--	--	--	--	--	Insufficient water	--	--	--	--	--	--	--	
04/13/92	274.52	--	--	--	--	--	Insufficient water	--	--	--	--	--	--	--	
08/03/92	274.52	--	--	--	--	--	Insufficient water	--	--	--	--	--	--	--	
10/22/92	274.52	--	--	--	--	--	Insufficient water	--	--	--	--	--	--	--	
01/18/93	274.52	--	--	--	--	--	Insufficient water	--	--	--	--	--	--	--	
04/19/93	274.52	--	--	--	--	--	Insufficient water	--	--	--	--	--	--	--	
07/21,22/93	274.52	--	--	--	--	--	Insufficient water	--	--	--	--	--	--	--	
10/25/93	274.52	--	--	--	--	--	--	--	--	--	--	--	--	--	
01/21/94	274.52	--	--	--	--	--	--	--	--	--	--	--	--	--	
04/18/94	274.52	--	--	--	--	--	--	--	--	--	--	--	--	--	
07/06-07/94	274.52	--	--	--	--	--	--	--	--	--	--	--	--	--	
10/07/94	274.52	--	--	--	--	--	--	--	--	--	--	--	--	--	
10/24/95	274.52	256.63	17.89	--	--	--	--	37,000	11,000	380	1100	3000	--	--	
01/16/96	274.52	259.09	15.43	--	--	--	--	59,000	17,000	660	1600	5400	<1000	--	

NO LONGER MONITORED OR SAMPLED

Cumulative Table of Well Data and Analytical Results

Vertical Measurements are in feet.

Analytical results are in parts per billion (ppb)

DATE	Well Head Elev.	Ground Water Elev.	Depth To Water	SPH Thickness	SPH Removed	Total SPH Removed	Notes	TPH-Gasoline	Benzene	Toluene	Ethyl-Benzene	Xylene	MTBE	Organic Lead
TRIP BLANK														
01/11/95	--	--	--	--	--	--	--	<50	<0.5	<0.5	<0.5	<0.5	--	--
04/24/95	--	--	--	--	--	--	--	<50	<0.5	<0.5	<0.5	<0.5	--	--
07/31/95	--	--	--	--	--	--	--	<50	<0.5	<0.5	<0.5	<0.5	--	--
10/02/95	--	--	--	--	--	--	--	<50	<0.5	<0.5	<0.5	<0.5	--	--
01/16/96	--	--	--	--	--	--	--	<50	<0.5	<0.5	<0.5	<0.5	--	--
04/18/96	--	--	--	--	--	--	--	<50	<0.5	<0.5	<0.5	<0.5	--	--
07/22/96	--	--	--	--	--	--	--	<50	<0.5	<0.5	<0.5	<0.5	--	--
10/10/96	--	--	--	--	--	--	--	<50	<0.5	<0.5	<0.5	<0.5	--	--
01/09/97	--	--	--	--	--	--	--	<50	<0.5	<0.5	<0.5	<0.5	<2.5	--
04/15/97	--	--	--	--	--	--	--	<50	<0.5	<0.5	<0.5	<0.5	<2.5	--
07/08/97	--	--	--	--	--	--	--	<50	<0.5	<0.5	<0.5	<0.5	<2.5	--
07/15/97	--	--	--	--	--	--	--	<50	<0.5	<0.5	<0.5	<0.5	<2.5	--
10/22/97	--	--	--	--	--	--	--	<50	<0.5	<0.5	<0.5	<0.5	<2.5	--
01/12/98	--	--	--	--	--	--	--	<50	<0.5	<0.5	<0.5	<0.5	<2.5	--
04/21/98	--	--	--	--	--	--	--	<50	<0.5	<0.5	<0.5	<0.5	<2.5	--

Note: Blaine Tech Services, Inc. began routine monitoring of the groundwater wells at this site on November 1, 1994.
 Earlier field data and analytical results are drawn from the November 4, 1994 Groundwater Technology, Inc. report.

ABBREVIATIONS:

TPH = Total Petroleum Hydrocarbons

ND = Not detected at or above the minimum quantitation limit. See laboratory reports for minimum quantitation limits.

MTBE = Methyl t-butyl ether

Analytical Appendix



Blaine Tech Services
1680 Rogers Avenue
San Jose, CA 95112

Client Proj. ID: Chevron, 9-5607, 980421-51
Sample Descript: C-1
Matrix: LIQUID
Analysis Method: 8015Mod/8020
Lab Number: 9804F78-01

Sampled: 04/21/98
Received: 04/22/98
Analyzed: 04/29/98
Reported: 05/05/98

QC Batch Number: GC042998BTEX17A
Instrument ID: GCHP17

Total Purgeable Petroleum Hydrocarbons (TPPH) with BTEX and MTBE

Analyte	Detection Limit ug/L	Sample Results ug/L
TPPH as Gas	10000	60000
Methyl t-Butyl Ether	500	1400
Benzene	100	3300
Toluene	100	2100
Ethyl Benzene	100	3100
Xylenes (Total)	100	10000
Chromatogram Pattern:		Gas

Surrogates	Control Limits %	% Recovery
Trifluorotoluene	70 130	105

Analytes reported as N.D. were not present above the stated limit of detection.

SEQUOIA ANALYTICAL - ELAP #1210

Peggy Penner
Project Manager





Blaine Tech Services 1680 Rogers Avenue San Jose, CA 95112	Client Proj. ID: Chevron, 9-5607, 980421-51 Sample Descript: C-3 Matrix: LIQUID Analysis Method: 8015Mod/8020 Lab Number: 9804F78-02	Sampled: 04/21/98 Received: 04/22/98 Analyzed: 04/30/98 Reported: 05/05/98
--	--	---

QC Batch Number: GC043098BTEX02A
Instrument ID: GCHP02

Total Purgeable Petroleum Hydrocarbons (TPPH) with BTEX and MTBE

Analyte	Detection Limit ug/L	Sample Results ug/L
TPPH as Gas	20000	70000
Methyl t-Butyl Ether	1000	N.D.
Benzene	200	13000
Toluene	200	5800
Ethyl Benzene	200	1600
Xylenes (Total)	200	7100
Chromatogram Pattern:		Gas
Surrogates	Control Limits %	% Recovery
Trifluorotoluene	70 130	86

Analytes reported as N.D. were not present above the stated limit of detection.

SEQUOIA ANALYTICAL - ELAP #1210

Peggy Penner
Project Manager





Blaine Tech Services 1680 Rogers Avenue San Jose, CA 95112	Client Proj. ID: Chevron, 9-5607, 980421-51 Sample Descript: C-6 Matrix: LIQUID Analysis Method: 8015Mod/8020 Lab Number: 9804F78-03	Sampled: 04/21/98 Received: 04/22/98 Analyzed: 04/30/98 Reported: 05/05/98
--	--	---

QC Batch Number: GC043098BTEX02A
Instrument ID: GCHP02

Total Purgeable Petroleum Hydrocarbons (TPPH) with BTEX and MTBE

Analyte	Detection Limit ug/L	Sample Results ug/L
TPPH as Gas	20000	51000
Methyl t-Butyl Ether	1000	N.D.
Benzene	200	16000
Toluene	200	310
Ethyl Benzene	200	1400
Xylenes (Total)	200	3400
Chromatogram Pattern:		Gas

Surrogates	Control Limits %	% Recovery
Trifluorotoluene	70 130	81

Analytes reported as N.D. were not present above the stated limit of detection.

SEQUOIA ANALYTICAL - ELAP #1210

Peggy Penner
Project Manager





Blaine Tech Services 1680 Rogers Avenue San Jose, CA 95112	Client Proj. ID: Chevron, 9-5607, 980421-51 Sample Descript: C-8 Matrix: LIQUID Analysis Method: 8015Mod/8020 Lab Number: 9804F78-04	Sampled: 04/21/98 Received: 04/22/98 Analyzed: 04/29/98 Reported: 05/05/98
--	--	---

QC Batch Number: GC042998BTEX21A
Instrument ID: GCHP21

Total Purgeable Petroleum Hydrocarbons (TPPH) with BTEX and MTBE

Analyte	Detection Limit ug/L	Sample Results ug/L
TPPH as Gas	50	N.D.
Methyl t-Butyl Ether	2.5	N.D.
Benzene	0.50	N.D.
Toluene	0.50	N.D.
Ethyl Benzene	0.50	N.D.
Xylenes (Total)	0.50	N.D.
Chromatogram Pattern:		
Surrogates	Control Limits %	% Recovery
Trifluorotoluene	70 130	93

Analytes reported as N.D. were not present above the stated limit of detection.

SEQUOIA ANALYTICAL - ELAP #1210

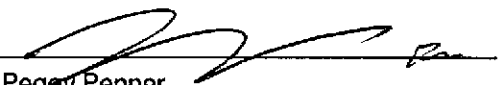
Peggy Penner
Project Manager





Blaine Tech Services 1680 Rogers Avenue San Jose, CA 95112	Client Proj. ID: Chevron, 9-5607, 980421-51 Sample Descript: C-10A Matrix: LIQUID Analysis Method: 8015Mod/8020 Lab Number: 9804F78-05	Sampled: 04/21/98 Received: 04/22/98 Analyzed: 04/29/98 Reported: 05/05/98
--	--	---

QC Batch Number: GC042998BTEX21A
Instrument ID: GCHP21

Total Purgeable Petroleum Hydrocarbons (TPPH) with BTEX and MTBE

Analyte	Detection Limit ug/L	Sample Results ug/L
TPPH as Gas	50	N.D.
Methyl t-Butyl Ether	2.5	N.D.
Benzene	0.50	N.D.
Toluene	0.50	N.D.
Ethyl Benzene	0.50	N.D.
Xylenes (Total)	0.50	N.D.
Chromatogram Pattern:		
Surrogates	Control Limits %	% Recovery
Trifluorotoluene	70 130	94

Analytes reported as N.D. were not present above the stated limit of detection.

SEQUOIA ANALYTICAL - ELAP #1210

Peggy Penner
Project Manager





Blaine Tech Services 1680 Rogers Avenue San Jose, CA 95112	Client Proj. ID: Chevron, 9-5607, 980421-51 Sample Descript: C-10B Matrix: LIQUID Analysis Method: 8015Mod/8020 Lab Number: 9804F78-06	Sampled: 04/21/98 Received: 04/22/98 Analyzed: 04/29/98 Reported: 05/05/98
--	--	---

QC Batch Number: GC042998BTEX21A
Instrument ID: GCHP21

Total Purgeable Petroleum Hydrocarbons (TPPH) with BTEX and MTBE

Analyte	Detection Limit ug/L	Sample Results ug/L
TPPH as Gas	50	N.D.
Methyl t-Butyl Ether	2.5	N.D.
Benzene	0.50	N.D.
Toluene	0.50	N.D.
Ethyl Benzene	0.50	N.D.
Xylenes (Total)	0.50	N.D.
Chromatogram Pattern:		
Surrogates	Control Limits %	% Recovery
Trifluorotoluene	70 130	96

Analytes reported as N.D. were not present above the stated limit of detection.

SEQUOIA ANALYTICAL - ELAP #1210

Peggy Penner
Project Manager





Blaine Tech Services 1680 Rogers Avenue San Jose, CA 95112	Client Proj. ID: Chevron, 9-5607, 980421-51 Sample Descript: C-11 Matrix: LIQUID Analysis Method: 8015Mod/8020 Lab Number: 9804F78-07	Sampled: 04/21/98 Received: 04/22/98 Analyzed: 04/29/98 Reported: 05/05/98
--	---	---

QC Batch Number: GC042998BTEX21A
Instrument ID: GCHP21

Total Purgeable Petroleum Hydrocarbons (TPPH) with BTEX and MTBE

Analyte	Detection Limit ug/L	Sample Results ug/L
TPPH as Gas	50	N.D.
Methyl t-Butyl Ether	2.5	N.D.
Benzene	0.50	N.D.
Toluene	0.50	N.D.
Ethyl Benzene	0.50	N.D.
Xylenes (Total)	0.50	N.D.
Chromatogram Pattern:		
Surrogates	Control Limits %	% Recovery
Trifluorotoluene	70 130	108

Analytes reported as N.D. were not present above the stated limit of detection.

SEQUOIA ANALYTICAL - ELAP #1210

Peggy Penner
Project Manager





Blaine Tech Services 1680 Rogers Avenue San Jose, CA 95112	Client Proj. ID: Chevron, 9-5607, 980421-51 Sample Descript: C-12 Matrix: LIQUID Analysis Method: 8015Mod/8020 Lab Number: 9804F78-08	Sampled: 04/21/98 Received: 04/22/98 Analyzed: 04/30/98 Reported: 05/05/98
--	---	---

QC Batch Number: GC043098BTEX21A
Instrument ID: GCHP21

Total Purgeable Petroleum Hydrocarbons (TPPH) with BTEX and MTBE

Analyte	Detection Limit ug/L	Sample Results ug/L
TPPH as Gas	500	2400
Methyl t-Butyl Ether	25	130
Benzene	5.0	410
Toluene	5.0	39
Ethyl Benzene	5.0	79
Xylenes (Total)	5.0	270
Chromatogram Pattern:		Gas

Surrogates	Control Limits %	% Recovery
Trifluorotoluene	70 130	89

Analytes reported as N.D. were not present above the stated limit of detection.

SEQUOIA ANALYTICAL - ELAP #1210

Peggy Penner
Project Manager





Blaine Tech Services 1680 Rogers Avenue San Jose, CA 95112	Client Proj. ID: Chevron, 9-5607, 980421-51 Sample Descript: C-15 Matrix: LIQUID Analysis Method: 8015Mod/8020 Lab Number: 9804F78-09	Sampled: 04/21/98 Received: 04/22/98 Analyzed: 05/01/98 Reported: 05/05/98
Attention: Fran Thie		

QC Batch Number: GC050198BTEX02A
Instrument ID: GCHP02

Total Purgeable Petroleum Hydrocarbons (TPPH) with BTEX and MTBE

Analyte	Detection Limit ug/L	Sample Results ug/L
TPPH as Gas	50	770
Methyl t-Butyl Ether	2.5	N.D.
Benzene	0.50	N.D.
Toluene	0.50	0.60
Ethyl Benzene	0.50	0.82
Xylenes (Total)	0.50	0.51
Chromatogram Pattern:		C6-C8
Surrogates	Control Limits %	% Recovery
Trifluorotoluene	70 130	89

Analytes reported as N.D. were not present above the stated limit of detection.

SEQUOIA ANALYTICAL - ELAP #1210

Peggy Penner
Project Manager





Blaine Tech Services 1680 Rogers Avenue San Jose, CA 95112	Client Proj. ID: Chevron, 9-5607, 980421-51 Sample Descript: C-16 Matrix: LIQUID Analysis Method: 8015Mod/8020 Lab Number: 9804F78-10	Sampled: 04/21/98 Received: 04/22/98 Analyzed: 04/29/98 Reported: 05/05/98
--	---	---

QC Batch Number: GC042998BTEX21A
Instrument ID: GCHP21

Total Purgeable Petroleum Hydrocarbons (TPPH) with BTEX and MTBE

Analyte	Detection Limit ug/L	Sample Results ug/L
TPPH as Gas	50	N.D.
Methyl t-Butyl Ether	2.5	N.D.
Benzene	0.50	N.D.
Toluene	0.50	N.D.
Ethyl Benzene	0.50	N.D.
Xylenes (Total)	0.50	N.D.
Chromatogram Pattern:		
Surrogates	Control Limits %	% Recovery
Trifluorotoluene	70 130	102

Analytes reported as N.D. were not present above the stated limit of detection.

SEQUOIA ANALYTICAL - ELAP #1210

Peggy Penner
Project Manager





Blaine Tech Services 1680 Rogers Avenue San Jose, CA 95112	Client Proj. ID: Chevron, 9-5607, 980421-51 Sample Descript: TB Matrix: LIQUID Analysis Method: 8015Mod/8020 Lab Number: 9804F78-11	Sampled: 04/21/98 Received: 04/22/98 Analyzed: 04/29/98 Reported: 05/05/98
Attention: Fran Thie		

QC Batch Number: GC042998BTEX21A
Instrument ID: GCHP21

Total Purgeable Petroleum Hydrocarbons (TPPH) with BTEX and MTBE

Analyte	Detection Limit ug/L	Sample Results ug/L
TPPH as Gas	50	N.D.
Methyl t-Butyl Ether	2.5	N.D.
Benzene	0.50	N.D.
Toluene	0.50	N.D.
Ethyl Benzene	0.50	N.D.
Xylenes (Total)	0.50	N.D.
Chromatogram Pattern:		
Surrogates	Control Limits %	% Recovery
Trifluorotoluene	70 130	100

Analytes reported as N.D. were not present above the stated limit of detection.

SEQUOIA ANALYTICAL - ELAP #1210

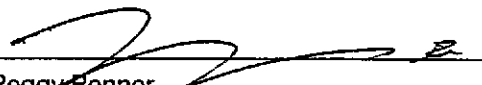
Peggy Penner
Project Manager





Sequoia Analytical

680 Chesapeake Drive
404 N. Wiger Lane
819 Striker Avenue, Suite 8
1455 McDowell Blvd., North, Ste. D

Redwood City, CA 94063
Walnut Creek, CA 94598
Sacramento, CA 95834
Petaluma, CA 94954

(650) 364-9600
(510) 988-9600
(916) 921-9600
(707) 792-1865

FAX (650) 364-9233
FAX (510) 988-9673
FAX (916) 921-0100
FAX (707) 792-0342

Blaine Tech Services
1680 Rogers Avenue
San Jose, CA 95112
Attention: Fran Thie

Client Project ID: Chevron, 9-5607,980421-51

QC Sample Group: 9804F78-01

Reported: May 5, 1998

QUALITY CONTROL DATA REPORT

Matrix: Liquid
Method: EPA 8015/8020
Analyst: C. DEMARTINI

ANALYTE	Benzene	Toluene	Ethylbenzene	Xylenes	BTEX as TPH
---------	---------	---------	--------------	---------	-------------

QC Batch #: GC042998BTEX17A

Sample No.: GW9804C47-8

Date Prepared:	4/29/98	4/29/98	4/29/98	4/29/98	4/29/98
Date Analyzed:	4/29/98	4/29/98	4/29/98	4/29/98	4/29/98
Instrument I.D.#:	GCHP17	GCHP17	GCHP17	GCHP17	GCHP17

Sample Conc., ug/L:	N.D.	N.D.	N.D.	N.D.	N.D.
Conc. Spiked, ug/L:	10	10	10	30	60

Matrix Spike, ug/L:	9.2	9.5	8.7	28	42
% Recovery:	92	95	87	93	70

Matrix

Spike Duplicate, ug/L:	9.4	9.7	9.1	29	43
% Recovery:	94	97	91	97	72

Relative % Difference:	2.2	2.1	4.5	4.2	2.8
------------------------	-----	-----	-----	-----	-----

RPD Control Limits:	0-25	0-25	0-25	0-25	0-25
---------------------	------	------	------	------	------

LCS Batch#: GAWBLK042998A

Date Prepared:	4/29/98	4/29/98	4/29/98	4/29/98	4/29/98
Date Analyzed:	4/29/98	4/29/98	4/29/98	4/29/98	4/29/98
Instrument I.D.#:	GCHP17	GCHP17	GCHP17	GCHP17	GCHP17

Conc. Spiked, ug/L:	10	10	10	30	60
---------------------	----	----	----	----	----

LCS Recovery, ug/L:	9.5	9.6	11	28	43
LCS % Recovery:	95	96	110	93	72

Percent Recovery Control Limits:

MS/MSD	60-140	60-140	60-140	60-140	60-140
LCS	70-130	70-130	70-130	70-130	70-130

Quality Assurance Statement: All standard operating procedures and quality control requirements have been met.

Please Note:

The LCS is a control sample of known, interferent free matrix that is analyzed using the same reagents, preparation, and analytical methods employed for the samples. The matrix spike is an aliquot of sample fortified with known quantities of specific compounds and subjected to the entire analytical procedure. If the recovery of analytes from the matrix spike does not fall within specified control limits due to matrix interference, the LCS recovery is to be used to validate the batch.

SEQUOIA ANALYTICAL

Peggy Penner
Project Manager





Sequoia Analytical

680 Chesapeake Drive
404 N. Wiget Lane
819 Striker Avenue, Suite 8
1455 McDowell Blvd. North, Ste. D

Redwood City, CA 94063
Walnut Creek, CA 94598
Sacramento, CA 95834
Petaluma, CA 94954

(650) 364-9600
(510) 988-9600
(916) 921-9600
(707) 792-1865

FAX (650) 364-9233
FAX (510) 988-9673
FAX (916) 921-0100
FAX (707) 792-0342

Blaine Tech Services
1680 Rogers Avenue
San Jose, CA 95112
Attention: Fran Thie

Client Project ID: Chevron, 9-5607,980421-51

QC Sample Group: 9804F78-02-03,-09

Reported: May 5, 1998

QUALITY CONTROL DATA REPORT

Matrix: Liquid
Method: EPA 8015/8020
Analyst: C. DEMARTINI

ANALYTE	Benzene	Toluene	Ethylbenzene	Xylenes	BTEX as TPH
---------	---------	---------	--------------	---------	-------------

QC Batch #: GC043098BTEX02A

Sample No.: GW9804F78-10

Date Prepared:	4/30/98	4/30/98	4/30/98	4/30/98	4/30/98
Date Analyzed:	4/30/98	4/30/98	4/30/98	4/30/98	4/30/98
Instrument I.D.#:	GCHP2	GCHP2	GCHP2	GCHP2	GCHP2

Sample Conc., ug/L:	N.D.	N.D.	N.D.	N.D.	N.D.
Conc. Spiked, ug/L:	10	10	10	30	60

Matrix Spike, ug/L:	9.2	9.1	9.4	29	67
% Recovery:	92	91	94	97	112

Matrix					
Spike Duplicate, ug/L:	9.0	9.0	9.2	28	74
% Recovery:	90	90	92	93	123

Relative % Difference:	2.2	1.1	2.2	4.2	9.4
------------------------	-----	-----	-----	-----	-----

RPD Control Limits:	0-25	0-25	0-25	0-25	0-25
---------------------	------	------	------	------	------

LCS Batch#: GAWBLK043098A

Date Prepared:	4/30/98	4/30/98	4/30/98	4/30/98	4/30/98
Date Analyzed:	4/30/98	4/30/98	4/30/98	4/30/98	4/30/98
Instrument I.D.#:	GCHP2	GCHP2	GCHP2	GCHP2	GCHP2

Conc. Spiked, ug/L:	10	10	10	30	60
---------------------	----	----	----	----	----

LCS Recovery, ug/L:	9.5	9.5	9.8	30	69
LCS % Recovery:	95	95	98	100	115

Percent Recovery Control Limits:

MS/MSD	60-140	60-140	60-140	60-140	60-140
LCS	70-130	70-130	70-130	70-130	70-130

Quality Assurance Statement: All standard operating procedures and quality control requirements have been met.

Please Note:

The LCS is a control sample of known, interferent free matrix that is analyzed using the same reagents, preparation, and analytical methods employed for the samples. The matrix spike is an aliquot of sample fortified with known quantities of specific compounds and subjected to the entire analytical procedure. If the recovery of analytes from the matrix spike does not fall within specified control limits due to matrix interference, the LCS recovery is to be used to validate the batch.

SEQUOIA ANALYTICAL

Peggy Penner
Project Manager





Sequoia Analytical

680 Chesapeake Drive
404 N. Wiget Lane
819 Striker Avenue, Suite 8
1455 McDowell Blvd. North, Ste. D

Redwood City, CA 94063
Walnut Creek, CA 94598
Sacramento, CA 95834
Petaluma, CA 94954

(650) 364-9600
(510) 988-9600
(916) 921-9600
(707) 792-1865

FAX (650) 364-9233
FAX (510) 988-9673
FAX (916) 921-0100
FAX (707) 792-0342

Blaine Tech Services
1680 Rogers Avenue
San Jose, CA 95112
Attention: Fran Thie

Client Project ID: Chevron, 9-5607,980421-51

QC Sample Group: 9804F78-04-08,-10-11

Reported: May 5, 1998

QUALITY CONTROL DATA REPORT

Matrix: Liquid
Method: EPA 8015/8020
Analyst: C. DEMARTINI

ANALYTE	Benzene	Toluene	Ethylbenzene	Xylenes	BTEX as TPH
---------	---------	---------	--------------	---------	-------------

QC Batch #: GC042998BTEX21A

Sample No.: GW9804C47-8

Date Prepared: 4/29/98 4/29/98 4/29/98 4/29/98 4/29/98

Date Analyzed: 4/29/98 4/29/98 4/29/98 4/29/98 4/29/98

Instrument I.D.#: GCHP21 GCHP21 GCHP21 GCHP21 GCHP21

Sample Conc., ug/L: N.D. N.D. N.D. N.D. N.D.

Conc. Spiked, ug/L: 10 10 10 30 60

Matrix Spike, ug/L: 9.5 9.4 9.5 29 47

% Recovery: 95 94 95 97 78

Matrix

Spike Duplicate, ug/L: 9.5 9.4 9.6 29 47

% Recovery: 95 94 96 97 78

Relative % Difference: 0.0 0.0 1.0 0.0 0.0

RPD Control Limits: 0-25 0-25 0-25 0-25 0-25

LCS Batch#: GAWBLK042998A

Date Prepared: 4/29/98 4/29/98 4/29/98 4/29/98 4/29/98

Date Analyzed: 4/29/98 4/29/98 4/29/98 4/29/98 4/29/98

Instrument I.D.#: GCHP21 GCHP21 GCHP21 GCHP21 GCHP21

Conc. Spiked, ug/L: 10 10 10 30 60

LCS Recovery, ug/L: 9.7 9.5 9.8 30 49

LCS % Recovery: 97 95 98 100 82

Percent Recovery Control Limits:

MS/MSD	60-140	60-140	60-140	60-140	60-140
LCS	70-130	70-130	70-130	70-130	70-130

Quality Assurance Statement: All standard operating procedures and quality control requirements have been met.

Please Note:

The LCS is a control sample of known, interferent free matrix that is analyzed using the same reagents, preparation, and analytical methods employed for the samples. The matrix spike is an aliquot of sample fortified with known quantities of specific compounds and subjected to the entire analytical procedure. If the recovery of analytes from the matrix spike does not fall within specified control limits due to matrix interference, the LCS recovery is to be used to validate the batch.

SEQUOIA ANALYTICAL

Peggy Penner
Project Manager





**Sequoia
Analytical**

680 Chesapeake Drive
404 N. Wiger Lane
819 Striker Avenue, Suite 8
1455 McDowell Blvd. North, Ste. D

Redwood City, CA 94063
Wainut Creek, CA 94598
Sacramento, CA 95834
Petaluma, CA 94954

(650) 364-9600
(510) 988-9600
(916) 921-9600
(707) 792-1865

FAX (650) 364-9233
FAX (510) 988-9673
FAX (916) 921-0100
FAX (707) 792-0342

Blaine Tech Services
1680 Rogers Avenue
San Jose, CA 95112
Attention: Fran Thie

Client Proj. ID: Chevron, 9-5607, 980421-51

Received: 04/22/98

Lab Proj. ID: 9804F78

Reported: 05/05/98

LABORATORY NARRATIVE

In order to properly interpret this report, it must be reproduced in its entirety. This report contains a total of 16 pages including the laboratory narrative, sample results, quality control, and related documents as required (cover page, COC, raw data, etc.).

TPGM2W: Samples 9804F78-04, -05, -06, -07, and 9804F78-10, -11 had a Benzene hit of 1.3ug/L in the method blank.

SEQUOIA ANALYTICAL

Peggy Penner
Project Manager



Chevron U.S.A. Inc.
P.O. BOX 5004
San Ramon, CA 94583
FAX (415)842-9591

Chevron Facility Number 9-5607
Facility Address 5269 Crow Canyon Rd., Castro Valley, CA
Consultant Project Number 980421-51
Consultant Name Blaine Tech Services, Inc.
Address 1680 Rogers Ave., San Jose, CA 95112
Project Contact (Name) Fran Thie
(Phone) 408-573-0555 (Fax Number) 408-573-7771

Chevron Contact (Name) Brett Hunter
(Phone) (510) 842-8695
Laboratory Name Sequoia
Laboratory Release Number 9033495
Samples Collected by (Name) DOUG SANDERS
Collection Date 4-21-98
Signature [Signature]

Chain-of-Custody-Record

Sample Number	Lab Sample Number	Number of Containers	Matrix S = Soil W = Water A = Air C = Charcoal	Type C = Grab C = Composite D = Discrete	Time	Sample Preservation	Iced (Yes or No)	Analytes To Be Performed														
								TEX + TPH GAS (8020 + 8015)	TPH Diesel (8015)	Oil and Grease (5520)	Purgeable Halocarbons (8010)	Purgeable Aromatics (8020)	Purgeable Organics (8240)	Extractable Organics (8270)	Metals Cd, Cr, Pb, Zn, Ni (ICAP or AA)							
* C-1	01	3	E	D	1115	HCl	Yes	X														
* C-3	02	3	E	D	1135			X														
* C-6	03	3	E	D	1135			X														
* C-8	04	3	E	D	1030			X														
* C-10A	05	3	E	D	925			X														
* C-10B	06	3	E	D	910			X														
* C-11	07	3	E	D	1010			X														
* C-12	08	3	E	D	1050			X														
* C-15	09	3	E	D	835			X														
* C-16	10	3	E	D	805			X														
* TB	11	2	E	D	1			X														

DO NOT BILL FOR TB-LB

AP 22 12 28

Remarks

Relinquished By (Signature) <u>[Signature]</u>	Organization <u>BTB</u>	Date/Time <u>4/22/98</u>	Received By (Signature) <u>Jeff Bonville</u>	Organization <u>Sequoia</u>	Date/Time <u>10:59</u>	Turn Around Time (Circle Choice) 24 Hrs. 48 Hrs. 5 Days 10 Days As Contracted
Relinquished By (Signature) <u>[Signature]</u>	Organization <u>Sequoia</u>	Date/Time <u>4/22/98</u>	Received By (Signature) <u>[Signature]</u>	Organization	Date/Time	
Relinquished By (Signature)	Organization	Date/Time	Received For Laboratory By (Signature) <u>[Signature]</u>		Date/Time <u>4-22/12:28</u>	

Field Data Sheets

CHEVRON WELL MONITORING DATA SHEET

Project #: 980421-51	Station #: 9-5607
Sampler: DOUG	Date: 4-21-98
Well I.D.: C-1	Well Diameter: 2 3 (4) 6 8 _____
Total Well Depth: 42.99	Depth to Water: 12.29
Depth to Free Product:	Thickness of Free Product (feet):
Referenced to: (PVC) Grade	D.O. Meter (if req'd): YSI HACH

Well Diameter	Multiplier	Well Diameter	Multiplier
2"	0.16	5"	1.02
3"	0.37	6"	1.47
4"	0.65	Other	radius ² * 0.163

Purge Method:	Sampling Method:
Bailer	Bailer
Disposable Bailer	Disposable Bailer <input checked="" type="checkbox"/>
Middleburg	Extraction Port
Electric Submersible <input checked="" type="checkbox"/>	Other: _____
Extraction Pump	
Other: _____	

20.0	x	3	=	59.9	Gals.
1 Case Volume (Gals.)		Specified Volumes		Calculated Volume	

Time	Temp (°F)	pH	Cond.	Gals. Removed	Observations
1103	78.6	7.0	2090	20.0	Odor (strong)
1106	75.9	7.1	1480	40.0	
1109	76.0	7.1	1490	60.0	
					(Reacts w/ HCl)

Did well dewater? Yes No Gallons actually evacuated: 60.0

Sampling Time: 1115 Sampling Date: 4-21-98

Sample I.D.: C-1 Laboratory: (Sequoia) GTEL N. Creek Assoc. Labs

Analyzed for: (TPH-G) (BTEX) (MTBE) TPH-D Other:

Duplicate I.D.: Analyzed for: TPH-G BTEX MTBE TPH-D Other:

D.O. (if req'd):	Pre-purge:	mg/L	Post-purge:	mg/L
O.R.P. (if req'd):	Pre-purge:	mV	Post-purge:	mV

CHEVRON WELL MONITORING DATA SHEET

Project #: 980421-S1	Station #: 9-5607
Sampler: DOUG	Date: 4-21-98
Well I.D.: C-3	Well Diameter: 2 3 (4) 6 8 _____
Total Well Depth: 31.82	Depth to Water: 15.28
Depth to Free Product:	Thickness of Free Product (feet):
Referenced to: (PVC) Grade	D.O. Meter (if req'd): YSI HACH

Well Diameter	Multiplier	Well Diameter	Multiplier
2"	0.16	5"	1.02
3"	0.37	6"	1.47
4"	0.65	Other	radius ² * 0.163

Purge Method: Bailer Sampling Method: Bailer

Disposable Bailer Disposable Bailer **X**

Middleburg Extraction Port

Electric Submersible **X** Other: _____

Extraction Pump

Other: _____

<u>10.8</u>	x	<u>3</u>	=	<u>32.3</u>	Gals.
1 Case Volume (Gals.)		Specified Volumes		Calculated Volume	

Time	Temp (°F)	pH	Cond.	Gals. Removed	Observations
1146	81.8	7.0	1150	11.0	<i>Strong odor</i>
1148	78.9	7.1	1140	22.0	
1150	79.1	7.1	1140	33.0	
					<i>(Reacts w/ Hcl)</i>

Did well dewater? Yes **(No)** Gallons actually evacuated: **33.0**

Sampling Time: **1155** Sampling Date: **4-21-98**

Sample I.D.: **C-3** Laboratory: **(Sequoia)** GTEL N. Creek Assoc. Labs

Analyzed for: **(TPH-G)** **(BTEX)** **(MTBE)** TPH-D Other:

Duplicate I.D.: Analyzed for: TPH-G BTEX MTBE TPH-D Other:

D.O. (if req'd):	Pre-purge:	mg/L	Post-purge:	mg/L
O.R.P. (if req'd):	Pre-purge:	mV	Post-purge:	mV

CHEVRON WELL MONITORING DATA SHEET

Project #: 980421-51	Station #: 9-5607
Sampler: DOUG	Date: 4-21-98
Well I.D.: C-6	Well Diameter: 2 3 (4) 6 8 _____
Total Well Depth: 29.98	Depth to Water: 7.55
Depth to Free Product:	Thickness of Free Product (feet):
Referenced to: (PVC) Grade	D.O. Meter (if req'd): YSI HACH

Well Diameter	Multiplier	Well Diameter	Multiplier
2"	0.16	5"	1.02
3"	0.37	6"	1.47
4"	0.65	Other	radius ² * 0.163

Purge Method:	Sampling Method:
Bailer Disposable Bailer Middleburg Electric Submersible X Extraction Pump Other: _____	Bailer Disposable Bailer X Extraction Port Other: _____

14.6	x	3	=	43.7	Gals.
1 Case Volume (Gals.)		Specified Volumes		Calculated Volume	

Time	Temp (°F)	pH	Cond.	Gals. Removed	Observations
1128	83.4	7.0	2310	15.0	Strong odor
1130	82.5	7.0	2310	30.0	
1132	81.8	7.0	2300	44.0	

Did well dewater? Yes (No)	Gallons actually evacuated: 44.0
Sampling Time: 1135	Sampling Date: 4-21-98
Sample I.D.: C-6	Laboratory: (Sequoia) GTEL N. Creek Assoc. Labs
Analyzed for: (TPH-G) (BTEX) (MTBE) TPH-D Other:	
Duplicate I.D.: Analyzed for: TPH-G BTEX MTBE TPH-D Other:	
D.O. (if req'd):	Pre-purge: _____ mg/L Post-purge: _____ mg/L
O.R.P. (if req'd):	Pre-purge: _____ mV Post-purge: _____ mV

CHEVRON WELL MONITORING DATA SHEET

Project #: 980421-51	Station #: 9-5607
Sampler: DOUG	Date: 4-21-98
Well I.D.: C-8	Well Diameter: (2) 3 4 6 8 _____
Total Well Depth: 25.12	Depth to Water: 4.56
Depth to Free Product:	Thickness of Free Product (feet):
Referenced to: (PVC) Grade	D.O. Meter (if req'd): YSI HACH

Well Diameter	Multiplier	Well Diameter	Multiplier
2"	0.16	5"	1.02
3"	0.37	6"	1.47
4"	0.65	Other	radius ² * 0.163

Purge Method:	Sampling Method:
Bailer Disposable Bailer <input checked="" type="checkbox"/> Middleburg Electric Submersible <input checked="" type="checkbox"/> Extraction Pump Other: _____	Bailer Disposable Bailer <input checked="" type="checkbox"/> Extraction Port Other: _____

<u>3.3</u>	x	<u>3</u>	=	<u>9.9</u>	Gals.
1 Case Volume (Gals.)		Specified Volumes		Calculated Volume	

Time	Temp (°F)	pH	Cond.	Gals. Removed	Observations
1017	75.9	7.2	760	3.5	
1022	76.2	7.3	720	7.0	
1026	76.4	7.2	720	10.0	

Did well dewater? Yes No Gallons actually evacuated: **10.0**

Sampling Time: **1030** Sampling Date: **4-21-98**

Sample I.D.: **C-8** Laboratory: **(Sequoia)** GTEL N. Creek Assoc. Labs

Analyzed for: **(TPH-G)** **(BTEX)** **(MTBE)** TPH-D Other:

Duplicate I.D.: Analyzed for: TPH-G BTEX MTBE TPH-D Other:

D.O. (if req'd):	Pre-purge:	mg/L	Post-purge:	mg/L
O.R.P. (if req'd):	Pre-purge:	mV	Post-purge:	mV

CHEVRON WELL MONITORING DATA SHEET

Project #: 980421-S1	Station #: 9-5607
Sampler: DOUG	Date: 4-21-98
Well I.D.: C-10A	Well Diameter: 2 (3) 4 6 8 _____
Total Well Depth: 22.70	Depth to Water: 16.80
Depth to Free Product:	Thickness of Free Product (feet):
Referenced to: (PVC) Grade	D.O. Meter (if req'd): YSI HACH

Well Diameter	Multiplier	Well Diameter	Multiplier
2"	0.16	5"	1.02
3"	0.37	6"	1.47
4"	0.65	Other	radius ² * 0.163

Purge Method:	Sampling Method:
Bailer Disposable Bailer X Middleburg Electric Submersible X Extraction Pump Other: _____	Bailer Disposable Bailer X Extraction Port Other: _____

<u>2.2</u>	x	<u>3</u>	=	<u>6.5</u>	Gals.
1 Case Volume (Gals.)		Specified Volumes		Calculated Volume	

Time	Temp (°F)	pH	Cond.	Gals. Removed	Observations
914	69.6	7.1	1130	2.5	
918	68.9	7.0	1150	5.0	
921	69.0	7.0	1140	6.5	

Did well dewater? Yes (No)	Gallons actually evacuated: 6.5	
Sampling Time: 925	Sampling Date: 4-21-98	
Sample I.D.: C-10A	Laboratory: (Sequoia) GTEL N. Creek Assoc. Labs	
Analyzed for: (TPH-G) (BTEX) (MTBE) TPH-D Other:		
Duplicate I.D.: Analyzed for: TPH-G BTEX MTBE TPH-D Other:		
D.O. (if req'd):	Pre-purge: _____ mg/L	Post-purge: _____ mg/L
O.R.P. (if req'd):	Pre-purge: _____ mV	Post-purge: _____ mV

CHEVRON WELL MONITORING DATA SHEET

Project #: 980421-S1	Station #: 9-5607
Sampler: DOUG	Date: 4-21-98
Well I.D.: C-10B	Well Diameter: 2 (3) 4 6 8 <u> </u>
Total Well Depth: 34.20	Depth to Water: 17.16
Depth to Free Product:	Thickness of Free Product (feet):
Referenced to: (PVC) Grade	D.O. Meter (if req'd): YSI HACH

Well Diameter	Multiplier	Well Diameter	Multiplier
2"	0.16	5"	1.02
3"	0.37	6"	1.47
4"	0.65	Other	radius ² * 0.163

Purge Method:	Sampling Method:
Bailer	Bailer
Disposable Bailer	Disposable Bailer X
Middleburg	Extraction Port
Electric Submersible X	Other: <u> </u>
Extraction Pump	
Other: <u> </u>	

<u>6.3</u>	x	<u>3</u>	=	<u>18.9</u>	Gals.
1 Case Volume (Gals.)		Specified Volumes		Calculated Volume	

Time	Temp (°F)	pH	Cond.	Gals. Removed	Observations
901	71.2	7.1	880	6.0	
902	69.4	7.1	880	12.0	
903	69.3	7.1	880	19.0	

Did well dewater? Yes **(No)** Gallons actually evacuated: **19.0**

Sampling Time: **910** Sampling Date: **4-21-98**

Sample I.D.: **C-10B** Laboratory: **(Sequoia)** GTEL N. Creek Assoc. Labs

Analyzed for: **(TPH-G)** **(BTEX)** **(MTBE)** TPH-D Other:

Duplicate I.D.: Analyzed for: TPH-G BTEX MTBE TPH-D Other:

D.O. (if req'd):	Pre-purge:	mg/L	Post-purge:	mg/L
O.R.P. (if req'd):	Pre-purge:	mV	Post-purge:	mV

CHEVRON WELL MONITORING DATA SHEET

Project #: 980421-S1	Station #: 9-5607
Sampler: DOUG	Date: 4-21-98
Well I.D.: C-11	Well Diameter: 2 (3) 4 6 8 _____
Total Well Depth: 33.57	Depth to Water: 16.68
Depth to Free Product:	Thickness of Free Product (feet):
Referenced to: (PVC) Grade	D.O. Meter (if req'd): YSI HACH

Well Diameter	Multiplier	Well Diameter	Multiplier
2"	0.16	5"	1.02
3"	0.37	6"	1.47
4"	0.65	Other	radius ² * 0.163

Purge Method: Bailer Sampling Method: Bailer

Disposable Bailer Disposable Bailer **X**

Middleburg Extraction Port

Electric Submersible **X** Other: _____

Extraction Pump

Other: _____

<u>6.2</u>	x	<u>3</u>	=	<u>18.7</u>	Gals.
1 Case Volume (Gals.)		Specified Volumes		Calculated Volume	

Time	Temp (°F)	pH	Cond.	Gals. Removed	Observations
1004	75.0	7.3	2100	6.0	
1005	72.9	7.3	1550	12.0	
1006	72.4	7.2	1540	19.0	

Did well dewater? Yes **(No)** Gallons actually evacuated: **19.0**

Sampling Time: **1010** Sampling Date: **4-21-98**

Sample I.D.: **C-11** Laboratory: **(Sequoia)** GTEL N. Creek Assoc. Labs

Analyzed for: **(TPH-G) (BTEX) (MTBE)** TPH-D Other:

Duplicate I.D.: Analyzed for: TPH-G BTEX MTBE TPH-D Other:

D.O. (if req'd):	Pre-purge:	mg/L	Post-purge:	mg/L
O.R.P. (if req'd):	Pre-purge:	mV	Post-purge:	mV

CHEVRON WELL MONITORING DATA SHEET

Project #: 980421-S1	Station #: 9-5607
Sampler: DOUG	Date: 4-21-98
Well I.D.: C-12	Well Diameter: 2 (3) 4 6 8 _____
Total Well Depth: 29.61	Depth to Water: 7.25
Depth to Free Product:	Thickness of Free Product (feet):
Referenced to: (PVC) Grade	D.O. Meter (if req'd): YSI HACH

Well Diameter	Multiplier	Well Diameter	Multiplier
2"	0.16	5"	1.02
3"	0.37	6"	1.47
4"	0.65	Other	radius ² * 0.163

Purge Method: Bailer Disposable Bailer Middleburg Electric Submersible X Extraction Pump Other: _____	Sampling Method: Bailer Disposable Bailer X Extraction Port Other: _____
---	--

8.3	X	3	=	24.8	Gals.
I Case Volume (Gals.)		Specified Volumes		Calculated Volume	

Time	Temp (°F)	pH	Cond.	Gals. Removed	Observations
1045	78.1	7.8	1060	8.0	• Odor
1046	77.5	7.8	1090	16.0	• gray color
1047	77.7	7.7	1100	25.0	
1048					

Did well dewater? Yes **(No)** Gallons actually evacuated: **25.0**

Sampling Time: **1050** Sampling Date: **4-21-98**

Sample I.D.: **C-12** Laboratory: **(Sequoia)** GTEL N. Creek Assoc. Labs

Analyzed for: **(TPH-G) (BTEX) (MTBE)** TPH-D Other:

Duplicate I.D.: Analyzed for: TPH-G BTEX MTBE TPH-D Other:

D.O. (if req'd):	Pre-purge:	mg/L	Post-purge:	mg/L
O.R.P. (if req'd):	Pre-purge:	mV	Post-purge:	mV

CHEVRON WELL MONITORING DATA SHEET

Project #: 980421-S1	Station #: 9-5607
Sampler: DOUG	Date: 4-21-98
Well I.D.: C-15	Well Diameter: 2 (3) 4 6 8
Total Well Depth: 19.68	Depth to Water: 8.10
Depth to Free Product:	Thickness of Free Product (feet):
Referenced to: (PVC) Grade	D.O. Meter (if req'd): YSI HACH

Well Diameter	Multiplier	Well Diameter	Multiplier
2"	0.16	5"	1.02
3"	0.37	6"	1.47
4"	0.65	Other	radius ² * 0.163

Purge Method: Bailer Sampling Method: Bailer
 Disposable Bailer Disposable Bailer
 Middleburg Extraction Port
 Electric Submersible Other: _____
 Extraction Pump

Other: _____

4.3	x	3	=	12.9	Gals.
1 Case Volume (Gals.)		Specified Volumes		Calculated Volume	

Time	Temp (°F)	pH	Cond.	Gals. Removed	Observations
819	67.6	7.0	1450	4.5	
824	67.8	7.0	1460	9.0	
829	68.0	6.9	1460	13.0	

Did well dewater? Yes No Gallons actually evacuated: 13.0

Sampling Time: 835 Sampling Date: 4-21-98

Sample I.D.: C-15 Laboratory: (Sequoia) GTEL N. Creek Assoc. Labs

Analyzed for: (TPH-G) (BTEX) (MTBE) TPH-D Other:

Duplicate I.D.: Analyzed for: TPH-G BTEX MTBE TPH-D Other:

D.O. (if req'd):	Pre-purge:	mg/L	Post-purge:	mg/L
O.R.P. (if req'd):	Pre-purge:	mV	Post-purge:	mV

CHEVRON WELL MONITORING DATA SHEET

Project #: 980421-S1	Station #: 9-5607
Sampler: DOUG	Date: 4-21-98
Well I.D.: C-16	Well Diameter: 2 (3) 4 6 8
Total Well Depth: 30.60	Depth to Water: 10.63
Depth to Free Product:	Thickness of Free Product (feet):
Referenced to: (PVC) Grade	D.O. Meter (if req'd): YSI HACH

Well Diameter	Multiplier	Well Diameter	Multiplier
2"	0.16	5"	1.02
3"	0.37	6"	1.47
4"	0.65	Other	radius ² * 0.163

Purge Method:	Sampling Method:
Bailer	Bailer
Disposable Bailer <input checked="" type="checkbox"/>	Disposable Bailer <input checked="" type="checkbox"/>
Middleburg	Extraction Port
Electric Submersible <input checked="" type="checkbox"/>	Other: _____
Extraction Pump	
Other: _____	

7.4	x	3	=	22.2	Gals.
1 Case Volume (Gals.)		Specified Volumes		Calculated Volume	

Time	Temp (°F)	pH	Cond.	Gals. Removed	Observations
748	71.4	7.3	1350	7.5	
756	71.2	7.4	1340	15.0	
804	71.0	7.4	1340	22.5	

Did well dewater? Yes <input type="checkbox"/> No <input checked="" type="checkbox"/>	Gallons actually evacuated: 22.5
Sampling Time: 805	Sampling Date: 4-21-98
Sample I.D.: C-16	Laboratory: (Sequoia) GTEL N. Creek Assoc. Labs
Analyzed for: (TPH-G) (BTEX) (MTBE) TPH-D Other:	
Duplicate I.D.:	Analyzed for: TPH-G BTEX MTBE TPH-D Other:
D.O. (if req'd):	Pre-purge: mg/L
O.R.P. (if req'd):	Pre-purge: mV
	Post-purge: mg/L
	Post-purge: mV