

ALAMEDA COUNTY ENVIRONMENTAL
HEALTH DEPARTMENT

ENVIRONMENTAL PROTECTION DIVISION
1131 Harbor Bay Parkway, Suite #250
Alameda, CA 94502-6577
Telephone (510) 567-6700
Fax Number (510) 337-9335

FAX COVER SHEET

DATE: 2/15, 1996

TO: Christine Ladd OR Brady Nagle
Atisto

FAX # () 295-1823

Total number of pages including cover sheet 2

FROM: Scott Scery

NOTE:

RE: BP Station # 11105 soil sampling

Please note product line appears to be represented
by linear asphalt patch between northern dispenser
island and western one (as opposed to such piping
running directly to UST cluster). Please modify plan

(SMILE) have a nice day.

DO SOMETHING FOR OUR ENVIRONMENT.

to reflect this and the need to collect one sample per
20 linear feet; hence, minimum of 3 samples (not 2).

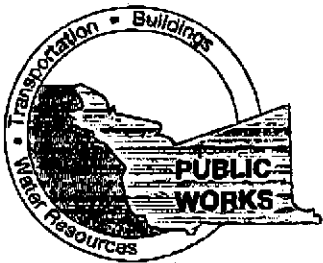

COUNTY OF ALAMEDA
PUBLIC WORKS AGENCY
399 Elmhurst Street • Hayward, CA 94544-1395
(510) 670-5480

February 1, 1996

Mr. Scott Hooton
BP Oil Company
295 S.W. 41st Street
Renton, Washington 98055

Dear Mr. Hooton:

Subject: Removal of Groundwater Monitoring Well - Former BP Station
3515 Castro Valley Boulevard, Castro Valley, California

This is a follow-up to our telephone discussion on January 30, 1996, regarding the removal of a groundwater monitoring well at the subject service station. This monitoring well is located on the westerly side of the property, within the planter area fronting Redwood Road.

This Agency has scheduled a roadway widening project on Redwood Road. Our construction activities will begin in the beginning of April 1996. In my recent telephone conversation with Scott Seery, (510) 567-6783, of the Alameda County Department of Environmental Health, it is my understanding that this well may be removed or relocated when the information required has been extracted from it. It is requested that you coordinate with Mr. Seery regarding this matter and the removal of the well prior to our construction activities in April 1996.

If you have any concerns regarding this schedule or have additional questions, please contact me at (510) 670-5581. Your cooperation with this Agency is sincerely appreciated.

Very truly yours,

Stanley Fung
Associate Engineer

SF:jcj

Enclosure

c: Ruel Brown, Construction Manager
Tat Cheung, Supervising Civil Engineer
John Fenstermacher, Chief Right-of-Way Agent
Property Owner, 3515 Castro Valley Blvd.

836712

MAIN FILE

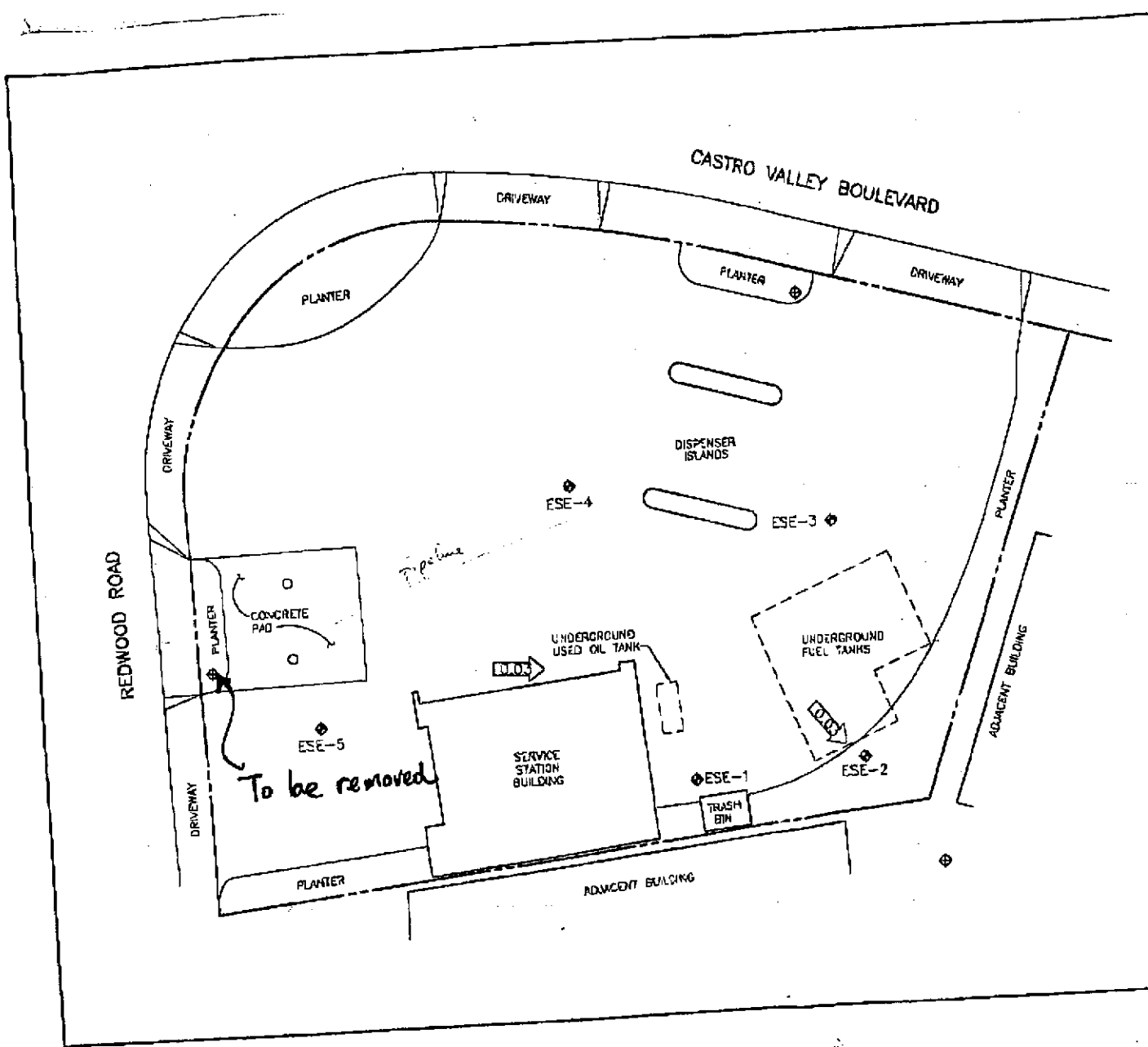

LEGEND

- ◆ EXISTING GROUNDWATER MONITORING WELL
- ◆ PROPOSED GROUNDWATER MONITORING WELL
- PROPOSED SOIL BORING
- ← 0.03 CALCULATED GROUNDWATER GRADIENT DIRECTION AND MAGNITUDE IN FOOT PER FOOT AS MEASURED ON FEBRUARY 17, 1994

FIGURE 2
SITE PLAN
 BP OIL SERVICE STATION NO. 11105
 3515 CASTRO VALLEY BOULEVARD
 CASTRO VALLEY, CALIFORNIA
 PROJECT NO. 10-138

 **ALISTO ENGINEERING GROUP**
 WILSON CREEK, CALIFORNIA

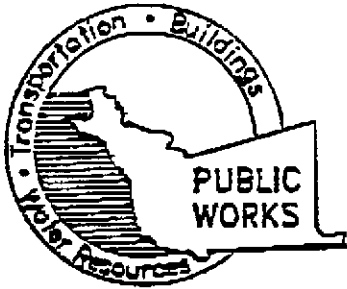

COUNTY OF ALAMEDA
 PUBLIC WORKS AGENCY
 399 Elmhurst Street • Hayward, CA 94544-1395
 (510)670-5480

FAX TRANSMITTAL

TO	<i>Scott Sperry</i>
	<i>Alameda County Health Agency</i>
	FAX NO. <i>337-9335</i>

DATE *2-1-96*
 JOB NO. *R 20084*

TRANSMITTING THE FOLLOWING:

SHEETS	DATED	TITLE/DESCRIPTION
<i>2</i>	<i>2-1-96</i>	<i>Letter to Scott Houston, PS station</i>

NUMBER OF PAGES, INCLUDING THIS PAGE, BEING TRANSMITTED: *3*

FROM: NAME: *Stanley Fung*
 FAX NUMBER: *(510) 782-1939*

IF YOU EXPERIENCE PROBLEMS WITH THIS TRANSMISSION, PLEASE CONTACT:
me AT *(510) 670-5581*

REMARKS: _____

