



gettler — ryan inc.

FILE #	5760	SS	<input checked="" type="checkbox"/>	BP	<input type="checkbox"/>
RPT	QM	TRANSMITTAL	<input type="checkbox"/>	<input type="checkbox"/>	<input type="checkbox"/>
1	2	3	4	5	6
				<input checked="" type="checkbox"/>	<input type="checkbox"/>

March 12, 1991

**RECEIVED**

MAR 18 1991

SAN RAMON  
MAINT. & CONST.

Don Del Company  
21119 Redwood Road  
Castro Valley, California 94546

Reference: Unocal Service Station # 5760  
376 Leveiling Boulevard  
San Lorenzo, California

Sir/Madam:

As requested by UNOCAL Corporation, Gettler Ryan Inc. is conducting a soil and ground-water investigation at the above referenced location. As part of a continuing investigation, we are requesting your approval to install one groundwater monitoring well on your property at the location shown on the attached site plan.

The monitoring well will be constructed by drilling an eight-inch diameter boring to an approximate depth of 30 feet. The monitoring well will be completed with 3-inch diameter PVC well casing. A Christy traffic box will be placed, flush with the existing pavement, over the well. The well installation can be completed in one day.

Once the well has been installed, it will be necessary to collect groundwater samples from the well on a quarterly basis (every three months). The well sampling can normally be completed within one hour. In addition, periodic water level measurements will be collected from the well. This procedure can be completed in five minutes.

Upon the completion of the investigation, the monitoring well will be destroyed in accordance with local and state guidelines and the property restored to its original condition.

As this investigation is being conducted to comply with state and local environmental regulations, your response to our request is desired.

FROM UNOCAL SAN RAMON 8. 2. 1991 9:33 P. 1

Don Del Company  
March 12, 1991  
page 2

In performing this work, UNOCAL Corporation shall indemnify, defend, protect and hold the Don Del Company harmless from and against any and all claims, loss, proceedings, damages, causes of action, liability, cost of expense (including attorney's fees) arising from or in connection with or caused by any negligence of UNOCAL Corporation, its employees or independent contractors, or agents in connection with entering the property and performing tests, sampling, monitoring and treating of the soil and/or groundwater on the property. In addition, UNOCAL Corporation agrees to accept full responsibility for repair and total restoration of site facilities damaged as a result of the subsurface sampling activity.

Please contact me at (415) 783-7500 with any questions or comments you may have regarding this request.

Sincerely,



Keith E. Bullock

KEB/jpz

Enclosures

cc: Mr. Ron Bock, UNOCAL Corporat

Keith Bullock

7/24/91

W/ Gettler Ryan

Unocal

Lewelling x Usher

---

Access difficult to offsite  
well placement,

---

well - <sup>proposed</sup> moved into S ~  
120' into albion av - Prop.  
owners due south have  
denied access - do we want  
to insist that well go onto  
prop directly south?  
call into Rich - 7/25/91

LEWELLING BOULEVARD

**EXPLANATION**

- ◆ Ground-water monitoring well
- ⊕ Proposed ground-water monitoring well

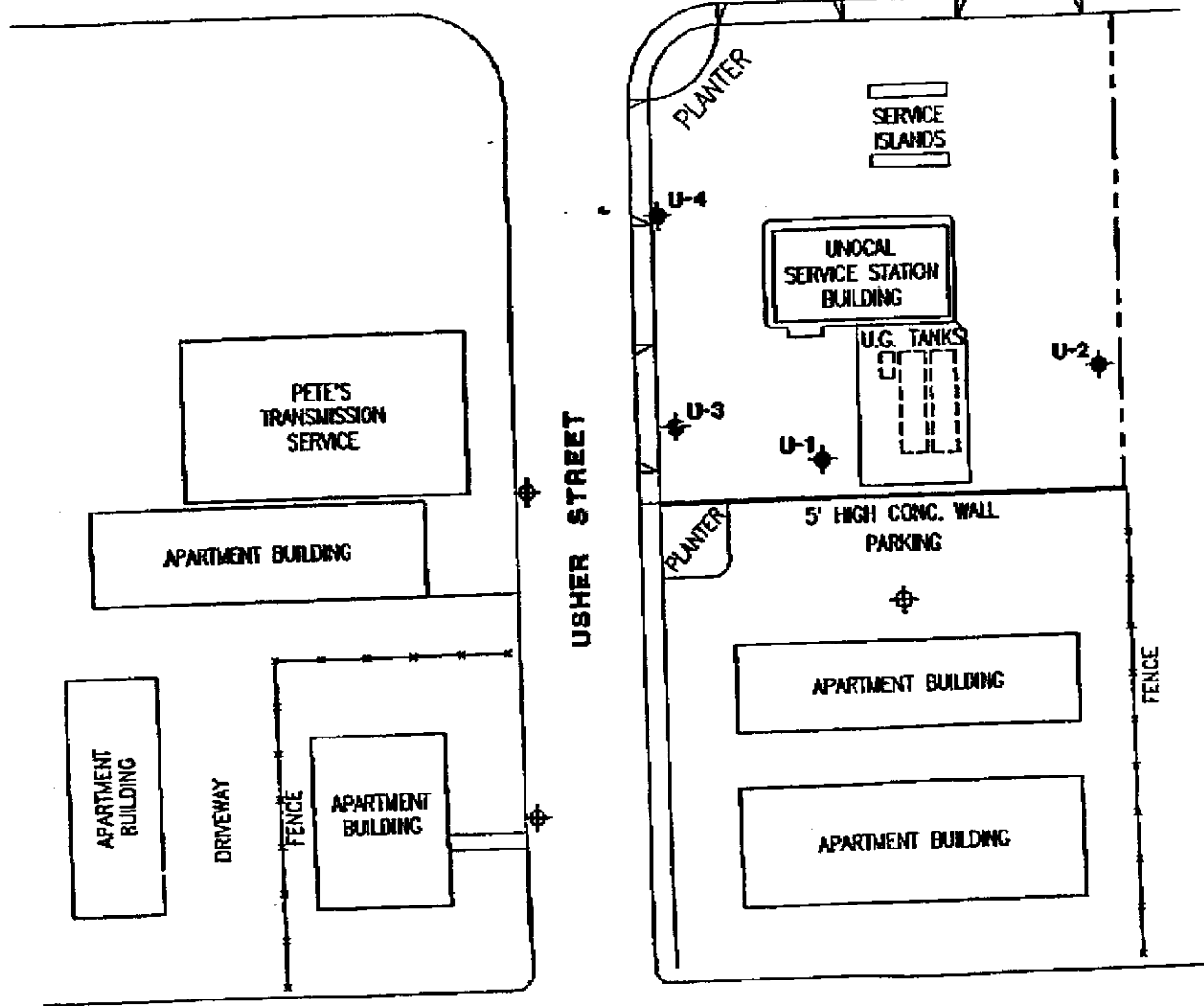

ALBION AVENUE

Base Map: Field observations

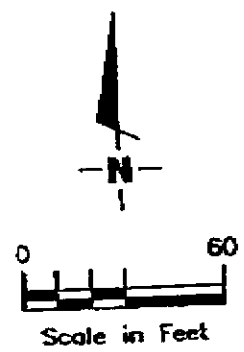

GeoStrategies Inc.

EXTENDED SITE PLAN  
 UNOCAL Service Station #5760  
 376 Lewelling Boulevard  
 San Lorenzo, California

DATE  
3/91

REVISED DATE

JOB NUMBER  
780902

REVIEWED BY

PLATE  
**2**

FROM UNOCAL SRN RAMON

8. 2.1991

1:33

6

**Don Del Co**

P.O. BOX #20006  
Castro Valley, Ca. 94546  
Ph. # (415) 538-7555

March 25, 1991

**GETTLER-RYAN INC.**  
2150 WEST WINTON AVE.  
HAYWARD, CA. 94545

Reference: Unocal Service Station #5760  
376 Lewelling Boulevard  
San Lorenzo, Ca.

Attn: Mr. Keith E. Bullock.

Dear Mr. Bullock,

This is to acknowledge receipt of your letter, dated March 12, 1991, (including pages 1, 2, & 3.) and to inform your company that we Don Del Co, the owners of the apartment project located adjacent to the subject property, find your request, totally unacceptable as stated.

We shall consider the acceptance of the request, as outlined in stated letter, with the following additional conditions:

1. Don Del Co receives a total cash deposit of \$10,000.00 (Ten Thousand Dollars) To be held by Don Del Co as specified in Paragraph 6.
2. Gettler Ryan Inc. may complete work as specified in the letter, but shall not be authorized to perform any additional work or tests, without additional written authorization, (including, but not limited to, installation and/or operation of any pumping equipment for sub surface water, contaminated or not)
3. Don Del Co shall receive 72 hour written notice of any proposed work, including time & type of work to be performed.
4. Any such work shall be done during normal working hours and shall in no way disrupt or interfere with the normal life styles of tenants occupying said apartment building, including garage access.
5. Gettler Ryan Inc. shall complete all work as authorized within a time period of one year of acceptance of the terms & conditions as stated here-in,
6. \$5,000.00 (Five Thousand Dollars) of the deposit shall be returned upon satisfactory compliance of all conditions as agreed upon. However, upon any violation of any of the conditions, (as determined by Don Del Co) and/or any rent loss suffered by Don Del Co due to this work, a justifiable amount, (as determined by Don Del Co) shall be deducted from said refundable deposit (with out recourse). Balance of \$5,000.00 will be non refundable!

Sincerely,

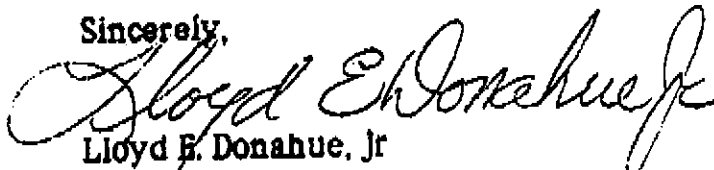
  
Lloyd E. Donahue, Jr.  
General Partner.

LEWELLING BOULEVARD

EXPLANATION

- ◆ Ground-water monitoring well
- ⊕ Proposed ground-water monitoring well

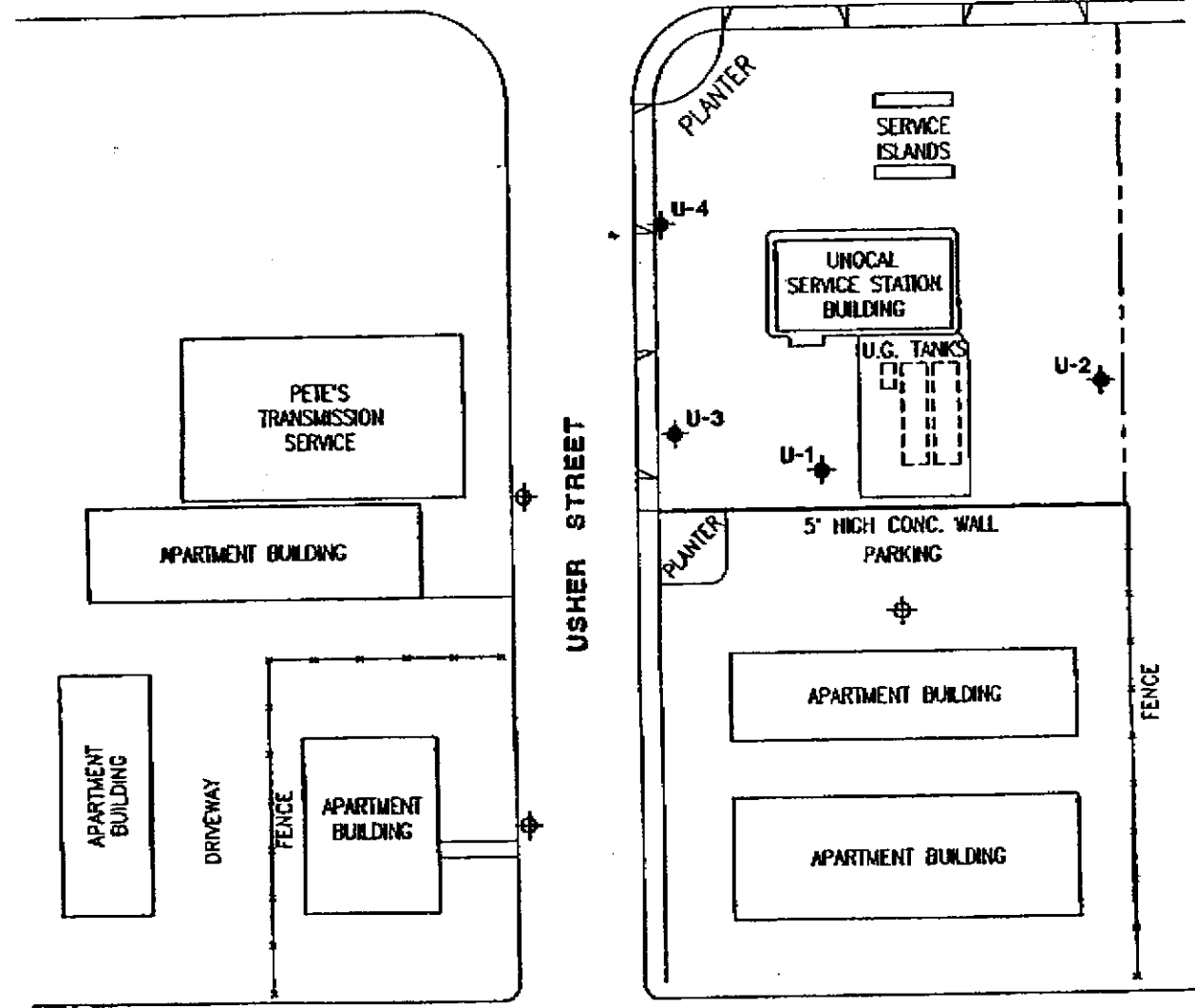

ALBION AVENUE

Base Map: Field observations

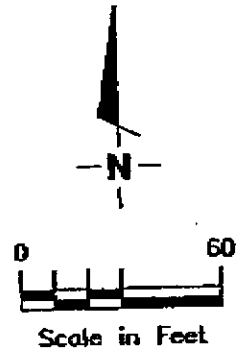

GeoStrategies Inc.

EXTENDED SITE PLAN  
 UNOCAL Service Station #5760  
 376 Lewelling Boulevard  
 San Lorenzo, California

PLATE

2

JOB NUMBER  
780902

REVIEWED BY

DATE  
3/91

REVISED DATE

Time Schedule for Work at  
UNOCAL Service Station No. 5760  
376 Lewelling Boulevard  
San Lorenzo, California

Task	Date
o Submit encroachment permit applications to the City of San Lorenzo and county of Alameda. Submit property access agreement requests to property owners for the installation of off-site monitoring wells.	March 15, 1991
o Receive all necessary permits and access agreements for well installations.	May 15, 1991
o Complete installation of monitoring wells and exploratory borings.	May 31, 1991
o Complete well development and ground-water sampling for all project wells.	June 7, 1991
o Receive all analytical data from laboratory.	June 25, 1991
o Issue a report presenting the findings of this investigation.	July 19, 1991

The time schedule for the installation of the proposed monitoring wells is contingent upon receiving the permits and access agreements by the dates specified.

Voice Mail  
msg to Ron  
Beck 7/26/91

o We will write letter  
o Interim remediation  
measurements - FP?



gertler — ryan inc.

(415) 783-7500

general and environmental contractors

LEWELLING BOULEVARD

EXPLANATION

- ◆ Ground-water monitoring well
- ⊕ Proposed ground-water monitoring well

⊙ = Floating Product

○ = >100,000 ppb TPH

\* = >10,000 ppb

= ND

3/91

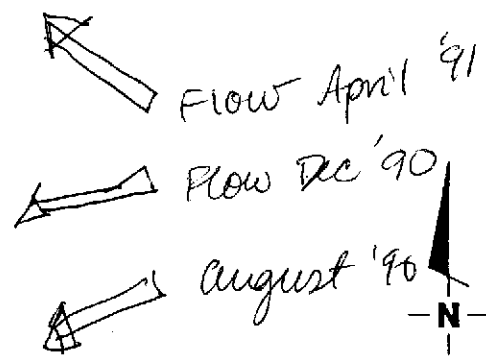

Base Map: Field observations

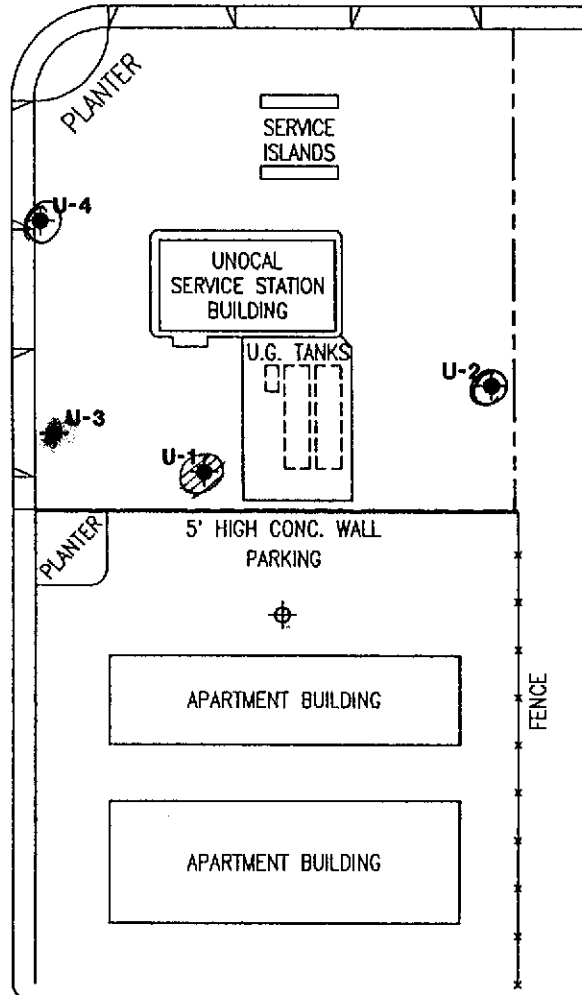
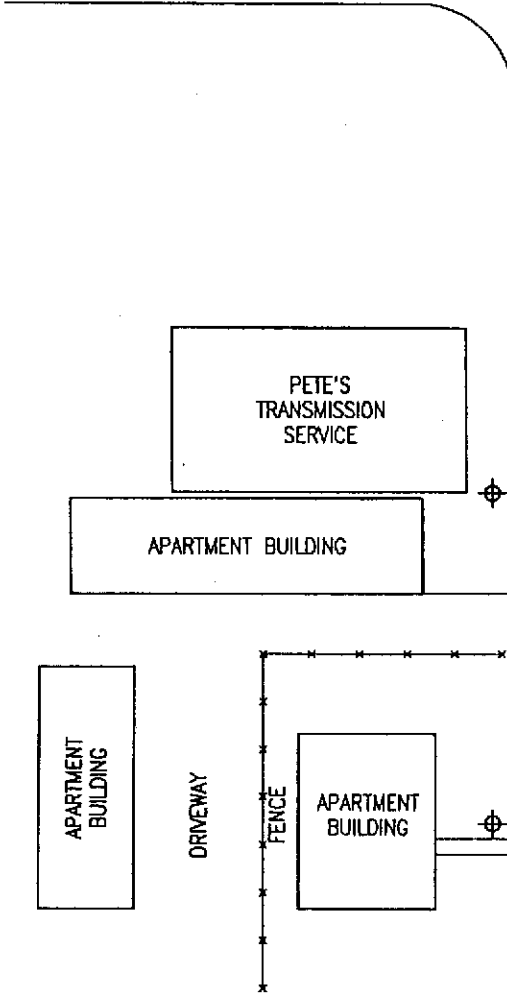

ALBION AVENUE



GeoStrategies Inc.

EXTENDED SITE PLAN  
 UNOCAL Service Station #5760  
 376 Lewelling Boulevard  
 San Lorenzo, California

PLATE

2

JOB NUMBER  
780901-4

REVIEWED BY  
DHP

DATE  
2/91

REVISED DATE

LEWELLING BOULEVARD

EXPLANATION

- ◆ Ground-water monitoring well
- ⊕ Proposed ground-water monitoring well

⊗ = Floating product  
 ○ = >100,000 ppb TPH  
 ⊗ = >10,000 ppb  
 = ND

12/90

1/91

Base Map: Field observations

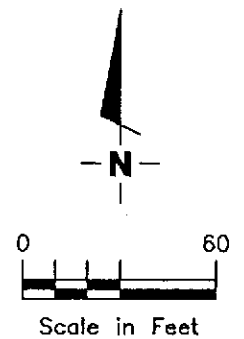

USHER STREET

ALBION AVENUE

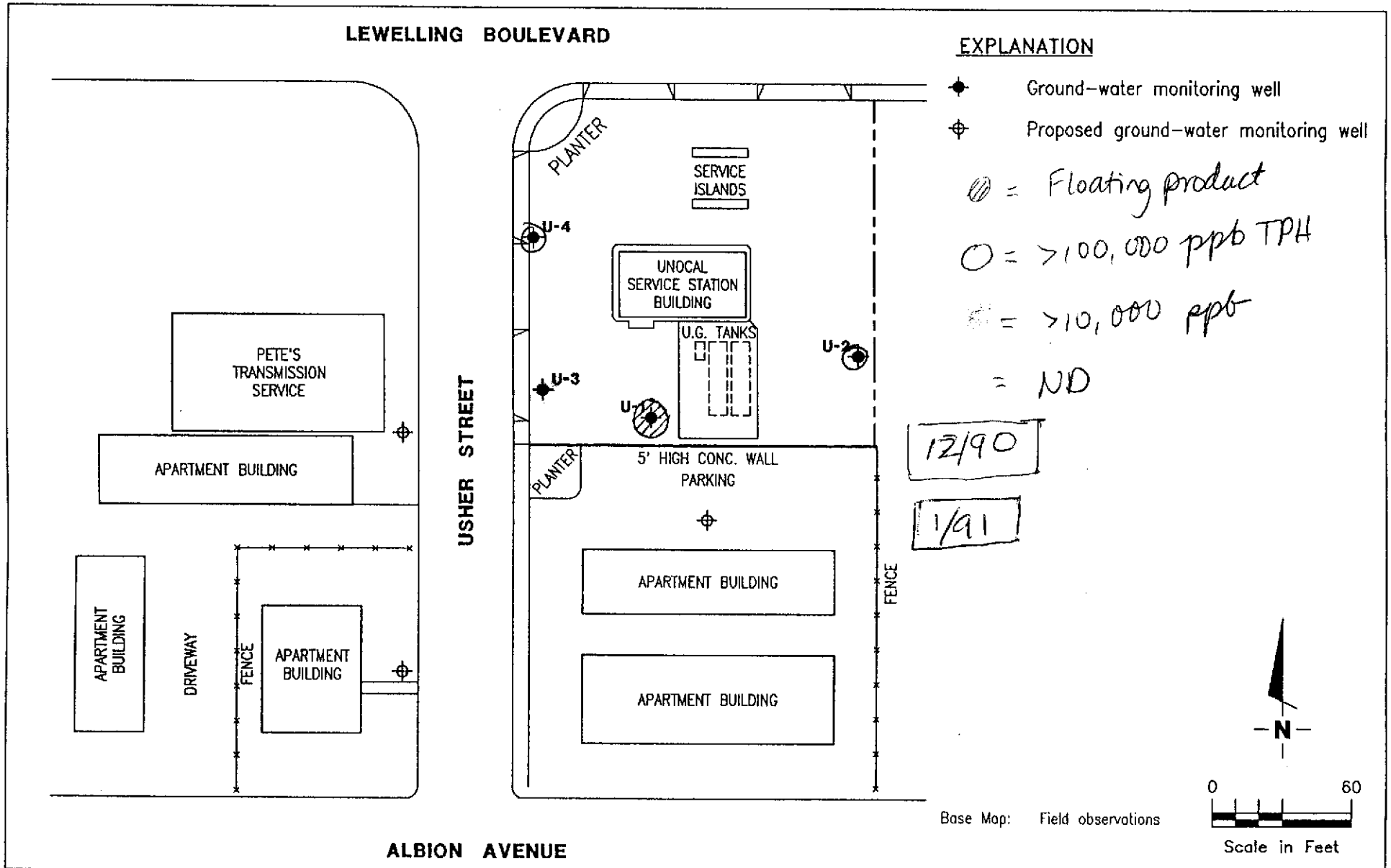

GeoStrategies Inc.

EXTENDED SITE PLAN  
 UNOCAL Service Station #5760  
 376 Lewelling Boulevard  
 San Lorenzo, California

PLATE

2

JOB NUMBER  
780901-4

REVIEWED BY  
DHP

DATE  
2/91

REVISED DATE



LEWELLING BOULEVARD

EXPLANATION

- ◆ Ground-water monitoring well
- ⊕ Proposed ground-water monitoring well

⊙ = Floating Product

○ = > 100,000 ppb TPH

○ = > 10,000 ppb

○ = ND

8/90

U4 had hits of 1.0 ppb Toluene  
1.8 ppb Xylene



Base Map: Field observations

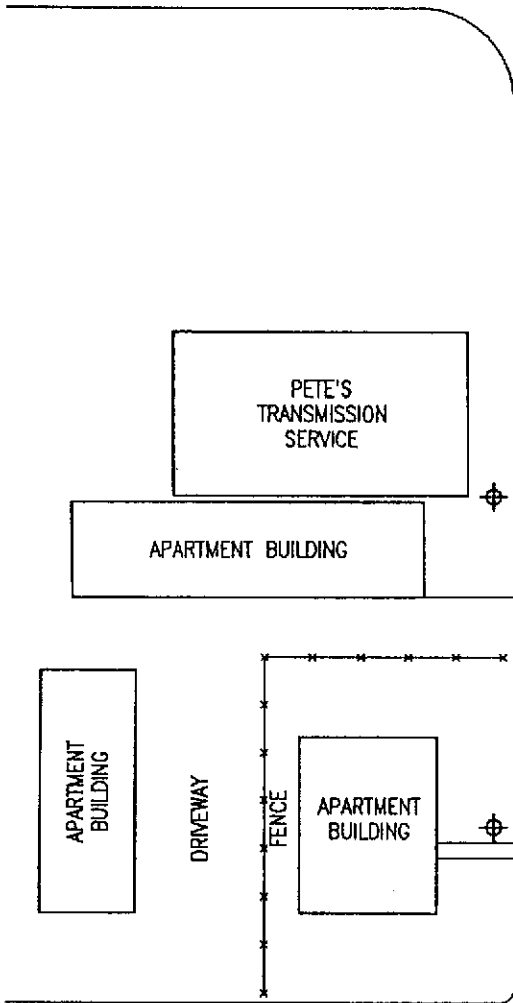

USHER STREET

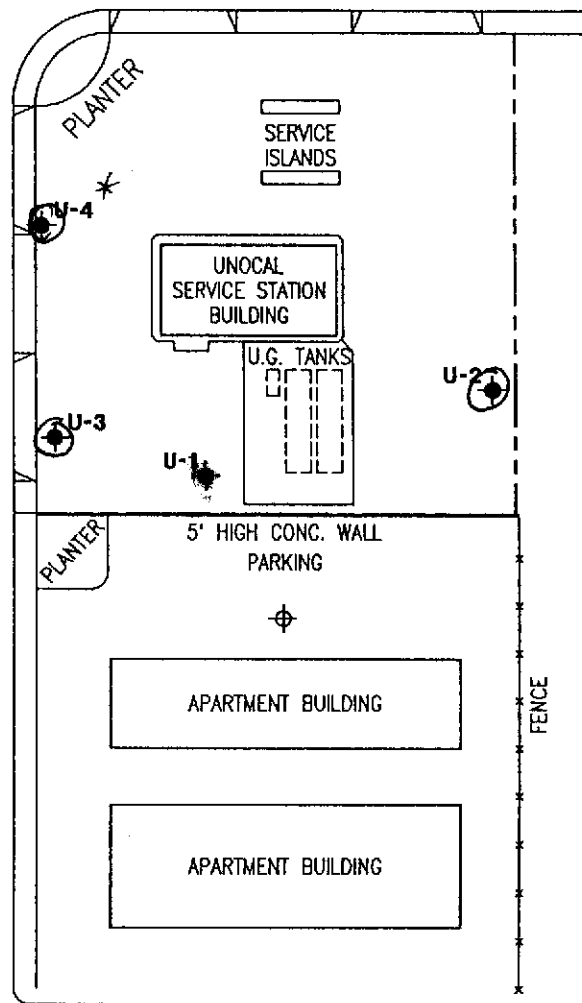

ALBION AVENUE



GeoStrategies Inc.

EXTENDED SITE PLAN  
UNOCAL Service Station #5760  
376 Lewelling Boulevard  
San Lorenzo, California

PLATE

2

JOB NUMBER  
780901-4

REVIEWED BY  
DHP

DATE  
2/91

REVISED DATE

LEWELLING BOULEVARD

EXPLANATION

- ◆ Ground-water monitoring well
- ⊕ Proposed ground-water monitoring well

⊗ = Floating Products  
 ○ = > 100,000 ppb TPH  
 ○ = > 10,000 ppb  
 ○ = N.D.

**8-90** U-1 only  
 No data for U2, U3, U4  
 not installed yet

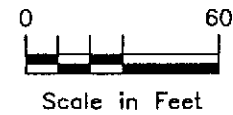

Base Map: Field observations

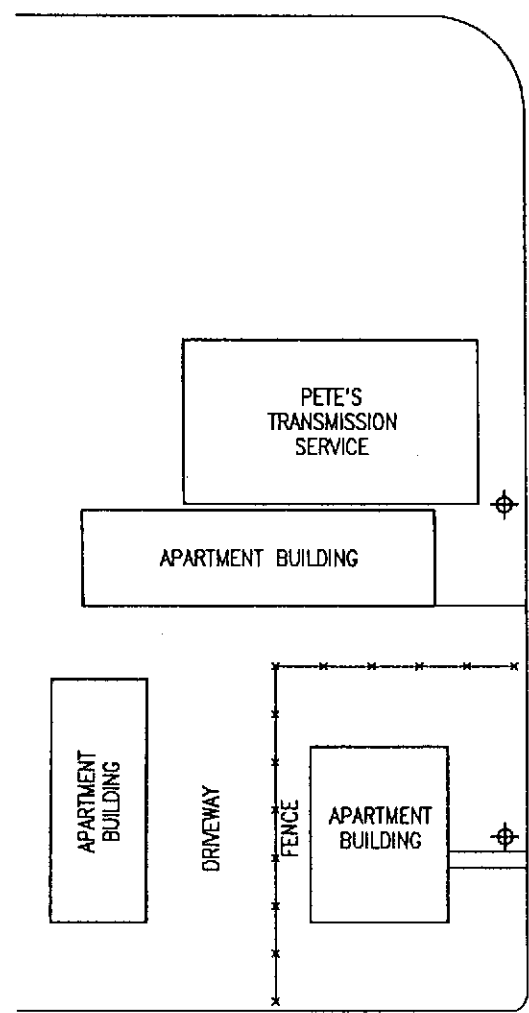

USHER STREET

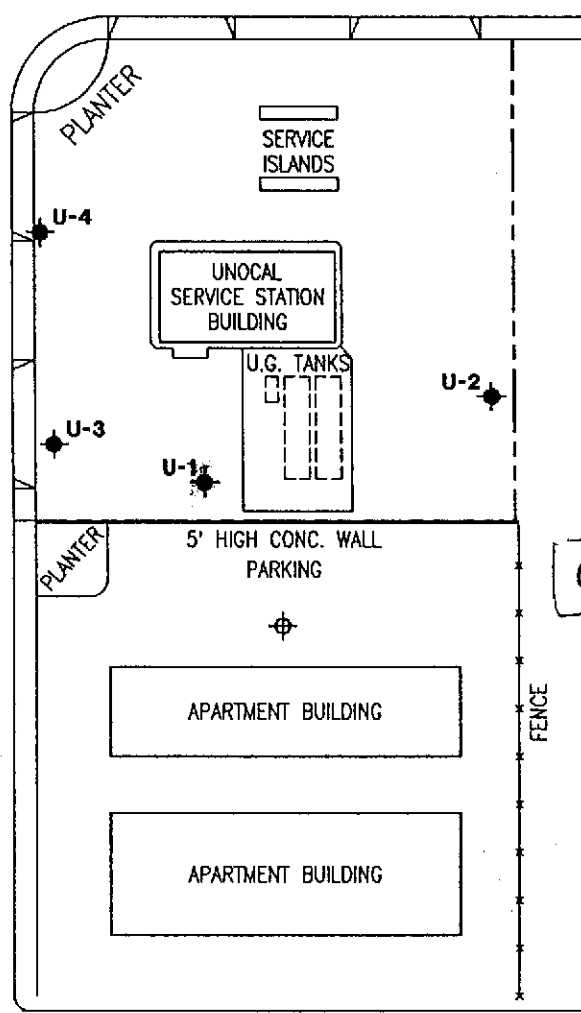

ALBION AVENUE



GeoStrategies Inc.

EXTENDED SITE PLAN  
 UNOCAL Service Station #5760  
 376 Lewelling Boulevard  
 San Lorenzo, California

PLATE  
**2**

JOB NUMBER  
 780901-4

REVIEWED BY  
 DHP

DATE  
 2/91

REVISED DATE

LEWELLING BOULEVARD

EXPLANATION

- ◆ Ground-water monitoring well
- ⊕ Proposed ground-water monitoring well

⊙ = Floating Product

○ = >100,000 ppb TPH

○ = >10,000 ppb TPH

○ = N.I.D.

3/20/90 U1 only

No data for U2, U3, U4  
not installed



Base Map: Field observations

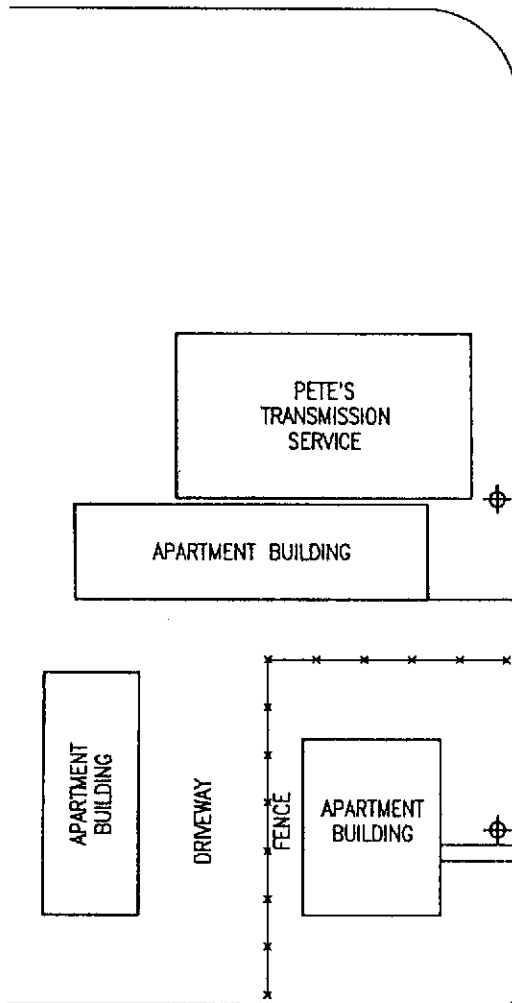

USHER STREET

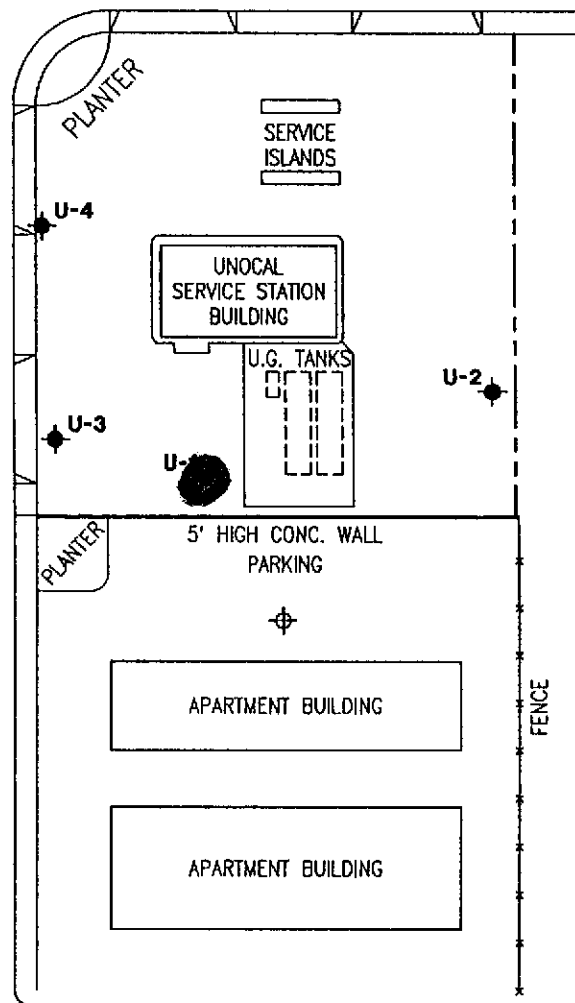

ALBION AVENUE



GeoStrategies Inc.

EXTENDED SITE PLAN  
 UNOCAL Service Station #5760  
 376 Lewelling Boulevard  
 San Lorenzo, California

PLATE

2

JOB NUMBER  
780901-4

REVIEWED BY  
DHP

DATE  
2/91

REVISED DATE

LEWELLING BOULEVARD

EXPLANATION

- ◆ Ground-water monitoring well
- ⊕ Proposed ground-water monitoring well

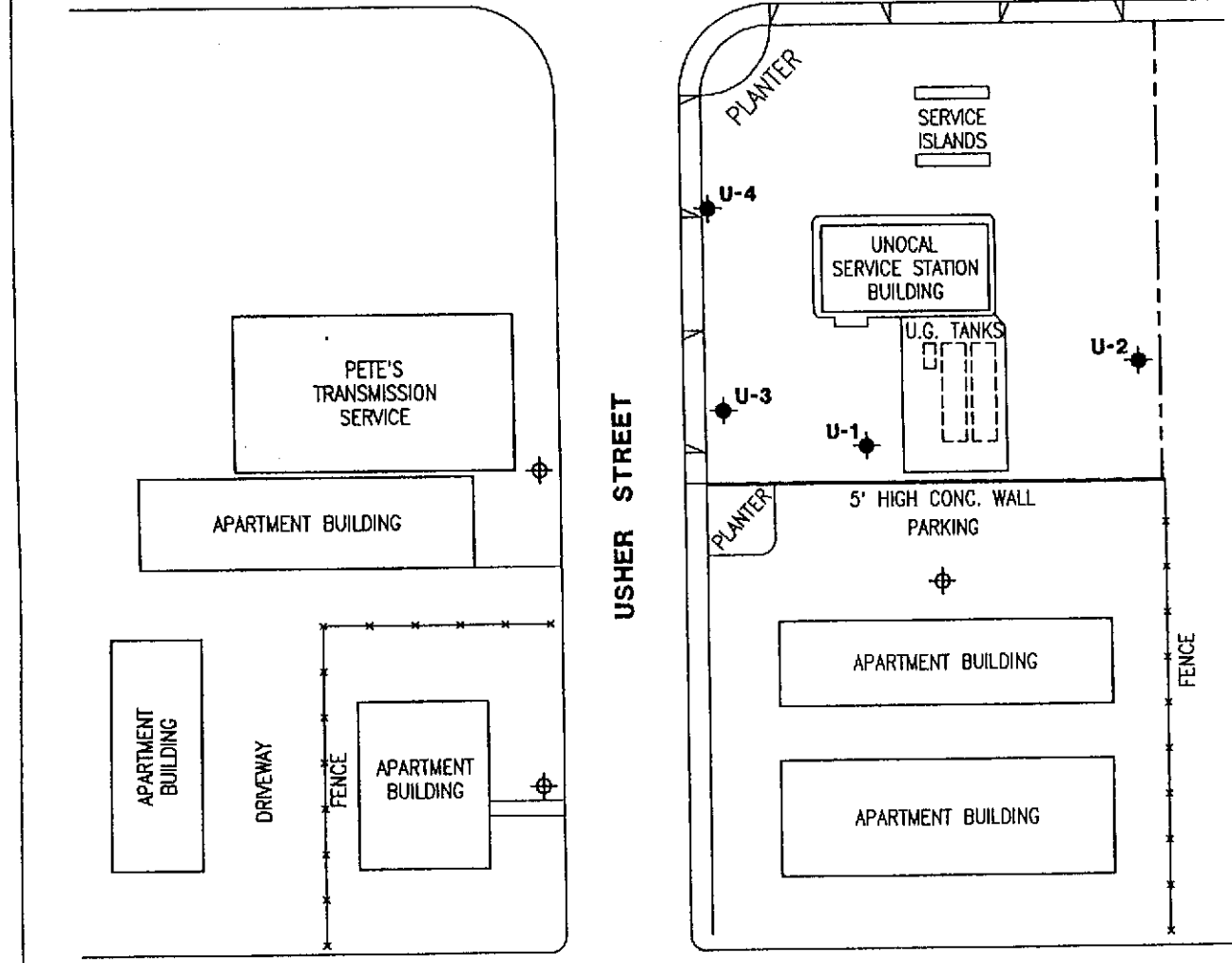

Base Map: Field observations

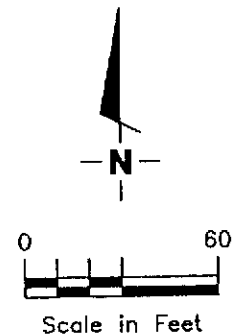

ALBION AVENUE



GeoStrategies Inc.

EXTENDED SITE PLAN  
 UNOCAL Service Station #5760  
 376 Lewelling Boulevard  
 San Lorenzo, California

PLATE  
**2**

JOB NUMBER  
780901-4

REVIEWED BY  
DHP

DATE  
2/91

REVISED DATE