



RECEIVED

By dehloptoxic at 1:10 pm, Jan 30, 2007

Denis L. Brown

Shell Oil Products US

HSE – Environmental Services
20945 S. Wilmington Avenue
Carson, CA 90810-1039
Tel (707) 865 0251
Fax (707) 865 2542
Email denis.l.brown@shell.com

Mr. Barney Chan
Alameda County Health Care Services Agency
1131 Harbor Bay Parkway, Suite 250
Alameda, California 94205-6577

Re: Former Shell Service Station
461 8th Street
Oakland, California
SAP Code: 129453
Incident No. 97093399
ACHCSA Case No. 0343

Dear Mr. Chan:

The attached document is provided for your review and comment. Upon information and belief, I declare, under penalty of perjury, that the information contained in the attached document is true and correct.

If you have any questions or concerns, please call me at (707) 865-0251.

Sincerely,

A handwritten signature in black ink that reads "Denis L. Brown". The signature is fluid and cursive, with a long horizontal line extending from the end.

Denis L. Brown
Project Manager

January 29, 2007

Mr. Barney Chan
Alameda County Health Care Services Agency
1131 Harbor Bay Parkway, Suite 250
Alameda, California 94502

Re: **Groundwater Monitoring Report – Fourth Quarter 2006**
Former Shell Service Station
461 8th Street
Oakland, California
SAP Code 129453
Incident No. 97093399
ACHCSA Case No. 0343



Dear Mr. Chan:

Cambria Environmental Technology, Inc. (Cambria) prepared this report on behalf of Equilon Enterprises LLC dba Shell Oil Products US (Shell) in accordance with the quarterly reporting requirements of 23 CCR 2652d.

If you have any questions regarding the contents of this document, please call Ana Friel at (707) 268-3812.

Sincerely,
Cambria Environmental Technology, Inc.



Ana Friel, PG
Associate Geologist

Enclosure: Groundwater Monitoring Report – Fourth Quarter 2006

cc: Mr. Denis Brown, Shell
A.F. Evans Company (Property Owners), c/o Greg Lunkes
Mr. Leroy Griffin, City of Oakland Fire Prevention Bureau

**Cambria
Environmental
Technology, Inc.**

19449 Riverside Drive
Suite 230
Sonoma, CA 95476
Tel (707) 935-4850
Fax (707) 935-6649

C A M B R I A

GROUNDWATER MONITORING REPORT – FOURTH QUARTER 2006

Site Address	<u>461 8th Street, Oakland</u>
Site Use	<u>Former Shell Service Station</u>
Shell Project Manager	<u>Denis Brown</u>
Consultant and Contact Person	<u>Cambria, Ana Friel</u>
Lead Agency and Contact	<u>ACHCSA, Barney Chan</u>
Agency Case No.	<u>0343</u>
Shell SAP Code	<u>129453</u>
Shell Incident No.	<u>97093399</u>
Date of Most Recent Agency Correspondence	<u>December 1, 2006 (electronic)</u>



Current Quarter's Activities

1. Blaine Tech Services, Inc. (Blaine) gauged and sampled wells according to the established monitoring program for this site.
2. Cambria prepared a vicinity map (Figure 1) and a groundwater contour and chemical concentration map (Figure 2). The Blaine report, presenting the analytical data, is included in Attachment A.
3. In electronic correspondence dated November 27, 2006, Cambria requested an extension for the submittal of a technical report from November 29, 2006 to March 2, 2007, due to difficulties negotiating access agreement and due to available driller's schedule. In electronic correspondence dated December 1, 2006, the extension was granted.
4. Cambria implemented the June 7, 2006 *Subsurface Investigation Work Plan* between December 7 and December 14, 2006.

Current Quarter's Findings

Groundwater Flow Direction	<u>South-westerly</u>
Hydraulic Gradient	<u>0.015</u>
Depth to Water	<u>20.03 to 22.68 feet below top of well casing</u>

C A M B R I A

Proposed Activities for Next Quarter

1. Blaine will gauge and sample wells during the second month of the quarter, according to the established monitoring program for this site.
2. The technical report of the investigation activities will be submitted by the required due date of March 2, 2007.



Figures: 1 - Vicinity Map
 2 - Groundwater Contour and Chemical Concentration Map

Attachments: A - Blaine Tech Services, Inc. - Groundwater Monitoring Report

Cambria Environmental Technology, Inc. (Cambria) prepared this document for use by our client and appropriate regulatory agencies. It is based partially on information available to Cambria from outside sources and/or in the public domain, and partially on information supplied by Cambria and its subcontractors. Cambria makes no warranty or guarantee, expressed or implied, included or intended in this document, with respect to the accuracy of information obtained from these outside sources or the public domain, or any conclusions or recommendations based on information that was not independently verified by Cambria. This document represents the best professional judgment of Cambria. None of the work performed hereunder constitutes or shall be represented as a legal opinion of any kind or nature.

K:\Oakland 461 8th\QMRs\2006\4Q06\4Q06 QMR TEXT.doc

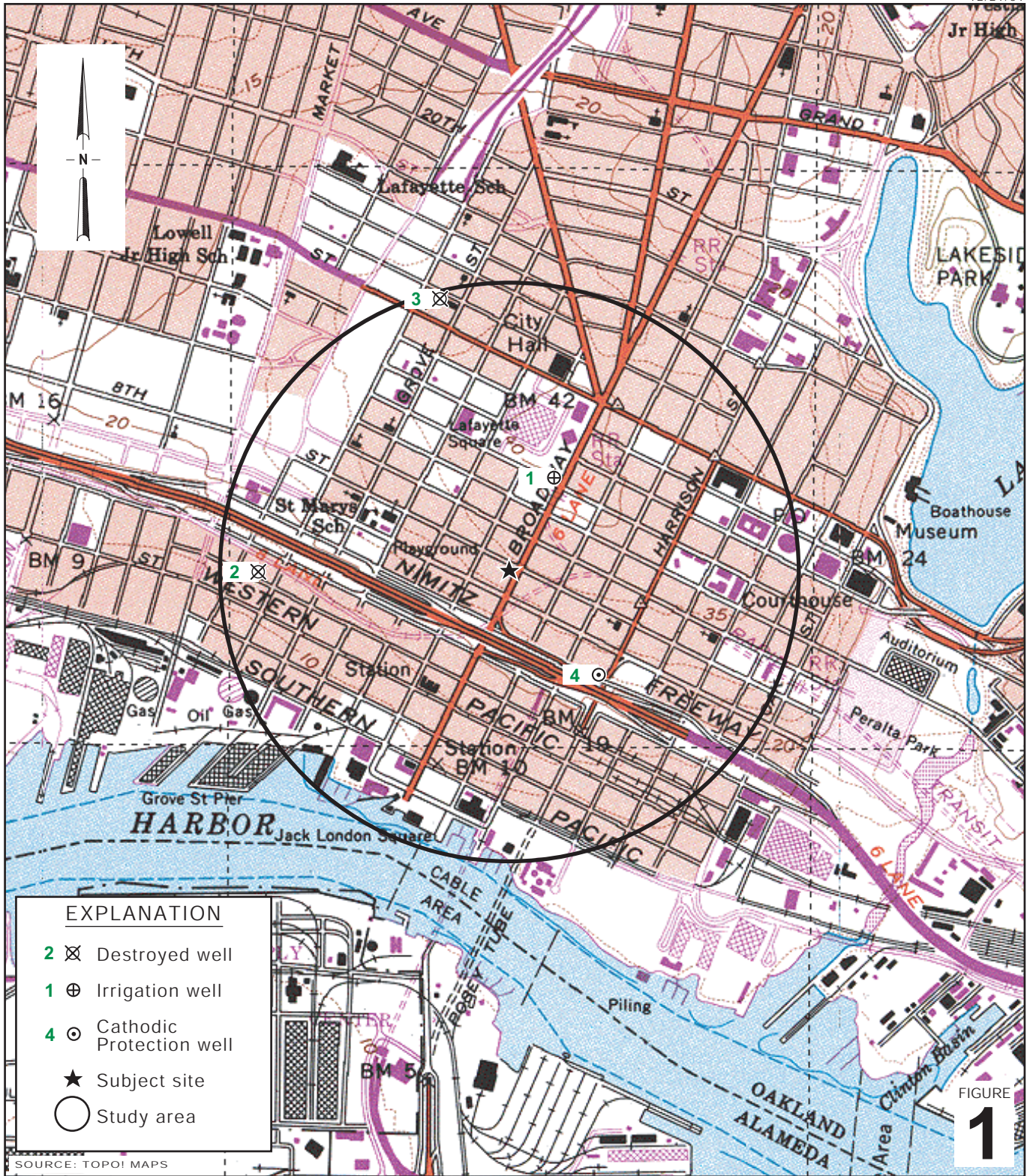

Former Shell Service Station
 461 8th Street
 Oakland, California



C A M B R I A

Vicinity Map

1/2 Mile Radius

EXPLANATION

	S-4	Groundwater monitoring well		Manhole
	S-1	Abandoned monitoring well		Flow line depth below ground surface
	XX.XX	Groundwater elevation contour in feet referenced to mean sea level (ft msl).		Flow direction indicator
		Groundwater flow direction and gradient		Underground BART line (B)
10.76		Groundwater elevation, in feet above msl		Storm Drain line (SD)
(19,000)		Benzene concentrations in micrograms per liter (µg/L)		Water line (W)
(ND)		MTBE concentrations in (µg/L)		Sanitary Sewer line (SS)
(ND)		Not Detected		Pacific Bell line (T)
(NS)		Not Sampled		Gas line (G)
				Electrical line (E)

* Because well S-5 is located in confined space, it is no longer gauged or sampled

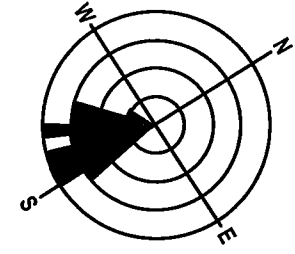

Groundwater Flow Direction (1Q00 to 3Q05)

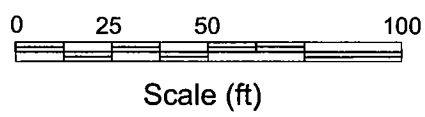
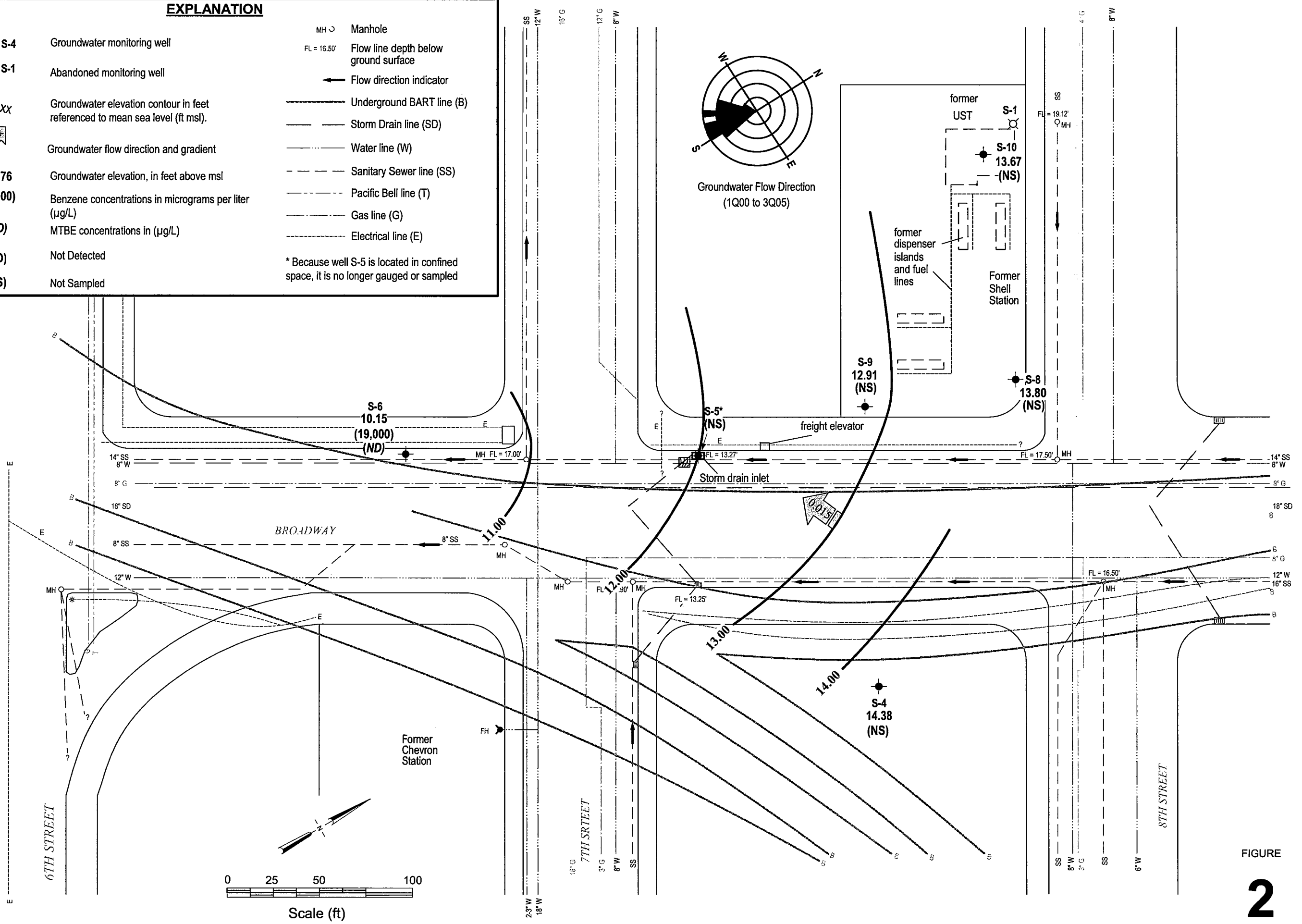

2

Groundwater Contour and Chemical Concentration Map



CAMBRIA

Former Shell Service Station

461 8th Street
Oakland, California

November 15, 2006

Attachment A

**Blaine Tech Services, Inc.
Groundwater Monitoring Report**

BLAINE
TECH SERVICES INC.

GROUNDWATER SAMPLING SPECIALISTS
SINCE 1985

December 15, 2006

Denis Brown
Shell Oil Products US
20945 South Wilmington Avenue
Carson, CA 90810

Fourth Quarter 2006 Groundwater Monitoring at
Former Shell Service Station
461 8th Street
Oakland, CA

Monitoring performed on November 15, 2006

Groundwater Monitoring Report **061115-JD-2**

This report covers the routine monitoring of groundwater wells at this former Shell-branded facility. In accordance with standard procedures that conform to Regional Water Quality Control Board requirements, routine field data collection includes depth to water, total well depth, thickness of any separate immiscible layer, water column volume, calculated purge volume (if applicable), elapsed evacuation time (if applicable), total volume of water removed (if applicable), and standard water parameter instrument readings. Sample material is collected, contained, stored, and transported to the laboratory in conformance with EPA standards. Purgewater (if applicable) is, likewise, collected and transported to the Martinez Refining Company.

Basic field information is presented alongside analytical values excerpted from the laboratory report in the cumulative table of **WELL CONCENTRATIONS**. The full analytical report for the most recent samples and the field data sheets are attached to this report.

At a minimum, Blaine Tech Services, Inc. field personnel are certified on completion of a forty-hour Hazardous Materials and Emergency Response training course per 29 CFR 1910.120. Field personnel are also enrolled in annual eight-hour refresher courses.

Blaine Tech Services, Inc. conducts sampling and documentation assignments of this type as an independent third party. Our activities at this site consisted of objective data and sample collection only. No interpretation of analytical results, defining of hydrological conditions or formulation of recommendations was performed.

Please call if you have any questions.

Yours truly,

Mike Ninokata
Project Manager

MN/ks

attachments: Cumulative Table of WELL CONCENTRATIONS
Certified Analytical Report
Field Data Sheets

cc: Ana Friel
Cambria Environmental Technology, Inc.
19449 Riverside Dr., Suite 230
Sonoma, CA 95476

WELL CONCENTRATIONS
Former Shell Service Station
461 8th Street
Oakland, CA

Well ID	Date	TPPH (ug/L)	B (ug/L)	T (ug/L)	E (ug/L)	X (ug/L)	MTBE 8020 (ug/L)	MTBE 8260 (ug/L)	DIPE (ug/L)	ETBE (ug/L)	TAME (ug/L)	TBA (ug/L)	TOC (MSL)	Depth to Water (ft.)	GW Elevation (MSL)	SPH Thickness (ft.)
S-4	10/26/1988	130	3.8	13	4.0	30	NA	NA	NA	NA	NA	NA	93.51 (TOC)	NA	NA	NA
S-4	02/14/1989	<50	0.5	<1	<1	3.0	NA	NA	NA	NA	NA	NA	93.51 (TOC)	12.82	80.69	NA
S-4	05/01/1989	Well dry	NA	NA	NA	NA	NA	NA	NA	NA	NA	NA	93.51 (TOC)	16.48	77.03	NA
S-4	07/27/1989	Well dry	NA	NA	NA	NA	NA	NA	NA	NA	NA	NA	93.51 (TOC)	15.84	77.67	NA
S-4	10/05/1989	Well dry	NA	NA	NA	NA	NA	NA	NA	NA	NA	NA	93.51 (TOC)	15.98	77.53	NA
S-4	01/09/1990	Well dry	NA	NA	NA	NA	NA	NA	NA	NA	NA	NA	93.51 (TOC)	15.86	77.65	NA
S-4	04/30/1990	<50	<0.5	<0.5	<0.5	<1	NA	NA	NA	NA	NA	NA	93.51 (TOC)	14.48	79.03	NA
S-4	07/31/1990	Well dry	NA	NA	NA	NA	NA	NA	NA	NA	NA	NA	93.51 (TOC)	NA	NA	NA
S-4	10/30/1990	Well dry	NA	NA	NA	NA	NA	NA	NA	NA	NA	NA	93.51 (TOC)	NA	NA	NA
S-4	05/06/1991	Well dry	NA	NA	NA	NA	NA	NA	NA	NA	NA	NA	93.51 (TOC)	15.23	78.28	NA
S-4	06/27/1991	<50	<0.5	<0.5	<0.5	<0.5	NA	NA	NA	NA	NA	NA	93.51 (TOC)	13.54	79.97	NA
S-4	09/24/1991	Well dry	NA	NA	NA	NA	NA	NA	NA	NA	NA	NA	93.51 (TOC)	15.85	77.66	NA
S-4	11/07/1991	Well dry	NA	NA	NA	NA	NA	NA	NA	NA	NA	NA	93.51 (TOC)	15.60	77.91	NA
S-4	02/13/1992	<50	<0.5	<0.5	<0.5	3.0	NA	NA	NA	NA	NA	NA	93.51 (TOC)	14.27	79.24	NA
S-4	05/11/1992	Well dry	NA	NA	NA	NA	NA	NA	NA	NA	NA	NA	93.51 (TOC)	NA	NA	NA
S-4	12/03/1992	Well inaccessible		NA	NA	NA	NA	NA	NA	NA	NA	NA	93.51 (TOC)	NA	NA	NA
S-4	05/13/1993	Well inaccessible		NA	NA	NA	NA	NA	NA	NA	NA	NA	93.51 (TOC)	14.81	78.70	NA
S-4	07/22/1993	Well inaccessible		NA	NA	NA	NA	NA	NA	NA	NA	NA	93.51 (TOC)	14.42	79.09	NA
S-4	10/20/1993	Well inaccessible		NA	NA	NA	NA	NA	NA	NA	NA	NA	93.51 (TOC)	NA	NA	NA
S-4	01/25/1994	Well inaccessible		NA	NA	NA	NA	NA	NA	NA	NA	NA	93.51 (TOC)	14.60	78.91	NA
S-4	04/25/1994	Well inaccessible		NA	NA	NA	NA	NA	NA	NA	NA	NA	93.51 (TOC)	14.39	79.12	NA
S-4	07/21/1994	<50	<0.5	<0.5	<0.5	<0.5	NA	NA	NA	NA	NA	NA	93.51 (TOC)	22.29	71.22	NA
S-4	10/24/1994	<500	<0.3	<0.3	<0.3	<0.6	NA	NA	NA	NA	NA	NA	93.51 (TOC)	22.72	70.79	NA
S-4	12/22/1994	<50	<0.5	<0.5	<0.5	<0.5	NA	NA	NA	NA	NA	NA	25.77*	22.25	3.52	NA
S-4	04/20/1995	<50	<0.5	<0.5	<0.5	<0.5	NA	NA	NA	NA	NA	NA	25.77	21.16	4.61	NA
S-4	10/04/1995	<50	1.2	0.7	<0.5	<0.5	NA	NA	NA	NA	NA	NA	25.77	22.25	3.52	NA
S-4	01/03/1996	<50	0.6	<0.5	<0.5	1.7	NA	NA	NA	NA	NA	NA	25.77	23.28	2.49	NA
S-4	04/11/1996	<50	<0.5	<0.5	<0.5	<0.5	<2.5	NA	NA	NA	NA	NA	25.77	21.58	4.19	NA

WELL CONCENTRATIONS
Former Shell Service Station
461 8th Street
Oakland, CA

Well ID	Date	TPPH (ug/L)	B (ug/L)	T (ug/L)	E (ug/L)	X (ug/L)	MTBE 8020 (ug/L)	MTBE 8260 (ug/L)	DIPE (ug/L)	ETBE (ug/L)	TAME (ug/L)	TBA (ug/L)	TOC (MSL)	Depth to Water (ft.)	GW Elevation (MSL)	SPH Thickness (ft.)
S-4	07/11/1996	<50	<0.50	<0.50	<0.50	<0.50	<2.5	NA	NA	NA	NA	NA	25.77	21.60	4.17	NA
S-4	10/02/1996	<50	<0.50	<0.50	<0.50	<0.50	2.6	NA	NA	NA	NA	NA	25.77	22.46	3.31	NA
S-4	01/22/1997	<50	0.73	<0.50	<0.50	0.63	<2.5	NA	NA	NA	NA	NA	25.77	20.06	5.71	NA
S-4	07/21/1997	<50	<0.50	<0.50	<0.50	<0.50	<2.5	NA	NA	NA	NA	NA	25.77	22.10	3.67	NA
S-4	01/22/1998	<50	<0.50	<0.50	<0.50	<0.50	<2.5	NA	NA	NA	NA	NA	25.77	20.50	5.27	NA
S-4	07/08/1998	<50	<0.50	<0.50	<0.50	<0.50	<2.5	NA	NA	NA	NA	NA	25.77	20.86	4.91	NA
S-4	10/26/1998	NA	NA	NA	NA	NA	NA	NA	NA	NA	NA	NA	25.77	21.41	4.36	NA
S-4	01/28/1999	<50	<0.50	<0.50	<0.50	<0.50	<2.5	NA	NA	NA	NA	NA	25.77	22.34	3.43	NA
S-4	04/23/1999	NA	NA	NA	NA	NA	NA	NA	NA	NA	NA	NA	25.77	21.43	4.34	NA
S-4	07/29/1999	<50.0	<0.500	<0.500	<0.500	<0.500	<5.00	NA	NA	NA	NA	NA	25.77	21.45	4.32	NA
S-4	11/01/1999	NA	NA	NA	NA	NA	NA	NA	NA	NA	NA	NA	25.77	22.08	3.69	NA
S-4	01/07/2000	<50	<0.50	<0.50	<0.50	<0.50	<2.5	NA	NA	NA	NA	NA	25.77	22.29	3.48	NA
S-4	04/11/2000	NA	NA	NA	NA	NA	NA	NA	NA	NA	NA	NA	25.77	21.11	4.66	NA
S-4	07/19/2000	<50.0	<0.500	<0.500	<0.500	<0.500	<2.50	NA	NA	NA	NA	NA	25.77	21.19	4.58	NA
S-4	10/12/2000	NA	NA	NA	NA	NA	NA	NA	NA	NA	NA	NA	25.77	22.22	3.55	NA
S-4	01/09/2001	<50.0	<0.500	<0.500	<0.500	<0.500	<2.50	NA	NA	NA	NA	NA	25.77	22.17	3.60	NA
S-4	04/06/2001	NA	NA	NA	NA	NA	NA	NA	NA	NA	NA	NA	25.77	21.50	4.27	NA
S-4	07/25/2001	<50	2.0	0.52	<0.50	1.0	NA	<5.0	NA	NA	NA	NA	25.77	21.50	4.27	NA
S-4	11/01/2001	NA	NA	NA	NA	NA	NA	NA	NA	NA	NA	NA	25.77	21.95	3.82	NA
S-4	01/17/2002 d	<50	<0.50	<0.50	<0.50	<0.50	NA	<5.0	NA	NA	NA	NA	25.77	21.13	4.64	NA
S-4	05/08/2002	NA	NA	NA	NA	NA	NA	NA	NA	NA	NA	NA	25.77	21.35	4.42	NA
S-4	07/18/2002	<50	<0.50	<0.50	<0.50	<0.50	NA	<5.0	NA	NA	NA	NA	34.41	21.19	13.22	NA
S-4	10/15/2002	NA	NA	NA	NA	NA	NA	NA	NA	NA	NA	NA	34.41	21.42	12.99	NA
S-4	01/02/2003	<50	<0.50	<0.50	<0.50	<0.50	NA	<5.0	NA	NA	NA	NA	34.41	20.75	13.66	NA
S-4	04/15/2003	NA	NA	NA	NA	NA	NA	NA	NA	NA	NA	NA	34.41	21.08	13.33	NA
S-4	07/14/2003	NA	NA	NA	NA	NA	NA	NA	NA	NA	NA	NA	34.41	19.93	14.48	NA
S-4	10/20/2003	NA	NA	NA	NA	NA	NA	NA	NA	NA	NA	NA	34.41	19.56	14.85	NA
S-4	01/22/2004	<50	<0.50	<0.50	<0.50	<1.0	NA	<0.50	NA	NA	NA	NA	34.41	19.12	15.29	NA

WELL CONCENTRATIONS
Former Shell Service Station
461 8th Street
Oakland, CA

Well ID	Date	TPPH (ug/L)	B (ug/L)	T (ug/L)	E (ug/L)	X (ug/L)	MTBE 8020 (ug/L)	MTBE 8260 (ug/L)	DIPE (ug/L)	ETBE (ug/L)	TAME (ug/L)	TBA (ug/L)	TOC (MSL)	Depth to Water (ft.)	GW Elevation (MSL)	SPH Thickness (ft.)
---------	------	----------------	-------------	-------------	-------------	-------------	------------------------	------------------------	----------------	----------------	----------------	---------------	--------------	----------------------------	--------------------------	---------------------------

S-4	04/19/2004	NA	NA	NA	NA	NA	NA	NA	NA	NA	NA	NA	34.41	19.15	15.26	NA
S-4	07/13/2004	NA	NA	NA	NA	NA	NA	NA	NA	NA	NA	NA	34.41	20.48	13.93	NA
S-4	10/28/2004	NA	NA	NA	NA	NA	NA	NA	NA	NA	NA	NA	34.41	21.00	13.41	NA
S-4	01/17/2005	<50	<0.50	<0.50	<0.50	<1.0	NA	<0.50	NA	NA	NA	NA	34.41	20.17	14.24	NA
S-4	04/14/2005	NA	NA	NA	NA	NA	NA	NA	NA	NA	NA	NA	34.41	19.82	14.59	NA
S-4	07/28/2005	NA	NA	NA	NA	NA	NA	NA	NA	NA	NA	NA	34.41	20.71	13.70	NA
S-4	10/05/2005	NA	NA	NA	NA	NA	NA	NA	NA	NA	NA	NA	34.41	20.85	13.56	NA
S-4	02/09/2006	<50.0	<0.500	<0.500	<0.500	<0.500	NA	<0.500	NA	NA	NA	NA	34.41	19.47	14.94	NA
S-4	05/15/2006	NA	NA	NA	NA	NA	NA	NA	NA	NA	NA	NA	34.41	19.52	14.89	NA
S-4	08/23/2006	NA	NA	NA	NA	NA	NA	NA	NA	NA	NA	NA	34.41	20.75	13.66	NA
S-4	11/15/2006	NA	NA	NA	NA	NA	NA	NA	NA	NA	NA	NA	34.41	20.03	14.38	NA

S-5	04/16/1987	130000	15000	16000	NA	14000a	NA	NA	NA	NA	NA	NA	99.36 (TOC)	NA	NA	NA
S-5	10/26/1988	110000	20000	25000	2300	10000	NA	NA	NA	NA	NA	NA	99.36 (TOC)	NA	NA	NA
S-5	02/14/1989	94000	16000	21000	1800	10000	NA	NA	NA	NA	NA	NA	99.36 (TOC)	19.87	79.49	NA
S-5	05/01/1989	120000	29000	35000	3100	15000	NA	NA	NA	NA	NA	NA	99.36 (TOC)	21.23	78.13	NA
S-5	07/27/1989	110000	20000	29000	2400	14000	NA	NA	NA	NA	NA	NA	99.36 (TOC)	20.41	78.95	NA
S-5	10/05/1989	NA	NA	NA	NA	NA	NA	NA	NA	NA	NA	NA	99.36 (TOC)	20.43	78.94	0.01
S-5	01/09/1990	NA	NA	NA	NA	NA	NA	NA	NA	NA	NA	NA	99.36 (TOC)	21.16	78.21	0.01
S-5	04/30/1990	100000	13000	22000	2100	11000	NA	NA	NA	NA	NA	NA	99.36 (TOC)	20.96	78.40	NA
S-5	07/31/1990	53000	8300	14000	1200	7400	NA	NA	NA	NA	NA	NA	99.36 (TOC)	20.88	78.48	NA
S-5	10/30/1990	NA	NA	NA	NA	NA	NA	NA	NA	NA	NA	NA	99.36 (TOC)	21.96	77.42	0.03
S-5	05/06/1991	NA	NA	NA	NA	NA	NA	NA	NA	NA	NA	NA	99.36 (TOC)	23.00	76.46	0.13
S-5	06/27/1991	NA	NA	NA	NA	NA	NA	NA	NA	NA	NA	NA	99.36 (TOC)	20.53	78.85	0.03
S-5	09/24/1991	NA	NA	NA	NA	NA	NA	NA	NA	NA	NA	NA	99.36 (TOC)	21.40	78.01	0.06
S-5	11/07/1991	NA	NA	NA	NA	NA	NA	NA	NA	NA	NA	NA	99.36 (TOC)	21.33	78.23	0.25
S-5	02/13/1992	NA	NA	NA	NA	NA	NA	NA	NA	NA	NA	NA	99.36 (TOC)	22.52	77.09	0.31
S-5	05/11/1992	NA	NA	NA	NA	NA	NA	NA	NA	NA	NA	NA	99.36 (TOC)	22.46	77.36	0.58

WELL CONCENTRATIONS
Former Shell Service Station
461 8th Street
Oakland, CA

Well ID	Date	TPPH (ug/L)	B (ug/L)	T (ug/L)	E (ug/L)	X (ug/L)	MTBE 8020 (ug/L)	MTBE 8260 (ug/L)	DIPE (ug/L)	ETBE (ug/L)	TAME (ug/L)	TBA (ug/L)	TOC (MSL)	Depth to Water (ft.)	GW Elevation (MSL)	SPH Thickness (ft.)
S-5	12/03/1992	Well inaccessible		NA	NA	NA	NA	NA	NA	NA	NA	NA	99.36 (TOC)	NA	NA	NA
S-5	05/13/1993	NA	NA	NA	NA	NA	NA	NA	NA	NA	NA	NA	99.36 (TOC)	22.22	77.36	0.27
S-5	07/22/1993	NA	NA	NA	NA	NA	NA	NA	NA	NA	NA	NA	99.36 (TOC)	21.68	77.88	0.25
S-5	10/20/1993	NA	NA	NA	NA	NA	NA	NA	NA	NA	NA	NA	99.36 (TOC)	20.51	79.03	0.23
S-5	01/25/1994	NA	NA	NA	NA	NA	NA	NA	NA	NA	NA	NA	99.36 (TOC)	21.93	77.57	0.18
S-5	04/25/1994	NA	NA	NA	NA	NA	NA	NA	NA	NA	NA	NA	99.36 (TOC)	21.97	77.67	0.35
S-5	05/26/1994	NA	NA	NA	NA	NA	NA	NA	NA	NA	NA	NA	99.36 (TOC)	20.84	78.80	0.35
S-5	06/10/1994	NA	NA	NA	NA	NA	NA	NA	NA	NA	NA	NA	99.36 (TOC)	21.01	78.61	0.32
S-5	07/21/1994	NA	NA	NA	NA	NA	NA	NA	NA	NA	NA	NA	99.36 (TOC)	22.18	77.56	0.47
S-5	08/25/1994	NA	NA	NA	NA	NA	NA	NA	NA	NA	NA	NA	99.36 (TOC)	22.01	77.70	0.44
S-5	09/22/1994	NA	NA	NA	NA	NA	NA	NA	NA	NA	NA	NA	99.36 (TOC)	22.00	77.48	0.15
S-5	10/24/1994	NA	NA	NA	NA	NA	NA	NA	NA	NA	NA	NA	99.36 (TOC)	22.28	77.53	0.56
S-5	12/22/1994	NA	NA	NA	NA	NA	NA	NA	NA	NA	NA	NA	22.94*	22.88	0.85	0.99
S-5	04/20/1995	NA	NA	NA	NA	NA	NA	NA	NA	NA	NA	NA	22.94	21.66	1.54	0.33
S-5	10/04/1995	NA	NA	NA	NA	NA	NA	NA	NA	NA	NA	NA	22.94	22.18	0.76	NA
S-5	01/03/1996	NA	NA	NA	NA	NA	NA	NA	NA	NA	NA	NA	22.94	22.80	0.80	0.83
S-5	04/11/1996	NA	NA	NA	NA	NA	NA	NA	NA	NA	NA	NA	22.94	21.15	2.33	0.67
S-5	07/11/1996	NA	NA	NA	NA	NA	NA	NA	NA	NA	NA	NA	22.94	22.62	1.04	0.90
S-5	10/02/1996	NA	NA	NA	NA	NA	NA	NA	NA	NA	NA	NA	22.94	23.07	0.38	0.64
S-5	01/22/1997	NA	NA	NA	NA	NA	NA	NA	NA	NA	NA	NA	22.94	20.83	2.24	0.16
S-5	07/21/1997	NA	NA	NA	NA	NA	NA	NA	NA	NA	NA	NA	22.94	21.16	1.82	0.05
S-5	01/22/1998	NA	NA	NA	NA	NA	NA	NA	NA	NA	NA	NA	22.94	20.04	2.93	0.04
S-5	07/08/1998	220	14	40	5.8	34	3.3	NA	NA	NA	NA	NA	22.94	18.61	4.33	NA
S-5	10/26/1998	NA	NA	NA	NA	NA	NA	NA	NA	NA	NA	NA	22.94	17.31	5.63	NA
S-5	01/28/1999	51000	13000	1200	1200	2400	2400	NA	NA	NA	NA	NA	22.94	20.11	2.83	NA
S-5	04/23/1999	65600	2540	7300	1790	9840	<1000	NA	NA	NA	NA	NA	22.94	19.21	3.73	NA
S-5	07/29/1999	61400	3320	6980	1520	7700	<1000	NA	NA	NA	NA	NA	22.94	14.77	8.17	NA
S-5	11/01/1999	48200	2700	5740	1290	7850	<500	<40.0	NA	NA	NA	NA	22.94	15.56	7.38	NA

WELL CONCENTRATIONS
Former Shell Service Station
461 8th Street
Oakland, CA

Well ID	Date	TPPH (ug/L)	B (ug/L)	T (ug/L)	E (ug/L)	X (ug/L)	MTBE 8020 (ug/L)	MTBE 8260 (ug/L)	DIPE (ug/L)	ETBE (ug/L)	TAME (ug/L)	TBA (ug/L)	TOC (MSL)	Depth to Water (ft.)	GW Elevation (MSL)	SPH Thickness (ft.)
---------	------	----------------	-------------	-------------	-------------	-------------	------------------------	------------------------	----------------	----------------	----------------	---------------	--------------	----------------------------	--------------------------	---------------------------

S-5	01/07/2000	39000	3900	8500	790	8300	1500	NA	NA	NA	NA	NA	22.94	15.82	7.12	NA
S-5	04/11/2000	29300	1680	5060	1130	6220	<250	NA	NA	NA	NA	NA	22.94	18.19	4.75	NA
S-5	07/19/2000	6420	2110	207	252	681	355	253b	NA	NA	NA	NA	22.94	19.01	3.93	NA
S-5	10/12/2000	41500	2940	4940	1520	7770	<250	<66.7	NA	NA	NA	NA	22.94	19.62	3.32	NA
S-5	01/09/2001	142000	7030	9550	2340	12600	779	NA	NA	NA	NA	NA	22.94	19.94	3.00	NA
S-5	04/06/2001	Well inaccessible		NA	NA	NA	NA	NA	NA	NA	NA	NA	22.94	NA	NA	NA
S-5	04/13/2001	59800	4810	10800	1950	10100	842	<10.0	NA	NA	NA	NA	22.94	14.72	8.22	NA
S-5	07/25/2001	71000	2900	6800	1700	9100	NA	<250	NA	NA	NA	NA	22.94	14.91	8.03	NA
S-5	08/13/2001	NA	NA	NA	NA	NA	NA	NA	NA	NA	NA	NA	22.94	19.43	3.51	NA
S-5	11/01/2001	Unable to locate		NA	NA	NA	NA	NA	NA	NA	NA	NA	22.94	NA	NA	NA
S-5	01/17/2002 d	58000	460	3300	1900	8400	NA	<200	NA	NA	NA	NA	c	14.27	NA	NA
S-5	05/08/2002 d	60000	650	2700	1800	8800	NA	<100	NA	NA	NA	NA	22.94	18.40	4.54	NA
S-5	07/18/2002	53000	240	1200	1500	6400	NA	<100	NA	NA	NA	NA	27.36	14.25	13.11	NA
S-5	10/15/2002	Well inaccessible		NA	NA	NA	NA	NA	NA	NA	NA	NA	27.36	NA	NA	NA
S-5	10/17/2002	42000	420	1100	1200	5500	NA	<10	NA	NA	NA	NA	27.36	14.90	12.46	NA
S-5	01/02/2003	26000	680	1500	780	3800	NA	<5.0	NA	NA	NA	NA	27.36	14.72	12.64	NA
S-5	04/15/2003	3600	29	38	65	370	NA	<5.0	NA	NA	NA	NA	e	14.45	NA	NA
S-5	07/14/2003	21000	210	460	650	2900	NA	<10	NA	NA	NA	NA	e	14.10	NA	NA
S-5	10/20/2003	37000	390	590	870	3500	NA	<13	NA	NA	NA	NA	e	14.63	NA	NA
S-5	01/22/2004	29000	200	210	710	2400	NA	<13	NA	NA	NA	NA	e	14.08	NA	NA
S-5	04/19/2004	25000	490	460	750	2400	NA	19	NA	NA	NA	NA	e	13.43	NA	NA
S-5	07/13/2004	28000	300	280	690	2400	NA	<13	NA	NA	NA	NA	e	14.88	NA	NA

S-6	04/16/1987	81000	16000	9000	NA	6400a	NA	NA	NA	NA	NA	NA	100.58 (TOC)	NA	NA	NA
S-6	10/26/1988	110000	29000	18000	2500	8200	NA	NA	NA	NA	NA	NA	100.58 (TOC)	NA	NA	NA
S-6	02/14/1989	54000	18000	4500	1400	4000	NA	NA	NA	NA	NA	NA	100.58 (TOC)	20.87	79.71	NA
S-6	05/01/1989	93000	43000	9900	3000	8000	NA	NA	NA	NA	NA	NA	100.58 (TOC)	20.49	80.09	NA
S-6	07/27/1989	52000	20000	3200	1700	5500	NA	NA	NA	NA	NA	NA	100.58 (TOC)	21.01	79.57	NA

WELL CONCENTRATIONS
Former Shell Service Station
461 8th Street
Oakland, CA

Well ID	Date	TPPH (ug/L)	B (ug/L)	T (ug/L)	E (ug/L)	X (ug/L)	MTBE 8020 (ug/L)	MTBE 8260 (ug/L)	DIPE (ug/L)	ETBE (ug/L)	TAME (ug/L)	TBA (ug/L)	TOC (MSL)	Depth to Water (ft.)	GW Elevation (MSL)	SPH Thickness (ft.)
S-6	10/05/1989	55000	20000	2900	1600	5500	NA	NA	NA	NA	NA	NA	100.58 (TOC)	21.24	79.34	NA
S-6	01/09/1990	76000	35000	9100	2300	8600	NA	NA	NA	NA	NA	NA	100.58 (TOC)	22.62	77.96	SHEEN
S-6	04/30/1990	39000	13000	2300	900	2800	NA	NA	NA	NA	NA	NA	100.58 (TOC)	22.10	78.48	NA
S-6	07/31/1990	48000	20000	4600	1500	4900	NA	NA	NA	NA	NA	NA	100.58 (TOC)	22.00	78.58	NA
S-6	10/30/1990	27000	7400	900	600	1400	NA	NA	NA	NA	NA	NA	100.58 (TOC)	22.14	78.44	NA
S-6	05/06/1991	35000	3900	2700	2300	3500	NA	NA	NA	NA	NA	NA	100.58 (TOC)	22.40	78.18	NA
S-6	06/27/1991	51000	19000	5600	1700	6300	NA	NA	NA	NA	NA	NA	100.58 (TOC)	21.21	79.37	NA
S-6	09/24/1991	42000	14000	4300	1200	4000	NA	NA	NA	NA	NA	NA	100.58 (TOC)	22.26	78.32	NA
S-6	11/07/1991	39000	11000	2000	800	2300	NA	NA	NA	NA	NA	NA	100.58 (TOC)	22.35	78.23	NA
S-6	02/13/1992	64000	21000	6200	1600	5100	NA	NA	NA	NA	NA	NA	100.58 (TOC)	22.28	78.30	NA
S-6	05/11/1992	57000	22000	7600	2200	7700	NA	NA	NA	NA	NA	NA	100.58 (TOC)	22.10	78.48	NA
S-6	12/03/1992	110000	26000	9400	2100	8700	NA	NA	NA	NA	NA	NA	100.58 (TOC)	22.14	78.44	NA
S-6	05/13/1993	58000	21000	6800	2500	9800	NA	NA	NA	NA	NA	NA	100.58 (TOC)	22.16	78.42	NA
S-6	07/22/1993	70000	31000	14000	3000	13000	NA	NA	NA	NA	NA	NA	100.58 (TOC)	21.64	78.94	NA
S-6	10/20/1993	48000	28000	9800	3200	12000	NA	NA	NA	NA	NA	NA	100.58 (TOC)	21.62	78.96	NA
S-6	01/25/1994	70000	23000	7500	2500	8000	NA	NA	NA	NA	NA	NA	100.58 (TOC)	21.80	78.78	NA
S-6	04/25/1994	61000	16000	4000	1800	5100	NA	NA	NA	NA	NA	NA	100.58 (TOC)	21.68	78.90	NA
S-6	07/21/1994	44000	8200	3600	1400	3900	NA	NA	NA	NA	NA	NA	100.58 (TOC)	21.78	78.80	NA
S-6 (D)	07/21/1994	32000	7800	3400	1300	3700	NA	NA	NA	NA	NA	NA	22.08	NA	NA	NA
S-6	10/24/1994	2936	1184	440.6	163	648.4	NA	NA	NA	NA	NA	NA	100.58 (TOC)	22.06	78.52	NA
S-6 (D)	10/24/1994	2968	770.8	325.3	144	622	NA	NA	NA	NA	NA	NA	22.08	NA	NA	NA
S-6	12/22/1994	32000	7000	2900	790	2400	NA	NA	NA	NA	NA	NA	22.08*	21.91	0.17	NA
S-6 (D)	12/22/1994	32000	8000	3800	1100	3400	NA	NA	NA	NA	NA	NA	22.08	NA	NA	NA
S-6	04/20/1995	56000	15000	3800	1900	4900	NA	NA	NA	NA	NA	NA	22.08	21.38	0.70	NA
S-6 (D)	04/20/1995	49000	13000	3500	1800	4700	NA	NA	NA	NA	NA	NA	22.08	NA	NA	NA
S-6	10/04/1995	49000	8400	4700	1800	4800	NA	NA	NA	NA	NA	NA	22.08	21.80	0.28	NA
S-6 (D)	10/04/1995	41000	8400	4100	1400	4400	NA	NA	NA	NA	NA	NA	22.08	NA	NA	NA
S-6	01/03/1996	52000	9100	7100	1800	5800	NA	NA	NA	NA	NA	NA	22.08	21.70	0.38	NA

WELL CONCENTRATIONS
Former Shell Service Station
461 8th Street
Oakland, CA

Well ID	Date	TPPH (ug/L)	B (ug/L)	T (ug/L)	E (ug/L)	X (ug/L)	MTBE 8020 (ug/L)	MTBE 8260 (ug/L)	DIPE (ug/L)	ETBE (ug/L)	TAME (ug/L)	TBA (ug/L)	TOC (MSL)	Depth to Water (ft.)	GW Elevation (MSL)	SPH Thickness (ft.)
S-6	04/11/1996	59000	11000	7100	2100	6400	<500	NA	NA	NA	NA	NA	22.08	21.62	0.46	NA
S-6 (D)	04/11/1996	59000	11000	6800	1900	6400	<500	NA	NA	NA	NA	NA	22.08	NA	NA	NA
S-6	07/11/1996	72000	18000	6600	2500	8400	<1000	NA	NA	NA	NA	NA	22.08	21.65	2.78	NA
S-6	10/02/1996	57000	11000	6500	1500	5100	<500	NA	NA	NA	NA	NA	22.08	21.80	2.63	NA
S-6	01/22/1997	67000	15000	5000	1800	5400	<1000	NA	NA	NA	NA	NA	22.08	19.95	2.13	NA
S-6 (D)	01/22/1997	63000	15000	4800	1800	5200	<1000	NA	NA	NA	NA	NA	22.08	NA	NA	NA
S-6	07/21/1997	61000	15000	2100	1100	3500	1900	NA	NA	NA	NA	NA	22.08	20.61	1.47	NA
S-6	01/22/1998	46000	14000	3200	1300	3400	<500	NA	NA	NA	NA	NA	22.08	19.82	2.26	NA
S-6	07/08/1998	74000	26000	7500	2200	6200	<1000	NA	NA	NA	NA	NA	22.08	18.20	3.88	NA
S-6	10/26/1998	NA	NA	NA	NA	NA	NA	NA	NA	NA	NA	NA	22.08	18.81	3.27	NA
S-6	01/28/1999	120000	9000	14000	2700	14000	3700	NA	NA	NA	NA	NA	22.08	19.73	2.35	NA
S-6	04/23/1999	58500	15900	1360	1640	3030	<2500	NA	NA	NA	NA	NA	22.08	17.58	4.50	NA
S-6	07/29/1999	36200	10300	760	930	1360	<1000	NA	NA	NA	NA	NA	22.08	21.35	0.73	NA
S-6	11/01/1999	36000	11700	767	865	1670	<1250	<40.0	NA	NA	NA	NA	22.08	19.23	2.85	NA
S-6	01/07/2000	36000	7600	4600	840	3600	<1000	NA	NA	NA	NA	NA	22.08	19.53	2.55	NA
S-6	04/11/2000	14600	7540	205	306	609	621	NA	NA	NA	NA	NA	22.08	18.16	3.92	NA
S-6	07/19/2000	2590	629	63.9	99.6	267	124	72.7b	NA	NA	NA	NA	22.08	18.40	3.68	NA
S-6	10/12/2000	32900	14200	966	1060	1790	<500	<100	NA	NA	NA	NA	22.08	19.52	2.56	NA
S-6	01/09/2001	27600	11200	675	666	1580	1430	<10.0b	NA	NA	NA	NA	22.08	19.69	2.39	NA
S-6	02/05/2001	NA	NA	NA	NA	NA	NA	NA	NA	NA	NA	NA	22.08	19.20	2.88	NA
S-6	04/06/2001	16900	7800	343	172	966	809	<20.0	NA	NA	NA	NA	22.08	18.25	3.83	NA
S-6	07/25/2001	29000	9800	1700	1000	1800	NA	<250	NA	NA	NA	NA	22.08	18.27	3.81	NA
S-6	11/01/2001	41000	15000	2400	1100	2500	NA	<500	NA	NA	NA	NA	22.08	19.30	2.78	NA
S-6	01/17/2002 d	38000	11000	1700	990	2200	NA	<500	NA	NA	NA	NA	22.08	18.51	3.57	NA
S-6	05/08/2002	72000	21000	4400	2200	5300	NA	<1000	NA	NA	NA	NA	22.08	18.30	3.78	NA
S-6	07/18/2002	71000	17000	4300	1700	4800	NA	<1000	NA	NA	NA	NA	30.56	18.19	12.37	NA
S-6	10/15/2002	55000	16000	4600	1500	4600	NA	<100	NA	NA	NA	NA	30.56	18.77	11.79	NA
S-6	01/02/2003	75000	21000	5000	2400	6400	NA	<50	NA	NA	NA	NA	30.56	18.60	11.96	NA

WELL CONCENTRATIONS
Former Shell Service Station
461 8th Street
Oakland, CA

Well ID	Date	TPPH (ug/L)	B (ug/L)	T (ug/L)	E (ug/L)	X (ug/L)	MTBE 8020 (ug/L)	MTBE 8260 (ug/L)	DIPE (ug/L)	ETBE (ug/L)	TAME (ug/L)	TBA (ug/L)	TOC (MSL)	Depth to Water (ft.)	GW Elevation (MSL)	SPH Thickness (ft.)
---------	------	----------------	-------------	-------------	-------------	-------------	------------------------	------------------------	----------------	----------------	----------------	---------------	--------------	----------------------------	--------------------------	---------------------------

S-6	04/15/2003	64000	29000	6400	2700	5600	NA	<1000	NA	NA	NA	NA	30.56	18.27	12.29	NA
S-6	07/14/2003	47000	19000	4300	1500	4300	NA	<100	NA	NA	NA	NA	30.56	18.05	12.51	NA
S-6	10/20/2003	63000	21000	5800	1900	5200	NA	<130	NA	NA	NA	NA	30.56	18.55	12.01	f
S-6	01/22/2004	41000	21000	4300	1800	4000	NA	<130	NA	NA	NA	NA	30.56	18.18	12.38	f
S-6	04/19/2004	58000	23000	4200	2200	3900	NA	<130	NA	NA	NA	NA	30.56	17.32	13.24	NA
S-6	05/03/2004	NA	NA	NA	NA	NA	NA	NA	NA	NA	NA	NA	30.56	17.30	13.26	NA
S-6	06/17/2004	NA	NA	NA	NA	NA	NA	NA	NA	NA	NA	NA	30.56	17.70	12.86	NA
S-6	07/13/2004	NA	NA	NA	NA	NA	NA	NA	NA	NA	NA	NA	30.56	17.85	12.71	NA
S-6	10/28/2004 g	45000	21000	3600	1700	3300	NA	<130	NA	NA	NA	NA	30.56	18.45	12.11	NA
S-6	01/17/2005	61000	21000	3500	1600	3200	NA	<130	NA	NA	NA	NA	30.56	17.52	13.04	NA
S-6	04/14/2005	36000	12000	6200	850	4800	NA	<50	NA	NA	NA	NA	30.56	22.49	8.07	NA
S-6	07/28/2005	54000	16000	9100	1800	5900	NA	<130	NA	NA	NA	NA	30.56	19.38	11.18	NA
S-6	10/05/2005	59000	14000	7500	1400	5000	NA	<50	NA	NA	NA	NA	30.56	18.32	12.24	NA
S-6	02/09/2006	41100	7060	3900	673	2380	NA	<0.500	NA	NA	NA	NA	30.56	17.11	13.45	NA
S-6	05/15/2006	188000	24800	20700	2540	12400	NA	<25.0	NA	NA	NA	NA	30.56	19.80	10.76	NA
S-6	08/23/2006	133000	24900	16100	2280	10500	NA	<0.500	NA	NA	NA	NA	30.56	20.45	10.11	NA
S-6	11/15/2006	66000	19000	8400	1900	7400	NA	<400	NA	NA	NA	NA	30.56	20.41	10.15	NA

S-8	12/22/1994	600	120	32	5.2	34	NA	NA	NA	NA	NA	NA	27.21	24.87	2.34	NA
S-8	04/20/1995	460	180	23	5.2	21	NA	NA	NA	NA	NA	NA	27.21	23.90	3.31	NA
S-8	10/04/1995	830	210	38	11	42	NA	NA	NA	NA	NA	NA	27.21	24.48	2.73	NA
S-8	01/03/1996	350	61	12	2.5	12	NA	NA	NA	NA	NA	NA	27.21	24.62	2.59	NA
S-8 (D)	01/03/1996	340	54	12	2.4	12	NA	NA	NA	NA	NA	NA	27.21	NA	NA	NA
S-8	04/11/1996	570	140	37	12	47	<6.2	NA	NA	NA	NA	NA	27.21	24.32	2.89	NA
S-8	07/11/1996	980	98	32	9.1	160	<12	NA	NA	NA	NA	NA	27.21	24.10	3.11	NA
S-8	10/02/1996	280	62	13	3.3	25	15	NA	NA	NA	NA	NA	27.21	25.38	1.83	NA
S-8 (D)	10/02/1996	490	110	24	7.0	45	22	<2.0	NA	NA	NA	NA	27.21	NA	NA	NA
S-8	01/22/1997	400	90	13	4.9	25	12	NA	NA	NA	NA	NA	27.21	23.91	3.30	NA

WELL CONCENTRATIONS
Former Shell Service Station
461 8th Street
Oakland, CA

Well ID	Date	TPPH (ug/L)	B (ug/L)	T (ug/L)	E (ug/L)	X (ug/L)	MTBE 8020 (ug/L)	MTBE 8260 (ug/L)	DIPE (ug/L)	ETBE (ug/L)	TAME (ug/L)	TBA (ug/L)	TOC (MSL)	Depth to Water (ft.)	GW Elevation (MSL)	SPH Thickness (ft.)
S-8	07/21/1997	2900	380	110	26	260	85	NA	NA	NA	NA	NA	27.21	23.62	3.59	NA
S-8 (D)	07/21/1997	3200	420	120	32	300	130	NA	NA	NA	NA	NA	27.21	NA	NA	NA
S-8	01/22/1998	3800	790	140	42	330	160	NA	NA	NA	NA	NA	27.21	23.52	3.69	NA
S-8 (D)	01/22/1998	3500	780	120	33	300	160	NA	NA	NA	NA	NA	27.21	NA	NA	NA
S-8	07/08/1998	3600	1800	<25	<25	<25	<125	NA	NA	NA	NA	NA	27.21	21.52	5.69	NA
S-8 (D)	07/08/1998	4000	1800	<25	<25	31	<125	NA	NA	NA	NA	NA	27.21	NA	NA	NA
S-8	10/26/1998	NA	NA	NA	NA	NA	NA	NA	NA	NA	NA	NA	27.21	22.01	5.20	NA
S-8	01/28/1999	2000	630	6.2	24	51	43	NA	NA	NA	NA	NA	27.21	23.03	4.18	NA
S-8	04/23/1999	1050	408	<5.00	<5.00	6.65	<50.0	NA	NA	NA	NA	NA	27.21	22.15	5.06	NA
S-8	07/29/1999	955	344	<2.50	6.90	16.2	<25.0	NA	NA	NA	NA	NA	27.21	21.95	5.26	NA
S-8	11/01/1999	1800	550	6.45	15	40.4	<50.0	NA	NA	NA	NA	NA	27.21	22.55	4.66	NA
S-8	01/07/2000	1300	600	11	29	48	<13	NA	NA	NA	NA	NA	27.21	22.87	4.34	NA
S-8	04/11/2000	342	101	4.42	4.24	14.7	21.4	NA	NA	NA	NA	NA	27.21	21.86	5.35	NA
S-8	07/19/2000	579	228	6.37	6.45	25.0	<12.5	NA	NA	NA	NA	NA	27.21	21.93	5.28	NA
S-8	10/12/2000	947	340	8.64	3.26	38.3	<12.5	<2.00	NA	NA	NA	NA	27.21	22.92	4.29	NA
S-8	01/09/2001	1090	394	<10.0	<10.0	33.3	57.6	NA	NA	NA	NA	NA	27.21	23.19	4.02	NA
S-8	04/06/2001	671	182	12.5	16.4	47.1	42.5	NA	NA	NA	NA	NA	27.21	22.46	4.75	NA
S-8	07/25/2001	500	70	6.7	11	23	NA	<5.0	NA	NA	NA	NA	27.21	22.50	4.71	NA
S-8	11/01/2001	1900	250	28	39	180	NA	<5.0	NA	NA	NA	NA	27.21	22.44	4.77	NA
S-8	01/17/2002 d	830	140	11	12	89	NA	<5.0	NA	NA	NA	NA	27.21	21.82	5.39	NA
S-8	05/08/2002 d	210	34	1.7	4.1	15	NA	<5.0	NA	NA	NA	NA	27.21	21.35	5.86	NA
S-8	07/18/2002	650	68	2.8	9.7	42	NA	<5.0	NA	NA	NA	NA	35.85	21.53	14.32	NA
S-8	10/15/2002	1000	160	4.2	7.7	74	NA	<0.50	NA	NA	NA	NA	35.85	21.97	13.88	NA
S-8	01/02/2003	440	55	1.8	2.9	31	NA	<0.50	NA	NA	NA	NA	35.85	21.95	13.90	NA
S-8	04/15/2003	NA	NA	NA	NA	NA	NA	NA	NA	NA	NA	NA	35.85	21.73	14.12	NA
S-8	07/14/2003	60	6.8	<0.50	0.98	4.9	NA	<0.50	NA	NA	NA	NA	35.85	21.40	14.45	NA
S-8	10/20/2003	NA	NA	NA	NA	NA	NA	NA	NA	NA	NA	NA	35.85	21.94	13.91	NA
S-8	01/22/2004	210	19	0.52	3.6	17	NA	<0.50	NA	NA	NA	NA	35.85	21.40	14.45	NA

WELL CONCENTRATIONS
Former Shell Service Station
461 8th Street
Oakland, CA

Well ID	Date	TPPH (ug/L)	B (ug/L)	T (ug/L)	E (ug/L)	X (ug/L)	MTBE 8020 (ug/L)	MTBE 8260 (ug/L)	DIPE (ug/L)	ETBE (ug/L)	TAME (ug/L)	TBA (ug/L)	TOC (MSL)	Depth to Water (ft.)	GW Elevation (MSL)	SPH Thickness (ft.)
---------	------	----------------	-------------	-------------	-------------	-------------	------------------------	------------------------	----------------	----------------	----------------	---------------	--------------	----------------------------	--------------------------	---------------------------

S-8	04/19/2004	NA	NA	NA	NA	NA	NA	NA	NA	NA	NA	NA	35.85	20.83	15.02	NA
S-8	07/13/2004	420	77	0.82	14	31	NA	<0.50	NA	NA	NA	NA	35.85	21.05	14.80	NA
S-8	10/28/2004	NA	NA	NA	NA	NA	NA	NA	NA	NA	NA	NA	35.85	21.77	14.08	NA
S-8	01/17/2005	490	85	0.89	13	28	NA	<0.50	NA	NA	NA	NA	35.85	20.92	14.93	NA
S-8	04/14/2005	NA	NA	NA	NA	NA	NA	NA	NA	NA	NA	NA	35.85	21.57	14.28	NA
S-8	07/28/2005	64	12	<0.50	1.5	1.6	NA	<0.50	NA	NA	NA	NA	35.85	21.62	14.23	NA
S-8	10/05/2005	NA	NA	NA	NA	NA	NA	NA	NA	NA	NA	NA	35.85	21.11	14.74	NA
S-8	02/09/2006	<50.0	2.79	<0.500	<0.500	<0.500	NA	<0.500	NA	NA	NA	NA	35.85	20.18	15.67	NA
S-8	05/15/2006	NA	NA	NA	NA	NA	NA	NA	NA	NA	NA	NA	35.85	20.53	15.32	NA
S-8	08/23/2006	<50.0	<0.500	<0.500	<0.500	<0.500	NA	<0.500	NA	NA	NA	NA	35.85	21.49	14.36	NA
S-8	11/15/2006	NA	NA	NA	NA	NA	NA	NA	NA	NA	NA	NA	35.85	22.05	13.80	NA

S-9	12/22/1994	2600	400	150	42	310	NA	NA	NA	NA	NA	NA	26.06	24.37	1.69	NA
S-9	04/20/1995	1900	400	130	51	200	NA	NA	NA	NA	NA	NA	26.06	23.49	2.57	NA
S-9	10/04/1995	3200	590	260	68	280	NA	NA	NA	NA	NA	NA	26.06	24.01	2.05	NA
S-9	01/03/1996	Well inaccessible		NA	NA	NA	NA	NA	NA	NA	NA	NA	26.06	NA	NA	NA
S-9	04/11/1996	2100	440	1500	42	210	<25	NA	NA	NA	NA	NA	26.06	23.61	2.45	NA
S-9	07/11/1996	5200	940	450	120	520	<50	NA	NA	NA	NA	NA	26.06	23.78	2.28	NA
S-9 (D)	07/11/1996	4800	890	430	110	500	<50	NA	NA	NA	NA	NA	26.06	NA	NA	NA
S-9	10/02/1996	3000	680	220	56	270	<62	NA	NA	NA	NA	NA	26.06	24.31	1.75	NA
S-9	01/22/1997	1500	230	71	36	130	<12	NA	NA	NA	NA	NA	26.06	23.08	2.98	NA
S-9	07/21/1997	3400	590	57	19	210	96	NA	NA	NA	NA	NA	26.06	22.83	3.23	NA
S-9	01/22/1998	2600	300	46	<10	270	62	NA	NA	NA	NA	NA	26.06	21.96	4.10	NA
S-9	07/08/1998	820	150	6.2	8	57	<10	NA	NA	NA	NA	NA	26.06	20.85	5.21	NA
S-9	10/26/1998	NA	NA	NA	NA	NA	NA	NA	NA	NA	NA	NA	26.06	21.39	4.67	NA
S-9	01/28/1999	<50	1.0	<0.50	<0.50	<0.50	<2.5	NA	NA	NA	NA	NA	26.06	22.32	3.74	NA
S-9	04/23/1999	NA	NA	NA	NA	NA	NA	NA	NA	NA	NA	NA	26.06	21.41	4.65	NA
S-9	07/29/1999	117	7.77	0.817	0.683	5.05	<5.00	NA	NA	NA	NA	NA	26.06	21.25	4.81	NA

WELL CONCENTRATIONS
Former Shell Service Station
461 8th Street
Oakland, CA

Well ID	Date	TPPH (ug/L)	B (ug/L)	T (ug/L)	E (ug/L)	X (ug/L)	MTBE 8020 (ug/L)	MTBE 8260 (ug/L)	DIPE (ug/L)	ETBE (ug/L)	TAME (ug/L)	TBA (ug/L)	TOC (MSL)	Depth to Water (ft.)	GW Elevation (MSL)	SPH Thickness (ft.)
S-9	11/01/1999	NA	NA	NA	NA	NA	NA	NA	NA	NA	NA	NA	26.06	21.92	4.14	NA
S-9	01/07/2000	<50	1.2	<0.50	<0.50	<0.50	<2.5	NA	NA	NA	NA	NA	26.06	22.11	3.95	NA
S-9	04/11/2000	NA	NA	NA	NA	NA	NA	NA	NA	NA	NA	NA	26.06	21.14	4.92	NA
S-9	07/19/2000	Well inaccessible		NA	NA	NA	NA	NA	NA	NA	NA	NA	26.06	NA	NA	NA
S-9	10/12/2000	NA	NA	NA	NA	NA	NA	NA	NA	NA	NA	NA	26.06	22.24	3.82	NA
S-9	01/09/2001	<50.0	1.45	<0.500	<0.500	<0.500	<2.50	NA	NA	NA	NA	NA	26.06	22.52	3.54	NA
S-9	04/06/2001	NA	NA	NA	NA	NA	NA	NA	NA	NA	NA	NA	26.06	23.61	2.45	NA
S-9	07/25/2001	Well inaccessible		NA	NA	NA	NA	NA	NA	NA	NA	NA	26.06	NA	NA	NA
S-9	08/13/2001	Well inaccessible		NA	NA	NA	NA	NA	NA	NA	NA	NA	26.06	NA	NA	NA
S-9	11/01/2001	NA	NA	NA	NA	NA	NA	NA	NA	NA	NA	NA	26.06	21.78	4.28	NA
S-9	01/17/2002	<50	<0.50	<0.50	<0.50	<0.50	NA	<5.0	NA	NA	NA	NA	26.06	21.15	4.91	NA
S-9	05/08/2002	NA	NA	NA	NA	NA	NA	NA	NA	NA	NA	NA	26.06	20.56	5.50	NA
S-9	07/18/2002	<50	<0.50	<0.50	<0.50	<0.50	NA	<5.0	NA	NA	NA	NA	34.70	20.88	13.82	NA
S-9	10/15/2002	NA	NA	NA	NA	NA	NA	NA	NA	NA	NA	NA	34.70	21.41	13.29	NA
S-9	01/02/2003	<50	<0.50	<0.50	<0.50	<0.50	NA	<5.0	NA	NA	NA	NA	34.70	21.35	13.35	NA
S-9	04/15/2003	NA	NA	NA	NA	NA	NA	NA	NA	NA	NA	NA	34.70	21.14	13.56	NA
S-9	07/14/2003	<50	<0.50	<0.50	<0.50	<1.0	NA	<0.50	NA	NA	NA	NA	34.70	20.80	13.90	NA
S-9	10/20/2003	NA	NA	NA	NA	NA	NA	NA	NA	NA	NA	NA	34.70	21.33	13.37	NA
S-9	01/22/2004	<50	<0.50	<0.50	<0.50	<1.0	NA	<0.50	NA	NA	NA	NA	34.70	20.77	13.93	NA
S-9	04/19/2004	NA	NA	NA	NA	NA	NA	NA	NA	NA	NA	NA	34.70	20.06	14.64	NA
S-9	07/13/2004	<50	<0.50	<0.50	<0.50	<1.0	NA	<0.50	NA	NA	NA	NA	34.70	20.44	14.26	NA
S-9	10/28/2004	NA	NA	NA	NA	NA	NA	NA	NA	NA	NA	NA	34.70	21.02	13.68	NA
S-9	01/17/2005	<50	<0.50	<0.50	<0.50	<1.0	NA	<0.50	NA	NA	NA	NA	34.70	20.18	14.52	NA
S-9	04/14/2005	NA	NA	NA	NA	NA	NA	NA	NA	NA	NA	NA	34.70	21.85	12.85	NA
S-9	07/28/2005	360	190	1.8	1.1	3.9	NA	<0.50	<2.0	<2.0	<2.0	<5.0	34.70	21.22	13.48	NA
S-9	10/05/2005	NA	NA	NA	NA	NA	NA	NA	NA	NA	NA	NA	34.70	20.63	14.07	NA
S-9	02/09/2006	<50.0	0.940	<0.500	<0.500	<0.500	NA	<0.500	NA	NA	NA	NA	34.70	19.23	15.47	NA
S-9	05/15/2006	NA	NA	NA	NA	NA	NA	NA	NA	NA	NA	NA	34.70	20.28	14.42	NA

WELL CONCENTRATIONS
Former Shell Service Station
461 8th Street
Oakland, CA

Well ID	Date	TPPH (ug/L)	B (ug/L)	T (ug/L)	E (ug/L)	X (ug/L)	MTBE 8020 (ug/L)	MTBE 8260 (ug/L)	DIPE (ug/L)	ETBE (ug/L)	TAME (ug/L)	TBA (ug/L)	TOC (MSL)	Depth to Water (ft.)	GW Elevation (MSL)	SPH Thickness (ft.)
---------	------	----------------	-------------	-------------	-------------	-------------	------------------------	------------------------	----------------	----------------	----------------	---------------	--------------	----------------------------	--------------------------	---------------------------

S-9	08/23/2006	7000	1740	55.6	193	278	NA	<0.500	<0.500	<0.500	<0.500	<10.0	34.70	21.31	13.39	NA
S-9	11/15/2006	NA	NA	NA	NA	NA	NA	NA	NA	NA	NA	NA	34.70	21.79	12.91	NA

S-10	12/22/1994	420	27	8.0	18	45	NA	NA	NA	NA	NA	NA	28.04	25.84	2.20	NA
S-10	04/20/1995	820	49	3.7	97	52	NA	NA	NA	NA	NA	NA	28.04	24.92	3.12	NA
S-10	10/04/1995	240	6.5	1.1	16	12	NA	NA	NA	NA	NA	NA	28.04	25.47	2.57	NA
S-10	01/03/1996	1100	27	4.9	110	70	NA	NA	NA	NA	NA	NA	28.04	25.60	2.44	NA
S-10	04/11/1996	530	19	1.6	82	52	<5.0	NA	NA	NA	NA	NA	28.04	25.27	2.77	NA
S-10	07/11/1996	570	16	3.2	53	53	<2.5	NA	NA	NA	NA	NA	28.04	25.46	2.58	NA
S-10	10/02/1996	270	8.2	0.77	24	23	3.3	NA	NA	NA	NA	NA	28.04	25.81	2.23	NA
S-10	01/22/1997	160	4.8	0.73	16	11	<2.5	NA	NA	NA	NA	NA	28.04	24.74	3.30	NA
S-10	07/21/1997	530	5.7	0.70	29	69	<2.5	NA	NA	NA	NA	NA	28.04	24.50	3.54	NA
S-10	01/22/1998	1500	15	<5.0	88	130	<25	NA	NA	NA	NA	NA	28.04	24.44	3.60	NA
S-10	07/08/1998	530	4.8	1.1	47	51	<2.5	NA	NA	NA	NA	NA	28.04	22.36	5.68	NA
S-10	10/26/1998	NA	NA	NA	NA	NA	NA	NA	NA	NA	NA	NA	28.04	22.81	5.23	NA
S-10	01/28/1999	630	4.6	0.98	<0.50	59	<2.5	NA	NA	NA	NA	NA	28.04	23.82	4.22	NA
S-10	04/23/1999	NA	NA	NA	NA	NA	NA	NA	NA	NA	NA	NA	28.04	22.96	5.08	NA
S-10	07/29/1999	728	3.40	<1.00	41.8	38.0	<10.0	NA	NA	NA	NA	NA	28.04	22.63	5.41	NA
S-10	11/01/1999	NA	NA	NA	NA	NA	NA	NA	NA	NA	NA	NA	28.04	23.02	5.02	NA
S-10	01/07/2000	870	8.5	1.3	110	110	<2.5	NA	NA	NA	NA	NA	28.04	23.33	4.71	NA
S-10	04/11/2000	NA	NA	NA	NA	NA	NA	NA	NA	NA	NA	NA	28.04	22.64	5.40	NA
S-10	07/19/2000	612	3.75	<0.500	41.6	43.6	<2.50	NA	NA	NA	NA	NA	28.04	23.04	5.00	NA
S-10	10/12/2000	NA	NA	NA	NA	NA	NA	NA	NA	NA	NA	NA	28.04	23.92	4.12	NA
S-10	01/09/2001	647	7.62	1.01	66.2	42.4	<2.50	NA	NA	NA	NA	NA	28.04	24.13	3.91	NA
S-10	04/06/2001	NA	NA	NA	NA	NA	NA	NA	NA	NA	NA	NA	28.04	25.37	2.67	NA
S-10	07/25/2001	340	1.5	<0.50	42	19	NA	<5.0	NA	NA	NA	NA	28.04	25.35	2.69	NA
S-10	11/01/2001	NA	NA	NA	NA	NA	NA	NA	NA	NA	NA	NA	28.04	23.22	4.82	NA
S-10	01/17/2002 d	1100	3.5	<0.50	55	46	NA	<5.0	NA	NA	NA	NA	28.04	22.72	5.32	NA

WELL CONCENTRATIONS
Former Shell Service Station
461 8th Street
Oakland, CA

Well ID	Date	TPPH (ug/L)	B (ug/L)	T (ug/L)	E (ug/L)	X (ug/L)	MTBE 8020 (ug/L)	MTBE 8260 (ug/L)	DIPE (ug/L)	ETBE (ug/L)	TAME (ug/L)	TBA (ug/L)	TOC (MSL)	Depth to Water (ft.)	GW Elevation (MSL)	SPH Thickness (ft.)
S-10	05/08/2002	NA	NA	NA	NA	NA	NA	NA	NA	NA	NA	NA	28.04	22.35	5.69	NA
S-10	07/18/2002	750	1.8	<0.50	42	26	NA	<5.0	NA	NA	NA	NA	36.35	22.05	14.30	NA
S-10	10/15/2002	NA	NA	NA	NA	NA	NA	NA	NA	NA	NA	NA	36.35	22.51	13.84	NA
S-10	01/02/2003	440	1.8	<0.50	14	24	NA	<5.0	NA	NA	NA	NA	36.35	22.50	13.85	NA
S-10	04/15/2003	NA	NA	NA	NA	NA	NA	NA	NA	NA	NA	NA	36.35	22.32	14.03	NA
S-10	07/14/2003	210	0.86	<0.50	13	12	NA	<0.50	NA	NA	NA	NA	36.35	21.99	14.36	NA
S-10	10/20/2003	NA	NA	NA	NA	NA	NA	NA	NA	NA	NA	NA	36.35	22.53	13.82	NA
S-10	01/22/2004	280	0.88	<0.50	10	11	NA	<0.50	NA	NA	NA	NA	36.35	22.02	14.33	NA
S-10	04/19/2004	NA	NA	NA	NA	NA	NA	NA	NA	NA	NA	NA	36.35	21.43	14.92	NA
S-10	07/13/2004	770	1.5	<0.50	70	42	NA	<0.50	NA	NA	NA	NA	36.35	21.68	14.67	NA
S-10	10/28/2004	NA	NA	NA	NA	NA	NA	NA	NA	NA	NA	NA	36.35	22.37	13.98	NA
S-10	01/17/2005	1100	1.5	<0.50	73	51	NA	<0.50	NA	NA	NA	NA	36.35	21.45	14.90	NA
S-10	04/14/2005	NA	NA	NA	NA	NA	NA	NA	NA	NA	NA	NA	36.35	22.18	14.17	NA
S-10	07/28/2005	260	<0.50	<0.50	19	9.7	NA	<0.50	<2.0	<2.0	<2.0	<5.0	36.35	22.25	14.10	NA
S-10	10/05/2005	NA	NA	NA	NA	NA	NA	NA	NA	NA	NA	NA	36.35	21.70	14.65	NA
S-10	02/09/2006	630	<0.500	<0.500	13.8	13.8	NA	<0.500	NA	NA	NA	NA	36.35	20.37	15.98	NA
S-10	05/15/2006	NA	NA	NA	NA	NA	NA	NA	NA	NA	NA	NA	36.35	21.31	15.04	NA
S-10	08/23/2006	<50.0	<0.500	<0.500	14.5	3.40	NA	<0.500	<0.500	<0.500	<0.500	<10.0	36.35	22.12	14.23	NA
S-10	11/15/2006	NA	NA	NA	NA	NA	NA	NA	NA	NA	NA	NA	36.35	22.68	13.67	NA

WELL CONCENTRATIONS
Former Shell Service Station
461 8th Street
Oakland, CA

Well ID	Date	TPPH (ug/L)	B (ug/L)	T (ug/L)	E (ug/L)	X (ug/L)	MTBE 8020 (ug/L)	MTBE 8260 (ug/L)	DIPE (ug/L)	ETBE (ug/L)	TAME (ug/L)	TBA (ug/L)	TOC (MSL)	Depth to Water (ft.)	GW Elevation (MSL)	SPH Thickness (ft.)
---------	------	----------------	-------------	-------------	-------------	-------------	------------------------	------------------------	----------------	----------------	----------------	---------------	--------------	----------------------------	--------------------------	---------------------------

Abbreviations:

TPPH = Total petroleum hydrocarbons as gasoline by EPA Method 8260B; prior to July 25, 2001, analyzed by EPA Method 8015.

BTEX = Benzene, toluene, ethylbenzene, xylenes by EPA Method 8260B; prior to July 25, 2001, analyzed by EPA Method 8020.

MTBE = Methyl tertiary butyl ether

ETBE = Ethyl tertiary butyl ether, analyzed by EPA Method 8260B.

DIPE = Di-isopropyl ether, analyzed by EPA Method 8260B.

TAME = Tertiary amyl methyl ether, analyzed by EPA Method 8260B.

TBA = Tertiary butyl alcohol, analyzed by EPA Method 8260B.

TOC = Top of Casing Elevation

TOB = Top of Wellbox Elevation

SPH = Separate-Phase Hydrocarbons

GW = Groundwater

ug/L = Parts per billion

MSL = Mean sea level

ft. = Feet

<n = Below detection limit

(D) = Duplicate sample

NA = Not applicable

WELL CONCENTRATIONS
Former Shell Service Station
461 8th Street
Oakland, CA

Well ID	Date	TPPH (ug/L)	B (ug/L)	T (ug/L)	E (ug/L)	X (ug/L)	MTBE 8020 (ug/L)	MTBE 8260 (ug/L)	DIPE (ug/L)	ETBE (ug/L)	TAME (ug/L)	TBA (ug/L)	TOC (MSL)	Depth to Water (ft.)	GW Elevation (MSL)	SPH Thickness (ft.)
---------	------	----------------	-------------	-------------	-------------	-------------	------------------------	------------------------	----------------	----------------	----------------	---------------	--------------	----------------------------	--------------------------	---------------------------

Notes:

a = Ethylbenzene and xylenes combined.

b = This sample analyzed outside of EPA recommended holding time.

c = Depth to water measured from Top of Casing; elevation unknown.

d = Grab sampled.

e = Casing broken; Top of Casing elevation unknown.

f = SPH detected at <0.01 feet.

g = S-6 was purged prior to sampling.

* = Prior to December 22, 1994, well elevations taken from Top of Casing.

Beginning July 18, 2002, well elevations taken from Top of Casing.

Site surveyed March 5, 2002 by Virgil Chavez Land Surveying of Vallejo, CA.

5 December, 2006

Michael Ninokata
Blaine Tech Services (Shell)
1680 Rogers Avenue
San Jose, CA 95112

RE: 461 8th St, Oakland
Work Order: S611423

Enclosed are the results of analyses for samples received by the laboratory on 11/17/06 09:30. If you have any questions concerning this report, please feel free to contact me.

Sincerely,



Sylvia Krenn
Project Manager

CA ELAP Certificate # 2630

Blaine Tech Services (Shell) 1680 Rogers Avenue San Jose CA, 95112	Project: 461 8th St, Oakland Project Number: 97093399 Project Manager: Michael Ninokata	S611423 Reported: 12/05/06 16:54
--	---	---

ANALYTICAL REPORT FOR SAMPLES

Sample ID	Laboratory ID	Matrix	Date Sampled	Date Received
S-6	S611423-01	Water	11/15/06 13:30	11/17/06 09:30

Blaine Tech Services (Shell) 1680 Rogers Avenue San Jose CA, 95112	Project: 461 8th St, Oakland Project Number: 97093399 Project Manager: Michael Ninokata	S611423 Reported: 12/05/06 16:54
--	---	---

Purgeable Hydrocarbons and BTEX by EPA 8015B/8021B
TestAmerica - Sacramento, CA

Analyte	Result	Reporting Limit	Units	Dilution	Batch	Prepared	Analyzed	Method	Notes
S-6 (S611423-01) Water Sampled: 11/15/06 13:30 Received: 11/17/06 09:30									
Gasoline Range Organics (C4-C12)	66000	10000	ug/l	200	6110304	11/27/06	11/28/06	EPA 8015B/8021B	
Benzene	19000	100	"	"	"	"	"	"	
Toluene	8400	100	"	"	"	"	"	"	
Ethylbenzene	1900	100	"	"	"	"	"	"	
Xylenes (total)	7400	100	"	"	"	"	"	"	
Methyl tert-butyl ether	ND	400	"	"	"	"	"	"	
Surrogate: 4-BFB (FID)		122 %		61-142	"	"	"	"	
Surrogate: a,a,a-TFT (PID)		105 %		75-122	"	"	"	"	

Blaine Tech Services (Shell) 1680 Rogers Avenue San Jose CA, 95112	Project: 461 8th St, Oakland Project Number: 97093399 Project Manager: Michael Ninokata	S611423 Reported: 12/05/06 16:54
--	---	---

Purgeable Hydrocarbons and BTEX by EPA 8015B/8021B - Quality Control
TestAmerica - Sacramento, CA

Analyte	Result	Reporting Limit	Units	Spike Level	Source Result	%REC	%REC Limits	RPD	RPD Limit	Notes
---------	--------	-----------------	-------	-------------	---------------	------	-------------	-----	-----------	-------

Batch 6110304 - EPA 5030B (P/T) / EPA 8015B/8021B

Blank (6110304-BLK1)

Prepared & Analyzed: 11/27/06

Gasoline Range Organics (C4-C12)	ND	50	ug/l							
Benzene	ND	0.50	"							
Toluene	ND	0.50	"							
Ethylbenzene	ND	0.50	"							
Xylenes (total)	ND	0.50	"							
Methyl tert-butyl ether	ND	2.0	"							
<i>Surrogate: 4-BFB (FID)</i>	<i>12.4</i>		<i>"</i>	<i>10.0</i>		<i>124</i>	<i>61-142</i>			
<i>Surrogate: a,a,a-TFT (PID)</i>	<i>9.71</i>		<i>"</i>	<i>10.0</i>		<i>97</i>	<i>75-122</i>			

Laboratory Control Sample (6110304-BS1)

Prepared & Analyzed: 11/27/06

Benzene	10.5	0.50	ug/l	10.0		105	76-119			
Toluene	10.3	0.50	"	10.0		103	74-122			
Ethylbenzene	10.3	0.50	"	10.0		103	74-122			
Xylenes (total)	30.7	0.50	"	30.0		102	70-126			
Methyl tert-butyl ether	10.3	2.0	"	10.0		103	70-136			
<i>Surrogate: 4-BFB (FID)</i>	<i>12.6</i>		<i>"</i>	<i>10.0</i>		<i>126</i>	<i>61-142</i>			
<i>Surrogate: a,a,a-TFT (PID)</i>	<i>10.2</i>		<i>"</i>	<i>10.0</i>		<i>102</i>	<i>75-122</i>			

Matrix Spike (6110304-MS1)

Source: S611417-08

Prepared & Analyzed: 11/27/06

Benzene	10.8	0.50	ug/l	10.0	ND	108	76-119			
Toluene	10.5	0.50	"	10.0	ND	105	74-122			
Ethylbenzene	10.7	0.50	"	10.0	0.223	105	74-122			
Xylenes (total)	31.4	0.50	"	30.0	ND	105	70-126			
Methyl tert-butyl ether	10.6	2.0	"	10.0	ND	106	70-136			
<i>Surrogate: 4-BFB (FID)</i>	<i>12.8</i>		<i>"</i>	<i>10.0</i>		<i>128</i>	<i>61-142</i>			
<i>Surrogate: a,a,a-TFT (PID)</i>	<i>10.1</i>		<i>"</i>	<i>10.0</i>		<i>101</i>	<i>75-122</i>			

Matrix Spike Dup (6110304-MSD1)

Source: S611417-08

Prepared & Analyzed: 11/27/06

Benzene	11.2	0.50	ug/l	10.0	ND	112	76-119	4	12	
Toluene	11.1	0.50	"	10.0	ND	111	74-122	6	13	
Ethylbenzene	11.2	0.50	"	10.0	0.223	110	74-122	5	12	
Xylenes (total)	33.1	0.50	"	30.0	ND	110	70-126	5	18	
Methyl tert-butyl ether	11.6	2.0	"	10.0	ND	116	70-136	9	25	
<i>Surrogate: 4-BFB (FID)</i>	<i>14.0</i>		<i>"</i>	<i>10.0</i>		<i>140</i>	<i>61-142</i>			
<i>Surrogate: a,a,a-TFT (PID)</i>	<i>10.8</i>		<i>"</i>	<i>10.0</i>		<i>108</i>	<i>75-122</i>			

Blaine Tech Services (Shell) 1680 Rogers Avenue San Jose CA, 95112	Project: 461 8th St, Oakland Project Number: 97093399 Project Manager: Michael Ninokata	S611423 Reported: 12/05/06 16:54
--	---	---

Notes and Definitions

DET	Analyte DETECTED
ND	Analyte NOT DETECTED at or above the reporting limit or MDL, if MDL is specified
NR	Not Reported
dry	Sample results reported on a dry weight basis
RPD	Relative Percent Difference

- LAB:
- TA - Irvine, California
 - TA - Morgan Hill, California
 - TA - Sacramento, California
 - TA - Nashville, Tennessee
 - Calscience
 - Other _____

SAC



SHELL Chain Of Custody Record

NAME OF PERSON TO BILL: Denis Brown

ENVIRONMENTAL SERVICES CHECK BOX TO VERIFY IF NO INCIDENT # APPLIES

NETWORK DEV / FE BILL CONSULTANT

COMPLIANCE RMT/CRMT

INCIDENT # (ES ONLY): 9 7 0 9 3 3 9 9

DATE: 11-15-06

PAGE: 1 of 1

SAMPLING COMPANY: Blaine Tech Services LOG CODE: BTSS

ADDRESS: 1680 Rogers Avenue, San Jose, CA 95112

PROJECT CONTACT (Hardcopy or PDF Report to): Michael Ninokata

TELEPHONE: 408-573-0555 FAX: 408-573-7771 E-MAIL: mninokata@blainetech.com

TAT (STD IS 10 BUSINESS DAYS / RUSH IS CALENDAR DAYS): STD 5 DAY 3 DAY 2 DAY 24 HOURS RESULTS NEEDED ON WEEKEND

SITE ADDRESS: Street and City: 461 8th St., Oakland State: CA GLOBAL ID NO.: T0600101263

EDF DELIVERABLE TO (Name, Company, Office Location): Ana Friel, Cambria, Eureka PHONE NO.: 707-268-3812 E-MAIL: sonomaedf@cambria-env.com CONSULTANT PROJECT NO.: BTS # 061115-JB-2

SAMPLER NAME(S) (Print): Dan Rompf

LAB USE ONLY

REQUESTED ANALYSIS: *Full 423*

LA - RWQCB REPORT FORMAT UST AGENCY:

SPECIAL INSTRUCTIONS OR NOTES:

- EDD NOT NEEDED
- SHELL CONTRACT RATE APPLIES
- STATE REIMB RATE APPLIES
- RECEIPT VERIFICATION REQUESTED

FIELD NOTES: Contalner/Preservative or PID Readings or Laboratory Notes

LAB USE ONLY	Field Sample Identification	SAMPLING		MATRIX	NO. OF CONT.	TPH - Gas, Purgeable (8260B)	TPH - Diesel, Extractable (8015M)	BTEX (8260B)	5 Oxygenates (8260B) (MTBE, TBA, DIPE, TAME, ETBE)	MTBE (8260B)	TBA (8260B)	DIPE (8260B)	TAME (8260B)	ETBE (8260B)	1,2 DCA (8260B)	EDB (8260B)	Ethanol (8260B)	Methanol (8015M)	TPH-motor oil (8015M)	TDS (160.1)	Total Iron (6010B)	Total Lead (6010B)	Total Oil and Grease (1664A)	TEMPERATURE ON RECEIPT C°
		DATE	TIME																					
	S-6	11-15-06	1330	H ₂ O	3	X	X	X																3.90

Relinquished by: (Signature) _____ Received by: (Signature) _____ (Sample custodian)

Date: 11-15-06 Time: 1600

Relinquished by: (Signature) _____ Received by: (Signature) _____

Date: 11/15/06 Time: 1712

Relinquished by: (Signature) _____ Received by: (Signature) _____ JIUNG, (M)

Date: 11/15/06 Time: 1850

11/17/06 9:30

05/02/06 Revision

5 December, 2006

Michael Ninokata
Blaine Tech Services (Shell)
1680 Rogers Avenue
San Jose, CA 95112

RE: 461 8th St, Oakland
Work Order: S611423

Enclosed are the results of analyses for samples received by the laboratory on 11/17/06 09:30. If you have any questions concerning this report, please feel free to contact me.

Sincerely,



Sylvia Krenn
Project Manager

CA ELAP Certificate # 2630

Blaine Tech Services (Shell) 1680 Rogers Avenue San Jose CA, 95112	Project: 461 8th St, Oakland Project Number: 97093399 Project Manager: Michael Ninokata	S611423 Reported: 12/05/06 16:54
--	---	---

ANALYTICAL REPORT FOR SAMPLES

Sample ID	Laboratory ID	Matrix	Date Sampled	Date Received
S-6	S611423-01	Water	11/15/06 13:30	11/17/06 09:30

Blaine Tech Services (Shell) 1680 Rogers Avenue San Jose CA, 95112	Project: 461 8th St, Oakland Project Number: 97093399 Project Manager: Michael Ninokata	S611423 Reported: 12/05/06 16:54
--	---	---

Purgeable Hydrocarbons and BTEX by EPA 8015B/8021B
TestAmerica - Sacramento, CA

Analyte	Result	Reporting Limit	Units	Dilution	Batch	Prepared	Analyzed	Method	Notes
---------	--------	-----------------	-------	----------	-------	----------	----------	--------	-------

S-6 (S611423-01) Water **Sampled: 11/15/06 13:30** **Received: 11/17/06 09:30**

Gasoline Range Organics (C4-C12)	66000	10000	ug/l	200	6110304	11/27/06	11/28/06	EPA 8015B/8021B	
Benzene	19000	100	"	"	"	"	"	"	
Toluene	8400	100	"	"	"	"	"	"	
Ethylbenzene	1900	100	"	"	"	"	"	"	
Xylenes (total)	7400	100	"	"	"	"	"	"	
Methyl tert-butyl ether	ND	400	"	"	"	"	"	"	
<i>Surrogate: 4-BFB (FID)</i>		122 %		61-142	"	"	"	"	
<i>Surrogate: a,a,a-TFT (PID)</i>		105 %		75-122	"	"	"	"	

Blaine Tech Services (Shell) 1680 Rogers Avenue San Jose CA, 95112	Project: 461 8th St, Oakland Project Number: 97093399 Project Manager: Michael Ninokata	S611423 Reported: 12/05/06 16:54
--	---	---

Purgeable Hydrocarbons and BTEX by EPA 8015B/8021B - Quality Control
TestAmerica - Sacramento, CA

Analyte	Result	Reporting Limit	Units	Spike Level	Source Result	%REC	%REC Limits	RPD	RPD Limit	Notes
---------	--------	-----------------	-------	-------------	---------------	------	-------------	-----	-----------	-------

Batch 6110304 - EPA 5030B (P/T) / EPA 8015B/8021B

Blank (6110304-BLK1)

Prepared & Analyzed: 11/27/06

Gasoline Range Organics (C4-C12)	ND	50	ug/l							
Benzene	ND	0.50	"							
Toluene	ND	0.50	"							
Ethylbenzene	ND	0.50	"							
Xylenes (total)	ND	0.50	"							
Methyl tert-butyl ether	ND	2.0	"							
<i>Surrogate: 4-BFB (FID)</i>	<i>12.4</i>		<i>"</i>	<i>10.0</i>		<i>124</i>	<i>61-142</i>			
<i>Surrogate: a,a,a-TFT (PID)</i>	<i>9.71</i>		<i>"</i>	<i>10.0</i>		<i>97</i>	<i>75-122</i>			

Laboratory Control Sample (6110304-BS1)

Prepared & Analyzed: 11/27/06

Benzene	10.5	0.50	ug/l	10.0		105	76-119			
Toluene	10.3	0.50	"	10.0		103	74-122			
Ethylbenzene	10.3	0.50	"	10.0		103	74-122			
Xylenes (total)	30.7	0.50	"	30.0		102	70-126			
Methyl tert-butyl ether	10.3	2.0	"	10.0		103	70-136			
<i>Surrogate: 4-BFB (FID)</i>	<i>12.6</i>		<i>"</i>	<i>10.0</i>		<i>126</i>	<i>61-142</i>			
<i>Surrogate: a,a,a-TFT (PID)</i>	<i>10.2</i>		<i>"</i>	<i>10.0</i>		<i>102</i>	<i>75-122</i>			

Matrix Spike (6110304-MS1)

Source: S611417-08

Prepared & Analyzed: 11/27/06

Benzene	10.8	0.50	ug/l	10.0	ND	108	76-119			
Toluene	10.5	0.50	"	10.0	ND	105	74-122			
Ethylbenzene	10.7	0.50	"	10.0	0.223	105	74-122			
Xylenes (total)	31.4	0.50	"	30.0	ND	105	70-126			
Methyl tert-butyl ether	10.6	2.0	"	10.0	ND	106	70-136			
<i>Surrogate: 4-BFB (FID)</i>	<i>12.8</i>		<i>"</i>	<i>10.0</i>		<i>128</i>	<i>61-142</i>			
<i>Surrogate: a,a,a-TFT (PID)</i>	<i>10.1</i>		<i>"</i>	<i>10.0</i>		<i>101</i>	<i>75-122</i>			

Matrix Spike Dup (6110304-MSD1)

Source: S611417-08

Prepared & Analyzed: 11/27/06

Benzene	11.2	0.50	ug/l	10.0	ND	112	76-119	4	12	
Toluene	11.1	0.50	"	10.0	ND	111	74-122	6	13	
Ethylbenzene	11.2	0.50	"	10.0	0.223	110	74-122	5	12	
Xylenes (total)	33.1	0.50	"	30.0	ND	110	70-126	5	18	
Methyl tert-butyl ether	11.6	2.0	"	10.0	ND	116	70-136	9	25	
<i>Surrogate: 4-BFB (FID)</i>	<i>14.0</i>		<i>"</i>	<i>10.0</i>		<i>140</i>	<i>61-142</i>			
<i>Surrogate: a,a,a-TFT (PID)</i>	<i>10.8</i>		<i>"</i>	<i>10.0</i>		<i>108</i>	<i>75-122</i>			

Blaine Tech Services (Shell) 1680 Rogers Avenue San Jose CA, 95112	Project: 461 8th St, Oakland Project Number: 97093399 Project Manager: Michael Ninokata	S611423 Reported: 12/05/06 16:54
--	---	---

Notes and Definitions

DET	Analyte DETECTED
ND	Analyte NOT DETECTED at or above the reporting limit or MDL, if MDL is specified
NR	Not Reported
dry	Sample results reported on a dry weight basis
RPD	Relative Percent Difference

- LAB:
- TA - Irvine, California
 - TA - Morgan Hill, California
 - TA - Sacramento, California
 - TA - Nashville, Tennessee
 - Calscience
 - Other _____

SAC



SHELL Chain Of Custody Record

NAME OF PERSON TO BILL: Denis Brown

ENVIRONMENTAL SERVICES CHECK BOX TO VERIFY IF NO INCIDENT # APPLIES

NETWORK DEV / FE BILL CONSULTANT

COMPLIANCE RMT/CRMT

INCIDENT # (ES ONLY): 9 7 0 9 3 3 9 9

DATE: 11-15-06

PAGE: 1 of 1

SAMPLING COMPANY: Blaine Tech Services LOG CODE: BTSS

ADDRESS: 1680 Rogers Avenue, San Jose, CA 95112

PROJECT CONTACT (Hardcopy or PDF Report to): Michael Ninokata

TELEPHONE: 408-573-0555 FAX: 408-573-7771 E-MAIL: mninokata@blainetech.com

TAT (STD IS 10 BUSINESS DAYS / RUSH IS CALENDAR DAYS): STD 5 DAY 3 DAY 2 DAY 24 HOURS RESULTS NEEDED ON WEEKEND

SITE ADDRESS: Street and City: 461 8th St., Oakland State: CA GLOBAL ID NO.: T0600101263

EDF DELIVERABLE TO (Name, Company, Office Location): Ana Friel, Cambria, Eureka PHONE NO.: 707-268-3812 E-MAIL: sonomaedf@cambria-env.com CONSULTANT PROJECT NO.: BTS # 061115-JB-2

SAMPLER NAME(S) (Print): Dan Rompf

LAB USE ONLY

REQUESTED ANALYSIS: *Full 423*

LA - RWQCB REPORT FORMAT UST AGENCY:

SPECIAL INSTRUCTIONS OR NOTES:

- EDD NOT NEEDED
- SHELL CONTRACT RATE APPLIES
- STATE REIMB RATE APPLIES
- RECEIPT VERIFICATION REQUESTED

FIELD NOTES: Contalner/Preservative or PID Readings or Laboratory Notes

LAB USE ONLY	Field Sample Identification	SAMPLING		MATRIX	NO. OF CONT.	TPH - Gas, Purgeable (8260B)	TPH - Diesel, Extractable (8015M)	BTEX (8260B)	5 Oxygenates (8260B) (MTBE, TBA, DIPE, TAME, ETBE)	MTBE (8260B)	TBA (8260B)	DIPE (8260B)	TAME (8260B)	ETBE (8260B)	1,2 DCA (8260B)	EDB (8260B)	Ethanol (8260B)	Methanol (8015M)	TPH-motor oil (8015M)	TDS (160.4)	Total Iron (6010B)	Total Lead (6010B)	Total Oil and Grease (1664A)	TEMPERATURE ON RECEIPT C°
		DATE	TIME																					
	S-6	11-15-06	1330	H ₂ O	3	X	X	X																3.90

Relinquished by: (Signature) _____ Received by: (Signature) _____ (Sample custodian)

Relinquished by: (Signature) _____ Received by: (Signature) _____

Relinquished by: (Signature) _____ Received by: (Signature) _____ JIUNG, (MT)

Date: 11-15-06 Time: 1600

Date: 11/15/06 Time: 1712

Date: 11/15/06 Time: 1850

11/17/06 9:30

05/02/06 Revision

Repair Data Sheet

Client Shell Date 10-3-06
 Site Address 461 8th St., Oakland
 Job Number 061003AA4 Technician Andrew Adinolfi

Inspection Point (Well ID or description of location)	Well Inspected, Cleaned, Labeled - No Further Corrective Action Required	Replaced Cap	Replaced Lock	Replaced Lid Seat	Check Indicates deficiency										Well Not Inspected (explain in notes)	Deficiency Logged on Repair Order	Deficiency Remains Uncorrected/Logged on Site Inspection Checklist	Partial Repair Completed/Outstanding Deficiency Logged on Repair Order	All Repairs Completed	
					Casing	Annular Seal	Tabs / Bolts	Box Structure	Apron	Trip Hazard	Below Grade	Not Securable by Design (12" diameter or less)	Lid not marked with words "MONITORING WELL"	Other Deficiency						Not Securable by Design (greater than 12" diameter)
S-10																				Notes: <u>Tag well</u>
																				Notes:
																				Notes:
																				Notes:
																				Notes:
																				Notes:

SHELL WELL MONITORING DATA SHEET

BTS #: 0611/S-D-2	Site: 461 8th St, Oakland
Sampler: Dan R.	Date: 11-15-06
Well I.D.: S-6	Well Diameter: 2 3 <u>4</u> 6 8
Total Well Depth (TD): 35.01	Depth to Water (DTW): 20.41
Depth to Free Product: NO SPH	Thickness of Free Product (feet):
Referenced to: <u>PVC</u> Grade	D.O. Meter (if req'd): YSI HACH
DTW with 80% Recharge [(Height of Water Column x 0.20) + DTW]:	

Purge Method: ~~Bailer~~ ~~Water~~ ~~Peristaltic~~ ~~Extraction Pump~~ ~~Other~~
 Disposable Bailer
 Positive Air Displacement
 Electric Submersible

Sampling Method: Bailer
 Disposable Bailer
 Extraction Port
 Dedicated Tubing

Other: _____

NO PURGE WELL

(Gals.) X _____ = _____ Gals.
 1 Case Volume Specified Volumes Calculated Volume

Well Diameter	Multiplier	Well Diameter	Multiplier
1"	0.04	4"	0.65
2"	0.16	6"	1.47
3"	0.37	Other	radius ² * 0.163

Time	Temp (°F)	pH	Cond. (mS or <u>µS</u>)	Turbidity (NTUs)	Gals. Removed	Observations
1320	67.1	6.2	837	118	—	Strong Odor

Did well dewater? Yes No Gallons actually evacuated: —

Sampling Date: 11-15-06 Sampling Time: 1330 Depth to Water: 20.41

Sample I.D.: S-6 Laboratory: STL TA

Analyzed for: TPH-G BTEX MTBE TPH-D Other:

EB I.D. (if applicable): _____ @ _____ Time Duplicate I.D. (if applicable): _____

Analyzed for: TPH-G BTEX MTBE TPH-D Other:

D.O. (if req'd):	Pre-purge:	mg/L	Post-purge:	mg/L
O.R.P. (if req'd):	Pre-purge:	mV	Post-purge:	mV