



RECEIVED

By Alameda County Environmental Health 3:22 pm, Aug 18, 2015

Mark Horne
Project Manager
Marketing Business Unit

**Chevron Environmental
Management Company**
6101 Bollinger Canyon Road
San Ramon, CA 94583
Tel (925) 790-3964
markhorne@chevron.com

Alameda County Health Care Services
1131 Harbor Bay Parkway, Suite 250
Alameda, CA 94502-6577

Re: Chevron Service Station No. 91153
3135 Gibbons Drive (3126 Fernside Blvd)
Alameda, CA

I have reviewed the attached report titled *Second Quarter 2015 Groundwater Monitoring and Sampling Report*.

The information in this report is accurate to the best of my knowledge and all local Agency/Regional Board guidelines have been followed. This report was prepared by Conestoga-Rovers & Associates, upon whose assistance and advice I have relied.

This letter is submitted pursuant to the requirements of California Water Code Section 13267(b)(1) and the regulating implementation entitled Appendix A pertaining thereto.

I declare under penalty of perjury that the foregoing is true and correct to the best of my knowledge.

Sincerely,

A handwritten signature in blue ink that reads "Mark E. Horne".

Mark Horne
Project Manager

Attachment: *Second Quarter 2015 Groundwater Monitoring and Sampling Report*



August 18, 2015

Reference No. 311642

Mr. Mark Detterman
Alameda County Environmental Health Services
1131 Harbor Bay Parkway, Suite 250
Alameda, California 94502-6577

**Re: Second Quarter 2015 Groundwater Monitoring and Sampling Report
Former Chevron Service Station 91153
3135 Gibbons Drive (3126 Fernside Boulevard)
Alameda, California
Agency Case RO0000341**

Dear Mr. Detterman:

On behalf of Chevron Environmental Management Company (Chevron), GHD Services Inc. (GHD) is submitting this *Second Quarter 2015 Groundwater Monitoring and Sampling Report* for the site referenced above (Figure 1). Groundwater monitoring was performed by Blaine Tech Services (Blaine Tech) of San Jose, California and their *Second Quarter 2015 Monitoring* report is included as Attachment A. Eurofins Lancaster Laboratories' of Lancaster, Pennsylvania *Analytical Results* report is included as Attachment B. Current and historical groundwater monitoring and sampling data are presented in Table 1. Sorbent sock field measurements are included as Attachment C.

Please contact Nathan Lee at (925) 849-1003 if you have any questions or require additional information.

Regards,

GHD



Nathan Lee, PG 8486

NL/aa/41

Encl.

- | | |
|--------------|---|
| Figure 1 | Vicinity Map |
| Figure 2 | Groundwater Elevation and Hydrocarbon Concentration Map |
| Table 1 | Groundwater Monitoring and Sampling Data |
| Attachment A | Monitoring Data Package |
| Attachment B | Laboratory Analytical Report |
| Attachment C | Sorben Sock Data |

cc: Mr. Mark Horne, Chevron (*electronic copy*)
Mr. Mark Hom, Property Owner

Figures

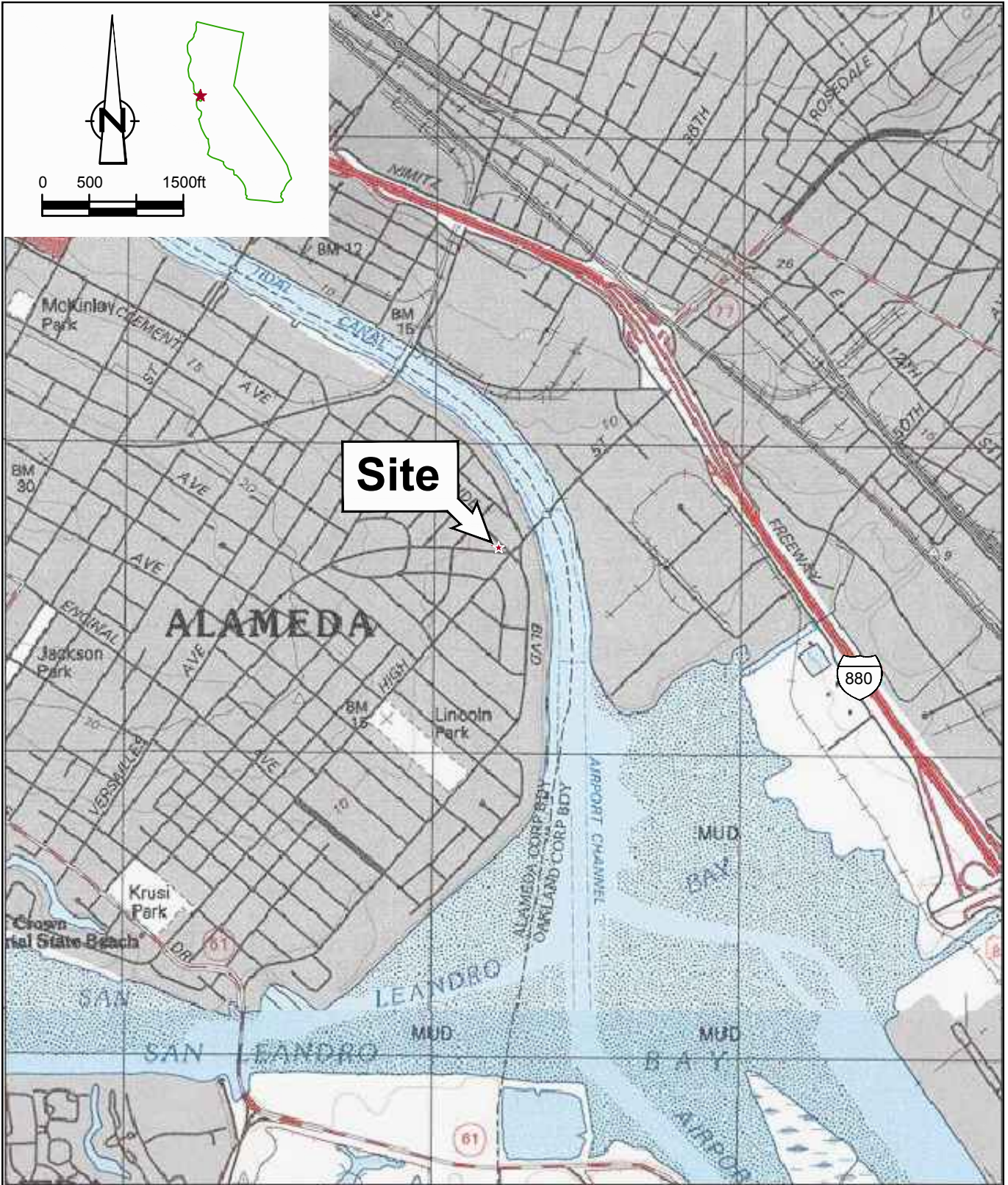

Site

Figure 1

VICINITY MAP
 FORMER CHEVRON SERVICE STATION 91153
 3135 GIBBONS DRIVE (3126 FERNSIDE BLVD)
 Alameda, California



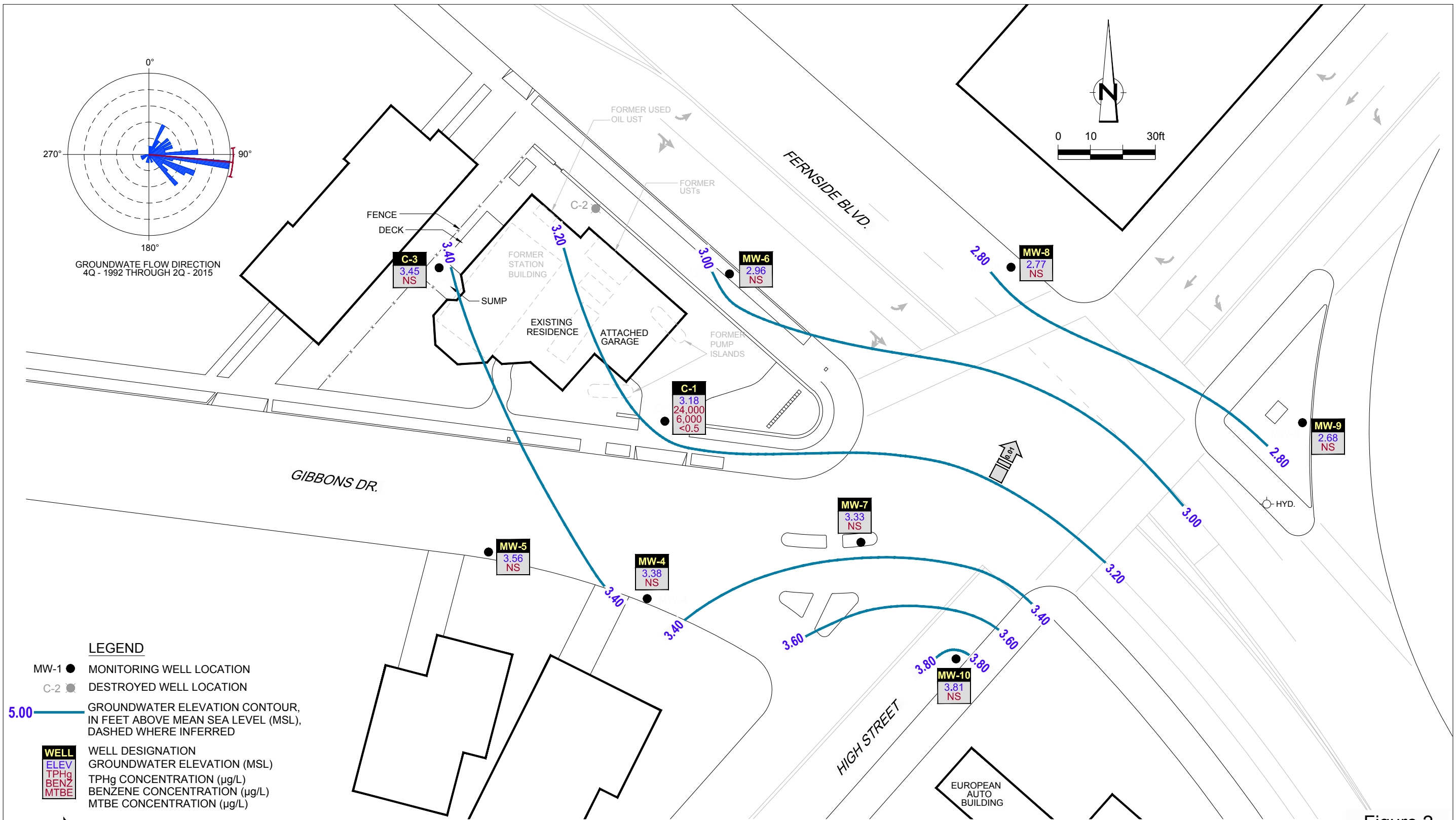

Figure 2
GROUNDWATER ELEVATION AND HYDROCARBON CONCENTRATION MAP
 FORMER CHEVRON SERVICE STATION 91153
 3135 GIBBONS DRIVE (3126 FERNSIDE BLVD)
 Alameda, California
 June 18, 2015



Table

Table 1

**Groundwater Monitoring and Sampling Data
Former Chevron Service Station 91153
3135 Gibbons Drive (3126 Fernside Boulevard)
Alameda, California**

Location	Date	TOC	DTW	GWE	LNAPLT	FIELD PARAMETERS	HYDROCARBONS	PRIMARY VOCS				
						Dissolved Oxygen	TPH-GRO	B	T	E	X	MTBE by SW6260
	Units	ft	ft	ft-amsl	ft	mg/L	µg/L	µg/L	µg/L	µg/L	µg/L	µg/L
C-1	08/18/1986	-	4.10	-	-	-	-	-	-	-	-	-
C-1	09/04/1986	-	-	-	-	-	15,000	760	820	1,500	-	-
C-1	07/22/1987	-	-	-	-	-	1,100	250	7.0	40	-	-
C-1	05/03/1989	-	4.46	-	-	-	6,900	3,800	190	229	-	-
C-1	12/04/1989	-	4.16	-	-	-	17,000	8,000	490	470	-	-
C-1	02/14/1990	-	3.64	-	-	-	19,000	12,000	990	1,050	-	-
C-1	03/07/1990	-	3.36	-	-	-	-	4,260	261	430	-	-
C-1	09/06/1991	-	4.43	-	-	-	21,000	10,000	100	240	560	-
C-1	12/15/1991	-	4.78	-	-	-	20,000	4,900	43	110	330	-
C-1	03/03/1992	-	2.39	-	-	-	13,000	5,800	730	340	1,200	-
C-1	06/04/1992	4.08	4.08	0.00	0.00	-	34,000	9,400	350	290	1,200	-
C-1	10/13/1992	4.08	4.75	-0.67	0.00	-	24,000	11,000	98	280	530	-
C-1	01/11/1993	4.08	2.26	1.82	Sheen	-	7,100	1,500	130	150	700	-
C-1	04/14/1993	4.08	2.90	1.18	Sheen	-	29,000	7,300	4,000	640	2,300	-
C-1	07/13/1993	4.08	3.97	0.11	Sheen	-	650,000	27,000	18,000	6,300	29,000	-
C-1	10/19/1993	4.08	4.50	-0.42	0.00	-	40,000	12,000	730	1,100	3,600	-
C-1	11/30/1993	7.50	4.27	3.23	0.00	-	-	-	-	-	-	-
C-1	01/27/1994	7.50	3.35	4.15	0.00	-	36,000	8,600	220	670	1,900	-
C-1	04/07/1994	7.50	3.42	4.08	0.00	-	53,000	12,000	3,500	480	3,300	-
C-1	07/01/1994	7.50	3.96	3.54	0.00	-	65,000	19,000	5,900	1,000	9,000	-
C-1	10/05/1994	7.50	4.39	3.11	0.00	-	160,000	23,000	12,000	2,200	11,000	-
C-1	01/12/1995	7.50	1.52	6.38	0.50	-	-	-	-	-	-	-
C-1	04/26/1995	7.50	4.40	4.86	2.20	-	-	-	-	-	-	-
C-1	07/12/1995	7.50	4.85	4.10	1.81	-	-	-	-	-	-	-
C-1	10/30/1995	7.50	5.67	3.13	1.63	-	-	-	-	-	-	-

Table 1

**Groundwater Monitoring and Sampling Data
Former Chevron Service Station 91153
3135 Gibbons Drive (3126 Fernside Boulevard)
Alameda, California**

Location	Date	TOC	DTW	GWE	LNAPLT	FIELD PARAMETERS	HYDROCARBONS	PRIMARY VOCS				
						Dissolved Oxygen	TPH-GRO	B	T	E	X	MTBE by SW6260
	Units	ft	ft	ft-amsl	ft	mg/L	µg/L	µg/L	µg/L	µg/L	µg/L	µg/L
C-1	01/04/1996	7.50	3.92	3.68	0.12	-	-	-	-	-	-	-
C-1	01/10/1996	7.50	3.48	4.12	0.13	-	-	-	-	-	-	-
C-1	01/17/1996	7.50	3.40	4.12	0.02	-	-	-	-	-	-	-
C-1	01/22/1996	7.50	2.90	4.60	0.00	-	82,000	18,000	4,400	1,400	5,200	<1,000
C-1	02/23/1996	7.50	4.10	4.89	1.86	-	-	-	-	-	-	-
C-1	02/28/1996	7.50	-	-	0.83 >	-	-	-	-	-	-	-
C-1	03/08/1996	7.50	2.86	6.10	1.83	-	-	-	-	-	-	-
C-1	03/26/1996	7.50	3.96	4.56	1.28	-	-	-	-	-	-	-
C-1	04/11/1996	7.50	5.61	3.29	1.75	-	-	-	-	-	-	-
C-1	04/19/1996	7.50	3.09	4.44	0.04	-	-	-	-	-	-	-
C-1	04/24/1996	7.50	3.04	4.48	0.03	-	-	-	-	-	-	-
C-1	05/03/1996	7.50	4.02	3.85	0.46	-	-	-	-	-	-	-
C-1	05/08/1996	7.50	4.25	3.53	0.35	-	-	-	-	-	-	-
C-1	05/17/1996	7.50	3.24	4.29	0.04	-	-	-	-	-	-	-
C-1	05/22/1996	7.50	3.10	4.46	0.07	-	-	-	-	-	-	-
C-1	06/18/1996	7.50	4.68	3.20	0.48	-	-	-	-	-	-	-
C-1	07/03/1996	7.50	5.03	2.57	0.13	-	-	-	-	-	-	-
C-1	07/09/1996	7.50	4.63	3.05	0.23	-	-	-	-	-	-	-
C-1	07/17/1996	7.50	4.73	2.89	0.15	-	-	-	-	-	-	-
C-1	07/29/1996	7.50	5.10	2.47	0.09	-	-	-	-	-	-	-
C-1	08/02/1996	7.50	5.68	1.84	0.03	-	-	-	-	-	-	-
C-1	08/07/1996	7.50	5.16	2.35	0.01	-	-	-	-	-	-	-
C-1	08/23/1996	7.50	5.75	1.77	0.03	-	-	-	-	-	-	-
C-1	08/28/1996	7.50	5.53	1.99	0.03	-	-	-	-	-	-	-
C-1	09/06/1996	7.50	5.38	2.12	0.00	-	-	-	-	-	-	-

Table 1

**Groundwater Monitoring and Sampling Data
Former Chevron Service Station 91153
3135 Gibbons Drive (3126 Fernside Boulevard)
Alameda, California**

Location	Date	TOC	DTW	GWE	LNAPLT	FIELD PARAMETERS	HYDROCARBONS	PRIMARY VOCS				
						Dissolved Oxygen	TPH-GRO	B	T	E	X	MTBE by SW6260
	Units	ft	ft	ft-amsl	ft	mg/L	µg/L	µg/L	µg/L	µg/L	µg/L	µg/L
C-1	09/12/1996	7.50	5.48	2.04	0.03	-	-	-	-	-	-	-
C-1	09/19/1996	7.50	6.32	1.20	0.03	-	-	-	-	-	-	-
C-1	10/10/1996	7.50	4.58	3.00	0.10	-	-	-	-	-	-	-
C-1	10/17/1996	7.50	5.61	1.90	0.01	-	-	-	-	-	-	-
C-1	10/29/1996	7.50	6.01	1.49	0.00	-	-	-	-	-	-	-
C-1	11/07/1996	7.50	5.56	1.94	0.04	-	-	-	-	-	-	-
C-1	11/11/1996	7.50	5.32	2.18	0.04	-	-	-	-	-	-	-
C-1	12/17/1996	7.50	3.73	3.77	0.01	-	-	-	-	-	-	-
C-1	12/20/1996	7.50	3.33	4.17	0.03	-	-	-	-	-	-	-
C-1	01/15/1997	7.50	2.74	4.76	0.00	-	47,000	16,000	2,800	1,300	4,900	<1,000
C-1	01/22/1997	7.50	1.37	6.13	0.19	-	-	-	-	-	-	-
C-1	02/04/1997	7.50	2.98	4.52	0.51	-	-	-	-	-	-	-
C-1	02/20/1997	7.50	4.09	3.41	0.13	-	-	-	-	-	-	-
C-1	03/06/1997	7.50	3.75	3.75	0.56	-	-	-	-	-	-	-
C-1	03/14/1997	7.50	3.82	3.68	0.03	-	-	-	-	-	-	-
C-1	03/20/1997	7.50	3.73	3.77	0.03	-	-	-	-	-	-	-
C-1	03/25/1997	7.50	4.32	3.18	0.01	-	-	-	-	-	-	-
C-1	03/31/1997	7.50	3.71	3.79	0.03	-	-	-	-	-	-	-
C-1	04/03/1997	7.50	4.60	2.92	0.03	-	-	-	-	-	-	-
C-1	04/09/1997	7.50	4.25	3.27	0.02	-	-	-	-	-	-	-
C-1	04/24/1997	7.50	4.65	2.87	0.02	-	-	-	-	-	-	-
C-1	04/30/1997	7.50	3.50	4.02	0.02	-	-	-	-	-	-	-
C-1	05/22/1997	7.50	4.97	2.53	0.00	-	-	-	-	-	-	-
C-1	06/03/1997	7.50	3.62	3.93	0.06	-	-	-	-	-	-	-
C-1	07/09/1997	7.50	4.30	3.25	0.06	-	-	-	-	-	-	-

Table 1

**Groundwater Monitoring and Sampling Data
Former Chevron Service Station 91153
3135 Gibbons Drive (3126 Fernside Boulevard)
Alameda, California**

Location	Date	TOC	DTW	GWE	LNAPLT	FIELD PARAMETERS	HYDROCARBONS	PRIMARY VOCS				
						Dissolved Oxygen	TPH-GRO	B	T	E	X	MTBE by SW6260
	Units	ft	ft	ft-amsl	ft	mg/L	µg/L	µg/L	µg/L	µg/L	µg/L	µg/L
C-1	08/12/1997	7.50	5.18	2.32	0.00	-	-	-	-	-	-	-
C-1	09/30/1997	7.50	5.25	2.65	0.50	-	-	-	-	-	-	-
C-1	10/29/1997	7.50	5.33	2.19	0.03	-	-	-	-	-	-	-
C-1	11/13/1997	7.50	4.86	2.66	0.02	-	-	-	-	-	-	-
C-1	12/18/1997	7.50	2.34	5.16	0.00	-	-	-	-	-	-	-
C-1	01/14/1998	7.50	0.25	7.27	0.02	-	-	-	-	-	-	-
C-1	02/02/1998	7.50	2.35	5.19	0.05	-	-	-	-	-	-	-
C-1	03/16/1998	7.50	2.50	5.40	0.50	-	-	-	-	-	-	-
C-1	04/17/1998	7.50	2.65	5.17	0.40	-	-	-	-	-	-	-
C-1	05/01/1998	7.50	2.39	5.14	0.04	-	-	-	-	-	-	-
C-1	06/17/1998	7.50	3.26	4.30	0.08	-	-	-	-	-	-	-
C-1	07/15/1998	7.50	3.55	3.95	0.00	-	110,000	22,000	22,000	1,000	10,000	<250
C-1	09/01/1998	7.50	4.00	3.50	0.00	-	-	-	-	-	-	-
C-1	10/27/1998	7.50	4.48	3.02	0.00	-	45,000	12,000	5,400	590	4,300	<500
C-1	11/19/1998	7.50	3.89	3.61	0.00	-	-	-	-	-	-	-
C-1	12/19/1998	7.50	2.13	5.39	0.02	-	-	-	-	-	-	-
C-1	01/20/1999	7.50	3.98	3.52	0.00	-	50,300	7,050	5,030	244	6,090	<40
C-1	02/24/1999	7.50	2.55	4.95	0.00	-	-	-	-	-	-	-
C-1	03/26/1999	7.50	2.14	5.97	0.76	-	-	-	-	-	-	-
C-1	04/19/1999	7.50	1.04	6.46	0.00	-	150,000	21,000	20,000	3,000	18,000	49 ² / _{<2.5}
C-1	07/29/1999	7.50	3.76	3.76	0.02	-	-	-	-	-	-	-
C-1	08/30/1999	7.50	4.30	3.20	0.00	-	-	-	-	-	-	-
C-1	09/23/1999	7.50	3.84	3.68	0.02	-	-	-	-	-	-	-
C-1	10/13/1999	7.50	1.27	6.23	0.00	-	136,000	23,900	30,000	2,390	17,300	<500
C-1	11/17/1999	7.50	3.59	3.91	0.00	-	-	-	-	-	-	-

Table 1

**Groundwater Monitoring and Sampling Data
Former Chevron Service Station 91153
3135 Gibbons Drive (3126 Fernside Boulevard)
Alameda, California**

Location	Date	TOC	DTW	GWE	LNAPLT	FIELD PARAMETERS	HYDROCARBONS	PRIMARY VOCS				
						Dissolved Oxygen	TPH-GRO	B	T	E	X	MTBE by SW6260
	Units	ft	ft	ft-amsl	ft	mg/L	µg/L	µg/L	µg/L	µg/L	µg/L	µg/L
C-1	12/08/1999	7.50	3.79	3.71	0.00	-	-	-	-	-	-	-
C-1	01/25/2000	7.50	1.99	5.54	0.04	-	-	-	-	-	-	-
C-1	04/03/2000**	7.50	2.20	5.38	0.10	-	-	-	-	-	-	-
C-1	05/26/2000**	7.50	2.52	5.16	0.23	-	-	-	-	-	-	-
C-1	06/19/2000**	7.50	2.89	4.76	0.19	-	-	-	-	-	-	-
C-1	07/03/2000**	7.50	3.45	4.25	0.25	-	-	-	-	-	-	-
C-1	08/01/2000**	7.50	3.78	3.85	0.16	-	-	-	-	-	-	-
C-1	09/30/2000**	7.50	4.03	3.50	0.04	-	-	-	-	-	-	-
C-1	10/23/2000**	7.50	4.15	3.37	0.03	-	-	-	-	-	-	-
C-1	11/21/2000	7.50	3.42	4.08	0.00	-	-	-	-	-	-	-
C-1	12/22/2000	7.50	2.96	4.54	0.00	-	-	-	-	-	-	-
C-1	01/08/2001	7.50	2.94	4.56	0.00	-	-	-	-	-	-	-
C-1	02/17/2001**	7.50	2.09	5.88	0.59	-	-	-	-	-	-	-
C-1	03/13/2001**	7.50	2.20	5.91	0.76	-	-	-	-	-	-	-
C-1	04/09/2001 ^{18,**}	7.50	2.45	5.26	0.26	-	-	-	-	-	-	-
C-1	05/18/2001**	7.50	2.70	5.27	0.59	-	-	-	-	-	-	-
C-1	06/12/2001**	7.50	3.50	4.78	0.97	-	-	-	-	-	-	-
C-1	07/19/2001**	7.50	4.25	4.01	0.95	-	-	-	-	-	-	-
C-1	08/23/2001 ^{18,**}	7.50	4.34	3.22	0.07	-	-	-	-	-	-	-
C-1	09/17/2001**	7.50	4.39	3.17	0.08	-	-	-	-	-	-	-
C-1	10/08/2001**	7.50	4.45	3.08	0.04	-	-	-	-	-	-	-
C-1	11/27/2001	7.50	3.89	3.61	0.00	-	330,000	9,800	5,300	3,800	22,000	<50
C-1	12/17/2001	7.50	1.81	5.69	0.00	-	-	-	-	-	-	-
C-1	01/07/2002**	7.50	2.27	5.64	0.51	-	-	-	-	-	-	-
C-1	02/26/2002 ^{18,**}	7.50	2.70	5.22	0.52	-	-	-	-	-	-	-

Table 1

**Groundwater Monitoring and Sampling Data
Former Chevron Service Station 91153
3135 Gibbons Drive (3126 Fernside Boulevard)
Alameda, California**

Location	Date	TOC	DTW	GWE	LNAPLT	FIELD PARAMETERS	HYDROCARBONS	PRIMARY VOCS				
						Dissolved Oxygen	TPH-GRO	B	T	E	X	MTBE by SW6260
	Units	ft	ft	ft-amsl	ft	mg/L	µg/L	µg/L	µg/L	µg/L	µg/L	µg/L
C-1	03/27/2002**	7.50	2.87	5.47	1.05	-	-	-	-	-	-	-
C-1	04/08/2002**	7.50	2.45	6.03	1.23	-	-	-	-	-	-	-
C-1	05/23/2002 ^{18,**}	7.50	3.57	4.35	0.52	-	-	-	-	-	-	-
C-1	06/17/2002**	7.50	3.90	3.88	0.35	-	-	-	-	-	-	-
C-1	07/31/2002**	7.50	4.12	3.54	0.20	-	-	-	-	-	-	-
C-1	08/09/2002 ^{18,**}	7.50	4.15	3.48	0.16	-	-	-	-	-	-	-
C-1	09/17/2002**	7.50	4.33	3.27	0.12	-	-	-	-	-	-	-
C-1	10/15/2002**	7.50	4.51	3.11	0.15	-	-	-	-	-	-	-
C-1	11/08/2002	7.50	4.11	3.39	0.00	-	51,000	7,000	510	820	5,800	<3.0
C-1	12/19/2002	7.50	1.14	6.36	0.00	-	-	-	-	-	-	-
C-1	01/14/2003	7.50	1.80	5.70	0.00	-	-	-	-	-	-	-
C-1	02/07/2003 ^{18,**}	7.50	2.95	4.79	0.30	-	-	-	-	-	-	-
C-1	03/20/2003**	7.50	2.86	4.97	0.41	-	-	-	-	-	-	-
C-1	04/15/2003**	7.50	2.12	5.46	0.10	-	-	-	-	-	-	-
C-1	05/09/2003 ^{18,**}	7.50	2.95	5.11	0.70	-	-	-	-	-	-	-
C-1	06/27/2003**	7.50	3.97	3.93	0.50	-	-	-	-	-	-	-
C-1	07/16/2003**	7.50	3.68	4.04	0.28	-	-	-	-	-	-	-
C-1	08/15/2003 ^{18,**}	7.50	4.29	3.39	0.22	-	-	-	-	-	-	-
C-1	09/26/2003**	7.50	4.60	3.05	0.19	-	-	-	-	-	-	-
C-1	10/18/2003**	7.50	4.72	2.90	0.15	-	-	-	-	-	-	-
C-1	11/14/2003 ^{18,**}	7.50	4.31	3.35	0.20	-	-	-	-	-	-	-
C-1	12/23/2003	7.50	1.81	5.69	0.00	-	-	-	-	-	-	-
C-1	01/22/2004**	7.50	4.19	3.32	0.01	-	-	-	-	-	-	-
C-1	02/13/2004 ^{18,**}	7.50	3.04	4.49	0.04	-	-	-	-	-	-	-
C-1	03/11/2004**	7.50	1.85	5.97	0.40	-	-	-	-	-	-	-

Table 1

**Groundwater Monitoring and Sampling Data
Former Chevron Service Station 91153
3135 Gibbons Drive (3126 Fernside Boulevard)
Alameda, California**

Location	Date	TOC	DTW	GWE	LNAPLT	FIELD PARAMETERS	HYDROCARBONS	PRIMARY VOCS				
						Dissolved Oxygen	TPH-GRO	B	T	E	X	MTBE by SW6260
	Units	ft	ft	ft-amsl	ft	mg/L	µg/L	µg/L	µg/L	µg/L	µg/L	µg/L
C-1	04/22/2004**	7.50	3.08	4.60	0.22	-	-	-	-	-	-	-
C-1	05/14/2004 ^{18,**}	7.50	3.49	4.03	0.03	-	-	-	-	-	-	-
C-1	06/18/2004**	7.50	3.41	4.19	0.13	-	-	-	-	-	-	-
C-1	07/23/2004**	7.50	3.28	4.31	0.11	-	-	-	-	-	-	-
C-1	08/13/2004 ^{18,**}	7.50	3.14	4.40	0.05	-	-	-	-	-	-	-
C-1	09/13/2004**	7.50	4.53	3.04	0.09	-	-	-	-	-	-	-
C-1	10/22/2004**	7.50	3.19	4.33	0.03	-	-	-	-	-	-	-
C-1	11/12/2004 ^{18,**}	7.50	3.22	4.30	0.03	-	-	-	-	-	-	-
C-1	12/02/2004**	7.50	3.28	4.24	0.02	-	-	-	-	-	-	-
C-1	01/28/2005**	7.50	3.19	4.32	0.01	-	-	-	-	-	-	-
C-1	02/11/2005 ^{18,**}	7.50	2.75	4.78	0.04	-	-	-	-	-	-	-
C-1	03/11/2005**	7.50	2.94	4.58	0.03	-	-	-	-	-	-	-
C-1	04/26/2005**	7.50	3.03	4.49	0.02	-	-	-	-	-	-	-
C-1	05/13/2005 ^{18,**}	7.50	3.18	4.34	0.02	-	-	-	-	-	-	-
C-1	06/01/2005**	7.50	3.22	4.30	0.02	-	-	-	-	-	-	-
C-1	07/15/2005**	7.50	3.09	4.43	0.02	-	-	-	-	-	-	-
C-1	08/19/2005 ^{18,**}	7.50	2.88	4.64	0.03	-	-	-	-	-	-	-
C-1	09/23/2005**	7.50	2.95	4.57	0.02	-	-	-	-	-	-	-
C-1	10/14/2005**	7.50	3.01	4.50	0.01	-	-	-	-	-	-	-
C-1	11/18/2005 ^{18,**}	7.50	3.21	4.31	0.02	-	-	-	-	-	-	-
C-1	12/09/2005**	7.50	3.61	3.90	0.01	-	-	-	-	-	-	-
C-1	01/12/2006**	7.50	2.98	4.53	0.01	-	-	-	-	-	-	-
C-1	02/10/2006 ^{15,**}	7.50	2.69	4.82	0.01	-	100,000	11,000	2,500	2,900	15,000	<10
C-1	03/13/2006**	7.50	2.81	4.70	0.01	-	-	-	-	-	-	-
C-1	04/13/2006**	7.50	2.75	4.76	0.01	-	-	-	-	-	-	-

Table 1

**Groundwater Monitoring and Sampling Data
Former Chevron Service Station 91153
3135 Gibbons Drive (3126 Fernside Boulevard)
Alameda, California**

Location	Date	TOC	DTW	GWE	LNAPLT	FIELD PARAMETERS	HYDROCARBONS	PRIMARY VOCS				
						Dissolved Oxygen	TPH-GRO	B	T	E	X	MTBE by SW6260
	Units	ft	ft	ft-amsl	ft	mg/L	µg/L	µg/L	µg/L	µg/L	µg/L	µg/L
C-1	05/12/2006 ^{18,**}	7.50	3.02	4.49	0.01	-	-	-	-	-	-	-
C-1	06/12/2006 ^{**}	7.50	3.10	4.41	0.01	-	-	-	-	-	-	-
C-1	07/13/2006 ^{**}	7.50	3.14	4.38	0.02	-	-	-	-	-	-	-
C-1	08/11/2006 ^{15,**}	7.50	3.70	3.81	0.01	-	200,000	8,600	470	1,700	8,800	<10
C-1	09/11/2006 ^{**}	7.50	3.75	3.77	0.02	-	-	-	-	-	-	-
C-1	10/17/2006 ^{**}	7.50	3.82	3.69	0.01	-	-	-	-	-	-	-
C-1	11/17/2006 ^{18,**}	7.50	3.11	4.41	0.03	-	-	-	-	-	-	-
C-1	12/15/2006 ^{**}	7.50	2.95	4.57	0.02	-	-	-	-	-	-	-
C-1	01/16/2007 ^{**}	7.50	2.98	4.54	0.02	-	-	-	-	-	-	-
C-1	02/16/2007 ¹⁵	7.50	2.77	4.73	0.00	-	25,000	4,300	260	310	3,300	<5
C-1	03/16/2007 ^{**}	7.50	3.07	4.44	0.01	-	-	-	-	-	-	-
C-1	04/17/2007 ^{**}	7.50	2.98	4.53	0.01	-	-	-	-	-	-	-
C-1	05/17/2007 ^{15,**}	7.50	3.05	4.46	0.01	-	110,000 ¹⁶	12,000 ¹⁶	1,000 ¹⁶	2,000 ¹⁶	15,000 ¹⁶	<5
C-1	06/15/2007 ^{**}	7.50	3.08	4.43	0.01	-	-	-	-	-	-	-
C-1	07/17/2007 ^{**}	7.50	3.13	4.38	0.01	-	-	-	-	-	-	-
C-1	08/09/2007 ^{18,**}	7.50	3.24	4.28	0.02	-	-	-	-	-	-	-
C-1	09/14/2007 ^{**}	7.50	3.16	4.35	0.01	-	-	-	-	-	-	-
C-1	10/16/2007 ^{**}	7.50	3.04	4.47	0.01	-	-	-	-	-	-	-
C-1	11/08/2007 ^{15,**}	7.50	3.11	4.40	0.01	-	150,000	13,000	570	1,800	10,000	<13
C-1	12/07/2007 ^{**}	7.50	2.98	4.54	0.03	-	-	-	-	-	-	-
C-1	01/16/2008 ^{**}	7.50	2.95	4.57	0.02	-	-	-	-	-	-	-
C-1	02/06/2008 ^{15,**}	7.50	2.61	4.90	0.01	-	110,000	13,000	500	5,300	21,000	<10
C-1	03/07/2008 ^{**}	7.50	2.87	4.65	0.02	-	-	-	-	-	-	-
C-1	04/16/2008 ^{**}	7.50	3.06	4.46	0.02	-	-	-	-	-	-	-
C-1	05/07/2008 ^{18,**}	7.50	2.98	4.54	0.03	-	-	-	-	-	-	-

Table 1

**Groundwater Monitoring and Sampling Data
Former Chevron Service Station 91153
3135 Gibbons Drive (3126 Fernside Boulevard)
Alameda, California**

Location	Date	TOC	DTW	GWE	LNAPLT	FIELD PARAMETERS	HYDROCARBONS	PRIMARY VOCS				
						Dissolved Oxygen	TPH-GRO	B	T	E	X	MTBE by SW6260
	Units	ft	ft	ft-amsl	ft	mg/L	µg/L	µg/L	µg/L	µg/L	µg/L	µg/L
C-1	06/06/2008**	7.50	3.02	4.50	0.02	-	-	-	-	-	-	-
C-1	07/16/2008**	7.50	3.12	4.40	0.02	-	-	-	-	-	-	-
C-1	09/05/2008**	7.50	3.97	3.75	0.28	-	-	-	-	-	-	-
C-1	09/11/2008 ^{18,**}	7.50	4.22	3.61	0.41	-	-	-	-	-	-	-
C-1	10/17/2008**	7.50	4.16	3.60	0.33	-	-	-	-	-	-	-
C-1	11/10/2008 ^{18,**}	7.50	4.05	3.54	0.11	-	-	-	-	-	-	-
C-1	12/15/2008**	7.50	3.85	3.69	0.05	-	-	-	-	-	-	-
C-1	01/21/2009**	7.50	3.91	3.62	0.04	-	-	-	-	-	-	-
C-1	02/09/2009 ^{15,**}	7.50	3.72	3.79	0.01	-	53,000	3,100	66	660	3,700	<1
C-1	05/28/2009	7.50	3.48	4.02	0.02	-	-	-	-	-	-	-
C-1	08/18/2009	7.50	4.40	3.10	0.02	-	-	-	-	-	-	-
C-1	11/17/2009	7.50	4.21	3.29	0.03	-	-	-	-	-	-	-
C-1	03/31/2010	7.50	2.07	5.46	0.04	-	-	-	-	-	-	-
C-1	05/17/2010	7.50	2.87	4.83	0.25	-	-	-	-	-	-	-
C-1	08/26/2010 ¹⁸	7.50	4.03	3.50	0.04	-	-	-	-	-	-	-
C-1	11/11/2010 ^{18,**}	7.50	3.82	3.70	0.03	-	-	-	-	-	-	-
C-1	03/02/2011 ^{18,**}	7.50	1.12	6.41	0.04	-	-	-	-	-	-	-
C-1	06/17/2011 ^{18,**}	7.50	3.00	4.51	0.01	-	-	-	-	-	-	-
C-1	09/08/2011 ^{18,**}	7.50	3.60	3.92	0.02	-	-	-	-	-	-	-
C-1	12/29/2011 ^{18,**}	7.50	4.14	3.37	0.01	-	-	-	-	-	-	-
C-1	03/28/2012 ^{18,**}	7.50	1.01	6.52	0.04	-	-	-	-	-	-	-
C-1	05/31/2012 ^{18,**}	7.50	2.96	4.56	0.02	-	-	-	-	-	-	-
C-1	09/28/2012	7.50	4.50	3.00	0.00	-	48,000	8,600	81	1,800	3,300	<5
C-1	12/21/2012 ^{18,**}	7.50	2.20	5.32	0.02	-	-	-	-	-	-	-
C-1	03/29/2013 ^{18,**}	7.50	3.20	4.33	0.04	-	-	-	-	-	-	-

Table 1

**Groundwater Monitoring and Sampling Data
Former Chevron Service Station 91153
3135 Gibbons Drive (3126 Fernside Boulevard)
Alameda, California**

Location	Date	TOC	DTW	GWE	LNAPLT	FIELD PARAMETERS	HYDROCARBONS	PRIMARY VOCS				
						Dissolved Oxygen	TPH-GRO	B	T	E	X	MTBE by SW6260
	Units	ft	ft	ft-amsl	ft	mg/L	µg/L	µg/L	µg/L	µg/L	µg/L	µg/L
C-1	06/28/2013 ^{18,**}	7.50	3.90	3.61	0.01	-	-	-	-	-	-	-
C-1	09/20/2013 ^{18,**}	7.50	4.73	2.79	0.02	-	-	-	-	-	-	-
C-1	12/30/2013 ^{18,**}	7.50	4.41	3.10	0.01	-	-	-	-	-	-	-
C-1	03/31/2014 ^{18,**}	7.50	2.55	4.97	0.02	-	-	-	-	-	-	-
C-1	06/30/2014	7.50	3.82	3.68	0.00	-	25,000	6,700	72	710	310	<10
C-1	09/30/2014 ^{18,**}	7.50	5.84	1.68	0.02	-	-	-	-	-	-	-
C-1	12/30/2014	7.50	1.90	5.60	0.00	-	20,000	5,200	48	510	310	<5
C-1	03/20/2015	7.50	2.29	5.22	0.01	-	21,000	6,700	130	850	480	<5
C-1	06/18/2015	7.50	4.32	3.18	0.00	-	24,000	6,000	65	600	1,000	<0.5
C-3	08/18/1986	-	4.00	-	-	-	-	-	-	-	-	-
C-3	09/04/1986	-	-	-	-	-	50	3.2	5.4	5.8	-	-
C-3	07/22/1987	-	-	-	-	-	<50	<0.5	<1.0	<4.0	-	-
C-3	05/03/1989	-	4.15	-	-	-	<50	<0.5	<1.0	<2.0	-	-
C-3	12/04/1989	-	4.24	-	-	-	<250	<0.5	<0.5	<0.5	-	-
C-3	02/14/1990	-	3.57	-	-	-	<50	<0.5	<0.5	<0.5	-	-
C-3	03/07/1990	-	3.31	-	-	-	-	<5.0	<5.0	<5.0	-	-
C-3	09/06/1991	-	4.59	-	-	-	<50	<0.5	<0.5	<0.5	<0.5	-
C-3	12/15/1991	-	4.84	-	-	-	<50	<0.5	<0.5	<0.5	<0.5	-
C-3	03/03/1992	-	2.17	-	-	-	<50	<0.5	<0.5	<0.5	<0.5	-
C-3	06/04/1992	4.41	4.01	0.40	0.00	-	<50	<0.5	<0.5	<0.5	<0.5	-
C-3	10/13/1992	4.41	4.79	-0.38	0.00	-	<50	<0.5	<0.5	<0.5	<0.5	-
C-3	01/11/1993	4.41	2.01	2.40	0.00	-	<50	<0.5	<0.5	<0.5	<0.5	-
C-3	04/14/1993	4.41	2.76	1.65	0.00	-	<50	<0.5	<0.5	<0.5	<0.5	-
C-3	07/13/1993	4.41	3.96	0.45	0.00	-	<50	<0.5	<0.5	<0.5	<1.5	-

Table 1

**Groundwater Monitoring and Sampling Data
Former Chevron Service Station 91153
3135 Gibbons Drive (3126 Fernside Boulevard)
Alameda, California**

Location	Date	TOC	DTW	GWE	LNAPLT	FIELD PARAMETERS	HYDROCARBONS	PRIMARY VOCS				
						Dissolved Oxygen	TPH-GRO	B	T	E	X	MTBE by SW6260
	Units	ft	ft	ft-amsl	ft	mg/L	µg/L	µg/L	µg/L	µg/L	µg/L	µg/L
C-3	10/19/1993	4.41	4.53	-0.12	0.00	-	66	12	1.4	1.0	8.4	-
C-3	11/30/1993	7.83	4.04	3.79	0.00	-	-	-	-	-	-	-
C-3	01/27/1994	7.83	3.17	4.66	0.00	-	<50	<0.5	<0.5	<0.5	<0.5	-
C-3	04/07/1994	7.83	3.20	4.63	0.00	-	<50	<0.5	<0.5	<0.5	<0.5	-
C-3	07/01/1994	7.83	3.99	3.84	0.00	-	<50	<0.5	<0.5	<0.5	<0.5	-
C-3	10/05/1994	7.83	4.54	3.29	0.00	-	<50	<0.5	<0.5	<0.5	<0.5	-
C-3	01/12/1995	7.83	0.80	7.03	0.00	-	<50	<0.5	<0.5	<0.5	<0.5	-
C-3	05/02/1995	7.83	2.15	5.68	0.00	-	<50	<0.5	<0.5	<0.5	<0.5	-
C-3	07/12/1995	7.83	3.42	4.41	0.00	-	<50	<0.5	<0.5	<0.5	<0.5	-
C-3	10/30/1995	7.83	4.46	3.37	0.00	-	<50	<0.5	<0.5	<0.5	<0.5	<2.5
C-3	01/22/1996	7.83	1.73	6.10	0.00	-	<50	<0.5	<0.5	<0.5	<0.5	<2.5
C-3	04/24/1996	7.83	2.62	5.21	0.00	-	<50	<0.5	<0.5	<0.5	<0.5	<2.5
C-3	07/29/1996	7.83	3.94	3.89	0.00	-	<50	<0.5	<0.5	<0.5	<0.5	<2.5
C-3	10/10/1996	7.83	4.06	3.77	0.00	-	<50	<0.5	<0.5	<0.5	<0.5	<2.5
C-3	01/15/1997	7.83	1.54	6.29	0.00	-	<50	<0.5	<0.5	<0.5	<0.5	<2.5
C-3	04/03/1997	7.83	3.23	4.60	0.00	-	<50	<0.5	<0.5	<0.5	<0.5	<2.5
C-3	07/09/1997	7.83	4.36	3.47	0.00	-	<50	<0.5	<0.5	<0.5	<0.5	<2.5
C-3	10/29/1997	7.83	4.65	3.18	0.00	-	<50	<0.5	<0.5	<0.5	<0.5	<2.5
C-3	01/14/1998	7.83	0.77	7.06	0.00	-	<50	<0.5	<0.5	<0.5	<0.5	<2.5
C-3	07/15/1998	7.83	3.72	4.11	0.00	-	<50	<0.5	<0.5	<0.5	<0.5	<2.5
C-3	01/20/1999	7.83	2.65	5.18	0.00	-	<50	<0.5	<0.5	<0.5	<0.5	<2.0
C-3	04/19/1999	7.83	1.78	6.05	0.00	-	-	-	-	-	-	-
C-3	04/03/2000 ¹⁹	7.83	-	-	-	-	-	-	-	-	-	-
C-3	07/03/2000	7.83	-	-	-	-	-	-	-	-	-	-
C-3	10/23/2000	7.83	-	-	-	-	-	-	-	-	-	-

Table 1

**Groundwater Monitoring and Sampling Data
Former Chevron Service Station 91153
3135 Gibbons Drive (3126 Fernside Boulevard)
Alameda, California**

Location	Date	TOC	DTW	GWE	LNAPL	FIELD PARAMETERS	HYDROCARBONS	PRIMARY VOCS				
						Dissolved Oxygen	TPH-GRO	B	T	E	X	MTBE by SW6260
	Units	ft	ft	ft-amsl	ft	mg/L	µg/L	µg/L	µg/L	µg/L	µg/L	µg/L
C-3	01/08/2001 ¹¹	7.83	3.71	4.12	0.00	-	<50	<0.50	<0.50	<0.50	<0.50	<2.5
C-3	04/09/2001	7.83	-	-	-	-	-	-	-	-	-	-
C-3	08/23/2001 ¹⁹	7.83	-	-	-	-	-	-	-	-	-	-
C-3	11/27/2001 ¹⁹	7.83	-	-	-	-	-	-	-	-	-	-
C-3	02/26/2002	7.83	2.38	5.45	0.00	-	<50	<0.50	<0.50	<0.50	<1.5	<2.5
C-3	05/23/2002 ¹⁹	7.83	-	-	-	-	-	-	-	-	-	-
C-3	08/09/2002 ¹⁹	7.83	-	-	-	-	-	-	-	-	-	-
C-3	11/08/2002 ¹⁹	7.83	-	-	-	-	-	-	-	-	-	-
C-3	02/07/2003	7.83	2.73	5.10	0.00	-	<50	<0.50	<0.50	<0.50	<1.5	<2.5
C-3	05/09/2003 ¹⁹	7.83	-	-	-	-	-	-	-	-	-	-
C-3	08/15/2003 ¹⁹	7.83	-	-	-	-	-	-	-	-	-	-
C-3	11/14/2003 ¹⁹	7.83	-	-	-	-	-	-	-	-	-	-
C-3	02/13/2004 ¹⁵	7.83	2.81	5.02	0.00	-	<50	<0.5	<0.5	<0.5	<0.5	<0.5
C-3	05/14/2004 ¹⁹	7.83	-	-	-	-	-	-	-	-	-	-
C-3	11/12/2004 ¹⁹	7.83	-	-	-	-	-	-	-	-	-	-
C-3	02/11/2005 ¹⁵	7.83	2.58	5.25	0.00	-	<50	<0.5	<0.5	<0.5	<0.5	<0.5
C-3	05/13/2005 ¹⁹	7.83	-	-	-	-	-	-	-	-	-	-
C-3	08/19/2005 ¹⁹	7.83	-	-	-	-	-	-	-	-	-	-
C-3	11/18/2005 ¹⁹	7.83	-	-	-	-	-	-	-	-	-	-
C-3	02/10/2006 ¹⁵	7.83	2.52	5.31	0.00	-	<50	<0.5	<0.5	<0.5	<0.5	<0.5
C-3	05/12/2006 ¹⁹	7.83	-	-	-	-	-	-	-	-	-	-
C-3	08/11/2006 ¹⁹	7.83	-	-	-	-	-	-	-	-	-	-
C-3	11/17/2006 ¹⁹	7.83	-	-	-	-	-	-	-	-	-	-
C-3	02/16/2007 ¹⁵	7.83	2.63	5.20	0.00	-	<50	<0.5	<0.5	<0.5	<0.5	<0.5
C-3	05/17/2007 ¹⁹	7.83	-	-	-	-	-	-	-	-	-	-

Table 1

**Groundwater Monitoring and Sampling Data
Former Chevron Service Station 91153
3135 Gibbons Drive (3126 Fernside Boulevard)
Alameda, California**

Location	Date	TOC	DTW	GWE	LNAPL	FIELD PARAMETERS	HYDROCARBONS	PRIMARY VOCS				
						Dissolved Oxygen	TPH-GRO	B	T	E	X	MTBE by SW6260
	Units	ft	ft	ft-amsl	ft	mg/L	µg/L	µg/L	µg/L	µg/L	µg/L	µg/L
C-3	08/09/2007 ¹⁹	7.83	-	-	-	-	-	-	-	-	-	-
C-3	11/08/2007 ¹⁹	7.83	-	-	-	-	-	-	-	-	-	-
C-3	02/06/2008 ¹⁵	7.83	2.91	4.92	0.00	-	<50	<0.5	<0.5	<0.5	<0.5	<0.5
C-3	05/07/2008 ¹⁹	7.83	-	-	-	-	-	-	-	-	-	-
C-3	09/11/2008 ¹⁹	7.83	-	-	-	-	-	-	-	-	-	-
C-3	11/10/2008 ¹⁹	7.83	-	-	-	-	-	-	-	-	-	-
C-3	02/09/2009 ¹⁵	7.83	2.95	4.88	0.00	-	<50	<0.5	<0.5	<0.5	<0.5	<0.5
C-3	03/31/2010	7.83	2.22	5.61	0.00	-	<50	<0.5	<0.5	<0.5	<0.5	<0.5
C-3	05/17/2010	7.83	3.07	4.76	0.00	-	-	-	-	-	-	-
C-3	08/26/2010 ¹⁹	7.83	4.29	3.54	0.00	-	-	-	-	-	-	-
C-3	11/11/2010 ¹⁹	7.83	4.48	3.35	0.00	-	-	-	-	-	-	-
C-3	03/02/2011 ¹⁹	7.83	1.45	6.38	0.00	-	<50	<0.5	<0.5	<0.5	<0.5	<0.5
C-3	06/17/2011 ¹⁹	7.83	3.24	4.59	0.00	-	-	-	-	-	-	-
C-3	09/08/2011 ¹⁹	7.83	4.02	3.81	0.00	-	-	-	-	-	-	-
C-3	12/29/2011 ¹⁹	7.83	4.42	3.41	0.00	-	-	-	-	-	-	-
C-3	03/28/2012	7.83	0.94	6.89	0.00	-	<50	<0.5	<0.5	<0.5	<0.5	<0.5
C-3	05/31/2012 ¹⁹	7.83	3.40	4.43	0.00	-	-	-	-	-	-	-
C-3	09/28/2012 ¹⁹	7.83	4.72	3.11	0.00	-	-	-	-	-	-	-
C-3	12/21/2012 ¹⁹	7.83	2.41	5.42	0.00	-	-	-	-	-	-	-
C-3	03/29/2013	7.83	3.45	4.38	0.00	-	<50	<0.5	<0.5	<0.5	<0.5	<0.5
C-3	06/28/2013	7.83	4.29	3.54	0.00	-	-	-	-	-	-	-
C-3	09/20/2013	7.83	4.81	3.02	0.00	-	-	-	-	-	-	-
C-3	12/30/2013	7.83	4.79	3.04	0.00	-	-	-	-	-	-	-
C-3	03/31/2014	7.83	2.79	5.04	0.00	-	<50	<0.5	<0.5	<0.5	<0.5	<0.5
C-3	06/30/2014	7.83	4.23	3.60	0.00	-	-	-	-	-	-	-

Table 1

**Groundwater Monitoring and Sampling Data
Former Chevron Service Station 91153
3135 Gibbons Drive (3126 Fernside Boulevard)
Alameda, California**

Location	Date	TOC	DTW	GWE	LNAPLT	FIELD PARAMETERS	HYDROCARBONS	PRIMARY VOCS				
						Dissolved Oxygen	TPH-GRO	B	T	E	X	MTBE by SW6260
	Units	ft	ft	ft-amsl	ft	mg/L	µg/L	µg/L	µg/L	µg/L	µg/L	µg/L
C-3	09/30/2014	7.83	5.00	2.83	0.00	-	-	-	-	-	-	-
C-3	12/30/2014	7.83	2.13	5.70	0.00	-	-	-	-	-	-	-
C-3	03/20/2015	7.83	3.36	4.47	0.00	-	<50	<0.5	<0.5	<0.5	<0.5	<0.5
C-3	06/18/2015	7.83	4.38	3.45	0.00	-	-	-	-	-	-	-
MW-4	06/04/1992	3.58	3.63	-0.05	0.00	-	<50	0.8	<0.5	<0.5	<0.5	-
MW-4	10/13/1992	3.58	-	-	-	-	-	-	-	-	-	-
MW-4	01/11/1993	3.58	1.89	1.69	0.00	-	<50	<0.5	<0.5	<0.5	<0.5	-
MW-4	04/14/1993	3.58	2.20	1.38	0.00	-	<50	<0.5	<0.5	<0.5	<1.5	-
MW-4	07/13/1993	3.58	3.51	0.07	0.00	-	54	2.6	1.6	<0.5	<1.5	-
MW-4	10/19/1993	3.58	4.22	-0.64	0.00	-	<50	<0.5	<0.5	<0.5	<0.5	-
MW-4	11/30/1993	7.01	4.01	3.00	0.00	-	-	-	-	-	-	-
MW-4	01/27/1994	7.01	2.89	4.12	0.00	-	<50	<0.5	<0.5	<0.5	<0.5	-
MW-4	04/07/1994	7.01	3.06	3.95	0.00	-	<50	<0.5	<0.5	<0.5	<0.5	-
MW-4	07/01/1994	7.01	3.59	3.42	0.00	-	<50	<0.5	<0.5	<0.5	<0.5	-
MW-4	10/05/1994	7.01	4.33	2.68	0.00	-	<50	<0.5	<0.5	<0.5	<0.5	-
MW-4	01/12/1995	7.01	1.20	5.81	0.00	-	<50	<0.5	<0.5	<0.5	<0.5	-
MW-4	04/26/1995	7.01	1.15	5.86	0.00	-	<50	<0.5	<0.5	<0.5	<0.5	-
MW-4	07/12/1995	7.01	2.72	4.29	0.00	-	<50	6.4	<0.5	0.63	0.72	-
MW-4	10/30/1995	7.01	4.08	2.93	0.00	-	<50	<0.5	<0.5	<0.5	<0.5	<2.5
MW-4	01/22/1996	7.01	1.76	5.25	0.00	-	<50	<0.5	<0.5	<0.5	<0.5	<2.5
MW-4	04/24/1996	7.01	1.95	5.06	0.00	-	<50	<0.5	<0.5	<0.5	<0.5	<2.5
MW-4	07/29/1996	7.01	3.37	3.64	0.00	-	<50	<0.5	<0.5	<0.5	<0.5	<2.5
MW-4	10/10/1996	7.01	3.96	3.05	0.00	-	<50	<0.5	<0.5	<0.5	<0.5	<2.5
MW-4	01/15/1997	7.01	1.27	5.74	0.00	-	<50	<0.5	<0.5	<0.5	<0.5	<2.5

Table 1

**Groundwater Monitoring and Sampling Data
Former Chevron Service Station 91153
3135 Gibbons Drive (3126 Fernside Boulevard)
Alameda, California**

Location	Date	TOC	DTW	GWE	LNAPLT	FIELD PARAMETERS	HYDROCARBONS	PRIMARY VOCS				
						Dissolved Oxygen	TPH-GRO	B	T	E	X	MTBE by SW6260
	Units	ft	ft	ft-amsl	ft	mg/L	µg/L	µg/L	µg/L	µg/L	µg/L	µg/L
MW-4	04/03/1997	7.01	2.11	4.90	0.00	-	<50	<0.5	<0.5	<0.5	<0.5	<2.5
MW-4	07/09/1997	7.01	4.04	2.97	0.00	-	<50	<0.5	<0.5	<0.5	<0.5	<2.5
MW-4	10/29/1997	7.01	4.56	2.45	0.00	-	<50	<0.5	<0.5	<0.5	<0.5	<2.5
MW-4	01/14/1998	7.01	0.39	6.62	0.00	-	<50	<0.5	<0.5	<0.5	<0.5	<2.5
MW-4	01/20/1999	7.01	2.83	4.18	0.00	-	<50	<0.5	<0.5	<0.5	<0.5	<2.0
MW-4	04/19/1999	7.01	2.91	4.10	0.00	-	-	-	-	-	-	-
MW-4	01/25/2000	7.01	1.92	5.09	0.00	-	<50	<0.5	<0.5	<0.5	<0.5	<2.5
MW-4	04/03/2000 ¹⁹	7.01	-	-	-	-	-	-	-	-	-	-
MW-4	07/03/2000	7.01	-	-	-	-	-	-	-	-	-	-
MW-4	10/23/2000	7.01	-	-	-	-	-	-	-	-	-	-
MW-4	01/08/2001 ¹¹	7.01	3.02	3.99	0.00	-	87 ¹²	<0.50	<0.50	0.55	2.9	<2.5
MW-4	04/09/2001	7.01	-	-	-	-	-	-	-	-	-	-
MW-4	08/23/2001 ¹⁹	7.01	-	-	-	-	-	-	-	-	-	-
MW-4	11/27/2001 ¹⁹	7.01	-	-	-	-	-	-	-	-	-	-
MW-4	02/26/2002	7.01	1.37	5.64	0.00	-	<50	<0.50	<0.50	<0.50	<1.5	<2.5
MW-4	05/23/2002 ¹⁹	7.01	-	-	-	-	-	-	-	-	-	-
MW-4	08/09/2002 ¹⁹	7.01	-	-	-	-	-	-	-	-	-	-
MW-4	11/08/2002 ¹⁹	7.01	-	-	-	-	-	-	-	-	-	-
MW-4	02/07/2003	7.01	1.72	5.29	0.00	-	<50	<0.50	<0.50	<0.50	<1.5	<2.5
MW-4	05/09/2003 ¹⁹	7.01	-	-	-	-	-	-	-	-	-	-
MW-4	08/15/2003 ¹⁹	7.01	-	-	-	-	-	-	-	-	-	-
MW-4	11/14/2003 ¹⁹	7.01	-	-	-	-	-	-	-	-	-	-
MW-4	02/13/2004 ¹⁵	7.01	1.82	5.19	0.00	-	<50	<0.5	<0.5	<0.5	<0.5	<0.5
MW-4	05/14/2004 ¹⁹	7.01	-	-	-	-	-	-	-	-	-	-
MW-4	11/12/2004 ¹⁹	7.01	-	-	-	-	-	-	-	-	-	-

Table 1

**Groundwater Monitoring and Sampling Data
Former Chevron Service Station 91153
3135 Gibbons Drive (3126 Fernside Boulevard)
Alameda, California**

Location	Date	TOC	DTW	GWE	LNAPLT	FIELD PARAMETERS	HYDROCARBONS	PRIMARY VOCS				
						Dissolved Oxygen	TPH-GRO	B	T	E	X	MTBE by SW6260
	Units	ft	ft	ft-amsl	ft	mg/L	µg/L	µg/L	µg/L	µg/L	µg/L	µg/L
MW-4	02/11/2005 ¹⁵	7.01	1.46	5.55	0.00	-	<50	<0.5	<0.5	<0.5	<0.5	<0.5
MW-4	05/13/2005 ¹⁹	7.01	-	-	-	-	-	-	-	-	-	-
MW-4	08/19/2005 ¹⁹	7.01	-	-	-	-	-	-	-	-	-	-
MW-4	11/18/2005 ¹⁹	7.01	-	-	-	-	-	-	-	-	-	-
MW-4	02/10/2006 ¹⁵	7.01	1.35	5.66	0.00	-	<50	<0.5	<0.5	<0.5	<0.5	<0.5
MW-4	05/12/2006 ¹⁹	7.01	-	-	-	-	-	-	-	-	-	-
MW-4	08/11/2006 ¹⁹	7.01	-	-	-	-	-	-	-	-	-	-
MW-4	11/17/2006 ¹⁹	7.01	-	-	-	-	-	-	-	-	-	-
MW-4	02/16/2007 ¹⁵	7.01	1.48	5.53	0.00	-	<50	<0.5	<0.5	<0.5	<0.5	<0.5
MW-4	05/17/2007 ¹⁹	7.01	-	-	-	-	-	-	-	-	-	-
MW-4	08/09/2007 ¹⁹	7.01	-	-	-	-	-	-	-	-	-	-
MW-4	11/08/2007 ¹⁹	7.01	-	-	-	-	-	-	-	-	-	-
MW-4	02/06/2008 ¹⁵	7.01	1.27	5.74	0.00	-	<50	<0.5	<0.5	<0.5	<0.5	<0.5
MW-4	05/07/2008 ¹⁹	7.01	-	-	-	-	-	-	-	-	-	-
MW-4	09/11/2008 ¹⁹	7.01	-	-	-	-	-	-	-	-	-	-
MW-4	11/10/2008 ¹⁹	7.01	-	-	-	-	-	-	-	-	-	-
MW-4	02/09/2009 ¹⁵	7.01	2.33	4.68	0.00	-	<50	<0.5	<0.5	<0.5	<0.5	<0.5
MW-4	03/31/2010	7.01	2.13	4.88	0.00	-	<50	<0.5	<0.5	<0.5	<0.5	<0.5
MW-4	05/17/2010	7.01	2.05	4.96	0.00	-	-	-	-	-	-	-
MW-4	08/26/2010 ¹⁹	7.01	3.70	3.31	0.00	-	-	-	-	-	-	-
MW-4	11/11/2010 ¹⁹	7.01	3.98	3.03	0.00	-	-	-	-	-	-	-
MW-4	03/02/2011 ¹⁹	7.01	0.75	6.26	0.00	-	<50	<0.5	<0.5	<0.5	<0.5	<0.5
MW-4	06/17/2011 ¹⁹	7.01	2.36	4.65	0.00	-	-	-	-	-	-	-
MW-4	09/08/2011 ¹⁹	7.01	3.36	3.65	0.00	-	-	-	-	-	-	-
MW-4	12/29/2011 ¹⁹	7.01	3.65	3.36	0.00	-	-	-	-	-	-	-

Table 1

**Groundwater Monitoring and Sampling Data
Former Chevron Service Station 91153
3135 Gibbons Drive (3126 Fernside Boulevard)
Alameda, California**

Location	Date	TOC	DTW	GWE	LNAPLT	FIELD PARAMETERS	HYDROCARBONS	PRIMARY VOCS				
						Dissolved Oxygen	TPH-GRO	B	T	E	X	MTBE by SW6260
	Units	ft	ft	ft-amsl	ft	mg/L	µg/L	µg/L	µg/L	µg/L	µg/L	µg/L
MW-4	03/28/2012	7.01	1.20	5.81	0.00	-	<50	<0.5	<0.5	<0.5	<0.5	<0.5
MW-4	05/31/2012 ¹⁹	7.01	1.62	5.39	0.00	-	-	-	-	-	-	-
MW-4	09/28/2012 ¹⁹	7.01	3.70	3.31	0.00	-	-	-	-	-	-	-
MW-4	12/21/2012 ¹⁹	7.01	1.31	5.70	0.00	-	-	-	-	-	-	-
MW-4	03/29/2013	7.01	2.35	4.66	0.00	-	<50	<0.5	<0.5	<0.5	<0.5	<0.5
MW-4	06/28/2013	7.01	3.46	3.55	0.00	-	-	-	-	-	-	-
MW-4	09/20/2013	7.01	4.29	2.72	0.00	-	<50	<0.5	<0.5	<0.5	<0.5	<0.5
MW-4	12/30/2013	7.01	4.00	3.01	0.00	-	-	-	-	-	-	-
MW-4	03/31/2014	7.01	3.11	3.90	0.00	-	<50	<0.5	<0.5	<0.5	<0.5	<0.5
MW-4	06/30/2014	7.01	3.67	3.34	0.00	-	-	-	-	-	-	-
MW-4	09/30/2014	7.01	4.41	2.60	0.00	-	-	-	-	-	-	-
MW-4	12/30/2014	7.01	2.44	4.57	0.00	-	-	-	-	-	-	-
MW-4	03/20/2015	7.01	2.14	4.87	0.00	-	<50	<0.5	<0.5	<0.5	<0.5	<0.5
MW-4	06/18/2015	7.01	3.63	3.38	0.00	-	-	-	-	-	-	-
MW-5	06/04/1992	3.61	3.25	0.36	0.00	-	560	110	0.5	37	2.2	-
MW-5	10/13/1992	3.61	4.20	-0.59	0.00	-	1,200	150	<2.5	84	8.6	-
MW-5	01/11/1993	3.61	1.30	2.31	0.00	-	1,300	48	1.0	83	33	-
MW-5	04/14/1993	3.61	1.20	2.41	0.00	-	2,600	240	6.1	250	170	-
MW-5	07/13/1993	3.61	3.15	0.46	0.00	-	1,700	260	7.8	160	100	-
MW-5	10/19/1993	3.61	3.82	-0.21	0.00	-	1,900	190	3.3	200	93	-
MW-5	11/30/1993	7.04	3.56	3.48	0.00	-	-	-	-	-	-	-
MW-5	01/27/1994	7.04	2.42	4.62	0.00	-	4,000	100	12	210	110	-
MW-5	04/07/1994	7.04	2.33	4.71	0.00	-	2,600	170	10	150	88	-
MW-5	07/01/1994	7.04	3.18	3.86	0.00	-	2,300	350	9.1	110	76	-

Table 1

**Groundwater Monitoring and Sampling Data
Former Chevron Service Station 91153
3135 Gibbons Drive (3126 Fernside Boulevard)
Alameda, California**

Location	Date	TOC	DTW	GWE	LNAPLT	FIELD PARAMETERS	HYDROCARBONS	PRIMARY VOCS				
						Dissolved Oxygen	TPH-GRO	B	T	E	X	MTBE by SW6260
	Units	ft	ft	ft-amsl	ft	mg/L	µg/L	µg/L	µg/L	µg/L	µg/L	µg/L
MW-5	10/05/1994	7.04	3.98	3.06	0.00	-	11,000	840	150	130	340	-
MW-5	01/12/1995	7.04	0.40	6.64	0.00	-	2,300	82	<2.5	54	20	-
MW-5	04/26/1995	7.04	0.50	6.54	0.00	-	1,600	52	<5.0	36	61	-
MW-5	07/12/1995	7.04	2.41	4.63	0.00	-	2,800	150	<5.0	34	38	-
MW-5	10/30/1995	7.04	3.78	3.26	0.00	-	1,100	81	<5.0	<5.0	<5.0	35
MW-5	01/22/1996	7.04	0.78	6.26	0.00	-	880	7.3	<2.0	15	4.8	<10
MW-5	04/24/1996	7.04	1.65	5.39	0.00	-	1,600	51	3.8	14	5.6	56
MW-5	07/29/1996 ²¹	7.04	-	-	-	-	-	-	-	-	-	-
MW-5	10/10/1996	7.04	3.60	3.44	0.00	-	1,000	18	<1.2	1.5	<1.2	<6.2
MW-5	01/15/1997	7.04	0.45	6.59	0.00	-	520	0.84	<0.5	3.1	1.2	8.4
MW-5	04/03/1997	7.04	2.11	4.93	0.00	-	1,400	13	<2.0	4.3	8.4	32
MW-5	07/09/1997	7.04	3.71	3.33	0.00	-	810	3.6	0.97	<0.5	<0.5	9.7
MW-5	10/29/1997	7.04	4.20	2.84	0.00	-	<50	<0.5	<0.5	<0.5	<0.5	<2.5
MW-5	01/14/1998	7.04	0.00	7.04	0.00	-	430	5.8	2.4	<0.5	1.6	17
MW-5	04/17/1998 ²⁰	7.04	0.71	6.33	0.00	-	-	-	-	-	-	-
MW-5	07/15/1998	7.04	0.00	7.04	0.00	-	990	11	3.9	0.56	2.2	61
MW-5	10/27/1998	7.04	4.23	2.81	0.00	-	-	-	-	-	-	-
MW-5	01/20/1999	7.04	2.58	4.46	0.00	-	168	<0.5	<0.5	<0.5	0.692	<2.0
MW-5	04/19/1999	7.04	2.07	4.97	0.00	-	-	-	-	-	-	-
MW-5	07/29/1999	7.04	3.43	3.61	0.00	-	246	1.54	<0.5	<0.5	<0.5	<2.0 ² / ² <5.0
MW-5	10/13/1999 ²¹	7.04	-	-	-	-	-	-	-	-	-	-
MW-5	01/25/2000	7.04	1.51	5.53	0.00	-	169	1.94	<0.5	<0.5	<0.5	201
MW-5	04/03/2000	7.04	1.20	5.84	0.00	-	-	-	-	-	-	-
MW-5	07/03/2000	7.04	2.98	4.06	0.00	-	320 ^{6,10}	5.3	1.1	<0.50	<0.50	5.0
MW-5	10/23/2000	7.04	4.18	2.86	0.00	-	-	-	-	-	-	-

Table 1

**Groundwater Monitoring and Sampling Data
Former Chevron Service Station 91153
3135 Gibbons Drive (3126 Fernside Boulevard)
Alameda, California**

Location	Date	TOC	DTW	GWE	LNAPLT	FIELD PARAMETERS	HYDROCARBONS	PRIMARY VOCS				
						Dissolved Oxygen	TPH-GRO	B	T	E	X	MTBE by SW6260
	Units	ft	ft	ft-amsl	ft	mg/L	µg/L	µg/L	µg/L	µg/L	µg/L	µg/L
MW-5	01/08/2001 ¹¹	7.04	2.92	4.12	0.00	-	220 ⁶	3.9	<0.50	<0.50	<0.50	7.7
MW-5	04/09/2001	7.04	1.01	6.03	0.00	-	-	-	-	-	-	-
MW-5	08/23/2001	7.04	3.48	3.56	0.00	-	630	40	3.5	<2.5	<2.5	43
MW-5	11/27/2001 ²⁰	7.04	3.05	3.99	0.00	-	-	-	-	-	-	-
MW-5	02/26/2002	7.04	1.00	6.04	0.00	-	410	4.3	<0.50	<0.50	<1.5	<2.5
MW-5	05/23/2002 ²⁰	7.04	2.21	4.83	0.00	-	-	-	-	-	-	-
MW-5	08/09/2002	7.04	3.38	3.66	0.00	-	240	1.3	<0.50	<0.50	<1.5	<2.5
MW-5	11/08/2002 ²⁰	7.04	4.56	2.48	0.00	-	-	-	-	-	-	-
MW-5	02/07/2003	7.04	1.42	5.62	0.00	-	380	3.2	<0.50	0.64	<1.5	<2.5
MW-5	05/09/2003 ²⁰	7.04	1.25	5.79	0.00	-	-	-	-	-	-	-
MW-5	08/15/2003 ¹⁵	7.04	3.61	3.43	0.00	-	<50	<0.5	<0.5	<0.5	<0.5	<0.5
MW-5	11/14/2003 ²⁰	7.04	3.57	3.47	0.00	-	-	-	-	-	-	-
MW-5	02/13/2004 ¹⁵	7.04	1.50	5.54	0.00	-	<50	<0.5	<0.5	<0.5	<0.5	<0.5
MW-5	05/14/2004 ²⁰	7.04	2.47	4.57	0.00	-	-	-	-	-	-	-
MW-5	08/13/2004 ¹⁵	7.04	5.46	1.58	0.00	-	<50	<0.5	<0.5	<0.5	<0.5	<0.5
MW-5	11/12/2004 ²⁰	7.04	4.65	2.39	0.00	-	-	-	-	-	-	-
MW-5	02/11/2005 ¹⁵	7.04	1.20	5.84	0.00	-	130	<0.5	<0.5	<0.5	<0.5	<0.5
MW-5	05/13/2005 ²⁰	7.04	4.36	2.68	0.00	-	-	-	-	-	-	-
MW-5	08/19/2005 ¹⁵	7.04	2.78	4.26	0.00	-	96	<0.5	<0.5	<0.5	<0.5	<0.5
MW-5	11/18/2005 ²⁰	7.04	4.51	2.53	0.00	-	-	-	-	-	-	-
MW-5	02/10/2006 ¹⁵	7.04	1.12	5.92	0.00	-	<50	<0.5	<0.5	<0.5	<0.5	<0.5
MW-5	05/12/2006 ²⁰	7.04	2.23	4.81	0.00	-	-	-	-	-	-	-
MW-5	08/11/2006 ¹⁵	7.04	3.40	3.64	0.00	-	<50	<0.5	<0.5	<0.5	<0.5	<0.5
MW-5	11/17/2006 ²⁰	7.04	4.16	2.88	0.00	-	-	-	-	-	-	-
MW-5	02/16/2007 ¹⁵	7.04	1.22	5.82	0.00	-	<50	<0.5	<0.7	<0.8	<0.8	<0.5

Table 1

**Groundwater Monitoring and Sampling Data
Former Chevron Service Station 91153
3135 Gibbons Drive (3126 Fernside Boulevard)
Alameda, California**

Location	Date	TOC	DTW	GWE	LNAPLT	FIELD PARAMETERS	HYDROCARBONS	PRIMARY VOCS				
						Dissolved Oxygen	TPH-GRO	B	T	E	X	MTBE by SW6260
	Units	ft	ft	ft-amsl	ft	mg/L	µg/L	µg/L	µg/L	µg/L	µg/L	µg/L
MW-5	05/17/2007 ²⁰	7.04	4.06	2.98	0.00	-	-	-	-	-	-	-
MW-5	08/09/2007 ¹⁵	7.04	3.61	3.43	0.00	-	<50	<0.5	<0.5	<0.5	<0.5	<0.5
MW-5	11/08/2007 ²⁰	7.04	3.70	3.34	0.00	-	-	-	-	-	-	-
MW-5	02/06/2008 ¹⁵	7.04	1.06	5.98	0.00	-	<50	<0.5	<0.5	<0.5	<0.5	<0.5
MW-5	05/07/2008 ²⁰	7.04	3.57	3.47	0.00	-	-	-	-	-	-	-
MW-5	09/11/2008 ¹⁵	7.04	4.58	2.46	0.00	-	<50	<0.5	<0.5	<0.5	<0.5	<0.5
MW-5	11/10/2008 ²⁰	7.04	4.26	2.78	0.00	-	-	-	-	-	-	-
MW-5	02/09/2009 ¹⁵	7.04	2.15	4.89	0.00	-	<50	<0.5	<0.5	<0.5	<0.5	<0.5
MW-5	05/28/2009	7.04	2.76	4.28	0.00	-	-	-	-	-	-	-
MW-5	08/18/2009 ¹⁵	7.04	3.81	3.23	0.00	-	<50	<0.5	<0.5	<0.5	<0.5	<0.5
MW-5	11/17/2009	7.04	4.02	3.02	0.00	-	-	-	-	-	-	-
MW-5	03/31/2010	7.04	1.86	5.18	0.00	-	<50	<0.5	<0.5	<0.5	<0.5	<0.5
MW-5	05/17/2010	7.04	1.57	5.47	0.00	-	-	-	-	-	-	-
MW-5	08/26/2010	7.04	3.25	3.79	0.00	-	<50	<0.5	<0.5	<0.5	<0.5	<0.5
MW-5	11/11/2010 ²⁰	7.04	3.52	3.52	0.00	-	-	-	-	-	-	-
MW-5	03/02/2011 ²⁰	7.04	1.55	5.49	0.00	-	<50	<0.5	<0.5	<0.5	<0.5	<0.5
MW-5	06/17/2011 ²⁰	7.04	1.84	5.20	0.00	-	-	-	-	-	-	-
MW-5	09/08/2011 ²⁰	7.04	2.50	4.54	0.00	-	<50	<0.5	<0.5	<0.5	<0.5	<0.5
MW-5	12/29/2011 ²⁰	7.04	3.40	3.64	0.00	-	-	-	-	-	-	-
MW-5	03/28/2012	7.04	1.72	5.32	0.00	-	<50	<0.5	<0.5	<0.5	<0.5	<0.5
MW-5	05/31/2012 ²⁰	7.04	0.20	6.84	0.00	-	-	-	-	-	-	-
MW-5	09/28/2012	7.04	3.90	3.14	0.00	-	<50	<0.5	<0.5	<0.5	<0.5	<0.5
MW-5	12/21/2012 ²⁰	7.04	1.59	5.45	0.00	-	-	-	-	-	-	-
MW-5	03/29/2013	7.04	2.00	5.04	0.00	-	<50	<0.5	<0.5	<0.5	<0.5	<0.5
MW-5	06/28/2013	7.04	3.35	3.69	0.00	-	-	-	-	-	-	-

Table 1

**Groundwater Monitoring and Sampling Data
Former Chevron Service Station 91153
3135 Gibbons Drive (3126 Fernside Boulevard)
Alameda, California**

Location	Date	TOC	DTW	GWE	LNAPLT	FIELD PARAMETERS	HYDROCARBONS	PRIMARY VOCS				
						Dissolved Oxygen	TPH-GRO	B	T	E	X	MTBE by SW8260
	Units	ft	ft	ft-amsl	ft	mg/L	µg/L	µg/L	µg/L	µg/L	µg/L	µg/L
MW-5	09/20/2013	7.04	4.04	3.00	0.00	-	<50	<0.5	<0.5	<0.5	<0.5	<0.5
MW-5	12/30/2013	7.04	3.80	3.24	0.00	-	-	-	-	-	-	-
MW-5	03/31/2014	7.04	1.90	5.14	0.00	-	<50	<0.5	<0.5	<0.5	<0.5	<0.5
MW-5	06/30/2014	7.04	3.41	3.63	0.00	-	-	-	-	-	-	-
MW-5	09/30/2014	7.04	4.34	2.70	0.00	-	<50	<0.5	<0.5	<0.5	<0.5	<0.5
MW-5	12/30/2014	7.04	2.15	4.89	0.00	-	-	-	-	-	-	-
MW-5	03/20/2015	7.04	1.78	5.26	0.00	-	<50	<0.5	<0.5	<0.5	<0.5	<0.5
MW-5	06/18/2015	7.04	3.48	3.56	0.00	-	-	-	-	-	-	-
MW-6	06/04/1992	3.85	3.89	-0.04	0.00	-	210	54	<0.5	1.9	2.4	-
MW-6	10/13/1992	3.85	4.56	-0.71	0.00	-	10,000	5,300	<10	70	<10	-
MW-6	01/11/1993	3.85	2.36	1.49	0.00	-	100	50	<0.5	<0.5	<0.5	-
MW-6	04/14/1993	3.85	3.15	0.70	0.00	-	<50	<0.5	<0.5	<0.5	<0.5	-
MW-6	07/13/1993	3.85	3.94	-0.09	0.00	-	<50	1.8	<0.5	<0.5	<1.5	-
MW-6	10/19/1993	3.85	4.40	-0.55	0.00	-	320	150	<0.5	0.8	<0.5	-
MW-6	11/30/1993	7.27	4.16	3.11	0.00	-	-	-	-	-	-	-
MW-6	01/27/1994	7.27	3.33	3.94	0.00	-	120	45	<0.5	<0.5	<0.5	-
MW-6	04/07/1994	7.27	3.43	3.84	0.00	-	<50	<0.5	<0.5	<0.5	<0.5	-
MW-6	07/01/1994	7.27	3.94	3.33	0.00	-	<50	<0.5	<0.5	<0.5	<0.5	-
MW-6	10/05/1994	7.27	4.38	2.89	0.00	-	8,300	2,400	160	42	190	-
MW-6	01/12/1995 ¹	7.27	2.43	4.84	0.00	-	<50	12	<0.5	<0.5	<0.5	-
MW-6	04/26/1995	7.27	2.06	5.21	0.00	-	<50	5.5	0.67	<0.5	1.3	-
MW-6	07/12/1995	7.27	3.53	3.74	0.00	-	65	27	<0.5	<0.5	<0.5	-
MW-6	10/30/1995	7.27	4.34	2.93	0.00	-	<50	3.9	<0.5	<0.5	<0.5	<2.5
MW-6	01/22/1996	7.27	2.61	4.66	0.00	-	<50	0.93	<0.5	<0.5	<0.5	<2.5

Table 1

**Groundwater Monitoring and Sampling Data
Former Chevron Service Station 91153
3135 Gibbons Drive (3126 Fernside Boulevard)
Alameda, California**

Location	Date	TOC	DTW	GWE	LNAPLT	FIELD PARAMETERS	HYDROCARBONS	PRIMARY VOCS				
						Dissolved Oxygen	TPH-GRO	B	T	E	X	MTBE by SW6260
	Units	ft	ft	ft-amsl	ft	mg/L	µg/L	µg/L	µg/L	µg/L	µg/L	µg/L
MW-6	04/24/1996	7.27	2.50	4.77	0.00	-	260	110	<1.2	<1.2	<1.2	<6.2
MW-6	07/29/1996	7.27	3.85	3.42	0.00	-	<50	23	<0.5	<0.5	<0.5	<2.5
MW-6	10/10/1996	7.27	4.37	2.90	0.00	-	79	31	<0.5	<0.5	<0.5	<2.5
MW-6	01/15/1997	7.27	2.63	4.64	0.00	-	<50	<0.5	<0.5	<0.5	<0.5	<2.5
MW-6	04/03/1997	7.27	3.42	3.85	0.00	-	670	360	<5.0	<5.0	<5.0	<25
MW-6	07/09/1997	7.27	4.29	2.98	0.00	-	330	140	<2.0	<2.0	<2.0	<10
MW-6	10/29/1997	7.27	4.56	2.71	0.00	-	400	260	<2.0	<2.0	<2.0	5.8
MW-6	01/14/1998	7.27	1.01	6.26	0.00	-	<50	<0.5	<0.5	<0.5	<0.5	<2.5
MW-6	04/17/1998	7.27	2.94	4.33	0.00	-	<50	1.7	<0.5	<0.5	<0.5	<2.5
MW-6	07/15/1998	7.27	4.72	2.55	0.00	-	<50	<0.5	<0.5	<0.5	<0.5	<2.5
MW-6	10/27/1998 ²¹	7.27	-	-	-	-	-	-	-	-	-	-
MW-6	11/25/1998	7.27	4.16	3.11	0.00	-	110 ³	54	<0.5	<0.5	<0.5	<2.5
MW-6	01/20/1999	7.27	3.45	3.82	0.00	-	<50	10	<0.5	<0.5	<0.5	<2.0
MW-6	04/19/1999	7.27	3.39	3.88	0.00	-	<50	2.6	<0.5	<0.5	<0.5	<2.0/<2.5 ²
MW-6	07/29/1999 ⁴	7.27	4.34	2.93	0.00	-	<5,000	2,590	<50	<50	<50	<500
MW-6	10/13/1999	7.27	5.89	1.38	0.00	-	9,270	4,610	44.2	<25	<25	<125
MW-6	01/25/2000	7.27	4.11	3.16	0.00	-	529	289	<0.5	<0.5	<0.5	738
MW-6	04/03/2000 ^{7,8}	7.27	2.84	4.43	0.00	-	<50	<0.50	<0.50	<0.50	<0.50	<2.5
MW-6	07/03/2000 ⁷	7.27	3.77	3.50	0.00	-	91 ⁶	89	0.77	<0.50	<0.50	<2.5
MW-6	10/12/2000	7.27	6.32	0.95	0.00	-	<50	8.0	<0.50	<0.50	<0.50	<2.5
MW-6	01/08/2001 ^{7,11}	7.27	3.74	3.53	0.00	-	400 ⁶	640	8.2	8.0	5.0	10
MW-6	04/09/2001 ⁷	7.27	3.03	4.24	0.00	-	91.3	22.0	3.36	0.751	2.14	<0.500
MW-6	08/23/2001 ⁷	7.27	4.70	2.57	0.00	-	53 ¹³	23	0.50	<0.50	1.1	<2.5
MW-6	11/27/2001 ¹⁴	7.27	4.43	2.84	0.00	-	<50	4.1	<0.50	<0.50	<1.5	<2.5
MW-6	02/26/2002 ¹⁴	7.27	2.50	4.77	0.00	-	100	53	<0.50	<0.50	<1.5	<2.5

Table 1

**Groundwater Monitoring and Sampling Data
Former Chevron Service Station 91153
3135 Gibbons Drive (3126 Fernside Boulevard)
Alameda, California**

Location	Date	TOC	DTW	GWE	LNAPLT	FIELD PARAMETERS	HYDROCARBONS	PRIMARY VOCS				
						Dissolved Oxygen	TPH-GRO	B	T	E	X	MTBE by SW6260
	Units	ft	ft	ft-amsl	ft	mg/L	µg/L	µg/L	µg/L	µg/L	µg/L	µg/L
MW-6	05/23/2002	7.27	3.27	4.00	0.00	-	610	260	4.2	1.7	2.1	<2.5
MW-6	08/09/2002	7.27	4.11	3.16	0.00	-	<50	1.1	<0.50	<0.50	<1.5	<2.5
MW-6	11/08/2002	7.27	4.12	3.15	0.00	2.10	<50	<0.50	<0.50	<0.50	<1.5	<2.5
MW-6	02/07/2003	7.27	2.60	4.67	0.00	2.60	<50	0.65	<0.50	<0.50	<1.5	<2.5
MW-6	05/09/2003	7.27	2.57	4.70	0.00	3.10	<50	1.9	<0.5	<0.5	<1.5	<2.5
MW-6	08/15/2003 ¹⁵	7.27	4.15	3.12	0.00	2.90	<50	<0.5	<0.5	<0.5	<0.5	<0.5
MW-6	11/14/2003 ¹⁵	7.27	4.10	3.17	0.00	3.41	<50	<0.5	0.6	<0.5	<0.5	1
MW-6	02/13/2004 ¹⁵	7.27	2.66	4.61	0.00	-	<50	<0.5	<0.5	<0.5	<0.5	<0.5
MW-6	05/14/2004 ¹⁵	7.27	3.55	3.72	0.00	-	<50	3	<0.5	<0.5	<0.5	<0.5
MW-6	08/13/2004 ¹⁵	7.27	4.32	2.95	0.00	-	<50	<0.5	<0.5	<0.5	<0.5	<0.5
MW-6	11/12/2004 ¹⁵	7.27	4.20	3.07	0.00	-	<50	<0.5	<0.5	<0.5	<0.5	<0.5
MW-6	02/11/2005 ¹⁵	7.27	2.18	5.09	0.00	-	<50	<0.5	<0.5	<0.5	<0.5	<0.5
MW-6	05/13/2005 ¹⁵	7.27	4.11	3.16	0.00	-	<50	<0.5	<0.5	<0.5	<0.5	<0.5
MW-6	08/19/2005 ¹⁵	7.27	3.70	3.57	0.00	1.90	<50	<0.5	<0.5	<0.5	<0.5	<0.5
MW-6	11/18/2005 ¹⁵	7.27	3.98	3.29	0.00	1.70	<50	<0.5	<0.5	<0.5	<0.5	<0.5
MW-6	02/10/2006 ¹⁵	7.27	2.11	5.16	0.00	2.20	<50	<0.5	<0.5	<0.5	<0.5	<0.5
MW-6	05/12/2006 ¹⁵	7.27	3.18	4.09	0.00	2.80	<50	<0.5	<0.5	<0.5	<0.5	<0.5
MW-6	08/11/2006 ¹⁵	7.27	3.80	3.47	0.00	2.50	<50	<0.5	<0.5	<0.5	<0.5	<0.5
MW-6	11/17/2006 ¹⁵	7.27	3.78	3.49	0.00	2.20	<50	<0.5	<0.5	<0.5	<0.5	<0.5
MW-6	02/16/2007 ¹⁵	7.27	2.08	5.19	0.00	1.80	<50	1	<0.5	<0.5	<0.5	<0.5
MW-6	05/17/2007 ¹⁵	7.27	3.61	3.66	0.00	2.0	<50	<0.5	<0.5	<0.5	<0.5	<0.5
MW-6	08/09/2007 ¹⁵	7.27	4.05	3.22	0.00	2.6	<50	<0.5	<0.5	<0.5	<0.5	<0.5
MW-6	11/08/2007 ¹⁵	7.27	4.12	3.15	0.00	2.2	<50	5	<0.5	<0.5	<0.5	<0.5
MW-6	02/06/2008 ¹⁵	7.27	1.85	5.42	0.00	2.4	<50	<0.5	<0.5	<0.5	<0.5	<0.5
MW-6	05/07/2008 ¹⁵	7.27	3.91	3.36	0.00	2.3	63	18	<0.5	<0.5	<0.5	<0.5

Table 1

**Groundwater Monitoring and Sampling Data
Former Chevron Service Station 91153
3135 Gibbons Drive (3126 Fernside Boulevard)
Alameda, California**

Location	Date	TOC	DTW	GWE	LNAPLT	FIELD PARAMETERS	HYDROCARBONS	PRIMARY VOCS				
						Dissolved Oxygen	TPH-GRO	B	T	E	X	MTBE by SW6260
	Units	ft	ft	ft-amsl	ft	mg/L	µg/L	µg/L	µg/L	µg/L	µg/L	µg/L
MW-6	09/11/2008 ¹⁵	7.27	4.93	2.34	0.00	1.9	<50	<0.5	<0.5	<0.5	<0.5	<0.5
MW-6	11/10/2008 ¹⁵	7.27	4.30	2.97	0.00	2.2	<50	<0.5	<0.5	<0.5	<0.5	<0.5
MW-6	02/09/2009 ¹⁵	7.27	2.97	4.30	0.00	2.0	<50	2	<0.5	<0.5	<0.5	<0.5
MW-6	05/28/2009 ¹⁵	7.27	3.53	3.74	0.00	1.77	<50	4	<0.5	<0.5	<0.5	<0.5
MW-6	08/18/2009 ¹⁵	7.27	3.38	3.89	0.00	1.81	560	130	3	<0.5	0.7 J	<0.5
MW-6	11/17/2009	7.27	4.00	3.27	0.00	-	-	-	-	-	-	-
MW-6	03/31/2010	7.27	2.44	4.83	0.00	-	<50	<0.5	<0.5	<0.5	<0.5	<0.5
MW-6	05/17/2010	7.27	3.30	3.97	0.00	-	-	-	-	-	-	-
MW-6	08/26/2010	7.27	4.15	3.12	0.00	-	<50	<0.5	<0.5	<0.5	<0.5	<0.5
MW-6	11/11/2010 ²⁰	7.27	4.16	3.11	0.00	-	-	-	-	-	-	-
MW-6	03/02/2011 ²⁰	7.27	2.27	5.00	0.00	-	<50	<0.5	<0.5	<0.5	<0.5	<0.5
MW-6	06/17/2011 ²⁰	7.27	3.69	3.58	0.00	-	-	-	-	-	-	-
MW-6	09/08/2011 ²⁰	7.27	3.82	3.45	0.00	-	<50	2	<0.5	<0.5	<0.5	<0.5
MW-6	12/29/2011 ²⁰	7.27	3.90	3.37	0.00	-	-	-	-	-	-	-
MW-6	03/28/2012	7.27	1.99	5.28	0.00	-	<50	<0.5	<0.5	<0.5	<0.5	<0.5
MW-6	05/31/2012 ²⁰	7.27	3.28	3.99	0.00	-	-	-	-	-	-	-
MW-6	09/28/2012	7.27	4.47	2.80	0.00	-	<50	<0.5	<0.5	<0.5	<0.5	<0.5
MW-6	12/21/2012 ²⁰	7.27	2.68	4.59	0.00	-	-	-	-	-	-	-
MW-6	03/29/2013	7.27	3.73	3.54	0.00	-	<50	<0.5	<0.5	<0.5	<0.5	<0.5
MW-6	06/28/2013	7.27	4.17	3.10	0.00	-	-	-	-	-	-	-
MW-6	09/20/2013	7.27	4.48	2.79	0.00	-	-	-	-	-	-	-
MW-6	12/30/2013	7.27	4.27	3.00	0.00	-	-	-	-	-	-	-
MW-6	03/31/2014	7.27	3.05	4.22	0.00	-	<50	<0.5	<0.5	<0.5	<0.5	<0.5
MW-6	06/30/2014	7.27	4.24	3.03	0.00	-	-	-	-	-	-	-
MW-6	09/30/2014	7.27	4.70	2.57	0.00	-	<50	<0.5	<0.5	<0.5	<0.5	<0.5

Table 1

**Groundwater Monitoring and Sampling Data
Former Chevron Service Station 91153
3135 Gibbons Drive (3126 Fernside Boulevard)
Alameda, California**

Location	Date	TOC	DTW	GWE	LNAPLT	FIELD PARAMETERS	HYDROCARBONS	PRIMARY VOCS				
						Dissolved Oxygen	TPH-GRO	B	T	E	X	MTBE by SW6260
	Units	ft	ft	ft-amsl	ft	mg/L	µg/L	µg/L	µg/L	µg/L	µg/L	µg/L
MW-6	12/30/2014	7.27	2.56	4.71	0.00	-	-	-	-	-	-	-
MW-6	03/20/2015	7.27	3.61	3.66	0.00	-	<50	<0.5	<0.5	<0.5	<0.5	<0.5
MW-6	06/18/2015	7.27	4.31	2.96	0.00	-	-	-	-	-	-	-
MW-7	11/30/1993	8.22	5.33	2.89	0.00	-	480	110	41	4.4	38	-
MW-7	01/27/1994	8.22	4.50	3.72	0.00	-	120	21	1.1	2.2	4.8	-
MW-7	04/07/1994	8.22	4.62	3.60	0.00	-	2,600	630	39	56	94	-
MW-7	07/01/1994	8.22	5.13	3.09	0.00	-	2,200	770	42	<10	92	-
MW-7	10/05/1994	8.22	5.61	2.61	0.00	-	15,000	3,300	90	130	320	-
MW-7	01/12/1995	8.22	2.83	5.39	0.00	-	340	57	<1.3	18	6.4	-
MW-7	04/26/1995	8.22	2.35	5.87	0.00	-	15,000	3,700	210	520	800	-
MW-7	07/12/1995	8.22	4.66	3.56	0.00	-	7,700	1,800	59	130	370	-
MW-7	10/30/1995	8.22	5.48	2.74	0.00	-	770	260	<5.0	33	48	25
MW-7	01/22/1996	8.22	3.34	4.88	0.00	-	290	63	<1.0	6.4	5.7	<5.0
MW-7	04/24/1996	8.22	4.12	4.10	0.00	-	12,000	2,500	510	380	810	<125
MW-7	07/29/1996	8.22	5.03	3.19	0.00	-	2,600	650	<25	61	150	<125
MW-7	10/10/1996	8.22	5.52	2.70	0.00	-	5,800	1,700	28	170	210	<62
MW-7	01/15/1997	8.22	2.92	5.30	0.00	-	1,000	230	<2.5	28	11	63
MW-7	04/03/1997	8.22	4.65	3.57	0.00	-	6,000	1,800	100	140	170	<100
MW-7	07/09/1997	8.22	5.39	2.83	0.00	-	5,500	2,200	<20	41	30	<100
MW-7	10/29/1997	8.22	5.58	2.64	0.00	-	220	40	0.61	3.0	2.4	7.6
MW-7	01/14/1998	8.22	2.80	5.42	0.00	-	140	5.1	<0.5	<0.5	1.4	<2.5
MW-7	04/17/1998	8.22	3.00	5.22	0.00	-	13,000	4,200	98	250	240	250
MW-7	07/15/1998 ²¹	8.22	-	-	-	-	-	-	-	-	-	-
MW-7	08/17/1998 ⁵	7.92	5.52	2.40	0.00	-	1,600	380	51	68	280	22

Table 1

**Groundwater Monitoring and Sampling Data
Former Chevron Service Station 91153
3135 Gibbons Drive (3126 Fernside Boulevard)
Alameda, California**

Location	Date	TOC	DTW	GWE	LNAPLT	FIELD PARAMETERS	HYDROCARBONS	PRIMARY VOCS				
						Dissolved Oxygen	TPH-GRO	B	T	E	X	MTBE by SW6260
	Units	ft	ft	ft-amsl	ft	mg/L	µg/L	µg/L	µg/L	µg/L	µg/L	µg/L
MW-7	10/27/1998	7.92	7.51	0.41	0.00	-	190	2.3	0.53	<0.5	<0.5	33
MW-7	01/20/1999	7.92	3.45	4.47	0.00	-	<50	<0.5	<0.5	<0.5	<0.5	<2.0
MW-7	04/19/1999	7.92	4.61	3.31	0.00	-	6,500	3,000	<0.5	110	210	150 ² /310
MW-7	07/29/1999 ⁴	7.92	5.00	2.92	0.00	-	8,390	2,100	129	222	729	248
MW-7	10/13/1999	7.92	5.61	2.31	0.00	-	14,300	6,600	58.8	117	190	<125
MW-7	01/25/2000	7.92	3.32	4.60	0.00	-	1,100	184	<5.0	13.5	33.7	151
MW-7	04/03/2000 ^{7,9}	7.92	3.38	4.54	0.00	-	2,600 ⁶	780	12	<5.0	61	95
MW-7	07/03/2000 ⁷	7.92	4.34	3.58	0.00	-	4,100 ⁶	2,600	72	240	690	<50
MW-7	10/23/2000	7.92	6.11	1.81	0.00	-	12,000 ⁶	2,600	<50	150	290	<250
MW-7	01/08/2001 ^{7,11}	7.92	4.32	3.60	0.00	-	3,900 ⁶	2,200	61	140	350	<25
MW-7	04/09/2001 ⁷	7.92	3.63	4.29	0.00	-	25,100	4,590	1,200	843	1,920	48.1
MW-7	08/23/2001 ⁷	7.92	4.83	3.09	0.00	-	27,000	4,100	970	1,100	3,500	<500
MW-7	11/27/2001	7.92	4.30	3.62	0.00	-	12,000	1,800	50	450	830	91
MW-7	02/26/2002	7.92	3.00	4.92	0.00	-	15,000	3,100	260	380	860	<10
MW-7	05/23/2002	7.92	3.69	4.23	0.00	-	28,000	6,000	120	820	1,900	42
MW-7	08/09/2002	7.92	4.38	3.54	0.00	-	24,000	3,700	81	710	1,300	56
MW-7	11/08/2002	7.92	4.43	3.49	0.00	-98.00	18,000	2,300	150	660	1,400	<100
MW-7	02/07/2003	7.92	3.20	4.72	0.00	2.90	13,000	2,300	200	310	620	<25
MW-7	05/09/2003	7.92	3.18	4.74	0.00	2.60	17,000	4,200	36	350	360	<50
MW-7	08/15/2003 ¹⁵	7.92	4.75	3.17	0.00	2.30	29,000	7,300	140	780	1,900	<5
MW-7	11/14/2003 ¹⁵	7.92	4.95	2.97	0.00	1.87	7,200	950	3	45	20	7
MW-7	02/13/2004 ¹⁵	7.92	3.29	4.63	0.00	-	3,300	360	4	82	130	3
MW-7	05/14/2004 ¹⁵	7.92	3.98	3.94	0.00	-	17,000	3,100	480	510	1,300	3
MW-7	08/13/2004 ¹⁵	7.92	5.94	1.98	0.00	-	10,000	2,000	4	130	150	4
MW-7	11/12/2004 ¹⁵	7.92	4.50	3.42	0.00	-	680	4	<0.5	1	0.7	0.8

Table 1

**Groundwater Monitoring and Sampling Data
Former Chevron Service Station 91153
3135 Gibbons Drive (3126 Fernside Boulevard)
Alameda, California**

Location	Date	TOC	DTW	GWE	LNAPLT	FIELD PARAMETERS	HYDROCARBONS	PRIMARY VOCS				
						Dissolved Oxygen	TPH-GRO	B	T	E	X	MTBE by SW8260
	Units	ft	ft	ft-amsl	ft	mg/L	µg/L	µg/L	µg/L	µg/L	µg/L	µg/L
MW-7	02/11/2005 ¹⁵	7.92	3.07	4.85	0.00	-	4,600	680	6	80	44	4
MW-7	05/13/2005 ¹⁵	7.92	4.51	3.41	0.00	-	4,200	380	3	38	13	2
MW-7	08/19/2005 ¹⁵	7.92	4.03	3.89	0.00	0.80	7,900	1,300	3	190	310	<1
MW-7	11/18/2005 ¹⁵	7.92	4.62	3.30	0.00	0.90	3,900	4	1	16	8	2
MW-7	02/10/2006 ¹⁵	7.92	3.12	4.80	0.00	1.30	3,200	320	2	14	8	2
MW-7	05/12/2006 ¹⁵	7.92	4.25	3.67	0.00	1.40	3,600	1,000	2	65	27	<1
MW-7	08/11/2006 ¹⁵	7.92	4.45	3.47	0.00	1.10	6,700	1,900	6	280	300	<1
MW-7	11/17/2006 ¹⁵	7.92	4.71	3.21	0.00	0.70	1,200	0.6	<0.5	1	0.8	<0.5
MW-7	02/16/2007 ¹⁵	7.92	3.26	4.66	0.00	1.10	110	<0.5	<0.5	<0.5	<0.5	<0.5
MW-7	05/17/2007 ¹⁵	7.92	4.62	3.30	0.00	1.7	6,400	1,400	4	130	26	<1
MW-7	08/09/2007 ¹⁵	7.92	4.61	3.31	0.00	1.2	10,000	1,400	4	230	12	<3
MW-7	11/08/2007 ¹⁵	7.92	4.72	3.20	0.00	0.9	2,300	4	1	3	7	0.9
MW-7	02/06/2008 ¹⁵	7.92	2.98	4.94	0.00	0.5	190	<0.5	<0.5	<0.5	<0.5	<0.5
MW-7	05/07/2008 ¹⁵	7.92	4.48	3.44	0.00	1.2	8,000	1,500	15	380	260	<1
MW-7	09/11/2008 ¹⁵	7.92	5.95	1.97	0.00	1.0	5,100	530	4	47	12	0.7
MW-7	11/10/2008 ¹⁵	7.92	5.81	2.11	0.00	0.6	2,800	13	1	1	7	<0.5
MW-7	02/09/2009 ¹⁵	7.92	4.06	3.86	0.00	0.8	3,900	190	2	51	11	0.5
MW-7	05/28/2009 ^{15,17}	7.92	3.84	4.08	0.00	0.45	5,800	870	8	220	27	<0.5
MW-7	08/18/2009 ¹⁵	7.92	4.80	3.12	0.00	0.57	6,700	660	4	110	13	0.7 J
MW-7	11/17/2009	7.92	4.52	3.40	0.00	-	-	-	-	-	-	-
MW-7	03/31/2010	7.92	3.11	4.81	0.00	-	2,000	110	1	2	3	0.7 J
MW-7	05/17/2010	7.92	3.41	4.51	0.00	-	-	-	-	-	-	-
MW-7	08/26/2010	7.92	4.60	3.32	0.00	-	5,100	470	3	150	9	<0.5
MW-7	11/11/2010 ²⁰	7.92	4.68	3.24	0.00	-	-	-	-	-	-	-
MW-7	03/02/2011 ²⁰	7.92	2.53	5.39	0.00	-	1,100	<0.5	<0.5	<0.5	<0.5	<0.5

Table 1

**Groundwater Monitoring and Sampling Data
Former Chevron Service Station 91153
3135 Gibbons Drive (3126 Fernside Boulevard)
Alameda, California**

Location	Date	TOC	DTW	GWE	LNAPL	FIELD PARAMETERS	HYDROCARBONS	PRIMARY VOCS				
						Dissolved Oxygen	TPH-GRO	B	T	E	X	MTBE by SW6260
	Units	ft	ft	ft-amsl	ft	mg/L	µg/L	µg/L	µg/L	µg/L	µg/L	µg/L
MW-7	06/17/2011 ²⁰	7.92	4.02	3.90	0.00	-	-	-	-	-	-	-
MW-7	09/08/2011 ²⁰	7.92	4.12	3.80	0.00	-	5,700	650	7	140	31	<0.5
MW-7	12/29/2011 ²⁰	7.92	4.12	3.80	0.00	-	-	-	-	-	-	-
MW-7	03/28/2012	7.92	2.61	5.31	0.00	-	370	<0.5	<0.5	<0.5	<0.5	<0.5
MW-7	05/31/2012 ²⁰	7.92	3.79	4.13	0.00	-	-	-	-	-	-	-
MW-7	09/28/2012	7.92	4.90	3.02	0.00	-	3,600	14	<5	<5	5 J	<5
MW-7	12/21/2012 ²⁰	7.92	3.09	4.83	0.00	-	-	-	-	-	-	-
MW-7	03/29/2013	7.92	3.70	4.22	0.00	-	5,000	770	11	57	12	<0.5
MW-7	06/28/2013	7.92	4.59	3.33	0.00	-	-	-	-	-	-	-
MW-7	09/20/2013	7.92	4.96	2.96	0.00	-	4,400	1	2	1	4	<0.5
MW-7	12/30/2013	7.92	4.60	3.32	0.00	-	-	-	-	-	-	-
MW-7	03/31/2014	7.92	3.68	4.24	0.00	-	350	<0.5	<0.5	<0.5	<0.5	<0.5
MW-7	06/30/2014	7.92	4.52	3.40	0.00	-	-	-	-	-	-	-
MW-7	09/30/2014 ²²	7.92	5.10	2.82	0.00	-	-	-	-	-	-	-
MW-7	12/30/2014	7.92	2.97	4.95	0.00	-	-	-	-	-	-	-
MW-7	03/20/2015	7.92	3.83	4.09	0.00	-	1,600	110	1	15	1	<0.5
MW-7	06/18/2015	7.92	4.59	3.33	0.00	-	-	-	-	-	-	-
MW-8	10/17/1995	6.96	4.40	2.56	0.00	-	-	-	-	-	-	-
MW-8	10/30/1995	6.96	4.44	2.52	0.00	-	<50	<0.5	<0.5	<0.5	<0.5	<2.5
MW-8	01/22/1996	6.96	2.24	4.72	0.00	-	<50	<0.5	<0.5	<0.5	<0.5	<2.5
MW-8	04/24/1996	6.96	2.97	3.99	0.00	-	<50	<0.5	<0.5	<0.5	<0.5	<2.5
MW-8	07/29/1996	6.96	3.37	3.59	0.00	-	<50	<0.5	<0.5	<0.5	<0.5	<2.5
MW-8	10/10/1996	6.96	4.12	2.84	0.00	-	<50	<0.5	<0.5	<0.5	<0.5	<2.5
MW-8	01/15/1997	6.96	0.94	6.02	0.00	-	<50	<0.5	<0.5	<0.5	<0.5	<2.5

Table 1

**Groundwater Monitoring and Sampling Data
Former Chevron Service Station 91153
3135 Gibbons Drive (3126 Fernside Boulevard)
Alameda, California**

Location	Date	TOC	DTW	GWE	LNAPL	FIELD PARAMETERS	HYDROCARBONS	PRIMARY VOCS				
						Dissolved Oxygen	TPH-GRO	B	T	E	X	MTBE by SW6260
	Units	ft	ft	ft-amsl	ft	mg/L	µg/L	µg/L	µg/L	µg/L	µg/L	µg/L
MW-8	04/03/1997	6.96	2.20	4.76	0.00	-	<50	<0.5	<0.5	<0.5	<0.5	<2.5
MW-8	07/09/1997	6.96	4.30	2.66	0.00	-	<50	<0.5	<0.5	<0.5	<0.5	<2.5
MW-8	10/29/1997	6.96	4.57	2.39	0.00	-	<50	<0.5	<0.5	<0.5	<0.5	<2.5
MW-8	01/14/1998	6.96	0.83	6.13	0.00	-	<50	<0.5	<0.5	<0.5	<0.5	<2.5
MW-8	01/20/1999	6.96	2.69	4.27	0.00	-	<50	<0.5	<0.5	<0.5	<0.5	<2.0
MW-8	04/19/1999	6.96	3.76	3.20	0.00	-	-	-	-	-	-	-
MW-8	01/25/2000	6.96	1.41	5.55	0.00	-	<50	<0.5	<0.5	<0.5	<0.5	<2.5
MW-8	04/03/2000 ¹⁹	6.96	-	-	-	-	-	-	-	-	-	-
MW-8	07/03/2000	6.96	-	-	-	-	-	-	-	-	-	-
MW-8	10/23/2000	6.96	-	-	-	-	-	-	-	-	-	-
MW-8	01/08/2001 ¹¹	6.96	3.58	3.38	0.00	-	<50	<0.50	<0.50	<0.50	<0.50	<2.5
MW-8	04/09/2001	6.96	-	-	-	-	-	-	-	-	-	-
MW-8	08/23/2001 ¹⁹	6.96	-	-	-	-	-	-	-	-	-	-
MW-8	11/27/2001 ¹⁹	6.96	-	-	-	-	-	-	-	-	-	-
MW-8	02/26/2002	6.96	2.91	4.05	0.00	-	<50	<0.50	<0.50	<0.50	<1.5	<2.5
MW-8	05/23/2002 ¹⁹	6.96	-	-	-	-	-	-	-	-	-	-
MW-8	08/09/2002 ¹⁹	6.96	-	-	-	-	-	-	-	-	-	-
MW-8	11/08/2002 ¹⁹	6.96	-	-	-	-	-	-	-	-	-	-
MW-8	02/07/2003	6.96	3.13	3.83	0.00	-	<50	<0.50	<0.50	<0.50	<1.5	<2.5
MW-8	05/09/2003 ¹⁹	6.96	-	-	-	-	-	-	-	-	-	-
MW-8	08/15/2003 ¹⁹	6.96	-	-	-	-	-	-	-	-	-	-
MW-8	11/14/2003 ¹⁹	6.96	-	-	-	-	-	-	-	-	-	-
MW-8	02/13/2004 ¹⁵	6.96	3.20	3.76	0.00	-	<50	<0.5	<0.5	<0.5	<0.5	<0.5
MW-8	05/14/2004 ¹⁹	6.96	-	-	-	-	-	-	-	-	-	-
MW-8	11/12/2004 ¹⁹	6.96	-	-	-	-	-	-	-	-	-	-

Table 1

**Groundwater Monitoring and Sampling Data
Former Chevron Service Station 91153
3135 Gibbons Drive (3126 Fernside Boulevard)
Alameda, California**

Location	Date	TOC	DTW	GWE	LNAPLT	FIELD PARAMETERS	HYDROCARBONS	PRIMARY VOCS				
						Dissolved Oxygen	TPH-GRO	B	T	E	X	MTBE by SW6260
	Units	ft	ft	ft-amsl	ft	mg/L	µg/L	µg/L	µg/L	µg/L	µg/L	µg/L
MW-8	02/11/2005 ¹⁵	6.96	2.85	4.11	0.00	-	<50	<0.5	<0.5	<0.5	<0.5	<0.5
MW-8	05/13/2005 ¹⁹	6.96	-	-	-	-	-	-	-	-	-	-
MW-8	08/19/2005 ¹⁹	6.96	-	-	-	-	-	-	-	-	-	-
MW-8	11/18/2005 ¹⁹	6.96	-	-	-	-	-	-	-	-	-	-
MW-8	02/10/2006 ¹⁵	6.96	2.74	4.22	<50	-	<0.5	<0.5	<0.5	<0.5	<0.5	<0.5
MW-8	05/12/2006 ¹⁹	6.96	-	-	-	-	-	-	-	-	-	-
MW-8	08/11/2006 ¹⁹	6.96	-	-	-	-	-	-	-	-	-	-
MW-8	11/17/2006 ¹⁹	6.96	-	-	-	-	-	-	-	-	-	-
MW-8	02/16/2007 ¹⁵	6.96	2.69	4.27	0.00	-	<50	<0.5	<0.5	<0.5	<0.5	<0.5
MW-8	05/17/2007 ¹⁹	6.96	-	-	-	-	-	-	-	-	-	-
MW-8	08/09/2007 ¹⁹	6.96	-	-	-	-	-	-	-	-	-	-
MW-8	11/08/2007 ¹⁹	6.96	-	-	-	-	-	-	-	-	-	-
MW-8	02/06/2008 ¹⁵	6.96	2.57	4.39	0.00	-	<50	<0.5	<0.5	<0.5	<0.5	<0.5
MW-8	05/07/2008 ¹⁹	6.96	-	-	-	-	-	-	-	-	-	-
MW-8	09/11/2008 ¹⁹	6.96	-	-	-	-	-	-	-	-	-	-
MW-8	11/10/2008 ¹⁹	6.96	-	-	-	-	-	-	-	-	-	-
MW-8	02/09/2009 ¹⁵	6.96	3.28	3.68	0.00	-	<50	<0.5	<0.5	<0.5	<0.5	<0.5
MW-8	03/31/2010	6.96	2.85	4.11	0.00	-	<50	<0.5	<0.5	<0.5	<0.5	<0.5
MW-8	05/17/2010	6.96	3.33	3.63	0.00	-	-	-	-	-	-	-
MW-8	08/26/2010 ¹⁹	6.96	4.27	2.69	0.00	-	-	-	-	-	-	-
MW-8	11/11/2010 ¹⁹	6.96	3.82	3.14	0.00	-	-	-	-	-	-	-
MW-8	03/02/2011 ¹⁹	6.96	1.66	5.30	0.00	-	<50	<0.5	<0.5	<0.5	<0.5	<0.5
MW-8	06/17/2011 ¹⁹	6.96	3.79	3.17	0.00	-	-	-	-	-	-	-
MW-8	09/08/2011 ¹⁹	6.96	2.97	3.99	0.00	-	-	-	-	-	-	-
MW-8	12/29/2011 ¹⁹	6.96	3.70	3.26	0.00	-	-	-	-	-	-	-

Table 1

**Groundwater Monitoring and Sampling Data
Former Chevron Service Station 91153
3135 Gibbons Drive (3126 Fernside Boulevard)
Alameda, California**

Location	Date	TOC	DTW	GWE	LNAPL	FIELD PARAMETERS	HYDROCARBONS	PRIMARY VOCS				
						Dissolved Oxygen	TPH-GRO	B	T	E	X	MTBE by SW6260
	Units	ft	ft	ft-amsl	ft	mg/L	µg/L	µg/L	µg/L	µg/L	µg/L	µg/L
MW-8	03/28/2012	6.96	0.48	6.48	0.00	-	<50	<0.5	<0.5	<0.5	<0.5	<0.5
MW-8	05/31/2012 ¹⁹	6.96	1.66	5.30	0.00	-	-	-	-	-	-	-
MW-8	09/28/2012 ¹⁹	6.96	4.87	2.09	0.00	-	-	-	-	-	-	-
MW-8	12/21/2012 ¹⁹	6.96	2.28	4.68	0.00	-	-	-	-	-	-	-
MW-8	03/29/2013	6.96	3.73	3.23	0.00	-	<50	<0.5	<0.5	<0.5	<0.5	<0.5
MW-8	06/28/2013	6.96	3.99	2.97	0.00	-	-	-	-	-	-	-
MW-8	09/20/2013	6.96	4.44	2.52	0.00	-	-	-	-	-	-	-
MW-8	12/30/2013	6.96	4.62	2.34	0.00	-	-	-	-	-	-	-
MW-8	03/31/2014	6.96	2.73	4.23	0.00	-	<50	<0.5	<0.5	<0.5	<0.5	<0.5
MW-8	06/30/2014	6.96	4.69	2.27	0.00	-	-	-	-	-	-	-
MW-8	09/30/2014	6.96	4.50	2.46	0.00	-	-	-	-	-	-	-
MW-8	12/30/2014	6.96	2.52	4.44	0.00	-	-	-	-	-	-	-
MW-8	03/20/2015	6.96	3.70	3.26	0.00	-	<50	<0.5	<0.5	<0.5	<0.5	<0.5
MW-8	06/18/2015	6.96	4.19	2.77	0.00	-	-	-	-	-	-	-
MW-9	10/17/1995	7.21	4.80	2.41	0.00	-	-	-	-	-	-	-
MW-9	10/30/1995	7.21	4.97	2.24	0.00	-	<50	<0.5	<0.5	<0.5	<0.5	<2.5
MW-9	01/22/1996	7.21	3.40	3.81	0.00	-	<50	<0.5	<0.5	<0.5	<0.5	<2.5
MW-9	04/24/1996	7.21	4.18	3.03	0.00	-	<50	<0.5	<0.5	<0.5	<0.5	<2.5
MW-9	07/29/1996	7.21	4.69	2.52	0.00	-	<50	<0.5	<0.5	<0.5	<0.5	<2.5
MW-9	10/10/1996	7.21	5.20	2.01	0.00	-	<50	<0.5	<0.5	<0.5	<0.5	<2.5
MW-9	01/15/1997	7.21	3.31	3.90	0.00	-	<50	<0.5	<0.5	<0.5	<0.5	<2.5
MW-9	04/03/1997	7.21	4.57	2.64	0.00	-	<50	<0.5	<0.5	<0.5	<0.5	<2.5
MW-9	07/09/1997	7.21	5.04	2.17	0.00	-	<50	<0.5	<0.5	<0.5	<0.5	<2.5
MW-9	10/29/1997	7.21	4.96	2.25	0.00	-	<50	<0.5	<0.5	<0.5	<0.5	<2.5

Table 1

**Groundwater Monitoring and Sampling Data
Former Chevron Service Station 91153
3135 Gibbons Drive (3126 Fernside Boulevard)
Alameda, California**

Location	Date	TOC	DTW	GWE	LNAPL	FIELD PARAMETERS	HYDROCARBONS	PRIMARY VOCS				
						Dissolved Oxygen	TPH-GRO	B	T	E	X	MTBE by SW6260
	Units	ft	ft	ft-amsl	ft	mg/L	µg/L	µg/L	µg/L	µg/L	µg/L	µg/L
MW-9	01/14/1998	7.21	2.40	4.81	0.00	-	<50	<0.5	<0.5	<0.5	<0.5	<2.5
MW-9	01/20/1999	7.21	4.31	2.90	0.00	-	<50	<0.5	<0.5	<0.5	<0.5	<2.0
MW-9	04/19/1999	7.21	3.92	3.29	0.00	-	-	-	-	-	-	-
MW-9	01/25/2000	7.21	2.95	4.26	0.00	-	<50	<0.5	<0.5	<0.5	<0.5	<2.5
MW-9	04/03/2000 ¹⁹	7.21	-	-	-	-	-	-	-	-	-	-
MW-9	07/03/2000	7.21	-	-	-	-	-	-	-	-	-	-
MW-9	10/23/2000	7.21	-	-	-	-	-	-	-	-	-	-
MW-9	01/08/2001 ¹¹	7.21	4.59	2.62	0.00	-	<50	<0.50	<0.50	<0.50	<0.50	<2.5
MW-9	04/09/2001	7.21	-	-	-	-	-	-	-	-	-	-
MW-9	08/23/2001 ¹⁹	7.21	-	-	-	-	-	-	-	-	-	-
MW-9	11/27/2001 ¹⁹	7.21	-	-	-	-	-	-	-	-	-	-
MW-9	02/26/2002	7.21	3.75	3.46	0.00	-	<50	<0.50	<0.50	<0.50	<1.5	<2.5
MW-9	05/23/2002 ¹⁹	7.21	-	-	-	-	-	-	-	-	-	-
MW-9	08/09/2002 ¹⁹	7.21	-	-	-	-	-	-	-	-	-	-
MW-9	11/08/2002 ¹⁹	7.21	-	-	-	-	-	-	-	-	-	-
MW-9	02/07/2003	7.21	3.97	3.24	0.00	-	<50	<0.50	<0.50	<0.50	<1.5	<2.5
MW-9	05/09/2003 ¹⁹	7.21	-	-	-	-	-	-	-	-	-	-
MW-9	08/15/2003 ¹⁹	7.21	-	-	-	-	-	-	-	-	-	-
MW-9	11/14/2003 ¹⁹	7.21	-	-	-	-	-	-	-	-	-	-
MW-9	02/13/2004 ¹⁵	7.21	3.94	3.27	0.00	-	<50	<0.5	<0.5	<0.5	<0.5	<0.5
MW-9	05/14/2004 ¹⁹	7.21	-	-	-	-	-	-	-	-	-	-
MW-9	11/12/2004 ¹⁹	7.21	-	-	-	-	-	-	-	-	-	-
MW-9	02/11/2005 ¹⁵	7.21	3.66	3.55	0.00	-	<50	<0.5	<0.5	<0.5	<0.5	<0.5
MW-9	05/13/2005 ¹⁹	7.21	-	-	-	-	-	-	-	-	-	-
MW-9	08/19/2005 ¹⁹	7.21	-	-	-	-	-	-	-	-	-	-

Table 1

**Groundwater Monitoring and Sampling Data
Former Chevron Service Station 91153
3135 Gibbons Drive (3126 Fernside Boulevard)
Alameda, California**

Location	Date	TOC	DTW	GWE	LNAPLT	FIELD PARAMETERS	HYDROCARBONS	PRIMARY VOCS				
						Dissolved Oxygen	TPH-GRO	B	T	E	X	MTBE by SW8260
	Units	ft	ft	ft-amsl	ft	mg/L	µg/L	µg/L	µg/L	µg/L	µg/L	µg/L
MW-9	11/18/2005 ¹⁹	7.21	-	-	-	-	-	-	-	-	-	-
MW-9	02/10/2006 ¹⁵	7.21	3.53	3.68	0.00	-	<0.5	<0.5	<0.5	<0.5	<0.5	<0.5
MW-9	05/12/2006 ¹⁹	7.21	-	-	-	-	-	-	-	-	-	-
MW-9	08/11/2006 ¹⁹	7.21	-	-	-	-	-	-	-	-	-	-
MW-9	11/17/2006 ¹⁹	7.21	-	-	-	-	-	-	-	-	-	-
MW-9	02/16/2007 ¹⁵	7.21	3.50	3.71	0.00	-	<50	<0.5	<0.5	<0.5	<0.5	<0.5
MW-9	05/17/2007 ¹⁹	7.21	-	-	-	-	-	-	-	-	-	-
MW-9	08/09/2007 ¹⁹	7.21	-	-	-	-	-	-	-	-	-	-
MW-9	11/08/2007 ¹⁹	7.21	-	-	-	-	-	-	-	-	-	-
MW-9	02/06/2008 ¹⁵	7.21	3.14	4.07	0.00	-	<50	<0.5	<0.5	<0.5	<0.5	<0.5
MW-9	05/07/2008 ¹⁹	7.21	-	-	-	-	-	-	-	-	-	-
MW-9	09/11/2008 ¹⁹	7.21	-	-	-	-	-	-	-	-	-	-
MW-9	11/10/2008 ¹⁹	7.21	-	-	-	-	-	-	-	-	-	-
MW-9	02/09/2009 ¹⁵	7.21	3.91	3.30	0.00	-	<50	<0.5	<0.5	<0.5	<0.5	<0.5
MW-9	03/31/2010	7.21	3.16	4.05	0.00	-	<50	<0.5	<0.5	<0.5	<0.5	<0.5
MW-9	05/17/2010	7.21	3.44	3.77	0.00	-	-	-	-	-	-	-
MW-9	08/26/2010 ¹⁹	7.21	4.77	2.44	0.00	-	-	-	-	-	-	-
MW-9	11/11/2010 ¹⁹	7.21	4.29	2.92	0.00	-	-	-	-	-	-	-
MW-9	03/02/2011 ¹⁹	7.21	2.75	4.46	0.00	-	<50	<0.5	<0.5	<0.5	<0.5	<0.5
MW-9	06/17/2011 ¹⁹	7.21	3.86	3.35	0.00	-	-	-	-	-	-	-
MW-9	09/08/2011 ¹⁹	7.21	4.28	2.93	0.00	-	-	-	-	-	-	-
MW-9	12/29/2011 ¹⁹	7.21	4.58	2.63	0.00	-	-	-	-	-	-	-
MW-9	03/28/2012	7.21	2.32	4.89	0.00	-	<50	<0.5	<0.5	<0.5	<0.5	<0.5
MW-9	05/31/2012 ¹⁹	7.21	4.15	3.06	0.00	-	-	-	-	-	-	-
MW-9	09/28/2012 ¹⁹	7.21	4.96	2.25	0.00	-	-	-	-	-	-	-

Table 1

**Groundwater Monitoring and Sampling Data
Former Chevron Service Station 91153
3135 Gibbons Drive (3126 Fernside Boulevard)
Alameda, California**

Location	Date	TOC	DTW	GWE	LNAPLT	FIELD PARAMETERS	HYDROCARBONS	PRIMARY VOCS				
						Dissolved Oxygen	TPH+GRO	B	T	E	X	MTBE by SW6260
	Units	ft	ft	ft-amsl	ft	mg/L	µg/L	µg/L	µg/L	µg/L	µg/L	µg/L
MW-9	12/21/2012 ¹⁹	7.21	2.32	4.89	0.00	-	-	-	-	-	-	-
MW-9	03/29/2013	7.21	4.20	3.01	0.00	-	<50	<0.5	<0.5	<0.5	<0.5	<0.5
MW-9	06/28/2013	7.21	4.61	2.60	0.00	-	-	-	-	-	-	-
MW-9	09/20/2013	7.21	4.71	2.50	0.00	-	-	-	-	-	-	-
MW-9	12/30/2013	7.21	5.12	2.09	0.00	-	-	-	-	-	-	-
MW-9	03/31/2014	7.21	3.16	4.05	0.00	-	<50	<0.5	<0.5	<0.5	<0.5	<0.5
MW-9	06/30/2014	7.21	4.51	2.70	0.00	-	-	-	-	-	-	-
MW-9	09/30/2014	7.21	4.80	2.41	0.00	-	-	-	-	-	-	-
MW-9	12/30/2014	7.21	2.67	4.54	0.00	-	-	-	-	-	-	-
MW-9	03/20/2015	7.21	4.02	3.19	0.00	-	<50	<0.5	<0.5	<0.5	<0.5	<0.5
MW-9	06/18/2015	7.21	4.53	2.68	0.00	-	-	-	-	-	-	-
MW-10	10/17/1995	7.28	5.05	2.23	0.00	-	-	-	-	-	-	-
MW-10	10/30/1995	7.28	5.11	2.17	0.00	-	<50	<0.5	<0.5	<0.5	<0.5	5.1
MW-10	01/22/1996	7.28	4.03	3.25	0.00	-	<50	<0.5	<0.5	<0.5	0.70	17
MW-10	04/24/1996	7.28	4.30	2.98	0.00	-	<50	<0.5	<0.5	<0.5	<0.5	12
MW-10	07/29/1996	7.28	4.70	2.58	0.00	-	<50	<0.5	<0.5	<0.5	<0.5	14
MW-10	10/10/1996	7.28	5.24	2.04	0.00	-	<50	<0.5	<0.5	<0.5	<0.5	<2.5
MW-10	01/15/1997	7.28	3.35	3.93	0.00	-	<50	<0.5	<0.5	<0.5	<0.5	<2.5
MW-10	04/03/1997	7.28	4.64	2.64	0.00	-	<50	<0.5	<0.5	<0.5	<0.5	8.2
MW-10	07/09/1997	7.28	5.12	2.16	0.00	-	<50	<0.5	<0.5	<0.5	<0.5	<2.5
MW-10	10/29/1997	7.28	5.10	2.18	0.00	-	<50	<0.5	<0.5	<0.5	<0.5	5.3
MW-10	01/14/1998	7.28	3.08	4.20	0.00	-	<50	<0.5	<0.5	<0.5	<0.5	8.6
MW-10	04/17/1998 ²⁰	7.28	3.79	3.49	0.00	-	-	-	-	-	-	-
MW-10	07/15/1998	7.28	4.55	2.73	0.00	-	<50	<0.5	<0.5	<0.5	<0.5	7.5

Table 1

**Groundwater Monitoring and Sampling Data
Former Chevron Service Station 91153
3135 Gibbons Drive (3126 Fernside Boulevard)
Alameda, California**

Location	Date	TOC	DTW	GWE	LNAPLT	FIELD PARAMETERS	HYDROCARBONS	PRIMARY VOCS				
						Dissolved Oxygen	TPH-GRO	B	T	E	X	MTBE by SW6260
	Units	ft	ft	ft-amsl	ft	mg/L	µg/L	µg/L	µg/L	µg/L	µg/L	µg/L
MW-10	10/27/1998	7.28	5.32	1.96	0.00	-	-	-	-	-	-	-
MW-10	01/20/1999	7.28	4.24	3.04	0.00	-	<50	<0.5	<0.5	<0.5	<0.5	<2.0
MW-10	04/19/1999	7.28	4.07	3.21	0.00	-	-	-	-	-	-	-
MW-10	07/29/1999	7.28	4.82	2.46	0.00	-	<50	<0.5	<0.5	<0.5	<0.5	<5.0/2.4 ²
MW-10	10/13/1999	7.28	4.86	2.42	0.00	-	-	-	-	-	-	-
MW-10	01/25/2000	7.28	3.00	4.28	0.00	-	<50	<0.5	<0.5	<0.5	<0.5	4.33
MW-10	04/03/2000	7.28	3.04	4.24	0.00	-	-	-	-	-	-	-
MW-10	07/03/2000	7.28	4.00	3.28	0.00	-	<50	<0.50	<0.50	<0.50	<0.50	4.7
MW-10	10/23/2000	7.28	5.86	1.42	0.00	-	-	-	-	-	-	-
MW-10	01/08/2001 ¹¹	7.28	3.98	3.30	0.00	-	<50	<0.50	<0.50	<0.50	<0.50	<2.5
MW-10	04/09/2001	7.28	3.74	3.54	0.00	-	-	-	-	-	-	-
MW-10	08/23/2001 ²¹	7.28	-	-	-	-	-	-	-	-	-	-
MW-10	11/27/2001 ²⁰	7.28	4.13	3.15	0.00	-	-	-	-	-	-	-
MW-10	02/26/2002	7.28	3.54	3.74	0.00	-	<50	<0.50	<0.50	<0.50	<1.5	<2.5
MW-10	05/23/2002 ²⁰	7.28	3.82	3.46	0.00	-	-	-	-	-	-	-
MW-10	08/09/2002	7.28	4.18	3.10	0.00	-	<50	<0.50	<0.50	<0.50	<1.5	<2.5
MW-10	11/08/2002 ²⁰	7.28	3.91	3.37	0.00	-	-	-	-	-	-	-
MW-10	02/07/2003	7.28	3.61	3.67	0.00	-	<50	<0.50	<0.50	<0.50	<1.5	<2.5
MW-10	05/09/2003 ²⁰	7.28	3.25	4.03	0.00	-	-	-	-	-	-	-
MW-10	08/15/2003 ¹⁵	7.28	4.35	2.93	0.00	-	<50	<0.5	<0.5	<0.5	<0.5	<0.5
MW-10	11/14/2003 ²⁰	7.28	4.30	2.98	0.00	-	-	-	-	-	-	-
MW-10	02/13/2004 ¹⁵	7.28	4.27	3.01	0.00	-	<50	<0.5	<0.5	<0.5	<0.5	<0.5
MW-10	05/14/2004 ²⁰	7.28	4.08	3.20	0.00	-	-	-	-	-	-	-
MW-10	08/13/2004 ¹⁵	7.28	3.92	3.36	0.00	-	<50	<0.5	<0.5	<0.5	<0.5	<0.5
MW-10	11/12/2004 ²⁰	7.28	3.98	3.30	0.00	-	-	-	-	-	-	-

Table 1

**Groundwater Monitoring and Sampling Data
Former Chevron Service Station 91153
3135 Gibbons Drive (3126 Fernside Boulevard)
Alameda, California**

Location	Date	TOC	DTW	GWE	LNAPLT	FIELD PARAMETERS	HYDROCARBONS	PRIMARY VOCS				
						Dissolved Oxygen	TPH-GRO	B	T	E	X	MTBE by SW6260
	Units	ft	ft	ft-amsl	ft	mg/L	µg/L	µg/L	µg/L	µg/L	µg/L	µg/L
MW-10	02/11/2005 ¹⁵	7.28	4.07	3.21	0.00	-	<50	<0.5	<0.5	<0.5	<0.5	<0.5
MW-10	05/13/2005 ²⁰	7.28	4.01	3.27	0.00	-	-	-	-	-	-	-
MW-10	08/19/2005 ¹⁵	7.28	3.69	3.59	0.00	-	<50	<0.5	<0.5	<0.5	<0.5	<0.5
MW-10	11/18/2005 ²⁰	7.28	3.86	3.42	0.00	-	-	-	-	-	-	-
MW-10	02/10/2006 ¹⁵	7.28	3.94	3.34	0.00	-	<0.5	<0.5	<0.5	<0.5	<0.5	<0.5
MW-10	05/12/2006 ²⁰	7.28	4.07	3.21	0.00	-	-	-	-	-	-	-
MW-10	08/11/2006 ¹⁵	7.28	4.21	3.07	0.00	-	<50	<0.5	<0.5	<0.5	<0.5	<0.5
MW-10	11/17/2006 ²⁰	7.28	3.83	3.45	0.00	-	-	-	-	-	-	-
MW-10	02/16/2007 ¹⁵	7.28	3.87	3.41	0.00	-	<50	<0.5	<0.5	<0.5	<0.5	<0.5
MW-10	05/17/2007 ²⁰	7.28	3.71	3.57	0.00	-	-	-	-	-	-	-
MW-10	08/09/2007 ²¹	7.28	-	-	-	-	-	-	-	-	-	-
MW-10	11/08/2007 ²¹	7.28	-	-	-	-	-	-	-	-	-	-
MW-10	02/06/2008 ²¹	7.28	-	-	-	-	-	-	-	-	-	-
MW-10	05/07/2008 ²¹	7.28	-	-	-	-	-	-	-	-	-	-
MW-10	09/11/2008 ¹⁵	7.28	4.63	2.65	0.00	-	<50	<0.5	<0.5	<0.5	<0.5	<0.5
MW-10	11/10/2008 ²⁰	7.28	4.28	3.00	0.00	-	-	-	-	-	-	-
MW-10	02/09/2009 ¹⁵	7.28	2.17	5.11	0.00	-	<50	<0.5	<0.5	<0.5	<0.5	<0.5
MW-10	05/28/2009	7.28	3.69	3.59	0.00	-	-	-	-	-	-	-
MW-10	08/18/2009 ¹⁵	7.28	4.07	3.21	0.00	-	<50	<0.5	<0.5	<0.5	<0.5	<0.5
MW-10	11/17/2009	7.28	4.12	3.16	0.00	-	-	-	-	-	-	-
MW-10	03/31/2010	7.28	3.43	3.85	0.00	-	<50	<0.5	<0.5	<0.5	<0.5	<0.5
MW-10	05/17/2010	7.28	3.53	3.75	0.00	-	-	-	-	-	-	-
MW-10	08/26/2010	7.28	4.33	2.95	0.00	-	<50	<0.5	<0.5	<0.5	<0.5	<0.5
MW-10	11/11/2010 ²⁰	7.28	4.34	2.94	0.00	-	-	-	-	-	-	-
MW-10	03/02/2011 ²⁰	7.28	3.33	3.95	0.00	-	<50	<0.5	<0.5	<0.5	<0.5	<0.5

Table 1

**Groundwater Monitoring and Sampling Data
Former Chevron Service Station 91153
3135 Gibbons Drive (3126 Fernside Boulevard)
Alameda, California**

Location	Date	TOC	DTW	GWE	LNAPLT	FIELD PARAMETERS	HYDROCARBONS	PRIMARY VOCS				
						Dissolved Oxygen	TPH-GRO	B	T	E	X	MTBE by SW6260
	Units	ft	ft	ft-amsl	ft	mg/L	µg/L	µg/L	µg/L	µg/L	µg/L	µg/L
MW-10	06/17/2011 ²⁰	7.28	3.92	3.36	0.00	-	-	-	-	-	-	-
MW-10	09/08/2011 ²⁰	7.28	3.95	3.33	0.00	-	<50	<0.5	<0.5	<0.5	<0.5	<0.5
MW-10	12/29/2011 ²⁰	7.28	4.00	3.28	0.00	-	-	-	-	-	-	-
MW-10	03/28/2012	7.28	2.96	4.32	0.00	-	<50	<0.5	<0.5	<0.5	<0.5	<0.5
MW-10	05/31/2012 ²⁰	7.28	3.90	3.38	0.00	-	-	-	-	-	-	-
MW-10	09/28/2012	7.28	3.60	3.68	0.00	-	<50	<0.5	<0.5	<0.5	<0.5	<0.5
MW-10	12/21/2012 ²⁰	7.28	3.44	3.84	0.00	-	-	-	-	-	-	-
MW-10	03/29/2013	7.28	2.95	4.33	0.00	-	<50	<0.5	<0.5	<0.5	<0.5	<0.5
MW-10	06/28/2013	7.28	3.50	3.78	0.00	-	-	-	-	-	-	-
MW-10	09/20/2013	7.28	3.37	3.91	0.00	-	<50	<0.5	<0.5	<0.5	<0.5	<0.5
MW-10	12/30/2013	7.28	3.09	4.19	0.00	-	-	-	-	-	-	-
MW-10	03/31/2014	7.28	3.35	3.93	0.00	-	<50	<0.5	<0.5	<0.5	<0.5	<0.5
MW-10	06/30/2014	7.28	3.52	3.76	0.00	-	-	-	-	-	-	-
MW-10	09/30/2014	7.28	3.20	4.08	0.00	-	<50	<0.5	<0.5	<0.5	<0.5	<0.5
MW-10	12/30/2014	7.28	3.18	4.10	0.00	-	-	-	-	-	-	-
MW-10	03/20/2015	7.28	3.16	4.12	0.00	-	<50	<0.5	<0.5	<0.5	<0.5	<0.5
MW-10	06/18/2015	7.28	3.47	3.81	0.00	-	-	-	-	-	-	-
C-2	09/04/1986	-	-	-	-	-	1,100	49	18	84	-	-
C-2	07/22/1987	-	-	-	-	-	<50	1.8	<1.0	<4.0	-	-
TMW-1	11/11/1993	-	-	-	-	-	<1.0	<0.5	<0.5	<0.5	<0.5	-
3115A GIBBONS DR.	01/14/1998	-	-	-	-	-	<50	<0.5	<0.5	<0.5	<0.5	<2.5

Table 1

**Groundwater Monitoring and Sampling Data
Former Chevron Service Station 91153
3135 Gibbons Drive (3126 Fernside Boulevard)
Alameda, California**

Location	Date	TOC	DTW	GWE	LNAPL	FIELD PARAMETERS	HYDROCARBONS	PRIMARY VOCS				
						Dissolved Oxygen	TPH-GRO	B	T	E	X	MTBE by SW6260
	Units	ft	ft	ft-amsl	ft	mg/L	µg/L	µg/L	µg/L	µg/L	µg/L	µg/L
QA	02/14/1990	-	-	-	-	-	<50	<0.5	1.1	<0.5	<0.5	-
QA	09/06/1991	-	-	-	-	-	<50	<0.5	<0.5	<0.5	<0.5	-
QA	12/15/1991	-	-	-	-	-	<50	<0.5	<0.5	<0.5	<0.5	-
QA	03/03/1992	-	-	-	-	-	<50	<0.5	<0.5	<0.5	<0.5	-
QA	06/04/1992	-	-	-	-	-	<50	<0.5	<0.5	<0.5	<0.5	-
QA	10/13/1992	-	-	-	-	-	<50	<0.5	<0.5	<0.5	<0.5	-
QA	01/11/1993	-	-	-	-	-	<50	<0.5	<0.5	<0.5	<0.5	-
QA	04/14/1993	-	-	-	-	-	<50	<0.5	<0.5	<0.5	<0.5	-
QA	07/13/1993	-	-	-	-	-	<50	<0.5	<0.5	<0.5	<0.5	-
QA	10/19/1993	-	-	-	-	-	<50	<0.5	<0.5	<0.5	<1.5	-
QA	01/27/1994	-	-	-	-	-	<50	<0.5	<0.5	<0.5	<0.5	-
QA	04/07/1994	-	-	-	-	-	<50	<0.5	<0.5	<0.5	<0.5	-
QA	07/01/1994	-	-	-	-	-	<50	<0.5	<0.5	<0.5	<0.5	-
QA	10/05/1994	-	-	-	-	-	<50	<0.5	<0.5	<0.5	<0.5	-
QA	01/12/1995	-	-	-	-	-	<50	<0.5	<0.5	<0.5	<0.5	-
QA	04/26/1995	-	-	-	-	-	<50	<0.5	<0.5	<0.5	<0.5	-
QA	07/12/1995	-	-	-	-	-	<50	<0.5	<0.5	<0.5	<0.5	-
QA	10/30/1995	-	-	-	-	-	<50	<0.5	<0.5	<0.5	<0.5	-
QA	01/22/1996	-	-	-	-	-	<50	<0.5	<0.5	<0.5	<0.5	<2.5
QA	04/24/1996	-	-	-	-	-	<50	<0.5	<0.5	<0.5	<0.5	<2.5
QA	07/29/1996	-	-	-	-	-	<50	<0.5	<0.5	<0.5	<0.5	<2.5
QA	01/15/1997	-	-	-	-	-	<50	<0.5	<0.5	<0.5	<0.5	<2.5
QA	04/03/1997	-	-	-	-	-	<50	<0.5	<0.5	<0.5	<0.5	<2.5
QA	07/09/1997	-	-	-	-	-	<50	<0.5	<0.5	<0.5	<0.5	<2.5
QA	10/29/1997	-	-	-	-	-	<50	<0.5	<0.5	<0.5	<0.5	<2.5

Table 1

**Groundwater Monitoring and Sampling Data
Former Chevron Service Station 91153
3135 Gibbons Drive (3126 Fernside Boulevard)
Alameda, California**

Location	Date	TOC	DTW	GWE	LNAPL	FIELD PARAMETERS	HYDROCARBONS	PRIMARY VOCS				
						Dissolved Oxygen	TPH-GRO	B	T	E	X	MTBE by SW6260
	Units	ft	ft	ft-amsl	ft	mg/L	µg/L	µg/L	µg/L	µg/L	µg/L	µg/L
QA	01/14/1998	-	-	-	-	-	<50	<0.5	<0.5	<0.5	<0.5	<2.5
QA	04/17/1998	-	-	-	-	-	<50	<0.5	<0.5	<0.5	<0.5	<2.5
QA	07/15/1998	-	-	-	-	-	<50	<0.5	<0.5	<0.5	<0.5	<2.5
QA	10/27/1998	-	-	-	-	-	<50	<0.5	<0.5	<0.5	<0.5	<2.5
QA	01/20/1999	-	-	-	-	-	<50	<0.5	<0.5	<0.5	<0.5	<2.0
QA	04/19/1999	-	-	-	-	-	<50	<0.5	<0.5	<0.5	<0.5	<2.5
QA	07/29/1999	-	-	-	-	-	<50	<0.5	<0.5	<0.5	<0.5	<5.0
QA	10/13/1999	-	-	-	-	-	<50	<0.5	<0.5	<0.5	<0.5	<2.5
QA	01/25/2000	-	-	-	-	-	<50	<0.5	<0.5	<0.5	<0.5	<2.5
QA	04/03/2000	-	-	-	-	-	<50	<0.50	<0.50	<0.50	<0.50	<2.5
QA	07/03/2000	-	-	-	-	-	<50	<0.50	<0.50	<0.50	<0.50	<2.5
QA	10/23/2000	-	-	-	-	-	<50	<0.50	<0.50	<0.50	<0.50	<2.5
QA	01/08/2001 ¹¹	-	-	-	-	-	<50	<0.50	<0.50	<0.50	<0.50	<2.5
QA	04/09/2001	-	-	-	-	-	<50.0	<0.500	<2.00	<0.500	<2.00	<0.500
QA	08/23/2001	-	-	-	-	-	<50	<0.50	<0.50	<0.50	<0.50	<2.5
QA	11/27/2001	-	-	-	-	-	<50	<0.50	<0.50	<0.50	<1.5	<2.5
QA	02/26/2002	-	-	-	-	-	<50	<0.50	<0.50	<0.50	<1.5	<2.5
QA	05/23/2002	-	-	-	-	-	<50	<0.50	<0.50	<0.50	<1.5	<2.5
QA	08/09/2002	-	-	-	-	-	<50	<0.50	<0.50	<0.50	<1.5	<2.5
QA	11/08/2002	-	-	-	-	-	<50	<0.50	<0.50	<0.50	<1.5	<2.5
QA	02/07/2003	-	-	-	-	-	<50	<0.50	<0.50	<0.50	<1.5	<2.5
QA	05/09/2003	-	-	-	-	-	<50	<0.5	<0.5	<0.5	<1.5	<2.5
QA	08/15/2003 ¹⁵	-	-	-	-	-	<50	<0.5	<0.5	<0.5	<0.5	<0.5
QA	11/14/2003	-	-	-	-	-	<50	<0.5	<0.5	<0.5	<0.5	<0.5
QA	02/13/2004 ¹⁵	-	-	-	-	-	<50	<0.5	<0.5	<0.5	<0.5	<0.5

Table 1

**Groundwater Monitoring and Sampling Data
Former Chevron Service Station 91153
3135 Gibbons Drive (3126 Fernside Boulevard)
Alameda, California**

Location	Date	TOC	DTW	GWE	LNAPL	FIELD PARAMETERS	HYDROCARBONS	PRIMARY VOCS				
						Dissolved Oxygen	TPH-GRO	B	T	E	X	MTBE by SW6260
	Units	ft	ft	ft-amsl	ft	mg/L	µg/L	µg/L	µg/L	µg/L	µg/L	µg/L
QA	05/14/2004 ¹⁵	-	-	-	-	-	<50	<0.5	<0.5	<0.5	<0.5	<0.5
QA	08/13/2004 ¹⁵	-	-	-	-	-	<50	<0.5	<0.5	<0.5	<0.5	<0.5
QA	11/12/2004 ¹⁵	-	-	-	-	-	<50	<0.5	<0.5	<0.5	<0.5	<0.5
QA	02/11/2005 ¹⁵	-	-	-	-	-	<50	<0.5	<0.5	<0.5	<0.5	<0.5
QA	05/13/2005 ¹⁵	-	-	-	-	-	<50	<0.5	<0.5	<0.5	<0.5	<0.5
QA	08/19/2005 ¹⁵	-	-	-	-	-	<50	<0.5	<0.5	<0.5	<0.5	<0.5
QA	11/18/2005 ¹⁵	-	-	-	-	-	<50	<0.5	<0.5	<0.5	<0.5	<0.5
QA	02/10/2006 ¹⁵	-	-	-	-	-	<50	<0.5	<0.5	<0.5	<0.5	<0.5
QA	05/12/2006 ¹⁵	-	-	-	-	-	<50	<0.5	<0.5	<0.5	<0.5	<0.5
QA	08/11/2006 ¹⁵	-	-	-	-	-	<50	<0.5	<0.5	<0.5	<0.5	<0.5
QA	11/17/2006 ¹⁵	-	-	-	-	-	<50	<0.5	<0.5	<0.5	<0.5	<0.5
QA	02/16/2007 ¹⁵	-	-	-	-	-	<50	<0.5	<0.5	<0.5	<0.5	<0.5
QA	05/17/2007 ¹⁵	-	-	-	-	-	<50	<0.5	<0.5	<0.5	<0.5	<0.5
QA	08/09/2007 ¹⁵	-	-	-	-	-	<50	<0.5	<0.5	<0.5	<0.5	<0.5
QA	11/08/2007 ¹⁵	-	-	-	-	-	<50	<0.5	<0.5	<0.5	<0.5	<0.5
QA	02/06/2008 ¹⁵	-	-	-	-	-	<50	<0.5	<0.5	<0.5	<0.5	<0.5
QA	05/07/2008 ¹⁵	-	-	-	-	-	<50	<0.5	<0.5	<0.5	<0.5	<0.5
QA	09/11/2008 ¹⁵	-	-	-	-	-	<50	<0.5	<0.5	<0.5	<0.5	<0.5
QA	11/10/2008 ¹⁵	-	-	-	-	-	<50	<0.5	<0.5	<0.5	<0.5	<0.5
QA	02/09/2009 ¹⁵	-	-	-	-	-	<50	<0.5	<0.5	<0.5	<0.5	<0.5
QA	05/28/2009 ¹⁵	-	-	-	-	-	<50	<0.5	<0.5	<0.5	<0.5	<0.5
QA	08/18/2009 ¹⁵	-	-	-	-	-	<50	<0.5	<0.5	<0.5	<0.5	<0.5
QA	03/31/2010	-	-	-	-	-	<50	<0.5	<0.5	<0.5	<0.5	<0.5
QA	08/26/2010	-	-	-	-	-	<50	<0.5	<0.5	<0.5	<0.5	<0.5
QA	03/02/2011	-	-	-	-	-	<50	<0.5	<0.5	<0.5	<0.5	<0.5

Table 1

**Groundwater Monitoring and Sampling Data
Former Chevron Service Station 91153
3135 Gibbons Drive (3126 Fernside Boulevard)
Alameda, California**

Location	Date	TOC	DTW	GWE	LNAPLT	FIELD PARAMETERS	HYDROCARBONS	PRIMARY VOCS				
						Dissolved Oxygen	TPH-GRO	B	T	E	X	MTBE by SW6260
	Units	ft	ft	ft-amsl	ft	mg/L	µg/L	µg/L	µg/L	µg/L	µg/L	µg/L
QA	09/08/2011	-	-	-	-	-	<50	<0.5	<0.5	<0.5	<0.5	<0.5
QA	03/28/2012	-	-	-	-	-	<50	<0.5	<0.5	<0.5	<0.5	<0.5
QA	09/28/2012	-	-	-	-	-	<50	<0.5	<0.5	<0.5	<0.5	<0.5
QA	03/29/2013	-	-	-	-	-	<50	<0.5	<0.5	<0.5	<0.5	<0.5
QA	09/20/2013	-	-	-	-	-	<50	<0.5	<0.5	<0.5	<0.5	<0.5
QA	03/31/2014	-	-	-	-	-	<50	<0.5	<0.5	<0.5	<0.5	<0.5
QA	06/30/2014	-	-	-	-	-	<50	<0.5	<0.5	<0.5	<0.5	<0.5
QA	03/20/2015	-	-	-	0.00	-	<50	<0.5	<0.5	<0.5	<0.5	<0.5
QA	06/18/2015	-	-	-	0.00	-	<50	<0.5	<0.5	<0.5	<0.5	<0.5
QA	09/30/2014	-	-	-	-	-	<50	<0.5	<0.5	<0.5	<0.5	<0.5
QA	12/30/2014	-	-	-	-	-	<50	<0.5	<0.5	<0.5	<0.5	<0.5
QA	03/20/2015	-	-	-	-	-	<50	<0.5	<0.5	<0.5	<0.5	<0.5
QA	06/18/2015	-	-	-	-	-	<50	<0.5	<0.5	<0.5	<0.5	<0.5

Abbreviations and Notes:

TOC = Top of casing

DTW = Depth to water

GWE = Groundwater elevation

LNAPL - Light Non-Aqueous Phase Liquid

LNAPLT - Light Non-Aqueous Phase Liquid

(ft-amsl) = Feet above mean sea level

ft = Feet

mg/L - Milligrams per liter

µg/L = Micrograms per liter

TPH-GRO = Total petroleum hydrocarbons - gasoline range organics

Table 1

**Groundwater Monitoring and Sampling Data
Former Chevron Service Station 91153
3135 Gibbons Drive (3126 Fernside Boulevard)
Alameda, California**

Location	Date	TOC	DTW	GWE	LNAPLT	FIELD PARAMETERS	HYDROCARBONS	PRIMARY VOCS				
						Dissolved Oxygen	TPH+GRO	B	T	E	X	MTBE by SW8260
	Units	ft	ft	ft-amsl	ft	mg/L	µg/L	µg/L	µg/L	µg/L	µg/L	µg/L

VOCS = Volatile organic compounds

B = Benzene

T = Toluene

E = Ethylbenzene

X = Xylenes (Total)

MTBE = Methyl tert butyl ether

J = Estimated value (the result \geq the method detection limit < the limit of quantitation)

-- = Not available / not applicable

<x = Not detected above laboratory method detection limit

** GWE has been corrected due to the presence of LNAPL; correction factor: $[(TOC - DTW) + (LNAPLT \times 0.80)]$.

1 Laboratory report indicates EPA 8010 were not detected (ND)

2 MTBE confirmed

3 Chromatogram report indicates an unidentified hydrocarbon

4 ORC installed

5 TOC elevation altered due to well head maintenance

6 Laboratory report indicates gasoline C6-C12

7 ORC in well

8 Laboratory report indicates Dissolved Oxygen was 1.50 parts per million (ppm) by EPA Method 360.1

9 Laboratory report indicates Dissolved Oxygen was 0.300 ppm by EPA Method 360.1

10 Laboratory report indicates sample originally shot in hold time at a raise D.L. re-analyzed and reported past hold time

11 Laboratory report indicates this sample was analyzed outside of the EPA recommended holding time

12 Laboratory report indicates unidentified hydrocarbons C6-C12

13 Laboratory report indicates hydrocarbon pattern is present in the requested fuel quantitation range but does not resemble the pattern of the requested fuel

14 ORC removed

15 BTEX and MTBE by EPA Method 8260

Table 1

**Groundwater Monitoring and Sampling Data
Former Chevron Service Station 91153
3135 Gibbons Drive (3126 Fernside Boulevard)
Alameda, California**

Location	Date	TOC	DTW	GWE	LNAPLT	FIELD PARAMETERS	HYDROCARBONS	PRIMARY VOCS				
						Dissolved Oxygen	TPH+GRO	B	T	E	X	MTBE by SW6260
	Units	ft	ft	ft-amsl	ft	mg/L	µg/L	µg/L	µg/L	µg/L	µg/L	µg/L

- 16 Laboratory confirmed analytical result
- 17 The vial submitted did not have pH<2. The pH of this sample used for the undiluted analysis was pH = 3
- 18 Not sampled due to the presence of LNAPL in the well.
- 19 Sampled annually.
- 20 Sampled semi-annually
- 21 Inaccessible
- 22 Insufficient Water

Attachment A Monitoring Data Package



June 26, 2015

Chevron Environmental Management Company
Mark Horne
6101 Bollinger Canyon Rd.
San Ramon, CA 94583

Second Quarter 2015 Monitoring at
Chevron Service Station 9-1153
3135 Gibbons Dr.
Alameda, CA

Monitoring performed on June 18, 2015

Blaine Tech Services, Inc. Groundwater Monitoring Event 150618-DB1

This submission covers the routine monitoring of groundwater wells conducted on June 18, 2015 at this location. Nine monitoring wells were measured for depth to groundwater (DTW). One monitoring well was sampled. The spent SPH sorbent sock in well C-1 was replaced with a new sorbent sock after the well was sampled. The sorbent sock was placed in a drum and removed the same day by Belshire Environmental Services. All sampling activities were performed in accordance with local, state and federal guidelines.

Water levels measurements were collected using an electronic slope indicator. All sampled wells were purged of three case volumes, depending on well recovery, or until water temperature, pH and conductivity stabilized. Purging was accomplished using electric submersible pumps, positive air displacement pumps, or stainless steel, Teflon, or disposable bailers. Subsequent sample collection and sample handling was performed in accordance with EPA protocols. Alternately, where applicable, wells were sampled utilizing no-purge methodology. All reused equipment was decontaminated in an integrated stainless steel sink with de-ionized water supplied Hotsy pressure washer and Liquinox or equivalent.

Second Quarter Groundwater Monitoring at Chevron 91153, 3135 Gibbons Dr., Alameda, CA

SAN JOSE

SACRAMENTO

LOS ANGELES

SAN DIEGO

1680 ROGERS AVENUE

SAN JOSE, CA 95112-1105

(408) 573-0555

FAX (408) 573-7771

LIC. 746684

www.blainetech.com

Samples were delivered under chain-of-custody to Lancaster Laboratories of Lancaster, Pennsylvania, for analysis. Monitoring well purgewater and equipment rinsate water was collected and transported under bill-of-lading to Blaine Tech of San Jose, California.

Enclosed documentation from this event includes copies of the Well Gauging Sheet, Well Monitoring Data Sheets, and Chain-of-Custody.

Blaine Tech Services, Inc.'s activities at this site consisted of objective data and sample collection only. No interpretation of analytical results, defining of hydrogeologic conditions or formulation of recommendations was performed.

Please call if you have any questions.

Sincerely,



Dustin Becker
Blaine Tech Services, Inc.
Senior Project Manager

attachments: SOP
Well Gauging Sheet
Individual Well Monitoring Data Sheets
Wellhead Inspection Form
Bill of Lading
Calibration Log

cc: Stantec
Attn: Nathan Lee
2300 Clayton Rd., Ste 920
Concord, CA 94520

Second Quarter Groundwater Monitoring at Chevron 91153, 3135 Gibbons Dr., Alameda, CA

SAN JOSE

SACRAMENTO

LOS ANGELES

SAN DIEGO

1680 ROGERS AVENUE

SAN JOSE, CA 95112-1105

(408) 573-0555

FAX (408) 573-7771

LIC. 746684

www.blainetech.com

BLAINE TECH SERVICES, INC. METHODS AND PROCEDURES FOR THE ROUTINE MONITORING OF GROUNDWATER WELLS AT CHEVRON SITES

Blaine Tech Services, Inc. performs environmental sampling and documentation as an independent third party. We specialize in groundwater monitoring assignments and intentionally limit the scope of our services to those centered on the generation of objective information.

To avoid conflicts of interest, Blaine Tech Services, Inc. personnel do not evaluate or interpret the information we collect. As a state licensed contractor (C-57 well drilling –water – 746684) performing strictly technical services, we do not make any professional recommendations and perform no consulting of any kind.

SAMPLING PROCEDURES OVERVIEW

SAFETY

All groundwater monitoring assignments performed for Chevron comply with Chevron's safety guidelines, 29 CFR 1910.120 and SB-198 Injury and Illness Prevention Program (IIPP). All Field Technicians receive the full 40-hour 29CFR 1910.120 OSHA SARA HAZWOPER course, medical clearance and on-the-job training prior to commencing any work on any Chevron site.

INSPECTION AND GAUGING

Wells are inspected prior to evacuation and sampling. The condition of the wellhead is checked and noted according to a wellhead inspection checklist.

Standard measurements include the depth to water (DTW) and the total well depth (TD) obtained with industry standard electronic water level indicators that are graduated in increments of hundredths of a foot.

The water in each well is inspected for the presence of immiscibles. When free product is suspected, its presence is confirmed using an electronic interface probe (e.g. GeoTech). No samples are collected from a well containing product.

TRADITIONAL PURGING & SAMPLING

Evacuation

Depth to water measurements are collected by our personnel prior to purging and minimum purge volumes are calculated anew for each well based on the height of the water column and the diameter of the well. Expected purge volumes are never less than three case volumes and are set at no less than four case volumes in some jurisdictions.

Well purging devices are selected on the basis of the well diameter and the total volume to be evacuated. In most cases the well will be purged using an electric submersible pump (i.e. Grundfos) suspended near (but not touching) the bottom of the well.

Parameter Stabilization

Well purging completion standards include minimum purge volumes, but additionally require stabilization of specific groundwater parameters prior to sample collection. Typical groundwater parameters used to measure stability are electrical conductivity, pH, and temperature. Instrument readings are obtained at regular intervals during the evacuation process (no less than once per case volume).

Stabilization standards for routine quarterly monitoring of fuel sites include the following: Temperature is considered to have stabilized when successive readings do not fluctuate more than +/- 1 degree Celsius. Electrical conductivity is considered stable when successive readings are within 10%. pH is considered to be stable when successive readings remain constant or vary no more than 0.2 of a pH unit.

Sample Collection

All samples are collected using disposable bailers.

Sample Containers

Sample material is decanted directly from the sampling bailer into sample containers provided by the laboratory that will analyze the samples. The transfer of sample material from the bailer to the sample container conforms to specifications contained in the USEPA T.E.G.D. The type of sample container, material of construction, method of closure and filling requirements are specific to the intended analysis. Chemicals needed to preserve the sample material are commonly placed inside the sample containers by the laboratory or glassware vendor prior to delivery of the bottle to our personnel. The laboratory sets the number of replicate containers.

Dewatered Wells

Normal evacuation removes no less than three case volumes of water from the well. However, less water may be removed in cases where the well dewateres and does not immediately recharge.

Measuring Recharge

Upon completion of well purging, a depth to water measurement is collected and notated to ensure that the well has recharged to within 80% of its static, pre-purge level prior to sampling.

Wells that do not immediately show 80% recharge or dewatered wells will be allowed approximately 2 hours to recharge prior to sampling or will be sampled at site departure. All wells requiring off-site traffic control in the public right-of-way, the 80% recharge rule may be disregarded in the interests of Health and Safety. The sample may be collected as soon as there is sufficient water. The water level at time of sampling will be noted.

Dissolved Oxygen Measurements

Dissolved Oxygen readings are taken pre- and/or post-purge using YSI meters (e.g. YSI Model 550) or HACH field test kits.

The YSI meters are able to collect accurate in-situ readings. The probe allows downhole measurements to be taken from wells with diameters as small as two inches. The probe and reel is decontaminated between wells as described above. The meter is calibrated

as per the instructions in the operating manual. The probe is lowered into the water column and the reading is allowed to stabilize prior to collection.

Oxidation Reduction Potential Measurements (ORP)

All readings are obtained with either Corning or Myron-L meters (e.g. Corning ORP-65 or a Myron-L Ultrameter). The meter is cleaned between wells as described above. The meter is calibrated at the start of each day according to the instruction manual.

LOW FLOW SAMPLING USING SAMPLE-PRO BLADDER PUMP

Calibration

Calibrate YSI Flow Cell as per manufacturer's specifications. Thoroughly rinse probe and cup between parameters. Calibration order as follows:

1. pH (use 3-point calibration of 7, 4, 10)
2. Specific Conductance
3. Temperature

Purging & Sampling Collection

1. Insert new bladder into Sample-Pro pump housing.
2. Remove dedicated PE tubing from the well or start with new PE tubing cut to the required length.
3. Attach the PE tubing to the Sample-Pro Bladder Pump.
4. Gently lower the Sample-Pro Bladder Pump, and PE tubing into the well, placing the Sample-Pro Bladder Pump intake at the specified screened interval. Take care to minimize disturbance to the water column.
5. Direct effluent line into YSI 556 Flow Cell.
6. Set Sample-Pro Bladder Pump speed at 100 - 500 ml/min.
7. Collect water quality parameter measurements for temperature, pH, conductivity, turbidity, DO and ORP every 3-5 minutes.
8. Monitor drawdown during purging with electronic water level meter. Record water level with each parameter measurement. **MAXIMUM DRAWDOWN IS 0.33 FEET.**
9. Collect parameter measurements until stability is achieved. Stability is defined as three consecutive measurements where:

Temp	± 1° Celsius
pH	± 0.1
Conductivity	± 3%

10. Sample may be collected once one system has been removed and stability readings have been achieved after the system volume has been removed.
11. Disconnect effluent line from YSI 556 Flow Cell.
12. Sample through effluent line while maintaining constant flow rate.
13. Remove Sample-Pro Bladder Pump, and PE tubing from well.
14. Detach and reinstall dedicated PE tubing in well.

PURGEWATER CONTAINMENT

All non-hazardous purgewater evacuated from each groundwater monitoring well is captured and contained in on-board storage tanks on the Sampling Vehicle and/or special water hauling trailers. Effluent from the decontamination of reusable apparatus (sounders, electric pumps and hoses etc.), consisting of groundwater combined with deionized water and non-phosphate soap, is also captured and pumped into effluent tanks.

Non-hazardous purgewater is transported under standard Bill of Lading or Non-Hazardous Waste Manifest to a Blaine Tech Services, Inc. facility before being transported to a Chevron approved disposal facility

TRIP BLANKS

Trip Blanks, if requested, are taken to the site and kept inside the sample cooler for the duration of the event. They are turned over to the laboratory for analysis with the samples from that site.

DUPLICATES

Duplicates, if requested, may be collected at a site.

SAMPLE STORAGE

All sample containers are promptly placed in food grade ice chests for storage in the field and transport (direct or via our facility) to the designated analytical laboratory. These ice chests contain quantities of restaurant grade ice as a refrigerant material. The samples are maintained in either an ice chest or a refrigerator until relinquished into the custody of the laboratory or laboratory courier.

DOCUMENTATION CONVENTIONS

A label must be affixed to all sample containers. In most cases these labels are generated by our office personnel and are partially preprinted. Labels can also be hand written by our field personnel. The site is identified with the store number and site address, as is the particular groundwater well from which the sample is drawn (e.g. MW-1, MW-2, S-1 etc.). The time and date of sample collection along with the initials of the person who collects the sample are handwritten onto the label. Field documentation is contemporaneous.

DECONTAMINATION

All equipment is brought to the site in clean and serviceable condition and is cleaned after use in each well and before subsequent use in any other well. Equipment such as hose reels, pumps and bailers is decontaminated before leaving the site.

The primary decontamination device is a commercial steam cleaner. The steam cleaner is de-tuned to function as a hot pressure washer that is then operated with high quality deionized water that is produced at our facility and stored onboard our sampling vehicle. Cleaning is facilitated by the use of proprietary fixtures and devices included in the patented workstation (U.S. Patent 5,535,775) that is incorporated in each sampling vehicle. Any sensitive equipment or parts (i.e. Dissolved Oxygen sensor membrane, water level

indicator, etc.) that cannot be washed using the high pressure water, will be sprayed with a non-phosphate soap and deionized water solution and rinsed with deionized water.

FERROUS IRON MEASUREMENTS

All field measurements are collected at time of sampling with a HACH test kit.

WELL GAUGING DATA

Project # 1570 150615-031 Date 6/15/15 Client Chevron

Site 3135 Gibbons Dr., Alameda

Well ID	Time	Well Size (in.)	Sheen / Odor	Depth to Immiscible Liquid (ft.)	Thickness of Immiscible Liquid (ft.)	Volume of Immiscibles Removed (ml)	Depth to water (ft.)	Depth to well bottom (ft.)	Survey Point: TOB or <u>TOC</u>	Notes
C-1	0845	3					4.32	17.50		SUCK
C-3	0907	3				4.38	18.81			
MW-4	0855	2				3.63	12.72			
MW-5	0850	2				3.48	12.34			
MW-6	0904	2				4.31	13.39			
MW-7	0915 0915	2				4.59	5.63			
MW-8	0910	2				4.19	9.07			
MW-9	0900	2				4.53	8.49			
MW-10	1020	2				3.47 3.88	8.88			

CHEVRON WELL MONITORING DATA SHEET

Project #: 150615 - DS1	Station #: 9-1153
Sampler: DS	Date: 6/18/15
Weather: Clear	Ambient Air Temperature: 68°F
Well I.D.: 4" C-1	Well Diameter: 2 (3) 4 6 8
Total Well Depth: 17.50	Depth to Water: 4.32
Depth to Free Product:	Thickness of Free Product (feet):
Referenced to: <u>PVC</u> Grade	D.O. Meter (if req'd): YSI HACH
DTW with 80% Recharge [(Height of Water Column x 0.20) + DTW]: 6.95	

Purge Method:

- Bailer
 Disposable Bailer
 Positive Air Displacement
 Electric Submersible
 Waterra
 Peristaltic
 Extraction Pump
 Other _____

Sampling Method:

- Bailer
 Disposable Bailer
 Extraction Port
 Dedicated Tubing
 Other: _____

4.9 (Gals.) X	3	= 14.7 Gals.
I Case Volume	Specified Volumes	Calculated Volume

Well Diameter	Multiplier	Well Diameter	Multiplier
1"	0.04	4"	0.65
2"	0.16	6"	1.47
3"	0.37	Other	radius ² * 0.163

Time	Temp (°F)	pH	Cond. (mS or <u>μS</u>)	Turbidity (NTUs)	Gals. Removed	Observations
0936	74.3	6.01	970.2	>1000	5	
0942	74.7	6.09	1001	>1000	10	
0950	74.7	6.11	1010	>1000	15	

Did well dewater? Yes No Gallons actually evacuated: 15

Sampling Date: 6/18/15 Sampling Time: 0955 Depth to Water: 6.51

Sample I.D.: C-1 Laboratory: Lancaster Other _____

Analyzed for: TPH-G BTEX MTBE OXYS Other: SEE COC

Duplicate I.D.: Analyzed for: TPH-G BTEX MTBE OXYS Other:

D.O. (if req'd):	Pre-purge: mg/L	Post-purge: mg/L
------------------	--	---

O.R.P. (if req'd):	Pre-purge: mV	Post-purge: mV
--------------------	--	---

CHAIN OF CUSTODY FORM

Chevron Environmental Management Company ■ 6111 Bollinger Canyon Rd. ■ San Ramon, CA 94583 COC 1 of 1

Chevron Site Number: 91153
 Chevron Site Global ID: T0600100330
 Chevron Site Address: 3135 Gibbons Dr., Alameda, CA
 Chevron PM: Mark Horne
 Chevron PM Phone No.: (925) 790-3964
 Retail and Terminal Business Unit (RTBU) Job
 Construction/Retail Job

Chevron Consultant: CRA
 Address: 2300 Clayton Rd., Ste 920, Concord, CA
 Consultant Contact: Nathan Lee
 Consultant Phone No. 925-849-1003
 Consultant Project No. 150615-081
 Sampling Company: Blaine Tech Services
 Sampled By (Print): Dustin Becker
 Sampler Signature: [Signature]

ANALYSES REQUIRED

<input type="checkbox"/> H	<input type="checkbox"/> H	<input type="checkbox"/> EPA 8260B/GC/MS TPH-G <input type="checkbox"/>	<input type="checkbox"/> BIEX <input checked="" type="checkbox"/>	<input type="checkbox"/> MTBE <input checked="" type="checkbox"/>	<input type="checkbox"/> OXYGENATES <input type="checkbox"/>	<input type="checkbox"/> HVOC <input type="checkbox"/>	<input type="checkbox"/> EPA 8015B GRO <input checked="" type="checkbox"/>	<input type="checkbox"/> DRO <input type="checkbox"/>	<input type="checkbox"/> ORO <input type="checkbox"/>	<input type="checkbox"/> HC SCREEN <input type="checkbox"/>	<input type="checkbox"/> EPA 8021B BTEX <input type="checkbox"/>	<input type="checkbox"/> MTBE <input type="checkbox"/>	<input type="checkbox"/> EPA 6010 Ca, Fe, K, Mg, Mn, Na	<input type="checkbox"/> EPA 6010/7000 TITLE 22 METALS <input type="checkbox"/>	<input type="checkbox"/> TTLC <input type="checkbox"/>	<input type="checkbox"/> STLC <input type="checkbox"/>	<input type="checkbox"/> EPA 310.1 ALKALINITY <input type="checkbox"/>	<input type="checkbox"/> SM2510B SPECIFIC CONDUCTIVITY	<input type="checkbox"/> EPA 418.1 TRPH <input type="checkbox"/>	<input type="checkbox"/> EPA 413.1 OIL & GREASE <input type="checkbox"/>	<input type="checkbox"/> EPA 8260 ETHANOL	<input type="checkbox"/> EPA 8015 TPH-D <input type="checkbox"/>
----------------------------	----------------------------	--	---	---	--	--	---	---	---	---	---	--	--	--	--	--	---	---	---	---	--	---

Preservation Codes
 H = HCL T = Thiosulfate
 N = HNO₃ B = NaOH
 S = H₂SO₄ O = Other

Charge Code: NWRTB-0098247-0-OML
NWRTB 00SITE NUMBER-0- WBS
(WBS ELEMENTS:
 SITE ASSESSMENT: A1L REMEDIATION IMPLEMENTATION: R5L
 SITE MONITORING: OML OPERATION MAINTENANCE & MONITORING: M1L
THIS IS A LEGAL DOCUMENT. ALL FIELDS MUST BE FILLED OUT CORRECTLY AND COMPLETELY.

Lancaster Laboratories
 Lancaster, PA
 Lab Contact: Nicole Maljovec
 2425 New Holland Pike,
 Lancaster, PA 17601
 Phone No:
 (717)656-2300

Other Lab	Temp. Blank Check Time	Temp.
	<u>0830</u>	<u>20C</u>
	<u>0730</u>	<u>20C</u>
	<u>1230</u>	<u>20C</u>

Special Instructions
 Must meet 5.0 PPB detection limit by 8260

SAMPLE ID				Sample Time	# of Containers	Container Type	ANALYSES REQUIRED												Notes/Comments								
Field Point Name	Matrix	Top Depth	Date (yyymmdd)				EPA 8260B/GC/MS TPH-G <input type="checkbox"/>	BIEX <input checked="" type="checkbox"/>	MTBE <input checked="" type="checkbox"/>	OXYGENATES <input type="checkbox"/>	HVOC <input type="checkbox"/>	EPA 8015B GRO <input checked="" type="checkbox"/>	DRO <input type="checkbox"/>	ORO <input type="checkbox"/>	HC SCREEN <input type="checkbox"/>	EPA 8021B BTEX <input type="checkbox"/>	MTBE <input type="checkbox"/>	EPA 6010 Ca, Fe, K, Mg, Mn, Na		EPA 6010/7000 TITLE 22 METALS <input type="checkbox"/>	TTLC <input type="checkbox"/>	STLC <input type="checkbox"/>	EPA 310.1 ALKALINITY <input type="checkbox"/>	SM2510B SPECIFIC CONDUCTIVITY	EPA 418.1 TRPH <input type="checkbox"/>	EPA 413.1 OIL & GREASE <input type="checkbox"/>	EPA 8260 ETHANOL
<u>C-1</u>	<u>W</u>		<u>150618</u>	<u>0955</u>	<u>6</u>	<u>VOAS</u>	<input checked="" type="checkbox"/>	<input checked="" type="checkbox"/>																			
<u>QA</u>	<u>W</u>		<u>150618</u>	<u>0830</u>	<u>2</u>	<u>VOAS</u>	<input checked="" type="checkbox"/>	<input checked="" type="checkbox"/>																			

Relinquished By <u>[Signature]</u>	Company <u>B13</u>	Date/Time: <u>6/18/15 1500</u>	Relinquished To	Company	Date/Time
Relinquished By	Company	Date/Time	Relinquished To	Company	Date/Time
Relinquished By	Company	Date/Time	Relinquished To	Company	Date/Time

Turnaround Time:
 Standard 24 Hours 48 hours 72
 Hours Other
 Sample Integrity: (Check by lab on arrival)
 Intact: _____ On Ice: _____ Temp: _____
 COC # _____

SHIPPED VIA UPS

WELLHEAD INSPECTION CHECKLIST

Page 1 of 1

Client Chowan Date 6/18/15

Site Address 3135 Gibbons Dr., Alameda

Job Number 150615-DB1 Technician [Signature]

Well ID	Well Inspected - No Corrective Action Required	WELL IS SECURABLE BY DESIGN (12" or less)	WELL IS CLEARLY MARKED WITH THE WORDS "MONITORING WELL" (12" or less)	Water Bailed From Wellbox	Wellbox Components Cleaned	Cap Replaced	Lock Replaced	Other Action Taken (explain below)	Well Not Inspected (explain below)	Repair Order Submitted
C-1	X	X	X							
C-3	X	X	X							
MW-4		X	X	X						
MW-5		X	X	X						
MW-6	X	X	X							
MW-7		X	X	X						
MW-8		X	X							
MW-9	X	X	X							
MW-10		X		X						

NOTES: MW-4 - 2/2 bolts missing
 MW-5 - 2/2 bolts missing
 MW-8 - 2/3 bolts missing
 MW-9 - 3/3 bolts missing

SOURCE RECORD **BILL OF LADING**

FOR PURGEWATER RECOVERED FROM GROUNDWATER WELLS AT CHEVRON FACILITIES IN THE STATE OF CALIFORNIA. THE PURGE- WATER WHICH HAS BEEN RECOVERED FROM GROUND- WATER WELLS IS COLLECTED BY THE CONTRACTOR AND HAULED TO THEIR FACILITY IN SAN JOSE, CALIFORNIA FOR TEMPORARILY HOLDING PENDING TRANSPORT BY OTHERS TO FINAL DESTINATION.

The contractor performing this work is BLAINE TECH SERVICES, INC. (BLAINE TECH), 1680 Rogers Ave. San Jose CA (408) 573-0555). BLAINE TECH. is authorized by Chevron Environmental Management Company (CHEVRON EMC) to recover, collect, apportion into loads, and haul the purgewater that is drawn from wells at the CHEVRON EMC facility indicated below and to deliver that purgewater to BLAINE TECH for temporarily holding. Transport routing of the purgewater may be direct from one CHEVRON EMC facility to BLAINE TECH; from one CHEVRON EMC facility to BLAINE TECH via another CHEVRON EMC facility; or any combination thereof. The well purgewater is and remains the property of CHEVRON EMC.

This **Source Record BILL OF LADING** was initiated to cover the recovery of Non-Hazardous Well Purgewater from wells at the Chevron facility described below:

9-1153	Mark Horne		
CHEVRON #	Chevron Engineer		
3135	Gibbons Dr.	Alameda	CA
street number	street name	city	state

WELL I.D.	GALS.	WELL I.D.	GALS.
C-1	15		
	/		/
	/		/
	/		/
	/		/
	/		/
	/		/
	/		/
	/		/
	/		/
	/		/
	/		/
	/		/
added equip.		any other	
rinse water	1	adjustments	/
TOTAL GALS.	<u>16</u>	loaded onto	<u>89</u>
RECOVERED		BTS vehicle #	
BTS event #	time	date	
150618-DB1	1030	6/18/15	
Transporter signature 			

REC'D AT	time	date	
BTS San Jose	1500	6/18/15	
Unloaded/received by			
signature 			

Attachment B Laboratory Analytical Report

ANALYTICAL RESULTS

Prepared by:

Eurofins Lancaster Laboratories Environmental
2425 New Holland Pike
Lancaster, PA 17601

Prepared for:

Chevron
6001 Bollinger Canyon Rd L4310
San Ramon CA 94583

July 08, 2015

Project: 91153

Submittal Date: 06/19/2015
Group Number: 1570572
PO Number: 0015166637
Release Number: HORNE
State of Sample Origin: CA

Client Sample Description

C-1-W-150618 NA Water
QA-T-150618 NA Water

Lancaster Labs (LL)

7936331
7936332

The specific methodologies used in obtaining the enclosed analytical results are indicated on the Laboratory Sample Analysis Record.

Regulatory agencies do not accredit laboratories for all methods, analytes, and matrices. Our scopes of accreditation can be viewed at <http://www.eurofinsus.com/environment-testing/laboratories/eurofins-lancaster-laboratories-environmental/resources/certifications/>.

ELECTRONIC COPY TO	CRA	Attn: Nathan Lee
ELECTRONIC COPY TO	Chevron	Attn: Anna Avina
ELECTRONIC COPY TO	Blaine Tech Services, Inc.	Attn: Dustin Becker
ELECTRONIC COPY TO	Chevron c/o CRA	Attn: Report Contact

Respectfully Submitted,



Amek Carter
Specialist

(717) 556-7252

Sample Description: C-1-W-150618 NA Water
Facility# 91153 BTST
3135 Gibbons-Alameda T0600100330

LL Sample # WW 7936331
LL Group # 1570572
Account # 10991

Project Name: 91153

Collected: 06/18/2015 09:55 by DB

Chevron

6001 Bollinger Canyon Rd L4310
San Ramon CA 94583

Submitted: 06/19/2015 09:50

Reported: 07/08/2015 01:08

GDAC1

CAT No.	Analysis Name	CAS Number	Result	Method Detection Limit*	Limit of Quantitation	Dilution Factor
GC/MS Volatiles SW-846 8260B						
10945	Benzene	71-43-2	6,000	ug/l	ug/l	
10945	Ethylbenzene	100-41-4	600	ug/l	ug/l	
10945	Methyl Tertiary Butyl Ether	1634-04-4	N.D.	ug/l	ug/l	
10945	Toluene	108-88-3	65	ug/l	ug/l	
10945	Xylene (Total)	1330-20-7	1,000	ug/l	ug/l	
GC Volatiles SW-846 8015B						
01728	TPH-GRO N. CA water C6-C12	n.a.	24,000	ug/l	ug/l	25

General Sample Comments

CA ELAP Lab Certification No. 2792

All QC is compliant unless otherwise noted. Please refer to the Quality Control Summary for overall QC performance data and associated samples.

Laboratory Sample Analysis Record

CAT No.	Analysis Name	Method	Trial#	Batch#	Analysis Date and Time	Analyst	Dilution Factor
10945	BTEX/MTBE	SW-846 8260B	1	D151762AA	06/25/2015 08:30	Anita M Dale	1
10945	BTEX/MTBE	SW-846 8260B	1	D151762AA	06/25/2015 16:56	Anita M Dale	20
10945	BTEX/MTBE	SW-846 8260B	1	D151792AA	06/28/2015 15:42	Anita M Dale	200
01163	GC/MS VOA Water Prep	SW-846 5030B	1	D151762AA	06/25/2015 08:30	Anita M Dale	1
01163	GC/MS VOA Water Prep	SW-846 5030B	2	D151762AA	06/25/2015 16:56	Anita M Dale	20
01163	GC/MS VOA Water Prep	SW-846 5030B	3	D151792AA	06/28/2015 15:42	Anita M Dale	200
01728	TPH-GRO N. CA water C6-C12	SW-846 8015B	1	15178A20A	06/27/2015 21:39	Jeremy C Giffin	25
01146	GC VOA Water Prep	SW-846 5030B	1	15178A20A	06/27/2015 21:39	Jeremy C Giffin	25

*=This limit was used in the evaluation of the final result

Sample Description: QA-T-150618 NA Water
Facility# 91153 BTST
3135 Gibbons-Alameda T0600100330

LL Sample # WW 7936332
LL Group # 1570572
Account # 10991

Project Name: 91153

Collected: 06/18/2015 08:30

Chevron

Submitted: 06/19/2015 09:50

6001 Bollinger Canyon Rd L4310

Reported: 07/08/2015 01:08

San Ramon CA 94583

GCAQA

CAT No.	Analysis Name	CAS Number	Result	Method Detection Limit*	Limit of Quantitation	Dilution Factor
GC/MS Volatiles SW-846 8260B						
10945	Benzene	71-43-2	N.D.	ug/l 0.5	ug/l 1	1
10945	Ethylbenzene	100-41-4	N.D.	0.5	1	1
10945	Methyl Tertiary Butyl Ether	1634-04-4	N.D.	0.5	1	1
10945	Toluene	108-88-3	N.D.	0.5	1	1
10945	Xylene (Total)	1330-20-7	N.D.	0.5	1	1
GC Volatiles SW-846 8015B						
01728	TPH-GRO N. CA water C6-C12	n.a.	N.D.	ug/l 50	ug/l 100	1

General Sample Comments

CA ELAP Lab Certification No. 2792

All QC is compliant unless otherwise noted. Please refer to the Quality Control Summary for overall QC performance data and associated samples.

Laboratory Sample Analysis Record

CAT No.	Analysis Name	Method	Trial#	Batch#	Analysis Date and Time	Analyst	Dilution Factor
10945	BTEX/MTBE	SW-846 8260B	1	D151762AA	06/25/2015 08:07	Anita M Dale	1
01163	GC/MS VOA Water Prep	SW-846 5030B	1	D151762AA	06/25/2015 08:07	Anita M Dale	1
01728	TPH-GRO N. CA water C6-C12	SW-846 8015B	1	15178A20A	06/27/2015 13:55	Jeremy C Giffin	1
01146	GC VOA Water Prep	SW-846 5030B	1	15178A20A	06/27/2015 13:55	Jeremy C Giffin	1

*=This limit was used in the evaluation of the final result

Quality Control Summary

Client Name: Chevron
Reported: 07/08/2015 01:08

Group Number: 1570572

Matrix QC may not be reported if insufficient sample or site-specific QC samples were not submitted. In these situations, to demonstrate precision and accuracy at a batch level, a LCS/LCSD was performed, unless otherwise specified in the method.

All Inorganic Initial Calibration and Continuing Calibration Blanks met acceptable method criteria unless otherwise noted on the Analysis Report.

Laboratory Compliance Quality Control

<u>Analysis Name</u>	<u>Blank Result</u>	<u>Blank MDL**</u>	<u>Blank LOQ</u>	<u>Report Units</u>	<u>LCS %REC</u>	<u>LCSD %REC</u>	<u>LCS/LCSD Limits</u>	<u>RPD</u>	<u>RPD Max</u>
Batch number: D151762AA	Sample number(s): 7936331-7936332								
Benzene	N.D.	0.5	1	ug/1	94		78-120		
Ethylbenzene	N.D.	0.5	1	ug/1	93		80-120		
Methyl Tertiary Butyl Ether	N.D.	0.5	1	ug/1	97		75-120		
Toluene	N.D.	0.5	1	ug/1	95		80-120		
Xylene (Total)	N.D.	0.5	1	ug/1	96		80-120		
Batch number: D151792AA	Sample number(s): 7936331								
Benzene	N.D.	0.5	1	ug/1	89	88	78-120	1	30
Batch number: 15178A20A	Sample number(s): 7936331-7936332								
TPH-GRO N. CA water C6-C12	N.D.	50.	100	ug/1	91	90	80-139	1	30

Sample Matrix Quality Control

Unspiked (UNSPK) = the sample used in conjunction with the matrix spike
Background (BKG) = the sample used in conjunction with the duplicate

<u>Analysis Name</u>	<u>MS %REC</u>	<u>MSD %REC</u>	<u>MS/MSD Limits</u>	<u>RPD</u>	<u>RPD MAX</u>	<u>BKG Conc</u>	<u>DUP Conc</u>	<u>DUP RPD</u>	<u>Dup RPD Max</u>
Batch number: D151762AA	Sample number(s): 7936331-7936332 UNSPK: 7936331								
Benzene	-416 (2)	-405 (2)	72-134	0	30				
Ethylbenzene	-102 (2)	-92 (2)	71-134	0	30				
Methyl Tertiary Butyl Ether	92	94	72-126	3	30				
Toluene	95	93	80-125	0	30				
Xylene (Total)	44 (2)	33 (2)	79-125	1	30				

Surrogate Quality Control

Surrogate recoveries which are outside of the QC window are confirmed unless attributed to dilution or otherwise noted on the Analysis Report.

Analysis Name: BTEX/MTBE
Batch number: D151762AA

	Dibromofluoromethane	1,2-Dichloroethane-d4	Toluene-d8	4-Bromofluorobenzene
7936331	97	92	100	105

*- Outside of specification

** - This limit was used in the evaluation of the final result for the blank

- (1) The result for one or both determinations was less than five times the LOQ.
- (2) The unspiked result was more than four times the spike added.

Quality Control Summary

Client Name: Chevron
Reported: 07/08/2015 01:08

Group Number: 1570572

Surrogate Quality Control

7936332	104	101	98	95
Blank	104	98	99	96
LCS	101	100	100	101
MS	97	94	101	107
MSD	96	97	101	105
Limits:	80-116	77-113	80-113	78-113

Analysis Name: TPH-GRO N. CA water C6-C12
Batch number: 15178A20A
Trifluorotoluene-F

7936331	99
7936332	94
Blank	93
LCS	105
LCSD	105
Limits:	63-135

*- Outside of specification

** - This limit was used in the evaluation of the final result for the blank

- (1) The result for one or both determinations was less than five times the LOQ.
- (2) The unspiked result was more than four times the spike added.

CHAIN OF CUSTODY FORM

Chevron Environmental Management Company ■ 6111 Bollinger Canyon Rd. ■ San Ramon, CA 94583 COC 1 of 1

Chevron Site Number: 91153
 Chevron Site Global ID: T0600100330
 Chevron Site Address: 3135 Gibbons Dr., Alameda, CA
 Chevron PM: Mark Horne
 Chevron PM Phone No.: (925) 790-3964
 Retail and Terminal Business Unit (RTBU) Job
 Construction/Retail Job

Chevron Consultant: CRA
 Address: 2300 Clayton Rd., Ste 920, Concord, CA
 Consultant Contact: Nathan Lee
 Consultant Phone No. 925-849-1003
 Consultant Project No. 150618-081
 Sampling Company: Blaine Tech Services
 Sampled By (Print): Dustin Becker
 Sampler Signature: [Signature]

ANALYSES REQUIRED

- TPH-G BTEX MTBE OXYGENATES HVOC
- EPA 8015B GRO DRO HC SCREEN
- EPA 8021B BTEX MTBE
- EPA 6010 Ca, Fe, K, Mg, Mn, Na
- EPA6010/7000 TITLE 22 METALS TTLC STLC
- EPA150.1 PH EPA 310.1 ALKALINITY
- SM2510B SPECIFIC CONDUCTIVITY
- EPA 418.1 TRPH EPA 413.1 OIL & GREASE
- EPA 8260 ETHANOL
- EPA 8015 TPH-D

Preservation Codes
 H = HCL T = Thiosulfate
 N = HNO₃ B = NaOH
 S = H₂SO₄ O = Other
 10991
 1570572
 7936331-32
 Special Instructions
 Must meet 5.0 PPB detection limit by 8260

Charge Code: NWRBTB-0098247-0-OML
 NWRBTB 00SITE NUMBER-0- WBS
(WBS ELEMENTS:
 SITE ASSESSMENT: A1L REMEDIATION IMPLEMENTATION: R5L
 SITE MONITORING: OML OPERATION MAINTENANCE & MONITORING: M1L
THIS IS A LEGAL DOCUMENT. ALL FIELDS MUST BE FILLED OUT CORRECTLY AND COMPLETELY.

Lancaster Laboratories
 Lancaster, PA
 Lab Contact: Nicole Maljovec
 2425 New Holland Pike, Lancaster, PA 17601
 Phone No: (717)656-2300

Other Lab	Temp. Blank	Check Time	Temp.
	0830		20C
	0730		20C
	0730		20C

SAMPLE ID				Sample Time	# of Containers	Container Type
Field Point Name	Matrix	Top Depth	Date (yymmdd)			
C-1	W		150618	0955	6	VOAS
QA	W		150618	0830	2	VOAS

Field Point Name	Matrix	Top Depth	Date (yymmdd)	Sample Time	# of Containers	Container Type
C-1	W		150618	0955	6	VOAS
QA	W		150618	0830	2	VOAS

Relinquished By <u>[Signature]</u>	Company B13	Date/Time: 6/16/15 1500	Relinquished To <u>[Signature]</u>	Company ELLE	Date/Time 6/19/15 0950
---------------------------------------	----------------	----------------------------	---------------------------------------	-----------------	---------------------------

Turnaround Time:
 Standard 24 Hours 48 hours 72 Hours Other
 Sample Integrity: (Check by lab on arrival)
 Intact: On Ice: Temp: 1.2 °C
 COC #

DELIVERED VIA UPS

Explanation of Symbols and Abbreviations

The following defines common symbols and abbreviations used in reporting technical data:

RL	Reporting Limit	BMQL	Below Minimum Quantitation Level
N.D.	none detected	MPN	Most Probable Number
TNTC	Too Numerous To Count	CP Units	cobalt-chloroplatinate units
IU	International Units	NTU	nephelometric turbidity units
umhos/cm	micromhos/cm	ng	nanogram(s)
C	degrees Celsius	F	degrees Fahrenheit
meq	milliequivalents	lb.	pound(s)
g	gram(s)	kg	kilogram(s)
µg	microgram(s)	mg	milligram(s)
mL	milliliter(s)	L	liter(s)
m3	cubic meter(s)	µL	microliter(s)
		pg/L	picogram/liter
<	less than		
>	greater than		
ppm	parts per million - One ppm is equivalent to one milligram per kilogram (mg/kg) or one gram per million grams. For aqueous liquids, ppm is usually taken to be equivalent to milligrams per liter (mg/l), because one liter of water has a weight very close to a kilogram. For gases or vapors, one ppm is equivalent to one microliter per liter of gas.		
ppb	parts per billion		
Dry weight basis	Results printed under this heading have been adjusted for moisture content. This increases the analyte weight concentration to approximate the value present in a similar sample without moisture. All other results are reported on an as-received basis.		

Laboratory Data Qualifiers:

- B - Analyte detected in the blank
- C - Result confirmed by reanalysis
- E - Concentration exceeds the calibration range
- J (or G, I, X) - estimated value \geq the Method Detection Limit (MDL or DL) and the $<$ Limit of Quantitation (LOQ or RL)
- P - Concentration difference between the primary and confirmation column $>40\%$. The lower result is reported.
- U - Analyte was not detected at the value indicated
- V - Concentration difference between the primary and confirmation column $>100\%$. The reporting limit is raised due to this disparity and evident interference...

Additional Organic and Inorganic CLP qualifiers may be used with Form 1 reports as defined by the CLP methods. Qualifiers specific to Dioxin/Furans and PCB Congeners are detailed on the individual Analysis Report.

Analytical test results meet all requirements of the associated regulatory program (i.e., NELAC (TNI), DoD, ISO17025) unless otherwise noted under the individual analysis.

Measurement uncertainty values, as applicable, are available upon request.

Tests results relate only to the sample tested. Clients should be aware that a critical step in a chemical or microbiological analysis is the collection of the sample. Unless the sample analyzed is truly representative of the bulk of material involved, the test results will be meaningless. If you have questions regarding the proper techniques of collecting samples, please contact us. We cannot be held responsible for sample integrity, however, unless sampling has been performed by a member of our staff.

This report shall not be reproduced except in full, without the written approval of the laboratory.

Times are local to the area of activity. Parameters listed in the 40 CFR Part 136 Table II as "analyze immediately" are not performed within 15 minutes.

WARRANTY AND LIMITS OF LIABILITY - In accepting analytical work, we warrant the accuracy of test results for the sample as submitted. THE FOREGOING EXPRESS WARRANTY IS EXCLUSIVE AND IS GIVEN IN LIEU OF ALL OTHER WARRANTIES, EXPRESSED OR IMPLIED. WE DISCLAIM ANY OTHER WARRANTIES, EXPRESSED OR IMPLIED, INCLUDING A WARRANTY OF FITNESS FOR PARTICULAR PURPOSE AND WARRANTY OF MERCHANTABILITY. IN NO EVENT SHALL EUROFINS LANCASTER LABORATORIES ENVIRONMENTAL, LLC BE LIABLE FOR INDIRECT, SPECIAL, CONSEQUENTIAL, OR INCIDENTAL DAMAGES INCLUDING, BUT NOT LIMITED TO, DAMAGES FOR LOSS OF PROFIT OR GOODWILL REGARDLESS OF (A) THE NEGLIGENCE (EITHER SOLE OR CONCURRENT) OF EUROFINS LANCASTER LABORATORIES ENVIRONMENTAL AND (B) WHETHER EUROFINS LANCASTER LABORATORIES ENVIRONMENTAL HAS BEEN INFORMED OF THE POSSIBILITY OF SUCH DAMAGES. We accept no legal responsibility for the purposes for which the client uses the test results. No purchase order or other order for work shall be accepted by Eurofins Lancaster Laboratories Environmental which includes any conditions that vary from the Standard Terms and Conditions, and Eurofins Lancaster Laboratories Environmental hereby objects to any conflicting terms contained in any acceptance or order submitted by client.

Attachment C

Sorben Sock Data



SORBENT SOCK EVALUATION FORM

Name: <u>D. Becker</u>	Date: <u>6/18/15</u>	Project Number: <u>150618-DB1</u>
Site Address: <u>3135 Gibbons Dr., Alameda</u>	Well ID: <u>C-1</u>	Weather: <u>Sunny</u>

1) Time absorbent sock removed from well for inspection:

0830

2) Condition of sock:

a) Length of sock showing product saturation:

9"

b) Length of sock showing dryness:

11"

c) Color of sock showing product saturation:

Black / Gray

d) Weight of the removed sock:

0.37 kg / 0.81 lbs / 13.05 oz

e) Weight of a new/clean/dry sock:

0.16 kg / 0.34 lbs / 5.75 oz

f) Difference in weight: (D-E) to 0.01 ounces.

0.21 kg / 0.47 lbs / 7.30 oz

3) Picture of sock removed from well taken:

4) Sock removed from well deposited into a waste drum:

-Is drum labeled? YES

How full is drum? (%) 1%

5) After at least 15 minutes after removing the sock from the well, measure (to 0.01 ft) from the top of the well casing. :

a) Depth to product:

b) Depth to water:

4.32

c) Thickness of product: (b-a)

6) Size and type of sock installed

2" x 20" RIBBON MOUNT PIB SOCK

7) Comments: