



**Catalina Espino  
Devine**  
Project Manager  
Marketing Business Unit

**Chevron Environmental  
Management Company**  
6101 Bollinger Canyon Road  
San Ramon, CA 94583  
Tel (925) 790-3949  
espino@chevron.com

Alameda County Health Care Services  
1131 Harbor Bay Parkway, Suite 250  
Alameda, CA 94502-6577

**RECEIVED**

*By Alameda County Environmental Health at 1:26 pm, Feb 14, 2013*

Re: Chevron Service Station No. 9-1153  
3135 Gibbons Drive (3126 Fernside Blvd)  
Alameda, CA

I have reviewed the attached report dated February 14, 2012.

The information in this report is accurate to the best of my knowledge and all local Agency/Regional Board guidelines have been followed. This report was prepared by Conestoga-Rovers & Associates, upon whose assistance and advice I have relied.

This letter is submitted pursuant to the requirements of California Water Code Section 13267(b)(1) and the regulating implementation entitled Appendix A pertaining thereto.

I declare under penalty of perjury that the foregoing is true and correct to the best of my knowledge.

Sincerely,

A handwritten signature in blue ink, appearing to read "Catalina Espino Devine".

Catalina Espino Devine  
Project Manager

Attachment: Report



**CONESTOGA-ROVERS  
& ASSOCIATES**

5900 Hollis Street, Suite A  
Emeryville, California 94608  
Telephone: (510) 420-0700 Fax: (510) 420-9170  
<http://www.craworld.com>

February 14, 2013

Reference No. 311642

Mr. Mark Detterman  
Alameda County Environmental Health Services  
1131 Harbor Bay Parkway, Suite 250  
Alameda, California 94502-6577

Re: Fourth Quarter 2012  
Groundwater Monitoring and Sampling Report  
Former Chevron Service Station 91153  
3135 Gibbons Drive (3126 Fernside Boulevard)  
Alameda, California  
Agency Case RO0000341

---

Dear Mr. Detterman:

Conestoga-Rovers & Associates (CRA) is submitting this *Fourth Quarter 2012 Groundwater Monitoring and Sampling Report* for the site referenced above (Figure 1) on behalf of Chevron Environmental Management Company. Based on Alameda County Environmental Health's established sampling plan, no groundwater samples were collected this quarter. Groundwater samples are collected for laboratory analysis during the first and third quarters, therefore groundwater samples will be collected during next quarter's monitoring and sampling event. Groundwater monitoring was performed by Blaine Tech Services (Blaine Tech) of San Jose, California and a copy of their *Fourth Quarter Monitoring* report and sorbent sock field measurements are included as Attachment A. Current and historical groundwater monitoring and sampling data are presented in Table 1.

---

Equal  
Employment Opportunity  
Employer

---



**CONESTOGA-ROVERS  
& ASSOCIATES**

February 14, 2013

Reference No. 311642

- 2 -

Please contact Nathan Lee at (510) 420-3333 if you have any questions or require additional information.

Sincerely,

CONESTOGA-ROVERS & ASSOCIATES



Nathan Lee, PG 8486

NL/aa/25

Encl.

Figure 1	Vicinity Map
Figure 2	Groundwater Elevation Map
Table 1	Groundwater Monitoring and Sampling Data
Attachment A	Monitoring Data Package

cc: Ms. Catalina Espino Devine, Chevron (*electronic copy*)  
Mr. Mark Hom, Property Owner

## FIGURES

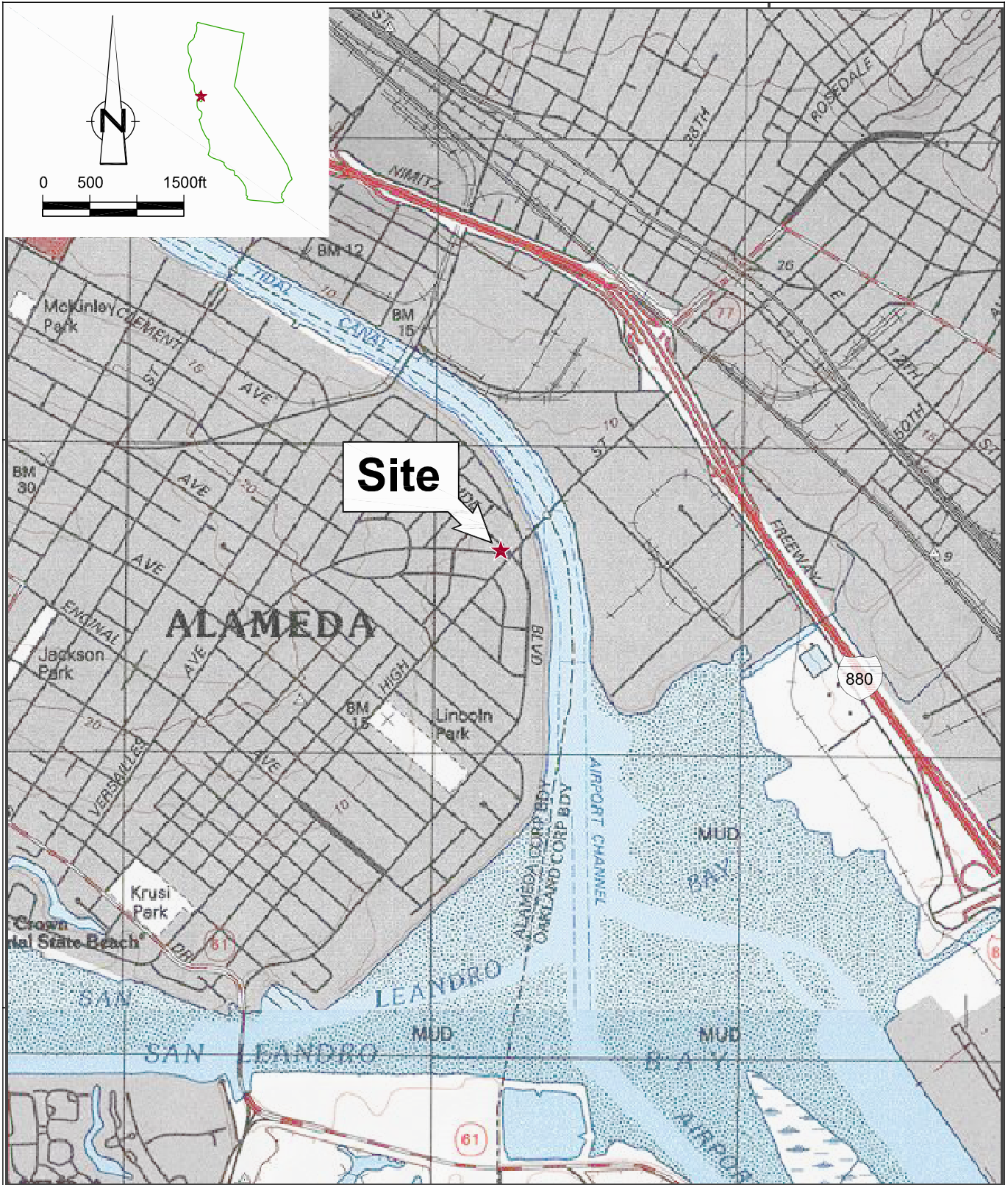

**Site**

Figure 1

VICINITY MAP  
 FORMER CHEVRON SERVICE STATION 91153  
 3135 GIBBONS DRIVE (3126 FERNSIDE BLVD)  
 Alameda, California



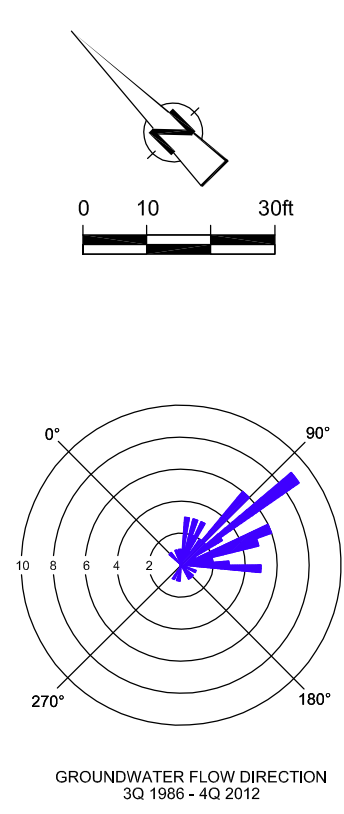

- LEGEND**
- MW-1 ● MONITORING WELL LOCATION
  - TMW-1 ⊕ TEMPORARY MONITORING WELL LOCATION
  - RW-1 ⊕ EXTRACTION WELL LOCATION
  - C-2 ⊕ DESTROYED WELL LOCATION
  - 3.00 — GROUNDWATER ELEVATION CONTOUR, IN FEET ABOVE MEAN SEA LEVEL (MSL), DASHED WHERE INFERRED
  - GROUNDWATER FLOW DIRECTION AND GRADIENT
  - WELL**  
ELEV GROUNDWATER ELEVATION (MSL)  
TPHg TPHg CONCENTRATION (µg/L)  
BENZ BENZENE CONCENTRATION (µg/L)  
MTBE MTBE CONCENTRATION (µg/L)
  - NS NOT SAMPLED
  - LNAPL LIGHT NON-AQUEOUS PHASE LIQUID

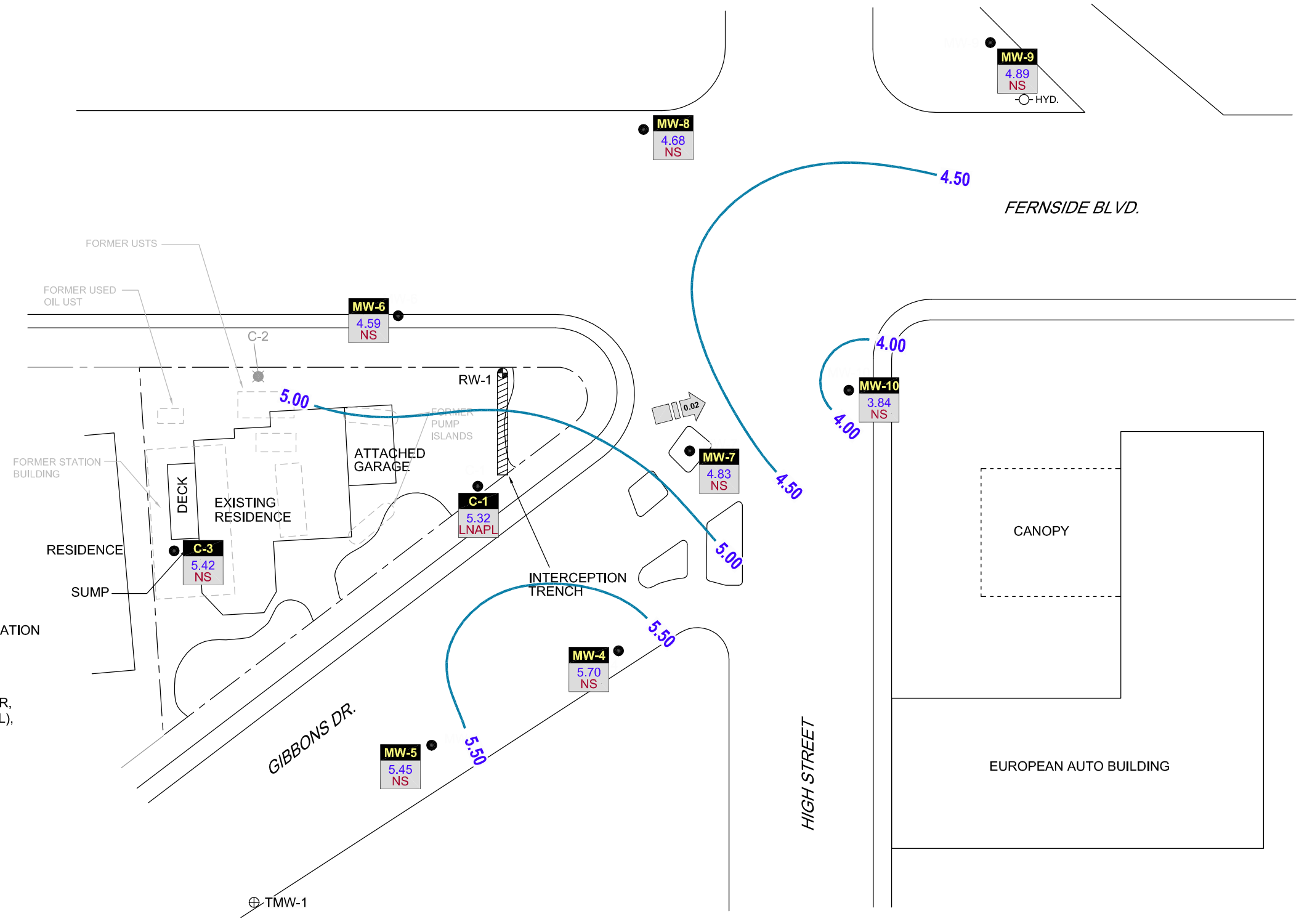

Figure 2  
GROUNDWATER ELEVATION AND HYDROCARBON CONCENTRATION MAP  
FORMER CHEVRON SERVICE STATION 91153  
3135 GIBBONS DRIVE (3126 FERN SIDE BLVD)  
Alameda, California  
December 21, 2012



## TABLE

TABLE 1

GROUNDWATER MONITORING AND SAMPLING DATA  
 FORMER CHEVRON SERVICE STATION 91153  
 3135 GIBBONS DRIVE  
 (3126 FERNSIDE BOULEVARD)  
 ALAMEDA, CALIFORNIA

Location	Date	TOC	DTW	GWE	LNAPL	FIELD PARAMETERS	HYDROCARBONS	PRIMARY VOCS				
						Dissolved Oxygen	TPH-GRO	B	T	E	X	MTBE by SW8260
	Units	ft	ft	ft-amsl	ft	mg/L	µg/L	µg/L	µg/L	µg/L	µg/L	µg/L
C-1	08/18/1986	-	4.10	-	-	-	-	-	-	-	-	-
C-1	09/04/1986	-	-	-	-	-	15,000	760	820	1,500	-	-
C-1	07/22/1987	-	-	-	-	-	1,100	250	7.0	40	-	-
C-1	05/03/1989	-	4.46	-	-	-	6,900	3,800	190	229	-	-
C-1	12/04/1989	-	4.16	-	-	-	17,000	8,000	490	470	-	-
C-1	02/14/1990	-	3.64	-	-	-	19,000	12,000	990	1,050	-	-
C-1	03/07/1990	-	3.36	-	-	-	-	4,260	261	430	-	-
C-1	09/06/1991	-	4.43	-	-	-	21,000	10,000	100	240	560	-
C-1	12/15/1991	-	4.78	-	-	-	20,000	4,900	43	110	330	-
C-1	03/03/1992	-	2.39	-	-	-	13,000	5,800	730	340	1,200	-
C-1	06/04/1992	4.08	4.08	0.00	0.00	-	34,000	9,400	350	290	1,200	-
C-1	10/13/1992	4.08	4.75	-0.67	0.00	-	24,000	11,000	98	280	530	-
C-1	01/11/1993	4.08	2.26	1.82	Sheen	-	7,100	1,500	130	150	700	-
C-1	04/14/1993	4.08	2.90	1.18	Sheen	-	29,000	7,300	4,000	640	2,300	-
C-1	07/13/1993	4.08	3.97	0.11	Sheen	-	650,000	27,000	18,000	6,300	29,000	-
C-1	10/19/1993	4.08	4.50	-0.42	0.00	-	40,000	12,000	730	1,100	3,600	-
C-1	11/30/1993	7.50	4.27	3.23	0.00	-	-	-	-	-	-	-
C-1	01/27/1994	7.50	3.35	4.15	0.00	-	36,000	8,600	220	670	1,900	-
C-1	04/07/1994	7.50	3.42	4.08	0.00	-	53,000	12,000	3,500	480	3,300	-
C-1	07/01/1994	7.50	3.96	3.54	0.00	-	65,000	19,000	5,900	1,000	9,000	-
C-1	10/05/1994	7.50	4.39	3.11	0.00	-	160,000	23,000	12,000	2,200	11,000	-
C-1	01/12/1995	7.50	1.52	6.38	0.50	-	-	-	-	-	-	-
C-1	04/26/1995	7.50	4.40	4.86	2.20	-	-	-	-	-	-	-



TABLE 1

GROUNDWATER MONITORING AND SAMPLING DATA  
 FORMER CHEVRON SERVICE STATION 91153  
 3135 GIBBONS DRIVE  
 (3126 FERNSIDE BOULEVARD)  
 ALAMEDA, CALIFORNIA

Location	Date	TOC	DTW	GWE	LNAPL	FIELD PARAMETERS	HYDROCARBONS	PRIMARY VOCS				
						Dissolved Oxygen	TPH-GRO	B	T	E	X	MTBE by SW8260
	Units	ft	ft	ft-amsl	ft	mg/L	µg/L	µg/L	µg/L	µg/L	µg/L	µg/L
C-1	07/12/1995	7.50	4.85	4.10	1.81	-	-	-	-	-	-	-
C-1	10/30/1995	7.50	5.67	3.13	1.63	-	-	-	-	-	-	-
C-1	01/04/1996	7.50	3.92	3.68	0.12	-	-	-	-	-	-	-
C-1	01/10/1996	7.50	3.48	4.12	0.13	-	-	-	-	-	-	-
C-1	01/17/1996	7.50	3.40	4.12	0.02	-	-	-	-	-	-	-
C-1	01/22/1996	7.50	2.90	4.60	0.00	-	82,000	18,000	4,400	1,400	5,200	<1,000
C-1	02/23/1996	7.50	4.10	4.89	1.86	-	-	-	-	-	-	-
C-1	02/28/1996	7.50	-	-	0.83 >	-	-	-	-	-	-	-
C-1	03/08/1996	7.50	2.86	6.10	1.83	-	-	-	-	-	-	-
C-1	03/26/1996	7.50	3.96	4.56	1.28	-	-	-	-	-	-	-
C-1	04/11/1996	7.50	5.61	3.29	1.75	-	-	-	-	-	-	-
C-1	04/19/1996	7.50	3.09	4.44	0.04	-	-	-	-	-	-	-
C-1	04/24/1996	7.50	3.04	4.48	0.03	-	-	-	-	-	-	-
C-1	05/03/1996	7.50	4.02	3.85	0.46	-	-	-	-	-	-	-
C-1	05/08/1996	7.50	4.25	3.53	0.35	-	-	-	-	-	-	-
C-1	05/17/1996	7.50	3.24	4.29	0.04	-	-	-	-	-	-	-
C-1	05/22/1996	7.50	3.10	4.46	0.07	-	-	-	-	-	-	-
C-1	06/18/1996	7.50	4.68	3.20	0.48	-	-	-	-	-	-	-
C-1	07/03/1996	7.50	5.03	2.57	0.13	-	-	-	-	-	-	-
C-1	07/09/1996	7.50	4.63	3.05	0.23	-	-	-	-	-	-	-
C-1	07/17/1996	7.50	4.73	2.89	0.15	-	-	-	-	-	-	-
C-1	07/29/1996	7.50	5.10	2.47	0.09	-	-	-	-	-	-	-
C-1	08/02/1996	7.50	5.68	1.84	0.03	-	-	-	-	-	-	-

TABLE 1

GROUNDWATER MONITORING AND SAMPLING DATA  
 FORMER CHEVRON SERVICE STATION 91153  
 3135 GIBBONS DRIVE  
 (3126 FERNSIDE BOULEVARD)  
 ALAMEDA, CALIFORNIA

Location	Date	TOC	DTW	GWE	LNAPL	FIELD PARAMETERS	HYDROCARBONS	PRIMARY VOCS				
						Dissolved Oxygen	TPH-GRO	B	T	E	X	MTBE by SW8260
	Units	ft	ft	ft-amsl	ft	mg/L	µg/L	µg/L	µg/L	µg/L	µg/L	µg/L
C-1	08/07/1996	7.50	5.16	2.35	0.01	-	-	-	-	-	-	-
C-1	08/23/1996	7.50	5.75	1.77	0.03	-	-	-	-	-	-	-
C-1	08/28/1996	7.50	5.53	1.99	0.03	-	-	-	-	-	-	-
C-1	09/06/1996	7.50	5.38	2.12	0.00	-	-	-	-	-	-	-
C-1	09/12/1996	7.50	5.48	2.04	0.03	-	-	-	-	-	-	-
C-1	09/19/1996	7.50	6.32	1.20	0.03	-	-	-	-	-	-	-
C-1	10/10/1996	7.50	4.58	3.00	0.10	-	-	-	-	-	-	-
C-1	10/17/1996	7.50	5.61	1.90	0.01	-	-	-	-	-	-	-
C-1	10/29/1996	7.50	6.01	1.49	0.00	-	-	-	-	-	-	-
C-1	11/07/1996	7.50	5.56	1.94	0.04	-	-	-	-	-	-	-
C-1	11/11/1996	7.50	5.32	2.18	0.04	-	-	-	-	-	-	-
C-1	12/17/1996	7.50	3.73	3.77	0.01	-	-	-	-	-	-	-
C-1	12/20/1996	7.50	3.33	4.17	0.03	-	-	-	-	-	-	-
C-1	01/15/1997	7.50	2.74	4.76	0.00	-	47,000	16,000	2,800	1,300	4,900	<1,000
C-1	01/22/1997	7.50	1.37	6.13	0.19	-	-	-	-	-	-	-
C-1	02/04/1997	7.50	2.98	4.52	0.51	-	-	-	-	-	-	-
C-1	02/20/1997	7.50	4.09	3.41	0.13	-	-	-	-	-	-	-
C-1	03/06/1997	7.50	3.75	3.75	0.56	-	-	-	-	-	-	-
C-1	03/14/1997	7.50	3.82	3.68	0.03	-	-	-	-	-	-	-
C-1	03/20/1997	7.50	3.73	3.77	0.03	-	-	-	-	-	-	-
C-1	03/25/1997	7.50	4.32	3.18	0.01	-	-	-	-	-	-	-
C-1	03/31/1997	7.50	3.71	3.79	0.03	-	-	-	-	-	-	-
C-1	04/03/1997	7.50	4.60	2.92	0.03	-	-	-	-	-	-	-

TABLE 1

GROUNDWATER MONITORING AND SAMPLING DATA  
 FORMER CHEVRON SERVICE STATION 91153  
 3135 GIBBONS DRIVE  
 (3126 FERNSIDE BOULEVARD)  
 ALAMEDA, CALIFORNIA

Location	Date	TOC	DTW	GWE	LNAPL	FIELD PARAMETERS	HYDROCARBONS	PRIMARY VOCS				
						Dissolved Oxygen	TPH-GRO	B	T	E	X	MTBE by SW8260
	Units	ft	ft	ft-amsl	ft	mg/L	µg/L	µg/L	µg/L	µg/L	µg/L	µg/L
C-1	04/09/1997	7.50	4.25	3.27	0.02	-	-	-	-	-	-	-
C-1	04/24/1997	7.50	4.65	2.87	0.02	-	-	-	-	-	-	-
C-1	04/30/1997	7.50	3.50	4.02	0.02	-	-	-	-	-	-	-
C-1	05/22/1997	7.50	4.97	2.53	0.00	-	-	-	-	-	-	-
C-1	06/03/1997	7.50	3.62	3.93	0.06	-	-	-	-	-	-	-
C-1	07/09/1997	7.50	4.30	3.25	0.06	-	-	-	-	-	-	-
C-1	08/12/1997	7.50	5.18	2.32	0.00	-	-	-	-	-	-	-
C-1	09/30/1997	7.50	5.25	2.65	0.50	-	-	-	-	-	-	-
C-1	10/29/1997	7.50	5.33	2.19	0.03	-	-	-	-	-	-	-
C-1	11/13/1997	7.50	4.86	2.66	0.02	-	-	-	-	-	-	-
C-1	12/18/1997	7.50	2.34	5.16	0.00	-	-	-	-	-	-	-
C-1	01/14/1998	7.50	0.25	7.27	0.02	-	-	-	-	-	-	-
C-1	02/02/1998	7.50	2.35	5.19	0.05	-	-	-	-	-	-	-
C-1	03/16/1998	7.50	2.50	5.40	0.50	-	-	-	-	-	-	-
C-1	04/17/1998	7.50	2.65	5.17	0.40	-	-	-	-	-	-	-
C-1	05/01/1998	7.50	2.39	5.14	0.04	-	-	-	-	-	-	-
C-1	06/17/1998	7.50	3.26	4.30	0.08	-	-	-	-	-	-	-
C-1	07/15/1998	7.50	3.55	3.95	0.00	-	110,000	22,000	22,000	1,000	10,000	<250
C-1	09/01/1998	7.50	4.00	3.50	0.00	-	-	-	-	-	-	-
C-1	10/27/1998	7.50	4.48	3.02	0.00	-	45,000	12,000	5,400	590	4,300	<500
C-1	11/19/1998	7.50	3.89	3.61	0.00	-	-	-	-	-	-	-
C-1	12/19/1998	7.50	2.13	5.39	0.02	-	-	-	-	-	-	-
C-1	01/20/1999	7.50	3.98	3.52	0.00	-	50,300	7,050	5,030	244	6,090	<40

TABLE 1

GROUNDWATER MONITORING AND SAMPLING DATA  
 FORMER CHEVRON SERVICE STATION 91153  
 3135 GIBBONS DRIVE  
 (3126 FERNSIDE BOULEVARD)  
 ALAMEDA, CALIFORNIA

Location	Date	TOC	DTW	GWE	LNAPL	FIELD PARAMETERS	HYDROCARBONS	PRIMARY VOCS				
						Dissolved Oxygen	TPH-GRO	B	T	E	X	MTBE by SW8260
	Units	ft	ft	ft-amsl	ft	mg/L	µg/L	µg/L	µg/L	µg/L	µg/L	µg/L
C-1	02/24/1999	7.50	2.55	4.95	0.00	-	-	-	-	-	-	-
C-1	03/26/1999	7.50	2.14	5.97	0.76	-	-	-	-	-	-	-
C-1	04/19/1999	7.50	1.04	6.46	0.00	-	150,000	21,000	20,000	3,000	18,000	49 <sup>2</sup> / <sub>&lt;2.5</sub>
C-1	07/29/1999	7.50	3.76	3.76	0.02	-	-	-	-	-	-	-
C-1	08/30/1999	7.50	4.30	3.20	0.00	-	-	-	-	-	-	-
C-1	09/23/1999	7.50	3.84	3.68	0.02	-	-	-	-	-	-	-
C-1	10/13/1999	7.50	1.27	6.23	0.00	-	136,000	23,900	30,000	2,390	17,300	<500
C-1	11/17/1999	7.50	3.59	3.91	0.00	-	-	-	-	-	-	-
C-1	12/08/1999	7.50	3.79	3.71	0.00	-	-	-	-	-	-	-
C-1	01/25/2000	7.50	1.99	5.54	0.04	-	-	-	-	-	-	-
C-1	04/03/2000**	7.50	2.20	5.38	0.10	-	-	-	-	-	-	-
C-1	05/26/2000**	7.50	2.52	5.16	0.23	-	-	-	-	-	-	-
C-1	06/19/2000**	7.50	2.89	4.76	0.19	-	-	-	-	-	-	-
C-1	07/03/2000**	7.50	3.45	4.25	0.25	-	-	-	-	-	-	-
C-1	08/01/2000**	7.50	3.78	3.85	0.16	-	-	-	-	-	-	-
C-1	09/30/2000**	7.50	4.03	3.50	0.04	-	-	-	-	-	-	-
C-1	10/23/2000**	7.50	4.15	3.37	0.03	-	-	-	-	-	-	-
C-1	11/21/2000	7.50	3.42	4.08	0.00	-	-	-	-	-	-	-
C-1	12/22/2000	7.50	2.96	4.54	0.00	-	-	-	-	-	-	-
C-1	01/08/2001	7.50	2.94	4.56	0.00	-	-	-	-	-	-	-
C-1	02/17/2001**	7.50	2.09	5.88	0.59	-	-	-	-	-	-	-
C-1	03/13/2001**	7.50	2.20	5.91	0.76	-	-	-	-	-	-	-
C-1	04/09/2001 <sup>18,**</sup>	7.50	2.45	5.26	0.26	-	-	-	-	-	-	-

TABLE 1

GROUNDWATER MONITORING AND SAMPLING DATA  
 FORMER CHEVRON SERVICE STATION 91153  
 3135 GIBBONS DRIVE  
 (3126 FERNSIDE BOULEVARD)  
 ALAMEDA, CALIFORNIA

Location	Date	TOC	DTW	GWE	LNAPL	FIELD PARAMETERS	HYDROCARBONS	PRIMARY VOCS				
						Dissolved Oxygen	TPH-GRO	B	T	E	X	MTBE by SW8260
	Units	ft	ft	ft-amsl	ft	mg/L	µg/L	µg/L	µg/L	µg/L	µg/L	µg/L
C-1	05/18/2001**	7.50	2.70	5.27	0.59	-	-	-	-	-	-	-
C-1	06/12/2001**	7.50	3.50	4.78	0.97	-	-	-	-	-	-	-
C-1	07/19/2001**	7.50	4.25	4.01	0.95	-	-	-	-	-	-	-
C-1	08/23/2001 <sup>18,**</sup>	7.50	4.34	3.22	0.07	-	-	-	-	-	-	-
C-1	09/17/2001**	7.50	4.39	3.17	0.08	-	-	-	-	-	-	-
C-1	10/08/2001**	7.50	4.45	3.08	0.04	-	-	-	-	-	-	-
C-1	11/27/2001	7.50	3.89	3.61	0.00	-	330,000	9,800	5,300	3,800	22,000	<50
C-1	12/17/2001	7.50	1.81	5.69	0.00	-	-	-	-	-	-	-
C-1	01/07/2002**	7.50	2.27	5.64	0.51	-	-	-	-	-	-	-
C-1	02/26/2002 <sup>18,**</sup>	7.50	2.70	5.22	0.52	-	-	-	-	-	-	-
C-1	03/27/2002**	7.50	2.87	5.47	1.05	-	-	-	-	-	-	-
C-1	04/08/2002**	7.50	2.45	6.03	1.23	-	-	-	-	-	-	-
C-1	05/23/2002 <sup>18,**</sup>	7.50	3.57	4.35	0.52	-	-	-	-	-	-	-
C-1	06/17/2002**	7.50	3.90	3.88	0.35	-	-	-	-	-	-	-
C-1	07/31/2002**	7.50	4.12	3.54	0.20	-	-	-	-	-	-	-
C-1	08/09/2002 <sup>18,**</sup>	7.50	4.15	3.48	0.16	-	-	-	-	-	-	-
C-1	09/17/2002**	7.50	4.33	3.27	0.12	-	-	-	-	-	-	-
C-1	10/15/2002**	7.50	4.51	3.11	0.15	-	-	-	-	-	-	-
C-1	11/08/2002	7.50	4.11	3.39	0.00	-	51,000	7,000	510	820	5,800	<3.0
C-1	12/19/2002	7.50	1.14	6.36	0.00	-	-	-	-	-	-	-
C-1	01/14/2003	7.50	1.80	5.70	0.00	-	-	-	-	-	-	-
C-1	02/07/2003 <sup>18,**</sup>	7.50	2.95	4.79	0.30	-	-	-	-	-	-	-
C-1	03/20/2003**	7.50	2.86	4.97	0.41	-	-	-	-	-	-	-

TABLE 1

GROUNDWATER MONITORING AND SAMPLING DATA  
 FORMER CHEVRON SERVICE STATION 91153  
 3135 GIBBONS DRIVE  
 (3126 FERNSIDE BOULEVARD)  
 ALAMEDA, CALIFORNIA

Location	Date	TOC	DTW	GWE	LNAPL	FIELD PARAMETERS	HYDROCARBONS	PRIMARY VOCS				
						Dissolved Oxygen	TPH-GRO	B	T	E	X	MTBE by SW8260
	Units	ft	ft	ft-amsl	ft	mg/L	µg/L	µg/L	µg/L	µg/L	µg/L	µg/L
C-1	04/15/2003**	7.50	2.12	5.46	0.10	-	-	-	-	-	-	-
C-1	05/09/2003 <sup>18,**</sup>	7.50	2.95	5.11	0.70	-	-	-	-	-	-	-
C-1	06/27/2003**	7.50	3.97	3.93	0.50	-	-	-	-	-	-	-
C-1	07/16/2003**	7.50	3.68	4.04	0.28	-	-	-	-	-	-	-
C-1	08/15/2003 <sup>18,**</sup>	7.50	4.29	3.39	0.22	-	-	-	-	-	-	-
C-1	09/26/2003**	7.50	4.60	3.05	0.19	-	-	-	-	-	-	-
C-1	10/18/2003**	7.50	4.72	2.90	0.15	-	-	-	-	-	-	-
C-1	11/14/2003 <sup>18,**</sup>	7.50	4.31	3.35	0.20	-	-	-	-	-	-	-
C-1	12/23/2003	7.50	1.81	5.69	0.00	-	-	-	-	-	-	-
C-1	01/22/2004**	7.50	4.19	3.32	0.01	-	-	-	-	-	-	-
C-1	02/13/2004 <sup>18,**</sup>	7.50	3.04	4.49	0.04	-	-	-	-	-	-	-
C-1	03/11/2004**	7.50	1.85	5.97	0.40	-	-	-	-	-	-	-
C-1	04/22/2004**	7.50	3.08	4.60	0.22	-	-	-	-	-	-	-
C-1	05/14/2004 <sup>18,**</sup>	7.50	3.49	4.03	0.03	-	-	-	-	-	-	-
C-1	06/18/2004**	7.50	3.41	4.19	0.13	-	-	-	-	-	-	-
C-1	07/23/2004**	7.50	3.28	4.31	0.11	-	-	-	-	-	-	-
C-1	08/13/2004 <sup>18,**</sup>	7.50	3.14	4.40	0.05	-	-	-	-	-	-	-
C-1	09/13/2004**	7.50	4.53	3.04	0.09	-	-	-	-	-	-	-
C-1	10/22/2004**	7.50	3.19	4.33	0.03	-	-	-	-	-	-	-
C-1	11/12/2004 <sup>18,**</sup>	7.50	3.22	4.30	0.03	-	-	-	-	-	-	-
C-1	12/02/2004**	7.50	3.28	4.24	0.02	-	-	-	-	-	-	-
C-1	01/28/2005**	7.50	3.19	4.32	0.01	-	-	-	-	-	-	-
C-1	02/11/2005 <sup>18,**</sup>	7.50	2.75	4.78	0.04	-	-	-	-	-	-	-

TABLE 1

GROUNDWATER MONITORING AND SAMPLING DATA  
 FORMER CHEVRON SERVICE STATION 91153  
 3135 GIBBONS DRIVE  
 (3126 FERNside BOULEVARD)  
 ALAMEDA, CALIFORNIA

Location	Date	TOC	DTW	GWE	LNAPL	FIELD PARAMETERS	HYDROCARBONS	PRIMARY VOCS				
						Dissolved Oxygen	TPH-GRO	B	T	E	X	MTBE by SW8260
	Units	ft	ft	ft-amsl	ft	mg/L	µg/L	µg/L	µg/L	µg/L	µg/L	µg/L
C-1	03/11/2005**	7.50	2.94	4.58	0.03	-	-	-	-	-	-	-
C-1	04/26/2005**	7.50	3.03	4.49	0.02	-	-	-	-	-	-	-
C-1	05/13/2005 <sup>18,**</sup>	7.50	3.18	4.34	0.02	-	-	-	-	-	-	-
C-1	06/01/2005**	7.50	3.22	4.30	0.02	-	-	-	-	-	-	-
C-1	07/15/2005**	7.50	3.09	4.43	0.02	-	-	-	-	-	-	-
C-1	08/19/2005 <sup>18,**</sup>	7.50	2.88	4.64	0.03	-	-	-	-	-	-	-
C-1	09/23/2005**	7.50	2.95	4.57	0.02	-	-	-	-	-	-	-
C-1	10/14/2005**	7.50	3.01	4.50	0.01	-	-	-	-	-	-	-
C-1	11/18/2005 <sup>18,**</sup>	7.50	3.21	4.31	0.02	-	-	-	-	-	-	-
C-1	12/09/2005**	7.50	3.61	3.90	0.01	-	-	-	-	-	-	-
C-1	01/12/2006**	7.50	2.98	4.53	0.01	-	-	-	-	-	-	-
C-1	02/10/2006 <sup>15,**</sup>	7.50	2.69	4.82	0.01	-	100,000	11,000	2,500	2,900	15,000	<10
C-1	03/13/2006**	7.50	2.81	4.70	0.01	-	-	-	-	-	-	-
C-1	04/13/2006**	7.50	2.75	4.76	0.01	-	-	-	-	-	-	-
C-1	05/12/2006 <sup>18,**</sup>	7.50	3.02	4.49	0.01	-	-	-	-	-	-	-
C-1	06/12/2006**	7.50	3.10	4.41	0.01	-	-	-	-	-	-	-
C-1	07/13/2006**	7.50	3.14	4.38	0.02	-	-	-	-	-	-	-
C-1	08/11/2006 <sup>15,**</sup>	7.50	3.70	3.81	0.01	-	200,000	8,600	470	1,700	8,800	<10
C-1	09/11/2006**	7.50	3.75	3.77	0.02	-	-	-	-	-	-	-
C-1	10/17/2006**	7.50	3.82	3.69	0.01	-	-	-	-	-	-	-
C-1	11/17/2006 <sup>18,**</sup>	7.50	3.11	4.41	0.03	-	-	-	-	-	-	-
C-1	12/15/2006**	7.50	2.95	4.57	0.02	-	-	-	-	-	-	-
C-1	01/16/2007**	7.50	2.98	4.54	0.02	-	-	-	-	-	-	-

TABLE 1

**GROUNDWATER MONITORING AND SAMPLING DATA  
FORMER CHEVRON SERVICE STATION 91153  
3135 GIBBONS DRIVE  
(3126 FERNside BOULEVARD)  
ALAMEDA, CALIFORNIA**

Location	Date	TOC	DTW	GWE	LNAPL	FIELD PARAMETERS	HYDROCARBONS	PRIMARY VOCS				
						Dissolved Oxygen	TPH-GRO	B	T	E	X	MTBE by SW8260
	Units	ft	ft	ft-amsl	ft	mg/L	µg/L	µg/L	µg/L	µg/L	µg/L	µg/L
C-1	02/16/2007 <sup>15</sup>	7.50	2.77	4.73	0.00	-	25,000	4,300	260	310	3,300	<5
C-1	03/16/2007 <sup>**</sup>	7.50	3.07	4.44	0.01	-	-	-	-	-	-	-
C-1	04/17/2007 <sup>**</sup>	7.50	2.98	4.53	0.01	-	-	-	-	-	-	-
C-1	05/17/2007 <sup>15,**</sup>	7.50	3.05	4.46	0.01	-	110,000 <sup>16</sup>	12,000 <sup>16</sup>	1,000 <sup>16</sup>	2,000 <sup>16</sup>	15,000 <sup>16</sup>	<5
C-1	06/15/2007 <sup>**</sup>	7.50	3.08	4.43	0.01	-	-	-	-	-	-	-
C-1	07/17/2007 <sup>**</sup>	7.50	3.13	4.38	0.01	-	-	-	-	-	-	-
C-1	08/09/2007 <sup>18,**</sup>	7.50	3.24	4.28	0.02	-	-	-	-	-	-	-
C-1	09/14/2007 <sup>**</sup>	7.50	3.16	4.35	0.01	-	-	-	-	-	-	-
C-1	10/16/2007 <sup>**</sup>	7.50	3.04	4.47	0.01	-	-	-	-	-	-	-
C-1	11/08/2007 <sup>15,**</sup>	7.50	3.11	4.40	0.01	-	150,000	13,000	570	1,800	10,000	<13
C-1	12/07/2007 <sup>**</sup>	7.50	2.98	4.54	0.03	-	-	-	-	-	-	-
C-1	01/16/2008 <sup>**</sup>	7.50	2.95	4.57	0.02	-	-	-	-	-	-	-
C-1	02/06/2008 <sup>15,**</sup>	7.50	2.61	4.90	0.01	-	110,000	13,000	500	5,300	21,000	<10
C-1	03/07/2008 <sup>**</sup>	7.50	2.87	4.65	0.02	-	-	-	-	-	-	-
C-1	04/16/2008 <sup>**</sup>	7.50	3.06	4.46	0.02	-	-	-	-	-	-	-
C-1	05/07/2008 <sup>18,**</sup>	7.50	2.98	4.54	0.03	-	-	-	-	-	-	-
C-1	06/06/2008 <sup>**</sup>	7.50	3.02	4.50	0.02	-	-	-	-	-	-	-
C-1	07/16/2008 <sup>**</sup>	7.50	3.12	4.40	0.02	-	-	-	-	-	-	-
C-1	09/05/2008 <sup>**</sup>	7.50	3.97	3.75	0.28	-	-	-	-	-	-	-
C-1	09/11/2008 <sup>18,**</sup>	7.50	4.22	3.61	0.41	-	-	-	-	-	-	-
C-1	10/17/2008 <sup>**</sup>	7.50	4.16	3.60	0.33	-	-	-	-	-	-	-
C-1	11/10/2008 <sup>18,**</sup>	7.50	4.05	3.54	0.11	-	-	-	-	-	-	-
C-1	12/15/2008 <sup>**</sup>	7.50	3.85	3.69	0.05	-	-	-	-	-	-	-



TABLE 1

GROUNDWATER MONITORING AND SAMPLING DATA  
 FORMER CHEVRON SERVICE STATION 91153  
 3135 GIBBONS DRIVE  
 (3126 FERNSIDE BOULEVARD)  
 ALAMEDA, CALIFORNIA

Location	Date	TOC	DTW	GWE	LNAPL	FIELD PARAMETERS	HYDROCARBONS	PRIMARY VOCS				
						Dissolved Oxygen	TPH-GRO	B	T	E	X	MTBE by SW8260
	Units	ft	ft	ft-amsl	ft	mg/L	µg/L	µg/L	µg/L	µg/L	µg/L	µg/L
C-1	01/21/2009**	7.50	3.91	3.62	0.04	-	-	-	-	-	-	-
C-1	02/09/2009 <sup>15,**</sup>	7.50	3.72	3.79	0.01	-	53,000	3,100	66	660	3,700	<1
C-1	05/28/2009	7.50	3.48	4.02	0.02	-	-	-	-	-	-	-
C-1	08/18/2009	7.50	4.40	3.10	0.02	-	-	-	-	-	-	-
C-1	11/17/2009	7.50	4.21	3.29	0.03	-	-	-	-	-	-	-
C-1	03/31/2010	7.50	2.07	5.46	0.04	-	-	-	-	-	-	-
C-1	05/17/2010	7.50	2.87	4.83	0.25	-	-	-	-	-	-	-
C-1	08/26/2010 <sup>18</sup>	7.50	4.03	3.50	0.04	-	-	-	-	-	-	-
C-1	11/11/2010 <sup>18,**</sup>	7.50	3.82	3.70	0.03	-	-	-	-	-	-	-
C-1	03/02/2011 <sup>18,**</sup>	7.50	1.12	6.41	0.04	-	-	-	-	-	-	-
C-1	06/17/2011 <sup>18,**</sup>	7.50	3.00	4.51	0.01	-	-	-	-	-	-	-
C-1	09/08/2011 <sup>18,**</sup>	7.50	3.60	3.92	0.02	-	-	-	-	-	-	-
C-1	12/29/2011 <sup>18,**</sup>	7.50	4.14	3.37	0.01	-	-	-	-	-	-	-
C-1	03/28/2012 <sup>18,**</sup>	7.50	1.01	6.52	0.04	-	-	-	-	-	-	-
C-1	05/31/2012 <sup>18,**</sup>	7.50	2.96	4.56	0.02	-	-	-	-	-	-	-
C-1	09/28/2012	7.50	4.50	3.00	0.00	-	48,000	8,600	81	1,800	3,300	<5
C-1	12/21/2012 <sup>18,**</sup>	7.50	2.20	5.32	0.02	-	-	-	-	-	-	-
C-3	08/18/1986	-	4.00	-	-	-	-	-	-	-	-	-
C-3	09/04/1986	-	-	-	-	-	50	3.2	5.4	5.8	-	-
C-3	07/22/1987	-	-	-	-	-	<50	<0.5	<1.0	<4.0	-	-
C-3	05/03/1989	-	4.15	-	-	-	<50	<0.5	<1.0	<2.0	-	-
C-3	12/04/1989	-	4.24	-	-	-	<250	<0.5	<0.5	<0.5	-	-

TABLE 1

**GROUNDWATER MONITORING AND SAMPLING DATA  
FORMER CHEVRON SERVICE STATION 91153  
3135 GIBBONS DRIVE  
(3126 FERNSIDE BOULEVARD)  
ALAMEDA, CALIFORNIA**

Location	Date	TOC	DTW	GWE	LNAPL	FIELD PARAMETERS	HYDROCARBONS	PRIMARY VOCS				MTBE by SW8260
						Dissolved Oxygen	TPH-GRO	B	T	E	X	
	Units	ft	ft	ft-amsl	ft	mg/L	µg/L	µg/L	µg/L	µg/L	µg/L	µg/L
C-3	02/14/1990	-	3.57	-	-	-	<50	<0.5	<0.5	<0.5	-	-
C-3	03/07/1990	-	3.31	-	-	-	-	<5.0	<5.0	<5.0	-	-
C-3	09/06/1991	-	4.59	-	-	-	<50	<0.5	<0.5	<0.5	<0.5	-
C-3	12/15/1991	-	4.84	-	-	-	<50	<0.5	<0.5	<0.5	<0.5	-
C-3	03/03/1992	-	2.17	-	-	-	<50	<0.5	<0.5	<0.5	<0.5	-
C-3	06/04/1992	4.41	4.01	0.40	0.00	-	<50	<0.5	<0.5	<0.5	<0.5	-
C-3	10/13/1992	4.41	4.79	-0.38	0.00	-	<50	<0.5	<0.5	<0.5	<0.5	-
C-3	01/11/1993	4.41	2.01	2.40	0.00	-	<50	<0.5	<0.5	<0.5	<0.5	-
C-3	04/14/1993	4.41	2.76	1.65	0.00	-	<50	<0.5	<0.5	<0.5	<0.5	-
C-3	07/13/1993	4.41	3.96	0.45	0.00	-	<50	<0.5	<0.5	<0.5	<1.5	-
C-3	10/19/1993	4.41	4.53	-0.12	0.00	-	66	12	1.4	1.0	8.4	-
C-3	11/30/1993	7.83	4.04	3.79	0.00	-	-	-	-	-	-	-
C-3	01/27/1994	7.83	3.17	4.66	0.00	-	<50	<0.5	<0.5	<0.5	<0.5	-
C-3	04/07/1994	7.83	3.20	4.63	0.00	-	<50	<0.5	<0.5	<0.5	<0.5	-
C-3	07/01/1994	7.83	3.99	3.84	0.00	-	<50	<0.5	<0.5	<0.5	<0.5	-
C-3	10/05/1994	7.83	4.54	3.29	0.00	-	<50	<0.5	<0.5	<0.5	<0.5	-
C-3	01/12/1995	7.83	0.80	7.03	0.00	-	<50	<0.5	<0.5	<0.5	<0.5	-
C-3	05/02/1995	7.83	2.15	5.68	0.00	-	<50	<0.5	<0.5	<0.5	<0.5	-
C-3	07/12/1995	7.83	3.42	4.41	0.00	-	<50	<0.5	<0.5	<0.5	<0.5	-
C-3	10/30/1995	7.83	4.46	3.37	0.00	-	<50	<0.5	<0.5	<0.5	<0.5	<2.5
C-3	01/22/1996	7.83	1.73	6.10	0.00	-	<50	<0.5	<0.5	<0.5	<0.5	<2.5
C-3	04/24/1996	7.83	2.62	5.21	0.00	-	<50	<0.5	<0.5	<0.5	<0.5	<2.5
C-3	07/29/1996	7.83	3.94	3.89	0.00	-	<50	<0.5	<0.5	<0.5	<0.5	<2.5

TABLE 1

**GROUNDWATER MONITORING AND SAMPLING DATA  
FORMER CHEVRON SERVICE STATION 91153  
3135 GIBBONS DRIVE  
(3126 FERNSIDE BOULEVARD)  
ALAMEDA, CALIFORNIA**

Location	Date	TOC	DTW	GWE	LNAPL	FIELD PARAMETERS	HYDROCARBONS	PRIMARY VOCS				
						Dissolved Oxygen	TPH-GRO	B	T	E	X	MTBE by SW8260
	Units	ft	ft	ft-amsl	ft	mg/L	µg/L	µg/L	µg/L	µg/L	µg/L	µg/L
C-3	10/10/1996	7.83	4.06	3.77	0.00	-	<50	<0.5	<0.5	<0.5	<0.5	<2.5
C-3	01/15/1997	7.83	1.54	6.29	0.00	-	<50	<0.5	<0.5	<0.5	<0.5	<2.5
C-3	04/03/1997	7.83	3.23	4.60	0.00	-	<50	<0.5	<0.5	<0.5	<0.5	<2.5
C-3	07/09/1997	7.83	4.36	3.47	0.00	-	<50	<0.5	<0.5	<0.5	<0.5	<2.5
C-3	10/29/1997	7.83	4.65	3.18	0.00	-	<50	<0.5	<0.5	<0.5	<0.5	<2.5
C-3	01/14/1998	7.83	0.77	7.06	0.00	-	<50	<0.5	<0.5	<0.5	<0.5	<2.5
C-3	07/15/1998	7.83	3.72	4.11	0.00	-	<50	<0.5	<0.5	<0.5	<0.5	<2.5
C-3	01/20/1999	7.83	2.65	5.18	0.00	-	<50	<0.5	<0.5	<0.5	<0.5	<2.0
C-3	04/19/1999	7.83	1.78	6.05	0.00	-	-	-	-	-	-	-
C-3	04/03/2000 <sup>19</sup>	7.83	-	-	-	-	-	-	-	-	-	-
C-3	07/03/2000	7.83	-	-	-	-	-	-	-	-	-	-
C-3	10/23/2000	7.83	-	-	-	-	-	-	-	-	-	-
C-3	01/08/2001 <sup>11</sup>	7.83	3.71	4.12	0.00	-	<50	<0.50	<0.50	<0.50	<0.50	<2.5
C-3	04/09/2001	7.83	-	-	-	-	-	-	-	-	-	-
C-3	08/23/2001 <sup>19</sup>	7.83	-	-	-	-	-	-	-	-	-	-
C-3	11/27/2001 <sup>19</sup>	7.83	-	-	-	-	-	-	-	-	-	-
C-3	02/26/2002	7.83	2.38	5.45	0.00	-	<50	<0.50	<0.50	<0.50	<1.5	<2.5
C-3	05/23/2002 <sup>19</sup>	7.83	-	-	-	-	-	-	-	-	-	-
C-3	08/09/2002 <sup>19</sup>	7.83	-	-	-	-	-	-	-	-	-	-
C-3	11/08/2002 <sup>19</sup>	7.83	-	-	-	-	-	-	-	-	-	-
C-3	02/07/2003	7.83	2.73	5.10	0.00	-	<50	<0.50	<0.50	<0.50	<1.5	<2.5
C-3	05/09/2003 <sup>19</sup>	7.83	-	-	-	-	-	-	-	-	-	-
C-3	08/15/2003 <sup>19</sup>	7.83	-	-	-	-	-	-	-	-	-	-

TABLE 1

GROUNDWATER MONITORING AND SAMPLING DATA  
 FORMER CHEVRON SERVICE STATION 91153  
 3135 GIBBONS DRIVE  
 (3126 FERNSIDE BOULEVARD)  
 ALAMEDA, CALIFORNIA

Location	Date	TOC	DTW	GWE	LNAPL	FIELD PARAMETERS	HYDROCARBONS	PRIMARY VOCS				
						Dissolved Oxygen	TPH-GRO	B	T	E	X	MTBE by SW8260
	Units	ft	ft	ft-amsl	ft	mg/L	µg/L	µg/L	µg/L	µg/L	µg/L	µg/L
C-3	11/14/2003 <sup>19</sup>	7.83	-	-	-	-	-	-	-	-	-	-
C-3	02/13/2004 <sup>15</sup>	7.83	2.81	5.02	0.00	-	<50	<0.5	<0.5	<0.5	<0.5	<0.5
C-3	05/14/2004 <sup>19</sup>	7.83	-	-	-	-	-	-	-	-	-	-
C-3	11/12/2004 <sup>19</sup>	7.83	-	-	-	-	-	-	-	-	-	-
C-3	02/11/2005 <sup>15</sup>	7.83	2.58	5.25	0.00	-	<50	<0.5	<0.5	<0.5	<0.5	<0.5
C-3	05/13/2005 <sup>19</sup>	7.83	-	-	-	-	-	-	-	-	-	-
C-3	08/19/2005 <sup>19</sup>	7.83	-	-	-	-	-	-	-	-	-	-
C-3	11/18/2005 <sup>19</sup>	7.83	-	-	-	-	-	-	-	-	-	-
C-3	02/10/2006 <sup>15</sup>	7.83	2.52	5.31	0.00	-	<50	<0.5	<0.5	<0.5	<0.5	<0.5
C-3	05/12/2006 <sup>19</sup>	7.83	-	-	-	-	-	-	-	-	-	-
C-3	08/11/2006 <sup>19</sup>	7.83	-	-	-	-	-	-	-	-	-	-
C-3	11/17/2006 <sup>19</sup>	7.83	-	-	-	-	-	-	-	-	-	-
C-3	02/16/2007 <sup>15</sup>	7.83	2.63	5.20	0.00	-	<50	<0.5	<0.5	<0.5	<0.5	<0.5
C-3	05/17/2007 <sup>19</sup>	7.83	-	-	-	-	-	-	-	-	-	-
C-3	08/09/2007 <sup>19</sup>	7.83	-	-	-	-	-	-	-	-	-	-
C-3	11/08/2007 <sup>19</sup>	7.83	-	-	-	-	-	-	-	-	-	-
C-3	02/06/2008 <sup>15</sup>	7.83	2.91	4.92	0.00	-	<50	<0.5	<0.5	<0.5	<0.5	<0.5
C-3	05/07/2008 <sup>19</sup>	7.83	-	-	-	-	-	-	-	-	-	-
C-3	09/11/2008 <sup>19</sup>	7.83	-	-	-	-	-	-	-	-	-	-
C-3	11/10/2008 <sup>19</sup>	7.83	-	-	-	-	-	-	-	-	-	-
C-3	02/09/2009 <sup>15</sup>	7.83	2.95	4.88	0.00	-	<50	<0.5	<0.5	<0.5	<0.5	<0.5
C-3	03/31/2010	7.83	2.22	5.61	0.00	-	<50	<0.5	<0.5	<0.5	<0.5	<0.5
C-3	05/17/2010	7.83	3.07	4.76	0.00	-	-	-	-	-	-	-

TABLE 1

**GROUNDWATER MONITORING AND SAMPLING DATA  
FORMER CHEVRON SERVICE STATION 91153  
3135 GIBBONS DRIVE  
(3126 FERNside BOULEVARD)  
ALAMEDA, CALIFORNIA**

Location	Date	TOC	DTW	GWE	LNAPL	FIELD PARAMETERS	HYDROCARBONS	PRIMARY VOCS				
						Dissolved Oxygen	TPH-GRO	B	T	E	X	MTBE by SW8260
	Units	ft	ft	ft-amsl	ft	mg/L	µg/L	µg/L	µg/L	µg/L	µg/L	µg/L
C-3	08/26/2010 <sup>19</sup>	7.83	4.29	3.54	0.00	-	-	-	-	-	-	-
C-3	11/11/2010 <sup>19</sup>	7.83	4.48	3.35	0.00	-	-	-	-	-	-	-
C-3	03/02/2011 <sup>19</sup>	7.83	1.45	6.38	0.00	-	<50	<0.5	<0.5	<0.5	<0.5	<0.5
C-3	06/17/2011 <sup>19</sup>	7.83	3.24	4.59	0.00	-	-	-	-	-	-	-
C-3	09/08/2011 <sup>19</sup>	7.83	4.02	3.81	0.00	-	-	-	-	-	-	-
C-3	12/29/2011 <sup>19</sup>	7.83	4.42	3.41	0.00	-	-	-	-	-	-	-
C-3	03/28/2012	7.83	0.94	6.89	0.00	-	<50	<0.5	<0.5	<0.5	<0.5	<0.5
C-3	05/31/2012 <sup>19</sup>	7.83	3.40	4.43	0.00	-	-	-	-	-	-	-
C-3	09/28/2012 <sup>19</sup>	7.83	4.72	3.11	0.00	-	-	-	-	-	-	-
C-3	12/21/2012 <sup>19</sup>	7.83	2.41	5.42	0.00	-	-	-	-	-	-	-
MW-4	06/04/1992	3.58	3.63	-0.05	0.00	-	<50	0.8	<0.5	<0.5	<0.5	-
MW-4	10/13/1992	3.58	-	-	-	-	-	-	-	-	-	-
MW-4	01/11/1993	3.58	1.89	1.69	0.00	-	<50	<0.5	<0.5	<0.5	<0.5	-
MW-4	04/14/1993	3.58	2.20	1.38	0.00	-	<50	<0.5	<0.5	<0.5	<1.5	-
MW-4	07/13/1993	3.58	3.51	0.07	0.00	-	54	2.6	1.6	<0.5	<1.5	-
MW-4	10/19/1993	3.58	4.22	-0.64	0.00	-	<50	<0.5	<0.5	<0.5	<0.5	-
MW-4	11/30/1993	7.01	4.01	3.00	0.00	-	-	-	-	-	-	-
MW-4	01/27/1994	7.01	2.89	4.12	0.00	-	<50	<0.5	<0.5	<0.5	<0.5	-
MW-4	04/07/1994	7.01	3.06	3.95	0.00	-	<50	<0.5	<0.5	<0.5	<0.5	-
MW-4	07/01/1994	7.01	3.59	3.42	0.00	-	<50	<0.5	<0.5	<0.5	<0.5	-
MW-4	10/05/1994	7.01	4.33	2.68	0.00	-	<50	<0.5	<0.5	<0.5	<0.5	-
MW-4	01/12/1995	7.01	1.20	5.81	0.00	-	<50	<0.5	<0.5	<0.5	<0.5	-

**GROUNDWATER MONITORING AND SAMPLING DATA  
FORMER CHEVRON SERVICE STATION 91153  
3135 GIBBONS DRIVE  
(3126 FERNSIDE BOULEVARD)  
ALAMEDA, CALIFORNIA**

Location	Date	TOC	DTW	GWE	LNAPL	FIELD PARAMETERS	HYDROCARBONS	PRIMARY VOCS				
						Dissolved Oxygen	TPH-GRO	B	T	E	X	MTBE by SW8260
	Units	ft	ft	ft-amsl	ft	mg/L	µg/L	µg/L	µg/L	µg/L	µg/L	µg/L
MW-4	04/26/1995	7.01	1.15	5.86	0.00	-	<50	<0.5	<0.5	<0.5	<0.5	-
MW-4	07/12/1995	7.01	2.72	4.29	0.00	-	<50	6.4	<0.5	0.63	0.72	-
MW-4	10/30/1995	7.01	4.08	2.93	0.00	-	<50	<0.5	<0.5	<0.5	<0.5	<2.5
MW-4	01/22/1996	7.01	1.76	5.25	0.00	-	<50	<0.5	<0.5	<0.5	<0.5	<2.5
MW-4	04/24/1996	7.01	1.95	5.06	0.00	-	<50	<0.5	<0.5	<0.5	<0.5	<2.5
MW-4	07/29/1996	7.01	3.37	3.64	0.00	-	<50	<0.5	<0.5	<0.5	<0.5	<2.5
MW-4	10/10/1996	7.01	3.96	3.05	0.00	-	<50	<0.5	<0.5	<0.5	<0.5	<2.5
MW-4	01/15/1997	7.01	1.27	5.74	0.00	-	<50	<0.5	<0.5	<0.5	<0.5	<2.5
MW-4	04/03/1997	7.01	2.11	4.90	0.00	-	<50	<0.5	<0.5	<0.5	<0.5	<2.5
MW-4	07/09/1997	7.01	4.04	2.97	0.00	-	<50	<0.5	<0.5	<0.5	<0.5	<2.5
MW-4	10/29/1997	7.01	4.56	2.45	0.00	-	<50	<0.5	<0.5	<0.5	<0.5	<2.5
MW-4	01/14/1998	7.01	0.39	6.62	0.00	-	<50	<0.5	<0.5	<0.5	<0.5	<2.5
MW-4	01/20/1999	7.01	2.83	4.18	0.00	-	<50	<0.5	<0.5	<0.5	<0.5	<2.0
MW-4	04/19/1999	7.01	2.91	4.10	0.00	-	-	-	-	-	-	-
MW-4	01/25/2000	7.01	1.92	5.09	0.00	-	<50	<0.5	<0.5	<0.5	<0.5	<2.5
MW-4	04/03/2000 <sup>19</sup>	7.01	-	-	-	-	-	-	-	-	-	-
MW-4	07/03/2000	7.01	-	-	-	-	-	-	-	-	-	-
MW-4	10/23/2000	7.01	-	-	-	-	-	-	-	-	-	-
MW-4	01/08/2001 <sup>11</sup>	7.01	3.02	3.99	0.00	-	87 <sup>12</sup>	<0.50	<0.50	0.55	2.9	<2.5
MW-4	04/09/2001	7.01	-	-	-	-	-	-	-	-	-	-
MW-4	08/23/2001 <sup>19</sup>	7.01	-	-	-	-	-	-	-	-	-	-
MW-4	11/27/2001 <sup>19</sup>	7.01	-	-	-	-	-	-	-	-	-	-
MW-4	02/26/2002	7.01	1.37	5.64	0.00	-	<50	<0.50	<0.50	<0.50	<1.5	<2.5

TABLE 1

**GROUNDWATER MONITORING AND SAMPLING DATA  
FORMER CHEVRON SERVICE STATION 91153  
3135 GIBBONS DRIVE  
(3126 FERNSIDE BOULEVARD)  
ALAMEDA, CALIFORNIA**

Location	Date	TOC	DTW	GWE	LNAPL	FIELD PARAMETERS	HYDROCARBONS	PRIMARY VOCS				
						Dissolved Oxygen	TPH-GRO	B	T	E	X	MTBE by SW8260
	Units	ft	ft	ft-amsl	ft	mg/L	µg/L	µg/L	µg/L	µg/L	µg/L	µg/L
MW-4	05/23/2002 <sup>19</sup>	7.01	-	-	-	-	-	-	-	-	-	-
MW-4	08/09/2002 <sup>19</sup>	7.01	-	-	-	-	-	-	-	-	-	-
MW-4	11/08/2002 <sup>19</sup>	7.01	-	-	-	-	-	-	-	-	-	-
MW-4	02/07/2003	7.01	1.72	5.29	0.00	-	<50	<0.50	<0.50	<0.50	<1.5	<2.5
MW-4	05/09/2003 <sup>19</sup>	7.01	-	-	-	-	-	-	-	-	-	-
MW-4	08/15/2003 <sup>19</sup>	7.01	-	-	-	-	-	-	-	-	-	-
MW-4	11/14/2003 <sup>19</sup>	7.01	-	-	-	-	-	-	-	-	-	-
MW-4	02/13/2004 <sup>15</sup>	7.01	1.82	5.19	0.00	-	<50	<0.5	<0.5	<0.5	<0.5	<0.5
MW-4	05/14/2004 <sup>19</sup>	7.01	-	-	-	-	-	-	-	-	-	-
MW-4	11/12/2004 <sup>19</sup>	7.01	-	-	-	-	-	-	-	-	-	-
MW-4	02/11/2005 <sup>15</sup>	7.01	1.46	5.55	0.00	-	<50	<0.5	<0.5	<0.5	<0.5	<0.5
MW-4	05/13/2005 <sup>19</sup>	7.01	-	-	-	-	-	-	-	-	-	-
MW-4	08/19/2005 <sup>19</sup>	7.01	-	-	-	-	-	-	-	-	-	-
MW-4	11/18/2005 <sup>19</sup>	7.01	-	-	-	-	-	-	-	-	-	-
MW-4	02/10/2006 <sup>15</sup>	7.01	1.35	5.66	0.00	-	<50	<0.5	<0.5	<0.5	<0.5	<0.5
MW-4	05/12/2006 <sup>19</sup>	7.01	-	-	-	-	-	-	-	-	-	-
MW-4	08/11/2006 <sup>19</sup>	7.01	-	-	-	-	-	-	-	-	-	-
MW-4	11/17/2006 <sup>19</sup>	7.01	-	-	-	-	-	-	-	-	-	-
MW-4	02/16/2007 <sup>15</sup>	7.01	1.48	5.53	0.00	-	<50	<0.5	<0.5	<0.5	<0.5	<0.5
MW-4	05/17/2007 <sup>19</sup>	7.01	-	-	-	-	-	-	-	-	-	-
MW-4	08/09/2007 <sup>19</sup>	7.01	-	-	-	-	-	-	-	-	-	-
MW-4	11/08/2007 <sup>19</sup>	7.01	-	-	-	-	-	-	-	-	-	-
MW-4	02/06/2008 <sup>15</sup>	7.01	1.27	5.74	0.00	-	<50	<0.5	<0.5	<0.5	<0.5	<0.5

TABLE 1

**GROUNDWATER MONITORING AND SAMPLING DATA  
FORMER CHEVRON SERVICE STATION 91153  
3135 GIBBONS DRIVE  
(3126 FERNside BOULEVARD)  
ALAMEDA, CALIFORNIA**

Location	Date	TOC	DTW	GWE	LNAPL	FIELD PARAMETERS	HYDROCARBONS	PRIMARY VOCS				
						Dissolved Oxygen	TPH-GRO	B	T	E	X	MTBE by SW8260
	Units	ft	ft	ft-amsl	ft	mg/L	µg/L	µg/L	µg/L	µg/L	µg/L	µg/L
MW-4	05/07/2008 <sup>19</sup>	7.01	-	-	-	-	-	-	-	-	-	-
MW-4	09/11/2008 <sup>19</sup>	7.01	-	-	-	-	-	-	-	-	-	-
MW-4	11/10/2008 <sup>19</sup>	7.01	-	-	-	-	-	-	-	-	-	-
MW-4	02/09/2009 <sup>15</sup>	7.01	2.33	4.68	0.00	-	<50	<0.5	<0.5	<0.5	<0.5	<0.5
MW-4	03/31/2010	7.01	2.13	4.88	0.00	-	<50	<0.5	<0.5	<0.5	<0.5	<0.5
MW-4	05/17/2010	7.01	2.05	4.96	0.00	-	-	-	-	-	-	-
MW-4	08/26/2010 <sup>19</sup>	7.01	3.70	3.31	0.00	-	-	-	-	-	-	-
MW-4	11/11/2010 <sup>19</sup>	7.01	3.98	3.03	0.00	-	-	-	-	-	-	-
MW-4	03/02/2011 <sup>19</sup>	7.01	0.75	6.26	0.00	-	<50	<0.5	<0.5	<0.5	<0.5	<0.5
MW-4	06/17/2011 <sup>19</sup>	7.01	2.36	4.65	0.00	-	-	-	-	-	-	-
MW-4	09/08/2011 <sup>19</sup>	7.01	3.36	3.65	0.00	-	-	-	-	-	-	-
MW-4	12/29/2011 <sup>19</sup>	7.01	3.65	3.36	0.00	-	-	-	-	-	-	-
MW-4	03/28/2012	7.01	1.20	5.81	0.00	-	<50	<0.5	<0.5	<0.5	<0.5	<0.5
MW-4	05/31/2012 <sup>19</sup>	7.01	1.62	5.39	0.00	-	-	-	-	-	-	-
MW-4	09/28/2012 <sup>19</sup>	7.01	3.70	3.31	0.00	-	-	-	-	-	-	-
<b>MW-4</b>	<b>12/21/2012<sup>19</sup></b>	<b>7.01</b>	<b>1.31</b>	<b>5.70</b>	<b>0.00</b>	-	-	-	-	-	-	-
MW-5	06/04/1992	3.61	3.25	0.36	0.00	-	560	110	0.5	37	2.2	-
MW-5	10/13/1992	3.61	4.20	-0.59	0.00	-	1,200	150	<2.5	84	8.6	-
MW-5	01/11/1993	3.61	1.30	2.31	0.00	-	1,300	48	1.0	83	33	-
MW-5	04/14/1993	3.61	1.20	2.41	0.00	-	2,600	240	6.1	250	170	-
MW-5	07/13/1993	3.61	3.15	0.46	0.00	-	1,700	260	7.8	160	100	-
MW-5	10/19/1993	3.61	3.82	-0.21	0.00	-	1,900	190	3.3	200	93	-



**GROUNDWATER MONITORING AND SAMPLING DATA  
FORMER CHEVRON SERVICE STATION 91153  
3135 GIBBONS DRIVE  
(3126 FERNside BOULEVARD)  
ALAMEDA, CALIFORNIA**

Location	Date	TOC	DTW	GWE	LNAPL	FIELD PARAMETERS	HYDROCARBONS	PRIMARY VOCS				
						Dissolved Oxygen	TPH-GRO	B	T	E	X	MTBE by SW8260
	Units	ft	ft	ft-amsl	ft	mg/L	µg/L	µg/L	µg/L	µg/L	µg/L	µg/L
MW-5	11/30/1993	7.04	3.56	3.48	0.00	-	-	-	-	-	-	-
MW-5	01/27/1994	7.04	2.42	4.62	0.00	-	4,000	100	12	210	110	-
MW-5	04/07/1994	7.04	2.33	4.71	0.00	-	2,600	170	10	150	88	-
MW-5	07/01/1994	7.04	3.18	3.86	0.00	-	2,300	350	9.1	110	76	-
MW-5	10/05/1994	7.04	3.98	3.06	0.00	-	11,000	840	150	130	340	-
MW-5	01/12/1995	7.04	0.40	6.64	0.00	-	2,300	82	<2.5	54	20	-
MW-5	04/26/1995	7.04	0.50	6.54	0.00	-	1,600	52	<5.0	36	61	-
MW-5	07/12/1995	7.04	2.41	4.63	0.00	-	2,800	150	<5.0	34	38	-
MW-5	10/30/1995	7.04	3.78	3.26	0.00	-	1,100	81	<5.0	<5.0	<5.0	35
MW-5	01/22/1996	7.04	0.78	6.26	0.00	-	880	7.3	<2.0	15	4.8	<10
MW-5	04/24/1996	7.04	1.65	5.39	0.00	-	1,600	51	3.8	14	5.6	56
MW-5	07/29/1996 <sup>21</sup>	7.04	-	-	-	-	-	-	-	-	-	-
MW-5	10/10/1996	7.04	3.60	3.44	0.00	-	1,000	18	<1.2	1.5	<1.2	<6.2
MW-5	01/15/1997	7.04	0.45	6.59	0.00	-	520	0.84	<0.5	3.1	1.2	8.4
MW-5	04/03/1997	7.04	2.11	4.93	0.00	-	1,400	13	<2.0	4.3	8.4	32
MW-5	07/09/1997	7.04	3.71	3.33	0.00	-	810	3.6	0.97	<0.5	<0.5	9.7
MW-5	10/29/1997	7.04	4.20	2.84	0.00	-	<50	<0.5	<0.5	<0.5	<0.5	<2.5
MW-5	01/14/1998	7.04	0.00	7.04	0.00	-	430	5.8	2.4	<0.5	1.6	17
MW-5	04/17/1998 <sup>20</sup>	7.04	0.71	6.33	0.00	-	-	-	-	-	-	-
MW-5	07/15/1998	7.04	0.00	7.04	0.00	-	990	11	3.9	0.56	2.2	61
MW-5	10/27/1998	7.04	4.23	2.81	0.00	-	-	-	-	-	-	-
MW-5	01/20/1999	7.04	2.58	4.46	0.00	-	168	<0.5	<0.5	<0.5	0.692	<2.0
MW-5	04/19/1999	7.04	2.07	4.97	0.00	-	-	-	-	-	-	-

TABLE 1

GROUNDWATER MONITORING AND SAMPLING DATA  
 FORMER CHEVRON SERVICE STATION 91153  
 3135 GIBBONS DRIVE  
 (3126 FERNside BOULEVARD)  
 ALAMEDA, CALIFORNIA

Location	Date	TOC	DTW	GWE	LNAPL	FIELD PARAMETERS	HYDROCARBONS	PRIMARY VOCS				
						Dissolved Oxygen	TPH-GRO	B	T	E	X	MTBE by SW8260
	Units	ft	ft	ft-amsl	ft	mg/L	µg/L	µg/L	µg/L	µg/L	µg/L	µg/L
MW-5	07/29/1999	7.04	3.43	3.61	0.00	-	246	1.54	<0.5	<0.5	<0.5	<2.0 <sup>2</sup> / <sup>2</sup> <5.0
MW-5	10/13/1999 <sup>21</sup>	7.04	-	-	-	-	-	-	-	-	-	-
MW-5	01/25/2000	7.04	1.51	5.53	0.00	-	169	1.94	<0.5	<0.5	<0.5	201
MW-5	04/03/2000	7.04	1.20	5.84	0.00	-	-	-	-	-	-	-
MW-5	07/03/2000	7.04	2.98	4.06	0.00	-	320 <sup>6,10</sup>	5.3	1.1	<0.50	<0.50	5.0
MW-5	10/23/2000	7.04	4.18	2.86	0.00	-	-	-	-	-	-	-
MW-5	01/08/2001 <sup>11</sup>	7.04	2.92	4.12	0.00	-	220 <sup>6</sup>	3.9	<0.50	<0.50	<0.50	7.7
MW-5	04/09/2001	7.04	1.01	6.03	0.00	-	-	-	-	-	-	-
MW-5	08/23/2001	7.04	3.48	3.56	0.00	-	630	40	3.5	<2.5	<2.5	43
MW-5	11/27/2001 <sup>20</sup>	7.04	3.05	3.99	0.00	-	-	-	-	-	-	-
MW-5	02/26/2002	7.04	1.00	6.04	0.00	-	410	4.3	<0.50	<0.50	<1.5	<2.5
MW-5	05/23/2002 <sup>20</sup>	7.04	2.21	4.83	0.00	-	-	-	-	-	-	-
MW-5	08/09/2002	7.04	3.38	3.66	0.00	-	240	1.3	<0.50	<0.50	<1.5	<2.5
MW-5	11/08/2002 <sup>20</sup>	7.04	4.56	2.48	0.00	-	-	-	-	-	-	-
MW-5	02/07/2003	7.04	1.42	5.62	0.00	-	380	3.2	<0.50	0.64	<1.5	<2.5
MW-5	05/09/2003 <sup>20</sup>	7.04	1.25	5.79	0.00	-	-	-	-	-	-	-
MW-5	08/15/2003 <sup>15</sup>	7.04	3.61	3.43	0.00	-	<50	<0.5	<0.5	<0.5	<0.5	<0.5
MW-5	11/14/2003 <sup>20</sup>	7.04	3.57	3.47	0.00	-	-	-	-	-	-	-
MW-5	02/13/2004 <sup>15</sup>	7.04	1.50	5.54	0.00	-	<50	<0.5	<0.5	<0.5	<0.5	<0.5
MW-5	05/14/2004 <sup>20</sup>	7.04	2.47	4.57	0.00	-	-	-	-	-	-	-
MW-5	08/13/2004 <sup>15</sup>	7.04	5.46	1.58	0.00	-	<50	<0.5	<0.5	<0.5	<0.5	<0.5
MW-5	11/12/2004 <sup>20</sup>	7.04	4.65	2.39	0.00	-	-	-	-	-	-	-
MW-5	02/11/2005 <sup>15</sup>	7.04	1.20	5.84	0.00	-	130	<0.5	<0.5	<0.5	<0.5	<0.5

TABLE 1

**GROUNDWATER MONITORING AND SAMPLING DATA  
FORMER CHEVRON SERVICE STATION 91153  
3135 GIBBONS DRIVE  
(3126 FERNSIDE BOULEVARD)  
ALAMEDA, CALIFORNIA**

Location	Date	TOC	DTW	GWE	LNAPL	FIELD PARAMETERS	HYDROCARBONS	PRIMARY VOCS				
						Dissolved Oxygen	TPH-GRO	B	T	E	X	MTBE by SW8260
	Units	ft	ft	ft-amsl	ft	mg/L	µg/L	µg/L	µg/L	µg/L	µg/L	µg/L
MW-5	05/13/2005 <sup>20</sup>	7.04	4.36	2.68	0.00	-	-	-	-	-	-	-
MW-5	08/19/2005 <sup>15</sup>	7.04	2.78	4.26	0.00	-	96	<0.5	<0.5	<0.5	<0.5	<0.5
MW-5	11/18/2005 <sup>20</sup>	7.04	4.51	2.53	0.00	-	-	-	-	-	-	-
MW-5	02/10/2006 <sup>15</sup>	7.04	1.12	5.92	0.00	-	<50	<0.5	<0.5	<0.5	<0.5	<0.5
MW-5	05/12/2006 <sup>20</sup>	7.04	2.23	4.81	0.00	-	-	-	-	-	-	-
MW-5	08/11/2006 <sup>15</sup>	7.04	3.40	3.64	0.00	-	<50	<0.5	<0.5	<0.5	<0.5	<0.5
MW-5	11/17/2006 <sup>20</sup>	7.04	4.16	2.88	0.00	-	-	-	-	-	-	-
MW-5	02/16/2007 <sup>15</sup>	7.04	1.22	5.82	0.00	-	<50	<0.5	<0.7	<0.8	<0.8	<0.5
MW-5	05/17/2007 <sup>20</sup>	7.04	4.06	2.98	0.00	-	-	-	-	-	-	-
MW-5	08/09/2007 <sup>15</sup>	7.04	3.61	3.43	0.00	-	<50	<0.5	<0.5	<0.5	<0.5	<0.5
MW-5	11/08/2007 <sup>20</sup>	7.04	3.70	3.34	0.00	-	-	-	-	-	-	-
MW-5	02/06/2008 <sup>15</sup>	7.04	1.06	5.98	0.00	-	<50	<0.5	<0.5	<0.5	<0.5	<0.5
MW-5	05/07/2008 <sup>20</sup>	7.04	3.57	3.47	0.00	-	-	-	-	-	-	-
MW-5	09/11/2008 <sup>15</sup>	7.04	4.58	2.46	0.00	-	<50	<0.5	<0.5	<0.5	<0.5	<0.5
MW-5	11/10/2008 <sup>20</sup>	7.04	4.26	2.78	0.00	-	-	-	-	-	-	-
MW-5	02/09/2009 <sup>15</sup>	7.04	2.15	4.89	0.00	-	<50	<0.5	<0.5	<0.5	<0.5	<0.5
MW-5	05/28/2009	7.04	2.76	4.28	0.00	-	-	-	-	-	-	-
MW-5	08/18/2009 <sup>15</sup>	7.04	3.81	3.23	0.00	-	<50	<0.5	<0.5	<0.5	<0.5	<0.5
MW-5	11/17/2009	7.04	4.02	3.02	0.00	-	-	-	-	-	-	-
MW-5	03/31/2010	7.04	1.86	5.18	0.00	-	<50	<0.5	<0.5	<0.5	<0.5	<0.5
MW-5	05/17/2010	7.04	1.57	5.47	0.00	-	-	-	-	-	-	-
MW-5	08/26/2010	7.04	3.25	3.79	0.00	-	<50	<0.5	<0.5	<0.5	<0.5	<0.5
MW-5	11/11/2010 <sup>20</sup>	7.04	3.52	3.52	0.00	-	-	-	-	-	-	-

TABLE 1

**GROUNDWATER MONITORING AND SAMPLING DATA  
FORMER CHEVRON SERVICE STATION 91153  
3135 GIBBONS DRIVE  
(3126 FERNside BOULEVARD)  
ALAMEDA, CALIFORNIA**

Location	Date	TOC	DTW	GWE	LNAPL	FIELD PARAMETERS	HYDROCARBONS	PRIMARY VOCS				
						Dissolved Oxygen	TPH-GRO	B	T	E	X	MTBE by SW8260
	Units	ft	ft	ft-amsl	ft	mg/L	µg/L	µg/L	µg/L	µg/L	µg/L	µg/L
MW-5	03/02/2011 <sup>20</sup>	7.04	1.55	5.49	0.00	-	<50	<0.5	<0.5	<0.5	<0.5	<0.5
MW-5	06/17/2011 <sup>20</sup>	7.04	1.84	5.20	0.00	-	-	-	-	-	-	-
MW-5	09/08/2011 <sup>20</sup>	7.04	2.50	4.54	0.00	-	<50	<0.5	<0.5	<0.5	<0.5	<0.5
MW-5	12/29/2011 <sup>20</sup>	7.04	3.40	3.64	0.00	-	-	-	-	-	-	-
MW-5	03/28/2012	7.04	1.72	5.32	0.00	-	<50	<0.5	<0.5	<0.5	<0.5	<0.5
MW-5	05/31/2012 <sup>20</sup>	7.04	0.20	6.84	0.00	-	-	-	-	-	-	-
MW-5	09/28/2012	7.04	3.90	3.14	0.00	-	<50	<0.5	<0.5	<0.5	<0.5	<0.5
<b>MW-5</b>	<b>12/21/2012<sup>20</sup></b>	<b>7.04</b>	<b>1.59</b>	<b>5.45</b>	<b>0.00</b>	-	-	-	-	-	-	-
MW-6	06/04/1992	3.85	3.89	-0.04	0.00	-	210	54	<0.5	1.9	2.4	-
MW-6	10/13/1992	3.85	4.56	-0.71	0.00	-	10,000	5,300	<10	70	<10	-
MW-6	01/11/1993	3.85	2.36	1.49	0.00	-	100	50	<0.5	<0.5	<0.5	-
MW-6	04/14/1993	3.85	3.15	0.70	0.00	-	<50	<0.5	<0.5	<0.5	<0.5	-
MW-6	07/13/1993	3.85	3.94	-0.09	0.00	-	<50	1.8	<0.5	<0.5	<1.5	-
MW-6	10/19/1993	3.85	4.40	-0.55	0.00	-	320	150	<0.5	0.8	<0.5	-
MW-6	11/30/1993	7.27	4.16	3.11	0.00	-	-	-	-	-	-	-
MW-6	01/27/1994	7.27	3.33	3.94	0.00	-	120	45	<0.5	<0.5	<0.5	-
MW-6	04/07/1994	7.27	3.43	3.84	0.00	-	<50	<0.5	<0.5	<0.5	<0.5	-
MW-6	07/01/1994	7.27	3.94	3.33	0.00	-	<50	<0.5	<0.5	<0.5	<0.5	-
MW-6	10/05/1994	7.27	4.38	2.89	0.00	-	8,300	2,400	160	42	190	-
MW-6	01/12/1995 <sup>1</sup>	7.27	2.43	4.84	0.00	-	<50	12	<0.5	<0.5	<0.5	-
MW-6	04/26/1995	7.27	2.06	5.21	0.00	-	<50	5.5	0.67	<0.5	1.3	-
MW-6	07/12/1995	7.27	3.53	3.74	0.00	-	65	27	<0.5	<0.5	<0.5	-

TABLE 1

**GROUNDWATER MONITORING AND SAMPLING DATA  
FORMER CHEVRON SERVICE STATION 91153  
3135 GIBBONS DRIVE  
(3126 FERNside BOULEVARD)  
ALAMEDA, CALIFORNIA**

Location	Date	TOC	DTW	GWE	LNAPL	FIELD PARAMETERS	HYDROCARBONS	PRIMARY VOCS				
						Dissolved Oxygen	TPH-GRO	B	T	E	X	MTBE by SW8260
	Units	ft	ft	ft-amsl	ft	mg/L	µg/L	µg/L	µg/L	µg/L	µg/L	µg/L
MW-6	10/30/1995	7.27	4.34	2.93	0.00	-	<50	3.9	<0.5	<0.5	<0.5	<2.5
MW-6	01/22/1996	7.27	2.61	4.66	0.00	-	<50	0.93	<0.5	<0.5	<0.5	<2.5
MW-6	04/24/1996	7.27	2.50	4.77	0.00	-	260	110	<1.2	<1.2	<1.2	<6.2
MW-6	07/29/1996	7.27	3.85	3.42	0.00	-	<50	23	<0.5	<0.5	<0.5	<2.5
MW-6	10/10/1996	7.27	4.37	2.90	0.00	-	79	31	<0.5	<0.5	<0.5	<2.5
MW-6	01/15/1997	7.27	2.63	4.64	0.00	-	<50	<0.5	<0.5	<0.5	<0.5	<2.5
MW-6	04/03/1997	7.27	3.42	3.85	0.00	-	670	360	<5.0	<5.0	<5.0	<25
MW-6	07/09/1997	7.27	4.29	2.98	0.00	-	330	140	<2.0	<2.0	<2.0	<10
MW-6	10/29/1997	7.27	4.56	2.71	0.00	-	400	260	<2.0	<2.0	<2.0	5.8
MW-6	01/14/1998	7.27	1.01	6.26	0.00	-	<50	<0.5	<0.5	<0.5	<0.5	<2.5
MW-6	04/17/1998	7.27	2.94	4.33	0.00	-	<50	1.7	<0.5	<0.5	<0.5	<2.5
MW-6	07/15/1998	7.27	4.72	2.55	0.00	-	<50	<0.5	<0.5	<0.5	<0.5	<2.5
MW-6	10/27/1998 <sup>21</sup>	7.27	-	-	-	-	-	-	-	-	-	-
MW-6	11/25/1998	7.27	4.16	3.11	0.00	-	110 <sup>3</sup>	54	<0.5	<0.5	<0.5	<2.5
MW-6	01/20/1999	7.27	3.45	3.82	0.00	-	<50	10	<0.5	<0.5	<0.5	<2.0
MW-6	04/19/1999	7.27	3.39	3.88	0.00	-	<50	2.6	<0.5	<0.5	<0.5	<2.0/<2.5 <sup>2</sup>
MW-6	07/29/1999 <sup>4</sup>	7.27	4.34	2.93	0.00	-	<5,000	2,590	<50	<50	<50	<500
MW-6	10/13/1999	7.27	5.89	1.38	0.00	-	9,270	4,610	44.2	<25	<25	<125
MW-6	01/25/2000	7.27	4.11	3.16	0.00	-	529	289	<0.5	<0.5	<0.5	738
MW-6	04/03/2000 <sup>7,8</sup>	7.27	2.84	4.43	0.00	-	<50	<0.50	<0.50	<0.50	<0.50	<2.5
MW-6	07/03/2000 <sup>7</sup>	7.27	3.77	3.50	0.00	-	91 <sup>6</sup>	89	0.77	<0.50	<0.50	<2.5
MW-6	10/12/2000	7.27	6.32	0.95	0.00	-	<50	8.0	<0.50	<0.50	<0.50	<2.5
MW-6	01/08/2001 <sup>7,11</sup>	7.27	3.74	3.53	0.00	-	400 <sup>6</sup>	640	8.2	8.0	5.0	10

TABLE 1

**GROUNDWATER MONITORING AND SAMPLING DATA  
FORMER CHEVRON SERVICE STATION 91153  
3135 GIBBONS DRIVE  
(3126 FERNSIDE BOULEVARD)  
ALAMEDA, CALIFORNIA**

Location	Date	TOC	DTW	GWE	LNAPL	FIELD PARAMETERS	HYDROCARBONS	PRIMARY VOCS				
						Dissolved Oxygen	TPH-GRO	B	T	E	X	MTBE by SW8260
	Units	ft	ft	ft-amsl	ft	mg/L	µg/L	µg/L	µg/L	µg/L	µg/L	µg/L
MW-6	04/09/2001 <sup>7</sup>	7.27	3.03	4.24	0.00	-	91.3	22.0	3.36	0.751	2.14	<0.500
MW-6	08/23/2001 <sup>7</sup>	7.27	4.70	2.57	0.00	-	53 <sup>13</sup>	23	0.50	<0.50	1.1	<2.5
MW-6	11/27/2001 <sup>14</sup>	7.27	4.43	2.84	0.00	-	<50	4.1	<0.50	<0.50	<1.5	<2.5
MW-6	02/26/2002 <sup>14</sup>	7.27	2.50	4.77	0.00	-	100	53	<0.50	<0.50	<1.5	<2.5
MW-6	05/23/2002	7.27	3.27	4.00	0.00	-	610	260	4.2	1.7	2.1	<2.5
MW-6	08/09/2002	7.27	4.11	3.16	0.00	-	<50	1.1	<0.50	<0.50	<1.5	<2.5
MW-6	11/08/2002	7.27	4.12	3.15	0.00	2.10	<50	<0.50	<0.50	<0.50	<1.5	<2.5
MW-6	02/07/2003	7.27	2.60	4.67	0.00	2.60	<50	0.65	<0.50	<0.50	<1.5	<2.5
MW-6	05/09/2003	7.27	2.57	4.70	0.00	3.10	<50	1.9	<0.5	<0.5	<1.5	<2.5
MW-6	08/15/2003 <sup>15</sup>	7.27	4.15	3.12	0.00	2.90	<50	<0.5	<0.5	<0.5	<0.5	<0.5
MW-6	11/14/2003 <sup>15</sup>	7.27	4.10	3.17	0.00	3.41	<50	<0.5	0.6	<0.5	<0.5	1
MW-6	02/13/2004 <sup>15</sup>	7.27	2.66	4.61	0.00	-	<50	<0.5	<0.5	<0.5	<0.5	<0.5
MW-6	05/14/2004 <sup>15</sup>	7.27	3.55	3.72	0.00	-	<50	3	<0.5	<0.5	<0.5	<0.5
MW-6	08/13/2004 <sup>15</sup>	7.27	4.32	2.95	0.00	-	<50	<0.5	<0.5	<0.5	<0.5	<0.5
MW-6	11/12/2004 <sup>15</sup>	7.27	4.20	3.07	0.00	-	<50	<0.5	<0.5	<0.5	<0.5	<0.5
MW-6	02/11/2005 <sup>15</sup>	7.27	2.18	5.09	0.00	-	<50	<0.5	<0.5	<0.5	<0.5	<0.5
MW-6	05/13/2005 <sup>15</sup>	7.27	4.11	3.16	0.00	-	<50	<0.5	<0.5	<0.5	<0.5	<0.5
MW-6	08/19/2005 <sup>15</sup>	7.27	3.70	3.57	0.00	1.90	<50	<0.5	<0.5	<0.5	<0.5	<0.5
MW-6	11/18/2005 <sup>15</sup>	7.27	3.98	3.29	0.00	1.70	<50	<0.5	<0.5	<0.5	<0.5	<0.5
MW-6	02/10/2006 <sup>15</sup>	7.27	2.11	5.16	0.00	2.20	<50	<0.5	<0.5	<0.5	<0.5	<0.5
MW-6	05/12/2006 <sup>15</sup>	7.27	3.18	4.09	0.00	2.80	<50	<0.5	<0.5	<0.5	<0.5	<0.5
MW-6	08/11/2006 <sup>15</sup>	7.27	3.80	3.47	0.00	2.50	<50	<0.5	<0.5	<0.5	<0.5	<0.5
MW-6	11/17/2006 <sup>15</sup>	7.27	3.78	3.49	0.00	2.20	<50	<0.5	<0.5	<0.5	<0.5	<0.5

TABLE 1

**GROUNDWATER MONITORING AND SAMPLING DATA  
FORMER CHEVRON SERVICE STATION 91153  
3135 GIBBONS DRIVE  
(3126 FERNside BOULEVARD)  
ALAMEDA, CALIFORNIA**

Location	Date	TOC	DTW	GWE	LNAPL	FIELD PARAMETERS	HYDROCARBONS	PRIMARY VOCS				
						Dissolved Oxygen	TPH-GRO	B	T	E	X	MTBE by SW8260
	Units	ft	ft	ft-amsl	ft	mg/L	µg/L	µg/L	µg/L	µg/L	µg/L	µg/L
MW-6	02/16/2007 <sup>15</sup>	7.27	2.08	5.19	0.00	1.80	<50	1	<0.5	<0.5	<0.5	<0.5
MW-6	05/17/2007 <sup>15</sup>	7.27	3.61	3.66	0.00	2.0	<50	<0.5	<0.5	<0.5	<0.5	<0.5
MW-6	08/09/2007 <sup>15</sup>	7.27	4.05	3.22	0.00	2.6	<50	<0.5	<0.5	<0.5	<0.5	<0.5
MW-6	11/08/2007 <sup>15</sup>	7.27	4.12	3.15	0.00	2.2	<50	5	<0.5	<0.5	<0.5	<0.5
MW-6	02/06/2008 <sup>15</sup>	7.27	1.85	5.42	0.00	2.4	<50	<0.5	<0.5	<0.5	<0.5	<0.5
MW-6	05/07/2008 <sup>15</sup>	7.27	3.91	3.36	0.00	2.3	63	18	<0.5	<0.5	<0.5	<0.5
MW-6	09/11/2008 <sup>15</sup>	7.27	4.93	2.34	0.00	1.9	<50	<0.5	<0.5	<0.5	<0.5	<0.5
MW-6	11/10/2008 <sup>15</sup>	7.27	4.30	2.97	0.00	2.2	<50	<0.5	<0.5	<0.5	<0.5	<0.5
MW-6	02/09/2009 <sup>15</sup>	7.27	2.97	4.30	0.00	2.0	<50	2	<0.5	<0.5	<0.5	<0.5
MW-6	05/28/2009 <sup>15</sup>	7.27	3.53	3.74	0.00	1.77	<50	4	<0.5	<0.5	<0.5	<0.5
MW-6	08/18/2009 <sup>15</sup>	7.27	3.38	3.89	0.00	1.81	560	130	3	<0.5	0.7 J	<0.5
MW-6	11/17/2009	7.27	4.00	3.27	0.00	-	-	-	-	-	-	-
MW-6	03/31/2010	7.27	2.44	4.83	0.00	-	<50	<0.5	<0.5	<0.5	<0.5	<0.5
MW-6	05/17/2010	7.27	3.30	3.97	0.00	-	-	-	-	-	-	-
MW-6	08/26/2010	7.27	4.15	3.12	0.00	-	<50	<0.5	<0.5	<0.5	<0.5	<0.5
MW-6	11/11/2010 <sup>20</sup>	7.27	4.16	3.11	0.00	-	-	-	-	-	-	-
MW-6	03/02/2011 <sup>20</sup>	7.27	2.27	5.00	0.00	-	<50	<0.5	<0.5	<0.5	<0.5	<0.5
MW-6	06/17/2011 <sup>20</sup>	7.27	3.69	3.58	0.00	-	-	-	-	-	-	-
MW-6	09/08/2011 <sup>20</sup>	7.27	3.82	3.45	0.00	-	<50	2	<0.5	<0.5	<0.5	<0.5
MW-6	12/29/2011 <sup>20</sup>	7.27	3.90	3.37	0.00	-	-	-	-	-	-	-
MW-6	03/28/2012	7.27	1.99	5.28	0.00	-	<50	<0.5	<0.5	<0.5	<0.5	<0.5
MW-6	05/31/2012 <sup>20</sup>	7.27	3.28	3.99	0.00	-	-	-	-	-	-	-
MW-6	09/28/2012	7.27	4.47	2.80	0.00	-	<50	<0.5	<0.5	<0.5	<0.5	<0.5

TABLE 1

**GROUNDWATER MONITORING AND SAMPLING DATA  
FORMER CHEVRON SERVICE STATION 91153  
3135 GIBBONS DRIVE  
(3126 FERNside BOULEVARD)  
ALAMEDA, CALIFORNIA**

Location	Date	TOC	DTW	GWE	LNAPL	FIELD PARAMETERS	HYDROCARBONS	PRIMARY VOCS				
						Dissolved Oxygen	TPH-GRO	B	T	E	X	MTBE by SW8260
	Units	ft	ft	ft-amsl	ft	mg/L	µg/L	µg/L	µg/L	µg/L	µg/L	µg/L
MW-6	12/21/2012 <sup>20</sup>	7.27	2.68	4.59	0.00	-	-	-	-	-	-	-
MW-7	11/30/1993	8.22	5.33	2.89	0.00	-	480	110	41	4.4	38	-
MW-7	01/27/1994	8.22	4.50	3.72	0.00	-	120	21	1.1	2.2	4.8	-
MW-7	04/07/1994	8.22	4.62	3.60	0.00	-	2,600	630	39	56	94	-
MW-7	07/01/1994	8.22	5.13	3.09	0.00	-	2,200	770	42	<10	92	-
MW-7	10/05/1994	8.22	5.61	2.61	0.00	-	15,000	3,300	90	130	320	-
MW-7	01/12/1995	8.22	2.83	5.39	0.00	-	340	57	<1.3	18	6.4	-
MW-7	04/26/1995	8.22	2.35	5.87	0.00	-	15,000	3,700	210	520	800	-
MW-7	07/12/1995	8.22	4.66	3.56	0.00	-	7,700	1,800	59	130	370	-
MW-7	10/30/1995	8.22	5.48	2.74	0.00	-	770	260	<5.0	33	48	25
MW-7	01/22/1996	8.22	3.34	4.88	0.00	-	290	63	<1.0	6.4	5.7	<5.0
MW-7	04/24/1996	8.22	4.12	4.10	0.00	-	12,000	2,500	510	380	810	<125
MW-7	07/29/1996	8.22	5.03	3.19	0.00	-	2,600	650	<25	61	150	<125
MW-7	10/10/1996	8.22	5.52	2.70	0.00	-	5,800	1,700	28	170	210	<62
MW-7	01/15/1997	8.22	2.92	5.30	0.00	-	1,000	230	<2.5	28	11	63
MW-7	04/03/1997	8.22	4.65	3.57	0.00	-	6,000	1,800	100	140	170	<100
MW-7	07/09/1997	8.22	5.39	2.83	0.00	-	5,500	2,200	<20	41	30	<100
MW-7	10/29/1997	8.22	5.58	2.64	0.00	-	220	40	0.61	3.0	2.4	7.6
MW-7	01/14/1998	8.22	2.80	5.42	0.00	-	140	5.1	<0.5	<0.5	1.4	<2.5
MW-7	04/17/1998	8.22	3.00	5.22	0.00	-	13,000	4,200	98	250	240	250
MW-7	07/15/1998 <sup>21</sup>	8.22	-	-	-	-	-	-	-	-	-	-
MW-7	08/17/1998 <sup>5</sup>	7.92	5.52	2.40	0.00	-	1,600	380	51	68	280	22



TABLE 1

**GROUNDWATER MONITORING AND SAMPLING DATA  
FORMER CHEVRON SERVICE STATION 91153  
3135 GIBBONS DRIVE  
(3126 FERNside BOULEVARD)  
ALAMEDA, CALIFORNIA**

Location	Date	TOC	DTW	GWE	LNAPL	FIELD PARAMETERS	HYDROCARBONS	PRIMARY VOCS				
						Dissolved Oxygen	TPH-GRO	B	T	E	X	MTBE by SW8260
	Units	ft	ft	ft-amsl	ft	mg/L	µg/L	µg/L	µg/L	µg/L	µg/L	µg/L
MW-7	10/27/1998	7.92	7.51	0.41	0.00	-	190	2.3	0.53	<0.5	<0.5	33
MW-7	01/20/1999	7.92	3.45	4.47	0.00	-	<50	<0.5	<0.5	<0.5	<0.5	<2.0
MW-7	04/19/1999	7.92	4.61	3.31	0.00	-	6,500	3,000	<0.5	110	210	150 <sup>2</sup> /310
MW-7	07/29/1999 <sup>4</sup>	7.92	5.00	2.92	0.00	-	8,390	2,100	129	222	729	248
MW-7	10/13/1999	7.92	5.61	2.31	0.00	-	14,300	6,600	58.8	117	190	<125
MW-7	01/25/2000	7.92	3.32	4.60	0.00	-	1,100	184	<5.0	13.5	33.7	151
MW-7	04/03/2000 <sup>7,9</sup>	7.92	3.38	4.54	0.00	-	2,600 <sup>6</sup>	780	12	<5.0	61	95
MW-7	07/03/2000 <sup>7</sup>	7.92	4.34	3.58	0.00	-	4,100 <sup>6</sup>	2,600	72	240	690	<50
MW-7	10/23/2000	7.92	6.11	1.81	0.00	-	12,000 <sup>6</sup>	2,600	<50	150	290	<250
MW-7	01/08/2001 <sup>7,11</sup>	7.92	4.32	3.60	0.00	-	3,900 <sup>6</sup>	2,200	61	140	350	<25
MW-7	04/09/2001 <sup>7</sup>	7.92	3.63	4.29	0.00	-	25,100	4,590	1,200	843	1,920	48.1
MW-7	08/23/2001 <sup>7</sup>	7.92	4.83	3.09	0.00	-	27,000	4,100	970	1,100	3,500	<500
MW-7	11/27/2001	7.92	4.30	3.62	0.00	-	12,000	1,800	50	450	830	91
MW-7	02/26/2002	7.92	3.00	4.92	0.00	-	15,000	3,100	260	380	860	<10
MW-7	05/23/2002	7.92	3.69	4.23	0.00	-	28,000	6,000	120	820	1,900	42
MW-7	08/09/2002	7.92	4.38	3.54	0.00	-	24,000	3,700	81	710	1,300	56
MW-7	11/08/2002	7.92	4.43	3.49	0.00	-98.00	18,000	2,300	150	660	1,400	<100
MW-7	02/07/2003	7.92	3.20	4.72	0.00	2.90	13,000	2,300	200	310	620	<25
MW-7	05/09/2003	7.92	3.18	4.74	0.00	2.60	17,000	4,200	36	350	360	<50
MW-7	08/15/2003 <sup>15</sup>	7.92	4.75	3.17	0.00	2.30	29,000	7,300	140	780	1,900	<5
MW-7	11/14/2003 <sup>15</sup>	7.92	4.95	2.97	0.00	1.87	7,200	950	3	45	20	7
MW-7	02/13/2004 <sup>15</sup>	7.92	3.29	4.63	0.00	-	3,300	360	4	82	130	3
MW-7	05/14/2004 <sup>15</sup>	7.92	3.98	3.94	0.00	-	17,000	3,100	480	510	1,300	3

TABLE 1

**GROUNDWATER MONITORING AND SAMPLING DATA  
FORMER CHEVRON SERVICE STATION 91153  
3135 GIBBONS DRIVE  
(3126 FERNSIDE BOULEVARD)  
ALAMEDA, CALIFORNIA**

Location	Date	TOC	DTW	GWE	LNAPL	FIELD PARAMETERS	HYDROCARBONS	PRIMARY VOCS				
						Dissolved Oxygen	TPH-GRO	B	T	E	X	MTBE by SW8260
	Units	ft	ft	ft-amsl	ft	mg/L	µg/L	µg/L	µg/L	µg/L	µg/L	µg/L
MW-7	08/13/2004 <sup>15</sup>	7.92	5.94	1.98	0.00	-	10,000	2,000	4	130	150	4
MW-7	11/12/2004 <sup>15</sup>	7.92	4.50	3.42	0.00	-	680	4	<0.5	1	0.7	0.8
MW-7	02/11/2005 <sup>15</sup>	7.92	3.07	4.85	0.00	-	4,600	680	6	80	44	4
MW-7	05/13/2005 <sup>15</sup>	7.92	4.51	3.41	0.00	-	4,200	380	3	38	13	2
MW-7	08/19/2005 <sup>15</sup>	7.92	4.03	3.89	0.00	0.80	7,900	1,300	3	190	310	<1
MW-7	11/18/2005 <sup>15</sup>	7.92	4.62	3.30	0.00	0.90	3,900	4	1	16	8	2
MW-7	02/10/2006 <sup>15</sup>	7.92	3.12	4.80	0.00	1.30	3,200	320	2	14	8	2
MW-7	05/12/2006 <sup>15</sup>	7.92	4.25	3.67	0.00	1.40	3,600	1,000	2	65	27	<1
MW-7	08/11/2006 <sup>15</sup>	7.92	4.45	3.47	0.00	1.10	6,700	1,900	6	280	300	<1
MW-7	11/17/2006 <sup>15</sup>	7.92	4.71	3.21	0.00	0.70	1,200	0.6	<0.5	1	0.8	<0.5
MW-7	02/16/2007 <sup>15</sup>	7.92	3.26	4.66	0.00	1.10	110	<0.5	<0.5	<0.5	<0.5	<0.5
MW-7	05/17/2007 <sup>15</sup>	7.92	4.62	3.30	0.00	1.7	6,400	1,400	4	130	26	<1
MW-7	08/09/2007 <sup>15</sup>	7.92	4.61	3.31	0.00	1.2	10,000	1,400	4	230	12	<3
MW-7	11/08/2007 <sup>15</sup>	7.92	4.72	3.20	0.00	0.9	2,300	4	1	3	7	0.9
MW-7	02/06/2008 <sup>15</sup>	7.92	2.98	4.94	0.00	0.5	190	<0.5	<0.5	<0.5	<0.5	<0.5
MW-7	05/07/2008 <sup>15</sup>	7.92	4.48	3.44	0.00	1.2	8,000	1,500	15	380	260	<1
MW-7	09/11/2008 <sup>15</sup>	7.92	5.95	1.97	0.00	1.0	5,100	530	4	47	12	0.7
MW-7	11/10/2008 <sup>15</sup>	7.92	5.81	2.11	0.00	0.6	2,800	13	1	1	7	<0.5
MW-7	02/09/2009 <sup>15</sup>	7.92	4.06	3.86	0.00	0.8	3,900	190	2	51	11	0.5
MW-7	05/28/2009 <sup>15,17</sup>	7.92	3.84	4.08	0.00	0.45	5,800	870	8	220	27	<0.5
MW-7	08/18/2009 <sup>15</sup>	7.92	4.80	3.12	0.00	0.57	6,700	660	4	110	13	0.7 J
MW-7	11/17/2009	7.92	4.52	3.40	0.00	-	-	-	-	-	-	-
MW-7	03/31/2010	7.92	3.11	4.81	0.00	-	2,000	110	1	2	3	0.7 J

TABLE 1

GROUNDWATER MONITORING AND SAMPLING DATA  
 FORMER CHEVRON SERVICE STATION 91153  
 3135 GIBBONS DRIVE  
 (3126 FERNside BOULEVARD)  
 ALAMEDA, CALIFORNIA

Location	Date	TOC	DTW	GWE	LNAPL	FIELD PARAMETERS	HYDROCARBONS	PRIMARY VOCS				
						Dissolved Oxygen	TPH-GRO	B	T	E	X	MTBE by SW8260
	Units	ft	ft	ft-amsl	ft	mg/L	µg/L	µg/L	µg/L	µg/L	µg/L	µg/L
MW-7	05/17/2010	7.92	3.41	4.51	0.00	-	-	-	-	-	-	-
MW-7	08/26/2010	7.92	4.60	3.32	0.00	-	5,100	470	3	150	9	<0.5
MW-7	11/11/2010 <sup>20</sup>	7.92	4.68	3.24	0.00	-	-	-	-	-	-	-
MW-7	03/02/2011 <sup>20</sup>	7.92	2.53	5.39	0.00	-	1,100	<0.5	<0.5	<0.5	<0.5	<0.5
MW-7	06/17/2011 <sup>20</sup>	7.92	4.02	3.90	0.00	-	-	-	-	-	-	-
MW-7	09/08/2011 <sup>20</sup>	7.92	4.12	3.80	0.00	-	5,700	650	7	140	31	<0.5
MW-7	12/29/2011 <sup>20</sup>	7.92	4.12	3.80	0.00	-	-	-	-	-	-	-
MW-7	03/28/2012	7.92	2.61	5.31	0.00	-	370	<0.5	<0.5	<0.5	<0.5	<0.5
MW-7	05/31/2012 <sup>20</sup>	7.92	3.79	4.13	0.00	-	-	-	-	-	-	-
MW-7	09/28/2012	7.92	4.90	3.02	0.00	-	3,600	14	<5	<5	5 J	<5
<b>MW-7</b>	<b>12/21/2012<sup>20</sup></b>	<b>7.92</b>	<b>3.09</b>	<b>4.83</b>	<b>0.00</b>	-	-	-	-	-	-	-
MW-8	10/17/1995	6.96	4.40	2.56	0.00	-	-	-	-	-	-	-
MW-8	10/30/1995	6.96	4.44	2.52	0.00	-	<50	<0.5	<0.5	<0.5	<0.5	<2.5
MW-8	01/22/1996	6.96	2.24	4.72	0.00	-	<50	<0.5	<0.5	<0.5	<0.5	<2.5
MW-8	04/24/1996	6.96	2.97	3.99	0.00	-	<50	<0.5	<0.5	<0.5	<0.5	<2.5
MW-8	07/29/1996	6.96	3.37	3.59	0.00	-	<50	<0.5	<0.5	<0.5	<0.5	<2.5
MW-8	10/10/1996	6.96	4.12	2.84	0.00	-	<50	<0.5	<0.5	<0.5	<0.5	<2.5
MW-8	01/15/1997	6.96	0.94	6.02	0.00	-	<50	<0.5	<0.5	<0.5	<0.5	<2.5
MW-8	04/03/1997	6.96	2.20	4.76	0.00	-	<50	<0.5	<0.5	<0.5	<0.5	<2.5
MW-8	07/09/1997	6.96	4.30	2.66	0.00	-	<50	<0.5	<0.5	<0.5	<0.5	<2.5
MW-8	10/29/1997	6.96	4.57	2.39	0.00	-	<50	<0.5	<0.5	<0.5	<0.5	<2.5
MW-8	01/14/1998	6.96	0.83	6.13	0.00	-	<50	<0.5	<0.5	<0.5	<0.5	<2.5

TABLE 1

GROUNDWATER MONITORING AND SAMPLING DATA  
 FORMER CHEVRON SERVICE STATION 91153  
 3135 GIBBONS DRIVE  
 (3126 FERNSIDE BOULEVARD)  
 ALAMEDA, CALIFORNIA

Location	Date	TOC	DTW	GWE	LNAPL	FIELD PARAMETERS	HYDROCARBONS	PRIMARY VOCS				
						Dissolved Oxygen	TPH-GRO	B	T	E	X	MTBE by SW8260
	Units	ft	ft	ft-amsl	ft	mg/L	µg/L	µg/L	µg/L	µg/L	µg/L	µg/L
MW-8	01/20/1999	6.96	2.69	4.27	0.00	-	<50	<0.5	<0.5	<0.5	<0.5	<2.0
MW-8	04/19/1999	6.96	3.76	3.20	0.00	-	-	-	-	-	-	-
MW-8	01/25/2000	6.96	1.41	5.55	0.00	-	<50	<0.5	<0.5	<0.5	<0.5	<2.5
MW-8	04/03/2000 <sup>19</sup>	6.96	-	-	-	-	-	-	-	-	-	-
MW-8	07/03/2000	6.96	-	-	-	-	-	-	-	-	-	-
MW-8	10/23/2000	6.96	-	-	-	-	-	-	-	-	-	-
MW-8	01/08/2001 <sup>11</sup>	6.96	3.58	3.38	0.00	-	<50	<0.50	<0.50	<0.50	<0.50	<2.5
MW-8	04/09/2001	6.96	-	-	-	-	-	-	-	-	-	-
MW-8	08/23/2001 <sup>19</sup>	6.96	-	-	-	-	-	-	-	-	-	-
MW-8	11/27/2001 <sup>19</sup>	6.96	-	-	-	-	-	-	-	-	-	-
MW-8	02/26/2002	6.96	2.91	4.05	0.00	-	<50	<0.50	<0.50	<0.50	<1.5	<2.5
MW-8	05/23/2002 <sup>19</sup>	6.96	-	-	-	-	-	-	-	-	-	-
MW-8	08/09/2002 <sup>19</sup>	6.96	-	-	-	-	-	-	-	-	-	-
MW-8	11/08/2002 <sup>19</sup>	6.96	-	-	-	-	-	-	-	-	-	-
MW-8	02/07/2003	6.96	3.13	3.83	0.00	-	<50	<0.50	<0.50	<0.50	<1.5	<2.5
MW-8	05/09/2003 <sup>19</sup>	6.96	-	-	-	-	-	-	-	-	-	-
MW-8	08/15/2003 <sup>19</sup>	6.96	-	-	-	-	-	-	-	-	-	-
MW-8	11/14/2003 <sup>19</sup>	6.96	-	-	-	-	-	-	-	-	-	-
MW-8	02/13/2004 <sup>15</sup>	6.96	3.20	3.76	0.00	-	<50	<0.5	<0.5	<0.5	<0.5	<0.5
MW-8	05/14/2004 <sup>19</sup>	6.96	-	-	-	-	-	-	-	-	-	-
MW-8	11/12/2004 <sup>19</sup>	6.96	-	-	-	-	-	-	-	-	-	-
MW-8	02/11/2005 <sup>15</sup>	6.96	2.85	4.11	0.00	-	<50	<0.5	<0.5	<0.5	<0.5	<0.5
MW-8	05/13/2005 <sup>19</sup>	6.96	-	-	-	-	-	-	-	-	-	-

TABLE 1

GROUNDWATER MONITORING AND SAMPLING DATA  
 FORMER CHEVRON SERVICE STATION 91153  
 3135 GIBBONS DRIVE  
 (3126 FERNSIDE BOULEVARD)  
 ALAMEDA, CALIFORNIA

Location	Date	TOC	DTW	GWE	LNAPL	FIELD PARAMETERS	HYDROCARBONS	PRIMARY VOCS				
						Dissolved Oxygen	TPH-GRO	B	T	E	X	MTBE by SW8260
	Units	ft	ft	ft-amsl	ft	mg/L	µg/L	µg/L	µg/L	µg/L	µg/L	µg/L
MW-8	08/19/2005 <sup>19</sup>	6.96	-	-	-	-	-	-	-	-	-	-
MW-8	11/18/2005 <sup>19</sup>	6.96	-	-	-	-	-	-	-	-	-	-
MW-8	02/10/2006 <sup>15</sup>	6.96	2.74	4.22	<50	-	<0.5	<0.5	<0.5	<0.5	<0.5	<0.5
MW-8	05/12/2006 <sup>19</sup>	6.96	-	-	-	-	-	-	-	-	-	-
MW-8	08/11/2006 <sup>19</sup>	6.96	-	-	-	-	-	-	-	-	-	-
MW-8	11/17/2006 <sup>19</sup>	6.96	-	-	-	-	-	-	-	-	-	-
MW-8	02/16/2007 <sup>15</sup>	6.96	2.69	4.27	0.00	-	<50	<0.5	<0.5	<0.5	<0.5	<0.5
MW-8	05/17/2007 <sup>19</sup>	6.96	-	-	-	-	-	-	-	-	-	-
MW-8	08/09/2007 <sup>19</sup>	6.96	-	-	-	-	-	-	-	-	-	-
MW-8	11/08/2007 <sup>19</sup>	6.96	-	-	-	-	-	-	-	-	-	-
MW-8	02/06/2008 <sup>15</sup>	6.96	2.57	4.39	0.00	-	<50	<0.5	<0.5	<0.5	<0.5	<0.5
MW-8	05/07/2008 <sup>19</sup>	6.96	-	-	-	-	-	-	-	-	-	-
MW-8	09/11/2008 <sup>19</sup>	6.96	-	-	-	-	-	-	-	-	-	-
MW-8	11/10/2008 <sup>19</sup>	6.96	-	-	-	-	-	-	-	-	-	-
MW-8	02/09/2009 <sup>15</sup>	6.96	3.28	3.68	0.00	-	<50	<0.5	<0.5	<0.5	<0.5	<0.5
MW-8	03/31/2010	6.96	2.85	4.11	0.00	-	<50	<0.5	<0.5	<0.5	<0.5	<0.5
MW-8	05/17/2010	6.96	3.33	3.63	0.00	-	-	-	-	-	-	-
MW-8	08/26/2010 <sup>19</sup>	6.96	4.27	2.69	0.00	-	-	-	-	-	-	-
MW-8	11/11/2010 <sup>19</sup>	6.96	3.82	3.14	0.00	-	-	-	-	-	-	-
MW-8	03/02/2011 <sup>19</sup>	6.96	1.66	5.30	0.00	-	<50	<0.5	<0.5	<0.5	<0.5	<0.5
MW-8	06/17/2011 <sup>19</sup>	6.96	3.79	3.17	0.00	-	-	-	-	-	-	-
MW-8	09/08/2011 <sup>19</sup>	6.96	2.97	3.99	0.00	-	-	-	-	-	-	-
MW-8	12/29/2011 <sup>19</sup>	6.96	3.70	3.26	0.00	-	-	-	-	-	-	-

TABLE 1

**GROUNDWATER MONITORING AND SAMPLING DATA  
FORMER CHEVRON SERVICE STATION 91153  
3135 GIBBONS DRIVE  
(3126 FERNSIDE BOULEVARD)  
ALAMEDA, CALIFORNIA**

Location	Date	TOC	DTW	GWE	LNAPL	FIELD PARAMETERS	HYDROCARBONS	PRIMARY VOCS				
						Dissolved Oxygen	TPH-GRO	B	T	E	X	MTBE by SW8260
	Units	ft	ft	ft-amsl	ft	mg/L	µg/L	µg/L	µg/L	µg/L	µg/L	µg/L
MW-8	03/28/2012	6.96	0.48	6.48	0.00	-	<50	<0.5	<0.5	<0.5	<0.5	<0.5
MW-8	05/31/2012 <sup>19</sup>	6.96	1.66	5.30	0.00	-	-	-	-	-	-	-
MW-8	09/28/2012 <sup>19</sup>	6.96	4.87	2.09	0.00	-	-	-	-	-	-	-
<b>MW-8</b>	<b>12/21/2012<sup>19</sup></b>	<b>6.96</b>	<b>2.28</b>	<b>4.68</b>	<b>0.00</b>	-	-	-	-	-	-	-
MW-9	10/17/1995	7.21	4.80	2.41	0.00	-	-	-	-	-	-	-
MW-9	10/30/1995	7.21	4.97	2.24	0.00	-	<50	<0.5	<0.5	<0.5	<0.5	<2.5
MW-9	01/22/1996	7.21	3.40	3.81	0.00	-	<50	<0.5	<0.5	<0.5	<0.5	<2.5
MW-9	04/24/1996	7.21	4.18	3.03	0.00	-	<50	<0.5	<0.5	<0.5	<0.5	<2.5
MW-9	07/29/1996	7.21	4.69	2.52	0.00	-	<50	<0.5	<0.5	<0.5	<0.5	<2.5
MW-9	10/10/1996	7.21	5.20	2.01	0.00	-	<50	<0.5	<0.5	<0.5	<0.5	<2.5
MW-9	01/15/1997	7.21	3.31	3.90	0.00	-	<50	<0.5	<0.5	<0.5	<0.5	<2.5
MW-9	04/03/1997	7.21	4.57	2.64	0.00	-	<50	<0.5	<0.5	<0.5	<0.5	<2.5
MW-9	07/09/1997	7.21	5.04	2.17	0.00	-	<50	<0.5	<0.5	<0.5	<0.5	<2.5
MW-9	10/29/1997	7.21	4.96	2.25	0.00	-	<50	<0.5	<0.5	<0.5	<0.5	<2.5
MW-9	01/14/1998	7.21	2.40	4.81	0.00	-	<50	<0.5	<0.5	<0.5	<0.5	<2.5
MW-9	01/20/1999	7.21	4.31	2.90	0.00	-	<50	<0.5	<0.5	<0.5	<0.5	<2.0
MW-9	04/19/1999	7.21	3.92	3.29	0.00	-	-	-	-	-	-	-
MW-9	01/25/2000	7.21	2.95	4.26	0.00	-	<50	<0.5	<0.5	<0.5	<0.5	<2.5
MW-9	04/03/2000 <sup>19</sup>	7.21	-	-	-	-	-	-	-	-	-	-
MW-9	07/03/2000	7.21	-	-	-	-	-	-	-	-	-	-
MW-9	10/23/2000	7.21	-	-	-	-	-	-	-	-	-	-
MW-9	01/08/2001 <sup>11</sup>	7.21	4.59	2.62	0.00	-	<50	<0.50	<0.50	<0.50	<0.50	<2.5

TABLE 1

GROUNDWATER MONITORING AND SAMPLING DATA  
 FORMER CHEVRON SERVICE STATION 91153  
 3135 GIBBONS DRIVE  
 (3126 FERNSIDE BOULEVARD)  
 ALAMEDA, CALIFORNIA

Location	Date	TOC	DTW	GWE	LNAPL	FIELD PARAMETERS	HYDROCARBONS	PRIMARY VOCS				
						Dissolved Oxygen	TPH-GRO	B	T	E	X	MTBE by SW8260
	Units	ft	ft	ft-amsl	ft	mg/L	µg/L	µg/L	µg/L	µg/L	µg/L	µg/L
MW-9	04/09/2001	7.21	-	-	-	-	-	-	-	-	-	-
MW-9	08/23/2001 <sup>19</sup>	7.21	-	-	-	-	-	-	-	-	-	-
MW-9	11/27/2001 <sup>19</sup>	7.21	-	-	-	-	-	-	-	-	-	-
MW-9	02/26/2002	7.21	3.75	3.46	0.00	-	<50	<0.50	<0.50	<0.50	<1.5	<2.5
MW-9	05/23/2002 <sup>19</sup>	7.21	-	-	-	-	-	-	-	-	-	-
MW-9	08/09/2002 <sup>19</sup>	7.21	-	-	-	-	-	-	-	-	-	-
MW-9	11/08/2002 <sup>19</sup>	7.21	-	-	-	-	-	-	-	-	-	-
MW-9	02/07/2003	7.21	3.97	3.24	0.00	-	<50	<0.50	<0.50	<0.50	<1.5	<2.5
MW-9	05/09/2003 <sup>19</sup>	7.21	-	-	-	-	-	-	-	-	-	-
MW-9	08/15/2003 <sup>19</sup>	7.21	-	-	-	-	-	-	-	-	-	-
MW-9	11/14/2003 <sup>19</sup>	7.21	-	-	-	-	-	-	-	-	-	-
MW-9	02/13/2004 <sup>15</sup>	7.21	3.94	3.27	0.00	-	<50	<0.5	<0.5	<0.5	<0.5	<0.5
MW-9	05/14/2004 <sup>19</sup>	7.21	-	-	-	-	-	-	-	-	-	-
MW-9	11/12/2004 <sup>19</sup>	7.21	-	-	-	-	-	-	-	-	-	-
MW-9	02/11/2005 <sup>15</sup>	7.21	3.66	3.55	0.00	-	<50	<0.5	<0.5	<0.5	<0.5	<0.5
MW-9	05/13/2005 <sup>19</sup>	7.21	-	-	-	-	-	-	-	-	-	-
MW-9	08/19/2005 <sup>19</sup>	7.21	-	-	-	-	-	-	-	-	-	-
MW-9	11/18/2005 <sup>19</sup>	7.21	-	-	-	-	-	-	-	-	-	-
MW-9	02/10/2006 <sup>15</sup>	7.21	3.53	3.68	0.00	-	<0.5	<0.5	<0.5	<0.5	<0.5	<0.5
MW-9	05/12/2006 <sup>19</sup>	7.21	-	-	-	-	-	-	-	-	-	-
MW-9	08/11/2006 <sup>19</sup>	7.21	-	-	-	-	-	-	-	-	-	-
MW-9	11/17/2006 <sup>19</sup>	7.21	-	-	-	-	-	-	-	-	-	-
MW-9	02/16/2007 <sup>15</sup>	7.21	3.50	3.71	0.00	-	<50	<0.5	<0.5	<0.5	<0.5	<0.5

TABLE 1

**GROUNDWATER MONITORING AND SAMPLING DATA  
FORMER CHEVRON SERVICE STATION 91153  
3135 GIBBONS DRIVE  
(3126 FERNSIDE BOULEVARD)  
ALAMEDA, CALIFORNIA**

Location	Date	TOC	DTW	GWE	LNAPL	FIELD PARAMETERS	HYDROCARBONS	PRIMARY VOCS				
						Dissolved Oxygen	TPH-GRO	B	T	E	X	MTBE by SW8260
	Units	ft	ft	ft-amsl	ft	mg/L	µg/L	µg/L	µg/L	µg/L	µg/L	µg/L
MW-9	05/17/2007 <sup>19</sup>	7.21	-	-	-	-	-	-	-	-	-	-
MW-9	08/09/2007 <sup>19</sup>	7.21	-	-	-	-	-	-	-	-	-	-
MW-9	11/08/2007 <sup>19</sup>	7.21	-	-	-	-	-	-	-	-	-	-
MW-9	02/06/2008 <sup>15</sup>	7.21	3.14	4.07	0.00	-	<50	<0.5	<0.5	<0.5	<0.5	<0.5
MW-9	05/07/2008 <sup>19</sup>	7.21	-	-	-	-	-	-	-	-	-	-
MW-9	09/11/2008 <sup>19</sup>	7.21	-	-	-	-	-	-	-	-	-	-
MW-9	11/10/2008 <sup>19</sup>	7.21	-	-	-	-	-	-	-	-	-	-
MW-9	02/09/2009 <sup>15</sup>	7.21	3.91	3.30	0.00	-	<50	<0.5	<0.5	<0.5	<0.5	<0.5
MW-9	03/31/2010	7.21	3.16	4.05	0.00	-	<50	<0.5	<0.5	<0.5	<0.5	<0.5
MW-9	05/17/2010	7.21	3.44	3.77	0.00	-	-	-	-	-	-	-
MW-9	08/26/2010 <sup>19</sup>	7.21	4.77	2.44	0.00	-	-	-	-	-	-	-
MW-9	11/11/2010 <sup>19</sup>	7.21	4.29	2.92	0.00	-	-	-	-	-	-	-
MW-9	03/02/2011 <sup>19</sup>	7.21	2.75	4.46	0.00	-	<50	<0.5	<0.5	<0.5	<0.5	<0.5
MW-9	06/17/2011 <sup>19</sup>	7.21	3.86	3.35	0.00	-	-	-	-	-	-	-
MW-9	09/08/2011 <sup>19</sup>	7.21	4.28	2.93	0.00	-	-	-	-	-	-	-
MW-9	12/29/2011 <sup>19</sup>	7.21	4.58	2.63	0.00	-	-	-	-	-	-	-
MW-9	03/28/2012	7.21	2.32	4.89	0.00	-	<50	<0.5	<0.5	<0.5	<0.5	<0.5
MW-9	05/31/2012 <sup>19</sup>	7.21	4.15	3.06	0.00	-	-	-	-	-	-	-
MW-9	09/28/2012 <sup>19</sup>	7.21	4.96	2.25	0.00	-	-	-	-	-	-	-
<b>MW-9</b>	<b>12/21/2012<sup>19</sup></b>	<b>7.21</b>	<b>2.32</b>	<b>4.89</b>	<b>0.00</b>	-	-	-	-	-	-	-
MW-10	10/17/1995	7.28	5.05	2.23	0.00	-	-	-	-	-	-	-
MW-10	10/30/1995	7.28	5.11	2.17	0.00	-	<50	<0.5	<0.5	<0.5	<0.5	5.1



TABLE 1

**GROUNDWATER MONITORING AND SAMPLING DATA  
FORMER CHEVRON SERVICE STATION 91153  
3135 GIBBONS DRIVE  
(3126 FERNSIDE BOULEVARD)  
ALAMEDA, CALIFORNIA**

Location	Date	TOC	DTW	GWE	LNAPL	FIELD PARAMETERS	HYDROCARBONS	PRIMARY VOCS				
						Dissolved Oxygen	TPH-GRO	B	T	E	X	MTBE by SW8260
	Units	ft	ft	ft-amsl	ft	mg/L	µg/L	µg/L	µg/L	µg/L	µg/L	µg/L
MW-10	01/22/1996	7.28	4.03	3.25	0.00	-	<50	<0.5	<0.5	<0.5	0.70	17
MW-10	04/24/1996	7.28	4.30	2.98	0.00	-	<50	<0.5	<0.5	<0.5	<0.5	12
MW-10	07/29/1996	7.28	4.70	2.58	0.00	-	<50	<0.5	<0.5	<0.5	<0.5	14
MW-10	10/10/1996	7.28	5.24	2.04	0.00	-	<50	<0.5	<0.5	<0.5	<0.5	<2.5
MW-10	01/15/1997	7.28	3.35	3.93	0.00	-	<50	<0.5	<0.5	<0.5	<0.5	<2.5
MW-10	04/03/1997	7.28	4.64	2.64	0.00	-	<50	<0.5	<0.5	<0.5	<0.5	8.2
MW-10	07/09/1997	7.28	5.12	2.16	0.00	-	<50	<0.5	<0.5	<0.5	<0.5	<2.5
MW-10	10/29/1997	7.28	5.10	2.18	0.00	-	<50	<0.5	<0.5	<0.5	<0.5	5.3
MW-10	01/14/1998	7.28	3.08	4.20	0.00	-	<50	<0.5	<0.5	<0.5	<0.5	8.6
MW-10	04/17/1998 <sup>20</sup>	7.28	3.79	3.49	0.00	-	-	-	-	-	-	-
MW-10	07/15/1998	7.28	4.55	2.73	0.00	-	<50	<0.5	<0.5	<0.5	<0.5	7.5
MW-10	10/27/1998	7.28	5.32	1.96	0.00	-	-	-	-	-	-	-
MW-10	01/20/1999	7.28	4.24	3.04	0.00	-	<50	<0.5	<0.5	<0.5	<0.5	<2.0
MW-10	04/19/1999	7.28	4.07	3.21	0.00	-	-	-	-	-	-	-
MW-10	07/29/1999	7.28	4.82	2.46	0.00	-	<50	<0.5	<0.5	<0.5	<0.5	<5.0/2.4 <sup>2</sup>
MW-10	10/13/1999	7.28	4.86	2.42	0.00	-	-	-	-	-	-	-
MW-10	01/25/2000	7.28	3.00	4.28	0.00	-	<50	<0.5	<0.5	<0.5	<0.5	4.33
MW-10	04/03/2000	7.28	3.04	4.24	0.00	-	-	-	-	-	-	-
MW-10	07/03/2000	7.28	4.00	3.28	0.00	-	<50	<0.50	<0.50	<0.50	<0.50	4.7
MW-10	10/23/2000	7.28	5.86	1.42	0.00	-	-	-	-	-	-	-
MW-10	01/08/2001 <sup>11</sup>	7.28	3.98	3.30	0.00	-	<50	<0.50	<0.50	<0.50	<0.50	<2.5
MW-10	04/09/2001	7.28	3.74	3.54	0.00	-	-	-	-	-	-	-
MW-10	08/23/2001 <sup>21</sup>	7.28	-	-	-	-	-	-	-	-	-	-

TABLE 1

GROUNDWATER MONITORING AND SAMPLING DATA  
 FORMER CHEVRON SERVICE STATION 91153  
 3135 GIBBONS DRIVE  
 (3126 FERNside BOULEVARD)  
 ALAMEDA, CALIFORNIA

Location	Date	TOC	DTW	GWE	LNAPL	FIELD PARAMETERS	HYDROCARBONS	PRIMARY VOCS				
						Dissolved Oxygen	TPH-GRO	B	T	E	X	MTBE by SW8260
	Units	ft	ft	ft-amsl	ft	mg/L	µg/L	µg/L	µg/L	µg/L	µg/L	µg/L
MW-10	11/27/2001 <sup>20</sup>	7.28	4.13	3.15	0.00	-	-	-	-	-	-	-
MW-10	02/26/2002	7.28	3.54	3.74	0.00	-	<50	<0.50	<0.50	<0.50	<1.5	<2.5
MW-10	05/23/2002 <sup>20</sup>	7.28	3.82	3.46	0.00	-	-	-	-	-	-	-
MW-10	08/09/2002	7.28	4.18	3.10	0.00	-	<50	<0.50	<0.50	<0.50	<1.5	<2.5
MW-10	11/08/2002 <sup>20</sup>	7.28	3.91	3.37	0.00	-	-	-	-	-	-	-
MW-10	02/07/2003	7.28	3.61	3.67	0.00	-	<50	<0.50	<0.50	<0.50	<1.5	<2.5
MW-10	05/09/2003 <sup>20</sup>	7.28	3.25	4.03	0.00	-	-	-	-	-	-	-
MW-10	08/15/2003 <sup>15</sup>	7.28	4.35	2.93	0.00	-	<50	<0.5	<0.5	<0.5	<0.5	<0.5
MW-10	11/14/2003 <sup>20</sup>	7.28	4.30	2.98	0.00	-	-	-	-	-	-	-
MW-10	02/13/2004 <sup>15</sup>	7.28	4.27	3.01	0.00	-	<50	<0.5	<0.5	<0.5	<0.5	<0.5
MW-10	05/14/2004 <sup>20</sup>	7.28	4.08	3.20	0.00	-	-	-	-	-	-	-
MW-10	08/13/2004 <sup>15</sup>	7.28	3.92	3.36	0.00	-	<50	<0.5	<0.5	<0.5	<0.5	<0.5
MW-10	11/12/2004 <sup>20</sup>	7.28	3.98	3.30	0.00	-	-	-	-	-	-	-
MW-10	02/11/2005 <sup>15</sup>	7.28	4.07	3.21	0.00	-	<50	<0.5	<0.5	<0.5	<0.5	<0.5
MW-10	05/13/2005 <sup>20</sup>	7.28	4.01	3.27	0.00	-	-	-	-	-	-	-
MW-10	08/19/2005 <sup>15</sup>	7.28	3.69	3.59	0.00	-	<50	<0.5	<0.5	<0.5	<0.5	<0.5
MW-10	11/18/2005 <sup>20</sup>	7.28	3.86	3.42	0.00	-	-	-	-	-	-	-
MW-10	02/10/2006 <sup>15</sup>	7.28	3.94	3.34	0.00	-	<0.5	<0.5	<0.5	<0.5	<0.5	<0.5
MW-10	05/12/2006 <sup>20</sup>	7.28	4.07	3.21	0.00	-	-	-	-	-	-	-
MW-10	08/11/2006 <sup>15</sup>	7.28	4.21	3.07	0.00	-	<50	<0.5	<0.5	<0.5	<0.5	<0.5
MW-10	11/17/2006 <sup>20</sup>	7.28	3.83	3.45	0.00	-	-	-	-	-	-	-
MW-10	02/16/2007 <sup>15</sup>	7.28	3.87	3.41	0.00	-	<50	<0.5	<0.5	<0.5	<0.5	<0.5
MW-10	05/17/2007 <sup>20</sup>	7.28	3.71	3.57	0.00	-	-	-	-	-	-	-

TABLE 1

GROUNDWATER MONITORING AND SAMPLING DATA  
 FORMER CHEVRON SERVICE STATION 91153  
 3135 GIBBONS DRIVE  
 (3126 FERNSIDE BOULEVARD)  
 ALAMEDA, CALIFORNIA

Location	Date	TOC	DTW	GWE	LNAPL	FIELD PARAMETERS	HYDROCARBONS	PRIMARY VOCS				
						Dissolved Oxygen	TPH-GRO	B	T	E	X	MTBE by SW8260
	Units	ft	ft	ft-amsl	ft	mg/L	µg/L	µg/L	µg/L	µg/L	µg/L	µg/L
MW-10	08/09/2007 <sup>21</sup>	7.28	-	-	-	-	-	-	-	-	-	-
MW-10	11/08/2007 <sup>21</sup>	7.28	-	-	-	-	-	-	-	-	-	-
MW-10	02/06/2008 <sup>21</sup>	7.28	-	-	-	-	-	-	-	-	-	-
MW-10	05/07/2008 <sup>21</sup>	7.28	-	-	-	-	-	-	-	-	-	-
MW-10	09/11/2008 <sup>15</sup>	7.28	4.63	2.65	0.00	-	<50	<0.5	<0.5	<0.5	<0.5	<0.5
MW-10	11/10/2008 <sup>20</sup>	7.28	4.28	3.00	0.00	-	-	-	-	-	-	-
MW-10	02/09/2009 <sup>15</sup>	7.28	2.17	5.11	0.00	-	<50	<0.5	<0.5	<0.5	<0.5	<0.5
MW-10	05/28/2009	7.28	3.69	3.59	0.00	-	-	-	-	-	-	-
MW-10	08/18/2009 <sup>15</sup>	7.28	4.07	3.21	0.00	-	<50	<0.5	<0.5	<0.5	<0.5	<0.5
MW-10	11/17/2009	7.28	4.12	3.16	0.00	-	-	-	-	-	-	-
MW-10	03/31/2010	7.28	3.43	3.85	0.00	-	<50	<0.5	<0.5	<0.5	<0.5	<0.5
MW-10	05/17/2010	7.28	3.53	3.75	0.00	-	-	-	-	-	-	-
MW-10	08/26/2010	7.28	4.33	2.95	0.00	-	<50	<0.5	<0.5	<0.5	<0.5	<0.5
MW-10	11/11/2010 <sup>20</sup>	7.28	4.34	2.94	0.00	-	-	-	-	-	-	-
MW-10	03/02/2011 <sup>20</sup>	7.28	3.33	3.95	0.00	-	<50	<0.5	<0.5	<0.5	<0.5	<0.5
MW-10	06/17/2011 <sup>20</sup>	7.28	3.92	3.36	0.00	-	-	-	-	-	-	-
MW-10	09/08/2011 <sup>20</sup>	7.28	3.95	3.33	0.00	-	<50	<0.5	<0.5	<0.5	<0.5	<0.5
MW-10	12/29/2011 <sup>20</sup>	7.28	4.00	3.28	0.00	-	-	-	-	-	-	-
MW-10	03/28/2012	7.28	2.96	4.32	0.00	-	<50	<0.5	<0.5	<0.5	<0.5	<0.5
MW-10	05/31/2012 <sup>20</sup>	7.28	3.90	3.38	0.00	-	-	-	-	-	-	-
MW-10	09/28/2012	7.28	3.60	3.68	0.00	-	<50	<0.5	<0.5	<0.5	<0.5	<0.5
MW-10	12/21/2012 <sup>20</sup>	7.28	3.44	3.84	0.00	-	-	-	-	-	-	-

TABLE 1

GROUNDWATER MONITORING AND SAMPLING DATA  
 FORMER CHEVRON SERVICE STATION 91153  
 3135 GIBBONS DRIVE  
 (3126 FERNSIDE BOULEVARD)  
 ALAMEDA, CALIFORNIA

Location	Date	TOC	DTW	GWE	LNAPL	FIELD PARAMETERS	HYDROCARBONS	PRIMARY VOCS				
						Dissolved Oxygen	TPH-GRO	B	T	E	X	MTBE by SW8260
	Units	ft	ft	ft-amsl	ft	mg/L	µg/L	µg/L	µg/L	µg/L	µg/L	µg/L
C-2	09/04/1986	-	-	-	-	-	1,100	49	18	84	-	-
C-2	07/22/1987	-	-	-	-	-	<50	1.8	<1.0	<4.0	-	-
TMW-1	11/11/1993	-	-	-	-	-	<1.0	<0.5	<0.5	<0.5	<0.5	-
3115A GIBBONS DR.	01/14/1998	-	-	-	-	-	<50	<0.5	<0.5	<0.5	<0.5	<2.5
QA	02/14/1990	-	-	-	-	-	<50	<0.5	1.1	<0.5	<0.5	-
QA	09/06/1991	-	-	-	-	-	<50	<0.5	<0.5	<0.5	<0.5	-
QA	12/15/1991	-	-	-	-	-	<50	<0.5	<0.5	<0.5	<0.5	-
QA	03/03/1992	-	-	-	-	-	<50	<0.5	<0.5	<0.5	<0.5	-
QA	06/04/1992	-	-	-	-	-	<50	<0.5	<0.5	<0.5	<0.5	-
QA	10/13/1992	-	-	-	-	-	<50	<0.5	<0.5	<0.5	<0.5	-
QA	01/11/1993	-	-	-	-	-	<50	<0.5	<0.5	<0.5	<0.5	-
QA	04/14/1993	-	-	-	-	-	<50	<0.5	<0.5	<0.5	<0.5	-
QA	07/13/1993	-	-	-	-	-	<50	<0.5	<0.5	<0.5	<0.5	-
QA	10/19/1993	-	-	-	-	-	<50	<0.5	<0.5	<0.5	<1.5	-
QA	01/27/1994	-	-	-	-	-	<50	<0.5	<0.5	<0.5	<0.5	-
QA	04/07/1994	-	-	-	-	-	<50	<0.5	<0.5	<0.5	<0.5	-
QA	07/01/1994	-	-	-	-	-	<50	<0.5	<0.5	<0.5	<0.5	-
QA	10/05/1994	-	-	-	-	-	<50	<0.5	<0.5	<0.5	<0.5	-
QA	01/12/1995	-	-	-	-	-	<50	<0.5	<0.5	<0.5	<0.5	-
QA	04/26/1995	-	-	-	-	-	<50	<0.5	<0.5	<0.5	<0.5	-

**GROUNDWATER MONITORING AND SAMPLING DATA  
FORMER CHEVRON SERVICE STATION 91153  
3135 GIBBONS DRIVE  
(3126 FERNSIDE BOULEVARD)  
ALAMEDA, CALIFORNIA**

Location	Date	TOC	DTW	GWE	LNAPL	FIELD PARAMETERS	HYDROCARBONS	PRIMARY VOCS				
						Dissolved Oxygen	TPH-GRO	B	T	E	X	MTBE by SW8260
	Units	ft	ft	ft-amsl	ft	mg/L	µg/L	µg/L	µg/L	µg/L	µg/L	µg/L
QA	07/12/1995	-	-	-	-	-	<50	<0.5	<0.5	<0.5	<0.5	-
QA	10/30/1995	-	-	-	-	-	<50	<0.5	<0.5	<0.5	<0.5	-
QA	01/22/1996	-	-	-	-	-	<50	<0.5	<0.5	<0.5	<0.5	<2.5
QA	04/24/1996	-	-	-	-	-	<50	<0.5	<0.5	<0.5	<0.5	<2.5
QA	07/29/1996	-	-	-	-	-	<50	<0.5	<0.5	<0.5	<0.5	<2.5
QA	01/15/1997	-	-	-	-	-	<50	<0.5	<0.5	<0.5	<0.5	<2.5
QA	04/03/1997	-	-	-	-	-	<50	<0.5	<0.5	<0.5	<0.5	<2.5
QA	07/09/1997	-	-	-	-	-	<50	<0.5	<0.5	<0.5	<0.5	<2.5
QA	10/29/1997	-	-	-	-	-	<50	<0.5	<0.5	<0.5	<0.5	<2.5
QA	01/14/1998	-	-	-	-	-	<50	<0.5	<0.5	<0.5	<0.5	<2.5
QA	04/17/1998	-	-	-	-	-	<50	<0.5	<0.5	<0.5	<0.5	<2.5
QA	07/15/1998	-	-	-	-	-	<50	<0.5	<0.5	<0.5	<0.5	<2.5
QA	10/27/1998	-	-	-	-	-	<50	<0.5	<0.5	<0.5	<0.5	<2.5
QA	01/20/1999	-	-	-	-	-	<50	<0.5	<0.5	<0.5	<0.5	<2.0
QA	04/19/1999	-	-	-	-	-	<50	<0.5	<0.5	<0.5	<0.5	<2.5
QA	07/29/1999	-	-	-	-	-	<50	<0.5	<0.5	<0.5	<0.5	<5.0
QA	10/13/1999	-	-	-	-	-	<50	<0.5	<0.5	<0.5	<0.5	<2.5
QA	01/25/2000	-	-	-	-	-	<50	<0.5	<0.5	<0.5	<0.5	<2.5
QA	04/03/2000	-	-	-	-	-	<50	<0.50	<0.50	<0.50	<0.50	<2.5
QA	07/03/2000	-	-	-	-	-	<50	<0.50	<0.50	<0.50	<0.50	<2.5
QA	10/23/2000	-	-	-	-	-	<50	<0.50	<0.50	<0.50	<0.50	<2.5
QA	01/08/2001 <sup>11</sup>	-	-	-	-	-	<50	<0.50	<0.50	<0.50	<0.50	<2.5
QA	04/09/2001	-	-	-	-	-	<50.0	<0.500	<2.00	<0.500	<2.00	<0.500

**GROUNDWATER MONITORING AND SAMPLING DATA  
FORMER CHEVRON SERVICE STATION 91153  
3135 GIBBONS DRIVE  
(3126 FERNSIDE BOULEVARD)  
ALAMEDA, CALIFORNIA**

Location	Date	TOC	DTW	GWE	LNAPL	FIELD PARAMETERS	HYDROCARBONS	PRIMARY VOCS				MTBE by SW8260
						Dissolved Oxygen	TPH-GRO	B	T	E	X	
	Units	ft	ft	ft-amsl	ft	mg/L	µg/L	µg/L	µg/L	µg/L	µg/L	µg/L
QA	08/23/2001	-	-	-	-	-	<50	<0.50	<0.50	<0.50	<0.50	<2.5
QA	11/27/2001	-	-	-	-	-	<50	<0.50	<0.50	<0.50	<1.5	<2.5
QA	02/26/2002	-	-	-	-	-	<50	<0.50	<0.50	<0.50	<1.5	<2.5
QA	05/23/2002	-	-	-	-	-	<50	<0.50	<0.50	<0.50	<1.5	<2.5
QA	08/09/2002	-	-	-	-	-	<50	<0.50	<0.50	<0.50	<1.5	<2.5
QA	11/08/2002	-	-	-	-	-	<50	<0.50	<0.50	<0.50	<1.5	<2.5
QA	02/07/2003	-	-	-	-	-	<50	<0.50	<0.50	<0.50	<1.5	<2.5
QA	05/09/2003	-	-	-	-	-	<50	<0.5	<0.5	<0.5	<1.5	<2.5
QA	08/15/2003 <sup>15</sup>	-	-	-	-	-	<50	<0.5	<0.5	<0.5	<0.5	<0.5
QA	11/14/2003	-	-	-	-	-	<50	<0.5	<0.5	<0.5	<0.5	<0.5
QA	02/13/2004 <sup>15</sup>	-	-	-	-	-	<50	<0.5	<0.5	<0.5	<0.5	<0.5
QA	05/14/2004 <sup>15</sup>	-	-	-	-	-	<50	<0.5	<0.5	<0.5	<0.5	<0.5
QA	08/13/2004 <sup>15</sup>	-	-	-	-	-	<50	<0.5	<0.5	<0.5	<0.5	<0.5
QA	11/12/2004 <sup>15</sup>	-	-	-	-	-	<50	<0.5	<0.5	<0.5	<0.5	<0.5
QA	02/11/2005 <sup>15</sup>	-	-	-	-	-	<50	<0.5	<0.5	<0.5	<0.5	<0.5
QA	05/13/2005 <sup>15</sup>	-	-	-	-	-	<50	<0.5	<0.5	<0.5	<0.5	<0.5
QA	08/19/2005 <sup>15</sup>	-	-	-	-	-	<50	<0.5	<0.5	<0.5	<0.5	<0.5
QA	11/18/2005 <sup>15</sup>	-	-	-	-	-	<50	<0.5	<0.5	<0.5	<0.5	<0.5
QA	02/10/2006 <sup>15</sup>	-	-	-	-	-	<50	<0.5	<0.5	<0.5	<0.5	<0.5
QA	05/12/2006 <sup>15</sup>	-	-	-	-	-	<50	<0.5	<0.5	<0.5	<0.5	<0.5
QA	08/11/2006 <sup>15</sup>	-	-	-	-	-	<50	<0.5	<0.5	<0.5	<0.5	<0.5
QA	11/17/2006 <sup>15</sup>	-	-	-	-	-	<50	<0.5	<0.5	<0.5	<0.5	<0.5
QA	02/16/2007 <sup>15</sup>	-	-	-	-	-	<50	<0.5	<0.5	<0.5	<0.5	<0.5

**GROUNDWATER MONITORING AND SAMPLING DATA  
FORMER CHEVRON SERVICE STATION 91153  
3135 GIBBONS DRIVE  
(3126 FERNSIDE BOULEVARD)  
ALAMEDA, CALIFORNIA**

Location	Date	TOC	DTW	GWE	LNAPLT	FIELD PARAMETERS	HYDROCARBONS	PRIMARY VOCS				MTBE by SW8260
						Dissolved Oxygen	TPH-GRO	B	T	E	X	
	Units	ft	ft	ft-amsl	ft	mg/L	µg/L	µg/L	µg/L	µg/L	µg/L	µg/L
QA	05/17/2007 <sup>15</sup>	-	-	-	-	-	<50	<0.5	<0.5	<0.5	<0.5	<0.5
QA	08/09/2007 <sup>15</sup>	-	-	-	-	-	<50	<0.5	<0.5	<0.5	<0.5	<0.5
QA	11/08/2007 <sup>15</sup>	-	-	-	-	-	<50	<0.5	<0.5	<0.5	<0.5	<0.5
QA	02/06/2008 <sup>15</sup>	-	-	-	-	-	<50	<0.5	<0.5	<0.5	<0.5	<0.5
QA	05/07/2008 <sup>15</sup>	-	-	-	-	-	<50	<0.5	<0.5	<0.5	<0.5	<0.5
QA	09/11/2008 <sup>15</sup>	-	-	-	-	-	<50	<0.5	<0.5	<0.5	<0.5	<0.5
QA	11/10/2008 <sup>15</sup>	-	-	-	-	-	<50	<0.5	<0.5	<0.5	<0.5	<0.5
QA	02/09/2009 <sup>15</sup>	-	-	-	-	-	<50	<0.5	<0.5	<0.5	<0.5	<0.5
QA	05/28/2009 <sup>15</sup>	-	-	-	-	-	<50	<0.5	<0.5	<0.5	<0.5	<0.5
QA	08/18/2009 <sup>15</sup>	-	-	-	-	-	<50	<0.5	<0.5	<0.5	<0.5	<0.5
QA	03/31/2010	-	-	-	-	-	<50	<0.5	<0.5	<0.5	<0.5	<0.5
QA	08/26/2010	-	-	-	-	-	<50	<0.5	<0.5	<0.5	<0.5	<0.5
QA	03/02/2011	-	-	-	-	-	<50	<0.5	<0.5	<0.5	<0.5	<0.5
QA	09/08/2011	-	-	-	-	-	<50	<0.5	<0.5	<0.5	<0.5	<0.5
QA	03/28/2012	-	-	-	-	-	<50	<0.5	<0.5	<0.5	<0.5	<0.5
QA	09/28/2012	-	-	-	-	-	<50	<0.5	<0.5	<0.5	<0.5	<0.5

**Abbreviations and Notes:**

TOC = Top of casing

DTW = Depth to water

GWE = Groundwater elevation

LNAPL - Light Non-Aqueous Phase Liquid

LNAPLT - Light Non-Aqueous Phase Liquid

**GROUNDWATER MONITORING AND SAMPLING DATA  
FORMER CHEVRON SERVICE STATION 91153  
3135 GIBBONS DRIVE  
(3126 FERNSIDE BOULEVARD)  
ALAMEDA, CALIFORNIA**

Location	Date	TOC	DTW	GWE	LNAPLT	FIELD PARAMETERS	HYDROCARBONS	PRIMARY VOCS				
						Dissolved Oxygen	TPH-GRO	B	T	E	X	MTBE by SW8260
Units		ft	ft	ft-amsl	ft	mg/L	µg/L	µg/L	µg/L	µg/L	µg/L	µg/L

(ft-amsl) = Feet above mean sea level

ft = Feet

mg/L - Milligrams per liter

µg/L = Micrograms per liter

TPH-GRO = Total petroleum hydrocarbons - gasoline range organics

VOCS = Volatile organic compounds

B = Benzene

T = Toluene

E = Ethylbenzene

X = Xylenes (Total)

MTBE = Methyl tert butyl ether

J = Estimated value (the result ≥ the method detection limit < the limit of quantitation)

-- = Not available / not applicable

<x = Not detected above laboratory method detection limit

\*\* GWE has been corrected due to the presence of LNAPL; correction factor: [(TOC - DTW) + (LNAPLT x 0.80)].

1 Laboratory report indicates EPA 8010 were not detected (ND)

2 MTBE confirmed

3 Chromatogram report indicates an unidentified hydrocarbon

4 ORC installed

5 TOC elevation altered due to well head maintenance

6 Laboratory report indicates gasoline C6-C12

7 ORC in well

8 Laboratory report indicates Dissolved Oxygen was 1.50 parts per million (ppm) by EPA Method 360.1



**GROUNDWATER MONITORING AND SAMPLING DATA  
FORMER CHEVRON SERVICE STATION 91153  
3135 GIBBONS DRIVE  
(3126 FERNSIDE BOULEVARD)  
ALAMEDA, CALIFORNIA**

Location	Date	TOC	DTW	GWE	LNAPL	FIELD PARAMETERS	HYDROCARBONS	PRIMARY VOCS				
						Dissolved Oxygen	TPH-GRO	B	T	E	X	MTBE by SW8260
Units		ft	ft	ft-amsl	ft	mg/L	µg/L	µg/L	µg/L	µg/L	µg/L	µg/L

- 9 Laboratory report indicates Dissolved Oxygen was 0.300 ppm by EPA Method 360.1
- 10 Laboratory report indicates sample originally shot in hold time at a raise D.L. re-analyzed and reported past hold time
- 11 Laboratory report indicates this sample was analyzed outside of the EPA recommended holding time
- 12 Laboratory report indicates unidentified hydrocarbons C6-C12
- 13 Laboratory report indicates hydrocarbon pattern is present in the requested fuel quantitation range but does not resemble the pattern of the requested fuel
- 14 ORC removed
- 15 BTEX and MTBE by EPA Method 8260
- 16 Laboratory confirmed analytical result
- 17 The vial submitted did not have pH<2. The pH of this sample used for the undiluted analysis was pH = 3
- 18 Not sampled due to the presence of LNAPL in the well.
- 19 Sampled annually.
- 20 Sampled semi-annually
- 21 Inaccessible

ATTACHMENT A  
MONITORING DATA PACKAGE



January 6, 2013

Chevron Environmental Management Company  
Catalina Devine  
6111 Bollinger Canyon Rd.  
San Ramon, CA 94583

Fourth Quarter 2012 Monitoring at  
Chevron Service Station 91153  
3135 Gibbons Dr.  
Alameda, CA

Monitoring performed on December 21, 2012

---

**Blaine Tech Services, Inc. Groundwater Monitoring Event 121221-DR1**

This submission covers the routine monitoring of groundwater wells conducted on December 21, 2012 at this location. Nine monitoring wells were measured for depth to groundwater (DTW). No monitoring wells were sampled. The spent SPH sorbent sock in well C-1 was replaced with a new sorbent sock after the SPH was bailed. The sorbent sock was placed in a drum that was removed by IWM the same day. All sampling activities were performed in accordance with local, state and federal guidelines.

Water levels measurements were collected using an electronic slope indicator. All sampled wells were purged of three case volumes, depending on well recovery, or until water temperature, pH and conductivity stabilized. Purging was accomplished using electric submersible pumps, positive air displacement pumps, or stainless steel, Teflon, or disposable bailers. Subsequent sample collection and sample handling was performed in accordance with EPA protocols. Alternately, where applicable, wells were sampled utilizing no-purge methodology. All reused equipment was decontaminated in an integrated stainless steel sink with de-ionized water supplied Hotsy pressure washer and Liquinox or equivalent.

Fourth Quarter Groundwater Monitoring at Chevron 91153, 3135 Gibbons Dr., Alameda, CA

SAN JOSE

SACRAMENTO

LOS ANGELES

SAN DIEGO

1680 ROGERS AVENUE

SAN JOSE, CA 95112-1105

(408) 573-0555

FAX (408) 573-7771

LIC: 746684

[www.blainetech.com](http://www.blainetech.com)

Samples were delivered under chain-of-custody to Lancaster Laboratories of Lancaster, Pennsylvania, for analysis. Monitoring well purgewater and equipment rinsate water was collected and transported under bill-of-lading to Blaine Tech of San Jose, California.

Enclosed documentation from this event includes copies of the Well Gauging Sheet, Well Monitoring Data Sheets, and Chain-of-Custody.

Blaine Tech Services, Inc.'s activities at this site consisted of objective data and sample collection only. No interpretation of analytical results, defining of hydrogeologic conditions or formulation of recommendations was performed.

Please call if you have any questions.

Sincerely,



Dustin Becker  
Blaine Tech Services, Inc.  
Senior Project Manager

attachments: SOP  
Well Gauging Sheet  
Individual Well Monitoring Data Sheets  
Chain of Custody  
Wellhead Inspection Form  
Bill of Lading  
Calibration Log

cc: CRA  
Attn: Nathan Lee  
5900 Hollis St. Suite A  
Emeryville, CA 94608

Fourth Quarter Groundwater Monitoring at Chevron 91153, 3135 Gibbons Dr., Alameda, CA

SAN JOSE

SACRAMENTO

LOS ANGELES

SAN DIEGO

1680 ROGERS AVENUE

SAN JOSE, CA 95112-1105

(408) 573-0555

FAX (408) 573-7771

LIC: 746684

[www.blainetech.com](http://www.blainetech.com)

# BLAINE TECH SERVICES, INC. METHODS AND PROCEDURES FOR THE ROUTINE MONITORING OF GROUNDWATER WELLS AT CHEVRON SITES

Blaine Tech Services, Inc. performs environmental sampling and documentation as an independent third party. We specialize in groundwater monitoring assignments and intentionally limit the scope of our services to those centered on the generation of objective information.

To avoid conflicts of interest, Blaine Tech Services, Inc. personnel do not evaluate or interpret the information we collect. As a state licensed contractor (C-57 well drilling –water – 746684) performing strictly technical services, we do not make any professional recommendations and perform no consulting of any kind.

---

## **SAMPLING PROCEDURES OVERVIEW**

### **SAFETY**

All groundwater monitoring assignments performed for Chevron comply with Chevron's safety guidelines, 29 CFR 1910.120 and SB-198 Injury and Illness Prevention Program (IIPP). All Field Technicians receive the full 40-hour 29CFR 1910.120 OSHA SARA HAZWOPER course, medical clearance and on-the-job training prior to commencing any work on any Chevron site.

### **INSPECTION AND GAUGING**

Wells are inspected prior to evacuation and sampling. The condition of the wellhead is checked and noted according to a wellhead inspection checklist.

Standard measurements include the depth to water (DTW) and the total well depth (TD) obtained with industry standard electronic water level indicators that are graduated in increments of hundredths of a foot.

The water in each well is inspected for the presence of immiscibles. When free product is suspected, its presence is confirmed using an electronic interface probe (e.g. GeoTech). No samples are collected from a well containing product.

### **TRADITIONAL PURGING & SAMPLING**

#### **Evacuation**

Depth to water measurements are collected by our personnel prior to purging and minimum purge volumes are calculated anew for each well based on the height of the water column and the diameter of the well. Expected purge volumes are never less than three case volumes and are set at no less than four case volumes in some jurisdictions.

Well purging devices are selected on the basis of the well diameter and the total volume to be evacuated. In most cases the well will be purged using an electric submersible pump (i.e. Grundfos) suspended near (but not touching) the bottom of the well.

### **Parameter Stabilization**

Well purging completion standards include minimum purge volumes, but additionally require stabilization of specific groundwater parameters prior to sample collection. Typical groundwater parameters used to measure stability are electrical conductivity, pH, and temperature. Instrument readings are obtained at regular intervals during the evacuation process (no less than once per case volume).

Stabilization standards for routine quarterly monitoring of fuel sites include the following: Temperature is considered to have stabilized when successive readings do not fluctuate more than +/- 1 degree Celsius. Electrical conductivity is considered stable when successive readings are within 10%. pH is considered to be stable when successive readings remain constant or vary no more than 0.2 of a pH unit.

### **Sample Collection**

All samples are collected using disposable bailers.

### **Sample Containers**

Sample material is decanted directly from the sampling bailer into sample containers provided by the laboratory that will analyze the samples. The transfer of sample material from the bailer to the sample container conforms to specifications contained in the USEPA T.E.G.D. The type of sample container, material of construction, method of closure and filling requirements are specific to the intended analysis. Chemicals needed to preserve the sample material are commonly placed inside the sample containers by the laboratory or glassware vendor prior to delivery of the bottle to our personnel. The laboratory sets the number of replicate containers.

### **Dewatered Wells**

Normal evacuation removes no less than three case volumes of water from the well. However, less water may be removed in cases where the well dewateres and does not immediately recharge.

### **Measuring Recharge**

Upon completion of well purging, a depth to water measurement is collected and notated to ensure that the well has recharged to within 80% of its static, pre-purge level prior to sampling.

Wells that do not immediately show 80% recharge or dewatered wells will be allowed approximately 2 hours to recharge prior to sampling or will be sampled at site departure. All wells requiring off-site traffic control in the public right-of-way, the 80% recharge rule may be disregarded in the interests of Health and Safety. The sample may be collected as soon as there is sufficient water. The water level at time of sampling will be noted.

### **Dissolved Oxygen Measurements**

Dissolved Oxygen readings are taken pre- and/or post-purge using YSI meters (e.g. YSI Model 550) or HACH field test kits.

The YSI meters are able to collect accurate in-situ readings. The probe allows downhole measurements to be taken from wells with diameters as small as two inches. The probe and reel is decontaminated between wells as described above. The meter is calibrated

as per the instructions in the operating manual. The probe is lowered into the water column and the reading is allowed to stabilize prior to collection.

### **Oxidation Reduction Potential Measurements (ORP)**

All readings are obtained with either Corning or Myron-L meters (e.g. Corning ORP-65 or a Myron-L Ultrameter). The meter is cleaned between wells as described above. The meter is calibrated at the start of each day according to the instruction manual.

## **LOW FLOW SAMPLING USING SAMPLE-PRO BLADDER PUMP**

### **Calibration**

Calibrate YSI Flow Cell as per manufacturer's specifications. Thoroughly rinse probe and cup between parameters. Calibration order as follows:

1. pH (use 3-point calibration of 7, 4, 10)
2. Oxygen Reduction Potential (ORP)
3. Specific Conductance
4. Dissolved Oxygen (DO) (calibrate simulating 100% oxygen saturation)

### **Purging & Sampling Collection**

1. Insert new bladder into Sample-Pro pump housing.
2. Remove dedicated PE tubing from the well or start with new PE tubing cut to the required length.
3. Attach the PE tubing to the Sample-Pro Bladder Pump.
4. Gently lower the Sample-Pro Bladder Pump, and PE tubing into the well, placing the Sample-Pro Bladder Pump intake at the center of the screened interval. Take care to minimize disturbance to the water column.
5. Direct effluent line into YSI 556 Flow Cell.
6. Set Sample-Pro Bladder Pump speed at 100 - 500 ml/min.
7. Collect water quality parameter measurements for temperature, pH, conductivity, turbidity, DO and ORP every 3-5 minutes.
8. Monitor drawdown during purging with electronic water level meter. Record water level with each parameter measurement. **MAXIMUM DRAWDOWN IS 0.33 FEET.**
9. Collect parameter measurements until stability is achieved. Stability is defined as three consecutive measurements where:

Temp	± 1 ° Celsius
pH	± 0.1
Conductivity	± 3%
Turbidity	± 10% NTU
DO	± 0.3 mg/l
ORP	± 10 Mv

10. Sample may be collected once stability is achieved and at least one system volume of water removed from the well.
11. Disconnect effluent line from YSI 556 Flow Cell.
12. Sample through effluent line while maintaining constant flow rate.
13. Remove Sample-Pro Bladder Pump, and PE tubing from well.
14. Detach and reinstall dedicated PE tubing in well.

## **PURGEWATER CONTAINMENT**

All non-hazardous purgewater evacuated from each groundwater monitoring well is captured and contained in on-board storage tanks on the Sampling Vehicle and/or special water hauling trailers. Effluent from the decontamination of reusable apparatus (sounders, electric pumps and hoses etc.), consisting of groundwater combined with deionized water and non-phosphate soap, is also captured and pumped into effluent tanks.

Non-hazardous purgewater is transported under standard Bill of Lading or Non-Hazardous Waste Manifest to a Blaine Tech Services, Inc. facility before being transported to a Chevron approved disposal facility

## **TRIP BLANKS**

Trip Blanks, if requested, are taken to the site and kept inside the sample cooler for the duration of the event. They are turned over to the laboratory for analysis with the samples from that site.

## **DUPLICATES**

Duplicates, if requested, may be collected at a site.

## **SAMPLE STORAGE**

All sample containers are promptly placed in food grade ice chests for storage in the field and transport (direct or via our facility) to the designated analytical laboratory. These ice chests contain quantities of restaurant grade ice as a refrigerant material. The samples are maintained in either an ice chest or a refrigerator until relinquished into the custody of the laboratory or laboratory courier.

## **DOCUMENTATION CONVENTIONS**

A label must be affixed to all sample containers. In most cases these labels are generated by our office personnel and are partially preprinted. Labels can also be hand written by our field personnel. The site is identified with the store number and site address, as is the particular groundwater well from which the sample is drawn (e.g. MW-1, MW-2, S-1 etc.). The time and date of sample collection along with the initials of the person who collects the sample are handwritten onto the label. Field documentation is contemporaneous.

## **DECONTAMINATION**

All equipment is brought to the site in clean and serviceable condition and is cleaned after use in each well and before subsequent use in any other well. Equipment such as hose reels, pumps and bailers is decontaminated before leaving the site.

The primary decontamination device is a commercial steam cleaner. The steam cleaner is de-tuned to function as a hot pressure washer that is then operated with high quality deionized water that is produced at our facility and stored onboard our sampling vehicle. Cleaning is



facilitated by the use of proprietary fixtures and devices included in the patented workstation (U.S. Patent 5,535,775) that is incorporated in each sampling vehicle.

Any sensitive equipment or parts (i.e. Dissolved Oxygen sensor membrane, water level indicator, etc.) that cannot be washed using the high pressure water, will be sprayed with a non-phosphate soap and deionized water solution and rinsed with deionized water.

## **FERROUS IRON MEASUREMENTS**

All field measurements are collected at time of sampling with a HACH test kit.

## WELL GAUGING DATA

Project # 121221-D21 Date 12/21/12 Client Chvron # 9-1153

Site 3135 Gibbons Dr. Alameda Ca.

Well ID	Time	Well Size (in.)	Sheen / Odor	Depth to Immiscible Liquid (ft.)	Thickness of Immiscible Liquid (ft.)	Volume of Immiscibles Removed (ml)	Depth to water (ft.)	Depth to well bottom (ft.)	Survey Point: TOB or TOC	Notes
C-1	0840	3	Yes	2.18	0.02	28	2.20	—	↓	sock
C-3	0830	3					2.41	18.95		
MW-4	0806	2					1.31	12.90		
MW-5	0800	2					1.59	12.58		
MW-6	0811	2					2.68	13.52		
MW-7	0837	2					3.09	5.90		
MW-8	0817	2					2.28	9.14		
MW-9	0824	2					2.32	8.57		
MW-10	0920	2					3.44	8.94		

## CHEVRON WELL MONITORING DATA SHEET

Project #: 121221-D11	Station #: 9-1153
Sampler: DR	Date: 12/21/12
Weather: Cloudy	Ambient Air Temperature: 50°F
Well I.D.: C-1	Well Diameter: 2 (3) 4 6 8
Total Well Depth: _____	Depth to Water: 2.20
Depth to Free Product: 2.18	Thickness of Free Product (feet): 0.02
Referenced to: (PVC) Grade	D.O. Meter (if req'd): YSI HACH
DTW with 80% Recharge [(Height of Water Column x 0.20) + DTW]: _____	

Purge Method:

- Bailer
- Disposable Bailer
- Positive Air Displacement
- Electric Submersible
- Waterra
- Peristaltic
- Extraction Pump
- Other \_\_\_\_\_

Sampling Method:

- Bailer
- ~~Disposable Bailer~~
- ~~Extraction Port~~
- ~~Dedicated Tubing~~
- Other: \_\_\_\_\_

\_\_\_\_\_ (Gals.) X \_\_\_\_\_ = \_\_\_\_\_ Gals.  
 I Case Volume      Specified Volumes      Calculated Volume

Well Diameter	Multiplier	Well Diameter	Multiplier
1"	0.04	4"	0.65
2"	0.16	6"	1.47
3"	0.37	Other	radius <sup>2</sup> * 0.163

Time	Temp (°F)	pH	Cond. (mS or µS)	Turbidity (NTUs)	Gals. Removed	Observations
-	Detected	0.02' dc	SPIT w/ interface probe.	No sample taken.		
-	Removed	absorbent sock.	(Total weight = 0.84 lb)			
-	Removed	28 ml of SPIT w/ disposable bailer				
-	Installed	new absorbent sock.	(Total weight = 0.34 lb)			
-	Absorbent sock/SPIT removed	by IWM the same day.				

Did well dewater?      Yes      No      Gallons actually evacuated: \_\_\_\_\_

Sampling Date: \_\_\_\_\_      Sampling Time: \_\_\_\_\_      Depth to Water: \_\_\_\_\_

Sample I.D.: (-)      Laboratory: Lancaster      Other \_\_\_\_\_

Analyzed for: TPH-G    BTEX    MTBE    OXYS    Other: \_\_\_\_\_

Duplicate I.D.: \_\_\_\_\_      Analyzed for: TPH-G    BTEX    MTBE    OXYS    Other: \_\_\_\_\_

D.O. (if req'd):      Pre-purge: \_\_\_\_\_ mg/L      Post-purge: \_\_\_\_\_ mg/L

O.R.P. (if req'd):      Pre-purge: \_\_\_\_\_ mV      Post-purge: \_\_\_\_\_ mV

# WELLHEAD INSPECTION CHECKLIST

Page 1 of 1

Client Chuvon Date 12/21/12

Site Address 3135 Gibbons Dr. Alameda Ca.

Job Number 12121-DRI Technician DR/BW

Well ID	Well Inspected - No Corrective Action Required	WELL IS SECURABLE BY DESIGN (12" or less)	WELL IS CLEARLY MARKED WITH THE WORDS "MONITORING WELL" (12" or less)	Water Bailed From Wellbox	Wellbox Components Cleaned	Cap Replaced	Lock Replaced	Other Action Taken (explain below)	Well Not Inspected (explain below)	Repair Order Submitted
C-1				X				X		
C-3			X					X		
MW-4		X	X	X				X		
MW-5		X	X	X				X		
MW-6	X	X	X	X						
MW-7		X	X	X				X		
MW-8		X	X	X				X		
MW-9		X	X	X				X		
MW-10				X				X		

NOTES: MW-5 -2/2 bolts/-2/2 tabs. MW-4 -2/2 bolts/-2/2 tabs.  
MW-8 2/3 bolts broken off in box. MW-9 -3/3 bolts C-3 Christy box. Lid broken. Very minor  
no lock. C-1 Christy box. Threaded cap. No lock. MW-10 No tabs. Monument lid. One  
bolt in middle of lid.



### SORBENT SOCK EVALUATION FORM

Name: <u>Brian Weeks</u>	Date: <u>12/21/12</u>	Project Number: <u>121221-DRI</u>
Site Address: <u>3133 Gibbons Dr. Munroe Co.</u>	Well ID: <u>C-1</u>	Weather: <u>overcast</u>

1) Time absorbent sock removed from well for inspection: 0825

2) Condition of sock:

a) Length of sock showing product saturation: 13"

b) Length of sock showing dryness: 0"

c) Color of sock showing product saturation: Light Brown

d) Weight of the removed sock: 0.84 lb

e) Weight of a new/clean/dry sock: 0.34 lb

f) Difference in weight: (D-E) to 0.01 ounces. 0.50 lb

3) Picture of sock removed from well taken:

4) Sock removed from well deposited into a waste drum:

-Is drum labeled? Yes      How full is drum? (%) 1 sock + 6gal

5) After at least 15 minutes after removing the sock from the well, measure (to 0.01ft) from the top of the well casing. :

a) Depth to product: 2.18'

b) Depth to water: 2.20'

c) Thickness of product: (b-a) 0.02'

6) Size and type of sock installed Pig Sock

7) Comments: New sock installed.