



RECEIVED

11:14 am, Aug 18, 2011

Alameda County
Environmental Health

Dave Patten
Project Manager
Marketing Business Unit

**Chevron Environmental
Management Company**
6111 Bollinger Canyon Road
San Ramon, CA 94583
Tel (925) 543-1740
Fax (925) 543-2324
drpattenchevron.com

Alameda County Health Care Services
1131 Harbor Bay Parkway, Suite 250
Alameda, CA 94502-6577

Re: Chevron Service Station No. 9-1153
3135 Gibbons Drive (3126 Fernside Blvd)
Alameda, CA

I have reviewed the attached report dated August 16, 2011.

The information in this report is accurate to the best of my knowledge and all local Agency/Regional Board guidelines have been followed. This report was prepared by Conestoga-Rovers & Associates, upon whose assistance and advice I have relied.

This letter is submitted pursuant to the requirements of California Water Code Section 13267(b)(1) and the regulating implementation entitled Appendix A pertaining thereto.

I declare under penalty of perjury that the foregoing is true and correct to the best of my knowledge.

Sincerely,

Dave Patten
Project Manager

Attachment: Report



**CONESTOGA-ROVERS
& ASSOCIATES**

5900 Hollis Street, Suite A
Emeryville, California 94608
Telephone: (510) 420-0700 Fax: (510) 420-9170
<http://www.craworld.com>

August 16, 2011

Reference No. 311642

Mr. Mark Detterman
Alameda County Environmental Health Services
1131 Harbor Bay Parkway, Suite 250
Alameda, California 94502-6577

Re: Second Quarter 2011
Groundwater Monitoring and Sampling Report
Former Chevron Service Station 9-1153
3135 Gibbons Drive (3126 Fernside Boulevard)
Alameda, California
Agency Case RO0000341

Dear Mr. Detterman:

Conestoga-Rovers & Associates (CRA) is submitting this *Second Quarter 2011 Groundwater Monitoring and Sampling Report* for the site referenced above (Figure 1) on behalf of Chevron Environmental Management Company. Groundwater monitoring was performed by Blaine Tech Services (Blaine Tech) of San Jose, California. Blaine Tech's July 7, 2011 *Second Quarter Monitoring* report is included as Attachment A. Current and historical groundwater monitoring and sampling data are presented in Table 1.

Equal
Employment Opportunity
Employer



**CONESTOGA-ROVERS
& ASSOCIATES**

August 16, 2011

Reference No. 311642

- 2 -

Please contact Nathan Lee at (510) 420-3333 if you have any questions or require additional information.

Sincerely,

CONESTOGA-ROVERS & ASSOCIATES



Nathan Lee, PG 8486

NL/aa/16

Encl.

Figure 1	Vicinity Map
Figure 2	Groundwater Elevation and Hydrocarbon Concentration Map
Table 1	Groundwater Monitoring and Sampling Data
Attachment A	Monitoring Data Package

cc: Mr. David Patten, Chevron
Mr. Mark Hom, Property Owner

FIGURES

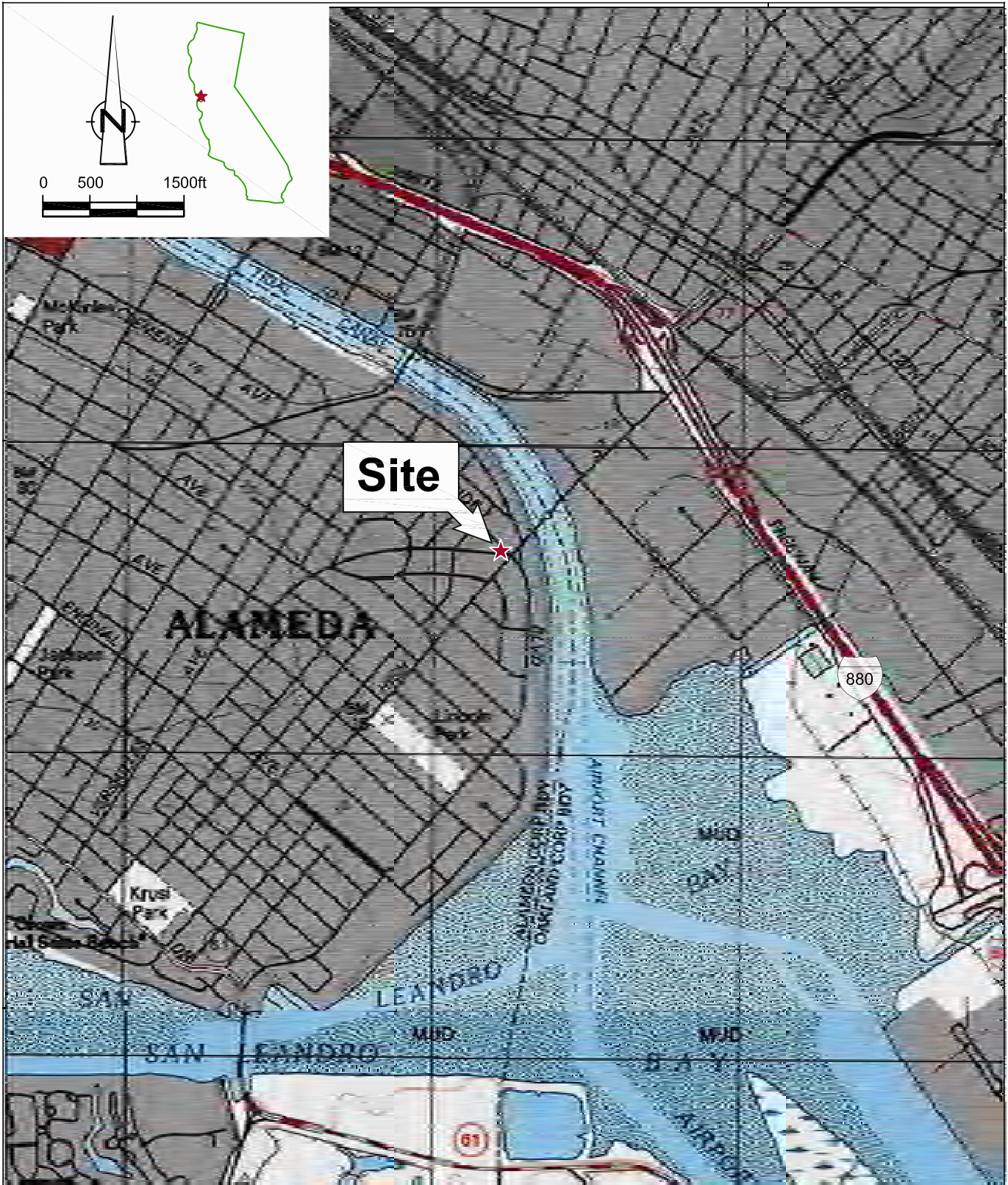
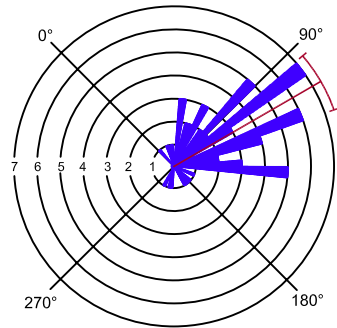
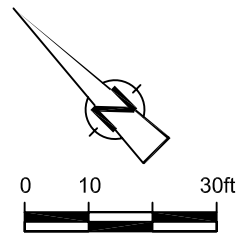

Figure 1
 VICINITY MAP
 FORMER CHEVRON SERVICE STATION 9-1153
 3135 GIBBONS DRIVE (3126 FERNSIDE BLVD)
 Alameda, California





GROUNDWATER FLOW DIRECTION
1986 - 2011

LEGEND

- MW-1 ● MONITORING WELL LOCATION
- TMW-1 ⊕ TEMPORARY MONITORING WELL LOCATION
- RW-1 ⊕ EXTRACTION WELL LOCATION
- C-2 ⊕ DESTROYED WELL LOCATION
- 5.00 — GROUNDWATER ELEVATION CONTOUR, IN FEET ABOVE MEAN SEA LEVEL (MSL), DASHED WHERE INFERRED
- GROUNDWATER FLOW DIRECTION AND GRADIENT
- SA SAMPLED ANNUALLY
- SSA SAMPLED SEMI-ANNUALLY
- LNAPL LIGHT NON-AQUEOUS PHASE LIQUID
- ** CORRECTED FOR PRESENCE OF LNAPL

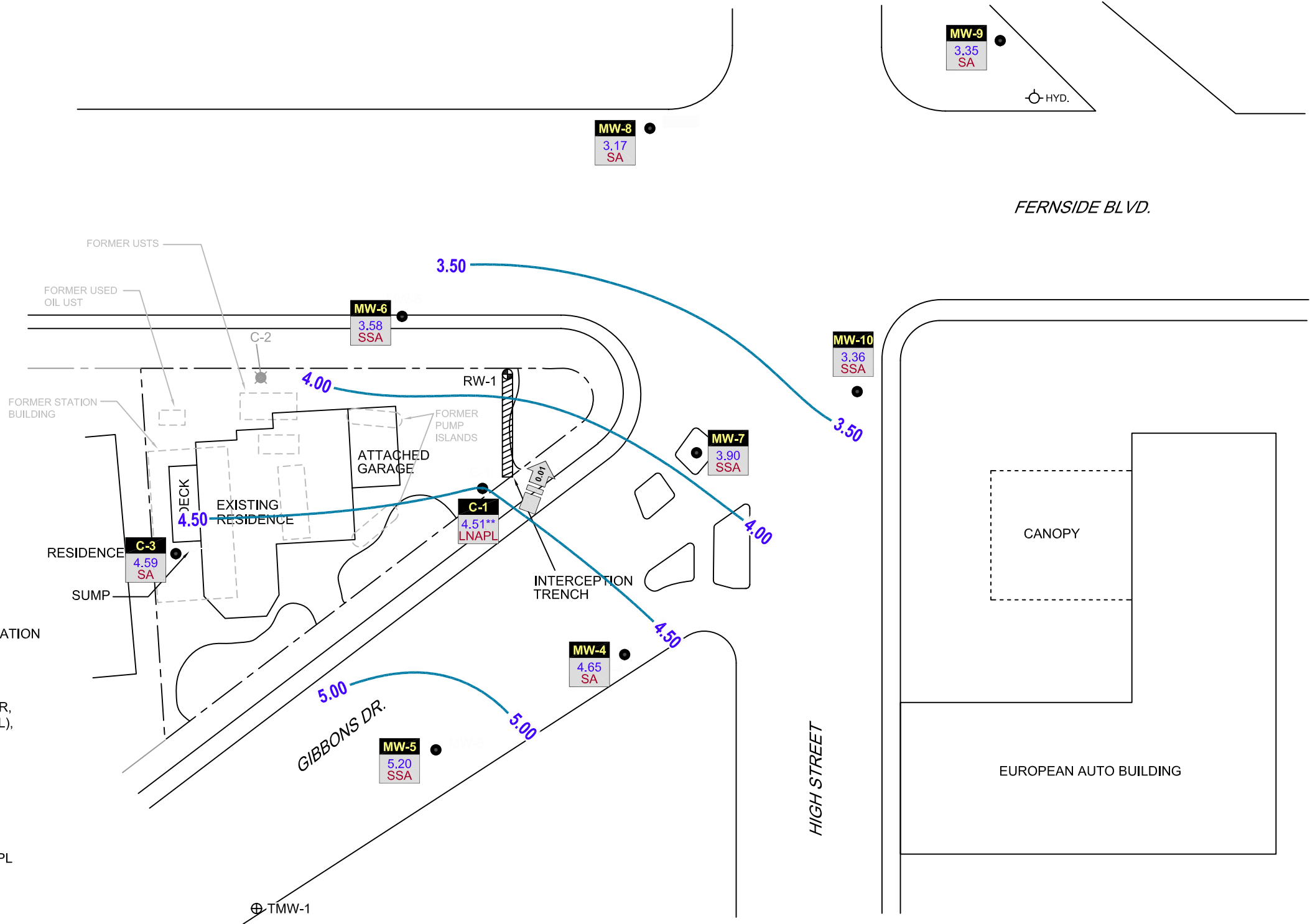

Figure 2
 GROUNDWATER ELEVATION AND HYDROCARBON CONCENTRATION MAP
 FORMER CHEVRON SERVICE STATION 9-1153
 3135 GIBBONS DRIVE (3126 FERNside BLVD)
 Alameda, California
 June 17, 2011



TABLE

TABLE 1

GROUNDWATER MONITORING AND SAMPLING DATA
 FORMER CHEVRON SERVICE STATION 9-1153
 3135 GIBBONS DRIVE
 (3126 FERNSIDE BOULEVARD)
 ALAMEDA, CALIFORNIA

Location	Date	TOC	DTW	GWE	LNAPL	FIELD PARAMETERS	HYDROCARBONS	PRIMARY VOCS				
						Dissolved Oxygen	TPH-GRO	B	T	E	X	MTBE by SW8260
	Units	ft	ft	ft-amsl	ft	mg/L	µg/L	µg/L	µg/L	µg/L	µg/L	µg/L
C-1	08/18/1986	-	4.10	-	-	-	-	-	-	-	-	-
C-1	09/04/1986	-	-	-	-	-	15,000	760	820	1,500	-	-
C-1	07/22/1987	-	-	-	-	-	1,100	250	7.0	40	-	-
C-1	05/03/1989	-	4.46	-	-	-	6,900	3,800	190	229	-	-
C-1	12/04/1989	-	4.16	-	-	-	17,000	8,000	490	470	-	-
C-1	02/14/1990	-	3.64	-	-	-	19,000	12,000	990	1,050	-	-
C-1	03/07/1990	-	3.36	-	-	-	-	4,260	261	430	-	-
C-1	09/06/1991	-	4.43	-	-	-	21,000	10,000	100	240	560	-
C-1	12/15/1991	-	4.78	-	-	-	20,000	4,900	43	110	330	-
C-1	03/03/1992	-	2.39	-	-	-	13,000	5,800	730	340	1,200	-
C-1	06/04/1992	4.08	4.08	0.00	0.00	-	34,000	9,400	350	290	1,200	-
C-1	10/13/1992	4.08	4.75	-0.67	0.00	-	24,000	11,000	98	280	530	-
C-1	01/11/1993	4.08	2.26	1.82	Sheen	-	7,100	1,500	130	150	700	-
C-1	04/14/1993	4.08	2.90	1.18	Sheen	-	29,000	7,300	4,000	640	2,300	-
C-1	07/13/1993	4.08	3.97	0.11	Sheen	-	650,000	27,000	18,000	6,300	29,000	-
C-1	10/19/1993	4.08	4.50	-0.42	0.00	-	40,000	12,000	730	1,100	3,600	-
C-1	11/30/1993	7.50	4.27	3.23	0.00	-	-	-	-	-	-	-
C-1	01/27/1994	7.50	3.35	4.15	0.00	-	36,000	8,600	220	670	1,900	-
C-1	04/07/1994	7.50	3.42	4.08	0.00	-	53,000	12,000	3,500	480	3,300	-
C-1	07/01/1994	7.50	3.96	3.54	0.00	-	65,000	19,000	5,900	1,000	9,000	-
C-1	10/05/1994	7.50	4.39	3.11	0.00	-	160,000	23,000	12,000	2,200	11,000	-
C-1	01/12/1995	7.50	1.52	6.38	0.50	-	-	-	-	-	-	-

TABLE 1

GROUNDWATER MONITORING AND SAMPLING DATA
 FORMER CHEVRON SERVICE STATION 9-1153
 3135 GIBBONS DRIVE
 (3126 FERNSIDE BOULEVARD)
 ALAMEDA, CALIFORNIA

Location	Date	TOC	DTW	GWE	LNAPL	FIELD PARAMETERS	HYDROCARBONS	PRIMARY VOCS				
						Dissolved Oxygen	TPH-GRO	B	T	E	X	MTBE by SW8260
	Units	ft	ft	ft-amsl	ft	mg/L	µg/L	µg/L	µg/L	µg/L	µg/L	µg/L
C-1	04/26/1995	7.50	4.40	4.86	2.20	-	-	-	-	-	-	-
C-1	07/12/1995	7.50	4.85	4.10	1.81	-	-	-	-	-	-	-
C-1	10/30/1995	7.50	5.67	3.13	1.63	-	-	-	-	-	-	-
C-1	01/04/1996	7.50	3.92	3.68	0.12	-	-	-	-	-	-	-
C-1	01/10/1996	7.50	3.48	4.12	0.13	-	-	-	-	-	-	-
C-1	01/17/1996	7.50	3.40	4.12	0.02	-	-	-	-	-	-	-
C-1	01/22/1996	7.50	2.90	4.60	0.00	-	82,000	18,000	4,400	1,400	5,200	<1,000
C-1	02/23/1996	7.50	4.10	4.89	1.86	-	-	-	-	-	-	-
C-1	02/28/1996	7.50	-	-	0.83 >	-	-	-	-	-	-	-
C-1	03/08/1996	7.50	2.86	6.10	1.83	-	-	-	-	-	-	-
C-1	03/26/1996	7.50	3.96	4.56	1.28	-	-	-	-	-	-	-
C-1	04/11/1996	7.50	5.61	3.29	1.75	-	-	-	-	-	-	-
C-1	04/19/1996	7.50	3.09	4.44	0.04	-	-	-	-	-	-	-
C-1	04/24/1996	7.50	3.04	4.48	0.03	-	-	-	-	-	-	-
C-1	05/03/1996	7.50	4.02	3.85	0.46	-	-	-	-	-	-	-
C-1	05/08/1996	7.50	4.25	3.53	0.35	-	-	-	-	-	-	-
C-1	05/17/1996	7.50	3.24	4.29	0.04	-	-	-	-	-	-	-
C-1	05/22/1996	7.50	3.10	4.46	0.07	-	-	-	-	-	-	-
C-1	06/18/1996	7.50	4.68	3.20	0.48	-	-	-	-	-	-	-
C-1	07/03/1996	7.50	5.03	2.57	0.13	-	-	-	-	-	-	-
C-1	07/09/1996	7.50	4.63	3.05	0.23	-	-	-	-	-	-	-
C-1	07/17/1996	7.50	4.73	2.89	0.15	-	-	-	-	-	-	-

TABLE 1

GROUNDWATER MONITORING AND SAMPLING DATA
 FORMER CHEVRON SERVICE STATION 9-1153
 3135 GIBBONS DRIVE
 (3126 FERNSIDE BOULEVARD)
 ALAMEDA, CALIFORNIA

Location	Date	TOC	DTW	GWE	LNAPL	FIELD PARAMETERS	HYDROCARBONS	PRIMARY VOCS				
						Dissolved Oxygen	TPH-GRO	B	T	E	X	MTBE by SW8260
	Units	ft	ft	ft-amsl	ft	mg/L	µg/L	µg/L	µg/L	µg/L	µg/L	µg/L
C-1	07/29/1996	7.50	5.10	2.47	0.09	-	-	-	-	-	-	-
C-1	08/02/1996	7.50	5.68	1.84	0.03	-	-	-	-	-	-	-
C-1	08/07/1996	7.50	5.16	2.35	0.01	-	-	-	-	-	-	-
C-1	08/23/1996	7.50	5.75	1.77	0.03	-	-	-	-	-	-	-
C-1	08/28/1996	7.50	5.53	1.99	0.03	-	-	-	-	-	-	-
C-1	09/06/1996	7.50	5.38	2.12	0.00	-	-	-	-	-	-	-
C-1	09/12/1996	7.50	5.48	2.04	0.03	-	-	-	-	-	-	-
C-1	09/19/1996	7.50	6.32	1.20	0.03	-	-	-	-	-	-	-
C-1	10/10/1996	7.50	4.58	3.00	0.10	-	-	-	-	-	-	-
C-1	10/17/1996	7.50	5.61	1.90	0.01	-	-	-	-	-	-	-
C-1	10/29/1996	7.50	6.01	1.49	0.00	-	-	-	-	-	-	-
C-1	11/07/1996	7.50	5.56	1.94	0.04	-	-	-	-	-	-	-
C-1	11/11/1996	7.50	5.32	2.18	0.04	-	-	-	-	-	-	-
C-1	12/17/1996	7.50	3.73	3.77	0.01	-	-	-	-	-	-	-
C-1	12/20/1996	7.50	3.33	4.17	0.03	-	-	-	-	-	-	-
C-1	01/15/1997	7.50	2.74	4.76	0.00	-	47,000	16,000	2,800	1,300	4,900	<1,000
C-1	01/22/1997	7.50	1.37	6.13	0.19	-	-	-	-	-	-	-
C-1	02/04/1997	7.50	2.98	4.52	0.51	-	-	-	-	-	-	-
C-1	02/20/1997	7.50	4.09	3.41	0.13	-	-	-	-	-	-	-
C-1	03/06/1997	7.50	3.75	3.75	0.56	-	-	-	-	-	-	-
C-1	03/14/1997	7.50	3.82	3.68	0.03	-	-	-	-	-	-	-
C-1	03/20/1997	7.50	3.73	3.77	0.03	-	-	-	-	-	-	-

TABLE 1

GROUNDWATER MONITORING AND SAMPLING DATA
 FORMER CHEVRON SERVICE STATION 9-1153
 3135 GIBBONS DRIVE
 (3126 FERNSIDE BOULEVARD)
 ALAMEDA, CALIFORNIA

Location	Date	TOC	DTW	GWE	LNAPL	FIELD PARAMETERS	HYDROCARBONS	PRIMARY VOCS				
						Dissolved Oxygen	TPH-GRO	B	T	E	X	MTBE by SW8260
	Units	ft	ft	ft-amsl	ft	mg/L	µg/L	µg/L	µg/L	µg/L	µg/L	µg/L
C-1	03/25/1997	7.50	4.32	3.18	0.01	-	-	-	-	-	-	-
C-1	03/31/1997	7.50	3.71	3.79	0.03	-	-	-	-	-	-	-
C-1	04/03/1997	7.50	4.60	2.92	0.03	-	-	-	-	-	-	-
C-1	04/09/1997	7.50	4.25	3.27	0.02	-	-	-	-	-	-	-
C-1	04/24/1997	7.50	4.65	2.87	0.02	-	-	-	-	-	-	-
C-1	04/30/1997	7.50	3.50	4.02	0.02	-	-	-	-	-	-	-
C-1	05/22/1997	7.50	4.97	2.53	0.00	-	-	-	-	-	-	-
C-1	06/03/1997	7.50	3.62	3.93	0.06	-	-	-	-	-	-	-
C-1	07/09/1997	7.50	4.30	3.25	0.06	-	-	-	-	-	-	-
C-1	08/12/1997	7.50	5.18	2.32	0.00	-	-	-	-	-	-	-
C-1	09/30/1997	7.50	5.25	2.65	0.50	-	-	-	-	-	-	-
C-1	10/29/1997	7.50	5.33	2.19	0.03	-	-	-	-	-	-	-
C-1	11/13/1997	7.50	4.86	2.66	0.02	-	-	-	-	-	-	-
C-1	12/18/1997	7.50	2.34	5.16	0.00	-	-	-	-	-	-	-
C-1	01/14/1998	7.50	0.25	7.27	0.02	-	-	-	-	-	-	-
C-1	02/02/1998	7.50	2.35	5.19	0.05	-	-	-	-	-	-	-
C-1	03/16/1998	7.50	2.50	5.40	0.50	-	-	-	-	-	-	-
C-1	04/17/1998	7.50	2.65	5.17	0.40	-	-	-	-	-	-	-
C-1	05/01/1998	7.50	2.39	5.14	0.04	-	-	-	-	-	-	-
C-1	06/17/1998	7.50	3.26	4.30	0.08	-	-	-	-	-	-	-
C-1	07/15/1998	7.50	3.55	3.95	0.00	-	110,000	22,000	22,000	1,000	10,000	<250
C-1	09/01/1998	7.50	4.00	3.50	0.00	-	-	-	-	-	-	-

TABLE 1

**GROUNDWATER MONITORING AND SAMPLING DATA
FORMER CHEVRON SERVICE STATION 9-1153
3135 GIBBONS DRIVE
(3126 FERNSIDE BOULEVARD)
ALAMEDA, CALIFORNIA**

Location	Date	TOC	DTW	GWE	LNAPL	FIELD PARAMETERS	HYDROCARBONS	PRIMARY VOCS				
						Dissolved Oxygen	TPH-GRO	B	T	E	X	MTBE by SW8260
	Units	ft	ft	ft-amsl	ft	mg/L	µg/L	µg/L	µg/L	µg/L	µg/L	µg/L
C-1	10/27/1998	7.50	4.48	3.02	0.00	-	45,000	12,000	5,400	590	4,300	<500
C-1	11/19/1998	7.50	3.89	3.61	0.00	-	-	-	-	-	-	-
C-1	12/19/1998	7.50	2.13	5.39	0.02	-	-	-	-	-	-	-
C-1	01/20/1999	7.50	3.98	3.52	0.00	-	50,300	7,050	5,030	244	6,090	<40
C-1	02/24/1999	7.50	2.55	4.95	0.00	-	-	-	-	-	-	-
C-1	03/26/1999	7.50	2.14	5.97	0.76	-	-	-	-	-	-	-
C-1	04/19/1999	7.50	1.04	6.46	0.00	-	150,000	21,000	20,000	3,000	18,000	49 ² / _{<2.5}
C-1	07/29/1999	7.50	3.76	3.76	0.02	-	-	-	-	-	-	-
C-1	08/30/1999	7.50	4.30	3.20	0.00	-	-	-	-	-	-	-
C-1	09/23/1999	7.50	3.84	3.68	0.02	-	-	-	-	-	-	-
C-1	10/13/1999	7.50	1.27	6.23	0.00	-	136,000	23,900	30,000	2,390	17,300	<500
C-1	11/17/1999	7.50	3.59	3.91	0.00	-	-	-	-	-	-	-
C-1	12/08/1999	7.50	3.79	3.71	0.00	-	-	-	-	-	-	-
C-1	01/25/2000	7.50	1.99	5.54	0.04	-	-	-	-	-	-	-
C-1	04/03/2000**	7.50	2.20	5.38	0.10	-	-	-	-	-	-	-
C-1	05/26/2000**	7.50	2.52	5.16	0.23	-	-	-	-	-	-	-
C-1	06/19/2000**	7.50	2.89	4.76	0.19	-	-	-	-	-	-	-
C-1	07/03/2000**	7.50	3.45	4.25	0.25	-	-	-	-	-	-	-
C-1	08/01/2000**	7.50	3.78	3.85	0.16	-	-	-	-	-	-	-
C-1	09/30/2000**	7.50	4.03	3.50	0.04	-	-	-	-	-	-	-
C-1	10/23/2000**	7.50	4.15	3.37	0.03	-	-	-	-	-	-	-
C-1	11/21/2000	7.50	3.42	4.08	0.00	-	-	-	-	-	-	-

TABLE 1

GROUNDWATER MONITORING AND SAMPLING DATA
 FORMER CHEVRON SERVICE STATION 9-1153
 3135 GIBBONS DRIVE
 (3126 FERNSIDE BOULEVARD)
 ALAMEDA, CALIFORNIA

Location	Date	TOC	DTW	GWE	LNAPL	FIELD PARAMETERS	HYDROCARBONS	PRIMARY VOCS				
						Dissolved Oxygen	TPH-GRO	B	T	E	X	MTBE by SW8260
	Units	ft	ft	ft-amsl	ft	mg/L	µg/L	µg/L	µg/L	µg/L	µg/L	µg/L
C-1	12/22/2000	7.50	2.96	4.54	0.00	-	-	-	-	-	-	-
C-1	01/08/2001	7.50	2.94	4.56	0.00	-	-	-	-	-	-	-
C-1	02/17/2001**	7.50	2.09	5.88	0.59	-	-	-	-	-	-	-
C-1	03/13/2001**	7.50	2.20	5.91	0.76	-	-	-	-	-	-	-
C-1	04/09/2001 ^{18,**}	7.50	2.45	5.26	0.26	-	-	-	-	-	-	-
C-1	05/18/2001**	7.50	2.70	5.27	0.59	-	-	-	-	-	-	-
C-1	06/12/2001**	7.50	3.50	4.78	0.97	-	-	-	-	-	-	-
C-1	07/19/2001**	7.50	4.25	4.01	0.95	-	-	-	-	-	-	-
C-1	08/23/2001 ^{18,**}	7.50	4.34	3.22	0.07	-	-	-	-	-	-	-
C-1	09/17/2001**	7.50	4.39	3.17	0.08	-	-	-	-	-	-	-
C-1	10/08/2001**	7.50	4.45	3.08	0.04	-	-	-	-	-	-	-
C-1	11/27/2001	7.50	3.89	3.61	0.00	-	330,000	9,800	5,300	3,800	22,000	<50
C-1	12/17/2001	7.50	1.81	5.69	0.00	-	-	-	-	-	-	-
C-1	01/07/2002**	7.50	2.27	5.64	0.51	-	-	-	-	-	-	-
C-1	02/26/2002 ^{18,**}	7.50	2.70	5.22	0.52	-	-	-	-	-	-	-
C-1	03/27/2002**	7.50	2.87	5.47	1.05	-	-	-	-	-	-	-
C-1	04/08/2002**	7.50	2.45	6.03	1.23	-	-	-	-	-	-	-
C-1	05/23/2002 ^{18,**}	7.50	3.57	4.35	0.52	-	-	-	-	-	-	-
C-1	06/17/2002**	7.50	3.90	3.88	0.35	-	-	-	-	-	-	-
C-1	07/31/2002**	7.50	4.12	3.54	0.20	-	-	-	-	-	-	-
C-1	08/09/2002 ^{18,**}	7.50	4.15	3.48	0.16	-	-	-	-	-	-	-
C-1	09/17/2002**	7.50	4.33	3.27	0.12	-	-	-	-	-	-	-

TABLE 1

GROUNDWATER MONITORING AND SAMPLING DATA
 FORMER CHEVRON SERVICE STATION 9-1153
 3135 GIBBONS DRIVE
 (3126 FERNSIDE BOULEVARD)
 ALAMEDA, CALIFORNIA

Location	Date	TOC	DTW	GWE	LNAPL	FIELD PARAMETERS	HYDROCARBONS	PRIMARY VOCS				
						Dissolved Oxygen	TPH-GRO	B	T	E	X	MTBE by SW8260
	Units	ft	ft	ft-amsl	ft	mg/L	µg/L	µg/L	µg/L	µg/L	µg/L	µg/L
C-1	10/15/2002**	7.50	4.51	3.11	0.15	-	-	-	-	-	-	-
C-1	11/08/2002	7.50	4.11	3.39	0.00	-	51,000	7,000	510	820	5,800	<3.0
C-1	12/19/2002	7.50	1.14	6.36	0.00	-	-	-	-	-	-	-
C-1	01/14/2003	7.50	1.80	5.70	0.00	-	-	-	-	-	-	-
C-1	02/07/2003 ^{18,**}	7.50	2.95	4.79	0.30	-	-	-	-	-	-	-
C-1	03/20/2003**	7.50	2.86	4.97	0.41	-	-	-	-	-	-	-
C-1	04/15/2003**	7.50	2.12	5.46	0.10	-	-	-	-	-	-	-
C-1	05/09/2003 ^{18,**}	7.50	2.95	5.11	0.70	-	-	-	-	-	-	-
C-1	06/27/2003**	7.50	3.97	3.93	0.50	-	-	-	-	-	-	-
C-1	07/16/2003**	7.50	3.68	4.04	0.28	-	-	-	-	-	-	-
C-1	08/15/2003 ^{18,**}	7.50	4.29	3.39	0.22	-	-	-	-	-	-	-
C-1	09/26/2003**	7.50	4.60	3.05	0.19	-	-	-	-	-	-	-
C-1	10/18/2003**	7.50	4.72	2.90	0.15	-	-	-	-	-	-	-
C-1	11/14/2003 ^{18,**}	7.50	4.31	3.35	0.20	-	-	-	-	-	-	-
C-1	12/23/2003	7.50	1.81	5.69	0.00	-	-	-	-	-	-	-
C-1	01/22/2004**	7.50	4.19	3.32	0.01	-	-	-	-	-	-	-
C-1	02/13/2004 ^{18,**}	7.50	3.04	4.49	0.04	-	-	-	-	-	-	-
C-1	03/11/2004**	7.50	1.85	5.97	0.40	-	-	-	-	-	-	-
C-1	04/22/2004**	7.50	3.08	4.60	0.22	-	-	-	-	-	-	-
C-1	05/14/2004 ^{18,**}	7.50	3.49	4.03	0.03	-	-	-	-	-	-	-
C-1	06/18/2004**	7.50	3.41	4.19	0.13	-	-	-	-	-	-	-
C-1	07/23/2004**	7.50	3.28	4.31	0.11	-	-	-	-	-	-	-

TABLE 1

GROUNDWATER MONITORING AND SAMPLING DATA
 FORMER CHEVRON SERVICE STATION 9-1153
 3135 GIBBONS DRIVE
 (3126 FERNSIDE BOULEVARD)
 ALAMEDA, CALIFORNIA

Location	Date	TOC	DTW	GWE	LNAPL	FIELD PARAMETERS	HYDROCARBONS	PRIMARY VOCS				
						Dissolved Oxygen	TPH-GRO	B	T	E	X	MTBE by SW8260
	Units	ft	ft	ft-amsl	ft	mg/L	µg/L	µg/L	µg/L	µg/L	µg/L	µg/L
C-1	08/13/2004 ^{18,**}	7.50	3.14	4.40	0.05	-	-	-	-	-	-	-
C-1	09/13/2004 ^{**}	7.50	4.53	3.04	0.09	-	-	-	-	-	-	-
C-1	10/22/2004 ^{**}	7.50	3.19	4.33	0.03	-	-	-	-	-	-	-
C-1	11/12/2004 ^{18,**}	7.50	3.22	4.30	0.03	-	-	-	-	-	-	-
C-1	12/02/2004 ^{**}	7.50	3.28	4.24	0.02	-	-	-	-	-	-	-
C-1	01/28/2005 ^{**}	7.50	3.19	4.32	0.01	-	-	-	-	-	-	-
C-1	02/11/2005 ^{18,**}	7.50	2.75	4.78	0.04	-	-	-	-	-	-	-
C-1	03/11/2005 ^{**}	7.50	2.94	4.58	0.03	-	-	-	-	-	-	-
C-1	04/26/2005 ^{**}	7.50	3.03	4.49	0.02	-	-	-	-	-	-	-
C-1	05/13/2005 ^{18,**}	7.50	3.18	4.34	0.02	-	-	-	-	-	-	-
C-1	06/01/2005 ^{**}	7.50	3.22	4.30	0.02	-	-	-	-	-	-	-
C-1	07/15/2005 ^{**}	7.50	3.09	4.43	0.02	-	-	-	-	-	-	-
C-1	08/19/2005 ^{18,**}	7.50	2.88	4.64	0.03	-	-	-	-	-	-	-
C-1	09/23/2005 ^{**}	7.50	2.95	4.57	0.02	-	-	-	-	-	-	-
C-1	10/14/2005 ^{**}	7.50	3.01	4.50	0.01	-	-	-	-	-	-	-
C-1	11/18/2005 ^{18,**}	7.50	3.21	4.31	0.02	-	-	-	-	-	-	-
C-1	12/09/2005 ^{**}	7.50	3.61	3.90	0.01	-	-	-	-	-	-	-
C-1	01/12/2006 ^{**}	7.50	2.98	4.53	0.01	-	-	-	-	-	-	-
C-1	02/10/2006 ^{15,**}	7.50	2.69	4.82	0.01	-	100,000	11,000	2,500	2,900	15,000	<10
C-1	03/13/2006 ^{**}	7.50	2.81	4.70	0.01	-	-	-	-	-	-	-
C-1	04/13/2006 ^{**}	7.50	2.75	4.76	0.01	-	-	-	-	-	-	-
C-1	05/12/2006 ^{18,**}	7.50	3.02	4.49	0.01	-	-	-	-	-	-	-

TABLE 1

**GROUNDWATER MONITORING AND SAMPLING DATA
FORMER CHEVRON SERVICE STATION 9-1153
3135 GIBBONS DRIVE
(3126 FERNSIDE BOULEVARD)
ALAMEDA, CALIFORNIA**

Location	Date	TOC	DTW	GWE	LNAPL	FIELD PARAMETERS	HYDROCARBONS	PRIMARY VOCS				
						Dissolved Oxygen	TPH-GRO	B	T	E	X	MTBE by SW8260
	Units	ft	ft	ft-amsl	ft	mg/L	µg/L	µg/L	µg/L	µg/L	µg/L	µg/L
C-1	06/12/2006**	7.50	3.10	4.41	0.01	-	-	-	-	-	-	-
C-1	07/13/2006**	7.50	3.14	4.38	0.02	-	-	-	-	-	-	-
C-1	08/11/2006 ^{15,**}	7.50	3.70	3.81	0.01	-	200,000	8,600	470	1,700	8,800	<10
C-1	09/11/2006**	7.50	3.75	3.77	0.02	-	-	-	-	-	-	-
C-1	10/17/2006**	7.50	3.82	3.69	0.01	-	-	-	-	-	-	-
C-1	11/17/2006 ^{18,**}	7.50	3.11	4.41	0.03	-	-	-	-	-	-	-
C-1	12/15/2006**	7.50	2.95	4.57	0.02	-	-	-	-	-	-	-
C-1	01/16/2007**	7.50	2.98	4.54	0.02	-	-	-	-	-	-	-
C-1	02/16/2007 ¹⁵	7.50	2.77	4.73	0.00	-	25,000	4,300	260	310	3,300	<5
C-1	03/16/2007**	7.50	3.07	4.44	0.01	-	-	-	-	-	-	-
C-1	04/17/2007**	7.50	2.98	4.53	0.01	-	-	-	-	-	-	-
C-1	05/17/2007 ^{15,**}	7.50	3.05	4.46	0.01	-	110,000 ¹⁶	12,000 ¹⁶	1,000 ¹⁶	2,000 ¹⁶	15,000 ¹⁶	<5
C-1	06/15/2007**	7.50	3.08	4.43	0.01	-	-	-	-	-	-	-
C-1	07/17/2007**	7.50	3.13	4.38	0.01	-	-	-	-	-	-	-
C-1	08/09/2007 ^{18,**}	7.50	3.24	4.28	0.02	-	-	-	-	-	-	-
C-1	09/14/2007**	7.50	3.16	4.35	0.01	-	-	-	-	-	-	-
C-1	10/16/2007**	7.50	3.04	4.47	0.01	-	-	-	-	-	-	-
C-1	11/08/2007 ^{15,**}	7.50	3.11	4.40	0.01	-	150,000	13,000	570	1,800	10,000	<13
C-1	12/07/2007**	7.50	2.98	4.54	0.03	-	-	-	-	-	-	-
C-1	01/16/2008**	7.50	2.95	4.57	0.02	-	-	-	-	-	-	-
C-1	02/06/2008 ^{15,**}	7.50	2.61	4.90	0.01	-	110,000	13,000	500	5,300	21,000	<10
C-1	03/07/2008**	7.50	2.87	4.65	0.02	-	-	-	-	-	-	-

TABLE 1

**GROUNDWATER MONITORING AND SAMPLING DATA
FORMER CHEVRON SERVICE STATION 9-1153
3135 GIBBONS DRIVE
(3126 FERNSIDE BOULEVARD)
ALAMEDA, CALIFORNIA**

Location	Date	TOC	DTW	GWE	LNAPL	FIELD PARAMETERS	HYDROCARBONS	PRIMARY VOCS				
						Dissolved Oxygen	TPH-GRO	B	T	E	X	MTBE by SW8260
	Units	ft	ft	ft-amsl	ft	mg/L	µg/L	µg/L	µg/L	µg/L	µg/L	µg/L
C-1	04/16/2008**	7.50	3.06	4.46	0.02	-	-	-	-	-	-	-
C-1	05/07/2008 ^{18,**}	7.50	2.98	4.54	0.03	-	-	-	-	-	-	-
C-1	06/06/2008**	7.50	3.02	4.50	0.02	-	-	-	-	-	-	-
C-1	07/16/2008**	7.50	3.12	4.40	0.02	-	-	-	-	-	-	-
C-1	09/05/2008**	7.50	3.97	3.75	0.28	-	-	-	-	-	-	-
C-1	09/11/2008 ^{18,**}	7.50	4.22	3.61	0.41	-	-	-	-	-	-	-
C-1	10/17/2008**	7.50	4.16	3.60	0.33	-	-	-	-	-	-	-
C-1	11/10/2008 ^{18,**}	7.50	4.05	3.54	0.11	-	-	-	-	-	-	-
C-1	12/15/2008**	7.50	3.85	3.69	0.05	-	-	-	-	-	-	-
C-1	01/21/2009**	7.50	3.91	3.62	0.04	-	-	-	-	-	-	-
C-1	02/09/2009 ^{15,**}	7.50	3.72	3.79	0.01	-	53,000	3,100	66	660	3,700	<1
C-1	05/28/2009	7.50	3.48	4.02	0.02	-	-	-	-	-	-	-
C-1	08/18/2009	7.50	4.40	3.10	0.02	-	-	-	-	-	-	-
C-1	11/17/2009	7.50	4.21	3.29	0.03	-	-	-	-	-	-	-
C-1	03/31/2010	7.50	2.07	5.46	0.04	-	-	-	-	-	-	-
C-1	05/17/2010	7.50	2.87	4.83	0.25	-	-	-	-	-	-	-
C-1	08/26/2010 ¹⁸	7.50	4.03	3.50	0.04	-	-	-	-	-	-	-
C-1	11/11/2010 ^{18,**}	7.50	3.82	3.70	0.03	-	-	-	-	-	-	-
C-1	03/02/2011 ^{18,**}	7.50	1.12	6.41	0.04	-	-	-	-	-	-	-
C-1	06/17/2011^{18,**}	7.50	3.00	4.51	0.01	-	-	-	-	-	-	-
C-3	08/18/1986	-	4.00	-	-	-	-	-	-	-	-	-

TABLE 1

GROUNDWATER MONITORING AND SAMPLING DATA
 FORMER CHEVRON SERVICE STATION 9-1153
 3135 GIBBONS DRIVE
 (3126 FERNSIDE BOULEVARD)
 ALAMEDA, CALIFORNIA

Location	Date	TOC	DTW	GWE	LNAPL	FIELD PARAMETERS	HYDROCARBONS	PRIMARY VOCS				
						Dissolved Oxygen	TPH-GRO	B	T	E	X	MTBE by SW8260
	Units	ft	ft	ft-amsl	ft	mg/L	µg/L	µg/L	µg/L	µg/L	µg/L	µg/L
C-3	09/04/1986	-	-	-	-	-	50	3.2	5.4	5.8	-	-
C-3	07/22/1987	-	-	-	-	-	<50	<0.5	<1.0	<4.0	-	-
C-3	05/03/1989	-	4.15	-	-	-	<50	<0.5	<1.0	<2.0	-	-
C-3	12/04/1989	-	4.24	-	-	-	<250	<0.5	<0.5	<0.5	-	-
C-3	02/14/1990	-	3.57	-	-	-	<50	<0.5	<0.5	<0.5	-	-
C-3	03/07/1990	-	3.31	-	-	-	-	<5.0	<5.0	<5.0	-	-
C-3	09/06/1991	-	4.59	-	-	-	<50	<0.5	<0.5	<0.5	<0.5	-
C-3	12/15/1991	-	4.84	-	-	-	<50	<0.5	<0.5	<0.5	<0.5	-
C-3	03/03/1992	-	2.17	-	-	-	<50	<0.5	<0.5	<0.5	<0.5	-
C-3	06/04/1992	4.41	4.01	0.40	0.00	-	<50	<0.5	<0.5	<0.5	<0.5	-
C-3	10/13/1992	4.41	4.79	-0.38	0.00	-	<50	<0.5	<0.5	<0.5	<0.5	-
C-3	01/11/1993	4.41	2.01	2.40	0.00	-	<50	<0.5	<0.5	<0.5	<0.5	-
C-3	04/14/1993	4.41	2.76	1.65	0.00	-	<50	<0.5	<0.5	<0.5	<0.5	-
C-3	07/13/1993	4.41	3.96	0.45	0.00	-	<50	<0.5	<0.5	<0.5	<1.5	-
C-3	10/19/1993	4.41	4.53	-0.12	0.00	-	66	12	1.4	1.0	8.4	-
C-3	11/30/1993	7.83	4.04	3.79	0.00	-	-	-	-	-	-	-
C-3	01/27/1994	7.83	3.17	4.66	0.00	-	<50	<0.5	<0.5	<0.5	<0.5	-
C-3	04/07/1994	7.83	3.20	4.63	0.00	-	<50	<0.5	<0.5	<0.5	<0.5	-
C-3	07/01/1994	7.83	3.99	3.84	0.00	-	<50	<0.5	<0.5	<0.5	<0.5	-
C-3	10/05/1994	7.83	4.54	3.29	0.00	-	<50	<0.5	<0.5	<0.5	<0.5	-
C-3	01/12/1995	7.83	0.80	7.03	0.00	-	<50	<0.5	<0.5	<0.5	<0.5	-
C-3	05/02/1995	7.83	2.15	5.68	0.00	-	<50	<0.5	<0.5	<0.5	<0.5	-

TABLE 1

**GROUNDWATER MONITORING AND SAMPLING DATA
FORMER CHEVRON SERVICE STATION 9-1153
3135 GIBBONS DRIVE
(3126 FERNSIDE BOULEVARD)
ALAMEDA, CALIFORNIA**

Location	Date	TOC	DTW	GWE	LNAPL	FIELD PARAMETERS	HYDROCARBONS	PRIMARY VOCS				
						Dissolved Oxygen	TPH-GRO	B	T	E	X	MTBE by SW8260
	Units	ft	ft	ft-amsl	ft	mg/L	µg/L	µg/L	µg/L	µg/L	µg/L	µg/L
C-3	07/12/1995	7.83	3.42	4.41	0.00	-	<50	<0.5	<0.5	<0.5	<0.5	-
C-3	10/30/1995	7.83	4.46	3.37	0.00	-	<50	<0.5	<0.5	<0.5	<0.5	<2.5
C-3	01/22/1996	7.83	1.73	6.10	0.00	-	<50	<0.5	<0.5	<0.5	<0.5	<2.5
C-3	04/24/1996	7.83	2.62	5.21	0.00	-	<50	<0.5	<0.5	<0.5	<0.5	<2.5
C-3	07/29/1996	7.83	3.94	3.89	0.00	-	<50	<0.5	<0.5	<0.5	<0.5	<2.5
C-3	10/10/1996	7.83	4.06	3.77	0.00	-	<50	<0.5	<0.5	<0.5	<0.5	<2.5
C-3	01/15/1997	7.83	1.54	6.29	0.00	-	<50	<0.5	<0.5	<0.5	<0.5	<2.5
C-3	04/03/1997	7.83	3.23	4.60	0.00	-	<50	<0.5	<0.5	<0.5	<0.5	<2.5
C-3	07/09/1997	7.83	4.36	3.47	0.00	-	<50	<0.5	<0.5	<0.5	<0.5	<2.5
C-3	10/29/1997	7.83	4.65	3.18	0.00	-	<50	<0.5	<0.5	<0.5	<0.5	<2.5
C-3	01/14/1998	7.83	0.77	7.06	0.00	-	<50	<0.5	<0.5	<0.5	<0.5	<2.5
C-3	07/15/1998	7.83	3.72	4.11	0.00	-	<50	<0.5	<0.5	<0.5	<0.5	<2.5
C-3	01/20/1999	7.83	2.65	5.18	0.00	-	<50	<0.5	<0.5	<0.5	<0.5	<2.0
C-3	04/19/1999	7.83	1.78	6.05	0.00	-	-	-	-	-	-	-
C-3	04/03/2000 ¹⁹	7.83	-	-	-	-	-	-	-	-	-	-
C-3	07/03/2000	7.83	-	-	-	-	-	-	-	-	-	-
C-3	10/23/2000	7.83	-	-	-	-	-	-	-	-	-	-
C-3	01/08/2001 ¹¹	7.83	3.71	4.12	0.00	-	<50	<0.50	<0.50	<0.50	<0.50	<2.5
C-3	04/09/2001	7.83	-	-	-	-	-	-	-	-	-	-
C-3	08/23/2001 ¹⁹	7.83	-	-	-	-	-	-	-	-	-	-
C-3	11/27/2001 ¹⁹	7.83	-	-	-	-	-	-	-	-	-	-
C-3	02/26/2002	7.83	2.38	5.45	0.00	-	<50	<0.50	<0.50	<0.50	<1.5	<2.5

TABLE 1

**GROUNDWATER MONITORING AND SAMPLING DATA
FORMER CHEVRON SERVICE STATION 9-1153
3135 GIBBONS DRIVE
(3126 FERNSIDE BOULEVARD)
ALAMEDA, CALIFORNIA**

Location	Date	TOC	DTW	GWE	LNAPL	FIELD PARAMETERS	HYDROCARBONS	PRIMARY VOCS				
						Dissolved Oxygen	TPH-GRO	B	T	E	X	MTBE by SW8260
	Units	ft	ft	ft-amsl	ft	mg/L	µg/L	µg/L	µg/L	µg/L	µg/L	µg/L
C-3	05/23/2002 ¹⁹	7.83	-	-	-	-	-	-	-	-	-	-
C-3	08/09/2002 ¹⁹	7.83	-	-	-	-	-	-	-	-	-	-
C-3	11/08/2002 ¹⁹	7.83	-	-	-	-	-	-	-	-	-	-
C-3	02/07/2003	7.83	2.73	5.10	0.00	-	<50	<0.50	<0.50	<0.50	<1.5	<2.5
C-3	05/09/2003 ¹⁹	7.83	-	-	-	-	-	-	-	-	-	-
C-3	08/15/2003 ¹⁹	7.83	-	-	-	-	-	-	-	-	-	-
C-3	11/14/2003 ¹⁹	7.83	-	-	-	-	-	-	-	-	-	-
C-3	02/13/2004 ¹⁵	7.83	2.81	5.02	0.00	-	<50	<0.5	<0.5	<0.5	<0.5	<0.5
C-3	05/14/2004 ¹⁹	7.83	-	-	-	-	-	-	-	-	-	-
C-3	11/12/2004 ¹⁹	7.83	-	-	-	-	-	-	-	-	-	-
C-3	02/11/2005 ¹⁵	7.83	2.58	5.25	0.00	-	<50	<0.5	<0.5	<0.5	<0.5	<0.5
C-3	05/13/2005 ¹⁹	7.83	-	-	-	-	-	-	-	-	-	-
C-3	08/19/2005 ¹⁹	7.83	-	-	-	-	-	-	-	-	-	-
C-3	11/18/2005 ¹⁹	7.83	-	-	-	-	-	-	-	-	-	-
C-3	02/10/2006 ¹⁵	7.83	2.52	5.31	0.00	-	<50	<0.5	<0.5	<0.5	<0.5	<0.5
C-3	05/12/2006 ¹⁹	7.83	-	-	-	-	-	-	-	-	-	-
C-3	08/11/2006 ¹⁹	7.83	-	-	-	-	-	-	-	-	-	-
C-3	11/17/2006 ¹⁹	7.83	-	-	-	-	-	-	-	-	-	-
C-3	02/16/2007 ¹⁵	7.83	2.63	5.20	0.00	-	<50	<0.5	<0.5	<0.5	<0.5	<0.5
C-3	05/17/2007 ¹⁹	7.83	-	-	-	-	-	-	-	-	-	-
C-3	08/09/2007 ¹⁹	7.83	-	-	-	-	-	-	-	-	-	-
C-3	11/08/2007 ¹⁹	7.83	-	-	-	-	-	-	-	-	-	-

TABLE 1

**GROUNDWATER MONITORING AND SAMPLING DATA
FORMER CHEVRON SERVICE STATION 9-1153
3135 GIBBONS DRIVE
(3126 FERNSIDE BOULEVARD)
ALAMEDA, CALIFORNIA**

Location	Date	TOC	DTW	GWE	LNAPL	FIELD PARAMETERS	HYDROCARBONS	PRIMARY VOCS				
						Dissolved Oxygen	TPH-GRO	B	T	E	X	MTBE by SW8260
	Units	ft	ft	ft-amsl	ft	mg/L	µg/L	µg/L	µg/L	µg/L	µg/L	µg/L
C-3	02/06/2008 ¹⁵	7.83	2.91	4.92	0.00	-	<50	<0.5	<0.5	<0.5	<0.5	<0.5
C-3	05/07/2008 ¹⁹	7.83	-	-	-	-	-	-	-	-	-	-
C-3	09/11/2008 ¹⁹	7.83	-	-	-	-	-	-	-	-	-	-
C-3	11/10/2008 ¹⁹	7.83	-	-	-	-	-	-	-	-	-	-
C-3	02/09/2009 ¹⁵	7.83	2.95	4.88	0.00	-	<50	<0.5	<0.5	<0.5	<0.5	<0.5
C-3	03/31/2010	7.83	2.22	5.61	0.00	-	<50	<0.5	<0.5	<0.5	<0.5	<0.5
C-3	05/17/2010	7.83	3.07	4.76	0.00	-	-	-	-	-	-	-
C-3	08/26/2010 ¹⁹	7.83	4.29	3.54	0.00	-	-	-	-	-	-	-
C-3	11/11/2010 ¹⁹	7.83	4.48	3.35	0.00	-	-	-	-	-	-	-
C-3	03/02/2011 ¹⁹	7.83	1.45	6.38	0.00	-	<50	<0.5	<0.5	<0.5	<0.5	<0.5
C-3	06/17/2011¹⁹	7.83	3.24	4.59	0.00	-	-	-	-	-	-	-
MW-4	06/04/1992	3.58	3.63	-0.05	0.00	-	<50	0.8	<0.5	<0.5	<0.5	-
MW-4	10/13/1992	3.58	-	-	-	-	-	-	-	-	-	-
MW-4	01/11/1993	3.58	1.89	1.69	0.00	-	<50	<0.5	<0.5	<0.5	<0.5	-
MW-4	04/14/1993	3.58	2.20	1.38	0.00	-	<50	<0.5	<0.5	<0.5	<1.5	-
MW-4	07/13/1993	3.58	3.51	0.07	0.00	-	54	2.6	1.6	<0.5	<1.5	-
MW-4	10/19/1993	3.58	4.22	-0.64	0.00	-	<50	<0.5	<0.5	<0.5	<0.5	-
MW-4	11/30/1993	7.01	4.01	3.00	0.00	-	-	-	-	-	-	-
MW-4	01/27/1994	7.01	2.89	4.12	0.00	-	<50	<0.5	<0.5	<0.5	<0.5	-
MW-4	04/07/1994	7.01	3.06	3.95	0.00	-	<50	<0.5	<0.5	<0.5	<0.5	-
MW-4	07/01/1994	7.01	3.59	3.42	0.00	-	<50	<0.5	<0.5	<0.5	<0.5	-

TABLE 1

GROUNDWATER MONITORING AND SAMPLING DATA
 FORMER CHEVRON SERVICE STATION 9-1153
 3135 GIBBONS DRIVE
 (3126 FERNSIDE BOULEVARD)
 ALAMEDA, CALIFORNIA

Location	Date	TOC	DTW	GWE	LNAPL	FIELD PARAMETERS	HYDROCARBONS	PRIMARY VOCS				
						Dissolved Oxygen	TPH-GRO	B	T	E	X	MTBE by SW8260
	Units	ft	ft	ft-amsl	ft	mg/L	µg/L	µg/L	µg/L	µg/L	µg/L	µg/L
MW-4	10/05/1994	7.01	4.33	2.68	0.00	-	<50	<0.5	<0.5	<0.5	<0.5	-
MW-4	01/12/1995	7.01	1.20	5.81	0.00	-	<50	<0.5	<0.5	<0.5	<0.5	-
MW-4	04/26/1995	7.01	1.15	5.86	0.00	-	<50	<0.5	<0.5	<0.5	<0.5	-
MW-4	07/12/1995	7.01	2.72	4.29	0.00	-	<50	6.4	<0.5	0.63	0.72	-
MW-4	10/30/1995	7.01	4.08	2.93	0.00	-	<50	<0.5	<0.5	<0.5	<0.5	<2.5
MW-4	01/22/1996	7.01	1.76	5.25	0.00	-	<50	<0.5	<0.5	<0.5	<0.5	<2.5
MW-4	04/24/1996	7.01	1.95	5.06	0.00	-	<50	<0.5	<0.5	<0.5	<0.5	<2.5
MW-4	07/29/1996	7.01	3.37	3.64	0.00	-	<50	<0.5	<0.5	<0.5	<0.5	<2.5
MW-4	10/10/1996	7.01	3.96	3.05	0.00	-	<50	<0.5	<0.5	<0.5	<0.5	<2.5
MW-4	01/15/1997	7.01	1.27	5.74	0.00	-	<50	<0.5	<0.5	<0.5	<0.5	<2.5
MW-4	04/03/1997	7.01	2.11	4.90	0.00	-	<50	<0.5	<0.5	<0.5	<0.5	<2.5
MW-4	07/09/1997	7.01	4.04	2.97	0.00	-	<50	<0.5	<0.5	<0.5	<0.5	<2.5
MW-4	10/29/1997	7.01	4.56	2.45	0.00	-	<50	<0.5	<0.5	<0.5	<0.5	<2.5
MW-4	01/14/1998	7.01	0.39	6.62	0.00	-	<50	<0.5	<0.5	<0.5	<0.5	<2.5
MW-4	01/20/1999	7.01	2.83	4.18	0.00	-	<50	<0.5	<0.5	<0.5	<0.5	<2.0
MW-4	04/19/1999	7.01	2.91	4.10	0.00	-	-	-	-	-	-	-
MW-4	01/25/2000	7.01	1.92	5.09	0.00	-	<50	<0.5	<0.5	<0.5	<0.5	<2.5
MW-4	04/03/2000 ¹⁹	7.01	-	-	-	-	-	-	-	-	-	-
MW-4	07/03/2000	7.01	-	-	-	-	-	-	-	-	-	-
MW-4	10/23/2000	7.01	-	-	-	-	-	-	-	-	-	-
MW-4	01/08/2001 ¹¹	7.01	3.02	3.99	0.00	-	87 ¹²	<0.50	<0.50	0.55	2.9	<2.5
MW-4	04/09/2001	7.01	-	-	-	-	-	-	-	-	-	-

TABLE 1

GROUNDWATER MONITORING AND SAMPLING DATA
 FORMER CHEVRON SERVICE STATION 9-1153
 3135 GIBBONS DRIVE
 (3126 FERNSIDE BOULEVARD)
 ALAMEDA, CALIFORNIA

Location	Date	TOC	DTW	GWE	LNAPL	FIELD PARAMETERS	HYDROCARBONS	PRIMARY VOCS				
						Dissolved Oxygen	TPH-GRO	B	T	E	X	MTBE by SW8260
	Units	ft	ft	ft-amsl	ft	mg/L	µg/L	µg/L	µg/L	µg/L	µg/L	µg/L
MW-4	08/23/2001 ¹⁹	7.01	-	-	-	-	-	-	-	-	-	-
MW-4	11/27/2001 ¹⁹	7.01	-	-	-	-	-	-	-	-	-	-
MW-4	02/26/2002	7.01	1.37	5.64	0.00	-	<50	<0.50	<0.50	<0.50	<1.5	<2.5
MW-4	05/23/2002 ¹⁹	7.01	-	-	-	-	-	-	-	-	-	-
MW-4	08/09/2002 ¹⁹	7.01	-	-	-	-	-	-	-	-	-	-
MW-4	11/08/2002 ¹⁹	7.01	-	-	-	-	-	-	-	-	-	-
MW-4	02/07/2003	7.01	1.72	5.29	0.00	-	<50	<0.50	<0.50	<0.50	<1.5	<2.5
MW-4	05/09/2003 ¹⁹	7.01	-	-	-	-	-	-	-	-	-	-
MW-4	08/15/2003 ¹⁹	7.01	-	-	-	-	-	-	-	-	-	-
MW-4	11/14/2003 ¹⁹	7.01	-	-	-	-	-	-	-	-	-	-
MW-4	02/13/2004 ¹⁵	7.01	1.82	5.19	0.00	-	<50	<0.5	<0.5	<0.5	<0.5	<0.5
MW-4	05/14/2004 ¹⁹	7.01	-	-	-	-	-	-	-	-	-	-
MW-4	11/12/2004 ¹⁹	7.01	-	-	-	-	-	-	-	-	-	-
MW-4	02/11/2005 ¹⁵	7.01	1.46	5.55	0.00	-	<50	<0.5	<0.5	<0.5	<0.5	<0.5
MW-4	05/13/2005 ¹⁹	7.01	-	-	-	-	-	-	-	-	-	-
MW-4	08/19/2005 ¹⁹	7.01	-	-	-	-	-	-	-	-	-	-
MW-4	11/18/2005 ¹⁹	7.01	-	-	-	-	-	-	-	-	-	-
MW-4	02/10/2006 ¹⁵	7.01	1.35	5.66	0.00	-	<50	<0.5	<0.5	<0.5	<0.5	<0.5
MW-4	05/12/2006 ¹⁹	7.01	-	-	-	-	-	-	-	-	-	-
MW-4	08/11/2006 ¹⁹	7.01	-	-	-	-	-	-	-	-	-	-
MW-4	11/17/2006 ¹⁹	7.01	-	-	-	-	-	-	-	-	-	-
MW-4	02/16/2007 ¹⁵	7.01	1.48	5.53	0.00	-	<50	<0.5	<0.5	<0.5	<0.5	<0.5

TABLE 1

**GROUNDWATER MONITORING AND SAMPLING DATA
FORMER CHEVRON SERVICE STATION 9-1153
3135 GIBBONS DRIVE
(3126 FERNSIDE BOULEVARD)
ALAMEDA, CALIFORNIA**

Location	Date	TOC	DTW	GWE	LNAPL	FIELD PARAMETERS	HYDROCARBONS	PRIMARY VOCS				
						Dissolved Oxygen	TPH-GRO	B	T	E	X	MTBE by SW8260
	Units	ft	ft	ft-amsl	ft	mg/L	µg/L	µg/L	µg/L	µg/L	µg/L	µg/L
MW-4	05/17/2007 ¹⁹	7.01	-	-	-	-	-	-	-	-	-	-
MW-4	08/09/2007 ¹⁹	7.01	-	-	-	-	-	-	-	-	-	-
MW-4	11/08/2007 ¹⁹	7.01	-	-	-	-	-	-	-	-	-	-
MW-4	02/06/2008 ¹⁵	7.01	1.27	5.74	0.00	-	<50	<0.5	<0.5	<0.5	<0.5	<0.5
MW-4	05/07/2008 ¹⁹	7.01	-	-	-	-	-	-	-	-	-	-
MW-4	09/11/2008 ¹⁹	7.01	-	-	-	-	-	-	-	-	-	-
MW-4	11/10/2008 ¹⁹	7.01	-	-	-	-	-	-	-	-	-	-
MW-4	02/09/2009 ¹⁵	7.01	2.33	4.68	0.00	-	<50	<0.5	<0.5	<0.5	<0.5	<0.5
MW-4	03/31/2010	7.01	2.13	4.88	0.00	-	<50	<0.5	<0.5	<0.5	<0.5	<0.5
MW-4	05/17/2010	7.01	2.05	4.96	0.00	-	-	-	-	-	-	-
MW-4	08/26/2010 ¹⁹	7.01	3.70	3.31	0.00	-	-	-	-	-	-	-
MW-4	11/11/2010 ¹⁹	7.01	3.98	3.03	0.00	-	-	-	-	-	-	-
MW-4	03/02/2011 ¹⁹	7.01	0.75	6.26	0.00	-	<50	<0.5	<0.5	<0.5	<0.5	<0.5
MW-4	06/17/2011¹⁹	7.01	2.36	4.65	0.00	-	-	-	-	-	-	-
MW-5	06/04/1992	3.61	3.25	0.36	0.00	-	560	110	0.5	37	2.2	-
MW-5	10/13/1992	3.61	4.20	-0.59	0.00	-	1,200	150	<2.5	84	8.6	-
MW-5	01/11/1993	3.61	1.30	2.31	0.00	-	1,300	48	1.0	83	33	-
MW-5	04/14/1993	3.61	1.20	2.41	0.00	-	2,600	240	6.1	250	170	-
MW-5	07/13/1993	3.61	3.15	0.46	0.00	-	1,700	260	7.8	160	100	-
MW-5	10/19/1993	3.61	3.82	-0.21	0.00	-	1,900	190	3.3	200	93	-
MW-5	11/30/1993	7.04	3.56	3.48	0.00	-	-	-	-	-	-	-

TABLE 1

**GROUNDWATER MONITORING AND SAMPLING DATA
FORMER CHEVRON SERVICE STATION 9-1153
3135 GIBBONS DRIVE
(3126 FERNSIDE BOULEVARD)
ALAMEDA, CALIFORNIA**

Location	Date	TOC	DTW	GWE	LNAPL	FIELD PARAMETERS	HYDROCARBONS	PRIMARY VOCS				
						Dissolved Oxygen	TPH-GRO	B	T	E	X	MTBE by SW8260
	Units	ft	ft	ft-amsl	ft	mg/L	µg/L	µg/L	µg/L	µg/L	µg/L	µg/L
MW-5	01/27/1994	7.04	2.42	4.62	0.00	-	4,000	100	12	210	110	-
MW-5	04/07/1994	7.04	2.33	4.71	0.00	-	2,600	170	10	150	88	-
MW-5	07/01/1994	7.04	3.18	3.86	0.00	-	2,300	350	9.1	110	76	-
MW-5	10/05/1994	7.04	3.98	3.06	0.00	-	11,000	840	150	130	340	-
MW-5	01/12/1995	7.04	0.40	6.64	0.00	-	2,300	82	<2.5	54	20	-
MW-5	04/26/1995	7.04	0.50	6.54	0.00	-	1,600	52	<5.0	36	61	-
MW-5	07/12/1995	7.04	2.41	4.63	0.00	-	2,800	150	<5.0	34	38	-
MW-5	10/30/1995	7.04	3.78	3.26	0.00	-	1,100	81	<5.0	<5.0	<5.0	35
MW-5	01/22/1996	7.04	0.78	6.26	0.00	-	880	7.3	<2.0	15	4.8	<10
MW-5	04/24/1996	7.04	1.65	5.39	0.00	-	1,600	51	3.8	14	5.6	56
MW-5	07/29/1996 ²¹	7.04	-	-	-	-	-	-	-	-	-	-
MW-5	10/10/1996	7.04	3.60	3.44	0.00	-	1,000	18	<1.2	1.5	<1.2	<6.2
MW-5	01/15/1997	7.04	0.45	6.59	0.00	-	520	0.84	<0.5	3.1	1.2	8.4
MW-5	04/03/1997	7.04	2.11	4.93	0.00	-	1,400	13	<2.0	4.3	8.4	32
MW-5	07/09/1997	7.04	3.71	3.33	0.00	-	810	3.6	0.97	<0.5	<0.5	9.7
MW-5	10/29/1997	7.04	4.20	2.84	0.00	-	<50	<0.5	<0.5	<0.5	<0.5	<2.5
MW-5	01/14/1998	7.04	0.00	7.04	0.00	-	430	5.8	2.4	<0.5	1.6	17
MW-5	04/17/1998 ²⁰	7.04	0.71	6.33	0.00	-	-	-	-	-	-	-
MW-5	07/15/1998	7.04	0.00	7.04	0.00	-	990	11	3.9	0.56	2.2	61
MW-5	10/27/1998	7.04	4.23	2.81	0.00	-	-	-	-	-	-	-
MW-5	01/20/1999	7.04	2.58	4.46	0.00	-	168	<0.5	<0.5	<0.5	0.692	<2.0
MW-5	04/19/1999	7.04	2.07	4.97	0.00	-	-	-	-	-	-	-

TABLE 1

**GROUNDWATER MONITORING AND SAMPLING DATA
FORMER CHEVRON SERVICE STATION 9-1153
3135 GIBBONS DRIVE
(3126 FERNSIDE BOULEVARD)
ALAMEDA, CALIFORNIA**

Location	Date	TOC	DTW	GWE	LNAPL	FIELD PARAMETERS	HYDROCARBONS	PRIMARY VOCS				
						Dissolved Oxygen	TPH-GRO	B	T	E	X	MTBE by SW8260
	Units	ft	ft	ft-amsl	ft	mg/L	µg/L	µg/L	µg/L	µg/L	µg/L	µg/L
MW-5	07/29/1999	7.04	3.43	3.61	0.00	-	246	1.54	<0.5	<0.5	<0.5	<2.0 ² / _{<5.0}
MW-5	10/13/1999 ²¹	7.04	-	-	-	-	-	-	-	-	-	-
MW-5	01/25/2000	7.04	1.51	5.53	0.00	-	169	1.94	<0.5	<0.5	<0.5	201
MW-5	04/03/2000	7.04	1.20	5.84	0.00	-	-	-	-	-	-	-
MW-5	07/03/2000	7.04	2.98	4.06	0.00	-	320 ^{6,10}	5.3	1.1	<0.50	<0.50	5.0
MW-5	10/23/2000	7.04	4.18	2.86	0.00	-	-	-	-	-	-	-
MW-5	01/08/2001 ¹¹	7.04	2.92	4.12	0.00	-	220 ⁶	3.9	<0.50	<0.50	<0.50	7.7
MW-5	04/09/2001	7.04	1.01	6.03	0.00	-	-	-	-	-	-	-
MW-5	08/23/2001	7.04	3.48	3.56	0.00	-	630	40	3.5	<2.5	<2.5	43
MW-5	11/27/2001 ²⁰	7.04	3.05	3.99	0.00	-	-	-	-	-	-	-
MW-5	02/26/2002	7.04	1.00	6.04	0.00	-	410	4.3	<0.50	<0.50	<1.5	<2.5
MW-5	05/23/2002 ²⁰	7.04	2.21	4.83	0.00	-	-	-	-	-	-	-
MW-5	08/09/2002	7.04	3.38	3.66	0.00	-	240	1.3	<0.50	<0.50	<1.5	<2.5
MW-5	11/08/2002 ²⁰	7.04	4.56	2.48	0.00	-	-	-	-	-	-	-
MW-5	02/07/2003	7.04	1.42	5.62	0.00	-	380	3.2	<0.50	0.64	<1.5	<2.5
MW-5	05/09/2003 ²⁰	7.04	1.25	5.79	0.00	-	-	-	-	-	-	-
MW-5	08/15/2003 ¹⁵	7.04	3.61	3.43	0.00	-	<50	<0.5	<0.5	<0.5	<0.5	<0.5
MW-5	11/14/2003 ²⁰	7.04	3.57	3.47	0.00	-	-	-	-	-	-	-
MW-5	02/13/2004 ¹⁵	7.04	1.50	5.54	0.00	-	<50	<0.5	<0.5	<0.5	<0.5	<0.5
MW-5	05/14/2004 ²⁰	7.04	2.47	4.57	0.00	-	-	-	-	-	-	-
MW-5	08/13/2004 ¹⁵	7.04	5.46	1.58	0.00	-	<50	<0.5	<0.5	<0.5	<0.5	<0.5
MW-5	11/12/2004 ²⁰	7.04	4.65	2.39	0.00	-	-	-	-	-	-	-

TABLE 1

GROUNDWATER MONITORING AND SAMPLING DATA
 FORMER CHEVRON SERVICE STATION 9-1153
 3135 GIBBONS DRIVE
 (3126 FERNSIDE BOULEVARD)
 ALAMEDA, CALIFORNIA

Location	Date	TOC	DTW	GWE	LNAPL	FIELD PARAMETERS	HYDROCARBONS	PRIMARY VOCS				
						Dissolved Oxygen	TPH-GRO	B	T	E	X	MTBE by SW8260
	Units	ft	ft	ft-amsl	ft	mg/L	µg/L	µg/L	µg/L	µg/L	µg/L	µg/L
MW-5	02/11/2005 ¹⁵	7.04	1.20	5.84	0.00	-	130	<0.5	<0.5	<0.5	<0.5	<0.5
MW-5	05/13/2005 ²⁰	7.04	4.36	2.68	0.00	-	-	-	-	-	-	-
MW-5	08/19/2005 ¹⁵	7.04	2.78	4.26	0.00	-	96	<0.5	<0.5	<0.5	<0.5	<0.5
MW-5	11/18/2005 ²⁰	7.04	4.51	2.53	0.00	-	-	-	-	-	-	-
MW-5	02/10/2006 ¹⁵	7.04	1.12	5.92	0.00	-	<50	<0.5	<0.5	<0.5	<0.5	<0.5
MW-5	05/12/2006 ²⁰	7.04	2.23	4.81	0.00	-	-	-	-	-	-	-
MW-5	08/11/2006 ¹⁵	7.04	3.40	3.64	0.00	-	<50	<0.5	<0.5	<0.5	<0.5	<0.5
MW-5	11/17/2006 ²⁰	7.04	4.16	2.88	0.00	-	-	-	-	-	-	-
MW-5	02/16/2007 ¹⁵	7.04	1.22	5.82	0.00	-	<50	<0.5	<0.7	<0.8	<0.8	<0.5
MW-5	05/17/2007 ²⁰	7.04	4.06	2.98	0.00	-	-	-	-	-	-	-
MW-5	08/09/2007 ¹⁵	7.04	3.61	3.43	0.00	-	<50	<0.5	<0.5	<0.5	<0.5	<0.5
MW-5	11/08/2007 ²⁰	7.04	3.70	3.34	0.00	-	-	-	-	-	-	-
MW-5	02/06/2008 ¹⁵	7.04	1.06	5.98	0.00	-	<50	<0.5	<0.5	<0.5	<0.5	<0.5
MW-5	05/07/2008 ²⁰	7.04	3.57	3.47	0.00	-	-	-	-	-	-	-
MW-5	09/11/2008 ¹⁵	7.04	4.58	2.46	0.00	-	<50	<0.5	<0.5	<0.5	<0.5	<0.5
MW-5	11/10/2008 ²⁰	7.04	4.26	2.78	0.00	-	-	-	-	-	-	-
MW-5	02/09/2009 ¹⁵	7.04	2.15	4.89	0.00	-	<50	<0.5	<0.5	<0.5	<0.5	<0.5
MW-5	05/28/2009	7.04	2.76	4.28	0.00	-	-	-	-	-	-	-
MW-5	08/18/2009 ¹⁵	7.04	3.81	3.23	0.00	-	<50	<0.5	<0.5	<0.5	<0.5	<0.5
MW-5	11/17/2009	7.04	4.02	3.02	0.00	-	-	-	-	-	-	-
MW-5	03/31/2010	7.04	1.86	5.18	0.00	-	<50	<0.5	<0.5	<0.5	<0.5	<0.5
MW-5	05/17/2010	7.04	1.57	5.47	0.00	-	-	-	-	-	-	-

TABLE 1

**GROUNDWATER MONITORING AND SAMPLING DATA
FORMER CHEVRON SERVICE STATION 9-1153
3135 GIBBONS DRIVE
(3126 FERNSIDE BOULEVARD)
ALAMEDA, CALIFORNIA**

Location	Date	TOC	DTW	GWE	LNAPL	FIELD PARAMETERS	HYDROCARBONS	PRIMARY VOCS				
						Dissolved Oxygen	TPH-GRO	B	T	E	X	MTBE by SW8260
	Units	ft	ft	ft-amsl	ft	mg/L	µg/L	µg/L	µg/L	µg/L	µg/L	µg/L
MW-5	08/26/2010	7.04	3.25	3.79	0.00	-	<50	<0.5	<0.5	<0.5	<0.5	<0.5
MW-5	11/11/2010 ²⁰	7.04	3.52	3.52	0.00	-	-	-	-	-	-	-
MW-5	03/02/2011 ²⁰	7.04	1.55	5.49	0.00	-	<50	<0.5	<0.5	<0.5	<0.5	<0.5
MW-5	06/17/2011²⁰	7.04	1.84	5.20	0.00	-	-	-	-	-	-	-
MW-6	06/04/1992	3.85	3.89	-0.04	0.00	-	210	54	<0.5	1.9	2.4	-
MW-6	10/13/1992	3.85	4.56	-0.71	0.00	-	10,000	5,300	<10	70	<10	-
MW-6	01/11/1993	3.85	2.36	1.49	0.00	-	100	50	<0.5	<0.5	<0.5	-
MW-6	04/14/1993	3.85	3.15	0.70	0.00	-	<50	<0.5	<0.5	<0.5	<0.5	-
MW-6	07/13/1993	3.85	3.94	-0.09	0.00	-	<50	1.8	<0.5	<0.5	<1.5	-
MW-6	10/19/1993	3.85	4.40	-0.55	0.00	-	320	150	<0.5	0.8	<0.5	-
MW-6	11/30/1993	7.27	4.16	3.11	0.00	-	-	-	-	-	-	-
MW-6	01/27/1994	7.27	3.33	3.94	0.00	-	120	45	<0.5	<0.5	<0.5	-
MW-6	04/07/1994	7.27	3.43	3.84	0.00	-	<50	<0.5	<0.5	<0.5	<0.5	-
MW-6	07/01/1994	7.27	3.94	3.33	0.00	-	<50	<0.5	<0.5	<0.5	<0.5	-
MW-6	10/05/1994	7.27	4.38	2.89	0.00	-	8,300	2,400	160	42	190	-
MW-6	01/12/1995 ¹	7.27	2.43	4.84	0.00	-	<50	12	<0.5	<0.5	<0.5	-
MW-6	04/26/1995	7.27	2.06	5.21	0.00	-	<50	5.5	0.67	<0.5	1.3	-
MW-6	07/12/1995	7.27	3.53	3.74	0.00	-	65	27	<0.5	<0.5	<0.5	-
MW-6	10/30/1995	7.27	4.34	2.93	0.00	-	<50	3.9	<0.5	<0.5	<0.5	<2.5
MW-6	01/22/1996	7.27	2.61	4.66	0.00	-	<50	0.93	<0.5	<0.5	<0.5	<2.5
MW-6	04/24/1996	7.27	2.50	4.77	0.00	-	260	110	<1.2	<1.2	<1.2	<6.2

TABLE 1

**GROUNDWATER MONITORING AND SAMPLING DATA
FORMER CHEVRON SERVICE STATION 9-1153
3135 GIBBONS DRIVE
(3126 FERNSIDE BOULEVARD)
ALAMEDA, CALIFORNIA**

Location	Date	TOC	DTW	GWE	LNAPL	FIELD PARAMETERS	HYDROCARBONS	PRIMARY VOCS				
						Dissolved Oxygen	TPH-GRO	B	T	E	X	MTBE by SW8260
	Units	ft	ft	ft-amsl	ft	mg/L	µg/L	µg/L	µg/L	µg/L	µg/L	µg/L
MW-6	07/29/1996	7.27	3.85	3.42	0.00	-	<50	23	<0.5	<0.5	<0.5	<2.5
MW-6	10/10/1996	7.27	4.37	2.90	0.00	-	79	31	<0.5	<0.5	<0.5	<2.5
MW-6	01/15/1997	7.27	2.63	4.64	0.00	-	<50	<0.5	<0.5	<0.5	<0.5	<2.5
MW-6	04/03/1997	7.27	3.42	3.85	0.00	-	670	360	<5.0	<5.0	<5.0	<25
MW-6	07/09/1997	7.27	4.29	2.98	0.00	-	330	140	<2.0	<2.0	<2.0	<10
MW-6	10/29/1997	7.27	4.56	2.71	0.00	-	400	260	<2.0	<2.0	<2.0	5.8
MW-6	01/14/1998	7.27	1.01	6.26	0.00	-	<50	<0.5	<0.5	<0.5	<0.5	<2.5
MW-6	04/17/1998	7.27	2.94	4.33	0.00	-	<50	1.7	<0.5	<0.5	<0.5	<2.5
MW-6	07/15/1998	7.27	4.72	2.55	0.00	-	<50	<0.5	<0.5	<0.5	<0.5	<2.5
MW-6	10/27/1998 ²¹	7.27	-	-	-	-	-	-	-	-	-	-
MW-6	11/25/1998	7.27	4.16	3.11	0.00	-	110 ³	54	<0.5	<0.5	<0.5	<2.5
MW-6	01/20/1999	7.27	3.45	3.82	0.00	-	<50	10	<0.5	<0.5	<0.5	<2.0
MW-6	04/19/1999	7.27	3.39	3.88	0.00	-	<50	2.6	<0.5	<0.5	<0.5	<2.0/<2.5 ²
MW-6	07/29/1999 ⁴	7.27	4.34	2.93	0.00	-	<5,000	2,590	<50	<50	<50	<500
MW-6	10/13/1999	7.27	5.89	1.38	0.00	-	9,270	4,610	44.2	<25	<25	<125
MW-6	01/25/2000	7.27	4.11	3.16	0.00	-	529	289	<0.5	<0.5	<0.5	738
MW-6	04/03/2000 ^{7,8}	7.27	2.84	4.43	0.00	-	<50	<0.50	<0.50	<0.50	<0.50	<2.5
MW-6	07/03/2000 ⁷	7.27	3.77	3.50	0.00	-	91 ⁶	89	0.77	<0.50	<0.50	<2.5
MW-6	10/12/2000	7.27	6.32	0.95	0.00	-	<50	8.0	<0.50	<0.50	<0.50	<2.5
MW-6	01/08/2001 ^{7,11}	7.27	3.74	3.53	0.00	-	400 ⁶	640	8.2	8.0	5.0	10
MW-6	04/09/2001 ⁷	7.27	3.03	4.24	0.00	-	91.3	22.0	3.36	0.751	2.14	<0.500
MW-6	08/23/2001 ⁷	7.27	4.70	2.57	0.00	-	53 ¹³	23	0.50	<0.50	1.1	<2.5

TABLE 1

**GROUNDWATER MONITORING AND SAMPLING DATA
FORMER CHEVRON SERVICE STATION 9-1153
3135 GIBBONS DRIVE
(3126 FERNSIDE BOULEVARD)
ALAMEDA, CALIFORNIA**

Location	Date	TOC	DTW	GWE	LNAPL	FIELD PARAMETERS	HYDROCARBONS	PRIMARY VOCS				
						Dissolved Oxygen	TPH-GRO	B	T	E	X	MTBE by SW8260
	Units	ft	ft	ft-amsl	ft	mg/L	µg/L	µg/L	µg/L	µg/L	µg/L	µg/L
MW-6	11/27/2001 ¹⁴	7.27	4.43	2.84	0.00	-	<50	4.1	<0.50	<0.50	<1.5	<2.5
MW-6	02/26/2002 ¹⁴	7.27	2.50	4.77	0.00	-	100	53	<0.50	<0.50	<1.5	<2.5
MW-6	05/23/2002	7.27	3.27	4.00	0.00	-	610	260	4.2	1.7	2.1	<2.5
MW-6	08/09/2002	7.27	4.11	3.16	0.00	-	<50	1.1	<0.50	<0.50	<1.5	<2.5
MW-6	11/08/2002	7.27	4.12	3.15	0.00	2.10	<50	<0.50	<0.50	<0.50	<1.5	<2.5
MW-6	02/07/2003	7.27	2.60	4.67	0.00	2.60	<50	0.65	<0.50	<0.50	<1.5	<2.5
MW-6	05/09/2003	7.27	2.57	4.70	0.00	3.10	<50	1.9	<0.5	<0.5	<1.5	<2.5
MW-6	08/15/2003 ¹⁵	7.27	4.15	3.12	0.00	2.90	<50	<0.5	<0.5	<0.5	<0.5	<0.5
MW-6	11/14/2003 ¹⁵	7.27	4.10	3.17	0.00	3.41	<50	<0.5	0.6	<0.5	<0.5	1
MW-6	02/13/2004 ¹⁵	7.27	2.66	4.61	0.00	-	<50	<0.5	<0.5	<0.5	<0.5	<0.5
MW-6	05/14/2004 ¹⁵	7.27	3.55	3.72	0.00	-	<50	3	<0.5	<0.5	<0.5	<0.5
MW-6	08/13/2004 ¹⁵	7.27	4.32	2.95	0.00	-	<50	<0.5	<0.5	<0.5	<0.5	<0.5
MW-6	11/12/2004 ¹⁵	7.27	4.20	3.07	0.00	-	<50	<0.5	<0.5	<0.5	<0.5	<0.5
MW-6	02/11/2005 ¹⁵	7.27	2.18	5.09	0.00	-	<50	<0.5	<0.5	<0.5	<0.5	<0.5
MW-6	05/13/2005 ¹⁵	7.27	4.11	3.16	0.00	-	<50	<0.5	<0.5	<0.5	<0.5	<0.5
MW-6	08/19/2005 ¹⁵	7.27	3.70	3.57	0.00	1.90	<50	<0.5	<0.5	<0.5	<0.5	<0.5
MW-6	11/18/2005 ¹⁵	7.27	3.98	3.29	0.00	1.70	<50	<0.5	<0.5	<0.5	<0.5	<0.5
MW-6	02/10/2006 ¹⁵	7.27	2.11	5.16	0.00	2.20	<50	<0.5	<0.5	<0.5	<0.5	<0.5
MW-6	05/12/2006 ¹⁵	7.27	3.18	4.09	0.00	2.80	<50	<0.5	<0.5	<0.5	<0.5	<0.5
MW-6	08/11/2006 ¹⁵	7.27	3.80	3.47	0.00	2.50	<50	<0.5	<0.5	<0.5	<0.5	<0.5
MW-6	11/17/2006 ¹⁵	7.27	3.78	3.49	0.00	2.20	<50	<0.5	<0.5	<0.5	<0.5	<0.5
MW-6	02/16/2007 ¹⁵	7.27	2.08	5.19	0.00	1.80	<50	1	<0.5	<0.5	<0.5	<0.5

TABLE 1

**GROUNDWATER MONITORING AND SAMPLING DATA
FORMER CHEVRON SERVICE STATION 9-1153
3135 GIBBONS DRIVE
(3126 FERNSIDE BOULEVARD)
ALAMEDA, CALIFORNIA**

Location	Date	TOC	DTW	GWE	LNAPL	FIELD PARAMETERS	HYDROCARBONS	PRIMARY VOCS				
						Dissolved Oxygen	TPH-GRO	B	T	E	X	MTBE by SW8260
	Units	ft	ft	ft-amsl	ft	mg/L	µg/L	µg/L	µg/L	µg/L	µg/L	µg/L
MW-6	05/17/2007 ¹⁵	7.27	3.61	3.66	0.00	2.0	<50	<0.5	<0.5	<0.5	<0.5	<0.5
MW-6	08/09/2007 ¹⁵	7.27	4.05	3.22	0.00	2.6	<50	<0.5	<0.5	<0.5	<0.5	<0.5
MW-6	11/08/2007 ¹⁵	7.27	4.12	3.15	0.00	2.2	<50	5	<0.5	<0.5	<0.5	<0.5
MW-6	02/06/2008 ¹⁵	7.27	1.85	5.42	0.00	2.4	<50	<0.5	<0.5	<0.5	<0.5	<0.5
MW-6	05/07/2008 ¹⁵	7.27	3.91	3.36	0.00	2.3	63	18	<0.5	<0.5	<0.5	<0.5
MW-6	09/11/2008 ¹⁵	7.27	4.93	2.34	0.00	1.9	<50	<0.5	<0.5	<0.5	<0.5	<0.5
MW-6	11/10/2008 ¹⁵	7.27	4.30	2.97	0.00	2.2	<50	<0.5	<0.5	<0.5	<0.5	<0.5
MW-6	02/09/2009 ¹⁵	7.27	2.97	4.30	0.00	2.0	<50	2	<0.5	<0.5	<0.5	<0.5
MW-6	05/28/2009 ¹⁵	7.27	3.53	3.74	0.00	1.77	<50	4	<0.5	<0.5	<0.5	<0.5
MW-6	08/18/2009 ¹⁵	7.27	3.38	3.89	0.00	1.81	560	130	3	<0.5	0.7 J	<0.5
MW-6	11/17/2009	7.27	4.00	3.27	0.00	-	-	-	-	-	-	-
MW-6	03/31/2010	7.27	2.44	4.83	0.00	-	<50	<0.5	<0.5	<0.5	<0.5	<0.5
MW-6	05/17/2010	7.27	3.30	3.97	0.00	-	-	-	-	-	-	-
MW-6	08/26/2010	7.27	4.15	3.12	0.00	-	<50	<0.5	<0.5	<0.5	<0.5	<0.5
MW-6	11/11/2010 ²⁰	7.27	4.16	3.11	0.00	-	-	-	-	-	-	-
MW-6	03/02/2011 ²⁰	7.27	2.27	5.00	0.00	-	<50	<0.5	<0.5	<0.5	<0.5	<0.5
MW-6	06/17/2011²⁰	7.27	3.69	3.58	0.00	-	-	-	-	-	-	-
MW-7	11/30/1993	8.22	5.33	2.89	0.00	-	480	110	41	4.4	38	-
MW-7	01/27/1994	8.22	4.50	3.72	0.00	-	120	21	1.1	2.2	4.8	-
MW-7	04/07/1994	8.22	4.62	3.60	0.00	-	2,600	630	39	56	94	-
MW-7	07/01/1994	8.22	5.13	3.09	0.00	-	2,200	770	42	<10	92	-

TABLE 1

**GROUNDWATER MONITORING AND SAMPLING DATA
FORMER CHEVRON SERVICE STATION 9-1153
3135 GIBBONS DRIVE
(3126 FERNSIDE BOULEVARD)
ALAMEDA, CALIFORNIA**

Location	Date	TOC	DTW	GWE	LNAPL	FIELD PARAMETERS	HYDROCARBONS	PRIMARY VOCS				
						Dissolved Oxygen	TPH-GRO	B	T	E	X	MTBE by SW8260
	Units	ft	ft	ft-amsl	ft	mg/L	µg/L	µg/L	µg/L	µg/L	µg/L	µg/L
MW-7	10/05/1994	8.22	5.61	2.61	0.00	-	15,000	3,300	90	130	320	-
MW-7	01/12/1995	8.22	2.83	5.39	0.00	-	340	57	<1.3	18	6.4	-
MW-7	04/26/1995	8.22	2.35	5.87	0.00	-	15,000	3,700	210	520	800	-
MW-7	07/12/1995	8.22	4.66	3.56	0.00	-	7,700	1,800	59	130	370	-
MW-7	10/30/1995	8.22	5.48	2.74	0.00	-	770	260	<5.0	33	48	25
MW-7	01/22/1996	8.22	3.34	4.88	0.00	-	290	63	<1.0	6.4	5.7	<5.0
MW-7	04/24/1996	8.22	4.12	4.10	0.00	-	12,000	2,500	510	380	810	<125
MW-7	07/29/1996	8.22	5.03	3.19	0.00	-	2,600	650	<25	61	150	<125
MW-7	10/10/1996	8.22	5.52	2.70	0.00	-	5,800	1,700	28	170	210	<62
MW-7	01/15/1997	8.22	2.92	5.30	0.00	-	1,000	230	<2.5	28	11	63
MW-7	04/03/1997	8.22	4.65	3.57	0.00	-	6,000	1,800	100	140	170	<100
MW-7	07/09/1997	8.22	5.39	2.83	0.00	-	5,500	2,200	<20	41	30	<100
MW-7	10/29/1997	8.22	5.58	2.64	0.00	-	220	40	0.61	3.0	2.4	7.6
MW-7	01/14/1998	8.22	2.80	5.42	0.00	-	140	5.1	<0.5	<0.5	1.4	<2.5
MW-7	04/17/1998	8.22	3.00	5.22	0.00	-	13,000	4,200	98	250	240	250
MW-7	07/15/1998 ²¹	8.22	-	-	-	-	-	-	-	-	-	-
MW-7	08/17/1998 ⁵	7.92	5.52	2.40	0.00	-	1,600	380	51	68	280	22
MW-7	10/27/1998	7.92	7.51	0.41	0.00	-	190	2.3	0.53	<0.5	<0.5	33
MW-7	01/20/1999	7.92	3.45	4.47	0.00	-	<50	<0.5	<0.5	<0.5	<0.5	<2.0
MW-7	04/19/1999	7.92	4.61	3.31	0.00	-	6,500	3,000	<0.5	110	210	150 ² /310
MW-7	07/29/1999 ⁴	7.92	5.00	2.92	0.00	-	8,390	2,100	129	222	729	248
MW-7	10/13/1999	7.92	5.61	2.31	0.00	-	14,300	6,600	58.8	117	190	<125

TABLE 1

**GROUNDWATER MONITORING AND SAMPLING DATA
FORMER CHEVRON SERVICE STATION 9-1153
3135 GIBBONS DRIVE
(3126 FERNSIDE BOULEVARD)
ALAMEDA, CALIFORNIA**

Location	Date	TOC	DTW	GWE	LNAPL	FIELD PARAMETERS	HYDROCARBONS	PRIMARY VOCS				
						Dissolved Oxygen	TPH-GRO	B	T	E	X	MTBE by SW8260
	Units	ft	ft	ft-amsl	ft	mg/L	µg/L	µg/L	µg/L	µg/L	µg/L	µg/L
MW-7	01/25/2000	7.92	3.32	4.60	0.00	-	1,100	184	<5.0	13.5	33.7	151
MW-7	04/03/2000 ^{7,9}	7.92	3.38	4.54	0.00	-	2,600 ⁶	780	12	<5.0	61	95
MW-7	07/03/2000 ⁷	7.92	4.34	3.58	0.00	-	4,100 ⁶	2,600	72	240	690	<50
MW-7	10/23/2000	7.92	6.11	1.81	0.00	-	12,000 ⁶	2,600	<50	150	290	<250
MW-7	01/08/2001 ^{7,11}	7.92	4.32	3.60	0.00	-	3,900 ⁶	2,200	61	140	350	<25
MW-7	04/09/2001 ⁷	7.92	3.63	4.29	0.00	-	25,100	4,590	1,200	843	1,920	48.1
MW-7	08/23/2001 ⁷	7.92	4.83	3.09	0.00	-	27,000	4,100	970	1,100	3,500	<500
MW-7	11/27/2001	7.92	4.30	3.62	0.00	-	12,000	1,800	50	450	830	91
MW-7	02/26/2002	7.92	3.00	4.92	0.00	-	15,000	3,100	260	380	860	<10
MW-7	05/23/2002	7.92	3.69	4.23	0.00	-	28,000	6,000	120	820	1,900	42
MW-7	08/09/2002	7.92	4.38	3.54	0.00	-	24,000	3,700	81	710	1,300	56
MW-7	11/08/2002	7.92	4.43	3.49	0.00	-98.00	18,000	2,300	150	660	1,400	<100
MW-7	02/07/2003	7.92	3.20	4.72	0.00	2.90	13,000	2,300	200	310	620	<25
MW-7	05/09/2003	7.92	3.18	4.74	0.00	2.60	17,000	4,200	36	350	360	<50
MW-7	08/15/2003 ¹⁵	7.92	4.75	3.17	0.00	2.30	29,000	7,300	140	780	1,900	<5
MW-7	11/14/2003 ¹⁵	7.92	4.95	2.97	0.00	1.87	7,200	950	3	45	20	7
MW-7	02/13/2004 ¹⁵	7.92	3.29	4.63	0.00	-	3,300	360	4	82	130	3
MW-7	05/14/2004 ¹⁵	7.92	3.98	3.94	0.00	-	17,000	3,100	480	510	1,300	3
MW-7	08/13/2004 ¹⁵	7.92	5.94	1.98	0.00	-	10,000	2,000	4	130	150	4
MW-7	11/12/2004 ¹⁵	7.92	4.50	3.42	0.00	-	680	4	<0.5	1	0.7	0.8
MW-7	02/11/2005 ¹⁵	7.92	3.07	4.85	0.00	-	4,600	680	6	80	44	4
MW-7	05/13/2005 ¹⁵	7.92	4.51	3.41	0.00	-	4,200	380	3	38	13	2

TABLE 1

**GROUNDWATER MONITORING AND SAMPLING DATA
FORMER CHEVRON SERVICE STATION 9-1153
3135 GIBBONS DRIVE
(3126 FERNSIDE BOULEVARD)
ALAMEDA, CALIFORNIA**

Location	Date	TOC	DTW	GWE	LNAPL	FIELD PARAMETERS	HYDROCARBONS	PRIMARY VOCS				
						Dissolved Oxygen	TPH-GRO	B	T	E	X	MTBE by SW8260
	Units	ft	ft	ft-amsl	ft	mg/L	µg/L	µg/L	µg/L	µg/L	µg/L	µg/L
MW-7	08/19/2005 ¹⁵	7.92	4.03	3.89	0.00	0.80	7,900	1,300	3	190	310	<1
MW-7	11/18/2005 ¹⁵	7.92	4.62	3.30	0.00	0.90	3,900	4	1	16	8	2
MW-7	02/10/2006 ¹⁵	7.92	3.12	4.80	0.00	1.30	3,200	320	2	14	8	2
MW-7	05/12/2006 ¹⁵	7.92	4.25	3.67	0.00	1.40	3,600	1,000	2	65	27	<1
MW-7	08/11/2006 ¹⁵	7.92	4.45	3.47	0.00	1.10	6,700	1,900	6	280	300	<1
MW-7	11/17/2006 ¹⁵	7.92	4.71	3.21	0.00	0.70	1,200	0.6	<0.5	1	0.8	<0.5
MW-7	02/16/2007 ¹⁵	7.92	3.26	4.66	0.00	1.10	110	<0.5	<0.5	<0.5	<0.5	<0.5
MW-7	05/17/2007 ¹⁵	7.92	4.62	3.30	0.00	1.7	6,400	1,400	4	130	26	<1
MW-7	08/09/2007 ¹⁵	7.92	4.61	3.31	0.00	1.2	10,000	1,400	4	230	12	<3
MW-7	11/08/2007 ¹⁵	7.92	4.72	3.20	0.00	0.9	2,300	4	1	3	7	0.9
MW-7	02/06/2008 ¹⁵	7.92	2.98	4.94	0.00	0.5	190	<0.5	<0.5	<0.5	<0.5	<0.5
MW-7	05/07/2008 ¹⁵	7.92	4.48	3.44	0.00	1.2	8,000	1,500	15	380	260	<1
MW-7	09/11/2008 ¹⁵	7.92	5.95	1.97	0.00	1.0	5,100	530	4	47	12	0.7
MW-7	11/10/2008 ¹⁵	7.92	5.81	2.11	0.00	0.6	2,800	13	1	1	7	<0.5
MW-7	02/09/2009 ¹⁵	7.92	4.06	3.86	0.00	0.8	3,900	190	2	51	11	0.5
MW-7	05/28/2009 ^{15,17}	7.92	3.84	4.08	0.00	0.45	5,800	870	8	220	27	<0.5
MW-7	08/18/2009 ¹⁵	7.92	4.80	3.12	0.00	0.57	6,700	660	4	110	13	0.7 J
MW-7	11/17/2009	7.92	4.52	3.40	0.00	-	-	-	-	-	-	-
MW-7	03/31/2010	7.92	3.11	4.81	0.00	-	2,000	110	1	2	3	0.7 J
MW-7	05/17/2010	7.92	3.41	4.51	0.00	-	-	-	-	-	-	-
MW-7	08/26/2010	7.92	4.60	3.32	0.00	-	5,100	470	3	150	9	<0.5
MW-7	11/11/2010 ²⁰	7.92	4.68	3.24	0.00	-	-	-	-	-	-	-

TABLE 1

**GROUNDWATER MONITORING AND SAMPLING DATA
FORMER CHEVRON SERVICE STATION 9-1153
3135 GIBBONS DRIVE
(3126 FERNSIDE BOULEVARD)
ALAMEDA, CALIFORNIA**

Location	Date	TOC	DTW	GWE	LNAPL	FIELD PARAMETERS	HYDROCARBONS	PRIMARY VOCS				
						Dissolved Oxygen	TPH-GRO	B	T	E	X	MTBE by SW8260
	Units	ft	ft	ft-amsl	ft	mg/L	µg/L	µg/L	µg/L	µg/L	µg/L	µg/L
MW-7	03/02/2011 ²⁰	7.92	2.53	5.39	0.00	-	1,100	<0.5	<0.5	<0.5	<0.5	<0.5
MW-7	06/17/2011²⁰	7.92	4.02	3.90	0.00	-	-	-	-	-	-	-
MW-8	10/17/1995	6.96	4.40	2.56	0.00	-	-	-	-	-	-	-
MW-8	10/30/1995	6.96	4.44	2.52	0.00	-	<50	<0.5	<0.5	<0.5	<0.5	<2.5
MW-8	01/22/1996	6.96	2.24	4.72	0.00	-	<50	<0.5	<0.5	<0.5	<0.5	<2.5
MW-8	04/24/1996	6.96	2.97	3.99	0.00	-	<50	<0.5	<0.5	<0.5	<0.5	<2.5
MW-8	07/29/1996	6.96	3.37	3.59	0.00	-	<50	<0.5	<0.5	<0.5	<0.5	<2.5
MW-8	10/10/1996	6.96	4.12	2.84	0.00	-	<50	<0.5	<0.5	<0.5	<0.5	<2.5
MW-8	01/15/1997	6.96	0.94	6.02	0.00	-	<50	<0.5	<0.5	<0.5	<0.5	<2.5
MW-8	04/03/1997	6.96	2.20	4.76	0.00	-	<50	<0.5	<0.5	<0.5	<0.5	<2.5
MW-8	07/09/1997	6.96	4.30	2.66	0.00	-	<50	<0.5	<0.5	<0.5	<0.5	<2.5
MW-8	10/29/1997	6.96	4.57	2.39	0.00	-	<50	<0.5	<0.5	<0.5	<0.5	<2.5
MW-8	01/14/1998	6.96	0.83	6.13	0.00	-	<50	<0.5	<0.5	<0.5	<0.5	<2.5
MW-8	01/20/1999	6.96	2.69	4.27	0.00	-	<50	<0.5	<0.5	<0.5	<0.5	<2.0
MW-8	04/19/1999	6.96	3.76	3.20	0.00	-	-	-	-	-	-	-
MW-8	01/25/2000	6.96	1.41	5.55	0.00	-	<50	<0.5	<0.5	<0.5	<0.5	<2.5
MW-8	04/03/2000 ¹⁹	6.96	-	-	-	-	-	-	-	-	-	-
MW-8	07/03/2000	6.96	-	-	-	-	-	-	-	-	-	-
MW-8	10/23/2000	6.96	-	-	-	-	-	-	-	-	-	-
MW-8	01/08/2001 ¹¹	6.96	3.58	3.38	0.00	-	<50	<0.50	<0.50	<0.50	<0.50	<2.5
MW-8	04/09/2001	6.96	-	-	-	-	-	-	-	-	-	-

TABLE 1

**GROUNDWATER MONITORING AND SAMPLING DATA
FORMER CHEVRON SERVICE STATION 9-1153
3135 GIBBONS DRIVE
(3126 FERNSIDE BOULEVARD)
ALAMEDA, CALIFORNIA**

Location	Date	TOC	DTW	GWE	LNAPL	FIELD PARAMETERS	HYDROCARBONS	PRIMARY VOCS				
						Dissolved Oxygen	TPH-GRO	B	T	E	X	MTBE by SW8260
	Units	ft	ft	ft-amsl	ft	mg/L	µg/L	µg/L	µg/L	µg/L	µg/L	µg/L
MW-8	08/23/2001 ¹⁹	6.96	-	-	-	-	-	-	-	-	-	-
MW-8	11/27/2001 ¹⁹	6.96	-	-	-	-	-	-	-	-	-	-
MW-8	02/26/2002	6.96	2.91	4.05	0.00	-	<50	<0.50	<0.50	<0.50	<1.5	<2.5
MW-8	05/23/2002 ¹⁹	6.96	-	-	-	-	-	-	-	-	-	-
MW-8	08/09/2002 ¹⁹	6.96	-	-	-	-	-	-	-	-	-	-
MW-8	11/08/2002 ¹⁹	6.96	-	-	-	-	-	-	-	-	-	-
MW-8	02/07/2003	6.96	3.13	3.83	0.00	-	<50	<0.50	<0.50	<0.50	<1.5	<2.5
MW-8	05/09/2003 ¹⁹	6.96	-	-	-	-	-	-	-	-	-	-
MW-8	08/15/2003 ¹⁹	6.96	-	-	-	-	-	-	-	-	-	-
MW-8	11/14/2003 ¹⁹	6.96	-	-	-	-	-	-	-	-	-	-
MW-8	02/13/2004 ¹⁵	6.96	3.20	3.76	0.00	-	<50	<0.5	<0.5	<0.5	<0.5	<0.5
MW-8	05/14/2004 ¹⁹	6.96	-	-	-	-	-	-	-	-	-	-
MW-8	11/12/2004 ¹⁹	6.96	-	-	-	-	-	-	-	-	-	-
MW-8	02/11/2005 ¹⁵	6.96	2.85	4.11	0.00	-	<50	<0.5	<0.5	<0.5	<0.5	<0.5
MW-8	05/13/2005 ¹⁹	6.96	-	-	-	-	-	-	-	-	-	-
MW-8	08/19/2005 ¹⁹	6.96	-	-	-	-	-	-	-	-	-	-
MW-8	11/18/2005 ¹⁹	6.96	-	-	-	-	-	-	-	-	-	-
MW-8	02/10/2006 ¹⁵	6.96	2.74	4.22	<50	-	<0.5	<0.5	<0.5	<0.5	<0.5	<0.5
MW-8	05/12/2006 ¹⁹	6.96	-	-	-	-	-	-	-	-	-	-
MW-8	08/11/2006 ¹⁹	6.96	-	-	-	-	-	-	-	-	-	-
MW-8	11/17/2006 ¹⁹	6.96	-	-	-	-	-	-	-	-	-	-
MW-8	02/16/2007 ¹⁵	6.96	2.69	4.27	0.00	-	<50	<0.5	<0.5	<0.5	<0.5	<0.5

TABLE 1

GROUNDWATER MONITORING AND SAMPLING DATA
 FORMER CHEVRON SERVICE STATION 9-1153
 3135 GIBBONS DRIVE
 (3126 FERNSIDE BOULEVARD)
 ALAMEDA, CALIFORNIA

Location	Date	TOC	DTW	GWE	LNAPL	FIELD PARAMETERS	HYDROCARBONS	PRIMARY VOCS				
						Dissolved Oxygen	TPH-GRO	B	T	E	X	MTBE by SW8260
	Units	ft	ft	ft-amsl	ft	mg/L	µg/L	µg/L	µg/L	µg/L	µg/L	µg/L
MW-8	05/17/2007 ¹⁹	6.96	-	-	-	-	-	-	-	-	-	-
MW-8	08/09/2007 ¹⁹	6.96	-	-	-	-	-	-	-	-	-	-
MW-8	11/08/2007 ¹⁹	6.96	-	-	-	-	-	-	-	-	-	-
MW-8	02/06/2008 ¹⁵	6.96	2.57	4.39	0.00	-	<50	<0.5	<0.5	<0.5	<0.5	<0.5
MW-8	05/07/2008 ¹⁹	6.96	-	-	-	-	-	-	-	-	-	-
MW-8	09/11/2008 ¹⁹	6.96	-	-	-	-	-	-	-	-	-	-
MW-8	11/10/2008 ¹⁹	6.96	-	-	-	-	-	-	-	-	-	-
MW-8	02/09/2009 ¹⁵	6.96	3.28	3.68	0.00	-	<50	<0.5	<0.5	<0.5	<0.5	<0.5
MW-8	03/31/2010	6.96	2.85	4.11	0.00	-	<50	<0.5	<0.5	<0.5	<0.5	<0.5
MW-8	05/17/2010	6.96	3.33	3.63	0.00	-	-	-	-	-	-	-
MW-8	08/26/2010 ¹⁹	6.96	4.27	2.69	0.00	-	-	-	-	-	-	-
MW-8	11/11/2010 ¹⁹	6.96	3.82	3.14	0.00	-	-	-	-	-	-	-
MW-8	03/02/2011 ¹⁹	6.96	1.66	5.30	0.00	-	<50	<0.5	<0.5	<0.5	<0.5	<0.5
MW-8	06/17/2011¹⁹	6.96	3.79	3.17	0.00	-	-	-	-	-	-	-
MW-9	10/17/1995	7.21	4.80	2.41	0.00	-	-	-	-	-	-	-
MW-9	10/30/1995	7.21	4.97	2.24	0.00	-	<50	<0.5	<0.5	<0.5	<0.5	<2.5
MW-9	01/22/1996	7.21	3.40	3.81	0.00	-	<50	<0.5	<0.5	<0.5	<0.5	<2.5
MW-9	04/24/1996	7.21	4.18	3.03	0.00	-	<50	<0.5	<0.5	<0.5	<0.5	<2.5
MW-9	07/29/1996	7.21	4.69	2.52	0.00	-	<50	<0.5	<0.5	<0.5	<0.5	<2.5
MW-9	10/10/1996	7.21	5.20	2.01	0.00	-	<50	<0.5	<0.5	<0.5	<0.5	<2.5
MW-9	01/15/1997	7.21	3.31	3.90	0.00	-	<50	<0.5	<0.5	<0.5	<0.5	<2.5

TABLE 1

GROUNDWATER MONITORING AND SAMPLING DATA
 FORMER CHEVRON SERVICE STATION 9-1153
 3135 GIBBONS DRIVE
 (3126 FERNSIDE BOULEVARD)
 ALAMEDA, CALIFORNIA

Location	Date	TOC	DTW	GWE	LNAPL	FIELD PARAMETERS	HYDROCARBONS	PRIMARY VOCS				
						Dissolved Oxygen	TPH-GRO	B	T	E	X	MTBE by SW8260
	Units	ft	ft	ft-amsl	ft	mg/L	µg/L	µg/L	µg/L	µg/L	µg/L	µg/L
MW-9	04/03/1997	7.21	4.57	2.64	0.00	-	<50	<0.5	<0.5	<0.5	<0.5	<2.5
MW-9	07/09/1997	7.21	5.04	2.17	0.00	-	<50	<0.5	<0.5	<0.5	<0.5	<2.5
MW-9	10/29/1997	7.21	4.96	2.25	0.00	-	<50	<0.5	<0.5	<0.5	<0.5	<2.5
MW-9	01/14/1998	7.21	2.40	4.81	0.00	-	<50	<0.5	<0.5	<0.5	<0.5	<2.5
MW-9	01/20/1999	7.21	4.31	2.90	0.00	-	<50	<0.5	<0.5	<0.5	<0.5	<2.0
MW-9	04/19/1999	7.21	3.92	3.29	0.00	-	-	-	-	-	-	-
MW-9	01/25/2000	7.21	2.95	4.26	0.00	-	<50	<0.5	<0.5	<0.5	<0.5	<2.5
MW-9	04/03/2000 ¹⁹	7.21	-	-	-	-	-	-	-	-	-	-
MW-9	07/03/2000	7.21	-	-	-	-	-	-	-	-	-	-
MW-9	10/23/2000	7.21	-	-	-	-	-	-	-	-	-	-
MW-9	01/08/2001 ¹¹	7.21	4.59	2.62	0.00	-	<50	<0.50	<0.50	<0.50	<0.50	<2.5
MW-9	04/09/2001	7.21	-	-	-	-	-	-	-	-	-	-
MW-9	08/23/2001 ¹⁹	7.21	-	-	-	-	-	-	-	-	-	-
MW-9	11/27/2001 ¹⁹	7.21	-	-	-	-	-	-	-	-	-	-
MW-9	02/26/2002	7.21	3.75	3.46	0.00	-	<50	<0.50	<0.50	<0.50	<1.5	<2.5
MW-9	05/23/2002 ¹⁹	7.21	-	-	-	-	-	-	-	-	-	-
MW-9	08/09/2002 ¹⁹	7.21	-	-	-	-	-	-	-	-	-	-
MW-9	11/08/2002 ¹⁹	7.21	-	-	-	-	-	-	-	-	-	-
MW-9	02/07/2003	7.21	3.97	3.24	0.00	-	<50	<0.50	<0.50	<0.50	<1.5	<2.5
MW-9	05/09/2003 ¹⁹	7.21	-	-	-	-	-	-	-	-	-	-
MW-9	08/15/2003 ¹⁹	7.21	-	-	-	-	-	-	-	-	-	-
MW-9	11/14/2003 ¹⁹	7.21	-	-	-	-	-	-	-	-	-	-

TABLE 1

GROUNDWATER MONITORING AND SAMPLING DATA
 FORMER CHEVRON SERVICE STATION 9-1153
 3135 GIBBONS DRIVE
 (3126 FERNSIDE BOULEVARD)
 ALAMEDA, CALIFORNIA

Location	Date	TOC	DTW	GWE	LNAPL	FIELD PARAMETERS	HYDROCARBONS	PRIMARY VOCS				
						Dissolved Oxygen	TPH-GRO	B	T	E	X	MTBE by SW8260
	Units	ft	ft	ft-amsl	ft	mg/L	µg/L	µg/L	µg/L	µg/L	µg/L	µg/L
MW-9	02/13/2004 ¹⁵	7.21	3.94	3.27	0.00	-	<50	<0.5	<0.5	<0.5	<0.5	<0.5
MW-9	05/14/2004 ¹⁹	7.21	-	-	-	-	-	-	-	-	-	-
MW-9	11/12/2004 ¹⁹	7.21	-	-	-	-	-	-	-	-	-	-
MW-9	02/11/2005 ¹⁵	7.21	3.66	3.55	0.00	-	<50	<0.5	<0.5	<0.5	<0.5	<0.5
MW-9	05/13/2005 ¹⁹	7.21	-	-	-	-	-	-	-	-	-	-
MW-9	08/19/2005 ¹⁹	7.21	-	-	-	-	-	-	-	-	-	-
MW-9	11/18/2005 ¹⁹	7.21	-	-	-	-	-	-	-	-	-	-
MW-9	02/10/2006 ¹⁵	7.21	3.53	3.68	0.00	-	<0.5	<0.5	<0.5	<0.5	<0.5	<0.5
MW-9	05/12/2006 ¹⁹	7.21	-	-	-	-	-	-	-	-	-	-
MW-9	08/11/2006 ¹⁹	7.21	-	-	-	-	-	-	-	-	-	-
MW-9	11/17/2006 ¹⁹	7.21	-	-	-	-	-	-	-	-	-	-
MW-9	02/16/2007 ¹⁵	7.21	3.50	3.71	0.00	-	<50	<0.5	<0.5	<0.5	<0.5	<0.5
MW-9	05/17/2007 ¹⁹	7.21	-	-	-	-	-	-	-	-	-	-
MW-9	08/09/2007 ¹⁹	7.21	-	-	-	-	-	-	-	-	-	-
MW-9	11/08/2007 ¹⁹	7.21	-	-	-	-	-	-	-	-	-	-
MW-9	02/06/2008 ¹⁵	7.21	3.14	4.07	0.00	-	<50	<0.5	<0.5	<0.5	<0.5	<0.5
MW-9	05/07/2008 ¹⁹	7.21	-	-	-	-	-	-	-	-	-	-
MW-9	09/11/2008 ¹⁹	7.21	-	-	-	-	-	-	-	-	-	-
MW-9	11/10/2008 ¹⁹	7.21	-	-	-	-	-	-	-	-	-	-
MW-9	02/09/2009 ¹⁵	7.21	3.91	3.30	0.00	-	<50	<0.5	<0.5	<0.5	<0.5	<0.5
MW-9	03/31/2010	7.21	3.16	4.05	0.00	-	<50	<0.5	<0.5	<0.5	<0.5	<0.5
MW-9	05/17/2010	7.21	3.44	3.77	0.00	-	-	-	-	-	-	-

TABLE 1

**GROUNDWATER MONITORING AND SAMPLING DATA
FORMER CHEVRON SERVICE STATION 9-1153
3135 GIBBONS DRIVE
(3126 FERNSIDE BOULEVARD)
ALAMEDA, CALIFORNIA**

Location	Date	TOC	DTW	GWE	LNAPL	FIELD PARAMETERS	HYDROCARBONS	PRIMARY VOCS				
						Dissolved Oxygen	TPH-GRO	B	T	E	X	MTBE by SW8260
	Units	ft	ft	ft-amsl	ft	mg/L	µg/L	µg/L	µg/L	µg/L	µg/L	µg/L
MW-9	08/26/2010 ¹⁹	7.21	4.77	2.44	0.00	-	-	-	-	-	-	-
MW-9	11/11/2010 ¹⁹	7.21	4.29	2.92	0.00	-	-	-	-	-	-	-
MW-9	03/02/2011 ¹⁹	7.21	2.75	4.46	0.00	-	<50	<0.5	<0.5	<0.5	<0.5	<0.5
MW-9	06/17/2011¹⁹	7.21	3.86	3.35	0.00	-	-	-	-	-	-	-
MW-10	10/17/1995	7.28	5.05	2.23	0.00	-	-	-	-	-	-	-
MW-10	10/30/1995	7.28	5.11	2.17	0.00	-	<50	<0.5	<0.5	<0.5	<0.5	5.1
MW-10	01/22/1996	7.28	4.03	3.25	0.00	-	<50	<0.5	<0.5	<0.5	0.70	17
MW-10	04/24/1996	7.28	4.30	2.98	0.00	-	<50	<0.5	<0.5	<0.5	<0.5	12
MW-10	07/29/1996	7.28	4.70	2.58	0.00	-	<50	<0.5	<0.5	<0.5	<0.5	14
MW-10	10/10/1996	7.28	5.24	2.04	0.00	-	<50	<0.5	<0.5	<0.5	<0.5	<2.5
MW-10	01/15/1997	7.28	3.35	3.93	0.00	-	<50	<0.5	<0.5	<0.5	<0.5	<2.5
MW-10	04/03/1997	7.28	4.64	2.64	0.00	-	<50	<0.5	<0.5	<0.5	<0.5	8.2
MW-10	07/09/1997	7.28	5.12	2.16	0.00	-	<50	<0.5	<0.5	<0.5	<0.5	<2.5
MW-10	10/29/1997	7.28	5.10	2.18	0.00	-	<50	<0.5	<0.5	<0.5	<0.5	5.3
MW-10	01/14/1998	7.28	3.08	4.20	0.00	-	<50	<0.5	<0.5	<0.5	<0.5	8.6
MW-10	04/17/1998 ²⁰	7.28	3.79	3.49	0.00	-	-	-	-	-	-	-
MW-10	07/15/1998	7.28	4.55	2.73	0.00	-	<50	<0.5	<0.5	<0.5	<0.5	7.5
MW-10	10/27/1998	7.28	5.32	1.96	0.00	-	-	-	-	-	-	-
MW-10	01/20/1999	7.28	4.24	3.04	0.00	-	<50	<0.5	<0.5	<0.5	<0.5	<2.0
MW-10	04/19/1999	7.28	4.07	3.21	0.00	-	-	-	-	-	-	-
MW-10	07/29/1999	7.28	4.82	2.46	0.00	-	<50	<0.5	<0.5	<0.5	<0.5	<5.0/2.4 ²

TABLE 1

GROUNDWATER MONITORING AND SAMPLING DATA
 FORMER CHEVRON SERVICE STATION 9-1153
 3135 GIBBONS DRIVE
 (3126 FERNSIDE BOULEVARD)
 ALAMEDA, CALIFORNIA

Location	Date	TOC	DTW	GWE	LNAPL	FIELD PARAMETERS	HYDROCARBONS	PRIMARY VOCS				
						Dissolved Oxygen	TPH-GRO	B	T	E	X	MTBE by SW8260
	Units	ft	ft	ft-amsl	ft	mg/L	µg/L	µg/L	µg/L	µg/L	µg/L	µg/L
MW-10	10/13/1999	7.28	4.86	2.42	0.00	-	-	-	-	-	-	-
MW-10	01/25/2000	7.28	3.00	4.28	0.00	-	<50	<0.5	<0.5	<0.5	<0.5	4.33
MW-10	04/03/2000	7.28	3.04	4.24	0.00	-	-	-	-	-	-	-
MW-10	07/03/2000	7.28	4.00	3.28	0.00	-	<50	<0.50	<0.50	<0.50	<0.50	4.7
MW-10	10/23/2000	7.28	5.86	1.42	0.00	-	-	-	-	-	-	-
MW-10	01/08/2001 ¹¹	7.28	3.98	3.30	0.00	-	<50	<0.50	<0.50	<0.50	<0.50	<2.5
MW-10	04/09/2001	7.28	3.74	3.54	0.00	-	-	-	-	-	-	-
MW-10	08/23/2001 ²¹	7.28	-	-	-	-	-	-	-	-	-	-
MW-10	11/27/2001 ²⁰	7.28	4.13	3.15	0.00	-	-	-	-	-	-	-
MW-10	02/26/2002	7.28	3.54	3.74	0.00	-	<50	<0.50	<0.50	<0.50	<1.5	<2.5
MW-10	05/23/2002 ²⁰	7.28	3.82	3.46	0.00	-	-	-	-	-	-	-
MW-10	08/09/2002	7.28	4.18	3.10	0.00	-	<50	<0.50	<0.50	<0.50	<1.5	<2.5
MW-10	11/08/2002 ²⁰	7.28	3.91	3.37	0.00	-	-	-	-	-	-	-
MW-10	02/07/2003	7.28	3.61	3.67	0.00	-	<50	<0.50	<0.50	<0.50	<1.5	<2.5
MW-10	05/09/2003 ²⁰	7.28	3.25	4.03	0.00	-	-	-	-	-	-	-
MW-10	08/15/2003 ¹⁵	7.28	4.35	2.93	0.00	-	<50	<0.5	<0.5	<0.5	<0.5	<0.5
MW-10	11/14/2003 ²⁰	7.28	4.30	2.98	0.00	-	-	-	-	-	-	-
MW-10	02/13/2004 ¹⁵	7.28	4.27	3.01	0.00	-	<50	<0.5	<0.5	<0.5	<0.5	<0.5
MW-10	05/14/2004 ²⁰	7.28	4.08	3.20	0.00	-	-	-	-	-	-	-
MW-10	08/13/2004 ¹⁵	7.28	3.92	3.36	0.00	-	<50	<0.5	<0.5	<0.5	<0.5	<0.5
MW-10	11/12/2004 ²⁰	7.28	3.98	3.30	0.00	-	-	-	-	-	-	-
MW-10	02/11/2005 ¹⁵	7.28	4.07	3.21	0.00	-	<50	<0.5	<0.5	<0.5	<0.5	<0.5

TABLE 1

GROUNDWATER MONITORING AND SAMPLING DATA
 FORMER CHEVRON SERVICE STATION 9-1153
 3135 GIBBONS DRIVE
 (3126 FERNSIDE BOULEVARD)
 ALAMEDA, CALIFORNIA

Location	Date	TOC	DTW	GWE	LNAPL	FIELD PARAMETERS	HYDROCARBONS	PRIMARY VOCS				
						Dissolved Oxygen	TPH-GRO	B	T	E	X	MTBE by SW8260
	Units	ft	ft	ft-amsl	ft	mg/L	µg/L	µg/L	µg/L	µg/L	µg/L	µg/L
MW-10	05/13/2005 ²⁰	7.28	4.01	3.27	0.00	-	-	-	-	-	-	-
MW-10	08/19/2005 ¹⁵	7.28	3.69	3.59	0.00	-	<50	<0.5	<0.5	<0.5	<0.5	<0.5
MW-10	11/18/2005 ²⁰	7.28	3.86	3.42	0.00	-	-	-	-	-	-	-
MW-10	02/10/2006 ¹⁵	7.28	3.94	3.34	0.00	-	<0.5	<0.5	<0.5	<0.5	<0.5	<0.5
MW-10	05/12/2006 ²⁰	7.28	4.07	3.21	0.00	-	-	-	-	-	-	-
MW-10	08/11/2006 ¹⁵	7.28	4.21	3.07	0.00	-	<50	<0.5	<0.5	<0.5	<0.5	<0.5
MW-10	11/17/2006 ²⁰	7.28	3.83	3.45	0.00	-	-	-	-	-	-	-
MW-10	02/16/2007 ¹⁵	7.28	3.87	3.41	0.00	-	<50	<0.5	<0.5	<0.5	<0.5	<0.5
MW-10	05/17/2007 ²⁰	7.28	3.71	3.57	0.00	-	-	-	-	-	-	-
MW-10	08/09/2007 ²¹	7.28	-	-	-	-	-	-	-	-	-	-
MW-10	11/08/2007 ²¹	7.28	-	-	-	-	-	-	-	-	-	-
MW-10	02/06/2008 ²¹	7.28	-	-	-	-	-	-	-	-	-	-
MW-10	05/07/2008 ²¹	7.28	-	-	-	-	-	-	-	-	-	-
MW-10	09/11/2008 ¹⁵	7.28	4.63	2.65	0.00	-	<50	<0.5	<0.5	<0.5	<0.5	<0.5
MW-10	11/10/2008 ²⁰	7.28	4.28	3.00	0.00	-	-	-	-	-	-	-
MW-10	02/09/2009 ¹⁵	7.28	2.17	5.11	0.00	-	<50	<0.5	<0.5	<0.5	<0.5	<0.5
MW-10	05/28/2009	7.28	3.69	3.59	0.00	-	-	-	-	-	-	-
MW-10	08/18/2009 ¹⁵	7.28	4.07	3.21	0.00	-	<50	<0.5	<0.5	<0.5	<0.5	<0.5
MW-10	11/17/2009	7.28	4.12	3.16	0.00	-	-	-	-	-	-	-
MW-10	03/31/2010	7.28	3.43	3.85	0.00	-	<50	<0.5	<0.5	<0.5	<0.5	<0.5
MW-10	05/17/2010	7.28	3.53	3.75	0.00	-	-	-	-	-	-	-
MW-10	08/26/2010	7.28	4.33	2.95	0.00	-	<50	<0.5	<0.5	<0.5	<0.5	<0.5

TABLE 1

GROUNDWATER MONITORING AND SAMPLING DATA
 FORMER CHEVRON SERVICE STATION 9-1153
 3135 GIBBONS DRIVE
 (3126 FERNSIDE BOULEVARD)
 ALAMEDA, CALIFORNIA

Location	Date	TOC	DTW	GWE	LNAPL	FIELD PARAMETERS	HYDROCARBONS	PRIMARY VOCS				
						Dissolved Oxygen	TPH-GRO	B	T	E	X	MTBE by SW8260
	Units	ft	ft	ft-amsl	ft	mg/L	µg/L	µg/L	µg/L	µg/L	µg/L	µg/L
MW-10	11/11/2010 ²⁰	7.28	4.34	2.94	0.00	-	-	-	-	-	-	-
MW-10	03/02/2011 ²⁰	7.28	3.33	3.95	0.00	-	<50	<0.5	<0.5	<0.5	<0.5	<0.5
MW-10	06/17/2011 ²⁰	7.28	3.92	3.36	0.00	-	-	-	-	-	-	-
C-2	09/04/1986	-	-	-	-	-	1,100	49	18	84	-	-
C-2	07/22/1987	-	-	-	-	-	<50	1.8	<1.0	<4.0	-	-
TMW-1	11/11/1993	-	-	-	-	-	<1.0	<0.5	<0.5	<0.5	<0.5	-
3115A GIBBONS DR.	01/14/1998	-	-	-	-	-	<50	<0.5	<0.5	<0.5	<0.5	<2.5
QA	02/14/1990	-	-	-	-	-	<50	<0.5	1.1	<0.5	<0.5	-
QA	09/06/1991	-	-	-	-	-	<50	<0.5	<0.5	<0.5	<0.5	-
QA	12/15/1991	-	-	-	-	-	<50	<0.5	<0.5	<0.5	<0.5	-
QA	03/03/1992	-	-	-	-	-	<50	<0.5	<0.5	<0.5	<0.5	-
QA	06/04/1992	-	-	-	-	-	<50	<0.5	<0.5	<0.5	<0.5	-
QA	10/13/1992	-	-	-	-	-	<50	<0.5	<0.5	<0.5	<0.5	-
QA	01/11/1993	-	-	-	-	-	<50	<0.5	<0.5	<0.5	<0.5	-
QA	04/14/1993	-	-	-	-	-	<50	<0.5	<0.5	<0.5	<0.5	-
QA	07/13/1993	-	-	-	-	-	<50	<0.5	<0.5	<0.5	<0.5	-
QA	10/19/1993	-	-	-	-	-	<50	<0.5	<0.5	<0.5	<1.5	-
QA	01/27/1994	-	-	-	-	-	<50	<0.5	<0.5	<0.5	<0.5	-

TABLE 1

GROUNDWATER MONITORING AND SAMPLING DATA
 FORMER CHEVRON SERVICE STATION 9-1153
 3135 GIBBONS DRIVE
 (3126 FERNSIDE BOULEVARD)
 ALAMEDA, CALIFORNIA

Location	Date	TOC	DTW	GWE	LNAPL	FIELD PARAMETERS	HYDROCARBONS	PRIMARY VOCS				
						Dissolved Oxygen	TPH-GRO	B	T	E	X	MTBE by SW8260
	Units	ft	ft	ft-amsl	ft	mg/L	µg/L	µg/L	µg/L	µg/L	µg/L	µg/L
QA	04/07/1994	-	-	-	-	-	<50	<0.5	<0.5	<0.5	<0.5	-
QA	07/01/1994	-	-	-	-	-	<50	<0.5	<0.5	<0.5	<0.5	-
QA	10/05/1994	-	-	-	-	-	<50	<0.5	<0.5	<0.5	<0.5	-
QA	01/12/1995	-	-	-	-	-	<50	<0.5	<0.5	<0.5	<0.5	-
QA	04/26/1995	-	-	-	-	-	<50	<0.5	<0.5	<0.5	<0.5	-
QA	07/12/1995	-	-	-	-	-	<50	<0.5	<0.5	<0.5	<0.5	-
QA	10/30/1995	-	-	-	-	-	<50	<0.5	<0.5	<0.5	<0.5	-
QA	01/22/1996	-	-	-	-	-	<50	<0.5	<0.5	<0.5	<0.5	<2.5
QA	04/24/1996	-	-	-	-	-	<50	<0.5	<0.5	<0.5	<0.5	<2.5
QA	07/29/1996	-	-	-	-	-	<50	<0.5	<0.5	<0.5	<0.5	<2.5
QA	01/15/1997	-	-	-	-	-	<50	<0.5	<0.5	<0.5	<0.5	<2.5
QA	04/03/1997	-	-	-	-	-	<50	<0.5	<0.5	<0.5	<0.5	<2.5
QA	07/09/1997	-	-	-	-	-	<50	<0.5	<0.5	<0.5	<0.5	<2.5
QA	10/29/1997	-	-	-	-	-	<50	<0.5	<0.5	<0.5	<0.5	<2.5
QA	01/14/1998	-	-	-	-	-	<50	<0.5	<0.5	<0.5	<0.5	<2.5
QA	04/17/1998	-	-	-	-	-	<50	<0.5	<0.5	<0.5	<0.5	<2.5
QA	07/15/1998	-	-	-	-	-	<50	<0.5	<0.5	<0.5	<0.5	<2.5
QA	10/27/1998	-	-	-	-	-	<50	<0.5	<0.5	<0.5	<0.5	<2.5
QA	01/20/1999	-	-	-	-	-	<50	<0.5	<0.5	<0.5	<0.5	<2.0
QA	04/19/1999	-	-	-	-	-	<50	<0.5	<0.5	<0.5	<0.5	<2.5
QA	07/29/1999	-	-	-	-	-	<50	<0.5	<0.5	<0.5	<0.5	<5.0
QA	10/13/1999	-	-	-	-	-	<50	<0.5	<0.5	<0.5	<0.5	<2.5

TABLE 1

GROUNDWATER MONITORING AND SAMPLING DATA
 FORMER CHEVRON SERVICE STATION 9-1153
 3135 GIBBONS DRIVE
 (3126 FERNSIDE BOULEVARD)
 ALAMEDA, CALIFORNIA

Location	Date	TOC	DTW	GWE	LNAPL	FIELD PARAMETERS	HYDROCARBONS	PRIMARY VOCS				
						Dissolved Oxygen	TPH-GRO	B	T	E	X	MTBE by SW8260
	Units	ft	ft	ft-amsl	ft	mg/L	µg/L	µg/L	µg/L	µg/L	µg/L	µg/L
QA	01/25/2000	-	-	-	-	-	<50	<0.5	<0.5	<0.5	<0.5	<2.5
QA	04/03/2000	-	-	-	-	-	<50	<0.50	<0.50	<0.50	<0.50	<2.5
QA	07/03/2000	-	-	-	-	-	<50	<0.50	<0.50	<0.50	<0.50	<2.5
QA	10/23/2000	-	-	-	-	-	<50	<0.50	<0.50	<0.50	<0.50	<2.5
QA	01/08/2001 ¹¹	-	-	-	-	-	<50	<0.50	<0.50	<0.50	<0.50	<2.5
QA	04/09/2001	-	-	-	-	-	<50.0	<0.500	<2.00	<0.500	<2.00	<0.500
QA	08/23/2001	-	-	-	-	-	<50	<0.50	<0.50	<0.50	<0.50	<2.5
QA	11/27/2001	-	-	-	-	-	<50	<0.50	<0.50	<0.50	<1.5	<2.5
QA	02/26/2002	-	-	-	-	-	<50	<0.50	<0.50	<0.50	<1.5	<2.5
QA	05/23/2002	-	-	-	-	-	<50	<0.50	<0.50	<0.50	<1.5	<2.5
QA	08/09/2002	-	-	-	-	-	<50	<0.50	<0.50	<0.50	<1.5	<2.5
QA	11/08/2002	-	-	-	-	-	<50	<0.50	<0.50	<0.50	<1.5	<2.5
QA	02/07/2003	-	-	-	-	-	<50	<0.50	<0.50	<0.50	<1.5	<2.5
QA	05/09/2003	-	-	-	-	-	<50	<0.5	<0.5	<0.5	<1.5	<2.5
QA	08/15/2003 ¹⁵	-	-	-	-	-	<50	<0.5	<0.5	<0.5	<0.5	<0.5
QA	11/14/2003	-	-	-	-	-	<50	<0.5	<0.5	<0.5	<0.5	<0.5
QA	02/13/2004 ¹⁵	-	-	-	-	-	<50	<0.5	<0.5	<0.5	<0.5	<0.5
QA	05/14/2004 ¹⁵	-	-	-	-	-	<50	<0.5	<0.5	<0.5	<0.5	<0.5
QA	08/13/2004 ¹⁵	-	-	-	-	-	<50	<0.5	<0.5	<0.5	<0.5	<0.5
QA	11/12/2004 ¹⁵	-	-	-	-	-	<50	<0.5	<0.5	<0.5	<0.5	<0.5
QA	02/11/2005 ¹⁵	-	-	-	-	-	<50	<0.5	<0.5	<0.5	<0.5	<0.5
QA	05/13/2005 ¹⁵	-	-	-	-	-	<50	<0.5	<0.5	<0.5	<0.5	<0.5

TABLE 1

GROUNDWATER MONITORING AND SAMPLING DATA
 FORMER CHEVRON SERVICE STATION 9-1153
 3135 GIBBONS DRIVE
 (3126 FERNSIDE BOULEVARD)
 ALAMEDA, CALIFORNIA

Location	Date	TOC	DTW	GWE	LNAPL	FIELD PARAMETERS	HYDROCARBONS	PRIMARY VOCS				
						Dissolved Oxygen	TPH-GRO	B	T	E	X	MTBE by SW8260
	Units	ft	ft	ft-amsl	ft	mg/L	µg/L	µg/L	µg/L	µg/L	µg/L	µg/L
QA	08/19/2005 ¹⁵	-	-	-	-	-	<50	<0.5	<0.5	<0.5	<0.5	<0.5
QA	11/18/2005 ¹⁵	-	-	-	-	-	<50	<0.5	<0.5	<0.5	<0.5	<0.5
QA	02/10/2006 ¹⁵	-	-	-	-	-	<50	<0.5	<0.5	<0.5	<0.5	<0.5
QA	05/12/2006 ¹⁵	-	-	-	-	-	<50	<0.5	<0.5	<0.5	<0.5	<0.5
QA	08/11/2006 ¹⁵	-	-	-	-	-	<50	<0.5	<0.5	<0.5	<0.5	<0.5
QA	11/17/2006 ¹⁵	-	-	-	-	-	<50	<0.5	<0.5	<0.5	<0.5	<0.5
QA	02/16/2007 ¹⁵	-	-	-	-	-	<50	<0.5	<0.5	<0.5	<0.5	<0.5
QA	05/17/2007 ¹⁵	-	-	-	-	-	<50	<0.5	<0.5	<0.5	<0.5	<0.5
QA	08/09/2007 ¹⁵	-	-	-	-	-	<50	<0.5	<0.5	<0.5	<0.5	<0.5
QA	11/08/2007 ¹⁵	-	-	-	-	-	<50	<0.5	<0.5	<0.5	<0.5	<0.5
QA	02/06/2008 ¹⁵	-	-	-	-	-	<50	<0.5	<0.5	<0.5	<0.5	<0.5
QA	05/07/2008 ¹⁵	-	-	-	-	-	<50	<0.5	<0.5	<0.5	<0.5	<0.5
QA	09/11/2008 ¹⁵	-	-	-	-	-	<50	<0.5	<0.5	<0.5	<0.5	<0.5
QA	11/10/2008 ¹⁵	-	-	-	-	-	<50	<0.5	<0.5	<0.5	<0.5	<0.5
QA	02/09/2009 ¹⁵	-	-	-	-	-	<50	<0.5	<0.5	<0.5	<0.5	<0.5
QA	05/28/2009 ¹⁵	-	-	-	-	-	<50	<0.5	<0.5	<0.5	<0.5	<0.5
QA	08/18/2009 ¹⁵	-	-	-	-	-	<50	<0.5	<0.5	<0.5	<0.5	<0.5
QA	03/31/2010	-	-	-	-	-	<50	<0.5	<0.5	<0.5	<0.5	<0.5
QA	08/26/2010	-	-	-	-	-	<50	<0.5	<0.5	<0.5	<0.5	<0.5
QA	03/02/2011	-	-	-	-	-	<50	<0.5	<0.5	<0.5	<0.5	<0.5

**GROUNDWATER MONITORING AND SAMPLING DATA
FORMER CHEVRON SERVICE STATION 9-1153
3135 GIBBONS DRIVE
(3126 FERNSIDE BOULEVARD)
ALAMEDA, CALIFORNIA**

Location	Date	TOC	DTW	GWE	LNAPL	FIELD PARAMETERS	HYDROCARBONS	PRIMARY VOCS				
						Dissolved Oxygen	TPH-GRO	B	T	E	X	MTBE by SW8260
Units		ft	ft	ft-amsl	ft	mg/L	µg/L	µg/L	µg/L	µg/L	µg/L	µg/L

Abbreviations and Notes:

TOC = Top of Casing

DTW = Depth to Water

GWE = Groundwater elevation

(ft-amsl) = Feet Above Mean sea level

ft = Feet

mg/L - Milligrams per Liter

µg/L = Micrograms per Liter

TPH-GRO = Total Petroleum Hydrocarbons - Gasoline Range Organics

VOCS = Volatile Organic Compounds

B = Benzene

T = Toluene

E = Ethylbenzene

X = Xylene

MTBE = Methyl tert butyl ether

J = Estimated concentration

-- = Not available / not applicable

<x = Not detected above laboratory method detection limit

** GWE has been corrected due to the presence of LNAPL; correction factor: [(TOC - DTW) + (LNAPL x 0.80)].

1 Laboratory report indicates EPA 8010 were not detected (ND)

2 MTBE confirmed

3 Chromatogram report indicates an unidentified hydrocarbon

**GROUNDWATER MONITORING AND SAMPLING DATA
FORMER CHEVRON SERVICE STATION 9-1153
3135 GIBBONS DRIVE
(3126 FERNSIDE BOULEVARD)
ALAMEDA, CALIFORNIA**

Location	Date	TOC	DTW	GWE	LNAPL	FIELD PARAMETERS	HYDROCARBONS	PRIMARY VOCS				
						Dissolved Oxygen	TPH-GRO	B	T	E	X	MTBE by SW8260
	Units	ft	ft	ft-amsl	ft	mg/L	µg/L	µg/L	µg/L	µg/L	µg/L	µg/L

- 4 ORC installed
- 5 TOC elevation altered due to well head maintenance
- 6 Laboratory report indicates gasoline C6-C12
- 7 ORC in well
- 8 Laboratory report indicates Dissolved Oxygen was 1.50 parts per million (ppm) by EPA Method 360.1
- 9 Laboratory report indicates Dissolved Oxygen was 0.300 ppm by EPA Method 360.1
- 10 Laboratory report indicates sample originally shot in hold time at a raise D.L. re-analyzed and reported past hold time
- 11 Laboratory report indicates this sample was analyzed outside of the EPA recommended holding time
- 12 Laboratory report indicates unidentified hydrocarbons C6-C12
- 13 Laboratory report indicates hydrocarbon pattern is present in the requested fuel quantitation range but does not resemble the pattern of the requested fuel
- 14 ORC removed
- 15 BTEX and MTBE by EPA Method 8260
- 16 Laboratory confirmed analytical result
- 17 The vial submitted did not have pH<2. The pH of this sample used for the undiluted analysis was pH = 3
- 18 Not sampled due to the presence of LNAPL in the well.
- 19 Sampled annually.
- 20 Sampled semi-annually
- 21 Inaccessible

ATTACHMENT A

MONITORING DATA PACKAGE



July 7, 2011

Chevron Environmental Management Company
Dave Patten
6111 Bollinger Canyon Rd.
San Ramon, CA 94583

Second Quarter 2011 Monitoring at
Chevron Service Station 91153
3135 Gibbons Dr.
Alameda, CA

Monitoring performed on June 17, 2011

Blaine Tech Services, Inc. Groundwater Monitoring Event 110617-JO1

This submission covers the routine monitoring of groundwater wells conducted on June 17, 2011 at this location. Nine monitoring wells were measured for depth to groundwater (DTW). One monitoring wells were sampled. Well C-1 was not sampled due to presence of SPH. SPH was bailed from the well and placed into a drum that was removed by IWM the same day. The spent SPH absorbent sock was replaced with a new absorbent sock after the SPH was bailed. All sampling activities were performed in accordance with local, state and federal guidelines.

Water levels measurements were collected using an electronic slope indicator. All sampled wells were purged of three case volumes, depending on well recovery, or until water temperature, pH and conductivity stabilized. Purging was accomplished using electric submersible pumps, positive air-displacement pumps or stainless steel, Teflon or disposable bailers. Subsequent sample collection and sample handling was performed in accordance with EPA protocols using disposable bailers. Alternately, where applicable, wells were sampled utilizing no-purge methodology. All reused equipment was decontaminated in an integrated stainless steel sink with de-ionized water supplied Hotsy pressure washer and Liquinox or equivalent.

Second Quarter Groundwater Monitoring at Chevron 91153, 3135 Gibbons Dr., Alameda, CA

SAN JOSE

SACRAMENTO

LOS ANGELES

SAN DIEGO

1680 ROGERS AVENUE

SAN JOSE, CA 95112-1105

(408) 573-0555

FAX (408) 573-7771

LIC: 746684

www.blainetech.com

Samples were delivered under chain-of-custody to Lancaster Laboratories of Lancaster, Pennsylvania, for analysis. Monitoring well purgewater and equipment rinsate water was collected and transported under bill-of-lading to IWM facilities of San Jose, California.

Enclosed documentation from this event includes copies of the Well Gauging Sheet, Well Monitoring Data Sheets, and Chain-of-Custody.

Blaine Tech Services, Inc.'s activities at this site consisted of objective data and sample collection only. No interpretation of analytical results, defining of hydrogeologic conditions or formulation of recommendations was performed.

Please call if you have any questions.

Sincerely,



Dustin Becker
Blaine Tech Services, Inc.
Senior Project Manager

attachments: SOP
Well Gauging Sheet
Individual Well Monitoring Data Sheets
Chain of Custody
Wellhead Inspection Form
Bill of Lading
Calibration Log

cc: CRA
Attn: Nathan Lee
5900 Hollis St. Suite A
Emeryville, CA 94608

Second Quarter Groundwater Monitoring at Chevron 91153, 3135 Gibbons Dr., Alameda, CA

SAN JOSE

SACRAMENTO

LOS ANGELES

SAN DIEGO

1680 ROGERS AVENUE

SAN JOSE, CA 95112-1105

(408) 573-0555

FAX (408) 573-7771

LIC: 746684

www.blainetech.com

BLAINE TECH SERVICES, INC. METHODS AND PROCEDURES FOR THE ROUTINE MONITORING OF GROUNDWATER WELLS AT CHEVRON SITES

Blaine Tech Services, Inc. performs environmental sampling and documentation as an independent third party. We specialize in groundwater monitoring assignments and intentionally limit the scope of our services to those centered on the generation of objective information.

To avoid conflicts of interest, Blaine Tech Services, Inc. personnel do not evaluate or interpret the information we collect. As a state licensed contractor (C-57 well drilling –water – 746684) performing strictly technical services, we do not make any professional recommendations and perform no consulting of any kind.

SAMPLING PROCEDURES OVERVIEW

SAFETY

All groundwater monitoring assignments performed for Chevron comply with Chevron's safety guidelines, 29 CFR 1910.120 and SB-198 Injury and Illness Prevention Program (IIPP). All Field Technicians receive the full 40-hour 29CFR 1910.120 OSHA SARA HAZWOPER course, medical clearance and on-the-job training prior to commencing any work on any Chevron site.

INSPECTION AND GAUGING

Wells are inspected prior to evacuation and sampling. The condition of the wellhead is checked and noted according to a wellhead inspection checklist.

Standard measurements include the depth to water (DTW) and the total well depth (TD) obtained with industry standard electronic water level indicators that are graduated in increments of hundredths of a foot.

The water in each well is inspected for the presence of immiscibles. When free product is suspected, its presence is confirmed using an electronic interface probe (e.g. GeoTech). No samples are collected from a well containing over two-hundredths of a foot (0.02') of product.

EVACUATION

Depth to water measurements are collected by our personnel prior to purging and minimum purge volumes are calculated anew for each well based on the height of the water column and the diameter of the well. Expected purge volumes are never less than three case volumes and are set at no less than four case volumes in some jurisdictions.

Well purging devices are selected on the basis of the well diameter and the total volume to be

evacuated. In most cases the well will be purged using an electric submersible pump (i.e. Grundfos) suspended near (but not touching) the bottom of the well.

PARAMETER STABILIZATION

Well purging completion standards include minimum purge volumes, but additionally require stabilization of specific groundwater parameters prior to sample collection. Typical groundwater parameters used to measure stability are electrical conductivity, pH, and temperature. Instrument readings are obtained at regular intervals during the evacuation process (no less than once per case volume).

Stabilization standards for routine quarterly monitoring of fuel sites include the following: Temperature is considered to have stabilized when successive readings do not fluctuate more than +/- 1 degree Celsius. Electrical conductivity is considered stable when successive readings are within 10%. pH is considered to be stable when successive readings remain constant or vary no more than 0.2 of a pH unit.

DEWATERED WELLS

Normal evacuation removes no less than three case volumes of water from the well. However, less water may be removed in cases where the well dewateres and does not immediately recharge.

MEASURING RECHARGE

Upon completion of well purging, a depth to water measurement is collected and notated to ensure that the well has recharged to within 80% of its static, pre-purge level prior to sampling.

Wells that do not immediately show 80% recharge or dewatered wells will be allowed approximately 2 hours to recharge prior to sampling or will be sampled at site departure. All wells requiring off-site traffic control in the public right-of-way, the 80% recharge rule may be disregarded in the interests of Health and Safety. The sample may be collected as soon as there is sufficient water. The water level at time of sampling will be noted.

PURGEWATER CONTAINMENT

All non-hazardous purgewater evacuated from each groundwater monitoring well is captured and contained in on-board storage tanks on the Sampling Vehicle and/or special water hauling trailers. Effluent from the decontamination of reusable apparatus (sounders, electric pumps and hoses etc.), consisting of groundwater combined with deionized water and non-phosphate soap, is also captured and pumped into effluent tanks.

Non-hazardous purgewater is transported under standard Bill of Lading documentation to a Blaine Tech Services, Inc. facility before being transported to a Chevron approved disposal facility.

SAMPLE COLLECTION DEVICES

All samples are collected using disposable bailers.

SAMPLE CONTAINERS

Sample material is decanted directly from the sampling bailer into sample containers provided by the laboratory that will analyze the samples. The transfer of sample material from the bailer to the sample container conforms to specifications contained in the USEPA T.E.G.D. The type of sample container, material of construction, method of closure and filling requirements are specific to the intended analysis. Chemicals needed to preserve the sample material are commonly placed inside the sample containers by the laboratory or glassware vendor prior to delivery of the bottle to our personnel. The laboratory sets the number of replicate containers.

TRIP BLANKS

Trip Blanks, if requested, are taken to the site and kept inside the sample cooler for the duration of the event. They are turned over to the laboratory for analysis with the samples from that site.

DUPLICATES

Duplicates, if requested, may be collected at a site. The Duplicate sample is collected, typically from the well containing the most measurable contaminants. The Duplicate sample is labeled the same as the original.

SAMPLE STORAGE

All sample containers are promptly placed in food grade ice chests for storage in the field and transport (direct or via our facility) to the designated analytical laboratory. These ice chests contain quantities of restaurant grade ice as a refrigerant material. The samples are maintained in either an ice chest or a refrigerator until relinquished into the custody of the laboratory or laboratory courier.

DOCUMENTATION CONVENTIONS

A label must be affixed to all sample containers. In most cases these labels are generated by our office personnel and are partially preprinted. Labels can also be hand written by our field personnel. The site is identified with the store number and site address, as is the particular groundwater well from which the sample is drawn (e.g. MW-1, MW-2, S-1 etc.). The time and date of sample collection along with the initials of the person who collects the sample are handwritten onto the label.

Chain of Custody records are created using client specific preprinted forms following USEPA specifications.

Bill of Lading records are contemporaneous records created in the field at the site where the non-hazardous purgewater is generated. Field Technicians use preprinted Bill of Lading forms.

DECONTAMINATION

All equipment is brought to the site in clean and serviceable condition and is cleaned after use in each well and before subsequent use in any other well. Equipment is decontaminated before leaving the site.

The primary decontamination device is a commercial steam cleaner. The steam cleaner is de-tuned to function as a hot pressure washer that is then operated with high quality deionized water that is produced at our facility and stored onboard our sampling vehicle. Cleaning is facilitated by the use of proprietary fixtures and devices included in the patented workstation (U.S. Patent 5,535,775) that is incorporated in each sampling vehicle. The steam cleaner is used to decon reels, pumps and bailers.

Any sensitive equipment or parts (i.e. Dissolved Oxygen sensor membrane, water level indicator, etc.) that cannot be washed using the high pressure water, will be sprayed with a non-phosphate soap and deionized water solution and rinsed with deionized water.

DISSOLVED OXYGEN READINGS

Dissolved Oxygen readings are taken pre- and/or post-purge using YSI meters (e.g. YSI Model 550) or HACH field test kits.

The YSI meters are able to collect accurate in-situ readings. The probe allows downhole measurements to be taken from wells with diameters as small as two inches. The probe and reel is decontaminated between wells as described above. The meter is calibrated between wells as per the instructions in the operating manual. The probe is lowered into the water column and the reading is allowed to stabilize prior to collection.

OXYIDATON REDUCTION POTENTIAL READINGS

All readings are obtained with either Corning or Myron-L meters (e.g. Corning ORP-65 or a Myron-L Ultrameter GP). The meter is cleaned between wells as described above. The meter is calibrated at the start of each day according to the instruction manual.

FERROUS IRON MEASUREMENTS

All field measurements are collected at time of sampling with a HACH test kit.

WELL GAUGING DATA

Project # 110617-J01 Date 6-17-11 Client Chewon

Site 3135 Gibbons Dr. Mamecha CA.

Well ID	Time	Well Size (in.)	Sheen / Odor	Depth to Immiscible Liquid (ft.)	Thickness of Immiscible Liquid (ft.)	Volume of Immiscibles Removed (ml)	Depth to water (ft.)	Depth to well bottom (ft.)	Survey Point: TOB or TOG	Notes
C-1	0850	3		2.99	0.01	14	3.00	—	↓	ABS SOCKS
C-3	0805	3				3.24	18.41			
MW-4	0810	2				2.36	12.92			
MW-5	0815	2				1.84	12.80			
MW-6	0820	2				3.69	13.34			
MW-7	0825	2				4.02	5.90			
MW-8	0840	2				3.79	9.18			
MW-9	0830	2				3.86	8.53			
MW-10	0835	2				3.92	8.87			

CHEVRON WELL MONITORING DATA SHEET

Project #: 110617-101	Station #: 9-1153
Sampler: SO	Date: 6-17-11
Weather: Sunny	Ambient Air Temperature: 70°
Well I.D.: C-1	Well Diameter: 2 (3) 4 6 8
Total Well Depth: —	Depth to Water: 3.00
Depth to Free Product: 2.99	Thickness of Free Product (feet): 0.01
Referenced to: (PVC) Grade	D.O. Meter (if req'd): YSI HACH
DTW with 80% Recharge [(Height of Water Column x 0.20) + DTW]:	

Purge Method:

- Bailer
- Disposable Bailer
- Positive Air Displacement
- Electric Submersible
- Waterra
- Peristaltic
- Extraction Pump
- Other _____

Sampling Method:

- Bailer
- Disposable Bailer
- Extraction Port
- Dedicated Tubing

Other: _____

	(Gals.) X		=		Gals.
1 Case Volume		Specified Volumes		Calculated Volume	

Well Diameter	Multiplier	Well Diameter	Multiplier
1"	0.04	4"	0.65
2"	0.16	6"	1.47
3"	0.37	Other	radius ² * 0.163

Time	Temp (°F)	pH	Cond. (mS or µS)	Turbidity (NTUs)	Gals. Removed	Observations
SPT removed			14mL SPT removed		2 gallons	F20
			- REMOVED OLD SPT SOCK AND REPLACED w/ NEW			
			SPT SOCKS			
			- SPT / SPT SOCKS REMOVED BY JWM SAME DAT			
			NO SAMPLE TAKEN			

Did well dewater? Yes No Gallons actually evacuated:

Sampling Date: Sampling Time: Depth to Water:

Sample I.D.: Laboratory: Lancaster Other _____

Analyzed for: TPH-G BTEX MTBE OXYS Other:

Duplicate I.D.: Analyzed for: TPH-G BTEX MTBE OXYS Other:

D.O. (if req'd):	Pre-purge:	mg/L	Post-purge:	mg/L
O.R.P. (if req'd):	Pre-purge:	mV	Post-purge:	mV

WELLHEAD INSPECTION CHECKLIST

CHEVRON

Client 3135 Gibbons Dr. Alameda CA Date 6-17-11

Site Address _____

Job Number 110617-J01 Technician JO

Well ID	Well Inspected - No Corrective Action Required	WELL IS SECURABLE BY DESIGN (12" or less)	WELL IS CLEARLY MARKED WITH THE WORDS "MONITORING WELL" (12" or less)	Water Bailed From Wellbox	Wellbox Components Cleaned	Cap Replaced	Lock Replaced	Other Action Taken (explain below)	Well Not Inspected (explain below)	Repair Order Submitted
C-1	X									
C-3	X									
MW-4		X		X				X		
MW-6	X									
MW-7	X									
MW-8				X				X		
MW-9								X		
MW-10				X				X		
MW-5		X		X				X		

NOTES: C-3 check Box, MW-4 212 Bolt missing, MW-8 213 Bolt missing, MW-9 212 Bolts missing, MW-5. 212 Bolt missing
MW-10 slip lid not securable



SORBENT SOCK EVALUATION FORM

Name: Jose Ortiz	Date: 6-17-11	Project Number: 110617-001
Site Address: 3135 Cribbens Dr. Alameda CA.	Well ID: C-1	Weather: Clear

1) Time absorbent sock removed from well for inspection: 0945

2) Condition of sock:

a) Length of sock showing product saturation: Sock saturated w/SPH and H2O

b) Length of sock showing dryness: none

c) Color of sock showing product saturation: light brown

d) Weight of the removed sock: 0.82 lbs (13.25 oz)

e) Weight of a new/clean/dry sock: 0.34 lbs (5.25 oz)

f) Difference in weight: (D-E) to 0.01 ounces. 0.48 lbs (8.00 oz)

3) Picture of sock removed from well taken:

4) Sock removed from well deposited into a waste drum:

-Is drum labeled? Yes How full is drum? (%) 1 SPH sock

5) After at least 15 minutes after removing the sock from the well, measure (to 0.01 ft) from the top of the well casing. :

a) Depth to product: 2.99

b) Depth to water: 3.00

c) Thickness of product: (b-a) 0.01

6) Size and type of sock installed Big 1/8" rigid sock

7) Comments: New sock installed

UNIFORM HAZARDOUS WASTE MANIFEST		1. Generator ID Number CAL 000 041 780	2. Page 1 of 12	3. Emergency Response Phone (408) 813-9428	4. Manifest Tracking Number 006276234 JJK					
5. Generator's Name and Mailing Address Chevron Products Company Attn: CPD's Waste Desk P.O. Box 6004, San Ramon, CA 94583 (925) 842-5931			Generator's Site Address (if different than mailing address) Chevron #9-1153 3135 Gibbons Avenue Alameda, CA							
6. Transporter 1 Company Name Integrated Wastestream Management Inc			U.S. EPA ID Number CAD 983 633 627							
7. Transporter 2 Company Name CLEAN HARBORS ENV SVC			U.S. EPA ID Number MAD 353 222 50							
8. Designated Facility Name and Site Address Clean Harbors San Jose LLC 1021 Berryessa Road, San Jose, CA 95133 408-441-0962			U.S. EPA ID Number CAD 059 494 310							
9a. HM										
9b. U.S. DOT Description (including Proper Shipping Name, Hazard Class, ID Number, and Packing Group (if any))				10. Containers	11. Total Quantity					
				No.	12. Unit Wt./Vol.					
				Type	13. Waste Codes					
1. Waste Flammable Liquid, N.O.S., 3, UN1993, PGII. (Gasoline with Water)				1	DM	Est. 15	G	343	D001	D018
2. Non-RCRA Hazardous Waste Solid (Oily Debris)				1	DM	Est. 40	P	352		
3.										
4.										
14. Special Handling Instructions and Additional Information Wear appropriate safety gear when handling. Business Unit: MBU Project Manager: David Patten IWM Job #: 99712-HZ Profile #: 9b.1. CH371889 (Gasoline with Water) 9b.2 CH486662 (Oily Debris) Project Manager Phone #: 925-543-1740 Order # DJ3592707 # 6/20/11										
15. GENERATOR'S/OFFEROR'S CERTIFICATION: I hereby declare that the contents of this consignment are fully and accurately described above by the proper shipping name, and are classified, packaged, marked and labeled/placarded, and are in all respects in proper condition for transport according to applicable international and national governmental regulations. If export shipment and I am the Primary Exporter, I certify that the contents of this consignment conform to the terms of the attached EPA Acknowledgment of Consent. I certify that the waste minimization statement identified in 40 CFR 262.27(a) (if I am a large quantity generator) or (b) (if I am a small quantity generator) is true.										
Generator's/Officer's Printed/Typed Name Tom DeLon for David Patten (MBU)				Signature <i>Tom DeLon</i>	Month 6	Day 17	Year 11			
16. International Shipments <input type="checkbox"/> Import to U.S. <input type="checkbox"/> Export from U.S. Port of entry/exit: _____ Transporter signature (for exports only): _____ Date leaving U.S.: _____										
17. Transporter Acknowledgment of Receipt of Materials										
Transporter 1 Printed/Typed Name SCOTT DUNDON				Signature <i>Scott Dundon</i>	Month 6	Day 17	Year 11			
Transporter 2 Printed/Typed Name CR...				Signature <i>[Signature]</i>	Month 6	Day 21	Year 11			
18. Discrepancy										
18a. Discrepancy Indication Space <input type="checkbox"/> Quantity <input type="checkbox"/> Type <input type="checkbox"/> Residue <input type="checkbox"/> Partial Rejection <input type="checkbox"/> Full Rejection										
18b. Alternate Facility (or Generator) Manifest Reference Number: _____ U.S. EPA ID Number: _____ Facility's Phone: _____										
18c. Signature of Alternate Facility (or Generator) _____ Month: _____ Day: _____ Year: _____										
19. Hazardous Waste Report Management Method Codes (i.e., codes for hazardous waste treatment, disposal, and recycling systems)										
1. H141		2. H141		3. _____		4. _____				
20. Designated Facility Owner or Operator: Certification of receipt of hazardous materials covered by the manifest except as noted in Item 18a										
Printed/Typed Name Santa C. HUGUER				Signature <i>Santa C. Huguer</i>	Month 6	Day 29	Year 11			