

Environmental Management  
Company  
6001 Bollinger Canyon Rd, L4050  
P.O. Box 6012  
San Ramon, CA 94583-2324  
Tel 925-842-1589  
Fax 925-842-8370

Karen Streich  
Project Manager

Alameda County

JUN 25 2003

Environmental Health

**ChevronTexaco**

June 24, 2003

Alameda County Health Care Services  
1131 Harbor Bay Parkway, Suite 250  
Alameda, CA 94502-6577

Re: Chevron Service Station # 9-1153

Address: 3135 Gibbons Drive, Alameda, CA

June 23, 2003

I have reviewed the attached routine groundwater monitoring report dated \_\_\_\_\_.

I agree with the conclusions and recommendations presented in the referenced report. The information in this report is accurate to the best of my knowledge and all local Agency/Regional Board guidelines have been followed. This report was prepared by Gettler-Ryan, Inc., upon whose assistance and advice I have relied.

This letter is submitted pursuant to the requirements of California Water Code Section 13267(b)(1) and the regulating implementation entitled Appendix A pertaining thereto.

I declare under penalty of perjury that the foregoing is true and correct.

Sincerely,

*Karen Streich*

Karen Streich  
Project Manager

Enclosure: Report



# GETTLER-RYAN INC.

Alameda County

## TRANSMITTAL

JUN 25 2003

June 9, 2003

G-R #386423

Environmental Health

TO: Mr. Robert Foss  
Cambria Environmental Technology, Inc.  
5900 Hollis Street, Suite A  
Emeryville, CA 94608

CC: Ms. Karen Streich  
Chevron Products Company  
P.O. Box 6004  
San Ramon, California 94583

FROM: Deanna L. Harding  
Project Coordinator  
Gettler-Ryan Inc.  
6747 Sierra Court, Suite J  
Dublin, California 94568

RE: **Former Chevron Service Station  
#9-1153  
3135 Gibbons Drive  
(Former Address: 3126 Fernside Blvd.)  
Alameda, California**

WE HAVE ENCLOSED THE FOLLOWING:

COPIES	DATED	DESCRIPTION
1	June 5, 2003	Groundwater Monitoring and Sampling Report Second Quarter - Event of May 9, 2003 and Monthly Site Visits

### COMMENTS:

This report is being sent for your review. Please provide any comments/changes and propose any groundwater monitoring modifications for the next event prior to **June 23, 2003**, at which time the final report will be distributed to the following:

cc: Ms. Eva Chu, Alameda County Health Care Services, Dept. of Environmental Health, 1153 Harbor Bay Parkway, Suite 250, Alameda, CA 94502-6577  
Mr. Mark Hom, 3135 Gibbons Drive, Alameda, CA 94501

Enclosures



# GETTLER-RYAN INC.

June 5, 2003  
G-R Job #386423

Ms. Karen Streich  
Chevron Products Company  
P.O. Box 6004  
San Ramon, CA 94583

**RE: Second Quarter Event of May 9, 2003  
and Monthly Site Visits**  
Groundwater Monitoring & Sampling Report  
Former Chevron Service Station #9-1153  
3135 Gibbons Drive  
(Former Address: 3126 Fernside Blvd.)  
Alameda, California

Dear Ms. Streich:

This report documents the monthly site visits and the most recent groundwater monitoring and sampling event performed by Gettler-Ryan Inc. (G-R) at the referenced site. All field work was conducted in accordance with G-R Standard Operating Procedure - Groundwater Sampling (attached).

Static groundwater levels were measured and the wells were checked for the presence of separate-phase hydrocarbons. Static water level data, groundwater elevations, and separate-phase hydrocarbon thickness (if any) are presented in the attached Tables 1 and 2. A Potentiometric Map is included as Figure 1.

Groundwater samples were collected from the monitoring wells and submitted to a state certified laboratory for analyses. The field data sheets for this event are attached. Analytical results are presented in the table(s) listed below. The chain of custody document and laboratory analytical report are also attached.

Please call if you have any questions or comments regarding this report. Thank you.

Sincerely,

Deanna L. Harding  
Project Coordinator

Robert C. Mallory  
Registered Geologist, No. 7285

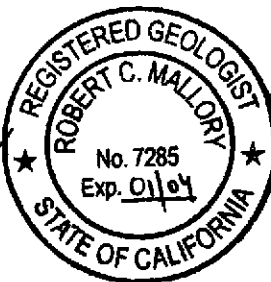

- Figure 1: Potentiometric Map
- Table 1: Groundwater Monitoring Data and Analytical Results
- Table 2: Separate Phase Hydrocarbon Thickness/Removal Data
- Table 3: Dissolved Oxygen Concentrations
- Attachments: Standard Operating Procedure - Groundwater Sampling  
Field Data Sheets  
Chain of Custody Document and Laboratory Analytical Reports

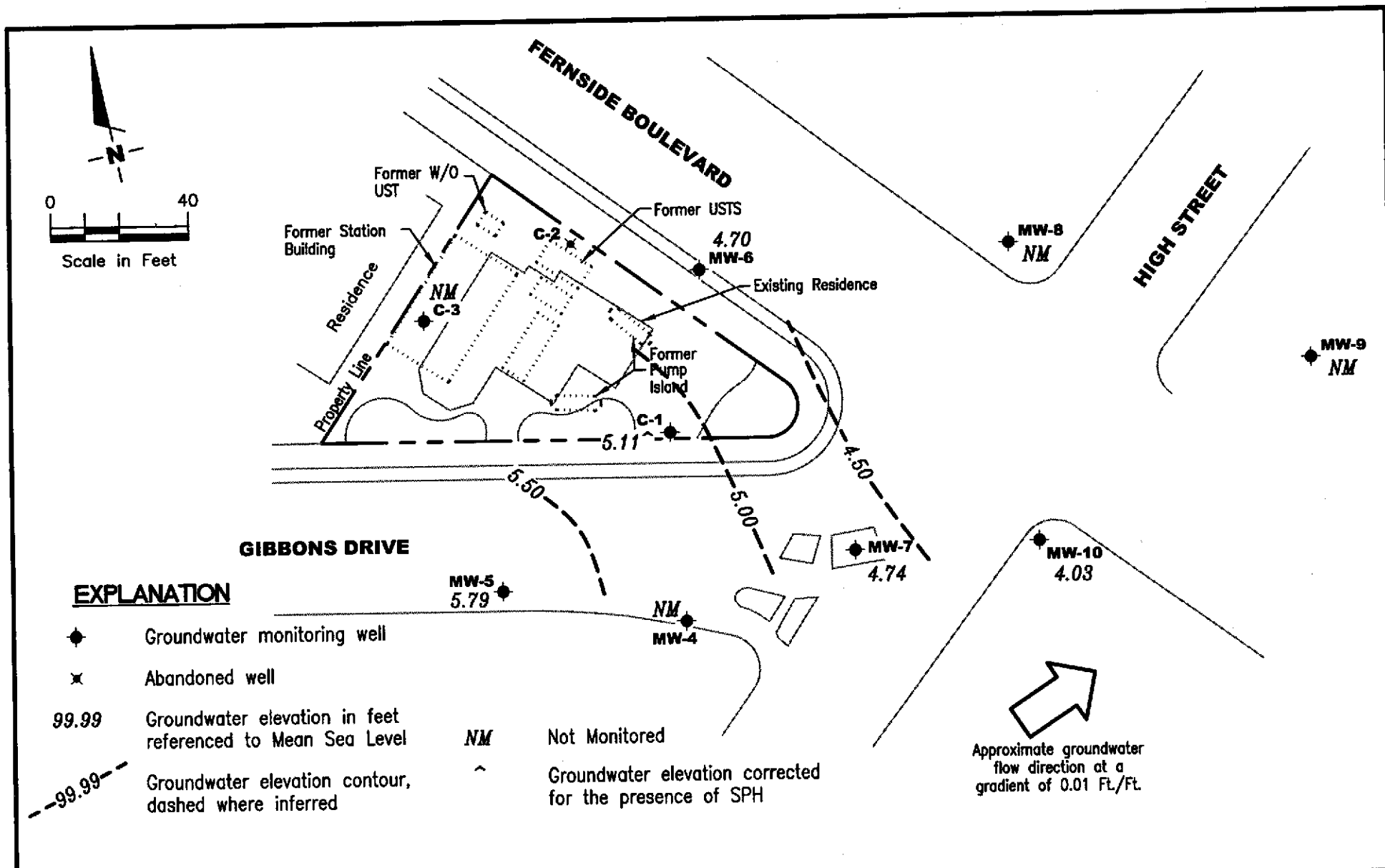

Source: Figure modified from drawing provided by Gettler - Ryan Inc.

**GETTLER - RYAN INC.**  
 6747 Sierra Ct., Suite J  
 Dublin, CA 94568 (925) 551-7555

**POTENTIOMETRIC MAP**  
 Former Chevron Service Station #9-1153  
 3135 Gibbons Drive (3126 Fernside Blvd)  
 Alameda, California

FIGURE

1

PROJECT NUMBER  
 386423

REVIEWED BY

DATE  
 May 9, 2003

REVISED DATE

**Table 1**  
**Groundwater Monitoring Data and Analytical Results**  
Former Chevron Service Station #9-1153  
3135 Gibbons Drive  
(3126 Fernside Boulevard)  
Alameda, California

WELL ID/ TOC*(ft.)	DATE	DTW (ft.)	GWE (msl)	SPHT (ft.)	TPH-G (ppb)	B (ppb)	T (ppb)	E (ppb)	X (ppb)	MTBE (ppb)
C-1	08/18/86	4.10	--	--	--	--	--	--	--	--
	09/04/86	--	--	--	15,000	760	820	1,500	--	--
	07/22/87	--	--	--	1,100	250	7.0	40	--	--
	05/03/89	4.46	--	--	6,900	3,800	190	229	--	--
	12/04/89	4.16	--	--	17,000	8,000	490	470	--	--
	02/14/90	3.64	--	--	19,000	12,000	990	1,050	--	--
	03/07/90	3.36	--	--	--	4,260	261	430	--	--
	09/06/91	4.43	--	--	21,000	10,000	100	240	560	--
	12/15/91	4.78	--	--	20,000	4,900	43	110	330	--
	03/03/92	2.39	--	--	13,000	5,800	730	340	1,200	--
4.08	06/04/92	4.08	0.00	--	34,000	9,400	350	290	1,200	--
	10/13/92	4.75	-0.67	--	24,000	11,000	98	280	530	--
	01/11/93	2.26	1.82	Sheen	7,100	1,500	130	150	700	--
	04/14/93	2.90	1.18	Sheen	29,000	7,300	4,000	640	2,300	--
	07/13/93	3.97	0.11	Sheen	650,000	27,000	18,000	6,300	29,000	--
	10/19/93	4.50	-0.42	--	40,000	12,000	730	1,100	3,600	--
7.50	11/30/93	4.27	3.23	--	--	--	--	--	--	--
	01/27/94	3.35	4.15	--	36,000	8,600	220	670	1,900	--
	04/07/94	3.42	4.08	--	53,000	12,000	3,500	480	3,300	--
	07/01/94	3.96	3.54	--	65,000	19,000	5,900	1,000	9,000	--
	10/05/94	4.39	3.11	--	160,000	23,000	12,000	2,200	11,000	--
	01/12/95	1.52	6.38	0.50	--	--	--	--	--	--
	04/26/95	4.40	4.86	2.20	--	--	--	--	--	--
	07/12/95	4.85	4.10	1.81	--	--	--	--	--	--
	10/30/95	5.67	3.13	1.63	--	--	--	--	--	--
	01/04/96	3.92	3.68	0.12	--	--	--	--	--	--
	01/10/96	3.48	4.12	0.13	--	--	--	--	--	--
	01/17/96	3.40	4.12	0.02	--	--	--	--	--	--
	01/22/96	2.90	4.60	0.00	82,000	18,000	4,400	1,400	5,200	<1,000
	02/23/96	4.10	4.89	1.86	--	--	--	--	--	--
	02/28/96	--	--	>0.83	--	--	--	--	--	--
	03/08/96	2.86	6.10	1.83	--	--	--	--	--	--
	03/08/96	2.30	5.49	0.36	--	--	--	--	--	--

**Table 1**  
**Groundwater Monitoring Data and Analytical Results**  
Former Chevron Service Station #9-1153  
3135 Gibbons Drive  
(3126 Fernside Boulevard)  
Alameda, California

WELL ID/ TOC* (ft.)	DATE	DTW (ft.)	GWE (msl)	SPHT (ft.)	TPH-G (ppb)	B (ppb)	T (ppb)	E (ppb)	X (ppb)	MTBE (ppb)
C-1	03/08/96	2.33	5.46	0.36	--	--	--	--	--	--
(cont)	03/08/96	2.28	5.40	0.22	--	--	--	--	--	--
	03/26/96	3.96	4.56	1.28	--	--	--	--	--	--
	04/11/96	5.61	3.29	1.75	--	--	--	--	--	--
	04/19/96	3.09	4.44	0.04	--	--	--	--	--	--
	04/24/96	3.04	4.48	0.03	--	--	--	--	--	--
	05/03/96	4.02	3.85	0.46	--	--	--	--	--	--
	05/03/96	3.89	3.99	0.47	--	--	--	--	--	--
	05/08/96	4.25	3.53	0.35	--	--	--	--	--	--
	05/17/96	3.24	4.29	0.04	--	--	--	--	--	--
	05/17/96	3.35	4.16	0.01	--	--	--	--	--	--
	05/17/96	3.43	4.08	0.01	--	--	--	--	--	--
	05/17/96	3.65	3.86	0.01	--	--	--	--	--	--
	05/22/96	3.10	4.46	0.07	--	--	--	--	--	--
	06/18/96	4.68	3.20	0.48	--	--	--	--	--	--
	07/03/96	5.03	2.57	0.13	--	--	--	--	--	--
	07/09/96	4.63	3.05	0.23	--	--	--	--	--	--
	07/17/96	4.73	2.89	0.15	--	--	--	--	--	--
	07/29/96	5.10	2.47	0.09	--	--	--	--	--	--
	08/02/96	5.68	1.84	0.03	--	--	--	--	--	--
	08/07/96	5.16	2.35	0.01	--	--	--	--	--	--
	08/23/96	5.75	1.77	0.03	--	--	--	--	--	--
	08/28/96	5.53	1.99	0.03	--	--	--	--	--	--
	09/06/96	5.38	2.12	--	--	--	--	--	--	--
	09/12/96	5.48	2.04	0.03	--	--	--	--	--	--
	09/19/96	6.32	1.20	0.03	--	--	--	--	--	--
	10/10/96	4.58	3.00	0.10	--	--	--	--	--	--
	10/17/96	5.61	1.90	0.01	--	--	--	--	--	--
	10/29/96	6.01	1.49	--	--	--	--	--	--	--
	11/07/96	5.56	1.94	0.04	--	--	--	--	--	--
	11/11/96	5.32	2.18	0.04	--	--	--	--	--	--
	12/20/96	3.33	4.17	0.03	--	--	--	--	--	--
	12/17/96	3.73	3.77	0.01	--	--	--	--	--	--

**Table 1**  
**Groundwater Monitoring Data and Analytical Results**  
Former Chevron Service Station #9-1153  
3135 Gibbons Drive  
(3126 Fernside Boulevard)  
Alameda, California

WELL ID/ TOC* (ft.)	DATE	DTW (ft.)	GWE (msl)	SPHT (ft.)	TPH-G (ppb)	B (ppb)	T (ppb)	E (ppb)	X (ppb)	MTBE (ppb)
					47,000	16,000	2,800	1,300	4,900	<1,000
C-1	01/15/97	2.74	4.76	--	--	--	--	--	--	--
(cont)	01/22/97	1.37	6.13	0.19	--	--	--	--	--	--
	02/04/97	2.98	4.52	0.51	--	--	--	--	--	--
	02/20/97	4.09	3.41	0.13	--	--	--	--	--	--
	03/06/97	3.75	3.75	0.56	--	--	--	--	--	--
	03/14/97	3.82	3.68	0.03	--	--	--	--	--	--
	03/20/97	3.73	3.77	0.03	--	--	--	--	--	--
	03/25/97	4.32	3.18	0.01	--	--	--	--	--	--
	03/31/97	3.71	3.79	0.03	--	--	--	--	--	--
	04/03/97	4.60	2.92	0.03	--	--	--	--	--	--
	04/09/97	4.25	3.27	0.02	--	--	--	--	--	--
	04/24/97	4.65	2.87	0.02	--	--	--	--	--	--
	04/30/97	3.50	4.02	0.02	--	--	--	--	--	--
	05/22/97	4.97	2.53	--	--	--	--	--	--	--
	06/03/97	3.62	3.93	0.06	--	--	--	--	--	--
	07/09/97	4.30	3.25	0.06	--	--	--	--	--	--
	08/12/97	5.18	2.32	0.00	--	--	--	--	--	--
	09/30/97	5.25	2.65	0.50	--	--	--	--	--	--
	10/29/97	5.33	2.19	0.03	--	--	--	--	--	--
	11/13/97	4.86	2.66	0.02	--	--	--	--	--	--
	12/18/97	2.34	5.16	--	--	--	--	--	--	--
	01/14/98	0.25	7.27	0.02	--	--	--	--	--	--
	02/02/98	2.35	5.19	0.05	--	--	--	--	--	--
	03/16/98	2.50	5.40	0.50	--	--	--	--	--	--
	04/17/98	2.65	5.17	0.40	--	--	--	--	--	--
	05/01/98	2.39	5.14	0.04	--	--	--	--	--	--
	06/17/98	3.26	4.30	0.08	--	--	--	--	--	--
	07/15/98	3.55	3.95	--	110,000	22,000	22,000	1,000	10,000	<250
	09/01/98	4.00	3.50	--	--	--	--	--	--	--
	10/27/98	4.48	3.02	--	45,000	12,000	5,400	590	4,300	<500
	11/19/98	3.89	3.61	--	--	--	--	--	--	--
	12/19/98	2.13	5.39	0.02	--	--	--	--	--	--
	01/20/99	3.98	3.52	--	50,300	7,050	5,030	244	6,090	<40

As of 05/09/03

**Table 1**  
**Groundwater Monitoring Data and Analytical Results**  
Former Chevron Service Station #9-1153  
3135 Gibbons Drive  
(3126 Fernside Boulevard)  
Alameda, California

WELL ID/ TOC*(ft.)	DATE	DTW (ft.)	GWE (msl)	SPHT (ft.)	TPH-G (ppb)	B (ppb)	T (ppb)	E (ppb)	X (ppb)	MTBE (ppb)
C-1	02/24/99	2.55	4.95	--	--	--	--	--	--	--
(cont)	03/26/99	2.14	5.97	0.76	--	--	--	--	--	--
	04/19/99	1.04	6.46	--	150,000	21,000	20,000	3,000	18,000	<2.5/49 <sup>2</sup>
	07/29/99	3.76	3.76	0.02	--	--	--	--	--	--
	08/30/99	4.30	3.20	--	--	--	--	--	--	--
	09/23/99	3.84	3.68	0.02	--	--	--	--	--	--
	10/13/99	1.27	6.23	--	136,000	23,900	30,000	2,390	17,300	<500
	11/17/99	3.59	3.91	--	--	--	--	--	--	--
	12/08/99	3.79	3.71	--	--	--	--	--	--	--
	01/25/00	1.99	5.54	0.04	--	--	--	--	--	--
	04/03/00	2.20	5.38**	0.10	--	--	--	--	--	--
	05/26/00	2.52	5.16**	0.23	--	--	--	--	--	--
	06/19/00	2.89	4.76**	0.19	--	--	--	--	--	--
	07/03/00	3.45	4.25**	0.25	--	--	--	--	--	--
	08/01/00	3.78	3.85**	0.16	--	--	--	--	--	--
	09/30/00	4.03	3.50**	0.04	--	--	--	--	--	--
	10/23/00	4.15	3.37**	0.03	--	--	--	--	--	--
	11/21/00	3.42	4.08	0.00	--	--	--	--	--	--
	12/22/00	2.96	4.54	0.00	--	--	--	--	--	--
	01/08/01	2.94	4.56	0.00	--	--	--	--	--	--
	02/17/01	2.09	5.88**	0.59	--	--	--	--	--	--
	03/13/01	2.20	5.91**	0.76	--	--	--	--	--	--
	04/09/01	2.45	5.26**	0.26	NOT SAMPLED DUE TO THE PRESENCE OF SPH			--	--	--
	05/18/01	2.70	5.27**	0.59	--	--	--	--	--	--
	06/12/01	3.50	4.78**	0.97	--	--	--	--	--	--
	07/19/01	4.25	4.01**	0.95	--	--	--	--	--	--
	08/23/01	4.34	3.22**	0.07	NOT SAMPLED DUE TO THE PRESENCE OF SPH			--	--	--
	09/17/01	4.39	3.17**	0.08	--	--	--	--	--	--
	10/08/01	4.45	3.08**	0.04	--	--	--	--	--	--
	11/27/01	3.89	3.61	0.00	330,000	9,800	5,300	3,800	22,000	<50
	12/17/01	1.81	5.69	0.00	--	--	--	--	--	--
	01/07/02	2.27	5.64**	0.51	--	--	--	--	--	--
	02/26/02	2.70	5.22**	0.52	NOT SAMPLED DUE TO THE PRESENCE OF SPH			--	--	--



**Table 1**  
**Groundwater Monitoring Data and Analytical Results**  
Former Chevron Service Station #9-1153  
3135 Gibbons Drive  
(3126 Fernside Boulevard)  
Alameda, California

WELL ID/ TOC* (ft.)	DATE	DTW (ft.)	GWE (msl)	SPHT (ft.)	TPH-G (ppb)	B (ppb)	T (ppb)	E (ppb)	X (ppb)	MTBE (ppb)
C-1 (cont)	03/27/02	2.87	5.47**	1.05	--	--	--	--	--	--
	04/08/02	2.45	6.03**	1.23	--	--	--	--	--	--
	05/23/02	3.57	4.35**	0.52	NOT SAMPLED DUE TO THE PRESENCE OF SPH				--	--
	06/17/02	3.90	3.88**	0.35	--	--	--	--	--	--
	07/31/02	4.12	3.54**	0.20	--	--	--	--	--	--
	08/09/02	4.15	3.48**	0.16	NOT SAMPLED DUE TO THE PRESENCE OF SPH				--	--
	09/17/02	4.33	3.27**	0.12	--	--	--	--	--	--
	10/15/02	4.51	3.11**	0.15	--	--	--	--	--	--
	11/08/02	4.11	3.39	0.00	51,000	7,000	510	820	5,800	<3.0
	12/19/02	1.14	6.36	0.00	--	--	--	--	--	--
	01/14/03	1.80	5.70	0.00	--	--	--	--	--	--
	02/07/03	2.95	4.79**	0.30	NOT SAMPLED DUE TO THE PRESENCE OF SPH				--	--
	03/20/03	2.86	4.97**	0.41	--	--	--	--	--	--
	04/15/03	2.12	5.46**	0.10	--	--	--	--	--	--
	05/09/03	2.95	5.11**	0.70	--	--	--	--	--	--
C-2	08/18/86	--	--	--	--	--	--	--	--	--
	09/04/86	--	--	--	1,100	49	18	84	--	--
	07/22/87	--	--	--	<50	1.8	<1.0	<4.0	--	--
ABANDONED										
C-3	08/18/86	4.00	--	--	--	--	--	--	--	--
	09/04/86	--	--	--	50	3.2	5.4	5.8	--	--
	07/22/87	--	--	--	<50	<0.5	<1.0	<4.0	--	--
	05/03/89	4.15	--	--	<50	<0.5	<1.0	<2.0	--	--
	12/04/89	4.24	--	--	<250	<0.5	<0.5	<0.5	--	--
	02/14/90	3.57	--	--	<50	<0.5	<0.5	<0.5	--	--
	03/07/90	3.31	--	--	--	<5.0	<5.0	<5.0	--	--
	09/06/91	4.59	--	--	<50	<0.5	<0.5	<0.5	<0.5	--

**Table 1**  
**Groundwater Monitoring Data and Analytical Results**  
Former Chevron Service Station #9-1153  
3135 Gibbons Drive  
(3126 Fernside Boulevard)  
Alameda, California

WELL ID/ TOC* (ft.)	DATE	DTW (ft.)	GWE (msl)	SPHT (ft.)	TPH-G (ppb)	B (ppb)	T (ppb)	E (ppb)	X (ppb)	MTBE (ppb)
C-3	12/15/91	4.84	--	--	<50	<0.5	<0.5	<0.5	<0.5	--
(cont)	03/03/92	2.17	--	--	<50	<0.5	<0.5	<0.5	<0.5	--
4.41	06/04/92	4.01	0.40	--	<50	<0.5	<0.5	<0.5	<0.5	--
	10/13/92	4.79	-0.38	--	<50	<0.5	<0.5	<0.5	<0.5	--
	01/11/93	2.01	2.40	--	<50	<0.5	<0.5	<0.5	<0.5	--
	04/14/93	2.76	1.65	--	<50	<0.5	<0.5	<0.5	<0.5	--
	07/13/93	3.96	0.45	--	<50	<0.5	<0.5	<0.5	<1.5	--
	10/19/93	4.53	-0.12	--	66	12	1.4	1.0	8.4	--
7.83	11/30/93	4.04	3.79	--	--	--	--	--	--	--
	01/27/94	3.17	4.66	--	<50	<0.5	<0.5	<0.5	<0.5	--
	04/07/94	3.20	4.63	--	<50	<0.5	<0.5	<0.5	<0.5	--
	07/01/94	3.99	3.84	--	<50	<0.5	<0.5	<0.5	<0.5	--
	10/05/94	4.54	3.29	--	<50	<0.5	<0.5	<0.5	<0.5	--
	01/12/95	0.80	7.03	--	<50	<0.5	<0.5	<0.5	<0.5	--
	05/02/95	2.15	5.68	--	<50	<0.5	<0.5	<0.5	<0.5	--
	07/12/95	3.42	4.41	--	<50	<0.5	<0.5	<0.5	<0.5	--
	10/30/95	4.46	3.37	--	<50	<0.5	<0.5	<0.5	<0.5	<2.5
	01/22/96	1.73	6.10	--	<50	<0.5	<0.5	<0.5	<0.5	<2.5
	04/24/96	2.62	5.21	--	<50	<0.5	<0.5	<0.5	<0.5	<2.5
	07/29/96	3.94	3.89	--	<50	<0.5	<0.5	<0.5	<0.5	<2.5
	10/10/96	4.06	3.77	--	<50	<0.5	<0.5	<0.5	<0.5	<2.5
	01/15/97	1.54	6.29	--	<50	<0.5	<0.5	<0.5	<0.5	<2.5
	04/03/97	3.23	4.60	--	<50	<0.5	<0.5	<0.5	<0.5	<2.5
	07/09/97	4.36	3.47	--	<50	<0.5	<0.5	<0.5	<0.5	<2.5
	10/29/97	4.65	3.18	--	<50	<0.5	<0.5	<0.5	<0.5	<2.5
	01/14/98	0.77	7.06	--	<50	<0.5	<0.5	<0.5	<0.5	<2.5
	07/15/98	3.72	4.11	--	<50	<0.5	<0.5	<0.5	<0.5	<2.5
	01/20/99	2.65	5.18	--	<50	<0.5	<0.5	<0.5	<0.5	<2.0
	04/19/99	1.78	6.05	--	--	--	--	--	--	--
	04/03/00	MONITORED/SAMPLED ANNUALLY			--	--	--	--	--	--
	07/03/00	--	--	--	--	--	--	--	--	--
	10/23/00	--	--	--	--	--	--	--	--	--
	01/08/01 <sup>11</sup>	3.71	4.12	0.00	<50	<0.50	<0.50	<0.50	<0.50	<2.5

**Table 1**  
**Groundwater Monitoring Data and Analytical Results**  
Former Chevron Service Station #9-1153  
3135 Gibbons Drive  
(3126 Fernside Boulevard)  
Alameda, California

WELL ID/ TOC*(ft.)	DATE	DTW (ft.)	GWE (mst)	SPHT (ft.)	TPH-G (ppb)	B (ppb)	T (ppb)	E (ppb)	X (ppb)	MTBE (ppb)
C-3 (cont)	04/09/01	--	--	--	--	--	--	--	--	--
	08/23/01	MONITORED/SAMPLED ANNUALLY			--	--	--	--	--	--
	11/27/01	MONITORED/SAMPLED ANNUALLY			--	--	--	--	--	--
	02/26/02	2.38	5.45	0.00	<50	<0.50	<0.50	<0.50	<1.5	<2.5
	05/23/02	MONITORED/SAMPLED ANNUALLY			--	--	--	--	--	--
	08/09/02	MONITORED/SAMPLED ANNUALLY			--	--	--	--	--	--
	11/08/02	MONITORED/SAMPLED ANNUALLY			--	--	--	--	--	--
	02/07/03	2.73	5.10	0.00	<50	<0.50	<0.50	<0.50	<1.5	<2.5
05/09/03	MONITORED/SAMPLED ANNUALLY			--	--	--	--	--	--	
MW-4 3.58  7.01	06/04/92	3.63	-0.05	--	<50	0.8	<0.5	<0.5	<0.5	--
	10/13/92	--	--	--	--	--	--	--	--	--
	01/11/93	1.89	1.69	--	<50	<0.5	<0.5	<0.5	<0.5	--
	04/14/93	2.20	1.38	--	<50	<0.5	<0.5	<0.5	<1.5	--
	07/13/93	3.51	0.07	--	54	2.6	1.6	<0.5	<1.5	--
	10/19/93	4.22	-0.64	--	<50	<0.5	<0.5	<0.5	<0.5	--
	11/30/93	4.01	3.00	--	--	--	--	--	--	--
	01/27/94	2.89	4.12	--	<50	<0.5	<0.5	<0.5	<0.5	--
	04/07/94	3.06	3.95	--	<50	<0.5	<0.5	<0.5	<0.5	--
	07/01/94	3.59	3.42	--	<50	<0.5	<0.5	<0.5	<0.5	--
	10/05/94	4.33	2.68	--	<50	<0.5	<0.5	<0.5	<0.5	--
	01/12/95	1.20	5.81	--	<50	<0.5	<0.5	<0.5	<0.5	--
	04/26/95	1.15	5.86	--	<50	<0.5	<0.5	<0.5	<0.5	--
	07/12/95	2.72	4.29	--	<50	6.4	<0.5	0.63	0.72	<2.5
	10/30/95	4.08	2.93	--	<50	<0.5	<0.5	<0.5	<0.5	<2.5
	01/22/96	1.76	5.25	--	<50	<0.5	<0.5	<0.5	<0.5	<2.5
	04/24/96	1.95	5.06	--	<50	<0.5	<0.5	<0.5	<0.5	<2.5
	07/29/96	3.37	3.64	--	<50	<0.5	<0.5	<0.5	<0.5	<2.5
	10/10/96	3.96	3.05	--	<50	<0.5	<0.5	<0.5	<0.5	<2.5
	01/15/97	1.27	5.74	--	<50	<0.5	<0.5	<0.5	<0.5	<2.5
04/03/97	2.11	4.90	--	<50	<0.5	<0.5	<0.5	<0.5	<2.5	

As of 05/09/03

**Table 1**  
**Groundwater Monitoring Data and Analytical Results**  
Former Chevron Service Station #9-1153  
3135 Gibbons Drive  
(3126 Fernside Boulevard)  
Alameda, California

WELL ID/ TOC*(ft.)	DATE	DTW (ft.)	GWE (msl)	SPHT (ft.)	TPH-G (ppb)	B (ppb)	T (ppb)	E (ppb)	X (ppb)	MTBE (ppb)
MW-4	07/09/97	4.04	2.97	--	<50	<0.5	<0.5	<0.5	<0.5	<2.5
(cont)	10/29/97	4.56	2.45	--	<50	<0.5	<0.5	<0.5	<0.5	<2.5
	01/14/98	0.39	6.62	--	<50	<0.5	<0.5	<0.5	<0.5	<2.5
	01/20/99	2.83	4.18	--	<50	<0.5	<0.5	<0.5	<0.5	<2.0
	04/19/99	2.91	4.10	--	--	--	--	--	--	--
	01/25/00	1.92	5.09	--	<50	<0.5	<0.5	<0.5	<0.5	<2.5
	04/03/00	MONITORED/SAMPLED ANNUALLY			--	--	--	--	--	--
	07/03/00	--	--	--	--	--	--	--	--	--
	10/23/00	--	--	--	--	--	--	--	--	--
	01/08/01 <sup>11</sup>	3.02	3.99	0.00	87 <sup>12</sup>	<0.50	<0.50	0.55	2.9	<2.5
	04/09/01	--	--	--	--	--	--	--	--	--
	08/23/01	MONITORED/SAMPLED ANNUALLY			--	--	--	--	--	--
	11/27/01	MONITORED/SAMPLED ANNUALLY			--	--	--	--	--	--
	02/26/02	1.37	5.64	0.00	<50	<0.50	<0.50	<0.50	<1.5	<2.5
	05/23/02	MONITORED/SAMPLED ANNUALLY			--	--	--	--	--	--
	08/09/02	MONITORED/SAMPLED ANNUALLY			--	--	--	--	--	--
	11/08/02	MONITORED/SAMPLED ANNUALLY			--	--	--	--	--	--
	02/07/03	1.72	5.29	0.00	<50	<0.50	<0.50	<0.50	<1.5	<2.5
	05/09/03	MONITORED/SAMPLED ANNUALLY			--	--	--	--	--	--
MW-5										
3.61	06/04/92	3.25	0.36	--	560	110	0.5	37	2.2	--
	10/13/92	4.20	-0.59	--	1,200	150	<2.5	84	8.6	--
	01/11/93	1.30	2.31	--	1,300	48	1.0	83	33	--
	04/14/93	1.20	2.41	--	2,600	240	6.1	250	170	--
	07/13/93	3.15	0.46	--	1,700	260	7.8	160	100	--
	10/19/93	3.82	-0.21	--	1,900	190	3.3	200	93	--
7.04	11/30/93	3.56	3.48	--	--	--	--	--	--	--
	01/27/94	2.42	4.62	--	4,000	100	12	210	110	--
	04/07/94	2.33	4.71	--	2,600	170	10	150	88	--
	07/01/94	3.18	3.86	--	2,300	350	9.1	110	76	--
	10/05/94	3.98	3.06	--	11,000	840	150	130	340	--

**Table 1**  
**Groundwater Monitoring Data and Analytical Results**  
Former Chevron Service Station #9-1153  
3135 Gibbons Drive  
(3126 Fernside Boulevard)  
Alameda, California

WELL ID/ TOC* (ft.)	DATE	DTW (ft.)	GWE (msl)	SPHT (ft.)	TPH-G (ppb)	B (ppb)	T (ppb)	E (ppb)	X (ppb)	MTBE (ppb)	
MW-5 (cont)	01/12/95	0.40	6.64	--	2,300	82	<2.5	54	20	--	
	04/26/95	0.50	6.54	--	1,600	52	<5.0	36	61	--	
	07/12/95	2.41	4.63	--	2,800	150	<5.0	34	38	--	
	10/30/95	3.78	3.26	--	1,100	81	<5.0	<5.0	<5.0	35	
	01/22/96	0.78	6.26	--	880	7.3	<2.0	15	4.8	<10	
	04/24/96	1.65	5.39	--	1,600	51	3.8	14	5.6	56	
	07/29/96	INACCESSIBLE			--	--	--	--	--	--	--
	10/10/96	3.60	3.44	--	1,000	18	<1.2	1.5	<1.2	<6.2	
	01/15/97	0.45	6.59	--	520	0.84	<0.5	3.1	1.2	8.4	
	04/03/97	2.11	4.93	--	1,400	13	<2.0	4.3	8.4	32	
	07/09/97	3.71	3.33	--	810	3.6	0.97	<0.5	<0.5	9.7	
	10/29/97	4.20	2.84	--	<50	<0.5	<0.5	<0.5	<0.5	<2.5	
	01/14/98	0.00	7.04	--	430	5.8	2.4	<0.5	1.6	17	
	04/17/98	0.71	6.33	--	SAMPLED SEMI-ANNUALLY		--	--	--	--	--
	07/15/98	0.00	7.04	--	990	11	3.9	0.56	2.2	61	
	10/27/98	4.23	2.81	--	--	--	--	--	--	--	--
	01/20/99	2.58	4.46	--	168	<0.5	<0.5	<0.5	0.692	<2.0	
	04/19/99	2.07	4.97	--	--	--	--	--	--	--	--
	07/29/99	3.43	3.61	--	246	1.54	<0.5	<0.5	<0.5	<5.0/<2.0 <sup>2</sup>	
	10/13/99	INACCESSIBLE			--	--	--	--	--	--	--
	01/25/00	1.51	5.53	--	169	1.94	<0.5	<0.5	<0.5	201	
	04/03/00	1.20	5.84	0.00	--	--	--	--	--	--	--
	07/03/00	2.98	4.06	0.00	320 <sup>6,10</sup>	5.3	1.1	<0.50	<0.50	5.0	
	10/23/00	4.18	2.86	0.00	--	--	--	--	--	--	--
	01/08/01 <sup>11</sup>	2.92	4.12	0.00	220 <sup>6</sup>	3.9	<0.50	<0.50	<0.50	7.7	
	04/09/01	1.01	6.03	0.00	--	--	--	--	--	--	--
	08/23/01	3.48	3.56	0.00	630	40	3.5	<2.5	<2.5	43	
	11/27/01	3.05	3.99	0.00	SAMPLED SEMI-ANNUALLY		--	--	--	--	--
	02/26/02	1.00	6.04	0.00	410	4.3	<0.50	<0.50	<1.5	<2.5	
	05/23/02	2.21	4.83	0.00	SAMPLED SEMI-ANNUALLY		--	--	--	--	--
08/09/02	3.38	3.66	0.00	240	1.3	<0.50	<0.50	<1.5	<2.5		

**Table 1**  
**Groundwater Monitoring Data and Analytical Results**  
Former Chevron Service Station #9-1153  
3135 Gibbons Drive  
(3126 Fernside Boulevard)  
Alameda, California

WELL ID/ TOC*(ft.)	DATE	DTW (ft.)	GWE (msl)	SPHT (ft.)	TPH-G (ppb)	B (ppb)	T (ppb)	E (ppb)	X (ppb)	MTBE (ppb)
MW-5	11/08/02	4.56	2.48	0.00	SAMPLED SEMI-ANNUALLY		--	--	--	--
(cont)	02/07/03	1.42	5.62	0.00	380	3.2	<0.50	0.64	<1.5	<2.5
	05/09/03	1.25	5.79	0.00	SAMPLED SEMI-ANNUALLY		--	--	--	--
MW-6										
3.85	06/04/92	3.89	-0.04	--	210	54	<0.5	1.9	2.4	--
	10/13/92	4.56	-0.71	--	10,000	5,300	<10	70	<10	--
	01/11/93	2.36	1.49	--	100	50	<0.5	<0.5	<0.5	--
	04/14/93	3.15	0.70	--	<50	<0.5	<0.5	<0.5	<0.5	--
	07/13/93	3.94	-0.09	--	<50	1.8	<0.5	<0.5	<1.5	--
	10/19/93	4.40	-0.55	--	320	150	<0.5	0.8	<0.5	--
7.27	11/30/93	4.16	3.11	--	--	--	--	--	--	--
	01/27/94	3.33	3.94	--	120	45	<0.5	<0.5	<0.5	--
	04/07/94	3.43	3.84	--	<50	<0.5	<0.5	<0.5	<0.5	--
	07/01/94	3.94	3.33	--	<50	<0.5	<0.5	<0.5	<0.5	--
	10/05/94	4.38	2.89	--	8,300	-2,400	160	42	190	--
	01/12/95 <sup>1</sup>	2.43	4.84	--	<50	12	<0.5	<0.5	<0.5	--
	04/26/95	2.06	5.21	--	<50	5.5	0.67	<0.5	1.3	--
	07/12/95	3.53	3.74	--	65	27	<0.5	<0.5	<0.5	--
	10/30/95	4.34	2.93	--	<50	3.9	<0.5	<0.5	<0.5	<2.5
	01/22/96	2.61	4.66	--	<50	0.93	<0.5	<0.5	<0.5	<2.5
	04/24/96	2.50	4.77	--	260	110	<1.2	<1.2	<1.2	<6.2
	07/29/96	3.85	3.42	--	<50	23	<0.5	<0.5	<0.5	<2.5
	10/10/96	4.37	2.90	--	79	31	<0.5	<0.5	<0.5	<2.5
	01/15/97	2.63	4.64	--	<50	<0.5	<0.5	<0.5	<0.5	<2.5
	04/03/97	3.42	3.85	--	670	360	<5.0	<5.0	<5.0	<25
	07/09/97	4.29	2.98	--	330	140	<2.0	<2.0	<2.0	<10
	10/29/97	4.56	2.71	--	400	260	<2.0	<2.0	<2.0	5.8
	01/14/98	1.01	6.26	--	<50	<0.5	<0.5	<0.5	<0.5	<2.5
	04/17/98	2.94	4.33	--	<50	1.7	<0.5	<0.5	<0.5	<2.5
	07/15/98	4.72	2.55	--	<50	<0.5	<0.5	<0.5	<0.5	<2.5
	10/27/98	INACCESSIBLE		--	--	--	--	--	--	--

**Table 1**  
**Groundwater Monitoring Data and Analytical Results**  
 Former Chevron Service Station #9-1153  
 3135 Gibbons Drive  
 (3126 Fernside Boulevard)  
 Alameda, California

WELL ID/ TOC* (ft.)	DATE	DTW (ft.)	GWE (msl)	SPHT (ft.)	TPH-G (ppb)	B (ppb)	T (ppb)	E (ppb)	X (ppb)	MTBE (ppb)
MW-6 (cont)	11/25/98	4.16	3.11	--	110 <sup>3</sup>	54	<0.5	<0.5	<0.5	<2.5
	01/20/99	3.45	3.82	--	<50	10	<0.5	<0.5	<0.5	<2.0
	04/19/99	3.39	3.88	--	<50	2.6	<0.5	<0.5	<0.5	<2.5/<2.0 <sup>2</sup>
	07/29/99 <sup>4</sup>	4.34	2.93	--	<5,000	2,590	<50	<50	<50	<500
	10/13/99	5.89	1.38	--	9,270	4,610	44.2	<25	<25	<125
	01/25/00	4.11	3.16	--	529	289	<0.5	<0.5	<0.5	738
	04/03/00 <sup>7,R</sup>	2.84	4.43	0.00	<50	<0.50	<0.50	<0.50	<0.50	<2.5
	07/03/00 <sup>7</sup>	3.77	3.50	0.00	91 <sup>6</sup>	89	0.77	<0.50	<0.50	<2.5
	10/12/00	6.32	0.95	0.00	<50	8.0	<0.50	<0.50	<0.50	<2.5
	01/08/01 <sup>7,11</sup>	3.74	3.53	0.00	400 <sup>6</sup>	640	8.2	8.0	5.0	10
	04/09/01 <sup>7</sup>	3.03	4.24	0.00	91.3	22.0	3.36	0.751	2.14	<0.500
	08/23/01 <sup>7</sup>	4.70	2.57	0.00	53 <sup>13</sup>	23	0.50	<0.50	1.1	<2.5
	11/27/01 <sup>14</sup>	4.43	2.84	0.00	<50	4.1	<0.50	<0.50	<1.5	<2.5
	02/26/02 <sup>14</sup>	2.50	4.77	0.00	100	53	<0.50	<0.50	<1.5	<2.5
	05/23/02	3.27	4.00	0.00	610	260	4.2	1.7	2.1	<2.5
	08/09/02	4.11	3.16	0.00	<50	1.1	<0.50	<0.50	<1.5	<2.5
	11/08/02	4.12	3.15	0.00	<50	<0.50	<0.50	<0.50	<1.5	<2.5
	02/07/03	2.60	4.67	0.00	<50	0.65	<0.50	<0.50	<1.5	<2.5
	05/09/03	2.57	4.70	0.00	<50	1.9	<0.5	<0.5	<1.5	<2.5
	MW-7 8.22	11/30/93	5.33	2.89	--	480	110	41	4.4	38
01/27/94		4.50	3.72	--	120	21	1.1	2.2	4.8	--
04/07/94		4.62	3.60	--	2,600	630	39	56	94	--
07/01/94		5.13	3.09	--	2,200	770	42	<10	92	--
10/05/94		5.61	2.61	--	15,000	3,300	90	130	320	--
01/12/95		2.83	5.39	--	340	57	<1.3	18	6.4	--
04/26/95		2.35	5.87	--	15,000	3,700	210	520	800	--
07/12/95		4.66	3.56	--	7,700	1,800	59	130	370	--
10/30/95		5.48	2.74	--	770	260	<5.0	33	48	25
01/22/96		3.34	4.88	--	290	63	<1.0	6.4	5.7	<5.0
04/24/96		4.12	4.10	--	12,000	2,500	510	380	810	<125

**Table 1**  
**Groundwater Monitoring Data and Analytical Results**  
Former Chevron Service Station #9-1153  
3135 Gibbons Drive  
(3126 Fernside Boulevard)  
Alameda, California

WELL ID/ TOC* (ft.)	DATE	DTW (ft.)	GWE (msl)	SPHT (ft.)	TPH-G (ppb)	B (ppb)	T (ppb)	E (ppb)	X (ppb)	MTBE (ppb)
MW-7	07/29/96	5.03	3.19	--	2,600	650	<25	61	150	<125
(cont)	10/10/96	5.52	2.70	--	5,800	1,700	28	170	210	<62
	01/15/97	2.92	5.30	--	1,000	230	<2.5	28	11	63
	04/03/97	4.65	3.57	--	6,000	1,800	100	140	170	<100
	07/09/97	5.39	2.83	--	5,500	2,200	<20	41	30	<100
	10/29/97	5.58	2.64	--	220	40	0.61	3.0	2.4	7.6
	01/14/98	2.80	5.42	--	140	5.1	<0.5	<0.5	1.4	<2.5
	04/17/98	3.00	5.22	--	13,000	4,200	98	250	240	250
	07/15/98	INACCESSIBLE		--	--	--	--	--	--	--
7.92	08/17/98 <sup>5</sup>	5.52	2.40	--	1,600	380	51	68	280	22
	10/27/98	7.51	0.41	--	190	2.3	0.53	<0.5	<0.5	33
	01/20/99	3.45	4.47	--	<50	<0.5	<0.5	<0.5	<0.5	<2.0
	04/19/99	4.61	3.31	--	6,500	3,000	<0.5	110	210	310/150 <sup>2</sup>
	07/29/99 <sup>4</sup>	5.00	2.92	--	8,390	2,100	129	222	729	248
	10/13/99	5.61	2.31	--	14,300	6,600	58.8	117	190	<125
	01/25/00	3.32	4.60	--	1,100	184	<5.0	13.5	33.7	151
	04/03/00 <sup>7,9</sup>	3.38	4.54	0.00	2,600 <sup>6</sup>	780	12	<5.0	61	95
	07/03/00 <sup>7</sup>	4.34	3.58	0.00	4,100 <sup>6</sup>	2,600	72	240	690	<50
	10/23/00	6.11	1.81	0.00	12,000 <sup>6</sup>	2,600	<50	150	290	<250
	01/08/01 <sup>7,11</sup>	4.32	3.60	0.00	3,900 <sup>6</sup>	2,200	61	140	350	<25
	04/09/01 <sup>7</sup>	3.63	4.29	0.00	25,100	4,590	1,200	843	1,920	48.1
	08/23/01 <sup>7</sup>	4.83	3.09	0.00	27,000	4,100	970	1,100	3,500	<500
	11/27/01	4.30	3.62	0.00	12,000	1,800	50	450	830	91
	02/26/02	3.00	4.92	0.00	15,000	3,100	260	380	860	<10
	05/23/02	3.69	4.23	0.00	28,000	6,000	120	820	1,900	42
	08/09/02	4.38	3.54	0.00	24,000	3,700	81	710	1,300	56
	11/08/02	4.43	3.49	0.00	18,000	2,300	150	660	1,400	<100
	02/07/03	3.20	4.72	0.00	13,000	2,300	200	310	620	<25
	05/09/03	3.18	4.74	0.00	17,000	4,200	36	350	360	<50



**Table 1**  
**Groundwater Monitoring Data and Analytical Results**  
Former Chevron Service Station #9-1153  
3135 Gibbons Drive  
(3126 Fernside Boulevard)  
Alameda, California

WELL ID/ TOC*(ft.)	DATE	DTW (ft.)	GWE (msl)	SPHT (ft.)	TPH-G (ppb)	B (ppb)	T (ppb)	E (ppb)	X (ppb)	MTBE (ppb)
MW-8										
6.96	10/17/95	4.40	2.56	--	--	--	--	--	--	--
	10/30/95	4.44	2.52	--	<50	<0.5	<0.5	<0.5	<0.5	<2.5
	01/22/96	2.24	4.72	--	<50	<0.5	<0.5	<0.5	<0.5	<2.5
	04/24/96	2.97	3.99	--	<50	<0.5	<0.5	<0.5	<0.5	<2.5
	07/29/96	3.37	3.59	--	<50	<0.5	<0.5	<0.5	<0.5	<2.5
	10/10/96	4.12	2.84	--	<50	<0.5	<0.5	<0.5	<0.5	<2.5
	01/15/97	0.94	6.02	--	<50	<0.5	<0.5	<0.5	<0.5	<2.5
	04/03/97	2.20	4.76	--	<50	<0.5	<0.5	<0.5	<0.5	<2.5
	07/09/97	4.30	2.66	--	<50	<0.5	<0.5	<0.5	<0.5	<2.5
	10/29/97	4.57	2.39	--	<50	<0.5	<0.5	<0.5	<0.5	<2.5
	01/14/98	0.83	6.13	--	<50	<0.5	<0.5	<0.5	<0.5	<2.0
	01/20/99	2.69	4.27	--	<50	<0.5	<0.5	<0.5	<0.5	<2.5
	04/19/99	3.76	3.20	--	--	--	--	--	--	--
	01/25/00	1.41	5.55	--	<50	<0.5	<0.5	<0.5	<0.5	<2.5
	04/03/00	MONITORED/SAMPLED ANNUALLY			--	--	--	--	--	--
	07/03/00	--	--	--	--	--	--	--	--	--
	10/23/00	--	--	--	--	--	--	--	--	--
	01/08/01 <sup>11</sup>	3.58	3.38	0.00	<50	<0.50	<0.50	<0.50	<0.50	<2.5
	04/09/01	--	--	--	--	--	--	--	--	--
	08/23/01	MONITORED/SAMPLED ANNUALLY			--	--	--	--	--	--
	11/27/01	MONITORED/SAMPLED ANNUALLY			--	--	--	--	--	--
	02/26/02	2.91	4.05	0.00	<50	<0.50	<0.50	<0.50	<1.5	<2.5
	05/23/02	MONITORED/SAMPLED ANNUALLY			--	--	--	--	--	--
	08/09/02	MONITORED/SAMPLED ANNUALLY			--	--	--	--	--	--
	11/08/02	MONITORED/SAMPLED ANNUALLY			--	--	--	--	--	--
	02/07/03	3.13	3.83	0.00	<50	<0.50	<0.50	<0.50	<1.5	<2.5
	05/09/03	MONITORED/SAMPLED ANNUALLY			--	--	--	--	--	--

**Table 1**  
**Groundwater Monitoring Data and Analytical Results**  
Former Chevron Service Station #9-1153  
3135 Gibbons Drive  
(3126 Fernside Boulevard)  
Alameda, California

WELL ID/ TOC*(ft.)	DATE	DTW (ft.)	GWE (msl)	SPHT (ft.)	TPH-G (ppb)	B (ppb)	T (ppb)	E (ppb)	X (ppb)	MTBE (ppb)
MW-9										
7.21	10/17/95	4.80	2.41	--	--	--	--	--	--	--
	10/30/95	4.97	2.24	--	<50	<0.5	<0.5	<0.5	<0.5	<2.5
	01/22/96	3.40	3.81	--	<50	<0.5	<0.5	<0.5	<0.5	<2.5
	04/24/96	4.18	3.03	--	<50	<0.5	<0.5	<0.5	<0.5	<2.5
	07/29/96	4.69	2.52	--	<50	<0.5	<0.5	<0.5	<0.5	<2.5
	10/10/96	5.20	2.01	--	<50	<0.5	<0.5	<0.5	<0.5	<2.5
	01/15/97	3.31	3.90	--	<50	<0.5	<0.5	<0.5	<0.5	<2.5
	04/03/97	4.57	2.64	--	<50	<0.5	<0.5	<0.5	<0.5	<2.5
	07/09/97	5.04	2.17	--	<50	<0.5	<0.5	<0.5	<0.5	<2.5
	10/29/97	4.96	2.25	--	<50	<0.5	<0.5	<0.5	<0.5	<2.5
	01/14/98	2.40	4.81	--	<50	<0.5	<0.5	<0.5	<0.5	<2.5
	01/20/99	4.31	2.90	--	<50	<0.5	<0.5	<0.5	<0.5	<2.0
	04/19/99	3.92	3.29	--	--	--	--	--	--	--
	01/25/00	2.95	4.26	--	<50	<0.5	<0.5	<0.5	<0.5	<2.5
	04/03/00	MONITORED/SAMPLED ANNUALLY			--	--	--	--	--	--
	07/03/00	--	--	--	--	--	--	--	--	--
	10/23/00	--	--	--	--	--	--	--	--	--
	01/08/01 <sup>11</sup>	4.59	2.62	0.00	<50	<0.50	<0.50	<0.50	<0.50	<2.5
	04/09/01	--	--	--	--	--	--	--	--	--
	08/23/01	MONITORED/SAMPLED ANNUALLY			--	--	--	--	--	--
	11/27/01	MONITORED/SAMPLED ANNUALLY			--	--	--	--	--	--
	02/26/02	3.75	3.46	0.00	<50	<0.50	<0.50	<0.50	<1.5	<2.5
	05/23/02	MONITORED/SAMPLED ANNUALLY			--	--	--	--	--	--
	08/09/02	MONITORED/SAMPLED ANNUALLY			--	--	--	--	--	--
	11/08/02	MONITORED/SAMPLED ANNUALLY			--	--	--	--	--	--
	02/07/03	3.97	3.24	0.00	<50	<0.50	<0.50	<0.50	<1.5	<2.5
	05/09/03	MONITORED/SAMPLED ANNUALLY			--	--	--	--	--	--

**Table 1**  
**Groundwater Monitoring Data and Analytical Results**  
 Former Chevron Service Station #9-1153  
 3135 Gibbons Drive  
 (3126 Fernside Boulevard)  
 Alameda, California

WELL ID/ TOC* (ft.)	DATE	DTW (ft.)	GWE (msl)	SPHT (ft.)	TPH-G (ppb)	B (ppb)	T (ppb)	E (ppb)	X (ppb)	MTBE (ppb)	
MW-10											
7.28	10/17/95	5.05	2.23	--	--	--	--	--	--	5.1	
	10/30/95	5.11	2.17	--	<50	<0.5	<0.5	<0.5	<0.5	17	
	01/22/96	4.03	3.25	--	<50	<0.5	<0.5	<0.5	<0.5	12	
	04/24/96	4.30	2.98	--	<50	<0.5	<0.5	<0.5	<0.5	14	
	07/29/96	4.70	2.58	--	<50	<0.5	<0.5	<0.5	<0.5	<2.5	
	10/10/96	5.24	2.04	--	<50	<0.5	<0.5	<0.5	<0.5	<2.5	
	01/15/97	3.35	3.93	--	<50	<0.5	<0.5	<0.5	<0.5	8.2	
	04/03/97	4.64	2.64	--	<50	<0.5	<0.5	<0.5	<0.5	<2.5	
	07/09/97	5.12	2.16	--	<50	<0.5	<0.5	<0.5	<0.5	5.3	
	10/29/97	5.10	2.18	--	<50	<0.5	<0.5	<0.5	<0.5	8.6	
	01/14/98	3.08	4.20	--	<50	<0.5	<0.5	<0.5	<0.5	--	
	04/17/98	3.79	3.49	--	SAMPLED SEMI-ANNUALLY		--	--	--	7.5	
	07/15/98	4.55	2.73	--	<50	<0.5	<0.5	<0.5	<0.5	--	
	10/27/98	5.32	1.96	--	--	--	--	--	--	<2.0	
	01/20/99	4.24	3.04	--	<50	<0.5	<0.5	<0.5	<0.5	--	
	04/19/99	4.07	3.21	--	--	--	--	--	--	<5.0/2.4 <sup>2</sup>	
	07/29/99	4.82	2.46	--	<50	<0.5	<0.5	<0.5	<0.5	--	
	10/13/99	4.86	2.42	--	--	--	--	--	--	4.33	
	01/25/00	3.00	4.28	--	<50	<0.5	<0.5	<0.5	<0.5	--	
	04/03/00	3.04	4.24	0.00	--	--	--	--	--	4.7	
	07/03/00	4.00	3.28	0.00	<50	<0.50	<0.50	<0.50	<0.50	--	
	10/23/00	5.86	1.42	0.00	--	--	--	--	--	<2.5	
	01/08/01 <sup>11</sup>	3.98	3.30	0.00	<50	<0.50	<0.50	<0.50	<0.50	--	
	04/09/01	3.74	3.54	0.00	--	--	--	--	--	--	
	08/23/01	INACCESSIBLE - DUE TO TRAFFIC CONTROL				--	--	--	--	--	--
	11/27/01	4.13	3.15	0.00	SAMPLED SEMI-ANNUALLY		--	--	--	--	
	02/26/02	3.54	3.74	0.00	<50	<0.50	<0.50	<0.50	<1.5	<2.5	
	05/23/02	3.82	3.46	0.00	SAMPLED SEMI-ANNUALLY		--	--	--	--	
	08/09/02	4.18	3.10	0.00	<50	<0.50	<0.50	<0.50	<1.5	<2.5	
	11/08/02	3.91	3.37	0.00	SAMPLED SEMI-ANNUALLY		--	--	--	--	
	02/07/03	3.61	3.67	0.00	<50	<0.50	<0.50	<0.50	<1.5	<2.5	
	05/09/03	3.25	4.03	0.00	SAMPLED SEMI-ANNUALLY		--	--	--	--	

**Table 1**  
**Groundwater Monitoring Data and Analytical Results**  
Former Chevron Service Station #9-1153  
3135 Gibbons Drive  
(3126 Fernside Boulevard)  
Alameda, California

WELL ID/ TOC* (ft.)	DATE	DTW (ft.)	GWE (msl)	SPHT (ft.)	TPH-G (ppb)	B (ppb)	T (ppb)	E (ppb)	X (ppb)	MTBE (ppb)
TMW-1	11/11/93	--	--	--	<1.0	<0.5	<0.5	<0.5	<0.5	--
NOT MONITORED/SAMPLED										
<b>3115A GIBBONS DR.</b>										
	01/14/98	--	--	--	<50	<0.5	<0.5	<0.5	<0.5	<2.5
<b>Trip Blank</b>										
TB-LB	02/14/90	--	--	--	<50	<0.5	1.1	<0.5	<0.5	--
	09/06/91	--	--	--	<50	<0.5	<0.5	<0.5	<0.5	--
	12/15/91	--	--	--	<50	<0.5	<0.5	<0.5	<0.5	--
	03/03/92	--	--	--	<50	<0.5	<0.5	<0.5	<0.5	--
	06/04/92	--	--	--	<50	<0.5	<0.5	<0.5	<0.5	--
	10/13/92	--	--	--	<50	<0.5	<0.5	<0.5	<0.5	--
	01/11/93	--	--	--	<50	<0.5	<0.5	<0.5	<0.5	--
	04/14/93	--	--	--	<50	<0.5	<0.5	<0.5	<0.5	--
	07/13/93	--	--	--	<50	<0.5	<0.5	<0.5	<0.5	--
	10/19/93	--	--	--	<50	<0.5	<0.5	<0.5	<1.5	--
	01/27/94	--	--	--	<50	<0.5	<0.5	<0.5	<0.5	--
	04/07/94	--	--	--	<50	<0.5	<0.5	<0.5	<0.5	--
	07/01/94	--	--	--	<50	<0.5	<0.5	<0.5	<0.5	--
	10/05/94	--	--	--	<50	<0.5	<0.5	<0.5	<0.5	--
	01/12/95	--	--	--	<50	<0.5	<0.5	<0.5	<0.5	--
	04/26/95	--	--	--	<50	<0.5	<0.5	<0.5	<0.5	--
	07/12/95	--	--	--	<50	<0.5	<0.5	<0.5	<0.5	--
	10/30/95	--	--	--	<50	<0.5	<0.5	<0.5	<0.5	--
	01/22/96	--	--	--	<50	<0.5	<0.5	<0.5	<0.5	<2.5
	04/24/96	--	--	--	<50	<0.5	<0.5	<0.5	<0.5	<2.5
	07/29/96	--	--	--	<50	<0.5	<0.5	<0.5	<0.5	<2.5
	10/10/96	--	--	--	--	--	--	--	--	--
	01/15/97	--	--	--	<50	<0.5	<0.5	<0.5	<0.5	<2.5
	04/03/97	--	--	--	<50	<0.5	<0.5	<0.5	<0.5	<2.5

**Table 1**  
**Groundwater Monitoring Data and Analytical Results**  
Former Chevron Service Station #9-1153  
3135 Gibbons Drive  
(3126 Fernside Boulevard)  
Alameda, California

WELL ID/ TOC* (ft.)	DATE	DTW (ft.)	GWE (mst)	SPHT (ft.)	TPH-G (ppb)	B (ppb)	T (ppb)	E (ppb)	X (ppb)	MTBE (ppb)
					<50	<0.5	<0.5	<0.5	<0.5	<2.5
TB-LB	07/09/97	--	--	--	<50	<0.5	<0.5	<0.5	<0.5	<2.5
(cont)	10/29/97	--	--	--	<50	<0.5	<0.5	<0.5	<0.5	<2.5
	01/14/98	--	--	--	<50	<0.5	<0.5	<0.5	<0.5	<2.5
	04/17/98	--	--	--	<50	<0.5	<0.5	<0.5	<0.5	<2.5
	07/15/98	--	--	--	<50	<0.5	<0.5	<0.5	<0.5	<2.5
	10/27/98	--	--	--	<50	<0.5	<0.5	<0.5	<0.5	<2.0
	01/20/99	--	--	--	<50	<0.5	<0.5	<0.5	<0.5	<2.5
	04/19/99	--	--	--	<50	<0.5	<0.5	<0.5	<0.5	<5.0
	07/29/99	--	--	--	<50	<0.5	<0.5	<0.5	<0.5	<2.5
	10/13/99	--	--	--	<50	<0.5	<0.5	<0.5	<0.5	<2.5
	01/25/00	--	--	--	<50	<0.50	<0.50	<0.50	<0.50	<2.5
	04/03/00	--	--	--	<50	<0.50	<0.50	<0.50	<0.50	<2.5
	07/03/00	--	--	--	<50	<0.50	<0.50	<0.50	<0.50	<2.5
	10/23/00	--	--	--	<50	<0.50	<0.50	<0.50	<0.50	<2.5
	01/08/01 <sup>11</sup>	--	--	--	<50	<0.50	<0.50	<0.50	<0.50	<0.500
	04/09/01	--	--	--	<50.0	<0.500	<2.00	<0.500	<2.00	<2.5
QA	08/23/01	--	--	--	<50	<0.50	<0.50	<0.50	<1.5	<2.5
	11/27/01	--	--	--	<50	<0.50	<0.50	<0.50	<1.5	<2.5
	02/26/02	--	--	--	<50	<0.50	<0.50	<0.50	<1.5	<2.5
	05/23/02	--	--	--	<50	<0.50	<0.50	<0.50	<1.5	<2.5
	08/09/02	--	--	--	<50	<0.50	<0.50	<0.50	<1.5	<2.5
	11/08/02	--	--	--	<50	<0.50	<0.50	<0.50	<1.5	<2.5
	02/07/03	--	--	--	<50	<0.50	<0.50	<0.50	<1.5	<2.5
	05/09/03	--	--	--	<50	<0.5	<0.5	<0.5	<1.5	<2.5

**Table 1**  
**Groundwater Monitoring Data and Analytical Results**  
Former Chevron Service Station #9-1153  
3135 Gibbons Drive  
(3126 Fernside Boulevard)  
Alameda, California

**EXPLANATIONS:**

Groundwater monitoring data and laboratory analytical results prior to April 3, 2000, were compiled from reports prepared by Blaine Tech Services, Inc.

TOC = Top of Casing	TPH-G = Total Petroleum Hydrocarbons as Gasoline	(ppb) = Parts per billion
(ft.) = Feet	B = Benzene	-- = Not Measured/Not Analyzed
DTW = Depth to Water	T = Toluene	QA = Quality Assurance/Trip Blank
GWE = Groundwater Elevation	E = Ethylbenzene	
(msl) = Mean sea level	X = Xylenes	
SPHT = Separate Phase Hydrocarbon Thickness	MTBE = Methyl tertiary butyl ether	

- \* TOC elevations are referenced to msl.
- \*\* GWE has been corrected due to the presence of SPH; correction factor:  $[(TOC - DTW) + (SPHT \times 0.80)]$ .
- 1 Laboratory report indicates EPA 8010 were not detected (ND).
- 2 MTBE confirmed.
- 3 Chromatogram report indicates an unidentified hydrocarbon.
- 4 ORC installed.
- 5 TOC elevation altered due to well head maintenance.
- 6 Laboratory report indicates gasoline C6-C12.
- 7 ORC in well.
- 8 Laboratory report indicates Dissolved Oxygen was 1.50 parts per million (ppm) by EPA Method 360.1.
- 9 Laboratory report indicates Dissolved Oxygen was 0.300 ppm by EPA Method 360.1.
- 10 Laboratory report indicates sample originally shot in hold time at a raise D.L. re-analyzed and reported past hold time.
- 11 Laboratory report indicates this sample was analyzed outside of the EPA recommended holding time.
- 12 Laboratory report indicates unidentified hydrocarbons C6-C12.
- 13 Laboratory report indicates hydrocarbon pattern is present in the requested fuel quantitation range but does not resemble the pattern of the requested fuel.
- 14 ORC removed.

**Table 2**  
**Separate Phase Hydrocarbon Thickness/Removal Data**  
Former Chevron Service Station #9-1153  
3135 Gibbons Drive  
(3126 Fernside Boulevard)  
Alameda, California

WELL ID	DATE	DTW (ft.)	SPHT (ft.)	AMOUNT BAILED (Product + Water) (gallons)	TOTAL BAILED (Product + Water) (gallons)
C-1	08/18/86	4.10	--	--	--
	09/04/86	--	--	--	--
	07/22/87	--	--	--	--
	05/03/89	4.46	--	--	--
	12/04/89	4.16	--	--	--
	02/14/90	3.64	--	--	--
	03/07/90	3.36	--	--	--
	09/06/91	4.43	--	--	--
	12/15/91	4.78	--	--	--
	03/03/92	2.39	--	--	--
	06/04/92	4.08	--	--	--
	10/13/92	4.75	--	--	--
	01/11/93	2.26	Sheen	--	--
	04/14/93	2.90	Sheen	--	--
	07/13/93	3.97	Sheen	--	--
	10/19/93	4.50	--	--	--
	11/30/93	4.27	--	--	--
	01/27/94	3.35	--	--	--
	04/07/94	3.42	--	--	--
	07/01/94	3.96	--	--	--
	10/05/94	4.39	--	--	--
	01/12/95	1.52	0.50	0.26	0.26
	04/26/95	4.40	2.20	1.32	1.59
	07/12/95	4.85	1.81	0.66	2.25
	10/30/95	5.67	1.63	0.53	2.77
	01/04/96	3.92	0.12	0.26	3.04
	01/10/96	3.48	0.13	0.07	3.10
	01/17/96	3.40	0.02	0.40	3.50
	01/22/96	2.90	0.00	0.00	3.50
	02/23/96	4.10	1.86	0.66	4.16
	02/28/96	--	>0.83	1.25	5.41
	03/08/96	2.86	1.83	0.26	5.68
	03/08/96	2.30	0.36	0.53	6.20
	03/08/96	2.33	0.36	0.26	6.47
	03/08/96	2.28	0.22	0.53	7.00
	03/26/96	3.96	1.28	0.40	7.39
	04/11/96	5.61	1.75	0.53	7.92
	04/19/96	3.09	0.04	0.40	8.32
	04/24/96	3.04	0.03	0.40	8.71
	05/03/96	4.02	0.46	0.40	9.11
	05/03/96	3.89	0.47	0.00	9.11
	05/08/96	4.25	0.35	0.07	9.17
	05/17/96	3.24	0.04	0.03	9.20
	05/17/96	3.35	0.01	0.03	9.23

**Table 2**  
**Separate Phase Hydrocarbon Thickness/Removal Data**  
 Former Chevron Service Station #9-1153  
 3135 Gibbons Drive  
 (3126 Fernside Boulevard)  
 Alameda, California

WELL ID	DATE	DTW (ft.)	SPHT (ft.)	AMOUNT BAILED (Product + Water) (gallons)	TOTAL BAILED (Product + Water) (gallons)
C-1	05/17/96	3.43	0.01	0.03	9.26
(cont)	05/17/96	3.65	0.01	0.00	9.26
	05/22/96	3.10	0.07	0.08	9.34
	06/18/96	4.68	0.48	0.26	9.60
	07/03/96	5.03	0.13	0.15	9.75
	07/09/96	4.63	0.23	0.09	9.84
	07/17/96	4.73	0.15	0.32	10.16
	07/29/96	5.10	0.09	0.26	10.42
	08/02/96	5.68	0.03	0.03	10.45
	08/07/96	5.16	0.01	0.13	10.59
	08/23/96	5.75	0.03	0.03	10.61
	08/28/96	5.53	0.03	0.01	10.63
	09/06/96	5.38	--	0.05	10.67
	09/12/96	5.48	0.03	0.01	10.68
	09/19/96	6.32	0.03	0.01	10.69
	10/10/96	4.58	0.10	0.13	10.83
	10/17/96	5.61	0.01	0.01	10.84
	10/29/96	6.01	--	--	10.84
	11/07/96	5.56	0.04	0.13	10.97
	11/11/96	5.32	0.04	0.13	11.10
	12/20/96	3.33	0.03	0.05	11.16
	12/17/96	3.73	0.01	0.01	11.17
	01/15/97	2.74	--	--	11.17
	01/22/97	1.37	0.19	0.07	11.23
	02/04/97	2.98	0.51	0.15	11.38
	02/20/97	4.09	0.13	0.11	11.48
	03/06/97	3.75	0.56	1.19	12.67
	03/14/97	3.82	0.03	0.12	12.79
	03/20/97	3.73	0.03	0.01	12.80
	03/25/97	4.32	0.01	--	12.80
	03/31/97	3.71	0.03	0.00	12.81
	04/03/97	4.60	0.03	0.00	12.81
	04/09/97	4.25	0.02	0.03	12.84
	04/24/97	4.65	0.02	0.01	12.84
	04/30/97	3.50	0.02	0.01	12.85
	05/22/97	4.97	--	0.01	12.86
	06/03/97	3.62	0.06	0.01	12.86
	07/09/97	4.30	0.06	0.13	13.00
	08/12/97	5.18	0.00	0.05	13.05
	09/30/97	5.25	0.50	0.07	13.12
	10/29/97	5.33	0.03	0.02	13.14
	11/13/97	4.86	0.02	0.03	13.16
	12/18/97	2.34	--	--	13.16
	01/14/98	0.25	0.02	0.13	13.29



**Table 2**  
**Separate Phase Hydrocarbon Thickness/Removal Data**  
Former Chevron Service Station #9-1153  
3135 Gibbons Drive  
(3126 Fernside Boulevard)  
Alameda, California

WELL ID	DATE	DTW (ft.)	SPHT (ft.)	AMOUNT BAILED (Product + Water) (gallons)	TOTAL BAILED (Product + Water) (gallons)
C-1 (cont)	02/02/98	2.35	0.05	0.03	13.32
	03/16/98	2.50	0.50	0.13	13.45
	04/17/98	2.65	0.40	0.11	13.56
	05/01/98	2.39	0.04	0.26	13.82
	06/17/98	3.26	0.08	0.03	13.86
	07/15/98	3.55	--	--	13.86
	09/01/98	4.00	--	--	13.86
	10/27/98	4.48	--	--	13.86
	11/19/98	3.89	--	--	13.86
	12/19/98	2.13	0.02	0.04	13.90
	01/20/99	3.98	--	--	13.90
	02/24/99	2.55	--	--	13.90
	03/26/99	2.14	0.76	0.26	14.16
	04/19/99	1.04	--	--	14.16
	04/19/99	1.04	--	--	--
	07/29/99	3.76	0.02	0.01	14.17
	08/30/99	4.30	--	--	14.17
	09/23/99	3.84	0.02	0.03	14.20
	10/13/99	1.27	--	--	14.20
	11/17/99	3.59	--	--	--
	12/08/99	3.79	--	--	--
	01/25/00	1.99	0.04	0.03	14.23
	04/03/00	2.20	0.10	0.00	14.23
	05/26/00	2.52	0.23	0.26	14.49
	06/19/00 <sup>1</sup>	2.89	0.19	0.26	14.75
	07/03/00	3.45	0.25	0.26	15.01
	08/01/00	3.78	0.16	0.10	15.11
	09/30/00	4.03	0.04	0.26	15.37
	10/23/00	4.15	0.03	0.26	15.63
	11/21/00	3.42	0.00	0.26	15.89
	12/22/00	2.96	0.00	0.26	16.15
	01/08/01	2.94	0.00	0.26	16.41
02/17/01	2.09	0.59	0.26	16.67	
03/13/01	2.20	0.76	0.26	16.93	
04/09/01	2.45	0.26	0.26	17.19	
05/18/01	2.70	0.59	0.26	17.45	
06/12/01	3.50	0.97	0.26	17.71	
07/19/01	4.25	0.95	0.26	17.97	
08/23/01	4.34	0.07	0.26	18.23	
09/17/01	4.39	0.08	0.00	18.23	
10/08/01	4.45	0.04	0.02	18.25	
11/27/01	3.89	0.00	0.00	18.25	
12/17/01	1.81	0.00	0.00	18.25	

**Table 2**  
**Separate Phase Hydrocarbon Thickness/Removal Data**  
 Former Chevron Service Station #9-1153  
 3135 Gibbons Drive  
 (3126 Fernside Boulevard)  
 Alameda, California

<b>WELL ID</b>	<b>DATE</b>	<b>DTW (ft.)</b>	<b>SPHT (ft.)</b>	<b>AMOUNT BAILED (Product + Water) (gallons)</b>	<b>TOTAL BAILED (Product + Water) (gallons)</b>
C-1	01/07/02	2.27	0.51	1.50	19.75
(cont)	02/26/02	2.70	0.52	0.13	19.88
	03/27/02	2.87	1.05	0.26	20.14
	04/08/02	2.45	1.23	0.53	20.67
	05/23/02	3.57	0.52	0.12	20.79
	06/17/02	3.90	0.35	0.07	20.86
	07/31/02	4.12	0.20	0.02	20.88
	08/09/02	4.15	0.16	0.02	20.90
	09/17/02	4.33	0.12	0.01	20.91
	10/15/02	4.51	0.15	0.04	20.95
	11/08/02	4.11	0.00	0.00	20.95
	12/19/02	1.14	0.00	0.00	20.95
	01/14/03	1.80	0.00	0.00	20.95
	02/07/03	2.95	0.30	0.05	21.00
	03/20/03	2.86	0.41	0.13	21.13
	04/15/03	2.12	0.10	0.03	21.16
	05/09/03	2.95	0.70	0.22	21.38

**Table 2**  
**Separate Phase Hydrocarbon Thickness/Removal Data**  
Former Chevron Service Station #9-1153  
3135 Gibbons Drive  
(3126 Fernside Boulevard)  
Alameda, California

---

**EXPLANATIONS:**

Groundwater monitoring data prior to July 3, 2000, were compiled from reports prepared by Blaine Tech Services, Inc.

DTW = Depth to Water

(ft.) = Feet

SPHT = Separate Phase Hydrocarbon Thickness

-- = Not Measured

1 There is no skimmer present in this well.

**Table 3**  
**Dissolved Oxygen Concentrations**  
Former Chevron Service Station #9-1153  
3135 Gibbons Drive  
(3126 Fernside Boulevard)  
Alameda, California

WELL ID	DATE	PRE-PURGE (mg/L)	POST-PURGE (mg/L)
MW-6	11/08/02	2.10	--
	02/07/03	2.60	--
	05/09/03	3.10	--
MW-7	11/08/02	98.00 <sup>1</sup>	--
	02/07/03	2.90	--
	05/09/03	2.60	--

**EXPLANATIONS:**

mg/L = milligrams per liter

-- = Not Measured

<sup>1</sup> Below D.O. meter range.

## STANDARD OPERATING PROCEDURE - GROUNDWATER SAMPLING

Gettler-Ryan Inc. field personnel adhere to the following procedures for the collection and handling of groundwater samples prior to analysis by the analytical laboratory. Prior to sample collection, the type of analysis to be performed is determined. Loss prevention of volatile compounds is controlled and sample preservation for subsequent analysis is maintained.

Prior to sampling, the presence or absence of free-phase hydrocarbons is determined using an interface probe. Product thickness, if present, is measured to the nearest 0.01 foot and is noted in the field notes. In addition, all depth to water level measurements are collected with a static water level indicator and are also recorded in the field notes, prior to purging and sampling any wells.

After water levels are collected and prior to sampling, if purging is to occur, each well is purged a minimum of three well casing volumes of water using pre-cleaned pumps (stack, suction, Grundfos), or disposable bailers. Temperature, pH and electrical conductivity are measured a minimum of three times during the purging. Purging continues until these parameters stabilize.

Groundwater samples are collected using disposable bailers. The water samples are transferred from the bailer into appropriate containers. Pre-preserved containers, supplied by analytical laboratories, are used when possible. When pre-preserved containers are not available, the laboratory is instructed to preserve the sample as appropriate. Duplicate samples are collected for the laboratory to use in maintaining quality assurance/quality control standards. The samples are labeled to include the job number, sample identification, collection date and time, analysis, preservation (if any), and the sample collector's initials. The water samples are placed in a cooler, maintained at 4°C for transport to the laboratory. Once collected in the field, all samples are maintained under chain of custody until delivered to the laboratory.

The chain of custody document includes the job number, type of preservation, if any, analysis requested, sample identification, date and time collected, and the sample collector's name. The chain of custody is signed and dated (including time of transfer) by each person who receives or surrenders the samples, beginning with the field personnel and ending with the laboratory personnel.

A laboratory supplied trip blank accompanies each sampling set. For sampling sets greater than 20 samples, 5% trip blanks are included. The trip blank is analyzed for some or all of the same compounds as the groundwater samples.

As requested by Chevron Products Company, the purge water and decontamination water generated during sampling activities is transported by IWM to McKittrick Waste Management located in McKittrick, California.

**CHEVRON SERVICE STATION #9-1153**  
**Alameda, CA**

**MONTHLY MONITORING EVENT**  
**Of March 20, 2003**



# GETTLER-RYAN INC.

## WELL MONITORING/SAMPLING FIELD DATA SHEET

Client/Facility #: ChevronTexaco #9-1153 Job Number: 386423  
 Site Address: 3135 Gibbons Dr.(3126 Fernside Dr.) Event Date: 3.20.03 (inclusive)  
 City: Alameda, CA Sampler: FT

Well ID: C-1  
 Well Diameter: 3 in.  
 Total Depth: 16.70 ft.  
 Depth to Water: 2.86 ft.

Date Monitored: 3.20.03 Well Condition: OK

Volume	3/4"= 0.02	1"= 0.04	2"= 0.17	3"= 0.38
Factor (VF)	4"= 0.66	5"= 1.02	6"= 1.50	12"= 5.80

N/A xVF \_\_\_\_\_ = \_\_\_\_\_ x3 (case volume) = Estimated Purge Volume: \_\_\_\_\_ gal.

### Purge Equipment:

Disposable Bailer   
 Stainless Steel Bailer \_\_\_\_\_  
 Stack Pump \_\_\_\_\_  
 Suction Pump \_\_\_\_\_  
 Grundfos \_\_\_\_\_  
 Other: \_\_\_\_\_

### Sampling Equipment:

Disposable Bailer \_\_\_\_\_  
 Pressure Bailer \_\_\_\_\_  
 Discrete Bailer \_\_\_\_\_  
 Other: \_\_\_\_\_

Time Started: 1520 (2400 hrs)  
 Time Bailed: 1528 (2400 hrs)  
 Depth to Product: 2.45 ft  
 Depth to Water: 2.96 ft  
 Hydrocarbon Thickness: .41 ft  
 Visual Confirmation/Description:  
YES | BLACK  
 Skimmer / Absorbent Sock (circle one)  
 Amt Removed from Skimmer: \_\_\_\_\_ gal  
 Amt Removed from Well: 500 ML gal  
 Product Transferred to: CONTAINER

Start Time (purge): \_\_\_\_\_ Weather Conditions: SUNNY  
 Sample Time/Date: / / Water Color: \_\_\_\_\_ Odor: \_\_\_\_\_  
 Purging Flow Rate: \_\_\_\_\_ gpm. Sediment Description: \_\_\_\_\_  
 Did well de-water? / If yes, Time: \_\_\_\_\_ Volume: \_\_\_\_\_ gal.

Time (2400 hr.)	Volume (gal.)	pH	Conductivity (umhos/cm)	Temperature (C/F)	D.O. (mg/L)	ORP (mV)
_____	_____	_____	_____	_____	_____	_____
_____	_____	_____	_____	_____	_____	_____
_____	_____	_____	_____	_____	_____	_____
_____	_____	_____	_____	_____	_____	_____

### LABORATORY INFORMATION

SAMPLE ID	(#) CONTAINER	REFRIG.	PRESERV. TYPE	LABORATORY	ANALYSES
_____	_____	_____	_____	_____	_____
_____	_____	_____	_____	_____	_____
_____	_____	_____	_____	_____	_____
_____	_____	_____	_____	_____	_____
_____	_____	_____	_____	_____	_____

### COMMENTS:

Add/Replaced Lock: \_\_\_\_\_

Add/Replaced Plug: \_\_\_\_\_ Size: \_\_\_\_\_

**CHEVRON SERVICE STATION #9-1153**  
*Alameda, CA*

**MONTHLY MONITORING EVENT**  
*Of April 15, 2003*





# GETTLER - RYAN INC.

## WELL MONITORING/SAMPLING FIELD DATA SHEET

Client/Facility #: ChevronTexaco #9-1153  
 Site Address: 3135 Gibbons Dr.(3126 Fernside Dr.)  
 City: Alameda, CA

Job Number: 386423  
 Event Date: 4.15.03 (inclusive)  
 Sampler: FT

Well ID: C-1  
 Well Diameter: 3 in.  
 Total Depth: 16.70 ft.  
 Depth to Water: 2.12 ft.  
NA xVF = \_\_\_\_\_

Date Monitored: 4.15.03 Well Condition: OK!

Volume	3/4"= 0.02	1"= 0.04	2"= 0.17	3"= 0.38
Factor (VF)	4"= 0.66	5"= 1.02	6"= 1.50	12"= 5.80

\_\_\_\_\_ x3 (case volume) = Estimated Purge Volume: \_\_\_\_\_ gal.

Purge Equipment:  
 Disposable Bailer   
 Stainless Steel Bailer \_\_\_\_\_  
 Stack Pump \_\_\_\_\_  
 Suction Pump \_\_\_\_\_  
 Grundfos \_\_\_\_\_  
 Other: \_\_\_\_\_

Sampling Equipment:  
 Disposable Bailer \_\_\_\_\_  
 Pressure Bailer \_\_\_\_\_  
 Discrete Bailer \_\_\_\_\_  
 Other: \_\_\_\_\_

Time Started: \_\_\_\_\_ (2400 hrs)  
 Time Bailed: \_\_\_\_\_ (2400 hrs)  
 Depth to Product: 2.02 ft.  
 Depth to Water: 2.12 ft.  
 Hydrocarbon Thickness: .10 ft.  
 Visual Confirmation/Description:  
Yes! OK!  
 Skimmer / Absorbant Sock (circle one)  
 Amt Removed from Skimmer: \_\_\_\_\_ gal  
 Amt Removed from Well: 100 ml gal  
 Product Transferred to: CONTAINER

Start Time (purge): \_\_\_\_\_  
 Sample Time/Date: 1 \_\_\_\_\_  
 Purging Flow Rate: \_\_\_\_\_ gpm.  
 Did well de-water?  If yes, Time: \_\_\_\_\_  
 Weather Conditions: \_\_\_\_\_  
 Water Color: \_\_\_\_\_  
 Sediment Description: \_\_\_\_\_  
 Volume: \_\_\_\_\_ gal.

Time (2400 hr.)	Volume (gal.)	pH	Conductivity (umhos/cm)	Temperature (C/F)	D.O. (mg/L)	ORP (mV)

### LABORATORY INFORMATION

SAMPLE ID	(#) CONTAINER	REFRIG.	PRESERV. TYPE	LABORATORY	ANALYSES

COMMENTS: \_\_\_\_\_  
 \_\_\_\_\_  
 \_\_\_\_\_

Add/Replaced Lock: \_\_\_\_\_

Add/Replaced Plug: \_\_\_\_\_ Size: \_\_\_\_\_

**CHEVRON SERVICE STATION #9-1153**  
**Alameda, CA**

**QUARTERLY MONITORING & SAMPLING EVENT**  
**Of May 9, 2003**



# GETTLER - RYAN INC.

## WELL MONITORING/SAMPLING FIELD DATA SHEET

Client/Facility #: ChevronTexaco #9-1153 Job Number: 386423  
 Site Address: 3135 Gibbons Dr.(3126 Fernside Dr.) Event Date: 5.9.03 (inclusive)  
 City: Alameda, CA Sampler: FT

Well ID: C-1 Date Monitored: 5.9.03 Well Condition: OK  
 Well Diameter: 2 1/3 in.  
 Total Depth: 16.70 ft.  
 Depth to Water: 2.95 ft.  
NA xVF = \_\_\_\_\_ x3 (case volume) = Estimated Purge Volume: \_\_\_\_\_ gal.

Volume	3/4"= 0.02	1"= 0.04	2"= 0.17	3"= 0.38
Factor (VF)	4"= 0.66	5"= 1.02	6"= 1.50	12"= 5.80

**Purge Equipment:**  
 Disposable Bailer   
 Stainless Steel Bailer \_\_\_\_\_  
 Stack Pump \_\_\_\_\_  
 Suction Pump \_\_\_\_\_  
 Grundfos \_\_\_\_\_  
 Other: \_\_\_\_\_

**Sampling Equipment:**  
 Disposable Bailer \_\_\_\_\_  
 Pressure Bailer \_\_\_\_\_  
 Discrete Bailer \_\_\_\_\_  
 Other: \_\_\_\_\_

Time Started: \_\_\_\_\_ (2400 hrs)  
 Time Bailed: \_\_\_\_\_ (2400 hrs)  
 Depth to Product: 2.25 ft  
 Depth to Water: 2.95 ft  
 Hydrocarbon Thickness: .70 ft  
 Visual Confirmation/Description:  
YES / BLACK  
 Skimmer / Absorbant Sock (circle one)  
 Amt Removed from Skimmer: \_\_\_\_\_ gal  
 Amt Removed from Well: 850 mL gal  
 Product Transferred to: CONTAINER

Start Time (purge): \_\_\_\_\_ Weather Conditions: \_\_\_\_\_  
 Sample Time/Date: 1 Water Color: \_\_\_\_\_ Odor: \_\_\_\_\_  
 Purging Flow Rate: \_\_\_\_\_ gpm. Sediment Description: \_\_\_\_\_  
 Did well de-water? \_\_\_\_\_ If yes, Time: \_\_\_\_\_ Volume: \_\_\_\_\_ gal.

Time (2400 hr.)	Volume (gal.)	pH	Conductivity (umhos/cm)	Temperature (C/F)	D.O. (mg/L)	ORP (mV)
					<u>Pre:</u>	

### LABORATORY INFORMATION

SAMPLE ID	(#) CONTAINER	REFRIG.	PRESERV. TYPE	LABORATORY	ANALYSES
	<u>x voc vial</u>	<u>YES</u>	<u>HCL</u>	<u>LANCASTER</u>	<u>TPH-G(8015)/BTEX+MTBE(8021)</u>

COMMENTS: \_\_\_\_\_  
 \_\_\_\_\_  
 \_\_\_\_\_

Add/Replaced Lock: \_\_\_\_\_ Add/Replaced Plug: \_\_\_\_\_ Size: \_\_\_\_\_



# GETTLER - RYAN INC.

## WELL MONITORING/SAMPLING FIELD DATA SHEET

Client/Facility #: ChevronTexaco #9-1153 Job Number: 386423  
 Site Address: 3135 Gibbons Dr.(3126 Fernside Dr.) Event Date: 5.9.03 (inclusive)  
 City: Alameda, CA Sampler: FT

Well ID: MW-5 Date Monitored: 5.9.03 Well Condition: OK  
 Well Diameter: 2 1/3 in.  
 Total Depth: 12.60 ft.  
 Depth to Water: 1.25 ft.  
N/A xVF = \_\_\_\_\_ x3 (case volume) = Estimated Purge Volume: \_\_\_\_\_ gal.

Volume	3/4"= 0.02	1"= 0.04	2"= 0.17	3"= 0.38
Factor (VF)	4"= 0.66	5"= 1.02	6"= 1.50	12"= 5.80

**Purge Equipment:**  
 Disposable Bailer \_\_\_\_\_  
 Stainless Steel Bailer \_\_\_\_\_  
 Stack Pump \_\_\_\_\_  
 Suction Pump \_\_\_\_\_  
 Grundfos \_\_\_\_\_  
 Other: \_\_\_\_\_

**Sampling Equipment:**  
 Disposable Bailer \_\_\_\_\_  
 Pressure Bailer \_\_\_\_\_  
 Discrete Bailer \_\_\_\_\_  
 Other: \_\_\_\_\_

Time Started: \_\_\_\_\_ (2400 hrs)  
 Time Bailed: \_\_\_\_\_ (2400 hrs)  
 Depth to Product: \_\_\_\_\_ ft  
 Depth to Water: \_\_\_\_\_ ft  
 Hydrocarbon Thickness: \_\_\_\_\_ ft  
 Visual Confirmation/Description: \_\_\_\_\_  
 Skimmer / Absorbent Sock (circle one)  
 Amt Removed from Skimmer: \_\_\_\_\_ gal  
 Amt Removed from Well: \_\_\_\_\_ gal  
 Product Transferred to: \_\_\_\_\_

Start Time (purge): \_\_\_\_\_ Weather Conditions: \_\_\_\_\_  
 Sample Time/Date: 5/9/03 Water Color: \_\_\_\_\_ Odor: \_\_\_\_\_  
 Purging Flow Rate: \_\_\_\_\_ gpm. Sediment Description: \_\_\_\_\_  
 Did well de-water? \_\_\_\_\_ If yes, Time: \_\_\_\_\_ Volume: \_\_\_\_\_ gal.

Time (2400 hr.)	Volume (gal.)	pH	Conductivity (umhos/cm)	Temperature (C/F)	D.O. (mg/L)	ORP (mV)
					Pre:	

### LABORATORY INFORMATION

SAMPLE ID	(#) CONTAINER	REFRIG.	PRESERV. TYPE	LABORATORY	ANALYSES
-	x voa vial	YES	HCL	LANCASTER	TPH-G(8015)/BTEX+MTBE(8021)

COMMENTS: "MONITORED ONLY"

Add/Replaced Lock: \_\_\_\_\_ Add/Replaced Plug: \_\_\_\_\_ Size: \_\_\_\_\_



# GETTLER - RYAN INC.

## WELL MONITORING/SAMPLING FIELD DATA SHEET

Client/Facility #: ChevronTexaco #9-1153 Job Number: 386423  
 Site Address: 3135 Gibbons Dr.(3126 Fernside Dr.) Event Date: 5.9.03 (inclusive)  
 City: Alameda, CA Sampler: FT

Well ID: MW - 6 Date Monitored: 5.9.03 Well Condition: ok

Well Diameter: 2 1/3 in.  
 Total Depth: 13.35 ft.  
 Depth to Water: 2.57 ft.

Volume	3/4"= 0.02	1"= 0.04	2"= 0.17	3"= 0.38
Factor (VF)	4"= 0.66	5"= 1.02	6"= 1.50	12"= 5.80

10.78 xVF .17 = 1.83 x3 (case volume) = Estimated Purge Volume: 5.49 gal.

### Purge Equipment:

Disposable Bailer   
 Stainless Steel Bailer \_\_\_\_\_  
 Stack Pump \_\_\_\_\_  
 Suction Pump \_\_\_\_\_  
 Grundfos \_\_\_\_\_  
 Other: \_\_\_\_\_

### Sampling Equipment:

Disposable Bailer   
 Pressure Bailer \_\_\_\_\_  
 Discrete Bailer \_\_\_\_\_  
 Other: \_\_\_\_\_

Time Started: \_\_\_\_\_ (2400 hrs)  
 Time Bailed: \_\_\_\_\_ (2400 hrs)  
 Depth to Product: \_\_\_\_\_ ft  
 Depth to Water: \_\_\_\_\_ ft  
 Hydrocarbon Thickness: \_\_\_\_\_ ft  
 Visual Confirmation/Description: \_\_\_\_\_  
 Skimmer / Absorbant Sock (circle one)  
 Amt Removed from Skimmer: \_\_\_\_\_ gal  
 Amt Removed from Well: \_\_\_\_\_ gal  
 Product Transferred to: \_\_\_\_\_

Start Time (purge): 10:31 Weather Conditions: SUNNY  
 Sample Time/Date: 10:48 / 5.9.03 Water Color: CLEAR Odor: SLIGHT  
 Purging Flow Rate: / gpm. Sediment Description: \_\_\_\_\_  
 Did well de-water? NO If yes, Time: \_\_\_\_\_ Volume: \_\_\_\_\_ gal.

Time (2400 hr.)	Volume (gal.)	pH	Conductivity (umhos/cm)	Temperature (°F)	D.O. (mg/L)	ORP (mV)
<u>10:34</u>	<u>2.0</u>	<u>7.48</u>	<u>70.0</u>	<u>16.5</u>	<u>Pre: 3.1</u>	
<u>10:37</u>	<u>4.0</u>	<u>7.22</u>	<u>68.1</u>	<u>16.4</u>		
<u>10:41</u>	<u>5.5</u>	<u>7.19</u>	<u>65.4</u>	<u>16.6</u>		

### LABORATORY INFORMATION

SAMPLE ID	(#) CONTAINER	REFRIG.	PRESERV. TYPE	LABORATORY	ANALYSES
<u>MW - 6</u>	<u>3</u> x voa vial	<u>YES</u>	<u>HCL</u>	<u>LANCASTER</u>	<u>TPH-G(8015)/BTEX+MTBE(8021)</u>

### COMMENTS:

Add/Replaced Lock: \_\_\_\_\_ Add/Replaced Plug: \_\_\_\_\_ Size: \_\_\_\_\_



# GETTLER - RYAN INC.

## WELL MONITORING/SAMPLING FIELD DATA SHEET

Client/Facility #: ChevronTexaco #9-1153 Job Number: 386423  
 Site Address: 3135 Gibbons Dr.(3126 Fernside Dr.) Event Date: 5.9.03 (inclusive)  
 City: Alameda, CA Sampler: FT

Well ID: MW - 7 Date Monitored: 5.9.03 Well Condition: OK  
 Well Diameter: 2 1/3 in.  
 Total Depth: 11.83 ft.  
 Depth to Water: 3.18 ft.  
8.65 xVF .17 = 1.47 x3 (case volume) = Estimated Purge Volume: 4.41 gal.

Volume	3/4" = 0.02	1" = 0.04	2" = 0.17	3" = 0.38
Factor (VF)	4" = 0.66	5" = 1.02	6" = 1.50	12" = 5.80

### Purge Equipment:

Disposable Bailer   
 Stainless Steel Bailer \_\_\_\_\_  
 Stack Pump \_\_\_\_\_  
 Suction Pump \_\_\_\_\_  
 Grundfos \_\_\_\_\_  
 Other: \_\_\_\_\_

### Sampling Equipment:

Disposable Bailer   
 Pressure Bailer \_\_\_\_\_  
 Discrete Bailer \_\_\_\_\_  
 Other: \_\_\_\_\_

Time Started: \_\_\_\_\_ (2400 hrs)  
 Time Bailed: \_\_\_\_\_ (2400 hrs)  
 Depth to Product: \_\_\_\_\_ ft  
 Depth to Water: \_\_\_\_\_ ft  
 Hydrocarbon Thickness: \_\_\_\_\_ ft  
 Visual Confirmation/Description: \_\_\_\_\_  
 Skimmer / Absorbant Sock (circle one)  
 Amt Removed from Skimmer: \_\_\_\_\_ gal  
 Amt Removed from Well: \_\_\_\_\_ gal  
 Product Transferred to: \_\_\_\_\_

Start Time (purge): 10:58 Weather Conditions: SUNNY  
 Sample Time/Date: 11:06 / 5.9.03 Water Color: CLOUDY / GREY Odor: YES / STRONG  
 Purging Flow Rate: 1 gpm. Sediment Description: SILTY  
 Did well de-water? YES If yes, Time: 11:02 Volume: 1.0 gal.

Time (2400 hr.)	Volume (gal.)	pH	Conductivity (umhos/cm)	Temperature (°F)	D.O. (mg/L)	ORP (mV)
<u>11:02</u>	<u>1.5</u>	<u>7.11</u>	<u>105.0</u>	<u>17.7</u>	<u>Pre: 2.6</u>	
	<u>3.0</u>					
	<u>4.0</u>					

### LABORATORY INFORMATION

SAMPLE ID	(#) CONTAINER	REFRIG.	PRESERV. TYPE	LABORATORY	ANALYSES
<u>MW - 7</u>	<u>3</u> x voa vial	<u>YES</u>	<u>HCL</u>	<u>LANCASTER</u>	<u>TPH-G(8015)/BTEX+MTBE(8021)</u>

### COMMENTS:

Add/Replaced Lock: \_\_\_\_\_

Add/Replaced Plug: \_\_\_\_\_ Size: \_\_\_\_\_



# GETTLER - RYAN INC.

## WELL MONITORING/SAMPLING FIELD DATA SHEET

Client/Facility #: ChevronTexaco #9-1153 Job Number: 386423  
 Site Address: 3135 Gibbons Dr.(3126 Fernside Dr.) Event Date: 5.9.03 (inclusive)  
 City: Alameda, CA Sampler: ET

Well ID: MW - 10 Date Monitored: 5.9.03 Well Condition: OK  
 Well Diameter: 2 1/3 in.  
 Total Depth: 9.05 ft.  
 Depth to Water: 3.25 ft.  
NA xVF \_\_\_\_\_ = \_\_\_\_\_ x3 (case volume) = Estimated Purge Volume: \_\_\_\_\_ gal.

Volume	3/4"= 0.02	1"= 0.04	2"= 0.17	3"= 0.38
Factor (VF)	4"= 0.66	5"= 1.02	6"= 1.50	12"= 5.80

### Purge Equipment:

Disposable Bailer \_\_\_\_\_  
 Stainless Steel Bailer \_\_\_\_\_  
 Stack Pump \_\_\_\_\_  
 Suction Pump \_\_\_\_\_  
 Grundfos \_\_\_\_\_  
 Other: \_\_\_\_\_

### Sampling Equipment:

Disposable Bailer \_\_\_\_\_  
 Pressure Bailer \_\_\_\_\_  
 Discrete Bailer \_\_\_\_\_  
 Other: \_\_\_\_\_

Time Started: \_\_\_\_\_ (2400 hrs)  
 Time Bailed: \_\_\_\_\_ (2400 hrs)  
 Depth to Product: \_\_\_\_\_ ft  
 Depth to Water: \_\_\_\_\_ ft  
 Hydrocarbon Thickness: \_\_\_\_\_ ft  
 Visual Confirmation/Description: \_\_\_\_\_  
 Skimmer / Absorbent Sock (circle one)  
 Amt Removed from Skimmer: \_\_\_\_\_ gal  
 Amt Removed from Well: \_\_\_\_\_ gal  
 Product Transferred to: \_\_\_\_\_

Start Time (purge): \_\_\_\_\_ Weather Conditions: \_\_\_\_\_  
 Sample Time/Date: \_\_\_\_\_ / \_\_\_\_\_ Water Color: \_\_\_\_\_ Odor: \_\_\_\_\_  
 Purging Flow Rate: \_\_\_\_\_ gpm. Sediment Description: \_\_\_\_\_  
 Did well de-water? \_\_\_\_\_ If yes, Time: \_\_\_\_\_ Volume: \_\_\_\_\_ gal.

Time (2400 hr.)	Volume (gal.)	pH	Conductivity (umhos/cm)	Temperature (C/F)	D.O. (mg/L)	ORP (mV)
					Pre:	

### LABORATORY INFORMATION

SAMPLE ID	(#) CONTAINER	REFRIG.	PRESERV. TYPE	LABORATORY	ANALYSES
	x voa vial	YES	HCL	LANCASTER	TPH-G(8015)/BTEX+MTBE(8021)

COMMENTS: "MONITORED ONLY"

Add/Replaced Lock: \_\_\_\_\_ Add/Replaced Plug: \_\_\_\_\_ Size: \_\_\_\_\_

# Chevron California Region Analysis Request/Chain of Custody



For Lancaster Laboratories use only  
 Acc. #: 10904 Sample #: 4043231-33 ser#: PS1723

051203-007

Facility #: SS#9-1153 G-R#386423 Global ID#T0800100330  
 Site Address: 3135 GIBBONS DRIVE (Former 3126 Fernside Dr.), ALAMEDA, CA  
 Chevron PM: KS Lead Consultant: CAMBRIA  
 Consultant/Office: G-R, Inc., 6747 Sierra Court, Suite J, Dublin, Ca. 94568  
 Consultant Prj. Mgr.: Deanna L. Harding (deanna@grinc.com)  
 Consultant Phone #: 925-551-7555 Fax #: 925-551-7899  
 Sampler: FRANK TERRONDI  
 Service Order #: \_\_\_\_\_  Non SAR:

Matrix		Analyses Requested									
		Preservation Codes									
Soil	Water	Oil	TPH 8015 MOD GRO	TPH 8015 MOD DRO	8260 full scan	Organates	Lead 7420	8021	8022	8023	8024
<input type="checkbox"/> Potable <input type="checkbox"/> NPDES	<input type="checkbox"/>	<input type="checkbox"/>	<input checked="" type="checkbox"/>	<input type="checkbox"/>	<input type="checkbox"/>	<input type="checkbox"/>	<input type="checkbox"/>	<input type="checkbox"/>	<input type="checkbox"/>	<input type="checkbox"/>	<input type="checkbox"/>

**Preservative Codes**  
 H = HCl      T = Thiosulfate  
 N = HNO<sub>3</sub>      B = NaOH  
 S = H<sub>2</sub>SO<sub>4</sub>      O = Other

J value reporting needed  
 Must meet lowest detection limits possible for 8260 compounds

8021 MTBE Confirmation  
 Confirm highest hit by 8260  
 Confirm all hits by 8260  
 Run \_\_\_ oxy s on highest hit  
 Run \_\_\_ oxy s on all hits

Sample Identification	Date Collected	Time Collected	Grab	Composite	Soil	Water	Oil	Air	Total Number of Containers	8260	TPH 8015 MOD GRO	TPH 8015 MOD DRO	8260 full scan	Organates	Lead 7420	8021	8022	8023	8024	
QA	5.9.03								2	X	X									
MW-6	↓	10:48	X						3	X	X									
MW-7	↓	11:06	X						3	X	X									

**Comments / Remarks**

Turnaround Time Requested (TAT) (please circle)

STD. TAT      72 hour      48 hour  
 24 hour      4 day      5 day

Data Package Options (please circle if required)

QC Summary      Type I — Full  
 Type VI (Raw Data)       Coeff Deliverable not needed  
 WIP (RWQCB)  
 Disk

Relinquished by: <u>Frank Ter...</u>	Date: <u>5.9.03</u>	Time: _____	Received by: <u>[Signature]</u>	Date: <u>5/13/03</u>	Time: <u>15:00</u>
Relinquished by: <u>[Signature]</u>	Date: <u>5/14/03</u>	Time: <u>14:50</u>	Received by: <u>[Signature]</u>	Date: <u>5/14/03</u>	Time: <u>14:45</u>
Relinquished by: <u>[Signature]</u>	Date: <u>5/14/03</u>	Time: <u>15:30</u>	Received by: <u>Airborne</u>	Date: <u>5/14/03</u>	Time: _____
Relinquished by Commercial Carrier: <u>[Signature]</u>	Date: _____	Time: _____	Received by: <u>[Signature]</u>	Date: <u>5/13/03</u>	Time: <u>09:00</u>
UPS      FedEx      Other: <u>[Signature]</u>	Temperature Upon Receipt: <u>5.0</u> °C		Custody Seals Intact? <input checked="" type="checkbox"/> Yes <input type="checkbox"/> No		



## ANALYTICAL RESULTS

Prepared for:

ChevronTexaco  
6001 Bollinger Canyon Rd L4310

San Ramon CA 94583  
925-842-8582

Prepared by:

Lancaster Laboratories  
2425 New Holland Pike  
Lancaster, PA 17605-2425

## SAMPLE GROUP

The sample group for this submittal is 851723. Samples arrived at the laboratory on Tuesday, May 13, 2003. The PO# for this group is 99011184 and the release number is STREICH.

### Client Description

QA-T-030509	NA	Water
MW-6-W-030509	Grab	Water
MW-7-W-030509	Grab	Water

### Lancaster Labs Number

4043231
4043232
4043233

ELECTRONIC      Gettler-Ryan  
COPY TO  
1 COPY TO      Cambria C/O Gettler- Ryan

Attn: Cheryl Hansen

Attn: Deanna L. Harding

Questions? Contact your Client Services Representative  
Teresa L. Cunningham at (717) 656-2300.

Respectfully Submitted,



Victoria M. Martel  
Chemist

**Lancaster Laboratories Sample No. WW 4043231**

Collected: 05/09/2003 00:00

Account Number: 10904

Submitted: 05/13/2003 09:20

ChevronTexaco

Reported: 05/18/2003 at 12:57

6001 Bollinger Canyon Rd L4310

Discard: 06/18/2003

QA-T-030509

NA

Water

San Ramon CA 94583

Facility# 91153

Job# 386423

GRD

3135 Gibbons Dr Alameda T0600100330 QA

CAT No.	Analysis Name	CAS Number	As Received Result	As Received Method Detection Limit	Units	Dilution Factor
01729	TPH-GRO - Waters					
01730	TPH-GRO - Waters	n.a.	N.D.	50.	ug/l	1
The reported concentration of TPH-GRO does not include MTBE or other gasoline constituents eluting prior to the C6 (n-hexane) TPH-GRO range start time.						
02159	BTEX, MTBE					
02161	Benzene	71-43-2	N.D.	0.5	ug/l	1
02164	Toluene	108-88-3	N.D.	0.5	ug/l	1
02166	Ethylbenzene	100-41-4	N.D.	0.5	ug/l	1
02171	Total Xylenes	1330-20-7	N.D.	1.5	ug/l	1
02172	Methyl tert-Butyl Ether	1634-04-4	N.D.	2.5	ug/l	1

A site-specific MSD sample was not submitted for the project. A LCS/LCSD was performed to demonstrate precision and accuracy at a batch level.

State of California Lab Certification No. 2116

### Laboratory Chronicle

CAT No.	Analysis Name	Method	Trial#	Analysis		Analyst	Dilution Factor
				Date and Time			
01729	TPH-GRO - Waters	N. CA LUFT Gasoline Method	1	05/16/2003 17:28		Melissa D Mann	1
02159	BTEX, MTBE	SW-846 8021B	1	05/16/2003 17:28		Melissa D Mann	1
01146	GC VOA Water Prep	SW-846 5030B	1	05/16/2003 17:28		Melissa D Mann	n.a.

Lancaster Laboratories Sample No. WW 4043232

Collected: 05/09/2003 10:48 by FT

Account Number: 10904

Submitted: 05/13/2003 09:20

ChevronTexaco

Reported: 05/18/2003 at 12:57

6001 Bollinger Canyon Rd L4310

Discard: 06/18/2003

MW-6-W-030509

Grab

Water

San Ramon CA 94583

Facility# 91153

Job# 386423

GRD

3135 Gibbons Dr Alameda T0600100330 MW-6

CAT No.	Analysis Name	CAS Number	As Received Result	As Received Method Detection Limit	Units	Dilution Factor
01729	TPH-GRO - Waters					
01730	TPH-GRO - Waters	n.a.	N.D.	50.	ug/l	1
The reported concentration of TPH-GRO does not include MTBE or other gasoline constituents eluting prior to the C6 (n-hexane) TPH-GRO range start time.						
02159	BTEX, MTBE					
02161	Benzene	71-43-2	1.9	0.5	ug/l	1
02164	Toluene	108-88-3	N.D.	0.5	ug/l	1
02166	Ethylbenzene	100-41-4	N.D.	0.5	ug/l	1
02171	Total Xylenes	1330-20-7	N.D.	1.5	ug/l	1
02172	Methyl tert-Butyl Ether	1634-04-4	N.D.	2.5	ug/l	1

A site-specific MSD sample was not submitted for the project. A LCS/LCSD was performed to demonstrate precision and accuracy at a batch level.

State of California Lab Certification No. 2116

### Laboratory Chronicle

CAT No.	Analysis Name	Method	Analysis		Analyst	Dilution Factor
			Trial#	Date and Time		
01729	TPH-GRO - Waters	N. CA LUFT Gasoline Method	1	05/16/2003 19:05	Melissa D Mann	1
02159	BTEX, MTBE	SW-846 8021B	1	05/16/2003 19:05	Melissa D Mann	1
01146	GC VOA Water Prep	SW-846 5030B	1	05/16/2003 19:05	Melissa D Mann	n.a.

Lancaster Laboratories Sample No. **WW 4043233**

Collected: 05/09/2003 11:06 by FT

Account Number: 10904

Submitted: 05/13/2003 09:20

ChevronTexaco

Reported: 05/18/2003 at 12:57

6001 Bollinger Canyon Rd L4310

Discard: 06/18/2003

MW-7-W-030509

Grab

Water

San Ramon CA 94583

Facility# 91153

Job# 386423

GRD

3135 Gibbons Dr Alameda

T0600100330

MW-7

CAT No.	Analysis Name	CAS Number	As Received Result	As Received Method Detection Limit	Units	Dilution Factor
01729	TPH-GRO - Waters					
01730	TPH-GRO - Waters	n.a.	17,000.	1,000.	ug/l	20
The reported concentration of TPH-GRO does not include MTBE or other gasoline constituents eluting prior to the C6 (n-hexane) TPH-GRO range start time.						
02159	BTEX, MTBE					
02161	Benzene	71-43-2	4,200.	10.	ug/l	20
02164	Toluene	108-88-3	36.	10.	ug/l	20
02166	Ethylbenzene	100-41-4	350.	10.	ug/l	20
02171	Total Xylenes	1330-20-7	360.	30.	ug/l	20
02172	Methyl tert-Butyl Ether	1634-04-4	N.D.	50.	ug/l	20
A site-specific MSD sample was not submitted for the project. A LCS/LCSD was performed to demonstrate precision and accuracy at a batch level.						

The reporting limits were raised because sample dilution was necessary to bring target compounds into the calibration range of the system.

State of California Lab Certification No. 2116

### Laboratory Chronicle

CAT No.	Analysis Name	Method	Trial#	Analysis		Analyst	Dilution Factor
				Date and Time			
01729	TPH-GRO - Waters	N. CA LUFT Gasoline	1	05/16/2003 22:21		Melissa D Mann	20
02159	BTEX, MTBE	SW-846 8021B	1	05/16/2003 22:21		Melissa D Mann	20
01146	GC VOA Water Prep	SW-846 5030B	1	05/16/2003 22:21		Melissa D Mann	n.a.

## Quality Control Summary

Client Name: ChevronTexaco

Group Number: 851723

Reported: 05/18/03 at 12:57 PM

### Laboratory Compliance Quality Control

<u>Analysis Name</u>	<u>Blank Result</u>	<u>Blank MDL</u>	<u>Report Units</u>	<u>LCS %REC</u>	<u>LCSD %REC</u>	<u>LCS/LCSD Limits</u>	<u>RPD</u>	<u>RPD Max</u>
Batch number: 03135A55A	Sample number(s): 4043231-4043233							
TPH-GRO - Waters	N.D.	50.	ug/l	106	101	70-130	4	30
Benzene	N.D.	0.5	ug/l	101	101	80-118	1	30
Toluene	N.D.	0.5	ug/l	101	102	82-119	1	30
Ethylbenzene	N.D.	0.5	ug/l	101	102	81-119	2	30
Total Xylenes	N.D.	1.5	ug/l	102	103	82-120	1	30
Methyl tert-Butyl Ether	N.D.	2.5	ug/l	103	102	79-127	1	30

### Sample Matrix Quality Control

<u>Analysis Name</u>	<u>MS %REC</u>	<u>MSD %REC</u>	<u>MS/MSD Limits</u>	<u>RPD</u>	<u>BKG MAX</u>	<u>DUP Conc</u>	<u>DUP RPD</u>	<u>Dup RPD Max</u>
Batch number: 03135A55A	Sample number(s): 4043231-4043233							
TPH-GRO - Waters	103	106	70-130	2	30			
Benzene	99		67-136					
Toluene	102		78-129					
Ethylbenzene	102		75-133					
Total Xylenes	102		86-132					
Methyl tert-Butyl Ether	98		66-136					

### Surrogate Quality Control

Analysis Name: BTEX, MTBE

Batch number: 03135A55A

Trifluorotoluene-F

Trifluorotoluene-P

4043231	101	112
4043232	100	114
4043233	103	115
Blank	103	115
LCS	107	114
LCSD	105	111
MS	108	112
MSD	109	
Limits:	57-146	66-136

\*- Outside of specification

- (1) The result for one or both determinations was less than five times the LOQ.
- (2) The background result was more than four times the spike added.

# Explanation of Symbols and Abbreviations

The following defines common symbols and abbreviations used in reporting technical data:

<b>N.D.</b>	none detected	<b>BMQL</b>	Below Minimum Quantitation Level
<b>TNTC</b>	Too Numerous To Count	<b>MPN</b>	Most Probable Number
<b>IU</b>	International Units	<b>CP Units</b>	cobalt-chloroplatinate units
<b>umhos/cm</b>	micromhos/cm	<b>NTU</b>	nephelometric turbidity units
<b>C</b>	degrees Celsius	<b>F</b>	degrees Fahrenheit
<b>meq</b>	milliequivalents	<b>lb.</b>	pound(s)
<b>g</b>	gram(s)	<b>kg</b>	kilogram(s)
<b>ug</b>	microgram(s)	<b>mg</b>	milligram(s)
<b>ml</b>	milliliter(s)	<b>l</b>	liter(s)
<b>m3</b>	cubic meter(s)	<b>ul</b>	microliter(s)
<b>&lt;</b>	less than - The number following the sign is the <u>limit of quantitation</u> , the smallest amount of analyte which can be reliably determined using this specific test.		
<b>&gt;</b>	greater than		
<b>J</b>	estimated value - The result falls within the Method Detection Limit (MDL) and Limit of Quantitation (LOQ).		
<b>ppm</b>	parts per million - One ppm is equivalent to one milligram per kilogram (mg/kg), or one gram per million grams. For aqueous liquids, ppm is usually taken to be equivalent to milligrams per liter (mg/l), because one liter of water has a weight very close to a kilogram. For gases or vapors, one ppm is equivalent to one microliter of gas per liter of gas.		
<b>ppb</b>	parts per billion		
<b>Dry weight basis</b>	Results printed under this heading have been adjusted for moisture content. This increases the analyte weight concentration to approximate the value present in a similar sample without moisture. All other results are reported on an as-received basis.		

## U.S. EPA CLP Data Qualifiers:

### Organic Qualifiers

<b>A</b>	TIC is a possible aldol-condensation product
<b>B</b>	Analyte was also detected in the blank
<b>C</b>	Pesticide result confirmed by GC/MS
<b>D</b>	Compound quantitated on a diluted sample
<b>E</b>	Concentration exceeds the calibration range of the instrument
<b>N</b>	Presumptive evidence of a compound (TICs only)
<b>P</b>	Concentration difference between primary and confirmation columns >25%
<b>U</b>	Compound was not detected
<b>X,Y,Z</b>	Defined in case narrative

### Inorganic Qualifiers

<b>B</b>	Value is <CRDL, but ≥IDL
<b>E</b>	Estimated due to interference
<b>M</b>	Duplicate injection precision not met
<b>N</b>	Spike sample not within control limits
<b>S</b>	Method of standard additions (MSA) used for calculation
<b>U</b>	Compound was not detected
<b>W</b>	Post digestion spike out of control limits
<b>*</b>	Duplicate analysis not within control limits
<b>+</b>	Correlation coefficient for MSA <0.995

Analytical test results for methods listed on the laboratories' accreditation scope meet all requirements of NELAC unless otherwise noted under the individual analysis.

Measurement uncertainty values, as applicable, are available upon request.

Tests results relate only to the sample tested. Clients should be aware that a critical step in a chemical or microbiological analysis is the collection of the sample. Unless the sample analyzed is truly representative of the bulk of material involved, the test results will be meaningless. If you have questions regarding the proper techniques of collecting samples, please contact us. We cannot be held responsible for sample integrity, however, unless sampling has been performed by a member of our staff. This report shall not be reproduced except in full, without the written approval of the laboratory.

**WARRANTY AND LIMITS OF LIABILITY** - In accepting analytical work, we warrant the accuracy of test results for the sample as submitted. THE FOREGOING EXPRESS WARRANTY IS EXCLUSIVE AND IS GIVEN IN LIEU OF ALL OTHER WARRANTIES, EXPRESSED OR IMPLIED. WE DISCLAIM ANY OTHER WARRANTIES, EXPRESSED OR IMPLIED, INCLUDING A WARRANTY OF FITNESS FOR PARTICULAR PURPOSE AND WARRANTY OF MERCHANTABILITY. IN NO EVENT SHALL LANCASTER LABORATORIES BE LIABLE FOR INDIRECT, SPECIAL, CONSEQUENTIAL, OR INCIDENTAL DAMAGES INCLUDING, BUT NOT LIMITED TO, DAMAGES FOR LOSS OF PROFIT OR GOODWILL REGARDLESS OF (A) THE NEGLIGENCE (EITHER SOLE OR CONCURRENT) OF LANCASTER LABORATORIES AND (B) WHETHER LANCASTER LABORATORIES HAS BEEN INFORMED OF THE POSSIBILITY OF SUCH DAMAGES. We accept no legal responsibility for the purposes for which the client uses the test results. No purchase order or other order for work shall be accepted by Lancaster Laboratories which includes any conditions that vary from the Standard Terms and Conditions of Lancaster Laboratories and we hereby object to any conflicting terms contained in any acceptance or order submitted by client.