

ENVIRONMENTAL
PROTECTION

00 APR 11 PM 3:59



Chevron

*3126 Fourside Ave
Alameda
STED 3565*

Chevron U.S.A. Products Company
6001 Bollinger Canyon Rd. Bldg. L
P. O. Box 6004
San Ramon, CA 94583-0804

Site Assessment and
Remediation Group
Phone (510) 842-8500
Fax (510) 842-8370

Date: 3-31-00
To: Distribution
Re: Groundwater Monitoring Report, 9-1153

The enclosed groundwater monitoring report has been properly reviewed by a Chevron authorized representative. Agency guidelines have been followed. Blaine Tech Services is authorized to distribute the report directly to interested parties.

If you have any questions, please call me at (510) 842-3695.

Sincerely,

Brett Hunter
Site Assessment and Remediation
Project Manager

BLAINE
TECH SERVICES, INC.

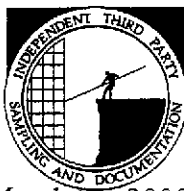

March 31, 2000

Brett Hunter
Chevron U.S.A. Products Company
P.O. Box 6004
San Ramon, CA 94583-0904

1680 ROGERS AVENUE
SAN JOSE, CALIFORNIA 95112-1105
(408) 573-7771 FAX
(408) 573-0555 PHONE

1st Quarter 2000 Monitoring at 9-1153

First Quarter 2000 Groundwater Monitoring at
Chevron Service Station Number 9-1153
3126 Fernside Blvd.
Alameda, CA

Monitoring Performed on January 25, 2000

Groundwater Sampling Report 000125-U-1

This report covers the routine monitoring of groundwater wells at this Chevron facility. Blaine Tech Services, Inc.'s work at the site includes inspection, gauging, evacuation, purgewater containment, sample collection and sample handling in accordance with standard procedures that conform to Regional Water Quality Control Board requirements.

Routine field data collection includes depth to water, total well depth, thickness of any separate immiscible layer, water column volume, calculated volume of a three-case volume purge, elapsed evacuation time, total volume of water removed, and standard water parameter instrument readings. Sample material is collected, contained, stored, and transported to the laboratory in conformance with EPA standards. Purgewater is, likewise, collected and transported to McKittrick Waste Treatment Site for disposal.

Basic field information is presented alongside analytical values excerpted from the laboratory report in the cumulative table of **WELL DATA AND ANALYTICAL RESULTS**. The full analytical report for the most recent samples is located in the **Analytical Appendix**. The table also contains new groundwater elevation calculations taken from the computer plotted gradient map which is located in the **Professional Engineering Appendix**.

At a minimum, Blaine Tech Services, Inc. field personnel are certified upon completion of a forty-hour Hazardous Materials and Emergency Response training course per 29 CFR 1910.120. Field personnel are also enrolled in annual eight hour refresher courses.

Blaine Tech Services, Inc. conducts sampling and documentation assignments of this type as an independent third party. In order to avoid compromising the objectivity necessary for the proper and disinterested performance of this work, Blaine Tech Services, Inc. concentrates on objective data collection and does not participate in the interpretation of analytical results, the definition of geological or hydrological conditions, the formulation of recommendations, or the marketing of remedial systems.

Please call if you have any questions.

Yours truly,



Scott Boor
Project Coordinator

SDB/jh

attachments: Professional Engineering Appendix
Cumulative Table of Well Data and Analytical Results
Analytical Appendix
Field Data Sheets

cc: ~~Larry Seto, Alameda County Health Care Services~~
Mr. & Mrs. Thompson
Greg Gurss, Gettler-Ryan, Inc.

Professional Engineering Appendix

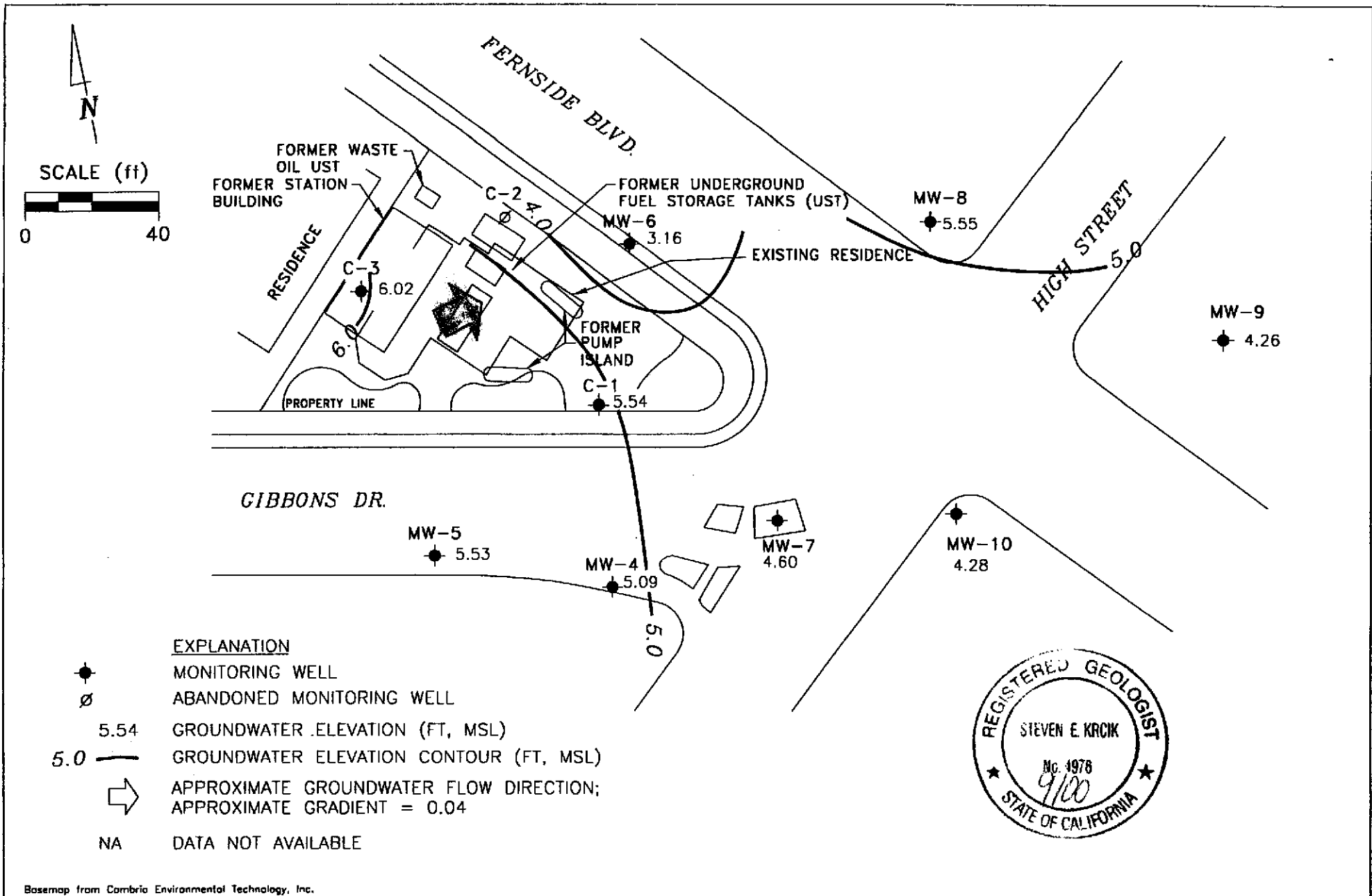

PREPARED BY 	Former Chevron Station 9-1153 3126 Fernside Boulevard Alameda, California	GROUNDWATER ELEVATION CONTOUR MAP, JANUARY 25, 2000	FIGURE: 1 PROJECT: DAC04
--	--	--	---

Table of Well Data and Analytical Results

Cumulative Table of Well Data and Analytical Results

Vertical Measurements are in feet.			Volumetric Measurements are in gallons.				Analytical results are in parts per billion (ppb)							
DATE	Well Head Elev.	Ground Water Elev.	Depth To Water	SPH Thickness	SPH Removed	Total SPH Removed	Notes	TPH-Gasoline	Benzene	Toluene	Ethyl-Benzene	Xylene	MTBE	Other
C-1														
08/18/86	--	--	4.10	--	--	--	--	--	--	--	--	--	--	--
09/04/86	--	--	--	--	--	--	--	15,000	760	820	1500	--	--	--
07/22/87	--	--	--	--	--	--	--	1100	250	7.0	40	--	--	--
05/03/89	--	--	4.46	--	--	--	--	6900	3800	190	229	--	--	--
12/04/89	--	--	4.16	--	--	--	--	17,000	8000	490	470	--	--	--
02/14/90	--	--	3.64	--	--	--	--	19,000	12,000	990	1050	--	--	--
03/07/90	--	--	3.36	--	--	--	--	--	4260	261	430	--	--	--
09/06/91	--	--	4.43	--	--	--	--	21,000	10,000	100	240	560	--	--
12/15/91	--	--	4.78	--	--	--	--	20,000	4900	43	110	330	--	--
03/03/92	--	--	2.39	--	--	--	--	13,000	5800	730	340	1200	--	--
06/04/92	4.08	0.00	4.08	--	--	--	--	34,000	9400	350	290	1200	--	--
10/13/92	4.08	-0.67	4.75	--	--	--	--	24,000	11,000	98	280	530	--	--
01/11/93	4.08	1.82	2.26	Sheen	--	--	--	7100	1500	130	150	700	--	--
04/14/93	4.08	1.18	2.90	Sheen	--	--	--	29,000	7300	4000	640	2300	--	--
07/13/93	4.08	0.11	3.97	Sheen	--	--	--	650,000	27,000	18,000	6300	29,000	--	--
10/19/93	4.08	-0.42	4.50	--	--	--	--	40,000	12,000	730	1100	3600	--	--
11/30/93	7.50	3.23	4.27	--	--	--	--	--	--	--	--	--	--	--
01/27/94	7.50	4.15	3.35	--	--	--	--	36,000	8600	220	670	1900	--	--
04/07/94	7.50	4.08	3.42	--	--	--	--	53,000	12,000	3500	480	3300	--	--
07/01/94	7.50	3.54	3.96	--	--	--	--	65,000	19,000	5900	1000	9000	--	--
10/05/94	7.50	3.11	4.39	--	--	--	--	160,000	23,000	12,000	2200	11,000	--	--
01/12/95	7.50	6.38	1.52	0.50	0.264	0.264	--	--	--	--	--	--	--	--
04/26/95	7.50	4.86	4.40	2.20	1.321	1.585	--	--	--	--	--	--	--	--
07/12/95	7.50	4.10	4.85	1.81	0.661	2.246	--	--	--	--	--	--	--	--
10/30/95	7.50	3.13	5.67	1.63	0.528	2.774	--	--	--	--	--	--	--	--
01/04/96	7.50	3.68	3.92	0.12	0.264	3.038	--	--	--	--	--	--	--	--
01/10/96	7.50	4.12	3.48	0.13	0.066	3.104	--	--	--	--	--	--	--	--
01/17/96	7.50	4.12	3.40	0.02	0.396	3.500	--	--	--	--	--	--	--	--
01/22/96	7.50	4.60	2.90	0.00	0.000	3.500	--	82,000	18,000	4400	1400	5200	< 1000	--
02/23/96	7.50	4.89	4.10	1.86	0.661	4.161	--	--	--	--	--	--	--	--
02/28/96	7.50	--	--	>0.83	1.250	5.411	--	--	--	--	--	--	--	--
03/08/96	7.50	6.10	2.86	1.83	0.264	5.675	--	--	--	--	--	--	--	--
03/08/96	7.50	5.49	2.30	0.36	0.528	6.203	--	--	--	--	--	--	--	--
03/08/96	7.50	5.46	2.33	0.36	0.264	6.467	--	--	--	--	--	--	--	--
03/08/96	7.50	5.40	2.28	0.22	0.528	6.995	--	--	--	--	--	--	--	--

CONTINUED ON NEXT PAGE

Cumulative Table of Well Data and Analytical Results

Vertical Measurements are in feet.			Volumetric Measurements are in gallons.				Analytical results are in parts per billion (ppb)							
DATE	Well Head Elev.	Ground Water Elev.	Depth To Water	SPH Thickness	SPH Removed	Total SPH Removed	Notes	TPH-Gasoline	Benzene	Toluene	Ethyl-Benzene	Xylene	MTBE	Other
C-1 (CONT'D)														
03/26/96	7.50	4.56	3.96	1.28	0.396	7.391	--	--	--	--	--	--	--	--
04/11/96	7.50	3.29	5.61	1.75	0.528	7.919	--	--	--	--	--	--	--	--
04/19/96	7.50	4.44	3.09	0.04	0.396	8.315	--	--	--	--	--	--	--	--
04/24/96	7.50	4.48	3.04	0.03	0.396	8.711	--	--	--	--	--	--	--	--
05/03/96	7.50	3.85	4.02	0.46	0.396	9.107	--	--	--	--	--	--	--	--
05/03/96	7.50	3.99	3.89	0.47	0.000	9.107	--	--	--	--	--	--	--	--
05/08/96	7.50	3.53	4.25	0.35	0.066	9.173	--	--	--	--	--	--	--	--
05/17/96	7.50	4.29	3.24	0.04	0.029	9.202	--	--	--	--	--	--	--	--
05/17/96	7.50	4.16	3.35	0.01	0.029	9.231	--	--	--	--	--	--	--	--
05/17/96	7.50	4.08	3.43	0.01	0.029	9.260	--	--	--	--	--	--	--	--
05/17/96	7.50	3.86	3.65	0.01	0.000	9.260	--	--	--	--	--	--	--	--
05/22/96	7.50	4.46	3.10	0.07	0.079	9.339	--	--	--	--	--	--	--	--
06/18/96	7.50	3.20	4.68	0.48	0.264	9.603	--	--	--	--	--	--	--	--
07/03/96	7.50	2.57	5.03	0.13	0.145	9.748	--	--	--	--	--	--	--	--
07/09/96	7.50	3.05	4.63	0.23	0.092	9.840	--	--	--	--	--	--	--	--
07/17/96	7.50	2.89	4.73	0.15	0.317	10.157	--	--	--	--	--	--	--	--
07/29/96	7.50	2.47	5.10	0.09	0.264	10.421	--	--	--	--	--	--	--	--
08/02/96	7.50	1.84	5.68	0.03	0.033	10.454	--	--	--	--	--	--	--	--
08/07/96	7.50	2.35	5.16	0.01	0.132	10.586	--	--	--	--	--	--	--	--
08/23/96	7.50	1.77	5.75	0.03	0.026	10.612	--	--	--	--	--	--	--	--
08/28/96	7.50	1.99	5.53	0.03	0.013	10.625	--	--	--	--	--	--	--	--
09/06/96	7.50	2.12	5.38	--	0.046	10.671	--	--	--	--	--	--	--	--
09/12/96	7.50	2.04	5.48	0.03	0.013	10.684	--	--	--	--	--	--	--	--
09/19/96	7.50	1.20	6.32	0.03	0.011	10.695	--	--	--	--	--	--	--	--
10/10/96	7.50	3.00	4.58	0.10	0.132	10.827	--	--	--	--	--	--	--	--
10/17/96	7.50	1.90	5.61	0.01	0.011	10.838	--	--	--	--	--	--	--	--
10/29/96	7.50	1.49	6.01	--	--	10.838	--	--	--	--	--	--	--	--
11/07/96	7.50	1.94	5.56	0.04	0.132	10.970	--	--	--	--	--	--	--	--
11/11/96	7.50	2.18	5.32	0.04	0.132	11.102	--	--	--	--	--	--	--	--
12/20/96	7.50	4.17	3.33	0.03	0.053	11.155	--	--	--	--	--	--	--	--
12/17/96	7.50	3.77	3.73	0.01	0.010	11.165	--	--	--	--	--	--	--	--
01/15/97	7.50	4.76	2.74	--	--	11.165	--	--	--	--	--	--	--	--
01/22/97	7.50	6.13	1.37	0.19	0.066	11.231	--	47,000	16,000	2800	1300	4900	< 1000	--
02/04/97	7.50	4.52	2.98	0.51	0.145	11.376	--	--	--	--	--	--	--	--
02/20/97	7.50	3.41	4.09	0.13	0.106	11.482	--	--	--	--	--	--	--	--

CONTINUED ON NEXT PAGE

Cumulative Table of Well Data and Analytical Results

Vertical Measurements are in feet.			Volumetric Measurements are in gallons.				Analytical results are in parts per billion (ppb)							
DATE	Well Head Elev.	Ground Water Elev.	Depth To Water	SPH Thickness	SPH Removed	Total SPH Removed	Notes	TPH-Gasoline	Benzene	Toluene	Ethyl-Benzene	Xylene	MTBE	Other
C-1 (CONT'D)														
03/06/97	7.50	3.75	3.75	0.56	1.189	12.671	--	--	--	--	--	--	--	--
03/14/97	7.50	3.68	3.82	0.03	0.119	12.790	--	--	--	--	--	--	--	--
03/20/97	7.50	3.77	3.73	0.03	0.013	12.803	--	--	--	--	--	--	--	--
03/25/97	7.50	3.18	4.32	0.01	--	12.803	--	--	--	--	--	--	--	--
03/31/97	7.50	3.79	3.71	0.03	0.003	12.806	--	--	--	--	--	--	--	--
04/03/97	7.50	2.92	4.60	0.03	0.004	12.810	--	--	--	--	--	--	--	--
04/09/97	7.50	3.27	4.25	0.02	0.026	12.836	--	--	--	--	--	--	--	--
04/24/97	7.50	2.87	4.65	0.02	0.005	12.841	--	--	--	--	--	--	--	--
04/30/97	7.50	4.02	3.50	0.02	0.005	12.846	--	--	--	--	--	--	--	--
05/22/97	7.50	2.53	4.97	--	0.011	12.857	--	--	--	--	--	--	--	--
06/03/97	7.50	3.93	3.62	0.06	0.007	12.864	--	--	--	--	--	--	--	--
07/09/97	7.50	3.25	4.30	0.06	0.132	12.996	--	--	--	--	--	--	--	--
08/12/97	7.50	2.32	5.18	0.00	0.050	13.046	--	--	--	--	--	--	--	--
09/30/97	7.50	2.65	5.25	0.50	0.070	13.116	--	--	--	--	--	--	--	--
10/29/97	7.50	2.19	5.33	0.03	0.020	13.136	--	--	--	--	--	--	--	--
11/13/97	7.50	2.66	4.86	0.02	0.026	13.162	--	--	--	--	--	--	--	--
12/18/97	7.50	5.16	2.34	--	--	13.162	--	--	--	--	--	--	--	--
01/14/98	7.50	7.27	0.25	0.02	0.132	13.294	--	--	--	--	--	--	--	--
02/02/98	7.50	5.19	2.35	0.05	0.026	13.320	--	--	--	--	--	--	--	--
03/16/98	7.50	5.40	2.50	0.50	0.132	13.452	--	--	--	--	--	--	--	--
04/17/98	7.50	5.17	2.65	0.40	0.106	13.558	--	--	--	--	--	--	--	--
05/01/98	7.50	5.14	2.39	0.04	0.264	13.822	--	--	--	--	--	--	--	--
06/17/98	7.50	4.30	3.26	0.08	0.033	13.855	--	--	--	--	--	--	--	--
07/15/98	7.50	3.95	3.55	--	--	13.855	--	110,000	22,000	22,000	1000	10,000	< 250	--
09/01/98	7.50	3.50	4.00	--	--	13.855	--	--	--	--	--	--	--	--
10/27/98	7.50	3.02	4.48	--	--	13.855	--	45,000	12,000	5400	590	4300	< 500	--
11/19/98	7.50	3.61	3.89	--	--	13.855	--	--	--	--	--	--	--	--
12/19/98	7.50	5.39	2.13	0.02	0.040	13.895	--	--	--	--	--	--	--	--
01/20/99	7.50	3.52	3.98	--	--	13.895	--	50,300	7050	5030	244	6090	< 40	--
02/24/99	7.50	4.95	2.55	--	--	13.895	--	--	--	--	--	--	--	--
03/26/99	7.50	5.97	2.14	0.76	0.2642	14.159	--	--	--	--	--	--	--	--
04/19/99	7.50	6.46	1.04	--	--	14.159	--	150,000	21,000	20,000	3000	18,000	< 2.5	--
04/19/99	7.50	6.46	1.04	--	--	--	Confirmation Run	--	--	--	--	--	49	--

CONTINUED ON NEXT PAGE

Cumulative Table of Well Data and Analytical Results

Vertical Measurements are in feet.			Volumetric Measurements are in gallons.				Analytical results are in parts per billion (ppb)							
DATE	Well Head Elev.	Ground Water Elev.	Depth To Water	SPH Thickness	SPH Removed	Total SPH Removed	Notes	TPH-Gasoline	Benzene	Toluene	Ethyl-Benzene	Xylene	MTBE	Other
C-1(CONT'D)														
07/29/99	7.50	3.76	3.76	0.02	0.01	14.169	--	--	--	--	--	--	--	--
08/30/99	7.50	3.20	4.30	--	--	14.169	--	--	--	--	--	--	--	--
09/23/99	7.50	3.68	3.84	0.02	0.03	14.199	--	--	--	--	--	--	--	--
10/13/99	7.50	6.23	1.27	--	--	14.199	--	136,000	23,900	30,000	2390	17,300	<500	--
11/17/99	7.50	3.91	3.59	--	--	14.199	--	--	--	--	--	--	--	--
12/08/99	7.50	3.71	3.79	--	--	14.199	--	--	--	--	--	--	--	--
01/25/00	7.50	5.54	1.99	0.04	0.03	14.229	--	--	--	--	--	--	--	--

Cumulative Table of Well Data and Analytical Results

Vertical Measurements are in feet.			Volumetric Measurements are in gallons.				Analytical results are in parts per billion (ppb)							
DATE	Well Head Elev.	Ground Water Elev.	Depth To Water	SPH Thickness	SPH Removed	Total SPH Removed	Notes	TPH-Gasoline	Benzene	Toluene	Ethyl-Benzene	Xylene	MTBE	Other
C-2														
08/18/86	--	--	--	--	--	--	--	--	--	--	--	--	--	--
09/04/86	--	--	--	--	--	--	--	1100	49	18	84	--	--	--
07/22/87	--	--	--	--	--	--	--	<50	1.8	<1.0	<4.0	--	--	--
05/03/89	--	--	--	--	--	--	Abandoned	--	--	--	--	--	--	--

Cumulative Table of Well Data and Analytical Results

Vertical Measurements are in feet.

Volumetric Measurements are in gallons.

Analytical results are in parts per billion (ppb)

DATE	Well	Ground	Depth	Total			Notes	TPH- Gasoline	Benzene	Toluene	Ethyl- Benzene	Xylene	MTBE	Other
	Head Elev.	Water Elev.	To Water	SPH Thickness	SPH Removed	SPH Removed								
C-3														
08/18/86	--	--	4.00	--	--	--	--	--	--	--	--	--	--	--
09/04/86	--	--	--	--	--	--	--	50	3.2	5.4	5.8	--	--	--
07/22/87	--	--	--	--	--	--	--	<50	<0.5	<1.0	<4.0	--	--	--
05/03/89	--	--	4.15	--	--	--	--	<50	<0.5	<1.0	<2.0	--	--	--
12/04/89	--	--	4.24	--	--	--	--	<250	<0.5	<0.5	<0.5	--	--	--
02/14/90	--	--	3.57	--	--	--	--	<50	<0.5	<0.5	<0.5	--	--	--
03/07/90	--	--	3.31	--	--	--	--	--	<5.0	<5.0	<5.0	--	--	--
09/06/91	--	--	4.59	--	--	--	--	<50	<0.5	<0.5	<0.5	<0.5	--	--
12/15/91	--	--	4.84	--	--	--	--	<50	<0.5	<0.5	<0.5	<0.5	--	--
03/03/92	--	--	2.17	--	--	--	--	<50	<0.5	<0.5	<0.5	<0.5	--	--
06/04/92	4.41	0.40	4.01	--	--	--	--	<50	<0.5	<0.5	<0.5	<0.5	--	--
10/13/92	4.41	-0.38	4.79	--	--	--	--	<50	<0.5	<0.5	<0.5	<0.5	--	--
01/11/93	4.41	2.40	2.01	--	--	--	--	<50	<0.5	<0.5	<0.5	<0.5	--	--
04/14/93	4.41	1.65	2.76	--	--	--	--	<50	<0.5	<0.5	<0.5	<0.5	--	--
07/13/93	4.41	0.45	3.96	--	--	--	--	<50	<0.5	<0.5	<0.5	<1.5	--	--
10/19/93	4.41	-0.12	4.53	--	--	--	--	66	12	1.4	1.0	8.4	--	--
11/30/93	7.83	3.79	4.04	--	--	--	--	--	--	--	--	--	--	--
01/27/94	7.83	4.66	3.17	--	--	--	--	<50	<0.5	<0.5	<0.5	<0.5	--	--
04/07/94	7.83	4.63	3.20	--	--	--	--	<50	<0.5	<0.5	<0.5	<0.5	--	--
07/01/94	7.83	3.84	3.99	--	--	--	--	<50	<0.5	<0.5	<0.5	<0.5	--	--
10/05/94	7.83	3.29	4.54	--	--	--	--	<50	<0.5	<0.5	<0.5	<0.5	--	--
01/12/95	7.83	7.03	0.80	--	--	--	--	<50	<0.5	<0.5	<0.5	<0.5	--	--
05/02/95	7.83	5.68	2.15	--	--	--	--	<50	<0.5	<0.5	<0.5	<0.5	--	--
07/12/95	7.83	4.41	3.42	--	--	--	--	<50	<0.5	<0.5	<0.5	<0.5	--	--
10/30/95	7.83	3.37	4.46	--	--	--	--	<50	<0.5	<0.5	<0.5	<0.5	<2.5	--
01/22/96	7.83	6.10	1.73	--	--	--	--	<50	<0.5	<0.5	<0.5	<0.5	<2.5	--
04/24/96	7.83	5.21	2.62	--	--	--	--	<50	<0.5	<0.5	<0.5	<0.5	<2.5	--
07/29/96	7.83	3.89	3.94	--	--	--	--	<50	<0.5	<0.5	<0.5	<0.5	<2.5	--
10/10/96	7.83	3.77	4.06	--	--	--	--	<50	<0.5	<0.5	<0.5	<0.5	<2.5	--
01/15/97	7.83	6.29	1.54	--	--	--	--	<50	<0.5	<0.5	<0.5	<0.5	<2.5	--
04/03/97	7.83	4.60	3.23	--	--	--	--	<50	<0.5	<0.5	<0.5	<0.5	<2.5	--
07/09/97	7.83	3.47	4.36	--	--	--	--	<50	<0.5	<0.5	<0.5	<0.5	<2.5	--
10/29/97	7.83	3.18	4.65	--	--	--	--	<50	<0.5	<0.5	<0.5	<0.5	<2.5	--
01/14/98	7.83	7.06	0.77	--	--	--	Gauged and sampled annually	<50	<0.5	<0.5	<0.5	<0.5	<2.5	--
07/15/98	7.83	4.11	3.72	--	--	--	--	<50	<0.5	<0.5	<0.5	<0.5	<2.5	--

CONTINUED ON NEXT PAGE

Cumulative Table of Well Data and Analytical Results

Vertical Measurements are in feet.			Volumetric Measurements are in gallons.				Analytical results are in parts per billion (ppb)							
DATE	Well Head Elev.	Ground Water Elev.	Depth To Water	SPH Thickness	SPH Removed	Total SPH Removed	Notes	TPH- Gasoline	Benzene	Toluene	Ethyl- Benzene	Xylene	MTBE	Other
C-3(CONT'D)														
01/20/99	7.83	5.18	2.65	--	--	--	--	<50	<0.5	<0.5	<0.5	<0.5	<2.0	--
04/19/99	7.83	6.05	1.78	--	--	--	--	--	--	--	--	--	--	--
01/25/00	7.83	6.02	1.81	--	--	--	--	<50	<0.5	<0.5	<0.5	<0.5	<2.5	--

Cumulative Table of Well Data and Analytical Results

Vertical Measurements are in feet.			Volumetric Measurements are in gallons.				Analytical results are in parts per billion (ppb)							
DATE	Well Head Elev.	Ground Water Elev.	Depth To Water	SPH Thickness	SPH Removed	Total SPH Removed	Notes	TPH-Gasoline	Benzene	Toluene	Ethyl-Benzene	Xylene	MTBE	Other
MW-4														
06/04/92	3.58	-0.05	3.63	--	--	--	--	<50	0.8	<0.5	<0.5	<0.5	--	--
10/13/92	3.58	--	--	--	--	--	--	--	--	--	--	--	--	--
01/11/93	3.58	1.69	1.89	--	--	--	--	<50	<0.5	<0.5	<0.5	<0.5	--	--
04/14/93	3.58	1.38	2.20	--	--	--	--	<50	<0.5	<0.5	<0.5	<1.5	--	--
07/13/93	3.58	0.07	3.51	--	--	--	--	54	2.6	1.6	<0.5	<1.5	--	--
10/19/93	3.58	-0.64	4.22	--	--	--	--	<50	<0.5	<0.5	<0.5	<0.5	--	--
11/30/93	7.01	3.00	4.01	--	--	--	--	--	--	--	--	--	--	--
01/27/94	7.01	4.12	2.89	--	--	--	--	<50	<0.5	<0.5	<0.5	<0.5	--	--
04/07/94	7.01	3.95	3.06	--	--	--	--	<50	<0.5	<0.5	<0.5	<0.5	--	--
07/01/94	7.01	3.42	3.59	--	--	--	--	<50	<0.5	<0.5	<0.5	<0.5	--	--
10/05/94	7.01	2.68	4.33	--	--	--	--	<50	<0.5	<0.5	<0.5	<0.5	--	--
01/12/95	7.01	5.81	1.20	--	--	--	--	<50	<0.5	<0.5	<0.5	<0.5	--	--
04/26/95	7.01	5.86	1.15	--	--	--	--	<50	<0.5	<0.5	<0.5	<0.5	--	--
07/12/95	7.01	4.29	2.72	--	--	--	--	<50	6.4	<0.5	0.63	0.72	--	--
10/30/95	7.01	2.93	4.08	--	--	--	--	<50	<0.5	<0.5	<0.5	<0.5	<2.5	--
01/22/96	7.01	5.25	1.76	--	--	--	--	<50	<0.5	<0.5	<0.5	<0.5	<2.5	--
04/24/96	7.01	5.06	1.95	--	--	--	--	<50	<0.5	<0.5	<0.5	<0.5	<2.5	--
07/29/96	7.01	3.64	3.37	--	--	--	--	<50	<0.5	<0.5	<0.5	<0.5	<2.5	--
10/10/96	7.01	3.05	3.96	--	--	--	--	<50	<0.5	<0.5	<0.5	<0.5	<2.5	--
01/15/97	7.01	5.74	1.27	--	--	--	--	<50	<0.5	<0.5	<0.5	<0.5	<2.5	--
04/03/97	7.01	4.90	2.11	--	--	--	--	<50	<0.5	<0.5	<0.5	<0.5	<2.5	--
07/09/97	7.01	2.97	4.04	--	--	--	--	<50	<0.5	<0.5	<0.5	<0.5	<2.5	--
10/29/97	7.01	2.45	4.56	--	--	--	--	<50	<0.5	<0.5	<0.5	<0.5	<2.5	--
01/14/98	7.01	6.62	0.39	--	--	--	Gauged and sampled annually	<50	<0.5	<0.5	<0.5	<0.5	<2.5	--
01/20/99	7.01	4.18	2.83	--	--	--	--	<50	<0.5	<0.5	<0.5	<0.5	<2.0	--
04/19/99	7.01	4.10	2.91	--	--	--	--	--	--	--	--	--	--	--
01/25/00	7.01	5.09	1.92	--	--	--	--	<50	<0.5	<0.5	<0.5	<0.5	<2.5	--

Cumulative Table of Well Data and Analytical Results

Vertical Measurements are in feet.

Volumetric Measurements are in gallons.

Analytical results are in parts per billion (ppb)

DATE	Well	Ground	Depth	Total			Notes	TPH- Gasoline	Benzene	Toluene	Ethyl- Benzene	Xylene	MTBE	Other
	Head Elev.	Water Elev.	To Water	SPH Thickness	SPH Removed	SPH Removed								
MW-5														
06/04/92	3.61	0.36	3.25	--	--	--	--	560	110	0.5	37	2.2	--	--
10/13/92	3.61	-0.59	4.20	--	--	--	--	1200	150	<2.5	84	8.6	--	--
01/11/93	3.61	2.31	1.30	--	--	--	--	1300	48	1.0	83	33	--	--
04/14/93	3.61	2.41	1.20	--	--	--	--	2600	240	6.1	250	170	--	--
07/13/93	3.61	0.46	3.15	--	--	--	--	1700	260	7.8	160	100	--	--
10/19/93	3.61	-0.21	3.82	--	--	--	--	1900	190	3.3	200	93	--	--
11/30/93	7.04	3.48	3.56	--	--	--	--	--	--	--	--	--	--	--
01/27/94	7.04	4.62	2.42	--	--	--	--	4000	100	12	210	110	--	--
04/07/94	7.04	4.71	2.33	--	--	--	--	2600	170	10	150	88	--	--
07/01/94	7.04	3.86	3.18	--	--	--	--	2300	350	9.1	110	76	--	--
10/05/94	7.04	3.06	3.98	--	--	--	--	11,000	840	150	130	340	--	--
01/12/95	7.04	6.64	0.40	--	--	--	--	2300	82	<2.5	54	20	--	--
04/26/95	7.04	6.54	0.50	--	--	--	--	1600	52	<5.0	36	61	--	--
07/12/95	7.04	4.63	2.41	--	--	--	--	2800	150	<5.0	34	38	--	--
10/30/95	7.04	3.26	3.78	--	--	--	--	1100	81	<5.0	<5.0	<5.0	35	--
01/22/96	7.04	6.26	0.78	--	--	--	--	880	7.3	<2.0	15	4.8	<10	--
04/24/96	7.04	5.39	1.65	--	--	--	--	1600	51	3.8	14	5.6	56	--
07/29/96	7.04	--	--	--	--	--	Inaccessible	--	--	--	--	--	--	--
10/10/96	7.04	3.44	3.60	--	--	--	--	1000	18	<1.2	1.5	<1.2	<6.2	--
01/15/97	7.04	6.59	0.45	--	--	--	--	520	0.84	<0.5	3.1	1.2	8.4	--
04/03/97	7.04	4.93	2.11	--	--	--	--	1400	13	<2.0	4.3	8.4	32	--
07/09/97	7.04	3.33	3.71	--	--	--	--	810	3.6	0.97	<0.5	<0.5	9.7	--
10/29/97	7.04	2.84	4.20	--	--	--	--	<50	<0.5	<0.5	<0.5	<0.5	<2.5	--
01/14/98	7.04	7.04	0.00	--	--	--	--	430	5.8	2.4	<0.5	1.6	17	--
04/17/98	7.04	6.33	0.71	--	--	--	Sampled biannually	--	--	--	--	--	--	--
07/15/98	7.04	7.04	0.00	--	--	--	--	990	11	3.9	0.56	2.2	61	--
10/27/98	7.04	2.81	4.23	--	--	--	--	--	--	--	--	--	--	--
01/20/99	7.04	4.46	2.58	--	--	--	--	168	<0.5	<0.5	<0.5	0.692	<2.0	--
04/19/99	7.04	4.97	2.07	--	--	--	--	--	--	--	--	--	--	--
07/29/99	7.04	3.61	3.43	--	--	--	--	246	1.54	<0.5	<0.5	<0.5	<5.0	--
07/29/99	7.04	3.61	3.43	--	--	--	Confirmation run	--	--	--	--	--	<2.0	--
10/13/99	7.04	--	--	--	--	--	Inaccessible	--	--	--	--	--	--	--
01/25/00	7.04	5.53	1.51	--	--	--	--	169	1.94	<0.5	<0.5	<0.5	201	--

Cumulative Table of Well Data and Analytical Results

Vertical Measurements are in feet.

Volumetric Measurements are in gallons.

Analytical results are in parts per billion (ppb)

DATE	Vertical Measurements are in feet.			Volumetric Measurements are in gallons.			Notes	Analytical results are in parts per billion (ppb)						
	Well Head Elev.	Ground Water Elev.	Depth To Water	SPH Thickness	SPH Removed	Total SPH Removed		TPH-Gasoline	Benzene	Toluene	Ethyl-Benzene	Xylene	MTBE	Other
MW-6														
06/04/92	3.85	-0.04	3.89	--	--	--	--	210	54	<0.5	1.9	2.4	--	--
10/13/92	3.85	-0.71	4.56	--	--	--	--	10,000	5300	<10	70	<10	--	--
01/11/93	3.85	1.49	2.36	--	--	--	--	100	50	<0.5	<0.5	<0.5	--	--
04/14/93	3.85	0.70	3.15	--	--	--	--	<50	<0.5	<0.5	<0.5	<0.5	--	--
07/13/93	3.85	-0.09	3.94	--	--	--	--	<50	1.8	<0.5	<0.5	<1.5	--	--
10/19/93	3.85	-0.55	4.40	--	--	--	--	320	150	<0.5	0.8	<0.5	--	--
11/30/93	7.27	3.11	4.16	--	--	--	--	--	--	--	--	--	--	--
01/27/94	7.27	3.94	3.33	--	--	--	--	120	45	<0.5	<0.5	<0.5	--	--
04/07/94	7.27	3.84	3.43	--	--	--	--	<50	<0.5	<0.5	<0.5	<0.5	--	--
07/01/94	7.27	3.33	3.94	--	--	--	--	<50	<0.5	<0.5	<0.5	<0.5	--	--
10/05/94	7.27	2.89	4.38	--	--	--	--	8300	2400	160	42	190	--	--
01/12/95	7.27	4.84	2.43	--	--	--	--	<50	12	<0.5	<0.5	<0.5	--	ND*
04/26/95	7.27	5.21	2.06	--	--	--	--	<50	5.5	0.67	<0.5	1.3	--	--
07/12/95	7.27	3.74	3.53	--	--	--	--	65	27	<0.5	<0.5	<0.5	--	--
10/30/95	7.27	2.93	4.34	--	--	--	--	<50	3.9	<0.5	<0.5	<0.5	<2.5	--
01/22/96	7.27	4.66	2.61	--	--	--	--	<50	0.93	<0.5	<0.5	<0.5	<2.5	--
04/24/96	7.27	4.77	2.50	--	--	--	--	260	110	<1.2	<1.2	<1.2	<6.2	--
07/29/96	7.27	3.42	3.85	--	--	--	--	<50	23	<0.5	<0.5	<0.5	<2.5	--
10/10/96	7.27	2.90	4.37	--	--	--	--	79	31	<0.5	<0.5	<0.5	<2.5	--
01/15/97	7.27	4.64	2.63	--	--	--	--	<50	<0.5	<0.5	<0.5	<0.5	<2.5	--
04/03/97	7.27	3.85	3.42	--	--	--	--	670	360	<5.0	<5.0	<5.0	<25	--
07/09/97	7.27	2.98	4.29	--	--	--	--	330	140	<2.0	<2.0	<2.0	<10	--
10/29/97	7.27	2.71	4.56	--	--	--	--	400	260	<2.0	<2.0	<2.0	5.8	--
01/14/98	7.27	6.26	1.01	--	--	--	--	<50	<0.5	<0.5	<0.5	<0.5	<2.5	--
04/17/98	7.27	4.33	2.94	--	--	--	--	<50	1.7	<0.5	<0.5	<0.5	<2.5	--
07/15/98	7.27	2.55	4.72	--	--	--	--	<50	<0.5	<0.5	<0.5	<0.5	<2.5	--
10/27/98	--	--	--	--	--	--	Inaccessible	--	--	--	--	--	--	--
11/25/98	7.27	3.11	4.16	--	--	--	--	110**	54	<0.5	<0.5	<0.5	<2.5	--
01/20/99	7.27	3.82	3.45	--	--	--	--	<50	10	<0.5	<0.5	<0.5	<2.0	--
04/19/99	7.27	3.88	3.39	--	--	--	--	<50	2.6	<0.5	<0.5	<0.5	<2.5	--
04/19/99	7.27	3.88	3.39	--	--	--	Confirmation Run	--	--	--	--	--	<2.0	--
07/29/99	7.27	2.93	4.34	--	--	--	ORC Socks Installed	<5000	2590	<50	<50	<50	<500	--
10/13/99	7.27	1.38	5.89	--	--	--	--	9270	4610	44.2	<25	<25	<125	--
01/25/00	7.27	3.16	4.11	--	--	--	--	529	289	<0.5	<0.5	<0.5	738	--

* EPA 8010

** Chromatogram report indicates an unidentified hydrocarbon.

Cumulative Table of Well Data and Analytical Results

Vertical Measurements are in feet.

Volumetric Measurements are in gallons.

Analytical results are in parts per billion (ppb)

DATE	Well	Ground	Depth	Total			Notes	TPH- Gasoline	Benzene	Toluene	Ethyl- Benzene	Xylene	MTBE	Other
	Head Elev.	Water Elev.	To Water	SPH Thickness	SPH Removed	SPH Removed								
MW-7														
11/30/93	8.22	2.89	5.33	--	--	--	--	480	110	41	4.4	38	--	--
01/27/94	8.22	3.72	4.50	--	--	--	--	120	21	1.1	2.2	4.8	--	--
04/07/94	8.22	3.60	4.62	--	--	--	--	2600	630	39	56	94	--	--
07/01/94	8.22	3.09	5.13	--	--	--	--	2200	770	42	<10	92	--	--
10/05/94	8.22	2.61	5.61	--	--	--	--	15,000	3300	90	130	320	--	--
01/12/95	8.22	5.39	2.83	--	--	--	--	340	57	<1.3	18	6.4	--	--
04/26/95	8.22	5.87	2.35	--	--	--	--	15,000	3700	210	520	800	--	--
07/12/95	8.22	3.56	4.66	--	--	--	--	7700	1800	59	130	370	--	--
10/30/95	8.22	2.74	5.48	--	--	--	--	770	260	<5.0	33	48	25	--
01/22/96	8.22	4.88	3.34	--	--	--	--	290	63	<1.0	6.4	5.7	<5.0	--
04/24/96	8.22	4.10	4.12	--	--	--	--	12,000	2500	510	380	810	<125	--
07/29/96	8.22	3.19	5.03	--	--	--	--	2600	650	<25	61	150	<125	--
10/10/96	8.22	2.70	5.52	--	--	--	--	5800	1700	28	170	210	<62	--
01/15/97	8.22	5.30	2.92	--	--	--	--	1000	230	<2.5	28	11	63	--
04/03/97	8.22	3.57	4.65	--	--	--	--	6000	1800	100	140	170	<100	--
07/09/97	8.22	2.83	5.39	--	--	--	--	5500	2200	<20	41	30	<100	--
10/29/97	8.22	2.64	5.58	--	--	--	--	220	40	0.61	3.0	2.4	7.6	--
01/14/98	8.22	5.42	2.80	--	--	--	--	140	5.1	<0.5	<0.5	1.4	<2.5	--
04/17/98	8.22	5.22	3.00	--	--	--	--	13,000	4200	98	250	240	250	--
07/15/98	8.22	--	--	--	--	--	Inaccessible	--	--	--	--	--	--	--
08/17/98	7.92*	2.40	5.52	--	--	--	--	1600	380	51	68	280	22	--
10/27/98	7.92	0.41	7.51	--	--	--	--	190	2.3	0.53	<0.5	<0.5	33	--
01/20/99	7.92	4.47	3.45	--	--	--	--	<50	<0.5	<0.5	<0.5	<0.5	<2.0	--
04/19/99	7.92	3.31	4.61	--	--	--	--	6500	3000	<0.5	110	210	310	--
04/19/99	7.92	3.31	4.61	--	--	--	Confirmation Run	--	--	--	--	--	150	--
07/29/99	7.92	2.92	5.00	--	--	--	ORC Socks Installed	8390	2100	129	222	729	248	--
10/13/99	7.92	2.31	5.61	--	--	--	--	14,300	6600	58.8	117	190	<125	--
01/25/00	7.92	4.60	3.32	--	--	--	--	1100	184	<5.0	13.5	33.7	151	--

* Well head elevation altered due to well head maintenance.

Cumulative Table of Well Data and Analytical Results

Vertical Measurements are in feet.

Volumetric Measurements are in gallons.

Analytical results are in parts per billion (ppb)

DATE	Well	Ground	Depth	Total			Notes	TPH- Gasoline	Benzene	Toluene	Ethyl- Benzene	Xylene	MTBE	Other
	Head Elev.	Water Elev.	To Water	SPH Thickness	SPH Removed	SPH Removed								
MW-8														
10/17/95	6.96	2.56	4.40	--	--	--	--	--	--	--	--	--	--	--
10/30/95	6.96	2.52	4.44	--	--	--	--	<50	<0.5	<0.5	<0.5	<0.5	<2.5	--
01/22/96	6.96	4.72	2.24	--	--	--	--	<50	<0.5	<0.5	<0.5	<0.5	<2.5	--
04/24/96	6.96	3.99	2.97	--	--	--	--	<50	<0.5	<0.5	<0.5	<0.5	<2.5	--
07/29/96	6.96	3.59	3.37	--	--	--	--	<50	<0.5	<0.5	<0.5	<0.5	<2.5	--
10/10/96	6.96	2.84	4.12	--	--	--	--	<50	<0.5	<0.5	<0.5	<0.5	<2.5	--
01/15/97	6.96	6.02	0.94	--	--	--	--	<50	<0.5	<0.5	<0.5	<0.5	<2.5	--
04/03/97	6.96	4.76	2.20	--	--	--	--	<50	<0.5	<0.5	<0.5	<0.5	<2.5	--
07/09/97	6.96	2.66	4.30	--	--	--	--	<50	<0.5	<0.5	<0.5	<0.5	<2.5	--
10/29/97	6.96	2.39	4.57	--	--	--	--	<50	<0.5	<0.5	<0.5	<0.5	<2.5	--
01/14/98	6.96	6.13	0.83	--	--	--	Gauged and sampled annually	<50	<0.5	<0.5	<0.5	<0.5	<2.5	--
01/20/99	6.96	4.27	2.69	--	--	--	--	<50	<0.5	<0.5	<0.5	<0.5	<2.0	--
04/19/99	6.96	3.20	3.76	--	--	--	--	--	--	--	--	--	--	--
01/25/00	6.96	5.55	1.41	--	--	--	--	<50	<0.5	<0.5	<0.5	<0.5	<2.5	--

Cumulative Table of Well Data and Analytical Results

Vertical Measurements are in feet.

Volumetric Measurements are in gallons.

Analytical results are in parts per billion (ppb)

DATE	Well	Ground	Depth	Total			Notes	TPH- Gasoline	Benzene	Toluene	Ethyl- Benzene	Xylene	MTBE	Other
	Head Elev.	Water Elev.	To Water	SPH Thickness	SPH Removed	SPH Removed								
MW-9														
10/17/95	7.21	2.41	4.80	--	--	--	--	--	--	--	--	--	--	--
10/30/95	7.21	2.24	4.97	--	--	--	--	<50	<0.5	<0.5	<0.5	<0.5	<2.5	--
01/22/96	7.21	3.81	3.40	--	--	--	--	<50	<0.5	<0.5	<0.5	<0.5	<2.5	--
04/24/96	7.21	3.03	4.18	--	--	--	--	<50	<0.5	<0.5	<0.5	<0.5	<2.5	--
07/29/96	7.21	2.52	4.69	--	--	--	--	<50	<0.5	<0.5	<0.5	<0.5	<2.5	--
10/10/96	7.21	2.01	5.20	--	--	--	--	<50	<0.5	<0.5	<0.5	<0.5	<2.5	--
01/15/97	7.21	3.90	3.31	--	--	--	--	<50	<0.5	<0.5	<0.5	<0.5	<2.5	--
04/03/97	7.21	2.64	4.57	--	--	--	--	<50	<0.5	<0.5	<0.5	<0.5	<2.5	--
07/09/97	7.21	2.17	5.04	--	--	--	--	<50	<0.5	<0.5	<0.5	<0.5	<2.5	--
10/29/97	7.21	2.25	4.96	--	--	--	--	<50	<0.5	<0.5	<0.5	<0.5	<2.5	--
01/14/98	7.21	4.81	2.40	--	--	--	Gauged and sampled annually	<50	<0.5	<0.5	<0.5	<0.5	<2.5	--
01/20/99	7.21	2.90	4.31	--	--	--	--	<50	<0.5	<0.5	<0.5	<0.5	<2.0	--
04/19/99	7.21	3.29	3.92	--	--	--	--	--	--	--	--	--	--	--
01/25/00	7.21	4.26	2.95	--	--	--	--	<50	<0.5	<0.5	<0.5	<0.5	<2.5	--

Cumulative Table of Well Data and Analytical Results

Vertical Measurements are in feet.

Volumetric Measurements are in gallons.

Analytical results are in parts per billion (ppb)

DATE	Well	Ground	Depth	Total			Notes	Analytical results are in parts per billion (ppb)						
	Head Elev.	Water Elev.	To Water	SPH Thickness	SPH Removed	SPH Removed		TPH-Gasoline	Benzene	Toluene	Ethyl-Benzene	Xylene	MTBE	Other
MW-10														
10/17/95	7.28	2.23	5.05	--	--	--	--	--	--	--	--	--	--	--
10/30/95	7.28	2.17	5.11	--	--	--	--	<50	<0.5	<0.5	<0.5	<0.5	5.1	--
01/22/96	7.28	3.25	4.03	--	--	--	--	<50	<0.5	<0.5	<0.5	<0.5	0.70	17
04/24/96	7.28	2.98	4.30	--	--	--	--	<50	<0.5	<0.5	<0.5	<0.5	12	--
07/29/96	7.28	2.58	4.70	--	--	--	--	<50	<0.5	<0.5	<0.5	<0.5	14	--
10/10/96	7.28	2.04	5.24	--	--	--	--	<50	<0.5	<0.5	<0.5	<0.5	<2.5	--
01/15/97	7.28	3.93	3.35	--	--	--	--	<50	<0.5	<0.5	<0.5	<0.5	<2.5	--
04/03/97	7.28	2.64	4.64	--	--	--	--	<50	<0.5	<0.5	<0.5	<0.5	8.2	--
07/09/97	7.28	2.16	5.12	--	--	--	--	<50	<0.5	<0.5	<0.5	<0.5	<2.5	--
10/29/97	7.28	2.18	5.10	--	--	--	--	<50	<0.5	<0.5	<0.5	<0.5	5.3	--
01/14/98	7.28	4.20	3.08	--	--	--	--	<50	<0.5	<0.5	<0.5	<0.5	8.6	--
04/17/98	7.28	3.49	3.79	--	--	--	Sampled biannually	--	--	--	--	--	--	--
07/15/98	7.28	2.73	4.55	--	--	--	--	<50	<0.5	<0.5	<0.5	<0.5	7.5	--
10/27/98	7.28	1.96	5.32	--	--	--	--	--	--	--	--	--	--	--
01/20/99	7.28	3.04	4.24	--	--	--	--	<50	<0.5	<0.5	<0.5	<0.5	<2.0	--
04/19/99	7.28	3.21	4.07	--	--	--	--	--	--	--	--	--	--	--
07/29/99	7.28	2.46	4.82	--	--	--	--	<50	<0.5	<0.5	<0.5	<0.5	<5.0	--
07/29/99	7.28	2.46	4.82	--	--	--	Confirmation run	--	--	--	--	--	2.4	--
10/13/99	7.28	2.42	4.86	--	--	--	--	--	--	--	--	--	--	--
01/25/00	7.28	4.28	3.00	--	--	--	--	<50	<0.5	<0.5	<0.5	<0.5	4.33	--
TMW-1														
11/11/93	--	--	--	--	--	--	--	<1.0	<0.5	<0.5	<0.5	<0.5	--	--
NO LONGER MONITORED OR SAMPLED														
3115A GIBBONS DR.														
01/14/98	--	--	--	--	--	--	--	<50	<0.5	<0.5	<0.5	<0.5	<2.5	--

Cumulative Table of Well Data and Analytical Results

Vertical Measurements are in feet.

Volumetric Measurements are in gallons.

Analytical results are in parts per billion (ppb)

DATE	Well	Ground	Depth	Total			Notes	TPH- Gasoline	Benzene	Toluene	Ethyl- Benzene	Xylene	MTBE	Other
	Head Elev.	Water Elev.	To Water	SPH Thickness	SPH Removed	SPH Removed								
TRIP BLANK														
02/14/90	--	--	--	--	--	--	--	<50	<0.5	1.1	<0.5	<0.5	--	--
09/06/91	--	--	--	--	--	--	--	<50	<0.5	<0.5	<0.5	<0.5	--	--
12/15/91	--	--	--	--	--	--	--	<50	<0.5	<0.5	<0.5	<0.5	--	--
03/03/92	--	--	--	--	--	--	--	<50	<0.5	<0.5	<0.5	<0.5	--	--
06/04/92	--	--	--	--	--	--	--	<50	<0.5	<0.5	<0.5	<0.5	--	--
10/13/92	--	--	--	--	--	--	--	<50	<0.5	<0.5	<0.5	<0.5	--	--
01/11/93	--	--	--	--	--	--	--	<50	<0.5	<0.5	<0.5	<0.5	--	--
04/14/93	--	--	--	--	--	--	--	<50	<0.5	<0.5	<0.5	<0.5	--	--
07/13/93	--	--	--	--	--	--	--	<50	<0.5	<0.5	<0.5	<0.5	--	--
10/19/93	--	--	--	--	--	--	--	<50	<0.5	<0.5	<0.5	<1.5	--	--
01/27/94	--	--	--	--	--	--	--	<50	<0.5	<0.5	<0.5	<0.5	--	--
04/07/94	--	--	--	--	--	--	--	<50	<0.5	<0.5	<0.5	<0.5	--	--
07/01/94	--	--	--	--	--	--	--	<50	<0.5	<0.5	<0.5	<0.5	--	--
10/05/94	--	--	--	--	--	--	--	<50	<0.5	<0.5	<0.5	<0.5	--	--
01/12/95	--	--	--	--	--	--	--	<50	<0.5	<0.5	<0.5	<0.5	--	--
04/26/95	--	--	--	--	--	--	--	<50	<0.5	<0.5	<0.5	<0.5	--	--
07/12/95	--	--	--	--	--	--	--	<50	<0.5	<0.5	<0.5	<0.5	--	--
10/30/95	--	--	--	--	--	--	--	<50	<0.5	<0.5	<0.5	<0.5	--	--
01/22/96	--	--	--	--	--	--	--	<50	<0.5	<0.5	<0.5	<0.5	<2.5	--
04/24/96	--	--	--	--	--	--	--	<50	<0.5	<0.5	<0.5	<0.5	<2.5	--
07/29/96	--	--	--	--	--	--	--	<50	<0.5	<0.5	<0.5	<0.5	<2.5	--
10/10/96	--	--	--	--	--	--	--	--	--	--	--	--	--	--
01/15/97	--	--	--	--	--	--	--	<50	<0.5	<0.5	<0.5	<0.5	<2.5	--
04/03/97	--	--	--	--	--	--	--	<50	<0.5	<0.5	<0.5	<0.5	<2.5	--
07/09/97	--	--	--	--	--	--	--	<50	<0.5	<0.5	<0.5	<0.5	<2.5	--
10/29/97	--	--	--	--	--	--	--	<50	<0.5	<0.5	<0.5	<0.5	<2.5	--
01/14/98	--	--	--	--	--	--	--	<50	<0.5	<0.5	<0.5	<0.5	<2.5	--
04/17/98	--	--	--	--	--	--	--	<50	<0.5	<0.5	<0.5	<0.5	<2.5	--
07/15/98	--	--	--	--	--	--	--	<50	<0.5	<0.5	<0.5	<0.5	<2.5	--
10/27/98	--	--	--	--	--	--	--	<50	<0.5	<0.5	<0.5	<0.5	<2.5	--

CONTINUED ON NEXT PAGE

Cumulative Table of Well Data and Analytical Results

Vertical Measurements are in feet.			Volumetric Measurements are in gallons.				Analytical results are in parts per billion (ppb)							
DATE	Well Head Elev.	Ground Water Elev.	Depth To Water	SPH Thickness	SPH Removed	Total SPH Removed	Notes	TPH-Gasoline	Benzene	Toluene	Ethyl-Benzene	Xylene	MTBE	Other
TRIP BLANK (CONT'D)														
01/20/99	--	--	--	--	--	--	--	<50	<0.5	<0.5	<0.5	<0.5	<2.0	--
04/19/99	--	--	--	--	--	--	--	<50	<0.5	<0.5	<0.5	<0.5	<2.5	--
07/29/99	--	--	--	--	--	--	--	<50	<0.5	<0.5	<0.5	<0.5	<5.0	--
10/13/99	--	--	--	--	--	--	--	<50	<0.5	<0.5	<0.5	<0.5	<2.5	--
01/25/00	--	--	--	--	--	--	--	<50	<0.5	<0.5	<0.5	<0.5	<2.5	--

Note: Blaine Tech Services, Inc. began routine monitoring of the groundwater wells at this site on November 1, 1994. Earlier field data and analytical results are drawn from the September 27, 1994 Groundwater Technology, Inc. report.

ABBREVIATIONS:

TPH = Total Petroleum Hydrocarbons
 SPH = Separate-Phase Hydrocarbons
 MTBE = Methyl t-butyl ether

Analytical Appendix



February 10, 2000

Scott Boor
Blaine Tech Services (Chev)
1680 Rogers Avenue
San Jose, CA 95112

RE: Chevron 9-1153 3126 Fernside Blvd., Alameda

Dear Scott Boor

Enclosed are the results of analyses for sample(s) received by the laboratory on January 26, 2000.
If you have any questions concerning this report, please feel free to contact me.

Sincerely,



Wendy Bonnes
Project Manager

CA ELAP Certificate Number 1210





Blaine Tech Services (Chev) 1680 Rogers Avenue San Jose, CA 95112	Project: Chevron 9-1153 Project Number: 3126 Fernside Blvd., Alameda Project Manager: Scott Boor	Sampled: 1/25/00 Received: 1/26/00 Reported: 2/10/00 10:03
---	--	--

ANALYTICAL REPORT FOR SAMPLES:

Sample Description	Laboratory Sample Number	Sample Matrix	Date Sampled
C-3	MJA0010-01	Water	1/25/00
MW-4	MJA0010-02	Water	1/25/00
MW-5	MJA0010-03	Water	1/25/00
MW-6	MJA0010-04	Water	1/25/00
MW-7	MJA0010-05	Water	1/25/00
MW-8	MJA0010-06	Water	1/25/00
MW-9	MJA0010-07	Water	1/25/00
MW-10	MJA0010-08	Water	1/25/00
TB	MJA0010-09	Water	1/25/00





Blaine Tech Services (Chev) 1680 Rogers Avenue San Jose, CA 95112	Project: Chevron 9-1153 Project Number: 3126 Fernside Blvd., Alameda Project Manager: Scott Boor	Sampled: 1/25/00 Received: 1/26/00 Reported: 2/10/00 10:03
---	--	--

Total Purgeable Hydrocarbons (C6-C12), BTEX and MTBE by DHS LUFT
Sequoia Analytical - Morgan Hill

Analyte	Batch Number	Date Prepared	Date Analyzed	Specific Method	Reporting Limit	Result	Units	Notes*
C-3		MJA0010-01			Water			
Purgeable Hydrocarbons	0A31001	1/31/00	1/31/00	DHS LUFT	50.0	ND	ug/l	
Benzene	"	"	"	DHS LUFT	0.500	ND	"	
Toluene	"	"	"	DHS LUFT	0.500	ND	"	
Ethylbenzene	"	"	"	DHS LUFT	0.500	ND	"	
Xylenes (total)	"	"	"	DHS LUFT	0.500	ND	"	
Methyl tert-butyl ether	"	"	"	DHS LUFT	2.50	ND	"	
Surrogate: <i>a,a,a</i> -Trifluorotoluene	"	"	"	70-130		96.3	%	
MW-4		MJA0010-02			Water			
Purgeable Hydrocarbons	0A31001	1/31/00	1/31/00	DHS LUFT	50.0	ND	ug/l	
Benzene	"	"	"	DHS LUFT	0.500	ND	"	
Toluene	"	"	"	DHS LUFT	0.500	ND	"	
Ethylbenzene	"	"	"	DHS LUFT	0.500	ND	"	
Xylenes (total)	"	"	"	DHS LUFT	0.500	ND	"	
Methyl tert-butyl ether	"	"	"	DHS LUFT	2.50	ND	"	
Surrogate: <i>a,a,a</i> -Trifluorotoluene	"	"	"	70-130		72.8	%	
MW-5		MJA0010-03			Water			
Purgeable Hydrocarbons	0A31001	1/31/00	1/31/00	DHS LUFT	50.0	169	ug/l	P-01
Benzene	"	"	"	DHS LUFT	0.500	1.94	"	
Toluene	"	"	"	DHS LUFT	0.500	ND	"	
Ethylbenzene	"	"	"	DHS LUFT	0.500	ND	"	
Xylenes (total)	"	"	"	DHS LUFT	0.500	ND	"	
Methyl tert-butyl ether	"	"	"	DHS LUFT	2.50	201	"	
Surrogate: <i>a,a,a</i> -Trifluorotoluene	"	"	"	70-130		113	%	
MW-6		MJA0010-04			Water			
Purgeable Hydrocarbons	0B04005	2/4/00	2/4/00	DHS LUFT	250	529	ug/l	P-01
Benzene	"	"	"	DHS LUFT	2.50	289	"	
Toluene	"	"	"	DHS LUFT	2.50	ND	"	
Ethylbenzene	"	"	"	DHS LUFT	2.50	ND	"	
Xylenes (total)	"	"	"	DHS LUFT	2.50	ND	"	
Methyl tert-butyl ether	"	"	"	DHS LUFT	12.5	738	"	
Surrogate: <i>a,a,a</i> -Trifluorotoluene	"	"	"	70-130		99.8	%	
MW-7		MJA0010-05			Water			
Purgeable Hydrocarbons	0A31001	1/31/00	1/31/00	DHS LUFT	500	1100	ug/l	P-01
Benzene	"	"	"	DHS LUFT	5.00	184	"	





Blaine Tech Services (Chev) 1680 Rogers Avenue San Jose, CA 95112	Project: Chevron 9-1153 Project Number: 3126 Fernside Blvd., Alameda Project Manager: Scott Boor	Sampled: 1/25/00 Received: 1/26/00 Reported: 2/10/00 10:03
---	--	--

**Total Purgeable Hydrocarbons (C6-C12), BTEX and MTBE by DHS LUFT
Sequoia Analytical - Morgan Hill**

Analyte	Batch Number	Date Prepared	Date Analyzed	Specific Method	Reporting Limit	Result	Units	Notes*
MW-7 (continued)		MJA0010-05			Water			
Toluene	0A31001	1/31/00	1/31/00	DHS LUFT	5.00	ND	ug/l	
Ethylbenzene	"	"	"	DHS LUFT	5.00	13.5	"	
Xylenes (total)	"	"	"	DHS LUFT	5.00	33.7	"	
Methyl tert-butyl ether	"	"	"	DHS LUFT	25.0	151	"	
<i>Surrogate: a,a,a-Trifluorotoluene</i>	"	"	"	70-130		94.5	%	
MW-8		MJA0010-06			Water			
Purgeable Hydrocarbons	0A31002	1/31/00	1/31/00	DHS LUFT	50.0	ND	ug/l	
Benzene	"	"	"	DHS LUFT	0.500	ND	"	
Toluene	"	"	"	DHS LUFT	0.500	ND	"	
Ethylbenzene	"	"	"	DHS LUFT	0.500	ND	"	
Xylenes (total)	"	"	"	DHS LUFT	0.500	ND	"	
Methyl tert-butyl ether	"	"	"	DHS LUFT	2.50	ND	"	
<i>Surrogate: a,a,a-Trifluorotoluene</i>	"	"	"	70-130		104	%	A-01a
MW-9		MJA0010-07			Water			
Purgeable Hydrocarbons	0A31001	1/31/00	1/31/00	DHS LUFT	50.0	ND	ug/l	
Benzene	"	"	"	DHS LUFT	0.500	ND	"	
Toluene	"	"	"	DHS LUFT	0.500	ND	"	
Ethylbenzene	"	"	"	DHS LUFT	0.500	ND	"	
Xylenes (total)	"	"	"	DHS LUFT	0.500	ND	"	
Methyl tert-butyl ether	"	"	"	DHS LUFT	2.50	ND	"	
<i>Surrogate: a,a,a-Trifluorotoluene</i>	"	"	"	70-130		96.8	%	
MW-10		MJA0010-08			Water			
Purgeable Hydrocarbons	0A31001	1/31/00	1/31/00	DHS LUFT	50.0	ND	ug/l	
Benzene	"	"	"	DHS LUFT	0.500	ND	"	
Toluene	"	"	"	DHS LUFT	0.500	ND	"	
Ethylbenzene	"	"	"	DHS LUFT	0.500	ND	"	
Xylenes (total)	"	"	"	DHS LUFT	0.500	ND	"	
Methyl tert-butyl ether	"	"	"	DHS LUFT	2.50	4.33	"	
<i>Surrogate: a,a,a-Trifluorotoluene</i>	"	"	"	70-130		94.9	%	
TB		MJA0010-09			Water			
Purgeable Hydrocarbons	0A31001	1/31/00	1/31/00	DHS LUFT	50.0	ND	ug/l	
Benzene	"	"	"	DHS LUFT	0.500	ND	"	
Toluene	"	"	"	DHS LUFT	0.500	ND	"	
Ethylbenzene	"	"	"	DHS LUFT	0.500	ND	"	





Blaine Tech Services (Chev) 1680 Rogers Avenue San Jose, CA 95112	Project: Chevron 9-1153 Project Number: 3126 Fernside Blvd., Alameda Project Manager: Scott Boor	Sampled: 1/25/00 Received: 1/26/00 Reported: 2/10/00 10:03
---	--	--

**Total Purgeable Hydrocarbons (C6-C12), BTEX and MTBE by DHS LUFT
Sequoia Analytical - Morgan Hill**

Analyte	Batch Number	Date Prepared	Date Analyzed	Specific Method	Reporting Limit	Result	Units	Notes*
TB (continued)				MJA0010-09			Water	
Xylenes (total)	0A31001	1/31/00	1/31/00	DHS LUFT	0.500	ND	ug/l	
Methyl tert-butyl ether	"	"	"	DHS LUFT	2.50	ND	"	
Surrogate: a,a,a-Trifluorotoluene	"	"	"	70-130		96.5	%	





Blaine Tech Services (Chev) 1680 Rogers Avenue San Jose, CA 95112	Project: Chevron 9-1153 Project Number: 3126 Fernside Blvd., Alameda Project Manager: Scott Boor	Sampled: 1/25/00 Received: 1/26/00 Reported: 2/10/00 10:03
---	--	--

**Total Purgeable Hydrocarbons (C6-C12), BTEX and MTBE by DHS LUFT/Quality Control
Sequoia Analytical - Morgan Hill**

Analyte	Date Analyzed	Spike Level	Sample Result	QC Result	Reporting Limit Units	Recov. Limits	Recov. %	RPD Limit	RPD %	Notes*
---------	---------------	-------------	---------------	-----------	-----------------------	---------------	----------	-----------	-------	--------

Batch: 0A31001

Date Prepared: 1/31/00

Extraction Method: EPA 5030B [P/T]

Blank

0A31001-BLK1

Purgeable Hydrocarbons	1/31/00			ND	ug/l	50.0				
Benzene	"			ND	"	0.500				
Toluene	"			ND	"	0.500				
Ethylbenzene	"			ND	"	0.500				
Xylenes (total)	"			ND	"	0.500				
Methyl tert-butyl ether	"			ND	"	2.50				
Surrogate: a,a,a-Trifluorotoluene	"	10.0		8.50	"	70-130	85.0			

LCS

0A31001-BS1

Purgeable Hydrocarbons	1/31/00			90.8	ug/l	70-130				
Benzene	"	10.0		8.16	"	70-130	81.6			
Toluene	"	10.0		8.08	"	70-130	80.8			
Ethylbenzene	"	10.0		8.21	"	70-130	82.1			
Xylenes (total)	"	30.0		24.5	"	70-130	81.7			
Methyl tert-butyl ether	"			ND	"	70-130				
Surrogate: a,a,a-Trifluorotoluene	"	10.0		9.60	"	70-130	96.0			

Matrix Spike

0A31001-MS1 MJA0010-01

Purgeable Hydrocarbons	1/31/00		ND	91.7	ug/l	60-140				
Benzene	"	10.0	ND	8.16	"	60-140	81.6			
Toluene	"	10.0	ND	8.05	"	60-140	80.5			
Ethylbenzene	"	10.0	ND	8.18	"	60-140	81.8			
Xylenes (total)	"	30.0	ND	24.6	"	60-140	82.0			
Methyl tert-butyl ether	"		ND	ND	"	60-140				
Surrogate: a,a,a-Trifluorotoluene	"	10.0		0	"	70-130				A-01b

Matrix Spike Dup

0A31001-MSD1 MJA0010-01

Purgeable Hydrocarbons	1/31/00		ND	102	ug/l	60-140		25	10.6	
Benzene	"	10.0	ND	9.14	"	60-140	91.4	25	11.3	
Toluene	"	10.0	ND	9.03	"	60-140	90.3	25	11.5	
Ethylbenzene	"	10.0	ND	9.08	"	60-140	90.8	25	10.4	
Xylenes (total)	"	30.0	ND	27.1	"	60-140	90.3	25	9.67	
Methyl tert-butyl ether	"		ND	ND	"	60-140		25		
Surrogate: a,a,a-Trifluorotoluene	"	10.0		9.61	"	70-130	96.1			





Blaine Tech Services (Chev) 1680 Rogers Avenue San Jose, CA 95112	Project: Chevron 9-1153 Project Number: 3126 Fernside Blvd., Alameda Project Manager: Scott Boor	Sampled: 1/25/00 Received: 1/26/00 Reported: 2/10/00 10:03
---	--	--

**Total Purgeable Hydrocarbons (C6-C12), BTEX and MTBE by DHS LUFT/Quality Control
Sequoia Analytical - Morgan Hill**

Analyte	Date Analyzed	Spike Level	Sample Result	QC Result	Reporting Limit Units	Recov. Limits	Recov. %	RPD Limit	RPD %	Notes*
Batch: 0A31002			Date Prepared: 1/31/00			Extraction Method: EPA 5030B [P/T]				
Blank			0A31002-BLK1							
Purgeable Hydrocarbons	1/31/00			ND	ug/l	50.0				
Benzene	"			ND	"	0.500				
Toluene	"			ND	"	0.500				
Ethylbenzene	"			ND	"	0.500				
Xylenes (total)	"			ND	"	0.500				
Methyl tert-butyl ether	"			ND	"	2.50				
Surrogate: <i>a,a,a</i> -Trifluorotoluene	"	10.0		10.7	"	70-130	107			A-01
LCS			0A31002-BS1							
Benzene	1/31/00	10.0		10.1	ug/l	70-130	101			
Toluene	"	10.0		9.57	"	70-130	95.7			
Ethylbenzene	"	10.0		10.1	"	70-130	101			
Xylenes (total)	"	30.0		30.2	"	70-130	101			
Surrogate: <i>a,a,a</i> -Trifluorotoluene	"	10.0		10.7	"	70-130	107			A-01
Matrix Spike			0A31002-MS1 MJA0010-06							
Benzene	1/31/00	10.0	ND	9.91	ug/l	60-140	99.1			
Toluene	"	10.0	ND	9.28	"	60-140	92.8			
Ethylbenzene	"	10.0	ND	9.87	"	60-140	98.7			
Xylenes (total)	"	30.0	ND	29.1	"	60-140	97.0			
Surrogate: <i>a,a,a</i> -Trifluorotoluene	"	10.0		10.8	"	70-130	108			A-01
Matrix Spike Dup			0A31002-MSD1 MJA0010-06							
Benzene	1/31/00	10.0	ND	10.2	ug/l	60-140	102	25	2.88	
Toluene	"	10.0	ND	9.67	"	60-140	96.7	25	4.12	
Ethylbenzene	"	10.0	ND	10.2	"	60-140	102	25	3.29	
Xylenes (total)	"	30.0	ND	29.9	"	60-140	99.7	25	2.71	
Surrogate: <i>a,a,a</i> -Trifluorotoluene	"	10.0		10.8	"	70-130	108			A-01
Batch: 0B04005			Date Prepared: 2/4/00			Extraction Method: EPA 5030B [P/T]				
Blank			0B04005-BLK1							
Purgeable Hydrocarbons	2/4/00			ND	ug/l	50.0				
Benzene	"			ND	"	0.500				
Toluene	"			ND	"	0.500				
Ethylbenzene	"			ND	"	0.500				
Xylenes (total)	"			ND	"	0.500				
Methyl tert-butyl ether	"			ND	"	2.50				





Blaine Tech Services (Chev) 1680 Rogers Avenue San Jose, CA 95112	Project: Chevron 9-1153 Project Number: 3126 Fernside Blvd., Alameda Project Manager: Scott Boor	Sampled: 1/25/00 Received: 1/26/00 Reported: 2/10/00 10:03
---	--	--

**Total Purgeable Hydrocarbons (C6-C12), BTEX and MTBE by DHS LUFT/Quality Control
Sequoia Analytical - Morgan Hill**

Analyte	Date Analyzed	Spike Level	Sample Result	QC Result	Reporting Limit Units	Recov. %	RPD Limit	RPD %	Notes*
Blank (continued)									
0B04005-BLK1									
Surrogate: <i>a,a,a</i> -Trifluorotoluene	2/4/00	10.0		9.86	ug/l	70-130	98.6		
LCS									
0B04005-BS1									
Benzene	2/4/00	10.0		8.30	ug/l	70-130	83.0		
Toluene	"	10.0		8.96	"	70-130	89.6		
Ethylbenzene	"	10.0		10.3	"	70-130	103		
Xylenes (total)	"	30.0		31.1	"	70-130	104		
Surrogate: <i>a,a,a</i> -Trifluorotoluene	"	10.0		9.29	"	70-130	92.9		
Matrix Spike									
0B04005-MS1 MJA0200-14									
Benzene	2/4/00	10.0	ND	8.56	ug/l	60-140	85.6		
Toluene	"	10.0	ND	9.17	"	60-140	91.7		
Ethylbenzene	"	10.0	ND	10.5	"	60-140	105		
Xylenes (total)	"	30.0	ND	31.3	"	60-140	104		
Surrogate: <i>a,a,a</i> -Trifluorotoluene	"	10.0		10.7	"	70-130	107		
Matrix Spike Dup									
0B04005-MSD1 MJA0200-14									
Benzene	2/4/00	10.0	ND	8.67	ug/l	60-140	86.7	25	1.28
Toluene	"	10.0	ND	9.34	"	60-140	93.4	25	1.84
Ethylbenzene	"	10.0	ND	10.5	"	60-140	105	25	0
Xylenes (total)	"	30.0	ND	31.7	"	60-140	106	25	1.27
Surrogate: <i>a,a,a</i> -Trifluorotoluene	"	10.0		10.4	"	70-130	104		





Blaine Tech Services (Chev) 1680 Rogers Avenue San Jose, CA 95112	Project: Chevron 9-1153 Project Number: 3126 Fernside Blvd., Alameda Project Manager: Scott Boor	Sampled: 1/25/00 Received: 1/26/00 Reported: 2/10/00 10:03
---	--	--

Notes and Definitions

#	Note
---	------

- A-01 Due to an isolated incident of high spiking, the opening std was out of range. The continuing std passed and the surrogate recoveries of the samples were within range, indicating that this set is valid.
- A-01a Due to an isolated incident of high spiking, the opening std was out of range. The continuing std passed, indicating that this set is valid and the surrogate recoveries of the samples were within range.
- A-01b The surrogate is not available due to the fact that it was not spiked. Recovery of the analytes in range indicate that this does not represent an out of control situation.
- P-01 Chromatogram Pattern: Gasoline C6-C12
- DET Analyte DETECTED
- ND Analyte NOT DETECTED at or above the reporting limit
- NR Not Reported
- dry Sample results reported on a dry weight basis
- Recov. Recovery
- RPD Relative Percent Difference



Fax copy of Lab Report and COC to Chevron Contact:

Yes
 No

Chain-of-Custody-Record

Chevron Products Co. P.O. BOX 6004 San Ramon, CA 94583 FAX (925)842-8370	Chevron Facility Number <u>9-1153</u>	Chevron Contact Name) <u>Brett Hunter</u>
	Facility Address <u>3126 Fernside Blvd., Alameda</u>	(Phone) <u>(925) 842-8695</u>
	Consultant Project Number <u>000125-113</u>	Laboratory Name <u>Sequoia</u>
	Consultant Name <u>Blaine Tech Services, Inc.</u>	Laboratory Service Order <u>9144488</u>
	Address <u>1680 Rogers Ave., San Jose</u>	Laboratory Service Code <u>ZZ02790</u>
Project Contact (Name) <u>Scott Boor</u>	Samples collected by (Name) <u>Sanjiv</u>	Signature <u>[Signature]</u>
(Phone) <u>408-573-0555</u> (Fax) <u>408-573-7771</u>		

Sample Number	Number of Containers	Matrix S = Soil W = Water C = Charcoal	Sample Preservation	Date/Time	State Method: <input type="checkbox"/> CA <input type="checkbox"/> OR <input type="checkbox"/> WA <input type="checkbox"/> NW Series <input type="checkbox"/> CO <input type="checkbox"/> UT													Remarks																				
					BTEX/MTBE + TPH GAS (8020 + 8015)	BTEX + TPH GAS (8020 + 8015)	TPH Diesel (8015)	Oxygenates (8260)	Purgeable Halocarbons (8010)	Purgeable Organics (8270)	Extractable Organics (8270)	Oil and Grease (5520)	Metals (ICAP or AA) Cd, Cr, Pb, Zn, Ni	BTEX (8020)	BTEX/MTBE/Naph. (8020)	TPH - HCID	TPH - D Extended		Lab Sample No.																			
C-3	3	W	HC1	01-25-00 9:28	X																																	
MW-4				01-25-00 11:19																																		1
MW-5				01-25-00 11:01																																	2	
MW-6				01-25-00 12:25																																	3	
MW-7				01-25-00 10:37																																	4	
MW-8				01-25-00 12:03																																	5	
MW-9				01-25-00 11:39																																	6	
MW-10				01-25-00 13:40																																7		
TB	2			01-25-00																																8		
																																				9		

MJA0010

Relinquished By (Signature)	Organization	Date/Time	Received By (Signature)	Organization	Date/Time	Iced Y/N	Turn Around Time (Circle One) 24 Hrs. 48 Hrs. 5 Days 10 Days
Relinquished By (Signature)	Organization	Date/Time	Received By (Signature)	Organization	Date/Time	Iced Y/N	
Relinquished By (Signature)	Organization	Date/Time	Received For Laboratory By (Signature)	Organization	Date/Time	Iced Y/N	

COC-3 DRG/07-98/HCH

Field Data Sheets

WELL GAUGING DATA

Project # 000125-43 Date 01-25-00 Client 9-1153

Site 3126 Fernside Blvd, Alameda, Ca

Well ID	Well Size (in.)	Sheen / Odor	Depth to Immiscible Liquid (ft.)	Thickness of Immiscible Liquid (ft.)	Volume of Immiscibles Removed (ml)	Depth to water (ft.)	Depth to well bottom (ft.)	Survey Point: TOB or TOC
C-1	3		1.94	.04	100ml	1.99		TOC
C-3	3					1.81	17.95	↓
MW-4	2					1.92	12.35	
MW-5	2					1.51	12.10	
MW-6	2					4.11	13.37	
MW-7	2					3.32	13.42	
MW-8	2					1.41	8.85	
MW-9	2					2.95	7.92	
MW-10	2					3.00	8.35	

18-64

CHEVRON WELL MONITORING DATA SHEET

Project #: 000125-41	Station #: 9-1153
Sampler: Sanjiv	Date: 01-25-00
Well I.D.: C-3	Well Diameter: 2 (3) 4 6 8
Total Well Depth: 17.95	Depth to Water: 1.81
Depth to Free Product:	Thickness of Free Product (feet):
Referenced to: PVC Grade	D.O. Meter (if req'd): YSI HACH

Purge Method:

Bailer

Disposable Bailer

Middleburg

Electric Submersible

Waterra

Peristaltic

Extraction Pump

Other _____

Sampling Method:

Bailer

Disposable Bailer

Extraction Port

Dedicated Tubing

Other: _____

5.9 (Gals.) X 3 = 17.7 Gals.
1 Case Volume Specified Volumes Calculated Volume

Well Diameter	Multiplier	Well Diameter	Multiplier
1"	0.04	4"	0.65
2"	0.16	6"	1.47
3"	0.37	Other	radius ² * 0.163

Time	Temp (°F)	pH	Cond.	Gals. Removed	Observations
9:12	56.6	5.9	1064	6	
9:18	56.9	6.7	508	12	
9:24	56.7	6.9	492	18	

Did well dewater? Yes No Gallons actually evacuated: 18

Sampling Time: 9:28 Sampling Date: 01-25-00

Sample I.D.: C-3 Laboratory: STL Sequoia OtherAnalyzed for: TPH-G BTEX MTBE TPH-D Other:

EB I.D. (if applicable): @ Time Duplicate I.D. (if applicable):

Analyzed for: TPH-G BTEX MTBE TPH-D Other:

D.O. (if req'd):	Pre-purge:	mg/L	Post-purge:	mg/L
O.R.P. (if req'd):	Pre-purge:	mV	Post-purge:	mV

CHEVRON WELL MONITORING DATA SHEET

Project #: <u>000125-41</u>	Station #: <u>9-1153</u>
Sampler: <u>Sanjiv</u>	Date: <u>01-25-00</u>
Well I.D.: <u>MW-4</u>	Well Diameter: <u>(2)</u> 3 4 6 8
Total Well Depth: <u>12.35</u>	Depth to Water: <u>1.92</u>
Depth to Free Product:	Thickness of Free Product (feet):
Referenced to: PVC Grade	D.O. Meter (if req'd): YSI HACH

Purge Method:

- | | |
|--|---|
| Bailer
<input checked="" type="radio"/> Disposable Bailer
Middleburg
Electric Submersible | Waterra
Peristaltic
Extraction Pump
Other: _____ |
|--|---|

Sampling Method: Bailer

- | | |
|---|--------------|
| <input checked="" type="radio"/> Disposable Bailer
Extraction Port
Dedicated Tubing | Other: _____ |
|---|--------------|

<u>1.6</u> (Gals.) X	<u>3</u>	<u>=</u>	<u>3</u> Gals.
1 Case Volume	Specified Volumes		Calculated Volume

Well Diameter	Multiplier	Well Diameter	Multiplier
1"	0.04	4"	0.65
2"	0.16	6"	1.47
3"	0.37	Other:	radius ² * 0.163

Time	Temp (°F)	pH	Cond.	Gals. Removed	Observations
11:13	61.7	7.2	937	2	
11:15	62.4	7.1	933	3	
11:17	62.6	7.1	936	5	

Did well dewater? Yes No Gallons actually evacuated: 5

Sampling Time: 11:19 Sampling Date: 01-25-00

Sample I.D.: MW-4 Laboratory: STL Sequoia Other

Analyzed for: TPH-G BTEX MTBE TPH-D Other: _____

EB I.D. (if applicable): _____ @ _____ Time Duplicate I.D. (if applicable): _____

Analyzed for: TPH-G BTEX MTBE TPH-D Other: _____

D.O. (if req'd):	Pre-purge:	mg/L	Post-purge:	mg/L
O.R.P. (if req'd):	Pre-purge:	mV	Post-purge:	mV

CHEVRON WELL MONITORING DATA SHEET

Project #: 000125-41	Station #: 9-1153
Sampler: Sanjiv	Date: 01-25-00
Well I.D.: MW-5	Well Diameter: (2) 3 4 6 8
Total Well Depth: 12.10	Depth to Water: 1.51
Depth to Free Product:	Thickness of Free Product (feet):
Referenced to: PVC Grade	D.O. Meter (if req'd): YSI HACH

Purge Method:

- Bailer
 Disposable Bailer
 Middleburg
 Electric Submersible
 Waterra
 Peristaltic
 Extraction Pump
 Other _____

Sampling Method:

Bailer

- Disposable Bailer
 Extraction Port
 Dedicated Tubing
 Other: _____

1.6 (Gals.) X	3	= 4.8 Gals.
1 Case Volume	Specified Volumes	Calculated Volume

Well Diameter	Multiplier	Well Diameter	Multiplier
1"	0.04	4"	0.65
2"	0.16	6"	1.47
3"	0.37	Other	radius ² * 0.163

Time	Temp (°F)	pH	Cond.	Gals. Removed	Observations
10:55	60.2	6.7	941	2	
10:57	60.2	6.8	1001	3	
10:59	60.1	6.8	1025	5	

Did well dewater? Yes No Gallons actually evacuated: 5

Sampling Time: 11:01 Sampling Date: 01-25-00

Sample I.D.: MW-5 Laboratory: STL Sequoia Other

Analyzed for: TPH-G BTEX MTBE TPH-D Other:

EB I.D. (if applicable): @ Time Duplicate I.D. (if applicable):

Analyzed for: TPH-G BTEX MTBE TPH-D Other:

D.O. (if req'd): Pre-purge: mg/L Post-purge: mg/L

O.R.P. (if req'd): Pre-purge: mV Post-purge: mV

CHEVRON WELL MONITORING DATA SHEET

Project #: 000125-41	Station #: 9-1153
Sampler: Sanjiv	Date: 01-25-00
Well I.D.: MW-6	Well Diameter: (2) 3 4 6 8
Total Well Depth: 13.31	Depth to Water: 4.11
Depth to Free Product:	Thickness of Free Product (feet):
Referenced to: PVC Grade	D.O. Meter (if req'd): YSI HACH

Well Diameter	Multiplier	Well Diameter	Multiplier
2"	0.16	5"	1.02
3"	0.37	6"	1.47
4"	0.65	Other	radius ² * 0.163

Purge Method: Bailer
~~Disposable Bailer~~
 Middleburg
 Electric Submersible
 Extraction Pump

Sampling Method: Bailer
~~Disposable Bailer~~
 Extraction Port
 Other: _____

Other: _____

1.4	x	3	=	4.2	Gals.
1 Case Volume (Gals.)		Specified Volumes		Calculated Volume	

Time	Temp (°F)	pH	Cond.	Gals. Removed	Observations
12:21	64.7	6.7	608	2	
12:22	63.4	6.9	643	3	
12:23	63.1	6.9	684	4.5	

Did well dewater? Yes No Gallons actually evacuated: 4.5

Sampling Time: 12:25 Sampling Date: 01-25-00

Sample I.D.: MW-6 Laboratory: Sequoia CORE N. Creek Assoc. Labs

Analyzed for: TPH-G BTEX MTBE TPH-D Other:

Duplicate I.D.: Analyzed for: TPH-G BTEX MTBE TPH-D Other:

D.O. (if req'd):	Pre-purge: 2.0	mg/L	Post-purge:	mg/L
O.R.P. (if req'd):	Pre-purge:	mV	Post-purge:	mV

CHEVRON WELL MONITORING DATA SHEET

Project #: 000125-41	Station #: 9-1153
Sampler: Sanjiv	Date: 01-25-00
Well I.D.: MW-7	Well Diameter: (2) 3 4 6 8
Total Well Depth: 13.42	Depth to Water: 3.32
Depth to Free Product:	Thickness of Free Product (feet):
Referenced to: PVC Grade	D.O. Meter (if req'd): YSI HACH

Purge Method: Bailer Waterra Peristaltic Extraction Pump Other _____

Disposable Bailer

Middleburg Electric Submersible

Sampling Method: Bailer Disposable Bailer Extraction Port Dedicated Tubing

Other: _____

1.6 (Gals.) X 3 = 4.8 Gals.

1 Case Volume Specified Volumes Calculated Volume

Well Diameter	Multiplier	Well Diameter	Multiplier
1"	0.04	4"	0.65
2"	0.16	6"	1.47
3"	0.37	Other	radius ² * 0.163

Time	Temp (°F)	pH	Cond.	Gals. Removed	Observations
10:29	61.2	6.1	1275	2	order
10:31	61.1	6.9	1276	3	
10:33	61.5	6.3	1292	5	

Did well dewater? Yes No Gallons actually evacuated: 5

Sampling Time: 10:37 Sampling Date: 01-25-00

Sample I.D.: MW-7 Laboratory: STL Sequoia Other

Analyzed for: TPH-G BTEX MTBE TPH-D Other:

EB I.D. (if applicable): @ Time Duplicate I.D. (if applicable):

Analyzed for: TPH-G BTEX MTBE TPH-D Other:

D.O. (if req'd):	Pre-purge: 1.4 mg/L	Post-purge: mg/L
O.R.P. (if req'd):	Pre-purge: mV	Post-purge: mV

CHEVRON WELL MONITORING DATA SHEET

Project #: 000125-42	Station #: 9-1153
Sampler: Sanjiv	Date: 01-25-00
Well I.D.: MW-8	Well Diameter: (2) 3 4 6 8
Total Well Depth: 8.85	Depth to Water: 1.91
Depth to Free Product:	Thickness of Free Product (feet):
Referenced to: PVC Grade	D.O. Meter (if req'd): YSI HACH

Purge Method:

- Bailer
- Disposable Bailer
- Middleburg
- Electric Submersible
- Waterra
- Peristaltic
- Extraction Pump
- Other _____

Sampling Method:

Bailer

- Disposable Bailer
- Extraction Port
- Dedicated Tubing
- Other: _____

	1 (Gals.) X	3	=	3.3	Gals.
1 Case Volume	Specified Volumes		Calculated Volume		

Well Diameter	Multiplier	Well Diameter	Multiplier
1"	0.04	4"	0.65
2"	0.16	6"	1.47
3"	0.37	Other	radius ² * 0.163

Time	Temp (°F)	pH	Cond.	Gals. Removed	Observations
11:59	60.2	7.3	413	1	
12:00	60.2	7.2	405	2	
12:01	59.9	7.1	396	3.5	

Did well dewater? Yes No Gallons actually evacuated: 3.5

Sampling Time: 12:03 Sampling Date: 01-25-00

Sample I.D.: MW-8 Laboratory: STL Sequoia Other

Analyzed for: TPH-G BTEX MTBE TPH-D Other:

EB I.D. (if applicable): @ Time Duplicate I.D. (if applicable):

Analyzed for: TPH-G BTEX MTBE TPH-D Other:

D.O. (if req'd): Pre-purge: _____ mg/L Post-purge: _____ mg/L

O.R.P. (if req'd): Pre-purge: _____ mV Post-purge: _____ mV

CHEVRON WELL MONITORING DATA SHEET

Project #: <u>000125-U1</u>	Station #: <u>9-1153</u>
Sampler: <u>Sanjiv</u>	Date: 000125-U1 <u>01-25-00</u>
Well I.D.: <u>MW-9</u>	Well Diameter: <u>(2)</u> 3 4 6 8 <u> </u>
Total Well Depth: <u>7.92</u>	Depth to Water: <u>2.95</u>
Depth to Free Product:	Thickness of Free Product (feet):
Referenced to: <u>PVC</u> <u>Grade</u>	D.O. Meter (if req'd): <u>YSI</u> <u>HACH</u>

Well Diameter	Multiplier	Well Diameter	Multiplier
2"	0.16	5"	1.02
3"	0.37	6"	1.47
4"	0.65	Other	radius ² * 0.163

Purge Method: Bailer Sampling Method: Bailer
Disposable Bailer Disposable Bailer
Middleburg Extraction Port
Electric Submersible Other: _____
Extraction Pump
Other: _____

<u>0.79</u>	x	<u>3</u>	=	<u>2.3</u>	Gals.
1 Case Volume (Gals.)		Specified Volumes		Calculated Volume	

Time	Temp (°F)	pH	Cond.	Gals. Removed	Observations
<u>11:35</u>	<u>62.9</u>	<u>7.2</u>	<u>911</u>	<u>1</u>	
<u>11:36</u>	<u>62.2</u>	<u>7.4</u>	<u>949</u>	<u>2</u>	
<u>11:37</u>	<u>61.8</u>	<u>7.4</u>	<u>891</u>	<u>2.5</u>	

Did well dewater? Yes No Gallons actually evacuated: 2.5

Sampling Time: 11:39 Sampling Date: 01-25-00

Sample I.D.: MW-9 Laboratory: Sequoia GTEL N. Creek Assoc. Labs

Analyzed for: TPH-G BTEX MTBE TPH-D Other:

Duplicate I.D.: Analyzed for: TPH-G BTEX MTBE TPH-D Other:

D.O. (if req'd):	Pre-purge:	mg/L	Post-purge:	mg/L
O.R.P. (if req'd):	Pre-purge:	mV	Post-purge:	mV

CHEVRON WELL MONITORING DATA SHEET

Project #: 000125-41	Station #: 9-1153
Sampler: Sanjiv	Date: 01-25-00
Well I.D.: MW-10	Well Diameter: (2) 3 4 6 8
Total Well Depth: 8.35	Depth to Water: 3.00
Depth to Free Product:	Thickness of Free Product (feet):
Referenced to: PVC Grade	D.O. Meter (if req'd): YSI HACH

Well Diameter	Multiplier	Well Diameter	Multiplier
2"	0.16	5"	1.02
3"	0.37	6"	1.47
4"	0.65	Other	radius ² * 0.163

Purge Method: Bailer Sampling Method: Bailer
Disposable Bailer Disposable Bailer
Middleburg Extraction Port
Electric Submersible Other: _____
Extraction Pump
Other: _____

new cap
 & lock
 needs
 a new lid
 10" holes

8.5	x	3	=	2.5	Gals.
1 Case Volume (Gals.)		Specified Volumes		Calculated Volume	

Time	Temp (°F)	pH	Cond.	Gals. Removed	Observations
13:27	60.0	6.9	3240	1	Shear / cap / lock
13:32	59.7	6.8	3351	2	off
13:36	59.7	6.8	3358	2.5	

Did well dewater? Yes No Gallons actually evacuated: 2.5

Sampling Time: 13:40 Sampling Date: 01-25-00

Sample I.D.: MW-10 Laboratory: CORE Del Mar Sequoia Associated

Analyzed for: TPH-G BTEX MTBE TPH-D Other:

Duplicate I.D.: Analyzed for: TPH-G BTEX MTBE TPH-D Other:

D.O. (if req'd):	Pre-purge:	mg/L	Post-purge:	mg/L
O.R.P. (if req'd):	Pre-purge:	mV	Post-purge:	mV