



**Chevron**

June 22, 1999

**Chevron Products Company**  
6001 Bollinger Canyon Road  
Building L, Room 1080  
PO Box 6004  
San Ramon, CA 94583-0904

Mr. Larry Seto  
Alameda County Health Care Services  
Department of Environmental Health  
1131 Harbor Bay Parkway, Suite 250  
Alameda, CA 94502-6577

**Philip R. Briggs**  
Project Manager  
Site Assessment & Remediation  
Phone 925 842-9136  
Fax 925 842-8370

**Re: Former Chevron Service Station #9-1153  
3126 Fernside Boulevard, Alameda, California**

Dear Mr. Seto:

Enclosed is the Second Quarter Groundwater Monitoring Report for 1999 that was prepared by our consultant Blaine Tech Services, Inc. for the above noted site. Samples were analyzed for TPH-g, BTEX and MtBE constituents.

The sampling frequency for monitoring wells C-3, MW-4, MW-8 and MW-9 is annually (1<sup>st</sup> quarter) and semi-annually (1<sup>st</sup> & 3<sup>rd</sup> quarters) for wells MW-5 and MW-10; the remaining wells C-1, MW-6 and MW-7 are sampled quarterly.

The use of hydrogen peroxide injection into monitoring well C-1 and the addition of Oxygen Releasing Compound (ORC) into wells MW-6 and MW-7 to remediate the groundwater at this site appear to be working.

The benzene concentration in well C-1 increased from the previous sampling event, with separate phase hydrocarbons (SPH) being detected in March at 0.76 feet, in which 0.2642 gallons of SPH was removed. The initial injection of hydrogen peroxide was effective in reducing the concentration of petroleum hydrocarbons in this well. Therefore, another injection of hydrogen peroxide will be performed prior to the next sampling event in July.

The benzene constituent decreased in well MW-6 from the previous sampling event, while increasing in well MW-7. The dissolved oxygen (DO) reading in well MW-7 was 0.8 mg/l which is very low for natural attenuation to take place, therefore, additional oxygen releasing material will be added to this well in the next sampling event.

99 JUN 28 PM 3:25  
ENVIRONMENTAL  
PROTECTION

June 22, 1999  
Mr. Larry Seto  
Former Chevron Service Station #9-1153  
Page 2

Depth to the ground water varied from 1.04 feet to 4.61 feet below grade with a direction of flow easterly.

Chevron will continue to monitor the wells in the sampling frequency as noted above. If you have questions or comments, call me at (925) 842-9136.

Sincerely,  
**CHEVRON PRODUCTS COMPANY**



Philip R. Briggs  
Site Assessment and Remediation Project Manager

Enclosure

Cc. Ms. Bette Owen, Chevron

Mr. & Mrs. Thompson  
3135 Gibbons Drive  
Alameda, CA 94501

**BLAINE**  
TECH SERVICES INC.



1680 ROGERS AVENUE  
SAN JOSE, CALIFORNIA 95112-1105  
(408) 573-7771 FAX  
(408) 573-0555 PHONE

May 27, 1999

Phil Briggs  
Chevron U.S.A. Products Company  
P.O. Box 6004  
San Ramon, CA 94583-0904

### **2nd Quarter 1999 Monitoring at 9-1153**

Second Quarter 1999 Groundwater Monitoring at  
Former Chevron Service Station Number 9-1153  
3126 Fernside Blvd.  
Alameda, CA

Monitoring Performed on April 19, 1999

---

### **Groundwater Sampling Report 990419-Y-3**

This report covers the routine monitoring of groundwater wells at this Chevron facility. Blaine Tech Services, Inc.'s work at the site includes inspection, gauging, evacuation, purgewater containment, sample collection and sample handling in accordance with standard procedures that conform to Regional Water Quality Control Board requirements.

Routine field data collection includes depth to water, total well depth, thickness of any separate immiscible layer, water column volume, calculated volume of a three-case volume purge, elapsed evacuation time, total volume of water removed, and standard water parameter instrument readings. Sample material is collected, contained, stored, and transported to the laboratory in conformance with EPA standards. Purgewater is, likewise, collected and transported to McKittrick Waste Treatment Site for disposal.

Basic field information is presented alongside analytical values excerpted from the laboratory report in the cumulative table of **WELL DATA AND ANALYTICAL RESULTS**. The full analytical report for the most recent samples is located in the **Analytical Appendix**. The table also contains new groundwater elevation calculations taken from the computer plotted gradient

map which is located in the **Professional Engineering Appendix**.

At a minimum, Blaine Tech Services, Inc. field personnel are certified upon completion of a forty-hour Hazardous Materials and Emergency Response training course per 29 CFR 1910.120. Field personnel are also enrolled in annual eight hour refresher courses.

Blaine Tech Services, Inc. conducts sampling and documentation assignments of this type as an independent third party. In order to avoid compromising the objectivity necessary for the proper and disinterested performance of this work, Blaine Tech Services, Inc. concentrates on objective data collection and does not participate in the interpretation of analytical results, the definition of geological or hydrological conditions, the formulation of recommendations, or the marketing of remedial systems.

Please call if you have any questions.

Yours truly,



Christine Lillie  
Project Coordinator

CAL/sb

attachments: Professional Engineering Appendix  
Cumulative Table of Well Data and Analytical Results  
Analytical Appendix  
Field Data Sheets

# **Professional Engineering Appendix**

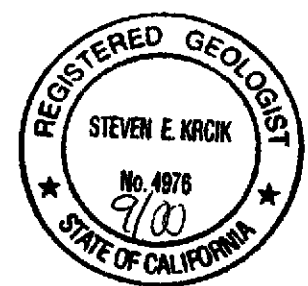
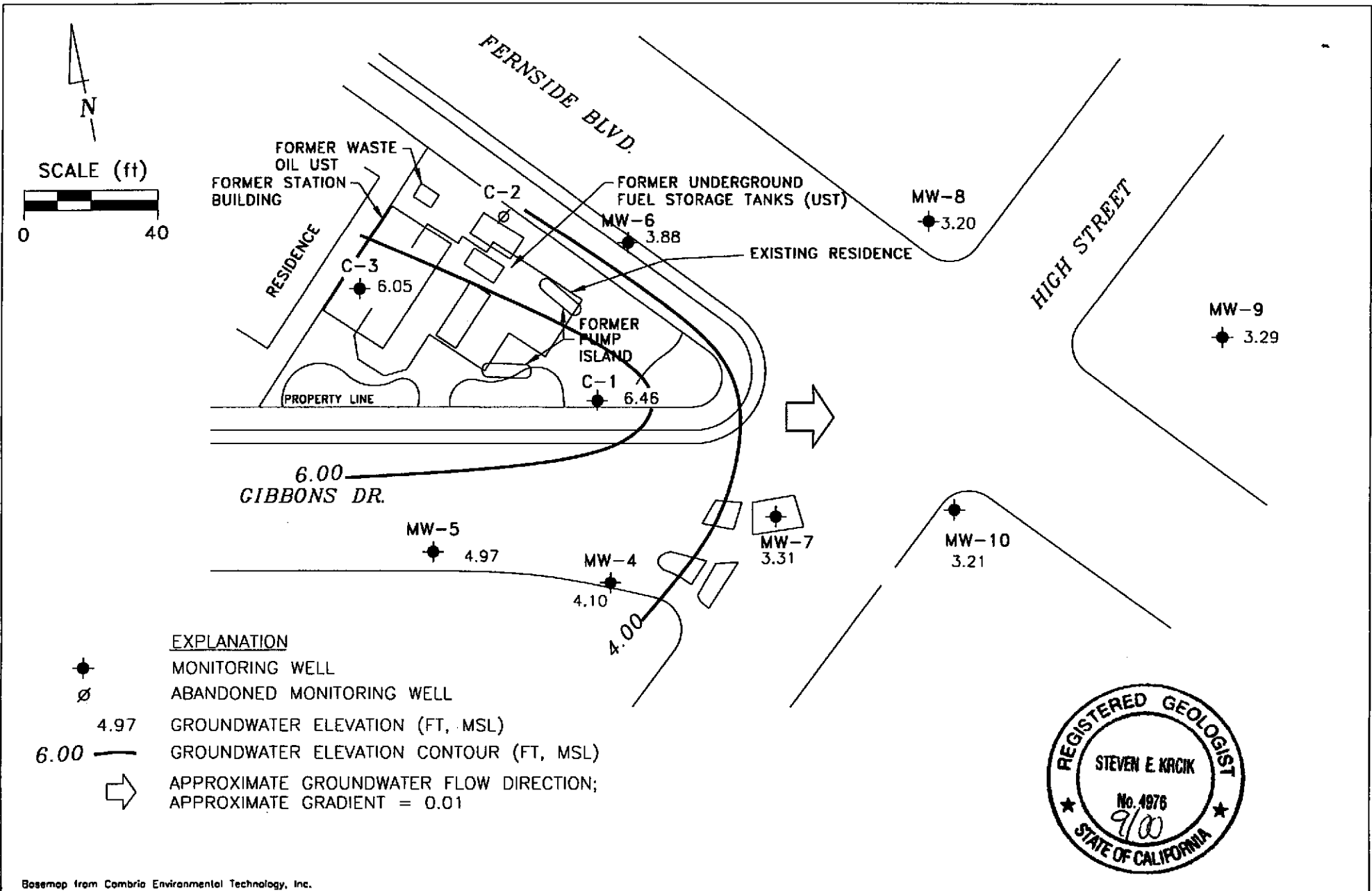

Base map from Combric Environmental Technology, Inc.

PREPARED BY

**Former Chevron Station 9-1153**  
 3126 Fernside Boulevard  
 Alameda, California

**GROUNDWATER ELEVATION CONTOUR MAP,**  
 APRIL 19, 1999

**FIGURE:**  
**1**  
**PROJECT:**  
 DAC04

# **Table of Well Data and Analytical Results**

## Cumulative Table of Well Data and Analytical Results

Vertical Measurements are in feet.

Volumetric Measurements are in gallons.

Analytical results are in parts per billion (ppb)

DATE	Vertical Measurements are in feet.			Volumetric Measurements are in gallons.			Notes	Analytical results are in parts per billion (ppb)							
	Well Head Elev.	Ground Water Elev.	Depth To Water	SPH Thickness	SPH Removed	Total SPH Removed		TPH-Gasoline	Benzene	Toluene	Ethyl-Benzene	Xylene	MTBE	Other	
<b>C-1</b>															
08/18/86	--	--	4.10	--	--	--	--	--	--	--	--	--	--	--	--
09/04/86	--	--	--	--	--	--	--	15,000	760	820	1500	--	--	--	--
07/22/87	--	--	--	--	--	--	--	1100	250	7.0	40	--	--	--	--
05/03/89	--	--	4.46	--	--	--	--	6900	3800	190	229	--	--	--	--
12/04/89	--	--	4.16	--	--	--	--	17,000	8000	490	470	--	--	--	--
02/14/90	--	--	3.64	--	--	--	--	19,000	12,000	990	1050	--	--	--	--
03/07/90	--	--	3.36	--	--	--	--	--	4260	261	430	--	--	--	--
09/06/91	--	--	4.43	--	--	--	--	21,000	10,000	100	240	560	--	--	--
12/15/91	--	--	4.78	--	--	--	--	20,000	4900	43	110	330	--	--	--
03/03/92	--	--	2.39	--	--	--	--	13,000	5800	730	340	1200	--	--	--
06/04/92	4.08	0.00	4.08	--	--	--	--	34,000	9400	350	290	1200	--	--	--
10/13/92	4.08	-0.67	4.75	--	--	--	--	24,000	11,000	98	280	530	--	--	--
01/11/93	4.08	1.82	2.26	Sheen	--	--	--	7100	1500	130	150	700	--	--	--
04/14/93	4.08	1.18	2.90	Sheen	--	--	--	29,000	7300	4000	640	2300	--	--	--
07/13/93	4.08	0.11	3.97	Sheen	--	--	--	650,000	27,000	18,000	6300	29,000	--	--	--
10/19/93	4.08	-0.42	4.50	--	--	--	--	40,000	12,000	730	1100	3600	--	--	--
11/30/93	7.50	3.23	4.27	--	--	--	--	--	--	--	--	--	--	--	--
01/27/94	7.50	4.15	3.35	--	--	--	--	36,000	8600	220	670	1900	--	--	--
04/07/94	7.50	4.08	3.42	--	--	--	--	53,000	12,000	3500	480	3300	--	--	--
07/01/94	7.50	3.54	3.96	--	--	--	--	65,000	19,000	5900	1000	9000	--	--	--
10/05/94	7.50	3.11	4.39	--	--	--	--	160,000	23,000	12,000	2200	11,000	--	--	--
01/12/95	7.50	6.38	1.52	0.50	0.264	0.264	--	--	--	--	--	--	--	--	--
04/26/95	7.50	4.86	4.40	2.20	1.321	1.585	--	--	--	--	--	--	--	--	--
07/12/95	7.50	4.10	4.85	1.81	0.661	2.246	--	--	--	--	--	--	--	--	--
10/30/95	7.50	3.13	5.67	1.63	0.528	2.774	--	--	--	--	--	--	--	--	--
01/04/96	7.50	3.68	3.92	0.12	0.264	3.038	--	--	--	--	--	--	--	--	--
01/10/96	7.50	4.12	3.48	0.13	0.066	3.104	--	--	--	--	--	--	--	--	--
01/17/96	7.50	4.12	3.40	0.02	0.396	3.500	--	--	--	--	--	--	--	--	--
01/22/96	7.50	4.60	2.90	0.00	0.000	3.500	--	82,000	18,000	4400	1400	5200	<1000	--	--
02/23/96	7.50	4.89	4.10	1.86	0.661	4.161	--	--	--	--	--	--	--	--	--
02/28/96	7.50	--	--	>0.83	1.250	5.411	--	--	--	--	--	--	--	--	--
03/08/96	7.50	6.10	2.86	1.83	0.264	5.675	--	--	--	--	--	--	--	--	--
03/08/96	7.50	5.49	2.30	0.36	0.528	6.203	--	--	--	--	--	--	--	--	--

CONTINUED ON NEXT PAGE



## Cumulative Table of Well Data and Analytical Results

Vertical Measurements are in feet.

Volumetric Measurements are in gallons.

Analytical results are in parts per billion (ppb)

DATE	Well Head Elev.	Ground Water Elev.	Depth To Water	Volumetric Measurements are in gallons.			Notes	Analytical results are in parts per billion (ppb)						
				SPH Thickness	SPH Removed	Total SPH Removed		TPH-Gasoline	Benzene	Toluene	Ethyl-Benzene	Xylene	MTBE	Other
<b>C-1 (CONT'D)</b>														
03/08/96	7.50	5.46	2.33	0.36	0.264	6.467	--	--	--	--	--	--	--	--
03/08/96	7.50	5.40	2.28	0.22	0.528	6.995	--	--	--	--	--	--	--	--
03/26/96	7.50	4.56	3.96	1.28	0.396	7.391	--	--	--	--	--	--	--	--
04/11/96	7.50	3.29	5.61	1.75	0.528	7.919	--	--	--	--	--	--	--	--
04/19/96	7.50	4.44	3.09	0.04	0.396	8.315	--	--	--	--	--	--	--	--
04/24/96	7.50	4.48	3.04	0.03	0.396	8.711	--	--	--	--	--	--	--	--
05/03/96	7.50	3.85	4.02	0.46	0.396	9.107	--	--	--	--	--	--	--	--
05/03/96	7.50	3.99	3.89	0.47	0.000	9.107	--	--	--	--	--	--	--	--
05/08/96	7.50	3.53	4.25	0.35	0.066	9.173	--	--	--	--	--	--	--	--
05/17/96	7.50	4.29	3.24	0.04	0.029	9.202	--	--	--	--	--	--	--	--
05/17/96	7.50	4.16	3.35	0.01	0.029	9.231	--	--	--	--	--	--	--	--
05/17/96	7.50	4.08	3.43	0.01	0.029	9.260	--	--	--	--	--	--	--	--
05/17/96	7.50	3.86	3.65	0.01	0.000	9.260	--	--	--	--	--	--	--	--
05/22/96	7.50	4.46	3.10	0.07	0.079	9.339	--	--	--	--	--	--	--	--
06/18/96	7.50	3.20	4.68	0.48	0.264	9.603	--	--	--	--	--	--	--	--
07/03/96	7.50	2.57	5.03	0.13	0.145	9.748	--	--	--	--	--	--	--	--
07/09/96	7.50	3.05	4.63	0.23	0.092	9.840	--	--	--	--	--	--	--	--
07/17/96	7.50	2.89	4.73	0.15	0.317	10.157	--	--	--	--	--	--	--	--
07/29/96	7.50	2.47	5.10	0.09	0.264	10.421	--	--	--	--	--	--	--	--
08/02/96	7.50	1.84	5.68	0.03	0.033	10.454	--	--	--	--	--	--	--	--
08/07/96	7.50	2.35	5.16	0.01	0.132	10.586	--	--	--	--	--	--	--	--
08/23/96	7.50	1.77	5.75	0.03	0.026	10.612	--	--	--	--	--	--	--	--
08/28/96	7.50	1.99	5.53	0.03	0.013	10.625	--	--	--	--	--	--	--	--
09/06/96	7.50	2.12	5.38	--	0.046	10.671	--	--	--	--	--	--	--	--
09/12/96	7.50	2.04	5.48	0.03	0.013	10.684	--	--	--	--	--	--	--	--
09/19/96	7.50	1.20	6.32	0.03	0.011	10.695	--	--	--	--	--	--	--	--
10/10/96	7.50	3.00	4.58	0.10	0.132	10.827	--	--	--	--	--	--	--	--
10/17/96	7.50	1.90	5.61	0.01	0.011	10.838	--	--	--	--	--	--	--	--
10/29/96	7.50	1.49	6.01	--	--	10.838	--	--	--	--	--	--	--	--
11/07/96	7.50	1.94	5.56	0.04	0.132	10.970	--	--	--	--	--	--	--	--
11/11/96	7.50	2.18	5.32	0.04	0.132	11.102	--	--	--	--	--	--	--	--
12/20/96	7.50	4.17	3.33	0.03	0.053	11.155	--	--	--	--	--	--	--	--

CONTINUED ON NEXT PAGE

## Cumulative Table of Well Data and Analytical Results

Vertical Measurements are in feet.

Volumetric Measurements are in gallons.

Analytical results are in parts per billion (ppb)

DATE	Well	Ground	Depth	Total			Notes	TPH- Gasoline	Benzene	Toluene	Ethyl- Benzene	Xylene	MTBE	Other
	Head Elev.	Water Elev.	To Water	SPH Thickness	SPH Removed	SPH Removed								
<b>C-1 (CONT'D)</b>														
12/17/96	7.50	3.77	3.73	0.01	0.010	11.165	--	--	--	--	--	--	--	--
01/15/97	7.50	4.76	2.74	--	--	11.165	--	47,000	16,000	2800	1300	4900	<1000	--
01/22/97	7.50	6.13	1.37	0.19	0.066	11.231	--	--	--	--	--	--	--	--
02/04/97	7.50	4.52	2.98	0.51	0.145	11.376	--	--	--	--	--	--	--	--
02/20/97	7.50	3.41	4.09	0.13	0.106	11.482	--	--	--	--	--	--	--	--
03/06/97	7.50	3.75	3.75	0.56	1.189	12.671	--	--	--	--	--	--	--	--
03/14/97	7.50	3.68	3.82	0.03	0.119	12.790	--	--	--	--	--	--	--	--
03/20/97	7.50	3.77	3.73	0.03	0.013	12.803	--	--	--	--	--	--	--	--
03/25/97	7.50	3.18	4.32	0.01	--	12.803	--	--	--	--	--	--	--	--
03/31/97	7.50	3.79	3.71	0.03	0.003	12.806	--	--	--	--	--	--	--	--
04/03/97	7.50	2.92	4.60	0.03	0.004	12.810	--	--	--	--	--	--	--	--
04/09/97	7.50	3.27	4.25	0.02	0.026	12.836	--	--	--	--	--	--	--	--
04/24/97	7.50	2.87	4.65	0.02	0.005	12.841	--	--	--	--	--	--	--	--
04/30/97	7.50	4.02	3.50	0.02	0.005	12.846	--	--	--	--	--	--	--	--
05/22/97	7.50	2.53	4.97	--	0.011	12.857	--	--	--	--	--	--	--	--
06/03/97	7.50	3.93	3.62	0.06	0.007	12.864	--	--	--	--	--	--	--	--
07/09/97	7.50	3.25	4.30	0.06	0.132	12.996	--	--	--	--	--	--	--	--
08/12/97	7.50	2.32	5.18	0.00	0.050	13.046	--	--	--	--	--	--	--	--
09/30/97	7.50	2.65	5.25	0.50	0.070	13.116	--	--	--	--	--	--	--	--
10/29/97	7.50	2.19	5.33	0.03	0.020	13.136	--	--	--	--	--	--	--	--
11/13/97	7.50	2.66	4.86	0.02	0.026	13.162	--	--	--	--	--	--	--	--
12/18/97	7.50	5.16	2.34	--	--	13.162	--	--	--	--	--	--	--	--

CONTINUED ON NEXT PAGE

## Cumulative Table of Well Data and Analytical Results

Vertical Measurements are in feet.			Volumetric Measurements are in gallons.				Analytical results are in parts per billion (ppb)							
DATE	Well Head Elev.	Ground Water Elev.	Depth To Water	SPH Thickness	SPH Removed	Total SPH Removed	Notes	TPH-Gasoline	Benzene	Toluene	Ethyl-Benzene	Xylene	MTBE	Other
<b>C-1 (CONT'D)</b>														
01/14/98	7.50	7.27	0.25	0.02	0.132	13.294	--	--	--	--	--	--	--	--
02/02/98	7.50	5.19	2.35	0.05	0.026	13.320	--	--	--	--	--	--	--	--
03/16/98	7.50	5.40	2.50	0.50	0.132	13.452	--	--	--	--	--	--	--	--
04/17/98	7.50	5.17	2.65	0.40	0.106	13.558	--	--	--	--	--	--	--	--
05/01/98	7.50	5.14	2.39	0.04	0.264	13.822	--	--	--	--	--	--	--	--
06/17/98	7.50	4.30	3.26	0.08	0.033	13.855	--	--	--	--	--	--	--	--
07/15/98	7.50	3.95	3.55	--	--	13.855	--	110,000	22,000	22,000	1000	10,000	<250	--
09/01/98	7.50	3.50	4.00	--	--	13.855	--	--	--	--	--	--	--	--
10/27/98	7.50	3.02	4.48	--	--	13.855	--	45,000	12,000	5400	590	4300	<500	--
11/19/98	7.50	3.61	3.89	--	--	13.855	--	--	--	--	--	--	--	--
12/19/98	7.50	5.39	2.13	0.02	0.040	13.895	--	--	--	--	--	--	--	--
01/20/99	7.50	3.52	3.98	--	--	13.895	--	50,300	7050	5030	244	6090	<40	--
02/24/99	7.50	4.95	2.55	--	--	13.895	--	--	--	--	--	--	--	--
03/26/99	7.50	5.97	2.14	0.76	0.2642	14.159	--	--	--	--	--	--	--	--
04/19/99	7.50	6.46	1.04	--	--	14.159	--	150,000	21,000	20,000	3000	18,000	<2.5	--
04/19/99	7.50	6.46	1.04	--	--	--	Confirmation Run	--	--	--	--	--	49	--

## Cumulative Table of Well Data and Analytical Results

Vertical Measurements are in feet.

Volumetric Measurements are in gallons.

Analytical results are in parts per billion (ppb)

DATE	Well	Ground	Depth	Volumetric Measurements are in gallons.			Notes	Analytical results are in parts per billion (ppb)							
	Head Elev.	Water Elev.	To Water	SPH Thickness	SPH Removed	Total SPH Removed		TPH-Gasoline	Benzene	Toluene	Ethyl-Benzene	Xylene	MTBE	Other	
<b>C-2</b>															
08/18/86	--	--	--	--	--	--	--	--	--	--	--	--	--	--	--
09/04/86	--	--	--	--	--	--	--	--	1100	49	18	84	--	--	--
07/22/87	--	--	--	--	--	--	--	--	<50	1.8	<1.0	<4.0	--	--	--
05/03/89	--	--	--	--	--	--	Abandoned	--	--	--	--	--	--	--	--

## Cumulative Table of Well Data and Analytical Results

Vertical Measurements are in feet.

Volumetric Measurements are in gallons.

Analytical results are in parts per billion (ppb)

DATE	Well Head Elev.	Ground Water Elev.	Depth To Water	SPH Thickness	SPH Removed	Total SPH Removed	Notes	TPH-Gasoline	Benzene	Toluene	Ethyl-Benzene	Xylene	MTBE	Other	
<b>C-3</b>															
08/18/86	--	--	4.00	--	--	--	--	--	--	--	--	--	--	--	
09/04/86	--	--	--	--	--	--	--	50	3.2	5.4	5.8	--	--	--	
07/22/87	--	--	--	--	--	--	--	<50	<0.5	<1.0	<4.0	--	--	--	
05/03/89	--	--	4.15	--	--	--	--	<50	<0.5	<1.0	<2.0	--	--	--	
12/04/89	--	--	4.24	--	--	--	--	<250	<0.5	<0.5	<0.5	--	--	--	
02/14/90	--	--	3.57	--	--	--	--	<50	<0.5	<0.5	<0.5	--	--	--	
03/07/90	--	--	3.31	--	--	--	--	--	<5.0	<5.0	<5.0	--	--	--	
09/06/91	--	--	4.59	--	--	--	--	<50	<0.5	<0.5	<0.5	<0.5	--	--	
12/15/91	--	--	4.84	--	--	--	--	<50	<0.5	<0.5	<0.5	<0.5	--	--	
03/03/92	--	--	2.17	--	--	--	--	<50	<0.5	<0.5	<0.5	<0.5	--	--	
06/04/92	4.41	0.40	4.01	--	--	--	--	<50	<0.5	<0.5	<0.5	<0.5	--	--	
10/13/92	4.41	-0.38	4.79	--	--	--	--	<50	<0.5	<0.5	<0.5	<0.5	--	--	
01/11/93	4.41	2.40	2.01	--	--	--	--	<50	<0.5	<0.5	<0.5	<0.5	--	--	
04/14/93	4.41	1.65	2.76	--	--	--	--	<50	<0.5	<0.5	<0.5	<0.5	--	--	
07/13/93	4.41	0.45	3.96	--	--	--	--	<50	<0.5	<0.5	<0.5	<1.5	--	--	
10/19/93	4.41	-0.12	4.53	--	--	--	--	66	12	1.4	1.0	8.4	--	--	
11/30/93	7.83	3.79	4.04	--	--	--	--	--	--	--	--	--	--	--	
01/27/94	7.83	4.66	3.17	--	--	--	--	<50	<0.5	<0.5	<0.5	<0.5	--	--	
04/07/94	7.83	4.63	3.20	--	--	--	--	<50	<0.5	<0.5	<0.5	<0.5	--	--	
07/01/94	7.83	3.84	3.99	--	--	--	--	<50	<0.5	<0.5	<0.5	<0.5	--	--	
10/05/94	7.83	3.29	4.54	--	--	--	--	<50	<0.5	<0.5	<0.5	<0.5	--	--	
01/12/95	7.83	7.03	0.80	--	--	--	--	<50	<0.5	<0.5	<0.5	<0.5	--	--	
05/02/95	7.83	5.68	2.15	--	--	--	--	<50	<0.5	<0.5	<0.5	<0.5	--	--	
07/12/95	7.83	4.41	3.42	--	--	--	--	<50	<0.5	<0.5	<0.5	<0.5	--	--	
10/30/95	7.83	3.37	4.46	--	--	--	--	<50	<0.5	<0.5	<0.5	<0.5	--	--	
01/22/96	7.83	6.10	1.73	--	--	--	--	<50	<0.5	<0.5	<0.5	<0.5	<2.5	--	
04/24/96	7.83	5.21	2.62	--	--	--	--	<50	<0.5	<0.5	<0.5	<0.5	<2.5	--	
07/29/96	7.83	3.89	3.94	--	--	--	--	<50	<0.5	<0.5	<0.5	<0.5	<2.5	--	
10/10/96	7.83	3.77	4.06	--	--	--	--	<50	<0.5	<0.5	<0.5	<0.5	<2.5	--	
01/15/97	7.83	6.29	1.54	--	--	--	--	<50	<0.5	<0.5	<0.5	<0.5	<2.5	--	
04/03/97	7.83	4.60	3.23	--	--	--	--	<50	<0.5	<0.5	<0.5	<0.5	<2.5	--	
07/09/97	7.83	3.47	4.36	--	--	--	--	<50	<0.5	<0.5	<0.5	<0.5	<2.5	--	
10/29/97	7.83	3.18	4.65	--	--	--	--	<50	<0.5	<0.5	<0.5	<0.5	<2.5	--	
01/14/98	7.83	7.06	0.77	--	--	--	Gauged and sampled annually	<50	<0.5	<0.5	<0.5	<0.5	<2.5	--	
07/15/98	7.83	4.11	3.72	--	--	--	--	<50	<0.5	<0.5	<0.5	<0.5	<2.5	--	
01/20/99	7.83	5.18	2.65	--	--	--	--	<50	<0.5	<0.5	<0.5	<0.5	<2.0	--	
04/19/99	7.83	6.05	1.78	--	--	--	--	--	--	--	--	--	--	--	

## Cumulative Table of Well Data and Analytical Results

Vertical Measurements are in feet.			Volumetric Measurements are in gallons.				Analytical results are in parts per billion (ppb)							
DATE	Well Head Elev.	Ground Water Elev.	Depth To Water	SPH Thickness	SPH Removed	Total SPH Removed	Notes	TPH-Gasoline	Benzene	Toluene	Ethyl-Benzene	Xylene	MTBE	Other
<b>MW-4</b>														
06/04/92	3.58	-0.05	3.63	--	--	--	--	<50	0.8	<0.5	<0.5	<0.5	--	--
10/13/92	3.58	--	--	--	--	--	--	--	--	--	--	--	--	--
01/11/93	3.58	1.69	1.89	--	--	--	--	<50	<0.5	<0.5	<0.5	<0.5	--	--
04/14/93	3.58	1.38	2.20	--	--	--	--	<50	<0.5	<0.5	<0.5	<1.5	--	--
07/13/93	3.58	0.07	3.51	--	--	--	--	54	2.6	1.6	<0.5	<1.5	--	--
10/19/93	3.58	-0.64	4.22	--	--	--	--	<50	<0.5	<0.5	<0.5	<0.5	--	--
11/30/93	7.01	3.00	4.01	--	--	--	--	--	--	--	--	--	--	--
01/27/94	7.01	4.12	2.89	--	--	--	--	<50	<0.5	<0.5	<0.5	<0.5	--	--
04/07/94	7.01	3.95	3.06	--	--	--	--	<50	<0.5	<0.5	<0.5	<0.5	--	--
07/01/94	7.01	3.42	3.59	--	--	--	--	<50	<0.5	<0.5	<0.5	<0.5	--	--
10/05/94	7.01	2.68	4.33	--	--	--	--	<50	<0.5	<0.5	<0.5	<0.5	--	--
01/12/95	7.01	5.81	1.20	--	--	--	--	<50	<0.5	<0.5	<0.5	<0.5	--	--
04/26/95	7.01	5.86	1.15	--	--	--	--	<50	<0.5	<0.5	<0.5	<0.5	--	--
07/12/95	7.01	4.29	2.72	--	--	--	--	<50	6.4	<0.5	0.63	0.72	--	--
10/30/95	7.01	2.93	4.08	--	--	--	--	<50	<0.5	<0.5	<0.5	<0.5	<2.5	--
01/22/96	7.01	5.25	1.76	--	--	--	--	<50	<0.5	<0.5	<0.5	<0.5	<2.5	--
04/24/96	7.01	5.06	1.95	--	--	--	--	<50	<0.5	<0.5	<0.5	<0.5	<2.5	--
07/29/96	7.01	3.64	3.37	--	--	--	--	<50	<0.5	<0.5	<0.5	<0.5	<2.5	--
10/10/96	7.01	3.05	3.96	--	--	--	--	<50	<0.5	<0.5	<0.5	<0.5	<2.5	--
01/15/97	7.01	5.74	1.27	--	--	--	--	<50	<0.5	<0.5	<0.5	<0.5	<2.5	--
04/03/97	7.01	4.90	2.11	--	--	--	--	<50	<0.5	<0.5	<0.5	<0.5	<2.5	--
07/09/97	7.01	2.97	4.04	--	--	--	--	<50	<0.5	<0.5	<0.5	<0.5	<2.5	--
10/29/97	7.01	2.45	4.56	--	--	--	--	<50	<0.5	<0.5	<0.5	<0.5	<2.5	--
01/14/98	7.01	6.62	0.39	--	--	--	--	<50	<0.5	<0.5	<0.5	<0.5	<2.5	--
01/20/99	7.01	4.18	2.83	--	--	--	Gauged and sampled annually	<50	<0.5	<0.5	<0.5	<0.5	<2.5	--
04/19/99	7.01	4.10	2.91	--	--	--	--	<50	<0.5	<0.5	<0.5	<0.5	<2.0	--

## Cumulative Table of Well Data and Analytical Results

Vertical Measurements are in feet.

Volumetric Measurements are in gallons.

Analytical results are in parts per billion (ppb)

DATE	Well Head Elev.	Ground Water Elev.	Depth To Water	Volumetric Measurements			Notes	Analytical Results (ppb)						
				SPH Thickness	SPH Removed	Total SPH Removed		TPH-Gasoline	Benzene	Toluene	Ethyl-Benzene	Xylene	MTBE	Other
<b>MW-5</b>														
06/04/92	3.61	0.36	3.25	--	--	--	--	560	110	0.5	37	2.2	--	--
10/13/92	3.61	-0.59	4.20	--	--	--	--	1200	150	<2.5	84	8.6	--	--
01/11/93	3.61	2.31	1.30	--	--	--	--	1300	48	1.0	83	33	--	--
04/14/93	3.61	2.41	1.20	--	--	--	--	2600	240	6.1	250	170	--	--
07/13/93	3.61	0.46	3.15	--	--	--	--	1700	260	7.8	160	100	--	--
10/19/93	3.61	-0.21	3.82	--	--	--	--	1900	190	3.3	200	93	--	--
11/30/93	7.04	3.48	3.56	--	--	--	--	--	--	--	--	--	--	--
01/27/94	7.04	4.62	2.42	--	--	--	--	4000	100	12	210	110	--	--
04/07/94	7.04	4.71	2.33	--	--	--	--	2600	170	10	150	88	--	--
07/01/94	7.04	3.86	3.18	--	--	--	--	2300	350	9.1	110	76	--	--
10/05/94	7.04	3.06	3.98	--	--	--	--	11,000	840	150	130	340	--	--
01/12/95	7.04	6.64	0.40	--	--	--	--	2300	82	<2.5	54	20	--	--
04/26/95	7.04	6.54	0.50	--	--	--	--	1600	52	<5.0	36	61	--	--
07/12/95	7.04	4.63	2.41	--	--	--	--	2800	150	<5.0	34	38	--	--
10/30/95	7.04	3.26	3.78	--	--	--	--	1100	81	<5.0	<5.0	<5.0	35	--
01/22/96	7.04	6.26	0.78	--	--	--	--	880	7.3	<2.0	15	4.8	<10	--
04/24/96	7.04	5.39	1.65	--	--	--	--	1600	51	3.8	14	5.6	56	--
07/29/96	7.04	--	--	--	--	--	Inaccessible	--	--	--	--	--	--	--
10/10/96	7.04	3.44	3.60	--	--	--	--	1000	18	<1.2	1.5	<1.2	<6.2	--
01/15/97	7.04	6.59	0.45	--	--	--	--	520	0.84	<0.5	3.1	1.2	8.4	--
04/03/97	7.04	4.93	2.11	--	--	--	--	1400	13	<2.0	4.3	8.4	32	--
07/09/97	7.04	3.33	3.71	--	--	--	--	810	3.6	0.97	<0.5	<0.5	9.7	--
10/29/97	7.04	2.84	4.20	--	--	--	--	<50	<0.5	<0.5	<0.5	<0.5	<2.5	--
01/14/98	7.04	7.04	0.00	--	--	--	--	430	5.8	2.4	<0.5	1.6	17	--
04/17/98	7.04	6.33	0.71	--	--	--	Sampled biannually	--	--	--	--	--	--	--
07/15/98	7.04	7.04	0.00	--	--	--	--	990	11	3.9	0.56	2.2	61	--
10/27/98	7.04	2.81	4.23	--	--	--	--	--	--	--	--	--	--	--
01/20/99	7.04	4.46	2.58	--	--	--	--	168	<0.5	<0.5	<0.5	0.692	<2.0	--
04/19/99	7.04	4.97	2.07	--	--	--	--	--	--	--	--	--	--	--

## Cumulative Table of Well Data and Analytical Results

Vertical Measurements are in feet.

Volumetric Measurements are in gallons.

Analytical results are in parts per billion (ppb)

DATE	Well Head Elev.	Ground Water Elev.	Depth To Water	Volumetric Measurements			Notes	Analytical results						
				SPH Thickness	SPH Removed	Total SPH Removed		TPH-Gasoline	Benzene	Toluene	Ethyl-Benzene	Xylene	MTBE	Other
<b>MW-6</b>														
06/04/92	3.85	-0.04	3.89	--	--	--	--	210	54	<0.5	1.9	2.4	--	--
10/13/92	3.85	-0.71	4.56	--	--	--	--	10,000	5300	<10	70	<10	--	--
01/11/93	3.85	1.49	2.36	--	--	--	--	100	50	<0.5	<0.5	<0.5	--	--
04/14/93	3.85	0.70	3.15	--	--	--	--	<50	<0.5	<0.5	<0.5	<0.5	--	--
07/13/93	3.85	-0.09	3.94	--	--	--	--	<50	1.8	<0.5	<0.5	<1.5	--	--
10/19/93	3.85	-0.55	4.40	--	--	--	--	320	150	<0.5	0.8	<0.5	--	--
11/30/93	7.27	3.11	4.16	--	--	--	--	--	--	--	--	--	--	--
01/27/94	7.27	3.94	3.33	--	--	--	--	120	45	<0.5	<0.5	<0.5	--	--
04/07/94	7.27	3.84	3.43	--	--	--	--	<50	<0.5	<0.5	<0.5	<0.5	--	--
07/01/94	7.27	3.33	3.94	--	--	--	--	<50	<0.5	<0.5	<0.5	<0.5	--	--
10/05/94	7.27	2.89	4.38	--	--	--	--	8300	2400	160	42	190	--	--
01/12/95	7.27	4.84	2.43	--	--	--	--	<50	12	<0.5	<0.5	<0.5	--	ND *
04/26/95	7.27	5.21	2.06	--	--	--	--	<50	5.5	0.67	<0.5	1.3	--	--
07/12/95	7.27	3.74	3.53	--	--	--	--	65	27	<0.5	<0.5	<0.5	--	--
10/30/95	7.27	2.93	4.34	--	--	--	--	<50	3.9	<0.5	<0.5	<0.5	<2.5	--
01/22/96	7.27	4.66	2.61	--	--	--	--	<50	0.93	<0.5	<0.5	<0.5	<2.5	--
04/24/96	7.27	4.77	2.50	--	--	--	--	260	110	<1.2	<1.2	<1.2	<6.2	--
07/29/96	7.27	3.42	3.85	--	--	--	--	<50	23	<0.5	<0.5	<0.5	<2.5	--
10/10/96	7.27	2.90	4.37	--	--	--	--	79	31	<0.5	<0.5	<0.5	<2.5	--
01/15/97	7.27	4.64	2.63	--	--	--	--	<50	<0.5	<0.5	<0.5	<0.5	<2.5	--
04/03/97	7.27	3.85	3.42	--	--	--	--	670	360	<5.0	<5.0	<5.0	<25	--
07/09/97	7.27	2.98	4.29	--	--	--	--	330	140	<2.0	<2.0	<2.0	<10	--
10/29/97	7.27	2.71	4.56	--	--	--	--	400	260	<2.0	<2.0	<2.0	5.8	--
01/14/98	7.27	6.26	1.01	--	--	--	--	<50	<0.5	<0.5	<0.5	<0.5	<2.5	--
04/17/98	7.27	4.33	2.94	--	--	--	--	<50	1.7	<0.5	<0.5	<0.5	<2.5	--
07/15/98	7.27	2.55	4.72	--	--	--	--	<50	<0.5	<0.5	<0.5	<0.5	<2.5	--
10/27/98	--	--	--	--	--	--	Inaccessible	--	--	--	--	--	--	--
11/25/98	7.27	3.11	4.16	--	--	--	--	110**	54	<0.5	<0.5	<0.5	<2.5	--
01/20/99	7.27	3.82	3.45	--	--	--	--	<50	10	<0.5	<0.5	<0.5	<2.0	--
04/19/99	7.27	3.88	3.39	--	--	--	--	<50	2.6	<0.5	<0.5	<0.5	<2.5	--
04/19/99	7.27	3.88	3.39	--	--	--	Confirmation Run	--	--	--	--	--	<2.0	--

\* EPA 8010

\*\* Chromatogram report indicates an unidentified hydrocarbon.



## Cumulative Table of Well Data and Analytical Results

Vertical Measurements are in feet.			Volumetric Measurements are in gallons.				Analytical results are in parts per billion (ppb)							
DATE	Well Head Elev.	Ground Water Elev.	Depth To Water	SPH Thickness	SPH Removed	Total SPH Removed	Notes	TPH-Gasoline	Benzene	Toluene	Ethyl-Benzene	Xylene	MTBE	Other
<b>MW-7</b>														
11/30/93	8.22	2.89	5.33	--	--	--	--	480	110	41	4.4	38	--	--
01/27/94	8.22	3.72	4.50	--	--	--	--	120	21	1.1	2.2	4.8	--	--
04/07/94	8.22	3.60	4.62	--	--	--	--	2600	630	39	56	94	--	--
07/01/94	8.22	3.09	5.13	--	--	--	--	2200	770	42	<10	92	--	--
10/05/94	8.22	2.61	5.61	--	--	--	--	15,000	3300	90	130	320	--	--
01/12/95	8.22	5.39	2.83	--	--	--	--	340	57	<1.3	18	6.4	--	--
04/26/95	8.22	5.87	2.35	--	--	--	--	15,000	3700	210	520	800	--	--
07/12/95	8.22	3.56	4.66	--	--	--	--	7700	1800	59	130	370	--	--
10/30/95	8.22	2.74	5.48	--	--	--	--	770	260	<5.0	33	48	25	--
01/22/96	8.22	4.88	3.34	--	--	--	--	290	63	<1.0	6.4	5.7	<5.0	--
04/24/96	8.22	4.10	4.12	--	--	--	--	12,000	2500	510	380	810	<125	--
07/29/96	8.22	3.19	5.03	--	--	--	--	2600	650	<25	61	150	<125	--
10/10/96	8.22	2.70	5.52	--	--	--	--	5800	1700	28	170	210	<62	--
01/15/97	8.22	5.30	2.92	--	--	--	--	1000	230	<2.5	28	11	63	--
04/03/97	8.22	3.57	4.65	--	--	--	--	6000	1800	100	140	170	<100	--
07/09/97	8.22	2.83	5.39	--	--	--	--	5500	2200	<20	41	30	<100	--
10/29/97	8.22	2.64	5.58	--	--	--	--	220	40	0.61	3.0	2.4	7.6	--
01/14/98	8.22	5.42	2.80	--	--	--	--	140	5.1	<0.5	<0.5	1.4	<2.5	--
04/17/98	8.22	5.22	3.00	--	--	--	--	13,000	4200	98	250	240	250	--
07/15/98	8.22	--	--	--	--	--	Inaccessible	--	--	--	--	--	--	--
08/17/98	7.92*	2.40	5.52	--	--	--	--	1600	380	51	68	280	22	--
10/27/98	7.92	0.41	7.51	--	--	--	--	190	2.3	0.53	<0.5	<0.5	33	--
01/20/99	7.92	4.47	3.45	--	--	--	--	<50	<0.5	<0.5	<0.5	<0.5	<2.0	--
04/19/99	7.92	3.31	4.61	--	--	--	--	6500	3000	<0.5	110	210	310	--
04/19/99	7.92	3.31	4.61	--	--	--	Confirmation Run	--	--	--	--	--	150	--

\* Well head elevation altered due to well head maintenance.

## Cumulative Table of Well Data and Analytical Results

Vertical Measurements are in feet.			Volumetric Measurements are in gallons.				Analytical results are in parts per billion (ppb)							
DATE	Well Head Elev.	Ground Water Elev.	Depth To Water	SPH Thickness	SPH Removed	Total SPH Removed	Notes	TPH- Gasoline	Benzene	Toluene	Ethyl- Benzene	Xylene	MTBE	Other
<b>MW-8</b>														
10/17/95	6.96	2.56	4.40	--	--	--	--	--	--	--	--	--	--	--
10/30/95	6.96	2.52	4.44	--	--	--	--	<50	<0.5	<0.5	<0.5	<0.5	<2.5	--
01/22/96	6.96	4.72	2.24	--	--	--	--	<50	<0.5	<0.5	<0.5	<0.5	<2.5	--
04/24/96	6.96	3.99	2.97	--	--	--	--	<50	<0.5	<0.5	<0.5	<0.5	<2.5	--
07/29/96	6.96	3.59	3.37	--	--	--	--	<50	<0.5	<0.5	<0.5	<0.5	<2.5	--
10/10/96	6.96	2.84	4.12	--	--	--	--	<50	<0.5	<0.5	<0.5	<0.5	<2.5	--
01/15/97	6.96	6.02	0.94	--	--	--	--	<50	<0.5	<0.5	<0.5	<0.5	<2.5	--
04/03/97	6.96	4.76	2.20	--	--	--	--	<50	<0.5	<0.5	<0.5	<0.5	<2.5	--
07/09/97	6.96	2.66	4.30	--	--	--	--	<50	<0.5	<0.5	<0.5	<0.5	<2.5	--
10/29/97	6.96	2.39	4.57	--	--	--	--	<50	<0.5	<0.5	<0.5	<0.5	<2.5	--
01/14/98	6.96	6.13	0.83	--	--	--	Gauged and sampled annually	<50	<0.5	<0.5	<0.5	<0.5	<2.5	--
01/20/99	6.96	4.27	2.69	--	--	--	--	<50	<0.5	<0.5	<0.5	<0.5	<2.0	--
04/19/99	6.96	3.20	3.76	--	--	--	--	--	--	--	--	--	--	--

### Cumulative Table of Well Data and Analytical Results

Vertical Measurements are in feet.

Volumetric Measurements are in gallons.

Analytical results are in parts per billion (ppb)

DATE	Well Head Elev.	Ground Water Elev.	Depth To Water	SPH Thickness	SPH Removed	Total SPH Removed	Notes	TPH-Gasoline	Benzene	Toluene	Ethyl-Benzene	Xylene	MTBE	Other
<b>MW-9</b>														
10/17/95	7.21	2.41	4.80	--	--	--	--	--	--	--	--	--	--	--
10/30/95	7.21	2.24	4.97	--	--	--	--	<50	<0.5	<0.5	<0.5	<0.5	<2.5	--
01/22/96	7.21	3.81	3.40	--	--	--	--	<50	<0.5	<0.5	<0.5	<0.5	<2.5	--
04/24/96	7.21	3.03	4.18	--	--	--	--	<50	<0.5	<0.5	<0.5	<0.5	<2.5	--
07/29/96	7.21	2.52	4.69	--	--	--	--	<50	<0.5	<0.5	<0.5	<0.5	<2.5	--
10/10/96	7.21	2.01	5.20	--	--	--	--	<50	<0.5	<0.5	<0.5	<0.5	<2.5	--
01/15/97	7.21	3.90	3.31	--	--	--	--	<50	<0.5	<0.5	<0.5	<0.5	<2.5	--
04/03/97	7.21	2.64	4.57	--	--	--	--	<50	<0.5	<0.5	<0.5	<0.5	<2.5	--
07/09/97	7.21	2.17	5.04	--	--	--	--	<50	<0.5	<0.5	<0.5	<0.5	<2.5	--
10/29/97	7.21	2.25	4.96	--	--	--	--	<50	<0.5	<0.5	<0.5	<0.5	<2.5	--
01/14/98	7.21	4.81	2.40	--	--	--	Gauged and sampled annually	<50	<0.5	<0.5	<0.5	<0.5	<2.5	--
01/20/99	7.21	2.90	4.31	--	--	--	--	<50	<0.5	<0.5	<0.5	<0.5	<2.0	--
04/19/99	7.21	3.29	3.92	--	--	--	--	--	--	--	--	--	--	--

## Cumulative Table of Well Data and Analytical Results

Vertical Measurements are in feet.				Volumetric Measurements are in gallons.			Analytical results are in parts per billion (ppb)							
DATE	Well Head Elev.	Ground Water Elev.	Depth To Water	SPH Thickness	SPH Removed	Total SPH Removed	Notes	TPH-Gasoline	Benzene	Toluene	Ethyl-Benzene	Xylene	MTBE	Other
<b>MW-10</b>														
10/17/95	7.28	2.23	5.05	--	--	--	--	--	--	--	--	--	--	--
10/30/95	7.28	2.17	5.11	--	--	--	--	<50	<0.5	<0.5	<0.5	<0.5	5.1	--
01/22/96	7.28	3.25	4.03	--	--	--	--	<50	<0.5	<0.5	<0.5	0.70	17	--
04/24/96	7.28	2.98	4.30	--	--	--	--	<50	<0.5	<0.5	<0.5	<0.5	12	--
07/29/96	7.28	2.58	4.70	--	--	--	--	<50	<0.5	<0.5	<0.5	<0.5	14	--
10/10/96	7.28	2.04	5.24	--	--	--	--	<50	<0.5	<0.5	<0.5	<0.5	<2.5	--
01/15/97	7.28	3.93	3.35	--	--	--	--	<50	<0.5	<0.5	<0.5	<0.5	<2.5	--
04/03/97	7.28	2.64	4.64	--	--	--	--	<50	<0.5	<0.5	<0.5	<0.5	8.2	--
07/09/97	7.28	2.16	5.12	--	--	--	--	<50	<0.5	<0.5	<0.5	<0.5	<2.5	--
10/29/97	7.28	2.18	5.10	--	--	--	--	<50	<0.5	<0.5	<0.5	<0.5	5.3	--
01/14/98	7.28	4.20	3.08	--	--	--	--	<50	<0.5	<0.5	<0.5	<0.5	8.6	--
04/17/98	7.28	3.49	3.79	--	--	--	Sampled biannually	--	--	--	--	--	--	--
07/15/98	7.28	2.73	4.55	--	--	--	--	<50	<0.5	<0.5	<0.5	<0.5	7.5	--
10/27/98	7.28	1.96	5.32	--	--	--	--	--	--	--	--	--	--	--
01/20/99	7.28	3.04	4.24	--	--	--	--	<50	<0.5	<0.5	<0.5	<0.5	<2.0	--
04/19/99	7.28	3.21	4.07	--	--	--	--	--	--	--	--	--	--	--
<b>TMW-1</b>														
11/11/93	--	--	--	--	--	--	--	<1.0	<0.5	<0.5	<0.5	<0.5	--	--
NO LONGER MONITORED OR SAMPLED														
<b>3115A GIBBONS DR.</b>														
01/14/98	--	--	--	--	--	--	--	<50	<0.5	<0.5	<0.5	<0.5	<2.5	--

## Cumulative Table of Well Data and Analytical Results

Vertical Measurements are in feet.

Volumetric Measurements are in gallons.

Analytical results are in parts per billion (ppb)

DATE	Well Head Elev.	Ground Water Elev.	Depth To Water	SPH Thickness	SPH Removed	Total SPH Removed	Notes	TPH-Gasoline	Benzene	Toluene	Ethyl-Benzene	Xylene	MTBE	Other
<b>TRIP BLANK</b>														
02/14/90	--	--	--	--	--	--	--	<50	<0.5	1.1	<0.5	<0.5	--	--
09/06/91	--	--	--	--	--	--	--	<50	<0.5	<0.5	<0.5	<0.5	--	--
12/15/91	--	--	--	--	--	--	--	<50	<0.5	<0.5	<0.5	<0.5	--	--
03/03/92	--	--	--	--	--	--	--	<50	<0.5	<0.5	<0.5	<0.5	--	--
06/04/92	--	--	--	--	--	--	--	<50	<0.5	<0.5	<0.5	<0.5	--	--
10/13/92	--	--	--	--	--	--	--	<50	<0.5	<0.5	<0.5	<0.5	--	--
01/11/93	--	--	--	--	--	--	--	<50	<0.5	<0.5	<0.5	<0.5	--	--
04/14/93	--	--	--	--	--	--	--	<50	<0.5	<0.5	<0.5	<0.5	--	--
07/13/93	--	--	--	--	--	--	--	<50	<0.5	<0.5	<0.5	<0.5	--	--
10/19/93	--	--	--	--	--	--	--	<50	<0.5	<0.5	<0.5	<1.5	--	--
01/27/94	--	--	--	--	--	--	--	<50	<0.5	<0.5	<0.5	<0.5	--	--
04/07/94	--	--	--	--	--	--	--	<50	<0.5	<0.5	<0.5	<0.5	--	--
07/01/94	--	--	--	--	--	--	--	<50	<0.5	<0.5	<0.5	<0.5	--	--
10/05/94	--	--	--	--	--	--	--	<50	<0.5	<0.5	<0.5	<0.5	--	--
01/12/95	--	--	--	--	--	--	--	<50	<0.5	<0.5	<0.5	<0.5	--	--
04/26/95	--	--	--	--	--	--	--	<50	<0.5	<0.5	<0.5	<0.5	--	--
07/12/95	--	--	--	--	--	--	--	<50	<0.5	<0.5	<0.5	<0.5	--	--
10/30/95	--	--	--	--	--	--	--	<50	<0.5	<0.5	<0.5	<0.5	--	--
01/22/96	--	--	--	--	--	--	--	<50	<0.5	<0.5	<0.5	<0.5	<2.5	--
04/24/96	--	--	--	--	--	--	--	<50	<0.5	<0.5	<0.5	<0.5	<2.5	--
07/29/96	--	--	--	--	--	--	--	<50	<0.5	<0.5	<0.5	<0.5	<2.5	--
10/10/96	--	--	--	--	--	--	--	--	--	--	--	--	--	--

CONTINUED ON NEXT PAGE

## Cumulative Table of Well Data and Analytical Results

Vertical Measurements are in feet.				Volumetric Measurements are in gallons.			Analytical results are in parts per billion (ppb)							
DATE	Well Head Elev.	Ground Water Elev.	Depth To Water	SPH Thickness	SPH Removed	Total SPH Removed	Notes	TPH-Gasoline	Benzene	Toluene	Ethyl-Benzene	Xylene	MTBE	Other
<b>TRIP BLANK (CONT'D)</b>														
01/15/97	--	--	--	--	--	--	--	<50	<0.5	<0.5	<0.5	<0.5	<2.5	--
04/03/97	--	--	--	--	--	--	--	<50	<0.5	<0.5	<0.5	<0.5	<2.5	--
07/09/97	--	--	--	--	--	--	--	<50	<0.5	<0.5	<0.5	<0.5	<2.5	--
10/29/97	--	--	--	--	--	--	--	<50	<0.5	<0.5	<0.5	<0.5	<2.5	--
01/14/98	--	--	--	--	--	--	--	<50	<0.5	<0.5	<0.5	<0.5	<2.5	--
04/17/98	--	--	--	--	--	--	--	<50	<0.5	<0.5	<0.5	<0.5	<2.5	--
07/15/98	--	--	--	--	--	--	--	<50	<0.5	<0.5	<0.5	<0.5	<2.5	--
10/27/98	--	--	--	--	--	--	--	<50	<0.5	<0.5	<0.5	<0.5	<2.5	--
01/20/99	--	--	--	--	--	--	--	<50	<0.5	<0.5	<0.5	<0.5	<2.0	--
01/20/99	--	--	--	--	--	--	--	<50	<0.5	<0.5	<0.5	<0.5	<2.0	--
04/19/99	--	--	--	--	--	--	--	<50	<0.5	<0.5	<0.5	<0.5	<2.5	--

Note: Blaine Tech Services, Inc. began routine monitoring of the groundwater wells at this site on November 1, 1994.  
 Earlier field data and analytical results are drawn from the September 27, 1994 Groundwater Technology, Inc. report.

**ABBREVIATIONS:**  
 TPH = Total Petroleum Hydrocarbons  
 SPH = Separate-Phase Hydrocarbons  
 MTBE = Methyl t-butyl ether

# **Analytical Appendix**



# Sequoia Analytical

680 Chesapeake Drive  
404 N. Wiget Lane  
819 Striker Avenue, Suite 8  
1455 McDowell Blvd. North, Ste. D  
1551 Industrial Road

Redwood City, CA 94063  
Walnut Creek, CA 94598  
Sacramento, CA 95834  
Petaluma, CA 94954  
San Carlos, CA 94070-4111

(650) 364-9600  
(925) 988-9600  
(916) 921-9600  
(707) 792-1865  
(650) 232-9600

FAX (650) 364-9233  
FAX (925) 988-9673  
FAX (916) 921-0100  
FAX (707) 792-0342  
FAX (650) 232-9612

Sequoia Analytical 1551 Industrial Blvd. San Carlos, CA. 94070 Attention: Mike Gregory	Client Project ID: L904274- Blaine Tech Service, Inc. Sample Matrix: Water Analysis Method: EPA 5030/8015 Mod./8020 First Sample #: 904-2360	Sampled: Apr 19, 1999 Received: Apr 26, 1999 Reported: May 5, 1999
---	---	--

QC Batch Number: GC043099 GC043099 GC043099 GC043099 GC043099

802002A 802002A 802002A 802002A 802002A

## TOTAL PURGEABLE PETROLEUM HYDROCARBONS with BTEX / MTBE

Analyte	Reporting Limit µg/L	Sample I.D. 904-2360 C-1	Sample I.D. 904-2361 MW-6	Sample I.D. 904-2362 MW-7	Sample I.D. 904-2363 TB	Sample I.D. Method Blank
Purgeable Hydrocarbons	50	150,000	N.D.	6,500	N.D.	N.D.
Benzene	0.50	21,000	2.6	3,000	N.D.	N.D.
Toluene	0.50	20,000	N.D.	N.D.	N.D.	N.D.
Ethyl Benzene	0.50	3,000	N.D.	110	N.D.	N.D.
Total Xylenes	0.50	18,000	N.D.	210	N.D.	N.D.
MTBE	2.5	N.D.	N.D.	310	N.D.	N.D.
Chromatogram Pattern:		Gasoline	--	Gasoline	--	--

### Quality Control Data

Report Limit Multiplication Factor:	1,000	1.0	40	1.0	1.0
Date Analyzed:	4/30/99	4/30/99	4/30/99	4/30/99	4/30/99
Instrument Identification:	HP-2	HP-2	HP-2	HP-2	HP-2
Surrogate Recovery, %: (QC Limits = 70-130%)	101	99	101	94	101

Purgeable Hydrocarbons are quantitated against a fresh gasoline standard.  
Analytes reported as N.D. were not detected above the stated reporting limit.

SEQUOIA ANALYTICAL, #1271

Charlie Westwater  
Project Manager

9042360.SSS <1>







# Sequoia Analytical

680 Chesapeake Drive  
404 N. Wiget Lane  
819 Striker Avenue, Suite 8  
1455 McDowell Blvd. North, Ste. D  
1551 Industrial Road

Redwood City, CA 94063  
Walnut Creek, CA 94598  
Sacramento, CA 95834  
Petaluma, CA 94954  
San Carlos, CA 94070-4111

(650) 364-9600  
(925) 988-9600  
(916) 921-9600  
(707) 792-1865  
(650) 232-9600

FAX (650) 364-9233  
FAX (925) 988-9673  
FAX (916) 921-0100  
FAX (707) 792-0342  
FAX (650) 232-9612

Sequoia Analytical 1551 Industrial Blvd. San Carlos, CA. 94070 Attention: Mike Gregory	Client Project ID: L904274- Blaine Tech Service, Inc. Sample Descript: Water, C-1 Analysis Method: EPA 8260 Lab Number: 904-2360	Sampled: Apr 19, 1999 Received: Apr 26, 1999 Analyzed: May 4, 1999 Reported: May 5, 1999
---	---	---

QC Batch Number: MS0429998260S2A

Instrument ID: GC/MS-2

## MTBE by EPA 8260

Analyte	Detection Limit µg/L	Sample Results µg/L
Methyl t-Butyl Ether (MTBE).....	2.0	49

Surrogates	Control Limit %	% Recovery
Dibromofluoromethane.....	50	150
		81

Analytes reported as N.D. were not present above the stated limit of detection.

SEQUOIA ANALYTICAL, #1271

Charlie Westwater  
Project Manager

9042360.SSS <2>





# Sequoia Analytical

680 Chesapeake Drive  
404 N. Wiget Lane  
819 Striker Avenue, Suite 8  
1455 McDowell Blvd. North, Ste. D  
1551 Industrial Road

Redwood City, CA 94063  
Walnut Creek, CA 94598  
Sacramento, CA 95834  
Petaluma, CA 94954  
San Carlos, CA 94070-4111

(650) 364-9600  
(925) 988-9600  
(916) 921-9600  
(707) 792-1865  
(650) 232-9600

FAX (650) 364-9233  
FAX (925) 988-9673  
FAX (916) 921-0100  
FAX (707) 792-0342  
FAX (650) 232-9612

Sequoia Analytical 1551 Industrial Blvd. San Carlos, CA. 94070 Attention: Mike Gregory	Client Project ID: L904274- Blaine Tech Service, Inc. Sample Descript: Water, MW-6 Analysis Method: EPA 8260 Lab Number: 904-2361	Sampled: Apr 19, 1999 Received: Apr 26, 1999 Analyzed: Apr 29, 1999 Reported: May 5, 1999
---	--	--

QC Batch Number: MS0429998260S2A  
Instrument ID: GC/MS-2

## MTBE by EPA 8260

Analyte	Detection Limit µg/L	Sample Results µg/L
Methyl t-Butyl Ether (MTBE).....	2.0	N.D.

Surrogates	Control Limit %	% Recovery
Dibromofluoromethane.....	50	150
		83

Analytes reported as N.D. were not present above the stated limit of detection.

SEQUOIA ANALYTICAL, #1271

  
Charlie Westwater  
Project Manager





# Sequoia Analytical

680 Chesapeake Drive  
404 N. Wiget Lane  
819 Striker Avenue, Suite 8  
1455 McDowell Blvd. North, Ste. D  
1551 Industrial Road

Redwood City, CA 94063  
Walnut Creek, CA 94598  
Sacramento, CA 95834  
Petaluma, CA 94954  
San Carlos, CA 94070-4111

(650) 364-9600  
(925) 988-9600  
(916) 921-9600  
(707) 792-1865  
(650) 232-9600

FAX (650) 364-9233  
FAX (925) 988-9673  
FAX (916) 921-0100  
FAX (707) 792-0342  
FAX (650) 232-9612

Sequoia Analytical 1551 Industrial Blvd. San Carlos, CA. 94070 Attention: Mike Gregory	Client Project ID: L904274- Blaine Tech Service, Inc. Sample Descript: Water, MW-7 Analysis Method: EPA 8260 Lab Number: 904-2362	Sampled: Apr 19, 1999 Received: Apr 26, 1999 Analyzed: Apr 29, 1999 Reported: May 5, 1999
---	--	--

QC Batch Number: MS0429998260S2A  
Instrument ID: GC/MS-2

### MTBE by EPA 8260

Analyte	Detection Limit µg/L	Sample Results µg/L
Methyl t-Butyl Ether (MTBE).....	2.0	150

Surrogates	Control Limit %	% Recovery
Dibromofluoromethane.....	50	150
		82

Analytes reported as N.D. were not present above the stated limit of detection.

SEQUOIA ANALYTICAL, #1271

Charlie Westwater  
Project Manager





# Sequoia Analytical

680 Chesapeake Drive  
404 N. Wiget Lane  
819 Striker Avenue, Suite 8  
1455 McDowell Blvd. North, Ste. D  
1551 Industrial Road

Redwood City, CA 94063  
Walnut Creek, CA 94598  
Sacramento, CA 95834  
Petaluma, CA 94954  
San Carlos, CA 94070-4111

(650) 364-9600  
(925) 988-9600  
(916) 921-9600  
(707) 792-1865  
(650) 232-9600

FAX (650) 364-9233  
FAX (925) 988-9673  
FAX (916) 921-0100  
FAX (707) 792-0342  
FAX (650) 232-9612

Sequoia Analytical 1551 Industrial Blvd. San Carlos, CA. 94070 Attention: Mike Gregory	Client Project ID: L904274- Blaine Tech Service, Inc. Sample Descript: Water Analysis Method: EPA 8260 Lab Number: Method Blank	Sampled: Apr 19, 1999 Received: Apr 26, 1999 Analyzed: Apr 29, 1999 Reported: May 5, 1999
---	--	--

QC Batch Number: MS0429998260S2A  
Instrument ID: GC/MS-2

## MTBE by EPA 8260

Analyte	Detection Limit µg/L	Sample Results µg/L
Methyl t-Butyl Ether (MTBE).....	2.0	N.D.

Surrogates	Control Limit %	% Recovery
Dibromofluoromethane.....	50	150.....
		86

Analytes reported as N.D. were not present above the stated limit of detection.

SEQUOIA ANALYTICAL, #1271

Charlie Westwater  
Project Manager





# Sequoia Analytical

680 Chesapeake Drive  
404 N. Wiget Lane  
819 Striker Avenue, Suite 8  
1455 McDowell Blvd. North, Ste. D  
1551 Industrial Road

Redwood City, CA 94063  
Walnut Creek, CA 94598  
Sacramento, CA 95834  
Petaluma, CA 94954  
San Carlos, CA 94070-4111

(650) 364-9600  
(925) 988-9600  
(916) 921-9600  
(707) 792-1865  
(650) 232-9600

FAX (650) 364-9233  
FAX (925) 988-9673  
FAX (916) 921-0100  
FAX (707) 792-0342  
FAX (650) 232-9612

Sequoia Analytical  
1551 Industrial Blvd.  
San Carlos, CA. 94070  
Attention: Mike Gregory

Client Project ID: L904274- Blaine Tech Service, Inc.  
Matrix: Liquid

QC Sample Group: 9042360-363

Reported: May 5, 1999

## QUALITY CONTROL DATA REPORT

Analyte:	Benzene	Toluene	Ethyl Benzene	Xylenes	MTBE
QC Batch#:	GC043099 802002A	GC043099 802002A	GC043099 802002A	GC043099 802002A	MS042999 8260S2A
Analy. Method:	EPA 8020	EPA 8020	EPA 8020	EPA 8020	EPA 8260
Prep. Method:	EPA 5030	EPA 5030	EPA 5030	EPA 5030	EPA 5030
Analyst:	J. Minkel	J. Minkel	J. Minkel	J. Minkel	N. Nelson
MS/MSD #:	8042151	8042151	8042151	8042151	9041859
Sample Conc.:	N.D.	N.D.	N.D.	N.D.	N.D.
Prepared Date:	4/30/99	4/30/99	4/30/99	4/30/99	4/29/99
Analyzed Date:	4/30/99	4/30/99	4/30/99	4/30/99	4/29/99
Instrument I.D.#:	HP-2	HP-2	HP-2	HP-2	GC/MS-2
Conc. Spiked:	20 µg/L	20 µg/L	20 µg/L	60 µg/L	50 µg/L
Result:	18	17	18	56	41
MS % Recovery:	90	85	90	93	82
Dup. Result:	17	17	16	54	41
MSD % Recov.:	85	85	80	90	82
RPD:	5.7	0.0	12	3.6	0.0
RPD Limit:	0-20	0-20	0-20	0-20	0-25

LCS #:	2LCS043099	2LCS043099	2LCS043099	2LCS043099	LCS042999
Prepared Date:	4/30/99	4/30/99	4/30/99	4/30/99	4/29/99
Analyzed Date:	4/30/99	4/30/99	4/30/99	4/30/99	4/29/99
Instrument I.D.#:	HP-2	HP-2	HP-2	HP-2	GC/MS-2
Conc. Spiked:	20 µg/L	20 µg/L	20 µg/L	60 µg/L	50 µg/L
LCS Result:	18	17	18	58	51
LCS % Recov.:	90	85	90	97	102

MS/MSD LCS Control Limits	70-130	70-130	70-130	70-130	70-130
---------------------------	--------	--------	--------	--------	--------

**Please Note:**

The LCS is a control sample of known, interferent-free matrix that is analyzed using the same reagents, preparation, and analytical methods employed for the samples. The matrix spike is an aliquot of sample fortified with known quantities of specific compounds and subjected to the entire analytical procedure. If the recovery of analytes from the matrix spike does not fall within specified control limits due to matrix interference, the LCS recovery is to be used to validate the batch.

\*\* MS = Matrix Spike, MSD = MS Duplicate, RPD = Relative % Difference

SEQUOIA ANALYTICAL, #1271

Charlie Westwater  
Project Manager





# **Field Data Sheets**





## CHEVRON WELL MONITORING DATA SHEET

Project #: 990419 <del>02</del> 43	Station #: 9-1153
Sampler: B TAYLOR	Date: 4/19
Well I.D.: C1	Well Diameter: 2 <u>3</u> 4 6 8
Total Well Depth: 17.13	Depth to Water: 1.04
Depth to Free Product:	Thickness of Free Product (feet):
Referenced to: <u>PVC</u> Grade	D.O. Meter (if req'd): YSI HACH

Well Diameter	Multiplier	Well Diameter	Multiplier
2"	0.16	5"	1.02
3"	0.37	6"	1.47
4"	0.65	Other	radius <sup>2</sup> * 0.163

Purge Method: Bailer      Sampling Method: Bailer  
                          Disposable Bailer      Disposable Bailer  
                          Middleburg      Extraction Port  
Electric Submersible      Other: \_\_\_\_\_  
                          Extraction Pump

6	X	3	=	18	Gals.
1 Case Volume (Gals.)		Specified Volumes		Calculated Volume	

Time	Temp (°F)	pH	Cond.	Gals. Removed	Observations
1327	69.1	7.6	1054	6	ODOR
1328	67.6	7.4	942	12	
1329	67.9	7.3	948	18	

Did well dewater?    Yes    No 0      Gallons actually evacuated: 18

Sampling Time: 13 32      Sampling Date: 4/19

Sample I.D.: C1      Laboratory: Sequoia CORE N. Creek Assoc. Labs

Analyzed for: TPH-G BTEX MTBE TPH-D Other:

Duplicate I.D.:      Analyzed for: TPH-G BTEX MTBE TPH-D Other:

D.O. (if req'd):	Pre-purge:	mg/L	Post-purge:	mg/L
O.R.P. (if req'd):	Pre-purge:	mV	Post-purge:	mV

## CHEVRON WELL MONITORING DATA SHEET

Project #: 990419 <del>102</del> 73	Station #: 9-1153
Sampler: B TAYLOR	Date: 4/19
Well I.D.: MWC	Well Diameter: (2) 3 4 6 8
Total Well Depth: 13.79	Depth to Water: 3.35
Depth to Free Product:	Thickness of Free Product (feet):
Referenced to: (PVC) Grade	D.O. Meter (if req'd): YSI HACH

Well Diameter	Multiplier	Well Diameter	Multiplier
2"	0.16	5"	1.02
3"	0.37	6"	1.47
4"	0.65	Other	radius <sup>2</sup> * 0.163

Purge Method: <u>Bailer</u> Disposable Bailer Middleburg Electric Submersible Extraction Pump Other: _____	Sampling Method: <u>Bailer</u> Disposable Bailer Extraction Port Other: _____
---	--

1.7	x	3	=	5.1	Gals.
1 Case Volume (Gals.)		Specified Volumes		Calculated Volume	

Time	Temp (°F)	pH	Cond.	Gals. Removed	Observations
1253	62.1	7.0	493	2	
1255	64.9	7.0	527	4	
1257	65.3	7.0	528	6	

Did well dewater? Yes <input type="checkbox"/> No <input checked="" type="checkbox"/>	Gallons actually evacuated: 6	
Sampling Time: 1300	Sampling Date: 4/19	
Sample I.D.: MWC	Laboratory: Sequoia CORE N. Creek Assoc. Labs	
Analyzed for: TPH-G BTEX MTBE TPH-D Other:		
Duplicate I.D.:	Analyzed for: TPH-G BTEX MTBE TPH-D Other:	
D.O. (if req'd):	Pre-purge: 1.7 mg/L	Post-purge: mg/L
O.R.P. (if req'd):	Pre-purge: mV	Post-purge: mV

## CHEVRON WELL MONITORING DATA SHEET

Project #: 990419 <del>42</del> 43	Station #: 9-1153
Sampler: B TAYLOR	Date: 4/19
Well I.D.: MW7	Well Diameter: (2) 3 4 6 8
Total Well Depth: 14.21	Depth to Water: 4.61
Depth to Free Product:	Thickness of Free Product (feet):
Referenced to: (PVC) Grade	D.O. Meter (if req'd): YSI HACH

Well Diameter	Multiplier	Well Diameter	Multiplier
2"	0.16	5"	1.02
3"	0.37	6"	1.47
4"	0.65	Other	radius <sup>2</sup> * 0.163

Purge Method:

Bailer  
 Disposable Bailer  
 Middleburg  
 Electric Submersible  
 Extraction Pump

Sampling Method:

Bailer  
 Disposable Bailer  
 Extraction Port  
 Other: \_\_\_\_\_

Other: \_\_\_\_\_

1.5	x	3	=	4.5	Gals.
1 Case Volume (Gals.)		Specified Volumes		Calculated Volume	

Time	Temp (°F)	pH	Cond.	Gals. Removed	Observations
1317	60.9	7.0	527	2	
1320	63.6	7.1	603	4	
1322	63.9	7.1	604	5	

Did well dewater?	Yes	<input checked="" type="radio"/> No	Gallons actually evacuated: 5
Sampling Time:	1323	Sampling Date:	4/19
Sample I.D.:	MW7	Laboratory:	(Sequoia) CORE N. Creek Assoc. Labs
Analyzed for:	(TPH-G BTEX MTBE) TPH-D Other:		
Duplicate I.D.:	Analyzed for: TPH-G BTEX MTBE TPH-D Other:		
D.O. (if req'd):	Pre-purge:	0.8 mg/L	Post-purge: mg/L
O.R.P. (if req'd):	Pre-purge:	mV	Post-purge: mV