

ALAMEDA COUNTY HAZARDOUS MATERIALS DIVISION

11/25/97

UNDERGROUND STORAGE TANK CLEANUP SITE

AGENCY#: 10000 SOURCE OF FUNDS: F-FEDERAL INSPECTOR: SH
 StID: 4074 SUBSTANCE: 12034 -Diesel
 SITE NAME: General Transportation DATE REPORTED : 05/19/92
 ADDRESS : 3211 Wood St DATE CONFIRMED: 05/19/92
 CITY/ZIP : Oakland, CA 94608 MULTIPLE RP's : Y

CASE TYPE: S CONTRACT STATUS: 4 PRIOR:2B4 EMERGENCY RESPONSE:

RP SEARCH	: S	DATE END:	10/13/92
PRELIM ASSESSMENT	:	DATE BEGIN:	DATE END:
REMEDIAL INVESTIG	:	DATE BEGIN:	DATE END:
REMEDIAL ACTION	:	DATE BEGIN:	DATE END:
POST REMED MONITOR:	DATE BEGIN:	DATE END:	

TYPE ENFORCEMENT ACTION TAKEN: 1 DATE OF ENFORC. ACTION: 10/13/92

UNDERGROUND STORAGE TANK CLEANUP SITE - SCREEN #2

LUFT FIELD MANUAL CONSIDERATION: HSCA CASE CLOSED: on:

DT EXC START: 05/19/92 REMEDIAL ACTIONS TAKEN: ED

RP #1: CONTACT: Henrietta Larson C/o RP COST:
 RP COMPANY NAME: Suzette Swanson Ph:
 ADDRESS: 43699 Skye Rd.
 CITY/STATE: Fremont, California 94539

ΔBrMENT:

SITE ID#: 4074

ADDITIONAL RP'S

RP #2
 CONTACT NAME: Jim Hardgrave
 COMPANY NAME: General Transportation RP Ph:
 ADDRESS: 4919 Tidewater
 CITY/ST/ZIP: Oakland, California 94623

Listing all LOP DAILY activities since 1991 for StID # 4074
as of 11/25/97

Act91_4
Act92_1
Act92_2
Act92_3
Act92_4
Act92_5

ActivDat	Insp	ACT	Activ	StID	ActCostf	acomment
10/15/92	SH	200	0.8	4074	\$36.33	RP search, notification letter
Act93_1						
Act93_2						
05/04/93	SH	215	2.2	4074	\$101.92	review file, letter out re: PSA sub-mittal
05/21/93	JE	212	0.4	4074	\$16.00	Mtg w/CalTrans
05/26/93	SH	212	0.4	4074	\$19.74	meeting, state/local coalition for Cypress project, discuss status of site
05/27/93	SH	212	0.5	4074	\$24.48	meeting CAC, discuss status of Cypress Project
Act93_3						
Act93_4						
Act94_1						
01/20/94	SH	212	0.2	4074	\$10.17	meeting with Cal Trans (Oakland Office) re: status of site
02/22/94	SH	212	1.	4074	\$50.84	meeting with DTSC & Ravi A.
Act94_2						
Act94_3						
Act94_4						
Act95_1						
01/04/95	SH	215	0.3	4074	\$15.99	review file, update database
Act95_2						
Act95_3						
Act95_4						
Act96_1						
01/22/96	TP	215	0.1	4074	\$5.29	supv. review
Act96_2						
Act96_3						
Act96_4						
Act97_1						
Act97_2						

complete

letter out re: further work
required

Act95_4

Act96_1

Act96_2

04/25/96 SH 212 0.4 4264 \$22.28 talked to Chris Wilson re: case
closure

06/17/96 SH 215 1. 4264 \$55.69 evaluate for case closure

Act96_3

Act96_4

Act97_1

Act97_2

04/29/97 SH 212 0.4 4264 \$24.35 talked to chris Wilson (Cal Trans)
re: closure

06/28/97 SH 215 3. 4264 \$182.59 case closure (OT)

10/06/97 SH 200 1.8 4264 \$0.00 case closure document / summary

complete



Cal/EPA

Department of
Toxic Substances
Control

700 Heinz Avenue
Suite 200
Berkeley, CA
94710-2737

April 16, 1997

Mr. Nino Cerruti
Caltrans
P.O. Box 23660
Oakland, California 94623-0660

Dear Mr. Cerruti:

**GENERAL TRANSPORTATION SITE, 3221 WOOD STREET, CYPRESS
RECONSTRUCTION PROJECT, OAKLAND**

The Department of Toxic Substances Control (DTSC) has completed review of the Preliminary Endangerment Assessment (PEA), dated June 1995 for the subject Site. DTSC provided guidance and/or oversight for the development and implementation of the PEA for this Site. In the future, one freeway footing along the north western edge of the Site will be constructed, and the remaining areas will be paved with asphalt and/or concrete during the reconstruction of the Cypress Freeway.

The referenced Site has been used by an auto freight company, and later by a cargo company and trucking companies. Numerous trucks were parked on the Site, and from aerial photographs, drums appeared stored along the western edge of the Site. Both soil and groundwater sampling and analysis were conducted for the following chemicals of concern: total petroleum hydrocarbons (TPH) as diesel, TPH as gasoline, total recoverable petroleum hydrocarbons, metals, semi-volatile organic compounds, volatile organic compounds, and pesticides and polychlorinated biphenyls (PCBs). The PEA compared the chemical levels found with health based criteria developed specifically for the Cypress Freeway Realignment project, and estimated potential health risks and hazards to freeway construction workers.

Based upon DTSC's review of the PEA, the Site does not appear to pose a threat to human health or the environment under a freeway use scenario; however, it must be noted in Caltrans' Right-of-Way records that the Site is not suitable for unrestricted use. DTSC determines that no further action is necessary with respect to investigation and remediation of hazardous substances at the Site provided that there is no change in land use. As with any real property, if previously unidentified contamination is discovered at the Site, additional assessment, investigation and/or cleanup may be required.



Pete Wilson
Governor

James M. Strock
Secretary for
Environmental
Protection



Printed on Recycled Paper

Mr. Nino Cerruti
April 16, 1997
Page Two

If you have any questions regarding this determination, please contact
Lynn Nakashima at (510) 540-3839.

Sincerely,

A handwritten signature in cursive script, appearing to read "Barbara J. Cook".

Barbara J. Cook, P.E., Chief
Northern California -
Coastal Cleanup Operations Branch

cc: Mr. Sum Arigala
Regional Water Quality Control Board
San Francisco Bay Region
2101 Webster Street, Suite 500
Oakland, California 94612

Ms. Susan Hugo
Alameda County Health Agency
Department of Environmental Health
1131 Harbor Bay Parkway, 2nd Floor
Alameda, California 94502

ALAMEDA COUNTY HAZARDOUS MATERIALS DIVISION
DEPOSIT / REFUND ACCOUNT SHEET

printed 03/31/97

SITE INFORMATION

3211 Wood St
Oakland 94608
Site Contact:
Site Phone :

StID: 4074 Site#: 1875
PROJECT#: 1875A
PROJECT TYPE: *** R ***
INSP: Susan Hugo
ACCT. SHEET PG #: _____

PROPERTY OWNER INFORMATION

Henrietta Larson
5601 Leona St.
Oakland, Ca 94605
Owner Contact: Henrietta Larson
Owner Phone : 510/531-7470

PAYOR INFORMATION

Larson, Henrietta
5601 Leona St
Oakland CA 94605 # 618
Payor Contact: Henrietta Larson
Payor Phone : 510/531-7470

Date	Action Taken	Insp Init	Hours Spent/ Depstd	Hour Balnce	Money Spent/ Depositd	Money Balance
	Rcpt# 604875 Balance from Prev. Page	NAF	569-
5/4/92	letter with revision		1.0	71-	71-	
5/13/92	site visit		2.75	71-	195.75	
6/3/92	lead report		1.0	71-	71-	
9/12/92	plan revision		3.5	71-	248.50	
				total	585.75	
						569-585.75 = (6.75)

UPON COMPLETION OF PROJECT

PROJ COMPLETED BY : amr ATTACH: State Forms A, B & C
Billing Adjustment*
DATE OF COMPLETION : 3/31/97 DATE SENT TO BILLING: 3/31/97
TOTAL COST OF PROJECT: 585.75 REFUND AMOUNT: 0 Rev. 7/96

* Billing adjustment forms needed when site is in our UST program. REPORT: WrkShtC (Continued balance)

DEPARTMENT OF TOXIC SUBSTANCES CONTROL

REGION 2
700 HEINZ AVE., SUITE 200
BERKELEY, CA 94710-2737
(510) 540-3843



June 7, 1996

Mr. Ace Forsen, Chief
Project Development/Benicia-Martinez Bridge
Caltrans
P.O. Box 23660
Oakland, California 94623-0660

Dear Mr. Forsen:

**GENERAL TRANSPORTATION, 3221 WOOD STREET, CYPRESS RECONSTRUCTION
PROJECT, OAKLAND, REVISED PRELIMINARY ENDANGERMENT ASSESSMENT (PEA)**

The Department of Toxic Substances Control (DTSC) has completed review of the Revised Preliminary Endangerment Assessment (PEA) dated April 30, 1996 for the subject Site. With the exception of the responses to comments #1 and #8, the revised PEA adequately addresses DTSC's April 17, 1996 comments. Both comments #1 and #8 concern groundwater which may be encountered during the footing excavation. The groundwater sample from boring B-5, located within the proposed footing excavation footprint, contained heavy metals. This sample likely reflects heavy metal concentrations which may be encountered if groundwater enters the footing excavation.

Therefore, the PEA is approved with the following modification: Page ES-2, Item 5 and Page 4-2, Item 2 are modified as follows: The second and third sentences are deleted and and last sentence is modified as follows: "The use of proper PPE and implementation of appropriate decontamination measures can also eliminate worker exposure to constituents present in groundwater."

If you have any questions, please contact Lynn Nakashima at (510) 540-3839.

Sincerely,

A handwritten signature in cursive script that reads "Barbara J. Cook".

Barbara J. Cook, P.E., Chief
North Coast Cleanup Operations Branch

cc: See next page

Mr. Ace Forsen
June 7, 1996
Page Two

cc: Mr. Sum Arigala
Regional Water Quality Control Board
San Francisco Bay Region
2101 Webster Street, Suite 500
Oakland, California 94612

Ms. Susan Hugo
Alameda County Health Agency
Department of Environmental Health
1131 Harbor Bay Parkway
Alameda, California 94502

Mr. Joel Howie
Caltrans
Environmental Engineering
P.O. Box 23660
Oakland, California 94623-0660

Ms. Kathleen Leiga
Caltrans
Cypress Construction Office
1545 Willow Street
Oakland, California 94607

DEPARTMENT OF TOXIC SUBSTANCES CONTROL

REGION 2
700 HEINZ AVE., SUITE 200
BERKELEY, CA 94710-2737
(510) 540-3724

ENVIRONMENTAL
PROTECTION

96 APR 22 PM 2: 28



April 17, 1996

Mr. Ace Forsen, Chief
Project Development/Benicia-Martinez Bridge
Caltrans
P.O. Box 23660
Oakland, California 94623-0660

Dear Mr. Forsen:

**REVISED PRELIMINARY ENDANGERMENT ASSESSMENT (PEA), GENERAL
TRANSPORTATION, 3211 WOOD STREET, CYPRESS RECONSTRUCTION
PROJECT, OAKLAND**

The Department of Toxic Substances Control (DTSC) received the revised Preliminary Endangerment Assessment for the General Transportation site prepared by Environmental Solutions, Inc. on behalf of Caltrans. The document was revised based on DTSC's comments contained in a letter dated November 6, 1995. DTSC has reviewed the responses and has the following comments:

Comment 1: Page ES-2, Item 5: The response to this comment states that chemicals in groundwater would flow away from the footing due to the direction of groundwater flow. Since Table 5 (Analytical Data) indicates that heavy metals have been detected in groundwater from the footing location, please indicate how construction workers would avoid contact with metals in groundwater.

Comment 2: Comment adequately addressed.

Comment 3: Page ES-2, Item 8: The risk assessment section states arsenic contributes 96.4 % of the total risk to the site; therefore, please explain why lead is discussed in this paragraph. The maximum concentration of lead found at the site was 220 mg/kg, below the established Preliminary Remediation Goal.

Comment 4: Comment adequately addressed.

Comment 5: Comment adequately addressed.

Comment 6: Comment adequately addressed.

Mr. Ace Forsen
April 17, 1996
Page Two

Comment 7: Comment adequately addressed.

Comment 8: See Comment 1.

Comment 9, Section 5.1.6: This section states that there "are areas of the Site covered with asphalt..." whereas figures 2, 5 and 9 indicate that the entire site is covered with asphalt. Please resolve this discrepancy.

Comment 10: Comment adequately addressed.

Comment 11: Comment adequately addressed.

Comment 12: Comment adequately addressed.

Additional Comments:

Page 10-1, Section 10.2, Item 1: This paragraph recommends no further action at the site because "the site will be mostly covered by asphalt or concrete;" however, the risk assessment calculated a 3.48×10^{-6} risk from arsenic found at the site. Either a recommendation to excavate the areas contaminated with arsenic should be made, or the levels of arsenic should be compared to ambient concentrations, or a recommendation to cap the site and place a land use restriction on the site should be made.

Figure 9: Arsenic concentrations should be added to the figure.

If you have any questions regarding this letter, please contact Lynn Nakashima at (510) 540-3839.

Sincerely,

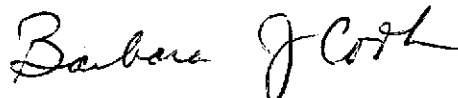

Barbara J. Cook, P.E., Chief
Site Mitigation Branch

cc: See next page

Mr. Ace Forsen
April 17, 1996
Page Three

cc: Mr. Sum Arigala
Regional Water Quality Control Board
San Francisco Bay Region
2101 Webster Street, Suite 500
Oakland, California 94612

Ms. Susan Hugo
Alameda County Health Agency
Department of Environmental Health
1131 Harbor Bay Parkway
Alameda, California 94502

Mr. Joel Howie
Caltrans
Environmental Engineering
P.O. Box 23660
Oakland, California 94623-0660

Ms. Kathleen Leiga
Caltrans
Cypress Construction Office
1545 Willow Street
Oakland, California 94607

DEPARTMENT OF TOXIC SUBSTANCES CONTROL

REGION 2
700 HEINZ AVE., SUITE 200
BERKELEY, CA 94710-2737
(510) 540-3724



November 6, 1995

Mr. Ace Forsen, Chief
Project Development/Benicia-Martinez Bridge
Caltrans
P.O. Box 23660
Oakland, California 94623-0660

Dear Mr. Forsen:

**COMMENTS TO DRAFT PRELIMINARY ENDANGERMENT ASSESSMENT (PEA),
GENERAL TRANSPORTATION, 3211 WOOD STREET, CYPRESS RECONSTRUCTION
PROJECT, OAKLAND**

The Department of Toxic Substances Control (DTSC) received the draft PEA, dated June 28, 1995, for General Transportation prepared by Environmental Solutions, Inc. on behalf of Caltrans. DTSC has reviewed the document and has the following comments:

1. Page ES-2, Item 5: Include the total depth of excavation at each of the footings. Since groundwater is located between four to five feet below ground surface, indicate if groundwater will be encountered during excavation. If groundwater will be a route of exposure, this should be included in the risk assessment.
2. Page ES-2, Item 7: Lead should be deleted from the Hazard Index (HI) total. It is DTSC's policy that a RfD value should not be used to calculate potential risk due to lead because most human health effects data are based on blood lead concentrations rather than external dose. the evaluation of lead should be done by comparing the site concentrations directly to the Preliminary Remedial Goal (PRG.) In addition, the PRG for lead was increased from 340 mg/kg to 840 mg/kg in the Remedial Action Plan (RAP).
3. Page ES-3, Item 8: This section states that the site will be mostly covered by asphalt or concrete and therefore the presence of elevated lead in soil does not currently pose a threat. A future activity on the site has no bearing on the current exposure routes. Revise this section to state what threats exist at the site in its current state. Future activities should be discussed separately.
4. Page ES-3, Item 9: Provide data to substantiate the claim that the presence of metals in groundwater at the site is indicative of the shallow ground water in the West Oakland area.
5. Page 1-1, Section 1, Introduction, Item 4: Add after the last sentence, "...PEA be performed on

the portion purchased by Caltrans."

6. Figure 2:
 - a. Show the location of the four former underground storage tanks on the figure.
 - b. There are discrepancies between figure 2 and figures 8 and 9. Figure 2 shows portions of the site paved with concrete, while figures 8 and 9 indicate an undetermined asphalt paved area. Clarify these discrepancies or correct the figure(s).
7. Page 2-2, Section 2.1.7, U.S. EPA Identification Number: DTSC's HAZNET data base indicates that EPA ID number CAC000731088 was assigned to Caltrans for this site. This number should be added to this section.
8. Page 4-2, Section 4.4, Exposure Pathways of Concern, Item 2: Explain why exposure to groundwater is "expected to be minimal."
9. Page 5-3, Section 5.1.6, Measures to Prevent Contact With Hazardous Substances/Wastes: Clarify whether the entire site will be covered with asphalt or concrete during construction activities, or only a portion. Also state whether the asphalt and/or concrete will remain after construction is completed.
10. Page 6-3, Section 6.4.1, Soil Samples: This section states that based on analytical data collected from other site investigations, it is believed that the presence of acetone and methyl ethyl ketone (MEK) is due to laboratory contamination. In order to determine if a contaminant is actually detected or due to laboratory contamination or non-site related contamination, the laboratory or trip blank data should be compared with results from samples with which the blanks were associated. The concentrations of MEK and acetone should be re-evaluated using U.S. EPA criteria found in U.S. EPA's Risk Assessment Guidance for Superfund, Volume I, Part A (EPA/540/1-89/002, December 1989, Interim Final).
11. Page 8-1, Section 8, Ecological Screening Evaluation: State why you believe that the site will not impact sensitive areas or species.
12. Table 5, Analytical Results: Indicate which sample results are reported in mg/l and ug/l.

If you have any questions regarding this letter, please contact Lynn Nakashima at (510) 540-3839.

Sincerely,

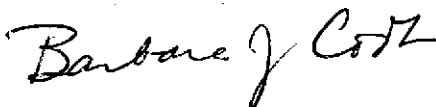

Barbara J. Cook, P.E., Chief
Site Mitigation Branch

Mr. Ace Forsen
November 6, 1995
Page Three

cc: Mr. Sum Arigala
Regional Water Quality Control Board
San Francisco Bay Region
2101 Webster Street, Suite 500
Oakland, California 94612

Ms. Susan Hugo
Alameda County Health Agency
Department of Environmental Health
1131 Harbor Bay Parkway
Alameda, California 94502

Mr. Chris Wilson
Caltrans
Environmental Engineering
P.O. Box 23660
Oakland, California 94623-0660

Ms. Kathleen Leiga
Caltrans
Cypress Construction Office
1545 Willow Street
Oakland, California 94607

Ms. Cydney Miller
Environmental Solutions, Inc.
1201 North McDowell Boulevard
Petaluma, CA 94954

DEPARTMENT OF TOXIC SUBSTANCES CONTROL

REGION 2
700 HEINZ AVE., SUITE 200
BERKELEY, CA 94710-2737
(510) 540-3724



May 19, 1995

Mr. Ace Forsen, Chief
Project Development/Benicia-Martinez Bridge
Caltrans
P.O. Box 23660
Oakland, California 94623-0660

Dear Mr. Forsen:

**REVISED DRAFT SOIL AND GROUND WATER INVESTIGATION WORK PLAN
AND HEALTH AND SAFETY PLAN, B&P DISAMANTLERS, 3211 WOOD STREET,
CYPRESS RECONSTRUCTION PROJECT, OAKLAND**

The Department of Toxic Substances Control (DTSC) has received the revised work plan and health and safety plan for B&P Dismantlers prepared by Environmental Solutions, Inc. on behalf of Caltrans. The plans contain revision made in response to comments made by DTSC in a letter dated May 10, 1995. DTSC has reviewed the changes made to the documents and find that they address the concerns contained in our comment letter; therefore, the work plan and health and safety plan are approved.

If you have any questions regarding this letter, please contact Lynn Nakashima at (510) 540-3839.

Sincerely,

A handwritten signature in cursive script that reads "Barbara J. Cook".

Barbara J. Cook, P.E., Chief
Site Mitigation Branch

cc: See next page



Mr. Ace Forsen
May 19, 1995
Page Two

cc: Mr. Chris Wilson
Caltrans
Environmental Engineering
P.O. Box 23660
Oakland, California 94623-0660

Mr. Sum Arigala
Regional Water Quality Control Board
San Francisco Bay Region
2101 Webster Street, Suite 500
Oakland, California 94612

Ms. Susan Hugo
Alameda County Health Agency
Department of Environmental Health
1131 Harbor Bay Parkway
Alameda, California 94502

Ms. Cydney M. Miller
Environmental Solutions, Inc.
1201 North McDowell Boulevard
Petaluma, California 94954

DEPARTMENT OF TOXIC SUBSTANCES CONTROL

REGION 2
700 HEINZ AVE., SUITE 200
BERKELEY, CA 94710-2737
(510) 540-3724

ENVIRONMENTAL
PROTECTION

95 MAY 18 PM 12:16



May 16, 1995

Mr. Ace Forsen, Chief
Project Development/Benicia-Martinez Bridge
Caltrans
P.O. Box 23660
Oakland, California 94623-0660

**REVISED DRAFT SOIL AND GROUND WATER INVESTIGATION WORK PLAN
AND HEALTH AND SAFETY PLAN, GENERAL TRANSPORTATION, 3211 WOOD
STREET, CYPRESS FREEWAY RECONSTRUCTION PROJECT, OAKLAND**

The Department of Toxic Substances Control (DTSC) has received the above revised work plan submitted by Environmental Solutions, Inc. on behalf of Caltrans. The work plan contains revisions based on comments submitted by DTSC in a letter dated May 8, 1995. DTSC has reviewed the work plan and found that all comments were addressed and therefore, the plan is approved. If you have any comments regarding this letter, please contact Lynn Nakashima at (510 540-3839).

Sincerely,

A handwritten signature in black ink that reads "Barbara J. Cook".

Barbara J. Cook, P.E., Chief
Site Mitigation Branch

cc: See next page



Mr. Ace Forsen
May 16, 1995
Page Two

cc: Mr. Sum Arigala
Regional Water Quality Control Board
2101 Webster Street, Suite 500
Oakland, California 94612

Ms. Susan Hugo
Alameda County Health Agency
Department of Environmental Health
1131 Harbor Bay Parkway
Alameda, California 94502

Mr. Chris Wilson
Caltrans
Environmental Engineering
111 Grand Avenue
P.O. Box 23660
Oakland, California 94623-0660

Ms. Cydney M. Miller
Environmental Solutions, Inc.
1201 North McDowell Boulevard
Petaluma, California 94954

DEPARTMENT OF TOXIC SUBSTANCES CONTROL

REGION 2
700 HEINZ AVE., SUITE 200
BERKELEY, CA 94710-2737
(510) 540-3724



95 MAY 11 PM 2:24

ENVIRONMENTAL
PROTECTION

May 10, 1995

Mr. Ace Forsen, Chief
Project Development/Benicia-Martinez Bridge
Caltrans
P.O. Box 23660
Oakland, California 94623-0660

Dear Mr. Forsen:

DRAFT SOIL AND GROUND WATER INVESTIGATION WORKPLAN AND HEALTH AND SAFETY PLAN, B&P DISMANTLERS, 3211 WOOD STREET, CYPRESS RECONSTRUCTION PROJECT, OAKLAND

The Department of Toxic Substances Control (DTSC) has received the above mentioned workplan prepared by Environmental Solutions, Inc. on behalf of Caltrans. The workplan describes proposed soil and groundwater sampling for the purpose of collecting data to prepare a Preliminary Endangerment Assessment (PEA). DTSC has reviewed both plans and has the following comments:

Soil and Ground Water Investigation Workplan

1. Page 1-1, Section 1.0, Introduction: This section should include a brief discussion regarding the proposed future use of the property. According to DTSC files, Caltrans has indicated that ownership of the property will be transferred to another party.
2. Page 3-1, Section 3.0, Scope of Work:
 - a. If possible, surface soil samples should be collected from all borings and analyzed for TRPH, TPH-d, TPH-g, and metals since extensive surface staining was observed in aerial photographs.
 - b. Item 2: It appears that borings 5 and 6 are reversed in the text. Please amend the text.
 - c. Two additional borings should be added to the plan, and one boring should be moved. Aerial photographs show a large area of staining between borings B-4 and B-2, DTSC recommends that boring B-2 be moved to the west. Because Storage of loose material in a pile between B-5 and B-6 was also observed in an aerial photograph, and no samples have been collected in the area between borings B-6 and B-1, DTSC requests that two additional borings be added. Please see the enclosed map for locations. Samples



Mr. Ace Forsen
May 10, 1995
Page Three

and the frequency.

4. Page C-14, Item 4, Physical Hazards: This section should also include that personnel should inspect the overhead area to ensure that the drill rig mast will not come into contact with overhead electrical wires.

If you have any questions regarding this letter, please contact Lynn Nakashima at (510) 540-3839.

Sincerely,



Barbara J. Cook, P.E., Chief
Site Mitigation Branch

Enclosure

cc: Mr. Chris Wilson
Caltrans
Environmental Engineering
P.O. Box 23660
Oakland, California 94623-0660

Mr. Sum Arigala
Regional Water Quality Control Board
San Francisco Bay Region
2101 Webster Street, Suite 500
Oakland, California 94612

Ms. Susan Hugo
Alameda County Health Agency
Department of Environmental Health
1131 Harbor Bay Parkway
Alameda, California 94502

Ms. Cydney M. Miller
Environmental Solutions, Inc.
1201 North McDowell Boulevard
Petaluma, California 94954

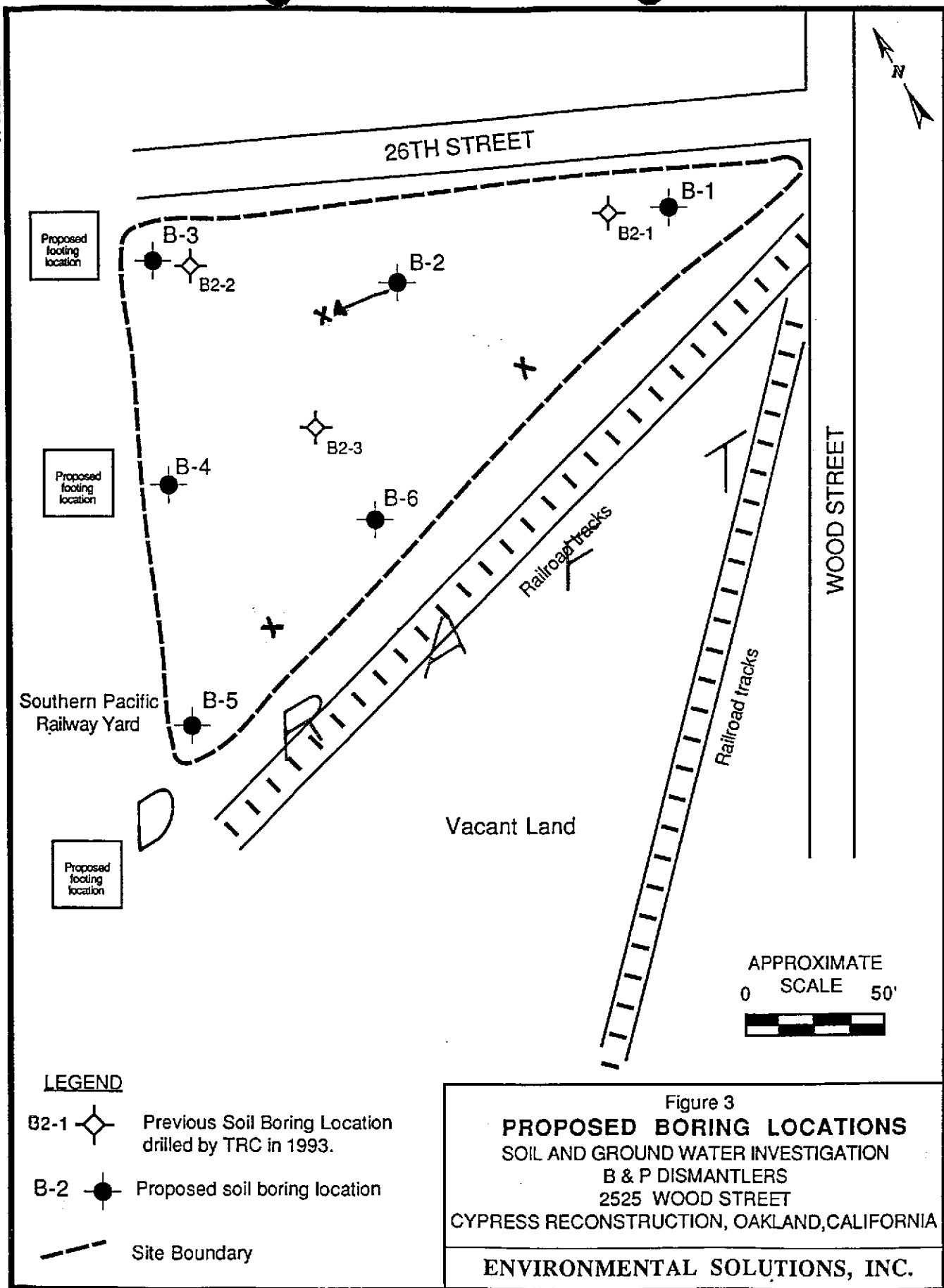

LEGEND



- B2-1  Previous Soil Boring Location drilled by TRC in 1993.
- B-2  Proposed soil boring location
-  Site Boundary

Figure 3
PROPOSED BORING LOCATIONS
 SOIL AND GROUND WATER INVESTIGATION
 B & P DISMANTLERS
 2525 WOOD STREET
 CYPRESS RECONSTRUCTION, OAKLAND, CALIFORNIA
 ENVIRONMENTAL SOLUTIONS, INC.

Enclosure

DEPARTMENT OF TOXIC SUBSTANCES CONTROL

REGION 2
700 HEINZ AVE., SUITE 200
BERKELEY, CA 94710-2737
(510) 540-3724



May 8, 1995

ENVIRONMENTAL
PROTECTION
MAY 9 9 PM 2:20
Mr. Ace Forsen, Chief
Project Development/Benicia-Martinez Bridge
Caltrans
P.O. Box 23660
Oakland, California 94623-0660

Dear Mr. Forsen:

**DRAFT SOIL AND GROUND WATER INVESTIGATION WORK PLAN AND
HEALTH AND SAFETY PLAN, GENERAL TRANSPORTATION, 3211 WOOD
STREET, CYPRESS FREEWAY RECONSTRUCTION PROJECT, OAKLAND**

The Department of Toxic Substances Control (DTSC) has received the work plan and health and safety plan for General Transportation prepared by Environmental Solutions, Inc. on behalf of Caltrans. The purpose of the sampling is to collect data in order to prepare a Preliminary Endangerment Assessment (PEA). DTSC has reviewed the plan and has the following comments:

1. Page 3-2, Section 3.1, Soil Boring Locations and Protocols, Item 2: An example of the drum label was not included in Appendix B.
2. Page 3-3, Section 3.2, Sampling Plan, Item 2: A copy of the boring log form was not included in Appendix B.
3. Page 3-4, Item 4: A copy of the Chain-of-Custody form was not included in Appendix B. In addition, the analytical laboratory should indicate on the form the internal temperature of the ice chest when received.
4. Page 3-5, Section 3.4, Analytical Program:
 - a. Unless Caltrans can provide documentation stating what types of compounds were stored in drums at the site, pesticides and PCBs should be added to the analytical program for samples collected from the former drum storage areas.
 - b. All soil samples collected from borings B-3 and B-4 (drum storage areas) should be analyzed for CAM 17 metals unless Caltrans can provide documentation of the materials/chemicals that were stored in these areas.



Mr. Ace Forsen
May 8, 1995
Page Two

5. Page 3-5, Section 3.4, Item 3, third line: Change STLC to TCLP. For disposal purposes, TCLP tests should be performed if the total concentration value exceeds 20 times the TCLP value.
6. A section needs to be added describing how Caltrans will handle and dispose of investigation derived waste.

Appendix C. Site Health and Safety Plan

7. A map showing the route from the site to the hospital needs to be included in the plan.
8. Page C-2, Item 5: The PEL for lead should be included.
9. Page C-4, Item 10: This section states that a Georgia-Pacific representative will be present at the site, please clarify this statement.
10. Page C-8, Section 1.3, Medical Surveillance:
 - a. In addition to annual physical examinations, employees should be given an examination as soon as possible upon notification by an employee either that the employee has developed signs or symptoms indicating possible overexposure to hazardous substances or health hazards or that the employee has been injured or exposed above the PELs or published exposure levels in an emergency situation.
 - b. Item 3 states that "end of employment" physicals will be conducted at the discretion of the HSO. Title 8, Section 5192(f)(3) requires that employees receive a medical examination at termination of employment or if reassigned to an area where the employee would not be covered if the employee has not had an examination within the last six months. Please revise this paragraph.
11. Page C-13, Section 3.1, SOP for Hollow Stem Auger Drilling:
 - a. Prior to the start of operations, employees should be made aware of the location of the drill rig cut-off switch.
 - b. Item 2: This section should specify the type of air monitoring that will be done and the frequency.
12. Page 1-14, Item 4, Physical Hazards: This section should include that personnel should inspect the area to ensure that the drill rig mast will not come into contact with overhead electrical wires.

Mr. Ace Forsen
May 8, 1995
Page Three

If you have any questions regarding this letter, please contact Lynn Nakashima at (510) 540-3839.

Sincerely,



Barbara J. Cook, P.E., Chief
Site Mitigation Branch

cc: Mr. Sum Arigala
Regional Water Quality Control Board
2101 Webster Street, Suite 500
Oakland, California 94612

Ms. Susan Hugo
Alameda County Health Agency
Department of Environmental Health
1131 Harbor Bay Parkway
Alameda, California 94502

Mr. Chris Wilson
Caltrans
Environmental Engineering
111 Grand Avenue
P.O. Box 23660
Oakland, California 94623-0660

Ms. Cydney M. Miller
Environmental Solutions, Inc.
1201 North McDowell Boulevard
Petaluma, California 94954

KNOX RICKSEN

ATTORNEYS AT LAW
LAKE MERRITT PLAZA
1999 HARRISON STREET, SUITE 1700
OAKLAND, CALIFORNIA 94612-3500
FAX (510) 446-1946

W. SAYER SNOOK
RUPERT H. RICKSEN
STEVEN R. ANTHONY
ROBERT G. ALLEN
RICHARD G. LOGAN, JR.
THOMAS E. FRAYSSE
MARK L. CEDERBORG
GREGORY D. PIKE
R. PATRICK SNOOK
THOMAS H. LEMMON
HUBERT LENCZOWSKI
ANN L. VACCARO
MARK C. SKILLING
T. CASS MCKENZIE
STEVEN P. BURKE

JOHN C. RICKSEN
WILLIAM C. ROBBINS III
STEPHEN S. HARPER
THOMAS A. PALMER
JEFFREY A. HARPER
FREDERICK D. SCHWARZ
KENNETH G. HECHT, JR.
THOMAS V. BRET
KENNETH J. MCCARTHY
KENNETH A. DREYFUSS
MARGARET P. BAKER
MELANIE R. WYNE
PAMELA C. CHRISTENSEN
JOHN S. BOAT

(510) 893-1000

WALLACE W. KNOX (1905-1982)
MARSHALL RICKSEN (1908-1975)

SOLANO COUNTY OFFICE
CORPORATE PLAZA
1261 TRAVIS BOULEVARD, SUITE 280
FAIRFIELD, CALIFORNIA 94533
FAX (707) 426-0426
(707) 426-3313

June 17, 1993

Susan L. Hugo
Senior Hazardous Materials Specialist
Alameda County Health Care Services Agency
80 Swan Way, Room 200
Oakland, CA 94621

Re: 3211 Wood Street
Oakland, CA 94608

Dear Ms. Hugo:

Our office represents Henrietta Larson, and we have received your letter regarding environmental assessment of the above referenced property.

This is to advise you that Henrietta Larson is not the owner of the property at 3211 Wood Street, but merely holds a life tenancy. Temple Sinai holds the remaining interest and the current tenant in possession is Mr. Steven Sutta.

We have received notification from the State of California that at least part of the Wood Street property is being taken for construction of the Cypress replacement freeway. Caltrans has notified us that they will be doing their own independent environmental assessment of the property. It is not clear to us at this time how much of the property will actually be taken. Our understanding is that Caltrans is currently conducting an appraisal of the property, but we also have learned that the project has been complicated by the filing of a lawsuit in United States District Court by the Clean Air Alternative Coalition and the Living God Faith Tabernacle Church. As we understand it, that lawsuit relates to the route chosen for the freeway replacement.

As things stand, it is not clear that Mrs. Larson has any obligations regarding the property, and it also not clear if she will have any interest at all in the property within the next few months. All documentation regarding the previous tank removal has been provided to Caltrans, and they have stated that they

KNOX RICKSEN

Susan L. Hugo
Senior Hazardous Materials Specialist
Re: 3211 Wood Street
Oakland, CA 94608
June 17, 1993
Page 2

intend to do their own assessment. We do not know how the condemnation action by Caltrans affects your interest in the property.

Due to the current circumstances, it is not clear who has responsibilities for this land, and it is certainly not clear that any meaningful work plan can be prepared as you have requested pending clarification of ownership and responsibility issues.

Thank you fo ryour attention to this matter. Please feel free to contact me if you have any questions.

Very truly yours,

KNOX RICKSEN

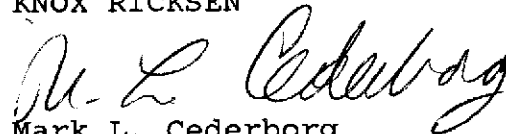
Mark L. Cederborg

MLC:pm

cc: Mrs. Henrietta Larson

ALAMEDA COUNTY
HEALTH CARE SERVICES
AGENCY

DAVID J. KEARS, Agency Director



RAFAT A. SHAHID, ASST. AGENCY DIRECTOR

DEPARTMENT OF ENVIRONMENTAL HEALTH
State Water Resources Control Board
Division of Clean Water Programs
UST Local Oversight Program
80 Swan Way, Rm 200
Oakland, CA 94621
(510) 271-4530

May 4, 1993
STID# 4074

Ms. Henrietta Larson
c/o Mr. Mark L. Cederborg
Knox Ricksen
1999 Harrison Street, Suite 1700
Oakland, California 94621

**RE: Removal of Four Underground Storage Tanks at General
Transportation - 3211 Wood Street, Oakland, CA 94608**

Dear Mr. Cederborg:

The Alameda County Department of Environmental Health, Hazardous Materials Division has reviewed the files concerning the removal of four underground storage tanks (one-8,000 gallon diesel, one-8,000 gallon gasoline, one-500 gallon waste oil, one-500 gallon solvent) on May 13, 1992 at the referenced site. We are in receipt of the Report of UST Closure Activities (June 1992) prepared by EOA, Inc. and an Underground Storage Tank Unauthorized Release (Leak)/Contamination Site Report.

Soil samples collected during the tank removal activities exhibited elevated levels of the following petroleum hydrocarbon contaminants - 26,000 ppm TPH diesel, 1.2 ppm benzene, 4.9 ppm ethyl benzene and 120 ppm G. Groundwater sample collected from the excavation showed 120 ppm TPH diesel, 190 ppb TPH gasoline and non detectable levels for benzene, toluene, ethyl benzene and xylene. In addition, free floating product was observed in the groundwater and strong soil staining was visible from the excavation walls. Because of the degree of contamination found at the site which exceeded regulatory threshold levels, further environmental assessment is required to determine the extent of the unauthorized release associated with the former tanks at the site.

This office will be the lead agency overseeing the environmental investigation and cleanup activities at the site. The RWQCB has delegated this authority to our office. However, you must keep the Water Board apprised of all actions taken to characterize and remediate contamination at the site, because the Board retains the ultimate responsibility for ensuring protection of the waters of the state.

Mr. Mark Cederborg
RE: 3211 Wood Street, Oakland, CA 94608
May 4, 1993
Page 2 of 3

A preliminary assessment should be conducted to determine the extent of soil and/or groundwater contamination that has resulted from the former leaking tank. The information gathered by this investigation will be used to assess the need for additional actions at the site. The preliminary assessment should be designed to provide all of the information in the format shown in the attachment at the end of this letter, which is based on the RWQCB's guidelines. You should be prepared to install at a minimum, three monitoring wells to establish gradient direction of the groundwater at the site. One of the wells should be installed within 10 feet downgradient of the former tank location. Monthly water elevation reading for the first six months (reduced to every quarter) is necessary to determine groundwater flow direction and quarterly sampling for target compounds (TPH diesel, TPH gasoline, benzene, ethyl benzene, toluene, xylene, total oil and grease, lead, EPA 8270 and EPA 8240) must occur to determine extent of the groundwater contamination.

Until cleanup is complete, you will need to submit reports to this office and to RWQCB every three months (or at a more frequent interval, if specified at any time by either agency). These reports must include information pertaining to further investigative results; the methods of cleanup actions implemented to date; and the method and disposal of any contaminated material. Copies of manifests for such disposal must be sent to this office. Stockpiled soil from the pit may not be used to backfill these holes without authorization from this office. Only clean fill can be used to backfill the excavation pit. Please provide our office with documentation of the stockpiled soil disposal.

Your work plan must be submitted to this office no later than **June 18, 1993**. All reports and proposals must be submitted under seal of a California Registered Geologist or Registered Civil Engineer with a statement of qualifications for each lead professionals involved with the project. Copies of the reports and proposals must also be submitted to:

Rich Hiett
RWQCB, San Francisco Bay Region
2101 Webster Street, Fourth Floor
Oakland, California 94612

Because we are overseeing this site under the designated authority of the Regional Water Quality Control Board, this letter constitutes a formal requests for technical reports pursuant to California Water Code Section 13267(b). Any extensions of stated deadlines or changes in the workplan must be confirmed in writing and approved by this agency or RWQCB.

Mr. Mark Cederborg
RE: 3211 Wood Street, Oakland, CA 94608
May 4, 1993
Page 3 of 3

Enclosed is a copy of Appendix A (Workplan for Initial Subsurface Investigation - August 20, 1991) for your reference.

Should you have any questions regarding this letter, please contact me at (510) 271-4530.

Sincerely,

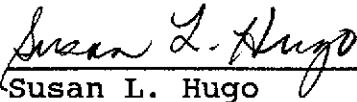

Susan L. Hugo
Senior Hazardous Materials Specialist

Enclosure

cc: Rafat A. Shahid, Asst. Agency Director, Environmental Health
Gil Jensen, Alameda County District Attorney's Office
Rich Hiett, San Francisco Bay RWQCB
Edgar B. Howell, Chief, Hazardous Materials Division / file
Henrietta Larson, 5601 Leona Street, Oakland CA 94605
Jim Crowley, EOA, Inc., 1410 Jackson Street, Oakland, CA 94612

Property Owner: Henrietta Larson

5601 Leona St.
Oakland 94605
c/o Mark Cedenberg
Knox Rickson
1999 Harrison St. Suite 1700
Oakland 94612

DATE: 7/15/92
TO : Local Oversight Program
FROM: SUSAN
SUBJ: Transfer of Eligible Oversight Case

ATTN: Jim Hardgrave

Site name: GENERAL TRANSPORTATION
Address: 3211 Wood St City Oakland zip 94608

Closure plan attached? Y N DepRef remaining \$ _____

DepRef Project # _____ STID #(if any) 4074

Number of Tanks: _____ removed? Y N Date of removal _____

Leak Report filed? Y N Date of Discovery _____ not listed
date first reported: 5/19/92

Samples received? Y N Contamination: Soil / Groundwater

Petroleum Y N Types: Avgas Jet leaded unleaded Diesel
fuel oil waste oil kerosene solvents

Monitoring wells on site _____ Monitoring schedule? Y N

LUFT category 1 2 3 * H S C A R W G O

Briefly describe the following:

Preliminary Assessment _____

Remedial Action _____

Post Remedial Action Monitoring _____

Enforcement Action _____

CONTENTS

- I. Sampling and Analysis
- II. Profile
- III. Disposal/Recycle



June 16, 1992

Ms. Susan Hugo
Hazardous Materials Specialist
Division of Hazardous Materials
Department of Environmental Health
80 Swan Way, Room 200
Oakland, CA 94621

Dear Ms. Hugo:

On behalf of DECON Environmental Services, Inc. (DECON) I would personally like to extend an apology for the off-color remarks made by our equipment operator on May 13, 1992, at the 3211 Wood Street site in Oakland, California.

This employees conduct did not conform to DECON's standards. Upon having discussed this incident with our Operations Manager, it was decided to terminate this equipment operator on May 14, 1992, for his poor judgement.

Again, please accept our sincerest apologies.

Sincerely,

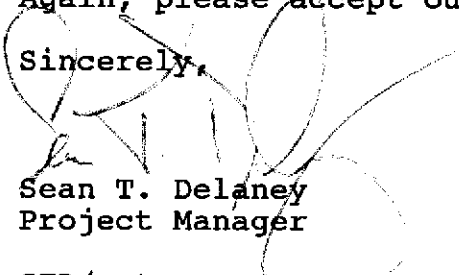

Sean T. Delaney
Project Manager

STD/emt

June 10, 1992

Susan Hugo
Alameda County
Department of Environmental Health
Hazardous Materials Program
80 Swan Way, Room 200
Oakland, CA 94621

RE: UST Removal at 3211 Wood Street in Oakland, California.

Dear Susan:

Pursuant to our telephone conversation, enclosed find a copy of a letter I received from DECON regarding the behavior of a DECON backhoe operator on May 13, 1992 while you observed the removal of four UST's. I want to confirm my strong disapproval for the conduct of the DECON employee. I assure you that EOA would not tolerate any such conduct by any EOA employee or EOA subcontractor. When the incident was brought to my attention, I asked that the offending individual be removed from the site, as he was interfering with the closure process, and suggested that DECON should apologize to you for the incident.

We also wish to clarify DECON was not a subcontractor to EOA, and was under direct contract with the property owner. EOA's role at the site was limited to observing and documenting the closure activities, ensuring compliance with the closure plan, and performing of sampling. EOA's role did not involve supervision of DECON or supervision of DECON employees.

I wish to indicate that EOA has taken this incident very seriously and followed through with DECON. EOA strives to maintain good working relationships with regulatory personnel in an effort to ensure the most effective solution to environmental problems for the benefit of our community and the environment. We want to make sure that this incident does not reflect on EOA. Maintaining our good working relationship with you and other Alameda County staff is extremely important to us.

Ms. Susan Hugo
June 10, 1992
Page 2

I appreciated the effort you put in during the above tank removal, working late into the afternoon, and your understanding of the regulations, cleanup issues, and the property owners concerns. I look forward to working with you again. If you have any questions, please feel free to call me at your convenience at (510) 832-2852.

Very truly yours,
EOA, Inc

Jim Crowley
Environmental Engineer

Attachment: 1

F:\KX02\AL-C0692.LTR {JSC}



KXSE

June 1, 1992

Mr. Jim Crowley
EOA Inc.
1410 Jackson St.
Oakland, CA 94612

RE: REMEDIATION SERVICES AT 3211 WOOD ST., OAKLAND, CALIFORNIA

Dear Mr. Crowley:

DECON has recently completed the requested remediation services at your Wood Street project site. We hope that everything performed by DECON met with your approval.

It was brought to my attention that one of our equipment operators acted in a manner which does not conform to DECON's standards. You will note that I have attached a memorandum from Sean Delaney, our Project Manager, to me regarding this incident. Upon having discussed this incident with our Operations Manager, it was decided to terminate the equipment operator for these off-color remarks.

If you have any questions regarding this project or other services we may provide, please call me at your convenience.

Sincerely,

A handwritten signature in black ink, appearing to read "Warren W. Dodge".

Warren W. Dodge
Vice President

WWD/td

Attachment: 1

UCY

01-0696

01

01-0690

UNDERGROUND STORAGE TANK UNAUTHORIZED RELEASE (LEAK) / CONTAMINATION SITE REPORT

EMERGENCY <input type="checkbox"/> YES <input checked="" type="checkbox"/> NO	HAS STATE OFFICE OF EMERGENCY SERVICES REPORT BEEN FILED? <input type="checkbox"/> YES <input checked="" type="checkbox"/> NO	FOR LOCAL AGENCY USE ONLY HEREBY CERTIFY THAT I AM A DESIGNATED GOVERNMENT EMPLOYEE AND THAT I HAVE REPORTED THIS INFORMATION TO LOCAL OFFICIALS PURSUANT TO SECTION 25180.7 OF THE HEALTH AND SAFETY CODE. SIGNED: <i>Susan Hugo</i> DATE: <i>6/13/92</i>
REPORT DATE <i>05/19/92</i>	CASE #	

REPORTED BY	NAME OF INDIVIDUAL FILING REPORT <i>HENRIETTA LARSON</i>	PHONE <i>(90) 531-7470</i>	SIGNATURE <i>Henrietta Larson</i>
	REPRESENTING <input type="checkbox"/> LOCAL AGENCY <input type="checkbox"/> OWNER/OPERATOR <input type="checkbox"/> REGIONAL BOARD <input checked="" type="checkbox"/> OTHER <i>as life TENANT</i>	COMPANY OR AGENCY NAME <i>City Control Board</i>	
	ADDRESS <i>5601 LEONA STREET OAKLAND</i>		

RESPONSIBLE PARTY	NAME <i>Maybe multiple R.P.'s</i>	CONTACT PERSON <i>Tenant at site</i>	PHONE <i>()</i>
	ADDRESS <i>Property owner / Tank operator</i>		

SITE LOCATION	FACILITY NAME (IF APPLICABLE) <i>GENERAL TRANSPORTATION</i>	OPERATOR	PHONE <i>()</i>
	ADDRESS <i>3211 WOOD ST OAKLAND</i>	ALAMEDA	94608
	CROSS STREET <i>32nd</i>		

IMPLEMENTING AGENCIES	LOCAL AGENCY <i>ALAMEDA CO. HEALTH</i>	AGENCY NAME	CONTACT PERSON <i>SUSAN HUGO</i>	PHONE <i>(510) 271-4530</i>
	REGIONAL BOARD <i>SAN FRANCISCO BAY RWQCB (2)</i>		<i>RICH HIETT</i>	PHONE <i>(510) 464-4359</i>

SUBSTANCES INVOLVED	(1) <i>PETROLEUM HYDROCARBONS</i>	QUANTITY LOST (GALLONS) <input checked="" type="checkbox"/> UNKNOWN
	(2)	<input type="checkbox"/> UNKNOWN

DISCOVERY/ABATEMENT	DATE DISCOVERED <i>05/13/92</i>	HOW DISCOVERED <input type="checkbox"/> INVENTORY CONTROL <input type="checkbox"/> SUBSURFACE MONITORING <input type="checkbox"/> NUISANCE CONDITIONS <input type="checkbox"/> TANK TEST <input checked="" type="checkbox"/> TANK REMOVAL <input type="checkbox"/> OTHER
	DATE DISCHARGE BEGAN <input checked="" type="checkbox"/> UNKNOWN	METHOD USED TO STOP DISCHARGE (CHECK ALL THAT APPLY) <input type="checkbox"/> REMOVE CONTENTS <input type="checkbox"/> REPLACE TANK <input type="checkbox"/> CLOSE TANK <input type="checkbox"/> REPAIR TANK <input type="checkbox"/> REPAIR PIPING <input type="checkbox"/> CHANGE PROCEDURE
	HAS DISCHARGE BEEN STOPPED? <input checked="" type="checkbox"/> YES <input type="checkbox"/> NO IF YES, DATE <i>05/13/92</i>	<input checked="" type="checkbox"/> OTHER <i>REMOVE CONTENTS / REMOVE TANK</i>

SOURCE/CAUSE	SOURCE OF DISCHARGE <input checked="" type="checkbox"/> TANK LEAK <input type="checkbox"/> UNKNOWN <input type="checkbox"/> PIPING LEAK <input type="checkbox"/> OTHER	CAUSE(S) <input type="checkbox"/> OVERFILL <input type="checkbox"/> RUPTURE/FAILURE <input type="checkbox"/> SPILL <input checked="" type="checkbox"/> CORROSION <input type="checkbox"/> UNKNOWN <input type="checkbox"/> OTHER
--------------	---	--

CASE TYPE	CHECK ONE ONLY <input checked="" type="checkbox"/> UNDETERMINED <input type="checkbox"/> SOIL ONLY <input type="checkbox"/> GROUNDWATER <input type="checkbox"/> DRINKING WATER - (CHECK ONLY IF WATER WELLS HAVE ACTUALLY BEEN AFFECTED)
-----------	--

CURRENT STATUS	CHECK ONE ONLY <input checked="" type="checkbox"/> NO ACTION TAKEN <input type="checkbox"/> PRELIMINARY SITE ASSESSMENT WORKPLAN SUBMITTED <input type="checkbox"/> POLLUTION CHARACTERIZATION <input type="checkbox"/> LEAK BEING CONFIRMED <input type="checkbox"/> PRELIMINARY SITE ASSESSMENT UNDERWAY <input type="checkbox"/> POST CLEANUP MONITORING IN PROGRESS <input type="checkbox"/> REMEDIATION PLAN <input type="checkbox"/> CASE CLOSED (CLEANUP COMPLETED OR UNNECESSARY) <input type="checkbox"/> CLEANUP UNDERWAY
----------------	--

REMEDIAL ACTION	CHECK APPROPRIATE ACTION(S) (SEE BACK FOR DETAILS) <input type="checkbox"/> EXCAVATE & DISPOSE (ED) <input type="checkbox"/> REMOVE FREE PRODUCT (FP) <input type="checkbox"/> ENHANCED BIO DEGRADATION (BT) <input type="checkbox"/> CAP SITE (CD) <input type="checkbox"/> EXCAVATE & TREAT (ET) <input type="checkbox"/> PUMP & TREAT GROUNDWATER (GT) <input type="checkbox"/> REPLACE SUPPLY (RS) <input type="checkbox"/> CONTAINMENT BARRIER (CB) <input type="checkbox"/> NO ACTION REQUIRED (NA) <input type="checkbox"/> TREATMENT AT HOOKUP (HU) <input type="checkbox"/> VENT SOIL (VS) <input type="checkbox"/> VACUUM EXTRACT (VE) <input checked="" type="checkbox"/> OTHER (OT) <i>REMOVE TANKS / PIPING / EXCAVATE SOIL / REMOVE GROUNDWATER</i>
-----------------	---

COMMENTS	
----------	--

INSTRUCTIONS

EMERGENCY

Indicate whether emergency response personnel and equipment were involved at any time. If so, a Hazardous Material Incident Report should be filed with the State Office of Emergency Services (OES) at 2800 Meadowview Road, Sacramento, CA 95832. Copies of the OES report form may be obtained at your local underground storage tank permitting agency. Indicate whether the OES report has been filed as of the date of this report.

LOCAL AGENCY ONLY

To avoid duplicate notification pursuant to Health and Safety code Section 25180.7, a designated government employee should sign and date the form in this block. A signature here does not mean that the leak has been determined to pose a significant threat to human health or safety, only that notification procedures have been followed if required.

REPORTED BY

Enter your name, telephone number, and address. Indicate which party you represent and provide company or agency name.

RESPONSIBLE PARTY

Enter name, telephone number, contact person, and address of the party responsible for the leak. The responsible party would normally be the tank owner.

SITE LOCATION

Enter information regarding the tank facility. At a minimum, you must provide the facility name and full address.

IMPLEMENTING AGENCIES

Enter names of the local agency and Regional Water Quality Control Board involved.

SUBSTANCES INVOLVED

Enter the name and quantity lost of the hazardous substance involved. Room is provided for information on two substances if appropriate. If more than two substances leaked, list the two of most concern for cleanup.

DISCOVERY/ABATEMENT

Provide information regarding the discovery and abatement of the leak.

SOURCE/CAUSE

Indicate source(s) of leak. Check box(es) indicating cause of leak.

CASE TYPE

Indicate the case type category for this leak. Check one box only. Case type is based on the most sensitive resource affected. For example, if both soil and ground water have been affected, case type will be "Ground Water". Indicate "Drinking Water" only if one or more municipal or domestic water wells have actually been affected. A "Ground Water" designation does not imply that the affected water cannot be, or is not, used for drinking water, but only that water wells have not yet been affected. It is understood that case type may change upon further investigation.

CURRENT STATUS

Indicate the category which best describes the current status of the case. Check one box only. The response should be relative to the case type. For example, if case type is "Ground Water", then "Current Status" should refer to the status of the ground water investigation or cleanup, as opposed to that of soil. Descriptions of options follow:

No Action Taken - No action has been taken by responsible party beyond initial report of leak.

Leak Being Confirmed - Leak suspected at site, but has not been confirmed.

Preliminary Site Assessment Workplan Submitted - workplan/proposal requested of/submitted by responsible party to determine whether ground water has been, or will be, impacted as a result of the release.

Preliminary Site Assessment Underway - implementation of workplan.

Pollution Characterization - responsible party is in the process of fully defining the extent of contamination in soil and ground water and assessing impacts on surface and/or ground water.

Remediation Plan - remediation plan submitted evaluating long term remediation options. Proposal and implementation schedule for appropriate remediation options also submitted.

Cleanup Underway - implementation of remediation plan.

Post Cleanup Monitoring in Progress - periodic ground water or other monitoring at site, as necessary, to verify and/or evaluate effectiveness of remedial activities.

Case Closed - regional board and local agency in concurrence that no further work is necessary at the site.

IMPORTANT: THE INFORMATION PROVIDED ON THIS FORM IS INTENDED FOR GENERAL STATISTICAL PURPOSES ONLY AND IS NOT TO BE CONSTRUED AS REPRESENTING THE OFFICIAL POSITION OF ANY GOVERNMENTAL AGENCY

REMEDIAL ACTION

Indicate which action have been used to cleanup or remediate the leak. Descriptions of options follow:

Cap Site - install horizontal impermeable layer to reduce rainfall infiltration.

Containment Barrier - install vertical dike to block horizontal movement of contaminant.

Excavate and Dispose - remove contaminated soil and dispose in approved site.

Excavate and Treat - remove contaminated soil and treat (includes spreading or land farming).

Remove Free Product - remove floating product from water table.

Pump and Treat Groundwater - generally employed to remove dissolved contaminants.

Enhanced Biodegradation - use of any available technology to promote bacterial decomposition of contaminants.

Replace Supply - provide alternative water supply to affected parties.

Treatment at Hookup - install water treatment devices at each dwelling or other place of use.

Vacuum Extract - use pumps or blowers to draw air through soil.

Vent Soil - bore holes in soil to allow volatilization of contaminants.

No Action Required - incident is minor, requiring no remedial action.

COMMENTS - Use this space to elaborate on any aspects of the incident.

SIGNATURE - Sign the form in the space provided.

DISTRIBUTION

If the form is completed by the tank owner or his agent, retain the last copy and forward the remaining copies intact to your local tank permitting agency for distribution.

1. Original - Local Tank Permitting Agency
2. State Water Resources Control Board, Division of Loans and Grants, Underground Storage Tank Program, P.O. Box 944212, Sacramento, CA 94244-2120
3. Regional Water Quality Control Board
4. County Board of Supervisors or designee to receive Proposition 65 notifications.
5. Owner/responsible party.

STATE ID NUMBER

APPLICATION FOR PERMIT TO OPERATE UNDERGROUND STORAGE TANK

01 NEW PERMIT 05 RENEWED PERMIT 07 TANK CLOSED 09 DELETE FROM FILE (NO FEE)
 02 CONDITIONAL PERMIT 06 AMENDED PERMIT 08 MINOR CHANGE (NO SURCHARGE)

I OWNER

NAME (CORPORATION, INDIVIDUAL OR PUBLIC AGENCY) <i>ESTATE OF JOSEPH STERNS 40 BANK OF AMERICA ATTN: SUSAN DENNER</i>		PUBLIC AGENCY ONLY <input type="checkbox"/> 01 FED <input type="checkbox"/> 02 STATE <input type="checkbox"/> 03 LOCAL	
STREET ADDRESS <i>P.O. Box 37121</i>	CITY <i>SAN FRANCISCO</i>	STATE <i>CA</i>	ZIP <i>94137</i>

II FACILITY

FACILITY NAME <i>GENERAL TRANSPORTATION INC</i>		DEALER/FOREMAN/SUPERVISOR <i>JIM HARDGRAVE</i>	
STREET ADDRESS <i>3211 WOOD ST</i>		NEAREST CROSS STREET <i>32ND ST</i>	
CITY <i>OAKLAND</i>		COUNTY <i>ALAMEDA</i>	ZIP <i>94608</i>
MAILING ADDRESS <i>P.O. Box 23734</i>		CITY <i>OAKLAND</i>	STATE <i>CA</i> ZIP <i>94623</i>
PHONE W/AREA CODE <i>415-652-0630</i>	TYPE OF BUSINESS <input type="checkbox"/> 01 GASOLINE STATION <input checked="" type="checkbox"/> 02 OTHER <i>MOTOR CARRIER</i>		
NUMBER OF CONTAINERS <i>2</i>	RURAL AREAS ONLY :	TOWNSHIP	RANGE SECTION

III 24 HOUR EMERGENCY CONTACT PERSON

DAYS: NAME (LAST NAME FIRST) AND PHONE W/AREA CODE <i>HARDGRAVE, JIM 415-652-0628 / 582-1007</i>	NIGHTS: NAME (LAST NAME FIRST) AND PHONE W/AREA CODE <i>McGUIRE, PATRICK 415-634-5162</i>
---	--

COMPLETE THE FOLLOWING ON A SEPARATE FORM FOR EACH CONTAINER

IV DESCRIPTION

A. <input checked="" type="checkbox"/> 01 TANK <input type="checkbox"/> 04 OTHER:	CONTAINER NUMBER <i>1001</i>
B. MANUFACTURER (IF APPROPRIATE): <i>UNKNOWN</i>	YEAR MFG: C. YEAR INSTALLED <i>(UNKNOWN)</i>
D. CONTAINER CAPACITY: <i>8000</i> GALLONS <input type="checkbox"/> UNKNOWN	E. DOES THE CONTAINER STORE: <input type="checkbox"/> 01 WASTE <input checked="" type="checkbox"/> 02 PRODUCT
F. DOES THE CONTAINER STORE MOTOR VEHICLE FUEL OR WASTE OIL? <input checked="" type="checkbox"/> 01 YES <input type="checkbox"/> 02 NO IF YES CHECK APPROPRIATE BOX(ES): <input type="checkbox"/> 01 UNLEADED <input checked="" type="checkbox"/> 02 REGULAR <input type="checkbox"/> 03 PREMIUM <input type="checkbox"/> 04 DIESEL <input type="checkbox"/> 05 WASTE OIL <input type="checkbox"/> 06 OTHER	

V CONTAINER CONSTRUCTION

A. THICKNESS OF PRIMARY CONTAINMENT: <input type="checkbox"/> GAUGE <input type="checkbox"/> INCHES <input type="checkbox"/> CM <input checked="" type="checkbox"/> UNKNOWN
B. <input type="checkbox"/> 01 VAULTED (LOCATED IN AN UNDERGROUND VAULT) <input type="checkbox"/> 02 NON-VAULTED <input checked="" type="checkbox"/> 03 UNKNOWN
C. <input type="checkbox"/> 01 DOUBLE WALLED <input type="checkbox"/> 02 SINGLE WALLED <input type="checkbox"/> 03 LINED <i>UNKNOWN</i>
D. <input type="checkbox"/> 01 CARBON STEEL <input type="checkbox"/> 02 STAINLESS STEEL <input type="checkbox"/> 03 FIBERGLASS <input type="checkbox"/> 04 POLYVINYL CHLORIDE <input type="checkbox"/> 05 CONCRETE <input type="checkbox"/> 06 ALUMINUM <input type="checkbox"/> 07 STEEL CLAD <input type="checkbox"/> 08 BRONZE <input type="checkbox"/> 09 COMPOSITE <input type="checkbox"/> 10 NON-METALLIC <input checked="" type="checkbox"/> 12 UNKNOWN <input type="checkbox"/> 13 OTHER:

CONTAINER CONSTRUCTION

E. 01 RUBBER LINED 02 ALKYD LINING 03 EPOXY LINING 04 PHENOLIC LINING 05 GLASS LINING
 07 UNLINED 08 UNKNOWN 09 OTHER:

F. 01 POLYETHYLENE WRAP 02 VINYL WRAPPING 03 CATHODIC PROTECTION 04 UNKNOWN 05 NONE
 06 TAR OR ASPHALT 09 OTHER:

VI PIPING

A. ABOVEGROUND PIPING: 01 DOUBLE-WALLED PIPE 02 CONCRETE-LINED TRENCH 03 GRAVITY
(CHECK APPROPRIATE BOX(ES)) 04 PRESSURE 05 SUCTION 06 UNKNOWN 07 NONE

B. UNDERGROUND PIPING: 01 DOUBLE-WALLED PIPE 02 CONCRETE-LINED TRENCH 03 GRAVITY
(CHECK APPROPRIATE BOX(ES)) 04 PRESSURE 05 SUCTION 06 UNKNOWN 07 NONE

VII LEAK DETECTION

01 VISUAL 02 STOCK INVENTORY 04 VAPOR SNIFF WELLS 05 SENSOR INSTRUMENT
 06 GROUND WATER MONITORING WELLS 07 PRESSURE TEST 09 NONE 10 OTHER:

VIII CHEMICAL COMPOSITION OF MATERIALS STORED IN UNDERGROUND CONTAINERS

IF YOU CHECKED YES TO IV-F YOU ARE NOT REQUIRED TO COMPLETE THIS SECTION

CURRENTLY STORED	PREVIOUSLY STORED	DELETE	CASH# (IF KNOWN)	CHEMICAL (DO NOT USE COMMERCIAL NAME)
<input type="checkbox"/> 01	<input type="checkbox"/> 02	<input type="checkbox"/> 03		
<input type="checkbox"/> 01	<input type="checkbox"/> 02	<input type="checkbox"/> 03		
<input type="checkbox"/> 01	<input type="checkbox"/> 02	<input type="checkbox"/> 03		
<input type="checkbox"/> 01	<input type="checkbox"/> 02	<input type="checkbox"/> 03		
<input type="checkbox"/> 01	<input type="checkbox"/> 02	<input type="checkbox"/> 03		
<input type="checkbox"/> 01	<input type="checkbox"/> 02	<input type="checkbox"/> 03		
<input type="checkbox"/> 01	<input type="checkbox"/> 02	<input type="checkbox"/> 03		
<input type="checkbox"/> 01	<input type="checkbox"/> 02	<input type="checkbox"/> 03		
<input type="checkbox"/> 01	<input type="checkbox"/> 02	<input type="checkbox"/> 03		
<input type="checkbox"/> 01	<input type="checkbox"/> 02	<input type="checkbox"/> 03		
<input type="checkbox"/> 01	<input type="checkbox"/> 02	<input type="checkbox"/> 03		
<input type="checkbox"/> 01	<input type="checkbox"/> 02	<input type="checkbox"/> 03		

IS CONTAINER LOCATED ON AN AGRICULTURAL FARM? 01 YES 02 NO

THIS FORM HAS BEEN COMPLETED UNDER THE PENALTY OF PERJURY AND, TO THE BEST OF MY KNOWLEDGE, IS TRUE AND CORRECT.

PERSON FILING (SIGNATURE) <i>Ronald James Hardgrave</i>	PHONE W/AREA CODE 415-652-0628
--	-----------------------------------

FOR LOCAL AGENCY USE ONLY

ADMINISTRATING AGENCY		CITY CODE		COUNTY CODE	
CONTACT PERSON			PHONE W/AREA CODE		
DATE OF LAST INSPECTION	IN COMPLIANCE <input type="checkbox"/> 01 YES <input type="checkbox"/> 02 NO	PERMIT APPROVAL DATE	TRANSACTION DATE	LOCAL PERMIT ID #	

STATE ID NUMBER

APPLICATION FOR PERMIT TO OPERATE UNDERGROUND STORAGE TANK

01 NEW PERMIT 05 RENEWED PERMIT 07 TANK CLOSED 09 DELETE FROM FILE (NO FEE)
 02 CONDITIONAL PERMIT 06 AMENDED PERMIT 08 MINOR CHANGE (NO SURCHARGE)

I OWNER

NAME (CORPORATION, INDIVIDUAL OR PUBLIC AGENCY) <i>ESTATE OF JOSEPH STERN'S 90 BANK OF AMERICA ATTN: SUSAN DENNER</i>		PUBLIC AGENCY ONLY <input type="checkbox"/> 01 FED <input type="checkbox"/> 02 STATE <input type="checkbox"/> 03 LOCAL	
STREET ADDRESS <i>PO BOX 37121</i>	CITY <i>SAN FRANCISCO</i>	STATE <i>CA</i>	ZIP <i>94137</i>

II FACILITY

FACILITY NAME <i>GENERAL TRANSPORTATION INC</i>		DEALER/FOREMAN/SUPERVISOR <i>JIM HARDGRAVE</i>	
STREET ADDRESS <i>3211 WOOD ST</i>		NEAREST CROSS STREET <i>32ND ST</i>	
CITY <i>OAKLAND</i>	COUNTY <i>ALAMEDA</i>	ZIP <i>94608</i>	
MAILING ADDRESS <i>PO BOX 83734</i>		CITY <i>OAKLAND</i>	STATE <i>CA</i> ZIP <i>94623</i>
PHONE W/AREA CODE <i>415-652-0628</i>	TYPE OF BUSINESS <input type="checkbox"/> 01 GASOLINE STATION <input checked="" type="checkbox"/> 02 OTHER <i>MOTOR CARRIER</i>		
NUMBER OF CONTAINERS <i>2</i>	RURAL AREAS ONLY :	TOWNSHIP	RANGE SECTION

III 24 HOUR EMERGENCY CONTACT PERSON

DAYS: NAME (LAST NAME FIRST) AND PHONE W/AREA CODE <i>HARDGRAVE, JIM 415-652-0628/582-1007</i>	NIGHTS: NAME (LAST NAME FIRST) AND PHONE W/AREA CODE <i>McGUIRE PATRICK 415-634-5168</i>
---	---

COMPLETE THE FOLLOWING ON A SEPARATE FORM FOR EACH CONTAINER

IV DESCRIPTION

A. <input checked="" type="checkbox"/> 01 TANK <input type="checkbox"/> 04 OTHER:	CONTAINER NUMBER <i>1002</i>		
B. MANUFACTURER (IF APPROPRIATE):	YEAR MFG:	C. YEAR INSTALLED	<input checked="" type="checkbox"/> UNKNOWN
D. CONTAINER CAPACITY: <i>10000</i> GALLONS <input type="checkbox"/> UNKNOWN	E. DOES THE CONTAINER STORE: <input type="checkbox"/> 01 WASTE <input checked="" type="checkbox"/> 02 PRODUCT		
F. DOES THE CONTAINER STORE MOTOR VEHICLE FUEL OR WASTE OIL ? <input type="checkbox"/> 01 YES <input type="checkbox"/> 02 NO IF YES CHECK APPROPRIATE BOX(ES): <input type="checkbox"/> 01 UNLEADED <input type="checkbox"/> 02 REGULAR <input type="checkbox"/> 03 PREMIUM <input checked="" type="checkbox"/> 04 DIESEL <input type="checkbox"/> 05 WASTE OIL <input type="checkbox"/> 06 OTHER			

V CONTAINER CONSTRUCTION

A. THICKNESS OF PRIMARY CONTAINMENT:	<input type="checkbox"/> GAUGE <input type="checkbox"/> INCHES <input type="checkbox"/> CM <input checked="" type="checkbox"/> UNKNOWN
B. <input type="checkbox"/> 01 VAULTED (LOCATED IN AN UNDERGROUND VAULT) <input type="checkbox"/> 02 NON-VAULTED <input checked="" type="checkbox"/> 03 UNKNOWN	
C. <input type="checkbox"/> 01 DOUBLE WALLED <input type="checkbox"/> 02 SINGLE WALLED <input type="checkbox"/> 03 LINED <i>UNKNOWN</i>	
D. <input type="checkbox"/> 01 CARBON STEEL <input type="checkbox"/> 02 STAINLESS STEEL <input type="checkbox"/> 03 FIBERGLASS <input type="checkbox"/> 04 POLYVINYL CHLORIDE <input type="checkbox"/> 05 CONCRETE <input type="checkbox"/> 06 ALUMINUM <input type="checkbox"/> 07 STEEL CLAD <input type="checkbox"/> 08 BRONZE <input type="checkbox"/> 09 COMPOSITE <input type="checkbox"/> 10 NON-METALLIC <input checked="" type="checkbox"/> 12 UNKNOWN <input type="checkbox"/> 13 OTHER:	

CONTAINER CONSTRUCTION

E. 01 RUBBER LINED 02 ALKYD LINING 03 EPOXY LINING 04 PHENOLIC LINING 05 GLASS LINING
 07 UNLINED 08 UNKNOWN 09 OTHER:

F. 01 POLYETHYLENE WRAP 02 VINYL WRAPPING 03 CATHODIC PROTECTION 04 UNKNOWN 05 NONE
 06 TAR OR ASPHALT 09 OTHER:

VI PIPING

A. ABOVEGROUND PIPING: 01 DOUBLE-WALLED PIPE 02 CONCRETE-LINED TRENCH 03 GRAVITY
(CHECK APPROPRIATE BOX(ES)) 04 PRESSURE 05 SUCTION 06 UNKNOWN 07 NONE

B. UNDERGROUND PIPING: 01 DOUBLE-WALLED PIPE 02 CONCRETE-LINED TRENCH 03 GRAVITY
(CHECK APPROPRIATE BOX(ES)) 04 PRESSURE 05 SUCTION 06 UNKNOWN 07 NONE

VII LEAK DETECTION

01 VISUAL 02 STOCK INVENTORY 04 VAPOR SNIFF WELLS 05 SENSOR INSTRUMENT
 06 GROUND WATER MONITORING WELLS 07 PRESSURE TEST 09 NONE 10 OTHER:

VIII CHEMICAL COMPOSITION OF MATERIALS STORED IN UNDERGROUND CONTAINERS

IF YOU CHECKED YES TO IV-F YOU ARE NOT REQUIRED TO COMPLETE THIS SECTION

CURRENTLY STORED	PREVIOUSLY STORED	DELETE	CASH (IF KNOWN)	CHEMICAL (DO NOT USE COMMERCIAL NAME)
<input type="checkbox"/> 01	<input type="checkbox"/> 02	<input type="checkbox"/> 03		
<input type="checkbox"/> 01	<input type="checkbox"/> 02	<input type="checkbox"/> 03		
<input type="checkbox"/> 01	<input type="checkbox"/> 02	<input type="checkbox"/> 03		
<input type="checkbox"/> 01	<input type="checkbox"/> 02	<input type="checkbox"/> 03		
<input type="checkbox"/> 01	<input type="checkbox"/> 02	<input type="checkbox"/> 03		
<input type="checkbox"/> 01	<input type="checkbox"/> 02	<input type="checkbox"/> 03		
<input type="checkbox"/> 01	<input type="checkbox"/> 02	<input type="checkbox"/> 03		
<input type="checkbox"/> 01	<input type="checkbox"/> 02	<input type="checkbox"/> 03		
<input type="checkbox"/> 01	<input type="checkbox"/> 02	<input type="checkbox"/> 03		
<input type="checkbox"/> 01	<input type="checkbox"/> 02	<input type="checkbox"/> 03		
<input type="checkbox"/> 01	<input type="checkbox"/> 02	<input type="checkbox"/> 03		

IS CONTAINER LOCATED ON AN AGRICULTURAL FARM? 01 YES 02 NO

THIS FORM HAS BEEN COMPLETED UNDER THE PENALTY OF PERJURY AND, TO THE BEST OF MY KNOWLEDGE, IS TRUE AND CORRECT.

PERSON FILING (SIGNATURE) <i>Ronald J. Hudgum</i>	PHONE W/AREA CODE 415-652-0628
--	-----------------------------------

FOR LOCAL AGENCY USE ONLY

ADMINISTRATING AGENCY	CITY CODE	COUNTY CODE		
CONTACT PERSON	PHONE W/AREA CODE			
DATE OF LAST INSPECTION	IN COMPLIANCE <input type="checkbox"/> 01 YES <input type="checkbox"/> 02 NO	PERMIT APPROVAL DATE	TRANSACTION DATE	LOCAL PERMIT ID #

UNDERGROUND STORAGE TANK UNAUTHORIZED RELEASE (LEAK) / CONTAMINATION SITE REPORT

EMERGENCY <input type="checkbox"/> YES <input checked="" type="checkbox"/> NO	HAS STATE OFFICE OF EMERGENCY SERVICES REPORT BEEN FILED? <input type="checkbox"/> YES <input checked="" type="checkbox"/> NO	FOR LOCAL AGENCY USE ONLY I HEREBY CERTIFY THAT I AM A DESIGNATED GOVERNMENT EMPLOYEE AND THAT I HAVE REPORTED THIS INFORMATION TO LOCAL OFFICIALS PURSUANT TO SECTION 25180.7 OF THE HEALTH AND SAFETY CODE. SIGNED: <u>Susan Hugo</u> DATE: <u>6/3/92</u>
REPORT DATE <u>05/19/92</u>	CASE #	

REPORTED BY	NAME OF INDIVIDUAL FILING REPORT <u>HENRIETTA LARSON</u>	PHONE <u>(80) 531-7470</u>	SIGNATURE <u>Henrietta Larson</u>	
	REPRESENTING <input type="checkbox"/> OWNER/OPERATOR <input checked="" type="checkbox"/> REGIONAL BOARD <input type="checkbox"/> LOCAL AGENCY <input checked="" type="checkbox"/> OTHER <u>as a life TENANT</u>	COMPANY OR AGENCY NAME		
	ADDRESS <u>5601 LEONA STREET OAKLAND CA 94605</u>			

RESPONSIBLE PARTY	NAME <u>Maybe multiple UNKNOWN</u>	CONTACT PERSON <u>Tenant at site</u>	PHONE ()
	ADDRESS <u>Property owner 1234 5th St</u>		

SITE LOCATION	FACILITY NAME (IF APPLICABLE) <u>GENERAL TRANSPORTATION</u>	OPERATOR	PHONE ()	
	ADDRESS <u>3211 WOOD ST OAKLAND ALAMEDA 94608</u>			
	CROSS STREET <u>32nd</u>			

IMPLEMENTING AGENCIES	LOCAL AGENCY <u>ALAMEDA CO. HEALTH</u>	AGENCY NAME	CONTACT PERSON <u>SUSAN HUGO</u>	PHONE <u>(510) 271-4530</u>
	REGIONAL BOARD <u>SAN FRANCISCO BAY RWQCB (2)</u>		CONTACT PERSON <u>RICH HETT</u>	

SUBSTANCES INVOLVED	(1) <u>PETROLEUM HYDROCARBONS</u>	QUANTITY LOST (GALLONS) <input checked="" type="checkbox"/> UNKNOWN
	(2)	

DISCOVERY/ABATEMENT	DATE DISCOVERED <u>05/13/92</u>	HOW DISCOVERED <input type="checkbox"/> INVENTORY CONTROL <input checked="" type="checkbox"/> SUBSURFACE MONITORING <input type="checkbox"/> NUISANCE CONDITIONS <input type="checkbox"/> TANK TEST <input checked="" type="checkbox"/> TANK REMOVAL <input type="checkbox"/> OTHER	
	DATE DISCHARGE BEGAN <input checked="" type="checkbox"/> UNKNOWN		METHOD USED TO STOP DISCHARGE (CHECK ALL THAT APPLY) <input type="checkbox"/> REMOVE CONTENTS <input type="checkbox"/> REPLACE TANK <input type="checkbox"/> CLOSE TANK <input type="checkbox"/> REPAIR TANK <input type="checkbox"/> REPAIR PIPING <input type="checkbox"/> CHANGE PROCEDURE <input checked="" type="checkbox"/> OTHER <u>REMOVE CONTENTS / REMOVE TANK</u>
	HAS DISCHARGE BEEN STOPPED? <input checked="" type="checkbox"/> YES <input type="checkbox"/> NO IF YES, DATE <u>05/13/92</u>		

SOURCE/CAUSE	SOURCE OF DISCHARGE <input checked="" type="checkbox"/> TANK LEAK <input type="checkbox"/> UNKNOWN <input type="checkbox"/> PIPING LEAK <input type="checkbox"/> OTHER	CAUSE(S) <input type="checkbox"/> OVERFILL <input type="checkbox"/> RUPTURE/FAILURE <input type="checkbox"/> SPILL <input checked="" type="checkbox"/> CORROSION <input type="checkbox"/> UNKNOWN <input type="checkbox"/> OTHER
--------------	--	--

CASE TYPE	CHECK ONE ONLY <input checked="" type="checkbox"/> UNDETERMINED <input type="checkbox"/> SOIL ONLY <input type="checkbox"/> GROUNDWATER <input type="checkbox"/> DRINKING WATER - (CHECK ONLY IF WATER WELLS HAVE ACTUALLY BEEN AFFECTED)
-----------	--

CURRENT STATUS	CHECK ONE ONLY <input checked="" type="checkbox"/> NO ACTION TAKEN <input type="checkbox"/> PRELIMINARY SITE ASSESSMENT WORKPLAN SUBMITTED <input type="checkbox"/> POLLUTION CHARACTERIZATION <input type="checkbox"/> LEAK BEING CONFIRMED <input type="checkbox"/> PRELIMINARY SITE ASSESSMENT UNDERWAY <input type="checkbox"/> POST CLEANUP MONITORING IN PROGRESS <input type="checkbox"/> REMEDIATION PLAN <input type="checkbox"/> CASE CLOSED (CLEANUP COMPLETED OR UNNECESSARY) <input type="checkbox"/> CLEANUP UNDERWAY
----------------	--

REMEDIAL ACTION	CHECK APPROPRIATE ACTION(S) (SEE BACK FOR DETAILS) <input type="checkbox"/> CAP SITE (CD) <input type="checkbox"/> CONTAINMENT BARRIER (CB) <input type="checkbox"/> VACUUM EXTRACT (VE)	<input type="checkbox"/> EXCAVATE & DISPOSE (ED) <input type="checkbox"/> REMOVE FREE PRODUCT (FP) <input type="checkbox"/> ENHANCED BIO DEGRADATION (IT) <input type="checkbox"/> EXCAVATE & TREAT (ET) <input type="checkbox"/> PUMP & TREAT GROUNDWATER (GT) <input type="checkbox"/> REPLACE SUPPLY (RS) <input type="checkbox"/> NO ACTION REQUIRED (NA) <input type="checkbox"/> TREATMENT AT HOOKUP (HU) <input type="checkbox"/> VENT SOIL (VS)	
	<input checked="" type="checkbox"/> OTHER (OT) <u>REMOVE TANKS / PIPING / EXCAVATE SOIL / REMOVE GROUNDWATER</u>		

COMMENTS	25/12/92
----------	----------

Alameda County Health Care Services Agency

Department of Environmental Health

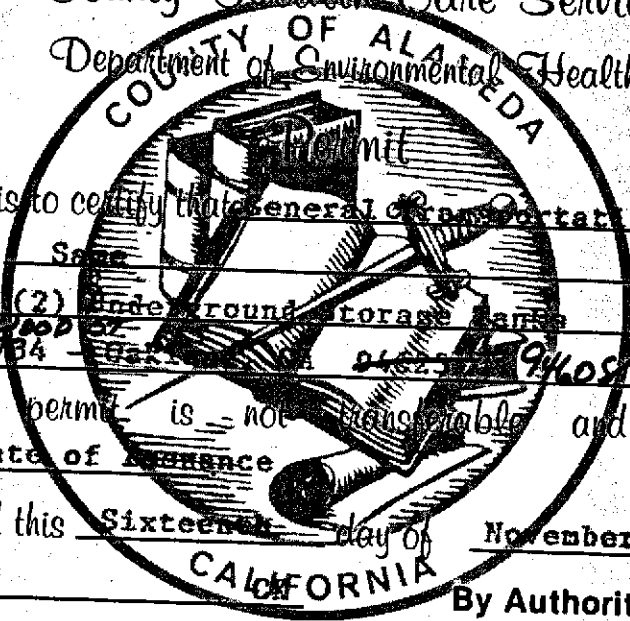

This is to certify that General Transportation Co.
doing business as Same is permitted
to operate a Two (2) underground storage tanks
at P.O. Box 23734 - San Francisco 94108

This permit is not transferable and is good until
6 Months From Date of Issuance

Issued this Sixteenth day of November, 19 88

Sanitarian

By Authority of
County Health Officer

white -env.health
 yellow -facility
 pink -files

ALAMEDA COUNTY, DEPARTMENT OF ENVIRONMENTAL HEALTH
 Hazardous Materials Inspection Form

80 Swan Way, #200
 Oakland, CA 94621
 (415) 271-4320

II, III

Site ID # _____ Site Name GENERAL TRANSPORTATION Today's Date 5/13/92

Site Address 3211 Wood St.

City Oakland Zip 94608 Phone _____

MAX AMT stored > 500 lbs, 55 gal., 200 cft.?

Inspection Categories:

- I. Haz. Mat/Waste GENERATOR/TRANSPORTER
- II. Business Plans, Acute Hazardous Materials
- III. Underground Tanks

11:10 AM - fire dept. requested ACPH to oversee tank removal for them

Calif. Administration Code (CAC) or the Health & Safety Code (HS&C)

Comments: *Cricketon tank number #205701 EPA 5/19/92 manifest # ~~206453~~ 90-1927 07 & UGI's removal*

II.A BUSINESS PLANS (Title 19)

- 1. Immediate Reporting 2703
- 2. Bus. Plan Sids. 25503(b)
- 3. RR Cars > 30 days 25503.7
- 4. Inventory Information 25504(a)
- 5. Inventory Complete 2730
- 6. Emergency Response 25504(b)
- 7. Training 25504(c)
- 8. Deficiency 25505(a)
- 9. Modification 25505(b)

II.B ACUTELY HAZ MATLS

- 10. Registration Form Filed 25533(a)
- 11. Form Complete 25533(b)
- 12. RMPP Contents 25534(c)
- 13. Implement Sch. Req'd? (Y/N)
- 14. OffSite Conseq. Assess. 25524(c)
- 15. Probable Risk Assessment 25534(d)
- 16. Persons Responsible 25534(g)
- 17. Certification 25534(i)
- 18. Exemption Request? (Y/N) 25536(b)
- 19. Trade Secret Requested? 25538

III. UNDERGROUND TANKS (Title 23)

- General
- 1. Permit Application 25284 (H&S)
 - 2. Pipeline Leak Detection 25292 (H&S)
 - 3. Records Maintenance 2712
 - 4. Release Report 2651
 - 5. Closure Plans 2670

- Monitoring for Existing Tanks
- 6. Method
 - 1) Monthly Test
 - 2) Daily Vadose Semi-annual groundwater One time soils
 - 3) Daily Vadose One time soils Annual tank test
 - 4) Monthly Groundwater One time soils
 - 5) Daily Inventory Annual tank testing Cont pipe leak det Vadose/gndwater mon.
 - 6) Daily Inventory Annual tank testing Cont pipe leak det
 - 7) Weekly Tank Gauge Annual tank testing
 - 8) Annual Tank Testing Daily Inventory
 - 9) Other _____

- 7. Precs Tank Test Date: _____ 2643
- 8. Inventory Rec. 2644
- 9. Soil Testing 2646
- 10. Ground Water. 2647

- New Tanks
- 11. Monitor Plan 2632
 - 12. Access. Secure 2634
 - 13. Plans Submit Date: _____ 2711
 - 14. As Built Date: _____ 2635

Quantity	Product	LEL	UEL
1-	8000 G diesel	4%	6%
1-	8000 G gasoline	13%	3.8%
1-	500 G waste oil	6%	3.2%
1-	500 G solvent	6%	13%

Groundwater (approx 6 ft) present - Floating product on top. Strong distribution around the excavation pit. * Gasoline tank - appears to be in good shape - tank was empty & no groundwater inside tank.

Floating product must be skimmed, pumped out then collect groundwater sample before backfilling with clean fill.

* Waste oil tank - appears to be corroded but no obvious holes

* Solvent tank - had lots of holes at bottom. corroded, one end open at rim.

* Diesel tank - wrapped in tar paper - corroded by tar paper coming off the tank. 2 dispenser islands close to bldg.

II, III

Contact: _____

Title: _____

Signature: _____

Inspector: _____

Signature: _____

white -env.health
 yellow -facility
 pink -files

ALAMEDA COUNTY, DEPARTMENT OF ENVIRONMENTAL HEALTH
Hazardous Materials Inspection Form

80 Swan Way, #200
 Oakland, CA 94621
 (415) 271-4320

II, III

Site ID # _____ Site Name GENERAL TRANSPORTATION Today's Date 5/13/92

II.A BUSINESS PLANS (Title 19)

- ___ 1. Immediate Reporting 2703
- ___ 2. Bus. Plan Stds. 25503(b)
- ___ 3. RR Cars > 30 days 25503.7
- ___ 4. Inventory Information 25504(a)
- ___ 5. Inventory Complete 2730
- ___ 6. Emergency Response 25504(b)
- ___ 7. Training 25504(c)
- ___ 8. Deficiency 25505(a)
- ___ 9. Modification 25505(b)

Site Address 3211 Wood Street
 City Oakland Zip 94608 Phone 56

MAX AMT stored > 500 lbs, 55 gal., 200 cft.?

Inspection Categories:

- ___ I. Haz. Mat/Waste GENERATOR/TRANSPORTER
- ___ II. Business Plans, Acute Hazardous Materials
- III. Underground Tanks

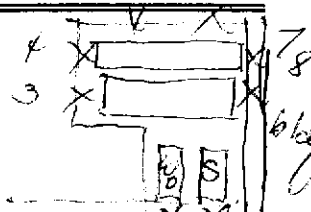

II.B ACUTELY HAZ. MATLS

- ___ 10. Registration Form Filed 25533(a)
- ___ 11. Form Complete 25533(b)
- ___ 12. RMPP Contents 25534(c)
- ___ 13. Implement Sch. Req'd? (Y/N)
- ___ 14. OffSite Conseq. Assess. 25524(c)
- ___ 15. Probable Risk Assessment 25534(d)
- ___ 16. Persons Responsible 25534(g)
- ___ 17. Certification 25534(i)
- ___ 18. Exemption Request? (Y/N) 25536(b)
- ___ 19. Trade Secret Requested? 25538

* Calif. Administration Code (CAC) or the Health & Safety Code (HS&C) 271

III. UNDERGROUND TANKS (Title 23)

- | | |
|-------------------------------|--|
| General | ___ 1. Permit Application 25284 (H&S) |
| | ___ 2. Pipeline Leak Detection 25292 (H&S) |
| | ___ 3. Records Maintenance 2712 |
| | ___ 4. Release Report 2651 |
| | ___ 5. Closure Plans 2670 |
| Monitoring for Existing Tanks | ___ 6. Method |
| | 1) Monthly Test |
| | 2) Daily Vadose |
| | Semi-annual groundwater |
| | One time soils |
| | 3) Daily Vadose |
| | One time soils |
| | Annual tank test |
| | 4) Monthly Groundwater |
| | One time soils |
| 5) Daily Inventory | |
| Annual tank testing | |
| Cont pipe leak det | |
| Vadose/gndwater mon. | |
| 6) Daily Inventory | |
| Annual tank testing | |
| Cont pipe leak det | |
| 7) Weekly Tank Gauge | |
| Annual tank testing | |
| 8) Annual Tank Testing | |
| Daily Inventory | |
| 9) Other _____ | |
| New Tanks | ___ 7. Precs Tank Test 2643 |
| | Date: _____ |
| | ___ 8. Inventory Rec. 2644 |
| | ___ 9. Soil Testing . 2646 |
| | ___ 10. Ground Water. 2647 |
| ___ 11. Monitor Plan 2632 | |
| ___ 12. Access. Secure 2634 | |
| ___ 13. Plans Submit 2711 | |
| Date: _____ | |
| ___ 14. As Built 2635 | |
| Date: _____ | |

page 2
Comments:
 After collecting sidewall samples at the soil/water interface & collecting ground-water sample, can backfill with clean fill only. The soil is unstable & Heavation is close to bldg.
 8 sidewall samples collected at the soil/water interface.

Rev 6/88

II, III

Contact: _____

Title: _____

Signature: _____

Inspector: _____

Signature: _____

white -env.health
yellow -facility
pink -files

ALAMEDA COUNTY, DEPARTMENT OF ENVIRONMENTAL HEALTH
Hazardous Materials Inspection Form

80 Swan Way, #200
Oakland, CA 94621
(415) 271-4320

II, III

Site ID # _____ Site Name GENERAL TRANSPORTATION Today's date 5/13/92

Site Address 3211 Wood St.

City Oakland Zip 94608 Phone _____

MAX AMT stored > 500 lbs, 55 gal., 200 cft.?

Inspection Categories:

- I. Haz. Mat/Waste GENERATOR/TRANSPORTER
- II. Business Plans, Acute Hazardous Materials
- III. Underground Tanks

11:10 AM - fire dept. requested ACPH to oversee tank removal for them

Calif. Administration Code (CAC) or the Health & Safety Code (HS&C)

Comments: *Cricketon tank number # 205701 2/19/92
manifest # ~~205701~~ 90-1927-07
4 UGIS removed*

	LEL	UCL
1- 8000 G diesel	4%	6%
1- 8000 G gasoline	13%	3.8%
1- 500 G waste oil	6%	3.2%
1- 500 G solvent	6%	13%

*Groundwater (approx 6 ft.) present - Floating product on top. Strong discoloration around the excavation pit. * Gasoline tank - appears to be in good shape - tank was empty & no groundwater inside tank. Floating product must be skimmed, pumped out then collect groundwater sample before backfilling with clean fill.*

** Waste oil tank - appears to be corroded but no obvious holes*

** Solvent tank - had lots of holes at bottom corroded, one end open at rim.*

** Diesel tank - wrapped in tar paper - corroded by tar paper coming off the tank. 2 dispenser island - close to bldg.*

II.A BUSINESS PLANS (Title 19)

- 1. Immediate Reporting 2703
- 2. Bus. Plan Stds. 25503(b)
- 3. RR Cars > 30 days 25503.7
- 4. Inventory Information 25504(a)
- 5. Inventory Complete 2730
- 6. Emergency Response 25504(b)
- 7. Training 25504(c)
- 8. Deficiency 25505(a)
- 9. Modification 25505(b)

II.B ACUTELY HAZ. MATLS

- 10. Registration Form Filed 25533(a)
- 11. Form Complete 25533(b)
- 12. RMPP Contents 25534(c)
- 13. Implement Sch. Req'd? (Y/N)
- 14. OffSite Conseq. Assess. 25524(c)
- 15. Probable Risk Assessment 25534(d)
- 16. Persons Responsible 25534(g)
- 17. Certification 25534(i)
- 18. Exemption Request? (Y/N) 25536(b)
- 19. Trade Secret Requested? 25538

III. UNDERGROUND TANKS (Title 23)

- General
- 1. Permit Application 25284 (H&S)
 - 2. Pipeline Leak Detection 25292 (H&S)
 - 3. Records Maintenance 2712
 - 4. Release Report 2651
 - 5. Closure Plans 2670

- Monitoring for Existing Tanks
- 6. Method
 - 1) Monthly Test
 - 2) Daily Vadose Semi-annual groundwater One time soils
 - 3) Daily Vadose One time soils Annual tank test
 - 4) Monthly Gndwater One time soils
 - 5) Daily Inventory Annual tank testing Cont pipe leak det Vadose/gndwater mon.
 - 6) Daily Inventory Annual tank testing Cont pipe leak det
 - 7) Weekly Tank Gauge Annual tank testing
 - 8) Annual Tank Testing Daily Inventory
 - 9) Other _____

- 7. Precs Tank Test Date: _____ 2643
- 8. Inventory Rec. 2644
- 9. Soil Testing 2646
- 10. Ground Water. 2647

- New Tanks
- 11. Monitor Plan 2632
 - 12. Access. Secure 2634
 - 13. Plans Submit Date: _____ 2711
 - 14. As Built Date: _____ 2635

Rev 8/88

II, III

Contact: _____

Title: _____

Signature: _____

Inspector: _____

Signature: _____

white -env.health
 yellow -facility
 pink -files

ALAMEDA COUNTY, DEPARTMENT OF ENVIRONMENTAL HEALTH

80 Swan Way, #200
 Oakland, CA 94621
 (415) 271-4320

Hazardous Materials Inspection Form

II, III

Site ID # _____ Site Name GENERAL TRANSPORTATION Today's Date 5/13/92

Site Address 3211 Wood Street

City Oakland Zip 94608 Phone 56

MAX AMT stored > 500 lbs, 55 gal., 200 cft.?

Inspection Categories:

- I. Haz. Mat/Waste GENERATOR/TRANSPORTER
- II. Business Plans, Acute Hazardous Materials
- III. Underground Tanks

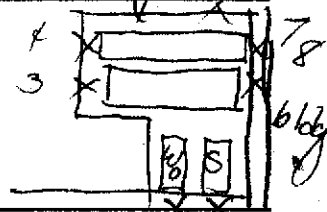

Calif. Administration Code (CAC) or the Health & Safety Code (HS&C) 27

II.A BUSINESS PLANS (Title 19)

- 1. Immediate Reporting 2703
- 2. Bus. Plan Stds. 25503(b)
- 3. RR Cars > 30 days 25503.7
- 4. Inventory Information 25504(a)
- 5. Inventory Complete 2730
- 6. Emergency Response 25504(b)
- 7. Training 25504(c)
- 8. Deficiency 25505(a)
- 9. Modification 25505(b)

II.B ACUTELY HAZ. MATLS

- 10. Registration Form Filed 25533(a)
- 11. Form Complete 25533(b)
- 12. RMPP Contents 25534(c)
- 13. Implement Sch. Req'd? (Y/N)
- 14. OffSite Conseq. Assess. 25524(c)
- 15. Probable Risk Assessment 25534(d)
- 16. Persons Responsible 25534(g)
- 17. Certification 25534(f)
- 18. Exemption Request? (Y/N) 25536(b)
- 19. Trade Secret Requested? 25538

III. UNDERGROUND TANKS (Title 23)

- General**
- 1. Permit Application 25284 (H&S)
 - 2. Pipeline Leak Detection 25292 (H&S)
 - 3. Records Maintenance 2712
 - 4. Release Report 2651
 - 5. Closure Plans 2670
- Monitoring for Existing Tanks**
- 6. Method
 - 1) Monthly Test
 - 2) Daily Vadose Semi-annual groundwater One time soils
 - 3) Daily Vadose One time soils Annual tank test
 - 4) Monthly Gndwater One time soils
 - 5) Daily Inventory Annual tank testing Cont pipe leak det Vadose/gndwater mon.
 - 6) Daily Inventory Annual tank testing Cont pipe leak det
 - 7) Weekly Tank Gauge Annual tank testing
 - 8) Annual Tank Testing Daily Inventory
 - 9) Other _____
- New Tanks**
- 7. Precis Tank Test Date: _____ 2643
 - 8. Inventory Rec. 2644
 - 9. Soil Testing 2646
 - 10. Ground Water. 2647
 - 11. Monitor Plan 2632
 - 12. Access. Secure 2634
 - 13. Plans Submit Date: _____ 2711
 - 14. As Built Date: _____ 2635

Page 2
Comments:
 After collecting sidewall sample at the soil/water interface & collecting ground-water sample, can backfill with clean fill only. The soil is unstable & Heavation is close to bldg.
 8 sidewall samples collected at the soil/water interface.

Rev 6/88

II, III

Contact: _____
 Title: _____ Inspector: _____
 Signature: _____ Signature: _____

5/4/93

STID 4074

General Transportation

3211 Wood St Oakland 94608

5-13-92

4 UGTs removed 1-8000 G diesel - corroded
1-8000 G gasoline - corroded
not listed 1-500 G waste oil - corroded
1-500 G solvent - had lots of holes

~~Storage tanks~~ abused. Groundwater (4 ft bgs)
8 sidewall samples collected at soil/H₂O interface

5-19-92

ULR filed

9-2-92

Rec'd Report fr. Mark Cederberg
prepared by EOA, Inc. dated 6/1/92
(Cederberg, Olivieri & Assoc.)

12,000 gal. water dispersed

groundwater - 3 1/2 ft; 8,000 gal tank base = 11.5 ft
smaller tanks (500 G) base - 7.5 ft

Highest conc. in soil = 26,000 ppm TPH d,

5,100 ppm TPH gasoline
near bldg.

1.4 ppm B, 0.96 ppm toluene, 4.9 ppm E
8.7 ppm X

Groundwater → 12,000 ppb TPH d

190 ppb TPH gasoline

* Manifest for 4 tanks submitted
no records of stockpiled soil disposal

H₂O Samples
 12,000 ppb TPHd
 190 ppb TPHg
 ND for BTEX
 Pb = 23.6 ppb
 Action = 50 ppb
 TOG = not tested

ND = B&T
 1.2 ppm E
 7.4 ppm X
 26,000 ppm TPHd
 8.7 ppm X
 4.9 ppm G
 0.96 ppm T
 1.4 ppm B
 5100 ppm TPHg

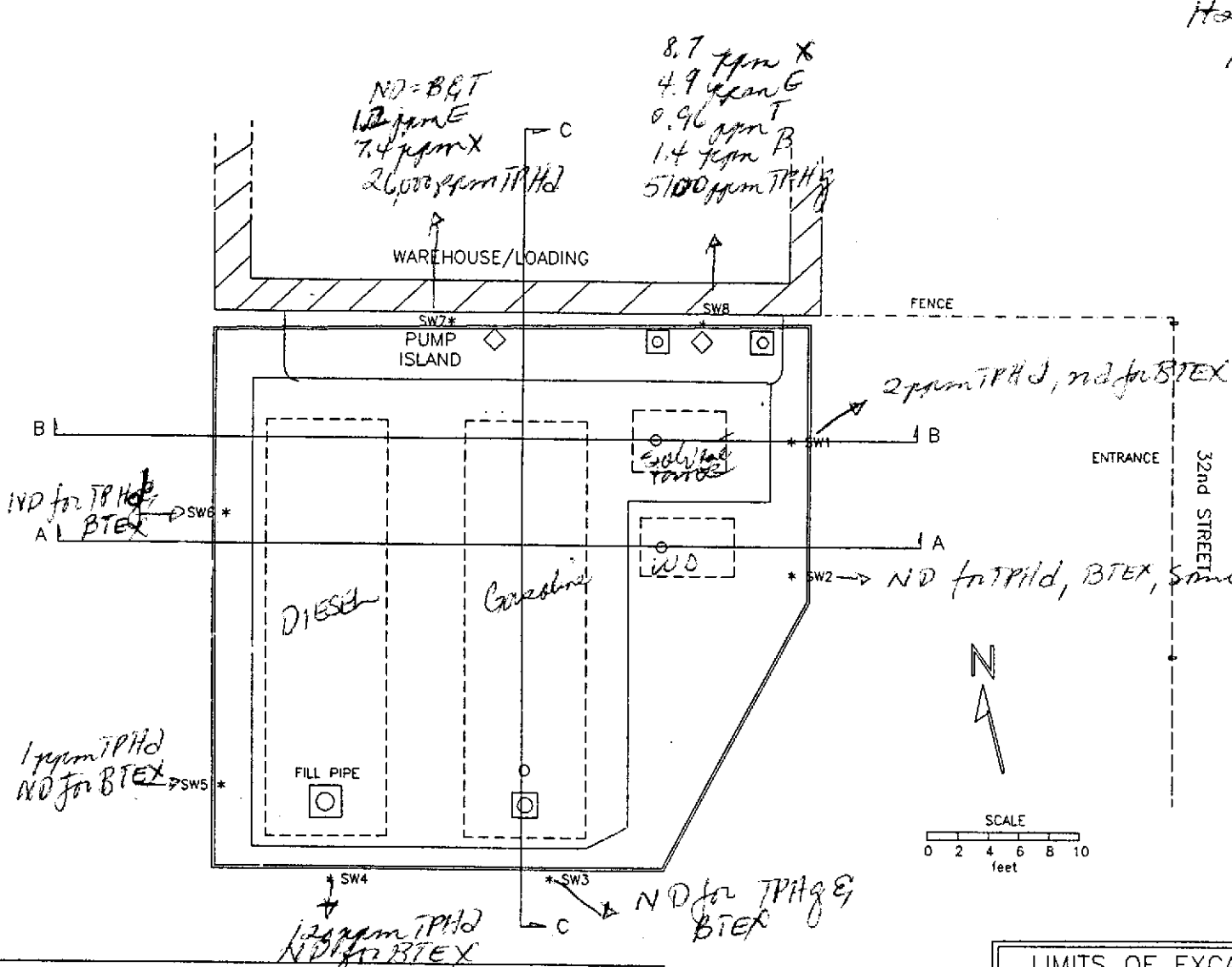

2 ppm TPHd, nd for BTEX

ND for TPHd, BTEX, some metals

ND for TPHd, BTEX

1 ppm TPHd
 ND for BTEX

12 ppm TPHd
 ND for BTEX

Stockpiled Soil
 highest conc.
 TPHd = 2300 ppb
 TPHg = 94 ppb
 B = 22 ppb
 T = 33 ppb
 E = 170 ppb
 X = 720 ppb

- NOTES:
 GROUNDWATER ENCOUNTERED AT A DEPTH OF 3.5' BELOW GROUND SURFACE.
- (1) TOP OF EXCAVATION
 - (2) BOTTOM OF EXCAVATION
 - (3) FORMER UST LOCATIONS
 - (4) SIDEWALL SAMPLE LOCATION

LIMITS OF EXCAVATION AND SIDEWALL
 SAMPLE LOCATIONS Pb = 7.4 ppb
 3211 WOOD ST. TOG = 9.20 ppb
 OAKLAND, CA 94608

EOA, Inc.	KX02PLAN.SKD	REV: 1	FIGURE
	DRAWN BY: PT	6/3/92	3



5/13/92

5/13/92 02216319174-8
3211 Wood St. Oakland 94608
Solvent tank - SPG



5/13/92 02216319174-8
3211 Wood St. Oak. 94608
800G. gasoline tank

EOA, Inc.

Eisenberg, Olivieri, & Associates
Environmental and Public Health Engineering
FAX Number (510) 832-2856

FACSIMILE TRANSMITTAL SHEET

Date: 5/4/92

To: SUSAN HUGO

ALAMEDA CO. - ENVIR. HEALTH

Fax#: 569-4757

From: SIM CROWLEY

Project: 3211 WOOD CLOSURE (UST.) KX02

Pages: 3 (including this transmittal)

Comments:

DECON WILL FAX COPIES OF THEIR CERTIFICATES
TODAY.

ANY QUESTIONS, PLEASE CALL.

Jim

COMPLETION OF TRAINING OSHA - SARA

JAMES S. CROWLEY

Has Met The 8 Hour Refresher Training Requirement Under OSHA
Standard, 29CFR1910.120 Hazardous Waste Operations And
Emergency Response

ACKNOWLEDGEMENT

Occupational Health & Safety Group, Inc.

January 9, 1992

DATE

COMPLETION OF TRAINING OSHA - SARA

RAYMOND GOEBEL

Has Met The 8 Hour Refresher Training Requirement Under OSHA
Standard, 29CFR1910.120 Hazardous Waste Operations And
Emergency Response

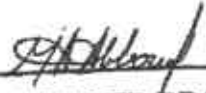
ACKNOWLEDGEMENT

Occupational Health & Safety Group, Inc.

January 9, 1992

DATE

DECON

FAX TRANSMISSION

DATE:

5/4/92

TIME:

1545

TOTAL NUMBER OF PAGES INCLUDING COVER:

4

FROM:

Susan Delaney
 DECON Environmental Services, Inc.
 26102 Eden Landing Road, Suite 4
 Hayward, California 94545
 (510) 732-6444
 FAX (510) 782-8584

ATTN:

Ms. Susan Hugo

COMPANY:

Alameda Co Health

FAX NUMBER:

(510) 569-4757

CONFIRMATION NUMBER:

(510) 271-4320

COMMENTS:

DEAR Ms. Hugo,
 Attached are certificates for refresher course
 of SARA training for employees we plan to
 have on site for Tank Removal.

The jobsite address is 3211 Wood St.,
 Oakland, CA. The consultant ~~is~~ we are
 working for is (EOA)

Please call if there are any questions.

Thx
 Susan D.

Certificate of Training

This certifies that

Agustin Guerrero

has successfully completed the training
program requirements for

8 hr. Haz Mat Refresher



Awarded on this 6th day of March 1992

Richard Kehr Jr.