

*Rec'd from
Reinhard Ruhmke
10/10/91 meeting*



Miller Environmental Company, Inc.

Engineering • Geology • Construction

~~September 24, 1991~~

Department of Environmental Health
Hazardous Materials Division
80 Swan Way, Room 200
Oakland, CA 94621

REINHARD RUHMKE

Project Geologist

385 Pittsburg Avenue • Richmond, CA 94801
Tel: (415) 233-9000 • Fax: (415) 233-2509 • CA License A-592360

Attn: Mr. Gil Wistar

Re: California Linen Rental Co., 989 41st Street,
Oakland, CA

Dear Mr. Wistar:

Enclosed are the laboratory results for the quarterly sampling interval for the above-mentioned site. This latest sampling episode is a continuation of the quarterly monitoring requirements recommended by Alameda County Health Care Services Agency (ACHCSA) in their letter dated 04/15/91. Also included in this report is the work are details regarding the proper abandonment of monitoring well MW3. ACHCSA agreed with Miller Environmental Company's recommendation to properly abandon ground water monitoring well MW3.

Ground Water Monitoring Results

Prior to well sampling, a visual observation for floating product was performed using a clear teflon bailer. No free product was observed in any of the monitoring wells. For ease of reference, a summary of laboratory results is presented in Table 1:

TABLE 1
Summary of Laboratory Results

Well #	Date	TPH gas	TPH dsl	TPH w.o.	B	T	E	X
MW1	10/02/89	70	0.61	ND	2.8	2.4	2.3	4.8
	02/20/90	73	2.2	3	7.5	5.9	0.68	5.3
	07/25/90	34	ND	1	2.0	0.67	0.12	1.5
	10/23/90	50	1.1	ND	3.3	4.0	4.2	4.7
	01/28/91	99	1.7	3	4.4	7.4	1.8	8.6
	06/05/91	23	0.56	ND	2.0	1.2	0.64	2.5
	08/15/91	59	3.5	3	3.8	5.5	1.1	4.8

California Linen - Quarter Sampling Results - 09/24/91

Table 1 cont'd

MW2	10/02/89	ND	ND	ND	ND	ND	ND	ND
	02/20/90	ND	ND	ND	ND	ND	ND	ND
	07/25/90	ND	ND	ND	ND	ND	ND	ND
	10/23/90	ND	ND	ND	ND	ND	ND	ND
	01/28/91	ND	ND	ND	ND	ND	ND	ND
	06/05/91	ND	ND	ND	ND	ND	ND	ND
	08/15/91	ND	ND	ND	ND	ND	ND	ND

a) all results are expressed in milligrams per liter (mg/L) which is equivalent to parts per million (ppm). *blank 0.11*

b) Laboratory note - ~~Blank was not subtracted from sample value.~~ Blank was not subtracted from sample value. Due to limited sample volume, re-extraction was not possible, and blank must be extracted with sample. The Method Blank (MB) monitors the level of contamination introduced by reagents or glassware. Since the MB was greater than the level of contamination detected, the analysis for TPH/diesel was probably ND.

Water level readings were collected. Table 2 is a summary of ground water elevations.

TABLE 2
Summary of Ground Water Elevations

	MW1	MW2
10/11/89	46.19	44.81
11/13/89	45.85	44.91
12/14/89	45.86	44.97
02/20/90	46.53	45.35
03/22/90	46.55	45.17
04/23/90	45.81	44.99
07/25/90	45.68	44.88
08/22/90	46.34	44.51
09/25/90	46.20	44.53
10/23/90	45.68	44.64
01/28/91	45.34	44.46
06/05/91	45.54	44.21
08/15/91	45.19	44.52

a) elevations are given in feet above mean sea level (MSL).

California Linen - Quarter Sampling Results - 09/24/91

Well Destruction

Following approval of the necessary permits from Alameda County Water Conservation and Flood Control District and the City of Oakland, monitoring well MW3 (Figure 1) was destroyed in accordance with Alameda County - Zone 7 minimum requirements as follows:

On July 19, 1991 monitoring well MW3 was overdrilled and the casing, seal, and gravel pack were removed to the bottom of the boring. Using a tremie pipe, the hole was grouted to within approximately 2-inches of grade level and asphalt patching was placed at the surface.

MEC considers ground water monitoring well MW3 to be properly abandoned as of 7/19/91. MEC also requests that "no further action" be taken in regards to the former tank located in the sidewalk area on 41st Street.

Future Work

Levels of benzene and TPH as gasoline have not diminished in monitoring well MW1 during the one and a half years of quarterly monitoring. Therefore, MEC recommends initiating a ground water remediation program in the vicinity of MW1. However, prior to initiation of such a program, a workplan will be submitted to ACHCSA outlining the scope of work.

If you have any questions please do not hesitate to call me.

Sincerely,
MILLER ENVIRONMENTAL COMPANY

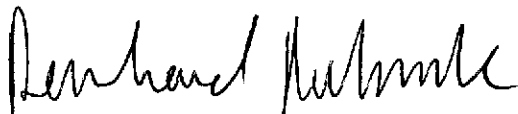

Reinhard Ruhmke
Project Geologist

Enc: Laboratory results, permits

cc: RWQCB
Joel Pitney - California Linen
file

FIGURE 1 SITE PLAN - CALIFORNIA LINEN

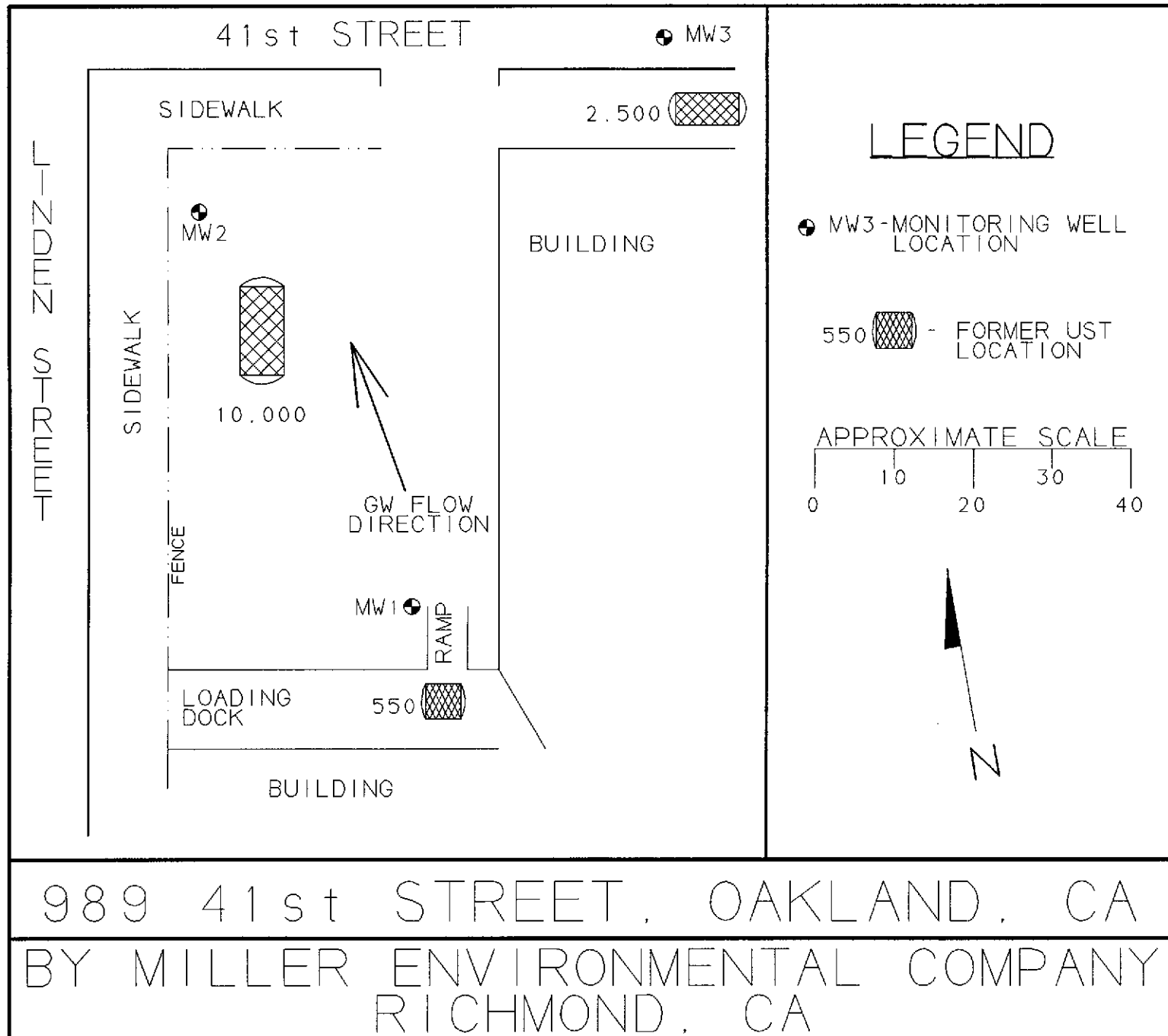



3700 Lakeville Highway, Petaluma, CA 94954
P.O. Box 808024, Petaluma, CA 94975-8024
Telephone: (707) 763-8245
FAX (707) 763-4065

Reinhard Ruhmke
Miller Environmental Co.
Environmental Engineering
385 Pittsburg Ave
Richmond, CA 94801

Client Code: MIEC1
Survey #
California Linen
Project/Release # 11108

Page 1

L A B O R A T O R Y R E S U L T S

Date Collected: 08/15/91
Date Extracted: 08/26/91
Date Analyzed: 08/26/91

Laboratory Job No.: 914428
Date Received: 08/16/91
Date Reported: 09/11/91

ASSAY: TOTAL RECOVERABLE PETROLEUM HYDROCARBONS (EPA 418.1)
MATRIX: WATER

LABNO	SMPLNO-ID	TRPH mg/L	DET. LIM. mg/L
30673	MW1	3.0	0.6
30674	MW2	ND	0.6
30675	MB	ND	0.6
30676	MBS	6.8	0.6
30677	MX	ND	0.6
30678	MS	7.0	0.6
30679	MSD	7.0	0.6

NOTE: MBS, MS AND MSD WERE SPIKED AT 8.3 mg/L.

THIS REPORT HAS BEEN REVIEWED
AND APPROVED FOR RELEASE.

DUF



3700 Lakeville Highway, Petaluma, CA 94954
P.O. Box 808024, Petaluma, CA 94975-8024
Telephone: (707) 763-8245
FAX (707) 763-4065

Page 2

L A B O R A T O R Y R E S U L T S

Date Collected: 08/15/91
Date Extracted: 08/22/91
Date Analyzed: 09/04/91

Laboratory Job No.: 914428
Date Received: 08/16/91
Date Reported: 09/11/91

ASSAY: TPH/DIESEL (EPA 8015)
MATRIX: WATER

LAB NUMBER	SAMPLE NUMBER	RESULTS mg/L	DET.LIM. mg/L
30673	MW1 DIESEL	3.50	0.50
30674	MW2 DIESEL	0.05	0.05
30675	MB DIESEL	0.11	0.05
30676	MBS DIESEL	0.73	0.05
30677	MX DIESEL	0.06	0.05
30678	MS DIESEL	0.81	0.05
30679	MSD DIESEL	0.98	0.05

NOTE: MS, MSD AND MB WERE SPIKED AT 0.83 mg/L.

NOTE: METHOD BLANK CONTAINED 0.11 mg/L DIESEL. BLANK WAS NOT SUBTRACTED FROM SAMPLE VALUE. DUE TO LIMITED SAMPLE VOLUME, RE-EXTRACTION WAS NOT POSSIBLE, AND BLANK MUST BE EXTRACTED WITH SAMPLE.

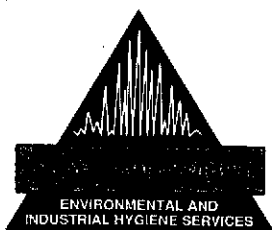

3700 Lakeville Highway, Petaluma, CA 94954
P.O. Box 808024, Petaluma, CA 94975-8024
Telephone: (707) 763-8245
FAX (707) 763-4065

Page 3

L A B O R A T O R Y R E S U L T S

Date Collected: 08/15/91
Date Extracted: 08/21/91
Date Analyzed: 08/21/91

Laboratory Job No.: 914428
Date Received: 08/16/91
Date Reported: 09/11/91

ASSAY: TPH/GASOLINE (EPA 5030/MQD.8015)
MATRIX: LIQUID

LABNO SMPLNO-ID	RESULTS mg/L	DET. LIM. mg/L
30673 MW1 GASOLINE	59.0	10.0
30674 MW2 GASOLINE	<0.05	0.05
30675 MB GASOLINE	<0.05	0.05
30676 MBS GASOLINE	0.82	0.05
30677 MX GASOLINE	<0.05	0.05
30678 MS GASOLINE	0.92	0.05
30679 MSD GASOLINE	0.88	0.05

NOTE: MBS, MS AND MSD WERE SPIKED AT 0.80 mg/L.



3700 Lakeville Highway, Petaluma, CA 94954
 P.O. Box 808024, Petaluma, CA 94975-8024
 Telephone: (707) 763-8245
 FAX (707) 763-4065

L A B O R A T O R Y R E S U L T S

Date Collected: 08/15/91
 Date Extracted: 08/21/91
 Date Analyzed: 08/21/91

Laboratory Job No.: 914428
 Date Received: 08/16/91
 Date Reported: 09/11/91

ASSAY: BTEX (EPA 5030/MOD.8020)
 MATRIX: LIQUID

LABNO SMPLNO-ID	RESULTS mg/L	DET. LIM. mg/L
30673 MW1		
BENZENE	3.8	0.1
TOLUENE	5.5	0.1
ETHYLBENZENE	1.1	0.1
XYLENES	4.8	0.1
30674 MW2		
BENZENE	<0.0005	0.0005
TOLUENE	<0.0005	0.0005
ETHYLBENZENE	<0.0005	0.0005
XYLENES	<0.0005	0.0005
30675 MB		
BENZENE	<0.0005	0.0005
TOLUENE	<0.0005	0.0005
ETHYLBENZENE	<0.0005	0.0005
XYLENES	<0.0005	0.0005
30676 MBS		
BENZENE	0.0099	0.0005
TOLUENE	0.0099	0.0005
ETHYLBENZENE	0.010	0.0005
XYLENES	0.031	0.0005



3700 Lakeville Highway, Petaluma, CA 94954
P.O. Box 808024, Petaluma, CA 94975-8024
Telephone: (707) 763-8245
FAX (707) 763-4065

LABORATORY RESULTS

Page 5

Laboratory Job No.: 914428

ASSAY: BTEX (EPA 5030/MOD.8020)
MATRIX: LIQUID

LABNO SMPLNO-ID	RESULTS mg/L	DET. LIM. mg/L
30677 MX		
BENZENE	<0.0005	0.0005
TOLUENE	<0.0005	0.0005
ETHYLBENZENE	<0.0005	0.0005
XYLENES	<0.0005	0.0005
30678 MS		
BENZENE	0.0055	0.0005
TOLUENE	0.0055	0.0005
ETHYLBENZENE	0.0057	0.0005
XYLENES	0.016	0.0005
30679 MSD		
BENZENE	0.0053	0.0005
TOLUENE	0.0059	0.0005
ETHYLBENZENE	0.0054	0.0005
XYLENES	0.017	0.0005

NOTE: MBS WAS SPIKED AT 0.010 mg/L FOR ALL ANALYTES EXCEPT FOR XYLENES WHICH WERE SPIKED AT 0.030 mg/L. MS AND MSD WERE SPIKED AT 0.0050 mg/L FOR ALL ANALYTES EXCEPT FOR XYLENES WHICH WERE SPIKED AT 0.015 mg/L.



3700 Lakeville Highway, Petaluma, CA 94954
P.O. Box 808024, Petaluma, CA 94975-8024
Telephone: (707) 763-8245
FAX (707) 763-4065

RECEIVED

SEP 1 1994

LABORATORY SERVICES

QUALITY CONTROL REPORT

In order to provide you with the means of assessing the quality of the data in our report, **D&M Laboratories** reports the results of Quality Control samples analyzed with your samples.

The Quality Control samples provide the following QC information:

The Method Blank (**MB**) monitors the level of contamination introduced by reagents or glassware. A minimum of one **MB** is run per batch of 20 samples or less.

The Method Blank Spike (**MBS**) measures the accuracy of analytical techniques and is not subject to matrix effects. A minimum of one **MBS** is run per batch of 20 samples or less.

The Matrix Spike (**MS**) measures the accuracy of the method for a matrix type. Due to the high variability within matrix types and the necessity of batching samples from varied sources, matrix spike information from one sample is not necessarily relevant to other samples on the batch. A minimum of two matrix spikes, **MS** and **MSD**, are run per batch of 20 samples or less. The sample selected for the matrix spike is designated **MX**.

The Matrix Spike Duplicate (**MSD**), along with the **MS**, is used to monitor the precision (**RPD**) of the method and to indicate possible non homogeneity of the sample matrix.

Equations used for determining percent recovery and relative percent difference (**RPD**) are as follows:

$$\text{MBS \% Recovery} = \text{MBS result} / \text{MBS spike level} \times 100$$

$$\text{MS \% Recovery} = (\text{MS} - \text{sample}) / \text{MS spike level} \times 100$$

$$\text{RPD} = | \text{MS} - \text{MSD} | / ((\text{MS} + \text{MSD}) / 2) \times 100$$

We continue to strive to improve the quality of service to our clients. We welcome any questions or comments you may have about this information, or about **D&M Laboratories** in general. Please contact a Project Manager for further information.



3700 Lakeville Highway, Petaluma, CA 94952
P.O. Box 808024, Petaluma, CA, 94975-8024
Telephone: (707)763-8245 FAX: (707)763-4065

SAMPLE CHAIN OF CUSTODY / WORK ORDER

Client's Name MEC Phone 415-233-9068

Address 385 Pittsburg Ave.
City, State, Zip Richmond, CA 94801

Client's or Representative's Signature [Signature]
(signature authorizes the work and terms listed below)

All samples remain the property of the client who is responsible for disposal. A disposal fee may be imposed if client fails to pick up samples.

PROJ. NO.		PROJECT NAME		NO. OF CONTAINERS			REMARKS	LAB USE ONLY LAB NO.			
11108		California Linen									
SAMPLERS (Signature)		STATION LOCATION									
Karin Reinholdt				TRPH TPH GAS/GTEX TPH Diesel							
STA. NO.	DATE	TIME	COMP				GRAB				
1	8/5	14:52	X					MW1	4		Normal TAT
2	8/6	13:28	X		MW2	4					

RECEIVED
 O&M LABS
 15th AUG 16 PM 3:55

Relinquished by: (Signature) <u>[Signature]</u>	DATE <u>8/16/01</u>	TIME <u>2:45</u>	Received by: (Signature) <u>[Signature]</u>	General Remarks: <u>Agreement 1076</u>
Relinquished by: (Signature) <u>[Signature]</u>	DATE	TIME	Received by: (Signature) <u>[Signature]</u>	
Relinquished by: (Signature)	DATE	TIME	Received by: (Signature)	



RECEIVED
DEC - 6 1989

ALAMEDA COUNTY FLOOD CONTROL AND WATER CONSERVATION DISTRICT
5997 PARKSIDE DRIVE PLEASANTON, CALIFORNIA 94566 (415) 484-2600

GROUNDWATER PROTECTION ORDINANCE PERMIT APPLICATION

FOR APPLICANT TO COMPLETE

FOR OFFICE USE

(1) LOCATION OF PROJECT California Linen Rental
989 41st Street
Oakland, CA

PERMIT NUMBER 91397
LOCATION NUMBER 1S/4W 23E1

(2) CLIENT
Name California Linen Rental
Address 989 41st Street Phone 653-6300
City Oakland, CA Zip 94608

PERMIT CONDITIONS

Circled Permit Requirements Apply

(3) APPLICANT
Name Miller Environmental Company
Address 385 Pittsburg Avenue Phone 232-9068
City Richmond, CA Zip 94801

A. GENERAL

1. A permit application should be submitted so as to arrive at the Zone 7 office five days prior to proposed starting date.
2. Submit to Zone 7 within 60 days after completion of permitted work the original Department of Water Resources Water Well Drillers Report or equivalent for well projects, or drilling log and location sketch for geotechnical projects.
3. Permit is void if project not begun within 90 days of approval date.

(4) DESCRIPTION OF PROJECT
Water Well Construction Geotechnical Investigation
Cathodic Protection General
Well Destruction Contamination
MW3

B. WATER WELLS, INCLUDING PIEZOMETERS

1. Minimum surface seal thickness is two inches of cement grout placed by tremie.
2. Minimum seal depth is 50 feet for municipal and industrial wells or 20 feet for domestic, irrigation, and monitoring wells unless a lesser depth is specially approved.

(5) PROPOSED WATER WELL USE
Domestic Industrial Irrigation
Municipal Monitoring Other

C. GEOTECHNICAL. Backfill bore hole with compacted cuttings or heavy bentonite and upper two feet with compacted material. In areas of known or suspected contamination, tremied cement grout shall be used in place of compacted cuttings.

(6) PROPOSED CONSTRUCTION
Drilling Method:
Mud Rotary Air Rotary Auger
Cable Other

D. CATHODIC. Fill hole above anode zone with concrete placed by tremie.

DRILLER'S LICENSE NO. 604987

E. WELL DESTRUCTION. See attached.

WELL PROJECTS
Drill Hole Diameter 12 in. Maximum Depth 20 ft.
Casing Diameter 4 in. Number 1
Surface Seal Depth ft.
1 monitoring well - MW3

GEOTECHNICAL PROJECTS
Number of Borings Maximum Depth ft.
Hole Diameter in.

(7) ESTIMATED STARTING DATE 7/19/91
ESTIMATED COMPLETION DATE 7/19/91

(8) I hereby agree to comply with all requirements of this permit and Alameda County Ordinance No. 73-68.

Approved Wyman Hong Date 16 Jul 91
Wyman Hong

APPLICANT'S SIGNATURE Richard Lubinski Date 7/19/91

RECEIVED

JUL 19 1991

MILLER ENVIRONMENTAL CO.



ALAMEDA COUNTY FLOOD CONTROL AND WATER CONSERVATION DISTRICT

5997 PARKSIDE DRIVE

PLEASANTON, CALIFORNIA 94588

(415) 484-2600

18 July 1991

Miller Environmental Company
385 Pittsburg Avenue
Richmond, CA 94801

Gentlemen:

Enclosed is Drilling permit 91397 for the destruction of well 1S/4W 23E1 at 989 - 41st Street in Oakland for California Linen Rental.

Please note that permit condition A-2 requires that a well destruction report be submitted after completion of the work. The report should include a description of methods and materials used to destroy the well, location sketch, date of destruction, and permit number.

If you have any questions, please contact Wyman Hong or me at 484-2600.

Very truly yours,

Craig A. Mayfield

Craig A. Mayfield
Water Resources Engineer

WH:mm
Enc.

RECEIVED

JUL 19 1991

MILLER ENVIRONMENTAL CO. 18 July 1991

ZONE 7
WATER RESOURCES ENGINEERING
GROUNDWATER PROTECTION ORDINANCE

CALIFORNIA LINEN RENTAL
989 - 41ST STREET
OAKLAND
WELL 1S/4W 23E1
PERMIT 91397

Destruction Requirements

1. Drill out the well so that the inner casing, seal, and gravel pack are removed to the bottom of the well.
2. Using a tremie pipe, fill the hole to 2 feet below the lower of finished grade or original ground with neat cement.
3. After seal has set, backfill the remaining hole with compacted material.

These destruction requirements as proposed by Reinhard Ruhmke of Miller Environmental meet or exceed the Zone 7 minimum requirements.

CITY OF OAKLAND PERMIT TO EXCAVATE IN STREETS OR OTHER WORK AS SPECIFIED

LOCATION OF WORK: 989 41st Street BETWEEN 40 AND 42nd
(Street or Address) (Street/Ave.) (Specify)

PERMISSION TO EXCAVATE IN THE PUBLIC RIGHT-OF-WAY IS HEREBY GRANTED TO:

APPLICANT: HEW drilling
ADDRESS: P.O. Box 110, Park Ave PHONE #: 415-322-2851

TYPE OF WORK: GAS _____ ELECTRIC _____ WATER _____ TELEPHONE _____ CABLE TV _____ SEWER _____ OTHER X
NATURE OF WORK: Destruction of ground water monitoring well (Specify)

I hereby affirm that I am exempt from the Contractor's License Law for the following reason (Sec. 7031.5. Business and Professions Code: Any city or county which requires a permit to construct, alter, improve, demolish, or repair any structure, prior to its issuance, also requires the applicant for such permit to file a signed statement that he is licensed pursuant to the provisions of the Contractor's License Law Chapter 9 (commencing with Sec. 7000) of Division 3 of the Business and Professions Code, or that he is exempt therefrom and the basis for the alleged exemption. Any violation of Section 7031.5 by any applicant for a permit subjects the applicant to a civil penalty of not more than \$500):

I, as owner of the property, or my employees with wages as their sole compensation, will do the work, and the structure is not intended or offered for sale (Sec. 70044, Business and Professions Code: The Contractor's License Law does not apply to an owner of property who builds or improves thereon, and who does such work himself or through his own employees, provided that such improvements are not intended or offered for sale. If, however, the building or improvement is sold within one year of completion, the owner-builder will have the burden of proving that he did not build or improve for the purpose of sale).

I, as owner of the property, am exempt from the sale requirements of the above due to: (1) I am improving my principal place of residence or appurtenances thereto, (2) the work will be performed prior to sale. (3) I have resided in the residence for the 12 months prior to completion of the work, and (4) I have not claimed exemption in this subdivision on more than two structures more than once during any three-year period. (Sec. 7044. Business and Professions Code).

I, as owner of the property, am exclusively contracting with licensed contractors to construct the project (Sec. 7044, Business and Professions Code: The Contractor's License Law does not apply to an owner of property who builds or improves thereon, and who contracts for such projects with a contractor(s) licensed pursuant to the Contractor's License Law).

I am exempt under Sec. _____, B&P.C. for this reason _____

Signature _____ Date _____

I hereby affirm that I have a certificate of consent to self-insure, or a certificate of Workers' Compensation Insurance, or a certified copy thereof (Sec. 3800, Lab C).

Policy # PC 995515 Company Name HEW

Certified copy is hereby furnished.

Certified copy is filed with the city building inspection dept.

Signature [Signature] Date 7/14/91

(This section need not be completed if the permit is for one hundred dollars (\$100) or less.)

I certify that in the performance of the work for which this permit is issued, I shall not employ any person in any manner so as to become subject to the Workers' Compensation Laws of California.

Signature _____ Date _____

NOTICE TO APPLICANT. If, after making this Certificate of Exemption, you should become subject to the Workers' Compensation provisions of the Labor Code, you must forthwith imply with such provisions or this permit shall be deemed revoked.

PERMIT VOID 90 DAYS FROM DATE OF ISSUE UNLESS EXTENSION GRANTED BY DIRECTOR OF PUBLIC WORKS.

Approximate Starting Date DATE 7/14/91

Approximate Completion Date DATE 7/14/91

HOLIDAY RESTRICTION (1 NOV - 1 JAN) YES _____ NO X

LIMITED OPERATION AREA (7AM - 9AM/4PM - 6PM) YES _____ NO X

DATE STREET LAST RESURFACED DATE 7/14/91

SPECIAL PAVING DETAIL REQUIRED YES _____ NO X

24-HOUR EMERGENCY PHONE NUMBER 415-233-9000

PERMIT NOT VALID WITHOUT 24 HOUR NUMBER.

Telephone 273-3668 Forty-eight (48) HOURS BEFORE ACTUAL CONSTRUCTION.

ATTENTION

State law requires that contractor/owner call Underground Service Alert two working days before excavating to have below-ground utilities located. This permit is not valid unless applicant has secured an inquiry identification number issued by Underground Service Alert.

Call Toll Free: 800-642-2444 USA ID Number 201908

This permit issued pursuant to all provisions of Chapter 6, Article 2 of the Oakland Municipal Code.

This permit is granted upon the express condition that the permittee shall be responsible for all claims and liabilities arising out of work performed under the permit or arising out of permittee's failure to perform the obligations with respect to street maintenance. The permittee shall, and by acceptance of the permit agrees to defend, indemnify, save and hold harmless the City, its officers and employees, from and against any and all suits, claims or actions brought by any person for or on account of any bodily injuries, disease or illness or damage to persons and/or property sustained or arising in the construction of the work performed under the permit or in consequence of permittee's failure to perform the obligations with respect to street maintenance.

CONTRACTOR

I hereby affirm that I am licensed under provisions of Chapter 9 (commencing with Section 7000) of Division 3 of the Business and Professions Code, and my license is in full force and effect.

LICENSE # AND CLASS 104487 CITY BUSINESS TAX # 582506

X _____ Date 7/14/91

Signature of Contractor Owner or Agent

Agent for Contractor Owner

EXC 125.00
APPL 30.00
EXCU 335.00
APPL 30.00
SUBTL 165.00
TOTAL 655.00

OFFICIAL USE ONLY UTILITY COMPANY REPORT

Supervisor ICL 0013 12125TH
Completion Date _____

CITY INSPECTOR'S REPORT

BACKFILL _____ PAVING _____

Initials _____

Hours _____

Date _____

Concrete _____

Asphalt _____

Sidewalk _____

Size of Cut: Sq. Ft. _____ Inches _____

Paved by _____ Type _____

Bill No. _____

Charges Backfill _____

Paving _____

Paving Insp. _____

Traffic Striping Replaced _____ Date _____

APPROVED Engineering Services JWO Date 7-16-91

Planning _____ Date _____

Field Services _____ Date _____

Construction _____ Date _____

Traffic Engineering _____ Date _____

Electrical Engineering _____ Date _____

DIRECTOR OF PUBLIC WORKS

APPROVED BY: [Signature]

EXTENSION GRANTED BY: _____

DATE: 7-16-91

OWNER/BUILDER

WORKER'S COMPENSATION