



Miller Environmental Company, Inc.

Engineering • Geology • Construction

June 25, 1991

Department of Environmental Health
Hazardous Materials Division
80 Swan Way, Room 200
Oakland, CA 94621

Attn: Mr. Gil Wistar

Re: California Linen Rental Co., 989 41st Street,
Oakland, CA

Dear Mr. Wistar:

Enclosed are the laboratory results for the fifth quarterly sampling interval for the above-mentioned site. This latest sampling episode is a continuation of the quarterly monitoring requirements recommended by Alameda County Health Care Services Agency (ACHCSA) in their letter dated 04/15/91. ACHCSA also agreed with Miller Environmental Company's recommendation to properly abandon ground water monitoring well MW3. This well has not been abandoned as of this writing, however it should be properly abandoned sometime during the next quarter. Ground water monitoring well MW3 was not sampled this quarter.

Ground Water Monitoring Results

Prior to well sampling, a visual observation for floating product was performed using a clear teflon bailer. No product was observed in any of the monitoring wells. For ease of reference, a summary of laboratory results is presented in Table 1 on page 2:

California Linen - Quarter Sampling Results - 06/25/91

TABLE 1
Summary of Laboratory Results

Well #	TPH Date	TPH gas	TPH dsl	w.o.	B	T	E	X
MW1	10/02/89	70	0.61	ND	2.8	2.4	2.3	4.8
	02/20/90	73	2.2	3	7.5	5.9	0.68	5.3
	07/25/90	34	ND	1	2.0	0.67	0.12	1.5
	10/23/90	50	1.1	ND	3.3	4.0	4.2	4.7
	01/28/91	99	1.7	3	4.4	7.4	1.8	8.6
	06/05/91	23	0.56	ND	2.0	1.2	0.64	2.5
MW2	10/02/89	ND	ND	ND	ND	ND	ND	ND
	02/20/90	ND	ND	ND	ND	ND	ND	ND
	07/25/90	ND	ND	ND	ND	ND	ND	ND
	10/23/90	ND	ND	ND	ND	ND	ND	ND
	01/28/91	ND	ND	ND	ND	ND	ND	ND
	06/05/91	ND	ND	ND	ND	ND	ND	ND

a) all results are expressed in milligrams per liter (mg/L) which is equivalent to parts per million (ppm).

Water level readings were collected. Table 2 is a summary of ground water elevations.

TABLE 2
Summary of Ground Water Elevations

	MW1	MW2
10/11/89	46.19	44.81
11/13/89	45.85	44.91
12/14/89	45.86	44.97
2/20/90	46.53	45.35
3/22/90	46.55	45.17
4/23/90	45.81	44.99
7/25/90	45.68	44.88
8/22/90	46.34	44.51
9/25/90	46.20	44.53
10/23/90	45.68	44.64
01/28/91	45.34	44.46
06/05/91	45.54	44.21

a) elevations are given in feet above mean sea level (MSL).

California Linen - Quarter Sampling Results - 06/25/91

Future Work

Ground water monitoring well MW3 should be properly abandoned during the next quarter. MEC is in discussion with California Linen Rental regarding various options for a ground water remediation program in the vicinity of MW1. However, prior to initiating a remediation program a workplan will be submitted to ACHCSA outlining the scope of work.

If you have any questions please do not hesitate to call me.

Sincerely,
MILLER ENVIRONMENTAL COMPANY

Reinhard Ruhmke
Project Geologist

Enc: Laboratory results

cc: RWQCB
Joel Pitney - California Linen
file

FIGURE 1 SITE PLAN - CALIFORNIA LINEN

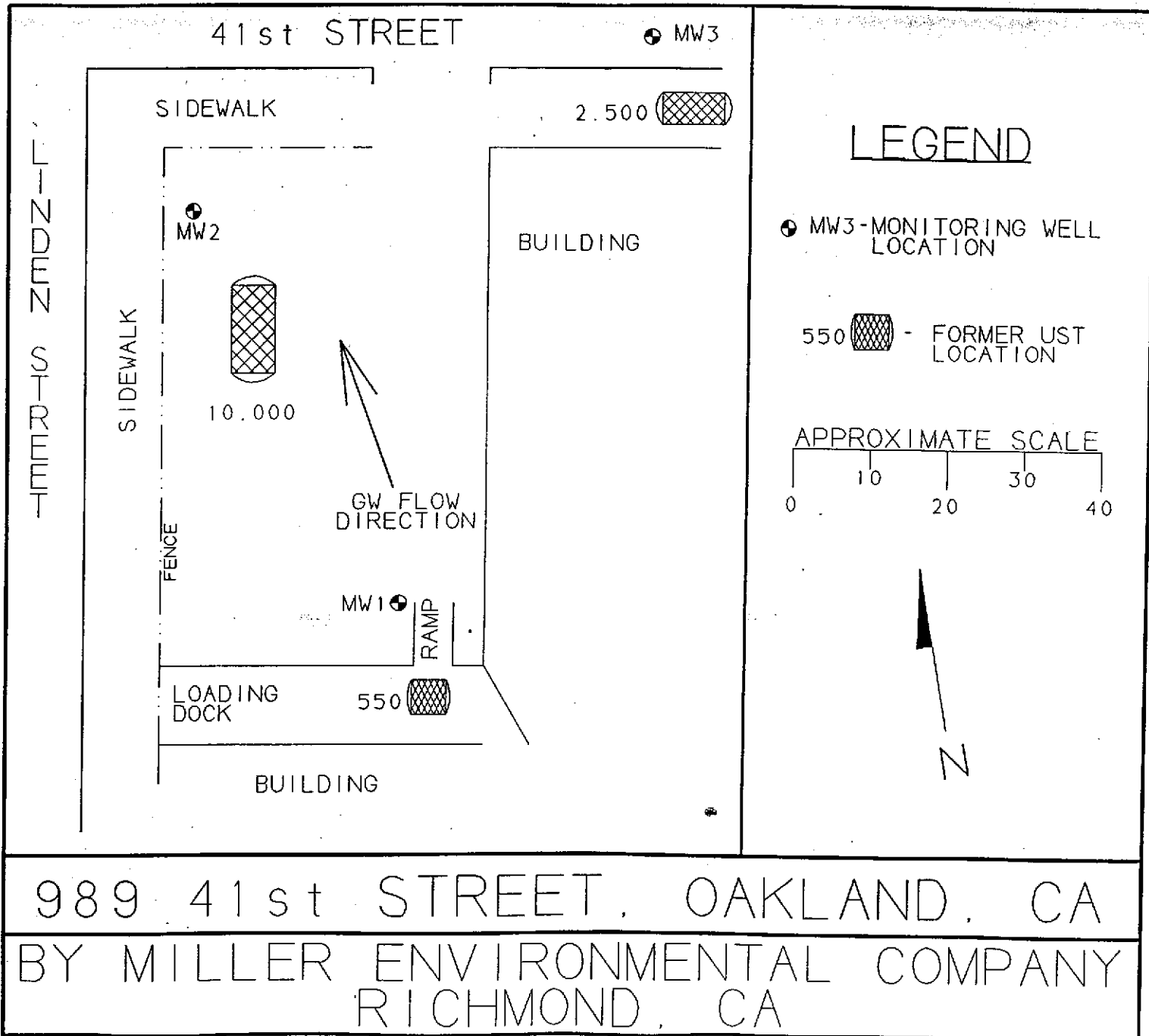

RECEIVED

JUN 18 1991

SUPERIOR ANALYTICAL LABORATORIES, INC.

MILLER ENVIRONMENTAL CO.

825 ARNOLD, STE. 114 • MARTINEZ, CALIFORNIA 94553 • (415) 229-1512

DOHS #319

C E R T I F I C A T E O F A N A L Y S I S

LABORATORY NO.: 83264
CLIENT: Miller Environmental Company
CLIENT JOB NO.: 11017

DATE RECEIVED: 06/05/91
DATE REPORTED: 06/13/91

ANALYSIS FOR TOTAL OIL AND GREASE
by Standard Method 5520F

LAB #	Sample Identification	Concentration (mg/L) Oil & Grease
1	MW2	ND<5
2	MW1	ND<5

mg/L - parts per million (ppm)

Method Detection Limit for Oil and Grease in Soil: 5 mg/L

Richard Srna, Ph.D.

Laboratory Director

OUTSTANDING QUALITY AND SERVICE

SUPERIOR ANALYTICAL LABORATORIES, INC.

825 ARNOLD, STE. 114 • MARTINEZ, CALIFORNIA 94553 • (415) 229-1512

DOHS #319

C E R T I F I C A T E O F A N A L Y S I S

LABORATORY NO.: 83264
CLIENT: Miller Environmental Company
CLIENT JOB NO.: 11017

DATE RECEIVED: 06/05/91
DATE REPORTED: 06/13/91

ANALYSIS FOR TOTAL PETROLEUM HYDROCARBONS by Modified EPA SW-846 Method 8015

LAB #	Sample Identification	Concentration (ug/L) Diesel Range
1	MW2	ND<50
2	MW1	560

ug/L - parts per billion (ppb)

Method Detection Limit for Diesel in Water: 50 ug/L

QAQC Summary:

Daily Standard run at 200mg/L: RPD Gasoline = NA
RPD Diesel = 4

MS/MSD Average Recovery = 103%:

Richard Srna, Ph.D.

Laboratory Manager

OUTSTANDING QUALITY AND SERVICE

C E R T I F I C A T E O F A N A L Y S I S

LABORATORY NO.: 83264
CLIENT: Miller Environmental Company
CLIENT JOB NO.: 11017

DATE RECEIVED: 06/05/91
DATE REPORTED: 06/13/91

ANALYSIS FOR TOTAL PETROLEUM HYDROCARBONS
by Modified EPA SW-846 Method 5030 and 8015

LAB #	Sample Identification	Concentration (ug/L) Gasoline Range
1	MW2	ND<50
2	MW1	23000

ug/L - parts per billion (ppb)

Method Detection Limit for Gasoline in Water: 50 ug/L

QAQC Summary:

Daily Standard run at 2mg/L: RPD Gasoline = <15
MS/MSD Average Recovery =91 %: Duplicate RPD =16

Richard Srna, Ph.D.

Laboratory Manager

SUPERIOR ANALYTICAL LABORATORIES, INC.

825 ARNOLD, STE. 114 • MARTINEZ, CALIFORNIA 94553 • (415) 229-1512

DOHS #319
DOHS #220

C E R T I F I C A T E O F A N A L Y S I S

LABORATORY NO.: 83264
CLIENT: Miller Environmental Company
CLIENT JOB NO.: 11017

DATE RECEIVED: 06/05/91
DATE REPORTED: 06/13/91

ANALYSIS FOR BENZENE, TOLUENE, ETHYL BENZENE & XYLENES
by EPA SW-846 Methods 5030 and 8020

LAB #	Sample Identification	Concentration(ug/L)			
		Benzene	Toluene	Ethyl Benzene	Xylenes
1	MW2	ND<0.3	ND<0.3	ND<0.3	ND<0.3
2	MW1	2000	1200	640	2500

ug/L - parts per billion (ppb)

Method Detection Limit in Water: 0.3 ug/L

QAQC Summary:

Daily Standard run at 20ug/L: RPD = <15%
MS/MSD Average Recovery =87%: Duplicate RPD = <2

1

Richard Srna, Ph.D.

Laboratory Manager

OUTSTANDING QUALITY AND SERVICE

8 3264
6-5-91
A

Sample Analysis Request / Chain of Custody

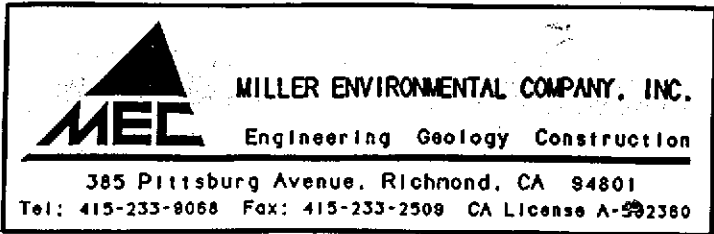

JOB NAME: **Cal Linen**
 JOB NUMBER: **11017** P.O. Number: _____

Samplers: **Darin J Reinholdt**

Sample I.D.	Date	Time	Comp.	Grab	Location	No. of Containers	Matrix	ANALYSES				Turn Around Time	
								TPH as Gasoline	BTXE	TPH as Diesel	Total oil & Grease		
1	6/5	1305		X	MW 2	4	H ₂ O	X	X	X	X	Normal	Normal
2	6/5	1500		X	MW 1	4	"	X	X	X	X	Det. Limit	

Please initial: **F7**
 Samples stored in ice
 Appropriate containers
 Samples preserved
 VOA's without hood space
 Comments: _____

Relinquished By (signature): Darin J Reinholdt	Date: 6/5/91	Time: 16:58	Accepted By (Signature): [Signature]
1			1
2			2
3			[Signature] 6/5/91 1658

Laboratory Name & Address: **SUPERIOR**
 REMARKS: