

REGA ENVIRONMENTAL, INC

PO 337



1466 66<sup>th</sup> Street, Emeryville California 94608  
Fax: 510-834-0152 Tel: 510-658-4363

E-mail: Paul.King@regaenv.com

FAX TRANSMITTAL SHEET

TO: *Barney Chan*  
COMPANY: *Alameda County*  
FAX NO:  
PHONE NO:  
RE: *California Lixen*

FROM: Paul King  
DATE: ~~10~~ *9/29/05*  
TOTAL NO. OF PAGES FAXED: *10*  
SENDER'S JOB REFERENCE NO:

URGENT     FOR REVIEW     PLEASE COMMENT     PLEASE REPLY

*Table of Contents is attached*

*570-337-9335*

# RGA ENVIRONMENTAL, INC



1466 66<sup>th</sup> Street, Emeryville California 94608

Fax: 510-834-0152 Tel: 510-658-4363

E-mail: Paul.King@rgaenv.com

## FAX TRANSMITTAL SHEET

TO: *Joel Pitney*  
 COMPANY: *California Liner*  
 FAX NO:  
 PHONE NO:  
 RE:

FROM: Paul King  
 DATE: *9/29/05*  
 TOTAL NO. OF PAGES FAXED: *9*  
 SENDER'S JOB REFERENCE NO:

URGENT     FOR REVIEW     PLEASE COMMENT     PLEASE REPLY

Hi Joel, Attached are the following

- <sup>Table of</sup> ✓ Historical water quality for well MW1
- " " " " " " MW2
- " " " " " " Borings B1-B3
- Table of Current water quality Data for Borings B4-B6
- Figure of historical and current water quality
- Table of Current Soil Sample results
- Figure of B4, B5, B6 Soil TPH-G results at 7.5F
- Figure of " " " " " " " 10 to 12F

601-8005

Historical

February 22, 2005  
Report 0304.R2  
RGA Job #CLR8503

mg/L

TABLE 3  
SUMMARY OF LABORATORY ANALYTICAL RESULTS  
HISTORICAL WATER QUALITY  
W-11 MW1

Well No.	DATE	TPH-D	TPH-G	Benzene	Toluene	Ethyl-benzene	Xylenes	Gasoline Additives*
MW1	04/02/03	NA	24	4.0	1.6	2.3	1.4	ND<0.05, except TBA = ND<0.5
	03/18/92	14	77	17	18	2.3	1.3	NA
	11/21/91	9.8	47	6.0	7.2	2.2	1.0	NA
	08/15/91	3.5	59	3.8	5.5	1.1	4.8	NA
	06/05/91	0.56 <b>BOLD</b>	23	2.0	1.2	0.64	2.5	NA
	01/28/91	1.7	99	4.4	7.4	1.8	8.6	NA
	10/23/90	1.1	50	3.3	4.0	4.2	4.7	NA
	07/25/90	ND	34	2.0	0.67	0.12	1.5	NA
	02/20/90	2.2	73	7.5	5.9	0.68	5.3	NA
	10/02/89	0.61 <b>BOLD</b>	70	2.8	2.4	2.3	4.8	NA

← all exceed ESL

ESL <sub>1</sub>	<del>0.68</del> 0.1	<del>0.5</del> 0.1	<del>0.048</del> 0.001	<del>0.13</del> 0.040	<del>0.29</del> 0.030	<del>0.073</del> 0.020
------------------	------------------------	-----------------------	---------------------------	--------------------------	--------------------------	---------------------------

Notes:  
 TPH-G = Total Petroleum Hydrocarbons as Gasoline.  
 \* = Gasoline Additives selected as target analytes were Methyl tert-Butyl Ether (MTBE), other fuel oxygenates, and lead scavengers.  
 ND = Not Detected.  
 NA = Not Analyzed.  
 Results in milligrams per liter (mg/L), unless otherwise indicated.  
 ESL<sub>1</sub> = Environmental Screening Level, developed by San Francisco Bay - Regional Water Quality Control Board (SF-RWQCB) created July 2003, updated February 2004, Table ~~B~~ A - Groundwater is ~~not~~ a current or potential source of drinking water.  
 Bold sample result indicates ESL exceeded.

*Historical*

*mg/L*

February 22, 2005  
 Report 0304.R2  
 RGA Job #CLR8503

TABLE 3 (CONT.)  
 SUMMARY OF LABORATORY ANALYTICAL RESULTS  
 HISTORICAL WATER QUALITY

Well No.	DATE	TPH-D	TPH-G	Benzene	Toluene	Ethyl-benzene	Xylenes	Gasoline Additives*
MW2	04/02/03	NA	ND<0.05	ND<0.0005	ND<0.0005	ND<0.0005	0.00074	ND<0.0005, except TBA = ND<0.005
	03/18/92	ND	ND	ND	0.0011	ND	0.0033	NA
	11/21/91	ND	ND	ND	ND	ND	ND	NA
	08/15/91	ND	ND	ND	ND	ND	ND	NA
	06/05/91	ND	ND	ND	ND	ND	ND	NA
	01/28/91	ND	ND	ND	ND	ND	ND	NA
	10/23/90	ND	ND	ND	ND	ND	ND	NA
	07/25/90	ND	ND	ND	ND	ND	ND	NA
	02/20/90	ND	ND	ND	ND	ND	ND	NA
	10/02/89	ND	ND	ND	ND	ND	ND	NA

ESL <sub>1</sub>	<del>0.1</del>	<del>0.1</del>	<del>0.005</del>	<del>0.01</del>	<del>0.030</del>	<del>0.040</del>	<del>0.030</del>	<del>0.020</del>
	0.1	0.1	0.001	0.040	0.030	0.020		

Notes:

TPH-G = Total Petroleum Hydrocarbons as Gasoline.

\* = Gasoline Additives selected as target analytes were Methyl tert-Butyl Ether (MTBE), other fuel oxygenates, and lead scavengers.

ND = Not Detected.

NA = Not Analyzed.

Results in milligrams per liter (mg/L), unless otherwise indicated.

ESL<sub>1</sub> = Environmental Screening Level, developed by San Francisco Bay - Regional Water Quality Control Board (SF-RWQCB) created July 2003, updated February 2004. Table A - Groundwater is ~~not~~ a current or potential source of drinking water.

2005 A

Historical

February 22, 2005  
 Report 0304.R2  
 RGA Job #CLR8503

mg/L

TABLE 1  
 SUMMARY OF LABORATORY ANALYTICAL RESULTS  
 BOREHOLE GROUNDWATER SAMPLES  
 (Samples Collected July 21, 2004)

Borehole No.	TPH-D	TPH-G	Benzene	Toluene	Ethylbenzene	Xylenes
B1	0.081,a	ND<0.05	ND<0.0005	ND<0.0005	ND<0.0005	ND<0.0005
B2	ND<0.05	ND<0.05	ND<0.0005	0.00056	ND<0.0005	0.0006
B3	0.18,b	0.5,c	ND<0.0005	0.00055	0.018	0.044
ESL <sub>1</sub>	<del>0.04</del> 0.1	<del>0.5</del> 0.1	<del>0.046</del> 0.001	<del>0.13</del> 0.040	<del>0.25</del> 0.020	0.013 0.020

## Notes:

TPH-D = Total Petroleum Hydrocarbons as Diesel.

TPH-G = Total Petroleum Hydrocarbons as Gasoline.

ND = Not detected.

a = Laboratory analytical report note: liquid sample contains greater than ~1 vol. % sediment.

b = Laboratory analytical report note: gasoline range compounds are significant.

c = Laboratory analytical report note: heavier gasoline range compounds are significant, possibly aged gasoline.

Results in milligrams per liter (mg/L), unless otherwise indicated.

ESL<sub>1</sub> = Environmental Screening Level, developed by San Francisco Bay - Regional Water Quality Control Board (SF-RWQCB) created July 2003, updated February 2004, Table A - Groundwater is ~~not~~ a current or potential source of drinking water.

2005 A  
 Bold sample result indicates ESL exceeded.

Borehole Groundwater Samples ~~Groundwater~~ mg/L

Borehole	TPH-SS	TPH-G	B	T	E	X	M
B4	NA	120	ND<0.05	1.6	ND<0.5	0.79	ND<5.0
B5	NA	120	1.0	1.0	1.1	5.0	ND<5.0
B6	1400	1900	23	0.95	62	240	ND<5.0
ESL ↑ Table A	100 ↑ middle distillates	100	1.0	40	30	20	5

NA = Not analyzed

B6 by 8260 C<sub>10</sub>W ESL

Benzene	26	1.0
n-butyl benzene	20	—
Ethylbenzene	82	30
Isopropylbenzene	17	—
1,2,4-Trimethylbenzene	200	—
Naphthalene	24	17
n-Propyl benzene	50	—
1,3,5-Trimethylbenzene	65	—
Xylenes	320	20

— Indicates no ESL exists for this compound

○ Circled values exceed the ESL

Groundwater  
 T P H - G  
 MW2  
 mg/L

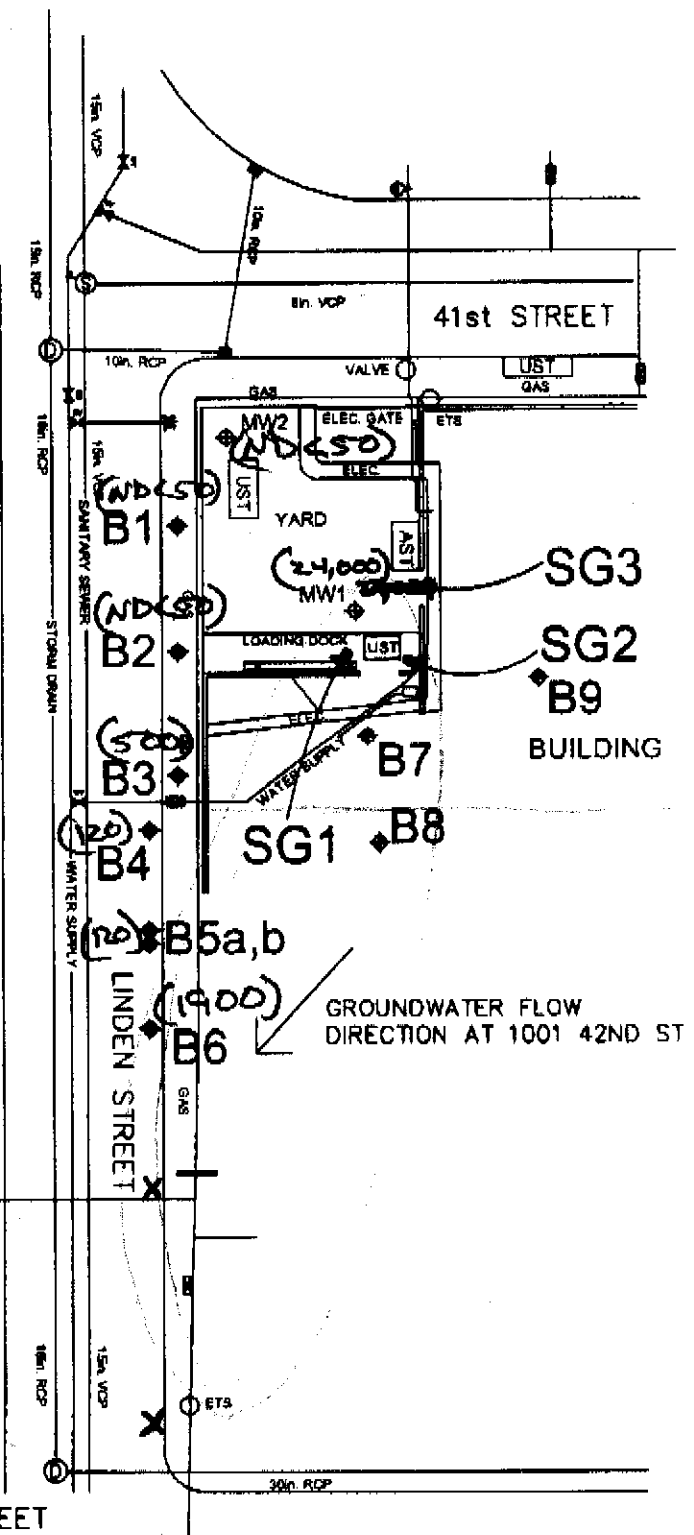

**LEGEND:**

- ◆ B3 EXISTING BOREHOLE LOCATION
- ◆ B9 PROPOSED BOREHOLE LOCATION
- UST FORMER UNDERGROUND STORAGE TANK
- AST ABOVEGROUND STORAGE TANK
- SG3 SOIL VAPOR SAMPLING LOCATION
- ◆ MW1 GROUNDWATER MONITORING WELL

Figure 2  
 Site Vicinity Map  
 California Linen Rental Company  
 989 41st. Street  
 Oakland, California



Based Map From  
 California Utility Survey  
 Utility Sketch Plan  
 Feb. 14, 2005

RGA Environmental, Inc.  
 1466 56th St.  
 Emeryville, CA 94608

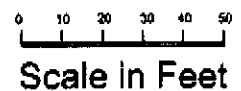

0304.R3

TABLE 1  
SUMMARY OF LABORATORY ANALYTICAL RESULTS  
BOREHOLE ~~GROUNDWATER~~ SAMPLES  
**SOIL**

Borehole No.	TPH-SS	TPH-G	Benzene	Toluene	Ethylbenzene	Xylenes	MTBE
B4-5.0	--	ND<1.0	ND<0.005	ND<0.005	ND<0.005	ND<0.005	ND<0.05
B4-7.5	--	ND<1.0	ND<0.005	ND<0.005	ND<0.005	ND<0.005	ND<0.05
B4-10.0	--	ND<1.0	ND<0.005	ND<0.005	ND<0.005	ND<0.005	ND<0.05
B4-21.5	--	ND<1.0	ND<0.005	ND<0.005	ND<0.005	ND<0.005	ND<0.05
B5-5.0	--	ND<1.0	ND<0.005	ND<0.005	ND<0.005	ND<0.005	ND<0.05
B5-7.5	--	590, b,c	ND<0.20	0.20	0.66	4.0	ND<2.0
B5-11.0	--	ND<1.0	ND<0.005	ND<0.005	ND<0.005	ND<0.005	ND<0.05
B5-19.5	--	ND<1.0	ND<0.005	ND<0.005	ND<0.005	ND<0.005	ND<0.05
B6-5	--	ND<1.0	ND<0.005	ND<0.005	ND<0.005	ND<0.005	ND<0.05
B6-7	--	240, a,c	ND<0.20	ND<0.20	1.7	9.2	ND<2.0
B6-10	ND<1.0	ND<1.0	ND<0.005	ND<0.005	ND<0.005	ND<0.005	ND<0.05
B6-12.5	5.1	4.9	ND<0.005	0.020	0.040	0.23	ND<0.05
B6-13.5	ND<1.0	ND<1.0	ND<0.005	ND<0.005	ND<0.005	0.019	ND<0.05
B6-17.0	12	15	0.0085	ND<0.005	0.17	0.84	ND<0.05
B6-19.0	ND<1.0	ND<1.0	ND<0.005	ND<0.005	ND<0.005	ND<0.005	ND<0.05
ESL Table A	100	100	0.044	2.9	3.3	2.3	

Notes:

TPH-SS = Total Petroleum Hydrocarbons as Stoddard Solvent.

TPH-G = Total Petroleum Hydrocarbons as Gasoline.

MTBE = Methyl tert-Butyl Ether

ND = Not detected.

-- = Not Analyzed.

a = Laboratory analytical report note: heavier gasoline range compounds are significant (aged gasoline?).

b = Laboratory analytical report note: strongly aged gasoline or diesel range compounds are significant.

c = Laboratory analytical report note: no recognizable pattern.

Res & Commercial/Indust



SOIL  
7.5 FT  
TPH-G  
(mg/kg)

LEGEND:

- ◆ B3 EXISTING BOREHOLE LOCATION
- ◆ B9 PROPOSED BOREHOLE LOCATION
- UST FORMER UNDERGROUND STORAGE TANK
- AST ABOVEGROUND STORAGE TANK
- SG3 SOIL VAPOR SAMPLING LOCATION
- ◆ MW1 GROUNDWATER MONITORING WELL

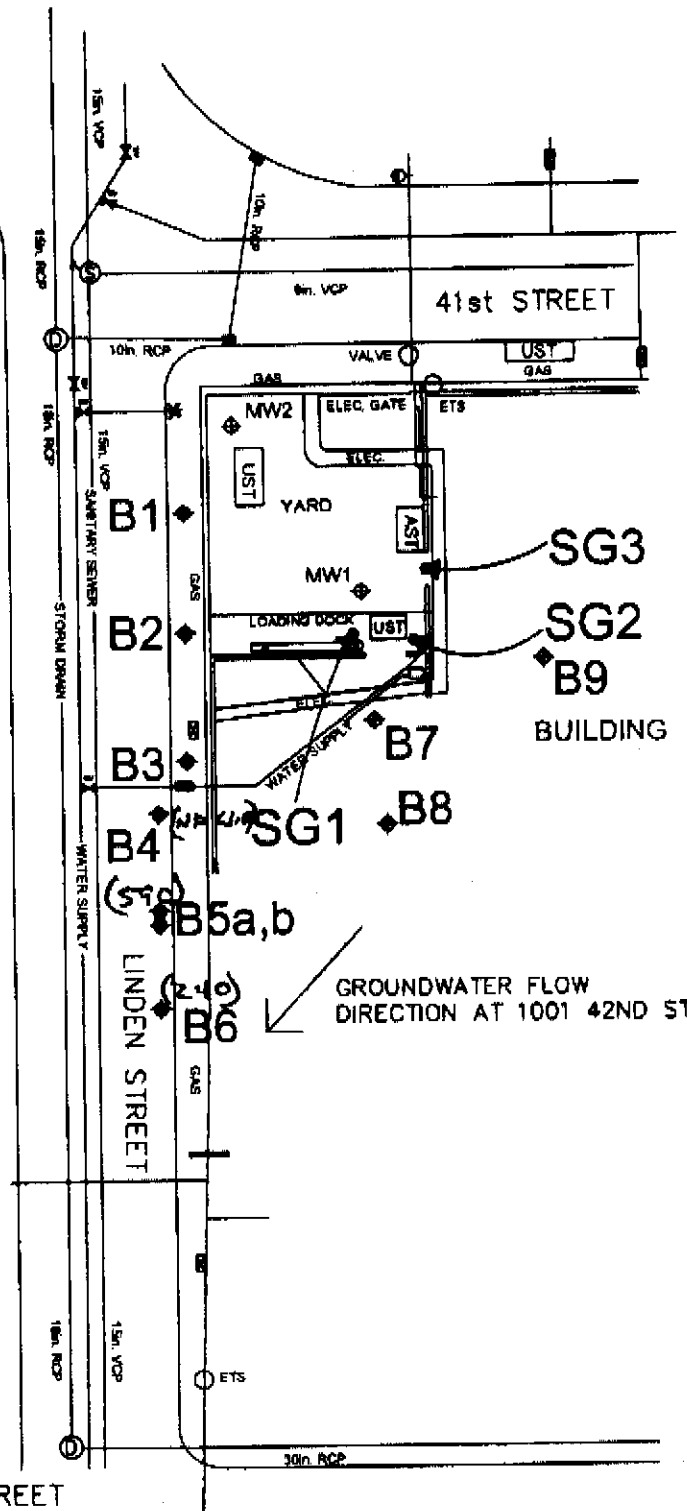

Figure 2  
 Site Vicinity Map  
 California Linen Rental Company  
 989 41st. Street  
 Oakland, California

TPH-G m Soil at 7.5-foot Depth  
 ↑ N

Based Map From  
 California Utility Survey  
 Utility Sketch Plan  
 Feb. 14, 2005

RGA Environmental, Inc.  
 1466 66th St.  
 Emeryville, CA 94608

0 10 20 30 40 50  
 Scale in Feet

SOIL  
10 to 12.5 FT

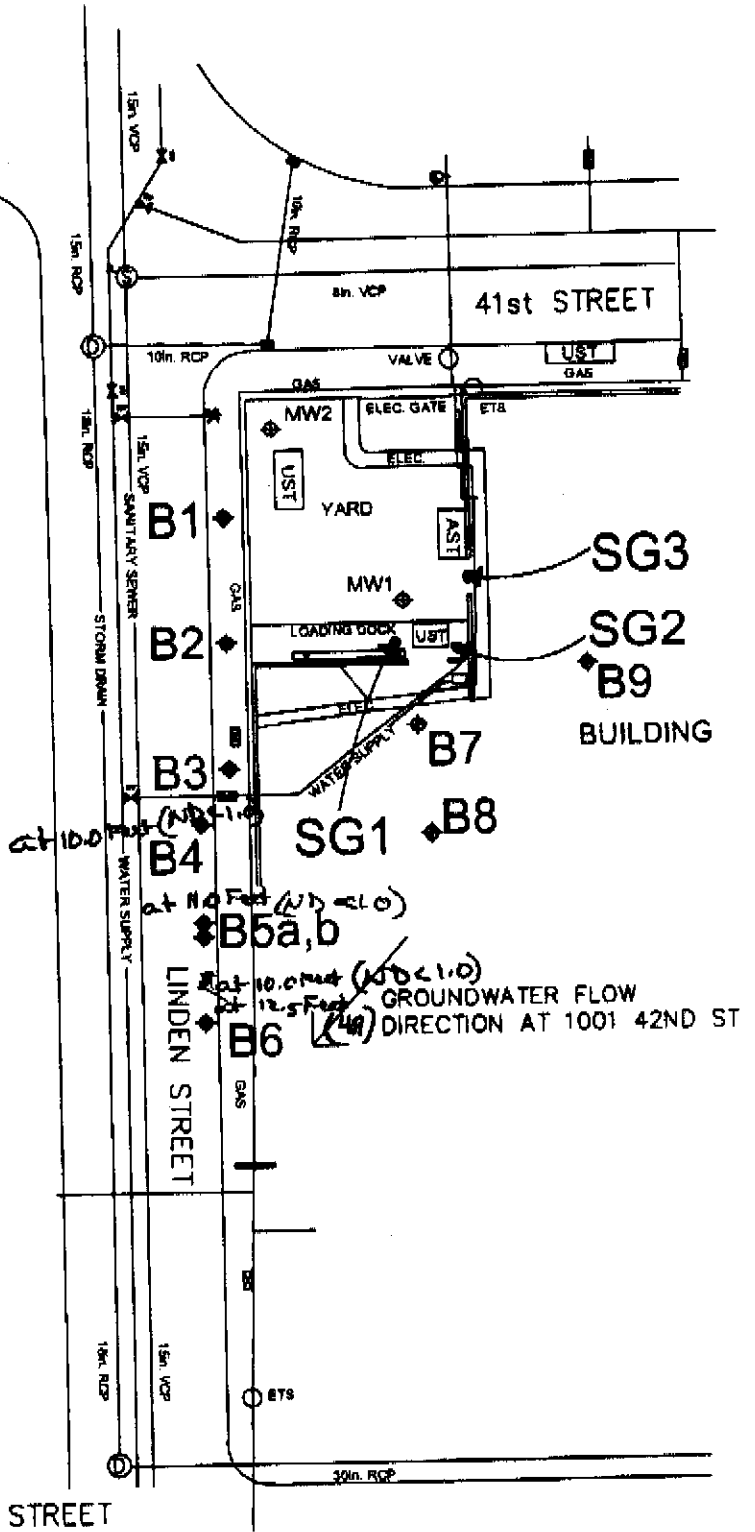

LEGEND:

- ◆ B3 EXISTING BOREHOLE LOCATION
- ◆ B9 PROPOSED BOREHOLE LOCATION
- UST FORMER UNDERGROUND STORAGE TANK
- AST ABOVEGROUND STORAGE TANK
- SG3 SOIL VAPOR SAMPLING LOCATION
- ◆ MW1 GROUNDWATER MONITORING WELL

Figure 2

TPH-6 in Soil at 10.0 to 12.5 Feet Depth  
 Site Utility Map  
 California Linen Rental Company  
 989 41st. Street  
 Oakland, California



Based Map From  
 California Utility Survey  
 Utility Sketch Plan  
 Feb. 14, 2005

RGA Environmental, Inc.  
 1466 66th St.  
 Emeryville, CA 94608

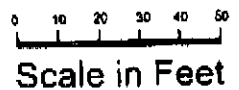

ARGA ENVIRONMENTAL, INC 120 337



1466 66<sup>th</sup> Street, Emeryville California 94608

Fax: 510-834-0152 Tel: 510-658-4363

E-mail: Paul.King@rgaenv.com

FAX TRANSMITTAL SHEET

TO: *Barney Chan*  
 COMPANY:  
 FAX NO:  
 PHONE NO:  
 RE: *California Litter*

FROM: Paul King  
 DATE: *9/29/05*  
 TOTAL NO. OF PAGES FAXED: *2*  
 SENDER'S JOB REFERENCE NO:

URGENT

FOR REVIEW

PLEASE COMMENT

PLEASE REPLY

*Proposed Drilling Locations*

*510-337-9335*

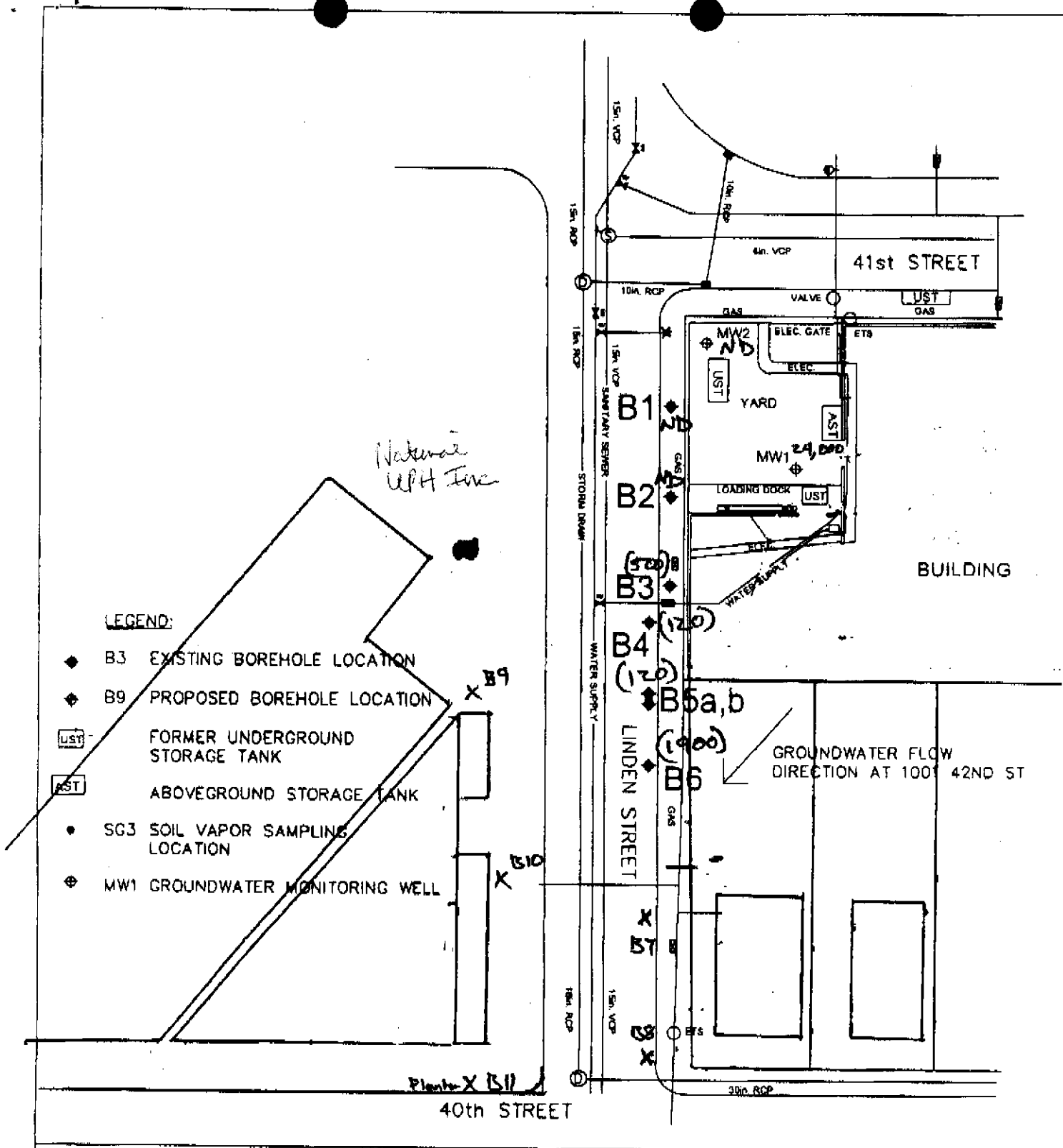

Figure 2  
 Site Vicinity Map  
 California Linen Rental Company  
 989 41st. Street  
 Oakland, California



Based Map From  
 California Utility Survey  
 Utility Sketch Plan  
 Feb. 14, 2005

RGA Environmental, Inc.  
 1466 68th St.  
 Emeryville, CA 94608

